

ARCHER, CATHRO & ASSOCIATES (1981) LIMITED
1016 -510 West Hastings Street
Vancouver, B.C. V6B 1L8

Telephone: 604-688-2568

Fax: 604-688-2578

ASSESSMENT REPORT

describing

SOIL GEOCHEMICAL SAMPLING

at the

CAD PROPERTY

CAD 1-28 YD05923-YD05950

NTS 115N/01

Latitude 63°08'N; Longitude 140°16'W

located in the

Whitehorse Mining District
Yukon Territory

prepared by

Archer, Cathro & Associates (1981) Limited

for

ATAC RESOURCES LTD.
and
SILVER QUEST RESOURCES LTD.

by

H. Smith, B.Sc. Geology, GIT
February 2010

CONTENTS

	<u>PAGE</u>
INTRODUCTION	1
PROPERTY LOCATION, CLAIM DATA AND ACCESS	1
HISTORY	1
GEOMORPHOLOGY	2
GEOLOGY	2
SOIL GEOCHEMISTRY	3
DISCUSSION AND CONCLUSIONS	3
REFERENCES	4

APPENDICES

- I STATEMENT OF QUALIFICATIONS
- II CERTIFICATES OF ANALYSIS

FIGURES

<u>No.</u>	<u>Description</u>	<u>Follows Page</u>
1	Property Location	1
2	Claim Locations	1
3	Tectonic Setting	2
4	Geology	2
5	Soil Sample Locations	3

INTRODUCTION

The CAD property was staked to cover ground at the headwaters of two creeks, which each yielded background to strong mercury, arsenic, copper and gold values from a stream sediment survey. The property is located in west-central Yukon, about two kilometres south of the White River. At the time of the exploration program, the claims were owned 100% by ATAC Resources Ltd.; however, they were subsequently sold to Silver Quest Resources Ltd.

This report describes a soil sampling program that was conducted by a three person crew on September 6, 2009. The work was done by Archer, Cathro & Associates (1981) Limited on behalf of ATAC. The author participated in the program and her Statement of Qualifications is in Appendix I.

PROPERTY LOCATION, CLAIM DATA AND ACCESS

The CAD property comprises 28 contiguous mineral claims located at latitude 63°08'N and longitude 140°16'W on NTS map sheet 115N/01, as shown on Figure 1. The claims are registered with the Whitehorse Mining Recorder in the name of Archer Cathro, which holds them in trust for ATAC pending completion of the sale. Claim data are listed below while the locations of individual claims are illustrated on Figure 2.

<u>Claim Name</u>	<u>Grant Number</u>	<u>Expiry Date*</u>
CAD 1-28	YD05923-YD05950	June 26, 2010

*Expiry date does not include 2009 work, which has not yet been filed for assessment credit.

Access to the property in 2009 was via a Bell 206B helicopter owned by Fireweed Helicopters Ltd. and operated from its permanent base in Dawson City. There is no road access to the CAD property.

HISTORY

There is no Minfile occurrence or public record of previous exploration on the CAD property.

In 1986, the Geological Survey of Canada performed a regional stream sediment survey on NTS map sheets 115N and 115O (Friske *et al.*, 1986). Samples were collected from two creeks draining the area of the CAD property. The sample from the western creek returned 99th percentile mercury (145 ppb) and copper (106 ppm) with 80th percentile gold (6 ppb) and background arsenic. The sample from the eastern creek yielded 99th percentile mercury (120 ppb), 98th percentile arsenic (19 ppm) and background copper and gold.

ATAC staked the CAD property in June 2009. ATAC sold the property to Silver Quest in December 2009.

**SILVER QUEST RESOURCES LTD.
ATAC RESOURCES LTD.**

FIGURE 1
ARCHER, CATHRO & ASSOCIATES (1981) LIMITED

**PROPERTY LOCATION
CAD PROPERTY**

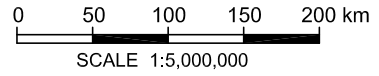

FILE: ...2009/DRG/CAD/F_1-LOC.DWG

FEBRUARY 2010

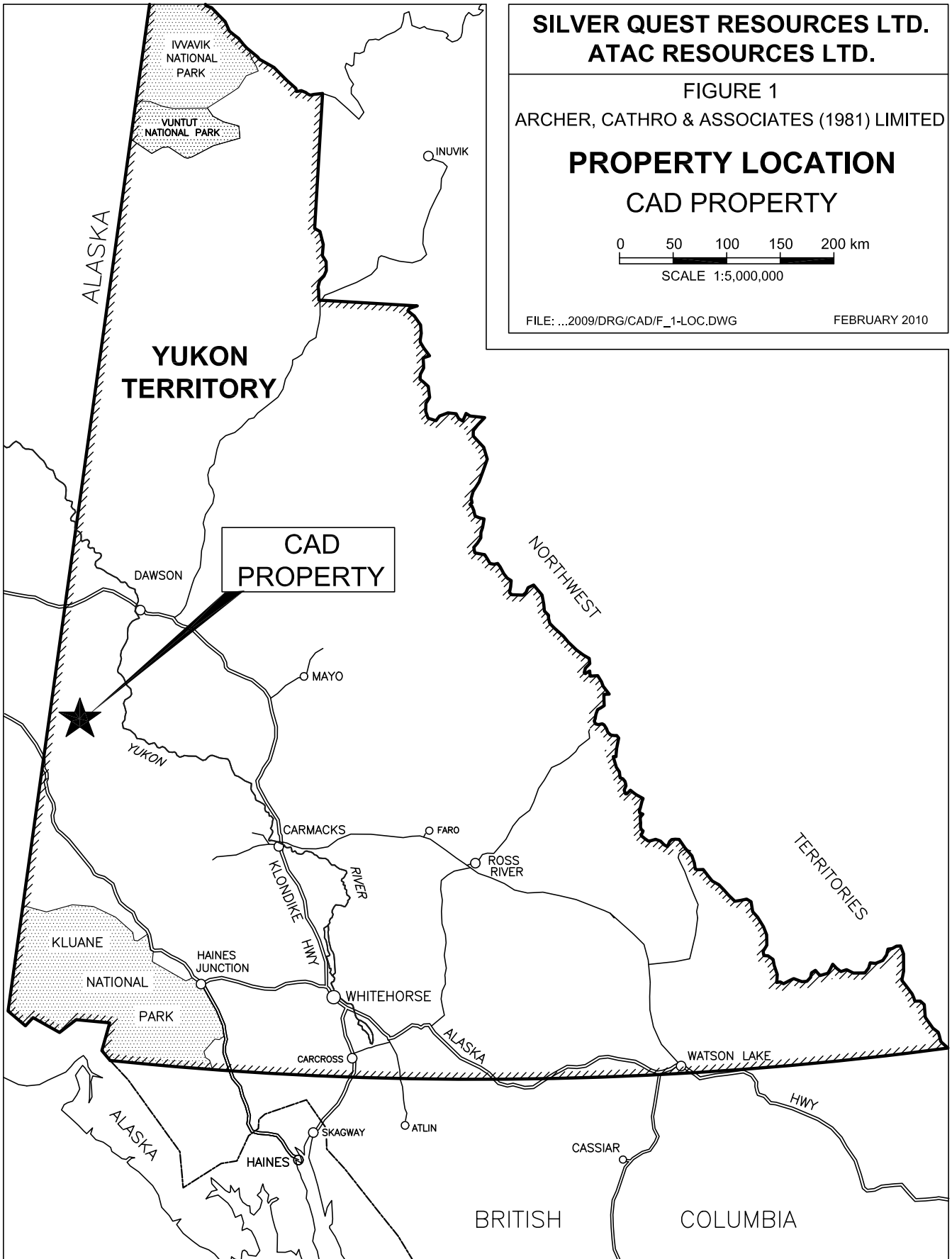

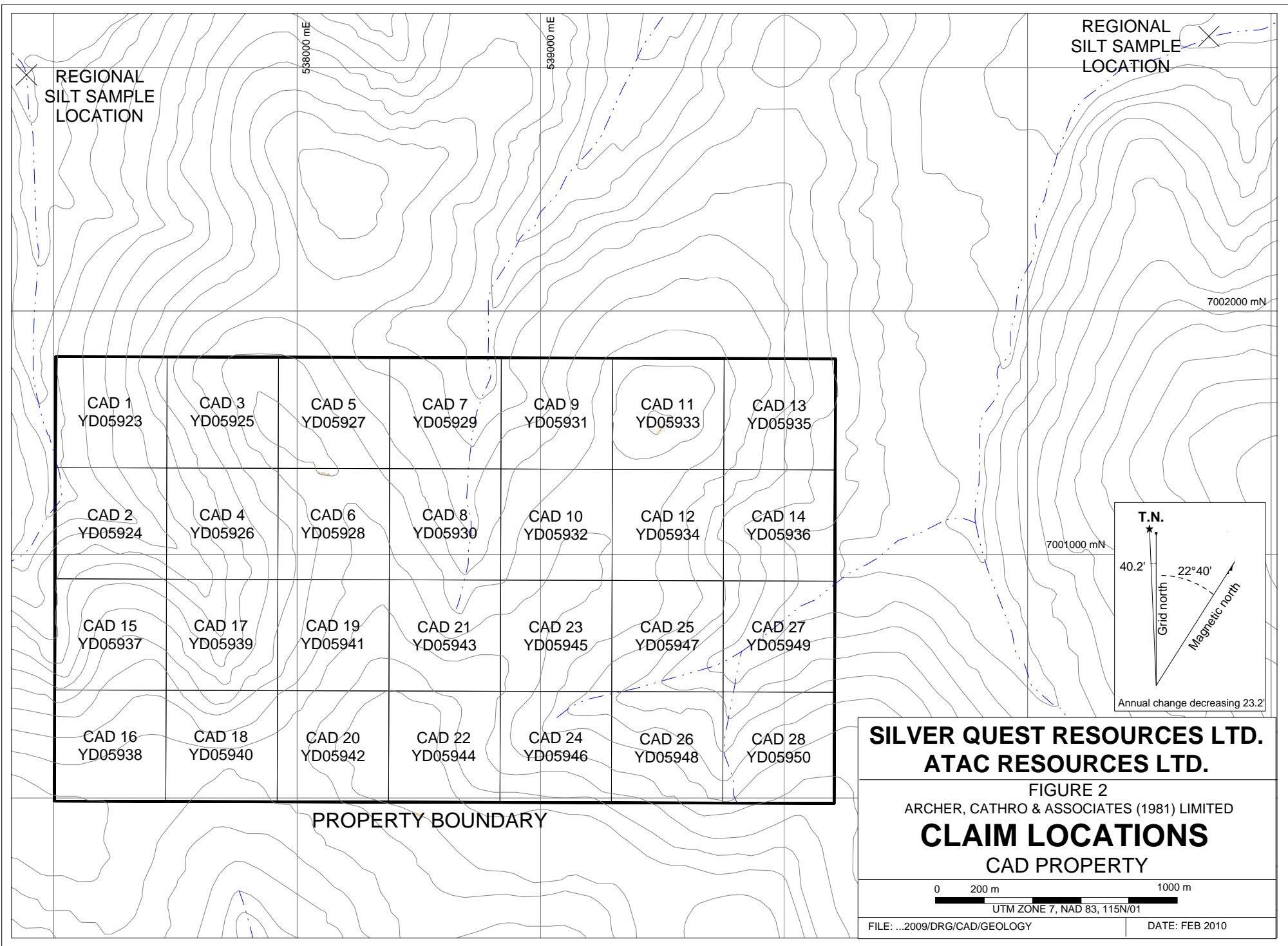

CAD 1 YD05923	CAD 3 YD05925	CAD 5 YD05927	CAD 7 YD05929	CAD 9 YD05931	CAD 11 YD05933	CAD 13 YD05935
CAD 2 YD05924	CAD 4 YD05926	CAD 6 YD05928	CAD 8 YD05930	CAD 10 YD05932	CAD 12 YD05934	CAD 14 YD05936
CAD 15 YD05937	CAD 17 YD05939	CAD 19 YD05941	CAD 21 YD05943	CAD 23 YD05945	CAD 25 YD05947	CAD 27 YD05949
CAD 16 YD05938	CAD 18 YD05940	CAD 20 YD05942	CAD 22 YD05944	CAD 24 YD05946	CAD 26 YD05948	CAD 28 YD05950

PROPERTY BOUNDARY

**SILVER QUEST RESOURCES LTD.
ATAC RESOURCES LTD.**

FIGURE 2
ARCHER, CATHRO & ASSOCIATES (1981) LIMITED

**CLAIM LOCATIONS
CAD PROPERTY**

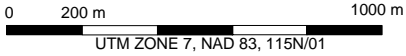

GEOMORPHOLOGY

The property lies in the northwestern part of the Dawson Range of western Yukon Territory. This part of the Dawson Range escaped Pleistocene glaciation. The property is drained by unnamed tributaries of the White River, which is part of the Yukon River watershed.

The geomorphological setting is gentle to moderate terrain with local elevations ranging from 575 to 880 m above sea level. Much of the claim block is thickly vegetated with buck brush, stunted black spruce and slide alder, growing in an old forest fire burn. Moss is the most common ground cover, particularly in areas underlain by permafrost. No part of the property is above tree line. There is limited outcrop exposure on the property.

GEOLOGY

The CAD property lies within the Yukon-Tanana Terrane approximately 110 km southwest of the Tintina Fault (Figure 3). The area was mapped by Tempelman-Kluit (1974) and his geology was re-evaluated as part of a territory-wide compilation by Gordey and Makepeace (1999). Figure 4 illustrates geology in the vicinity of the CAD property.

The oldest rocks in the area are assigned to the Devonian, Mississippian and older (?) Nasina Assemblage (DMN3). This unit has been described by Gordey and Makepeace (1999) as quartzite, micaceous quartzite and quartz-muscovite (\pm chlorite; \pm feldspar augen) schist with minor metaconglomerate and metagrit. The entire CAD property has been mapped as DMN3.

Approximately three kilometres southwest of the CAD property lies an area of Carboniferous and Permian Anvil Group (CPA1). Gordey and Makepeace (1999) describe this unit as a dominantly mafic volcanic assemblage including: variably altered and foliated, locally augite-phyric basalt; diorite and gabbro; chloritic greenstone; amphibolitic greenstone and amphibolite; and minor metachert and siliceous argillite.

Two patches of Upper Cretaceous Carmacks Group Volcanics (uKC1) lie within seven kilometres of the CAD property. One is situated to the east and the other to the south-southeast of the property. This unit has been described by Gordey and Makepeace (1999) as a volcanic succession of olivine basalt and breccia; hornblende feldspar porphyry and andesite and dacite flows with minor sandy tuff, granite boulder conglomerate, agglomerate and associated epiclastic rocks.

About six kilometres southwest of the CAD property lies a northwest trending pluton of Early Tertiary Nisling Range Suite (ETgN). ETgN is described as: leucocratic, biotite granite; miarolitic alaskite; saccharoidal textured, mafic-poor biotite granite; biotite quartz monzonite; and biotite-hornblende granite to leucocratic granodiorite with sparse white alkali feldspar phenocrysts (Gordey and Makepeace, 1999).

No regional-scale faults are mapped in the immediate vicinity of the CAD property.

No property-scale mapping was completed in 2009.

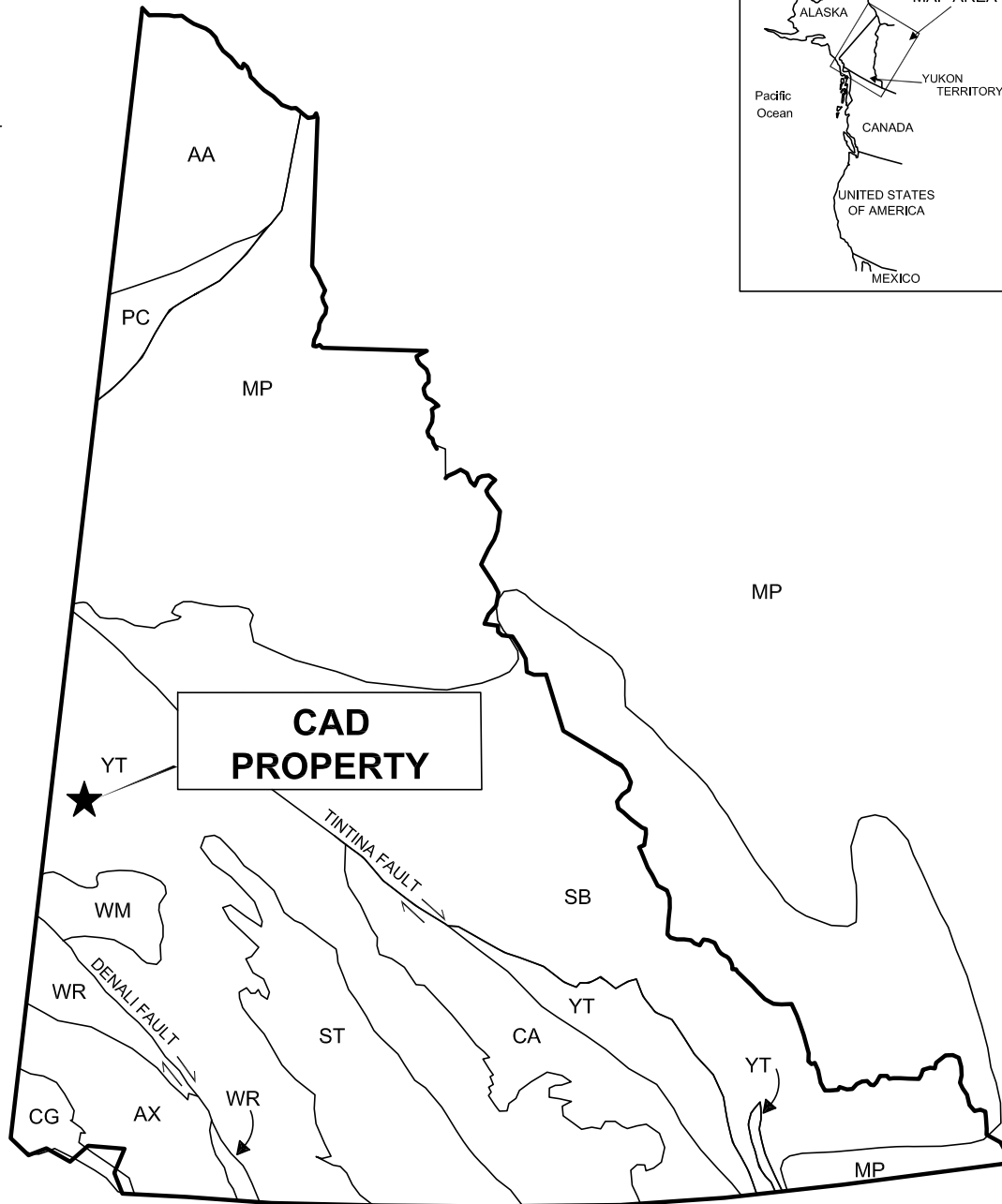
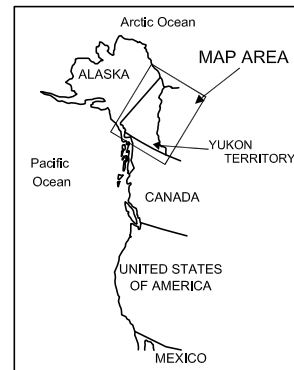

ANCESTRAL NORTH AMERICA

- MP Mackenzie Platform
- SB Selwyn Basin

TERRANES
Displaced Continental Margin

- AA Arctic Alaska
- CA Casslar
- PC Porcupine

Pericratonic Terranes

- YT Yukon-Tanana / Slide Mountain

ACCRETED TERRANES

- ST Sikinia / Cache Creek
- AX Alexander
- WR Wrangellia
- CG Chugach
- WM Windy McKinley

**SILVER QUEST RESOURCES LTD.
ATAC RESOURCES LTD.**

FIGURE 3
ARCHER, CATHRO & ASSOCIATES (1981) LIMITED
**TECTONIC SETTING
CAD PROPERTY**

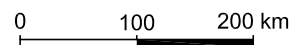

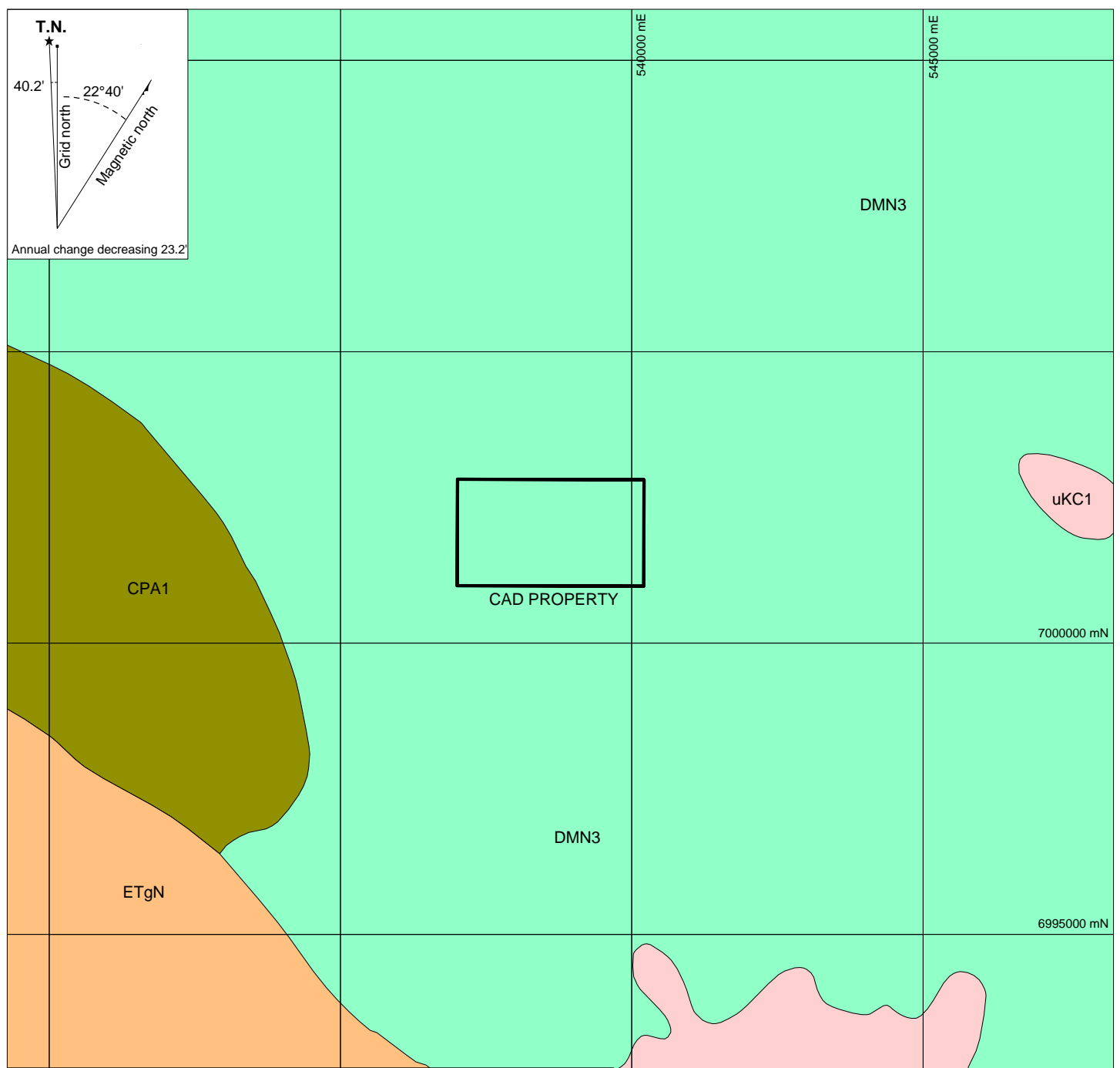
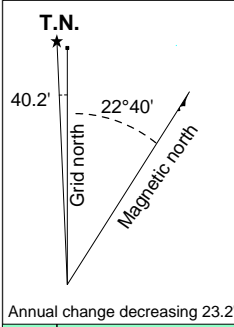

EARLY TERTIARY

ETgN NISLING RANGE SUITE
 Leucocratic, biotite granite; miarolitic alaskite; saccharoidal textured, mafic-poor biotite granite; biotite-hornblende granite to leucocratic granodiorite with sparse white, alkali feldspar phenocrysts; biotite-quartz monzonite.

UPPER CRETACEOUS

uKC1 CARMACKS GROUP
 Augite olivine basalt and breccia; hornblende-feldspar porphyry with andesite and dacite flows; vesicular, augite phyric andesite and trachyte; minor sandy tuff, granite boulder conglomerate, agglomerate and associated epiclastic rocks.

CARBONIFEROUS AND PERMIAN

CPA1 ANVIL GROUP
 Dominantly an assemblage of mafic volcanics including: variably altered and foliated, locally augite-phyric basalt; diorite and gabbro; chloritic greenstone; amphibolitic greenstone and amphibolite; minor metachert and argillite.

DEVONIAN, MISSISSIPPIAN AND OLDER

DMN3 NASINA ASSEMBLAGE
 Quartzite, micaceous quartzite, quartz muscovite (± chlorite; ± feldspar augen) schist, and minor metaconglomerate and metagrit.

**SILVER QUEST RESOURCES LTD.
 ATAC RESOURCES LTD.**

FIGURE 4
 ARCHER, CATHRO & ASSOCIATES (1981) LIMITED

**GEOLOGY
 CAD PROPERTY**

0 1000 m 5000 m

UTM ZONE 7, NAD 83, 115N/01

SOIL GEOCHEMISTRY

A total of 67 augered soil samples were taken during the 2009 program. Augered samples were used to test as deep in the soil profile as possible. They were collected at 50 m spacings from three sample lines along three ridge spines. All soil sample sites were located by means of compass and hip chain surveys with frequent checks using hand-held GPS units. The sites were marked with two pieces of orange flagging labelled with the corresponding sample number. Soil samples were taken from the bottoms of 25 to 60 cm deep holes and were placed into individually pre-numbered kraft paper bags. Soil sample locations are illustrated on Figure 5.

Multi-element analyses for soil samples were carried out at ALS Chemex in North Vancouver, B.C. The samples were dried and sieved to -80 mesh. The fine fraction was then analyzed for gold and 35 other elements (Au-ICP21 and ME-ICP41). Certificates of Analysis are in Appendix II.

Results from the 2009 soil geochemistry were generally low; however, considering the deep weathering regime, the thick moss cover in the region and the low sample density, these results were not surprising.

DISCUSSION AND CONCLUSIONS

The CAD property is favourably situated in the headwaters of two drainages, which yielded elevated stream sediment values. cursory soil sampling in 2009 failed to identify a source for the anomalous metals.

Based on the low sample density and small area sampled, additional work is warranted on the property. This work should include a property-wide, closely-spaced, deep auger grid soil sampling program to thoroughly evaluate the mineral potential. If outcrops are encountered during soil sampling, mapping and prospecting should be done.

Respectfully submitted,

ARCHER, CATHRO & ASSOCIATES (1981) LIMITED

Heather Smith B.Sc. Geology, GIT

REFERENCES

Friske, P.W., Hornbrook, E.H., Schmitt, H.R., Galletta, A.C., Ellwood, D.J., and McCurdy, M.
1986 Regional stream sediment and water geochemical reconnaissance data, Yukon
1986, GSC Open File 1364, NTS 115N(E1/2), 115O.

Gordey, S.P. and Makepeace, A.J. (comp.).

1999 Yukon digital geology; Geological Survey of Canada; Open File D3826 and
Exploration and Geological Services Division, Yukon Region, Indian and
Northern Affairs Canada.

Tempelman-Kluit, D.J.

1974 Reconnaissance Geology of the Snag River Map Area, Yukon; Geological Survey
of Canada.

APPENDIX I
STATEMENT OF QUALIFICATIONS

STATEMENT OF QUALIFICATIONS

I, Heather Smith, geologist, with business addresses in Vancouver, British Columbia and Whitehorse, Yukon Territory and residential address at #604-175 West 1 Street, North Vancouver, British Columbia, V7M 3N9 do hereby certify that:

1. I graduated from the University of British Columbia in 2006 with a B. Sc in Geological Sciences.
2. From 2004 to present, I have been actively engaged in mineral exploration in the Yukon Territory, British Columbia and Northwest Territories.
3. I am a Geoscientist in Training (GIT) with the Association of Professional Engineers and Geoscientists of British Columbia (Member Number 150000).
4. I have personally participated in the fieldwork reported herein and have interpreted all data resulting from this work.

Heather Smith, B.Sc. Geology, GIT

APPENDIX II
CERTIFICATES OF ANALYSIS



ALS Chemex

EXCELLENCE IN ANALYTICAL CHEMISTRY

ALS Canada Ltd.

2103 Dollarton Hwy
North Vancouver BC V7H 0A7

Phone: 604 984 0221 Fax: 604 984 0218 www.alschemex.com

To: ATAC RESOURCES LTD.
C/O ARCHER, CATHRO & ASSOCIATES (1981)
LIMITED
1016-510 W HASTINGS ST
VANCOUVER BC V6B 1L8

Page: 1
Finalized Date: 5-OCT-2009
Account: RCM

CERTIFICATE VA09104224

Project: CAD

P.O. No.:

This report is for 67 Soil samples submitted to our lab in Vancouver, BC, Canada on 22-SEP-2009.

The following have access to data associated with this certificate:

AL ARCHER
BILL WENGZYNOWSKI

DOUG EATON

JOAN MARIACHER

SAMPLE PREPARATION

ALS CODE	DESCRIPTION
WEI-21	Received Sample Weight
LOG-22	Sample login - Rcd w/o BarCode
SCR-41	Screen to -180um and save both

ANALYTICAL PROCEDURES

ALS CODE	DESCRIPTION	INSTRUMENT
Au-ICP21	Au 30g FA ICP-AES Finish	ICP-AES
ME-ICP41	35 Element Aqua Regia ICP-AES	ICP-AES

To: ATAC RESOURCES LTD.
ATTN: AL ARCHER
C/O ARCHER, CATHRO & ASSOCIATES (1981) LIMITED
1016-510 W HASTINGS ST
VANCOUVER BC V6B 1L8

This is the Final Report and supersedes any preliminary report with this certificate number. Results apply to samples as submitted. All pages of this report have been checked and approved for release.

Signature:

Colin Ramshaw, Vancouver Laboratory Manager



ALS Chemex

EXCELLENCE IN ANALYTICAL CHEMISTRY

ALS Canada Ltd.

2103 Dollarton Hwy

North Vancouver BC V7H 0A7

Phone: 604 984 0221 Fax: 604 984 0218 www.alschemex.com

To: ATAC RESOURCES LTD.

C/O ARCHER, CATHRO & ASSOCIATES (1981)

LIMITED

1016-510 W HASTINGS ST

VANCOUVER BC V6B 1L8

Project: CAD

Page: 2 - A

Total # Pages: 3 (A - C)

Plus Appendix Pages

Finalized Date: 5-OCT-2009

Account: RCM

CERTIFICATE OF ANALYSIS VA09104224

Sample Description	Method Analyte Units LOR	WEI-21	Au-ICP21	ME-ICP41	ME-ICP41	ME-ICP41	ME-ICP41	ME-ICP41	ME-ICP41	ME-ICP41	ME-ICP41	ME-ICP41	ME-ICP41	ME-ICP41	ME-ICP41	ME-ICP41
		Recvd Wt. kg	Au ppm	Ag ppm	Al %	As ppm	B ppm	Ba ppm	Be ppm	Bi ppm	Ca %	Cd ppm	Co ppm	Cr ppm	Cu ppm	Fe %
CC58410		0.30	0.001	0.2	1.86	5	<10	250	0.5	<2	0.34	<0.5	12	33	24	3.22
CC58411		0.22	0.001	0.2	1.93	3	<10	420	0.8	<2	1.21	<0.5	11	25	24	2.63
CC58412		0.30	0.002	<0.2	2.42	4	<10	250	0.7	<2	0.51	<0.5	12	40	22	3.71
CC58413		0.28	0.001	0.2	2.02	7	<10	310	1.1	<2	0.69	<0.5	12	47	25	3.29
CC58414		0.28	<0.001	<0.2	1.82	24	<10	220	1.0	<2	0.50	<0.5	11	33	27	3.23
CC58415		0.30	0.001	<0.2	1.79	11	<10	220	1.0	<2	1.10	<0.5	17	38	30	3.34
CC58416		0.22	0.001	<0.2	1.46	8	<10	190	0.8	<2	1.61	<0.5	10	31	26	2.59
CC58417		0.20	0.006	0.2	1.41	10	<10	220	0.8	<2	1.20	<0.5	10	25	35	2.52
CC58418		0.22	<0.001	<0.2	1.58	8	<10	230	1.0	<2	0.96	<0.5	11	29	28	2.76
CC58419		0.18	0.001	0.3	2.03	10	<10	290	0.7	<2	0.68	<0.5	11	30	17	3.11
CC58420		0.16	0.001	<0.2	1.61	7	<10	210	0.5	<2	0.46	<0.5	8	23	20	2.35
CC58421		0.20	<0.001	<0.2	1.23	5	<10	100	<0.5	<2	0.52	<0.5	7	16	14	2.15
CC58364		0.20	0.001	<0.2	1.80	11	<10	240	0.9	<2	0.65	<0.5	14	31	18	3.36
CC58365		0.32	0.002	0.2	1.83	16	<10	250	1.0	<2	0.87	<0.5	13	35	38	3.25
CC58366		0.28	0.002	<0.2	1.26	16	<10	170	1.0	<2	0.63	<0.5	9	23	35	2.80
CC58367		0.22	0.003	<0.2	2.01	12	<10	260	1.0	<2	0.77	<0.5	12	33	38	3.27
CC58368		0.22	0.001	0.2	1.71	8	<10	460	0.9	<2	1.06	<0.5	14	26	38	3.05
CC58369		0.22	<0.001	<0.2	1.71	14	<10	330	0.8	<2	0.66	<0.5	12	32	26	3.60
CC58370		0.20	<0.001	<0.2	2.07	11	<10	260	<0.5	<2	0.50	<0.5	9	37	16	3.34
CC58371		0.26	<0.001	0.2	1.29	7	<10	150	0.5	<2	0.35	<0.5	8	25	21	2.76
CC58372		0.26	<0.001	<0.2	1.82	7	<10	140	<0.5	<2	0.67	<0.5	12	56	32	2.66
CC58373		0.26	0.001	<0.2	2.47	8	<10	200	<0.5	<2	0.30	<0.5	21	272	34	3.32
CC31926		0.24	<0.001	0.2	1.67	6	<10	200	<0.5	<2	0.22	<0.5	8	23	16	2.81
CC31927		0.32	0.001	<0.2	2.82	11	<10	330	<0.5	<2	0.30	<0.5	11	40	19	3.75
CC31928		0.26	0.001	0.3	1.70	10	<10	210	<0.5	<2	0.15	<0.5	6	27	13	3.37
CC31929		0.38	0.004	0.3	2.76	4	<10	540	0.5	<2	0.36	<0.5	20	101	61	4.77
CC31930		0.30	0.001	0.2	1.73	4	<10	540	0.5	<2	0.48	<0.5	10	36	27	2.66
CC31931		0.32	0.001	0.2	1.59	7	<10	210	<0.5	<2	0.21	<0.5	6	18	14	3.01
CC31932		0.26	0.001	0.2	2.11	6	<10	370	<0.5	<2	0.31	<0.5	9	32	20	2.91
CC31933		0.28	0.001	0.2	2.56	5	<10	420	0.7	<2	0.36	<0.5	12	49	18	3.72
CC31934		0.24	0.001	<0.2	0.38	3	<10	60	<0.5	<2	0.09	<0.5	1	6	3	0.59
CC31935		0.30	0.001	<0.2	2.56	4	<10	140	<0.5	<2	0.26	<0.5	14	106	28	3.80
CC31936		0.34	0.001	0.2	2.00	4	<10	320	0.5	<2	0.65	<0.5	10	25	40	2.78
CC31937		0.28	0.010	0.2	2.44	3	<10	140	<0.5	<2	0.28	<0.5	9	33	34	3.37
CC31938		0.32	0.001	0.2	2.59	11	<10	200	<0.5	<2	0.23	<0.5	10	43	25	3.81
CC31939		0.16	0.001	<0.2	2.92	6	<10	270	0.6	<2	0.33	<0.5	20	184	36	4.03
CC31940		0.12	0.005	0.5	3.17	6	<10	1060	1.3	2	0.35	<0.5	10	35	49	3.50
CC31941		0.18	<0.001	<0.2	2.36	4	<10	380	<0.5	<2	0.91	<0.5	24	210	46	2.98
CC31942		0.14	<0.001	0.2	0.82	3	<10	110	<0.5	<2	0.22	<0.5	5	30	18	1.32
CC31943		0.18	0.003	<0.2	1.65	5	<10	200	<0.5	2	0.53	<0.5	8	55	29	2.14



ALS Chemex

EXCELLENCE IN ANALYTICAL CHEMISTRY

ALS Canada Ltd.

2103 Dollarton Hwy

North Vancouver BC V7H 0A7

Phone: 604 984 0221 Fax: 604 984 0218 www.alschemex.com

To: ATAC RESOURCES LTD.

C/O ARCHER, CATHRO & ASSOCIATES (1981)

LIMITED

1016-510 W HASTINGS ST

VANCOUVER BC V6B 1L8

Project: CAD

Page: 2 - B

Total # Pages: 3 (A - C)

Plus Appendix Pages

Finalized Date: 5-OCT-2009

Account: RCM

CERTIFICATE OF ANALYSIS VA09104224

Sample Description	Method	ME-ICP41	ME-ICP41	ME-ICP41	ME-ICP41	ME-ICP41	ME-ICP41	ME-ICP41	ME-ICP41	ME-ICP41	ME-ICP41	ME-ICP41	ME-ICP41	ME-ICP41	ME-ICP41	
	Analyte	Ga	Hg	K	La	Mg	Mn	Mo	Na	Ni	P	Pb	S	Sb	Sc	
Units		ppm	ppm	%	ppm	%	ppm	ppm	%	ppm	ppm	ppm	%	ppm	ppm	
LOR		10	1	0.01	10	0.01	5	1	0.01	1	10	2	0.01	2	1	
CC58410		<10	<1	0.06	30	0.65	375	1	0.01	31	400	8	<0.01	3	5	23
CC58411		<10	<1	0.04	40	0.36	1510	1	0.03	24	520	6	0.03	2	5	68
CC58412		10	<1	0.05	10	0.71	348	<1	0.01	33	280	9	<0.01	2	6	39
CC58413		10	<1	0.06	20	0.62	327	<1	0.02	41	440	7	<0.01	2	6	56
CC58414		10	<1	0.06	20	0.44	303	1	0.02	25	490	13	0.01	<2	6	38
CC58415		<10	<1	0.06	20	0.61	717	<1	0.02	36	700	10	0.02	<2	7	82
CC58416		<10	<1	0.06	20	0.43	326	<1	0.03	26	610	10	0.05	<2	5	124
CC58417		<10	<1	0.08	20	0.38	466	<1	0.02	22	740	24	0.04	<2	4	97
CC58418		<10	<1	0.10	20	0.44	512	<1	0.02	26	620	18	0.02	<2	5	76
CC58419		10	<1	0.05	10	0.47	434	<1	0.02	21	340	11	<0.01	<2	5	58
CC58420		10	<1	0.05	10	0.42	179	1	0.01	18	490	5	<0.01	2	3	36
CC58421		<10	1	0.06	10	0.43	153	1	0.01	16	720	4	<0.01	<2	3	43
CC58364		10	<1	0.07	10	0.35	367	<1	0.01	24	410	14	<0.01	<2	5	51
CC58365		10	<1	0.06	20	0.50	407	<1	0.03	37	620	7	0.02	2	7	62
CC58366		<10	<1	0.07	50	0.33	334	<1	0.02	26	370	10	0.01	<2	6	51
CC58367		<10	1	0.04	20	0.47	521	<1	0.03	29	510	9	0.01	3	6	60
CC58368		<10	<1	0.06	30	0.34	1015	1	0.03	25	620	34	0.02	<2	6	73
CC58369		<10	<1	0.08	20	0.30	384	1	0.02	28	310	4	0.01	2	6	42
CC58370		10	<1	0.07	10	0.47	386	1	0.01	20	170	10	0.01	2	4	34
CC58371		<10	<1	0.10	10	0.38	259	1	0.01	22	480	10	0.01	<2	4	25
CC58372		<10	<1	0.05	10	0.89	225	<1	0.01	37	1100	<2	<0.01	<2	3	60
CC58373		<10	<1	0.05	10	1.75	330	<1	0.02	122	170	6	<0.01	<2	5	27
CC31926		10	1	0.04	10	0.46	236	1	0.01	15	290	14	0.01	2	3	29
CC31927		10	<1	0.04	10	0.60	283	1	0.02	27	240	8	<0.01	<2	4	26
CC31928		10	<1	0.06	10	0.39	200	2	0.01	14	280	24	0.02	<2	2	17
CC31929		10	1	0.07	30	1.79	514	1	0.02	51	490	44	0.06	<2	9	45
CC31930		10	<1	0.06	20	0.59	444	1	0.03	21	430	25	0.01	<2	4	34
CC31931		<10	<1	0.04	10	0.55	248	1	0.01	11	220	16	0.01	<2	3	16
CC31932		10	<1	0.04	10	0.52	231	<1	0.03	19	290	8	0.01	<2	5	24
CC31933		10	<1	0.04	20	0.54	476	1	0.03	23	310	15	<0.01	2	5	26
CC31934		<10	<1	0.03	<10	0.08	41	<1	0.02	3	120	6	0.01	<2	1	8
CC31935		10	<1	0.07	10	1.56	510	<1	0.01	52	390	9	0.01	<2	9	17
CC31936		<10	<1	0.03	20	0.51	492	<1	0.03	16	360	13	0.01	<2	7	36
CC31937		10	<1	0.06	10	1.61	364	<1	0.01	21	950	2	0.01	<2	4	11
CC31938		10	<1	0.04	10	0.74	208	<1	0.01	19	200	9	0.01	<2	6	19
CC31939		10	<1	0.04	10	2.03	457	<1	0.02	63	270	10	0.01	<2	15	24
CC31940		10	<1	0.03	80	0.29	241	<1	0.02	19	480	15	0.02	<2	8	31
CC31941		<10	<1	0.03	10	1.40	623	<1	0.02	146	530	3	0.02	<2	8	37
CC31942		<10	<1	0.02	<10	0.27	156	<1	0.02	14	250	3	0.01	<2	2	13
CC31943		10	<1	0.03	10	0.55	254	<1	0.02	28	360	4	0.02	<2	3	24



ALS Chemex

EXCELLENCE IN ANALYTICAL CHEMISTRY

ALS Canada Ltd

2103 Dollarton Hwy

North Vancouver BC V7H 0A7

Phone: 604 984 0221 Fax: 604 984 0218 www.alschemex.com

To: ATAC RESOURCES LTD.

C/O ARCHER, CATHRO & ASSOCIATES (1981)

LIMITED

1016-510 W HASTINGS ST

VANCOUVER BC V6B 1L8

Project: CAD

Page: 2 - C

Total # Pages: 3 (A - C)

Plus Appendix Pages

Finalized Date: 5-OCT-2009

Account: RCM

CERTIFICATE OF ANALYSIS VA09104224

Sample Description	Method Analyte Units LOR	ME-ICP41	ME-ICP41	ME-ICP41	ME-ICP41	ME-ICP41	ME-ICP41	ME-ICP41
		Th	Ti	Ti	U	V	W	Zn
		ppm	%	ppm	ppm	ppm	ppm	ppm
		20	0.01	10	10	1	10	2
CC58410		<20	0.04	<10	<10	43	<10	49
CC58411		<20	0.02	<10	<10	42	<10	36
CC58412		<20	0.03	<10	<10	54	<10	51
CC58413		<20	0.07	<10	<10	56	<10	52
CC58414		<20	0.04	<10	<10	54	<10	57
CC58415		<20	0.07	<10	<10	60	<10	60
CC58416		<20	0.05	<10	<10	47	<10	49
CC58417		<20	0.03	<10	<10	41	<10	54
CC58418		<20	0.04	<10	<10	48	<10	48
CC58419		<20	0.05	<10	<10	61	<10	47
CC58420		<20	0.06	<10	<10	50	<10	31
CC58421		<20	0.09	<10	<10	51	<10	28
CC58364		<20	0.04	<10	<10	60	<10	47
CC58365		<20	0.06	<10	<10	58	<10	47
CC58366		<20	0.03	<10	<10	39	<10	44
CC58367		<20	0.06	<10	<10	64	<10	51
CC58368		<20	0.04	<10	<10	50	<10	64
CC58369		<20	0.02	<10	<10	49	<10	52
CC58370		<20	0.09	<10	<10	76	<10	49
CC58371		<20	0.06	<10	<10	49	<10	41
CC58372		<20	0.11	<10	<10	50	<10	39
CC58373		<20	0.08	<10	<10	67	<10	39
CC31926		<20	0.05	<10	<10	72	<10	33
CC31927		<20	0.11	<10	<10	85	<10	45
CC31928		<20	0.09	<10	<10	80	<10	43
CC31929		<20	0.03	<10	<10	68	<10	84
CC31930		<20	0.04	<10	<10	47	<10	53
CC31931		<20	0.03	<10	<10	42	<10	61
CC31932		<20	0.06	<10	<10	66	<10	42
CC31933		<20	0.09	<10	<10	82	<10	46
CC31934		<20	0.04	<10	<10	14	<10	9
CC31935		<20	0.05	<10	<10	90	<10	49
CC31936		<20	0.05	<10	<10	56	<10	46
CC31937		<20	0.03	<10	<10	42	<10	93
CC31938		<20	0.11	<10	<10	106	<10	48
CC31939		<20	0.09	<10	<10	114	<10	66
CC31940		<20	0.08	<10	<10	67	<10	28
CC31941		<20	0.03	<10	<10	61	<10	43
CC31942		<20	0.06	<10	<10	33	<10	20
CC31943		<20	0.07	<10	<10	55	<10	33



ALS Chemex

EXCELLENCE IN ANALYTICAL CHEMISTRY

ALS Canada Ltd.

2103 Dollarton Hwy

North Vancouver BC V7H 0A7

Phone: 604 984 0221 Fax: 604 984 0218 www.alschemex.com

To: ATAC RESOURCES LTD.

C/O ARCHER, CATHRO & ASSOCIATES (1981)

LIMITED

1016-510 W HASTINGS ST

VANCOUVER BC V6B 1L8

Project: CAD

Page: 3 - A

Total # Pages: 3 (A - C)

Plus Appendix Pages

Finalized Date: 5-OCT-2009

Account: RCM

CERTIFICATE OF ANALYSIS VA09104224

Sample Description	Method Analyte Units LOR	WEI-21	Au-ICP21	ME-ICP41	ME-ICP41	ME-ICP41	ME-ICP41	ME-ICP41	ME-ICP41	ME-ICP41	ME-ICP41	ME-ICP41	ME-ICP41	ME-ICP41	ME-ICP41	ME-ICP41
		Recvd Wt. kg	Au ppm	Ag ppm	Al %	As ppm	B ppm	Ba ppm	Be ppm	Bi ppm	Ca %	Cd ppm	Co ppm	Cr ppm	Cu ppm	Fe %
		0.02	0.001	0.2	0.01	2	10	10	0.5	2	0.01	0.5	1	1	1	0.01
CC31944		0.16	0.002	<0.2	2.08	4	<10	270	<0.5	3	0.49	<0.5	12	66	42	2.86
CC31945		0.16	0.001	<0.2	2.08	3	<10	140	<0.5	2	0.35	<0.5	17	83	61	2.46
CC31946		0.16	0.003	<0.2	2.00	2	<10	170	<0.5	2	0.22	<0.5	13	70	39	2.36
CC31947		0.10	0.001	<0.2	1.38	7	<10	110	<0.5	<2	0.22	<0.5	5	26	10	2.03
CC31948		0.08	0.003	NSS	NSS	NSS	NSS	NSS	NSS	NSS	NSS	NSS	NSS	NSS	NSS	NSS
CC31949		0.16	0.001	0.2	1.35	15	<10	170	<0.5	2	0.11	<0.5	7	20	20	2.81
CC31950		0.12	0.001	<0.2	1.17	5	<10	140	<0.5	3	0.22	<0.5	4	18	8	1.73
CC32849		0.24	0.001	<0.2	0.57	<2	<10	60	<0.5	2	0.11	<0.5	1	9	4	0.70
CC32850		0.24	0.003	<0.2	1.53	7	<10	170	0.5	<2	0.21	<0.5	5	21	9	2.09
CC32851		0.14	<0.001	<0.2	1.17	3	<10	110	0.5	<2	0.18	<0.5	3	14	10	1.61
CC32852		0.24	0.003	0.2	2.82	9	<10	190	0.8	2	0.22	<0.5	12	41	20	3.65
CC32853		0.26	0.002	<0.2	1.37	4	<10	140	0.5	2	0.25	<0.5	7	24	10	2.26
CC32854		0.24	0.004	<0.2	1.60	6	<10	170	<0.5	<2	0.19	<0.5	6	23	9	2.60
CC32855		0.32	0.002	<0.2	2.05	6	<10	190	<0.5	2	0.22	<0.5	8	31	15	3.19
CC32856		0.28	0.002	<0.2	2.02	7	<10	200	0.5	2	0.28	<0.5	8	35	13	3.20
CC32857		0.34	0.001	<0.2	2.03	5	<10	300	0.5	3	0.38	<0.5	10	24	14	3.09
CC32858		0.36	0.002	<0.2	2.15	7	<10	200	0.5	<2	0.28	<0.5	10	41	20	3.24
CC32859		0.36	<0.001	<0.2	1.96	5	<10	180	<0.5	2	0.33	<0.5	10	37	18	3.19
CC32860		0.36	0.001	<0.2	2.17	12	<10	170	<0.5	2	0.27	<0.5	9	37	14	3.49
CC32861		0.34	0.001	0.2	1.86	4	<10	150	0.5	2	0.27	<0.5	8	45	23	2.86
CC32862		0.34	0.001	<0.2	1.85	5	<10	150	<0.5	2	0.37	<0.5	9	36	12	2.67
CC32863		0.28	0.001	<0.2	1.03	3	<10	90	<0.5	3	0.17	<0.5	3	17	8	1.73
CC32864		0.26	0.002	<0.2	2.28	7	<10	220	0.5	<2	0.34	<0.5	10	33	18	3.09
CC32865		0.36	0.001	0.3	2.32	5	<10	160	0.5	<2	0.23	<0.5	11	36	20	3.15
CC32866		0.38	0.001	<0.2	2.11	8	<10	180	0.5	2	0.19	<0.5	10	38	18	3.17
CC32867		0.46	0.003	0.2	2.08	6	<10	290	0.5	<2	0.32	<0.5	11	39	23	3.25
CC32868		0.44	0.002	<0.2	1.72	6	<10	340	0.6	2	0.36	<0.5	9	33	18	2.79



ALS Chemex

EXCELLENCE IN ANALYTICAL CHEMISTRY

ALS Canada Ltd.

2103 Dollarton Hwy

North Vancouver BC V7H 0A7

Phone: 604 984 0221 Fax: 604 984 0218 www.alschemex.com

To: ATAC RESOURCES LTD.

C/O ARCHER, CATHRO & ASSOCIATES (1981)

LIMITED

1016-510 W HASTINGS ST

VANCOUVER BC V6B 1L8

Project: CAD

Page: 3 - B

Total # Pages: 3 (A - C)

Plus Appendix Pages

Finalized Date: 5-OCT-2009

Account: RCM

CERTIFICATE OF ANALYSIS VA09104224

Sample Description	Method Analyte Units LOR	ME-ICP41	ME-ICP41	ME-ICP41	ME-ICP41	ME-ICP41	ME-ICP41	ME-ICP41	ME-ICP41	ME-ICP41	ME-ICP41	ME-ICP41	ME-ICP41	ME-ICP41	ME-ICP41	
		Ga	Hg	K	La	Mg	Mn	Mo	Na	Ni	P	Pb	S	Sb	Sc	Sr
		ppm	ppm	%	ppm	%	ppm	ppm	%	ppm	ppm	ppm	%	ppm	ppm	ppm
		10	1	0.01	10	0.01	5	1	0.01	1	10	2	0.01	2	1	1
CC31944		10	<1	0.03	10	0.77	430	<1	0.02	34	340	3	<0.01	<2	6	26
CC31945		<10	<1	0.02	<10	1.10	293	<1	0.01	54	410	<2	<0.01	<2	4	17
CC31946		<10	<1	0.03	<10	0.91	238	<1	0.01	47	230	4	0.01	<2	3	13
CC31947		10	<1	0.02	10	0.33	143	<1	0.01	11	150	5	0.01	<2	3	16
CC31948		NSS	NSS	NSS	NSS	NSS	NSS	NSS	NSS	NSS	NSS	NSS	NSS	NSS	NSS	NSS
CC31949		10	<1	0.06	10	0.20	142	1	0.01	11	310	9	0.01	<2	2	16
CC31950		<10	<1	0.03	10	0.29	134	<1	0.01	9	180	8	0.01	<2	2	18
CC32849		<10	<1	0.06	10	0.07	63	<1	0.01	1	200	6	0.01	<2	1	10
CC32850		10	<1	0.03	10	0.35	124	<1	0.01	10	120	10	0.01	<2	2	18
CC32851		<10	<1	0.05	10	0.22	166	1	0.01	6	230	13	0.01	<2	2	17
CC32852		10	<1	0.05	20	0.53	276	1	0.01	23	230	8	0.01	<2	4	24
CC32853		<10	<1	0.05	20	0.41	203	<1	0.01	12	320	7	<0.01	<2	3	19
CC32854		10	<1	0.07	10	0.36	173	1	0.01	10	340	8	0.01	<2	3	15
CC32855		10	<1	0.06	10	0.46	199	<1	0.01	15	220	8	0.01	<2	3	20
CC32856		10	<1	0.05	20	0.51	240	1	0.01	16	200	11	<0.01	<2	5	22
CC32857		10	<1	0.08	30	0.46	207	<1	0.01	16	480	7	<0.01	<2	4	23
CC32858		10	<1	0.04	30	0.55	277	<1	0.01	24	160	5	<0.01	<2	6	23
CC32859		10	<1	0.04	10	0.47	243	1	0.01	23	200	8	<0.01	<2	4	22
CC32860		10	<1	0.04	10	0.45	260	1	0.01	18	220	8	<0.01	<2	4	22
CC32861		10	<1	0.04	20	0.51	209	<1	0.01	28	220	6	0.01	<2	4	20
CC32862		10	<1	0.03	10	0.53	238	<1	0.02	17	220	3	<0.01	<2	5	25
CC32863		<10	<1	0.05	10	0.23	126	1	0.01	8	250	8	0.01	<2	2	14
CC32864		10	<1	0.05	20	0.59	179	<1	0.02	22	420	8	<0.01	<2	4	25
CC32865		10	<1	0.05	10	0.63	265	<1	0.01	20	150	13	<0.01	<2	4	18
CC32866		10	<1	0.03	10	0.52	246	<1	0.01	23	210	7	<0.01	<2	4	19
CC32867		10	<1	0.04	20	0.53	308	<1	0.02	21	220	6	<0.01	<2	7	28
CC32868		<10	<1	0.05	20	0.51	235	<1	0.01	19	410	5	<0.01	<2	5	24



ALS Chemex

EXCELLENCE IN ANALYTICAL CHEMISTRY

ALS Canada Ltd.

2103 Dollarton Hwy

North Vancouver BC V7H 0A7

Phone: 604 984 0221 Fax: 604 984 0218 www.alschemex.com

To: ATAC RESOURCES LTD.

C/O ARCHER, CATHRO & ASSOCIATES (1981)

LIMITED

1016-510 W HASTINGS ST

VANCOUVER BC V6B 1L8

Project: CAD

Page: 3 - C

Total # Pages: 3 (A - C)

Plus Appendix Pages

Finalized Date: 5-OCT-2009

Account: RCM

CERTIFICATE OF ANALYSIS VA09104224

Sample Description	Method Analyte Units LOR	ME-ICP41	ME-ICP41	ME-ICP41	ME-ICP41	ME-ICP41	ME-ICP41	ME-ICP41
		Th	Ti	Ti	U	V	W	Zn
		ppm	%	ppm	ppm	ppm	ppm	ppm
		20	0.01	10	10	1	10	2
CC31944		<20	0.09	<10	<10	69	<10	44
CC31945		<20	0.07	<10	<10	48	<10	31
CC31946		<20	0.11	<10	<10	47	<10	32
CC31947		<20	0.10	<10	<10	68	<10	29
CC31948		NSS	NSS	NSS	NSS	NSS	NSS	NSS
CC31949		<20	0.03	<10	<10	59	<10	33
CC31950		<20	0.07	<10	<10	46	<10	25
CC32849		<20	0.07	<10	<10	27	<10	13
CC32850		<20	0.07	<10	<10	52	<10	25
CC32851		<20	0.04	<10	<10	38	<10	22
CC32852		<20	0.07	<10	<10	70	<10	51
CC32853		<20	0.06	<10	<10	50	<10	33
CC32854		<20	0.06	<10	<10	63	<10	36
CC32855		<20	0.09	<10	<10	69	<10	36
CC32856		<20	0.06	<10	<10	72	<10	45
CC32857		<20	0.03	<10	<10	50	<10	42
CC32858		<20	0.09	<10	<10	69	<10	44
CC32859		<20	0.04	<10	<10	59	<10	43
CC32860		<20	0.08	<10	<10	79	<10	42
CC32861		<20	0.05	<10	<10	61	<10	39
CC32862		<20	0.08	<10	<10	63	<10	36
CC32863		<20	0.05	<10	<10	43	<10	24
CC32864		<20	0.06	<10	<10	62	<10	43
CC32865		<20	0.05	<10	<10	58	<10	53
CC32866		<20	0.10	<10	<10	72	<10	49
CC32867		<20	0.11	<10	<10	72	<10	40
CC32868		<20	0.07	<10	<10	58	<10	40



ALS Chemex

EXCELLENCE IN ANALYTICAL CHEMISTRY

ALS Canada Ltd.

2103 Dollarton Hwy

North Vancouver BC V7H 0A7

Phone: 604 984 0221 Fax: 604 984 0218 www.alschemex.com

To: ATAC RESOURCES LTD.

C/O ARCHER, CATHRO & ASSOCIATES (1981)

LIMITED

1016-510 W HASTINGS ST

VANCOUVER BC V6B 1L8

Project: CAD

je: Appendix 1

Total # Appendix Pages: 1

Finalized Date: 5-OCT-2009

Account: RCM

CERTIFICATE OF ANALYSIS VA09104224

Method	CERTIFICATE COMMENTS
ALL METHODS	NSS is non-sufficient sample.

QW28537

ARCHER, CATHRO & ASSOCIATES (1981) LIMITED
1016 – 510 West Hastings Street
Vancouver, B.C. V6B 1L8

Telephone: 604-688-2568

Fax: 604-688-2578

AFFIDAVIT



I, Joan Mariacher, of Vancouver, B.C. make oath and say:

That to the best of my knowledge the attached Statement of Expenditures for exploration work on the Cad 1-28 mineral claims on Claim Sheet 115N/1 is accurate.

Joan Mariacher

Sworn before me at Vancouver, B.C.

this 24th day of March 2010.

Barrister & Solicitor

IAN J. TALBOT
Barrister & Solicitor
281 East 5th Street
North Vancouver
British Columbia
Canada V7L 1L8

Statement of Expenditures
CAD 1-28 Mineral Claims
March 22, 2010



Labour

H. Smith (geologist) September 6, 2009 – 1 day @ \$560/day	\$ 588.00
January to March 2010 – 10 1/2 hrs @ \$75/hr	826.88
D. Arnold-Wallinger (field assistant) September 6, 2009 – 1 day @ \$440/day	462.00
E. Jacobsen (field assistant) September 6, 2009 – 1 day @ \$288/day	302.40
S. Newman (office work) March 2010 – 2 1/2 hrs @ \$44/hr	115.50
	<u>2,294.78</u>

Expenses

Field room and board – 3 days @ \$125/day	393.75
Fireweed Helicopters – 1.1 hrs Bell 206 @ \$995/hr plus fuel	1,149.23
ALS Chemex	<u>1,336.22</u>
	2,879.20
Total	<u>\$5,173.98</u>



FLIGHT TICKET / INVOICE

WHITEHORSE DAWSON CITY
 867-668-5888 ☎ 867-993-5700
 fax: 867-668-7875 fax: 867-993-6839
 Box 26, Whitehorse, Yukon Y1A 5X9

No 6580

GST # 128659828

CHARTERER Archer Cathro		PILOT K. Scholz		DATE Sept 6/09	
		SIGNATURE <i>K. Scholz</i>		AIRCRAFT FWH	
		CHEQUE	CASH	CHARGE	
TELEPHONE		POSTAL CODE		PURCHASE ORDER NO.	
				BASE YDA	
CUSTOMER FUEL		FLIGHT ITINERARY		PASS	TIME
125.4 LIT FROM Thistle		Kirkman - Thistle fuel - Card			
LIT FROM		DLO 3		3	
		Card Plus 3 - Kirkman - Thistle		3	1:1
FIREWEED FUEL					
LIT FROM @ \$					
LIT FROM @ \$					
LIT FROM @ \$					
OTHER CHARGES		DESCRIPTION	AMOUNT		
		CAD A ✓			
		Heather Smith			
		<i>Heather Smith</i>			
PILOT EXPENSES		DESCRIPTION	AMOUNT	RATE PER HOUR WET/DRY	TOTAL
				995.00	1:1
		PASSENGERS (names)	FLIGHT	GST	\$
		Heather Dillon	1094.50	54.73	1149.23
		+ 1	FUEL	GST	\$
			OTHER	GST	\$
			TOTAL		\$ 1149.23
AUTHORIZED BY (print)					
SIGNATURE X					





ALS Chemex

EXCELLENCE IN ANALYTICAL CHEMISTRY

ALS Canada Ltd

2103 Dollarton Hwy
North Vancouver BC V7H 0A7

Phone: 604 984 0221 Fax: 604 984 0218 www.alschemex.com

To: ATAC RESOURCES LTD.
C/O ARCHER, CATHRO & ASSOCIATES (1981) LIMITED
1016-510 W HASTINGS ST
VANCOUVER BC V6B 1L8

INVOICE NUMBER 1971500

BILLING INFORMATION

Certificate: **VA09104224**
Sample Type: **Soil**
Account: **RCM**
Date: **6-OCT-2009** *AM*
Project: **CAD**
P.O. No.:
Quote: **ALSC-CW09-032-F-R1**
Terms: **Net 30 Days** **C1**
Comments:

ANALYSED FOR

QUANTITY	CODE	DESCRIPTION	UNIT PRICE	TOTAL
67	PREP-41	Dry, Sieve (180 um) Soil	0.96	64.32
17.10	PREP-41	Weight Charge (kg) - Dry, Sieve (180 um) Soil	1.80	30.78
67	Au-ICP21	Au 30g FA ICP-AES Finish	10.61	710.87
66	ME-ICP41	35 Element Aqua Regia ICP-AES	4.72	311.52
66	GEO-AR01	Aqua regia digestion	2.35	155.10

*DRF
NAYO*

SUBTOTAL (CAD) \$ 1,272.59

R100938885 GST \$ 63.63

TOTAL PAYABLE (CAD) \$ 1,336.22

To: **ATAC RESOURCES LTD.**
ATTN: ACCOUNTS PAYABLE
C/O ARCHER, CATHRO & ASSOCIATES (1981) LIMITED
1016-510 W HASTINGS ST
VANCOUVER BC V6B 1L8

Payment may be made by: Cheque or Bank Transfer

Beneficiary Name: ALS Canada Ltd.
Bank: Royal Bank of Canada
SWIFT: ROYCCAT2
Address: Vancouver, BC, CAN
Account: 003-00010-1001098

Please Remit Payments To :
ALS Chemex
2103 Dollarton Hwy
North Vancouver BC V7H 0A7

