

ASSESSMENT REPORT

describing

PROSPECTING

on the:

BOX PROPERTY

Box Claims 41-105, 107-120

Claims are 100% owned by Yukon Zinc Corporation.

NTS Sheet 105G/10
Box Centre: 407,459mE; 6,839,028mN
UTM Nad27 zone9

In the Watson Lake Mining District
Yukon Territory

Prepared by

David Legault, B.Sc.

January 2006

Table of contents

| | Page |
|--|------|
| Introduction | 1 |
| Accessibility, Climate, and Physiography | 1 |
| List of Claims by name and by grant number being renewed | 1 |
| Description of Undertakings | 3 |
| Results | 3 |
| Discussion and Recommendations | 3 |

Tables

| | |
|--|---|
| Table 01 – List of claims by name and grant number being renewed | 1 |
|--|---|

Appendixes

- Appendix A - List of Personal
- Appendix B - Statement of Expenditures
- Appendix C - Statement of Qualification
- Appendix D – Assays Certificates

Figures

- Figure 1 – Location of the Box Property
- Figure 2 – Box Property, YT Claim Map and Sample Location
- Figure 3 – Box Property, YT Soil Geochemistry Zn (ppm)
- Figure 4 – Box Property, YT Soil Geochemistry Pb (ppm)
- Figure 5 – Box Property, YT Soil Geochemistry Cu (ppm)

1. Introduction

The Box property is 100% owned by Yukon Zinc Corporation (“Yukon Zinc”). The claims subject to this report (Table 1) were worked on between June 18-22, 2005 by a ten-person crew working from fly camps on the property. Prospecting and soil sampling were the primary undertakings during this time.

2. Accessibility, Climate and Physiography

The Box property is located in the Watson Lake Mining District in southeast Yukon on NTS sheet 105G/10 at coordinate: 407,459mE and 6,839028mN in NAD27 zone 9 (Figure 01). Access into site is 275km by fixed wing charters from Whitehorse to Wolverine airstrip (61°01’N, 131°20’W) and then 41 km via helicopter from Wolverine airstrip to the Box Property. In 2005, air transportation was provided by Trans North Helicopter (Astar 350B2) and Alkan Air (Single Turbo Otter).

The Box property is situated in the Campbell Mountain Range in the sub-alpine at an elevation of 900m to 1100m. The property drains into Finlayson Lake Watershed. Black spruce, alder, willow, back brush, moss and lichen make up the vegetation on the property. The property is overlain by Pleistocene colluviums and glacial till and outcropping rocks are only found along streams in the centre of the property.

3. List of claims by name and grant number being renewed

Table 1. List of claims being renewed in this assessment report.

| Claim Name | Grant Number | Expiry Date |
|------------|--------------|-------------|
| BOX 41 | YB94174 | 2008/09/10 |
| BOX 42 | YB94175 | 2008/09/10 |
| BOX 43 | YB94176 | 2008/09/10 |
| BOX 44 | YB94177 | 2008/09/10 |
| BOX 45 | YB94178 | 2008/09/10 |
| BOX 46 | YB94179 | 2008/09/10 |
| BOX 47 | YB94180 | 2008/09/10 |
| BOX 48 | YB94181 | 2008/09/10 |
| BOX 49 | YB94182 | 2008/09/10 |
| BOX 50 | YB94183 | 2008/09/10 |
| BOX 51 | YB94184 | 2008/09/10 |
| BOX 52 | YB94185 | 2008/09/10 |
| BOX 53 | YB94186 | 2008/09/10 |
| BOX 54 | YB94187 | 2007/09/10 |
| BOX 55 | YB94188 | 2008/09/10 |
| BOX 56 | YB94189 | 2008/09/10 |
| BOX 57 | YB94190 | 2008/09/10 |
| BOX 58 | YB94191 | 2008/09/10 |
| BOX 59 | YB94192 | 2008/09/10 |

| | | |
|---------|---------|------------|
| BOX 60 | YB94193 | 2008/09/10 |
| BOX 61 | YB94194 | 2008/09/10 |
| BOX 62 | YB94195 | 2008/09/10 |
| BOX 63 | YB94196 | 2008/09/10 |
| BOX 64 | YB94197 | 2008/09/10 |
| BOX 65 | YB94198 | 2008/09/10 |
| BOX 66 | YB94199 | 2008/09/10 |
| BOX 67 | YB94200 | 2008/09/10 |
| BOX 68 | YB94201 | 2007/09/10 |
| BOX 69 | YB94202 | 2007/09/10 |
| BOX 70 | YB94203 | 2008/09/10 |
| BOX 71 | YB94204 | 2008/09/10 |
| BOX 72 | YB94205 | 2008/09/10 |
| BOX 73 | YB94206 | 2008/09/10 |
| BOX 74 | YB94207 | 2008/09/10 |
| BOX 75 | YB94208 | 2008/09/10 |
| BOX 76 | YB94209 | 2008/09/10 |
| BOX 77 | YB94210 | 2008/09/10 |
| BOX 78 | YB94211 | 2007/09/10 |
| BOX 79 | YB94212 | 2007/09/10 |
| BOX 80 | YB94213 | 2007/09/10 |
| BOX 81 | YB94214 | 2007/09/10 |
| BOX 82 | YB94215 | 2008/09/10 |
| BOX 83 | YB94216 | 2008/09/10 |
| BOX 84 | YB94217 | 2008/09/10 |
| BOX 85 | YB94218 | 2008/09/10 |
| BOX 86 | YB94219 | 2007/09/10 |
| BOX 87 | YB94220 | 2007/09/10 |
| BOX 88 | YB94221 | 2008/09/10 |
| BOX 89 | YB94222 | 2008/09/10 |
| BOX 90 | YB94223 | 2008/09/10 |
| BOX 91 | YB94224 | 2008/09/10 |
| BOX 92 | YB94225 | 2007/09/10 |
| BOX 93 | YB94226 | 2008/09/10 |
| BOX 94 | YB94227 | 2007/09/10 |
| BOX 95 | YB94228 | 2008/09/10 |
| BOX 96 | YB94229 | 2007/09/10 |
| BOX 97 | YB94230 | 2008/09/10 |
| BOX 98 | YB94231 | 2007/09/10 |
| BOX 99 | YB94232 | 2008/09/10 |
| BOX 100 | YB94233 | 2007/09/10 |
| BOX 101 | YB94234 | 2008/09/10 |
| BOX 102 | YB94235 | 2007/09/10 |
| BOX 103 | YB94236 | 2008/09/10 |
| BOX 104 | YB94237 | 2007/09/10 |
| BOX 105 | YB94238 | 2008/09/10 |
| BOX 107 | YB94239 | 2008/09/10 |
| BOX 108 | YB94240 | 2008/09/10 |

| | | |
|---------|---------|------------|
| BOX 109 | YB94241 | 2008/09/10 |
| BOX 110 | YB94242 | 2008/09/10 |
| BOX 111 | YB94243 | 2008/09/10 |
| BOX 112 | YB94244 | 2008/09/10 |
| BOX 113 | YB94245 | 2008/09/10 |
| BOX 114 | YB94246 | 2008/09/10 |
| BOX 115 | YB94247 | 2008/09/10 |
| BOX 116 | YB94248 | 2008/09/10 |
| BOX 117 | YB94249 | 2007/09/10 |
| BOX 118 | YB94250 | 2007/09/10 |
| BOX 119 | YB94251 | 2007/09/10 |
| BOX 120 | YB94252 | 2007/09/10 |

4. Description of Undertakings

Prospecting and Soil Sampling

Field crews consisted of four Geologists and six Field Assistants. Soil samples were taken on each claims. Soil samples were collected by removing top soil using steel spades and sampling the unweathered material at a depth of one foot below ground surface interpreted to be the “B”-horizon. Each sample was packaged in a Kraft soil sample bag (4"x6" folded) and transported to Wolverine Camps for drying.

Rock samples were collected where outcrops were observed. Hand specimens, approximately 1-1.5 kg, were collected and stored in properly labeled plastic sample bags for future references.

5. Results

All soil samples (267) and rock samples (10) with potential for volcanogenic massive sulphide deposit were sent for assay at ALS-Chemex, 212 Brooksbank Avenue, North Vancouver, British Columbia, V6J 2C1. Analyses of the samples were by a 27 element ICP-AES after a 4-acid digestion process. Please see Appendix D for assay certificates and figures 2 through 5 for plotted results.

6. Discussion and Conclusions

The 2005 prospecting program was focused on gathering data to evaluate the potential of the property to host Volcanic Massive Sulphide (VMS). The description is as follows:

Fine-grained sediments:

The rocks sampled are fine-grained ranging in color from bluish grey to greenish grey. They contain 1-2% graphite. The fabric is pervasive and strong in all the samples collected. Crenulation cleavage can be observed locally. These rocks are interpreted to have a sedimentary origin.

Soil geochemistry does not reveal strong anomalies in Zinc, Lead, or Copper (See Figure 3, Figure 4, and Figure 5).

The Box Property should be maintained in good standing and warrants further geological, geochemical, and drilling for VMS exploration.

Respectfully Submitted,

David Legault, B.Sc.
Project Geologist

Vancouver, B.C., January 17th, 2006



#701 – 475 Howe Street
Vancouver, British Columbia
Canada V6C 2B3
Telephone: (604) 682-5474
Toll-free: 1-877-682-5474
Fax: (604) 682-5404
www.yukonzinc.com

Appendix A – List of Personal

| Name | Position | Period |
|------------------|-----------------|------------------|
| David Legault | Geologist | June 18-22, 2005 |
| Justin Laberge | Geologist | June 18-22, 2005 |
| Matthew Jodrey | Geologist | June 18-22, 2005 |
| Lorraine Tam | Geologist | June 18-22, 2005 |
| Kyioko Nakano | Field Assistant | June 18-22, 2005 |
| Scott Blevings | Field Assistant | June 18-22, 2005 |
| Tyler Caswell | Field Assistant | June 18-22, 2005 |
| Anthony Peter | Field Assistant | June 18-22, 2005 |
| Vashti Etzel | Field Assistant | June 18-22, 2005 |
| Matthew Williams | Field Assistant | June 18-22, 2005 |

STATEMENT OF EXPENDITURES

I, Jason Dunning, as agent for Yukon Zinc Corporation, #701-475 Howe Street, Vancouver, B.C. do solemnly declare that geological examination, prospecting, and soil geochemistry survey sampling carried out on the Box Claims (see attached list) between the dates of June 18th and June 22nd, 2005.

| | |
|-------------------------------|-------------------|
| Assays/Geochemical Analysis | \$591.59 |
| Meals & Accommodation | \$2155.14 |
| Aircraft | \$1516.25 |
| Fuel | \$48.60 |
| Wages (professional) | \$12085.80 |
| Wages (WCB) | \$259.57 |
| Material and Supplies – Expl. | \$4129.47 |
| Travel Costs | \$463.50 |
| Printing and Reproduction | \$72.99 |
| Total | \$21274.31 |

I make this solemn declaration conscientiously believing it to be true and knowing that it is of the same force and effect as if made under oath and by virtue of the Canada Evidence Act.

Declared before me at Vancouver in the Province of British Columbia this 24th day of August 2005.

Jason Dunning, MSc, P.Geo.

Appendix C – Statement of Qualifications

I, David Legault, resident of Vancouver, British Columbia, do certify that:

1. I graduated from Université du Québec À Montréal in May 2001 with a B.Sc. in Geology;
2. From 1998 to present, I have been actively engaged in mineral exploration in Québec, Ontario, and Yukon Territory and am presently employed with the Expatriate Group of Companies to which Yukon Zinc Corporation is part of;
3. I have personally participated in the logistical support during the fieldwork and analysis of data for the filed undertakings herein.

Respectfully Submitted,

David Legault, B.Sc.



ALS Chemex

EXCELLENCE IN ANALYTICAL CHEMISTRY

ALS Canada Ltd.

212 Brooksbank Avenue
North Vancouver BC V7J 2C1

Phone: 604 984 0221 Fax: 604 984 0218 www.alschemex.com

YUKON ZINC CORPORATION
701-475 HOWE ST
VANCOUVER BC V6C 2B3

Page: 1
Finalized Date: 10-JUL-2005
Account: MPO

CERTIFICATE VA05051804

Project: 1647

P.O. No.:

This report is for 238 Soil samples submitted to our lab in Vancouver, BC, Canada on 28-JUN-2005.

The following have access to data associated with this certificate:

JASON DUNNING

SAMPLE PREPARATION

| ALS CODE | DESCRIPTION |
|----------|--------------------------------|
| WEI-21 | Received Sample Weight |
| LOG-22 | Sample login - Rcd w/o BarCode |
| SCR-41 | Screen to -180um and save both |

ANALYTICAL PROCEDURES

| ALS CODE | DESCRIPTION | INSTRUMENT |
|----------|------------------------------|------------|
| ME-ICP61 | 27 element four acid ICP-AES | ICP-AES |

To: YUKON ZINC CORPORATION
ATTN: JASON DUNNING
701-475 HOWE ST
VANCOUVER BC V6C 2B3

This is the Final Report and supersedes any preliminary report with this certificate number. Results apply to samples as submitted. All pages of this report have been checked and approved for release.

Signature:



ALS Chemex

EXCELLENCE IN ANALYTICAL CHEMISTRY

ALS Canada Ltd.

212 Brooksbank Avenue
North Vancouver BC V7J 2C1

Phone: 604 984 0221 Fax: 604 984 0218 www.alschemex.com

o: YUKON ZINC CORPORATION
701-475 HOWE ST
VANCOUVER BC V6C 2B3

Page: 2 - A
Total # Pages: 7 (A - B)
Finalized Date: 10-JUL-2005
Account: MPO

Project: 1647

CERTIFICATE OF ANALYSIS VA05051804

| Sample Description | Method Analyte Units LOR | WEI-21 | ME-ICP61 | ME-ICP61 | ME-ICP61 | ME-ICP61 | ME-ICP61 | ME-ICP61 | ME-ICP61 | ME-ICP61 | ME-ICP61 | ME-ICP61 | ME-ICP61 | ME-ICP61 | ME-ICP61 | ME-ICP61 |
|--------------------|--------------------------|-----------------|-----------|----------|-----------|-----------|-----------|-----------|----------|-----------|-----------|-----------|-----------|----------|----------|----------|
| | | Recvd Wt. kg | Ag ppm | Al % | As ppm | Ba ppm | Be ppm | Bi ppm | Ca % | Cd ppm | Co ppm | Cr ppm | Cu ppm | Fe % | K % | Mg % |
| | | 0.02 | 0.5 | 0.01 | 5 | 10 | 0.5 | 2 | 0.01 | 0.5 | 1 | 1 | 0.01 | 0.01 | 0.01 | |
| A083601 | | 0.44 | <0.5 | 7.32 | 12 | 980 | 2.1 | 2 | 0.57 | <0.5 | 14 | 74 | 46 | 3.68 | 2.53 | 1.04 |
| A083602 | | 0.38 | <0.5 | 7.02 | 13 | 990 | 2.1 | 3 | 0.75 | <0.5 | 13 | 76 | 49 | 3.43 | 2.42 | 0.95 |
| A083603 | | 0.60 | <0.5 | 7.28 | 25 | 960 | 1.7 | 2 | 0.79 | <0.5 | 17 | 103 | 53 | 4.02 | 2.39 | 1.18 |
| A083604 | | 0.46 | <0.5 | 6.20 | 11 | 1180 | 1.7 | <2 | 0.68 | <0.5 | 12 | 62 | 33 | 3.21 | 2.19 | 1.06 |
| A083605 | | 0.34 | <0.5 | 5.10 | 6 | 1040 | 1.3 | <2 | 0.69 | <0.5 | 9 | 59 | 33 | 2.50 | 1.66 | 0.79 |
| A083606 | | 0.42 | <0.5 | 4.55 | 14 | 1030 | 1.3 | <2 | 0.67 | <0.5 | 9 | 54 | 36 | 2.55 | 1.39 | 0.77 |
| A083607 | | 0.20 | <0.5 | 5.42 | 7 | 820 | 1.0 | <2 | 0.81 | <0.5 | 9 | 46 | 15 | 2.32 | 1.38 | 0.54 |
| A083608 | | 0.28 | <0.5 | 6.21 | 14 | 1360 | 1.8 | <2 | 0.77 | <0.5 | 12 | 79 | 41 | 3.14 | 1.96 | 1.04 |
| A083609 | | 0.36 | <0.5 | 4.56 | 13 | 990 | 1.2 | <2 | 1.06 | <0.5 | 12 | 54 | 33 | 3.29 | 1.29 | 0.97 |
| A083610 | | 0.40 | <0.5 | 5.02 | 25 | 960 | 1.3 | <2 | 0.79 | <0.5 | 13 | 54 | 21 | 3.04 | 1.64 | 0.94 |
| A083611 | | 0.48 | <0.5 | 6.19 | 11 | 1260 | 1.7 | <2 | 0.94 | <0.5 | 18 | 245 | 33 | 3.81 | 1.73 | 2.32 |
| A083612 | | 0.22 | <0.5 | 4.07 | 11 | 810 | 0.9 | <2 | 0.98 | <0.5 | 11 | 60 | 23 | 2.61 | 0.95 | 0.61 |
| A083613 | | 0.38 | <0.5 | 5.36 | 12 | 1130 | 1.3 | <2 | 1.03 | <0.5 | 13 | 62 | 30 | 2.76 | 1.42 | 0.93 |
| A083614 | | 0.52 | <0.5 | 5.94 | 21 | 1120 | 1.5 | <2 | 0.64 | <0.5 | 10 | 66 | 39 | 3.12 | 1.86 | 0.89 |
| A083615 | | 0.46 | <0.5 | 6.77 | 31 | 1130 | 1.5 | 2 | 0.61 | <0.5 | 18 | 66 | 57 | 3.74 | 2.53 | 0.93 |
| A083616 | | 0.40 | <0.5 | 10.70 | 11 | 800 | 3.1 | 3 | 0.20 | <0.5 | 21 | 78 | 96 | 5.07 | 4.11 | 1.10 |
| A083617 | | 0.26 | <0.5 | 7.29 | 12 | 960 | 1.3 | 2 | 0.96 | <0.5 | 12 | 68 | 43 | 3.58 | 1.87 | 1.20 |
| A083618 | | 0.22 | <0.5 | 6.15 | 11 | 720 | 1.1 | <2 | 1.31 | <0.5 | 14 | 102 | 28 | 3.22 | 1.50 | 1.24 |
| A083619 | | 0.44 | <0.5 | 5.27 | <5 | 830 | 1.1 | <2 | 0.60 | <0.5 | 12 | 101 | 36 | 3.12 | 1.24 | 1.09 |
| A083620 | | 0.46 | <0.5 | 5.58 | <5 | 1120 | 1.4 | <2 | 0.64 | <0.5 | 7 | 61 | 22 | 2.74 | 1.66 | 0.84 |
| A083621 | | 0.50 | <0.5 | 5.08 | 19 | 1260 | 1.1 | <2 | 0.43 | <0.5 | 8 | 65 | 10 | 2.40 | 1.37 | 0.69 |
| A083622 | | 0.50 | <0.5 | 4.79 | 6 | 1030 | 1.2 | <2 | 0.69 | <0.5 | 9 | 60 | 27 | 2.37 | 1.43 | 0.73 |
| A083623 | | 0.46 | <0.5 | 7.12 | 14 | 1040 | 1.9 | <2 | 1.30 | 0.5 | 15 | 63 | 53 | 3.77 | 2.61 | 0.98 |
| A083624 | | 0.56 | <0.5 | 5.99 | 11 | 1150 | 1.5 | <2 | 0.84 | <0.5 | 13 | 60 | 45 | 3.20 | 1.95 | 0.83 |
| A083625 | | 0.56 | <0.5 | 5.87 | 13 | 960 | 1.5 | <2 | 0.70 | 0.5 | 9 | 59 | 51 | 3.34 | 1.86 | 0.87 |
| A083626 | | 0.50 | <0.5 | 4.89 | 6 | 880 | 1.2 | <2 | 0.87 | <0.5 | 10 | 50 | 50 | 2.71 | 1.46 | 0.71 |
| A083627 | | 0.40 | <0.5 | 5.02 | 9 | 930 | 1.1 | <2 | 1.52 | <0.5 | 10 | 45 | 15 | 2.24 | 1.38 | 0.71 |
| A083628 | | 0.52 | <0.5 | 6.22 | 33 | 1130 | 1.6 | <2 | 0.70 | 0.9 | 12 | 68 | 49 | 3.64 | 1.98 | 0.80 |
| A083629 | | 0.52 | <0.5 | 5.11 | 5 | 1080 | 1.3 | <2 | 0.69 | <0.5 | 11 | 59 | 30 | 2.68 | 1.56 | 0.80 |
| A083630 | | 0.42 | <0.5 | 5.51 | 10 | 930 | 1.2 | <2 | 1.18 | 0.5 | 13 | 86 | 23 | 3.07 | 1.54 | 0.98 |
| A083631 | | 0.54 | <0.5 | 5.84 | 25 | 890 | 1.2 | 3 | 0.65 | 0.7 | 13 | 83 | 39 | 3.95 | 1.51 | 1.04 |
| A083662 | | 0.32 | <0.5 | 7.31 | <5 | 1080 | 1.7 | <2 | 0.75 | <0.5 | 14 | 83 | 39 | 3.72 | 2.07 | 1.19 |
| A083663 | | 0.32 | <0.5 | 5.69 | 9 | 710 | 1.0 | 2 | 1.74 | <0.5 | 8 | 37 | 32 | 2.79 | 1.42 | 0.75 |
| A083664 | | 0.24 | <0.5 | 4.85 | 23 | 770 | 0.9 | <2 | 1.34 | <0.5 | 9 | 47 | 38 | 2.71 | 1.12 | 0.65 |
| A083665 | | 0.20 | <0.5 | 5.84 | <5 | 900 | 1.1 | <2 | 1.58 | 0.6 | 10 | 37 | 26 | 2.47 | 1.44 | 0.71 |
| A083666 | | 0.38 | <0.5 | 6.17 | 21 | 1380 | 1.6 | <2 | 0.72 | <0.5 | 11 | 66 | 41 | 3.13 | 1.80 | 0.93 |
| A083667 | | 0.38 | <0.5 | 8.82 | 7 | 1080 | 2.4 | <2 | 0.60 | <0.5 | 14 | 68 | 28 | 3.98 | 3.74 | 0.81 |
| A083668 | | 0.36 | <0.5 | 6.02 | 20 | 1060 | 1.5 | <2 | 0.72 | <0.5 | 13 | 60 | 40 | 3.20 | 1.96 | 0.89 |
| A083669 | | 0.22 | <0.5 | 2.22 | <5 | 530 | 0.5 | <2 | 3.32 | <0.5 | 3 | 13 | 36 | 0.99 | 0.52 | 0.36 |
| A083670 | | 0.16 | <0.5 | 7.11 | <5 | 820 | 1.1 | <2 | 2.48 | <0.5 | 5 | 5 | 18 | 1.78 | 1.92 | 0.63 |



ALS Chemex

EXCELLENCE IN ANALYTICAL CHEMISTRY

ALS Canada Ltd.

212 Brooksbank Avenue
North Vancouver BC V7J 2C1

Phone: 604 984 0221 Fax: 604 984 0218 www.alschemex.com

YUKON ZINC CORPORATION
701-475 HOWE ST
VANCOUVER BC V6C 2B3

Page: 2 - B
Total # Pages: 7 (A - B)
Finalized Date: 10-JUL-2005
Account: MPO

Project: 1647

CERTIFICATE OF ANALYSIS VA05051804

| Sample Description | Method Analyte Units LOR | ME-ICP61 | ME-ICP61 | ME-ICP61 | ME-ICP61 | ME-ICP61 | ME-ICP61 | ME-ICP61 | ME-ICP61 | ME-ICP61 | ME-ICP61 | ME-ICP61 | ME-ICP61 | |
|--------------------|--------------------------|----------|----------|-----------|----------|----------|----------|----------|----------|----------|-----------|----------|----------|----------|
| | | Mn ppm 5 | Mo ppm 1 | Na % 0.01 | Ni ppm 1 | P ppm 10 | Pb ppm 2 | S % 0.01 | Sb ppm 5 | Sr ppm 1 | Ti % 0.01 | V ppm 1 | W ppm 10 | Zn ppm 2 |
| A083601 | | 535 | <1 | 0.69 | 40 | 370 | 33 | 0.02 | <5 | 75 | 0.30 | 114 | <10 | 133 |
| A083602 | | 615 | <1 | 0.53 | 44 | 780 | 25 | 0.01 | <5 | 70 | 0.33 | 115 | <10 | 95 |
| A083603 | | 507 | <1 | 0.72 | 43 | 950 | 36 | 0.03 | <5 | 79 | 0.32 | 131 | <10 | 101 |
| A083604 | | 571 | <1 | 0.82 | 35 | 830 | 31 | 0.01 | <5 | 78 | 0.30 | 124 | <10 | 118 |
| A083605 | | 394 | <1 | 0.86 | 32 | 880 | 20 | 0.01 | <5 | 92 | 0.30 | 97 | <10 | 90 |
| A083606 | | 474 | <1 | 0.82 | 32 | 860 | 21 | 0.01 | <5 | 84 | 0.31 | 99 | <10 | 82 |
| A083607 | | 1030 | 1 | 1.22 | 12 | 400 | 24 | 0.02 | <5 | 106 | 0.30 | 68 | <10 | 81 |
| A083608 | | 537 | <1 | 0.66 | 47 | 530 | 22 | 0.01 | <5 | 92 | 0.32 | 154 | <10 | 93 |
| A083609 | | 513 | 1 | 0.83 | 27 | 790 | 22 | 0.02 | <5 | 138 | 0.28 | 110 | <10 | 85 |
| A083610 | | 446 | 1 | 0.86 | 30 | 570 | 35 | 0.02 | <5 | 104 | 0.32 | 118 | <10 | 112 |
| A083611 | | 708 | 1 | 0.73 | 129 | 1000 | 20 | 0.02 | <5 | 114 | 0.34 | 150 | <10 | 106 |
| A083612 | | 401 | 1 | 0.92 | 27 | 380 | 28 | 0.04 | <5 | 131 | 0.23 | 74 | <10 | 54 |
| A083613 | | 411 | 1 | 0.84 | 34 | 710 | 22 | 0.03 | <5 | 123 | 0.34 | 103 | <10 | 70 |
| A083614 | | 642 | 1 | 0.77 | 39 | 790 | 24 | 0.01 | <5 | 81 | 0.31 | 104 | <10 | 97 |
| A083615 | | 471 | 1 | 0.54 | 43 | 900 | 35 | 0.03 | <5 | 62 | 0.34 | 102 | <10 | 106 |
| A083616 | | 477 | 1 | 0.21 | 44 | 380 | 24 | 0.02 | <5 | 43 | 0.41 | 119 | <10 | 87 |
| A083617 | | 500 | <1 | 0.89 | 22 | 540 | 20 | 0.05 | <5 | 103 | 0.31 | 132 | <10 | 80 |
| A083618 | | 473 | <1 | 0.72 | 28 | 630 | 25 | 0.08 | <5 | 106 | 0.28 | 98 | <10 | 82 |
| A083619 | | 393 | <1 | 0.69 | 44 | 440 | 16 | 0.01 | <5 | 84 | 0.29 | 97 | <10 | 126 |
| A083620 | | 353 | <1 | 0.70 | 31 | 650 | 19 | 0.01 | <5 | 78 | 0.32 | 101 | <10 | 180 |
| A083621 | | 389 | 1 | 0.68 | 18 | 270 | 15 | 0.01 | <5 | 73 | 0.31 | 110 | <10 | 60 |
| A083622 | | 359 | <1 | 0.71 | 32 | 920 | 19 | 0.01 | <5 | 86 | 0.31 | 94 | <10 | 87 |
| A083623 | | 528 | <1 | 0.55 | 32 | 810 | 29 | 0.01 | <5 | 76 | 0.31 | 102 | <10 | 108 |
| A083624 | | 706 | <1 | 0.58 | 36 | 840 | 37 | 0.03 | <5 | 80 | 0.30 | 93 | <10 | 114 |
| A083625 | | 655 | 1 | 0.65 | 32 | 800 | 35 | 0.02 | <5 | 73 | 0.30 | 88 | 10 | 120 |
| A083626 | | 308 | <1 | 0.62 | 37 | 910 | 22 | 0.02 | <5 | 86 | 0.28 | 83 | <10 | 99 |
| A083627 | | 1135 | 1 | 0.79 | 23 | 950 | 19 | 0.05 | <5 | 167 | 0.27 | 82 | <10 | 91 |
| A083628 | | 432 | 1 | 0.60 | 41 | 1010 | 27 | 0.02 | <5 | 80 | 0.31 | 109 | 10 | 104 |
| A083629 | | 387 | <1 | 0.67 | 37 | 760 | 23 | 0.01 | <5 | 84 | 0.29 | 100 | 10 | 111 |
| A083630 | | 556 | 1 | 0.70 | 34 | 620 | 14 | 0.04 | <5 | 118 | 0.28 | 104 | <10 | 106 |
| A083631 | | 733 | 1 | 0.73 | 37 | 1080 | 27 | 0.02 | <5 | 72 | 0.29 | 101 | <10 | 108 |
| A083662 | | 697 | 1 | 1.03 | 31 | 680 | 26 | 0.02 | <5 | 77 | 0.36 | 106 | <10 | 88 |
| A083663 | | 459 | 1 | 1.31 | 14 | 560 | 31 | 0.05 | <5 | 249 | 0.25 | 62 | <10 | 74 |
| A083664 | | 656 | 1 | 1.03 | 25 | 530 | 25 | 0.05 | <5 | 169 | 0.24 | 64 | <10 | 77 |
| A083665 | | 809 | 1 | 1.25 | 21 | 650 | 25 | 0.04 | <5 | 260 | 0.26 | 71 | <10 | 80 |
| A083666 | | 496 | 1 | 0.63 | 41 | 780 | 18 | 0.01 | <5 | 82 | 0.32 | 134 | <10 | 110 |
| A083667 | | 1750 | <1 | 0.39 | 29 | 560 | 31 | 0.03 | <5 | 55 | 0.23 | 94 | <10 | 73 |
| A083668 | | 775 | <1 | 0.66 | 34 | 690 | 26 | 0.02 | <5 | 82 | 0.28 | 95 | <10 | 108 |
| A083669 | | 586 | 1 | 0.41 | 17 | 1060 | 8 | 0.22 | <5 | 199 | 0.07 | 22 | <10 | 51 |
| A083670 | | 446 | 1 | 2.47 | 6 | 550 | 9 | 0.04 | <5 | 583 | 0.21 | 42 | 10 | 49 |



ALS Chemex

EXCELLENCE IN ANALYTICAL CHEMISTRY

ALS Canada Ltd.
 212 Brooksbank Avenue
 North Vancouver BC V7J 2C1
 Phone: 604 984 0221 Fax: 604 984 0218 www.alschemex.com

To: YUKON ZINC CORPORATION
 701-475 HOWE ST
 VANCOUVER BC V6C 2B3

Page: 3 - A
 Total # Pages: 7 (A - B)
 Finalized Date: 10-JUL-2005
 Account: MPO

Project: 1647

CERTIFICATE OF ANALYSIS VA05051804

| Sample Description | Method Analyte Units LOR | WEI-21 | ME-ICP61 | ME-ICP61 | ME-ICP61 | ME-ICP61 | ME-ICP61 | ME-ICP61 | ME-ICP61 | ME-ICP61 | ME-ICP61 | ME-ICP61 | ME-ICP61 | ME-ICP61 | ME-ICP61 | |
|--------------------|-----------------------------------|-----------------|-----------|----------|-----------|-----------|-----------|-----------|----------|-----------|-----------|-----------|-----------|----------|----------|---------|
| | | Recvd Wt. kg | Ag ppm | Al % | As ppm | Ba ppm | Be ppm | Bi ppm | Ca % | Cd ppm | Co ppm | Cr ppm | Cu ppm | Fe % | K % | Mg % |
| A083671 | | 0.38 | <0.5 | 5.43 | <5 | 970 | 1.3 | <2 | 0.94 | 0.6 | 13 | 61 | 59 | 2.82 | 1.46 | 0.82 |
| A083672 | | 0.20 | <0.5 | 4.72 | <5 | 670 | 0.8 | <2 | 3.40 | 0.7 | 7 | 18 | 29 | 1.58 | 1.08 | 0.54 |
| A083673 | | 0.30 | <0.5 | 7.48 | <5 | 1090 | 1.8 | 2 | 0.61 | <0.5 | 11 | 80 | 50 | 3.88 | 2.35 | 1.12 |
| A083674 | | 0.38 | <0.5 | 7.45 | 10 | 1150 | 1.8 | 2 | 1.02 | <0.5 | 12 | 90 | 49 | 3.78 | 2.36 | 1.19 |
| A083675 | | 0.34 | <0.5 | 6.00 | 12 | 900 | 1.2 | <2 | 1.05 | <0.5 | 17 | 119 | 35 | 3.36 | 1.60 | 1.20 |
| A083801 | | 0.20 | <0.5 | 5.73 | 5 | 920 | 0.9 | <2 | 1.35 | <0.5 | 2 | 25 | 12 | 1.27 | 1.56 | 0.49 |
| A083802 | | 0.42 | <0.5 | 5.24 | 9 | 1070 | 0.9 | <2 | 0.85 | 0.7 | 7 | 37 | 14 | 2.45 | 1.34 | 0.56 |
| A083803 | | 0.16 | <0.5 | 5.31 | <5 | 1210 | 1.2 | <2 | 1.31 | 0.8 | 6 | 44 | 23 | 1.96 | 1.37 | 0.68 |
| A083804 | | 0.20 | 0.6 | 5.76 | <5 | 1060 | 1.0 | <2 | 1.12 | 1.7 | 7 | 32 | 15 | 1.78 | 1.59 | 0.45 |
| A083805 | | 0.18 | 0.8 | 7.30 | <5 | 1060 | 1.2 | <2 | 1.68 | 0.9 | 7 | 12 | 22 | 1.79 | 2.20 | 0.52 |
| A083806 | | 0.24 | <0.5 | 6.39 | 15 | 1440 | 1.7 | <2 | 1.02 | 0.5 | 10 | 82 | 21 | 2.54 | 2.02 | 1.04 |
| A083807 | | 0.18 | <0.5 | 3.65 | <5 | 950 | 0.9 | <2 | 3.14 | 1.2 | 6 | 22 | 34 | 1.22 | 1.03 | 0.49 |
| A083808 | | 0.10 | <0.5 | 5.04 | 22 | 910 | 1.2 | <2 | 1.16 | <0.5 | 12 | 55 | 15 | 2.32 | 1.52 | 0.83 |
| A083809 | | 0.18 | 0.5 | 6.34 | <5 | 1100 | 1.4 | <2 | 1.48 | <0.5 | 9 | 55 | 21 | 2.48 | 1.84 | 0.88 |
| A083810 | | 0.30 | <0.5 | 5.02 | 6 | 1140 | 1.3 | <2 | 0.70 | 0.5 | 13 | 58 | 30 | 2.52 | 1.55 | 0.83 |
| A083811 | | 0.32 | <0.5 | 4.18 | <5 | 980 | 1.1 | <2 | 0.78 | <0.5 | 10 | 50 | 23 | 2.19 | 1.20 | 0.61 |
| A083812 | | 0.32 | <0.5 | 4.78 | <5 | 1100 | 1.2 | <2 | 1.42 | 0.6 | 12 | 57 | 37 | 2.56 | 1.53 | 0.74 |
| A083813 | | 0.22 | <0.5 | 5.95 | 10 | 1320 | 1.3 | <2 | 1.84 | <0.5 | 11 | 52 | 34 | 2.92 | 1.86 | 1.06 |
| A083814 | | 0.18 | <0.5 | 5.64 | <5 | 990 | 1.2 | <2 | 3.16 | 0.5 | 7 | 25 | 31 | 1.73 | 1.77 | 0.57 |
| A083815 | | 0.34 | <0.5 | 6.56 | 6 | 1520 | 1.6 | <2 | 0.93 | <0.5 | 14 | 58 | 53 | 3.24 | 2.32 | 0.98 |
| A083816 | | 0.30 | <0.5 | 4.73 | 10 | 960 | 1.2 | <2 | 0.87 | <0.5 | 10 | 54 | 35 | 2.69 | 1.52 | 0.67 |
| A083817 | | 0.34 | <0.5 | 5.25 | <5 | 1190 | 1.4 | <2 | 0.82 | 0.7 | 14 | 62 | 33 | 3.03 | 1.59 | 0.81 |
| A083818 | | 0.28 | 0.5 | 6.35 | 9 | 1020 | 1.2 | <2 | 1.92 | <0.5 | 7 | 40 | 26 | 2.23 | 1.81 | 0.73 |
| A083819 | | 0.30 | <0.5 | 6.11 | <5 | 1140 | 1.5 | <2 | 1.00 | 0.5 | 12 | 69 | 33 | 2.81 | 1.76 | 0.98 |
| A083820 | | 0.24 | <0.5 | 5.83 | 7 | 870 | 1.1 | <2 | 1.54 | <0.5 | 10 | 42 | 23 | 2.40 | 1.60 | 0.82 |
| A083821 | | 0.26 | <0.5 | 4.51 | 8 | 1160 | 1.2 | <2 | 1.38 | 1.1 | 10 | 65 | 34 | 2.40 | 1.47 | 0.74 |
| A083822 | | 0.20 | <0.5 | 6.35 | 25 | 1550 | 1.7 | <2 | 1.18 | 0.7 | 14 | 87 | 35 | 3.32 | 2.16 | 1.09 |
| A083823 | | 0.16 | <0.5 | 5.80 | 25 | 1380 | 1.4 | <2 | 1.62 | 0.7 | 12 | 75 | 26 | 3.57 | 1.81 | 0.93 |
| A083824 | | 0.18 | <0.5 | 5.59 | 20 | 1320 | 1.5 | <2 | 1.14 | 0.8 | 11 | 76 | 20 | 2.79 | 1.85 | 0.95 |
| A083825 | | 0.30 | <0.5 | 6.46 | 31 | 1730 | 1.8 | <2 | 0.92 | 1.1 | 15 | 102 | 33 | 3.72 | 2.10 | 1.09 |
| A083826 | | 0.20 | 0.5 | 6.43 | 9 | 1100 | 1.1 | <2 | 1.28 | 0.7 | 10 | 57 | 15 | 2.32 | 1.65 | 0.64 |
| A083827 | | 0.36 | <0.5 | 6.35 | 14 | 1320 | 1.2 | <2 | 1.06 | 1.0 | 11 | 90 | 17 | 3.35 | 1.43 | 0.89 |
| A083828 | | 0.20 | 0.6 | 7.82 | <5 | 1020 | 1.3 | <2 | 1.90 | <0.5 | 6 | 9 | 22 | 1.76 | 2.46 | 0.55 |
| A083829 | | 0.12 | 0.8 | 1.38 | <5 | 400 | 0.5 | <2 | 3.60 | 0.6 | 3 | 14 | 31 | 0.58 | 0.40 | 0.29 |
| A083830 | | 0.18 | <0.5 | 5.71 | 10 | 1100 | 1.4 | <2 | 0.75 | <0.5 | 13 | 76 | 38 | 2.97 | 1.69 | 1.03 |
| A083831 | | 0.10 | <0.5 | 1.80 | <5 | 440 | <0.5 | <2 | 3.08 | 1.7 | 5 | 20 | 19 | 0.81 | 0.52 | 0.40 |
| A083832 | | 0.28 | <0.5 | 4.72 | <5 | 800 | 1.0 | <2 | 1.28 | <0.5 | 7 | 47 | 16 | 1.79 | 1.28 | 0.68 |
| A083833 | | 0.16 | <0.5 | 6.01 | <5 | 950 | 1.5 | <2 | 1.21 | 0.8 | 9 | 54 | 28 | 2.29 | 2.12 | 0.71 |
| A083834 | | 0.20 | <0.5 | 7.37 | 5 | 1060 | 1.9 | <2 | 1.16 | <0.5 | 9 | 61 | 28 | 2.58 | 2.85 | 0.74 |
| A083835 | | 0.34 | <0.5 | 8.18 | 21 | 1280 | 2.2 | <2 | 0.44 | <0.5 | 13 | 86 | 37 | 3.40 | 3.05 | 1.00 |



ALS Chemex

EXCELLENCE IN ANALYTICAL CHEMISTRY

ALS Canada Ltd.

212 Brooksbank Avenue

North Vancouver BC V7J 2C1

Phone: 604 984 0221 Fax: 604 984 0218 www.alschemex.com

YUKON ZINC CORPORATION

701-475 HOWE ST

VANCOUVER BC V6C 2B3

Page: 3 - B
 Total # pages: 7 (A - B)
 Finalized Date: 10-JUL-2005
 Account: MPO

Project: 1647

CERTIFICATE OF ANALYSIS VA05051804

| Sample Description | Method Analyte Units LOR | ME-ICP61 | ME-ICP61 | ME-ICP61 | ME-ICP61 | ME-ICP61 | ME-ICP61 | ME-ICP61 | ME-ICP61 | ME-ICP61 | ME-ICP61 | ME-ICP61 | ME-ICP61 | |
|--------------------|--------------------------|----------|----------|----------|----------|----------|----------|----------|----------|----------|----------|----------|----------|-----|
| | | Mn | Mo | Na | Ni | P | Pb | S | Sb | Sr | Ti | V | W | Zn |
| | | ppm | ppm | % | ppm | ppm | ppm | % | ppm | ppm | % | ppm | ppm | ppm |
| | | 5 | 1 | 0.01 | 1 | 10 | 2 | 0.01 | 5 | 1 | 0.01 | 1 | 10 | 2 |
| A083671 | | 745 | 1 | 0.78 | 31 | 890 | 28 | 0.03 | <5 | 94 | 0.28 | 81 | 10 | 89 |
| A083672 | | 771 | 1 | 1.19 | 9 | 870 | 11 | 0.12 | <5 | 354 | 0.16 | 38 | <10 | 59 |
| A083673 | | 715 | <1 | 0.75 | 34 | 740 | 22 | 0.01 | <5 | 70 | 0.36 | 110 | <10 | 103 |
| A083674 | | 893 | <1 | 0.79 | 34 | 900 | 23 | 0.04 | <5 | 84 | 0.32 | 108 | <10 | 83 |
| A083675 | | 1625 | 1 | 0.74 | 44 | 800 | 15 | 0.03 | <5 | 81 | 0.31 | 104 | <10 | 80 |
| A083801 | | 262 | <1 | 1.53 | 5 | 310 | 6 | 0.01 | <5 | 327 | 0.26 | 73 | <10 | 65 |
| A083802 | | 341 | 2 | 1.06 | 15 | 730 | 13 | 0.01 | <5 | 201 | 0.31 | 116 | <10 | 111 |
| A083803 | | 730 | <1 | 0.95 | 19 | 1000 | 12 | 0.11 | <5 | 206 | 0.24 | 93 | <10 | 130 |
| A083804 | | 455 | <1 | 1.67 | 9 | 440 | 12 | 0.01 | <5 | 316 | 0.29 | 86 | <10 | 110 |
| A083805 | | 702 | 1 | 2.59 | 6 | 610 | 10 | 0.01 | <5 | 537 | 0.23 | 48 | <10 | 82 |
| A083806 | | 242 | <1 | 0.79 | 30 | 840 | 16 | 0.07 | <5 | 125 | 0.33 | 120 | <10 | 101 |
| A083807 | | 445 | 1 | 0.94 | 15 | 1020 | 7 | 0.14 | <5 | 294 | 0.15 | 49 | <10 | 76 |
| A083808 | | 659 | <1 | 0.98 | 22 | 670 | 20 | 0.05 | <5 | 140 | 0.32 | 84 | <10 | 72 |
| A083809 | | 677 | <1 | 1.41 | 20 | 800 | 10 | 0.06 | <5 | 235 | 0.31 | 81 | <10 | 90 |
| A083810 | | 433 | 1 | 0.87 | 33 | 780 | 21 | 0.01 | <5 | 87 | 0.30 | 100 | <10 | 88 |
| A083811 | | 714 | <1 | 0.78 | 20 | 680 | 18 | 0.02 | <5 | 76 | 0.25 | 77 | <10 | 66 |
| A083812 | | 893 | <1 | 0.64 | 28 | 720 | 17 | 0.04 | <5 | 87 | 0.24 | 85 | <10 | 85 |
| A083813 | | 507 | <1 | 0.58 | 23 | 620 | 12 | 0.07 | <5 | 104 | 0.20 | 86 | <10 | 100 |
| A083814 | | 489 | <1 | 1.25 | 19 | 790 | 12 | 0.11 | <5 | 285 | 0.16 | 49 | <10 | 83 |
| A083815 | | 531 | <1 | 0.59 | 35 | 820 | 24 | 0.02 | <5 | 87 | 0.24 | 95 | <10 | 100 |
| A083816 | | 307 | 1 | 0.78 | 27 | 880 | 23 | 0.02 | <5 | 81 | 0.27 | 84 | <10 | 94 |
| A083817 | | 379 | <1 | 0.84 | 29 | 710 | 25 | 0.03 | <5 | 96 | 0.29 | 100 | <10 | 82 |
| A083818 | | 418 | <1 | 1.75 | 21 | 570 | 12 | 0.04 | <5 | 357 | 0.25 | 66 | <10 | 70 |
| A083819 | | 597 | <1 | 1.11 | 29 | 750 | 19 | 0.03 | <5 | 136 | 0.33 | 93 | <10 | 80 |
| A083820 | | 382 | 1 | 1.49 | 18 | 450 | 18 | 0.03 | <5 | 290 | 0.29 | 75 | <10 | 91 |
| A083821 | | 2840 | <1 | 0.70 | 30 | 970 | 21 | 0.10 | <5 | 141 | 0.25 | 79 | <10 | 104 |
| A083822 | | 1435 | 1 | 0.67 | 40 | 990 | 28 | 0.09 | <5 | 126 | 0.29 | 126 | <10 | 126 |
| A083823 | | 1925 | 2 | 0.70 | 31 | 740 | 20 | 0.12 | <5 | 132 | 0.29 | 110 | <10 | 118 |
| A083824 | | 1425 | <1 | 0.75 | 32 | 850 | 16 | 0.06 | <5 | 126 | 0.31 | 112 | <10 | 118 |
| A083825 | | 1285 | 1 | 0.75 | 51 | 950 | 27 | 0.04 | <5 | 108 | 0.34 | 143 | <10 | 148 |
| A083826 | | 429 | 1 | 1.69 | 21 | 370 | 14 | 0.02 | <5 | 319 | 0.36 | 87 | <10 | 96 |
| A083827 | | 404 | 2 | 1.20 | 36 | 350 | 14 | 0.01 | <5 | 187 | 0.37 | 132 | <10 | 94 |
| A083828 | | 385 | 1 | 3.00 | 5 | 380 | 7 | 0.02 | <5 | 617 | 0.23 | 43 | <10 | 54 |
| A083829 | | 225 | <1 | 0.29 | 14 | 780 | 5 | 0.16 | <5 | 177 | 0.04 | 15 | <10 | 37 |
| A083830 | | 451 | 1 | 1.02 | 33 | 700 | 31 | 0.02 | <5 | 88 | 0.35 | 101 | <10 | 86 |
| A083831 | | 238 | <1 | 0.38 | 12 | 870 | 4 | 0.16 | <5 | 169 | 0.09 | 25 | <10 | 41 |
| A083832 | | 314 | <1 | 1.21 | 17 | 800 | 8 | 0.08 | <5 | 190 | 0.29 | 67 | <10 | 86 |
| A083833 | | 709 | <1 | 0.79 | 26 | 860 | 18 | 0.07 | <5 | 134 | 0.22 | 72 | <10 | 107 |
| A083834 | | 462 | <1 | 0.68 | 29 | 760 | 17 | 0.07 | <5 | 121 | 0.23 | 79 | <10 | 92 |
| A083835 | | 508 | <1 | 0.50 | 31 | 590 | 25 | 0.02 | <5 | 78 | 0.25 | 112 | <10 | 90 |



ALS Chemex

EXCELLENCE IN ANALYTICAL CHEMISTRY

ALS Canada Ltd.

212 Brooksbank Avenue
North Vancouver BC V7J 2C1

Phone: 604 984 0221 Fax: 604 984 0218 www.alschemex.com

To: YUKON ZINC CORPORATION
701-475 HOWE ST
VANCOUVER BC V6C 2B3

Page: 4 - A
Total # pages: 7 (A - B)
Finalized Date: 10-JUL-2005
Account: MPO

Project: 1647

CERTIFICATE OF ANALYSIS VA05051804

| Sample Description | Method Analyte Units LOR | WEI-21 | ME-ICP61 | ME-ICP61 | ME-ICP61 | ME-ICP61 | ME-ICP61 | ME-ICP61 | ME-ICP61 | ME-ICP61 | ME-ICP61 | ME-ICP61 | ME-ICP61 | ME-ICP61 | ME-ICP61 | ME-ICP61 |
|--------------------|--------------------------|-----------------|-----------|----------|-----------|-----------|-----------|-----------|----------|-----------|-----------|-----------|-----------|----------|----------|----------|
| | | Recvd Wt. kg | Ag ppm | Al % | As ppm | Ba ppm | Be ppm | Bi ppm | Ca % | Cd ppm | Co ppm | Cr ppm | Cu ppm | Fe % | K % | Mg % |
| A083836 | | 0.32 | <0.5 | 7.98 | 10 | 1380 | 2.1 | <2 | 0.85 | 0.5 | 16 | 77 | 45 | 3.70 | 3.08 | 0.99 |
| A083837 | | 0.24 | 0.6 | 6.82 | <5 | 1080 | 1.3 | <2 | 1.48 | 0.6 | 8 | 49 | 31 | 2.16 | 1.91 | 0.64 |
| A083838 | | 0.22 | <0.5 | 6.68 | 5 | 1120 | 1.0 | <2 | 1.27 | 1.3 | 10 | 46 | 18 | 2.38 | 1.52 | 0.60 |
| A083839 | | 0.34 | <0.5 | 9.25 | 28 | 1360 | 2.6 | <2 | 1.86 | <0.5 | 13 | 93 | 38 | 3.83 | 3.85 | 1.01 |
| A083840 | | 0.26 | <0.5 | 8.17 | 11 | 1150 | 2.3 | 4 | 0.53 | <0.5 | 15 | 69 | 37 | 3.92 | 3.35 | 0.89 |
| A083841 | | 0.30 | <0.5 | 8.17 | 8 | 990 | 2.2 | 2 | 0.51 | <0.5 | 9 | 66 | 23 | 3.15 | 3.54 | 0.78 |
| A083842 | | 0.34 | <0.5 | 5.50 | 8 | 960 | 1.4 | 2 | 0.85 | <0.5 | 8 | 56 | 24 | 2.50 | 1.83 | 0.78 |
| A083843 | | 0.44 | <0.5 | 5.60 | 12 | 770 | 0.9 | 2 | 0.82 | <0.5 | 7 | 37 | 17 | 2.03 | 1.41 | 0.55 |
| A083844 | | 0.34 | <0.5 | 5.74 | 8 | 650 | 0.8 | 2 | 0.94 | <0.5 | 4 | 22 | 15 | 1.44 | 1.35 | 0.38 |
| A083845 | | 0.18 | <0.5 | 6.75 | <5 | 740 | 1.1 | 3 | 2.21 | <0.5 | 6 | 4 | 16 | 1.84 | 1.92 | 0.63 |
| A083846 | | 0.38 | <0.5 | 5.78 | 9 | 960 | 1.3 | <2 | 0.96 | <0.5 | 12 | 66 | 24 | 2.91 | 1.71 | 0.94 |
| A083847 | | 0.34 | <0.5 | 4.36 | 7 | 730 | 0.9 | <2 | 1.19 | <0.5 | 7 | 54 | 16 | 1.96 | 1.18 | 0.63 |
| A083848 | | 0.34 | <0.5 | 6.74 | 16 | 900 | 1.4 | 2 | 1.11 | <0.5 | 14 | 44 | 40 | 3.04 | 1.92 | 0.78 |
| A083849 | | 0.40 | <0.5 | 6.26 | 6 | 820 | 1.2 | 3 | 1.97 | <0.5 | 7 | 23 | 53 | 2.17 | 1.72 | 0.62 |
| A083850 | | 0.36 | <0.5 | 6.24 | 9 | 1010 | 1.4 | 2 | 0.99 | <0.5 | 14 | 87 | 26 | 3.32 | 1.86 | 1.14 |
| A083951 | | 0.24 | 0.8 | 5.01 | 6 | 900 | 1.1 | 2 | 2.48 | 0.5 | 5 | 16 | 72 | 1.88 | 1.26 | 0.47 |
| A083952 | | 0.40 | <0.5 | 4.85 | 13 | 1460 | 1.3 | <2 | 1.16 | 0.5 | 10 | 71 | 37 | 2.66 | 1.41 | 0.81 |
| A083953 | | 0.44 | 1.1 | 6.62 | <5 | 2140 | 2.3 | 2 | 0.43 | <0.5 | 2 | 102 | 67 | 2.56 | 2.85 | 1.06 |
| A083954 | | 0.46 | <0.5 | 4.11 | 13 | 1020 | 1.1 | <2 | 0.76 | <0.5 | 8 | 75 | 20 | 2.27 | 1.14 | 0.73 |
| A083955 | | 0.46 | <0.5 | 5.84 | 13 | 1030 | 1.3 | 2 | 1.22 | <0.5 | 14 | 90 | 29 | 3.35 | 1.54 | 1.37 |
| A083956 | | 0.36 | <0.5 | 7.20 | 10 | 1160 | 1.8 | <2 | 0.80 | <0.5 | 10 | 67 | 36 | 3.38 | 2.62 | 0.98 |
| A083957 | | 0.58 | <0.5 | 5.80 | 29 | 950 | 1.4 | <2 | 2.64 | <0.5 | 11 | 73 | 49 | 3.47 | 1.88 | 1.11 |
| A083958 | | 0.22 | <0.5 | 6.51 | <5 | 820 | 1.0 | <2 | 2.27 | <0.5 | 3 | 5 | 19 | 1.56 | 2.01 | 0.53 |
| A083959 | | 0.68 | <0.5 | 6.43 | 30 | 1000 | 1.6 | <2 | 0.55 | <0.5 | 17 | 67 | 56 | 3.64 | 2.37 | 0.83 |
| A083960 | | 0.30 | <0.5 | 3.16 | <5 | 480 | 0.5 | <2 | 4.14 | <0.5 | 3 | 5 | 19 | 0.88 | 0.86 | 0.59 |
| A083961 | | 0.34 | <0.5 | 0.70 | <5 | 560 | <0.5 | <2 | 4.97 | 0.6 | 2 | 15 | 27 | 0.42 | 0.11 | 0.32 |
| A083962 | | 0.28 | <0.5 | 7.02 | 5 | 910 | 1.2 | <2 | 2.01 | <0.5 | 5 | 4 | 21 | 1.84 | 2.15 | 0.50 |
| A083963 | | 0.26 | <0.5 | 0.69 | <5 | 120 | <0.5 | <2 | 2.02 | <0.5 | <1 | 1 | 14 | 0.41 | 0.10 | 0.26 |
| A083964 | | 0.50 | <0.5 | 4.67 | 6 | 1300 | 1.2 | <2 | 1.09 | 0.7 | 10 | 75 | 30 | 2.39 | 1.39 | 0.89 |
| A083965 | | 0.64 | <0.5 | 5.75 | 16 | 1220 | 1.5 | 2 | 0.91 | <0.5 | 13 | 114 | 55 | 3.50 | 1.75 | 0.93 |
| A083966 | | 0.24 | <0.5 | 3.57 | <5 | 540 | 0.7 | <2 | 3.30 | 0.8 | 3 | 8 | 56 | 0.98 | 0.87 | 0.47 |
| A083967 | | 0.50 | <0.5 | 5.13 | 10 | 950 | 1.4 | <2 | 0.73 | <0.5 | 10 | 59 | 33 | 2.57 | 1.63 | 0.74 |
| A083968 | | 0.30 | <0.5 | 1.22 | <5 | 310 | <0.5 | <2 | 3.81 | 0.7 | 2 | 4 | 30 | 0.60 | 0.29 | 0.49 |
| A083969 | | 0.46 | <0.5 | 4.99 | 9 | 1080 | 1.2 | <2 | 1.66 | <0.5 | 12 | 112 | 30 | 2.74 | 1.31 | 1.19 |
| A083970 | | 0.42 | <0.5 | 5.30 | 8 | 1200 | 1.1 | <2 | 0.79 | <0.5 | 6 | 70 | 17 | 2.25 | 1.49 | 0.70 |
| A083971 | | 0.24 | <0.5 | 4.26 | 7 | 980 | 0.8 | <2 | 2.98 | 0.5 | 5 | 21 | 24 | 1.34 | 1.06 | 0.54 |
| A083972 | | 0.18 | <0.5 | 1.38 | 5 | 710 | 0.5 | <2 | 3.94 | 1.1 | 4 | 14 | 34 | 0.74 | 0.27 | 0.31 |
| A083973 | | 0.36 | 0.6 | 6.15 | 15 | 1280 | 1.5 | <2 | 1.28 | <0.5 | 12 | 204 | 55 | 3.12 | 1.77 | 1.52 |
| A083974 | | 0.42 | <0.5 | 4.85 | 13 | 1470 | 1.4 | <2 | 0.88 | 0.7 | 11 | 75 | 44 | 3.09 | 1.63 | 0.76 |
| A083975 | | 0.16 | <0.5 | 3.74 | 7 | 870 | 0.8 | <2 | 2.86 | 0.5 | 6 | 27 | 22 | 1.44 | 1.06 | 0.50 |



ALS Chemex

EXCELLENCE IN ANALYTICAL CHEMISTRY

ALS Canada Ltd.

212 Brooksbank Avenue
North Vancouver BC V7J 2C1

Phone: 604 984 0221 Fax: 604 984 0218 www.alschemex.com

o: YUKON ZINC CORPORATION
701-475 HOWE ST
VANCOUVER BC V6C 2B3

Page: 4 - B
Total # pages: 7 (A - B)
Finalized Date: 10-JUL-2005
Account: MPO

Project: 1647

CERTIFICATE OF ANALYSIS VA05051804

| Sample Description | Method Analyte Units LOR | ME-ICP61 | ME-ICP61 | ME-ICP61 | ME-ICP61 | ME-ICP61 | ME-ICP61 | ME-ICP61 | ME-ICP61 | ME-ICP61 | ME-ICP61 | ME-ICP61 | ME-ICP61 | |
|--------------------|-----------------------------------|----------|----------|----------|----------|----------|----------|----------|----------|----------|----------|----------|----------|-----|
| | | Mn | Mo | Na | Ni | P | Pb | S | Sb | Sr | Ti | V | W | Zn |
| | | ppm | ppm | % | ppm | ppm | ppm | % | ppm | ppm | % | ppm | ppm | ppm |
| | | 5 | 1 | 0.01 | 1 | 10 | 2 | 0.01 | 5 | 1 | 0.01 | 1 | 10 | 2 |
| A083836 | | 997 | <1 | 0.50 | 39 | 780 | 23 | 0.02 | <5 | 71 | 0.26 | 108 | <10 | 106 |
| A083837 | | 607 | 1 | 1.90 | 22 | 340 | 26 | 0.01 | <5 | 384 | 0.28 | 69 | <10 | 81 |
| A083838 | | 813 | <1 | 1.58 | 17 | 310 | 23 | 0.01 | <5 | 279 | 0.32 | 78 | <10 | 177 |
| A083839 | | 323 | <1 | 0.53 | 33 | 630 | 22 | 0.06 | <5 | 96 | 0.29 | 116 | <10 | 104 |
| A083840 | | 761 | 1 | 0.57 | 34 | 720 | 32 | 0.02 | <5 | 63 | 0.28 | 95 | <10 | 88 |
| A083841 | | 351 | <1 | 0.55 | 22 | 680 | 24 | 0.02 | <5 | 59 | 0.24 | 87 | <10 | 76 |
| A083842 | | 449 | 1 | 0.92 | 23 | 870 | 20 | 0.02 | <5 | 118 | 0.28 | 85 | <10 | 93 |
| A083843 | | 306 | 1 | 1.51 | 12 | 260 | 19 | 0.01 | <5 | 221 | 0.28 | 70 | <10 | 58 |
| A083844 | | 233 | 1 | 1.90 | 5 | 260 | 9 | 0.01 | <5 | 278 | 0.30 | 61 | <10 | 53 |
| A083845 | | 370 | 1 | 2.57 | 3 | 380 | 7 | 0.02 | <5 | 558 | 0.24 | 46 | <10 | 46 |
| A083846 | | 802 | 1 | 1.21 | 29 | 630 | 21 | 0.02 | <5 | 135 | 0.34 | 89 | <10 | 85 |
| A083847 | | 314 | 1 | 1.07 | 19 | 600 | 10 | 0.03 | <5 | 146 | 0.29 | 68 | <10 | 46 |
| A083848 | | 561 | 1 | 1.47 | 20 | 400 | 37 | 0.02 | <5 | 243 | 0.27 | 73 | <10 | 64 |
| A083849 | | 385 | 1 | 1.92 | 12 | 390 | 15 | 0.03 | <5 | 389 | 0.26 | 58 | <10 | 48 |
| A083850 | | 1550 | <1 | 1.07 | 29 | 760 | 21 | 0.03 | <5 | 90 | 0.34 | 101 | <10 | 91 |
| A083951 | | 404 | 3 | 1.49 | 27 | 900 | 9 | 0.11 | <5 | 373 | 0.14 | 45 | <10 | 74 |
| A083952 | | 455 | 3 | 0.63 | 41 | 980 | 13 | 0.03 | <5 | 108 | 0.32 | 129 | <10 | 102 |
| A083953 | | 204 | 3 | 0.24 | 23 | 740 | 13 | 0.15 | <5 | 95 | 0.28 | 251 | <10 | 54 |
| A083954 | | 407 | 1 | 0.72 | 41 | 650 | 14 | 0.01 | <5 | 91 | 0.32 | 100 | <10 | 56 |
| A083955 | | 686 | 1 | 1.19 | 41 | 1160 | 17 | 0.01 | <5 | 126 | 0.36 | 124 | <10 | 83 |
| A083956 | | 323 | 1 | 0.75 | 40 | 930 | 18 | 0.01 | <5 | 103 | 0.29 | 104 | <10 | 104 |
| A083957 | | 470 | 1 | 0.63 | 40 | 900 | 27 | 0.02 | <5 | 114 | 0.29 | 106 | <10 | 92 |
| A083958 | | 377 | 1 | 2.50 | 5 | 450 | 9 | 0.06 | <5 | 541 | 0.18 | 34 | 10 | 49 |
| A083959 | | 514 | <1 | 0.53 | 45 | 800 | 25 | 0.04 | <5 | 69 | 0.24 | 94 | <10 | 95 |
| A083960 | | 229 | 1 | 1.07 | 6 | 490 | 5 | 0.16 | <5 | 371 | 0.11 | 21 | <10 | 21 |
| A083961 | | 120 | <1 | 0.08 | 22 | 680 | <2 | 0.25 | <5 | 173 | 0.03 | 12 | <10 | 7 |
| A083962 | | 479 | 2 | 2.79 | 4 | 560 | 9 | 0.10 | <5 | 555 | 0.20 | 32 | <10 | 55 |
| A083963 | | 51 | 2 | 0.12 | 5 | 470 | <2 | 1.48 | <5 | 118 | 0.02 | 6 | <10 | 7 |
| A083964 | | 497 | 1 | 0.75 | 46 | 1050 | 15 | 0.03 | <5 | 110 | 0.31 | 121 | <10 | 88 |
| A083965 | | 499 | 1 | 0.53 | 55 | 750 | 21 | 0.02 | <5 | 79 | 0.28 | 133 | <10 | 93 |
| A083966 | | 272 | 1 | 1.10 | 17 | 700 | 6 | 0.17 | <5 | 334 | 0.10 | 22 | <10 | 24 |
| A083967 | | 336 | 1 | 0.64 | 34 | 890 | 14 | 0.01 | <5 | 79 | 0.29 | 89 | <10 | 81 |
| A083968 | | 201 | <1 | 0.32 | 10 | 690 | 3 | 0.55 | <5 | 221 | 0.04 | 11 | <10 | 25 |
| A083969 | | 747 | 1 | 0.92 | 49 | 650 | 13 | 0.04 | <5 | 134 | 0.33 | 108 | <10 | 64 |
| A083970 | | 288 | 2 | 1.01 | 25 | 420 | 11 | 0.01 | <5 | 150 | 0.34 | 118 | <10 | 60 |
| A083971 | | 360 | 1 | 1.12 | 16 | 950 | 6 | 0.11 | <5 | 324 | 0.16 | 53 | <10 | 51 |
| A083972 | | 182 | 1 | 0.20 | 29 | 1080 | 4 | 0.19 | <5 | 178 | 0.05 | 23 | <10 | 41 |
| A083973 | | 656 | 2 | 0.87 | 130 | 1100 | 13 | 0.03 | <5 | 206 | 0.31 | 144 | <10 | 140 |
| A083974 | | 733 | 3 | 0.59 | 47 | 1110 | 18 | 0.03 | <5 | 91 | 0.33 | 142 | <10 | 118 |
| A083975 | | 838 | 1 | 0.85 | 16 | 1060 | 10 | 0.16 | <5 | 241 | 0.15 | 51 | <10 | 61 |



ALS Chemex

EXCELLENCE IN ANALYTICAL CHEMISTRY

ALS Canada Ltd.

212 Brooksbank Avenue
North Vancouver BC V7J 2C1

Phone: 604 984 0221 Fax: 604 984 0218 www.alschemex.com

o: YUKON ZINC CORPORATION
701-475 HOWE ST
VANCOUVER BC V6C 2B3

Page: 5 - A
Total # Pages: 7 (A - B)
Finalized Date: 10-JUL-2005
Account: MPO

Project: 1647

CERTIFICATE OF ANALYSIS VA05051804

| Sample Description | Method | WEI-21 | ME-ICP61 | ME-ICP61 | ME-ICP61 | ME-ICP61 | ME-ICP61 | ME-ICP61 | ME-ICP61 | ME-ICP61 | ME-ICP61 | ME-ICP61 | ME-ICP61 | ME-ICP61 | ME-ICP61 | ME-ICP61 |
|--------------------|---------|-----------|----------|----------|----------|----------|----------|----------|----------|----------|----------|----------|----------|----------|----------|----------|
| | Analyte | Recvd Wt. | Ag | Al | As | Ba | Be | Bi | Ca | Cd | Co | Cr | Cu | Fe | K | Mg |
| Units | | kg | ppm | % | ppm | ppm | ppm | ppm | % | ppm | ppm | ppm | ppm | % | % | % |
| LOR | | 0.02 | 0.5 | 0.01 | 5 | 10 | 0.5 | 2 | 0.01 | 0.5 | 1 | 1 | 1 | 0.01 | 0.01 | 0.01 |
| A083976 | | 0.58 | <0.5 | 5.16 | 11 | 1080 | 1.2 | <2 | 1.34 | <0.5 | 8 | 55 | 34 | 2.34 | 1.68 | 0.76 |
| A083977 | | 0.36 | <0.5 | 4.78 | 10 | 1200 | 1.3 | 2 | 0.59 | <0.5 | 9 | 77 | 21 | 2.68 | 1.29 | 0.83 |
| A083978 | | 0.28 | <0.5 | 4.52 | 8 | 1170 | 1.2 | <2 | 0.65 | <0.5 | 6 | 80 | 20 | 2.28 | 1.26 | 0.76 |
| A083979 | | 0.34 | <0.5 | 5.29 | 9 | 1020 | 1.3 | <2 | 1.28 | <0.5 | 13 | 118 | 23 | 2.87 | 1.50 | 1.32 |
| A083980 | | 0.42 | <0.5 | 6.19 | 16 | 1170 | 1.5 | <2 | 2.98 | <0.5 | 18 | 123 | 45 | 3.83 | 1.92 | 1.20 |
| A083981 | | 0.22 | <0.5 | 6.56 | <5 | 860 | 1.1 | <2 | 2.44 | <0.5 | 4 | 12 | 30 | 1.50 | 1.91 | 0.56 |
| A083982 | | 0.20 | <0.5 | 3.96 | <5 | 860 | 0.8 | <2 | 3.41 | 0.9 | 8 | 21 | 32 | 1.44 | 1.12 | 0.49 |
| A083983 | | 0.30 | <0.5 | 6.75 | <5 | 840 | 1.2 | <2 | 2.00 | <0.5 | 5 | 4 | 18 | 1.76 | 2.18 | 0.55 |
| A083984 | | 0.36 | <0.5 | 4.64 | 9 | 1260 | 1.2 | <2 | 1.54 | 0.5 | 10 | 86 | 24 | 2.59 | 1.33 | 0.93 |
| A083985 | | 0.28 | <0.5 | 2.76 | <5 | 1050 | 0.8 | <2 | 3.28 | 1.4 | 9 | 65 | 33 | 2.10 | 0.68 | 0.84 |
| A083986 | | 0.14 | <0.5 | 0.98 | <5 | 5050 | <0.5 | 4 | 2.64 | <0.5 | 12 | 3 | 25 | 3.75 | 0.17 | 0.10 |
| A083987 | | 0.24 | <0.5 | 5.91 | <5 | 1380 | 1.5 | <2 | 1.34 | 1.0 | 19 | 94 | 28 | 3.14 | 1.88 | 1.29 |
| A083988 | | 0.18 | <0.5 | 5.50 | <5 | 720 | 0.9 | <2 | 2.61 | <0.5 | 5 | 8 | 16 | 1.38 | 1.52 | 0.52 |
| A083989 | | 0.52 | <0.5 | 4.77 | <5 | 1100 | 1.1 | <2 | 0.67 | <0.5 | 5 | 90 | 20 | 1.82 | 1.42 | 0.61 |
| A083990 | | 0.62 | <0.5 | 4.36 | 8 | 1160 | 1.1 | <2 | 2.30 | 0.9 | 7 | 51 | 41 | 2.01 | 1.19 | 0.70 |
| A083991 | | 0.44 | 0.5 | 5.82 | <5 | 1460 | 1.6 | <2 | 1.54 | 1.2 | 14 | 73 | 70 | 2.67 | 1.44 | 0.76 |
| A083992 | | 0.30 | <0.5 | 6.98 | <5 | 900 | 1.2 | <2 | 2.08 | <0.5 | 5 | 4 | 19 | 1.68 | 2.04 | 0.51 |
| A083993 | | 0.32 | <0.5 | 6.07 | <5 | 830 | 1.0 | <2 | 2.79 | <0.5 | 5 | 8 | 22 | 1.59 | 1.70 | 0.56 |
| A083994 | | 0.32 | <0.5 | 5.64 | <5 | 1060 | 1.2 | <2 | 1.99 | <0.5 | 7 | 41 | 31 | 1.94 | 1.69 | 0.72 |
| A083995 | | 0.32 | <0.5 | 7.00 | <5 | 810 | 1.2 | <2 | 2.00 | <0.5 | 6 | 4 | 15 | 1.83 | 2.13 | 0.61 |
| A083996 | | 0.18 | <0.5 | 6.74 | <5 | 850 | 1.2 | <2 | 1.98 | <0.5 | 4 | 3 | 18 | 1.38 | 2.12 | 0.49 |
| A083997 | | 0.38 | <0.5 | 5.45 | 10 | 1520 | 1.5 | <2 | 1.47 | <0.5 | 12 | 92 | 51 | 2.98 | 1.50 | 1.04 |
| A083998 | | 0.18 | <0.5 | 3.38 | 8 | 660 | 0.8 | <2 | 2.34 | 1.0 | 6 | 30 | 52 | 1.90 | 0.83 | 0.50 |
| A083999 | | 0.18 | <0.5 | 5.93 | 8 | 1300 | 0.9 | <2 | 2.43 | <0.5 | 6 | 6 | 18 | 2.93 | 1.56 | 0.63 |
| A134086 | | 0.40 | <0.5 | 4.15 | 15 | 1170 | 1.1 | <2 | 0.43 | <0.5 | 8 | 61 | 21 | 2.87 | 1.14 | 0.62 |
| A134087 | | 0.22 | 1.0 | 4.02 | <5 | 1160 | 0.8 | <2 | 1.36 | 1.3 | 5 | 50 | 28 | 1.88 | 0.92 | 0.51 |
| A134088 | | 0.20 | <0.5 | 1.04 | <5 | 610 | <0.5 | <2 | 2.82 | 1.2 | 4 | 9 | 15 | 0.51 | 0.12 | 0.36 |
| A134089 | | 0.16 | <0.5 | 0.92 | <5 | 500 | <0.5 | <2 | 3.26 | <0.5 | 2 | 4 | 12 | 0.88 | 0.15 | 0.31 |
| A134090 | | 0.14 | 0.5 | 0.51 | 9 | 610 | <0.5 | <2 | 3.20 | 1.0 | 5 | 6 | 30 | 1.41 | 0.08 | 0.25 |
| A134091 | | 0.30 | <0.5 | 3.49 | 5 | 940 | 0.9 | <2 | 1.70 | <0.5 | 6 | 49 | 25 | 1.72 | 1.03 | 0.61 |
| A134092 | | 0.26 | <0.5 | 4.11 | <5 | 770 | 0.8 | <2 | 3.16 | <0.5 | 4 | 23 | 52 | 1.36 | 1.04 | 0.52 |
| A134093 | | 0.24 | <0.5 | 5.00 | <5 | 690 | 0.9 | <2 | 2.88 | <0.5 | 4 | 5 | 21 | 1.12 | 1.38 | 0.46 |
| A134094 | | 0.20 | <0.5 | 4.43 | <5 | 820 | 0.8 | <2 | 3.11 | 1.3 | 4 | 9 | 56 | 1.08 | 1.23 | 0.45 |
| A134095 | | 0.20 | 0.5 | 3.99 | <5 | 550 | 0.6 | <2 | 3.64 | <0.5 | 5 | 6 | 13 | 1.16 | 0.92 | 0.63 |
| A134096 | | 0.34 | <0.5 | 3.48 | 16 | 720 | 0.9 | <2 | 0.51 | <0.5 | 11 | 77 | 20 | 2.47 | 0.89 | 0.55 |
| A134097 | | 0.40 | <0.5 | 3.75 | 7 | 890 | 1.0 | <2 | 0.77 | <0.5 | 8 | 57 | 26 | 2.48 | 1.10 | 0.71 |
| A134098 | | 0.12 | 0.5 | 1.66 | <5 | 540 | <0.5 | <2 | 3.52 | 1.0 | 4 | 7 | 30 | 0.53 | 0.44 | 0.33 |
| A134099 | | 0.30 | 0.7 | 3.77 | <5 | 1120 | 0.9 | <2 | 2.01 | <0.5 | 5 | 32 | 27 | 1.48 | 1.06 | 0.50 |
| A134100 | | 0.18 | 2.1 | 2.16 | 7 | 760 | 0.6 | <2 | 2.67 | 0.8 | 7 | 23 | 54 | 1.02 | 0.63 | 0.44 |
| A134346 | | 0.14 | <0.5 | 6.09 | <5 | 760 | 1.0 | <2 | 1.64 | <0.5 | 6 | 3 | 16 | 1.76 | 1.83 | 0.54 |



ALS Chemex

EXCELLENCE IN ANALYTICAL CHEMISTRY

ALS Canada Ltd.

212 Brooksbank Avenue

North Vancouver BC V7J 2C1

Phone: 604 984 0221 Fax: 604 984 0218 www.alschemex.com

YUKON ZINC CORPORATION
701-475 HOWE ST
VANCOUVER BC V6C 2B3

Page: 5 - B
Total # pages: 7 (A - B)
Finalized Date: 10-JUL-2005
Account: MPO

Project: 1647

CERTIFICATE OF ANALYSIS VA05051804

| Sample Description | Method Analyte Units LOR | ME-ICP61 | ME-ICP61 | ME-ICP61 | ME-ICP61 | ME-ICP61 | ME-ICP61 | ME-ICP61 | ME-ICP61 | ME-ICP61 | ME-ICP61 | ME-ICP61 | ME-ICP61 | |
|--------------------|--------------------------|----------|----------|-----------|----------|-----------|----------|-----------|----------|----------|-----------|----------|-----------|----------|
| | | Mn | Mo | Na | Ni | P | Pb | S | Sb | Sr | Ti | V | W | Zn |
| | | ppm 5 | ppm 1 | % 0.01 | ppm 1 | ppm 10 | ppm 2 | % 0.01 | ppm 5 | ppm 1 | % 0.01 | ppm 1 | ppm 10 | ppm 2 |
| A083976 | | 392 | <1 | 1.19 | 33 | 900 | 15 | 0.02 | <5 | 206 | 0.26 | 93 | <10 | 88 |
| A083977 | | 365 | <1 | 0.70 | 37 | 500 | 16 | 0.01 | <5 | 79 | 0.32 | 128 | <10 | 75 |
| A083978 | | 271 | <1 | 0.76 | 34 | 490 | 14 | 0.01 | <5 | 83 | 0.30 | 116 | <10 | 75 |
| A083979 | | 365 | <1 | 1.06 | 39 | 1100 | 14 | 0.02 | <5 | 124 | 0.35 | 124 | <10 | 85 |
| A083980 | | 387 | <1 | 0.70 | 48 | 700 | 22 | 0.03 | <5 | 118 | 0.26 | 126 | <10 | 96 |
| A083981 | | 313 | 1 | 2.43 | 6 | 620 | 11 | 0.11 | <5 | 522 | 0.19 | 37 | <10 | 46 |
| A083982 | | 2370 | 1 | 1.16 | 27 | 810 | 12 | 0.21 | <5 | 316 | 0.13 | 38 | <10 | 45 |
| A083983 | | 391 | 1 | 2.94 | 4 | 550 | 11 | 0.02 | <5 | 581 | 0.22 | 41 | <10 | 51 |
| A083984 | | 336 | <1 | 0.69 | 43 | 610 | 17 | 0.10 | <5 | 126 | 0.27 | 126 | <10 | 93 |
| A083985 | | 625 | <1 | 0.47 | 42 | 710 | 13 | 0.29 | <5 | 174 | 0.16 | 73 | <10 | 63 |
| A083986 | | 76900 | 3 | 0.18 | 65 | 1000 | 10 | 0.22 | <5 | 172 | 0.03 | 7 | <10 | 170 |
| A083987 | | 675 | <1 | 0.71 | 53 | 960 | 13 | 0.08 | <5 | 136 | 0.33 | 154 | <10 | 165 |
| A083988 | | 415 | <1 | 2.02 | 5 | 480 | 8 | 0.07 | <5 | 467 | 0.18 | 34 | <10 | 41 |
| A083989 | | 219 | <1 | 0.80 | 19 | 390 | 12 | 0.01 | <5 | 99 | 0.36 | 135 | <10 | 59 |
| A083990 | | 1755 | 1 | 0.83 | 36 | 830 | 12 | 0.10 | <5 | 215 | 0.18 | 87 | <10 | 74 |
| A083991 | | 1090 | <1 | 1.24 | 54 | 900 | 19 | 0.03 | <5 | 238 | 0.25 | 113 | <10 | 110 |
| A083992 | | 403 | <1 | 2.73 | 2 | 470 | 11 | 0.03 | <5 | 544 | 0.19 | 36 | <10 | 47 |
| A083993 | | 382 | <1 | 2.28 | 6 | 570 | 11 | 0.06 | <5 | 504 | 0.19 | 40 | <10 | 49 |
| A083994 | | 437 | <1 | 1.67 | 25 | 640 | 11 | 0.07 | <5 | 351 | 0.22 | 74 | <10 | 60 |
| A083995 | | 370 | <1 | 2.95 | 3 | 220 | 10 | 0.01 | <5 | 607 | 0.23 | 45 | <10 | 50 |
| A083996 | | 378 | <1 | 2.87 | 2 | 600 | 12 | 0.08 | <5 | 559 | 0.18 | 26 | <10 | 51 |
| A083997 | | 614 | <1 | 0.73 | 59 | 820 | 16 | 0.05 | <5 | 142 | 0.29 | 139 | <10 | 81 |
| A083998 | | 290 | <1 | 0.89 | 34 | 810 | 12 | 0.52 | <5 | 243 | 0.11 | 43 | <10 | 38 |
| A083999 | | 12250 | 2 | 2.32 | 11 | 1020 | 9 | 0.13 | <5 | 536 | 0.21 | 42 | <10 | 145 |
| A134086 | | 265 | 1 | 0.53 | 30 | 970 | 15 | 0.01 | <5 | 67 | 0.26 | 137 | <10 | 84 |
| A134087 | | 198 | <1 | 0.74 | 18 | 930 | 13 | 0.03 | <5 | 174 | 0.24 | 104 | <10 | 80 |
| A134088 | | 1155 | 1 | 0.12 | 9 | 1340 | 4 | 0.65 | <5 | 142 | 0.03 | 15 | <10 | 58 |
| A134089 | | 1850 | 1 | 0.18 | 9 | 830 | 5 | 0.32 | <5 | 166 | 0.03 | 12 | <10 | 26 |
| A134090 | | 305 | <1 | 0.07 | 16 | 960 | 2 | 0.40 | <5 | 142 | 0.02 | 10 | <10 | 24 |
| A134091 | | 532 | <1 | 0.74 | 24 | 920 | 12 | 0.11 | <5 | 155 | 0.21 | 80 | <10 | 78 |
| A134092 | | 412 | <1 | 1.32 | 22 | 890 | 9 | 0.16 | <5 | 349 | 0.15 | 39 | <10 | 49 |
| A134093 | | 315 | <1 | 1.82 | 5 | 740 | 7 | 0.11 | <5 | 427 | 0.14 | 24 | <10 | 36 |
| A134094 | | 616 | <1 | 1.60 | 21 | 680 | 5 | 0.29 | <5 | 397 | 0.12 | 24 | <10 | 38 |
| A134095 | | 1600 | <1 | 1.41 | 6 | 800 | 6 | 0.15 | <5 | 427 | 0.14 | 32 | <10 | 45 |
| A134096 | | 330 | <1 | 0.71 | 33 | 480 | 22 | 0.01 | <5 | 74 | 0.26 | 83 | <10 | 54 |
| A134097 | | 399 | 1 | 0.77 | 36 | 850 | 18 | 0.01 | <5 | 90 | 0.27 | 91 | <10 | 73 |
| A134098 | | 158 | <1 | 0.50 | 12 | 610 | 5 | 0.17 | <5 | 214 | 0.05 | 14 | <10 | 30 |
| A134099 | | 274 | <1 | 0.99 | 16 | 720 | 4 | 0.06 | <5 | 229 | 0.18 | 67 | <10 | 44 |
| A134100 | | 730 | <1 | 0.49 | 14 | 840 | 15 | 0.17 | <5 | 168 | 0.10 | 37 | <10 | 99 |
| A134346 | | 311 | <1 | 2.38 | 2 | 320 | 5 | 0.08 | <5 | 481 | 0.22 | 45 | <10 | 43 |



ALS Chemex

EXCELLENCE IN ANALYTICAL CHEMISTRY

ALS Canada Ltd.

212 Brooksbank Avenue
North Vancouver BC V7J 2C1

Phone: 604 984 0221 Fax: 604 984 0218 www.alschemex.com

o: YUKON ZINC CORPORATION
701-475 HOWE ST
VANCOUVER BC V6C 2B3

Page: 6 - A
Total # pages: 7 (A - B)
Finalized Date: 10-JUL-2005
Account: MPO

Project: 1647

CERTIFICATE OF ANALYSIS VA05051804

| Sample Description | Method | WEI-21 | ME-ICP61 | ME-ICP61 | ME-ICP61 | ME-ICP61 | ME-ICP61 | ME-ICP61 | ME-ICP61 | ME-ICP61 | ME-ICP61 | ME-ICP61 | ME-ICP61 | ME-ICP61 | ME-ICP61 | ME-ICP61 |
|--------------------|---------|-----------|----------|----------|----------|----------|----------|----------|----------|----------|----------|----------|----------|----------|----------|----------|
| | Analyte | Recvd Wt. | Ag | Al | As | Ba | Be | Bi | Ca | Cd | Co | Cr | Cu | Fe | K | Mg |
| Units | | kg | ppm | % | ppm | ppm | ppm | ppm | % | ppm | ppm | ppm | ppm | % | % | % |
| LOR | | 0.02 | 0.5 | 0.01 | 5 | 10 | 0.5 | 2 | 0.01 | 0.5 | 1 | 1 | 1 | 0.01 | 0.01 | 0.01 |
| A134347 | | 0.14 | <0.5 | 0.22 | <5 | 210 | <0.5 | <2 | 2.57 | <0.5 | 2 | <1 | 10 | 0.25 | 0.05 | 0.24 |
| A134348 | | 0.32 | <0.5 | 3.64 | 12 | 1220 | 1.0 | <2 | 0.73 | <0.5 | 7 | 54 | 19 | 2.13 | 1.20 | 0.68 |
| A134349 | | 0.32 | 0.6 | 6.14 | 7 | 1340 | 1.3 | <2 | 1.14 | <0.5 | 8 | 34 | 24 | 2.15 | 1.67 | 0.65 |
| A134393 | | 0.14 | 0.6 | 7.91 | 9 | 1030 | 1.3 | <2 | 2.25 | <0.5 | 6 | 1 | 18 | 1.81 | 2.42 | 0.66 |
| A134394 | | 0.40 | <0.5 | 6.85 | 11 | 1100 | 1.5 | <2 | 1.59 | <0.5 | 17 | 78 | 35 | 3.67 | 1.91 | 1.44 |
| A134395 | | 0.28 | <0.5 | 6.85 | 5 | 1070 | 1.7 | <2 | 0.88 | <0.5 | 13 | 61 | 39 | 3.62 | 2.16 | 1.28 |
| A134396 | | 0.32 | <0.5 | 7.20 | 11 | 1070 | 1.6 | <2 | 1.02 | <0.5 | 16 | 69 | 54 | 3.70 | 2.14 | 1.45 |
| A134397 | | 0.24 | <0.5 | 6.93 | 15 | 1240 | 1.7 | <2 | 2.09 | <0.5 | 15 | 68 | 36 | 3.54 | 2.27 | 1.48 |
| A134398 | | 0.36 | <0.5 | 7.04 | 11 | 1210 | 1.5 | <2 | 1.78 | <0.5 | 13 | 61 | 34 | 3.54 | 1.94 | 1.39 |
| A134399 | | 0.28 | <0.5 | 7.31 | <5 | 1260 | 1.5 | <2 | 1.48 | <0.5 | 14 | 54 | 33 | 3.29 | 2.04 | 1.29 |
| A134400 | | 0.28 | <0.5 | 6.74 | 7 | 1180 | 1.7 | <2 | 1.47 | <0.5 | 15 | 83 | 43 | 3.72 | 2.18 | 1.26 |
| A134401 | | 0.36 | 1.1 | 7.00 | 41 | 1310 | 2.1 | <2 | 1.14 | <0.5 | 36 | 95 | 132 | 6.09 | 2.60 | 1.28 |
| A134402 | | 0.36 | <0.5 | 5.60 | 10 | 1460 | 1.6 | <2 | 1.50 | 0.6 | 11 | 77 | 37 | 2.58 | 1.77 | 0.97 |
| A134403 | | 0.60 | <0.5 | 5.40 | <5 | 1380 | 1.4 | <2 | 1.20 | <0.5 | 12 | 68 | 24 | 2.62 | 1.68 | 0.91 |
| A134404 | | 0.42 | <0.5 | 5.67 | 11 | 1580 | 1.6 | <2 | 1.87 | <0.5 | 13 | 64 | 36 | 3.02 | 1.92 | 1.13 |
| A134405 | | 0.22 | 0.5 | 7.28 | <5 | 930 | 1.2 | <2 | 2.73 | <0.5 | 7 | 3 | 23 | 1.82 | 2.05 | 0.73 |
| A134406 | | 0.28 | 0.6 | 7.78 | <5 | 1040 | 1.3 | <2 | 2.14 | <0.5 | 6 | 1 | 20 | 1.88 | 2.37 | 0.64 |
| A134451 | | 0.26 | <0.5 | 7.14 | 14 | 1110 | 1.9 | <2 | 1.04 | <0.5 | 15 | 75 | 38 | 3.78 | 2.43 | 1.27 |
| A134452 | | 0.36 | <0.5 | 7.18 | 25 | 1190 | 2.0 | <2 | 1.26 | <0.5 | 13 | 69 | 33 | 3.35 | 2.80 | 1.09 |
| A134453 | | 0.32 | <0.5 | 6.53 | 13 | 1320 | 1.7 | <2 | 1.34 | <0.5 | 16 | 76 | 37 | 3.35 | 2.18 | 1.29 |
| A134454 | | 0.26 | <0.5 | 5.48 | 10 | 1220 | 1.4 | <2 | 1.55 | <0.5 | 15 | 70 | 46 | 3.00 | 1.49 | 1.21 |
| A134455 | | 0.20 | <0.5 | 5.43 | 18 | 1010 | 1.2 | <2 | 1.71 | <0.5 | 13 | 52 | 30 | 2.53 | 1.36 | 0.96 |
| A134456 | | 0.34 | <0.5 | 6.68 | 19 | 1820 | 1.9 | <2 | 2.06 | 0.6 | 13 | 67 | 45 | 3.34 | 2.35 | 1.18 |
| A134457 | | 0.22 | <0.5 | 3.69 | 11 | 650 | 0.6 | <2 | 0.47 | <0.5 | 8 | 49 | 15 | 2.14 | 0.61 | 0.39 |
| A134458 | | 0.28 | <0.5 | 3.90 | <5 | 1030 | 1.0 | <2 | 1.12 | <0.5 | 9 | 75 | 18 | 2.01 | 1.11 | 0.65 |
| A134459 | | 0.20 | <0.5 | 4.22 | 8 | 1100 | 0.9 | <2 | 0.59 | <0.5 | 6 | 63 | 14 | 2.02 | 1.12 | 0.69 |
| A134460 | | 0.18 | <0.5 | 4.19 | <5 | 850 | 0.9 | <2 | 1.48 | <0.5 | 5 | 66 | 10 | 1.81 | 1.11 | 0.87 |
| A134461 | | 0.30 | <0.5 | 4.46 | 15 | 1000 | 1.2 | <2 | 1.24 | <0.5 | 9 | 64 | 24 | 2.57 | 1.22 | 0.93 |
| A134462 | | 0.32 | <0.5 | 4.61 | 11 | 900 | 1.2 | <2 | 1.80 | <0.5 | 14 | 67 | 51 | 2.50 | 1.20 | 1.11 |
| A134463 | | 0.16 | 0.6 | 7.51 | <5 | 970 | 1.3 | <2 | 2.15 | <0.5 | 6 | <1 | 20 | 1.56 | 2.35 | 0.61 |
| A134464 | | 0.28 | <0.5 | 6.46 | 11 | 1210 | 1.6 | <2 | 1.90 | <0.5 | 14 | 49 | 32 | 3.07 | 1.88 | 1.23 |
| A134465 | | 0.22 | <0.5 | 4.14 | 13 | 860 | 1.1 | <2 | 0.62 | <0.5 | 10 | 65 | 10 | 2.44 | 1.06 | 0.66 |
| A134466 | | 0.14 | 0.6 | 7.60 | 7 | 970 | 1.3 | <2 | 1.92 | <0.5 | 6 | <1 | 17 | 1.56 | 2.31 | 0.58 |
| A134467 | | 0.28 | <0.5 | 5.13 | 10 | 1090 | 1.5 | <2 | 2.17 | <0.5 | 12 | 66 | 29 | 2.71 | 1.57 | 1.24 |
| A134468 | | 0.38 | <0.5 | 4.78 | 20 | 990 | 1.4 | <2 | 0.79 | <0.5 | 14 | 58 | 33 | 2.85 | 1.56 | 0.84 |
| A134469 | | 0.28 | <0.5 | 4.69 | 8 | 980 | 1.3 | <2 | 2.67 | <0.5 | 13 | 69 | 25 | 2.56 | 1.33 | 1.30 |
| A134470 | | 0.26 | 0.7 | 7.25 | 6 | 980 | 1.3 | <2 | 1.73 | <0.5 | 6 | <1 | 17 | 1.47 | 2.33 | 0.49 |
| A134471 | | 0.22 | <0.5 | 4.12 | 6 | 890 | 1.0 | <2 | 1.67 | <0.5 | 9 | 55 | 23 | 2.15 | 1.12 | 0.91 |
| A134472 | | 0.36 | <0.5 | 3.54 | 15 | 960 | 1.0 | <2 | 1.45 | <0.5 | 9 | 58 | 31 | 2.21 | 1.08 | 0.83 |
| A139937 | | 0.12 | <0.5 | 2.45 | 14 | 770 | 0.6 | <2 | 2.84 | 1.3 | 4 | 15 | 33 | 1.09 | 0.70 | 0.48 |



ALS Chemex

EXCELLENCE IN ANALYTICAL CHEMISTRY

ALS Canada Ltd.

212 Brooksbank Avenue

North Vancouver BC V7J 2C1

Phone: 604 984 0221 Fax: 604 984 0218 www.alschemex.com

o: YUKON ZINC CORPORATION

701-475 HOWE ST

VANCOUVER BC V6C 2B3

Page: 6 - B
 Total # Pages: 7 (A - B)
 Finalized Date: 10-JUL-2005
 Account: MPO

Project: 1647

CERTIFICATE OF ANALYSIS VA05051804

| Sample Description | Method Analyte Units LOR | ME-ICP61 | ME-ICP61 | ME-ICP61 | ME-ICP61 | ME-ICP61 | ME-ICP61 | ME-ICP61 | ME-ICP61 | ME-ICP61 | ME-ICP61 | ME-ICP61 | ME-ICP61 | |
|--------------------|--------------------------|----------|----------|----------|----------|----------|----------|----------|----------|----------|----------|----------|----------|-----|
| | | Mn | Mo | Na | Ni | P | Pb | S | Sb | Sr | Ti | V | W | Zn |
| | | ppm | ppm | % | ppm | ppm | ppm | % | ppm | ppm | % | ppm | ppm | ppm |
| | | 5 | 1 | 0.01 | 1 | 10 | 2 | 0.01 | 5 | 1 | 0.01 | 1 | 10 | 2 |
| A134347 | | 294 | <1 | 0.05 | <1 | 640 | <2 | 0.32 | <5 | 118 | 0.01 | 3 | <10 | 17 |
| A134348 | | 238 | <1 | 0.59 | 23 | 610 | 8 | 0.02 | <5 | 88 | 0.27 | 114 | <10 | 89 |
| A134349 | | 347 | <1 | 1.66 | 18 | 540 | 9 | 0.01 | <5 | 304 | 0.26 | 88 | <10 | 74 |
| A134393 | | 401 | <1 | 3.30 | 3 | 340 | 6 | 0.04 | <5 | 669 | 0.23 | 40 | <10 | 51 |
| A134394 | | 494 | <1 | 1.33 | 28 | 1020 | 16 | 0.01 | <5 | 125 | 0.42 | 112 | <10 | 89 |
| A134395 | | 484 | <1 | 1.20 | 25 | 770 | 13 | 0.01 | <5 | 87 | 0.49 | 106 | <10 | 75 |
| A134396 | | 553 | <1 | 1.47 | 28 | 880 | 26 | 0.01 | <5 | 102 | 0.42 | 108 | <10 | 116 |
| A134397 | | 535 | <1 | 1.35 | 30 | 990 | 11 | 0.01 | <5 | 133 | 0.40 | 113 | <10 | 96 |
| A134398 | | 593 | <1 | 1.76 | 24 | 940 | 11 | <0.01 | <5 | 137 | 0.43 | 106 | <10 | 79 |
| A134399 | | 548 | <1 | 1.88 | 24 | 830 | 8 | 0.02 | <5 | 228 | 0.36 | 100 | <10 | 83 |
| A134400 | | 465 | <1 | 0.90 | 38 | 900 | 17 | 0.02 | <5 | 106 | 0.34 | 128 | <10 | 102 |
| A134401 | | 1105 | <1 | 0.47 | 66 | 900 | 70 | 0.10 | <5 | 86 | 0.27 | 138 | <10 | 130 |
| A134402 | | 348 | <1 | 1.11 | 44 | 820 | 11 | 0.06 | <5 | 188 | 0.30 | 112 | <10 | 104 |
| A134403 | | 398 | <1 | 1.04 | 29 | 970 | 13 | 0.03 | <5 | 178 | 0.32 | 116 | <10 | 87 |
| A134404 | | 495 | <1 | 0.74 | 43 | 1010 | 8 | 0.02 | <5 | 112 | 0.33 | 130 | <10 | 110 |
| A134405 | | 391 | <1 | 2.87 | <1 | 740 | 8 | 0.05 | <5 | 626 | 0.22 | 43 | <10 | 56 |
| A134406 | | 393 | <1 | 3.17 | <1 | 370 | 5 | 0.02 | <5 | 636 | 0.22 | 42 | <10 | 53 |
| A134451 | | 528 | <1 | 0.96 | 36 | 900 | 20 | 0.01 | <5 | 111 | 0.32 | 102 | <10 | 91 |
| A134452 | | 349 | <1 | 0.80 | 29 | 960 | 13 | 0.01 | <5 | 93 | 0.30 | 100 | <10 | 91 |
| A134453 | | 600 | <1 | 0.83 | 40 | 960 | 13 | 0.01 | <5 | 92 | 0.30 | 131 | <10 | 108 |
| A134454 | | 616 | <1 | 1.20 | 37 | 950 | 26 | 0.04 | <5 | 133 | 0.36 | 110 | <10 | 95 |
| A134455 | | 484 | <1 | 1.44 | 27 | 450 | 14 | 0.01 | <5 | 223 | 0.29 | 90 | <10 | 65 |
| A134456 | | 538 | <1 | 0.61 | 44 | 1040 | 18 | 0.02 | <5 | 116 | 0.31 | 168 | <10 | 148 |
| A134457 | | 983 | <1 | 0.72 | 10 | 140 | 8 | 0.01 | <5 | 89 | 0.28 | 87 | <10 | 38 |
| A134458 | | 374 | <1 | 0.88 | 28 | 770 | 7 | 0.03 | <5 | 150 | 0.23 | 77 | <10 | 53 |
| A134459 | | 215 | <1 | 0.70 | 19 | 260 | 4 | 0.01 | <5 | 85 | 0.29 | 100 | <10 | 47 |
| A134460 | | 290 | <1 | 1.13 | 12 | 930 | 2 | 0.02 | <5 | 157 | 0.34 | 92 | <10 | 49 |
| A134461 | | 366 | <1 | 1.08 | 28 | 1020 | 16 | 0.02 | <5 | 136 | 0.30 | 93 | <10 | 76 |
| A134462 | | 628 | <1 | 1.16 | 31 | 900 | 16 | 0.02 | <5 | 156 | 0.32 | 94 | <10 | 65 |
| A134463 | | 373 | <1 | 3.11 | 2 | 610 | 9 | 0.05 | <5 | 628 | 0.21 | 32 | <10 | 50 |
| A134464 | | 680 | <1 | 1.56 | 23 | 870 | 17 | 0.01 | <5 | 148 | 0.35 | 106 | <10 | 75 |
| A134465 | | 356 | <1 | 0.90 | 20 | 550 | 11 | 0.01 | <5 | 97 | 0.26 | 83 | <10 | 52 |
| A134466 | | 370 | <1 | 3.03 | 1 | 200 | 9 | 0.01 | <5 | 601 | 0.20 | 31 | <10 | 46 |
| A134467 | | 415 | <1 | 1.03 | 34 | 1030 | 12 | 0.01 | <5 | 149 | 0.34 | 99 | <10 | 82 |
| A134468 | | 557 | <1 | 0.75 | 33 | 920 | 11 | 0.02 | <5 | 88 | 0.28 | 93 | <10 | 88 |
| A134469 | | 419 | <1 | 1.05 | 25 | 990 | 10 | 0.01 | <5 | 174 | 0.34 | 100 | <10 | 71 |
| A134470 | | 357 | <1 | 3.02 | <1 | 270 | 4 | 0.01 | <5 | 566 | 0.19 | 27 | <10 | 45 |
| A134471 | | 346 | <1 | 1.10 | 23 | 840 | 11 | 0.01 | <5 | 150 | 0.29 | 80 | <10 | 61 |
| A134472 | | 359 | <1 | 0.84 | 24 | 960 | 14 | 0.01 | <5 | 111 | 0.27 | 86 | <10 | 82 |
| A139937 | | 490 | <1 | 0.63 | 15 | 1000 | <2 | 0.19 | <5 | 221 | 0.10 | 34 | <10 | 84 |



ALS Chemex

EXCELLENCE IN ANALYTICAL CHEMISTRY

ALS Canada Ltd.

212 Brooksbank Avenue

North Vancouver BC V7J 2C1

Phone: 604 984 0221 Fax: 604 984 0218 www.alschemex.com

YUKON ZINC CORPORATION
701-475 HOWE ST
VANCOUVER BC V6C 2B3

Page: 7 - A
Total # pages: 7 (A - B)
Finalized Date: 10-JUL-2005
Account: MPO

Project: 1647

CERTIFICATE OF ANALYSIS VA05051804

| Method Analyte Units LOR | WEI-21 Recvd Wt. kg | ME-ICP61 Ag ppm | ME-ICP61 Al % | ME-ICP61 As ppm | ME-ICP61 Ba ppm | ME-ICP61 Be ppm | ME-ICP61 Bi ppm | ME-ICP61 Ca % | ME-ICP61 Cd ppm | ME-ICP61 Co ppm | ME-ICP61 Cr ppm | ME-ICP61 Cu ppm | ME-ICP61 Fe % | ME-ICP61 K % | ME-ICP61 Mg % |
|---------------------------|---------------------------|-----------------------|---------------------|-----------------------|-----------------------|-----------------------|-----------------------|---------------------|-----------------------|-----------------------|-----------------------|-----------------------|---------------------|--------------------|---------------------|
| Sample Description | 0.02 | 0.5 | 0.01 | 5 | 10 | 0.5 | 2 | 0.01 | 0.5 | 1 | 1 | 1 | 0.01 | 0.01 | 0.01 |
| A139938 | 0.34 | <0.5 | 4.34 | 17 | 1480 | 1.3 | <2 | 0.92 | <0.5 | 11 | 65 | 31 | 2.80 | 1.40 | 0.86 |
| A139939 | 0.22 | 0.7 | 4.01 | <5 | 720 | 0.8 | <2 | 2.95 | <0.5 | 9 | 6 | 27 | 1.24 | 1.11 | 0.51 |
| A139940 | 0.28 | <0.5 | 4.62 | 15 | 1360 | 1.3 | <2 | 0.57 | <0.5 | 11 | 58 | 35 | 2.46 | 1.50 | 0.75 |
| A139941 | 0.18 | <0.5 | 1.14 | <5 | 1220 | <0.5 | <2 | 2.99 | 1.9 | 7 | 1 | 30 | 1.24 | 0.22 | 0.38 |
| A139942 | 0.14 | 0.7 | 1.72 | <5 | 700 | <0.5 | <2 | 3.95 | 0.5 | 4 | 1 | 20 | 0.47 | 0.39 | 0.43 |
| A139943 | 0.28 | 1.0 | 4.64 | 24 | 1420 | 1.4 | <2 | 0.26 | <0.5 | 5 | 92 | 25 | 2.47 | 1.63 | 0.61 |
| A139944 | 0.30 | 0.5 | 4.36 | 11 | 1370 | 0.9 | <2 | 0.53 | 0.9 | 8 | 60 | 21 | 2.10 | 1.14 | 0.49 |
| A139945 | 0.14 | 0.6 | 0.38 | 5 | 460 | <0.5 | <2 | 3.71 | 0.5 | 3 | 2 | 17 | 0.79 | 0.09 | 0.44 |
| A139946 | 0.20 | 1.9 | 1.64 | <5 | 1420 | 0.8 | <2 | 4.30 | 2.7 | 7 | 23 | 60 | 0.92 | 0.25 | 0.49 |
| A139947 | 0.16 | <0.5 | 0.57 | <5 | 510 | <0.5 | <2 | 4.31 | 1.1 | 2 | 1 | 20 | 0.31 | 0.09 | 0.42 |
| A139948 | 0.22 | <0.5 | 4.06 | <5 | 770 | 0.7 | <2 | 3.19 | <0.5 | 4 | 5 | 22 | 1.05 | 1.09 | 0.47 |
| M243264 | 0.20 | 0.6 | 4.50 | <5 | 980 | 1.0 | <2 | 2.63 | <0.5 | 7 | 30 | 29 | 1.82 | 1.31 | 0.68 |
| M243265 | 0.32 | <0.5 | 4.16 | 7 | 1260 | 1.1 | <2 | 0.79 | <0.5 | 9 | 58 | 28 | 2.37 | 1.33 | 0.73 |
| M243266 | 0.20 | <0.5 | 3.69 | <5 | 1090 | 0.8 | <2 | 2.39 | 0.7 | 6 | 29 | 35 | 1.41 | 0.78 | 0.41 |
| M243267 | 0.20 | <0.5 | 4.03 | <5 | 900 | 0.9 | <2 | 1.71 | <0.5 | 8 | 46 | 20 | 1.91 | 1.15 | 0.67 |
| M243268 | 0.28 | <0.5 | 3.44 | <5 | 650 | 0.7 | <2 | 0.40 | <0.5 | 6 | 49 | 7 | 1.18 | 0.95 | 0.36 |
| M243269 | 0.28 | <0.5 | 3.66 | 9 | 880 | 0.9 | <2 | 1.24 | <0.5 | 9 | 52 | 19 | 1.86 | 1.12 | 0.61 |
| M243270 | 0.38 | <0.5 | 3.82 | <5 | 860 | 1.0 | <2 | 0.74 | <0.5 | 9 | 62 | 12 | 1.95 | 1.10 | 0.66 |
| M243271 | 0.24 | <0.5 | 3.02 | 11 | 720 | 0.9 | <2 | 1.64 | <0.5 | 7 | 46 | 20 | 1.50 | 0.87 | 0.57 |
| M243272 | 0.36 | <0.5 | 3.17 | <5 | 830 | 0.8 | <2 | 0.60 | <0.5 | 8 | 65 | 10 | 1.68 | 0.90 | 0.59 |
| M243273 | 0.18 | 0.5 | 0.60 | <5 | 360 | <0.5 | <2 | 5.89 | 0.5 | 2 | 3 | 14 | 0.22 | 0.12 | 0.32 |
| M243274 | 0.20 | 0.5 | 1.78 | <5 | 800 | 0.5 | <2 | 3.48 | 0.5 | 4 | 10 | 31 | 0.71 | 0.32 | 0.26 |
| M243275 | 0.18 | <0.5 | 0.46 | <5 | 670 | <0.5 | <2 | 5.72 | 0.8 | 2 | 3 | 18 | 0.25 | 0.07 | 0.30 |
| M243276 | 0.20 | 0.5 | 2.37 | <5 | 1200 | 0.5 | <2 | 4.05 | <0.5 | 4 | 7 | 37 | 0.69 | 0.52 | 0.22 |
| M243277 | 0.18 | <0.5 | 0.71 | <5 | 530 | <0.5 | <2 | 4.53 | 1.5 | 2 | 4 | 24 | 0.28 | 0.15 | 0.27 |
| M243278 | 0.24 | <0.5 | 4.00 | <5 | 880 | 0.9 | <2 | 2.26 | 0.6 | 6 | 38 | 17 | 1.61 | 1.17 | 0.65 |
| M243279 | 0.22 | 0.5 | 3.74 | <5 | 780 | 0.7 | <2 | 3.01 | 0.7 | 4 | 13 | 28 | 1.00 | 1.08 | 0.43 |
| M243280 | 0.30 | <0.5 | 4.73 | <5 | 930 | 0.9 | <2 | 0.64 | <0.5 | 5 | 50 | 20 | 1.56 | 1.22 | 0.40 |
| M243281 | 0.58 | <0.5 | 3.93 | 7 | 1110 | 1.0 | <2 | 0.61 | <0.5 | 7 | 69 | 35 | 2.27 | 1.02 | 0.68 |
| M243282 | 0.56 | <0.5 | 4.06 | <5 | 1150 | 1.1 | <2 | 0.73 | 0.6 | 9 | 60 | 42 | 2.53 | 1.30 | 0.76 |
| M243283 | 0.18 | 0.5 | 0.82 | <5 | 620 | <0.5 | <2 | 2.82 | 1.9 | 11 | 7 | 21 | 0.91 | 0.10 | 0.24 |
| M243284 | 0.30 | 0.6 | 4.96 | <5 | 1050 | 1.0 | <2 | 1.97 | 0.5 | 7 | 34 | 30 | 1.88 | 1.37 | 0.56 |
| M243285 | 0.16 | 0.5 | 2.94 | <5 | 610 | 0.5 | <2 | 3.13 | 0.7 | 5 | 5 | 36 | 0.75 | 0.72 | 0.33 |
| M243286 | 0.22 | <0.5 | 1.18 | <5 | 390 | <0.5 | <2 | 3.29 | <0.5 | 3 | 4 | 26 | 0.59 | 0.22 | 0.31 |
| M243287 | 0.20 | 0.5 | 2.38 | <5 | 760 | 0.5 | <2 | 3.19 | <0.5 | 3 | 7 | 31 | 0.74 | 0.58 | 0.57 |
| M243288 | 0.46 | <0.5 | 3.91 | 6 | 1280 | 1.1 | <2 | 0.99 | 0.6 | 10 | 61 | 27 | 2.14 | 1.22 | 0.67 |
| M243289 | 0.40 | <0.5 | 5.19 | 25 | 1670 | 1.5 | <2 | 0.99 | 0.6 | 11 | 65 | 31 | 3.12 | 1.70 | 0.81 |
| M243290 | 0.34 | <0.5 | 4.04 | 9 | 1820 | 1.2 | <2 | 0.79 | 1.4 | 9 | 48 | 41 | 2.39 | 1.44 | 0.70 |



ALS Chemex

EXCELLENCE IN ANALYTICAL CHEMISTRY

ALS Canada Ltd.

212 Brooksbank Avenue

North Vancouver BC V7J 2C1

Phone: 604 984 0221 Fax: 604 984 0218 www.alschemex.com

to: YUKON ZINC CORPORATION

701-475 HOWE ST

VANCOUVER BC V6C 2B3

Page: 7 - B

Total # pages: 7 (A - B)

Finalized Date: 10-JUL-2005

Account: MPO

Project: 1647

CERTIFICATE OF ANALYSIS VA05051804

| Sample Description | Method | ME-ICP61 | ME-ICP61 | ME-ICP61 | ME-ICP61 | ME-ICP61 | ME-ICP61 | ME-ICP61 | ME-ICP61 | ME-ICP61 | ME-ICP61 | ME-ICP61 | ME-ICP61 | |
|--------------------|--------------|----------|----------|----------|----------|----------|----------|----------|----------|----------|----------|----------|----------|-----|
| | Analyte | Mn | Mo | Na | Ni | P | Pb | S | Sb | Sr | Ti | V | W | Zn |
| | Units LOR | ppm | ppm | % | ppm | ppm | ppm | % | ppm | ppm | % | ppm | ppm | ppm |
| | | 5 | 1 | 0.01 | 1 | 10 | 2 | 0.01 | 5 | 1 | 0.01 | 1 | 10 | 2 |
| A139938 | | 422 | <1 | 0.73 | 36 | 1020 | 14 | 0.03 | <5 | 110 | 0.29 | 121 | <10 | 97 |
| A139939 | | 597 | <1 | 1.38 | 8 | 740 | 3 | 0.17 | <5 | 366 | 0.13 | 32 | <10 | 43 |
| A139940 | | 336 | <1 | 0.69 | 27 | 960 | 3 | 0.01 | <5 | 104 | 0.34 | 135 | <10 | 92 |
| A139941 | | 18100 | 4 | 0.29 | 19 | 1210 | 4 | 0.39 | <5 | 188 | 0.04 | 13 | <10 | 259 |
| A139942 | | 880 | <1 | 0.50 | 9 | 720 | <2 | 0.26 | <5 | 334 | 0.04 | 11 | <10 | 13 |
| A139943 | | 133 | 4 | 0.39 | 15 | 1210 | 13 | 0.14 | <5 | 124 | 0.27 | 328 | <10 | 52 |
| A139944 | | 737 | <1 | 0.74 | 14 | 480 | 9 | 0.01 | <5 | 108 | 0.29 | 113 | <10 | 106 |
| A139945 | | 2940 | 1 | 0.08 | 6 | 760 | <2 | 0.42 | <5 | 149 | 0.02 | 8 | <10 | 15 |
| A139946 | | 621 | <1 | 0.22 | 33 | 1040 | 5 | 0.13 | <5 | 234 | 0.08 | 35 | <10 | 28 |
| A139947 | | 1195 | <1 | 0.10 | 10 | 800 | <2 | 0.31 | <5 | 192 | 0.01 | 7 | <10 | 24 |
| A139948 | | 312 | <1 | 1.45 | 11 | 660 | 3 | 0.12 | <5 | 384 | 0.12 | 25 | <10 | 45 |
| M243264 | | 448 | <1 | 1.18 | 22 | 730 | 9 | 0.09 | <5 | 307 | 0.19 | 70 | <10 | 98 |
| M243265 | | 686 | <1 | 0.64 | 32 | 790 | 14 | 0.01 | <5 | 100 | 0.31 | 108 | <10 | 89 |
| M243266 | | 436 | <1 | 0.80 | 15 | 830 | 12 | 0.07 | <5 | 235 | 0.19 | 57 | <10 | 59 |
| M243267 | | 319 | <1 | 0.90 | 21 | 820 | 10 | 0.08 | <5 | 205 | 0.24 | 72 | <10 | 58 |
| M243268 | | 133 | <1 | 0.65 | 8 | 250 | 10 | 0.01 | <5 | 70 | 0.30 | 88 | <10 | 32 |
| M243269 | | 362 | <1 | 0.75 | 27 | 850 | 16 | 0.03 | <5 | 132 | 0.24 | 74 | <10 | 58 |
| M243270 | | 304 | <1 | 0.73 | 25 | 910 | 17 | 0.01 | <5 | 85 | 0.27 | 88 | <10 | 57 |
| M243271 | | 208 | <1 | 0.69 | 21 | 720 | 12 | 0.05 | <5 | 138 | 0.20 | 66 | <10 | 43 |
| M243272 | | 186 | <1 | 0.59 | 25 | 230 | 14 | 0.01 | <5 | 76 | 0.23 | 94 | <10 | 43 |
| M243273 | | 99 | <1 | 0.14 | 5 | 590 | 4 | 0.18 | <5 | 224 | 0.02 | 6 | <10 | 9 |
| M243274 | | 191 | <1 | 0.30 | 16 | 830 | 7 | 0.14 | <5 | 215 | 0.05 | 14 | <10 | 15 |
| M243275 | | 498 | <1 | 0.08 | 11 | 790 | 3 | 0.26 | <5 | 229 | 0.01 | 8 | <10 | 6 |
| M243276 | | 184 | <1 | 0.59 | 13 | 750 | 8 | 0.16 | <5 | 324 | 0.06 | 12 | <10 | 24 |
| M243277 | | 416 | <1 | 0.14 | 11 | 890 | 4 | 0.20 | <5 | 178 | 0.02 | 7 | <10 | 62 |
| M243278 | | 351 | <1 | 0.87 | 15 | 930 | 10 | 0.08 | <5 | 231 | 0.22 | 68 | <10 | 74 |
| M243279 | | 273 | <1 | 1.16 | 14 | 740 | 11 | 0.12 | <5 | 313 | 0.12 | 28 | <10 | 62 |
| M243280 | | 205 | 1 | 0.98 | 8 | 350 | 14 | 0.01 | <5 | 156 | 0.32 | 107 | <10 | 69 |
| M243281 | | 267 | 1 | 0.56 | 32 | 520 | 19 | 0.01 | <5 | 73 | 0.28 | 116 | <10 | 70 |
| M243282 | | 364 | <1 | 0.61 | 36 | 890 | 18 | 0.01 | <5 | 92 | 0.30 | 121 | <10 | 92 |
| M243283 | | 2690 | 3 | 0.09 | 13 | 1780 | 7 | 0.51 | <5 | 131 | 0.03 | 17 | <10 | 44 |
| M243284 | | 320 | <1 | 1.30 | 20 | 680 | 16 | 0.06 | <5 | 314 | 0.21 | 63 | <10 | 59 |
| M243285 | | 404 | <1 | 0.85 | 7 | 730 | 8 | 0.14 | <5 | 294 | 0.08 | 18 | <10 | 26 |
| M243286 | | 171 | 1 | 0.25 | 4 | 580 | 8 | 0.48 | <5 | 188 | 0.03 | 11 | <10 | 11 |
| M243287 | | 490 | <1 | 0.69 | 24 | 810 | 5 | 0.20 | <5 | 247 | 0.07 | 16 | <10 | 24 |
| M243288 | | 415 | <1 | 0.59 | 30 | 990 | 18 | 0.03 | <5 | 95 | 0.30 | 106 | <10 | 89 |
| M243289 | | 277 | 1 | 0.38 | 33 | 1200 | 22 | 0.05 | <5 | 96 | 0.34 | 177 | <10 | 176 |
| M243290 | | 284 | 1 | 0.46 | 36 | 1460 | 23 | 0.02 | <5 | 91 | 0.28 | 155 | <10 | 147 |



ALS Chemex

EXCELLENCE IN ANALYTICAL CHEMISTRY

ALS Canada Ltd.

212 Brooksbank Avenue

North Vancouver BC V7J 2C1

Phone: 604 984 0221 Fax: 604 984 0218 www.alschemex.com

To: YUKON ZINC CORPORATION

701-475 HOWE ST

VANCOUVER BC V6C 2B3

Page: 1
Finalized Date: 5-JUL-2005

Account: MPO

CERTIFICATE VA05051805

Project: 1647

P.O. No.:

This report is for 4 Rock samples submitted to our lab in Vancouver, BC, Canada on 28-JUN-2005.

The following have access to data associated with this certificate:

JASON DUNNING

SAMPLE PREPARATION

| ALS CODE | DESCRIPTION |
|----------|--------------------------------|
| WEI-21 | Received Sample Weight |
| LOG-22 | Sample login - Rcd w/o BarCode |
| CRU-31 | Fine crushing - 70% <2mm |
| SPL-21 | Split sample - riffle splitter |
| PUL-31 | Pulverize split to 85% <75 um |

ANALYTICAL PROCEDURES

| ALS CODE | DESCRIPTION | INSTRUMENT |
|----------|------------------------------|------------|
| Au-AA23 | Au 30g FA-AA finish | AAS |
| ME-ICP61 | 27 element four acid ICP-AES | ICP-AES |

To: YUKON ZINC CORPORATION
ATTN: JASON DUNNING
701-475 HOWE ST
VANCOUVER BC V6C 2B3

This is the Final Report and supersedes any preliminary report with this certificate number. Results apply to samples as submitted. All pages of this report have been checked and approved for release.

Signature: 



ALS Chemex

EXCELLENCE IN ANALYTICAL CHEMISTRY

ALS Canada Ltd.

212 Brooksbank Avenue

North Vancouver BC V7J 2C1

Phone: 604 984 0221 Fax: 604 984 0218 www.alschemex.com

YUKON ZINC CORPORATION

701-475 HOWE ST

VANCOUVER BC V6C 2B3

Page: 2 - A

Total # Pages: 2 (A - B)

Finalized Date: 5-JUL-2005

Account: MPO

Project: 1647

CERTIFICATE OF ANALYSIS VA05051805

| Sample Description | Method Analyte Units LOR | WEI-21 | Au-AA23 | ME-ICP61 | ME-ICP61 | ME-ICP61 | ME-ICP61 | ME-ICP61 | ME-ICP61 | ME-ICP61 | ME-ICP61 | ME-ICP61 | ME-ICP61 | ME-ICP61 | ME-ICP61 | ME-ICP61 |
|--------------------|-----------------------------------|-----------------|-----------|-----------|----------|-----------|-----------|-----------|-----------|----------|-----------|-----------|-----------|-----------|----------|----------|
| | | Recvd Wt. kg | Au ppm | Ag ppm | Al % | As ppm | Ba ppm | Be ppm | Bi ppm | Ca % | Cd ppm | Co ppm | Cr ppm | Cu ppm | Fe % | K % |
| | | 0.02 | 0.005 | 0.5 | 0.01 | 5 | 10 | 0.5 | 2 | 0.01 | 0.5 | 1 | 1 | 1 | 0.01 | 0.01 |
| A134025 | | 0.46 | <0.005 | <0.5 | 1.50 | 8 | 410 | <0.5 | <2 | 0.08 | <0.5 | 4 | 17 | 25 | 2.05 | 0.44 |
| A134026 | | 0.14 | <0.005 | <0.5 | 7.02 | 8 | 710 | 1.3 | <2 | 1.15 | <0.5 | 26 | 130 | 16 | 5.61 | 1.94 |
| A134027 | | 0.20 | <0.005 | <0.5 | 3.89 | 16 | 430 | 0.6 | <2 | 0.39 | 0.9 | 4 | 18 | 15 | 1.30 | 0.52 |
| A134122 | | 1.22 | <0.005 | <0.5 | 8.40 | 29 | 440 | 0.8 | <2 | 5.33 | <0.5 | 28 | 49 | 42 | 7.13 | 0.84 |



ALS Chemex

EXCELLENCE IN ANALYTICAL CHEMISTRY

ALS Canada Ltd.

212 Brooksbank Avenue

North Vancouver BC V7J 2C1

Phone: 604 984 0221 Fax: 604 984 0218 www.alschemex.com

Client: YUKON ZINC CORPORATION
 701-475 HOWE ST
 VANCOUVER BC V6C 2B3

Page: 2 - B
 Total # pages: 2 (A - B)
 Finalized Date: 5-JUL-2005
 Account: MPO

Project: 1647

CERTIFICATE OF ANALYSIS VA05051805

| Sample Description | Method Analyte Units LOR | ME-ICP61 | ME-ICP61 | ME-ICP61 | ME-ICP61 | ME-ICP61 | ME-ICP61 | ME-ICP61 | ME-ICP61 | ME-ICP61 | ME-ICP61 | ME-ICP61 | ME-ICP61 | ME-ICP61 | |
|--------------------|-----------------------------------|----------|----------|----------|----------|----------|----------|----------|----------|----------|----------|----------|----------|----------|-----|
| | | Mg | Mn | Mo | Na | Ni | P | Pb | S | Sb | Sr | Ti | V | W | Zn |
| | | % | ppm | ppm | % | ppm | ppm | ppm | % | ppm | ppm | % | ppm | ppm | ppm |
| | | 0.01 | 5 | 1 | 0.01 | 1 | 10 | 2 | 0.01 | 5 | 1 | 0.01 | 1 | 10 | 2 |
| A134025 | | 0.28 | 459 | <1 | 0.02 | 14 | 300 | 269 | 0.12 | <5 | 6 | 0.07 | 35 | <10 | 91 |
| A134026 | | 2.60 | 1140 | <1 | 2.37 | 27 | 220 | 276 | 0.01 | <5 | 63 | 0.30 | 186 | <10 | 134 |
| A134027 | | 0.37 | 291 | <1 | 2.13 | 4 | 190 | 34 | 0.06 | <5 | 57 | 0.15 | 22 | <10 | 101 |
| A134122 | | 3.13 | 1320 | <1 | 2.94 | 22 | 430 | 18 | 0.01 | <5 | 164 | 0.50 | 300 | <10 | 91 |



ALS Chemex

EXCELLENCE IN ANALYTICAL CHEMISTRY

ALS Canada Ltd.

212 Brooksbank Avenue

North Vancouver BC V7J 2C1

Phone: 604 984 0221 Fax: 604 984 0218 www.alschemex.com

YUKON ZINC CORPORATION
701-475 HOWE ST
VANCOUVER BC V6C 2B3

Page: 1
Finalized Date: 4-JUL-2005
Account: MPO

CERTIFICATE VA05051500

Project: 1647

P.O. No.:

This report is for 29 Soil samples submitted to our lab in Vancouver, BC, Canada on 27-JUN-2005.

The following have access to data associated with this certificate:

JASON DUNNING

SAMPLE PREPARATION

| ALS CODE | DESCRIPTION |
|----------|--------------------------------|
| WEI-21 | Received Sample Weight |
| LOG-22 | Sample login - Rcd w/o BarCode |
| SCR-41 | Screen to -180um and save both |

ANALYTICAL PROCEDURES

| ALS CODE | DESCRIPTION | INSTRUMENT |
|----------|------------------------------|------------|
| ME-ICP61 | 27 element four acid ICP-AES | ICP-AES |

To: YUKON ZINC CORPORATION
ATTN: JASON DUNNING
701-475 HOWE ST
VANCOUVER BC V6C 2B3

This is the Final Report and supersedes any preliminary report with this certificate number. Results apply to samples as submitted. All pages of this report have been checked and approved for release.

Signature: 



ALS Chemex

EXCELLENCE IN ANALYTICAL CHEMISTRY

ALS Canada Ltd.

212 Brooksbank Avenue

North Vancouver BC V7J 2C1

Phone: 604 984 0221 Fax: 604 984 0218 www.alschemex.com

To: YUKON ZINC CORPORATION

701-475 HOWE ST

VANCOUVER BC V6C 2B3

Page: 2 - A

Total # Pages: 2 (A - B)

Finalized Date: 4-JUL-2005

Account: MPO

Project: 1647

CERTIFICATE OF ANALYSIS VA05051500

| Sample Description | Method Analyte Units LOR | WEI-21 | ME-ICP61 | ME-ICP61 | ME-ICP61 | ME-ICP61 | ME-ICP61 | ME-ICP61 | ME-ICP61 | ME-ICP61 | ME-ICP61 | ME-ICP61 | ME-ICP61 | ME-ICP61 | ME-ICP61 | |
|--------------------|--------------------------|--------------|----------|----------|----------|----------|----------|----------|----------|----------|----------|----------|----------|----------|----------|------|
| | | Recvd Wt. kg | Ag ppm | Al % | As ppm | Ba ppm | Be ppm | Bi ppm | Ca % | Cd ppm | Co ppm | Cr ppm | Cu ppm | Fe % | K % | Mg % |
| M243291 | | 0.20 | <0.5 | 1.22 | <5 | 1040 | <0.5 | <2 | 4.10 | 0.9 | 3 | 12 | 36 | 0.76 | 0.26 | 0.27 |
| M243292 | | 0.30 | <0.5 | 4.66 | <5 | 670 | 0.8 | <2 | 2.03 | <0.5 | 3 | 5 | 14 | 1.16 | 1.28 | 0.38 |
| M243293 | | 0.22 | <0.5 | 4.68 | 8 | 1330 | 1.0 | <2 | 0.81 | <0.5 | 8 | 50 | 20 | 2.11 | 1.08 | 0.51 |
| M243294 | | 0.16 | 0.5 | 0.35 | <5 | 200 | <0.5 | <2 | 0.52 | 0.9 | <1 | 7 | 19 | 0.16 | 0.14 | 0.12 |
| M243295 | | 0.10 | <0.5 | 0.21 | 5 | 100 | <0.5 | 2 | 0.33 | <0.5 | <1 | 5 | 10 | 0.11 | 0.12 | 0.06 |
| M243296 | | 0.20 | <0.5 | 2.02 | <5 | 310 | <0.5 | <2 | 0.80 | <0.5 | 2 | 4 | 14 | 0.75 | 0.44 | 0.13 |
| M243297 | | 0.24 | <0.5 | 1.14 | 25 | 1530 | <0.5 | <2 | 2.93 | 4.1 | 83 | 8 | 19 | 4.86 | 0.10 | 0.22 |
| M243298 | | 0.48 | <0.5 | 4.57 | 9 | 1300 | 1.2 | <2 | 0.85 | <0.5 | 9 | 77 | 40 | 2.57 | 1.41 | 0.81 |
| M243299 | | 0.46 | <0.5 | 4.27 | 17 | 1240 | 1.1 | <2 | 0.72 | 0.5 | 9 | 68 | 47 | 2.77 | 1.14 | 0.70 |
| M243300 | | 0.32 | <0.5 | 4.52 | 8 | 980 | 0.8 | <2 | 0.66 | <0.5 | 6 | 58 | 21 | 2.06 | 1.11 | 0.55 |
| A083676 | | 0.24 | <0.5 | 6.52 | 5 | 1080 | 1.3 | <2 | 1.85 | <0.5 | 7 | 35 | 26 | 2.23 | 1.87 | 0.67 |
| A083677 | | 0.32 | <0.5 | 4.81 | <5 | 1300 | 1.2 | <2 | 1.24 | 0.5 | 9 | 99 | 42 | 2.66 | 1.35 | 0.87 |
| A083678 | | 0.20 | <0.5 | 1.36 | <5 | 630 | <0.5 | <2 | 3.08 | 1.7 | 5 | 5 | 22 | 0.66 | 0.24 | 0.25 |
| A083679 | | 0.24 | <0.5 | 6.48 | <5 | 970 | 1.1 | <2 | 1.44 | <0.5 | 5 | 29 | 19 | 1.68 | 1.84 | 0.51 |
| A083680 | | 0.24 | <0.5 | 6.04 | 5 | 1110 | 1.2 | <2 | 1.03 | <0.5 | 10 | 44 | 26 | 2.30 | 1.58 | 0.57 |
| A083681 | | 0.30 | <0.5 | 4.78 | 8 | 1120 | 0.9 | <2 | 0.71 | <0.5 | 7 | 47 | 12 | 2.58 | 1.07 | 0.60 |
| A083682 | | 0.22 | <0.5 | 7.14 | <5 | 860 | 1.1 | <2 | 1.97 | <0.5 | 6 | 5 | 17 | 1.60 | 2.05 | 0.51 |
| A083683 | | 0.40 | <0.5 | 3.91 | <5 | 700 | 0.8 | <2 | 0.72 | <0.5 | 7 | 49 | 12 | 1.89 | 1.12 | 0.47 |
| A083684 | | 0.26 | <0.5 | 6.93 | 10 | 770 | 1.2 | <2 | 1.67 | <0.5 | 17 | 205 | 23 | 3.85 | 1.24 | 2.48 |
| A139951 | | 0.20 | 2.0 | 0.97 | <5 | 410 | <0.5 | <2 | 3.40 | 2.0 | 3 | 8 | 25 | 0.35 | 0.23 | 0.37 |
| A139952 | | 0.26 | 1.1 | 4.08 | <5 | 750 | 0.8 | <2 | 3.29 | 4.0 | 5 | 8 | 55 | 1.15 | 1.08 | 0.49 |
| A139953 | | 0.36 | 0.6 | 4.17 | <5 | 760 | 0.7 | <2 | 3.28 | 1.0 | 4 | 7 | 31 | 1.16 | 1.06 | 0.53 |
| A139954 | | 0.60 | <0.5 | 4.65 | 11 | 1390 | 1.3 | <2 | 0.76 | <0.5 | 10 | 74 | 27 | 2.66 | 1.38 | 0.86 |
| A139955 | | 0.60 | <0.5 | 4.29 | 5 | 1300 | 1.2 | <2 | 0.90 | <0.5 | 11 | 75 | 36 | 2.57 | 1.35 | 0.79 |
| A139956 | | 0.48 | <0.5 | 3.78 | 6 | 830 | 0.7 | <2 | 0.38 | <0.5 | 4 | 72 | 14 | 1.83 | 1.02 | 0.40 |
| A139957 | | 0.38 | <0.5 | 4.40 | <5 | 860 | 0.9 | <2 | 3.43 | 0.6 | 7 | 16 | 26 | 1.54 | 1.14 | 0.50 |
| A139958 | | 0.32 | <0.5 | 4.20 | 5 | 570 | 0.7 | <2 | 3.56 | <0.5 | 6 | 7 | 15 | 1.35 | 0.96 | 0.53 |
| A139959 | | 0.28 | <0.5 | 1.18 | <5 | 220 | <0.5 | <2 | 0.57 | <0.5 | 2 | 3 | 5 | 0.43 | 0.26 | 0.09 |
| A139960 | | 0.42 | <0.5 | 4.00 | <5 | 790 | 0.9 | <2 | 1.32 | <0.5 | 5 | 37 | 19 | 1.48 | 1.11 | 0.47 |



ALS Chemex

EXCELLENCE IN ANALYTICAL CHEMISTRY

ALS Canada Ltd.

212 Brooksbank Avenue
North Vancouver BC V7J 2C1

Phone: 604 984 0221 Fax: 604 984 0218 www.alschemex.com

To: YUKON ZINC CORPORATION

701-475 HOWE ST

VANCOUVER BC V6C 2B3

Page: 2 - B

Total # pages: 2 (A - B)

Finalized Date: 4-JUL-2005

Account: MPO

Project: 1647

CERTIFICATE OF ANALYSIS VA05051500

| Sample Description | Method Analyte Units LOR | ME-ICP61 | ME-ICP61 | ME-ICP61 | ME-ICP61 | ME-ICP61 | ME-ICP61 | ME-ICP61 | ME-ICP61 | ME-ICP61 | ME-ICP61 | ME-ICP61 | ME-ICP61 | |
|--------------------|--------------------------|----------|----------|----------|----------|----------|----------|----------|----------|----------|----------|----------|----------|-----|
| | | Mn | Mo | Na | Ni | P | Pb | S | Sb | Sr | Ti | V | W | Zn |
| | | ppm | ppm | % | ppm | ppm | ppm | % | ppm | ppm | % | ppm | ppm | ppm |
| | | 5 | 1 | 0.01 | 1 | 10 | 2 | 0.01 | 5 | 1 | 0.01 | 1 | 10 | 2 |
| M243291 | | 769 | <1 | 0.19 | 18 | 770 | 5 | 0.17 | <5 | 185 | 0.05 | 25 | <10 | 21 |
| M243292 | | 229 | <1 | 1.68 | 3 | 610 | 7 | 0.10 | <5 | 378 | 0.14 | 22 | <10 | 31 |
| M243293 | | 436 | 1 | 0.85 | 16 | 440 | 14 | 0.02 | <5 | 146 | 0.29 | 113 | <10 | 70 |
| M243294 | | 393 | <1 | 0.08 | 5 | 770 | 3 | 0.18 | <5 | 25 | 0.02 | 7 | <10 | 75 |
| M243295 | | 289 | <1 | 0.05 | 1 | 840 | 2 | 0.15 | <5 | 12 | 0.01 | 4 | <10 | 41 |
| M243296 | | 87 | <1 | 0.55 | 6 | 650 | 4 | 0.14 | <5 | 145 | 0.06 | 13 | <10 | 26 |
| M243297 | | 20700 | 22 | 0.06 | 28 | 1320 | 6 | 0.28 | <5 | 154 | 0.03 | 31 | <10 | 147 |
| M243298 | | 431 | 1 | 0.62 | 38 | 1050 | 15 | 0.02 | <5 | 100 | 0.30 | 127 | <10 | 106 |
| M243299 | | 500 | 2 | 0.55 | 37 | 860 | 12 | 0.02 | <5 | 82 | 0.26 | 134 | <10 | 104 |
| M243300 | | 239 | 2 | 0.78 | 20 | 310 | 10 | 0.01 | <5 | 125 | 0.31 | 125 | <10 | 104 |
| A083676 | | 381 | 1 | 1.74 | 19 | 650 | 15 | 0.04 | <5 | 371 | 0.23 | 85 | <10 | 99 |
| A083677 | | 357 | 2 | 0.60 | 36 | 750 | 18 | 0.04 | 5 | 126 | 0.28 | 135 | <10 | 112 |
| A083678 | | 1365 | 3 | 0.27 | 15 | 1200 | 3 | 0.24 | <5 | 184 | 0.03 | 14 | <10 | 23 |
| A083679 | | 312 | 1 | 2.11 | 7 | 460 | 12 | 0.01 | <5 | 443 | 0.25 | 59 | <10 | 55 |
| A083680 | | 422 | 2 | 1.57 | 20 | 510 | 13 | 0.02 | <5 | 308 | 0.25 | 79 | <10 | 69 |
| A083681 | | 460 | 1 | 1.01 | 19 | 320 | 11 | 0.01 | <5 | 140 | 0.24 | 86 | <10 | 56 |
| A083682 | | 356 | 1 | 2.66 | 3 | 270 | 9 | 0.02 | <5 | 587 | 0.19 | 33 | <10 | 47 |
| A083683 | | 275 | 1 | 0.93 | 16 | 580 | 14 | 0.01 | <5 | 143 | 0.21 | 71 | <10 | 46 |
| A083684 | | 560 | 1 | 1.63 | 34 | 690 | 14 | 0.05 | <5 | 306 | 0.21 | 112 | <10 | 73 |
| A139951 | | 458 | 5 | 0.22 | 19 | 980 | 2 | 0.39 | <5 | 158 | 0.03 | 12 | <10 | 42 |
| A139952 | | 437 | 1 | 1.32 | 34 | 870 | 5 | 0.14 | <5 | 398 | 0.12 | 25 | <10 | 94 |
| A139953 | | 364 | <1 | 1.39 | 17 | 830 | 8 | 0.13 | <5 | 405 | 0.13 | 28 | <10 | 69 |
| A139954 | | 359 | <1 | 0.65 | 33 | 890 | 17 | 0.02 | <5 | 94 | 0.30 | 107 | <10 | 89 |
| A139955 | | 408 | 1 | 0.66 | 40 | 1110 | 15 | 0.01 | <5 | 101 | 0.30 | 103 | <10 | 95 |
| A139956 | | 162 | 1 | 0.65 | 16 | 240 | 11 | 0.01 | <5 | 71 | 0.32 | 105 | <10 | 53 |
| A139957 | | 414 | <1 | 1.31 | 15 | 840 | 11 | 0.13 | <5 | 376 | 0.16 | 40 | <10 | 40 |
| A139958 | | 228 | 1 | 1.39 | 6 | 680 | 7 | 0.13 | <5 | 435 | 0.17 | 38 | <10 | 42 |
| A139959 | | 57 | <1 | 0.33 | 4 | 260 | 3 | 0.07 | <5 | 102 | 0.04 | 10 | <10 | 10 |
| A139960 | | 218 | 1 | 1.10 | 16 | 670 | 12 | 0.04 | <5 | 226 | 0.21 | 60 | <10 | 39 |



ALS Chemex

EXCELLENCE IN ANALYTICAL CHEMISTRY

ALS Canada Ltd.

212 Brooksbank Avenue
North Vancouver BC V7J 2C1

Phone: 604 984 0221 Fax: 604 984 0218 www.alschemex.com

o: YUKON ZINC CORPORATION
701-475 HOWE ST
VANCOUVER BC V6C 2B3

Page: 1
Finalized Date: 5-JUL-2005
Account: MPO

CERTIFICATE VA05051501

Project: 1647

P.O. No.:

This report is for 6 Rock samples submitted to our lab in Vancouver, BC, Canada on 28-JUN-2005.

The following have access to data associated with this certificate:

JASON DUNNING

SAMPLE PREPARATION

| ALS CODE | DESCRIPTION |
|----------|--------------------------------|
| WEI-21 | Received Sample Weight |
| LOG-22 | Sample login - Rcd w/o BarCode |
| CRU-31 | Fine crushing - 70% <2mm |
| SPL-21 | Split sample - riffle splitter |
| PUL-31 | Pulverize split to 85% <75 um |

ANALYTICAL PROCEDURES

| ALS CODE | DESCRIPTION | INSTRUMENT |
|----------|------------------------------|------------|
| ME-ICP61 | 27 element four acid ICP-AES | ICP-AES |
| Au-AA23 | Au 30g FA-AA finish | AAS |

To: YUKON ZINC CORPORATION
ATTN: JASON DUNNING
701-475 HOWE ST
VANCOUVER BC V6C 2B3

This is the Final Report and supersedes any preliminary report with this certificate number. Results apply to samples as submitted. All pages of this report have been checked and approved for release.

Signature: 



ALS Chemex

EXCELLENCE IN ANALYTICAL CHEMISTRY

ALS Canada Ltd.

212 Brooksbank Avenue

North Vancouver BC V7J 2C1

Phone: 604 984 0221 Fax: 604 984 0218 www.alschemex.com

o: YUKON ZINC CORPORATION

701-475 HOWE ST

VANCOUVER BC V6C 2B3

Page: 2 - A

Total # Pages: 2 (A - B)

Finalized Date: 5-JUL-2005

Account: MPO

Project: 1647

CERTIFICATE OF ANALYSIS VA05051501

| Sample Description | Method Analyte Units LOR | WEI-21 | Au-AA23 | ME-ICP61 | ME-ICP61 | ME-ICP61 | ME-ICP61 | ME-ICP61 | ME-ICP61 | ME-ICP61 | ME-ICP61 | ME-ICP61 | ME-ICP61 | ME-ICP61 | ME-ICP61 | ME-ICP61 |
|--------------------|-----------------------------------|-----------|---------|----------|----------|----------|----------|----------|----------|----------|----------|----------|----------|----------|----------|----------|
| | | Recvd Wt. | Au | Ag | Al | As | Ba | Be | Bi | Ca | Cd | Co | Cr | Cu | Fe | K |
| | | kg | ppm | ppm | % | ppm | ppm | ppm | % | ppm | ppm | ppm | ppm | % | % | |
| | | 0.02 | 0.005 | 0.5 | 0.01 | 5 | 10 | 0.5 | 2 | 0.01 | 0.5 | 1 | 1 | 1 | 0.01 | 0.01 |
| A134028 | | 0.66 | <0.005 | <0.5 | 1.93 | 5 | 240 | <0.5 | <2 | 1.58 | <0.5 | 1 | 128 | 5 | 0.95 | 0.58 |
| A134029 | | 0.94 | <0.005 | <0.5 | 5.22 | <5 | 710 | 0.8 | <2 | 0.20 | <0.5 | 4 | 20 | 4 | 1.11 | 1.47 |
| A134030 | | 0.82 | <0.005 | <0.5 | 6.98 | <5 | 850 | 1.4 | <2 | 1.90 | <0.5 | 11 | 56 | 35 | 3.94 | 2.03 |
| A134031 | | 0.40 | <0.005 | <0.5 | 8.80 | <5 | 1760 | 2.6 | <2 | 0.44 | <0.5 | 10 | 70 | 36 | 4.53 | 4.80 |
| A134032 | | 0.20 | <0.005 | <0.5 | 8.57 | 26 | 1210 | 1.8 | <2 | 2.89 | <0.5 | 29 | 16 | 9 | 5.78 | 3.61 |
| A134033 | | 0.40 | <0.005 | <0.5 | 7.94 | <5 | 1040 | 2.7 | <2 | 0.61 | <0.5 | 5 | 120 | 17 | 5.22 | 3.40 |



ALS Chemex

EXCELLENCE IN ANALYTICAL CHEMISTRY

ALS Canada Ltd.

212 Brooksbank Avenue

North Vancouver BC V7J 2C1

Phone: 604 984 0221 Fax: 604 984 0218 www.alschemex.com

Client: YUKON ZINC CORPORATION

701-475 HOWE ST

VANCOUVER BC V6C 2B3

Page: 2 - B

Total # Pages: 2 (A - B)

Finalized Date: 5-JUL-2005

Account: MPO

Project: 1647

CERTIFICATE OF ANALYSIS VA05051501

| Sample Description | Method Analyte Units LOR | ME-ICP61 | ME-ICP61 | ME-ICP61 | ME-ICP61 | ME-ICP61 | ME-ICP61 | ME-ICP61 | ME-ICP61 | ME-ICP61 | ME-ICP61 | ME-ICP61 | ME-ICP61 | ME-ICP61 | |
|--------------------|-----------------------------------|----------|-----------|-----------|----------|-----------|----------|-----------|----------|-----------|-----------|----------|----------|----------|-----------|
| | | Mg % | Mn ppm | Mo ppm | Na % | Ni ppm | P ppm | Pb ppm | S % | Sb ppm | Sr ppm | Ti % | V ppm | W ppm | Zn ppm |
| | | 0.01 | 5 | 1 | 0.01 | 1 | 10 | 2 | 0.01 | 5 | 1 | 0.01 | 1 | 10 | 2 |
| A134028 | | 0.20 | 294 | <1 | 0.73 | 4 | 120 | 14 | 0.02 | <5 | 86 | 0.05 | 10 | <10 | 8 |
| A134029 | | 0.35 | 208 | <1 | 2.36 | 7 | 200 | 10 | 0.02 | <5 | 48 | 0.15 | 24 | <10 | 15 |
| A134030 | | 1.56 | 796 | <1 | 2.51 | 18 | 280 | 16 | 0.02 | <5 | 92 | 0.34 | 73 | <10 | 57 |
| A134031 | | 1.31 | 720 | <1 | 0.32 | 15 | 430 | 5 | 0.02 | <5 | 44 | 0.51 | 88 | <10 | 107 |
| A134032 | | 2.24 | 774 | <1 | 1.53 | 10 | 510 | 14 | 0.01 | <5 | 180 | 0.45 | 252 | <10 | 109 |
| A134033 | | 2.04 | 836 | <1 | 0.97 | 26 | 910 | 5 | 0.03 | <5 | 50 | 0.45 | 99 | <10 | 101 |



Figure 1. Location Map of the Box Property.

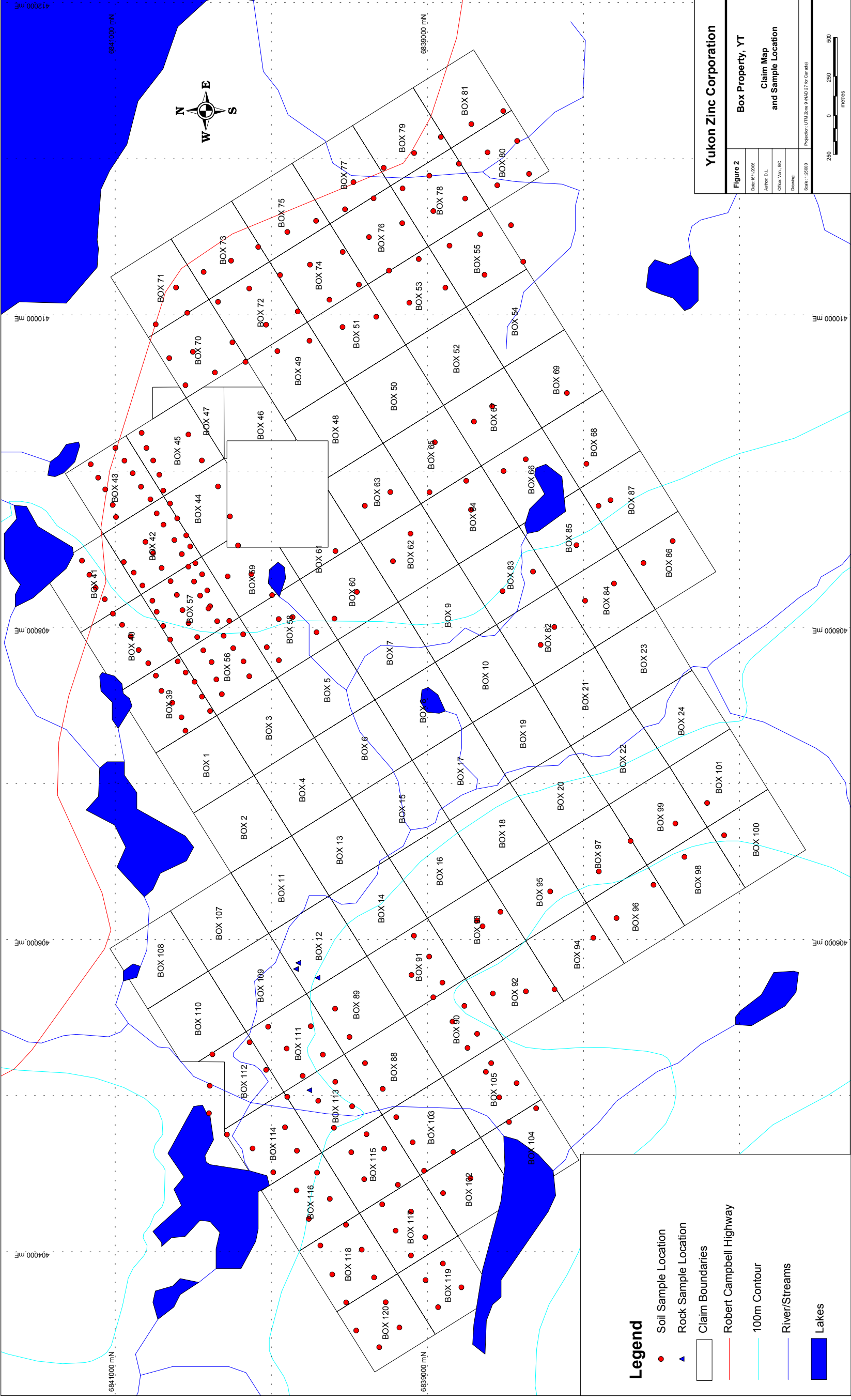

Legend

- Soil Sample Location
- ▲ Rock Sample Location
- Claim Boundaries
- Robert Campbell Highway
- 100m Contour
- River/Streams
- Lakes

Yukon Zinc Corporation

| | |
|-----------------|---|
| Figure 2 | Box Property, YT |
| Date: 16/1/2008 | Author: D.L.L. |
| Office: Van, BC | Projection: UTM, Zone 9 (NAD 27 for Canada) |
| Scale: 1:25000 | Scale: 1:25000 |

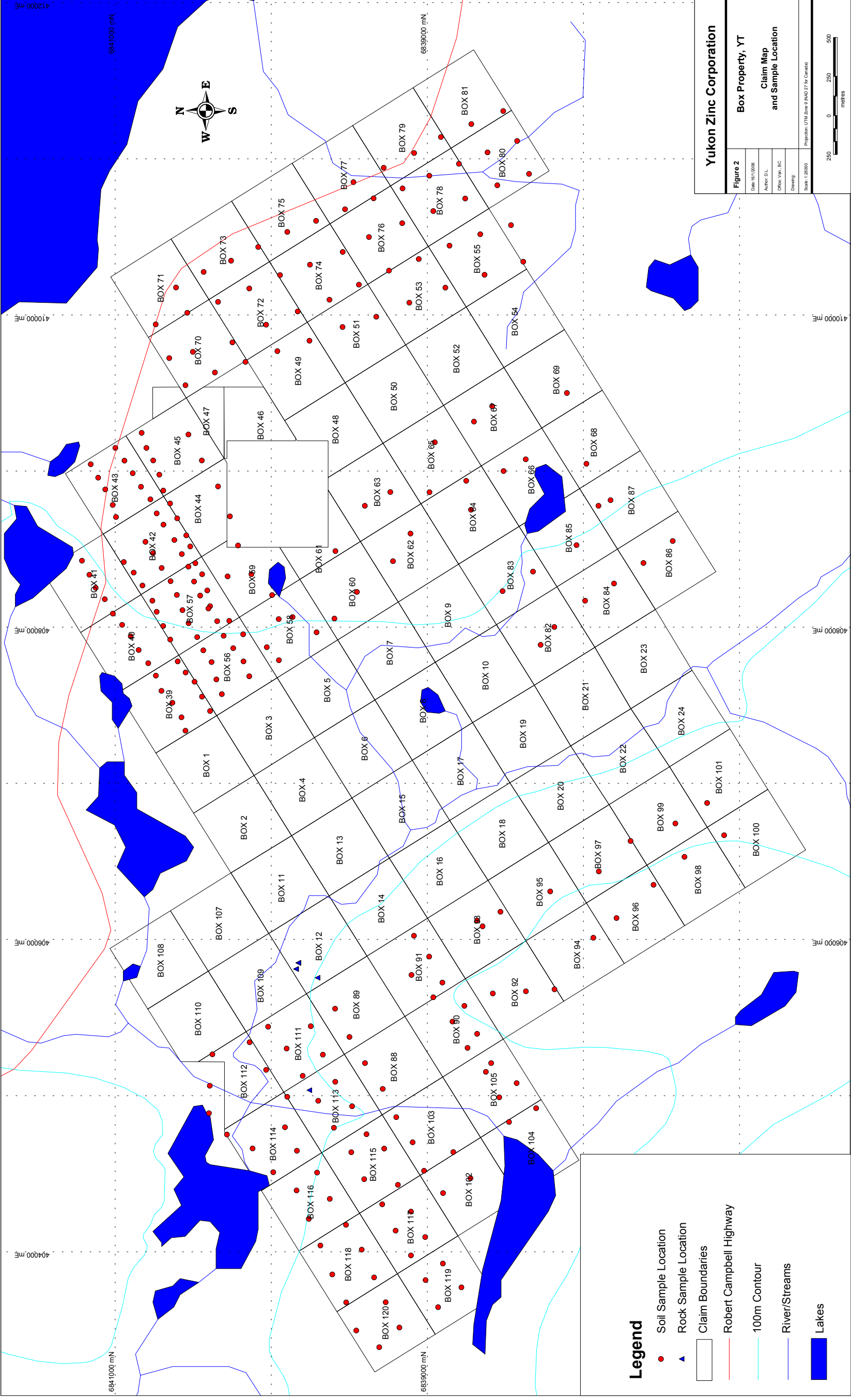
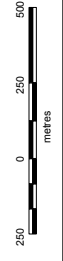

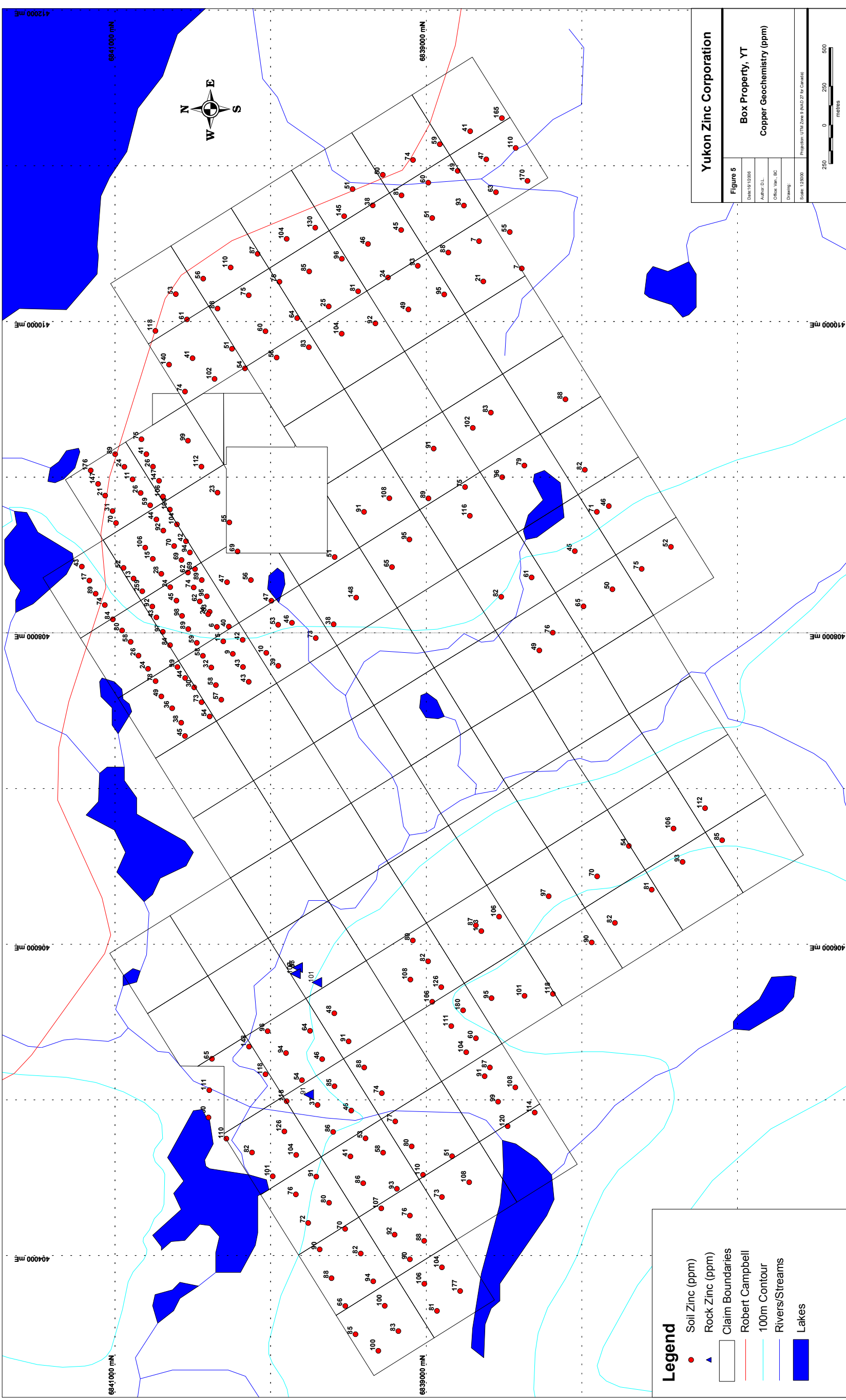

Legend

- Soil Zinc (ppm)
- ▲ Rock Zinc (ppm)
- Claim Boundaries
- ▭ Robert Campbell
- 100m Contour
- Rivers/Streams
- Lakes

Yukon Zinc Corporation

Figure 5
Box Property, YT
Copper Geochemistry (ppm)

Date: 10/2008
Author: D.L.
Office: Vancouver, BC
Drawing:
Scale: 1:25000
Projection: UTM, Zone 9 (NAD 27 for Canada)

250 0 250 500
metres

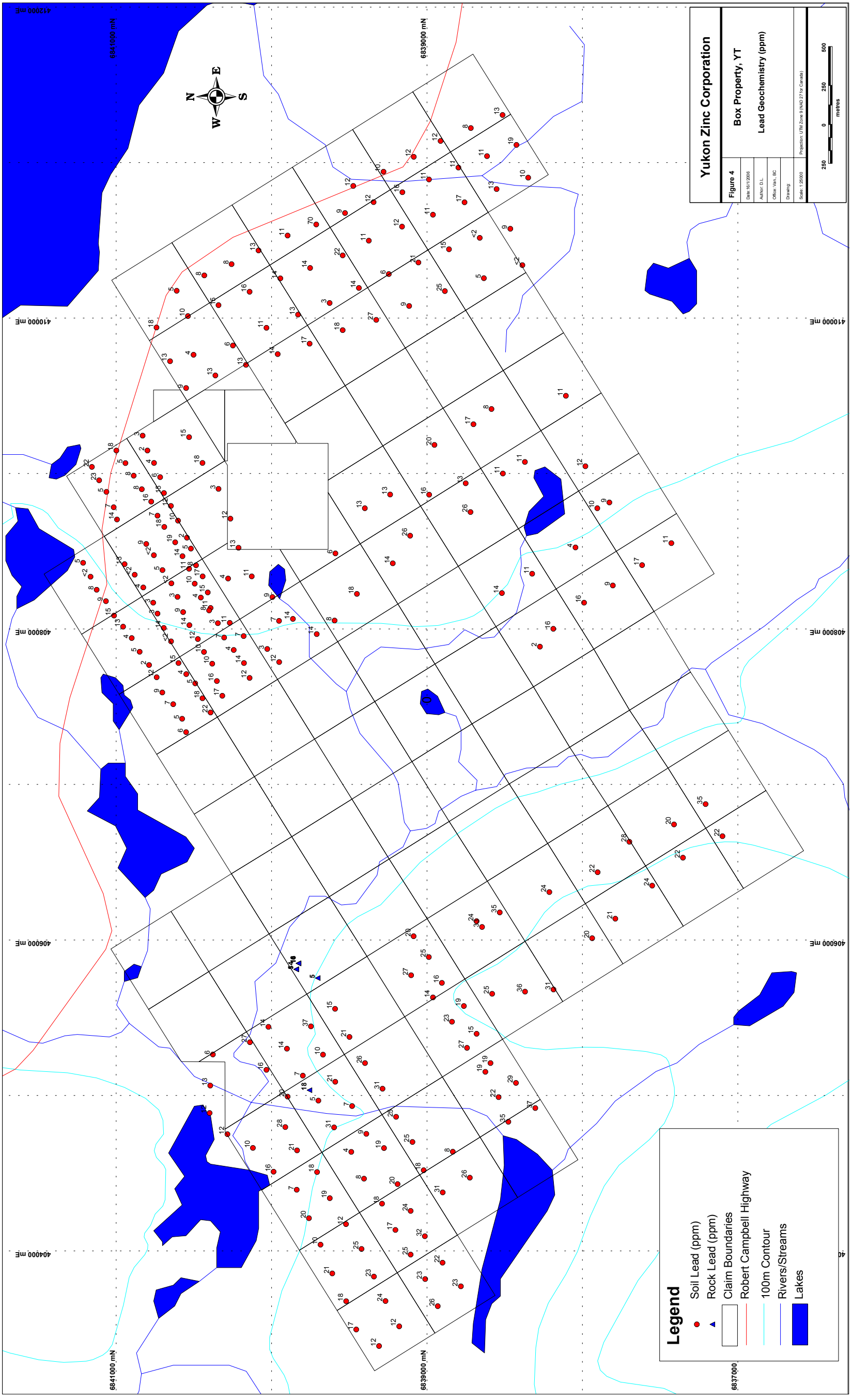

Legend

- Soil Lead (ppm)
- ▲ Rock Lead (ppm)
- Claim Boundaries
- Robert Campbell Highway
- 100m Contour
- Rivers/Streams
- Lakes

Yukon Zinc Corporation

Figure 4
Box Property, YT
Lead Geochemistry (ppm)

| |
|-------------------|
| Date: 01/2005 |
| Author: D.L. |
| Client: Yukon, BC |
| Drawing: |
| Scale: 1:25000 |

Projection: UTM Zone 11N (NAD 27 for Canada)

250 0 250 500 metres



