



#701 – 475 Howe Street
Vancouver, British Columbia
Canada V6C 2B3
Telephone: (604) 682-5474
Toll-free: 1-877-682-5474
Fax: (604) 682-5404
www.pacifica-resources.com

ASSESSMENT REPORT

describing

PROSPECTING

on the:

FALCON PROPERTY

Falcon Claims 155-166

Claims are 100% owned by Pacifica Resources Ltd.

NTS Sheet 105I/12
Centered on Latitude 62⁰37' North, Longitude 129⁰40' West

In the Watson Lake Mining District
Yukon Territory

Prepared by

David Legault, B.Sc.

January 2006

Table of contents

	Page
Introduction	1
Accessibility, Climate, and Physiography	1
List of Claims by name and by grant number being renewed	1
Description of Undertakings	2
Results	2
Discussion and Recommendations	2

Tables

Table 01 – List of claims by name and grant number being renewed	1
--	---

Appendixes

- Appendix A - List of Personal
- Appendix B - Statement of Expenditures
- Appendix C - Statement of Qualification
- Appendix D – Assays Certificates

Figures

- Figure 1 – Location of the Falcon Property
- Figure 2 – Falcon Property, YT Claim Map and Sample Location
- Figure 3 – Falcon Property, YT Silt Geochemistry Zn (ppm)
- Figure 4 – Falcon Property, YT Silt Geochemistry Pb (ppm)
- Figure 5 – Falcon Property, YT Soil Geochemistry Zn (ppm)
- Figure 6 – Falcon Property, YT Soil Geochemistry Pb (ppm)

1. Introduction

The Falcon property is 100% owned by Pacifica Resources Ltd (“Pacifica”). The claims subject to this report (Table 1) were worked on between August 9-11, 2005 by a helicopter supported four-person crew working from Howard’s Pass camp. Prospecting and soil sampling were the primary undertakings during this time.

2. Accessibility, Climate and Physiography

The Falcon property is part of the Watson Lake Mining District in southeast Yukon on NTS sheet 105I/12 at Latitude 62°37’North and Longitude 129°40’West (Figure 01). Access into site is 350km by fixed wing charters from Whitehorse to Anniv airstrip and 10km by helicopter from Anniv airstrip to the property. In 2005, air transportation was provided by Trans North Helicopter (Astar 350B2) and Alkan Air (Single Turbo Otter). The Falcon property is located in the Howard’s Pass SEDEX district.

The Falcon property is located in the Selwyn Mountain Range and ranges in elevation from 1200 metres to 1400 metres. The property is densely vegetated by black spruce, alder, willow, back brush, moss and lichen.

3. List of claims by name and grant number being renewed

Table 1. List of claims being renewed in this assessment report.

Claim Name	Grant Number	Claim Expiry Date
FALCON 155	YB34094	20/9/2008
FALCON 156	YB34095	20/9/2008
FALCON 157	YB34096	20/9/2008
FALCON 158	YB34097	20/9/2008
FALCON 159	YB34098	20/9/2008
FALCON 160	YB34099	20/9/2008
FALCON 161	YB34100	20/9/2008
FALCON 162	YB34101	20/9/2008
FALCON 163	YB34102	20/9/2007
FALCON 164	YB34103	20/9/2008
FALCON 165	YB34104	20/9/2007
FALCON 166	YB34105	20/9/2008

4. Description of Undertakings

Prospecting and Soil Sampling

Field crews consisted of 2 Geologists and 2 Field Assistants. Soil samples were taken on each claims. Soil samples were collected by removing top soil using steel spades and sampling the unweathered material at a depth of one foot below ground surface interpreted to be the "B"-horizon. Each sample was packaged in a Kraft soil sample bag (4"x6" folded). Silt samples were collected where spring run-off occurred and treated in the same manner as the soil samples.

5. Results

All soil samples (41) and silt samples (7) were sent for assay at ALS-Chemex, 212 Brooksbank Avenue, North Vancouver, British Columbia, V6J 2C1. Analyses of the samples were by a 27 element ICP-AES after a 4-acid digestion process. Please see Appendix D for assay certificates and figures 2 through 6 for plotted results.

6. Discussion and Conclusions

The 2005 prospecting program was focused on gathering data to define drilling targets. Soil geochemistry reveals strong anomalies in zinc throughout the property. Although the soil geochemistry for lead does not overlap with the zinc; future work should include trenching; to identify the underlying rocks, in order to provide stratigraphic control and ensure the presence of the Active member; which is host to the SEDEX mineralization in the Howard's Pass district.

The Falcon Property should be maintained in good standing and warrants further geological, geochemical, and drilling for SEDEX exploration.

Respectfully Submitted,

David Legault, B.Sc.
Project Geologist

Vancouver, B.C., January 27th, 2006



#701 – 475 Howe Street
Vancouver, British Columbia
Canada, V6C 2B3

Telephone: (604) 682-5474
Toll-free: 1-877-682-5474

Fax: (604) 682-5404

info@pacific-resources.com
www.pacific-resources.com

Appendix A – List of Personnel

Name	Position	Period
Justin Laberge	Geologist	August 9-11, 2005
Lorraine Tam	Geologist	August 9-11, 2005
Tyler Caswell	Field Assistant	August 9-11, 2005
Matthew Williams	Field Assistant	August 9-11, 2005

STATEMENT OF EXPENDITURES

I, Jason Dunning, as agent for Pacifica Resources Ltd, #701-475 Howe Street, Vancouver, B.C. do solemnly declare that geological examination, prospecting, and geochemistry survey sampling carried out on the Falcon Claims (see attached list) between the dates of August 9th and August 11th, 2005.

Assays/Geochemical Analysis	\$1440.00
Aircraft	\$1147.50
Wages (professional)	\$885.00
Total	\$3472.50

I make this solemn declaration conscientiously believing it to be true and knowing that it is of the same force and effect as if made under oath and by virtue of the Canada Evidence Act.

Declared before me at Vancouver in the Province of British Columbia this 6th day of September 2005.

Jason Dunning, MSc, P.Geo.



#701 – 475 Howe Street
Vancouver, British Columbia
Canada, V6C 2B3

Telephone: (604) 682-5474
Toll-free: 1-877-682-5474
Fax: (604) 682-5404

info@pacific-resources.com
www.pacific-resources.com

Appendix C – Statement of Qualifications

I, David Legault, resident of Vancouver, British Columbia, do certify that:

1. I graduated from Université du Québec À Montréal in May 2001 with a B.Sc. in Geology;
2. From 1998 to present, I have been actively engaged in mineral exploration in Québec, Ontario, and Yukon Territory and am presently employed with the Expatriate Group of Companies to which Yukon Zinc Corporation is part of;
3. I have personally participated in the logistical support during the fieldwork and analysis of data for the filed undertakings herein.

Respectfully Submitted,

David Legault, B.Sc.



ALS Chemex

EXCELLENCE IN ANALYTICAL CHEMISTRY

ALS Canada Ltd.

212 Brooksbank Avenue

North Vancouver BC V7J 2C1

Phone: 604 984 0221 Fax: 604 984 0218 www.alschemex.com

PACIFICA RESOURCES LTD.
701 - 475 HOWE ST.
VANCOUVER BC V6C 2B3

Page: 1
Finalized Date: 2-SEP-2005
Account: PACIRE

CERTIFICATE VA05072321

Project: 1702

P.O. No.:

This report is for 48 Soil samples submitted to our lab in Vancouver, BC, Canada on 25-AUG-2005.

The following have access to data associated with this certificate:

JASON DUNNING

SAMPLE PREPARATION

ALS CODE	DESCRIPTION
WEI-21	Received Sample Weight
LOG-22	Sample login - Rcd w/o BarCode
SCR-41	Screen to -180um and save both

ANALYTICAL PROCEDURES

ALS CODE	DESCRIPTION	INSTRUMENT
ME-ICP61	27 element four acid ICP-AES	ICP-AES

To: PACIFICA RESOURCES LTD.
ATTN: JASON DUNNING
701 - 475 HOWE ST.
VANCOUVER BC V6C 2B3

This is the Final Report and supersedes any preliminary report with this certificate number. Results apply to samples as submitted. All pages of this report have been checked and approved for release.

Signature: _____



ALS Chemex

EXCELLENCE IN ANALYTICAL CHEMISTRY

ALS Canada Ltd.

212 Brooksbank Avenue
North Vancouver BC V7J 2C1

Phone: 604 984 0221 Fax: 604 984 0218 www.alschemex.com

PACIFICA RESOURCES LTD.
701 - 475 HOWE ST.
VANCOUVER BC V6C 2B3

Page: 2 - A
Total # Pages: 3 (A - B)
Finalized Date: 2-SEP-2005
Account: PACIRE

Project: 1702

CERTIFICATE OF ANALYSIS VA05072321

Sample Description	Method Analyte Units LOR	WEI-21	ME-ICP61	ME-ICP61	ME-ICP61	ME-ICP61	ME-ICP61	ME-ICP61	ME-ICP61	ME-ICP61	ME-ICP61	ME-ICP61	ME-ICP61	ME-ICP61	ME-ICP61	ME-ICP61
		Recd Wt. kg	Ag ppm	Al %	As ppm	Ba ppm	Be ppm	Bi ppm	Ca %	Cd ppm	Co ppm	Cr ppm	Cu ppm	Fe %	K %	Mg %
		0.02	0.5	0.01	5	10	0.5	2	0.01	0.5	1	1	1	0.01	0.01	0.01
B384365		0.38	1.2	5.30	24	3190	1.7	<2	0.49	4.0	3	103	37	2.12	1.80	0.58
B384366		0.34	1.0	5.00	20	810	0.9	<2	2.18	54.9	4	44	31	1.49	1.32	0.48
B384367		0.40	<0.5	5.54	42	2240	2.0	<2	0.04	<0.5	6	67	46	3.53	2.60	0.78
B384368		0.36	<0.5	5.51	10	3060	1.6	<2	0.26	<0.5	1	87	12	0.86	2.05	0.51
B384369		0.40	<0.5	5.63	26	2920	2.1	<2	0.12	0.8	6	124	32	2.49	2.24	0.70
B384370		0.42	0.9	5.37	20	2970	1.8	<2	0.60	1.9	5	99	31	1.94	2.01	0.62
B384371		0.46	0.8	5.32	52	2540	1.6	<2	0.25	1.2	5	88	34	3.08	2.09	0.69
B384372		0.40	1.1	5.67	23	3520	2.1	<2	0.87	12.6	8	97	65	2.58	2.20	0.73
B384373		0.44	1.3	5.21	43	2870	2.3	<2	1.94	19.5	61	97	128	4.07	2.22	1.44
B384374		0.42	<0.5	4.68	41	1800	1.3	<2	0.12	<0.5	6	70	22	2.36	1.76	0.52
B384375		0.46	1.4	6.76	7	4400	1.6	<2	1.34	20.7	8	43	116	2.53	2.02	0.75
B384376		0.40	<0.5	4.20	57	2310	1.5	<2	0.26	3.5	6	97	58	4.43	1.33	0.40
B384377		0.32	4.9	5.83	16	3130	1.0	<2	0.97	0.5	2	23	64	2.17	1.36	0.37
B384378		0.52	0.5	6.87	19	6750	1.7	<2	0.10	<0.5	7	94	43	3.06	2.26	0.53
B384379		0.30	1.7	7.00	<5	900	1.0	<2	1.76	<0.5	5	6	36	1.83	1.91	0.55
B384380		0.42	0.6	5.76	24	4890	1.5	<2	0.30	<0.5	3	79	28	3.12	2.09	0.58
B384381		0.38	1.4	4.22	10	2990	1.1	<2	0.20	1.3	3	57	79	1.72	1.24	0.30
B384382		0.32	0.6	5.96	<5	3490	1.2	<2	0.66	<0.5	1	44	22	1.33	1.74	0.44
B384383		0.44	<0.5	6.20	<5	2430	1.2	<2	1.05	<0.5	3	33	21	1.47	1.90	0.47
B384384		0.36	4.8	4.02	35	1980	0.8	<2	0.16	<0.5	3	49	185	4.14	1.00	0.28
B384385		0.30	<0.5	4.92	8	1650	1.0	<2	0.53	1.0	3	44	78	1.37	1.37	0.34
B384386		0.46	2.4	5.64	21	2780	1.3	<2	0.47	<0.5	4	62	102	2.59	1.66	0.81
B384387		0.26	2.3	6.90	23	3650	1.8	<2	1.45	6.3	9	81	80	3.07	2.19	1.04
B384388		0.48	1.5	6.33	12	3220	2.0	<2	0.95	4.7	14	74	114	2.89	2.03	1.06
B384614		0.30	2.0	4.56	66	940	1.6	<2	0.28	0.6	5	160	110	3.74	1.43	0.39
B384615		0.30	<0.5	5.12	40	7070	2.0	<2	0.11	0.5	8	82	36	2.73	1.88	0.56
B384616		0.36	0.5	5.50	25	3160	2.0	<2	0.10	<0.5	6	130	42	3.04	2.00	0.69
B384617		0.34	2.3	5.40	33	1570	1.4	<2	1.62	36.5	6	119	117	1.96	1.32	0.54
B384618		0.40	1.2	6.37	<5	1560	1.5	<2	0.75	<0.5	2	60	18	1.46	2.17	0.66
B384619		0.44	1.4	6.19	28	4120	2.2	<2	1.48	6.3	12	94	58	3.02	2.54	1.27
B384620		0.34	<0.5	5.86	23	3980	2.2	<2	1.36	7.2	12	92	57	2.81	2.37	1.09
B384621		0.32	<0.5	5.20	17	2980	1.5	<2	0.10	<0.5	5	82	17	2.27	1.70	0.48
B384622		0.34	<0.5	5.18	10	2790	1.5	<2	0.08	<0.5	3	90	14	1.00	1.68	0.44
B384623		0.36	<0.5	6.20	35	2950	2.0	<2	0.05	<0.5	6	118	29	2.66	2.11	0.60
B384624		0.50	<0.5	5.33	28	9800	1.8	<2	0.44	1.8	11	74	52	3.51	2.05	0.52
B384625		0.52	<0.5	6.37	23	4580	2.2	<2	0.67	1.7	5	112	41	2.32	2.13	0.65
B384626		0.40	0.6	5.66	51	5200	2.5	<2	0.19	3.6	9	95	67	3.34	2.09	0.54
B384627		0.42	0.6	5.63	28	4770	2.2	<2	1.76	12.6	16	94	71	2.80	2.32	1.23
B384628		0.50	0.9	5.52	25	5460	2.0	<2	2.80	9.2	7	82	61	2.48	2.35	1.78
B384629		0.40	0.7	5.77	27	7260	2.5	<2	0.69	6.8	15	103	56	3.25	2.49	0.78



ALS Chemex

EXCELLENCE IN ANALYTICAL CHEMISTRY

ALS Canada Ltd.

212 Brooksbank Avenue
North Vancouver BC V7J 2C1

Phone: 604 984 0221 Fax: 604 984 0218 www.alschemex.com

PACIFICA RESOURCES LTD.
701 - 475 HOWE ST.
VANCOUVER BC V6C 2B3

Page: 2 - B
Total # Pages: 3 (A - B)
Finalized Date: 2-SEP-2005
Account: PACIRE

Project: 1702

CERTIFICATE OF ANALYSIS VA05072321

Sample Description	Method	ME-ICP61	ME-ICP61	ME-ICP61	ME-ICP61	ME-ICP61	ME-ICP61	ME-ICP61	ME-ICP61	ME-ICP61	ME-ICP61	ME-ICP61	ME-ICP61	
	Analyte Units LOR	Mn ppm	Mo ppm	Na %	Ni ppm	P ppm	Pb ppm	S %	Sb ppm	Sr ppm	Ti %	V ppm	W ppm	Zn ppm
		5	1	0.01	1	10	2	0.01	5	1	0.01	1	10	2
B384365		110	13	0.33	58	1960	22	0.05	11	86	0.35	721	<10	460
B384366		365	5	1.38	264	1990	10	0.11	<5	364	0.18	190	<10	3060
B384367		147	50	0.04	102	760	24	0.02	12	13	0.29	432	<10	397
B384368		74	4	0.48	12	820	9	0.02	<5	94	0.39	612	<10	67
B384369		67	19	0.15	76	1020	22	0.03	9	26	0.33	872	<10	464
B384370		76	15	0.33	73	1130	15	0.05	7	80	0.31	660	10	481
B384371		110	38	0.31	66	1150	31	0.04	19	77	0.38	1985	<10	463
B384372		269	18	0.34	254	1560	17	0.05	5	94	0.32	718	<10	2560
B384373		1595	60	0.06	386	1870	24	0.08	16	60	0.27	979	<10	2790
B384374		69	30	0.24	70	670	19	0.02	14	50	0.37	952	10	388
B384375		326	14	1.60	196	1220	19	0.09	6	380	0.23	408	<10	1460
B384376		91	89	0.35	172	1900	24	0.08	31	99	0.32	2560	<10	1190
B384377		200	11	1.42	17	1740	23	0.14	<5	320	0.14	173	10	50
B384378		147	13	0.26	37	700	17	0.02	<5	55	0.58	371	<10	278
B384379		343	2	2.44	6	800	13	0.03	<5	545	0.20	54	<10	46
B384380		104	14	0.48	25	970	37	0.11	6	121	0.39	491	<10	147
B384381		59	7	0.27	25	1810	18	0.14	<5	68	0.24	217	10	72
B384382		156	4	1.02	9	580	13	0.02	<5	217	0.40	156	<10	33
B384383		228	3	1.58	6	590	11	0.02	<5	337	0.30	142	10	44
B384384		75	13	0.26	35	3410	26	0.17	5	59	0.21	313	<10	69
B384385		134	2	0.79	12	1050	43	0.04	<5	178	0.32	132	<10	36
B384386		211	10	0.62	33	2420	18	0.09	<5	144	0.26	439	<10	202
B384387		385	8	0.70	181	1560	32	0.14	<5	280	0.30	385	<10	915
B384388		642	6	0.53	221	1500	20	0.07	<5	171	0.30	341	<10	1115
B384614		99	207	0.47	247	1520	72	0.06	57	110	0.44	4890	<10	940
B384615		118	101	0.54	153	850	18	0.03	<5	47	0.34	522	10	238
B384616		94	36	0.29	101	2460	21	0.03	6	31	0.34	841	<10	371
B384617		515	12	1.28	276	3450	19	0.08	11	346	0.21	560	<10	3060
B384618		164	3	1.13	12	1330	13	0.02	<5	236	0.30	289	<10	65
B384619		274	16	0.10	140	1360	16	0.10	7	60	0.33	474	<10	1265
B384620		303	18	0.15	145	1580	8	0.08	5	73	0.32	544	<10	1315
B384621		66	13	0.15	30	990	19	0.02	5	42	0.42	611	<10	186
B384622		40	7	0.18	20	930	6	0.02	5	43	0.43	603	<10	96
B384623		59	25	0.05	67	1420	17	0.02	8	23	0.38	806	<10	302
B384624		174	7	0.16	62	1220	14	0.06	6	74	0.35	299	<10	340
B384625		85	20	0.20	65	1180	15	0.03	11	66	0.38	826	<10	305
B384626		181	40	0.04	164	2110	16	0.03	8	30	0.30	642	<10	578
B384627		405	26	0.11	214	2020	12	0.10	11	88	0.31	809	<10	2140
B384628		268	19	0.15	136	1910	20	0.07	<5	116	0.29	607	<10	1095
B384629		352	25	0.14	140	3140	21	0.07	7	59	0.32	792	<10	942



ALS Chemex

EXCELLENCE IN ANALYTICAL CHEMISTRY

ALS Canada Ltd.

212 Brooksbank Avenue

North Vancouver BC V7J 2C1

Phone: 604 984 0221 Fax: 604 984 0218 www.alschemex.com

PACIFICA RESOURCES LTD.

701 - 475 HOWE ST.

VANCOUVER BC V6C 2B3

Page: 3 - A

Total #. pages: 3 (A - B)

Finalized Date: 2-SEP-2005

Account: PACIRE

Project: 1702

CERTIFICATE OF ANALYSIS	VA05072321
-------------------------	------------

Sample Description	Method	WEI-21	ME-ICP61	ME-ICP61	ME-ICP61	ME-ICP61	ME-ICP61	ME-ICP61	ME-ICP61	ME-ICP61	ME-ICP61	ME-ICP61	ME-ICP61	ME-ICP61	ME-ICP61	ME-ICP61
	Analyte	Recvd Wt.	Ag	Al	As	Ba	Be	Bi	Ca	Cd	Co	Cr	Cu	Fe	K	Mg
		Units	kg	ppm	%	ppm	ppm	ppm	%	ppm	ppm	ppm	ppm	%	%	%
LOR																
B384630		0.38	0.6	4.39	40	4810	1.5	<2	0.53	8.5	5	64	64	2.50	1.82	0.93
B384631		0.38	0.9	7.34	15	7020	2.6	<2	0.32	6.7	12	116	53	3.44	3.18	0.95
B384632		0.32	1.0	5.21	18	4510	1.5	<2	1.70	19.5	6	73	87	1.96	1.60	0.79
B384633		0.30	0.9	5.44	36	3010	1.7	<2	1.42	34.2	27	73	51	3.31	1.82	0.79
B384634		0.30	1.7	6.58	41	3690	2.6	<2	0.98	28.1	20	165	71	2.95	2.83	0.89
B384635		0.44	1.5	5.48	34	9030	2.3	<2	0.82	8.6	11	110	69	3.26	2.27	0.93
B384636		0.46	1.0	5.72	43	2460	1.8	<2	1.08	35.8	25	71	62	2.36	2.13	1.13
B384637		0.38	0.8	5.75	12	5710	1.8	<2	1.25	6.4	4	69	65	1.99	2.03	0.91



ALS Chemex

EXCELLENCE IN ANALYTICAL CHEMISTRY

ALS Canada Ltd.

212 Brooksbank Avenue
North Vancouver BC V7J 2C1

Phone: 604 984 0221 Fax: 604 984 0218 www.alschemex.com

PACIFICA RESOURCES LTD.
701 - 475 HOWE ST.
VANCOUVER BC V6C 2B3

Page: 3 - B
Total # pages: 3 (A - B)
Finalized Date: 2-SEP-2005
Account: PACIRE

Project: 1702

CERTIFICATE OF ANALYSIS VA05072321

Sample Description	Method Analyte Units LOR	ME-ICP61	ME-ICP61	ME-ICP61	ME-ICP61	ME-ICP61	ME-ICP61	ME-ICP61	ME-ICP61	ME-ICP61	ME-ICP61	ME-ICP61	ME-ICP61	ME-ICP61
		Mn	Mo	Na	Ni	P	Pb	S	Sb	Sr	Ti	V	W	Zn
		ppm	ppm	%	ppm	ppm	ppm	%	ppm	ppm	%	ppm	ppm	ppm
		5	1	0.01	1	10	2	0.01	5	1	0.01	1	10	2
B384630		106	28	0.22	176	1870	19	0.08	14	131	0.31	852	<10	2400
B384631		219	15	0.22	132	650	17	0.08	<5	39	0.42	266	<10	1310
B384632		192	7	0.61	206	1370	18	0.12	11	192	0.23	887	<10	2390
B384633		865	36	0.70	526	1750	16	0.07	12	213	0.28	680	<10	6990
B384634		658	42	0.11	446	2120	20	0.06	12	92	0.42	798	<10	5660
B384635		433	28	0.18	210	2300	23	0.12	12	106	0.35	833	<10	2000
B384636		120	20	0.48	347	1450	29	0.28	<5	150	0.31	469	<10	3380
B384637		142	5	0.38	85	1190	27	0.10	<5	151	0.31	395	<10	570

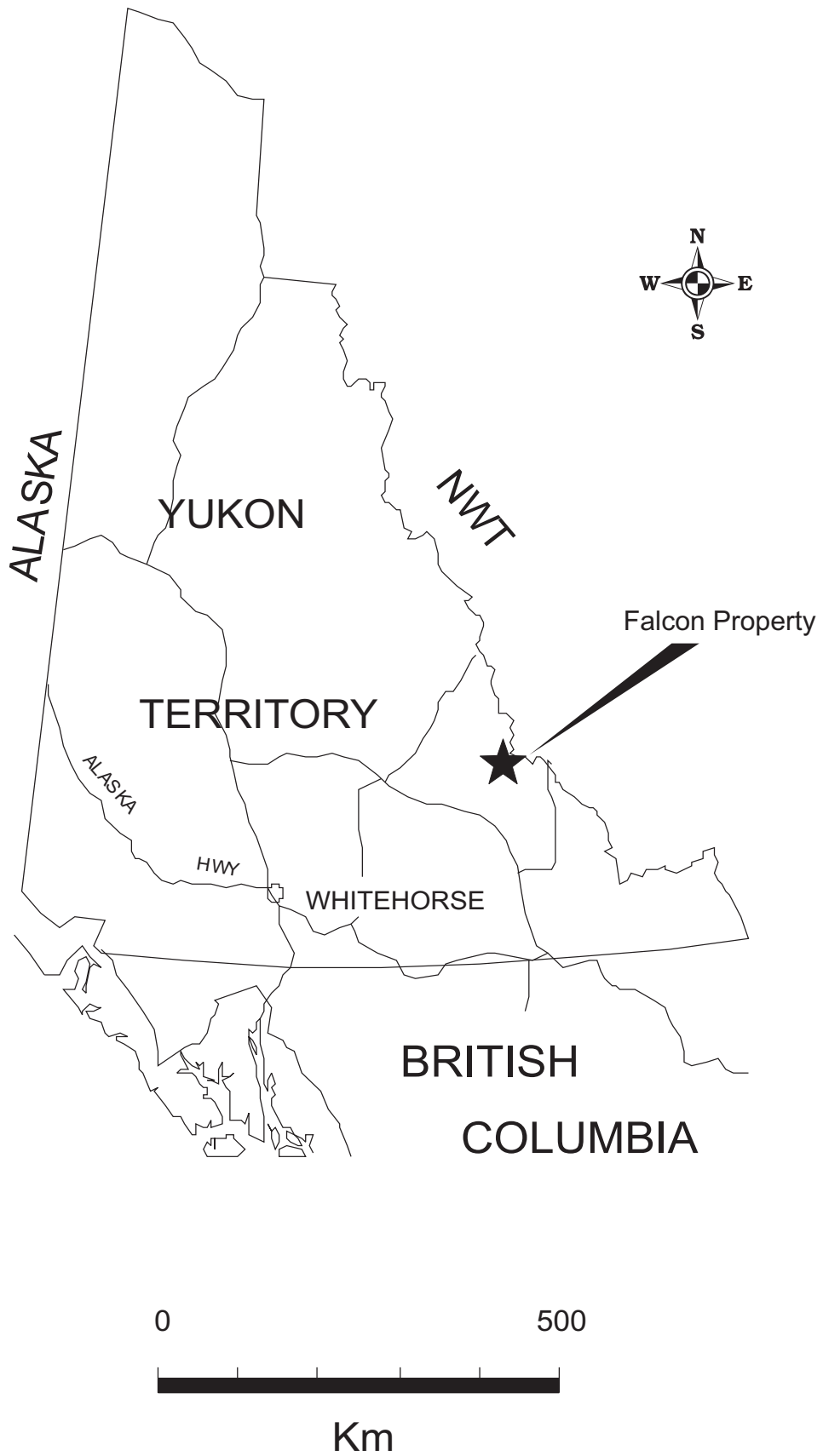
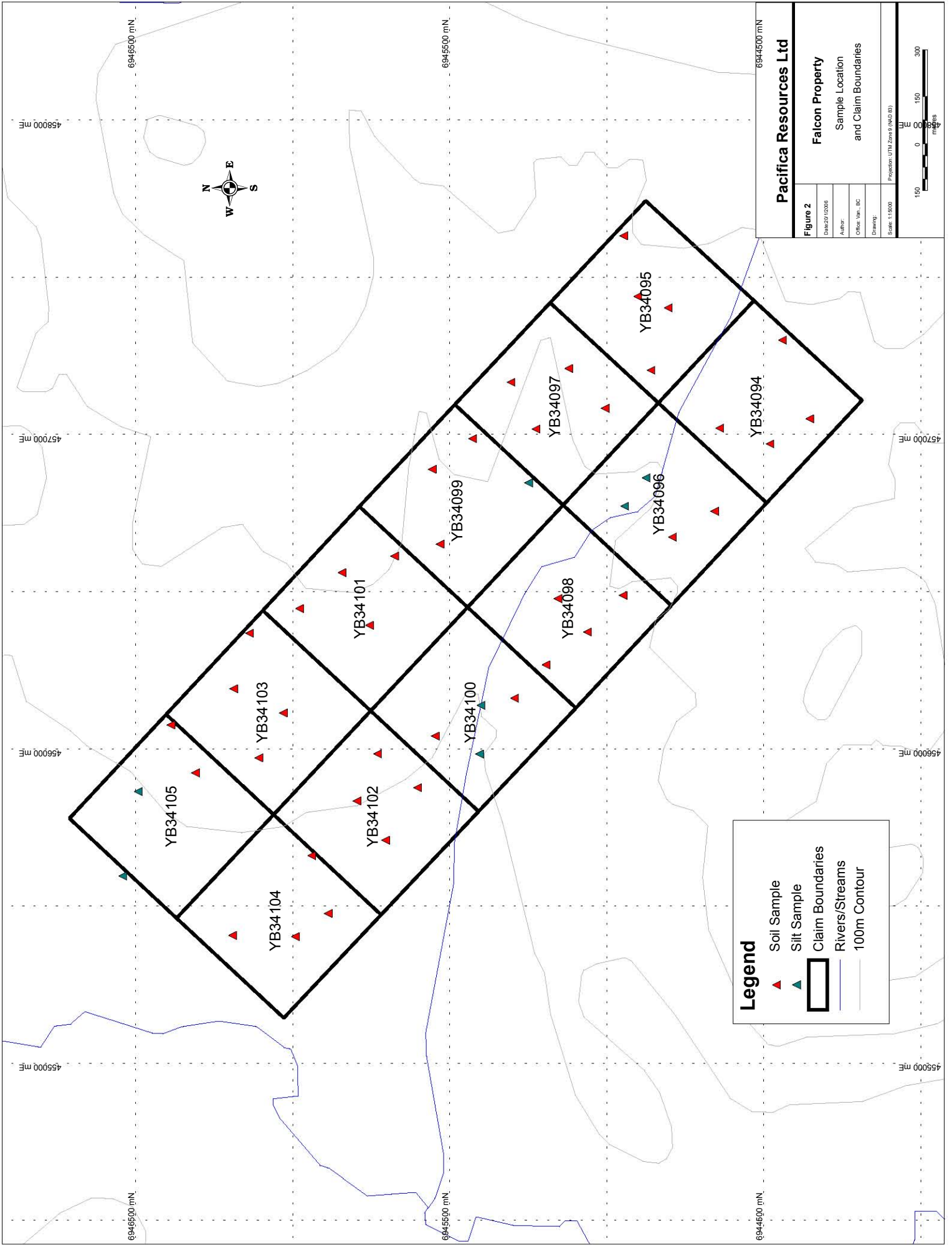

Figure 1. Location Map of the Falcon Property.



Pacifica Resources Ltd

Falcon Property
 Sample Location
 and Claim Boundaries

Figure 2

Date: 20/10/2018
Author:
Office: Vln - BC
Drawing:
Scale: 1:10000
Projection: UTM Zone 9 (NAD 83)



Legend

- ▲ Soil Sample
- ▲ Silt Sample
- Claim Boundaries
- Rivers/Streams
- 100m Contour



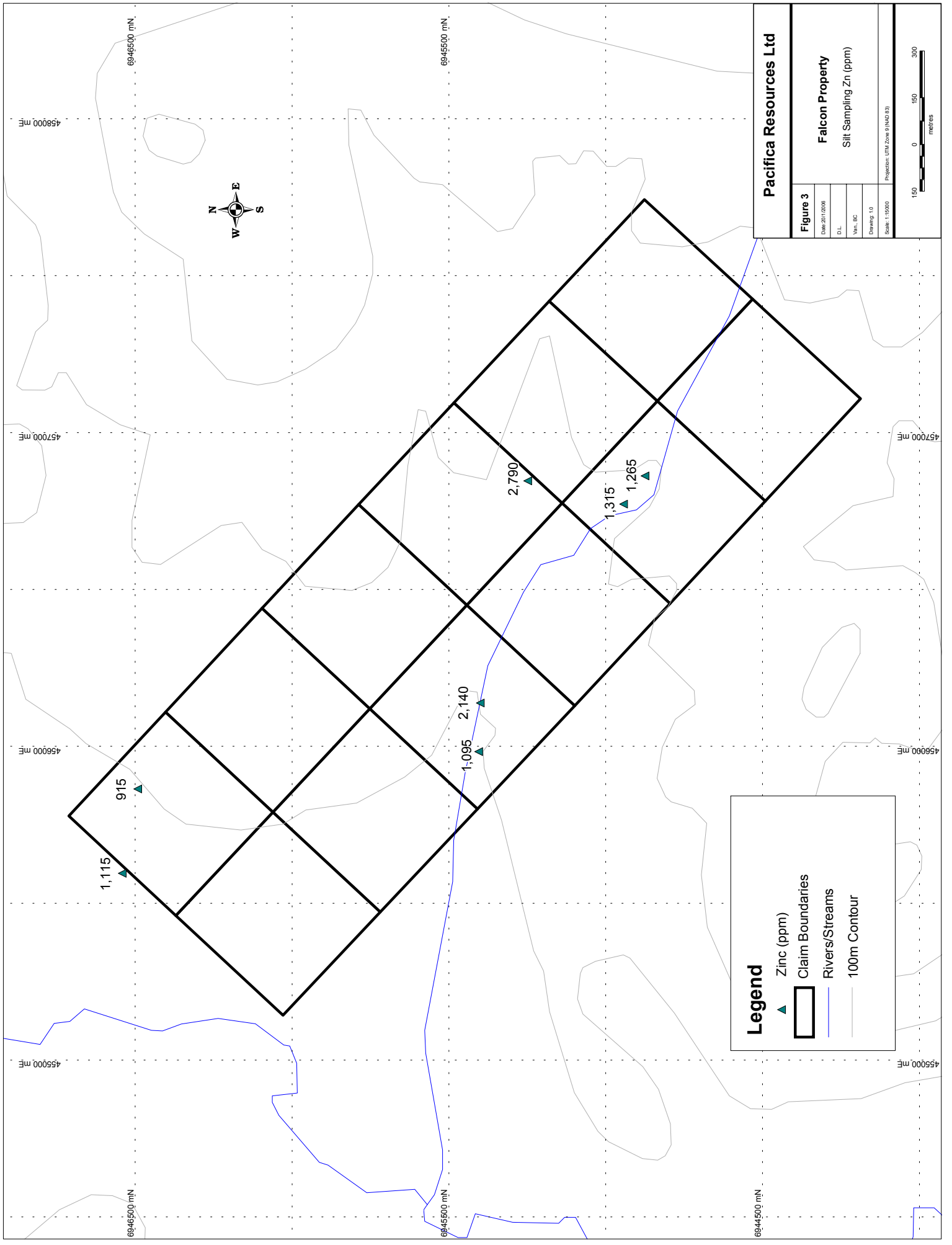

Pacifica Resources Ltd	
Figure 3	
Date: 20/11/2008	
D.L.	
Year: BC	
Drawing: 1.0	
Scale: 1:10000	Projection: UTM Zone 8 (NAD 83)

Falcon Property
Silt Sampling Zn (ppm)

150 0 150 300
metres

Legend

- ▲ Zinc (ppm)
- Claim Boundaries
- Rivers/Streams
- 100m Contour

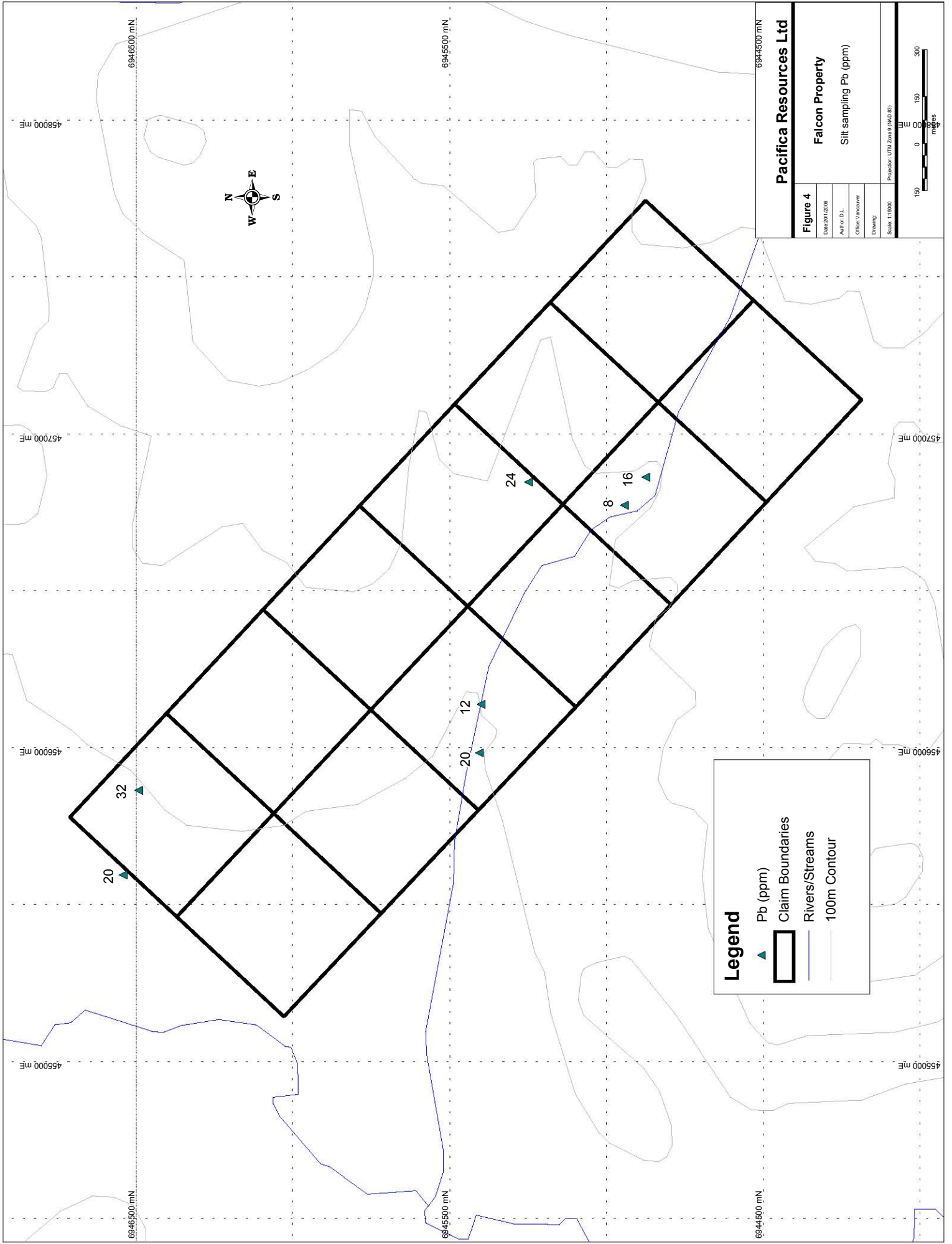

Legend

- ▲ Pb (ppm)
- Claim Boundaries
- Rivers/Streams
- 100m Contour

Pacifica Resources Ltd	
Figure 4	
Date: 20/1/2008	Author: D.L.
Office: Vancouver	Projection: UTM Zone 9 (NAD 83)
Scale: 1:1000	

Falcon Property
Silt sampling Pb (ppm)

0 150 300
meters

