

ARCHER, CATHRO & ASSOCIATES (1981) LIMITED
1016 – 510 West Hastings Street
Vancouver, B.C. V6B 1L8

Telephone: 604-688-2568

Fax: 604-688-2578

ASSESSMENT REPORT

describing

RADON GAS SURVEYS AND DIAMOND DRILLING

on the

HOT DOG PROPERTY

Hot Dog 1-42 YC41145-YC41186
43-146 YC54033-YC54136

NTS 115H/8
Latitude 61°20'N; Longitude 136°27'W

in the

Whitehorse Mining District
Yukon Territory

prepared by

Archer, Cathro & Associates (1981) Limited

for

TWENTY-SEVEN CAPITAL CORP.

by

W. Douglas Eaton, B.Sc. Geology
December 2006

TABLE OF CONTENTS

	<u>PAGE</u>
INTRODUCTION	1
PROPERTY LOCATION, CLAIM DATA AND ACCESS	1
HISTORY	1
GEOMORPHOLOGY	2
REGIONAL GEOLOGY	2
PROPERTY GEOLOGY	2
GEOCHEMISTRY	3
RADIOMETRIC SURVEYS	3
RADON GAS SURVEYS	3
DIAMOND DRILLING	4
DISCUSSION AND CONCLUSIONS	5
REFERENCES	6

APPENDICES

- I. STATEMENT OF QUALIFICATIONS
- II. CERTIFICATE OF ANALYSIS
- III. DRILL LOGS

FIGURES

1	Property Location	Following Page 1
2	Claim Location	Following Page 1
3	Regional Geology	Following page 2
4.	Geology, Airborne Radiometrics and Geochemistry	Following page 2
5.	Radon Gas Surveys and Drill Hole Locations	Following page 4

INTRODUCTION

The Hot Dog property hosts unconformity type uranium mineralization. It is owned 100% by Twenty-Seven Capital Corp. subject to a net smelter return royalty interest and certain earn-back rights owned by Cash Minerals Ltd.

The 2006 work program was funded by Twenty-Seven Capital. It consisted of a geophysical survey that measured radon gas in soil followed by 433.43 m of diamond drilling in eight holes. The radon gas survey was conducted from a tent camp on the property between August 13 and 27 while the diamond drilling was done with daily helicopter support from a camp on the Division Mountain property between September 19 and October 8. Both programs were managed by Archer, Cathro & Associates (1981) Limited under the author's supervision. Appendix I contains his Statement of Qualifications.

PROPERTY LOCATION, CLAIM DATA AND ACCESS

The Hot Dog property comprises 146 contiguous mineral claims located in southwestern Yukon at latitude 61°20' north and longitude 136°27' west on NTS map sheet 115H/8 (Figure 1). The claims are registered with the Whitehorse Mining Recorder in the name of Archer Cathro, which holds them in trust for Twenty-Seven Capital. Specifics concerning claim registration appear below while locations of individual claims are shown on Figure 2.

<u>Claim Number</u>	<u>Grant Number</u>	<u>Expiry Date*</u>
Hot Dog 1-42	YC41145-YC41186	February 15, 2007
43-146	YC54033-YC54136	October 5, 2007

*Expiry dates do not include 2006 work which has not yet been filed for assessment credit.

The claims are located 100 km northwest of Whitehorse, the territorial capital and main supply centre. Access in 2006 was from a campsite at the Division Mountain coal property, 19 km east of the Hot Dog claims. The Division Mountain campsite is reached via 31 km of dirt road from Braeburn, which lies alongside the Klondike Highway 100 km north of Whitehorse.

Helicopter support for the radon gas survey was provided by a Bell 206B operated by Capital Helicopters (1995) Inc. from its base in Whitehorse. The drill program was supported by a Hughes 500D contracted from Fireweed Helicopters, which operated from the Division Mountain campsite.

HISTORY

The core of the area now covered by the Hot Dog property was first staked in 1969 as the ED 1-16 claims by E. Chisholm, who later transferred the claims to Lion Mining Ltd. The ED claims were staked for porphyry copper potential. They covered weakly anomalous copper and molybdenum values associated with a quartz veined gossanous zone within a granodiorite intrusion (Chisholm, 1970).

**CASH MINERALS LTD.
TWENTY-SEVEN CAPITAL CORP.**

FIGURE 1

ARCHER, CATHRO & ASSOCIATES (1981) LIMITED

**PROPERTY LOCATION
HOT DOG PROPERTY**

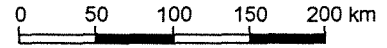

FILE: ...2006/YUJV/HOTDOG-F_1-LOCATION.DWG

JANUARY 2007

★ Uranium prospect described in this report

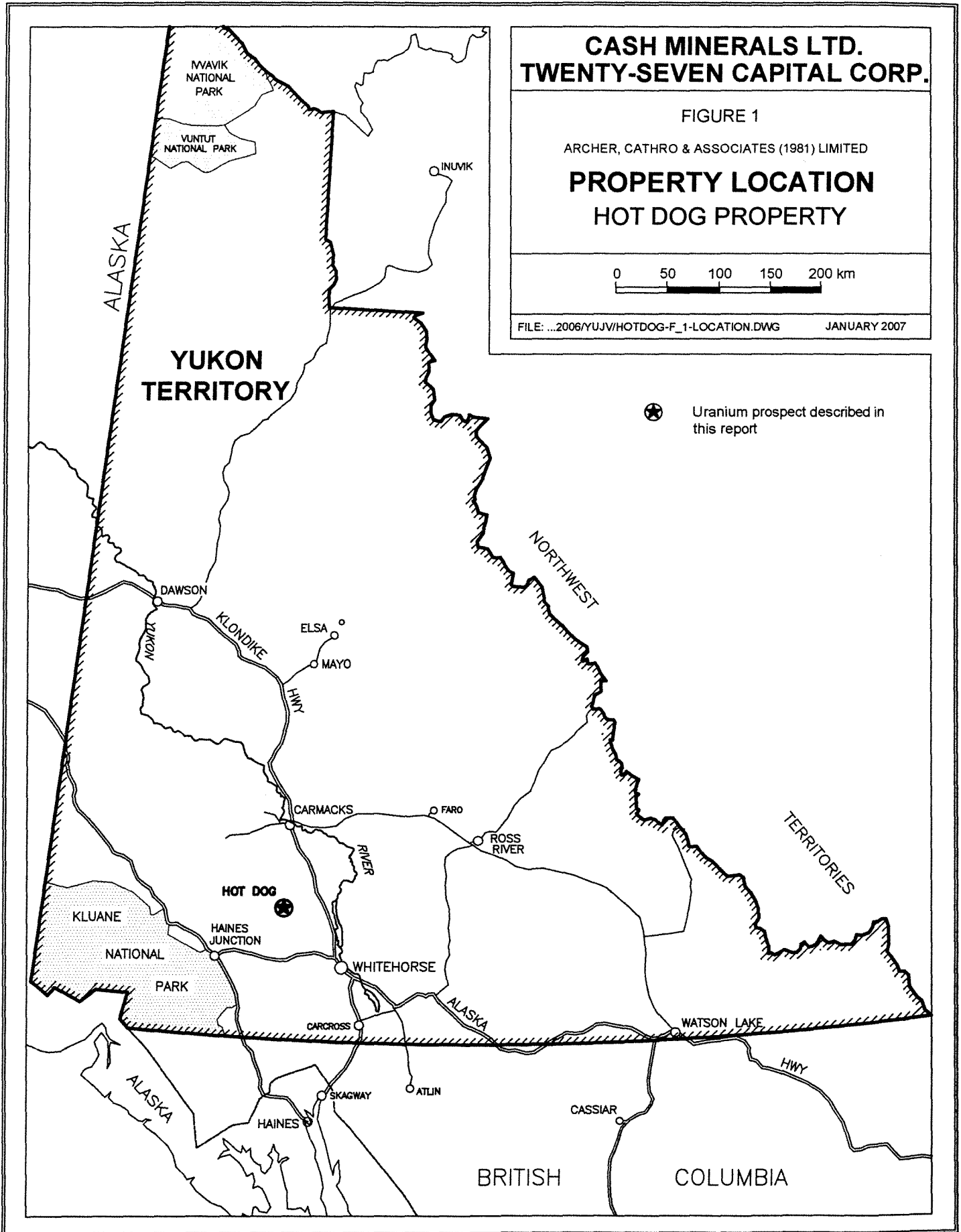

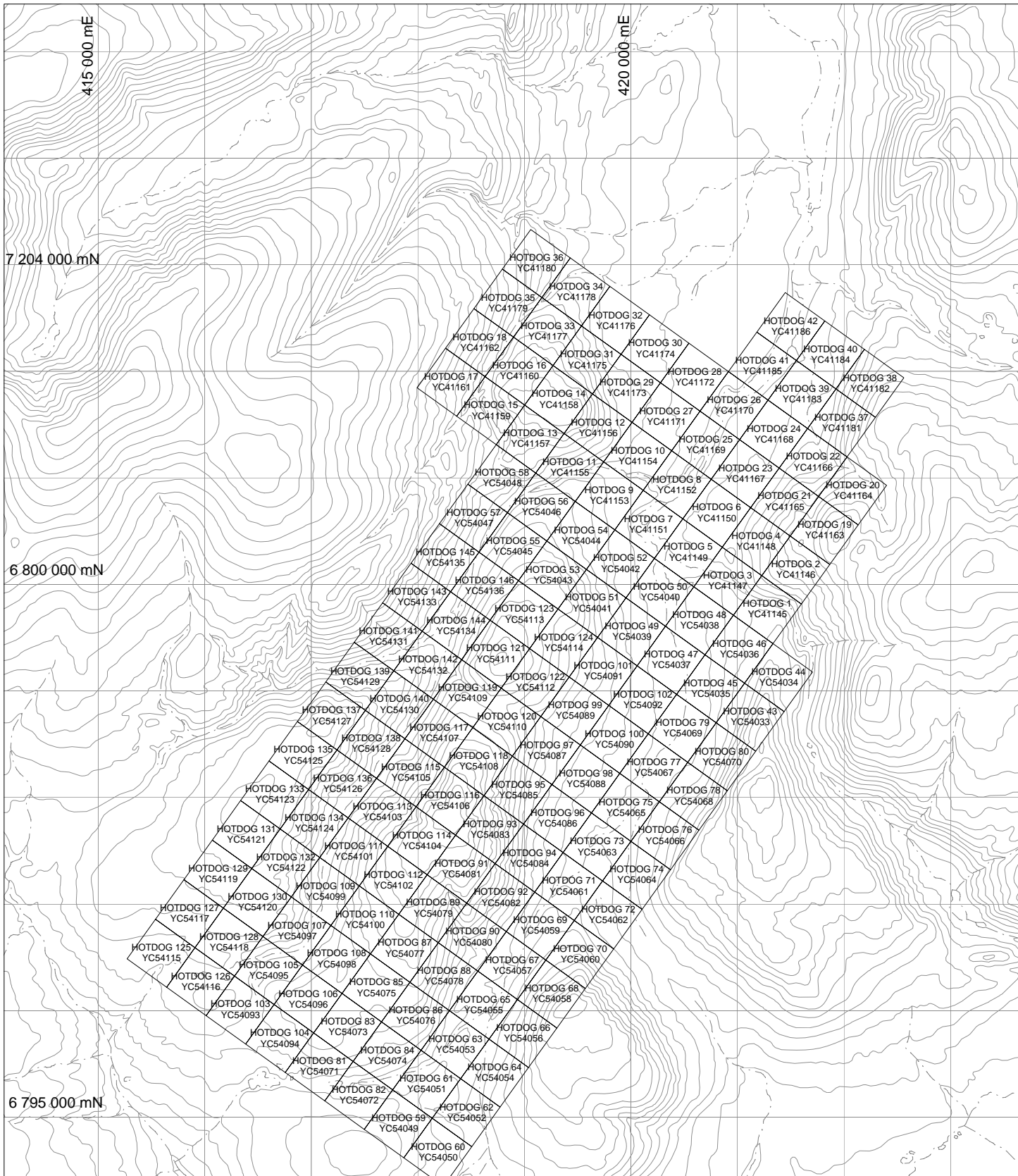

7 204 000 mN

6 800 000 mN

6 795 000 mN

415 000 mE

420 000 mE

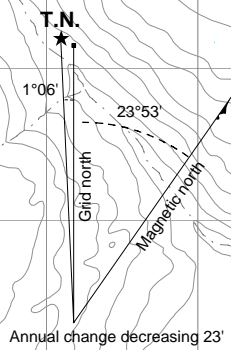

**CASH MINERALS LTD.
 TWENTY-SEVEN CAPITAL CORP.**

FIGURE 2
 ARCHER, CATHRO & ASSOCIATES (1981) LIMITED

**CLAIM LOCATION
 HOT DOG PROPERTY**

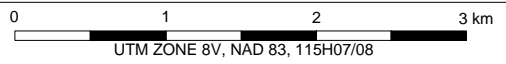

In 1976, Ukon Joint Venture (Chevron Minerals Ltd. and Kerr-Addison Mines Ltd.) discovered a radioactive zone along a contact between the granodiorite stock and a younger volcanic unit. The radioactivity is due to uranium that appears to have been leached from the granodiorite and precipitated where oxygenated groundwater encountered reducing conditions either in organic rich sections within a regolith at the base of the volcanic flows or in sulphide rich fracture zones within the volcanics. Organic rich soil collected by Ukon JV in 1976 near the contact assayed between 0.02 and 0.46% U_3O_8 (Archer and Onasick, 1976). In 1977 Ukon JV completed 166 m of diamond drilling in seven, IAX (3.5 cm diameter) holes. Core recovery was very poor and no downhole radioactive logging was done. The best results were obtained from hole B-5 where 0.34 m of 0.61 m of core recovered from a 2.4 m interval in the hole averaged 0.13% U_3O_8 (Archer, 1977). No further work was done before the claims allowed were to expire.

In 1985, the Geological Survey of Canada published reconnaissance scale stream sediment geochemical data for the Aishihik map sheet (115H) which includes the Hot Dog area (Hornbrook, et al., 1985).

Yukon Uranium Project (Twenty-Seven Capital and Cash Minerals) staked the Hot Dog claims in spring 2006.

GEOMORPHOLOGY

The property is situated near the southern end of the Dawson Range. Some peaks in the area crest at about 1500 m but most of the property lies between 1100 to 1300 m above sea level. The main area of interest flanks a broad valley floored by meandering creeks and a chain of small lakes, which form the headwaters of Kirkland Creek. This drainage is part of the Yukon River watershed.

The area was heavily affected by the Pleistocene to recent valley and alpine glaciation. Large scale outwash features are particularly prevalent. Vegetation on the property is mostly low brush and stunted black spruce. This area is very dry, receiving about 40 cm of annual precipitation. The climate can be characterized as continental with short cool summers, long cold winters, and limited spring and fall seasons.

REGIONAL GEOLOGY

The Hot Dog property lies within the Intermontane Belt which locally consists of Paleozoic metamorphic rocks assigned to the Yukon-Tanana Terrane, a variety of Mesozoic granitic plutons and younger continental sediments and volcanic rocks. This package of rocks is bounded by large transcurrent faults with the Tintina Fault to the northeast and the Denali Fault to the southwest (Figure 3). The geology was mapped at 1:250,000 scale by D. Tempelman-Kluit (1973) and was re-interpreted by Gordey and Makepeace (1999) to incorporate recent age dating and stratigraphic correlations.

PROPERTY GEOLOGY

Geology in the immediate vicinity of the property is illustrated on Figure 4. The oldest rock unit is medium grained quartz monzonite that is part of a batholith size body of Early Jurassic

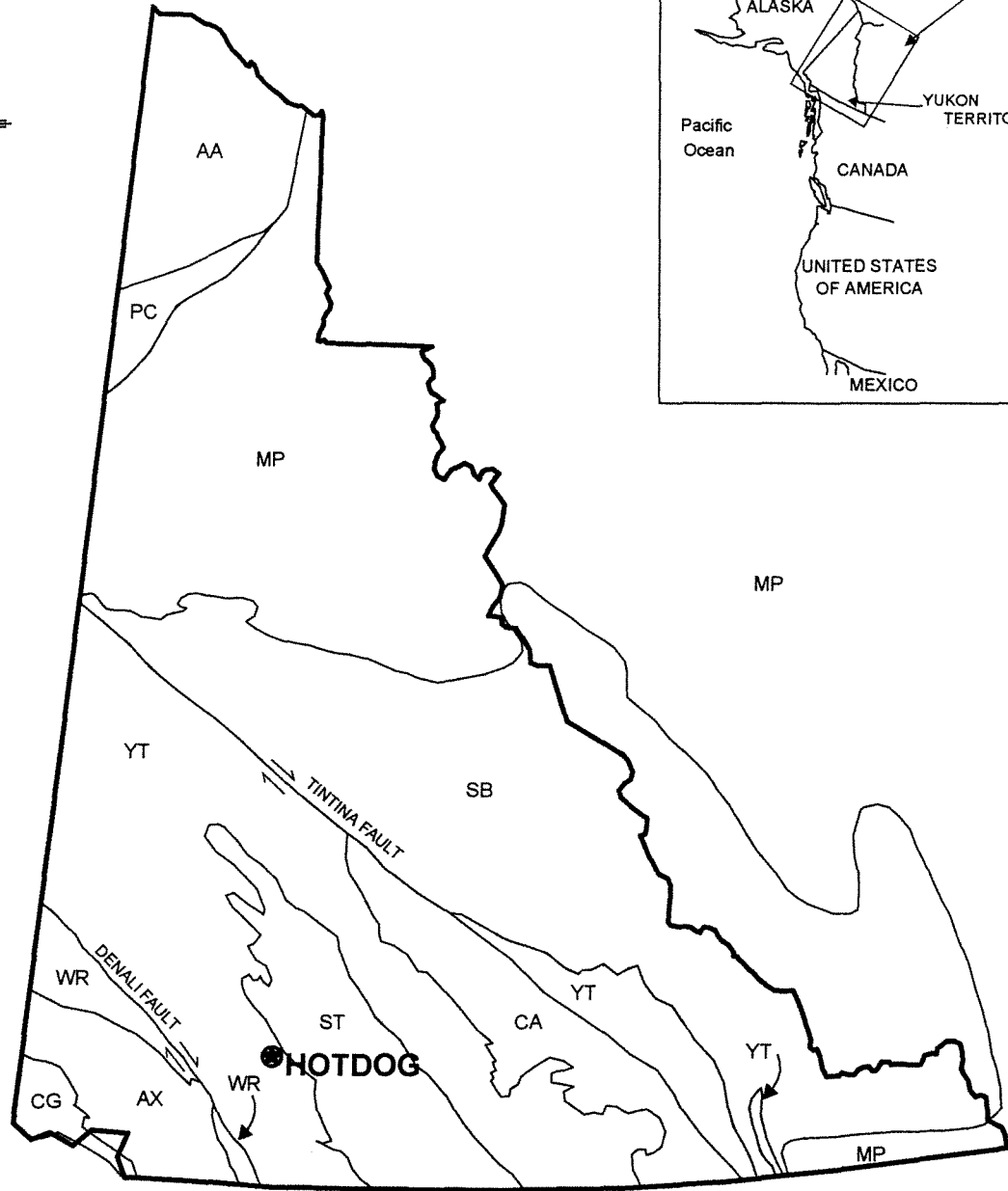
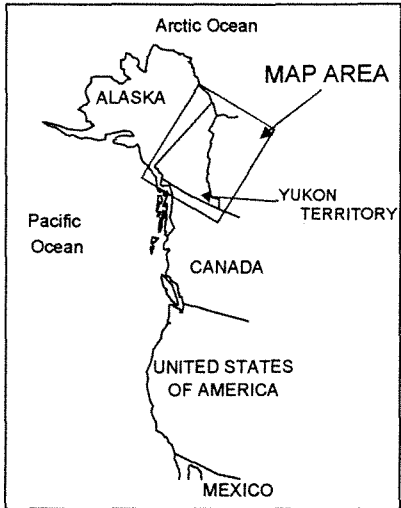

ANCESTRAL NORTH AMERICA

- MP Mackenzie Platform
- SB Selwyn Basin
- TERRANES**
- Displaced Continental Margin**
- AA Arctic Alaska
- CA Cassiar
- PC Porcupine
- Pericratonic Terranes**
- YT Yukon-Tanana / Slide Mountain

ACCRETED TERRANES

- ST Stikinia / Cache Creek
- AX Alexander
- WR Wrangellia
- CG Chugach

**CASH MINERALS LTD.
 TWENTY-SEVEN CAPITAL CORP.**

FIGURE 3

ARCHER, CATHRO & ASSOCIATES (1981) LIMITED

**REGIONAL GEOLOGY
 HOT DOG PROPERTY**

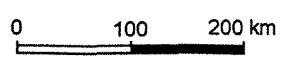

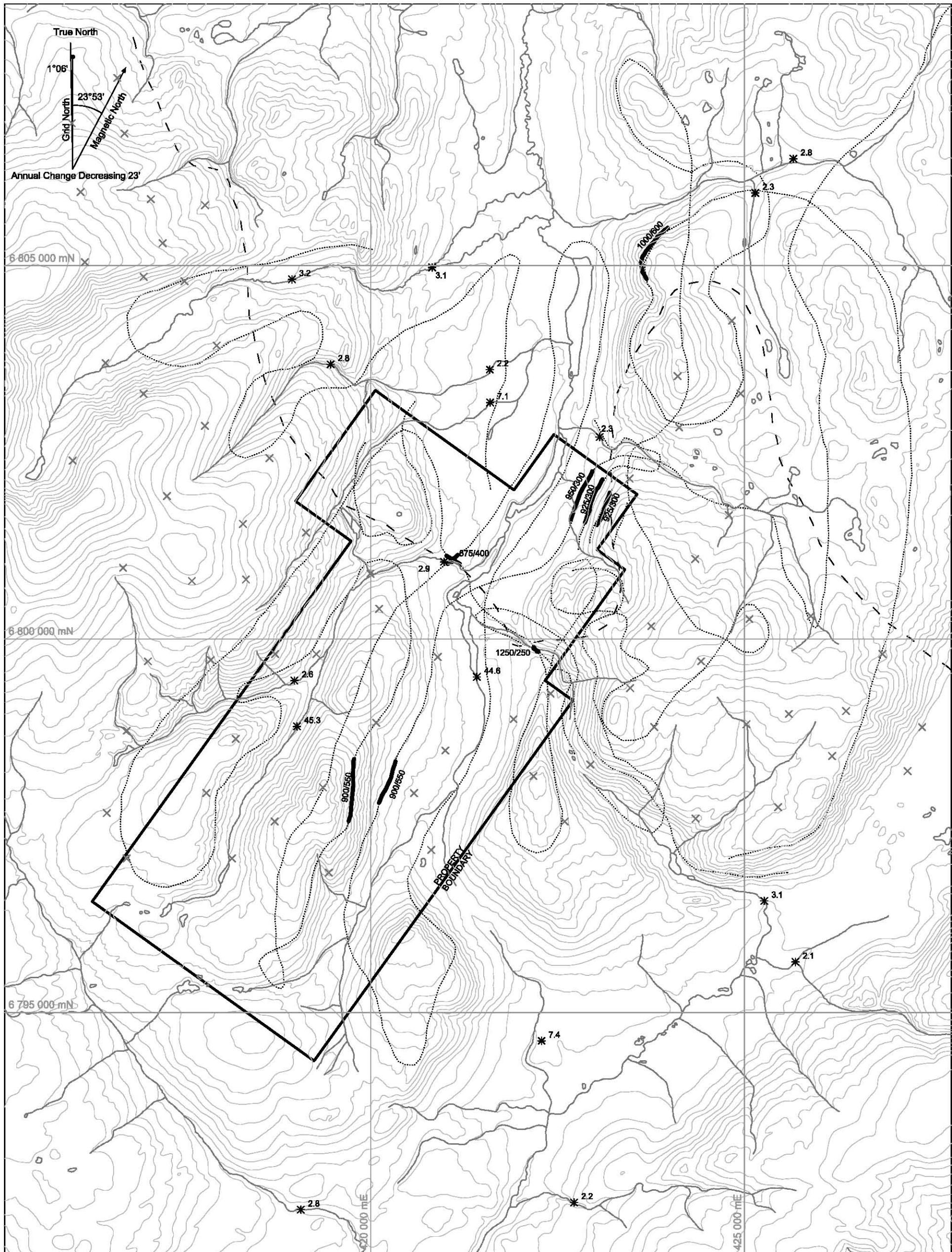

950/300 Helicopter-borne radiometric survey flight line (anomaly/background cps)

Geologic contact

* 2.3 Regional geochemical stream sediment sample (U ppm)

X Granite

Volcanics

**CASH MINERALS LTD.
TWENTY-SEVEN CAPITAL CORP.**

FIGURE 4
ARCHER, CATHRO & ASSOCIATES (1981) LIMITED
**GEOLOGY, AIRBORNE RADIOMETRICS
AND GEOCHEMISTRY**

HOT DOG PROPERTY

0 1 2 3 km
UTM ZONE 8V, NAD 83, 115H07/08

age. The quartz monzonite is typically light grey to pink weathering and contains 5 to 15 mm phenocrysts of potash feldspar. At surface, it is locally gossanous and often exhibits weak clay and/or sericite alteration especially along fractures. Pyrite and quartz are common fracture filling minerals while chalcopyrite, galena and molybdenite are present in trace amounts. Based on limited sampling by Ukon JV, the uranium content in the quartz monzonite is estimated at between 5 and 20 ppm.

Eocene volcanic flows and pyroclastic rocks overlie the granodiorite across much of the property. The contact between the two units generally dips to the northeast but is irregular because the volcanics were deposited on an old weathered surface (regolith). This assumption is supported by large quartz monzonite boulders that are surrounded by volcanic rock. The contact has not been observed in outcrop but based on observations from drill core, it is at least locally marked by poorly consolidated material. The volcanics are typically dark green trachytic andesite flows that also include amygdaloid rich, pale green rhyolite and pale green to black, sometimes finely layered tuff horizons. Magnetite, hermatite and pyrite have all been noted in the volcanics.

No large faults have been mapped on the property but air photo examination has identified a number of north trending recessive linears that could represent fault zones.

GEOCHEMISTRY

Reconnaissance scale stream sediment surveys conducted in the Hot Dog area identified 98 percentile uranium values (45.3 and 44.6 ppm) from two creeks on the property (Figure 4). Background values in the area are between 1 and 4 ppm uranium (Hornbrook, et al., 1985).

RADIOMETRIC SURVEYS

In 1976, Ukon JV flew several reconnaissance lines across the area now covered by the property with helicopter borne radiometric equipment and outlined several areas of anomalous response (Figure 4). Later that year and in 1977 it performed ground radiometric surveys with scintillometers along a portion of the quartz monzonite-volcanic contact, which had produced the strongest radiometric response from the helicopter borne surveys. The detailed surveys defined an approximately 100 m wide band of double to several times background readings that approximately coincide with the contact. The highest reading (2850 counts per second) was obtained at the site where an organic rich soil sample was collected, which assayed 0.46% U_3O_8 .

RADON GAS SURVEYS

Grid surveys were conducted in 2006 using alphaMeters to determine radon gas level in soil within and adjacent to the main radiometric anomaly. The surveys spanned an area approximately 1200 m long and 700 m wide. Readings were taken at 50 m intervals on lines spaced 100 m apart, except within a 400 by 200 m area around the main radiometric anomaly where line spacing was reduced to 50 m apart and readings were taken at 25 m intervals.

In order to ensure that the alphaMeters were reading correctly, all were tested at a common site and any that read abnormally high or low were removed from service. Additionally, when

particularly high readings were obtained on the grid, those sites were retested with different instruments to confirm the results.

Figure 5 shows results expressed as counts per day (24 hour period). The alphaMeter readings were actually recorded as cumulative counts from the time they were activated (put into the ground) until they were read the next day. Because the instruments had slightly different times in the ground, cumulative counts were divided by time in the ground expressed in hours to yield counts per hour then multiplied by 24 to determine counts per day.

DIAMOND DRILLING

General

In mid September, eight diamond drill holes totaling 434.93 m were drilled to test areas with high radon gas readings, which were thought to be underlain by volcanic rocks capping the favourable regolith horizon. The drilling was done by Full Force Diamond Drilling Ltd. of Peachland, B.C. using a Mandrill 1200 hydraulic machine with NTW equipment. The holes were drilled from hand built pads and moves were done by helicopter.

Drill hole locations are shown on Figure 5. Data related to hole depth, orientation and location are tabulated below.

<u>Hole Number</u>	<u>Easting</u>	<u>Northing</u>	<u>Depth (m)</u>	<u>Dip</u>
HD-06-1	421919	6800013	48.77	-90°
HD-06-2	421883	6800057	47.24	-90°
HD-06-3	422107	6800037	49.07	-90°
HD-06-4	422272	6800002	48.76	-90°
HD-06-5	422070	6800207	49.07	-90°
HD-06-6	422126	6800457	89.91	-90°
HD-06-7	421665	6800122	53.34	-90°
HD-06-8	421565	6800310	48.77	-90°

Downhole radiometric logging was done on holes HD06-1 to 5 using a Mount Sopris MGX II portable digital logger. The last 3 holes were not downhole logged because the radiometric equipment malfunctioned.

All core was flown from the drill site to the Division Mountain camp and was later trucked to the Archer Cathro office in Whitehorse by crew members. The core was then geotechnically logged, radiometrically logged with a hand held scintillometer and geologically logged. Radiometrically anomalous intervals were marked for sampling and were split lengthwise with a core splitter. One-half of the core from each sample interval was placed in a plastic bag along with a pre-numbered assay tag. Another portion of the same assay tag was stapled to the bottom of the core box at the start of the assay interval and the remaining half of the core was returned to the box. The core is currently stored in the yard at the Archer Cathro office complex.

The samples were shipped to ALS Chemex in North Vancouver, B.C. where they were fine crushed to better than 70% passing -2 mm, then split to produce a 250 g fraction that was

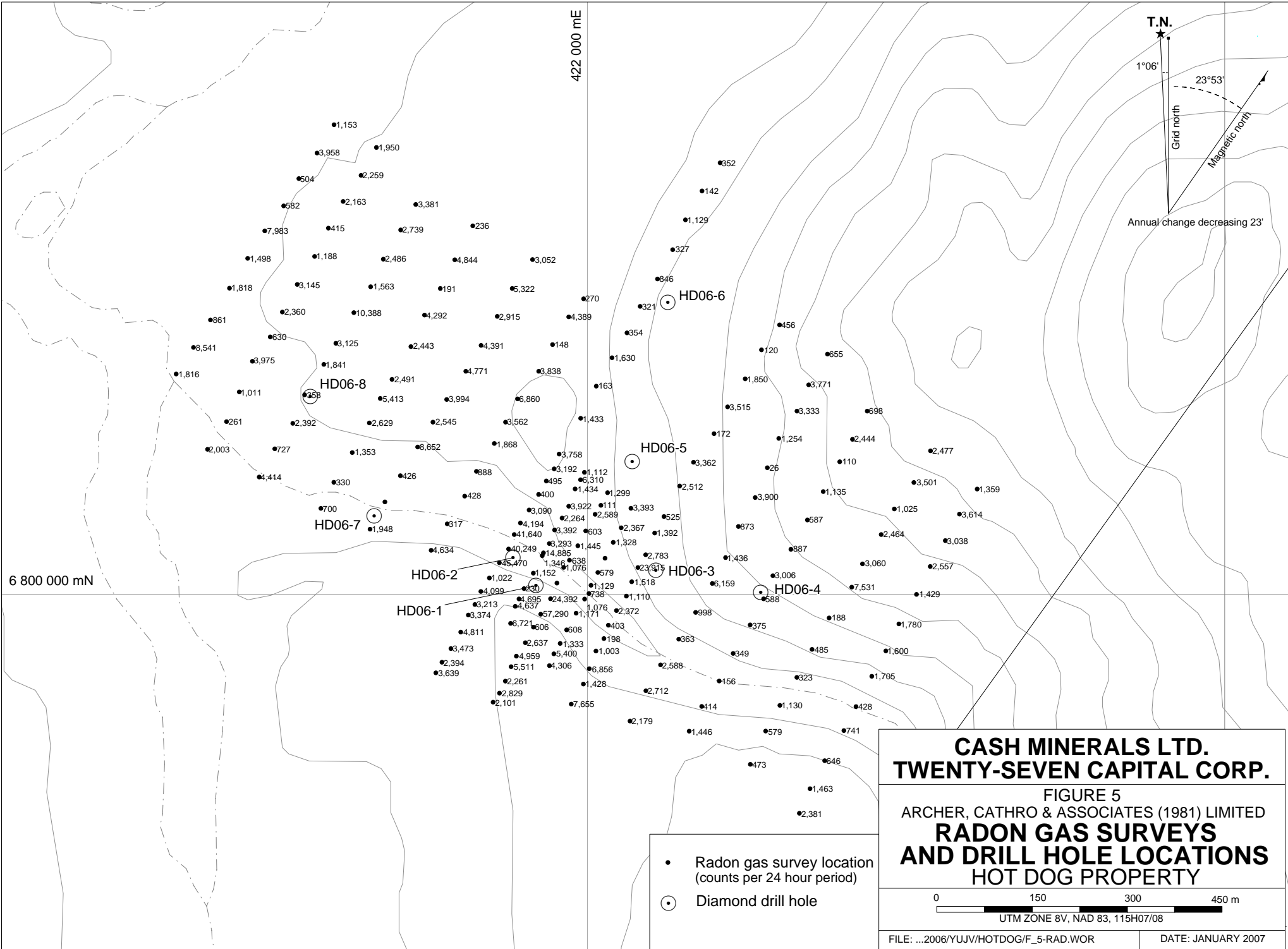

**CASH MINERALS LTD.
TWENTY-SEVEN CAPITAL CORP.**

FIGURE 5
ARCHER, CATHRO & ASSOCIATES (1981) LIMITED
**RADON GAS SURVEYS
AND DRILL HOLE LOCATIONS**
HOT DOG PROPERTY

pulverized to better than 85% passing 75 microns. From this pulverized fraction another split was taken and dissolved by aqua regia acid digestion before being analyzed for 34 elements by inductively coupled plasma with atomic emission spectroscopy. Uranium values were checked by XRF analysis of a pressed pellet. Certificate of Analysis appear in Appendix II. Drill logs are in Appendix III.

Results

The drill holes were spaced 50 to 250 m apart in a largely till and outwash covered valley bottom (Figure 5). Although they were intended to cut volcanic cover rocks, test the favourable regolith and then extend into the underlying quartz monzonite, the volcanic contact proved to be more complex than anticipated and four of the holes went directly into quartz monzonite. The highest levels of radioactivity and only significant uranium values came from hole HD-06-01, which is located near the centre of the main radiometric anomaly and within the area of highest soil radon readings. Core from 3.05 to 8.00 m averaged 0.0165% U_3O_8 across 4.95 m, with peak values of 0.0271 % U_3O_8 across 2.07 m. The highest assays are from dark grey to black tuff.

DISCUSSION AND CONCLUSIONS

Although only one hole from the 2006 drill program returned elevated uranium values, the work did confirm that uranium is concentrating along the regolith atop the weathered quartz monzonite and below the volcanic cap. Organics within the regolith appear to be reducing the uranium from oxygenated groundwater that has leaked from the quartz monzonite. Four of the eight holes were collared on the wrong side of the volcanic quartz monzonite contact and thus did not test the regolith.

The favourable contact extends for several kilometers along strike and out under the volcanic unit. Little is known about the paleosurface beneath the volcanics and old stream channels are likely present. Reconnaissance scale stream sediment geochemistry has identified two strongly anomalous values in unexplored areas on the property, while widely spaced airborne radiometric lines have detected several highs that have not been followed up.

The next stage of exploration should consist of helicopter-borne, multispectrum radiometric surveys on close spaced grid lines across the property and surrounding areas. This should be followed by detailed ground radiometric surveys and possibly radon gas surveys. If areas with radioactivity exceeding that in the vicinity of HD-06-01 are located, they should be tested with additional drilling.

Respectfully submitted

Archer, Cathro & Associates (1981) Limited

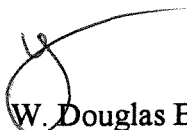
W. Douglas Eaton, B.Sc. Geology

REFERENCES

- Archer, A.R.
1977 Bun Property in 1977 Final Report for Ukon Joint Venture, unpublished report.
- Archer, A.R. and Onasick, E.P.
1976 Bun Property, assessment report filed on behalf of Ukon Joint Venture.
- Chisholm, E.O.
1970 Geochemical Soil Sampling Survey on the ED Claim Group, Yukon Territory, assessment report.
- Hornbrook, E.H.W, Friske, P.W.B., Lynch, J.J., Schmitt, H.B., Lund, N.G., Elliott, B.E. and Yelle, J.
1985 Regional Stream Sediment and Water Geochemical Reconnaissance Data, Geological Survey of Canada Open File 1219, Southern Yukon, 1985, NTS 115H.
- Tempelman-Kluit, D.J.
1973 Geology Map, Aishihik Lake, Yukon Territory.
- Gordey, S.P. and Makepeace, A.J. (compilers).
1999 Yukon Digital Geology, Geological Survey of Canada, Open File 1999 – 1(0).

APPENDIX I
STATEMENT OF QUALIFICATIONS

STATEMENT OF QUALIFICATIONS

I, W. Douglas Eaton, geologist, with business address in Whitehorse, Yukon Territory and Vancouver, British Columbia and residential address in North Vancouver, British Columbia, hereby declare that:

1. I graduated from the University of British Columbia in 1980 with a B.Sc. majoring in Geological Sciences.
2. From 1971 to present, I have been actively engaged in mineral exploration in British Columbia and Yukon Territory and on June 1, 1981, became a partner in Archer, Cathro & Associates (1981) Limited.
3. I have personally participated in or supervised the field work reported herein and have interpreted all data resulting from this work.



W. Douglas Eaton, B.Sc. Geology

APPENDIX II
CERTIFICATE OF ANALYSIS



ALS Chemex

EXCELLENCE IN ANALYTICAL CHEMISTRY

ALS Canada Ltd.

212 Brooksbank Avenue
North Vancouver BC V7J 2C1

Phone: 604 984 0221 Fax: 604 984 0218 www.alschemex.com

: TWENTY-SEVEN CAPITAL CORP
C/O ARCHER, CATHRO & ASSOCIATES (1981)
LIMITED
1016-510 W HASTINGS ST
VANCOUVER BC V6B 1L8

Page: 1
Finalized Date: 24-NOV-2006
Account: TWSEV

CERTIFICATE VA06117814

Project: Hotdog

P.O. No.:

This report is for 35 Drill Core samples submitted to our lab in Vancouver, BC, Canada on 26-OCT-2006.

The following have access to data associated with this certificate:

JOAN MARIACHER

SAMPLE PREPARATION

ALS CODE	DESCRIPTION
WEI-21	Received Sample Weight
CRU-QC	Crushing QC Test
LOG-22	Sample login - Rcd w/o BarCode
CRU-31	Fine crushing - 70% <2mm
SPL-21	Split sample - riffle splitter
PUL-31	Pulverize split to 85% <75 um

ANALYTICAL PROCEDURES

ALS CODE	DESCRIPTION	INSTRUMENT
ME-ICP41	34 Element Aqua Regia ICP-AES	ICP-AES

To: TWENTY-SEVEN CAPITAL CORP
ATTN: JOAN MARIACHER
C/O ARCHER, CATHRO & ASSOCIATES (1981) LIMITED
1016-510 W HASTINGS ST
VANCOUVER BC V6B 1L8

This is the Final Report and supersedes any preliminary report with this certificate number. Results apply to samples as submitted. All pages of this report have been checked and approved for release.

Signature:

Keith Rogers, Executive Manager Vancouver Laboratory



ALS Chemex

EXCELLENCE IN ANALYTICAL CHEMISTRY

ALS Canada Ltd.

212 Brooksbank Avenue
North Vancouver BC V7J 2C1

Phone: 604 984 0221 Fax: 604 984 0218 www.alschemex.com

TWENTY-SEVEN CAPITAL CORP
C/O ARCHER, CATHRO & ASSOCIATES (1981)
LIMITED
1016-510 W HASTINGS ST
VANCOUVER BC V6B 1L8

Page: 2 - A
Total # Pages: 2 (A - C)
Finalized Date: 24-NOV-2006
Account: TWESSEV

Project: Hotdog

CERTIFICATE OF ANALYSIS VA06117814

Sample Description	Method Analyte Units LOR	WEI-21	ME-ICP41	ME-ICP41	ME-ICP41	ME-ICP41	ME-ICP41	ME-ICP41	ME-ICP41	ME-ICP41	ME-ICP41	ME-ICP41	ME-ICP41	ME-ICP41	ME-ICP41	ME-ICP41
		Recvd Wt. kg	Ag ppm	Al %	As ppm	B ppm	Ba ppm	Be ppm	Bi ppm	Ca %	Cd ppm	Co ppm	Cr ppm	Cu ppm	Fe %	Ga ppm
		0.02	0.2	0.01	2	10	10	0.5	2	0.01	0.5	1	1	1	0.01	10
C105563		1.56	0.2	2.81	11	<10	90	7.5	<2	3.44	<0.5	18	29	52	5.47	10
C105564		1.46	0.2	2.13	38	<10	30	8.9	<2	2.07	<0.5	16	20	51	4.05	<10
C105565		3.06	<0.2	1.69	22	<10	50	11.4	<2	2.48	<0.5	13	14	40	2.89	<10
C105566		4.76	<0.2	2.55	62	<10	50	8.9	<2	2.40	<0.5	20	21	43	5.20	<10
C105567		5.52	0.2	1.74	23	<10	70	8.2	<2	1.27	<0.5	13	12	34	3.06	<10
C105568		4.60	<0.2	1.64	9	<10	60	8.9	<2	2.03	<0.5	10	10	25	3.56	<10
C105569		5.68	<0.2	0.84	17	<10	80	7.6	<2	2.39	<0.5	13	6	21	2.97	<10
C105570		5.32	0.2	1.78	26	<10	190	16.3	2	3.35	<0.5	24	13	41	5.82	<10
C105571		5.24	<0.2	0.58	20	<10	100	9.3	<2	1.29	<0.5	11	4	25	2.76	<10
C105572		4.12	<0.2	0.52	48	<10	100	3.7	<2	1.09	<0.5	10	5	15	1.30	<10
C105573		0.60	<0.2	0.10	6	<10	20	0.6	<2	0.18	<0.5	2	13	4	0.49	<10
C105574		1.46	<0.2	0.34	36	<10	70	1.1	<2	0.90	<0.5	3	5	4	0.87	<10
C105575		0.80	<0.2	0.34	130	<10	70	1.4	<2	1.24	<0.5	4	6	5	2.04	<10
C105576		1.98	<0.2	0.43	18	<10	90	1.7	<2	1.31	<0.5	2	4	4	1.05	<10
C105577		4.96	<0.2	0.29	15	<10	60	0.9	<2	0.30	<0.5	1	7	2	0.66	<10
C105578		4.34	<0.2	0.26	16	<10	150	0.6	<2	0.18	<0.5	1	6	4	0.60	<10
C105579		6.60	0.2	0.26	39	<10	80	0.6	<2	0.14	<0.5	1	9	3	0.79	<10
C105580		4.96	0.3	0.19	9	<10	30	0.6	<2	0.12	<0.5	1	8	4	0.44	<10
C105581		1.92	<0.2	2.53	<2	<10	220	3.1	<2	4.04	<0.5	20	26	105	5.02	10
C105582		6.08	<0.2	2.34	<2	<10	730	2.1	2	4.21	<0.5	20	46	97	4.82	10
C105583		4.98	<0.2	1.17	12	<10	250	10.6	<2	1.86	<0.5	11	8	25	2.48	<10
C105584		4.60	<0.2	0.54	13	<10	140	5.5	<2	1.39	<0.5	15	6	21	2.16	<10
C105585		4.82	<0.2	0.37	4	<10	70	2.1	<2	1.27	<0.5	3	8	10	1.06	<10
C105586		6.44	<0.2	0.18	3	<10	40	0.9	<2	0.43	<0.5	1	9	9	0.67	<10
C105587		5.82	<0.2	0.22	3	<10	40	0.6	<2	0.16	<0.5	1	6	4	0.77	<10
C105588		7.14	<0.2	0.27	25	<10	80	0.5	<2	0.10	<0.5	1	10	7	0.95	<10
C105589		5.22	<0.2	0.28	23	<10	130	0.8	<2	0.14	<0.5	2	6	5	0.71	<10
C105590		6.12	<0.2	3.18	<2	<10	90	<0.5	<2	1.34	<0.5	20	13	26	5.21	10
C105591		3.38	0.3	0.74	<2	<10	790	2.6	<2	4.33	<0.5	10	3	6	3.62	<10
C105592		5.64	0.2	0.33	11	<10	270	<0.5	<2	0.06	<0.5	1	5	3	0.74	<10
C105593		6.04	<0.2	0.30	2	<10	190	0.6	<2	0.08	<0.5	2	4	3	0.78	<10
C105594		6.06	0.2	0.30	2	<10	130	0.6	<2	0.07	<0.5	2	7	2	0.87	<10
C105595		6.40	0.3	0.30	5	<10	340	0.6	<2	0.05	<0.5	1	5	4	0.86	<10
C105596		5.42	0.3	0.29	<2	<10	50	0.7	<2	0.04	<0.5	1	5	2	0.70	<10
C105597		2.56	0.5	0.42	5	<10	360	1.0	<2	0.08	<0.5	2	3	3	0.58	<10



ALS Chemex

EXCELLENCE IN ANALYTICAL CHEMISTRY

ALS Canada Ltd.

212 Brooksbank Avenue
North Vancouver BC V7J 2C1

Phone: 604 984 0221 Fax: 604 984 0218 www.alschemex.com

TWENTY-SEVEN CAPITAL CORP
C/O ARCHER, CATHRO & ASSOCIATES (1981)
LIMITED
1016-510 W HASTINGS ST
VANCOUVER BC V6B 1L8

Project: Hotdog

Page: 2 - B
Total Pages: 2 (A - C)
Finalized Date: 24-NOV-2006
Account: TWESEV

CERTIFICATE OF ANALYSIS VA06117814

Sample Description	Method	ME-ICP41	ME-ICP41	ME-ICP41	ME-ICP41	ME-ICP41	ME-ICP41	ME-ICP41	ME-ICP41	ME-ICP41	ME-ICP41	ME-ICP41	ME-ICP41	ME-ICP41	ME-ICP41	ME-ICP41
	Analyte	Hg	K	La	Mg	Mn	Mo	Na	Ni	P	Pb	S	Sb	Sc	Sr	Ti
Units	ppm	%	ppm	%	ppm	ppm	%	ppm	ppm	ppm	%	ppm	ppm	ppm	ppm	%
LOR	1	0.01	10	0.01	5	1	0.01	1	10	2	0.01	2	1	1	0.01	
C105563	<1	0.15	10	1.18	1390	1	0.03	15	890	15	0.07	<2	12	797	0.01	
C105564	<1	0.10	<10	0.91	695	6	0.01	19	420	22	0.32	2	9	478	<0.01	
C105565	<1	0.16	10	0.76	585	5	0.01	12	420	16	0.41	<2	7	487	<0.01	
C105566	<1	0.10	10	1.02	1150	3	0.01	21	950	20	0.38	<2	11	584	<0.01	
C105567	<1	0.19	10	0.67	548	1	0.01	14	450	15	0.26	<2	6	428	<0.01	
C105568	<1	0.19	10	0.86	883	<1	0.01	8	370	16	0.10	<2	7	572	<0.01	
C105569	<1	0.22	10	0.88	670	3	0.01	12	430	18	0.35	<2	7	557	<0.01	
C105570	<1	0.47	20	1.55	1245	1	0.04	23	1130	29	0.24	<2	15	1030	<0.01	
C105571	<1	0.22	10	0.59	621	1	0.01	7	330	16	0.28	<2	7	442	<0.01	
C105572	<1	0.21	10	0.33	282	3	0.01	14	290	29	0.54	2	2	339	<0.01	
C105573	<1	0.04	<10	0.05	72	2	<0.01	2	30	4	0.10	<2	<1	56	<0.01	
C105574	<1	0.13	<10	0.24	391	1	0.04	3	40	23	0.34	2	<1	138	<0.01	
C105575	<1	0.13	<10	0.10	359	22	0.03	4	40	48	1.08	2	1	179	<0.01	
C105576	<1	0.20	<10	0.33	404	4	0.03	2	30	32	0.28	<2	1	225	<0.01	
C105577	<1	0.14	10	0.09	97	2	0.04	2	50	16	0.22	<2	<1	82	<0.01	
C105578	<1	0.14	<10	0.04	118	1	0.05	2	60	12	0.21	<2	<1	57	<0.01	
C105579	<1	0.15	<10	0.03	197	4	0.05	2	50	14	0.34	<2	<1	55	<0.01	
C105580	<1	0.12	10	0.02	85	3	0.02	1	20	11	0.27	<2	<1	37	<0.01	
C105581	<1	0.25	20	0.99	830	1	0.04	24	1630	15	0.24	<2	12	686	<0.01	
C105582	<1	0.21	20	1.83	890	2	0.07	24	1510	12	0.07	<2	14	483	0.01	
C105583	<1	0.22	10	0.64	720	1	0.02	9	570	13	0.18	<2	7	570	<0.01	
C105584	<1	0.21	10	0.53	487	1	0.02	10	250	25	0.44	<2	4	393	<0.01	
C105585	<1	0.15	<10	0.35	321	1	0.04	3	50	11	0.25	<2	1	259	<0.01	
C105586	<1	0.10	10	0.09	179	<1	0.04	<1	40	13	0.21	<2	1	77	<0.01	
C105587	<1	0.12	10	0.04	152	1	0.06	3	50	10	0.25	<2	<1	44	<0.01	
C105588	<1	0.16	10	0.03	145	3	0.08	3	60	12	0.57	<2	<1	36	<0.01	
C105589	<1	0.16	10	0.03	159	3	0.05	2	30	12	0.27	<2	<1	43	<0.01	
C105590	<1	0.06	10	3.69	927	<1	0.10	3	900	7	0.01	<2	14	170	0.27	
C105591	<1	0.43	20	1.45	1030	<1	0.03	<1	1320	18	0.06	<2	9	694	<0.01	
C105592	<1	0.21	<10	0.08	235	4	0.04	2	110	32	0.07	<2	<1	38	<0.01	
C105593	<1	0.19	10	0.02	294	2	0.06	2	160	15	0.16	<2	1	29	<0.01	
C105594	<1	0.20	10	0.02	446	1	0.06	3	150	13	0.28	<2	1	27	<0.01	
C105595	<1	0.21	10	0.02	347	18	0.05	2	110	21	0.36	<2	<1	29	<0.01	
C105596	<1	0.17	10	0.02	50	4	0.05	2	120	12	0.31	<2	<1	19	<0.01	
C105597	<1	0.27	10	0.02	171	42	0.02	2	100	239	0.39	<2	<1	24	<0.01	



ALS Chemex

EXCELLENCE IN ANALYTICAL CHEMISTRY

ALS Canada Ltd.

212 Brooksbank Avenue
North Vancouver BC V7J 2C1

Phone: 604 984 0221 Fax: 604 984 0218 www.alschemex.com

1: TWENTY-SEVEN CAPITAL CORP
C/O ARCHER, CATHRO & ASSOCIATES (1981)
LIMITED
1016-510 W HASTINGS ST
VANCOUVER BC V6B 1L8

Project: Hotdog

Page: 2 - C
Total # Pages: 2 (A - C)
Finalized Date: 24-NOV-2006
Account: TWSEV

CERTIFICATE OF ANALYSIS VA06117814

Sample Description	Method Analyte Units LOR	ME-ICP41	ME-ICP41	ME-ICP41	ME-ICP41	ME-ICP41
		Tl	U	V	W	Zn
		ppm	ppm	ppm	ppm	ppm
		10	10	1	10	2
C105563		<10	70	79	<10	100
C105564		<10	110	49	<10	138
C105565		<10	40	31	<10	144
C105566		<10	230	59	<10	107
C105567		<10	50	32	<10	72
C105568		<10	50	29	<10	67
C105569		<10	30	20	<10	81
C105570		<10	10	47	<10	119
C105571		<10	20	20	<10	69
C105572		<10	160	8	<10	147
C105573		<10	10	2	<10	7
C105574		<10	90	3	<10	24
C105575		<10	150	5	<10	99
C105576		<10	80	7	<10	37
C105577		<10	30	3	<10	20
C105578		<10	10	3	<10	22
C105579		<10	10	2	<10	26
C105580		<10	<10	2	<10	18
C105581		<10	<10	77	<10	76
C105582		<10	<10	110	<10	77
C105583		<10	<10	25	<10	53
C105584		<10	20	16	<10	55
C105585		<10	10	7	<10	25
C105586		<10	<10	4	<10	23
C105587		<10	<10	4	<10	24
C105588		<10	10	3	<10	24
C105589		<10	<10	2	<10	21
C105590		<10	<10	174	<10	80
C105591		<10	<10	44	<10	74
C105592		<10	<10	5	<10	10
C105593		<10	10	4	<10	13
C105594		<10	<10	4	<10	20
C105595		<10	<10	4	<10	14
C105596		<10	10	3	<10	17
C105597		<10	<10	3	<10	15

APPENDIX III

DRILL LOGS

QW28021

ARCHER, CATHRO & ASSOCIATES (1981) LIMITED
1016 – 510 West Hastings Street
Vancouver, B.C. V6B 1L8

Telephone: 604-688-2568

Fax: 604-688-2578

AFFIDAVIT

I, Joan Mariacher, of Vancouver, B.C. make oath and say:

That to the best of my knowledge the attached Statement of Expenditures for exploration work on the Hot Dog 1 and 3 to 5 mineral claims on Claim Sheet 115H/8 is accurate.

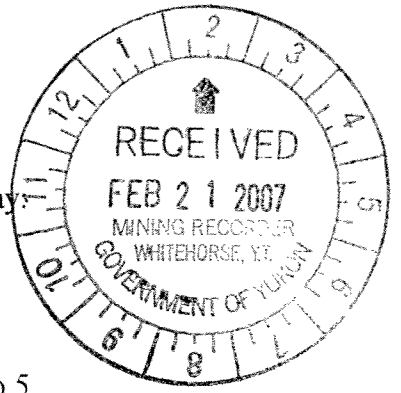

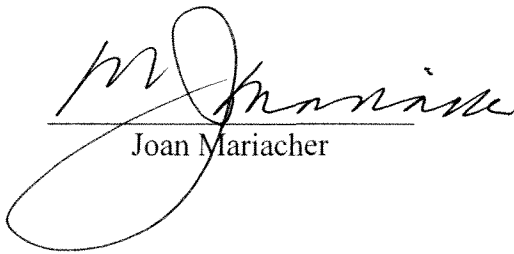
Joan Mariacher

Sworn before me at Vancouver, B.C.
this 18th day of February 2007.

Notary, Yukon Territory

Statement of Expenditures
Hot Dog 1, 3 to 5 Mineral Claims
February 15, 2007

Contract Diamond Drilling to October 4

Full Force Diamond Drilling Ltd.
DDH-01 to DDH-06 plus prorated mob/demob \$80,792.02

Contract Diamond Drilling October 5 on

Full Force Diamond Drilling Ltd.
DDH-07 and -08 plus prorated mob/demob \$19,363.50

Labour

M. Turner – geologist – 8 days at \$440/day	\$ 3,731.20
B. Duncan – field assistant – 9 days at \$256/day	2,442.24
R. Brandt – field assistant – 6 days at \$272/day	1,729.92
S. Moodie – cook – 5 days at \$480/day	<u>2,544.00</u>
	10,447.36

Labour prorated 2,452.76

Expenses

Fireweed Helicopters – 14.4 hours Hughes 500D at \$900/hr plus fuel	13,737.60
Fireweed Helicopters – 6.9 hours demob at \$900/hr plus fuel - prorated	<u>1,545.42</u>
	15,283.02

Total October 5 on \$37,099.28

DDH-01	48.77 m	\$ 11,838.91	Hot Dog 3)	
DDH-02	47.24 m	11,467.51	Hot Dog 3)	\$ 35,218.16
DDH-03	49.07 m	11,911.74	Hot Dog 3)	
DDH-04	48.76 m	11,836.48	Hot Dog 1	11,836.48
DDH-05	49.07 m	11,911.74	Hot Dog 4)	
DDH-06	89.91 m	21,825.64	Hot Dog 4)	33,737.38
DDH-07	53.34 m	19,379.84	Hot Dog 5)	
DDH-08	48.77 m	<u>17,719.44</u>	Hot Dog 5)	<u>37,099.28</u>
		\$117,891.30		\$117,891.30

Full Force Diamond Drilling Ltd.
6261 Miller Rd
Peachland BC
V0H 1X7
Tel 250-767-6457 / Fax 250-767-6459

Date Sept. 26 2006

Invoice 49738

Sold To Twenty - Seven Capital Corp.
Address 1016 - 510 West Hastings
Vancouver B.C. V6B 1L8

HOT DOG PROJECT
Sept. 19 - 22 2006 Hole HD - 06 - 01

1	Casing 3.04 @ 94.00 / m	285.76	
2	Coring 48.76 @ 94.00 / m	4,583.44	
3	Chargeable man time 82 @ 50.00 / hr / man	4,100.00	
4	Chargeable drill time 15.5 @ 85.00 / hr	1,317.50	
5	1 Drill Shift @ 950.00	950.00	<u>11,236.70</u>

Materials Consumed

1	1 Pail #1 @ 195.50ea.	195.50	<u>195.50</u>
---	-----------------------	--------	---------------

Subtotal 11,432.20

GST # 852182831

GST 6% 685.93

Total \$ 12,118.13

Handwritten mark

pd SEPT 28, 2006

0008

TOTAL - 18 695.43

Full Force Diamond Drilling Ltd.
6261 Miller Rd
Peachland BC
V0H 1X7
Tel 250-767-6457 / Fax 250-767-6459

Date Oct.2 2006

Invoice 49741

Sold To Twenty - Seven Capital Corp.
Address 1016 - 510 West Hastings
Vancouver B.C. V6B 1L8

HOT DOG PROJECT
Sept.23 - 24 2006 Hole HD - 06 - 02

1	Casing 3.65 @ 94.00 / m	343.10	
2	Coring 45.72 @ 94.00 / m	4,297.68	
3	Chargeable man time 79 @ 50.00 / hr / man	3,950.00	
4	Chargeable drill time 12.5 @ 85.00 / hr	1,062.50	
5	1 Drill Shift @ 950.00	950.00	<u>10,603.28</u>

Materials Consumed

1	1 Pail Linseed Soap @ 78.48ea.	78.48	
2	15 % s / h	11.77	<u>90.25</u>

GST # 852182831

Subtotal 10,693.53

GST 6% 641.61

Total \$ 11,335.14

AH

4

Full Force Diamond Drilling Ltd.
6261 Miller Rd
Peachland BC
V0H 1X7
Tel 250-767-6457 / Fax 250-767-6459

Date Oct.2 2006

Invoice 49742

Sold To Twenty - Seven Capital Corp.
Address 1016 - 510 West Hastings
Vancouver B.C. V6B 1L8

HOT DOG PROJECT
Sept.25 - 27 2006 Hole HD - 06 - 03

1	Casing 4.57 @ 94.00 / m	429.58	
2	Coring 49.07 @ 94.00 / m	4,612.58	
3	Chargeable man time 110 @ 50.00 / hr / man	5,500.00	
4	Chargeable drill time 7.5 @ 85.00 / hr	637.50	
5	1 Drill Shift @ 950.00	950.00	<u>12,129.66</u>

Materials Consumed

1	1 Pail # 1 @ 195.50ea.	195.50	
2	15 % s / h	29.32	<u>224.82</u>

Subtotal 12,354.48

GST # 852182831

GST 6% 741.27

Total \$ 13,095.75

AK

Full Force Diamond Drilling Ltd.
6261 Miller Rd
Peachland BC
V0H 1X7
Tel 250-767-6457 / Fax 250-767-6459

Date Oct.2 2006

Invoice 49743

Sold To Twenty - Seven Capital Corp.
Address 1016 - 510 West Hastings
Vancouver B.C. V6B 1L8

HOT DOG PROJECT
Sept.27 - 28 2006 Hole HD - 06 - 04

1	Casing 7.62 @ 94.00 / m	716.28	
2	Coring 48.76 @ 94.00 / m	4,583.44	
3	Chargeable man time 18 @ 50.00 / hr / man	900.00	
4	Chargeable drill time 3 @ 85.00 / hr	255.00	<u>6,454.72</u>

Materials Consumed

1	1 NW Shoe @ 333.50ea.	333.50	
2	15 % s / h	50.02	<u>383.52</u>

GST # 852182831

Subtotal 6,838.24

GST 6% 410.29

Total \$ 7,248.53

A k

↑

Full Force Diamond Drilling Ltd.
6261 Miller Rd
Peachland BC
V0H 1X7
Tel 250-767-6457 / Fax 250-767-6459

Date Oct. 14 2006

Invoice 49745

Sold To Twenty - Seven Capital Corp.
Address 1016 - 510 West Hastings
Vancouver B.C. V6B 1L8

HOT DOG PROJECT
Sept.28 - 30 2006 Hole HD - 06 - 05

1	Casing 3.65 @ 94.00 / m	343.10	
2	Coring 49.07 @ 94.00 / m	4,612.58	
3	Chargeable man time 52 @ 50.00 / hr / man	2,600.00	
4	Chargeable drill time 7 @ 85.00 / hr	595.00	
5	1 Drill Shift @ 950.00	950.00	<u>9,100.68</u>
		Subtotal	<u>9,100.68</u>
	GST # 852182831	GST 6%	546.04
		Total	<u>\$ 9,646.72</u>

↗

Full Force Diamond Drilling Ltd.
6261 Miller Rd
Peachland BC
V0H 1X7

Date Oct.14 2006

Tel 250-767-6457 / Fax 250-767-6459

Invoice 49746

Sold To Twenty - Seven Capital Corp.
Address 1016 - 510 West Hastings
Vancouver B.C. V6B 1L8

HOT DOG PROJECT

Oct.1 - 4 2006 Hole HD - 06 - 06

1	Casing 2.16 @ 94.00 / m	200.22	
2	Coring 59.43 @ 94.00 / m	5,586.42	
3	Chargeable man time 117 @ 50.00 / hr / man	5,850.00	
4	Chargeable drill time 19 @ 85.00 / hr	1,615.00	
5	2 Drill Shifts @ 950.00ea.	1,900.00	<u>15,151.64</u>
		Subtotal	<u>15,151.64</u>
		GST 6%	909.10
		Total	<u><u>\$ 16,060.74</u></u>

GST # 852182831

5

Full Force Diamond Drilling Ltd.

6261 Miller Rd

Peachland BC

V0H 1X7

Tel 250-767-6457 / Fax 250-767-6459

Date Oct.14 2006

Invoice 49747

Sold To Twenty - Seven Capital Corp.

Address 1016 - 510 West Hastings

Vancouver B.C. V6B 1L8

HOT DOG PROJECT

Oct.5 - 6 2006 Hole HD - 06 - 07

1	Casing 7.62 @ 94.00 / m	716.28	
2	Coring 53.34 @ 94.00 / m	5,013.96	
3	Chargeable man time 46 @ 50.00 / hr / man	2,300.00	
4	Chargeable drill time 3 @ 85.00 / hr	255.00	<u>8,285.24</u>

Materials Consumed

1	1 Pail #1 @ 195.50ea.	195.50	
2	15 % s / h	29.32	<u>224.82</u>

GST # 852182831

Subtotal 8,510.06

GST 6% 510.60

Total \$ 9,020.66

Full Force Diamond Drilling Ltd.
6261 Miller Rd
Peachland BC
V0H 1X7

Tel 250-767-6457 / Fax 250-767-6459

Date Oct.14 2006

Invoice 49748

Sold To Twenty - Seven Capital Corp.
Address 1016 - 510 West Hastings
Vancouver B.C. V6B 1L8

HOT DOG PROJECT

Oct.6 - 7 2006 Hole HD - 06 - 08

1	Casing 4.57 @ 94.00 / m	429.58	
2	Coring 48.76 @ 94.00 / m	4,583.44	
3	Chargeable man time 27 @ 50.00 / hr / man	1,350.00	
4	Chargeable drill time 1.5 @ 85.00 / hr	127.50	<u>6,490.52</u>
		Subtotal	<u>6,490.52</u>
	GST # 852182831	GST 6%	389.43
		Total	<u><u>\$ 6,879.95</u></u>

Full Force Diamond Drilling Ltd.

6261 Miller Rd

Peachland BC

V0H 1X7

Tel 250-767-6457 / Fax 250-767-6459

Date Sept.26 2006

Invoice 49737

Sold To Twenty - Seven Capital Corp.

Address 1016 - 510 West Hastings

Vancouver B.C. V6B 1L8

1	Demobilization and mobilization of crew and equipment from Magnum Property to Hot Dog Property to first hole 117.5 chargeable man hours @ 50.00 / hr / man.	5,875.00
2	1 Truck Sept. 18 - 20 @ 110.00 per day	330.00

GST # 852182831

Subtotal 6,205.00

GST 6% 372.30

Total \$ 6,577.30

pd SEPT 28, 2006

#0008

Full Force Diamond Drilling Ltd.
6261 Miller Rd
Peachland BC
V0H 1X7
Tel 250-767-6457 / Fax 250-767-6459

Date Oct.14 2006

Invoice 49749

Sold To Twenty - Seven Capital Corp.
Address 1016 - 510 West Hastings
Vancouver B.C. V6B 1L8

Oct.8 and 10 2006

1	Demobilization of crew and equipment to Whitehorse 62 man hours @ 50.00 / hr / man	3,100.00	
2	1 Truck Oct.10 @ 110.00 per day	110.00	<u>3,210.00</u>
		Subtotal	<u>3,210.00</u>
		GST 6%	192.60
		Total	<u><u>\$ 3,402.60</u></u>

GST # 852182831

Full Force Diamond Drilling Ltd.

6261 Miller Rd

Peachland BC

V0H 1X7

Tel 250-767-6457 / Fax 250-767-6459

Date Oct.14 2006

Invoice 49750

Sold To Twenty -Seven Capital Corp.

Address 1016 - 510 West Hastings

Vancouver B.C. V6B 1L8

Demobilization of equipment from Whitehorse to
to Kelowna

4,500.00

GST # 852182831

Subtotal 4,500.00

GST 6% 270.00

Total \$ 4,770.00



FLIGHT TICKET / INVOICE

WHITEHORSE DAWSON CITY
867-668-5888 ☎ **867-993-5700** No 4272
 fax: 867-668-7875 fax: 867-993-6839
 Box 26, Whitehorse, Yukon Y1A 5X9 GST # 128659828

CHARTERER <i>Archer, Cathro</i>		PILOT <i>Jeff Brown</i>		DATE <i>Oct-5/06</i>	
		SIGNATURE <i>[Signature]</i>		AIRCRAFT <i>F04S</i>	
		CHEQUE	CASH	CHARGE	TYPE <i>SOOD</i>
TELEPHONE	POSTAL CODE	PURCHASE ORDER NO.		BASE	
CUSTOMER FUEL	FLIGHT ITINERARY			PASS	TIME
LIT FROM <i>✓ Div. Mtn.</i>	<i>2 crews camp-drill, move drill, sling propane + coke boxes to drill, 1 crew to camp</i>				<i>3:3</i>
LIT FROM					
FIREWEED FUEL					
LIT FROM @ \$	<i>PM crew change</i>				<i>0:4</i>
LIT FROM @ \$					
LIT FROM @ \$					
OTHER CHARGES	DESCRIPTION	AMOUNT			
PILOT EXPENSES	DESCRIPTION	AMOUNT	RATE PER HOUR WET/DRY	TOTAL	
			<i>900.-</i>		<i>3:7</i>
	PASSENGERS (names)		FLIGHT	GST	\$
	<i>Full Force x 4</i>		<i>3330.-</i>	<i>199.80</i>	<i>\$ 3529.80</i>
	<i>AIC x 2</i>		FUEL	GST	\$
			OTHER	GST	\$
AUTHORIZED BY (print)	<i>Bruno Duncan</i>		TOTAL		<i>\$ 3529.80</i>
SIGNATURE	<i>[Signature]</i>				



FLIGHT TICKET / INVOICE

WHITEHORSE **DAWSON CITY**
867-668-5888 ☎ **867-993-5700** No 4274
fax: 867-668-7875 *fax: 867-993-6839*
 Box 26, Whitehorse, Yukon Y1A 5X9 GST # 128659828

CHARTERER <i>Archer, Cathro</i>		PILOT <i>Jeff Brown</i>		DATE <i>Oct. 6/06</i>	
		SIGNATURE <i>[Signature]</i>		AIRCRAFT <i>FoHS</i>	
		CHEQUE	CASH	CHARGE	
TELEPHONE		POSTAL CODE		PURCHASE ORDER NO.	
				BASE	
CUSTOMER FUEL <input checked="" type="checkbox"/>		FLIGHT ITINERARY		PASS	TIME
LIT FROM	<i>Div. Mth.</i>	<i>AM crew change</i>			<i>0:4</i>
LIT FROM		<i>camp-drill (scint core) - camp</i>			<i>0:4</i>
FIREWEED FUEL					
LIT FROM	@ \$	<i>camp-drill (sling timbers, drill move, lay out waterline), back to camp</i>			<i>2:1</i>
LIT FROM	@ \$				0:4
LIT FROM	@ \$				
OTHER CHARGES	DESCRIPTION	AMOUNT			
			<i>PM crew change, flips, fuel</i>		<i>0:5</i>
PILOT EXPENSES	DESCRIPTION	AMOUNT	RATE PER HOUR WET/DRY	TOTAL	
			<i>900-</i>	<i>3:4</i>	
	PASSENGERS (names)		FLIGHT	GST	
	<i>AIC x 7</i>		<i>3060.-</i>	<i>183.60</i>	<i>\$ 3243.60</i>
	<i>FF x 4</i>		FUEL	GST	\$
			OTHER	GST	\$
			TOTAL		<i>\$ 3243.60</i>
AUTHORIZED BY (print)	<i>Brian Duncan</i>				
SIGNATURE	<i>[Signature]</i>				



FLIGHT TICKET / INVOICE

WHITEHORSE **DAWSON CITY**
867-668-5888 ☎ **867-993-5700** No 4275
fax: 867-668-7875 *fax: 867-993-6839*
 Box 26, Whitehorse, Yukon Y1A 5X9 GST # 128659828

CHARTERER <i>Archer, Cathro</i>		PILOT <i>Jeff Brown</i>		DATE <i>Oct. 7 / 06</i>	
		SIGNATURE <i>[Signature]</i>		AIRCRAFT <i>Folks</i>	
		CHEQUE	CASH	CHARGE	
TELEPHONE		POSTAL CODE		PURCHASE ORDER NO.	
CUSTOMER FUEL <input checked="" type="checkbox"/>		FLIGHT ITINERARY		PASS	TIME
LIT FROM	<i>Div. Mtn.</i>	<i>All crew change, flap, fuel</i>			<i>0 15</i>
LIT FROM		<i>2 loads people to drill, drill de-mobe (partial), 3 loads people to camp, sling hole 7+8 core to camp</i>			<i>6 8</i>
FIREWEED FUEL					
LIT FROM	@ \$				
LIT FROM	@ \$				
LIT FROM	@ \$				
OTHER CHARGES	DESCRIPTION	AMOUNT			
PILOT EXPENSES	DESCRIPTION	AMOUNT	RATE PER HOUR WET <i>DRY 900.-</i>	TOTAL	<i>7 3</i>
	PASSENGERS (names)		FLIGHT <i>6570.-</i>	GST <i>394.20</i>	\$ <i>6964.20</i>
	<i>AC x 2</i>		FUEL	GST	\$
	<i>FF x 4</i>		OTHER	GST	\$
AUTHORIZED BY (print)	<i>Brendan Dunean</i>		TOTAL		\$ <i>6964.20</i>
SIGNATURE	<i>[Signature]</i>				



FLIGHT TICKET / INVOICE

WHITEHORSE **DAWSON CITY**
867-668-5888 ☎ **867-993-5700** No 4071
 fax: 867-668-7875 fax: 867-993-6839
 Box 26, Whitehorse, Yukon Y1A 5X9 GST # 128659828

CHARTERER <i>Archer, Cathro</i>		PILOT <i>Jeff Brown</i>		DATE <i>Oct. 8/06</i>	
		SIGNATURE <i>[Signature]</i>		AIRCRAFT <i>F0HS</i>	
		CHEQUE	CASH	CHARGE	TYPE <i>500D</i>
TELEPHONE	POSTAL CODE	PURCHASE ORDER NO.		BASE	
CUSTOMER FUEL <input checked="" type="checkbox"/>	FLIGHT ITINERARY			PASS	TIME
LIT FROM <i>Div. Mtn.</i>	<i>Finish drill de-mobe from Hot Dog - Division Mtn.</i>				<i>6:2</i>
LIT FROM					
FIREWEED FUEL	<i>Div. Mtn. - Fireweed Base (Whitehorse)</i>				
LIT FROM @ \$					
LIT FROM @ \$					
LIT FROM @ \$					
OTHER CHARGES	DESCRIPTION	AMOUNT			
PILOT EXPENSES	DESCRIPTION	AMOUNT	RATE PER HOUR WET/DRY	TOTAL	
			<i>900.-</i>		<i>6:9</i>
	PASSENGERS (names)		FLIGHT	GST	\$
	<i>FF x 2</i>		<i>6210.-</i>	<i>372.60</i>	<i>6582.60</i>
			FUEL	GST	\$
			OTHER	GST	\$
AUTHORIZED BY (print)			TOTAL		\$ <i>6582.60</i>
SIGNATURE X					

ARCHER, CATHRO & ASSOCIATES (1981) LIMITED

In Account With

Project *HOT DOG PROPERTY*
 Date *OCTOBER 2006*

LABOUR

Field	Description	Amount	
	<i>D. EATON - 5 HR AT 80/HR</i>	<i>400.00</i>	
	<i>D. HUSTON - 58 HR AT 60/HR</i>	<i>3480.00</i>	
	<i>K. LESNIKOV - 24 HR AT 60/HR</i>	<i>1440.00</i>	
	<i>B. JOHNSON - 15 DAY AT 336/DAY</i>	<i>5040.00</i>	
	<i>G. JOHNS - 3 HR AT 55/HR</i>	<i>165.00</i>	
	<i>M. TURNER - 64 HR AT 55/HR</i>	<i>3520.00</i>	
	<i>B. BRANT - 10 1/2 DAY AT 271/DAY</i>	<i>2856.00</i>	
	<i>D. CARNE - 5 1/2 DAY AT 271/DAY</i>	<i>1496.00</i>	
	<i>S. MOORE - 8 DAY AT 480/DAY</i>	<i>3840.00</i>	
	<i>M. GONZALEZ - 5 1/2 HR AT 36/HR</i>	<i>198.00</i>	
	<i>M. WONG - 4 HR AT 36/HR</i>	<i>144.00</i>	
Accounting and Expediting	<i>J. Mariacher - 2 1/2 hrs at \$65/hr</i>	<i>157.50</i>	
	<i>L. CORBETT - 1 1/2 HR AT 60/HR</i>	<i>90.00</i>	<i>24245.25</i>
OTHER SERVICES			
Room and Board in Whitehorse	<i>19 days at \$100/day</i>	<i>1900.00</i>	
Field equipment from AC stock	<i>58 DAY AT 55/DAY</i>	<i>3190.00</i>	
Printing	<i>Photocopies @.15</i>		
Rentals from AC			
	<i>PROPANE FROM ACBI STOCK</i>	<i>846.08</i>	
	<i>2 JETB BOT FROM MAGNUM</i>	<i>912.76</i>	
	<i>4 JETB BOT FROM MAGNUM</i>	<i>1825.52</i>	
	<i>4 DIESEL BOT FROM RANCHERIA 4 T100</i>	<i>912.00</i>	<i>9586.36</i>