

ARCHER, CATHRO & ASSOCIATES (1981) LIMITED
1016 -510 West Hastings Street
Vancouver, B.C. V6B 1L8

Telephone: 604-688-2568

Fax: 604-688-2578

ASSESSMENT REPORT

describing

GEOLOGY AND GEOCHEMISTRY

at the

TIMBER PROPERTY

Timber 1-16 Claims

YC29084-YC29099

located at

Latitude 63°13' N; Longitude 131°32' W
NTS 105J/3

in

Watson Lake Mining District
Central Yukon Territory

prepared by

Archer, Cathro & Associates (1981) Limited

for

STRATEGIC METALS LTD.

by

W. Douglas Eaton, B.Sc. Geology
January 2006

TABLE OF CONTENTS

	<u>PAGE</u>
INTRODUCTION	1
PROPERTY, LOCATION AND ACCESS	1
GEOMORPHOLOGY	1
REGIONAL GEOLOGY	2
PROPERTY GEOLOGY	2
MINERALIZATION	3
SOIL GEOCHEMISTRY	3
CONCLUSIONS	4

APPENDICES

- I AUTHOR'S STATEMENTS OF QUALIFICATIONS
- II CERTIFICATES OF ANALYSIS

FIGURES

<u>Number</u>		<u>Following Page</u>
1	Property Location	1
2	Claim Location	1
3	Regional Geology	2
4	Property Geology	2
5	Sample Location	3
6	Copper Geochemistry	4
7	Molybdenum Geochemistry	4
8	Silver Geochemistry	4
9	Lead Geochemistry	4
10	Zinc Geochemistry	4

INTRODUCTION

The Timber property is owned 100% by Strategic Metals Ltd. and was acquired by staking in July 2005. It hosts copper, molybdenum and silver soil geochemical anomalies that may mark a high level porphyry style deposit.

The area was previously staked as part of a larger claim block by SMD Mining Co. in 1981 (Walker, 1981). Exploration by SMD consisted of geological mapping and soil geochemistry that year and additional mapping and sampling plus magnetic and induced polarization surveys in 1982 (Walker, 1982). The claims were transferred in 1987 to A & M Exploration Ltd., which reanalyzed soil samples for gold and arsenic and blasted test pits.

The 2005 work program was designed to confirm the geochemical anomalies identified by previous operators and to obtain more complete, multi-element data. The work targeted porphyry copper-molybdenum potential with a particular bias toward possible silver enrichment. It was done between August 3 and 10 by a four person crew from a tent camp on the property. The program was managed by Archer, Cathro & Associates (1981) Limited and was performed under the author's supervision. The Author's Statement of Qualifications appears in Appendix I.

PROPERTY, LOCATION AND ACCESS

The Timber property consists of 16 contiguous mineral claims located in central Yukon at latitude 63°13' N and longitude 131°32'W on NTS 105J/3 (Figure 1). The claims are registered with the Watson Lake Mining Recorder in the name of Archer, Cathro & Associates (1981) Limited, which holds them in trust for Strategic. Claim registration data are listed below while the locations of individual claims are shown on Figure 2.

<u>Claim Name</u>	<u>Grant Number</u>	<u>Expiry Date*</u>
Timber 1-16	YC29084-YC29099	July 20, 2006

*does not include assessment credit for 2005 work described in this report

The Timber claims are situated 50 km northeast of the village of Ross River and 7 km east of the North Canol Road. Access in 2005 was by Bell 206B helicopter operating from the Trans North Helicopter base in Ross River.

GEOMORPHOLOGY

The property lies on the eastern flank of the Ross River Valley. Most of it is situated on a steep, west facing sidehill. Local elevations range from about 900 m on the valley floor to 1500 m atop a ridge immediately east of the property. Although the terrain is relatively rugged, outcrop is sparse. The best exposures are on glacially scoured hummocks near the ridge crest and on oversteepened hillsides where soil has washed away.

STRATEGIC METALS LTD.

FIGURE 1

ARCHER, CATHRO & ASSOCIATES (1981) LIMITED

**PROPERTY LOCATION
TIMBER PROPERTY**

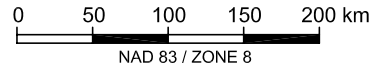

FILE: ...2006/TIMBER/F_1-LOCATION.DWG

JANUARY 2006

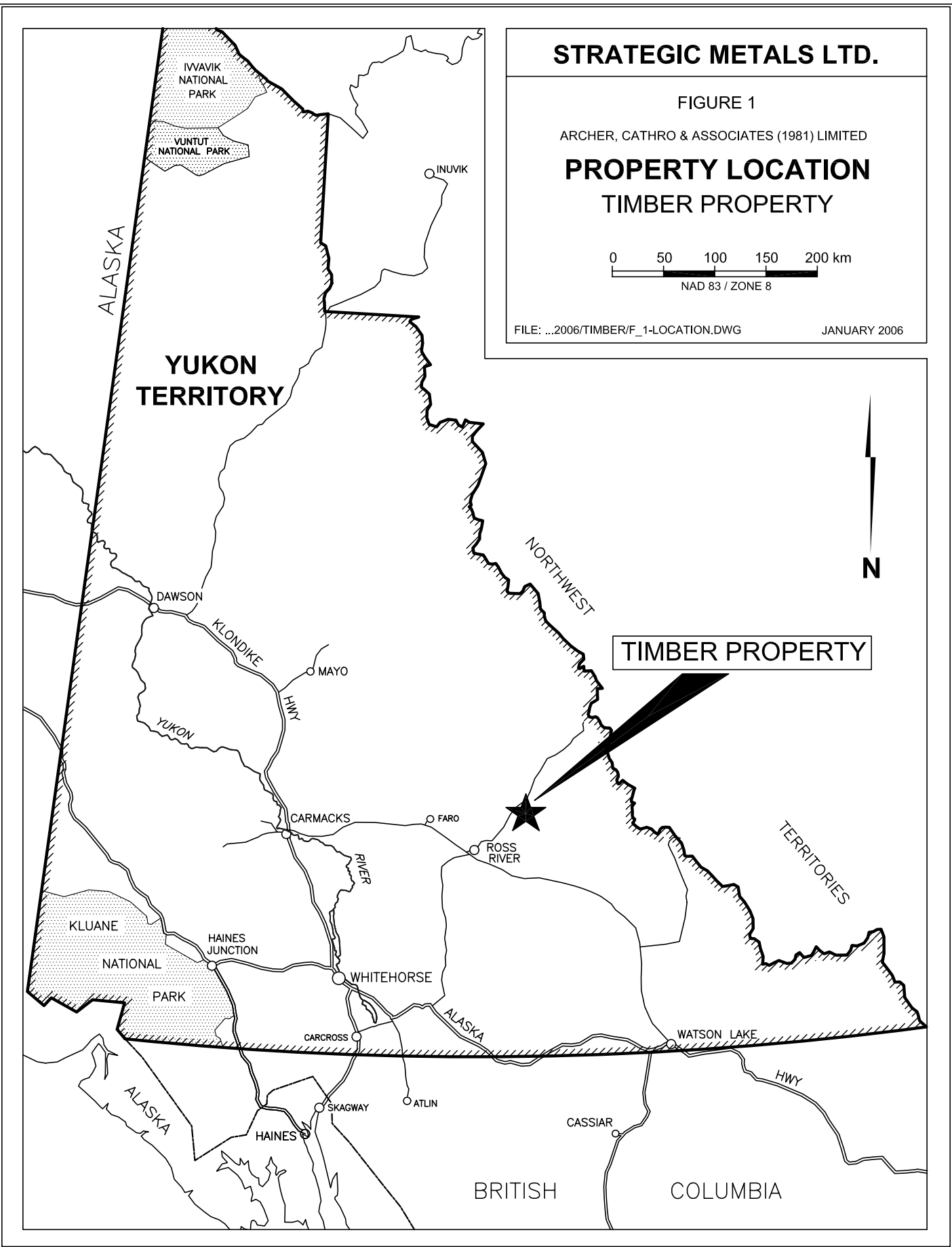

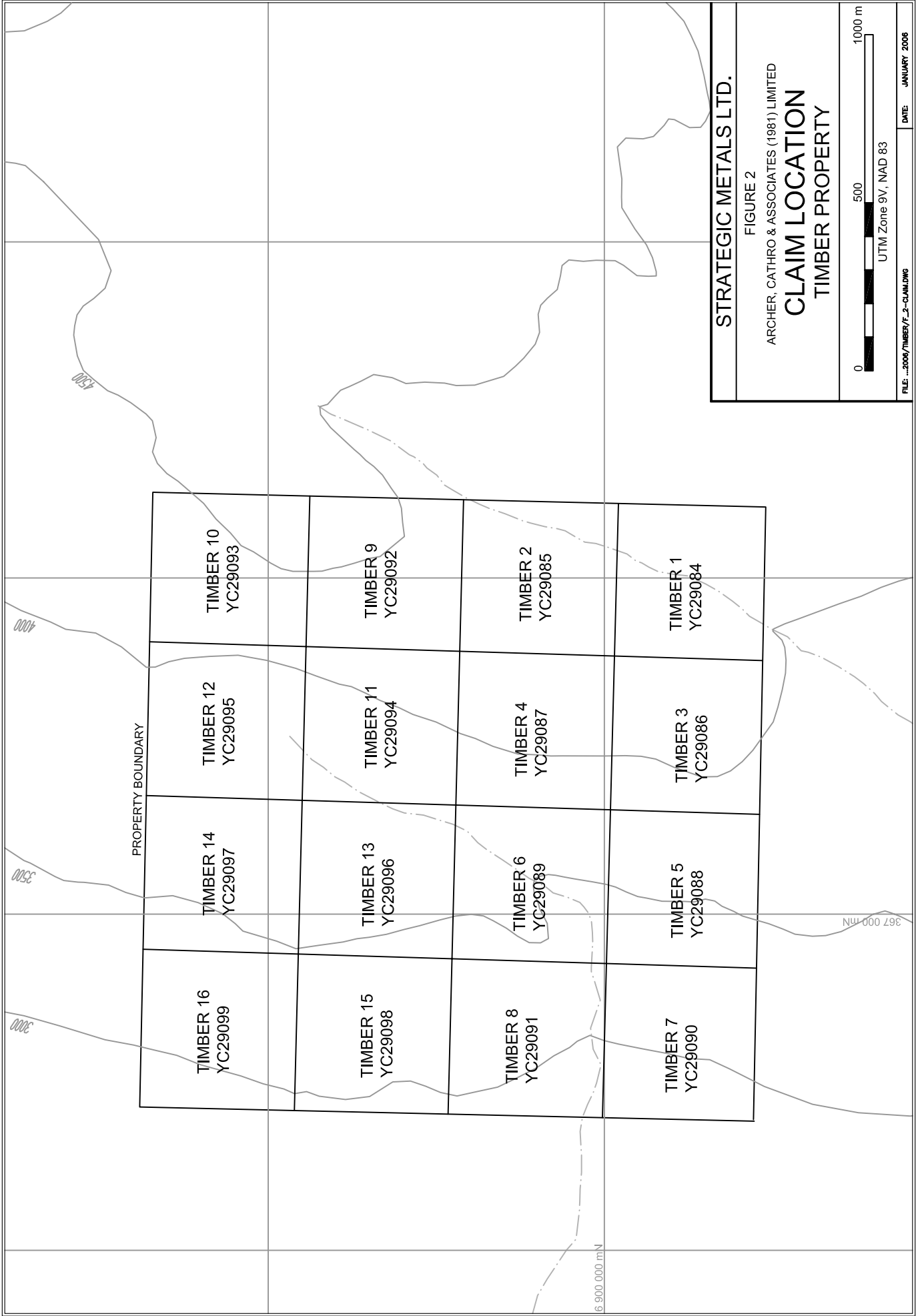

STRATEGIC METALS LTD.

FIGURE 2

ARCHER, CATHRO & ASSOCIATES (1981) LIMITED

**CLAIM LOCATION
TIMBER PROPERTY**

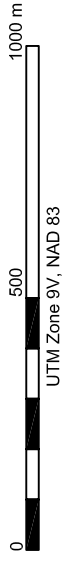

Soil development and thickness are variable. Maximum depths are reached near the valley floor and on an upland plateau in the east-central part of the claim block. Glacial transport and soil creep have both affected soil development. Interpretation of glacial transport could be complex because the main ice movement in the area was northwesterly but local valley glaciation likely moved southwesterly down the valley.

A number of small lakes are situated on the valley floor immediately west of the property and on the upland plateau to the southeast. The only flowing water on the claim block is a small creek that flows south before hooking to the west to drain into a swampy lowland alongside the Ross River. The Ross River is a tributary of the Pelly River, which is part of the Yukon River watershed.

Much of the claim block is heavily vegetated with stunted black spruce or slide alder growing in an old forest fire burn. A stand of mature black spruce up to 10 m tall flanks the creek. Moss is the most common ground cover, particularly in areas underlain by permafrost. Tree line is about 1350 m.

REGIONAL GEOLOGY

The Timber property is located in the Selwyn Basin tectonic element, approximately 50 km northeast of the Tintina Fault (Figure 3). The most recent published maps (Gordey and Irwin, 1987) show that the property and surrounding area are underlain by Ordovician to Silurian Road River Formation and Devonian to Mississippian Earn Group sedimentary units cut by Mid Cretaceous granitic intrusions. The intrusions and sediments are partially capped to the east by Late Cretaceous volcanic and volcanoclastic strata of the South Fork Volcanics.

Unpublished mapping by Cyprus Anvil geologists (A.R.O.F., 1980) depicts a similar environment with a sequence of Late Precambrian to Upper Devonian sediments draped around west-northwest trending fold axes, again cut by Mid Cretaceous stocks and plugs and capped by Late Cretaceous volcanic and volcanoclastic units belonging to the South Fork Volcanics. The main difference is that the Ordovician to Silurian sediments are shown as Rabbitkettle Formation rather than Road River Formation.

PROPERTY GEOLOGY

The sediments in the immediate vicinity of the property are assigned to the Rabbitkettle Formation and Earn Group while the main intrusions belong to the Tay River Suite (Figure 4). In addition to the main units, there are a series of younger dykes in the southern part of the property. It is uncertain whether these dykes are associated with the Tay River Suite, the South Fork Volcanics or an independent event, such as Tertiary age dykes and plugs reported in the vicinity of the Tintina Fault. Main lithologies on the property are briefly described in the following paragraphs.

Sedimentary Rocks are dominantly grey to black siliceous clastics, which vary from mudstone to fine sandstone and often exhibit fine laminations. Chert pebble conglomerate, black chert and pyritic and carbonaceous shales are relatively common on the northern edge of the property.

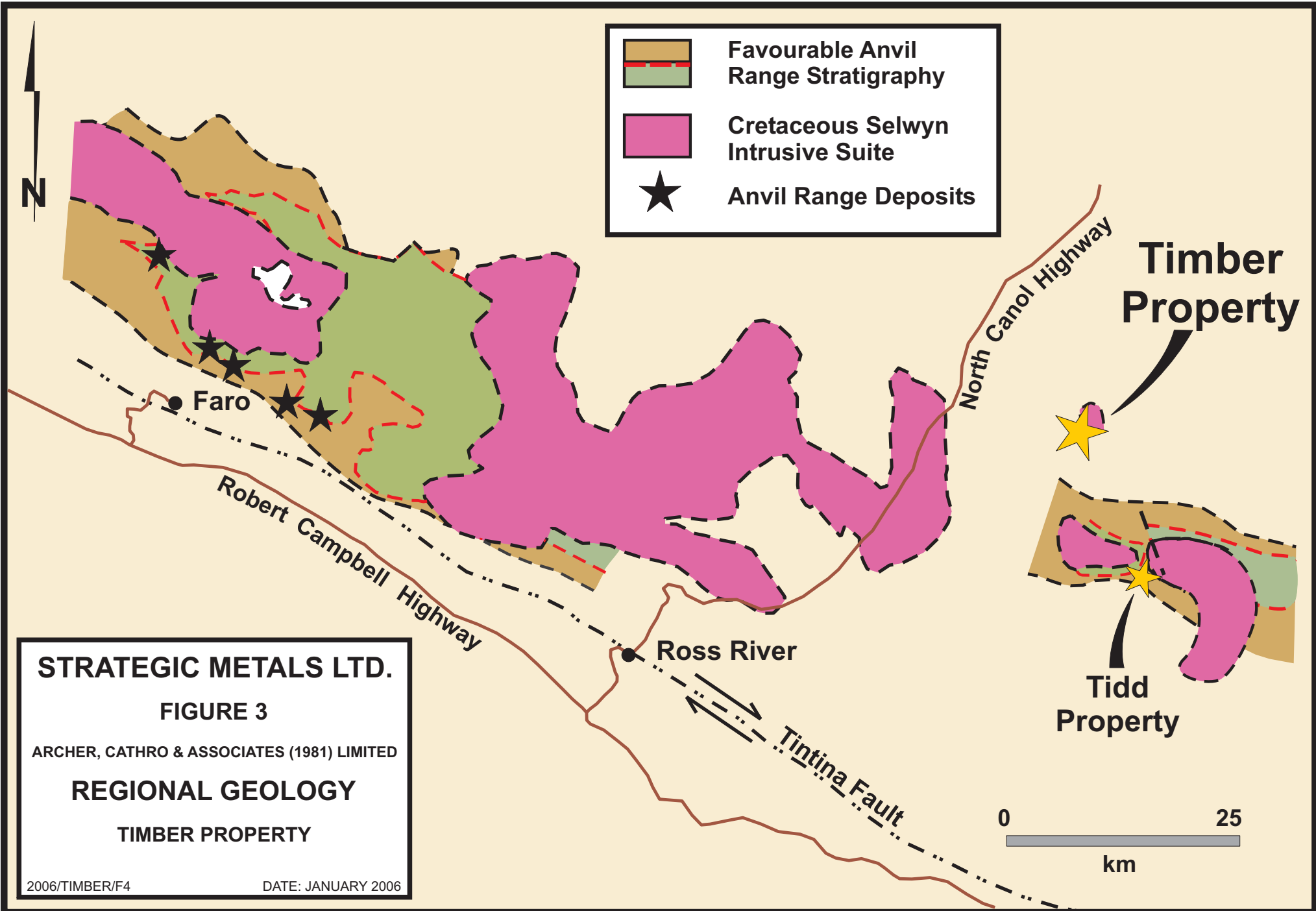

STRATEGIC METALS LTD.

FIGURE 3

ARCHER, CATHRO & ASSOCIATES (1981) LIMITED

REGIONAL GEOLOGY



TIMBER PROPERTY

2006/TIMBER/F4







DATE: JANUARY 2006

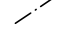

INTRUSIVE ROCKS

-  Fine grained equigranular to porphyritic qtz-hbl-bio granodiorite to qtz diorite
-  Fine grained aphanitic to microscopic apite to porph qtz rhyolite dyke rocks

HORNFELS ZONE

-  Pale grey to green bleached and silicified sediments
-  Intense quartz stockwork and breccia veining
-  Quartz +/- carbonate veining
-  Skarn zones mineralized with cpy, sph +/- gal, py and po
-  Cpy, sph and gal bearing carbonate / quartz cemented breccia
-  IP anomaly

STRATEGIC METALS LTD.

FIGURE 4
ARCHER, CATHRO & ASSOCIATES (1981) LIMITED
PROPERTY GEOLOGY
TIMBER PROPERTY

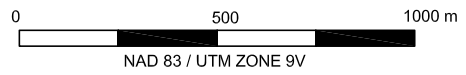

Grey limestone and calcareous siltstone are minor constituents of the stratigraphy. All of the sediments are thermally metamorphosed to varying degrees by the intrusions. Hornfels is more common than skarn, which is localized within limy units. The largest, most intense hornfels zone is an approximately 1000 m diameter area that is extensively intruded by aplite/rhyolite dykes. This zone also contains mineralized quartz vein stockwork and breccia. Other hornfels zones form 200 to 300 m wide halos surrounding granodiorite plugs.

Granodiorite occurs in a series of circular to north-northeasterly elongated plugs. This unit ranges in composition from quartz-hornblende-biotite granodiorite to quartz diorite.

Aplite/Rhyolite forms a swarm of dykes that trend northwesterly or northeasterly. The dykes range from equigranular fine grained aplite to porphyritic quartz-feldspar rhyolite. The orientations of the dykes parallel the two main fracture sets on the property.

MINERALIZATION

The most widespread mineralization consists of chalcopyrite and molybdenite in quartz veinlets within a 1000 m diameter stockwork/breccia zone centred on the aplite/rhyolite dyke swarm in the southern part of the property. Ground magnetic surveys conducted by SMD indicate this zone is underlain by a “plug-like” body at moderate depth (Walker, 1982).

Skarn mineralization has been identified at several locations on and adjacent to the property. Most of these showings consist of pale green to white, siliceous diopside bearing skarn with disseminated, blebby and fracture filling chalcopyrite and galena.

SOIL GEOCHEMISTRY

General

Soil geochemical sampling was intended to be done at 50 m intervals on east-west trending lines spaced 100 m apart. However, many proposed sites were not sampled because of thick accumulations of frozen organics or sand which appears to have washed into an upland basin. Sample lines were oriented using a compass and lengths were established using hip-chains. Survey control was provided by a central baseline oriented north-south with periodic checks using GPS readings. Sample sites are marked by 0.5 m wooden lath bearing metal tags inscribed with the grid co-ordinates and sample numbers. Soil samples were taken from B horizon material at depths ranging from 20 to 100 cm below surface. Figure 5 shows soil sample locations.

At the completion of the program, the crew transported the samples to Whitehorse where they were shipped by Greyhound Courier Express to ALS Chemex in North Vancouver, British Columbia. At ALS Chemex, the samples were dried, sieved to 180 microns (-80 mesh) and routinely analyzed for 34 elements using aqua regia digestion followed by inductively coupled plasma with atomic emission spectroscopy (ICP-AES). Some of the sample pulps were later reanalyzed for resistate elements using HF-HN₃-HClO₄ acid digestion followed by HCl leach and ICP-AES finish, and for gold using fire assay followed by atomic absorption. Appendix II

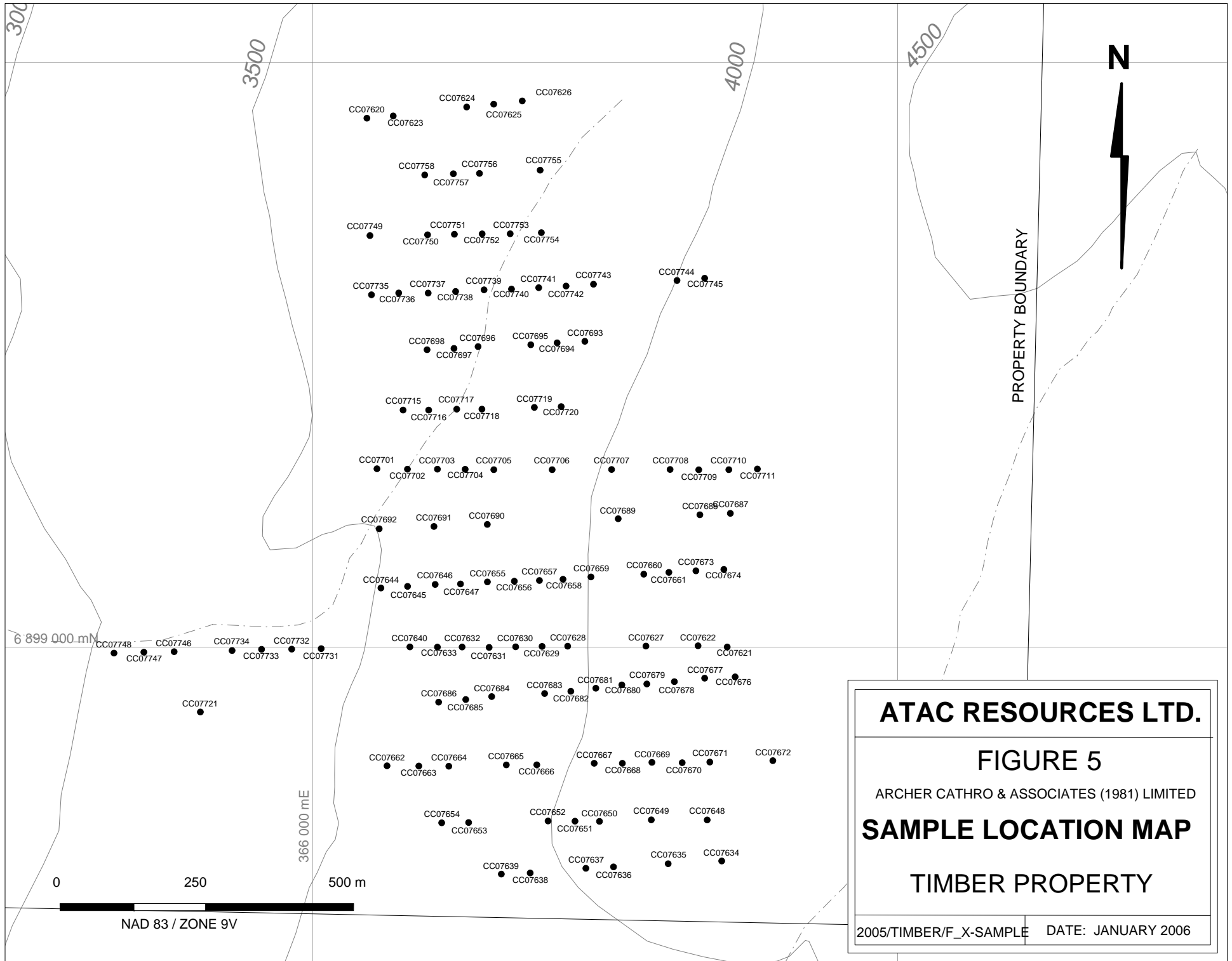

ATAC RESOURCES LTD.

FIGURE 5

ARCHER CATHRO & ASSOCIATES (1981) LIMITED

SAMPLE LOCATION MAP

TIMBER PROPERTY

2005/TIMBER/F_X-SAMPLE DATE: JANUARY 2006

contains Certificates of Analysis.

Results

Figures 6 through 10 illustrate contoured results for copper, molybdenum, silver, lead and zinc, respectively. These metals demonstrate relatively well defined “bulls’ eye” zoning with moderately to strongly anomalous molybdenum values in the core flanked by high copper, silver, lead and zinc values. Peak values are 2300 ppm copper, 81 ppm molybdenum, 13.1 ppm silver, 146 ppm lead and 2070 ppm zinc.

The highest soil values approximately coincide with the aplite/rhyolite dyke swarm and the surrounding quartz stockwork/breccia zone, which are both located in the southern part of the property.

CONCLUSIONS

The soil geochemical anomalies appear to mark the upper fringes of a porphyry style system. The geochemical anomalies are weaker and less continuous than would be expected directly above an outcropping deposit; however, the best part of the porphyry mineralization at Timber is likely buried.

Future work should consist of ground magnetic and deep array IP surveys using modern equipment. Diamond drilling will be required to test any geophysical anomalies.

Respectfully submitted,

ARCHER, CATHRO & ASSOCIATES (1981) LIMITED

W. Douglas Eaton, B.Sc., Geology

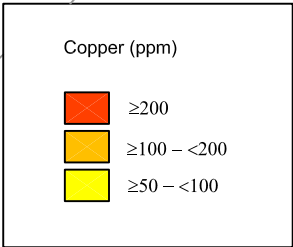
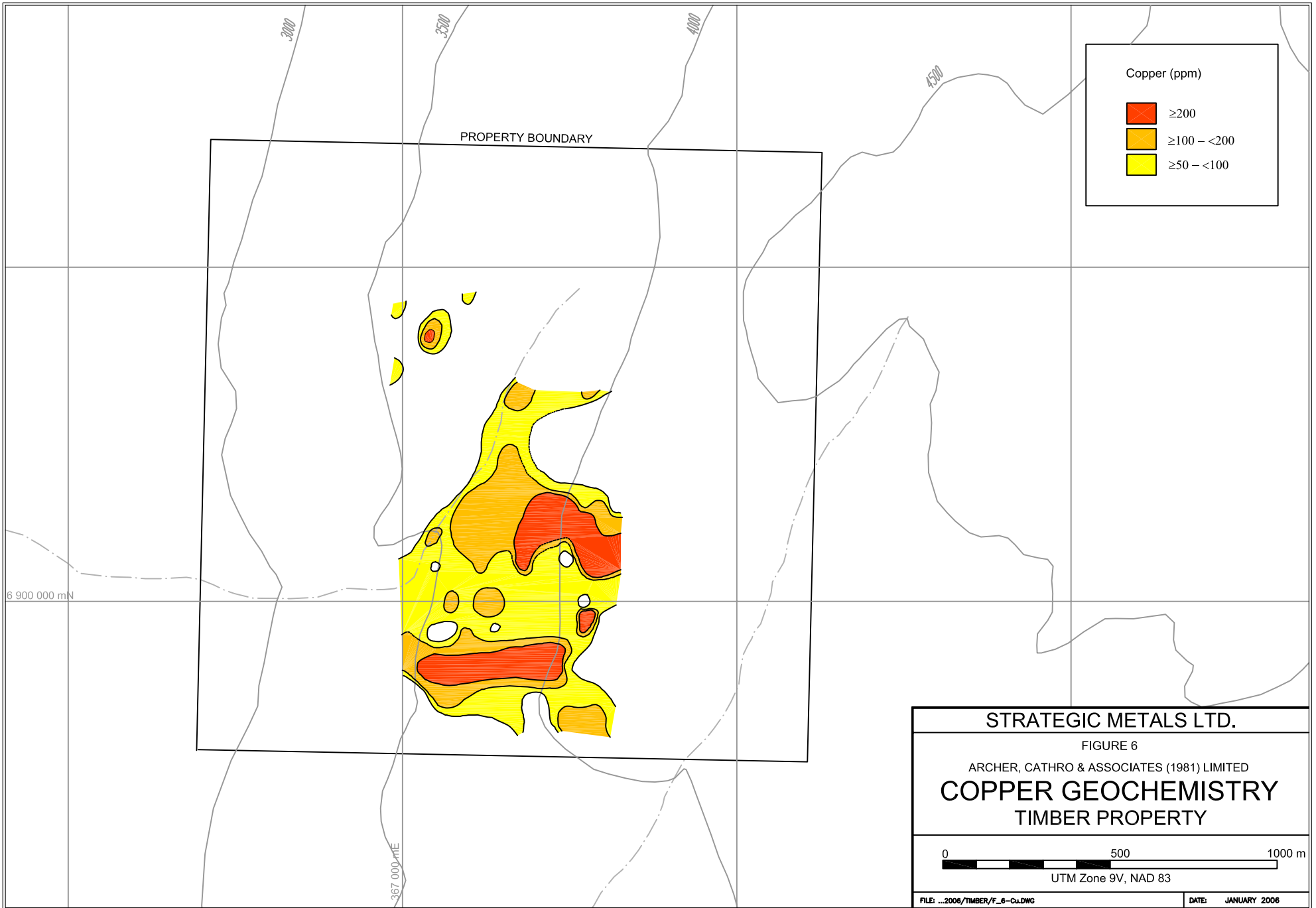

STRATEGIC METALS LTD.

FIGURE 6
 ARCHER, CATHRO & ASSOCIATES (1981) LIMITED
COPPER GEOCHEMISTRY
 TIMBER PROPERTY

0 500 1000 m

UTM Zone 9V, NAD 83

FILE: ...2006/TIMBER/F_6-C.dwg DATE: JANUARY 2006

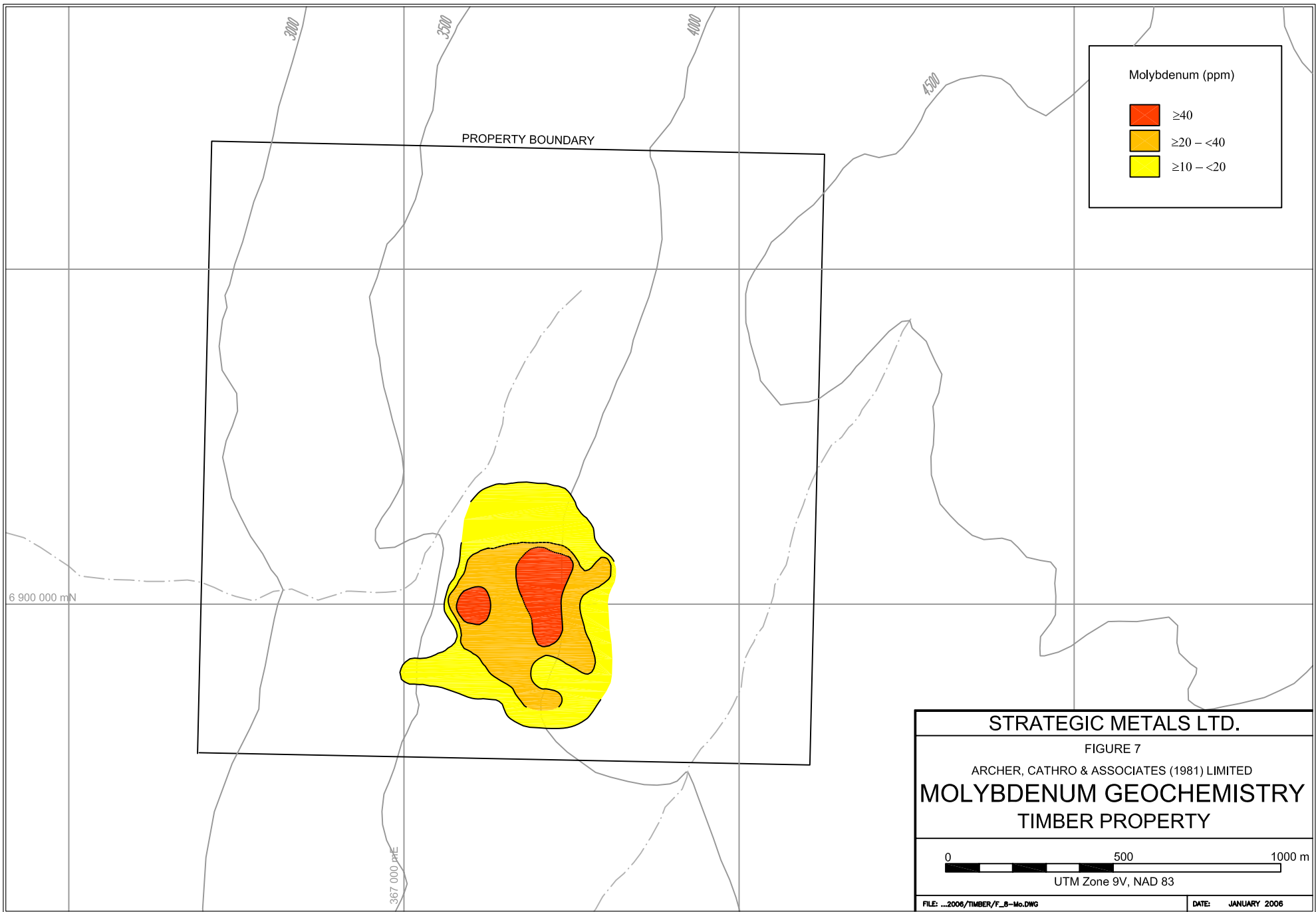

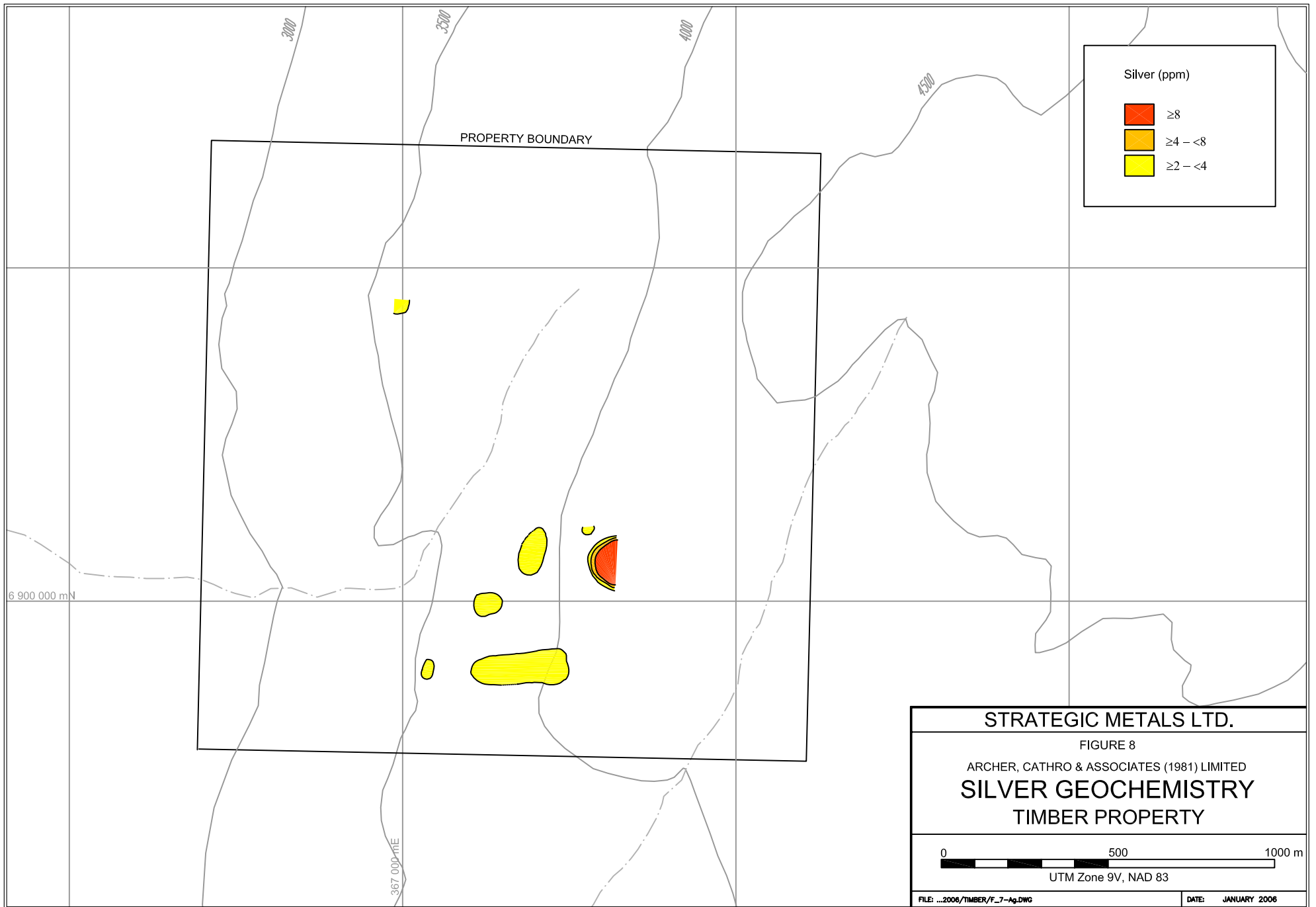

STRATEGIC METALS LTD.

FIGURE 8

ARCHER, CATHRO & ASSOCIATES (1981) LIMITED
SILVER GEOCHEMISTRY
 TIMBER PROPERTY

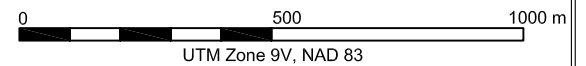

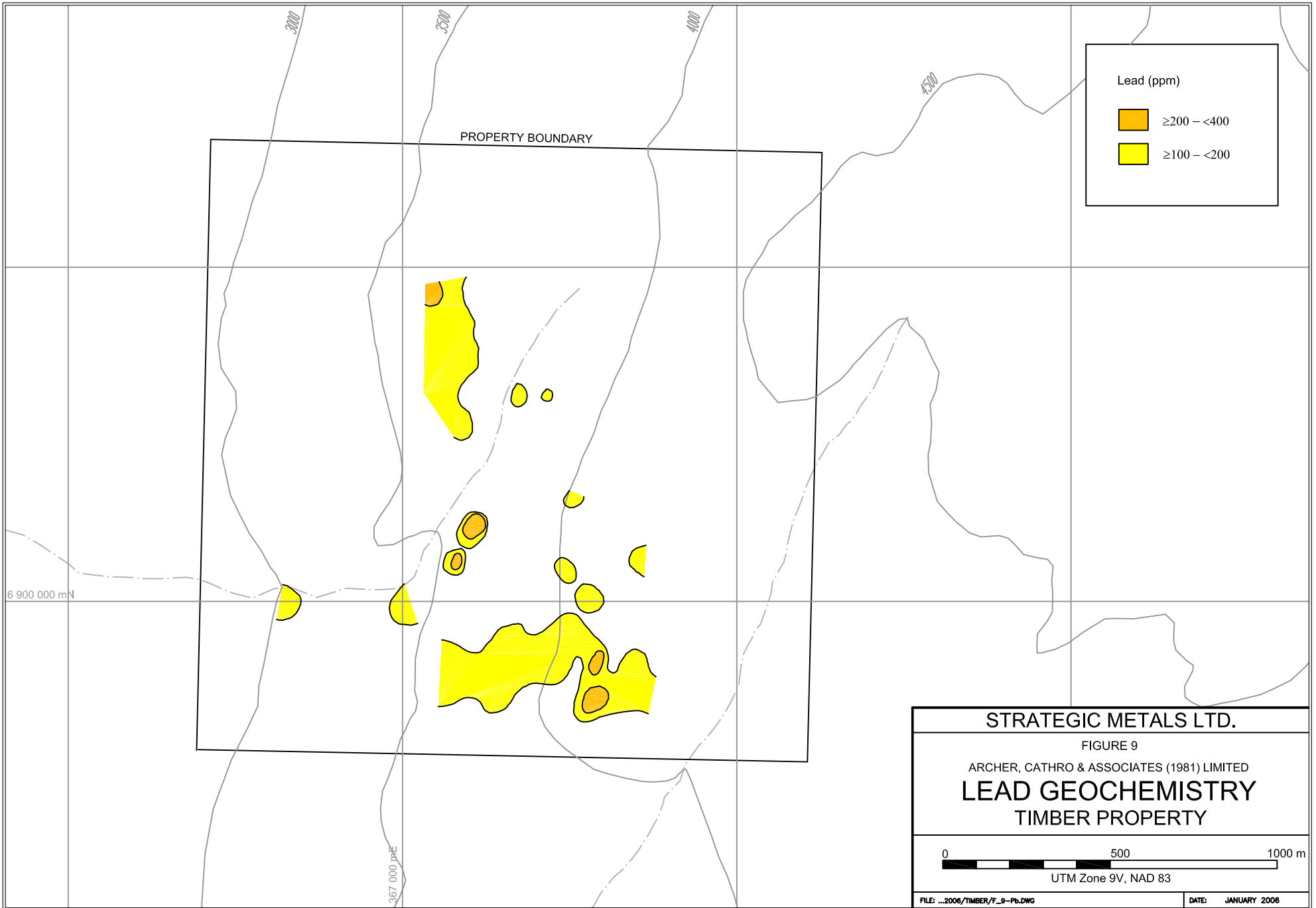

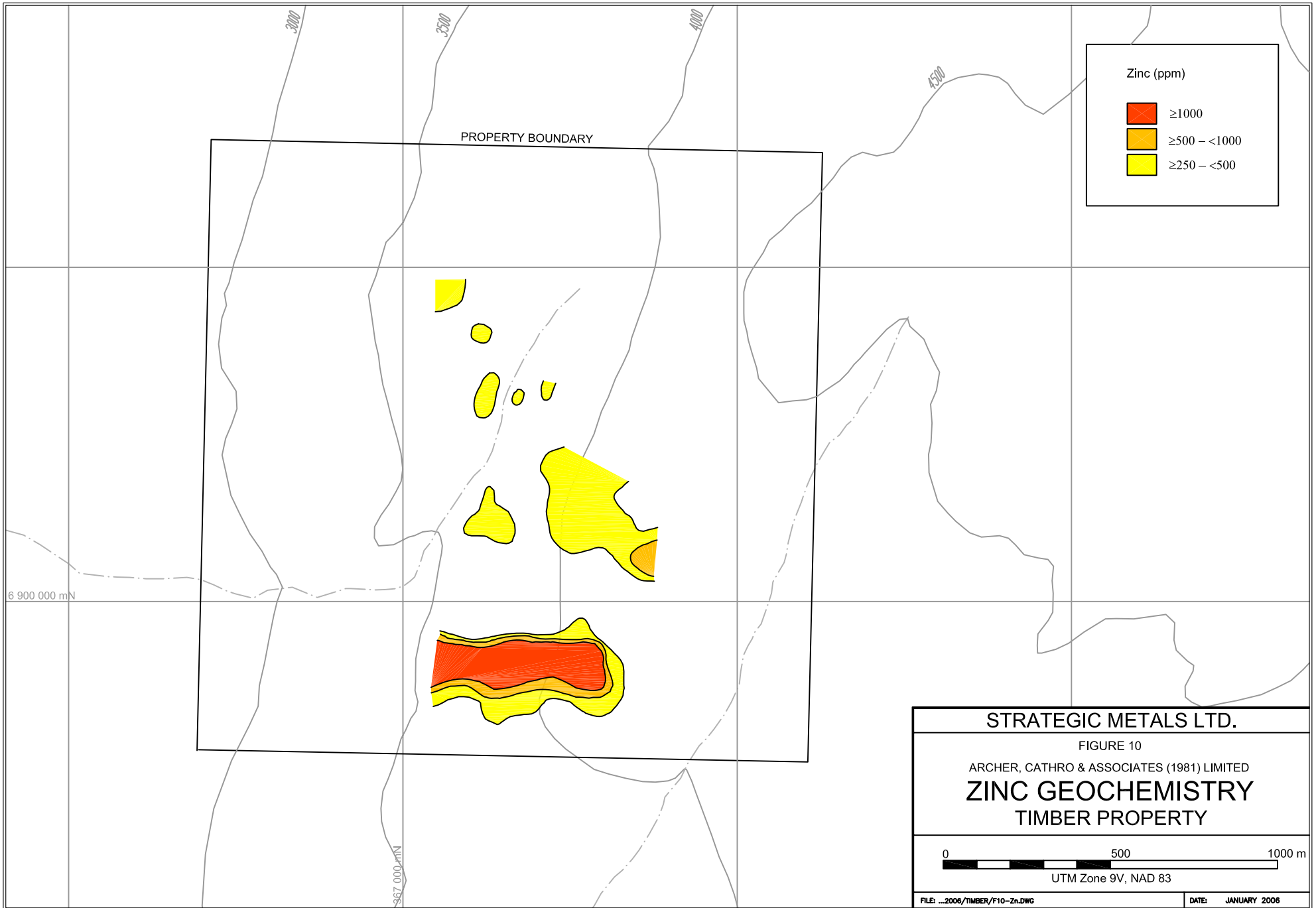

REFERENCES

- A.R.O.F.
1980 Anvil Range Open File, NTS map sheet 105J, Cyprus Anvil Mining Corporation.
- Gordey, S.P. and Irwin, S.E.B.
1987 Geology, Sheldon Lake and Tay River Map areas, Yukon Territory; Geological Survey of Canada, Map 19-1987.
- Walker, T.
1981 Geological and Geochemical Assessment Report on the AM Group of Claims, SMD Mining Co. Ltd., p. 8.
- 1982 Geological, Geochemical and Geophysical Assessment Report on the AM Group of Claims, SMD Mining Co. Ltd., p. 7.

APPENDIX I
AUTHOR'S STATEMENT OF QUALIFICATIONS

STATEMENT OF QUALIFICATIONS

I, W. Douglas Eaton, geologist, with business addresses in Whitehorse, Yukon Territory and Vancouver, British Columbia and residential address in North Vancouver, British Columbia, hereby certify that:

1. I graduated from the University of British Columbia in 1980 with a B.Sc. majoring in Geological Sciences.
2. From 1971 to present, I have been actively engaged in mineral exploration in British Columbia and Yukon Territory and on June 1, 1981, became a partner in Archer, Cathro & Associates (1981) Limited.
3. I have personally participated in or supervised the field work reported herein and have interpreted all data resulting from this work.

W. Douglas Eaton, B.Sc. Geology

APPENDIX II
CERTIFICATES OF ANALYSIS



ALS Chemex
 EXCELLENCE IN ANALYTICAL CHEMISTRY
 ALS Canada Ltd.

212 Brooksbank Avenue
 North Vancouver BC V7J 2C1
 Phone: 604 984 0221 Fax: 604 984 0218 www.alschemex.com

STRATEGIC METALS LTD.
 C/O ARCHER, CATHRO & ASSOCIATES (1981)
 LIMITED
 1016-510 W HASTINGS ST
 VANCOUVER BC V6B 1L8

Page: 1
 Finalized Date: 15-OCT-2005
 Account: MTT

CERTIFICATE VA05081688

Project: Ross Copper- Timber

P.O. No.:

This report is for 121 Pulp samples submitted to our lab in Vancouver, BC, Canada on 26-SEP-2005.

The following have access to data associated with this certificate:

AL-ARCHER
 VANCOUVER OFFICE

DOUG EATON
 BILL WENGZYNOWSKI

JOAN MARIACHER

SAMPLE PREPARATION	
ALS CODE	DESCRIPTION
FND-02	Find Sample for Addn Analysis

ANALYTICAL PROCEDURES		
ALS CODE	DESCRIPTION	INSTRUMENT
Au-AA23	Au 30g FA-AA finish	AAS
ME-MS61	47 element four acid ICP-MS	

To: STRATEGIC METALS LTD.
 C/O ARCHER, CATHRO & ASSOCIATES (1981) LIMITED
 1016-510 W HASTINGS ST
 VANCOUVER BC V6B 1L8

This is the Final Report and supersedes any preliminary report with this certificate number. Results apply to samples as submitted. All pages of this report have been checked and approved for release.

Signature:

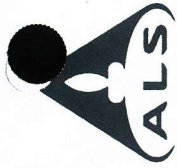

ALS Chemex
EXCELLENCE IN ANALYTICAL CHEMISTRY

STRATEGIC METALS LTD.
C/O ARCHER, CATHRO & ASSOCIATES (1981)
LIMITED

1016-510 W HASTINGS ST
VANCOUVER BC V6B 1L8

212 Brooksbank Avenue
North Vancouver BC V7J 2C1
Phone: 604 984 0221 Fax: 604 984 0218 www.alschemex.com

Page: 2 - A
Total # Pages: 3 (A - D)
Finalized Date: 15-OCT-2005
Account: MTT

Project: Ross Copper- Timber

CERTIFICATE OF ANALYSIS VA05081688

Method Analyte Units LOR	Au-AA23	ME-MS61	ME-MS61	ME-MS61	ME-MS61	ME-MS61	ME-MS61	ME-MS61	ME-MS61	ME-MS61	ME-MS61	ME-MS61	ME-MS61	ME-MS61	ME-MS61	ME-MS61	ME-MS61	ME-MS61	ME-MS61	ME-MS61
Sample Description	Au ppm	Ag ppm	Al %	As ppm	Ba ppm	Be ppm	Bi ppm	Ca %	Cd ppm	Ce ppm	Co ppm	Cr ppm	Cs ppm	Cu ppm	Fe %					
CC07620	0.006																			
CC07623	0.005																			
CC07627	0.019	1.70	5.94	21.8	1480	1.42	11.40	0.91	1.28	59.40	7.0	41	10.50	92.3	2.65					
CC07628	0.024	0.86	5.73	9.9	1340	1.36	3.24	1.24	0.64	48.10	5.9	32	4.86	76.2	1.99					
CC07629	0.028	2.22	5.72	11.2	1570	1.39	5.10	1.34	0.61	58.50	6.1	45	7.30	176.0	2.29					
CC07630	0.035	2.43	5.82	11.0	1460	1.42	4.70	1.35	2.29	52.90	9.0	42	7.57	148.0	2.13					
CC07631	0.031	1.45	5.54	13.2	1400	1.30	5.67	1.32	3.31	50.30	11.4	44	6.45	101.0	2.25					
CC07632	0.018	1.44	5.58	12.2	1480	1.66	4.69	2.08	3.80	57.10	8.2	42	7.11	164.5	2.19					
CC07634	0.005																			
CC07647		0.68	5.41	7.7	1890	1.65	0.76	1.37	1.78	68.80	7.8	57	5.28	80.7	1.98					
CC07648	0.021	1.31	6.36	28.2	1210	1.70	26.70	1.05	1.20	50.70	6.5	45	7.95	87.8	3.26					
CC07649	0.015	1.31	5.61	29.5	1440	1.52	16.65	0.94	2.26	52.40	7.1	48	7.27	93.9	2.91					
CC07650		0.46	5.93	14.9	1370	1.37	0.91	1.03	2.95	47.40	6.7	30	7.59	36.5	1.92					
CC07651		0.71	5.34	17.1	1280	1.38	3.87	1.32	5.67	52.80	4.9	35	4.43	90.1	1.82					
CC07652		0.90	6.08	12.2	1350	1.72	2.49	1.39	4.95	57.60	7.4	35	4.82	93.9	2.20					
CC07653		1.36	4.75	29.1	1570	1.63	3.91	0.95	2.39	60.00	7.2	39	7.42	119.5	2.42					
CC07654		0.91	5.01	17.7	1590	1.63	2.19	1.33	1.88	56.40	7.3	42	5.59	110.0	2.24					
CC07655		0.76	6.16	12.9	2020	1.79	4.12	0.57	0.40	62.90	11.1	58	7.98	55.9	2.58					
CC07656		0.77	5.63	16.3	1790	1.76	9.53	1.18	0.45	62.60	8.6	42	6.60	125.5	2.40					
CC07657		0.62	5.14	13.0	1590	1.44	6.30	0.96	1.45	55.60	6.8	42	6.55	85.0	2.04					
CC07658		0.78	5.03	11.8	1590	1.32	5.77	0.84	0.60	54.10	4.5	38	6.62	67.5	1.84					
CC07659		3.03	5.44	18.5	1680	1.80	7.86	1.05	1.16	61.40	6.6	50	10.80	391.0	2.28					
CC07660		0.88	4.61	19.0	1670	1.26	10.50	0.68	0.79	53.20	3.9	43	9.85	64.9	2.00					
CC07661		0.51	4.92	39.0	1480	1.13	14.25	0.46	0.95	58.60	4.8	49	8.20	28.6	3.25					
CC07662		1.36	5.10	20.3	1540	1.56	6.28	1.68	14.10	50.20	7.8	43	7.33	157.5	2.47					
CC07663		2.14	4.84	14.4	1290	1.56	4.72	2.11	35.60	54.80	6.0	38	9.38	295.0	2.04					
CC07664		1.67	5.23	21.0	1390	1.57	5.22	1.62	25.10	45.30	7.4	39	8.77	217.0	2.32					
CC07665		2.01	5.54	16.9	1350	1.70	4.58	1.82	44.60	52.30	8.4	40	8.92	319.0	2.31					
CC07666		2.56	5.55	19.8	1510	1.82	5.08	1.60	46.30	52.40	5.9	47	10.85	388.0	2.37					
CC07667		2.41	5.97	17.3	1290	1.85	4.24	1.98	62.00	56.20	8.7	40	10.15	390.0	2.71					
CC07668		2.05	5.76	5.5	890	1.36	1.43	2.75	58.30	44.20	6.7	17	5.67	369.0	2.02					
CC07669		4.07	5.59	12.2	1570	1.78	5.07	1.74	82.00	52.50	8.6	50	11.85	510.0	2.34					
CC07670		0.88	11.75	47.6	3880	3.37	9.78	1.55	3.90	94.80	15.1	113	35.40	79.9	4.77					
CC07671		1.33	6.31	14.7	2060	1.46	6.48	0.70	2.76	57.80	6.8	42	19.40	21.1	2.23					
CC07673	0.039	1.59	4.57	35.0	1740	1.54	12.20	0.65	2.61	66.50	6.3	43	9.80	619.0	2.46					
CC07674	0.059	13.00	6.23	55.2	1200	3.60	20.20	2.07	23.00	255.00	13.6	28	30.00	2500.0	2.34					
CC07676	0.011																			
CC07677	0.021	0.44	4.84	38.4	1600	1.33	13.10	0.47	0.78	59.50	5.6	40	8.16	317.0	2.39					
CC07678		0.36	5.07	29.1	1600	1.33	7.37	0.57	0.51	60.30	6.3	39	8.04	58.8	2.49					
CC07679		1.34	5.25	32.7	1620	1.48	11.30	0.54	0.78	52.10	6.6	43	10.50	104.0	2.58					

Comments: REE's may not be totally soluble in MS61 method.

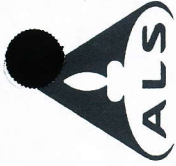

ALS Chemex
EXCELLENCE IN ANALYTICAL CHEMISTRY

ALS Canada Ltd.
212 Brooksbank Avenue
North Vancouver BC V7J 2C1
Phone: 604 984 0221 Fax: 604 984 0218 www.alschemex.com

STRATEGIC METALS LTD.
C/O ARCHER, CATHRO & ASSOCIATES (1981)
LIMITED

1016-510 W HASTINGS ST
VANCOUVER BC V6B 1L8

Project: Ross Copper- Timber

Page: 2 - B
Total Pages: 3 (A - D)
Finalized Date: 15-OCT-2005
Account: MTT

CERTIFICATE OF ANALYSIS VA05081688

Method Analyte Units LOR	ME-MS61 Ga ppm 0.05	ME-MS61 Ge ppm 0.05	ME-MS61 Hf ppm 0.1	ME-MS61 In ppm 0.005	ME-MS61 K % 0.01	ME-MS61 La ppm 0.5	ME-MS61 Li ppm 0.2	ME-MS61 Mg % 0.01	ME-MS61 Mn ppm 5	ME-MS61 Mo ppm 0.05	ME-MS61 Na % 0.01	ME-MS61 Nb ppm 0.1	ME-MS61 Ni ppm 0.2	ME-MS61 P ppm 10	ME-MS61 Pb ppm 0.5	
CC07620																
CC07623																
CC07627																
CC07628																
CC07629																
CC07630																
CC07631																
CC07632																
CC07634																
CC07647																
CC07648																
CC07649																
CC07650																
CC07651																
CC07652																
CC07653																
CC07654																
CC07655																
CC07656																
CC07657																
CC07658																
CC07659																
CC07660																
CC07661																
CC07662																
CC07663																
CC07664																
CC07665																
CC07666																
CC07667																
CC07668																
CC07669																
CC07670																
CC07671																
CC07673																
CC07674																
CC07676																
CC07677																
CC07678																
CC07679																

Comments: REE's may not be totally soluble in MS61 method.



ALS Chemex
EXCELLENCE IN ANALYTICAL CHEMISTRY

ALS Canada Ltd.
212 Brooksbank Avenue
North Vancouver BC V7J 2C1
Phone: 604 984 0221 Fax: 604 984 0218 www.alschemex.com

STRATEGIC METALS LTD.
C/O ARCHER, CATHRO & ASSOCIATES (1981)
LIMITED

1016-510 W HASTINGS ST
VANCOUVER BC V6B 1L8

Project: Ross Copper- Timber

Page: 2 - C
Total # Pages: 3 (A - D)
Finalized Date: 15-OCT-2005
Account: MTT

CERTIFICATE OF ANALYSIS VA05081688

Method Analyte Units LOR	ME-MS61	ME-MS61	ME-MS61	ME-MS61	ME-MS61	ME-MS61	ME-MS61	ME-MS61	ME-MS61	ME-MS61	ME-MS61	ME-MS61	ME-MS61	ME-MS61	ME-MS61	ME-MS61	ME-MS61	ME-MS61	ME-MS61
Sample Description	Rb ppm	Re ppm	S %	Sb ppm	Se ppm	Sn ppm	Sr ppm	Ta ppm	Te ppm	Th ppm	Ti %	Ti ppm	U ppm	V ppm	W ppm				
CC07620	99.2	0.003	0.02	3.53	1	1.9	236.0	0.74	0.54	7.7	0.273	1.06	3.4	152	1.6				
CC07623	76.1	0.006	0.03	2.02	1	1.4	288.0	0.63	0.23	7.7	0.240	0.68	4.6	121	1.2				
CC07628	80.8	0.006	0.05	1.97	3	1.8	230.0	0.67	0.28	9.8	0.255	0.77	6.1	165	2.1				
CC07630	85.5	0.007	0.06	2.15	3	1.8	245.0	0.64	0.26	9.2	0.234	0.74	5.5	150	2.0				
CC07631	90.2	0.005	0.05	1.96	2	1.8	235.0	0.61	0.29	8.5	0.239	0.70	4.0	159	1.2				
CC07632	84.7	0.008	0.06	2.16	3	1.9	244.0	0.61	0.25	8.6	0.231	0.69	6.3	147	1.2				
CC07634																			
CC07647	80.7	0.006	0.03	2.05	2	1.8	168.0	0.84	0.09	10.3	0.282	0.64	5.6	150	1.1				
CC07648	88.0	0.003	0.01	2.20	1	3.8	264.0	0.96	1.16	7.0	0.310	0.88	3.8	282	6.8				
CC07649	89.7	0.004	0.01	2.19	2	3.4	182.5	0.93	0.70	7.4	0.297	0.75	3.8	324	11.6				
CC07650	99.0	0.003	0.02	2.07	1	1.4	282.0	0.66	0.09	6.8	0.260	0.65	2.7	152	0.9				
CC07651	87.1	0.003	0.02	1.33	1	2.2	244.0	0.73	0.22	7.6	0.286	0.58	3.7	160	2.4				
CC07652	90.7	0.002	0.02	1.47	1	1.8	254.0	0.72	0.15	8.2	0.276	0.60	3.0	130	1.8				
CC07653	86.9	0.003	0.02	2.69	2	2.3	116.0	0.75	0.23	10.8	0.278	0.77	3.0	143	2.0				
CC07654	82.6	0.003	0.03	2.71	2	1.9	146.5	0.71	0.15	10.7	0.267	0.69	3.0	153	3.1				
CC07655	98.6	0.004	0.01	2.05	1	2.4	97.8	0.95	0.27	10.4	0.354	0.80	3.3	194	1.6				
CC07656	98.2	0.005	0.03	2.38	2	1.8	206.0	0.67	0.47	9.4	0.257	0.88	4.4	189	1.7				
CC07657	88.3	0.007	0.02	1.86	1	1.9	161.5	0.73	0.42	9.1	0.267	0.83	3.5	182	2.3				
CC07658	100.0	0.007	0.02	1.77	1	1.9	174.5	0.73	0.35	7.9	0.297	0.79	3.2	164	1.6				
CC07659	93.2	0.006	0.03	2.16	3	1.7	165.0	0.62	0.53	11.4	0.243	0.88	12.3	176	1.2				
CC07660	106.0	0.004	0.01	1.94	<1	2.5	118.0	0.76	0.64	6.6	0.303	1.00	3.4	216	2.3				
CC07661	99.3	<0.002	0.01	3.02	1	2.2	94.2	0.90	0.70	8.4	0.335	0.86	3.0	218	3.1				
CC07662	93.4	0.007	0.04	3.27	4	2.5	201.0	0.67	0.42	9.4	0.298	0.75	5.4	190	3.4				
CC07663	87.4	0.006	0.09	2.18	6	1.9	233.0	0.55	0.29	8.2	0.201	0.65	7.3	145	1.4				
CC07664	90.3	0.007	0.06	2.12	3	2.3	221.0	0.59	0.35	8.1	0.260	0.66	5.2	170	12.6				
CC07665	90.6	0.007	0.07	2.02	5	2.0	259.0	0.57	0.28	9.7	0.247	0.71	6.0	168	1.6				
CC07666	84.6	0.007	0.06	2.37	6	2.5	206.0	0.66	0.32	9.9	0.252	0.82	7.7	179	1.4				
CC07667	89.1	0.007	0.06	2.09	5	2.1	297.0	0.65	0.25	9.7	0.323	0.69	7.0	176	1.1				
CC07668	51.6	0.004	0.09	1.59	6	0.9	464.0	0.40	0.09	5.8	0.241	0.36	6.0	82	0.6				
CC07669	95.0	0.005	0.05	2.14	6	2.1	220.0	0.77	0.25	10.6	0.268	0.88	13.8	182	1.8				
CC07670	223.0	0.006	0.03	8.40	3	5.6	404.0	1.86	0.61	16.6	0.625	2.27	7.6	616	3.7				
CC07671	179.0	0.002	0.01	4.88	1	2.5	209.0	0.98	0.30	8.2	0.352	1.10	3.5	253	2.0				
CC07673	86.1	0.004	0.01	3.10	1	2.1	106.0	0.75	0.70	9.3	0.284	0.82	5.3	208	1.7				
CC07674	54.7	0.005	0.12	2.81	12	1.3	293.0	0.33	1.25	11.1	0.137	0.58	44.0	112	0.7				
CC07676																			
CC07677	90.6	0.002	0.01	3.45	1	2.4	110.0	0.84	0.71	7.7	0.325	0.85	2.9	168	3.3				
CC07678	94.2	0.002	0.01	2.74	1	1.8	131.0	0.83	0.41	8.3	0.320	0.74	2.7	161	1.8				
CC07679	96.0	0.003	0.01	2.69	1	2.3	128.0	0.74	0.64	7.6	0.283	0.95	2.6	166	2.3				

Comments: REE's may not be totally soluble in MS61 method.



ALS Chemex
EXCELLENCE IN ANALYTICAL CHEMISTRY

ALS Canada Ltd.
212 Brooksbank Avenue
North Vancouver BC V7J 2C1
Phone: 604 984 0221 Fax: 604 984 0218 www.alschemex.com

STRATEGIC METALS LTD.
C/O ARCHER, CATHRO & ASSOCIATES (1981)
LIMITED
1016-510 W HASTINGS ST
VANCOUVER BC V6B 1L8
Project: Ross Copper- Timber

Page: 2 - D
Total # Pages: 3 (A - D)
Finalized Date: 15-OCT-2005
Account: MTT

CERTIFICATE OF ANALYSIS VA05081688

Sample Description	Method Analyte Units LOR	ME-MS61	ME-MS61	ME-MS61
		Y ppm 0.1	Zn ppm 2	Zr ppm 0.5
CC07620				
CC07623		11.8	232	92.3
CC07627		13.4	101	88.5
CC07628		18.8	144	89.9
CC07629				
CC07630		16.3	171	89.7
CC07631		14.4	170	80.3
CC07632		21.7	237	79.9
CC07634				
CC07647		22.8	187	74.3
CC07648		14.0	254	108.0
CC07649		14.3	514	92.4
CC07650		10.2	182	100.5
CC07651		13.4	190	91.6
CC07652		13.4	324	87.7
CC07653		19.5	450	58.7
CC07654		20.6	212	70.0
CC07655		17.2	190	70.2
CC07656		14.0	165	88.1
CC07657		13.9	156	78.2
CC07658		13.6	120	71.2
CC07659		22.4	232	69.9
CC07660		12.5	150	70.7
CC07661		8.5	134	73.3
CC07662		18.5	720	65.0
CC07663		21.8	1295	61.8
CC07664		18.5	1110	62.2
CC07665		20.8	1435	66.6
CC07666		25.0	1775	69.6
CC07667		23.8	2090	70.5
CC07668		17.7	1550	81.6
CC07669		26.6	2210	69.2
CC07670		25.2	531	175.0
CC07671		12.0	246	93.3
CC07673		16.6	300	73.6
CC07674		99.9	741	75.9
CC07676				
CC07677		12.3	222	72.0
CC07678		13.2	172	83.3
CC07679		10.8	244	66.8

Comments: REE's may not be totally soluble in MS61 method.



ALS Chemex
EXCELLENCE IN ANALYTICAL CHEMISTRY

ALS Canada Ltd.
212 Brooksbank Avenue
North Vancouver BC V7J 2C1
Phone: 604 984 0221 Fax: 604 984 0218 www.alschemex.com

STRATEGIC METALS LTD.
C/O ARCHER, CATHRO & ASSOCIATES (1981)
LIMITED
1016-510 W HASTINGS ST
VANCOUVER BC V6B 1L8
Project: Ross Copper- Timber

Page: 3 - A
Total # Pages: 3 (A - D)
Finalized Date: 15-OCT-2005
Account: MTT

CERTIFICATE OF ANALYSIS VA05081688

Sample Description	Method Analyte Units LOR	Au-AA23 ppm 0.005	ME-MS61 Ag ppm 0.01	ME-MS61 Al % 0.01	ME-MS61 As ppm 0.2	ME-MS61 Ba ppm 10	ME-MS61 Be ppm 0.05	ME-MS61 Bi ppm 0.01	ME-MS61 Ca % 0.01	ME-MS61 Cd ppm 0.02	ME-MS61 Ce ppm 0.01	ME-MS61 Co ppm 0.1	ME-MS61 Cr ppm 1	ME-MS61 Cs ppm 0.05	ME-MS61 Cu ppm 0.2	ME-MS61 Fe % 0.01
CC07680			0.95	5.72	16.4	1620	1.58	6.25	0.84	1.33	60.00	8.5	43	9.08	54.5	2.34
CC07681			0.42	5.11	19.4	1630	1.58	6.15	0.45	0.85	51.00	7.0	43	6.20	69.9	2.48
CC07682			0.45	4.93	15.0	1760	1.52	3.17	0.77	1.49	55.10	8.6	39	5.85	82.4	2.18
CC07683			0.68	5.00	15.3	1640	1.48	3.26	0.83	1.84	61.20	8.9	48	6.65	46.2	2.22
CC07684			1.31	5.76	20.9	1640	1.52	7.25	1.22	2.89	58.70	10.7	49	7.92	124.0	2.47
CC07756		<0.005														
CC07757		0.007														
CC07758		0.010														

Comments: REE's may not be totally soluble in MS61 method.



ALS Chemex
 EXCELLENCE IN ANALYTICAL CHEMISTRY
 ALS Canada Ltd.

212 Brooksbank Avenue
 North Vancouver BC V7J 2C1
 Phone: 604 984 0221 Fax: 604 984 0218 www.alschemex.com

STRATEGIC METALS LTD.
 C/O ARCHER, CATHRO & ASSOCIATES (1981)
 LIMITED
 1016-510 W HASTINGS ST
 VANCOUVER BC V6B 1L8
 Project: Ross Copper- Timber

Page: 3 - B
 Total Pages: 3 (A - D)
 Finalized Date: 15-OCT-2005
 Account: MTT

CERTIFICATE OF ANALYSIS VA05081688

Method Analyte Units LOR	ME-MS61 Ga ppm	ME-MS61 Ge ppm	ME-MS61 Hf ppm	ME-MS61 In ppm	ME-MS61 K %	ME-MS61 La ppm	ME-MS61 Li ppm	ME-MS61 Mg %	ME-MS61 Mn ppm	ME-MS61 Mo ppm	ME-MS61 Na %	ME-MS61 Nb ppm	ME-MS61 Ni ppm	ME-MS61 P ppm	ME-MS61 Pb ppm
CC07680	14.95	0.18	2.4	0.186	1.75	31.1	55.3	0.85	291	45.80	0.90	11.5	26.3	500	51.2
CC07681	13.05	0.19	2.2	0.106	1.46	31.9	42.9	0.71	201	23.60	0.50	11.8	29.4	640	31.9
CC07682	12.80	0.19	2.4	0.164	1.53	33.0	37.5	0.70	342	22.10	0.65	11.4	25.5	920	28.2
CC07683	13.30	0.18	2.3	0.102	1.67	31.7	37.3	0.73	371	31.00	0.51	11.4	27.7	1410	31.8
CC07684	15.90	0.18	2.4	0.176	1.78	29.6	48.5	0.92	554	35.70	0.75	10.8	26.3	970	32.1

CC07756
 CC07757
 CC07758

Comments: REE's may not be totally soluble in MS61 method.



ALS Chemex
 EXCELLENCE IN ANALYTICAL CHEMISTRY

ALS Canada Ltd.
 212 Brooksbank Avenue
 North Vancouver BC V7J 2C1
 Phone: 604 984 0221 Fax: 604 984 0218 www.alschemex.com

STRATEGIC METALS LTD.
 C/O ARCHER, CATHRO & ASSOCIATES (1981)
 LIMITED

1016-510 W HASTINGS ST
 VANCOUVER BC V6B 1L8

Project: Ross Copper- Timber

Page: 3 - C
 Total Pages: 3 (A - D)
 Finalized Date: 15-OCT-2005
 Account: MTT

CERTIFICATE OF ANALYSIS VA05081688

Method Analyte Units LOR	ME-MS61 Rb ppm	ME-MS61 Re ppm	ME-MS61 S %	ME-MS61 Sb ppm	ME-MS61 Se ppm	ME-MS61 Sn ppm	ME-MS61 Sr ppm	ME-MS61 Ta ppm	ME-MS61 Te ppm	ME-MS61 Th ppm	ME-MS61 Ti %	ME-MS61 Ti ppm	ME-MS61 U ppm	ME-MS61 V ppm	ME-MS61 W ppm
CC07680	90.1	0.002	0.01	2.78	1	2.6	179.5	0.83	0.38	8.2	0.307	0.78	2.9	175	2.0
CC07681	87.9	0.002	0.01	2.66	1	1.9	90.8	0.85	0.32	9.1	0.306	0.69	2.7	164	2.7
CC07682	84.0	0.006	0.01	2.69	2	1.8	143.0	0.82	0.18	9.8	0.308	0.68	3.2	160	1.5
CC07683	99.7	0.004	0.02	2.92	2	2.0	120.0	0.80	0.20	9.7	0.294	0.93	3.4	210	1.7
CC07684	91.0	0.004	0.02	2.67	4	2.5	182.0	0.76	0.39	10.1	0.295	1.01	3.5	192	1.8
CC07756															
CC07757															
CC07758															

Comments: REE's may not be totally soluble in MS61 method.

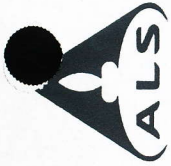

ALS Chemex
 EXCELLENCE IN ANALYTICAL CHEMISTRY

ALS Canada Ltd.
 212 Brooksbank Avenue
 North Vancouver BC V7J 2C1
 Phone: 604 984 0221 Fax: 604 984 0218 www.alschemex.com

STRATEGIC METALS LTD.
 C/O ARCHER, CATHRO & ASSOCIATES (1981)
 LIMITED
 1016-510 W HASTINGS ST
 VANCOUVER BC V6B 1L8
 Project: Ross Copper- Timber

Page: 3 - D
 Total Pages: 3 (A - D)
 Finalized Date: 15-OCT-2005
 Account: MTT

CERTIFICATE OF ANALYSIS VA05081688

Sample Description	Method Analyte Units LOR	ME-MS61		ME-MS61		ME-MS61	
		Y ppm	Zr ppm	Zr ppm	Zr ppm	Zr ppm	Zr ppm
CC07680		13.8	363	72.1			
CC07681		14.0	154	63.6			
CC07682		12.4	240	70.7			
CC07683		17.6	200	66.4			
CC07684		15.4	240	71.8			
CC07756							
CC07757							
CC07758							

Comments: REE's may not be totally soluble in MS61 method.

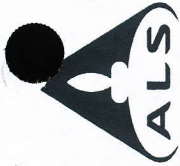

ALS Chemex
EXCELLENCE IN ANALYTICAL CHEMISTRY

ALS Canada Ltd.
212 Brooksbank Avenue
North Vancouver BC V7J 2C1
Phone: 604 984 0221 Fax: 604 984 0218 www.alschemex.com

STRATEGIC METALS LTD.
C/O ARCHER, CATHRO & ASSOCIATES (1981)
LIMITED
1016-510 W HASTINGS ST
VANCOUVER BC V6B 1L8

Page: 1
Finalized Date: 26-AUG-2005
Account: MTT

CERTIFICATE VA05068612

Project: Ross Copper- Timber

P.O. No.:

This report is for 121 Soil samples submitted to our lab in Vancouver, BC, Canada on 16-AUG-2005.

The following have access to data associated with this certificate:

AL ARCHER
VANCOUVER OFFICE

DOUG EATON
BILL WENGZYNOWSKI

JOAN MARIACHER

SAMPLE PREPARATION

ALS CODE	DESCRIPTION
WEI-21	Received Sample Weight
SCR-41	Screen to -180um and save both
LOG-22	Sample login - Rod w/o BarCode

ANALYTICAL PROCEDURES

ALS CODE	DESCRIPTION	INSTRUMENT
ME-ICP41	34 Element Aqua Regia ICP-AES	ICP-AES

To: STRATEGIC METALS LTD.
C/O ARCHER, CATHRO & ASSOCIATES (1981) LIMITED
1016-510 W HASTINGS ST
VANCOUVER BC V6B 1L8

This is the Final Report and supersedes any preliminary report with this certificate number. Results apply to samples as submitted. All pages of this report have been checked and approved for release.

Signature:



ALS Chemex
EXCELLENCE IN ANALYTICAL CHEMISTRY

STRATEGIC METALS LTD.
C/O ARCHER, CATHRO & ASSOCIATES (1981)
LIMITED

Page: 2 - A
Total # Pages: 5 (A - C)
Finalized Date: 26-AUG-2005
Account: MTT

1016-510 W HASTINGS ST
VANCOUVER BC V6B 1L8

212 Brooksbank Avenue
North Vancouver BC V7J 2C1
Phone: 604 984 0221 Fax: 604 984 0218 www.alschemex.com

Project: Ross Copper- Timber

CERTIFICATE OF ANALYSIS VA05068612

Method Analyte Units LOR	WEI-21 Recvd Wt. kg	ME-ICP41 Ag ppm	ME-ICP41 Al %	ME-ICP41 As ppm	ME-ICP41 B ppm	ME-ICP41 Ba ppm	ME-ICP41 Be ppm	ME-ICP41 Bi ppm	ME-ICP41 Ca %	ME-ICP41 Cd ppm	ME-ICP41 Co ppm	ME-ICP41 Cr ppm	ME-ICP41 Cu ppm	ME-ICP41 Fe %	ME-ICP41 Ga ppm
CC07620	0.34	3.3	1.96	46	<10	320	1.0	<2	1.02	5.1	13	24	70	2.19	10
CC07621	0.24	1.3	0.73	17	<10	230	<0.5	14	0.08	0.8	5	26	63	2.27	10
CC07622	0.28	1.2	0.79	10	<10	130	<0.5	9	0.07	0.6	3	13	28	1.34	<10
CC07623	0.30	0.3	1.75	49	<10	300	0.5	2	0.27	0.5	10	22	20	2.45	10
CC07624	0.26	0.3	1.23	8	<10	540	0.6	<2	0.67	1.1	5	17	37	1.96	<10
CC07625	0.24	0.5	1.47	8	<10	410	0.6	<2	0.77	1.4	6	22	52	1.97	<10
CC07626	0.26	0.3	1.20	9	<10	350	<0.5	<2	0.49	0.7	4	18	26	1.96	<10
CC07627	0.28	1.5	1.14	17	<10	260	0.5	12	0.17	1.0	5	17	95	2.03	<10
CC07628	0.24	0.7	0.77	8	<10	220	<0.5	4	0.35	0.6	3	12	75	1.29	<10
CC07629	0.34	2.2	1.09	6	<10	350	<0.5	6	0.64	0.5	4	17	166	1.62	<10
CC07630	0.30	2.5	1.15	9	<10	360	<0.5	5	0.69	2.1	7	16	146	1.52	<10
CC07631	0.20	1.5	1.04	13	<10	310	<0.5	7	0.64	2.9	9	15	98	1.64	<10
CC07632	0.36	1.5	1.24	13	<10	390	0.7	6	1.42	3.2	6	14	154	1.58	<10
CC07633	0.16	0.8	1.05	4	<10	450	0.6	3	1.58	3.8	5	11	81	1.27	<10
CC07634	0.30	0.7	2.18	46	<10	290	0.8	2	0.36	2.0	6	24	170	2.28	<10
CC07635	0.30	1.2	1.90	18	<10	330	0.6	4	0.27	1.0	8	24	128	2.29	10
CC07636	0.30	0.4	1.40	16	<10	400	<0.5	3	0.29	0.9	4	17	34	1.80	<10
CC07637	0.40	0.3	1.57	16	<10	380	<0.5	3	0.15	1.0	5	19	59	1.86	10
CC07638	0.40	0.6	1.21	14	<10	360	0.5	2	0.22	<0.5	6	16	21	2.14	<10
CC07639	0.32	0.5	1.14	10	<10	390	<0.5	2	0.16	1.4	5	15	15	1.96	<10
CC07640	0.30	0.9	1.35	18	<10	260	1.0	2	1.02	1.0	8	13	56	1.96	<10
CC07644	0.34	0.9	1.62	16	<10	230	1.0	2	2.24	0.5	10	25	60	2.14	<10
CC07645	0.30	1.1	1.63	80	<10	210	1.1	<2	3.96	0.9	13	27	78	2.98	<10
CC07646	0.24	0.4	1.18	10	<10	300	0.5	3	0.53	<0.5	8	17	26	1.70	<10
CC07647	0.26	0.8	1.14	9	<10	540	0.6	<2	0.92	1.6	7	17	86	1.62	<10
CC07648	0.22	1.2	1.68	28	<10	180	0.5	29	0.17	1.1	4	24	80	2.44	10
CC07649	0.28	1.3	1.69	32	<10	220	0.6	18	0.30	2.0	5	28	90	2.32	10
CC07650	0.40	0.5	0.61	11	<10	130	<0.5	3	0.14	2.8	4	9	26	1.24	<10
CC07651	0.30	0.6	0.90	17	<10	230	<0.5	6	0.42	5.5	3	15	85	1.22	<10
CC07652	0.28	0.9	1.33	11	<10	370	0.6	4	0.36	5.0	5	15	92	1.59	<10
CC07653	0.36	1.7	1.38	30	<10	370	0.7	4	0.54	2.4	6	18	126	2.33	<10
CC07654	0.32	1.0	1.25	11	<10	410	0.6	3	0.80	1.8	6	16	110	1.98	<10
CC07655	0.24	0.8	1.48	14	<10	410	0.6	5	0.33	0.5	10	22	53	2.33	<10
CC07656	0.26	0.9	1.51	14	<10	500	0.6	10	0.64	<0.5	6	22	124	2.03	<10
CC07657	0.24	0.7	1.13	13	<10	280	<0.5	7	0.50	1.5	5	19	80	1.74	<10
CC07658	0.26	0.9	0.89	10	<10	260	<0.5	6	0.29	0.5	3	16	63	1.38	<10
CC07659	0.24	3.6	1.58	18	<10	590	0.8	10	0.56	1.2	5	20	441	2.09	<10
CC07660	0.22	0.8	1.08	20	<10	270	<0.5	11	0.27	0.8	3	22	61	1.68	<10
CC07661	0.24	0.6	1.39	41	<10	200	<0.5	17	0.16	1.0	4	24	27	3.09	10
CC07662	0.24	1.4	1.17	17	<10	280	0.5	7	1.01	12.6	6	17	156	1.88	<10

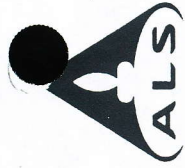

ALS Chemex
EXCELLENCE IN ANALYTICAL CHEMISTRY

ALS Canada Ltd.
212 Brooksbank Avenue
North Vancouver BC V7J 2C1
Phone: 604 984 0221 Fax: 604 984 0218 www.alschemex.com

STRATEGIC METALS LTD.
C/O ARCHER, CATHRO & ASSOCIATES (1981)
LIMITED

1016-510 W HASTINGS ST
VANCOUVER BC V6B 1L8

Project: Ross Copper- Timber

Page: 2 - B
Total # Pages: 5 (A - C)
Finalized Date: 26-AUG-2005
Account: MTT

CERTIFICATE OF ANALYSIS VA05068612

Sample Description	Method Analyte Units LOR	ME-ICP41														
		Hg ppm	K %	La ppm	Mg %	Mn ppm	Mo ppm	Na %	Ni ppm	P ppm	Pb ppm	S %	Sb ppm	Sc ppm	Sr ppm	Ti %
CC07620		1	0.14	20	0.59	1160	1	0.02	29	550	70	0.04	2	4	41	0.04
CC07621		<1	0.10	20	0.45	126	5	0.01	21	400	13	0.03	<2	2	11	0.05
CC07622		<1	0.09	10	0.24	74	10	0.02	10	260	10	0.02	4	1	10	0.04
CC07623		<1	0.12	10	0.53	297	1	0.01	27	270	33	0.02	2	3	25	0.04
CC07624		<1	0.12	20	0.37	234	3	0.01	21	1010	11	0.04	3	3	41	0.02
CC07625		<1	0.13	20	0.52	296	2	<0.01	25	1000	12	0.02	2	3	46	0.02
CC07626		<1	0.09	20	0.45	178	2	<0.01	20	1020	10	0.02	2	2	37	0.02
CC07627		<1	0.14	10	0.38	146	46	0.01	20	420	28	0.01	4	2	16	0.03
CC07628		<1	0.10	10	0.30	131	36	0.01	15	640	9	0.02	3	2	29	0.03
CC07629		<1	0.11	20	0.41	142	37	0.01	20	880	16	0.04	<2	3	46	0.03
CC07630		<1	0.11	10	0.38	599	84	0.01	17	960	18	0.05	2	3	47	0.02
CC07631		<1	0.12	10	0.39	702	92	0.01	15	950	22	0.05	2	2	44	0.03
CC07632		1	0.11	20	0.37	507	30	0.01	22	910	16	0.05	4	3	73	0.02
CC07633		1	0.08	20	0.32	442	7	0.02	21	990	9	0.08	<2	2	92	0.02
CC07634		1	0.10	10	0.53	214	4	0.01	29	410	15	0.02	4	3	26	0.03
CC07635		<1	0.08	10	0.46	231	6	0.01	26	350	12	0.01	3	3	24	0.03
CC07636		<1	0.09	20	0.41	198	4	<0.01	15	480	15	0.01	2	3	24	0.04
CC07637		<1	0.08	20	0.44	215	7	<0.01	15	290	10	0.01	2	2	18	0.03
CC07638		<1	0.11	20	0.40	232	3	<0.01	22	570	14	0.01	2	3	24	0.03
CC07639		1	0.10	10	0.30	132	3	<0.01	16	140	11	<0.01	2	2	15	0.03
CC07640		<1	0.09	40	0.78	393	3	0.01	30	770	10	0.03	<2	5	51	0.01
CC07644		<1	0.15	20	1.00	279	2	0.01	28	520	22	0.04	4	5	91	0.01
CC07645		1	0.12	30	1.06	324	2	0.01	31	680	51	0.05	<2	5	122	0.01
CC07646		<1	0.17	20	0.46	293	5	0.01	20	780	13	0.01	3	3	40	0.04
CC07647		<1	0.09	20	0.37	301	7	0.01	28	800	13	0.02	<2	4	67	0.03
CC07648		<1	0.10	10	0.67	134	18	0.01	24	500	30	0.01	4	2	23	0.06
CC07649		<1	0.12	20	0.70	263	22	0.01	30	840	77	0.01	<2	2	32	0.06
CC07650		<1	0.08	10	0.22	199	22	0.01	12	480	13	0.01	<2	1	16	0.03
CC07651		1	0.09	10	0.38	101	16	0.01	20	500	15	0.02	2	2	27	0.04
CC07652		<1	0.10	20	0.36	211	9	0.01	21	370	16	0.02	4	2	22	0.03
CC07653		<1	0.16	20	0.66	269	7	0.01	28	1070	44	0.01	2	4	47	0.05
CC07654		<1	0.12	20	0.47	373	7	0.02	23	1000	18	0.02	<2	4	56	0.04
CC07655		<1	0.18	20	0.59	370	20	<0.01	24	720	14	0.01	2	3	29	0.03
CC07656		<1	0.19	20	0.57	407	27	0.02	29	1090	16	0.02	<2	3	49	0.04
CC07657		<1	0.23	10	0.48	211	21	0.01	20	900	12	0.01	<2	3	38	0.04
CC07658		1	0.18	10	0.39	98	33	0.01	14	680	8	0.01	<2	2	27	0.04
CC07659		1	0.15	30	0.47	173	51	0.01	42	1020	28	0.03	2	5	45	0.02
CC07660		<1	0.25	20	0.65	102	45	0.01	18	660	18	0.01	2	2	21	0.05
CC07661		<1	0.18	20	0.51	112	42	<0.01	18	1560	20	0.01	3	2	16	0.04
CC07662		1	0.15	20	0.52	354	14	0.01	25	1040	30	0.04	3	3	63	0.03



ALS Chemex
EXCELLENCE IN ANALYTICAL CHEMISTRY

ALS Canada Ltd.
212 Brooksbank Avenue
North Vancouver BC V7J 2C1
Phone: 604 984 0221 Fax: 604 984 0218 www.alschemex.com

STRATEGIC METALS LTD.
C/O ARCHER, CATHRO & ASSOCIATES (1981)
LIMITED
1016-510 W HASTINGS ST
VANCOUVER BC V6B 1L8

Project: Ross Copper- Timber

Page: 2 - C
Total Pages: 5 (A - C)
Finalized Date: 26-AUG-2005
Account: MTT

CERTIFICATE OF ANALYSIS VA05068612

Sample Description	Method Analyte Units LOR	ME-ICP41		ME-ICP41		ME-ICP41		ME-ICP41	
		Ti ppm	U ppm	V ppm	W ppm	Zn ppm	Zn ppm		
CC07620		<10	<10	53	<10	<10	391		
CC07621		<10	<10	111	<10	<10	153		
CC07622		<10	<10	52	<10	<10	100		
CC07623		<10	<10	57	<10	<10	260		
CC07624		<10	<10	49	<10	<10	140		
CC07625		<10	<10	74	<10	<10	174		
CC07626		<10	<10	66	<10	<10	134		
CC07627		<10	<10	70	<10	<10	204		
CC07628		<10	<10	46	<10	<10	85		
CC07629		<10	<10	65	<10	<10	115		
CC07630		<10	<10	59	<10	<10	144		
CC07631		<10	<10	67	<10	<10	142		
CC07632		<10	<10	56	<10	<10	198		
CC07633		<10	<10	34	<10	<10	136		
CC07634		<10	<10	112	<10	<10	197		
CC07635		<10	<10	95	<10	<10	153		
CC07636		<10	<10	71	<10	<10	136		
CC07637		<10	<10	72	<10	<10	176		
CC07638		<10	<10	54	<10	<10	130		
CC07639		<10	<10	56	<10	<10	149		
CC07640		<10	<10	26	<10	<10	71		
CC07644		<10	<10	42	<10	<10	99		
CC07645		<10	<10	31	<10	<10	110		
CC07646		<10	<10	58	<10	<10	150		
CC07647		<10	<10	46	<10	<10	157		
CC07648		<10	<10	195	<10	<10	215		
CC07649		<10	<10	222	<10	<10	471		
CC07650		<10	<10	46	<10	<10	150		
CC07651		<10	<10	84	<10	<10	163		
CC07652		<10	<10	56	<10	<10	290		
CC07653		<10	<10	62	<10	<10	454		
CC07654		<10	<10	56	<10	<10	198		
CC07655		<10	<10	70	<10	<10	178		
CC07656		<10	<10	104	<10	<10	150		
CC07657		<10	<10	81	<10	<10	144		
CC07658		<10	<10	69	<10	<10	107		
CC07659		<10	<10	75	<10	<10	225		
CC07660		<10	<10	114	<10	<10	134		
CC07661		<10	<10	132	<10	<10	124		
CC07662		<10	<10	82	<10	<10	675		

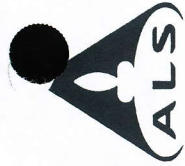

ALS Chemex
EXCELLENCE IN ANALYTICAL CHEMISTRY

ALS Canada Ltd.
212 Brooksbank Avenue
North Vancouver BC V7J 2C1
Phone: 604 984 0221 Fax: 604 984 0218 www.alschemex.com

STRATEGIC METALS LTD.
C/O ARCHER, CATHRO & ASSOCIATES (1981)
LIMITED

1016-510 W HASTINGS ST
VANCOUVER BC V6B 1L8

Project: Ross Copper- Timber

Page: 3 - A
Total # Pages: 5 (A - C)
Finalized Date: 26-AUG-2005
Account: MTT

CERTIFICATE OF ANALYSIS VA05068612

Method Analyte Units LOR	WEI-21 Recy'd Wt. kg	ME-ICP41 Ag ppm	ME-ICP41 Al %	ME-ICP41 As ppm	ME-ICP41 B ppm	ME-ICP41 Ba ppm	ME-ICP41 Be ppm	ME-ICP41 Bi ppm	ME-ICP41 Ca %	ME-ICP41 Cd ppm	ME-ICP41 Co ppm	ME-ICP41 Cr ppm	ME-ICP41 Cu ppm	ME-ICP41 Fe %	ME-ICP41 Ga ppm
CC07663	0.10	2.2	1.30	13	<10	350	0.7	6	1.68	31.8	5	15	296	1.68	<10
CC07664	0.26	1.8	1.27	18	<10	280	0.6	6	0.95	22.8	5	16	216	1.71	<10
CC07665	0.18	2.1	1.31	17	<10	310	0.6	5	1.12	39.8	5	15	316	1.67	<10
CC07666	0.22	2.7	1.47	16	<10	320	0.7	6	1.06	39.6	3	17	372	1.86	<10
CC07667	0.28	2.5	1.31	16	<10	270	0.7	4	1.00	53.6	5	14	373	1.82	<10
CC07668	0.16	2.3	0.72	3	<10	210	<0.5	<2	1.43	53.3	2	6	369	0.84	<10
CC07669	0.20	4.0	1.53	9	<10	460	0.8	5	1.26	71.7	7	19	488	1.91	<10
CC07670	0.32	0.7	1.15	11	<10	250	<0.5	3	0.31	2.4	5	14	47	1.42	<10
CC07671	0.34	<0.2	0.70	29	<10	160	<0.5	7	0.09	1.1	4	13	18	2.14	<10
CC07672	0.24	1.1	0.82	7	<10	200	<0.5	6	0.08	2.1	4	10	10	1.47	<10
CC07673	0.26	1.6	1.40	24	<10	320	0.6	12	0.35	2.5	5	21	569	2.11	<10
CC07674	0.16	13.1	2.63	48	<10	560	2.2	18	1.37	18.7	9	11	2300	1.60	<10
CC07676	0.32	0.9	1.67	17	<10	230	0.5	12	0.12	1.1	5	24	38	2.23	10
CC07677	0.32	0.4	1.58	33	<10	220	0.5	12	0.12	0.8	4	24	288	1.97	<10
CC07678	0.34	0.5	1.40	21	<10	210	0.5	7	0.19	0.5	4	19	50	2.09	<10
CC07679	0.30	1.3	1.57	30	<10	210	0.5	10	0.14	0.8	5	22	92	2.24	10
CC07680	0.36	1.0	1.29	13	<10	280	0.5	7	0.26	1.3	6	18	49	1.85	<10
CC07681	0.38	0.5	1.76	13	<10	300	0.6	6	0.20	1.0	6	20	69	2.24	<10
CC07682	0.36	0.5	1.04	7	<10	290	0.5	3	0.33	1.3	7	15	72	1.63	<10
CC07683	0.46	0.7	1.15	7	<10	270	<0.5	3	0.52	1.6	7	18	42	1.88	<10
CC07684	0.44	1.4	1.48	9	<10	350	0.5	8	0.75	2.6	8	22	114	2.08	10
CC07685	0.30	0.2	0.94	8	<10	230	<0.5	2	0.33	1.6	3	14	30	1.24	10
CC07686	0.40	0.8	1.14	7	<10	270	<0.5	3	0.36	1.0	5	15	35	1.60	<10
CC07687	0.32	0.9	0.78	11	<10	190	<0.5	6	0.45	2.9	3	14	166	1.06	<10
CC07688	0.38	2.2	1.55	21	<10	380	0.7	8	0.50	3.8	6	23	551	2.08	<10
CC07689	0.30	2.0	1.40	12	<10	400	0.6	7	0.72	6.6	5	20	436	1.79	<10
CC07690	0.34	1.1	1.12	13	<10	320	0.5	3	0.78	2.6	6	15	148	1.63	<10
CC07691	0.32	1.7	1.30	28	<10	320	0.8	5	0.82	2.8	7	18	160	1.95	<10
CC07692	0.32	0.4	0.93	19	<10	270	<0.5	3	0.23	0.6	5	15	21	2.03	<10
CC07693	0.40	0.9	1.15	16	<10	390	0.5	2	0.65	1.8	9	16	78	1.77	<10
CC07694	0.42	1.1	1.14	15	<10	320	0.5	2	0.97	2.7	5	14	83	1.62	<10
CC07695	0.38	0.5	1.23	17	<10	530	0.6	<2	0.36	0.8	6	18	55	2.01	<10
CC07696	0.26	0.5	1.23	9	<10	440	<0.5	<2	0.36	0.9	7	16	14	1.72	<10
CC07697	0.32	0.2	0.89	9	<10	240	<0.5	<2	0.17	0.9	6	12	8	1.40	<10
CC07698	0.38	0.6	1.31	32	<10	210	0.5	<2	0.30	1.4	7	15	22	1.98	<10
CC07701	0.24	0.5	1.00	9	<10	320	<0.5	<2	0.37	1.6	4	10	11	1.61	<10
CC07702	0.28	0.6	0.96	4	<10	440	<0.5	<2	0.13	1.5	4	17	10	1.54	<10
CC07703	0.20	0.2	1.04	7	<10	260	<0.5	<2	0.40	0.5	5	14	7	1.48	<10
CC07704	0.28	1.4	1.25	22	<10	440	0.7	4	0.59	4.3	8	19	50	2.17	<10
CC07705	0.26	1.1	1.38	24	10	620	0.7	4	0.79	2.4	7	20	154	2.30	<10



ALS Chemex
EXCELLENCE IN ANALYTICAL CHEMISTRY

ALS Canada Ltd.
212 Brooksbank Avenue
North Vancouver BC V7J 2C1
Phone: 604 984 0221 Fax: 604 984 0218 www.alschemex.com

STRATEGIC METALS LTD.
C/O ARCHER, CATHRO & ASSOCIATES (1981)
LIMITED
1016-510 W HASTINGS ST
VANCOUVER BC V6B 1L8
Project: Ross Copper- Timber

Page: 3 - C
Total Pages: 5 (A - C)
Finalized Date: 26-AUG-2005
Account: MTT

CERTIFICATE OF ANALYSIS VA05068612

Sample Description	Method Analyte Units LOR	ME-ICP41		ME-ICP41		ME-ICP41		ME-ICP41		ME-ICP41	
		Ti ppm	U ppm	V ppm	W ppm	Zn ppm					
CC07663		<10	<10	59	<10	<10	1200				
CC07664		<10	<10	71	<10	<10	1085				
CC07665		<10	<10	66	<10	<10	1370				
CC07666		<10	<10	72	<10	<10	1620				
CC07667		<10	<10	67	<10	<10	1885				
CC07668		<10	<10	25	<10	<10	1470				
CC07669		<10	<10	79	<10	<10	2070				
CC07670		<10	<10	67	<10	<10	269				
CC07671		<10	<10	111	<10	<10	186				
CC07672		<10	<10	85	<10	<10	141				
CC07673		<10	<10	105	<10	<10	273				
CC07674		<10	20	43	<10	<10	620				
CC07676		<10	<10	94	<10	<10	183				
CC07677		<10	<10	95	<10	<10	196				
CC07678		<10	<10	77	<10	<10	150				
CC07679		<10	<10	88	<10	<10	217				
CC07680		<10	<10	69	<10	<10	325				
CC07681		<10	<10	75	<10	<10	150				
CC07682		<10	<10	55	<10	<10	207				
CC07683		<10	<10	77	<10	<10	184				
CC07684		<10	<10	95	<10	<10	215				
CC07685		<10	<10	43	<10	<10	130				
CC07686		<10	<10	59	<10	<10	170				
CC07687		<10	<10	62	<10	<10	142				
CC07688		<10	<10	91	<10	<10	378				
CC07689		<10	<10	88	<10	<10	322				
CC07690		<10	<10	66	<10	<10	274				
CC07691		<10	<10	70	<10	<10	380				
CC07692		<10	<10	52	<10	<10	97				
CC07693		<10	<10	61	<10	<10	172				
CC07694		10	<10	56	<10	<10	189				
CC07695		<10	<10	70	<10	<10	166				
CC07696		<10	<10	50	<10	<10	208				
CC07697		<10	<10	44	<10	<10	160				
CC07698		<10	<10	53	<10	<10	163				
CC07701		<10	<10	45	<10	<10	159				
CC07702		<10	<10	41	<10	<10	190				
CC07703		<10	<10	50	<10	<10	158				
CC07704		10	<10	69	<10	<10	484				
CC07705		<10	<10	86	<10	<10	230				

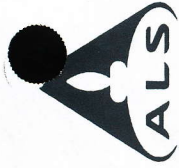

ALS Chemex
EXCELLENCE IN ANALYTICAL CHEMISTRY

ALS Canada Ltd.
212 Brooksbank Avenue
North Vancouver BC V7J 2C1
Phone: 604 984 0221 Fax: 604 984 0218 www.alschemex.com

STRATEGIC METALS LTD.
C/O ARCHER, CATHRO & ASSOCIATES (1981)
LIMITED

1016-510 W HASTINGS ST
VANCOUVER BC V6B 1L8

Project: Ross Copper- Timber

Page: 4 - A
Total Pages: 5 (A - C)
Finalized Date: 26-AUG-2005
Account: MTT

CERTIFICATE OF ANALYSIS VA05068612

Method Analyte Units LOR	Sample Description	WEI-21 Recvd Wt. kg	ME-ICP41 Ag ppm	ME-ICP41 Al %	ME-ICP41 As ppm	ME-ICP41 B ppm	ME-ICP41 Ba ppm	ME-ICP41 Be ppm	ME-ICP41 Bi ppm	ME-ICP41 Ca %	ME-ICP41 Cd ppm	ME-ICP41 Co ppm	ME-ICP41 Cr ppm	ME-ICP41 Cu ppm	ME-ICP41 Fe %	ME-ICP41 Ga ppm
	CC07706	0.22	1.3	0.88	12	<10	280	0.5	5	0.60	2.3	4	11	166	1.45	<10
	CC07707	0.30	1.7	1.34	31	<10	310	0.6	7	0.66	2.4	6	19	210	2.16	<10
	CC07708	0.26	1.2	1.28	22	<10	270	0.5	6	0.47	1.9	5	21	242	2.03	<10
	CC07709	0.18	0.9	0.17	<2	<10	40	<0.5	<2	0.17	<0.5	1	1	52	0.34	<10
	CC07710	0.28	0.4	0.66	10	<10	180	<0.5	5	0.16	0.8	2	10	102	0.82	<10
	CC07711	0.28	0.4	0.82	5	<10	230	<0.5	<2	0.20	1.0	4	14	28	1.07	<10
	CC07715	0.30	0.4	1.02	9	<10	240	<0.5	<2	1.04	0.7	5	14	40	1.43	<10
	CC07716	0.28	0.8	1.45	16	<10	290	0.5	2	0.74	0.6	7	20	51	1.99	<10
	CC07717	0.24	0.6	0.49	5	<10	150	<0.5	<2	0.16	0.6	2	6	12	0.80	<10
	CC07718	0.34	0.4	0.87	5	<10	420	<0.5	<2	0.25	1.2	6	12	18	1.51	<10
	CC07719	0.28	1.0	1.13	14	<10	300	0.5	3	0.98	1.9	6	15	69	1.65	<10
	CC07720	0.22	0.9	1.06	12	<10	310	0.5	2	1.38	3.9	4	14	132	1.50	<10
	CC07721	0.26	0.6	0.94	4	<10	260	<0.5	2	1.15	2.7	4	12	53	1.35	<10
	CC07731	0.26	0.8	1.39	9	<10	330	0.6	5	0.73	1.9	7	20	44	2.13	<10
	CC07732	0.30	0.6	1.54	23	<10	310	0.6	7	0.68	0.8	8	21	58	2.20	<10
	CC07733	0.28	0.6	0.83	9	<10	190	<0.5	3	0.14	1.2	3	11	8	1.39	<10
	CC07734	0.28	0.6	1.14	14	<10	310	<0.5	3	0.30	1.0	6	15	30	1.82	<10
	CC07735	0.24	0.2	1.43	25	<10	250	0.5	<2	0.27	3.3	10	17	17	2.23	<10
	CC07736	0.24	0.4	1.59	12	<10	320	<0.5	<2	0.38	1.6	7	20	11	2.37	<10
	CC07737	0.28	0.4	1.16	5	<10	230	<0.5	<2	0.42	1.8	6	15	12	1.81	<10
	CC07738	0.22	0.2	1.00	3	<10	220	<0.5	<2	0.18	3.2	6	14	9	1.70	<10
	CC07739	0.30	0.3	0.89	3	<10	290	<0.5	<2	0.20	0.9	6	12	4	1.31	<10
	CC07740	0.20	0.5	1.54	19	<10	300	<0.5	<2	0.42	2.4	6	15	11	2.36	<10
	CC07741	0.26	0.2	1.19	8	<10	360	<0.5	<2	0.18	0.8	4	17	11	1.61	<10
	CC07742	0.22	1.0	1.54	74	<10	380	<0.5	<2	1.31	5.6	7	18	168	1.96	<10
	CC07743	0.26	0.6	1.40	20	<10	360	0.5	2	0.85	2.9	6	20	142	1.69	10
	CC07744	0.34	0.6	1.06	14	<10	300	<0.5	<2	0.76	2.8	7	15	54	1.59	<10
	CC07745	0.16	1.1	1.22	14	<10	290	0.6	2	1.58	4.6	4	15	148	1.45	<10
	CC07746	0.32	0.7	1.12	7	<10	240	<0.5	3	0.47	0.7	5	16	22	1.68	<10
	CC07747	0.32	1.3	1.41	5	<10	480	0.6	4	1.14	4.3	6	19	63	1.90	<10
	CC07748	0.22	0.8	1.13	6	<10	370	0.5	<2	0.70	4.3	7	14	58	1.43	<10
	CC07749	0.32	1.2	1.65	98	<10	320	0.7	<2	0.29	1.0	9	22	59	2.19	<10
	CC07750	0.36	0.2	1.44	17	<10	220	<0.5	<2	0.34	0.6	6	17	17	1.97	<10
	CC07751	0.34	<0.2	1.17	20	<10	200	<0.5	<2	0.23	1.2	5	14	13	2.19	<10
	CC07752	0.34	0.2	1.08	14	<10	220	<0.5	<2	0.12	1.1	5	14	11	2.13	<10
	CC07753	0.38	0.4	1.42	37	<10	250	<0.5	<2	0.23	0.7	7	17	22	2.34	<10
	CC07754	0.38	0.2	0.84	11	<10	300	<0.5	<2	0.20	0.7	3	12	6	1.14	<10
	CC07755	0.36	0.2	0.94	9	<10	300	<0.5	<2	0.17	2.6	6	11	15	1.42	<10
	CC07756	0.36	0.3	0.91	297	<10	220	<0.5	<2	0.52	0.6	6	13	32	1.70	<10
	CC07757	0.24	0.6	1.14	49	<10	280	0.7	<2	0.88	3.1	5	14	78	1.72	<10



ALS Chemex
EXCELLENCE IN ANALYTICAL CHEMISTRY

ALS Canada Ltd.
212 Brooksbank Avenue
North Vancouver BC V7J 2C1
Phone: 604 984 0221 Fax: 604 984 0218 www.alschemex.com

STRATEGIC METALS LTD.
C/O ARCHER, CATHRO & ASSOCIATES (1981)
LIMITED

1016-510 W HASTINGS ST
VANCOUVER BC V6B 1L8

Project: Ross Copper- Timber

Page: 4 - B
Total # Pages: 5 (A - C)
Finalized Date: 26-AUG-2005
Account: MTT

CERTIFICATE OF ANALYSIS VA05068612

Method Analyte Units LOR	Sample Description	ME-ICP41 Hg ppm	ME-ICP41 K %	ME-ICP41 La ppm	ME-ICP41 Mg %	ME-ICP41 Mn ppm	ME-ICP41 Mo ppm	ME-ICP41 Na %	ME-ICP41 Ni ppm	ME-ICP41 P ppm	ME-ICP41 Pb ppm	ME-ICP41 S %	ME-ICP41 Sb ppm	ME-ICP41 Sc ppm	ME-ICP41 Sr ppm	ME-ICP41 Ti %
CC07706		<1	0.09	10	0.25	306	12	0.02	21	710	15	0.03	2	2	39	0.02
CC07707		<1	0.18	20	0.51	237	12	0.01	29	1020	36	0.01	2	4	51	0.03
CC07708		<1	0.18	20	0.58	174	13	<0.01	29	870	15	<0.01	<2	3	35	0.04
CC07709		<1	0.03	<10	0.03	101	5	0.04	2	290	<2	<0.01	<2	<1	15	0.02
CC07710		<1	0.07	10	0.17	90	6	<0.01	12	260	11	<0.01	<2	1	15	0.02
CC07711		<1	0.12	10	0.37	203	6	<0.01	11	370	14	<0.01	<2	1	26	0.05
CC07715		<1	0.10	10	0.36	201	1	0.01	16	620	7	0.03	<2	3	56	0.02
CC07716		<1	0.15	10	0.58	260	2	0.01	26	720	12	0.01	2	4	48	0.04
CC07717		<1	0.06	10	0.14	116	7	0.02	7	350	5	<0.01	<2	1	14	0.02
CC07718		<1	0.15	10	0.23	688	3	0.01	13	1020	10	0.01	<2	1	32	0.02
CC07719		<1	0.12	10	0.45	390	4	0.01	24	910	18	0.04	2	3	60	0.03
CC07720		<1	0.10	10	0.38	316	4	0.01	31	1030	16	0.06	2	2	73	0.02
CC07721		<1	0.13	10	0.45	186	3	0.02	19	750	13	0.02	2	2	70	0.03
CC07731		<1	0.21	20	0.64	261	3	0.01	25	1060	28	0.01	4	4	66	0.04
CC07732		1	0.17	20	0.73	326	3	0.01	26	770	25	<0.01	<2	4	51	0.03
CC07733		<1	0.14	10	0.26	117	3	<0.01	9	210	8	<0.01	2	1	14	0.02
CC07734		<1	0.15	20	0.45	227	3	<0.01	20	410	18	<0.01	<2	3	27	0.03
CC07735		<1	0.15	10	0.39	457	2	<0.01	21	210	50	<0.01	2	3	18	0.03
CC07736		<1	0.14	10	0.39	201	2	<0.01	18	230	28	<0.01	<2	3	23	0.03
CC07737		<1	0.10	10	0.34	286	1	<0.01	14	330	14	<0.01	<2	3	16	0.03
CC07738		1	0.07	10	0.28	395	1	<0.01	13	320	14	<0.01	<2	2	15	0.02
CC07739		<1	0.08	10	0.24	447	1	<0.01	8	250	12	<0.01	<2	1	14	0.02
CC07740		<1	0.05	10	0.36	276	1	<0.01	11	220	44	<0.01	<2	3	20	0.01
CC07741		<1	0.10	10	0.39	172	2	<0.01	14	270	10	<0.01	<2	2	17	0.03
CC07742		1	0.13	10	0.41	264	3	<0.01	30	1050	28	0.04	<2	3	65	0.02
CC07743		<1	0.11	20	0.38	382	5	<0.01	20	540	23	0.01	2	3	51	0.02
CC07744		<1	0.09	20	0.45	491	4	0.01	19	1130	13	0.02	<2	2	49	0.03
CC07745		<1	0.09	20	0.45	321	3	0.02	20	1030	13	0.07	<2	2	75	0.03
CC07746		<1	0.14	10	0.50	253	3	0.01	17	550	15	<0.01	3	3	49	0.04
CC07747		<1	0.17	10	0.58	184	2	0.01	24	870	22	0.02	2	4	152	0.03
CC07748		<1	0.11	10	0.31	584	3	0.02	17	500	34	0.01	2	2	110	0.02
CC07749		<1	0.19	20	0.50	386	2	<0.01	30	350	28	0.01	3	4	24	0.03
CC07750		<1	0.11	10	0.48	224	2	<0.01	19	530	19	<0.01	<2	3	22	0.03
CC07751		1	0.06	10	0.31	162	3	0.01	13	200	18	0.01	<2	2	19	0.02
CC07752		<1	0.06	10	0.25	129	3	0.01	14	260	10	0.01	2	2	12	0.01
CC07753		1	0.06	10	0.35	152	2	0.01	18	160	16	0.01	2	2	18	0.01
CC07754		<1	0.07	10	0.27	152	1	0.01	9	340	7	<0.01	2	2	19	0.02
CC07755		<1	0.05	10	0.19	325	2	0.01	9	180	16	<0.01	2	2	14	0.01
CC07756		<1	0.06	20	0.31	190	1	0.01	18	880	13	0.01	2	2	40	0.02
CC07757		1	0.08	10	0.29	249	1	0.02	24	880	18	0.03	2	2	48	0.02



ALS Chemex
EXCELLENCE IN ANALYTICAL CHEMISTRY

ALS Canada Ltd.
212 Brooksbank Avenue
North Vancouver BC V7J 2C1
Phone: 604 984 0221 Fax: 604 984 0218 www.alschemex.com

STRATEGIC METALS LTD.
C/O ARCHER, CATHRO & ASSOCIATES (1981)
LIMITED
1016-510 W HASTINGS ST
VANCOUVER BC V6B 1L8

Project: Ross Copper- Timber

Page: 4 - C
Total Pages: 5 (A - C)
Finalized Date: 26-AUG-2005
Account: MTT

CERTIFICATE OF ANALYSIS VA05068612

Sample Description	Method Analyte Units LOR	ME-ICP41		ME-ICP41		ME-ICP41		ME-ICP41		ME-ICP41	
		Ti ppm	U ppm	V ppm	W ppm	Zn ppm	Zn ppm				
CC07706		<10	<10	51	<10	<10	<10	169			
CC07707		<10	<10	75	<10	<10	<10	333			
CC07708		<10	<10	94	<10	<10	<10	297			
CC07709		<10	<10	11	<10	<10	<10	12			
CC07710		<10	<10	60	<10	<10	<10	82			
CC07711		<10	<10	65	<10	<10	<10	100			
CC07715		<10	<10	39	<10	<10	<10	84			
CC07716		<10	<10	67	<10	<10	<10	144			
CC07717		<10	<10	25	<10	<10	<10	49			
CC07718		<10	<10	54	<10	<10	<10	113			
CC07719		<10	<10	67	<10	<10	<10	204			
CC07720		<10	<10	59	<10	<10	<10	255			
CC07721		<10	<10	46	<10	<10	<10	156			
CC07731		<10	<10	74	<10	<10	<10	283			
CC07732		<10	<10	83	<10	<10	<10	205			
CC07733		<10	<10	55	<10	<10	<10	140			
CC07734		<10	<10	59	<10	<10	<10	170			
CC07735		<10	<10	53	<10	<10	<10	260			
CC07736		<10	<10	61	<10	<10	<10	170			
CC07737		<10	<10	46	<10	<10	<10	221			
CC07738		<10	<10	34	<10	<10	<10	496			
CC07739		<10	<10	38	<10	<10	<10	153			
CC07740		<10	<10	58	<10	<10	<10	271			
CC07741		<10	<10	54	<10	<10	<10	124			
CC07742		<10	<10	63	<10	<10	<10	292			
CC07743		<10	<10	80	<10	<10	<10	173			
CC07744		<10	<10	66	<10	<10	<10	184			
CC07745		10	<10	64	<10	<10	<10	249			
CC07746		<10	<10	64	<10	<10	<10	164			
CC07747		<10	<10	68	<10	<10	<10	221			
CC07748		<10	<10	47	<10	<10	<10	191			
CC07749		<10	<10	51	<10	<10	<10	223			
CC07750		<10	<10	50	<10	<10	<10	145			
CC07751		<10	<10	53	<10	<10	<10	108			
CC07752		<10	<10	53	<10	<10	<10	147			
CC07753		<10	<10	52	<10	<10	<10	158			
CC07754		<10	<10	34	<10	<10	<10	87			
CC07755		<10	<10	37	<10	<10	<10	191			
CC07756		<10	<10	42	<10	<10	<10	120			
CC07757		<10	<10	47	<10	<10	<10	291			



ALS Chemex
 EXCELLENCE IN ANALYTICAL CHEMISTRY

ALS Canada Ltd.
 212 Brooksbank Avenue
 North Vancouver BC V7J 2C1
 Phone: 604 984 0221 Fax: 604 984 0218 www.alschemex.com

STRATEGIC METALS LTD.
 C/O ARCHER, CATHRO & ASSOCIATES (1981)
 LIMITED
 1016-510 W HASTINGS ST
 VANCOUVER BC V6B 1L8
 Project: Ross Copper- Timber

Page: 5 - A
 Total Pages: 5 (A - C)
 Finalized Date: 26-AUG-2005
 Account: MTT

CERTIFICATE OF ANALYSIS VA05068612

Method	Sample Description	WEI-21	Ag	Al	As	B	Ba	Be	Bi	Ca	Cd	Co	Cr	Cu	Fe	Ga
Analyte		kg	ppm	%	ppm	ppm	ppm	ppm	ppm	%	ppm	ppm	ppm	ppm	%	ppm
Units																
LOR																
	CC07758	0.34	0.9	1.28	375	<10	330	1.1	2	0.69	3.5	7	16	334	1.99	<10



ALS Chemex
 EXCELLENCE IN ANALYTICAL CHEMISTRY

ALS Canada Ltd.
 212 Brooksbank Avenue
 North Vancouver BC V7J 2C1
 Phone: 604 984 0221 Fax: 604 984 0218 www.alschemex.com

STRATEGIC METALS LTD.
 C/O ARCHER, CATHRO & ASSOCIATES (1981)
 LIMITED
 1016-510 W HASTINGS ST
 VANCOUVER BC V6B 1L8

Project: Ross Copper- Timber

Page: 5 - B
 Total Pages: 5 (A - C)
 Finalized Date: 26-AUG-2005
 Account: MTT

CERTIFICATE OF ANALYSIS VA05068612

Method Analyte Units LOR	ME-ICP41	ME-ICP41	ME-ICP41	ME-ICP41	ME-ICP41	ME-ICP41	ME-ICP41	ME-ICP41	ME-ICP41	ME-ICP41	ME-ICP41	ME-ICP41	ME-ICP41	ME-ICP41	ME-ICP41	ME-ICP41	ME-ICP41
Sample Description	Hg	K	La	Mg	Mn	Mo	Na	Ni	P	Pb	S	Sb	Sc	Sr	Ti		
	ppm	%	ppm	%	ppm	ppm	%	ppm	ppm	ppm	%	ppm	ppm	ppm	%		
CC07758	<1	0.08	20	0.37	263	1	0.01	31	590	31	0.02	2	4	39	0.02		

ARCHER, CATHRO & ASSOCIATES (1981) LIMITED
1016 – 510 West Hastings Street
Vancouver, B.C. V6B 1L8

Telephone: 604-688-2568

Fax: 604-688-2578

AFFIDAVIT

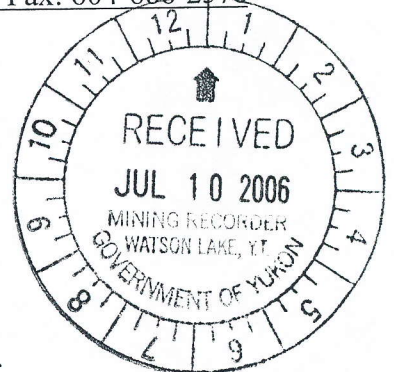

I, Joan Mariacher, of Vancouver, B.C. make oath and say:

That to the best of my knowledge the attached Statement of
Expenditures for exploration work on the Timber 1-16
mineral claims on Claim Sheet 105J/3 is accurate.

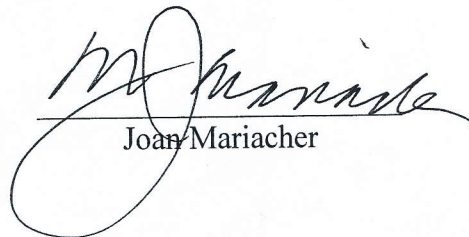
Joan Mariacher

Sworn before me at Vancouver, B.C.

this 4th day of July 2006.

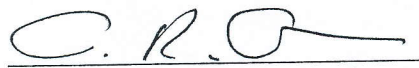
Notary Public, Yukon Territory

Statement of Expenditures
Timber 1-16 Mineral Claims
July 4, 2006

Labour

S. Eaton – field assistant – 8 days August at \$304/day	\$ 2,602.24
S. Inkster – field assistant – 8 days August at \$256/day	2,191.36
D. Arnold-Wallinger – field assistant – 8 days August at \$240/day	2,054.40
R. Moore – field assistant – 8 days August at \$240/day	<u>2,054.40</u>
	8,902.40

Expenses

Field room and board – 32 days at \$125/day	4,280.00
ALS Chemex	<u>1,959.44</u>
	6,239.44
	<u>\$15,141.84</u>

A total of 121 soil samples taken on the following claims at \$125.14/sample:

Timber 1	YC29084	1
3	YC29086	26
4	YC29087	25
5	YC29088	8
6	YC29089	25
7	YC29090	4
11	YC29094	12
12	YC29095	1
13	YC29096	16
14	YC29097	3

ARCHER, CATHRO & ASSOCIATES (1981) LIMITED

1/2

In Account With

Project ROSS COPPER PROJECT
Date SEPTEMBER 2005

LABOUR

Field	Description	Rate	Amount	Total
	A. ARCHER - 2 HRS AT 90/HR	AVG	180.00	
	D. EATON - 47 HRS AT 70/HR	AVG	2940.00	
	- 18 HRS AT 70/HR	SEPT	910.00	
	B. WENBYNOWSKI - 78 HRS AT 70/HR	AVG	5460.00	
	- 110 HRS AT 70/HR	SEPT	7700.00	
	N. MITCHELL - 10 1/2 DAYS AT 520/DAY	SEPT	5460.00	
	M. TURNER - 6 1/3 DAYS AT 400/DAY	SEPT	2533.20	
	B. GELBER - 10 1/6 DAYS AT 357/DAY	SEPT	3754.78	
	H. SMITH - 1 DAY AT 370/DAY	SEPT	370.00	
	S. EATON - 21 DAYS AT 304/DAY	AVG	6384.00	
	D. GREWALY - 20 DAYS AVG + 8 DAY SEPT AT 277/DAY		7616.00	
	B. DUNCAN - 1 DAY AVG + 23 DAYS SEPT AT 256/DAY		6144.00	
	R. FORTNER - 1/2 DAY AT 256/DAY	AVG	128.00	
	R. GIBSON - 2 DAYS AVG + 30 DAYS SEPT AT 256/DAY		8192.00	
	S. INKSTER - 10 DAYS AT 256/DAY	AVG	2560.00	
	D. PANDOL-WALLINER - 31 DAYS AT 240/DAY + 1600 BONUS	AVG	9040.00	
Accounting and Expediting	J. Mariacher - 14 1/4 hrs at \$58/hr	AVG	826.50	
	20 3/4	SEPT	1203.50	88066.48
				(P. 14 Y)
OTHER SERVICES				
	Room and Board in Whitehorse	AVG - 23 1/2 SEPT - 22 days at \$90/day	4095.00	
	Field equipment from AC stock	108 DAYS AVG + 125 DAYS SEPT AT 50/DAY	14450.00	
	Printing	Photocopies @.15		
	Rentals from AC			
	Express Courier - 2 1/2 @ 23.25 + 2 @ 20 + 1 1/2 @ 14.85		121.66	18366.66

EXPENSES

Petty Cash 33.5001		33.50	
Telephone 8.91 + 27.93		36.84	
TND 133.09 + 239.67		372.76	
YUKON EXPLOSIVES		19.20	
AVROA GEOSCIENCES - 11214.91 + 21340.00		32554.91	
MAC'S FIREWEED - 25.92 + 23.88		49.80	
YUKON HONDA - 10.39 + 161.32		171.71	
SUNRISE SERVICE - 66.97 + 202.40 + 66.06		335.43	
YUKON TIRE		70.10	
NORTH 60 PETRO - 149.38 62 + 1911.90 62		2061.28	
B. WENT EXPENSES	D4	67.73	
BUILDERS SUPPLYLAND		661.61	
CORPORATE COURIER - 10.11 + 16.86		26.97	
RIVERDALE SUPER A - 2034.89 + 2681.92		4716.81	
MACHELLON RENTALS - 259.83 + 16.82 D1 + 389.42		666.07	
ROSS RIVER SERVICE - 11186.01 + 5277.02 + 40.03 + 228.07 04 + 1670.04 + 3360.00		1167.76	
TRANS NORTH HELICOPTER - 14742.72 + 19891.80		34634.52	
GREYHOUND COURIER - 223.78 + 128.48 + 22.55 + 223.62		598.43	
JOAN M EXPENSES - 332.74 D1 + 1001.01 03 + 443. F + 412.53 D1 + 236.68 03 + 353.50 F		2784.46	
91 DELIVERY		43.22	
INTEGRAPHICS		21.82	
COUREUR DES BOIS	I2	5850.00	
BYERS		44.12	
HOME HARDWARE		142.48	
POTHIEL ENTERPRISES		760.00	
M. PHILLIPS		30.84	
LORNA C EXPENSES	D1	150.61	88073.02
Management 6% on Expenses		5284.38	
on Field A/C		511.92	5796.31
			200302.51
GST (R100247667) 7% on 200302.51			14021.18
			214323.69

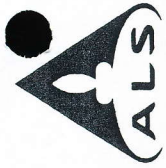

ALS Chemex
EXCELLENCE IN ANALYTICAL CHEMISTRY

ALS Canada Ltd.
212 Brooksbank Avenue
North Vancouver BC V7J 2C1
Phone: 604 984 0221 Fax: 604 984 0218 www.alschemex.com

To: STRATEGIC METALS LTD.
C/O ARCHER, CATHRO & ASSOCIATES (1981)
LIMITED
1016-510 W HASTINGS ST
VANCOUVER BC V6B 1L8

INVOICE NUMBER 1260369

BILLING INFORMATION

Certificate: **VA05068612**

Account: **MTT**

Date: **26-AUG-2005**

Project: Ross Copper- Timber *✓*

P.O. No.:

Quote:

Terms: **Net 30 Days**

Comments: **C1**

QUANTITY	CODE	ANALYSED FOR	DESCRIPTION	UNIT	PRICE	TOTAL
121	PREP-41		Dry, Sieve (180 um) Soil	0.94		113.74
35.02	PREP-41		Weight Charge (kg) - Dry, Sieve (180 um) Soil	1.31		45.88
121	ME-ICP41		34 Element Aqua Regia ICP-AES	4.88		590.48
121	GEO-AR01		Aqua regia digestion	1.88		227.48

SUBTOTAL (CAD) \$ 977.58

R100938885 GST \$ 68.43

TOTAL PAYABLE (CAD) \$ 1,046.01

To: STRATEGIC METALS LTD.
ATTN: ACCOUNTS PAYABLE
C/O ARCHER, CATHRO & ASSOCIATES (1981) LIMITED
1016-510 W HASTINGS ST
VANCOUVER BC V6B 1L8

Payment may be made by: Cheque or Bank Transfer

Beneficiary Name: ALS Canada Ltd.
Bank: Royal Bank of Canada
SWIFT: ROYCCAT2
Address: Vancouver, BC, CAN
Account: 003-00010-1001098

Please Remit Payments To :

ALS Chemex
212 Brooksbank Avenue
North Vancouver BC V7J 2C1

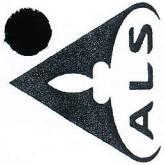

ALS Chemex
EXCELLENCE IN ANALYTICAL CHEMISTRY

ALS Canada Ltd.
212 Brooksbank Avenue
North Vancouver BC V7J 2C1
Phone: 604 984 0221 Fax: 604 984 0218 www.alschemex.com

To: STRATEGIC METALS LTD.
C/O ARCHER, CATHRO & ASSOCIATES (1981)
LIMITED
1016-510 W HASTINGS ST
VANCOUVER BC V6B 1L8

INVOICE NUMBER 1310790

BILLING INFORMATION

Certificate: **VA05081688**

Account: **MTT**

Date: **15-OCT-2005**

Project: Ross Copper- Timber

P.O. No.:

Quote:

Terms: **Net 30 Days**

Comments: **C1**

QUANTITY	CODE	ANALYSED FOR DESCRIPTION	UNIT PRICE	TOTAL
18	AU-AA23	Au 30g FA-AA finish	9.00	162.00
41	ME-MS61	47 element four acid ICP-MS	14.06	576.46
41	GEO-4A01	Four Acid Dig - ME-MS61	2.81	115.21

SUBTOTAL (CAD) \$ 853.67

R100938885 GST \$ 59.76

TOTAL PAYABLE (CAD) \$ 913.43

To: STRATEGIC METALS LTD.
ATTN: ACCOUNTS PAYABLE
C/O ARCHER, CATHRO & ASSOCIATES (1981) LIMITED
1016-510 W HASTINGS ST
VANCOUVER BC V6B 1L8

Payment may be made by: Cheque or Bank Transfer

Beneficiary Name: ALS Canada Ltd.
Bank: Royal Bank of Canada
SWIFT: ROYCCAT2
Address: Vancouver, BC, CAN
Account: 003-00010-1001098

Please Remit Payments To :

ALS Chemex
212 Brooksbank Avenue
North Vancouver BC V7J 2C1