

ASSESSMENT REPORT

describing

PROSPECTING

on the:

JILL PROPERTY

TOE CLAIMS
JILL CLAIMS
LIN CLAIM

Claims are 100% owned by Yukon Zinc Corporation.

NTS Sheet 105G/09 and 105G/08
Latitude 61°30'N and Longitude 130°20'W

In the Watson Lake Mining District
Yukon Territory

Prepared by

David Legault, B.Sc.

February 2006

Table of contents

	Page
Introduction	1
Accessibility, Climate, and Physiography	1
List of Claims by name and by grant number being renewed	1
Description of Undertakings	3
Results	3
Discussion and Recommendations	3

Tables

Table 01 – List of claims by name and grant number being renewed	1
--	---

Appendixes

- Appendix A - List of Personal
- Appendix B - Statement of Expenditures
- Appendix C - Statement of Qualification
- Appendix D – Assays Certificates

Figures

- Figure 1 – Location of the Jack Property
- Figure 2 – Jack Property, YT Claim Map and Sample Location
- Figure 3 – Jack Property, YT Geochemistry Zn (ppm)
- Figure 4 – Jack Property, YT Geochemistry Pb (ppm)
- Figure 5 – Jack Property, YT Geochemistry Cu (ppm)

1. Introduction

The Jill property is 100% owned by Yukon Zinc Corporation (“Yukon Zinc”). The claims subject to this report (Table 1) comprise the Toe claims, Lin claim, and Jill claims. Fieldwork was carried on between July 5th to July 6th, 2005 by a ten-person crew working from fly camp on the property. Prospecting and soil sampling were the primary undertakings during this time.

2. Accessibility, Climate and Physiography

The Jill property is located in the Watson Lake Mining District in southeast Yukon on NTS sheet 105G/09 and 105/G08 at coordinate: latitude 61°30’N and longitude 130°20’W (Figure 01). Access into site is 275km by fixed wing charters from Whitehorse to Wolverine airstrip (61°01’N, 131°20’W) and then 10 km via helicopter from Wolverine airstrip to the Jill Property. In 2005, air transportation was provided by Trans North Helicopter (Astar 350B2) and Alkan Air (Single Turbo Otter).

The Jill property is located in the northern Pelly Mountains of the Yukon Plateau, north of Wolverine Lake. Elevation on the property ranges from 900m to 1100m.

3. List of claims by name and grant number being renewed

Table 1. List of claims being renewed in this assessment report.

Grant number	Claim name	New Expiry date
YB86778	JILL 1	2009/03/31
YB86779	JILL 2	2009/03/31
YB86780	JILL 3	2009/03/31
YB86781	JILL 4	2009/03/31
YB86782	JILL 5	2009/03/31
YB86783	JILL 6	2009/03/31
YB86784	JILL 7	2009/03/31
YB86785	JILL 8	2009/03/31
YB86786	JILL 9	2009/03/31
YB86787	JILL 10	2009/03/31
YB86788	JILL 11	2009/03/31
YB86789	JILL 12	2009/03/31
YB86790	JILL 13	2009/03/31
YB86791	JILL 14	2009/03/31
YB86792	JILL 15	2009/03/31
YB86793	JILL 16	2009/03/31
YB86794	JILL 17	2008/03/31
YB86795	JILL 18	2008/03/31
YB86796	JILL 19	2008/03/31
YB86797	JILL 20	2008/03/31
YB86798	JILL 21	2008/03/31
YB86799	JILL 22	2008/03/31

YB86800	JILL 23	2009/03/31
YB86801	JILL 24	2009/03/31
YB87470	JILL 25	2008/03/31
YB87471	JILL 26	2008/03/31
YB87472	JILL 27	2008/03/31
YB87473	JILL 28	2008/03/31
YB87474	JILL 29	2008/03/31
YB87475	JILL 30	2008/03/31
YB87476	JILL 31	2008/03/31
YB87477	JILL 32	2008/03/31
YB87481	JILL 36	2008/03/31
YB87482	JILL 37	2008/03/31
YB87483	JILL 38	2008/03/31
YB87484	JILL 39	2008/03/31
YB87485	JILL 40	2008/03/31
YB87486	JILL 41	2008/03/31
YB56214	TOE 1	2008/03/31
YB56215	TOE 2	2008/03/31
YB56216	TOE 3	2008/03/31
YB56217	TOE 4	2008/03/31
YB56218	TOE 5	2008/03/31
YB56219	TOE 6	2008/03/31
YB56220	TOE 7	2008/03/31
YB56221	TOE 8	2009/03/31
YB56222	TOE 9	2008/03/31
YB56223	TOE 10	2008/03/31
YB56224	TOE 11	2008/03/31
YB56225	TOE 12	2008/03/31
YB56226	TOE 13	2008/03/31
YB56227	TOE 14	2008/03/31
YB56228	TOE 15	2008/03/31
YB56229	TOE 16	2008/03/31
YB59962	TOE 17	2008/03/31
YB59963	TOE 18	2008/03/31
YB59964	TOE 19	2008/03/31
YB59965	TOE 20	2008/03/31
YB59966	TOE 21	2008/03/31
YB59967	TOE 22	2008/03/31
YB59968	TOE 23	2008/03/31
YB59969	TOE 24	2008/03/31
YB59970	TOE 25	2008/03/31
YB59971	TOE 26	2008/03/31
YB59972	TOE 27	2008/03/31
YB59973	TOE 28	2008/03/31
YB59974	TOE 29	2008/03/31
YB59975	TOE 30	2008/03/31
YB59976	TOE 31	2008/03/31
YB59977	TOE 32	2008/03/31

YB59978	TOE 33	2008/03/31
YB59979	TOE 34	2008/03/31
YB59980	TOE 35	2008/03/31
YB59981	TOE 36	2008/03/31
YB87469	LIN 1	2008/03/31

4. Description of Undertakings

Prospecting and Soil Sampling

Field crews consisted of four Geologists and six Field Assistants. Soil samples were collected by removing top soil using steel spades and sampling the unweathered material at a depth of one foot below ground surface interpreted to be the "B"-horizon. Each sample was packaged in a Kraft soil sample bag (4"x6" folded) and transported to Wolverine Camps for drying. Silt samples were collected where spring run-off was visible, in dried-out creek along mountain slopes or along tributaries of streams and rivers. They were packaged in Kraft soil sample bag. Rock samples were labeled and put in plastic sample bags.

5. Results

All soil and silt samples (92) were sent for assay at ALS-Chemex, 212 Brooksbank Avenue, North Vancouver, British Columbia, V6J 2C1. Analyses of the soil and silt samples were by a 27 element ICP-AES after a 4-acid digestion process. Please see Appendix D for assay certificates and figures 2 through 5 for plotted results.

6. Discussion and Conclusions

Soil and silt geochemistry shows anomalies in zinc along the northern edge of the property. Copper and lead results do not define anomalies over the property. However, there are some high numbers in copper in certain area of the property (see Figure 3 to 5). No outcrops were observed on the property.

The Jill Property should be maintained in good standing and warrants further geological, geochemical, and drilling for VMS exploration.

Respectfully Submitted,

David Legault, B.Sc.
Project Geologist

Vancouver, B.C., February 13th, 2006

Appendix A – List of Personal

Name	Position	Period
David Legault	Geologist	July 5 to July 6, 2005
Justin Laberge	Geologist	July 5 to July 6, 2005
Matthew Jodrey	Geologist	July 5 to July 6, 2005
Lorraine Tam	Geologist	July 5 to July 6, 2005
Kyioko Nakano	Field Assistant	July 5 to July 6, 2005
Scott Blevings	Field Assistant	July 5 to July 6, 2005
Tyler Caswell	Field Assistant	July 5 to July 6, 2005
Anthony Peter	Field Assistant	July 5 to July 6, 2005
Vashti Etzel	Field Assistant	July 5 to July 6, 2005
Matthew Williams	Field Assistant	July 5 to July 6, 2005

STATEMENT OF EXPENDITURES

I, David Legault, as agent for Yukon Zinc Corporation, #701-475 Howe Street, Vancouver, B.C. do solemnly declare that geological examination, prospecting, and soil geochemistry survey sampling carried out on the Toe, Jill, and Lin Claims (see attached list) between the dates of July 5th and July 6th, 2005.

Assays/Geochemical Analysis	\$933.94
Meals & Accommodation	\$488.16
Fixed Wing	\$1329.80
Helicopter	\$2047.50
Fuel	\$34.30
Wages (professional)	\$5790.82
Wages (WCB)	\$466.24
Travel Costs	\$1183.88
Communications	\$740.62
Shipping & Postage	\$72.60
Writing Report	\$560.00
Total	\$13647.56

I make this solemn declaration conscientiously believing it to be true and knowing that it is of the same force and effect as if made under oath and by virtue of the Canada Evidence Act.

Declared before me at Vancouver in the Province of British Columbia this 17th day of January 2006.

David Legault, B.Sc.

Appendix C – Statement of Qualifications

I, David Legault, resident of Vancouver, British Columbia, do certify that:

1. I graduated from Université du Québec À Montréal in May 2001 with a B.Sc. in Geology;
2. From 1998 to present, I have been actively engaged in mineral exploration in Québec, Ontario, and Yukon Territory and am presently employed with the Expatriate Group of Companies to which Yukon Zinc Corporation is part of;
3. I have personally participated in the logistical support during the fieldwork and analysis of data for the filed undertakings herein.

Respectfully Submitted,

David Legault, B.Sc.



ALS Chemex

EXCELLENCE IN ANALYTICAL CHEMISTRY

ALS Canada Ltd.

212 Brooksbank Avenue

North Vancouver BC V7J 2C1

Phone: 604 984 0221 Fax: 604 984 0218 www.alschemex.com

To: YUKON ZINC CORPORATION

701-475 HOWE ST

VANCOUVER BC V6C 2B3

Page: 1
Finalized Date: 26-JUL-2005
Account: MPO

CERTIFICATE VA05059499

Project: 1611-LIN

P.O. No.:

This report is for 2 Soil samples submitted to our lab in Vancouver, BC, Canada on 20-JUL-2005.

The following have access to data associated with this certificate:

JASON DUNNING

SAMPLE PREPARATION

ALS CODE	DESCRIPTION
WEI-21	Received Sample Weight
LOG-22	Sample login - Rcd w/o BarCode
SCR-41	Screen to -180um and save both

ANALYTICAL PROCEDURES

ALS CODE	DESCRIPTION	INSTRUMENT
ME-ICP61	27 element four acid ICP-AES	ICP-AES

To: YUKON ZINC CORPORATION
ATTN: JASON DUNNING
701-475 HOWE ST
VANCOUVER BC V6C 2B3

This is the Final Report and supersedes any preliminary report with this certificate number. Results apply to samples as submitted. All pages of this report have been checked and approved for release.

Signature:



ALS Chemex

EXCELLENCE IN ANALYTICAL CHEMISTRY

ALS Canada Ltd.

212 Brooksbank Avenue
North Vancouver BC V7J 2C1

Phone: 604 984 0221 Fax: 604 984 0218 www.alschemex.com

Client: YUKON ZINC CORPORATION

701-475 HOWE ST

VANCOUVER BC V6C 2B3

Page: 2 - A

Total # Pages: 2 (A - B)

Finalized Date: 26-JUL-2005

Account: MPO

Project: 1611-LIN

CERTIFICATE OF ANALYSIS VA05059499

Sample Description	Method Analyte Units LOR	WEI-21	ME-ICP61	ME-ICP61	ME-ICP61	ME-ICP61	ME-ICP61	ME-ICP61	ME-ICP61	ME-ICP61	ME-ICP61	ME-ICP61	ME-ICP61	ME-ICP61	ME-ICP61	ME-ICP61
		Recvd Wt. kg	Ag ppm	Al %	As ppm	Ba ppm	Be ppm	Bi ppm	Ca %	Cd ppm	Co ppm	Cr ppm	Cu ppm	Fe %	K %	Mg %
		0.02	0.5	0.01	5	10	0.5	2	0.01	0.5	1	1	1	0.01	0.01	0.01
B372921		0.42	<0.5	6.76	6	1310	1.8	<2	1.03	<0.5	8	101	13	2.71	2.00	1.05
B372922		0.52	<0.5	6.14	14	1350	2.2	<2	1.08	<0.5	9	110	21	2.65	1.94	1.24



ALS Chemex

EXCELLENCE IN ANALYTICAL CHEMISTRY

ALS Canada Ltd.

212 Brooksbank Avenue
North Vancouver BC V7J 2C1

Phone: 604 984 0221 Fax: 604 984 0218 www.alschemex.com

To: YUKON ZINC CORPORATION
701-475 HOWE ST
VANCOUVER BC V6C 2B3

Page: 2 - B
Total # pages: 2 (A - B)
Finalized Date: 26-JUL-2005
Account: MPO

Project: 1611-LIN

CERTIFICATE OF ANALYSIS VA05059499

Sample Description	Method Analyte Units LOR	ME-ICP61	ME-ICP61	ME-ICP61	ME-ICP61	ME-ICP61	ME-ICP61	ME-ICP61	ME-ICP61	ME-ICP61	ME-ICP61	ME-ICP61	ME-ICP61	ME-ICP61
		Mn	Mo	Na	Ni	P	Pb	S	Sb	Sr	Ti	V	W	Zn
		ppm	ppm	%	ppm	ppm	ppm	%	ppm	ppm	%	ppm	ppm	ppm
B372921	5	1	0.01	1	10	2	0.01	5	1	0.01	1	10	2	
B372922		461	1	1.40	34	630	16	0.01	<5	170	0.48	156	<10	98
		325	1	1.22	49	1180	13	0.01	<5	132	0.43	142	<10	78



ALS Chemex

EXCELLENCE IN ANALYTICAL CHEMISTRY

ALS Canada Ltd.

212 Brooksbank Avenue
North Vancouver BC V7J 2C1

Phone: 604 984 0221 Fax: 604 984 0218 www.alschemex.com

To: YUKON ZINC CORPORATION
701-475 HOWE ST
VANCOUVER BC V6C 2B3

Page: 1
Finalized Date: 28-JUL-2005
Account: MPO

CERTIFICATE VA05059676

Project: 1611- TOE

P.O. No.:

This report is for 74 Soil samples submitted to our lab in Vancouver, BC, Canada on 20-JUL-2005.

The following have access to data associated with this certificate:

JASON DUNNING

SAMPLE PREPARATION

ALS CODE	DESCRIPTION
WEI-21	Received Sample Weight
LOG-22	Sample login - Rcd w/o BarCode
SCR-41	Screen to -180um and save both

ANALYTICAL PROCEDURES

ALS CODE	DESCRIPTION	INSTRUMENT
ME-ICP61	27 element four acid ICP-AES	ICP-AES

To: YUKON ZINC CORPORATION
ATTN: JASON DUNNING
701-475 HOWE ST
VANCOUVER BC V6C 2B3

This is the Final Report and supersedes any preliminary report with this certificate number. Results apply to samples as submitted. All pages of this report have been checked and approved for release.

Signature: _____



ALS Chemex

EXCELLENCE IN ANALYTICAL CHEMISTRY

ALS Canada Ltd.

212 Brooksbank Avenue

North Vancouver BC V7J 2C1

Phone: 604 984 0221 Fax: 604 984 0218 www.alschemex.com

YUKON ZINC CORPORATION

701-475 HOWE ST

VANCOUVER BC V6C 2B3

Page: 2 - A

Total # Pages: 3 (A - B)

Finalized Date: 28-JUL-2005

Account: MPO

Project: 1611- TOE

CERTIFICATE OF ANALYSIS VA05059676

Sample Description	Method Analyte Units LOR	WEI-21	ME-ICP61	ME-ICP61	ME-ICP61	ME-ICP61	ME-ICP61	ME-ICP61	ME-ICP61	ME-ICP61	ME-ICP61	ME-ICP61	ME-ICP61	ME-ICP61	ME-ICP61	ME-ICP61
		Recvd Wt. kg	Ag ppm	Al %	As ppm	Ba ppm	Be ppm	Bi ppm	Ca %	Cd ppm	Co ppm	Cr ppm	Cu ppm	Fe %	K %	Mg %
A083851		0.70	<0.5	7.11	14	1440	2.2	<2	0.69	<0.5	6	54	16	2.95	3.00	1.12
A083852		0.32	<0.5	6.19	14	1340	2.0	<2	2.26	0.6	6	54	41	2.84	1.86	1.12
A083853		0.56	<0.5	8.90	<5	940	5.5	3	0.64	<0.5	3	6	8	2.78	2.64	0.52
A083854		0.44	<0.5	5.44	27	1230	1.7	<2	0.57	<0.5	5	73	11	3.00	1.43	0.69
A083855		0.48	<0.5	5.60	6	1020	2.6	3	1.13	<0.5	7	93	82	3.14	1.33	0.85
A083856		0.34	<0.5	5.00	11	1120	1.7	<2	1.25	<0.5	6	68	14	1.66	1.33	0.89
A083857		0.50	<0.5	6.22	9	1220	1.8	<2	1.06	<0.5	7	58	14	2.22	1.67	0.86
A083858		0.58	<0.5	5.43	8	1330	2.0	2	0.97	<0.5	5	82	12	1.86	1.43	1.08
A083859		0.56	<0.5	6.85	<5	1440	2.8	<2	0.66	<0.5	6	84	13	2.44	1.97	0.98
A083860		0.24	<0.5	7.01	9	1290	2.6	2	0.80	<0.5	9	68	12	2.51	1.94	0.95
A083861		0.44	<0.5	5.61	<5	680	1.9	<2	0.58	<0.5	2	27	6	1.13	1.46	0.52
A083862		0.44	<0.5	5.32	<5	860	2.0	<2	1.32	<0.5	4	48	18	1.84	1.39	0.73
A083863		0.34	<0.5	6.39	14	1450	2.0	2	1.49	0.5	8	58	39	2.36	1.80	1.03
A083864		0.66	<0.5	6.05	17	1350	2.2	2	0.91	<0.5	7	65	16	2.96	2.26	1.08
A083865		0.60	<0.5	6.22	14	1200	2.3	<2	1.34	<0.5	8	79	28	2.97	2.02	1.12
A083866		0.84	<0.5	6.72	6	1500	2.4	3	0.89	<0.5	8	81	38	2.99	2.68	1.25
A083870		0.58	<0.5	5.90	6	1050	2.3	<2	0.77	<0.5	8	106	14	3.55	1.67	1.08
A083871		0.46	<0.5	4.89	<5	920	1.7	3	1.64	<0.5	10	114	9	2.29	1.52	0.73
A083872		0.46	<0.5	5.48	82	1360	1.7	<2	1.68	3.5	27	84	21	6.47	1.58	0.98
A083873		0.42	<0.5	5.18	14	1130	1.4	2	1.52	0.5	7	75	28	2.05	1.48	0.83
A139383		0.36	<0.5	5.87	<5	1260	2.1	2	1.93	<0.5	7	94	15	2.24	1.90	1.03
A139384		0.64	<0.5	7.07	<5	1850	2.1	<2	0.66	<0.5	8	39	7	2.73	3.29	0.80
A139385		0.44	0.5	6.84	15	1870	2.3	<2	1.51	3.3	7	87	61	2.37	2.32	1.45
A139386		0.36	<0.5	5.89	11	870	1.5	<2	1.13	<0.5	5	61	30	2.09	1.75	0.57
A139387		0.50	<0.5	5.14	5	1090	1.8	<2	0.53	<0.5	4	53	6	1.85	2.07	0.63
A139388		0.36	<0.5	5.47	<5	1260	1.7	<2	0.49	<0.5	2	77	4	1.25	2.40	0.50
A139389		0.50	<0.5	5.55	8	1520	1.8	2	0.46	<0.5	4	53	5	1.95	2.32	0.62
A139390		0.54	<0.5	5.58	14	1430	1.9	<2	0.47	<0.5	4	49	6	1.74	2.35	0.66
A139451		0.38	<0.5	5.92	<5	1290	2.0	<2	0.50	<0.5	4	56	5	2.01	2.53	0.60
A139452		0.50	<0.5	5.30	8	920	2.5	<2	1.36	<0.5	9	290	10	3.12	1.58	1.20
A139453		0.54	<0.5	7.08	9	1470	2.6	<2	0.97	<0.5	9	89	22	2.92	2.66	1.16
A139454		0.30	<0.5	6.22	6	1270	2.0	2	1.46	<0.5	5	58	28	1.89	1.94	0.99
A139455		0.50	<0.5	6.42	15	1440	2.4	3	0.94	<0.5	7	80	19	2.63	1.87	1.19
A139456		0.34	<0.5	6.06	15	1040	2.4	2	0.74	0.5	7	62	17	2.41	1.59	0.78
A139457		0.30	<0.5	5.49	7	1040	2.0	2	1.57	0.8	8	71	33	2.54	1.49	0.87
A139458		0.44	<0.5	5.43	<5	950	1.9	2	0.71	<0.5	5	57	12	1.74	1.45	0.69
A139459		0.34	<0.5	6.69	11	1110	2.3	<2	0.79	<0.5	23	60	15	2.73	1.84	0.74
A139460		0.38	<0.5	6.61	10	1340	2.3	2	0.78	<0.5	12	79	12	2.38	1.81	0.90
A139461		0.36	<0.5	6.57	7	1360	2.4	2	0.93	<0.5	9	90	14	2.62	1.78	0.97
A139462		0.50	<0.5	6.08	12	1200	2.5	<2	0.71	<0.5	6	77	15	2.09	1.66	0.89



ALS Chemex

EXCELLENCE IN ANALYTICAL CHEMISTRY
ALS Canada Ltd.

212 Brooksbank Avenue
North Vancouver BC V7J 2C1
Phone: 604 984 0221 Fax: 604 984 0218 www.alschemex.com

o: YUKON ZINC CORPORATION
701-475 HOWE ST
VANCOUVER BC V6C 2B3

Page: 2 - B
Total # Pages: 3 (A - B)
Finalized Date: 28-JUL-2005
Account: MPO

Project: 1611- TOE

CERTIFICATE OF ANALYSIS VA05059676

Sample Description	Method Analyte Units LOR	ME-ICP61	ME-ICP61	ME-ICP61	ME-ICP61	ME-ICP61	ME-ICP61	ME-ICP61	ME-ICP61	ME-ICP61	ME-ICP61	ME-ICP61	ME-ICP61	
		Mn ppm	Mo ppm	Na %	Ni ppm	P ppm	Pb ppm	S %	Sb ppm	Sr ppm	Ti %	V ppm	W ppm	Zn ppm
		5	1	0.01	1	10	2	0.01	5	1	0.01	1	10	2
A083851		361	2	0.86	31	1510	11	0.01	<5	81	0.29	89	<10	68
A083852		449	3	0.82	32	1710	17	0.15	<5	191	0.24	115	<10	154
A083853		620	1	2.20	5	1200	13	0.01	<5	134	0.21	43	<10	27
A083854		232	2	1.35	24	290	14	0.01	<5	91	0.35	182	10	85
A083855		303	6	1.01	64	1320	23	0.06	<5	143	0.26	130	10	111
A083856		306	1	1.34	30	1060	11	0.04	<5	127	0.25	168	10	86
A083857		598	5	1.66	21	1280	16	0.03	<5	222	0.25	174	<10	81
A083858		270	3	1.23	35	1490	29	0.02	<5	107	0.25	252	10	110
A083859		269	3	1.39	37	1000	9	0.01	<5	87	0.32	185	<10	100
A083860		535	8	1.64	26	1320	15	0.04	<5	119	0.27	188	<10	84
A083861		138	2	1.92	13	800	5	0.02	<5	102	0.19	68	10	34
A083862		291	2	1.46	28	1200	10	0.04	<5	141	0.25	108	<10	97
A083863		800	3	1.41	39	1280	14	0.08	<5	235	0.26	137	10	144
A083864		311	4	1.17	22	1340	21	0.01	<5	98	0.30	116	<10	112
A083865		359	4	1.24	39	1460	19	0.05	<5	125	0.32	116	<10	168
A083866		456	2	1.05	61	1520	13	0.01	<5	96	0.30	112	<10	106
A083870		340	2	1.29	35	730	24	0.01	<5	93	0.44	124	<10	88
A083871		1990	2	1.18	28	1300	13	0.08	<5	161	0.30	73	10	102
A083872		1075	2	0.99	71	2020	15	0.07	<5	184	0.26	126	<10	205
A083873		295	1	1.07	41	1080	13	0.07	<5	205	0.25	110	<10	93
A139383		501	1	1.07	36	990	17	0.09	<5	161	0.33	91	10	83
A139384		258	2	0.84	19	730	10	0.01	<5	84	0.27	68	10	60
A139385		256	1	1.00	43	980	21	0.25	<5	114	0.31	123	<10	272
A139386		282	2	1.47	25	1080	22	0.04	<5	293	0.24	57	<10	44
A139387		206	1	1.05	19	660	14	0.01	<5	82	0.23	69	<10	40
A139388		169	1	1.19	14	330	15	0.01	<5	104	0.26	54	10	25
A139389		233	1	1.01	14	490	17	0.01	<5	89	0.25	78	<10	45
A139390		188	1	1.04	17	710	12	<0.01	<5	76	0.23	72	<10	44
A139451		225	1	1.06	16	440	11	<0.01	<5	94	0.27	58	<10	31
A139452		571	2	1.32	56	1070	20	0.01	<5	126	0.50	85	10	81
A139453		379	2	1.30	43	1330	21	0.01	<5	112	0.35	102	10	132
A139454		348	1	1.33	24	1380	20	0.07	<5	182	0.28	101	<10	116
A139455		319	2	1.36	35	1430	17	0.02	<5	119	0.33	163	10	139
A139456		328	4	1.60	31	1100	12	0.03	<5	104	0.23	134	10	112
A139457		543	4	1.20	44	1220	16	0.07	<5	146	0.25	112	<10	138
A139458		188	1	1.53	25	1030	16	0.02	<5	102	0.24	107	10	73
A139459		1855	4	1.73	25	1180	20	0.02	<5	165	0.25	125	<10	86
A139460		589	4	1.60	35	1070	17	0.03	<5	123	0.29	159	10	88
A139461		613	6	1.51	34	1160	18	0.04	<5	129	0.29	160	<10	89
A139462		205	3	1.77	33	970	12	0.01	<5	88	0.29	146	<10	80



ALS Chemex

EXCELLENCE IN ANALYTICAL CHEMISTRY

ALS Canada Ltd.

212 Brooksbank Avenue
North Vancouver BC V7J 2C1

Phone: 604 984 0221 Fax: 604 984 0218 www.alschemex.com

To: YUKON ZINC CORPORATION
701-475 HOWE ST
VANCOUVER BC V6C 2B3

Page: 3 - A
Total # Pages: 3 (A - B)
Finalized Date: 28-JUL-2005
Account: MPO

Project: 1611- TOE

CERTIFICATE OF ANALYSIS VA05059676

Sample Description	Method Analyte Units LOR	WEI-21	ME-ICP61	ME-ICP61	ME-ICP61	ME-ICP61	ME-ICP61	ME-ICP61	ME-ICP61	ME-ICP61	ME-ICP61	ME-ICP61	ME-ICP61	ME-ICP61	ME-ICP61	ME-ICP61
		Recvd Wt. kg	Ag ppm	Al %	As ppm	Ba ppm	Be ppm	Bi ppm	Ca %	Cd ppm	Co ppm	Cr ppm	Cu ppm	Fe %	K %	Mg %
		0.02	0.5	0.01	5	10	0.5	2	0.01	0.5	1	1	1	0.01	0.01	0.01
A139463		0.30	<0.5	5.84	<5	940	1.8	<2	1.84	0.5	5	36	34	1.89	1.55	0.62
A139464		0.32	<0.5	7.00	16	1210	2.7	2	1.16	<0.5	6	64	19	2.30	1.95	0.89
A139465		0.30	<0.5	6.68	9	1370	2.8	3	0.80	<0.5	8	75	24	3.01	1.95	1.05
A139466		0.48	<0.5	6.56	18	1500	2.4	2	1.01	0.5	8	89	26	3.30	2.14	1.30
A139467		0.64	<0.5	6.01	23	1260	2.4	<2	1.07	0.8	11	123	28	5.65	2.00	1.07
A139468		0.46	<0.5	6.73	12	1140	2.4	2	1.08	<0.5	7	107	19	3.04	2.16	1.11
A139469		0.74	<0.5	6.65	18	1580	2.4	<2	0.60	<0.5	7	65	29	2.91	2.96	0.97
A139470		0.46	<0.5	5.74	8	1070	2.2	<2	0.55	0.5	6	88	9	2.37	1.89	0.80
A139471		0.38	<0.5	5.64	11	1190	2.0	<2	0.61	<0.5	6	67	9	2.06	2.11	0.75
B372901		0.50	<0.5	7.13	17	1520	2.6	<2	1.00	<0.5	13	117	21	3.37	2.67	1.20
B372902		0.32	<0.5	5.96	11	1440	1.9	<2	1.12	0.7	6	60	21	2.44	2.30	0.91
B372903		0.30	<0.5	5.52	24	1290	1.8	<2	1.76	<0.5	8	71	22	2.54	1.83	0.92
B372904		0.42	<0.5	5.99	34	1410	2.1	<2	1.03	<0.5	12	103	28	3.10	1.97	1.04
B372905		0.36	<0.5	5.63	9	1440	1.9	<2	1.88	3.3	11	75	33	2.41	1.89	1.04
B372906		0.42	<0.5	7.28	26	1930	2.4	<2	0.48	<0.5	5	83	6	2.39	3.26	0.99
B372907		0.38	<0.5	6.73	65	1700	2.2	<2	1.36	<0.5	17	177	89	4.22	2.05	1.50
B372908		0.30	<0.5	5.14	24	1400	1.7	2	2.18	0.5	12	146	36	2.58	1.59	1.18
B372909		0.50	<0.5	6.60	14	1840	2.4	2	1.18	<0.5	13	122	32	3.27	2.21	1.31
B372910		0.62	<0.5	6.49	13	1330	2.4	<2	0.93	<0.5	10	92	13	2.84	2.26	1.01
B372911		0.38	1.1	6.23	16	1170	2.0	2	1.71	0.7	15	106	48	3.33	1.62	1.05
B372912		0.54	<0.5	6.70	12	1610	2.8	<2	1.24	<0.5	12	114	47	3.38	2.02	1.25
B372913		0.58	<0.5	6.08	13	1180	2.1	4	1.41	<0.5	8	81	24	3.05	1.84	1.09
B372914		0.56	<0.5	6.41	15	1110	2.6	<2	1.30	<0.5	11	106	28	3.32	1.96	1.32
B372915		0.66	<0.5	5.51	29	1630	1.8	<2	1.10	<0.5	8	105	28	2.68	1.77	1.15
B372916		0.32	<0.5	6.21	24	1600	1.9	<2	1.63	0.8	9	94	42	2.76	1.87	1.13
B372917		0.30	<0.5	5.23	22	1360	1.5	<2	2.15	1.1	9	81	41	2.38	1.47	1.02
B372918		0.44	<0.5	5.31	32	1680	1.5	2	1.68	0.6	12	102	44	3.50	1.45	1.02
B372919		0.56	<0.5	5.97	32	1470	1.9	<2	1.04	<0.5	11	112	35	3.29	1.78	1.16
B372920		0.50	<0.5	5.99	14	1400	2.0	<2	1.32	0.8	16	124	49	3.57	1.77	1.19
B372923		0.48	<0.5	5.43	15	1410	1.7	2	0.90	<0.5	11	125	21	2.97	1.65	1.18
B372924		0.54	<0.5	4.77	8	740	2.1	<2	1.36	<0.5	4	79	3	1.94	1.38	0.76
B372925		0.58	<0.5	5.11	19	1310	1.6	<2	1.28	<0.5	11	108	36	3.28	1.48	0.96
B372926		0.32	<0.5	5.16	18	1260	1.6	<2	1.55	<0.5	10	87	34	2.60	1.52	1.09
B372927		0.44	<0.5	5.76	24	1330	2.4	2	1.27	1.0	11	96	30	3.18	1.78	1.06



ALS Chemex

EXCELLENCE IN ANALYTICAL CHEMISTRY

ALS Canada Ltd.

212 Brooksbank Avenue
North Vancouver BC V7J 2C1

Phone: 604 984 0221 Fax: 604 984 0218 www.alschemex.com

To: YUKON ZINC CORPORATION
701-475 HOWE ST
VANCOUVER BC V6C 2B3

Page: 3 - B
Total Pages: 3 (A - B)
Finalized Date: 28-JUL-2005
Account: MPO

Project: 1611- TOE

CERTIFICATE OF ANALYSIS VA05059676

Sample Description	Method Analyte Units LOR	ME-ICP61	ME-ICP61	ME-ICP61	ME-ICP61	ME-ICP61	ME-ICP61	ME-ICP61	ME-ICP61	ME-ICP61	ME-ICP61	ME-ICP61	ME-ICP61	
		Mn ppm	Mo ppm	Na %	Ni ppm	P ppm	Pb ppm	S %	Sb ppm	Sr ppm	Ti %	V ppm	W ppm	Zn ppm
		5	1	0.01	1	10	2	0.01	5	1	0.01	1	10	2
A139463		517	5	1.58	31	1440	10	0.11	<5	283	0.18	89	<10	91
A139464		327	1	1.69	38	1160	13	0.05	<5	118	0.24	138	10	163
A139465		406	2	1.36	39	1420	20	0.03	<5	119	0.29	164	10	149
A139466		437	9	1.08	38	1340	19	0.02	<5	104	0.33	148	<10	176
A139467		554	10	1.07	42	1320	20	0.05	<5	106	0.34	118	<10	134
A139468		364	3	1.25	37	1680	18	0.04	<5	170	0.33	111	10	95
A139469		371	2	1.01	52	1090	17	0.01	<5	87	0.27	95	<10	111
A139470		245	2	1.31	41	690	17	<0.01	<5	78	0.27	89	<10	56
A139471		235	2	1.17	34	930	15	0.01	<5	88	0.26	74	10	51
B372901		549	1	1.01	46	1120	18	0.01	<5	114	0.37	103	10	84
B372902		287	1	0.87	31	990	18	0.06	<5	104	0.25	97	10	130
B372903		571	1	0.99	34	1090	16	0.08	<5	148	0.25	100	<10	142
B372904		628	3	0.94	48	970	27	0.03	<5	98	0.29	122	<10	149
B372905		888	1	0.85	39	960	24	0.06	<5	132	0.27	111	<10	285
B372906		174	<1	0.99	20	260	18	0.01	<5	60	0.35	109	<10	93
B372907		532	2	0.69	110	1330	33	0.06	<5	121	0.31	192	<10	184
B372908		1105	<1	0.60	67	1300	21	0.10	<5	136	0.28	125	<10	118
B372909		587	<1	1.11	67	890	23	0.03	<5	108	0.34	110	<10	86
B372910		429	1	1.15	38	470	25	0.01	<5	104	0.32	98	10	79
B372911		915	1	0.97	63	1000	27	0.03	<5	143	0.37	149	<10	205
B372912		570	1	1.30	66	530	35	0.01	<5	129	0.36	110	<10	104
B372913		569	3	1.21	40	1000	98	0.04	<5	120	0.33	109	10	196
B372914		645	1	1.29	55	1040	24	0.02	<5	146	0.38	118	10	104
B372915		462	1	0.87	53	1060	15	0.01	<5	104	0.30	133	10	96
B372916		418	1	0.94	50	940	17	0.09	<5	175	0.30	133	<10	124
B372917		359	1	0.95	54	860	14	0.13	<5	202	0.26	110	<10	97
B372918		472	1	0.68	71	1060	16	0.09	<5	142	0.30	147	10	122
B372919		472	1	0.96	56	1110	15	0.01	<5	123	0.35	157	<10	94
B372920		479	3	0.93	73	1240	22	0.04	<5	126	0.35	167	10	133
B372923		326	2	0.82	52	1260	16	0.01	<5	98	0.35	159	10	97
B372924		257	1	1.37	22	1120	15	0.01	<5	134	0.32	71	<10	50
B372925		824	2	0.80	57	1120	19	0.05	<5	128	0.29	140	<10	107
B372926		794	1	0.87	55	1100	14	0.07	<5	154	0.28	129	<10	120
B372927		718	2	1.06	69	1090	20	0.09	<5	115	0.32	119	10	111



ALS Chemex

EXCELLENCE IN ANALYTICAL CHEMISTRY

ALS Canada Ltd.

212 Brooksbank Avenue
North Vancouver BC V7J 2C1

Phone: 604 984 0221 Fax: 604 984 0218 www.alschemex.com

To: YUKON ZINC CORPORATION
701-475 HOWE ST
VANCOUVER BC V6C 2B3

Page: 1
Finalized Date: 29-JUL-2005
Account: MPO

CERTIFICATE VA05059670

Project: 1633

P.O. No.:

This report is for 16 Soil samples submitted to our lab in Vancouver, BC, Canada on 20-JUL-2005.

The following have access to data associated with this certificate:

JASON DUNNING

SAMPLE PREPARATION

ALS CODE	DESCRIPTION
WEI-21	Received Sample Weight
LOG-22	Sample login - Rcd w/o BarCode
SCR-41	Screen to -180um and save both

ANALYTICAL PROCEDURES

ALS CODE	DESCRIPTION	INSTRUMENT
ME-ICP61	27 element four acid ICP-AES	ICP-AES

To: YUKON ZINC CORPORATION
ATTN: JASON DUNNING
701-475 HOWE ST
VANCOUVER BC V6C 2B3

This is the Final Report and supersedes any preliminary report with this certificate number. Results apply to samples as submitted. All pages of this report have been checked and approved for release.

Signature: _____



ALS Chemex

EXCELLENCE IN ANALYTICAL CHEMISTRY

ALS Canada Ltd.

212 Brooksbank Avenue
North Vancouver BC V7J 2C1

Phone: 604 984 0221 Fax: 604 984 0218 www.alschemex.com

Client: YUKON ZINC CORPORATION

701-475 HOWE ST

VANCOUVER BC V6C 2B3

Page: 2 - A

Total # pages: 2 (A - B)

Finalized Date: 29-JUL-2005

Account: MPO

Project: 1633

CERTIFICATE OF ANALYSIS VA05059670

Sample Description	Method Analyte Units LOR	WEI-21	ME-ICP61	ME-ICP61	ME-ICP61	ME-ICP61	ME-ICP61	ME-ICP61	ME-ICP61	ME-ICP61	ME-ICP61	ME-ICP61	ME-ICP61	ME-ICP61	ME-ICP61	ME-ICP61
		Recvd Wt. kg	Ag ppm	Al %	As ppm	Ba ppm	Be ppm	Bi ppm	Ca %	Cd ppm	Co ppm	Cr ppm	Cu ppm	Fe %	K %	Mg %
		0.02	0.5	0.01	5	10	0.5	2	0.01	0.5	1	1	1	0.01	0.01	0.01
B 372928		0.42	<0.5	4.95	9	890	1.9	<2	1.66	<0.5	6	77	16	2.10	1.52	0.81
A 083867		0.50	<0.5	6.35	<5	1170	2.1	<2	0.49	<0.5	4	53	6	2.38	2.84	0.84
A 083868		0.62	<0.5	6.09	<5	1380	2.0	<2	0.58	<0.5	3	74	6	2.15	2.67	0.84
A 083869		0.62	<0.5	5.45	<5	1000	2.2	<2	0.93	<0.5	7	97	14	2.02	1.88	0.93
B 373172		0.54	<0.5	4.96	8	900	1.8	<2	0.68	<0.5	6	115	11	1.76	1.47	0.69
B 373173		0.36	<0.5	6.10	12	1190	2.3	<2	1.22	<0.5	8	82	11	2.81	1.95	1.08
B 373174		0.28	<0.5	6.15	10	1060	1.9	<2	1.75	<0.5	9	66	56	2.55	1.61	0.92
B 373175		0.28	<0.5	6.09	6	940	1.4	<2	1.63	0.7	5	32	41	1.63	1.66	0.47
A 139375		0.40	0.8	5.17	266	2530	1.4	<2	1.24	13.4	26	80	61	8.66	1.44	0.69
A 139376		0.26	0.5	3.87	17	960	1.1	<2	2.92	6.4	8	56	66	1.87	1.11	0.62
A 139377		0.22	1.0	5.42	6	1020	1.6	<2	1.53	9.3	9	66	69	2.57	1.64	0.75
A 139378		0.46	<0.5	4.68	15	990	1.3	<2	1.35	2.2	12	73	30	2.71	1.31	0.70
A 139379		0.66	<0.5	6.86	53	1690	2.0	<2	0.65	<0.5	23	120	66	4.59	2.21	1.00
A 139380		0.52	<0.5	6.83	38	1890	1.7	<2	0.29	<0.5	8	122	31	4.11	1.97	0.72
A 139381		0.40	<0.5	7.04	85	1460	1.7	<2	1.49	<0.5	26	91	166	5.70	1.55	1.13
A 139382		0.24	<0.5	5.41	41	660	0.9	<2	2.88	<0.5	11	34	80	2.13	1.32	0.66



ALS Chemex

EXCELLENCE IN ANALYTICAL CHEMISTRY

ALS Canada Ltd.

212 Brooksbank Avenue
North Vancouver BC V7J 2C1

Phone: 604 984 0221 Fax: 604 984 0218 www.alschemex.com

To: YUKON ZINC CORPORATION
701-475 HOWE ST
VANCOUVER BC V6C 2B3

Page: 2 - B
Total # Pages: 2 (A - B)
Finalized Date: 29-JUL-2005
Account: MPO

Project: 1633

CERTIFICATE OF ANALYSIS VA05059670

Sample Description	Method Analyte Units LOR	ME-ICP61	ME-ICP61	ME-ICP61	ME-ICP61	ME-ICP61	ME-ICP61	ME-ICP61	ME-ICP61	ME-ICP61	ME-ICP61	ME-ICP61	ME-ICP61	ME-ICP61
		Mn ppm	Mo ppm	Na %	Ni ppm	P ppm	Pb ppm	S %	Sb ppm	Sr ppm	Ti %	V ppm	W ppm	Zn ppm
		5	1	0.01	1	10	2	0.01	5	1	0.01	1	10	2
B 372928		601	1	1.40	39	1160	13	0.04	<5	145	0.29	80	<10	67
A 083867		231	2	0.94	15	730	9	0.01	<5	75	0.27	70	<10	38
A 083868		215	1	1.21	23	1020	12	<0.01	<5	82	0.28	86	<10	49
A 083869		439	1	1.48	49	1000	13	0.01	<5	98	0.30	89	10	68
B 373172		291	1	1.42	39	800	12	<0.01	<5	87	0.27	73	<10	45
B 373173		709	<1	1.16	43	1180	23	0.04	<5	123	0.32	112	<10	152
B 373174		737	2	1.62	67	1340	19	0.07	<5	278	0.25	77	<10	81
B 373175		637	1	1.94	35	1100	15	0.07	<5	383	0.20	40	<10	49
A 139375		2450	4	0.45	196	5140	20	0.10	7	173	0.20	164	<10	2110
A 139376		849	2	0.32	404	900	9	0.18	5	225	0.15	116	<10	5090
A 139377		281	2	0.70	119	1700	17	0.08	<5	193	0.25	133	<10	1345
A 139378		606	2	0.68	53	1220	14	0.04	<5	156	0.25	116	<10	347
A 139379		775	2	0.65	83	1300	19	0.01	<5	99	0.31	162	10	107
A 139380		269	3	0.92	32	440	18	0.01	<5	85	0.90	244	10	50
A 139381		1175	2	0.99	62	1300	26	0.05	<5	144	0.33	183	<10	94
A 139382		674	2	1.70	43	820	10	0.10	<5	411	0.16	41	<10	43



Figure 1. Location Map of the Jill Property.

Yukon Zinc Corporation

Jill Property, YT
Claim Map
and Sample Location

Date: 13/02/06
By: J. G. Gault
Version: 1.0
Scale: 1:20000
Projection: UTM Zone 9 (NAD 83 for Canada)
Rev. Date:



Legend

- Soil sample (red dot)
- Silt sample (blue star)
- Claim Boundaries (black line)
- 100m Contour (dashed line)
- Rivers/Streams (light blue line)
- Lakes (cyan area)

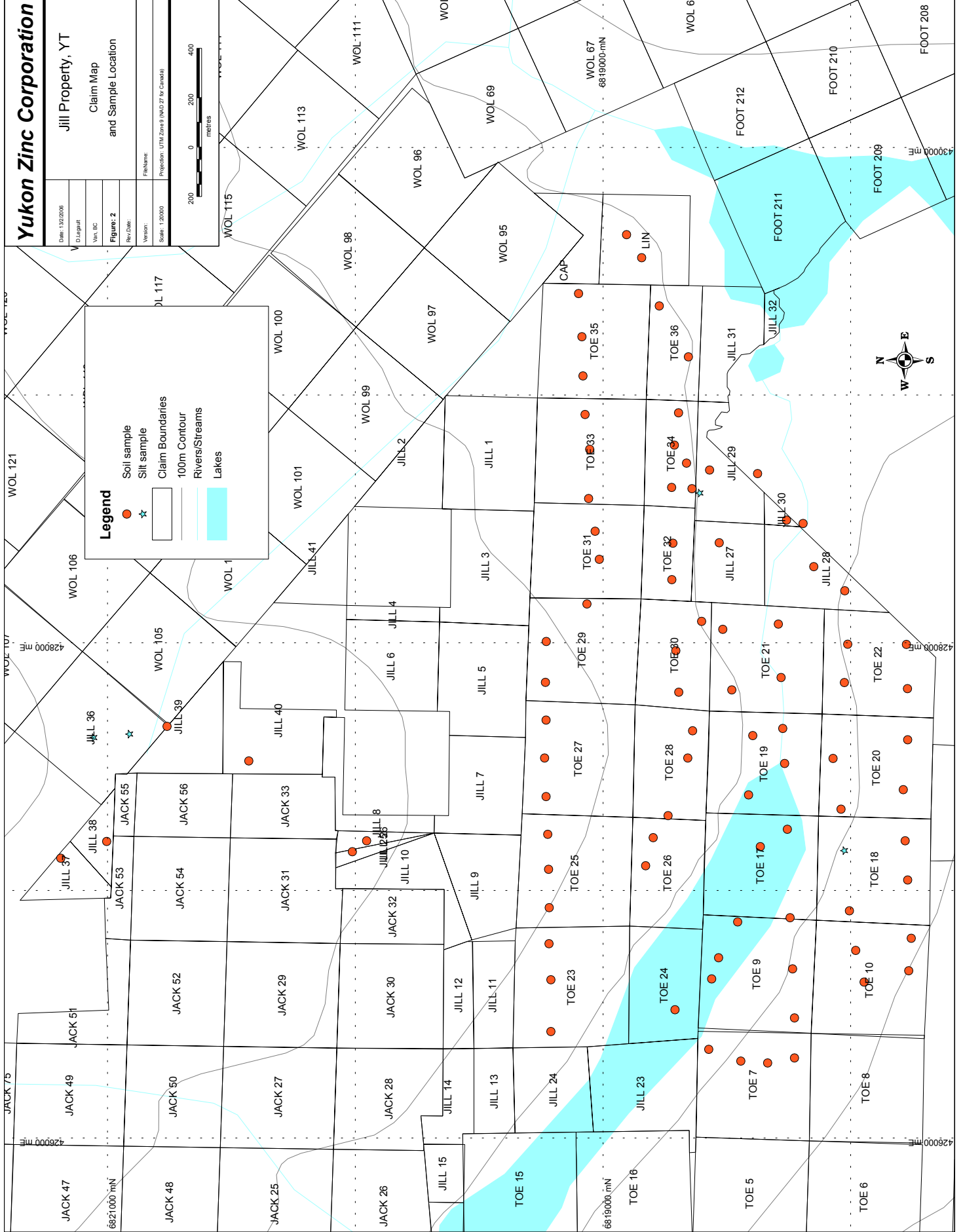

Yukon Zinc Corporation

Jill Property, YT
Zinc Geochemistry

Date: 13/2/2006
D:\jgoff
Win, BC
Figure: 3
Rev/Date:
Version:
Scale: 1:20000
Projection: UTM Zone 9 (NAD 83 for Canada)



Legend

- Zinc soil (ppm) [Red circle]
- Zinc silt (ppm) [Star]
- Claim Boundaries [Black outline]
- 100m Contour [Grey line]
- Rivers/Streams [Blue line]
- Lakes [Cyan area]

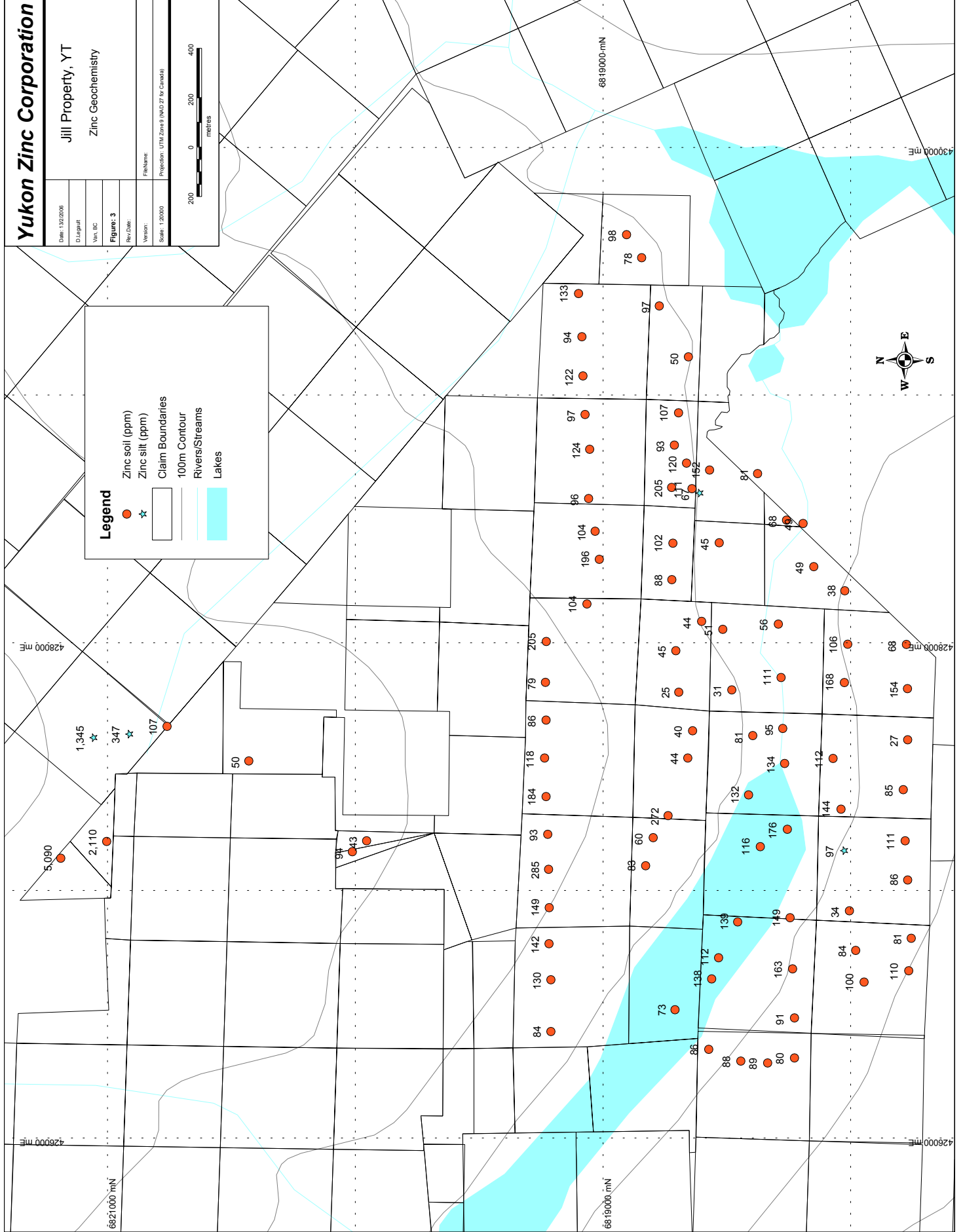

Yukon Zinc Corporation

Jill Property, YT
Lead Geochemistry

Date: 13/2/2016
D:\jgoff
Win, BC
Figure: 4
Rev/Date:
Rev/Date:
Version:
Scale: 1:20000
Projection: UTM Zone 9 (NAD 83 for Canada)



Legend

- Lead soil (ppm) [Red circle]
- Lead silt (ppm) [Star]
- Claim Boundaries [Black outline]
- 100m Contour [Grey line]
- Rivers/Streams [Blue line]
- Lakes [Cyan area]

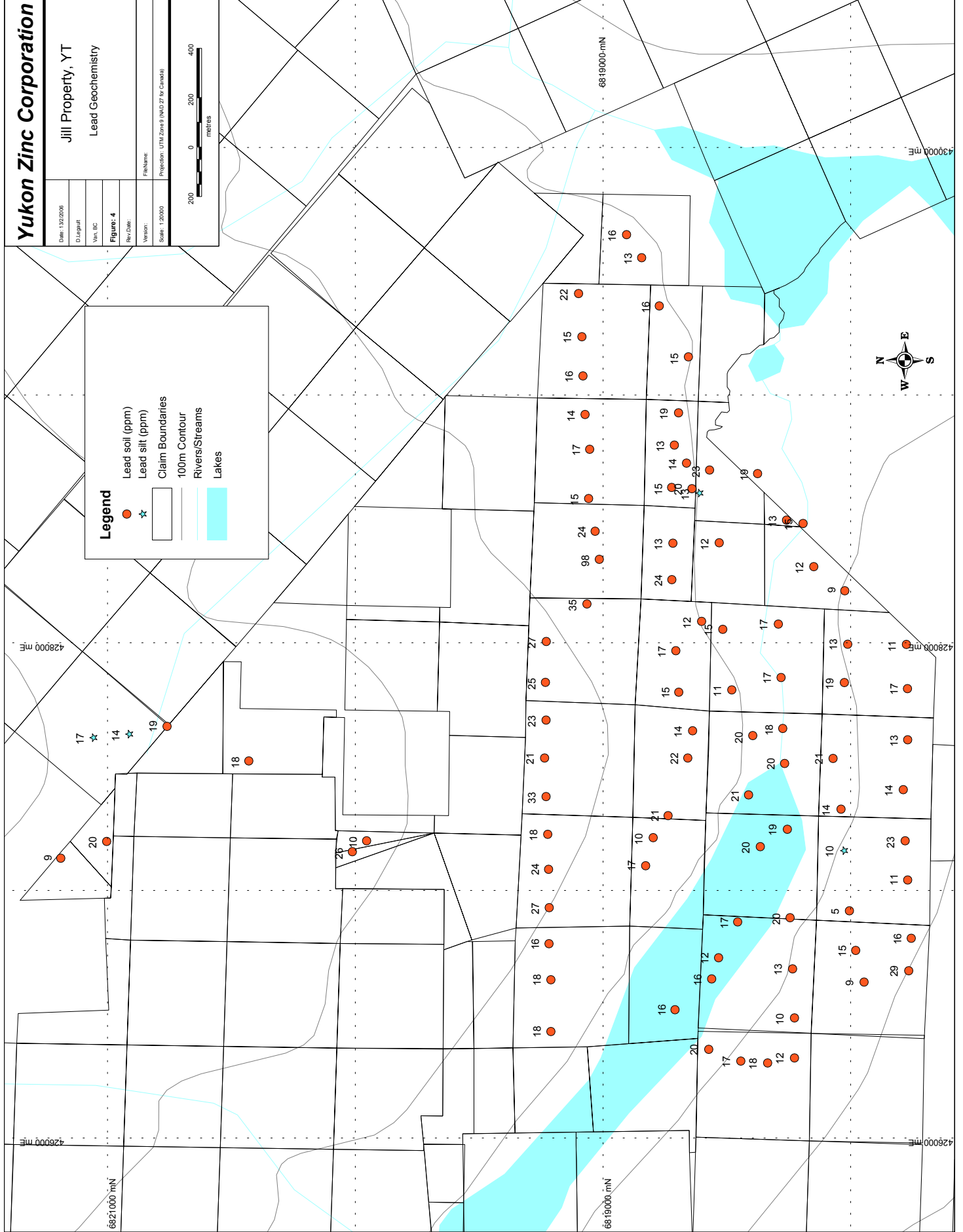

Yukon Zinc Corporation

Jill Property, YT
Copper Geochemistry

Date: 13/2/2016
D:\jz\jill
Yukon, BC
Figure: 5
Rev/Date:
Filename:
Project: UTM Zones (NAD 83 for Canada)
Scale: 1:20000



Legend

- Copper soil (ppm) (Red circle)
- Copper silt (ppm) (Star)
- Claim Boundaries (Black outline)
- 100m Contour (Grey line)
- Rivers/Streams (Blue line)
- Lakes (Cyan area)

