

093850

GEOLOGICAL AND GEOCHEMICAL REPORT

ON THE

CHUB PROPERTY  
CHUB 1-18 CLAIMS



WATSON LAKE MINING DISTRICT  
YUKON TERRITORY, CANADA  
NTS MAP SHEET 105G/11

Centred at Latitude: 61° 30' 30"N; Longitude: 131° 14' 30"W  
Work Performed: September 19, 1997

FOR:

PACIFIC BAY MINERALS LTD.  
#908-700 West Pender Street  
Vancouver, B.C. V6C 1G8

Francis Moyle, B.Sc.  
Gary L. Wesa, B.Sc., F.G.A.C.

May, 1998

This report has been examined by  
the Geological Evaluation Unit  
under Section 53 (4) Yukon Quartz  
Mining Act and is allowed as  
representation work in the amount  
of \$ 1800.00.

*M. R. L.*  
Regional Manager, Exploration and  
Geological Services for Commissioner  
of Yukon Territory.

# TABLE OF CONTENTS

	<u>PAGE #</u>
SUMMARY .....	1
INTRODUCTION .....	2
Location and Access.....	2
Physiography and Climate .....	2
Property Status and Ownership.....	4
HISTORY OF EXPLORATION.....	6
Regional History .....	6
Property History .....	7
1994 Exploration Program .....	7
1997 Exploration Program .....	7
GEOLOGY .....	8
Regional Geology .....	8
Property Geology .....	12
Lithologies.....	12
Alteration .....	12
Mineralization.....	13
GEOCHEMISTRY .....	13
Sampling Procedure.....	13
Geochemical Results.....	13
CONCLUSIONS .....	14
RECOMMENDATIONS .....	14
REFERENCES.....	15
STATEMENT OF QUALIFICATIONS .....	17

## LIST OF FIGURES

### PAGE #

1. Property Location Map .....	3
2. Claim Map (1" = ½ mile).....	5
3. Regional Tectonic Map (1:10,000,000).....	9
4. Regional Geology .....	10

## LIST OF TABLES

### PAGE #

I. Claim Status .....	4
II. Geochemical Backgrounds & Anomalous Thresholds .....	14

## LIST OF MAPS

1. Property Geology (1:10,000) .....	In Pocket
2. Geochemistry (Cu, Zn and Pb in ppm) (1:10,000).....	In Pocket

## LIST OF APPENDICES

APPENDIX I	Itemized Cost Statement
APPENDIX II	Summary of Personnel
APPENDIX III	Analytical Procedure
APPENDIX IV	Rock and Soil Geochemical Lab Reports

**CHUB PROPERTY**  
**ASSESSMENT REPORT 1997**  
**PAGE 1**

**SUMMARY:**

The CHUB Property comprises 18 claims located approximately 80 km southeast of Ross River, Yukon in the Watson Lake Mining District. The claims were staked in 1994 to protect an area of potentially favourable stratigraphy similar to that hosting Cominco's Kudz Ze Kayah polymetallic volcanogenic massive sulphide deposit located 35 km to the east-southeast. Access to the CHUB property is provided via helicopter from the Mink Creek airstrip on the Robert Campbell Highway 22 km to the northwest or directly from Ross River.

This report presents the results of a helicopter supported geological and geochemical sampling survey conducted during September, 1997 by personnel from Pacific Bay Minerals Ltd.

The property is located within the Finlayson Lake map area (104/G) in the Yukon Plateau physiographic region of the northern Cordillera. The claims cover an area of moderate to low relief with limited outcrop exposures occurring only on ridges and slopes.

The property is underlain by mixed metasedimentary and mafic metavolcanic rocks, belonging to the Middle Unit of the Paleozoic Layered Metamorphic Complex, which are intruded by locally Fe-carbonate altered and pyritic mafic sills and dykes. Mafic dykes contain minor magnetite and pyrite.

A review of all available information indicates that the area has experienced little or no prospecting. Cominco staked the CHUB claims in early 1994 and followed this up with a short geological and geochemical survey over targets delineated by an airborne geophysical survey.

In 1997, Pacific Bay Minerals conducted an exploration program comprised of geological mapping and litho-geochemical and soil sampling with the objective of evaluating the property's economic potential and following up on geophysical and geological work by Cominco's personnel in 1994. A total of 1 rock samples and 6 soil samples were collected.

Geochemical analysis of rock and soil samples returned low to strongly anomalous values for base metals. A single station anomaly documented a strongly anomalous value for zinc (2751 ppm) and cadmium (10.8 ppm). Analytical values were low for other elements tested.

The 1997 program has identified a prospective mineral target and a follow up program consisting of detailed mapping and prospecting and close spaced soil sampling of mineral occurrences is recommended.

**CHUB PROPERTY**  
**ASSESSMENT REPORT 1997**  
**PAGE 2**

**INTRODUCTION:**

This report discusses the exploration procedures and results of a helicopter supported geological and geochemical program conducted by Pacific Bay Minerals Ltd. on the CHUB property. Field work was performed by a two member crew during the period of September 19, 1997. Personnel operated out of a trailer situated at the Mink Creek airstrip.

The objective of the 1997 program was to evaluate the property's economic potential through follow up geological mapping and sampling.

The 1997 exploration program included geological mapping and lithochemical and soil sampling. A total of 1 rock sample and 6 soil samples were collected. Geological and geochemical data were compiled on 1:10,000 scale contour maps prepared from 1:50,000 scale NTS topographic maps and all final data were produced on 1:10,000 scale hand drafted maps.

All geochemical samples were shipped to ACME Analytical Labs in Vancouver, B.C. for geochemical analysis utilizing 30-element ICP method and gold analysis by wet extraction followed with analysis by graphite furnace AA finish. Analytical procedures are described in Appendix III and analytical results are presented in Appendix IV.

**Location and Access:**

The CHUB property is located in the southeastern Yukon Territory approximately 80 km southeast of Ross River. The claims are situated within NTS map sheet 105G/11 and are centred at 61° 30' 30" North latitude and 131° 14' 30" West longitude. Access to the property is provided via helicopter from the Mink Creek airstrip located 22 km to the north on the Robert Campbell Highway. The claims may also be directly accessed via helicopter from Ross River (Figure 1).

**Physiography and Climate:**

The property is located within the Yukon Plateau physiographic region of the northern Cordillera. Elevations in the area range from 1250 metres (4,100') in valley bottoms to 1402 metres (4,600'). The property is bounded to the west and east by low ridges. A single, main drainage flows northwest across the property.

During the Pleistocene Epoch, ice covered the entire area except for the tops of the highest peaks. McConnell glaciation covered the area during the period from 26,500 to 10,000 years ago. Glaciation has produced isolated, rounded mountains; valleys are occupied by abundant small lakes connected by a network of streams. Valley bottoms are typically underlain with glaciofluvial sediments exceeding five metres in thickness.

# PROPERTY LOCATION MAP

Figure 1

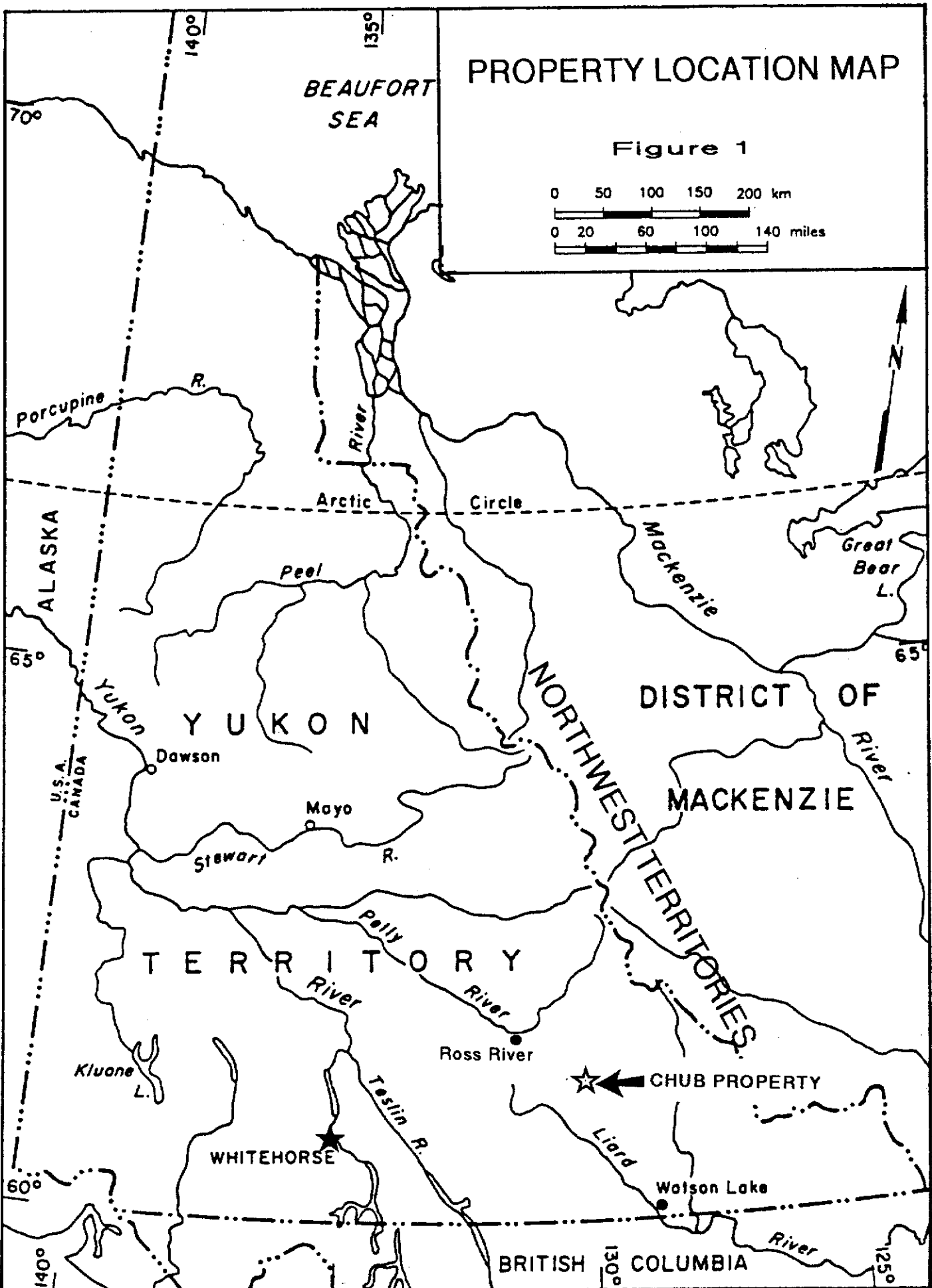
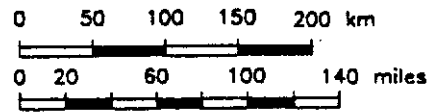

**CHUB PROPERTY**  
**ASSESSMENT REPORT 1997**  
**PAGE 4**

The regional terrain is covered with a thick growth of "buckbrush", alder and dwarf birch up to 4-5 metres in height. Slopes also support scattered black spruce and balsam fir. Tree line occurs at roughly 1400 (4,592') to 1500 metres (4,875'). Outcrop on the property is generally restricted to ridges and slopes. Timber is restricted to slopes and ridges; the majority of the property is covered by glacial till supporting buckbrush and grasses.

Weather records are unavailable for the area; however, general climatic data indicates that precipitation is light, averaging 50cm per annum, and falls mostly as rain during summer months. Snow cover averages approximately 60cm by late winter. The climate is continental type with warm summers and long, cold winters. Annual mean daily temperature is -5°C with ranges from lows of -30° to -50°C in January to 10° to 20°C in July. Permafrost at this latitude is discontinuous but widespread. It is rarely possible to commence surface geological work before the end of June and difficult to continue past September.

**Property Status and Ownership:**

The CHUB property (Figure 2) consists of 18 contiguous claims located within the Watson Lake Mining District. The claims were staked to protect airborne geophysical targets identified during a Cominco survey conducted in early 1994. The claims are currently 100% owned by Cominco; however, an option agreement granted by Cominco to Pacific Bay Minerals permits the latter the right to acquire 60% interest upon completion of a specified work program. Relevant claim data are tabulated in Table 1 below:

**TABLE 1: CHUB PROPERTY - CLAIM STATUS**

<b><u>CLAIM NAME</u></b>	<b><u># OF CLAIMS</u></b>	<b><u>GRANT #</u></b>	<b><u>RECORDING DATE</u></b>	<b><u>NEW EXPIRY DATE</u></b>
CHUB	18	YB49829- YB49846	1994/05/15	1999/05/15

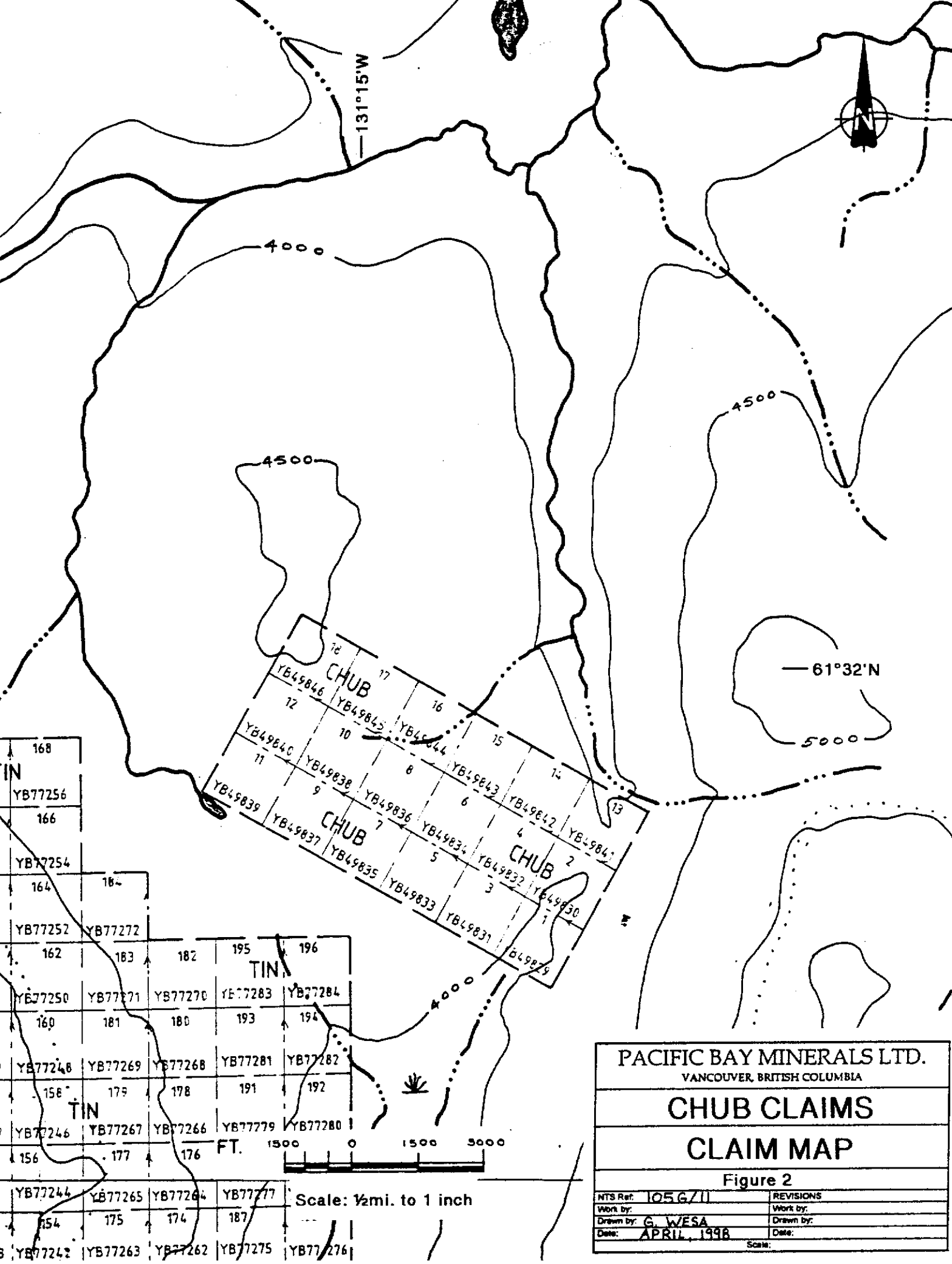

168				
IN				
YB77256				
166				
YB77254				
164	164			
YB77252	YB77272			
162	183	182	195	196
YB77250	YB77271	YB77270	YB77283	YB77284
160	181	180	193	194
YB77248	YB77269	YB77268	YB77281	YB77282
158	179	178	191	192
YB77246	YB77267	YB77266	YB77279	YB77280
156	177	176	1500	0
YB77244	YB77265	YB77264	YB77277	
154	175	174	187	
YB77242	YB77263	YB77262	YB77275	YB77276

PACIFIC BAY MINERALS LTD.	
VANCOUVER, BRITISH COLUMBIA	
<b>CHUB CLAIMS</b>	
<b>CLAIM MAP</b>	
Figure 2	
NTS Ref: 105 G/11	REVISIONS
Work by:	Work by:
Drawn by: G. WESA	Drawn by:
Date: APRIL, 1998	Date:
Scale:	

Scale: 1/2 mi. to 1 inch

**CHUB PROPERTY**  
**ASSESSMENT REPORT 1997**  
**PAGE 6**

**HISTORY OF EXPLORATION:**

**Regional History:**

The area was first mapped by Wheeler et al. (1960). Detailed mapping and re-interpretation was subsequently carried out by personnel of the Geological Survey of Canada (Tempelman-Kluit et al, 1975, 1976; Gordey and Tempelman-Kluit, 1976; Tempelman-Kluit, 1977; Gordey, 1977).

Finlayson Lake area has experienced reconnaissance exploration by numerous companies at various times since the mid-1960's following discovery and development of the Faro zinc-lead-silver deposits.

Beginning in the early 1970's up to the early 1980's, several companies conducted exploration programs in the area for SEDEX mineralization (HOO) VMS mineralization (PY, FYRE, FETISH, PAK, BEV) and tungsten-bearing skarns (BOOT). In 1973, the FETISH claims were staked by Finlayson Joint Venture over a target 25 km east of the Kudz Ze Kayah deposit. This target exhibited similar geology to Kudz Ze Kayah and was tested by two shallow drill holes. The PY claims were staked in 1975 by Cyprus Anvil Mining Corporation 40 km southeast of Kudz Ze Kayah.

In 1985, J.K. Mortensen and G.A. Jilson published the results of geological mapping conducted in the late 1970's and early 1980's. Their interpretation forms the basis of current knowledge of the regional geology. Mortensen and Jilson recognized the presence of a thick package of Devonian-Mississippian metamorphosed felsic and mafic volcanic rocks in carbonaceous metasediments in the pericratonic Yukon-Tanana Terrane.

In 1988, the G.S.C. released Open File 1648 causing many claims to be staked over gold and arsenic stream sediment anomalies. Many claims were located over allochthonous ophiolitic rocks that appear associated with thrust sheets that border the ultramafic succession.

Current exploration activity in the Finlayson Lake area commenced in late 1993 when Cominco conducted soil geochemical and geophysical surveys in the headwaters of a drainage in which government regional stream sediment survey results delineated strongly anomalous lead, zinc and copper values. Initial Cominco surveys outlined approximately coincident soil geochemical anomalies, electromagnetic conductors and positive magnetic anomalies. The first hole drilled in April, 1994 immediately intersected the deposit. Cominco followed with regional-scale, helicopter-borne magnetic and electromagnetic surveys, diamond drilling and regional staking programs. Exploration and development continued in 1995 with construction of a 23 km access road connecting the Robert Campbell Highway to the discovery site. Published reserves to the end of 1997 are quoted at 13 million tons grading 5.5% Zn, 1.0% Cu, 1.3% Pb, 12 g/t Ag and 1.2 g/t Au.

**CHUB PROPERTY**  
**ASSESSMENT REPORT 1997**  
**PAGE 7**

In 1996-97, D.C. Murphy of the Yukon Geology Program, Department of Indian Affairs and Northern Development conducted detailed 1:50,000 scale geological mapping of the Grass Lakes map sheet (NTS 105 G/7). Cominco's Kudz Ze Kayah massive sulphide deposit occurs in the northeastern corner of this map sheet. Results of this work were released in November, 1997.

**Property History:**

A review of government Assessment Report Archives and Archer, Cathro Mineral Inventory files indicates that no previous work has been recorded within the CHUB property boundary area. Two showings are noted proximal to the CHUB property. Minfile #74 (Bev) is located about 3 km to the south. This area was initially staked by Hudson Bay in 1974 following airborne geophysical surveys. Hudson Bay conducted ground EM and Mag surveys in 1975. The claims subsequently lapsed. The area was restaked in 1988 by Welcome North as part of a large block including the El showing (Cominco's TIN property). The location of the claims were apparently in the valley bottom. Minfile #75 (McIntosh or Bev) was also staked by Hudson Bay in 1974 approximately 2 km to the west of the CHUB property. Ground EM and Mag surveys were completed in 1975. The claims subsequently lapsed.

**1994 Exploration Program:**

During the period of July 24, 1994, 1:10,000 scale geological mapping and prospecting was completed by Cominco personnel. A total of 45 soil samples and 1 rock sample were collected concurrent with the geological survey.

**1997 Exploration Program:**

Approximately 75-80% of the property was examined through geochemical sampling, geological mapping and prospecting at a scale of 1:10,000. Less than 10% outcrop occurs within the claims area and is restricted mainly along slopes and on domed ridges.

Soil samples and a single rock sample were collected concurrent with prospecting. Soil samples were collected from gossanous patches proximal to mafic dykes.

**GEOLOGY:**

**Regional Geology:**

A large portion of the western to southeastern Yukon, from the Alaska border to British Columbia, is underlain by a geologically complex terrane composed of polydeformed, dynamothermally metamorphosed sedimentary, volcanic and plutonic rocks. These rocks have been grouped within the Yukon-Tanana and Slide Mountain Terranes and are believed to represent a mid-Paleozoic volcanic-plutonic arc assemblage (Yukon-Tanana Terrane) imbricated with middle and upper Paleozoic ophiolitic sheets (Slide Mountain Terrane); these accreted terranes are believed to be thrust northeastward over the North American Continental Margin (Figure 3). This allochthonous assemblage is preserved in klippen above autochthonous, structurally imbricated Paleozoic and lower Mesozoic North American Shelf strata in the central to southeastern Yukon.

The southwestern side of the allochthon is bounded by the Tintina Fault Zone comprising a series of subparallel transcurrent faults which have produced 450 km of dextral displacement during late Cretaceous and/or early Tertiary times. The northeastern boundary traces a broad arc marking the surface expression of the Finalyson Lake Fault Zone which comprises a complex assemblage of thrust and high angle faults that may, in part, represent a transpressive paleosuture. Both faults juxtapose the allochthonous rocks with autochthonous rocks of the North American miogeocline (Figure 4).



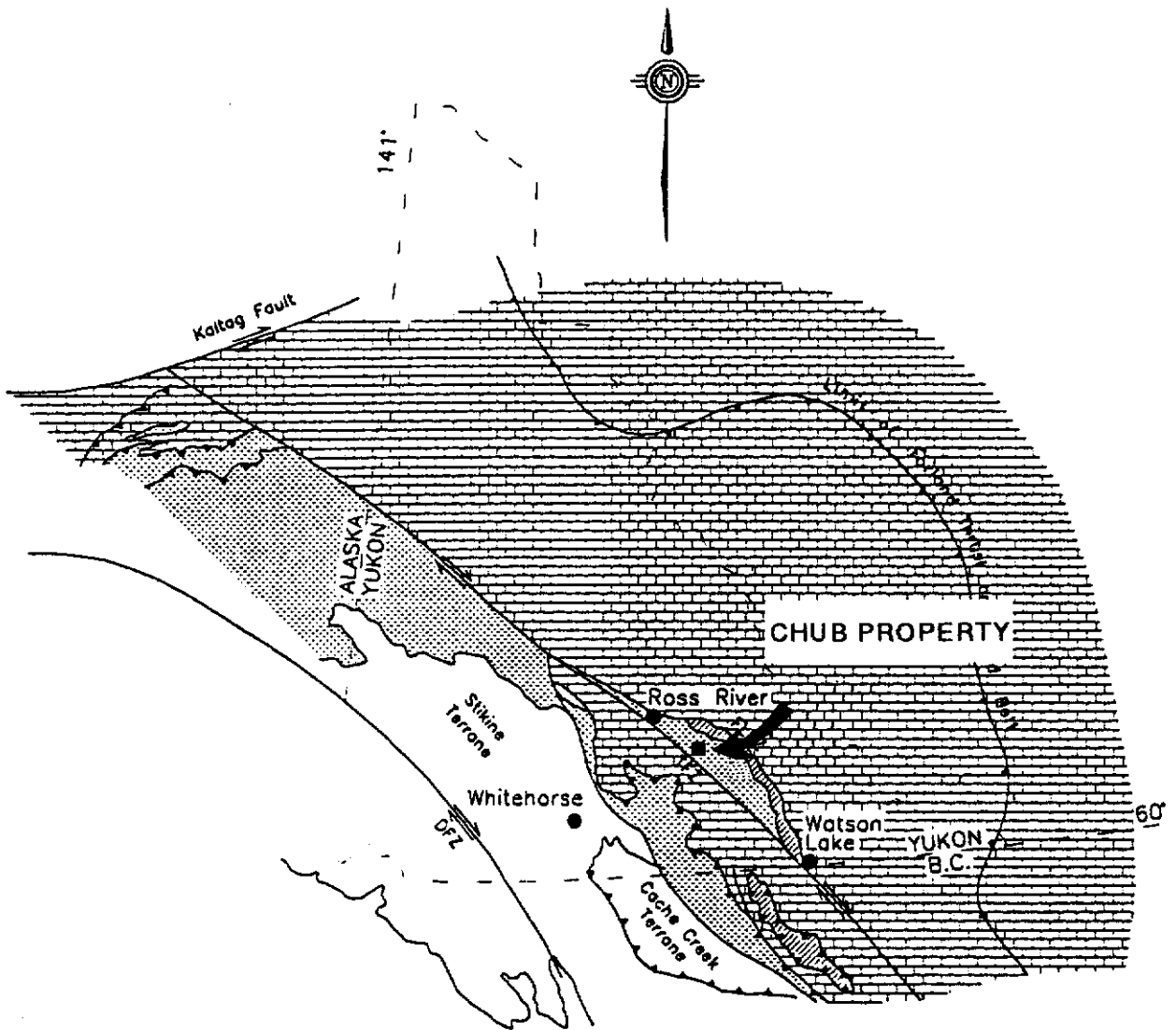

Rocks of the Yukon-Tanana and Slide Mountain Terranes are believed to have evolved offshore of North America in Paleozoic and early Mesozoic time and were subsequently deformed and metamorphosed in pre-early Jurassic time in a southwest dipping, right-oblique subduction system. These rocks were derived from a basin which formed outboard of present day western North America. This basin was constructed, in part, on oceanic crust locally preserved as ophiolitic assemblages within the Slide Mountain Terrane.

Yukon-Tanana rocks are generally more metamorphosed and contain more felsic metaplutonic suites whereas Slide Mountain Terrane is characterized by the presence of obducted ophiolitic rocks. These lithologies comprise massive to pillowed greenstones, basalt, chert and variably serpentized mafic to ultramafic plutonic rocks. This suite of rocks has been interpreted by Tempelman-Kluit (1979) and Mortensen and Jilson (1985) as fragments of a dismembered ophiolite complex. The rocks range in age from late Devonian to early Permian based upon U-Pb zircon dating methods and fossil ages. Fossil collections made in the Anvil district from ophiolitic rocks of the Anvil Range Group (Tempelman-Kluit, 1972) gave latest Pennsylvanian or earliest Permian ages. These ages were recorded from fusulinids and conodonts recovered from a limestone interfingering depositionally with red and green chert and basalt of the Anvil Range assemblage.



Scale: 1:10,000,000

LEGEND

-  North American Miogeoclinal Strata
-  Yukon - Tanana Terrane
-  Slide Mountain Terrane
-  Thrust Fault
-  Strike-Slip Fault, with sense of movement  
 FLFZ - Finlayson Lake Fault Zone  
 TFZ - Tintina Fault Zone  
 DFZ - Denai Fault Zone

PACIFIC BAY MINERALS LTD.  
VANCOUVER, BRITISH COLUMBIA

CHUB PROJECT

REGIONAL TECTONIC MAP

Figure 3

MTB Ref: 1056/11	REVISIONS
Work by: G. Wesa	Work by:
Drawn by: G. Wesa	Drawn by:
Date: March, 1998	Date:

Scale

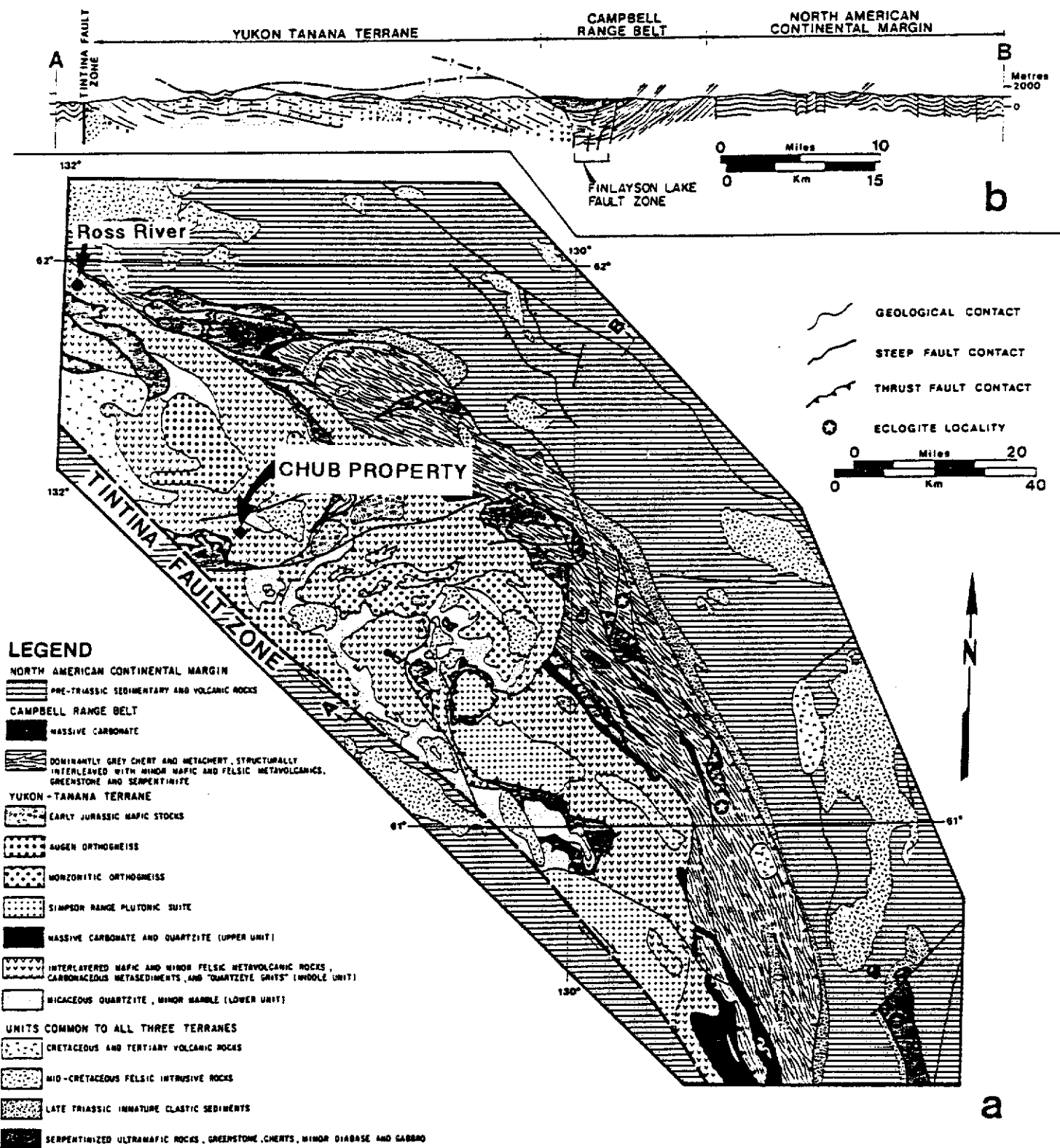

Figure 4: Regional Geology (After Mortensen & Jilson, 1985).

**CHUB PROPERTY**  
**ASSESSMENT REPORT 1997**  
**PAGE 11**

Six principal lithological packages have been identified within the allochthonous rocks in the Finlayson Lake area (Mortensen and Jilson, 1985). These include two metamorphic assemblages that comprise the bulk of Yukon-Tanana Terrane, a relatively unmetamorphosed package belonging to Slide Mountain Terrane and three younger units that are found in both terranes. Descriptions of these lithologies are presented below:

Paleozoic Layered Metamorphic Sequence is the oldest and most abundant lithological package within Yukon-Tanana Terrane. It consists of three distinct stratigraphic units with a total thickness of approximately 3.0 km. The lowest unit contains pre-late Devonian micaceous feldspathic quartzite with minor marble. The middle unit is late Devonian to mid-Mississippian in age and is the focus of volcanogenic massive sulphide exploration in the Finlayson Lake area. It consists of dark siliceous phyllite that becomes increasingly carbonaceous toward the base of the section where it interfingers with widespread mafic metavolcanic schist. Localized felsic metavolcanic centres are found throughout the section. The uppermost unit contains early Pennsylvanian to early Permian white carbonate and quartzite.

Paleozoic Metaplutonic Rocks are also confined to Yukon-Tanana Terrane. They are subdivided into three suites, all of which are coarse grain and have yielded mid-Mississippian age dates (340 to 359 Ma). The quartz monzonitic to quartz dioritic Simpson Range plutonic suite is slightly older than augen orthogneiss (leucogranite) and monzonitic orthogneiss (quartz monzonite). Most contacts between metaplutonic rocks and the layered metamorphic sequence are foliaform.

Both the layered metamorphic sequence and the metaplutonic rocks underwent intense deformation (F1) during Permian or early Triassic time. This event resulted in pervasive foliation that usually parallels subhorizontal or shallow-dipping compositional layering. The F1 deformation was accompanied by middle greenschist to middle amphibolite facies regional metamorphism. A second phase of deformation (F2) is observed locally but appears to have been a relatively minor event.

Slide Mountain Terrane consists of obducted ophiolitic assemblages that are most abundant within the Campbell Range Belt but also appears as imbricate slices along thrust faults elsewhere in the allochthon. The Campbell Range Belt is up to 25 km wide and forms the northeastern edge of the allochthon. It contains relatively unmetamorphosed but strongly folded and imbricated cherts with mafic and felsic volcanics, massive greenstone and serpentinite. Thrust slices elsewhere in the allochthon are also unmetamorphosed but typically contain a higher proportion of mafic to ultramafic plutonic rocks. Fossils in the cherts have been dated as late Pennsylvanian to early Permian while the mafic and ultramafic rocks are late Devonian. Slide Mountain rocks do not exhibit the F1 foliation characteristic of the Yukon-Tanana layered metamorphic sequence and metaplutonic rocks.

**CHUB PROPERTY**  
**ASSESSMENT REPORT 1997**  
**PAGE 12**

The remaining three units are all younger and unmetamorphosed. They are found in both Yukon-Tanana and Slide Mountain Terranes. Mesozoic Clastic Rocks are late Triassic immature sediments containing cobbles derived from both Yukon-Tanana and Slide Mountain. Mesozoic Plutonic Rocks include a number of early Jurassic mafic to intermediate plutons plus scattered late Cretaceous quartz monzonite stocks. Major thrust faults in the district post-date the early Jurassic plutons but pre-date the late Cretaceous quartz monzonite. This structural event is believed to have occurred during accretion of the allochthon to the North American craton because the thrusts cut the miogeoclinal rocks as well as the allochthonous rocks. Transcurrent movement on the Tintina Fault Zone occurred soon after the thrust faults. Young Volcanic Rocks unconformably overlie the other units and consist of late Cretaceous to Tertiary felsic volcanic flows and volcanoclastic deposits. They are usually found in close proximity to the Tintina Fault Zone.

**Property Geology:**

**Lithologies:**

A major fault structure, represented by a dry drainage gully, trends northeast through the centre of the property. Stratigraphy on the northwest side of this fault comprises massive quartz-chlorite-biotite-feldspar schist and phyllitic schist which is intruded by three magnetite bearing mafic dykes. At this location and along the southern claim boundary, metasedimentary and metavolcanic lithologies appear locally Fe-carbonate altered. Associated with these lithologies are minor, dark grey, variably carbonaceous phyllitic argillite and chloritic phyllites. This stratigraphy appears well foliated with dips of 28°-38° south at 090° azimuth.

Stratigraphy southeast of the structure comprises phyllitic sediments intruded by three magnetite bearing mafic dykes. Foliations in this area are moderately south dipping and strike roughly east to northeast.

This mixed metasedimentary/mafic metavolcanic sequence is representative of the "Middle Unit" of the Paleozoic Layered Metamorphic Sequence.

**Alteration:**

A subhorizontal to moderately north to northeast dipping, penetrative, ductile deformation fabric associated with middle greenschist facies (chlorite-biotite grade) metamorphism affects all Yukon-Tanana Terrane lithologies. This fabric reflects the first and most significant deformational and metamorphic event resulting from continent-arc collision during the late Permian to early Triassic period.

**CHUB PROPERTY**  
**ASSESSMENT REPORT 1997**  
**PAGE 13**

**Mineralization:**

Mafic dykes are magnetite bearing and may contain pyrite; however, no economic sulphide mineralization was detected during this survey.

**GEOCHEMISTRY:**

A total of 1 lithochemical sample and 6 soil samples were collected to provide first-pass coverage and delineate targets for follow up investigation.

**Sampling Procedure:**

Soil samples were collected from 30-40 cm deep pits dug with a long handle mattock. Sites sampled were characterized by strongly gossanous soils surrounding exposures of mafic dykes. Soil profiles are not well developed at this location and probably represent C horizon soils. Samples taken were placed in numbered, large gusseted kraft paper soil bags and sample sites were marked with similarly coded fluorescent ribbon. Rock samples were placed in numbered plastic sample bags and samples sites similarly marked.

Ground control for soil sampling, plus geological mapping, was provided by compass, altimeter and hip chain. Field crews were supplied with 1:10,000 scale contoured base maps for plotting data and navigation. Analytical results are presented in Appendix IV and geochemical values are plotted on Map 2.

**Geochemical Results:**

Analytical values for elements tested were low. A single strongly anomalous zinc-in-soil value (2,751 ppm) was documented from sample CBFS 97-04. This sample was obtained from a moss covered frost heave in an area of quartz-biotite-chlorite-feldspar phyllitic schist in float. An anomalous Cd value of 10.8 ppm accompanies the anomalous zinc value.

Geochemical background values and anomalous thresholds for Cu, Pb, Zn and Mo mineralization within soil samples collected on the CHUB property are presented in Table II. These values were confirmed in a summary report on the Finlayson Lake Properties by M.A. Powers (1996) for Expatriate Resources Ltd. and are valid for geochemical surveys conducted on the CHUB property.

**CHUB PROPERTY**  
**ASSESSMENT REPORT 1997**  
**PAGE 14**

**TABLE II - GEOCHEMICAL BACKGROUNDS & ANOMALOUS THRESHOLDS**

	Background (ppm)	Weak (ppm)	Moderate (ppm)	Strong (ppm)	Peak Value (ppm)
Copper	25	50	100	200	1720
Lead	30	50	100	200	>4000
Zinc	80	200	500	1000	>4000
Molybdenum	<1	2	5	10	65

**CONCLUSIONS:**

Geological mapping, prospecting and lithogeochemical and soil sampling, on targets delineated by previous Cominco (1994) surveys, was the focus of exploration activity on the CHUB claims during examination by Pacific Bay Minerals personnel in 1997.

A total of 1 rock and 6 soil samples were collected; however, analytical results were not encouraging. A single soil sample documented 2751 ppm Zn and 10.8 ppm Cd with no associated precious metal values.

Geological mapping indicates that bedrock in the project area comprises mainly mixed metasedimentary and mafic metavolcanic rocks which locally are intruded by magnetic and non-magnetic mafic dykes and sills. A major northeast trending fault is interpreted through the centre of the property.

Geological mapping and prospecting failed to identify significant economic mineralization and no felsic metavolcanic rocks or Kudz Ze Kayah VMS style mineralization was detected.

The lithologies examined during this program appear correlative to the assemblage of mixed metasediments and mafic metavolcanic rocks comprising the Middle Unit of the Paleozoic Layered Metamorphic Sequence of Yukon-Tanana Terrane.

**RECOMMENDATIONS:**

It is recommended that limited additional work be conducted in the area of the single, strongly anomalous zinc-in-soil sample site. Detailed prospecting, close spaced, grid controlled soil sampling and trenching to bedrock is required to fully assess the significance of this anomaly.

Respectively Submitted  
 PACIFIC BAY MINERALS LTD.

Gary L. Wesa, B.Sc. F.G.A.C.S.

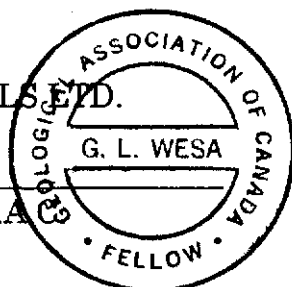

**REFERENCES**

- Hansen, V.L. (1990): Yukon-Tanana Terrane: A partial acquittal; Geology, Vol. 18, pp. 365-369.
- Hornbrook, E.H.W. and Friske, P.W.B. (1988): Regional Stream Sediment and Water Geochemical Data, Southeast Yukon (105G), Geological Survey of Canada, Open File 1648.
- Jackson Jr., L.E. (1986): Terrain Inventory, Yukon Territory, Geological Survey of Canada, Open File 1379.
- MacRobbie, P.A. (1995): 1994 Assessment Report on the CHUB Property, Cominco Ltd.
- Morin, J.A. (1981): Volcanogenic iron and base metal occurrences in Klondike Schist, Yukon Geology and Exploration, 1979-80, Department of Indian and Northern Affairs, pp. 91-97.
- Mortensen, J.K. and Jilson, G.A. (1985): Evolution of the Yukon-Tanana Terrane; Evidence from southeastern Yukon Territory, Geology, Vol. 13, pp 806-810.
- Mortensen, J.K. (1992): Pre-Mid-Mesozoic Tectonic Evolution of the Yukon-Tanana Terrane, Yukon and Alaska, Tectonics, Vol. 11, No. 4, pp. 836-853.
- Murphy, D.C. and Timmerman, J.R.M., (1997): Geological map of part of Grass Lakes map area, Pelly Mountains, southeastern Yukon. Exploration and Geological Services Division, Yukon. Indian and Northern Affairs Canada, Open File 1997-1.
- Nelson, J.L. and Bradford, J.A. (1993): Geology of the Midway-Cassiar area, northern British Columbia, MEMPR, Mineral Resources Division, Bull. 83, pp. 14-38.
- Powers, M.A. (1996): Summary Report on the Finlayson Lake Properties, Watson Lake and Whitehorse Mining Districts, Yukon Territory, Canada, Report for Expatriate Resources Ltd., pp 16-19.

**CHUB PROPERTY**  
**ASSESSMENT REPORT 1997**  
**PAGE 16**

- Tempelman-Kluit, D.J., Gordey, S.P. and Read, B.C. (1976): Stratigraphic and structural studies in the Pelly Mountains, Yukon Territory, Geological Survey of Canada, Paper 76-1A, pp. 97-106.
- Tempelman-Kluit, D.J. (1979): Transported cataclasite, ophiolite, and granodiorite in Yukon: Evidence of arc-continent collision, Geological Survey of Canada, Paper 79-14, pp. 1-27.
- Whiteway, P. (1995): "Fast-Tracking" ABM, Canadian Mining Journal, June, 1995, pp. 17-21.

**CHUB PROPERTY  
ASSESSMENT REPORT 1997  
PAGE 17**

**STATEMENT OF QUALIFICATIONS**

I, Gary L. Wesa, of #309 - 6669 Telford Avenue, in the City of Burnaby, B.C., do hereby certify that:

1. I am presently employed as Project Geologist to Pacific Bay Minerals Ltd. with offices at #908-700 West Pender Street, Vancouver, British Columbia.
2. I am a graduate of the University of Saskatchewan with a B.Sc. Degree in Geology (1974) and I have practiced my profession continuously since graduation.
3. I have been employed in mineral exploration in Canada and the U.S.A. since 1970.
4. I am a registered Fellow of the Geological Association of Canada.
5. I am familiar with the regional geology of the Yukon-Tanana and Slide Mountain Terranes and have personally performed work on several properties in this region.
6. I am the author of this report entitled: "Geological and Geochemical Report on the CHUB Property", which is based upon researched documents, referenced in this report, and supervision of the 1997 field program.

Dated at Vancouver, British Columbia this  26  day of May, 1998

Respectfully submitted:

*Pacific Bay Minerals Ltd.*

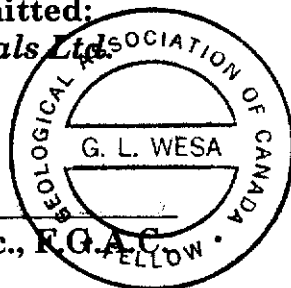

Gary L. Wesa, B.Sc., F.G.A.C.

# **APPENDIX I**

## **Itemized Cost Statement**

**CHUB CLAIM  
ITEMIZED COST STATEMENT**

**FIELD COSTS**

**Salaries**

F. Moyle	1 day @ \$200 per day	\$200.00
J. Hunt	1 day @ \$125 per day	\$125.00
	<b>Total</b>	<b><u>\$325.00</u></b>

**Field Expenses:**

Helicopter Transport (Trans North Helicopters)	\$ 400.00	
Helicopter Fuel	\$ 50.00	
Truck/Trailer Rental	\$ 200.00	
Trailer Insurance	\$ 25.00	
Generator Rental	\$ 50.00	
Sat. Phone Rental	\$ 40.00	
Gas	\$ 75.00	
Meals	\$ 80.00	
Misc. Supplies	\$ 80.00	
Radio Rental	\$ 15.00	
Travel Airfare	\$ 73.00	
Freight/Shipping	\$ 50.00	
7% GST on Field Expenses	\$ 79.66	
	<b>Total</b>	<b><u>\$1217.66</u></b>

**GEOCHEMICAL ANALYSIS**

Rock Samples	1 @ \$16.00 per sample	\$ 16.00
Soil Samples	6 @ \$13.25 per sample	\$ 79.50
	<b>Total</b>	<b><u>\$95.50</u></b>

**OFFICE COSTS**

**Salaries**

F. Moyle	2 days @ \$145 per day	\$290.00
	<b>Total</b>	<b><u>\$290.00</u></b>

**TOTAL EXPENDITURES:**

**\$1928.16**

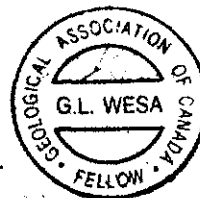

## **APPENDIX II**

### **Summary of Personnel**

## Summary of Personnel

<u>NAME</u>	<u>TITLE</u>	<u>ADDRESS</u>
Gary L. Wesa	Project Geologist	Vancouver, BC
Francis Moyle	Geologist	North Vancouver, BC
John Hunt	Sampler	Watson Lake, BC

# **APPENDIX III**

## **Analytical Procedure**

# ACME ANALYTICAL LABORATORIES LTD.

Assaying & Trace Analysis

852 E. Hastings St., Vancouver, B.C., Canada V6A 1R6

Telephone: (604) 253-3158 Fax: (604) 253-1716

## METHODS AND SPECIFICATIONS FOR ANALYTICAL PACKAGE GROUP 1D - 30 ELEMENT ICP BY AQUA REGIA

### Sample Preparation:

Soils and sediments are dried (60°C) and sieved to -80 mesh (-177 microns), rocks and drill core are crushed and pulverized to -100 mesh (-150 microns). Plant samples are dried (60°C) and pulverized or dry ashed (550°C). Moss-mat samples are dried (60°C), pounded to loosen trapped sediment then sieved to -80 mesh. At the clients request, moss mats can be ashed at 550°C then sieved to -80 mesh although this can result in the potential loss by volatilization of Hg, As, Sb, Bi and Cr. A 0.5 g split from each sample is placed in a test tube. A duplicate split is taken from 1 sample in each batch of 34 samples for monitoring precision. A sample standard is added to each batch of samples to monitor accuracy.

### Sample Digestion:

Aqua Regia is a 3:1:2 mixture of ACS grade conc. HCl, conc. HNO<sub>3</sub> and demineralized H<sub>2</sub>O. Aqua Regia is added to each sample and to the empty reagent blank test tube in each batch of samples. Sample solutions are heated for 1 hour in a boiling hot water bath (95°C).

### Sample Analysis:

Sample solutions are aspirated into an ICP emission spectrograph (Jarrel Ash Atom Comp model 800 or 975) for the determination of 30 elements comprising: Ag, Al, As, Au, B, Ba, Bi, Ca, Cd, Co, Cr, Cu, Fe, K, La, Mg, Mn, Mo, Na, Ni, P, Pb, Sb, Sr, Th, Ti, U, V, W, Zn.

### Data Evaluation:

Raw and final data from the ICP-ES undergoes a final verification by a British Columbia Certified Assayer who then signs the Analytical Report before it is released to the client. Chief Assayer is Clarence Leong, other certified assayers are Dean Toye and Jacky Wang.

# ACME ANALYTICAL LABORATORIES LTD.

## Assaying & Trace Analysis

852 E. Hastings St., Vancouver, B.C., Canada V6A 1R6

Telephone: (604) 253-3153 Fax: (604) 253-1716

## METHOD FOR WET GEOCHEM GOLD ANALYSIS

### Sample Preparation:

Soils and sediments are dried (60°C) and sieve to -80 mesh.

Rocks and cores are crushed and pulverized to -100 mesh.

### Sample Digestion

1. 10g samples in 250 ml beaker, ignite at 600°C for four hours.
2. Add 40 ml of 3:1:2 mixture HCL:HNO<sub>3</sub>:H<sub>2</sub>O.
3. Cover beaker with lids.
4. Boil in hot water bath for one hour.
5. Swirl samples 2 to 3 times within the hour.
6. Cool, add 60 ml of distilled water and settle.
7. Pour 50 ml of leached solution using a graduated cylinder into 100 ml volumetric flask.
8. Add 10 ml of MIBK and 25 ml of distilled water.
9. Shake 3 to 4 minutes in shaker.
10. Add additional 25 ml of distilled water to stripe out excess iron.
11. Shake each flask 10 times.
12. Pour MIBK into container for graphite AA finished.

# **APPENDIX IV**

## **Rock And Soil Geochemical Lab Reports**

## GEOCHEMICAL ANALYSIS CERTIFICATE

Pacific Bay Minerals Ltd. PROJECT MINK CREEK File # 97-5806

908 - 700 W. Pender St., Vancouver BC V6C 1G8 Submitted by: Frank Moyle

SAMPLE#

SAMPLE#	Mo ppm	Cu ppm	Pb ppm	Zn ppm	Ag ppm	Ni ppm	Co ppm	Mn ppm	Fe %	As ppm	U ppm	Au ppm	Th ppm	Sr ppm	Cd ppm	Sb ppm	Bi ppm	V ppm	Ca %	P %	La ppm	Cr ppm	Mg %	Ba ppm	Ti %	B ppm	Al %	Na %	K %	W ppm	Au* ppb
B 149951	1	13	38	49	<.3	18	8	293	2.07	<2	<8	<2	6	89	<.2	<3	<3	48	1.08	.047	15	40	.63	9	.05	<3	1.32	.04	<.01	3	<1
B 149952	2	19	23	69	<.3	28	12	734	3.22	<2	<8	<2	11	54	<.2	<3	<3	63	3.91	.092	24	64	1.06	185	.17	<3	1.95	.08	.82	<2	1
B 149953	1	17	28	15	<.3	13	7	89	1.41	<2	<8	<2	2	174	<.2	<3	<3	15	1.22	.059	5	17	.11	4	.14	<3	.77	.02	.01	4	<1
B 149954	1	8	19	36	<.3	5	5	320	2.34	<2	<8	<2	24	46	<.2	<3	<3	21	1.12	.033	46	11	.51	41	.01	<3	1.02	.05	.11	2	<1
B 149955	3	18	18	58	<.3	11	14	596	4.08	3	<8	<2	22	16	<.2	<3	<3	102	.27	.052	34	17	1.25	122	.05	<3	1.57	.07	.31	<2	1
B 149956	14	52	21	93	<.3	86	6	386	1.32	3	<8	<2	<2	55	.2	<3	<3	408	1.72	.106	16	42	.32	44	<.01	<3	.65	<.01	.19	9	<1
B 149957	2	180	16	49	<.3	30	36	324	3.77	5	<8	<2	13	17	<.2	<3	<3	92	.72	.062	31	88	1.53	91	.18	<3	1.89	.04	.36	5	<1
B 149958	2	59	116	20	<.3	69	14	99	.93	12	<8	<2	<2	86	<.2	<3	<3	16	1.36	.079	5	29	.13	18	.27	<3	.52	.03	.01	3	1
B 149959	1	89	9	79	.3	49	32	1114	5.24	7	<8	<2	2	281	.4	<3	3	198	12.68	.203	22	10	1.71	54	.06	<3	1.97	.02	.01	<2	2
B 149960	1	39	9	37	<.3	81	21	971	2.76	4	<8	<2	<2	220	.2	<3	<3	95	8.21	.094	8	197	1.00	191	.03	<3	1.23	.02	.07	<2	2
B 149961	1	8	13	74	<.3	9	10	1258	3.28	2	<8	<2	4	111	<.2	<3	3	54	2.64	.043	18	16	1.16	237	.02	7	2.87	.20	.13	<2	2
B 149962	4	29	4	124	<.3	17	37	1764	9.70	19	<8	<2	9	292	.2	<3	<3	84	4.71	.397	93	5	2.72	29	.02	<3	3.45	.02	<.01	<2	2
B 149963	3	51	19	66	<.3	31	30	2738	7.80	15	<8	<2	3	287	.8	<3	<3	49	10.20	.204	41	27	2.00	37	.01	<3	1.15	.02	.01	<2	1
B 149964	7	62	14	139	<.3	26	8	345	1.98	11	<8	<2	6	50	2.2	<3	<3	44	.81	.329	33	19	.51	137	<.01	<3	.91	.01	.16	4	1
B 149965	1	8	11	46	<.3	17	7	351	1.97	<2	<8	<2	10	35	<.2	<3	<3	23	1.45	.490	32	33	.55	71	.06	<3	1.10	.02	.27	4	1
B 149966	2	20	65	267	<.3	8	30	1339	8.20	5	<8	<2	3	75	.3	<3	<3	174	2.19	.197	8	46	2.36	44	.32	<3	3.27	.02	<.01	<2	1
B 149967	3	52	9	154	.4	17	19	728	8.21	<2	<8	<2	5	36	<.2	<3	<3	187	1.80	.243	38	57	2.18	50	.03	<3	3.64	.02	<.01	<2	1
B 149968	2	14	35	180	<.3	23	28	1858	8.12	<2	<8	<2	7	10	<.2	<3	3	213	.58	.093	16	69	2.16	15	.33	<3	3.81	.02	<.01	<2	1
B 149969	1	10	<3	63	<.3	153	32	879	6.02	<2	<8	<2	3	221	.4	<3	3	74	9.20	.114	19	281	1.81	1787	.03	<3	2.50	<.01	.05	<2	1
B 149970	2	10	7	143	<.3	15	38	1161	10.83	<2	<8	<2	3	70	<.2	<3	<3	245	2.17	.206	15	30	2.67	538	.18	<3	3.64	.02	.04	<2	1
RE B 149970	2	10	11	142	<.3	15	38	1147	10.67	<2	<8	<2	3	70	<.2	<3	<3	242	2.14	.204	15	31	2.64	524	.18	4	3.61	.02	.04	<2	1
B 149971	<1	3	6	13	<.3	5	2	1112	1.96	2	<8	<2	<2	297	.8	<3	<3	11	32.61	.017	1	4	.97	23	<.01	3	.06	<.01	<.01	<2	<1
B 149972	<1	1624	10	51	.9	64	34	3201	3.21	2	<8	<2	3	265	.7	4	<3	30	16.34	.077	27	41	.77	609	.02	4	.34	.03	.05	2	20
B 149973	<1	52	13	87	.3	37	28	793	5.56	<2	<8	<2	<2	107	.2	<3	<3	152	1.38	.098	8	194	2.42	76	.41	3	2.27	.04	.05	<2	<1
B 149974	<1	76	11	73	<.3	54	27	667	4.86	<2	<8	<2	<2	165	<.2	<3	<3	124	2.40	.174	11	179	2.12	268	.31	6	1.98	.03	.18	<2	7
B 149975	<1	73	<3	79	<.3	108	24	793	3.81	<2	<8	<2	2	211	<.2	<3	<3	81	2.64	.296	27	192	1.81	246	.32	3	1.99	.03	.36	<2	<1
B 149976	1	126	8	104	<.3	125	31	908	5.60	<2	<8	<2	2	105	<.2	<3	<3	100	2.45	.287	21	226	3.00	261	.31	8	2.93	.02	.30	<2	<1
CHUB B 149977 ROCK	1	12	12	65	<.3	59	29	1508	7.06	4	<8	<2	3	1708	1.3	<3	<3	55	10.73	.186	11	28	2.57	100	.01	12	.31	.03	.01	<2	<1
B 149978	<1	17	<3	26	<.3	2265	103	757	5.47	3	<8	<2	<2	12	1.1	<3	3	31	.29	.002	<1	950	19.86	7	.01	8	.65	<.01	<.01	<2	1
B 149979	1	10	11	46	<.3	36	6	519	3.13	2	<8	<2	4	20	.3	<3	<3	7	.13	.025	13	20	.43	213	<.01	<3	.87	.01	.13	5	<1
C 27901	1	12	16	33	<.3	22	6	413	1.98	<2	<8	<2	13	22	<.2	<3	<3	19	1.30	.020	22	41	.68	61	.04	<3	.96	.04	.12	4	<1
STANDARD C3/AU-R	27	67	38	166	5.6	34	12	727	3.37	55	21	<2	18	30	23.6	13	26	83	.59	.084	18	163	.60	146	.10	15	1.90	.04	.16	23	456
STANDARD G-1	2	4	5	50	<.3	8	4	590	2.21	<2	<8	<2	2	69	<.2	<3	<3	45	.65	.078	7	91	.67	254	.16	<3	1.06	.06	.51	<2	2

ICP - .500 GRAM SAMPLE IS DIGESTED WITH 3ML 3-1-2 HCL-HNO3-H2O AT 95 DEG. C FOR ONE HOUR AND IS DILUTED TO 10 ML WITH WATER.

THIS LEACH IS PARTIAL FOR MN FE SR CA P LA CR MG BA TI B W AND LIMITED FOR NA K AND AL.

ASSAY RECOMMENDED FOR ROCK AND CORE SAMPLES IF CU/PB/ZN/AS &gt; 1%, AG &gt; 30 PPM &amp; AU &gt; 1000 PPB

- SAMPLE TYPE: ROCK AU\* - IGNITED, AQUA-REGIA/MIBK EXTRACT, GF/AA FINISHED.(10 GM)

Samples beginning 'RE' are Reruns and 'RRE' are Reject Reruns.

DATE RECEIVED: OCT 3 1997 DATE REPORT MAILED: Oct 9/97 SIGNED BY: [Signature] D. TOYE, C. LEONG, J. WANG; CERTIFIED B.C. ASSAYERS



GEOCHEMICAL ANALYSIS CERTIFICATE

Pacific Bay Minerals Ltd. PROJECT MINK CREEK File # 97-5807 Page 1  
 908 - 700 W. Pender St., Vancouver BC V6C 1G8 Submitted by: Frank Moyle

SAMPLE#	Mo ppm	Cu ppm	Pb ppm	Zn ppm	Ag ppm	Ni ppm	Co ppm	Mn ppm	Fe %	As ppm	U ppm	Au ppm	Th ppm	Sr ppm	Cd ppm	Sb ppm	Bi ppm	V ppm	Ca %	P %	La ppm	Cr ppm	Mg %	Ba ppm	Ti %	B ppm	Al %	Na %	K %	W ppm	Au* ppb
CBFS-9701	3	30	18	98	<.3	37	38	2606	11.63	7	<8	<2	4	75	<.2	<3	<3	164	1.49	.080	50	69	1.29	607	.01	<3	2.65	.01	.07	<2	<1
CBFS-9702	1	28	6	58	<.3	62	23	504	4.94	16	<8	<2	3	26	<.2	8	<3	135	.34	.031	16	138	1.52	252	.09	<3	2.26	.01	.07	2	<1
CBFS-9703	1	22	22	59	.3	106	47	1967	9.10	6	<8	<2	3	416	.2	4	<3	77	2.19	.145	37	103	.94	155	<.01	<3	2.02	.01	.05	2	<1
CBFS-9704	1	56	14	2751	<.3	137	44	1308	5.71	13	<8	<2	9	80	10.8	10	<3	109	1.01	.229	69	233	2.48	301	.10	<3	2.89	.01	.07	5	<1
CBFS-9705	1	52	15	84	<.3	65	25	1276	4.53	12	<8	<2	8	31	.3	7	<3	87	.56	.135	45	102	1.71	223	.05	<3	2.50	.01	.07	2	<1
CBFS-9706	1	35	13	71	<.3	51	17	546	3.77	13	<8	<2	8	15	<.2	<3	<3	60	.20	.078	28	80	1.12	192	.03	<3	2.10	<.01	.07	<2	4
NMFS-9701	1	80	5	98	.5	133	71	1996	10.97	32	<8	<2	6	57	.6	12	<3	248	1.59	.263	52	133	4.53	148	.06	<3	4.92	.01	.05	3	1
NMFS-9702	1	68	7	97	.3	113	55	1468	8.31	33	<8	<2	6	40	.4	9	<3	136	1.08	.275	45	134	2.81	152	.04	<3	3.41	.01	.06	<2	1
NMFS-9703	<1	89	5	88	<.3	184	62	1617	8.15	62	<8	<2	6	34	<.2	<3	<3	162	.97	.196	35	249	3.24	200	.07	<3	3.86	<.01	.08	<2	1
NMFS-9704	1	62	8	74	.4	149	45	1564	6.73	126	<8	<2	3	32	.2	9	<3	147	1.06	.146	26	234	2.64	314	.04	<3	3.51	.01	.06	<2	<1
NMFS-9705	1	94	8	94	.4	201	48	1005	7.61	45	<8	<2	5	67	.6	5	<3	156	2.77	.166	27	261	3.29	245	.10	<3	3.79	.01	.11	<2	4
NMFS-9706	1	86	10	73	.3	138	33	937	5.73	29	<8	<2	3	39	.2	4	<3	120	1.20	.129	29	187	2.23	363	.05	<3	3.10	.01	.07	<2	1
NMFS-9707	1	75	7	82	<.3	143	36	797	6.31	32	<8	<2	3	37	.3	8	<3	133	1.22	.135	24	221	2.69	267	.06	<3	3.30	.01	.07	2	<1
NMFS-9708	1	79	7	90	.3	302	60	795	5.92	45	<8	<2	6	62	.3	8	<3	150	2.23	.151	28	665	2.34	157	.04	<3	2.44	.01	.05	<2	<1
BDFS-9701	1	51	9	88	.3	63	31	705	5.69	30	<8	<2	8	32	<.2	8	<3	119	.49	.106	43	60	1.88	370	.01	<3	2.96	.01	.08	<2	1
BDFS-9702	5	36	3	93	<.3	32	39	809	10.39	31	<8	<2	5	72	<.2	3	<3	116	.80	.249	65	15	2.20	100	.01	<3	4.46	.01	.02	<2	<1
BDFS-9703	7	147	24	51	.4	57	76	3199	14.74	21	<8	<2	6	75	<.2	14	<3	68	1.15	.224	139	11	.88	30	.01	<3	1.85	.01	.01	<2	<1
RE BDFS-9703	8	154	26	52	<.3	58	76	3281	14.97	20	<8	<2	5	75	<.2	15	<3	70	1.17	.225	143	11	.90	31	.01	<3	1.89	.01	<.01	2	1
BDFS-9704	6	18	13	63	<.3	19	18	402	5.70	9	<8	<2	5	38	<.2	4	<3	115	.42	.056	41	25	1.37	181	.02	<3	2.98	.01	.02	<2	<1
BDFS-9705	4	33	11	88	.4	49	23	620	4.96	14	<8	<2	7	24	.3	3	<3	97	.29	.087	38	53	1.21	392	.02	<3	2.31	.01	.05	<2	<1
BDFS-9706	1	25	5	144	.3	36	52	1207	11.60	27	<8	<2	3	252	.4	19	<3	29	3.92	.282	17	10	.79	222	<.01	<3	.78	.01	.09	<2	2
BDFS-9707	3	60	16	102	.3	56	18	459	4.21	14	<8	<2	8	30	.3	4	<3	77	.45	.084	46	52	1.00	417	.02	<3	1.93	.01	.06	<2	<1
BDFS-9708	1	23	9	54	<.3	26	8	229	2.20	8	<8	<2	6	28	<.2	<3	<3	46	.41	.111	24	24	.58	344	.02	3	1.08	.01	.05	<2	1
BDFS-9709	1	13	4	63	.4	35	34	879	8.63	5	<8	<2	2	78	<.2	<3	<3	104	2.44	.186	31	10	.60	307	<.01	<3	1.02	.01	.06	<2	<1
BDFS-9710	1	35	8	56	<.3	64	18	347	3.84	16	<8	<2	4	24	<.2	4	<3	84	.44	.033	15	81	.98	181	.02	<3	2.43	.01	.05	<2	<1
NKFS-9701	2	59	14	92	.8	130	15	599	2.78	10	<8	<2	3	41	.6	<3	<3	49	.72	.070	22	47	.46	720	.01	<3	1.06	.02	.07	<2	2
NKFS-9702	1	16	8	76	.4	51	12	437	1.89	5	<8	<2	2	29	.6	<3	<3	34	.57	.052	9	64	.31	309	.01	<3	.71	.02	.07	<2	<1
NKFS-9703	2	44	18	77	.3	153	19	753	3.65	15	<8	<2	4	38	.5	3	<3	54	.63	.038	20	101	.64	440	.02	3	.91	.01	.05	<2	1
NKFS-9704	2	53	12	125	.3	164	12	463	2.84	14	<8	<2	5	65	1.3	3	<3	42	1.75	.105	17	68	1.28	518	.02	3	.66	.02	.08	<2	10
NKFS-9705	1	21	9	46	<.3	450	27	328	2.53	9	<8	<2	3	26	.2	4	<3	39	.45	.035	13	320	3.67	268	.03	3	.82	.02	.04	<2	1
NKFS-9706	2	45	15	125	.5	153	14	311	2.62	13	<8	<2	7	72	1.4	<3	<3	47	2.01	.117	24	67	1.25	742	.03	4	.93	.01	.10	<2	1
NKFS-9707	1	41	10	80	.5	117	14	638	2.68	11	<8	<2	4	28	.3	<3	<3	40	.35	.048	16	65	.66	491	.02	3	.73	.01	.05	<2	3
NKFS-9708	1	46	15	84	<.3	66	9	309	2.89	12	<8	<2	4	19	.2	4	<3	40	.21	.038	19	37	.40	393	.02	<3	.82	.01	.05	<2	3
NKFS-9709	2	40	10	74	.6	68	15	582	3.53	9	<8	<2	4	42	<.2	<3	<3	52	.74	.110	26	37	.81	843	.02	<3	1.30	.03	.08	<2	1
NKFS-9710	2	39	11	101	.4	53	8	410	2.20	9	<8	<2	4	47	.8	<3	<3	39	.86	.098	18	33	.59	643	.02	<3	.69	.01	.08	<2	3
STANDARD C3/AU-S	26	66	38	149	5.8	37	12	776	3.46	57	21	2	20	30	23.8	22	23	86	.60	.089	21	174	.61	152	.10	20	1.91	.04	.16	22	44
STANDARD G-1	1	5	<3	38	<.3	6	4	539	2.08	<2	<8	<2	5	72	<.2	<3	<3	44	.64	.092	10	81	.56	227	.14	3	.94	.09	.48	3	<1

ICP - .500 GRAM SAMPLE IS DIGESTED WITH 3ML 3-1-2 HCL-HNO3-H2O AT 95 DEG. C FOR ONE HOUR AND IS DILUTED TO 10 ML WITH WATER.  
 THIS LEACH IS PARTIAL FOR MN FE SR CA P LA CR MG BA TI B W AND LIMITED FOR NA K AND AL.  
 - SAMPLE TYPE: SOIL AU\* - AQUA-REGIA/MIBK EXTRACT, GF/AA FINISHED.(10 GM)  
 Samples beginning 'RE' are Reruns and 'RRE' are Reject Reruns.

DATE RECEIVED: OCT 3 1997 DATE REPORT MAILED: *Oct 8/97* SIGNED BY: *C.L.* D. TOYE, C. LEONG, J. WANG; CERTIFIED B.C. ASSAYERS

All results are considered the confidential property of the client. Acme assumes the liabilities for actual cost of the analysis only.

Data FA

093850

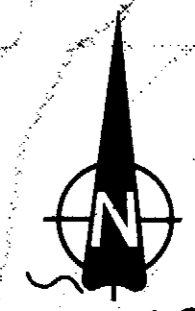

# CHUB CLAIMS 1-18

### SYMBOLS

#### FROM REGIONAL MAPPING

- conformable (?) contact
- intrusive contact
- fault

#### FROM DETAILED MAPPING

- conformable (?) contact
- intrusive contact
- fault
- outcrop
- small outcrop
- talus / subcrop
- float
- laterite altered zone / gossan
- S, dip
- S, foliation
- S, foliation
- lineation with plunge
- joint surface
- Cominco rock sample
- Cominco stream silt sample
- Cominco soil sample
- Cominco lithochem. sample
- Cominco heavy mineral sample
- R.G.S. stream silt sample
- Mirdle showing
- trench
- D.D.H. collar
- Cominco 1994 geophysical grid

### GEOLOGY

- #### FINLAYSON LAKE FAULT ZONE
- 2a Cretaceous and / or Tertiary volcanics
  - 2b Early Mesozoic sediments
  - 2c Massive carbonate
  - 2d Undifferentiated metamorphic rocks
  - 2e Sheared mafic to ultramafic plutonic rocks
  - 2f Sheared greenstones and chert
  - 2g Two-mica quartz monzonite

- #### YUKON - TANANA TERRANE
- 3a Cretaceous and / or Tertiary volcanics
  - 3b Early Mesozoic sediments
  - 3c Sheared mafic to ultramafic rocks
  - 3d Sheared greenstone
  - 3e Massive carbonate
  - 3f Mainly mafic metavolcanics and associated sediments
  - 3g Felsic metavolcanics
  - 3h Foliated K feldspar porphyry
  - 3i Lower unit micaceous quartzite and marble
  - 3j Two-mica quartz monzonite
  - 3k Mafic stocks
  - 3l Augen orthogneiss
  - 3m Monzonitic orthogneiss
  - 3n Simpson Range Plutonic Suite

(after Mortensen, 1983)

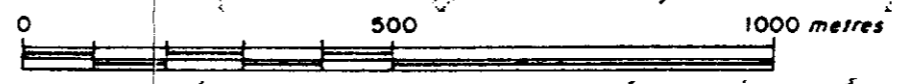
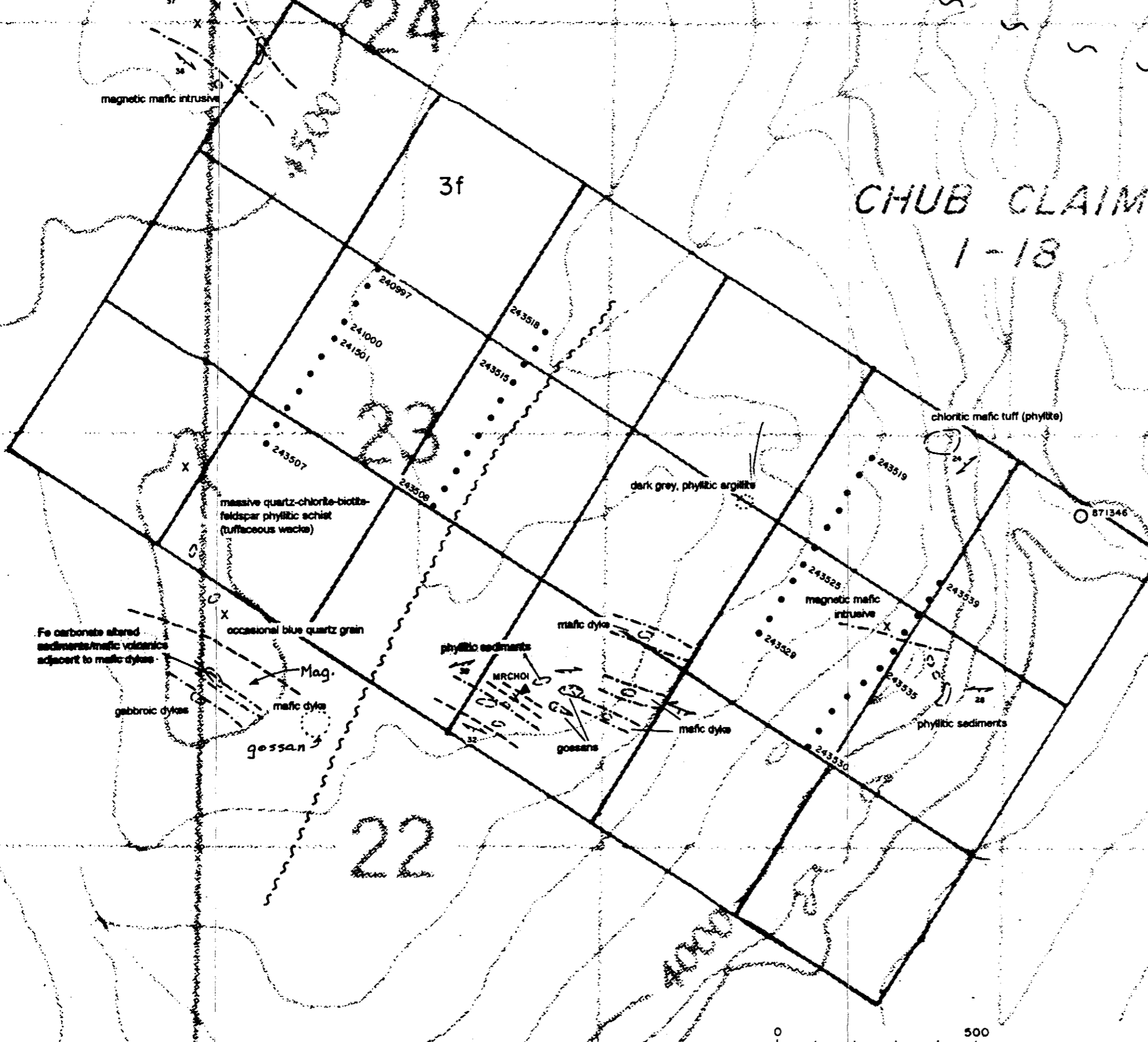

PACIFIC BAY MINERALS LTD. VANCOUVER, BRITISH COLUMBIA	
<b>CHUB CLAIMS</b>	
<b>PROPERTY GEOLOGY</b>	
<b>MAP 1</b>	
NTS Ref: 1056/11	REVISIONS
Work by: F. MOYLE	Work by:
Drawn by: G. WESA	Drawn by:
Date: MAY, 1998	Date:
Scale: 1:10,000	

3f

22



093 850

# CHUB CLAIMS 1-18

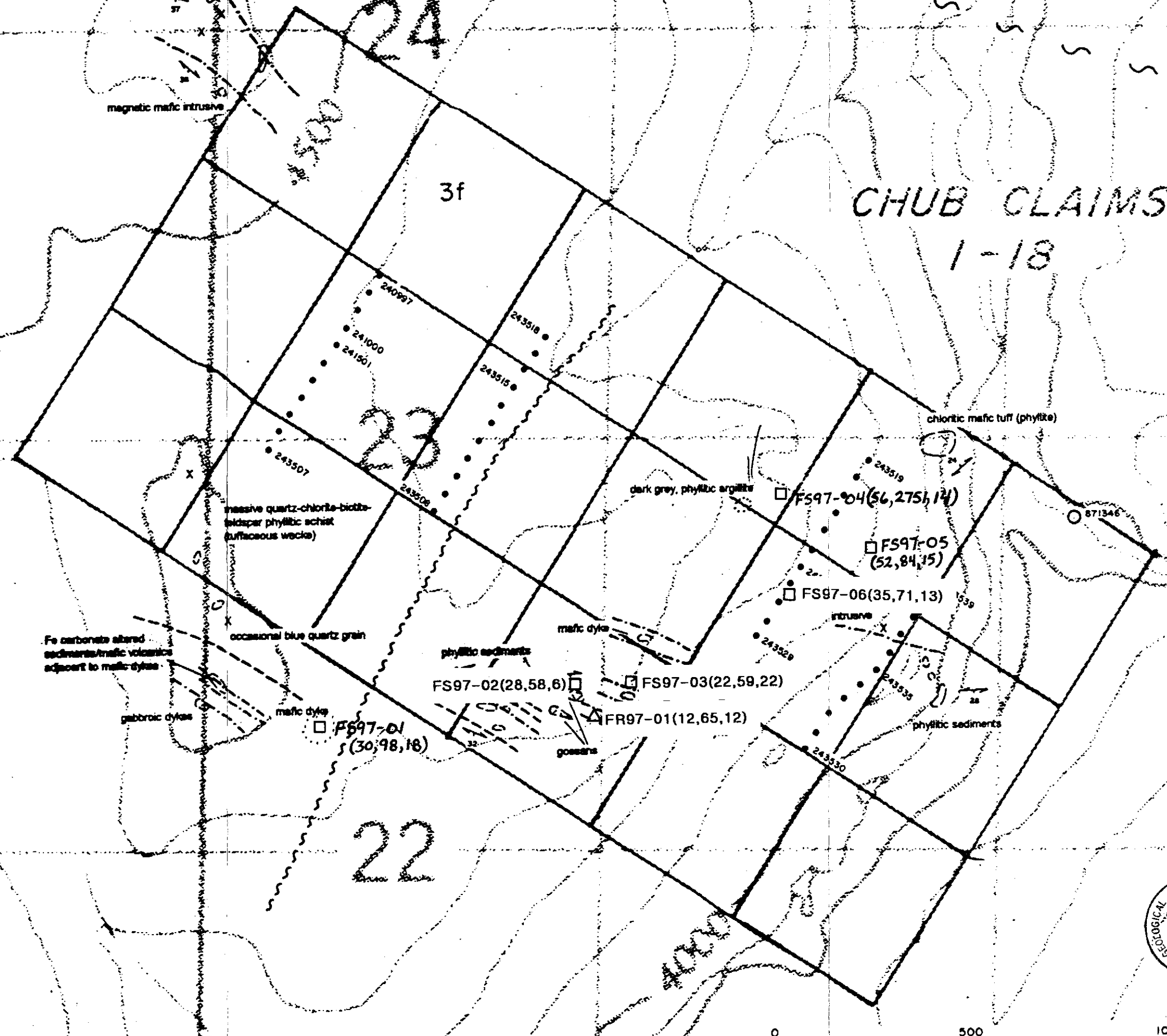

### 1997 GEOCHEMISTRY

- SOIL SAMPLE
- △ ROCK SAMPLE

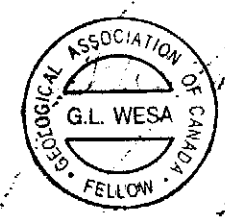

PACIFIC BAY MINERALS LTD. VANCOUVER, BRITISH COLUMBIA	
<b>CHUB CLAIMS</b>	
<b>GEOCHEMISTRY (Cu, Zn &amp; Pb in ppm)</b>	
<b>MAP 2</b>	
NTS Ref: 1056/11	REVISIONS
Work by: F. MOYLE	Work by:
Drawn by: G. WESA	Drawn by:
Date: MAY, 1998	Date:
Scale: 1:10,000	

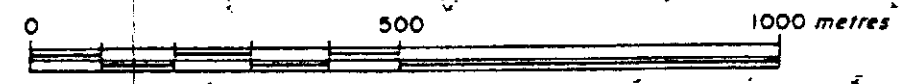

3f

22