

QA23088

to

QA23089.

0117-82660

093727

EVALUATION REPORT
PHYSICAL REPRESENTATION REPORT
CMC/GL QUARTZ CLAIMS
CLAIM SHEET 105B-07
WATSON LAKE MINING DISTRICT
YUKON, CANADA

04 SEPTEMBER, 1993

62° 20' 130° 43'

Prepared by

James S. Dodge, P.Eng.
Whitehorse, Yukon

QA23068

to

QA23089

TABLE OF CONTENTS

<u>Section</u>		<u>Page No.</u>
1.0	INTRODUCTION	1
2.0	PROPERTY, LOCATION, ACCESS	
	2.1 Property	2
	2.2 Location	2
	2.3 Access	2
3.0	REPRESENTATION WORK	2
	3.1 Mobilization	2
	3.2 Qualifying Representation Work	3
4.0	CONCLUSIONS	6
5.0	CERTIFICATE OF QUALIFICATIONS	7

ILLUSTRATIONS

		<u>Following Page</u>
<u>Figure 1</u>	GMC/GL Claim Map 105B-07	1
<u>Figure 2</u>	Sketch Map of Restoration CMC 25,26,27,28	5
<u>Figure 3</u>	Sketch Map of Waste Pile Restoration CMC 28	5
<u>Photo 1</u>	Bedrock Ripping - Connector Road CMC 12 . .	4
<u>Photo 2</u>	Cut-fill Rebuilding Northwest Road CMC 77&78	4
<u>Photo 3</u>	Reclamation CMC 10	5
<u>Photo 4</u>	Panorama of Restoration CMC 11,27,28 . . .	5

CMC	1 - 24	YA56628 - YA56651	Terry McCrory Bill Preston A. W. Hyde
	25 - 38	YA70616 - YA70629	Terry McCrory Bill Preston A. W. Hyde
	39 - 41	YA70708 - YA70710	Terry McCrory Bill Preston A. W. Hyde
	43 - 104	YA70712 - YA70773	Terry McCrory Bill Preston A. W. Hyde
G.L.	1 - 2	YA99544 - YA99545	SILVER HART MINES LTD.
	12 - 13	YA99546 - YA99547	SILVER HART MINES LTD.
	3 - 10	YA99548 - YA99555	SILVER HART MINES LTD.
	11	YA99557	SILVER HART MINES LTD.

1.0 INTRODUCTION

During the period 26 June to 26 August, 1993, Mr. A. Wallace Hyde of Whitehorse carried out assessment representation work on the CMC and GL quartz claims north of Edgar Lake on Claim Sheet 105B-07 in the Watson Lake Mining District.

Mr. James S. Dodge, Professional Engineer-Yukon of Whitehorse visited the CMC property during 10-13, August, 1993 to inspect and evaluate the representation work being completed by Mr. Hyde. This report summarizes those findings.

2.0 PROPERTY, LOCATION, ACCESS

2.1 Property

The CMC/GL property is centered at approximately 60°20' north latitude and 130°43' west longitude on Claim Sheet 105B-07 of the Watson Lake Mining District roughly 3 kilometers north-northeast of Edgar Lake.

The property comprises a block of one-hundred and four CMC 1-104 contiguous quartz claims plus twelve GL 1-12 fractional claims.

Encompassing these claims are eight grouping certificates all of which were applied by the Watson Lake Mining Recorder on 17 February, 1993. The contiguous relationships of the eight groups, WA05587-WA05594 inclusive, are shown on Figure 1.

2.2 Location

Altitudes on the CMC property range from a low of 1000 meters in the Meister River valley up to the highest point at 1465 meters approximately 1.1 kilometers northeast of the main camp. Situated on CMC 28 claim at the end of the access road, this camp is at an altitude of 1400 meters. Buckbrush (dwarf birch) covers the terrain above the irregular fingers of balsam forest defining timberline near the camp.

2.3 Access

Access is by way of a 42 kilometer unimproved road from the Alaska Highway, near the 1160 kilometer post, at a point approximately 20 kilometers east of the settlement of Swift River. Mr. Hyde used four-wheel drive pickup vehicles to conveniently negotiate several steep grades and washouts.

3.0 REPRESENTATION WORK

3.1 Mobilization

Mr. Hyde's D7G CAT bulldozer with single ripper was transported from Whitehorse to (and return from) the CMC access road turnoff on the Alaska Highway by Nikon Trucking Ltd. of Whitehorse.

The bulldozer was 'walked' the 42 kilometer access road into, and return from, the campsite on CMC claims. Mr. Hyde, as the principal bulldozer operator, was supplemented by Mr. L. Leas of Swift River who bulldozed under Mr. Hyde's direction.

3.2 Qualifying Representation Work

Physical representation work by Mr. Hyde focused on bulldozing within the CMC/GL claim block. In addition, one day's bulldozing was employed in making improvements to the access road between the Alaska Highway and the property.

Bulldozing on the CMC property was carried out to perform a variety of work, namely, ripping bedrock, stripping overburden, constructing intra-claim roads, and conducting purposeful environmental reclamation and restoration by both in filling of abandoned sloughing trenches, and in levelling berms of waste material alongside retained trenches.

Details of physical representation work have been differentiated as to (A) bedrock ripping, (B) northwest road reconstruction, (C) intra-claim road construction, and (D) environmental reclamation/restoration.

Measurements were made with a brunton compass and a hip-chain calibrated in feet, not meters, in conformity with guidelines for claim staking and representation allowances under the Yukon Quartz Mining Act.

- (A) Bedrock ripping was carried out to facilitate access on the connector road along the northwest boundary of CMC 12 claim (Photo 1).

$$300' \times 16' \times 1.5' = 265 \text{yd}^3$$

$$@\$1.50/\text{yd}^3 = \$398$$

QA23068

4

to

QA23089

(B) Northwest road reconstruction was carried out on both CMC 77 and 78 claims and comprised:

1) stripping, widening, and re-aligning the roadbed within the following distance intervals as chained from its junction with the main connector road on CMC 12.

20'- 80' 60'x18'x2.1' = 84yd³
425'- 525' 100'x18'x3.0' = 198yd³
2210'-2349' 139'x18'x3.0' = 278yd³
2788'-3058' 274'x15'x3.0' = 455yd³
4212'-4308' 96'x15'x2.4' = 128yd³

1143yd³ @\$1.50 = \$1715

2) a major bedrock stripping and cut-fill upgrading of the road at a former nearly impassable muckhole between 3142'-3370' chained from the connector road junction (Photo 2).

228'x24'x12' = 2432yd³ @\$1.50/yd³ = \$3648

(C) Intra-claim road building

1) comprised stripping and bedrock cut-fill for a distance of 450 feet near the eastern boundary of CMC 27 claim.

450'x18'x4' = 1170yd³ @\$1.50/yd³ = \$1755

2) Stripping and road building on CMC 8 and 10 claims were carried out to upgrade the main connector road.

900'x12'x2.0' = 850yd³
200'x15'x3.0' = 330yd³
70'x50'x2.0' = 274yd³
50'x20'x3.0' = 119yd³

1563yd³ @\$1.50/yd³ = \$2345

(D) Environmental reclamation/restoration **

- 1) Southeastern CMC 10 claim (Photo 3)
- | | | | |
|-----------------|---|---------------------------|----------------------------------|
| a. 400'x40'x8' | = | 4740yd ³ | |
| b. 125'x60'x12' | = | 3360yd ³ | |
| | | <u>8100yd³</u> | @\$1.00/yd ³ = \$8100 |
- 2) West-central CMC 7 claim
- | | | | |
|------------------|---|---------------------------|--------------------------------|
| a. 130'x60'x6.0' | = | 1733yd ³ | |
| b. 55'x30'x5.7' | = | 348yd ³ | |
| c. 60'x30'x6.0' | = | 400yd ³ | |
| | | <u>2481yd³</u> | @1.00/yd ³ = \$2481 |
- 3) CMC 25,26,27,28 claims reclaiming trench berms of waste in order to promote natural revegetation and control erosion (Figure 2 and Photo 4) \$33,778
- 4) CMC 28 claim - waste dumps from underground workings ca. 700 feet south of Post No. 1 (Figure 3) and \$5401
- TOTAL REPRESENTATION PHYSICAL WORK \$59,621

** Considered "loose material" as per Yukon Quartz Mining Act.



QA23068

to

QA23089

6

4.0 CONCLUSIONS

- 4.1 During the period 26 June to 26 August, 1993 Mr. A. Wallace Hyde carried out physical representation work on the block of CMC/GL quartz claims.
- 4.2 Total volume of overburden stripping, bedrock ripping, and road construction by bulldozing was 6574 cubic yards valued at \$1.50 per cubic yard for a representation of \$9,861.
- 4.3 Total environmental reclamation and restoration of waste berms and stockpiles by bulldozing was 49,760 cubic yards valued at \$1.00 per cubic yard for a representation of \$49,760.
- 4.4 Combined total physical representation work was \$59,621.

Respectfully submitted,

James S. Dodge

James S. Dodge
Professional Engineer-Yukon 301
14 MacDonald Road
Whitehorse, Yukon Y1A 4L2

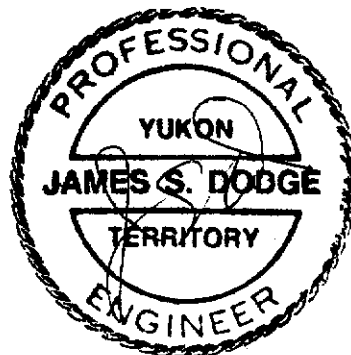

QA23068

to

QA23089

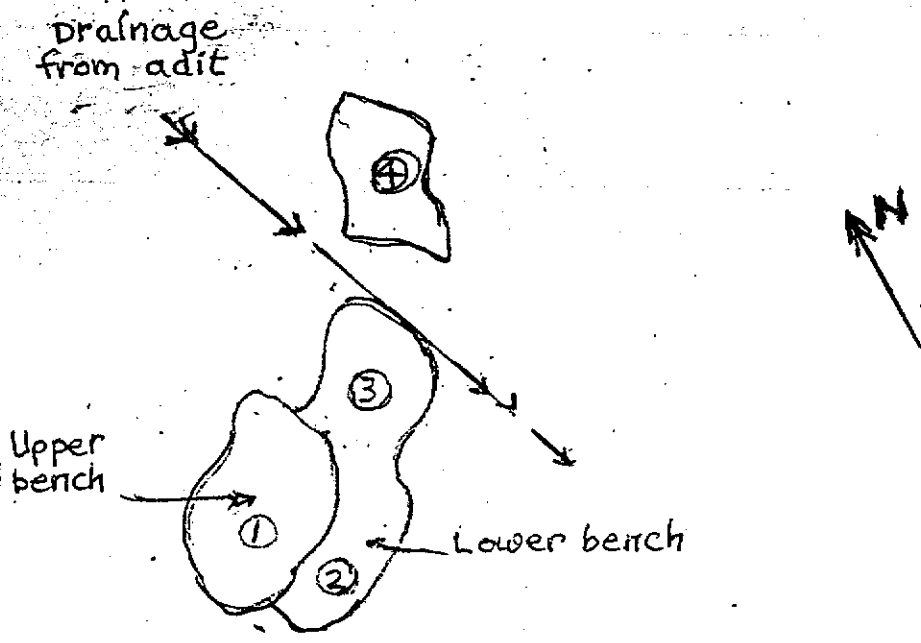

SCALE
1:1500

RECLAIMED
WASTE DUMPS FROM
UNDERGROUND WORKINGS
CMC 28 CLAIM

Hip-chain Sketch
Bulldozed Waste Piles

Block Number	Feet	yd ³
1	150x60x6.3	= 2100
2	125x40x6.0	= 1111
3	80x60x4.8	= 857
4	100x60x6.0	= 1333
		<u>5401 yd³</u>
		@ \$1.00/yd ³ = \$5,401

FIG. 3

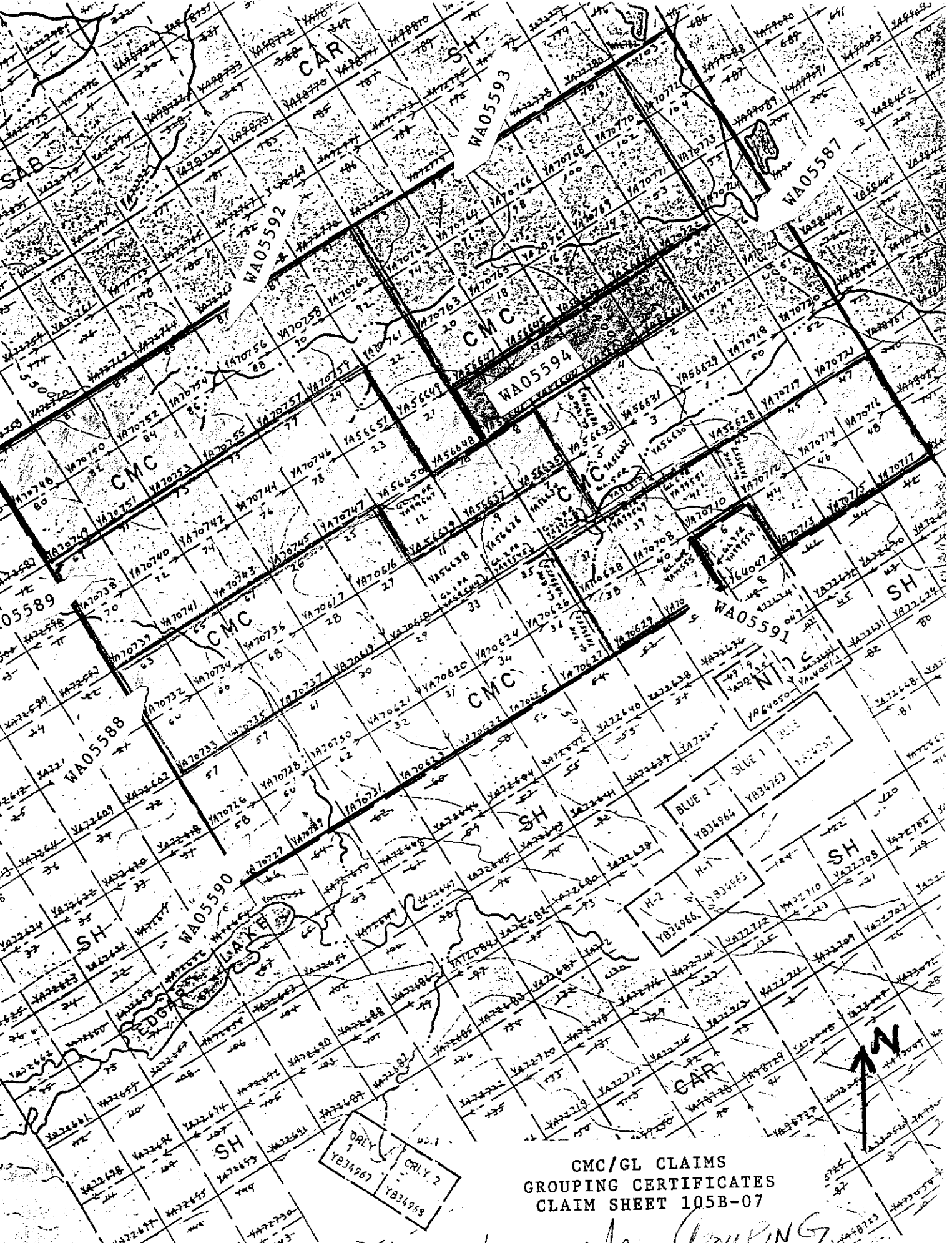

CMC/GL CLAIMS
 GROUPING CERTIFICATES
 CLAIM SHEET 105B-07

ONLY
 YB31967
 ONLY ?
 YB31968

LAST PR. GROUPING

QA23068 to QA23089

QA 23068 TO QA 23089

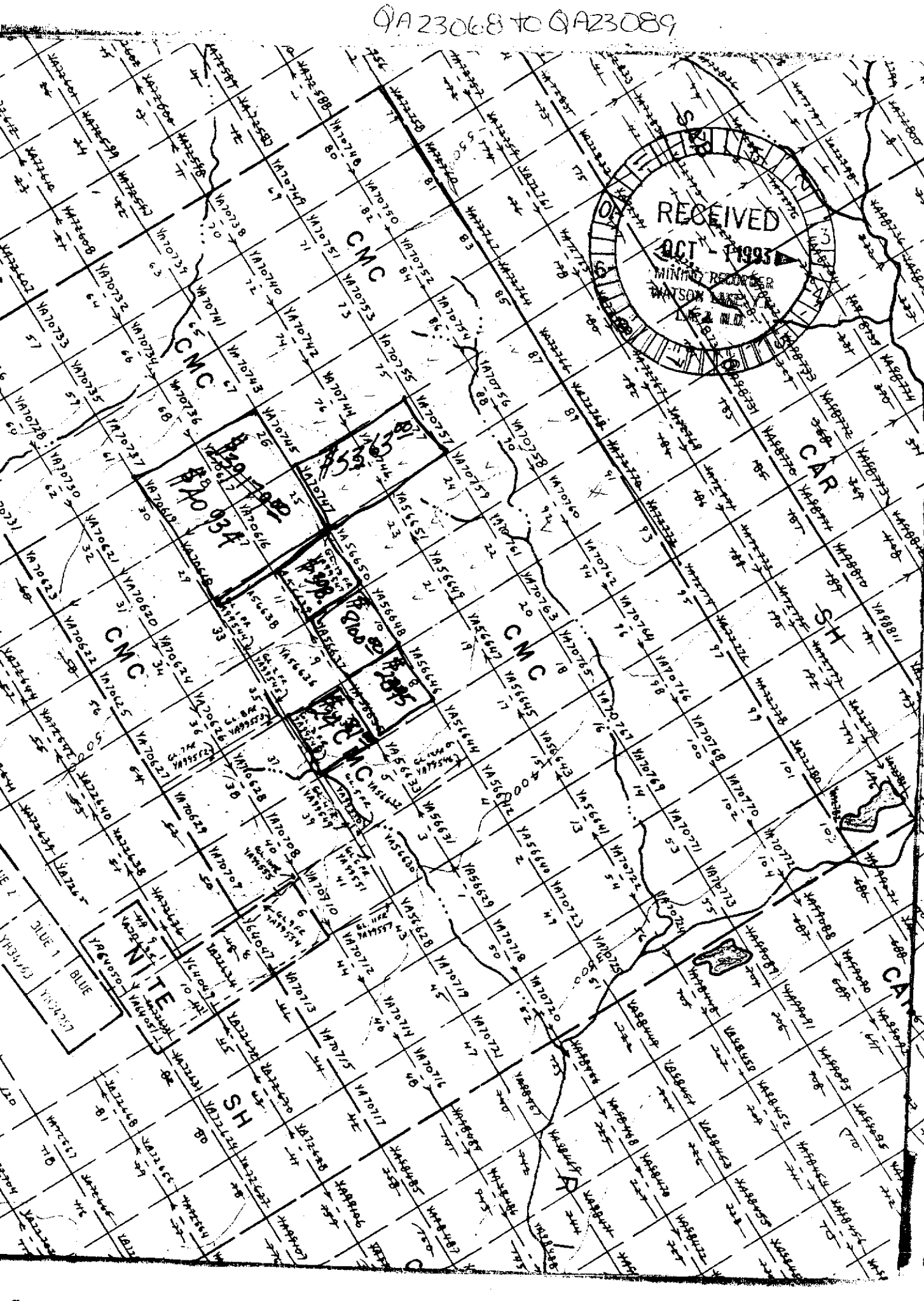

Map grid labels and identifiers:

- Parcel numbers: VA70710, VA70712, VA70714, VA70716, VA70718, VA70720, VA70722, VA70724, VA70726, VA70728, VA70730, VA70732, VA70734, VA70736, VA70738, VA70740, VA70742, VA70744, VA70746, VA70748, VA70750, VA70752, VA70754, VA70756, VA70758, VA70760, VA70762, VA70764, VA70766, VA70768, VA70770, VA70772, VA70774, VA70776, VA70778, VA70780, VA70782, VA70784, VA70786, VA70788, VA70790, VA70792, VA70794, VA70796, VA70798, VA70800, VA70802, VA70804, VA70806, VA70808, VA70810, VA70812, VA70814, VA70816, VA70818, VA70820, VA70822, VA70824, VA70826, VA70828, VA70830, VA70832, VA70834, VA70836, VA70838, VA70840, VA70842, VA70844, VA70846, VA70848, VA70850, VA70852, VA70854, VA70856, VA70858, VA70860, VA70862, VA70864, VA70866, VA70868, VA70870, VA70872, VA70874, VA70876, VA70878, VA70880, VA70882, VA70884, VA70886, VA70888, VA70890, VA70892, VA70894, VA70896, VA70898, VA70900, VA70902, VA70904, VA70906, VA70908, VA70910, VA70912, VA70914, VA70916, VA70918, VA70920, VA70922, VA70924, VA70926, VA70928, VA70930, VA70932, VA70934, VA70936, VA70938, VA70940, VA70942, VA70944, VA70946, VA70948, VA70950, VA70952, VA70954, VA70956, VA70958, VA70960, VA70962, VA70964, VA70966, VA70968, VA70970, VA70972, VA70974, VA70976, VA70978, VA70980, VA70982, VA70984, VA70986, VA70988, VA70990, VA70992, VA70994, VA70996, VA70998, VA71000.
- Other labels: CMC, SH, CAR, NITE, BLUE 1, BLUE.
- Handwritten annotations: 834, 835, 836, 837, 838, 839, 840, 841, 842, 843, 844, 845, 846, 847, 848, 849, 850, 851, 852, 853, 854, 855, 856, 857, 858, 859, 860, 861, 862, 863, 864, 865, 866, 867, 868, 869, 870, 871, 872, 873, 874, 875, 876, 877, 878, 879, 880, 881, 882, 883, 884, 885, 886, 887, 888, 889, 890, 891, 892, 893, 894, 895, 896, 897, 898, 899, 900.

QA23068 to QA23089

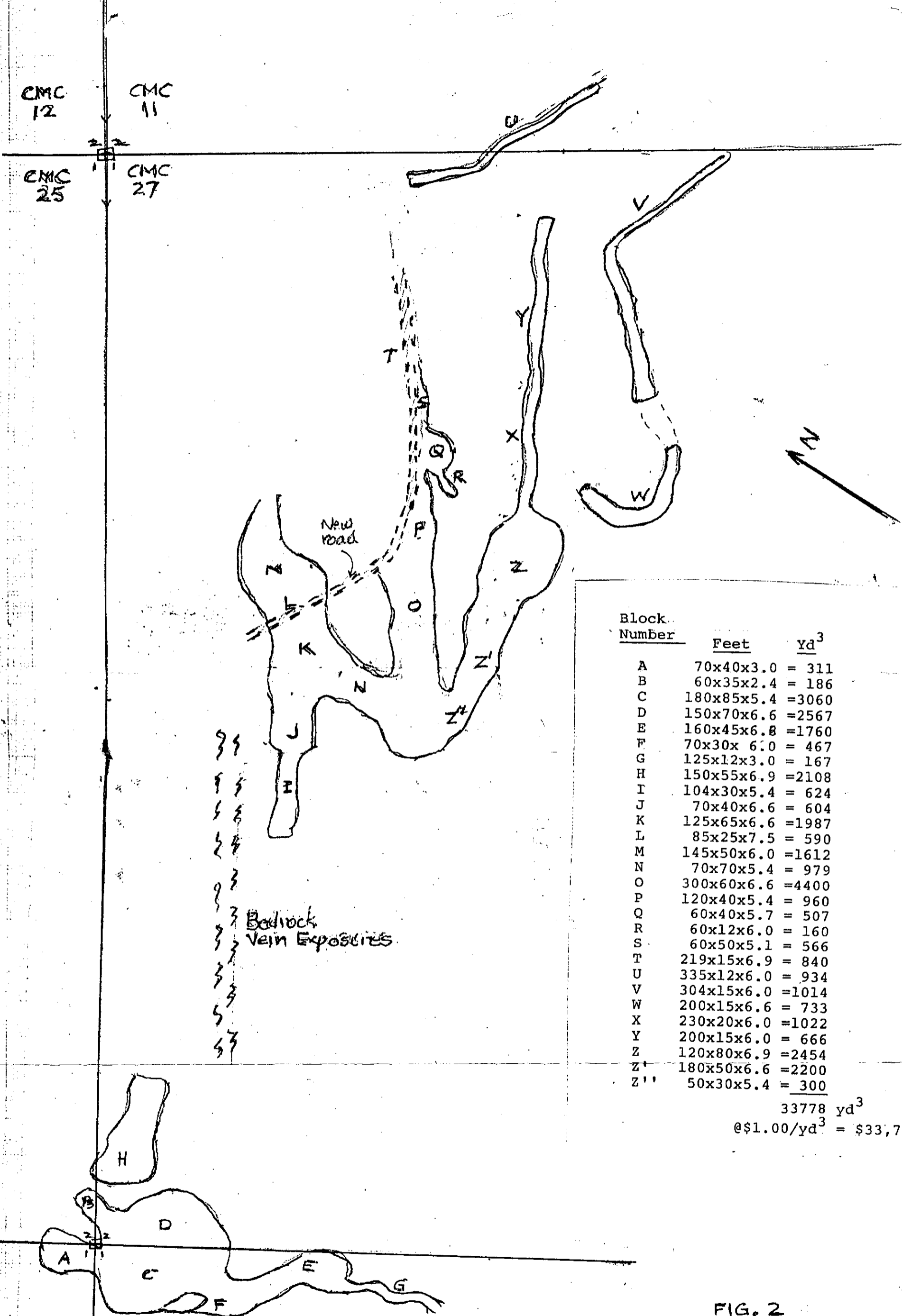

Block Number	Feet	Yd ³
A	70x40x3.0	= 311
B	60x35x2.4	= 186
C	180x85x5.4	=3060
D	150x70x6.6	=2567
E	160x45x6.8	=1760
F	70x30x 6.0	= 467
G	125x12x3.0	= 167
H	150x55x6.9	=2108
I	104x30x5.4	= 624
J	70x40x6.6	= 604
K	125x65x6.6	=1987
L	85x25x7.5	= 590
M	145x50x6.0	=1612
N	70x70x5.4	= 979
O	300x60x6.6	=4400
P	120x40x5.4	= 960
Q	60x40x5.7	= 507
R	60x12x6.0	= 160
S	60x50x5.1	= 566
T	219x15x6.9	= 840
U	335x12x6.0	= 934
V	304x15x6.0	=1014
W	200x15x6.6	= 733
X	230x20x6.0	=1022
Y	200x15x6.0	= 666
Z	120x80x6.9	=2454
Z'	180x50x6.6	=2200
Z''	50x30x5.4	= 300

33778 yd³
 @ \$1.00/yd³ = \$33,778

CMC 26

CMC 28

CAMP

SCALE 1:1500

FIG. 2
 Hip-Chain Sketch of
 Bulldozing Areas 1993
 J.S. Dodge, P. Eng.

CERTIFICATE

QA23068
40
QA23089

7

I, James S. Dodge, consulting economic geologist located at 14 MacDonald Road, Whitehorse, Yukon, Canada do hereby certify that:

1. I am a graduate of the Missouri School of Mines (1941), Rolla, Missouri, receiving a degree as a Mining Engineer, that I am a graduate of Leland Stanford University (1951), Palo Alto, California, receiving a master of science degree in economic geology. Training also included summer geological mapping (1940) with Princeton University in Montana, and studies in exploration geochemistry and ore deposits at Albert Ludwigs Universitaet (1952), Freiburg, Germany.
2. I am a Registered Professional Engineer in the Yukon Territory, Canada; certificate number 301.
3. I have practiced the profession of mining engineering and economic geology since 1941, with the exception during service in the U.S.Army (1944-1946).
4. I have personally examined the bulldozing work carried out by Mr. A. Wallace Hyde on the CMC/GL quartz claims in the Watson Lake Mining District during 1993.
5. I have no beneficial or financial interest direct or indirect in the CMC/GL quartz claims, nor do I expect to receive any.

Dated at Whitehorse, Yukon this 04 September, 1993 A.D.

Respectfully submitted,

James S. Dodge

James S. Dodge
Professional Engineer, Yukon
14 MacDonald Road
Whitehorse, Yukon Y1A 4L2

