

093689

CRA-MAR
Mining Inc.

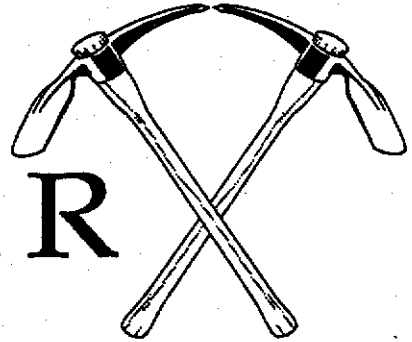

**Drilling
Program
on
Log Property**

105D-08

Date: March 12, 1997



36 Payne Close
Red Deer, Alberta
T4P 1T7

Ph: (403) 347-3844

Fax: (403) 346-3347

Email: Goldeneye@supernet.ab.ca

Mining Recorder
Room 102,
300 Main Street,
Whitehorse, Yukon
Y1A 2B5

March 12, 1997

Dear Mrs. Southwick,

This letter is a brief overview of the drilling program that Cra-Mar Mining Inc. under took back in November 1997.

Don MacGregor was in charge of the drilling program. Along with Peter Hildebrand, they started a drilling package that would end up having 34 holes drilled.

Don started on the project on November 12, 1997 and was finished and December 9, 1997.

The equipment used was as follows:

- F250 four wheel drive (diesel)
- 3500 GMC (gas)
- Trailer mounted hydraulic drill w/ 18' mast capable of 120' + depth (provide by Vince Young)
- 4.5" bulldog cutter head bit with 8 carbide insert bits
- hex core 4.5" auger pipe in 5' lengths

We chose to drill it with the dry auger drill because of the weather and the samples brought up hole with the bit.

All samples were recovered and bagged with the hole number and depth recorded. A portion of each sample was taken and washed. There was no visible signs of either Gold or Silver. As a result we did not send any sample in to be assayed. We do think the ore body is longer than we had originally thought because of our drilling on claim #13. The other holes helped us to put an exploration program together for later this year.

I hope the information in this package is satisfactory. If you have any questions please feel free to contact me at the above address or phone number.

Thank you.

Sincerely,

Dan MacGregor
President
Per: Cra-Mar Mining Inc.



Sections:

Section 1
Drilling Schedule

Section 2
Location Maps

Section 3
Daily Work Schedule

**I
N
D
E
X**

**D
R
I
L
L
I
N
G

S
C
H
E
D
U
L
E**

**L
O
C
A
T
I
O
N**

**M
A
P
S**

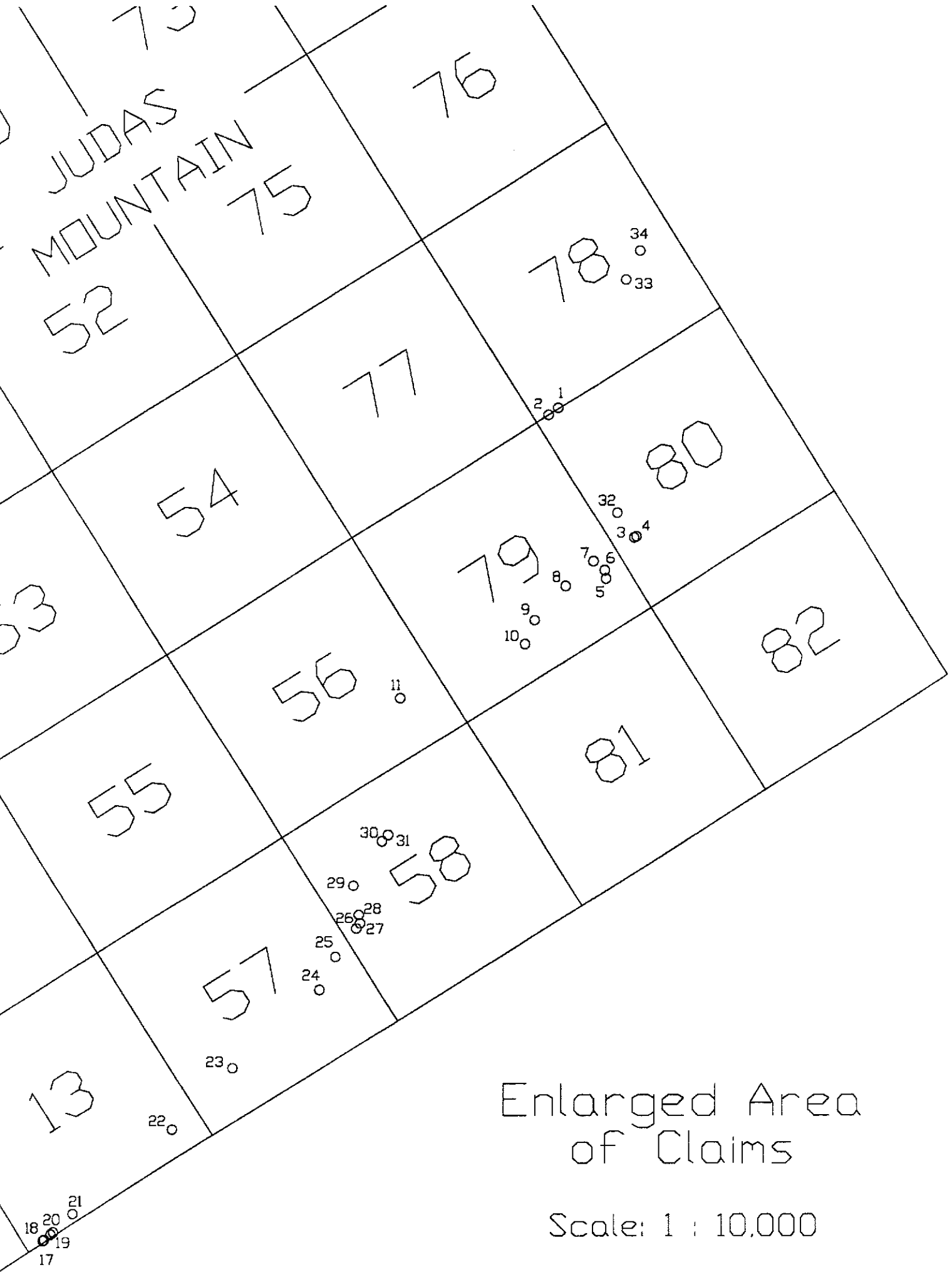

Enlarged Area
of Claims

Scale: 1 : 10,000

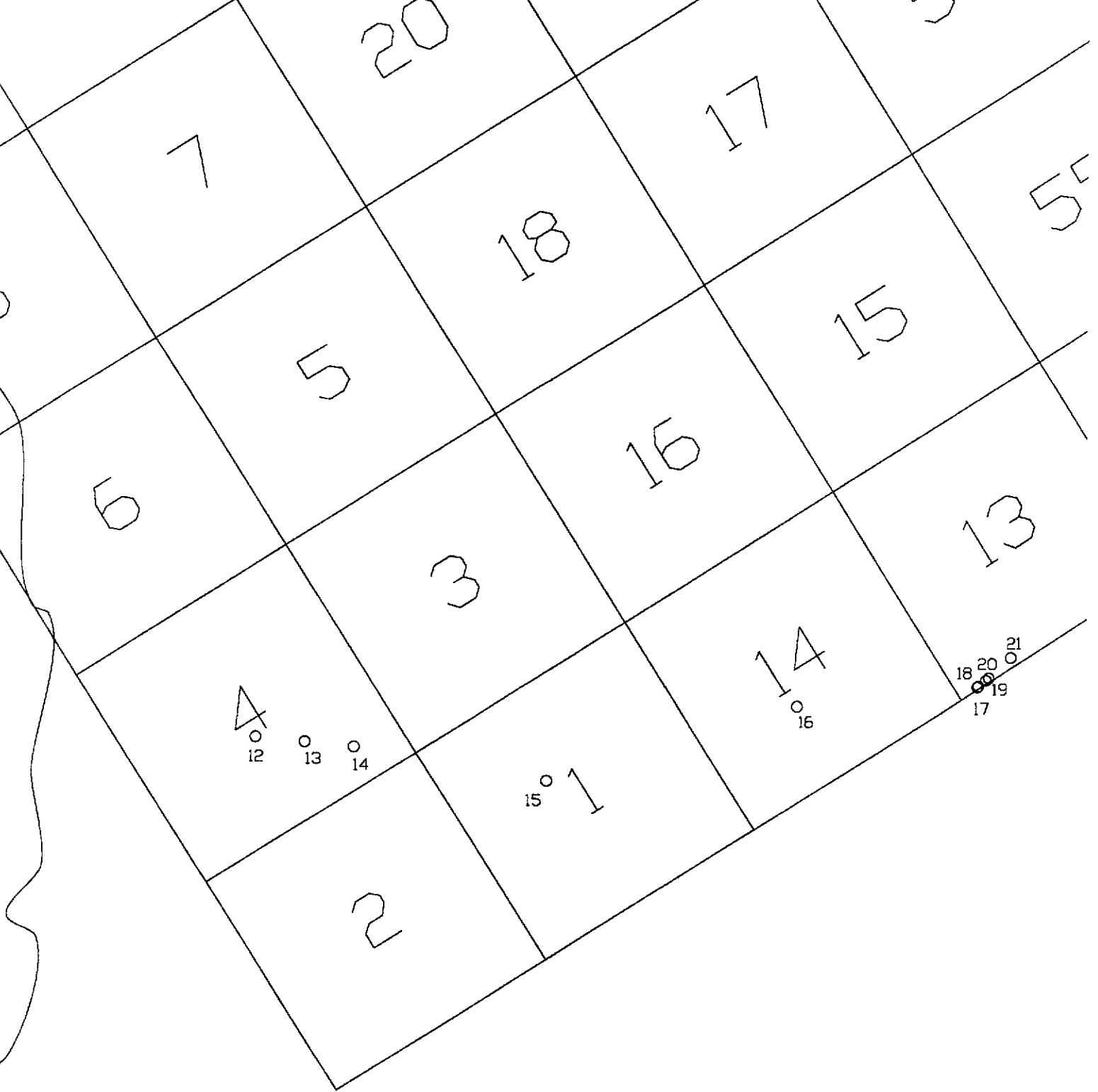

Enlarged Area
of Claims

Scale: 1 : 10,000

Drill Hole Locations

HOLE #1 : F.P. 55m 56° E of N	Claim #: YB66540 (#78)
HOLE #2 : F.P. 30m 58° E of N	Claim #: YB66540 (#78)
HOLE #3 : F.P. 149m 14° W of N	Claim #: YB66542 (#80)
HOLE #4 : F.P. 150m 12° W of N	Claim #: YB66542 (#80)
HOLE #5 : F.P. 113m 32° W of N	Claim #: YB66541 (#79)
HOLE #6 : F.P. 125m 52° W of N	Claim #: YB66541 (#79)
HOLE #7 : F.P. 155m 52° W of N	Claim #: YB66541 (#79)
HOLE #8 : F.P. 186m 76° W of N	Claim #: YB66541 (#79)
HOLE #9 : F.P. 247m 96° W of N	Claim #: YB66541 (#79)
HOLE #10 : F.P. 277m 106° W of N	Claim #: YB66541 (#79)
HOLE #11 : F.P. 384m 40° E of N	Claim #: YB66518 (#56)
HOLE #12 : I.P. 299m 84° E of N	Claim #: YB66466 (#4)
HOLE #13 : I.P. 207m 84° W of N	Claim #: YB66466 (#4)
HOLE #14 : I.P. 116m 84° W of N	Claim #: YB66466 (#4)
HOLE #15 : I.P. 335m 56° Due North	Claim #: YB66463 (#1)
HOLE #16 : I.P. 244m 19° W of N	Claim #: YB66476 (#14)
HOLE #17 : I.P. 38m 52° E of N	Claim #: YB66475 (#13)
HOLE #18 : I.P. 41m 52° E of N	Claim #: YB66475 (#13)
HOLE #19 : I.P. 59m 52° E of N	Claim #: YB66475 (#13)
HOLE #20 : I.P. 66m 52° E of N	Claim #: YB66475 (#13)
HOLE #21 : I.P. 122m 50° E of N	Claim #: YB66475 (#13)
HOLE #22 : I.P. 396m 50° E of N	Claim #: YB66475 (#13)
HOLE #23 : F.P. 360m 106° W of N	Claim #: YB66519 (#57)
HOLE #24 : F.P. 177m 68° W of N	Claim #: YB66519 (#57)
HOLE #25 : F.P. 188m 44° W of N	Claim #: YB66519 (#57)
HOLE #26 : F.P. 213m 24° W of N	Claim #: YB66520 (#58)
HOLE #27 : F.P. 226m 21° W of N	Claim #: YB66520 (#58)
HOLE #28 : F.P. 238m 20° E of N	Claim #: YB66520 (#58)
HOLE #29 : F.P. 301m 18° E of N	Claim #: YB66520 (#58)
HOLE #30 : F.P. 381m 5° W of N	Claim #: YB66520 (#58)
HOLE #31 : F.P. 393m 3° W of N	Claim #: YB66520 (#58)
HOLE #32 : F.P. 210m 20° W of N	Claim #: YB66542 (#80)
HOLE #33 : F.P. 356m 32° E of N	Claim #: YB66540 (#78)
HOLE #34 : F.P. 424m 31° E of N	Claim #: YB66540 (#78)

Overlay for Government Map

Scale: 1 : 30.000

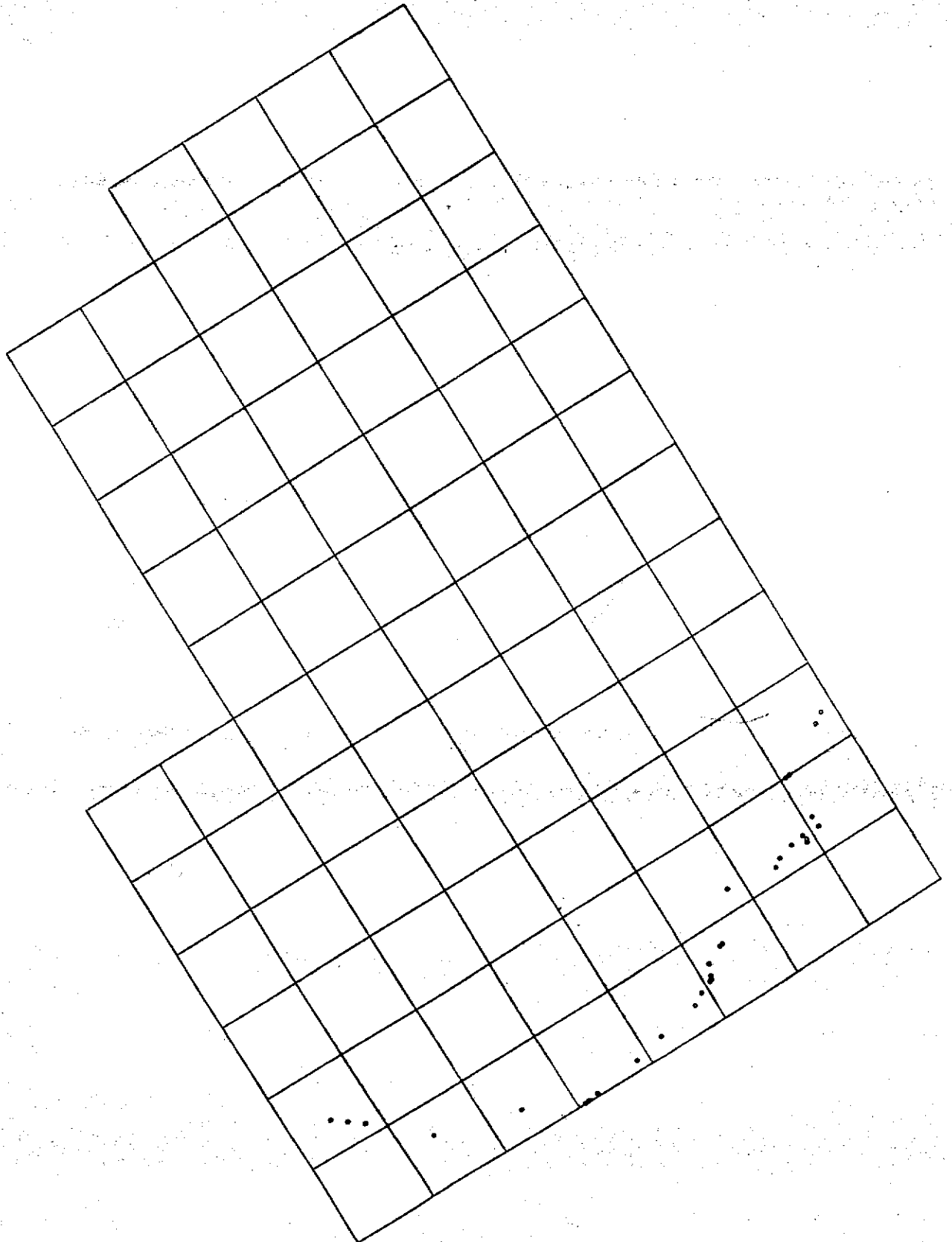

**D
A
I
L
Y

W
O
R
K

S
C
H
E
D
U
L
E**

D
A
I
L
Y

W
O
R
K

S
C
H
E
D
U
L
E



36 Payne Close
Red Deer, Alberta
T4P 1T7

Ph: (403) 347-3844

Fax: (403) 346-3347

Email: Goldeneye@supernet.ab.ca

Date: NOV 12 1996

Job: LDC CLAIMS 1

Area: JUPAS MTN WHITE HORSE MINING DISTRICT

Supervisor: DON M^{AC}GREGOR

Description of Work:

PACK TOOLS AND EQUIPMENT TO TAKE
TO WHITE HORSE TO DO SOME EXPLORATION
DRUG ON LDC CLAIM.
1 PM LEAVE FOR YUKON.

D
A
I
L
Y



36 Payne Close
Red Deer, Alberta
T4P 1T7

Ph: (403) 347-3844

Fax: (403) 346-3347

Email: Goldeneye@supernet.ab.ca

Date: NOV 13 1996

Job: LOG CLAIMS

2

Area: JUDAS MTN

Supervisor: DON MAC GREGOR

W
O
R
K

S
C
H
E
D
U
L
E

Description of Work:

ROADS ARE ILY AND AT TIMES QUITE
BAD.

BREAKFAST AT TOAD RIVE

4 PM IN WHITE HORSE.

DISCUSS USING HYDRAULIC TRAILER RIG
WITH VINCE YOUNG. IT WILL TAKE 4 OR 5
DAYS TO GET IT RUNNING.

D
A
I
L
Y

W
O
R
K

S
C
H
E
D
U
L
E



36 Payne Close
Red Deer, Alberta
T4P 1T7

Ph: (403) 347-3844

Fax: (403) 346-3347

Email: Goldeneye@supernet.ab.ca

Date: NOV 14 1996

Job: LOG CLAIMS 3

Area: JUDAS MTN. 1

Supervisor: DON MACGREGOR - PETER HILDEBRAND

Description of Work:

PETE AND I WENT OUT TO THE RIG
AND WENT OVER IT.
TAKE WHEEL OFF AND TAKE IT INTO
ARCTIC TIRE FOR REPAIRS.

TALK TO BO ZAKRISSON ABOUT REPAIRS.

D
A
I
L
Y

W
O
R
K

S
C
H
E
D
U
L
E

C
RA-MAR
Mining Inc.

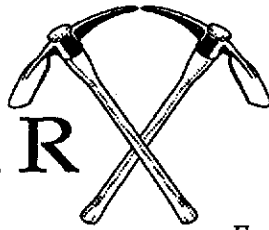

36 Payne Close
Red Deer, Alberta
T4P 1T7

Ph: (403) 347-3844

Fax: (403) 346-3347

Email: Goldeneye@supernet.ab.ca

Date: NOV 15 1996

Job: LOG CLAIMS

4

Area: JUDAS MTN

Supervisor: DON MACGREGOR PETER HILDEBRAND.

Description of Work:

PETE AND I WENT TO JUDAS MOUNTAIN
TO CHECK ON ROAD CONDITIONS.

WE WILL NOT NEED A CAT AT
THIS TIME

PICK UP TIRE FOR RIG AND PUT
IT ON.

D
A
I
L
Y

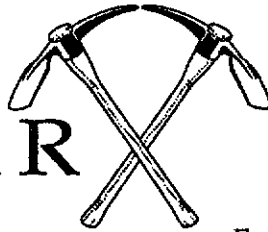

36 Payne Close
Red Deer, Alberta
T4P 1T7

Ph: (403) 347-3844

Fax: (403) 346-3347

Email: Goldeneye@supernet.ab.ca

Date: NOV. 16 1996

Job: LOG CLAIMS

5

Area: JUDAS MTN

Supervisor: DON MAC GREGOR - PETER HILDEBRAND.

W
O
R
K

S
C
H
E
D
U
L
E

Description of Work:

GO OUT AND PICK UP RIG. MOVE
TO BO'S SHOP AND START REPAIRS.

D
A
I
L
Y

W
O
R
K

S
C
H
E
D
U
L
E



36 Payne Close
Red Deer, Alberta
T4P 1T7

Ph: (403) 347-3844

Fax: (403) 346-3347

Email: Goldeneye@supernet.ab.ca

Date: NOV 17 1996

Job: LOG CLAIMS

.6

Area: JUDAS MTN

Supervisor: DON MACGREGOR - PETER HILDEBRAND

Description of Work:

WORK ON RIG IN BO'S SHOP.

D
A
I
L
Y

W
O
R
K

S
C
H
E
D
U
L
E



36 Payne Close
Red Deer, Alberta
T4P 1T7

Ph: (403) 347-3844

Fax: (403) 346-3347

Email: Goldeneye@supernet.ab.ca

Date: NOV 18 1996

Job: LOG CLAIMS 7

Area: JUDAS MTN

Supervisor: DON MACGREGOR.

Description of Work:

WORK ON RIG.
PICK UP NEW HITCH FOR TRAILER
PICK UP HYDRAULIC OIL FOR RIG.

2^{PM} GO TO MINING RECORDER. DO NOT
HAVE TO GROUP CLAIMS UNTILL ASSESS-
MENT WORK IS DONE.

CONTINUE WITH RIG REPAIRS.

D
A
I
L
Y

W
O
R
K

S
C
H
E
D
U
L
E



36 Payne Close
Red Deer, Alberta
T4P 1T7

Ph: (403) 347-3844

Fax: (403) 346-3347

Email: Goldeneye@supernet.ab.ca

Date: NOV 19 1996

Job: LOG CLAIMS

8

Area: JUDAS MTN

Supervisor: DON M^{RE} GREGOR - PETER HILDEBRAND.

Description of Work:

FINISH WORK AT BO'S AND MOVE
RIG TO YOUNG'S REFRIGERATION.

START RIG UP AND RAISE MAST. EVERY
THING WORKS.

RIG UP TENT TO CLOSE IN RIG SO
WE CAN PUT HEAT ON IT FOR OVER
NIGHT.

D
A
I
L
Y

W
O
R
K

S
C
H
E
D
U
L
E



36 Payne Close
Red Deer, Alberta
T4P 1T7

Ph: (403) 347-3844

Fax: (403) 346-3347

Email: Goldeneye@supernet.ab.ca

Date: NOV 20 1996

Job: LOG CLAIMS 9

Area: JUDAS MOUNTAIN

Supervisor: Don McGREGOR - PETER HILDEBRAND.

Description of Work:

9 AM MET PITZEL.

FINISH RIGGING UP. PICK UP 2 X 100 LBS
PROPANE BOTTLES. READY TO MOVE TO
CLAIMS IN THE MORNING.

D
A
I
L
Y

CRA-MAR

Mining Inc.

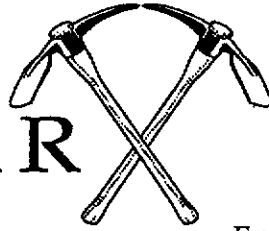

36 Payne Close
Red Deer, Alberta
T4P 1T7

Ph: (403) 347-3844

Fax: (403) 346-3347

Email: Goldeneye@supernet.ab.ca

Date: NOV 21 1996

Job: LOG CLAIMS

10

Area: JUDAS MTN.

Supervisor: DON MCGREGOR - PETER HILDEBRAND.

W
O
R
K

S
C
H
E
D
U
L
E

Description of Work:

6^{AM} TAKE RIG TO LOG CLAIMS.

8³⁰ RIGGING UP

DRLG. BOULDERS REALY TOUGH DIGGING.

3³⁰ BLEW UP MOTOR ON SECOND HOLE.

LOWER MAST AND JACK AUGER SECTION
AND BIT OUT BY HAND

RIG OUT AND TAKE RIG BACK TO
W.H.

POT RIG IN NINCE'S SHOP.

D
A
I
L
Y

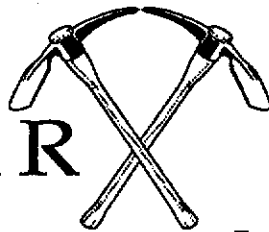

36 Payne Close
Red Deer, Alberta
T4P 1T7

Ph: (403) 347-3844

Fax: (403) 346-3347

Email: Goldeneye@supernet.ab.ca

Date: NOV 23 1996

Job: LOG CLAIMS

12

Area: JUDAS MTN

Supervisor: DON MACGREGOR.

W
O
R
K

S
C
H
E
D
U
L
E

Description of Work:

RIG IS WARM ENOUGH TO WORK ON
IN VINCE'S SHOP.

PULLED RIGHT HEAD AND FOUND
A 2" HOLE IN PISTON. EVERYTHING
ELSE LOOKS LIKE NEW. CLEAN UP.

D
A
I
L
Y



36 Payne Close
Red Deer, Alberta
T4P 1T7

Ph: (403) 347-3844

Fax: (403) 346-3347

Email: Goldeneye@supernet.ab.ca

Date: NOV 24 1996

Job: LOG CLAIMS

13

Area: JUDAS MTN

Supervisor: DON MACGREGOR

W
O
R
K

S
C
H
E
D
U
L
E

Description of Work:

GOT SERIAL NUMBERS AND PHONED AROUND
W.H. AND AREA FOR PARTS. FOUND NOTHING.

D
A
I
L
Y

W
O
R
K

S
C
H
E
D
U
L
E



36 Payne Close
Red Deer, Alberta
T4P 1T7

Ph: (403) 347-3844

Fax: (403) 346-3347

Email: Goldeneye@supernet.ab.ca

Date: NOV 25 1996

Job: LOG CLAIMS

14

Area: JUDAS MTN

Supervisor: DON MACGREGOR - PETER HILDEBRAND.

Description of Work:

LOOKED EVERY WHERE IN WHITE HORSE
AND AREA. NO LUCK SO WE STARTED
PHONING VANCOUVER, KAMLOOPS, KELDNA
PRINCE GEORGE. VINCE IS IN CALGARY
BUT HAS HAD NO LUCK. WE MAY
HAVE TO ORDER OUT OF THE U.S.

D
A
I
L
Y



36 Payne Close
Red Deer, Alberta
T4P 1T7

Ph: (403) 347-3844

Fax: (403) 346-3347

Email: Goldeneye@supernet.ab.ca

Date: NOV 26 1996

Job: LOG CLAIMS 15

Area: JUDAS MTN

Supervisor: DON MACGREGOR

W
O
R
K

Description of Work:

FOUND AN ENGINE REPAIR SHOP IN
EDMONTON THAT HAD THE PARTS ASKED
TO HAVE THEM FLOWN UP.

S
C
H
E
D
U
L
E

D
A
I
L
Y

W
O
R
K

S
C
H
E
D
U
L
E

CRA-MAR
Mining Inc.

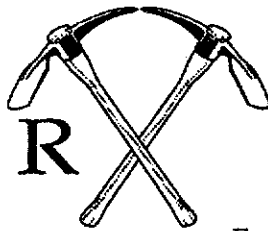

36 Payne Close
Red Deer, Alberta
T4P 1T7

Ph: (403) 347-3844

Fax: (403) 346-3347

Email: Goldeneye@supernet.ab.ca

Date: NOV 27 1996

Job: LOG CLAIMS

16

Area: JUDAS MTN.

Supervisor: DON MACGREGOR - PETER HILDEBRAND.

Description of Work:

WORK ON RIG IN SHOP.

NOON. PETE AND I HAD LUNCH WITH
ROD SAMUELS (S.E.A. RESOURCES) DISCUSSED
LOG PROPERTY.

CONTINUE TO WORK IN SHOP. HAD A
MAJOR MESS WHEN A FROZEN HYDRAULIC
LINE THAWED AND WE LOST 20 LITRES
OF HYDRAULIC OIL ON FLOOR AND UNDER
PALLET.

D
A
I
L
Y

W
O
R
K

S
C
H
E
D
U
L
E

CRA-MAR

Mining Inc.

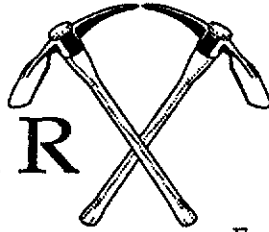

36 Payne Close
Red Deer, Alberta
T4P 1T7

Ph: (403) 347-3844

Fax: (403) 346-3347

Email: Goldeneye@supernet.ab.ca

Date: NOV 28 1996

Job: LOG CLAIMS

17

Area: JUDAS MTN

Supervisor: DON MCGREGOR.

Description of Work:

NO PARTS CAME IN. CHECKED WITH EDMONTON
AND THEY WERE SHIPPED BY BUS.

CLEAN UP ENGINE AND HAVE IT READY
TO PUT BACK TO-GETHER.

TALK TO MINING RECORDER ABOUT
ASSESSMENT WORK.

D
A
I
L
Y

W
O
R
K

S
C
H
E
D
U
L
E



36 Payne Close
Red Deer, Alberta
T4P 1T7
Ph: (403) 347-3844
Fax: (403) 346-3347

Email: Goldeneye@supernet.ab.ca

Date: NOV 29 1996

Job: LOG CLAIMS .18

Area: JUDAS MTN

Supervisor: DON MACGREGOR. PETER HILDEBRAND.

Description of Work:

PARTS CAME IN.
PUT ENGINE BACK TOGETHER.
SET TIMING. START ENGINE UP. AND
IT WORKS BEAUTIFULLY.

RIG IS READY TO DRILL. LOAD OUT
FOR JUDAS MTN.

D
A
I
L
Y

W
O
R
K

S
C
H
E
D
U
L
E



36 Payne Close
Red Deer, Alberta
T4P 1T7

Ph: (403) 347-3844

Fax: (403) 346-3347

Email: Goldeneye@supernet.ab.ca

Date: NOV 30 1996

Job: LDC CLAIMS

19

Area: JUDAS MTN

Supervisor: Don MacGregor - Peter Hildebrand.

Description of Work:

6³⁰ AM LEAVE FOR CLAIMS

DRLG. RIG IS REALY WORKING GOOD.

D
A
I
L
Y



36 Payne Close
Red Deer, Alberta
T4P 1T7

Ph: (403) 347-3844

Fax: (403) 346-3347

Email: Goldeneye@supernet.ab.ca

Date: DEC 1 1996

Job: LOG CLAIMS 20

Area: JUDAS MTN

Supervisor: DON MACGREGOR - PETER HILDEBRAND.

Description of Work:

DRLG. HOLE # 11 HIT SOMETHING
HARD AND ABRASIVE, RUINED BIT.

W
O
R
K

S
C
H
E
D
U
L
E

D
A
I
L
Y

W
O
R
K

S
C
H
E
D
U
L
E

C
RA-MAR
Mining Inc.

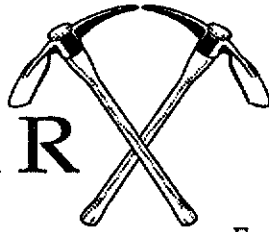

36 Payne Close
Red Deer, Alberta
T4P 1T7

Ph: (403) 347-3844

Fax: (403) 346-3347

Email: Goldeneye@supernet.ab.ca

Date: DEC 2 1996

Job: LOG CLAIMS

21

Area: JUDAS MTN

Supervisor: DON MACGREGOR - PETER HILDEBRAND

Description of Work:

DR LG.

D
A
I
L
Y

W
O
R
K

S
C
H
E
D
U
L
E

CRA-MAR
Mining Inc.

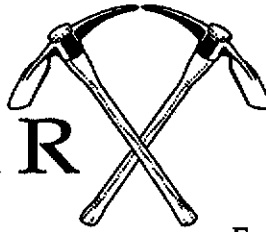

36 Payne Close
Red Deer, Alberta
T4P 1T7

Ph: (403) 347-3844

Fax: (403) 346-3347

Email: Goldeneye@supernet.ab.ca

Date: DEC 3 1996

Job: LOG CLAIMS

22

Area: JUDAS MTN

Supervisor: DON MACGREGOR - PETER HILDEBRAND

Description of Work:

DALG.

D
A
I
L
Y

W
O
R
K

S
C
H
E
D
U
L
E

CRA-MAR
Mining Inc.

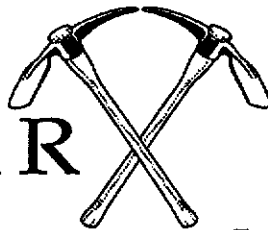

36 Payne Close
Red Deer, Alberta
T4P 1T7

Ph: (403) 347-3844

Fax: (403) 346-3347

Email: Goldeneye@supernet.ab.ca

Date: DEC 4 1996

Job: LOG CLAIMS 23

Area: JUDAS MTN

Supervisor: DON M^{AG}GREGOR - PETER HILDEBRAND.

Description of Work:

DALG.

D
A
I
L
Y



36 Payne Close
Red Deer, Alberta

T4P 1T7

Ph: (403) 347-3844

Fax: (403) 346-3347

Email: Goldeneye@supernet.ab.ca

Date: DEC 5 1996

Job: LDC CLAIMS

24

Area: JUDAS MTN.

Supervisor: DON MACGREGOR - PETER HILDEBRAND.

Description of Work:

DRLG.

TWISTED OFF IN HOLE # 34

W
O
R
K

S
C
H
E
D
U
L
E

D
A
I
L
Y

W
O
R
K

S
C
H
E
D
U
L
E



36 Payne Close
Red Deer, Alberta
T4P 1T7

Ph: (403) 347-3844

Fax: (403) 346-3347

Email: Goldeneye@supernet.ab.ca

Date: DEC 4 1996

Job: LOG CLAIMS

25

Area: JUDAS MTN

Supervisor: Don MacGREGOR - PETER HILDEBRAND.

Description of Work:

LOAD OUT RIG AND MOVE TO
WHITE HORSE. ONE SECTION OF AUGER AND BIT
WERE LEFT IN HOLE DUE TO FROST.
WILL RECOVER IN THE SPRING.

DROP OFF \$1000.00 CHEQUE AT PITZEL'S OFFICE
PAY CIBC. (FELIX KEDGH) 673"
PAY BOZAK \$300.00

D
A
I
L
Y

W
O
R
K

S
C
H
E
D
U
L
E

CRA-MAR
Mining Inc.

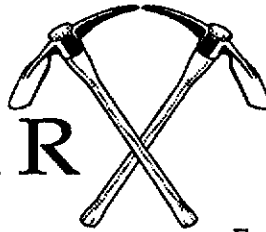

36 Payne Close
Red Deer, Alberta
T4P 1T7
Ph: (403) 347-3844
Fax: (403) 346-3347
Email: Goldeneye@supernet.ab.ca

Date: DEC 7 1996
Job: LOG CLAIMS 26
Area: JVDAS MTD
Supervisor: DON MCGREGOR

Description of Work:

GO OVER DRUG. INFO WITH TIM DORAN
SO HE COULD DO CLAIM GROUPING.

WORK ON COMPANY REPORTS.

D
A
I
L
Y



36 Payne Close
Red Deer, Alberta
T4P 1T7

Ph: (403) 347-3844

Fax: (403) 346-3347

Email: Goldeneye@supernet.ab.ca

Date: DEC 8 1996

Job: LOG CLAIMS

27

Area: JUDAS MTD.

Supervisor: DOJ MACGREGOR

Description of Work:

WORK ON COMPANY REPORTS.

TAKE STOCK ON RIG TO SEE WHAT
WE ARE SHORT.

W
O
R
K

S
C
H
E
D
U
L
E

D
A
I
L
Y



36 Payne Close
Red Deer, Alberta
T4P 1T7

Ph: (403) 347-3844

Fax: (403) 346-3347

Email: Goldeneye@supernet.ab.ca

Date: Dec 9 1996

Job: LOG CLAIMS 28

Area: JUDAS MTA

Supervisor: DON MACGREGOR.

W
O
R
K

Description of Work:

FILE FOR ASSESSMENT WITH MINING
RECORDER.

PACK UP TO HEAD FOR HOME. TIRE
TROUBLE NEAR RANCHARIA ANOTHER FLAT
28 KM. OUT OF WATSON LAKE. TOWED
IN TO WATSON AND BOUGHT 2 NEW TIRES
CONTINUE HOME

S
C
H
E
D
U
L
E

D
A
I
L
Y

W
O
R
K

S
C
H
E
D
U
L
E



36 Payne Close
Red Deer, Alberta
T4P 1T7

Ph: (403) 347-3844

Fax: (403) 346-3347

Email: Goldeneye@supernet.ab.ca

Date: DEC 9 1994
Job: LOG CLAIMS 29
Area: JUDAS MTN
Supervisor: DON MAC GREGOR.

Description of Work:

DROVE ALL NIGHT. HAD BREAKFAST IN
FORT NELSON DINNER IN GRANDE PRAIRIE
9³⁰ PM ARR. IN RED DEER.