

ARCHER, CATHRO

& ASSOCIATES (1981) LIMITED

CONSULTING GEOLOGICAL ENGINEERS

1016 - 510 WEST HASTINGS STREET, VANCOUVER, B.C. V6B 1L8 TEL (604) 688 - 2568 • FAX (604) 688 - 2578

0935 12

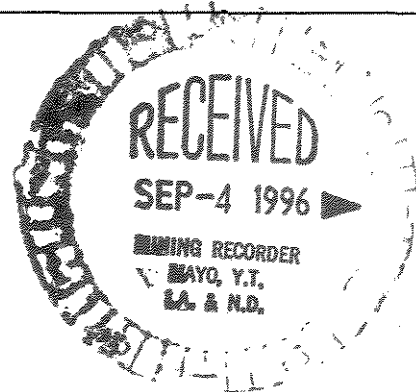

HAND TRENCHING REPORT

on the

JOLI PROPERTY

Joli 55-68 YB22215-YB22228
85-98 YB22245-YB22258
107-120 YB22267-YB22280

Latitude 64°48' N; Longitude 133°54' W

NTS 106C/13

in the

MAYO MINING DISTRICT

YUKON TERRITORY

Owned by: Nordac Resources Ltd.

Operated by: Archer, Cathro & Associates (1981) Limited

R.C. Carne, M.Sc., P.Geo.
T.C. Becker, B.Sc., P.Geo.

March, 1996

TABLE OF CONTENTS

	<u>PAGE</u>
SUMMARY AND RECOMMENDATIONS	1
INTRODUCTION	3
PROPERTY, LOCATION AND ACCESS	4
TOPOGRAPHY, VEGETATION AND CLIMATE	5
HISTORY AND PREVIOUS WORK	6
1995 WORK PROGRAM	7
GEOLOGY	8
Regional Geology and Mineralization	8
Property Geology	9
Property Geochemistry and Mineralization	11

TABLE

I TRENCH SAMPLE DATA D1 ZONE	13
------------------------------------	----

APPENDICES

I AUTHORS' STATEMENTS OF QUALIFICATIONS	
II CERTIFICATES OF ANALYSIS	

FIGURES

<u>NO.</u>	<u>DESCRIPTION</u>	<u>LOCATION</u>
1	Property Location	Following Page 4
2	Claim Location	Following Page 4
3	Property Geology	Following Page 9
4	D1 Zone Geology	Following Page 11
5	D1 Zone Sample Location	Following Page 12
6	D1 Zone Lead Geochemistry	Following Page 12
7	D1 Zone Zinc Geochemistry	Following Page 12
9	D1 Zone Silver Geochemistry	Following Page 12

SUMMARY AND RECOMMENDATIONS

The Joli property in north-central Yukon contains a structurally-controlled, carbonate-hosted lead-zinc prospect. Although mineralization was first reported on the property in 1978, very little physical work was carried out to define the exploration potential prior to the 1995 program of hand trenching and chip sampling.

Country rocks are Middle Proterozoic Gillespie Lake Group dolomites and dolomitic shale. Slightly older strata host significant stratiform lead-zinc-silver mineralization on the adjacent Cord claims, also owned by Nordac Resources Ltd.

A number of poorly exposed mineralized areas are present on the Joli property. The most significant of these is the D1 Zone, a 1 km long recessive gossanous area which contains numerous scattered sulphide mineral-bearing outcrops. Galena, sphalerite and pyrite occur in veins, in stockworks of intersecting veins and veinlets, and as matrix material in altered dolomite breccias. Average width of potential mineralization exceeds 75 m. Chip sampling of isolated outcrops in 1995 returned values up to 1.6% lead, 7.0% zinc and 19.0 g/t silver over 18 m.

Less than 5% of the potential area of mineralization is exposed as outcrop with the remainder covered by talus derived from the host cliff-forming dolomite. Since the intensity of weathering in mineralized zones is probably proportional to the degree of sulphide impregnation, it follows that much of the area surrounding the individual, relatively small areas sampled may well have a higher degree of sulphide mineralization with corresponding higher grades of lead, zinc and silver.

The Joli property was originally explored as a sedex exploration target because the adjacent Cord property contains bedded accumulations of pyrite, galena and sphalerite in Lower Gillespie Group dolomitic shales (Unit G1). The D1 Zone on the Joli claims, however, is hosted by overlying Unit G2 thick-bedded dolomite and clearly crosscuts stratigraphy. There is a possibility that the D1 Zone mineralization may be remobilized from Cord-type sedex mineralization in underlying rocks. This theory could easily be tested by comparison of lead isotope signatures of the two occurrences. If they are close enough to suggest a similar source then detailed regional-scale geological mapping should be carried out over the Cord and Joli occurrences to confirm their relative geological settings. Diamond drilling would be required to confirm that sedex mineralization is present at depth on the property but this could be carried out in conjunction with drill testing of the D1 Zone which itself is large enough to offer economic potential.

Respectfully submitted,

ARCHER, CATHRO & ASSOCIATES (1981) LIMITED



R.C. Carne, M.Sc., P. Geo.

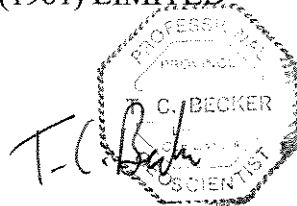

T.C. Becker, B.Sc., P. Geo.

INTRODUCTION

The Joli property in north-central Yukon contains a structurally-controlled, carbonate-hosted lead-zinc prospect. Although mineralization was first reported on the property in 1978, very little physical work has been carried out to define the exploration potential. Between June 10 and 18, 1995 a hand trenching program was performed to determine the source area of anomalous geochemical response resulting from 1993 exploration. This report documents results of the 1995 program with recommendations for further work.

PROPERTY, LOCATION AND ACCESS

The Joli property is located approximately 160 km northeast of Mayo in east-central Yukon Territory (Figure 1) at 64°48'N latitude and 133°54'W longitude on NTS map sheet 106C/13. Access to the property in 1993 was by helicopter based in Mayo. Gravel airstrips suitable for aircraft up to DC-3 size are located at Bear River, 18 km to the northwest, and Slab Mountain, 25 km to the north. A winter road along the Bonnet Plume River passes within 10 km of the property. Gillespie Lake, 9 km to the southwest, is suitable for float planes.

The Joli property is wholly-owned by Nordac Resources Ltd. It comprises 42 contiguous claims covering approximately 877 hectares (Figure 2) in the Mayo Mining District as listed below.

<u>Claim Name</u>	<u>Grant Number</u>	<u>Expiry Date</u>
Joli 55-68	YB22215-YB22228	June 21, 1997
85-98	YB22245-YB22258	June 21, 1997
107-120	YB22267-YB22280	June 21, 1997

FIGURE 1

ARCHER, CATHRO & ASSOCIATES (1981) LTD.

PROPERTY LOCATION

JOLI PROPERTY

NORDAC RESOURCES LTD.

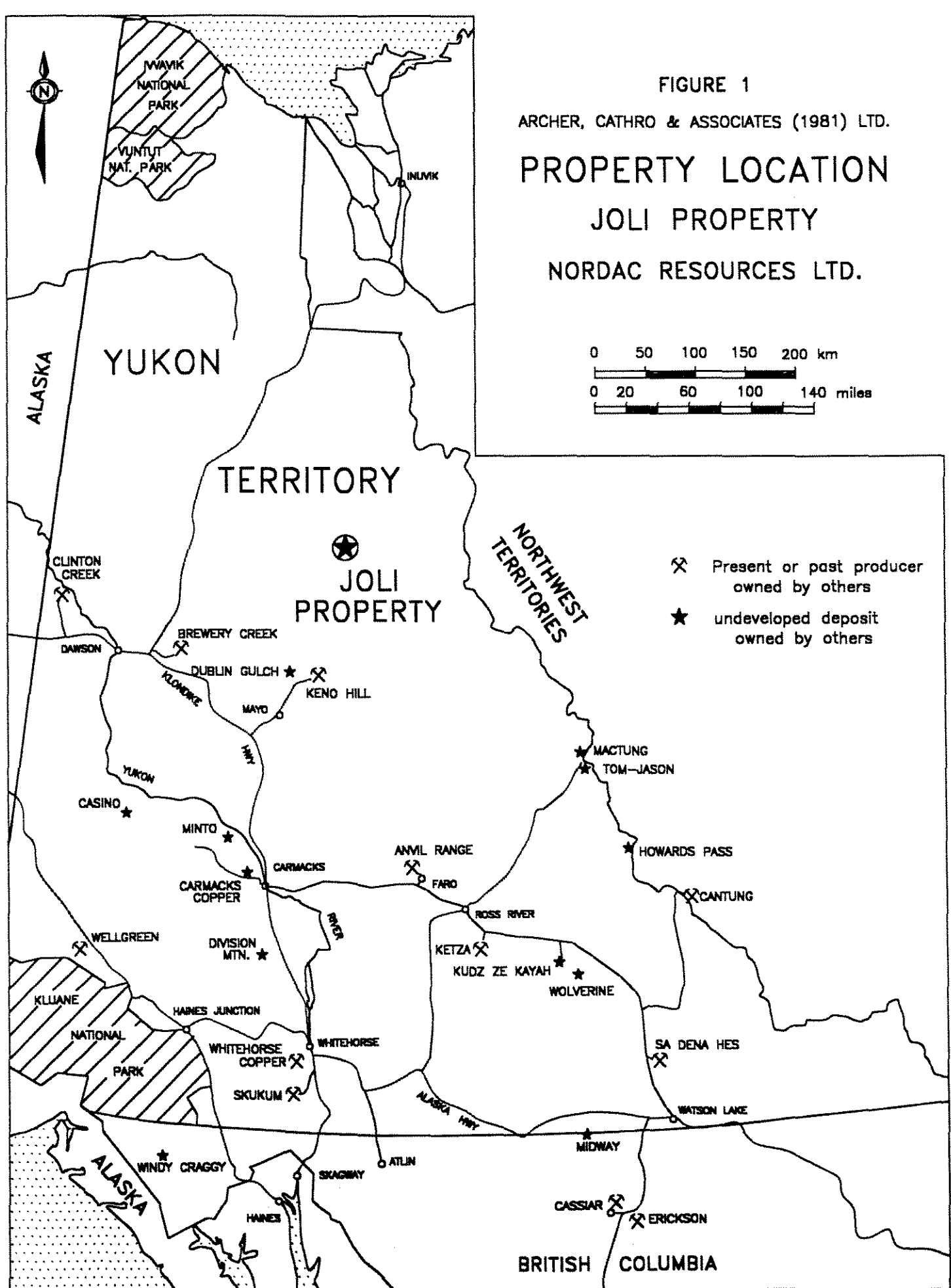

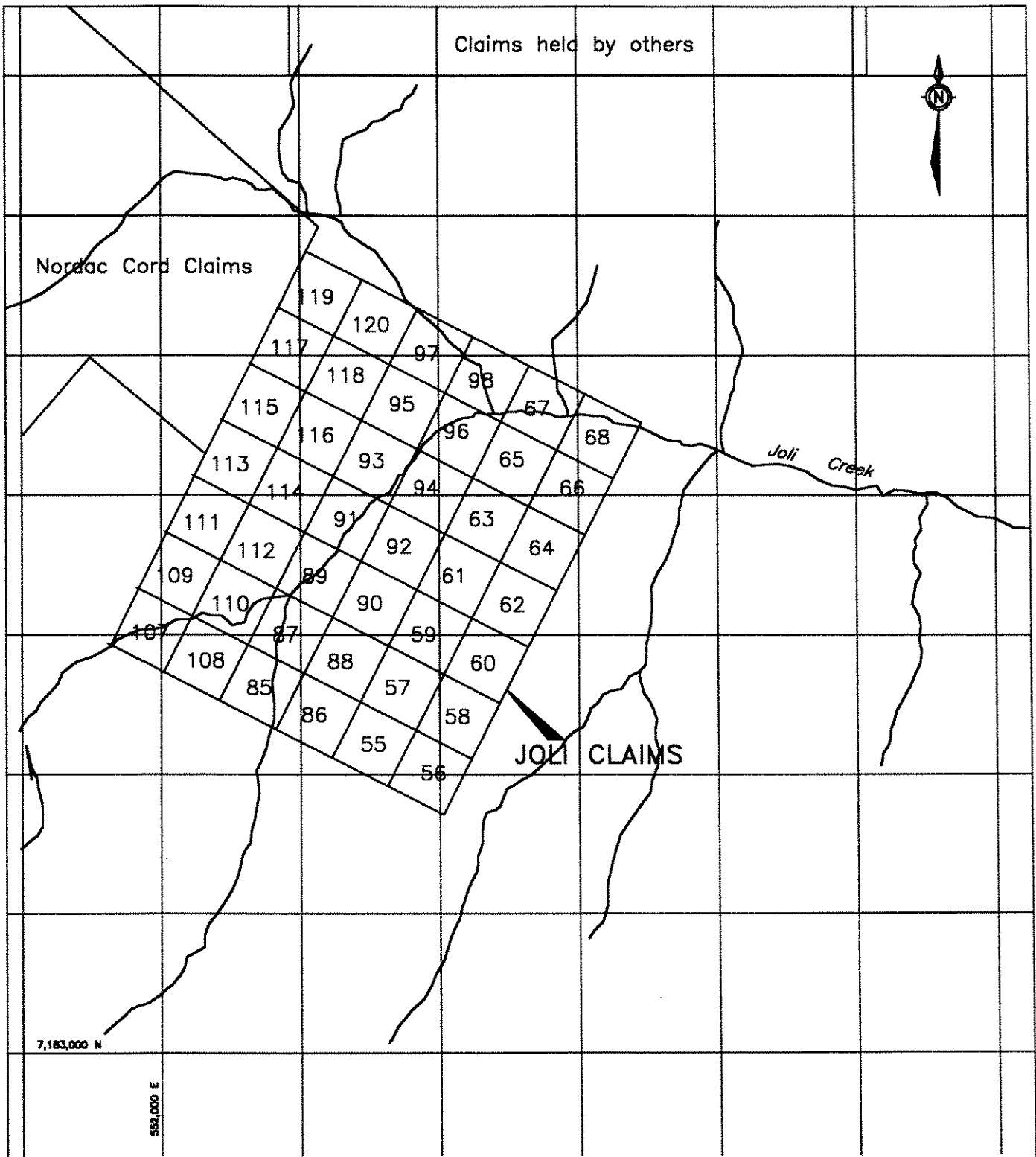
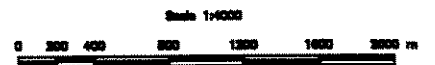

FIGURE 2
 ARCHER, CATHRO & ASSOCIATES (1981) LIMITED

CLAIM LOCATION
 JOLI PROPERTY
 NORDAC RESOURCES LTD.



TOPOGRAPHY, VEGETATION AND CLIMATE

The Joli property lies within the Wernecke Mountains. The district was subjected to alpine glaciation during the Pleistocene and is rugged with craggy ridges, mountain peaks and U-shaped valleys headed by cirques and small glaciers. Valleys are generally floored by glacial debris and glaciofluvial outwash, while hillsides are mantled with talus. Elevations on the property range between 900 and 2000 m.

Outcrop is generally restricted to ridges, cliffs and creek exposures. Soils consist of talus fines and glaciofluvial deposits. Permafrost is assumed to be prevalent throughout the property.

Vegetation in the valleys consists of alder, sparse white and black spruce up to an elevation of about 1050 m on south-facing slopes, less on north-facing slopes. Ground cover in areas of thin tree cover consists of alpine fir, dwarf birch, willow, grasses, sedges and moss. Above about 1200 m elevation there is virtually no vegetation.

The climate of central Yukon is characterized by low precipitation and a wide temperature range. Winters are cold and temperatures of -30 to -40°C are common. The property is generally snow free from late June to early September.

HISTORY AND PREVIOUS WORK

Lead-zinc-silver mineralization on the Joli property was first discovered by the Geological Survey of Canada (GSC) in 1978 during follow-up of previously released government reconnaissance geochemical survey data. Wernecke Joint Venture (Chevron Canada Limited and Aquitaine Company of Canada Ltd.) explored the property by prospecting, mapping and geochemical sampling in 1981 and hand trenching in 1982. Following this the claims were allowed to expire. NDU Resources Ltd. restaked the property in 1989 because of its similarities with the nearby Blende occurrence but did not record any work and allowed the claims to lapse in 1990.

The present property was staked in June 1993 by Archer, Cathro & Associates (1981) Limited with partner Kennecott Canada Inc. as part of the Wernecke Project which conducted geological mapping and geochemical sampling the same year. Kennecott declined to participate further in the project and Archer Cathro sold the property to Nordac Resources Ltd., a private company, in 1994.

1995 WORK PROGRAM

The 1995 work program consisted of hand trenching, mapping and sampling carried out under the supervision of the senior author by Archer Cathro employees T. Becker and D. Barrett between June 10 and 18, 1995. The program was supported by a Bell 206 Jet Ranger operated by Trans North Air from a base at Mayo. Assays and geochemical analyses were carried out by Chemex Labs Ltd. of North Vancouver, B.C.

GEOLOGY

Regional Geology and Mineralization

The Wernecke Mountains lie within the Ogilvie-Mackenzie Platform, a sequence of Proterozoic and younger sedimentary and volcanic rocks that are deformed by easterly-directed compressional tectonics. The Joli and other nearby lead-zinc prospects are hosted by the Middle Proterozoic Wernecke Supergroup which is divided into three distinct sequences. Deep marine shales and siltstones at the base of the Fairchild Lake Group grade upward to shallow marine clastic-carbonate shelf deposition of calcareous siltstones and limestones. This is unconformably or disconformably overlain by pyritic Quartet Group distal turbidites and shales deposited in a deep water rift environment. In contrast, algal mats, mud crack casts and karst features in succeeding Gillespie Lake Group thin-bedded dolomite and dolomitic shale indicate shallow water to emergent conditions.

Late Proterozoic Pinguicula Group fine-grained clastic sedimentary rocks and carbonates overlie the Wernecke Supergroup with angular unconformity. Paleozoic carbonate rocks unconformably overlie both sequences.

Emplacement of enigmatic Wernecke Breccias which host numerous Olympic Dam-type copper±cobalt-gold-uranium deposits took place prior to deposition of Pinguicula Group.

GSC geologists and others have compared the similarities of Proterozoic stratigraphy in southeastern Australia and the northern Canadian Cordillera. They believe that the two Proterozoic cratons were part of one land mass until separation in Cambrian time. Stratiform lead-zinc-silver±copper occurrences in Australia (Century, McArthur River, Mount Isa and

Broken Hill) were deposited in rocks with similar composition, age and setting to the Quartet and Gillespie Lake Groups.

The Joli claims lie adjacent to the Cord property (also owned by Nordac) which contains significant stratiform lead-zinc-silver sedex mineralization in Lower Gillespie Lake Group dolomitic shales. Structurally-controlled lead-zinc-silver mineralization present in Middle Gillespie Lake Group dolomites on the Joli property may have been remobilized from an underlying stratiform source correlative with the Cord mineralization. Igneous rocks in the area, not observed on the Joli claims, consist of mafic flows and diorite, anorthosite and andesite stocks, sills and dykes that may be contemporaneous with, or slightly younger than, Gillespie Lake Group sedex deposit deposition.

Property Geology

Geology of the Joli property, largely taken from previous work, is summarized on Figure 3. Much of the claim block is underlain by units of Gillespie Group strata dipping moderately to gently northeast. Nomenclature of lithologies described below is adapted from descriptions of regional geology by government geologists in areas to the west and north of the property. No recent mapping has been carried out by government workers in the Joli area.

Unit G1, a distinctive laminated green limestone exposed in Western Creek, is the lowermost unit of the Gillespie Lake Group seen on the property. Sedex lead-zinc-silver mineralization on the adjacent Cord property occurs within a brick red weathering dolomite and dolomitic shale-exhalite sequence that stratigraphically underlies lowermost exposures of Unit G1 exposed on the Joli claims.

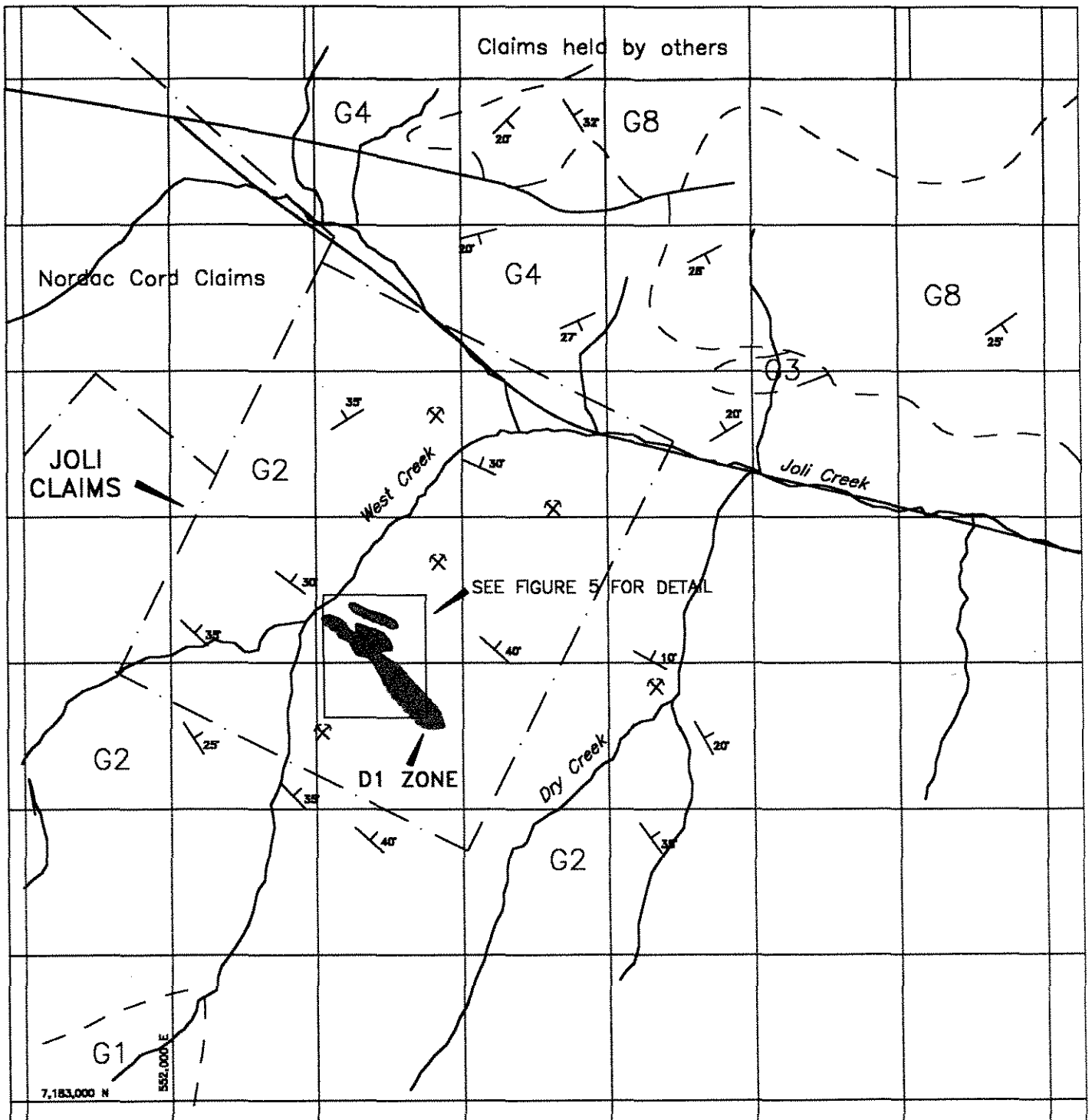

PROTEROZOIC GILLESPIE LAKE GROUP

G8

black shale, mudstone



unconformity

G4

stromatolitic dolomite

G3

dolomite, dolomite mudstone

G2

dolomite, silty dolomite, shale



lithologic contact



normal or strike-slip fault



bedding attitude



minor lead-zinc occurrence

FIGURE 3

ARCHER, CATHRO & ASSOCIATES (1981) LIMITED

PROPERTY GEOLOGY

JOLI PROPERTY

NORDAC RESOURCES LTD.

Scale 1:4000



Unit G2 underlies most of the property south of Joli Creek. Dominant lithologies are orange, brown and grey weathering bedded dolomite and silty dolomite with thin dark grey shale horizons that are especially common toward the base of the unit. A castellated, massive grey weathering dolomite unit, dipping gently south, forms the ridge between Western and Dry Creeks. All lead-zinc-silver showings found to date on the property occur within Unit G2.

Outcrops of Unit G3 grey and orange weathering "ribbed" dolomite and dolomitic mudstone with shale interbeds are exposed north of Joli Creek. Bulk of the exposures north of Joli Creek consist of massive stromatolitic dolomite of the overlying Unit G4.

Units G5, G6 and G7 are dolomitic shale and dolomite units of limited extent that are not found in the immediate property area.

Unit G8 black shale and mudstone is the uppermost Gillespie Lake Group sequence exposed in the property vicinity. Northeast of the property, this unit is overlain by a prominent grey weathering massive dolomite section which is, in turn, overlain by an orange weathering medium-bedded dolomite with shale interbeds. Unit G8 probably overlies older Gillespie Group strata above an angular unconformity.

In addition to stromatolites found in Units G2 and G4, mud cracks have been documented in Unit G2 indicating shallow marine environments to partly emergent conditions during sedimentation. Because of this, contacts between various lithologies and units could well be unconformities or disconformities. As well as this, some of the units may be facies equivalents of each other.

Structural geology of the Joli claim is uncomplicated. Most of the property area is underlain by easterly or northeasterly-trending, southeasterly-dipping strata. North of Joli Creek, dolomite and shale units dip moderately southeast across a syncline axis. A major east-west fault that lies north of the property can be traced some 20 km to the west. Sense of movement is not well defined by mapping to date. G3 and younger strata are juxtaposed against G2 lithologies north of a fault postulated to run down the Joli Creek valley.

Property Geochemistry and Mineralization

Property geochemistry is detailed in previous reports submitted for assessment credit. Results of that work established that most creeks draining the Joli claim area are moderately to highly anomalous for lead, zinc and silver. Reconnaissance soil sampling and prospecting has outlined numerous areas of lead-zinc-silver mineralization in fault breccias and shear zones. Delineation of the most significant of these, the D1 Zone, was the object of the 1995 exploration and the subject of this report.

The D1 Zone was discovered in 1981 when reconnaissance-scale soil samples returned values in the percent range from a large gossanous recessive area in steep terrain underlain by resistant, cliff-forming Middle Gillespie Lake Group Unit G2 dolomite.

Approximately forty separate outcroppings of altered dolomite with sulphide mineralization were identified in three subparallel, linear recessive zones at the northwest end of the main area of interest (Figure 4). The D1 Zone is the most prominent of these and extends southeast from West Creek valley bottom, where the northwest end is buried under talus cover at 1250 m elevation, for a distance of about 1 km up a steep ridge to an elevation of about 1830 m. Work in 1995

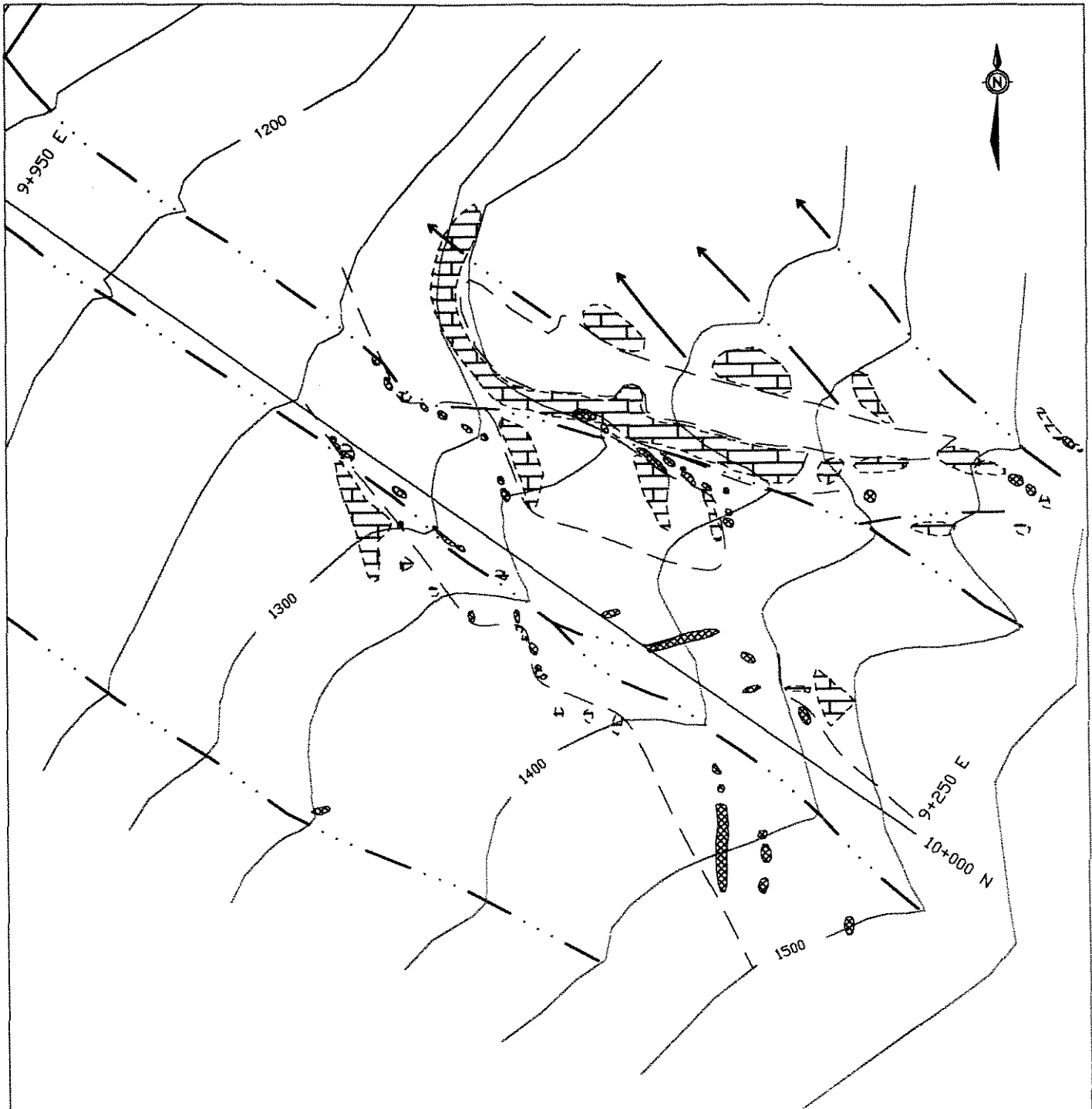

- — Mineralized area
- - - - Outcrop extent
- ▬▬▬ Dolomite, silty dolomite
- ▣▣▣ Stockwork veins, breccia or gossan outcrop

FIGURE 4
 ARCHER, CATHRO & ASSOCIATES (1981) LIMITED
D1 ZONE GEOLOGY
 JOLI PROPERTY
 NORDAC RESOURCES LTD.

0 100m

consisted of detailed mapping and hand trenching with chip sampling of exposed sulphide mineralization in this area. Average width of the area of potential mineralization exceeds 75 m.

Geology of the D1 Zone is summarized on Figure 4. Descriptions of material sampled in the trenches are given in Table I following while locations of individual trenches are shown on Figure 5. Lead, zinc and silver geochemistry of the D1 Zone is documented on Figures 6, 7 and 8, respectively. Complete multi-element analyses are given in Appendix II.

Inspection of the assay data and sample descriptions coupled with field observations provide several generalizations about the nature of mineralization in the D1 Zone.

- i) Less than 5% of the potential area of mineralization is exposed as outcrop and the remainder is covered by talus derived from resistant cliff-forming dolomite higher upslope. Resistant knobs of outcrop within the recessive zones consist of bleached and weakly silicified dolomite hosting pyrite with lesser sphalerite and galena in simple veins, stockwork veins and breccia matrix. The greater the degree of sulphide mineralization, the greater the intensity of weathering of sulphides and breakdown of host dolomite. Hand trenching in recessive areas adjacent to mineralized outcrops failed to reach bedrock, presumably because of the intensity of weathering. It follows from this that more than 95% of the potential area of mineralization, which is deeply weathered, may be mineralized to a higher degree than the moderate level of sulphide mineral impregnation present in the isolated outcrop areas.

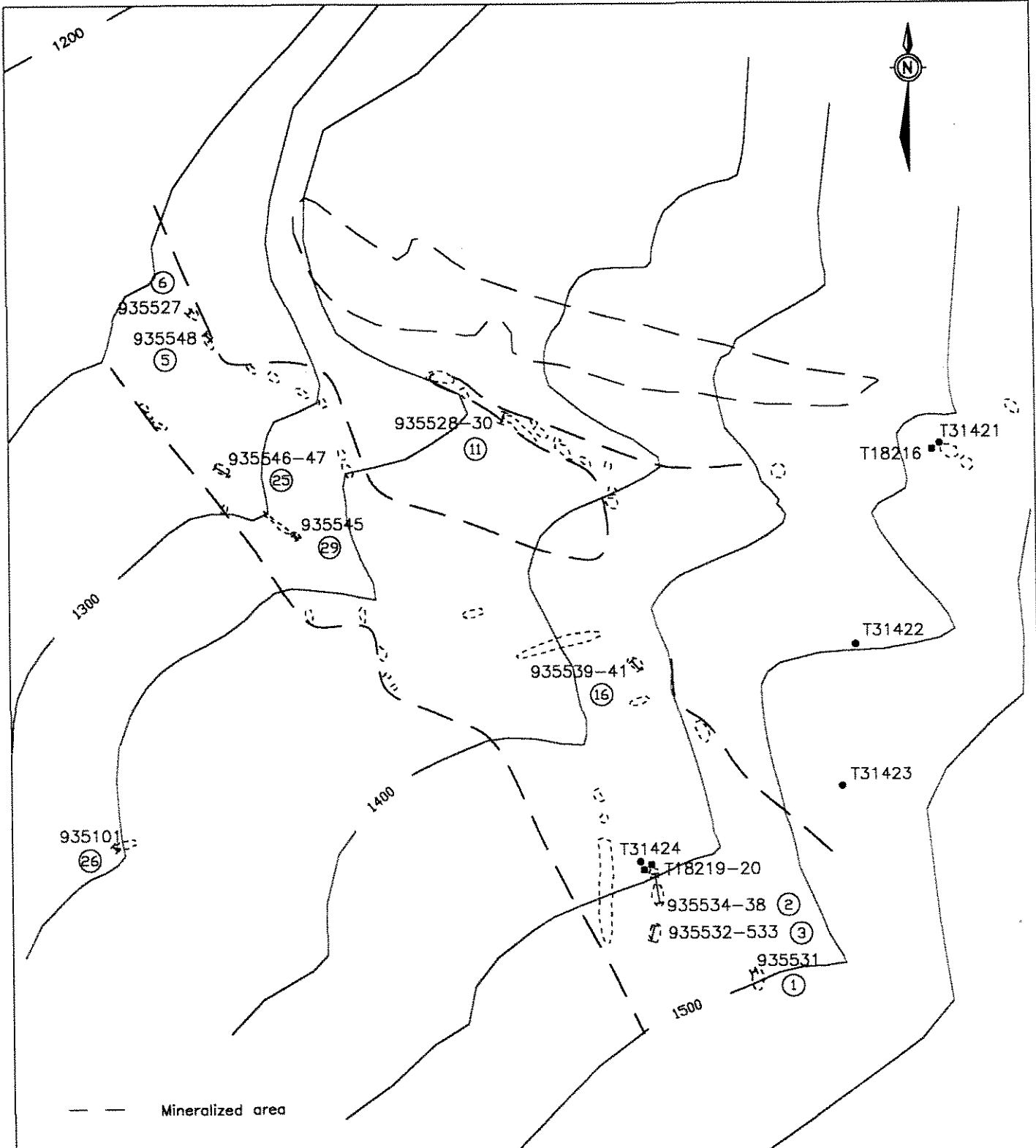

- — Mineralized area
- ⋯ Stockwork veins, breccia or gossan outcrop
- T31423 ● 1993 soil sample with sample number
- T18216 ■ 1993 rock sample with sample number
- 935547 I 1995 trench sample with sample number
- ① 1995 showing number (see Table I for description)

FIGURE 5
 ARCHER, CATHRO & ASSOCIATES (1981) LIMITED
D1 ZONE
SAMPLE LOCATION
 JOLI PROPERTY
 NORDAC RESOURCES LTD.
 Scale 1:3000

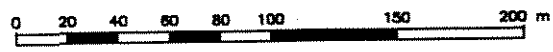

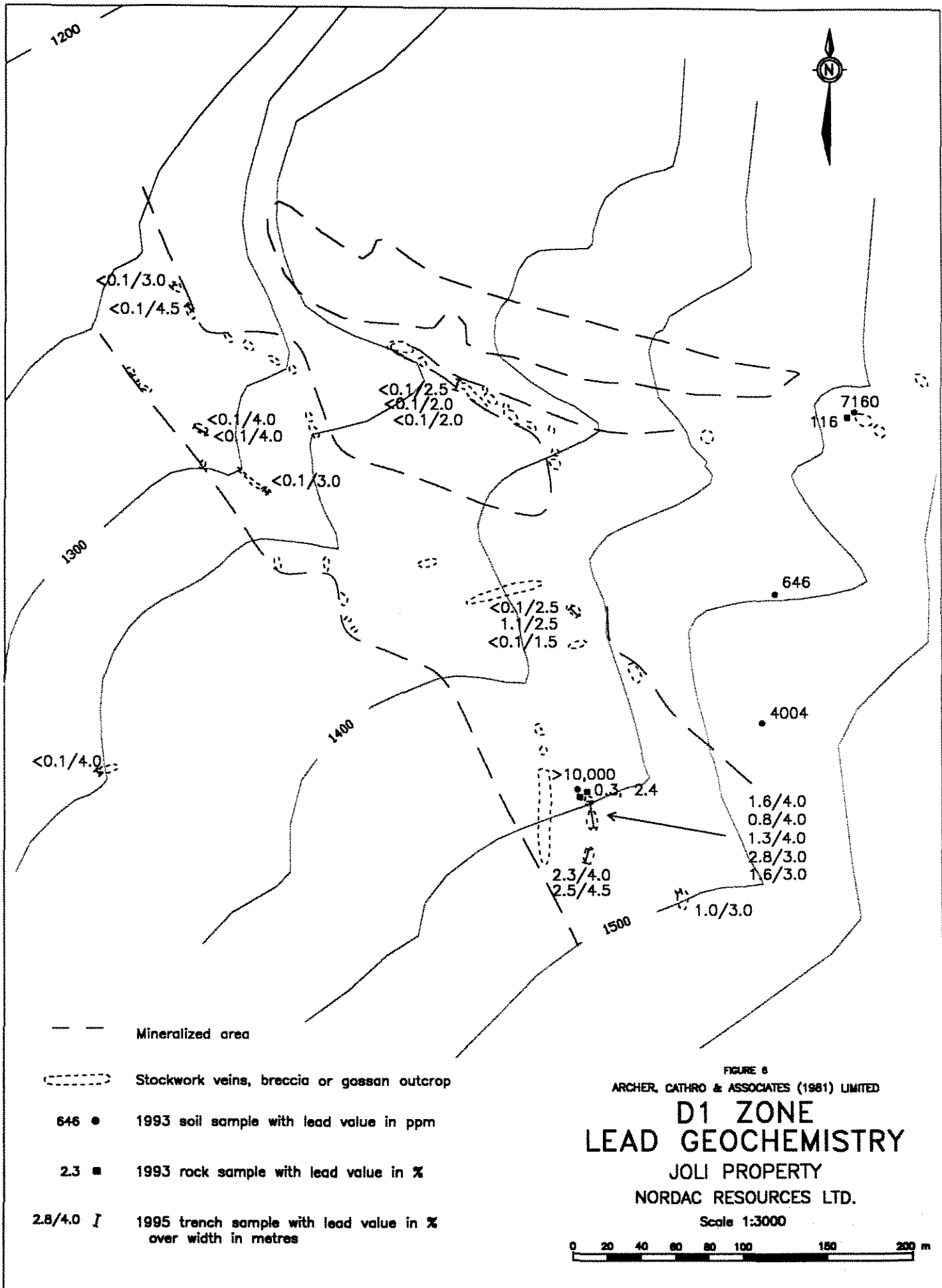

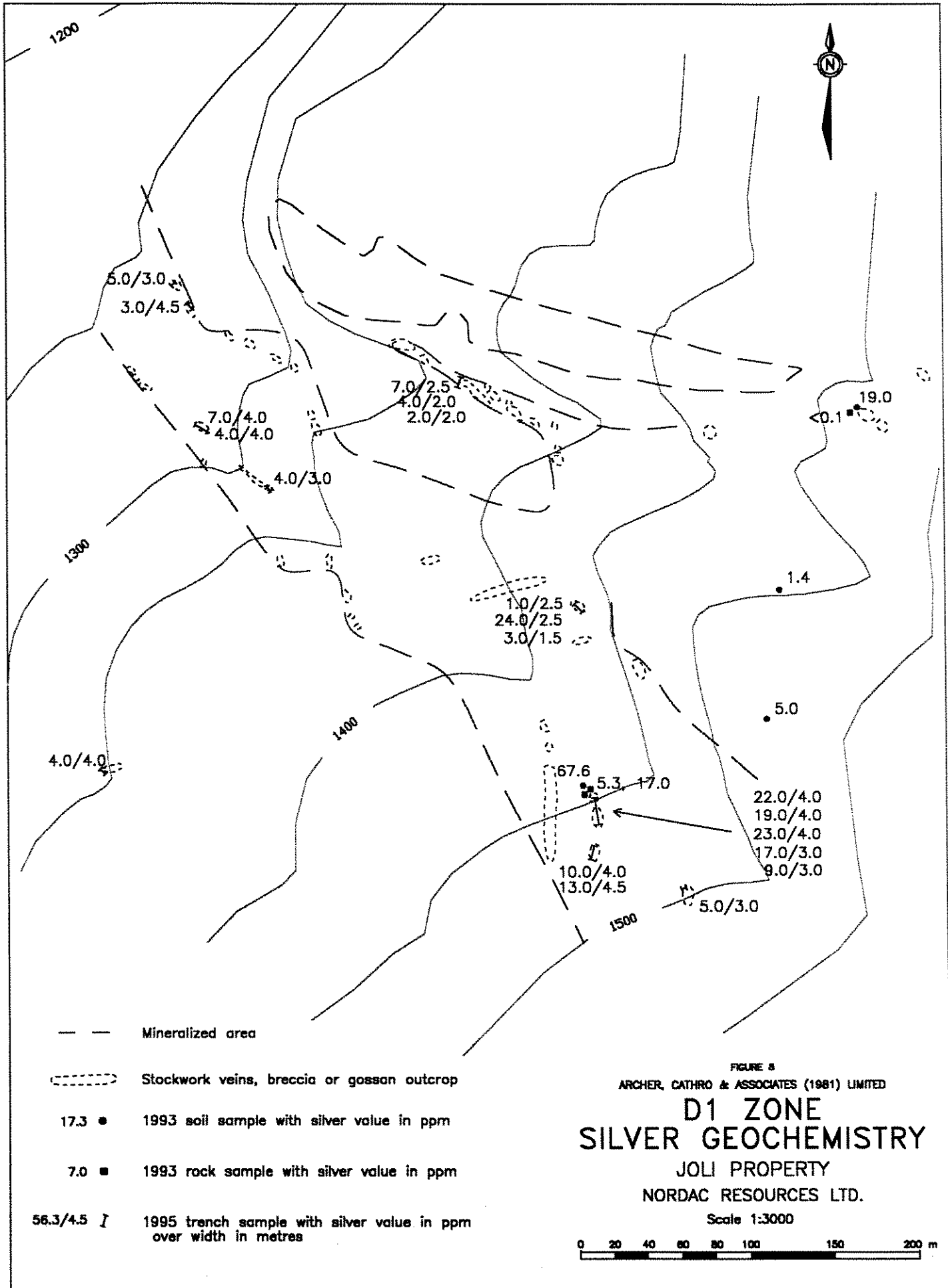

FIGURE 8
 ARCHER, CATHRO & ASSOCIATES (1981) LIMITED

**D1 ZONE
 SILVER GEOCHEMISTRY**
 JOLI PROPERTY
 NORDAC RESOURCES LTD.

Scale 1:3000



**TABLE I
TRENCH SAMPLE DATA
D1 ZONE - JOLI PROPERTY**

<u>Showing Number</u>	<u>Sample Number</u>	<u>Sample Width(m)</u>	<u>Description</u>	<u>Lead (%)</u>	<u>Zinc (%)</u>	<u>Silver (g/t)</u>
1	935531	3.0	PY-GL-SP in BRX-STK	0.98	2.72	5.0
2	935534	4.0	PY-GL-SP in BRX	1.63	3.44	22.0
2	935535	4.0	PY-GL-SP in BRX	0.79	8.04	19.0
2	935536	4.0	PY-GL-SP in BRX	1.32	7.15	23.0
2	935537	3.0	PY-GL-SP in BRX	2.85	7.54	17.0
2	935538	<u>3.0</u> 18.0	PY-GL-SP in BRX	<u>1.61</u> 1.57	<u>9.40</u> 6.96	<u>9.0</u> 19.0
3	935532	4.0	PY-GL-SP in BRX/VEN	2.35	4.33	10.0
3	935533	<u>4.5</u> 8.5	PY-GL-SP in BRX/VEN	<u>2.50</u> 2.43	<u>7.34</u> 5.92	<u>13.0</u> 12.0
5	935548	4.5	PY in BRX/VEN/STK	0.03	0.07	3.0
6	935527	3.0	three 2-15 cm PY VEN	0.08	0.09	5.0
11	935528	2.5	two 5.7 cm PY VEN+STK	0.06	0.17	7.0
11	935529	2.0	PY in VEN/BRX	0.06	0.10	4.0
11	935530	2.0	PY in minor BRX	0.01	0.06	2.0
16	935539	2.5	minor PY in dolomite	0.09	0.91	1.0
16	935540	2.5	limonitic VEN	1.07	0.18	24.0
16	935541	1.5	minor PY in dolomite	0.06	0.20	3.0
25	935546	4.0	PY in STK-VEN	0.05	0.07	7.0
25	935547	4.0	PY in STK-VEN	0.03	0.05	4.0
26	935101	4.0	PY in VEN-BRX	0.03	0.03	4.0
29	935545	3.0	three 5-10 cm PY VEN	0.08	0.66	4.0

Abbreviations:

PY = pyrite

GL = galena

SP = sphalerite

BRX = breccia

VEN = vein

STK = stockwork veins

Sample widths represent continuous chip samples.

- ii) There may be metal zoning present within the mineralized area. Outcrops sampled in the northwest part of the D1 Zone contain mainly pyrite with minor lead, zinc and silver values. Samples taken to the southeast and from a higher elevation returned potentially economic grades of lead, zinc and silver (e.g. 18.0 m grading 7.0% zinc, 1.6% lead and 19 g/t silver from Showing 2).
- iii) The Joli property was originally explored as a sedex exploration target because the adjacent Cord property (also owned by Nordac Resources Ltd.) contains bedded accumulations of pyrite, galena and sphalerite in Lower Gillespie Group dolomitic shales (Unit G1). The D1 Zone however, is hosted by overlying Unit G2 thick-bedded dolomite and clearly crosscuts stratigraphy.
- iv) The potential area of mineralization is very large. The D1 Zone has a greater than 1 km strike length with an average width exceeding 75 m. If mineralization is present throughout the zone from the lowest elevation near the West Creek valley bottom to the ridge crest above, then a potential of over six million tonnes exists without taking the zone to depths below the lowest observed exposures. A large recessive area with ferricrete and limonitic talus parallels the D1 Zone to the north (Figure 4) but, because no natural bedrock exposures are present here, sampling was not carried out in 1995. In addition, a number of other similar but smaller zones are present elsewhere on the property (Figure 3).

- iv) There is no direct evidence to suggest that the D1 Zone is derived by remobilization from an underlying sedex source in G1 dolomitic shales. However, since Proterozoic sedex lead-zinc-silver mineralization is present in G1 dolomitic shales on the adjoining Cord claims, this potential should be fully investigated.

APPENDIX I

AUTHORS' STATEMENTS OF QUALIFICATIONS

STATEMENT OF QUALIFICATIONS

I, Robert C. Carne, geologist, with business addresses in Whitehorse, Yukon Territory and Vancouver, British Columbia and residential address in Burnaby, British Columbia, hereby certify that:

1. I graduated from the University of British Columbia in 1974 with a B.Sc. and in 1979 with an M.Sc. majoring in Geological Sciences.
2. I am a Professional Geoscientist registered with the Association of Professional Engineers and Geoscientists of the Province of British Columbia (registration number 19868).
3. From 1974 to present, I have been actively engaged as a geologist in mineral exploration in British Columbia and Yukon Territory and on June 1, 1981 became a partner of Archer, Cathro & Associates (1981) Limited.
4. I have personally participated in or supervised the field work reported herein and have interpreted all data resulting from this work.

A handwritten signature in black ink, appearing to read 'R. Carne', followed by a long horizontal line extending to the right.

Robert C. Carne, M.Sc., P. Geo.

STATEMENT OF QUALIFICATIONS

I, Thomas C. Becker, geologist, with business addresses in Vancouver, British Columbia and Whitehorse, Yukon Territory and residential address in Port Moody, British Columbia, do hereby certify that:

1. I graduated from the University of Alberta in 1989 with a B.Sc. (Honours) in Geological Sciences.
2. I am a member of the Association of Professional Engineers and Geoscientists of British Columbia in the Province of British Columbia (registration number 20021).
3. I have been actively involved in mineral exploration in the Northern Cordillera since 1984.
4. I have personally participated in or supervised the field work reported herein.

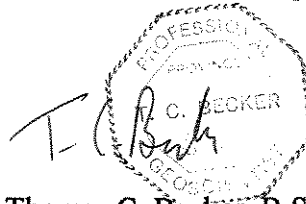

Thomas C. Becker, B.Sc., P. Geo.

APPENDIX II
CERTIFICATES OF ANALYSIS



Chemex Labs Ltd.

Analytical Chemists * Geochemists * Registered Assayers
212 Brooksbank Ave., North Vancouver
British Columbia, Canada V7J 2C1
PHONE: 604-984-0221 FAX: 604-984-0218

No: NORDAC RESOURCES LTD.
C/O ARCHER, CATHRO
BOX 4127, 2054 SECOND AVE.
WHITEHORSE, YT
Y1A 3S9

**

Page Number : 1-A
Total Pages : 1
Certificate Date: 30-JUN-95
Invoice No. : I9520315
P.O. Number :
Account : MTT

Project : JOLI
Comments:

CERTIFICATE OF ANALYSIS

A9520315

SAMPLE	PREP CODE	Ag ppm	Al %	As ppm	Ba ppm	Be ppm	Bi ppm	Ca %	Cd ppm	Co ppm	Cr ppm	Cu ppm	Fe %	Ga ppm	Hg ppm	K %	La ppm	Mg %	Mn ppm	Mo ppm
R15092	201 229	5.6	0.76	192	50	< 0.5	20	8.08	1.5	11	14	721	11.70	20	< 1	0.44	< 10	4.49	1815	< 1
R15093	201 229	1.6	0.67	50	50	0.5	< 2	5.71	1.5	8	17	98	4.51	< 10	< 1	0.14	10	4.32	1485	< 1
R15094	201 229	0.6	0.64	32	70	1.0	< 2	6.54	1.0	14	14	106	3.45	< 10	< 1	0.14	10	4.94	1645	1
R15095	201 229	1.4	0.15	24	10	< 0.5	< 2	7.11	4.0	6	11	30	9.55	10	< 1	0.09	< 10	5.58	1220	< 1
R15096	201 229	1.4	0.67	30	10	0.5	< 2	7.92	8.0	7	15	27	3.57	< 10	< 1	0.46	< 10	6.59	935	1

CERTIFICATION:

Hart Bickler



Chemex Labs Ltd.

Analytical Chemists * Geochemists * Registered Assayers

212 Brooksbank Ave., North Vancouver
British Columbia, Canada V7J 2C1
PHONE: 604-984-0221 FAX: 604-984-0218

o: NORDAC RESOURCES LTD.
C/O ARCHER, CATHRO
BOX 4127, 2054 SECOND AVE.
WHITEHORSE, YT
Y1A 3S9

Project : JOLI
Comments:

Page Number : 1-B
Total Pages : 1
Certificate Date: 30-JUN-95
Invoice No. : I9520315
P.O. Number :
Account : MTT

CERTIFICATE OF ANALYSIS

A9520315

SAMPLE	PREP CODE	Na %	Ni ppm	P ppm	Pb ppm	Sb ppm	Sc ppm	Sr ppm	Ti %	Tl ppm	U ppm	V ppm	W ppm	Zn ppm
R15092	201 229	0.03	29	260	398	40	2	17	< 0.01	< 10	< 10	15	60	932
R15093	201 229	0.01	19	490	266	6	4	13	< 0.01	< 10	< 10	20	20	1120
R15094	201 229	0.01	22	370	140	4	4	19	0.01	< 10	< 10	18	20	1690
R15095	201 229	0.01	15	190	618	6	2	13	< 0.01	< 10	< 10	13	50	2390
R15096	201 229	0.01	17	310	1150	4	3	14	< 0.01	< 10	< 10	17	30	4620

CERTIFICATION:

Hart Bechler



Chemex Labs Ltd.

Analytical Chemists * Geochemists * Registered Assayers

212 Brooksbank Ave., North Vancouver
 British Columbia, Canada V7J 2C1
 PHONE: 604-984-0221 FAX: 604-984-0218

Client: NORDAC RESOURCES LTD.
 C/O ARCHER, CATHRO
 BOX 4127, 2054 SECOND AVE.
 WHITEHORSE, YT
 Y1A 3S9

Page Number : 1-A
 Total Pages : 1
 Certificate Date: 10-JUL-95
 Invoice No. : I9520316
 P.O. Number :
 Account : MTT

Project : JOLI
 Comments:

CERTIFICATE OF ANALYSIS A9520316

SAMPLE	PREP CODE	Ag ppm AAS	Al % (ICP)	Ba ppm (ICP)	Be ppm (ICP)	Bi ppm (ICP)	Ca % (ICP)	Cd ppm (ICP)	Co ppm (ICP)	Cr ppm (ICP)	Cu ppm (ICP)	Fe % (ICP)	K % (ICP)	Mg % (ICP)	Mn ppm (ICP)
935527	208 294	5.0	1.15	< 100	< 10	< 20	21.8	< 10	10	20	90	7.90	0.8	2.10	530
935528	208 294	7.0	1.80	< 100	< 10	< 20	12.70	< 10	< 10	20	80	7.55	1.3	3.90	440
935529	208 294	4.0	0.60	< 100	< 10	< 20	27.2	< 10	< 10	10	20	6.25	0.5	1.00	70
935530	208 294	2.0	0.90	< 100	< 10	< 20	23.8	< 10	< 10	< 10	10	2.40	0.7	6.90	850
935531	208 294	5.0	1.00	< 100	< 10	< 20	15.45	60	10	10	20	4.95	1.0	9.40	1330
935532	208 294	10.0	1.15	< 100	< 10	< 20	13.85	90	10	20	30	6.05	0.9	8.50	1340
935533	208 294	13.0	0.95	< 100	< 10	< 20	11.75	100	< 10	10	30	7.85	0.8	7.35	1080
935534	208 294	22.0	0.50	< 100	< 10	< 20	12.15	90	< 10	20	60	12.60	0.2	5.20	610
935535	208 294	19.0	0.65	< 100	< 10	< 20	11.00	210	10	40	60	11.50	0.4	6.50	820
935536	208 294	23.0	0.80	< 100	< 10	< 20	10.25	200	10	30	100	13.10	0.6	6.40	1120
935537	208 294	17.0	1.05	< 100	< 10	< 20	11.20	170	10	30	80	8.20	0.8	7.00	1020
935538	208 294	9.0	1.00	< 100	< 10	< 20	13.15	140	10	10	100	3.65	0.7	8.05	1210
935539	208 294	1.0	1.30	< 100	< 10	< 20	18.30	10	< 10	10	10	6.00	1.2	6.05	970
935540	208 294	24.0	0.15	< 100	< 10	< 20	31.6	< 10	< 10	< 10	< 10	2.30	0.3	1.20	20
935541	208 294	3.0	1.05	< 100	< 10	< 20	15.90	< 10	< 10	10	< 10	4.05	0.9	9.40	910
935542	208 294	5.0	0.75	< 100	< 10	< 20	0.25	< 10	< 10	70	40	18.15	0.4	0.20	40
935543	208 294	2.0	2.20	100	< 10	< 20	12.20	< 10	< 10	30	< 10	1.20	2.1	7.40	500
935544	208 294	3.0	1.30	< 100	< 10	< 20	0.90	180	< 10	230	90	4.75	1.1	0.85	90
935545	208 294	4.0	2.15	< 100	< 10	< 20	5.35	10	< 10	50	20	14.25	1.7	2.50	570
935546	208 294	7.0	0.50	< 100	< 10	< 20	14.75	< 10	10	30	360	14.20	0.2	4.70	1150
935547	208 294	4.0	0.60	< 100	< 10	< 20	15.80	< 10	10	10	370	12.50	0.2	6.65	1140
935548	208 294	3.0	0.80	< 100	< 10	< 20	23.8	< 10	< 10	< 10	10	6.45	0.7	0.85	310
935101	208 294	4.0	1.50	< 100	< 10	< 20	7.35	< 10	20	70	100	11.95	1.1	4.25	990

CERTIFICATION: Hart Bichler



Chemex Labs Ltd.

Analytical Chemists * Geochemists * Registered Assayers

212 Brooksbank Ave., North Vancouver
British Columbia, Canada V7J 2C1
PHONE: 604-984-0221 FAX: 604-984-0218

Client: NORDAC RESOURCES LTD.
C/O ARCHER, CATHRO
BOX 4127, 2054 SECOND AVE.
WHITEHORSE, YT
Y1A 3S9

Project: JOLI
Comments:

Page Number: 1-B
Total Pages: 1
Certificate Date: 10-JUL-95
Invoice No.: I9520316
P.O. Number:
Account: MTT

CERTIFICATE OF ANALYSIS A9520316

SAMPLE	PREP CODE	Mo ppm (ICP)	Na % (ICP)	Ni ppm (ICP)	Pb % AAS	Sr ppm (ICP)	Ti % (ICP)	V ppm (ICP)	Zn ppm (ICP)						
935527	208 294	< 10	0.35	15	0.083	40	< 0.05	10	880						
935528	208 294	< 10	0.05	10	0.064	20	< 0.05	20	1660						
935529	208 294	< 10	1.15	18	0.064	60	< 0.05	10	1040						
935530	208 294	< 10	0.65	6	0.013	50	< 0.05	20	620						
935531	208 294	< 10	0.05	22	0.977	20	< 0.05	20	27200						
935532	208 294	< 10	0.05	11	2.35	20	< 0.05	20	43300						
935533	208 294	< 10	0.05	13	2.50	20	< 0.05	20	73400						
935534	208 294	< 10	0.05	33	1.630	20	< 0.05	10	34400						
935535	208 294	< 10	0.05	18	0.787	10	< 0.05	10	80400						
935536	208 294	< 10	0.05	24	1.320	10	< 0.05	10	71500						
935537	208 294	< 10	0.05	30	2.85	20	< 0.05	10	75400						
935538	208 294	< 10	0.15	10	1.610	20	< 0.05	20	94000						
935539	208 294	< 10	0.15	12	0.089	30	< 0.05	10	9100						
935540	208 294	< 10	1.10	13	1.070	50	< 0.05	< 10	1820						
935541	208 294	< 10	0.05	15	0.060	30	< 0.05	20	2000						
935542	208 294	< 10	< 0.05	4	0.054	< 10	< 0.05	< 10	560						
935543	208 294	< 10	0.05	16	0.014	20	< 0.05	30	220						
935544	208 294	< 10	0.05	22	0.037	< 10	< 0.05	10	94800						
935545	208 294	< 10	0.05	15	0.081	10	< 0.05	20	6640						
935546	208 294	< 10	0.05	45	0.052	20	< 0.05	10	720						
935547	208 294	< 10	0.10	21	0.029	10	< 0.05	10	480						
935548	208 294	< 10	0.70	16	0.029	30	< 0.05	10	700						
935101	208 294	< 10	< 0.05	77	0.034	10	0.05	20	340						

CERTIFICATION: Hart Bichler

ARCHER, CATHRO

& ASSOCIATES (1981) LIMITED

CONSULTING GEOLOGICAL ENGINEERS

Box 4127, 2054 SECOND AVENUE, WHITEHORSE, Y.T. Y1A 3S9 TEL (403) 667 - 4415

RECEIVED

DEC 18 1995

MINING RECORDER
MAYO, Y.T.
L.A. & N.D.

AFFIDAVIT

I, Joan Mariacher, of Whitehorse, Yukon make oath and say:

That to the best of my knowledge the attached Statement of Expenditures for exploration work on the Joli 55-68, 85-98 and 107-120 mineral claims on Claim Sheet 106C/13 is accurate.



Joan Mariacher

Sworn before me at Whitehorse, Yukon
this 15th day of
December, 1995



Notary, Yukon Territory

Statement of Expenditures
Joli 55-68, 85-98 and 107-120 Mineral Claims
December 15, 1995

Labour

A. Archer (geologist) - 1 hour at \$60/hr	\$ 64.20	
R. Carne (geologist) - 18 hours June at \$50/hr	963.00	
D. Eaton (geologist) - 3 hours June at \$50/hr	160.50	
T. Becker (geologist) - June 10-18 - 8½ days at \$270/day	2,455.65	
D. Barrett (field ass't) - June 10-18 - 8½ days at \$195/day	1,773.53	
J. Mariacher - 17 3/4 hours June-July at \$42.50/hr	<u>807.18</u>	\$ 6,224.06

Expenses

Field room and board - 17 mandays at \$60/day	1,091.40	
Trans North Air - 3.6 hours Bell 206 at \$615/hr plus fuel	2,753.37	
Chemex Labs	457.63	
CAIL - freight	207.58	
Bedrock Hotel	240.75	
Norcan Leasing - truck rental	399.42	
Sunrise Service - gas	<u>81.50</u>	<u>5,231.65</u>
		<u>\$11,455.71</u>



REMIT PAYMENT TO:
TRANS NORTH AIR
 TRANS NORTH TURBO AIR LTD.
 AIRPORT HANGAR "C" • WHITEHORSE • YUKON • Y1A 3E4
 TELEPHONE (403) 668-2177 FAX (403) 668-3420

ACCOUNT NUMBER	ARCHCAT		
INVOICE NUMBER	06864		
INVOICE DATE	19/06/95		AREA BC YUKON NWT ALTA
A/C TYPE	AIRCRAFT REGISTRATION C		
BH206B	GT	MD	
FLIGHT DATE	DAY	MONTH	YEAR
	10	06	95
PURCHASE ORDER NO.			

Archer Cathro + Associates

CHARTERER

P.O. Box 4127

BILLING ADDRESS

Whitehorse, Y.T. Y1A 3S9

FUEL & OIL-X	TNTA FUEL USED	HRS./LITRES	FROM
TNTA LOUST			YMA

FROM	HOURS	REMARKS - NO. OF PASS - FREIGHT Kg
Mazo		
TO JD	0.3	1 pax + gear
Joli	1.9	3 trips incl. 1 sling load
Chord	0.3	5/0 + P/U 2 pax
Pamicon	0.2	fuel
Mazo	0.9	P/U samples @ JD

SUB	GL	AMOUNT			
1303502		2214.00	3.6	@ 615 ⁰⁰	2214.00
1300131		287.00		@	
1303531		77.30		HOLDING TIME: @ / HR.	
0000323		1750.7	FUEL 410L	@ .70 / LITRE	287.00

TERMS: PAYABLE UPON RECEIPT OF INVOICE.
 2% INTEREST PER MONTH (24% PER ANNUM) WILL BE CHARGED ON ALL OUTSTANDING AMOUNTS OVER 30 DAYS. IF INTEREST IS NOT PAID, FUTURE FLIGHTS WILL BE ON A CASH BASIS.

X 
 CHARTERER'S SIGNATURE

CHARTERER'S NAME (PRINTED)

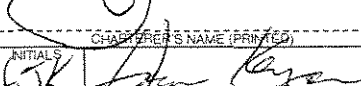
INITIALS HSK 
 PILOT'S SIGNATURE

ENGINEER'S NAME DPH HLAOUW

FUEL	@	/ LITRE	
MEALS & LODGINGS			
OTHER	Groceries paid		
OTHER	by Harman Keyser		77.30
SUB TOTAL			2578.30
GOODS & SERVICES TAX			
REGISTRATION NO. R121483135			175.07
TOTAL	\$		2753.37

CARRIAGE SUBJECT TO TERMS OF PUBLISHED TARIFF.
 TARIFF AVAILABLE TO PUBLIC VIEW AT TRANS NORTH OFFICE.

THIS IS YOUR ONLY INVOICE - PAY UPON RECEIPT



Chemex Labs Ltd.

Analytical Chemists * Geochemists * Registered Assayers
212 Brooksbank Ave., North Vancouver
British Columbia, Canada V7J 2C1
PHONE: 604-984-0221

To: NORDAC RESOURCES LTD.
C/O ARCHER, CATHRO
BOX 4127, 2054 SECOND AVE.
WHITEHORSE, YT
Y1A 3S9

**

INVOICE NUMBER **I 9 5 2 0 3 1 5**

BILLING INFORMATION

Date: 7-JUL-95
 Project: JOLI
 P.O. No.:
 Account: MTT

Comments:

Billing: For analysis performed on
 Certificate A9520315

Terms: Payment due on receipt of invoice
 1.25% per month (15% per annum)
 charged on overdue accounts

Please Remit Payments to:

CHEMEX LABS LTD.
 212 Brooksbank Ave.,
 North Vancouver, B.C.
 Canada V7J 2C1

# OF SAMPLES	ANALYSED FOR CODE - DESCRIPTION	UNIT PRICE	SAMPLE PRICE	AMOUNT
5	201 - Dry, sieve to -80 mesh ICP-32	1.25 7.00	8.25	41.25
Total Cost \$				41.25
Client Discount (25%) \$				<u>-10.31</u>
Net Cost \$				30.94
(Reg# R100938885) GST \$				<u>2.17</u>
TOTAL PAYABLE (CDN) \$				33.11

ord July 24/95
#119

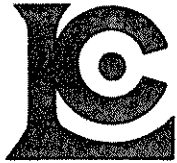

Chemex Labs Ltd.

Analytical Chemists * Geochemists * Registered Assayers
212 Brooksbank Ave., North Vancouver
British Columbia, Canada V7J 2C1
PHONE: 604-984-0221

To: NORDAC RESOURCES LTD.
C/O ARCHER, CATHRO
BOX 4127, 2054 SECOND AVE.
WHITEHORSE, YT
Y1A 3S9

INVOICE NUMBER

I 9 5 2 0 3 1 6

BILLING INFORMATION

Date: 11-JUL-95
Project: JOLI
P.O. No.:
Account: MTT

Comments:

Billing: For analysis performed on
Certificate A9520316

Terms: Payment due on receipt of invoice
1.25% per month (15% per annum)
charged on overdue accounts

Please Remit Payments to:

CHEMEX LABS LTD.
212 Brooksbank Ave.,
North Vancouver, B.C.
Canada V7J 2C1

# OF SAMPLES	ANALYSED FOR CODE - DESCRIPTION	UNIT PRICE	SAMPLE PRICE	AMOUNT
23	208 - Assay ring to approx 150 mesh	2.50		
	294 - 4-7 Kg crush and split	3.50		
	3202 - Rock - save entire reject	0.50		
	A-22 ICP Package	16.50	23.00	529.00
Total Cost \$				529.00
Client Discount (25%) \$				<u>-132.25</u>
Net Cost \$				396.75
(Reg# R100938885) GST \$				<u>27.77</u>
TOTAL PAYABLE (CDN) \$				424.52

Shipper's Name and Address
Nom et adresse de l'expéditeur

ARCHER CATHRO
2054 SECOND AVENUE
WHITEHORSE, YT
Y1A3S9*CA PH-403-667-4415

Shipper's Account Number
Numéro de compte de l'expéditeur

Not negotiable / Non négociable
Air Waybill Lettre de transport aérien
Issued by / Émise par
CANADIAN AIRLINES INTERNATIONAL
STE 2800-700 2ND ST SW
CALGARY AB

Copies 1, 2 and 3 of this Air Waybill are originals and have the same validity
Les exemplaires 1, 2 et 3 de cette lettre de transport aérien sont originaux et ont la même validité

Consignee's Name and Address
Nom et adresse du destinataire

CHEMEX LABS LTD
212 BROOKSBANK AVE
NORTH VANCOUVER, BC
-YVR-

Consignee's Account Number
Numéro de compte du destinataire

It is agreed that the goods described herein are accepted in apparent good order and condition (except as noted) for carriage SUBJECT TO THE CONDITIONS OF CONTRACT ON THE REVERSE HEREOF. THE SHIPPER'S ATTENTION IS DRAWN TO THE NOTICE CONCERNING CARRIER'S LIMITATION OF LIABILITY. Shipper may increase such limitation of liability by declaring a higher value for carriage and paying a supplemental charge if required.

Il est convenu que les marchandises décrites dans le présent document sont acceptées pour le transport en bon état apparent (sauf annotation contraire) et que le transport est SOUMIS AUX CONDITIONS DU CONTRAT QUI FIGURENT AU VERSO. L'ATTENTION DE L'EXPÉDITEUR EST ATTIRÉE SUR L'AVIS CONCERNANT LA LIMITATION DE RESPONSABILITÉ DU TRANSPORTEUR. L'expéditeur peut augmenter cette limitation de responsabilité en déclarant une valeur pour le transport plus élevée et en payant des frais supplémentaires s'il y a lieu.

Issuing Carrier's Agent Name and City / Nom et ville de l'agent du transporteur émetteur

CANADIAN AIRLINES INTL

Accounting information / Renseignements comptables

*possibly collect
sent by
Sali*

Agent's IATA Code / Code IATA de l'agent

71-9 9020 C

Account Number / Numéro de compte

Airport of Departure (Address of first Carrier) and Requested Routing
Aéroport de départ (Adresse du premier transporteur) et itinéraire demandé

WHITEHORSE

to / à	By first Carrier Par premier transport	Routing and Destination Routage et destination	to / à	by / par	to / à	by / par
YVR	CP					

Currency Monnaie	CHGS Code Frais	WT/Poids-Val	Other/Autres	Declared Value of Carriage Valeur déclarée pour le transport	Declared Value for Customs Valeur déclarée pour la douane
CAD	PPX		X	NVI	NCV

Airport of Destination / Aéroport de destination

VANCOUVER

Flight Date
Vol. / Date

For Carrier Use Only
Réservé au transporteur

Flight Date
Vol. / Date

Amount of Insurance
Montant de l'assurance

XXX

INSURANCE - If Carrier offers insurance, and such insurance is requested in accordance with the conditions thereof, indicate amount to be insured in figures in box marked "Amount of Insurance".
ASSURANCE - Si le transporteur propose une assurance et que l'expéditeur en fait la demande conformément aux présentes conditions indiquer le montant à assurer en chiffres dans la case "Montant de l'assurance".

Handling Information / Renseignements pour le traitement de l'expédition

NTF-HOLD FOR PICK UP
NTF-604 984 0221

Number of Pieces Nombre de colis RCP	Gross Weight Poids brut	kg	Rate Class / Classif. du tarif Commodity Item No. N° d'article de la marchandise	Chargeable Weight Poids de taxation	Rate / Charge Tarif / Montant	Total	Nature and Quantity of Goods (including Dimensions or Volume) Nature et quantité des marchandises (y compris dimensions ou volume)
8	100.00	kg		100.00	1.94	194.00	ROCKS B43X11X24IN-1
8	100.00					194.00	

Prepaid / Port payé	Weight Charge / Taxation au poids	Collect / Port dû	Other Charges / Autres frais
194.00			GOC13.58
Valuation charge / Taxation à la valeur			
Tax / Taxe			
Total other Charges Due Agent / Total des autres frais dus à l'agent			
Total other Charges Due Carrier / Total des autres frais dus au transporteur		13.58	
Total prepaid / Total port payé		207.58	
Total collect / Total port dû			
Currency Conversion Rate Taux conversion monnaie	CC Charges in Destination Currency Port dû en monnaie du pays de destination	20 JUN 1995	
1.000000		Executed on (Date) at (Place) Signature of Issuing Carrier or its Agent	
For Carrier's Use only at Destination Réservé au transporteur à destination	Charges at Destination / Frais à l'arrivée	Total collect Charges / Total dû	
		CAD	

Signature of Shipper or his Agent

Signature de l'expéditeur ou de son agent

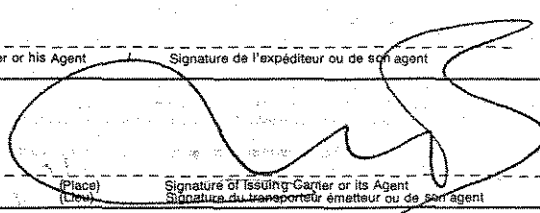

BEDROCK MOTEL
 Box 69, MAYO, YT YOB, MO

OUR NUMBER	35023
DATE	JUNE 12/95
CUSTOMER'S ORDER	
SALESMAN	<i>[Signature]</i>
TERMS	
F.O.B.	

TAX REG. NO. 113 804 967
 SOLD TO ARCHER CATHRO MINING
P.O. Box 4127
 SHIP TO WHITEHORSE, YT
 ADDRESS Y1A 3B9 VIA _____

INVOICE

QUANTITY	DESCRIPTION	PRICE	AMOUNT
Reg. # 404A	1 room 2 nights	140 ⁰⁰	
4/25 to 4/25	Rob CARNE GST	9 ⁸⁰	
4/25	MEALS	10 ⁰⁰	
	TOTAL		159 ⁸⁰

BEDROCK MOTEL
 Box 69, MAYO, VT Y0B1MO

OUR NUMBER	35033
DATE	JUNE 19/95
CUSTOMER'S ORDER	
SALESMAN	Looper
TERMS	
F.O.B.	

TAX REG. NO. 113 804 967
 SOLD TO ARCHER CATHOD MINING
Box 4127, Whitehorse, VT
 SHIP TO VIA 359
 ADDRESS _____ VIA _____

INVOICE

QUANTITY	DESCRIPTION	PRICE	AMOUNT
Reg. # 4071	1 room 1 night		
	Beckern Barret	80 ⁰⁰	
	G ST	5 ⁶⁰	
			85 ⁶⁰
Reg. # 4072	1 room 1 night		
	Doug Eaton	70 ⁰⁰	
	G ST	4 ⁹⁰	
			74 ⁹⁰
	TOTAL		160 ⁵⁰

BLUENLINE · D 32

Jali

NORCAN LEASING LTD.

Mile 917.4 Alaska Hwy. Whitehorse, Y.T., Y1A 3E5

Phone: (403) 668-2137 or Toll Free: 1-800-661-0445, FAX: (403) 633-7596

G.S.T. Registration Number R121995476

RENTAL AGREEMENT NUMBER

SEE TERMS AND CONDITIONS ON REVERSE SIDE		RENT LOCATION: NORCAN OFFICE	DATE: Jun 22/95
RENTER: NDA KASANT CBS C/O ARCHER CATHRO	ND100	UNIT NUMBER 4301930	
P.O. BOX 4127		LICENCE NUMBER RFB 92	
WHITEHORSE YT Y1A 3S9		MAKE 1995 FORD GREEN	
DRIVER		STYLE 4x4 CAB/CHASSI F350	
		DAY / TIME / KILO - IN Jun 19/95 10:30	6450
		DAY / TIME / KILO - OUT Jun 16/95 13:00	5369
	Y1A 3S9	KILOMETERS DRIVEN	1081
LICENCE NO.	EXPIRY DATE Jun 15/96	PROVINCE	KILOMETERS ALLOWED
AUTH'D BY P.O. NUMBER		KILOMETERS @	0.37 1081 KMS 399.97
PAYMENT TYPE DIRECT BILL		HOURS @	14.50 HOURS
OUT BY DDL		DAYS @	58.00 3 DAYS 174.00
IN BY RAS		DAYS @	0.00 DAYS
VEHICLE WILL BE RETURNED Jun 19/95		WEEKS @	348.00 WEEKS
OPTIONAL EQUIPMENT JACK/WHEEL WRENCH, IF LOST-\$100.00		MONTHS @	0.00 MONTHS
<p><i>Blonde - 319.23</i> <i>22.35</i> <i>341.58</i> <i>H. Jeli - 319.24</i> <i>657 - 44.69</i> <i>22.34</i></p>	TOTAL TIME AND KILOMETERS		573.97
	TOTAL TIME AND KILOMETERS		573.97
	FUEL:	LITERS @	46 .75 34.50
	INSURANCE CHARGE:	DAYS @	3 10.00 30.00
	ADDITIONAL CHARGES		
	DROP OFF CHARGES		
	SUB TOTAL		638.47
	GOOD AND SERVICES TAX @ 7%		44.69
	TOTAL CHARGES		683.16
	LESS ROAD EXPENSE		
LESS DEPOSIT			
TOTAL AMOUNT DUE		683.16	

NOTICE
ALL AUTHORIZED DRIVERS MUST BE 21 OR OLDER AND LICENCED. RENTER IS RESPONSIBLE FOR ALL DAMAGES SUFFERED BY NORCAN IF VEHICLE IS USED BY A DRIVER NOT LISTED IN SPACE PROVIDED.
THIS VEHICLE IS EQUIPPED WITH A BLOCK HEATER AND EXTENSION CORD. CUSTOMER IS RESPONSIBLE FOR COLD WEATHER STARTING.
FUEL NOT INCLUDED IN RATES
CUSTOMER IS RESPONSIBLE FOR ALL PARKING AND TRAFFIC VIOLATIONS

LOSS DAMAGE WAIVER (L.D.W.) INITIAL ACCEPTS OR DECLINE BOX ACCEPTS DECLINES

IN CONSIDERATION OF THE PAYMENT OF "L.D.W. CHARGE" PER DAY OR PART THEREOF AS INDICATED BELOW THE RENTERS FINANCIAL RESPONSIBILITY FOR THE LOSS OR DAMAGE TO THE RENTED VEHICLE PER OCCURANCE IS LIMITED TO THE AMOUNT INDICATED BELOW, EXCEPT FOR TRUCK BOX DAMAGE, PROVIDED THE TERMS AND CONDITIONS OF THIS AGREEMENT ARE NOT VIOLATED. L.D.W. IS NOT INSURANCE.

DEDUCTIBLE AMOUNT OTHER THAN FULL REPLACEMENT VALUE: **5000.00**

REMARKS/ADDITIONAL TERMS AND CONDITIONS:
ADD DRIVER

CUSTOMER AUTHORIZES NORCAN TO PROCESS A CREDIT CARD VOUCHER, IF ANY, IN HIS/HER NAME HEREUNDER. I HAVE READ THE TERMS ON BOTH SIDES OF THIS RENTAL AGREEMENT AND AGREE THERETO.

THIS IS YOUR INVOICE PAYABLE ON RECEIPT TO NORCAN LEASING LTD. THIS INVOICE NUMBER MUST APPEAR ON ALL CORRESPONDENCE AND REMITTANCES.

RENTAL AGREEMENT NUMBER

WHILE ON THE ROAD:
• OBTAIN RECEIPTS FOR ALL REIMBURSABLE EXPENSES AND PRESENT THEM WITH THIS COPY AT CHECK IN.
• REPORT ACCIDENTS IMMEDIATELY TO LOCAL POLICE AND CALL NORCAN COLLECT.
• IF DELAYED IN RETURNING THE VEHICLE PLEASE CALL NORCAN COLLECT OR ON OUR TOLL FREE NUMBER.

31910

NORCAN LEASING LTD.

OUR NUMBER	33300
DATE	July 1995
CUSTOMER'S ORDER	
SALESMAN	
TERMS	
F.O.B.	

TAX REG. NO. _____
 SOLD TO ARCAHA LATINA
 SHIP TO R140305061
 ADDRESS GT # R121995476 VIA AR100

INVOICE

QUANTITY	DESCRIPTION	PRICE	AMOUNT
	PREBILL FOR VEHICLE 330206		
	RENTAL AGREEMENT 31515		
	DATE OUT MAY 29/95 @ 1650 ⁰⁰ /mo		
FD-10646	MAY 29 TO MAY 31/95 3 DAYS @ 53.23		159 69
	JUNE 1 TO JUNE 30/95		1650 00
	JULY 1 TO JULY 31/95		1650 00
Blue - 54.06	Tote - 54.05		
Dirt hat - 378.40	Keys - 918.98		3459 69
FD - 1378.47	Norcan - F - 270.29	63 -	242 18
JD - 270.29	Silver IV - 81.09		3701 87

BLUELINE - 31

89-F-54.06 / 3459.69



SUNRISE SERVICE CENTRE

CARMACKS, YUKON, Y0B 1C0

PHONE 863-5291

GARAGE • TIRE REPAIRS • TOWING • PROPANE
GAS • DIESEL • WATER

DATE, June 11 19 95

NAME Archer - Cathor

ADDRESS _____

MAKE		ODOMETER		LICENCE NO.	
QUANTITY	DESCRIPTION		TAXABLE	NON TAXABLE	
<u>117.3</u>	LITRES GAS <input checked="" type="checkbox"/>	LITRES DIESEL <input type="checkbox"/>		<u>81.50</u>	
	LITRES OIL				
	LUBRICATION				
<u>John</u>					
			TOTAL		
GST REGISTRATION NO.		<u>R105075782</u>	GST		
RECEIVED BY <u>[Signature]</u>		RG4-70	SUB-TOTAL		
			PST	<u>4</u>	
SOLD BY	CASH	CHARGE	ON ACCT.	GRAND TOTAL <u>81.50</u>	

COMDA SERVICE LTD., TORONTO, ONT., 243-8766 - 10128

0163

John - 76.17

ARCHER, CATHRO & ASSOCIATES (1981) LIMITED

In Account With

Project: —

JOLI PROJECT

Date: —

JULY 31, 1995

LABOUR

Field A. ARCHER - 1 HR AT 60/HR

60.00

Office

Accounting & Expediting: J. MARIACHEL - 3 1/4 HRS AT 47.50/HR

138.13

198.13

OTHER SERVICES

Room & Board In Whitehorse

Field equipment from AC stock

Photocopies, // copies at 25 ¢/copy

Rentals from AC.

2.25

Blueprinting, sq.ft. Ozalid at ¢/ft, plus sq.ft. Dilar at \$ /ft.
Drafting, hrs at \$ /hr.

2.25

EXPENSES

Petty Cash

Telephone 2.53

TRANS NORTH AIR

MAC'S FIREWOOD

YULON BUILDING SUPPLIES

INTEGRAPHIX

REGENER GENERAL - MAPS

NORCAN LEASING

NELSON'S HARDWARE

2.53

1489.15

7.00

15.66

33.59

1.00

54.05

3.79

1406.77

MANAGEMENT, 6% - ON EXPENSES

- ON FIELD AMT

84.41

0

84.41

1692.06

GST (R100247667): 7% ON 1692.06

118.44

1810.50

E = GST Exempt