

DODGEX LTD.

MIDAS PROPERTY

Claims: Midas 1-19 and
Midas 21, 23, 25, 26, and 27

YB56539-567.

1994/1995 SUMMARY REPORT
GEOLOGY AND GEOCHEMISTRY



Prepared by:

James S. Dodge, MSc., P.Eng.

Watson Lake Mining District
Claim Map - 105G-12 Starr Creek

61°42' N Latitude / 131°44' W Longitude

June - October, 1995

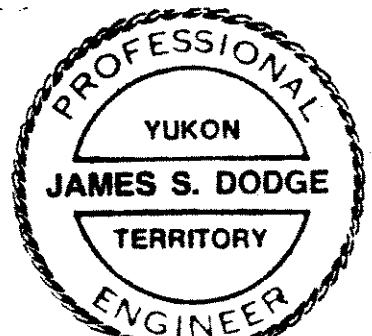

SUMMARY

Dodgex Ltd. holds the Midas Property comprising 24 contiguous claims near the Hoole River 52 km southeast of the town of Ross River, southern Yukon.

The property covers a largely drift-covered bedrock area where in 1995 gold/copper-bearing float has been found, and where anomalously high gold/copper/arsenic values have been obtained from nine, deep, top-of-till, -200 mesh samples.

This report presents results from reconnaissance geological mapping and geochemical sampling. Recommendations are made for follow-up geochemical and geophysical surveys to assist in delineating the probable bedrock source for the gold/copper mineralization.

TABLE OF CONTENTS

Page No.

SUMMARY

1.0	<u>Introduction</u>	
	1.1 Location and Access	1
	1.2 Terrain	1
	1.3 Claim Ownership	2
	1.4 Personnel/Work Schedule	2
2.0	<u>Geology</u>	
	2.1 Introduction	3
	2.2 Regional Geology	3
	2.3 Midas Claims Geology	3
	2.4 Midas Claims Mineralization	4
3.0	<u>Geochemical Till Sampling</u>	
	3.1 Introduction	5
	3.2 Sampling Procedures	5
	3.3 Laboratory Sample Preparation	6
	3.4 Sampling Results	6
4.0	<u>Conclusions</u>	
	4.1 Geology	7
	4.2 Mineralization	7
	4.3 Geochemical Sampling	7
5.0	<u>Recommendations</u>	
	5.1 Geochemical Till Sampling	8
	5.2 Geophysical Survey	8
6.0	<u>References</u>	9
7.0	<u>Statement of Expenditures</u>	10
8.0	<u>Statement of Qualifications</u>	11

ILLUSTRATIONS

	<u>After Page No.</u>
<u>Maps</u>	
Yukon Location	1
Claim Sheet 105G-12	Pocket
Enlarged Midas Claims	Pocket
Geochemical Sample Sites	5
<u>Assays</u>	
Midas Mineralization NAL WO#25393/a	9
Midas Mineralization NAL WO#27977	9
Midas Geochemical Samples NAL WO#15420	9
<u>Photographs</u>	
Photo 1 Midas #11 Chlorite schist	4
Photo 2 Midas #25 Geochemical sample site	4
Photo 3 Midas #10 Muscovite/quartz schist	6
Photo 4 MIDAS #25 Geochemical sieving	6
Photo 5	Quaternary Section 8

1.0 Introduction

1.1 Location and Access

The Midas Property comprises 24 contiguous quartz claims in southern Yukon held by Dodgex Ltd. of Whitehorse.

The claims are situated approximately 52 km southeast of the town of Ross River (Figure) with the centre of the property at 61°42' north latitude and 131°44' west longitude on the 105G-12 claim sheet.

Access to the property is by 1/2 km of foot trail beyond the end of a 1.5 km bulldozed track from the end of a 4x4 pioneer road extending 5 km south from the Campbell Highway at a point 63 km southeast of the town of Ross River and 200 meters west of the Hoole River bridge.

Trans North Air helicopter based at Ross River can also provide access to the property.

1.2 Terrain

Midas claims cover both glaciofluvial terrace deposits near the Hoole River, and morainal till blanket deposits on the higher slopes southwest of the river. Bedrock exposures comprise less than 5 percent of the claim area, with most outcrops found within the terrace deposit domain near the Hoole River.

Elevations on the property range 900-990 meters above sea level.

Vegetation cover comprises mixed stands of mature spruce and aspen along the Hoole River; patchy open mixes of spruce, alder, and muskeg dominate at higher elevations.

Permafrost is present discontinuously and commonly below the post-glacial solum which ranges 0.5 - 1.0 meter in thickness.

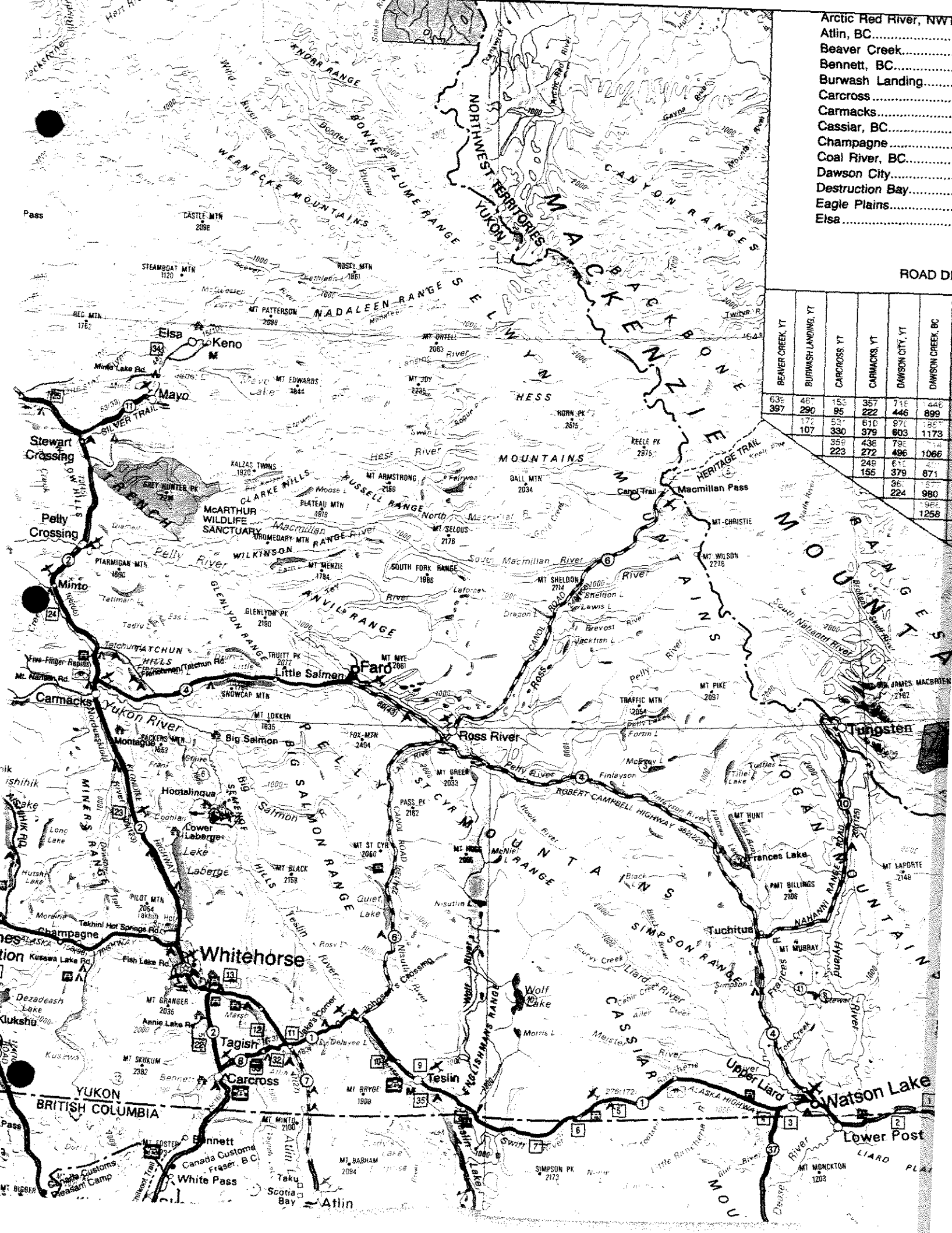

- Arctic Red River, NW
- Atlin, BC.....
- Beaver Creek.....
- Bennett, BC.....
- Burwash Landing.....
- Carcross.....
- Carmacks.....
- Cassiar, BC.....
- Champagne.....
- Coal River, BC.....
- Dawson City.....
- Destruction Bay.....
- Eagle Plains.....
- Elsa.....

ROAD DISTANCE

BEAVER CREEK, YT	BURWASH LANDING, YT	CARCROSS, YT	CARMACKS, YT	DAWSON CITY, YT	DAWSON CREEK, BC
636	487	156	357	715	446
397	290	95	222	446	899
	172	330	379	603	1173
	107	359	272	496	1066
		223	438	782	1474
			155	379	871
			248	611	1144
			36	224	980
				192	1258

1.3 Claim Ownership

The Midas property, located in the Watson Lake Mining District, comprises 24 contiguous quartz claims, namely Midas 1-19, and Midas 21, 23, 25, 26, and 27. Midas claims 20, 22, 24, 28, and 29, of the original staking in October, 1994 are not being renewed.

Dodgex Ltd. of 14 MacDonald Road, Whitehorse, Yukon, Y1A 4L2 is the registered owner of all the Midas claims. The expiry date for the claims is 30 October, 1995.

1.4 Personnel/Work Schedule

Field work in geological mapping and geochemical sampling was conducted by James S. Dodge, P.Eng. Mining Geologist, during 29-30 August and 01 September, 1995. Sieving of nine geochemical till sediment samples to -200 mesh was carried out by James S. Dodge at the Northern Analytical Laboratory on 22 September, 1995.

Office preparation of this report of findings took place from time to time during mid to late October, 1995.

2.0 Geology

2,i Introduction

Combined geological-prospecting mapping was carried out systematically (1) along the banks of the Hoole River, (2) along claim staking lines, (3) along a northeast flowing creek, (4) along claim boundaries perpendicular to staking lines, and (5) several property perimeter traverses (Figure).

2.2 Regional Geology

The Midas claims are situated in the Nisutlin allochthon 10 km northeast of the Tintina strike-slip geosuture fault zone displayed at the western border of the Finlayson Lake geological map NTS 105G (Templeman-Kluit, 1977).

The Nisutlin Phanerozoic allochthon in the broad area of the Midas property comprises dominantly Cambrian(?) muscovite chlorite quartz phyllite, limestone, and amphibolite with prominent shearing both parallel to the northwesterly trending Tintina fault and to its splays which host Cretaceous-Tertiary feldspar quartz porphyry plugs. Several small areas of Tertiary basalt, both olivine and non-olivine bearing, outcrop in the Hoole River and Starr Creek drainages.

2.3 Midas Claims Geology

Glacial till and post-glacial solum effectively conceal bedrock over 95% of the area underlying the Midas claims. Bedrock exposures on Midas claims 1,3,5,7,10, and 11 (Figure) reveal a stratigraphic triad comprising a basal chlorite schist, overlain by thin bedded limestone, and an upper sericite quartz chlorite schist. Open folds and foliation/bedding inclinations of 10⁰-25⁰ westerly characterize all three units. A Cambrian age is tentatively assigned to the triad.

Basal chlorite schist is exposed only along the shoreline of the Hoole River on Midas 5 and 7, and on Midas 11 where stratigraphically only 10 meters of its upper portion of overall thickness is exposed (Photo 1).

The thin-bedded, buff weathering, grey limestone is well exposed in cliffs along the glaciofluvial terraces near the Hoole River on Midas 1, 3,7, and 11. Including the upper and lower contacts, which incorporating calcareous facies in the bounding schists, the estimated minimum thickness of the limestone is 25 meters.

The upper chlorite quartz phyllite and interfoliated chlorite muscovite quartz schist are exposed on an isolated hillock on Midas 10 and on knolls near the southeastern corner of Midas 11 claim.

2.4 Midas Claims Mineralization

No bedrock mineralization has been found to date on the Midas property.

Detailed prospecting of glaciofluvial terrace cliff exposures and river banks on Midas 1, 3, 5, 7, 9, and 11 was carried out to search for evidence of mineralization and alteration (carbonitization) in till derived from an up-ice bedrock direction, i.e., 120°-130°Azimuth.

Numerous cobbles and small boulders of milky white, fine grained quartz, with sheeted pyrite/chalcopyrite/chlorite, were found along the Hoole River on Midas 1 claim. Assays of up to 1378 ppb gold and 1.68% copper were obtained from select boulders. Orange weathering silicified ankerite boulders, with minor pyrite and occasionally mariposite, were prominent constituents of the till. One 0.5 meter boulder on Midas 1 claim comprised striking, dun-weathering, stratabound, syngenetic sphalerite in a calcareous meta-quartzite which assayed 12%-16% zinc.



PHOTO 1 Calcareous chlorite schist 20 meters stratigraphically below contact with overlying limestone.

BEST ATTAINABLE IMAGE



PHOTO 2 Geochemical till sample site (L1-40W) MIDAS #25 claim. Pit is 1.0 meter deep to top of glaciofluvial gravel sample.

3.0 Geochemical Till Sampling

3.1 Introduction

Investigative geochemical till sampling was undertaken along the northern property boundary of Midas 1 and 25 claims.

The sampling site was positioned (a) up-ice from boulders of auriferous chalcopyrite-quartz-chlorite bulldozed out of glaciofluvial till on the adjoining claims 400 meters to the north, and (b) laterally onto a glaciofluvial terrace 75 - 200 meters west of the cluster of auriferous quartz-pyrite-chalcopyrite bearing till boulders found along the Hoole River.

3.2 Sampling Procedures

Sampling procedures followed till sampling concepts and procedures outlined by Plouffe and Jackson (1995) and Shilts (1984).

A preliminary survey was conducted in which an east-west trending "fence" or line was laid out and nine sample sites were flagged at 20 meter intervals.

A grubhoe and shovel were used to dig through the A/B/C soil horizons and bottomed in the top of the glaciofluvial silt/sand/gravel horizon. Depths through post-glacial solum ranged 0.5 to 1.5 meters. No permafrost was encountered at any site.

A long handled shovel was used to bring up damp samples averaging 5 kg weight per site. Sieving was by hand at the site (Photos 2 and 4) with the -2.0 mm fraction bagged for laboratory analysis. Each of the sieved samples weighed approximately 1 kg.

Field examination of coarse fractions identified chlorite schist, sericite feldspar quarta (augen gneiss), sericite quartz schist, listwaenite, limestone, and basalt.

SCALE:
20 Meters

●
33 As ppm
157 Cu ppm
108 Au ppb

ELDORADO CLS.



Terrace Scarp

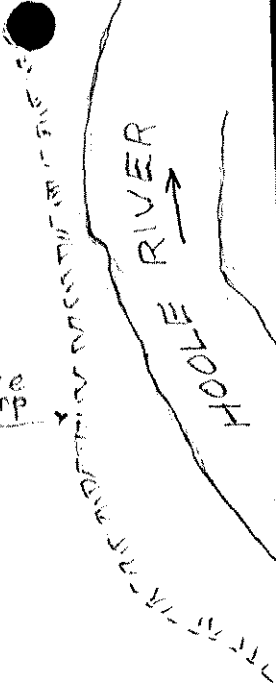

120W

33
157
108

100W

33
146
5

80W

33
103
6

60W

77
300
9

40W

61
156
30

20W

36
195
65

00W

37
55
5

POSTS No 2
MIDAS 1, 2, 25

20E

27
51
5

40E

38
125
10

MIDAS 25

MIDAS 2

MIDAS 1

CREEK

1995 GEOCHEMICAL SAMPLE SITES

J.S. Dodge

3.3 Laboratory Sample Preparation

Laboratory preparation of each of the nine samples at the Northern Analytical laboratory in Whitehorse, Yukon comprised drying by NAL and then mechanical sieving by James S. Dodge, P.Eng. to obtain the -200 mesh fraction of largely silt and clay composition for analysis. Average weight of the fine fraction for each sample was 25 grams.

The -200 mesh size range was chosen because . . . "the greatest concentration of most metals occur in the clay size fraction because: phyllosilicates, which preferentially occur in the clay size fraction, have a primary metal enrichment within their structure, and metals, released by weathering of labile minerals, are scavenged by colloidal particles such as clay minerals, oxides, and hydroxides" (Plouffe/Jackson/Shilts). Moreover, gold is preferentially enriched in fine fractions of oxidized till (DeLabio, 1985).

10-gram, -200 mesh samples were analyzed for gold by atomic absorption at Northern Analytical laboratory and a sample split was forwarded to International Plasma Laboratory in Vancouver, British Columbia for 30-element ICP analysis. Till boulders evidenced copper and arsenic accompanied by gold (in pyrite?) in quartz-rich chlorite sheeted fabric; thus, base metals might serve as gold pathfinders.

3.4 Sampling Results

Results shown on certificate of analyses (Appendix) point up anomalous concentrations of gold from several sample sites at 108 ppb maximum; copper and arsenic in all samples with maximum 300 ppm and 77 ppm respectively. As outlined by Plouffe and Jackson (1995) in their till sampling in the allochthonous terrane encompassing the Midas property area, background values of 5-7 ppb gold was indicated. In this context, five out of nine till samples on the Midas claims were above background in gold.



PHOTO 3 Muscovite, quartz schist knoll on Midas 10 claim.



PHOTO 4 Geochemical till sample and -2.00mm sieve. LI-20W Midas 25 claim.

BEST ATTAINABLE IMAGE

4.0 Conclusions

4.1 Geology

Geological mapping of the Midas property indicated presence of outcrops of the sheared muscovite quartz chlorite schist (upper triad) low-grade metamorphic terrane which exhibit pyritic quartz dilation fabric.

4.2 Mineralization

Auriferous chalcopyrite-pyrite-arsenopyrite-quartz till cobbles and boulders on the Midas claims indicate mineralized bedrock source lies up-ice now covered by glacial moraine - possibly within the boundaries of the Midas claims.

4.3 Geochemical Sampling

Preliminary geochemical till sampling revealed anomalously high values in gold, copper and arsenic from nine sites aligned as a 'fence' oriented perpendicular to the ice movement direction of bedrock dispersion. Till sampling appears to be an effective method of identifying mineralized bedrock glacial dispersion pattern on the Midas claims.

5.0 Recommendations

5.1 Geochemical Till Sampling

Extend the 1995 line of till sample sites to the west for at least 200 meters; the 20-meter site interval to remain the same.

Conduct till sampling on at least three additional lines parallel to the 1995 line and at 20 meter line intervals southward.

Larger -2.00 mm field samples are recommended so that laboratory sieving of -200 mesh fraction will yield at least a 50 gram analytical sample.

5.2 Geophysical Survey

Conduct a VLF-electromagnetic survey with stations at each of the expanded geochemical sample sites, as well as parallel (East-West) lines 200-, 300-, and 400-meters respectively south of the 1995 sample line.

The EM survey is recommended as a geophysical method which can detect concealed bedrock conductors such as sulfide mineralization and shear zones.

BEST ATTAINABLE IMAGE



PHOTO 5 Quaternary Stratigraphic Section
300 meters north of MIDAS #1 claim

Top	Black	Humus
	White	White River tephra underlain by 10cm "B" soil horizon
	Grey	Compacted diamicton with abundant clasts
	Black	Humus 1-2cm
	Peach/tan	Oxidized glaciofluvial stratified sand and silt
Bottom	Grey	Stratified gravel and cobbles. Several partially rounded cobbles of sheeted chalcopyrite-quartz in quartz chlorite schist

6.0 References

- Bohike, J.K. and Kistler, R.W., 1986, Rb-Sr, K-Ar, and stable isotope evidence for the ages and sources of fluid compositions of gold-bearing quartz in the northern Sierra Nevada Foothills metamorphic belt, California: *Economic Geology*, v. 81, p.296-322.
- Jackson, L.E., Jr., 1993, Surficial geology, Hoole River, Yukon Territory: Geological Survey of Canada, Map 1794A.
- Leitch, C.H.B., Godwin, C.I., Brown, T.H. and Taylor, B.E., 1991. Geochemistry of mineralizing fluids in the Bralorne-Pioneer mesothermal gold vein deposit, British Columbia, Canada: *Economic Geology*, v. 86, p. 318-353.
- Plouffe, A. and Jackson, L.E., Jr., 1995. Quaternary stratigraphy and till geochemistry in the Tintina Trench, near Faro and Ross River, Yukon Territory: Geological Survey of Canada, Contribution No. 34693.
- Shilts, W.W., 1975. Principles of geochemical exploration for sulfide deposits using shallow samples of glacial drift Canadian Institute of Mining and Metallurgy, Bulletin, v. 68, p. 73-80.
- Templeman-Kluit, D.J., 1977. Quiet Lake (105F) and Finlayson Lake (105G) Map Areas, Yukon: Geological Survey of Canada, Open File 486, (3 sheets) scale 1:250,000.

09/21/94

Assay Certificate

Page 1

James Dodge

WO#25393

Sample #	Au ppb
8651	146
8652	218
8653	21
8654	33
8655	29
8656	6
8657	>6667
8658	5
8659	15
8660	<5
8661	61
8662	<5
8663	70
8664	24
8665	43
8666	<5

Certified by

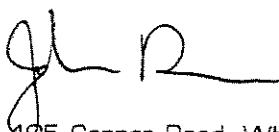

05/10/94

Assay Certificate

Page 1

James Dodge

WC#25393a

Sample #	Reanalysis Au ppb
8657	1378

Certified by 



17/07/95

Assay Certificate

Page 1

James Dodge

WO#27977

Sample #	Au ppb
8678	17
8679	248
8680	14
8681	167
8682	9
8683	<5

Certified by

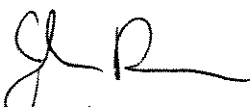

24/10/95

Assay Certificate

Page 1

James Dodge

WO#15420

Sample #	CLAIM	STATION	Au ppb	Cu ppm*	As ppm*
2669	MIDAS 1	L1-40E	10	125	38
2670	MIDAS 1	L1-20E	5	51	27
2671	MIDAS 25	L1-0/0	5	55	37
2672	MIDAS 25	L1-20W	65	195	36
2673	MIDAS 25	L1-40W	30	156	61
2674	MIDAS 25	L1-60W	9	300	77
2675	MIDAS 25	L1-80W	6	103	33
2676	MIDAS 25	L1-100W	5	146	33
2677	MIDAS 25	L1-120W	108	157	33

Note: Analyses of -200 mesh pulps.

* Copper (Cu) and Arsenic (As) values from ICP analyses
by International Plasma Laboratory Ltd. Project #15420
17 October, 1995

Certified by



CERTIFICATE OF ANALYSIS
iPL 95J1007

2036 Columbia St.
Vancouver, B.C.
Canada V5Y 3E1
Phone (604) 879-7878
Fax (604) 879-7898

Client: Northern Analytical Laboratories
Project: 15420 9 Pulp

iPL: 95J1007

Out: Oct 17, 1995
In: Oct 10, 1995

Page 1 of 1
[085517:01:14:59101795]

Section 1 of 1
Certified BC Assayer: David Chiu

Sample Name	Ag ppm	Cu ppm	Pb ppm	Zn ppm	As ppm	Sb ppm	Hg ppm	Mo ppm	Tl ppm	Bi ppm	Cd ppm	Co ppm	Ni ppm	Ba ppm	W ppm	Cr ppm	V ppm	Mn ppm	La ppm	Sr ppm	Zr ppm	Sc ppm	Ti %	Al %	Ca %	Fe %	Mg %	K %	Na %	P %
2669	P 0.5	125	77	202	38	<	<	4	<	<	0.6	10	31	200	<	31	48	382	16	19	1	1	0.01	1.12	0.32	2.94	0.48	0.09	0.02	0.05
2670	P 0.1	51	20	134	27	<	<	3	<	<	0.5	9	30	190	<	26	41	408	14	17	1	1	0.02	1.12	0.38	2.64	0.47	0.08	0.02	0.04
2671	P 0.1	55	14	108	37	<	<	2	<	<	0.3	13	43	278	<	41	48	451	19	26	1	2	0.02	1.48	0.36	2.82	0.70	0.10	0.02	0.13
2672	P 0.2	195	16	120	36	<	<	2	<	<	0.4	11	39	248	<	37	45	332	25	32	2	1	0.03	1.13	0.45	2.67	0.60	0.09	0.02	0.16
2673	P 0.1	156	21	132	61	<	<	3	<	<	0.4	16	48	333	<	41	53	656	21	22	1	1	0.02	1.48	0.26	3.17	0.69	0.10	0.02	0.12
2674	P 0.3	300	23	159	77	<	<	3	<	<	0.7	22	61	425	<	45	51	979	22	53	2	2	0.03	1.48	0.94	3.37	0.94	0.11	0.03	0.15
2675	P 0.5	103	22	165	33	<	<	3	<	<	0.9	14	45	514	<	31	61	443	20	58	2	1	0.02	1.37	1.04	2.54	0.65	0.16	0.03	0.10
2676	P 0.5	146	25	162	33	<	<	3	<	<	0.7	13	46	539	<	33	61	380	18	86	3	2	0.02	1.44	1.85	2.69	0.84	0.19	0.04	0.13
2677	P 0.7	157	22	205	33	<	<	4	<	<	1.5	13	46	749	<	32	70	381	17	113	7	2	0.02	1.64	2.53	2.91	1.04	0.24	0.04	0.14

Min Limit: 0.1 1 2 1 5 5 3 1 10 2 0.1 1 1 2 5 1 2 1 2 1 1 1 0.01 0.01 0.01 0.01 0.01 0.01 0.01 0.01 0.01
 Max Reported*: 99.9 20000 20000 20000 9999 9999 9999 9999 999 999 99.9 999 999 9999 999 9999 999 9999 9999 9999 9999 999 99 1.00 9.99 9.99 9.99 9.99 9.99 9.99 5.00 5.00
 Method: ICP
 —No Test ins=Insufficient Sample S=Soil R=Rock C=Core L=Silt P=Pulp U=Undefined e=Estimate/1000 %=Estimate % Max=No Estimate
 International Plasma Lab Ltd. 2036 Columbia St. Vancouver BC V5Y 3E1 Ph: 604/879-7878 Fax: 604/879-7898

Doc. No. 95-04 0000 NAL WHITEHORSE 1-400-0400-4050

STATEMENT OF EXPENDITURESTransportation

Whitehorse-Hoole River area with 4x4 pickup w. camper. 1010 km return @ 42¢/km	\$ 424.20
--	-----------

Assays

Northern Analytical Laboratories, Whitehorse. 9 till samples -200 mesh Au+30 ICP (receipt attached)	153.55
---	--------

Subsistence

In-field 30-31 August and 01 Sept- ember, 1995 3 days @ YMIP con- tractors' rate of \$55.20/day	165.60
---	--------

Labor

Geological reconnaissance mapping J.S. Dodge, P.Eng. Yukon 11 and 30-31 August; 3 days @ \$400/day	\$1,200
Hand digging 9 pits for till sampling and field sieving to -2mm. J.S.Dodge as laborer 8 hrs. 01 Sept. @ \$12/hr.	96
Laboratory mechanical repeat- sieving 9 samples and weighing J.S.Dodge, P.Eng. 0.5 day @ \$400/d	200
Office report preparation/typing 2 days, 28-30 October, 1995 @ \$200/day J.S.Dodge, P.Eng.	<u>400</u>
	1,896.00

Expendables

Report binders, flagging, sample bags, office supplies	<u>22.00</u>
---	--------------

\$ 2,661.35

NORTHERN ANALYTICAL LABORATORIES LTD.

105 COPPER ROAD
 WHITEHORSE, YUKON Y1A 2Z7
 403-668-4968
 GST REG #R121285662

OUR NUMBER	628338
DATE	OCT 18 1995
CUSTOMER'S ORDER	
SALESMAN	
TERMS	
F.O.B.	

TAX REG. NO. _____
 SOLD TO JAMES DODGE

 SHIP TO _____
 ADDRESS _____ VIA _____

INVOICE

QUANTITY	DESCRIPTION	PRICE	AMOUNT
	WO # 15420		
9	AW + 30	15 50	139 50
1	FAX SET-UP CHARGE	2 00	2 00
2	PER PAGE FAX CHARGE	1 00	2 00
	PAID CK # 195		\$143 50
		7% GST	10 05
	JR	TOTAL	\$153 55

STATEMENT OF QUALIFICATIONS

I, James S. Dodge, of 14 MacDonald Road, Whitehorse, Yukon Canada submit the following information which establishes some of my qualifications bearing on the necessary level of competence required to carry out the field work and preparation of this preliminary report on the MIDAS quartz claims in the Yukon.

Education

Missouri School of Mines, B.S. Mining Engineering, 1941
Princeton University, Field Geology, 1940
Stanford University, M.S. Economic Geology, 1951
Albert Ludwigs Universitaet (Germany), Economic Geology, 1952

Experience

Active in mineral industry since 1941 (including U.S. Army engineers) in North and South America, Asia and Africa as prospector, company geologist, mining engineer, mine operator, and consultant in ferrous and non-ferrous metals and in industrial minerals. Among the many organizations which I have been associated as an employee and consultant:

Anaconda, Esso, Mitsui, USAEC, Ventures, DIAND, SCAP-Japan, Atlas, Glidden, Spartan/Nuspar, Hirst-Chichagof, Floyd Odium, Yukon Barite and numerous small mining ventures.

Experience in vein-type gold mines in Colorado (South London) and Alaska (Hirst-Chichagof) is specifically applicable to evaluation of the MIDAS property.

Professional Affiliations

Registered Professional Engineer (No. 311) by Association of Professional Engineers of the Yukon Territory
Senior Fellow of the Society of Economic Geologists
Senior Member of Society of Mining, Metallurgy and Exploration

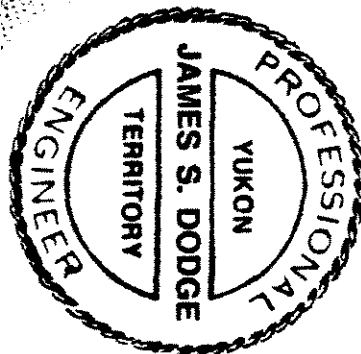

James S. Dodge
James S. Dodge, P.Eng.

ROSS RIVER - 62 KM

HOOLE R BRIDGE

A. CARLOS 1988

ACCESS ROAD

ELDORADO

ELDORADO

MIDAS

MIDAS

MIDAS

MIDAS

DODGEX 1994

1°42'N

3500

093355

DWG ①

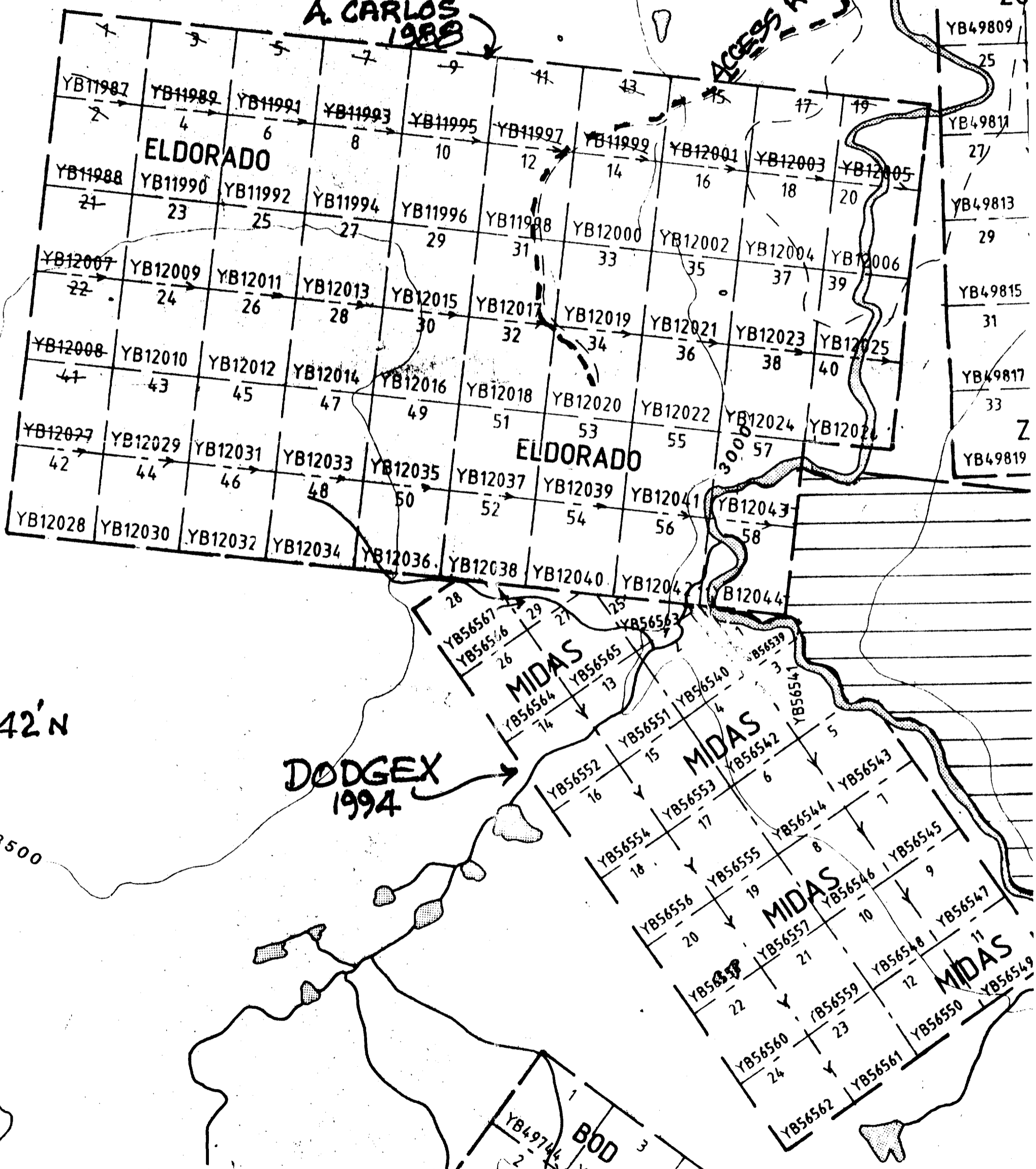

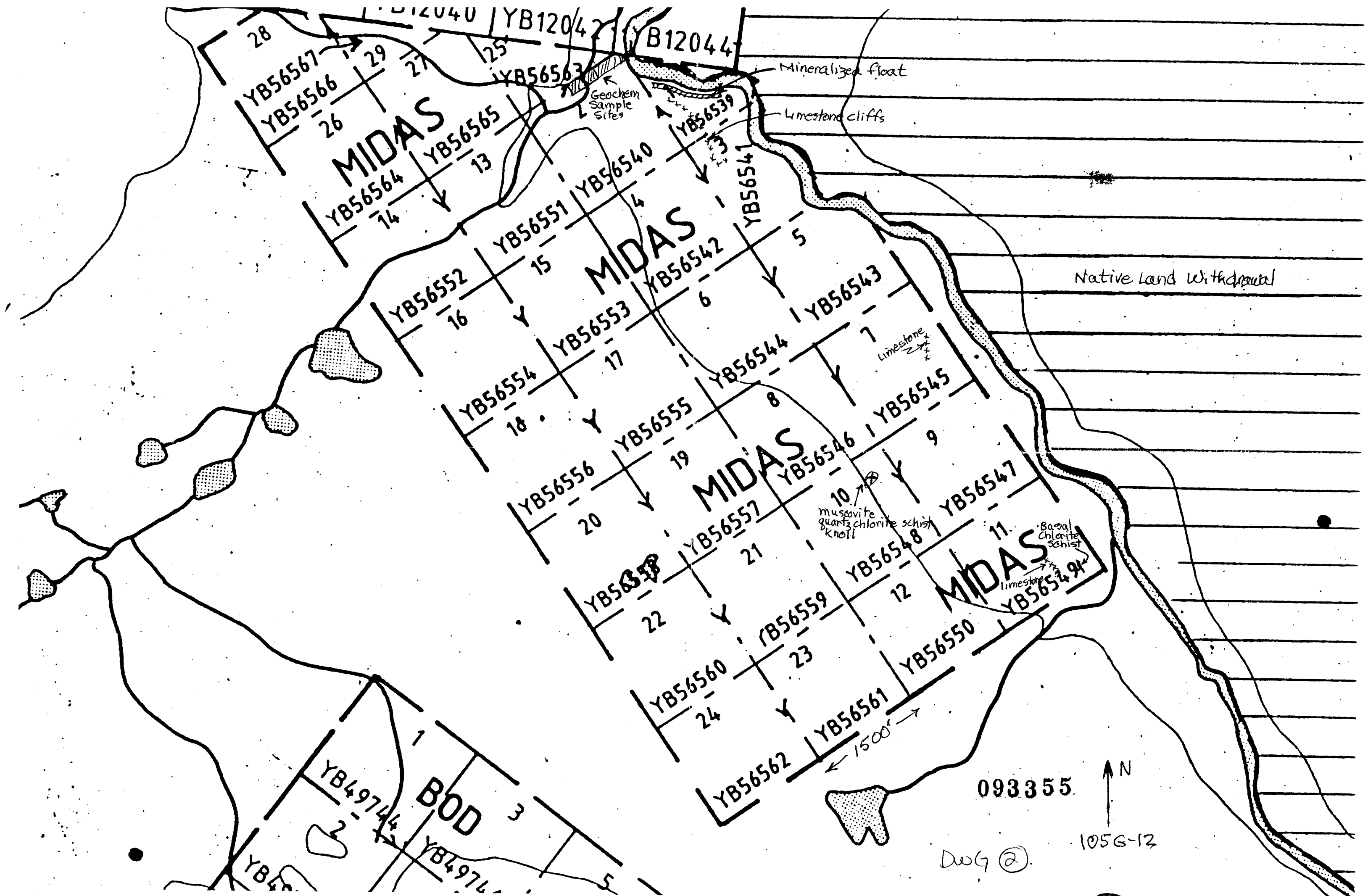

28
YB56567
YB56566
26

MIDAS

YB56564
14

YB56565
13

YB56551
15

MIDAS

YB56540
4

YB56552
16

YB56553
17

YB56554
18

YB56555
19

MIDAS

YB56556
20

YB56557
21

YB56544
8

YB56546
10

YB56548
12

MIDAS

YB56547
11

YB56549
13

YB56560
24

YB56559
23

YB56561
25

YB56550
26

YB49744
2

BOD

YB49744
3

YB49744
5

YB56562
27

YB56563
28

YB56564
29

YB56565
30

YB12044
31

Mineralized float

Limestone cliffs

Native Land Withdrawal

limestone

muscovite
quartz chlorite schist
knoll

Basal
Chlorite
schist

limestone

093355

N

1056-12

DWG ②

1500'

Geochem
Sample
Sites