

COMINCO LTD.

EXPLORATION

NTS 105 G/8

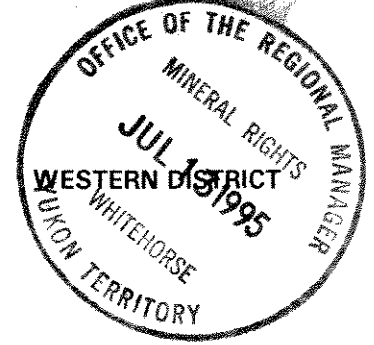

1994 ASSESSMENT REPORT

GO and NAD PROPERTIES



SOIL GEOCHEMISTRY AND GEOLOGICAL MAPPING

WATSON LAKE M.D., YUKON

CAMPBELL RANGE AREA

WORK PERIOD

JULY 16, 18 and 23 and AUGUST 9, 1994

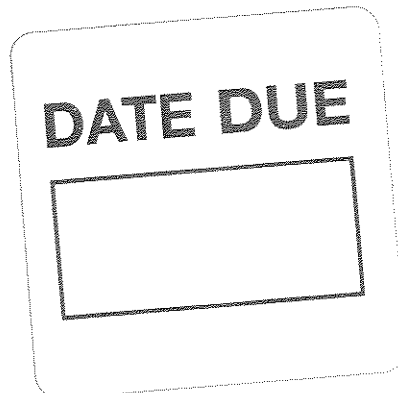

APRIL, 1995

PAUL A. MacROBBIE

TABLE OF CONTENTS

	<u>Page</u>
1. SUMMARY	1
2. LOCATION AND ACCESS	2
3. PROPERTY AND OWNERSHIP	2
4. PREVIOUS WORK	2
5. 1994 WORK	2
6. REGIONAL GEOLOGY	4
7. GO PROPERTY GEOLOGY AND GEOCHEMISTRY	4
8. NAD PROPERTY GEOLOGY AND GEOCHEMISTRY	5
9. CONCLUSIONS AND RECOMMENDATIONS	5
10. REFERENCES	7
FIGURE 1 GENERAL LOCATION	3
APPENDIX 1 STATEMENT OF QUALIFICATIONS	
APPENDIX 2 1994 GEOCHEMISTRY DATA	
APPENDIX 3 STATEMENTS OF EXPENDITURES	

ATTACHMENTS

FIGURE 2 CLAIM MAP (1:10,000)	
FIGURE 3 GEOLOGY MAP (1:10,000)	
FIGURE 4 GEOCHEMISTRY MAP (1:10,000)	

This report has been examined by the Geological Evaluation Unit under Section 53 (4) Yukon Quartz Mining Act and is allowed as representation work in the amount of \$ 9200.

M. B. ...

for Regional Manager, Exploration and Geological Services for Commissioner, of Yukon Territory.

1994 ASSESSMENT REPORT
GO AND NAD PROPERTIES, YUKON TERRITORY

1. SUMMARY

The GO and NAD properties, comprising 62 and 4 units respectively, are located south of Wolverine Lake, about 25 kms southeast of Cominco's ABM VHMS Deposit and approximately 140 kms southeast of Ross River.

The properties were staked to cover airborne geophysical targets identified during a Cominco survey conducted in early 1994.

The rocks underlying this part of southeastern Yukon have been assigned to 2 terranes: the Yukon-Tanana Terrane (YTT) and the Slide Mountain Terrane (SMT). The YTT consists primarily of a layered sequence of metamorphosed rocks comprising a "lower unit" of pre-Devonian quartzite, pelitic schist and minor marble, a late Devonian to mid-Mississippian "middle unit" comprising carbonaceous phyllite and schist with interbanded mafic and, locally significant, felsic metavolcanics, and an "upper unit" of Pennsylvanian marbles and quartzite. Volcanism within the "middle unit" was accompanied by the intrusion of 2-3, late Devonian to Mississippian, mafic to felsic metaplutonic suites. Felsic volcanics of the middle unit are host to Cominco's ABM VHMS Deposit.

Both the GO and NAD properties are underlain by late Devonian to mid-Mississippian, "middle unit" felsic metavolcanics (3G) and carbonaceous phyllite and schist with interbanded mafic metavolcanics (3F) of the Yukon Tanana Terrane.

Stratigraphy on the GO property generally trends northwest with shallow to moderate northeast dips. The structurally uppermost units comprise thin interbedded/banded, variably carbonaceous siltstone/mudstone with minor quartzite interbeds underlain by a coarse-grained tuffaceous metawacke containing feldspar augen and opalescent blue quartz grains and minor carbonaceous mudstone/siltstone and pyritic, felsic quartz-sericite schists interbands/beds. This metasedimentary sequence overlies a thick package of fine-grained massive quartz-feldspar-sericite schist (tuff and locally fine crystal-rich tuff).

Contour soil sampling along the western margin of the GO property returned elevated Ag, Pb and Zn values in an area downslope of the interbedded, pyritic felsic volcanics and mudstones. To the southeast, elevated to strongly anomalous Zn (up to 2645 ppm) and Cu (up to 275 ppm) with supporting elevated Ag values are present in an area underlain by the uppermost siltstone/mudstone unit.

Stratigraphy on the NAD property generally trends north to northeast with shallow to moderate east to southeast dips. The property is underlain by a package of rusty weathering, pyritic and siliceous, laminated to thin banded/bedded felsic quartz-sericite±chlorite phyllitic schists (cherty tuffs?) and more massive, fine-grained quartz-sericite±feldspar schists (tuffs to crystal-rich tuffs?) with occasional quartz crystal fragments. White quartz±tourmaline veins are present on the property. Underlying light to medium grey, thin to medium interbanded/bedded quartz-feldspar-biotite±chlorite gneissic schists likely reflecting an interbedded, arkosic sandstone-siltstone sequence, are exposed lower on the slopes.

A single, short soil contour line on the NAD property returned several coincident, weak to strong Zn (up to 660 ppm), Pb (up to 130 ppm) and supporting elevated to moderately anomalous Cu (up to 187 ppm) values downslope of the pyritic felsic volcanics. Rock samples from these outcrops returned no anomalous base or precious metal values.

Further geological mapping, prospecting and soil geochemistry sampling is recommended for the GO and NAD properties. A small ground HLEM/Mag survey in the area of the NAD AEM/Mag anomaly is warranted.

2. LOCATION AND ACCESS

The GO and NAD properties are located south of Wolverine Lake, about 25 kms southeast of Cominco's ABM VHMS Deposit and approximately 140 kms southeast of Ross River (Figures 1). The gravel, all-weather Robert Campbell Highway provides access to within 15 kms of the GO property. Direct access is by helicopter.

3. PROPERTY AND OWNERSHIP

The GO property, totalling 62 units, and NAD property, totalling 4 units, (Figure 2) are 100% owned by Cominco Ltd. The GO and NAD claim blocks, with subsequent Cominco staking, are now contiguous with the larger MONY and EXPO claim blocks.

<u>NAME</u>	<u>UNITS</u>	<u>CLAIM NO.</u>	<u>DUE DATES</u>
GO 1-28	28	YB47402-429	April 15/95
GO 29-62	34	YB47760-793	May 2/95
NAD 1-4	4	YB47430-433	April 15/95

4. PREVIOUS WORK

No previous work or known showings were recorded by the government in the immediate GO and NAD property area.

At the south end of Wolverine Lake, approximately 2 kms north of the GO property, is the Fetish showing (Minfile #72) (Figure 3). This showing was initially staked by the Finlayson JV in 1973. The FJV conducted grid soil sampling, geological mapping, trenching and drilled 2 holes (249 m) in the same year and more soil sampling in 1974. The mineralization consists of trace chalcopryrite and galena in strongly leached, limonitic chloritic schists and quartz float. Drilling intersected thin bands of chalcopryrite and sphalerite in a soft, contorted talc-sericite-chlorite schist unit up to 20 metres thick. Several magnetite Fe-formations are present stratigraphically above the Fetish mineralization.

Approximately 8 kms south of the NAD property is the Money showing (Minfile #81). This occurrence was initially staked by Cyprus Anvil Mining Corp. in 1975 and explored by grid soil sampling and a Mag survey. The showings comprise minor galena as discontinuous lenses within felsic volcanic schists. A Zn-Mo + Pb-Cu soil anomaly was attributed to elevated backgrounds within black shale interbeds. The claims subsequently lapsed.

5. 1994 WORK

GO PROPERTY GEOLOGICAL MAPPING

On July 23, 1994, 1:10,000 scale geological mapping and prospecting was carried out by A.B. Mawer (Figure 3).

SOIL GEOCHEMISTRY

A total of 158 soil samples were collected on August 9, 1994. Data is presented in Figure 3 and Appendix 2.

NAD PROPERTY GEOLOGICAL MAPPING

On July 16 and 18, 1994, 1:10,000 scale geological mapping and prospecting was carried out by P.A. MacRobbie, N.J. Callen and A.B. Mawer (Figure 3).

SOIL GEOCHEMISTRY

A total of 18 soil samples and 3 rocks were collected. Data is presented in Figure 3 and Appendix 2.

The soil and rock samples were analyzed for Cu, Pb, Zn, Ag, As, Cd, Co, Ni, Fe, Mo, Cr, Bi, Sb, V, Sn, W, Sr, Y, La, Mn, Mg, Ti, Al, Ca, Na and K by I.C.P., Au by Aqua Regia decomposition/AAS and Ba by XRF at Cominco Exploration Research Laboratory (CERL) in Vancouver.

6. REGIONAL GEOLOGY

The rocks underlying this part of southeastern Yukon have been assigned to 2 terranes: the Yukon-Tanana Terrane (YTT) and the Slide Mountain Terrane (SMT) (Mortensen, 1983a; Mortensen and Jilson, 1985).

The YTT consists primarily of a layered sequence of metamorphosed rocks comprising a "lower unit" of pre-Devonian quartzite, pelitic schist and minor marble, a late Devonian to mid-Mississippian "middle unit" (3F) comprising carbonaceous phyllite and schist with interbanded mafic and, locally significant, felsic metavolcanics (3G), and an "upper unit" of Pennsylvanian marbles and quartzite. Volcanism within the "middle unit" was accompanied by the intrusion of 2-3, late Devonian to Mississippian, mafic to felsic metaplutonic suites (Simpson Range suite and augen and monzonitic orthogneisses). This sequence appears to reflect stable platformal or shelf sedimentation with an intervening period of mafic to felsic arc volcanism developed within a more reduced basinal setting.

The late Devonian to Triassic SMT comprises a heterogeneous package of mafic to ultramafic plutonic rocks, mafic volcanics, massive carbonate and chert. This sequence was structurally emplaced as thrust bounded klippen on YTT rocks or as thrust slices imbricated within YTT rocks during a period of crustal shortening (D2). The SMT is thought to represent a disrupted oceanic crust and volcanic arc assemblage thought to be located between the YTT and ancestral North America(?).

A subhorizontal to moderately north to northeast dipping, penetrative ductile deformation fabric (S2) and associated middle greenschist facies (chlorite-biotite grade) metamorphism affects all YTT rocks. This fabric reflects the first, and most significant, deformational and metamorphic event (D1) perhaps related to a continent-arc collision during late Permian to early Triassic time.

Late Triassic immature clastics comprising micaceous argillite, siltstone and sandstone unconformably(?) overlie the deformed and metamorphosed YTT rocks. These sediments are often closely associated with SMT volcanics and are invariably in fault contact with YTT rocks.

The SMT, Late Triassic sediments and Late Triassic to Middle Jurassic plutons are all affected by a period of Middle Jurassic to Late Cretaceous thrust faulting (D2), during which the Finlayson Lake Fault Zone was formed. This complex fault zone contains both thrust and steep, transcurrent(?) faults and separates the YTT from autochthonous North America (Mortensen, 1983a; Mortensen and Jilson, 1985). Thrust faulting continued after the formation of the Finlayson Lake Fault Zone as indicated by the presence of over thrust sheets of SMT rocks (Campbell Range Belt) above the fault zone.

7. GO PROPERTY GEOLOGY and GEOCHEMISTRY

GEOLOGY

The GO property is underlain by late Devonian to mid-Mississippian, "middle unit" felsic metavolcanics (3G) and carbonaceous phyllite and schist with interbanded mafic metavolcanics (3F).

The property is generally poorly exposed with outcrops restricted to creeks and ridges. The stratigraphy generally trends northwest with shallow to moderate northeast dips and has been divided into a felsic volcanic interval and several metasedimentary intervals (Figure 3). The structurally uppermost unit is exposed on a ridge on the GO-1 and GO-4 claims. Here the unit comprises thin interbedded/banded dark grey to black, variably carbonaceous siltstone and mudstone with thicker dark grey quartzite interbeds containing abundant white quartz veins. This metasedimentary interval appears to be underlain by a metasedimentary/felsic metavolcanic(?) unit consisting of light green grey, massive quartz-feldspar-biotite gneissic schist and phyllitic schist, up to several 100's of metres thick, containing feldspar augen and opalescent blue quartz grains. The presence of blue quartz and locally significant biotite suggest this interval is in fact a coarse-grained, tuffaceous metawacke, similar to wackes in the structural hangingwall

to the ABM VHMS Deposit. Interbeds/bands of black carbonaceous mudstone and siltstone and pyritic, quartz-sericite schists (felsic tuffs?) are present near a gradational contact into a thick package of grey weathering, fine-grained massive quartz-feldspar tuff (locally fine crystal-rich tuff) exposed in creek cuts. The base of this felsic volcanic unit has not been defined.

GEOCHEMISTRY

Contour soil sampling along the western margin of the property returned elevated Ag (>0.6, up to 1.7 ppm), Pb (>30, up to 100 ppm) and Zn (>125, up to 246 ppm) values in an area downslope of the interbedded, pyritic felsic volcanics and mudstones. To the southeast, elevated to strongly anomalous Zn (>125, up to 2645 ppm) and Cu (>30, up to 275 ppm) with supporting elevated Ag (>0.6, up to 1.8 ppm) values are present in an area underlain by the uppermost siltstone/mudstone unit.

8. NAD PROPERTY GEOLOGY and GEOCHEMISTRY

GEOLOGY

The NAD property is located about 5 kms south of the GO property and is also underlain by late Devonian to mid-Mississippian, "*middle unit*" felsic metavolcanics (3G) and carbonaceous phyllite and schist with interbanded mafic metavolcanics (3F).

The property is generally poorly exposed. The stratigraphy generally trends north to northeast with shallow to moderate east to southeast dips (Figure 3). The upper slopes are underlain by a package of rusty weathering, pyritic and siliceous, laminated to thin banded/bedded felsic quartz-sericite±chlorite phyllitic schists (cherty tuffs?) and more massive, fine-grained quartz-sericite±feldspar schists (tuffs to crystal-rich tuffs?) with occasional quartz crystal fragments. White quartz±tourmaline veins are present on the property. Lower on the slope are light to medium grey, thin to medium interbanded/bedded quartz-feldspar-biotite±chlorite gneissic schists likely reflecting an interbedded, arkosic sandstone-siltstone sequence.

GEOCHEMISTRY

A single, short soil contour line returned several coincident, weak to strong Zn (>300, up to 660 ppm), Pb (>40, up to 130 ppm) and supporting elevated to moderately anomalous Cu (up to 187 ppm) values downslope of the pyritic felsic volcanics. Rock samples from these outcrops returned no anomalous base or precious metal values.

9. CONCLUSIONS and RECOMMENDATIONS

Both the GO and NAD properties are underlain by late Devonian to mid-Mississippian, "*middle unit*" felsic metavolcanics (3G) and carbonaceous phyllite and schist with interbanded mafic metavolcanics (3F) of the Yukon Tanana Terrane.

Stratigraphy on the GO property generally trends northwest with shallow to moderate northeast dips. The structurally uppermost units comprise thin interbedded/banded, variably carbonaceous siltstone/mudstone with minor quartzite interbeds underlain by a coarse-grained tuffaceous metawacke containing feldspar augen and opalescent blue quartz grains and minor carbonaceous mudstone/siltstone and pyritic, felsic quartz-sericite schists interbands/beds. This metasedimentary sequence overlies a thick package of fine-grained massive quartz-feldspar-sericite schist (tuff and locally fine crystal-rich tuff).

Contour soil sampling along the western margin of the GO property returned elevated Ag, Pb and Zn values in an area downslope of the interbedded, pyritic felsic volcanics and mudstones. To the southeast, elevated to strongly anomalous Zn (up to 2645 ppm) and Cu (up to 275 ppm) with supporting elevated Ag values are present in an area underlain by the uppermost siltstone/mudstone unit.

Further geological mapping, prospecting and soil geochemistry sampling is recommended for the GO property.

Stratigraphy on the NAD property generally trends north to northeast with shallow to moderate east to southeast dips. The property is underlain by a package of rusty weathering, pyritic and siliceous, laminated to thin banded/bedded felsic quartz-sericite±chlorite phyllitic schists (cherty tuffs?) and more

massive, fine-grained quartz-sericite±feldspar schists (tuffs to crystal-rich tuffs?) with occasional quartz crystal fragments. White quartz±tourmaline veins are present on the property. Underlying light to medium grey, thin to medium interbanded/bedded quartz-feldspar-biotite±chlorite gneissic schists likely reflecting an interbedded, arkosic sandstone-siltstone sequence are exposed lower on the slopes.

A single, short soil contour line on the NAD property returned several coincident, weak to strong Zn (up to 660 ppm), Pb (up to 130 ppm) and supporting elevated to moderately anomalous Cu (up to 187 ppm) values downslope of the pyritic felsic volcanics. Rock samples from these outcrops returned no anomalous base or precious metal values.

Further geological mapping, prospecting and soil geochemistry sampling is recommended for the NAD property. A small ground HLEM/Mag survey in the area of the AEM/Mag anomaly is warranted.

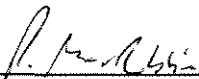
Report by: 
P.A. MacRobbie, P.Geol
Geologist

Endorsed by: 
D. Rhodes,
Senior Geologist

Approved for
Release by: 
J.M. Hamilton
Manager, Exploration
Western Canada

PAM/

DISTRIBUTION:
W.D. Files
Mining Recorder

- MORTENSEN, J. K., 1983a. AGE AND EVOLUTION OF THE YUKON-TANANA TERRANE, SOUTHEASTERN YUKON TERRITORY [Ph.D. Thesis]; Santa Barbara, University of California, 155 p.
- MORTENSEN, J. K. AND JILSON, G. A., 1985. EVOLUTION OF THE YUKON-TANANA TERRANE : EVIDENCE FROM SOUTHEASTERN YUKON TERRITORY; *Geology*, 13, p. 806-810.

APPENDIX 1
STATEMENT OF QUALIFICATIONS

STATEMENT OF QUALIFICATIONS

I, Paul A. MacRobbie, of 11164 Southridge Rd., Delta, B.C. hereby declare that I:

1. Graduated from Carleton University, Ottawa, Ontario with a B.Sc. in Geology in May, 1986 and a M.Sc. in Geology in June, 1988.
2. Have been actively engaged in mineral exploration in Western Canada as a permanent geologist with Cominco Ltd. since June, 1988.
3. Am a registered member of The Association of Professional Engineers and Geoscientists of the Province of British Columbia.

Date: April 10, 1995



P.A MacROBBIE, P.Geo
GEOLOGIST

APPENDIX 2

1994 GEOCHEMISTRY DATA

Property	LabNo	FieldNo	S	M	O	S	Col	Sz	O	W	Dph	W/S	FW	P	Cu	Pb	Zn	Ag	As	Ba(1cp)	Cd	Co	Ni	Fe	Mo	Cr	Bi	Sb	V	Sn	W	Sr	Y	La	Mn	Mg	Ti	Al	Ca	Na	K	Au	Wt	Ba(xrf)
Go	S9419224	243418	**	1	5	**	YB	24	1	1	20	2	B	**	12	15	81	0.2	11	84	1	6	19	1.75	6	20	2	2	25	13	1	8	15	27	201	0.38	0.02	1.24	0.11	0.01	0.05	5	10	1405
Go	S9419225	243419	**	1	5	**	YB	23	1	1	20	3	B	**	9	27	95	0.4	10	75	1	6	19	1.95	5	19	2	2	24	12	1	6	13	24	182	0.29	0.01	1.64	0.07	0.01	0.08	5	10	1218
Go	S9419226	243420	**	1	5	**	YB	23	1	1	20	2	B	**	5	22	65	0.2	6	74	1	3	10	1.56	5	15	2	7	23	5	1	5	10	23	115	0.19	0.01	1.05	0.03	0.01	0.04	5	10	1515
Go	S9419227	243421	**	1	5	**	YB	23	1	1	25	2	B	**	5	21	51	0.2	2	68	1	2	8	1.08	5	11	2	2	17	9	1	4	9	23	82	0.16	0.01	0.94	0.03	0.01	0.04	5	10	1480
Go	S9419228	243422	**	1	5	**	YB	43	1	1	20	1	B	**	3	21	49	0.4	8	86	1	2	8	1.25	4	12	2	2	20	7	1	5	9	19	88	0.15	0.01	1.10	0.03	0.01	0.03	5	10	1385
Go	S9419229	243423	**	1	5	**	2B	23	1	1	20	2	B	**	2	18	24	0.2	1	40	1	1	1	0.51	4	2	2	2	13	1	1	4	2	10	34	0.02	0.01	0.37	0.01	0.01	0.02	5	10	1263
Go	S9419230	243424	**	1	5	**	YB	23	1	1	20	1	B	**	4	16	40	0.2	10	95	1	2	6	1.08	3	10	2	6	18	7	1	8	12	21	59	0.12	0.01	1.09	0.03	0.01	0.03	5	10	1251
Go	S9419231	243425	**	1	5	**	YB	24	1	2	20	1	B	**	7	36	85	0.2	9	132	1	4	11	1.77	1	17	2	2	25	8	1	7	14	33	130	0.25	0.01	1.45	0.04	0.01	0.06	5	10	1691
Go	S9419232	243426	**	1	5	**	YB	24	1	2	20	1	B	**	8	36	96	0.2	9	141	1	5	12	1.90	5	18	2	2	26	11	1	7	14	32	128	0.28	0.01	1.49	0.04	0.01	0.06	5	10	1655
Go	S9419233	243427	**	1	5	**	2B	23	1	1	20	1	B	**	9	32	70	0.2	7	110	1	3	11	1.69	3	17	2	2	26	8	1	8	11	24	138	0.26	0.01	1.32	0.04	0.01	0.06	5	10	1545
Go	S9419234	243428	**	1	5	**	2B	23	1	1	15	1	B	**	7	25	48	0.2	11	60	1	2	7	1.60	1	13	2	2	21	4	1	6	4	11	130	0.15	0.01	1.03	0.03	0.01	0.05	5	10	1281
Go	S9419235	243429	**	1	5	**	YB	24	1	1	20	1	B	**	7	16	66	0.2	5	65	1	6	26	2.43	1	28	2	5	36	10	1	8	7	11	345	0.58	0.08	1.88	0.14	0.01	0.13	5	10	1089
Go	S9419236	243430	**	1	5	**	YB	34	1	1	25	1	B	**	15	25	111	0.2	7	94	1	6	22	2.52	1	29	2	2	35	1	1	8	18	25	266	0.48	0.03	2.20	0.10	0.01	0.12	5	10	1327
Go	S9419237	243431	**	1	5	**	2B	23	1	1	20	1	B	**	8	18	68	0.2	1	77	1	3	12	2.15	1	15	2	2	33	3	1	7	6	12	213	0.35	0.04	1.34	0.05	0.01	0.18	5	10	1350
Go	S9419238	243432	**	1	5	**	3B	24	1	1	30	1	B	**	7	11	71	0.2	4	100	1	4	17	2.29	2	23	2	2	36	7	1	6	7	11	446	0.35	0.08	1.46	0.07	0.01	0.09	5	10	1002
Go	S9419239	243433	**	1	5	**	RB	24	1	1	15	1	B	**	8	13	91	0.2	16	66	1	7	20	2.93	1	30	2	2	39	2	1	6	6	7	634	0.49	0.09	2.10	0.14	0.01	0.18	5	10	936
Go	S9419240	243434	**	1	5	**	RB	23	1	1	20	1	B	**	11	16	74	0.2	8	99	1	5	19	2.44	1	26	2	2	40	3	1	8	7	14	212	0.44	0.04	1.61	0.09	0.01	0.08	5	10	1291
Go	S9419241	243435	**	1	5	**	RB	24	1	1	15	1	B	**	7	16	86	0.2	9	67	1	6	33	2.73	1	38	2	2	36	2	1	4	5	9	212	0.58	0.09	2.11	0.09	0.01	0.12	5	10	983
Go	S9419242	243436	**	1	5	**	RB	24	1	1	20	1	B	**	7	19	67	0.2	1	71	1	4	18	2.30	1	28	2	2	33	7	1	5	6	10	192	0.45	0.05	1.98	0.08	0.01	0.08	5	10	1091
Go	S9419243	243437	**	1	5	**	RB	23	1	1	20	1	B	**	7	15	72	0.2	13	59	1	6	25	2.41	1	30	2	2	32	2	1	5	7	10	275	0.56	0.07	1.78	0.14	0.01	0.13	5	10	1027
Go	S9419244	243438	**	1	5	**	RB	34	1	1	25	1	B	**	9	22	78	0.2	8	98	1	5	16	3.50	1	34	2	2	68	10	1	6	5	8	352	0.56	0.13	1.99	0.09	0.01	0.16	5	10	955
Go	S9419245	243439	**	1	5	**	2B	24	1	1	20	1	B	**	10	12	65	0.2	3	78	1	5	21	1.92	1	23	2	2	30	5	1	7	9	17	215	0.43	0.05	1.98	0.12	0.01	0.09	5	10	1247
Go	S9419246	243440	**	1	5	**	RB	34	1	1	20	1	B	**	5	16	47	0.5	10	79	1	3	13	2.17	1	23	2	2	35	3	1	6	7	13	209	0.34	0.04	1.91	0.08	0.01	0.09	5	10	1037
Go	S9419247	243441	**	1	5	**	RY	34	1	1	20	1	B	**	8	19	84	0.2	11	99	1	6	23	2.86	1	33	2	2	41	8	1	5	5	10	283	0.56	0.07	2.25	0.08	0.01	0.12	5	10	1118
Go	S9419248	243442	**	1	5	**	RB	24	1	1	20	1	B	**	9	17	78	0.2	7	76	1	7	30	2.54	1	31	2	2	34	8	1	6	8	12	326	0.61	0.07	1.80	0.16	0.01	0.16	5	10	1080
Go	S9419249	243443	**	1	5	**	2B	23	1	1	20	1	B	**	9	38	106	0.2	9	68	1	2	9	1.92	2	14	2	2	24	3	1	8	10	20	171	0.22	0.01	1.01	0.04	0.01	0.09	5	10	1363
Go	S9419250	243444	**	1	5	**	2B	23	1	1	25	2	B	**	8	27	80	0.2	11	91	1	1	7	1.62	4	10	2	2	23	10	1	8	15	23	82	0.13	0.02	1.00	0.04	0.01	0.06	5	10	1333
Go	S9419251	243445	**	1	5	**	2B	23	1	1	30	2	B	**	7	32	78	0.2	14	70	1	1	6	1.35	2	7	2	2	18	3	1	7	11	23	160	0.11	0.01	0.62	0.02	0.01	0.07	5	10	1308
Go	S9419252	243446	**	1	5	**	1B	23	1	1	20	2	B	**	5	19	63	0.2	3	89	1	1	2	0.74	1	2	2	2	11	1	1	5	5	13	49	0.04	0.01	0.50	0.02	0.01	0.05	5	10	1352
Go	S9419253	243447	**	1	5	**	1B	23	1	1	20	2	B	**	4	14	61	0.2	3	51	1	1	3	0.75	1	2	2	2	13	1	1	5	4	11	83	0.04	0.01	0.48	0.03	0.01	0.05	5	10	1439
Go	S9419254	243448	**	1	5	**	1B	23	1	1	20	2	B	**	6	15	72	0.2	3	62	1	1	2	0.80	1	4	2	2	16	1	1	4	3	12	44	0.03	0.01	0.47	0.02	0.01	0.05	5	10	1493
Go	S9419255	243449	**	1	5	**	2B	23	1	1	20	2	B	**	8	16	114	0.2	11	91	2	2	6	1.46	1	10	2	2	24	1	1	6	4	12	135	0.15	0.02	0.76	0.05	0.01	0.08	5	10	1388
Go	S9419256	243450	**	1	5	**	1B	23	1	1	20	3	B	**	4	11	64	0.2	4	73	1	1	3	0.74	1	4	2	2	11	2	1	5	5	12	157	0.07	0.01	0.39	0.04	0.01	0.08	5	10	1261
Go	S9419257	243451	**	1	5	**	YB	24	1	1	20	3	B	**	4	11	75	0.2	1	73	1	3	11	1.97	1	18	2	2	32	1	1	5	3	8	150	0.35	0.07	1.13	0.06	0.01	0.13	5	10	1227
Go	S9419258	243452	**	1	5	**	YB	23	1	1	30	3	B	**	5	6	108	0.2	6	88	1	3	12	1.68	1	21	2	2	34	3	1	6	3	11	176	0.32	0.04	0.95	0.08	0.01	0.11	5	10	1548
Go	S9419259	243453	**	1	5	**	RY	23	1	1	20	3	B	**	6	16	102	0.2	17	126	1	5	17	2.76	1	27	2	2	39	7	1	6	5	10	175	0.49	0.07	1.56	0.10	0.01	0.17	5	10	1250
Go	S9419260	243454	**	1	5	**	RB	24	1	1	20	3	B	**	4	13	91	0.2	2	92	1	2	9	1.47	1	12	2	2	22	1	1	7	4	11	114	0.24	0.03	0.90	0.07	0.01	0.12	5	10	1287
Go	S9419261	243455	**	1	5	**	1B	23	1	1	20	3	B	**	5	15	68	0.2	3	143																								

Go	S9419288	243482	**	1	5	**	YB	34	1	1	25	3	B	**	92	14	252	0.6	7	140	1	3	37	2.46	1	13	2	2	42	8	1	23	9	15	106	0.40	0.01	1.14	0.16	0.01	0.08	5	10	1613
Go	S9419289	243483	**	1	2	**	RB	24	1	1	15	3	B	**	7	10	218	0.2	7	215	3	6	10	1.71	1	13	2	2	24	1	1	8	3	6	783	0.20	0.02	1.02	0.07	0.01	0.11	5	10	1611
Go	S9419290	243484	**	1	5	**	1B	24	1	1	15	3	B	**	10	9	87	0.2	8	156	1	7	10	1.31	1	13	2	2	20	3	1	12	4	10	606	0.29	0.05	0.81	0.12	0.01	0.22	5	10	1593
Go	S9419291	243485	**	1	2	**	Y	24	1	1	20	3	B	**	9	11	68	0.2	6	112	1	2	7	1.39	1	8	2	2	20	1	1	8	4	11	136	0.18	0.03	0.55	0.05	0.01	0.14	5	10	1463
Go	S9419292	243486	**	1	2	**	RB	2	1	1	30	3	B	**	12	90	174	0.2	1	163	1	4	12	3.40	1	2	2	2	14	2	1	20	12	26	216	0.02	0.01	0.65	0.04	0.01	0.18	5	10	1579
Go	S9419293	243487	**	1	2	**	BR	34	1	1	25	3	B	**	22	12	112	0.4	15	97	2	5	23	2.53	1	26	2	2	48	2	1	10	4	8	187	0.57	0.06	1.45	0.09	0.01	0.16	5	10	1606
Go	S9419615	217047	**	1	2	**	1B	23	1	1	25	2	B	**	7	14	42	0.4	1	75	1	2	5	0.94	2	5	2	2	15	2	1	6	4	11	87	0.06	0.01	0.58	0.03	0.02	0.05	5	10	1410
Go	S9419616	217048	**	1	2	**	BY	23	1	1	25	2	B	**	8	19	78	0.8	1	86	1	3	10	1.69	3	13	2	2	26	1	1	8	5	12	132	0.21	0.01	1.32	0.03	0.01	0.06	5	10	1498
Go	S9419617	217049	**	1	2	**	1B	23	1	1	25	2	B	**	6	13	53	0.2	1	74	1	1	3	0.63	3	2	2	2	10	1	1	4	6	10	38	0.02	0.01	0.60	0.01	0.01	0.04	5	10	1587
Go	S9419618	217050	**	1	2	**	2B	23	1	1	25	2	B	**	5	19	81	0.2	1	52	1	1	2	0.71	3	2	2	2	10	1	1	4	5	8	34	0.02	0.01	0.49	0.02	0.01	0.05	5	10	1693
Go	S9419619	217051	**	1	2	**	2B	23	1	1	25	2	B	**	19	42	40	0.2	4	98	5	1	15	1.05	8	7	2	2	8	1	1	5	38	78	29	0.04	0.01	2.37	0.03	0.02	0.03	5	10	841
Go	S9419620	217052	**	1	2	**	2B	23	1	1	25	2	B	**	7	31	86	0.4	1	104	1	1	6	1.32	4	5	2	2	18	4	1	7	11	21	53	0.07	0.01	0.76	0.03	0.01	0.05	5	10	1693
Go	S9419621	217053	**	1	2	**	BG	23	1	1	25	2	B	**	5	23	75	0.2	2	45	1	1	4	0.68	5	2	2	2	12	1	1	4	5	9	32	0.03	0.01	0.36	0.02	0.01	0.05	5	10	1937
Go	S9419622	217054	**	1	2	**	BY	23	1	1	25	2	B	**	10	17	79	0.2	5	141	1	6	18	1.91	2	17	2	2	29	1	1	7	13	29	137	0.35	0.01	1.70	0.04	0.01	0.07	5	10	1519
Go	S9419623	217055	**	1	2	**	1B	23	1	1	20	2	B	**	3	20	77	0.2	1	40	1	1	2	0.45	2	2	2	2	8	1	1	5	4	8	28	0.02	0.01	0.32	0.01	0.01	0.04	5	10	1782
Go	S9419624	217056	**	1	2	**	BG	23	1	1	20	2	B	**	6	31	113	0.2	4	59	1	1	3	0.76	4	2	2	2	17	1	1	4	5	8	45	0.01	0.01	0.36	0.01	0.01	0.04	5	10	1995
Go	S9419625	217057	**	1	2	**	2B	23	1	1	25	2	B	**	5	43	77	0.2	1	62	1	1	3	0.66	2	2	2	2	12	1	1	5	5	10	98	0.02	0.01	0.30	0.01	0.01	0.04	5	10	1613
Go	S9419626	217058	**	1	2	**	BY	23	1	1	25	2	B	**	12	26	156	0.2	7	113	1	4	17	2.12	7	15	2	2	32	1	1	6	17	24	140	0.30	0.02	1.65	0.04	0.01	0.07	5	10	1545
Go	S9419627	217059	**	1	2	**	BY	23	1	1	25	2	B	**	13	28	155	0.2	3	134	1	5	18	1.92	4	15	2	2	28	1	1	7	18	39	134	0.31	0.01	1.67	0.04	0.01	0.07	5	10	1605
Go	S9419628	217060	**	1	2	**	2B	23	1	1	25	2	B	**	3	20	137	0.2	6	85	1	1	4	0.75	8	2	2	2	9	1	1	3	6	8	63	0.02	0.01	0.47	0.02	0.01	0.04	5	10	1854
Go	S9419629	217061	**	1	2	**	2B	23	1	1	25	2	B	**	12	83	168	1.4	20	148	1	2	11	2.47	9	11	2	2	41	5	1	9	7	17	155	0.15	0.01	1.15	0.03	0.01	0.07	5	10	1892
Go	S9419630	217062	**	1	2	**	1B	23	1	1	30	2	B	**	3	21	41	0.6	1	181	1	2	4	1.10	2	7	2	2	24	1	1	7	7	19	75	0.08	0.01	1.39	0.04	0.01	0.03	5	10	1584
Go	S9419631	217063	**	1	2	**	BY	23	1	1	25	2	B	**	12	46	111	0.4	6	131	1	4	15	1.95	5	17	2	2	32	1	1	9	9	22	158	0.30	0.01	1.47	0.05	0.01	0.07	5	10	2049
Go	S9419632	217064	**	1	2	**	BG	23	1	1	30	2	B	**	31	114	118	1.7	13	317	1	8	27	2.45	7	22	2	2	45	1	1	13	21	31	250	0.48	0.02	1.68	0.05	0.01	0.08	5	10	2294
Go	S9419633	217065	**	1	2	**	3B	23	1	1	30	2	B	**	18	89	86	0.7	14	129	1	4	17	1.85	7	16	2	2	31	2	1	10	10	18	141	0.31	0.01	1.33	0.05	0.01	0.06	5	10	1927
Go	S9419634	217066	**	1	2	**	2B	34	1	1	30	2	B	**	5	100	55	0.8	1	82	1	1	6	1.14	6	9	2	2	29	1	1	6	4	9	94	0.08	0.02	0.54	0.03	0.01	0.04	5	10	1774
Go	S9419635	217067	**	1	2	**	1B	23	1	1	25	2	B	**	7	12	73	0.2	7	84	1	1	6	0.84	5	4	2	2	22	1	1	6	3	9	140	0.03	0.01	0.39	0.04	0.01	0.05	5	10	1373
Go	S9419636	217068	**	1	2	**	2B	2	1	1	30	2	B	**	9	30	246	0.4	13	78	1	3	12	2.17	6	9	2	2	23	1	1	12	13	25	99	0.16	0.01	0.89	0.02	0.01	0.06	5	10	1383
Go	S9419637	217069	**	1	2	**	3B	23	1	1	30	2	B	**	11	10	71	0.4	2	122	1	2	8	0.93	4	13	2	2	19	1	1	8	7	12	50	0.12	0.01	1.24	0.04	0.01	0.06	5	10	1245
Go	S9419638	217070	**	1	2	**	2B	23	1	1	30	2	B	**	23	5	29	0.2	1	118	4	1	6	0.24	2	2	2	2	3	1	1	12	22	24	56	0.01	0.01	0.53	0.08	0.04	0.04	5	10	1157
Go	S9419639	217071	**	1	2	**	3B	23	1	1	30	2	B	**	20	12	108	0.4	3	155	2	3	7	0.76	7	6	2	2	10	1	1	18	40	21	589	0.06	0.01	0.91	0.20	0.04	0.05	5	10	1113
Go	S9419640	217072	**	1	2	**	2G	23	1	1	25	2	B	**	4	6	33	0.2	1	37	1	1	2	0.33	5	2	2	2	9	1	1	4	2	16	18	0.01	0.01	0.32	0.01	0.02	0.04	5	10	1186
Go	S9419641	217073	**	1	2	**	3Y	3	1	1	20	2	B	**	9	16	67	0.2	4	55	1	3	10	1.49	3	13	2	2	22	1	1	7	6	15	116	0.25	0.01	0.94	0.07	0.01	0.05	5	10	1326
Go	S9419642	217074	**	1	2	**	3B	23	1	1	30	2	B	**	13	13	55	0.2	2	127	1	2	9	1.05	2	8	2	2	22	1	1	9	8	16	106	0.06	0.01	0.79	0.05	0.01	0.06	5	10	1286
Go	S9419643	217075	**	1	2	**	1B	23	1	1	25	2	B	**	6	5	31	0.2	1	60	1	1	5	0.76	2	4	2	2	14	1	1	5	3	10	53	0.03	0.01	0.55	0.04	0.01	0.05	5	10	1191
Go	S9419644	217076	**	1	2	**	1B	23	1	1	25	2	B	**	6	5	32	0.2	1	63	1	1	1	0.72	3	2	2	2	10	2	1	5	2	6	466	0.02	0.01	0.54	0.03	0.02	0.05	5	10	1313
Go	S9419645	217077	**	1	2	**	1B	23	1	1	25	2	B	**	7	14	44	0.2	3	83	1	1	5	0.88	4	4	2	2	17	1	1	8	3	10	55	0.04	0.01	0.59	0.07	0.02	0.07	5	10	1320
Go	S9419646	217078	**	1	2	**	BG	23	1	1	25	2	B	**	6	12	50	0.2	5	62	1	2	7	1.10	2	6	2	2	15	2	1	6	4	9	76	0.13	0.01	0.83	0.05	0.02	0.07	5	10	1303
Go	S9419647	217079	**	1	2	**	2B	23	1	1	25	2	B	**	16	25	25	0.2	2	102	1	2	7	1.52	2																			

Go	S9419674	217108	** 1 2 ** 2B	23 1 1 25	2 B **	8	38	51	0.2	4	101	1	4	11	1.54	2	11	2	2	22	1	1	12	6	18	123	0.30	0.03	0.90	0.14	0.02	0.13	5	10	1538
Go	S9419675	217107	** 1 2 ** 3B	34 1 1 30	2 B **	13	39	81	0.2	8	84	1	5	13	2.21	7	23	2	2	105	1	1	6	8	27	784	0.38	0.01	1.29	0.07	0.01	0.07	5	10	1377
Go	S9419676	217108	** 1 2 ** 1B	23 1 1 30	2 B **	12	18	25	0.2	12	82	1	2	10	1.34	1	16	2	2	69	1	1	7	3	7	88	0.37	0.04	0.97	0.06	0.01	0.05	5	10	2615
Go	S9419677	217109	** 1 2 ** 2B	23 1 1 25	2 B **	13	16	29	0.2	13	80	1	2	11	1.52	5	19	2	2	73	2	1	8	3	6	93	0.49	0.04	1.06	0.08	0.01	0.07	5	10	2361
Go	S9419678	217110	** 1 2 ** 2B	23 1 1 25	1 B **	12	19	24	0.2	9	95	1	2	8	1.28	2	14	2	2	66	1	1	7	3	7	85	0.34	0.04	0.92	0.06	0.01	0.05	5	10	2869
Go	S9419679	242137	2 1 2 ** 1B	23 1 2 20	3 B2 **	31	14	81	0.2	4	89	1	4	13	1.47	2	10	2	2	24	1	1	15	6	14	155	0.21	0.01	0.79	0.07	0.01	0.07	5	10	1696
Go	S9419680	242138	2 1 2 ** 2B	23 1 2 25	3 B2 **	16	21	53	0.8	7	96	1	1	5	0.92	1	5	2	2	16	1	1	11	5	7	59	0.09	0.01	0.81	0.05	0.02	0.06	5	10	1593
Go	S9419681	242139	2 1 2 ** 2B	23 1 2 30	3 B2 **	42	14	171	0.2	8	123	1	4	22	2.22	1	10	2	2	64	1	1	11	7	10	156	0.16	0.01	0.58	0.08	0.01	0.06	5	10	2496
Go	S9419682	242140	2 1 2 ** 2B	23 1 2 35	3 B2 **	28	16	104	0.2	7	104	1	3	15	1.30	3	6	2	2	38	1	1	9	6	9	78	0.05	0.01	0.58	0.03	0.01	0.05	5	10	2918
Go	S9419683	242141	2 1 2 ** 2B	23 1 2 30	3 B2 **	20	17	232	0.5	17	83	3	18	21	2.17	6	13	8	2	34	1	1	14	8	14	1922	0.26	0.01	1.17	0.09	0.01	0.08	5	10	1596
Go	S9419684	242142	2 1 2 ** 3B	23 1 2 35	3 B2 **	50	18	167	0.4	15	122	1	5	25	2.42	3	18	2	2	51	1	1	53	12	16	250	0.32	0.01	1.08	0.18	0.01	0.10	5	10	1921
Go	S9419685	242143	2 1 2 ** 2B	23 1 2 21	3 B2 **	25	14	129	0.2	3	76	1	3	15	1.41	2	4	2	2	28	1	1	10	4	13	139	0.05	0.01	0.56	0.02	0.01	0.07	5	10	2484
Go	S9419686	242144	2 1 2 ** 2B	23 1 2 25	3 B2 **	73	12	94	0.2	3	142	1	1	15	0.88	5	2	2	2	16	1	1	23	6	17	47	0.01	0.01	0.93	0.04	0.01	0.04	5	10	1835
Go	S9419687	242145	2 1 2 ** 2G	23 1 2 30	3 B2 **	30	6	84	0.2	3	67	1	2	15	0.91	2	2	5	2	28	1	1	6	3	8	43	0.03	0.01	0.42	0.02	0.01	0.05	5	10	2589
Go	S9419688	242146	2 1 2 ** BR	23 1 2 28	3 B2 **	73	14	201	0.8	13	123	1	5	26	2.80	4	18	2	2	64	3	1	27	9	13	184	0.53	0.02	1.16	0.27	0.01	0.12	5	10	2299
Go	S9419689	242147	2 1 2 ** 2B	23 1 2 35	3 B2 **	125	7	291	0.8	1	372	3	18	91	4.11	3	59	2	2	141	5	1	77	15	12	358	1.70	0.04	1.85	0.64	0.01	0.50	5	10	5101
Go	S9419690	242148	2 1 2 ** BR	23 1 2 25	3 B2 **	78	18	177	0.7	16	96	1	7	34	2.89	3	21	2	2	68	4	1	22	10	13	309	0.77	0.04	1.39	0.30	0.01	0.24	5	10	2419
Go	S9419691	242149	2 1 2 ** BR	23 1 2 20	3 B2 **	43	10	227	1.3	17	59	1	8	30	2.97	2	18	2	2	47	7	1	13	6	9	455	0.37	0.01	1.02	0.09	0.01	0.07	5	10	2000
Go	S9419692	242150	2 1 2 ** 2B	23 1 2 23	3 B2 **	166	8	2645	0.9	13	355	72	28	196	4.47	5	41	2	2	131	5	1	32	34	36	1509	1.42	0.08	1.68	0.58	0.01	0.62	5	10	2256
Go	S9419693	242151	2 1 2 ** 2B	12 1 2 20	3 B2 **	275	31	1090	1.8	28	202	15	11	97	3.38	6	24	2	2	97	1	1	64	29	23	359	0.78	0.03	1.33	0.65	0.01	0.30	85	10	2497
Go	S9419694	242152	2 1 2 ** BR	23 1 2 28	3 B2 **	40	6	378	0.4	6	117	3	13	59	2.63	1	22	2	2	59	1	1	10	8	19	855	1.46	0.05	1.79	0.10	0.01	0.08	5	10	1452
Go	S9419695	242153	2 1 2 ** BR	23 1 2 25	3 B2 **	81	19	227	1.0	2	290	8	8	32	3.08	3	18	2	2	82	2	1	96	15	35	483	0.75	0.02	1.10	0.56	0.01	0.30	5	10	3095
Go	S9419696	242154	2 1 2 ** BY	23 1 2 20	3 B2 **	21	23	141	0.9	3	181	5	6	17	1.94	2	18	2	2	38	1	1	14	6	10	288	0.40	0.04	1.15	0.12	0.01	0.19	5	10	1796
Go	S9419697	242155	2 1 2 ** 1B	23 1 2 25	3 B2 **	32	15	135	0.5	1	145	1	5	23	2.00	5	16	5	2	42	1	1	16	6	11	150	0.43	0.03	0.90	0.10	0.01	0.25	5	10	2352
Go	S9419698	242156	2 1 2 ** Y	23 1 2 20	3 B2 **	9	11	161	0.2	1	158	1	7	21	2.12	2	25	2	2	38	1	1	11	3	6	247	0.62	0.08	1.30	0.14	0.01	0.21	5	10	1494
Go	S9419699	242157	2 1 2 ** 2B	23 1 2 21	3 B2 **	33	15	111	0.6	7	229	2	5	19	2.52	1	13	2	6	59	3	1	27	3	8	358	0.13	0.01	0.61	0.28	0.01	0.11	5	10	2598
Go	S9419700	242158	2 1 2 ** BR	23 1 2 23	3 B2 **	7	8	85	0.2	1	80	1	3	7	1.34	3	9	2	2	25	1	1	5	3	8	162	0.24	0.03	0.74	0.07	0.01	0.18	5	10	1632
Go	S9419701	242159	2 1 2 ** 1B	23 1 2 25	3 B2 **	3	2	45	0.2	1	130	1	1	4	0.53	1	5	2	2	10	1	1	8	2	7	182	0.07	0.01	0.39	0.09	0.01	0.08	5	10	1528
Go	S9419702	242160	2 1 2 ** 1B	23 1 2 31	3 B2 **	23	10	114	0.5	6	157	4	3	12	1.34	1	7	6	2	27	1	1	17	3	8	608	0.13	0.02	0.43	0.23	0.01	0.14	5	10	2435
Go	S9419703	242161	2 1 2 ** 1N	3 1 2 20	3 B2 **	11	10	178	0.2	14	192	1	7	20	2.42	2	23	2	2	45	1	1	28	4	8	327	0.84	0.08	1.29	0.54	0.01	0.25	5	10	1737
Go	S9419704	242162	2 1 2 ** RY	23 1 2 25	3 B2 **	7	13	102	0.2	5	72	1	8	17	2.80	1	26	2	2	45	5	1	6	4	6	230	0.55	0.07	1.40	0.14	0.01	0.21	5	10	1181
Go	S9419705	242163	2 1 2 ** 2B	23 1 2 20	3 B2 **	4	2	45	0.2	2	107	2	1	2	0.34	2	5	2	2	8	1	1	18	1	4	115	0.04	0.01	0.32	0.21	0.01	0.08	5	10	1287
Go	S9419706	242164	2 1 2 ** 1B	23 1 2 25	3 B2 **	8	2	120	0.2	2	290	6	2	7	0.54	1	2	2	2	10	3	1	33	2	8	484	0.05	0.01	0.32	0.37	0.01	0.08	5	10	1813
Go	S9419707	242165	2 1 2 ** 2B	23 1 2 20	3 B2 **	13	6	100	0.2	1	191	4	3	10	1.26	2	4	2	2	20	3	1	19	3	8	176	0.05	0.01	0.42	0.21	0.01	0.07	5	10	1999
Go	S9419708	242166	2 1 2 ** BR	23 1 2 20	2 B2 **	28	37	186	0.6	6	307	1	11	34	3.53	4	19	2	6	53	9	1	29	8	15	549	0.34	0.02	1.41	0.51	0.01	0.18	5	10	1704
Go	S9419709	242167	2 1 2 ** 1B	23 1 2 20	2 B2 **	19	2	82	0.2	1	93	1	2	9	0.89	3	2	5	2	18	1	1	7	3	7	164	0.02	0.01	0.41	0.07	0.01	0.04	5	10	2091
Go	S9419710	242168	2 1 2 ** 1G	23 1 2 25	2 B2 **	12	4	52	0.2	3	67	1	1	5	0.65	1	2	2	5	12	1	1	5	2	6	125	0.04	0.01	0.37	0.04	0.01	0.05	5	10	1942
Go	S9419711	242169	2 1 2 ** 2B	23 1 2 30	2 B2 **	22	10	93	0.2	5	50	1	2	12	1.40	2	5	2	2	27	1	1	7	3	7	129	0.09	0.01	0.43	0.08	0.01	0.06	5	10	2255
Go	S9419712	242170	2 1 2 ** 1N	23 1 2 25	2 B2 **	16	11	101	0.2	45	176	1	4	21	2.24	3	15	2	7	39	1	1	12	6	11	127	0.43	0.01	1.33	0.10	0.01	0.08	5	10	1909
Go	S9419713	242171	2 1 2 ** BR	23 1 2 26	3 B2 **	22	9	106	0.2	3	90	1	4	18	1.92	3	15	2	2	39	1	1	13	6	10	161	0.42	0.02	0.92	0.14	0.01	0.12	5	10	2283
Go	S9419714	242172	2 1 2 ** 2B	23 1 2 20	2 B2 **	6	4	40	0.2	1	85	1	1	4	0.56	1	4	2	2	9	1	1	8	2	7	132	0.09	0.01	0.48	0.05	0.01	0.10	5	10	1302
Go	S9419715	242173	2 1 2 ** RY	23 1 2 25	2 B2 **	5	5	47	0.2	1	79	1	2	7	1.02	2	8	2	2	20	1	1	6	3	8	123	0.20	0.02	0.57	0.06	0.01	0.09	5	10	1457
Go	S9419716	242174	2 1 2 ** BR	23 1 2 20	2 B2 **	9	11	64	0.2	4	139	1	3	10	1.46	2	10	2	2	25	1	1	9	3	8	194	0.22	0.02	0.66	0.08	0.01				

Go S9419739 242197 2 1 2 ** 3B 34 1 2 25 2 B2 ** 15 9 110 0.2 1 168 1 7 12 1.68 1 15 2 2 29 1 1 9 4 9 1870 0.34 0.05 1.11 0.14 0.01 0.11 5 10 1441

Property	LabNo	FieldNo	S	M	O	S	Col	Sz	O	W	Dph	W/S	FW	P	Cu	Pb	Zn	Ag	As	Ba(1cp)	Cd	Co	Ni	Fe	Mo	Cr	Bl	Sb	V	Sn	W	Sr	Y	La	Mn	Mg	Ti	Al	Ca	Na	K	Au	Wt	Ba(xrf)
Nad	S9414855	243001	**	1	2	2	2G	3	2	2	40	3	C	**	17	10	132	0.2	1	140	1	8	10	2.78	2	24	2	2	51	1	1	14	32	55	437	0.97	0.18	1.85	0.67	0.02	0.62	5	10	903
Nad	S9414856	243002	**	1	2	2	2B	2	2	3	30	3	C	**	49	187	320	0.5	5	58	1	3	6	1.52	1	12	2	2	24	1	1	5	16	23	191	0.48	0.10	1.06	0.28	0.01	0.38	5	10	891
Nad	S9414857	243003	**	1	2	2	2B	2	1	2	30	3	C	**	86	38	660	0.2	1	62	1	5	6	1.35	1	11	2	2	25	1	1	6	15	18	260	0.46	0.09	0.85	0.35	0.01	0.30	5	10	835
Nad	S9414858	243004	**	1	2	2	2B	3	1	3	35	3	C	**	8	16	98	0.2	1	67	1	4	6	1.63	3	13	2	2	25	1	1	6	19	29	226	0.50	0.10	1.17	0.32	0.01	0.38	5	10	804
Nad	S9414859	243005	**	1	2	2	2B	3	2	3	40	3	C	**	29	130	302	0.4	1	88	1	4	7	1.50	4	12	2	2	22	1	1	10	49	97	209	0.48	0.09	1.14	0.44	0.02	0.23	5	10	1050
Nad	S9414860	243006	**	1	2	2	BR	2	1	2	25	3	C	**	38	17	225	0.2	7	75	1	17	6	2.70	3	13	2	2	26	1	1	4	27	57	1577	0.56	0.10	1.30	0.12	0.01	0.44	5	10	886
Nad	S9414861	243007	**	1	2	2	2B	3	1	2	30	2	C	**	8	4	70	0.2	5	48	1	3	4	1.41	2	12	2	2	27	1	1	3	12	24	181	0.51	0.12	0.93	0.17	0.01	0.29	5	10	831
Nad	S9414862	243008	**	1	2	2	2B	3	1	2	30	2	C	**	7	5	85	0.2	4	36	1	4	6	1.77	1	17	2	2	35	2	1	2	7	12	180	0.61	0.15	1.17	0.10	0.01	0.24	5	10	887
Nad	S9414863	243009	**	1	2	2	BR	2	1	2	25	2	C	**	12	7	68	0.2	1	48	1	4	6	2.25	2	17	2	2	39	1	1	2	7	17	219	0.61	0.14	1.39	0.08	0.01	0.31	5	10	841
Nad	S9414867	243016	**	1	2	2	3B	4	1	2	40	3	B	**	13	6	77	0.2	1	185	1	7	9	2.11	1	19	2	2	37	2	1	23	15	20	356	0.72	0.12	1.54	0.84	0.02	0.45	5	10	1043
Nad	S9414868	243017	**	1	2	2	3B	4	1	2	50	3	B	**	8	8	83	0.2	1	224	1	5	8	1.89	2	17	2	2	31	3	1	22	28	40	265	0.67	0.11	1.32	0.72	0.02	0.36	5	10	1021
Nad	S9414869	243018	**	1	2	2	GB	34	1	2	50	2	B	**	13	9	77	0.2	7	255	1	12	12	2.91	2	31	2	2	59	1	1	25	11	15	537	1.18	0.21	1.93	0.91	0.02	0.71	5	10	969
Nad	S9414870	243019	**	1	2	2	3B	4	2	2	50	2	B	**	12	7	66	0.2	8	283	1	8	10	2.17	1	22	2	2	41	1	1	28	12	13	495	0.82	0.13	1.46	0.91	0.02	0.54	5	10	1163
Nad	S9414871	243020	**	1	2	2	BK	42	2	2	30	2	B	**	12	7	66	0.2	1	218	1	10	11	2.62	1	23	2	2	51	1	1	27	11	13	592	0.94	0.15	1.55	1.07	0.01	0.58	5	10	982
Nad	S9414872	243021	**	1	3	2	GB	13	1	1	35	2	B	**	9	10	76	0.2	3	186	1	12	11	3.16	1	27	2	2	63	2	1	13	7	10	448	1.21	0.23	1.73	0.51	0.01	0.66	5	10	951
Nad	S9414873	243022	**	1	2	2	GB	24	1	2	40	2	B	**	19	7	203	0.2	1	329	1	9	17	2.94	2	32	2	2	53	1	1	22	53	52	339	1.02	0.15	2.17	0.70	0.01	0.43	5	10	1414
Nad	S9414874	243023	**	1	2	2	GB	24	1	2	55	2	B	**	40	8	75	0.2	3	247	1	9	14	2.81	3	26	2	2	49	1	1	17	33	39	373	0.95	0.17	2.06	0.54	0.01	0.78	5	10	1092
Nad	S9414875	243024	**	1	2	2	GB	14	1	1	40	2	B	**	30	7	76	0.2	7	164	1	10	14	2.96	3	30	2	2	58	1	1	8	18	24	312	1.02	0.21	1.86	0.40	0.01	0.67	5	10	881

APPENDIX 3

STATEMENTS OF EXPENDITURES

GO PROPERTY

STAFF COSTS	1,374
DOMICILE	545
GEOCHEMISTRY	2,686
HELICOPTER	1,656
COMMUNICATIONS	108
TRUCK RENTAL	228
FREIGHT	707
EXPEDITING	143
DRAFTING/REPRODUCTIONS	684
TOTAL	8,131

NAD PROPERTY

STAFF COSTS	1,335
DOMICILE	327
GEOCHEMISTRY	369
HELICOPTER	1,512
COMMUNICATIONS	15
TRUCK RENTAL	32
FREIGHT	99
EXPEDITING	20
DRAFTING/REPRODUCTIONS	96
TOTAL	3,805

COMINCO LTD.

EXPLORATION

WESTERN DISTRICT

NTS 105 G/8

1994 ASSESSMENT REPORT

GO and NAD PROPERTIES

SOIL GEOCHEMISTRY AND GEOLOGICAL MAPPING

WATSON LAKE M.D., YUKON

CAMPBELL RANGE AREA

GO - LAT: 61°24'
NAD - LAT: 61°21'

GO - LONG: 130°17'
NAD - LONG: 130°08'

WORK PERIOD

JULY 16, 18 and 23 and AUGUST 9, 1994

APRIL, 1995

PAUL A. MacROBBIE

STATEMENT OF QUALIFICATIONS

I, Paul A. MacRobbie, of 11164 Southridge Rd., Delta, B.C. hereby declare that I:

1. Graduated from Carleton University, Ottawa, Ontario with a B.Sc. in Geology in May, 1986 and a M.Sc. in Geology in June, 1988.
2. Have been actively engaged in mineral exploration in Western Canada as a permanent geologist with Cominco Ltd. since June, 1988.
3. Am a registered member of The Association of Professional Engineers and Geoscientists of the Province of British Columbia.

Date: April 10, 1995



P.A MacROBBIE, P. Geo
GEOLOGIST

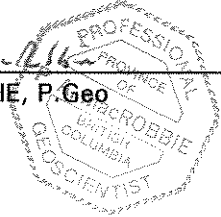

MAP NO:105G/8

ASSESSMENT REPORT: X

DOCUMENT NO: 093336

PROSPECTUS:

MINING DISTRICT: Watson Lake

CONFIDENTIAL: X

TYPE OF WORK:Geochemistry,
mapping

OPEN FILE:

REPORT FILED UNDER: Cominco Ltd.

DATE PERFORMED:July, August, 1994

DATE FILED:June 23, 1995

LATITUDE:61 24

AREA:Campbell Range

LONGITUDE:130 17

VALUE:\$9200

CLAIM NAME AND #:Go 1-62, Nad 1-4

WORK DONE BY:Paul MacRobbie

WORK DONE FOR:Cominco Ltd.

DATE TO GOOD STANDING	REMARKS: Favourable stratigraphy exists on both properties. Multi-element soil anomalies were outlined on both properties.



NOTE: COORDINATES ARE NAD27

SOIL GEOCHEMISTRY LOCATION
SAMPLE NUMBER

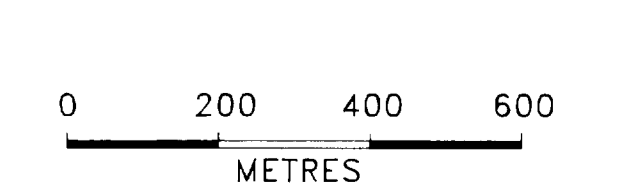

WATSON LAKE MINING DISTRICT

EXPO PROPERTY		N.T.S. 1056/8	
MONTANA GOLD & SILVER CLAIM GROUPS		SAMPLE LOCATIONS 09336	
Drawn by: APR	Traced by:	SOIL GEOCHEMISTRY	
Revised by:	Date:	DATE: JUL 1995	
SCALE: 1:10,000		PLATE NO: 4	



207	208	249	250	289	288	321	322	347	348	349	350	351	352	353	354	355	356	357	358	359	360	361	362	363	364	365	366	367	368	369	370	371	372	373	374	375	376	377	378	379	380	381	382	383	384	385	386	387	388	389	390	391	392	393	394	395	396	397	398	399	400	401	402	403	404	405	406	407	408	409	410	411	412	413	414	415	416	417	418	419	420	421	422	423	424	425	426	427	428	429	430	431	432	433	434	435	436	437	438	439	440	441	442	443	444	445	446	447	448	449	450	451	452	453	454	455	456	457	458	459	460	461	462	463	464	465	466	467	468	469	470	471	472	473	474	475	476	477	478	479	480	481	482	483	484	485	486	487	488	489	490	491	492	493	494	495	496	497	498	499	500	501	502	503	504	505	506	507	508	509	510	511	512	513	514	515	516	517	518	519	520	521	522	523	524	525	526	527	528	529	530	531	532	533	534	535	536	537	538	539	540	541	542	543	544	545	546	547	548	549	550	551	552	553	554	555	556	557	558	559	560	561	562	563	564	565	566	567	568	569	570	571	572	573	574	575	576	577	578	579	580	581	582	583	584	585	586	587	588	589	590	591	592	593	594	595	596	597	598	599	600	601	602	603	604	605	606	607	608	609	610	611	612	613	614	615	616	617	618	619	620	621	622	623	624	625	626	627	628	629	630	631	632	633	634	635	636	637	638	639	640	641	642	643	644	645	646	647	648	649	650	651	652	653	654	655	656	657	658	659	660	661	662	663	664	665	666	667	668	669	670	671	672	673	674	675	676	677	678	679	680	681	682	683	684	685	686	687	688	689	690	691	692	693	694	695	696	697	698	699	700	701	702	703	704	705	706	707	708	709	710	711	712	713	714	715	716	717	718	719	720	721	722	723	724	725	726	727	728	729	730	731	732	733	734	735	736	737	738	739	740	741	742	743	744	745	746	747	748	749	750	751	752	753	754	755	756	757	758	759	760	761	762	763	764	765	766	767	768	769	770	771	772	773	774	775	776	777	778	779	780	781	782	783	784	785	786	787	788	789	790	791	792	793	794	795	796	797	798	799	800	801	802	803	804	805	806	807	808	809	810	811	812	813	814	815	816	817	818	819	820	821	822	823	824	825	826	827	828	829	830	831	832	833	834	835	836	837	838	839	840	841	842	843	844	845	846	847	848	849	850	851	852	853	854	855	856	857	858	859	860	861	862	863	864	865	866	867	868	869	870	871	872	873	874	875	876	877	878	879	880	881	882	883	884	885	886	887	888	889	890	891	892	893	894	895	896	897	898	899	900	901	902	903	904	905	906	907	908	909	910	911	912	913	914	915	916	917	918	919	920	921	922	923	924	925	926	927	928	929	930	931	932	933	934	935	936	937	938	939	940	941	942	943	944	945	946	947	948	949	950	951	952	953	954	955	956	957	958	959	960	961	962	963	964	965	966	967	968	969	970	971	972	973	974	975	976	977	978	979	980	981	982	983	984	985	986	987	988	989	990	991	992	993	994	995	996	997	998	999	1000
-----	-----	-----	-----	-----	-----	-----	-----	-----	-----	-----	-----	-----	-----	-----	-----	-----	-----	-----	-----	-----	-----	-----	-----	-----	-----	-----	-----	-----	-----	-----	-----	-----	-----	-----	-----	-----	-----	-----	-----	-----	-----	-----	-----	-----	-----	-----	-----	-----	-----	-----	-----	-----	-----	-----	-----	-----	-----	-----	-----	-----	-----	-----	-----	-----	-----	-----	-----	-----	-----	-----	-----	-----	-----	-----	-----	-----	-----	-----	-----	-----	-----	-----	-----	-----	-----	-----	-----	-----	-----	-----	-----	-----	-----	-----	-----	-----	-----	-----	-----	-----	-----	-----	-----	-----	-----	-----	-----	-----	-----	-----	-----	-----	-----	-----	-----	-----	-----	-----	-----	-----	-----	-----	-----	-----	-----	-----	-----	-----	-----	-----	-----	-----	-----	-----	-----	-----	-----	-----	-----	-----	-----	-----	-----	-----	-----	-----	-----	-----	-----	-----	-----	-----	-----	-----	-----	-----	-----	-----	-----	-----	-----	-----	-----	-----	-----	-----	-----	-----	-----	-----	-----	-----	-----	-----	-----	-----	-----	-----	-----	-----	-----	-----	-----	-----	-----	-----	-----	-----	-----	-----	-----	-----	-----	-----	-----	-----	-----	-----	-----	-----	-----	-----	-----	-----	-----	-----	-----	-----	-----	-----	-----	-----	-----	-----	-----	-----	-----	-----	-----	-----	-----	-----	-----	-----	-----	-----	-----	-----	-----	-----	-----	-----	-----	-----	-----	-----	-----	-----	-----	-----	-----	-----	-----	-----	-----	-----	-----	-----	-----	-----	-----	-----	-----	-----	-----	-----	-----	-----	-----	-----	-----	-----	-----	-----	-----	-----	-----	-----	-----	-----	-----	-----	-----	-----	-----	-----	-----	-----	-----	-----	-----	-----	-----	-----	-----	-----	-----	-----	-----	-----	-----	-----	-----	-----	-----	-----	-----	-----	-----	-----	-----	-----	-----	-----	-----	-----	-----	-----	-----	-----	-----	-----	-----	-----	-----	-----	-----	-----	-----	-----	-----	-----	-----	-----	-----	-----	-----	-----	-----	-----	-----	-----	-----	-----	-----	-----	-----	-----	-----	-----	-----	-----	-----	-----	-----	-----	-----	-----	-----	-----	-----	-----	-----	-----	-----	-----	-----	-----	-----	-----	-----	-----	-----	-----	-----	-----	-----	-----	-----	-----	-----	-----	-----	-----	-----	-----	-----	-----	-----	-----	-----	-----	-----	-----	-----	-----	-----	-----	-----	-----	-----	-----	-----	-----	-----	-----	-----	-----	-----	-----	-----	-----	-----	-----	-----	-----	-----	-----	-----	-----	-----	-----	-----	-----	-----	-----	-----	-----	-----	-----	-----	-----	-----	-----	-----	-----	-----	-----	-----	-----	-----	-----	-----	-----	-----	-----	-----	-----	-----	-----	-----	-----	-----	-----	-----	-----	-----	-----	-----	-----	-----	-----	-----	-----	-----	-----	-----	-----	-----	-----	-----	-----	-----	-----	-----	-----	-----	-----	-----	-----	-----	-----	-----	-----	-----	-----	-----	-----	-----	-----	-----	-----	-----	-----	-----	-----	-----	-----	-----	-----	-----	-----	-----	-----	-----	-----	-----	-----	-----	-----	-----	-----	-----	-----	-----	-----	-----	-----	-----	-----	-----	-----	-----	-----	-----	-----	-----	-----	-----	-----	-----	-----	-----	-----	-----	-----	-----	-----	-----	-----	-----	-----	-----	-----	-----	-----	-----	-----	-----	-----	-----	-----	-----	-----	-----	-----	-----	-----	-----	-----	-----	-----	-----	-----	-----	-----	-----	-----	-----	-----	-----	-----	-----	-----	-----	-----	-----	-----	-----	-----	-----	-----	-----	-----	-----	-----	-----	-----	-----	-----	-----	-----	-----	-----	-----	-----	-----	-----	-----	-----	-----	-----	-----	-----	-----	-----	-----	-----	-----	-----	-----	-----	-----	-----	-----	-----	-----	-----	-----	-----	-----	-----	-----	-----	-----	-----	-----	-----	-----	-----	-----	-----	-----	-----	-----	-----	-----	-----	-----	-----	-----	-----	-----	-----	-----	-----	-----	-----	-----	-----	-----	-----	-----	-----	-----	-----	-----	-----	-----	-----	-----	-----	-----	-----	-----	-----	-----	-----	-----	-----	------