

INTERNATIONAL BARYTEX RESOURCES LTD

Geological Report on the Fran and Pat Claims

Barb Project

Frances Lake Area
Watson Lake Mining District, Yukon Territory

Latitude 62 degrees 28' N, Longitude 129 degrees 25' W
NTS 105 H/6, 105H/11

H.L. King, P.Geo.
July 1995

093322

TABLE OF CONTENTS

	Page
Summary	1
Introduction	2
Location & Access	2
Physiography & Climate	2
Property	3
1995 Work Program	4
Regional Geology	4
Local Geology	4
Structure	5
Mineralization	5
Conclusions & Recommendations	6

LIST OF FIGURES

	<u>Following</u> <u>Page</u>
Figure 1 Property Location Map	2
Figure 2 Claim Map	3
Figure 3 Regional Geology	4

MAPS (in pocket)

Map 1	Fran Claims Geology
Map 2	Pat Claims Geology

APPENDICES

Appendix I	Bibliography
Appendix II	Assay Certificate
Appendix III	Statement of Qualifications - Certificate
Appendix IV	Statement of Costs
Appendix V	Names & Addresses of Employees and Contractors Employed in carrying out the survey and preparing report.



SUMMARY

Field work including geological mapping and prospecting was carried out by T. Muraro, B. Cross and L. King during June, 1995 on the Fran and Pat mineral claims on behalf of International Barytex Resources Ltd. The claims are located on the east shore of Frances Lake, approximately 160 kilometers north of the town of Watson Lake. Access to the claims is via the Robert Campbell Highway from Watson Lake to Frances Lake and then by boat to the east arm of Frances Lake.

Work was carried out on 2 of the 3 claim groups making up the large property. The property described in this report consists of 2 claim groups; 38 Fran claims and 40 Pat claims.

The area underlain by the claims consists of mainly phyllitic rocks with minor quartz, sericite augen schist.

Due to the extensive overburden cover outcrop is scarce. It is expected that the target, a massive sulphide deposit containing lead and zinc similar to the stratiform mineralization found on adjacent claims, would probably respond to electromagnetic geophysical methods. An airborne EM and magnetic survey is considered to be the most direct and effective way of delineating massive sulphide mineralization. It is recommended that such a geophysical survey be flown over the claim groups.

INTRODUCTION

A program of geological mapping and prospecting was carried out on the Fran 1 to 38 and Pat 1 to 40 claims (total 78 claims) during the period June 15 to July 2, 1995.

The Fran and Pat claim groups border the Barb, Binti and Beth claims to the north and south respectively. All of the above-mentioned claims are held by International Barytex Resources Ltd.

LOCATIONS AND ACCESS

The Fran and Pat mineral claims are located on the east shore of the east arm of Frances Lake about 160 km north of Watson Lake (see Fig. 1). The property can be accessed with float equipped aircraft from Watson Lake or via the Robert Campbell Highway leading north from Watson Lake to the west arm of Frances Lake, a distance of about 160 km.

A boat may then be used for water travel to the property from an access point at a campsite on the west arm of Frances Lake. The water distance is about 45 km. Accommodation for the duration of the work was provided by Mr. & Mrs. Paul Rogers, long term residents on the east arm of Frances Lake.

PHYSIOGRAPHY AND CLIMATE

The claims are located on the western margin of the Logan Mountains, on the east shore of the east arm of Frances Lake. On the Fran claims, the land rises abruptly from the shoreline to a bench about 100 meters above lake level, and then rises to about 200 meters above lake level at the eastern claim boundary. The Pat claims are located on a moderate slope with elevations rising from 775 meters at lake level to 1,400 meters on the eastern claim boundary.

Outcrop on the claims is sparse with overburden estimated at up to 20 meters and more. The area is forested with willow, alder, spruce and tamarack in low-lying areas; pine and balsam fir generally at higher elevations. A burn about 20 years-old covers the southern part of the Pat claim group.

The area is subjected to long cold winters and short temperate summers. Field work can best be carried out from mid June to early October.

FRAN AND PAT CLAIMS

PROPERTY LOCATION MAP

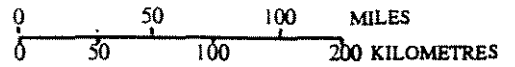

DRAWN: H.L. KING	N.T.S. 105 H/6/11	DATE: JULY 1995	FIG.: 1
---------------------	----------------------	--------------------	---------

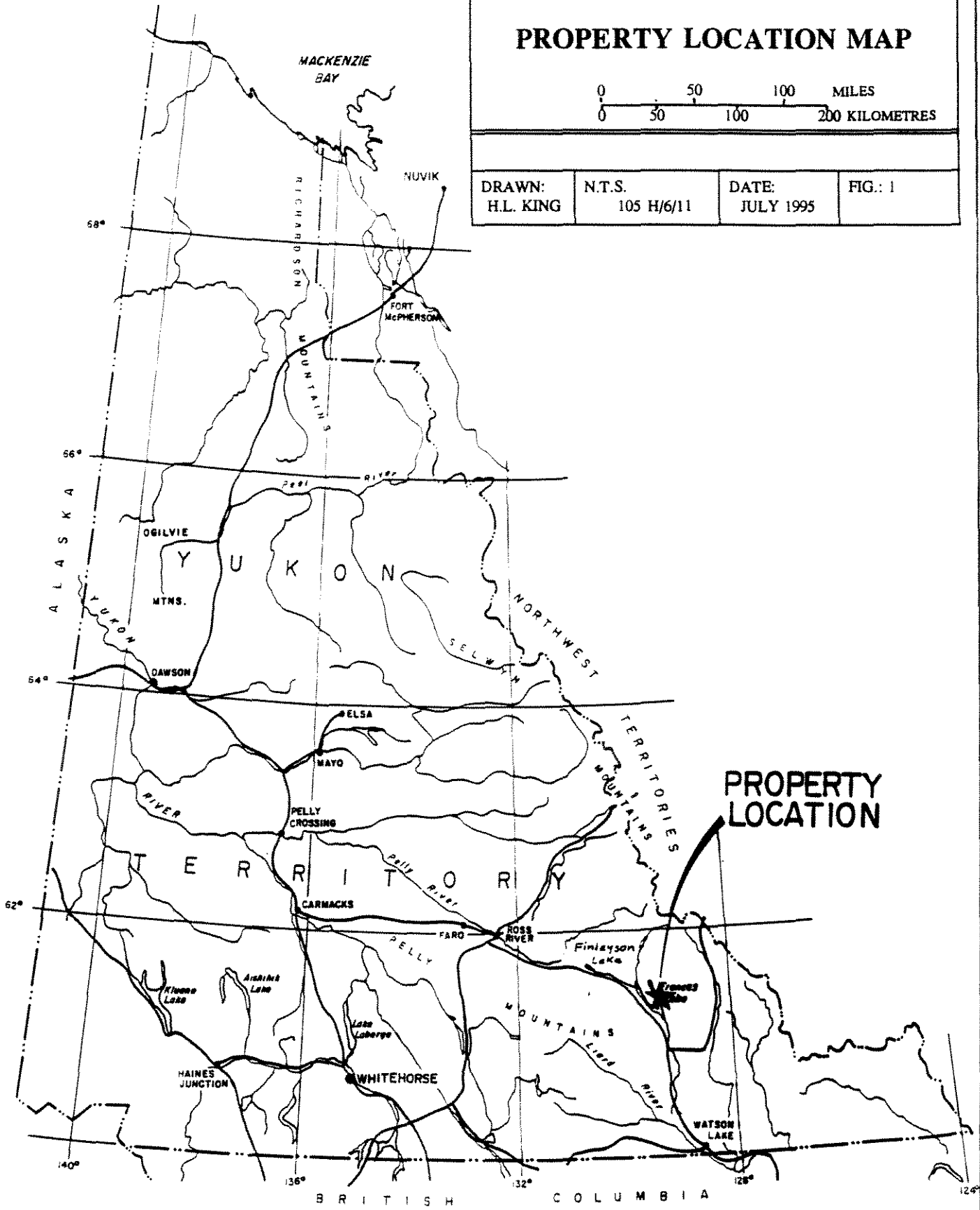

PROPERTY

The 38 Fran mineral claims form the northern portion of a larger property known as the Barb Property with the 40 Pat mineral claims making up the southernmost portion. The Fran and Pat claims (Fig. 2) are located in the Watson Lake Mining District and are held by International Barytex Resources Ltd.

The claim information is summarized as follows:

<u>Claim Name</u>	<u>Record No.</u>	<u>Expiry Date</u>
Fran 1-38	YB51788-YB51825	August 29, 1995
Pat 1-40	YB51826-YB51865	August 29, 1995

EXPLORATION HISTORY

Considerable work has been carried out over the past 50 years on the adjacent Barb claims where lead-zinc-silver mineralization was first discovered on Thompson Creek. The area was prospected by Cominco in 1943 and trenching and sampling on the Thompson Creek showings was carried out by Datalaska Mines in the early 1960's. Matt Berry Mines Ltd. carried out considerable work from 1966 to 1970 including trenching geophysical and geochemical surveys and 2,728 meters of drilling in the area of the base metals showings.

In 1970 an additional 391 meters (1282 feet) of diamond drilling was carried out under an agreement with Metallgesellschaft Canada Ltd. and Canadian Nickel Co. Ltd. In 1974 Cypruss Anvil Mining Corp. carried out a limited gravity survey in the immediate Thompson Creek area.

A pulse EM survey was carried out in 1978 by New Frontier and a trenching program and reserve estimate were completed by Sovereign Metals Corp. on the Thompson Creek deposit in 1979.

In 1980 Cominco drilled 5 widely spaced holes (219 m) on the Barb claims in an attempt to find extensions to the Thompson Creek mineralization but failed to intersect significant mineralization. During 1981, Cominco carried out geological mapping and soil geochemical surveys.

In 1987, geochemical, magnetic and geological surveys were completed by Pulse Resources on the Barb, Beth and Binti claims and in 1991 drilled 4 diamond drill holes totalling

303 meters on the Money Zone. Minor base metal and pyrite mineralization was intersected in 3 of the 4 holes.

In 1993, the Fran and Pat claims were staked to cover the possible extensions to the favorable stratigraphy hosting the base metal mineralization at Thompson Creek and at the Money Zone.

1995 WORK PROGRAM

The 1995 work program carried out from June 15 to July 2, 1995 consisted of geological mapping and prospecting on the Fran and Pat claims. Grid lines extending east and west from a baseline and claim lines were used as control for the mapping.

REGIONAL GEOLOGY

The regional geology (Fig. 3) in the area of the claims has been mapped by the Geological Survey of Canada at a scale of 1" 4 miles. The claim area is covered by extensive glacial and alluvial material which is underlain by Devonian and Mississippian metasediments and minor volcanics in contact with the Cretaceous Mt. Billings Batholith to the southeast of the property.

LOCAL GEOLOGY

The two claim areas are underlain mainly by dark grey phyllites, generally thin bedded and in places hornfelsed with a well developed slaty cleavage. Only one outcrop area was found on the Fran claims along Beaver Creek. At this location an oxidized quartz vein containing sulphides was hosted in thin bedded, dark blue-grey hornfelsic phyllite.

A number of outcrops were located on the Pat claims. Most exposures consisted of dark grey, thin-bedded and strongly foliated phyllites. Quartz veining, both concordant and discordant, is common. In the area of the easternmost Pat claims nearer to the phyllite-quartz monzonite contact, the phyllites are more hornfelsed.

A number of outcrops of quartz augen schist, probably volcanic in origin, were mapped within the phyllite. The unit is estimated to be about 150 m thick. The quartz augen schist is light grey to light green in color, is highly sericitic and contains from 25 to 35% quartz eyes.

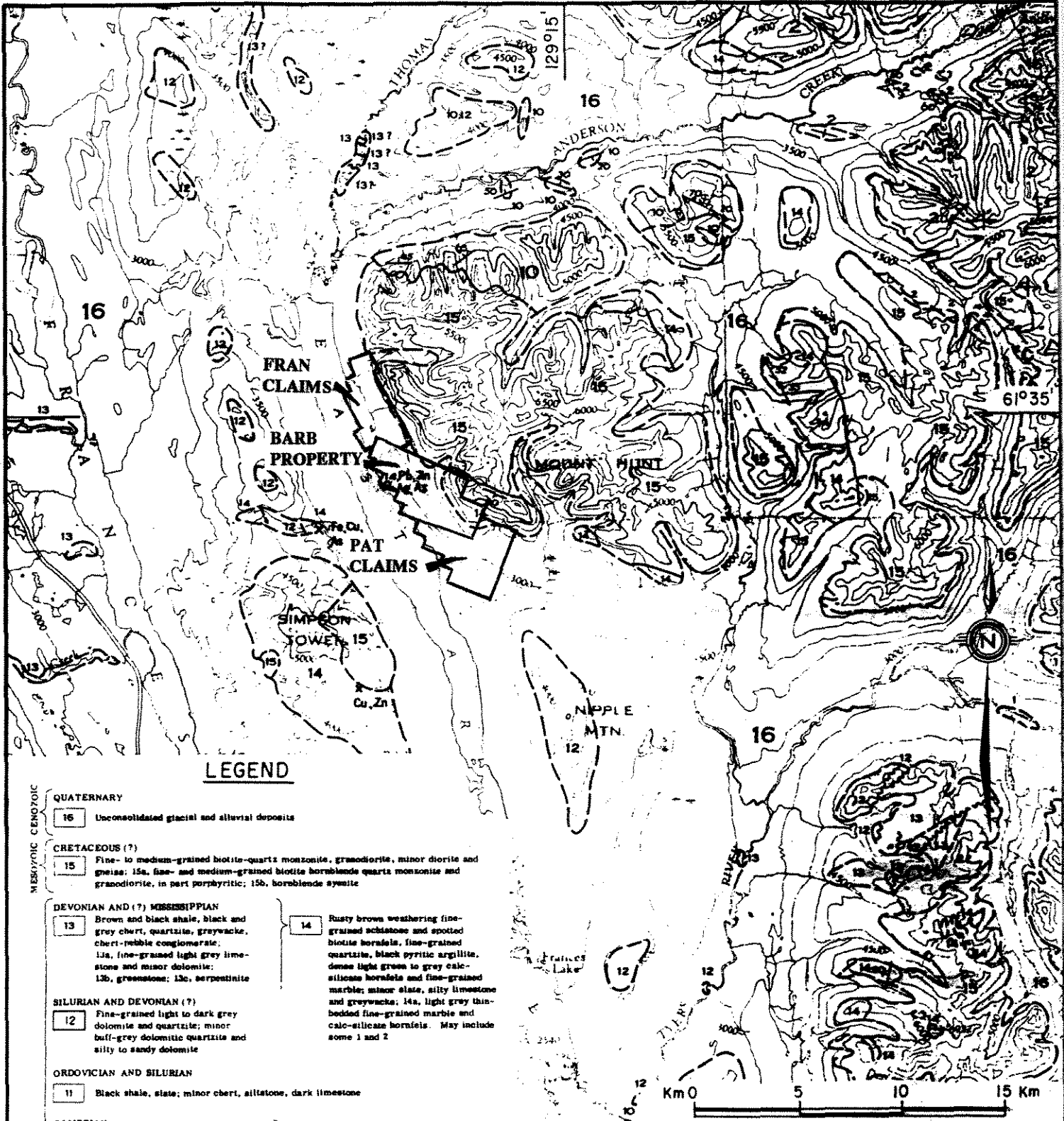

LEGEND

- MESOZOIC CENOZOIC**
- QUATERNARY**
- 16 Unconsolidated glacial and alluvial deposits
- CRETACEOUS (?)**
- 15 Fine- to medium-grained biotite-quartz monzonite, granodiorite, minor diorite and gneiss; 15a, fine- and medium-grained biotite hornblende quartz monzonite and granodiorite, in part porphyritic; 15b, hornblende syenite
- DEVONIAN AND (?) MISSISSIPPIAN**
- 13 Brown and black shale, black and grey chert, quartzite, graywacke, chert-pebble conglomerate; 13a, fine-grained light grey limestone and minor dolomite; 13b, greenstone; 13c, serpentinite
- 14 Rusty brown weathering fine-grained schistose and spotted biotite hornfels, fine-grained quartzite, black pyritic argillite, dense light green to grey calc-silicate hornfels and fine-grained marble; minor slate, silty limestone and graywacke; 14a, light grey thin-bedded fine-grained marble and calc-silicate hornfels. May include some 1 and 2
- SILURIAN AND DEVONIAN (?)**
- 12 Fine-grained light to dark grey dolomite and quartzite; minor buff-grey dolomitic quartzite and silty to sandy dolomite
- ORDOVICIAN AND SILURIAN**
- 11 Black shale, slate; minor chert, siltstone, dark limestone
- PALAEZOIC**
- CAMBRIAN**
- MIDDLE AND LATE CAMBRIAN**
- 9 Light grey and brownish grey weathering, intercalated platy argillaceous silty limestone, siltstone, and fine-grained grey limestone
- 10 Dark grey and brown silty shale and finely laminated siltstone, dark grey slate, thin-bedded brown-grey fine-grained sandstone; minor hornfels
- CAMBRIAN AND/OR EARLIER**
- 3 Brown to red-brown weathering siltite, phyllite, siltstone and fine-grained quartzite; 3a, green-grey slate and phyllite
- PROTEROZOIC**
- 1 Brown, grey, maroon and green shale; grey to green slate and phyllite, gritty feldspathic quartzite, quartz- and feldspar-pebble conglomerate, sandstone; 1a, minor limestone; 1b, light grey weathering, fine-grained grey limestone; 1c, mainly grey to green slate and phyllite; 1d, maroon and green shale and slate; 1e, mainly brown and grey shale and slate, minor maroon and green shale. 1d and 1e are probably equivalent and perhaps correlative with 1c
- 2 Quartz-feldspar-mica gneiss and schist, granitoid gneiss, feldspathic and micaceous quartzite, biotite schist, minor marble and skarn; numerous small granitic bodies, orthite and pegmatite; 2a, fine- to coarse-grained marble

FRAN AND PAT CLAIMS			
REGIONAL GEOLOGY			
WATSON LAKE MINING DISTRICT, Y.T.			
INTERNATIONAL BARYTEX RESOURCES LTD.			
DRAWN: H.L. KING	N.T.S. 105 H/6/11	DATE: JULY 1995	FIG.: 3

AFTER G.S.C. MAP 6 -1966

Most of the boulders observed on the Fran claims are quartz monzonite shed from the mountain slopes to the east. On the Pat claims quartz monzonite boulders predominate with boulders of hornfelsed phyllite and barren white quartz less frequent.

STRUCTURE

The claim groups are located on the shallow, east-dipping limb of a north-trending syncline. In general, bedding where observed, strikes northeast to east with dips to the southeast and northerly from 20 degrees to 50 degrees. Foliations are generally concordant to layering but local discordance was noted indicating several stages of deformation.

MINERALIZATION

On the Fran claims, an oxidized, deformed quartz vein hosting pyrite, pyrrhotite, galena, sphalerite and traces of chalcopyrite was located on the northwest side of Beaver Creek.

Following is a description of the showing by T. Muraro. Please refer to the accompanying geological map (Map No.1).

Near the northern end of the Fran claims a pair of creeks enter the east arm of Frances lake through a marked depression (probably a former land slip) in the 50 meter lakeside terrace of gravel and sand. The southernmost creek at a point 480 meters upstream from the lakeshore splits with the strongest flow entering at right angles from the southeast. On the northeast bank of this creek (Beaver Creek) a low bedrock supported terrace stands 3-4 meters above the creek levels and presents a string of outcrops trending northwest, parallel to the creek for about 40 meters then swinging to the northeast for another 35 meters to occupy the internal part of the junction between the two drainage courses. Bedrock is grey to dark blue-grey, thin bedded to laminated, somewhat hornfelsic with a slaty cleavage. Both bedding and cleavage strike northwest and dip vertical to steeply SW.

At the southern upstream end of the outcrop an oxidized quartz vein, which appears to be rolled into a near horizontal rod 30 cm in diameter, extends for 15 meters along the edge of the bedrock terrace before being truncated by the erosion surface. The zone of rusty quartz vein material and included lithic material carries pyrite pyrrhotite, galena, sphalerite and traces of chalcopyrite. An assay across the 30 cm zone returned 0.06%Cu, 0.56%Pb, 0.01%Zn, 0.12 oz/ton Ag and 0.002 oz/ton Au.

Twenty meters further northwest along the outcrop ledge a sampled quartz vein 2 meters wide gave no significant values.

In the opinion of the writer, the rolled quartz vein is similar in nature to the sulfide bearing bedded veins in the trenches at Thompson Creek.

No mineralization was found on the Pat claims. However, the quartz augen schist unit mapped on the claims is on strike with the Money Zone located on the Beth claims where 3 of the 4 holes drilled in 1991 intersected 1 to 3 m thick zones of semi-massive to massive sulphides. Values of 5.87% zinc and 1.82% lead over 0.5 m are reported to have been intersected in hole PUL 91-1.

Several boulders of mineralized quartz found along the shoreline on the Pat claims were assayed for gold but did not return any values.

CONCLUSION & RECOMMENDATIONS

Outcrop is scarce on the claim groups surveyed and as a results the chance of finding mineral showings by prospecting is considered poor.

Both of the known stratiform mineralized zones on the adjacent claims, the Matt Zone and the Money Zone, responded to geochemistry and geophysical techniques.

The Fran claims appear to be underlain by relatively thick overburden and as a result soil geochemical surveys may not be effective in delineating areas of massive sulphide potential. However, a series of soil geochemical anomalies extending southeast of the Money Zone toward the Pat claims were outlined by Cominco's 1981 work. It is recommended that geochemical soil surveys be carried out on the Pat claims.

The mineralization situated on the adjacent claims is considered to represent stratiform, bedded massive sulphide deposits typical of the Selwyn Basin. The Pat and Fran claims have the potential to host similar type mineralization. An airborne EM and Magnetic survey is considered to be the most direct and effective method of delineating massive sulphide mineralization. It is recommended that such a geophysical survey be flown over the claim groups.

Respectfully submitted:



The seal is a circular emblem with a double-line border. The outer ring contains the text 'PROFESSIONAL' at the top, 'PROVINCE OF' in the middle, and 'BRITISH COLUMBIA' at the bottom. The inner circle contains the name 'H. L. KING' and the title 'GEOSCIENTIST' at the bottom.

H. Leo King, M.A. FGAC, P. Geo.

BIBLIOGRAPHY

- Ikona, C.K. (1977) : Geological Report on Barb Claim Group for Sovereign Metals Corporation.
- Ikona, C.K. (1980) : Summary Report on the Barb Group for Sovereign Metals Corporation.
- Ostler, J. (1979) : Geological Report, Barb 1-15, 16-32 Mineral Claims for Sovereign Metals Corporation.
- Roots, E.F., L.H. Green, J.A. Roddick, S.L. Blusson: Map 6-1966, Geological Survey of Canada.
- Symonds, D.F., F. Dispirito (1987): Geological, Geophysical and Geochemical Report, Barb Claim Group, for Pulse Resources Ltd.
- Stammers, M.A., Montgomery, A.J.(1991): Diamond Drilling Report on the Barb Project for Pulse Resources Ltd.

APPENDIX II

ACME ANALYTICAL LABORATORIES LTD. 852 E. HASTINGS ST. VANCOUVER BC V6A 1R6 PHONE(604)253-3158 FAX(604)253-1716

ASSAY CERTIFICATE

International Barytex Resources Ltd. File # 95-2235

520 - 470 Granville St., Vancouver BC V6C 1V5 Submitted by: Ted Muraro



SAMPLE#	Cu %	Pb %	Zn %	Ag** oz/t	Au** oz/t
D 96701	.013	.04	.01	.01	.001
D 96702	.059	.56	.01	.12	.002
D 96703	.248	12.50	.01	1.99	.005
D 96704	.243	6.73	2.50	2.40	.002
D 96705	-	-	-	-	.002
D 96706	-	-	-	-	.001
D 96707	-	-	-	-	<.001

Samples of the Main showing on the Barb claims.

1 GM SAMPLE LEACHED IN 50 ML AQUA - REGIA, DILUTE TO 100 ML, ANALYSIS BY ICP.
 AG** & AU** BY FIRE ASSAY FROM I.A.T. SAMPLE.
 - SAMPLE TYPE: ROCK

DATE RECEIVED: JUL 11 1995

DATE REPORT MAILED:

July 18/95

SIGNED BY:

C. Leong

D.TOYE, C.LEONG, J.WANG; CERTIFIED B.C. ASSAYERS

**STATEMENT OF QUALIFICATIONS
CERTIFICATE**

I, H.Leo King, of 4747 Marguerite Street, Vancouver, British Columbia do hereby certify that:

I am a geologist and a graduate of the University of Saskatchewan, B.A. (Geology) 1961, M.A. (Geology) 1965.

I am a member of the Association of Professional Engineers and Geoscientists of B.C. and a member of the Association of Professional Engineers of Ontario.

I am a Fellow of the Geological Association of Canada.

I have practice my profession for over 30 years.

This report is based on field examinations made on the mineral claims during June 1995 and a review of maps and reports pertaining to the area.

I am currently employed by International Barytex Resources Ltd., as General Manager and Corporate Secretary.

H. Leo King, P.Ge.
July 27, 1995



The seal is a circular emblem with a scalloped border. The text inside the seal reads: 'PROFESSIONAL' at the top, 'PROVINCE OF' in the middle, 'H. L. KING' in the center, 'BRITISH COLUMBIA' below the name, and 'GEOSCIENTIST' at the bottom.

STATEMENT OF COSTS

Salaries & benefits	16,190.71
Travel (including Airfare & Hotels in Watson Lake)	3,088.59
Fuel	767.67
Freight (Land & Water)	1,620.00
Charter Aircraft (Watson Lake Flying)	343.60
Lodging at Frances Lake	6,925.00
Assaying	146.24
Cartographic Services (Nadir Mapping)	645.00
Printing	174.08
Equipment rental: radio (Falcon Reseach)	433.20
: boat and motor	800.00
Map preparation - drafting (F.Y. Chong)	397.10
	<hr/>
	\$ <u>31,531.19</u>

APPENDIX V

Names and addresses of employees and contractors employed in survey and report preparation and time employed in carrying out the survey and preparing report.

- 1) H.L. King 4747 Marguerite Street, Vancouver, B.C., V6J 4H1
- 2) T.W. Muraro 4438 Stone Court, West Vancouver, B.C., V7W 2V5
- 3) B. Cross Hornby Island, B.C., V0R 1Z0
- 4) F.Y. Chong 5990 Nelson Avenue, Burnaby, B.C., V5H 3H9

Time spent on field in geological survey:

	<u>Days</u>
H.L. King	19
T. Muraro	15
B. Cross	19

Time spent in report writing and map preparation:

H.L. King	4.5
T. Muraro	1.0
F.Y. Chong	2.0

MAP NO:105H6/11

ASSESSMENT REPORT: X

DOCUMENT NO: 093322

PROSPECTUS:

MINING DISTRICT: Watson Lake

CONFIDENTIAL: X

TYPE OF WORK:Geological

OPEN FILE:

REPORT FILED UNDER: International Barytex Resources Ltd.

DATE PERFORMED:June 15-July 2, 1995

DATE FILED:August 3, 1995

LATITUDE:62 28

AREA:Frances Lake

LONGITUDE:129 25

VALUE:\$31,200

CLAIM NAME AND #:Fran 1-38, Pat 1-40

WORK DONE BY:H.L. King

WORK DONE FOR:International Barytex Resources Ltd.

DATE TO GOOD STANDING	REMARKS:Geological mapping and prospecting were carried out on the claims. Outcrop is very poor on the property. An oxidized quartz vein located on Beaver creek contains pyrite, pyrrotite, galena, sphalerite and traces of chalcopyrite assayed 0.06% Cu, 0.56% Pb, 0.01 Zn, 4.1 g/T Ag and 0.07 g/T Au.



61° 30'

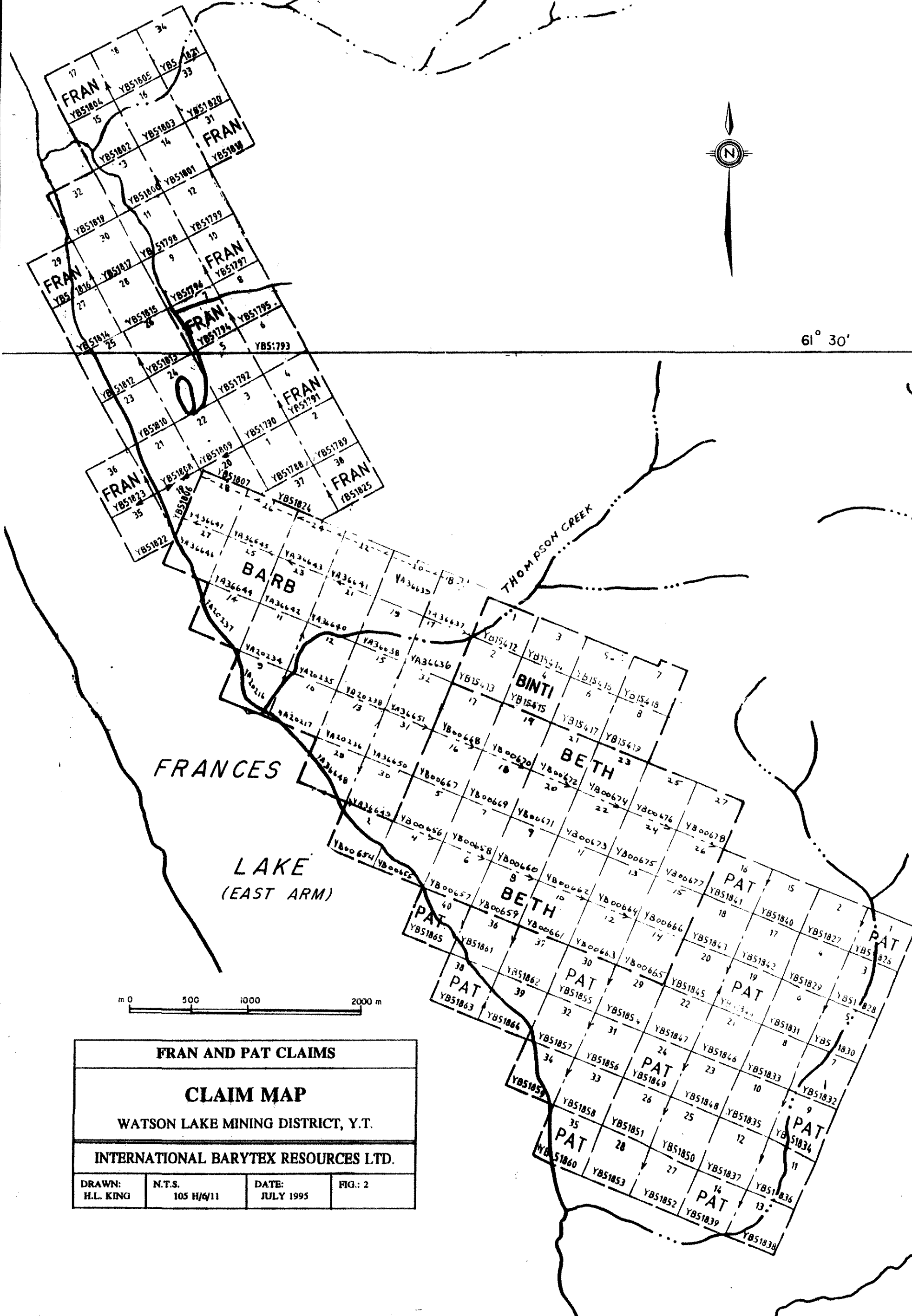

0 500 1000 2000 m

FRAN AND PAT CLAIMS			
CLAIM MAP			
WATSON LAKE MINING DISTRICT, Y.T.			
INTERNATIONAL BARYTEX RESOURCES LTD.			
DRAWN: H.L. KING	N.T.S. 105 H/q/11	DATE: JULY 1995	FIG.: 2

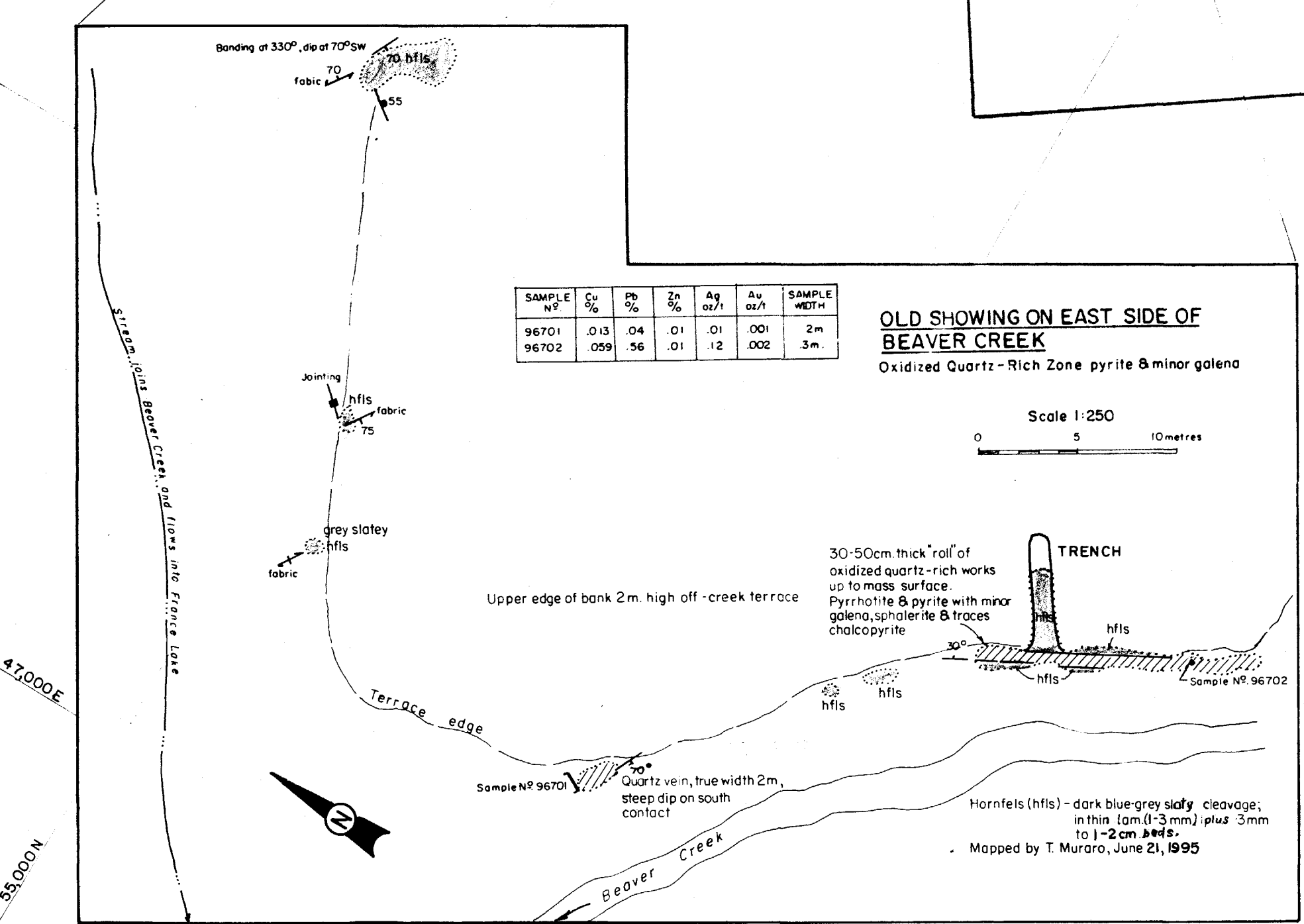
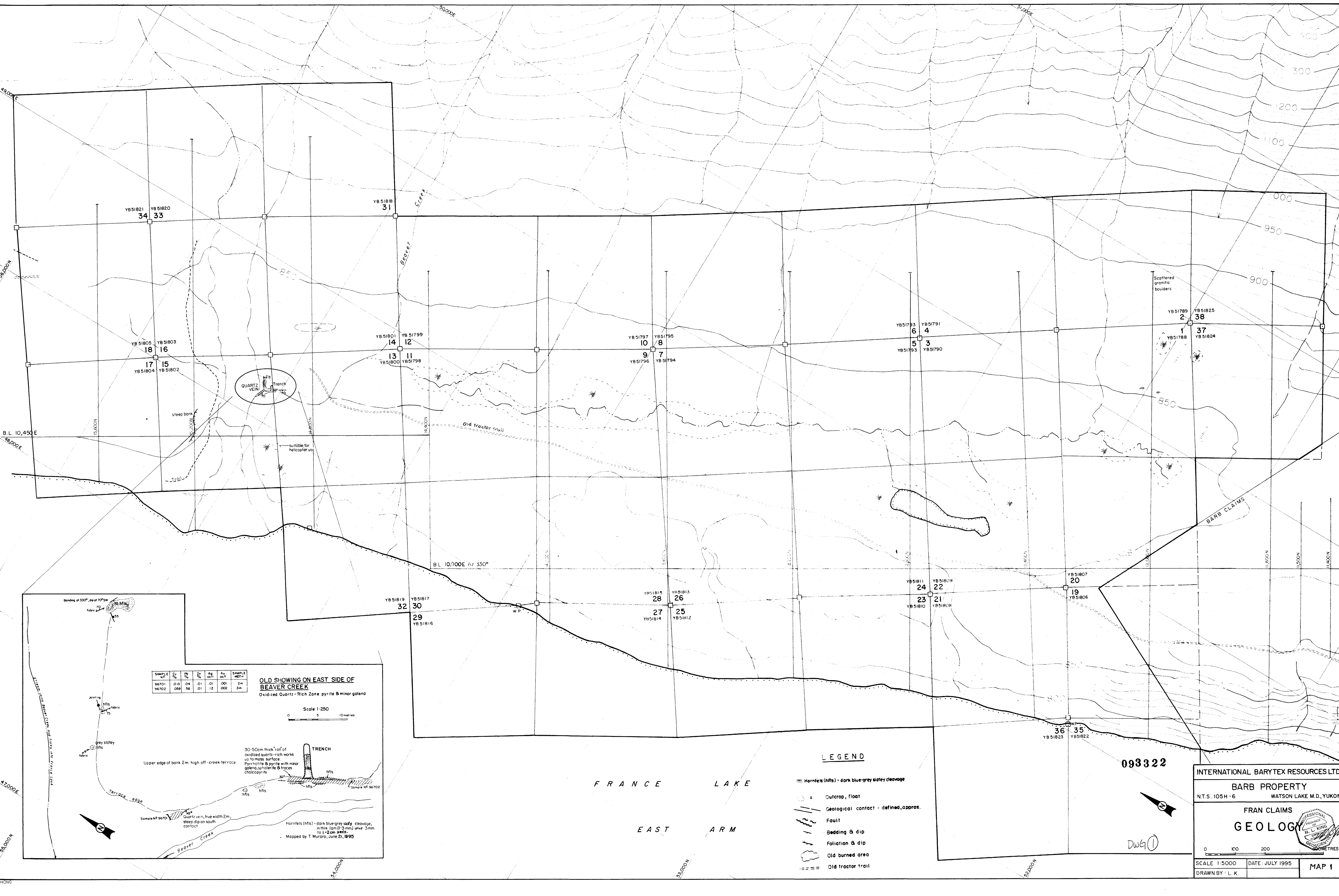

- LEGEND**
- Hornfels (hfs) - dark blue-grey silty cleavage
 - x Outcrop, float
 - Geological contact - defined, approx.
 - - - Fault
 - / - Bedding & dip
 - \ - Foliation & dip
 - Old burned area
 - - - Old tractor trail

093322

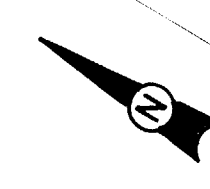

DWG 1

INTERNATIONAL BARYTEX RESOURCES LTD.
BARB PROPERTY
 N.T.S. 105H-6 WATSON LAKE M.D., YUKON
 FRAN CLAIMS
GEOLOGY

SCALE 1:5000 DATE: JULY 1995
 DRAWN BY: L. K. MAP 1

LEGEND

- Quartz augen schist - light grey to light green, weathers grey, strongly foliated with 20-50% quartz augens to 8mm set in a chlorite, sericite, quartz matrix
- Phyllite - dark grey to black, strongly foliated
- Outcrop, float
- Geological contact - defined, approx.
- Fault
- Bedding & dip
- Foliation & dip
- Old burned area
- Old tractor trail

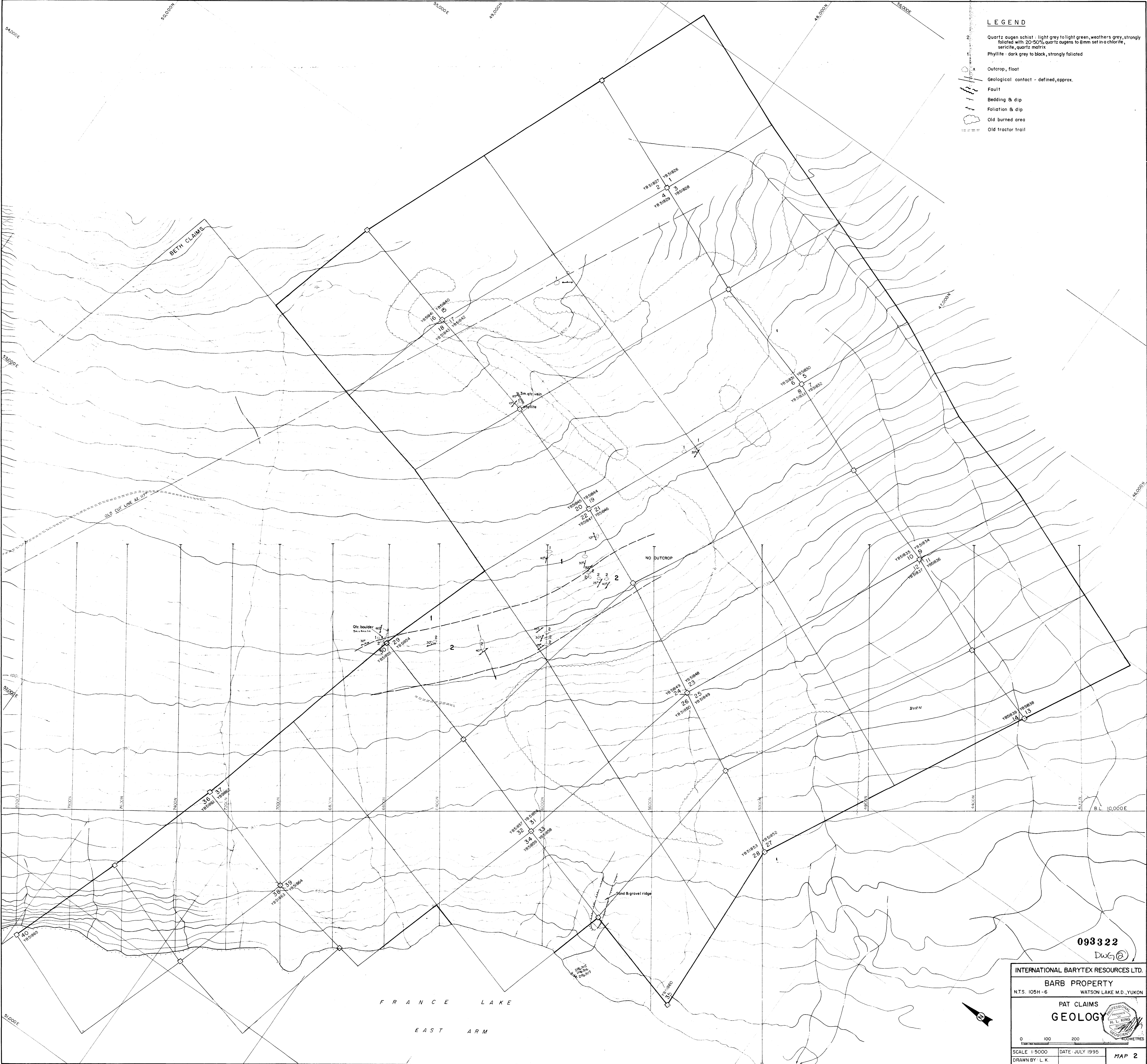

093322
DWG 2

INTERNATIONAL BARYTEX RESOURCES LTD.	
BARB PROPERTY	
N.T.S. 105H-6	WATSON LAKE M.D., YUKON
PAT CLAIMS	
GEOLOGY	
SCALE 1:5000	DATE JULY 1995
DRAWN BY L.K.	MAP 2