

MAP NO:1150/14

ASSESSMENT REPORT: X

DOCUMENT NO: 093235

PROSPECTUS:

MINING DISTRICT:Dawson

CONFIDENTIAL: X

TYPE OF WORK:Geochemical

OPEN FILE:

REPORT FILED UNDER: Pacific Mariner Explorations and Faith Mines Ltd.

DATE PERFORMED:June 10-11, 1995

DATE FILED:January 18, 1995

LATITUDE:63 58

AREA:Colorado Creek

LONGITUDE:139 01

VALUE:\$4811

CLAIM NAME AND #:Star 11-14, 31-34

WORK DONE BY:Hastings Management Corporation

WORK DONE FOR:Pacific Mariner Explorations and Faith Mines Ltd.

DATE TO GOOD STANDING	REMARKS
	An assumed thrust fault trends northwest and dips southwest on the property and was considered to be a possible conduit for placer gold in the area. 150 soil samples were collected from two soil lines and fire assayed for gold and 32 element ICP, no significant anomalies were identified. The highest value obtained was 20 ppb Au.

093235

YUKON ASSESSMENT REPORT

PROPERTY: STAR CLAIMS

NTS MAP SHEET: 115 0/14

LATITUDE: 63° 58'N

LONGITUDE: 139° 01'W

CLAIMS AND GRANT NUMBERS WORKED:

STAR 11 - 14, 31 - 34

YB45378 - 81, 94 - 97

OWNER OF PROPERTY: *Colin Little*
~~Pacific Mariner Explorations Ltd. and~~
~~Faith Mines Ltd.~~ *MB*

ADDRESS: #1000 - 675 West Hastings Street
Vancouver, B.C.
V6B 1N2

TELEPHONE: (604) 685-2222

OPERATOR: Hastings Management Corporation

TYPE OF WORK: Geochemical sampling

DATE WORK WAS DONE: June 10 - 11, 1994

AUTHOR OF REPORT: Philip Southam, P. Geo.

LIST OF PERSONNEL:

Philip Southam, Hastings Management Corp.
Lee Persinger, Hastings Management Corp.

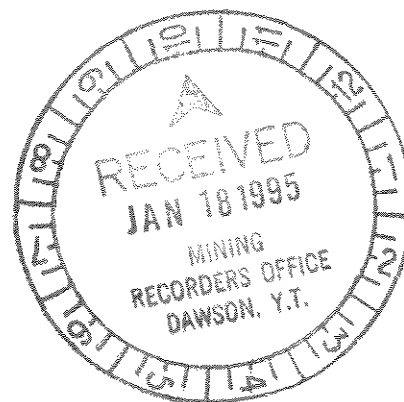

GEOCHEMICAL REPORT
ON THE
STAR CLAIMS

Dawson Mining Division, Yukon

NTS 115 0/14

Latitude: 63° 58'N

Longitude: 139° 01'W

OWNERS: *Colin Little*

Pacific Mariner Explorations Ltd.
Faith Mines Ltd.
#1000 - 675 West Hastings Street
Vancouver, B.C.
V6B 1N2

OPERATOR:

Hastings Management Corporation
#1000 - 675 West Hastings Street
Vancouver, B.C.
V6B 1N2

BY:

P. SOUTHAM, P. Geo. (BC)

January 7, 1995

TABLE OF CONTENTS

LOCATION AND ACCESS	1
TOPOGRAPHY AND VEGETATION	1
PROPERTY STATUS	1
HISTORY	1
REGIONAL GEOLOGY	4
PROPERTY GEOLOGY	4
WORK PROGRAM	10
GEOCHEMICAL SURVEY METHOD	10
GEOCHEMICAL SURVEY RESULTS	10
SUMMARY AND CONCLUSIONS	10

LIST OF TABLES

Table 1 - Claims List	1
Table 2 - Property Geology Legend	7
Table 3 - Sample Data	10

LIST OF FIGURES

Figure 1 - Location Map	2
Figure 2 - Claim Location Map	3
Figure 3 - Regional Geology	5
Figure 4 - Property Geology	6
Figure 5 - Gold Geochemistry, ST1 Grid	8
Figure 6 - Arsenic Geochemistry, ST1 Grid	9

APPENDICES

Appendix I - STATEMENT OF EXPENDITURES
Appendix II - STATEMENT OF QUALIFICATIONS
Appendix III - ANALYTICAL METHOD
Appendix IV - ASSAY RESULTS

LOCATION AND ACCESS

The property is located 27 kilometers southeast of Dawson City, Yukon (figure 1) near Hunker Creek, centered on 63° 58' north latitude and 139° 01' west longitude on NTS sheet 115 O/14. It is accessible by gravel road from spring to fall or by helicopter from Dawson City in the winter.

TOPOGRAPHY AND VEGETATION

The topography is rolling hills ranging in elevation from 488 meters (1600 ft.) above sea level (ASL) to 823 meters (2700 ft.) ASL covered with spruce, poplar and birch trees. The area escaped glaciation, thus the valleys are V-shaped and there is less than 1% natural outcrop exposure. The best exposure of bedrock is usually found in placer mine cuts and along road cuts.

On north facing slopes and shaded areas the vegetation consists of spruce trees and thick moss due to permafrost in the underlying soil. Spruce trees are also found in damp soil conditions on the property, such as creek gullies. Poplar and birch trees grow on the dry, thawed south, east and west facing slopes. Alder thickets are commonly found along creeks and gullies.

PROPERTY STATUS

The property consists of 34 quartz claims staked as the Star claims (figure 2). They are:

Table 1 - Claims List

<u>CLAIM NAME</u>	<u>GRANT NUMBER</u>	<u>EXPIRY DATE*</u>	<u>OWNER</u>
Star 1 - 16, 21 - 38	YB45368 - 401	Aug. 17/95	<i>Colin Little</i> Pacific Mariner Expl. Ltd. and Faith Mines Ltd.

With acceptance of this report.

HISTORY

The property is located in the historic Klondike region where more than eleven million ounces of gold has been mined from placer deposits in existing creeks and former river channels. Placer gold was discovered in 1896 and mining of the creek and bench deposits still continues today.

The southeast corner of the Star property has significant old and recent bench placer workings. There are no known hard rock prospects on the property.

PACIFIC MARINER EXPLORATIONS LTD.
FAITH MINES LTD.

STAR PROPERTY
DAWSON M.D., YUKON NTS 115-O-14,15

LOCATION MAP

DATE: JAN. 95
BY: P.S.

FIGURE 1

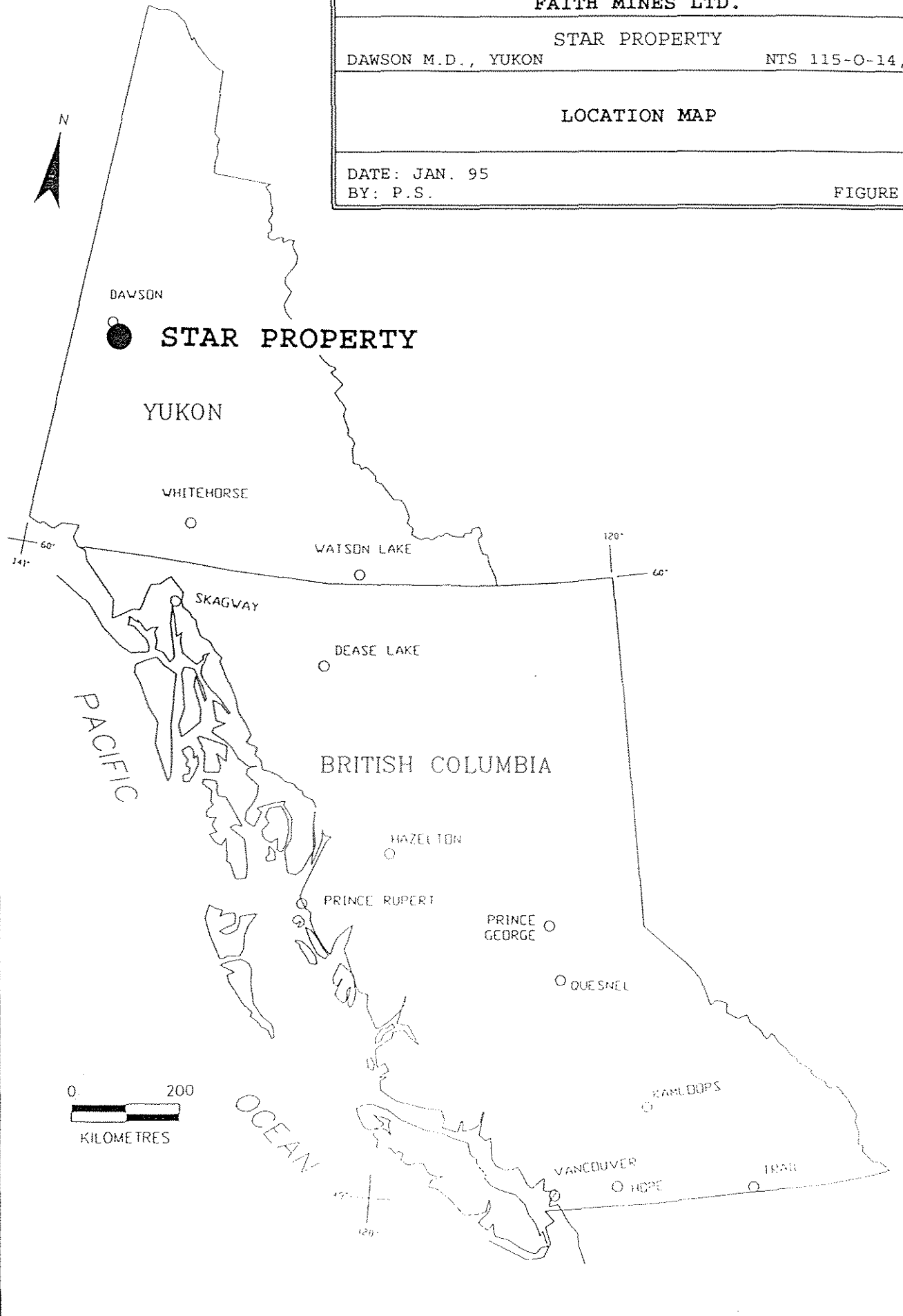

KILOMETRES

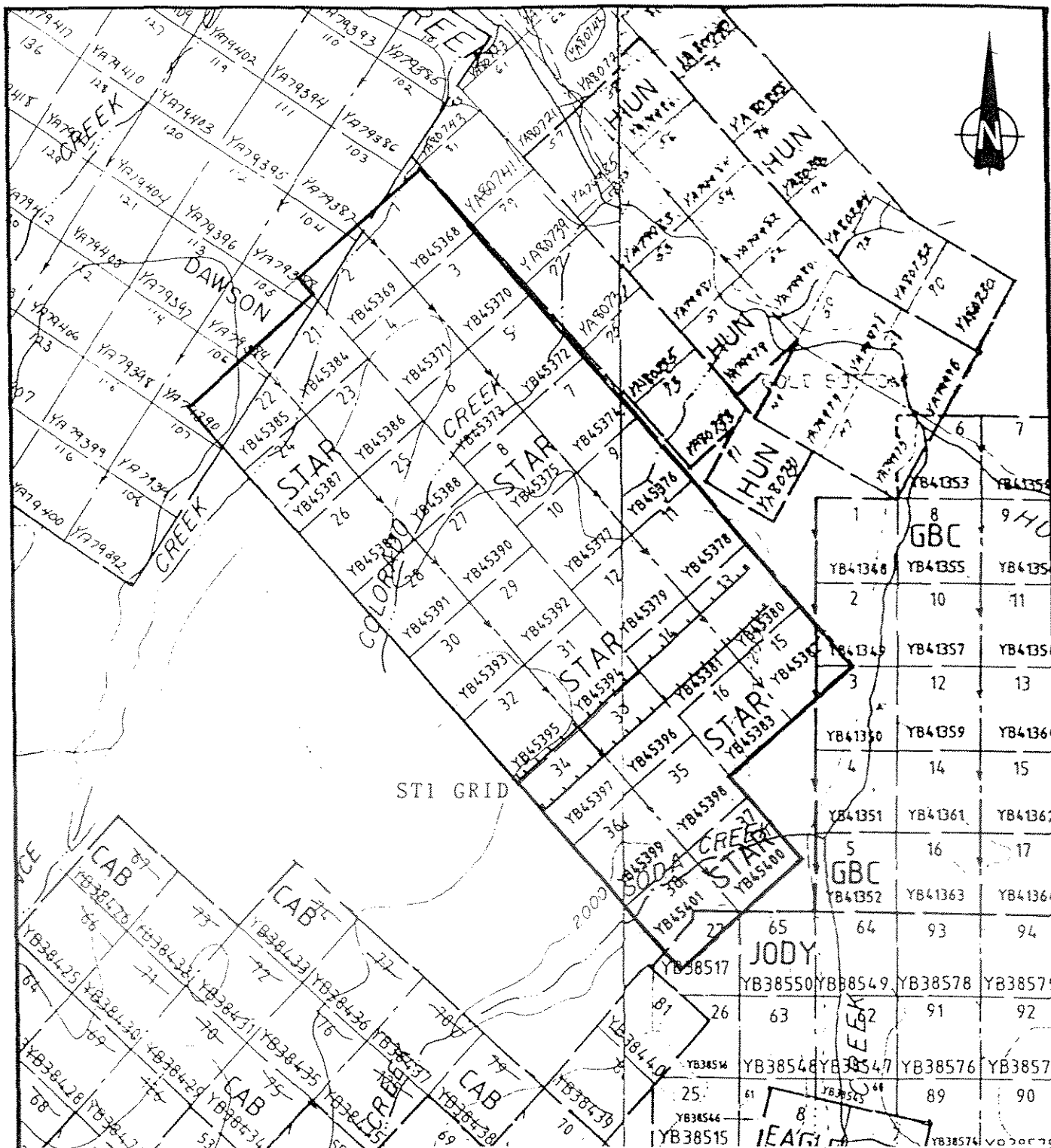

1	8	9
YB41348	GBC YB41355	HO YB41356
2	10	11
YB41349	YB41357	YB41358
3	12	13
YB41350	YB41359	YB41360
4	14	15
YB41351	YB41361	YB41362
5	16	17
GBC YB41352	YB41363	YB41364
65	64	93
JODY YB38517	YB38550	YB38549
26	63	91
YB38516	YB38548	YB38547
25	61	89
YB38546	YB38545	YB38544
8	8	90
YB38515	YB38514	YB38513

PACIFIC MARINER EXPLORATIONS LTD.
FAITH MINES LTD.

STAR PROPERTY

DAWSON M.D., YUKON

NTS 115-O-14,15

CLAIM AND GRID LOCATION MAP

SCALE 1 : 31,680

DATE: JAN. 95

BY: P.S.

FIGURE 2



REGIONAL GEOLOGY

The Klondike region is underlain by a group of moderately metamorphosed rocks of late-Paleozoic age known as the Klondike Series and Nasina Series (represented as Klondike schist and Yukon Group in figure 3). They form part of the Yukon-Tanana Terrane (YTT) on the SW side of the Tintina Trench. The YTT is formed from the merging of the Omineca Crystalline Belt and the Coast Plutonic Complex into the Intermontane Belt (Tempelman-Kluit, 1977). The Tintina Trench is a major transcurrent fault along which at least 450 km of dextral offset has occurred (Mortensen, 1990).

The gross lithologic assemblages within the YTT consist of Proterozoic and Paleozoic strata which can be correlated with the Omineca Crystalline Belt (OCB). The OCB includes a succession of clastic and carbonate rocks equivalent to miogeoclinal sequences to the east. The western part of the belt is overlain by upper Paleozoic mafic and felsic volcanic rocks with intercalated chert and slate (Tempelman-Kluit, 1977).

Mortensen (1990) describes the Klondike and Nasina geology as several imbricated thrust panels of polydeformed metavolcanics and metasediments of a buried island arc which can be subdivided into three assemblages. Assemblage I, the uppermost and more widely extensive thrust panel, is metamorphosed mid-Permian felsic plutonic, subvolcanic, and tuffaceous rocks. Assemblage II is mid-Paleozoic or older metasedimentary and mafic and felsic metavolcanic rocks intruded by a large body of latest Devonian - Early Mississippian granitic augen orthogneiss. Assemblage III underlies I and II structurally in the northern and southwestern part of the study area and consists of carbonaceous schists and phyllite.

PROPERTY GEOLOGY

The area is underlain by schistose rocks of quartzofelspathic to mafic affinity (figure 4; from Debicki, 1984). The quartzofelspathic unit is described as buff weathering well foliated muscovite-feldspar-quartz schist; the mafic material is light to medium green and buff weathering chlorite-quartz schist (table 2).

Ultramafic rocks have been mapped in along Independence Creek at the assumed contact of a thrust fault trending northwest and dipping to the southwest. It underlies old and recent bench placer gold mining operations and is considered to be a possible source conduit of the gold.

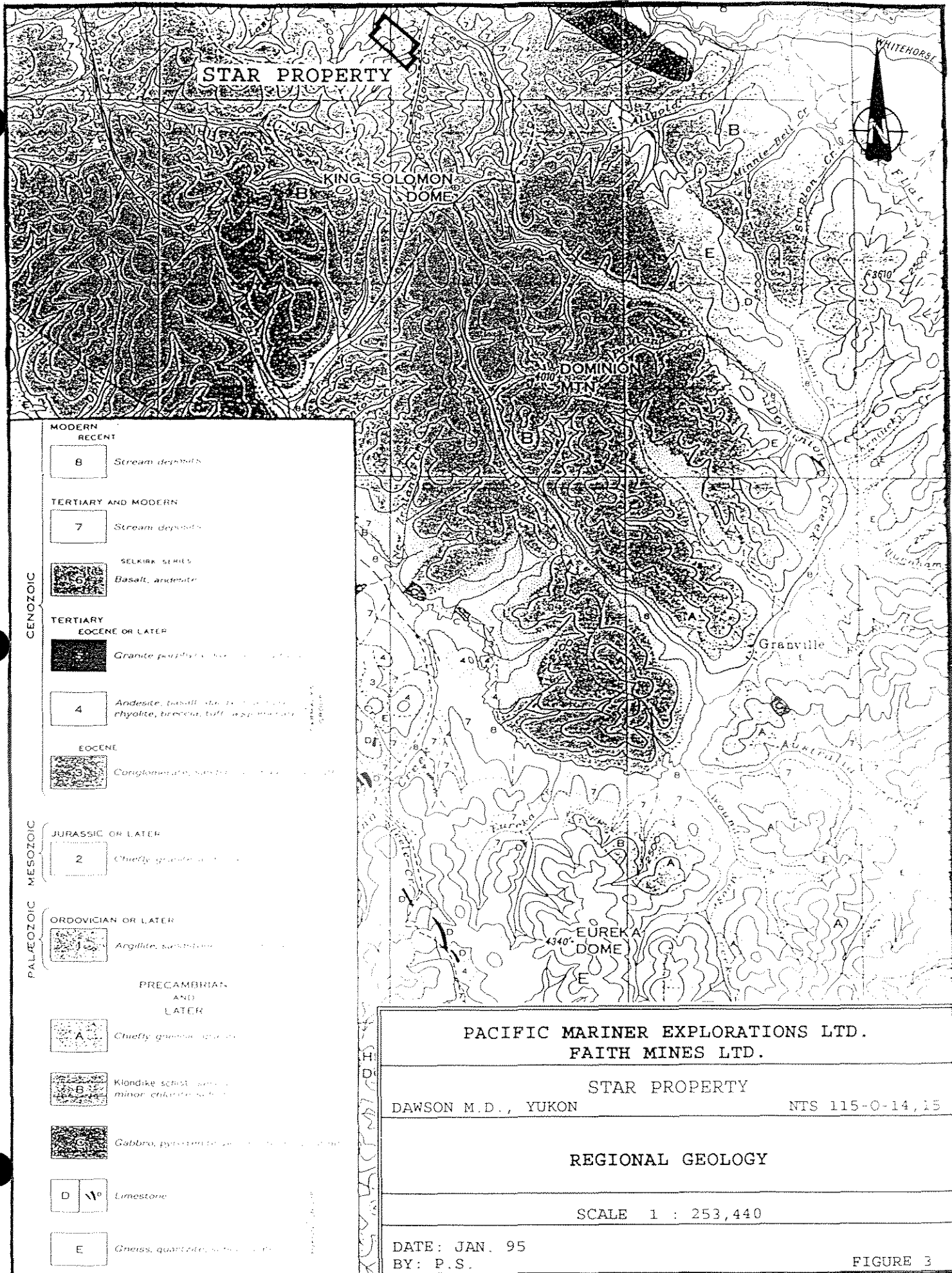

STAR PROPERTY

KING SOLOMON DOME

DOMINION MT.

EUREKA DOME

Granville

- MODERN RECENT
 - 8 Stream deposits
- TERTIARY AND MODERN
 - 7 Stream deposits
 - SELKIRK SERIES
 - Basalt, andesite
- TERTIARY EOCENE OR LATER
 - 5 Granite porphyry, andesite, rhyolite
 - 4 Andesite, basalt, diorite, gabbro, rhyolite, breccia, tuff, agglomerate
- EOCENE
 - 3 Conglomerate, sandstone, siltstone
- MESOZOIC
 - JURASSIC OR LATER
 - 2 Chiefly granite, andesite
 - ORDOVICIAN OR LATER
 - 1 Argillite, sandstone, siltstone
- PRECAMBRIAN AND LATER
 - A Chiefly granitic gneiss
 - B Klondike schist, minor calcareous schist
 - C Gabbro, pyroxenite, andesite, rhyolite
 - D Limestone
 - E Gneiss, quartzite, schist, etc.

PACIFIC MARINER EXPLORATIONS LTD.
FAITH MINES LTD.

STAR PROPERTY
DAWSON M.D., YUKON NTS 115-0-14,15

REGIONAL GEOLOGY

SCALE 1 : 253,440

DATE: JAN. 95
BY: P.S.

FIGURE 3

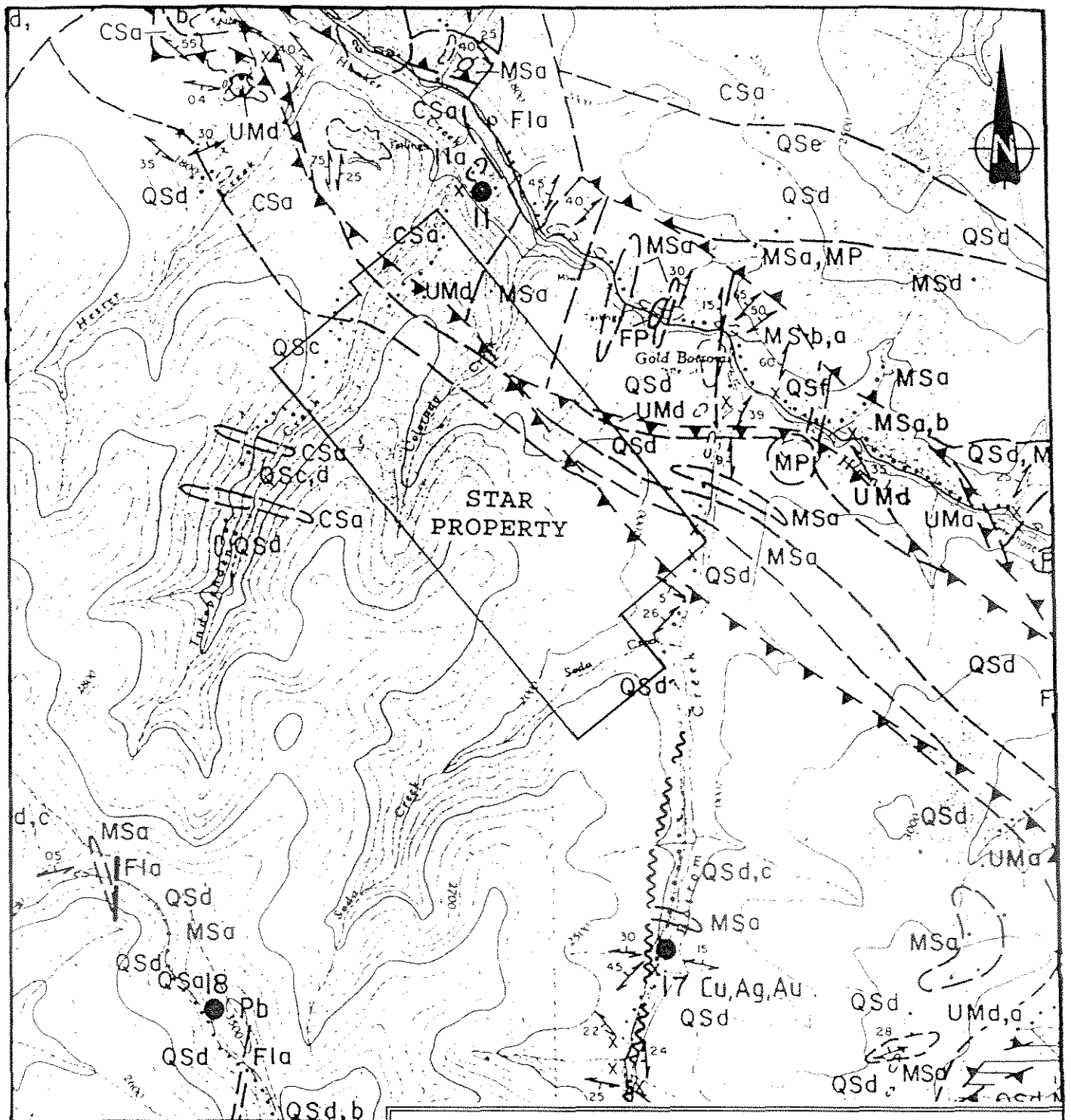

KILOMETERS

PACIFIC MARINER EXPLORATIONS LTD.
 FAITH MINES LTD.

STAR PROPERTY
 DAWSON M.D., YUKON NTS 115-O-14,15

PROPERTY GEOLOGY
 (From Debicki, 1984)

SCALE 1 : 50,000

DATE: JAN. 95
 BY: P.S.

FIGURE 4

Table 2 - Property Geology Legend
(from Debicki, 1985)

LATE CRETACEOUS TO EARLY TERTIARY

Felsic intrusive and volcanic rocks

FI
 FIa light coloured quartz-feldspar rhyolite porphyry and rhyolite

TRIASSIC OR OLDER

Rocks of varying metamorphic grade and degree and style of deformation

Felsic plutonic rocks

FP, QS
 FP foliated equigranular biotite granodiorite
 QSa blocky weathering light grey to pinkish feldspar-quartz schist

Mafic plutonic rocks

MP
 MP weakly to strongly foliated amphibolite

Quartzofeldspathic schistose rocks

QS
 QSB buff to pale green weathering well foliated muscovite-feldspar-quartz schist with quartz and feldspar porphyroclasts, and lithic fragments
 QSc buff weathering well foliated muscovite-feldspar-quartz schist with quartz porphyroclasts
 QSD buff weathering well foliated muscovite-feldspar-quartz schist
 QSe light green weathering hornblende/muscovite-feldspar-quartz schist
 QSF silvery grey weathering sericite-quartz schist

Carbonaceous rocks

CS
 CSa massive to foliated dark grey to black carbonaceous quartzite and muscovite-quartz schist

Mafic schistose rocks

MS
 MSa light to medium green and buff weathering chlorite-quartz schist
 MSb dark green weathering chlorite schist
 MSd grey-brown weathering quartz-amphibole schist

Ultramafic rocks

UM
 UMa massive dark green serpentinite
 UMd foliated strongly altered serpentinite, including talc schist and listwanite

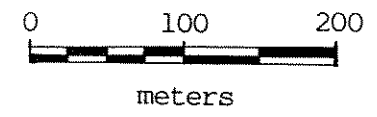
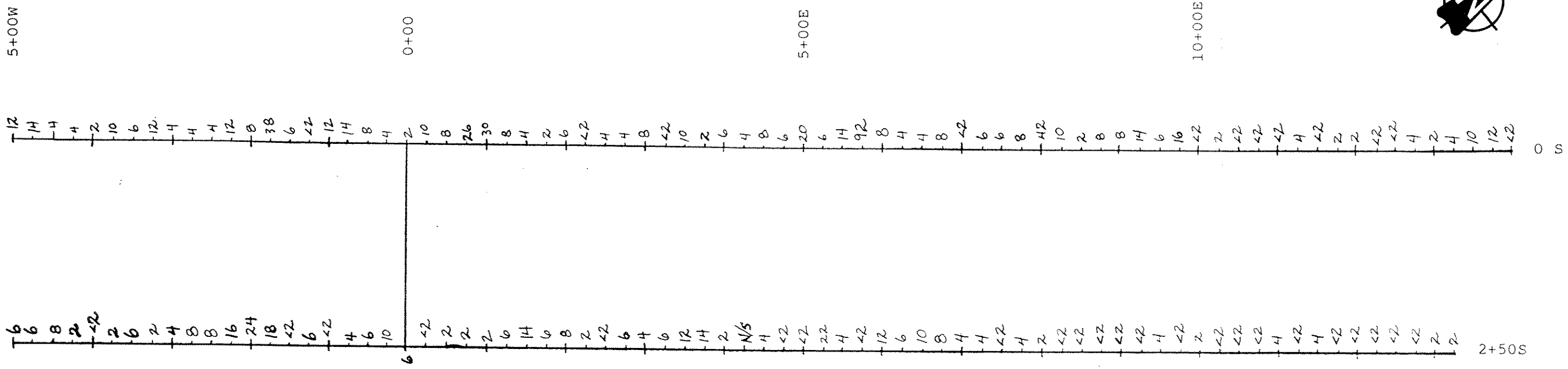
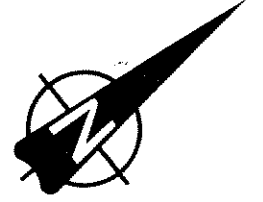

PACIFIC MARINER EXPLORATIONS LTD. FAITH MINES LTD.	
STAR PROPERTY DAWSON M.D., YUKON	NTS 115-O-14,15
ARSENIC GEOCHEMISTRY, ST1 GRID (ppm)	
SCALE 1 : 5,000	
DATE: JAN. 95 BY: P.S.	FIGURE 6

WORK PROGRAM

Two lines of soil samples (table 3) were completed to test for mineralization along the thrust and in the surrounding rocks.

Table 3 - Sample Data

<u>Grid Name</u>	<u>Line Kilometers</u>	<u>No. of Samples</u>	<u>Sample Spacing</u>	<u>Line Spacing</u>
ST1	3.7	150	25 m	250 m

GEOCHEMICAL SURVEY METHOD

The two soil lines were taken on the top of the bench overlooking Hunker Creek, north of Gold Bottom Creek (figure 2). Sample stations are at 25 meter intervals and are marked with flagging tape. Soil samples were taken from the B-horizon, found at depths of 5 to 40 centimeters, using a standard mattock. The samples were placed in kraft soil sample bags and dried prior to shipping to Chemex Labs for analysis. Each sample was tested by fire assay for gold and by 32-element ICP.

GEOCHEMICAL SURVEY RESULTS

There is not much encouragement from the soil sample results, however the key area of interest, over the thrust fault, was not sampled due to placer mining activity.

SUMMARY AND CONCLUSIONS

The Star property is underlain by rocks of the Klondike Schist which have been thrust faulted into position. The thrust fault may have been a conduit for mineralizing fluids from depth which deposited gold in the surrounding rocks. Two lines of soil samples were completed over the thrust to test for mineralization. No significant results were returned from any of the samples. Further geochemical work ought to be performed over the northern end of the property to test for mineralization.

BIBLIOGRAPHY

- Debicki, R.L., 1984. Bedrock geology and mineralization of the Klondike Area (west), 115 O/14,15 and 116 B/2,3 Exploration and Geological Services Division, Yukon; Indian and Northern Affairs Canada. Open File, 1:50,000 scale map with marginal notes.
- MacLean, T.A., 1914. Lode mining in Yukon: an investigation of quartz deposits in the Klondike division; Canada Dept. of Mines, Mines Branch Publication 222, Ottawa.
- Mortensen, J.K., 1990. Geology and U-Pb geochronology of the Klondike district, west-central Yukon Territory; Canadian Journal of Earth Sciences, Vol. 27, p. 903-914.
- Templeman-Kluit, D., 1976. The Yukon crystalline terrane: Enigma in the Canadian Cordillera; Geol. Soc. America Bull., v. 87, p. 1343-1357.

APPENDIX I

STATEMENT OF EXPENDITURES

STAR CLAIMS - EXPENDITURES

SALARIES

Phil Southam - 2 mandays @ \$180/day	360
Lee Persinger - 2 mandays @ \$150/day	300
Report preparation - P. Southam - 2 mandays @ \$180/day	360

GEOCHEMICAL ANALYSIS

150 soil samples @ \$17.17/sample	2576
-----------------------------------	------

LOGISTICAL COSTS

Food and lodging - 4 mandays @ \$50/day	200
Sample shipping	80
Vehicle fuel and maintenance	100

FILING FEES

170

SUBTOTAL

4146

Administration Fee (15%)
GST on Administration (#129350518)

622

43

TOTAL

\$4811

APPENDIX II

STATEMENT OF QUALIFICATIONS

STATEMENT OF QUALIFICATIONS

I, Philip James Southam of 103 - 6615 Telford Avenue, Burnaby, British Columbia, do hereby certify:

1. I am a geologist registered with the Association of Professional Engineers and Geoscientists of British Columbia.
2. I graduated from Brandon University in 1987 with a Bachelor of Science degree majoring in geology.
3. I have practised my profession continuously since graduation in British Columbia, Manitoba, Yukon Territory and California in the field of mineral exploration.
4. I am employed by Hastings Management Corp. to provide geological services for Pacific Mariner Explorations Limited and Faith Mines Limited.
5. All work completed for the purpose of this report was done under my supervision.



APPENDIX III

ANALYTICAL METHOD

Screening Procedure

Chemex Code: 201

Geochemical samples (soils, silts) are dried at 50 deg C and then sieved through an 80 mesh stainless steel screen. If insufficient material is obtained, the sample is sieved through a 35 mesh screen (code 203) and the -35 mesh material is ring pulverized (code 205).

If there is still insufficient material for analysis after sieving to -35 mesh, then the whole sample is recombined and ground (code 217).

Screening Procedure

Chemex Code: 203

Geochemical samples (soils, silts) are dried at 50 deg C. and then screened through a 35 mesh stainless steel screen. The -35 mesh material is then ring pulverized using a ring mill with either a chrome steel ring set (code 205) or a zirconia ring set (code 248). If there is insufficient -35 mesh material for analysis, then the entire sample is ground (code 217).

Gold

Fire Assay Collection/ Atomic Absorption Spectroscopy (FA-AA)

Chemex Code: 100

A 10g sample is fused with a neutral lead oxide flux inquarted with 6mg of gold-free silver and then cupelled to yield a precious metal bead.

These beads are digested for 30 mins in 0.5ml concentrated nitric acid, then 1.5ml of concentrated hydrochloric acid are added and the mixture is digested for 1 hr. The samples are cooled, diluted to a final volume of 5ml, homogenized and analyzed by atomic absorption spectroscopy.

Detection limit: 5 ppb

Upper Limit: 10,000 ppb

32-Element Geochemistry Package (32-ICP)
Inductively-Coupled Plasma-Atomic Emission Spectroscopy (ICP-AES)

A prepared sample (1.0g) is digested with concentrated nitric and aqua regia acids at medium heat for two hours. The acid solution is diluted to 25ml with demineralized water, mixed and analyzed using a Jarrell Ash 1100 plasma spectrometer after calibration with proper standards. The analytical results are corrected for spectral inter-element interferences.

Chemex Codes	Element	Detection Limit	Upper Limit
229	Digestion		
2119	* Aluminum	0.01 %	15 %
2118	Silver	0.2 ppm	0.02 %
2120	Arsenic	2 ppm	1 %
2121	* Barium	10 ppm	1 %
2122	* Beryllium	0.5 ppm	0.01 %
2123	Bismuth	2 ppm	1 %
2124	* Calcium	0.01 %	15 %
2125	Cadmium	0.5 ppm	0.05 %
2126	Cobalt	1 ppm	1 %
2127	* Chromium	1 ppm	1 %
2128	Copper	1 ppm	1 %
2150	Iron	0.01 %	15 %
2130	* Gallium	10 ppm	1 %
2132	* Potassium	0.01 %	10 %
2151	* Lanthanum	10 ppm	1 %
2134	* Magnesium	0.01 %	15 %
2135	Manganese	5 ppm	1 %
2136	Molybdenum	1 ppm	1 %
2137	* Sodium	0.01 %	10 %
2138	Nickel	1 ppm	1 %
2139	Phosphorus	10 ppm	1 %
2140	Lead	2 ppm	1 %
2141	Antimony	2 ppm	1 %
2142	* Scandium	1 ppm	1 %
2143	* Strontium	1 ppm	1 %
2144	* Titanium	0.01 %	10 %
2145	* Thallium	10 ppm	1 %
2146	Uranium	10 ppm	1 %
2147	Vanadium	1 ppm	1 %
2148	* Tungsten	10 ppm	1 %
2149	Zinc	2 ppm	1 %
2131	Mercury	1 ppm	1 %

* Elements for which the digestion is possibly incomplete.

APPENDIX IV

ASSAY RESULTS

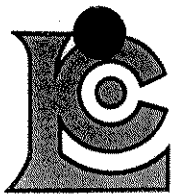

Chemex Labs Ltd.

Analytical Chemists * Geochemists * Registered Assayers
212 Brooksbank Ave., North Vancouver
British Columbia, Canada V7J 2C1
PHONE: 604-984-0221

WEALTH RESOURCES LTD.

1000 - 675 W. HASTINGS ST.
VANCOUVER, BC
V6B 1N6

INVOICE NUMBER

I 9 4 1 8 5 2 0

BILLING INFORMATION

Date: 28-JUN-94
Project: STAR CLAIMS
P.O. No.:
Account: GDR

Comments:

Billing: For analysis performed on
Certificate A9418520

Terms: Payment due on receipt of invoice
1.25% per month (15% per annum)
charged on overdue accounts

Please Remit Payments to:

CHEMEX LABS LTD.
212 Brooksbank Ave.,
North Vancouver, B.C.
Canada V7J 2C1

# OF SAMPLES	ANALYSED FOR CODE - DESCRIPTION	UNIT PRICE	SAMPLE PRICE	AMOUNT
150	201 - Dry, sieve to -80 mesh	1.10		
	202 - save reject	0.75		
	ICP-32	6.25		
	100 - Au ppb FA+AA	7.95	16.05	2407.50
Total Cost \$				2407.50
(Reg# R100938885) GST \$				<u>168.53</u>
TOTAL PAYABLE (CDN) \$				2576.03

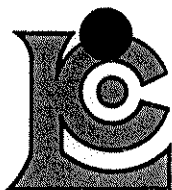

Chemex Labs Ltd.

Analytical Chemists * Geochemists * Registered Assayers
212 Brooksbank Ave., North Vancouver
British Columbia, Canada V7J 2C1
PHONE: 604-984-0221

WEALTH RESOURCES LTD.

1000 - 675 W. HASTINGS ST.
VANCOUVER, BC
V6B 1N6

A9418520

Comments: ATTN: P. SOUTHAM

CERTIFICATE

A9418520

WEALTH RESOURCES LTD.

Project: STAR CLAIMS
P.O. #:

Samples submitted to our lab in Vancouver, BC.
This report was printed on 28-JUN-94.

SAMPLE PREPARATION

CHEMEX CODE	NUMBER SAMPLES	DESCRIPTION
201	150	Dry, sieve to -80 mesh save reject ICP - AQ Digestion charge
202	150	
229	150	

* NOTE 1:

The 32 element ICP package is suitable for trace metals in soil and rock samples. Elements for which the nitric-aqua regia digestion is possibly incomplete are: Al, Ba, Be, Ca, Cr, Ga, K, La, Mg, Na, Sr, Ti, Tl, W.

ANALYTICAL PROCEDURES

CHEMEX CODE	NUMBER SAMPLES	DESCRIPTION	METHOD	DETECTION LIMIT	UPPER LIMIT
100	150	Au ppb: Fuse 10 g sample	FA-AAS	5	10000
2118	150	Ag ppm: 32 element, soil & rock	ICP-AES	0.2	200
2119	150	Al %: 32 element, soil & rock	ICP-AES	0.01	15.00
2120	150	As ppm: 32 element, soil & rock	ICP-AES	2	10000
2121	150	Ba ppm: 32 element, soil & rock	ICP-AES	10	10000
2122	150	Be ppm: 32 element, soil & rock	ICP-AES	0.5	100.0
2123	150	Bi ppm: 32 element, soil & rock	ICP-AES	2	10000
2124	150	Ca %: 32 element, soil & rock	ICP-AES	0.01	15.00
2125	150	Cd ppm: 32 element, soil & rock	ICP-AES	0.5	100.0
2126	150	Co ppm: 32 element, soil & rock	ICP-AES	1	10000
2127	150	Cr ppm: 32 element, soil & rock	ICP-AES	1	10000
2128	150	Cu ppm: 32 element, soil & rock	ICP-AES	1	10000
2150	150	Fe %: 32 element, soil & rock	ICP-AES	0.01	15.00
2130	150	Ga ppm: 32 element, soil & rock	ICP-AES	10	10000
2131	150	Hg ppm: 32 element, soil & rock	ICP-AES	1	10000
2132	150	K %: 32 element, soil & rock	ICP-AES	0.01	10.00
2151	150	La ppm: 32 element, soil & rock	ICP-AES	10	10000
2134	150	Mg %: 32 element, soil & rock	ICP-AES	0.01	15.00
2135	150	Mn ppm: 32 element, soil & rock	ICP-AES	5	10000
2136	150	Mo ppm: 32 element, soil & rock	ICP-AES	1	10000
2137	150	Na %: 32 element, soil & rock	ICP-AES	0.01	5.00
2138	150	Ni ppm: 32 element, soil & rock	ICP-AES	1	10000
2139	150	P ppm: 32 element, soil & rock	ICP-AES	10	10000
2140	150	Pb ppm: 32 element, soil & rock	ICP-AES	2	10000
2141	150	Sb ppm: 32 element, soil & rock	ICP-AES	2	10000
2142	150	Sc ppm: 32 elements, soil & rock	ICP-AES	1	10000
2143	150	Sr ppm: 32 element, soil & rock	ICP-AES	1	10000
2144	150	Ti %: 32 element, soil & rock	ICP-AES	0.01	5.00
2145	150	Tl ppm: 32 element, soil & rock	ICP-AES	10	10000
2146	150	U ppm: 32 element, soil & rock	ICP-AES	10	10000
2147	150	V ppm: 32 element, soil & rock	ICP-AES	1	10000
2148	150	W ppm: 32 element, soil & rock	ICP-AES	10	10000
2149	150	Zn ppm: 32 element, soil & rock	ICP-AES	2	10000

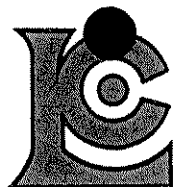

Chemex Labs Ltd.

Analytical Chemists * Geochemists * Registered Assayers
 212 Brooksbank Ave., North Vancouver
 British Columbia, Canada V7J 2C1
 PHONE: 604-984-0221

WEALTH RESOURCES LTD.

1000 - 675 W. HASTINGS ST.
 VANCOUVER, BC
 V6B 1N6

Project : STAR CLAIMS
 Comments: ATTN: P. SOUTHAM

Page Number : 1-A
 Total Pages : 4
 Certificate Date: 28-JUN-94
 Invoice No. : I9418520
 P.O. Number :
 Account : GDR

CERTIFICATE OF ANALYSIS A9418520

SAMPLE	PREP CODE	Au ppb FA+AA	Ag ppm	Al %	As ppm	Ba ppm	Be ppm	Bi ppm	Ca %	Cd ppm	Co ppm	Cr ppm	Cu ppm	Fe %	Ga ppm	Hg ppm	K %	La ppm	Mg %	Mn ppm
ST1 00S 00+00W	201 202	< 5	< 0.2	2.39	2	190	< 0.5	< 2	0.28	< 0.5	9	57	33	3.33	< 10	< 1	0.06	10	1.06	205
ST1 00S 00+25W	201 202	< 5	< 0.2	1.35	4	180	< 0.5	< 2	0.09	< 0.5	4	18	10	1.97	< 10	< 1	0.08	10	0.34	100
ST1 00S 00+50W	201 202	< 5	< 0.2	1.91	8	180	< 0.5	< 2	0.06	< 0.5	4	21	10	2.93	< 10	< 1	0.07	10	0.36	130
ST1 00S 00+75W	201 202	< 5	< 0.2	1.93	14	190	< 0.5	< 2	0.08	< 0.5	6	28	11	3.10	< 10	< 1	0.04	10	0.38	165
ST1 00S 01+00W	201 202	< 5	0.2	1.78	12	320	< 0.5	< 2	0.15	< 0.5	13	16	11	2.95	< 10	< 1	0.08	10	0.70	1370
ST1 00S 01+25W	201 202	< 5	< 0.2	1.43	< 2	200	< 0.5	< 2	0.09	< 0.5	3	15	7	1.88	< 10	2	0.08	20	0.37	110
ST1 00S 01+50W	201 202	< 5	< 0.2	1.50	6	190	< 0.5	< 2	0.10	< 0.5	5	18	7	2.43	< 10	< 1	0.07	10	0.31	240
ST1 00S 01+75W	201 202	< 5	< 0.2	1.06	38	160	< 0.5	< 2	0.07	< 0.5	3	14	5	2.13	< 10	< 1	0.04	10	0.34	165
ST1 00S 02+00W	201 202	< 5	< 0.2	2.04	8	120	< 0.5	2	0.22	< 0.5	13	35	18	3.26	< 10	< 1	0.08	< 10	1.24	245
ST1 00S 02+25W	201 202	15	0.2	1.70	12	160	< 0.5	< 2	0.09	< 0.5	6	25	16	3.49	< 10	< 1	0.08	10	0.58	180
ST1 00S 02+50W	201 202	< 5	< 0.2	1.69	4	170	< 0.5	< 2	0.10	< 0.5	8	27	14	2.86	< 10	1	0.07	< 10	0.59	245
ST1 00S 02+75W	201 202	< 5	0.2	2.06	4	200	< 0.5	< 2	0.09	< 0.5	10	29	18	2.99	< 10	< 1	0.06	10	0.88	280
ST1 00S 03+00W	201 202	< 5	< 0.2	1.12	4	160	< 0.5	< 2	0.08	< 0.5	3	16	7	1.59	< 10	< 1	0.05	< 10	0.31	80
ST1 00S 03+25W	201 202	< 5	< 0.2	1.96	12	270	< 0.5	< 2	0.14	< 0.5	6	29	16	2.65	< 10	1	0.07	10	0.49	165
ST1 00S 03+50W	201 202	< 5	< 0.2	1.53	6	170	< 0.5	< 2	0.08	< 0.5	4	18	6	2.38	< 10	< 1	0.06	20	0.35	210
ST1 00S 03+75W	201 202	< 5	< 0.2	1.57	10	150	< 0.5	< 2	0.07	< 0.5	3	19	10	2.45	< 10	< 1	0.06	10	0.40	145
ST1 00S 04+00W	201 202	< 5	< 0.2	1.35	2	150	< 0.5	< 2	0.09	< 0.5	3	22	8	2.08	< 10	< 1	0.04	10	0.36	95
ST1 00S 04+25W	201 202	< 5	< 0.2	1.20	4	100	< 0.5	< 2	0.12	< 0.5	3	17	8	1.94	< 10	< 1	0.09	10	0.36	115
ST1 00S 04+50W	201 202	< 5	0.2	1.48	4	160	< 0.5	< 2	0.15	< 0.5	3	22	10	2.06	< 10	< 1	0.07	10	0.27	155
ST1 00S 04+75W	201 202	< 5	< 0.2	1.92	14	170	0.5	< 2	0.09	< 0.5	6	32	21	2.55	< 10	< 1	0.08	30	0.57	190
ST1 00S 05+00W	201 202	< 5	< 0.2	1.24	12	110	< 0.5	< 2	0.06	< 0.5	3	20	11	1.60	< 10	< 1	0.08	10	0.42	85
ST1 00S 00+25E	201 202	< 5	< 0.2	2.13	10	210	< 0.5	< 2	0.14	< 0.5	7	33	12	3.21	< 10	< 1	0.04	10	0.51	125
ST1 00S 00+50E	201 202	< 5	< 0.2	1.61	8	200	< 0.5	< 2	0.16	< 0.5	6	28	13	2.46	< 10	< 1	0.03	10	0.47	145
ST1 00S 00+75E	201 202	< 5	< 0.2	2.16	26	200	< 0.5	< 2	0.19	< 0.5	7	30	18	2.81	< 10	< 1	0.04	10	0.79	190
ST1 00S 01+00E	201 202	< 5	< 0.2	2.48	30	190	< 0.5	8	0.12	< 0.5	11	33	12	3.87	10	< 1	0.08	10	1.42	250
ST1 00S 01+25E	201 202	< 5	< 0.2	1.47	8	130	< 0.5	< 2	0.10	< 0.5	3	20	6	2.06	< 10	< 1	0.04	10	0.28	110
ST1 00S 01+50E	201 202	< 5	< 0.2	1.33	4	120	< 0.5	< 2	0.18	< 0.5	3	18	7	1.66	< 10	< 1	0.04	10	0.39	95
ST1 00S 01+75E	201 202	< 5	< 0.2	0.95	2	100	< 0.5	< 2	0.14	< 0.5	2	9	4	1.33	< 10	< 1	0.05	10	0.25	75
ST1 00S 02+00E	201 202	< 5	< 0.2	2.83	6	290	< 0.5	< 2	0.14	< 0.5	10	42	36	3.34	< 10	< 1	0.07	10	0.62	285
ST1 00S 02+25E	201 202	< 5	< 0.2	2.68	< 2	160	< 0.5	2	0.11	< 0.5	11	100	12	3.87	10	< 1	0.23	10	2.24	335
ST1 00S 02+50E	201 202	< 5	< 0.2	1.14	4	130	< 0.5	< 2	0.06	< 0.5	2	16	7	2.14	< 10	< 1	0.07	20	0.33	120
ST1 00S 02+75E	201 202	< 5	< 0.2	0.75	4	100	< 0.5	< 2	0.04	< 0.5	1	8	2	1.26	< 10	< 1	0.06	10	0.06	45
ST1 00S 03+00E	201 202	< 5	< 0.2	1.73	8	100	< 0.5	< 2	0.06	< 0.5	3	18	8	2.53	< 10	< 1	0.06	20	0.26	145
ST1 00S 03+25E	201 202	< 5	< 0.2	0.89	< 2	70	< 0.5	< 2	0.06	< 0.5	2	9	4	1.34	< 10	< 1	0.08	20	0.28	95
ST1 00S 03+50E	201 202	< 5	< 0.2	1.85	10	160	< 0.5	< 2	0.12	< 0.5	8	28	18	2.74	< 10	< 1	0.09	20	0.59	235
ST1 00S 03+75E	201 202	< 5	< 0.2	1.43	2	120	< 0.5	< 2	0.08	< 0.5	4	13	7	1.83	< 10	< 1	0.06	10	0.39	130
ST1 00S 04+00E	201 202	< 5	< 0.2	1.80	6	190	< 0.5	< 2	0.09	< 0.5	5	23	13	2.79	< 10	< 1	0.04	10	0.40	160
ST1 00S 04+25E	201 202	< 5	< 0.2	0.82	4	130	< 0.5	< 2	0.05	< 0.5	1	7	4	0.99	< 10	< 1	0.06	20	0.12	65
ST1 00S 04+50E	201 202	< 5	< 0.2	1.36	8	150	< 0.5	< 2	0.08	< 0.5	3	8	3	1.99	< 10	< 1	0.09	20	0.50	140
ST1 00S 04+75E	201 202	< 5	< 0.2	0.87	6	90	< 0.5	< 2	0.04	< 0.5	2	11	7	1.45	< 10	< 1	0.07	20	0.16	105

CERTIFICATION:

Jhai J Ma

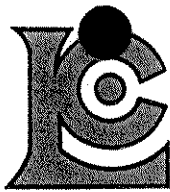

Chemex Labs Ltd.

Analytical Chemists * Geochemists * Registered Assayers
 212 Brooksbank Ave., North Vancouver
 British Columbia, Canada V7J 2C1
 PHONE: 604-984-0221

WEALTH RESOURCES LTD.

1000 - 675 W. HASTINGS ST.
 VANCOUVER, BC
 V6B 1N6

Project : STAR CLAIMS
 Comments: ATTN: P. SOUTHAM

Page No. : 1-B
 Total Pages : 4
 Certificate Date: 28-JUN-94
 Invoice No. : I9418520
 P.O. Number :
 Account : GDR

CERTIFICATE OF ANALYSIS A9418520

SAMPLE	PREP CODE	Mo ppm	Na %	Ni ppm	P ppm	Pb ppm	Sb ppm	Sc ppm	Sr ppm	Ti %	Tl ppm	U ppm	V ppm	W ppm	Zn ppm
ST1 00S 00+00W	201 202	< 1	< 0.01	20	500	8	6	4	14	0.21	< 10	< 10	81	< 10	36
ST1 00S 00+25W	201 202	< 1	< 0.01	11	300	16	< 2	1	10	0.04	< 10	< 10	34	< 10	32
ST1 00S 00+50W	201 202	< 1	< 0.01	12	450	22	< 2	2	7	0.03	< 10	< 10	40	< 10	40
ST1 00S 00+75W	201 202	< 1	< 0.01	14	190	8	< 2	2	10	0.06	< 10	< 10	57	< 10	40
ST1 00S 01+00W	201 202	< 1	< 0.01	13	500	8	4	3	14	0.06	< 10	< 10	66	< 10	52
ST1 00S 01+25W	201 202	< 1	< 0.01	8	480	16	4	1	10	0.03	< 10	< 10	38	< 10	30
ST1 00S 01+50W	201 202	< 1	< 0.01	8	530	18	< 2	1	11	0.04	< 10	< 10	51	< 10	40
ST1 00S 01+75W	201 202	< 1	< 0.01	7	480	16	< 2	1	9	0.05	< 10	< 10	57	< 10	30
ST1 00S 02+00W	201 202	< 1	< 0.01	18	400	2	< 2	2	11	0.19	< 10	< 10	80	< 10	42
ST1 00S 02+25W	201 202	< 1	< 0.01	14	340	12	12	2	8	0.09	< 10	< 10	75	< 10	42
ST1 00S 02+50W	201 202	< 1	< 0.01	14	490	6	< 2	2	9	0.07	< 10	< 10	64	< 10	38
ST1 00S 02+75W	201 202	< 1	< 0.01	18	230	16	10	2	7	0.10	< 10	< 10	61	< 10	40
ST1 00S 03+00W	201 202	< 1	< 0.01	8	620	8	4	2	8	0.04	< 10	< 10	33	< 10	22
ST1 00S 03+25W	201 202	< 1	< 0.01	15	240	18	4	2	13	0.05	< 10	< 10	50	< 10	40
ST1 00S 03+50W	201 202	< 1	< 0.01	9	380	14	6	2	9	0.05	< 10	< 10	55	< 10	30
ST1 00S 03+75W	201 202	< 1	< 0.01	10	240	18	< 2	2	8	0.04	< 10	< 10	48	< 10	36
ST1 00S 04+00W	201 202	< 1	< 0.01	10	160	12	< 2	2	8	0.06	< 10	< 10	45	< 10	30
ST1 00S 04+25W	201 202	< 1	< 0.01	9	310	12	< 2	1	10	0.04	< 10	< 10	47	< 10	32
ST1 00S 04+50W	201 202	< 1	< 0.01	9	200	18	< 2	2	13	0.08	< 10	< 10	52	< 10	24
ST1 00S 04+75W	201 202	< 1	< 0.01	17	450	22	< 2	3	11	0.05	< 10	< 10	43	< 10	42
ST1 00S 05+00W	201 202	< 1	< 0.01	10	170	12	< 2	2	7	0.02	< 10	< 10	32	< 10	30
ST1 00S 00+25E	201 202	< 1	< 0.01	17	350	10	< 2	2	13	0.10	< 10	< 10	69	< 10	50
ST1 00S 00+50E	201 202	< 1	< 0.01	14	410	8	< 2	3	14	0.07	< 10	< 10	51	< 10	42
ST1 00S 00+75E	201 202	< 1	< 0.01	16	260	8	< 2	4	12	0.04	< 10	< 10	70	< 10	44
ST1 00S 01+00E	201 202	< 1	< 0.01	18	250	12	< 2	7	10	0.16	< 10	< 10	84	< 10	50
ST1 00S 01+25E	201 202	< 1	< 0.01	9	150	16	< 2	2	11	0.08	< 10	< 10	52	< 10	30
ST1 00S 01+50E	201 202	< 1	< 0.01	9	140	14	< 2	2	12	0.12	< 10	< 10	48	< 10	30
ST1 00S 01+75E	201 202	< 1	< 0.01	4	200	6	< 2	1	9	0.11	< 10	< 10	43	< 10	22
ST1 00S 02+00E	201 202	< 1	< 0.01	22	210	12	< 2	4	15	0.10	< 10	< 10	66	< 10	54
ST1 00S 02+25E	201 202	< 1	< 0.01	30	280	4	< 2	9	9	0.23	< 10	< 10	85	< 10	56
ST1 00S 02+50E	201 202	< 1	< 0.01	8	400	18	< 2	1	9	0.04	< 10	< 10	41	< 10	30
ST1 00S 02+75E	201 202	< 1	< 0.01	2	550	20	< 2	< 1	8	0.01	< 10	< 10	25	< 10	14
ST1 00S 03+00E	201 202	< 1	< 0.01	8	770	18	< 2	2	7	0.02	< 10	< 10	51	< 10	46
ST1 00S 03+25E	201 202	< 1	< 0.01	4	230	12	< 2	1	7	0.04	< 10	< 10	29	< 10	20
ST1 00S 03+50E	201 202	< 1	< 0.01	17	280	12	< 2	3	12	0.07	< 10	< 10	52	< 10	54
ST1 00S 03+75E	201 202	< 1	< 0.01	7	160	12	4	1	8	0.06	< 10	< 10	38	< 10	34
ST1 00S 04+00E	201 202	< 1	< 0.01	12	280	20	< 2	2	9	0.07	< 10	< 10	49	< 10	36
ST1 00S 04+25E	201 202	< 1	< 0.01	3	400	10	< 2	< 1	6	0.03	< 10	< 10	24	< 10	22
ST1 00S 04+50E	201 202	< 1	< 0.01	4	460	18	< 2	2	8	0.10	< 10	< 10	48	< 10	40
ST1 00S 04+75E	201 202	< 1	< 0.01	5	610	22	< 2	< 1	5	0.02	< 10	< 10	25	< 10	38

CERTIFICATION:

Phai D Ma

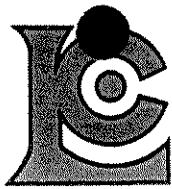

Chemex Labs Ltd.

Analytical Chemists * Geochemists * Registered Assayers
 212 Brooksbank Ave., North Vancouver
 British Columbia, Canada V7J 2C1
 PHONE: 604-984-0221

WEALTH RESOURCES LTD.

1000 - 675 W. HASTINGS ST.
 VANCOUVER, BC
 V6B 1N6

Project : STAR CLAIMS
 Comments: ATTN: P. SOUTHAM

Page Number : 2-A
 Total Pages : 4
 Certificate Date: 28-JUN-94
 Invoice No. : 19418520
 P.O. Number :
 Account : GDR

CERTIFICATE OF ANALYSIS

A9418520

SAMPLE	PREP CODE		Au ppb	Ag ppm	Al %	As ppm	Ba ppm	Be ppm	Bi ppm	Ca %	Cd ppm	Co ppm	Cr ppm	Cu ppm	Fe %	Ga ppm	Hg ppm	K %	La ppm	Mg %	Mn ppm
	FA+AA																				
ST1 00S 05+00E	201	202	< 5	< 0.2	1.15	20	100	< 0.5	< 2	0.03	< 0.5	2	14	5	1.85	< 10	< 1	0.09	10	0.26	115
ST1 00S 05+25E	201	202	< 5	< 0.2	1.42	6	120	< 0.5	< 2	0.07	< 0.5	2	13	5	1.49	< 10	1	0.07	20	0.21	90
ST1 00S 05+50E	201	202	< 5	< 0.2	0.89	14	110	< 0.5	< 2	0.02	< 0.5	2	7	6	1.07	< 10	1	0.09	60	0.12	40
ST1 00S 05+75E	201	202	< 5	< 0.2	2.10	92	210	< 0.5	< 2	0.07	< 0.5	4	18	10	2.52	< 10	< 1	0.08	30	0.52	135
ST1 00S 06+00E	201	202	< 5	< 0.2	1.15	8	200	< 0.5	< 2	0.06	< 0.5	2	11	8	1.67	< 10	< 1	0.08	20	0.26	115
ST1 00S 06+25E	201	202	< 5	< 0.2	0.39	4	90	< 0.5	< 2	0.07	< 0.5	< 1	3	1	0.32	< 10	< 1	0.06	10	0.06	20
ST1 00S 06+50E	201	202	< 5	< 0.2	1.52	4	170	< 0.5	< 2	0.08	< 0.5	4	18	11	1.87	< 10	1	0.06	40	0.53	100
ST1 00S 06+75E	201	202	< 5	< 0.2	1.86	8	170	< 0.5	< 2	0.08	< 0.5	4	26	13	2.28	< 10	2	0.05	20	0.56	125
ST1 00S 07+00E	201	202	< 5	< 0.2	1.63	< 2	240	< 0.5	2	0.11	< 0.5	5	8	7	1.77	< 10	1	0.11	90	0.93	105
ST1 00S 07+25E	201	202	< 5	< 0.2	1.20	6	180	< 0.5	< 2	0.11	< 0.5	3	13	10	1.72	< 10	< 1	0.07	40	0.45	100
ST1 00S 07+50E	201	202	< 5	< 0.2	2.28	6	180	< 0.5	< 2	0.11	< 0.5	8	46	16	2.91	< 10	1	0.05	10	0.82	220
ST1 00S 07+75E	201	202	< 5	< 0.2	0.91	8	100	< 0.5	< 2	0.02	< 0.5	1	8	3	1.35	< 10	< 1	0.04	30	0.13	60
ST1 00S 08+00E	201	202	< 5	< 0.2	0.61	42	80	< 0.5	< 2	0.01	< 0.5	< 1	4	3	0.94	< 10	1	0.08	30	0.08	55
ST1 00S 08+25E	201	202	< 5	< 0.2	0.89	10	80	< 0.5	< 2	0.04	< 0.5	2	13	4	1.44	< 10	< 1	0.04	20	0.20	85
ST1 00S 08+50E	201	202	< 5	< 0.2	1.08	2	130	< 0.5	< 2	0.04	< 0.5	3	12	7	1.29	< 10	< 1	0.09	20	0.29	105
ST1 00S 08+75E	201	202	< 5	< 0.2	0.87	8	90	< 0.5	< 2	0.04	< 0.5	1	9	4	1.39	< 10	1	0.08	20	0.20	100
ST1 00S 09+00E	201	202	< 5	< 0.2	1.10	8	130	< 0.5	< 2	0.06	< 0.5	2	13	7	1.58	< 10	1	0.10	20	0.31	100
ST1 00S 09+25E	201	202	< 5	< 0.2	1.74	14	130	< 0.5	< 2	0.08	< 0.5	4	24	14	2.26	< 10	< 1	0.09	20	0.53	140
ST1 00S 09+50E	201	202	< 5	< 0.2	0.80	6	100	< 0.5	< 2	0.03	< 0.5	1	7	4	0.81	< 10	1	0.09	40	0.17	40
ST1 00S 09+75E	201	202	< 5	< 0.2	2.31	16	210	< 0.5	8	0.23	< 0.5	9	59	23	3.05	< 10	1	0.07	10	1.21	260
ST1 00S 10+00E	201	202	20	< 0.2	1.90	< 2	210	< 0.5	4	0.18	< 0.5	9	51	23	2.65	< 10	< 1	0.04	10	1.07	225
ST1 00S 10+25E	201	202	< 5	< 0.2	1.88	2	220	< 0.5	< 2	0.14	< 0.5	8	44	21	2.69	< 10	< 1	0.05	10	0.79	195
ST1 00S 10+50E	201	202	< 5	< 0.2	1.51	< 2	210	< 0.5	< 2	0.11	< 0.5	4	30	13	2.16	< 10	< 1	0.05	10	0.51	105
ST1 00S 10+75E	201	202	< 5	< 0.2	1.35	< 2	130	< 0.5	< 2	0.09	< 0.5	4	25	11	1.78	< 10	< 1	0.06	20	0.43	115
ST1 00S 11+00E	201	202	< 5	< 0.2	1.05	< 2	120	< 0.5	< 2	0.05	< 0.5	3	19	7	1.43	< 10	< 1	0.07	10	0.31	85
ST1 00S 11+25E	201	202	< 5	< 0.2	1.32	4	160	< 0.5	< 2	0.08	< 0.5	4	19	9	1.64	< 10	1	0.08	10	0.33	105
ST1 00S 11+50E	201	202	< 5	< 0.2	0.97	< 2	120	< 0.5	< 2	0.06	< 0.5	2	15	8	1.36	< 10	< 1	0.08	20	0.25	75
ST1 00S 11+75E	201	202	< 5	< 0.2	1.36	2	170	< 0.5	< 2	0.16	< 0.5	5	25	14	1.88	< 10	< 1	0.08	20	0.50	130
ST1 00S 12+00E	201	202	< 5	< 0.2	1.31	2	130	< 0.5	< 2	0.10	< 0.5	3	18	11	1.57	< 10	< 1	0.08	30	0.32	120
ST1 00S 12+25E	201	202	< 5	< 0.2	0.69	< 2	310	< 0.5	< 2	0.08	< 0.5	6	15	10	1.17	< 10	< 1	0.06	30	0.28	295
ST1 00S 12+50E	201	202	15	< 0.2	1.56	< 2	200	< 0.5	< 2	0.10	< 0.5	3	21	14	1.76	< 10	1	0.07	20	0.37	115
ST1 00S 12+75E	201	202	10	< 0.2	1.26	4	370	< 0.5	< 2	0.07	< 0.5	3	15	9	1.69	< 10	1	0.09	30	0.28	85
ST1 00S 13+00E	201	202	< 5	< 0.2	0.70	2	430	< 0.5	< 2	0.06	< 0.5	1	5	5	0.85	< 10	1	0.09	40	0.11	35
ST1 00S 13+25E	201	202	< 5	< 0.2	1.63	4	800	< 0.5	< 2	0.22	< 0.5	4	21	23	2.12	< 10	1	0.08	30	0.36	110
ST1 00S 13+50E	201	202	< 5	< 0.2	2.98	10	1020	< 0.5	< 2	0.40	< 0.5	6	26	35	2.87	< 10	< 1	0.10	30	0.31	120
ST1 00S 13+75E	201	202	< 5	< 0.2	1.50	12	320	< 0.5	< 2	0.24	< 0.5	6	23	24	2.02	< 10	< 1	0.05	20	0.45	160
ST1 00S 14+00E	201	202	< 5	< 0.2	1.74	< 2	330	< 0.5	< 2	0.21	< 0.5	5	25	23	2.26	< 10	< 1	0.06	10	0.41	125
ST1 2+50S 00+00E	201	202	< 5	< 0.2	0.90	6	110	< 0.5	< 2	0.03	< 0.5	1	10	4	1.26	< 10	< 1	0.08	10	0.16	80
ST1 2+50S 00+25E	201	202	< 5	< 0.2	1.27	< 2	140	< 0.5	< 2	0.07	< 0.5	2	12	6	1.48	< 10	< 1	0.08	10	0.21	85
ST1 2+50S 00+50E	201	202	< 5	< 0.2	1.56	2	160	< 0.5	< 2	0.08	< 0.5	4	21	7	2.38	< 10	< 1	0.09	10	0.33	145

CERTIFICATION: *[Signature]*

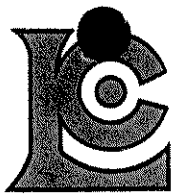

Chemex Labs Ltd.

Analytical Chemists * Geochemists * Registered Assayers
 212 Brooksbank Ave., North Vancouver
 British Columbia, Canada V7J 2C1
 PHONE: 604-984-0221

WEALTH RESOURCES LTD.

1000 - 675 W. HASTINGS ST.
 VANCOUVER, BC
 V6B 1N6

Project : STAR CLAIMS
 Comments: ATTN: P. SOUTHAM

Page No. : 2-B
 Total Pages : 4
 Certificate Date: 28-JUN-94
 Invoice No. : I9418520
 P.O. Number :
 Account : GDR

CERTIFICATE OF ANALYSIS A9418520

SAMPLE	PREP CODE	Mo ppm	Na %	Ni ppm	P ppm	Pb ppm	Sb ppm	Sc ppm	Sr ppm	Ti %	Tl ppm	U ppm	V ppm	W ppm	Zn ppm
ST1 00S 05+00E	201 202	< 1 < 0.01		7	660	22	< 2	1	4	0.04	< 10	< 10	37	< 10	32
ST1 00S 05+25E	201 202	< 1 < 0.01		6	180	22	< 2	1	8	0.05	< 10	< 10	33	< 10	26
ST1 00S 05+50E	201 202	< 1 < 0.01		3	210	18	< 2	1	9	0.01	< 10	< 10	15	< 10	22
ST1 00S 05+75E	201 202	< 1 < 0.01		10	240	22	< 2	2	10	0.02	< 10	< 10	40	< 10	38
ST1 00S 06+00E	201 202	< 1 < 0.01		7	400	14	< 2	1	8	0.03	< 10	< 10	31	< 10	28
ST1 00S 06+25E	201 202	< 1 < 0.01		1	80	10	< 2	< 1	9	0.05	< 10	< 10	11	< 10	6
ST1 00S 06+50E	201 202	< 1 < 0.01		10	160	26	< 2	2	10	0.04	< 10	< 10	29	< 10	52
ST1 00S 06+75E	201 202	< 1 < 0.01		13	150	16	< 2	2	10	0.05	< 10	< 10	39	< 10	46
ST1 00S 07+00E	201 202	< 1 < 0.01		8	280	30	< 2	1	16	0.02	< 10	< 10	12	< 10	60
ST1 00S 07+25E	201 202	< 1 < 0.01		9	490	22	< 2	1	13	0.03	< 10	< 10	29	< 10	32
ST1 00S 07+50E	201 202	< 1 < 0.01		16	230	10	< 2	3	11	0.10	< 10	< 10	59	< 10	52
ST1 00S 07+75E	201 202	< 1 < 0.01		4	140	14	< 2	< 1	3	0.01	< 10	< 10	18	< 10	32
ST1 00S 08+00E	201 202	< 1 < 0.01		1	180	12	< 2	< 1	2	0.01	< 10	< 10	9	< 10	34
ST1 00S 08+25E	201 202	< 1 < 0.01		4	200	14	< 2	1	4	0.03	< 10	< 10	26	< 10	32
ST1 00S 08+50E	201 202	< 1 < 0.01		6	120	24	< 2	1	7	0.03	< 10	< 10	19	< 10	38
ST1 00S 08+75E	201 202	< 1 < 0.01		4	160	20	< 2	1	6	0.05	< 10	< 10	26	< 10	32
ST1 00S 09+00E	201 202	< 1 < 0.01		7	150	16	< 2	1	7	0.04	< 10	< 10	26	< 10	42
ST1 00S 09+25E	201 202	< 1 < 0.01		12	140	22	< 2	2	9	0.07	< 10	< 10	38	< 10	56
ST1 00S 09+50E	201 202	< 1 < 0.01		4	150	8	< 2	< 1	6	0.01	< 10	< 10	13	< 10	34
ST1 00S 09+75E	201 202	< 1 < 0.01		20	390	14	< 2	4	17	0.16	< 10	< 10	64	< 10	96
ST1 00S 10+00E	201 202	< 1 < 0.01		20	330	12	< 2	3	13	0.10	< 10	< 10	46	< 10	82
ST1 00S 10+25E	201 202	< 1 < 0.01		19	370	16	< 2	3	12	0.09	< 10	< 10	51	< 10	70
ST1 00S 10+50E	201 202	< 1 < 0.01		12	160	16	< 2	2	11	0.07	< 10	< 10	44	< 10	50
ST1 00S 10+75E	201 202	< 1 < 0.01		12	150	16	< 2	2	10	0.05	< 10	< 10	30	< 10	46
ST1 00S 11+00E	201 202	< 1 < 0.01		9	130	12	< 2	1	6	0.03	< 10	< 10	24	< 10	36
ST1 00S 11+25E	201 202	< 1 < 0.01		10	170	14	< 2	2	9	0.04	< 10	< 10	31	< 10	40
ST1 00S 11+50E	201 202	< 1 < 0.01		7	170	12	< 2	1	7	0.03	< 10	< 10	23	< 10	32
ST1 00S 11+75E	201 202	< 1 < 0.01		13	400	12	< 2	2	13	0.06	< 10	< 10	36	< 10	48
ST1 00S 12+00E	201 202	< 1 < 0.01		9	170	24	< 2	1	10	0.04	< 10	< 10	29	< 10	36
ST1 00S 12+25E	201 202	< 1 < 0.01		8	230	20	< 2	1	8	0.03	< 10	< 10	19	< 10	30
ST1 00S 12+50E	201 202	< 1 < 0.01		11	130	14	< 2	2	11	0.07	< 10	< 10	36	< 10	48
ST1 00S 12+75E	201 202	< 1 < 0.01		8	160	14	< 2	1	9	0.03	< 10	< 10	29	< 10	42
ST1 00S 13+00E	201 202	< 1 < 0.01		4	160	6	< 2	< 1	7	0.01	< 10	< 10	9	< 10	26
ST1 00S 13+25E	201 202	< 1 < 0.01		14	480	12	< 2	2	24	0.03	< 10	< 10	31	< 10	52
ST1 00S 13+50E	201 202	< 1 < 0.01		19	870	24	< 2	1	41	0.03	< 10	< 10	32	< 10	76
ST1 00S 13+75E	201 202	< 1 < 0.01		16	410	14	< 2	3	18	0.06	< 10	< 10	39	< 10	58
ST1 00S 14+00E	201 202	< 1 < 0.01		15	510	12	< 2	2	18	0.04	< 10	< 10	37	< 10	60
ST1 2+50S 00+00E	201 202	< 1 < 0.01		4	140	12	< 2	< 1	4	0.02	< 10	< 10	21	< 10	26
ST1 2+50S 00+25E	201 202	< 1 < 0.01		6	120	16	< 2	1	7	0.02	< 10	< 10	25	< 10	30
ST1 2+50S 00+50E	201 202	< 1 < 0.01		11	150	18	< 2	1	8	0.05	< 10	< 10	47	< 10	44

CERTIFICATION:

[Signature]

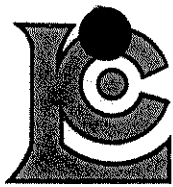

Chemex Labs Ltd.

Analytical Chemists * Geochemists * Registered Assayers
 212 Brooksbank Ave., North Vancouver
 British Columbia, Canada V7J 2C1
 PHONE: 604-984-0221

WEALTH RESOURCES LTD.

1000 - 675 W. HASTINGS ST.
 VANCOUVER, BC
 V6B 1N6

Project : STAR CLAIMS
 Comments: ATTN: P. SOUTHAM

Page No : 3-A
 Total Pages : 4
 Certificate Date: 28-JUN-94
 Invoice No. : I9418520
 P.O. Number :
 Account : GDR

CERTIFICATE OF ANALYSIS A9418520

SAMPLE	PREP CODE		Au ppb	Ag ppm	Al %	As ppm	Ba ppm	Be ppm	Bi ppm	Ca %	Cd ppm	Co ppm	Cr ppm	Cu ppm	Fe %	Ga ppm	Hg ppm	K %	La ppm	Mg %	Mn ppm
	FA	AA																			
ST1 2+50S 00+75E	201	202	< 5	< 0.2	1.56	2	270	0.5	< 2	0.09	< 0.5	7	21	9	2.54	< 10	< 1	0.09	< 10	0.40	370
ST1 2+50S 01+00E	201	202	< 5	< 0.2	1.09	2	110	< 0.5	< 2	0.04	< 0.5	2	11	4	1.61	< 10	< 1	0.07	< 10	0.21	100
ST1 2+50S 01+25E	201	202	< 5	< 0.2	1.58	6	260	< 0.5	< 2	0.09	< 0.5	5	21	9	2.43	< 10	< 1	0.10	< 10	0.38	335
ST1 2+50S 01+50E	201	202	< 5	< 0.2	1.60	14	240	< 0.5	< 2	0.11	< 0.5	7	19	8	2.75	< 10	< 1	0.10	< 10	0.49	345
ST1 2+50S 01+75E	201	202	< 5	< 0.2	1.30	6	160	< 0.5	< 2	0.09	< 0.5	3	19	8	2.25	< 10	< 1	0.07	< 10	0.30	125
ST1 2+50S 02+00E	201	202	< 5	< 0.2	0.87	8	140	< 0.5	< 2	0.08	< 0.5	1	8	3	1.57	< 10	< 1	0.09	10	0.25	115
ST1 2+50S 02+25E	201	202	< 5	< 0.2	1.40	2	190	< 0.5	< 2	0.12	< 0.5	3	16	6	2.58	< 10	< 1	0.12	< 10	0.46	160
ST1 2+50S 02+50E	201	202	< 5	< 0.2	1.07	< 2	160	< 0.5	< 2	0.10	< 0.5	3	14	5	1.88	< 10	< 1	0.08	< 10	0.30	185
ST1 2+50S 02+75E	201	202	< 5	< 0.2	0.81	6	120	< 0.5	< 2	0.06	< 0.5	2	5	2	1.31	< 10	< 1	0.12	10	0.32	205
ST1 2+50S 03+00E	201	202	10	< 0.2	1.21	4	160	< 0.5	< 2	0.09	< 0.5	2	17	6	2.15	< 10	< 1	0.09	< 10	0.33	165
ST1 2+50S 03+25E	201	202	< 5	< 0.2	1.07	6	110	< 0.5	< 2	0.06	< 0.5	2	17	7	2.39	< 10	< 1	0.07	< 10	0.26	135
ST1 2+50S 03+50E	201	202	< 5	< 0.2	1.70	12	190	< 0.5	< 2	0.06	< 0.5	5	23	12	2.77	< 10	< 1	0.08	< 10	0.53	200
ST1 2+50S 03+75E	201	202	< 5	< 0.2	0.91	14	100	< 0.5	< 2	0.05	< 0.5	1	13	6	1.83	< 10	< 1	0.10	< 10	0.30	120
ST1 2+50S 04+00E	201	202	< 5	< 0.2	0.63	2	120	< 0.5	< 2	0.07	< 0.5	1	7	3	1.12	< 10	< 1	0.09	10	0.20	145
ST1 2+50S 04+50E	201	202	< 5	< 0.2	0.92	4	140	< 0.5	< 2	0.11	< 0.5	3	15	7	1.66	< 10	< 1	0.09	< 10	0.39	110
ST1 2+50S 04+75E	201	202	< 5	< 0.2	1.26	< 2	160	< 0.5	< 2	0.13	< 0.5	4	20	10	2.07	< 10	< 1	0.09	< 10	0.44	165
ST1 2+50S 05+00E	201	202	< 5	< 0.2	1.03	< 2	150	< 0.5	< 2	0.13	< 0.5	2	16	8	1.59	< 10	< 1	0.08	< 10	0.41	135
ST1 2+50S 05+25E	201	202	< 5	< 0.2	1.41	22	180	< 0.5	< 2	0.16	< 0.5	6	33	11	2.22	< 10	< 1	0.11	< 10	0.59	195
ST1 2+50S 05+50E	201	202	< 5	< 0.2	1.83	4	210	< 0.5	< 2	0.18	< 0.5	9	50	12	2.75	< 10	< 1	0.07	< 10	0.75	265
ST1 2+50S 05+75E	201	202	< 5	< 0.2	1.48	< 2	170	< 0.5	2	0.18	< 0.5	7	43	13	2.38	< 10	< 1	0.06	< 10	0.67	225
ST1 2+50S 06+00E	201	202	< 5	< 0.2	0.94	12	90	< 0.5	< 2	0.12	< 0.5	6	33	9	1.65	< 10	< 1	0.04	< 10	0.63	165
ST1 2+50S 06+25E	201	202	< 5	< 0.2	1.06	6	250	< 0.5	< 2	0.09	< 0.5	3	12	7	1.83	< 10	< 1	0.08	10	0.42	120
ST1 2+50S 06+50E	201	202	< 5	< 0.2	1.40	10	190	< 0.5	< 2	0.11	< 0.5	4	24	11	2.39	< 10	< 1	0.07	< 10	0.65	215
ST1 2+50S 06+75E	201	202	< 5	< 0.2	1.36	8	300	< 0.5	< 2	0.13	< 0.5	6	24	9	2.29	< 10	< 1	0.07	< 10	0.45	260
ST1 2+50S 07+00E	201	202	< 5	< 0.2	1.43	4	510	< 0.5	2	0.14	< 0.5	11	26	10	2.58	< 10	< 1	0.09	< 10	0.63	570
ST1 2+50S 07+25E	201	202	< 5	< 0.2	1.08	4	380	< 0.5	< 2	0.08	< 0.5	11	17	8	2.14	< 10	< 1	0.07	< 10	0.39	320
ST1 2+50S 07+50E	201	202	< 5	< 0.2	0.43	< 2	280	< 0.5	< 2	0.02	< 0.5	< 1	6	6	0.85	< 10	< 1	0.08	< 10	0.11	50
ST1 2+50S 07+75E	201	202	< 5	< 0.2	0.90	4	230	< 0.5	< 2	0.05	< 0.5	2	17	7	1.79	< 10	< 1	0.04	< 10	0.31	110
ST1 2+50S 08+00E	201	202	< 5	< 0.2	0.90	2	200	< 0.5	< 2	0.06	< 0.5	2	17	6	1.67	< 10	< 1	0.04	< 10	0.36	85
ST1 2+50S 08+25E	201	202	< 5	< 0.2	0.50	< 2	140	< 0.5	2	0.02	< 0.5	1	7	8	0.75	< 10	< 1	0.07	10	0.15	35
ST1 2+50S 08+50E	201	202	< 5	< 0.2	0.99	< 2	140	< 0.5	< 2	0.09	< 0.5	4	18	10	1.93	< 10	< 1	0.06	< 10	0.44	140
ST1 2+50S 08+75E	201	202	< 5	< 0.2	1.14	< 2	130	< 0.5	< 2	0.06	< 0.5	3	20	10	2.04	< 10	< 1	0.07	< 10	0.43	130
ST1 2+50S 09+00E	201	202	< 5	< 0.2	0.99	< 2	180	< 0.5	< 2	0.05	< 0.5	2	15	6	1.73	< 10	< 1	0.08	10	0.30	130
ST1 2+50S 09+25E	201	202	< 5	< 0.2	0.91	< 2	310	< 0.5	< 2	0.06	< 0.5	4	14	13	1.65	< 10	< 1	0.08	10	0.28	220
ST1 2+50S 09+50E	201	202	< 5	< 0.2	1.10	4	220	< 0.5	< 2	0.05	< 0.5	4	18	11	1.97	< 10	< 1	0.07	< 10	0.37	150
ST1 2+50S 09+75E	201	202	< 5	< 0.2	0.87	< 2	170	< 0.5	< 2	0.04	< 0.5	2	13	7	1.42	< 10	< 1	0.04	< 10	0.27	95
ST1 2+50S 10+00E	201	202	< 5	< 0.2	0.96	2	220	< 0.5	< 2	0.06	< 0.5	3	16	9	1.77	< 10	< 1	0.07	< 10	0.32	110
ST1 2+50S 10+25E	201	202	< 5	< 0.2	0.64	< 2	200	< 0.5	< 2	0.02	< 0.5	2	12	5	1.05	< 10	< 1	0.06	10	0.36	135
ST1 2+50S 10+50E	201	202	< 5	< 0.2	0.61	< 2	340	< 0.5	< 2	0.03	< 0.5	1	8	6	0.98	< 10	< 1	0.08	< 10	0.17	65
ST1 2+50S 10+75E	201	202	< 5	< 0.2	0.55	< 2	400	< 0.5	< 2	0.04	< 0.5	1	8	4	0.86	< 10	< 1	0.06	< 10	0.20	45

CERTIFICATION: Yhai Dima



Chemex Labs Ltd.

Analytical Chemists * Geochemists * Registered Assayers
 212 Brooksbank Ave., North Vancouver
 British Columbia, Canada V7J 2C1
 PHONE: 604-984-0221

WEALTH RESOURCES LTD.

1000 - 675 W. HASTINGS ST.
 VANCOUVER, BC
 V6B 1N6

Project : STAR CLAIMS
 Comments: ATTN: P. SOUTHAM

Page Number : 3-B
 Total Pages : 4
 Certificate Date: 28-JUN-94
 Invoice No. : I9418520
 P.O. Number :
 Account : GDR

CERTIFICATE OF ANALYSIS

A9418520

SAMPLE	PREP CODE	Mo ppm	Na %	Ni ppm	P ppm	Pb ppm	Sb ppm	Sc ppm	Sr ppm	Ti %	Tl ppm	U ppm	V ppm	W ppm	Zn ppm
ST1 2+50S 00+75E	201 202	1 < 0.01		13	190	20	< 2	1	10	0.04	< 10	< 10	42	< 10	54
ST1 2+50S 01+00E	201 202	1 < 0.01		5	190	20	< 2	1	4	0.01	< 10	< 10	21	< 10	22
ST1 2+50S 01+25E	201 202	< 1 < 0.01		11	220	18	< 2	2	9	0.04	< 10	< 10	44	< 10	50
ST1 2+50S 01+50E	201 202	< 1 < 0.01		10	290	22	< 2	2	10	0.08	< 10	< 10	54	< 10	46
ST1 2+50S 01+75E	201 202	1 < 0.01		9	220	28	< 2	1	8	0.03	< 10	< 10	36	< 10	40
ST1 2+50S 02+00E	201 202	< 1 < 0.01		3	200	18	< 2	< 1	7	0.02	< 10	< 10	26	< 10	30
ST1 2+50S 02+25E	201 202	< 1 < 0.01		7	240	24	< 2	2	12	0.06	< 10	< 10	56	< 10	38
ST1 2+50S 02+50E	201 202	< 1 < 0.01		6	360	18	< 2	1	10	0.04	< 10	< 10	44	< 10	28
ST1 2+50S 02+75E	201 202	1 < 0.01		2	470	16	< 2	1	7	0.02	< 10	< 10	14	< 10	28
ST1 2+50S 03+00E	201 202	< 1 < 0.01		7	550	18	< 2	1	9	0.04	< 10	< 10	41	< 10	28
ST1 2+50S 03+25E	201 202	1 < 0.01		7	240	18	< 2	1	7	0.04	< 10	< 10	52	< 10	32
ST1 2+50S 03+50E	201 202	1 < 0.01		10	190	18	< 2	2	6	0.06	< 10	< 10	45	< 10	42
ST1 2+50S 03+75E	201 202	< 1 < 0.01		5	300	20	< 2	1	5	0.05	< 10	< 10	33	< 10	26
ST1 2+50S 04+00E	201 202	< 1 < 0.01		3	380	12	< 2	< 1	7	0.02	< 10	< 10	18	< 10	20
ST1 2+50S 04+50E	201 202	< 1 < 0.01		6	260	8	< 2	2	9	0.06	< 10	< 10	31	< 10	26
ST1 2+50S 04+75E	201 202	< 1 < 0.01		9	370	14	< 2	2	11	0.07	< 10	< 10	38	< 10	32
ST1 2+50S 05+00E	201 202	< 1 < 0.01		7	290	12	< 2	2	10	0.07	< 10	< 10	32	< 10	28
ST1 2+50S 05+25E	201 202	< 1 < 0.01		13	400	8	< 2	2	13	0.07	< 10	< 10	44	< 10	40
ST1 2+50S 05+50E	201 202	< 1 < 0.01		17	450	6	< 2	3	14	0.07	< 10	< 10	56	< 10	40
ST1 2+50S 05+75E	201 202	< 1 < 0.01		17	340	8	< 2	2	13	0.10	< 10	< 10	50	< 10	38
ST1 2+50S 06+00E	201 202	< 1 < 0.01		13	290	6	< 2	1	7	0.06	< 10	< 10	30	< 10	26
ST1 2+50S 06+25E	201 202	< 1 < 0.01		7	240	14	< 2	1	10	0.02	< 10	< 10	26	< 10	28
ST1 2+50S 06+50E	201 202	< 1 < 0.01		10	350	12	< 2	2	10	0.06	< 10	< 10	46	< 10	50
ST1 2+50S 06+75E	201 202	< 1 < 0.01		10	400	26	< 2	2	12	0.03	< 10	< 10	45	< 10	54
ST1 2+50S 07+00E	201 202	< 1 < 0.01		9	380	26	< 2	3	14	0.07	< 10	< 10	49	< 10	70
ST1 2+50S 07+25E	201 202	< 1 < 0.01		6	250	22	< 2	1	9	0.02	< 10	< 10	33	< 10	54
ST1 2+50S 07+50E	201 202	< 1 < 0.01		3	110	14	< 2	< 1	4	0.01	< 10	< 10	15	< 10	28
ST1 2+50S 07+75E	201 202	< 1 < 0.01		8	100	16	< 2	1	6	0.02	< 10	< 10	32	< 10	34
ST1 2+50S 08+00E	201 202	1 < 0.01		7	130	14	< 2	1	7	0.02	< 10	< 10	30	< 10	34
ST1 2+50S 08+25E	201 202	< 1 < 0.01		2	130	18	< 2	< 1	5	0.01	< 10	< 10	15	< 10	30
ST1 2+50S 08+50E	201 202	< 1 < 0.01		9	320	12	< 2	1	8	0.04	< 10	< 10	34	< 10	42
ST1 2+50S 08+75E	201 202	1 < 0.01		8	240	18	< 2	2	7	0.04	< 10	< 10	36	< 10	48
ST1 2+50S 09+00E	201 202	< 1 < 0.01		5	350	26	< 2	1	6	0.02	< 10	< 10	33	< 10	42
ST1 2+50S 09+25E	201 202	1 < 0.01		6	290	44	< 2	2	7	0.01	< 10	< 10	26	< 10	62
ST1 2+50S 09+50E	201 202	< 1 < 0.01		8	200	24	< 2	1	6	0.02	< 10	< 10	31	< 10	60
ST1 2+50S 09+75E	201 202	< 1 < 0.01		8	140	16	< 2	1	4	0.01	< 10	< 10	23	< 10	30
ST1 2+50S 10+00E	201 202	< 1 < 0.01		9	280	16	< 2	1	7	0.02	< 10	< 10	28	< 10	44
ST1 2+50S 10+25E	201 202	< 1 < 0.01		6	140	12	< 2	1	3	0.02	< 10	< 10	15	< 10	32
ST1 2+50S 10+50E	201 202	< 1 < 0.01		3	100	10	< 2	< 1	5	0.02	< 10	< 10	18	< 10	26
ST1 2+50S 10+75E	201 202	< 1 < 0.01		3	70	10	< 2	< 1	6	0.02	< 10	< 10	16	< 10	22

CERTIFICATION:

Jhai D Ma

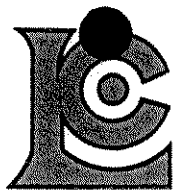

Chemex Labs Ltd.

Analytical Chemists * Geochemists * Registered Assayers
 212 Brooksbank Ave., North Vancouver
 British Columbia, Canada V7J 2C1
 PHONE: 604-984-0221

WEALTH RESOURCES LTD.
 1000 - 675 W. HASTINGS ST.
 VANCOUVER, BC
 V6B 1N6

Project : STAR CLAIMS
 Comments: ATTN: P. SOUTHAM

Page Number : 4-A
 Total Pages : 4
 Certificate Date: 28-JUN-94
 Invoice No. : 19418520
 P.O. Number :
 Account : GDR

CERTIFICATE OF ANALYSIS A9418520

SAMPLE	PREP CODE	Au ppb FA+AA	Ag ppm	Al %	As ppm	Ba ppm	Be ppm	Bi ppm	Ca %	Cd ppm	Co ppm	Cr ppm	Cu ppm	Fe %	Ga ppm	Hg ppm	K %	La ppm	Mg %	Mn ppm
ST1 2+50S 11+00E	201 202	< 5	< 0.2	1.19	4	900	< 0.5	< 2	0.13	< 0.5	4	21	12	1.97	< 10	< 1	0.08	10	0.41	145
ST1 2+50S 11+25E	201 202	< 5	< 0.2	0.98	< 2	380	< 0.5	< 2	0.09	< 0.5	3	16	9	1.61	< 10	< 1	0.07	< 10	0.41	95
ST1 2+50S 11+50E	201 202	< 5	< 0.2	0.96	4	390	< 0.5	< 2	0.07	< 0.5	3	17	9	1.65	< 10	< 1	0.06	< 10	0.37	120
ST1 2+50S 11+75E	201 202	< 5	< 0.2	0.93	< 2	660	< 0.5	< 2	0.09	< 0.5	2	15	9	1.61	< 10	< 1	0.06	10	0.36	70
ST1 2+50S 12+00E	201 202	< 5	< 0.2	0.78	< 2	500	< 0.5	< 2	0.12	< 0.5	2	13	8	1.40	< 10	< 1	0.04	< 10	0.32	70
ST1 2+50S 12+25E	201 202	< 5	< 0.2	0.70	< 2	800	< 0.5	2	0.12	< 0.5	3	11	14	1.16	< 10	< 1	0.04	< 10	0.24	60
ST1 2+50S 12+50E	201 202	< 5	< 0.2	0.81	< 2	320	< 0.5	< 2	0.08	< 0.5	2	14	10	1.39	< 10	< 1	0.04	< 10	0.29	90
ST1 2+50S 12+75E	201 202	< 5	< 0.2	0.83	< 2	290	< 0.5	< 2	0.12	< 0.5	2	16	12	1.47	< 10	< 1	0.04	< 10	0.28	95
ST1 2+50S 13+00E	201 202	< 5	< 0.2	1.01	2	490	< 0.5	< 2	0.16	< 0.5	4	17	12	1.59	< 10	< 1	0.05	< 10	0.29	215
ST1 2+50S 13+25E	201 202	< 5	< 0.2	1.21	2	300	< 0.5	< 2	0.13	< 0.5	4	19	11	1.96	< 10	< 1	0.05	< 10	0.30	125
ST1 2+50S 00+25W	201 202	< 5	< 0.2	1.51	10	180	< 0.5	< 2	0.08	< 0.5	4	25	12	2.47	< 10	< 1	0.08	< 10	0.36	140
ST1 2+50S 00+50W	201 202	< 5	< 0.2	0.76	6	170	< 0.5	< 2	0.07	< 0.5	1	7	4	1.62	< 10	< 1	0.10	< 10	0.30	120
ST1 2+50S 00+75W	201 202	< 5	< 0.2	1.07	4	170	< 0.5	< 2	0.09	< 0.5	3	17	8	1.76	< 10	< 1	0.05	< 10	0.30	120
ST1 2+50S 01+00W	201 202	< 5	< 0.2	0.99	< 2	170	< 0.5	< 2	0.09	< 0.5	4	18	9	1.96	< 10	< 1	0.03	< 10	0.41	125
ST1 2+50S 01+25W	201 202	< 5	< 0.2	0.75	6	210	< 0.5	< 2	0.16	< 0.5	2	8	5	1.53	< 10	< 1	0.09	< 10	0.46	100
ST1 2+50S 01+50W	201 202	< 5	< 0.2	1.04	< 2	340	< 0.5	< 2	0.13	< 0.5	13	12	9	2.31	< 10	< 1	0.10	< 10	0.37	1610
ST1 2+50S 01+75W	201 202	< 5	< 0.2	0.52	18	100	< 0.5	< 2	0.01	< 0.5	< 1	3	3	1.02	< 10	< 1	0.09	< 10	0.17	135
ST1 2+50S 02+00W	201 202	< 5	< 0.2	1.21	24	120	< 0.5	< 2	0.07	< 0.5	4	8	10	2.27	< 10	< 1	0.22	< 10	0.63	155
ST1 2+50S 02+25W	201 202	< 5	< 0.2	1.38	16	340	< 0.5	< 2	0.20	< 0.5	6	19	10	2.26	< 10	< 1	0.08	10	0.49	260
ST1 2+50S 02+50W	201 202	< 5	< 0.2	1.11	8	160	< 0.5	< 2	0.09	< 0.5	2	15	9	1.89	< 10	< 1	0.07	< 10	0.37	100
ST1 2+50S 02+75W	201 202	< 5	< 0.2	1.00	8	120	< 0.5	< 2	0.05	< 0.5	2	13	9	1.76	< 10	< 1	0.06	< 10	0.32	125
ST1 2+50S 03+00W	201 202	< 5	< 0.2	0.87	4	120	< 0.5	< 2	0.07	< 0.5	1	11	7	1.60	< 10	< 1	0.05	< 10	0.28	85
ST1 2+50S 03+25W	201 202	< 5	< 0.2	1.36	2	240	< 0.5	< 2	0.17	< 0.5	4	22	13	2.29	< 10	< 1	0.06	< 10	0.43	165
ST1 2+50S 03+50W	201 202	< 5	< 0.2	1.39	6	120	< 0.5	< 2	0.10	< 0.5	2	20	10	2.24	< 10	< 1	0.06	< 10	0.38	110
ST1 2+50S 03+75W	201 202	< 5	< 0.2	1.12	2	100	< 0.5	< 2	0.09	< 0.5	3	14	12	1.95	< 10	< 1	0.08	< 10	0.47	150
ST1 2+50S 04+00W	201 202	< 5	< 0.2	0.78	< 2	60	< 0.5	< 2	0.03	< 0.5	2	10	9	1.52	< 10	< 1	0.06	10	0.20	85
ST1 2+50S 04+25W	201 202	< 5	< 0.2	1.08	2	100	< 0.5	< 2	0.04	< 0.5	3	18	8	2.02	< 10	< 1	0.03	< 10	0.25	110
ST1 2+50S 04+50W	201 202	< 5	< 0.2	0.80	8	120	< 0.5	2	0.02	< 0.5	1	6	11	1.63	< 10	< 1	0.07	10	0.08	100
ST1 2+50S 04+75W	201 202	< 5	0.2	2.26	6	190	0.5	< 2	0.04	< 0.5	7	34	18	2.93	< 10	< 1	0.06	< 10	0.37	185
ST1 2+50S 05+00W	201 202	< 5	< 0.2	1.02	6	120	< 0.5	< 2	0.03	< 0.5	2	13	4	1.94	< 10	< 1	0.06	< 10	0.19	195

CERTIFICATION:

Phai D. Kha

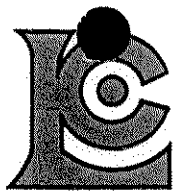

Chemex Labs Ltd.

Analytical Chemists * Geochemists * Registered Assayers
 212 Brooksbank Ave., North Vancouver
 British Columbia, Canada V7J 2C1
 PHONE: 604-984-0221

WEALTH RESOURCES LTD.
 1000 - 675 W. HASTINGS ST.
 VANCOUVER, BC
 V6B 1N6

Project : STAR CLAIMS
 Comments: ATTN: P. SOUTHAM

Page No. : 4-B
 Total Pages : 4
 Certificate Date: 28-JUN-94
 Invoice No. : I9418520
 P.O. Number :
 Account : GDR

CERTIFICATE OF ANALYSIS A9418520

SAMPLE	PREP CODE	Mo ppm	Na %	Ni ppm	P ppm	Pb ppm	Sb ppm	Sc ppm	Sr ppm	Ti %	Tl ppm	U ppm	V ppm	W ppm	Zn ppm
ST1 2+50S 11+00E	201 202	1 < 0.01		10	280	14	< 2	2	16	0.03	< 10	< 10	33	< 10	52
ST1 2+50S 11+25E	201 202	< 1 < 0.01		7	250	12	< 2	1	9	0.03	< 10	< 10	26	< 10	46
ST1 2+50S 11+50E	201 202	< 1 < 0.01		8	170	10	< 2	1	9	0.02	< 10	< 10	27	< 10	38
ST1 2+50S 11+75E	201 202	< 1 < 0.01		7	150	8	< 2	1	11	0.01	< 10	< 10	26	< 10	38
ST1 2+50S 12+00E	201 202	< 1 < 0.01		7	290	8	< 2	1	13	0.01	< 10	< 10	23	< 10	34
ST1 2+50S 12+25E	201 202	< 1 < 0.01		8	380	10	< 2	1	16	0.01	< 10	< 10	19	< 10	34
ST1 2+50S 12+50E	201 202	< 1 < 0.01		7	240	6	< 2	1	8	0.02	< 10	< 10	24	< 10	30
ST1 2+50S 12+75E	201 202	< 1 < 0.01		8	290	6	< 2	1	11	0.02	< 10	< 10	27	< 10	36
ST1 2+50S 13+00E	201 202	< 1 < 0.01		10	350	8	< 2	2	16	0.02	< 10	< 10	29	< 10	36
ST1 2+50S 13+25E	201 202	1 < 0.01		9	250	8	< 2	1	13	0.03	< 10	< 10	41	< 10	34
ST1 2+50S 00+25W	201 202	< 1 < 0.01		12	160	14	< 2	1	9	0.03	< 10	< 10	46	< 10	44
ST1 2+50S 00+50W	201 202	1 < 0.01		4	180	6	< 2	< 1	6	0.01	< 10	< 10	19	< 10	56
ST1 2+50S 00+75W	201 202	< 1 < 0.01		8	130	14	2	1	8	0.02	< 10	< 10	33	< 10	34
ST1 2+50S 01+00W	201 202	< 1 < 0.01		8	590	12	< 2	1	8	0.02	< 10	< 10	37	< 10	34
ST1 2+50S 01+25W	201 202	< 1 < 0.01		3	410	12	< 2	1	11	0.02	< 10	< 10	25	< 10	30
ST1 2+50S 01+50W	201 202	< 1 < 0.01		7	390	24	< 2	1	13	0.02	< 10	< 10	43	< 10	38
ST1 2+50S 01+75W	201 202	< 1 < 0.01		1	130	6	< 2	< 1	2	0.01	< 10	< 10	13	< 10	18
ST1 2+50S 02+00W	201 202	< 1 < 0.01		4	270	10	2	2	6	0.07	< 10	< 10	30	< 10	50
ST1 2+50S 02+25W	201 202	< 1 < 0.01		8	440	20	< 2	2	16	0.02	< 10	< 10	40	< 10	50
ST1 2+50S 02+50W	201 202	1 < 0.01		7	270	22	< 2	1	9	0.03	< 10	< 10	33	< 10	44
ST1 2+50S 02+75W	201 202	< 1 < 0.01		5	150	16	8	1	5	0.03	< 10	< 10	28	< 10	34
ST1 2+50S 03+00W	201 202	< 1 < 0.01		4	160	14	< 2	1	7	0.02	< 10	< 10	31	< 10	30
ST1 2+50S 03+25W	201 202	< 1 < 0.01		11	300	16	< 2	2	16	0.04	< 10	< 10	43	< 10	42
ST1 2+50S 03+50W	201 202	< 1 < 0.01		8	200	16	< 2	1	9	0.06	< 10	< 10	45	< 10	40
ST1 2+50S 03+75W	201 202	< 1 < 0.01		6	180	14	2	1	8	0.04	< 10	< 10	42	< 10	40
ST1 2+50S 04+00W	201 202	1 < 0.01		5	150	34	< 2	< 1	4	0.02	< 10	< 10	24	< 10	40
ST1 2+50S 04+25W	201 202	< 1 < 0.01		8	130	12	< 2	1	4	0.02	< 10	< 10	39	< 10	28
ST1 2+50S 04+50W	201 202	1 < 0.01		1	230	48	2	< 1	4	< 0.01	< 10	< 10	20	< 10	36
ST1 2+50S 04+75W	201 202	1 < 0.01		16	280	28	< 2	1	5	0.03	< 10	< 10	51	< 10	42
ST1 2+50S 05+00W	201 202	1 < 0.01		4	330	14	2	1	4	0.01	< 10	< 10	42	< 10	26

CERTIFICATION: *Yhai D Ma*