

MAP NO.: 1150 15
ASSESSMENT REPORT
PROSPECTUS
CONFIDENTIAL X
OPEN FILE

DOCUMENT NO: 093158
MINING DISTRICT: DAWSON
TYPE OF WORK: GEOCHEMISRTY

REPORT FILED UNDER: DAWSON SYNDICATE LTD

DATE PERFORMED: AUG 16 - 21, 1993

DATE FILED: DEC 15, 1993

LOCATION: LAT.: 63°47'N

AREA: DOMINION MOUNTAIN

LONG.: 138°47'W

VALUE \$: 6,000

CLAIM NAME & NO.: KING 1-60 (YB41555-614)

WORK DONE BY: P. SOUTHAM; PEARL PETROLEUM CORP

WORK DONE FOR: OTIS J EXPLORATION CORPORATION

DATE TO GOOD STANDING:

REMARKS: SOIL SAMPLING AND PROSPECTING COMPLETED ON PROPERTY

| | |
|--|--|
| | |
| | |
| | |
| | |
| | |

YUKON ASSESSMENT REPORT

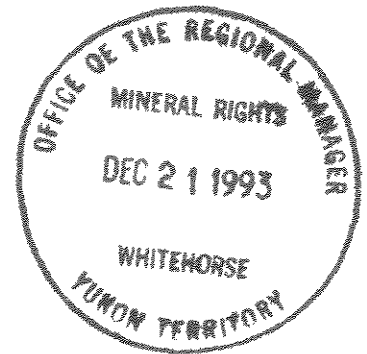

PROPERTY: KING CLAIMS

NTS MAP SHEET: 115 O/15

LATITUDE: 63° 47'N

LONGITUDE: 138° 47'W

CLAIMS AND GRANT NUMBERS WORKED:

KING 1 - 60

YB41555 - 614

OWNER OF PROPERTY: Dawson Syndicate (1983) Ltd.

ADDRESS: 13046 Summerhill Crescent
South Surrey, B.C.
V4A 7R8

TELEPHONE: (604) 685-2222

OPERATOR: Otis J. Exploration Corporation

TYPE OF WORK: Geochemical sampling

DATE WORK WAS DONE: August 16 - 21, 1993

AUTHOR OF REPORT: Philip Southam, P. Geo.

LIST OF PERSONNEL:

Philip Southam, Pearl Petroleum Corp.

Lee Persinger, Pearl Petroleum Corp.

James McNaughton, Pearl Petroleum Corp.

093158

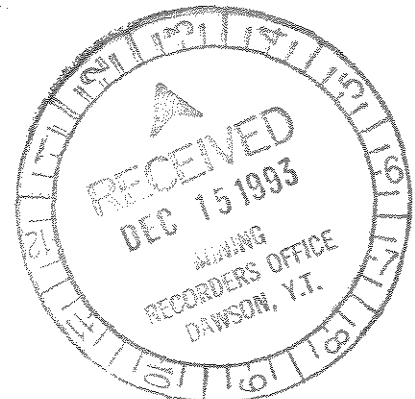

TABLE OF CONTENTS

| | |
|----------------------------|----|
| LOCATION AND ACCESS | 1 |
| TOPOGRAPHY AND VEGETATION | 1 |
| PROPERTY STATUS | 1 |
| HISTORY | 1 |
| REGIONAL GEOLOGY | 4 |
| PROPERTY GEOLOGY | 4 |
| WORK PROGRAM | 8 |
| GEOCHEMICAL SURVEY METHOD | 8 |
| GEOCHEMICAL SURVEY RESULTS | 8 |
| SUMMARY AND CONCLUSIONS | 10 |

LIST OF TABLES

| | |
|-----------------------------------|---|
| Table 1 - Claims List | 1 |
| Table 2 - Property Geology Legend | 7 |
| Table 3 - Sample Data | 8 |

LIST OF FIGURES

| | |
|---------------------------------------|---|
| Location Map | 2 |
| Claim Location Map | 3 |
| Regional Geology | 5 |
| Property Geology | 6 |
| Sample Location and Gold Geochemistry | 9 |

APPENDICES

| |
|---|
| Appendix I - STATEMENT OF EXPENDITURES |
| Appendix II - STATEMENT OF QUALIFICATIONS |
| Appendix III - ANALYTICAL METHOD |
| Appendix IV - ASSAYS |

LOCATION AND ACCESS

The property is located 44 kilometers southeast of Dawson City, Yukon (figure 1) on Dominion Mountain, centered on 63° 47' north latitude and 138° 47' west longitude on NTS sheet 115 O/15. It is accessible by gravel road from spring to fall or by helicopter from Dawson City in the winter.

TOPOGRAPHY AND VEGETATION

The topography is rolling hills ranging in elevation from 680 meters (2070 ft.) above sea level (ASL) to 1090 meters (3320 ft.) ASL covered with spruce, poplar and birch trees. The area escaped glaciation, thus the valleys are V-shaped and there is less than 1% natural outcrop exposure. The best exposure of bedrock is usually found in placer mine cuts and along road cuts.

On north facing slopes and shaded areas the vegetation consists of spruce trees and thick moss due to permafrost in the underlying soil. Spruce trees are also found in damp soil conditions on the property, such as recessive fault zones or creek gullies. Poplar and birch trees grow on the dry, thawed south, east and west facing slopes. Alder thickets are commonly found along creeks and gullies.

PROPERTY STATUS

The property consists of 60 quartz claims staked as the King claims (figure 2). They are:

Table 1 - Claims List

| <u>CLAIM NAME</u> | <u>GRANT NUMBER</u> | <u>EXPIRY DATE*</u> | <u>OWNER</u> |
|-------------------|---------------------|---------------------|--------------|
| King 1 - 60 | YB41555 - 614 | 7 Oct. 94 | W. J. Dawson |

* With acceptance of this report.

HISTORY

The property is located in the historic Klondike region where more than eleven million ounces of gold has been mined from placer deposits in existing creeks and former river channels. Placer gold was discovered in 1896 and mining of the creek and bench deposits still continues today.

Within the property there is some evidence of hard rock exploration in the past as indicated by a few trenches visited by Maclean in 1914 and several old log buildings in the vicinity.

OTIS J.
EXPLORATION CORP.

KING CLAIMS

DAWSON M.D., YUKON

NTS 115-0-15

LOCATION MAP

DATE: NOV. 93
BY: P.S.

FIGURE 1

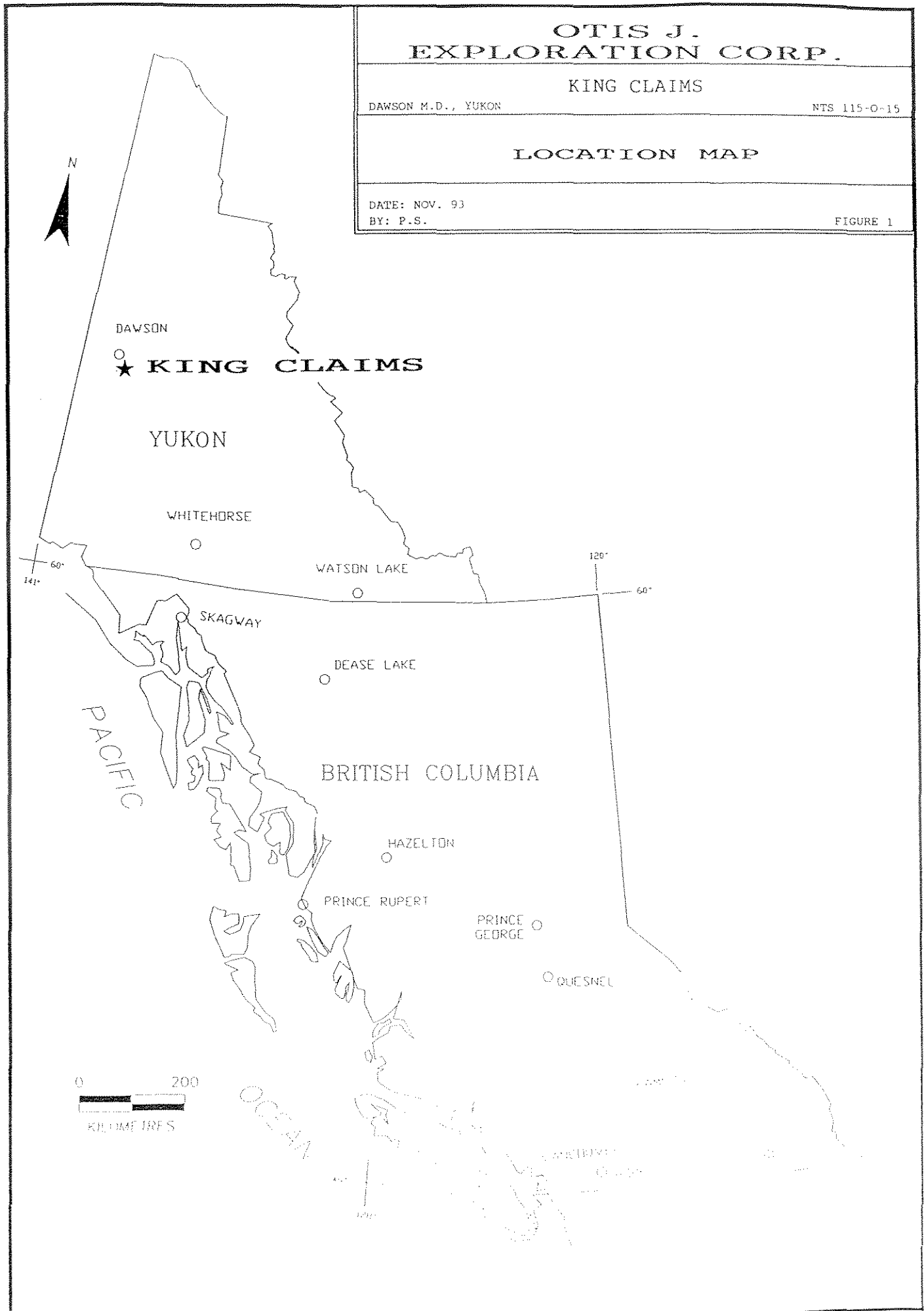

OTIS J. EXPLORATION CORP.

KING CLAIMS

DAWSON M.D., YUKON

NTS 115-O-15

CLAIM LOCATION MAP

SCALE 1 : 31,680

DATE: NOV. 93

BY: P.S.

FIGURE 2

NTS 115 O/15b

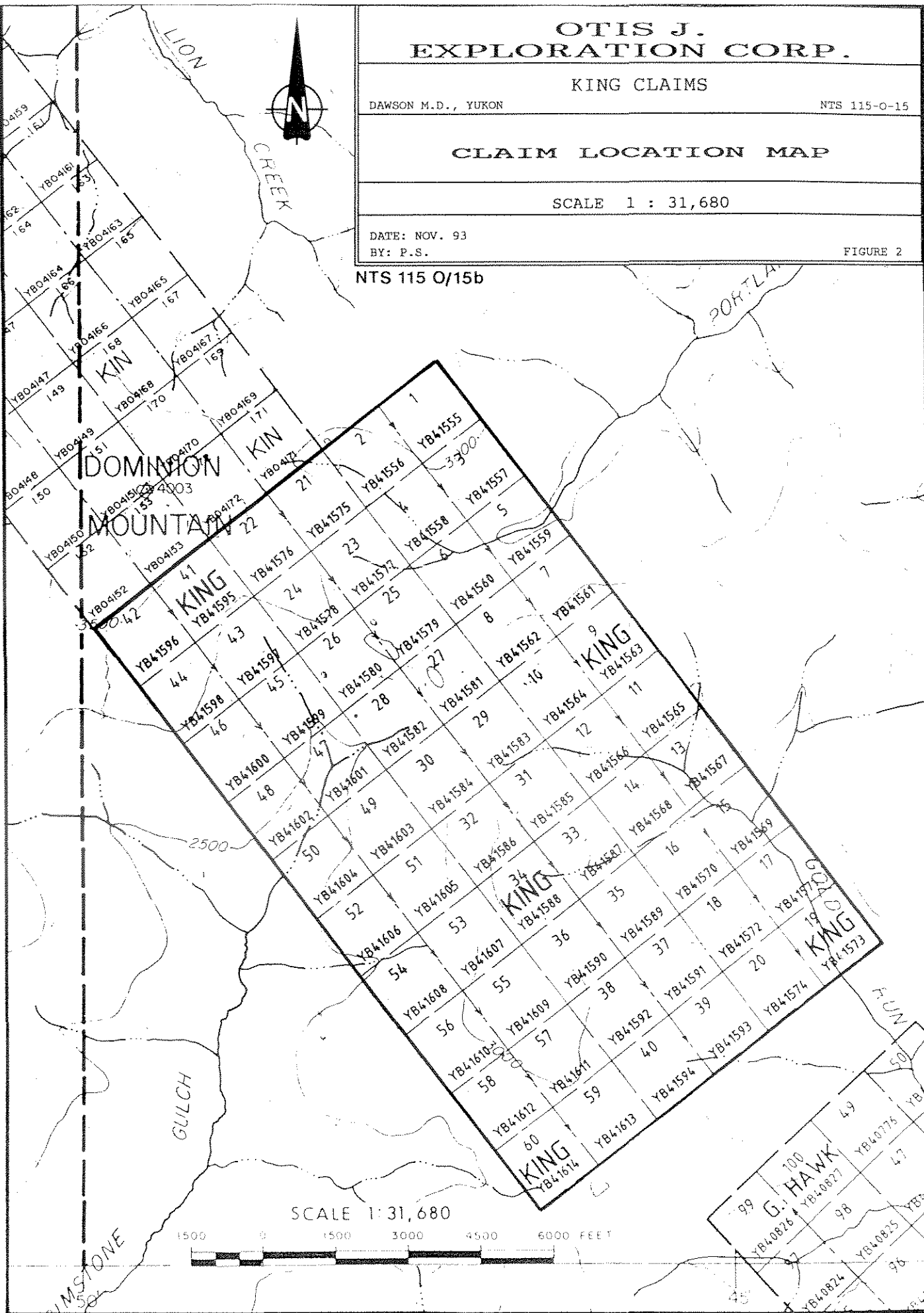

REGIONAL GEOLOGY

The Klondike region is underlain by a group of moderately metamorphosed rocks of late-Paleozoic age known as the Klondike Series and Nasina Series (figure 3). They form part of the Yukon-Tanana Terrane (YTT) on the SW side of the Tintina Trench. The YTT is formed from the merging of the Omineca Crystalline Belt and the Coast Plutonic Complex into the Intermontane Belt (Tempelman-Kluit, 1977). The Tintina Trench is a major transcurrent fault along which at least 450 km of dextral offset has occurred (Mortensen, 1990).

The gross lithologic assemblages within the YTT consist of Proterozoic and Paleozoic strata which can be correlated with the Omineca Crystalline Belt (OCB). The OCB includes a succession of clastic and carbonate rocks equivalent to miogeoclinal sequences to the east. The western part of the belt is overlain by upper Paleozoic mafic and felsic volcanic rocks with intercalated chert and slate (Tempelman-Kluit, 1977).

Mortensen (1990) describes the Klondike and Nasina geology as several imbricated thrust panels of polydeformed metavolcanics and metasediments of a buried island arc which can be subdivided into three assemblages. Assemblage I, the uppermost and more widely extensive thrust panel, is metamorphosed mid-Permian felsic plutonic, subvolcanic, and tuffaceous rocks. Assemblage II is mid-Paleozoic or older metasedimentary and mafic and felsic metavolcanic rocks intruded by a large body of latest Devonian - Early Mississippian granitic augen orthogneiss. Assemblage III underlies I and II structurally in the northern and southwestern part of the study area and consists of carbonaceous schists and phyllite.

PROPERTY GEOLOGY

The area is underlain by schistose rocks of quartzofelspathic to mafic affinity (figure 4; from Debicki, 1985). The quartzofelspathic unit is described as buff weathering well foliated muscovite-feldspar-quartz schist; the mafic material is light to medium green and buff weathering chlorite-quartz schist (table 2).

The feature of primary interest is a NW-SE trending southwest-dipping thrust fault which bisects the property. The thrust may be a potential conduit for mineralizing fluids from depth. It is exposed in the road cut at the center of the property as a thin sliver of massive serpentinite. Serpentinite has also been exposed further to the southeast where the thrust apparently crosses the Gold Run road near the northwest end of Teck Corp.'s placer operation.

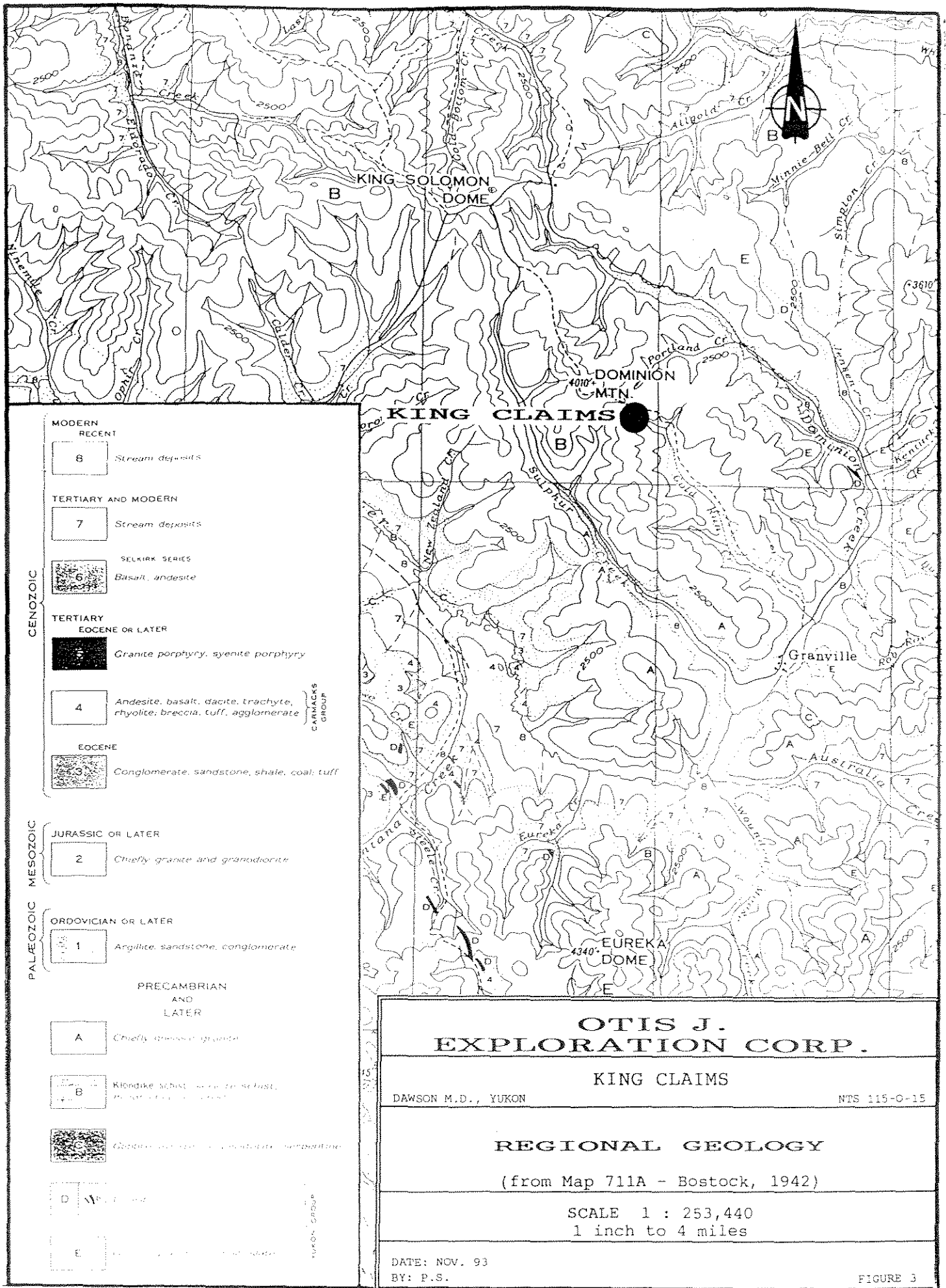

MODERN RECENT

8 Stream deposits

TERTIARY AND MODERN

7 Stream deposits

SELKIRK SERIES

6 Basalt, andesite

TERTIARY EOCENE OR LATER

Granite porphyry, syenite porphyry

4 Andesite, basalt, dacite, trachyte, rhyolite; breccia, tuff, agglomerate

CARMACKS GROUP

EOCENE

3 Conglomerate, sandstone, shale, coal, tuff

MESOZOIC

JURASSIC OR LATER

2 Chiefly granite and granodiorite

PALEOZOIC

ORDOVICIAN OR LATER

1 Argillite, sandstone, conglomerate

PRECAMBRIAN AND LATER

A Chiefly dioritic granite

B Klondike Schist, Yukon Schist, massive gneiss, amphibolite

Green schist, amphibolite, serpentinite

D Metasediments

E Metasediments, gneiss, schist

YUKON GROUP

OTIS J. EXPLORATION CORP.

KING CLAIMS

DAWSON M.D., YUKON

NTS 115-O-15

REGIONAL GEOLOGY

(from Map 711A - Bostock, 1942)

SCALE 1 : 253,440
1 inch to 4 miles

DATE: NOV. 93
BY: P.S.

FIGURE 3

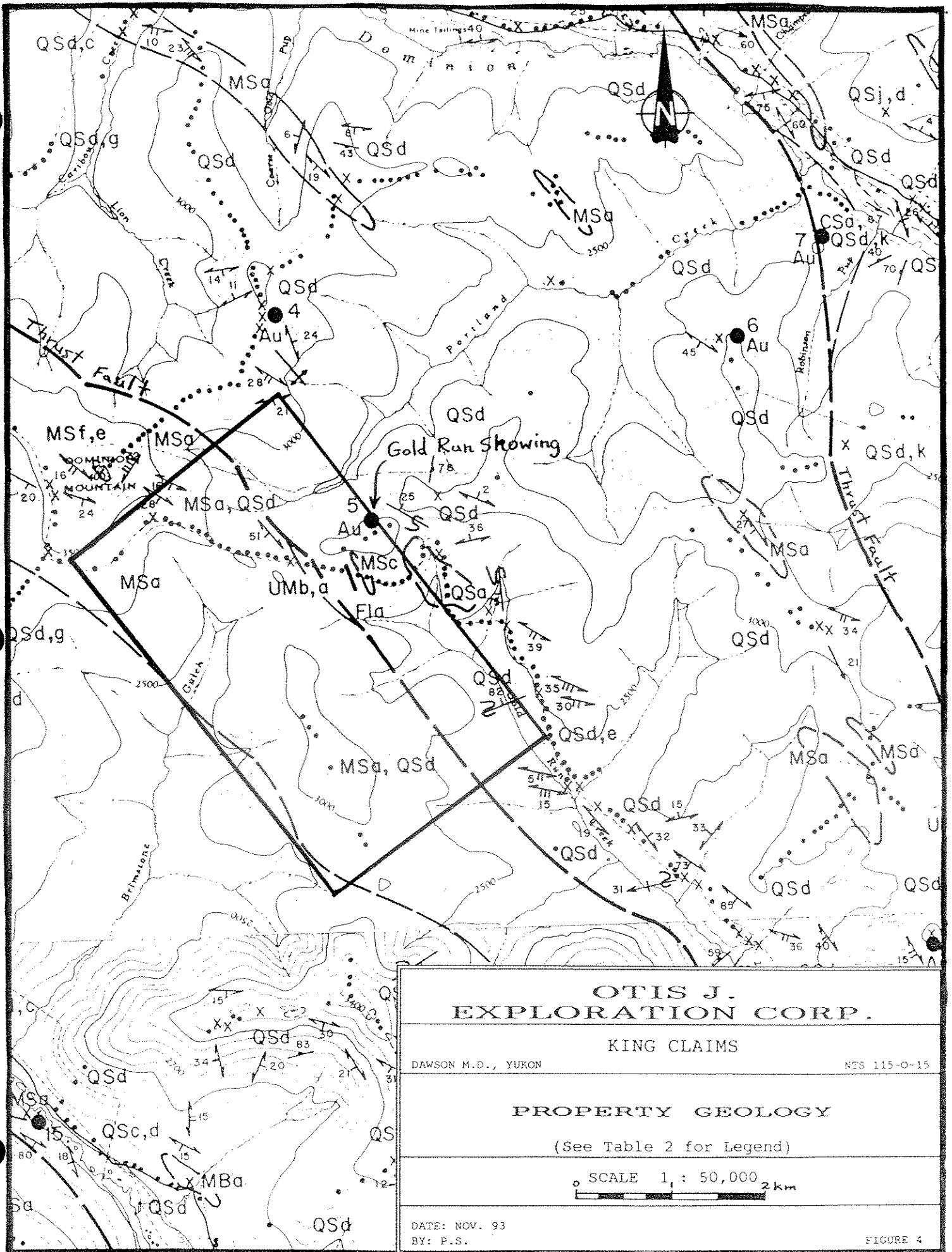

Table 2 - Property Geology Legend
(from Debicki, 1985)

LATE CRETACEOUS TO EARLY TERTIARY

Felsic intrusive and volcanic rocks

FI

FIa light coloured quartz-feldspar rhyolite porphyry
and rhyolite

TRIASSIC OR OLDER

Rocks of varying metamorphic grade and degree and style of
deformation

Felsic plutonic rocks

FP, QS

QSa blocky weathering light grey to pinkish feldspar-
quartz schist

Quartzofeldspathic schistose rocks

QS

QSc buff weathering well foliated muscovite-feldspar-
quartz schist with quartz porphyroclasts

QSD buff weathering well foliated muscovite-feldspar-
quartz schist

QSe light green weathering hornblende/muscovite-
feldspar-quartz schist

Qsj muscovite-quartz schist with more than 5% garnet,
and with or without chlorite

QSk biotite-quartz schist, with or without calcite

Marble

MB

Mba cream and grey banded marble, with or without minor
quartz, muscovite and garnet

Mafic schistose rocks

MS

MSa light to medium green and buff weathering chlorite-
quartz schist

MSC silvery green weathering actinolite-chlorite schist

MSe light to medium green and buff weathering
calcareous chlorite-quartz schist: calcite may be
disseminated, in thin layers, or as small pink
blebs

MSf silvery green weathering muscovite-chlorite quartz
schist with bluish quartz porphyroclasts

Ultramafic rocks

UM

Uma massive dark green serpentinite

UMB foliated dark green serpentinite

Minor amounts of silvery green weathering actinolite-chlorite schist and blocky weathering light grey to pinkish feldspar-quartz schist are exposed in the road cut along the northeastern corner of the property.

A gold occurrence, called the Gold Run showing, is located in the northeast corner of the property. Four shallow test pits have uncovered buff to pale weathering muscovite-feldspar quartz schist and minor white bull quartz vein material. It was visited by Maclean (1914) who reported traces of galena and gold in pyritic quartz cutting the schist. Two samples from his visit returned 58.2g/t Au, 51.3 g/t Ag and 5.5g/t Au, 13.0 g/t Ag. More recent sampling of the vein by Debicki (1985) and the author did not return any significant gold or silver values.

WORK PROGRAM

Two contour lines of soil samples (table 3) were completed to test for mineralization along the thrust and in the surrounding rocks. The road cut and Gold Run showing were prospected; one rock sample was taken from the Gold Run showing.

Table 3 - Sample Data

| <u>Grid Name</u> | <u>Line Kilometers</u> | <u>No. of Samples</u> | <u>Sample Spacing</u> | <u>Line Spacing</u> |
|------------------|----------------------------|---------------------------|---------------------------|-------------------------|
| 93JKC | 2.0 | 78 | 25 m | contour |
| 93LKC | 2.9 | 116 | 25 m | contour |

GEOCHEMICAL SURVEY METHOD

The two contour soil lines were taken around the headwaters of Portland Creek and Gold Run Creek (figure 5). Sample stations are at 25 meter intervals and are marked with flagging tape. Soil samples were taken from the B-horizon, found at depths of 5 to 40 centimeters, using a standard mattock. The samples were placed in kraft soil sample bags and dried prior to shipping to Chemex Labs for analysis. Each sample was tested by fire assay for gold and by 32-element ICP.

GEOCHEMICAL SURVEY RESULTS

There is not much encouragement from the soil sample results with the exception of a few small anomalies in the Portland Creek headwaters. The two highest samples, 140 and 45 ppb gold, are located downslope from the Gold Run showing (figure 4). A third sample, returning 2.6 ppm silver, is located near the postulated

DOMINION
MOUNTAIN

OTIS J.
EXPLORATION CORP.

KING CLAIMS

DAWSON M.D., YUKON

NTS 115-0-15

SAMPLE LOCATION MAP
AND
GOLD GEOCHEMISTRY

SCALE 1 : 12,500

0 400m

DATE: NOV. 93

BY: P.S.

FIGURE 5

| SAMPLE | Au ppb FA+AA | SAMPLE | Au ppb FA+AA | SAMPLE | Au ppb FA+AA | SAMPLE | Au ppb FA+AA | SAMPLE | Au ppb FA+AA |
|-----------|-----------------|------------|-----------------|------------|-----------------|------------|-----------------|------------|-----------------|
| 93JJC-D01 | < 5 | 93JJC-D44 | < 5 | 93LKC-D003 | < 5 | 93LKC-D043 | < 5 | 93LKC-D083 | < 5 |
| 93JJC-D02 | < 5 | 93JJC-D45 | < 5 | 93LKC-D004 | < 5 | 93LKC-D044 | < 5 | 93LKC-D084 | < 5 |
| 93JJC-D03 | < 5 | 93JJC-D46 | < 5 | 93LKC-D005 | < 5 | 93LKC-D045 | < 5 | 93LKC-D085 | < 5 |
| 93JJC-D04 | < 5 | 93JJC-D47 | < 5 | 93LKC-D006 | < 5 | 93LKC-D046 | < 5 | 93LKC-D086 | < 5 |
| 93JJC-D05 | < 5 | 93JJC-D48 | < 5 | 93LKC-D007 | < 5 | 93LKC-D047 | < 5 | 93LKC-D087 | < 5 |
| 93JJC-D06 | < 5 | 93JJC-D49 | < 5 | 93LKC-D008 | < 5 | 93LKC-D048 | < 5 | 93LKC-D088 | < 5 |
| 93JJC-D07 | < 5 | 93JJC-D50 | < 5 | 93LKC-D009 | < 5 | 93LKC-D049 | < 5 | 93LKC-D089 | < 5 |
| 93JJC-D08 | < 5 | 93JJC-D51 | < 5 | 93LKC-D010 | < 5 | 93LKC-D050 | < 5 | 93LKC-D090 | < 5 |
| 93JJC-D09 | < 5 | 93JJC-D52 | < 5 | 93LKC-D011 | < 5 | 93LKC-D051 | < 5 | 93LKC-D091 | < 5 |
| 93JJC-D10 | < 5 | 93JJC-D53 | < 5 | 93LKC-D012 | < 5 | 93LKC-D052 | < 5 | 93LKC-D092 | < 5 |
| 93JJC-D11 | < 5 | 93JJC-D54 | < 5 | 93LKC-D013 | < 5 | 93LKC-D053 | < 5 | 93LKC-D093 | < 5 |
| 93JJC-D12 | < 5 | 93JJC-D55 | < 5 | 93LKC-D014 | < 5 | 93LKC-D054 | < 5 | 93LKC-D094 | < 5 |
| 93JJC-D13 | < 5 | 93JJC-D56 | 10 | 93LKC-D015 | < 5 | 93LKC-D055 | < 5 | 93LKC-D095 | < 5 |
| 93JJC-D14 | < 5 | 93JJC-D57 | < 5 | 93LKC-D016 | < 5 | 93LKC-D056 | < 5 | 93LKC-D096 | < 5 |
| 93JJC-D15 | < 5 | 93JJC-D58 | < 5 | 93LKC-D017 | < 5 | 93LKC-D057 | < 5 | 93LKC-D097 | < 5 |
| 93JJC-D16 | < 5 | 93JJC-D59 | < 5 | 93LKC-D018 | < 5 | 93LKC-D058 | < 5 | 93LKC-D098 | < 5 |
| 93JJC-D17 | < 5 | 93JJC-D60 | < 5 | 93LKC-D019 | < 5 | 93LKC-D059 | < 5 | 93LKC-D099 | < 5 |
| 93JJC-D18 | < 5 | 93JJC-D61 | < 5 | 93LKC-D020 | < 5 | 93LKC-D060 | < 5 | 93LKC-D100 | < 5 |
| 93JJC-D19 | < 5 | 93JJC-D62 | < 5 | 93LKC-D021 | < 5 | 93LKC-D061 | < 5 | 93LKC-D101 | < 5 |
| 93JJC-D20 | < 5 | 93JJC-D63 | < 5 | 93LKC-D022 | < 5 | 93LKC-D062 | < 5 | 93LKC-D102 | < 5 |
| 93JJC-D21 | < 5 | 93JJC-D64 | < 5 | 93LKC-D023 | < 5 | 93LKC-D063 | < 5 | 93LKC-D103 | < 5 |
| 93JJC-D22 | < 5 | 93JJC-D65 | < 5 | 93LKC-D024 | < 5 | 93LKC-D064 | < 5 | 93LKC-D104 | < 5 |
| 93JJC-D26 | 10 | 93JJC-D66 | < 5 | 93LKC-D025 | < 5 | 93LKC-D065 | < 5 | 93LKC-D105 | < 5 |
| 93JJC-D27 | < 5 | 93JJC-D67 | < 5 | 93LKC-D026 | < 5 | 93LKC-D066 | < 5 | 93LKC-D106 | < 5 |
| 93JJC-D28 | < 5 | 93JJC-D68 | < 5 | 93LKC-D027 | < 5 | 93LKC-D067 | < 5 | 93LKC-D107 | < 5 |
| 93JJC-D29 | < 5 | 93JJC-D69 | < 5 | 93LKC-D028 | < 5 | 93LKC-D068 | < 5 | 93LKC-D108 | < 5 |
| 93JJC-D30 | < 5 | 93JJC-D70 | 25 | 93LKC-D029 | < 5 | 93LKC-D069 | < 5 | 93LKC-D109 | < 5 |
| 93JJC-D31 | 45 | 93JJC-D71 | < 5 | 93LKC-D030 | < 5 | 93LKC-D070 | < 5 | 93LKC-D110 | < 5 |
| 93JJC-D32 | 140 | 93JJC-D72 | < 5 | 93LKC-D031 | < 5 | 93LKC-D071 | < 5 | 93LKC-D111 | < 5 |
| 93JJC-D33 | < 5 | 93JJC-D73 | < 5 | 93LKC-D032 | < 5 | 93LKC-D072 | < 5 | 93LKC-D112 | < 5 |
| 93JJC-D34 | < 5 | 93JJC-D74 | < 5 | 93LKC-D033 | < 5 | 93LKC-D073 | < 5 | 93LKC-D113 | < 5 |
| 93JJC-D35 | < 5 | 93JJC-D75 | < 5 | 93LKC-D034 | < 5 | 93LKC-D074 | < 5 | 93LKC-D114 | < 5 |
| 93JJC-D36 | < 5 | 93JJC-D76 | < 5 | 93LKC-D035 | < 5 | 93LKC-D075 | < 5 | 93LKC-D115 | < 5 |
| 93JJC-D37 | < 5 | 93JJC-D77 | < 5 | 93LKC-D036 | < 5 | 93LKC-D076 | < 5 | 93LKC-D116 | < 5 |
| 93JJC-D38 | < 5 | 93JJC-D78 | < 5 | 93LKC-D037 | < 5 | 93LKC-D077 | < 5 | | |
| 93JJC-D39 | < 5 | 93JJC-D79 | < 5 | 93LKC-D038 | < 5 | 93LKC-D078 | < 5 | | |
| 93JJC-D40 | < 5 | 93JJC-D80 | < 5 | 93LKC-D039 | < 5 | 93LKC-D079 | < 5 | | |
| 93JJC-D41 | < 5 | 93JJC-S26 | < 5 | 93LKC-D040 | < 5 | 93LKC-D080 | < 5 | | |
| 93JJC-D42 | < 5 | 93LKC-D001 | < 5 | 93LKC-D041 | < 5 | 93LKC-D081 | < 5 | | |
| 93JJC-D43 | < 5 | 93LKC-D002 | < 5 | 93LKC-D042 | < 5 | 93LKC-D082 | < 5 | | |

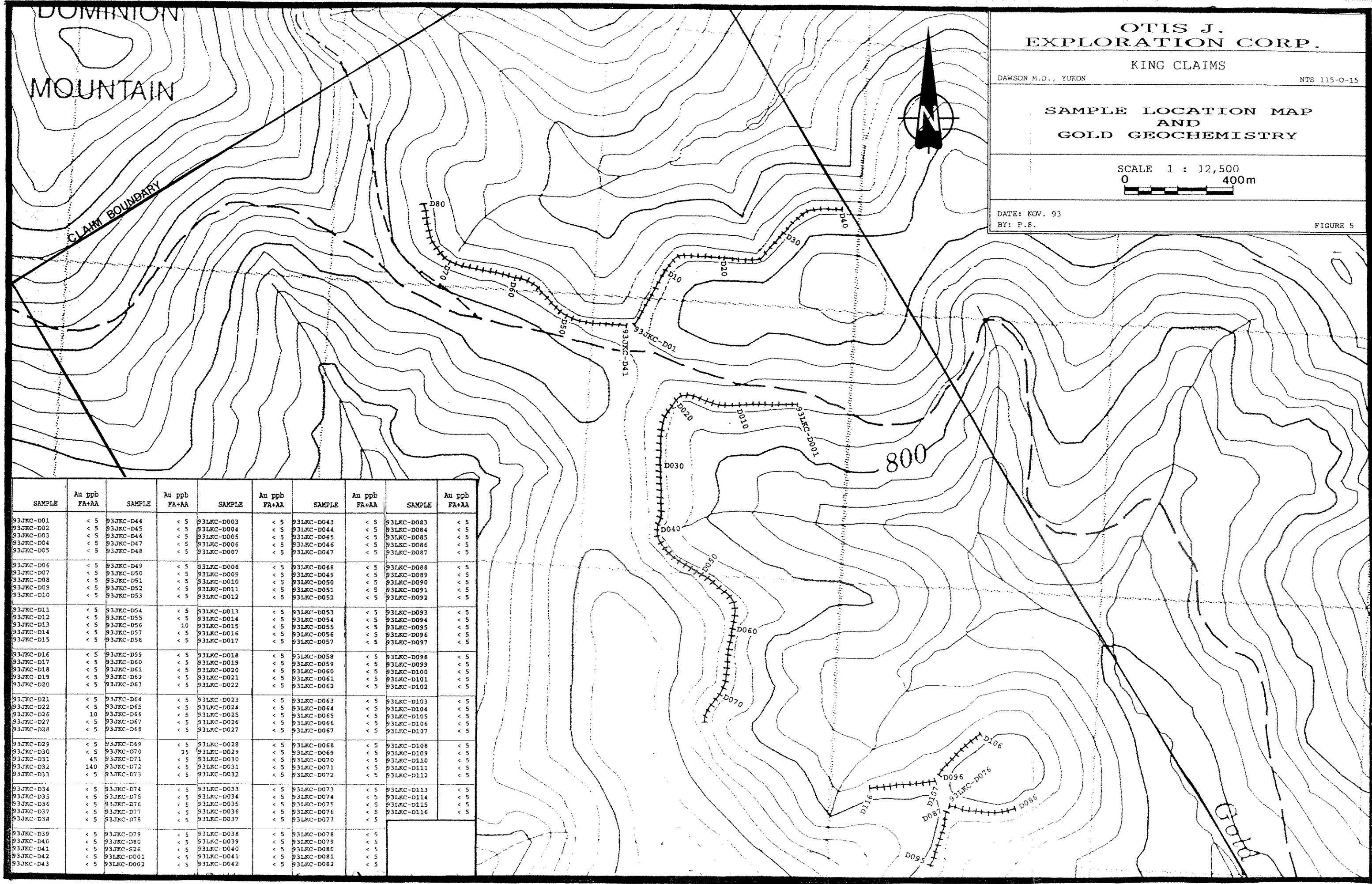

trace of the thrust fault.

None of the samples from the Gold Run Creek headwaters returned significant gold or silver values.

SUMMARY AND CONCLUSIONS

The King claims are underlain by schist rocks that have been thrust faulted, juxtaposing chlorite-quartz schist and a thin sliver of ultramafic over feldspar-quartz schist. The ductile nature of the rocks seems to have preempted the movement of mineralizing fluids along the thrust in the areas tested. The most northwestern and southeastern ends of the thrust remain untested. The western side of the property lying in Brimstone Gulch is also untested. A small program of geochemical sampling in these areas and follow-up sampling around the Gold Run showing is recommended.

BIBLIOGRAPHY

- Debicki, R.L., 1985. Bedrock geology and mineralization of the Klondike Area (east), 115 O/9,10,11,14,15,16 and 116 B/2 Exploration and Geological Services Division, Yukon; Indian and Northern Affairs Canada. Open File, 1:50,000 scale map with marginal notes.
- MacLean, T.A., 1914. Lode mining in Yukon: an investigation of quartz deposits in the Klondike division; Canada Dept. of Mines, Mines Branch Publication 222, Ottawa.
- Mortensen, J.K., 1990. Geology and U-Pb geochronology of the Klondike district, west-central Yukon Territory; Canadian Journal of Earth Sciences, Vol. 27, p. 903-914.
- Templeman-Kluit, D., 1976. The Yukon crystalline terrane: Enigma in the Canadian Cordillera; Geol. Soc. America Bull., v. 87, p. 1343-1357.

APPENDIX I

STATEMENT OF EXPENDITURES

KING CLAIMS - EXPENDITURES

SALARIES

| | |
|---|-----|
| Phil Southam - 2 mandays @ \$145/day | 290 |
| James McNaughton - 2 mandays @ \$130/day | 260 |
| Lee Persinger - 2 mandays @ \$130/day | 260 |
| Report preparation - P. Southam - 6 mandays @ \$145/day | 870 |

GEOCHEMICAL ANALYSIS

| | |
|-----------------------------------|------|
| 194 soil samples @ \$16.37/sample | 3176 |
| 1 rock samples @ \$21/sample | 21 |

LOGISTICAL COSTS

| | |
|---|-----|
| Food and lodging - 6 mandays @ \$50/day | 300 |
| Sample shipping | 126 |
| Vehicle rental - 2 trucks for 2 days @ \$30/day | 120 |
| Vehicle fuel and maintenance | 80 |

| | |
|----------|-------------|
| SUBTOTAL | <u>5503</u> |
|----------|-------------|

| | |
|------------------------------------|-----|
| Administration Fee (15%) | 825 |
| GST on Administration (#129350518) | 56 |

| | |
|-------|---------------|
| TOTAL | <u>\$6384</u> |
|-------|---------------|

APPENDIX II

STATEMENT OF QUALIFICATIONS

STATEMENT OF QUALIFICATIONS

I, Philip James Southam of 6348 Kerr Street, Vancouver, British Columbia, do hereby certify:

1. I am a geologist registered with the Association of Professional Engineers and Geoscientists of British Columbia.
2. I graduated from Brandon University in 1987 with a Bachelor of Science degree majoring in geology.
3. I have practised my profession continuously since graduation in British Columbia, Manitoba, Yukon Territory and California in the field of mineral exploration.
4. I am employed by Pearl Petroleum Corporation to provide geological services for Otis J. Exploration Corporation.
5. All work completed for the purpose of this report was done under my supervision.

Philip Southam
Philip Southam

APPENDIX III

ANALYTICAL METHOD

Screening Procedure

Chemex Code: 201

Geochemical samples (soils, silts) are dried at 50 deg C and then sieved through an 80 mesh stainless steel screen. If insufficient material is obtained, the sample is sieved through a 35 mesh screen (code 203) and the -35 mesh material is ring pulverized (code 205).

If there is still insufficient material for analysis after sieving to -35 mesh, then the whole sample is recombined and ground (code 217).

Gold

Fire Assay Collection/ Atomic Absorption Spectroscopy (FA-AA)

Chemex Code: 100

A 10g sample is fused with a neutral lead oxide flux inquarted with 6mg of gold-free silver and then cupelled to yield a precious metal bead.

These beads are digested for 30 mins in 0.5ml concentrated nitric acid, then 1.5ml of concentrated hydrochloric acid are added and the mixture is digested for 1 hr. The samples are cooled, diluted to a final volume of 5ml, homogenized and analyzed by atomic absorption spectroscopy.

Detection limit: 5 ppb

Upper Limit: 10,000 ppb

**32-Element Geochemistry Package (32-ICP)
Inductively-Coupled Plasma-Atomic Emission Spectroscopy (ICP-AES)**

A prepared sample (1.0g) is digested with concentrated nitric and aqua regia acids at medium heat for two hours. The acid solution is diluted to 25ml with demineralized water, mixed and analyzed using a Jarrell Ash 1100 plasma spectrometer after calibration with proper standards. The analytical results are corrected for spectral inter-element interferences.

| Chemex Codes | Element | Detection Limit | Upper Limit |
|--------------|-------------|-----------------|-------------|
| 229 | Digestion | | |
| 2119 | * Aluminum | 0.01 % | 15 % |
| 2118 | Silver | 0.2 ppm | 0.02 % |
| 2120 | Arsenic | 2 ppm | 1 % |
| 2121 | * Barium | 10 ppm | 1 % |
| 2122 | * Beryllium | 0.5 ppm | 0.01 % |
| 2123 | Bismuth | 2 ppm | 1 % |
| 2124 | * Calcium | 0.01 % | 15 % |
| 2125 | Cadmium | 0.5 ppm | 0.05 % |
| 2126 | Cobalt | 1 ppm | 1 % |
| 2127 | * Chromium | 1 ppm | 1 % |
| 2128 | Copper | 1 ppm | 1 % |
| 2150 | Iron | 0.01 % | 15 % |
| 2130 | * Gallium | 10 ppm | 1 % |
| 2132 | * Potassium | 0.01 % | 10 % |
| 2151 | * Lanthanum | 10 ppm | 1 % |
| 2134 | * Magnesium | 0.01 % | 15 % |
| 2135 | Manganese | 5 ppm | 1 % |
| 2136 | Molybdenum | 1 ppm | 1 % |
| 2137 | * Sodium | 0.01 % | 10 % |
| 2138 | Nickel | 1 ppm | 1 % |
| 2139 | Phosphorus | 10 ppm | 1 % |
| 2140 | Lead | 2 ppm | 1 % |
| 2141 | Antimony | 2 ppm | 1 % |
| 2142 | * Scandium | 1 ppm | 1 % |
| 2143 | * Strontium | 1 ppm | 1 % |
| 2144 | * Titanium | 0.01 % | 10 % |
| 2145 | * Thallium | 10 ppm | 1 % |
| 2146 | Uranium | 10 ppm | 1 % |
| 2147 | Vanadium | 1 ppm | 1 % |
| 2148 | * Tungsten | 10 ppm | 1 % |
| 2149 | Zinc | 2 ppm | 1 % |
| 2131 | Mercury | 1 ppm | 1 % |

* Elements for which the digestion is possibly incomplete.

APPENDIX IV

ASSAY RESULTS



Chemex Labs Ltd.

Analytical Chemists * Geochemists * Registered Assayers
212 Brooksbank Ave., North Vancouver
British Columbia, Canada V7J 2C1
PHONE: 604-984-0221

To: PEARL PETROLEUM CORP.

1100 - 675 W. HASTINGS ST.
VANCOUVER, BC
V6B 1N6

Project : KING CLAIMS-DAWSON
Comments:

Page Number : 1-A
Total Pages : 5
Certificate Date: 08-SEP-93
Invoice No. : I9320293
P.O. Number :
Account : KYW

CERTIFICATE OF ANALYSIS A9320293

| SAMPLE | PREP CODE | | Au ppb | Ag ppm | Al % | As ppm | Ba ppm | Be ppm | Bi ppm | Ca % | Cd ppm | Co ppm | Cr ppm | Cu ppm | Fe % | Ga ppm | Hg ppm | K % | La ppm | Mg % | Mn ppm |
|-----------|-----------|-----|--------|--------|------|--------|--------|--------|--------|------|--------|--------|--------|--------|------|--------|--------|------|--------|------|--------|
| | | | FA+AA | | | | | | | | | | | | | | | | | | |
| 93JKC-D01 | 201 | 229 | < 5 | < 0.2 | 0.98 | < 2 | 190 | < 0.5 | < 2 | 0.03 | < 0.5 | 2 | 14 | 10 | 1.83 | < 10 | < 1 | 0.06 | < 10 | 0.20 | 100 |
| 93JKC-D02 | 201 | 229 | < 5 | < 0.2 | 0.92 | 2 | 270 | < 0.5 | < 2 | 0.07 | < 0.5 | 2 | 10 | 10 | 1.39 | < 10 | < 1 | 0.07 | 20 | 0.28 | 110 |
| 93JKC-D03 | 201 | 229 | < 5 | < 0.2 | 0.67 | < 2 | 220 | < 0.5 | < 2 | 0.07 | < 0.5 | 4 | 9 | 32 | 1.27 | < 10 | < 1 | 0.09 | 40 | 0.25 | 185 |
| 93JKC-D04 | 201 | 229 | < 5 | < 0.2 | 1.07 | < 2 | 500 | < 0.5 | < 2 | 0.07 | < 0.5 | 1 | 14 | 23 | 1.63 | < 10 | < 1 | 0.07 | 10 | 0.24 | 115 |
| 93JKC-D05 | 201 | 229 | < 5 | < 0.2 | 1.20 | 8 | 250 | < 0.5 | < 2 | 0.08 | < 0.5 | 2 | 18 | 13 | 2.06 | < 10 | < 1 | 0.03 | < 10 | 0.26 | 95 |
| 93JKC-D06 | 201 | 229 | < 5 | < 0.2 | 0.56 | < 2 | 140 | < 0.5 | < 2 | 0.10 | < 0.5 | 3 | 3 | 14 | 1.09 | < 10 | < 1 | 0.09 | < 10 | 0.37 | 195 |
| 93JKC-D07 | 201 | 229 | < 5 | < 0.2 | 0.92 | < 2 | 190 | < 0.5 | < 2 | 0.04 | < 0.5 | 2 | 12 | 9 | 1.45 | < 10 | < 1 | 0.06 | < 10 | 0.21 | 80 |
| 93JKC-D08 | 201 | 229 | < 5 | < 0.2 | 0.91 | 8 | 160 | < 0.5 | 2 | 0.07 | < 0.5 | 3 | 19 | 12 | 2.18 | < 10 | < 1 | 0.04 | < 10 | 0.25 | 135 |
| 93JKC-D09 | 201 | 229 | < 5 | < 0.2 | 0.32 | < 2 | 130 | < 0.5 | 2 | 0.03 | < 0.5 | 1 | 2 | 6 | 0.77 | < 10 | < 1 | 0.06 | < 10 | 0.04 | 45 |
| 93JKC-D10 | 201 | 229 | < 5 | < 0.2 | 1.34 | 8 | 170 | < 0.5 | 2 | 0.08 | < 0.5 | 7 | 20 | 20 | 2.14 | < 10 | < 1 | 0.06 | 20 | 0.35 | 125 |
| 93JKC-D11 | 201 | 229 | < 5 | < 0.2 | 1.03 | < 2 | 160 | < 0.5 | < 2 | 0.14 | < 0.5 | 4 | 17 | 14 | 2.00 | < 10 | < 1 | 0.08 | 10 | 0.35 | 165 |
| 93JKC-D12 | 201 | 229 | < 5 | < 0.2 | 0.62 | 2 | 190 | < 0.5 | < 2 | 0.07 | < 0.5 | 1 | 7 | 10 | 1.06 | < 10 | < 1 | 0.10 | 20 | 0.19 | 60 |
| 93JKC-D13 | 201 | 229 | < 5 | 0.2 | 1.25 | < 2 | 370 | < 0.5 | < 2 | 0.21 | < 0.5 | 7 | 24 | 25 | 2.25 | < 10 | < 1 | 0.04 | 10 | 0.43 | 225 |
| 93JKC-D14 | 201 | 229 | < 5 | < 0.2 | 1.38 | 2 | 450 | < 0.5 | < 2 | 0.29 | < 0.5 | 7 | 25 | 20 | 2.35 | < 10 | < 1 | 0.06 | 10 | 0.44 | 220 |
| 93JKC-D15 | 201 | 229 | < 5 | < 0.2 | 1.44 | 4 | 310 | < 0.5 | 2 | 0.23 | < 0.5 | 7 | 25 | 16 | 2.30 | < 10 | < 1 | 0.04 | 10 | 0.39 | 230 |
| 93JKC-D16 | 201 | 229 | < 5 | < 0.2 | 1.35 | 2 | 340 | < 0.5 | < 2 | 0.20 | < 0.5 | 4 | 22 | 15 | 1.95 | < 10 | < 1 | 0.06 | 10 | 0.37 | 120 |
| 93JKC-D17 | 201 | 229 | < 5 | 0.2 | 1.25 | 12 | 280 | < 0.5 | < 2 | 0.20 | < 0.5 | 3 | 22 | 14 | 1.95 | < 10 | < 1 | 0.04 | 10 | 0.36 | 125 |
| 93JKC-D18 | 201 | 229 | < 5 | < 0.2 | 1.00 | 4 | 290 | < 0.5 | < 2 | 0.17 | < 0.5 | 2 | 18 | 12 | 1.48 | < 10 | < 1 | 0.04 | 10 | 0.25 | 75 |
| 93JKC-D19 | 201 | 229 | < 5 | 0.2 | 1.20 | 14 | 280 | < 0.5 | < 2 | 0.22 | < 0.5 | 5 | 24 | 13 | 1.89 | < 10 | < 1 | 0.04 | 10 | 0.36 | 130 |
| 93JKC-D20 | 201 | 229 | < 5 | < 0.2 | 0.93 | 2 | 160 | < 0.5 | 2 | 0.19 | < 0.5 | 2 | 19 | 10 | 1.21 | < 10 | < 1 | 0.03 | 10 | 0.25 | 65 |
| 93JKC-D21 | 201 | 229 | < 5 | < 0.2 | 0.94 | < 2 | 170 | < 0.5 | < 2 | 0.24 | < 0.5 | 2 | 19 | 9 | 1.47 | < 10 | < 1 | 0.03 | 10 | 0.33 | 90 |
| 93JKC-D22 | 201 | 229 | < 5 | 0.2 | 1.24 | 4 | 290 | < 0.5 | 2 | 0.27 | 0.5 | 5 | 28 | 23 | 2.32 | < 10 | < 1 | 0.05 | 10 | 0.44 | 135 |
| 93JKC-D26 | 201 | 229 | 10 | 0.2 | 1.00 | 6 | 490 | < 0.5 | < 2 | 0.42 | < 0.5 | 1 | 19 | 10 | 1.27 | < 10 | < 1 | 0.07 | 20 | 0.28 | 65 |
| 93JKC-D27 | 201 | 229 | < 5 | < 0.2 | 0.92 | < 2 | 400 | < 0.5 | < 2 | 0.17 | < 0.5 | 1 | 18 | 8 | 1.20 | < 10 | < 1 | 0.07 | 20 | 0.23 | 60 |
| 93JKC-D28 | 201 | 229 | < 5 | 0.2 | 0.72 | < 2 | 270 | < 0.5 | < 2 | 0.25 | < 0.5 | 2 | 16 | 7 | 1.18 | < 10 | < 1 | 0.08 | 20 | 0.20 | 80 |
| 93JKC-D29 | 201 | 229 | < 5 | 0.2 | 0.82 | < 2 | 240 | < 0.5 | < 2 | 0.26 | < 0.5 | 2 | 15 | 6 | 1.40 | < 10 | < 1 | 0.09 | 20 | 0.25 | 145 |
| 93JKC-D30 | 201 | 229 | < 5 | < 0.2 | 0.66 | 2 | 180 | < 0.5 | < 2 | 0.13 | < 0.5 | 1 | 12 | 7 | 1.13 | < 10 | < 1 | 0.09 | 10 | 0.20 | 80 |
| 93JKC-D31 | 201 | 229 | 45 | 0.2 | 0.58 | 4 | 550 | < 0.5 | 2 | 0.18 | < 0.5 | < 1 | 11 | 8 | 0.99 | < 10 | < 1 | 0.06 | 40 | 0.13 | 45 |
| 93JKC-D32 | 201 | 229 | 140 | 1.0 | 0.86 | 10 | 1010 | < 0.5 | < 2 | 0.45 | < 0.5 | 3 | 19 | 20 | 1.70 | 10 | < 1 | 0.08 | 80 | 0.20 | 205 |
| 93JKC-D33 | 201 | 229 | < 5 | < 0.2 | 0.65 | 4 | 260 | < 0.5 | < 2 | 0.12 | < 0.5 | 1 | 12 | 7 | 1.20 | < 10 | < 1 | 0.07 | 10 | 0.16 | 80 |
| 93JKC-D34 | 201 | 229 | < 5 | < 0.2 | 0.55 | 6 | 240 | < 0.5 | 2 | 0.14 | < 0.5 | < 1 | 11 | 8 | 0.98 | < 10 | < 1 | 0.06 | 10 | 0.11 | 55 |
| 93JKC-D35 | 201 | 229 | < 5 | 0.2 | 0.76 | 2 | 540 | < 0.5 | < 2 | 0.21 | < 0.5 | 1 | 14 | 12 | 1.04 | < 10 | < 1 | 0.07 | 20 | 0.16 | 55 |
| 93JKC-D36 | 201 | 229 | < 5 | < 0.2 | 1.20 | < 2 | 300 | < 0.5 | 2 | 0.22 | < 0.5 | 3 | 23 | 15 | 1.84 | < 10 | < 1 | 0.04 | 10 | 0.38 | 155 |
| 93JKC-D37 | 201 | 229 | < 5 | 0.2 | 1.24 | 2 | 430 | < 0.5 | < 2 | 0.22 | < 0.5 | 5 | 22 | 13 | 2.22 | < 10 | < 1 | 0.06 | 10 | 0.32 | 155 |
| 93JKC-D38 | 201 | 229 | < 5 | < 0.2 | 1.73 | 6 | 350 | < 0.5 | < 2 | 0.25 | < 0.5 | 7 | 25 | 22 | 2.52 | < 10 | < 1 | 0.05 | 10 | 0.42 | 240 |
| 93JKC-D39 | 201 | 229 | < 5 | 0.2 | 1.88 | 2 | 230 | < 0.5 | < 2 | 0.30 | < 0.5 | 6 | 28 | 20 | 2.32 | < 10 | < 1 | 0.06 | 10 | 0.51 | 170 |
| 93JKC-D40 | 201 | 229 | < 5 | < 0.2 | 1.07 | < 2 | 280 | < 0.5 | < 2 | 0.31 | < 0.5 | 3 | 23 | 11 | 1.56 | < 10 | < 1 | 0.06 | 10 | 0.41 | 120 |
| 93JKC-D41 | 201 | 229 | < 5 | < 0.2 | 1.92 | 12 | 240 | < 0.5 | 2 | 0.08 | < 0.5 | 8 | 25 | 17 | 2.60 | < 10 | < 1 | 0.09 | 10 | 0.39 | 190 |
| 93JKC-D42 | 201 | 229 | < 5 | < 0.2 | 1.42 | 8 | 290 | < 0.5 | 4 | 0.10 | < 0.5 | 3 | 18 | 8 | 1.97 | < 10 | < 1 | 0.07 | 20 | 0.25 | 130 |
| 93JKC-D43 | 201 | 229 | < 5 | < 0.2 | 1.63 | 6 | 310 | < 0.5 | < 2 | 0.09 | < 0.5 | 1 | 16 | 10 | 1.77 | < 10 | < 1 | 0.06 | 10 | 0.30 | 95 |

CERTIFICATION:

Hart Buehler



Chemex Labs Ltd.

Analytical Chemists * Geochemists * Registered Assayers
212 Brooksbank Ave., North Vancouver
British Columbia, Canada V7J 2C1
PHONE: 604-984-0221

To: PEARL PETROLEUM CORP.

1100 - 675 W. HASTINGS ST.
VANCOUVER, BC
V6B 1N6

Project: KING CLAIMS-DAWSON
Comments:

Page Number :1-B
Total Pages :5
Certificate Date: 08-SEP-90
Invoice No. : I9320293
P.O. Number :
Account : KYW

CERTIFICATE OF ANALYSIS

A9320293

| SAMPLE | PREP CODE | Mo ppm | Na % | Ni ppm | P ppm | Pb ppm | Sb ppm | Sc ppm | Sr ppm | Ti % | Tl ppm | U ppm | V ppm | W ppm | Zn ppm |
|-----------|-----------|------------|------|--------|-------|--------|--------|--------|--------|--------|--------|-------|-------|-------|--------|
| 93JJC-D01 | 201 229 | 1 < 0.01 | | 7 | 260 | 16 < 2 | | 1 | 4 | 0.01 | < 10 | < 10 | 23 | < 10 | 34 |
| 93JJC-D02 | 201 229 | < 1 < 0.01 | | 7 | 300 | 14 < 2 | | 2 | 9 | 0.02 | < 10 | < 10 | 19 | < 10 | 32 |
| 93JJC-D03 | 201 229 | < 1 < 0.01 | | 6 | 310 | 50 < 2 | | 2 | 5 | 0.02 | < 10 | < 10 | 13 | < 10 | 46 |
| 93JJC-D04 | 201 229 | < 1 < 0.01 | | 7 | 290 | 30 < 2 | | 1 | 9 | 0.02 | < 10 | < 10 | 25 | < 10 | 40 |
| 93JJC-D05 | 201 229 | < 1 < 0.01 | | 8 | 320 | 54 < 2 | | 1 | 7 | 0.04 | < 10 | < 10 | 40 | < 10 | 38 |
| 93JJC-D06 | 201 229 | < 1 < 0.01 | | 4 | 460 | 38 < 2 | | 1 | 6 | 0.03 | < 10 | < 10 | 9 | < 10 | 56 |
| 93JJC-D07 | 201 229 | 1 < 0.01 | | 5 | 160 | 30 < 2 | | 1 | 4 | 0.02 | < 10 | < 10 | 26 | < 10 | 40 |
| 93JJC-D08 | 201 229 | 1 < 0.01 | | 10 | 390 | 16 < 2 | | 2 | 6 | 0.04 | < 10 | < 10 | 45 | < 10 | 40 |
| 93JJC-D09 | 201 229 | < 1 < 0.01 | | 1 | 180 | 6 < 2 | | 1 | 6 | < 0.01 | < 10 | < 10 | 15 | < 10 | 14 |
| 93JJC-D10 | 201 229 | 1 < 0.01 | | 13 | 240 | 20 < 2 | | 3 | 8 | 0.04 | < 10 | < 10 | 32 | < 10 | 48 |
| 93JJC-D11 | 201 229 | < 1 < 0.01 | | 12 | 440 | 18 < 2 | | 2 | 13 | 0.04 | < 10 | < 10 | 31 | < 10 | 50 |
| 93JJC-D12 | 201 229 | < 1 < 0.01 | | 3 | 160 | 14 < 2 | | 1 | 6 | 0.02 | < 10 | < 10 | 16 | < 10 | 32 |
| 93JJC-D13 | 201 229 | < 1 < 0.01 | | 16 | 530 | 22 < 2 | | 3 | 16 | 0.04 | < 10 | < 10 | 38 | < 10 | 74 |
| 93JJC-D14 | 201 229 | < 1 < 0.01 | | 17 | 560 | 14 < 2 | | 3 | 22 | 0.06 | < 10 | < 10 | 41 | < 10 | 72 |
| 93JJC-D15 | 201 229 | 1 < 0.01 | | 15 | 500 | 16 < 2 | | 3 | 17 | 0.06 | < 10 | < 10 | 46 | < 10 | 62 |
| 93JJC-D16 | 201 229 | < 1 < 0.01 | | 13 | 480 | 30 < 2 | | 2 | 15 | 0.05 | < 10 | < 10 | 34 | < 10 | 64 |
| 93JJC-D17 | 201 229 | < 1 < 0.01 | | 13 | 550 | 18 < 2 | | 2 | 14 | 0.04 | < 10 | < 10 | 39 | < 10 | 58 |
| 93JJC-D18 | 201 229 | < 1 < 0.01 | | 10 | 460 | 14 < 2 | | 1 | 13 | 0.03 | < 10 | < 10 | 26 | < 10 | 44 |
| 93JJC-D19 | 201 229 | 1 < 0.01 | | 13 | 560 | 16 < 2 | | 2 | 16 | 0.03 | < 10 | < 10 | 33 | < 10 | 62 |
| 93JJC-D20 | 201 229 | < 1 < 0.01 | | 8 | 360 | 16 < 2 | | 1 | 13 | 0.03 | < 10 | < 10 | 20 | < 10 | 40 |
| 93JJC-D21 | 201 229 | 1 < 0.01 | | 10 | 570 | 16 < 2 | | 2 | 15 | 0.04 | < 10 | < 10 | 30 | < 10 | 46 |
| 93JJC-D22 | 201 229 | < 1 < 0.01 | | 15 | 600 | 18 < 2 | | 3 | 17 | 0.04 | < 10 | < 10 | 45 | < 10 | 72 |
| 93JJC-D26 | 201 229 | 1 < 0.01 | | 8 | 290 | 16 < 2 | | 2 | 31 | 0.04 | < 10 | < 10 | 26 | < 10 | 34 |
| 93JJC-D27 | 201 229 | 1 < 0.01 | | 9 | 390 | 12 < 2 | | 2 | 15 | 0.03 | < 10 | < 10 | 19 | < 10 | 34 |
| 93JJC-D28 | 201 229 | < 1 < 0.01 | | 8 | 350 | 14 < 2 | | 2 | 17 | 0.03 | < 10 | < 10 | 21 | < 10 | 34 |
| 93JJC-D29 | 201 229 | < 1 < 0.01 | | 7 | 450 | 36 < 2 | | 2 | 19 | 0.03 | < 10 | < 10 | 21 | < 10 | 38 |
| 93JJC-D30 | 201 229 | < 1 < 0.01 | | 6 | 310 | 14 < 2 | | 1 | 13 | 0.03 | < 10 | < 10 | 18 | < 10 | 38 |
| 93JJC-D31 | 201 229 | 1 < 0.01 | | 4 | 410 | 26 < 2 | | 2 | 20 | 0.02 | < 10 | < 10 | 14 | < 10 | 30 |
| 93JJC-D32 | 201 229 | 2 < 0.01 | | 9 | 380 | 26 < 2 | | 4 | 33 | 0.02 | < 10 | < 10 | 22 | < 10 | 60 |
| 93JJC-D33 | 201 229 | < 1 < 0.01 | | 6 | 160 | 38 < 2 | | 1 | 10 | 0.02 | < 10 | < 10 | 18 | < 10 | 44 |
| 93JJC-D34 | 201 229 | 1 < 0.01 | | 6 | 200 | 10 < 2 | | 1 | 13 | 0.02 | < 10 | < 10 | 18 | < 10 | 32 |
| 93JJC-D35 | 201 229 | < 1 < 0.01 | | 8 | 360 | 20 < 2 | | 1 | 22 | 0.02 | < 10 | < 10 | 14 | < 10 | 38 |
| 93JJC-D36 | 201 229 | 1 < 0.01 | | 13 | 450 | 18 < 2 | | 2 | 16 | 0.04 | < 10 | < 10 | 33 | < 10 | 62 |
| 93JJC-D37 | 201 229 | 1 < 0.01 | | 12 | 630 | 10 < 2 | | 2 | 20 | 0.04 | < 10 | < 10 | 40 | < 10 | 58 |
| 93JJC-D38 | 201 229 | 1 < 0.01 | | 16 | 540 | 18 < 2 | | 3 | 19 | 0.04 | < 10 | < 10 | 44 | < 10 | 62 |
| 93JJC-D39 | 201 229 | < 1 < 0.01 | | 18 | 630 | 14 < 2 | | 3 | 21 | 0.06 | < 10 | < 10 | 41 | < 10 | 78 |
| 93JJC-D40 | 201 229 | < 1 < 0.01 | | 14 | 590 | 14 < 2 | | 2 | 21 | 0.06 | < 10 | < 10 | 30 | < 10 | 60 |
| 93JJC-D41 | 201 229 | < 1 < 0.01 | | 14 | 240 | 32 < 2 | | 4 | 7 | 0.04 | < 10 | < 10 | 34 | < 10 | 54 |
| 93JJC-D42 | 201 229 | < 1 < 0.01 | | 9 | 260 | 22 < 2 | | 2 | 12 | 0.04 | < 10 | < 10 | 37 | < 10 | 34 |
| 93JJC-D43 | 201 229 | 1 < 0.01 | | 8 | 140 | 12 < 2 | | 2 | 8 | 0.03 | < 10 | < 10 | 29 | < 10 | 38 |

CERTIFICATION:

Hart/Sichler



Chemex Labs Ltd.

Analytical Chemists * Geochemists * Registered Assayers
212 Brooksbank Ave., North Vancouver
British Columbia, Canada V7J 2C1
PHONE: 604-984-0221

To: PEARL PETROLEUM CORP.

1100 - 675 W. HASTINGS ST.
VANCOUVER, BC
V6B 1N6

Project : KING CLAIMS-DAWSON
Comments:

Page Number : 2-A
Total Pages : 5
Certificate Date: 08-SEP-91
Invoice No. : 19320293
P.O. Number :
Account : KYW

CERTIFICATE OF ANALYSIS

A9320293

| SAMPLE | PREP CODE | | Au ppb | Ag ppm | Al % | As ppm | Ba ppm | Be ppm | Bi ppm | Ca % | Cd ppm | Co ppm | Cr ppm | Cu ppm | Fe % | Ga ppm | Hg ppm | K % | La ppm | Mg % | Mn ppm |
|------------|-----------|-----|--------|--------|------|--------|--------|--------|--------|------|--------|--------|--------|--------|------|--------|--------|------|--------|------|--------|
| | | | FA+AA | | | | | | | | | | | | | | | | | | |
| 93JJC-D44 | 201 | 229 | < 5 | < 0.2 | 2.31 | < 2 | 150 | < 0.5 | 4 | 0.45 | < 0.5 | 11 | 119 | 29 | 2.58 | < 10 | < 1 | 0.02 | < 10 | 1.43 | 240 |
| 93JJC-D45 | 201 | 229 | < 5 | < 0.2 | 3.09 | < 2 | 350 | < 0.5 | < 2 | 0.58 | < 0.5 | 20 | 189 | 44 | 4.42 | < 10 | < 1 | 0.05 | 10 | 2.73 | 835 |
| 93JJC-D46 | 201 | 229 | < 5 | 0.2 | 1.72 | 2 | 820 | < 0.5 | < 2 | 1.17 | 0.5 | 18 | 197 | 43 | 2.95 | < 10 | < 1 | 0.06 | < 10 | 1.68 | 1595 |
| 93JJC-D47 | 201 | 229 | < 5 | < 0.2 | 2.33 | < 2 | 580 | < 0.5 | 2 | 0.67 | < 0.5 | 16 | 56 | 59 | 3.86 | < 10 | < 1 | 0.29 | < 10 | 1.71 | 585 |
| 93JJC-D48 | 201 | 229 | < 5 | < 0.2 | 1.48 | < 2 | 210 | < 0.5 | < 2 | 0.39 | < 0.5 | 8 | 45 | 28 | 2.46 | < 10 | < 1 | 0.03 | 10 | 0.91 | 205 |
| 93JJC-D49 | 201 | 229 | < 5 | < 0.2 | 1.98 | < 2 | 180 | < 0.5 | < 2 | 0.45 | < 0.5 | 18 | 99 | 51 | 2.97 | < 10 | < 1 | 0.01 | < 10 | 1.84 | 515 |
| 93JJC-D50 | 201 | 229 | < 5 | < 0.2 | 1.45 | < 2 | 300 | < 0.5 | 4 | 0.34 | 0.5 | 7 | 33 | 30 | 2.90 | < 10 | < 1 | 0.04 | 10 | 0.77 | 200 |
| 93JJC-D51 | 201 | 229 | < 5 | 0.2 | 1.17 | 10 | 230 | < 0.5 | < 2 | 0.37 | < 0.5 | 7 | 27 | 19 | 2.71 | < 10 | < 1 | 0.06 | 10 | 0.54 | 225 |
| 93JJC-D52 | 201 | 229 | < 5 | < 0.2 | 1.16 | < 2 | 310 | < 0.5 | < 2 | 0.49 | 0.5 | 7 | 26 | 15 | 2.36 | < 10 | < 1 | 0.06 | 10 | 0.54 | 250 |
| 93JJC-D53 | 201 | 229 | < 5 | < 0.2 | 1.14 | < 2 | 270 | < 0.5 | < 2 | 0.31 | < 0.5 | 9 | 21 | 11 | 1.79 | < 10 | < 1 | 0.03 | 10 | 0.45 | 360 |
| 93JJC-D54 | 201 | 229 | < 5 | < 0.2 | 1.37 | < 2 | 200 | < 0.5 | 2 | 0.34 | 0.5 | 6 | 29 | 14 | 2.61 | < 10 | < 1 | 0.06 | 10 | 0.60 | 220 |
| 93JJC-D55 | 201 | 229 | < 5 | 0.4 | 1.58 | 12 | 330 | < 0.5 | < 2 | 0.31 | < 0.5 | 6 | 24 | 17 | 2.31 | < 10 | < 1 | 0.05 | 10 | 0.61 | 255 |
| 93JJC-D56 | 201 | 229 | 10 | 2.6 | 2.37 | 4 | 1040 | < 0.5 | < 2 | 0.87 | 0.5 | 15 | 30 | 49 | 3.36 | 10 | < 1 | 0.09 | 70 | 0.56 | 880 |
| 93JJC-D57 | 201 | 229 | < 5 | < 0.2 | 1.89 | < 2 | 290 | < 0.5 | < 2 | 0.26 | 0.5 | 6 | 23 | 20 | 2.26 | < 10 | < 1 | 0.06 | 10 | 0.56 | 250 |
| 93JJC-D58 | 201 | 229 | < 5 | < 0.2 | 1.72 | 12 | 350 | < 0.5 | < 2 | 0.33 | < 0.5 | 9 | 30 | 35 | 2.88 | < 10 | < 1 | 0.08 | 20 | 0.80 | 380 |
| 93JJC-D59 | 201 | 229 | < 5 | < 0.2 | 1.56 | 6 | 260 | < 0.5 | < 2 | 0.28 | < 0.5 | 6 | 24 | 21 | 2.33 | < 10 | < 1 | 0.06 | 10 | 0.55 | 255 |
| 93JJC-D60 | 201 | 229 | < 5 | < 0.2 | 1.47 | 8 | 260 | < 0.5 | < 2 | 0.23 | < 0.5 | 7 | 29 | 20 | 2.50 | < 10 | < 1 | 0.07 | 10 | 0.62 | 245 |
| 93JJC-D61 | 201 | 229 | < 5 | < 0.2 | 1.35 | 6 | 200 | < 0.5 | 4 | 0.19 | < 0.5 | 6 | 24 | 19 | 2.30 | < 10 | < 1 | 0.07 | 10 | 0.47 | 220 |
| 93JJC-D62 | 201 | 229 | < 5 | < 0.2 | 1.47 | < 2 | 340 | < 0.5 | 2 | 0.30 | < 0.5 | 6 | 26 | 22 | 2.45 | < 10 | < 1 | 0.08 | 10 | 0.55 | 230 |
| 93JJC-D63 | 201 | 229 | < 5 | < 0.2 | 1.53 | 2 | 290 | < 0.5 | < 2 | 0.21 | < 0.5 | 9 | 24 | 23 | 2.86 | < 10 | < 1 | 0.10 | 10 | 0.57 | 280 |
| 93JJC-D64 | 201 | 229 | < 5 | 0.2 | 1.49 | < 2 | 380 | < 0.5 | 2 | 0.22 | < 0.5 | 5 | 23 | 21 | 2.34 | < 10 | < 1 | 0.11 | 10 | 0.52 | 190 |
| 93JJC-D65 | 201 | 229 | < 5 | 0.2 | 1.05 | 38 | 290 | < 0.5 | < 2 | 0.26 | < 0.5 | 6 | 22 | 25 | 2.72 | < 10 | < 1 | 0.11 | 20 | 0.58 | 280 |
| 93JJC-D66 | 201 | 229 | < 5 | < 0.2 | 1.36 | 8 | 270 | < 0.5 | < 2 | 0.34 | < 0.5 | 7 | 22 | 22 | 2.46 | < 10 | < 1 | 0.22 | 20 | 0.81 | 320 |
| 93JJC-D67 | 201 | 229 | < 5 | 0.2 | 1.39 | < 2 | 400 | < 0.5 | < 2 | 0.28 | < 0.5 | 7 | 24 | 19 | 2.25 | < 10 | < 1 | 0.11 | 10 | 0.62 | 285 |
| 93JJC-D68 | 201 | 229 | < 5 | < 0.2 | 1.55 | 2 | 450 | < 0.5 | < 2 | 0.38 | 0.5 | 10 | 34 | 34 | 2.81 | < 10 | < 1 | 0.06 | 10 | 0.65 | 360 |
| 93JJC-D69 | 201 | 229 | < 5 | < 0.2 | 1.46 | 8 | 300 | < 0.5 | 4 | 0.37 | < 0.5 | 6 | 28 | 19 | 2.48 | < 10 | < 1 | 0.07 | 10 | 0.62 | 235 |
| 93JJC-D70 | 201 | 229 | 25 | < 0.2 | 1.18 | < 2 | 180 | < 0.5 | < 2 | 0.29 | 0.5 | 6 | 23 | 14 | 2.28 | < 10 | < 1 | 0.17 | 10 | 0.64 | 240 |
| 93JJC-D71 | 201 | 229 | < 5 | < 0.2 | 0.83 | 6 | 200 | < 0.5 | 2 | 0.27 | < 0.5 | 3 | 8 | 8 | 1.32 | < 10 | < 1 | 0.23 | 10 | 0.58 | 460 |
| 93JJC-D72 | 201 | 229 | < 5 | < 0.2 | 0.95 | 2 | 190 | < 0.5 | < 2 | 0.21 | < 0.5 | 4 | 11 | 11 | 1.77 | < 10 | < 1 | 0.17 | < 10 | 0.53 | 255 |
| 93JJC-D73 | 201 | 229 | < 5 | < 0.2 | 1.74 | < 2 | 290 | < 0.5 | < 2 | 0.40 | < 0.5 | 10 | 19 | 27 | 2.95 | < 10 | < 1 | 0.14 | < 10 | 1.06 | 350 |
| 93JJC-D74 | 201 | 229 | < 5 | < 0.2 | 0.90 | 8 | 160 | < 0.5 | 2 | 0.35 | < 0.5 | 6 | 24 | 21 | 2.09 | < 10 | < 1 | 0.07 | 10 | 0.47 | 230 |
| 93JJC-D75 | 201 | 229 | < 5 | < 0.2 | 1.45 | 8 | 280 | < 0.5 | < 2 | 0.29 | < 0.5 | 9 | 32 | 24 | 2.51 | < 10 | < 1 | 0.07 | 10 | 0.73 | 300 |
| 93JJC-D76 | 201 | 229 | < 5 | < 0.2 | 1.90 | 12 | 220 | < 0.5 | < 2 | 0.27 | < 0.5 | 13 | 85 | 38 | 3.14 | < 10 | < 1 | 0.31 | < 10 | 1.48 | 390 |
| 93JJC-D77 | 201 | 229 | < 5 | < 0.2 | 1.68 | < 2 | 180 | < 0.5 | 2 | 0.20 | < 0.5 | 8 | 24 | 25 | 2.95 | < 10 | < 1 | 0.31 | < 10 | 0.92 | 330 |
| 93JJC-D78 | 201 | 229 | < 5 | < 0.2 | 1.23 | < 2 | 210 | < 0.5 | < 2 | 0.21 | < 0.5 | 5 | 21 | 14 | 2.11 | < 10 | < 1 | 0.08 | 10 | 0.56 | 220 |
| 93JJC-D79 | 201 | 229 | < 5 | 0.2 | 1.71 | < 2 | 250 | < 0.5 | < 2 | 0.24 | < 0.5 | 8 | 26 | 32 | 2.81 | < 10 | < 1 | 0.14 | < 10 | 0.88 | 295 |
| 93JJC-D80 | 201 | 229 | < 5 | < 0.2 | 1.49 | < 2 | 180 | < 0.5 | 2 | 0.15 | < 0.5 | 7 | 27 | 25 | 2.40 | < 10 | < 1 | 0.08 | 10 | 0.66 | 200 |
| 93JJC-S26 | 201 | 229 | < 5 | 0.2 | 0.24 | < 2 | 350 | < 0.5 | < 2 | 0.10 | < 0.5 | < 1 | 4 | 4 | 0.51 | < 10 | < 1 | 0.04 | 10 | 0.09 | 35 |
| 93LKC-D001 | 201 | 229 | < 5 | < 0.2 | 1.15 | 2 | 290 | < 0.5 | < 2 | 0.19 | < 0.5 | 4 | 25 | 14 | 2.02 | < 10 | < 1 | 0.07 | 10 | 0.41 | 175 |
| 93LKC-D002 | 201 | 229 | < 5 | < 0.2 | 1.22 | < 2 | 360 | < 0.5 | < 2 | 0.14 | < 0.5 | 7 | 24 | 16 | 2.09 | < 10 | < 1 | 0.07 | 10 | 0.39 | 425 |

CERTIFICATION: Hart Buehler

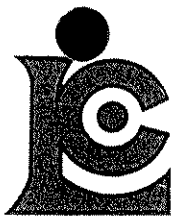

Chemex Labs Ltd.

Analytical Chemists * Geochemists * Registered Assayers
212 Brooksbank Ave., North Vancouver
British Columbia, Canada V7J 2C1
PHONE: 604-984-0221

To: PEARL PETROLEUM CORP.

1100 - 675 W. HASTINGS ST.
VANCOUVER, BC
V6B 1N6

Project : KING CLAIMS-DAWSON
Comments:

Page Number :2-B
Total Pages :5
Certificate Date: 08-SEP-93
Invoice No. : I9320293
P.O. Number :
Account : KYW

CERTIFICATE OF ANALYSIS

A9320293

| SAMPLE | PREP CODE | | Mo | Na | Ni | P | Pb | Sb | Sc | Sr | Ti | Tl | U | V | W | Zn |
|------------|-----------|-----|-----|--------|-----|------|-----|-----|-----|-----|------|------|------|-----|------|-----|
| | | | ppm | % | ppm | ppm | ppm | ppm | ppm | ppm | % | ppm | ppm | ppm | ppm | ppm |
| 93JKC-D44 | 201 | 229 | < 1 | < 0.01 | 60 | 270 | 6 | < 2 | 3 | 18 | 0.21 | < 10 | < 10 | 60 | < 10 | 50 |
| 93JKC-D45 | 201 | 229 | 1 | < 0.01 | 108 | 680 | 6 | < 2 | 9 | 23 | 0.12 | < 10 | < 10 | 101 | 10 | 88 |
| 93JKC-D46 | 201 | 229 | < 1 | 0.01 | 96 | 730 | 8 | < 2 | 6 | 43 | 0.06 | < 10 | 10 | 63 | 10 | 66 |
| 93JKC-D47 | 201 | 229 | < 1 | < 0.01 | 30 | 710 | 2 | < 2 | 6 | 25 | 0.14 | < 10 | < 10 | 110 | 10 | 80 |
| 93JKC-D48 | 201 | 229 | < 1 | < 0.01 | 24 | 560 | 16 | < 2 | 4 | 18 | 0.06 | < 10 | < 10 | 45 | < 10 | 70 |
| 93JKC-D49 | 201 | 229 | < 1 | < 0.01 | 48 | 820 | 14 | < 2 | 4 | 13 | 0.09 | < 10 | < 10 | 56 | < 10 | 60 |
| 93JKC-D50 | 201 | 229 | < 1 | 0.01 | 20 | 730 | 12 | < 2 | 4 | 20 | 0.05 | < 10 | < 10 | 46 | < 10 | 88 |
| 93JKC-D51 | 201 | 229 | 1 | 0.01 | 18 | 840 | 58 | < 2 | 3 | 22 | 0.04 | < 10 | < 10 | 43 | < 10 | 100 |
| 93JKC-D52 | 201 | 229 | < 1 | 0.01 | 19 | 820 | 12 | 2 | 3 | 28 | 0.06 | < 10 | < 10 | 46 | < 10 | 82 |
| 93JKC-D53 | 201 | 229 | 1 | 0.01 | 13 | 510 | 18 | < 2 | 3 | 18 | 0.03 | < 10 | < 10 | 32 | < 10 | 62 |
| 93JKC-D54 | 201 | 229 | 1 | 0.01 | 16 | 740 | 14 | < 2 | 3 | 22 | 0.05 | < 10 | < 10 | 47 | < 10 | 74 |
| 93JKC-D55 | 201 | 229 | < 1 | < 0.01 | 14 | 630 | 14 | 2 | 3 | 20 | 0.04 | < 10 | < 10 | 40 | < 10 | 74 |
| 93JKC-D56 | 201 | 229 | 1 | 0.01 | 23 | 1080 | 76 | < 2 | 8 | 48 | 0.02 | < 10 | < 10 | 40 | 10 | 122 |
| 93JKC-D57 | 201 | 229 | 1 | < 0.01 | 14 | 470 | 10 | < 2 | 4 | 18 | 0.06 | < 10 | < 10 | 40 | < 10 | 60 |
| 93JKC-D58 | 201 | 229 | 1 | < 0.01 | 21 | 610 | 18 | < 2 | 6 | 17 | 0.04 | < 10 | < 10 | 44 | < 10 | 82 |
| 93JKC-D59 | 201 | 229 | < 1 | < 0.01 | 16 | 430 | 8 | < 2 | 4 | 19 | 0.06 | < 10 | < 10 | 40 | < 10 | 62 |
| 93JKC-D60 | 201 | 229 | < 1 | < 0.01 | 16 | 500 | 8 | 2 | 4 | 14 | 0.05 | < 10 | < 10 | 42 | < 10 | 68 |
| 93JKC-D61 | 201 | 229 | < 1 | < 0.01 | 14 | 480 | 12 | 2 | 3 | 13 | 0.05 | < 10 | < 10 | 38 | < 10 | 60 |
| 93JKC-D62 | 201 | 229 | < 1 | < 0.01 | 14 | 420 | 8 | < 2 | 4 | 17 | 0.06 | < 10 | < 10 | 41 | 10 | 68 |
| 93JKC-D63 | 201 | 229 | 1 | < 0.01 | 14 | 430 | 8 | < 2 | 4 | 15 | 0.06 | < 10 | < 10 | 47 | 10 | 64 |
| 93JKC-D64 | 201 | 229 | 1 | < 0.01 | 13 | 470 | 6 | < 2 | 4 | 16 | 0.04 | < 10 | < 10 | 38 | < 10 | 62 |
| 93JKC-D65 | 201 | 229 | < 1 | < 0.01 | 16 | 720 | 16 | 2 | 4 | 14 | 0.03 | < 10 | < 10 | 33 | < 10 | 88 |
| 93JKC-D66 | 201 | 229 | < 1 | < 0.01 | 14 | 590 | 10 | < 2 | 5 | 17 | 0.05 | < 10 | < 10 | 40 | < 10 | 92 |
| 93JKC-D67 | 201 | 229 | 1 | 0.01 | 14 | 490 | 6 | < 2 | 3 | 19 | 0.04 | < 10 | < 10 | 40 | < 10 | 66 |
| 93JKC-D68 | 201 | 229 | 1 | 0.01 | 22 | 780 | 4 | < 2 | 6 | 26 | 0.07 | < 10 | < 10 | 51 | 10 | 94 |
| 93JKC-D69 | 201 | 229 | < 1 | 0.01 | 16 | 610 | 12 | < 2 | 4 | 23 | 0.08 | < 10 | < 10 | 49 | < 10 | 68 |
| 93JKC-D70 | 201 | 229 | < 1 | < 0.01 | 11 | 710 | 8 | 2 | 3 | 19 | 0.07 | < 10 | < 10 | 38 | < 10 | 72 |
| 93JKC-D71 | 201 | 229 | < 1 | < 0.01 | 4 | 530 | 14 | < 2 | 2 | 14 | 0.03 | < 10 | < 10 | 13 | < 10 | 58 |
| 93JKC-D72 | 201 | 229 | < 1 | < 0.01 | 6 | 340 | 10 | 2 | 2 | 11 | 0.04 | < 10 | < 10 | 30 | < 10 | 52 |
| 93JKC-D73 | 201 | 229 | < 1 | 0.01 | 9 | 400 | 4 | < 2 | 3 | 15 | 0.09 | < 10 | < 10 | 61 | 10 | 68 |
| 93JKC-D74 | 201 | 229 | < 1 | 0.01 | 18 | 800 | 2 | < 2 | 2 | 22 | 0.06 | < 10 | < 10 | 39 | < 10 | 60 |
| 93JKC-D75 | 201 | 229 | < 1 | < 0.01 | 17 | 580 | 2 | < 2 | 3 | 18 | 0.08 | < 10 | < 10 | 52 | 10 | 70 |
| 93JKC-D76 | 201 | 229 | < 1 | < 0.01 | 36 | 530 | 2 | 4 | 3 | 9 | 0.15 | < 10 | < 10 | 67 | 10 | 62 |
| 93JKC-D77 | 201 | 229 | < 1 | < 0.01 | 10 | 540 | 2 | < 2 | 3 | 8 | 0.12 | < 10 | < 10 | 57 | < 10 | 62 |
| 93JKC-D78 | 201 | 229 | < 1 | < 0.01 | 11 | 480 | 4 | < 2 | 2 | 13 | 0.05 | < 10 | < 10 | 41 | < 10 | 60 |
| 93JKC-D79 | 201 | 229 | < 1 | < 0.01 | 13 | 400 | 6 | < 2 | 3 | 12 | 0.10 | < 10 | < 10 | 58 | 10 | 64 |
| 93JKC-D80 | 201 | 229 | < 1 | < 0.01 | 12 | 310 | 8 | < 2 | 2 | 10 | 0.07 | < 10 | < 10 | 48 | < 10 | 54 |
| 93JKC-S26 | 201 | 229 | < 1 | < 0.01 | 3 | 150 | 4 | < 2 | < 1 | 10 | 0.01 | < 10 | < 10 | 6 | < 10 | 16 |
| 93LKC-D001 | 201 | 229 | 1 | < 0.01 | 12 | 500 | 4 | 2 | 3 | 15 | 0.05 | < 10 | < 10 | 35 | < 10 | 42 |
| 93LKC-D002 | 201 | 229 | < 1 | < 0.01 | 11 | 310 | 8 | < 2 | 2 | 12 | 0.04 | < 10 | < 10 | 33 | < 10 | 52 |

CERTIFICATION:

Haut Buchler



Chemex Labs Ltd.

Analytical Chemists * Geochemists * Registered Assayers
212 Brooksbank Ave., North Vancouver
British Columbia, Canada V7J 2C1
PHONE: 604-984-0221

To: PEARL PETROLEUM CORP.

1100 - 675 W. HASTINGS ST.
VANCOUVER, BC
V6B 1N6

Project : KING CLAIMS-DAWSON
Comments:

Page Number :3-A
Total Pages :5
Certificate Date: 08-SEP-93
Invoice No. :19320293
P.O. Number :
Account : KYW

CERTIFICATE OF ANALYSIS

A9320293

| SAMPLE | PREP CODE | | Au ppb | Ag ppm | Al % | As ppm | Ba ppm | Be ppm | Bi ppm | Ca % | Cd ppm | Co ppm | Cr ppm | Cu ppm | Fe % | Ga ppm | Hg ppm | K % | La ppm | Mg % | Mn ppm |
|------------|-----------|-----|--------|--------|------|--------|--------|--------|--------|------|--------|--------|--------|--------|------|--------|--------|------|--------|------|--------|
| | | | FA+AA | | | | | | | | | | | | | | | | | | |
| 93LKC-D003 | 201 | 229 | < 5 | < 0.2 | 1.27 | 6 | 340 | < 0.5 | < 2 | 0.11 | < 0.5 | 4 | 23 | 20 | 2.13 | < 10 | < 1 | 0.07 | 10 | 0.31 | 345 |
| 93LKC-D004 | 201 | 229 | < 5 | 0.2 | 1.37 | 8 | 360 | < 0.5 | < 2 | 0.13 | < 0.5 | 10 | 21 | 13 | 1.99 | < 10 | < 1 | 0.07 | 10 | 0.27 | 1050 |
| 93LKC-D005 | 201 | 229 | < 5 | 0.2 | 1.36 | 16 | 420 | < 0.5 | < 2 | 0.10 | < 0.5 | 4 | 20 | 23 | 2.08 | < 10 | < 1 | 0.09 | 20 | 0.34 | 195 |
| 93LKC-D006 | 201 | 229 | < 5 | < 0.2 | 1.30 | 2 | 360 | < 0.5 | 2 | 0.18 | < 0.5 | 6 | 24 | 22 | 2.24 | < 10 | < 1 | 0.06 | 10 | 0.41 | 215 |
| 93LKC-D007 | 201 | 229 | < 5 | < 0.2 | 0.83 | 2 | 270 | < 0.5 | < 2 | 0.11 | < 0.5 | 2 | 15 | 9 | 1.53 | < 10 | < 1 | 0.09 | < 10 | 0.24 | 145 |
| 93LKC-D008 | 201 | 229 | < 5 | < 0.2 | 1.60 | 4 | 270 | < 0.5 | < 2 | 0.07 | < 0.5 | 6 | 25 | 16 | 2.43 | < 10 | < 1 | 0.05 | 10 | 0.37 | 190 |
| 93LKC-D009 | 201 | 229 | < 5 | < 0.2 | 1.58 | 12 | 230 | < 0.5 | < 2 | 0.06 | < 0.5 | 7 | 25 | 10 | 2.72 | < 10 | < 1 | 0.07 | < 10 | 0.30 | 255 |
| 93LKC-D010 | 201 | 229 | < 5 | < 0.2 | 0.37 | < 2 | 160 | < 0.5 | < 2 | 0.03 | < 0.5 | 1 | 6 | 5 | 0.62 | < 10 | < 1 | 0.09 | 10 | 0.06 | 60 |
| 93LKC-D011 | 201 | 229 | < 5 | < 0.2 | 1.43 | 8 | 330 | < 0.5 | 4 | 0.08 | < 0.5 | 5 | 19 | 12 | 2.57 | < 10 | < 1 | 0.07 | 10 | 0.29 | 255 |
| 93LKC-D012 | 201 | 229 | < 5 | < 0.2 | 1.95 | 2 | 500 | < 0.5 | 4 | 0.08 | < 0.5 | 6 | 28 | 21 | 2.48 | < 10 | < 1 | 0.06 | 10 | 0.43 | 215 |
| 93LKC-D013 | 201 | 229 | < 5 | 0.2 | 0.96 | < 2 | 370 | < 0.5 | < 2 | 0.08 | < 0.5 | 1 | 15 | 8 | 1.39 | < 10 | < 1 | 0.07 | 10 | 0.16 | 80 |
| 93LKC-D014 | 201 | 229 | < 5 | < 0.2 | 1.41 | 4 | 400 | < 0.5 | 2 | 0.09 | < 0.5 | 3 | 18 | 19 | 1.77 | < 10 | < 1 | 0.08 | 10 | 0.28 | 110 |
| 93LKC-D015 | 201 | 229 | < 5 | 0.2 | 1.23 | 6 | 530 | < 0.5 | 2 | 0.08 | < 0.5 | 5 | 20 | 17 | 1.85 | < 10 | < 1 | 0.07 | 10 | 0.40 | 195 |
| 93LKC-D016 | 201 | 229 | < 5 | < 0.2 | 1.00 | 2 | 420 | < 0.5 | < 2 | 0.13 | < 0.5 | 3 | 10 | 28 | 1.61 | < 10 | < 1 | 0.08 | 20 | 0.57 | 200 |
| 93LKC-D017 | 201 | 229 | < 5 | < 0.2 | 1.08 | < 2 | 320 | < 0.5 | < 2 | 0.10 | < 0.5 | 2 | 16 | 11 | 1.68 | < 10 | < 1 | 0.06 | 10 | 0.40 | 130 |
| 93LKC-D018 | 201 | 229 | < 5 | < 0.2 | 1.50 | 4 | 440 | < 0.5 | 4 | 0.07 | < 0.5 | 4 | 24 | 15 | 2.64 | < 10 | < 1 | 0.07 | 10 | 0.36 | 175 |
| 93LKC-D019 | 201 | 229 | < 5 | 0.2 | 0.73 | 4 | 230 | < 0.5 | < 2 | 0.03 | < 0.5 | 2 | 7 | 12 | 1.35 | < 10 | < 1 | 0.11 | 10 | 0.14 | 65 |
| 93LKC-D020 | 201 | 229 | < 5 | < 0.2 | 0.91 | < 2 | 280 | < 0.5 | 2 | 0.08 | < 0.5 | 2 | 13 | 6 | 1.27 | < 10 | < 1 | 0.09 | 10 | 0.20 | 70 |
| 93LKC-D021 | 201 | 229 | < 5 | < 0.2 | 1.33 | 10 | 290 | < 0.5 | < 2 | 0.09 | < 0.5 | 4 | 21 | 14 | 2.33 | < 10 | < 1 | 0.10 | 10 | 0.35 | 165 |
| 93LKC-D022 | 201 | 229 | < 5 | < 0.2 | 1.59 | < 2 | 750 | < 0.5 | < 2 | 0.55 | 0.5 | 14 | 92 | 41 | 2.73 | < 10 | < 1 | 0.04 | 10 | 1.21 | 665 |
| 93LKC-D023 | 201 | 229 | < 5 | < 0.2 | 2.54 | < 2 | 380 | < 0.5 | < 2 | 0.79 | 0.5 | 19 | 280 | 61 | 3.62 | < 10 | < 1 | 0.03 | < 10 | 3.25 | 510 |
| 93LKC-D024 | 201 | 229 | < 5 | < 0.2 | 1.44 | < 2 | 650 | < 0.5 | < 2 | 0.72 | < 0.5 | 11 | 13 | 65 | 2.96 | < 10 | < 1 | 0.25 | < 10 | 0.81 | 495 |
| 93LKC-D025 | 201 | 229 | < 5 | < 0.2 | 2.45 | 4 | 560 | < 0.5 | < 2 | 0.53 | < 0.5 | 18 | 35 | 84 | 4.11 | < 10 | < 1 | 0.22 | < 10 | 1.43 | 495 |
| 93LKC-D026 | 201 | 229 | < 5 | 0.2 | 2.47 | < 2 | 290 | < 0.5 | 4 | 0.74 | < 0.5 | 14 | 109 | 53 | 3.27 | < 10 | < 1 | 0.03 | 10 | 1.58 | 435 |
| 93LKC-D027 | 201 | 229 | < 5 | 0.4 | 2.39 | 6 | 380 | < 0.5 | < 2 | 0.44 | < 0.5 | 12 | 112 | 39 | 3.06 | < 10 | < 1 | 0.06 | 10 | 2.02 | 610 |
| 93LKC-D028 | 201 | 229 | < 5 | 0.4 | 1.62 | 4 | 460 | < 0.5 | < 2 | 0.45 | < 0.5 | 7 | 30 | 26 | 2.29 | < 10 | < 1 | 0.08 | 20 | 0.84 | 245 |
| 93LKC-D029 | 201 | 229 | < 5 | < 0.2 | 1.79 | < 2 | 390 | < 0.5 | < 2 | 0.46 | < 0.5 | 8 | 29 | 30 | 3.05 | < 10 | < 1 | 0.06 | 10 | 0.65 | 345 |
| 93LKC-D030 | 201 | 229 | < 5 | 0.2 | 2.04 | 2 | 310 | < 0.5 | < 2 | 0.27 | < 0.5 | 10 | 27 | 26 | 3.30 | < 10 | < 1 | 0.05 | 10 | 0.89 | 415 |
| 93LKC-D031 | 201 | 229 | < 5 | < 0.2 | 2.25 | 12 | 280 | < 0.5 | < 2 | 0.33 | < 0.5 | 7 | 30 | 28 | 3.37 | < 10 | < 1 | 0.06 | 10 | 1.08 | 325 |
| 93LKC-D032 | 201 | 229 | < 5 | 0.2 | 1.94 | < 2 | 230 | < 0.5 | 2 | 0.22 | < 0.5 | 9 | 28 | 26 | 3.19 | < 10 | < 1 | 0.06 | 10 | 0.91 | 335 |
| 93LKC-D033 | 201 | 229 | < 5 | < 0.2 | 1.72 | 6 | 210 | < 0.5 | < 2 | 0.13 | < 0.5 | 7 | 31 | 26 | 2.95 | < 10 | < 1 | 0.04 | 10 | 0.78 | 280 |
| 93LKC-D034 | 201 | 229 | < 5 | < 0.2 | 1.83 | < 2 | 210 | < 0.5 | < 2 | 0.10 | < 0.5 | 8 | 29 | 21 | 3.26 | < 10 | < 1 | 0.04 | 10 | 0.71 | 295 |
| 93LKC-D035 | 201 | 229 | < 5 | < 0.2 | 1.57 | 10 | 250 | < 0.5 | 2 | 0.08 | < 0.5 | 9 | 25 | 25 | 3.62 | < 10 | < 1 | 0.05 | 10 | 0.56 | 390 |
| 93LKC-D036 | 201 | 229 | < 5 | < 0.2 | 1.42 | 14 | 200 | < 0.5 | < 2 | 0.13 | < 0.5 | 8 | 22 | 28 | 3.38 | < 10 | < 1 | 0.06 | 10 | 0.68 | 300 |
| 93LKC-D037 | 201 | 229 | < 5 | < 0.2 | 1.92 | < 2 | 190 | < 0.5 | < 2 | 0.09 | < 0.5 | 6 | 26 | 23 | 3.38 | < 10 | < 1 | 0.06 | < 10 | 0.98 | 320 |
| 93LKC-D038 | 201 | 229 | < 5 | < 0.2 | 1.77 | 8 | 260 | < 0.5 | 2 | 0.22 | < 0.5 | 10 | 26 | 26 | 3.23 | < 10 | < 1 | 0.07 | 10 | 0.99 | 375 |
| 93LKC-D039 | 201 | 229 | < 5 | < 0.2 | 1.81 | < 2 | 250 | < 0.5 | < 2 | 0.15 | < 0.5 | 10 | 26 | 24 | 3.29 | < 10 | < 1 | 0.29 | < 10 | 1.11 | 350 |
| 93LKC-D040 | 201 | 229 | < 5 | < 0.2 | 2.10 | < 2 | 200 | < 0.5 | < 2 | 0.13 | < 0.5 | 10 | 21 | 23 | 3.57 | < 10 | < 1 | 0.28 | < 10 | 1.37 | 445 |
| 93LKC-D041 | 201 | 229 | < 5 | < 0.2 | 1.87 | < 2 | 180 | < 0.5 | < 2 | 0.13 | < 0.5 | 7 | 17 | 18 | 3.10 | < 10 | < 1 | 0.23 | < 10 | 1.22 | 410 |
| 93LKC-D042 | 201 | 229 | < 5 | < 0.2 | 1.80 | < 2 | 150 | < 0.5 | < 2 | 0.10 | < 0.5 | 4 | 20 | 10 | 3.01 | < 10 | < 1 | 0.08 | < 10 | 0.91 | 430 |

CERTIFICATION:

Barth Beckler



Chemex Labs Ltd.

Analytical Chemists * Geochemists * Registered Assayers
212 Brooksbank Ave., North Vancouver
British Columbia, Canada V7J 2C1
PHONE: 604-984-0221

To: PEARL PETROLEUM CORP.

1100 - 675 W. HASTINGS ST.
VANCOUVER, BC
V6B 1N6

Project : KING CLAIMS-DAWSON
Comments:

Page Number : 3-B
Total Pages : 5
Certificate Date: 08-SEP-93
Invoice No. : 19320293
P.O. Number :
Account : KYW

CERTIFICATE OF ANALYSIS

A9320293

| SAMPLE | PREP | | Mo | Na | Ni | P | Pb | Sb | Sc | Sr | Ti | Tl | U | V | W | Zn |
|------------|------|-----|-----|--------|-----|-----|-----|-----|-----|-----|--------|------|------|-----|------|-----|
| | CODE | | ppm | % | ppm | ppm | ppm | ppm | ppm | ppm | % | ppm | ppm | ppm | ppm | ppm |
| 93LKC-D003 | 201 | 229 | < 1 | < 0.01 | 11 | 230 | 14 | < 2 | 2 | 9 | 0.04 | < 10 | < 10 | 35 | < 10 | 46 |
| 93LKC-D004 | 201 | 229 | 1 | < 0.01 | 9 | 340 | 18 | < 2 | 2 | 11 | 0.06 | < 10 | < 10 | 44 | < 10 | 48 |
| 93LKC-D005 | 201 | 229 | 1 | < 0.01 | 9 | 480 | 50 | < 2 | 3 | 10 | 0.03 | < 10 | < 10 | 34 | < 10 | 70 |
| 93LKC-D006 | 201 | 229 | < 1 | < 0.01 | 13 | 340 | 20 | < 2 | 3 | 15 | 0.04 | < 10 | < 10 | 38 | < 10 | 52 |
| 93LKC-D007 | 201 | 229 | < 1 | < 0.01 | 8 | 250 | 8 | 2 | 1 | 10 | 0.03 | < 10 | < 10 | 29 | < 10 | 28 |
| 93LKC-D008 | 201 | 229 | < 1 | < 0.01 | 15 | 200 | 8 | < 2 | 2 | 7 | 0.03 | < 10 | < 10 | 42 | < 10 | 44 |
| 93LKC-D009 | 201 | 229 | < 1 | < 0.01 | 12 | 710 | 22 | < 2 | 1 | 6 | 0.03 | < 10 | < 10 | 47 | < 10 | 56 |
| 93LKC-D010 | 201 | 229 | < 1 | < 0.01 | 1 | 130 | 16 | < 2 | < 1 | 4 | 0.01 | < 10 | < 10 | 15 | < 10 | 14 |
| 93LKC-D011 | 201 | 229 | 1 | < 0.01 | 8 | 270 | 22 | 2 | 2 | 8 | 0.05 | < 10 | < 10 | 56 | < 10 | 38 |
| 93LKC-D012 | 201 | 229 | < 1 | < 0.01 | 12 | 200 | 12 | 2 | 3 | 9 | 0.05 | < 10 | < 10 | 46 | < 10 | 50 |
| 93LKC-D013 | 201 | 229 | < 1 | < 0.01 | 6 | 170 | 12 | < 2 | 1 | 8 | 0.05 | < 10 | < 10 | 35 | < 10 | 26 |
| 93LKC-D014 | 201 | 229 | < 1 | < 0.01 | 9 | 160 | 26 | < 2 | 2 | 9 | 0.04 | < 10 | < 10 | 32 | < 10 | 34 |
| 93LKC-D015 | 201 | 229 | < 1 | < 0.01 | 10 | 200 | 18 | < 2 | 2 | 10 | 0.03 | < 10 | < 10 | 29 | < 10 | 48 |
| 93LKC-D016 | 201 | 229 | < 1 | < 0.01 | 6 | 430 | 40 | < 2 | 1 | 9 | 0.02 | < 10 | < 10 | 13 | < 10 | 76 |
| 93LKC-D017 | 201 | 229 | < 1 | < 0.01 | 7 | 250 | 16 | < 2 | 2 | 9 | 0.04 | < 10 | < 10 | 29 | < 10 | 38 |
| 93LKC-D018 | 201 | 229 | 1 | < 0.01 | 11 | 410 | 18 | < 2 | 2 | 8 | 0.04 | < 10 | < 10 | 45 | < 10 | 42 |
| 93LKC-D019 | 201 | 229 | < 1 | < 0.01 | 3 | 220 | 16 | < 2 | 2 | 6 | < 0.01 | < 10 | < 10 | 8 | < 10 | 28 |
| 93LKC-D020 | 201 | 229 | < 1 | < 0.01 | 5 | 230 | 16 | < 2 | 1 | 8 | 0.03 | < 10 | < 10 | 27 | < 10 | 28 |
| 93LKC-D021 | 201 | 229 | < 1 | < 0.01 | 10 | 270 | 18 | < 2 | 2 | 10 | 0.03 | < 10 | < 10 | 33 | < 10 | 42 |
| 93LKC-D022 | 201 | 229 | < 1 | < 0.01 | 43 | 730 | < 2 | 2 | 7 | 21 | 0.04 | < 10 | < 10 | 57 | 10 | 50 |
| 93LKC-D023 | 201 | 229 | < 1 | < 0.01 | 151 | 680 | < 2 | < 2 | 9 | 27 | 0.08 | < 10 | < 10 | 77 | 20 | 72 |
| 93LKC-D024 | 201 | 229 | < 1 | < 0.01 | 8 | 870 | < 2 | 4 | 3 | 29 | 0.07 | < 10 | < 10 | 57 | 10 | 54 |
| 93LKC-D025 | 201 | 229 | 1 | 0.01 | 17 | 860 | 2 | < 2 | 4 | 30 | 0.12 | < 10 | < 10 | 98 | 20 | 64 |
| 93LKC-D026 | 201 | 229 | < 1 | 0.01 | 46 | 440 | 14 | < 2 | 7 | 23 | 0.13 | < 10 | < 10 | 70 | 10 | 84 |
| 93LKC-D027 | 201 | 229 | 1 | < 0.01 | 78 | 630 | 16 | 2 | 7 | 20 | 0.05 | < 10 | < 10 | 50 | 10 | 96 |
| 93LKC-D028 | 201 | 229 | 1 | < 0.01 | 18 | 510 | 12 | < 2 | 6 | 23 | 0.07 | < 10 | < 10 | 35 | < 10 | 70 |
| 93LKC-D029 | 201 | 229 | 1 | 0.01 | 21 | 720 | 12 | < 2 | 6 | 21 | 0.05 | < 10 | < 10 | 51 | 10 | 86 |
| 93LKC-D030 | 201 | 229 | 1 | < 0.01 | 20 | 590 | 4 | 2 | 6 | 14 | 0.04 | < 10 | < 10 | 56 | 10 | 82 |
| 93LKC-D031 | 201 | 229 | < 1 | < 0.01 | 17 | 340 | 6 | < 2 | 6 | 18 | 0.12 | < 10 | < 10 | 60 | 10 | 82 |
| 93LKC-D032 | 201 | 229 | 1 | < 0.01 | 18 | 320 | 8 | < 2 | 5 | 13 | 0.10 | < 10 | < 10 | 55 | 10 | 74 |
| 93LKC-D033 | 201 | 229 | 1 | < 0.01 | 17 | 160 | 6 | < 2 | 5 | 10 | 0.07 | < 10 | < 10 | 52 | < 10 | 68 |
| 93LKC-D034 | 201 | 229 | < 1 | < 0.01 | 15 | 210 | 10 | < 2 | 4 | 8 | 0.05 | < 10 | < 10 | 58 | < 10 | 62 |
| 93LKC-D035 | 201 | 229 | 1 | < 0.01 | 15 | 390 | 4 | < 2 | 6 | 6 | 0.02 | < 10 | < 10 | 59 | < 10 | 68 |
| 93LKC-D036 | 201 | 229 | 1 | < 0.01 | 16 | 590 | 6 | < 2 | 6 | 8 | 0.01 | < 10 | < 10 | 61 | < 10 | 70 |
| 93LKC-D037 | 201 | 229 | < 1 | < 0.01 | 15 | 260 | 4 | < 2 | 4 | 8 | 0.04 | < 10 | < 10 | 63 | < 10 | 70 |
| 93LKC-D038 | 201 | 229 | 1 | < 0.01 | 18 | 360 | 6 | < 2 | 5 | 14 | 0.09 | < 10 | < 10 | 61 | < 10 | 74 |
| 93LKC-D039 | 201 | 229 | 1 | < 0.01 | 15 | 250 | 8 | < 2 | 3 | 12 | 0.15 | < 10 | < 10 | 75 | < 10 | 68 |
| 93LKC-D040 | 201 | 229 | < 1 | < 0.01 | 10 | 210 | 4 | < 2 | 4 | 10 | 0.13 | < 10 | < 10 | 72 | 10 | 72 |
| 93LKC-D041 | 201 | 229 | < 1 | < 0.01 | 8 | 360 | 6 | < 2 | 4 | 9 | 0.11 | < 10 | < 10 | 64 | < 10 | 66 |
| 93LKC-D042 | 201 | 229 | < 1 | < 0.01 | 7 | 280 | 8 | < 2 | 3 | 8 | 0.07 | < 10 | < 10 | 43 | < 10 | 64 |

CERTIFICATION: *Hart Buehler*



Chemex Labs Ltd.

Analytical Chemists * Geochemists * Registered Assayers
 212 Brooksbank Ave., North Vancouver
 British Columbia, Canada V7J 2C1
 PHONE: 604-984-0221

To: PEARL PETROLEUM CORP.

1100 - 675 W. HASTINGS ST.
 VANCOUVER, BC
 V6B 1N6

Page Number :4-A
 Total Pages :5
 Certificate Date: 08-SEP-93
 Invoice No. :19320293
 P.O. Number :
 Account :KYW

Project : KING CLAIMS-DAWSON
 Comments:

CERTIFICATE OF ANALYSIS A9320293

| SAMPLE | PREP CODE | Au ppb FA+AA | Ag ppm | Al % | As ppm | Ba ppm | Be ppm | Bi ppm | Ca % | Cd ppm | Co ppm | Cr ppm | Cu ppm | Fe % | Ga ppm | Hg ppm | K % | La ppm | Mg % | Mn ppm |
|------------|-----------|-----------------|--------|------|-----------|--------|------------|--------|------|--------|-----------|--------|-----------|------|--------|--------|-----|--------|------|--------|
| 93LKC-D043 | 201 229 | < 5 < 0.2 | 1.50 | < 2 | 120 < 0.5 | < 2 | 0.10 < 0.5 | 6 | 11 | 13 | 2.36 < 10 | < 1 | 0.13 < 10 | 1.21 | 345 | | | | | |
| 93LKC-D044 | 201 229 | < 5 < 0.2 | 1.05 | < 2 | 190 < 0.5 | < 2 | 0.07 < 0.5 | 4 | 13 | 11 | 2.08 < 10 | < 1 | 0.16 < 10 | 0.35 | 200 | | | | | |
| 93LKC-D045 | 201 229 | < 5 < 0.2 | 1.09 | 4 | 470 < 0.5 | 6 | 0.31 < 0.5 | 4 | 21 | 11 | 1.69 < 10 | < 1 | 0.10 < 10 | 0.53 | 245 | | | | | |
| 93LKC-D046 | 201 229 | < 5 < 0.2 | 1.44 | < 2 | 290 < 0.5 | < 2 | 0.41 < 0.5 | 9 | 13 | 25 | 2.82 < 10 | < 1 | 0.53 < 10 | 0.88 | 425 | | | | | |
| 93LKC-D047 | 201 229 | < 5 < 0.2 | 1.82 | < 2 | 260 < 0.5 | 2 | 0.42 < 0.5 | 15 | 48 | 37 | 2.92 < 10 | < 1 | 0.04 < 10 | 1.40 | 405 | | | | | |
| 93LKC-D048 | 201 229 | < 5 < 0.2 | 1.49 | < 2 | 430 < 0.5 | 2 | 0.64 < 0.5 | 9 | 30 | 29 | 2.68 < 10 | < 1 | 0.26 < 10 | 0.95 | 405 | | | | | |
| 93LKC-D049 | 201 229 | < 5 < 0.2 | 2.16 | < 2 | 330 < 0.5 | < 2 | 0.50 < 0.5 | 17 | 53 | 37 | 3.72 < 10 | < 1 | 0.08 < 10 | 1.52 | 1005 | | | | | |
| 93LKC-D050 | 201 229 | < 5 < 0.2 | 1.89 | < 2 | 230 < 0.5 | < 2 | 0.32 < 0.5 | 8 | 40 | 15 | 2.75 < 10 | < 1 | 0.04 < 10 | 1.20 | 315 | | | | | |
| 93LKC-D051 | 201 229 | < 5 < 0.2 | 1.58 | 2 | 250 < 0.5 | < 2 | 0.40 < 0.5 | 7 | 33 | 13 | 2.35 < 10 | < 1 | 0.04 < 10 | 0.81 | 255 | | | | | |
| 93LKC-D052 | 201 229 | < 5 < 0.2 | 1.69 | < 2 | 200 < 0.5 | < 2 | 0.39 < 0.5 | 12 | 43 | 27 | 2.94 < 10 | < 1 | 0.13 < 10 | 1.37 | 560 | | | | | |
| 93LKC-D053 | 201 229 | < 5 < 0.2 | 1.46 | 2 | 290 < 0.5 | 4 | 0.44 < 0.5 | 9 | 33 | 23 | 2.42 < 10 | < 1 | 0.04 < 10 | 0.80 | 285 | | | | | |
| 93LKC-D054 | 201 229 | < 5 < 0.2 | 1.85 | < 2 | 200 < 0.5 | < 2 | 0.36 < 0.5 | 13 | 62 | 36 | 2.97 < 10 | < 1 | 0.03 < 10 | 1.45 | 395 | | | | | |
| 93LKC-D055 | 201 229 | < 5 < 0.2 | 1.86 | < 2 | 180 < 0.5 | < 2 | 0.31 < 0.5 | 14 | 45 | 38 | 2.86 < 10 | < 1 | 0.02 < 10 | 1.42 | 320 | | | | | |
| 93LKC-D056 | 201 229 | < 5 < 0.2 | 1.47 | < 2 | 150 < 0.5 | 4 | 0.23 < 0.5 | 13 | 78 | 32 | 2.49 < 10 | < 1 | 0.03 < 10 | 1.22 | 355 | | | | | |
| 93LKC-D057 | 201 229 | < 5 < 0.2 | 2.00 | 2 | 190 < 0.5 | 2 | 0.36 < 0.5 | 13 | 64 | 30 | 3.05 < 10 | < 1 | 0.03 < 10 | 1.36 | 440 | | | | | |
| 93LKC-D058 | 201 229 | < 5 < 0.2 | 1.77 | < 2 | 130 < 0.5 | 2 | 0.30 < 0.5 | 12 | 51 | 27 | 2.83 < 10 | < 1 | 0.05 < 10 | 1.27 | 355 | | | | | |
| 93LKC-D059 | 201 229 | < 5 < 0.2 | 1.33 | < 2 | 170 < 0.5 | < 2 | 0.19 < 0.5 | 6 | 29 | 15 | 2.12 < 10 | < 1 | 0.07 < 10 | 0.66 | 270 | | | | | |
| 93LKC-D060 | 201 229 | < 5 < 0.2 | 1.62 | < 2 | 230 < 0.5 | 2 | 0.25 < 0.5 | 10 | 44 | 22 | 2.45 < 10 | < 1 | 0.03 < 10 | 0.98 | 290 | | | | | |
| 93LKC-D061 | 201 229 | < 5 < 0.2 | 0.32 | < 2 | 120 < 0.5 | < 2 | 0.06 < 0.5 | < 1 | 2 | 2 | 0.38 < 10 | < 1 | 0.11 < 10 | 0.07 | 40 | | | | | |
| 93LKC-D062 | 201 229 | < 5 < 0.2 | 1.13 | 4 | 280 < 0.5 | < 2 | 0.20 < 0.5 | 6 | 19 | 11 | 1.84 < 10 | < 1 | 0.08 < 10 | 0.60 | 255 | | | | | |
| 93LKC-D063 | 201 229 | < 5 < 0.2 | 1.77 | < 2 | 370 < 0.5 | 4 | 0.34 < 0.5 | 13 | 37 | 23 | 3.31 < 10 | < 1 | 0.07 < 10 | 1.18 | 400 | | | | | |
| 93LKC-D064 | 201 229 | < 5 < 0.2 | 1.83 | < 2 | 340 < 0.5 | 2 | 0.37 < 0.5 | 13 | 45 | 28 | 3.33 < 10 | < 1 | 0.04 < 10 | 1.30 | 460 | | | | | |
| 93LKC-D065 | 201 229 | < 5 < 0.2 | 1.95 | < 2 | 260 < 0.5 | < 2 | 0.42 < 0.5 | 13 | 57 | 34 | 3.54 < 10 | < 1 | 0.14 < 10 | 1.45 | 485 | | | | | |
| 93LKC-D066 | 201 229 | < 5 < 0.2 | 2.15 | < 2 | 180 < 0.5 | 4 | 0.31 < 0.5 | 9 | 30 | 27 | 3.69 < 10 | < 1 | 0.15 < 10 | 1.29 | 435 | | | | | |
| 93LKC-D067 | 201 229 | < 5 < 0.2 | 1.90 | 2 | 360 < 0.5 | < 2 | 0.39 < 0.5 | 13 | 27 | 21 | 2.87 < 10 | < 1 | 0.12 < 10 | 0.98 | 1350 | | | | | |
| 93LKC-D068 | 201 229 | < 5 < 0.2 | 2.04 | < 2 | 250 < 0.5 | < 2 | 0.42 < 0.5 | 6 | 36 | 15 | 2.72 < 10 | < 1 | 0.06 < 10 | 0.95 | 230 | | | | | |
| 93LKC-D069 | 201 229 | < 5 < 0.2 | 1.46 | 14 | 190 < 0.5 | 2 | 0.33 < 0.5 | 7 | 37 | 19 | 2.42 < 10 | < 1 | 0.13 < 10 | 1.02 | 360 | | | | | |
| 93LKC-D070 | 201 229 | < 5 < 0.2 | 2.12 | 8 | 320 < 0.5 | < 2 | 0.43 < 0.5 | 11 | 34 | 25 | 3.10 < 10 | < 1 | 0.06 < 10 | 30 | 1.24 | 470 | | | | |
| 93LKC-D071 | 201 229 | < 5 < 0.2 | 2.03 | < 2 | 270 < 0.5 | 2 | 0.32 < 0.5 | 7 | 33 | 22 | 2.91 < 10 | < 1 | 0.06 < 10 | 1.21 | 385 | | | | | |
| 93LKC-D072 | 201 229 | < 5 < 0.2 | 1.95 | < 2 | 250 < 0.5 | < 2 | 0.26 < 0.5 | 8 | 33 | 17 | 3.00 < 10 | < 1 | 0.07 < 10 | 0.83 | 360 | | | | | |
| 93LKC-D073 | 201 229 | < 5 < 0.2 | 2.01 | 6 | 250 < 0.5 | < 2 | 0.17 < 0.5 | 8 | 31 | 16 | 3.00 < 10 | < 1 | 0.07 < 10 | 10 | 0.77 | 325 | | | | |
| 93LKC-D074 | 201 229 | < 5 < 0.2 | 1.96 | < 2 | 270 < 0.5 | < 2 | 0.41 < 0.5 | 12 | 29 | 28 | 2.90 < 10 | < 1 | 0.06 < 10 | 30 | 1.52 | 575 | | | | |
| 93LKC-D075 | 201 229 | < 5 < 0.2 | 3.08 | 10 | 130 < 0.5 | 4 | 0.47 < 0.5 | 19 | 67 | 32 | 4.55 < 10 | < 1 | 0.13 < 10 | 10 | 3.18 | 595 | | | | |
| 93LKC-D076 | 201 229 | < 5 < 0.2 | 1.62 | < 2 | 100 < 0.5 | < 2 | 0.13 < 0.5 | 11 | 101 | 31 | 2.61 < 10 | < 1 | 0.03 < 10 | < 10 | 1.44 | 270 | | | | |
| 93LKC-D077 | 201 229 | < 5 < 0.2 | 0.61 | < 2 | 330 < 0.5 | < 2 | 0.02 < 0.5 | 1 | 8 | 6 | 1.28 < 10 | < 1 | 0.06 < 10 | 10 | 0.04 | 30 | | | | |
| 93LKC-D078 | 201 229 | < 5 < 0.2 | 1.59 | 6 | 390 < 0.5 | < 2 | 0.20 < 0.5 | 8 | 45 | 24 | 2.68 < 10 | < 1 | 0.06 < 10 | 10 | 0.91 | 170 | | | | |
| 93LKC-D079 | 201 229 | < 5 < 0.2 | 1.11 | 2 | 270 < 0.5 | < 2 | 0.05 < 0.5 | 4 | 20 | 11 | 2.38 < 10 | < 1 | 0.08 < 10 | < 10 | 0.24 | 110 | | | | |
| 93LKC-D080 | 201 229 | < 5 < 0.2 | 1.49 | < 2 | 440 < 0.5 | < 2 | 0.08 < 0.5 | 5 | 23 | 12 | 2.47 < 10 | < 1 | 0.08 < 10 | < 10 | 0.43 | 135 | | | | |
| 93LKC-D081 | 201 229 | < 5 < 0.2 | 1.39 | < 2 | 590 < 0.5 | < 2 | 0.14 < 0.5 | 8 | 22 | 13 | 2.36 < 10 | < 1 | 0.07 < 10 | < 10 | 0.36 | 235 | | | | |
| 93LKC-D082 | 201 229 | < 5 < 0.2 | 1.56 | < 2 | 320 < 0.5 | < 2 | 0.07 < 0.5 | 6 | 21 | 33 | 2.65 < 10 | < 1 | 0.08 < 10 | < 10 | 0.53 | 275 | | | | |

CERTIFICATION: *Hart Bichler*



Chemex Labs Ltd.

Analytical Chemists * Geochemists * Registered Assayers
212 Brooksbank Ave., North Vancouver
British Columbia, Canada V7J 2C1
PHONE: 604-984-0221

To: PEARL PETROLEUM CORP.

1100 - 675 W. HASTINGS ST.
VANCOUVER, BC
V6B 1N6

Project : KING CLAIMS-DAWSON
Comments:

Page Number : 4-B
Total Pages : 5
Certificate Date: 08-SEP-91
Invoice No. : I9320293
P.O. Number :
Account : KYW

CERTIFICATE OF ANALYSIS

A9320293

| SAMPLE | PREP | | Mo | Na | Ni | P | Pb | Sb | Sc | Sr | Ti | Tl | U | V | W | Zn |
|------------|------|-----|------------|------|-----|-----|-----|-----|-----|-----|--------|------|------|-----|------|-----|
| | CODE | | ppm | % | ppm | ppm | ppm | ppm | ppm | ppm | % | ppm | ppm | ppm | ppm | ppm |
| 93LKC-D043 | 201 | 229 | 1 < 0.01 | | 5 | 300 | 4 | < 2 | 2 | 7 | 0.04 | < 10 | < 10 | 26 | < 10 | 64 |
| 93LKC-D044 | 201 | 229 | 1 < 0.01 | | 4 | 480 | 6 | < 2 | 2 | 7 | 0.07 | < 10 | < 10 | 43 | < 10 | 38 |
| 93LKC-D045 | 201 | 229 | < 1 < 0.01 | | 8 | 220 | 4 | 2 | 3 | 16 | 0.08 | < 10 | < 10 | 40 | < 10 | 34 |
| 93LKC-D046 | 201 | 229 | < 1 < 0.01 | | 7 | 840 | 6 | < 2 | 4 | 17 | 0.10 | < 10 | < 10 | 51 | < 10 | 62 |
| 93LKC-D047 | 201 | 229 | < 1 < 0.01 | | 27 | 420 | < 2 | < 2 | 4 | 14 | 0.09 | < 10 | < 10 | 48 | < 10 | 60 |
| 93LKC-D048 | 201 | 229 | < 1 < 0.01 | | 15 | 760 | < 2 | < 2 | 5 | 26 | 0.08 | < 10 | < 10 | 52 | < 10 | 64 |
| 93LKC-D049 | 201 | 229 | < 1 < 0.01 | | 24 | 520 | 6 | 2 | 4 | 19 | 0.12 | < 10 | < 10 | 63 | 10 | 74 |
| 93LKC-D050 | 201 | 229 | < 1 < 0.01 | | 17 | 760 | 12 | < 2 | 4 | 16 | 0.05 | < 10 | < 10 | 50 | < 10 | 78 |
| 93LKC-D051 | 201 | 229 | < 1 < 0.01 | | 16 | 650 | 2 | < 2 | 4 | 23 | 0.06 | < 10 | < 10 | 45 | < 10 | 74 |
| 93LKC-D052 | 201 | 229 | < 1 < 0.01 | | 23 | 820 | 2 | < 2 | 4 | 19 | 0.10 | < 10 | < 10 | 51 | 10 | 80 |
| 93LKC-D053 | 201 | 229 | 1 | 0.01 | 19 | 650 | 8 | < 2 | 4 | 24 | 0.06 | < 10 | < 10 | 44 | < 10 | 74 |
| 93LKC-D054 | 201 | 229 | < 1 < 0.01 | | 31 | 510 | 2 | 2 | 3 | 14 | 0.12 | < 10 | < 10 | 52 | < 10 | 70 |
| 93LKC-D055 | 201 | 229 | < 1 < 0.01 | | 22 | 400 | 4 | < 2 | 3 | 10 | 0.13 | < 10 | < 10 | 48 | < 10 | 62 |
| 93LKC-D056 | 201 | 229 | 1 < 0.01 | | 33 | 360 | < 2 | < 2 | 3 | 9 | 0.08 | < 10 | < 10 | 40 | < 10 | 46 |
| 93LKC-D057 | 201 | 229 | < 1 < 0.01 | | 28 | 440 | < 2 | 2 | 4 | 16 | 0.16 | < 10 | < 10 | 56 | < 10 | 64 |
| 93LKC-D058 | 201 | 229 | 1 < 0.01 | | 23 | 380 | 4 | < 2 | 3 | 12 | 0.17 | < 10 | < 10 | 53 | < 10 | 58 |
| 93LKC-D059 | 201 | 229 | < 1 < 0.01 | | 13 | 290 | 4 | < 2 | 2 | 10 | 0.09 | < 10 | < 10 | 39 | < 10 | 44 |
| 93LKC-D060 | 201 | 229 | < 1 < 0.01 | | 19 | 270 | 2 | 2 | 3 | 11 | 0.13 | < 10 | < 10 | 45 | < 10 | 50 |
| 93LKC-D061 | 201 | 229 | < 1 < 0.01 | | < 1 | 150 | 4 | < 2 | 1 | 4 | 0.01 | < 10 | < 10 | 8 | < 10 | 8 |
| 93LKC-D062 | 201 | 229 | < 1 < 0.01 | | 8 | 380 | 4 | < 2 | 3 | 12 | 0.05 | < 10 | < 10 | 40 | < 10 | 40 |
| 93LKC-D063 | 201 | 229 | 1 < 0.01 | | 17 | 770 | 4 | < 2 | 6 | 17 | 0.06 | < 10 | < 10 | 63 | < 10 | 68 |
| 93LKC-D064 | 201 | 229 | < 1 < 0.01 | | 22 | 710 | 6 | < 2 | 6 | 18 | 0.06 | < 10 | < 10 | 66 | < 10 | 72 |
| 93LKC-D065 | 201 | 229 | < 1 < 0.01 | | 28 | 820 | 6 | < 2 | 8 | 19 | 0.09 | < 10 | < 10 | 73 | 10 | 82 |
| 93LKC-D066 | 201 | 229 | < 1 < 0.01 | | 20 | 720 | 6 | < 2 | 7 | 14 | 0.11 | < 10 | < 10 | 68 | < 10 | 86 |
| 93LKC-D067 | 201 | 229 | 1 < 0.01 | | 15 | 840 | 12 | < 2 | 5 | 20 | 0.02 | < 10 | < 10 | 40 | < 10 | 78 |
| 93LKC-D068 | 201 | 229 | 1 < 0.01 | | 15 | 380 | 14 | < 2 | 4 | 23 | 0.06 | < 10 | < 10 | 48 | < 10 | 60 |
| 93LKC-D069 | 201 | 229 | < 1 < 0.01 | | 18 | 750 | 20 | < 2 | 5 | 17 | 0.08 | < 10 | < 10 | 32 | < 10 | 60 |
| 93LKC-D070 | 201 | 229 | < 1 < 0.01 | | 19 | 380 | 24 | < 2 | 5 | 26 | 0.04 | < 10 | < 10 | 43 | 10 | 86 |
| 93LKC-D071 | 201 | 229 | < 1 < 0.01 | | 17 | 480 | 14 | < 2 | 3 | 17 | 0.06 | < 10 | < 10 | 45 | < 10 | 80 |
| 93LKC-D072 | 201 | 229 | < 1 < 0.01 | | 16 | 260 | 16 | < 2 | 3 | 17 | 0.07 | < 10 | < 10 | 55 | < 10 | 62 |
| 93LKC-D073 | 201 | 229 | 1 < 0.01 | | 14 | 170 | 14 | 2 | 3 | 12 | 0.07 | < 10 | < 10 | 60 | < 10 | 58 |
| 93LKC-D074 | 201 | 229 | < 1 < 0.01 | | 17 | 740 | 32 | < 2 | 3 | 24 | 0.02 | < 10 | < 10 | 38 | < 10 | 76 |
| 93LKC-D075 | 201 | 229 | 2 < 0.01 | | 26 | 710 | 20 | 2 | 9 | 20 | 0.04 | < 10 | < 10 | 105 | 10 | 98 |
| 93LKC-D076 | 201 | 229 | 1 < 0.01 | | 59 | 400 | 6 | < 2 | 3 | 7 | 0.04 | < 10 | < 10 | 45 | < 10 | 72 |
| 93LKC-D077 | 201 | 229 | 1 < 0.01 | | 4 | 140 | 12 | 2 | 1 | 5 | < 0.01 | < 10 | < 10 | 8 | < 10 | 12 |
| 93LKC-D078 | 201 | 229 | < 1 < 0.01 | | 19 | 150 | 12 | < 2 | 4 | 13 | 0.13 | < 10 | < 10 | 47 | < 10 | 46 |
| 93LKC-D079 | 201 | 229 | 1 < 0.01 | | 9 | 250 | 22 | < 2 | 2 | 6 | 0.03 | < 10 | < 10 | 40 | < 10 | 34 |
| 93LKC-D080 | 201 | 229 | 1 < 0.01 | | 11 | 210 | 16 | < 2 | 2 | 10 | 0.04 | < 10 | < 10 | 42 | < 10 | 44 |
| 93LKC-D081 | 201 | 229 | < 1 < 0.01 | | 13 | 510 | 20 | < 2 | 2 | 13 | 0.04 | < 10 | < 10 | 42 | < 10 | 46 |
| 93LKC-D082 | 201 | 229 | < 1 < 0.01 | | 10 | 320 | 38 | < 2 | 2 | 8 | 0.05 | < 10 | < 10 | 41 | < 10 | 126 |

CERTIFICATION:

Heath Buchler

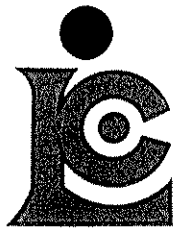

Chemex Labs Ltd.

Analytical Chemists * Geochemists * Registered Assayers
 212 Brooksbank Ave., North Vancouver
 British Columbia, Canada V7J 2C1
 PHONE: 604-984-0221

To: PEARL PETROLEUM CORP.

1100 - 675 W. HASTINGS ST.
 VANCOUVER, BC
 V6B 1N6

Project : KING CLAIMS-DAWSON
 Comments:

Page Number :5-A
 Total Pages :5
 Certificate Date: 08-SEP-93
 Invoice No. : 19320293
 P.O. Number :
 Account : KYW

CERTIFICATE OF ANALYSIS A9320293

| SAMPLE | PREP CODE | Au ppb FA+AA | Ag ppm | Al % | As ppm | Ba ppm | Be ppm | Bi ppm | Ca % | Cd ppm | Co ppm | Cr ppm | Cu ppm | Fe % | Ga ppm | Hg ppm | K % | La ppm | Mg % | Mn ppm |
|------------|-----------|-----------------|--------|------|--------|--------|--------|--------|------|--------|--------|--------|--------|------|--------|--------|------|--------|------|--------|
| 93LKC-D083 | 201 229 | < 5 | < 0.2 | 0.87 | 2 | 160 | < 0.5 | < 2 | 0.05 | < 0.5 | 2 | 8 | 9 | 0.66 | < 10 | < 1 | 0.13 | < 10 | 0.09 | 50 |
| 93LKC-D084 | 201 229 | < 5 | < 0.2 | 1.48 | < 2 | 280 | < 0.5 | < 2 | 0.08 | < 0.5 | 3 | 15 | 22 | 1.61 | < 10 | < 1 | 0.07 | < 10 | 0.26 | 120 |
| 93LKC-D085 | 201 229 | < 5 | 0.2 | 2.60 | 8 | 360 | < 0.5 | 4 | 0.12 | < 0.5 | 9 | 38 | 17 | 3.18 | < 10 | < 1 | 0.07 | 10 | 0.77 | 245 |
| 93LKC-D086 | 201 229 | < 5 | 0.2 | 2.23 | < 2 | 350 | < 0.5 | < 2 | 0.13 | < 0.5 | 8 | 37 | 36 | 3.02 | < 10 | < 1 | 0.08 | 10 | 0.76 | 255 |
| 93LKC-D087 | 201 229 | < 5 | < 0.2 | 1.79 | < 2 | 220 | < 0.5 | < 2 | 0.12 | < 0.5 | 5 | 30 | 20 | 2.94 | < 10 | < 1 | 0.05 | < 10 | 0.96 | 300 |
| 93LKC-D088 | 201 229 | < 5 | < 0.2 | 1.83 | < 2 | 130 | < 0.5 | 2 | 0.06 | 0.5 | 8 | 31 | 19 | 3.07 | < 10 | < 1 | 0.05 | < 10 | 0.72 | 245 |
| 93LKC-D089 | 201 229 | < 5 | < 0.2 | 1.51 | 4 | 190 | < 0.5 | < 2 | 0.08 | < 0.5 | 6 | 23 | 16 | 2.65 | < 10 | < 1 | 0.04 | < 10 | 0.70 | 260 |
| 93LKC-D090 | 201 229 | < 5 | 0.2 | 1.64 | < 2 | 180 | < 0.5 | 2 | 0.08 | < 0.5 | 6 | 23 | 15 | 2.68 | < 10 | < 1 | 0.04 | < 10 | 0.73 | 280 |
| 93LKC-D091 | 201 229 | < 5 | < 0.2 | 1.89 | 6 | 170 | < 0.5 | 2 | 0.13 | < 0.5 | 8 | 30 | 24 | 3.67 | < 10 | < 1 | 0.03 | < 10 | 0.81 | 310 |
| 93LKC-D092 | 201 229 | < 5 | 0.2 | 1.78 | < 2 | 210 | < 0.5 | < 2 | 0.18 | < 0.5 | 7 | 29 | 16 | 3.07 | < 10 | < 1 | 0.03 | < 10 | 0.68 | 250 |
| 93LKC-D093 | 201 229 | < 5 | < 0.2 | 2.25 | 4 | 250 | < 0.5 | 2 | 0.15 | < 0.5 | 10 | 37 | 29 | 3.22 | < 10 | < 1 | 0.04 | 10 | 0.70 | 255 |
| 93LKC-D094 | 201 229 | < 5 | < 0.2 | 2.11 | < 2 | 230 | < 0.5 | < 2 | 0.15 | < 0.5 | 8 | 33 | 20 | 3.18 | < 10 | < 1 | 0.05 | < 10 | 0.66 | 240 |
| 93LKC-D095 | 201 229 | < 5 | < 0.2 | 2.23 | < 2 | 230 | < 0.5 | < 2 | 0.16 | 0.5 | 11 | 36 | 25 | 3.21 | < 10 | < 1 | 0.04 | < 10 | 0.69 | 250 |
| 93LKC-D096 | 201 229 | < 5 | 0.2 | 1.59 | < 2 | 820 | < 0.5 | 2 | 0.39 | < 0.5 | 11 | 23 | 23 | 3.79 | 10 | < 1 | 0.48 | 50 | 0.71 | 470 |
| 93LKC-D097 | 201 229 | < 5 | 0.2 | 0.38 | < 2 | 480 | < 0.5 | 2 | 0.19 | < 0.5 | 2 | 11 | 14 | 1.00 | 10 | < 1 | 0.11 | 80 | 0.19 | 130 |
| 93LKC-D098 | 201 229 | < 5 | 0.2 | 0.34 | 4 | 180 | < 0.5 | < 2 | 0.15 | < 0.5 | 1 | 8 | 13 | 0.94 | < 10 | < 1 | 0.10 | 50 | 0.09 | 50 |
| 93LKC-D099 | 201 229 | < 5 | < 0.2 | 0.77 | < 2 | 480 | < 0.5 | 2 | 0.29 | < 0.5 | 3 | 12 | 11 | 1.23 | < 10 | < 1 | 0.10 | 30 | 0.40 | 150 |
| 93LKC-D100 | 201 229 | < 5 | < 0.2 | 1.49 | 2 | 790 | < 0.5 | 2 | 0.37 | < 0.5 | 7 | 24 | 35 | 2.20 | 10 | < 1 | 0.09 | 40 | 0.55 | 210 |
| 93LKC-D101 | 201 229 | < 5 | < 0.2 | 0.81 | < 2 | 330 | < 0.5 | < 2 | 0.24 | < 0.5 | 7 | 13 | 29 | 1.83 | < 10 | < 1 | 0.07 | 30 | 0.24 | 190 |
| 93LKC-D102 | 201 229 | < 5 | 0.2 | 1.22 | < 2 | 570 | < 0.5 | < 2 | 0.29 | < 0.5 | 4 | 21 | 27 | 1.95 | < 10 | < 1 | 0.07 | 40 | 0.39 | 160 |
| 93LKC-D103 | 201 229 | < 5 | < 0.2 | 1.42 | < 2 | 510 | < 0.5 | 2 | 0.29 | < 0.5 | 6 | 24 | 18 | 2.15 | < 10 | < 1 | 0.09 | 40 | 0.76 | 220 |
| 93LKC-D104 | 201 229 | < 5 | < 0.2 | 1.07 | < 2 | 400 | < 0.5 | < 2 | 0.34 | < 0.5 | 5 | 20 | 14 | 1.86 | < 10 | < 1 | 0.10 | 20 | 0.53 | 165 |
| 93LKC-D105 | 201 229 | < 5 | < 0.2 | 1.53 | 6 | 640 | < 0.5 | 2 | 0.35 | < 0.5 | 8 | 32 | 28 | 2.51 | < 10 | < 1 | 0.05 | 20 | 0.56 | 240 |
| 93LKC-D106 | 201 229 | < 5 | < 0.2 | 1.39 | 6 | 530 | < 0.5 | < 2 | 0.36 | < 0.5 | 8 | 30 | 27 | 2.51 | < 10 | < 1 | 0.04 | 10 | 0.51 | 305 |
| 93LKC-D107 | 201 229 | < 5 | < 0.2 | 1.97 | < 2 | 370 | < 0.5 | < 2 | 0.57 | < 0.5 | 12 | 87 | 48 | 2.70 | < 10 | < 1 | 0.05 | 10 | 1.39 | 345 |
| 93LKC-D108 | 201 229 | < 5 | < 0.2 | 1.52 | < 2 | 280 | < 0.5 | 2 | 0.23 | < 0.5 | 7 | 33 | 26 | 2.51 | < 10 | < 1 | 0.08 | 10 | 0.92 | 250 |
| 93LKC-D109 | 201 229 | < 5 | < 0.2 | 1.90 | < 2 | 170 | < 0.5 | 4 | 0.14 | < 0.5 | 8 | 32 | 23 | 3.19 | < 10 | < 1 | 0.10 | 10 | 0.98 | 270 |
| 93LKC-D110 | 201 229 | < 5 | < 0.2 | 1.85 | 4 | 130 | < 0.5 | 4 | 0.18 | < 0.5 | 6 | 30 | 23 | 2.86 | < 10 | < 1 | 0.15 | 10 | 0.86 | 305 |
| 93LKC-D111 | 201 229 | < 5 | < 0.2 | 1.85 | < 2 | 180 | < 0.5 | 2 | 0.23 | < 0.5 | 6 | 29 | 21 | 2.98 | < 10 | < 1 | 0.04 | < 10 | 0.77 | 290 |
| 93LKC-D112 | 201 229 | < 5 | < 0.2 | 2.17 | < 2 | 150 | < 0.5 | 2 | 0.26 | < 0.5 | 9 | 29 | 26 | 3.24 | < 10 | < 1 | 0.06 | 10 | 1.07 | 340 |
| 93LKC-D113 | 201 229 | < 5 | < 0.2 | 1.72 | < 2 | 160 | < 0.5 | 4 | 0.23 | 0.5 | 7 | 23 | 29 | 3.22 | < 10 | < 1 | 0.08 | < 10 | 1.02 | 305 |
| 93LKC-D114 | 201 229 | < 5 | < 0.2 | 1.37 | < 2 | 200 | < 0.5 | < 2 | 0.15 | < 0.5 | 3 | 14 | 12 | 1.93 | < 10 | < 1 | 0.11 | 10 | 0.65 | 195 |
| 93LKC-D115 | 201 229 | < 5 | < 0.2 | 1.41 | 4 | 140 | < 0.5 | 4 | 0.20 | < 0.5 | 4 | 19 | 16 | 2.21 | < 10 | < 1 | 0.16 | 10 | 0.63 | 240 |
| 93LKC-D116 | 201 229 | < 5 | 0.2 | 1.20 | < 2 | 190 | < 0.5 | 2 | 0.29 | < 0.5 | 3 | 15 | 18 | 1.80 | < 10 | < 1 | 0.18 | 20 | 0.72 | 250 |

CERTIFICATION:

Hart Buehler



Chemex Labs Ltd.

Analytical Chemists * Geochemists * Registered Assayers
212 Brooksbank Ave., North Vancouver
British Columbia, Canada V7J 2C1
PHONE: 604-984-0221

To: PEARL PETROLEUM CORP.

1100 - 675 W. HASTINGS ST.
VANCOUVER, BC
V6B 1N6

Project : KING CLAIMS-DAWSON
Comments:

Page Number : 5-B
Total Pages : 5
Certificate Date: 08-SEP-93
Invoice No. : I9320293
P.O. Number :
Account : KYW

CERTIFICATE OF ANALYSIS

A9320293

| SAMPLE | PREP CODE | Mo ppm | Na % | Ni ppm | P ppm | Pb ppm | Sb ppm | Sc ppm | Sr ppm | Ti % | Tl ppm | U ppm | V ppm | W ppm | Zn ppm |
|------------|-----------|--------|--------|--------|-------|--------|--------|--------|--------|--------|--------|-------|-------|-------|--------|
| 93LKC-D083 | 201 229 | < 1 | < 0.01 | 2 | 210 | 14 | < 2 | < 1 | 5 | 0.01 | < 10 | < 10 | 12 | < 10 | 14 |
| 93LKC-D084 | 201 229 | < 1 | < 0.01 | 7 | 270 | 22 | < 2 | 1 | 7 | 0.03 | < 10 | < 10 | 28 | < 10 | 50 |
| 93LKC-D085 | 201 229 | 1 | < 0.01 | 19 | 190 | 16 | < 2 | 3 | 12 | 0.07 | < 10 | < 10 | 55 | < 10 | 62 |
| 93LKC-D086 | 201 229 | 1 | < 0.01 | 19 | 230 | 14 | < 2 | 3 | 12 | 0.08 | < 10 | < 10 | 52 | < 10 | 70 |
| 93LKC-D087 | 201 229 | 1 | < 0.01 | 15 | 390 | 8 | < 2 | 3 | 9 | 0.10 | < 10 | < 10 | 55 | < 10 | 72 |
| 93LKC-D088 | 201 229 | 1 | < 0.01 | 16 | 410 | 12 | < 2 | 3 | 5 | 0.06 | < 10 | < 10 | 50 | < 10 | 56 |
| 93LKC-D089 | 201 229 | 1 | < 0.01 | 12 | 320 | 12 | < 2 | 3 | 6 | 0.05 | < 10 | < 10 | 43 | < 10 | 60 |
| 93LKC-D090 | 201 229 | < 1 | < 0.01 | 11 | 280 | 6 | < 2 | 2 | 6 | 0.07 | < 10 | < 10 | 41 | < 10 | 60 |
| 93LKC-D091 | 201 229 | < 1 | < 0.01 | 18 | 420 | 10 | < 2 | 2 | 9 | 0.10 | < 10 | < 10 | 56 | < 10 | 70 |
| 93LKC-D092 | 201 229 | 2 | < 0.01 | 14 | 550 | 4 | < 2 | 2 | 11 | 0.09 | < 10 | < 10 | 55 | < 10 | 62 |
| 93LKC-D093 | 201 229 | < 1 | < 0.01 | 22 | 200 | 4 | 2 | 4 | 13 | 0.10 | < 10 | < 10 | 62 | < 10 | 66 |
| 93LKC-D094 | 201 229 | 1 | < 0.01 | 16 | 490 | 4 | < 2 | 3 | 14 | 0.10 | < 10 | < 10 | 65 | < 10 | 62 |
| 93LKC-D095 | 201 229 | 1 | < 0.01 | 22 | 270 | 10 | 4 | 3 | 14 | 0.10 | < 10 | < 10 | 64 | < 10 | 64 |
| 93LKC-D096 | 201 229 | < 1 | < 0.01 | 12 | 1000 | 22 | < 2 | 10 | 18 | 0.07 | < 10 | < 10 | 53 | < 10 | 88 |
| 93LKC-D097 | 201 229 | < 1 | < 0.01 | 6 | 320 | 88 | < 2 | 2 | 10 | < 0.01 | < 10 | < 10 | 6 | < 10 | 62 |
| 93LKC-D098 | 201 229 | 1 | < 0.01 | 4 | 450 | 94 | < 2 | 2 | 16 | < 0.01 | < 10 | < 10 | 8 | < 10 | 98 |
| 93LKC-D099 | 201 229 | < 1 | < 0.01 | 5 | 480 | 22 | 2 | 2 | 16 | 0.02 | < 10 | < 10 | 14 | < 10 | 46 |
| 93LKC-D100 | 201 229 | < 1 | < 0.01 | 15 | 410 | 44 | 2 | 4 | 20 | 0.06 | < 10 | < 10 | 35 | < 10 | 80 |
| 93LKC-D101 | 201 229 | 1 | < 0.01 | 7 | 390 | 86 | < 2 | 2 | 15 | 0.04 | < 10 | < 10 | 22 | < 10 | 82 |
| 93LKC-D102 | 201 229 | < 1 | < 0.01 | 12 | 450 | 30 | < 2 | 2 | 19 | 0.03 | < 10 | < 10 | 26 | < 10 | 66 |
| 93LKC-D103 | 201 229 | < 1 | < 0.01 | 11 | 480 | 18 | < 2 | 3 | 17 | 0.05 | < 10 | < 10 | 29 | < 10 | 76 |
| 93LKC-D104 | 201 229 | < 1 | < 0.01 | 9 | 380 | 14 | < 2 | 3 | 20 | 0.04 | < 10 | < 10 | 26 | < 10 | 60 |
| 93LKC-D105 | 201 229 | < 1 | 0.01 | 18 | 540 | 10 | 2 | 4 | 23 | 0.07 | < 10 | < 10 | 45 | < 10 | 76 |
| 93LKC-D106 | 201 229 | < 1 | 0.01 | 20 | 560 | 18 | < 2 | 4 | 25 | 0.07 | < 10 | < 10 | 44 | < 10 | 72 |
| 93LKC-D107 | 201 229 | 1 | 0.01 | 42 | 400 | 12 | < 2 | 6 | 23 | 0.12 | < 10 | < 10 | 50 | < 10 | 88 |
| 93LKC-D108 | 201 229 | < 1 | < 0.01 | 13 | 440 | 10 | < 2 | 5 | 13 | 0.10 | < 10 | < 10 | 40 | < 10 | 72 |
| 93LKC-D109 | 201 229 | < 1 | < 0.01 | 17 | 290 | 8 | < 2 | 4 | 10 | 0.08 | < 10 | < 10 | 46 | < 10 | 76 |
| 93LKC-D110 | 201 229 | 1 | < 0.01 | 17 | 370 | 18 | 2 | 3 | 13 | 0.13 | < 10 | < 10 | 50 | < 10 | 72 |
| 93LKC-D111 | 201 229 | < 1 | < 0.01 | 15 | 320 | 2 | < 2 | 3 | 13 | 0.12 | < 10 | < 10 | 59 | < 10 | 72 |
| 93LKC-D112 | 201 229 | < 1 | < 0.01 | 18 | 260 | 8 | < 2 | 4 | 13 | 0.19 | < 10 | < 10 | 61 | < 10 | 80 |
| 93LKC-D113 | 201 229 | < 1 | < 0.01 | 15 | 200 | 2 | < 2 | 4 | 11 | 0.20 | < 10 | < 10 | 72 | < 10 | 78 |
| 93LKC-D114 | 201 229 | < 1 | < 0.01 | 6 | 230 | 8 | < 2 | 3 | 10 | 0.08 | < 10 | < 10 | 36 | < 10 | 52 |
| 93LKC-D115 | 201 229 | < 1 | < 0.01 | 10 | 420 | 8 | < 2 | 3 | 13 | 0.07 | < 10 | < 10 | 34 | < 10 | 68 |
| 93LKC-D116 | 201 229 | < 1 | < 0.01 | 9 | 500 | 12 | < 2 | 3 | 18 | 0.06 | < 10 | < 10 | 23 | < 10 | 62 |

CERTIFICATION:

Hart Bichler



Chemex Labs Ltd.

Analytical Chemists * Geochemists * Registered Assayers
212 Brooksbank Ave., North Vancouver
British Columbia, Canada V7J 2C1
PHONE: 604-984-0221

Client: PEARL PETROLEUM CORP.
1100 - 675 W. HASTINGS ST.
VANCOUVER, BC
V6B 1N6

Page Number : 1-A
Total Pages : 1
Certificate Date: 06-SEP-93
Invoice No. : 19319799
P.O. Number :
Account : KYW

Project : KLONDIKE II
Comments: CC: COLIN LITTLE

CERTIFICATE OF ANALYSIS A9319799

| SAMPLE | PREP CODE | Au ppb FA+AA | Ag ppm | Al % | As ppm | Ba ppm | Be ppm | Bi ppm | Ca % | Cd ppm | Co ppm | Cr ppm | Cu ppm | Fe % | Ga ppm | Hg ppm | K % | La ppm | Mg % | Mn ppm |
|--------|-----------|-----------------|-----------|---------|-----------|-----------|-----------|-----------|---------|-----------|-----------|-----------|-----------|---------|-----------|-----------|--------|-----------|---------|-----------|
|--------|-----------|-----------------|-----------|---------|-----------|-----------|-----------|-----------|---------|-----------|-----------|-----------|-----------|---------|-----------|-----------|--------|-----------|---------|-----------|

| | | | | | | | | | | | | | | | | | | | | |
|----------|----------|---|-----|------|-----|------|-------|-----|------|-------|---|----|----|------|------|-----|------|------|------|-----|
| 93PKC-R3 | 212 274 | 5 | 0.2 | 0.07 | < 2 | 1450 | < 0.5 | < 2 | 0.91 | < 0.5 | 1 | 30 | 23 | 1.33 | < 10 | < 1 | 0.03 | < 10 | 0.07 | 210 |
|----------|----------|---|-----|------|-----|------|-------|-----|------|-------|---|----|----|------|------|-----|------|------|------|-----|

CERTIFICATION: Hartl/Bachler



Chemex Labs Ltd.

Analytical Chemists * Geochemists * Registered Assayers
212 Brooksbank Ave., North Vancouver
British Columbia, Canada V7J 2C1
PHONE: 604-984-0221

To: PEARL PETROLEUM CORP.
1100 - 675 W. HASTINGS ST.
VANCOUVER, BC
V6B 1N6

Project : KLONDIKE II
Comments: CC: COLIN LITTLE

Page Number : 1-B
Total Pages : 1
Certificate Date: 06-SEP-93
Invoice No. : I9319799
P.O. Number :
Account : KYW

CERTIFICATE OF ANALYSIS A9319799

| SAMPLE | PREP CODE | Mo ppm | Na % | Ni ppm | P ppm | Pb ppm | Sb ppm | Sc ppm | Sr ppm | Ti % | Tl ppm | U ppm | V ppm | W ppm | Zn ppm |
|--------|-----------|-----------|---------|-----------|----------|-----------|-----------|-----------|-----------|---------|-----------|----------|----------|----------|-----------|
|--------|-----------|-----------|---------|-----------|----------|-----------|-----------|-----------|-----------|---------|-----------|----------|----------|----------|-----------|

| | | | | | | | | | | | | | | | |
|----------|---------|----------|----|----|---|-----|-----|-----------|------|------|---|------|---|--|--|
| 93PKC-R3 | 212 274 | 2 < 0.01 | 12 | 40 | 2 | < 2 | < 1 | 28 < 0.01 | < 10 | < 10 | 2 | < 10 | 4 | | |
|----------|---------|----------|----|----|---|-----|-----|-----------|------|------|---|------|---|--|--|

| | | | | | | | | | | | | | | | |
|--|--|--|--|--|--|--|--|--|--|--|--|--|--|--|--|
| | | | | | | | | | | | | | | | |
|--|--|--|--|--|--|--|--|--|--|--|--|--|--|--|--|

CERTIFICATION: Heath Baskin

needs approval

copy

MINFILE: 1150 063
PAGE NO: 1 of 2
UPDATED: 07/14/94

**YUKON MINFILE
STANDARD REPORT
EXPLORATION AND GEOLOGICAL SERVICES DIVISION, DIAND
WHITEHORSE**

NAME(S): Gold Run
MINFILE #: 1150 063
MAJOR COMMODITIES: Au,Pb
MINOR COMMODITIES: Ag
TECTONIC ELEMENT: Yukon Tanana Terrane

NTS MAP SHEET: 115 O 15
LATITUDE: 63°47'32"N
LONGITUDE: 138°45'54"W
DEPOSIT TYPE: Vein
STATUS: Prospect

CLAIMS (PREVIOUS AND CURRENT)

MACKAY, PIONEER, KLUN, KIN, KING

WORK HISTORY

Staked as MacKay, Pioneer, etc cl (12000) (Gold Run Group) commencing in Aug/10 by W.D. MacKay, N.J. Donahue, etc., who explored with a total of about 30 m of shafting and 23 m of adits at several locations plus extensive hand trenching until 1924. When examined by MacLean in 1912, the workings consisted of several trenches on the ridge crest between upper Portland Creek and the head of Gold Run Creek and a small open cut on the slope between the ridge crest and Portland Creek.

Restaked as Klun cl (YA65707) in Jun/83 by Dawson Eldorado Gold EL, which performed mapping and geochem sampling later in the year, and as Kin cl (YB4197) in Jul/87 by United Keno Hill ML which performed mapping, geochem sampling and trenching in 1988.

Restaked in Nov/92 as part of a block of 60 King cl (YB41555) by W.T. Dawson. Dawson Syndicate (1983) Ltd. performed geochemical sampling on the King cl in Aug/93.

GEOLOGY

The area is traversed by a shallow southwest-dipping thrust fault that places medium to dark green chlorite schist and minor rusty yellow muscovite quartz schist on top of a sequence of tan to pale green weathering muscovitic quartzite and quartz-muscovite schist. Small lenses of sheared serpentinite occur along the fault trace.

MacLean examined the Gold Run occurrence in 1912, at which time the workings included several trenches on the ridge crest between upper Portland Creek and the head of Gold Run Creek and a small open cut on the slope between the ridge crest and Portland Creek. Three samples from the ridge trenches assayed by MacLean in 1914 were barren. He described the occurrence in the open cut on the slope as as follows:

"...outcroppings of white quartz occur for a distance of several hundred feet in a southeasterly-northwesterly direction from the ridge towards Portland Gulch, where the vein is uncovered by an open cut, which is at an elevation about 300 ft above the bed of the gulch and distant 1200 to 1500 ft from its right limit. This open cut is 8 ft long, 4 ft wide and 6 ft in depth at the face. It is made into the side hill and uncovers a vein 18" wide, which dips 50° NE, cutting the schists but striking with them.

This vein has the appearance of a regular fissure, but the general lack of continuity of the quartz veins in this vicinity causes one to hesitate in pronouncing it a persistent one without more proof than present development affords. It is altogether likely, however, that it will be found to follow the line of outcroppings referred to above as occurring for a distance of several hundred feet.

A small showing of free gold was here found in the quartz. Some galena was also noted. The quartz is generally very white, though occasional stains, due to iron oxides, were seen.

GEOLOGY (CONTINUED)

Three samples of quartz were taken from this lead. One of them, from an outcrop, and two from the above open cut, all panned colours of gold, and the two latter assayed \$34.90 (1.75 oz/t) and \$3.42 (5.7 oz/t) respectively." (Gold at \$20.00 and silver at \$0.60 per ounce). (MacLean 1914, p. 83-84).

J.K. Mortensen examined the trenches on the ridge during 1983. All of the quartz present is concordant with foliation in the schist. The open cut north of the ridge could not be located.

REFERENCES

DAWSON SYNDICATE (1983) LTD., Dec/93. Assessment Report #093158 by P. Southam.

MACLEAN, T.A., 1914. Lode Mining in Yukon. Mines Branch Publication 222, p. 83-85.

YUKON EXPLORATION AND GEOLOGY 1983, p. 262; 1984, p. 207-208.