

MAP NO.: ASSESSMENT REPORT X DOCUMENT NO: 093014
106 D /4 PROSPECTUS MINING DISTRICT: Mayo
105 M /13 CONFIDENTIAL X TYPE OF WORK: Evaluation Survey
OPEN FILE

REPORT FILED UNDER: M. J. Moreau Enterprises Ltd.

DATE PERFORMED: June 17 - 19, 1991. DATE FILED: February 14, 1992

LOCATION: LAT.: 64°01'N AREA: Secret and Haggart Creeks
LONG.: 135°56'W VALUE \$: 4,800

CLAIM NAME & NO.: Pierre 1 - 12, YB03799 - YB03810, Pierre 27, 29, 30 YB03729 - YB03731,
Pierre 33 YB03746, Pierre 75, 77, 79, 81, YB03732 - YB03735
Peso 1, 2, 11, 12, YB03795 - YB03798, Rex 1 - 8 YB03721 - YB03728
Mole 1 - 6, 13, 14, YB03787 - YB03794, Mole 15 - 18, YB03747 - YB03750.

WORK DONE BY: R. W. Hulstein B.Sc.

WORK DONE FOR: M. J. Moreau Enterprises Ltd.

DATE TO GOOD STANDING:

REMARKS: # 106 - D - Secret and Haggart Creeks
Monreau Enterprises contracted Arum Geological Services to
undertake a evaluation survey of the property. Sampling confirmed
the existence of high grade silver-lead veins (greater than
20 oz/ton silver) on property. Also several samples from No. 3 vein
(east) returned anomalous gold values at depth. Study recommends
operating property as high grade silver mine and examining it for
Fort Knox type gold deposit. Dimond drilling from No. 3 vein
(east) drift is recommended to determine if mineralization is
controlled in part by elevation and or proximity to the biotite
granodiorite stock.

of course - need and proper and
limited authorized jurisdiction
of course for the purpose
of having a one job
for the rest of the world

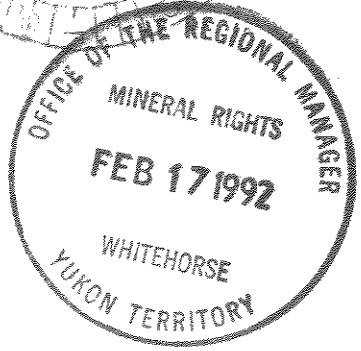
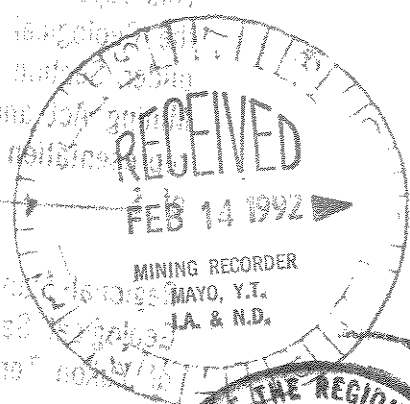

**REPORT ON THE 1991
GEOLOGICAL AND GEOCHEMICAL
WORK ON THE PIERRE PROPERTY**

MAYO MINING DISTRICT, YUKON TERRITORY
JUNE 17-19, 1991

Claims:

PIERRE 1-12	YB03799-3810
PIERRE 27,29,30,	YB03729-3731
PIERRE 33	YB03746
PIERRE 75,77,79,81	YB03732-3735
PESO 1,2,11,12	YB03795-3798
REX 1-8	YB03721-3728
MOLE 1-6,13,14	YB03787-3794
MOLE 15-18	YB03747-3750

Location:

1. 24 km NW of Elsa, Yukon
2. NTS 106 D/4 and 105 M/13
3. Latitude 64°01'08"
Longitude 135°56'43"

For: M. J. MOREAU ENTERPRISES LTD.
P.O. Box 5282,
Whitehorse, Yukon
Y1A 4Z2

By: R. W. Hulstein, B.Sc., FGAC
AURUM GEOLOGICAL CONSULTANTS INC.
412-675 West Hastings Street,
Vancouver, B.C.
V6B 1N2

January 31, 1992

093014

This report has been examined by
the Geological Evaluation Unit
under Section 53 (4) Yukon Quartz
Mining Act and is allowed as
representation work in the amount
of \$ 4,800.00.

Robert Debbok

for
Regional Manager, Exploration and
Geological Services for Commissioner
of Yukon Territory.

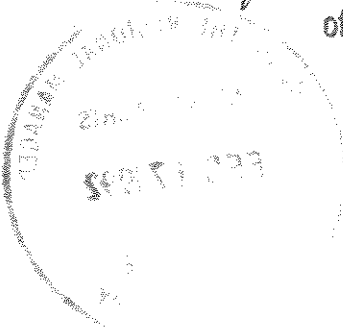

SUMMARY

The Pierre Property consists of 44 mineral claims located between Secret Creek and Haggert Creek, in the Dublin Gulch area, of the Mayo Mining District. The claims are accessible by road, approximately 37 miles (60 km), from Mayo, Yukon.

The property has been explored for epithermal to mesothermal silver-lead-antimony vein deposits localized in faults and fractures in phyllites and quartzites. Mineralization is believed to be genetically related to the Cretaceous Potato Hills Stock of biotite granodiorite. Currently the neighboring claims at Dublin Gulch are being aggressively explored for bulk tonnage gold deposits.

Six veins have been discovered (No. 1-4, 6 and Rex Vein) on the ground presently covered by the Pierre Property. Peso Silver Mines Ltd. carried out extensive exploration from 1961 to 1965 including significant underground development on the No. 1 and Rex Vein. Results of this work outlined a total mineralized reserve in the proven and probable category of 154,000 tons grading 20.9 oz/ton silver and 3.7 % lead. Another 217,000 tons in the possible category of undetermined grade are indicated. Only limited surface work has been carried out on the other veins.

Rock samples collected in 1991 returned up to 1720 ppb gold and 37.8 oz/ton silver. Arsenic and antimony values were extremely anomalous returning numerous values greater than 90,000 ppm and 10,000 ppm respectively. The possibility of significant gold mineralization on the No. 3 Vein is indicated by increased gold/silver ratios to the east at lower elevations and near a biotite granodiorite intrusive. An aeromagnetic anomaly is also located in the same area.

The Pierre Property is an attractive target for developing high grade silver deposits. The property has potential to host bulk tonnage gold deposits similar to the Fort Knox deposit, located at Fairbanks Alaska, being developed by Amax Gold.

Based on these results, a program of data compilation, surveying, underground examinations, geological mapping, and geochemical sampling is warranted and recommended.

TABLE OF CONTENTS

SUMMARY	i
TABLE OF CONTENTS	ii
INTRODUCTION	1
LOCATION AND ACCESS	2
CLIMATE, TOPOGRAPHY AND VEGETATION	4
PROPERTY	5
HISTORY	7
GEOLOGY	9
Regional Geology	9
Property Geology	10
Structure	12
MINERALIZATION	13
GEOCHEMISTRY	17
GEOPHYSICS	19
CONCLUSIONS AND RECOMMENDATIONS	20
REFERENCES	22
STATEMENT OF QUALIFICATIONS	24

LIST OF FIGURES

Figure 1: Location Map; 1:1,000,000	3
Figure 2: Claim Map; 1:31,680	6
Figure 3: Geology of the Dublin Gulch Area; 1:770	11
Figure 4: Property Geology and Geochemistry; 1:12,000	in pocket
Figure 5: No.1 Vein, Geology and Geochemistry; 1:1000	in pocket

LIST OF APPENDICES

Appendix A - Rock Sample Descriptions
Appendix B - Analytical Methods and Reports
Appendix C - Selected Papers

INTRODUCTION

This report was prepared at the request of M. J. Moreau of Whitehorse, Yukon, President of M.J. Moreau Enterprises Ltd., and owner of the property. Its purpose is to summarize the economic potential of the Pierre Property and to satisfy 1991 assessment requirements.

Exploration for gold, silver, tin and tungsten in the Dublin Gulch area has been continuous since placer miners first explored the area in the late 1800's. Currently an aggressive exploration program is being carried out by Amax Gold at Dublin Gulch for bulk tonnage 'porphyry gold' deposits related to Cretaceous felsic intrusives (INAC, 1992).

The report consists of a compilation of available data from exploration programs conducted by Peso Silver Mines Ltd. during the period 1961 to 1965, on government geological maps and reports, a 1987 report by R.A. Doherty with Aurum Geological Consultants Inc., and from data collected by the writer and M. J. Moreau during the period June 17-19, 1991. To date the detailed plan maps, sections, drill logs, etc., relating to the Pierre Property, have not been located.

The ground now covered by Peso, Rex, Mole, and Pierre quartz claims are collectively called the Pierre Property. The ground was first staked in 1910 when vein occurrences of silver-lead-antimony were first discovered. Exploration since then has been sporadic except during the period 1960-64 when Peso Silver Mines Ltd. carried out an extensive surface and underground exploration program on the silver-lead-antimony veins.

LOCATION AND ACCESS

The Pierre Property is located in central Yukon, approximately 229 miles (368 km) north of Whitehorse, within the Mayo Mining District. Specifically, the claims cover the high ground between Secret Creek and Haggart Creek, 30 miles (48 km) north of Mayo and 15 miles (25 km) northwest of Elsa (Figure 1).

Secret Creek is a tributary of Haggart Creek which in turn flows into the South McQuesten River. Access to the area is very good with well maintained gravel roads leaving the Mayo road approximately 15 miles (25 km) north of Mayo, travelling a further 22 miles (35 km) along the South McQuesten river valley and up Haggart Creek and then Secret Creek and onto the property. Numerous 'cat' roads have been constructed on the property and most are passable with two or four wheel drive vehicles. However some 'cat' roads are not passable due to deadfall, extensive new growth (alders), and washouts. Placer miners operating on the middle reaches of Secret Creek have recently re-routed parts of the road.

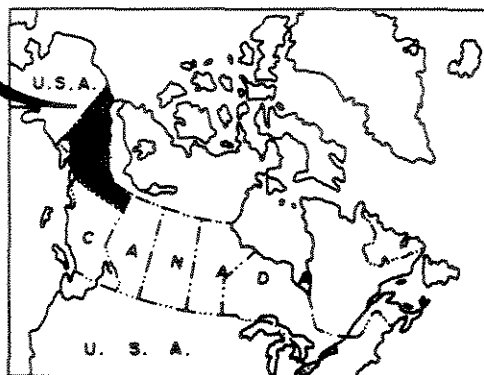
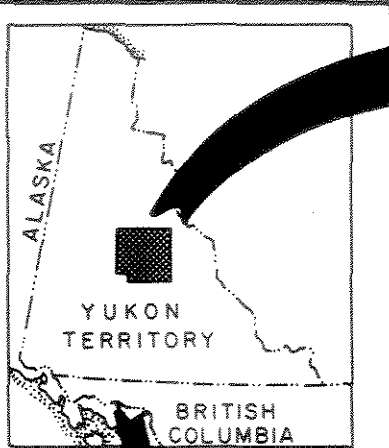
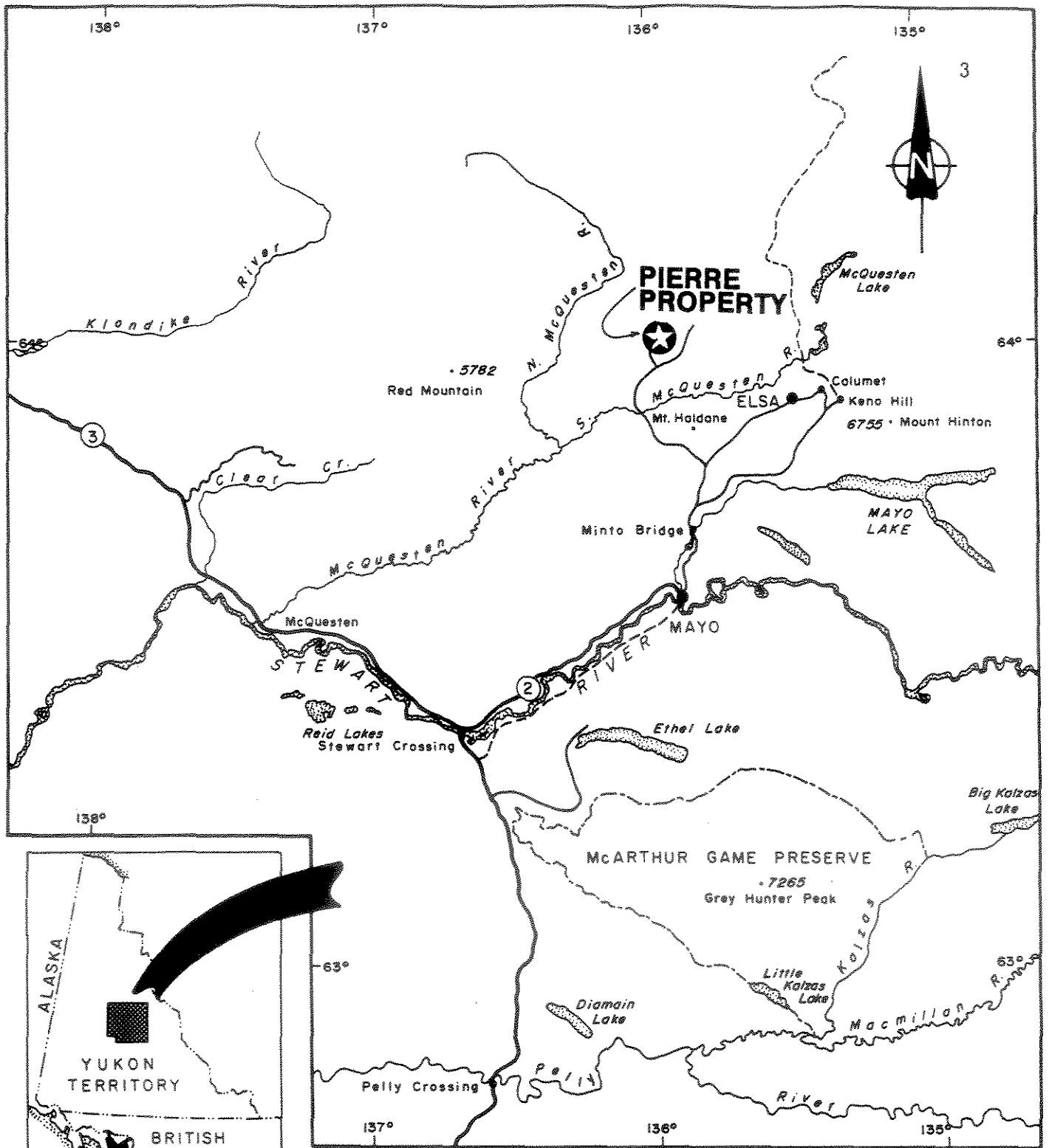

M.J. MOREAU ENTERPRISES LTD.

PIERRE PROPERTY
MAYO MINING DISTRICT, Y.T.

LOCATION

Aurum Geological Consultants Inc. Jan., 1992
 Drawn by NH Checked by RAD Scale 1:1,000,000 FIGURE 1

CLIMATE, TOPOGRAPHY AND VEGETATION

The climate in this area of the central Yukon is characterized by low precipitation and a wide temperature range. Winters are cold and long with temperatures of -30 to -40 degrees Celsius not uncommon. The summers are short with variable temperatures. Frost or snow can occur during any of the summer months.

This area of McQuesten River is part of the Stewart Plateau, a subdivision of the Yukon Plateau. The terrain consists of undulating broad smooth uplands, varying between 1900 to 4000 feet (600 to 1200 m) elevation, with some higher peaks reaching 6000 feet (1800 m) elevation. Evidence suggests that glaciation was confined to the broad through-going valleys and that parts of the upland plateau escaped glaciation (Green, 1971).

Outcrop in the area is generally less than 5% and is found on ridge tops, steep slopes and in the bottoms of some creeks.

Much of the area has been burned over and only isolated stands of white spruce and alpine fir remain above the river valleys. The burned areas contain thick willow brush which can make foot travel difficult.

PROPERTY

The Pierre Property (Figure 2) consists of 44 full two-post unsurveyed mineral claims, staked under the Yukon Quartz Mining Act, covering approximately 886 hectares (2189 acres). Claim data are as follows:

<u>CLAIM NAME</u>	<u>GRANT No.</u>	<u>EXPIRY DATE*</u>
PIERRE 1-12	YB03799-3810	August 21, 1992
PIERRE 27,29,30	YB03729-3731	August 6, 1992
PIERRE 33	YB03746	August 13, 1992
PIERRE 75,77,79,81	YB03732-3735	August 7, 1992
PESO 1,2,11,12	YB03795-3798	August 21, 1993
REX 1-8	YB03721-3728	August 3, 1992
MOLE 1-6,13,14	YB03787-3794	August 14, 1992
MOLE 15-18	YB03747-3750	August 13, 1992



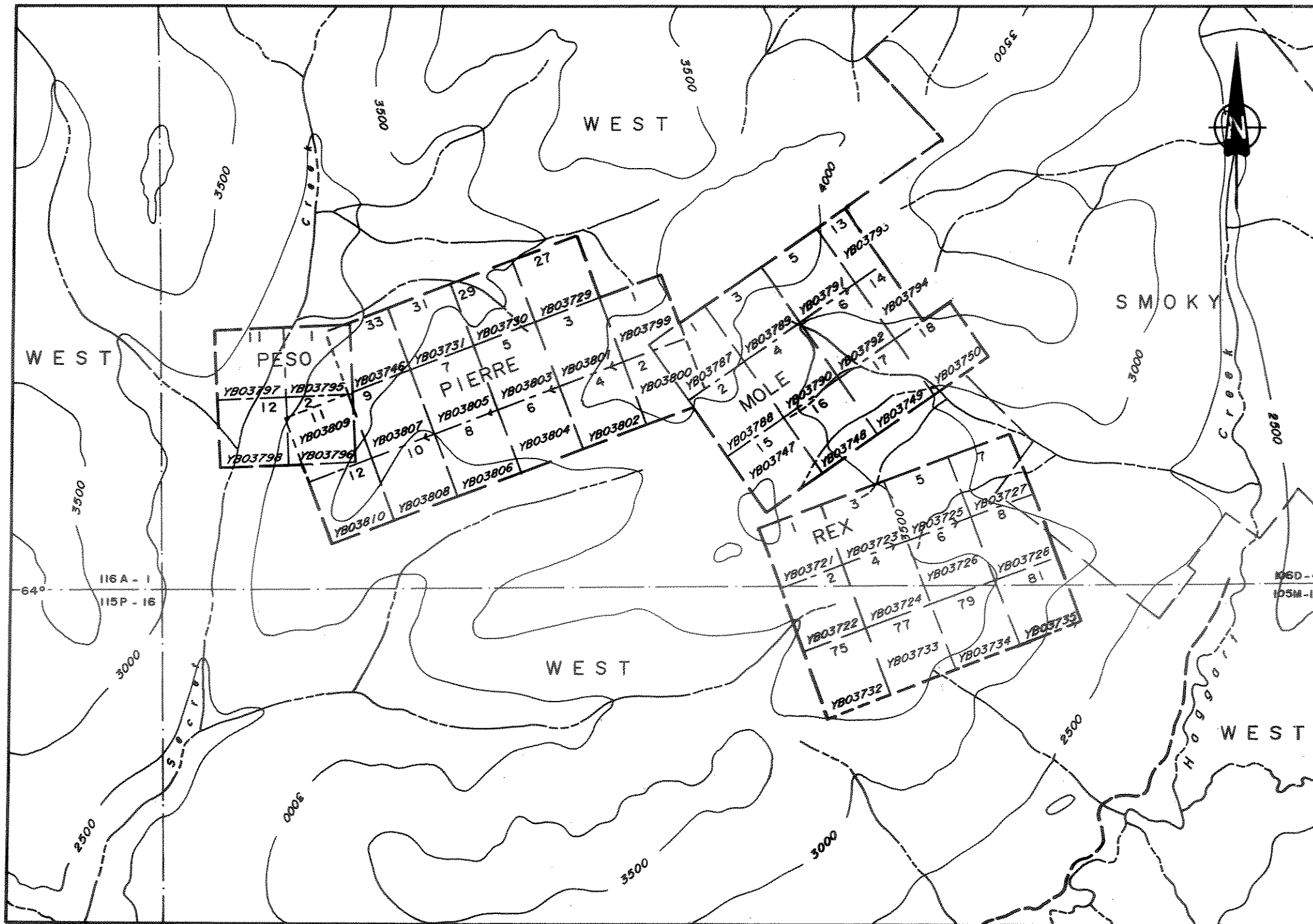

* Subject to approval of 1991 assessment work.

The claims comprising the Pierre property are owned 100% by M.J. Moreau Enterprises Ltd. of Whitehorse, Yukon Territory. They are shown on Yukon Quartz Map Sheets 106 D-4 and 105 M-13.

The Smokey claims to the east and the West claims surrounding the Pierre Property are owned or under option by Amax Gold.

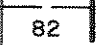

LEGEND

-  82 claim boundary
-  claim number
-  tag number
-  creek
-  4000 elevation contour: interval 500ft

Note - adapted from D.I.A.N.D.
 claim map sheets 104 D-6,
 105 M-13, 115 P-16 &
 116 A-1.

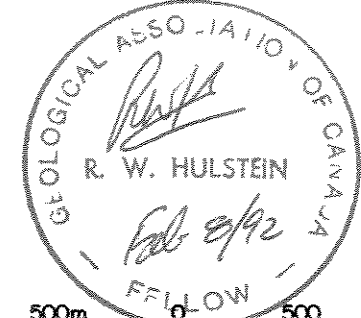

M. J. MOREAU ENTERPRISES LTD.
 PIERRE 1-52, 61-88 & 93-96 CLAIMS
 MAYO MINING DISTRICT, Y.T.

CLAIM MAP

Aurum Geological Consultants Inc. JANUARY 1992
 NTS 106D/4, 105M/13 Drawn by NH Scale 1" = .5 ml. FIGURE 2

HISTORY

The following property history is compiled from mineral industry reports of the Yukon Territory summarized in Geological Survey of Canada papers by Skinner (1961), Green and Godwin (1963, 1964), and Green (1964). Additional data is referenced as it appears in the text.

The Peso property was first staked by J. Alverson and G Huffman in 1910 and restaked as the Peso Group in 1949 by Alverson and C.D. Poli who reopened an existing shaft and traced the silver-lead-antimony veins eastward over a 1.8 mile (3 km) strike length onto adjoining properties then known as the Barber Group (presently the Mole and Smokey claim groups). The property was optioned during 1951-52 to A.W. Johnston and J.W. Powelson and in 1960 was optioned to Tanamar Gold Mines Ltd. who added additional claims to make up a 100 claim block.

In 1961, Peso Silver Mines Ltd. acquired the ground from Tanamar Gold Mines Ltd. and began detailed exploration on the silver-lead-antimony veins. Exploration and development work was carried out until 1964. During this period, at least \$640,000 was spent developing the property, (Province newspaper, July 20, 1963). Work consisted of stripping, trenching, EM survey, geological mapping, geochemical sampling and line cutting. Diamond drilling confirmed high grade silver-lead-antimony veins at depth and a shaft was sunk and a 360 foot (110 m) adit was driven from a point approximately 300 feet (90 m) west of the shaft at the 3350 foot (1020 m) level on the No. 1 vein. Additional veins outlined include the No. 2, 3, 4, 5, and 6 veins, these vary in strike length from 130 to 9185 feet (40 to 2800 m).

By the end of February 1963, a total of 1250 feet (381m) of underground drifting had been completed on the No.1 vein. Sample results indicated a 30' (9 m) width of oxidized vein on the second crosscut to the northeast (#4 crosscut), which showed a high grade section of 8' (2.4 m) width grading 0.06 oz/ton gold and 61.7 oz/ton silver with 6.85% lead and 4.14% antimony. A wider section of 17' (5.2 m) assayed 0.04 oz/ton gold, 35.6 oz/ton silver, or a 21' (6.4 m) section of 0.03 oz/ton gold and 30.05 oz/ton silver.

During the same period, work was undertaken on the Rex Vein located approximately 11800 feet (3600 m) southeast of the No. 1 vein located within the Rex 1-8 claims. Work prior to 1964 included trenching, diamond drilling and a

shallow shaft indicated that the Rex vein was traceable for 1500 feet (457 m), had an average width of 7 feet (2.1 m) and extended to a depth of between 250-300 feet (75-91 m). An adit was collared at the 3550 foot (1082 m) level and intersected the Rex vein about 900 feet (275 m) from the portal and the vein was explored for about 750 feet (228 m) to the west and 600 feet (183 m) to the east. The total program on the Rex vein involved 3,500 feet (1065 m) of crosscutting, drifting and raising.

Published combined proven and probable mineralized reserves for the No. 1 and Rex Veins are 154,000 tons grading 20.9 oz/ton silver and 3.7% lead, (Mineral Bulletin MR 198, 1983; Campbell, 1965).

Work on the Peso and Rex claims was intermittent after 1964, partially due to metal prices and because of the declining status of Peso Silver Mines Ltd. due to court actions and infighting among company directors. The claims remained in good standing and additional surface trenching, diamond drilling and geochemical exploration were undertaken in 1972-74 and 1977. In 1979, Peso Silver Mines Ltd. was renamed Rex Silver Mines Ltd on a five shares for one basis.

By 1985, only about 24 claims remained in good standing on the Peso and Rex properties, and when the Mic and Kyla claims lapsed in 1986, the ground was re-staked by M. J. Moreau as the Pierre 1-12 claims. In September 1986, the Pierre 13-22 fractions were staked and in the spring of 1987 additional ground was acquired by staking the Pierre 23-52, 61-88, and 93-96 claims. The Peso and Rex claims were bought by M.J. Moreau at a sheriffs sale in August 1988. The Mole claims were staked in 1990. The current claim group covers the No.1-4, 6 and Rex Veins. The No. 5 Vein lies just north of the property boundary.

In 1992 the surrounding West claims were staked for their 'porphyry gold' potential and are now owned by, or under option to, Amax Gold. A total of 2,500 meters of diamond drilling and 2.3 kilometers of bulldozer trenching were completed in 1991 exploring the Potato Hills Stock and surrounding area (INAC, 1992).

GEOLOGY

Regional Geology

This area of the central Yukon lies to the east of the Tintina fault and consists of the Mackenzie Platform and Selwyn fold belt which comprises Precambrian clastic strata containing two angular unconformities. This lithologic package is overlain by a Cambrian to Devonian carbonate assemblage and Mississippian and younger clastic rocks, (Tempelman-Kluit, 1981). Transported rocks were thrust over the Selwyn fold belt from the west and are now called the Nisutlan, Anvil, and Simpson Allochthonous Assemblages, (Tempelman-Kluit, 1979).

Previous to this revision, the chloritic schists and quartzites hosting the No. 1 Vein had been assigned a PreCambrian age by some authors (Green and Roddick, 1962) or PreCambrian or Paleozoic, (Boyle, 1965) but are now considered to be Lower Schist Unit and Keno Hill Quartzite (Tempelman-Kluit, 1981).

Silver-lead mineralization in the Keno Hill-Galena Hill and silver-lead-antimony +/- gold and tungsten in Dublin Gulch appear to be genetically related to Late Cretaceous biotite granodiorites and related intrusions. A district zonation related to lateral fluid flow away from the Cretaceous granitic rocks has been proposed by (Lynch, 1986) and this model may prove useful for mineral exploration in the area.

On a regional scale the general fault pattern is as follows (Bianconi, 1971):

1. Strong faults trending 060° to E-W, partly mineralized by arsenopyrite, pyrite, freibergite, jamesonite, etc. (Keno Hill, Pierre Property).
2. Vein-fault zones trending NE, mineralized by silver-lead-zinc in the Keno Hill quartzites, by silver-lead-antimony and minor zinc on the Pierre Property.
3. Barren faults, trending NNE to NW, termed cross-faults.

West of the Haggert Creek Fault biotite granodiorite, porphyritic granites and quartz feldspar porphyries intrude the metamorphic rocks on an E-W trend (Tempelman-Kluit, 1964). A geological sketch map of the Dublin Gulch area by D. Tempelman-Kluit is presented in Figure 3.

Property Geology

Precambrian to Paleozoic phyllite, schist, and quartzite underlie most of the property but are limited to less than 5% outcrop (Figure 4). The rocks have a well developed schistosity and are strongly folded. These units are intruded by Cretaceous biotite diorite to granodiorite dykes and sills, and by Tertiary? quartz-feldspar porphyry dikes.

Because of the uncertain age of the metamorphic rocks, units have been designated by number as opposed to age symbols. A brief description, drawn in part from D. Tempelman-Kluit (1964), of each map unit follows:

Map unit 1. Grey Phyllite

This unit consists of grey to grey-green phyllite. Minor graphitic to chloritic shears are present. The phyllites locally have strong wrinkle lineations and thin quartz sweats are common.

Map unit 2. Micaceous quartzite, Schist, Phyllite.

This unit is basically the same as unit 1, but with well developed quartzite bands and graphitic to chloritic schist horizons. Quartz sweats up to 30-50 cm are found parallel to the schistosity. This unit is commonly more resistive weathering than the phyllites.

Unit 3. Massive Quartzite.

This unit outcrops on the northern side of the claim block where it forms a resistive ridge. It consists of massive quartzite that weathers a brownish yellow colour. Thin phyllitic partings and quartz sweats are common along bedding planes.



MAP MODIFIED FROM TEMPELMAN-KLUIT D.J. 1964
THE GEOLOGY OF THE HAGGART CREEK-DUBLIN GULCH
AREA, MAYO DISTRICT, YUKON TERRITORY:
UNPUBLISHED M.A.Sc. THESIS U.B.C. DEPT. OF GEOLOGY

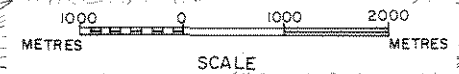
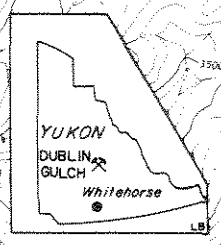

- Limit of mapping.
- Contact, defined-approximate.
- ▲ Thrust fault; teeth indicate dip direction.
- ▲ Dip and strike of bedding; right way up.

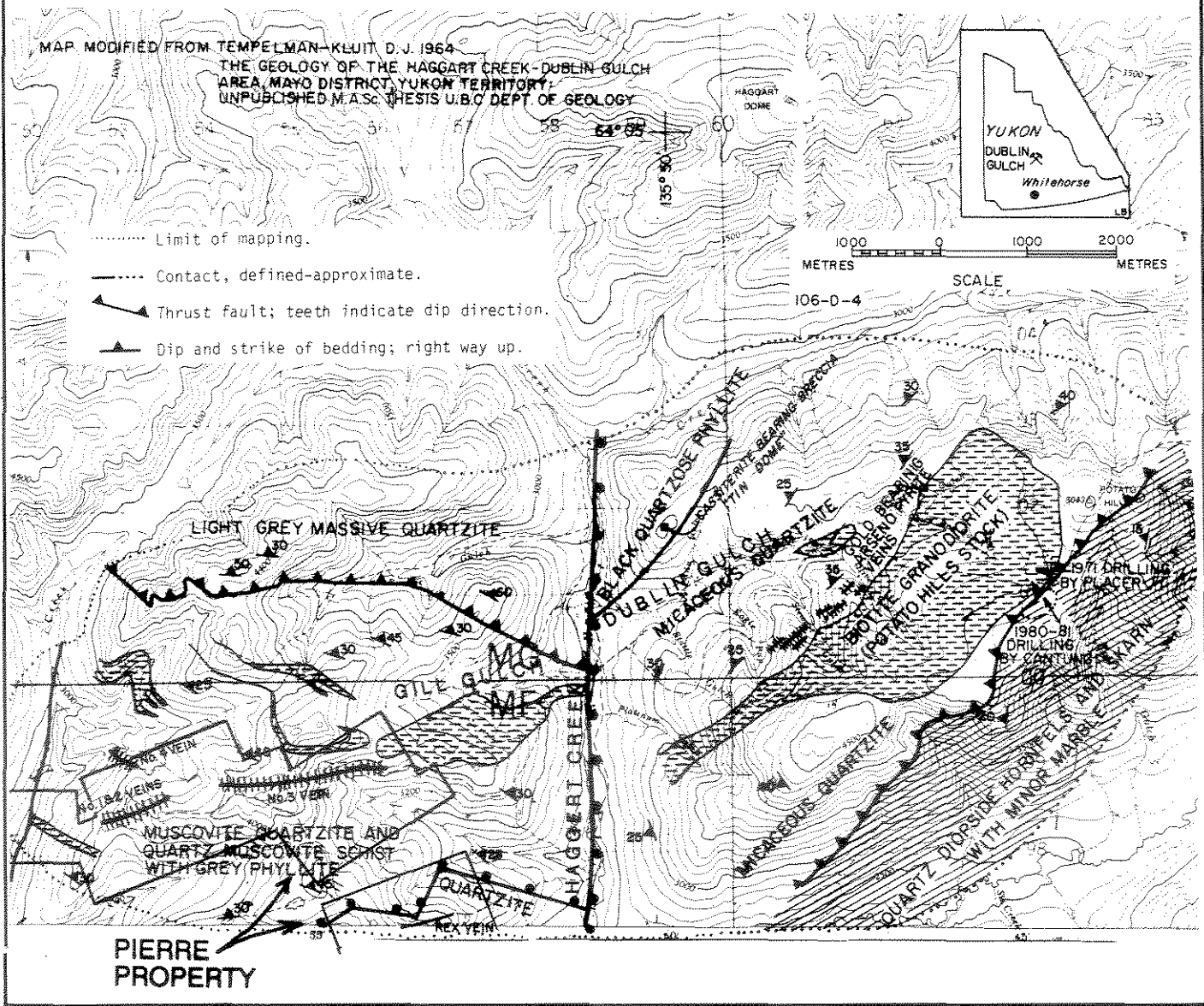

PIERRE PROPERTY

4WD trail
creek, lake



M.J. MOREAU ENTERPRISES LTD.	
PIERRE PROPERTY MAYO MINING DISTRICT - Y.T.	
GEOLOGY OF THE DUBLIN GULCH AREA	
Aurum Geological Consultants Inc.	Jan. 1992
NTS 10/3 M	DRAWN BY NH SCALE 1:770 FIGURE: 3

Unit 4. Biotite Diorite-Granodiorite

This unit outcrops north of the No. 3 vein in two locations and consists of grey to grey green weathering medium grained intrusive of intermediate composition. According to D. Tempelman-Kluit (1964) this unit is possibly a sill and probably part of the Potato Hills Stock outcropping east of Haggert Creek.

Unit 5. Quartz-Feldspar Porphyry

This unit occurs as a number of discontinuous thin 5-20 m thick dykes, predominantly west of Secret Creek. It has an altered whitish fine grained groundmass and contains quartz and /or feldspar phenocrysts. This unit may be of Tertiary age.

Structure

The Quartzites in Units 2 and 3 are commonly highly contorted, isoclinally folded and strongly lineated. The attitude of schistosity is parallel to the bedding but may be highly variable over short distances. Foliations on the property generally strike E-W and dip moderately to the north. An anticline plunging moderately to the east is indicated by the outcrop pattern of the grey phyllite unit, map unit #1 (Tempelman-Kluit, 1964).

Several northeasterly trending faults dipping 35° to 65° NW were intersected in the No.1 Vein adit and southeasterly trending faults are indicated on surface, (Skinner, 1961). The northerly trending Fifteen Pup Cross Fault exposed in one trench crosses the western extension of the Rex vein-fault structure, the No. 3 vein, and the granodiorite north of the No. 3 Vein. Another northerly trending fault crosses the Rex vein. These cross faults are barren and are often marked by wide zones of shearing and gouge.

MINERALIZATION

Mineralization on the Pierre Property consists of silver-lead-antimony fracture filling epithermal to mesothermal veins which are part of the McQuesten Mineral Belt (Aho, 1963b) which extends from Clear Creek on the west through to the Keno Hill district on the east (Figure 1). The belt is 100 miles (160 km) long by 20-30 miles (32-48 km) wide and is a zone of folding, granitic emplacement and mineralization. Mineralization within the belt consists of: placer gold, tin and tungsten; lode deposits of gold bearing quartz-sulfide veins; tin and tungsten in quartz veins, skarns and pegmatites. Mineralization is spatially related to granitoid intrusions, and in some cases, granites host the mineralization.

In the Dublin Gulch area, 6 km east of the Pierre Property, a series of auriferous quartz-arsenopyrite veins have been traced for over 2.5 kilometers. Samples from the vein collected by Tempelman-Kluit (1981), returned gold values of 30 gm/t (0.88 oz/ton) over widths of near 1m (3.2 feet). Currently Amax Gold is aggressively exploring the biotite granodiorite, Potato Hill Stock, on the Dublin Gulch Property for bulk tonnage gold deposits. The exploration model is based on the Fort Knox 'porphyry gold' deposit located at Fairbanks, Alaska also owned or under option to Amax Gold (INAC, 1992). Mineralization at Fort Knox consists of auriferous quartz veins, veinlets and quartz stockworks and breccias within a Mesozoic granite. The Fort Knox deposit, like the Dublin Gulch area, is historically a rich placer gold area.

According to Tempelman-Kluit (1981), the gold arsenopyrite veins at Dublin Gulch and the silver-lead-antimony veins in the Haggart Creek-Secret Creek area are most likely genetically related to the Potato Hills biotite granodiorite stock.

At least six (No. 1 to 6 veins) mineralogically complex silver-lead-antimony veins and one simpler silver-lead vein (Rex Vein), have been located on and about the Pierre Property. The Rex and Peso No. 1 Veins have mineralized reserves totalling 370,630 tons in the following categories (after D.D. Campbell, 1965):

Total Proven tons	91,745	@	23.7 oz/ton silver, 3.7%lead
Total Probable tons	61,885	@	16.7 oz/ton silver, 3.7% lead
Total Possible tons	<u>217,000</u>	@	undetermined grade
Total tons	<u>370,630</u>		

Appendix 'C' contains selected references, including a description of the Rex and No. 1 Vein mineralized reserves by D.D. Campbell (1965).

The bulk of the exploration was carried out by Peso Silver Mines Ltd. between 1961-64. Exploration consisted of geological mapping, soil geochemical surveys, geophysical surveys, bulldozer trenching, diamond drilling, shafting, underground drifting, crosscutting and raising.

Mineralization is found in NE and E-W trending, north dipping fault zones containing brecciated, fractured and sheared host rock, gouge and varying amounts of quartz-sulfide-carbonate veining. Mineralized sections are commonly bound on both sides by well defined parallel faults, with mineralization more or less concentrated at the walls with the footwall favoured, (Tempelman-Kluit 1964). Dark black pyritic gouge is common on the footwall of the veins.

The quartz diorite intrusive 'sill', located immediately south of Gill Gulch, may have had some thermal control over mineralization (Aho, 1963b). Veins No. 1-6 are more complex than the Rex, and silver values appear to be higher further from the intrusive.

The No. 1-4 & 6 Veins are hosted in a major shear zone. The veins are localized along northeast striking, steeply west dipping vein segments lying between east-west intramineral cross faults that dip moderately to flatly north, (Aho, 1963). They contain abundant pyrite and arsenopyrite, with jamesonite, tetrahedrite, and minor sphalerite and bismuthinite. Other metallic minerals reported include galena and chalcopyrite and the copper sulfate calcanthite (Green and Roddick, 1962); secondary minerals include limonite (goethite), scorodite, bindheimite, jarosite, anglesite, covellite, malachite and chalcocite (Tempelman-Kluit, 1964). The sulfides are found with abundant sintery to chalcedonic and vitreous quartz.

The Rex Vein, also in a major shear zone, consists of abundant siderite with quartz, jamesonite, galena, tetrahedrite, lesser sphalerite, and minor pyrite (Aho, 1963a). Secondary minerals are predominantly limonite, bidheimite, and anglesite.

Control on mineralization appears to be the configuration and intersection of faults - fractures rather than host rock types or competence as is more the case in the Keno Hill silver camp (Aho, 1963a).

Vein material is commonly highly oxidized near the surface and is recessive weathering. Silver, being easily leached in near surface environments is depleted in surface outcrops but values up to 185 oz/ton have been reported below the leached zone. Values from within the leached zone are more commonly in the 15-20 oz/ton range, (Aho, 1962).

Within the boundary of the Pierre Claims, the No. 1 and Rex Veins (Figure 3 and 4) have been the focus of the most detailed exploration. The following brief descriptions of each vein is taken from Skinner (1961), Doherty (1987), and from property notes collected by the writer, during June 1991.

No. 1 Vein is located about 1/2 mile (0.8 km) west of Secret Creek, at an altitude of 3700 feet (1127 m). The vein has an average strike of 045° and dips 65° NW. It has been exposed over a length of 900 feet (275 m) on surface and has also been explored by sinking a 40 foot (12 m) inclined shaft and by about 275 feet (83 m) of drifting and crosscuts about 120 feet (36 m) below surface. Assays of samples from the walls of the shaft averaged 0.06 oz/ton gold, 62 oz/ton silver, 2.5% lead and 2.3% antimony, over an average width of 8.5 feet (2.6 m). An 18 foot (5.5 m) down-dip length of the footwall of the vein on the east wall averaged 0.09 oz/ton gold, 102 oz/ton silver, 5% lead and 4.7% antimony over an average width of 2.6 feet (0.8 m).

In 1991 the western section of the exposed No. 1 Vein was mapped and sampled (Figure 5) over a strike length of some 200 meters. Both mapping and sampling are made difficult due to weathering and leaching of the exposed sulfides. The widest mineralized sections appear to be at flexures in the vein. Samples (P91-011 & 012), collected in 1991 one meter down the shaft, returned 251.5 ppm silver (approx. 7.3 oz/ton) with one sample (#P91-012) returning 936 ppb gold.

No. 2 Vein exposed approximately 500 feet (150 m) east of the east end of the No. 1 Vein has been traced over a length of 2000 feet (610 m). It has an average strike 070° and dips 45° to 80°N. Bianconi (1971) reports a 40 foot (12 m) strike length averaging 40.6 oz/ton silver over a true width of 8.4 feet (2.56 m) and 6.25% lead over a true width of 7.3 feet (2.2 m).

No. 3 Vein lies ENE of the shaft on No. 1 Vein and has been traced discontinuously by a series of trenches for about 9800 feet (3000 m). The vein

strikes on average 070° and dips north. Mineralized exposures are found beside an old shaft approximately 6650 feet (2000 m) east of the shaft on the No. 1 Vein. Little assay data has been reported from this vein, (see geochemistry section following). Bianconi (1971), reports the best recorded value being 4.6 oz/ton silver over 6.3 feet (1.9 m).

Sampling in 1991 on the eastern portion of the No. 3 Vein, below the 1100 m elevation and near the biotite granodiorite 'sill', returned anomalous gold values up to 1720 ppb. Silver values from samples in the same area returned less than 74.3 ppm. Although the sample population is small this suggests that gold-silver mineralization is controlled, in part, by elevation and or proximity to the biotite granodiorite stock.

The No. 4, 5, and 6 Veins are all located north of the No. 1 Vein adit and are generally less than 900 feet (300 m) in strike length. The No. 5 Vein is located north of the current property boundary. Available assay data reports low to negligible silver values.

The Rex Vein, located approximately 11580 feet (3500 m) southeast of the shaft on the No. 1 Vein, has been traced on surface for over 1500 feet (460 m). The vein strikes approximately 090° and dips $45-60^{\circ}$ to the north (Bianconi, 1971). Significant underground development consists of 3500 feet (1050 m) of crosscutting, drifting, and raising, and 31 diamond drill holes totalling 3500 feet (1050 m). Unfortunately, as was noted by Campbell (1965), the underground work commenced prior to mineralization being delineated by diamond drilling at the adit elevation level. This led to a large amount of underground development and perhaps ultimately the cessation of exploration on the property.

On the Rex Vein four significant mineralized sections, termed the B, C, D, and E have been delineated to date with the B and E zones being the most significant. One of the best results came near the end of the project, late 1964, when the 74 raise was driven to surface. Results from this raise returned 0.01 oz/ton gold, 44 oz/ton silver, 7.79% lead, and 4.35% antimony over a length of 250 feet (76.2 m) and an average width of 5.2 feet (1.6 m) (Green, 1965). A grab sample collected from the face assayed 0.04 oz/ton gold, 224 oz/ton silver, 8.9% lead, 0.2% zinc, and 6.86% antimony, (Green, 1965).

GEOCHEMISTRY

Stream sediment samples collected by the Geological Survey of Canada in 1965 covered the Dublin Gulch area (Bianconi, 1971). Analytical results returned anomalous values in samples from Secret Creek, Fifteen Pup and Gill Gulch. The anomalous samples in Secret Creek and Fifteen Pup can be explained by known veins while the anomalous samples Gill Gulch are currently unexplained. Bianconi (1971) thought that possible porphyry type disseminated mineralization in the biotite granodiorite, located south of Gill Gulch, may be responsible for the anomalies.

In 1964 Mayo Silver Mines conducted a regional silt and soil sampling program (65 square miles and 5200 samples) including the area covered by the Pierre Property (Bianconi, 1971). Samples were analyzed for lead and zinc. Two anomalous values relating to the Pierre property were returned, one each at Fisher and Gill Gulch's.

A total of 42 samples (32 rock and 10 soil) were collected during the June 1991 exploration program. The analytical work was performed by Northern Analytical Laboratories Ltd. of Whitehorse and Acme Analytical Laboratories Ltd. of Vancouver. Analytical procedures and certificates are in Appendix B to this report. Results are shown on Figures 4 and 5.

Rock Samples

Results from 1991 and the work by Doherty (1987) confirm the silver values reported in the literature. Samples, collected in 1991, from the No. 1 Vein returned a high silver value of 318.5 ppm (sample P91-005) which when fire assayed returned 37.8 oz/ton silver. Gold values returned in 1991 were generally anomalous with a high value of 936 ppb sample (P91-012) being returned from a 0.60 m chip sample in the old shaft. Most of the results for antimony and arsenic, the latter commonly in the 90,000+ ppm range exceed the accuracy limits for the ICP method.

One grab sample (#72012) collected by Doherty (1987) from the No. 2 Vein returned 42.0 ppm silver and 1250 ppb gold. A number of samples collected near the old shaft on the No. 3 Vein returned gold values between 100 and 540 ppb, and silver values between 11 and 45 ppm (Doherty, 1987).

Samples collected from rubble filled and overgrown trenches on the No. 3 Vein returned generally anomalous values (samples P91-017 to 026) for silver, lead, antimony, and arsenic. Gold values were generally low except for sample P91-018 which returned 743 ppb.

Samples (P91-027-032) collected from the eastern end of the No.3 vein returned several anomalous values. Samples P91-030 to 032 returned between 1239 and 1720 ppb gold from float and grab samples of green fine grained to sintery quartz containing arsenopyrite, pyrite and stibnite. These samples, as noted above, are closest to the biotite granodiorite 'sill' and at the lowest elevation of all the samples collected from the No. 3 vein.

Soil Samples

A total of ten soil samples were collected over the Rex Vein or fault structure as an orientation survey. Due to the extensive trenching over the vein samples were collected from the bottom or sides of trenches. Generally the sample medium was the lower B or the C horizon. Overall the anomalous values increase as the vein is approached although the values are not obviously anomalous until the vein itself is sampled, i.e. sample P91-S009 returned 18 ppb gold, 2.9 ppm silver, 114 ppm lead, 48 ppm antimony, and 682 ppm arsenic. The arithmetic average of the ten samples are; 15 ppb gold, 0.5 ppm silver, 60 ppm lead, 23 ppm antimony, and 91 ppm arsenic.

GEOPHYSICS

Aeromagnetic data (GSC Geophysics Paper 3372) for NTS map 106 D/4, by the Geological Survey of Canada, shows a magnetic high south of Gill Gulch (shown on Figure 4). The eastern side of the Mole claims cover part of this anomaly. This magnetic anomaly, the highest on the map sheet, straddles the biotite granodiorite 'sill' contact south of Gill Gulch. The No. 3 East Vein is located within the magnetic anomaly, but was not examined in 1991.

A magnetic low, <3100 gammas, is located east of the Rex and Pierre claims just south of Rex Creek.

In 1962 a Turam electromagnetic survey was carried out by Hunting Survey Corporation Limited (Aho, 1963a; Bianconi, 1971). Approximately 43 line miles were surveyed. A large number of weak to moderate intensity anomalies were detected, including anomalous measurements over known mineralization. The report on the Turam survey recommended that all unexplained anomalous trends striking in an east-northeast direction be investigated by stripping and trenching (Bianconi, 1974). So far as it is known these recommendations have not been carried out.

CONCLUSIONS AND RECOMMENDATIONS

The Pierre property covers a sequence of quartzite, schist, and phyllite intruded by a Cretaceous biotite granodiorite 'sill', and dykes and related Tertiary felsic intrusives. Numerous faults cut all rock units. The property is located in the McQuesten mineral belt at Dublin Gulch, historically and currently an important placer gold camp.

On the Pierre Property silver-lead-antimony veins, hosted by faults and shear zones, have been worked intermittently since 1910. The No. 1 and Rex Veins were explored underground in 1960-1964 and contain proven and probable mineralized reserves totalling 154,000 tons grading 20.9 oz/ton silver and 3.7% lead with another 217,000 tons of unknown grade in the possible category.

Mineralization is thought to be controlled by the configuration and intersection of fractures rather than the host rock types or their competence as is the case at the nearby Keno Hill silver camp. The spatial relationship of the veins to the biotite granodiorite, part of the Potato Hill Stock, cannot be ignored. The silver-lead-antimony veins are probably genetically related to the Potato Hills Stock. Mineralization may also be vertically zoned, with gold at lower elevations.

At Dublin Gulch, six kilometers to the east, Amax Gold is currently exploring for a 'porphyry gold' deposit similar to the Fort Knox deposit Amax Gold acquired in 1991 near Fairbanks, Alaska.

Rock Samples from the No. 1 Vein in 1991 returned silver values grading up to 24.1 oz/ton over 0.80 m while grab samples returned up to 37.8 oz/ton silver. Gold values ranged as high as 936 ppb. Rock samples from the No. 3 Vein collected at a low elevation and near the biotite granodiorite 'sill' returned gold values up to 1720 ppb and low silver values.

Stream sediment samples collected by the GSC and others returned unexplained anomalous values for lead and zinc from Gill Gulch. Gill Gulch drains the eastern portion of the property.

Soil samples collected over the Rex Vein as an orientation survey returned obviously anomalous values directly over the vein. Away from the vein, anomalous values were less obvious indicating very little dispersion.

Aeromagnetic data shows an anomaly covering the margin of the biotite granodiorite and the No. 3 East Vein.

The possibility of developing high grade zones of silver mineralization using presently existing underground workings is an attractive and potentially profitable scenario. The presence of a vein deposit carrying economic concentrations of gold-silver is suggested by the possible increasing gold/silver ratios with depth and to the east, towards the biotite granodiorite.

Results of previous exploration programs on the Pierre Property warrant additional precious metal exploration. The main targets at this time are disseminated mineralization in the biotite granodiorite and high grade gold - silver veins near, or in the granodiorite, or at depth. Based on the above the following work is recommended:

1. Exploration data on the Pierre Property collected by previous exploration companies should be acquired if at all possible.
2. Surveying with base map preparation is required to correlate claim locations, drill holes, geology and infrastructure.
3. The underground workings on the No. 1 and Rex Vein should be examined, underground rehabilitation, sampling, and drilling should be considered.
4. The eastern end of the No. 3 Vein should be trenched, and diamond drilling should be undertaken to test the zone at depth.
5. Additional geological mapping, geochemical sampling and prospecting need to be carried out over the entire property. Special attention must be given to the area underlain by the biotite granodiorite and covered by the magnetic anomaly. Electromagnetic surveys should be considered as a tool to identify hidden veins and structures.

Respectfully submitted,
Aurum Geological Consultants Inc.

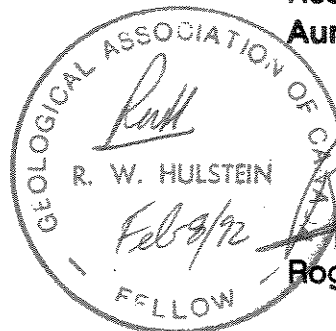

January 31, 1992

Roger Hulstein, B.Sc., FGAC

REFERENCES

- Aho, A.E. 1962. Prospecting and Mineral Development in Yukon; *Western Miner & Oil Review*, Vol. 35 No. 2, p32.
- Aho, A.E. 1963a. 1963 Spring Summary Report on Peso Silver Mines Property at Secret Creek, Y.T.; Private Company Report prepared for Peso Silver Mines Ltd.
- Aho, A.E. 1963b. Silver in the Yukon; *CIM Bulletin*, vol 56, No.611, p 232-238.
- Anonymous, 1983. Canadian Mineral Deposits Not Being Mined in 1983; *Energy Mines and Resources Canada, Mineral Bulletin MR 198*.
- Bianconi, F. 1971. Review Report on the Peso Silver Mines Limited Property in the Mayo District, Yukon Territory; Private Company Report by Bianconi - Saager, Geological Consultants prepared for Peso Silver Mines Limited.
- Boyle, R. W. 1965. Geology, Geochemistry and Origin of the Lead-Zinc-Silver Deposits of the Keno Hill-Galena Hill Area, Yukon Territory; *Geol. Surv. Can.*, Bulletin 111, 302p.
- Campbell, D.D. 1965. Review Report on the Geology and Ore Reserves of the, Peso Silver Mines Ltd., Yukon Territory; Private Company Report by Douglas D. Campbell Consultant.
- Doherty, R.A. 1987. Geological Evaluation of the Pierre Property; Private Company Report by Aurum Geological Consultants Inc. for M.J. Moreau Enterprises Ltd.
- Green, L.H. 1965. The Mineral Industry of Yukon Territory and District of MacKenzie, 1965; *Geol.Surv. Can.*, Paper 66-31.
- Green, L.H. 1971. Geology of Mayo Lake, Scougale Creek and Mcqueston Lake Map Area, Yukon Territory (105 M16, 106 D2, 106 D3); *Geol. Surv.Can.*, Mem. 357.
- Green, L.H., Godwin, C.I. 1963. The Mining Industry of Yukon Territory and Southwestern District of MacKenzie, 1962; *Geol. Surv. Can.*, Paper 63-38.
- Green, L.H., Godwin, C.I. 1964. The Mineral Industry of Yukon Territory and Southwestern District of MacKenzie, Northwest Territories, 1963; *Geol. Surv. Can.*, Paper 64-36.
- INAC, 1992. Yukon Exploration 1991; Exploration and Geological Services Division, Yukon, Indian and Northern Affairs Canada.
- Lynch, G. 1986. Mineral Zoning in the Keno Hill Ag-Pb-Zn Mining District, Yukon; in J.A. Morin and D. S. Emomnd, (eds.) *Yukon Geology Vol.1*; Exploration and Geological Services Division, Indian and Northern Affairs, Canada.

- Skinner, R. 1961. Mineral industry of Yukon Territory and Southwestern District of MacKenzie. 1960; Geol. Surv. Can., Paper 61-23.
- Tempelman-Kluit, D.J. 1964. Geology of the Haggart Creek-Dublin Gulch Area, Mayo District, Yukon Territory. M.Sc. Thesis, U.B.C.
- Tempelman-Kluit, D.J. 1979. Transported cataclastite, Ophiolite and Granodiorite in Yukon: Evidence of Arc-Continent Collision; Geol. Surv. Can., Paper 79-14.
- Tempelman-Kluit, D.J. 1981. Geology and Mineral Deposits of Southern Yukon; in Yukon Geology and Exploration 1979-80. Geology Section, Department of Indian and Northern Affairs, Whitehorse, pp. 23 and 238.

STATEMENT OF QUALIFICATIONS

I, ROGER W. HULSTEIN, with business address:

Aurum Geological Consultants Inc.
P.O. Box 4367
Whitehorse, Yukon
Y1A 3T5

do hereby certify that:

1. I am a geologist with AURUM GEOLOGICAL CONSULTANTS INC., 205-1116 1st Avenue Whitehorse, Yukon territory
2. I am a graduate of Saint Mary's University, Halifax, with a degree in geology (B.Sc., 1981) and have been involved in geology and mineral exploration continuously since 1978.
3. I am a fellow of the Geological Association of Canada (F3572).
4. I have no direct or indirect interest in the properties of M.J. Moreau Enterprises Ltd.
5. I am the author of this report on the Pierre property, Mayo mining district, Yukon, which is based on my personal examination of the ground during June 1991 and on referenced sources.
6. I consent to the use of this report, in a company report or statement, provided no portion is used out of context in such a manner as to convey a meaning differing from that set out in the whole.

January 31, 1992



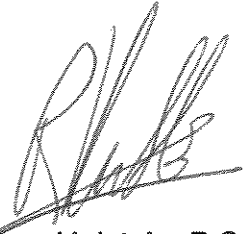

Roger Hulstein, B.Sc., FGAC



LEGEND

- LITHOLOGIES**
- MESOZOIC**
- 5 quartz - feldspar porphyry
 - 4 biotite diorite - granodiorite
- PRECAMBRIAN - PALEOZOIC**
- 3 massive quartzite
 - 2 micaceous quartzite, schist, phyllite
 - 1 grey phyllite

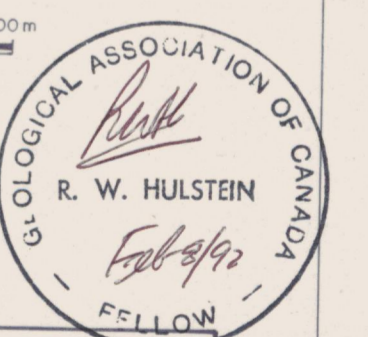
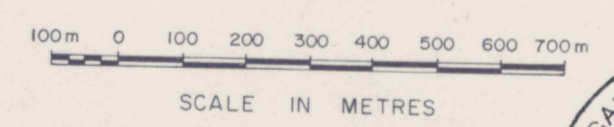
- SYMBOLS**
- 1986 sample location \times 71015 / 50, 620, 5700 (1.32 o.p.t. Ag) Ag(ppm) Sb(ppm) silver assay
 - sample number Au (ppb)
 - trace of silver-lead-antimony vein
 - area of outcrop
 - geological contact (defined, approximate, assumed)
 - fault
 - shaft
 - adit
 - trench
 - building
 - road
 - creek
 - elevation contour-interval 100m
 - claim post
- Notes - all claim boundaries are unsurveyed and locations are approximate
- topography modified from 1:50,000 NTS 106D/4 and 105M/13 and from Templeman-Kluit 1964
 - geology after Green & Roddick 1961, Templeman-Kluit 1964, Boyle 1965
 - GSC Geophysics Paper 3372



1991 SOIL SAMPLES

Sample Number	Sample Site	Au ppb	Ag ppm	Pb ppm	Sb ppm	As ppm
P91-S001	2S	<10	0.1	49	3	8
P91-S002	40S	<10	0.5	123	38	61
P91-S003	60S	18	0.4	32	52	24
P91-S004	80S	20	0.3	61	26	32
P91-S005	20W80S	21	0.1	107	20	10
P91-S006	20W60S	16	0.1	16	9	15
P91-S007	20W40S	14	0.1	23	4	2
P91-S008	20W20S	<10	0.2	35	14	51
P91-S009	20W00	18	2.9	114	48	682
P91-S010	20W18N	<10	0.1	38	8	23

1991 ROCK SAMPLES

Sample Number	True Width	Au ppb	Ag ppm	Pb ppm	Sb ppm	As ppm
P91-001	Grab	132	22.9	2673	1802	47261
P91-017	Floater	N/A	N/A	N/A	N/A	N/A
P91-018	Floater	743	30.1	15037	5224	32994
P91-019	Grab	54	22.0	12035	7492	15419
P91-020	Floater	66	3.2	959	529	1279
P91-021	Grab	44	58.4	24400	12118	7119
P91-022	Grab	132	40.6	24272	10189	1952
P91-023	Grab	21	1.5	500	377	409
P91-024	Floater	16	13.2	11901	2636	1056
P91-025	Floater	20	11.9	11638	5464	411
P91-026	Grab	16	156.5	23011	12446	9
P91-027	1.5m	14	8.7	16089	10459	401
P91-028	1.0m	244	14.9	3103	923	15152
P91-029	Floater	10	74.3	21133	7032	37763
P91-030	Floater	1720	9.4	4333	1760	97789
P91-031	Grab	1239	13.2	2131	1753	97284
P91-032	Grab	1407	5.3	4160	1280	74137

M. J. MOREAU ENTERPRISES LTD.
 PIERRE PROPERTY
 MAYO MINING DISTRICT, Y.T.

DWG 44 093014

GEOLOGY & GEOCHEMISTRY 388

MAP# 106/4, 105M/13

Aurum Geological Consultants Inc. APRIL 1987
 REVERSED JANUARY 1992

NTS 106D/4, 105M/13 Drawn by RAD/NH Scale 1:12,000 FIGURE 5

APPENDIX A
ROCK SAMPLE DESCRIPTIONS

PESO-REX PROJECT

AURUM GEOLOGICAL CONSULTANTS INC.

JUNE 17-19, 1991 NTS: 105M/13 & 106D/4 SAMPLERS: RWH, MJM LAB: NAL and ACME ANALYTICAL

Sample No.	Location	Description	Altitude	Width	Au ppb	Au opt	Ag ppm	Ag opt	Pb ppm	Sb ppm	As ppm
P91-001	Dump at Peso #1 Adit	Scattered fragments of grey friable shale with local striations, qtz and py veinlets. 50% of sample is well mineralized with massive arsenopyrite, galena and pyrite. Remaining 50% consists of more massive schist and gneiss crosscut by qtz and py veinlets (<5%).	Float	Float	132	N/A	22.9	N/A	2673	1802	47261
P91-002	Peso #1 Vein approx. 150m E of P91-001	High grade. Green arsenical qtz vein with green chalcedonic banding. Vein rubble exposed in trench for 17 meters, avg. 0.4-0.5m wide, in quartzite host rock where exposed on S side. Grey spotted phyllite near north side contact.	072/?	~ 1.0m Grab	382	N/A	50.5	N/A	1.22%	8292	92462
P91-003	Peso #1 Vein	Grey qtz-sulfide vein, vuggy, green and white stained, aspy and py, total ~ 3%, in brecciated qtz vein.	N/A	Grab	268	N/A	63.1	N/A	0.87%	3635	68364
P91-004	Peso #1 Vein 11+75E	Green qtz-sulfide vein rubble, vuggy, approx 4% pyrite, minor aspy.	035/?	~ 1.0m Grab	325	N/A	116.9	N/A	1157	1330	90918
P91-005	Peso #1 Vein 11+75E	Same as above (#004)	N/A	Grab	11	N/A	318.5	37.768	1.20%	6886	92176
P91-006	Peso #1 Vein 11+75E	Grey quartzite with 1-3mm vuggy qtz veinlets. Minor limonite (?) stain.	N/A	Grab	23	N/A	17.0	N/A	971	371	3060
P91-007	Peso #1 Vein 11+64E	Stringer vein east of #1 vein. Qtz-aspery-py.	045/75N?	Grab	399	N/A	25.3	N/A	1370	1300	91026
P91-008	Peso #1 Vein 11+52E	Stringer vein east of #1 vein. Qtz-aspery-py. similar to #007.	N/A	Grab	762	0.035	142.7	N/A	5554	3537	93253
P91-009	Peso #1 Vein 11+50E	Main vein (as #004 & 005). Brecciated and partly silicified shale, schist with qtz matrix and x-cutting qtz veinlets.	N/A	Grab	42	N/A	71.1	N/A	5429	2165	4181

PESO-REX PROJECT

AURUM GEOLOGICAL CONSULTANTS INC.

JUNE 17-19, 1991 NTS: 105M/13 & 106D/4 SAMPLERS: RWH, MJM LAB: NAL and ACME ANALYTICAL

Sample No.	Location	Description	Attitude	Width	Au ppb	Au opt	Ag ppm	Ag opt	Pb ppm	Sb ppm	As ppm
P91-010	Peso #1 Vein 11+25E	Qtz-sulfide vein-bx, ~ 10-15% sulfides (aspy, py, stibnite?), graphitic shale pods (10 X 10cm).	N/A	Grab	814	0.025	24.6	N/A	3817	2780	93907
P91-011	Peso #1 Vein 11+05E (1.0m down)	In old raise, east wall/footwall. Massive fine grained sulfide and phyllite, <10% qtz in pods ~ 5cm across. Vein is sheared, brecciated and vuggy. Fractures coated by yellow and green clays, 10% lithic clasts. Sample across south side of vein	N/A	0.80m	27	N/A	215.0	24.133	4571	2525	68073
P91-012	As #011	Same as #011, north side of vein. Sample contains more clay than #011. Contains green chalcedonic qtz veinlets in qtz sulfide breccia. Approx. 30% fine grained grey sulfides.	N/A (phyllite) (055/25N)	0.60m	936	0.022	300.1	11.304	5436	4339	92417
P91-013	Peso #1 Vein 10+65N	Massive fine grained grey sulfide-qtz mixture, ~ 50% sulfides. sample partially leached and limonitic.	N/A	0.40m	560	0.019	20.2	N/A	2487	1469	90033
P91-014	Peso #1 Vein 10+62N	Quartz vein float with <5% fine grained pyrite + chalcopyrite? + Sb? + +??. As and Sb stains and ochres.	Float	Float	501	N/A	36.5	N/A	3349	3681	93313
P91-015	Peso #1 Vein 10+43N	Qtz-sulfide veining, ~ 20% fine gr. sulfides.	N/A	Grab	525	0.017	40.7	N/A	1.41%	3667	93961

PESO-REX PROJECT AURUM GEOLOGICAL CONSULTANTS INC.
 JUNE 17-19, 1991 NTS: 105M/13 & 106D/4 SAMPLERS: RWH, MJM LAB: NAL and ACME ANALYTICAL

Sample No.	Location	Description	Attitude	Width	Au ppb	Au opt	Ag ppm	Ag opt	Pb ppm	Sb ppm	As ppm
P91-016	Peso #1 Vein 10+00N	Trench rubble. Grey qtz-sulfide, vuggy, porous. Bands of green chalcedonic qtz x-cutting vein material. Limonitic & leached.	N/A	Grab	430	N/A	85.1	N/A	6881	4249	94911
P91-017	Peso #3 Vein Trench 91-1	Overgrown trench. Sample of 1) white-yellow-green qtz, bx & frac., tr original sulfides. 2) thin, 1-3cm, slabs of qtz-sulfide material with dark green qtz bands, ~50% fine grained weathered sulfides, Py cubes and voids.	Float	Grab	N/A	N/A	N/A	N/A	N/A	N/A	N/A
P91-018	Peso #3 Vein Trench 91-2	Quartz vein float, no sulfides. qtz lithic brecciated and bx qtz veining.	Float	Grab	743	0.022	38.4	N/A	1.51%	6224	32694
P91-019	Peso #3 Vein Trench 91-3 S end	Qtz vein float, Grey partially silicified schist/phyllite locally; brecciated, yellow clay filled vugs, yellow-green stain.	Float	Grab	54	N/A	22.0	N/A	1.09%	7492	15419
P91-020	Peso #3 Vein Trench 91-3 at road	White quartz (bull qtz), minor vugs and lithic clasts, limonite and Mn stained.	Float	Grab	66	N/A	3.2	N/A	959	529	1279
P91-021	Peso #3 Vein Trench 91-4	Float of limonite coated and yellow stained grey quartz with possible fine grained grey sulfides, locally brecciated. Minor thin bands (< 1cm) of massive stibnite.	Float	Grab	44	N/A	71.8	N/A	8.62%	12118	7119
P91-022	Peso #3 Vein Trench 91-5	Grey phyllite, locally silicified, possible fine grained disseminated grey sulfides.	Float	Grab	132	N/A	51.7	N/A	1.95%	10169	1952
P91-023	Peso #3 Vein Trench 91-5	White limonite stained quartz float.	Float	Grab	17	N/A	1.5	N/A	900	377	409
P91-024	Peso #3 Vein Trench 91-6	Weathered, vuggy limonitic quartz breccia.	Float	Grab	21	N/A	13.2	N/A	1.13%	2639	1056
P91-025	Peso #3 Vein Trench 91-8	Massive stibnite, piece 15 X 8 X 8cm.	Float	Grab	16	N/A	167.3	N/A	27.20%	12446	9

PESO-REX PROJECT AURUM GEOLOGICAL CONSULTANTS INC.
 JUNE 17-19, 1991 NTS: 105M/13 & 106D/4 SAMPLERS: RWH, MJM LAB: NAL and ACME ANALYTICAL

Sample No.	Location	Description	Attitude	Width	Au ppb	Au opt	Ag ppm	Ag opt	Pb ppm	Sb ppm	As ppm
P91-026	Peso #3 Vein Trench 91-8	Micaceous quartzite, brecciated with quartz vein material.	Outcrop	Grab	20	N/A	11.9	N/A	1.00%	5464	411
P91-027	Peso #3E Trench 91-9	Float over ~ 1.5m of grey quartz-lithic breccia, hosted by bphyllite and micaceous quartzite. No visible sulfides.	Subcrop	Grab	14	N/A	8.7	N/A	1.39%	10439	401
P91-028	Peso #3E Trench 91-10	Float over ~ 0.8m in trench bottom, close to being in situ, of grey brecciated vuggy quartz, minor lithic clasts, trace Sb?	Subcrop	Grab	244	N/A	14.9	N/A	3103	923	15152
P91-029	Peso #3E Trench 91-11	Grey clay gouge in sloughed trench wall. Contains float of grey quartz lithic bx with minor, <5%, sulfides, (Sb,py,aspy?)	Subcrop	Grab	10	N/A	121.7	N/A	1.79%	7032	37763
P91-030	Peso #3E Trench 91-11	Float of well banded, 1-2mm, white-grey qtz with 5% aspy. Blebs of stibnite in quartz-lithic breccia. Minor yellow antimony ochres.	Float	Grab	1720	0.061	9.4	N/A	4333	1760	97789
P91-031	Peso #3E Trench 91-12	Lithic-qtz breccia containing very fine grained disseminated black sulfides. Minor blebs and patches of very fine grained stibnite. X-cut by rare 1-2mm green qtz stringers. Sample is vuggy and stained yellow.	Subcrop	Grab	1239	0.042	13.2	N/A	2131	1753	97284
P91-032	Peso #3E Trench 91-13 on road	Large boulders, fairly fresh, of qtz-lithic -sulfide breccia > 1.0m across. Green stained. Float Blebs of py,aspy <5-10% of sample. Exterior is pitted-vuggy. White and grey qtz clasts.	Subcrop	Grab	1407	0.056	5.3	N/A	4160	1280	74137

APPENDIX B
ANALYTICAL METHODS AND REPORTS

ANALYTICAL METHODS

All analytical work ~~was~~ performed by Acme Analytical Laboratories Ltd., 852 East Hastings Street, Vancouver, B.C. ^{V.W.A.S} by methods described below.

Sample Preparation

All drill core samples are crushed to -10 mesh, riffle split to 300 grams, ring pulverize to -150 mesh.

Analytical Methods

For Au; 20 or 30 gram samples are fused ignited at 600°C, digested with hot aqua regia, extracted by MIBK and, analysed by graphite furnace atomic absorption (AA).

<u>For;</u> <u>Element</u>	<u>Detection</u>
Ag	0.1 ppm
Cd, Co, Cr, Cu, Mn, Mo, Ni, Sr, Zn	1 ppm
As, Au, B, Ba, Bi, La, Pb, Sb, Th, V, W	2 ppm
U	5 ppm
Al, Ca, Fe, K, Mg, Na, P, Ti;	0.01%

For the elements above the following procedure is followed: 0.5 gram samples are digested with 3 mls 3-1-2 HCL-HNO₃-H₂O at 95°C for one hour then diluted to 10 ml with water. This leach is near total for base metals, partial for Mn, Fe, Sr, Ca, P, La, Cr, Mg, Ba, Tl, B, W and, limited for Na, K and, Al. Solubility limits Ag, Pb, Sb, Bi, and, W for high grade samples. Extracted metals are determined by inductively coupled argon plasma (ICP).

SAMPLE PREPARATION

Soils

Incoming soils are sorted, counted and logged. The soils are placed in an oven devoted to geochem and dried at 150 F.

When soils are dry, they are sieved through an 80 mesh screen. If 20g of -80 # soil is not obtained, the +80 # is then sieved through a 40 # sieve and placed in a separate bag. The reject is stored in its original bag.

Rocks

Incoming rocks are sorted, counted and logged. Rocks are first crushed through a jaw crusher set at 3/8" gap and then crushed through a 1/8" gap.

The crushed sample is split using a Jones Riffle until a 250g sample is obtained. The reject is placed in its original bag and stored.

The sample is then dried at 150 F and pulverized to -150 # using a ring pulverizer.

ATOMIC ABSORPTION ANALYSIS

Geochem Digestion [Trace Level Analysis]

0.500g of sample is weighed into a 16 x 150 mm test tube. 2 mls of 1:1 Nitric Acid is added and the test tube is placed in a hot water bath for 20 minutes. 3 ml of HCl is added and the sample is heated for 40 minutes. When digestion is completed, the sample is cooled in a cold water bath. The test tube is then bulked to 10 mls using a reference, stirred and allowed to settle. The sample is now ready to run on the A.A.

For ICF the sample is digested in one step using 5 mls of 3 parts HCl, 1 Part Nitric Acid and 2 parts water.

Assay Digestion [Ore Level Analysis]

1.000g of sample is weighed into a class A 100 ml volumetric flask. 5 mls of Nitric Acid is added and the flask is placed on a 400 F hot plate until the red fumes indicating reaction subside. 20 mls of water* and 10 mls of HCL are added and placed on the hot plate for 5 minutes. The flask is then bulked to the neck with water and brought to a boil. The flask is then cooled, bulked to the mark, shaken and allowed to settle prior to running on the A.A.

* Some elements require special treatment. For example, Sb requires 20 mls 10% Tartaric acid.

TRACE LEVEL GOLD FIRE ASSAY

15g of sample is mixed with a suitable flux in a 30g crucible, inquarted with 2 mg Ag and fused at 1900 F. The contents of the crucible is poured into a mold and allowed to cool. The slag is broken off and discarded. The lead button is then pounded into a cube.

The lead button is placed into a bone ash cupel which has been preheated to 1800 F. When the lead is completely molten, the temperature is dropped to 1750 F. The dampers are opened to allow air inside the furnace. When cupelation is complete, the cupel is taken out and allowed to cool.

The silver-gold prill is picked out of the cupel and dropped into a 16 x 150 mm test tube. 2 mls of 1:1 Nitric Acid is added and the test tube is heated to dissolve the silver. 3 mls of HCl is then added to dissolve the gold. The test tube is made up to 10 mls using a reference, mixed and run on the A.A.

July 2, 1991

Work Order # 13178

M.J. Moreau
 Aurum Geological Consultants Inc.
 P.O. Box 5179
 Whitehorse, Yukon
 Y1A 4S3

File #13178a
 Project #

Assay Certificate for Samples Provided

Sample #	Au ppb	
P91-001	132	
P91-002	382	
P91-003	268	
P91-004	325	
P91-005	11	Ag 19.892 oz/ton
P91-006	23	
P91-007	399	
P91-008	762	
P91-009	42	
P91-010	814	
P91-011	27	
P91-012	936	
P91-013	560	
P91-014	501	
P91-015	525	
P91-016	430	
P91-018	743	
P91-019	54	
P91-020	66	
P91-021	44	
P91-022	132	
P91-023	17	
P91-024	21	
P91-025	16	
P91-026	20	
P91-027	14	
P91-028	244	
P91-029	10	
P91-030	1720	
P91-031	1239	
P91-032	1407	

Certified by Chyokki



July 2, 1991

Work Order # 13178

M. J. Moreau
Aurum Geological Consultants Inc.
P.O. Box 5179
Whitehorse, Yukon
Y1A 4S3

File #13178b
Project #

Assay Certificate for Samples Provided

Sample #	Au ppb
P91-S001	<10
P91-S002	<10
P91-S003	18
P91-S004	20
P91-S005	21
P91-S006	16
P91-S007	14
P91-S008	<10
P91-S009	18
P91-S010	<10

Certified by

Chyokai





GEOCHEMICAL ANALYSIS CERTIFICATE



Northern Analytical Labs. Ltd. File # 91-2212 Page 1

105 Copper Road, Whitehorse YT Y1A 2Z7

SAMPLE#	Mo ppm	Cu ppm	Pb ppm	Zn ppm	Ag ppm	Ni ppm	Co ppm	Mn ppm	Fe %	As ppm	U ppm	Au ppm	Th ppm	Sr ppm	Cd ppm	Sb ppm	Bi ppm	V ppm	Ca %	P %	La ppm	Cr ppm	Mg %	Ba ppm	Ti %	B ppm	Al %	Na %	K %	W ppm
13178 P91-001	2	1846	2673	1646	22.9	20	65	3163	20.64	47261	5	ND	7	91	14.2	1802	245	3	.07	.023	7	89	.18	14	.01	27	.26	.01	.03	1
13178 P91-002	1	486	11311	32	40.9	1	2	28	15.17	92462	9	ND	3	45	2.2	8292	581	1	.01	.025	3	65	.01	14	.01	16	.07	.01	.03	43
13178 P91-003	7	288	9415	106	56.5	6	3	49	6.30	68364	11	ND	21	12	3.7	3635	598	3	.01	.029	11	123	.01	32	.01	28	.19	.01	.06	1
13178 P91-004	4	126	1157	18	86.4	1	1	26	7.85	90918	5	ND	3	4	.2	1330	67	1	.01	.004	5	64	.01	19	.01	14	.06	.01	.03	1
13178 P91-005	1	691	11133	174	318.5	1	1	159	18.24	92176	16	ND	10	8	3.9	6886	1473	2	.01	.009	4	93	.02	29	.01	16	.16	.01	.04	43
13178 P91-006	17	35	971	23	17.0	1	1	57	.76	3060	5	ND	3	9	.2	371	25	2	.01	.008	13	203	.01	22	.01	14	.19	.01	.11	1
13178 P91-007	6	1831	1370	22	25.3	9	31	37	11.09	91026	5	ND	45	24	2.0	1300	80	3	.01	.048	9	92	.01	23	.01	28	.14	.01	.04	19
13178 P91-008	1	769	5554	108	98.1	4	6	26	16.23	93253	24	ND	63	4	5.9	3537	356	1	.01	.010	2	35	.01	11	.01	16	.05	.01	.03	49
13178 P91-009	3	190	5429	688	56.3	10	5	146	6.84	4181	5	ND	17	304	.8	2165	66	18	.05	.087	15	75	.01	50	.01	28	.50	.01	.02	1
13178 P91-010	3	776	3817	100	24.6	17	41	74	14.87	93907	9	ND	17	59	5.6	2780	114	5	.04	.034	6	32	.06	33	.01	11	.22	.01	.03	40
13178 P91-011	5	221	4571	13	215.0	2	1	8	4.73	68073	5	ND	3	6	1.7	2525	80	1	.01	.022	3	56	.01	21	.01	46	.08	.01	.02	1
13178 P91-012	4	187	5436	9	300.1	1	1	10	6.65	92417	5	ND	3	5	2.9	4339	287	1	.01	.050	2	72	.01	14	.01	38	.07	.01	.01	1
13178 P91-013	4	188	2487	32	20.2	1	1	19	5.74	90033	8	ND	11	26	2.4	1469	144	1	.01	.013	6	58	.01	11	.01	49	.11	.01	.01	1
13178 P91-014	3	576	3349	34	31.0	1	1	11	11.40	93313	19	ND	9	5	2.9	3681	735	1	.01	.021	2	70	.01	13	.01	18	.05	.01	.02	20
13178 P91-015	1	3702	11439	436	31.8	5	37	456	18.27	93961	18	ND	46	328	7.8	3667	626	4	.03	.128	3	62	.02	45	.01	10	.27	.01	.04	34
13178 P91-016	3	1323	6881	23	48.8	1	1	49	16.51	94911	26	ND	19	101	7.8	4249	448	4	.06	.059	11	48	.05	39	.01	2	.20	.01	.09	42
13178 P91-018	6	42	15057	45	30.1	2	1	16	3.09	32694	6	ND	8	44	18.9	6224	29	1	.01	.022	18	68	.01	40	.01	27	.09	.01	.04	1
13178 P91-019	11	24	12065	13	22.0	1	1	19	1.68	15419	10	ND	6	31	2.1	7492	86	1	.01	.014	15	135	.01	76	.01	24	.13	.01	.09	1
13178 P91-020	21	12	959	23	3.2	7	2	79	.53	1279	5	ND	1	5	.4	529	8	1	.01	.004	2	243	.01	7	.01	6	.04	.01	.01	1
13178 P91-021	4	436	24400	113	58.4	1	5	22	6.13	7119	12	ND	1	25	13.5	12118	12	1	.01	.007	7	69	.01	31	.01	33	.05	.01	.08	1
13178 P91-022	8	68	24072	15	40.6	2	1	30	1.52	1952	12	ND	12	9	4.7	10169	10	1	.01	.004	16	109	.01	23	.01	50	.08	.01	.05	3
13178 P91-023	19	13	900	14	1.5	2	1	45	.47	409	5	ND	3	4	.3	377	2	2	.01	.003	4	215	.01	8	.01	4	.05	.01	.02	1
13178 P91-024	11	65	11801	54	13.2	2	3	73	6.39	1056	12	ND	205	1037	.3	2636	15	12	.05	.229	37	166	.01	93	.01	59	.38	.01	.21	1
13178 P91-025	1	81	23011	78	156.5	6	1	83	1.34	9	5	ND	1	21	51.8	12446	391	1	.01	.001	3	53	.01	8	.01	7	.02	.01	.01	2
13178 P91-026	11	16	11638	23	11.9	1	1	38	.52	411	6	ND	12	38	21.6	5464	13	2	.01	.017	24	157	.01	16	.01	80	.11	.01	.03	2
13178 P91-027	12	42	16069	52	8.7	5	1	38	2.25	401	5	ND	9	10	2.9	10439	35	10	.01	.022	23	144	.01	11	.01	61	.13	.01	.02	1
13178 P91-028	12	151	3103	52	14.9	1	6	32	1.81	15152	5	ND	7	47	1.4	923	10	4	.01	.006	14	148	.01	30	.01	26	.29	.01	.10	1
13178 P91-029	7	564	21133	214	74.3	5	31	15	3.61	37763	5	ND	9	32	53.8	7032	10	3	.01	.011	18	92	.01	41	.01	38	.19	.01	.05	1
13178 P91-030	5	458	4333	196	9.4	8	37	10	6.06	97789	5	ND	15	26	9.0	1760	4	1	.01	.015	28	58	.01	36	.01	35	.08	.01	.03	1
13178 P91-031	3	125	2131	89	13.2	1	1	30	9.82	97284	5	ND	7	16	2.0	1753	22	1	.01	.098	111	33	.01	8	.01	46	.05	.01	.03	15
13178 P91-032	17	109	4160	39	5.3	10	80	35	6.98	74137	5	ND	3	11	3.6	1280	7	2	.01	.004	6	198	.01	14	.01	52	.11	.01	.01	1
STANDARD C	19	65	39	131	6.9	69	32	1087	3.93	40	18	6	40	52	18.9	16	18	60	.48	.090	40	58	.87	175	.09	35	1.92	.07	.14	11

ICP - .500 GRAM SAMPLE IS DIGESTED WITH 3ML 3-1-2 HCL-HNO3-H2O AT 95 DEG. C FOR ONE HOUR AND IS DILUTED TO 10 ML WITH WATER. THIS LEACH IS PARTIAL FOR MN FE SR CA P LA CR MG BA TI B W AND LIMITED FOR NA K AND AL. AU DETECTION LIMIT BY ICP IS 3 PPM. - SAMPLE TYPE: PULP

DATE RECEIVED: JUL 2 1991

DATE REPORT MAILED: July 8/91

SIGNED BY: C. Leong, D. TOYE, C. LEONG, J. WANG; CERTIFIED B.C. ASSAYERS

ASSAY RECOMMENDED for Pb, As > 1%
Ag > 30 ppm



SAMPLE#	Mo ppm	Cu ppm	Pb ppm	Zn ppm	Ag ppm	Ni ppm	Co ppm	Mn ppm	Fe %	As ppm	U ppm	Au ppm	Th ppm	Sr ppm	Cd ppm	Sb ppm	Bi ppm	V ppm	Ca %	P %	La ppm	Cr ppm	Mg %	Ba ppm	Ti %	B ppm	Al %	Na %	K %	W ppm
13178 P91-S001	1	51	123	209	.5	103	21	870	3.52	61	5	ND	10	16	1.2	38	2	33	.10	.041	50	128	.89	189	.02	2	1.43	.01	.05	1
13178 P91-S002	1	62	49	92	.1	49	18	366	3.92	8	5	ND	26	24	.8	9	2	17	.13	.039	76	31	.64	144	.01	2	1.31	.01	.06	1
13178 P91-S003	1	68	32	138	.4	237	85	1457	4.84	24	5	ND	30	67	1.2	52	2	13	.25	.059	98	38	.49	32	.01	2	1.29	.01	.07	1
13178 P91-S004	1	61	61	166	.3	93	27	1230	4.43	32	5	ND	15	37	1.3	26	2	23	.17	.046	36	73	.38	134	.02	3	.73	.01	.08	1
13178 P91-S005	1	41	18	97	.1	46	14	504	3.38	15	5	ND	9	27	.9	9	2	36	.22	.049	27	47	.52	257	.04	3	1.16	.01	.07	1
13178 P91-S006	4	103	107	147	.1	87	39	3420	8.15	10	5	ND	31	32	2.0	20	2	13	.18	.066	79	20	.39	93	.01	3	.78	.01	.06	1
13178 P91-S007	2	86	23	65	.1	121	24	468	3.80	2	5	ND	19	17	.3	4	2	25	.17	.050	50	60	1.74	57	.01	2	1.66	.01	.04	1
13178 P91-S008	1	88	35	129	.2	242	66	1483	7.15	51	5	ND	16	34	1.8	14	2	148	.30	.123	69	570	3.85	135	.01	2	3.98	.01	.03	1
13178 P91-S009	1	20	114	376	2.9	39	9	339	4.33	682	5	ND	26	89	3.9	48	2	5	.08	.032	78	19	.07	29	.01	3	.28	.01	.09	1
13178 P91-S010	1	21	38	77	.1	20	9	348	2.93	23	5	ND	9	12	.6	8	2	44	.07	.021	23	29	.45	172	.05	2	1.72	.01	.04	1
STANDARD C	17	60	38	131	7.2	69	33	1039	3.92	36	21	7	39	53	18.7	16	18	57	.49	.092	40	57	.89	177	.09	33	1.90	.06	.15	11

September 17, 1991

Work Order # 13372

work order 13178 - JWC

M. J. Moreau

Assay Certificate For Samples Provided

Sample #	Au oz/ton	Ag ppm	Ag oz/ton	Pb %
P91-002	----	50.5	----	1.22
P91-003	----	63.1	----	0.87
P91-004	----	116.9	----	----
P91-005	----	----	37.768	1.20
P91-008	0.035	142.7	----	----
P91-009	----	71.1	----	----
P91-010	0.025	----	----	----
P91-011	----	----	24.133	----
P91-012	0.022	----	11.304	----
P91-013	0.019	----	----	----
P91-014	----	36.5	----	----
P91-015	0.017	40.7	----	1.41
P91-016	----	85.1	----	----
P91-018	0.022	38.4	----	1.51
P91-019	----	----	----	1.09
P91-021	----	71.8	----	8.62
P91-022	----	51.7	----	1.95
P91-024	----	----	----	1.13
P91-025	----	167.3	----	27.20
P91-026	----	----	----	1.00
P91-027	----	----	----	1.39
P91-029	----	121.7	----	1.79
P91-030	0.061	----	----	----
P91-031	0.042	----	----	----
P91-032	0.056	----	----	----

Certified by Chyokki



APPENDIX C
SELECTED PAPERS

106 134

REVIEW REPORT ON THE GEOLOGY
AND ORE RESERVES
OF THE

PESO SILVER MINES LTD.
PROPERTIES
YUKON TERRITORY

NOVEMBER 10, 1965
DOUGLAS D. CAMPBELL CONSULTANT VANCOUVER, CANADA

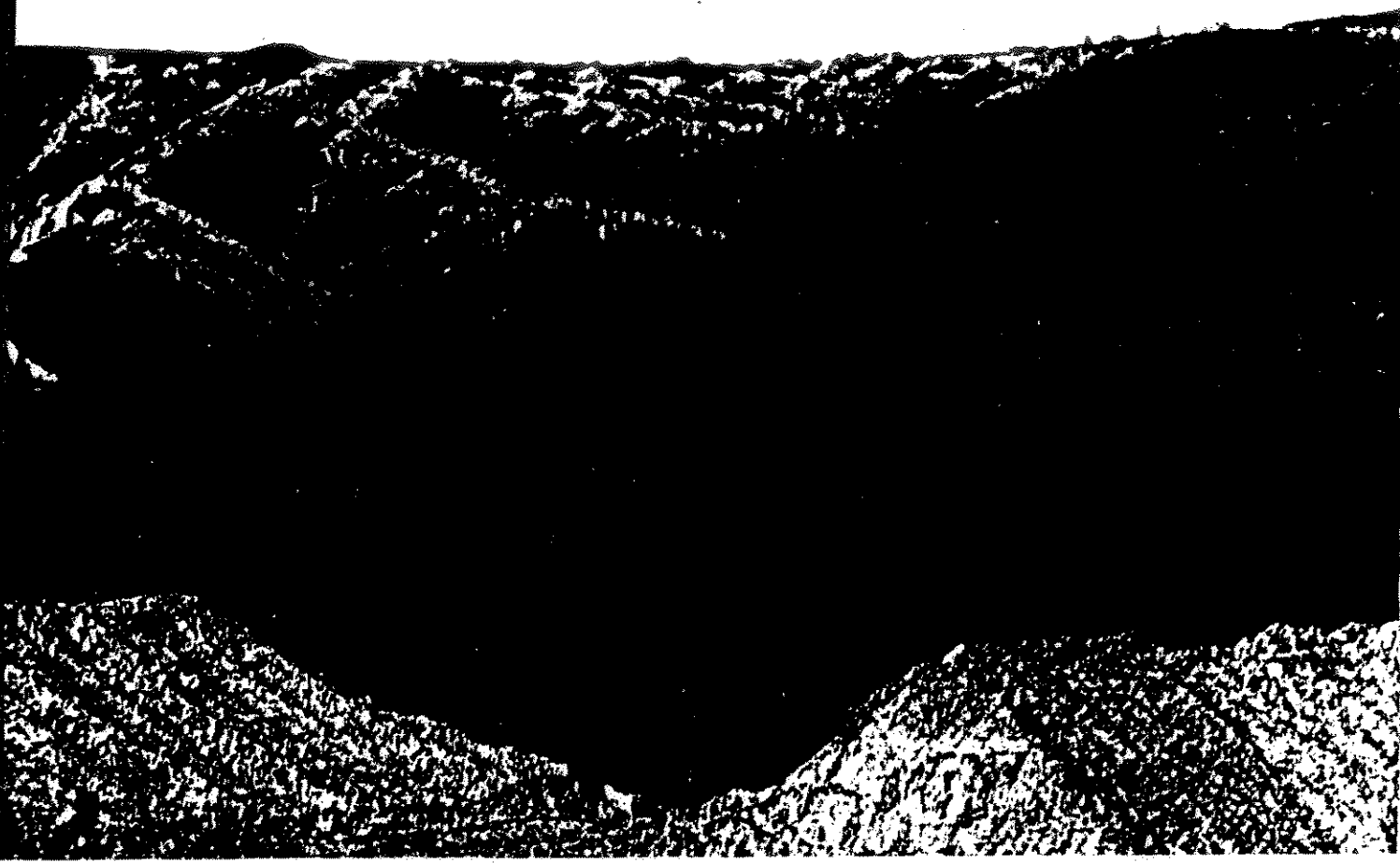

PART TWO

PESO SILVER MINES LTD.
MAYO DISTRICT PROPERTIES, Y.T.

INTRODUCTION

Peso Silver Mines Ltd. owns or has controlling interest in 532 mineral claims in the Mayo area of the Yukon. These claims are contained in twenty groups which are distributed along bands of quartzites west and north of Keno Hill and Galena Hill. The proven, rich silver-lead orebodies presently being mined on Keno and Galena Hills by United Keno Hill Mines Ltd. comprise the primary type of targets for exploration by Peso Silver Mines in the Mayo District; however, increased exploration to the west of Keno Hill has indicated that economic silver deposits occur in somewhat different structural environments than those at Keno therefore the target for silver exploration has been broadened from limited high-grade galena-silver deposits only to include possible lower grade but more continuous deposits. With this realization, that the type of ore deposits in the Mayo District may be more diverse than heretofore anticipated, the emphasis on the work of Peso Silver Mines in the district has been directed toward accumulating enough ore of all grades, on various properties, to warrant the construction of a mill by Peso Silver Mines. (An alternative proposal under the same conditions would be to approach United Keno Hill and offer that company a proposition of expanding their concentrator to take any ore Peso may develop in the district). A secondary purpose in the exploration by Peso Silver Mines in the Mayo District has been to acquire property in those areas that are geologically most promising, the purpose being to accumulate worthwhile holdings in one of the world's richest silver mining camps, in anticipation of the almost certain depletion of the world's silver resources and the consequent rise in price of the metal.

Because of this dual purpose for exploration, Peso Silver now controls in the Mayo District: 1) a large number of claim groups that have been staked in geologically and geochemically favourable areas but which have not been otherwise explored, and 2) a number of other properties on which considerable underground work has been done and on which silver ore has been proven. Most of these properties require, and warrant, further development work to properly assess their potential and to determine if any one or all of them can support a mill.

In view of the fact that geology has controlled the location of the Mayo properties, the following discussion presents an outline of the general geology of the area to provide a setting for more detailed discussion of the individual properties.

MAYO GEOLOGY:

An area roughly rectangular in shape surrounding Mayo is underlain by a series of rock formations known as the Yukon Group, believed to be Precambrian or later in age, the oldest rocks in the Yukon. The area of these rocks around Mayo is bounded 40 miles west of Mayo by the Tintina Fault Trench, down which flows the Stewart River, and 30 miles south of Mayo by an east west contact of overlying Carboniferous formations, and 70 miles east of Mayo by a northwest-trending contact of Paleozoic sedimentary rocks, and finally, 40 miles north of Mayo by an east-west contact by unmetamorphosed sedimentary formations, (Fig. 1). Keno Hill is located in the northeast corner of this rectangular area and all of the known orebodies and prospects are within 20-30 miles of Keno, principally to the northwest.

The Yukon Group is comprised of metamorphosed stratified rocks which are principally quartzites and schists with minor limestones. These rocks are repetively interlayered with one another and include schistose phases of quartzites and quartzitic phases of schists as well as many varieties of schists from graphitic to gneissic. All of these rocks have been intruded by basic dikes and sills (greenstones) by later granitic bodies and finally by minor rhyolite and lamprophyre dikes. Of the above-described rocks, the quartzites, greenstones and the granitic intrusives are structurally competent and sustain prominent fracture-fault zones, whereas the remaining rocks are incompetent and do not sustain such fracture zones.

In the Mayo District all of the presently mined silver-lead deposits occur within or close to a major belt of quartzites that strikes generally northwestward along the northeast side of the rectangular exposure of Yukon Group rocks. This quartzite belt, termed the Central Quartzite, is made up of a number of sequences of quartzites and quartzitic schists interlayered with sequences of schists. The Dominion Government Geologist, R. W. Boyle has calculated the Central Quartzite sequence to be approximately 2400 feet in stratigraphic thickness with about 800 feet of this being comprised

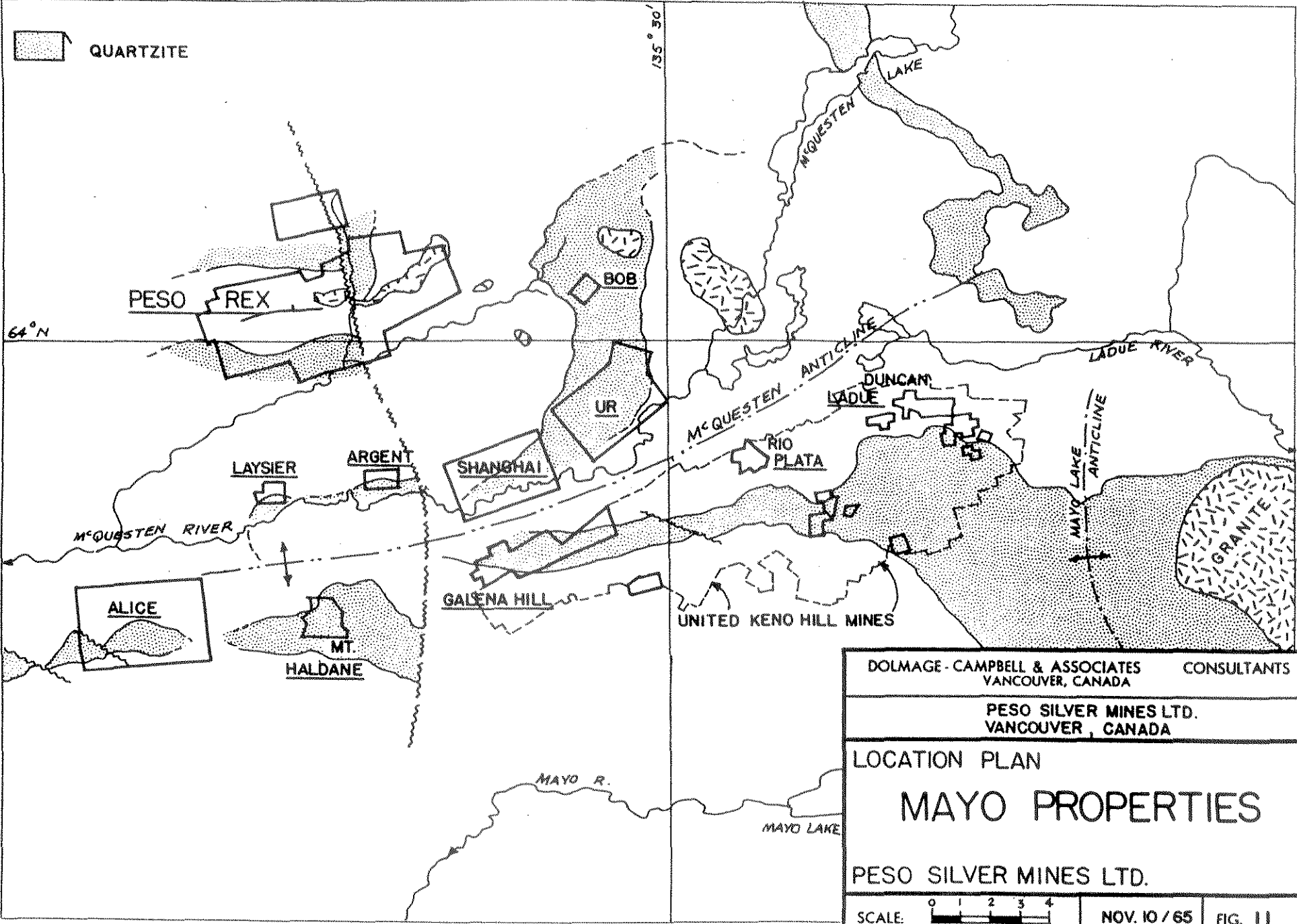

DOLMAGE - CAMPBELL & ASSOCIATES CONSULTANTS
VANCOUVER, CANADA

PESO SILVER MINES LTD.
VANCOUVER, CANADA

LOCATION PLAN
MAYO PROPERTIES

PESO SILVER MINES LTD.



NOV. 10 / 65 FIG. II

of interbedded schistose material confined principally to the top and bottom of the sequence. (G.S.C. Paper 57-1). Above and below the Central Quartzite the rock sequences consist predominantly of schists and are known as the Upper Schist and Lower Schist formations respectively. Quartzite beds or sequences, occurring within these schist formations attain thicknesses up to 100 feet so that environments favourable to vein-type ore deposits do exist in these otherwise less favourable formations.

Within the Central Quartzite formation as well as the adjacent schist formations are numerous discontinuous sill-like bodies of basic igneous rock termed "greenstone". These bodies are interpreted to be boudin relicts formed by the dislocation of sills and/or flows during metamorphism and deformation of the formations. Because of their good competency the greenstone bodies tend to sustain fracture systems favourable for deposition of silver-lead ores.

STRUCTURE: The principal structure in the area is a major anticline whose axis trends S15° E from the Davidson Range, eight miles north of Keno, across the Patterson Range to the east end of Mayo Lake, ten miles southeast of Keno. This regional structure has been locally deformed by a number of cross folds and faults which trend S65° W. The principal components of these cross-structures are the McQueston Anticline, which trends westward down the McQueston River valley from the Davidson Range, and the system of vein-faults which occur on the south flank of the McQueston Anticline and which are the ore structures on Keno and Galena hills.

Late faults with vertical displacements up to hundreds of feet cut all the formations in the area and trend northwest to northeastward. They both displace and merge with the ore-bearing fracture systems in the district, most of which trend northeastward.

ORE OCCURRENCES:

In the Galena Hill-Keno Hill silver-lead deposits all productive orebodies occur as fracture fillings within vein zones which lie within the major quartzite and greenstone bands of the Central Quartzite formation. The vein zones strike northeastward and dip to the southeast at about 65°. Individual veins range in width from one to ten feet, but zones of multiple veins and/or replaced breccia zones occur to widths as great as 70 feet. The 30 veins exposed along the fifteen miles of quartzites on Keno and Galena hills are apparently branches and faulted segments of about four main vein zones. These vein zones are broken by many southeast and southwestward striking faults which have right hand horizontal displacement up to 1000 feet. The vein zones themselves have faulted the rocks they traverse in left hand displacements. Within schists and thin-bedded quartzites the vein-fault zones tend to narrow down sharply to tight slips, or breccia faults and in many places become gouge-filled faults a few inches in width.

Most of the orebodies occur at or near junctions of vein structures or next to a contact between competent and incompetent rock. The vein zones invariably widen out within the competent rock (quartzite) near a schist contact. Some vein zones have been traced by drifting and drilling for lengths exceeding 6000 feet, with orebodies occupying approximately 10% of the strike of any one vein on any one level and practically all of that 10% being within the Central Quartzite.

Most of the orebody portions of the vein zones are comprised of quartz and/or siderite and/or quartzite breccia along with lenses, veins and/or disseminations of ore minerals, i.e. galena, sphalerite, freibergite and pyrite. Large masses of solid metallic minerals form local portions of the orebodies but they are not commonly extensive when the entire vein system is considered. The principal silver-bearing mineral in the district is freibergite (argentiferous tetrahedrite), but at the Keno and Galena hill deposits the freibergite is generally intimately intermixed with galena therefore the mill concentrates are mostly galena which imposes a heavy burden in the cost of shipping. In other parts of the district the freibergite occurs with less galena or with jame-sonite, thus concentrating to a higher grade (by weight) shipping product.

PRODUCTION—MAYO DISTRICT

Production began on the Silver King vein on the western flank of Galena Hill in about 1913. Veins were discovered on Keno Hill in 1919 and during the 1920's other veins were exposed, but only where overburden was shallow because all work at that time was done by hand in the permafrost, a slow difficult job. Between 1921 and 1942

most of the mining was done on orebodies that had been found on the surface, but due to high costs and apprehensions that the ore was shallow, no mining was done below about the 400 feet depth and only a slight amount of exploration and development was done. The camp was closed in 1942 because of the war and because of depletion of near-surface ores.

The camp reopened as a salvage operation in 1946 and the major amount of production from the district has been achieved since 1948 with the mining extending to deeper levels. Recently transportation and equipment costs as well as metal prices have improved enabling lower grades of ore to be mined. A summary record of production from Galena and Keno hills is as follows:

	Silver oz.	Lead lb.	Zinc lb.	Cadmium lb.
(All units in millions)				
1) Independents	2	4		
2) Keno Hill Ltd. Yukon Gold (1921-24)	2	4		
3) Treadwell Yukon Corp. (1922-42)	44.3	96		
4) United Keno Hill (1946-63)	84.2	305.3	233	3.06
TOTALS.....	132.5	409.3	233	3.06

At present metal prices: (Ag \$1.40/oz., Pb, Zn 15¢/lb. Cd \$1.70/lb.), the value of the above production is approximately \$287 million (Can.). Considering that most of this has been attained since 1951, it is evident that the Mayo District comprises one of the world's major silver camps. In view of the fact that the surrounding favourable area has remained unexplored because of difficulties imposed by permafrost, etc., it comprises one of the best targets available in the search for new silver mines.

EXPLORATION BY PESO SILVER MINES LTD.

Within the framework of well-established characteristics of Keno-Galena hills silver-lead ore deposits described above, Peso Silver Mines Ltd. has directed its exploration to those areas wherein the Central Quartzite formations are deformed by folding and faulting and where some traces of ore grade silver mineralization occur. In the latter case the occurrences may be as float or as anomalous geochemical contents of lead-zinc in soil or in creek silts. Most of the most promising prospects are located on the northwest flank of the McQueston Anticline since the southwest flank is almost entirely covered by United Keno Hill claims.

The Peso properties in the Mayo area will now be described either individually, or as members of groups, in order from those with the most work done on them to those with the least.

REFERENCES:

- (1) "Yukon Territory," H. S. Bostock, G.S.C. Mem. 284, 1957.
- (2) Geology & Geochemistry of Keno Hill, etc., R. W. Boyle, G.S.C. Paper 55-30, 1956.

PESO SILVER MINES (REX)

About 20 miles northwest of Elsa Mine on Galena Hill near Haggart Creek, is an area of mixed quartzitic and schistose rocks intruded by granitic sills. This belt of quartzites is not connected with Keno Hill Quartzite formation, which lies to the east and south, but it may represent an upfolded window of that formation. In the central, schistose, portion of this area at least two major shear zones cut the formations. These zones are extensively mineralized with quartz, carbonate, pyrite, jamesonite and minor galena over widths ranging from three feet to thirty feet. The westernmost zone is known as No. 1 Vein and the easternmost is termed the Rex Vein. Both vein zones have been explored by one adit level each and have been locally stripped and sampled on the surface. The area is covered by a total of 551 mineral claims separated into two groups of 519 and 32 claims each (Fig. 15). This property is the original Peso Silver Mines Ltd. holding in the Yukon. The southeastern portion of the Peso block shown on Fig. 15 is comprised of approximately 61 claims staked by Rio Plata Silver Mines Ltd., 37% of which is owned by Peso Silver Mines Ltd.

Both No. 1 and Rex Vein zones strike east to 20° north of east and dip 60° to 45° to the north. No. 1 Zone is located on the east side of Secret Creek and the Rex Zone is located about two miles to the east and south, on the west side of Haggart Creek. The

two zones probably represent separate near-parallel mineralized fault zones. The principal country rock in the vicinity of the workings is schist, but sequences of quartzite up to 100 feet in thickness are not uncommon. A drift adit about 600 feet in length was driven on No. 1 Vein from the Secret Creek slope and a system of drifts totalling 2000 feet was driven on the Rex Vein from a crosscut adit on the Haggart Creek slope. The underground development in both areas exposed lower grade ore than anticipated from surface exposures and in the case of the Rex, more complex geology than expected; however, in both locations considerable tonnages of low-grade ore have been proven and in neither location has the indicated ore potential been comprehensively explored. Much more work is required on this property to truly evaluate its worth.

Each vein zone is described separately below, followed by a summary of the ore reserves and potential. Detailed plans and sections of all surface and underground workings of Rex and No. 1 Vein are available, but in order to decrease the bulk of this report they have not been included, in their place the writer has attempted to present sufficient descriptions to properly represent the established facts. All of the surface and underground workings have been properly and thoroughly sampled wherever exposures permit and the results of these samples have been weighted and averaged by the writer to obtain the figures presented in this report. All assay plans and calculations are available for checking. The writer has examined all of the surface exposures on the property and has mapped much of the Rex underground workings. He has not examined the drift on No. 1 Vein.

PESO REX

This vein zone was stripped by longitudinal and cross trenches for a length of 1400 feet. For most of this length the zone was exposed as a single highly oxidized mineralized shear up to 20 feet in width, but for a length of 400 feet at the east end of the exposures the zone divides into three main branches which enclose a lense-shaped area of branching veins and shears known as the E-Zone. Scattered lenses of good grade silver ore occur in this complex of veins. To the west of the E-Zone, 500 feet from the western junction of the branches, surface stripping and sampling exposed a section of the main Rex zone 270 feet in length that assays 32.2 oz. silver/ton and 3.6% lead per ton across an average width of 7 feet. This was termed the B-Zone. Fifteen surface diamond drill holes were drilled between the E and B zones and three of the holes intersected fair silver values within 100 feet of the surface directly below the B-Zone. Four other holes returned marginal values slightly to the east and at depths between 100 and 200 feet below surface. The decision to explore the B-Zone underground was made and in 1963-64 a cross cut was driven to intersect the vein directly beneath B—Zone. Unfortunately the operators at that time chose to drive the level at a depth of 350 feet beneath the surface, which, on an unexplored structure, is too great a depth from known conditions. A great deal of subsequent, costly underground drifting and crosscutting have revealed that the branching portion of the Rex Zone, known as E—Zone on the surface, rakes down to the west along the structure at about 20° angle and the crosscut intersected this maze of branching veins and shears exactly in the middle. The large amount of drifting and diamond drilling, as well as long raises, that was necessary to sort out and evaluate the complex structure encountered underground imposed a severe financial burden on the company with the result that when the decision had to be made whether to continue to spend money on the Rex or divert it to Mt. Nansen, where results of development were more encouraging, the work on the Rex was ceased and the deposit has not yet been properly evaluated. Results obtained to date have been fair and the deposit has good potential which should be further explored. A summary description of the deposit follows:

STRUCTURE:

The lense of veins termed the E-Zone, as explored underground, is comprised of major hanging wall and footwall mineralized sinuous shear zones both of which dip northward at 30°-60° and both of which range up to 10 feet in width. These two vein zones are 220 feet apart at the widest part of the lens where the main crosscut intersected the structure. Between them lie at least four branching subsidiary vein zones of similar character and dip to the main zones but generally much narrower and less mineralized. The western junction of the hanging wall and footwall zones is exposed underground 500 feet west of the crosscut and the main vein structure has been drifted a length of 220 feet further west. The eastern junction is about 500 feet east of the crosscut but is not exposed underground because of displacement by crossfaulting.

Drill holes from the crosscut intersected the structures below the level and two raises, the 74 Raise on the hanging wall zone and the 112 Raise on the footwall zone, exposed the vein zones above the level. These exposures indicate that the lens of vein splits is raking at a low angle to the west and comes down from the E-Zone at the eastern surface exposures. Also, and most important, the ore shoots on the veins also apparently rake to the west and the downward extension of the B-Zone is probably about 200 feet west of the present westernmost drift face on the level.

In the area of the mine workings the rocks in the footwall of the vein zone structure are largely quartzite and those in the hanging wall are schists.

MINERALIZATION:

The vein zones are predominantly chloritic shear zones with extensive quartz mineralization. Locally the zones are mineralized to widths of 10 feet by lenses of mixed pyrite, jamesonite, sphalerite, galena and freibergite in a gangue of chlorite and siderite. The freibergite carries ore quantities of silver but the jamesonite and galena are not significantly silver-bearing. The Rex ores differ greatly from the Keno Hill type insofar as they contain very little galena and a large amount of jamesonite.

ORE OCCURRENCES:

Underground development exposed a low grade ore shoot on the footwall vein of the E-Zone and three higher grade shoots on the hanging wall vein. The 112 Raise, on the footwall ore shoot, was driven straight up the dip 115 feet and exposed 37 feet of ore from the level, indicating that the ore shoot rakes up to the east at about 25°. The 74 Raise, on the longest (145 ft.) hangingwall ore shoot, was driven straight up dip to within 70 feet of the surface in the middle of the B-Zone ore shoot. The top 46 feet of the raise exposed the B-Zone ore and indicated that the zone rakes down to the west from the surface and therefore has not been explored at depth west of the raise. The bottom 54 feet of the 74 Raise exposed comparable ore as that in the hanging wall ore shoot and indicates that the ore rakes up to the east at a low angle. Four diamond drill holes below the 74 Raise intersected good ore to depths of 120 feet below the level. These intersections are in the hangingwall ore shoots and are of higher grade than those exposed on the level.

In summary: The B-Zone ore shoot apparently rakes down to the west at a low angle and has been explored underground by only 46 feet of the 74 Raise. It should be further explored by subdrifting from the raise, by drifting west on the level, and by dry-drilling from the surface. At least three lower grade ore shoots occur within the E-Zone lense in the mine drifts and have been partially exposed in the 74 and 112 raises. They apparently rake up to the east to the scattered ore sections exposed on the surface in the E-Zone. They should be further explored by subdrifting from the raises and by dry-drilling from the surface. Further diamond drilling above and below the level in ore areas is also warranted.

A summary of the ore grades in the different shoots is as follows:

		Length (ft.)	Width (ft.)	Ag. oz./t.	Pb. %
B-Zone	—Surface	270	7	32.2	3.6
	—74 Raise	(46 ft. of vert. rse.)	4	17.2	4.5
Hanging Wall West	—Drift	75	3.75	19.1	4.8
	—74 Raise Drift	145	4	12	4.8
	—Drill Holes	100	4	25	not assayed
	—below level				
Hanging Wall East	—Drift	40	5.4	113.	5.6
	Footwall (112 rse)				
	—Drift	130	4	9.2	1.6
	—Raise	(37)	4	14.4	5

The lowest grade of the above ores has a gross value of \$17.70 and the highest grade has a gross value of \$56. (All values in Canadian dollars at present metal prices, Ag = \$1.40/oz., Pb = \$0.15/lb). The values are low but the tonnage potential may be good and, of course, the main high grade ore shoot (B-Zone) has not yet been explored. An increase in the price of silver will appreciably enhance the worth of this property.

No. 1 VEIN

This vein zone is essentially the same as the Rex in character, mineralization and habit. It was exposed by surface stripping east of Secret Creek for a length of 600 feet within which three A, B and C medium-grade silver ore sections were revealed. Drifting 250 feet below the surface confirmed the A and B shoots but missed the C shoot due to complex geology.

East and north of the easternmost exposure of No. 1 Vein there is deep overburden for a distance of 600 feet but at that point a strong wide zone has been stripped for a length of about 120 feet. This has been termed No. 2 Vein but probably represents the eastern extension of No. 1 Vein.

Ore Occurrences: The ore exposed on No. 1 Vein, both on the surface and underground, is characteristically low grade but distributed across widths as great as 30 feet. This structure has promise principally for large tonnages of medium to low grade ore, essentially the same as Peso Rex.

In the adit the following ore sections have been well confirmed:

	Length (ft.)	Width (ft.)	Ag/oz./ton	Pb/(%)	Gross Value/ton
A Zone (West)	80	9	6.1	5.1	\$23.85
A Zone (South)	40	12	8.8	2.1	\$18.60
A Zone (East)	105	14.3	20.9	4.4	\$42.45
B Zone	160	6.4	17.6	1.7	\$29.75

On the surface at the easternmost section of the vein zone (No. 2 Vein?) thorough surface sampling has confirmed the following two are sections:

	Length (ft)	Width (ft.)	Ag. oz./t.	Pb. (%)	Gross Value/ton
A Zone	100	12	82	5 (approx.)	\$54.20
B Zone	60	10	25.3	"	\$50.40

As in Peso Rex, the ore shoots on the No. 1 Vein appear to rake down to the west but not at such a low angle as at Rex.

All of the No. 1 Vein ore shoots warrant extensive dry-drilling from the surface, (diamond drilling has proven unsatisfactory on this zone because of very low core recovery), and further underground exploration.

ORE RESERVES AND POTENTIAL

The history of exploration and development on the Peso property has been one of finding very good surface values but of not finding correspondingly high values underground. In most cases this has been due to not exposing the proper structures underground because of lack of knowledge of the complexities of the vein zone structures. Much of the potential indicated by surface exposures has thus not been properly explored. Also, in other instances even though lower values have been encountered underground they still could comprise fair to low grade ore if more tons were developed and/or the price of silver would rise. Thus the Peso property has a very real and good potential value but it requires further development properly directed to specific ore targets.

In calculating the reserves shown in Table 3 the writer has considered "proven" ore to be that within 30 feet of good surface or underground exposures; "probable" ore is that which is 30 feet beyond the proven or that which is indicated by drill hole intersections. These categories are reasonably assured. As an indication of the potential target for further exploration the category of "possible" ore is given. This ore represents the possible ore existing on known structures projected along the trend of the known orebodies between and/or beyond "probable" ore and within reasonable reach of existing workings.

The total reserves on all occurrences at Peso Silver Mines (Mayo) is:

Proven	91,745 tons @ 23.7 oz. Ag/ton, 3.7% Pb
Probable	61,885 tons @ 16.7 oz. Ag/ton, 3.7% Pb
TOTAL	153,630 tons @ 20.9 oz. Ag/ton, 3.7% Pb

The gross value of this ore, in Canadian funds at present metal prices is \$40.40 per ton for a total in the ground of \$6.2 million. Total costs of mining, milling, marketing etc., at Peso have been calculated to be \$25 per ton of ore. Assuming a 90% recovery and \$25 per ton costs, the net profit obtainable from Peso ore would be approximately \$11 per ton at present prices.

TABLE 3
PESO REX ORE RESERVES—1965
Peso Silver Mines Ltd. (Mayo)

Structure	Category	Tons	Ag oz./t.	Pb%	Gross Value*
Rex B-Zone	Proven	39,500	32.2	3.6	\$56.00
	Probable	4,900	32.2	3.6	\$56.00
	Possible	130,000	—	—	
Rex Hanging Wall	Proven	4,800	12.	4.8	\$31.20
	Proven	1,500	19.	4.8	\$41.00
	Probable	1,500	19.	4.8	\$41.00
	Probable	5,550	20.	4.8	\$42.00
	Probable	12,600	12.	4.8	\$31.20
	Possible	15,000	—	—	
Rex Footwall	Proven	11,500	11.	3.3	\$25.30
	Probable	3,160	11.	3.3	\$25.30
	Possible	12,000	—	—	
No. 1 Vein West (A1)	Proven	20,850	20.9	4.4	\$42.45
	Probable	3,910	20.9	4.4	\$42.45
	(A2) Probable	6,250	6.1	5.1	\$23.85
	(A3) Probable	4,170	8.8	2.1	\$18.60
	(B) Proven	8,900	17.6	1.7	\$29.75
	Probable	15,150	17.6	1.7	\$29.75
	Possible	60,000	—	—	
No. 1 Vein East (A)	Proven	3,130	28	5 (approx.)	\$54.20
	Probable	3,130	28	5 "	\$54.20
	(B) Proven	1,565	25.3	5 "	\$50.40
	Probable	1,565	25.3	5 "	\$50.40
Total tons:		370,630			
Total Proven tons		91,745 @	23.7	3.7	
Probable		61,885 @	16.7	3.7	
		153,630 @	20.9 oz. Ag	3.7% Pb	\$40.40 (Can.)

*Gross value = Canadian dollars at \$1.40/oz. Ag and \$0.15/lb Pb.

METALLURGY

As can be deduced from the preceding descriptions of the type of ore at Peso Rex and No. 1 Vein, this ore is quite different from the United Keno Hill type of ore. The Keno Hill ore is characteristic in that the high silver-bearing freibergite is intimately associated with galena which forms the bulk of the ore and which is also silver bearing. The Rex type of ore has minor amounts of galena but considerable amounts of jamesonite. The important economic differences in the ores are: 1) the Keno ores are generally much higher grade silver, and 2) the Rex ores are not burdened with a large amount of galena in their concentrate which, in times of low lead prices, will not pay for shipping from the Yukon, in other words the profit from the contained silver is depleted by the cost of shipping non-remunerative lead. At present metal prices, (\$0.15/lb. lead), a profit is realized on the galena from United Keno Hill.

In 1964 the Britton Research Laboratories in Vancouver, Canada, did extensive metallurgical testing on a bulk sample of Rex ore obtained from the Hanging Wall Vein west orebody on the drift underground. This bulk sample assayed:

Silver	30.5 oz./t.
Lead	6.46%
Antimony	4.17%
Zinc	0.73%
Arsenic	2.23%

This sample is higher in silver than the average from the Rex but is otherwise typical. The reader is referred to the report by Britton Laboratories, (Investigation of a Sample of Silver-Lead-Antimony Ore, Peso Silver Mines Ltd., November 25, 1964), for details of all the experimental tests and various results for this work, the salient conclusions of the research are as follows:

- 1) If a silver-lead-antimony concentrate is made an effective recovery of 92%, 90% and 90% respectively can be made of the metals. The concentrate would assay about 150 oz. Ag/ton, 30% Pb and 19% Sb.
- 2) If a silver concentrate is made a total recovery of 88% of the silver can be attained in two concentrates; one assaying 1000 oz. Ag/ton and the other (13%) assaying 27 oz. Ag/ton.
- 3) If necessary a silver-lead concentrate can be obtained by removal of 99% of the antimony from the silver-lead-antimony circuit. The concentrate would assay about 188 oz. Ag/t. and 37% Pb.

All of the foregoing processes were accomplished by relatively ordinary milling procedures and common reagents. Reagent consumptions are generally low and milling costs can be assumed to lie between \$3 and \$5 per ton, probably closer to the lower figure. A recovery of 90% of the silver and lead seems assured.

It may be possible to market the jamesonite as a lead-antimony concentrate but at the present time this requires some effort to find a buyer for such a product.

CONCLUSIONS AND RECOMMENDATIONS

The principal objective at Peso (Mayo) should be to outline enough ore reserves to either justify a mill or shipment to United Keno Hill should they be agreeable to an adjustment in their mill circuit. In view of the relatively large tonnage of possible ore on the property, plus the unexplored lengths and depths of the two known ore-bearing structures, and considering that other Peso properties in the Mayo area have either proven ore or reasonably good potential for ore, it is recommended that primary consideration should be given to the objective of doing further development in order to prove more ore reserves. At Peso Rex an approximate budget to prove 500,000 tons and indicate an additional 500,000 tons is as follows:

Drifting and subdrifting at Rex and No. 1 Vein	4,100 ft. @ \$ 50/ft.	\$ 20,500
Raising at Rex and No. 1 Vein	1,800 ft. @ \$100/ft.	180,000
Diamond Drilling (Rex)	5,000 ft. @ \$ 10/ft.	50,000
Diamond Drilling (No. 1)	4,000 ft. @ \$ 10/ft.	40,000
Surface dry-drilling (Total)	10,000 ft. @ \$ 3/ft.	30,000
Mobilization (Camp, roads, etc.)		9,500
	Total	\$415,500

Should the above program be successful in attaining the stated objectives then additional expenditures to prepare the mine for production and for mill construction would be approximately:

Mine preparation and development	\$1,000,000
Surface plant and roads	500,000
Mill (300 t./day)	1,000,000
Total	\$2,500,000

At 300 tons per day and assuming a net profit of \$10 per ton the operation would return approximately \$1 million net per year for the first three tax-free years.

The above figures do not include the possibility of obtaining additional reserves of possible higher grade from other Peso properties in the Mayo district.

CONCLUSIONS

The diverse holdings of Peso Silver Mines Ltd cover a wide spectrum of opportunities from prospecting favourable claims to bring partially developed properties into production. All of the ores are primarily silver with subsidiary lead and zinc, some are the heavy silver-lead ores of the Keno Hill type.

The properties of principal immediate interest are the Peso Rex and the Rio Plata (37% Peso) because there is enough ore proven and indicated on these two properties to warrant further development toward production and the installation of a common mill or possibly the shipping of ore to Keno Hill. The former alternative would almost assuredly be the more profitable. The two main vein zones at Peso Rex presently contain a reasonably well proven-probable reserve of about 154,000 tons @ 20.9 oz. Ag/t. and 3.7% Pb for a gross value of \$40.40. Most of the property requires and warrants exploration for further reserves. Two vein zones at the Formo property of Rio Plata contain a probable and indicated reserve of 44,000 tons @ 16 oz. Ag/t., 6.9% Pb and 10.7% Zn for a gross value of \$77 per ton. Although much confirmatory development work needs to be done on these properties it appears evident that between the two of them enough reserves of ore are indicated to operate a 100 ton/day mill for six years. Since the potential of the properties is good and much is relatively unexplored it is reasonable to expect that the reserves could readily be expanded to support a 300 ton/day mill for a more extended period.

Metallurgical tests and cost studies indicate that a net profit of \$15-\$20 per ton could be realized from the combined Peso Rex and Rio Plata ore thus returning profit of about \$1.5 million annually from a 300 t./day operation. Capital costs for development of the properties and installation of the mill etc., would be approximately \$3 million of which about \$800,000 would be expended initially on development work to confirm the probable reserves and indicate whether the full project would be warranted.

The installation of a mill in the Mayo Area by Peso Silver Mines Ltd is further encouraged by the ore potential of a number of other properties in the district which are either totally or partially owned by Peso. In order of immediate importance these properties are: Duncan Ladue, Shanghai and Mt. Haldane. The many other claim groups held by Peso Silver Mines Ltd are promising ground for exploration and some may prove to harbour ore-bearing structures. The Duncan Ladue, Shanghai and Mt. Haldane properties are in the very preliminary stages of exploration and although each have encouraging indications of ore on them each will require considerable expenditures to properly evaluate and develop.

The writer recommends that if possible the development of the Peso Rex and the Rio Plata be resumed at least through the preliminary phase proposed to firm up the ore reserves presently indicated. If a milling operation can be established in the Mayo Area on these properties by Peso Silver Mines Ltd the potential of the area is such that the mill will in all probability be assured of feed for 10-20 years or more.

Respectfully submitted,



Douglas D. Campbell, P. Eng., Ph.D.

cemented by white quartz and minor calcite and mineralized with sphalerite and pyrite. Some of the quartz is in fine needle-like crystals. Siderite, typical of the deposits of the district, was lacking in the specimens collected. The sphalerite is lustrous, dark brown, and often coarsely crystalline and the pyrite frequently occurs in bright crystals to about 5 mm. The footwall of the zone was not exposed at the face, but the thickness is reported to be up to 20 feet. A specimen of the sphalerite-rich material taken near the face assayed*: 0.01 ounces of gold and 0.60 ounces of silver per ton, 0.02 per cent lead, and 17.5 per cent zinc. The company reports (The Northern Miner, 3 September 1964, p. 13) that the drift cut a length of 170 feet, averaging 8.2 feet wide, with an average grade of 1.08 ounces of silver per ton, 13.6 per cent zinc, 0.4 per cent lead, and 0.5 per cent copper.

*Assayed by G. Spalding, Whitehorse, Y.T.

Haggart and Secret Creeks

(Silver-Lead-Antimony)

Peso Silver Mines Limited (Rex Property) (64°00'N, 135°54'W)

References: Green and Roddick (1962); Skinner (1962, pp. 33-34);
Green and Godwin (1963, pp. 14-15; 1964, p. 16).

During 1964, Peso Silver Mines Limited carried out an extensive underground exploration program on the Rex property. The property, about 2 1/2 miles east-southeast of the main camp near the Peso No. 1 vein, is reached by a road from the camp, which in turn is about 26 miles by road from the main Mayo-Elsa road.

Prior to the 1964 work, the Rex property had been explored by surface work, diamond drilling, and a shallow shaft. The adit, at an elevation of 3,550 feet and about 300 feet below the surface outcrop, intersected the Rex vein about 900 feet from the portal. The vein was explored for about 750 feet to the west and for 600 feet to the east. The total underground program involved about 3,500 feet of cross-cutting, drifting, and raising, and 31 diamond drill holes with a total length of about 3,500 feet. Up to 60 men were employed during the peak period and a small crew continued work until late October 1964.

*Assayed by G. Spalding, Whitehorse, Y.T.

Green & Roddick	1962	Page 62-7
Skinner	1962	pp. 33-34
Green & Godwin	1963	63-38
	1964	64-36

ized with sphalerite
crystals. Siderite,
he specimens collected.
rsely crystalline and
mm. The footwall
is reported to be
erial taken near the
f silver per ton, 0.02
ports (The Northern
length of 170 feet,
8 ounces of silver per
cent copper.

Country rock of the showing is buff weathering, grey phyllitic quartzite and dark grey to grey-green phyllite of probable Precambrian age (Green and Roddick, 1962). The rocks are strongly foliated parallel to the bedding and show evidence of considerable shearing, although less deformed than rocks of similar lithology on the main Peso showing nearby. The Rex vein trends about N70°E and dips between 50° and 55°N. In the underground workings the vein appeared to have a strong, well defined footwall shear, but subsidiary subparallel breaks occur in the hanging wall.

135°54'W)

62, pp. 33-34);
16).

carried out an
property. The
camp near the Peso
ch in turn is about 26

ty had been explored by
The adit, at an
face outcrop, inter-
The vein was explored
east. The total under-
ing, drifting, and
of about 3,500 feet.
and a small crew

When visited in mid-June 1964, the footwall shear was exposed in the main drive about 400 feet west of the intersection of the main crosscut. Here, the footwall rocks consisted of interbedded grey quartzite, with beds 2 to 3 inches thick, separated by bands of dark grey phyllite, 1 inch to 2 inches thick. The main shear was marked by a band of rubbery gouge about 1/2 inch thick, and the footwall rocks for about 4 feet below showed minor subparallel shears and some evidence of deformation. The zone itself consisted of a breccia of fragments of quartzite and phyllite mineralized with dark brown siderite, pyrite, and jamesonite. Hanging wall rocks were not exposed in the face, but nearby they consist of light grey phyllitic quartzite. A grab sample from the face, composed mainly of siderite darkened by fine needles of arsenopyrite(?) plus minor tetrahedrite and fine pyrite assayed*: 0.04 ounces of gold and 224.0 ounces of silver per ton, 8.9 per cent lead, 0.2 per cent zinc, 6.86 per cent antimony.

At the same date, the intersection between a shear about 50 feet in the hanging wall from the main footwall shear and a shear trending about N40°E was exposed in the 74 raise, about 270 feet west of the main crosscut. The face, about 70 feet above the level, showed from footwall to hanging wall, chloritic phyllite containing some pyrite, a 1/2 inch zone of black rubbery gouge in part with a pyrite-coated surface, 6 feet of breccia composed of fragments of chloritic phyllite and phyllitic quartzite cemented with siderite, minor bull quartz and sulphide minerals, and a hanging wall of chloritic phyllite. The gouge appears to be blackened by a high content of fine sulphide minerals, chiefly pyrite. Late in the season, the 74 raise was extended to within about 20 feet of the mineralized zone on surface, which assayed (Peso Silver Mines Limited, Annual Report 1963, p. 7) 0.01 ounces of gold and 44.0 ounces of silver per ton, 7.79 per cent lead, and 4.35 per cent antimony, over a length of 250 feet and an average width of 5.2 feet. When the writer visited the property early in October 1964, the face of the raise, about 300 feet above the level, showed from footwall to hanging wall; dark grey phyllite, a zone about 50 inches thick, the lower third of which contained siderite with some sulphide minerals and the remainder an altered breccia streaked with limonite and containing minor sulphides, and a hanging wall of grey phyllite.

*Assayed by G. Spalding, Whitehorse, Y. T.

In general, the shear in the footwall of the Rex vein appears to be much more continuous, contains more gouge, and shows more evidence of deformation along it than the subsidiary breaks in the hanging-wall. Some of the larger of the latter appear to turn into and join the main zone. Erratic mineralization occurs along the breaks, particularly at junctions between two subparallel breaks. Minerals identified in the veins are siderite*, quartz, jamesonite*, boulangerite*, galena, tetrahedrite*, pyrite, arsenopyrite*, and sphalerite. The siderite varies from light amber to an adamantine grey; the darker colour is produced by fine needles of arsenopyrite*, and possibly other minerals, within the siderite crystals. Jamesonite occurs as dense matted areas of fine crystals and probably as fine hair-like crystals, although one specimen of the latter was found to be boulangerite*. Tetrahedrite occurs as irregular grains to about 5 mm in diameter in the silver-rich parts of the vein. Fine grains of pyrite are common throughout much of the vein. Fine grains of pyrite are common throughout much of the vein. Tiny crystals of arsenopyrite* were identified in a jamesonite lens and are probably common to most of the high-jamesonite portions. Minor amounts of lustrous dark brown sphalerite are present.

Bindheimite*, a hydrous antimonate of lead, is widespread in the surface cuts on the Rex vein. Very minor amounts of a medium to dark green, nickel-bearing mica, were encountered both in the underground workings and the diamond drilling.

*Identified by X-ray Diffraction Laboratory, Geological Survey of Canada.

SNAKE RIVER AREA

(Iron)

Crest Exploration Limited (about 65°15'N, 133°00'W)

References: Bamber et al. (1963); Green and Godwin (1963, pp. 15-18; 1964, pp. 16-17).

Crest Exploration Limited, a wholly-owned subsidiary of the Standard Oil Company of California, holds 433 claims and 94 fractional claims in Yukon and 190 claims in the Mackenzie Mining District of North-west Territories covering a major sedimentary iron deposit. The property is accessible from a 4,300 foot airstrip (65°21 1/2'N, 133°20'W) in the valley of Snake River, which is connected to the main camp (about 9 miles southeast of the airstrip) by road. While the camp was in operation transportation was supplied by a company aircraft operating from Whitehorse, Y. T. The nearest lake (65°28'N, 133°49'W) suitable for use

YUKON MINFILE
STANDARD REPORT
CANADA YUKON ECONOMIC DEVELOPMENT PLAN - MINERAL RESOURCES SUBAGREEMENT

1060 021 PESO
Other Names: ()
Deposit Types: VEIN

NtsMaps: NASH CREEK

Status: DEPOSIT
Commodities: SILVER, LEAD, ZINC

Location: 64 01'29"N, 135 56'35"W

CAPSULE WORK HISTORY

Staked as Independence 1-8 (8098) in June/10 by J. Alverson and G. Huffman, who sank a 4.9 m shaft in 1912 and trenched until 1916. Restaked in June/49 as Peso cl(59282) by Alverson and C.D. Poll, who trenched with a bulldozer in 1950. The claims were optioned in 1951 and 1952 by A.W. Johnston and J.W. Powelson, and in 1960 by Tanar Gold ML, which transferred the claims to a new company, Peso Silver ML, in 1961. In late 1961 and 1962, Peso did 381 m of drifting and cross-cutting on the No. 1 Vein (northwest showing) and 874.8 m of drilling (16 holes), extensive trenching and 11.3 m of cross-cutting on the Rex vein. In late 1963, Charter OCL purchased a major interest in Peso and completed about 1067 m of underground development and 1067 m of underground drilling (35 holes) on the Rex vein in 1964. Thirty-six claims on the north side of the Peso property were optioned early in 1972 to Alaskex Mg Corp L, which drilled 2 holes (127.4 m) later that year on the No.1 Vein. Peso partially restaked the No. 1 Vein as MIC cl(YA15331) in July/77, bulldozer trenched the Rex and Peso groups in Sept/77, added W cl(YA30639) in June/78 and changed its name to Rex Silver ML in 1979. Partially restaked as Mole cl(YA41643) in May-Oct/80 by a joint venture between Canada Tungsten Mg Corp & Queenstake Res L. P. Howard staked Colleen cl(YA62493) to the north of the old workings in June/81 and optioned them briefly to Mattagami Lake ML, which performed preliminary mapping and sampling. M.J. Moreau tied on Pierre cl(YA77744) in Aug/85, explored with hand trenching in 1986 and bought the Peso & Rex claims at a Sheriff's sale in Aug/8 and added more Pierre cl(YB2095) in Mar and Oct/88 and Oct/89. A. Johnny restaked the Mole (YB 03787), Peso (YB03795), Rex (YB03721) and Pierre (YB03799) claims in August, 1990.

CAPSULE GEOLOGY

The veins cut a quartzite-schist sequence, that is not the Keno Hill Quartzite. They are typically highly sheared, chloritic, narrow, many-branching vein-faults which trend 070 degrees and dip 45 to 60 degrees. Less than 20% of the drifted veins are mineralized. Mineralized sections vary from 1.2 to 4.3 m wide and contain quartz, carbonates, pyrite, jamesonite, tetrahedrite, galena and sphalerite. Proven and probable reserves in the Rex and No. 1 veins were calculated at 139 373 tonnes grading 716.6 g/t Ag and 3.7% Pb. Ground conditions are very poor and mining conditions are more difficult than average for the Keno Hill district. The 1977 trenching on the Rex group exposed the vein zone over a length of 83.8 m. The best chip sample returned 318.8 g/t Ag and 0.07 g/t Au across 1.4 m. Another trench to the southwest located the faulted offset of the Rex Vein, a highly oxidized grab sample from it assayed 270.8 g/t Ag and 0.17 g/t Au.

BIBLIOGRAPHY

- MacLean, T.A., 1914. Lode Mining in Yukon. Mines Branch Publ. 222, 1914, pp.153-157
Mineral Inventory Cards, Dept. of Energy, Mines & Resources. P61-23, pp32-3
P65-19, pp20-22
ER, Nov/65 by D.D. Campbell for Peso Silver ML, pp.31-39
M364, pp 134-37
MIR, 1978, p.14
ER, Jan/88 by G. Guttrath for Peso Silver ML - A.R- #091699

YUKON MINFILE
STANDARD REPORT
CANADA YUKON ECONOMIC DEVELOPMENT PLAN - MINERAL RESOURCES SUBAGREEMENT

1060 022 BARKER

Other Names: ()
Deposit Types: VEIN

NtsMaps: NASH CREEK

Status: SHOWING
Commodities: LEAD, ANTIMONY

Location: 64 01'54"N, 135 51'34"W

CAPSULE WORK HISTORY

Staked as Barber cl(59497) in Sept/49 by E.H. Barker, who explored with bulldozer trenching and ground sluicing until 1962. The property was optioned by Conwest in 1952, by Stride E & Dev CL in 1956, by Prospectors Airways CL in 1960 and by Peso Silver ML in 1962. The Eleven cl(55381) were staked 1.6 km north on Fisher Creek in Oct/45. Restaked as Smoky cl(YA17930) in Apr/78 by a joint venture between Canada Tungsten Mg Corp and Queenstake Res L, which mapped in 1981. Some of the Smoky claims were transferred to G. Dickson in Feb/86 and the remainder to Queenstake in Aug/86. M. Moreau tied on Rex cl(YB2241) to the south and Mole cl(YB2249) to the southwest in Apr/88. Can-Pro Development Ltd optioned the Smoky and Mole claims as part of a larger block in the Dublin Gulch area in 1989. A. Johnny restaked the Rex (YB03271) and Mole (YB03787) claims in August, 1990.

CAPSULE GEOLOGY

Quartz veins with pyrite and jamesonite occur in breccia zones along Haggart Creek. A grab sample of sulphides assayed 25.6% Pb, 18.2% Sb, 1.7% Zn, 44.6 g/t Ag and 1.0 g/t Au. The veins were discovered during placer mining.

BIBLIOGRAPHY

Stride E & Dev CL Prospectus, Aug/56
B 111, p.84
YMI, 1941-59, pp.108,133
P61-23, p.33
YGE 1979-80, pp.238-240
ER, Feb/90 by D. Philpot for Can-Pro Development Ltd. - A.R.
#092841

YUKON MINFILE
STANDARD REPORT
CANADA YUKON ECONOMIC DEVELOPMENT PLAN - MINERAL RESOURCES SUBAGREEMENT

1060 025 DUBLIN GULCH

Other Names: ()
Deposit Types: VEIN

NtsMaps: NASH CREEK

Status: DEVELOPED PROSPECT

Location: 64 01'57"N, 135 47'44"W

Commodities:
SILVER

CAPSULE WORK HISTORY

Placer gold was discovered on Haggart Creek in 1895 and on Dublin Gulch in 1898. The first lode staking was Dublin Lode, North Star, etc. (2404) in Oct/1901, on which a 14 m adit was driven by 1904. By 1912, development work had been done on five separate properties. On the Stewart-Catto group (Happy Jack (8029) and Victoria (8022) cl) recorded in June-Oct/08, two adits were driven, the first 38 m long and off the vein, and the second a 600 m crosscut with 23 m of drifting on the vein. On the Olive claim (8025) recorded in June/08, an adit was driven about 21 m of which the last metre was on a vein. Trenching and pitting was performed on the Shamrock group, while a 8 m shaft was sunk on the Blue Lead group (8049), recorded in Dec/09. T. McKay and A.W. Martin tied on Bob, Mucking Futch, etc cl(55056) to the Olive claim in Nov/37, prospected with pits and shallow shafts in 1938 and sold the claims to Treadwell Yukon L, which performed more trenching. The property was transferred to Keno Hill Mg Cl in 1946. Restaked as Avoca, etc cl(59052) in Oct/48 by J.B. O'Neill and J.J. Colt, who explored with hand and bulldozer trenching in 1949-54, sold an interest in 1958 to E.H. Barker, who trenched in 1958-61 and sold the property to Peso Silver ML in 1962. Peso performed trenching in 1962. Restaked as part of the Pea, etc cl (Y84832) in Aug/73 by Adonis ML in conjunction with nearby placer work; Shal cl(Y95002) in July/74 by J.M. McNulty; Dog cl(Y97149) in Nov/74 by H. Fromme; Pup cl(YA15128) in May/77 by R. Grant; and Smoky, Bob, etc cl(YA17729) in Apr/78 by Queenstake Res L & Canada Tungsten Mg Corp L, which conducted extensive mapping, and geochem and geophysical surveys in 1978 and 1979, backhoe trenching in 1980 and geochem sampling and mapping in 1981. In 1986, Canada Tungsten transferred some of the Smoky, Bob, to C. Dickson and the remainder to Queenstake, which performed bulldozer trenching and 705 m of diamond drilling in 4 holes later that year. In 1988, the property was optioned to Can Pro Dev L which performed additional diamond drilling later that year and trenched in 1989.

CAPSULE GEOLOGY

Quartz-arsenopyrite veins are common for a length of two miles along the north edge of the Potato Hills stock. Most veins strike NE and range in width from a few cm to 2 m and occasionally wider, although the arsenopyrite-rich section is usually restricted to widths of 10 to 25 cm near the centre. Minor amounts of pyrite occur with the arsenopyrite. Host rocks are Proterozoic or Lower Cambrian metasedimentary rocks. The vein drifted on the Victoria claims assayed 8.6 g/t Au and 13 g/t Ag over a width of 0.6 m for the 23 m length. Similar assays were obtained from other veins. Rio Plata conducted a Turam survey and bulldozing program which reportedly outlined a narrow, silver-rich vein and more arsenopyrite veins. The presence of silver veins in the area is further suggested by the presence of siderite containing sphalerite, galena and jamesonite in the placer gravels. The 1986 drilling tested 4 of 14 veins outlined by Queenstake. The best results were obtained from the Catto Vein where 1 hole returned 44.6 g/t Au over 0.4 m, while a second, 91 m to the west, assayed 60.3 g/t Au, also over 0.4 m. A hole on the No. 23 Vein intersected 74.7 g/t Au over 0.5 m. In 1988, additional drilling on the Catto Vein returned up to 11.2 g/t Au across 2.7 m true thickness while work elsewhere on the property located a few veins on the floor of Dublin Gulch. A chip sample from one of these assayed 41.1 g/t Au over 1 m. Trenching on the Smoky 64, R&D 6,16 and Bob 3 claims in 1989 exposed three new vein systems localized along ENE-trending faults which dip steeply

MINFILE NUMBER: 1060 025
REVISED: 91/07/10

YUKON MINFILE
STANDARD REPORT
CANADA YUKON ECONOMIC DEVELOPMENT PLAN - MINERAL RESOURCES SUBAGREEMENT

1060 025 DUBLIN GULCH

Other Names: ()
Deposit Types: VEIN

NtsMaps: NASH CREEK

Status: DEVELOPED PROSPECT
Commodities:
SILVER

Location: 64 01'57"N, 135 47'44"W

CAPSULE GEOLOGY

south. Channel samples from the trenches returned values up to
8.61 g/t Au.

BIBLIOGRAPHY

Ann. Rept. 1904, Pt A, pp 38-9
Maclean, T.A., 1914. Lode Mining in Yukon. Mines Branch Publ. 222,
1914, pp 127-158
P63-38, p. 9
P61-23, p. 33
B 111. Fig. 18
YGE 1979-80, pp-238-240
YEG 1981, p.194
GCNL Mar. 16/87; Apr.20/88; Jan.3/90
YE 1985-86, pp.293-294
YME0 1988, pp-30-31
NM May 2/88
ER, March/90 by D.R. Brown for Can-Pro Development Ltd. A.R. -
#092841

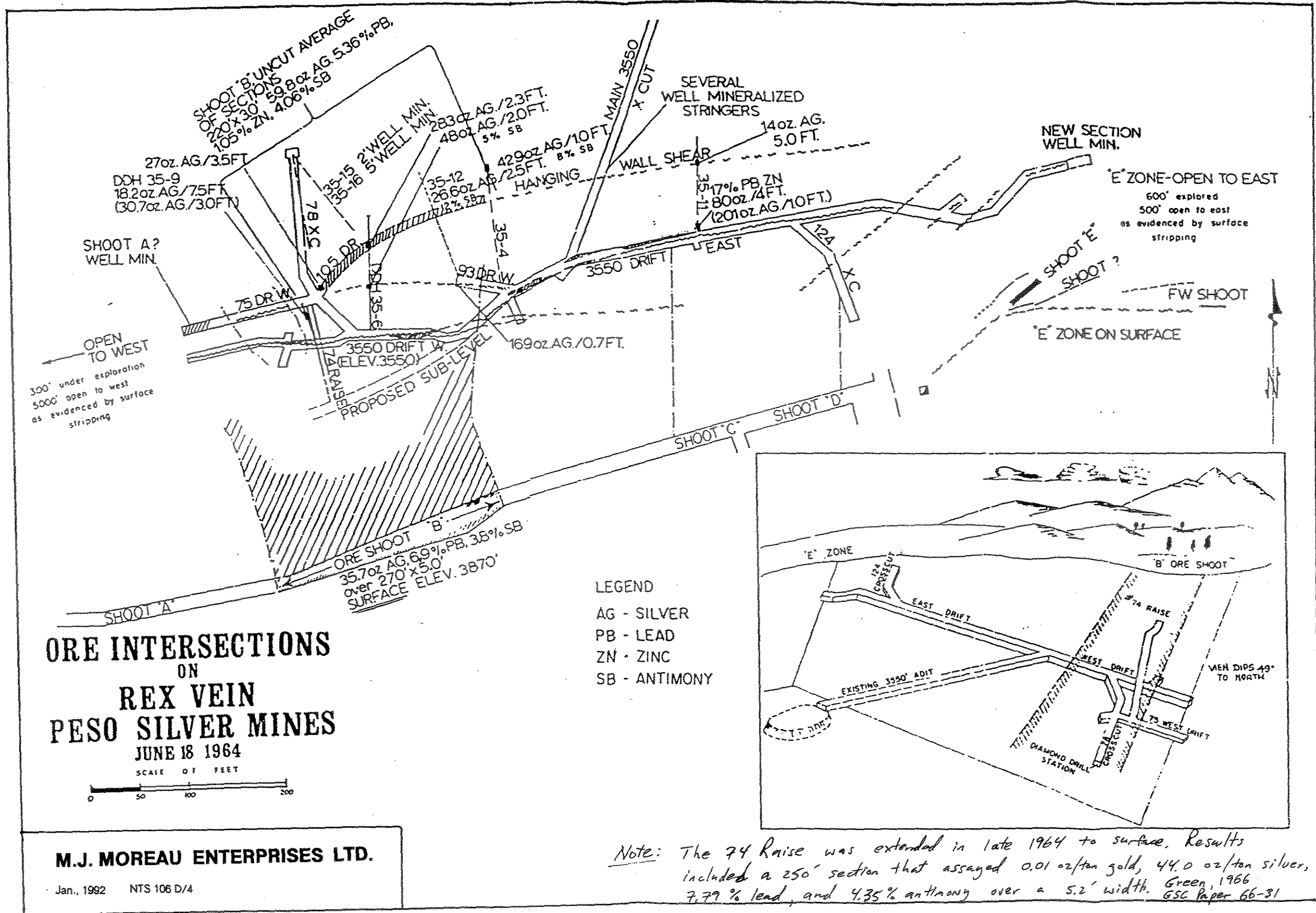

ORE INTERSECTIONS ON REX VEIN PESO SILVER MINES
 JUNE 18 1964

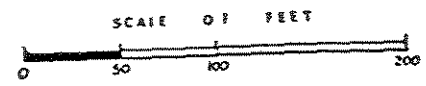

M.J. MOREAU ENTERPRISES LTD.

Jan., 1992 NTS 106 D/4

LEGEND
 AG - SILVER
 PB - LEAD
 ZN - ZINC
 SB - ANTIMONY

Note: The 74 Raise was extended in late 1964 to surface. Results included a 250' section that assayed 0.01 oz/ton gold, 44.0 oz/ton silver, 7.79% lead, and 4.35% antimony over a 5.2' width. GSC Paper 66-31

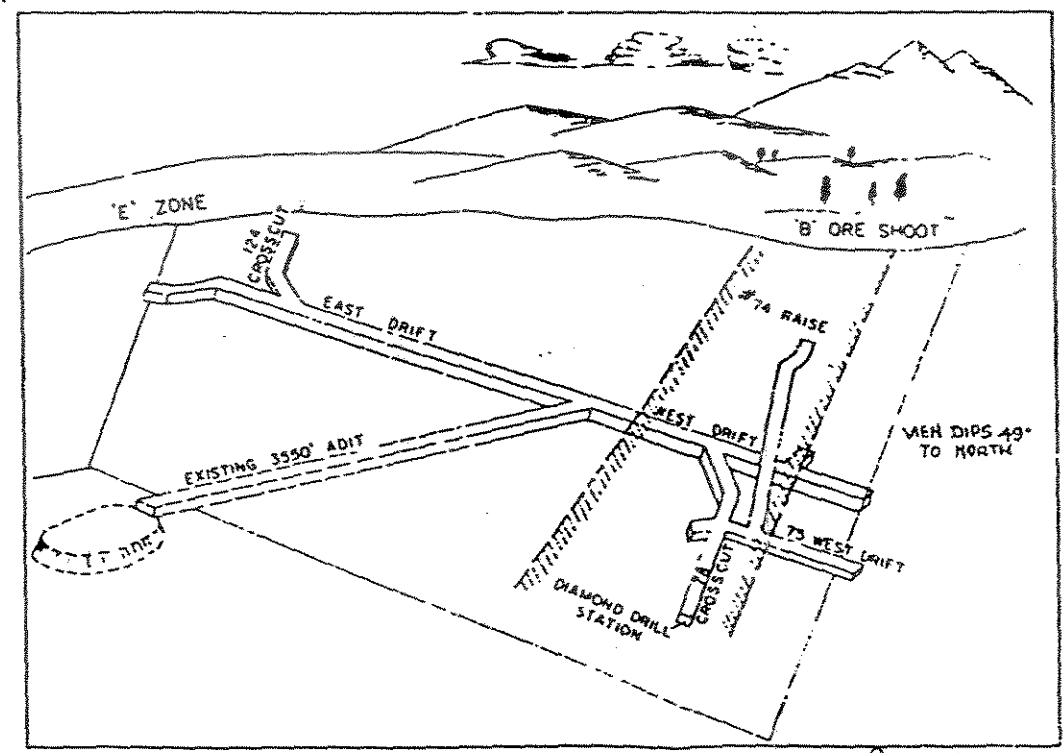

OPEN TO WEST
 300' under exploration
 5000' open to west
 as evidenced by surface stripping

'E' ZONE-OPEN TO EAST
 600' explored
 500' open to east
 as evidenced by surface stripping

SHOOT 'B' UNCUT AVERAGE
 OF SECTIONS
 220' x 30' 59.8oz AG, 5.36% PB,
 105% ZN, 4.06% SB

DDH 35-9
 18.2oz AG/7.5FT
 (30.7oz AG/30FT)

27oz AG/3.5FT

35-15 2' WELL MIN.
 35-16 5' WELL MIN.

283oz AG/2.3FT.
 48oz 5% SB

429oz AG/10FT.
 8% SB

35-12
 26.6oz AG/2.5FT.
 12% SB

35-4
 169oz AG/0.7FT.

14oz AG.
 5.0 FT.

17% PB ZN
 80oz/4FT.
 (201oz AG/10FT.)

SHOOT A?
 WELL MIN.

OPEN TO WEST

ORE SHOOT 'B'
 35.7oz AG, 6.9% PB, 3.8% SB
 over 270' x 5.0'
 SURFACE ELEV. 3870'

SEVERAL WELL MINERALIZED STRINGERS

NEW SECTION WELL MIN.

'E' ZONE ON SURFACE

SHOOT 'C'
 SHOOT 'D'

FW SHOOT

SHOOT 'A'

SHOOT 'B'

SHOOT 'D'

'E' ZONE ON SURFACE

'E' ZONE

'B' ORE SHOOT

EAST DRIFT

WEST DRIFT

EXISTING 3550' ADIT

DIAMOND DRILL STATION

VEN DIPS 49° TO NORTH

75 WEST DRIFT

74 RAISE

EAST DRIFT

WEST DRIFT

EXISTING 3550' ADIT

DIAMOND DRILL STATION

VEN DIPS 49° TO NORTH

75 WEST DRIFT

74 RAISE

EAST DRIFT

WEST DRIFT

EXISTING 3550' ADIT

DIAMOND DRILL STATION

VEN DIPS 49° TO NORTH

75 WEST DRIFT

74 RAISE

- VEIN LEGEND**
- Y YELLOW "OXIDES"
 - B BROWN, LIMONITIC
 - G GREENISH
 - YG YELLOW GREEN
 - Q QUARTZ
 - AQ ARSENICAL QUARTZ
 - W LIGHT GREY (GONGEY)
 - GS GRAPHITIC SCHIST, GONGEY

DETAILED PLAN OF
STRIPPING W. OF TR. #18
PESO #1 VEIN

PESO SILVER MINES
MAYO MD., VT.
SCALE: 1 IN. = 10 FT.
FROM A.M.D. SEPT 11/61
A.E.AHO

NOTE:
A STA 2.8 S.G.W. OF 2000
ASSUMED 45° DIP FOR VEIN
TO CALCULATE AVE TRUE WIDTH

Handwritten signature

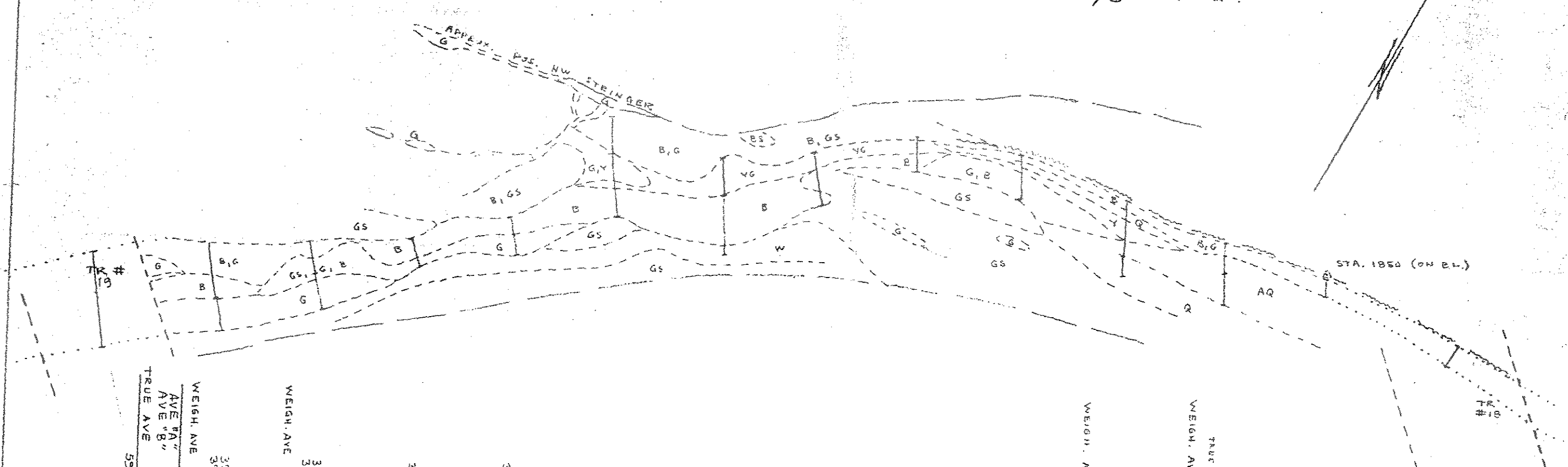

STATION	APP. WIDTH	OZ/TON AG	OZ/TON AS	% Pb	% Sb
59-31	2.5'	.01	1.24		
3951	2.0'	.01	5.34		
3952	5.0' FW 8' HW	.02	8.92		
3953	5.7'	.06	20.72		
3954	2.0' FW 2.3' HW	.02	16.28		
3955	7.3'	.02	13.50		
3956	4.5'	.03	25.80	4.4	
3957	3.8'	.01	15.78		
3958	5.2'	.04	3.46		
3959	9.5'	.01	42.35	3.16	
3960	10.6'	.005	12.00	2.3	
3961	3.6'	.02	57.3		
3962	3.0'	.005	19.10		
3963	3.5' FW 1.5' HW	.01	9.70		
3964	5.0'	.005	1.60		
3965	2.5' FW 5.5' HW	.005	7.2		
3966	9.0'	.005	2.44		
3967	5.2 (3.7) 5.8 (4.1)	.015	19.8		
3968	12.0' x 4.0'	.015	18.6		
3969	5.0'	.02	19.0		
3970	5.0'	2.08	1.31		
					12.94% AS

FIGURE 61-5

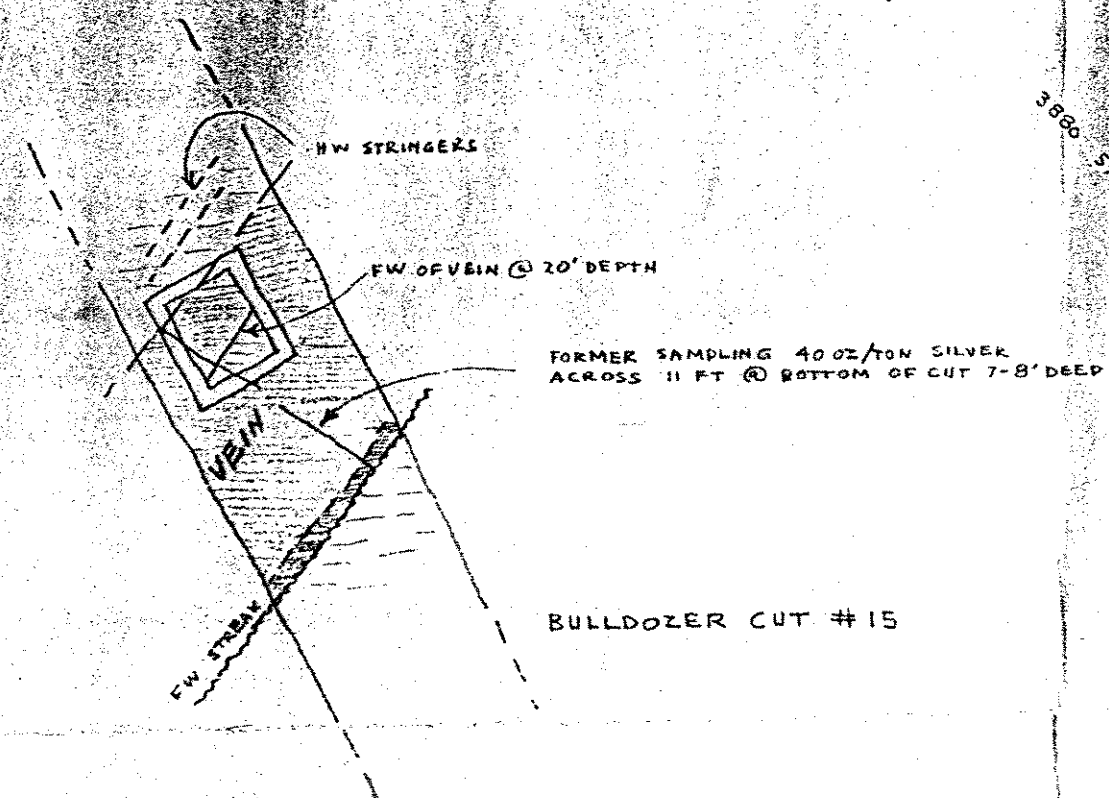

PLAN SHOWING
POSITION OF #1 SHAFT
 1 IN = 10 FT
 SEPT. 15/61 A.E. AHO

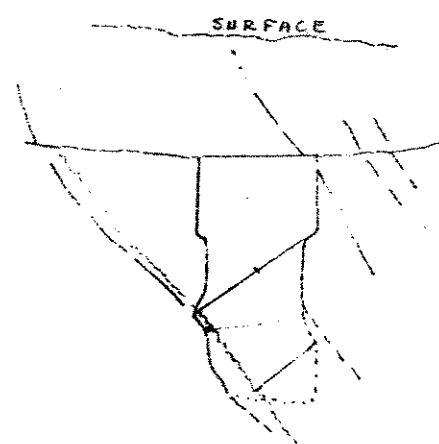

WEST WALL
 TO JULY 20/61

WIDTH	AU oz/ton	AG oz/ton	LEAD %	ANTIMONY %
3.0	.04	60.7	0.84	1.20
4.0	.04	74.0	2.29	2.24
FW.GRAB	.30	91.0	4.30	3.59
4.5	.04	53.9	0.82	1.66

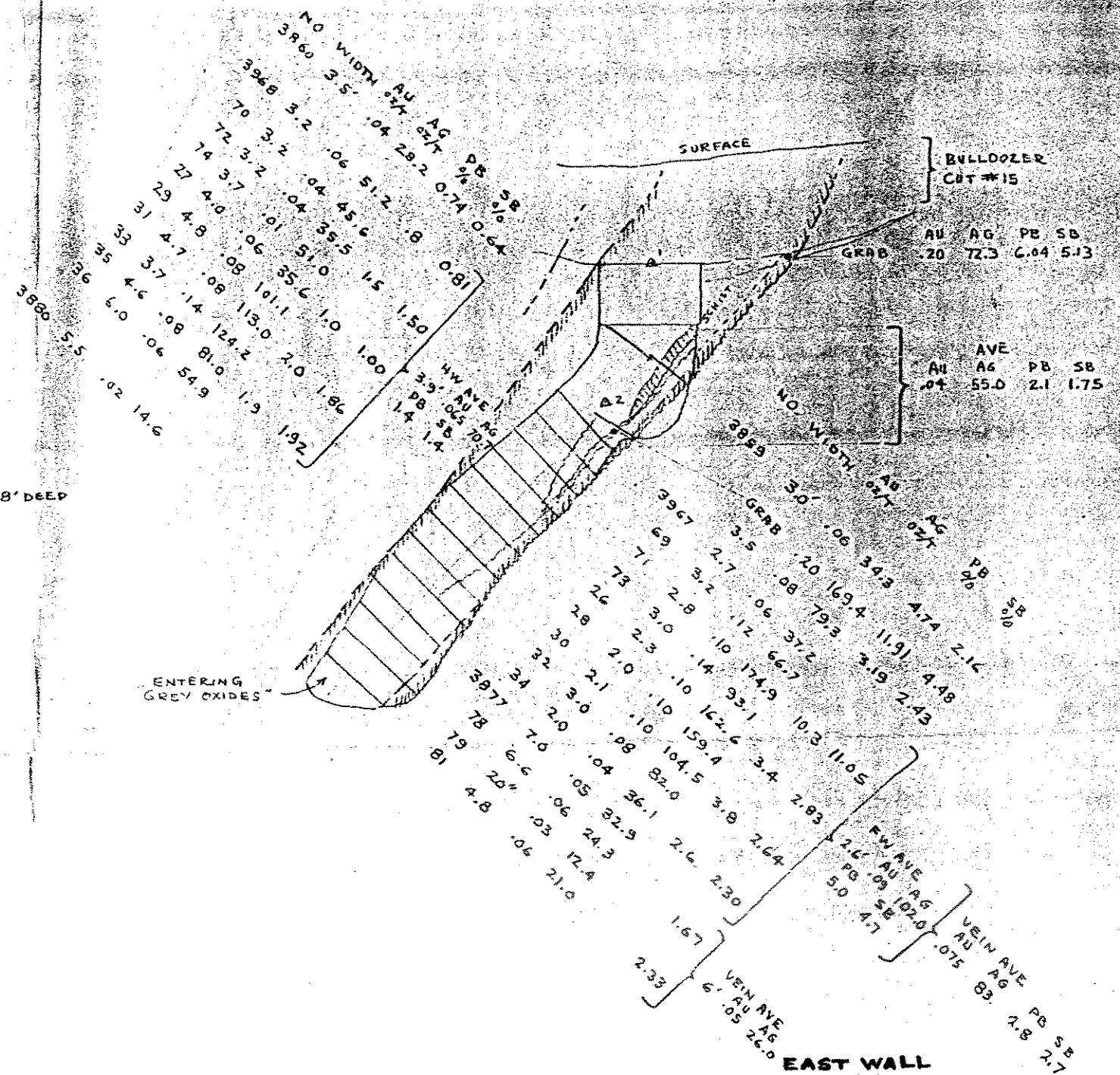

EAST WALL
NO. 1 SHAFT
PESO SILVER MINES
 1 IN. = 10 FT.
 SEPT. 15/61 A.E. AHO

A.E. AHO

SHAFT AVE 8.5' X 40'	AU	AG	PB	SB
	.06	62.0	2.5	2.3

FIGURE 61-G

M.J. MOREAU ENTERPRISES LTD.

Office: #21 - 4078 - 4th Avenue, Whitehorse, Yukon Bus. Phone: (403) 667-7067 Res. Phone: (403) 633-2541
Mailing Address: P.O. Box 5282, Whitehorse, Yukon, Y1A 4Z2

July 04, 1991

GST No. R103722187

Jacques Moreau
31 MacDonald Road
Whitehorse, Yukon

Dear Sir:

RE: PIERRE CLAIM GROUP
SECRET CREEK AREA
MAP 105/M-13, 106/D-4

To invoice you for 3 days' prospecting:

3 days at \$300.00/day	\$ 900.00
Running Mileage: (All truck and travelling expenses) \$0.74 per km x 936 km	692.64
	<hr/>
	1,592.64
7% GST	111.48
	<hr/>
TOTAL:	<u>\$1,704.12</u>

Work period: June 17-18-19, 1991.

Yours truly

M. J. MOREAU ENTERPRISES LTD.

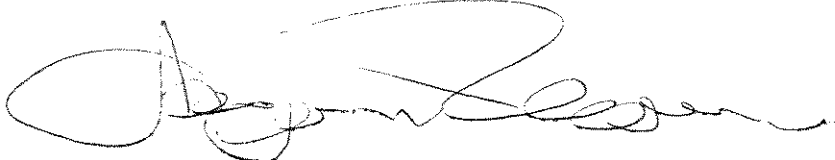
M. J. Moreau

MJM/ks

093014

*Mr Moreau's three days prospecting +
sampling.*



AURUM GEOLOGICAL CONSULTANTS INC.

604-675 West Hastings Street, Vancouver, B.C., Canada V6B 1N2

Tel: (604) 683-9656 Fax: (604) 683-7625

INVOICE

**Invoice No. 91034
July 2, 1991
GST REG #R100341692**

In Account with: **M.J. Moreau Enterprises Ltd.**
P.O. Box 5282
Whitehorse, Yukon Territory
Y1A 4Z2

Attention: Mr. Jacques Moreau

Re: Exploration on the Pierre Property, Mayo M.D., Yukon.

To:

Professional Services

R. Hulstein, B.Sc.; June 17-19, 1991,
3 Days @ \$300.00/day: \$900.00

GST (7% of \$900.00): 63.00

TOTAL INVOICE \$963.00

Aurum 3 days on property.

RECEIVED
July 2/91

July 2, 1991

Work Order # 13178

M. J. Moreau
Aurum Geological Consultants Inc.
P.O. Box 5179
Whitehorse, Yukon
Y1A 4S3

Invoice for Analytical Services

Sample preparation (rocks)	31 x \$ 4.25 = \$ 131.75
Sample preparation (soils)	10 x \$ 1.50 = \$ 15.00
Au + ICP	41 x \$ 15.50 = \$ 635.50

Subtotal	\$ 781.25
GST @ 7% (REG #R121285662)	\$ 54.69
Total due on receipt of invoice	\$ 835.94
2% interest charge on accounts over 30 days	





July 2, 1991

Work Order # 13178

M. J. Moreau
Aurum Geological Consultants Inc.
P.O. Box 5179
Whitehorse, Yukon
Y1A 4S3

File #13178a

Project #

Assay Certificate for Samples Provided

Sample #	Au ppb	
P91-001	132	
P91-002	382	
P91-003	268	
P91-004	325	
P91-005	11	Ag 19.892 oz/ton
P91-006	23	
P91-007	399	
P91-008	762	
P91-009	42	
P91-010	814	
P91-011	27	
P91-012	936	
P91-013	560	
P91-014	501	
P91-015	525	
P91-016	430	
P91-018	743	
P91-019	54	
P91-020	66	
P91-021	44	
P91-022	132	
P91-023	17	
P91-024	21	
P91-025	16	
P91-026	20	
P91-027	14	
P91-028	244	
P91-029	10	
P91-030	1720	
P91-031	1239	
P91-032	1407	

Certified by Chyokki



AURUM GEOLOGICAL CONSULTANTS INC.

412-675 West Hastings Street, Vancouver, B.C., Canada V6B 1N2 Tel: (604) 683-9656 Fax: (604) 683-7625

INVOICE

**Invoice No. 92004
February 10, 1992
GST REG #R100341692**

In Account with: **M.J. Moreau Enterprises Ltd.**
P.O. Box 5282
Whitehorse, Yukon Territory
Y1A 4Z2

Attention: Mr. Jacques Moreau

Re: Assessment Report, Pierre Property, Mayo M.D., Yukon.

To:

Professional Services

R. Hulstein, B.Sc.; 4 Days @ \$300.00/day:	\$1,200.00
R. Allan Doherty, B.Sc.: 2 hrs @ \$37.50/hr	75.00

Expenses

Reprographics (#11777,11516,11783,11080,11802)	\$276.32
Drafting (#047):	140.00
Telephone calls (Whse to Mayo & Van.- estimate):	15.00
Airfreight (Van.-Whse 72882073):	14.00
Report Covers (8 sets \$7.00 ea):	56.00
Postage:	3.00
Accounting Charge @ 10% of \$504.32	50.43
 GST (7% of \$1,829.75):	 128.08

TOTAL INVOICE \$1,957.83

Aurum - Writing Report.



302 Jarvis St., Whitehorse, Yukon Y1A 2H2
 Phone (403) 667-4639 Fax 668-2734

INVOICE 11777

DATE: Jul 7/92

"The Complete Printing & Engineering Supply Centre"

S O L D T O Curium Biological
Order # 1020

S H I P T O VIA _____

ORDER NO.		P.O. NO.	CUST. REQ'D NO.	
QTY.	DESCRIPTION		UNIT COST	EXT. COST
21.6 [#]	W. tip printing		.20	4.32
21.6 [#]	Holding		.05	1.08
240	8 1/2 x 11 3/5 Pc		.10	24.00
16	11 x 17 "		.20	3.20
4	1/2" carbon		2.75	11.00
} 25				
SUB-TOTAL			43.60	
G.S.T.			3.05	
TOTAL			46.65	

G.S.T. REG. NO. R102500287

TERMS: NET 30 DAYS FROM DATE OF INVOICE
 2% PER MONTH CHARGED ON OVERDUE ACCOUNTS

SUB-TOTAL 43.60
 G.S.T. 3.05
 TOTAL 46.65

4360

intographics LTD.

302 Jarvis St., Whitehorse, Yukon Y1A 2H2
Phone (403) 667-4639 Fax 668-2734

INVOICE N^o 011516

W AUTHORIZED DEALER
wade DRAFTING & SURVEY SUPPLIES

COMPLETE ENGINEERING SUPPLY,
REPRODUCTION & DRAFTING CENTRE

DATE: Jan 13/92

S
O
L
D

T
O

S
H
I
P

T
O

VIA

Aurum Geological

cust# 1020

PROJECT # 25

ORDER NO.		P.O. NO.		CUST. REQ'D NO.	
QTY.	DESCRIPTION	UNIT COST	EXT. COST		
18 [#]	Xerox Bond papers	1.30	23.40		
24	8 1/2 x 11 3/8 1/2	.10	2.40		
28	" 0/5 1/2	.16	4.48		
9	11 x 17 3/8 1/2	.20	1.80		
38	8 1/2 x 14 " "	.12	4.56		
15	11 x 17 4/5 1/2	.32	4.80		
6	11 x 17 colour papers	5.75	34.50		
2	Map Pockets	.95	1.90		
3	Labels		5.00		
3	Powers.	.35	1.05		
1.5 HRS SHOP TIME (CORRECTING, FOLDING, SPICING)			52.50		
G.S.T. REG. NO. R102500287			141.39		
TERMS: NET 30 DAYS FROM DATE OF INVOICE			9.90		
2% PER MONTH CHARGED ON OVERDUE ACCOUNTS			151.29		
			SUB-TOTAL		
			G.S.T.		
			TOTAL		

141.39



302 Jarvis St., Whitehorse, Yukon Y1A 2H2
 Phone (403) 667-4639 Fax 668-2734

INVOICE 11783

DATE: June 14/92

"The Complete Printing & Engineering Supply Centre"

S Curran Geological
 O _____
 L _____
 D _____
 T Order # 1020
 O _____
 O _____

S _____
 H _____
 I _____
 P _____
 T _____
 O _____
 VIA _____

ORDER NO.		P.O. NO.		CUST. REQ'D NO.	
QTY.	DESCRIPTION			UNIT COST	EXT. COST
4	11x17			.26	1.04
8	8 1/2 x 11			.13	1.04
19.60	Whiteprinting			.20	3.92
19.60	Holding			.05	.98
3	Re-litho Bind			1.00	3.00

} \$25

G.S.T. REG. NO. R102500287

TERMS : NET 30 DAYS FROM DATE OF INVOICE
 2% PER MONTH CHARGED ON OVERDUE ACCOUNTS

SUB-TOTAL	9.98
G.S.T.	.70
TOTAL	10.68

9.98

inte graphics LTD.

302 Jarvis St., Whitehorse, Yukon Y1A 2H2
Phone (403) 667-4639 Fax 668-2734

INVOICE N° 011080

W AUTHORIZED DEALER
wade DRAFTING & SURVEY SUPPLIES

COMPLETE ENGINEERING SUPPLY,
REPRODUCTION & DRAFTING CENTRE

DATE: 2/02/91

S
O
L
D
T
O

Curran
Leas # 1020

S
H
I
P
T
O
VIA

JOB # 12

ORDER NO.		P.O. NO.		CUST. REQ'D NO.	
QTY.	DESCRIPTION	UNIT COST	EXT. COST		
235	8 1/2 x 11 3/8 P/c	.10	23.50		
5	3/8 Curlox	1.50	7.50		
5	Whip Pockets	.95	4.75		
20	Whiterenting	.20	4.00		
20	Holding	.05	1.00		

G.S.T. REG. NO. R102500287
TERMS: NET 30 DAYS FROM DATE OF INVOICE
2% PER MONTH CHARGED ON OVERDUE ACCOUNTS

SUB-TOTAL	40.75
G.S.T.	2.85
TOTAL	43.60

40.75

+ Ages Report covers.



302 Jarvis St., Whitehorse, Yukon Y1A 2H2
Phone (403) 667-4639 Fax 668-2734

INVOICE 11802

DATE: *Jul 13/92*

"The Complete Printing & Engineering Supply Centre"

S *Aureus Biological*
O _____
L _____
D _____
T *Quest # 1020*
O _____

S _____
H _____
I _____
P _____
T _____
O _____
VIA _____

ORDER NO.		P.O. NO.		CUST. REQ'D NO.	
QTY.	DESCRIPTION			UNIT COST	EXT. COST
<i>21.66</i>	<i>Whitprinting</i>			<i>.20</i>	<i>4.32</i>
<i>21.66</i>	<i>Holding</i>			<i>.05</i>	<i>1.08</i>
<i>240</i>	<i>8/2x11 3/8 7/8</i>			<i>.10</i>	<i>24.00</i>
<i>16</i>	<i>11x17 "</i>			<i>.20</i>	<i>3.20</i>
<i>4</i>	<i>1/2" cover box</i>			<i>2.00</i>	<i>8.00</i>

25

G.S.T. REG. NO. R102500287

TERMS: NET 30 DAYS FROM DATE OF INVOICE
2% PER MONTH CHARGED ON OVERDUE ACCOUNTS

SUB-TOTAL	<i>40.60</i>
G.S.T.	<i>2.84</i>
TOTAL	<i>43.44</i>

40.60

Handesign

SUITE 206-100 MAIN STREET
WHITEHORSE, YUKON Y1A 2A8

TELEPHONE: (403) 668-2768

FAX: (403) 668-6803

N: 000047

DATE: 31 JANUARY 1992

BILL TO: AURUM GEOLOGICAL CONSULTANTS INC.
205-100 MAIN STREET, WHITEHORSE, YUKON Y1A 2A8

QUANTITY	JOB DESCRIPTION	PRICE PER/	AMOUNT
5 hrs.	PROJECT 25 for drafting services rendered.	28.00/hr	\$140.00
		SUB TOTAL	140.00
TERMS: INTEREST AT THE RATE OF 2% PER MONTH (24% PER ANNUM) WILL BE CHARGED ON THE BALANCE AFTER THE 15TH OF NEXT MONTH.		GST REGISTRATION #R122842693	9.80
		INVOICE TOTAL >	\$149.80

QWANLIN MALL POSTAL OUTLET
12-303 OGILVIE ROAD
WHITEHORSE, YUKON (Y1A 2S0)
GST/TPS R# 110811247
PST/TVP R#

92/02/11 14:33 720348 OPER
PR 00000089
* OF ITEMS/* D'ITEMS (L/E) 1
UNIT WEIGHT/POIDS UNIT. 0.935KG
UNIT COST/COUT UNITAIRE 3.00
SUB-TL GST/SOUS-TOT TPS 3.00
GST/TPS 0.21

TOTAL COST/COUT TOTAL 3.21
AMT PAID /MONTANT PAYE 3.21
CASH/COMPTANT 0.00
CHANGE/MONNAIE

#25



September 17, 1991

Work Order # 13372

M. J. Moreau

Invoice for Analytical Services

Au 1AT fire assay gravimetric	9 x \$ 11.00	=	\$ 99.00
1st element AAS assay	13 x \$ 6.00	=	\$ 78.00
2nd element AAS assay	13 x \$ 2.00	=	\$ 26.00
Ag 1AT fire assay gravimetric	3 x \$ 11.00	=	\$ 33.00

Subtotal \$ 236.00

GST @ 7% (REG #R121285662) \$ 16.52

Total due on receipt of invoice \$ 252.52

2% interest charge on accounts over 30 days