

MAP NO.: ASSESSMENT REPORT X

DOCUMENT NO: 092984

115 P /15
115 P /14

PROSPECTUS
CONFIDENTIAL X
OPEN FILE

MINING DISTRICT: Dawson
TYPE OF WORK: Geochemical Survey
Rock and Soil

REPORT FILED UNDER: Noranda Exploration Co. Ltd.

DATE PERFORMED: June 8, to Oct. 3, 1990
May 1, to June 16, 1991

DATE FILED: Dec 13, 1991

LOCATION: LAT.: 63°52'N
LONG.: 137°05'W

AREA: Clear Lake Area
VALUE \$: 16,650.00

CLAIM NAME & NO.:
Rum 1 - 50, YA88956 - YA89005, Rum 51 - 90, YA89345 - YA89384.
Rye 1 - 24, YB05624 - YB05647, Rye 29 - 41, YB05652 - YB05664.
Rye 43, YB05665, Rye 45, YB05666, Rye 47, YB05667, Rye 49, YB05668.
Rye 51, YB05669, Rye 54, YB05671, Rye 56, YB05673.
Rye 61 - 62, YB05678 - YB05679, Rye 75 - 84, YB05692 - YB05701.

WORK DONE BY: Jesse L. Duke.

WORK DONE FOR: Noranda Exploration Co. Ltd.

DATE TO GOOD STANDING:

REMARKS: # 115 P
Preliminary soil and rock sampling was conducted on the property to verify results obtained by previous operators. The results confirmed the presence of significant gold anomalies in several areas of the property. A larger work program continued on the property in the latter part of the 1991 field season.

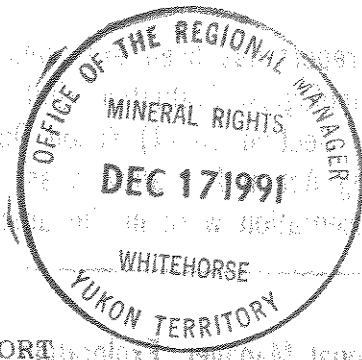

TRENCHING AND SAMPLING REPORT

on the

RUM 1-90, RYE 1-41, 43, 45, 47, 49, 51, 54, 56,

and RYE 61-62, 75-84 CLAIMS

Dawson Mining District

N.T.S.: 11 $\frac{1}{2}$ P/14, 11 $\frac{1}{2}$ P/15

Latitude: 063 52'N

Longitude: 137 05'W

092984

Noranda Exploration Co. Ltd.

(no personal liability)

Jesse L. Duke

November, 1991



TABLE OF CONTENTS

	SUMMARY	3
CHAPTER ONE	: INTRODUCTION	
1-1	: Introductory Statement	4
1-2	: Access & Location	4
1-3	: History of Claims	6
1-4	: Physiography & Vegetation	8
1-5	: Work Program	8
CHAPTER TWO	: GEOLOGY	
2-1	: Regional Geology	11
2-2	: Property Geology	11
CHAPTER THREE:	MINERALIZATION	12
CHAPTER FOUR :	CONCLUSIONS & RECOMMENDATIONS	13
Statement of Costs		15
Statement of Qualifications		16

LIST OF APPENDICES

Appendix I	: Geochemical Results	17
------------	-----------------------	----

LIST OF FIGURES

Fig. 1:	Location Map	1:2,000,000	5
Fig. 2:	Claim Location Map	1:63,360	7
Fig. 3:	Trench and sample locations	1:10,000	in pocket

SUMMARY

The Clear Creek gold property is located in central Yukon 472 km by road north of Whitehorse. It consists of 146 contiguous quartz claims. Work was performed on the property twice in 1990 and in the spring of 1991. The 1991 work was the start of a larger program which continued throughout the season.

The work consisted of an evaluation in 1990 and an early-season trenching program in 1991 to assess the potential for gold mineralization on the property. A total of one hundred metres of cat trenching, 90 soil samples, and 69 rock samples were collected.

The presence of significant gold anomalies obtained by previous work on the property was confirmed.

CHAPTER ONE: INTRODUCTION

1-1: Introductory Statement

During the period between June 8, 1990 and October 3, 1990 two visits to the property for the purposes of sampling and evaluation were conducted.

During the period between May 1st and June 7th, ¹⁹⁹¹ a trenching and sampling program was conducted on the property. A D-8 Catapillar bulldozer completed 100 metres of trenching, constructed 650 metres of access road and upgraded 900 metres of existing access road.

1-2: Access & Location

The property is located in the Dawson Mining District in central Yukon. Access is provided by the paved Klondike Highway, at a point 435 km north of Whitehorse, and then 37 km east on a well maintained gravel road to the west boundary of the property. Four-wheel-drive roads provide access on the property.

The claims cover gold mineralization that occurs as disseminations in quartz-monzonite, along high-angle faults associated with porphyry dykes, disseminated in hornfelsed metasediments, and in quartz veins cutting both hornfelsed sediments and diorite.

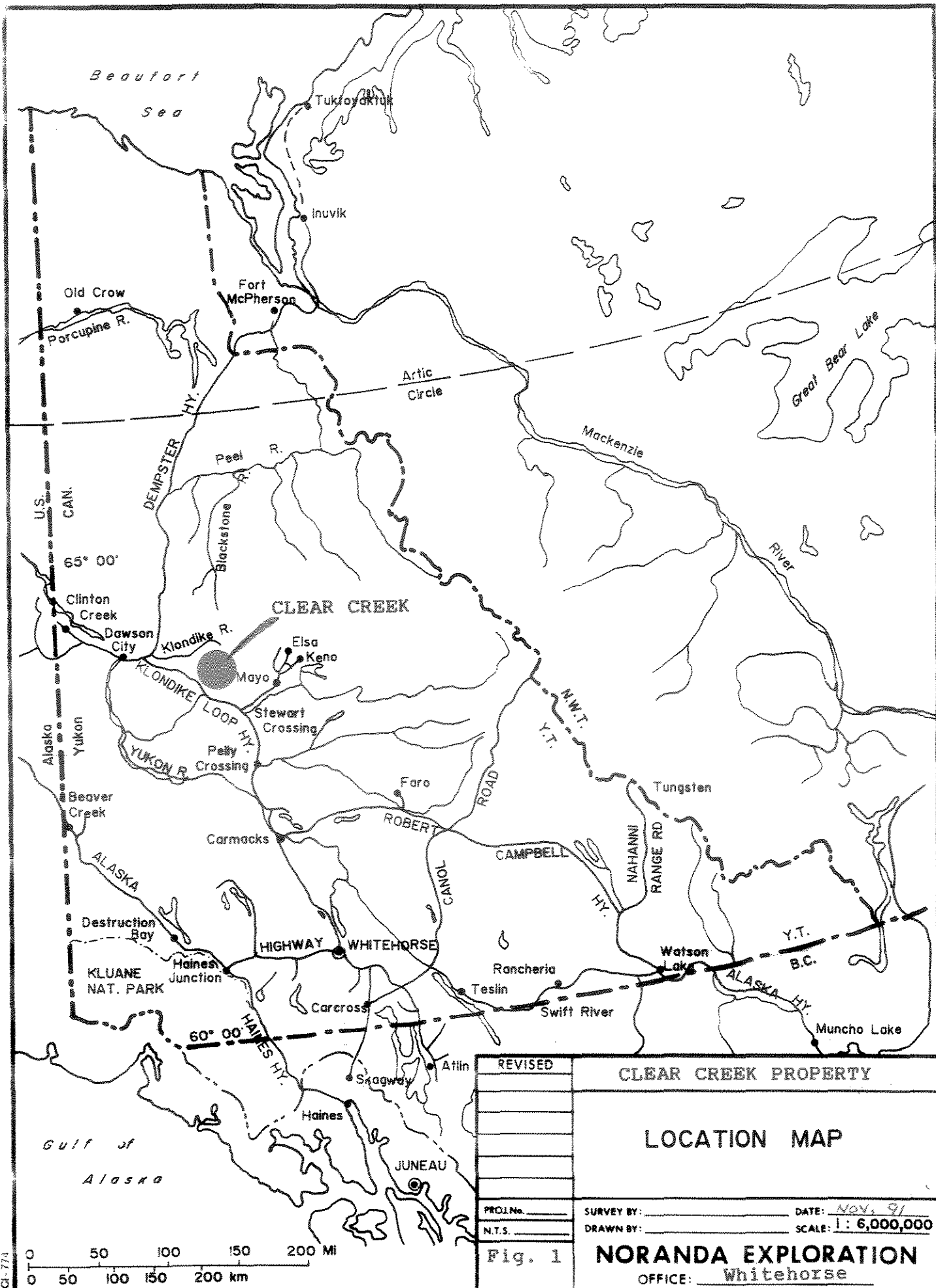

REVISED	CLEAR CREEK PROPERTY	
	LOCATION MAP	
PROJ. No. _____	SURVEY BY: _____	DATE: <u>Nov. 91</u>
N.T.S. _____	DRAWN BY: _____	SCALE: <u>1 : 6,000,000</u>
Fig. 1		
NORANDA EXPLORATION		
OFFICE: <u>Whitehorse</u>		

NCI-774

1-3: History of Claims

The property consists of 146 contiguous unsurveyed quartz claims, staked in accordance with the Yukon Quartz Mining Act. The property covers an area of approximately 1,051.4 hectares.

The Rum 1-90 claims were staked in 1987 by Ron Robertson. The RYE 1-24, 29-41, 43, 45, 47, 49, 51, 54, 56, 61-62, 75-84 were added in 1988 to cover additional areas of interest. Other claims staked in the area as part of the property have been allowed to lapse where the potential has been considered minimal.

Upon acceptance of this report the status of the claims will be as follows:

CLAIM NAME	GRANT No.	No. CLAIMS	EXPIRY DATE
RUM 1-50	YA88956-YA89005	24	April 1, 1992
RUM 51-90	YA89345-YA89384	40	June 17, 1992
RYE 1-24	YB05624-YB05647	24	June 8, 1992
RYE 29-41	YB05652-YB05664	14	June 8, 1992
RYE 43	YB05665	1	June 8, 1992
RYE 45	YB05666	1	June 8, 1992
RYE 47	YB05667	1	June 8, 1992
RYE 49	YB05668	1	June 8, 1992
RYE 51	YB05669	1	June 8, 1992
RYE 54	YB05671	1	June 8, 1992
RYE 56	YB05673	1	June 8, 1992
RYE 61-62	YB05678-YB05679	2	June 8, 1992
RYE 75-84	YB05692-YB05701	10	June 8, 1992

The region is an active placer camp with operating mines on many of the drainages in the area. The area was first explored for tin and tungsten mineralization in the late 1970's and early 1980's. The potential for gold mineralization was recognized by Canada Tungsten Mining

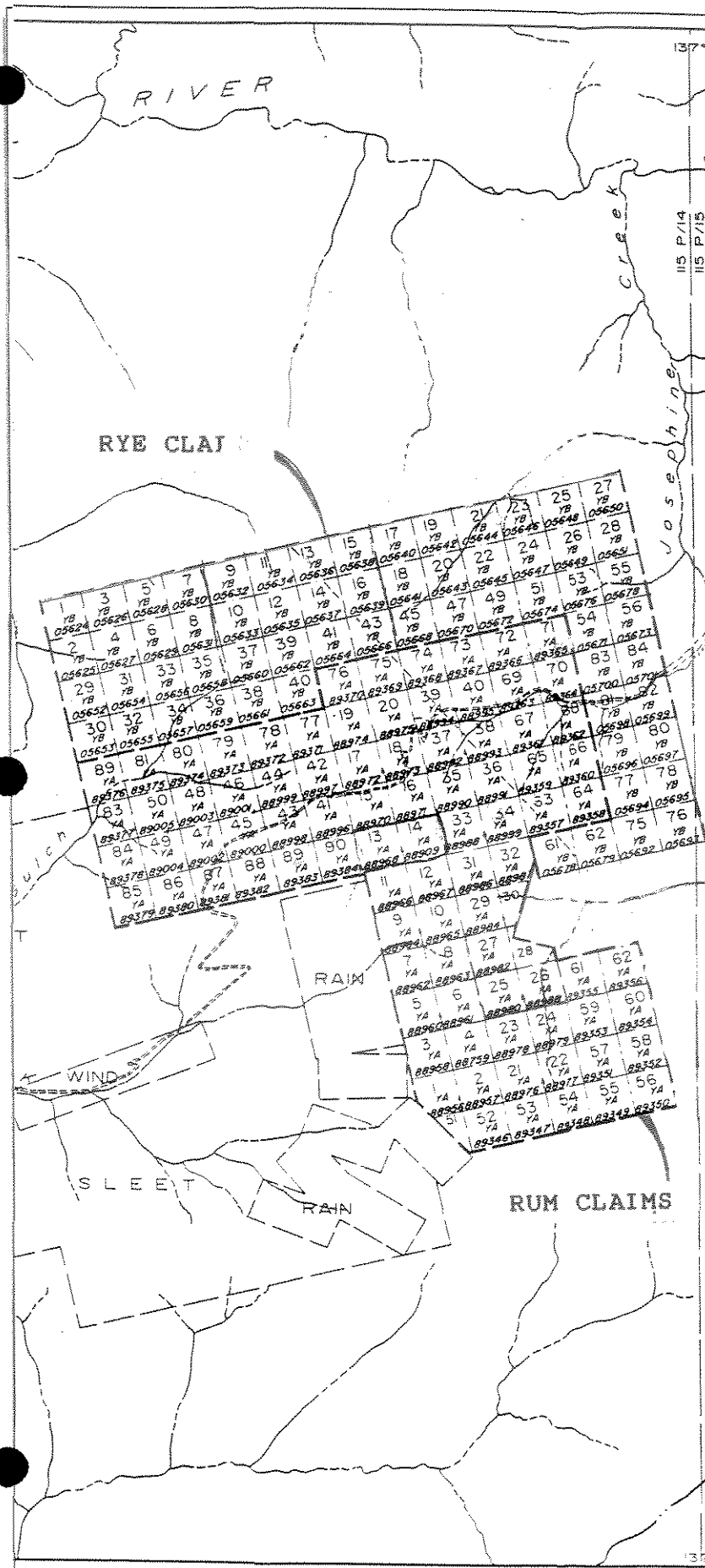

LEGEND

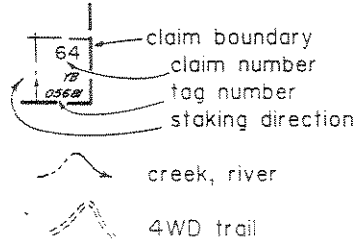

NOTE: adapted from D.I.A.N.D. map sheets 115 P-14 & 15

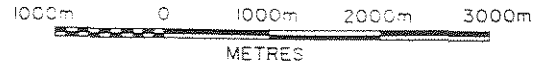

NORANDA EXPLORATION COMPANY LIMITED
CLEAR CREEK PROPERTY
 DAWSON MINING DISTRICT

CLAIM MAP

Corporation while exploring for tungsten. However, they discontinued their interest in the area in 1982.

In 1987 the property was staked by Ron Robertson and optioned to Goldrite Mining Corporation. Between 1987 and 1989 geological mapping various geochemical surveys, prospecting and 1236 metres of drilling were completed. Goldrite dropped its option on the property in 1990. Noranda conducted two property examinations in 1990 and optioned the property in February of 1991. Extensive geochemistry, sampling, geophysics, and some trenching were completed on the property during the 1991 season. This report covers some of this work.

1-4: Physiography & Vegetation

The property lies in the Ogilvie Mountains at elevations that range from 900 metres to 1800 metres. Glaciation is limited to small alpine glaciers in the highest mountains. Most of the property is unglaciated and consists of talus-covered slopes, cliffs, and felsenmeer covered ridges.

The property is primarily above treeline and vegetation consists of dwarf willow, mosses and lichens, birch, and scattered fir.

1-5: Work Program:

On June 9, 1991 a crew of four drove to the property and established a fly-camp. The Contact and Saddle Zones

were visited and sampled. The crew returned to Whitehorse on June 11. A total of 39 soil samples and 48 rock samples were collected and shipped to Northern Analytical Labs of Whitehorse for gold analysis and then to the Noranda lab in Vancouver for analysis by ICP. The results are found in Appendix I .

On September 6, 1990 a crew of four returned to the property to further assess the Contact and Saddle Zone areas. A total of 21 rocks and 51 soil samples were collected. Snow hampered field efforts. The crew returned to Whitehorse on September 8.

On May 18, 1991, a sampling crew and bulldozer were mobilized onto the property to test soil anomalies identified in 1988 by Goldrite Mines Ltd and Noranda in 1990. Snow drifts and fresh snow fall hampered the field crew's efforts. A base camp was established on the Left Clear Creek road west of the property and the crew drove to the work site on a daily basis. Thawing frozen ground hampered the trenching and considerable hand digging was required to obtain a suitable sample. A total of 25 rock samples were collected.

Access road to the target area was repaired and four trenches were completed in two target areas. Trench locations and sample numbers are indicated on Figure 3. ICP results are attached in the Appendix.

Personnel involved in the program were as follows:

NAME	TITLE	RESIDENCE
Jesse Duke	Project Geologist	Whitehorse, Yukon
Danielle Heon	Geologist	Montreal, Quebec
Greg Gillstrom	Geologist	Vancouver, B.C.
Eeric Lilles	Assistant	Whitehorse, Yukon
Wilson Muir	Assistant	Whitehorse, Yukon
Everet Wickland	Assistant	Vancouver, B.C.
Kim Traff	Assistant	Vancouver, B.C.
Tony Bazylnski	Cat operator	Whitehorse, Yukon

CHAPTER TWO: GEOLOGY

2-1: Regional Geology

The region is located within Selwyn Basin and is mostly underlain by Paleozoic metasedimentary rocks thought to be part of the Road River Formation. The dominant lithologies in the area include quartzite, phyllite, quartz-feldspar-mica schists, conglomerate sandstones, slate, and limestone. The property is located on the northwest end of the McQuesten anticline. The McQuesten anticline hosts a 90 km long region of scattered intrusive rock of dominantly quartz-monzonite to diorite composition. Acid stocks and mafic dykes also occur.

2-2: Property Geology

The property is underlain by Proterozoic to early Paleozoic metasedimentary rocks of the "Grit Unit". These have been intruded by stocks that vary in composition from quartz monzonite to diorite. Extensive hornfelsing of the sediments occur peripheral to the stocks. The area is also cut by scattered narrow quartz-feldspar porphyry, aplite and lamprophyre dykes.

CHAPTER THREE: MINERALIZATION

Gold mineralization occurs spatially associated with arsenopyrite as fine disseminations in quartz monzonite, in quartz veins cutting diorite and hornfelsed sediments, finely disseminated in hornfelsed sediments around quartz monzonite, finely disseminated in aplite dykes, and in quartz veining associated with quartz-feldspar porphyry dykes.

Work completed by Aurum Geological Consultants of Whitehorse in 1988 for Goldrite Mining Corporation of Vancouver outlined an impressive gold in talus-fines anomaly greater than 100 ppb gold, and often greater than 500 ppb gold over a one square kilometre area called the Contact Zone. Another gold anomaly, less well defined, was found in the Saddle Zone area 2.5 kilometres to the north. Subsequent work by Goldrite focussed on the potential for high-grade vein-style mineralization associated with a quartz-feldspar-porphyry dyke cutting the Contact Zone. No work was done to assess the bulk-tonnage low-grade potential of either area.

CHAPTER FOUR: CONCLUSIONS & RECOMMENDATIONS

Results from the 1990 sampling was very encouraging. Geochem anomalies reported from earlier sampling were confirmed. The large size of the soil anomalies and low-grade disseminated style of mineralization provides encouragement for future work. All analysis are in Appendix I .

Results from the June 1991 sampling program was dissappointing. Frozen ground hampered efforts to reach bedrock. Bedrock samples were obtained in three of five localities. Trench locations and sample results are indicated on Figure ³⁻⁴ and are discussed below.

TR-91-R: Forty metres of fresh cuts were made in the bank of existing access road and were sampled in three locations. A total of 21 samples were collected at one metre intervals. The best sample returned 400 ppb gold. Other results are all low.

TR-91-1: Forty metres of trenching attempted to expose bedrock over a magnetic low associated with an east-trending linear physiographic feature. Strongly anomalous soil geochemistry also marked the area. Frozen overburden hampered work and prevented exposure of bedrock.

TR-91-2: Twenty metres of trenching was attempted to expose bedrock about forty metres east of TR-91-1. The trenching was unsuccessful. Four samples of float from the trench were analyzed. They returned low values for gold.



Jesse L. Duke

Respectfully submitted by;
Jesse L. Duke
Project Geologist

STATEMENT OF COSTS

June 8 to October 3, 1990:

Labour (25 man days at \$150/day)	\$3,750.
Truck Rental gas and mileage	\$ 600.
Rock geochemistry (49 X \$25)	\$1,225.
Soil geochemistry (90 X \$25)	\$2,250.
TOTAL:	<u>\$7,825.</u>

May 1st to June 16, 1991:

D8 contract work: (20 hours)	\$4,000.
Labour (20 mandays @ \$150/day)	\$3,000.
Truck Rental	\$ 700.
Rock Geochemistry (25 X \$25 ea.)	\$ 625.
Report preparation	\$ 500.
TOTAL	<u>\$8,825.</u>

STATEMENT OF QUALIFICATIONS

I, Jesse L. Duke hereby certify that:

1. I am a Geologist with a B.Sc degree in geology from the University of Alaska, Fairbanks and have been involved in mineral exploration continuously since that time.
2. I reside in Whitehorse, Yukon Territory and have been employed by Noranda Exploration Company Limited (No Personal Liability) since April, 1988.
3. I am a member in good standing of the Geological Association of Canada.
4. I supervised or conducted the work carried out on the property described in this report.

November 6, 1991

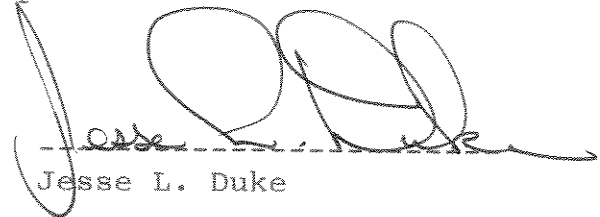

Jesse L. Duke

Gold in soil (ppb)	Gold in rock (ppb)	Resamples	Gold in rock (ppb)
73	4102	R142682	549
42	189	R139713	531
15	412		
48	51		
30	240		
924	37		
71	43		
133	75	R139712	4818
83	129		
10	67	R139711	67
8	584	R139710	584
10	5		
45	27		
26	27		
5	27		
43	10		
83	45		

REVISIONS

CLEAR CREEK
SADDLE ZONE
NORANDA SAMPLING

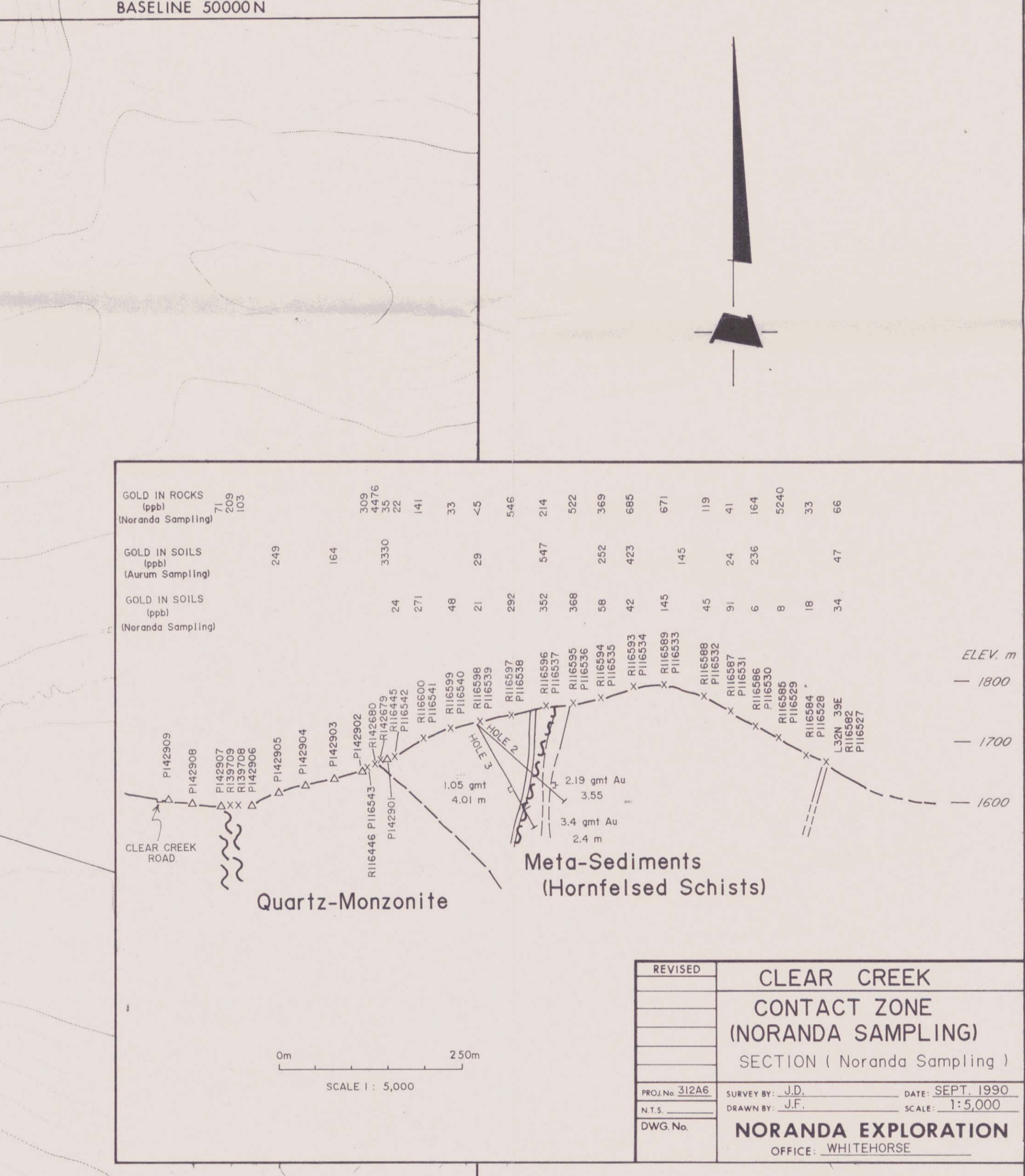
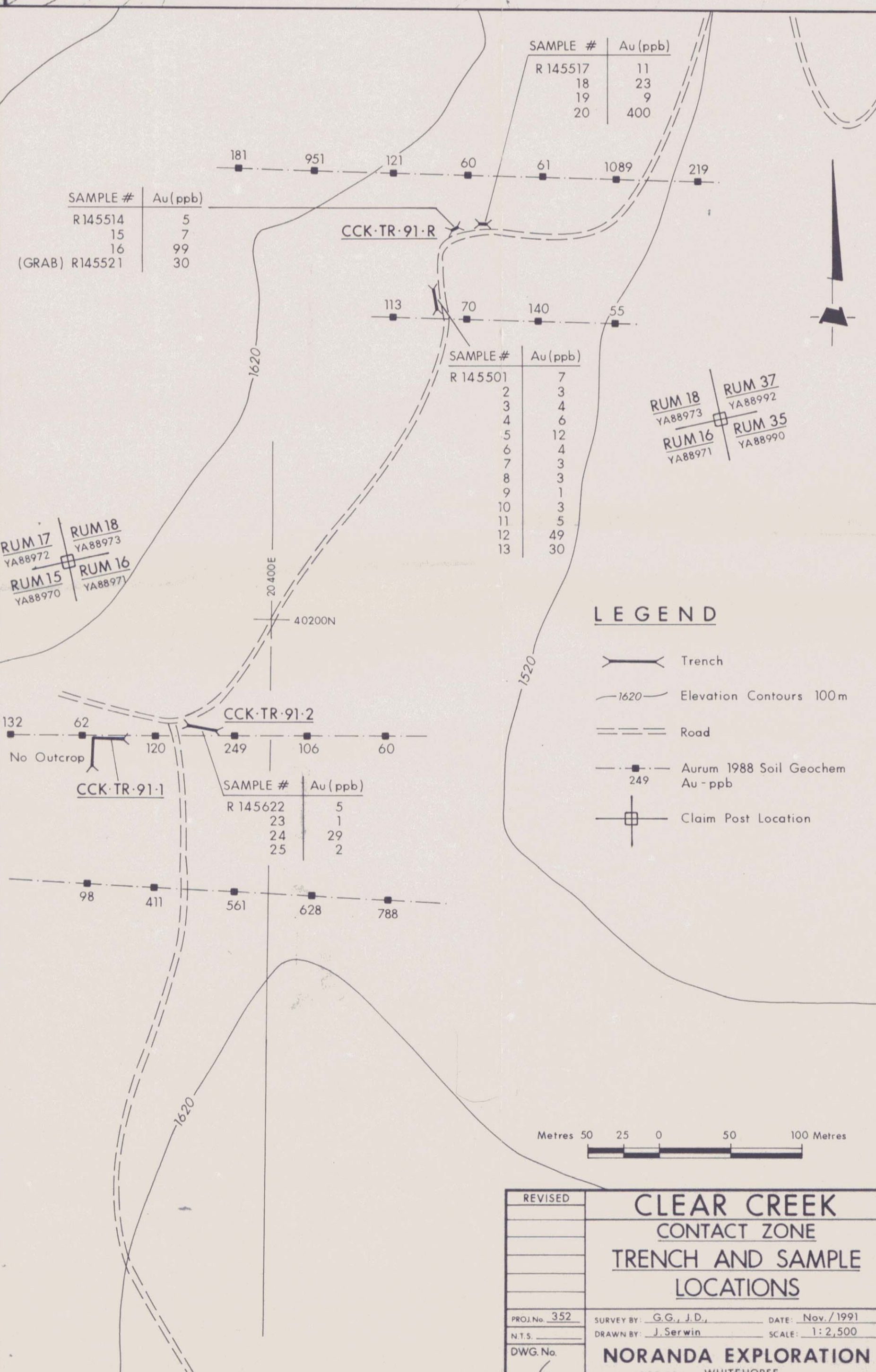
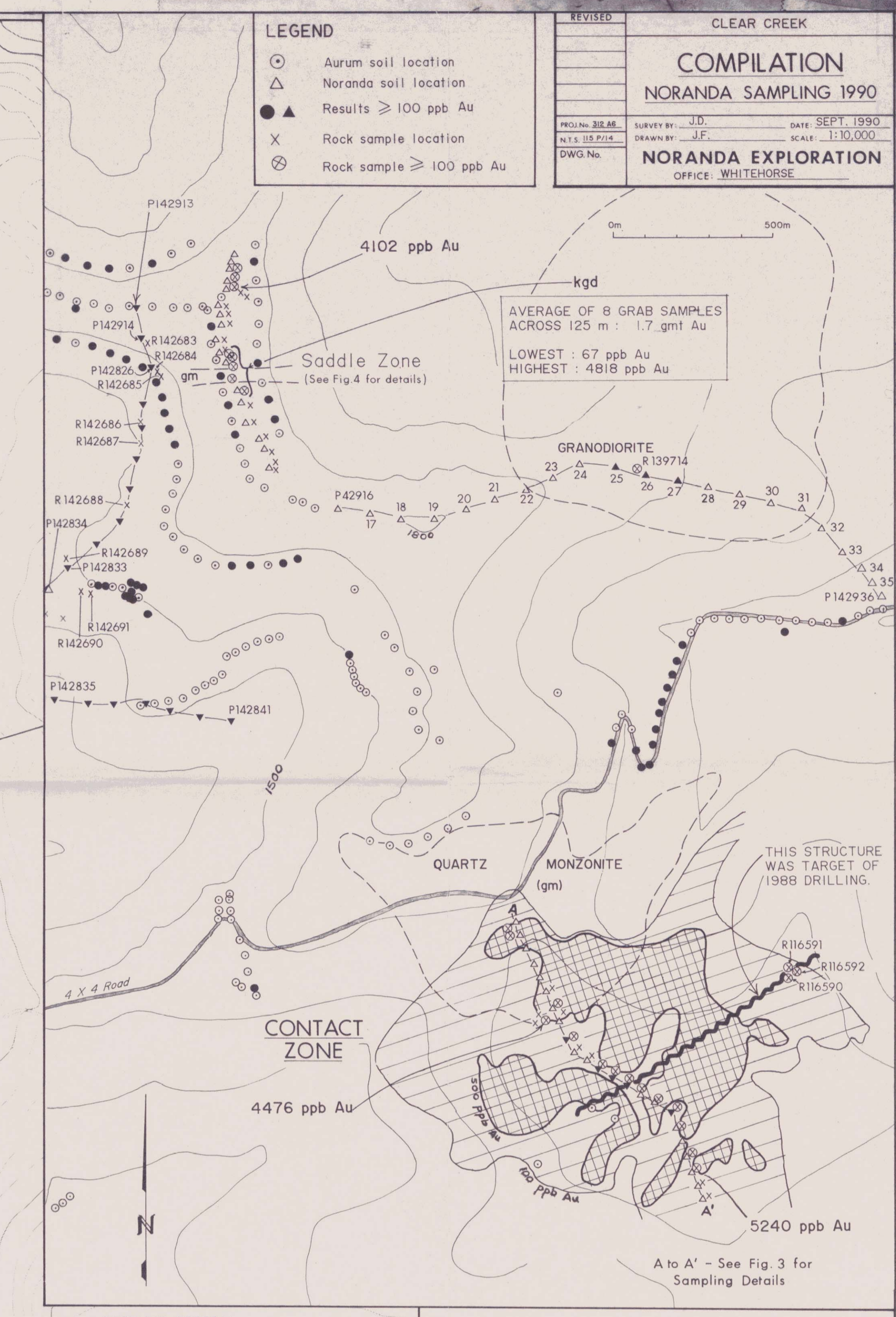
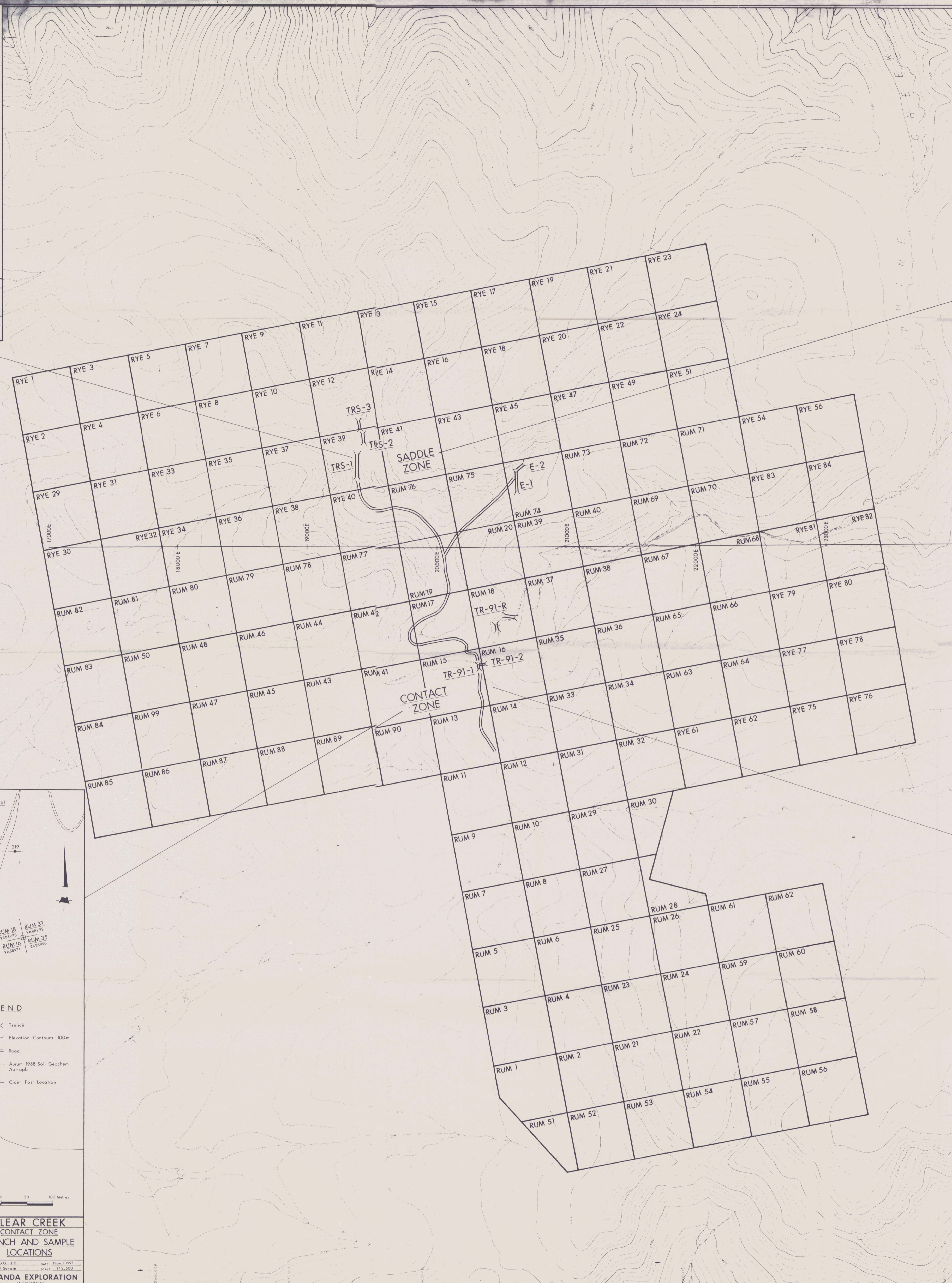
PROJ. No. 332 SURVEYED BY: J.D. DATE: SEPT. 1990
 N.T.S. DRAWN BY: J.F. SCALE: 1:10,000
 DWG. No. NORANDA EXPLORATION OFFICE: WHITEHORSE



REVISIONS

CLEAR CREEK
CONTACT ZONE
TRENCH AND SAMPLE LOCATIONS

PROJ. No. 332 SURVEYED BY: G.G. DATE: Nov. 1991
 N.T.S. DRAWN BY: J.S. SCALE: 1:10,000
 DWG. No. 6 NORANDA EXPLORATION OFFICE: WHITEHORSE

REVISIONS

CLEAR CREEK
CONTACT ZONE
(NORANDA SAMPLING)
SECTION (Noranda Sampling)

PROJ. No. 332 SURVEYED BY: J.D. DATE: SEPT. 1990
 N.T.S. DRAWN BY: J.F. SCALE: 1:5,000
 DWG. No. NORANDA EXPLORATION OFFICE: WHITEHORSE

REVISIONS

CLEAR CREEK
CLAIM & TRENCH LOCATIONS

PROJ. No. 332 SURVEYED BY: G.G. DATE: Nov. 1991
 N.T.S. DRAWN BY: J.S. SCALE: 1:10,000
 DWG. No. 3 NORANDA EXPLORATION OFFICE: WHITEHORSE

MAP # 115/114 Doc # 092984 (175)
 DWG 289
 SCALE 1:10,000
 Metres 200 300 0 200 400 600 800 Metres

APPENDIX I
GEOCHEMICAL RESULTS



CLEAR CREEK

June 25, 1990

Work Order # 34656

Noranda Exploration Company Ltd.
Suite 208, 107 Main St.
Whitehorse, Yukon
Y1A 2A7

File # 34656c

Project # 312 A/4

Assay Certificate for Samples Provided

Sample	ppb Au
R117292	9
R117293a	<5
R117293b	<5
R117294	10
R117295	<5
R117296	<5
R117297	27
R117298	5
R117299	<5
R117300	3359
R119237	2590
R119238	1730
R119239	913
R119240	1291
R119241	25
R119242	8
R119243	<5
R119244	<5
R119245	37
R119246	4102
R119247	189
R119248	11
R119249	412
R119250	2599
P52277	83
P52278	<5
P52279	5
P52280	56
P52282	<5
P52283	10
P52284	8
P52285	129
P52286	10
P52287	<5
P52288	83

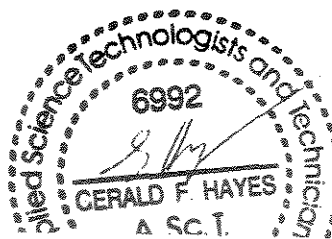

June 26, 1990

Work Order # 34656

Noranda Exploration Company Ltd.
Suite 208, 107 Main St.
Whitehorse, Yukon
Y1A 2A7

File # 34656e

Project # 312 A/4

Assay Certificate for Samples Provided

Sample	ppb Au
P116526	5
P116527	34
P116528	18
P116529	8
P116530	6
P116531	91
P116532	45
P116533	145
P116534	42
P116535	58
P116536	368
P116537	352
P116538	292
P116539	21
P116540	48
P116541	271
P116542	24
P116543	1342
P34250	45
R116582	141
R116583	66
R116584	33
R116585	5240
R116586	164
R116587	41
R116588	119
R116589	671
R116590	181
R116591	789
R116592	1047
R116593	685
R116594	369
R116595	522
R116596	214
R116597	546
R116598	<5
R116599	33
R116600	141
R116445	22
R116446	309



SAMPLE#	Mo ppm	Cu ppm	Pb ppm	Zn ppm	Ag ppm	Ni ppm	Co ppm	Mn ppm	Fe %	As ppm	U ppm	Au ppm	Th ppm	Sr ppm	Cd ppm	Sb ppm	Bi ppm	V ppm	Ca %	P %	La ppm	Cr ppm	Mg %	Ba ppm	Ti %	B ppm	Al %	Na %	K %	W ppm	Hg ppb
116526	1	54	14	67	.7	26	13	402	3.43	702	5	ND	4	26	.4	3	3	30	.10	.075	23	22	.40	131	.04	5	1.39	.02	.14	2	20
116527	1	55	17	79	.8	26	11	270	3.30	759	5	ND	1	28	.6	2	4	33	.10	.070	20	22	.37	136	.04	3	1.31	.02	.11	8	40
116528	1	45	16	68	.2	32	15	371	3.37	758	5	ND	4	24	.2	2	2	42	.11	.053	19	28	.52	117	.07	2	1.46	.02	.14	19	20
116529	1	35	7	72	.7	19	7	294	3.14	618	5	ND	1	19	.4	2	2	32	.05	.059	18	21	.39	97	.04	2	1.45	.02	.11	5	30
116530	1	74	9	68	.3	40	25	393	4.06	899	5	ND	9	37	.7	2	2	34	.17	.081	19	21	.44	123	.06	2	1.36	.04	.14	11	20
116531	1	83	25	92	.3	50	27	393	4.54	1028	5	ND	9	29	.6	2	2	29	.09	.045	22	26	.63	137	.05	2	2.07	.02	.23	8	40
116532	1	103	14	86	.4	46	29	526	6.26	1122	5	ND	13	37	.8	6	2	31	.15	.067	20	30	.61	147	.05	2	2.11	.03	.29	4	20
116533	1	45	11	72	.4	28	17	313	3.67	965	5	ND	4	21	.4	3	2	28	.11	.058	16	20	.38	92	.04	2	1.19	.04	.09	7	30
116534	1	28	15	68	.1	23	11	369	2.68	467	5	ND	3	15	.6	2	2	34	.12	.050	15	21	.38	80	.04	6	1.26	.01	.04	17	20
116535	1	16	6	40	.1	16	5	172	1.98	195	5	ND	1	10	.4	2	2	38	.07	.040	12	28	.26	62	.05	2	.94	.01	.04	4	30
116536	1	59	34	83	1.0	38	18	513	2.27	586	5	ND	2	25	.8	8	24	16	.14	.052	20	16	.30	123	.01	2	1.32	.01	.06	100	10
116537	1	54	24	66	1.6	18	8	187	3.78	1404	5	ND	7	23	.8	10	2	29	.16	.073	21	21	.35	107	.05	2	1.11	.02	.17	5	30
116538	1	36	9	72	.2	24	11	296	2.86	735	5	ND	2	21	.7	2	2	37	.15	.063	13	26	.46	87	.05	3	1.35	.02	.10	2	20
116539	1	34	7	83	.1	23	10	360	3.34	142	5	ND	2	19	.5	4	2	38	.10	.052	12	26	.49	105	.05	3	1.80	.02	.07	7	30
116540	1	104	10	80	.2	34	10	251	5.20	196	5	ND	6	23	.6	10	4	55	.18	.063	13	151	1.37	100	.16	9	1.98	.03	.59	18	10
116541	1	179	13	79	.6	33	16	300	6.79	1308	5	ND	6	73	1.2	11	9	54	.13	.091	15	31	.65	130	.09	5	2.22	.09	.30	42	10
116542	1	65	5	72	.2	21	8	300	3.67	203	5	ND	2	21	.7	4	2	42	.08	.066	13	29	.50	99	.07	3	1.93	.03	.15	11	50
116543	1	75	16	97	.3	47	26	702	4.28	1060	5	ND	9	110	1.0	3	2	41	.19	.084	30	31	.56	164	.08	2	1.93	.02	.19	14	20
P 034250	3	49	28	67	.3	28	13	180	5.71	2366	8	ND	27	98	.3	2	13	12	.23	.135	74	7	.35	94	.01	3	1.32	.01	.22	2	5
116445	16	23	45	38	.2	16	4	124	.53	962	5	ND	12	10	.2	3	2	3	.08	.015	11	182	.05	71	.01	4	.31	.04	.14	1	15
116446	6	8	10	63	.1	10	6	542	2.39	24	5	ND	18	39	.3	2	2	37	.62	.078	43	96	.64	286	.22	2	1.22	.07	.68	2	20
052277	1	45	17	83	.2	38	19	505	2.72	137	5	ND	3	15	.7	2	2	37	.10	.050	21	32	.44	106	.06	2	1.58	.01	.17	3	40
052278	1	30	14	89	.1	27	9	394	2.97	28	5	ND	1	12	.7	2	3	47	.07	.048	14	39	.54	140	.10	2	2.08	.01	.15	1	40
052279	1	26	11	80	.2	21	8	329	2.82	29	5	ND	1	9	1.2	2	2	45	.07	.053	16	35	.43	98	.07	5	1.66	.01	.10	1	60
052280	1	27	11	61	.1	23	9	301	2.56	53	5	ND	2	13	.7	2	2	43	.12	.052	17	29	.40	85	.07	2	1.24	.01	.07	6	50
052282	1	31	24	99	.2	32	15	374	2.55	39	5	ND	2	12	.6	2	2	37	.14	.059	13	31	.55	68	.07	8	1.55	.01	.13	1	30
052283	1	24	12	73	.1	25	10	317	2.42	94	5	ND	1	12	.7	2	2	40	.08	.043	11	28	.46	86	.06	2	1.40	.01	.07	1	30
052284	1	19	19	69	.1	21	8	329	2.55	49	5	ND	1	10	.7	2	2	44	.09	.045	11	27	.39	85	.06	3	1.31	.01	.06	1	20
052285	1	32	14	106	.1	37	17	423	2.80	462	5	ND	3	19	.7	3	6	41	.22	.075	17	39	.55	94	.07	2	1.57	.01	.10	17	10
052287	1	26	16	80	.1	28	11	398	2.98	124	5	ND	2	19	.7	2	2	65	.20	.047	13	81	.87	213	.13	5	1.65	.01	.07	3	20
052288	1	39	15	76	.1	33	18	747	3.34	539	6	ND	4	14	.7	5	3	32	.08	.037	19	31	.41	113	.04	4	1.38	.01	.06	6	20
052289	1	43	13	66	.1	24	10	318	2.50	771	7	ND	2	16	.8	2	11	38	.17	.061	15	26	.45	103	.05	2	1.48	.01	.04	14	10
052290	1	25	9	58	.1	39	10	323	2.19	41	5	ND	2	15	.5	2	2	36	.17	.059	12	57	.53	73	.07	2	1.42	.01	.06	14	20
052291	1	91	12	97	.2	34	28	916	3.11	297	5	ND	13	26	.5	2	11	31	.30	.032	34	28	.40	58	.03	2	1.37	.01	.16	9	10
052292	1	37	10	106	.2	21	18	1144	5.02	59	5	ND	6	76	1.5	10	2	77	.83	.168	18	187	2.24	618	.38	7	4.14	.02	1.06	3	30
052293	1	32	8	61	.1	26	8	258	2.64	132	5	ND	2	6	1.0	3	5	39	.06	.036	11	39	.54	74	.08	6	1.62	.01	.19	8	20
052294	1	31	10	59	.1	115	17	447	2.70	87	5	ND	2	22	.4	5	4	59	.19	.057	13	234	1.31	130	.11	6	1.95	.01	.32	1	20
052295	1	24	12	66	.1	32	10	386	2.50	33	5	ND	1	9	.6	2	5	47	.07	.041	14	49	.55	74	.09	2	1.44	.01	.17	1	50
052296	1	22	8	74	.1	24	10	322	2.05	74	5	ND	2	15	.6	2	2	31	.19	.065	12	24	.38	71	.05	4	1.10	.01	.04	1	60
052296A	1	75	17	110	.1	53	23	1163	5.40	18	5	ND	13	105	1.1	10	2	115	.82	.260	35	213	3.30	675	.22	6	3.11	.02	1.30	1	20
052297	1	63	12	76	.1	185	28	749	4.34	74	5	ND	7	55	1.2	10	12	65	.33	.050	20	370	2.98	158	.21	2	3.96	.02	1.16	14	20
116506	2	59	13	76	.2	29	15	359	4.21	45	5	ND	8	31	.9	5	2	47	.44	.025	12	73	1.30	68	.18	7	2.67	.05	1.35	1	30
116507	6	26	6	21	1.1	12	10	534	2.12	252	5	ND	6	3	.2	9	2	5	.01	.010	15	46	.02	27	.01	3	.24	.01	.10	2	20
116508	58	45	15	68	.2	17	9	257	4.29	11	5	ND	8	2	.8	3	2	42	.02	.022	14	64	1.34	74	.15	2	2.16	.02	1.23	1	15



CLEAR CREEK

June 26, 1990

Work Order # 34656

Noranda Exploration Company Ltd.
Suite 208, 107 Main St.
Whitehorse, Yukon
Y1A 2A7

File # 34656f

Project # 312 A/4

Assay Certificate for Samples Provided

Sample	ppb Au
P52289	139
P52290	71
P52291	258
P52292	30
P52293	63
P52294	58
P52295	<5
P52296	<5
P52297	73
R116506	51
R116507	33
R116508	240

September 14, 1990

Work Order # 08369

Noranda Exploration Company Limited
 201 - 107 Main St.
 Whitehorse, Yukon
 Y1A 2A7

File # 08369a

Project # 312 a/4

Assay Certificate for Samples Provided

Sample	ppb Au
R139707	71
R139708	103
R139709	209
R139710	584
R139711	67
R139712	4818
R139713	531
R139714	575
R142679	35
R142680	4476
R142681	42
R142682	249
R142683	104
R142684	<5
R142685	51
R142686	26
R142687	102
R142688	<5
R142689	24
R142690	<5
R142691	93

Au -- 30g Fire Assay/AAS

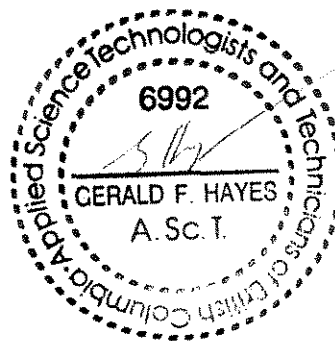

GEOCHEMICAL ANALYSIS CERTIFICATE

Noranda Exploration Co. Ltd. PROJECT 9009-074 312 File # 90-4779
 P.O. Box 2380, 1050 Davie, Vancouver BC V6B 3T5

SAMPLE#	Mo ppm	Cu ppm	Pb ppm	Zn ppm	Ag ppm	Ni ppm	Co ppm	Mn ppm	Fe %	As ppm	U ppm	Au ppm	Th ppm	Sr ppm	Cd ppm	Sb ppm	Bi ppm	V ppm	Ca %	P %	La ppm	Cr ppm	Mg %	Ba ppm	Ti %	B ppm	Al %	Na %	K %	W ppm	Hg ppb
R139707	3	30	63	293	.7	8	3	186	2.65	845	5	ND	10	20	1.6	2	2	33	.03	.013	20	56	.67	110	.04	2	1.61	.03	.44	4	20
R139708	4	8	55	286	.7	8	6	459	2.24	300	5	ND	17	18	2.0	3	2	30	.31	.070	29	54	.54	105	.10	5	.97	.03	.22	18	30
R139709	7	7	57	254	.6	7	6	538	2.60	289	5	ND	18	50	1.4	2	5	34	1.13	.068	33	69	.70	109	.09	2	1.19	.04	.43	7	5
R139710	6	27	59	261	.8	10	3	83	1.25	967	5	ND	4	24	1.6	2	17	11	.09	.010	11	95	.24	72	.03	4	.58	.01	.18	279	5
R139711	3	26	96	389	.9	19	7	198	2.84	763	5	ND	11	5	2.5	2	3	44	.04	.019	21	74	.78	98	.17	3	1.69	.02	.89	10	10
R139712	6	41	51	205	1.3	3	2	97	1.80	668	7	8	20	41	1.6	4	128	32	.24	.052	26	78	.57	185	.12	2	1.21	.06	.38	30	5
R139713	10	40	102	399	.8	28	5	235	6.61	1993	5	ND	6	19	1.8	31	5	30	.10	.056	18	69	.16	44	.01	6	.57	.01	.16	8	5
R139714	2	27	43	125	.3	6	7	54	.87	304	5	ND	18	30	.9	2	27	8	.10	.022	18	28	.11	300	.01	3	1.51	.03	.08	3	5
R142679	4	1139	14027	14399	73.7	7	2	133	5.59	893	5	ND	4	11	62.9	177	60	21	.18	.008	7	40	.38	43	.01	3	1.19	.02	.26	2	5
R142680	6	352	4073	7459	25.5	11	6	313	4.33	8625	5	3	12	30	31.8	74	30	25	.77	.058	28	82	.55	63	.06	6	.95	.03	.29	384	5
R142681	8	295	446	1699	3.7	149	51	379	5.12	324	5	ND	3	25	6.8	10	3	91	.28	.042	8	74	1.47	69	.07	2	2.61	.08	.37	1	50
R142682	3	190	240	1127	2.1	35	13	93	2.45	763	5	ND	5	52	5.4	6	38	16	.26	.011	7	56	.30	35	.04	2	1.60	.01	.10	58	10
R142683	6	206	178	650	1.7	4	4	111	2.92	116	6	ND	21	44	3.5	5	6	35	.30	.058	15	68	.61	173	.13	2	1.19	.07	.45	35	20
R142684	2	37	106	470	1.1	18	12	301	4.18	50	5	ND	4	10	2.7	2	4	43	.01	.009	10	72	1.06	150	.23	2	2.18	.02	1.34	1	40
R142685	5	36	245	1060	1.7	10	3	115	3.72	304	5	ND	11	2	5.0	8	2	19	.01	.015	15	52	.01	32	.01	3	.32	.01	.08	3	30
R142686	8	32	139	593	1.0	16	3	89	3.19	934	5	ND	10	7	3.0	4	2	18	.02	.019	20	66	.03	18	.01	3	.45	.01	.07	2	40
R142687	5	22	179	621	5.7	2	1	18	.94	411	5	ND	12	10	2.9	11	2	2	.01	.005	31	43	.02	151	.01	10	.38	.01	.21	1	50
R142688	2	83	705	651	3.1	27	5	81	7.03	210	5	ND	14	3	2.5	13	2	20	.01	.026	28	31	.01	19	.01	2	.32	.01	.10	3	60
R142689	17	55	94	406	.9	18	9	199	3.61	123	5	ND	13	7	2.1	3	2	42	.03	.016	20	88	.99	92	.11	2	1.77	.02	.73	1	20
R142690	2	67	69	326	.8	32	16	294	4.17	286	5	ND	8	6	1.8	2	2	47	.03	.022	12	75	1.36	80	.15	3	2.19	.02	1.23	1	10
R142691	6	17	101	424	.8	7	4	85	1.47	3408	5	ND	4	20	1.9	10	2	3	.02	.006	7	76	.07	140	.01	4	.26	.01	.12	1	10
STANDARD C	18	61	38	132	7.2	72	31	1061	3.98	40	17	7	37	53	18.9	15	17	56	.50	.094	37	59	.91	180	.07	38	1.91	.06	.13	12	1600

ICP - .500 GRAM SAMPLE IS DIGESTED WITH 3ML 3-1-2 HCL-HNO3-H2O AT 95 DEG. C FOR ONE HOUR AND IS DILUTED TO 10 ML WITH WATER.
 THIS LEACH IS PARTIAL FOR MN FE SR CA P LA CR MG BA TI B W AND LIMITED FOR NA K AND AL. AU DETECTION LIMIT BY ICP IS 3 PPM.
 - SAMPLE TYPE: ROCK PULP HG ANALYSIS BY FLAMELESS AA.

DATE RECEIVED: SEP 24 1990 DATE REPORT MAILED: *Sept 29/90* SIGNED BY: *C. Leung* D. TOYE, C. LEONG, J. WANG; CERTIFIED B.C. ASSAYERS

✓ ASSAY RECOMMENDED

October 3, 1990

Work Order # 08369

Noranda Exploration Company Limited
 201 - 107 Main St.
 Whitehorse, Yukon
 Y1A 2A7

File # 08369b

Project # 312 a/4

Assay Certificate for Samples Provided

Sample	ppb Au
P142826	1056
P142827	79
P142828	51
P142829	28
P142830	31
P142831	44
P142832	62
P142833	5
P142834	56
P142835	45
P142836	35
P142837	39
P142838	58
P142839	89
P142840	150
P142841	>5000
P142901	587
P142902	83
P142903	45
P142904	51
P142905	73
P142906	48
P142907	39
P142908	>5000
P142909	114
P142910	54
P142911	56
P142912	23
P142913	66
P142914	737

Au -- 30g Fire Assay/AAS

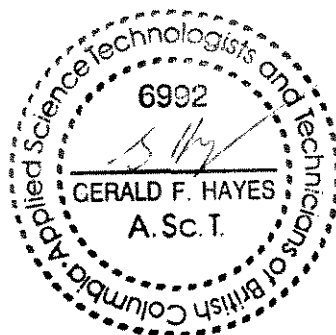

October 3, 1990

Work Order # 08369

Noranda Exploration Company Limited
201 - 107 Main St.
Whitehorse, Yukon
Y1A 2A7

File # 08369c

Project # 312 a/4

Assay Certificate for Samples Provided

Sample	ppb Au
P142916	17
P142917	36
P142918	37
P142919	16
P142920	28
P142921	35
P142922	21
P142923	37
P142924	58
P142925	585
P142926	162
P142927	255
P142928	40
P142929	26
P142930	70
P142931	34
P142932	40
P142933	52
P142934	28
P142935	40
P142936	24

Au -- 30g Fire Assay/AAS

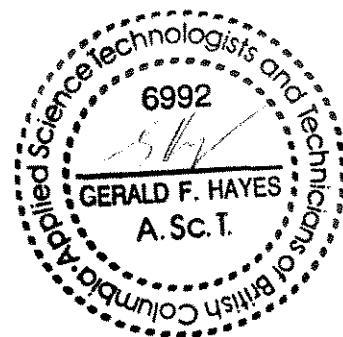

NORANDA VANCOUVER LABORATORY

PROPERTY/LOCATION: CLEAR CREEK EXAM (RERUNS)

CODE : 9009-074

Project No. : 312
 Material : 53 SOILS
 Remarks : 21 RX

Sheet: 1 of 2
 Geol.: J.D.

Date rec'd: SEP 24
 Date compl: OCT 19

Values in PPM, except where noted.

T.T. No.	SAMPLE No.	PPB Au
74	SOIL 142826	700
75	142827	240
76	142828	300
77	142829	160
78	142830	10
79	142831	35
80	142832 5.0g	10
81	142833	100
82	142834	55
83	142835	70
84	142835 (40) 5.0g	50
85	142836	130
86	142837	5
87	142838	5
88	142839	5
89	142840	3
90	142841	25
91	142901	15
92	142902	1200
93	142903	590
94	142904	500
95	142905	200
96	142906	100
97	142907	320
98	142908	160
99	142909	65
100	142910	20
2	142911 1.0g	5
3	142912 3.0g	5
4	142912 (40)	5
5	142913	90
6	142914	500
7	142916 2.0g	5
8	142917	5
9	142918	15
10	142919	5
11	142920	5
12	142921	45
13	142922	5
14	142923	5
15	142924	10
16	142925	400
17	142926	120
18	142927	250
19	142928	10
20	142929	25
21	142930	40
22	142931	5
23	142932	5
24	142933	5
25	142934	5
26	142935	5
27	SOIL 142936	5
28	RX 139707	80
29	139708	55
30	139709	150
31	139710	750
32	139711	40
33	139712	590
34	139713	590
35	139714	630
36	RX 142679	30

T. No.		SAMPLE No.	PPB Au
37	RX	142680	9800 —
38		142681	35
39		142682	270
40		142683	85
41		142684	5
42		142685	5
43		142686	20
44		142687	110
45		142688	10
46		142689	5
47		142690	5
48	RX	142691	100

9009-074
Pg. 2 of 2



GEOCHEMICAL ANALYSIS CERTIFICATE

Clear Creek (GG)



Noranda Exploration Co. Ltd. PROJECT 9106-004-352

File # 91-1506

1050 Davie St., Vancouver BC V6E 1M4

SAMPLE#	Mo	Cu	Pb	Zn	Ag	Ni	Co	Mn	Fe	As	U	Au	Th	Sr	Cd	Sb	Bi	V	Ca	P	La	Cr	Mg	Ba	Ti	B	Al	Na	K	W	Au*
	ppm	ppm	ppm	ppm	ppm	ppm	ppm	ppm	%	ppm	ppm	ppm	ppm	ppm	ppm	ppm	ppm	ppm	%	%	ppm	ppm	%	ppm	%	ppm	%	%	ppm	ppb	
R145501	2	21	10	106	.3	35	15	377	2.91	149	5	ND	14	11	.3	2	4	28	.21	.027	27	36	.50	74	.07	6	1.16	.02	.43	1	7
R145502	2	40	2	76	.6	45	19	453	4.41	63	5	ND	13	16	.2	4	2	72	.25	.040	23	58	1.00	145	.19	4	1.80	.05	.74	1	3
R145503	1	20	5	68	.4	28	14	329	3.39	53	5	ND	14	9	.2	2	2	39	.09	.025	26	44	.72	70	.13	6	1.66	.02	.71	1	4
R145504	3	55	11	100	1.4	21	16	818	3.72	99	5	ND	32	85	.6	5	3	49	1.10	.132	66	29	.79	429	.12	10	1.62	.05	.65	6	6
R145505	2	45	20	126	.7	16	11	533	2.91	209	5	ND	18	30	.8	4	8	23	.70	.056	37	23	.48	71	.04	4	1.05	.02	.39	1	12
R145506	2	41	2	67	.4	37	15	362	3.87	53	5	ND	11	10	.6	2	2	63	.11	.021	22	54	1.00	102	.13	4	1.93	.03	.65	1	4
R145507	1	38	2	79	.1	43	24	468	4.83	38	5	ND	11	22	.2	2	5	103	.31	.051	29	67	1.57	224	.27	2	2.93	.10	1.25	31	3
R145508	1	38	4	97	.5	41	16	341	4.22	36	5	ND	15	7	.4	2	2	63	.09	.031	33	54	.98	115	.15	8	2.14	.03	.79	2	3
R145509	4	47	12	111	.7	42	18	373	3.66	146	5	ND	16	8	.4	3	2	35	.09	.028	38	38	.67	83	.05	10	1.59	.02	.50	12	1
R145510	2	39	46	146	.6	39	18	406	3.32	77	5	ND	13	7	.3	2	2	45	.07	.022	25	43	.69	92	.09	2	1.54	.02	.56	3	3
R145511	1	30	45	98	.6	33	15	430	3.35	165	5	ND	10	12	.5	2	2	58	.10	.019	17	41	.73	116	.15	2	1.51	.04	.71	1	5
R145512	1	28	3	54	.4	40	16	338	3.97	2696	5	ND	10	10	.5	3	3	78	.15	.023	17	63	1.02	138	.12	4	2.01	.04	.60	2	49
R145513	3	92	18	148	.8	53	21	390	4.60	95	5	ND	12	20	.6	2	5	89	.29	.052	32	55	1.04	120	.09	8	2.31	.04	.46	229	30
R145514	2	42	7	55	.3	37	15	498	4.06	142	5	ND	13	19	.4	2	2	66	.19	.043	19	46	.96	113	.09	5	1.99	.04	.48	5	5
R145515	1	50	3	29	.3	21	10	194	2.17	110	5	ND	15	97	.2	2	2	47	.80	.029	38	29	.45	126	.13	7	2.20	.22	.36	36	7
R145516	2	41	3	54	1.4	22	10	282	3.53	441	5	ND	9	16	.6	5	12	55	.15	.025	18	54	.96	124	.21	3	2.02	.06	1.25	64	99
R145517	1	52	2	68	.1	51	18	539	5.53	153	5	ND	10	57	.2	2	6	133	.64	.054	27	99	1.70	312	.39	6	3.89	.19	1.89	3	11
R145518	2	43	2	58	.1	33	14	344	4.36	126	5	ND	12	27	.2	2	2	79	.28	.025	24	59	1.33	185	.23	3	2.89	.10	1.34	12	23
R145519	1	58	2	47	.3	39	18	308	4.54	73	5	ND	9	71	.2	2	2	113	.82	.021	15	75	1.37	206	.29	3	3.75	.22	1.53	2	9
R145520	1	34	2	24	.1	19	8	164	2.10	84	5	ND	8	30	.2	2	8	33	.29	.021	23	28	.49	90	.08	2	1.59	.09	.41	20	400
R145521	3	26	14	26	3.6	9	4	59	.90	866	5	ND	8	5	.2	11	9	1	.03	.009	9	8	.03	14	.01	4	.15	.01	.07	248	430
R145522	2	9	4	28	.1	7	4	319	2.20	30	5	ND	18	48	.2	2	2	27	.51	.050	25	34	.61	221	.13	2	1.18	.06	.51	3	5
R145523	1	6	2	19	.3	14	4	339	1.37	24	5	ND	5	6	.2	2	2	19	.06	.013	9	20	.45	41	.05	2	.66	.03	.13	1	1
R145524	2	13	5	52	.1	8	9	724	2.75	206	5	ND	18	38	.2	2	2	34	.34	.065	36	22	.65	210	.14	2	1.26	.07	.59	15	29
R145525	1	18	2	67	.3	25	11	279	3.66	28	5	ND	8	7	.5	2	5	58	.07	.027	18	62	1.13	95	.22	2	2.32	.03	1.26	1	2
STANDARD C/AU-R	18	58	43	133	7.3	69	32	1057	3.97	38	15	7	39	53	18.4	16	18	57	.48	.090	40	58	.88	176	.09	32	1.88	.06	.15	13	460

ICP - .500 GRAM SAMPLE IS DIGESTED WITH 3ML 3-1-2 HCL-HNO3-H2O AT 95 DEG. C FOR ONE HOUR AND IS DILUTED TO 10 ML WITH WATER. THIS LEACH IS PARTIAL FOR MN FE SR CA P LA CR MG BA TI B W AND LIMITED FOR NA K AND AL. AU DETECTION LIMIT BY ICP IS 3 PPM. - SAMPLE TYPE: ROCK AU* ANALYSIS BY ACID LEACH/AA FROM 10 GM SAMPLE.

DATE RECEIVED: MAY 30 1991

DATE REPORT MAILED:

June 4/91

SIGNED BY: *C. Leong* D. TOYE, C. LEONG, J. WANG; CERTIFIED B.C. ASSAYERS