

MAP NO.: ASSESSMENT REPORT X  
105 F 9 PROSPECTUS  
CONFIDENTIAL  
OPEN FILE

DOCUMENT NO: 092914  
MINING DISTRICT: WATSON LAKE  
TYPE OF WORK: SAMPLING  
TRENCHING

REPORT FILED UNDER: NORTHWEST EXPLORERS LIMITED

DATE PERFORMED: 1968

DATE FILED: JAN 11, 1991

LOCATION: LAT.: 61°32'N

AREA: KETZA RIVER

LONG.: 132°10'W

VALUE \$:

CLAIM NAME & NO.: SHARON, SUSIE  
TERRY  
VERNA  
JANET

WORK DONE BY: ALAN R. ARCHER; ARCHER, CATIRO AND ASSOCIATES LIMITED

WORK DONE FOR: NORTHWEST EXPLORERS LIMITED

DATE TO GOOD STANDING:

REMARKS: A program of trenching geochemical anomalies was carried out on the property in search of galena veins. As well, a soil sampling program was completed. A total of 20,190 yards of material were moved from 42 trenches. Two veins were exposed. The remainder of the anomalies were thought to have been caused by "erratic, weakly mineralized quartz lenses in the limy phyllitic country rock". The veins were two feet and five feet wide respectively. Assays of the material were generally poor. A splay from one vein was strongly mineralized and returned 13.9 opt Ag, 20.6% Pb over 6 feet. The vein is thought to be limited in strike length. Ag/Pb ratios were about 1:1 or less for all of the material sampled.

TRANSMITTAL FORM

M.R. file no.
R.M.M.R. file no.
Date forwarded <b>07 JAN 1991</b>

From Mining Recorder at: **WATSON LAKE**

To Regional Manager, Mineral Rights at Whitehorse, Y.T.

For action are:

<input type="checkbox"/> NEW APPLICATION FOR PLACER LEASE TO PROSPECT	Name	
<input type="checkbox"/> RENEWAL APPLICATION PLACER LEASE TO PROSPECT	Name	Lease no.
<input type="checkbox"/> AFFIDAVIT OF EXPENDITURE ON PLACER LEASE	Name	Lease no.
<input type="checkbox"/> SECURITY DEPOSIT		
<input type="checkbox"/> FINANCIAL ABILITY		

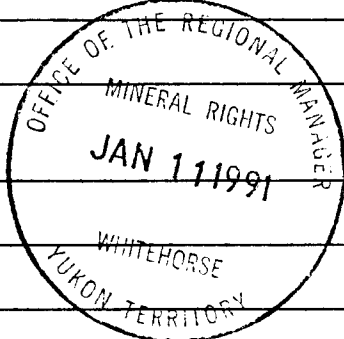

<input type="checkbox"/> ASSIGNMENT OF PLACER LEASE NO.	From	To
---	------	----

<input type="checkbox"/> GROUPING APPLICATION UNDER SEC. 52(2) PLACER MINING ACT.	Owner
---	-------

<input type="checkbox"/> DIAMOND DRILL LOGS	Claims	Claim sheet no.
---	--------	-----------------

<input checked="" type="checkbox"/> QUARTZ ASSESSMENT REPORT For Numbering Only Please return this copy	Claims	Claim sheet no.
	Type of report	Submitted by
	Cls. work performed on	\$ req. for ren. application

**SHARON, SUSIE, TERRY, VERNA, JANET**  
**105-F-09**  
**Geochemical, Trenching Northwest Explorers Ltd.**

*[Handwritten Signature]*  
 Signature

REPLY ACTION Date returned

**092914**

*17/1/91*  
*- Copy in Watson Lake contains 2 maps not included here.*

Signature

ARCHER, CATERS  
AND ASSOCIATES LTD.  
CONSULTING GEOLOGICAL ENGINEERS

SCA BUILDING, WHITEHORSE, Y.T. 667-4113

BENTALL CENTRE, VANCOUVER, B.C. 688-3022 OR 522-1562



770 ONE BENTALL CENTRE  
505 BARRARD ST.  
VANCOUVER 1, B.C.

1968 EXPLORATION REPORT

ON

SHARON, SUZIE, TERRY, VERNA & JANET CLAIMS

KETZA RIVER AREA, YUKON

092914

for

NORTHWEST EXPLORERS (1967) LTD.

December 12, 1968

Alan R. Archer

Consultant

Vancouver, B.C.

INDEX

Page No.

Introduction -----	1
Geochemical Sampling -----	2
Bulldozer Trenching	
General -----	2
Mineral Showings -----	6
Regional Exploration -----	7
Conclusions & Recommendations -----	7

Figures in Text

Details Trench 2 and 2A -----	6A
Details Trench 6, 6A, 6E and 6H -----	6B

Maps in Pocket

Scale

Figure 1 - Location Map -----	1" = 1/2 mile
Figure 2 - Detailed soil sampling Suzie, Terry, Verna option -----	1" = 400'
Figure 3 - Location Bulldozer Trenching -----	1" = 200'

## INTRODUCTION

This report details the results of the 1968 exploration program on the Sharon, Suzie, Terry, Verna and Janet claims held by Northwest Explorers (1967) Ltd. in the Ketz River area of the Yukon Territory. This work consisted mainly of bulldozer trenching of geochemical anomalies located during a program of reconnaissance soil sampling and geological mapping conducted under the writer's supervision in 1967. The property location, access, history of the area and regional geological setting are already described in detail in the writer's 1967 report and are not repeated here.

A permanent camp consisting of two heated tents on wooden frames was established near the boundary of the Sharon and Terry claims during July 1968. Mobilization was by truck from Whitehorse to Stump Mines and from there by helicopter and bombardier. A two man crew supervised the bulldozing and completed the detailed soil sampling required in the immediate area.

During early August complete airphoto coverage of the property was done under contract to Northwest Survey Corp. Ltd. and in early September all trenches and the pertinent claims were mapped by transit survey.

### GEOCHEMICAL SAMPLING

The southern part of the Terry, Verna, Janet option was soil sampled in a 100 foot by 200 foot spacing (see map in pocket) to better define anomalies located by reconnaissance sampling during the 1967 field season. Sampling procedure and analysis techniques were similar to those described in the 1967 report. The strongest anomaly found, from 17+00W to 29+00W on baseline L, was examined by bulldozer trenching but no vein was located. Float in the overburden indicates that the anomaly is caused by minor disseminations of lead in quartz lenses in the phyllitic country rocks.

A program of helicopter supported detailed sampling of anomalous areas some distance from the camp, as recommended in the 1967 report, was not done due to unfavourable weather conditions late in the season, during the time a helicopter was available.

### BULLDOZER TRENCHING

#### General

A D7E bulldozer with rippers was contracted from Arctic Circle Construction Co., Whitehorse, for a minimum of 400 hours of stripping. The bulldozer was mobilized

in late July by truck to the junction of the Ross River - Watson Lake road with the Stump Mines road and walked from there to the property. A total of 261-1/2 hours were used in constructing a tote road from the Stump Mines camp to the property and trenching geochemical anomalies. The bulldozing was terminated in early September and the remaining hours of the contract sub-let to Stump Mines Ltd.

A total of 42 trenches were cut. The trenches and other pertinent features on the property were surveyed by transit in early September (see figure in pocket). Details of the dimensions (in feet) of each trench are summarized as follows:

<u>TR. #</u>	<u>WIDTH</u>	<u>LENGTH</u>	<u>DEPTH</u>	<u>DEPTH TO BED ROCK</u>	<u>CUBIC YRDS.</u>	<u>COMMENTS</u>
1	14	150	5	3	390	
1A	14	160	4	4+	320	bed rock not reached
2	14	110	6	2	340	see figure in text
2A	15	100	8	7	440	see figure in text
2B	16	110	8	8	520	
2C	14	120	7	7+	440	bed rock not reached
3	14	340	6	3	1050	

<u>TR. #</u>	<u>WIDTH</u>	<u>LENGTH</u>	<u>DEPTH</u>	<u>DEPTH TO BED ROCK</u>	<u>CUBIC YDS.</u>	<u>COMMENTS</u>
3A	15	120	3	3	200	
3B	15	100	4	2	220	
3C	14	60	3	3+	940	bed rock not reached
3D	14	75	4	4	150	
4	14	350	6	6+	1090	bed rock not reached
4A	14	200	6	4	620	
4B	16	100	4	2	240	
4C	14	100	5	4	260	
4D	15	200	4	4+	440	bed rock not reached
4E	14	240	4	4+	500	bed rock not reached
5	14	120	8	8+	500	bed rock not reached
5A	13	100	7	7+	340	bed rock not exposed
5B	14	130	5	3	340	
5C	14	300	4	3	620	
5D	14	270	4	3	560	
6	14	210	8	4	870	see figure in text
6A	14	100	7	3	360	see figure in text
6B	14	160	10	6	830	

<u>TR. #</u>	<u>WIDTH</u>	<u>LENGTH</u>	<u>DEPTH</u>	<u>DEPTH TO BED ROCK</u>	<u>CUBIC YDS.</u>	<u>COMMENTS</u>
6C	14	75	4	2	150	
6D	14	100	7	3	360	
6E	14	100	8	3	410	
6F	14	60	5	5+	150	bed rock not reached
6G	14	80	4	4+	160	bed rock not reached
6H	14	150	6	4	460	see figure in text
7	14	160	6	5	500	
7A	14	245	5	5+	910	bed rock not reached
7B	14	100	6	3	310	
7C	14	175	8	2	730	
7D	14	160	8	3	660	
8	14	130	4	3	270	
8A	15	120	5	5+	330	bed rock not exposed
8B	14	170	7	7+	620	bed rock not exposed
8C	15	90	7	7+	350	bed rock not exposed
9	14	180	6	5	560	
9A	14	250	6	4	780	
Total Yards					20,190	

### Mineral Showings

Of the numerous geochemical anomalies located in 1967 only two were found to be caused by mineralized veins. The remainder appear to be caused by erratic, weakly mineralized quartz lenses in the limy phyllitic country rock. The phyllite strikes about N 45°W and dips southwest. The quartz lenses are narrow, discontinuous and lie parallel to the schistosity.

Details of the two veins, called Vein 2 and Vein 6, are shown on the figures following in the text. Vein 2, exposed in trenches 2 and 2A, averages a little less than 2.0 feet in width, strikes north-south and dips steeply east. The vein fault is weak and could not be followed south. It is still open to the north. The average assay of the vein exposures in the two trenches, representing a strike length of 70 feet, is 5.9 ounces silver/ton and 5.5% lead over a 2.0 foot width. Vein 6 is exposed in trenches 6, 6A and 6H. It strikes northsouth, dips steeply east and is a strong structure although it is only weakly mineralized. The best assay on this vein was 0.9 ounces silver per ton and 2.0% lead over a 5.0 foot width. A hangingwall split from vein 6 exposed in trench 6 showed excellent silver-lead mineralization. Assays of the mineralized portion of this split averaged 13.9 ounces silver per ton, 20.6 % lead over a width of 6.0 feet and



CUT No.	WIDTH (Ft.)	Ag.02/t	Pb %
A	2.0	7.0	7.6
B	0.2	5.6	4.8
C	0.5	19.0	15.6

TRENCH 2A

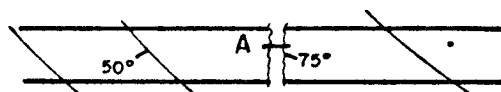

TRENCH 2

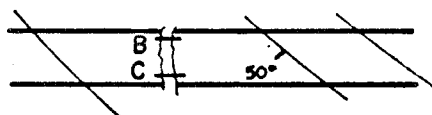

<b>DETAILS TRENCH 2 &amp; 2A</b> 1968 PROGRAM NORTHWEST EXPLORERS (1967) LTD. KETZA RIVER AREA, YUKON		
<b>ARCHER, CATHRO &amp; ASSOC. LTD.</b> Consulting Geological Engineers		
DATE	Nov. 30, 1968	DWG. No.
DRAWN	Aitair	
SCALE	1" = 40'	

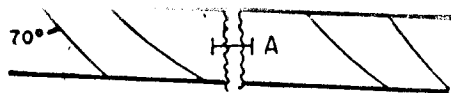

TRENCH 6A

Actual Location  
Of Trench 6A  
is 120' North



CUT No.	WIDTH (Ft.)	Ag.OZ/T	Pb %
A	5.0	Tr	Tr
B	5.0	0.6	1.0
C	5.0	0.9	2.0
D	5.0	0.4	0.1
E	5.0	0.8	1.0
F	3.0	13.6	34.0
G	6.0	20.7	28.0
H	5.5	15.4	18.3
I	3.0	1.5	2.0
J	3.0	.5	.9

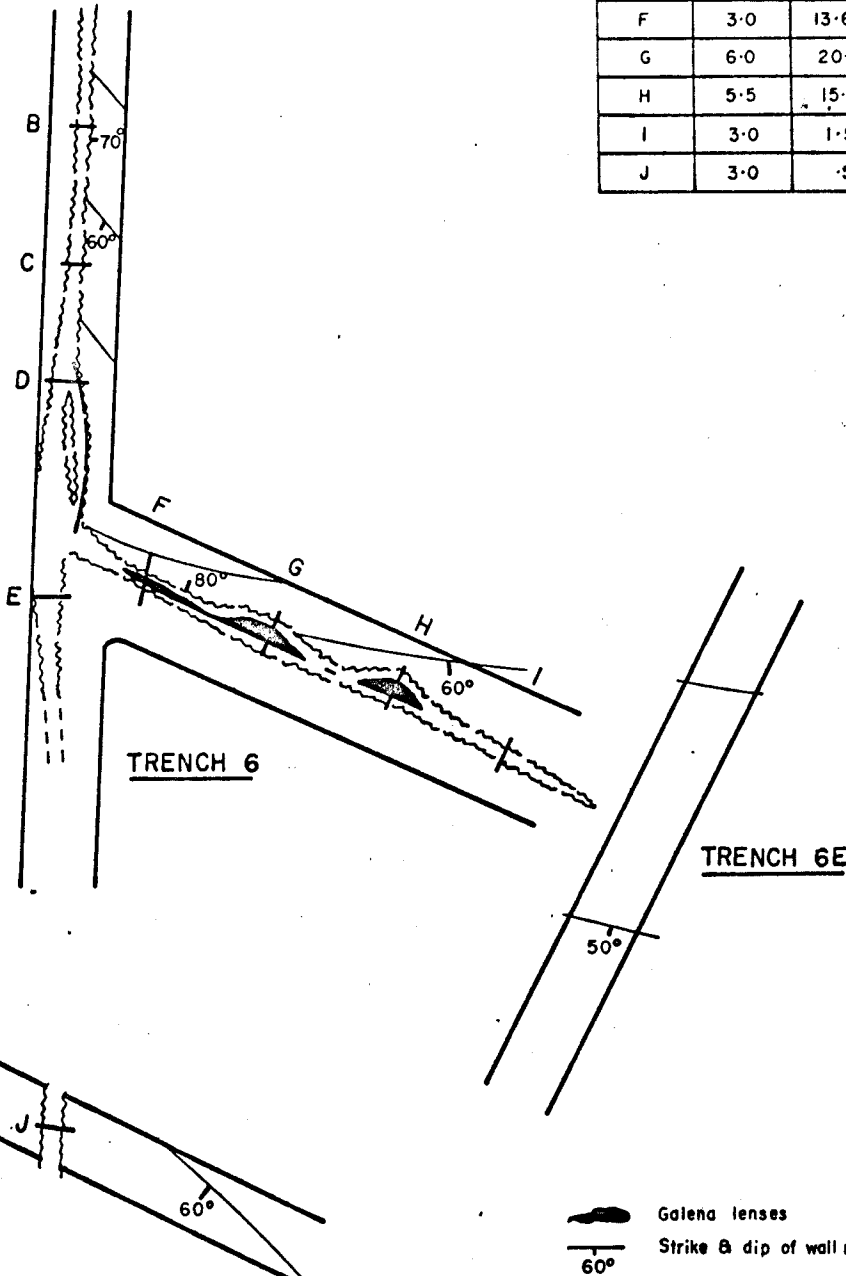

TRENCH 6H

TRENCH 6

TRENCH 6E

**DETAILS TRENCH 6, 6A, 6E, & 6H**  
 1968 PROGRAM  
 NORTHWEST EXPLORERS (1967) LTD.  
 KETZA RIVER AREA, YUKON

---

**ARCHER, CATHRO & ASSOC. LTD.**  
 Consulting Geological Engineers

DATE	Nov. 30, 1968	DWG. No.
DRAWN	Altair	
SCALE	1" = 40'	

length of 70 feet. The split structure is very weak, more of a tension fracture, and could not be followed beyond the southeast end of trench 6.

#### REGIONAL EXPLORATION

A Bell G2 helicopter under lease from Klondike Helicopters Ltd. was moved to the property in early September to support a program of regional silt sampling and detailed sampling of soil anomalies found in 1967. Unfortunately, the weather was bad and several attempts to move the field crew were unsuccessful. On September 7th an unseasonably heavy snowfall precluded any possibility of completing the work and the program was abandoned.

#### CONCLUSIONS and RECOMMENDATIONS

The two veins located, although containing interesting silver-lead values, are of insufficient size and grade to be of interest in such a remote location. Further work on the property, including the regional exploration program, should not be considered until the viability of the nearby Stump Mines property is established.

Respectfully submitted,

ARCHER, CATHRO & ASSOCIATES LTD.

*Alan R. Archer*

Alan R. Archer,

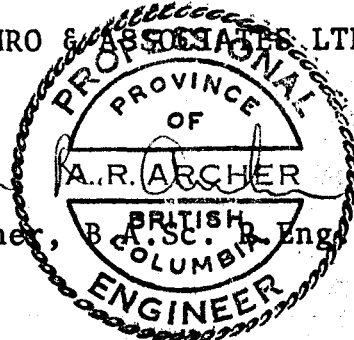

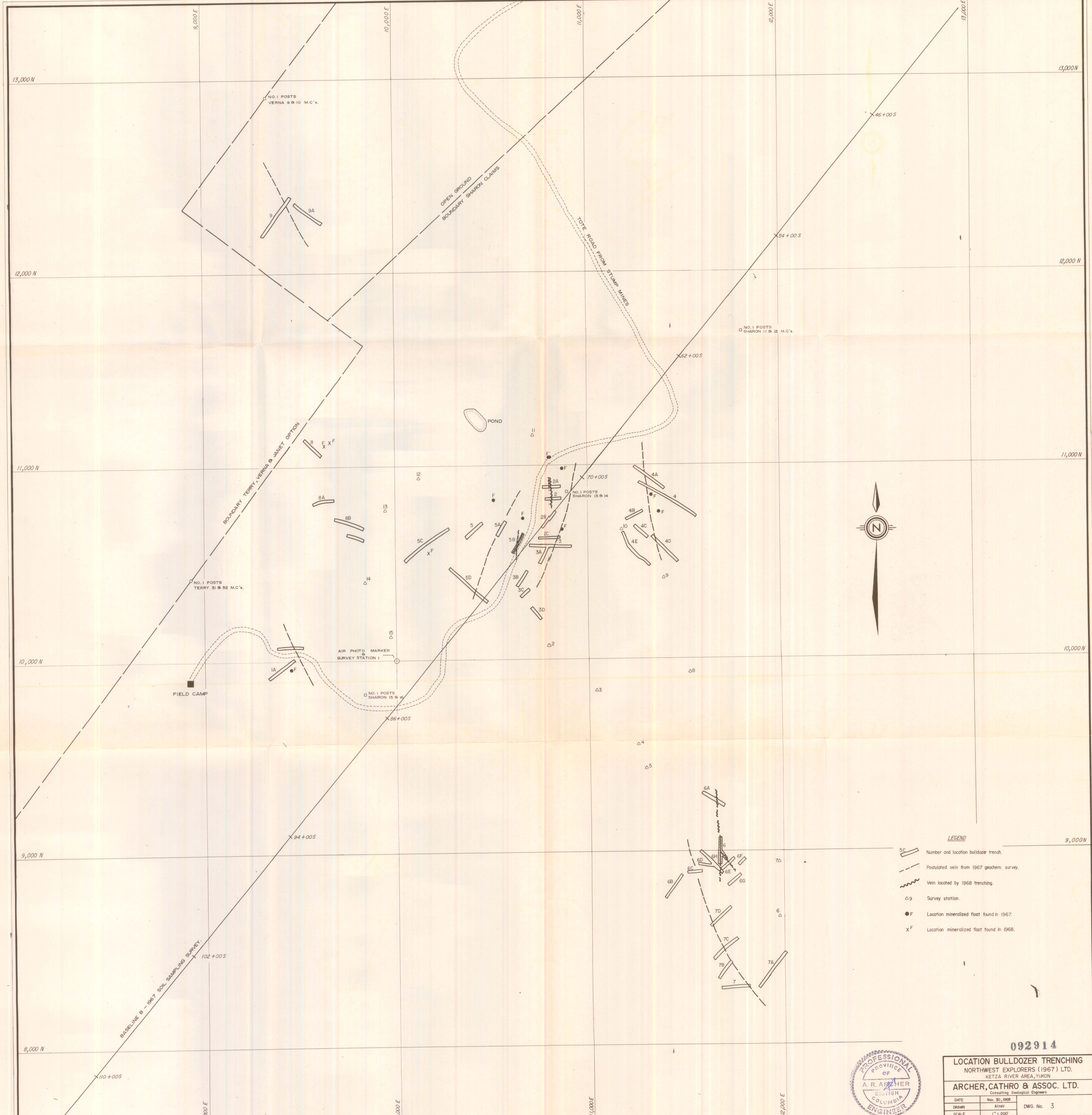

- LEGEND**
- SC Number and location bulldozer trench.
  - - - Postulated vein from 1967 geochem. survey.
  - ~~~~~ Vein located by 1968 trenching.
  - △ Survey station.
  - F Location mineralized float found in 1967.
  - X<sup>F</sup> Location mineralized float found in 1968.

092914

**LOCATION BULLDOZER TRENCHING**  
 NORTHWEST EXPLORERS (1967) LTD.  
 KETZKA RIVER AREA, YUKON

**ARCHER, CATHRO & ASSOC. LTD.**  
 Consulting Geological Engineers

DATE	Nov. 30, 1968	DWG. No.	3
DRAWN	Althair		
SCALE	1" = 200'		

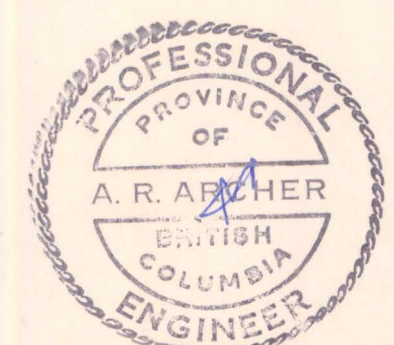

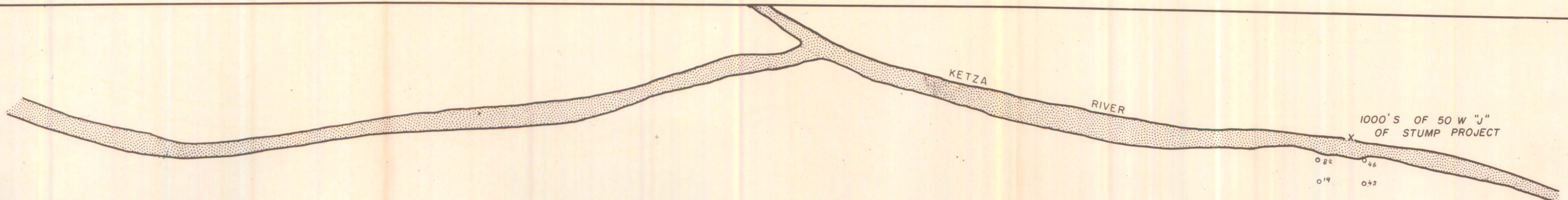

55+00W —  
 53+00W —  
 51+00W —  
 49+00W —  
 47+00W —  
 45+00W —  
 43+00W —  
 41+00W —  
 39+00W —  
 37+00W —  
 35+00W —  
 33+00W —  
 31+00W —  
 29+00W —  
 27+00W —  
 25+00W —  
 23+00W —  
 21+00W —  
 19+00W —  
 17+00W —

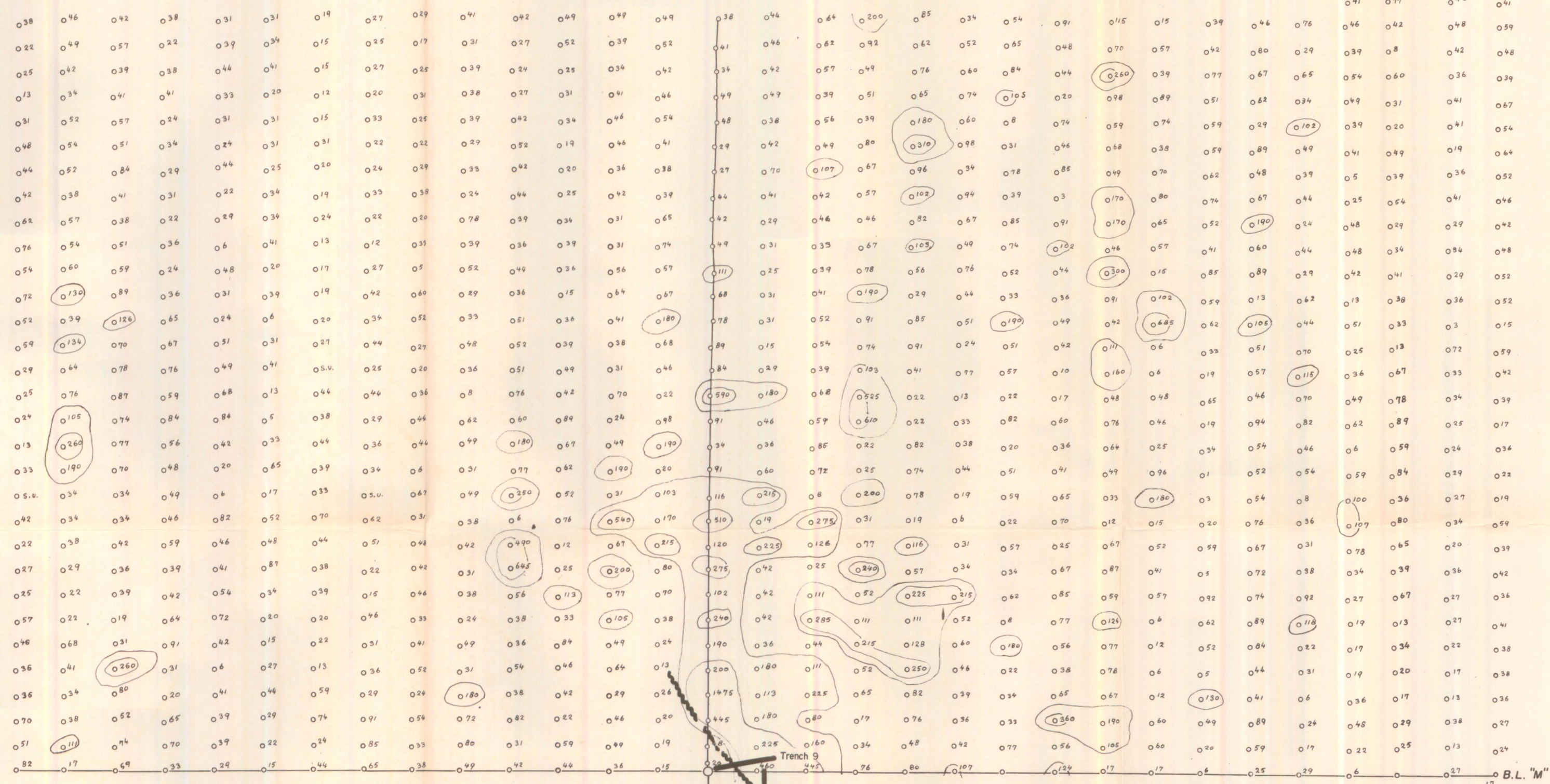

CAMP

92+00S —  
 90+00S —  
 88+00S —  
 86+00S —  
 84+00S —  
 82+00S —  
 80+00S —  
 78+00S —  
 76+00S —  
 74+00S —  
 72+00S —  
 70+00S —  
 68+00S —  
 66+00S —  
 64+00S —  
 62+00S —  
 60+00S —  
 58+00S —  
 56+00S —  
 54+00S —  
 52+00S —  
 50+00S —  
 48+00S —  
 46+00S —  
 44+00S —  
 42+00S —  
 40+00S —  
 38+00S —  
 36+00S —  
 34+00S —  
 32+00S —

CLAIM POSTS  
 71+00S

B.L. "L"

B.L. "B"

Trench 9A

100-200ppm  
 200+ ppm  
 INTERPRETED VEIN



092914

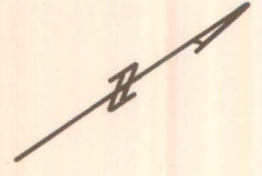

NORTHWEST EXPLORERS LTD. DETAILED SAMPLING SUZIE, TERRY, VERA OPTION		
ARCHER, CATHRO & ASSOC. LTD. Consulting Geological Engineers		
DATE	18 Aug. 1968	DWG. 2
DRAWN	Ammer	
SCALE	1" = 400'	