

MAP NO.: ASSESSMENT REPORT X
095 D 5, 12 PROSPECTUS
CONFIDENTIAL
OPEN FILE

DOCUMENT NO: 092910
MINING DISTRICT: WATSON LAKE
TYPE OF WORK: LINE CUTTING

REPORT FILED UNDER: HYLAND JOINT VENTURE: ARCHER CATHRO & ASSOCIATES LIMITED

DATE PERFORMED: 1974 DATE FILED: AUG 15, 1974

LOCATION: LAT.: 60°30'N AREA: QUARTZ LAKE

LONG.: 127°50'W VALUE \$:

CLAIM NAME & NO.: PORKER

WORK DONE BY: EASTERN ASSOCIATES

WORK DONE FOR: ARCHER CATHRO & ASSOCIATES LIMITED

DATE TO GOOD STANDING:

REMARKS: Map with lines to be cut by contractor and a paid invoice for the 30.4 miles (48.92 km) of line cut.

Microfilm as title page

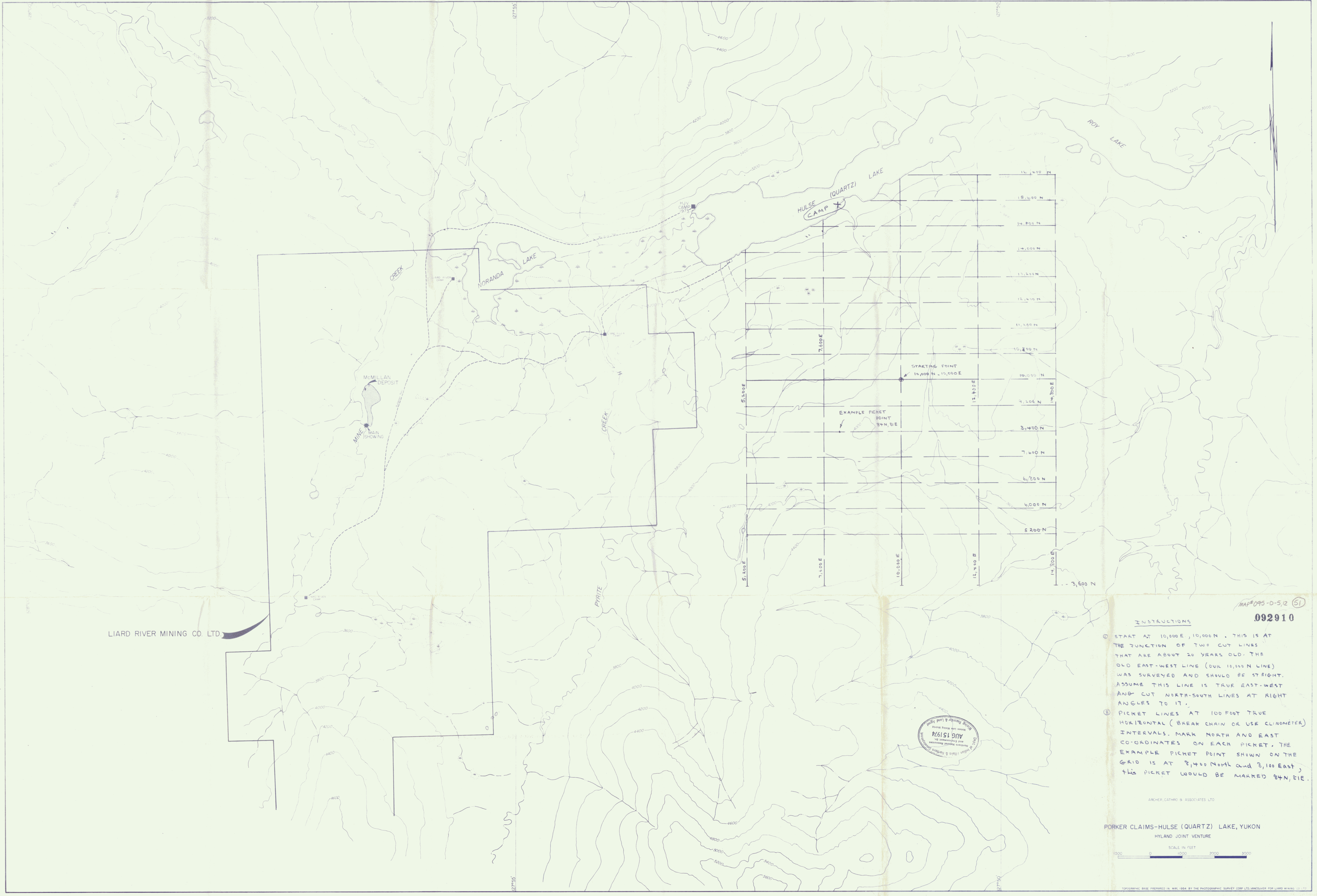

LIARD RIVER MINING CO. LTD.

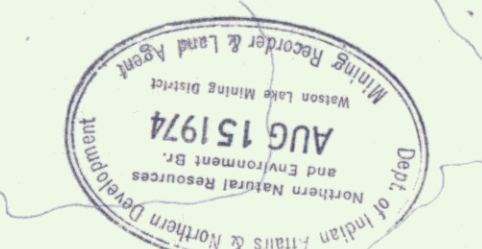

MAP 095-0-5,12 (51)
092910

INSTRUCTIONS

- 1) START AT 10,000 E, 10,000 N. THIS IS AT THE JUNCTION OF TWO CUT LINES THAT ARE ABOUT 20 YEARS OLD. THE OLD EAST-WEST LINE (OUL 10,000 N LINE) WAS SURVEYED AND SHOULD BE STRAIGHT. ASSUME THIS LINE IS TRUE EAST-WEST AND CUT NORTH-SOUTH LINES AT RIGHT ANGLES TO IT.
- 2) PICKET LINES AT 100 FOOT TRUE HORIZONTAL (BREAK CHAIN OR USE CLINOMETER) INTERVALS. MARK NORTH AND EAST CO-ORDINATES ON EACH PICKET. THE EXAMPLE PICKET POINT SHOWN ON THE GRID IS AT 8,400 North and 810 East. THIS PICKET WOULD BE MARKED 84N, 81E.

ARCHER, CATWRIGHT & ASSOCIATES LTD.

PORKER CLAIMS-HULSE (QUARTZ) LAKE, YUKON
HYLAND JOINT VENTURE

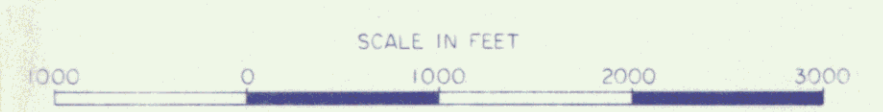

TOPOGRAPHIC BASE PREPARED IN NOV. 1954 BY THE PHOTOGRAPHIC SURVEY CORP. LTD., WASHINGTON FOR LIARD MINING CO. LTD.