

MAP NO.: ASSESSMENT REPORT X
115 I 3 PROSPECTUS
CONFIDENTIAL X
OPEN FILE

DOCUMENT NO: 092585
MINING DISTRICT: Whitehorse
TYPE OF WORK: Trenching Diamond Drilling

REPORT FILED UNDER: Archer, Cathro & Associates (1981) Ltd.

DATE PERFORMED: June - 12 September 1988

DATE FILED: 5 December 1988

LOCATION: LAT.: 62 07'N

AREA: Mt. Nansen

LONG.: 137 15'W

VALUE \$: 32,000.00

CLAIM NAME & NO.: TAWA 1-90 (YA 75263-75286, YA 95051-95052, YA 95151-95179
YA 95301-YA 95308, YB 06963-YB 06978)

WORK DONE BY: W.D. Eaton, M.J. Walls

WORK DONE FOR: Chevron Minerals Ltd., B.Y.G. Natural Resources Ltd.

DATE TO GOOD STANDING:

REMARKS: # 42 ESANSEE

Gold occurs in northwest-trending veins associated with porphyry dykes similar to those on the Mt. Nansen property. Trenches in the BRX zone exposed mineralized veins over a 750 m strike length, the best assay being 16.3 g/t Au and 1289.1 g/t Ag over 1.7 m. In the KLAZA zone a new trench intersected veins grading up to 43.1 g/t Au and 101.8 g/t Ag across 1.1 m. Drillholes intersected numerous narrow veins which returned low gold values.

012585

ARCHER, CATHRO

& ASSOCIATES (1981) LIMITED

CONSULTING GEOLOGICAL ENGINEERS

1016-510 WEST HASTINGS STREET
VANCOUVER, B. C. V6B 1L8

(604) 688-2568

TAWA PROPERTY
1988 FINAL REPORT



November, 1988

M.J. Walls, B.Sc.

W.D. Eaton, B.A., B.Sc.

TABLE OF CONTENTS

	<u>PAGE</u>
INTRODUCTION	1
PROPERTY, LOCATION AND ACCESS	3
HISTORY	4
PHYSIOGRAPHY AND GEOMORPHOLOGY	5
GEOLOGY	6
MINERALIZATION	7
TRENCHING	8
DIAMOND DRILLING	10
CONCLUSIONS	11

TABLES

1	1988 Trench Results, Tawa Property	Following Page 8
2	1988 Diamond Drill Results, Tawa Property	Following Page 10

APPENDICES

- I AUTHORS' STATEMENTS OF QUALIFICATIONS
- II LIST OF PERSONNEL
- III ASSAY CERTIFICATES
- IV DRILL LOGS

FIGURES

	<u>LOCATION</u>
1 Location Map	Following Page 3
2 Claim Data	In Pocket
3 Compilation Map	In Pocket
4 Section DDH 80-6, 88-1 and 88-2	In Pocket
5 Section DDH 88-3	In Pocket
6 Section DDH 88-4	In Pocket
7 Section DDH 88-5	In Pocket
8 Section DDH 88-6	In Pocket

INTRODUCTION

Chevron Minerals Ltd. optioned the Tawa 1-24 claims from Consolidated BRX Mining and Petroleum Corporation in spring, 1986 on behalf of Freegold Venture. The claims cover gold- and silver-bearing veins similar to those on the nearby Mt. Nansen property which Chevron has held under option from B.Y.G. Natural Resources Inc. since 1985.

Geological mapping, prospecting, grid soil geochemistry and EM-16 surveys conducted in June, 1986 produced encouraging results and 37 additional Tawa claims were staked in late July to cover extensions of the anomalous trends. In August and early September, approximately 50% of the new claims were explored by grid soil geochemistry while several geochemical and geophysical anomalies on the core property were examined by bulldozer and excavator trenching. The best vein exposed assayed 0.102 oz/ton Au and 0.44 oz/ton Ag over 4 m and was located in a trench cut directly over a 1980 diamond drill intersection that averaged 0.183 oz/ton Au and 0.44 oz/ton Ag over 8.9 m (approximate true width 8.0 m). This and most other high assays came from a northwest-trending steeply south-dipping vein system (BRX Zone). Significant values (up to 0.062 oz/ton Au over 7.5 m) were also obtained about 200 m to the south from a weakly clay altered porphyry dyke trending subparallel to the veins.

In 1987, exploration continued with the staking of sixteen additional Tawa claims, plus claim surveys, pre-stripping of proposed trench sites, excavator trenching and road construction. The work extended the strike length of the BRX Zone and located a second parallel vein system called the Klaza Zone, some 1,000 m to the northeast. The best assays came from the only trench completed on the Klaza Zone, which returned 0.123 oz/ton Au and 1.38 oz/ton Ag over 8.0 m.

In June, 1988, Chevron Minerals Ltd. entered into an option agreement with B.Y.G. Natural Resources Inc. which allowed the latter to earn an interest in the Tawa property by funding the next phase of exploration.

The 1988 exploration program was funded by B.Y.G. and consisted of continued road construction, pre-stripping of trench sites and excavator trenching, plus 377 m of diamond drilling in six holes. All of the drilling was done on the BRX Zone, while the trenching was almost equally split between the BRX and Klaza Zones. The work was supervised by M. Walls under the direction of D. Eaton. Appendix I contains the Author's Statement of Qualifications and Appendix II lists personnel who worked on the program.

PROPERTY, LOCATION AND ACCESS

The Tawa property is located 50 km west of Carmacks on NTS map sheet 115I/3 at latitude 62°07'N and longitude 137°15'W, as shown on Figure 1 on the following page. It consists of 71 full and 2 fractional claims as illustrated on Figure 2 in the pocket. During 1986, surveys established that the Tawa 13 and 14 claims optioned by Chevron did not exist on the ground and they were allowed to expire. The claims are registered with the Whitehorse Mining Recorder as follows:

<u>CLAIM NAME</u>	<u>GRANT NUMBERS</u>	<u>EXPIRY DATE*</u>
Tawa 1-12	YA75263-YA75274	January 3, 1994
Tawa 15-24	YA75277-YA75286	January 3, 1994
Tawa 25F-26F	YA95051-YA95052	January 3, 1995
Tawa 27-34	YA95151-YA95158	January 3, 1995
Tawa 47-63	YA95163-YA95179	January 3, 1995
Tawa 64-71	YA95301-YA95308	January 3, 1995
Tawa 72-79	YB06963-YB06970	January 3, 1993
Tawa 83-90	YB06971-YB06978	January 3, 1993

*Expiry dates shown above do not include assessment credits for work performed in 1988.

Two-wheel drive road access is available to within 0.5 km of the property during summer and fall using the gravel Nansen Road which is maintained by the Yukon Territorial Government. During 1987, a 1.7 km four-wheel drive road was constructed from the Nansen Road to the centre of the property. This road was upgraded and extended in 1988.

Figure 1

ARCHER, CATHRO & ASSOCIATES (1981) LIMITED

LOCATION MAP

TAWA PROPERTY

NANSEN PROJECT

★ major deposit

SCALE 1:5,000,000

0 50 100 150 200 km

0 20 40 60 80 100 120 140 miles

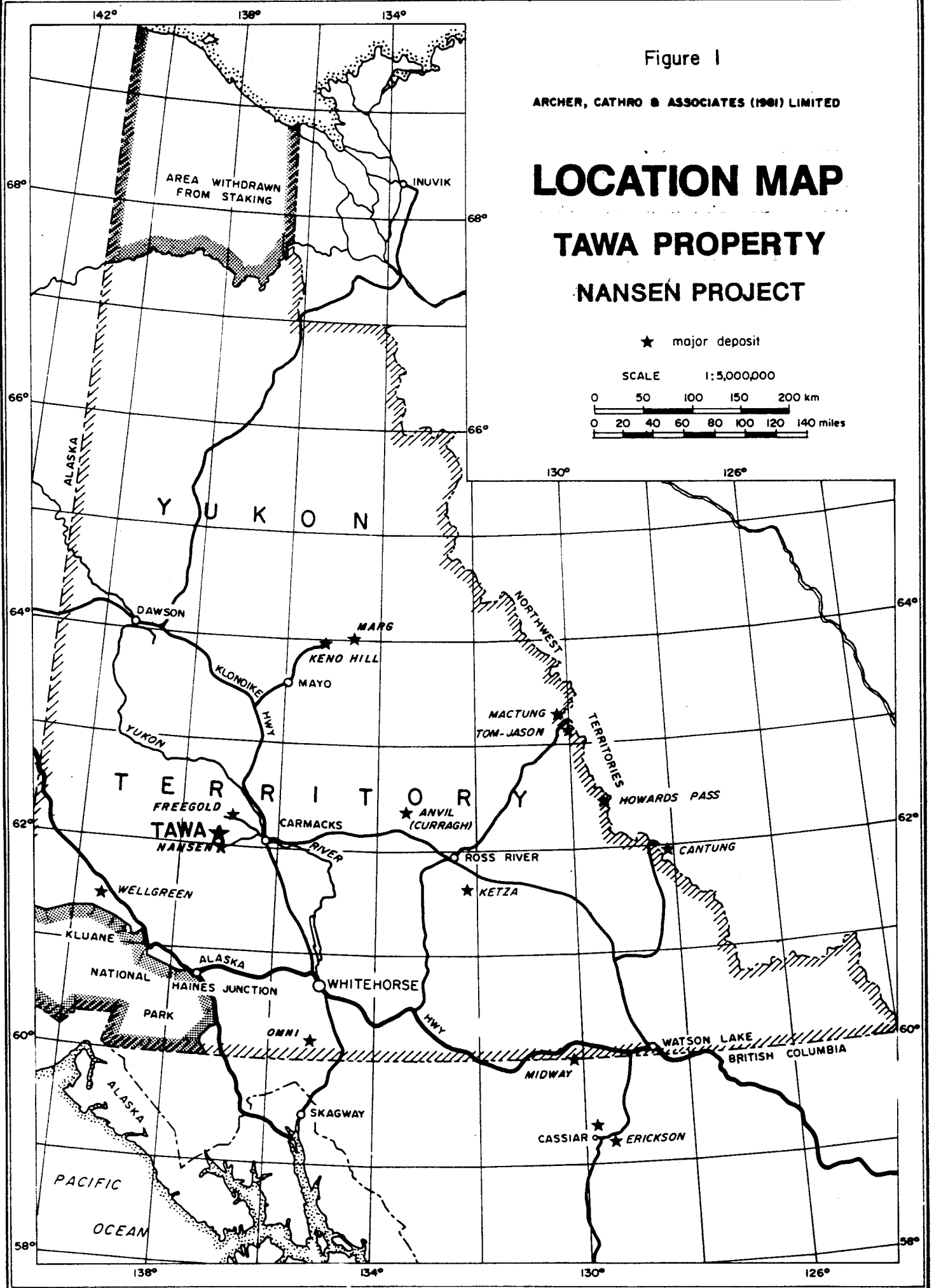

HISTORY

The first report of lode mineralization on what is now the Tawa property was in 1937 when Karl Paulson, a placer miner, was rumoured to have discovered high grade silver-lead float. The first claims were staked in October, 1947 by G. Dickson who optioned them to Conwest Exploration Limited which performed minor bulldozer trenching in 1948. From then until the late 1960's the property was dormant.

In 1967, J. Smith and associates of Whitehorse staked the May 1-8 claims and collected reconnaissance soil samples that yielded anomalous lead and silver values. This group also dug one bulldozer trench but no mineralization was intersected. In 1968 and 1969 Esensee Explorations Ltd. built a 14 km tote road from the Mt. Nansen millsite to the edge of the property and conducted geological mapping, geochemical and geophysical surveys and bulldozer trenching.

No further work was done until 1980 when BRX Mining and Petroleum Corporation restaked the property as the Tawa claims and explored with a soil geochemical survey, three short bulldozer trenches (two of which deepened 1968 trenches) and seven diamond drill holes totalling 447.3 m. BRX later changed its name to Consolidated BRX Mining and Petroleum Corporation.

PHYSIOGRAPHY AND GEOMORPHOLOGY

The property covers a broad rounded ridge that lies on the eastern flank of Mt. Nansen between Nansen Creek and the Klaza River. Local elevations range from 1200 to 1500 m above sea level. The area escaped Pleistocene continental glaciation; thus, overburden consists of a few centimetres of organics, 0 to 5 cm of volcanic ash and up to 200 cm of immature soil mixed with locally derived rock fragments over weathered bedrock. Outcrops are rare and exposed talus is restricted to a few patches on the ridge crest. Permafrost is extensive, particularly on the north- and west-facing slopes. Vegetation ranges from stunted black spruce, buckbrush and moss on the lower slopes to lichen and grass near the ridge top.

GEOLOGY

The Tawa property is situated within the Yukon Crystalline Terrane which consists of Paleozoic or older metamorphic basement rocks intruded and overlain by a variety of igneous rocks related to the Coast Plutonic Complex. The basement schist and gneiss are not exposed on the property and the igneous suite is limited to a granodiorite stock with lesser volcanic and hypabyssal dyke rocks, all of which are believed to be Mid-Cretaceous in age. The granodiorite contains up to 30% hornblende plus biotite and is massive, coarse grained and non-foliated. Northwest-trending feldspar porphyry dykes (up to 30 m wide) cut the granodiorite in the main area of interest. These felsic rocks are strongly fractured and contain up to 15%, 1 to 2 mm orthoclase phenocrysts plus rare biotite and quartz phenocrysts in a buff aphanitic groundmass. Volcanic rocks are found on the periphery of the property and include medium green-grey andesite flows and pyroclastic rocks with occasional buff to tan rhyolitic tuff horizons.

Two main fault trends (NW and NE) are present on the property. Northwesterly faults generally lack strong topographic expression but are highly significant as they host vein mineralization and appear to control the distribution of the porphyry dykes. Faults and porphyry dykes with the same orientation are associated with vein and stockwork mineralization at the Brown-McDade, Huestis and Webber Zones on the Mt. Nansen property. Northeasterly faults usually form prominent topographic linears but appear to be unmineralized cross faults. These structures commonly produce 5 to 50 m dextral offsets on northwest-trending faults.

MINERALIZATION

Precious metal mineralization occurs in a series of northwest-trending veins and associated feldspar porphyry dykes that dip moderately to the southwest within the granodiorite host rocks. The veins typically consist of 1 to 10 m wide gouge zones containing pitted, light green quartz bands up to 3 m in width. In some areas, up to 30 cm wide lenses of relatively massive pyrite, arsenopyrite, galena and/or sphalerite are developed alongside the quartz. The footwall contacts are generally sharp while the hanging wall contacts show a gradual decrease in fracture density and alteration intensity. Typical alteration grades from quartz, sericite and kaolinite in the core of the vein, to strongly montmorillonite altered gouge containing orange limonite, to highly fractured, weakly montmorillonite altered and manganese stained wallrocks on the periphery.

Previous operators reported trench assays as high as 0.962 oz/ton Au with 17.72 oz/ton Ag over 30 cm (from a trench that was deepened in 1986 and renamed T-4) and drill intersections grading up to 0.183 oz/ton Au with 0.44 oz/ton Ag over 8.9 m, including 0.715 oz/ton Au with 1.46 oz/ton Ag over 1.5 m (from Hole 80-6 which was drilled beneath T-4). The other holes returned low values or were unmineralized, however, many had poor recovery and some were drilled subparallel to the veins never getting out of the footwall rocks. Three specimens of nearly massive galena (one collected by previous operators and the others by Freegold Venture) returned 50 to 55% Pb with 0.048 to 1.702 oz/ton Au and 70.10 to 145.42 oz/ton Ag. Drilling by previous operators indicated that weak to moderate oxidation is present to a depth of about 20 m in mineralized structures.

TRENCHING

General

Trenching was done under contract by IbeX Contracting Limited of Whitehorse using a ripper-equipped Caterpillar D7G bulldozer to strip soil from proposed trench sites and a Caterpillar 225 excavator to finish them. Eighteen trenches totalling 6471 m were pre-stripped, of which ten totalling 1924 m were excavated, as shown on Figure 3 in the pocket. Frozen ground and slumping, which occurred when the frost thawed, limited the speed of trenching and, in some instances, severely hindered mapping and sampling. Continuous 7 kg chip samples were normally collected over 1 to 5 m intervals from the trench ribs across all mineralized or strongly altered exposures. A total of 247 chip samples were sent to Chemex Labs in North Vancouver where they were fire assayed for gold and silver.

Results

Significant assays are listed on Table 1 on the following page and shown with geology, gold geochemistry and EM-16 conductors on Figure 3. Results from 1988 better defined the veins in the BRX and Klaza Zones and located a third vein system (BYG Zone) approximately halfway between them.

Excavator trenches on the BRX Zone have exposed the veins at approximately 75 m centres over a 750 m strike length, while bulldozer trenching has stripped soil from four proposed trenches that could extend the zone 1000 m to the northwest. The work has shown that the veins exhibit numerous splays and that mineralization and alteration are most intense at or near vein junctions. The best assay obtained in 1988 (0.474 oz/ton Au and 37.60 oz/ton Ag over 1.7 m) came from Trench T-22, which is located near

TABLE 1: 1988 TRENCH RESULTS, TAWA PROPERTY

<u>Trench No.</u>	<u>Zone</u>	<u>From (m)</u>	<u>To (m)</u>	<u>Intersected Width (m)</u>	<u>Au oz/ton</u>	<u>Ag oz/ton</u>
T-3X	BRX	166.5	167.5	1.0	0.133	1.98
T-6X	BRX	162.4	164.2	1.8	0.166	2.83
		167.7	169.2	1.5	0.036	0.79
		177.4	179.6	2.2	0.025	0.48
		184.5	186.6	2.1	0.020	0.16
T-16X	BRX	121.7	122.3	0.6	0.253	0.54
T-17X	BRX	46.3	49.0	2.7	0.238	5.13
		101.5	102.0	0.5	0.108	0.89
T-19	BRX	65.8	69.3	3.5	0.026	1.15
T-21	BRX	12.2	13.5	1.3	0.105	2.77
		58.8	59.7	0.9	0.097	3.47
		61.5	62.5	1.0	0.028	4.26
		75.2	76.2	1.0	0.024	0.07
		84.4	85.0	0.6	0.022	0.06
		197.5	199.3	1.8	0.031	0.10
		227.0	229.0	2.0	0.033	1.04
T-22	BRX	79.2	80.9	1.7	0.474	37.60
T-23	Klaza	12.7	14.2	1.5	0.074	0.28
		127.0	128.3	1.3	0.132	0.70
		147.0	148.1	1.1	0.068	15.20
		181.6	182.4	0.8	0.030	2.45
		187.8	188.9	1.1	1.256	2.97
		200.0	201.0	1.0	0.327	13.30
		226.6	227.6	1.0	0.081	7.29
		238.0	240.7	2.7	0.069	0.10
T-24	Klaza	67.0	70.7	3.7	0.060	0.71
		106.0	106.8	0.8	0.024	6.42
T-25	BYG	5.0	6.0	1.0	0.118	0.61
		45.8	47.0	1.2	0.161	1.34
		78.5	81.8	3.3	0.176	0.70

the northwest end of the trenched area. Almost every trench on the BRX Zone has produced at least one assay better than 0.10 oz/ton Au over 1 m.

Most of the work in the Klaza Zone consisted of bulldozer stripping of proposed trench sites and only one and one-half new trenches were actually completed to bedrock. Proposed trenches have been stripped at 100 to 200 m centres for a total length of 1500 m along the projections of the zone. The completed trench (T-23) is located 90 m southeast of the discovery trench (T-11). It cut a number of veins and shears that are separated by several metres of barren wallrock. The best vein returned 1.256 oz/ton Au and 2.97 oz/ton Ag across 1.1 m, while another assayed 0.327 oz/ton Au and 13.30 oz/ton Ag across 1.0 m. The partially completed trench lies 100 m northwest of the discovery trench and intersected two mineralized structures, the better of which returned 0.060 oz/ton Au and 0.71 oz/ton Ag over 3.7 m.

Only one 1988 trench (T-25) was completed on the BYG Zone and it cut three veins about 40 m apart, one of which assayed 0.176 oz/ton Au and 0.70 oz/ton Ag over 3.3 m. A mineralized structure exposed in 1986 Trench T-8, 200 m to the southeast, is probably part of the BYG Zone. This vein returned 0.068 oz/ton Au and 0.11 oz/ton Ag over 5.0 m.

Comparison of trench assays to soil geochemical and geophysical results shows that the BRX Zone is marked by strong geochemical anomalies with coincident VLF-EM conductors while the Klaza Zone is best defined by geochemistry and the BYG Zone by VLF-EM conductors.

DIAMOND DRILLING

The drilling was done with a unitized and wireline equipped Longyear 38 diamond drill contracted from E. Caron Diamond Drilling Limited of Whitehorse. The Ibx Contracting bulldozer was used for drill moves. Core recovery was generally good except in near surface vein zones where it averaged about 60%. Mud was used in all holes and no calcium chloride was required. A good source of water was available on the property but it was a considerable distance from the drill targets and the waterlines were up to 2000 m long.

Drill hole locations are shown on Figure 3 while significant intersections are summarized on Table 2 on the following page. Drill sections are illustrated on Figures 4 to 8 in the pocket and assay certificates and drill logs are in Appendices III and IV, respectively. Although numerous narrow veins were intersected, they generally returned low values. The best assay (0.176 oz/ton Au and 3.79 oz/ton Ag over 1.36 m) came from Hole 88-6 which tested 32 m directly downdip from the vein in Trench T-22 that returned 0.474 oz/ton Au and 37.60 oz/ton Ag over 1.7 m. The most disappointing results came from Holes 88-1 and 88-2 which were drilled beneath the 1988 BRX hole (80-6) that assayed 0.183 oz/ton Au and 0.44 oz/ton Ag over 8.9 m. These holes, plus holes 88-3 and 88-4 which were drilled 55 m to the southeast and 140 m to the northwest, respectively, produced only narrow intersections, the best of which was 0.159 oz/ton Au and 1.28 oz/ton Ag over 0.72 m.

Wallrock alteration is much less intense in the drill holes than was observed in the trenches, suggesting that much of the clay gouge in the trenches is supergene in origin. Wallrock for most veins is either fresh or exhibited weak to moderate montmorillonite alteration. Oxidation is weak to non-existent in most holes.

TABLE 2: 1988 DIAMOND DRILL RESULTS, TAWA PROPERTY

<u>Hole No.</u>	<u>Zone</u>	<u>From (m)</u>	<u>To (m)</u>	<u>Intersected Width (m)</u>	<u>Au oz/ton</u>	<u>Ag oz/ton</u>
88-1	BRX	13.30	14.02	0.72	0.159	1.28
		28.35	28.95	0.60	0.150	6.71
		35.08	36.88	1.80	0.031	0.57
88-2	BRX	47.30	49.02	1.72	0.031	0.26
		60.96	62.48	1.52	0.038	0.35
		68.88	70.41	1.53	0.031	0.35
		78.20	79.05	0.85	0.091	0.36
88-3	BRX	30.18	30.33	0.15	0.078	2.17
		39.92	41.45	1.53	0.022	0.04
88-4	BRX	50.29	51.05	0.76	0.028	1.06
		55.90	56.90	1.00	0.047	7.58
		60.96	62.48	1.52	0.021	0.95
88-5	BRX	31.50	32.05	0.55	0.118	11.70
		37.96	40.15	2.19	0.030	1.30
		49.07	51.04	1.97	0.031	0.29
88-6	BRX	35.14	35.69	0.55	0.040	3.30
		36.88	37.27	0.39	0.474	1.43
		41.61	42.97	1.36	0.176	3.79

CONCLUSIONS

The 1988 exploration programs produced mixed results. On the positive side, excavator trenching has demonstrated 750 m of mineralized strike length continuity on the BRX Zone and returned several high assays from the poorly exposed Klaza and BYG Zones, which have not yet been tested by drilling. On the other hand, drilling on the BRX Zone intersected only weakly mineralized structures beneath some of the most promising trenches, suggesting that the mineralization is erratically distributed. Most veins in all three zones are narrow (less than 2 m), separated by several metres of barren wallrock and weakly oxidized. Therefore, potential for open pit mining is limited and the ores would likely require milling with flotation to produce a sulphide concentrate or pre-oxidation followed by cyanidization. Fortunately, the veins are not severely disturbed by cross faults, exhibit steep dips, have relatively competent wallrocks and are often high grade, all of which are favourable for underground mining. Future programs should attempt to define high grade ore shoots that could be mined from small open pits or underground workings and trucked to the Mt. Nansen mill, assuming that it is reactivated and equipped to treat sulphide ores.

The next stage of exploration should consist of additional bulldozer and excavator trenching along strike from the known zones, coupled with a few diamond drill holes to test downdip continuity on the Klaza and BYG Zones.

Respectfully submitted,

ARCHER, CATHRO & ASSOCIATES (1981) LIMITED



M. J. Walls, B.Sc.

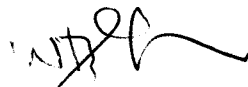

W.D. Eaton, B.A., B.Sc.

APPENDIX I

AUTHORS' STATEMENTS OF QUALIFICATIONS

STATEMENT OF QUALIFICATIONS

I, W. Douglas Eaton, geologist, with business addresses in Whitehorse, Yukon Territory and Vancouver, British Columbia, and residential address in Burnaby, British Columbia, do hereby declare:

1. I graduated from the University of British Columbia in 1980 with a B.Sc.
2. From 1971 to present, I have been actively engaged in mineral exploration in British Columbia and Yukon Territory and on June 1, 1981, I became a partner in Archer, Cathro & Associates (1981) Limited.
3. I have personally participated in or supervised the field work reported herein and have interpreted all data resulting from this work.



W. Douglas Eaton, B.A., B.Sc.

STATEMENT OF QUALIFICATIONS

I, Michael J. Walls, geologist, with business addresses in Whitehorse, Yukon Territory and Vancouver, British Columbia, and residential address in Vancouver, British Columbia, hereby certify that:

1. I graduated from the University of British Columbia in 1985 with a B.Sc. majoring in Geological Sciences.
2. From 1985 to present, I have been actively engaged as a geologist in mineral exploration in Yukon Territory and am presently employed with Archer, Cathro & Associates (1981) Limited.
3. I have personally participated in or supervised the field work reported herein and have interpreted all data resulting from this work.



Michael J. Walls, B.Sc.

APPENDIX II
LIST OF PERSONNEL

LIST OF PERSONNEL

<u>NAME</u>	<u>POSITION</u>
Doug Eaton	Geologist
Mike Walls	Geologist
Jack Dennett	Geologist
Maggie Dittrick	Geologist
Diane Lister	Fieldperson
Dave Parry	Fieldperson
Rob Hancox	Fieldperson
Lesley Leroux	Surveyor
Bill Wengzynowski	Fieldperson
Gord Cockell	Fieldperson
Glen Emery	Fieldperson
Lori Eaton	Fieldperson
Keith Richmond	Fieldperson

APPENDIX III
ASSAY CERTIFICATES



Chemex Labs Ltd.

Analytical Chemists * Geochemists * Registered Assayers
 212 BROOKSBANK AVE., NORTH VANCOUVER
 BRITISH COLUMBIA, CANADA V7J-2C1
 PHONE (604) 984-0221

T. R. CATHRO & ASSOC. (1981) LTD.

BOX 4127
 WHITEHORSE, Y.T.
 Y1A 3S9

Project: TAWA
 Comments:

Page No.
 Tot. Pages
 Date : 14-AUG-88
 Invoice # : I-8820338
 P.O. # : NONE

CERTIFICATE OF ANALYSIS A8820338

SAMPLE DESCRIPTION	PREP CODE	Au FA oz/T	Ag FA oz/T						
T-0501	208 ---	0.003	0.20	<i>0.26/1.15</i> <i>3.5m.</i>					
T-0502	208 ---	0.026	1.15						
T-0503	208 ---	0.008	0.19						
T-0504	208 ---	0.002	0.06						
T-0505	208 ---	0.006	0.19						
T-0506	208 ---	0.005	0.10						
T-0507	208 ---	0.002	0.15						
T-0508	208 ---	0.007	0.41						
T-0509	208 ---	0.001	0.07						
T-0510	208 ---	0.002	0.15						
T-0511	208 ---	0.003	0.36						
T-0512	208 ---	0.001	0.15						
T-0513	208 ---	0.001	0.10						

B. Swales



Chemex Labs Ltd.

Analytical Chemists • Geochemists • Registered Assayers

212 BROOKSBANK AVE., NORTH VANCOUVER,
BRITISH COLUMBIA, CANADA V7J-2C1

PHONE (604) 984-0221

ARCHER CATHERO & ASSOC. (1981) LTD.

BOX 4127
WHITEHORSE, Y.T.
Y1A 3S9

Project : TAWA

Comments :

Page No
Tot. Pages : 2
Date : 19-AUG-88
Invoice # : I-8820966
P.O. # : NONE

CERTIFICATE OF ANALYSIS A8820966

SAMPLE DESCRIPTION	PREP CODE	Au oz/T	Ag oz/T								
T-514	208 ---	0.003	0.09								
T-515	208 ---	0.001	0.03								
T-516	208 ---	0.001	0.03								
T-517	208 ---	0.006	0.13								
T-518	208 ---	0.002	0.15								
T-519	208 ---	0.004	0.04								
T-520	208 ---	0.004	0.04								
T-521	208 ---	0.004	0.04								
T-522	208 ---	0.006	0.38								
T-523	208 ---	0.005	0.16								
T-524	208 ---	0.007	0.16								
T-525	208 ---	0.002	0.06								
T-526	208 ---	0.002	0.06								
T-527	208 ---	0.004	0.12								
T-528	208 ---	0.013	0.16								
T-529	208 ---	0.002	0.01								
T-530	208 ---	0.002	0.05								
T-531	208 ---	0.005	0.13								
T-532	208 ---	0.001	0.02								
T-533	208 ---	0.005	0.23								
T-534	208 ---	0.003	0.17								
T-535	208 ---	0.003	0.13								
T-536	208 ---	0.002	0.05								
T-537	208 ---	0.006	0.10								
T-538	208 ---	0.005	0.03								
T-539	208 ---	0.014	0.44								
T-540	208 ---	0.003	0.02								
T-541	208 ---	0.007	0.47								
T-542	208 ---	0.005	0.07								
T-543	208 ---	0.003	0.07								
T-544	208 ---	0.005	0.51								
T-545	208 ---	0.019	0.08								
T-546	208 ---	0.003	0.05								
T-547	208 ---	0.097	3.47								
T-548	208 ---	0.007	0.27								
T-549	208 ---	0.028	4.26								
T-550	208 ---	0.015	0.25								
T-1602	208 ---	0.007	0.09								
T-1603	208 ---	0.010	0.02								
T-1604	208 ---	0.011	0.02								

ALL ASSAY DETERMINATIONS ARE PERFORMED OR SUPERVISED BY B.C. CERTIFIED ASSAYERS

CERTIFICATION :

[Signature]



Chemex Labs Ltd.

Analytical Chemists • Geochemists • Registered Assayers

212 BROOKSBANK AVE., NORTH VANCOUVER,
BRITISH COLUMBIA, CANADA V7J-2C1

PHONE (604) 984-0221

ARCHER CATIRO & ASSOC. (1981) LTD.

BOX 4127
WHITEHORSE, Y.T.
Y1A 3S9

Project : TAWA
Comments :

Page No. 2
Tot. Pages: 2
Date : 19-AUG-88
Invoice # : I-8820966
P.O. # : NONE

CERTIFICATE OF ANALYSIS A8820966

SAMPLE DESCRIPTION	PREP CODE		Au	Ag							
			oz/T	oz/T							
T-1605	208	--	0.008	0.04							
T-1606	208	--	0.005	0.01							
T-1607	208	--	0.024	0.07							
T-1608	208	--	0.006	0.03							

ALL ASSAY DETERMINATIONS ARE PERFORMED OR SUPERVISED BY BC CERTIFIED ASSAYERS

CERTIFICATION :



Chemex Labs Ltd.

Analytical Chemists • Geochemists • Registered Assayers

212 BROOKSBANK AVE., NORTH VANCOUVER,
BRITISH COLUMBIA, CANADA V7J-2C1

PHONE (604) 984-0221

MARCHER CATHRO & ASSOC. (1981) LTD.

BOX 4127
WHITEHORSE, Y.T.
Y1A 3S9

Project : TAWA

Comments :

Page N 1
Tot. Pages: 2
Date : 25-AUG-88
Invoice # : I-8821176
P.O. # : NONE

CERTIFICATE OF ANALYSIS A8821176

SAMPLE DESCRIPTION	PREP CODE	Au oz/T	Ag oz/T								
T-1609	208 ---	0.022	0.06								
T-1610	208 ---	0.017	0.03								
T-1611	208 ---	0.007	0.08								
T-1612	208 ---	0.007	0.06								
T-1613	208 ---	0.003	0.06								
T-1614	208 ---	0.031	0.10								
T-1615	208 ---	0.004	0.04								
T-1616	208 ---	0.010	0.09								
T-1617	208 ---	0.003	0.04								
T-1618	208 ---	0.016	0.12								
T-1619	208 ---	0.033	1.04								
T-1620	208 ---	0.005	0.08								
T-1621	208 ---	0.008	0.05								
T-1622	208 ---	0.002	0.04								
T-1623	208 ---	0.009	0.45								
T-1624	208 ---	0.004	0.34								
T-1625	208 ---	0.105	2.77								
T-1626	208 ---	0.004	0.15								
T-1627	208 ---	0.001	0.02								
T-1628	208 ---	0.002	0.29								
T-1629	208 ---	< 0.001	0.01								
T-1630	208 ---	0.001	0.11								
T-1631	208 ---	0.474	37.6								
T-1632	208 ---	0.016	1.21								
T-1633	208 ---	0.003	0.19								
T-1634	208 ---	0.002	0.13								
T-1635	208 ---	0.193	7.07								
T-1636	208 ---	0.005	0.12								
T-1637	208 ---	0.004	0.07								
T-1638	208 ---	0.004	0.07								
T-1639	208 ---	0.008	0.21								
T-1640	208 ---	0.003	0.07								
T-1641	208 ---	0.001	0.02								
T-1642	208 ---	0.002	0.05								
T-1643	208 ---	0.166	2.83								
T-1644	208 ---	0.017	1.78								
T-1645	208 ---	0.014	0.42								
T-1646	208 ---	0.036	0.79								
T-1647	208 ---	0.006	0.12								
T-1648	208 ---	0.006	0.29								

ALL ASSAY DETERMINATIONS ARE PERFORMED OR SUPERVISED BY B.C. CERTIFIED ASSAYERS

CERTIFICATION :

Pat Stewart



Chemex Labs Ltd.

Analytical Chemists • Geochemists • Registered Assayers
212 BROOKSBANK AVE., NORTH VANCOUVER,
BRITISH COLUMBIA, CANADA V7J-2C1
PHONE (604) 984-0221

ARCHER CATIRO & ASSOC. (1981) LTD.

BOX 4127
WHITEHORSE, Y.T.
Y1A 3S9

Project : TAWA
Comments :

Page N. 2
Tot. Pages: 2
Date : 25-AUG-88
Invoice # : I-8821176
P.O. # : NONE

CERTIFICATE OF ANALYSIS A8821176

SAMPLE DESCRIPTION	PREP CODE		Au	Ag							
			oz/T	oz/T							
T-1649	208	--	0.008	0.21							
T-1650	208	--	0.009	0.64							
T-1651	208	--	0.025	0.48							

ALL ASSAY DETERMINATIONS ARE PERFORMED OR SUPERVISED BY B.C. CERTIFIED ASSAYERS

CERTIFICATION :

R. J. White



Chemex Labs Ltd.

Analytical Chemists • Geochemists • Registered Assayers
 212 BROOKSBANK AVE., NORTH VANCOUVER,
 BRITISH COLUMBIA, CANADA V7J-2C1
 PHONE (604) 944-0221

To: ARCHER CATHER & ASSOC. (1981) LTD.

BOX 4127
 WHITEHORSE, Y.T.
 Y1A 3S9

Project: TAWA
 Comments:

Page No. : 1
 Tot. Pages: 1
 Date : 29-AUG-81
 Invoice #: J-882149
 P.O. #: NONE

CERTIFICATE OF ANALYSIS A8821497

SAMPLE DESCRIPTION	PREP CODE		Au	Ag FA
			oz/T	oz/T
T-1652	208	---	0.008	0.10
T-1653	208	---	0.001	0.03
T-1654	208	---	0.004	0.10
T-1655	208	---	0.007	0.28
T-1656	208	---	0.001	0.01
T-1657	208	---	< 0.001	< 0.01
T-1658	208	---	0.253	0.54
T-1659	208	---	0.001	< 0.01
T-1660	208	---	0.008	0.07
T-1661	208	---	0.004	0.06
T-1662	208	---	0.012	0.32
T-1663	208	---	0.003	0.22
T-1664	208	---	0.015	0.50
T-1665	208	---	0.006	0.17
T-1666	208	---	0.012	0.13
T-1667	208	---	0.006	0.04
T-1668	208	---	0.004	0.03
T-1669	208	---	0.006	0.03
T-1670	208	---	0.004	0.03
T-1671	208	---	0.011	0.22
T-1672	208	---	0.002	0.04
T-1673	208	---	0.005	0.02
T-1674	208	---	0.009	0.26
T-1675	208	---	0.004	0.09
T-1676	208	---	0.003	0.02
T-1677	208	---	0.001	0.03
T-1678	208	---	0.074	0.28
T-1679	208	---	0.045	0.17

ALL ASSAY DETERMINATIONS ARE PERFORMED OR SUPERVISED BY B.C. CERTIFIED ASSAYERS

CERTIFICATION : _____



Chemex Labs Ltd.

Analytical Chemists • Geochemists • Registered Assayers

212 BROOKSBANK AVE., NORTH VANCOUVER,
BRITISH COLUMBIA, CANADA V7J-2C1

PHONE (604) 984-0221

ARCHER CATHER & ASSOC. (1981) LTD.

BOX 4127
WHITEHORSE, Y.T.
Y1A 3S9

Project : TAWA

Comments :

Page : 1
Tot. : 1
Date : 1-SEP-88
Invoice # : I-8821819
P.O. # : NONE

CERTIFICATE OF ANALYSIS A8821819

SAMPLE DESCRIPTION	PREP CODE		Au	Ag								
			oz/T	oz/T								
T-1680	208	--	0.056	0.13								
T-1681	208	--	0.016	0.13								
T-1682	208	--	0.001	< 0.01								
T-1683	208	--	0.001	< 0.01								
T-1684	208	--	0.007	0.19								
T-1685	208	--	0.006	0.60								
T-1686	208	--	0.003	0.10								
T-1687	208	--	0.006	0.29								
T-1688	208	--	0.066	0.08								
T-1689	208	--	0.012	< 0.01								
T-1690	208	--	0.002	0.02								
T-1701	208	--	0.003	0.02								
T-1702	208	--	0.003	0.09								
T-1703	208	--	0.003	0.01								
T-1704	208	--	0.003	0.09								
T-1705	208	--	0.016	0.16								
T-1706	208	--	0.012	0.23								
T-1707	208	--	0.013	0.22								
T-1708	208	--	0.020	0.16								
T-1709	208	--	0.006	0.15								
T-1710	208	--	0.004	0.17								

ALL ASSAY DETERMINATIONS ARE PERFORMED OR SUPERVISED BY BC CERTIFIED ASSAYERS

CERTIFICATION : *W. H. ...*



Chemex Labs Ltd.

Analytical Chemists • Geochemists • Registered Assayers

211 BROOKSBANK AVE., NORTH VANCOUVER,
BRITISH COLUMBIA, CANADA V7J-3C1

PHONE (604) 984-0211

To: ARCHER CATHRO & ASSOC. (1981) LTD.

BOX 4127
WHITEHORSE, Y.T.
Y1A 3S9

Project: TAWA

Comments:

Page No.: 1

Tot. Pages: 2

Date: 4-SEP-88

Invoice #: I-8822132

P.O. #: NONE

CERTIFICATE OF ANALYSIS A8822132

SAMPLE DESCRIPTION	PREP CODE	As	Ag
		oz/T	oz/T
T-1691	208 ---	0.019	0.07
T-1692	208 ---	0.002	0.01
T-1693	208 ---	0.002	0.03
T-1694	208 ---	0.132	0.70
T-1695	208 ---	0.008	0.10
T-1696	208 ---	0.039	6.85
T-1697	208 ---	0.002	0.04
T-1698	208 ---	0.001	0.04
T-1699	208 ---	0.002	0.04
T-1700	208 ---	0.004	0.08
T-1711	208 ---	0.001	0.01
T-1712	208 ---	0.001	0.03
T-1713	208 ---	0.001	0.19
T-1714	208 ---	0.068	15.20
T-1715	208 ---	0.001	0.06
T-1716	208 ---	0.001	0.02
T-1717	208 ---	0.002	0.15
T-1718	208 ---	0.002	0.07
T-1719	208 ---	0.001	0.03
T-1720	208 ---	0.002	0.44
T-1721	208 ---	0.003	0.17
T-1722	208 ---	0.004	0.03
T-1723	208 ---	0.030	2.45
T-1724	208 ---	0.009	0.16
T-1725	208 ---	0.014	3.15
T-1726	208 ---	0.003	0.13
T-1727	208 ---	1.256	2.97
T-1728	208 ---	0.003	0.09
T-1729	208 ---	0.006	2.86
T-1730	208 ---	0.001	0.13
T-1731	208 ---	0.041	1.04
T-1732	208 ---	0.004	0.09
T-1733	208 ---	0.327	13.30
T-1734	208 ---	0.005	0.19
T-1735	208 ---	0.002	0.15
T-1736	208 ---	0.008	0.29
T-1737	208 ---	0.081	7.29
T-1738	208 ---	0.002	0.28
T-1739	208 ---	0.003	0.23
T-1740	208 ---	0.002	0.03

CERTIFICATE INCOMPLETE

CERTIFICATION: _____



Chemex Labs Ltd.

Analytical Chemists * Geochemists * Registered Assayers
212 BROOKSBANK AVE., NORTH VANCOUVER,
BRITISH COLUMBIA, CANADA V7J-2C1
PHONE (604) 984-0221

RESEARCHER CATHRO & ASSOC. (1981) LTD.

BOX 4127
WHITEHORSE, Y.T.
Y1A 3S9

Project : TAWA
Comments :

Page No : 2
Tot. Pa. : 2
Date : 6-SEP-88
Invoice # : I-8822132
P.O. # : NONE

CERTIFICATE OF ANALYSIS A8822132

SAMPLE DESCRIPTION	PREP CODE	Au oz/T	Ag oz/T								
T-1741	208 ---	0.069	0.10								
T-1742	208 ---	0.003	0.04								
T-1743	208 ---	0.001	0.18								
T-1744	208 ---	0.001	12.40								
T-1745	208 ---	0.652	0.62								

T-53
22

ALL ASSAY DETERMINATIONS ARE PERFORMED OR SUPERVISED BY B.C. CERTIFIED ASSAYERS

CERTIFICATION :

W. Schumacher



Chemex Labs Ltd.

Analytical Chemists • Geochemists • Registered Assayers

211 BROOKSBANK AVE. NORTH VANCOUVER,
BRITISH COLUMBIA, CANADA V7J-2C1

PHONE (604) 984-0221

7 RESEARCH CATHRO & ASSOC. (1981) LTD.

BOX 4127
WHITEHORSE, Y.T.
Y1A 3S9

Project : TAWA

Comments :

Page No :
Tot. Pages: 1
Date : 27-SEP-88
Invoice # : I-8823481
P.O. # : NONE

CERTIFICATE OF ANALYSIS A8823481

SAMPLE DESCRIPTION	PREP CODE		Au	Ag								
			oz/T	oz/T								
T 0327 T 0328 T 0329 T 0330 T 0331	208	---	0.006	0.28								
	208	---	0.007	0.22								
	208	---	0.133	1.98								
	208	---	< 0.001	0.01								
	208	---	0.001	0.01								
T 0332 T 0333 T 0334 T 0335 T 0336	208	---	0.013	0.17								
	208	---	< 0.001	0.03								
	208	---	< 0.001	< 0.01								
	208	---	0.003	0.06								
	208	---	0.016	0.25								

ALL ASSAY DETERMINATIONS ARE PERFORMED OR SUPERVISED BY B.C. CERTIFIED ASSAYERS

CERTIFICATION : 



Chemex Labs Ltd.

Analytical Chemists • Geochemists • Registered Assayers

212 BROOKSBANK AVE. NORTH VANCOUVER,
BRITISH COLUMBIA, CANADA V7J-2C1

PHONE (604) 984-0221

ARCHER CATHRO & ASSOC. (1981) LTD.

BOX 4127
WHITEHORSE, Y.T.
Y1A 3S9

Project : TAWA

Comments :

Page No. 1
Tot. Pages: 1
Date : 29-SEP-88
Invoice # : I-8824025
P.O. # : NONE

CERTIFICATE OF ANALYSIS A8824025

88-17X

SAMPLE DESCRIPTION	PREP CODE	Au oz/T	Ag oz/T									
T-0337	208 ---	0.003	0.14									
T-0338	208 ---	0.002	0.07									
T-0339	208 ---	0.055	1.49									
T-0340	208 ---	0.003	0.17									
T-0341	208 ---	0.003	0.17									
T-0396	208 ---	0.005	0.23									
T-0397	208 ---	0.010	0.60									
T-0398	208 ---	0.004	0.29									
T-0399	208 ---	0.003	0.10									
T-0400	208 ---	0.002	0.09									
T-1748	208 ---	0.004	0.17									
T-1749	208 ---	0.002	0.14									
T-1750	208 ---	0.003	0.13									
T-1751	208 ---	0.003	0.29									
T-1752	208 ---	0.238	5.13									
T-1753	208 ---	0.058	2.77									
T-1754	208 ---	0.014	0.91									
T-1755	208 ---	0.008	0.28									
T-1756	208 ---	0.002	0.12									
T-1757	208 ---	0.108	0.89									
T-1758	208 ---	0.001	0.03									
T-1759	208 ---	0.002	0.07									
T-1760	208 ---	0.118	0.61									
T-1761	208 ---	0.002	0.03									
T-1762	208 ---	0.020	0.35									
T-1763	208 ---	0.161	1.34									
T-1764	208 ---	0.006	0.73									
T-1765	208 ---	0.001	0.01									
T-5983	208 ---	0.002	0.01									
T-5984	208 ---	0.176	0.70									
T-5985	208 ---	0.014	0.03									
T-5986	208 ---	0.007	0.08									
T-5987	208 ---	0.011	0.07									
T-5988	208 ---	0.003	0.02									

B. Swates



Chemex Labs Ltd.

Analytical Chemists • Geochemists • Registered Assayers
112 BROOKSBANK AVE., NORTH VANCOUVER,
BRITISH COLUMBIA, CANADA V7J-2C1
PHONE (604) 984-0221

ARCHER CAIYRO & ASSOC. (1981) LTD.

BOX 4127
WHITEHORSE, Y.T.
Y1A 3S9

Project : TAWA
Comments :

Page N 1
Tot. Pages: 1
Date : 3-OCT-88
Invoice # : I-8824276
P.O. # : NONE

CERTIFICATE OF ANALYSIS A8824276

SAMPLE DESCRIPTION	PREP CODE	Au oz/T	Ag oz/T								
T-5999	208	--	0.001	< 0.01							
T-6000	208	--	0.001	0.04							
T-6013	208	--	0.001	0.08							
T-6014	208	--	0.007	0.05							
T-6015	208	--	0.001	0.01							
T-6016	208	--	0.060	0.71							
T-6017	208	--	0.004	0.04							
T-6018	208	--	0.024	6.42							
T-6019	208	--	0.003	0.38							

88-24

R. Swaites



Chemex Labs Ltd.

Analytical Chemists * Geochemists * Registered Assayers

212 BROOKSBANK AVE., NORTH VANCOUVER,
BRITISH COLUMBIA, CANADA V7J-2C1

PHONE (604) 984-0221

ARCHER CATURO & ASSOC. (1981) LTD.

1016 - 510 W. HASTINGS ST.
VANCOUVER, BC
V6B 1L8

Project : TAWA
Comments :

Page 1 : 1
Tot. Pages: 3
Date : 14-OCT-88
Invoice # : I-8824681
P.O. # : NONE

CERTIFICATE OF ANALYSIS A8824681

554
88 T-1
557
88 T-2

SAMPLE DESCRIPTION	PREP CODE		Au oz/T	Ag oz/T										
T6201	208	---	0.013	0.17										
T6202	208	---	0.010	0.18										
T6203	208	---	0.159	1.28										
T6204	208	---	0.005	0.12										
T6205	208	---	0.002	0.01										
T6206	208	---	0.005	0.09										
T6207	208	---	<	0.001	0.01									
T6208	208	---	0.004	0.03										
T6209	208	---	0.003	0.10										
T6210	208	---	0.001	0.05										
T6211	208	---	<	0.001	0.04									
T6212	208	---	0.001	0.05										
T6213	208	---	0.150	6.71										
T6214	208	---	0.002	0.09										
T6215	208	---	0.007	0.13										
T6216	208	---	0.003	0.04										
T6217	208	---	0.005	0.02										
T6218	208	---	0.031	0.57										
T6219	208	---	0.001	0.06										
T6220	208	---	0.003	0.06										
T6221	208	---	0.002	0.06										
T6222	208	---	<	0.001	0.04									
T6223	208	---	0.001	0.05										
T6224	208	---	0.019	0.09										
T6225	208	---	0.019	0.34										
T6226	208	---	0.003	0.09										
T6227	208	---	0.002	0.06										
T6228	208	---	0.002	0.09										
T6229	208	---	0.007	0.09										
T6230	208	---	0.002	0.07										
T6231	208	---	0.002	0.10										
T6232	208	---	0.002	0.07										
T6233	208	---	0.004	0.04										
T6234	208	---	0.002	0.03										
T6235	208	---	0.002	0.03										
T6236	208	---	0.037	0.20										
T6237	208	---	0.001	0.06										
T6238	208	---	<	0.001	0.03									
T6239	208	---	0.002	0.07										
T6240	208	---	0.015	0.13										



Chemex Labs Ltd.

Analytical Chemists * Geochemists * Registered Assayers

212 BROOKSBANK AVE., NORTH VANCOUVER,
BRITISH COLUMBIA, CANADA V7J-2C1

PHONE (604) 984-0221

MARCHER CATHRO & ASSOC. (1981) LTD.

1016 - 510 W. HASTINGS ST.
VANCOUVER, BC
V6B 1L8

Project : TAWA
Comments :

Page 1 of 2
Tot. Pages: 3
Date : 14-OCT-88
Invoice # : I-8824681
P.O. # : NONE

CERTIFICATE OF ANALYSIS A8824681

DPH 88 T-2
CCN 88 T-6
SI 88 T-3

SAMPLE DESCRIPTION	PREP CODE	Au oz/T	Ag oz/T								
T6241	208 ---	0.031	0.26								
T6242	208 ---	0.001	0.03								
T6243	208 ---	0.004	0.09								
T6244	208 ---	0.003	0.39								
T6245	208 ---	0.038	0.35								
T6246	208 ---	0.023	0.24								
T6247	208 ---	0.002	0.09								
T6248	208 ---	0.001	0.03								
T6249	208 ---	0.001	< 0.01								
T6250	208 ---	0.031	0.35								
T6251	208 ---	0.002	0.04								
T6252	208 ---	0.016	0.09								
T6253	208 ---	0.002	0.06								
T6254	208 ---	< 0.001	0.03								
T6255	208 ---	0.003	0.12								
T6256	208 ---	0.091	0.36								
T6257	208 ---	0.004	0.11								
T6258	208 ---	< 0.001	0.03								
T6259	208 ---	0.002	0.07								
T6260	208 ---	0.040	3.30								
T6261	208 ---	0.002	0.12								
T6262	208 ---	0.474	1.43								
T6263	208 ---	0.004	0.01								
T6264	208 ---	0.004	< 0.01								
T6265	208 ---	< 0.001	0.03								
T6266	208 ---	0.176	3.79								
T6267	208 ---	0.002	0.04								
T6268	208 ---	0.001	0.04								
T6301	208 ---	0.001	< 0.01								
T6302	208 ---	0.004	0.05								
T6303	208 ---	0.078	2.17								
T6304	208 ---	0.003	0.04								
T6305	208 ---	< 0.001	0.01								
T6306	208 ---	0.017	0.13								
T6307	208 ---	0.001	< 0.01								
T6308	208 ---	< 0.001	< 0.01								
T6309	208 ---	0.022	0.04								
T6310	208 ---	<< 0.001	<< 0.01								
T6311	208 ---	<< 0.001	<< 0.01								
T6312	208 ---	0.002	0.12								

ALL ASSAY DETERMINATIONS ARE PERFORMED OR SUPERVISED BY BC CERTIFIED ASSAYERS

CERTIFICATION :



Chemex Labs Ltd.

Analytical Chemists * Geochemists * Registered Assayers
212 BROOKSBANK AVE., NORTH VANCOUVER,
BRITISH COLUMBIA, CANADA V7J-2C1
PHONE (604) 984-0221

ARCHER CATIRO & ASSOC. (1981) LTD.

1016 - 510 W. HASTINGS ST.
VANCOUVER, BC
V6B 1L8

Project : TAWA
Comments :

Page 1 of 3
Tot. Pages: 3
Date : 14-OCT-88
Invoice # : I-8824681
P.O. # : NONE

CERTIFICATE OF ANALYSIS A8824681

DDH 88-4
20-33 T-5

SAMPLE DESCRIPTION	PREP CODE		Au oz/T	Ag oz/T							
T6313	208	---	0.002	0.02							
T6314	208	---	0.006	0.29							
T6315	208	---	0.001	0.02							
T6316	208	---	0.028	1.06							
T6317	208	---	0.019	3.09							
T6318	208	---	^^ 0.001	< 0.04							
T6319	208	---	^^ 0.001	< 0.01							
T6320	208	---	0.047	7.58							
T6321	208	---	0.002	0.10							
T6322	208	---	0.005	0.32							
T6323	208	---	0.019	0.48							
T6324	208	---	0.021	0.95							
T6325	208	---	0.009	0.17							
T6326	208	---	^^ 0.001	^^ 0.01							
T6327	208	---	^^ 0.001	^^ 0.01							
T6328	208	---	0.003	0.15							
T6329	208	---	0.118	11.70							
T6330	208	---	^^ 0.001	0.07							
T6331	208	---	^^ 0.001	0.04							
T6332	208	---	0.002	0.08							
T6333	208	---	^ 0.001	< 0.01							
T6334	208	---	0.030	1.30							
T6335	208	---	0.001	0.02							
T6336	208	---	^ 0.001	< 0.01							
T6337	208	---	0.031	0.29							
T6338	208	---	^^ 0.001	^^ 0.01							
T6339	208	---	^^ 0.001	^^ 0.01							

APPENDIX IV

DRILL LOGS

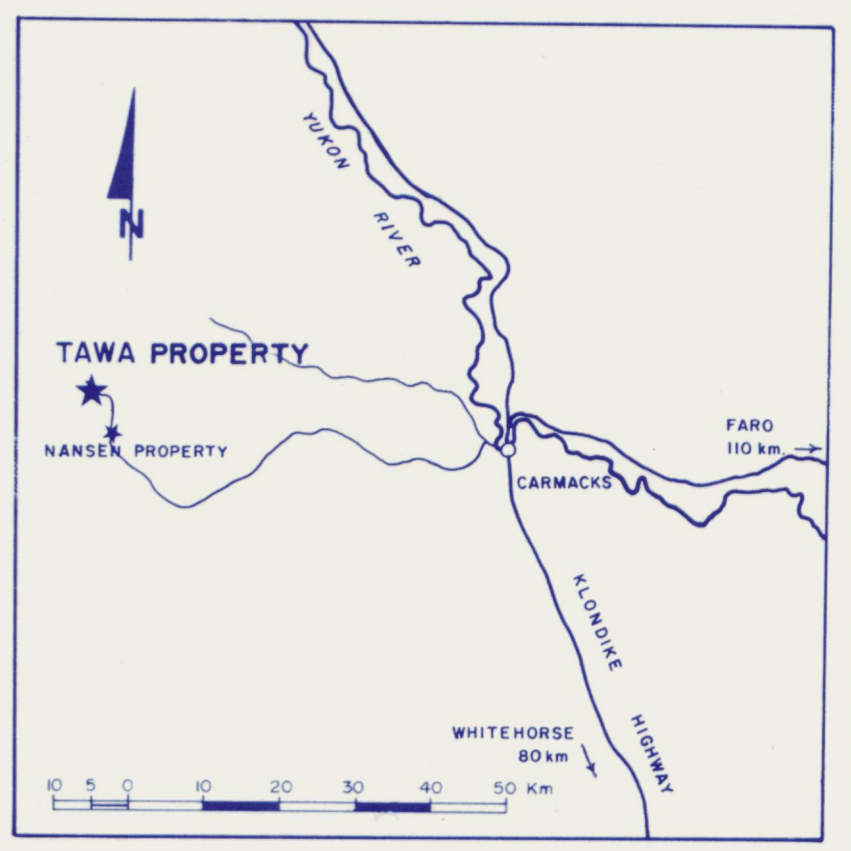
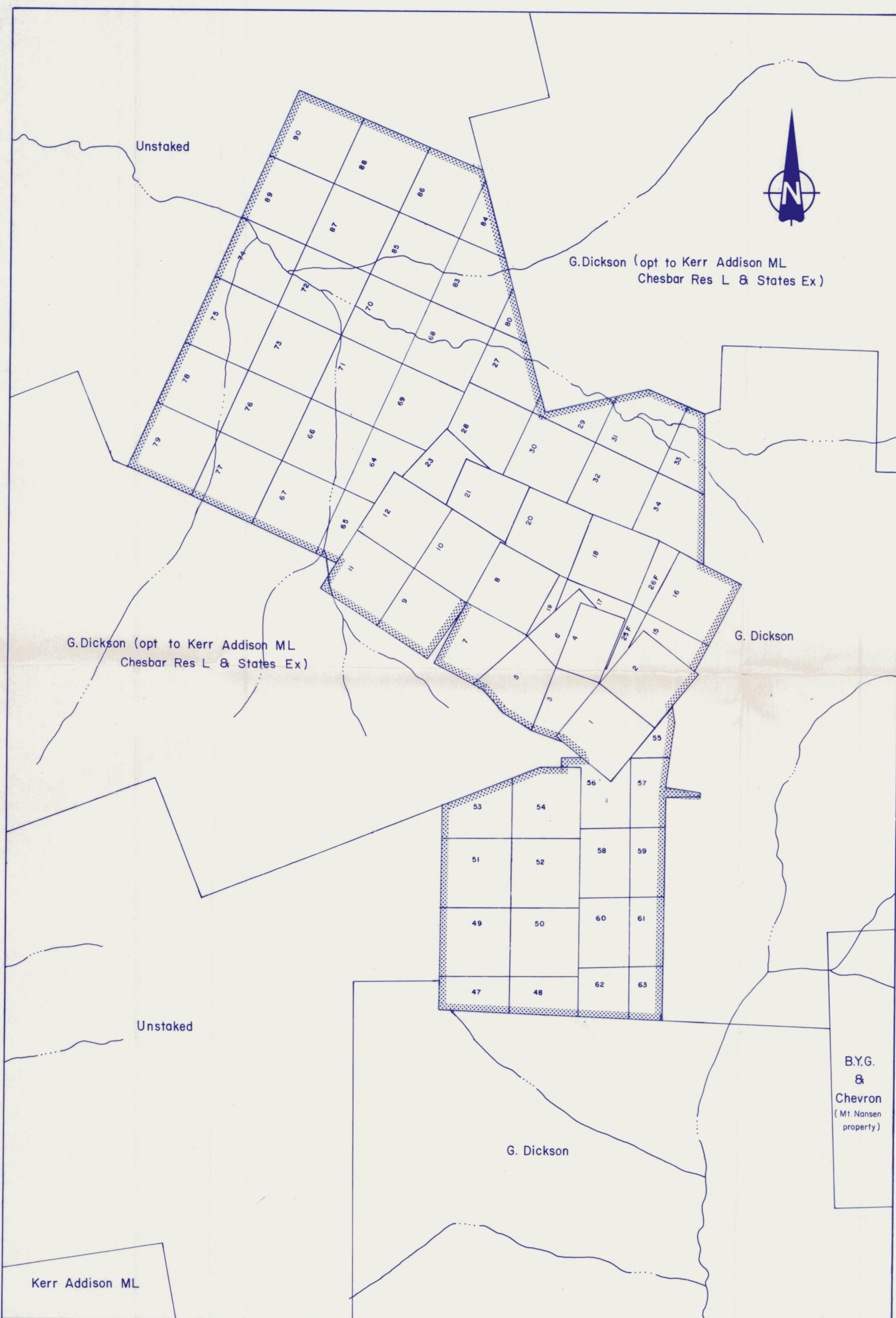

 Tawa property boundary
 (Cons BRX Mg & Pet Corp optioned to
 Chevron MI L & B.Y.G. Nat Res Inc)

B.Y.G.
 &
 Chevron
 (Mt. Nansen
 property)

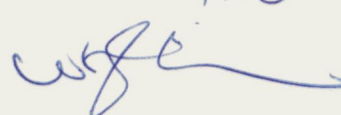
NOV 29/88

 Mike Walls

CLAIM DATA		TAWA PROPERTY	
FIGURE No. 2		PROJECT - NANSEN	
DATE DEC. 1987	REVISIONS	NOV. 1988	SCALE 1:20000
NTS No. 115 1-3		FILE No.	
COMPILED BY ARCHER, CATHRO & ASSOCIATES (1981) LTD.			

466

To accompany report dated Nov. 88

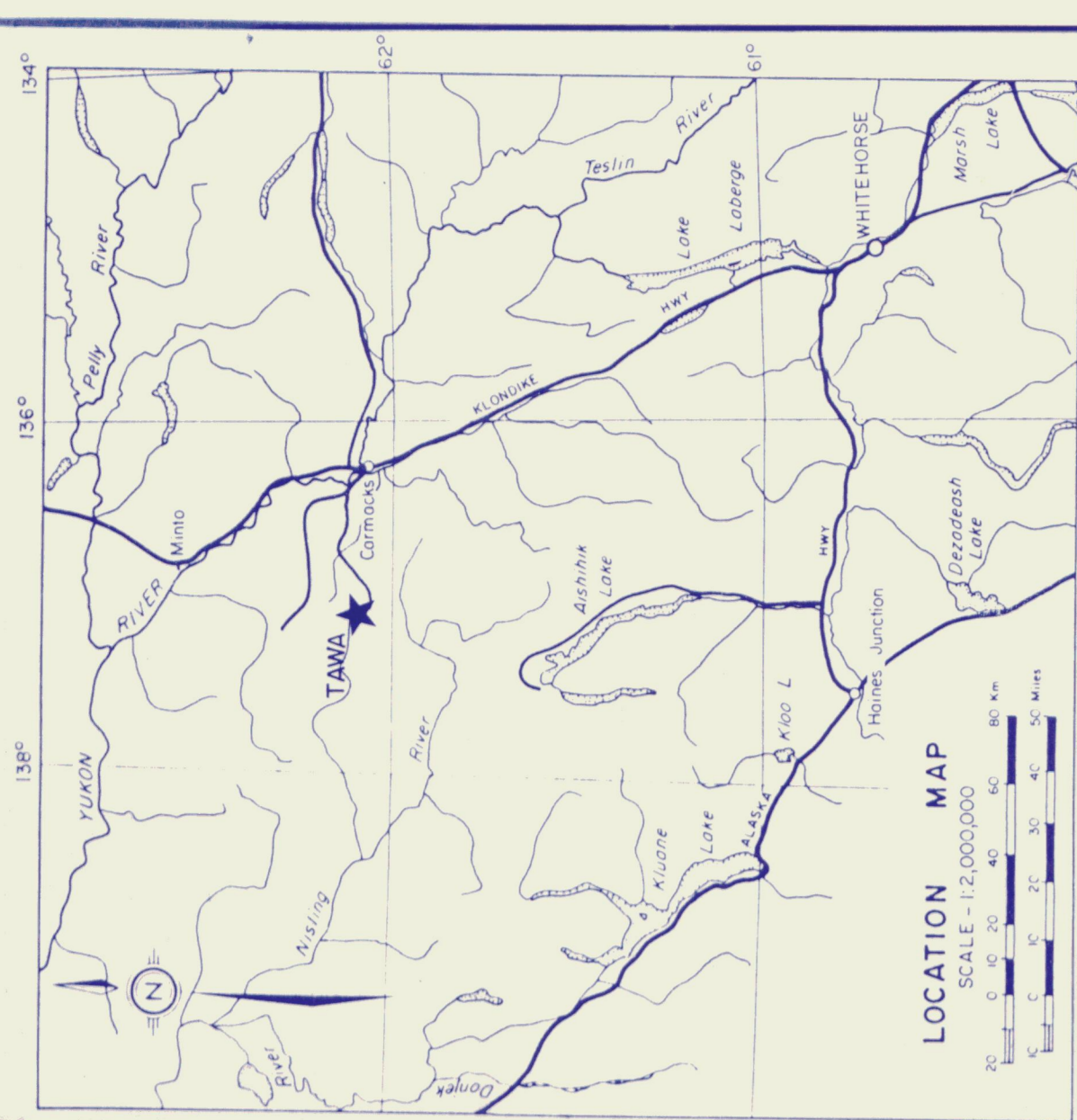
092585



- Excavator tracks to bedrock
- Striped area for assessed reserves
- Vein with mineralized intervals — 100 g/t Au
- Trend of EM-IG conductor
- Property boundary
- Producing placer mine
- Road
- Car trail
- Dimmed drill hole
- ≥ 25 < 50 ppb Au
- ≥ 50 < 100 ppb Au
- ≥ 100 ppb Au

Nov 29/88
WST
MPL/MLB

COMPILATION MAP
TAWA PROPERTY

FIGURE No	3	PROJECT	NANSEN
DATE	NOV/88	REVISIONS	SCALE 1:5000
BY		FILE No	
COMPILED BY: ARCHER, CARTHO & ASSOCIATES (1983) LIMITED			

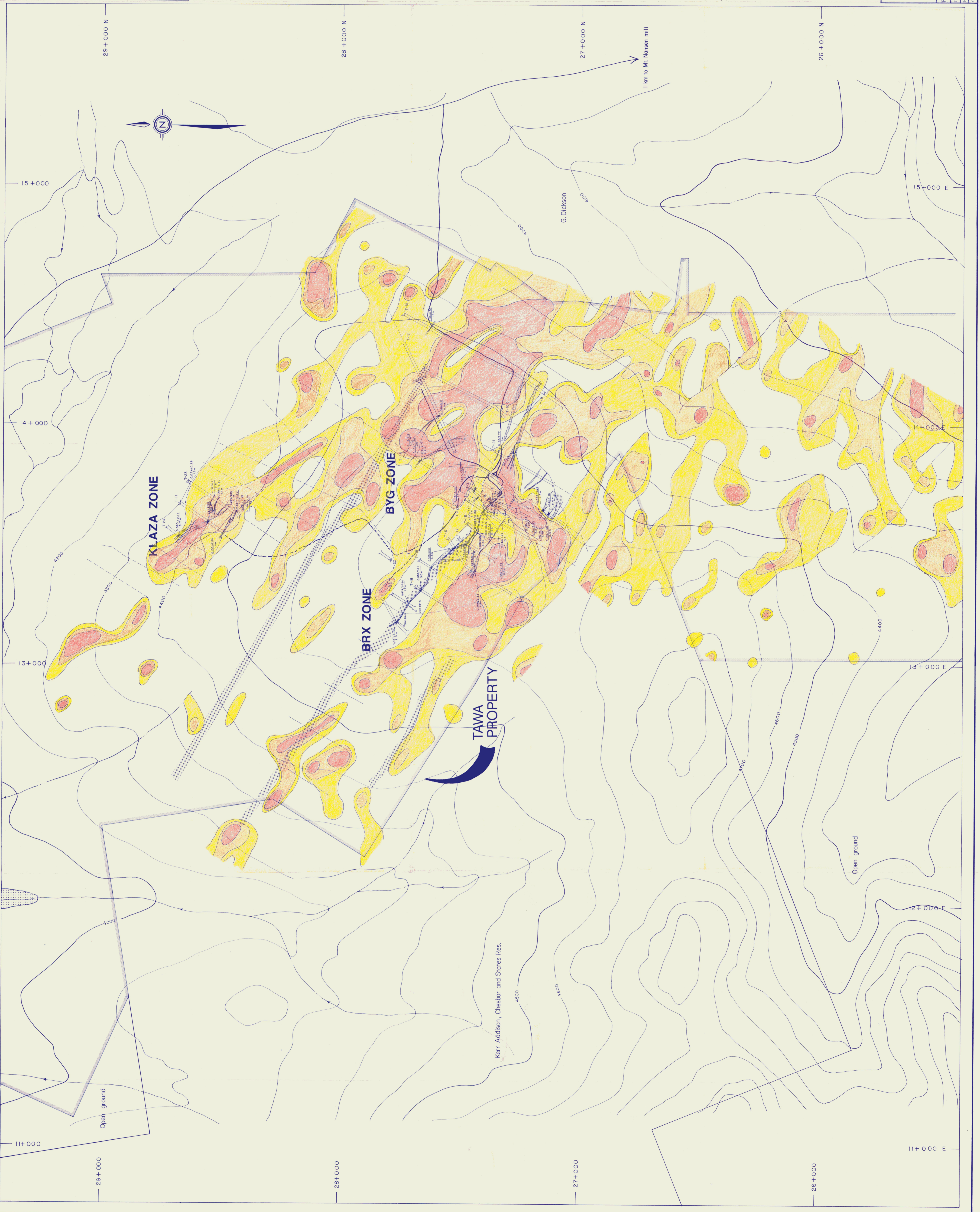

(METRES)
 - 1520
 - 1510
 - 1500
 - 1490
 - 1480
 - 1470
 - 1460
 - 1450
 - 1440

(METRES)
 1520
 1510
 1500
 1490
 1480
 1470
 1460
 1450
 1440

- ⋯⋯ — OVERBURDEN
 - + + — GRANODIORITE
 - ▭ — FELDSPAR PORPHYRY
 - ▲ — VEIN BRECCIA
 - ▭ — VEIN
 - ▭ — VEINLET
 - ▭ — GOUGE
 - 30° — FRACTURE ANGLE
-
- QZ — QUARTZ
 - SD — SIDERITE
 - CY — CLAY
 - SE — SERICITE
 - CA — CALCITE
 - GY — GYPSUM
 - CP — CHALCOPYRITE
 - PY — PYRITE
 - HE — HEMATITE
 - GA — GALENA
 - SP — SPHALERITE
 - AS — ARSENOPYRITE
 - SX — SULFOSALTS
 - SSX — FINE-GRAINED MIXED SULPHIDES
 - LM — LIMONITE
 - SC — SCORODITE

0.031/0.26 Au/Ag/oz/ton
 1.72 METRES

msr 29/88
W. H. Halls

Figure 4

ARCHER, CATHRO & ASSOCIATES (1981) LIMITED

SECTION DDH 88-1&2

BRX ZONE

TAWA PROPERTY



SECTION FACING NORTH-WEST

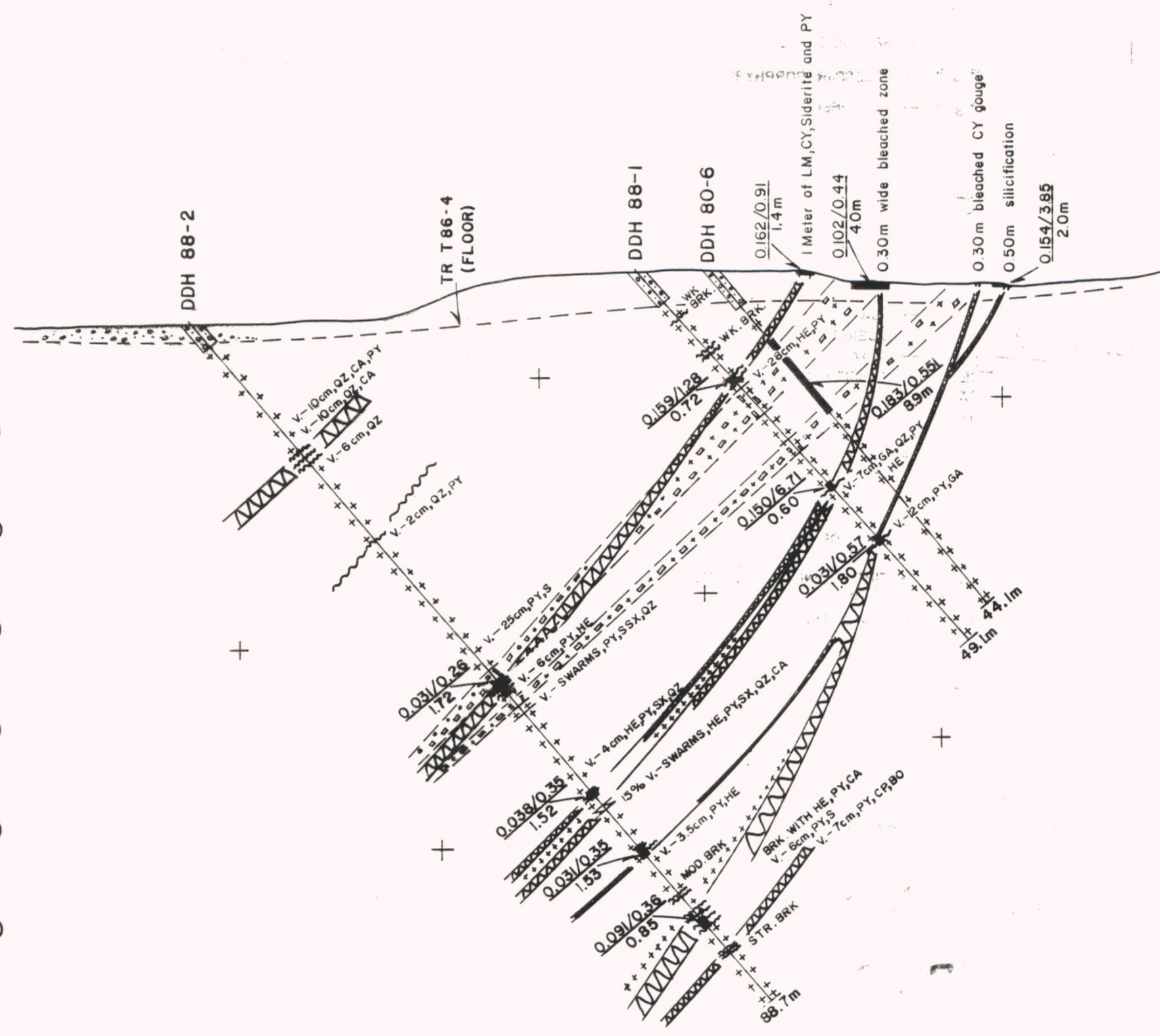

092585

(METRES)
 - 1520
 - 1510
 - 1500
 - 1490
 - 1480
 - 1470
 - 1460
 - 1450
 - 1440

(METRES)
 1520
 1510
 1500
 1490
 1480
 1470
 1460
 1450
 1440

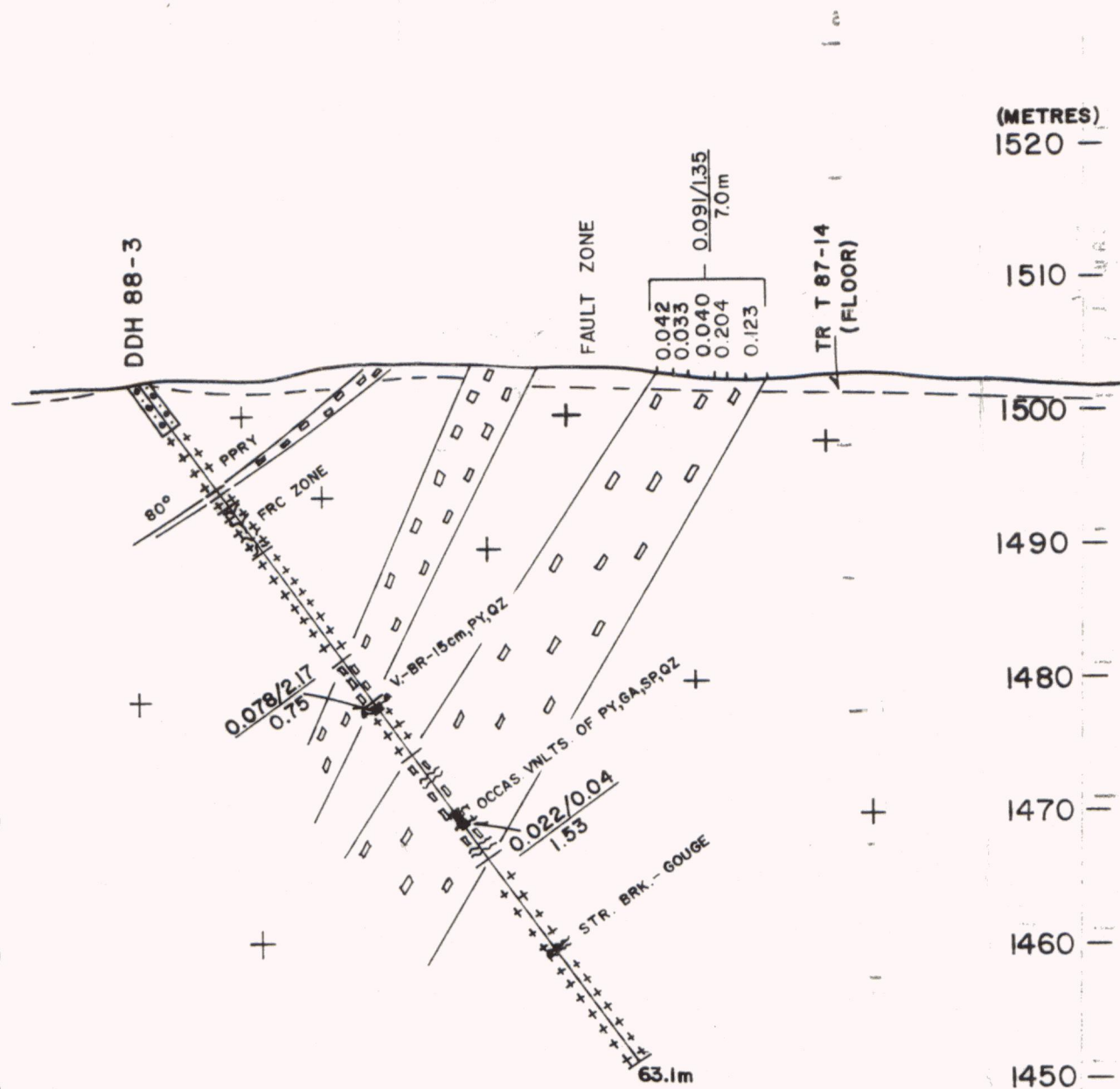

SECTION FACING NORTH-WEST

- ⋯ — OVERBURDEN
- + + + — GRANODIORITE
- ▭ — FELDSPAR PORPHYRY
- ▲ — VEIN BRECCIA
- ▨ — VEIN
- ||||| — VEINLET
- ~~~~~ — GOUGE
- 30° — FRACTURE ANGLE

- QZ — QUARTZ
- SD — SIDERITE
- CY — CLAY
- SE — SERICITE
- CA — CALCITE
- GY — GYPSUM
- CP — CHALCOPYRITE
- PY — PYRITE
- HE — HEMATITE
- GA — GALENA
- SP — SPHALERITE
- AS — ARSENOPYRITE
- SX — SULFOSALTS
- SSX — FINE-GRAINED MIXED SULPHIDES
- LM — LIMONITE
- SC — SCORODITE

0.031/0.26
1.72 Au/Ag/oz/ton
METRES

Mar 29/88
WJ
Mike Walls

Figure 5

ARCHER, CATHRO & ASSOCIATES (1981) LIMITED

SECTION DDH 88-3

BRX ZONE

TAWA PROPERTY



To accompany report dated 26/7/88

092585

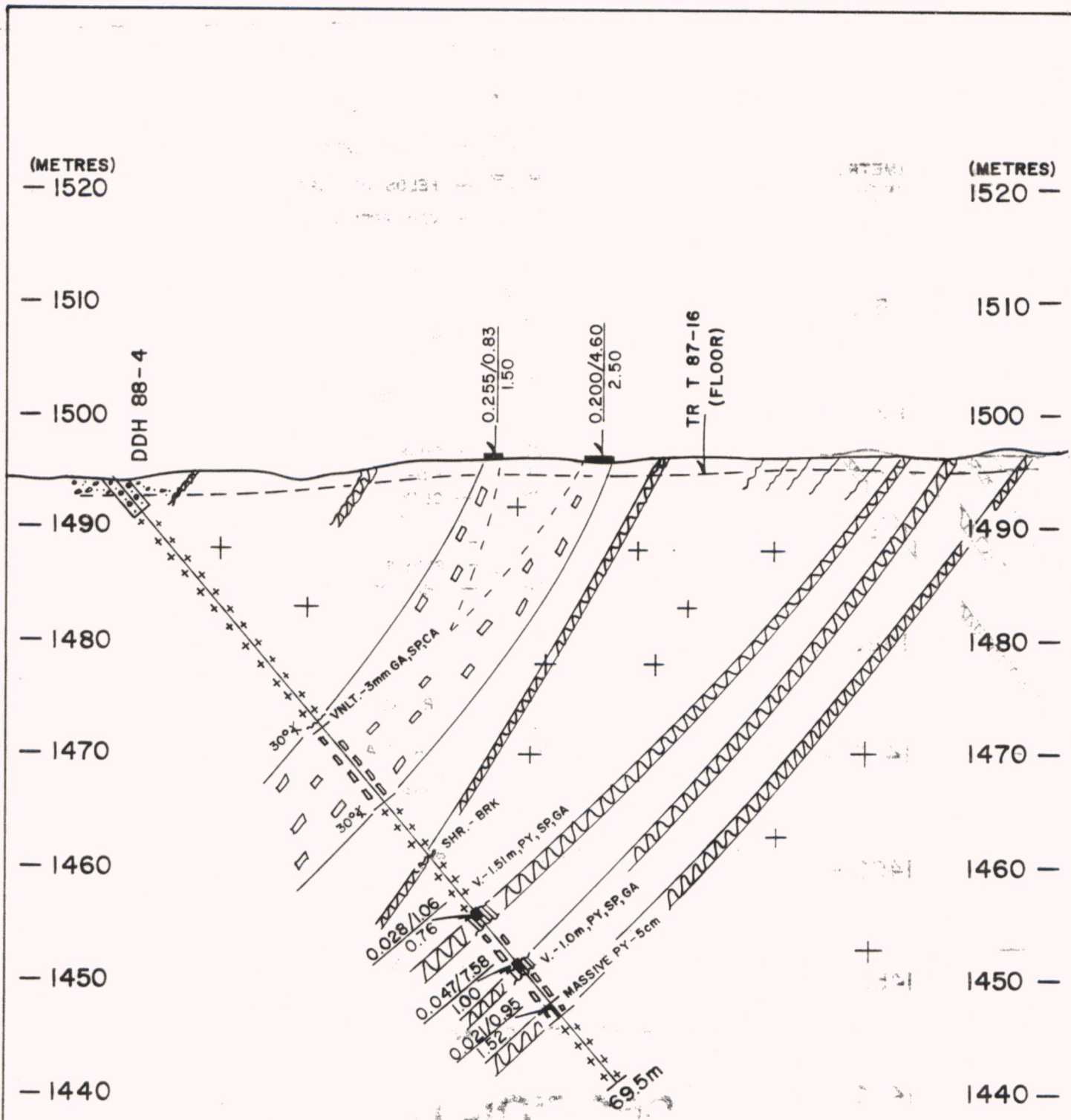

- — OVERBURDEN
- + + + — GRANODIORITE
- — FELDSPAR PORPHYRY
- ▲ — VEIN BRECCIA
- ▨ — VEIN
- ||||| — VEINLET
- ~~~~~ — GOUGE
- 30°X — FRACTURE ANGLE

- QZ — QUARTZ
- SD — SIDERITE
- CY — CLAY
- SE — SERICITE
- CA — CALCITE
- GY — GYPSUM
- CP — CHALCOPYRITE
- PY — PYRITE
- HE — HEMATITE
- GA — GALENA
- SP — SPHALERITE
- AS — ARSENOPYRITE
- SX — SULFOSALTS
- SSX — FINE-GRAINED MIXED SULPHIDES
- LM — LIMONITE
- SC — SCORODITE

0.031/0.26
1.72 Au/Ag/oz/ton
METRES

Nov 29/88
[Signature]
Mike Walker

Figure 6

ARCHER, CATHRO & ASSOCIATES (1981) LIMITED

SECTION DDH 88-4

BRX ZONE

TAWA PROPERTY



SECTION FACING NORTH-WEST

To accompany report dated NOV./88

(METRES)
 - 1470
 - 1460
 - 1450
 - 1440
 - 1430
 - 1420
 - 1410
 - 1400
 - 1390

(METRES)
 1470 -
 1460 -
 1450 -
 1440 -
 1430 -
 1420 -
 1410 -
 1400 -
 1390 -

SECTION FACING NORTH-WEST

- — OVERBURDEN
- + + + — GRANODIORITE
- ▭ — FELDSPAR PORPHYRY
- ▲▲▲ — VEIN BRECCIA
- ▨ — VEIN
- ++++ — VEINLET
- ~~~~~ — GOUGE
- 30° — FRACTURE ANGLE

- QZ — QUARTZ
- SD — SIDERITE
- CY — CLAY
- SE — SERICITE
- CA — CALCITE
- GY — GYPSUM
- CP — CHALCOPYRITE
- PY — PYRITE
- HE — HEMATITE
- GA — GALENA
- SP — SPHALERITE
- AS — ARSENOPYRITE
- SX — SULFOSALTS
- SSX — FINE-GRAINED MIXED SULPHIDES
- LM — LIMONITE
- SC — SCORODITE

$\frac{0.031/0.26}{1.72}$ $\frac{\text{Au/Ag/oz/ton}}{\text{METRES}}$

Nov 29/88
[Signature]

Figure 7

ARCHER, CATHRO & ASSOCIATES (1981) LIMITED

SECTION DDH 88-5

BRX ZONE

TAWA PROPERTY



To accompany report dated Nov./88

092585

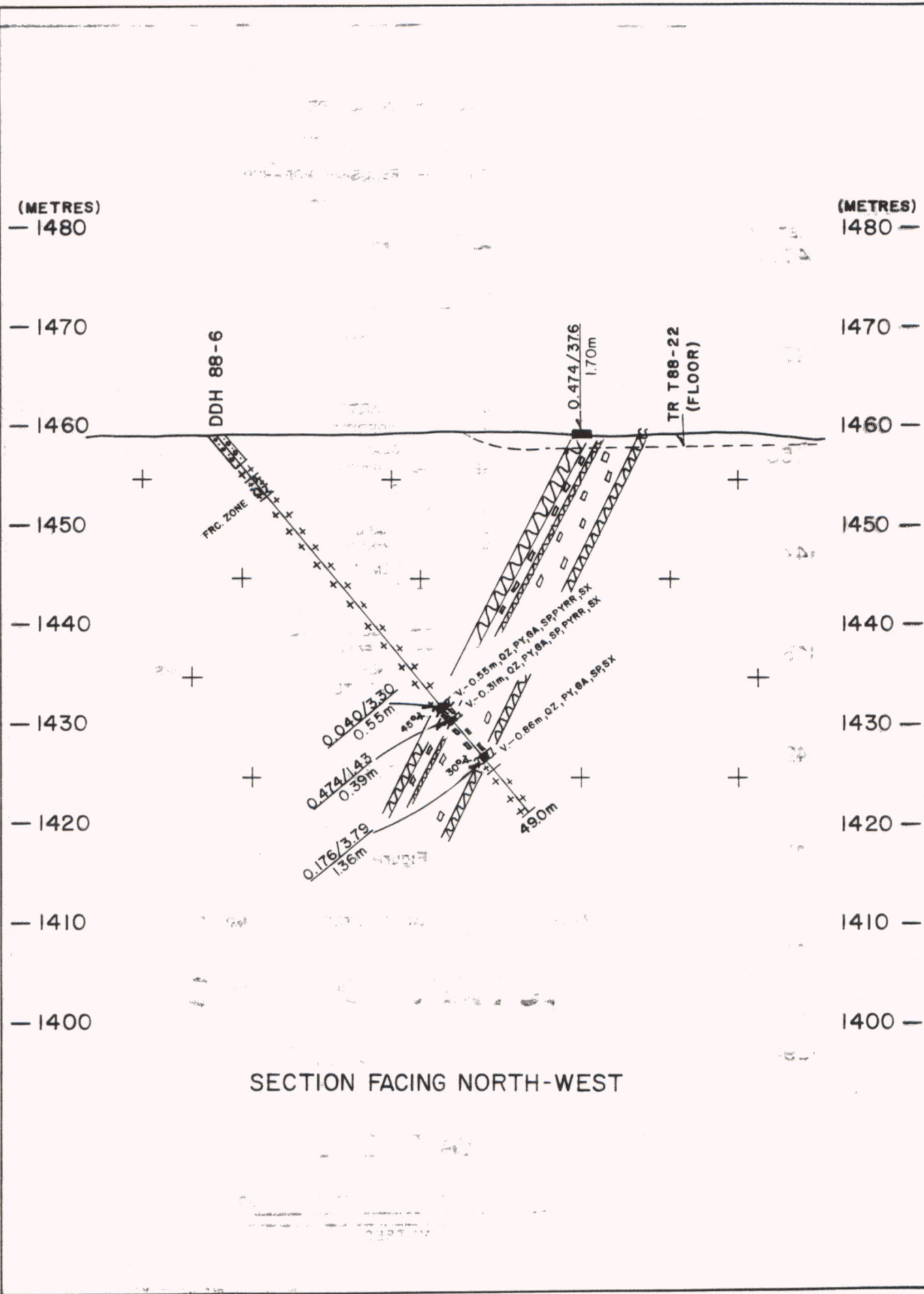

- — OVERBURDEN
- + + + — GRANODIORITE
- ▭ — FELDSPAR PORPHYRY
- ▲▲▲ — VEIN BRECCIA
- ▭▭▭ — VEIN
- ||||| — VEINLET
- ~~~~~ — GOUGE
- 30° — FRACTURE ANGLE

- QZ — QUARTZ
- SD — SIDERITE
- CY — CLAY
- SE — SERICITE
- CA — CALCITE
- GY — GYPSUM
- CP — CHALCOPYRITE
- PY — PYRITE
- HE — HEMATITE
- GA — GALENA
- SP — SPHALERITE
- AS — ARSENOPYRITE
- SX — SULFOSALTS
- SSX — FINE-GRAINED MIXED SULPHIDES
- LM — LIMONITE
- SC — SCORODITE

0.031/0.26 Au/Ag/oz/ton
1.72 METRES

Mr 27/00
WJ
Michael Walks

Figure 8

ARCHER, CATHRO & ASSOCIATES (1981) LIMITED

SECTION DDH 88-6

BRX ZONE

TAWA PROPERTY



To accompany report dated 08/1/88

092585

ARCHER, CATHRO & ASSOCIATES LIMITED

CONSULTING GEOLOGICAL ENGINEERS

VANCOUVER, B.C. (604) 688-2568

BOX 4127, WHITEHORSE, Y.T. Y1A 3S9 (403) 667-4415

1016 - 510 WEST HASTINGS STREET
VANCOUVER, B.C. V6B 1L8

AFFIDAVIT

I, Joan Mariacher, of Whitehorse, Yukon make oath and say:

That to the best of my knowledge the attached Statement of Expenditures for exploration work on the Tawa 1-12, 15-24, 25F-26F, 27-38, 47-79 and 83-90 mineral claims on Claim Sheet 115I/3 is accurate.



Joan Mariacher

Sworn before me at Whitehorse, Yukon

this 25th day of

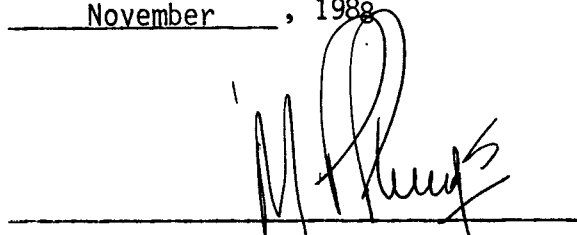
November, 1988

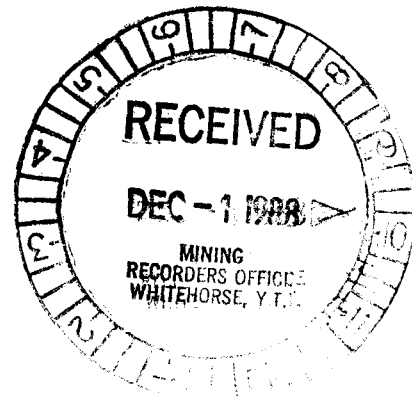
Notary, Yukon Territory



Statement of Expenditures
Tawa 1-12,15-24,25F-26F,27-38,47-79 and 83-90 Mineral Claims
November 25, 1988

Contract Diamond Drilling

E. Caron Diamond Drilling Ltd. - Holes 88T-1 to 88T5

\$53,881.40



August 31, 1988
Invoice #-2507
Drill #6

IN ACCOUNT WITH:

Archer, Cathro & Associates Ltd
3125 - 3rd Avenue
Whitehorse, Yukon

Jawa-
17163.90
paid by 1/1/89
#615

Drilling Charges August 16 to 31, 1988:

(Mt Nansen)

Hole # 88-130/-50/H

Moving

28 man hrs. (-10) @ \$32.00 per hr. = \$ 576.00

Waterline

6 man hrs. @ \$32.00 per hr. = \$ 192.00

Conditioning Hole (mud)

2 man hrs. @ \$32.00 per hr. = \$ 64.00

1 man hrs. @ \$21.00 per hr. = \$ 21.00 \$ 85.00

Tractor

3 machine hrs. @ \$75.00 per hr. = \$ 225.00

Casing

0 - 22 = 22 ft. @ \$26.00 per ft. = \$ 572.00

Coring

22 - 301 = 279 ft. @ \$26.50 per ft. = \$7,393.50 \$ 9,043.50

Hole: # 88-131/-50/H

Conditioning Hole (mud)

2 man hrs. @ \$32.00 per hr. = \$ 64.00

1 machine hrs. @ \$21.00 per hr. = \$ 21.00 \$ 85.00

Casing

0 - 12 = 12 ft. @ \$26.00 per ft. = \$ 312.00

Coring

12 - 241 = 229 ft. @ \$26.50 per ft. = \$6,068.50

241 - 332 = 91 ft. (69-5) @ \$26.50 per ft. = \$2,411.50 \$8,480.00 \$ 8,877.00

Hole: #T-88-1/-50/HQ

Moving

16 man hrs. @ \$32.00 per hr. = \$ 512.00

Reaming Cave

2 man hrs. @ \$32.00 per hr. = \$ 64.00

1 machine hr. @ \$21.00 per hr. = \$ 21.00 \$ 85.00

Waterline

23 man hrs. @ \$32.00 per hr. = \$ 736.00

Standby

16 man hrs. @ \$32.00 per hr. = \$ 512.00





Travelling Time

4 man hrs.	@ \$32.00 per hr.	=	\$ 128.00	
<u>Casing</u>				
0 - 12 = 12 ft.	@ \$26.00 per ft.	=	\$ 312.00	
<u>Coring</u>				
12 - 161 = 149 ft.	@ \$26.50 per ft.	=	<u>\$3,948.50</u>	\$ 6,233.50

Hole: *T-88-2/-50/HQ

Conditioning Hole (mud)

6 man hrs.	@ \$32.00 per hr.	= \$ 192.00		
3 machine hrs.	@ \$21.00 per hr.	= \$ 63.00	\$ 255.00	

Travelling Time

10 man hrs.	@ \$32.00 per hr.	=	\$ 320.00	
<u>Casing</u>				
0 - 10 = 10 ft.	@ \$26.00 per ft.	=	\$ 260.00	
<u>Coring</u>				
10 - 301 = 291 ft.	@ \$26.50 per ft.	=	<u>\$7,711.50</u>	\$ 8,546.50

Hole: *T-88-3/-50/HQ

Waterline

10 man hrs.	@ \$32.00 per hr.	=	\$ 320.00	
-------------	-------------------	---	-----------	--

Conditioning Hole (mud)

2 man hrs.	@ \$32.00 per hr.	= \$ 64.00		
1 machine hrs.	@ \$21.00 per hr.	= \$ 21.00	\$ 85.00	

Travelling Time

4 man hrs.	@ \$32.00 per hr.	=	\$ 128.00	
<u>Casing</u>				
0 - 8 = 8 ft.	@ \$26.00 per ft.	=	\$ 208.00	
<u>Coring</u>				
16 - 31 = 15 ft.	@ \$26.50 per ft.	=	<u>\$ 397.50</u>	\$ 1,138.50

Items Consumed & Chargeable

Hole: #88-T-2

10 - 2 ft. HW casing	@ \$80.50 each	= \$ 805.00		
1 HW shoe	@ \$440.40 each	= \$ 440.40		<u>\$ 1,245.40</u>

Total Invoice \$35,084.40





September 12, 1988
Invoice #-2554
Drill #6

IN ACCOUNT WITH:

Archer, Cathro & Associates Ltd
3125 - 3rd Avenue
Whitehorse, Yukon

Jawa
(Mt Nansen)

Drilling Charges September 1 to 12, 1988:

Hole # 88T-3/-50/H

Drilling (Reduce)

8 man hrs. @ \$32.00 per hr. = \$ 256.00
4 machine hrs. @ \$21.00 per hr. = \$ 84.00 \$ 340.00

Casing(Reaming)

3 man hrs. @ \$32.00 per hr. = \$ 96.00
1.5 machine hrs. @ \$21.00 per hr. = \$ 31.50 \$ 127.50

Reaming cave

30 man hrs. @ \$32.00 per hr. = \$ 960.00
15 machine hrs. @ \$21.00 per hr. = \$ 315.00 \$ 1,275.00

Waterline

23 man hrs. @ \$32.00 per hr. = \$ 736.00

Conditioning Hole (mud)

8 man hrs. @ \$32.00 per hr. = \$ 256.00
4 machine hrs. @ \$21.00 per hr. = \$ 84.00 \$ 340.00

Travelling

12 machine hrs. @ \$32.00 per hr. = \$ 384.00

Coring

31 - 127 = 96 ft. @ \$26.50 per ft. = \$2,544.00
127 - 207 = 80 ft. @ \$23.50 per ft. = \$1,880.00 \$ 4,424.00 \$ 7,626.50

and Oct 1988 #6 v3

Hole: # 88T-4/-50/H

Moving

12 man hrs. (-10) @ \$32.00 per hr. = \$ 64.00

Casing (reaming)

4 man hrs. @ \$32.00 per hr. = \$ 128.00
2 machine hrs. @ \$21.00 per hr. = \$ 42.00 \$ 170.00

Reaming Cave

4 man hrs. @ \$32.00 per hr. = \$ 128.00
2 machine hr. @ \$21.00 per hr. = \$ 42.00 \$ 170.00

Waterline

2 man hrs. @ \$32.00 per hr. = \$ 64.00



**Conditioning hole(mud)**

4 man hrs.	• \$32.00 per hr.	= \$ 128.00	
2 machine hrs.	• \$ 21.00 per hr.	= \$ 42.00	\$ 170.00

Travelling Time

10 man hrs.	• \$32.00 per hr.	=	\$ 320.00
-------------	-------------------	---	-----------

Casing

0 - 12 = 12 ft.	• \$26.00 per ft.	=	\$ 312.00
-----------------	-------------------	---	-----------

Coring

12 - 229 = 217 ft.	• \$26.50 per ft.	=	\$ 5,750.50	\$ 7,020.50
--------------------	-------------------	---	-------------	-------------

Hole: *88T-5/-50/HQ**Moving**

28 man hrs.(-10)	• \$32.00 per hr.	=	\$ 576.00
------------------	-------------------	---	-----------

Reaming Cave

5 man hrs.	• \$32.00 per hr.	= \$ 160.00	
2.5 machine hrs.	• \$21.00 per hr.	= \$ 52.50	\$ 212.50

Waterline

22 man hrs.	• \$32.00 per hr.	=	\$ 704.00
-------------	-------------------	---	-----------

Travelling Time

27 man hrs.	• \$32.00 per hr.	=	\$ 864.00
-------------	-------------------	---	-----------

Casing

0 - 10 = 10 ft.	• \$26.00 per ft.	=	\$ 260.00
-----------------	-------------------	---	-----------

Coring

10 - 179 = 169 ft.	• \$26.50 per ft.	=	\$ 4,478.50	\$ 7,095.00
--------------------	-------------------	---	-------------	-------------

Hole: *T-88-6/-50/HQ**Moving-Demob**

23 man hrs.	• \$32.00 per hr	=	\$ 736.00
-------------	------------------	---	-----------

Reaming Cave

2 man hrs.	• \$32.00 per hr	= \$ 64.00	
1 machine hr.	• \$21.00 per hr.	= \$ 21.00	\$ 85.00

Waterline

14 man hrs.	• \$32.00 per hr.	= \$	\$ 448.00
-------------	-------------------	------	-----------

Conditioning Hole (mud)

5 man hrs.	• \$32.00 per hr.	= \$ 160.00	
2.5 machine hrs.	• \$21.00 per hr.	= \$ 52.50	\$ 212.50

Travelling Time

12 man hrs.	• \$32.00 per hr.	=	\$ 384.00
-------------	-------------------	---	-----------

Tractor D-6

14 machine hrs.	• \$75.00 per hr.	=	\$ 1,050.00
-----------------	-------------------	---	-------------

Casing

0 - 12 = 12 ft.	• \$26.00 per ft.	=	\$ 312.00
-----------------	-------------------	---	-----------

Coring

12 - 161 = 149 ft.	• \$26.50 per ft.	=	\$ 3,948.50	\$ 7,176.00
--------------------	-------------------	---	-------------	-------------





E. CARON DIAMOND DRILLING LTD.

7 Roundel Road Whitehorse, Yukon Y1A 3H3

Phone (403) 668-2424 FAX (403) 668-4520

Items Consumed & Chargeable

Hole: #88-T-

1 - HQ Bit. LY #2722	• \$978.00 each	=	\$ 978.00	
2 - 10 ft. HW rods	• \$216.00 each	=	\$ 432.00	
<u>Hole #88-T-4</u>				
2 - 2 ft. HW casing	• \$ 80.50 each	=	\$ <u>161.00</u>	\$ 1,571.00

Truck Trips

Sept 24/88--Mack & pup

6.5 truck hrs.	• \$65.00 per hr.	= \$ 422.50	
6.5 man hrs.	• \$32.00 per hr.	= \$ <u>208.00</u>	\$ 630.50

Mud

July 29/88

256 bags Quik Gel	• \$15.00 each	= \$ 3,840.00	
60 bags Quik Trol	• \$15.00 each	= \$ 900.00	

Aug 22/88 Mack

96 bags Quik Gel	• \$15.00 each	= \$ 1,440.00	
------------------	----------------	---------------	--

Aug 25/88 Mack

192 bags Quik Gel	• \$15.00 each	= \$ 2,880.00	
200 bags Quik Trol	• \$15.00 each	= \$ 3,000.00	

Aug 26/88 4X4

15 bags Quik Trol	• \$15.00 each	= \$ 225.00	
-------------------	----------------	-------------	--

Aug 31/88 D. McLellan

64 bags Quik Gel	• \$15.00 each	= \$ 960.00	
------------------	----------------	-------------	--

Sept 14/88

128 bags Quik Gel	• \$15.00 each	= \$ 1,920.00	
40 bags Quik Trol	• \$15.00 each	= \$ 600.00	\$15,765.00

Propane

8 refills	• \$51.00 each	=	\$ <u>408.00</u>
-----------	----------------	---	------------------

Total Invoice \$47,292.50

Jan 24/88 - 3460.00
5190.00
Jan 25/88 - 10575.00

Jan 26/88 - 36717.50



TABLE 1
ASSESSMENT CALCULATIONS
DIAMOND DRILLING
 TAWA CLAIMS
 SUMMIT CREEK - KLAZA RIVER
 115 I/3

<u>LOCATION</u>		<u>CLAIM NAME</u>	<u>GRANT NO</u>	<u>HOLE NO</u>	<u>EXPENDITURE</u>
TAWA 5	YA75267			T-88-1	6,233.50
				-2	9,791.90
				-3	8,765.00✓
				-4	7,020.50✓
				TOTAL	\$ 31,810.90
TAWA 7	YA75269			5	7,055.00
				6	7,176.00
				TOTAL	\$ 14,271.00

