

MAP NO.: ASSESSMENT REPORT X
105 D 3 & 6 PROSPECTUS
CONFIDENTIAL X
OPEN FILE

DOCUMENT NO: 092486
MINING DISTRICT: WHITEHORSE
TYPE OF WORK: GEOLOGICAL

REPORT FILED UNDER: Skukum Ventures Inc. & Berglynn Resources Inc.

DATE PERFORMED: June 4-8 & September 25, 1987 DATE FILED: May 30, 1988

LOCATION: LAT.: 60°14'N AREA: Wheaton River
LONG.: 135°07'W VALUE \$: 3,100.00

CLAIM NAME & NO.: RM 1-27 YA94645-671; RM 28-31 YA97930-933

WORK DONE BY: Ian Coster

WORK DONE FOR: Skukum Ventures Inc. & Berglynn Resources Inc.

DATE TO GOOD STANDING:

REMARKS: #170 MR

In 1988 the property was mapped at a scale of 1:5000 and soil and talus samples were analysed for Au, Ag, Sb, Pb, Zn, and Cu. Three of seven samples of quartz vein material taken along the main north-east trending shear zone assayed better than 8.56 g/t Au. One 10 cm wide vein containing traces of chalcopyrite assayed 14.8 g/t Au.



TRANSMITTAL FORM

M.R. file no.
R.M.M.R. file no.
Date forwarded 30 May 1988

From Mining Recorder at: *Whitehorse*

To Regional Manager, Mineral Rights at Whitehorse, Y.T.

For action are:

<input type="checkbox"/> NEW APPLICATION FOR PLACER LEASE TO PROSPECT	Name	
<input type="checkbox"/> RENEWAL APPLICATION PLACER LEASE TO PROSPECT	Name	Lease no.
<input type="checkbox"/> AFFIDAVIT OF EXPENDITURE ON PLACER LEASE	Name	Lease no.
<input type="checkbox"/> SECURITY DEPOSIT		
<input type="checkbox"/> FINANCIAL ABILITY		
<input type="checkbox"/> ASSIGNMENT OF PLACER LEASE NO.	From	To
<input type="checkbox"/> GROUPING APPLICATION UNDER SEC. 52(2) PLACER MINING ACT.	Owner	
<input type="checkbox"/> DIAMOND DRILL LOGS	Claims	Claim sheet no.
<input type="checkbox"/> QUARTZ ASSESSMENT REPORT	Claims <i>RM 1-27 28-31</i>	Claim sheet no. <i>105-D-3/6</i>
	Type of report <i>Geological Survey</i>	Submitted by <i>Stantum Ventures Inc.</i>
	Cls. work performed on <i>RM 18, 20, 16, 27</i>	\$ req. for ren. application <i>#3100</i>

092486

[Signature]
Signature

Date returned <i>9 July 88</i>

REPLY ACTION

Approved for amount required

[Signature]
Signature

092486

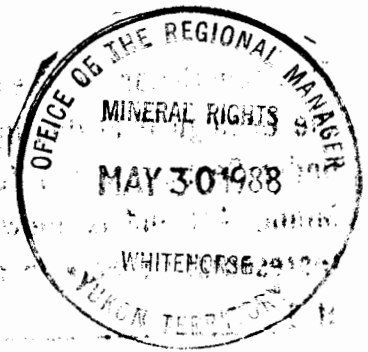

GEOLOGICAL SURVEY

OF THE

RM 1 - 31 MINERAL CLAIMS
(YA-94645 to 671, YA-97930 to 933)

WHITEHORSE MINING DISTRICT
YUKON TERRITORY

NTS 105 D-3, 6
LAT. 60 14' N LONG. 135 7' W

JUNE 4 - 8, SEPTEMBER 25, 1987

by

IAN COSTER B.Sc., F.G.A.C.

SKUKUM VENTURES INC.
706 - 595 HOWE STREET
VANCOUVER, B.C.
V6C 2T5

MAY 15, 1988



092486

This report has been examined by
the Geological Evaluation Unit
under Section 53 (4) Yukon Quartz
Mining Act and is allowed as
representation work in the amount
of \$ 3100.00.

J. J. Brennan

for Regional Manager, Exploration and
Geological Services for Commissioner,
of Yukon Territory.

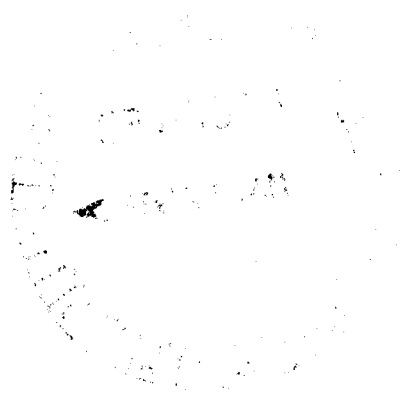

TABLE OF CONTENTS

	Page
Introduction	1
Location and Access	1
Property	2
Previous Work History	3
Personnel	4
Climate, Topography and Vegetation	4
Regional Geology	5
Property Geology	5
Mineralization	6
Anomalous Sample Results	9
Conclusions	10
Recommendations	11
References	12
Statement of Qualifications	13
Statement of Costs	14
Appendix (Analytical Results)	

LIST OF FIGURES

Fig. 1	Location Map	1:1,000,000
2	Claim Location Map	1:30,000
3	Geology Map	1:5,000

INTRODUCTION

This report describes prospecting, rock sampling and geological mapping carried out on the RM 1 - 31 claim group, which is located in the Wheaton River Valley, south of Whitehorse, Yukon. The work was carried out to follow up anomalous soil and talus fine samples collected in May, 1987. Four additional claims were staked (RM 28 - 31) in June, 1987 to cover a fractional piece of ground between the WAL claims and the RM 1 - 27 claims. Approximately 10% of the area of the property is outcrop, which is situated on the southeast facing slope into the Wheaton River Valley.

LOCATION AND ACCESS

The RM 1 - 31 claims are a contiguous group of mineral claims located in southwestern Yukon Territory. Specifically, the claims straddle the Wheaton River, between Dawson Charlie Creek and Dail Creek. The center of the claim group lies at approximately 60 14' N latitude and 135 7' W longitude.

Access to the south side of the property is provided by the all-weather road running along the south side of the Wheaton River. This road links the producing Mt. Skukum Au-Ag mine with the Annie Lake road which is accessed by the road linking Carcross with Whitehorse. Total distance by road from Whitehorse to the claim group is approximately 80 km (50 miles). The higher elevations and northern part of

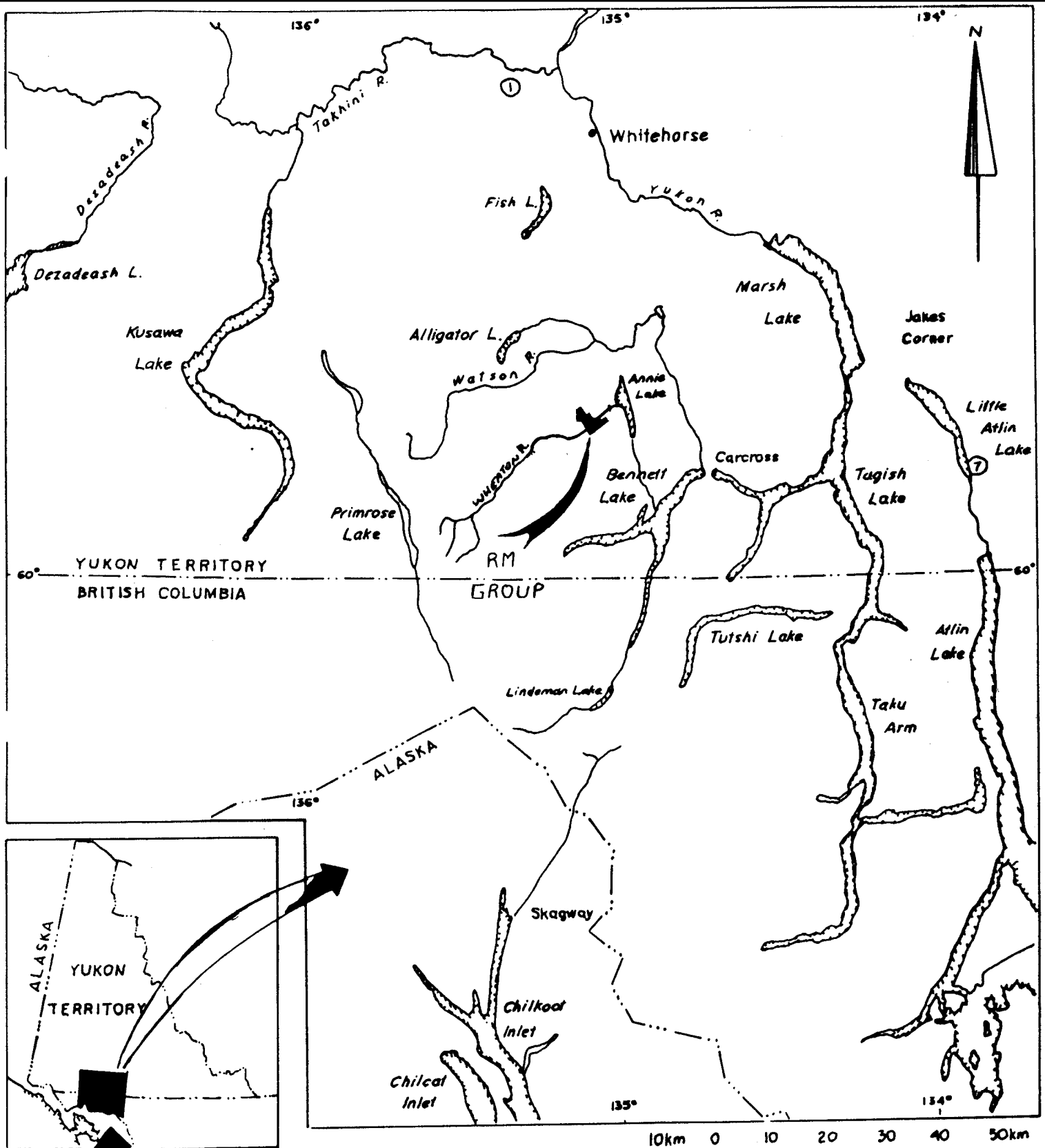

SKUKUM GOLD. - BERGLYNN RES.

RM - CLAIMS

**LOCATION
MAP**

MAY, 89

SCALE
1: 100,000

FIGURE: 1

the property is accessed by helicopter. Several helicopter companies have bases in Whitehorse, and there is usually a helicopter based at the Mt. Skukum mine or at OMNI RESOURCES Skukum Creek camp.

PROPERTY

The claims discussed in this report consist of 31 contiguous, two post, unsurveyed mineral claims, staked under the Yukon Quartz Mining Act, and total approximately 5600 acres (2266 hectares). Four claims (RM 28 - 31) were staked in June, 1987 to cover a fractional piece of open ground between the WAL claims to the west and the RM 1 - 27 claims to the east. The claims are listed as follows:

NAME	NUMBER	RECORDING DATE	EXPIRY DATE
RM 1-27	YA-94645-671	MAY 28, 1986	MAY 28, 1988
RM 28-31	YA-97930-933	JUNE 24, 1987	JUNE 24, 1988

These claims are shown on D.I.A.N.D. Quartz and Placer Sheets 105 D-3 and 105 D-6, and are in the Whitehorse Mining District. The claims are owned 50% by SKUKUM VENTURES INC., and 50% by BERGLYNN RESOURCES INC.

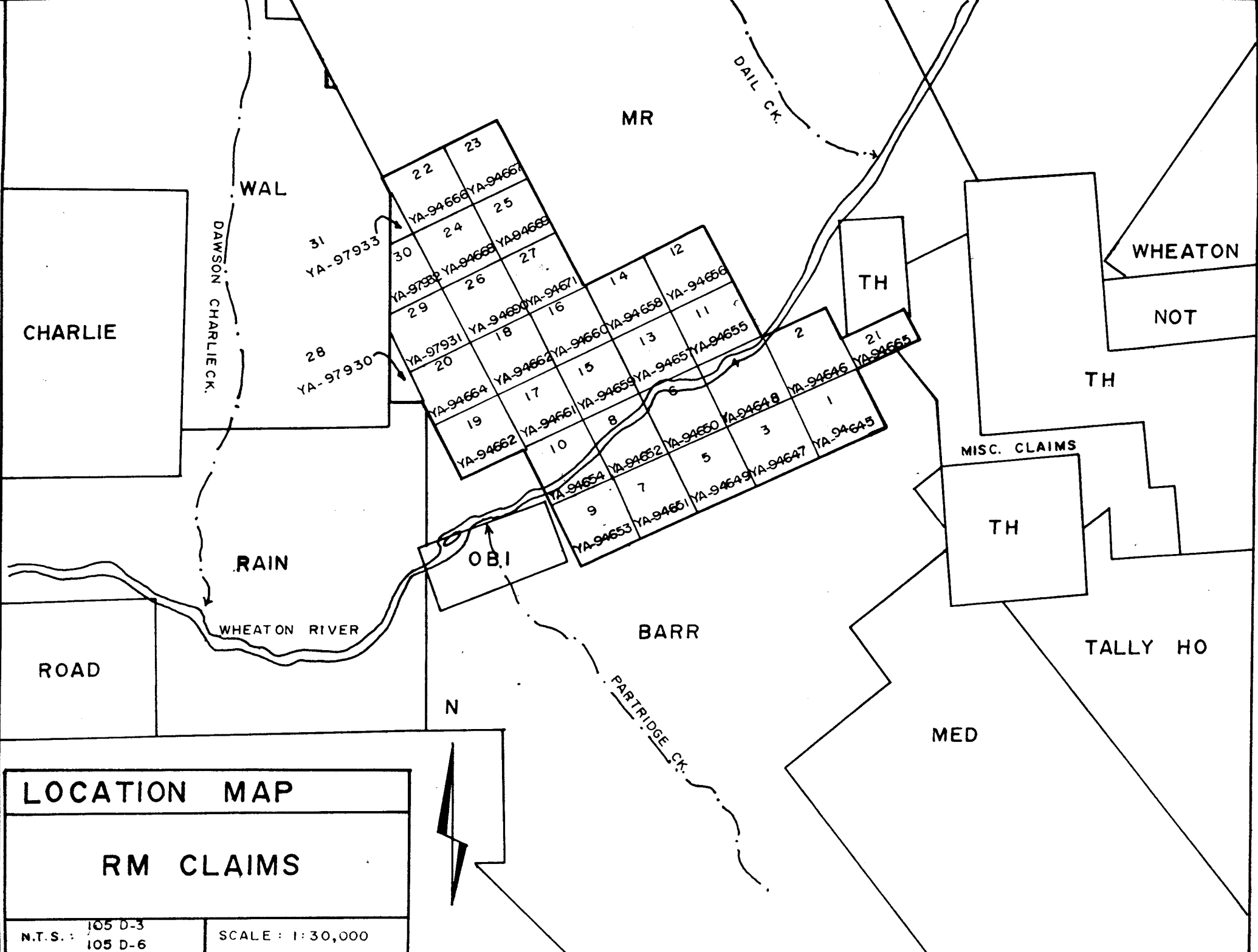

LOCATION MAP

RM CLAIMS

N.T.S.: 105 D-3
105 D-6

SCALE: 1:30,000



PREVIOUS WORK HISTORY

Exploration began in the Wheaton River area in the late 1800's with the discovery and staking of gold bearing veins on Mt. Anderson, Chieftan Hill and on Carbon Hill by Frank Corwin and Thomas Rickman, and turned into a staking rush in 1906 with the discovery of high grade gold and gold telluride bearing veins on Gold Hill. By the First World War, adits had been driven into structures on Gold Hill, Tally Ho Mountain, Mount Stevens and Carbon Hill. Higher grade gold bearing zones on Tally Ho Mountain, Mount Stevens and Gold Hill saw "limited production" until the mid 1920's. From the mid 1920's to the mid 1970's, the Wheaton River area saw only sporadic exploration activity, and mainly in search for base metals. In 1981 AGIP CANADA LTD. discovered a high grade gold-silver deposit near Mt. Skukum that soon developed into a reported 165,000 tons grading 0.73 opt Au, 0.63 opt Ag. Production began in early 1986. The consequence of this discovery has influenced a dramatic increase in claims staked and in exploration work being performed in the Wheaton River area. In 1985, OMNI RESOURCES INC. announced the discovery of a Au-Ag deposit at Skukum Creek. Reserves to November 1987 are reported at 600,000 tons of 0.39 opt Au equivalent.

The lower parts of the RM 1 - 27 claims were geochemically surveyed in May 1987 utilizing a metric grid (conventional soil samples) in the valley flats, and utilizing (talus fine samples) traverses near the base of

outcrop. Twenty five samples were deemed anomalous in gold and most of these came from two separate clusters in the talus fines traverses (Coster, 1987).

PERSONNEL

The geological (and prospecting and sampling) survey was carried out by Hugh Mckinnon and Marco Van Wermeskerken of Skukum Ventures Inc. Data compilation and report preparation was completed by Ian Coster of Skukum Ventures Inc.

CLIMATE, TOPOGRAPHY and VEGETATION

The climate in the Wheaton River area is variable with hot summers enhanced by 18 - 20 hours of daylight, and long cold winters. Precipitation is relatively light (40 cm) with about half falling as rain. The rivers are open from early May to late October.

Topography consists of upland plateau, incised by v-shaped drainage systems. The average elevation of the plateau surface is approximately 5,000 ft. (1,525 m), giving a relative relief in the area of approximately 3,000 ft. (900 m). Relief on the RM claim group is in the order of 2,000 ft. (600 m).

Vegetation is typically alpine above the 1,200 m elevation where stunted willow, alpine grasses and shrubs thrive. In the lower creek valleys, mixed spruce and poplar forests prevail.

REGIONAL GEOLOGY

The RM 1 - 31 claims lie on the eastern edge of the Cretaceous Coast Plutonic Belt, near the boundary with folded Mesozoic and Paleozoic volcanic and sedimentary rocks of the Whitehorse Trough (Intermontaine Belt). The region was mapped in detail by D.D. Cairnes (1912) and J.O. Wheeler (1961), and the Mount Skukum area was mapped in detail by M.J. Pride (1986). In general, Wheeler concludes that this part of the Coast Plutonic Belt comprises foliated Mesozoic (Cretaceous) granitoid rocks flanked by metamorphosed and unmetamorphosed sedimentary and volcanic rocks. Irregular belts of metavolcanic and metasedimentary rocks of Mesozoic, Paleozoic and Precambrian age occur as roof pendants. All of the above geology is overlain and intruded by a coeval suite of Tertiary (Eocene) rhyolite to andesite flows, dikes and stocks derived from volcanic (caldera) complexes at Montana Mountain, Mount Macauley and Mount Skukum. Most mineral occurrences in the Wheaton River area are associated with the Tertiary igneous event of the Mount Skukum volcanic complex. This complex is Paleocene-Eocene in age, covers roughly 140 square km. and is elliptical in shape (Pride, 1986).

PROPERTY GEOLOGY

The RM property is underlain predominantly by Cretaceous aged (?) hornblend granodiorite, belonging to the Coast Crystalline complex. These rocks are coarse to medium

grained, equigranular to subporphyritic (plagioclase) and generally quite fresh. A few narrow aplitic dikes were mapped within the granodiorites, which probably represent a later, more felsic phase of the intrusion.

The oldest rock mapped on the property is a roof pendant of hornblendic orthogneiss belonging to the Paleozoic (Hadrynian ?) Yukon Group. This roof pendant is located on the west side of the property, facing the Wheaton River.

All of the above rocks have been intruded by Tertiary (Eocene ?) aged dikes of variable composition, that vary in width from < 1 m to 4 m. The more felsic dikes (dacitic to rhyolitic in composition) commonly trend westerly to northwesterly (110 to 140) and dip steeply northeast. These typically have a pale green aphanitic matrix, hosting fine quartz and feldspar phenocrysts, and sporadically portray weakly flow banded contacts. The Andesitic dikes are less common and trend northeasterly with a steep northwestern dip. These dikes are typically medium to dark green colored, with a fine grained, chloritized matrix hosting fine grained plagioclase phenocrysts and a few rare quartz eyes. Dikes commonly intrude the granodiorite along pre-existing weak shears.

MINERALIZATION

Mineralization exposed on the RM property is of two main types. The first is granodiorite hosted alteration/

gossanous patches, typified by malachite ± azurite staining with traces of disseminated chalcopyrite and pyrite, all accompanied by pervasive sericite and carbonate. These zones are of limited extent (generally less than 4 m). The other type of mineralization is structurally controlled. Two main orientations of shearing have been mapped, with most shears hosting irregular lensey quartz veining. Shears trending northeasterly (average 060 with an average dip of 31 northwest) to easterly are dominant and average 1/2 meter in width. These shears are usually accompanied by variable degrees of carbonate, chlorite, silica, sericite and argillic alteration. Thin (less than 10 cm wide), lensey quartz veining is often hosted in the shears, as well as minor amounts of calcite and siderite. Often, the quartz is chalcedonic in composition. Sulphides are sporadically present in trace amounts, as pyrite, chalcopyrite, galena and sphalerite. One shear, termed the MAIN NE SHEAR has been intermittently traced for approximately 1100 meters across the property. This shear is located at approximately the 4000 foot elevation, near the base of outcrop. Other parallel shears exist at upper elevations, but due to the ruggedness of topography, and preliminary nature of the prospecting/ mapping survey, no appreciable strike length has, as yet, been traced.

The other main shearing orientation on the property is northwesterly (average 126 with an average dip of 44

northeast) and average less than 1/2 m in width. These shears are virtually identical in mineralogy and alteration with the northeasterly set. Eocene diking tends to follow this northwesterly shear trend, and it may be that this is an earlier shearing event, as the northeasterly shears were found to offset a dike trending northwesterly.

ANOMALOUS SAMPLE RESULTS

SAMPLE	DESCRIPTION	GOLD	OTHER
4e-1-3*	10 cm wide vuggy Q.V.; tr.py, cpy and mal	0.432 opt	med. Cu, Ag
4e-1-6*	5 cm wide Q.V.; tr. py	265 ppb	0
4e-1-8	banded Q.V. with siderite; near Rhyl. and shear	560 ppb	med. Pb, Zn
4e-1-11	vuggy Q.V.; minor py.	1695 ppb	0
4e-1-13	5 cm wide Q.V.'s; tr. py and galena	615 ppb	low Pb
4e-1-19	7 cm wide rusty Q.V.	6470 ppb	low Ag
4e-1-20	4 cm wide Q.V.; 3% py	1075 ppb	0
4d-1-1*	5 cm Q.V.; leached, lensey	0.162 opt	low Ag
4d-1-2*	as above; 5% py, tr.mal.& az.	425 ppb	0
4d-1-3*	vuggy, leached Q.V.	0.288 opt	hi Cu, Ag
4d-1-4	as above; tr.galena; 4 cm wide	445 ppb	low Pb
4d-1-5	5 cm wide Q.V. with much MnO stain	0.293 opt	low Ag
4d-1-10	200 cm wide chalcedonic shear	165 ppb	0
4d-1-11	30 cm wide shear; vuggy Q.V.'s and calcite	122 ppb	0

*From MAIN NE SHEAR

CONCLUSIONS

Outcrop on the RM claims encompasses roughly 10% of the area of the property. Numerous thin, lensey quartz and chalcedonic quartz veinlets were prospected, that occupy narrow shear zones. Although narrow and discontinuous, these veins commonly assay an economic grade of gold. An epithermal style of mineralization is indicated by the style of alteration and by the presence of chalcedonic quartz. The MAIN NE SHEAR trends at least 1100 meters across the property, and of the seven samples taken of quartz occupying this shear, three assay better than 0.25 opt Au, with attendant moderately anomalous Cu and Ag values. Because the strike of this structure is at least 1100 m, it may be assumed that the structure is traceable down dip from surface for possibly half the strike length. The width of quartz veining hosted within the MAIN NE SHEAR is very narrow where exposed, but may dilate to a desirable width at depth.

More prospecting and sampling of the outcrop area of the RM property would better define trends and grade of known mineralization, as other quartz-bearing shears hosting good gold values have been identified.

RECOMMENDATIONS

More work on the RM 1 - 31 claim group is definitely warranted. It is recommended that:

1. More geological mapping and sampling be conducted on the outcrop area of the property, to better define structural trends, and trace out auriferous veins.
2. Establish a 1100 m X 1300 m grid on the overburden covered plateau area of the property (elevation over 4700 ft) and conduct an extensive soil sampling survey of the "C" horizon. Samples should be collected initially at 50 m intervals along lines spaced 100 m apart, and should be geochemically analyzed for Au, Ag, Pb, Zn, As, Cu.
3. V.L.F.-EM surveying of areas determined as anomalous by the soil survey, to better delineate structural trends and locations. All VLF data should be FRASER filtered in order to minimize topographic noise.

Any diamond drilling would be contingent upon results of the aforementioned surveys.

Respectfully Submitted,



Ian Coster B.Sc., F.G.A.C.

REFERENCES

- Coster, Ian Soil Geochemical Survey on part of the RM
1987 1 - 27 Mineral Claims. Assessment Report
- Garagan, T. Summary Report on the Wheaton Gold
1987 Property; Engineering report for Skukum
Ventures Inc.
- Pride, M.J. Description of the Mount Skukum Volcanic
1986 Complex, Southern Yukon; in Yukon Geology,
Vol. 1; Exploration and Geological Services
Division, Yukon; Indian and Northern
Affairs Canada, p. 148 - 160.
- Wheeler, J.O. Whitehorse Map Area, Yukon Territory,
1961 105 D; G.S.C. Memoir 312

STATEMENT OF QUALIFICATIONS

I, Ian P.D.A. Coster of P.O. Box 27, Atlin, B.C., hereby certify that:

1. I am a geologist with Skukum Ventures Inc. of 706 - 595 Howe Street, Vancouver, B.C.
2. I obtained a Bachelor of Science degree in Geology from the University of British Columbia, in 1981.
3. I am a Fellow of the Geological Association of Canada, and a member of the Prospectors and Developers Association.
4. I have been engaged in mineral exploration since 1979 in Ontario, Quebec, N.W.T., British Columbia and Yukon.
5. I oversaw and was involved in all the work performed on the RM claims in 1987 and am the author of this report.

Dated this 15th day of May, 1988



Ian P.D.A. Coster, B.Sc. F.G.A.C.

STATEMENT OF COSTS

Assessment Valuation; RM 1 - 27, RM 28 - 31 Mineral Claims,
Whitehorse M.D., Yukon.

Ian Coster, B.Sc., F.G.A.C. of Atlin, B.C. 6 days @ \$150.00/ day.....	\$ 900.00
Hugh Mckinnon, B.Sc. of Rossland, B.C. 7 days @ \$100.00/ day.....	700.00
Marco Van Wermeskerken, B.Sc. of Vancouver, B.C. 7 days @ \$100.00/ day.....	700.00
Camp Costs 16 mandays @ \$35.00/ manday.....	560.00
Helicopter Costs.....	480.00
Analytical Costs 25 rocks @ \$12.00/ sample (geochem)..... 4 rocks @ \$22.00/ sample (assay)..... 3 talus fines @ \$9.25/ sample.....	300.00 88.00 27.75
Shipping.....	100.00
Report (typing, printing, binding).....	200.00
TOTAL EXPENDITURES	<u>\$4,055.75</u>



LEGEND & SYMBOLS

Tertiary

Ta Porphyritic andesite dike
 Tr Rhyolite dike
 Td Dacite porphyry (Plagioclase porphyry) dike

Cretaceous

Kgd Granodiorite; minor apfites
 Proterozoic - Hadrynian (?)

Gn Hornblende granodiorite orthogneiss

Fault, shear or shear zone
 50 Follation
 270 Dike, vein orientation
 50 Joint / fracture orientation

ABBREVIATIONS:

q.v. quartz vein
 chl chlorite alteration
 cct calcite alteration
 arg clay altered
 chalc chalcadonic quartz vein
 Py pyrite
 Gn galena
 Cpy chalcopyrite
 Mal malachite
 Az azurite
 Sph Sphalerite
 Sid siderite
 O/B overburden
 X 4d-1-1 Sample location (note all numbers should be prefixed 87-2q)

092486

SKUKUM VENTURES INC.
 BERGLYNN RESOURCES INC. JOINT VENTURE 789

RM 1-31
 MINERAL CLAIMS
 GEOLOGY
 SAMPLE LOCATIONS

MINING DISTRICT: WHITEHORSE SCALE: 1: 5000
 N.T.S.: 105 D/ 3,6 DATE: MAY, 1988
 DRAWN BY: P.V./H.M. FIGURE: 3

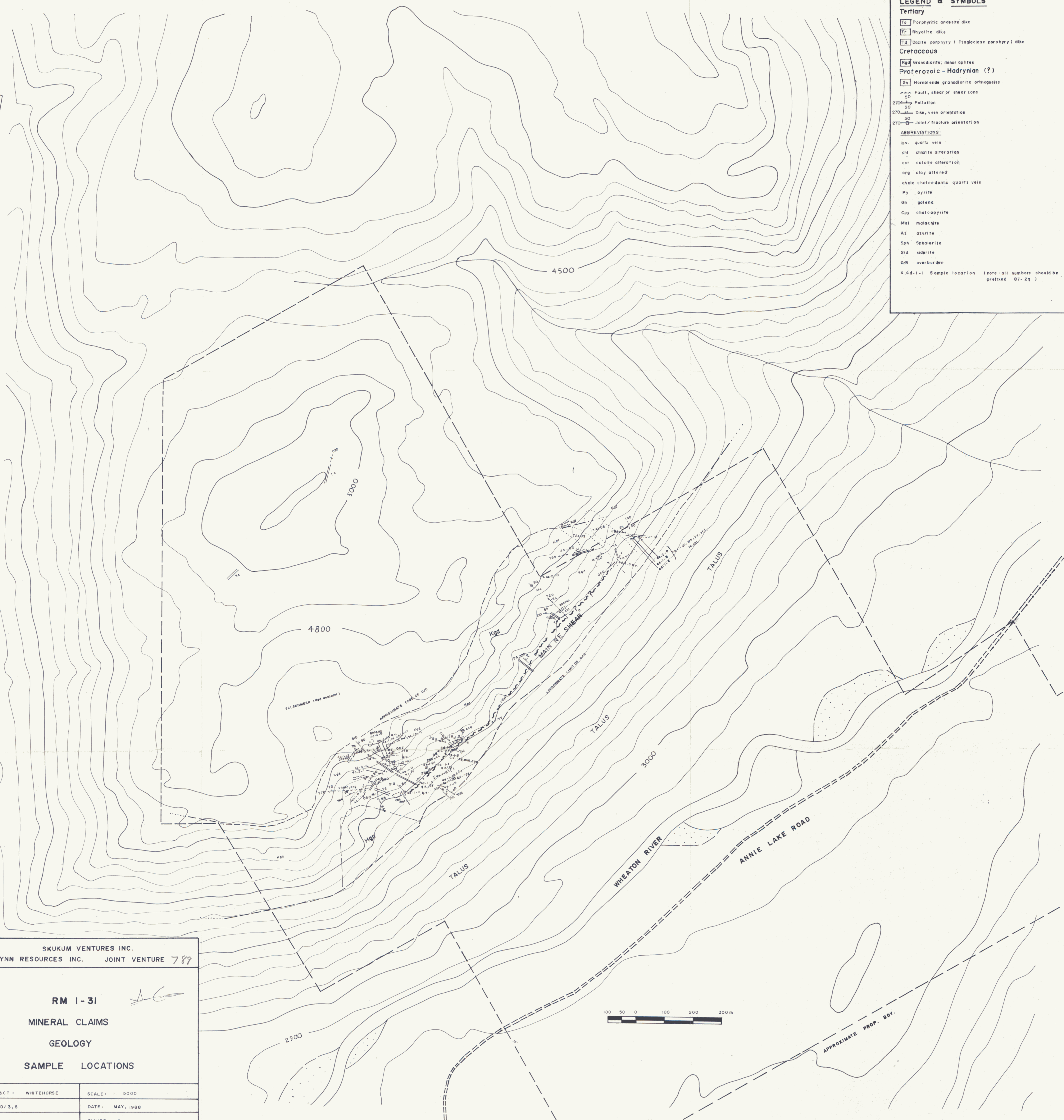

APPROXIMATE PROP. B.D.Y.

APPENDIX:
ANALYTICAL RESULTS

ACME ANALYTICAL LABORATORIES
 852 E. HASTINGS ST. VANCOUVER B.C. V6A 1R6
 PHONE 253-3158 DATA LINE 251-1011

DATE RECEIVED: JUNE 15 1987

DATE REPORT MAILED: *June 20/87..*

GEOCHEMICAL ICP ANALYSIS

.500 GRAM SAMPLE IS DIGESTED WITH JML 3-1-2 HCL-HNO3-H2O AT 95 DEG.C FOR ONE HOUR AND IS DILUTED TO 10 ML WITH WATER.
 THIS LEACH IS PARTIAL FOR MN FE CA P LA CR MG BA TI B W AND LIMITED FOR NA AND K. AU DETECTION LIMIT BY ICP IS 3 PPM.
 - SAMPLE TYPE: P1-ROCK P2-TALUS FINES AU* ANALYSIS BY AA FROM 10 GRAM SAMPLE.

ASSAYER: *D. Toye* DEAN TOYE, CERTIFIED B.C. ASSAYER

SKUKUM VENTURES INC. File # 87-1772 Page 1

SAMPLE#	CU PPM	PB PPM	ZN PPM	AG PPM	SB PPM	AU* PPB
87-29-4e-2-1 8001	3	11	75	.4	2	3
" " 4e-1-2 8002	9	10	41	.1	2	2
" " 4e-1-3 8003	297	136	12	16.5	2	24900
" " 4e-1-6 8004	8	7	12	1.1	3	265
" " 4e-1-7 8005	5	6	25	.1	2	18
" " 4e-1-8 8006	6	853	445	2.3	2	560
" " 4e-1-9 8007	10	9	49	.5	2	12
" " 4e-2-10 8008	2	17	24	.2	2	1
" " 4e-1-11 8009	15	21	13	4.2	5	6495
" " 4e-1-12 8010	5	27	8	.3	2	425
" " 4e-1-13 8011	7197	141	35	103.9	2	5960
" " 4e-1-14 8012	2	331	58	.6	2	445
" " 4e-1-15 8013	44	31	37	4.9	2	11300
" " 4e-1-16 8014	4	17	71	.1	2	43
" " 4e-1-17 8015	14	13	38	.2	2	165
" " 4e-1-18 8016	18	16	16	.6	2	1695
" " 4e-1-19 8017	142	9	42	.4	2	16
" " 4e-1-20 8018	7	350	121	2.8	2	615
" " 4e-1-21 8019	8	8	14	.1	2	32
" " 4e-1-22 8020	8496	18	143	8.9	2	51
" " 4e-1-23 8021	903	2	48	.4	2	26
STD C/AU-R	61	42	141	7.1	16	510

SAMPLE#	CU PPM	PB PPM	ZN PPM	AG PPM	SB PPM	AU* PPB
87-20-4D-3-6	39	37	88	.4	2	16
87-20-4D-3-7	32	27	85	.2	2	44
87-20-4D-3-8	14	15	64	.1	2	5

ACME ANALYTICAL LABORATORIES LTD.
852 E. HASTINGS, VANCOUVER B.C.
PH: (604)253-3158 COMPUTER LINE:251-1011

DATE RECEIVED JUNE 24 1987
DATE REPORTS MAILED *July 1/87*

ASSAY CERTIFICATE

SAMPLE TYPE : PULP
AG** & AU** BY FIRE ASSAY

ASSAYER *Dean Toye* DEAN TOYE , CERTIFIED B.C. ASSAYER

SKUKUM VENTURES INC. FILE# 87-1772 R

PAGE# 1

SAMPLE	Ag** oz/t	Au** oz/t
<i>87-2g-4c-1-3</i> 8003	.52	.432
<i>87-2g-4d-1-1</i> 8009	.14	.162
<i>87-2g-4d-1-3</i> 8011	3.10	.288
<i>87-2g-4d-1-5</i> 8013	.16	.293

ACME ANALYTICAL LABORATORIES LTD. DATE RECEIVED: OCT 21 1987
 852 E. HASTINGS ST. VANCOUVER B.C. V6A 1R6
 PHONE (604) 253-3158 FAX (604) 253-1716 DATE REPORT MAILED: *Oct 31/87*

GEOCHEMICAL ANALYSIS CERTIFICATE

ICP - .500 GRAM SAMPLE IS DIGESTED WITH 3ML 3-1-2 HCL-HNO3-H2O AT 95 DEC. C FOR ONE HOUR AND IS DILUTED TO 10 ML WITH WATER. THIS LEACH IS PARTIAL FOR MN FE CA P LA CR MG BA TI B W AND LIMITED FOR NA K AND AL. AU DETECTION LIMIT BY ICP IS 3 PPM.
 - SAMPLE TYPE: Rock Chips AU* ANALYSIS BY AA FROM 10 GRAM SAMPLE.

ASSAYER: *D. Toye* DEAN TOYE, CERTIFIED B.C. ASSAYER

SKUKUM VENTURES File # 87-5099

SAMPLE# FB ZN AG AS SB AU*

87-2g-4d-1-11	38	42	1.0	2	2	122
87-2g-4d-1-12	19	39	.5	3	2	72
87-2g-4e-1-19	33	5	5.8	3	2	6470
87-2g-4e-1-20	25	26	.7	3	2	1075

STD (C/AU-R) 41 133 7.5 39 18 495

*should be
2g*