

MAP NO.

ASSESSMENT REPORT X

DOCUMENT NO.: 092147

PROSPECTUS

MINING DISTRICT: WATSON LAKE

CONFIDENTIAL X

TYPE OF WORK: ROAD CONSTRUCTION, TRENCHING

105 F 9

OPEN FILE

REPORT FILED UNDER: Canamax Resources Inc.

DATE PERFORMED: June 12 - September 7, 1987

DATE FILED: May 3, 1988

LOCATION: LAT.: 61°34'N

AREA: Slide Lake (Ketzka River)

LONG.: 132°15'W

VALUE \$: 41,700.25

CLAIM NAME & NO.: KON 23-25, 27, 30, 62-67, 175, 194, 196-197, 239-240, 131 Fr. YA70934-36, YA70938, YA70941, YA70973-78, YA90866, YA90885, YA90887-88, YA90920, YA99319, YA90431; QUILL 6, 21

WORK DONE BY: D.B. Fleming, R.L. Cranswick

WORK DONE FOR: Canamax Resources Inc.

DATE TO GOOD STANDING	REMARKS:
	#56 FURY Road access (9.3 km) was constructed and 11
	trenches were excavated (11 478 cu. m.). Sheared quartz veins
	on KON 240 contain up to 7 g/t Au over 4.3 m.; and quartz-
	arsenopyrite-pyrite veins contain up to 13 g/t Au over 1.0 m.

1987 ASSESSMENT REPORT



TITLE: Road Construction and Trenching

CLAIMS: Ketz River Property:
Kon 23-25, 27, 30, 131F, 62-67
High River/Quillo Property:
Kon 240; Quill 6, 21
Slide Lake Property:
Kon 175, 194, 196, 197, 239

AUTHORS: D.B. Fleming, R.L. Cranswick

DATE: April, 1988

WORK PERIOD: June 12 - September 7, 1987

COMMODITY: Au

LOCATION:

- Area Ketz River Area, Central Yukon
- Mining District Watson Lake
- Coordinates Latitude 61°34'
Longitude 132°15'
- NTS 105 F/9

OPERATOR: Canamax Resources Inc.



CANAMAX VANCOUVER OFFICE

092147

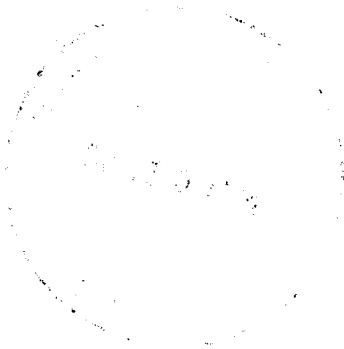

This report has been examined by
the Geological Evaluation Unit
under Section 53 (4) Yukon Quartz
Mining Act and is allowed as
representation work in the amount
of \$ 4,700.25.

W. H. Barge
for Regional Manager, Exploration and
Geological Services for Commissioner
of Yukon Territory.

TABLE OF CONTENTS

	<u>Page</u>
SUMMARY.....	1
CONCLUSIONS.....	2
INTRODUCTION.....	3
Location and Access.....	3
Claims.....	3
ROAD CONSTRUCTION.....	4
TRENCHING.....	5
Pass Showing.....	5
Lake Zone.....	6
Misery #1.....	7

FIGURES

FIGURE 1	-	Location Map.....	After Page 3
FIGURE 2	-	Road and Trenches (1:15,000).....	In Pocket
FIGURE 3	-	Pass Showing - Geological Map (1:1,000).....	In Pocket
FIGURE 4	-	Lake Zone - Geological Map (1:2,000).....	In Pocket
PLATE I	-	Lake Zone: Trench 87-1 Sampling.....	After Page 6

APPENDICES

APPENDIX I	-	Statement of Costs	092147
APPENDIX II	-	Statements of Qualifications	
APPENDIX III	-	Rock Geochemical and Assay Sample Description - Results	

SUMMARY

This report describes road construction and trenching conducted on 20 claims of the Ketz River, High River/Quillo and Slide Lake properties in the period June 12-September 7, 1987. The three properties are located in the Ketz River area, 45 to 50 kilometres south-southeast of Ross River, in the Watson Lake Mining District, Yukon Territory.

A total of 9.3 kilometres of access road was constructed intermittently in the period with two D8 and one D6 bulldozers. Permafrost was encountered for over 3 kilometres of the route.

The trenching program consisted of 48 cubic metres of blasting and hand excavating and 11,430 cubic metres of D8 bulldozer trenching in eleven trenches on three claims. The trenching tested three zones of oxidized gold-bearing float and anomalous gold soil geochemistry in areas underlain by Lower Cambrian limestone and/or dolomite. A total of 100 samples were collected from trenches, assayed for gold and geochemically analyzed for silver, lead and zinc.

092147.

CONCLUSIONS

1. Pass Showing (Kon 240) trenches expose a 30-metre strike length of quartz up to 24 metres wide occupying a fault contact between Lower Cambrian dolomite and Upper Cambrian phyllite. The sheared, mineralized margins of the vein consist of scorodite and oxide assaying up to 0.25 oz/ton Au across 1.7 metres and 0.20 oz/ton Au across 4.3 metres.

2. Lake Zone (Kon 239) trenching has exposed widespread quartz-pyrite-arsenopyrite veining and breccia zones in silicified dolomite. Oxidized float samples within trenches assayed up to 1.60 oz/ton Au. The best assay channel sample returned 0.39 oz/ton Au across a 1.0-metre vein width. No strike length on any vein structure has been determined.

3. The Misery #1 (Kon 25) trench was excavated to determine the source of anomalous gold in soils. Trenching encountered frozen till. No bedrock was exposed.

INTRODUCTION

Location and Access (Figure 1)

The subject area is located 45 to 50 kilometres south-southeast of Ross River, Yukon. The access road departs the Ketzka Mine Road at Kilometre 36.5, traverses the south flank of the Misery Creek valley to its headwaters for a distance of 5.8 kilometres, then turns north for a distance of 3.4 kilometres.

Claims (Figure 2)

Work was conducted on Canamax properties for a total of 20 claims. These claims are tabulated below:

<u>Property Name</u>	<u>Claim Name</u>	<u>Record No.</u>
Ketzka River	Kon 23	YA 70934
Ketzka River	Kon 24	YA 70935
Ketzka River	Kon 25	YA 70936
Ketzka River	Kon 27	YA 70938
Ketzka River	Kon 30	YA 70941
Ketzka River	Kon 131F	YA 90431
Ketzka River	Kon 62	YA 70973
Ketzka River	Kon 63	YA 70974
Ketzka River	Kon 64	YA 70975
Ketzka River	Kon 65	YA 70976
Ketzka River	Kon 66	YA 70977
Ketzka River	Kon 67	YA 70978
Slide Lake	Kon 175	YA 90866
Slide Lake	Kon 194	YA 90885
Slide Lake	Kon 196	YA 90887
Slide Lake	Kon 197	YA 90888
Slide Lake	Kon 239	YA 90920
High River/Quillo	Kon 240	YA 99319

CANAMAX RESOURCES INC.

KETZA RIVER PROPERTIES

WATSON LAKE MINING DISTRICT — YUKON TERRITORY

LOCATION MAP

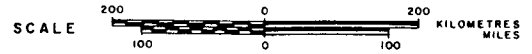

N. T. S. Ref. 105 F 9

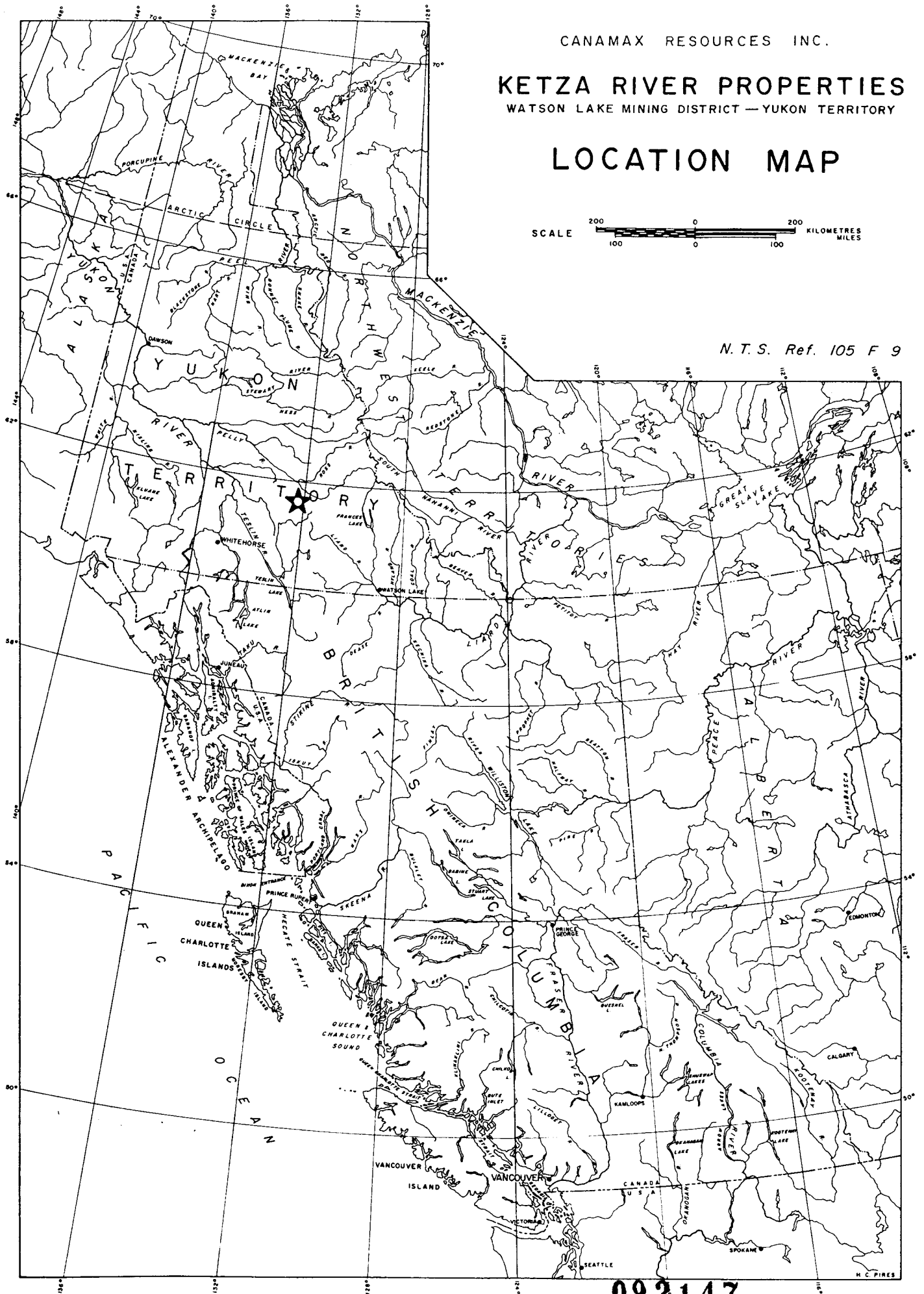

092147

FIG. 1

ROAD CONSTRUCTION

Intermittently in the period June 12 to September 7, 1987, two D8 and one D6 bulldozers were utilized to construct a 9.2-kilometre access road. The equipment and operators were under contract from Grant Stewart Construction Ltd. of Watson Lake, Yukon.

Permafrost was initially encountered on Kon 23, 25 and 27 and later on Kon 68, 70 and Kon 197, requiring extensive ripping and blading.

The road crossed Misery Creek near its headwaters and, hence, no major drainage crossings were required.

TRENCHING (Figure 2)

A total of 48 cubic metres of blasting and hand trenching and 11,430 metres of D8 bulldozer trenching in 11 trenches was carried out in three areas. Permafrost was encountered in all 11 trenches which required extensive ripping. Blasting was under contract to Gordon Clark and Associates of Whitehorse, Yukon and the D8 bulldozer was contracted from Grant Stewart Construction Ltd. of Watson Lake, Yukon. Descriptions and results of individual trenches are provided below. Assay results are tabulated in Appendix III.

Table I

<u>Zone</u>	<u>Claim</u>	<u>Trench</u>	<u>Type</u>	<u>Dimensions (metres)</u>	<u>Volume Cubic (metres)</u>
Pass Showing	Kon 240	P-1	D8	50x4x2	400
Pass Showing	Kon 240	P-2	D8	50x4x2	400
Pass Showing	Kon 240	P-3	D8	50x4x2	400
Pass Showing	Kon 240	P-4	D8	35x4x2	280
Lake Zone	Kon 239	87-1	Blast/Hand	12x2x2	48
Lake Zone	Kon 239	87-1	D8	60x10x4	2,400
Lake Zone	Kon 239	87-2	D8	60x10x3	1,800
Lake Zone	Kon 239	87-3	D8	60x5x3	900
Lake Zone	Kon 239	87-4	D8	70x5x3	1,050
Lake Zone	Kon 239	87-5	D8	80x10x3	2,400
Lake Zone	Kon 239	87-6	D8	80x5x1	400
Misery #1	Kon 25	5+00N	D8	4x5x50	<u>1,000</u>
Total D8 (cubic metres)					<u>11,430</u>

Pass Showing (Figure 3)

Trench P-1 exposed a 22-metre-wide quartz vein at a fault contact between Lower Cambrian dolomite and Upper Cambrian phyllite. Within the vein, a 2.0-metre section of sheared quartz-scorodite assayed 0.11 oz/ton Au.

Pass Showing (cont'd)

Trench P-2 cut 24 metres of quartz with a 1.7-metre section along the eastern contact assaying 0.25 oz/ton Au.

Trench P-3 uncovered 23 metres of quartz, also at the fault contact, that assayed 0.20 oz/ton Au across 4.3 metres at the eastern margin.

Trench P-4 intersected 16 metres of dolomite and barren quartz.

Lake Zone (Figure 4, Plate I)

Trench 87-1 was initially excavated by blasting and hand trenching to a depth of two metres. Assay sampling (87 SFT 13-22) returned up to 0.9 metres grading 1.10 oz/ton Au across an oxidized quartz-sulphide vein in silicified, brecciated dolomite. Subsequent bulldozer trenching to a depth of four metres exposed the unoxidized vein which assayed 0.22 oz/ton Au across 1.0 metre and 0.32 oz/ton Au across 0.4 metre. A quartz-pyrite-arsenopyrite breccia zone adjacent to the vein returned local auriferous sections.

Trench 87-2 encountered local sections of silicified dolomite bedrock and frozen loamy till. Three quartz-pyrite-arsenopyrite veins were exposed assaying up to 0.22 oz/ton Au across 2.0 metres.

Trench 87-3 exposed silicified dolomite along the south wall. No mineralized veins were noted in bedrock although float samples within the overlying till assayed up to 0.91 oz/ton Au.

Trench 87-4 consists of a 47-metre continuous exposure of silicified dolomite. A composite pyrite-arsenopyrite-quartz vein assayed 0.39 oz/ton Au across 1.0 metres.

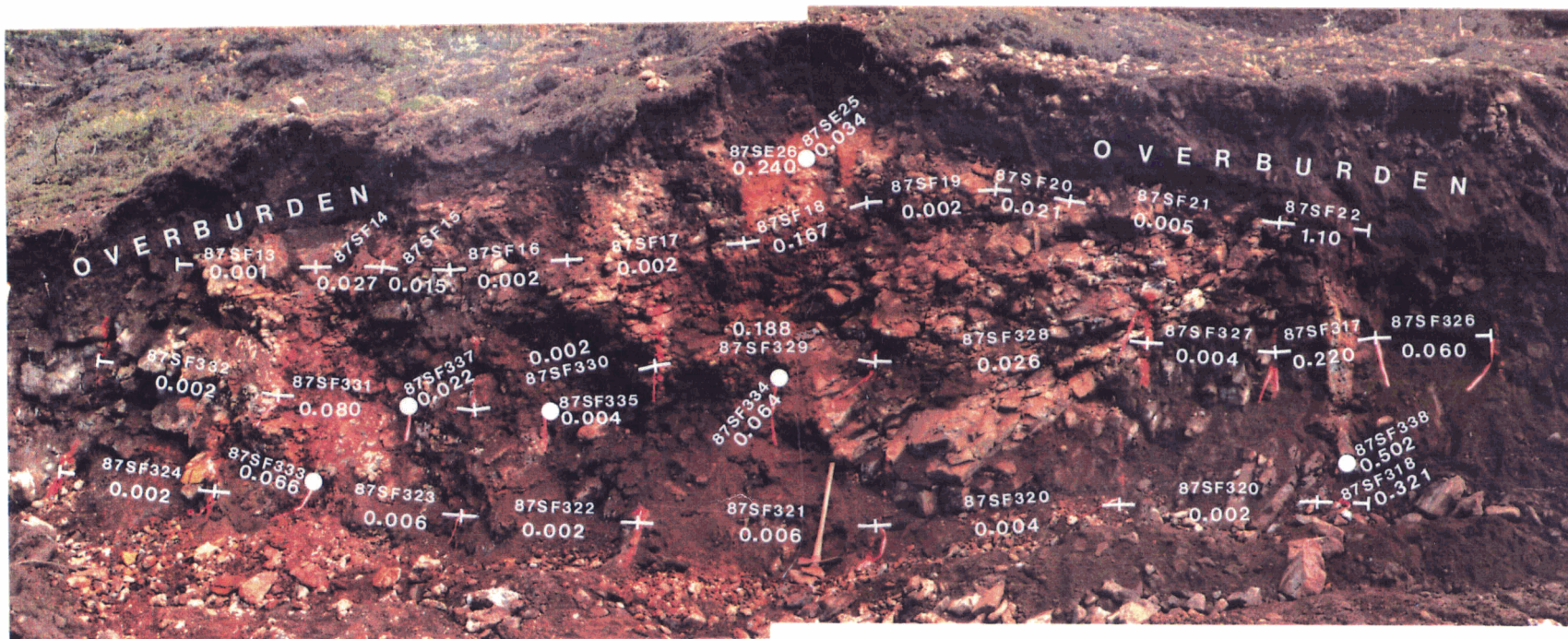

Assay values in oz/ton.

092147

Lake Zone (cont'd)

Trench 87-5 failed to reach bedrock. Up to 3 metres of frozen loamy till was encountered in which float samples assayed up to 0.18 oz/ton Au.

Trench 87-6 failed to reach bedrock. Glacial till immediately beneath the moss-covered surface was frozen.

Misery #1

Trench 5+00N failed to reach bedrock. A considerable thickness of frozen till was encountered.

Dave [Signature]

CANAMAX RESOURCES INC.

KETZA RIVER PROPERTIES
WATSON LAKE MINING DISTRICT — YUKON TERRITORY

ROAD AND TRENCHES

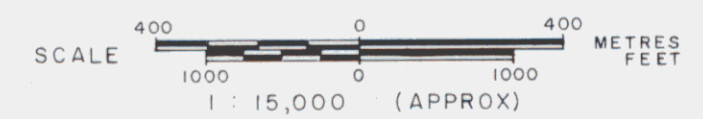

To accompany 1987 Assessment Report by: D. B. Fleming and R. L. Cranswick.

092147

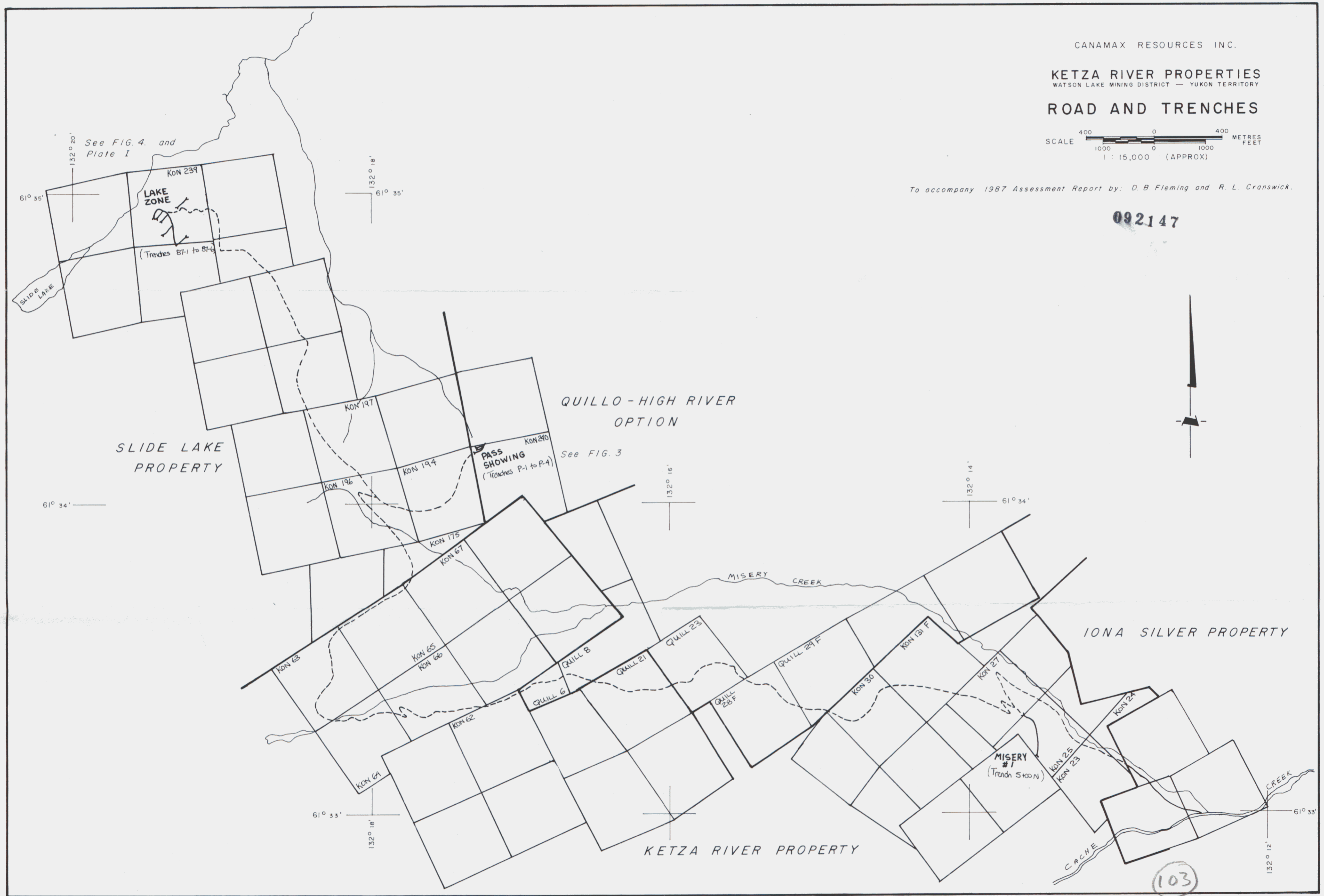

103

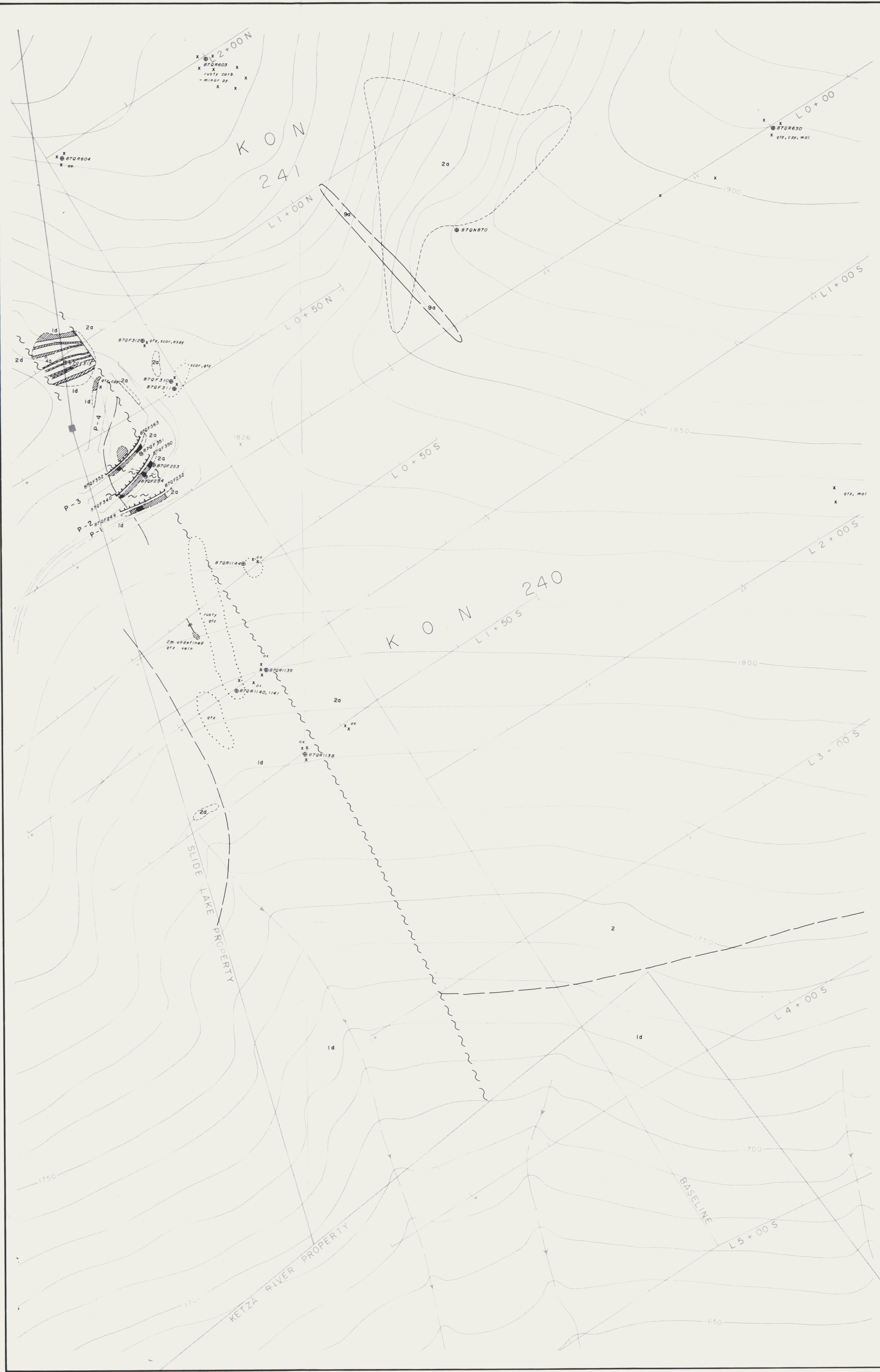

LEGEND

- INTRUSIVE ROCKS**
 9a Syenite
- UPPER CAMBRIAN**
 2a Calcareous phyllite, phyllitic limestone and dolomite.
 2d Black slate or shale.
- DISCONFORMITY**
- LOWER CAMBRIAN**
 1d Wavy banded gray limestone to massive fossiliferous gray limestone

- Quartz vein
 Scorodite vein

SYMBOLS

- Outcrop
 Boulder or float
 Geological contact (defined, approximate, assumed)
 Limit of float
 Vein attitude
 Fault
 Rock chip sample site, sample number
 Continuous chip sample
 Grid Line
 Claim post, property boundary
 Trench
 Road or trench
 Stream
 Topographic contour (contour interval 10 metres).

ABBREVIATIONS

aspy	Arsenopyrite	ox	Oxide
carb	Carbonate	py	Pyrite
cpy	Chalcopyrite	qtz	Quartz
mal	Malachite	scor	Scorodite

092147

CANAMAX RESOURCES INC.

QUILLO - HIGH RIVER OPTION
 KETZA RIVER PROPERTIES
 WATSON LAKE MINING DISTRICT - YUKON TERRITORY

GEOLOGICAL MAP
 PASS SHOWING

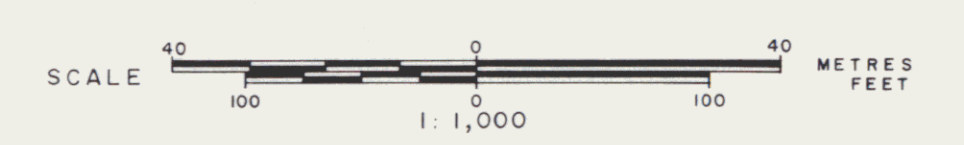

APPENDIX I

STATEMENT OF COSTS

STATEMENT OF COSTS

1. Gordon Clark & Associates
164078 - 4th Avenue
Whitehorse, Yukon

Drilling and Blasting -
June 18-23, 1987 \$ 4,529.44

2. Grant Stewart Construction Ltd.
P.O. Box 410
Watson Lake, Yukon

Invoice Nos. 5865, 5899, 5918 \$84,724.30

APPENDIX II

STATEMENTS OF QUALIFICATIONS

Statement of Qualifications

Name: D.B. Fleming

Address: 9071 Oakmond Avenue
Richmond, B.C. V7E 1L7

Education: B.Sc. Geology 1979
University of British Columbia

Experience: 1976-1977 Seumotech (64) Ltd.
Explosives Assistant

1978 Amax Minerals
Field Assistant

1979 Amax Minerals
Field Assistant

1980 Amax of Canada Limited
Field Assistant

1981 CSR Minerals, Sydney, Australia
Contract Geologist

1982 Amax Minerals Exploration
Senior Assistant

1983-1986 Canamax Resources Inc.
Senior Assistant

1986 Canamax Resources Inc.
Project Geologist

1987 Canamax Resources Inc.
Project Geologist

Statement of Qualifications

Name: R.L. Cranswick

Address: #102 - 2110 West 5th Avenue
Vancouver, B.C. V6K 1A2

Education: B.Sc. Geology 1987
University of British Columbia

Experience:	1984	Newmont Exploration Field Assistant
	1985	Esso Minerals Field Assistant
	1986	Utah Mines Field Assistant
	1987	Canamax Resources Inc. Senior Assistant

APPENDIX III

ROCK GEOCHEMICAL AND ASSAY SAMPLE DESCRIPTION - RESULTS

APPENDIX III

ROCK GEOCHEM AND ASSAY SAMPLE DESCRIPTIONS AND RESULTS - LAKE ZONE

Sample Number	Au (oz/ton)	As (ppm)	Ag (ppm)	Pb (ppm)	Sample Description
					<u>Trench 87-1</u>
87SFA13	0.001	344	0.2	4	1.4m chip; stockwork qtz in lst - aspy, py
14	0.027	1,780	2.6	24	0.7m chip; stockwork and brecciated qtz in lst
15	0.015	7,000	1.4	12	0.6m chip; qtz vein/breccia - 10% py, aspy
16	0.002	268	0.2	4	1.3m chip; calcite vein
17	0.002	1,040	0.8	16	1.4m chip; qtz/lst breccia - 3% py
18	0.167	>10,000	14.2	212	1.2m chip; variegated clay with qtz, aspy, py vein fragments
19	0.002	1,400	1.2	20	1.4m chip; silicified and veined lst - py, aspy casts
20	0.021	>10,000	3.2	40	0.7m chip; qtz vein/breccia - py, aspy
21	0.005	1,220	1.6	40	2.1m chip; stockwork veined lst - 2% py, aspy
			(oz/ton)	(%)	
22	1.10	>10,000	5.66	0.34	0.9m chip; red lim and green scor clay
				(ppm)	
87SFT317	0.220	>10,000	1.10	1,200	1m channel; 40cm scor-qtz-asp vein with ox envelope and dol wallrock
318	0.321	>10,000	0.76	620	0.4m channel; 30cm massive py, aspy vein - ox envelope
			(ppm)		
319	0.002	830	0.2	8	2m channel; silicified dol - trace py
320	0.004	7,000	10.4	660	2m channel; clay altered/silicified dol
321	0.006	>10,000	1.0	56	2m channel; ferricrete, ox, qtz breccia
322	0.002	>10,000	1.0	38	2m channel; silicified dol - 30% ox
323	0.006	5,280	0.8	18	3m channel; sheared qtz with ox, aspy, qtz and hisingerite
324	0.002	6,500	0.8	26	2m channel; silicified dol - trace py with 40% ox
			(oz/ton)	(%)	
325	0.637	>10,000	3.24	0.10	grab; massive py, aspy
			(ppm)	(ppm)	
326	0.060	>10,000	4.4	104	1.1m channel; altered sandy dol - minor ox
327	0.004	2,020	0.6	26	1.1m channel; dol, ox, breccia vein

NOTE: 87SFT 317-339, 364-373 and 376-389 have been fire assayed for Au.

ROCK GEOCHEM AND ASSAY SAMPLE DESCRIPTIONS AND RESULTS - LAKE ZONE

Sample Number	Au (oz/ton)	As (ppm)	Ag (ppm)	Pb (ppm)	Sample Description
<u>Trench 87-1 (cont'd)</u>					
87SFT328	0.026	9,800	2.4	80	2.6m channel; dol, ox, qtz breccia
329	0.188	>10,000	16.6	290	1.8m channel; ox, 20% qtz, hisingerite, rare py, aspy
330	0.002	8,800	0.8	30	3.2m channel; 80% qtz, ox and dol
331	0.080	>10,000	4.6	82	1.2m channel; qtz, aspy, py, ox in silicified dol
332	0.002	1,180	0.4	16	2.7m channel; sheared and silicified dol
333	0.066	>10,000	7.8	418	grab; orange hisingerite
334	0.064	>10,000	0.96	840	grab; chips of 1cm hisingerite band
			(ppm)		
335	0.004	>10,000	1.2	64	grab; ox-ferricrete
337	0.022	>10,000	1.2	34	grab; qtz-sulphide material - 5% py, 5% aspy
338	0.502	>10,000	6.0	720	grab; massive py, aspy vein
<u>Trench 87-1 - samples from initial surface blasting; relative location unknown.</u>					
87SDT101	0.010	3,760	0.8	12	1m chip; qtz breccia/lst-asy, py
102	0.004	840	0.2	10	1m chip; calcite vein
103	0.134	>10,000	10.4	138	3m chip; qtz breccia - ox lenses
104	0.041	>10,000	4.2	90	3m chip; qtz breccia - scor, aspy lenses
105	0.262	>10,000	18.2	266	0.75m channel; scor, aspy in qtz-ox
87SEA25	0.034	>10,000	8.0	174	grab; limonite
			(oz/ton)	(%)	
26	0.240	>10,000	8.14	0.86	grab; scor clay
			(ppm)	(ppm)	
87SFT01	0.026	>10,000	2.2	74	2m chip; qtz breccia vein - py, aspy
02	0.083	>10,000	6.0	86	grab; qtz, aspy vein selvage

NOTE: 87SFT 317-339, 364-373 and 376-389 have been fire assayed for Au.

ROCK CHIP AND ASSAY SAMPLE DESCRIPTIONS AND RESULTS - LAKE ZONE

Sample Number	Au (oz/ton)	As (ppm)	Ag (ppm)	Pb (ppm)	Sample Description
87SFA08	0.042	>10,000	2.6	50	0.6m chip; qtz, py, aspy vein
09	0.019	3,140	2.4	36	1.5m chip; qtz breccia and stockwork in lst - 10% py, trace aspy
10	0.027	8,800	2.6	36	0.6m chip; qtz, py, aspy vein
11	0.056	>10,000	3.6	54	grab; vein material
12	0.172	>10,000	13.2	328	grab; vein material - 20% aspy, py
23B	0.003	780	0.2	10	grab; sanded dol
<u>Trench 87-2</u>					
87SFT336	0.034	6,000	1.4	96	grab; sulphide-dol breccia boulder
339	0.146	>10,000	0.82 (oz/ton) (ppm)	1,700	grab; dol breccia - 1% py, aspy
364	0.100	>10,000	1.0	8	grab; qtz-sulphide vein
365	0.142	7,000	1.2	26	1.4m channel; qtz, dol - 8% py, 2% aspy
366	0.078	6,400	0.6	18	grab; punky orange ox
367	0.052	>10,000	9.8	406	grab; hisingerite-ox
368	0.220	>10,000	1.00 (oz/ton) (ppm)	488	2.2m channel; ox and qtz-scor-asp
378	0.016	2,540	3.0	88	2.5m channel; dol, qtz-sulphide breccia and ox
379	0.052	3,640	0.74 (oz/ton) (ppm)	920	grab; ox
380	0.058	7,000	7.0	368	grab; ox
381	0.076	>10,000	4.6	108	grab; qtz, py, aspy cobble
<u>Trench 87-3</u>					
369	0.062	>10,000	3.6	100	grab; qtz, aspy, scor and ox cobbles
370	0.132	1,620	9.4	18	0.1m chip; ox-calcite vein
382	0.908	>10,000	4.0	540	grab; boulder of 50% qtz, 25% py, 25% aspy
<u>Trench 87-4</u>					
383	0.182	>10,000	7.6 (oz/ton)	640	grab; ox in silicified dol
384	0.296	>10,000	0.66 (oz/ton) (ppm)	590	grab; massive py, aspy
385	0.393	>10,000	12.2	1,540	1m channel; ox, dol with massive sulphide
386	1.602	3,800	6.68	0.20	grab; ox, ferricrete float

NOTE: 87SFT 317-339, 364-373 and 376-389 have been fire assayed for Au.

APPENDIX III

4.

ROCK CHIP AND ASSAY SAMPLE DESCRIPTIONS AND RESULTS - LAKE ZONE

Sample Number	Au (oz/ton)	As (ppm)	Ag (oz/ton)	Pb (%)	Sample Description
387	0.248	5,800	0.76	(ppm) 940	grab; 20cm qtz vein - 8% py, 2% aspy
87SFA23A	0.266	5,900	(ppm) 18.2	380	grab; oxide
371	0.040	>10,000	6.0	352	grab; <u>Trench 87-5</u> qtz-asp-y-py and ox
372	0.096	7,000	3.8	68	grab; qtz, py, aspy vein in float
373	0.177	6,100	(oz/ton) 1.64	1,220	grab; 20x35cm py, qtz boulder
388	0.072	>10,000	0.58	1,040	grab; qtz subcrop - 5% py, 2% aspy, trace gal
389	0.032	3,440	(ppm) 5.2	392	grab; black-yellow-orange ox
376	0.050	>10,000	3.6	80	grab; <u>Trench 87-6</u> qtz, py, aspy cobbles
377	0.002	700	0.4	2	grab; ox cobbles

ROCK GEOCHEMICAL AND ASSAY SAMPLE DESCRIPTIONS AND RESULTS - PASS SHOWING

Sample Number	Au (oz/ton)	As (ppm)	Ag (ppm)	Pb (ppm)	Sample Description
87QF 212	0.030	>10,000	2.2	94	Grab; oxide in 1d limestone
213	0.034	8,800	1.2	20	Grab; oxide in 1d limestone
					<u>Trench P-1</u>
244	0.002*	3,080	0.4	16	0-3m channel; sid with qtz veinlets
245	<0.002*	1,600	0.2	22	3-5.7m channel; sid with qtz veinlets
246	0.034*	>10,000	8.0	430	5.7-9m channel; scor-qtz breccia and oxide
247	0.110*	1,560	17.2	810	9-11m channel; sheared qtz vein
248	0.012*	4,600	8.6	70	11-15m channel; sid, qtz stockwork, oxide
249	0.004*	1,280	2.6	28	15-18m channel; qtz vein and stockwork in dol
250	0.016*	1,700	3.0	44	18-21m channel; massive qtz-trace aspy, py
251	0.008*	2,240	2.0	14	21-24m channel; qtz and dol-sid-trace py
252	0.002*	1,740	0.4	10	24-27m channel; sid, qtz, phyll
253	0.024*	>10,000	10.2	1,400	grab at 6.3m; massive hisingerite
					<u>Trench P-2</u>
254	0.346*	>10,000	27.8	3,760	80cm channel; hisingerite ox, scor, 80% qtz rubble
255	0.228*	>10,000	34.0	6,400	grab; 60% scor clay, 30% red soil, 10% qtz frags
87QFT310	0.094	>10,000	0.02	172	grab; ox pebble, cobble talus train
311	0.003	800	0.2	10	grab; mottled qtz in talus
312	0.014	5,100	6.0	144	grab; 1x2m patch of qtz, scor, aspy chips
313	0.001	78	0.2	12	grab; silicified, stockwork veined dol
					<u>Trench P-2</u>
340	0.066*	>10,000	29.2	840	0-1.2m channel; red soil, 20% qtz chips
341	0.010*	4,920	3.6	50	1.2-4.2m channel; sheared, stained qtz
342	0.004*	146	3.0	48	4.2-7.2m channel; sheared, ox stained qtz

* Gold assays are from three difference sources, as follows:

- (a) gold results shown as oz/ton are acid digestion, atomic absorption analyses on one assay ton samples analyzed at the on-site field laboratory.
- (b) gold results shown in ppb are acid digestion, atomic absorption analyses on 10-gram samples by Rossbacher Laboratory, Burnaby.
- (c) gold results shown as oz/ton* are fire assays on one assay ton samples by Chemex Laboratory, North Vancouver.

ROCK GEOCHEMICAL AND ASSAY SAMPLE DESCRIPTIONS AND RESULTS - PASS SHOWING

Sample Number	Au (oz/ton)	As (ppm)	Ag (ppm)	Pb (ppm)	Sample Description
87QFT343	<0.002*	120	1.8	56	7.2-10.2m channel; blocky to massive qtz
344	<0.002*	860	2.4	60	10.2-13.2m channel; 85% qtz, 15% ox-sid
345	0.002*	1,680	3.8	150	13.2-16.5m channel; 90% qtz, 10% ox-sid
346	0.224*	>10,000	16.0	5,400	16.5-17.2m channel; 50% qtz vein, 50% oxidized hisingerite
347	0.004*	860	4.6	148	17.2-19.2m channel; sheared qtz vein-trace gal
348	0.014*	5,800	17.4	2,740	19.2-22.6m channel; 80% phyll clay, 20% qtz blocks
349	0.252*	>10,000	48.0	2,800	22.6-24.3m channel; 50% variegated clay, 50% graphitic clay
350	0.004*	1,820	3.6	104	24.3-27.2m channel; qtz blocks, graphitic clay, phyll
351	0.455*	>10,000	20.8	372	<u>Trench P-3</u> grab; aphanitic scor with qtz frags
87QF 352	0.002*	>10,000	3.4	16	0-0.8m channel; limonitic soil, qtz chips
353	<0.002*	3,060	0.2	14	0.8-4.5m channel; broken up qtz, limonitic soil, Mn siderite
354	0.004*	2,450	8.8	114	4.5-6.3m channel; sheared, green-stained qtz
355	0.074*	2,040	13.2	168	6.3-8.6m channel; 50% red clay, 50% dark qtz
356	0.004*	870	0.6	12	8.6-11.6m channel; 100% qtz - locally stained red
357	0.008*	840	0.8	16	11.6-14.6m channel; blocky, stained qtz
358	0.004*	1,120	1.4	46	14.6-17.6m channel; massive, stained qtz
359	0.005*				17.6-20.7m channel; blocky, stained qtz
360	0.200*	>10,000	>100.0	4,400	20.7-23.3m channel; 90% qtz pebbles, 10% scor clay
361	0.196*	>10,000	20.6	432	23.2-25.0m channel; 90% qtz pebbles, 10% scor clay and massive scor
362	0.014*	4,800	7.0	12	25.0-27.5m channel; 95% sheared qtz, 5% ox
363	0.008*	4,760	3.0	24	27.5-29.8m channel; 90% sheared qtz, 5% ox, 5% Mn-sid

Gordon Clark & Associates Ltd.
 STAKING, LINECUTTING, TRENCHING, DRILL SET-UPS, ASSESSMENT WORK

#16 - 4078 - 4th Ave., Whitehorse, Yukon Y1A 4K8
 Phone: (403) 668-6600

Bruce: 1 day mob (Ketza 7067)
 5 days work (Ketza 7067)
 5 days work (Slide Lake 7087)
 1 day demob (Slide Lake 7087)

CANAMAX
RECEIVED
 JUL 3 1987
 VANCOUVER OFFICE
 JUL 16 1987
 VANCOUVER OFFICE

INVOICE TO:

Canamax Resources Inc.,
 601-535 Thurlow Street,
 Vancouver, B.C.
 V6E 3L6

split materials 50/50

29 June 1987

split bill equally between 7067 and 7087

Jeff Toohay

\$4530 each project

Re: Surface drilling and blasting performed on the Ketza property for Canamax Resources Inc. (Jeff Toohay), June 15-26, 1987.

089	Two men and gear for 12 days @ \$550/day	\$6,600.00 ✓
	Compressor and drill for 12 days @ \$50/day	600.00 ✓
	Explosives*	382.10 ✓
		330.22 ✓
227	Vehicle expense:	
	One 4x4 truck for 12 days @ \$50/day	600.00 ✓
	1300 km @ 25¢/km	325.00 ✓
226	Gasoline	221.55

TOTAL INVOICE

\$9,058.87



Thank you,

Gordon Clark
 Gordon Clark.

092147

Done 50% 7087

* Other explosives used were supplied by Main Street Mining, who will send a separate invoice for them.

APPROVED	DATE
6/29	7/23
70067 089	3956.16
70067 226	110.78
70067 227	46.25
70087 089	3956.16
70087 226	110.77
70087 227	46.25

JUL 16 1987

CK. 2510014 870723

GRANT LEWART CONSTRUCTION LTD.

P.O. BOX 410 - WATSON LAKE, Y.T. - Y0A 1C0

Telephone (403) 536-7472

CANAMAX
RECEIVED
 AUG 25 1987
 VANCOUVER OFFICE

CANAMAX
RECEIVED
 AUG 18 1987
 VANCOUVER OFFICE

To: Canamax Resources Inc.
 601 - 535 Thurlow Street
 Vancouver, B.C.
 V6E 3L6

DATE: July 31, 1987
 INVOICE: No 5865
 CLIENT: #5310

Accounts Due When Rendered. Service Charge On Overdue Accounts.

Date	Details	Charges	Credits	Balance
	<u>"7067"</u>			
July 1-13, 20-31/87	#31 D8H - Make drill road & sites, Move drill, Build road & trenching at Misery Creek, Build road at Break zone, Make drill sites - Shamrock, Make drill roads & sites, Move drill, Clean roads and trenches, Make road & trench - Break zone, Trenching - Knoll zone, Gully vein		<u>7067</u>	
	224 Hours @ 115.00 per hour	\$25,760.00 ✓	48,720	
	re: Contractor's operator - additional charge -		1,760	
	224 Hours @ 30.00 per hour	\$6,720.00 ✓	<u>\$50,470</u>	total for 7067
July 1-12/87	#28 D8H - Building tote road, Push road through perma-frost, Work on new road, Trench Scharff vein, Trench across creek, Push new road up Misery Creek, Push road to Slide Lake, Walk Cat from Misery Creek main road -			
	110 Hours @ 115.00 per hour	\$12,650.00 ✓		
	re: Contractor's operator - additional charge -			
	110 Hours @ 30.00 per hour	\$3,300.00 ✓	092147	
June 29/87	#28 D8H - Additional hours (not invoiced in June) -			
	2 Hours @ 115.00 per hour	\$230.00 ✓		
	re: Contractor's operator - additional charge -			
	2 Hours @ 30.00 per hour	\$60.00 ✓		<u>48,720</u> ←
July 1987	#49 D6D - Working Hours -			
	102 Hours @ 28.40 per hour	\$2,896.80	<u>7079</u>	
		CK. 2570015	870903	

GRANT STEWART CONSTRUCTION LTD.

P.O. BOX 160 — CASSIAR, B.C. V0C 1E0

Telephone: 778-7455

P.O. BOX 410
WATSON LAKE
YUKON Y0A 1C0
TELEPHONE 536-7472

Telex: 036 8523

CANAMAX
RECEIVED
AUG 25 1987
VANCOUVER OFFICE

To: Canamax Resources
601 - 535 Thurlow Street
Vancouver, B.C.
V6E 3L6

CANAMAX
RECEIVED
AUG 18 1987
VANCOUVER OFFICE

July 31, 1987

STATEMENT

INVOICE NO. 5865, continued

Interest Charged on Overdue Accounts

Date	Details	Charges	Credits	Balance
July 14/87	#49 D6D - Additional charge, re Contractor's operator - 10 Hours @ 30.00 per hour	\$300.00	<u>7079</u>	
July 15-21/87	re: "7079" #49 D6D - Additional charge, re Contractor's operator - Walk Cat to drill, Move drill & trench, Build road & sump, Make drill road & sites, Drill moves - 37 Hours @ 30.00 per hour	\$1,110.00		
July 11/87	Operator Travel - from Ketza to Watson Lake - 6 Hours @ 30.00 per hour	\$180.00	<i>should be no charge operator demob.</i>	
July 1-31/87	Pickup Rental - Operator's vehicle - 31 Days @ 50.00 per day	\$1,550.00	24 days 7067 \$1200	
July 1-11/87	Pickup Rental - Operator's vehicle - 11 Days @ 50.00 per day 7067	\$550.00	2 days Brian Hall \$100 5 days 7079 \$250	\$55,306.80
				55,026.80
	7067 \$ 50,470.00			
	7079 4,556.80			
	55,026.80			
		092147	Approved August 12 1987 Jeff Toohay	
		CK 2570015 870903		

GRANT EWART CONSTRUCTION LTD.

P.O. BOX 410 - WATSON LAKE, Y.T. - Y0A 1C0

0319

Telephone (403) 536-7472

5899	10/01 8/31
70067 228	18,494.50
70079 228	62480
70081 228	2470.00
70087 228	9586.60
31,959.00	

DATE: August 31, 1987

INVOICE: NO 5899

CLIENT: #5310

To: Canamax Resources Inc.
601 - 535 Thurlow Street
Vancouver, B.C.
V6E 3L6

Accounts Due When Rendered. Service Charge On Overdue Accounts.

AUTHORIZED COPY ATTACHED

Date	Details	Charges	Credits	Balance
Aug. 1-4, 10-24/87	"7067" #31 D8H - Trenching - Gully zone, Break zone, by Lab., & Fraction zone; Drill moves; Make drill sites - Peel, Gully, & Knoll zones - 127½ Hours @ 115.00 per hour re: Contractor's Operator - additional charge - 123 Hours @ 30.00 per hour	CK 26200 \$14,662.50 ✓ \$3,690.00 ✓	016 871002	
Aug. 1987	#49 D6D - Working Hours - 51 Hours @ 28.40 per hour	\$1,448.40 ✓		
Aug. 24,30/87	#49 D6D - Move drill - additional charge, re Contractor's operator - 7 Hours @ 30.00 per hour	\$210.00 ✓		
Aug. 22,23/87	"7087" #49 D6D - Build road at Misery Creek - additional charge, re Contractor's operator - 20 Hours @ 30.00 per hour	\$600.00 ✓		
Aug. 24-28/87	#31 D8H - Build road at Misery Creek - 45 Hours @ 115.00 per hour re: Contractor's Operator - additional charge - 45 Hours @ 30.00 per hour	\$5,175.00 ✓ \$1,350.00		
Aug. 29-31/87	"7084" #31 D8H - Trench & build road at Misery Creek - 28 Hours @ 115.00 per hour re: Contractor's Operator - additional charge - 28 Hours @ 30.00 per hour	\$3,220.00 ✓ \$840.00		
			SEP 28 1987	
			092147	
			<i>B</i>	
				\$31,195.90 ✓

GRANT EWART CONSTRUCT N LTD.

P.O. BOX 160 CASSIAR, B.C. V0C 1E0

Telephone: 778-7455

P.O. BOX 410
WATSON LAKE
YUKON Y0A 1C0
TELEPHONE 536-7472

Telex: 036-8-852

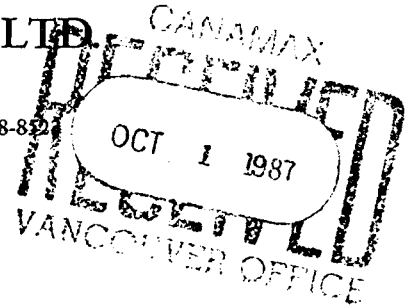

319

To: Canamax Resources Inc.
601 - 535 Thurlow Street
Vancouver, B.C.
V6E 3L6

September 24, 1987

~~STATEMENT~~

INVOICE NO. 5918

Interest Charged on Overdue Accounts

Date	Details	Charges	Credits	Balance
Sept. 1-10, 17/87	#31 D8H - Build road, Trench, Blade road, widen switchbacks - Misery Creek; Trench by Camp, Make drill site - Knoll Zone, Blade Misery Creek road - 103 Hours @ 115.00 per hour re: Contractor's Operator - additional charge - 103 Hours @ 30.00 per hour	\$11,845.00 \$3,090.00		
Sept. 1/87	#49 D6D - Move Drill - Additional charge, re Contractor's operator - 3 Hours @ 30.00 per hour	\$90.00		
Sept. 1-10, 17/87	Pickup Rental - Operator's vehicle - 11 Days @ 50.00 per day	\$550.00		
Aug. 1987	Pickup Rental - Operator's vehicle - 24 Days @ 50.00 per day	\$1,200.00		\$16,775.00

AUTHORIZED COPY ATTACHED

APPROVED	DUE 11/05
5918	DATE 9/24
70067 227	700.00
70067 228	13,015.00
70084 227	100.00
70084 228	120.00
70087 227	3,000.00
70087 228	1,200.00

CK 2680013 871105

092147