



Energy, Mines and
Resources Canada

Énergie, Mines et
Ressources Canada

Earth Sciences

Sciences de la Terre

Geological Survey of Canada
601 Booth Street
Ottawa, Ontario
K1A 0E8

Commission géologique du Canada
601, rue Booth
Ottawa (Ontario)
K1A 0E8

Your file *Voire référence*

Our file *Notre référence*

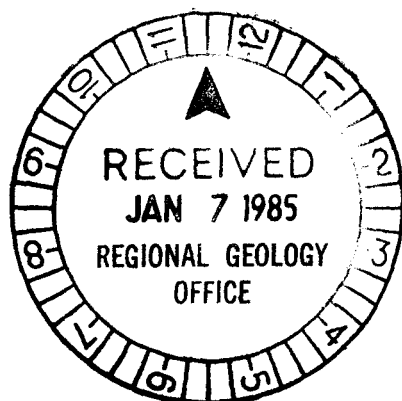

December 28, 1984

Dr. J.A. Morin
Chief Geologist and Regional Manager
Mineral Resources Division
Indian and Northern Affairs Canada
200 Range Road
Whitehorse, Yukon Territory
Y1A 3V1

Dear Jim:

I have been sorting through my "ancient" files on Wolf Lake map area (105 B) and sending off to GSC archives my field plotting base maps, airphotographs, notebooks, thin sections, etc.

I noticed some items (enclosed) bearing on mineral deposits which you may wish to add to your files.

1. Photocopy of: Gower, J.A., 1952, The Seagull Creek Batholith and its metamorphic aureole; unpubl. M.Sc. thesis, University of British Columbia, 56 p.
2. Copy of report of RCMP winter patrol from Teslin to Sayyea and Cabin creeks to report on mining activities, 1934.
3. Rough notes and sketches of prospecting by Yukon Ranges Prospecting Syndicate, D.R. Derry, 1946-1948.

Yours sincerely,

W.H. Poole

Encl.

Canada

092052

Ventures Limited
25 King Street West
Toronto, Canada

December 8, 1953.

Mr. W. H. Poole,
Dept. of Mines & Technical Surveys,
Victoria Museum,
OTTAWA, Ontario.

Dear Sir:

This will acknowledge your letter of November 27th,
addressed to Dr. Derry, who has asked me to forward to you the
following reports:

Western Range's, 1946 D. R. Derry

Western Range's, 1947 D. R. Derry

Yukon Range's, 1948 D. R. Derry.

As these have been removed from our report file,
it would be appreciated if you will kindly return them when they
have served their purpose.

Yours very truly,

VENTURES LIMITED

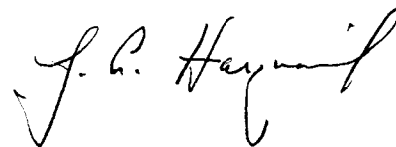

J. Harquail..

D.

~~Encs.~~

092052



CANADA

GEOLOGICAL SURVEY OF CANADA

DEPARTMENT
OF

MINES AND TECHNICAL SURVEYS

December 31, 1953

YUKON RANGES PROSPECTING SYNDICATE

Summary of report of 1948 season by D.R. DERRY

Introduction:

- a) Prospecting: Field Engineer - Mr. M.K. Pickard, in charge of prospecting
- b) Examinations of promising ground and prospects - Dr. D.R. Derry
Joint Manager.

Prospecting:

- a) Vicinity of Mile 701, Alaska Highway.
Previously the Western Ranges interested in north and south of Hwy.
Hold Sterling and Star Claims. Groups.
Now extend north and south of these properties:
 - a) To south parties ran into Hudson Bay Mining and Smelting
Company prospectors - hence all attention to north of Hwy.
 - b) To north of Hwy:
Located promising area about 15 miles north of Hwy.
Twelve mineral showing noted - most hi oxidized, showed
iron and manganese oxides on sfc with varying proportion
of galena. Two places narrow and hi grade galena
showed in gossans. Stripping attempted, but too tough
to get through to unoxidized mineral.
All in ls Qzites and schists of Camb? age
None good enough to stake without further attention -
planned further attention, but unable that year.
see attached map

Examinations of Properties:

- a) Holliday-Ranson Claims, B.C.-Yukon Bdy.
Discovered late 1947 season
June 1948 - vein traced 120 feet, showed hi grade galena over
widths of 6 to 12 inches. Small, but hi grade and accessible.
Option signed: 1) Syn given 65%, vendor 35% for \$500.00 cash
and guarantee to work on claims shortly.
2) Syn permitted to ship ore at any time during term.
Net profit to be split 65:35.
3) To hold option, Syn must:
 - a) By June 15th, 1949, do 5000 feet drilling
 - b) By Nov. 1st, 1949, carry out development
programme with the object of bringing the property into production
- Location: 20 claims (12 in B.C., 8 in Yukon) straddle bdy at 5 miles
south of Mile 706. Access by trail from 706, cross river by
"bos'n chair" rigged by Mr. Roy Ranson
Topog: At head of broad, flat, high level valley - bottom 4000 to
4500' Main showing at 5200, original discovery at 6000
Geology: All granite, subsidiary peg and some later basic dykes
varying between lamp and diabase. Narrow long inclusion of altered
band of seds comes in from southeast and runs NW just south of
property bdy
Mineralization: Two main types:
 - a) Dissem or spotty galena with pyrite in brecciated or
sheared zones in granite. Original disc. where
dissem galena occurs over 8 feet width
 - b) Narrow veins of hi grade galena Trenched
- Operations: Two men with a Warsop gasoline drill to trench
120 feet, depth 3 to 6 feet. Results: vein lensy with

0920-2



CANADA

GEOLOGICAL SURVEY OF CANADA

DEPARTMENT
OF

MINES AND TECHNICAL SURVEYS

2. -- 1948

hi grade galena varying from 7 inches to nil. Places where shear recognized but no galena. Sorted and sacked the hi grade.

Total 113 sacks (about 7 tons) - 78 sacks (4.675 tons) shipped in Sept. to Trail

35 " on property left.

Of 78 sacks:	Grade	Au	0.037	ozs/ton
		Ag	40.1	ozs/Ton
		Pb	65.4%	
		Zn	1.5%	

see B.C. Ann Rpt 1949 p. 69

Gross recovered value \$1,264.42

Conclusion: Vein of galena not quite wide enough or continuous enough to make a profitable operation possible. Odd bits of hi grade galena float around country may lead to better showings. Recommend drop option.

Yukon Ranges Prospecting Syndicate
Financial Statement for 1948

	Units Allotted at \$50 ea.	Units Allotted re truck	Total Units Allotted	Money rec'd re units
Frobisher Exploration Co., Ltd.	100		100	\$5,000.00
Nova-Co Exploration Co., Ltd.	60	8	60	3,000.00
Western Ranges Prospecting Syn.	60	8	68	3,000.00
D.R. Derry	10		10	500.00
J.M. Easson	10		10	500.00
	<u>240</u>	<u>8</u>	<u>248</u>	<u>\$12,000.00</u>

Money rec'd re units	\$12,000.00
" " re sale of ore	950.49
Total money rec'd	<u>12,950.49</u>

Less expenses as per statement	
	<u>12,543.49</u>

BALANCE	<u>407.00</u>
---------	---------------

092052



092052

CANADA

GEOLOGICAL SURVEY OF CANADA

DEPARTMENT
OF

MINES AND TECHNICAL SURVEYS

January 2, 1954

WESTERN RANGES PROSPECTING SYNDICATE

Summary of report of the 1947 season by D.R. Derry

Introduction:

a) Personnel: George Jones, leader; Charles MacNeil, S. LeGuyader, and Harry MacLean, prospectors; and Ronald Lamb Lake, W. Lamb, and W. Griffith students. Three pairs of prospector-student.

Properties staked or owned:1) Sterling Group 703 Hwy.History: Charles MacNeil and Ronald Lake disc early in 1947 season.First native Ag, later silver-lead-zinc showing
24 claims in all staked.Location: Straddle Alaska Hwy at Mile 703.4. Main showing at 1500 feet
from Hwy. Approx lat. 60-04, long 130-25Geology: Claim lines run 125 true, parallel to east sid contact.Seds: Ls Dol, minor arg sl schists. No fossils. Same series as
Star claims. Intruded by granite.

Youngest:	Slate and shale, black to light gray	600' plus
	Limestone, gray	200 - 300'
	Dolomite, Faith Hill (?), creamy buff white, weathers buff	150 - 600'
	Limestone, gray, well bedded in places	500 - 900'

Oldest: Schist 800' plus

Structure: On northwest flank of anticline, local. Axis may be in
valley followed by the highway.Regionally - ls and sl series trends NW ly close to flank
of Cassiar granite. General trend broken by cross-
folds of NE trend. One example seen at Star - Sterling
is similar case, but rather steeper dips and closer folding.Mineralization: Two types: a) Native silver, with galena and ruby silver,
in a narrow vein within granite, not far from the contact.b) Pyrite, galena, sphalerite, and subordinate
copper sulphides, forming replacement lenses and veins in dolomite
or limestone.No. 1 Vein : Only example of type a).

Vein follows fracture, str. 140, dip 85 W, some movement.

Central part: 1 to 8 inches is fissure-filling of well-crystallized
quartz in comb-structure, with minor amounts calcite, chlorite,
and mica. Ore min. native silver, in wire form and larger
pieces up to inch in diameter; 5 - 8% galena; some ruby
silver; some other metallic minerals unidentified.West wall: streak of galena up to 2 inches wide next to central.
Granite walls altered to griesen-like material of feld to mica,
chlorite, and (probably) kaolin, from one to three feet on
each side of vein.Silver values erratic; where not seen by naked eye, are
below commercial grade. Assays up to 103 oz/ton, max.No. 1 Trench - 12 foot length of cut, avoiding hi grade,
averaged 11.7 ozs./ton over a width of 10.5 inches

No. 2 Trench - 13 feet to NW; showed vein but very low values

No. 3 Trench - 15 feet to SE; 5 ozs/ton over 23 inches

Too erratic.

First native Ag found in vicinity of Alaska Hwy

(Derry)



CANADA

GEOLOGICAL SURVEY OF CANADA

DEPARTMENT
OF

MINES AND TECHNICAL SURVEYS

2.
January 7, 1954

No. 2 (Derry) Vein: Found June 23 by float. After bedrock reached, showed irregular zone about 6 by 8 feet of pyrite galena, and sphalerite, minor copper stain; in limestone breccia with ls (or dol) and cherty fragments. Min even dissem, and running through this are hi grade stringers of ~~fine~~ fairly pure fine-grained ~~mineralization~~ galena. Some strgers extend beyond area of mixed mineralization. Shape and attitude not known - west end where most heavily mineralized, zone appears to plunge or dip under ls breccia to west. Near east end a fairly strong cross strger appears to cut off the main mineralization - strger consists of banded sphalerite and galena. No definite shear or vein structure could be recognized. Belong to zone of brecciation, 300 to 450 feet wide, running northeasterly; showing near top Faith dol. Mineralization: Galena forms 10 to 20% - carried 3 ozs per unit of lead. 3 oz Ag to 1% Pb.

McLean Showing: McLean near end of season, in rusty and brecciated Faith dol. Grab sample of galena scattered through brec dol assayed 4.28 ozs./ton Ag, 12.79% Pb. McLean trenched after party left for 'outside' at end of season; ex osed footwall and part of a zone containing seams of galena 2 to 3 inches wide. McLean thinks may be bigger than No. 2 showing.

No. 3 ("Lake") Vein: In 'gray' limestone not over 25 feet from granite contact. Zone of brec limestone, considerably oxidized and limonitic. Some galena strgers and small lenses. Grab sample assayed 42.0 ozs/ton Ag, 62.27% Pb Interesting.

Other indications: Galena float and in small strgers and dissem i in place on a number of points of mountain. One piece of float found 600 feet mag west of No. 2 showing assayed 141 ozs/ton. Ag.

- 2) Star Group Additional work done on Star early in season. New discovery of float on Ho e Hill; grab assayed 11.37% Pb and 21.26 ozs/ton Ag. Guy Hill some more float - nothing. Faith Hill try to extend main vein discovered last year to SW, no definite continuity.
- 3) OWL Group and J.M. Smith Option: Partridge Creek - Munson Lake HBE&D discover late 1946 head of Swift River. Hence Charles McNeil sent in to s take around. Staked in early 1947 ten claims; later when HBE&E Co had three drills on the pro erty optioned group staked by J.M. Smith, adjoining to east of our group. When snow gone, all prospected (Moon staked but not recorded) and roughly mapped by McNeil and Lake. Geology (by McN. and Lake??): HBE&D in sediments (sl phyll qtzites) with minor limestones. OWL and JMS ground in Quartz Dior and assoc types. Dior is considerably altered and min with f.gr. pyrite and pyrrhotite. Four zones of more intense mineralization were found and sampled. One - near SW corner of JMS group was 12 feet wide and traced 50 feet. - prel assay 0.25 oz/ton Au 1.10 oz/ton Ag;- later sampling showed erratic zinc (up to 15%), no Au, one went 12 oz/ on Ag. Decided to drop JMS option since HBE&D drilling seemed unfavourable. OWL group good standing until next season- drop then.



CANADA

GEOLOGICAL SURVEY OF CANADA

DEPARTMENT
OF



MINES AND TECHNICAL SURVEYS

January 7, 1954^{3.}

4) The "G" Group: Logjam Creek

Staked by WRPS 1946 adjoining HBE&D claims on discovery of galena and sphalerite in two places. HBE&D drilled it in 1946 no good results.

Hence drop "G" Group.

Areas Prospected:

1) South of the Star Group: MacLean and LeGuyader

Geology: White-gray cherty quartzites str 000, dip almost vertical, to east of these is belt of rusty weathering dol (Faith?) then (to east) by gray gritty limestone.

Granite contact swings sharply to west and encroaches within 4 miles of west contact.

Mineralization: Years ago Berg staked f.gr. galena and sphalerite magnetite. Too much snow - not seen.

2) Star and Sterling Groups, between:

Too little outcrop - disappointing. Not staked.

3) North of Sterling Group:

Not enough done. Same rocks continue to north.

4) Carlick Creek:

Eden claims (not WRPS) - have galena in contorted shales or schist. Not much picked up.

Noted coal south of the bdy. Cret or Tert ??????????????????????

~~5) Porcupine Creek:~~

5) West flank of Cassiar Granite, north of highway.

HBE&D late 1946 discover Ag-Pb-Zn deposits; staked BOM claims.

Showing reported been traced 480 feet on surface, width 20 feet.

Min: mixed f.gr. galena, sphalerite, alabandite, pyrite and pyrrhotite

Reported hi Ag values, (specimen taken by our men ran 3.3 oz/ ton Ag)

Three drills during 1947 - results disappointing.

Atom Group - nil known.

Independently-owned claims examined:

1) Fromm Claims: Staked by Harry Fromm of Whitehorse, after discovery of galena by Indians of Whitehorse. Reported trail goes in from Mile 702. Not found when visited.

2) Holliday-Ransome Claims:

Late 1947 galena discovered by Allan F. Holliday (GNT Re-eater Sta., Swift River) while hunting sheep. R. Ransom joined in staking. (see 1948 report for details on geology)

Lake investigated - took four ~~continuous~~ contiguous channel samples across 4-foot width of the vein - average 4.43 ozs/ton of silver and 1.88% Pb. Highest was 16.75 ozs Ag and 9.93% Pb One of two other showing - grab sample a 2 1/2 inch stringer assayed 1.47 ozs Ag and 15.3% Pb.

0920-2



CANADA

GEOLOGICAL SURVEY OF CANADA

DEPARTMENT
OF

MINES AND TECHNICAL SURVEYS

January 7, 1954^{4.}

Western Ranges Prospecting Syndicate
Financial Statement ending December 1947

Frobisher Exploration Co. Ltd.	233	11,650.00	3,495.00
Conwent Exploration Co. Ltd	233	11,650.00	3,495.00
Cockeram Red Lake Mines Ltd.	100	5,000.00	1,500.00
C.H.E. Stewart - In trust	100	5,000.00	1,500.00
Thayer Lindsay, Esq.	33	1,650.00	495.00
C.H.E. Stewart	1	50.00	15.00
	<u>700</u>	<u>35,000.00</u>	<u>10,500.00</u>

Total capital Received	35,000.00
" loan "	<u>10,500.00</u>
	<u>45,500.00</u>

Less expenditures:

Statement of March 31/47	19,107.62	
December 1947	<u>19,226.80</u>	
		<u>38,334.42</u>
		7,165.58

J.M. Easson, Manager.

092052

Geological Survey of Canada
Victoria Museum
January 8, 1954.

Mr. J.A. Harquail
Ventures Limited
25 King Street West
Toronto, Ontario.

Dear Mr. Harquail:

Under separate cover are the three annual reports, 1946 to 1948, inclusive, of Western Ranges and Yukon Ranges, by Dr. D.R. Derry, which you were so kind to allow me to study.

I found the reports so informative that I made summaries and rough copies of the maps of the most interesting areas. They will serve as an excellent guide when I am able to examine the properties and adjacent areas.

Of course, I shall regard this information as completely confidential. Should I wish to use any ideas or portions of maps, I shall first seek your permission. If this be granted, full recognition of the source will be made.

Yours very truly,

W.H. Poole

092052



CANADA

GEOLOGICAL SURVEY OF CANADA

DEPARTMENT OF

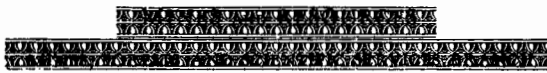

MINES AND TECHNICAL SURVEYS

1)
January 15, 1954

WESTERN RANGES PROSPECTING SYNDICATE

Summary of report on the 1946 season by D.R. Derry

Introduction:

a) Personnel: Ralph MacDonald, field engineer; senior prospectors George Jones, Percy Page and S. Leguyader; Charlie MacNeil; and two assistant prospectors Percy Page and S. Leguyader.

Properties Staked:

1) Star Group: George Jones and S. Leguyader staked after finding float.
17 claims staked by Syn men
8 " " " " J.B. Gordon, Hoyle Mining Co., turned to Syn
Total 25 claims held by the Syn.
Bulldozer hired to cut self in and trench.

Geology: a) Strat.

Top Charity Hill Limestone - ls or dol, grey xline, weather pink buff. (Fritz - Ordovician)

Limestone - grey xline; occasionally dark gray limey shale at base.

Faith Hill Limestone - ls or dol, creamy white, wther buff rarely shows bedding; ALL ORE HERE

Shale, buff wethering; sometimes missing.

Limestone, grey weathering, xline.

Bottom Limestone, banded and argill, and bedded schistose sediments.

b) Struct.

Suggests broad anticline, Charity Hill at apex, pitching 25 SE. Subsidiary anticlinal fold included within the major fold is shown by the configuration of the base of the Faith Hill ls on claims 6 and 8. Suggest a southerly pitch, probably steeper than the major fold. Note all galena showings occur on a short distance west of the axis of the minor structure, and limonite occurs on the east of it. Structure control of the deposits? Fault on the contact? a) Seds dip into granite.
b) No granite tongues into limestone
c) No appreciable devel silicates.

c) Mineralization.

All galena in Faith Hill ls or in und erlying Fm near top. In zone, ls criss-crossed by fine rusty-coloured fractures. Occasionally the alteration is accompanied by dissem galena in sub-marginal quantities, in three places by definite veinlets or strgers. 1st disc is 6-3 - trenched for 160 feet, shear traceable for greater part of length, within which galena occurs in lenses from few to 22 inches wide. Str 155 true, dip vert to 80 SW. Walls Faith Hill ls cream coloured, wthers rusty brown. Shear contains black soft oxidized material. Lenses of galena are pure, usually coarse, often fine gr. Av. of 9 samples of av width 6.6 in taken accross various lenses is 21.2 ozs (cut) or 30 ozs (uncut) Ag and 67.62% Pb. One 100 ozs Ag * exceptional
2nd Disc. trenches 1-1 and 1-0 Rough sample across 8 in stgreof fresh galena assayed 28.80 ozs Ag and 70.86% Pb. Zones str 167 true, dip 68 West. Zone 65 feet, altho galena only in one trench.

092052



CANADA

GEOLOGICAL SURVEY OF CANADA

DEPARTMENT
OF

MINES AND TECHNICAL SURVEYS

2)
January 15, 1954.

3rd occurrence trench 1-6. stger 2-4 inch galena in 4-6 inch band of limonite. traced 15 feet str 140 true, dip 30 W sample No. 76 across 2½ inches of galena and limonite assayed 18.94 ozs Ag and 25.48% Pb

All others nil but dissem gal in fractured ls.

Data on trenches

Trench No.	Length (ft.)	Width (ft.)	Average Depth (ft)	Max. Depth (ft)	Remarks
1-0	55	6	½	1	No limonite on surface. Shear traced from 1-1
1-1	100	7	2½	4	Limonite float. Vein zone 6"-12" wide contains gal and brn limonite. Str 167, dip 68W. Tr 65 ft.
1-2	70	8	2	4	No limonite or fract ls
1-3	85	8	2	3	Nil
1-4	75	8	1½	2	Much fract ls. No limonite
1-5	50	6	2½	3	
1-6-	25	20	2	4	2"-4" wide gal vn along 4"-6" wide limonite; continuous for 14 ft. str 140, dip 30W
1-7	25	8	2	4	Limonite continues from 1-6
1-8	25	7	2½	3½	Nil
3-2	16	6	2½	3	Dissem gal in fract ls. Minor pyrite
3-3	4	4	2	4	Ditto 3-2
3-4	6	6	3	4½	Nil
3-5	8	6	4	6	Nil
3-6	80	8	3	7	Dissem gal in ls. Minor pyrite
3-7	20	3½	2	3	Dissem gal in fract ls
3-8	30	8	3	5½	Sandy soil only; on flat
3-9	50	8	1½	2	Limonite float, fract ls and calcite
3-10	35	8	2	3½	18" wide limonite zone in place.
3-11	50	7	1½	4½	6"-12" wide limonite zone str 160, dip flat north Calcite fractured ls and manganeseiferous rock.
3-12	140	7	2	3	Well - No lim. Calcite and fract ls
3-13	50	7	3½	5	'Contact' trench. Actual contact un seen
3-14	60	8	2½	3½	6" wide lim zone in place. Much fract ls
3-15	130	8	2½	4½	Nil
5-1	20	4	2	2½	Nil
6-1	90	9	3	4½	Near east end a 12" wide pink oxidized zone. No lim. Fract ls
6-2	85	7	3	4½	Nil
6-3	180	20	3	11	See detailed sketch. Main gal showing
6-4	60	8	2	3	Minor calcite. No lim
6-5	115	8	3	7	Limonite, rust, ice. Depression
6-6	40	9	4	8	Lim. rust Depressions, ice
6-7	400	8	2	4	No limonite
6-8	215	8	2	8	Limonite and reddish rust. Ice. Depression
6-9	35	8	1½	3	Lim Depression
6-10	65	10	4	7	Quartz porphyry, reddish rust. Ice depression
6-					
10-1	100	10	4	6	Rotted quartz porphyry, brn rust. lim. Ice gully
10-2	65	8	2½	6	Quartz porphyry and lim
10-3	55	8	2½	5	Fract ls and calcite gully
10-4	50	8	3	4	Nil

092052

Geological Survey of Canada
Victoria Museum
Ottawa, Ontario
January 16, 1954

Dr. D.R. Derry
Ventures Limited
25 King Street West
Toronto, Ontario.

Dear Dr. Derry:

Under separate cover are the three annual reports, 1946 to 1948, inclusive, of the Western Ranges and the Yukon Ranges, which you were so kind to allow me to study.

I found the reports so informative that I made summaries and rough copies of the maps of the most interesting areas. They will serve as excellent guides when I am able to examine the properties and adjacent areas.

Of course, I shall regard this information as completely confidential. Should I wish to use any ideas or portions of maps, I shall first seek your permission. If this be granted, full recognition of the source will be made.

Many thanks again.

Yours very truly,

W.H. Poole

092072

2810
25 KING STREET WEST
TORONTO

January 19th, 1954.

Mr. W. H. Poole,
Geological Survey of Canada,
Victoria Museum,
Ottawa, Ontario.

Dear Mr. Poole:

Many thanks for your letter of January 16th and for returning the three annual reports of Western Ranges and Yukon Ranges.

I am very glad these were of some use to you and if there is any further information in this regard that you would like I hope you will let me know.

If I am in Ottawa I will try and drop in and have a talk with you about this district in general.

With all best regards,

Yours sincerely,

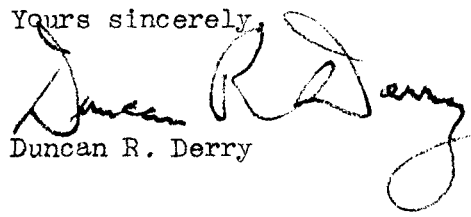
Duncan R. Derry

DRD:dw

092032

Victoria Museum
Ottawa, Ontario
January 27, 1951.

Dr. D.R. Derry
Ventures Limited
25 King Street West
Toronto, Ontario.

Dear Dr. Derry:

It was very good of you to advise me in your letter of January 19th that you had received the three annual reports.

I would be very pleased to discuss with you the district if you find time when in Ottawa.

Yours truly,

W.H. Poole

092052

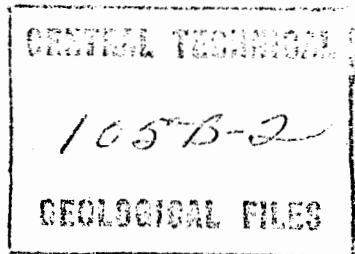

ROYAL CANADIAN MOUNTED POLICE.

34D 1456-3 Q.24

May 15th, 1934.

From: The Commissioner, R.C.M. Police, Ottawa, Ont.
TO: The Deputy Minister, Department of the Interior,
Ottawa, Ont.

Mining Activities - Sayyea and Cabin Creek
District - Yukon Territory.
.....

1. Referring to previous correspondence on the above mentioned subject, your file No.9., I now enclose copy of a report of a winter patrol made by Constable W.T. Irvine from Teslin Detachment, Y.T., dated March 14th, 1934, and forwarded here by the Officer Commanding at Dawson, with his letter of April 21st.
2. I also attach a copy of the sketch also made by Const. Irvine in connection with this matter.
3. I have informed the Officer Commanding at Dawson that there is no objection to him furnishing a copy to Mr. G.A. Jeckell, Comptroller of the Yukon Territory.

34D 1456-3 Q.24

J. H. MacBrien,
Commissioner.

The O.C. "B" Division,
Dawson, Y.T.

Copy for your information and necessary action in connection with the last paragraph of your letter of the 21st April on this subject.

Ottawa, Ont.
15-5-34.

J. H. MacBrien,
Commissioner.

092052

ROYAL CANADIAN MOUNTED POLICE.

M 97
Hdqrs. File No. 33D 1456-3-Q.24

Dawson, Y.T.
April 21, 1934.

The Commissioner,
R.C.M. Police,
Ottawa, Ont.

Sir,

Re; R.C.M. Police Patrol - Teslin to Sayyea
and Cabin Creek Areas, Yukon Territory.

1. Re the above and your memorandum of December 13th, 1933, I have the honour to forward herewith the report of Reg. No. 10926, Constable Irvine, W.T. of the Teslin Detachment, under date of March 14th, 1934, covering the Patrol made by him into the above mentioned areas, together with a copy of the map referred to in the General Remarks.

2. From the investigations and observations made by Constable Irvine, considerable activity in mining and prospecting appears certain in that district, which would now seem of easy access from the Teslin Detachment.

3. Mr. G.A. Jeckell, Comptroller of the Yukon Territory, informed me he would like to obtain a copy of Constable Irvine's report of this Patrol when completed, and I would ask that I be instructed whether it will meet with your approval to do so.

I have the honour to be,
Sir,
Your obedient servant,

T. B. Caulkin, Supt.
O.C. "B" Division.

092052

ROYAL CANADIAN MOUNTED POLICE.

"B" Division,
Teslin Lake Detachment,

M 97

Teslin, Y.T. March, 14th. 1934.

The Officer Commanding,
R.C.M. Police,
Yukon District,
Dawson, Y.T.

Sir,

Re; R.C.M. Police Patrol, Teslin Y.T. to Sayyea
and Cabin Creek Areas, Yukon Territory.

1. In compliance with instructions re. the above Patrol, I have the honour to report that I left Teslin Lake Detachment, per Police Dog train No's 89, 90, 91, 92, 93, accompanied by B. Fox, Guide Interpreter, on March 1st. and arrived back to Detachment on March 11th.

2. The route followed was up the Nisutlin River to Wolf River, then along the course of Wolf River to Red Mountain Cut-off, across Red Mountain Cut-off, thence along Little Wolf River to Wolf Lake. The Patrol then went across Wolf Lake and followed a low pass up to the summit, this summit being the height of land between the Yukon and MacKenzie River waters, course then followed was down a small creek to Shootinook Creek, Shootinook was then followed to Scurvey Creek, Scurvey was followed to the Liard River and then the Liard was followed to Sayyea and Cabin Creeks. The same route was followed on return patrol, leaving Sayyea on the 8th. as there was no object in prolonging stay and there was signs of the weather breaking.

3. The trail throughout the Patrol was good, taking into consideration that the district beyond Wolf Lake is untrav-
elled in winter, this was due to the late thaws and there was sufficient crust to hold up the dogs, however it was necessary to snowshoe ahead of the dogs from Wolf Lake on as the creeks were partially open and had to be crossed and re-crossed a number of times, the most difficult part of the trail was on Scurvey Creek, at the fork where Shootinook flows into it the creek was open and it was necessary to gravel the high bench along the right side for about three miles, to get of the bench and into the creek again it was necessary to take the dogs out and lower the Toboggan with a rope, fortunately it was cold weather whilst patrol was on this creek, otherwise a lot of open water would have had to been contented with, even with the Temperature at 20 below when patrol was in this district, on return parts of our trail where we had crossed the creek had disappeared and new crossings had to be made. A detour had to be made at the Canyon which is approximately four miles from the river, to go around the canyon it was necessary to take the high bank on the left side, no difficulty was had here, but would not be a practical route if large loads were being freighted, on account of the high banks and steep pitches to be contented with. After getting around the Canyon the trail is good to Sayyea and Cabin Creeks.

4. Dog feed and rations were carried from this point for patrol due to the fact that patrol was made in a shorter time than was planned, I was able to make a small cache of grub on Sayyea Creek, this consists of 10 lbs.

092002

of flour, 51 bs. of suger, beans, Rice and dried fruit enough to last for a week, this cache may be of use to future patrols in this district. Dogs were in fine condition throughout the patrol and averaged 35 miles per day on return, early starts being made, with an hour and a half rest at noon, and camp being made at about 5.30 in the evening.

5. B. Fox, Guide Interpreter proved very satisfactory throughout the patrol, being energetic, clean and has a natives instinct for picking trails.

6. GAME

Moose and Caribou are plentiful throughout the district More Fur signs were seen in the Liard District than in the Teslin Lake, particularly Lynx, Martin and Wolverine.

7. MINING.

As I was instructed to specially observe Mining activities in this district, I include the following for your information on Feb. 21st. Pilot Stan MacMillan arrived in Teslin from Edmonton and the Liard River District with passengers Anderson and Tiggert, Tiggert, being the man who staked Discovery on Sayyea Creek last summer and also interested the Northern Aerial Mining and Exploration Co. in this district. In an interview with Tiggert at this point he stated as follows: During the past summer whilst I was employed with nine other men in the Liard district, by the N.A.M.E. we prospected on a number of Creeks, staking two, one being six miles above Scurvey (this was reported in my report of last spring) and Sayyea Creek, on the creek six miles above Scurvey we did not record the claims as there was not sufficient prospects to warrant same. Sayyea Creek was prospected from the mouth to about two miles up the creek, cross cuts and shafts being made, in these operations 34 oz. of gold was taken out, one nugget weighing 3 oz. The claims on this creek were recorded through Corpl. Harvey and Const. Johnson when they were on Sayyea Creek. Tiggert further stated that it was his belief that this Company would be back to Sayyea Creek again early this year to carry on further prospecting operations on the Creek and in the surrounding district. Further Tiggert stated that he had staked other creeks in the district this trip and also some Quartz and that he was going to record same at Carcrosse, Y.T. Tiggert did not mention the location of these creeks or quartz property, but said that he would be carrying on prospecting operations in the district this summer and that he was making arrangements to have 5 tons of supplies flew in this summer. In furtherance to the above he said, that he would like to see the Police with appointment of Acting Mining Recorder stationed at a central point in the district, and said that the patrol of last summer proved very satisfactory and was very convenient for them in recording their claims.

b. Whilst in this district, patrol covered Shootinook, Scurvey, Sayyea and Cabin Creeks, on Shootinook I found new staking had been done, this was by Tiggert and party on Feb. 20th. four claims being staked, also Billy Smith (Indian) and family have staked 5 new claims, Smith lives on the creek and holds a Double Discovery, R. McCleery of Teslin and W. Smarch, (Indian) caught up to patrol at this point and also staked claims, if the new claims staked on this creek are recorded, this will make the total of claims on Shootinook in good standing amount to thirteen. Shootinook Creek was originally staked in the spring of 1932 but since that time some 50 claims have been let lapse, discovery claim alone being kept in good standing.

c. On Sayyea Creek, I found that it stood much the same as when Corpl. Harvey and Const. Johnson left it, and the men who were operating on it last year have gone outside for the winter. On this creek I found that forty-one claims and a mile lease has been staked. Twenty-four being staked by N.A.M.E. Co. men as well as the mile prospecting lease, the other claims have been staked by individual prospectors, some of which I believe were recorded with Corpl. Harvey. Claims 24 to 29 were staked on Powers of Attorney and applications for same was made at Teslin, these I believe have been turned down, I also noted that six claims were staked on Co's one mile lease in November, of these I am informed only three have been recorded, and that the application has been returned for same, not being granted. R. McCleery and W. Smarch also staked claims whilst on the creek and I believe intend recording same, of the other claims I have no check as to whether they have been recorded or not, as I believe they were applied for through the Carcross office, but a check could be made of Applications made through the Mining Recorders Office at Dawson, Y.T.

d. On Scurvey and Cabin Creeks there was no sign of any staking and I do not believe any has been done.

e. Two cabins and a large cache has been built on Sayyea Creek in these are stored a considerable amount of supplies and Mining equipment all belonging to the N.A.M.E. Since my return to Teslin I have been informed through N. Forbes, Prospector that the N.A.M.E. party are leaving Carcross between April 15th. and 25th. to fly into Sayyea Creek. With this Co. returning to this district and Tiggert being interested in other creeks as it does not seem likely that the staking on Shootinook would warrant the expenditure of flying in from Edmonton, and as this district has been getting considerable publicity in the Mining Journals during the past winter, it seems likely that there will be considerable activity at that point during the coming summer.

8. GENERAL.

A very heavy snow fall has been had in the Liard District this winter, so great that it has broke down the overhang on one of the N.A.M.E. Cabins on Sayyea Creek. Whilst travelling down Scurvey Creek it was noted that there was a considerable number of Tamarack trees along the creek, this may be of interest as I do not believe this tree grows on this side of the Height of Land. On Scurvey Creek about three miles above the Canyon I have seen a notice which was placed there during last summer by Corpl. Harvey and Const. Johnson, I also found a small cache of Hardtack in an old cabin at this point which I presume they left there whilst at that point.

Further notations have been compiled on map which I have made of this district, a copy of this map is being forwarded, it will be noted on same that the course of Murray Creek and Cabin creek seems a practical route and I am of the opinion should it be necessary to freight by dog team in the winter that this route would be the best.

No expense incurred.
Mileage 288
Days occupied. 11

092052

COPY OF PATROL DIARY.

- WEDNESDAY: 1-3-34. Const. Irvine - Started on Sayyea Creek Patrol accompanied by B. Fox, Guide Interpreter, and patrolled per Police dog team from Teslin to English Creek. Nooned at Caldwell's Bay.
Miles.....35? = 20?
- THURSDAY: 2-3-34 Const. Irvine - Broke camp at 6.30 A.M. and patrolled per Police Dog team from English Creek to little Wolf River, Nooned at Fish Lake, Brush camp made at Little Wolf.
Miles.....32 = 24⁺
- FRIDAY: 3-3-34. Const. Irvine - Broke camp at 6.30 A.M. and patrolled from Little Wolf, across Wolf Lake following course of creeks to Summit, then down, unnamed creek to Shootinook, snowshoeing was necessary ahead of dogs after Wolf Lake, Brush camped on Shootinook.
Miles.....28 = 20
- SATURDAY: 4-3-34. Const. Irvine - Broke camp at 6.30 a.m. and patrol continued down Shootinook, Nooned at Billy Smith's camp and continued down Shootinook and course of Scurvey, Scurvey Creek was partially open and high benches had to be travelled for the first part, then creek was followed with much crossing and re-crossing to an old cabin, where Corpl. Harvey and Const. Johnson's sign was seen, brush camp for the night was made here.
Miles20
- SUNDAY: 5-3-34 Const. Irvine - Broke camp at 7 A.M. and patrol continued down Scurvey, detour was made around Canyon on left side, trail very steep in places, Scurvey and the Liard River was then followed to Sayyea Creek, noon camp was made at Miller, McLean and Forbes old Cache at the Mouth of Scurvey Creek.
Miles.....20
- MONDAY: 6-3-34 Const. Irvine - Camp was made in N.A.M.E. cabin whilst on Sayyea Creek, note left. In the A.M. a patrol was made up the Creek to as far as staking went and a check was made of the people staking, very little new staking was seen and is much the same as last fall, No signs of anyone being on the creek since last November.
Miles.....12 Foot.
- TUESDAY: 7-3-34 Const. Irvine - Patrolled in A.M. to Cabin Creek and return, no signs seen and no one is on the creek; In P.M. employed on Sayyea, cooking bannocks and preparing for return trip.
Miles.....6 dogs.

092052

THURSDAY: Const. Irvine - Started on return patrol as there
8-3-34 was no object in staying in this locality and there
was signs of the cold weather breaking. Patrol
camped at B. Smith's camp on Shootinook at 5 P.M.
Patrol was then made of the creek and a check was
made of the new staking at that point.

Miles.....28 dogs.

FRIDAY: Const. Irvine - Patrolled from B. Smith's camp in A.M
9-3-34 Nooned on Summit and camped for night at old camp
on Little Wolf River, trail in good condition.

Miles.....40 dogs.

Saturday: Const. Irvine - Broke camp at 6 a.m. and patrolled
10-3-34 per Police Dog team to English Creek, nooned in Red
Mountain Cutoff, trail breaking as weather turned
decidely soft.

Miles.....32 dogs.

SUNDAY: Const. Irvine - Broke camp at 4.30 A.M. and
11-3-34 patrolled per Police Dog team from English Creek
to Teslin, patrol arrived in Teslin at 1 P.M.

Miles.....35 dogs.

No expanse incurred.
Mileage.....288
Days occupied..... 11

I have the honour to be ,
Sir,
Your obedient servant,

W. T. Irvine)Const.
Reg. No. 10926
I/C Teslin Lake Detachment..

092052

GEOLOGICAL SURVEY OF CANADA

MINES AND TECHNICAL SURVEYS

MEMORANDUM

TO..... DATE January 1954

SUBJECT

Summary and copies of Maps of Annual Reports submitted to

1946-47 WESTERN RANGES PROSPECTING SYNDICATE
1948 YUKON RANGES PROSPECTING SYNDICATE

by D.R. Derry

List of maps:

- 1946 -- Section and plan of Trench 6-3 Star Group (Main showing)
"G" Group, Logjam Creek 1" to 1,000 ft
- 1947 -- Star Group, geology, 1" to 500'
Sterling Group, Geology, 1" to 300'
Sterling Group, No.1 Vein, 1" to 5'
Sterling Group, No.2 Vein, 1" to 5'
Map south of Carlock Creek
HBE&D and OWL Groups Munson Lake 1 mi to 1 in
- 1948 -- Map area north of Sterling Group, prospected

W.H. Poole

092052

WESTERN RANGES PROSPECTING SYNDICATE

— STAR GROUP —

SECTION & PLAN OF TRENCH 6-3 ON FAITH HILL

SCALE 10' = 1"

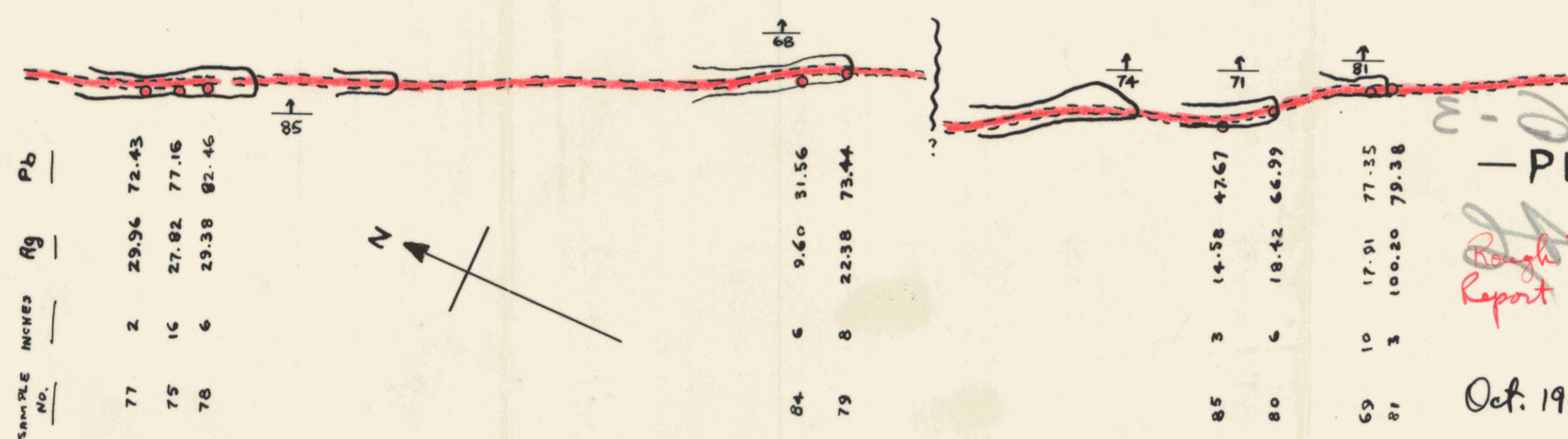
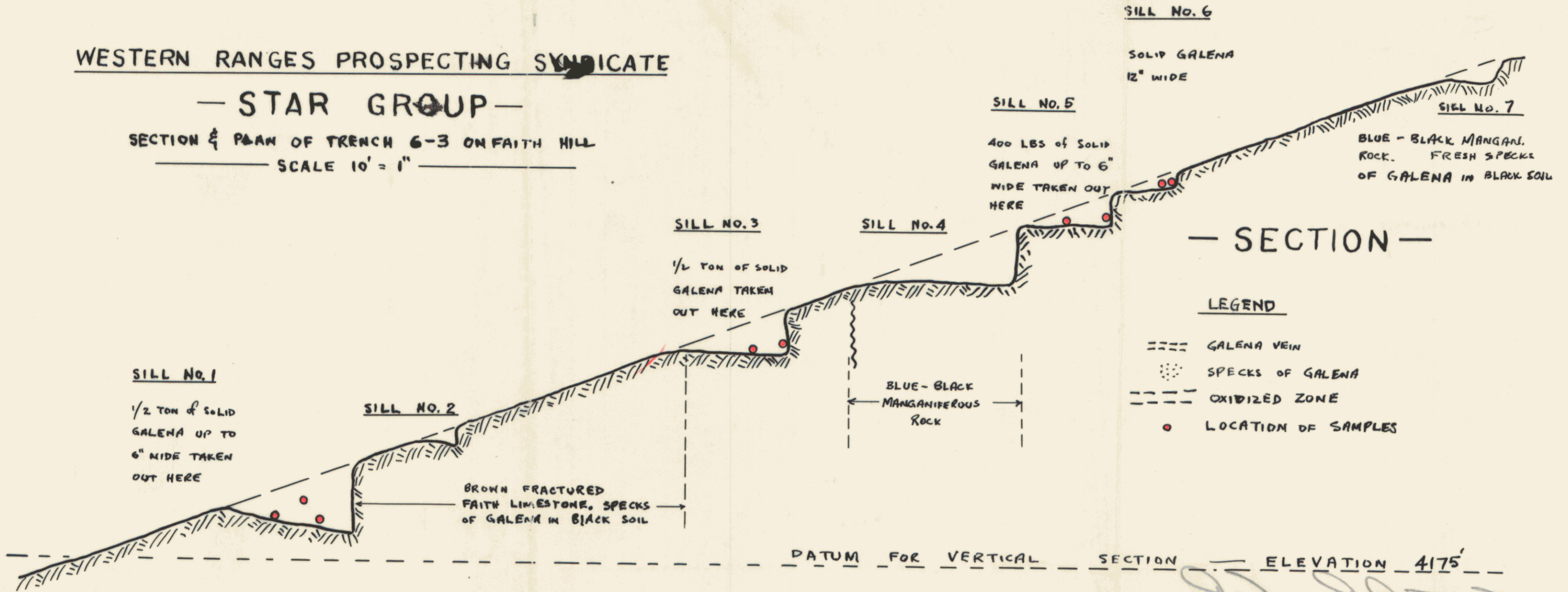

SAMPLE NO.	INCHES	Ag	Pb
77	2	29.96	72.43
75	16	27.82	77.16
78	6	29.38	82.46
84	6	9.60	31.56
79	8	22.38	73.44
85	3	14.58	47.67
80	6	18.42	66.99
69	10	17.91	77.35
81	3	100.20	79.38

— PLAN —

Rough Tracing of Annual Report 1946 - by D.R. Denny
Jan/1954 W.A. Poole
 Oct. 1946.

50503

"G GROUP CLAIMS"

(AND ADJACENT PROPERTY)

OCT. 1946.

SCALE 1" = 1000'

D.R. DERRY.

LEGEND

- GRANITE
- QUARTZ PORPHYRY, APLITE
- GRANODIORITE, QUARTZ DIORITE
- SEDIMENTS - QUARTZITE, LIMESTONE, SHALE

HUDSON BAY EXPLORATION & DEVELOPMENT CO.

H.B. N^o 1 SHOWING.
(APPROX. POSITION)

H.B. N^o 2 SHOWING

DB.H.'S
SILIC'D DK. SHALE
& LIMESTONE

QUARTZITE

Rusty granodiorite with
dessem. Pgn-pgn &
occasional chpy. on cliff side.

YUKON TERRITORY
BRITISH COLUMBIA.

CLAIMS STAKED BY W.R.P.S.

ROUGH CONTOURS DRAWN ONLY TO
ILLUSTRATE GENERAL TOPOGRAPHY
AND SPOT ELEVATIONS.

Rough Tracing included with annual Report
to W.R.P.S. by D.R. Derry 1946
Jan/54 with photo

092052

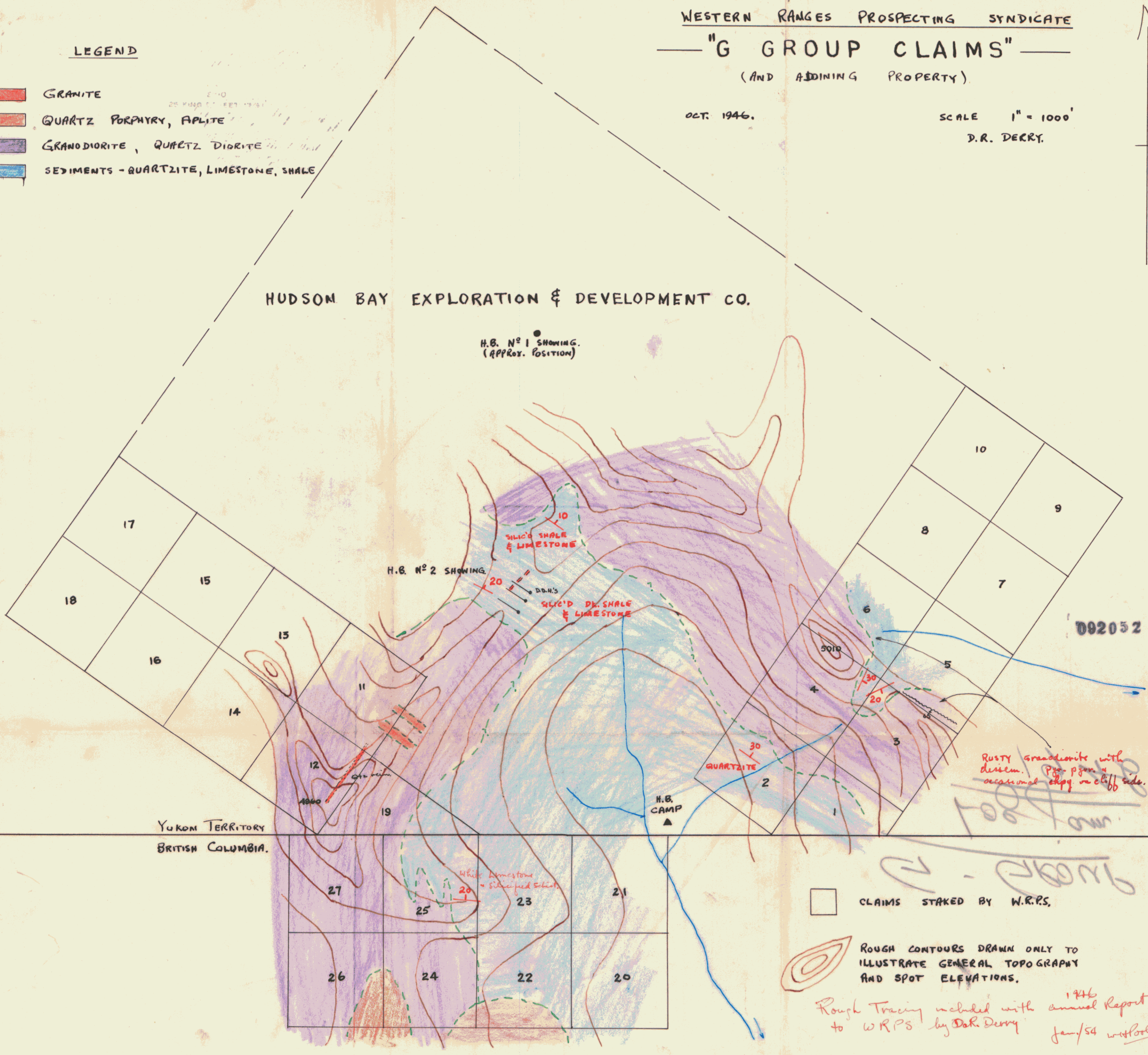

WESTERN RANGES PROSPECTING SYNDICATE
STAR GROUP

SCALE 1" = 500'

Oct 1944
 Nov. 1947

D.R. DERRY
 R.C. MACDONALD

CAMP
 ELEV. 3600'

Note - Add 400' TO ALL
 CONTOUR ELEV'S.

SYMBOLS

- Galena Vein in Place
- Trench or Pit
- Areas with gossan float
- Limit of Tree Growth
- Contours - 50 ft interval.

LEGEND

- QUARTZ PORPHYRY
- GRANITE
- DEVONIAN or CARBONIFEROUS (doubtful) = CAMBRIAN (Pole)
- CHARITY HILL LIMESTONE (with fossiliferous shale bands)
- CAL GRAY LIMESTONE
- SHALE (rusty weathering)
- FAITH Dolomite
- SHALE
- GREY LIMESTONE
- BANDED ARGILLACEOUS SANDSTONE
- CHERT, QUARTZITE, SHALE, SLATE, = Position unknown.

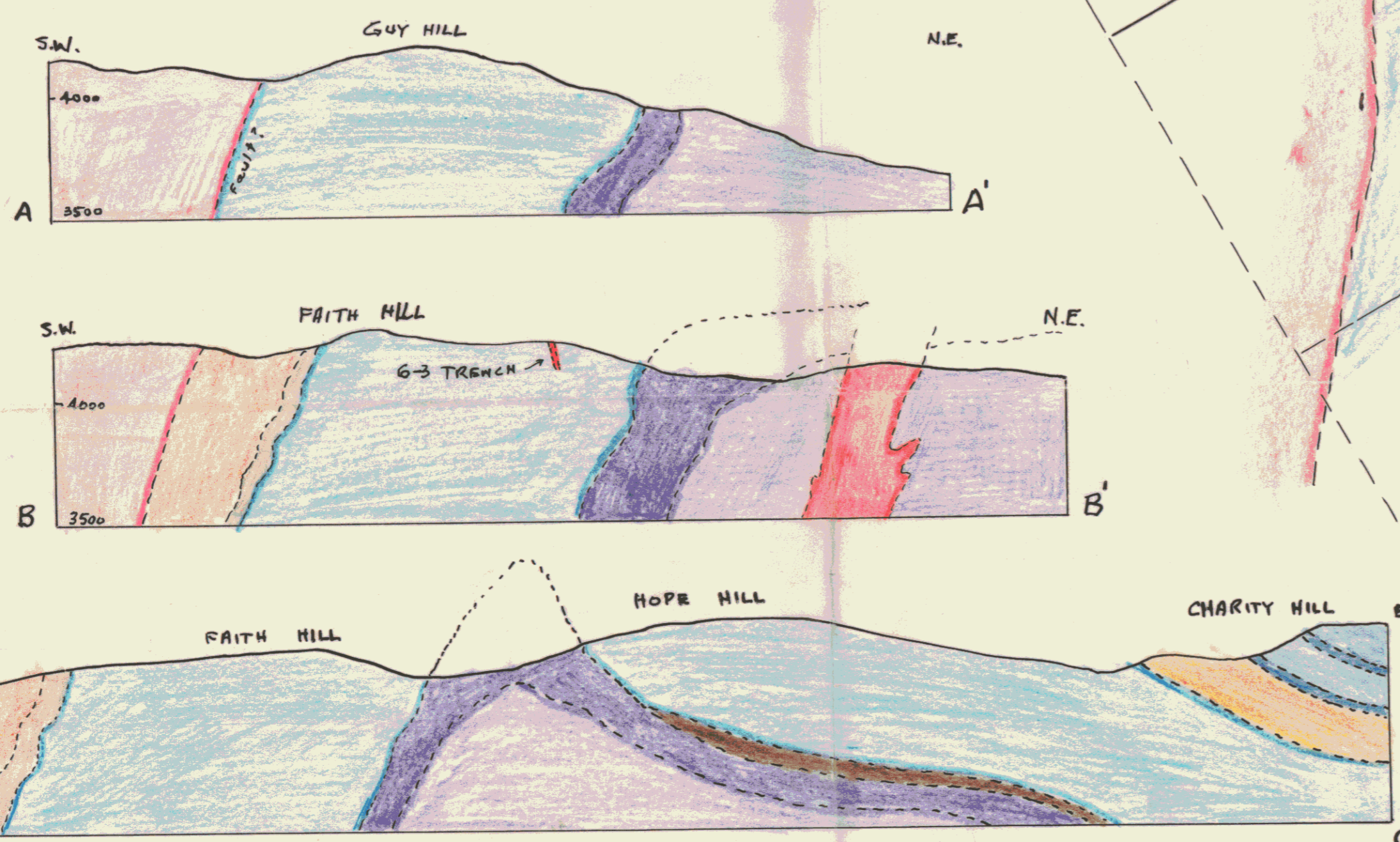
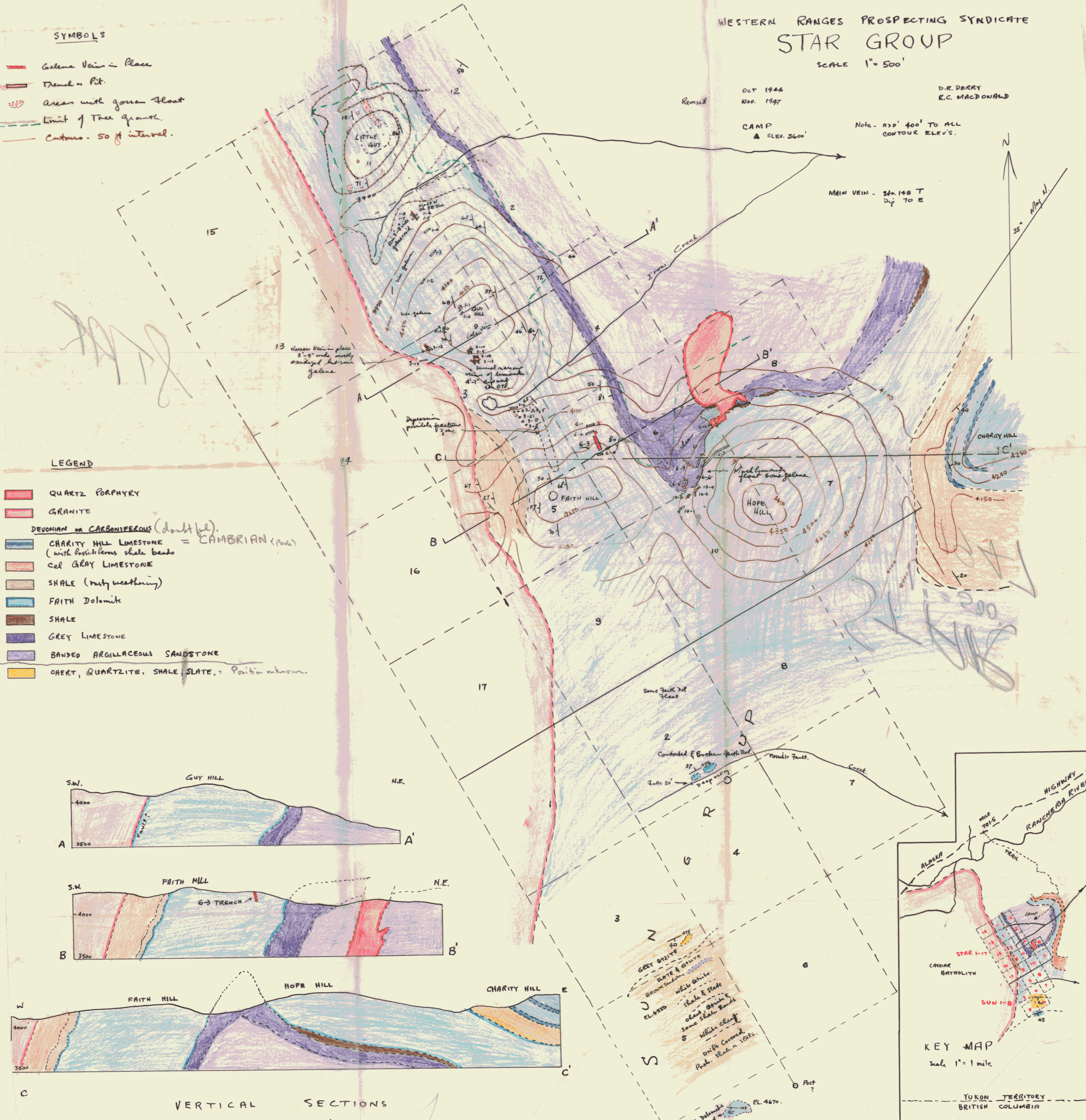

VERTICAL SECTIONS
 SCALE 1" = 500'

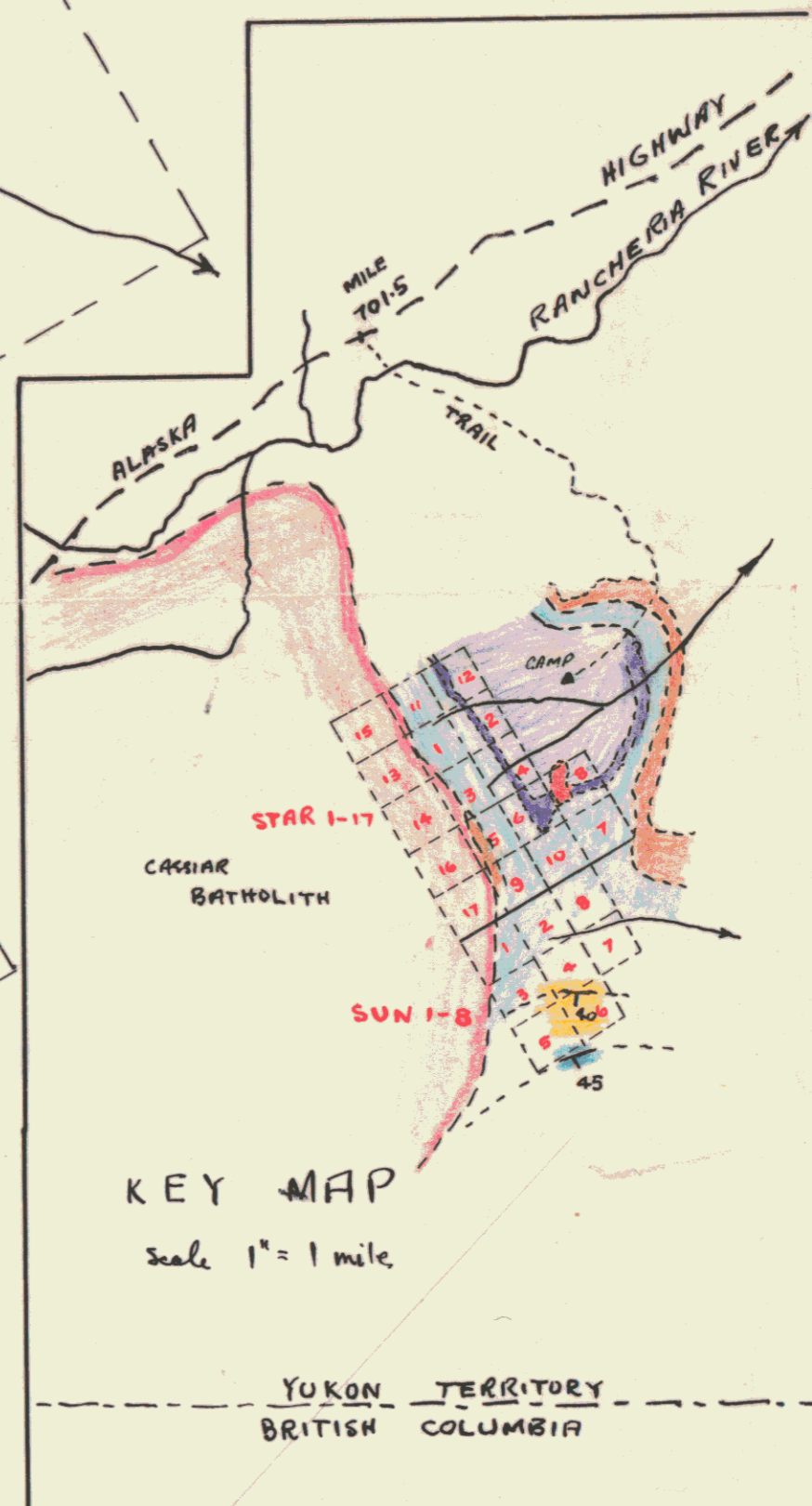

KEY MAP
 Scale 1" = 1 mile

Map enclosed with report on 1947 season. W.R.P.S.
 by D.R. Derry.

ROUGH TRACING
 of MAP by D.R. Derry 1947.

by W.H. Poole, 1954.

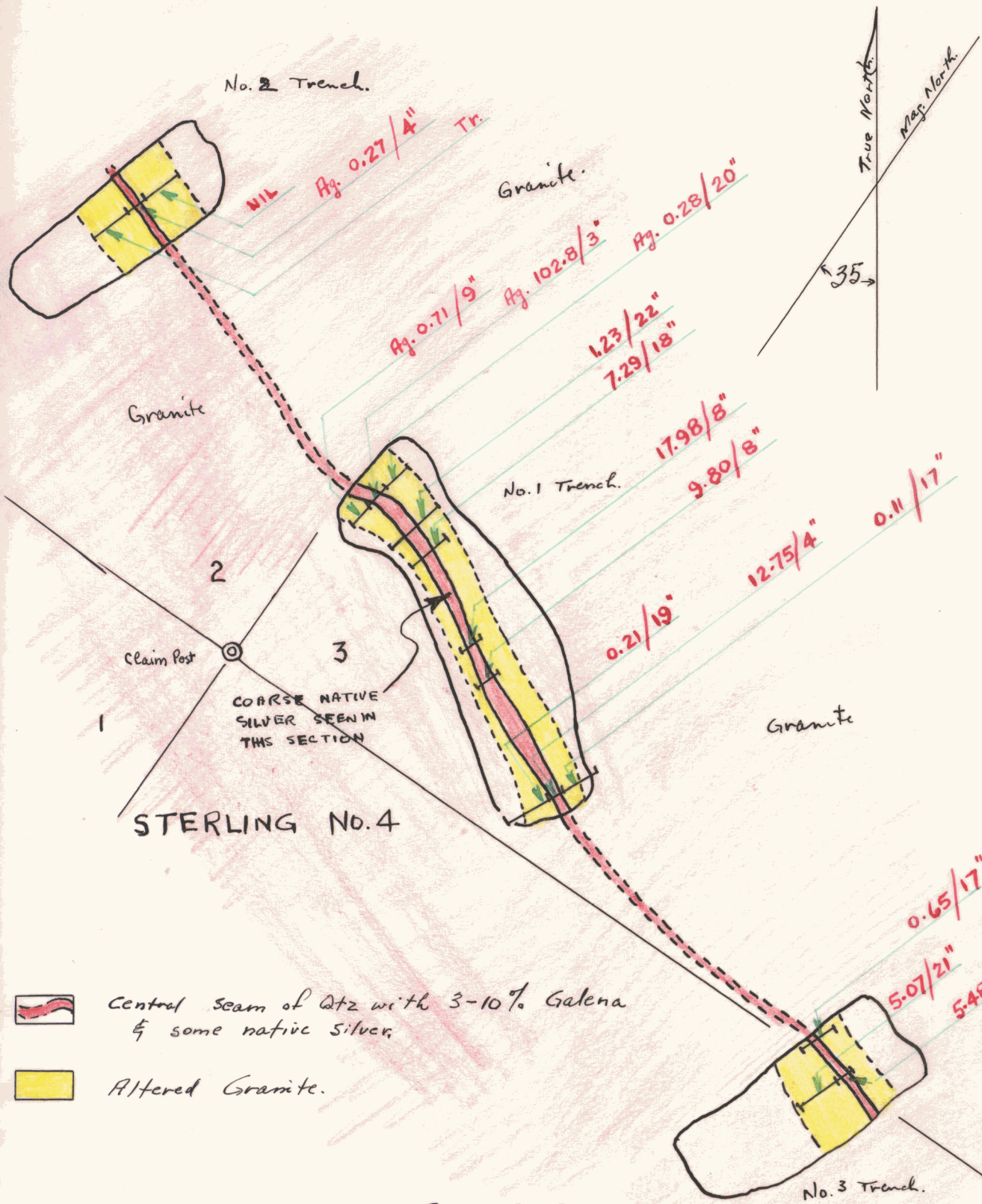

Central seam of Qtz with 3-10% Galena & some native silver.



Altered Granite.

STERLING CLAIMS

No. 1 VEIN - ASSAY PLAN

SCALE 1" = 5'

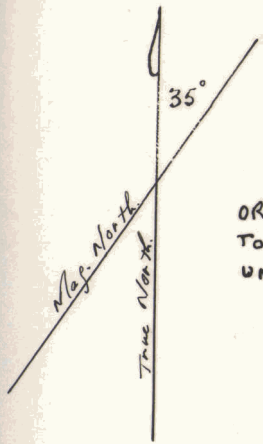

ORE HERE APPEARS TO DIP OR PLUNGE UNDER BRECCIA

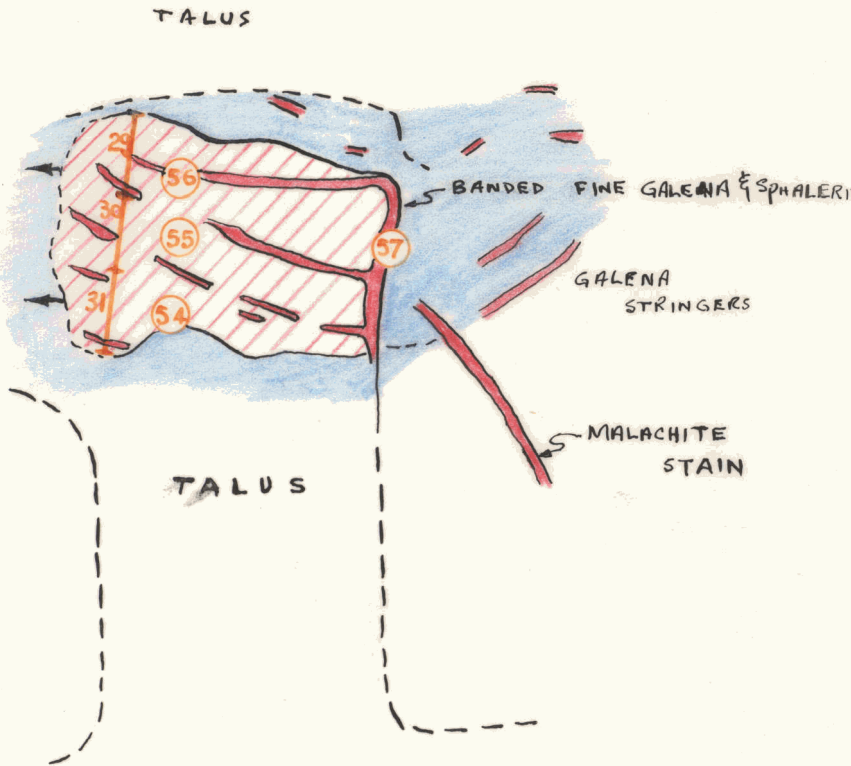

ASSAY RESULTS

CHANNELS

NO.	WIDTH	OZS. SILVER	% LEAD	% ZINC
29	2'	23.46	7.32	0.64
30	2'	43.20	13.41	1.46
31	2'	28.25	14.49	1.06
AV.	6'	31.63	11.74	1.05

GRABS

54	-	47.60	29.34	8.31
55	-	96.84	16.83	5.65
56	-	37.60	19.52	4.76
AV.	-	60.68	21.80	6.24

OZS. (GOLD)

57	0.08	30.20	14.14	20.75
----	------	-------	-------	-------

LEGEND

- Massive Galena Stringers.
- Sulphide Mineralization (Pyrite, Galena, Sphalerite)
- Limestone Breccia.

092052

STERLING CLAIMS
(NO. 2 CLAIM)

NO. 2 (DERRY) VEIN - ASSAY PLAN

SCALE 1" = 5'

↑ airstrip

Alaska

Highway

Rancheria Rv.

EDEN GROUP
(approx location)

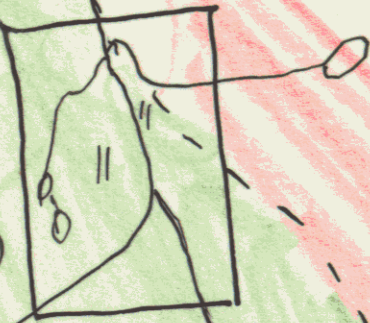

Y.T.
B.C.

← Plate Creek

shale, limestone
some younger beds
with coal

of Plate Creek
005025
of Plate Creek

Rough tracing
from map enclosed
with Annual Report on
1947 season for W.K.P.S.
by D.K. Derry without Jan/54

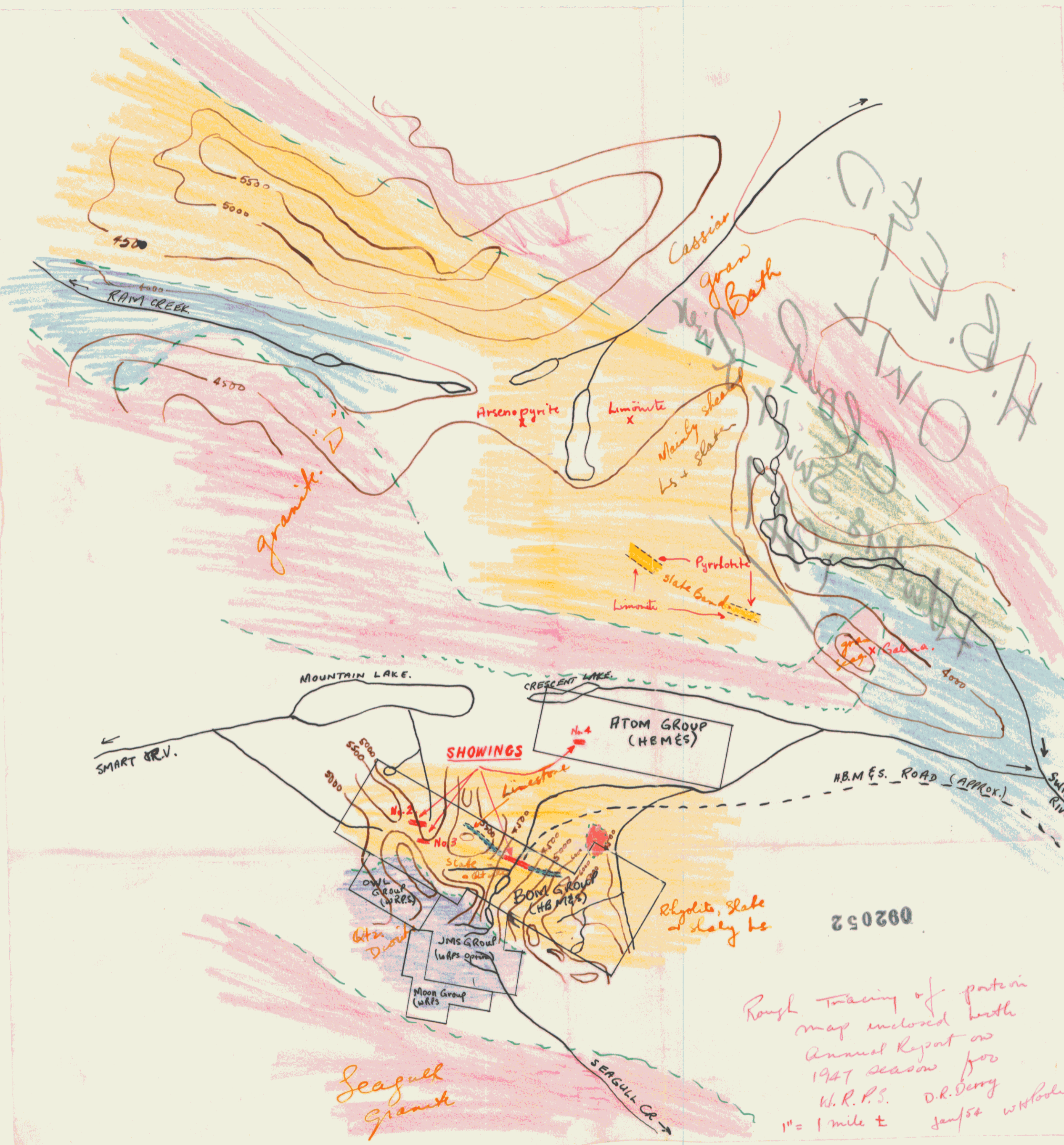

092052

Rough tracing of pattern
 map enclosed with
 Annual Report on
 1947 season for
 W.R.P.S. D.R. Berry
 Jan 54 W.H. Wood

1" = 1 mile ±

085023



Rough Tracing of map with
 1948 report to Y.R.P.S
 by D.R. Perry
 Jan/54 W.H.Bole.