

1.S.N. 134672

MAP NO. ASSESSMENT REPORT
116 B 11, 12 PROSPECTUS
105 D 2,11-13 CONFIDENTIAL

DOCUMENT NO.: 092023
MINING DISTRICT: WHITEHORSE, DAWSON
TYPE OF WORK: Prospector Diary OPEN FILE

REPORT FILED UNDER: James L. Simcoe
DATE PERFORMED: March 31 - September 5, 1968 DATE FILED: 1968
LOCATION: LAT.: 61°00'N, 64°38'N AREA: Montana Mountain, Joe Creel
LONG.: 135°50'W, 139°30'W Ibex River, Fifteenmile River

CLAIM NAME & NO.:

WORK DONE BY: James L. Simcoe

WORK DONE FOR: James L. Simcoe

DATE TO GOOD STANDING	REMARKS: PROSPECTOR DIARY

092028

RESOURCES DIVISION
DEPARTMENT OF NORTHERN AFFAIRS AND NATIONAL RESOURCES

PROSPECTORS' ASSISTANCE PROGRAM
YUKON TERRITORY AND NORTHWEST TERRITORIES

DAILY DIARY

1968

Name

James L. Simcof

Name

Box 626

Address

703-A MAIN ST.

Whitehorse

Yukon Terr.

PROSPECTORS' ASSISTANCE PROGRAM
YUKON TERRITORY AND NORTHWEST TERRITORIES

Date Day No.

Weather

Latitude and Longitude of area prospected

Rock types encountered

(a) Granite

(b) Intrusives

(c) Sediments

(d) Volcanics

(e) Mineralization

GENERAL COMMENTS:

Applied for Prospector's assistance for the year of 1968 to prospect the head waters of the Fifteen mile River area. I had been told of copper deposits by old Dawson trappers in this region and ~~we~~ went in to the area two years ago in late Sept

Sketch Map of Area Covered, or Additional Comments:

to prospect. I had located one sediment vein but due to extreme rain and snow, little work was done. This event warranted further prospecting in this region and in general had potential of being a large mineralogical area.

I locked the mine to return to the Fifteen mile region until 1968 and with the prospector's assistance for financial help returned to prospect area. Fred Chudy and I teamed up to prospect 15 mile together and other areas of interest.

Date *March 31/68* Day No. *1*

Weather

Latitude and Longitude of area prospected *139°15' - 64°45'*

Rock types encountered

(a) Granite

(b) Intrusives

(c) Sediments

(d) Volcanics

(e) Mineralization

GENERAL COMMENTS:

*March 31/68 Departed from
Whitehorse with two double
track ski dogs to stake
property in the 15 mile area
Drove to Chapman lake
with supplies and gasoline
provisions enough for two
week trip Arrived at
Chapman lake and camped*

Sketch Map of Area Covered, or Additional Comments.

*in old Con West camp to
cook up, sleep and load
shigh and ski dogs for
departure.*

Date April 1st / 68

Day No. 2

Weather Clear

Latitude and Longitude of area prospected

Rock types encountered

(a) Granite

(b) Intrusives

(c) Sediments

(d) Volcanics

(e) Mineralization

GENERAL COMMENTS:

Departed from Chapman
Lake camp eight o'clock
in morning. Will travel
down Sela Pass on route.
Ten miles down Sela Pass
one ski doo stopped due to
potholes and soil trouble. We
left ski doo on hill side
and returned to Chapman

Sketch Map of Area Covered, or Additional Comments.

Lake. Will have to return
to Whitehorse for more
ignition parts as if we use
spare will leave us with
no spare for rest of trip.
Left 40 gallons gas and
most of supplies with
broken ski doo.

Date *April 2nd / 68.*

Day No. *3*

Sketch Map of Area Covered, or Additional Comments.

Weather *Clear*

Latitude and Longitude of area prospected

Rock types encountered

(a) Granite

(b) Intrusives

(c) Sediments

(d) Volcanics

(e) Mineralization

GENERAL COMMENTS:

*Left early in the morning
Five AM for Whitehorse
Uneventful trip except
roads are slippery. Had
a flat tire at Pelly
and arrived at Whitehorse
in time to buy pants, oil
condenser at Hudson Bay Store.*

Date *April 3 / 68*

Day No. *4*

Weather *Clear*

Latitude and Longitude of area prospected

Rock types encountered

(a) Granite

(b) Intrusives

(c) Sediments

(d) Volcanics

(e) Mineralization

GENERAL COMMENTS:

*Prepared to leave Whitehorse
for Chapman Lake but
had trouble with pick
up motor missing and
cutting out. Remained
carb and blew out gas
line and carb. Due to
both gas hoses picked
up sediment and rust in gas.*

Sketch Map of Area Covered, or Additional Comments.

Date *April 4th/68.*

Day No. *5*

Sketch Map of Area Covered, or Additional Comments.

Weather *Clear*

Latitude and Longitude of area prospected

Rock types encountered

(a) Granite

(b) Intrusives

(c) Sediments

(d) Volcanics

(e) Mineralization

GENERAL COMMENTS:

*Drove back to Chopman
Lake day of 4th of
April and spent the
night in Con West camp.
Will double up on
ski to go out and
fix the one that is
down.*

Date *April 5th/68*

Day No. *6*

Weather *Clear*

Latitude and Longitude of area prospected

Rock types encountered

(a) Granite

(b) Intrusives

(c) Sediments

(d) Volcanics

(e) Mineralization

GENERAL COMMENTS:

*Drove by ski doo approx
ten miles to down ski doo
Took out old equation but
spent all day trying to
get the ski doo to run.
Instruction book for replacing
equation is in German and
do not know German. Trial
and error prevails and*

Sketch Map of Area Covered, or Additional Comments.

*return to Chapman Lake
with the both ski doos
running perfectly. Spent
the night again in Chapman
and am getting impatient
to advance while the
weather is still clear.*

Date April 6th/68. Day No. 7

Weather Clear

Latitude and Longitude of area prospected

Rock types encountered

(a) Granite

(b) Intrusives

(c) Sediments

(d) Volcanics

(e) Mineralization

GENERAL COMMENTS:

Started out over snow for
15 mile run tracking approx
five miles per hour pulling
close to 1000 lbs gross weight
We progressed about twenty
miles when a storm formed
and a white out build
over the mountain from the
east. We ran ahead of it

Sketch Map of Area Covered, or Additional Comments.

and where forced to camp
at the head of a unknown
creek with only buck brush
being the largest timber.
Could not pitch tent so
made a small shelter over the
ski door and sleep. It snowed
very hard and visibility is nil
On arrival at this point one
ski door went down with a burned
out clutch.

Date *April 7th / 68.*

Day No. *8*

Sketch Map of Area Covered, or Additional Comments.

Weather *Snow*

Latitude and Longitude of area prospected

Rock types encountered

(a) Granite

(b) Intrusives

(c) Sediments

(d) Volcanics

(e) Mineralization

GENERAL COMMENTS:

*Still had a white out.
Sat under tarp and
waited for the weather to
clear. Also used the tent
for a mattress and a tarp
for protective cover. Only
went out to chop down
rotten willow and get snow
for water. Our sleeping*

*bags and clothes are
starting to get wet from
blowing snow melting from
body heat.*

Date *April 8th/68.*

Day No. *9*

Sketch Map of Area Covered, or Additional Comments.

Weather *Snow*

Latitude and Longitude of area prospected

Rock types encountered

(a) Granite

(b) Intrusives

(c) Sediments

(d) Volcanics

(e) Mineralization

GENERAL COMMENTS:

*Still a white out with
very strong blowing wind
and very uncomfortable
and every thing is getting
more wet as the hours
slowly go by.*

Date *April 9th/68.* Day No. *10*

Weather *Snow & windy.*

Latitude and Longitude of area prospected

Rock types encountered

(a) Granite

(b) Intrusives

(c) Sediments

(d) Volcanics

(e) Mineralization

GENERAL COMMENTS:

Still in white out conditions in the morning. Selection the same at noon but towards evening the weather is starting to break. Still have a lot of wind in the evening. Have to sleep in wet robes again.

Sketch Map of Area Covered, or Additional Comments.

Date *April 10th 1968* Day No. *11*

Weather

Latitude and Longitude of area prospected

Rock types encountered

(a) Granite

(b) Intrusives

(c) Sediments

(d) Volcanics

(e) Mineralization

GENERAL COMMENTS:

White out has cleared up leaving lots of loose snow to make it difficult of travel with ski doo. Will have to abandon my ski doo and continue ahead with one. Had went ahead with empty ski doo to break trail and find a camp site at the

Sketch Map of Area Covered, or Additional Comments.

head of the fifteen mile run. Must find a camp location with timber to pitch the tent and dry our gear. Had returned to camp around dusk after finding a camp site approx four miles from the 15 mile. The head water are in a canyonized area and can go no further by ski doo.

Date *April 11th/68.* Day No. *12*

Weather *Clear.*

Latitude and Longitude of area prospected

Rock types encountered

- (a) Granite
- (b) Intrusives
- (c) Sediments
- (d) Volcanics
- (e) Mineralization

GENERAL COMMENTS:

*Moved to new camp site
in small spruce timber.
We pitched the tent then
I drove up to the canyon
to see if it is possible to
go down it by ski doo. This
is impossible due to canyon
Returned to camp to dry
our gear and make up*

Sketch Map of Area Covered, or Additional Comments.

*jacks for movement into
the fifteen mile run. Had
not expect this amount of
snow in area and at the
head of the fifteen mile the
snow is four feet deep but
hard and good for ski doo
travel. Here at this point is
critical due to breaking trail
constantly before we are able to
move the sleigh.*

Date *April 12/68.* Day No. *13*

Weather *Clear and cold*

Latitude and Longitude of area prospected

Rock types encountered

(a) Granite

(b) Intrusives

(c) Sediments *X*

(d) Volcanics

(e) Mineralization

GENERAL COMMENTS:

*Drove ski doo to fifteen mile
canyon, at the break of
down thin snow shed
down canyon to old base
camp. Proceeded down river
taking turn's breaking trail
on snow shore and found
gulch that sediment vein was
in. Because of snow slides*

Sketch Map of Area Covered, or Additional Comments.

*could not find the exact
location of the vein but
staked the first group of
eight claims in the area
excluding these the claims
claims. Returned to ski doo
and then to camp to make
supper and rest.*

Date *April 13/68.* Day No. *14*

Weather *Clear and cold*

Latitude and Longitude of area prospected

Rock types encountered

(a) Granite

(b) Intrusives

(c) Sediments *X*

(d) Volcanics

(e) Mineralization

GENERAL COMMENTS:

Returned by ski doo to canyon, snow shovled back down fifteen miles to ice dam and trail to locate vein by digging into snow slide. Could not locate vein but took a sample of wall rock for assay. We feel this sample is very close to vein.

Sketch Map of Area Covered, or Additional Comments.

Returned to base camp early as it started to snow and found another white out watch is common it seems in this area.

Date *April 14th/68.*

Day No. *15*

Sketch Map of Area Covered, or Additional Comments.

Weather

Latitude and Longitude of area prospected

Rock types encountered

(a) Granite

(b) Intrusives

(c) Sediments

(d) Volcanics

(e) Mineralization

GENERAL COMMENTS:

*Drove ski doo to canyon,
snow shed down to second
gulch passed old bore
camp to see if there is
less slide snow and more
rock contact exposed. Situation
similar to discovery gulch so
returned to bore camp.*

Date *April 15th 1968.* Day No. *16*

Weather

Latitude and Longitude of area prospected

Rock types encountered

(a) Granite

(b) Intrusives *X*

(c) Sediments *X*

(d) Volcanics

(e) Mineralization

GENERAL COMMENTS:

Returned to discovery gulch and attempted to locate vein under snow slide. Again failed to find vein and only encountered basic host rock which is a dolomite contact. Copy of map gives location of claim on opposite page.

Sketch Map of Area Covered, or Additional Comments.

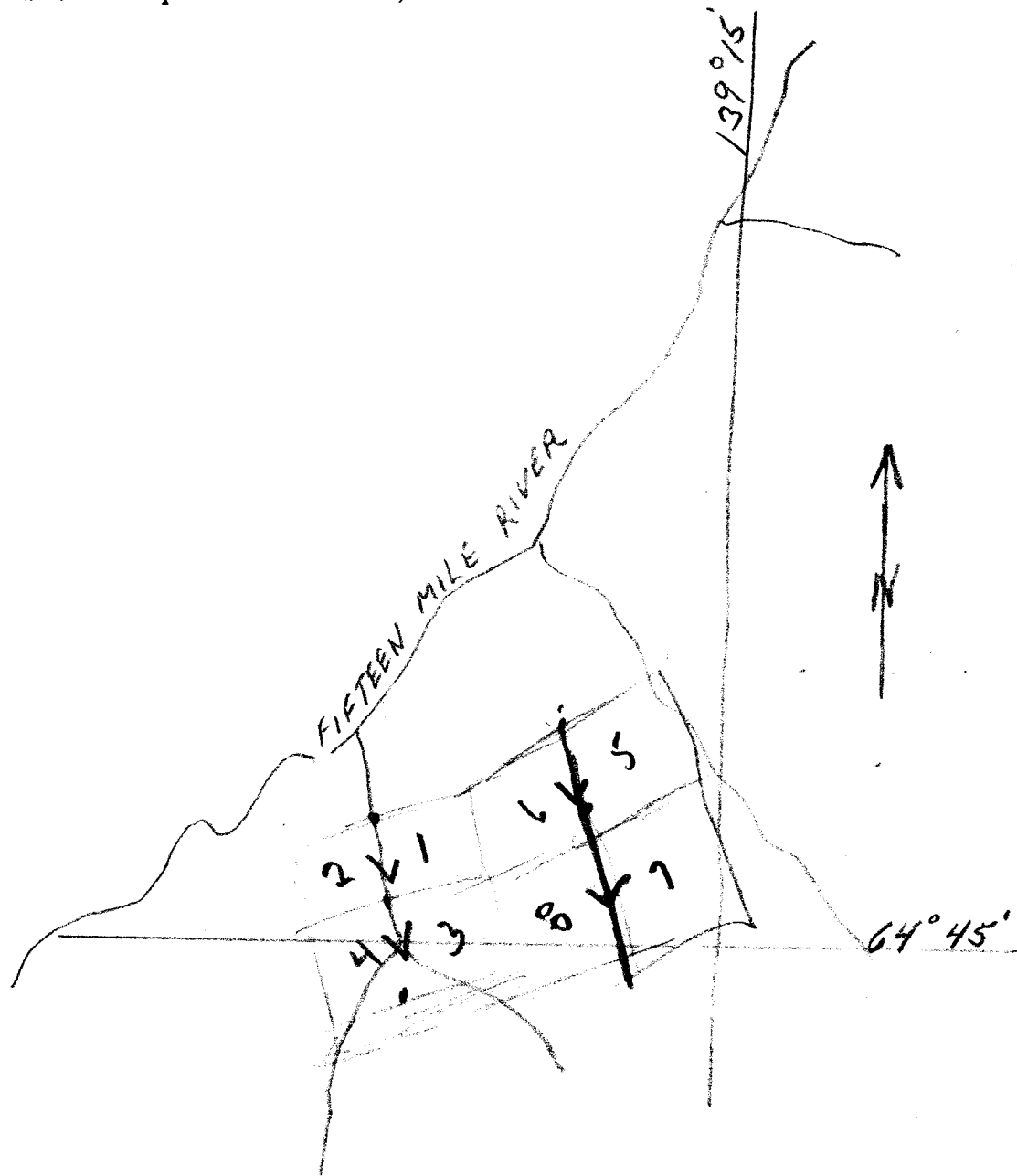

Date *April 16 1958*

Day No. *17*

Sketch Map of Area Covered, or Additional Comments.

Weather

Latitude and Longitude of area prospected

Rock types encountered

(a) Granite

(b) Intrusives

(c) Sediments

(d) Volcanics

(e) Mineralization

GENERAL COMMENTS:

Broke camp and because of having only one ski dog to pull two men and the gear we left heavy tent and stove behind. Moved back to first camp in unknown gulch and attempted to make ports to fix the clutch on second ski dog

Date April 19/68 Day No. 13

Weather

Latitude and Longitude of area prospected

Rock types encountered

(a) Granite

(b) Intrusives

(c) Sediments

(d) Volcanics

(e) Mineralization

GENERAL COMMENTS:

Spent most of day
repairing clutch on the duo
using spikes and bolts
cut with a hacksaw
at last have ski doo
fixed and I gave it a
short test run. Gas
supply is dangerously low
and I doubt if we have

Sketch Map of Area Covered, or Additional Comments.

enough to get both machines
out to the Dempster highway.
Repacked supplies and threw
away excess food. Then
turned in early under the
stars. The weather is holding
clear.

Date *April 18/68.* Day No. *19*

Weather *Clear but warmer*

Latitude and Longitude of area prospected

Rock types encountered

(a) Granite

(b) Intrusives

(c) Sediments *X*

(d) Volcanics

(e) Mineralization *Sediments • Dolomite shales*

GENERAL COMMENTS:

*Headed out for Chapman
Lake with both ski
doo's running OK. Had to
dump most of supplies
plus the sligh because
of new snow and low
amount of gas. Made
Chapman Lake at darkness
and do not imagine there*

Sketch Map of Area Covered, or Additional Comments.

*is a gallon of gas between
the both ski doo's. Camped
for the night at Chapman
Lake.*

Date *April 19/68*

Day No. *20*

Sketch Map of Area Covered, or Additional Comments.

Weather

Latitude and Longitude of area prospected

Rock types encountered

(a) Granite

(b) Intrusives

(c) Sediments

(d) Volcanics

(e) Mineralization

GENERAL COMMENTS:

*Broke camp at chop man
lake and the repaired
ski doo broke down completely
two hundred yards from
highway and Truck Piggy
backed the broken ski doo
to highway and loaded
up and left for Whitehorse
arriving in town after twenty*

*days in the bush and
approx 100 miles put on
the skidoos.*

Date June 16th/68 Day No. 21

Weather Warm & clear

Latitude and Longitude of area prospected

Rock types encountered

(a) Granite

(b) Intrusives

(c) Sediments

(d) Volcanics

(e) Mineralization

GENERAL COMMENTS:

Left Whitehorse for Chapman Lake and to meet helicopter ordered from Irons North Turbo to take us into the fifteen mile river region to prospect further the mineralization in this area. Left Whitehorse at 10 AM to meet helicopter

Sketch Map of Area Covered, or Additional Comments.

~~at four o'clock. Chopper came in at 14:15 hrs and took gear in first and part of the supplies~~
some time the next day depending on weather. Camped at the bridge near Chapman Lake that night. Saw moose come down for water.

Date *June 17th* Day No. *22*
Weather *nic in morning then rain*
Latitude and Longitude of area prospected

Sketch Map of Area Covered, or Additional Comments.

Rock types encountered

- (a) Granite
- (b) Intrusives
- (c) Sediments
- (d) Volcanics
- (e) Mineralization

GENERAL COMMENTS:

Helicopter was late and
came in at 3:30 P.M. He
took me in first and I
started to make a base camp
at mouth of discovery gulch
Bud came in at 4:30 and
helped to complete the camp.
Went up gulch and found
vein on left hand side

of gulch 1500 ft up from
mouth This vein is six feet
wide of schist composed of
chalcopyrite mineralization.
Went further up gulch and
found three more veins to
be described later.

Date *June 18th 1968.* Day No. *23*

Weather *Rain*

Latitude and Longitude of area prospected

Rock types encountered

(a) Granite

(b) Intrusives

(c) Sediments

(d) Volcanics

(e) Mineralization

GENERAL COMMENTS:

Located vein six feet wide at bottom of gulch seven hundred feet up mountain found an outcropping took a sample from it. Vein in creek bottom is running NE-SW all veins appear to run some way.

Sketch Map of Area Covered, or Additional Comments.

Date *June 19th 1968*

Day No. *24*

Weather *Rain*

Latitude and Longitude of area prospected

Rock types encountered

(a) Granite

(b) Intrusives

(c) Sediments *X*

(d) Volcanics

(e) Mineralization

GENERAL COMMENTS:

*Located three more veins
one eight feet wide and
one six feet wide in some
gully. One vein is about
130 feet wide sulfide with
chalcopyrite. The 130-foot
vein appears to be low
grade. We sampled A-B-
and C veins. Had to dig*

Sketch Map of Area Covered, or Additional Comments.

*out A vein because of
slide material covering it.*

Date *June 20/68.*

Day No. *25*

Weather

Rain

Latitude and Longitude of area prospected

Rock types encountered

(a) Granite

(b) Intrusives

(c) Sediments *X*

(d) Volcanics

(e) Mineralization *iron (specular)*

GENERAL COMMENTS:

Went down river one gulch on the left side going down and found a hematite vein about fifty to sixty feet wide. We took a sample and came back to base camp. We prospected entire gulch but hematite vein is the only

Sketch Map of Area Covered, or Additional Comments.

mineralization prominent in this area. This hematite vein is about one hundred yards up above from mouth of gulch at fifteen mile river.

Date *June 21/68*

Day No. *26*

Sketch Map of Area Covered, or Additional Comments.

Weather *Rainy*

Latitude and Longitude of area prospected

Rock types encountered

(a) Granite

(b) Intrusives

(c) Sediments

(d) Volcanics

(e) Mineralization

GENERAL COMMENTS:

Raining very hard while waiting for it to break we cut wood for camp and had break fast. Letter went up gulch and sampled four more veins. Sampled one 25 foot vein and one six feet wide and one three foot wide on right summit

Very heavy rain and snow during the night. There was snow on mountains in the morning.

Date *June 22/68.*

Day No. *27*

Sketch Map of Area Covered, or Additional Comments.

Weather *Rainy*

Latitude and Longitude of area prospected

Rock types encountered

(a) Granite

(b) Intrusives

(c) Sediments

(d) Volcanics

(e) Mineralization

GENERAL COMMENTS:

*Went up mountain and
tied on four more claims
on top end of other's claims
where very tough to stake
and had to pack up all
the posts by pack board*

Date *June 23/68*

Day No. *28*

Weather *Rainy*

Latitude and Longitude of area prospected

Rock types encountered

(a) Granite

(b) Intrusives

(c) Sediments

(d) Volcanics

(e) Mineralization

GENERAL COMMENTS:

*Went up fifteen mile
and prospected up first
gulch for approx seven
miles found nothing of
interest but a ten foot
quartz vein at mouth of
gulch on right hand side
going up. This quartz
appears to be barren.*

Sketch Map of Area Covered, or Additional Comments.

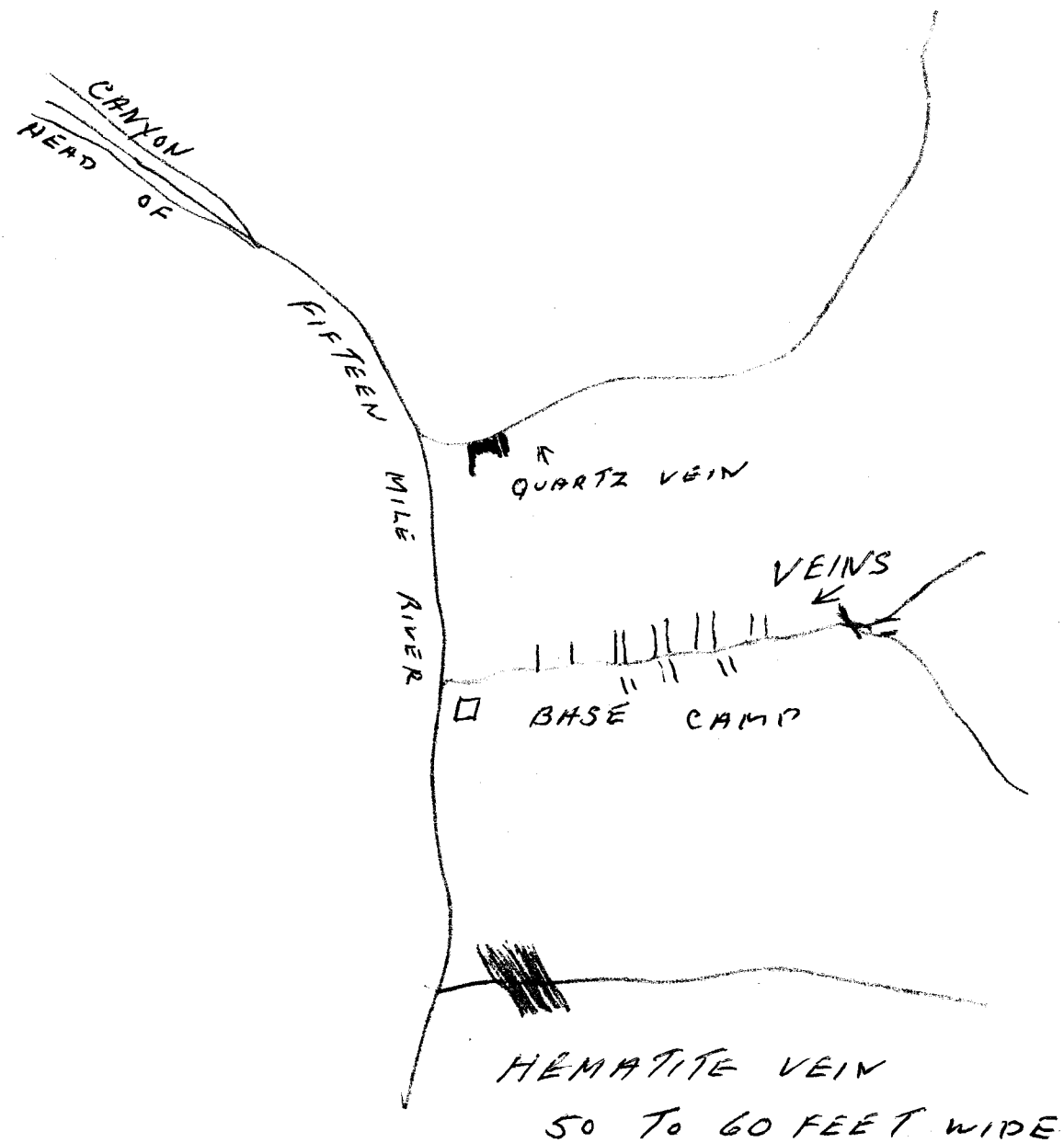

Date *June 24/68.*

Day No. *29*

Sketch Map of Area Covered, or Additional Comments.

Weather *Rainy*

Latitude and Longitude of area prospected *139°15' - 64°45'*

Rock types encountered

(a) Granite

(b) Intrusives

(c) Sediments

(d) Volcanics

(e) Mineralization

GENERAL COMMENTS:

*Waited for chopper till
4 PM to come in and take
us out. No helicopter so
went up gulch and found
another vein across from
E VEIN Very rich in
Chalcopyrite Siderite
Running through center
Siderite is two feet thick*

leaving at a south angle.

Date *June 25/68*

Day No. *30*

Sketch Map of Area Covered, or Additional Comments.

Weather *Rainy*

Latitude and Longitude of area prospected

Rock types encountered

(a) Granite

(b) Intrusives

(c) Sediments

(d) Volcanics

(e) Mineralization

GENERAL COMMENTS:

*Waited again for helicopter
and when it did not
come in we went up and
staked four more claims
in my name. Worked
till twelve midnight and
had to pack parts in
rain.*

Date *June 26/68*

Day No. *31*

Sketch Map of Area Covered, or Additional Comments.

Weather *Reiny*

Latitude and Longitude of area prospected

Rock types encountered

(a) Granite

(b) Intrusives

(c) Sediments

(d) Volcanics

(e) Mineralization

GENERAL COMMENTS:

Agave helicopter did not come in by four o'clock so forded the fifteen mile river and prospected the opposite side from gulch. Nothing of interest and no mineralized float in area

Date June 29/68 Day No. 32

Weather Rainy again

Latitude and Longitude of area prospected

Rock types encountered

- (a) Granite
- (b) Intrusives
- (c) Sediments
- (d) Volcanics
- (e) Mineralization

GENERAL COMMENTS:

Rained heavy all day
Noticed a silver tip
quartzite on hill side about
a thousand feet away from
us with a cut gun fire
would not scare her away.
Finally the chopper came
and we broke camp
and moved to Dempster Highway.

Sketch Map of Area Covered, or Additional Comments.

We stayed on the Dempster
refueled the helicopter with
our fuel we took in for
her and a sleep till
four AM.

Date June 28 / 68. Day No. 33

Weather Rainy

Latitude and Longitude of area prospected

Rock types encountered

- (a) Granite
- (b) Intrusives
- (c) Sediments
- (d) Volcanics
- (e) Mineralization

GENERAL COMMENTS:

Left for Whitehouse at 4:41 from the Chapman Lake area and arrived in Whitehouse at three o'clock PM. Had two blow outs on return trip and gas trouble. On opposite page see assay reports on the fifteen mile and plus information.

Sketch Map of Area Covered, or Additional Comments.

Mineralization is chalcocyanite in a series of crystalline dolomite, siderite filling shear zones in a sequence of elastic sediments near a dolomite contact. There is 200 ft of mineralization in two thousand feet in the gulch.

Assay of samples taken from Certificate no 4609-10.

	Gold	SILVER	COPPER
A zone	TR	.18	.54
B-1	TR	.14	.81
D-1	TR	TR	TR
E1	TR	.22	.70
F-1	.01	.25	1.36
F2	TR	.26	1.23
G-1	TR	TR	.12
G-2	TR	.18	.18
A-2	TR	.14	.90
C-1	TR	.14	TR.

Date *July 21st / 68*

Day No. *34*

Sketch Map of Area Covered, or Additional Comments.

Weather *clear*

Latitude and Longitude of area prospected

135° 45' - 60° 10'

Rock types encountered

(a) Granite

(b) Intrusives

(c) Sediments

(d) Volcanics

(e) Mineralization

GENERAL COMMENTS:

Left Whitehorse 10 AM and drove out to Carcross. Set up a base camp by bridge. Looked around general area for signs of mineralization and studied maps for position of area to be prospected. Found quartzite float.

Date July 22/68

Day No. 35

Weather Clear

Latitude and Longitude of area prospected.....

135° 45' - 60° 10'

Rock types encountered.....

(a) Granite

(b) Intrusives

(c) Sediments

(d) Volcanics X.....

(e) Mineralization -.....

GENERAL COMMENTS:

Spent day prospecting west side of Montana Hill
Followed up gulches on knob hill and nearby area
Worked this area because of information given from 1948 geology reports indicating mineral veins in area. Most rock is Porphyrites and andesites

Sketch Map of Area Covered, or Additional Comments.

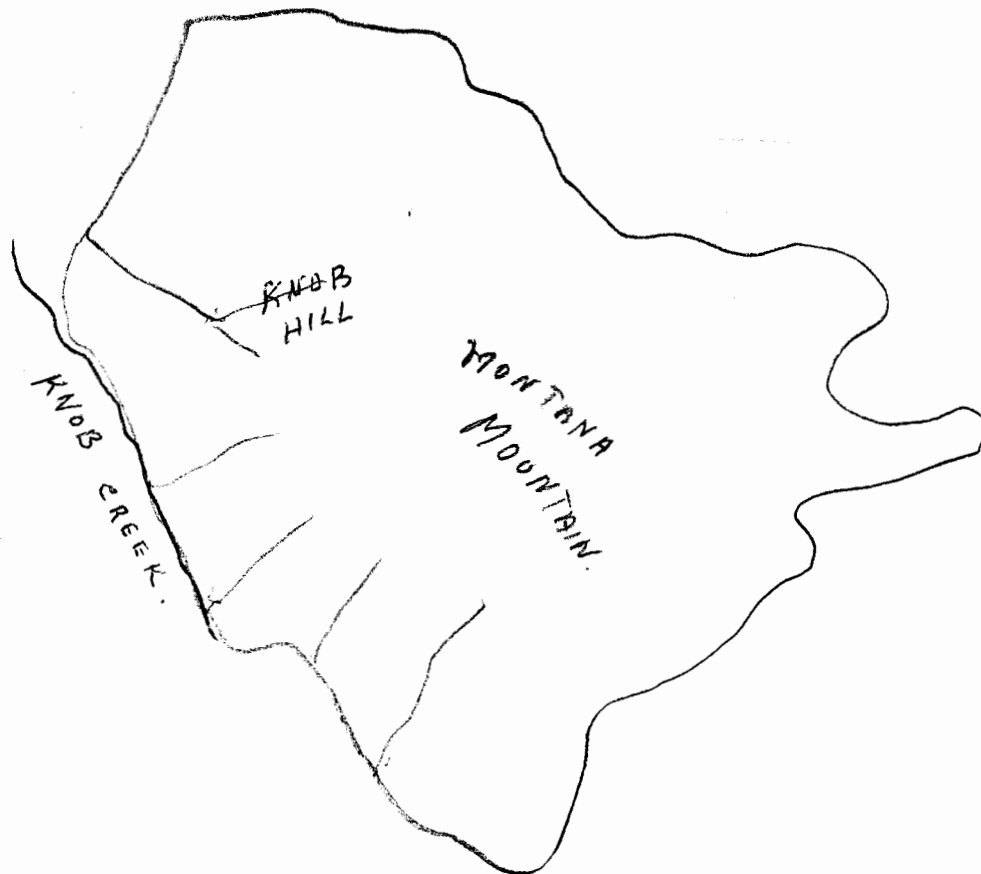

Date July 23 1968

Day No. 36

Weather Cloudy

Latitude and Longitude of area prospected

135°52' - 60°-20'

Rock types encountered

(a) Granite X

(b) Intrusives

(c) Sediments

(d) Volcanics X

(e) Mineralization

GENERAL COMMENTS:

Moved camp to base of grey ridge. Have seen what appears to be a drift at the summit. spent day prospecting ridge on the ascent and found another small drift three quarters distance from summit. Drifts seem to be done for assessment work and there is no mineralization to warrant work.

Sketch Map of Area Covered, or Additional Comments.

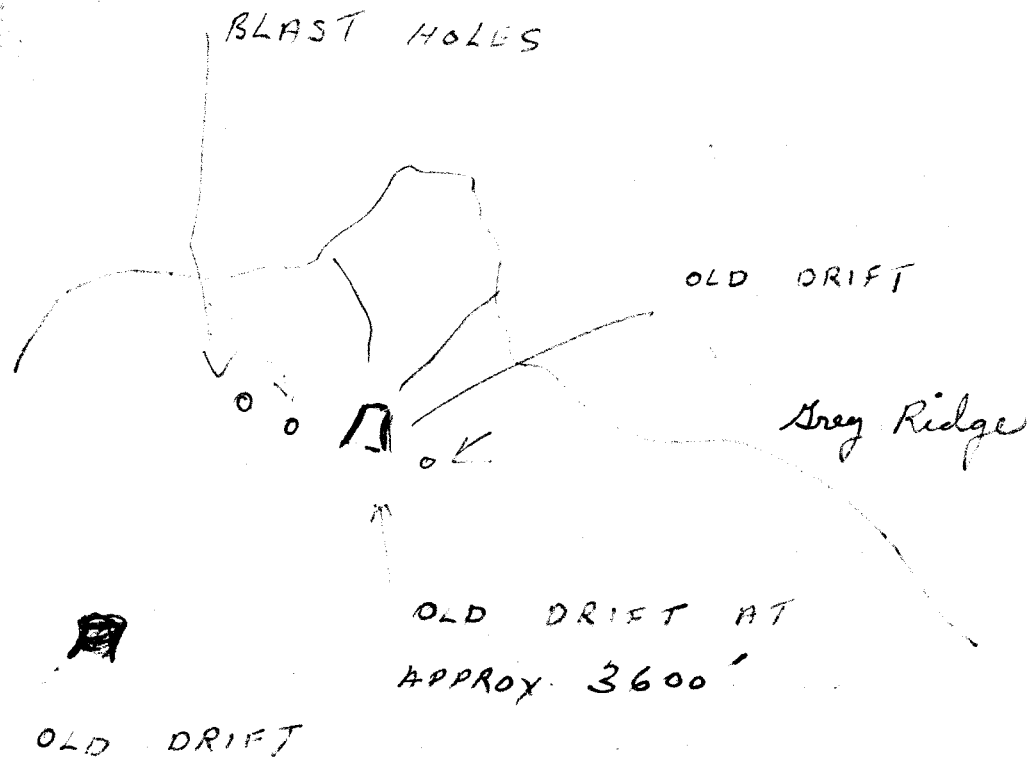

Date *July 24/68*

Day No. *37*

Sketch Map of Area Covered, or Additional Comments.

Weather *Overcast*

Latitude and Longitude of area prospected

Rock types encountered

(a) Granite

(b) Intrusives

(c) Sediments

(d) Volcanics

(e) Mineralization

GENERAL COMMENTS:

*Returned to grey ridge and
prospected along ridge for
approx six miles above
Cannon Lake. Found no
float with mineralization to
warrant further efforts. Returned
to base camp and had
supper.*

Date *July 25 / 68*

Day No. *38*

Sketch Map of Area Covered, or Additional Comments.

Weather *Rainy*

Latitude and Longitude of area prospected

Rock types encountered

(a) Granite

(b) Intrusives

(c) Sediments

(d) Volcanics

(e) Mineralization

GENERAL COMMENTS:

*Went down by truck to
Wheaton river to Anderson
Mountain to see Newsom's
scoria then drive by
to Whitehouse*

Date August 2/68

Day No. 39

Sketch Map of Area Covered, or Additional Comments.

Weather Clear

Latitude and Longitude of area prospected

Rock types encountered

(a) Granite

(b) Intrusives

(c) Sediments

(d) Volcanics

(e) Mineralization

GENERAL COMMENTS:

Drove out to Jackson Lake to look for old Indian Trappers trail into the Iby River. Found trail and walked it for two miles. Lots of iron float in this area. Came out to Alaska highway and drove up to mile 945

and drove in to Iby River. Found trail at Iby and returned to Whitehorse. Dropper Frank McKay told of copper and silver lead at the head of Iby. Are planning to prospect area.

Date August 10th/68

Day No. 40

Weather Clear

Latitude and Longitude of area prospected approx

135° 30' - 60° 35'

Rock types encountered

(a) Granite

(b) Intrusives

(c) Sediments X

(d) Volcanics X

(e) Mineralization

GENERAL COMMENTS:

Drive from Whitehorse to
the end of the road up
the Ikey River Had benches
and packed packs loads.
Walked up Ikey River on
old trail for eight miles
Have had time locating trail
Camped for night in timber
and by water in unnamed gulch.

Sketch Map of Area Covered, or Additional Comments.

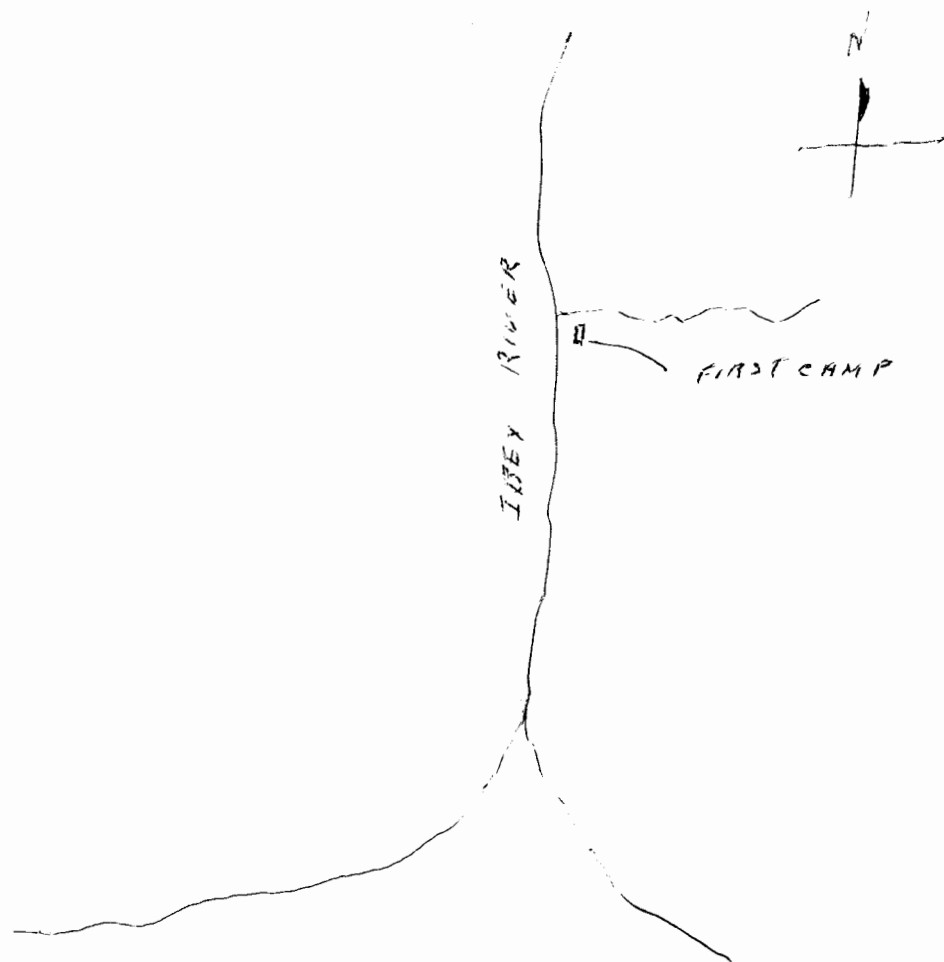

Date August 11/68

Day No. 41

Weather Clear

Latitude and Longitude of area prospected

135° 30' - 60° 35'

Rock types encountered

(a) Granite X

(b) Intrusives

(c) Sediments

(d) Volcanics

(e) Mineralization

GENERAL COMMENTS:

Walked all day in hard going due to loss of trail and wind falls. Made approx twelve miles up. They from 1st camp and made new camp in the 1st gulch from the left. Back of the They looks like the weather will change for the worst.

Sketch Map of Area Covered, or Additional Comments.

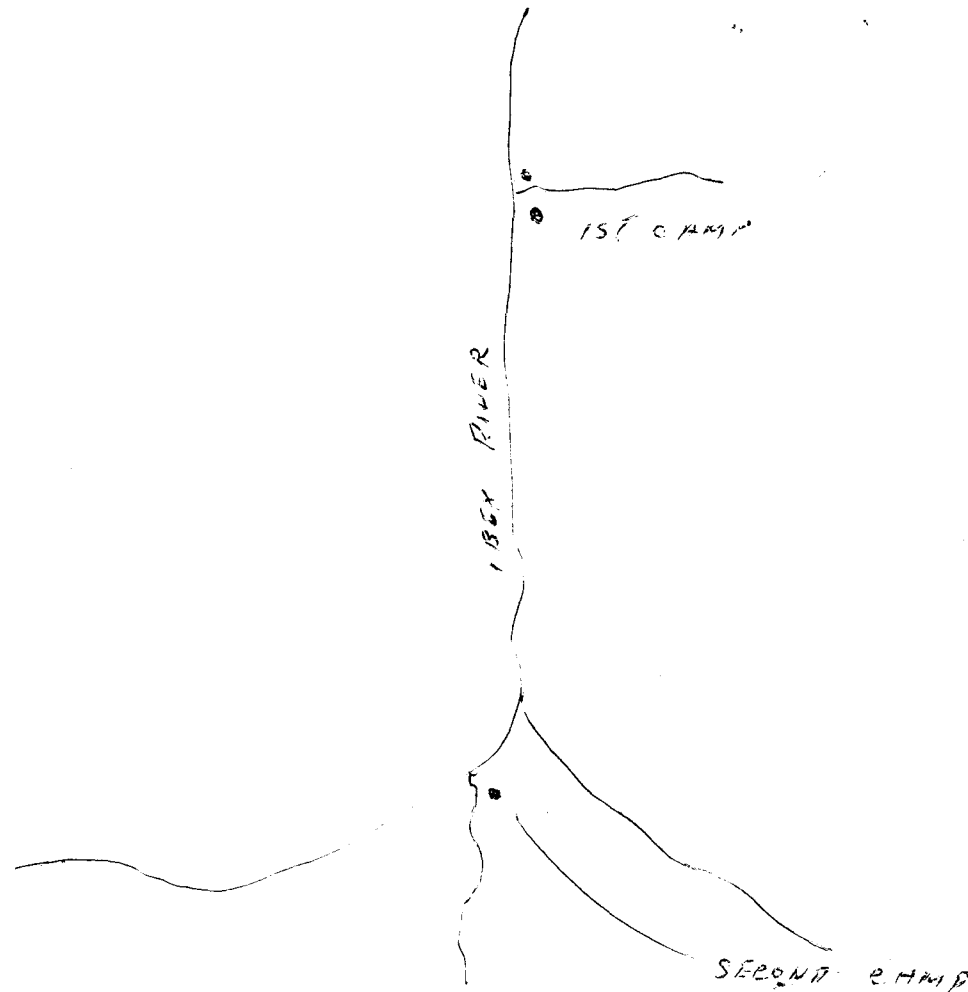

Date *August 12/68* Day No. *42*

Weather *Clear.*

Latitude and Longitude of area prospected

135° 30' - 60° - 35'

Rock types encountered

(a) Granite

(b) Intrusives

(c) Sediments

(d) Volcanics

(e) Mineralization

GENERAL COMMENTS:

Prospected second gulch on left side up from forks of the river. Found two calcite veins with crystals in upper two feet of gouge material. Traveled two or three head of gulch but found no other mineralization in the gulch. Returned to base camp.

Sketch Map of Area Covered, or Additional Comments.

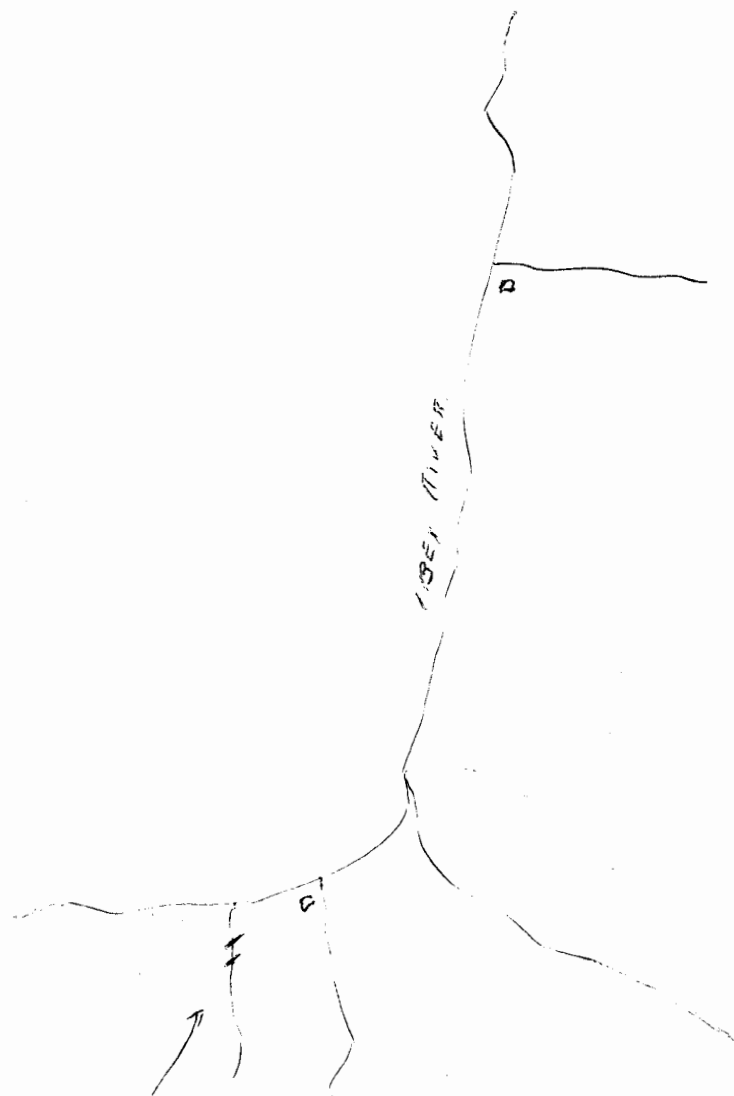

Two calcite veins with gouge material

Date August 13/68

Day No. 43

Sketch Map of Area Covered, or Additional Comments.

Weather Clear

Latitude and Longitude of area prospected

135° 30' - 60 - 35'

Rock types encountered

(a) Granite X

(b) Intrusives

(c) Sediments

(d) Volcanics

(e) Mineralization porphyry & Green stone

GENERAL COMMENTS:

Moved camp three miles up
Ilex River and prospected two
gulches on left side going
up. Found a porphyry vein
in last gulch on left, one
quarter mile from mouth of
gulch. There is three green
stone dykes near vein. No mineralization
is evident but took sample for
assay.

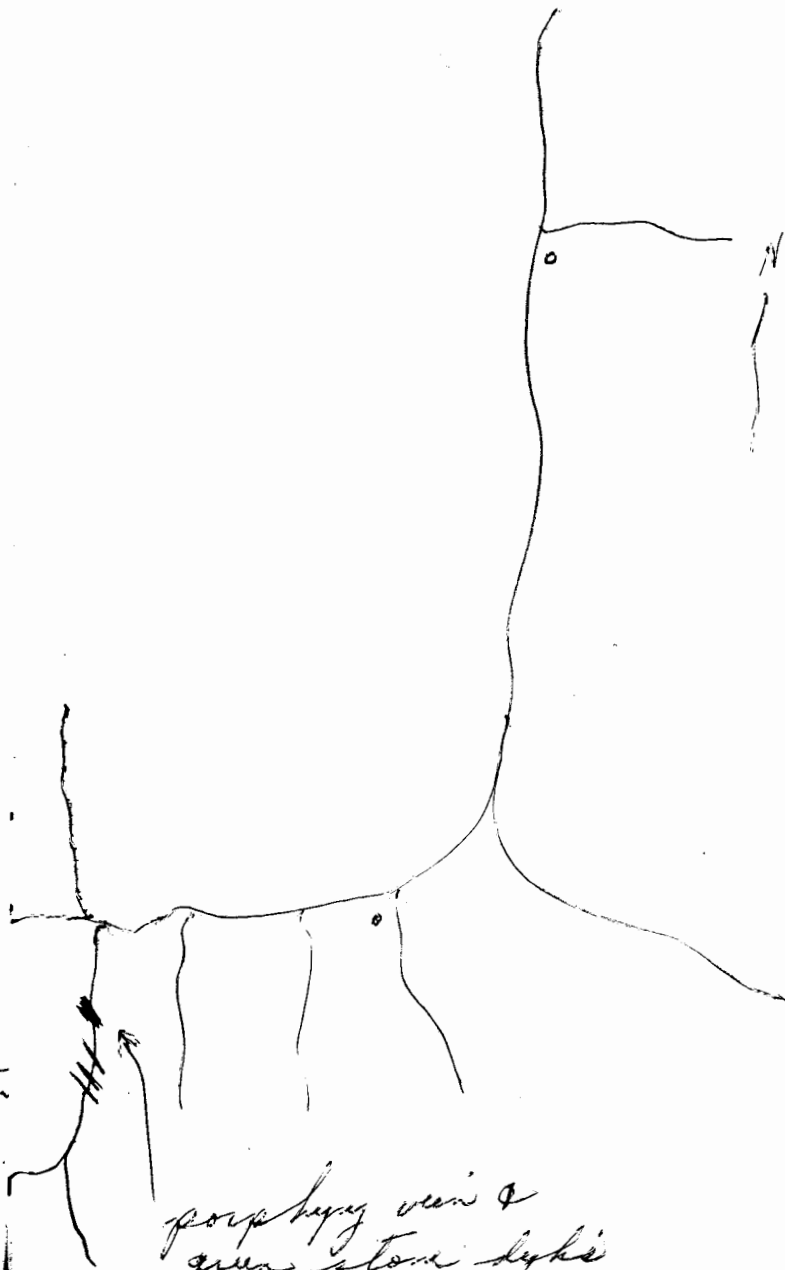

Date August 14 Day No. 44

Weather Clear

Latitude and Longitude of area prospected

135° 30' - 60 - 35'

Rock types encountered

(a) Granite X

(b) Intrusives

(c) Sediments

(d) Volcanics

(e) Mineralization

GENERAL COMMENTS:

Prospected right hand gulch on the river access from Porphyry vein. Heavy bush and boulders in creek, very narrow and had difficult time in reaching summit. Found no mineralization and returned to camp around dark. Will leave for Whitehorse in the morning.

Sketch Map of Area Covered, or Additional Comments.

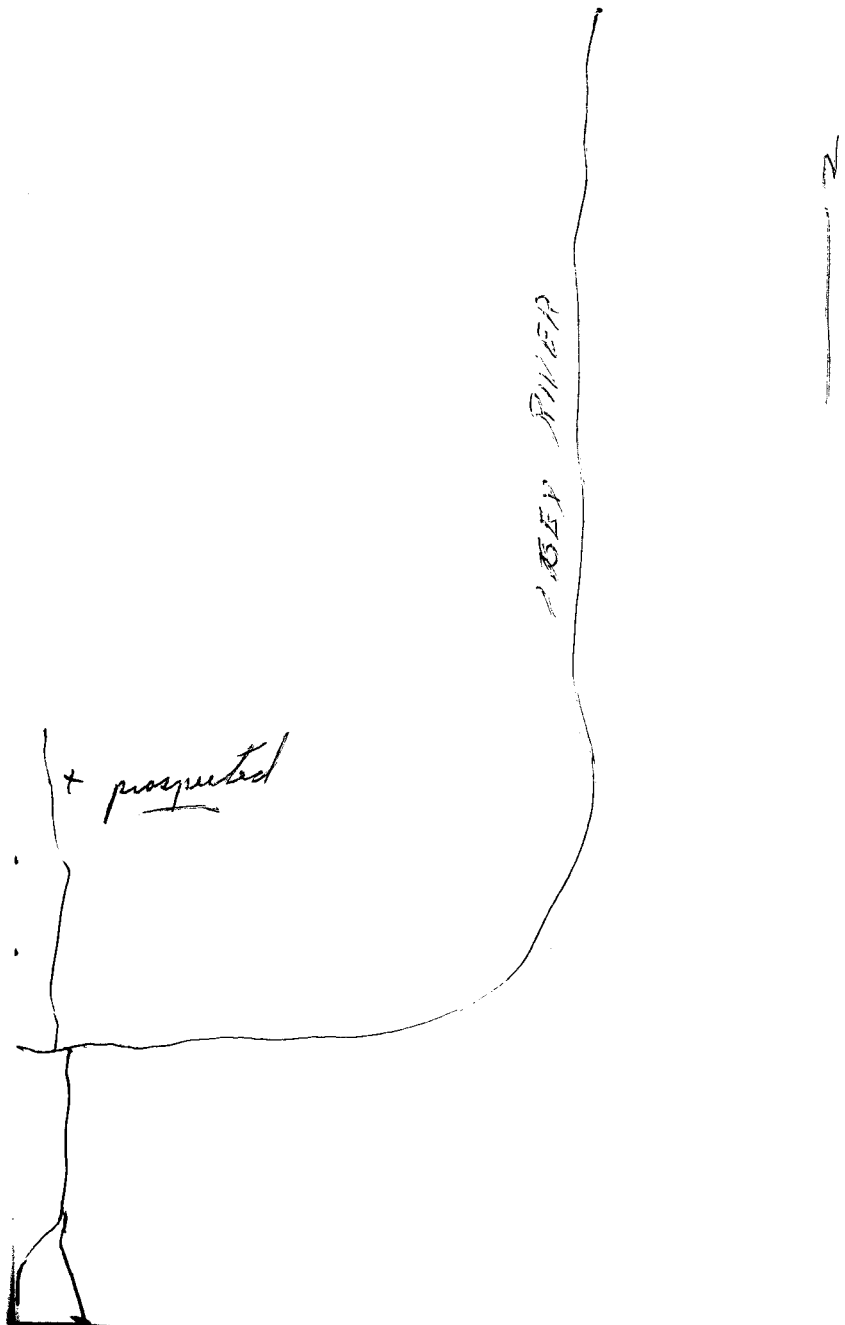

Date August 15/68 Day No. 45

Weather Clear

Latitude and Longitude of area prospected

Rock types encountered

(a) Granite

(b) Intrusives

(c) Sediments

(d) Volcanics

(e) Mineralization

GENERAL COMMENTS:

Broke camp in the morning loaded packs and started to walk out following old trapper's trail. Travel is very difficult because of heavy brush and trail is grown in Mt Hunter's at crossing and had trouble crossing. Mt Hunter's almost lost pack horse in this area because of deep water and high river banks.

Sketch Map of Area Covered, or Additional Comments.

Camped for night across the. They are dyed cloths and foot wear.

Date *August 16/68*

Day No. *46*

Sketch Map of Area Covered, or Additional Comments.

Weather *Clear*

Latitude and Longitude of area prospected

Rock types encountered

(a) Granite

(b) Intrusives

(c) Sediments

(d) Volcanics

(e) Mineralization

GENERAL COMMENTS:

Walked rest of the way out to where we left the truck on the end of the bush road. Total walk out was twenty three miles. Drove into whitehorse and tore up fenders on the truck due to rough bush road and darkness.

Date August 20/68 Day No. 47

Weather Clear

Latitude and Longitude of area prospected approx
61°00' - 135°50'

Rock types encountered

- (a) Granite
- (b) Intrusives
- (c) Sediments
- (d) Volcanics
- (e) Mineralization

GENERAL COMMENTS:

Left Whitehouse road drove
by truck to east side of
Yukon River Drive on new
mill road as far as possible
and walked up road 6-8
miles to mouth of Joe creek
Camped at old cabins on Lake
Laberge for the night will
start up Joe creek in morning.

Sketch Map of Area Covered, or Additional Comments.

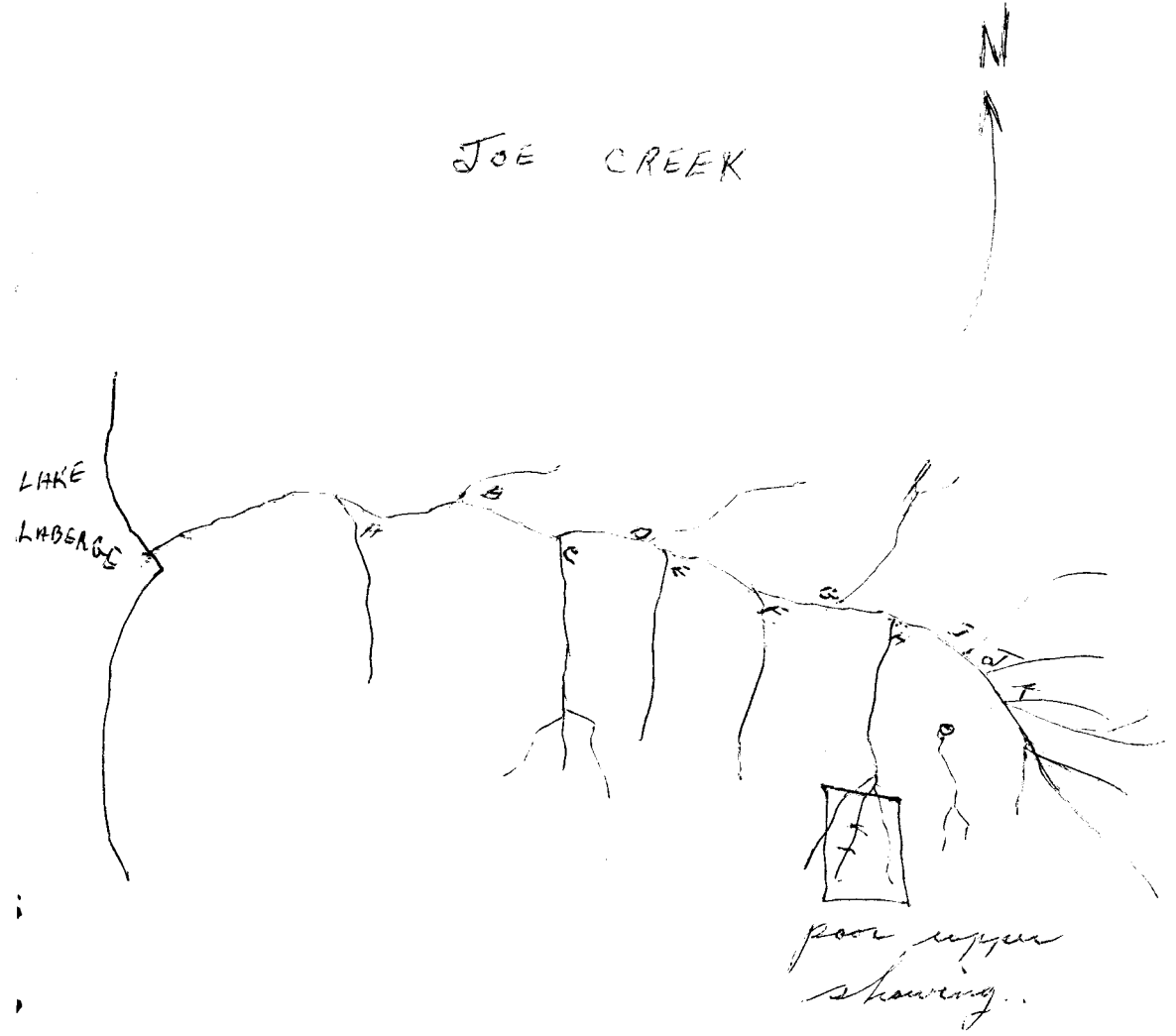

Date August 21/68

Day No. 48

Sketch Map of Area Covered, or Additional Comments.

Weather Clear

Latitude and Longitude of area prospected

61° 00' - 135° 50'

Rock types encountered

(a) Granite

(b) Intrusives

(c) Sediments

(d) Volcanics

(e) Mineralization

GENERAL COMMENTS:

Traveled up Joe creek to
first gulch and prospected gulch
A. No Mineralization. Moved up
and prospected gulch B. No
mineralization. Returned to
Joe creek and made camp.
Very windy with a few
drops of rain.

Date August 22/68

Day No. 49

Sketch Map of Area Covered, or Additional Comments.

Weather cloudy

Latitude and Longitude of area prospected

61° 00' - 135° 50'

Rock types encountered

(a) Granite

(b) Intrusives

(c) Sediments

(d) Volcanics

(e) Mineralization *iron stain*

GENERAL COMMENTS:

Broke camp and moved up to next gulch. Left peak at mouth and prospected up gulch called C gulch. Nothing of interest so moved up to top gulch. Went up to head of gulch, only encountered bit of iron stain. Nothing of value. Returned to Joe's made camp.

Date August 23/68 Day No. 50

Weather Cloudy

Latitude and Longitude of area prospected

61° 00' - 135° 50'

Rock types encountered

(a) Granite

(b) Intrusives

(c) Sediments

(d) Volcanics

(e) Mineralization

GENERAL COMMENTS:

Prospected E gulch on
right hand side of Joe creek
Encountered nothing of interest
except lots of heavy signs.
Prospected E gulch, found
some green slates but no
calcite. Made camp at
mouth of gulch E for the
night.

Sketch Map of Area Covered, or Additional Comments.

Date August 24/68 Day No. 51

Weather Cloudy

Latitude and Longitude of area prospected

61°00' - 135°50'

Rock types encountered

(a) Granite

(b) Intrusives

(c) Sediments

(d) Volcanics

(e) Mineralization

GENERAL COMMENTS:

Prospected up G gulch
found no mineralization
Moved up to H gulch and
found scales quartz on float
in gulch bottom Lots of
green stain float in area
Did not make head of gulch
Went by tomorrow Mineralization
is evident to be some where
down.

Sketch Map of Area Covered, or Additional Comments.

Date August 25 Day No. 52

Weather Cloudy

Latitude and Longitude of area prospected

61° 00' - 135° 50'

Rock types encountered

(a) Granite

(b) Intrusives

(c) Sediments

(d) Volcanics

(e) Mineralization calc. quartz & iron

GENERAL COMMENTS:

Prospected up to head of gulch #4 and found staker from Burgundy. Prospected area staked but now open and only found two inch vein at head of creek.

Mineralization is calc. quartz and very poor showing. Indian is crazy for staking in area.

Sketch Map of Area Covered, or Additional Comments.

Date *August 26/68* Day No. *53*

Weather *Rain & Cloudy*

Latitude and Longitude of area prospected

61° 00' - 135° 50'

Rock types encountered

(a) Granite

(b) Intrusives

(c) Sediments

(d) Volcanics

(e) Mineralization

GENERAL COMMENTS:

*Prospected further up Joe
creek on left hand side
of Joe creek in gulches
E-S-K. Iron stain in area
but no great showing returned
to camp will prospect right
hand side of Joe creek tomorrow.
This area is badly faulted
with poor rock*

Sketch Map of Area Covered, or Additional Comments.

Date *August 27/68* Day No. *54*

Weather *Cloudy & Raining*

Latitude and Longitude of area prospected

61°00' - 135°50'

Rock types encountered

(a) Granite

(b) Intrusives

(c) Sediments

(d) Volcanics

(e) Mineralization

GENERAL COMMENTS:

*Prospected head of Joe creek
in right hand gulch.
Found no mineralization except
iron float and small
amounts of green stain from
copper body. Returned to
camp, we are running
low on supplies, must have
to leave soon.*

Sketch Map of Area Covered, or Additional Comments.

Date *August 28 1968* Day No. *55*

Weather *Cloudy & raining*

Latitude and Longitude of area prospected

61°00' 135°50'

Rock types encountered

(a) Granite

(b) Intrusives

(c) Sediments

(d) Volcanics

(e) Mineralization

GENERAL COMMENTS:

Returned to area staked before by Mr. Gandy. Spent day on mountain looking for a good showing. Found another vein of very poor calcite a couple inches wide with no length punched out. Returned to camp fed up with for week.

Sketch Map of Area Covered, or Additional Comments.

Date *August 29/68* Day No. *56*

Weather *Cloudy + Rainy*

Latitude and Longitude of area prospected

61°00' - 135°50'

Rock types encountered

(a) Granite

(b) Intrusives

(c) Sediments

(d) Volcanics

(e) Mineralization

GENERAL COMMENTS:

Broke camp at the head of Joe creek and started to walk out at Dawn. Lost trail several times and travelled in steps to Lake Laberge and on to truck then drove out. Staked claims on Joe creek but does not warrant staking, will forget area.

Sketch Map of Area Covered, or Additional Comments.

Date *Sept 2 1968* Day No. *59*

Weather *Cloudy*

Latitude and Longitude of area prospected

Rock types encountered

(a) Granite

(b) Intrusives

(c) Sediments *X*

(d) Volcanics

(e) Mineralization *gypsum float and
mountain of gypsum.*

GENERAL COMMENTS:

*Drove up to Bullion Creek
and prospected in this
area. Camped at Johnny Gardner's
place for three days.
Crossed on Bullion creek at
our vehicle and went up
through canyon to prospect
on left side of creek. Returned
at dusk.*

Sketch Map of Area Covered, or Additional Comments.

Date Sept 3rd. Day No. 58.

Weather ~~Partly~~ Rain

Latitude and Longitude of area prospected

Rock types encountered

- (a) Granite
- (b) Intrusives
- (c) Sediments
- (d) Volcanics
- (e) Mineralization

GENERAL COMMENTS:

Next morning we prospected to head of Bullion creek. Came across some copper float in creek bottom but did not locate copper mineralization in the solid. There is interesting porphyry float in creek bottom. Also

Sketch Map of Area Covered, or Additional Comments. Day 59
Sept 4/68

Went up Bullion creek and prospected right hand gulch area across gypsum in this area but this showing is held. Did not locate copper in solid contact and had to climb steep mountain to prospect ridge. There is no mineralization worth striking on hill side other than known showing.

Met geologist from Kennecott copper as he landed his helicopter to talk. He interested in seeing our fifteen mile property.

~~Sept 7~~ Sept 7 5th 1868

Day 60

Rained in the morning so feel we can not go through creek in canyon. It had rained all night and all morning so packed gear and walked down to truck left at mouth of Bullion creek because of bad roads. Drove into whitehouse. Since end of sixty day prospect we have been out to Nickel Creek in 60 mile to look at nickel deposit and silver. We bought in nickel ore for assay but have not received assays as yet.

ROGER DUHAMEL, F.R.S.C.
QUEEN'S PRINTER AND CONTROLLER OF STATIONERY
OTTAWA, 1961