

MAP NO.
105 E 14,15

ASSESSMENT REPORT X
PROSPECTUS
CONFIDENTIAL X
OPEN FILE

DOCUMENT NO.: 091968
MINING DISTRICT: Whitehorse
TYPE OF WORK: Geochemistry, Geophysics

REPORT FILED UNDER: Noranda Exploration Co. Ltd.

DATE PERFORMED: June 1987

DATE FILED: December 2, 1987

LOCATION: LAT.: 61°45'N

AREA: Big Salmon & Yukon Rivers

LONG.: 134°45'W

VALUE \$: 18,000.00

CLAIM NAME & NO.: DAVE 1-10 YA 95192-YA95201

SEM 1-2 YA96080-YA96081

SEM 3-28 YA96518-YA96543; SEM 11 YA95717

WORK DONE BY: H. Copland

WORK DONE FOR: Noranda Exploration Co. Ltd.

DATE TO GOOD STANDING | REMARKS: #10 SEMENOF

DATE TO GOOD STANDING	REMARKS: #10 SEMENOF

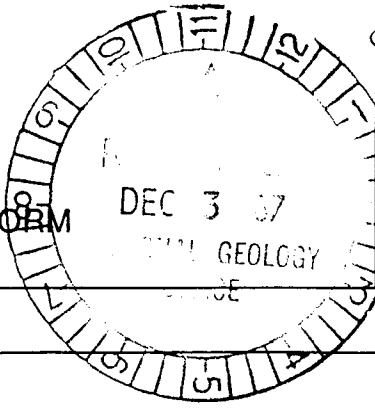

091968

M.R. file no.
B.M.M.R. file no.
Date forwarded 12/2/87

TRANSMITTAL FORM

From Mining Recorder at: Whitehorse

To Regional Manager, Mineral Rights at Whitehorse, Y.T.

For action are:

<input type="checkbox"/> NEW APPLICATION FOR PLACER LEASE TO PROSPECT	Name	
<input type="checkbox"/> RENEWAL APPLICATION PLACER LEASE TO PROSPECT	Name	Lease no.
<input type="checkbox"/> AFFIDAVIT OF EXPENDITURE ON PLACER LEASE	Name	Lease no.
<input type="checkbox"/> SECURITY DEPOSIT		
<input type="checkbox"/> FINANCIAL ABILITY		
<input type="checkbox"/> ASSIGNMENT OF PLACER LEASE NO.	From	To
<input type="checkbox"/> GROUPING APPLICATION UNDER SEC. 52(2) PLACER MINING ACT.	Owner	
<input type="checkbox"/> DIAMOND DRILL LOGS	Claims	Claim sheet no.
<input checked="" type="checkbox"/> QUARTZ ASSESSMENT REPORT	Claims	Claim sheet no.
	Type of report	Submitted by
	Cl. work performed on	\$ req. for ren. application

Sem 1-28 DAVE 1-10 105-E-15

Geological/Geochem/Geo physical H. Copland for minerals

Sem 1-28, DAVE 1-10 \$ 18000.00

H. Southwick
Signature

REPLY ACTION

Date returned

Approved for amount required

J. L. Turner
Signature

GEOLOGICAL, GEOCHEMICAL, & GEOPHYSICAL REPORT

on the

SEM 1-28 CLAIMS

DAVE 1-10 CLAIMS

SEM 11 CLAIMS

Whitehorse Mining District

N.T.S. 105E/14, 15

Latitude 61°45'N

Longitude 134°45'W

DATE DUE

Author: H. Cooland

Owner: Noranda Exploration Company Limited
(No Personal Liability)

Date: November, 1987

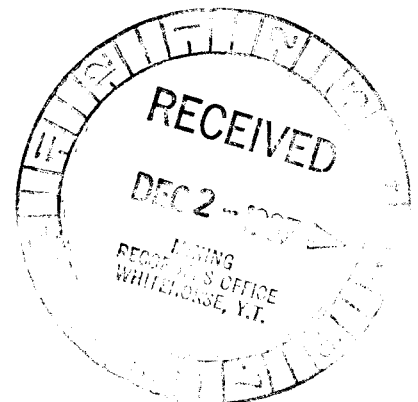

091968

This report has been examined by
the Geological Evaluation Unit
under Section 53 (4) Yukon Quartz
Mining Act and is allowed as
representation work in the amount

of \$ ~~18,000~~ 18450.⁰⁰ J.J.B. 21 Dec 87

J. J. B.

for Regional Manager, Exploration and
Geological Services for Commissioner
of Yukon Territory.

SUMMARY

The Semenov Property consists of 39 contiguous claims (SEM 1-28, SEM 11, & DAVE 1-10) located in the Semenov Hills, approximately 120 km northwest of Whitehorse, Y.T.. A program of soil geochemistry, geophysics (IP, magnetometer, & VLF-EM) geological mapping and trenching were conducted in 1987. Disseminated copper - gold mineralization is hosted by a Triassic propylitized andesitic lapilli tuff. Values as high as 29,000 ppb Au in grab samples occur in an isolated pod less than 1 metre in size. No other mineralization was observed over the altered zone. Due to the very limited size of the showing no further action is recommended on the property.

TABLE OF CONTENTS

	Page
SUMMARY	2
CHAPTER ONE: INTRODUCTION	
1-1: Introductory Statement	5
1-2: Location & Access	5
1-3: Physiography	5
1-4: Claim Definition	9
1-5: History	9
1-6: 1987 Work Program	9
CHAPTER TWO: GEOLOGY	
2-1: Regional Geology	11
2-2: Property Geology	13
2-3: Economic Geology	16
CHAPTER THREE: GEOCHEMISTRY	
3-1: Procedure	17
3-2: Results	17
CHAPTER FOUR: GEOPHYSICS	
4-1: Procedure	18
4-2: Results	18
CHAPTER FIVE: CONCLUSIONS & RECOMMENDATIONS	20
Cost Statement	21
Selected References	23
Qualifications	24

LIST OF FIGURES

FIGURE 1:	Location Map	6
FIGURE 2:	Location Map 1:250,000	7
FIGURE 3:	Claim Map 1:30,000	8
FIGURE 4:	Regional Geology 1:10000	in pocket
FIGURE 5:	Geology & Rock Sample Locations 1:2500	"
FIGURE 6:	Geochemistry 1:10000	"
FIGURE 7:	Soil Geochem (Cu, Zn, Pb) 1:2500	"
FIGURE 8:	Soil Geochem (Ag, As, Mo, Au) 1:2500	"
FIGURE 9:	Magnetometer Survey 1:2500	"
FIGURE 10:	IP Survey (Resistivity) 1:2500	"
FIGURE 11:	VLF-EM Survey 1:2500	"
FIGURE 12:	IP Profiles	"

LIST OF TABLES

		Page
TABLE 1:	Table of Formations	12

LIST OF APPENDICES

Appendix 1:	Sample Description & Results	25
Appendix 2:	Results	30

CHAPTER ONE: INTRODUCTION

1-1: INTRODUCTORY STATEMENT

The SEM 1-28, SEM 11, and DAVE 1-10 claims are located 120 km northwest of Whitehorse, Y.T. (see Figure 1&2). The claims were optioned from local prospector Orlo Davis in 1987. Prophyritically altered basic tuffs carry significant gold and copper values in one small zone on the property.

1-2: LOCATION & ACCESS

The claims are located on NTS 105E/14,15 (Latitude $61^{\circ}45'N$. Longitude $134^{\circ}45'W$) approximately 120 km northwest of Whitehorse. The property is located between the Big Salmon and Yukon Rivers. Access is via helicopter from either Whitehorse or Carmacks, Y.T.. The D'Abbadie airstrip located 18 km east of the property is suitable for light aircraft and was used as a transfer point for helicopter access.

1-3: PHYSIOGRAPHY

The claims are located within the Semenov Hills an area of low rolling mountainous terrain with maximum elevations approximately 1,370 metres in elevation. Maximum elevation on the property is 1,200 metres with a minimum of 800 metres.

The area is covered with dense stands of spruce and pine. A large burn approximately 15-20 years old, fringes the claim group. A few small creeks and ponds are located on the property. The main stream flowing into the Big Salmon River cuts the DAVE claims in the south.

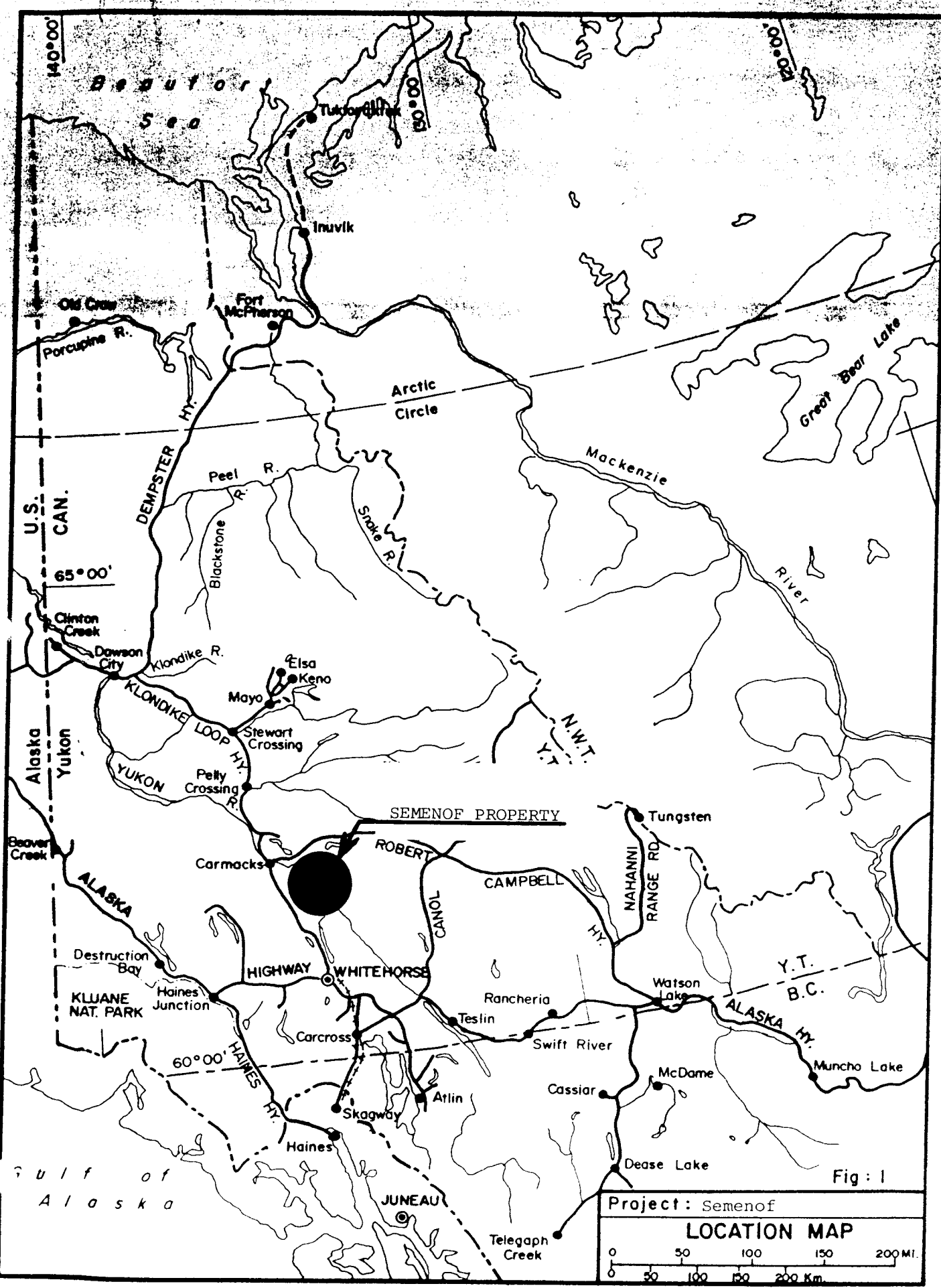

Project: Semenov
LOCATION MAP
 0 50 100 150 200 MI.
 0 50 100 150 200 Km.

VANCAL 11926

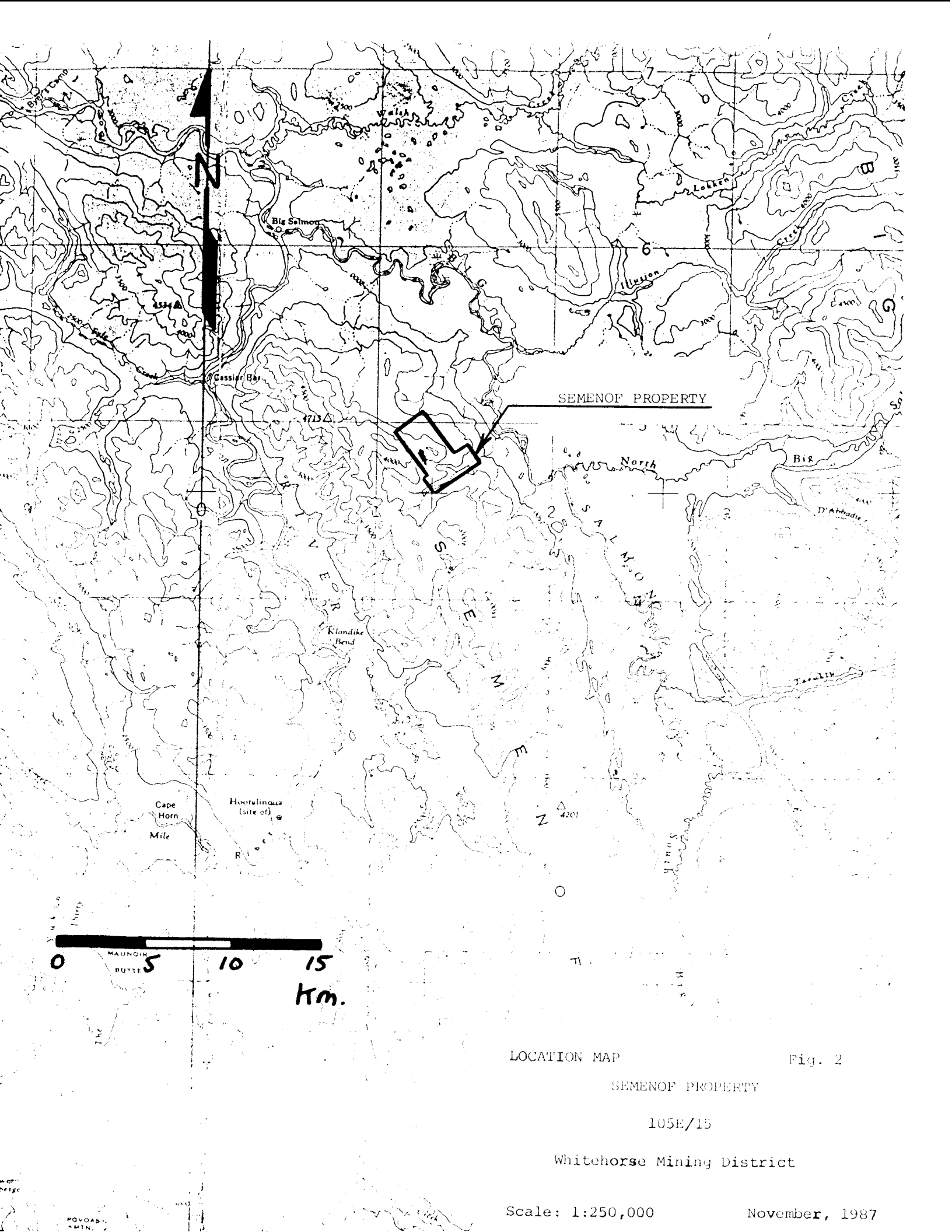

SEMENOV PROPERTY

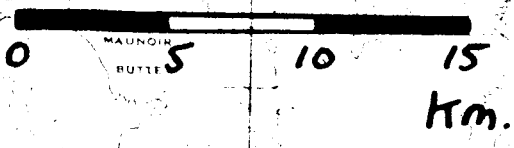

LOCATION MAP

Fig. 2

SEMENOV PROPERTY

105E/15

Whitehorse Mining District

Scale: 1:250,000

November, 1987

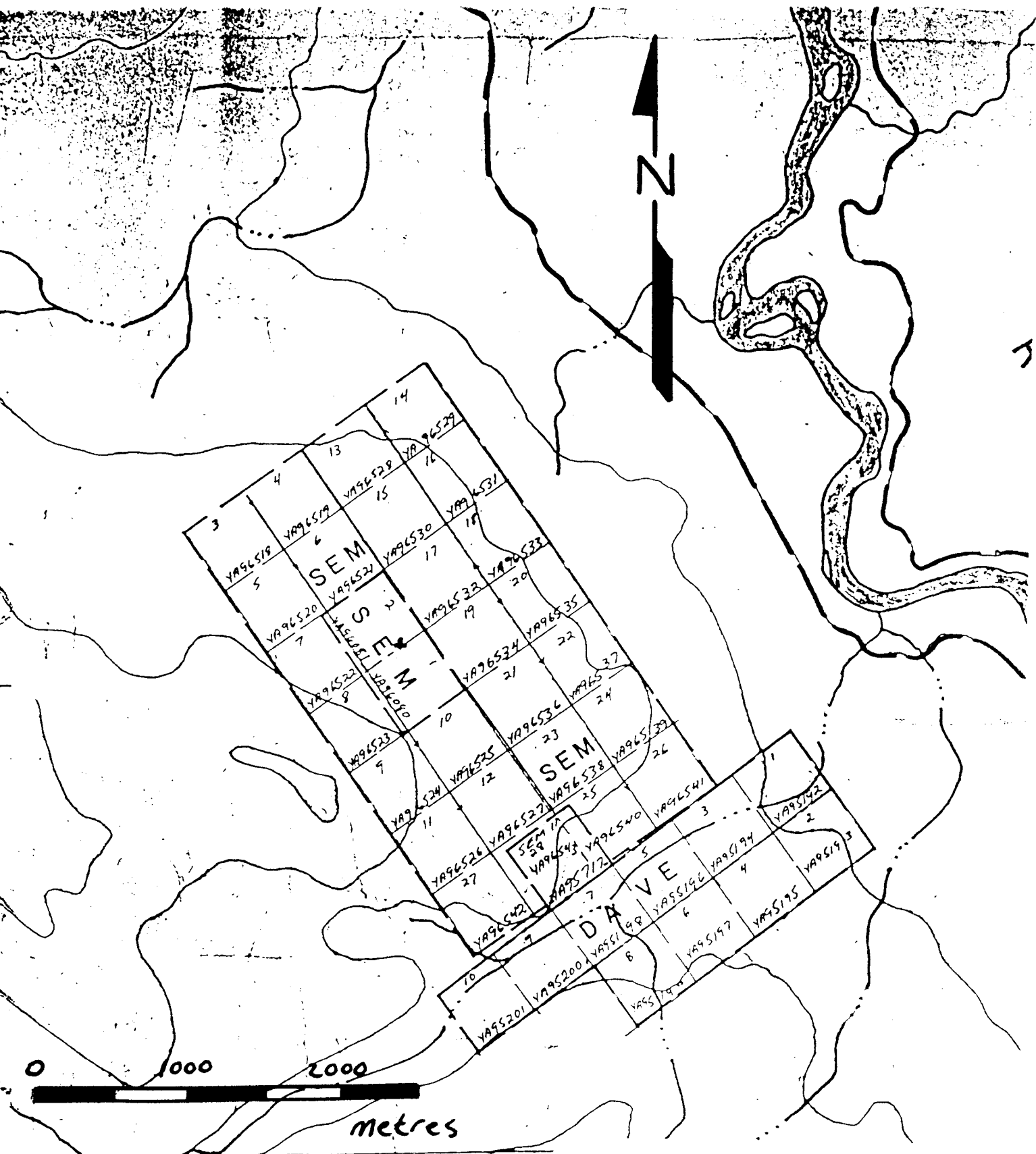

CLAIM MAP

Fig. 3

SEMENOF PROPERTY

105E/15

Whitehorse Mining Division

Scale: 1:30,000

November, 1987

105E-15

1-4: CLAIM DEFINITION (see Figure 3)

The property consists of the following claims:

CLAIMS	RECORD NO.	ANNIVERSARY
DAVE 1-10	YA 95192 - 95201	Nov. 24, 1990
SEM 1- 2	YA 96080 - 81	Nov. 24, 1990
SEM 3-28	YA 96518 - 43	Nov. 24, 1990
SEM 11	YA 95717	Nov. 24, 1990

1-5: HISTORY

The claims were originally staked as the SEM group in 1972 by United Keno Hill Mines Ltd. as a copper prospect. Minor sampling and mapping was conducted at that time and the claims were allowed to lapse. Orlo Davis of Whitehorse restaked the area as the SEM and DAVE claims and subsequently optioned the ground to Noranda Exploration Company Limited in 1987.

1-6: 1987 WORK PROGRAM

An intensive program of soil, rock, silt and pan samples along with geological mapping and geophysics (VLF-EM, magnetometer, IP) and trenching were carried out during 1987.

Personnel involved included:

H. Copland	Geologist	June 14 - 26
M. Trudzik	Geologist	June 14 - 26
G. MacKay	Geological Assistant	June 14 - 26
T. Daly	Field Assistant	June 14 - 26
J. Thomas	Cook	June 14 - 26

B. Kerby	Geophysicist	June 18 - 26
T. Lippert	Geophysicist	June 18 - 26
G. Clark & Associates	Linecutters	June 4 - 14
J. Moreau & Associates	Blasters	June 15 - 18

CHAPTER TWO: GEOLOGY

2-1: REGIONAL GEOLOGY

The property lies within the Whitehorse Trough of the Intermontane Belt of the Western Cordillera. The basal unit in the trough is the Upper Triassic Lewes River Group which is generally exposed on the margins. This unit comprises an assemblage of mafic flows, pyroclastics, and limestone reefs. Overlying this unit, clastic units of the Jurassic Laberge Group, crop out primarily in the centre of the trough. Minor granitic to dioritic plugs crop out in the area. These range in age from Jurassic to Upper Triassic.

The property lies within a structural province of the trough known as the Semenof Hills Block. This area is bounded on the east by the Big Salmon Fault and on the west by the Teslin Fault. Geologically the area is predominately the Lower to Mid Pennsylvanian Semenof Formation consisting of massive altered basalt, breccia, tuff, and greenstone. The Boswell Formation comprised of phyllite, greywacke, chert, conglomerate, and limestone with associated volcanoclastic units occurs in a belt just east of the claim block. Small plutons ranging in composition from Pennsylvanian gabbro to Cretaceous quartz monzonite crop out through the Semenof Formation.

TABLE OF FORMATIONS

Semenof Hills Block (after Tempelman-Kluit, 1984)

TERTIARY

Walsh Creek Fm.: conglomerate, mudstone and rhyolite

UPPER CRETACEOUS

Open Creek Volcanics: dacite flows and flow breccia

MIDDLE TRIASSIC

Headless Plug: hornblende - quartz diorite

LOWER & MIDDLE PENNSYLVANIAN

Semenof Formation: basalt, breccia, tuff and greenstone

Boswell Formation: phyllite, greywacke, chert, limestone, basalt
and grabbo

2-2: PROPERTY GEOLOGY (see Figure 4 & 5)

The property is underlain primarily by andesitic tuffs and flows, of the Semenof Formation. These are in contact with limestone and chert of the Boswell Formation on the eastern fringes of the claims. Small plutons and dykes of quartz - feldspar porphyry and quartz monzonite - diorite crop out on the western borders of the property.

A brief description of the units observed follows:

VOLCANIC ROCKS

1) Andesite

This unit is typically fine grained, green and massive. It appears to be a flow unit and can be subdivided into:

1a) Feldspar Porphyritic:

Subangular white phenocrysts less than 5mm in size comprise 0 - 20% of the rock.

1b) Hornblende Porphyritic:

Subrounded to subangular tabular phenocrysts of hornblende less than 1cm in size comprise 0 - 10% of the rock.

1c) Feldspar - Hornblende Porphyritic:

Appears to be a mix of 1a & 1b with feldspar being the predominate phenocryst.

Tuffaceous andesitic equivalent to the above units include:

1d) Lapilli Tuff:

This is the predominate volcanic rock on the property and the one in which the alteration and mineralization occurs. Characteristically the rock is medium to dark green on both weathered and fresh surfaces with subangular andesitic clasts in a lighter coloured, fine grained matrix. These clasts are typically subangular averaging 5mm in size. Locally the unit grades into a coarser volcanic conglomerate - breccia with multi-lithic clasts up to 10cm in size. This was observed over a small area and thus a separate unit was not assigned. Alteration and mineralization of this unit will be described in the following section.

1e) Cherty Tuff:

This unit is very fine grained and very siliceous. It is typically maroon to a reddish tint and occurs adjacent to the tuff/sediment contact and may represent a gradational unit between the two.

1f) Lithic Tuff:

This minor unit is gradational with the lapilli tuff rock with a smaller clast size than the lapilli tuff.

INTRUSIVE ROCKS

2) Quartz Monzonite:

This unit crops out at the western edge of the property and is typically fine grained, equigranular and quite fresh looking.

2a) Quartz - Feldspar Porphyry:

Probably the youngest unit on the property this rock occurs as dykes cutting both volcanic and intrusive rocks. It is medium - coarse grained with subangular feldspar phenocrysts averaging 5mm in size and up to 50% of the rock. Glassy quartz eyes to 5mm in size comprise 5 - 15% of the unit.

2b) Quartz Diorite:

A series of outcrops in the southwestern part of the claims is composed of this fine grained unit. It is equigranular with approximately 10% quartz, 70% feldspar (plagioclase) and 20% hornblende as small euhedral crystals.

SEDIMENTARY ROCKS

3) Limestone:

Typically bleached white on weathered surface and white - grey on fresh surface; fine to medium grained micritic, and partially recrystallized. No fossils were observed although similar limestone to the north has been dated as Lower to Middle Pennsylvanian.

4) Chert:

Minor grey to white chert beds and pods are present throughout the limestone unit.

2-3: ECONOMIC GEOLOGY

The lapilli tuff has been propylitically altered in several places on the property. The main zone occurs in a northerly trending band approximately 50 metres wide extending for a strike length of 700 metres. The alteration consists largely of epidote (65%) and calcite (20%) with minor tremolite and garnet development.

Bornite, malachite \pm azurite, and specular hematite occur in varying proportions near the centre of the grid (10000 N, 10000 E). A 24 metre long trench exposed two main zones of mineralization both approximately 2 metres in width. Malachite staining to 75% of the rock was concentrated in small near surface pods less than 0.5 metres across. Visible gold was seen in one piece of rock from one of these intensely mineralized zones. Bornite and hematite (1 - 10%) were disseminated throughout the mineralized sections.

Grab samples of the best looking mineralization carried values as high as 29,000 ppb Au (R20272) and greater than 4% Cu. A one metre chip sample across the best mineralization returned 0.5% Cu and 0.162 oz/t Au whereas unbiased sampling over 24 metres of trench length returned best values of 640 ppm Cu (R16986) and 150 ppb Au (R16987) over a 2 metre length.

These results confirm the erratic nature of the gold mineralization and its intimate association with copper. Aside from very minor malachite staining no other mineralization was observed in the propylitic altered zones outside of the discovery outcrop. Small 1 - 2cm wide quartz-carbonate veins cutting volcanic, volcanoclastic and sedimentary units in the main creek carry minor disseminated chalcocopyrite and malachite with best values of 3100 ppm Cu, and 560 ppb Au (R20467).

CHAPTER THREE: GEOCHEMISTRY

3-1: PROCEDURE (see Figure 6)

A total of 374 soil, 16 silt, 65 rock and 9 panned concentrate samples were collected on the property. Soil sampling was conducted over a 11.6km. grid with line spacings of 10 metres tightened to 50 metres near the centre of the grid. Samples were collected at 50 metre intervals with detailed 2 metre intervals near the discovery zone. Where possible B-horizon material was collected at a depth ranging from 30 - 50 cm. Silt and panned concentrate samples were collected from active stream sediments primarily in the main creek on the southern portion of the claims. All samples were shipped to Noranda's Vancouver Laboratory for preparation and analysis. Samples were analysed using standard procedures for Cu, Pb, Zn, Ag, As, and Au.

3-2: RESULTS (see Figure 7 & 8)

Soil sampling results were disappointing. Only sporadic weak to moderate anomalies in copper (120 - 620 ppm) occurred in a handful of samples over a scattered area. Likewise only two samples had greater than 20 ppb Au (60 - 400 ppb). Three panned samples from the main creek were anomalous (310 - 660 ppb Au). Corresponding silts taken with these samples were not anomalous in gold.

Some of the rock samples have been discussed under Economic Geology. A description of samples collected and their values is included in the appendix.

CHAPTER FOUR: GEOPHYSICS

4-1: PROCEDURE

In April 1987 an initial orientation magnetometer (12.6km) and VLF-EM (12.6km) survey were conducted over the claims. These were followed in June by a further 10.8km magnetometer survey using 12.5 metre stations and approximately 5km of Time Domain Induced Polarization employing a Dipole-Dipole array with 25 metre dipole spacing. All geophysical surveys were centred upon the discovery outcrop at 10000 N, 10000 E.

4-2: RESULTS

The following interpretation was completed by L. Bradish, Noranda District Geophysicist.

MAGNETOMETER SURVEY (Fig. 9)

The magnetometer survey has defined a number of interesting features of which the most prominent are two zones of low magnetic susceptibility as shown on the Mag map. These magnetic depletion zones are possibly (1) the result of strong alteration and define a general N-S trend.

Some faults or magnetic breaks are evident with the most prominent defining a 0 and 095 degree direction as shown on the mag map.

INDUCED POLARIZATION SURVEY (Fig. 10)

The I.P. results were disappointing in that the P.F.E.'s recorded were very low being typically less than 1%. Some increases in the background can be discerned however this is usually about a maximum of 1%.

The resistivity data shows some interesting variations particularly when compared to the magnetic data. Specifically there is a distinct relationship between the magnetic depletion zones and low resistivity responses. This is not a one to one relationship but there is good correlation. The low resistivity areas define a definite N-S direction.

VLF-EM (Fig. 11)

The VLF-EM has defined numerous responses and requires additional analysis to sort the bedrock from topographic responses.

CONCLUSIONS

The I.P. survey failed to define any source of polarization which would represent possible sources of sulphide mineralization. The resistivity and magnetics however have mapped a number of interesting features which should be correlated with the known and interpreted geology. Specifically the combination of low resistivity and 'low magnetics' indicates that these areas may be significantly altered and thus should be investigated closely. If additional work is planned for this area consideration should be given to re-establishing the grid so that the survey lines run in an E-W direction and the magnetics rerun. This would allow for a more detailed interpretation of this data set.

CHAPTER FIVE: CONCLUSIONS & RECOMMENDATIONS

Copper and gold mineralization on the Semenov property is restricted to a very small area of a northerly trending belt of propylitized andesitic laobilli tuff. This alteration appears as a zone of low resistivity and low magnetic response. Geochemistry has failed to pick up any anomalies over this zone. Gold and copper values are restricted to a near surface pocket approximately 1 metre wide at the discovery outcrop.

This type of alteration and style of mineralization is known to host sub-economic deposits of gold in copper in similar terrain in the Quesnel Trough of south central B.C.. The potential for an economic deposit of this type on the SEM and DAVE claims is low.

Respectfully submitted by

A handwritten signature in cursive script, appearing to read "H. Cooland", is written over a horizontal dashed line.

Hugh Cooland

Project Geologist

STATEMENT OF COST

1) LABOUR

a) Field

Geologist	:	13 days @ 110/day	\$ 1430.
Geologist	:	13 days @ 90/day	1170.
Assistants	:	26 days @ 80/day	2080.
Cook	:	13 days @ 100/day	1300.
Geophysicists	:	18 days @ 100/day	1800.
Linecutters	:	12.6 km @ 400/km	5040.
Trenchers	:	3 days @ 700/day	2100.

14920.

b) Office

Geologist/Geophysicist:	8 days @ 110/day	880.
Typing	: 1 day @ 100/day	100.
Drafting	: 10 days @ 150/day	1500.

2480.

SUBTOTAL 17400.

2) GEOCHEMISTRY

a) Analysis	:	374 soils @ \$12/sample	4480.
	:	65 rocks @ \$15/sample	975.
	:	25 silts & pans @ \$12/sample	300.
b) Supplies	:	flagging sample bags etc.	500.

SUBTOTAL 6263.

3) GEOPHYSICS

Equipment Rental	:	9 days @ \$300/day	2700.
------------------	---	--------------------	-------

4) TRENCHING

Explosives etc.	:		1200.
-----------------	---	--	-------

5) TRANSPORTATION

Fixed Wing	:	1800 miles @ \$1.65/mi	2970.
Helicopter	:	12 hours @ \$600/hr.	7200.
Truck Rental	:	14 days @ \$35/day	490.
Gas & Oil	:		250.
Sample & Equipment Shipment			750.

SUBTOTAL 11660.

6) FOOD & ACCOMODATIONS			3500.
-------------------------	--	--	-------

7) MISCELLANEOUS			500.
------------------	--	--	------

TOTAL \$43,223.

SELECTED REFERENCES

Bostock, H.S. & Lees, E.J.

1938: Laberge Map Area; GSC Memoir #217

Bradish, L

1987: Geophysical Report on the Semerof Property; Internal Memo, Noranda Exploration Co. Ltd..

Tempelman - Kluit, D.J.

1984: Geology, Laberge (105E) & Carmacks (115I); GSC Open File #1101.

VanTassell, R.E.

1970: Report on the Fox Claim Group (105E/15); Internal United Keno Hill Mines Report.

STATEMENT OF QUALIFICATIONS

I Hugh Cooland of the City of Whitehorse, Yukon, do hereby certify that:

1. I have been an employee of Noranda Exploration Company Limited (NPL) in Whitehorse since May, 1985.
2. I am a graduate of the University of British Columbia with a B.Sc. in Geology and of McMaster University, Hamilton, Ontario with a B.Eng..
3. I am a member of the Yukon Professional Geoscientists Society, and the Geological Association of Canada.
4. I supervised work on the SEM & DAVE Claims during June, 1987.

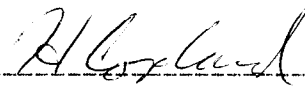

Hugh Cooland
Geologist

APPENDIX 1
Sample Description & Results

NORANDA EXPLORATION COMPANY, LIMITED

N.T.S. 105E/15

PROPERTY SEM

DATE June, 1987

ROCK SAMPLE REPORT

PROJECT: _____

SAMPLE NO.	LOCATION & DESCRIPTION	% SULPHIDES	TYPE	WIDTH	G	A	G	A	G	A	G	A	G	A	SAMPLED BY
					Cu	Ag	Zn	Pb	Au	As					
20266	Andesite: Hb prophyritic moderate propylitic alteration		Grab		24	0.2	60	2	5	2					
267	Andesite: Feldspar porphyritic pervasive epidote alteration		"		14	0.2	38	2	5	12					
268	as 267, minor malachite		"		208	0.2	64	2	5	4					
269	Andesite: intense propylitic alt.		"		4	0.2	36	2	5	18					
270	Lapilli tuff: Moderate propylitic alt.		"		290	0.2	56	48	5	18					
271	as 270		"		640	0.2	44	2	5	18					
20272	Showing: intense malachite, azurite, bornite, lematite in propylitic altered tuff TRENCH CHIP SAMPLES		"		40,000	40.0	40	2	29000	12					
16976	(0-1 metres) unaltered lapilli tuff		Chip	1m	10	0.2	68	2	5	8					
977	(1-2m) as above		"	"	20	0.2	60	2	40	4					
978	(2-3m) intensely altered malachite, azurite, bornite to 10%		"	"	58	0.2	60	2	20	12					
979	(3-4m) unaltered lapilli tuff		"	"	4	0.2	50	2	5	6					
980	(4-5m) as 979		"	"	4	0.2	60	2	5	14					
981	(5-8m) minor epidote altered lapilli tuff		"	3m	4	0.2	38	2	5	6					
982	(8-10m) as 981		"	2m	10	0.2	48	2	5	24					
983	(10-12m) crumbly lapilli tuff & clay		"	"	12	0.2	72	2	5	16					
984	(12-14m)		"	"	4	0.2	74	2	5	16					
985	(14-16m) intensely propylitic altered tuff		"	"	26	0.2	78	2	5	14					

hematite (5%)

G = GEOCHEM A = ASSAY

NORANDA EXPLORATION COMPANY, LIMITED

N.T.S. 105E/15

PROPERTY SEM

DATE June, 1987

ROCK SAMPLE REPORT

PROJECT

SAMPLE NO.	LOCATION & DESCRIPTION	% SULPHIDES	TYPE	WIDTH	G	A	G	A	G	A	G	A	G	A	SAMPLED BY
					Cu	Ag	Zn	Pb	Au	As	Mo				
16986	(16-18m) as 985		chip	2m	640	0.2	94	2	5	20					
987	(18-20) andesite (minor alt.) minor epidote alt.		"	"	620	0.4	74	2	150	16					
988	(20-22) minor epidote on fract surface lapilli tuff		"	"	92	0.2	68	2	5	10					
989	(1.5-2.5m) intensely altered section (resample)		"	1m	0.50%				0.162 oz/t						
990	(14-15m) as 985		"	"	0.02%				0.001 oz/t						
991	(15-16.5) as 990		"	1.5m	0.02%				0.001 "						
992	(17.5-18.3) as 990		"	0.8m	0.32%				0.003 "						
993	bleby hematite in altered tuff south of trench			4m	44	0.2	100	2	5	-					
20273	Diorite with dissem. cpy 1%		Grab		246	0.2	36	2	5	-					
274	very siliceous volcanic, malachite		"		9800	4.0	72	2	5	-					
275	hematite stained volcanic		"		30	12	0.2	82	2	5	1				
16994	intensely propylitic altered tuff		"		10	10	0.2	60	2	5	1				
995	as 994		"		124	16	0.2	60	2	5	1				
996	moderately propylitic altered tuff		"		30	6	0.2	26	2	5	1				
997	as 994		"		80	8	0.2	40	2	5	1				
998	foliated chloritic lapilli tuff		"		38	8	0.2	66	2	5	1				
999	altered lapilli tuff (glaucothane?)		"		30	8	0.2	52	8	5	1				
17000	quartz-carbonate vein (2-3cm) with azurite/malachite stain		"		8000	410	108	2	5	-	-				
20476	as 16999		"		20	0.2	78	2	5	-	-				
477	pyritiferous lapilli tuff (2%) Py		"		358	0.2	48	2	5	2					

G = GEOCHEM A = ASSAY

NORANDA EXPLORATION COMPANY, LIMITED

N.T.S. 105E/15

PROPERTY SEM

DATE June, 1987

ROCK SAMPLE REPORT

PROJECT

SAMPLE NO.	LOCATION & DESCRIPTION	% SULPHIDES	TYPE	WIDTH	G	A	G	A	G	A	G	A	SAMPLED BY
					Cu	Ag	Zn	Pb	Au	As			
20401	quartz veinlet in metavolcanic		Grab		128	0.2	20	8	30	8			
402	as 401 minor malachite				1040	1.6	34	6	80	26			
403	quartz-carbonate & clay altered volcanic rx.				20	0.2	30	2	5	8			
404	2cm wide chalcedonic vein				52	0.2	84	2	5	2			
412	Hb porphyritic andesite with calcite veinlets				3260	1.0	28	2	220	6			
414	chloritic andesite, minor epidote				64	0.2	28	2	5	2			
415	pyritiferous diorite				84	0.2	26	2	5	2			
416	porphyritic andesite (5%Py)				100	0.2	4	2	5	2			
417	lapilli tuff, epidote, calcite alt				6	0.2	30	2	5	2			
418	Andesite, minor epidote alt				298	0.2	30	2	5	2			
419	Andesite, moderate epidote alt.				12	0.2	48	2	5	2			
420	as 419				44	0.2	38	2	5	2			
421	propylitic lapilli tuff, minor bornite & malachite				2500	0.2	40	2	30	2			
422	weakly alt. lapilli tuff				18	0.2	42	2	5	2			
423	carbonate alt andesite, minor malachite				1200	1.4	22	2	5	12			
424	clay alt qua-tz veinlet (2cm wide)				22	0.2	56	2	5	10			
425	as 424				52	0.2	56	2	5	14			
20451	minor calcite veining in tuff				16	0.2	48	2	5	14			
452	propylitic lapilli tuff				398	0.2	38	4	5	8			
453	propylitic lapilli tuff				22	0.2	20	2	5	2			
20462	epidote alt. mafic volcanic				16	0.2	40	2	5	2			
463	propylitic lapilli tuff minor calcite veining				6	0.2	44	2	5	16			

G = GEOCHEM A = ASSAY

APPENDIX 2

Results

8706-090

ROSSBACHER LABORATORY LTD.

2225 S. SPRINGER AVENUE
BURNABY, B.C. V5B 3N1
TEL : (604) 299 - 6910

CERTIFICATE OF ANALYSIS

CLIENT: NORANDA EXPLORATION CO. LTD.
1050 DAVIE STREET
VANCOUVER B.C.
PROJECT: 330 8706-090
TYPE OF ANALYSIS: GEOCHEMICAL

Semenof (HC)

CERTIFICATE#: 87266
INVOICE#: 7707
DATE ENTERED: 87-07-03
FILE NAME: NOR87266
PAGE #: 1

INDEX	SAMPLE NAME	PPM Cu	PPM Ag	PPM Zn	PPM Pb	PPB Au	PPM As
A	16976	10	0.2	68	2	5	8
A	16977	20	0.2	60	2	40	4
A	16978	58	0.2	60	2	20	12
A	16979	4	0.2	50	2	5	6
A	16980	4	0.2	60	2	5	14
A	16981	4	0.2	38	2	5	6
A	16982	10	0.2	48	2	5	24
A	16983	12	0.2	72	2	5	16
A	16984	4	0.2	74	2	5	16
A	16985	26	0.2	78	2	5	14
A	16986	640	0.2	94	2	5	20
A	16987	620	0.4	74	2	150	16
A	16988	92	0.2	68	2	5	10
A	20266	24	0.2	60	2	5	2
A	20267	14	0.2	38	2	5	12
A	20268	208	0.2	64	2	5	4
A	20269	4	0.2	36	2	5	18
A	20270	290	0.2	56	48	5	18
A	20271	640	0.2	44	2	5	18
A	20272	>40000	40.0	40	2	29000	12
A	20401	128	0.2	20	8	30	8
A	20402	1040	1.6	34	6	80	26
A	20403	20	0.2	30	2	5	8
A	20404	52	0.2	84	2	5	2
A	20412	3260	1.0	28	2	220	6

CERTIFIED BY :

J. Rossbach

8707-018

ROSSBACHER LABORATORY LTD.

2225 S. SPRINGER AVENUE
BURNABY, B.C. V5B 3N1
TEL : (604) 299 - 6910

CERTIFICATE OF ANALYSIS

TO : NORANDA EXPLORATION CO. LTD.
1050 DAVIE STREET
VANCOUVER B.C.

CERTIFICATE#: 87294.A
INVOICE#: 7748
DATE ENTERED: 87-08-14
FILE NAME: NOR87294.A
PAGE # : 1

PROJECT: 330 8707-018
TYPE OF ANALYSIS: GEOCHEMICAL SEM (HC)

PRE FIX	SAMPLE NAME	PPM Mo	PPM Cu	PPM Co	PPM Ag	PPM Zn	PPM Pb	PPB Au	PPM Sb
A	16993	1	44	20	0.2	100	2	5	2
A	16994	1	10	10	0.2	60	2	5	2
A	16995	1	124	16	0.2	60	2	5	2
A	16996	1	30	6	0.2	26	2	5	2
A	16997	1	80	8	0.2	40	2	5	2
A	16998	1	38	8	0.2	66	2	5	2
A	16999	1	30	8	0.2	52	2	5	2
A	17000	1	8000	20	4.0	108	2	5	2
A	20273	1	246	14	0.2	36	2	5	2
A	20274	1	9800	6	4.0	72	2	5	2
A	20275	1	30	12	0.2	82	2	5	2
A	20476	1	20	6	0.2	75	2	5	2

CERTIFIED BY :

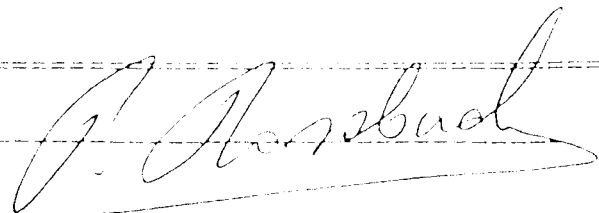

NORANDA VANCOUVER LABORATORY

PROPERTY/LOCATION: SEMENOF

CODE : 8706-090

Project No. : 330
 Material : PAN
 Remarks :

Sheet: 1 of 1
 Geol.: H.C

Date rec'd: JUN. 22
 Date compl: JUL. 02

Values in PPM, except where noted.

T. No.	SAMPLE No.	SAMPLE wt. (g)	PPB Au	PPM			
				Cu	Zn	Pb	Ag
30	PAN 20405	19.4	10	38	130	1	0.8
31	20406	12.8	10	20	100	1	0.6
32	PAN 20407	20.3	10	34	90	1	0.6

B. Pan-con: entire sample used for Au determination.

*Cu, Zn, Pb, Ag values obtained from Aqua Regia sol'n.

*Above ^B
 on creek*

8707-018

ROSSBACHER LABORATORY LTD.

2225 S. SPRINGER AVENUE
BURNABY, B.C. V5B 3N1
TEL : (604) 299 - 6910

CERTIFICATE OF ANALYSIS

TO : NORANDA EXPLORATION CO. LTD.
1050 DAVIE STREET
VANCOUVER B.C.

CERTIFICATE#: 87294
INVOICE#: 7736
DATE ENTERED: 87-07-10
FILE NAME: NOR87294
PAGE # : 1

PROJECT: 330 8707-018
TYPE OF ANALYSIS: ASSAY

SEM (Hc)

RE IX	SAMPLE NAME	oz/t Au	% Cu
A	16989	0.162	0.50
A	16990	0.001	0.02
A	16991	0.001	0.02
A	16992	0.003	0.32

PARTIAL FILE,
Sb TO FOLLOW.

CERTIFIED BY :

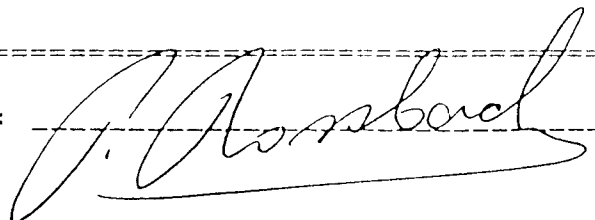

OSBACHER LABORATORY LTD.
CERTIFICATE OF ANALYSIS

2225 S. SPRINGER AVENUE
 BURNABY, B.C. V5B 3N1
 TEL : (604) 299 - 6910

CLIENT: NORANDA EXPLORATION CO. LTD.
 1050 DAVIE STREET
 VANCOUVER B.C.
 PROJECT: 330 8707-018
 TYPE OF ANALYSIS: GEOCHEMICAL

CERTIFICATE#: 87294.A
 INVOICE#: 7748
 DATE ENTERED: 87-08-14
 FILE NAME: NOR87294.A
 PAGE # : 1 A

SAMPLE NAME	PPM	PPM	PPM	PPM	PPM	PPM	PPB	PPM
	Mo	Cu	Co	Ag	Zn	Pb	Au	Sb
16993	1	44	20	0.2	100	2	5	
16994	1	10	10	0.2	60	2	5	
16995	1	124	16	0.2	60	2	5	
16996	1	30	6	0.2	26	2	5	
16997	1	80	8	0.2	40	2	5	
16998	1	38	8	0.2	66	2	5	
16999	1	30	8	0.2	52	8	5	
17000	1	8000	20	4.0	108	2	5	
20273	1	246	14	0.2	36	2	5	
20274	1	9800	6	4.0	72	2	5	
20275	1	30	12	0.2	82	2	5	
20476	1	20	6	0.2	78	2	5	

CERTIFIED BY :

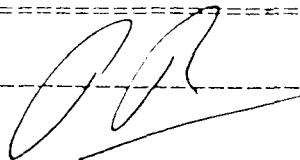

JOSSBACHER LABORATORY LTD.

2225 S. SPRINGER AVENUE
BURNABY, B.C. V5B 3N1
TEL : (604) 299 - 6910

CERTIFICATE OF ANALYSIS

CLIENT: NORANDA EXPLORATION CO. LTD.
1050 DAVIE STREET
VANCOUVER B.C.
PROJECT: 330 8707-018
TYPE OF ANALYSIS: GEOCHEMICAL

CERTIFICATE#: 87294.A
INVOICE#: 7748
DATE ENTERED: 87-08-14
FILE NAME: NOR87294.A
PAGE # : 1 B

EX	SAMPLE NAME	PPM As	PPM Cd
	16993	2	0.2
	16994	2	0.2
	16995	2	0.8
	16996	14	1.0
	16997	6	0.6
	16998	14	0.6
	16999	12	0.4
	17000	1280	0.4
	20273	2	0.2
	20274	20	0.2
	20275	116	0.2
	20476	22	0.2

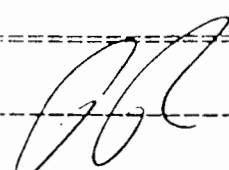
CERTIFIED BY : 

NORANDA VANCOUVER LABORATORY

PROPERTY/LOCATION: *US*

CODE :8707-017

Project No. : 330
 Material : PAN-CON
 Remarks :

Sheet:1 of 1
 Geol.:H.C.

Date rec'd:JUN.29
 Date compl:JUL.03

Values in PPM, except where noted.

T. T. No.	SAMPLE No.	SAMPLE wt (g)	PPB Au	Cu	Zn	Pb	Ag
44	PAN 20454	13.0	10	26	60	1	0.4
45	20455	28.5	10	48	160	1	0.4
46	20456	17.7	310	32	86	1	0.4
47	20457	16.0	320	32	80	1	0.4
48	20458	16.1	10	30	74	1	0.4
49	PAN 20460	26.9	660	38	160	1	0.4

B. Pan-con: entire sample used for Au determination.
 *Cu, Zn, Pb, Ag values obtained from Aqua Regia sol'n.

House 28

ROSSBACHER LABORATORY LTD.

2225 S. SPRINGER AVENUE
 BURNABY, B.C. V5B 3N1
 TEL : (604) 299 - 6910

CERTIFICATE OF ANALYSIS

TO : NORANDA EXPLORATION CO. LTD.
 1050 DAVIE STREET
 VANCOUVER B.C.
 PROJECT: 330 8707-017
 TYPE OF ANALYSIS: GEOCHEMICAL

CERTIFICATE#: 87293
 INVOICE#: 7738
 DATE ENTERED: 87-07-10
 FILE NAME: NOR87293
 PAGE # : 1

PRE FIX	SAMPLE NAME	PPM Cu	PPM Ag	PPM Zn	PPM Pb	PPB Au	PPM As
A	20413	8	0.2	18	12	5	2
A	20414	64	0.2	28	2	5	2
A	20415	84	0.2	26	2	5	2
A	20416	100	0.2	4	2	5	2
A	20417	6	0.2	30	2	5	2
A	20418	298	0.2	30	2	5	2
A	20419	12	0.2	48	2	5	2
A	20420	44	0.2	38	2	5	2
A	20421	2500	0.2	40	2	30	2
A	20422	18	0.2	42	2	5	2
A	20423	1200	1.4	22	2	5	12
A	20424	22	0.2	56	2	5	10
A	20425	52	0.2	56	2	5	14
A	20451	16	0.2	48	2	5	4
A	20452	398	0.2	38	4	5	8
A	20453	22	0.2	20	2	5	2
A	20462	16	0.2	40	2	5	2
A	20463	6	0.2	44	2	5	16
A	20464	28	0.2	48	2	5	8
A	20465	122	0.2	44	2	5	4
A	20466	348	0.2	36	2	5	12
A	20467	3100	1.4	46	2	560	2
A	20469	580	0.2	46	2	5	4
A	20477	358	0.2	48	2	5	2

CERTIFIED BY :

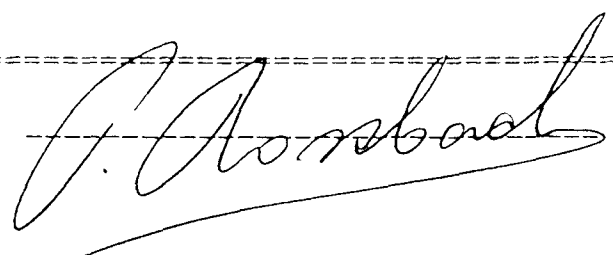

NORANDA VANCOUVER LABORATORY

RL RTY/LOCATION: SEMINOFF

CODE : 8706-089

Project No. : 330 Sheet: 1 of 6 Date rec'd: JUN. 22
 Material : SILT & SOIL Geol.: H.C. Date compl: JUL. 14
 Remarks :

Values in PPM, except where noted.

T.	SAMPLE No.	Cu	Zn	Pb	Ag	As	Mo	PPB Au
2	SILT T 20408	30	48	2	0.2	4	1	10
3	20409	30	50	1	0.2	6	1	10
4	20410	34	60	1	0.2	6	2	10
5	SILT T 20411	30	50	1	0.2	10	1	10
6	9500M-9700E	20	48	2	0.2	2	1	10
7	E 9750 ^N	12	36	1	0.2	2	1	10
8	9800	22	46	1	0.2	6	1	10
9	9850	24	44	1	0.2	4	1	10
0	9900	32	48	2	0.2	1	2	10
1	9950	46	42	2	0.2	1	2	10
2	10000	64	40	1	0.2	2	2	10
3	10050	120	44	1	0.2	2	2	10
4	10100	22	50	1	0.2	6	1	10
5	10150	120	66	1	0.2	4	1	10
6	10200	48	64	1	0.2	10	1	10
7	E 10250	64	42	1	0.2	6	1	10
8	9500M-10300E ^N	50	56	1	0.2	10	1	10
9	9600M-9700E ^N	42	62	1	0.2	12	2	10
0	E 9750	26	40	1	0.2	8	1	10
1	9800	18	22	1	0.2	2	1	10
2	9850	30	44	1	0.2	4	1	10
3	9900	48	46	1	0.2	2	1	10
4	9950	24	48	2	0.2	6	1	10
5	10000	70	56	1	0.2	12	2	10
6	10050	180	64	1	0.2	6	1	10
7	10100	36	70	1	0.2	10	1	10
8	10150	82	100	1	0.2	6	1	10
9	E 10250	6	40	1	0.2	4	1	10
0	9600M-10300E ^N	8	42	2	0.2	8	1	10
1	9700M-9700E ^N	10	40	2	0.2	14	2	10
2	E 9750	12	40	1	0.2	10	2	10
3	9800	8	36	1	0.2	4	2	10
4	9850	42	52	1	0.2	10	2	10
5	9900	10	44	1	0.2	12	1	10
6	9950	38	52	2	0.2	12	1	10
7	10000	30	54	2	0.2	8	2	10
8	10050	20	42	1	0.2	8	2	10
9	10150	22	36	1	0.2	6	2	10
0	10200	12	44	2	0.2	6	2	10
1	E 10250	30	44	2	0.2	10	1	10
2	9700M-10300E ^N	52	54	1	0.2	10	1	10
3	9800M-9700E	48	48	1	0.2	10	1	10
4	E 9750 ^N	8	36	1	0.2	12	1	10
5	9800	8	38	2	0.2	10	2	10
6	9850	6	42	4	0.2	8	2	10
7	9900	20	50	2	0.2	12	1	10
8	E 9950	22	52	2	0.2	4	1	10
9	9800M-10050E ^N	28	54	1	0.2	2	1	10

T.	SAMPLE No.	Cu	Zn	Pb	Ag	As	Mo	PPB 8706-08E	
								Au	Pg. 2 of 6
0	9800M-10100Z ^N	16	42	2	0.2	12	2	10	
1	10150	36	50	1	0.2	6	2	10	
2	10200	40	54	1	0.2	10	2	10	
3	10250	46	52	2	0.2	6	2	10	
4	9800N-10300E	20	60	1	0.2	1	2	10	
5	9850M-10050Z ^N	16	60	1	0.2	6	2	10	
6	10100	24	44	1	0.2	8	2	10	
7	10150	30	58	2	0.2	6	2	10	
8	10250	52	54	1	0.2	10	2	10	
9	9850M-10300E	32	62	1	0.2	4	2	10	
0	10300M-9500E	10	26	1	0.2	1	1	10	
1	9550 ^N	8	34	2	0.2	10	2	10	
2	9600	44	48	1	0.2	4	2	10	
3	9650	54	44	2	0.2	16	2	10	
4	9700	10	50	2	0.2	4	2	10	
5	9750	8	46	2	0.2	10	2	10	
6	9800	10	36	1	0.2	8	1	10	
7	9850	6	24	1	0.2	6	2	10	
8	9900	8	40	2	0.2	6	1	10	
9	9950	10	56	1	0.2	4	2	10	
0	10000	8	76	1	0.2	2	2	10	
1	10050	8	40	2	0.2	4	2	10	
2	10100	20	42	2	0.2	2	1	10	
3	10150	6	34	2	0.2	8	1	10	
4	10200	24	62	1	0.2	12	2	10	
5	10250	6	16	1	0.2	2	1	10	
6	10300M-10300E	8	38	1	0.2	1	1	10	
7	10400M-9500E	52	50	1	0.2	16	1	10	
8	9550 ^N	68	48	1	0.2	12	2	10	
9	9600	58	30	1	0.2	4	1	10	
0	9700	140	32	1	0.2	8	2	10	
1	9750	38	40	1	0.2	14	2	10	
2	9800	36	48	2	0.2	12	2	10	
3	9850	240	66	1	0.2	16	2	10	
4	9900	12	50	2	0.2	10	2	10	
5	9950	28	56	1	0.2	6	2	10	
6	10000	14	44	2	0.2	6	1	10	
7	10050	14	46	1	0.2	4	2	10	
8	10100	10	34	1	0.2	1	2	10	
9	10150	50	76	2	0.2	4	2	10	
0	10200	20	52	1	0.2	2	2	10	
1	10250	18	54	1	0.2	8	2	10	
2	10400M-10300E	8	48	4	0.2	8	2	10	
3	10500M-9500E	14	48	2	0.2	10	1	10	
4	9550 ^N	16	32	1	0.2	12	2	10	
5	9620	44	46	2	0.2	12	2	10	
6	9650	38	54	1	0.2	8	2	10	
7	9700	18	44	2	0.2	2	2	10	
8	9750	24	48	1	0.2	1	2	10	
9	10500M-9800E	34	46	4	0.2	1	2	10	
0	CHECK NL-5	26	68	70		62	8	-	
1	10500M-9850Z ^N	24	42	2	0.2	4	2	10	
2	9900	16	40	2	0.2	4	2	10	
3	9950	28	52	4	0.2	2	2	10	
4	10000	14	50	2	0.2	2	2	10	
5	10050	16	56	4	0.2	4	2	20	
6	10500M-10100E	46	76	2	0.2	6	2	10	

T.	SAMPLE No.	Cu	Zn	Pb	Ag	As	Mo
7	10500M-10150E N	16	92	2	0.2	4	2
8	10200	28	50	2	0.2	10	2
9	10250	18	60	2	0.2	6	2
0	10500M-10300E	20	60	1	0.2	10	2
1	BL E 9525E N	100	60	1	0.2	6	2
2	9550	200	66	1	0.2	4	2
3	9575	12	32	2	0.2	4	2
4	9625	20	42	1	0.2	2	2
5	9650	24	46	2	0.2	6	2
6	9675	12	50	2	0.2	8	2
7	9725	60	34	1	0.2	2	2
8	9750	40	50	1	0.2	2	2
9	9825	26	60	1	0.2	2	2
0	10250	16	48	2	0.2	2	2
1	10350	12	46	1	0.2	10	2
2	BL 10450E	52	40	1	0.2	8	2
3	9850M-9700E N	20	44	1	0.2	10	2
4	E 9725	220	48	1	0.2	16	2
5	9750	52	54	1	0.2	12	2
6	9775	24	38	2	0.2	8	2
7	9800	12	54	2	0.2	6	2
8	9825	12	48	2	0.2	14	2
9	9850	16	46	2	0.2	10	2
0	9875	20	56	1	0.2	16	2
1	9900	32	50	1	0.2	6	2
2	9950	18	48	1	0.2	4	2
3	9850M-9975E	18	46	1	0.2	2	2
4	9900M-9700E	34	44	1	0.2	8	2
5	E 9725 N	88	50	1	0.2	8	2
6	9750	22	40	2	0.2	10	1
7	9775	12	32	1	0.2	12	2
8	9800	12	44	2	0.2	16	2
9	9825	16	46	1	0.2	8	2
0	9850	12	52	2	0.2	4	2
1	9875	14	52	1	0.2	8	1
2	9900	24	58	1	0.2	10	2
3	9925	34	50	1	0.2	10	2
4	9950	14	54	1	0.2	6	1
5	9975	38	50	1	0.2	1	2
6	10000	38	54	1	0.2	8	1
7	10025	8	34	1	0.2	10	2
8	10050	16	56	1	0.2	24	2
9	9900M-10075E N	8	90	1	0.2	4	2
0	E 10100	18	46	2	0.2	10	1
1	10125	26	40	4	0.2	8	1
2	10150	52	50	2	0.2	10	1
3	10175	96	54	2	0.2	2	1
4	10200	44	40	1	0.2	14	1
5	10225	20	40	2	0.2	12	1
6	10250	16	42	2	0.2	6	1
7	10275	14	42	4	0.2	1	1
8	9900M-10300E	16	42	2	0.2	1	1
9	9950M-9700E N	22	42	2	0.2	4	1
0	E 9725	72	38	1	0.2	8	1
1	9750	16	42	2	0.2	6	1
2	9775	12	48	2	0.2	4	1
3	9950M-9800E	30	50	1	0.2	6	1

T.	SAMPLE No.	Cu	Zn	Pb	Ag	As	Mo	PPB Au
5	9950M-9825E	14	44	4	0.2	2	1	20
6	E 9850 N	16	38	1	0.2	1	1	10
7	9875	10	38	4	0.2	4	1	10
8	9900	16	42	2	0.2	6	1	10
9	9925	18	50	1	0.2	8	1	10
0	9950	18	34	1	0.2	4	1	10
1	9975	12	36	4	0.2	2	1	10
2	10000	22	30	1	0.2	1	1	10
3	10025	16	52	2	0.2	8	2	10
4	10050	16	42	2	0.2	6	1	10
5	10075	12	120	1	0.2	20	2	10
6	10100	14	44	2	0.2	14	1	10
7	10125	12	44	2	0.2	10	1	10
8	10150	180	22	1	0.2	2	1	10
9	10175	44	38	1	0.2	6	1	10
0	10200	78	48	1	0.2	16	2	10
1	10225	12	36	4	0.2	10	1	10
2	10250	14	48	4	0.2	8	1	10
3	10275	12	42	2	0.2	4	1	10
4	9950M-10300E	14	46	4	0.2	6	1	10
5	10100M-9700E	40	32	1	0.2	1	1	10
6	E 9725 N	28	38	2	0.2	2	1	10
7	9750	20	52	2	0.2	1	1	10
8	9775	16	52	2	0.2	1	1	10
9	9800	18	40	2	0.2	1	1	10
0	9825	26	46	1	0.2	6	1	10
1	9850	620	42	1	0.2	8	1	10
2	9875	16	38	2	0.2	6	1	10
3	9900	20	46	2	0.2	1	1	10
4	9925	14	50	1	0.2	14	1	10
5	9950	10	38	2	0.2	4	1	10
6	10025	14	16	1	0.2	8	1	10
7	10050	32	26	1	0.2	1	1	10
8	10075	50	34	2	0.2	1	1	10
9	10100	66	42	2	0.2	1	2	10
0	10125	44	44	4	0.2	12	1	10
1	10150	30	46	2	0.2	1	1	10
2	10175	14	40	4	0.2	6	1	10
3	10200	18	38	2	0.2	2	1	10
4	10225	16	40	2	0.2	4	1	10
5	10250	24	46	2	0.2	8	2	10
6	10275	16	38	4	0.2	10	1	10
7	10100M-10300E	16	36	4	0.2	8	1	10
8	10150M-9700E	18	40	1	0.2	4	1	10
9	E 9725 N	32	36	2	0.2	6	1	10
0	9750	34	44	1	0.2	10	2	10
1	9775	14	40	4	0.2	8	1	10
2	9800	20	38	2	0.2	6	1	10
3	9825	18	44	4	0.2	8	1	10
4	9850	12	42	2	0.2	10	1	10
5	9875	12	56	1	0.2	6	1	10
6	9900	16	34	1	0.2	6	1	10
7	9925	18	30	1	0.2	6	1	10
8	9950	34	36	2	0.2	10	1	10
9	9975	16	38	1	0.2	8	1	400
0	10000	14	42	4	0.2	16	2	10
1	10150M-10025E	14	50	1	0.2	12	1	10
2	E N							

T.
3
4
5
6
7
8
9
0
1
2
3
4
5
6
7
8
9
0
1
2
3
4
5
6
7
8
9
0
1
2
3
4
5
6
7
8
9
0
1
2
3
4
5
6
7
8
9

SAMPLE No.	Cu	Zn	Pb	Ag	As	Mo
10150N-10050E	14	44	2	0.2	4	1
10075	26	50	1	0.2	12	1
10100	30	44	1	0.2	10	1
10125	36	40	4	0.2	18	1
10150	54	60	1	0.2	18	1
10175	18	42	2	0.2	10	1
10200	12	36	2	0.2	14	1
10225	22	38	4	0.2	12	1
10250	18	46	2	0.2	6	2
10275	14	46	2	0.2	6	1
10150N-10300E	12	40	2	0.2	6	1
10000M-9700E ^N	26	42	2	0.2	1	1
E 9725	16	38	2	0.2	4	1
9750	16	42	4	0.2	12	1
9775	18	38	2	0.2	10	1
9800	18	46	2	0.2	12	1
9825	14	36	2	0.2	8	1
9850	14	44	2	0.2	10	1
9875	26	60	2	0.2	14	1
9900	120	54	2	0.2	10	1
9925	10	68	2	0.2	8	1
9950	22	50	4	0.2	12	1
9975	18	46	4	0.2	8	1
10000	36	50	1	0.2	12	1
10025	8	56	2	0.2	16	1
10050	18	50	2	0.2	16	1
10000M-10075E	60	46	1	0.2	10	1
CHECK NL-5	24	66	66	1.2	60	8
10000M-10100E	18	26	1	0.2	16	1
E 10125 ^N	40	56	1	0.2	18	1
10150	22	46	1	0.2	16	1
10175	18	42	2	0.2	18	1
10200	16	42	4	0.2	12	1
10225	16	54	4	0.2	10	1
10250	12	36	1	0.2	12	1
10275	36	46	1	0.2	10	1
10000M-10300E	12	40	1	0.2	10	1
10050M-9700E	18	40	1	0.2	8	1
E 9725 ^N	50	44	2	0.2	12	1
9750	42	46	1	0.2	10	1
9775	62	40	1	0.2	6	1
9800	30	44	2	0.2	12	1
9825	36	48	2	0.2	8	1
9850	16	46	2	0.2	12	1
9875	82	48	1	0.2	10	1
9900	110	28	1	0.2	10	1
9925	20	42	2	0.2	8	1
9950	36	68	1	0.2	8	1
9975	14	24	1	0.2	10	1
10000	10	36	2	0.2	8	1
10025	16	50	1	0.2	14	1
10050	110	44	2	0.2	14	1
10075	20	56	1	0.2	16	1
10100	56	48	1	0.2	8	1
10125	12	32	1	0.2	1	1
10150	28	46	1	0.2	8	1
10050M-10175E	12	36	1	0.2	6	1

E N

T.	SAMPLE No.	Cu	Zn	Pb	Ag	As	Mo	PPB	8706-08E
								Au	Pg. 6 of E
0	10050N-10200E	12	36	1	0.2	4	1	10	
1	10225	10	30	2	0.2	1	1	10	
2	10250	18	48	2	0.2	8	1	10	
3	10275	20	44	1	0.2	4	1	10	
4	10050N-10300E	28	50	1	0.2	4	1	10	
5	10000N-10550E	20	38	1	0.2	1	1	10	
6	E 10600 N	12	40	1	0.2	1	1	10	
7	10650	12	36	1	0.2	1	1	10	
8	10700	28	42	1	0.2	2	1	10	
9	10750	16	54	2	0.2	8	1	10	
0	10800	14	46	2	0.2	6	1	10	
1	10850	22	24	1	0.2	1	1	10	
2	10900	32	56	1	0.2	8	1	10	
3	10950	20	56	1	0.2	10	1	10	
4	11000	14	48	1	0.2	6	1	10	
5	11050	14	42	1	0.2	1	1	10	
6	10000N-11100E	14	36	1	0.2	12	1	10	
7	10200N-9700E	16	20	1	0.2	1	1	10	
8	9725	36	40	1	0.2	1	1	10	
9	10200N-9750E	14	40	1	0.2	6	1	10	
0	CHECK NL-5	24	64	68	1.0	60	10	-	
1	10200N-9775E	14	44	2	0.2	14	1	10	
2	E 9800 N	14	46	4	0.2	16	1	10	
3	9825	20	48	2	0.2	12	1	10	
4	9850	18	36	1	0.2	26	1	10	
5	9875	14	22	1	0.2	6	1	10	
6	9900	32	48	1	0.2	12	1	10	
7	9925	20	48	2	0.2	14	1	10	
8	9950	16	44	2	0.2	14	1	10	
9	9975	10	46	2	0.2	10	1	10	
0	10000	14	66	2	0.2	10	1	10	
1	10025	12	36	2	0.2	8	1	10	
2	10050	16	40	1	0.2	10	1	10	
3	10075	24	62	4	0.2	12	1	10	
4	10100	20	38	1	0.2	10	1	10	
5	10125	14	38	2	0.2	12	1	10	
6	10150	12	42	2	0.2	8	1	10	
7	10175	28	40	2	0.2	16	1	10	
8	10200	14	42	2	0.2	10	1	10	
9	10225	12	38	2	0.2	10	1	10	
0	10250	14	40	1	0.2	8	1	10	
1	10275	10	36	2	0.2	8	1	10	
2	10200N-10300E	22	48	1	0.2	12	1	10	

NORANDA VANCOUVER LABORATORY

PRG. RTY/LOCATION: SEM

CODE :8707-019

Project No. : 330
 Material :61 SOILS &
 Remarks :12 SILTS

Sheet:1 of 2
 Geol.:H.C.

Date rec'd:JUN.29
 Date compl:JUL.15

Values in PPM, except where noted.

T.	SAMPLE No.	Cu	Zn	Pb	Ag	As	PPM Au
4	10000E-9970N	6	20	1	0.2	1	20
5	9972	8	44	4	0.2	1	10
6	9980	16	42	2	0.2	8	10
7	9982	16	44	2	0.2	1	10
8	9984	20	52	4	0.2	4	10
9	10000E-9986N	18	40	2	0.2	8	10
0	CHECK NL-5	26	62	66	1.2	80	-
1	10000E-9988N	14	38	4	0.2	1	10
2	9990	18	44	4	0.2	16	10
3	9992	12	40	4	0.2	1	10
4	9994	8	34	2	0.2	1	10
5	9996	8	42	2	0.2	1	10
6	9998	12	48	4	0.2	1	10
7	10000	10	44	1	0.2	4	10
8	10002	22	46	1	0.2	1	10
9	10004	10	52	2	0.2	1	10
0	10006	10	56	2	0.2	1	10
1	10008	16	38	2	0.2	1	10
2	10010	12	38	4	0.2	1	10
3	10012	12	32	4	0.2	4	10
4	10014	14	36	2	0.2	1	10
5	10016	10	34	2	0.2	1	10
6	10018	8	34	4	0.2	1	10
7	10000E-10020N	10	34	2	0.2	1	10
8	9975E-9986N	18	44	1	0.2	1	10
9	9988	18	36	2	0.2	1	10
0	9990	14	38	2	0.2	1	10
1	9992	22	36	4	0.2	1	10
2	9994	14	40	4	0.2	1	10
3	9996	10	40	4	0.2	1	10
4	9998	2	18	1	0.2	1	10
5	10000	14	38	2	0.2	1	10
6	10002	16	40	2	0.2	1	10
7	10004	14	40	2	0.2	1	10
8	10006	12	38	2	0.2	1	10
9	10008	16	36	1	0.2	1	10
0	10010	14	24	1	0.2	1	10
1	10012	26	34	1	0.2	1	10
2	10016	18	22	1	0.2	1	10
3	10020	30	22	1	0.2	1	10
4	10022	40	22	2	0.2	1	10
5	10024	14	36	2	0.2	1	10
6	10026	16	34	2	0.2	1	10
7	9975E-10028N	2	10	1	0.2	1	10
8	10025E-9940N	12	26	1	0.2	1	10
9	9942	18	38	2	0.2	1	10
0	9944	14	34	1	0.2	1	10
1	10025E-9946N	10	42	2	0.2	1	10

T.	SAMPLE No.	PPB								Au	Pg. 2 of 2
		Cu	Zn	Pb	Ag	As	Sb	Cd	Co		
2	10025E-9948N	10	46	2	0.2	1				10	
3	9950	12	34	1	0.2	1				10	
4	9952	12	88	2	0.2	1				10	
5	9954	12	78	2	0.2	1				10	
6	9956	10	48	1	0.2	1				10	
7	9958	12	42	1	0.2	1				10	
8	9960	12	52	2	0.2	1				10	
9	10025E-9962N	14	46	1	0.2	1				10	
10	CHECK NL-5	24	62	66	1.0	60				-	
11	10025E-9966N	12	38	4	0.2	1				10	
12	9968	14	42	4	0.2	1				10	
13	9970	12	42	2	0.2	1				10	
14	9972	14	40	2	0.2	1				10	
15	9974	12	40	2	0.2	1				10	
16	10025E-9976N	10	38	4	0.2	1				10	
17	T 93617	36	62	1	0.2	1	2	0.4	16	10	
18	93618	24	54	1	0.2	1	1	0.2	12	10	
19	93619	26	40	1	0.2	1	1	0.2	10	10	
20	93620	32	34	1	0.2	1	1	0.2	10	10	
21	93621	34	50	1	0.2	1	2	0.4	16	10	
22	93622	36	58	1	0.2	1	1	0.4	16	10	
23	93623	34	52	1	0.2	1	1	0.4	14	10	
24	93624	34	52	1	0.2	1	4	0.4	14	10	
25	20459	30	48	1	0.2	1	1	0.4	14	10	
26	20461	34	54	1	0.2	1	2	0.4	14	10	
27	20468	24	44	1	0.2	1	2	0.2	12	10	
28	T 20478	42	94	1	0.2	1	1	0.4	16	10	

Legend

- Andesite
- 1a Feldspar porphyritic
- 1b Hornblende porphyritic
- 1c Feldspar-hornblende porphyrite
- 1d Lapilli tuff
- 1e Intensely epidote-calcite-chlorite altered (propylitic)
- 1f Cherty tuff
- 1g Lithic tuff
- 2 Quartz monzonite
- 2a Quartz feldspar porphyry
- 2b Diorite
- 3 Limestone
- 4 Chert
- 5 Siltstone
- 6 Basalt : Feldspar porphyritic
- 7 Epiclastic rocks
- 7a Volcanic conglomerate
- 7b Tuffaceous sandstone

Symbols

- Outcrop
- Geological contact (defined, assumed)
- R20413 x Rock sample location & no.

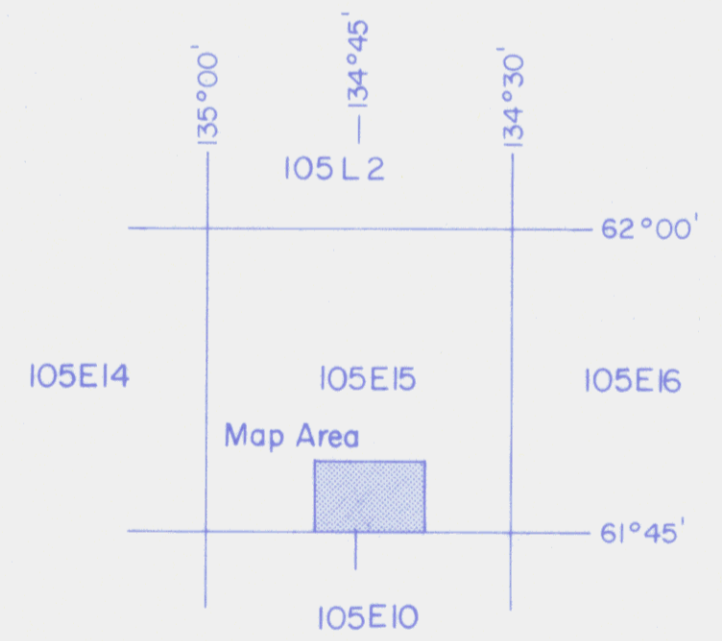

REVISED	Semenof Hills (SEM/DAVE Claims)	
	Regional Geology 1191	
	(Rock Sample Location)	
	091968	
PROJ. No. 30	SURVEY BY: HC	DATE: JUL 87
N.T.S. 105 E 15	DRAWN BY: AI	SCALE: 1:10,000
DWG. No.	NORANDA EXPLORATION	
	OFFICE: Whitehorse	

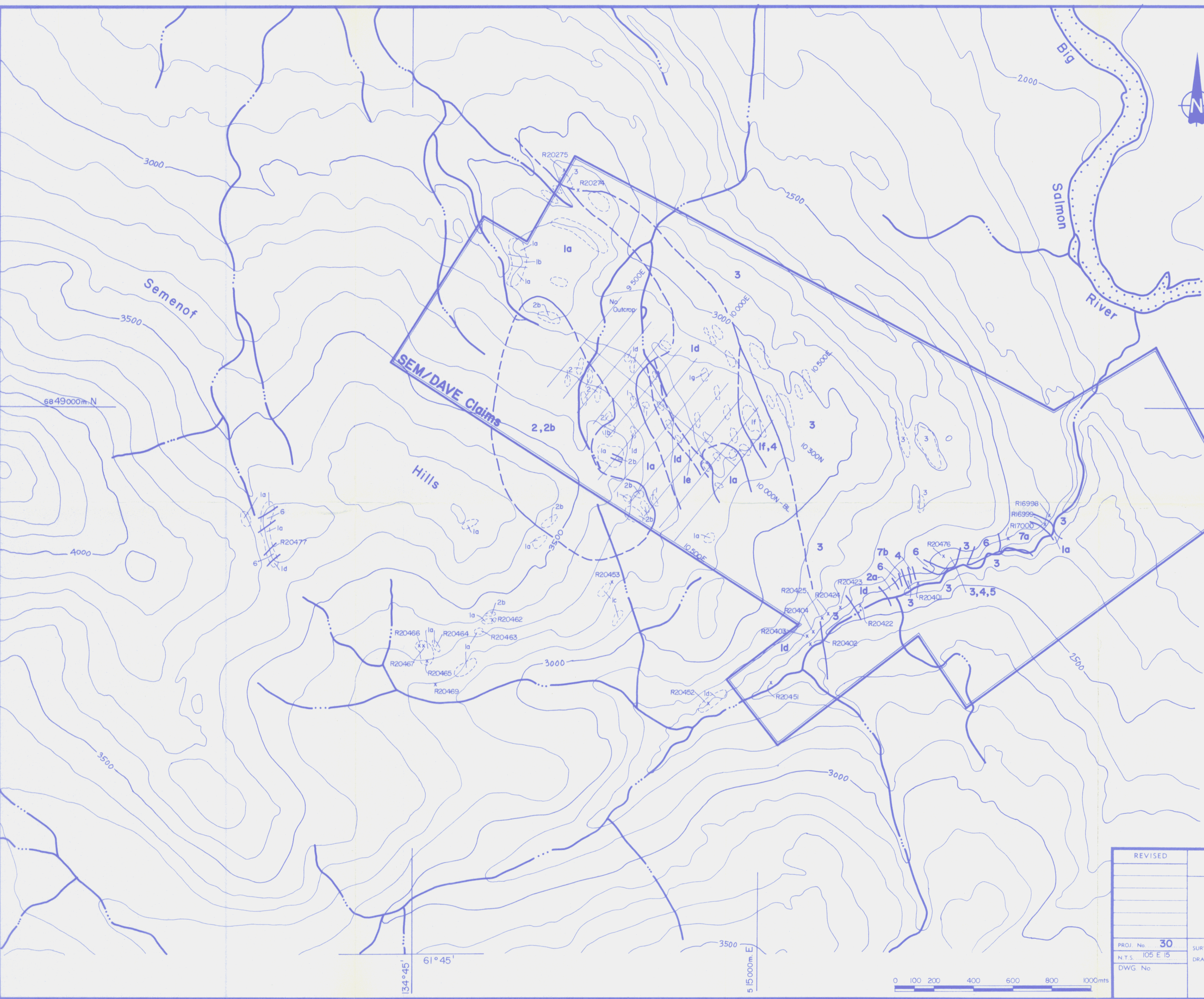
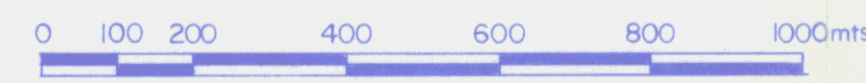

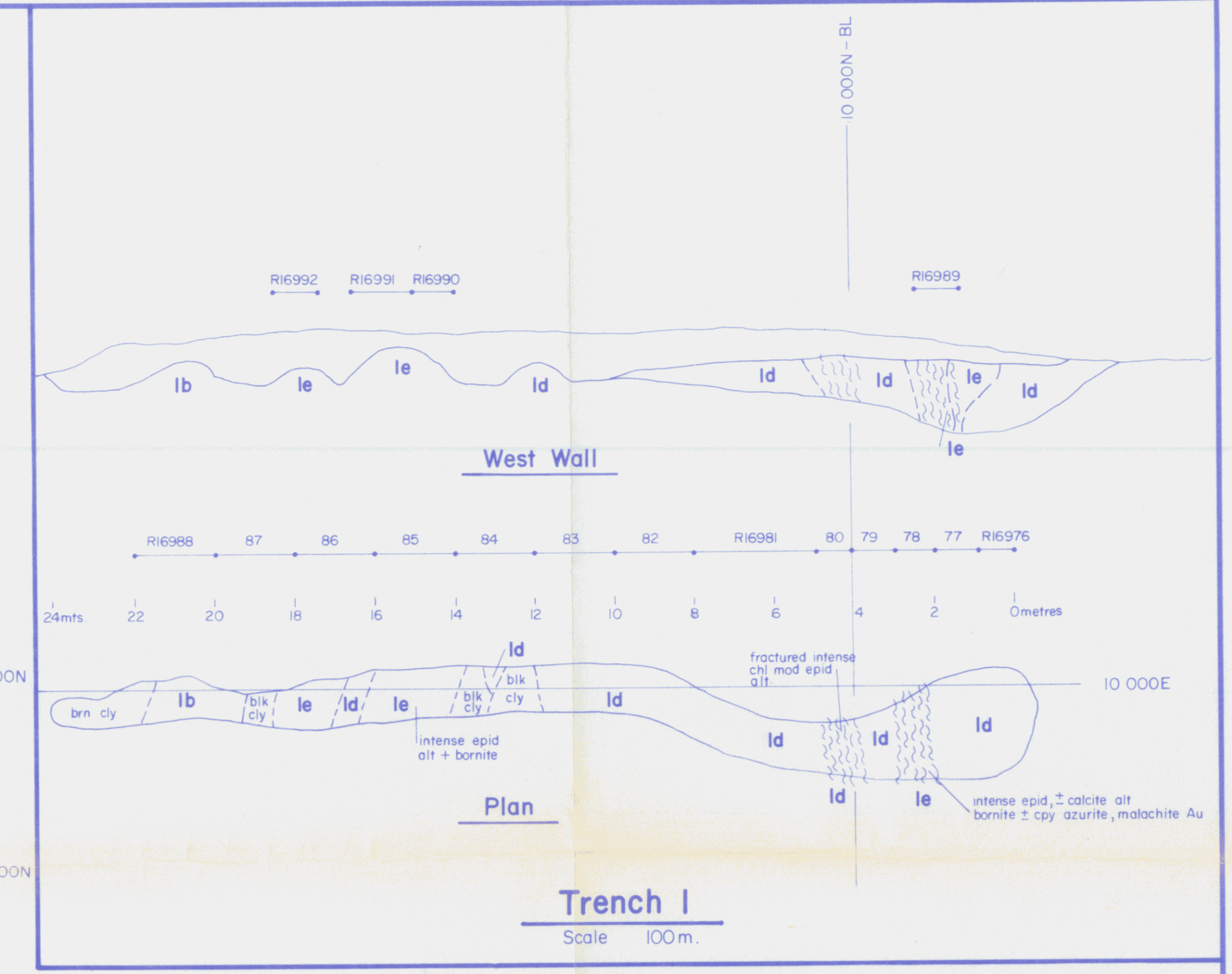
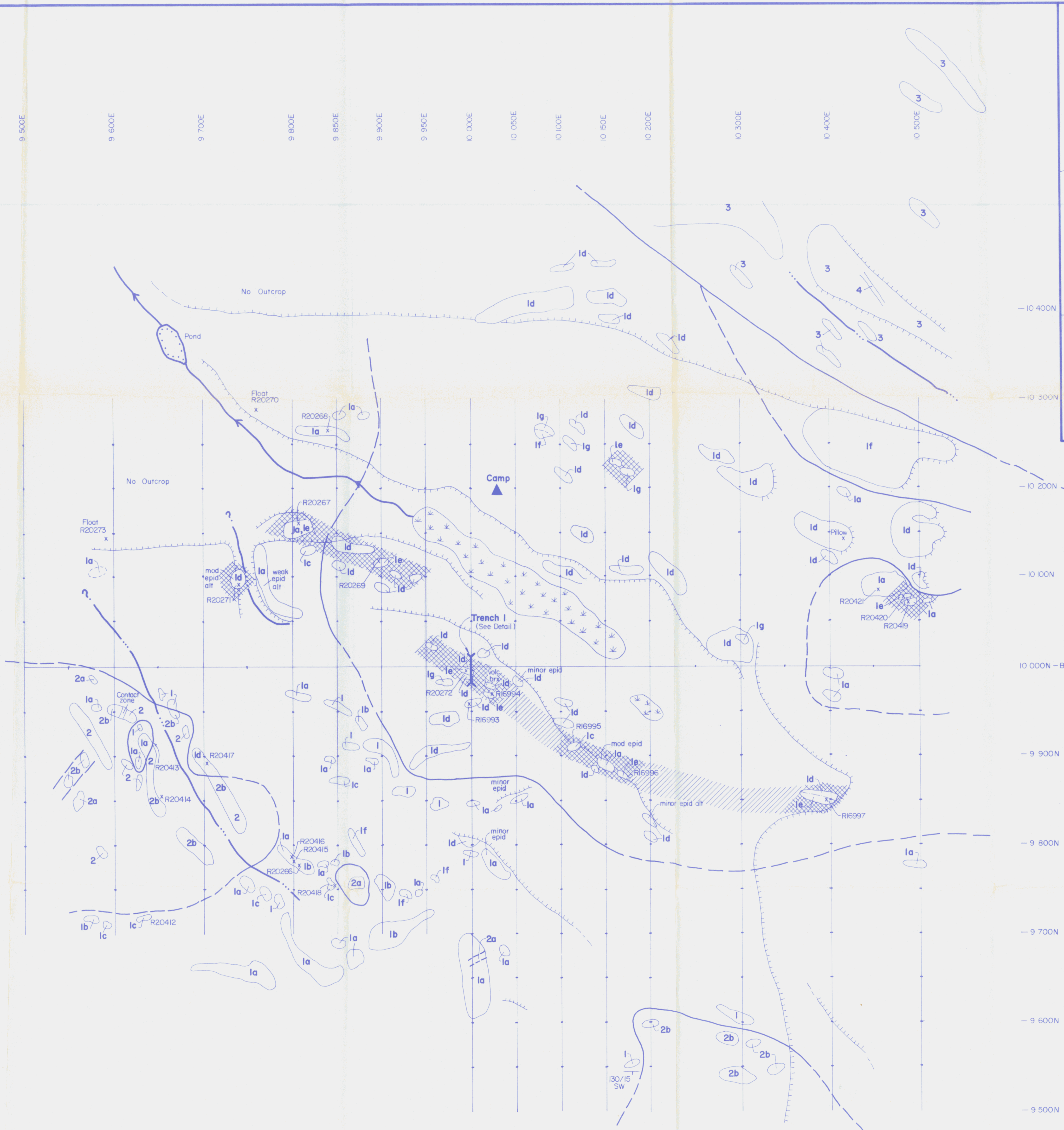
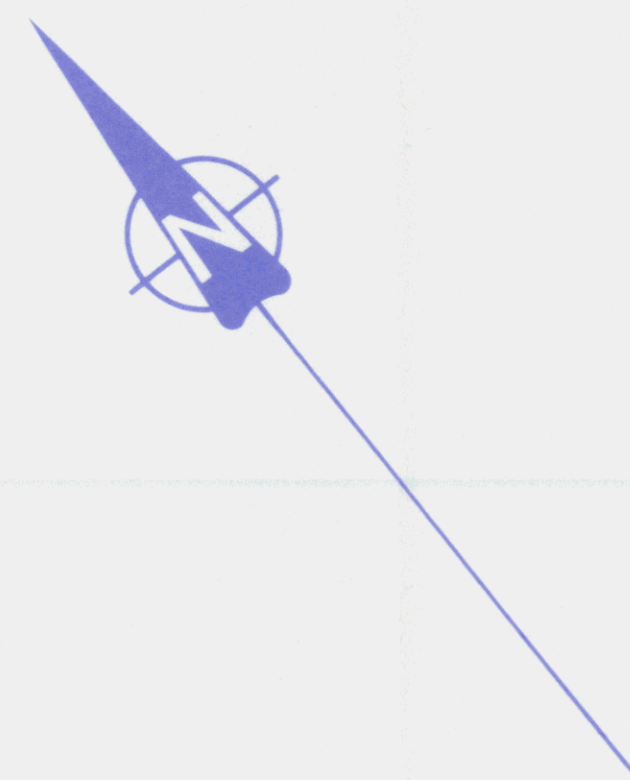

Legend

- 1 Andesite
- 1a Feldspar porphyritic
- 1b Hornblende porphyritic
- 1c Feldspar - Hornblende porphyrite
- 1d Lapilli tuff
- 1e Intensely epidote-calcite-chlorite altered (propylitic)
- 1f Cherty tuff
- 1g Lithic tuff
- 2 Quartz monzonite
- 2a Quartz - Feldspar porphyry
- 2b Diorite
- 3 Limestone
- 4 Chert

Symbols

- Outcrop
- Geological contact (defined, assumed)
- Scarp
- Marsh
- Propylitic alteration
- Inferred propylitic alteration
- R38755 x Rock sample location & no.

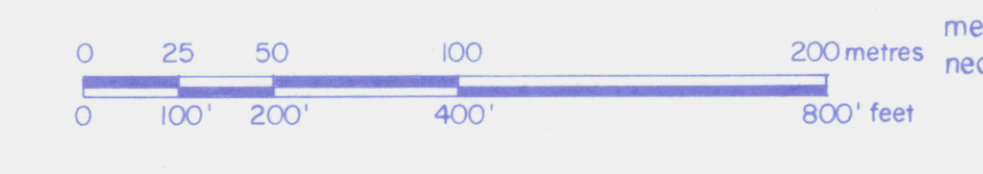

NOTE:
Grid line chaining of 25m intervals was mistakenly measured 100 feet, thus necessary adjustments.

Fig. :

REVISED	Semenof Hills (SEM/DAVE Claims)		
	Geology (Rock Sample Location)		
PRJ. No. 30	SURVY BY: HC	DATE: AUG 87	1198
N.T.S. 105 E 15	DRAWN BY: AI	SCALE: 1:2500	
DWG. No.	NORANDA EXPLORATION Whitehorse		

091060

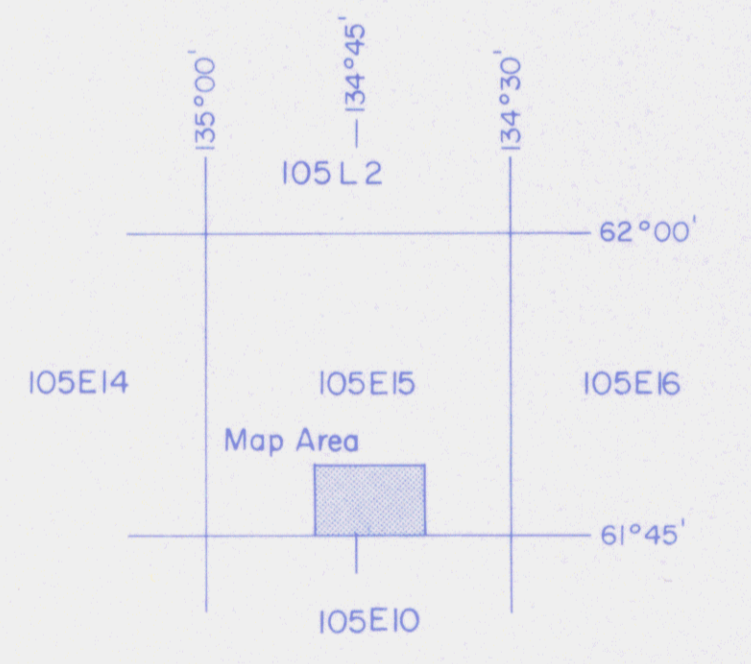
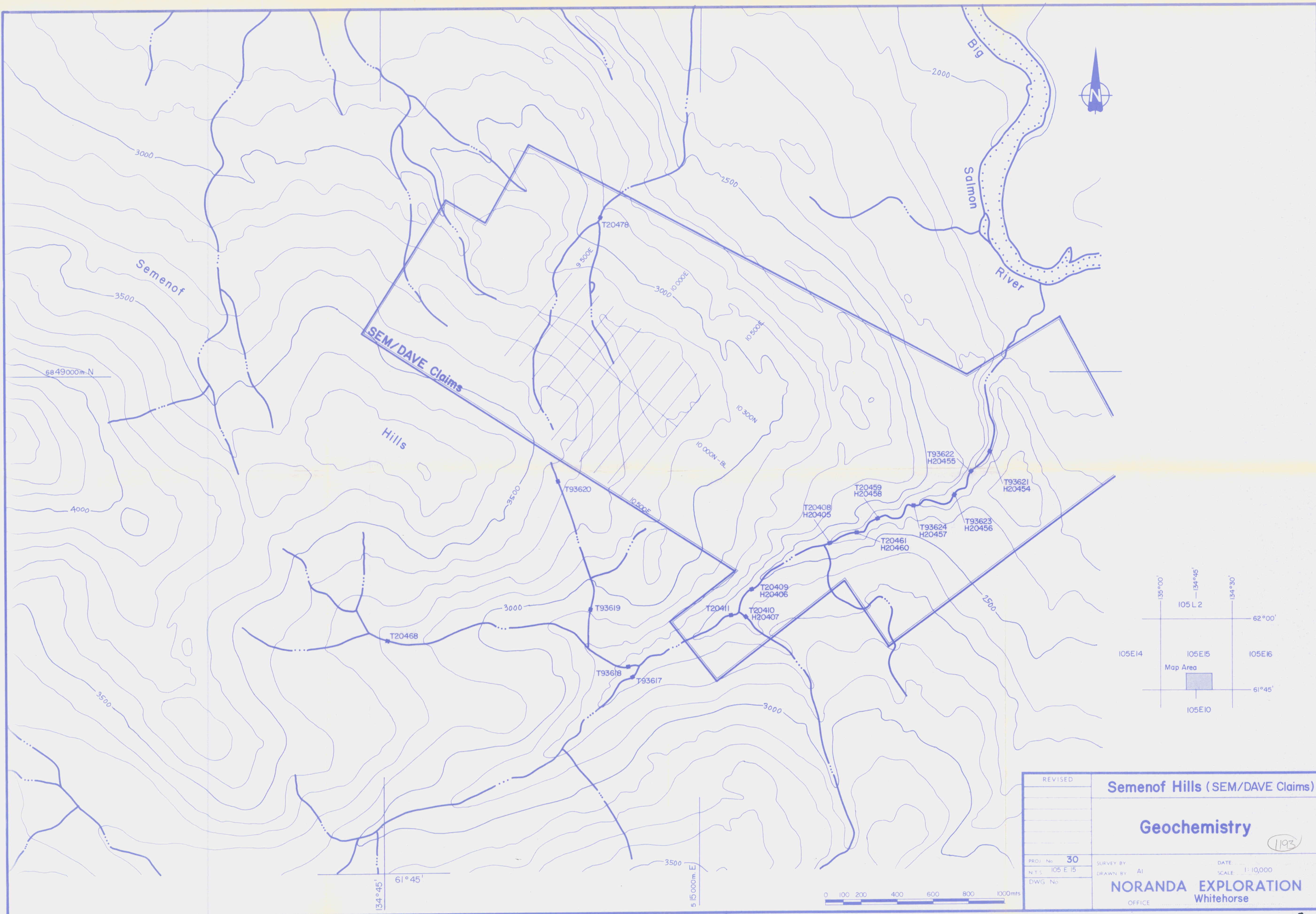

REVISED	Semenof Hills (SEM/DAVE Claims)	
	Geochemistry	
	1193	
PROJ No: 30	SURVEY BY:	DATE:
N.T.S. 105 E 15	DRAWN BY: AI	SCALE: 1:10,000
DWG No:	NORANDA EXPLORATION	
	OFFICE Whitehorse	

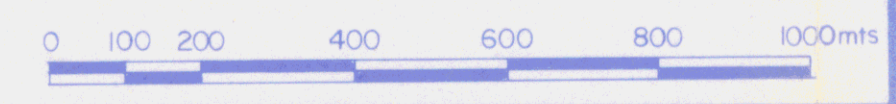

001068

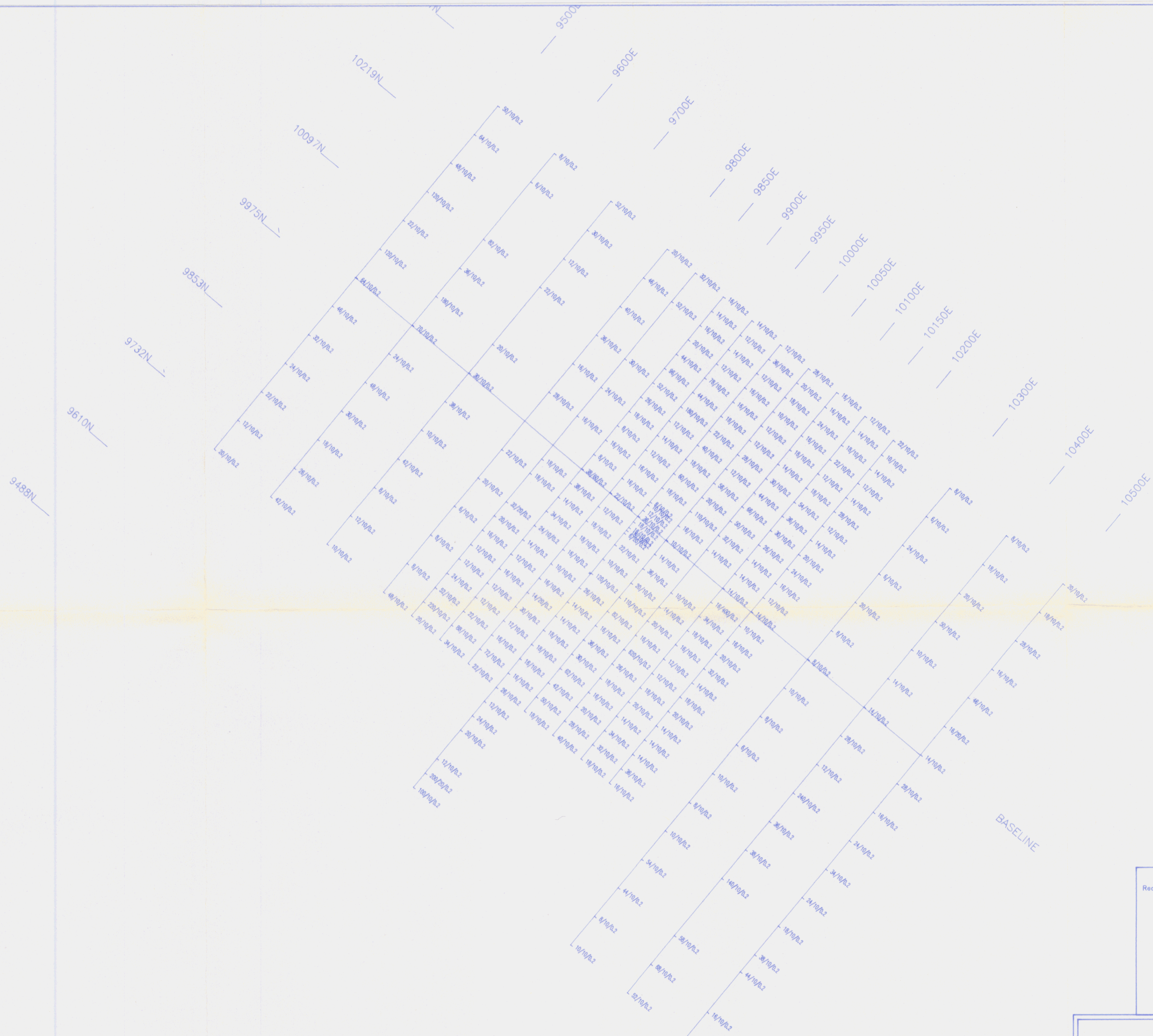

Reading Presentation : PPM Cu / PPG Au / PPM Ag

Contour Interval :

SEMENOFF	
GEOCHEMICAL SURVEY	
PROJECT: SEMENOFF	PROJECT # : 330
BASELINE AZIMUTH : 310 Deg. (1194)	
SCALE = 1: 2500	DATE : 9/20/87
SURVEY BY : HC	NTS : 105E11
FILE: C330SEM	
NORANDA EXPLORATION	

091968

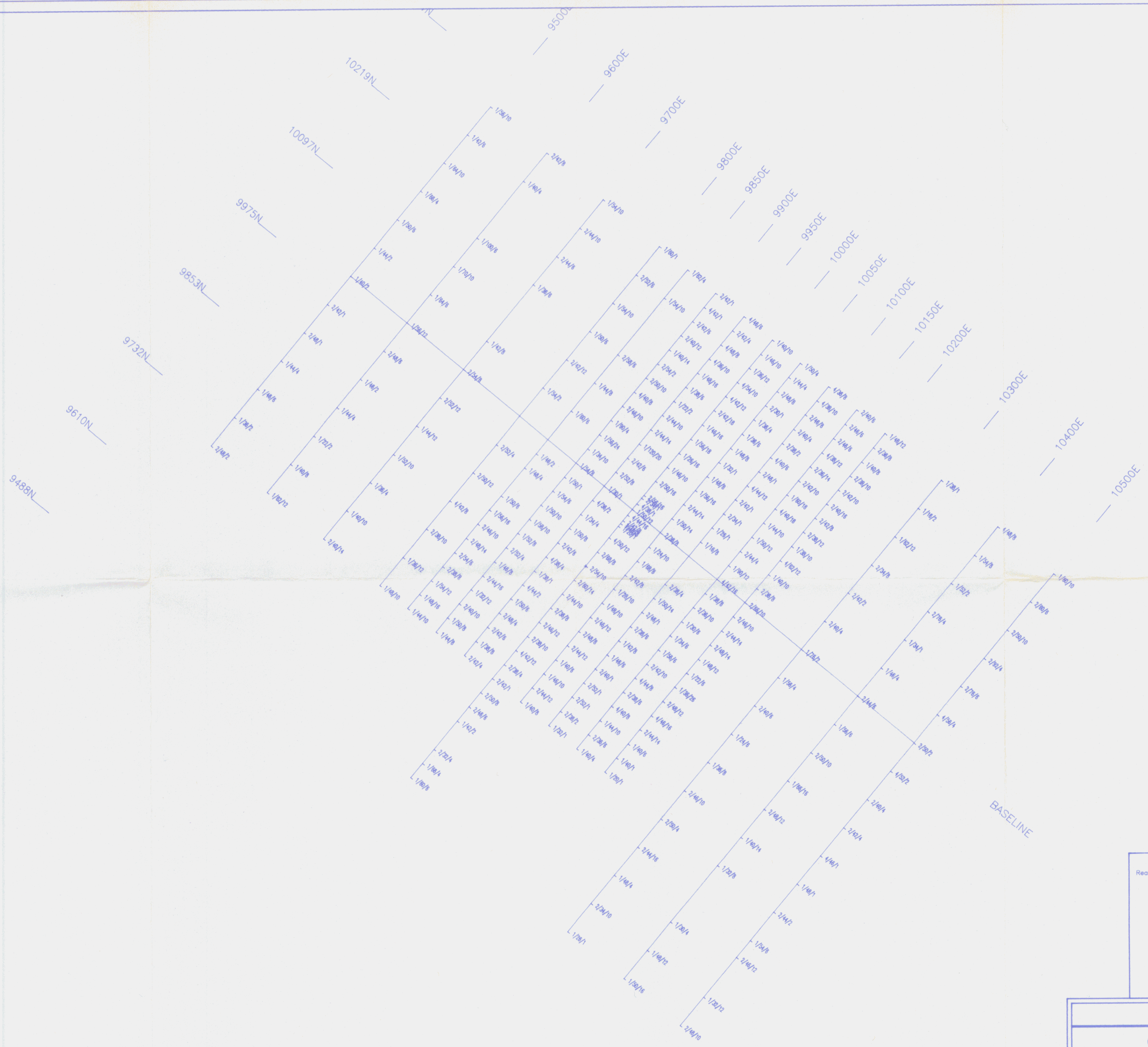

Reading Presentation : PPM Pb / PPM Zn / PPM As
Contour Interval :
50m 25m 0m 50m 100m

SEMENOFF
GEOCHEMICAL SURVEY (1195)
PROJECT: SEMENOFF PROJECT # : 330
BASELINE AZIMUTH : 310 Deg.
SCALE = 1: 2500 DATE : 9/20/87
SURVEY BY : HC NTS : 105E11
FILE: C330SEM
NORANDA EXPLORATION 091968

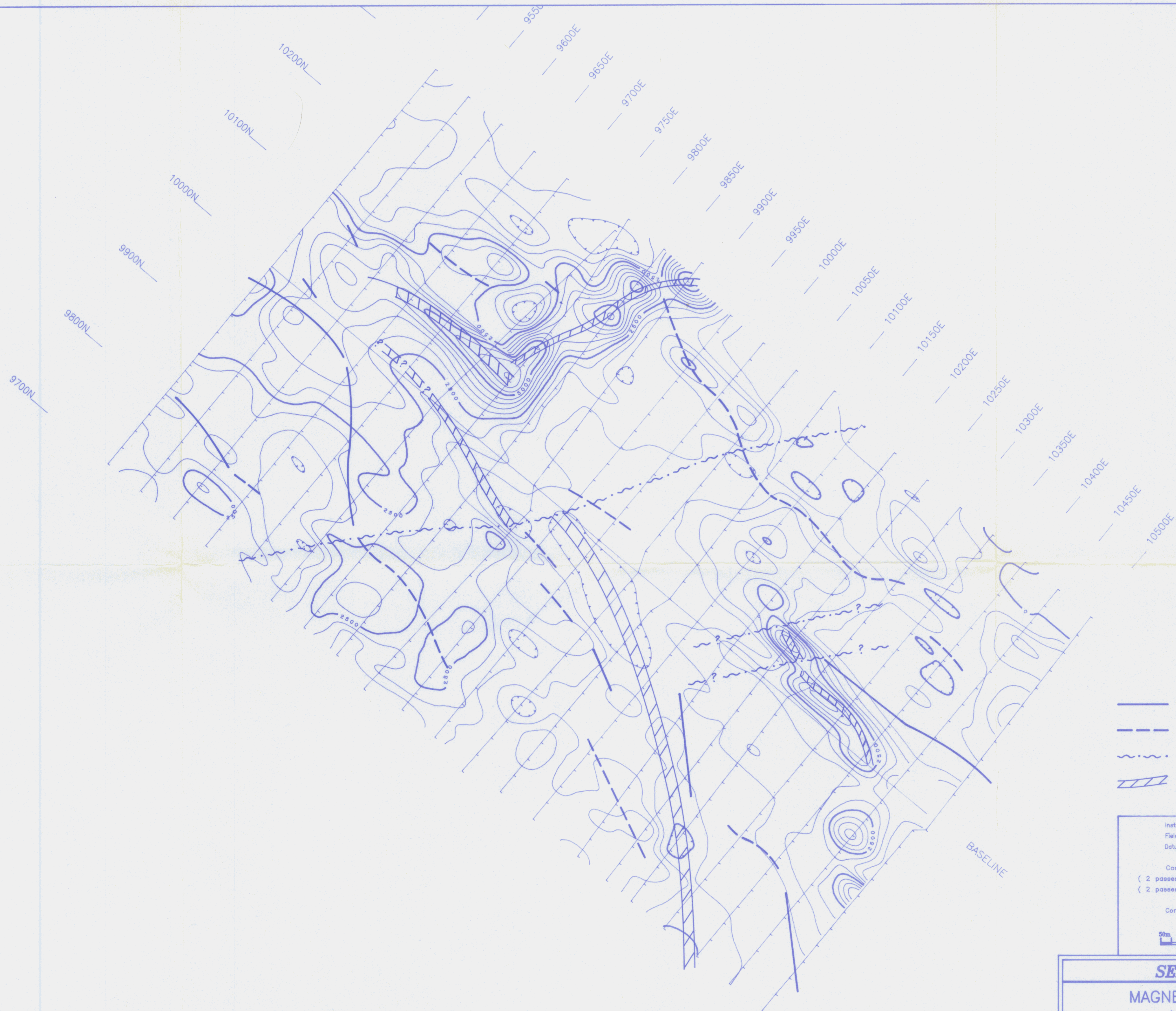

- VLF-EM Axes
- - - Probable Topographic Features
- ... Magnetic Break
- /// Mag Features of Interest

Instrument : G-836
 Field : TOTAL
 Datum : 57000.0 nT

 Contour Interval : 500 nT
 (2 passes through a 9 pt. Hanning Filter.)
 (2 passes through a 3 pt. Hanning Filter.)

 Conductor Axis :



SEMINOFF HILLS

MAGNETOMETER SURVEY
(FILTERED CONTOUR PRESENTATION)

PROJECT: SEMINOFF PROJECT # : 3 196
 BASELINE AZIMUTH : 310 Deg.

SCALE = 1: 2500 DATE : 4/15/87
 SURVEY BY : T.D. NTS :
 FILE: M3SEM
NORANDA EXPLORATION

091964



 Low Resistivity Zone

Instrument	: Phoenix
Parameter	: Resistivity
Array	: 25m. Dipole-Dipole
Contour Interval	: 50 ohm-m
(4 passes through a 9 pt. Hanning Filter.)	
(4 passes through a 3 pt. Hanning Filter.)	
Conductor Axis	:

50m 25m 0 50m 100m

SEMENOF GRID	
I.P. SURVEY (RES.)	
(FILTERED CONTOUR PRESENTATION)	
PROJECT: SEMENOF HILLS	PROJECT # : 330
BASELINE AZIMUTH : 310 Deg.	
SCALE = 1:2500	DATE : 6/25/87
SURVEY BY : WK/TL	NTS :
FILE: M330MIP	
NORANDA EXPLORATION	

1197

091968

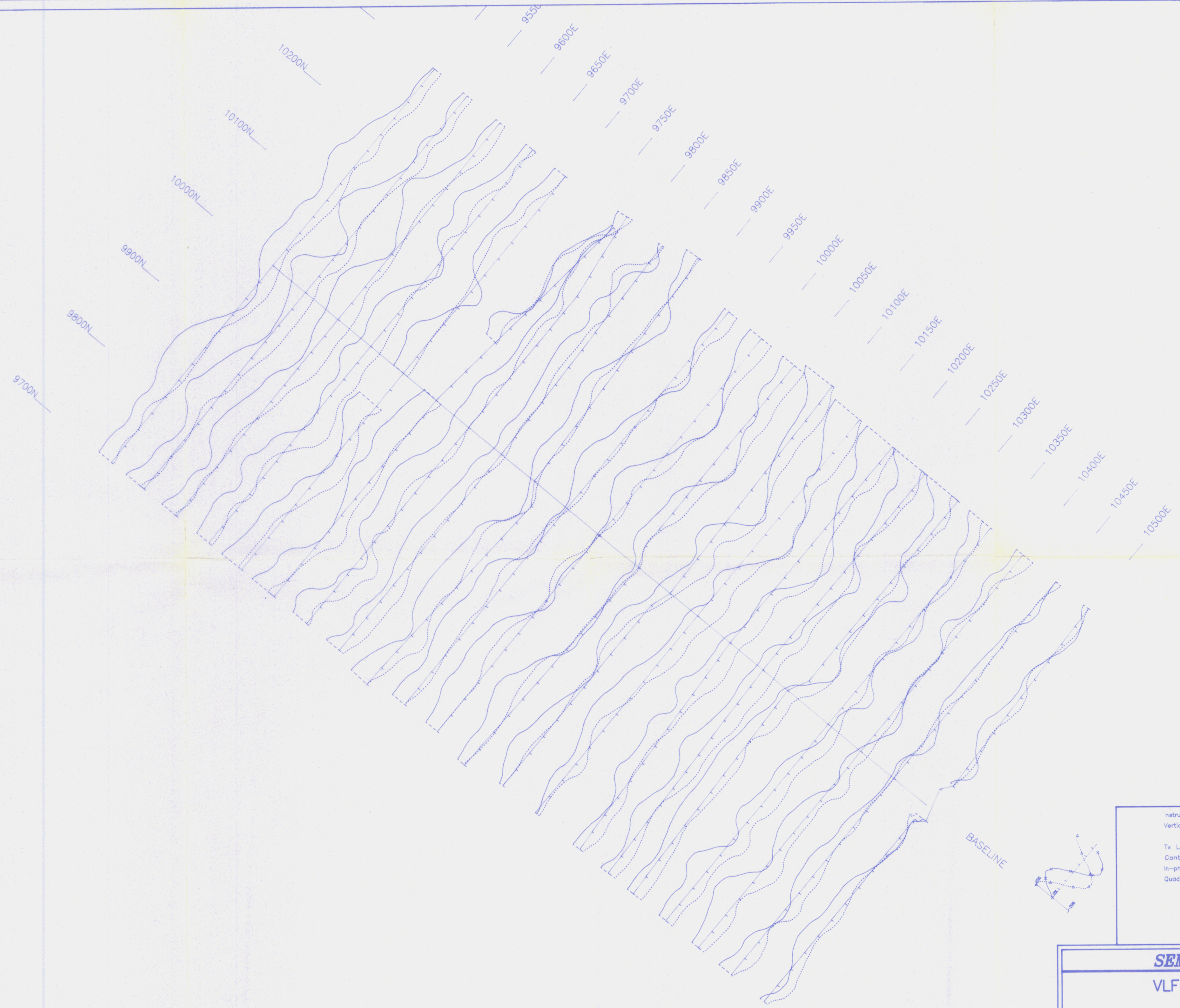
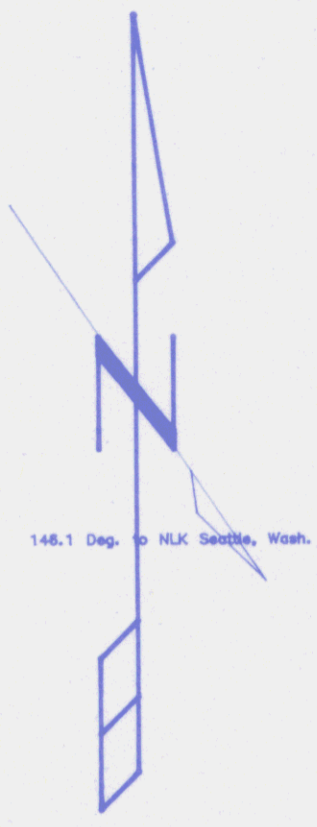

Instrument : EM-16
 Vertical Scale: 1 cm = 20%
 Tx Location : NLK Seattle, Wash.
 Contour Interval :
 In-phase : ———
 Quadrature : ·····



SEMINOFF HILLS	
VLF-EM SURVEY (1198)	
PROJECT : SEMINOFF	PROJECT # : 330
BASELINE AZIMUTH : 310 Deg.	
SCALE = 1: 2500	DATE : 232/20/87
SURVEY BY : HC	NTS :
FILE: V330SEM	FREQ.: 24.8 KHz.
NORANDA EXPLORATION 091968	

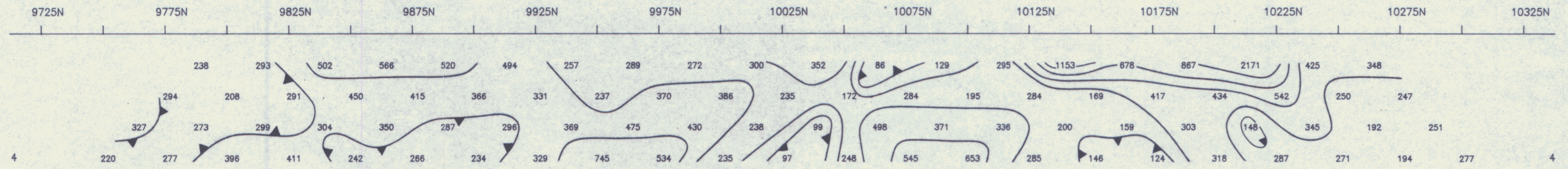

INDUCED POLARIZATION SURVEY

ARRAY: DIPOLE-DIPOLE
 FREQUENCY: .25/4Hz
 CONTOUR MULTIPLES: 1.5 3 5 7.5 10
 SPACING: 25 m
 SURVEY DATE: 24/06/87
 OPERATOR: WK/TL
 Rx: PHEONIX IPV1
 Tx: PHEONIX IPT1

APPARENT RESISTIVITY (OHM-M)

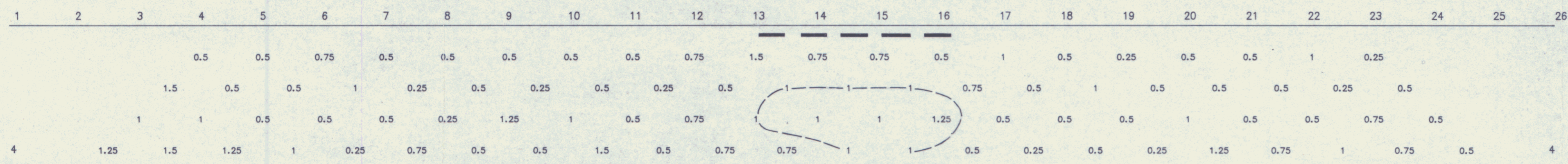

DIPOLE LENGTH: 25 m

1199

SCALE = 1: 1250

SEMENOF HILLS I.P. SURVEY SEMENOF HILLS GRID L 9600.0E AREA: YUKON DISTRICT	
NORANDA EXPLORATION	
Surveyed by: WK/TL	Date: 24/06/87
Plotted by: WK	Project No: 330

091968

9725N 9775N 9825N 9875N 9925N 9975N 10025N 10075N 10125N 10175N 10225N 10275N 10325N

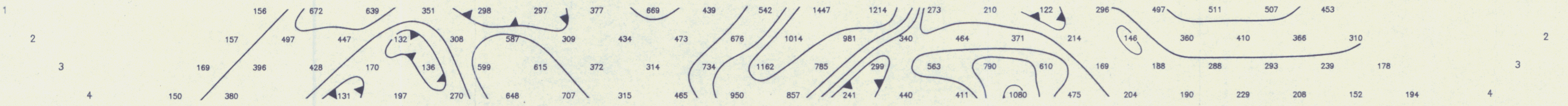

APPARENT RESISTIVITY (OHM-M)

1 2 3 4 5 6 7 8 9 10 11 12 13 14 15 16 17 18 19 20 21 22 23 24 25 26

1			0.75	0.5	1.75	0.25	0.75	0.5	1	1.25	1	1.25	0.75	1.25	1	0.5	0.25	0	0.5	1.25	1.25	0.5		
2		1.25	0.75	1	0.75	0.5	0.5	0.5	1.25	1.25	1.25	0.5	0.75	0.5	0.75	0.5	0	0.5	1	0.75	0.75	0.5		
3		1	1.5	1.25	0.75	1	0.75	0.5	1	1.5	1.5	0.5	0.5	0.5	0.5	0.5	0.25	0.25	0.5	1	1	0.75		
4		1.5	1.25	1.5	1.25	0.25	1	0.75	1	1.5	0.5	0.75	0.75	0.25	0.5	0.75	0.75	0.5	0.5	0.25	0.25	1	1	0.5

INDUCED POLARIZATION SURVEY

ARRAY: DIPOLE-DIPOLE
 FREQUENCY: .25/4Hz
 CONTOUR MULTIPLES: 1.5 3 5 7.5 10
 SPACING: 25 m
 SURVEY DATE: 23/06/87
 OPERATOR: WK/TD
 Rx: PHEONIX IPV1
 Tx: PHEONIX IPT1

DIPOLE LENGTH: 25 m



1200

SCALE = 1: 1250

SEMENOF HILLS	
I.P. SURVEY	
SEMENOF HILLS GRID	
L 9700.0E	
AREA: YUKON DISTRICT	
NORANDA EXPLORATION	
Surveyed by: WK/TD	Date: 23/06/87
Plotted by: WK	Project No: 330

091968

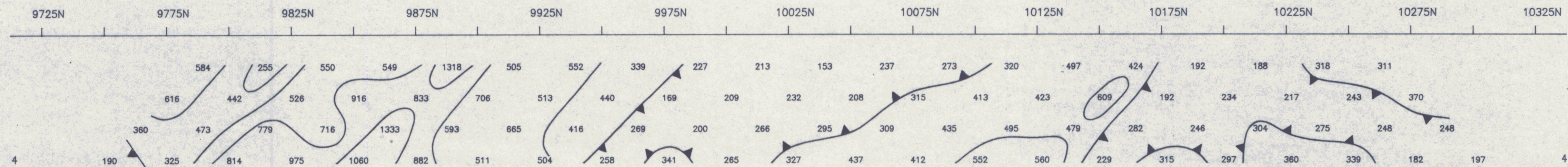

INDUCED POLARIZATION SURVEY

ARRAY: DIPOLE-DIPOLE
 FREQUENCY: .25/4Hz
 CONTOUR MULTIPLES: 1.5 3 5 7.5 10

SPACING: 25 m
 SURVEY DATE: 22/06/87
 OPERATOR: WK/TL
 Rx: PHEONIX IPV1
 Tx: PHEONIX IPT1

APPARENT RESISTIVITY (OHM-M)

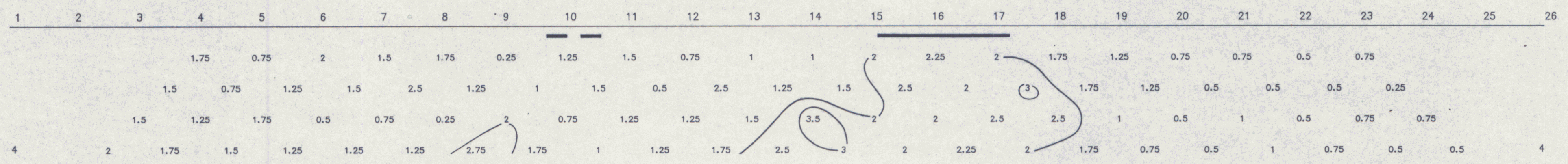

DIPOLE LENGTH: 25 m

1202

SCALE = 1: 1250

SEMENOF HILLS	
I.P. SURVEY	
SEMENOF HILLS GRID	
L 9900.0E	
AREA: YUKON DISTRICT	
091968	
NORANDA EXPLORATION	
Surveyed by: WK/TL	Date: 22/06/87
Plotted by: WK	Project No: 330

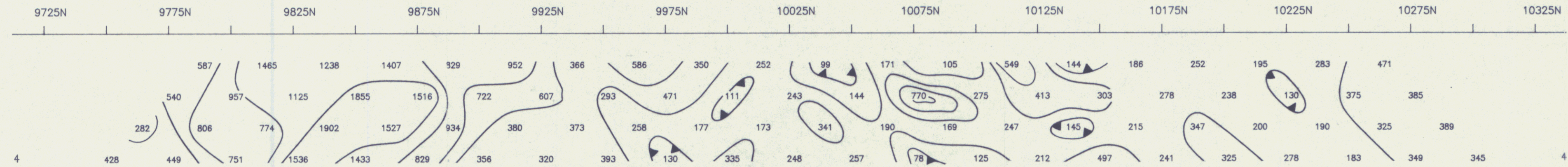

APPARENT RESISTIVITY (OHM-M)

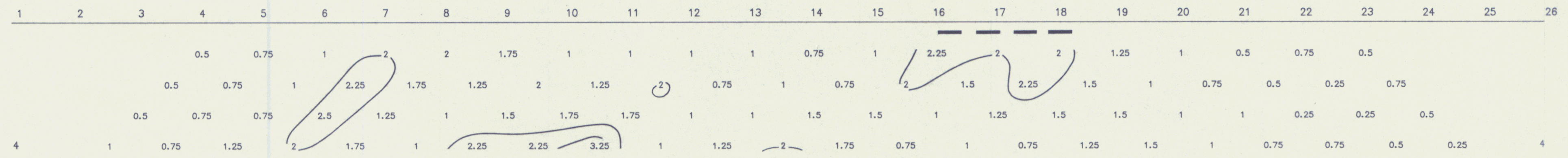

PERCENT FREQUENCY EFFECT

SCALE

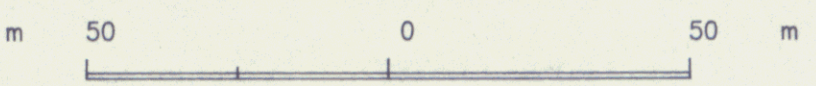

DIPOLE LENGTH: 25 m

INDUCED POLARIZATION SURVEY

ARRAY: DIPOLE-DIPOLE
 FREQUENCY: 4/.25Hz
 CONTOUR MULTIPLES: 1.5 3 5 7.5 10
 SPACING: 25 m
 SURVEY DATE: 20/06/87
 OPERATOR: WK/TL
 Rx: PHEONIX IPV-1
 Tx: PHEONIX IPT-1

1203

SCALE = 1: 1250

SEMENOF HILLS	
I.P. SURVEY	
SEMENOF HILLS GRID	
L 10000.0E	
AREA: YUKON DISTRICT	
091968	
NORANDA EXPLORATION	
Surveyed by: WK/TL	Date: 21/06/87
Plotted by: SK	Project No: 330

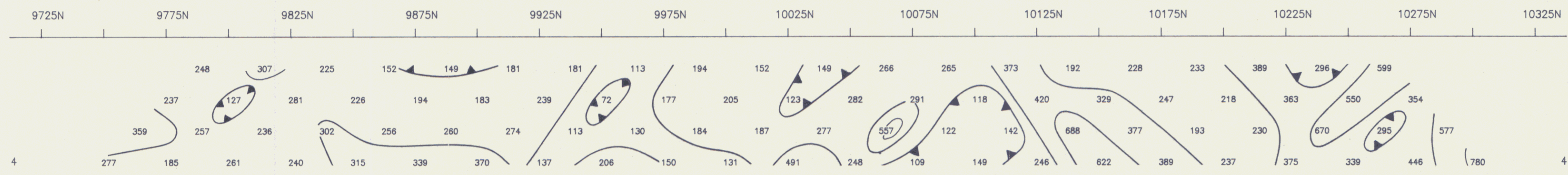

APPARENT RESISTIVITY (OHM-M)

1	2	3	4	5	6	7	8	9	10	11	12	13	14	15	16	17	18	19	20	21	22	23	24	25	26
1			0.75	1	1	1	0.5	0.75	0.25	0.5	0.5	0.5	1	1	0.75	0.75	0.5	0.75	0.5	0.25	0.25	0.25			
2			0.75	1.25	1.25	1	0.75	1.25	0.5	0.5	0.5	0.75	0.75	0.5	0.5	0.5	0.75	0.25	0.5	0.5	0.25	0.5	0		
3		1	1	1	0.75	1.25	1.5	1	0.5	0.75	0.25	0.5	0.75	0.25	0.5	0.5	0.5	0.5	0.5	0.25	0.5	0.25	0.5		
4	0.75	1	0.75	0.5	1	0.75	1	1.5	0.5	1	0.5	0.5	0.75	0.25	0.5	0.5	0.75	0.5	0.75	0.5	0.5	0.25	0.25		

PERCENT FREQUENCY EFFECT (%)

SCALE

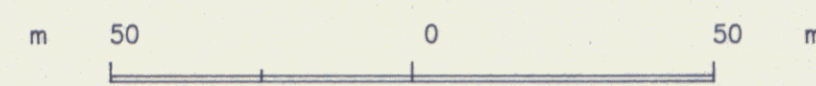

DIPOLE LENGTH: 25 m

INDUCED POLARIZATION SURVEY

ARRAY: DIPOLE-DIPOLE
 FREQUENCY: 4/.25 Hz
 CONTOUR MULTIPLES: 1,3,5,7.5,10,12.5
 SPACING: 25 m
 SURVEY DATE: 20/06/87
 OPERATOR: WK/TL
 Rx: PHEONIX IPV-1
 Tx: PHEONIX IPT-1

1204

SCALE = 1: 1250

SEMENOF HILLS	
I.P. SURVEY	
SEMENOF HILLS GRID	
L 10100.0E	
AREA: YUKON DISTRICT	
091968	
NORANDA EXPLORATION	
Surveyed by: WK/TL	Date: 20/06/87
Plotted by: SK	Project No: 330

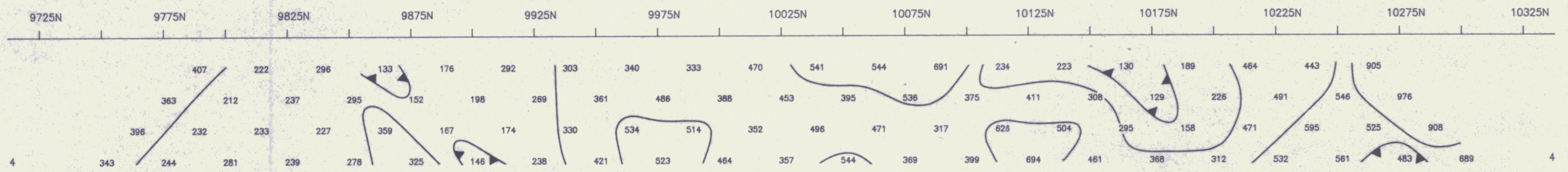

APPARENT RESISTIVITY (OHM-M)

1	2	3	4	5	6	7	8	9	10	11	12	13	14	15	16	17	18	19	20	21	22	23	24	25	26
		0.5	0.25	0.75	1.25	0.5	0.5	0.5	0.25	0.25	1	0.75	0.75	1	1	0.5	0.5	0.75	0.5	0.5	0.75	0.25	0.25		
	0.25	0.75	1	0.5	0.75	1	0.75	0.5	0.75	0.5	0.25	0.5	2.5	0.5	0.5	0.5	0.5	0.25	0.75	0.25	0.25				
		0.75	0.5	0.75	0.5	0.5	0.75	0.75	1.25	0.5	0.5	0.75	0.25	1	3	0.5	1	0.25	0.25	0.5	1.25	0.25	0.25		
	0.75	0.75	1	1	0.25	0.5	0.75	0.5	0.5	0.5	0.5	1.25	1	0.5	3.5	1	0.75	0.5	0.25	0.25	0.5	0.5	0.5		

INDUCED POLARIZATION SURVEY

ARRAY: DIPOLE-DIPOLE
 FREQUENCY: .25/4Hz
 CONTOUR MULTIPLES: 1.5 3 5 7.5 10
 SPACING: 25 m
 SURVEY DATE: 22/06/87
 OPERATOR: WK/TL
 Rx: PHEONIX IPV1
 Tx: PHEONIX IPT1

DIPOLE LENGTH: 25 m



PERCENT FREQUENCY EFFECT

SCALE = 1: 1250

1805

SEMENOF HILLS	
I.P. SURVEY	
SEMENOF HILLS GRID	
10200.0E	
AREA: YUKON DISTRICT	
091968	
NORANDA EXPLORATION	
Surveyed by: WK/TL	Date: 22/06/87
Plotted by: WK	Project No: 330

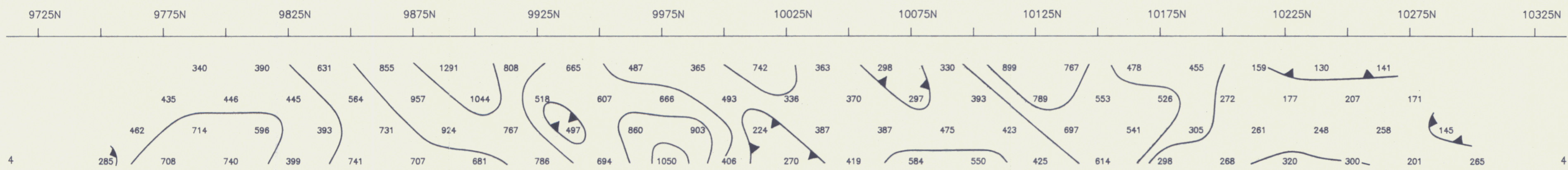

APPARENT RESISTIVITY (OHM-M)

	1	2	3	4	5	6	7	8	9	10	11	12	13	14	15	16	17	18	19	20	21	22	23	24	25	26
1			0.5	0.5	0.5	1	0.25	0.25	0.5	0.25	0.5	1	0.5	0.5	0.5	0.5	0.5	0.5	0.5	0.25	0.25	0.25				
2			0.25	0.25	0.25	0.5	0.25	0.5	0.5	0.25	0.5	0.5	0.25	0.5	0.5	0	0.25	0.5	0.25	0.25	0.75	0.25	0.5			
3			0.25	0.25	0.25	0.5	0.25	0.25	0.25	0.25	0.25	0	0.5	0.25	0.25	0.25	0.25	0.25	0.25	0.25	0.5	0.5	0.25	0.5		
4			0.25	0	0.25	0.25	0.5	0.25	0.25	0.25	0.25	0.5	0	0.25	0.25	0.5	0.25	0.25	0.25	0.25	0.25	0.5	0.5	0.25	0.25	

INDUCED POLARIZATION SURVEY

ARRAY: DIPOLE-DIPOLE
 FREQUENCY: .25/4Hz
 CONTOUR MULTIPLES: 1.5 3 5 7.5 10
 SPACING: 25 m
 SURVEY DATE: 25/06/87
 OPERATOR: WK/TL
 Rx: PHEONIX IPV1
 Tx: PHEONIX IPT1



DIPOLE LENGTH: 25 m

1207

SEMENOF HILLS	
I.P. SURVEY	
SEMENOF HILLS GRID	
L 10400.0E	
AREA: YUKON DISTRICT	
091968	
NORANDA EXPLORATION	
Surveyed by: WK/TL	Date: 25/06/87
Plotted by: WK	Project No: 330

SCALE = 1: 1250

