



1986 REPORT
on the
BOTWAT CLAIMS

091884

Including prospecting, sampling
and details of diamond drilling
on the adjacent SAID and THE
Claims.

WHITEHORSE MINING DIVISION , Y.T.

NTS - 105 D-5

60°17'N, 135°27'W

so far as the...
and...
...
...
...

For:

Kerr Addison Mines Ltd.
703-1112 W. Pender St.
Vancouver, B.C. V6E 2S1

By:

Robert Potter, P.Eng.
Vancouver, B.C.
November 1, 1986

Program: June 26 to July 26,
and August 5, 6, 8,
1986.

091884

This report has been examined by
the Geological Evaluation Unit
under Section 53 (4) Yukon Quartz
Mining Act and is allowed as
representation work in the amount
of \$ 8400.00.

DoEmond

for Regional Manager, Exploration and
Geological Services for Commissioner
of Yukon Territory.

TABLE OF CONTENTS

	<u>Page</u>
SUMMARY	1
INTRODUCTION	1
LOCATION AND ACCESS	2
LEGAL DESCRIPTION	2
PHYSIOGRAPHY AND VEGETATION	3
HISTORY	3
GEOLOGICAL SETTING	4
1986 PROGRAM	4
Prospecting	5
Sample Descriptions	6
Diamond Drilling	9

APPENDICES

Appendix I	Drill Logs
Appendix II	Statement of Costs
Appendix III	Sample Preparation and Analyses
Appendix IV	Statement of Qualifications
Appendix V	Selected References

ILLUSTRATIONS

Figure 1	Location Map
Figure 2	Property Map
Figure 3	Geology and Sample Locations
Figure 4	Section AA'
Figure 5	Section CC'
Figure 6	Section DD'
Figure 7	Section EE'

SUMMARY

The Botwat claims are underlain in part by felsic rocks of the Mt. Skukum Volcanic Complex.

Some low level anomalous values in Ag and Au have been obtained from surface quartz rubble.

Mapping and diamond drilling on the adjacent Said The property has delineated a major structure with economic potential. This feature may extend onto the eastern part of the Botwat claims. Parallel structures are evident in the southeast corner of the property.

INTRODUCTION

Following completion of a drilling program on the Said The property (June 26 to July 26, 1986), Kerr Addison Mines Ltd. entered into an agreement with Rockridge Mining Corporation on the Botwat claims. The Botwat property lies immediately to the north of Said The.

During August 5, 6 and 8 Kerr Addison expended 6 man days on Botwat ground in prospecting and the collection of quartz vein material.

On August 20 grouping forms and work were filed for the Botwat claims in Whitehorse. Grouping was arranged to include some of the Said and The claims and thereby include some of the drilling cost in support of assessment requirements on the Botwat claims.

This report presents the results of prospecting and details of drilling on Said The pertinent to furthering the understanding of the potential of the Botwat claims.

A handwritten signature in black ink, appearing to be 'L. Addison', located at the bottom right of the page.

LOCATION and ACCESS (Figure 1)

The Botwat claims are located approximately 54 kilometers southwest of Whitehorse and 12 kilometers northeast of the Mt. Skukum Mine within NTS sheet 105 D 5. Geographic co-ordinates are: 60°17'N, 135°27'W.

During the 1986 season helicopter access was available from a Frontier Helicopter's base on the Wheaton River about 14 kilometers southeast of the property. The Wheaton River valley is accessible by road from Whitehorse via the Alaska and Carcross highways and Annie Lake road. Recent upgrading of the Annie Lake road has reduced the travel time from Whitehorse to about 1 hour.

LEGAL DESCRIPTION (Figure 2)

The Botwat property comprises 84 contiguous mineral claims located in the Whitehorse Mining Division and having the following details:

<u>Claim Name</u>	<u>Record #</u>	<u>Expiry Date</u>
Botwat 1-64	YA82841-904	August 26, 1987
Botwat 65-84	YA93356-375	August 23, 1986

The claim block is bounded on the south by the Said and The claims.

The registered owner of the property is Rockridge Mining Corporation of Vancouver, B.C. They are currently under option to Kerr Addison Mines Limited.

Grouping notices and exploration work were filed by the writer in Whitehorse on August 19, 1986.

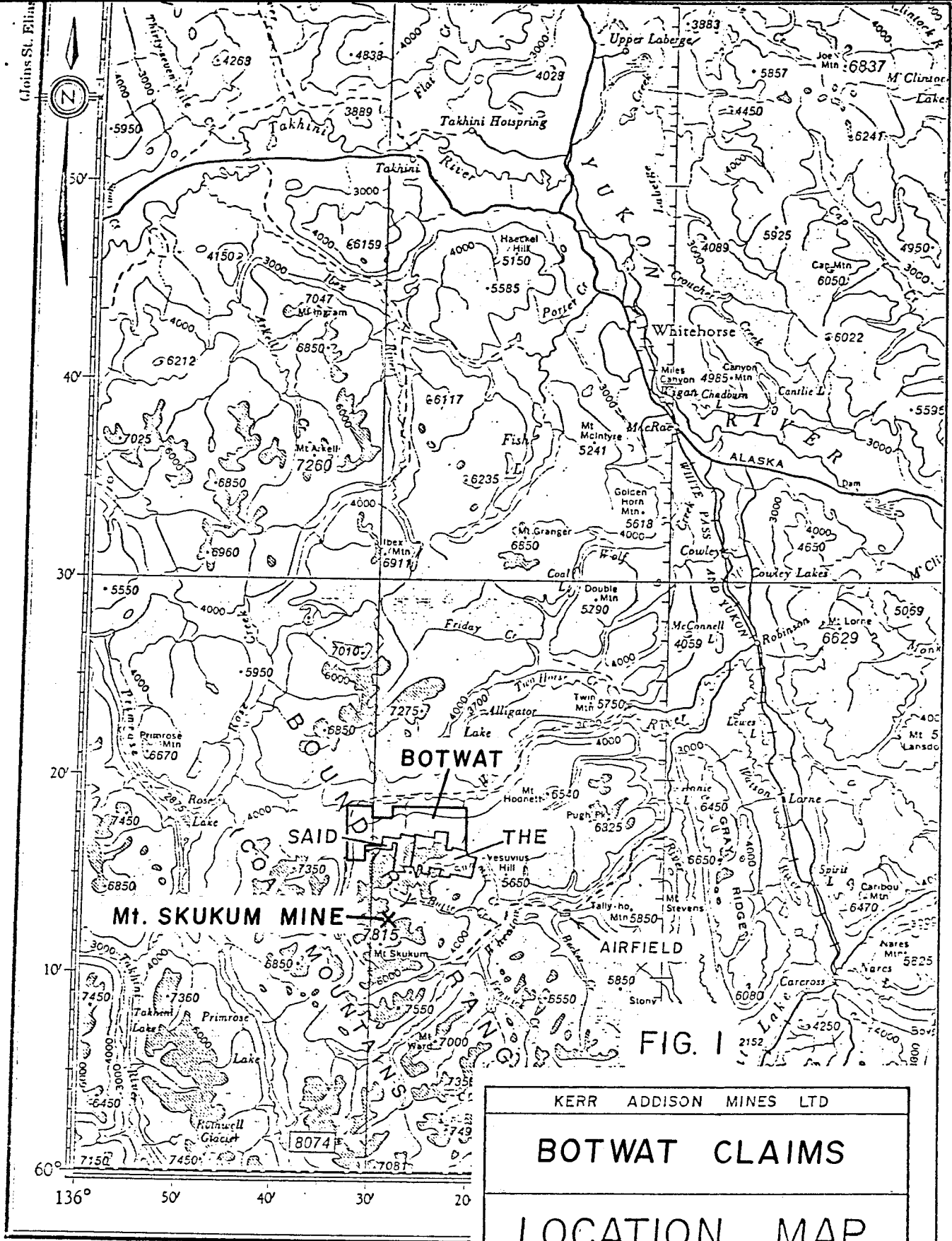

FIG. 1

KERR ADDISON MINES LTD	
BOTWAT CLAIMS	
LOCATION MAP	
SCALE - 1 : 500 000	DATE - OCT. , 1926
DRAWN BY: P.H.	DATA - J.P.
NTS - 105 D	REVISED -

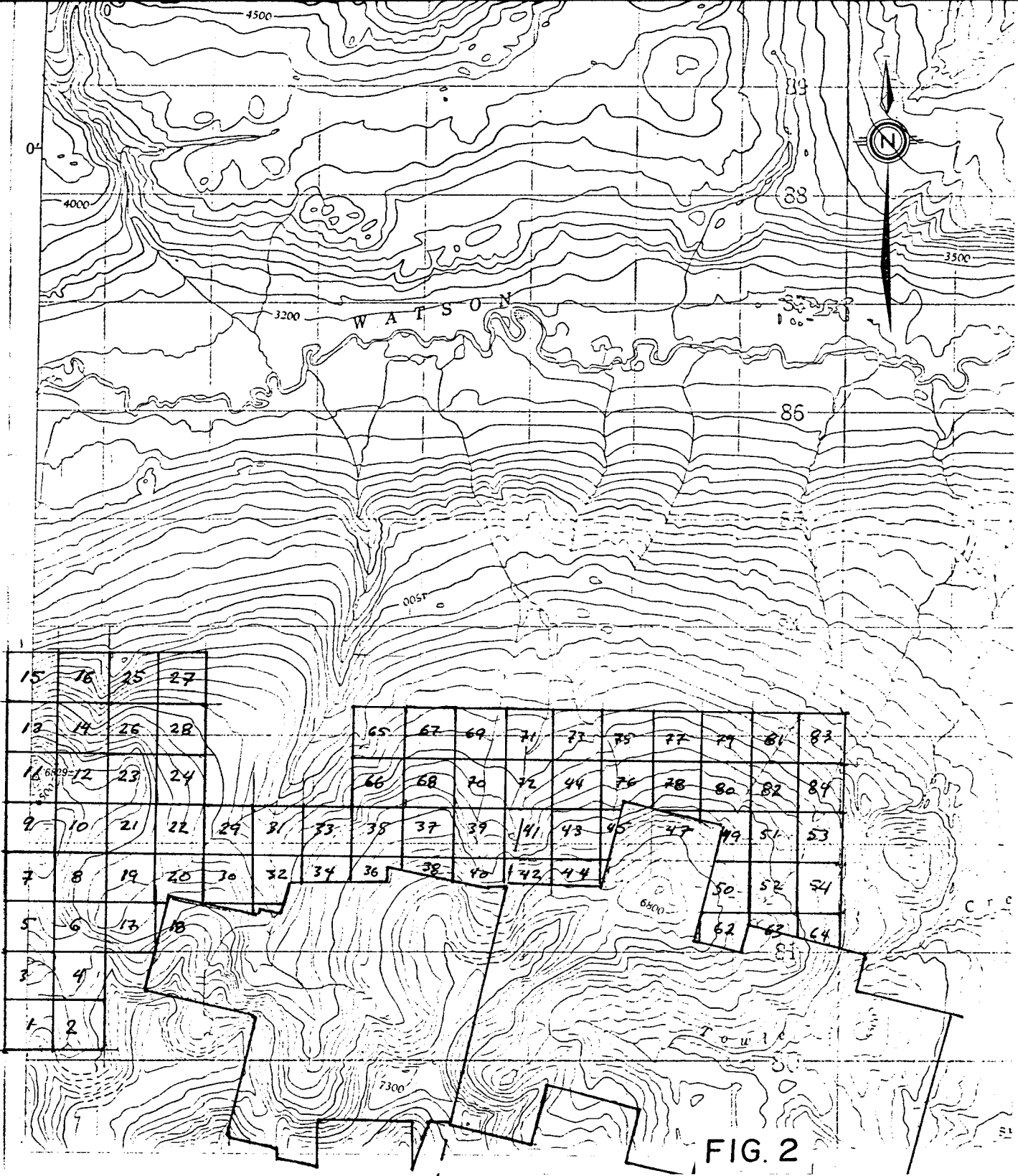

FIG. 2

KERR ADDISON MINES LTD	
BOTWAT CLAIMS	
CLAIM MAP	
SCALE - 1: 50 000	DATE - OCT., 1986
DRAWN BY: P.H.	DATA - J.P.
NTS - 105 D	REVISED -

PHYSIOGRAPHY and VEGETATION

The Botwat property is located within the boundary ranges of the Coast Mountain system of the southwestern Yukon. Topography is characterized by moderate north aspect slopes which lie immediately south of the Watson River. Elevations within the claim block range from 1500 to 2000 meters. The area is drained by several small well incised creeks which flow north to Watson River.

The northern lower levels of the property are covered by a mixed growth of spruce and alpine fir. The zone immediately above timberline has a cover of dwarf birch and willow. Upper areas show patchy grass and moss between active talus slopes.

HISTORY

Claims 1 to 64 were staked in August of 1984 in response to activities at and around the Mt. Skukum gold deposit.

In 1985 Archer Cathro and Associates (1981) Limited conducted reconnaissance geology and geochem surveys. This work confirmed the presence of Mt. Skukum volcanics and of quartz vein material bearing traces of gold. Claims 65 to 84 were staked following this work.

In August of 1986, Kerr Addison Mines Limited entered into an option agreement on the Botwat claims with Rockridge. Kerr subsequently carried out a reconnaissance survey of the property and filed work sufficient to hold the ground until August of 1987.

GEOLOGICAL SETTING (Figure 3)

The Botwat claims cover an area along the northern edge of the Mt. Skukum Volcanic Complex. The Skukum volcanics were developed in Eocene time over a basement of Yukon Group metasediments and Cretaceous granitic rocks.

Regional geology is detailed in G.S.C. Memoir 312 by J.O. Wheeler. The Mt. Skukum Volcanic Complex has been mapped by M. Pride at a scale of 1:25,000 (D.I.A.N.D Open File).

Much of the claim area is covered by glacial till and colluvium. The northern edge and much of the western part of the property is underlain by Cretaceous granodiorite. The eastern and northwestern parts are covered by Mt. Skukum volcanic rocks. Lithologies represented here are felsic tuffs, breccias and epiclastics (Formation 2 of Pride); intermediate lava flows and related epiclastic rocks (Formation 3 of Pride); and flow banded spherulitic felsic rocks (Formation 3 of Pride).

Reconnaissance sampling by Archer Cathro shows the widespread occurrence of quartz vein material some of which carries anomalous amounts of gold and may be of local derivation.

1986 PROGRAM

During the 1986 field season work carried out on the Botwat claims included prospecting and reconnaissance sampling. On the adjoining Said The property diamond drilling produced results which may be extrapolated to further the understanding of the potential of the Botwat claim area.

PROSPECTING (Figure 3)

During August 5, 6 and 8 a two man party prospected the claims from a helicopter supported camp on Said The. This effort was directed toward confirmation of the Archer Cathro results of 1985 and to the search for structures or mineralized material similar in nature to those of the Mt. Skukum camp and the quartz vein systems of the Said The property. Two man days were spent on each of :

- 1) The northwest outlier
- 2) The central area north of Said The southwest zone (location of the 0.025 opt material found by Archer Cathro)
- 3) The eastern area which may host an extension of the Said The northeast structure.

Samples were sent to Chemex Labs Ltd. of North Vancouver, B.C. for processing according to the procedures outlined in Appendix III.

Sample Descriptions

SAMPLE #	DESCRIPTION SAMPLE DESCRIPTION -WEST END OF CLAIMS	Au (ppm)	Ag (ppb)
YB6L1R	Quartz float:pale grey to white with white feldspar crystals and rhyolite fragments, 3 pieces to 10cm.	0.2	<5
YB6L2R	Quartz veining in grey siliceous porphyritic rhyolite: White cockscomb texture,veins to 10cm with limonite and hematite on fractures and vein selvages. Very local talus slope.	0.2	<5
YB6L3R	Irregular quartz veins in mylonitized hematitic siliceous host.	0.3	<5
YB6L4R	Brecciated siliceous vein: med to dark grey, crosscut by calcite veining to 3cm and ribbon cockscomb quartz stringers, some surrounding breccia fragments.	0.2	<5
YB6L5R	Quartz boulder: limonitic, intensely fractured.	0.1	<5
YB6B1R	Cobble of massive coarse textured white to grey quartz: Probably "sweat" from meta-sedimentary basement.	0.8	<5
YB6B2R	5cm thick calcite vein: Coarse grained, rusty and chloritic patches. From area of granodioritic outcrop and rubble (YB6L4R from same location).	0.2	<5
YB6B3R	Massive quartz cobble: coarse grained white to grey, rusty fractures (probable metasedimentary source).	0.3	<5
YB6B9R	Coarse bladed textured quartz (after calcite): rusty, vuggy with fragments of black carbonaceous material. Block 15 x 15 x 20 cm from felsenmeer.	0.4	30
YB6B10R	Sericitized rusty felsic tuffs cut by stockwork of fine quartz veins: (2% quartz veins from 1 to 3mm wide). Sample of chips over 10 meter width (in place).	0.7	<5
YB6B11R	Tight spaced quartz veins cutting silicified rhyolite tuff. Buff coloured, vuggy. From rubble at base of scree slope.	0.3	<5

Sample #	DESCRIPTION	Ag (ppm)	Au (ppb)
YB6B12R	<p>From 1 meter wide zone of braided quartz veining and silicified rhyolite tuffs. (015°/80E). Buff coloured. Lies within package of rusty weathering felsic tuffs carrying scattered quartz veins which lies adjacent to contact with basement granodiorite.</p>	0.1	<5
<u>SAMPLE DESCRIPTION - CENTRAL AREA</u>			
YB6L6R	<p>Stongly limonitic siliceous rhyolite cut by ribbon cockscomb quartz stringers. Partially brecciated with quartz enveloped fragments as matrix. Single boulder. Similar to material found on Said The up slope from this location(South-west zone).</p>	1.4	75
YB6L7R	<p>Same as L6R</p>	4.8	<5
<u>SAMPLE DESCRIPTION - EAST END OF CLAIMS</u>			
YB6L8R	<p>Quartz stringers in rhyolite tuff, cockscomb texture. Small pieces from frost boils.</p>	0.1	<5
YB6L9R	<p>as L6R with up to 50% quartz in 30cm boulder from downslope, creeping frost heaved boulder field.</p>	0.2	<5
YB6B4R	<p>Quartz breccia with vuggy chalcedonic veining. 60 x 40 x 20 cm block. From rubble within easterly trending linear depression.</p>	1.0	<5
YB6B5R	<p>Siliceous rhyolite breccia with banded vuggy quartz veining 25 x 20 x 12 cm block. Same location as above sample (B4R)</p>	0.4	<5

Sample #	DESCRIPTION	Ag (ppm)	Au (ppb)
YB6B6R	Sheared rusty silicified rhyolite tuff breccia. Chip sample over 3 meter width in place.(085/70°S)	0.8	25
YB6B7R	Banded chalcedonic and cockscomb quartz 25 x 10 x 5 cm block from talus slope.	0.9	160
YB6B8R	<p>Rubble of fine cockscomb and drusy quartz Composite grab sample over 8x10 meter area within a prominent linear slot (060°/dip?).</p> <p>The quartz rubble is mixed with rubble of sericitized rhyolite (conspicuous light green color) dyke?, which is itself cut by fine quartz veins.</p> <p>Wall rocks are rusty weathering rhyolite lapilli tuff.</p>		

DIAMOND DRILLING - SAID THE (Figures 4 to 7)

Drilling on the Said The property was laid out to investigate the subsurface character of quartz vein subcrops which are discontinuously exposed over a 3 kilometer northeast trending feature. Drilling was done by Drilcor Industries Limited of Delta, B.C. Logistic support was provided by Frontier Helicopter with a Hughes 500D machine operating out of the Wheaton River base.

Work was concentrated at Southwest Zone on Said claims (upslope from the central area of Botwat) and at Northeast Zone on The claims (near the boundary with the eastern block of Botwat claims). Holes 1, 3 and 4 at Southwest Zone and 5,6 and 8 at Northeast Zone best illustrate the subsurface potential of Botwat. Partial expenditures on these holes have been applied to the Botwat claims in accordance with assessment requirements.

Drilling at Southwest Zone shows strong shear structures dipping to the south. Only very little quartz veining was found within these features. Sample results show only minor anomalous levels of Ag and Au.

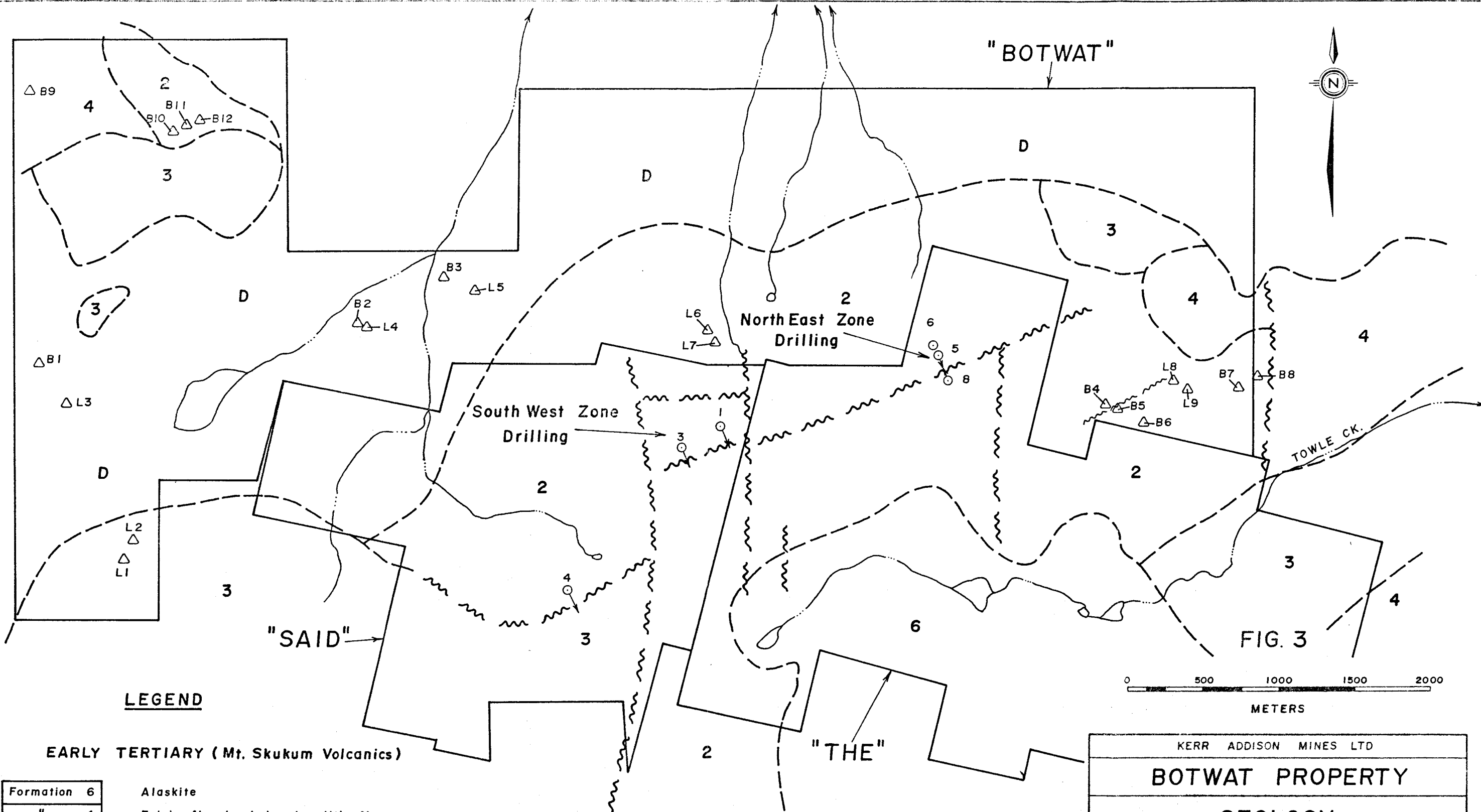

LEGEND

EARLY TERTIARY (Mt. Skukum Volcanics)

Formation 6	Alaskite
" 4	Felsic flow banded spherulitic flows.
" 3	Interlayered epiclastic rocks and intermediate flows.
" 2	Rhyolitic lapilli tuff, tuff, breccia and epiclastic rocks.

CRETACEOUS (Coast Intrusions)

D	Granodiorite
---	--------------

- △L5 Rock sample location.
- Diamond drill hole (SAID-THE).

FIG. 3



KERR ADDISON MINES LTD	
BOTWAT PROPERTY	
GEOLOGY	
SAMPLE LOCATIONS	
& DRILLING (SAID-THE)	
SCALE - 1: 25 000	DATE - OCTOBER, 1986
DRAWN BY - P.H., B.P.	DATA - B.P.
NTS - 105 D/6	REVISED -

Summary Logs from Southwest Zone:

DDH YS-86-01

Location 11+00N, 3+89W

Az 137° Dip -45° Depth 141.4 m.

		<u>Sample Number</u>	<u>Interval (meters)</u>	<u>Au (ppb)</u>
0-3.1 meters	surface rubble:	YS-01		
31.-7.7	Andesite dyke:			
7.7-21.0	Rhyolite lapilli tuff: moderate to strong argillization	-03	14.3-15.5	<5
21.0-29.2	Rhyolite lapilli tuff: Fresh			
29.2-33.8	Rhyolite lapilli tuff: moderate to intense argillization	-04	26.3-29.2	<5
	approx. 5% qtz veins	-01	29.2-31.1	<5
		-02	31.1-33.8	<5
33.8-36.9	Rhyolite lapilli tuff: Fresh			
36.9-43.8	Tuffaceous sediments:			
43.8-79.8	Interbedded andesite, dacite and rhyolite tuffs. Relatively fresh no veining			
79.8-83.1	Rhyolite/Dacite breccia	16	79.8-81.4	5
	void filling of opaline quartz	17	81.4-83.1	<5
83.1-102.7	Tuffaceous sediments: minor rhyolite tuff	05	93.8-95.3	<5
102.7-118.5	Altered zone:	06	103.5-105.8	5
	argillized rhyolite tuffs	07	105.8-107.3	<5
	conspicuous pyrolusite and rhodochrosite	08	107.3-108.8	<5
		09	108.8-110.3	<5
	No quartz veining	10	110.3-111.9	<5
		11	111.9-113.4	20
		12	113.4-114.9	<5

<u>Interval</u>	<u>Description</u>	<u>Sample Number</u>	<u>Interval (meters)</u>	<u>Au (ppb)</u>
		YS-13	114.9-116.4	<5
		14	116.4-118.0	5
		15	118.0-119.5	<5
118.5-131.7	Rhyolite lapilli tuff: fresh			
131.7-134.4	Tuffaceous sediments:			
134.4-141.4	Rhyolite lapilli tuff and tuff breccia.			
EOH				

- - - - -

DDH-YS-86-03

Location: 6+30N, 5+45W

Az: 138° Dip -45° Length 71.0 m.

<u>Interval</u>	<u>Description</u>	<u>Sample Number</u>	<u>Interval (Meters)</u>	<u>Ag ppm</u>	<u>Au ppb</u>
0-53.8	Rhyolite lapilli tuff: welded, fresh	YS-03			
53.8-55.8	Rhyolite tuff: fresh				
55.8-58.8	Rhyolite tuff: shattered argillized numerous fine qtz veinlets.	01	55.8-57.3	NS	<5
		02	57.3-58.8	NS	<5
58.8-59.0	Quartz vein: coarse cockscomb texture	03	58.8-59.0	NS	<5
59.0-61.5	Rhyolite lapilli tuff strong to intense argillization	04	59.0-60.4	0.1	<5
		05	60.4-61.5	0.1	<5
61.5-64.7	Rhyolite lapilli tuff: Moderate argillization Scattered fine qtz veins.				
64.7-71.0	Rhyolite lapilli tuff: Fresh				

EOH

- - - - -

DDH-YS-86-04 SUMMARY LOG

Location: Southeast ridge

Az: 155° Dip -45° Length 142.6 m.

<u>Interval</u>	<u>Description</u>	<u>Sample Number</u>	<u>Interval (Meters)</u>	<u>Ag ppm</u>	<u>Au ppb</u>
0-93.2	Rhyolite lapilli tuff: welded, very hard	YS-04			
93.2-96.5	Andesite dyke				
96.5-128.8	Rhyolite lapilli tuff slight to moderate sericitization and argillization. Minor fine qtz and calcite veins. Trace pyrite.	01	128.8-131.1	0.1	<5
131.1-132.7	Rhyolite lapilli tuff: sheared at 20° to core axis mod to strongly argillized 2% qtz and calcite veins pyrrhotite on fractures	02	131.1-132.7	0.1	<5
132.7-142.6	Rhyolite lapilli tuff: welded, very hard				

EOH

The block of ground north of the fault comprises massive welded rhyolite lapilli tuffs and breccias (Formation 2 of Pride). These are cut by trachyte and andesite dykes. The down dropped southern block includes rhyolite and andesite (Formation 3 of Pride). Incorporated here are large exotic blocks or fault slices of Cretaceous granodiorite.

The north flank of the fault is a steeply dipping shear about 3 meters wide. The south flank is a zone of shearing and intense argillization about 14 meters wide which appears to extend from the surface rubble zone to the intersection in hole 8. This gives it an apparent dip of about 80° to the south. Broken vuggy cockscomb quartz material makes up about 5% of the core of hole 8 in this zone.

The block of ground between the two flanking structures comprises volcanics which are well fractured and slightly to moderately argillized.

Sampled core from the holes on line 28 N returned very low values in Ag and Au. The best sample was from the south flank intersection of hole 8. Here material with a 7% quartz vein content returned 1.3 ppm Ag and 360 ppb Au.

Topographic lineations indicate that the structure of Northeast Zone continues into the eastern part of the Botwat claims. Prospecting to the south of this extension has located parallel lineations with associated quartz rubble which may be similar in nature.

Summary Logs - Northeast Zone

Holes 5,6 and 8 were located on line 28N to intersect the structure delineated by surface mapping at Northeast Zone. This drilling shows a steeply dipping zone of shearing fracturing and argillization.

Northeast Zone Log Summaries

DDH-YS-86-05

Location: 28+00N, 1+45E

Az: 135° Dip -44° Length 58.8 m

<u>Interval</u>	<u>Description</u>	<u>Sample Number</u>	<u>Interval (Meter)</u>	<u>Ag ppm</u>	<u>Au ppb</u>
0-42.1	Rhyolite lapilli tuff Welded hard, massive				
42.1-43.6	Rhyolite lapilli tuff Welded, well fractured				
43.6-47.7	Rhyolite lapilli tuff Intensely argillized and sheared. Minor qtz veinlets, no calcite	01	43.6-45.1	1.2	20
	Pyrolusite common, trace rhodochrosite	02	45.1-47.7	0.1	< 5
47.7-52.6	Rhyolite lapilli tuff: moderately argillized	03	47.7-49.7	0.1	< 5
	minor qtz/calcite veins	04	49.7-51.2	0.1	< 5
	conspicuous pyrolusite and rhodochrosite	05	51.2-52.6	0.1	< 5
52.6-54.6	Andesite dyke:				
54.6-58.6	Feldspar porphyry: Strong to intense argill- ization, manganese minerals conspicuous in fractures minor calcite veining	06	54.6-57.3	0.1	< 5
		07	57.3-58.8	1.9	< 5

EOH

- - - - -

DDH-YS-86-06

Location: 28+00N, 1+25E

Az: 135° Dip -60° Length 146.3 m

<u>Interval</u>	<u>Description</u>	<u>Sample Number</u>	<u>Interval (Meter)</u>	<u>Ag ppm</u>	<u>Au ppb</u>
0-30.4	Rhyolite lapilli tuff: welded, massive, hard	YS-06			
30.4-44.6	Trachyte dyke: porphyritic				
44.6-53.8	Rhyolite lapilli tuff: welded, hard				
53.8-61.4	Feldspar porphyry dyke:				
61.4-75.8	Rhyolite tuff breccia:				
75.8-78.0	Trachyte tuff:				
78.0-119.2	Rhyolite tuff breccia;	01	90.8-92.4	0.1	<5
	Conspicuous fine calcite	02	92.4-93.9	0.1	5
	veining crushed and	03	93.9-95.4	0.1	<5
	sheared core. Moderate	04	95.4-96.9	1.2	<5
	to intense argillization	05	96.9-98.1	0.5	<5
	Conspicuous manganese	06	100.3-102.3	0.4	<5
	minerals. Rare qtz veins	07	107.8-109.1	0.2	<5
	Samples are from sections	08	114.0-115.2	0.9	<5
	of notable alteration and	09	115.2-117.0	2.1	10
	calcite veining	10	117.5-118.5	2.9	65
119.2-127.7	Granodiorite: Sl chloritization and saus ⁿ	11	125.7-126.4	0.4	5
127.7-139.0	Andesite feldspar porphyry: dyke				
139.0-146.0	Granodiorite	12	139.0-141.1	0.4	<5
	well fractured to shattered	13	141.1-142.6	0.1	<5
	Moderate to intense argill-	14	142.6-144.2	0.1	<5
	ization Conspicuous	15	144.2-146.0	0.1	<5
	manganese minerals				
146.0-146.3	Andesite feldspar porphyry:				

EOH

- - - - -

DDH-YS-86-08

Location: 28+00N, 2+35E

Az: 315° Dip: -61° Length 89.6 m

<u>Interval</u>	<u>Description</u>	<u>Sample Number</u> YS-08	<u>Interval (Meter)</u>	<u>Ag ppm</u>	<u>Au ppb</u>
0-5.0 meters	Dacite:				
5.0-8.0	Granodiorite:				
8.0-12.4	Andesite:				
12.4-28.5	Rhyolite lapilli tuff and minor Rhyolite tuff breccia:				
28.5-37.0	Granodiorite:				
37.0-46.2	Rhyolite lapilli tuff: slight sericitization and silicification				
46.2-58.6	Granodiorite:				
58.6-58.8	Feldspar porphyry				
58.8-79.0	Rhyolite lapilli tuff:	01	58.8-60.4	0.8	< 5
	Intensely sheared and	02	60.4-61.9	0.7	< 5
	argillized, about 3%	03	61.9-63.4	0.5	< 5
	scattered coarse quartz	04	63.4-64.9	0.8	< 5
	vein material.	05	64.9-66.4	1.3	360
		06	66.4-68.0	2.2	30
79.0-81.7	Andesite:	07	68.0-69.5	1.2	5
	well fractured,	08	69.5-71.0	2.6	10
	moderate argillization	09	71.0-72.5	0.9	< 5
		10	72.5-74.1	0.7	< 5
		11	74.1-75.6	0.6	< 5
81.7-89.6	Rhyolite tuff:	12	75.6-77.1	2.5	< 5
	very broken core, slight	13	77.1-78.6	1.8	< 5
	to intense argillization				

EOH

- - - - -

DDH YS - 86 - 01

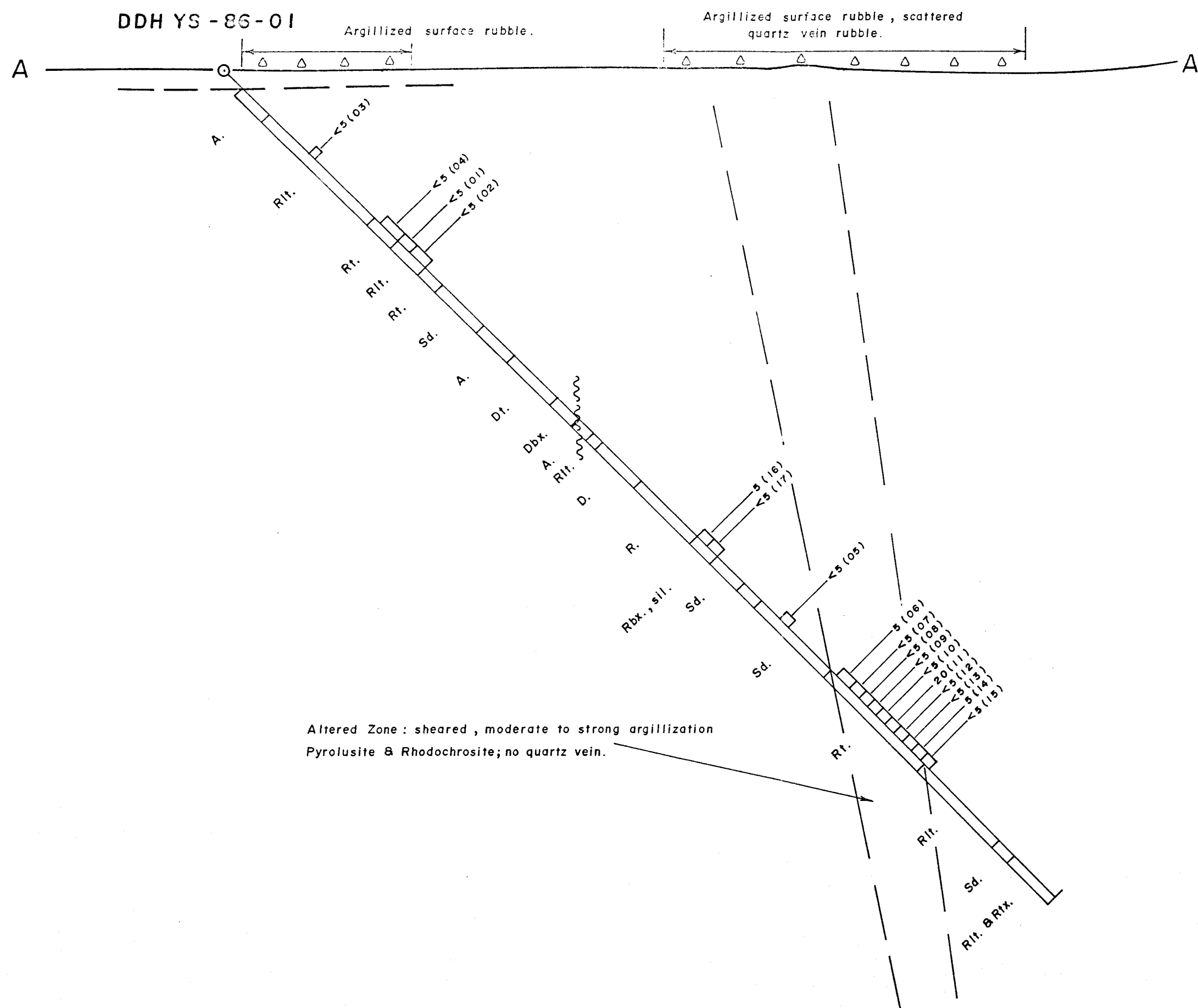

LEGEND

Rt.	Rhyolite tuff.
Rlt.	Rhyolite lapilli tuff.
Rtx.	Rhyolite tuff breccia.
R.dy.	Rhyolite dyke.
Tt.	Trachyte tuff.
T.dy.	Trachyte dyke.
Dt.	Dacite tuff.
Dbx.	Dacite breccia.
A.	Andesite.
A.dy.	Andesite dyke.
P.dy.	Feldspar porphyry.
Sd.	Epiclastic sediments.
Gd.	Granodiorite.

QV.	Quartz vein.
△	Quartz vein rubble.
arg.	Argillized.
2°bx.	Secondary breccia.
Flt.	Fault.
○---○	Drill hole collar.

Ag - ppm, Au - ppb (sample number).
5 (03)

FIG. 4

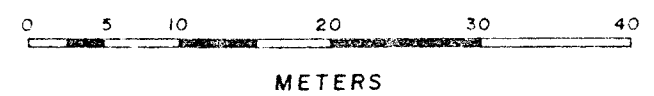

Altered Zone: sheared, moderate to strong argillization
Pyrolusite & Rhodochrosite; no quartz vein.

KERR ADDISON MINES LTD	
SAID & THE PROPERTY	
DRILLING 1986	
SECTION A-A'	
GEOLOGY & ASSAYS	
SCALE - 1 : 500	DATE - OCTOBER, 1986
DRAWN BY - P.H., B.P.	DATA - B.P.
NTS - 105 D/6	REVISED -

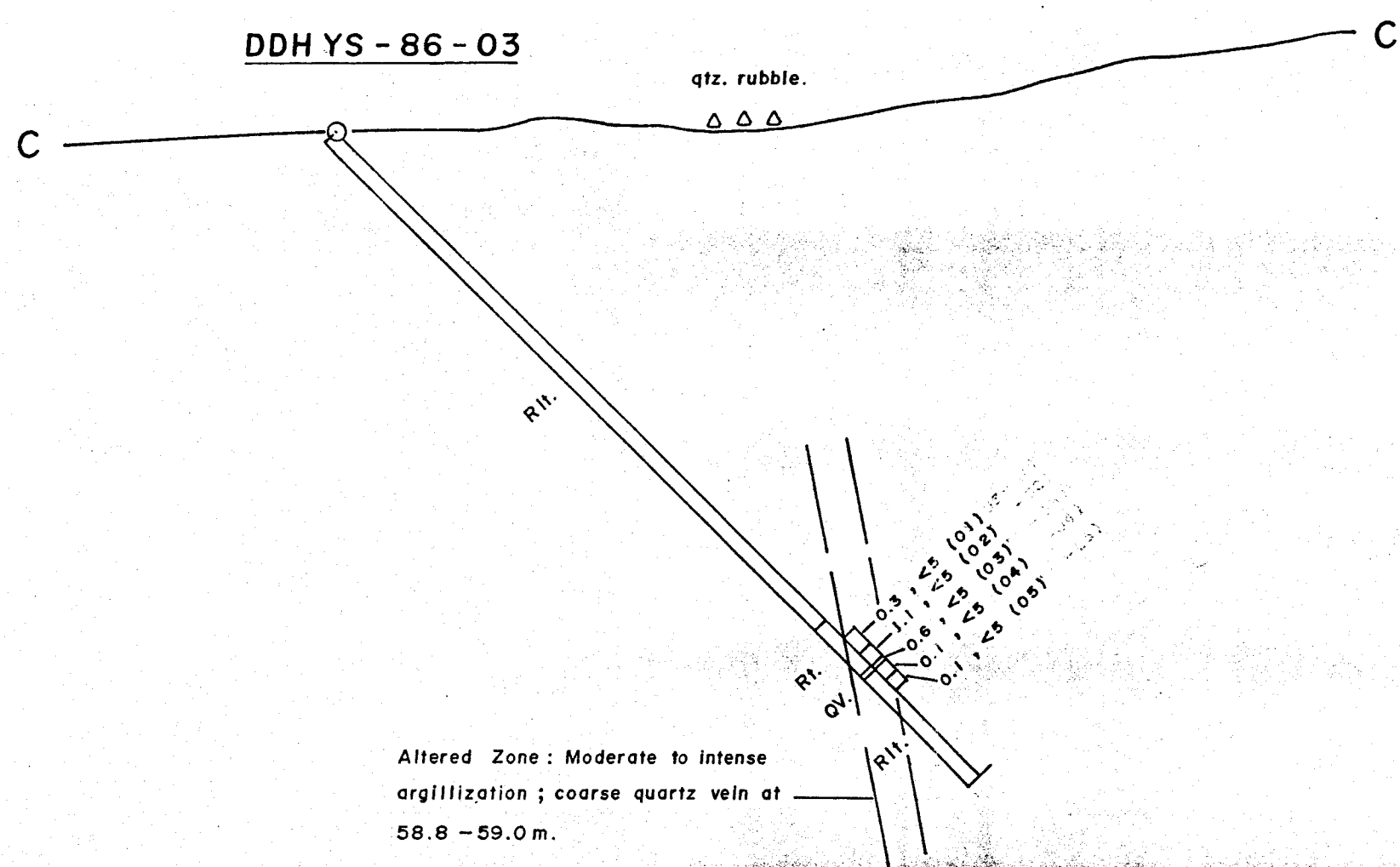

LEGEND

Rt.	Rhyolite tuff.
Rlt.	Rhyolite lapilli tuff.
Rtx.	Rhyolite tuff breccia.
Rdy.	Rhyolite dyke.
Tt.	Trachyte tuff.
Tdy.	Trachyte dyke.
Dt.	Dacite tuff.
Dbx.	Dacite breccia.
A.	Andesite.
Ady.	Andesite dyke.
Pdy.	Feldspar porphyry dyke.
Sd.	Epiclastic sediments.
Gd.	Granodiorite.
QV.	Quartz vein.
\triangle	Quartz vein rubble.
arg.	Argillized.
2°bx.	Secondary breccia.
Flt.	Fault.
\odot	Drill hole collar.

Ag - ppm , Au - ppb (sample number).
0.3 , 5 (01)

FIG. 5

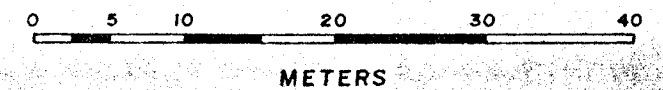

KERR ADDISON MINES LTD	
SAID & THE PROPERTY	
DRILLING 1986	
SECTION C-C'	
GEOLOGY & ASSAYS	
SCALE - 1 : 500	DATE - OCTOBER , 1986
DRAWN BY - P.H. , B.P.	DATA - B.P.
NTS - 105. D/6	REVISED -

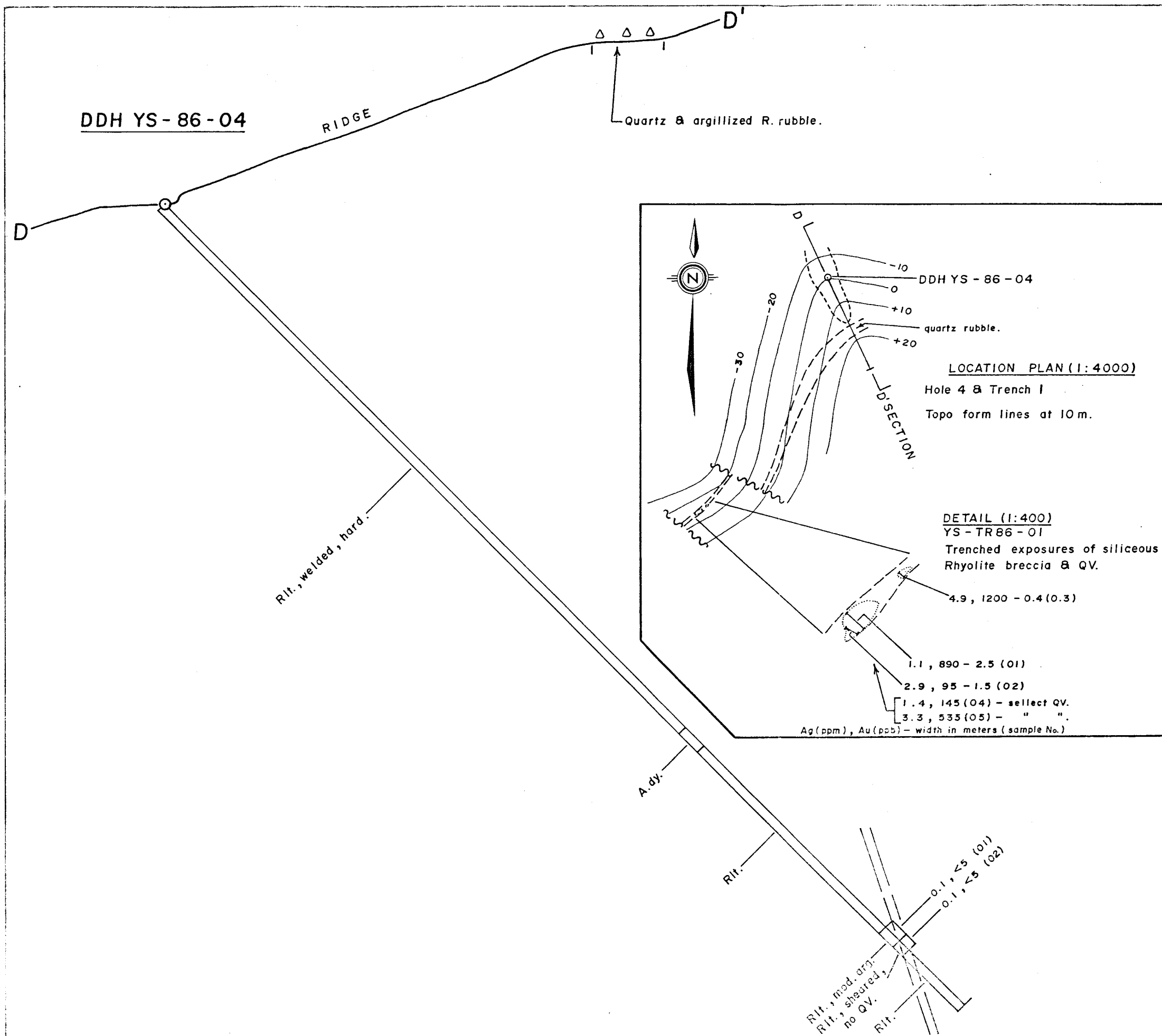

LEGEND

Rt.	Rhyolite tuff.
Rlt.	Rhyolite lapilli tuff.
Rtx.	Rhyolite tuff breccia.
R.dy.	Rhyolite dyke.
Tt.	Trachyte tuff.
T.dy.	Trachyte dyke.
Dt.	Dacite tuff.
Dbx.	Dacite breccia.
A.	Andesite.
A.dy.	Andesite dyke.
P.dy.	Feldspar porphyry dyke.
Sd.	Epiclastic sediment.
Gd.	Granodiorite.

QV.	Quartz vein.
Δ	Quartz vein rubble.
arg.	Argillized.
2°bx.	Secondary breccia.
Flt.	Fault.
○	Drill hole collar

Ag (ppm), Au (ppb) (sample number)
0.1, <5 (01)

FIG. 6



KERR ADDISON MINES LTD

SAID & THE PROPERTY

DRILLING 1986

SECTION D-D'

GEOLOGY & ASSAYS

SCALE - 1:5000	DATE - OCTOBER, 1986
DRAWN BY - CH, B.P.	DATA - B.P.
YS-125 D/S	REVISED -

DDH YS - 86 - 08

DDH YS - 86 - 06

DDH YS - 86 - 05

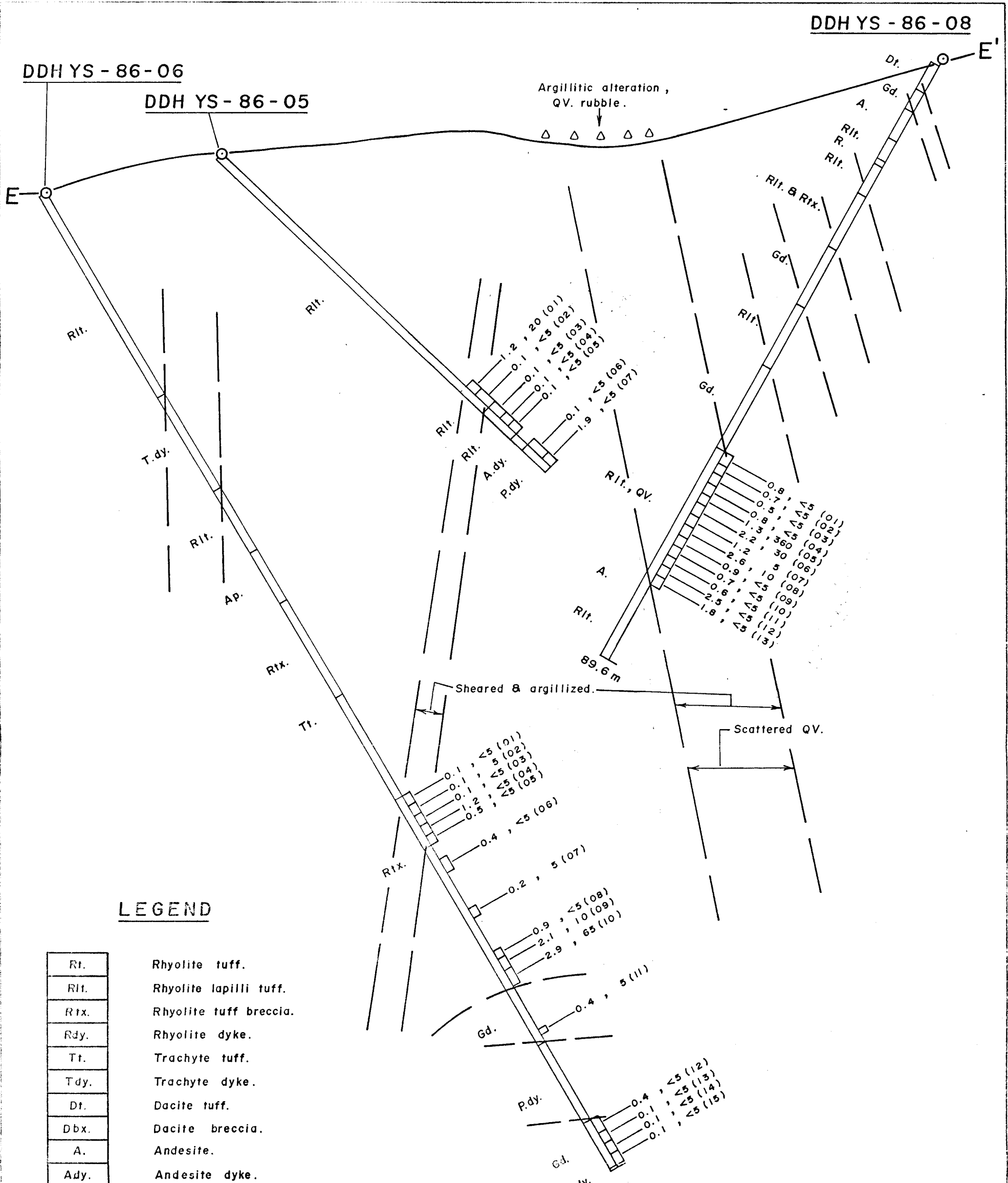

LEGEND

Rt.	Rhyolite tuff.
Rlt.	Rhyolite lapilli tuff.
Rtx.	Rhyolite tuff breccia.
Rdy.	Rhyolite dyke.
Tt.	Trachyte tuff.
Tdy.	Trachyte dyke.
Dt.	Dacite tuff.
Dbx.	Dacite breccia.
A.	Andesite.
Ady.	Andesite dyke.
Pdy.	Feldspar porphyry dyke.
Sd.	Epiclastic sediments.
Gd.	Granodiorite.

- QV. Quartz vein.
- △ Quartz vein rubble.
- arg. Argillized.
- 2°bx. Secondary breccia.
- Flt. Fault.
- Drill hole collar.

Ag - ppm, Au - ppb (sample number).
0.4, 5 (15)

FIG. 7



KERR ADDISON MINES LTD	
SAID & THE PROPERTY	
DRILLING 1986	
SECTION E-E'	
GEOLOGY & ASSAYS	
SCALE - 1:500	DATA - OCTOBER, 1985
DRAWN BY - P.H., B.P.	DATA - B.P.
NTS - 105 D/6	REVISED -

APPENDIX I

DIAMOND DRILL LOGS - SAID THE 1986

HOLES DDH-YS-86-01
DDH-YS-86-03
DDH-YS-86-04
DDH-YS-86-05
DDH-YS-86-06
DDY-YS-86-08

SAID - THE

KERR ADDISON MINES LIMITED

#355

DDH No. YS-86-01 PAGE 1 of 6

SAID THE PROPERTY-Y10

LATITUDE 11-00N DEPARTURE 3-89.5W

CORE SIZE B0 FINAL DEPTH 141.4

1986 DIAMOND DRILLING

DIP AT COLLAR -45° BEARING 137°

STARTED JUNE 27/86 FINISHED JUNE 30/86

COLLAR ELEV. _____ LOGGED BY RP

EQUIVALENT METERS		%	GRAPHIC LOG				%	DESCRIPTION	MINERALIZATION		ALTERATION		STRUCTURE	ASSAYS			
FROM	TO		RECOVERY	ROCK TYPE	ALTERATION	MINERALIZED ZONE			STRUCTURE TO CORE	MoS ₂	VOL. %	MODE OF OCCURRENCE	VOL. %	TYPE MODE OF OCCURRENCE	KIND, DENSITY, ETC.	SAMPLE NO.	Ag %
0	3.0																
3.1	7.7		A														
7.7	21.0		RH														
21.0	25.4		RH														
25.4	26.3		RH														

Rubble - casing

Andesite dyke:
dark green, fg, massive
fresh, well fractured

Rhyolite lapilli tuff:
white to yellow to grey
Fragments to 2 cm - 6d, 5d
rhyolite.
Matrix - Qtz, aq feld, litt haze
Dark brown secondary mineral
(bottle or pyroclastic) pronounced
at 9.8 m. Auth from fac. nodularitic

Alteration: moderate
to strong
Strong to 15.2
decreasing below this
2° bi or
pyroclastic

14.3-15.2

YS-01-03 - <5

Rhyolite lapilli tuff:
Blue green with red (jasper) flecks
Fresh, massive.
Lapilli: Rhy, Qtz, 6d
Band of fg siliceous tuff
@ 22.8, N 45° to axis

Rhyolite tuff:
light gray, v fg, siliceous
finely banded with inclusion
of feld xls.
Abundant 2° brown mineral
(bottle or pyroclastic)
Dist. remarkable after pyrocl.

KERR ADDISON MINES LIMITED

DDH No. YS-86-01 PAGE 3 of 6
 CORE SIZE _____ FINAL DEPTH _____
 STARTED _____ FINISHED _____

SAID THE PROPERTY-Y10
 1986 DIAMOND DRILLING

LATITUDE _____ DEPARTURE _____
 DIP AT COLLAR _____ BEARING _____
 COLLAR ELEV. _____ LOGGED BY _____

FOOTAGE		%	GRAPHIC LOG				%	DESCRIPTION	MINERALIZATION		ALTERATION		STRUCTURE KIND, DENSITY, ETC.	ASSAYS		
FROM	TO		RECO- VERY	ROCK TYPE	ALTER- ATION	MINERAL- IZED ZONE			STRUC- TURE TO CORE	VOL. %	MODE OF OCCURRENCE	VOL. %		TYPE MODE OF OCCURRENCE	SAMPLE NO.	%
34.6	36.9		Rt				Rhyolitic crystal tuff: Dark green, massive, mg qtz. feld of lithic frags bedding @ 45°									
36.9	43.8		S				Tuffaceous sediment: Interlamated f of mg material Bedding: 35° @ 37.4m 40° @ 38.5m									
43.2	48.9		A				Andesite: Dark to light green, Amygdaloidal flow banded tuff (flattened shands) Massive dense.									
48.9	56.0		Dt				Dacitic tuff: Med grey green, medium massive Depositional banding 50° @ 49.6m Scattered 1-2mm feldspar phenes in qtz filled mafic matrix. Scattered fine frac with epidote / qtz filling.				epidote alt ⁿ of feld and in frac.					
56.0	59.2		Dtx				Dacite breccia: Angular fragments of med to lt gray dacite. Coarse infilling chlorite, epidote and locally magnetite. Lower 40 cm rusty oxidized				Chlorite-epidote Dacite Breccial silicified base 1-3mm					

KERR ADDISON MINES LIMITED

SAID THE PROPERTY-Y10

1986 DIAMOND DRILLING

DDH No. YS-86-01 PAGE 5 of 6

CORE SIZE _____ FINAL DEPTH _____

STARTED _____ FINISHED _____

LATITUDE _____ DEPARTURE _____

DIP AT COLLAR _____ BEARING _____

COLLAR ELEV. _____ LOGGED BY _____

FOOTAGE		%	GRAPHIC LOG				%	DESCRIPTION	MINERALIZATION		ALTERATION		STRUCTURE	ASSAYS					
FROM	TO		RECOVERY	ROCK TYPE	ALTERATION	MINERALIZED ZONE			STRUCTURE TO CORE	MOS ₂	VOL. %	MODE OF OCCURRENCE	VOL. %	TYPE MODE OF OCCURRENCE	KIND, DENSITY, ETC.	SAMPLE NO.	A ₃ %	A ₂ %	
83.1	87.8		Sd																
							Tuffaceous sed: Dark grey green, fine-medium Fresh, siliceous Dd: 45° @ 83.4 30° @ 84.3										ppm	ppb	
87.8	90.8						Rhyolite lapilli Tuff: Lt grey to white with minor fine white s/z vlls jasper flecks and epidote					mod silicification minor epidote							
90.8	102.7						Tuffaceous sediments: Interbedded fine to coarse, siliceous-epidote bands Redding: 10° @ 90.8 35° @ 91.0 40° @ 92.2 50° @ 98.2 45° @ 101.3												
							93.8-95.3 - Fine wavy banded; light (siliceous) dark (chloritic) green (epidote rich). Aligned approximately with core. Dissected											YS	LS
													93.8-95.3	01-05					

KERR ADDISON MINES LIMITED

0333

DDH No. YS-01-05 PAGE 6 of 6

SAID THE PROPERTY-Y10

LATITUDE _____ DEPARTURE _____

CORE SIZE _____ FINAL DEPTH _____

1986 DIAMOND DRILLING

DIP AT COLLAR _____ BEARING _____

STARTED _____ FINISHED _____

COLLAR ELEV. _____ LOGGED BY _____

FOOTAGE		%	GRAPHIC LOG				%	DESCRIPTION	MINERALIZATION		ALTERATION		STRUCTURE	ASSAYS			
FROM	TO		RECOVERY	ROCK TYPE	ALTERATION	MINERALIZED ZONE			STRUCTURE TO CORE	MoS ₂	VOL. %	MODE OF OCCURRENCE	VOL. %	TYPE MODE OF OCCURRENCE	KIND, DENSITY, ETC.	SAMPLE NO.	% Ag
102.7	118.5		Rt	A	?		Altered zone: Rhyolite: coarse crystal lithic to lapilli tuff Fold phenos to 3mm Alteration begins at 102.7 - 103.5 with slight veins of arg ² and pyralusite. Below this mod to strong Arg ² with pyralusite and porphyritic pink rhodochrosite and white clays No quartz veining		Rhodochrosite and pyralusite		Mod to strong peruvianite argillization		103.5 - 105.8 105.8 - 107.3 107.3 - 108.8 108.8 - 110.3 110.3 - 111.9 111.9 - 113.4 113.4 - 114.9 114.9 - 116.4 116.4 - 118.0 118.0 - 119.5	YS 01-06 01-07 01-08 01-09 01-10 01-11 01-12 01-13 01-14 01-15	ppm 5 <5 <5 <5 <5 20 <5 <5 5 <5	ppb 5 <5 <5 <5 <5 20 <5 <5 5 <5	
118.5	131.7		RtH				Rhyolite lapilli tuff: light green to purple 20% Arg ² , siliceous massive, epidote in frac 5cm Gd clast @ 124.6		—		—						
131.7	134.8						Tuffaceous silt: Dark grey; fg, massive mg,		—		—						
134.8	141.4						Rhyolite Lapilli Tuff & Tuff Bx		—		—						
								END of HOLE									

KERR ADDISON MINES LIMITED

DDH No. YS-EG-03 PAGE 1 of 2
 CORE SIZE BQ FINAL DEPTH 71.0 m
 STARTED JULY 4/86 FINISHED JULY 6/86

SAID THE PROPERTY-Y10

1986 DIAMOND DRILLING

LATITUDE 6730N DEPARTURE 5745W
 DIP AT COLLAR -45° BEARING 138°
 COLLAR ELEV. _____ LOGGED BY RP

FOOTAGE Meters		%	GRAPHIC LOG				%	DESCRIPTION	MINERALIZATION		ALTERATION		STRUCTURE	ASSAYS			
FROM	TO	RECO- VERY	ROCK TYPE	ALTER- ATION	MINERA- LIZED ZONE	STRUC- TURE TO CORE	Mos ₂		VOL. %	MODE OF OCCURRENCE	VOL. %	TYPE MODE OF OCCURRENCE	KIND, DENSITY, ETC.	SAMPLE NO.	% Ag ppm	% Au ppb	
0	53.8	100	RH														
							Rhyolite tuff - welded - Pale gray green - Flattened, shaly and clastic deforming foliation @ 45° to 60° - Hard. Vugs - Fresh white subhedral feldspar crystals to 6 mm - Thin coarse clasts - Fract. part slightly waxy		Foliation: 45° @ 13m 50° @ 25m 55° @ 32m 80° @ 43m 70° @ 48m 60° @ 52m								
53.8	55.8	100	RT				Rhyolite Tuff: - gray green to brown to pale yellow - fine grained, fossils laminated with coarse (up to 2cm) fresh white subhedral feld vlt - Well fractured - Sl. oxidized below 55m		bedding: 70° @ 54.3 30° @ 54.5 60° @ 55.0 - Curving (plastic deformation - post- or contemporaneous								
55.8	58.8	70	RT				Rhyolite Tuff: - gray to white - shattered core - Numerous fine vlt. vlt - 0.1 m muddy sheared material at base above Qtz vein				Moderate arg ²			YS			
														03-01	0.3	<5	
														03-02	1.1	<5	
58.8	59.0	?	QV				Quartz vein: Coarse rock comb dilation textures.								03-03	0.6	<5

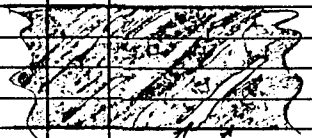

Black matrix
etc/feld dark
149ppm

KERR ADDISON MINES LIMITED

DDH No. YS-86-05 PAGE 1 of 2
 CORE SIZE BQ FINAL DEPTH 58.8 meters
 STARTED July 14/86 FINISHED JULY 17/86

SAID THE PROPERTY-Y10

1986 DIAMOND DRILLING

LATITUDE 28+00 N DEPARTURE 1+43 N
 DIP AT COLLAR -44° BEARING 135°
 COLLAR ELEV. _____ LOGGED BY RP

FOOTAGE		%	GRAPHIC LOG					%	DESCRIPTION	MINERALIZATION		ALTERATION		STRUCTURE KIND, DENSITY, ETC.	ASSAYS		
FROM	TO		RECO- VERY	ROCK TYPE	ALTER- ATION	MINER- ALIZED ZONE	STRUC- TURE TO CORE			MOS ₂	VOL. %	MODE OF OCCURRENCE	VOL. %		TYPE MODE OF OCCURRENCE	SAMPLE NO.	% Ag ppm
0	42.1	100	RH	sp	/												
<p>Rhyolite lapilli Tuff: welded Dark brown to maroon matrix (60%) with gray to green f. breccia clasts (40%) Elong. Rhyolite, some finely laminated, flattened shreds. Rare Cd clasts. 23.6-23.8 fine banded rhyolite @ 20°. very hard, siliceous 0-5.8 broken core 5.7 down core intact shears: 17.4m @ 35° 19.6m @ 65° 20.5m @ 40° rusty, pyroclastic 23.2m @ 30° - rusty, arg 4mm calcite vlt @ 35.5m</p>																	
42.1	43.6	40	RH														
<p>Rhyolite lapilli Tuff: welded as above section but broken core < 5cm pieces and some strong arg²</p>																	
43.6	47.7	85	RH	inf arg	?												
<p>Rhyolite lapilli Tuff: Brown to yellow to grey soft matrix of ground up core. Very much arg, no calcite Pyroclastic common, trace rhodochrosite</p>																	
														YS			
														43.6-45.1	05-01	1.2	20
														45.1-47.7	05-02	0.1	<5

KERR ADDISON MINES LIMITED

SAID THE PROPERTY-Y10

1986 DIAMOND DRILLING

DDH No. YS-86-06 PAGE 5 of 5

CORE SIZE _____ FINAL DEPTH _____

STARTED _____ FINISHED _____

LATITUDE _____ DEPARTURE _____

DIP AT COLLAR _____ BEARING _____

COLLAR ELEV. _____ LOGGED BY _____

FOOTAGE		%	GRAPHIC LOG					%	DESCRIPTION	MINERALIZATION		ALTERATION		STRUCTURE KIND, DENSITY, ETC.	ASSAYS		
FROM	TO		RECO- VERY	ROCK TYPE	ALTER- ATION	MINERAL- IZED ZONE	STRUC- TURE TO CORE			MoS ₂	VOL. %	MODE OF OCCURRENCE	VOL. %		TYPE MODE OF OCCURRENCE	SAMPLE NO.	% Ag
139.0	146.0		gd						Granodiorite: grey green coarse grained well fractured to shattered Calcite veins common. Qtz veins coarse 4 cm mud slices at 139.8				Moderate pervasive cloudy green alt. of plagioclase "saub" or incipient sericitization Arg ⁺ - adj to fractures and strong in coarse sections	139.0-141.1	06-12	0.4	LS
									(Sample #14 (142.6-144.2) → has 4 mm Qtz jkt with massive fluorite)				141.1-142.6	06-13	0.1	LS	
													142.6-144.2	06-14	0.1	LS	
													144.2-146.0	06-15	0.1	LS	
146.0	146.3								Feldspar Porphyry 115% plagioclase in green f.g. matrix highly broken muddy core.				Med crystallization				
— END of Hole —																	

KERR ADDISON MINES LIMITED

SAID THE PROPERTY-Y10

1986 DIAMOND DRILLING

DDH No. YS-86-08 PAGE 1 of 4
 CORE SIZE BC FINAL DEPTH 89.6 Meters
 STARTED July 21/86 FINISHED July 23/86

LATITUDE 28+00N DEPARTURE 2+35E
 DIP AT COLLAR -61° BEARING 315°
 COLLAR ELEV. _____ LOGGED BY RP

FOOTAGE		%	GRAPHIC LOG					%	DESCRIPTION	MINERALIZATION		ALTERATION		STRUCTURE KIND, DENSITY, ETC.	ASSAYS			
FROM	TO		RECOVERY	ROCK TYPE	ALTERATION	MINERALIZED ZONE	STRUCTURE CORE			MOS ₂	VOL. %	MODE OF OCCURRENCE	VOL. %		TYPE MODE OF OCCURRENCE	SAMPLE NO.	%	%
0	5.0	100	D															
								Dacite: Black, sl porphyritic fine grained, hard siliceous fresh	—		—							
5.0	8.0	100	cd															
								Granodiorite: grey to pink Coarse grained, fresh Strong banded contact with a base dacite	—		—							
8.0	12.4	100	A															
								Andesite: Dark green, med. hard Fine grained. Flow banding along and up to 26° to core axis last 1 meter rusty broken core					Slight pervasive chloritization.					
12.4	15.5	100	RH															
								Rhyolite Lapilli Truffi light grey green to pink clasts: Rhyolite and base (to 8 cm) plg crystals Matrix: fg, gr, kg, r, p, s moderate to very hard					Sl aug to sl silicified					
15.5	16.3	100	R															
								Rhyolite: grey to lavender Distinctive radiating sprays of elongate fibrous phalacofits (white) in fine grained siliceous (lavender) colored matrix. Dotted with tiny Hard siliceous, matrix to fine grained	—		—							

KERR ADDISON MINES LIMITED

DDH No. Y5-86-08 PAGE 2 of 4
 CORE SIZE _____ FINAL DEPTH _____
 STARTED _____ FINISHED _____

SAID THE PROPERTY-Y10
 1986 DIAMOND DRILLING

LATITUDE _____ DEPARTURE _____
 DIP AT COLLAR _____ BEARING _____
 COLLAR ELEV. _____ LOGGED BY _____

FOOTAGE		%	GRAPHIC LOG					%	DESCRIPTION	MINERALIZATION		ALTERATION		STRUCTURE	ASSAYS	
FROM	TO	RECO-VERY	ROCK TYPE	ALTERATION	MINERALIZED ZONE	STRUCTURE TO CORE	MOS ₂	VOL. %		MODE OF OCCURRENCE	VOL. %	TYPE MODE OF OCCURRENCE	KIND, DENSITY, ETC.	SAMPLE NO.	%	%
16.3	20.7	90	Rt Rt						Rhyolite lapilli Tuff and Rhyolite Tuff green to grey very brecciated core			slight argillization				
20.7	28.5		Rt Rt						Rhyolite Lapilli Tuff & Rhyolite Tuff/Breccia: - Lt grey to lavender to light yellow - Clasts are very finely banded rhyolite in siliceous matrix - Clasts become progressively more rounded down hole culminating in dense brecciated fine grained banded rhyolite. Massive, very hard	—	—					
29.5	37.0		Gd						Grauwolonite: Dark grey green Massive, coarse grained Not of fine healed fracture with chlorite and epidote 31.1-33.1 bleached to very micaceous slightly argillized	—	—	sl. epidotization and chloritization				
37.0	46.2		Rt						Rhyolite lapilli Tuff: green to rusty yellow Rhyolite with some very coarse feld Xls (2 cm) 34.7-46.2 - green to red - sericitic epidotized patchy silicification hematitic, no ataxen	—	—	local sericitization and silicification				

KERR ADDISON MINES LIMITED
SAID THE PROPERTY-Y10

1986 DIAMOND DRILLING

DDH No. YS-86-08 PAGE 3 of 4

CORE SIZE _____ FINISHED _____

STARTED _____ FINISHED _____

LATITUDE _____ DEPARTMENT _____

DIP AT COLLAR _____ BEARING _____

COLLAR ELEV. _____ LOGGED BY _____

FOOTAGE		%	GRAPHIC LOG					%	DESCRIPTION	MINERALIZATION		ALTERATION			STRUCTURE		ASSAYS																																																																																																																																																																																												
FROM	TO	RECOVERY	ROCK TYPE	ALTERATION	MINERALIZED ZONE	STRUCTURE TO CORE	MDS ₂	VOL. %		MODE OF OCCURRENCE	VOL. %	TYPE	MODE OF OCCURRENCE	KIND, DENSITY, ETC.	SAMPLE NO.	%	%																																																																																																																																																																																												
46.2	58.6	100	Gd						Granodiorite: grey green coarse grained minor Qtz and calcite veining Herakite fractures			mod sericitization and epidotization along fractures																																																																																																																																																																																																	
58.6	58.8								Feldspar porphyry Crystal Tuff with pink green 20% feld crystals to 5mm one large XII - 25mm			slight sericitization																																																																																																																																																																																																	
58.8	79.0		Rt						Rhyolite tuff: Patchy bleached/musty Intensely argillized scattered Qtz v. (see samples) soft broken core																																																																																																																																																																																																				
										<table border="1"> <thead> <tr> <th colspan="10">SAMPLES</th> </tr> <tr> <th>INTERVAL</th> <th>Rec %</th> <th colspan="3">Alteration</th> <th colspan="3">Mineralization</th> <th>Sample #</th> <th>g/g</th> <th>Au</th> </tr> <tr> <td></td> <td>%</td> <th>Arg²</th> <th>S.1.5</th> <th>Serⁿ</th> <th>QV %</th> <th>Calc Vn</th> <th>Mn Py Rhod.</th> <th>#</th> <th>ppm</th> <th>ppb</th> </tr> </thead> <tbody> <tr> <td>YS</td> <td></td> <td></td> <td></td> <td></td> <td></td> <td></td> <td></td> <td></td> <td></td> <td></td> </tr> <tr> <td>58.8-60.4</td> <td>100</td> <td>St</td> <td>x</td> <td>✓</td> <td>5</td> <td>x</td> <td>✓ x</td> <td>08-01</td> <td>0.8</td> <td>45</td> </tr> <tr> <td>60.4-61.9</td> <td>100</td> <td>Int</td> <td>x</td> <td>x</td> <td>3</td> <td>✓</td> <td>✓ x</td> <td>08-02</td> <td>0.7</td> <td>45</td> </tr> <tr> <td>61.9-63.4</td> <td>100</td> <td>St</td> <td>x</td> <td>✓</td> <td>5</td> <td>✓</td> <td>✓ x</td> <td>08-03</td> <td>0.5</td> <td>45</td> </tr> <tr> <td>63.4-64.9</td> <td>70</td> <td>Int</td> <td>x</td> <td>x</td> <td>7</td> <td>✓</td> <td>✓ ✓</td> <td>08-04</td> <td>0.8</td> <td>45</td> </tr> <tr> <td>64.9-66.4</td> <td>80</td> <td>Int</td> <td>x</td> <td>x</td> <td>7</td> <td>x</td> <td>✓ x</td> <td>08-05</td> <td>1.3</td> <td>360</td> </tr> <tr> <td>66.4-68.0</td> <td>80</td> <td>St</td> <td>x</td> <td>x</td> <td>3</td> <td>✓</td> <td>✓ x</td> <td>08-06</td> <td>2.2</td> <td>30</td> </tr> <tr> <td>68.0-69.5</td> <td>100</td> <td>Int</td> <td>x</td> <td>x</td> <td>1</td> <td>x</td> <td>✓ x</td> <td>08-07</td> <td>1.2</td> <td>5</td> </tr> <tr> <td>69.5-71.0</td> <td>100</td> <td>St</td> <td>x</td> <td>x</td> <td>2</td> <td>x</td> <td>✓ x</td> <td>08-08</td> <td>2.6</td> <td>10</td> </tr> <tr> <td>71.0-72.5</td> <td>100</td> <td>Int</td> <td>x</td> <td>x</td> <td>2</td> <td>x</td> <td>✓ x</td> <td>08-09</td> <td>0.9</td> <td>45</td> </tr> <tr> <td>72.5-74.1</td> <td>95</td> <td>Int</td> <td>✓</td> <td>x</td> <td>5</td> <td>x</td> <td>✓ x</td> <td>08-10</td> <td>0.7</td> <td>45</td> </tr> <tr> <td>74.1-75.6</td> <td>95</td> <td>Int</td> <td>x</td> <td>✓</td> <td>3</td> <td>✓</td> <td>✓ x</td> <td>08-11</td> <td>0.6</td> <td>45</td> </tr> <tr> <td>75.6-77.1</td> <td>95</td> <td>Int</td> <td>x</td> <td>x</td> <td>1</td> <td>x</td> <td>✓ x</td> <td>08-12</td> <td>2.5</td> <td>45</td> </tr> <tr> <td>77.1-78.6</td> <td>90</td> <td>Int</td> <td>x</td> <td>x</td> <td>1</td> <td>x</td> <td>✓ x</td> <td>08-13</td> <td>1.8</td> <td>45</td> </tr> </tbody> </table>										SAMPLES										INTERVAL	Rec %	Alteration			Mineralization			Sample #	g/g	Au		%	Arg ²	S.1.5	Ser ⁿ	QV %	Calc Vn	Mn Py Rhod.	#	ppm	ppb	YS											58.8-60.4	100	St	x	✓	5	x	✓ x	08-01	0.8	45	60.4-61.9	100	Int	x	x	3	✓	✓ x	08-02	0.7	45	61.9-63.4	100	St	x	✓	5	✓	✓ x	08-03	0.5	45	63.4-64.9	70	Int	x	x	7	✓	✓ ✓	08-04	0.8	45	64.9-66.4	80	Int	x	x	7	x	✓ x	08-05	1.3	360	66.4-68.0	80	St	x	x	3	✓	✓ x	08-06	2.2	30	68.0-69.5	100	Int	x	x	1	x	✓ x	08-07	1.2	5	69.5-71.0	100	St	x	x	2	x	✓ x	08-08	2.6	10	71.0-72.5	100	Int	x	x	2	x	✓ x	08-09	0.9	45	72.5-74.1	95	Int	✓	x	5	x	✓ x	08-10	0.7	45	74.1-75.6	95	Int	x	✓	3	✓	✓ x	08-11	0.6	45	75.6-77.1	95	Int	x	x	1	x	✓ x	08-12	2.5	45	77.1-78.6	90	Int	x	x	1	x	✓ x	08-13	1.8	45
SAMPLES																																																																																																																																																																																																													
INTERVAL	Rec %	Alteration			Mineralization			Sample #	g/g	Au																																																																																																																																																																																																			
	%	Arg ²	S.1.5	Ser ⁿ	QV %	Calc Vn	Mn Py Rhod.	#	ppm	ppb																																																																																																																																																																																																			
YS																																																																																																																																																																																																													
58.8-60.4	100	St	x	✓	5	x	✓ x	08-01	0.8	45																																																																																																																																																																																																			
60.4-61.9	100	Int	x	x	3	✓	✓ x	08-02	0.7	45																																																																																																																																																																																																			
61.9-63.4	100	St	x	✓	5	✓	✓ x	08-03	0.5	45																																																																																																																																																																																																			
63.4-64.9	70	Int	x	x	7	✓	✓ ✓	08-04	0.8	45																																																																																																																																																																																																			
64.9-66.4	80	Int	x	x	7	x	✓ x	08-05	1.3	360																																																																																																																																																																																																			
66.4-68.0	80	St	x	x	3	✓	✓ x	08-06	2.2	30																																																																																																																																																																																																			
68.0-69.5	100	Int	x	x	1	x	✓ x	08-07	1.2	5																																																																																																																																																																																																			
69.5-71.0	100	St	x	x	2	x	✓ x	08-08	2.6	10																																																																																																																																																																																																			
71.0-72.5	100	Int	x	x	2	x	✓ x	08-09	0.9	45																																																																																																																																																																																																			
72.5-74.1	95	Int	✓	x	5	x	✓ x	08-10	0.7	45																																																																																																																																																																																																			
74.1-75.6	95	Int	x	✓	3	✓	✓ x	08-11	0.6	45																																																																																																																																																																																																			
75.6-77.1	95	Int	x	x	1	x	✓ x	08-12	2.5	45																																																																																																																																																																																																			
77.1-78.6	90	Int	x	x	1	x	✓ x	08-13	1.8	45																																																																																																																																																																																																			

KERR ADDISON MINES LIMITED

SAID THE PROPERTY-Y10

1986 DIAMOND DRILLING

DDH No. YS-86-08 PAGE 4 of 4

CORE SIZE _____ FINAL DEPTH _____

STARTED _____ FINISHED _____

LATITUDE _____ DEPARTURE _____

DIP AT COLLAR _____ BEARING _____

COLLAR ELEV. _____ LOGGED BY _____

FOOTAGE		%	GRAPHIC LOG					%	DESCRIPTION	MINERALIZATION		ALTERATION		STRUCTURE	ASSAYS		
FROM	TO	RECO-VERY	ROCK TYPE	ALTERATION	MINERALIZED ZONE	STRUCTURE TO CORE	MOS ₂	VOL. %		MODE OF OCCURRENCE	VOL. %	TYPE MODE OF OCCURRENCE	KIND, DENSITY, ETC.	SAMPLE NO.	%	%	
79.0	80.2	100	A	Ang					Andesite: Feldspar porphyritic K-feldspar to warty very broken core No veining.			Moderate					
80.2	81.7	95	A	Ang					Andesite: Dark green, warty Fine grained. Shedding 10° to 30° Badly broken dirty core.			Moderate					
81.7	88.6	95	RT						Rhyolite tuff: light green to warty broken to muddy core No veining			Slight to moderate					
----- END of HOLE -----																	

APPENDIX II
STATEMENT OF COSTS

PROSPECTING

Labor (days)	Office	Field	Travel	Total		
R. Potter, Geologist RR 1 Fulford Harbor B.C. V0S 1C0	2	3	1	6		
		6 days @ \$176/day				\$1056.
L. Lyons Geologist 3685 W. 11th Ave Vancouver, B.C.	-	3	-	3		
		3 days @ \$150/day				<u>450.</u>
						\$1506.00
Helicopter - Frontier Helicopters Hughes 500 D		1 hr @ \$440 Fuel				530.00
Food and accommodation: 6 man days @ \$30.00						180.00
Samples:						
Analyses :	Chemex Labs Ltd. 212 Brooksbank Ave. North Vancouver, B.C.					
Preparation	\$3.75, Au \$6.50, Ag \$2.10					
21 samples @ \$12.35						\$259.35
Shipping						<u>65.00</u>
						<u>324.00</u>
						Total Prospecting \$2540.00

DIAMOND DRILLING

Total cost of 1986 drilling program on Said The property	- \$140,025.00	
Portion assigned to assessment requirements of Botwat claims	- \$6,000.00	\$6000.00
		Total cost - Botwat 1986 \$8540.00

APPENDIX III

SAMPLE PREPARATION AND ANALYSES

All samples of drill core were sent to Chemex Labs Ltd. of North Vancouver, B.C. for treatment by the following procedures:

Sample preparation:

Dry, crush entire sample in two stages using jaw and cone crushers, subsample and pulverize using a rotary grinder. Screen sample to -140 mesh and examine screen for metallics. If metallics are present, they are analyzed separately, otherwise the +140 mesh fraction is hand pulverized and homogenized with the original sample.

Cost per sample - \$3.75

Analyses:

Gold: Fire assay, atomic absorption
Detection limit 5 ppb.

Cost per sample - \$6.50

Silver: Nitric-aqua regia digestion
Analysis, atomic absorption
Detection limit 0.1 ppm

Cost per sample - \$2.10

APPENDIX IV

STATEMENT OF QUALIFICATIONS

I, Robert Potter, am a Professional Engineer registered with the Association of Professional Engineers of British Columbia. (#7650).

I have 22 years of experience in Mineral Exploration mainly in the Canadian Cordillera. I directed and took part in the 1986 program on the Botwat and on the Said The Claims.

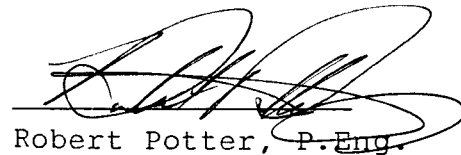

Robert Potter, P.Eng.

APPENDIX V

SELECTED REFERENCES

- Main, C.A., 1985 Geology and Geochemical Survey
Botwat 1-64 claims, Whitehorse
Mining District, Yukon Territory.
- Pride, Monica J., 1985 Preliminary Geological Map of Mount
Skukum Volcanic Complex.
105 D/2,3,4,5; 1:25000 Scale Map
D.I.A.N.D. Open File.
- Wheeler, J.O., 1961 Whitehorse Map Area, Yukon
Territory, 105 D. G.S.C.
Memoir 312.