

**091883**  
1986 DRILLING REPORT  
on the  
SAID/THE CLAIMS  
WHITEHORSE MINING DIVISION  
NTS - 105 D 5  
60°16'N, 135°27'W



For:

Kerr Addison Mines Ltd.  
703 - 1112 W. Pender Street  
Vancouver, B.C.  
V6E 2S1

By:

Robert Potter, P.Eng.  
Vancouver, B.C.  
November 1, 1986

Program June 26 to July 26, 1986

**091883**

## TABLE OF CONTENTS

	<u>Page</u>
1. Summary	1
2. Location and Access	2
3. Legal Description	3
4. Physiogrpahy and Vegetation	3
5. History	3
6. Geology	4
7. 1986 program	7

## APPENDICES

- I. Drill Logs
- II. Statement of Costs
- III. Sample Preparation and Analyses
- IV. Statement of Qualificatons
- V. Selected References

## ILLUSTRATIONS

- Figure 1. Location Map
- 2. Property Map
- 3. Drilling and Geology 1:5000
- 4. Drilling and Geology - Northeast Zone 1:1000
- 5. Section AA' Holes 1
- 6. Section BB' Hole 2
- 7. Section CC' Hole 3
- 8. Section DD' Hole 4
- 9. Section EE' Holes 5,6,8
- 10. Section FF' Holes 7,9

## 1. SUMMARY

During the period June 26 to July 26, 1986, Kerr Addison Mines Ltd. drilled a total of 905 meters of BQ core on the Said and The claims. Drilling was laid out to investigate the occurrence of quartz veins and associated precious metals along a major fault within the Eocene Mount Skukum Volcanic Complex. Quartz vein material along this feature shows textures indicative of emplacement at high levels of an epithermal system.

At Southwest Zone four holes intersected strong southerly dipping shears. Minor quartz veining here does not differ materially from that found on surface. The gold content of the sheared volcanics is generally less than 5 ppb. The best quartz vein sample returned 30 ppb Au.

The subcrops at Northeast Zone include quartz rich material characterized by banded chalcedony, open space textures, fluorite molds, and fine grained amethyst. The gold content of surface samples ranged up to 6450 ppb.

Five holes drilled at Northeast Zone show a complex fault structure, the south flank of which hosts the quartz veins. Textures are similar to those found on surface. The highest gold value obtained was 360 ppb.

Drilling has confirmed the presence of a major structure at Said The. Any economic potential of this structure will however be well below the  $\pm$  100 meter depths tested by the 1986 program.

A handwritten signature in black ink, appearing to be 'L. H. H.', located at the bottom right of the page.

## 2. LOCATION AND ACCESS (Figure 1)

The Said and The claims are located approximately 56 km southwest of Whitehorse and 10 km northeast of the Mt. Skukum Mine within NTS sheet 105 D 5/ Geographic co-ordinates are 60°16'N and 135°27'W.

During the summer of 1986 helicopter access was available from a base on the Wheaton River about 12 km southeast of the property. The Wheaton River valley is accessible from Whitehorse via the Alaska and Carcross highways and the Annie Lake road. Recent upgrading of the Annie Lake road has reduced the driving time from Whitehorse to about 1 hour.

## 3. LEGAL DESCRIPTION (Figure 2)

The property comprises a contiguous block of 39 Said and 56 The claims located in the Whitehorse Mining Division.

### List of Claims

<u>Name</u>	<u>Record Number</u>	<u>Record Date</u>
Said 1-16	YA77877-892	July 28, 1983
Said 17-23	YA92024-030	August 14, 1985
Said 24-35	YA93522-533	September 12, 1985
Said 1F-3F	YA92021-023	August 14, 1985
Said 4F	YA93534	September 12, 1985
The 1-48	YA77925-972	July 28, 1983
The 49	YA93036	August 14, 1985
The 1F-5F	YA93031-035	August 14, 1985
The 6F,7F	YA93687-688	August 14, 1985

The Said and The claim block is bounded on the south by the Kuku claims (Erickson Mt. Skukum property) on the north and west by the Botwot claims (Rockridge Mines) and on the east by the Stone claims (independent stakers).

(Joins St. Elias)

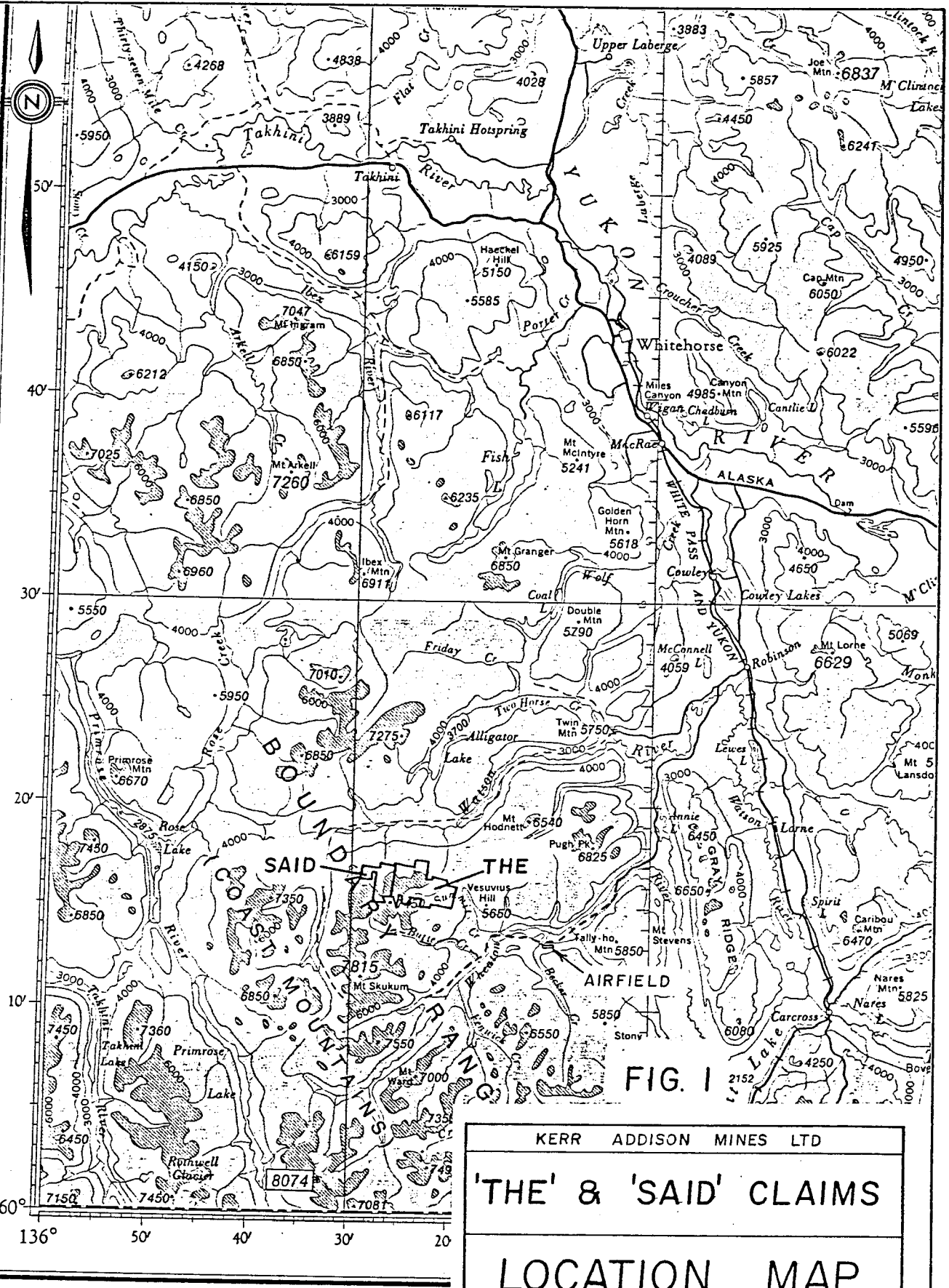

FIG. 1

KERR ADDISON MINES LTD	
'THE' & 'SAID' CLAIMS	
LOCATION MAP	
SCALE - 1 : 500 000	DATE - OCT. , 1985
DRAWN BY : P.H.	DATA - J.P.
NTS - 105 D	REVISED -

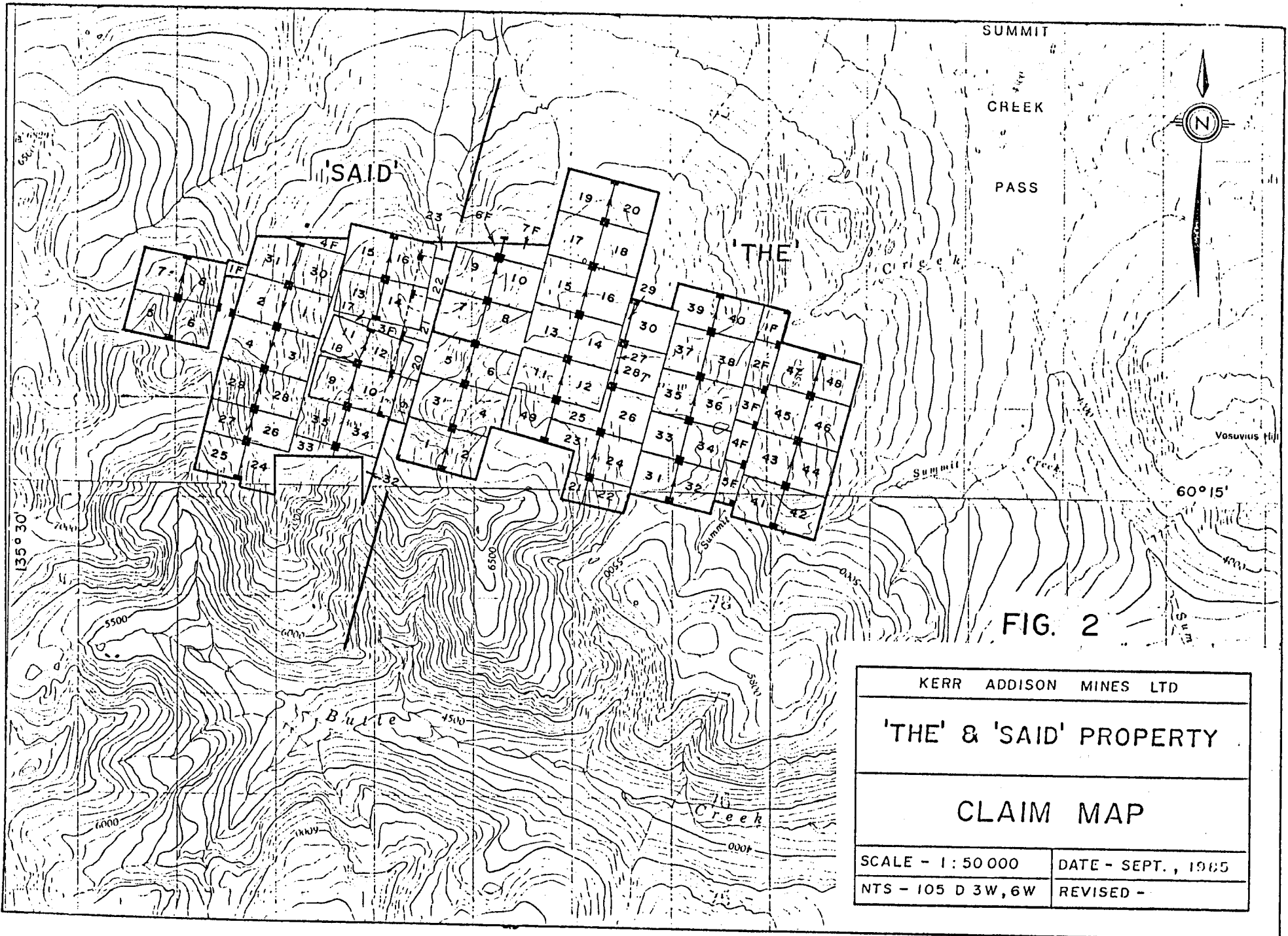

FIG. 2

KERR ADDISON MINES LTD	
'THE' & 'SAID' PROPERTY	
CLAIM MAP	
SCALE - 1 : 50 000	DATE - SEPT. , 1985
NTS - 105 D 3W, 6W	REVISED -

The registered owner of the subject property is AGIP Canada Ltd. of Calgary, Alberta. The claims are currently under option to Kerr Addison Mines Ltd. of Vancouver, B.C.

Grouping notices and statements of exploration work were filed in Whitehorse on July 28, 1986. This report documents the work filed at that time.

#### 4. PHYSIOGRAPHY AND VEGETATION

The Said The property is situated within the Boundary Ranges of the Coast Mountain System of the southwestern Yukon. Local topography is characterized by moderate to precipitous north aspect slopes and cirque basins. Elevations range from 1450 to 2250 meters.

The entire property is above tree-line with vegetation largely limited to alpine grass and mosses. Willow and dwarf birch cover the lowest slopes.

#### 5. HISTORY

Reconnaissance prospecting and geochemistry were carried out by AGIP Canada Ltd. over the Mt. Skukum volcanic area in 1980 and 1981. Recognition of significant gold mineralization at what is now the Mt. Skukum Mine led to staking which included the Said and The claims in 1983.

Late in 1984 the property was optioned to Kerr Addison Mines Ltd.

In 1985 Kerr Addison carried out a two phase program at Said The. Phase 1 consisted of property-wide geochemical and geological surveys. Phase 2 comprised detailed studies of the central area of interest including geology, geochemistry, VLF and trenching.

The results of the Kerr studies are documented in assessment reports by J. Pautler and J. Nelson dated October 1985. Recommendation arising from the conclusions of the 1985 work included the diamond drilling program which is the subject of the present report.

## 6. GEOLOGY

The Said and The claims cover an area along the northern edge of the Mt. Skukum Volcanic Complex. The Mt. Skukum volcanics were developed in Eocene time over a basement of Yukon Group metasediments and Cretaceous granitic rocks. Regional geology is detailed in G.S.C. Memoir 312 by J.O. Wheeler. The Mt. Skukum Volcanic Complex has been mapped by Monica Pride on a scale of 1:25000 (D.I.A.N.D. Open File).

The general sequence of lithologies underlying Said The is as follows:

### Cretaceous:

GDi-QM      Biotite hornblende granodiorite to quartz monzonite intrusions. Medium to coarse grained, equigranular. Age implied by similarities to dated intrusions in the S.W. Yukon. Exposed at low elevations along northern edge of claims.

### Eocene:

Cgl              Conglomerate of andesitic matrix with clasts of quartz monzonite. Represents erosional surface between andesites and older intrusives. (Corresponds to Fm 1 of Pride).

Rt                Felsic sequence comprising rhyolitic to rhyodacitic pyroclastic rocks and related epiclastics. Unit includes the welded tuffs and crowded tuffs which are prominent under the northeastern Said and northern The claims. (Fm 2 of Pride).

- Ivs Intermediate sequence including andesitic to dacitic flows, tuffs, lapilli tuffs and agglomerates. Minor rhyodacite and epiclastic rocks occur with this unit. The sequence is exposed within the west and southwest Said claims and to the east along the southern edge of The claims. (Fm 3 of Pride).
- Rf1 Rhyolite to rhyodacite with rare dacite. Typically flow banded and spherulitic. Occurs under the southeast and northwest corners of the property. (Fm 4 of Pride).
- Al Alaskite pluton intruding the volcanic rocks along the southern edge of the claims. This unit is fine to medium grained, equigranular to quartz feldspar porphyritic. Rare biotite.
- Rdy, Tdy, Ady Rhyolite, trachyte and andesite dykes which cut all of the older units. Aphanitic to porphyritic. The rhyolite dykes show similarities of texture and lithology to the alaskite which suggests a genetic relationship.

The volcanic sequence has been disrupted by major vertical movement along northerly and northeasterly trending faults.

Within the central area of interest the units represented are Rt and Ivs. Steep local contacts between these have been interpreted as block faults. Several zones of quartz veining and brecciated silicified wall rock have been delineated along a 60° trend over a 3 km strike length. These zones are localized in or adjacent to fault contacts between Ivs and Rt units.

### Northeast Zone

A 60° trending fault zone between andesite flows of the Ivs unit and welded rhyolite lapilli tuffs of the Rt unit is expressed by a slight depression filled with argillized volcanics and quartz vein rubble. The quartz rich material is characterized by banded chalcedony, open space textures, fluorite molds and fine grained amethyst. Analyses of twenty-eight rock samples collected here in 1985 give a scattering of anomalous values with a high of 6450 ppb.Au.

### Central Zone

Downslope debris from a snow covered area on strike with NE zone shows characteristics similar to material from the latter. An extension of the NE zone structure and veining is inferred. Samples of quartz rich material returned values up to 25 ppb Au.

### Southwest Zone

Quartz vein rubble and argillized volcanic rock occur along linear trends within an 800 by 800 meter area at southwest zone. The area is underlain by felsic pyroclastics and epiclastics of unit Rt. Gold values from quartz material range up to 540 ppb.

### Far Southwest Zone

The bounding fault between Ivs and Rt hosts quartz veins and silicified quartz breccia. Values of 7900 ppb Au and 53 ppm Ag were obtained from samples collected here in 1985.

## 7. 1986 DIAMOND DRILLING (Figure 3, 4)

During the period June 26 to July 26, 1986, a total of 905 meters of BQ core was drilled on the Said The property. Drilling was carried out by Drilcor Industries Limited of Delta, B.C. Logistic support was provided by Frontier Helicopters with a Hughes 500D aircraft operating out of the Wheaton River base.

Drill core was logged and sampled on site by Kerr Addison personnel. Split core samples were sent to Chemex Labs Ltd. of North Vancouver, B.C. for processing according to the procedures outlined in Appendix III. Holes were numbered in the series DDH-YS-86-01 to 09.

Figure 3 shows the location of all drill holes and traces of vertical sections in relation to property geology. Figures 5 to 10 are vertical sections showing summarized geology and sample results. Drill logs are included in Appendix I.

Drill core was stored on the property following completion of the program.

### 7.1 SOUTHEST ZONE (Figures 5, 6, 7).

Holes 1, 2 and 3 were located to intersect downdip extensions of quartz vein rubble and argillized rhyolitic tuffs. All three reached their intended targets but very little quartz veining was found within intensely sheared and argillized fault structures. The two structures intersected by both holes 1 and 2 dip steeply to the south. Most samples from these returned less than 5 ppb Au. A sample of vuggy quartz vein material from hole 2 returned the highest value of 30 ppb.

Summary Logs from Southwest Zone:

DDH YS-86-01

Location 11+00N, 3+89W

Az 137° Dip -45° Depth 141.4 m.

		Sample Number	Interval (meters)	Au (ppb)
0-3.1 meters	surface rubble:	YS-01		
31.-7.7	Andesite dyke:			
7.7-21.0	Rhyolite lapilli tuff: moderate to strong argillization	-03	14.3-15.5	<5
21.0-29.2	Rhyolite lapilli tuff: Fresh			
29.2-33.8	Rhyolite lapilli tuff: moderate to intense argillization	-04	26.3-29.2	<5
	approx. 5% qtz veins	-01	29.2-31.1	<5
		-02	31.1-33.8	<5
33.8-36.9	Rhyolite lapilli tuff: Fresh			
36.9-43.8	Tuffaceous sediments:			
43.8-79.8	Interbedded andesite, dacite and rhyolite tuffs. Relatively fresh no veining			
79.8-83.1	Rhyolite/Dacite breccia	16	79.8-81.4	5
	void filling of opaline quartz	17	81.4-83.1	<5
83.1-102.7	Tuffaceous sediments: minor rhyolite tuff	05	93.8-95.3	<5
102.7-118.5	Altered zone:	06	103.5-105.8	5
	argillized rhyolite tuffs	07	105.8-107.3	<5
	conspicuous pyrolusite and rhodochrosite	08	107.3-108.8	<5
		09	108.8-110.3	<5
	No quartz veining	10	110.3-111.9	<5
		11	111.9-113.4	20
		12	113.4-114.9	<5

<u>Interval</u>	<u>Description</u>	<u>Sample Number</u>	<u>Interval (meters)</u>	<u>Au (ppb)</u>
		YS-13	114.9-116.4	<5
		14	116.4-118.0	5
		15	118.0-119.5	<5
118.5-131.7	Rhyolite lapilli tuff: fresh			
131.7-134.4	Tuffaceous sediments:			
134.4-141.4	Rhyolite lapilli tuff and tuff breccia.			
EOH				

- - - - -

DDH-YS86-02

Location 8+00N, 3+75 W

Az: 138°, Dip -55° Length 117.4 m

0-3.1 meters	Surface rubble	YS-02		
3.1-28.3	Rhyolite lapilli tuff: siliceous, fresh			
28.3-42.7	Rhyolite lapilli tuff: sheared, argillized, minor qtz/calc veins. Q.V. 29.2-30.35	01	28.2-29.2	<5
		02	29.2-30.35	30
		03	30.35-32.0	5
		04	32.0-33.5	<5
		05	33.5-35.1	<5
		06	35.1-36.4	<5
		07	36.4-38.1	<5
		08	38.1-39.6	<5
		09	39.6-41.2	<5
		10	41.2-42.7	<5
42.7-53.4	Rhyolite tuff breccia strong argillization, no quartz veining	11	42.7-44.2	<5
		12	44.2-45.7	<5
		13	45.7-47.2	<5
		14	47.2-48.8	<5
		15	48.8-50.3	<5
		16	50.3-51.8	<5
53.4-95.8	Rhyolite tuff and rhyolite lapilli tuff: Fresh			
95.8-117.4	Rhyolite lapilli tuff: intensely sheared and argillized minor fine qtz and calcite veins. conspicuous pyrolusite and rhodochrosite.	17	96.0-92.5	<5
		18	97.5-99.1	<5
		19	99.1-100.6	<5
		20	100.6-102.1	<5
		21	102.1-103.6	<5
		22	103.6-105.2	<5

<u>Interval</u>	<u>Description</u>	<u>Sample Number</u>	<u>Interval (meters)</u>	<u>Au (ppb)</u>
		23	105.2-106.7	5
		24	106.7-108.2	<5
		25	108.2-109.7	<5
		26	109.7-111.3	<5
		27	111.3-112.8	<5
		28	112.8-114.3	<5
		29	114.3-115.8	<5
		30	115.8-117.4	<5

- - - - -

DDH-YS-86-03

Location: 6+30N, 5+45W

Az: 138° Dip -45° Length 71.0 m.

<u>Interval</u>	<u>Description</u>	<u>Sample Number</u>	<u>Interval (Meters)</u>	<u>Ag ppm</u>	<u>Au ppb</u>
0-53.8	Rhyolite lapilli tuff: welded, fresh	YS-03			
53.8-55.8	Rhyolite tuff: fresh				
55.8-58.8	Rhyolite tuff: shattered argillized numerous fine qtz veinlets.	01	55.8-57.3	NS	<5
		02	57.3-58.8	NS	<5
58.8-59.0	Quartz vein: coarse cockscomb texture	03	58.8-59.0	NS	<5
59.0-61.5	Rhyolite lapilli tuff strong to intense argillization	04	59.0-60.4	0.1	<5
		05	60.4-61.5	0.1	<5
61.5-64.7	Rhyolite lapilli tuff: Moderate argillization Scattered fine qtz veins.				
64.7-71.0	Rhyolite lapilli tuff: Fresh				

EOH

- - - - -

7.2 FAR SOUTHEST ZONE (Figure 8)

Trenching on the precipitous slopes at Far Southeast Zone revealed a siliceous rhyolite breccia with strong quartz veining. A sample from the widest part (2.5 meters) returned 1.1 ppm Ag and 890 ppb Au. About 10 meters to the north-west of this a sample across 0.4 meters returned 4.9 ppm Ag and 1200 ppb Au. This vein structure probably extends from the trenched exposure to the sharp ridge about 200 meters to the northeast. At the ridge quartz vein rubble and argillized rhyolite subcrop cover an area 5 x 20 meters.

Hole 4 was drilled from the foot wall side of the vein structure from one of the few available drill sites. For most of its length the hole remained in extremely hard welded rhyolite lapilli tuff. A short section between 128.8 and 132.7 meters was of sheared tuff with minor quartz and calcite veins and traces of pyrite. This may represent the downdip extension of the surface vein but it is likely that the vein is flatter than was expected and was not intersected by this hole.

DDH-YS-86-04      SUMMARY LOG

Location: Southeast ridge

Az: 155°      Dip -45°      Length 142.6 m.

<u>Interval</u>	<u>Description</u>	<u>Sample Number</u>	<u>Interval (Meters)</u>	<u>Ag ppm</u>	<u>Au ppb</u>
0-93.2	Rhyolite lapilli tuff: welded, very hard	YS-04			
93.2-96.5	Andesite dyke				
96.5-128.8	Rhyolite lapilli tuff slight to moderate sericitization and argillization. Minor fine qtz and calcite veins. Trace pyrite.	01	128.8-131.1	0.1	<5
131.1-132.7	Rhyolite lapilli tuff: sheared at 20° to core axis mod to strongly argillized 2% qtz and calcite veins pyrrhotite on fractures	02	131.1-132.7	0.1	<5
132.7-142.6	Rhyolite lapilli tuff: welded, very hard				

EOH

### 7.3 NORTHEAST ZONE (Figures 3, 9, 10)

Five holes were drilled on 2 sections at Northeast Zone. Holes 5, 6 and 8 were located on line 28N (Section EE) to intersect the structure delineated by surface mapping. This drilling shows a steeply dipping zone of shearing fracturing and argillization.

The block of ground north of the fault comprises massive welded rhyolite lapilli tuffs and breccias. (unit Rt). These are cut by trachyte and andesite dykes. The down dropped southern block includes rhyolite and andesite (unit Ivs). Incorporated here are large exotic blocks or fault slices of Cretaceous granodiorite.

The north flank of the fault is a steeply dipping shear about 3 meters wide. The south flank is a zone of shearing and intense argillization about 14 meters wide which appears to extend from the surface rubble zone to the intersection of hole 8. This gives it an apparent dip of about 80° to the south. Broken quartz vein material similar to that found on surface makes up about 5% of the core of hole 8 in this zone.

The block of ground between the two flanking structures comprises volcanics which are well fractured and slightly to moderately argillized.

Sampled core from the holes on line 28N returned very low values in Ag and Au. The best sample was from the south flank intersection of hole 8. Material here with a 7% quartz vein content returned 1.3 ppm Ag and 360 ppb Au.

Holes 7 and 9 were drilled close to line 27N. The section here shows lithologies and structures consistent with those of section 28N. The quartz veining seen at the top of hole 7 is probably from the same southerly dipping structure intersected by hole 8.

Again samples from altered and quartz rich material were disappointingly low. The best sample was from hole 7 with only 0.6 ppm Ag and 25 ppb Au.

The granodiorite intersected at depth in holes 6 and 9 is Cretaceous basement.

Northeast Zone Log Summaries

DDH-YS-86-05

Location: 28+00N, 1+45E

Az: 135° Dip -44° Length 58.8 m

<u>Interval</u>	<u>Description</u>	<u>Sample Number</u>	<u>Interval (Meter)</u>	<u>Ag ppm</u>	<u>Au ppb</u>
0-42.1	Rhyolite lapilli tuff Welded hard, massive	YS-05			
42.1-43.6	Rhyolite lapilli tuff Welded, well fractured				
43.6-47.7	Rhyolite lapilli tuff Intensely argillized and sheared. Minor qtz veinlets, no calcite	01	43.6-45.1	1.2	20
	Pyrolusite common, trace rhodochrosite	02	45.1-47.7	0.1	< 5
47.7-52.6	Rhyolite lapilli tuff: moderately argillized	03	47.7-49.7	0.1	< 5
	minor qtz/calcite veins	04	49.7-51.2	0.1	< 5
	conspicuous pyrolusite and rhodochrosite	05	51.2-52.6	0.1	< 5
52.6-54.6	Andesite dyke:				
54.6-58.6	Feldspar porphyry: Strong to intense argill- ization, manganese minerals conspicuous in fractures minor calcite veining	06	54.6-57.3	0.1	< 5
		07	57.3-58.8	1.9	< 5

EOH

- - - - -

DDH-YS-86-06

Location: 28+00N, 1+25E

Az: 135° Dip -60° Length 146.3 m

<u>Interval</u>	<u>Description</u>	<u>Sample Number</u>	<u>Interval (Meter)</u>	<u>Ag ppm</u>	<u>Au ppb</u>
0-30.4	Rhyolite lapilli tuff: welded, massive, hard	YS-06			
30.4-44.6	Trachyte dyke: porphyritic				
44.6-53.8	Rhyolite lapilli tuff: welded, hard				
53.8-61.4	Feldspar porphyry dyke:				
61.4-75.8	Rhyolite tuff breccia:				
75.8-78.0	Trachyte tuff:				
78.0-119.2	Rhyolite tuff breccia;	01	90.8-92.4	0.1	<5
	Conspicuous fine calcite	02	92.4-93.9	0.1	5
	veining crushed and	03	93.9-95.4	0.1	<5
	sheared core. Moderate	04	95.4-96.9	1.2	<5
	to intense argillization	05	96.9-98.1	0.5	<5
	Conspicuous manganese	06	100.3-102.3	0.4	<5
	minerals. Rare qtz veins	07	107.8-109.1	0.2	<5
	Samples are from sections	08	114.0-115.2	0.9	<5
	of notable alteration and	09	115.2-117.0	2.1	10
	calcite veining	10	117.5-118.5	2.9	65
119.2-127.7	Granodiorite: S1 chloritization and saus <sup>n</sup>	11	125.7-126.4	0.4	5
127.7-139.0	Andesite feldspar porphyry: dyke				
139.0-146.0	Granodiorite	12	139.0-141.1	0.4	<5
	well fractured to shattered	13	141.1-142.6	0.1	<5
	Moderate to intense argill-	14	142.6-144.2	0.1	<5
	ization Conspicuous	15	144.2-146.0	0.1	<5
	manganese minerals				
146.0-146.3	Andesite feldspar porphyry:				

EOH

- - - - -

DDH-YS-86-07

Location: 26+65N, 2+00E

Az: 337° Dip -42° Length 39.0 m

<u>Interval</u>	<u>Description</u>	<u>Sample Number</u> YS-07	<u>Interval (Meter)</u>	<u>Ag ppm</u>	<u>Au ppb</u>
0-12.1	Overburden: granodiorite boulders	01	12.2-15.2	4.1	15
12.1-23.8	Rhyolite lapilli tuff: moderate argillization and silicification. Approx 12% drusy to chalcedonic quartz vein material. No carbonate veins.	01	12.2-15.2	4.1	15
		02	15.2-16.8	1.9	10
		03	16.8-18.3	0.5	5
		04	18.3-19.8	1.0	<5
		05	19.8-21.3	0.6	25
		06	21.3-23.8	1.2	<5
23.8-27.4	Rhyolite lapilli tuff and Rhyolite tuff: moderate to intense argillization -no veining.				
27.4-34.3	Rhyolite lapilli tuff: Silicified, minor quartz veining no carbonates				
34.4-39.0	Rhyolite lapilli tuff: moderate to intense argillization.				

EOH

- - - - -

DDH-YS-86-08

Location: 28+00N, 2+35E.

Az: 315° Dip -61° Length 89.6 m

<u>Interval</u>	<u>Description</u>	<u>Sample Number</u> YS-08	<u>Interval (Meter)</u>	<u>Ag ppm</u>	<u>Au ppb</u>
0-5.0 meters	Dacite:				
5.0-8.0	Granodiorite:				
8.0-12.4	Andesite:				
12.4-28.5	Rhyolite lapilli tuff and minor Rhyolite tuff breccia:				
28.5-37.0	Granodiorite:				
37.0-46.2	Rhyolite lapilli tuff: slight sericitization and silicification				
46.2-58.6	Granodiorite:				
58.6-58.8	Feldspar porphyry				
58.8-79.0	Rhyolite lapilli tuff: Intensely sheared and argillized, about 3% scattered coarse quartz vein material.	01 02 03 04 05 06	58.8-60.4 60.4-61.9 61.9-63.4 63.4-64.9 64.9-66.4 66.4-68.0	0.8 0.7 0.5 0.8 1.3 2.2	< 5 < 5 < 5 < 5 360 30
79.0-81.7	Andesite: well fractured, moderate argillization	07 08 09 10 11	68.0-69.5 69.5-71.0 71.0-72.5 72.5-74.1 74.1-75.6	1.2 2.6 0.9 0.7 0.6	5 10 < 5 < 5 < 5
81.7-89.6	Rhyolite tuff: very broken core, slight to intense argillization	12 13	75.6-77.1 77.1-78.6	2.5 1.8	< 5 < 5

EOH

- - - - -

DDH-YS-86-09

Location: 26+97N, 1+00E

Az: 142° Dip -45° Length 98.8 m

<u>Interval</u>	<u>Description</u>	<u>Sample Number</u> YS-09	<u>Interval (Meter)</u>	<u>Ag ppm</u>	<u>Au ppb</u>
0-18.4	Rhyolite lapilli tuff: welded, hard				
18.4-34.3	Rhyolite tuff breccia: welded, hard				
34.3-37.5	Rhyolite lapilli tuff: welded, hard				
37.5-40.2	Rhyolite tuff:	01	37.5-39.0	5.0	15
		02	39.0-40.2	4.2	<5
40.2-47.0	Rhyolite dyke:				
47.0-58.6	Rhyolite lapilli tuff: slight to strong argillization				
58.6-62.8	Rhyolite tuff: strongly silicified scattered quartz veinlets.				
62.8-65.0	Granodiorite				
65.0-65.3	Rhyolite lapilli tuff: slightly argillized				
65.3-95.3	Granodiorite:				
95.3-98.8	Fault: sheared, crushed intensely argillized.				

EOH

- - - - -

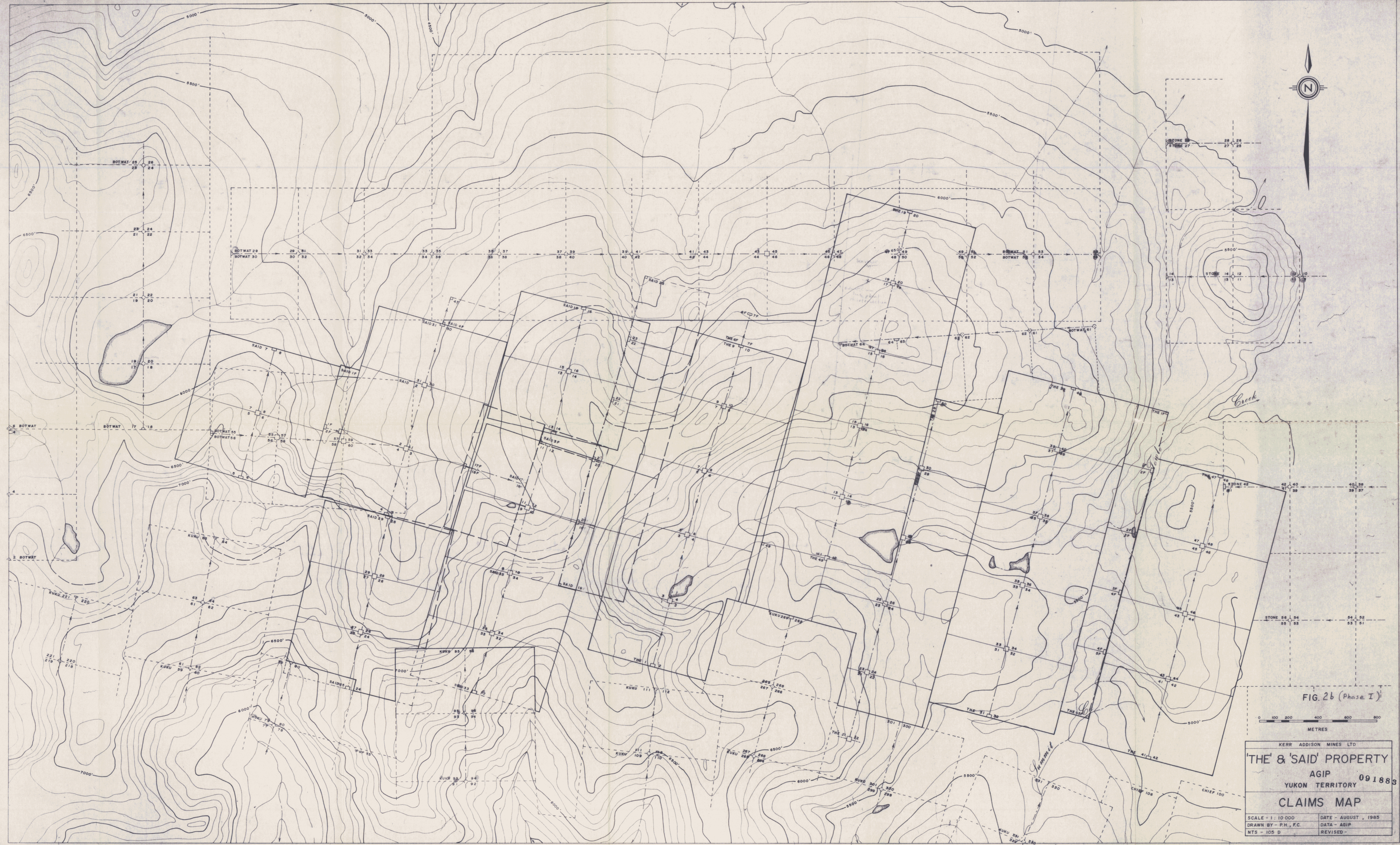
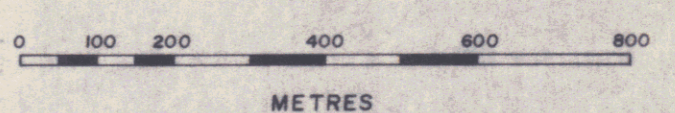

FIG. 2b (Phase I)



KERR ADDISON MINES LTD  
**'THE' & 'SAID' PROPERTY**  
AGIP 091883  
YUKON TERRITORY  
**CLAIMS MAP**  
SCALE - 1 : 10 000  
DRAWN BY - P.H., F.C.  
NTS - 105 D  
DATE - AUGUST, 1985  
DATA - AGIP  
REVISED -

**QUARTZ BOULDER TRAINS**

Sample numbers	Au ppb	Ag ppm	As ppm	Sb ppm	Hg ppb	DESCRIPTION
Y55 M1R	<5	0.3	7	0.4	50	Next to slope break: Quartz breccia, drusy, vein-swarm quartz. Matrix M2R of NE zone, where largest boulders (to 30 cm) have considerable downhill transport.
Y55 M2R	<5	0.4	1	0.4	20	Quartz breccia; largest boulders (10-30 cm) at north end of train; abundant smaller material to south (uphill).
Y55 M3R	<5	0.5	4	0.5	40	Quartz breccia, drusy and vein-swarm quartz. About 25-50 cm quartz boulders; considerable downhill transport.
Y55 M4R	480	0.3	3	0.2	70	Quartz breccia, vein-swarm and drusy quartz (to 20 cm), highest density to SE - considerable downhill transport.
Y55 M5R	<5	0.2	2	0.1	50	Swarm of quartz veinlets in bleached argillized apron - clear tuff; quartz breccia to 30 cm. S5R, S6R represent densely concentrated float, overall trace 200 m.
Y55 M6R	<5	0.1	3	0.2	50	Vein-swarm and drusy quartz in linear topographic depression, most <10 cm.
Y55 M7R	<5	0.4	1	0.2	70	Quartz breccia with drusy quartz in linear topographic depression, most <10 cm.
Y55 M8R	<5	0.2	7	0.1	30	A few quartz streakwork; quartz breccia with drusy quartz, pieces up to 25 cm strong downhill transport.
Y55 M9R	<5	0.2	4	0.3	40	Cobble quartz, drusy quartz to 20 cm, strongly anomalous NNW trend, intersecting M7R and S2R.
Y55 M10R	<5	0.6	5	0.3	40	Parallel to and in the same altered zone as M7R; vein-swarm quartz.
Y55 S2R	100	0.8	4	0.4	30	Like S2R; at edge of altered zone.
Y55 S4R	190	1.8	3	0.2	30	Quartz breccia to 10 cm; in area of low fracture density, no alteration.
Y55 S7R	200	1.6	9	0.4	30	Indistinct train, perhaps from NNW trending pod at upper edge of alteration; sparse quartz breccia to 20 cm.
Y55 S8R	40	0.3	2	0.2	30	Quartz breccia to 10 cm.
Y55 S9R	<5	0.1	2	0.2	30	Quartz breccia to 10 cm.

**ALTERATION SAMPLES**

Sample	Al	Fe	Ca	Mg	Si
Y55 M5R	<5	0.1	1	0.2	30
Y55 M1R	10	0.1	2	0.1	30
Y55 M12R	105	0.1	1	0.2	30
Y55 M13R	10	0.1	1	0.2	30
Y55 M14R	<5	0.1	2	0.2	30
Y55 M15R	<5	0.1	2	0.1	30
Y55 M16R	<5	0.2	6	0.3	30
Y55 M17R	<5	0.1	—	—	—
Y55 M18R	<5	0.7	—	—	—
Y55 M19R	5	0.1	1	0.2	30
Y55 M20R	<5	0.1	—	—	—

**NE ZONE**

SAMPLE No.	Au ppb	Ag ppm	As ppm	Sb ppm	Hg ppb	DESCRIPTION
Y55 N11R	10	0.6	5	0.3	40	Silicified, argillized rhyolite breccia, sampled area 5 x 5 m.
Y55 N12R	5	0.4	4	0.5	40	Silicified boulders in argillized rhyolite breccia in 10 x 10 m area.
Y55 N25R	10	0.2	9	0.2	30	Bleached trachyte dyke with quartz veinlets.
Y55 N27R	5	0.5	3	0.1	30	1 cm open space quartz veins in sheared purple rhyolite tuff breccia.

**CENTRAL ZONE**

SAMPLE No.	Au ppb	Ag ppm	As ppm	Sb ppm	Hg ppb	DESCRIPTION
Y55 N33R	<5	0.3	2	0.2	40	Quartz - streakwork pebbles in light green sericite-quartz altered andesite.
Y55 N21R	25	0.9	3	0.1	30	Quartz breccia (silicified andesite clasts); matrix coarse quartz with secondary features. Boulders to 50 cm, below snowline.
Y55 N22R	15	0.3	3	0.1	30	Quartz breccia boulders like N21R, to 30 cm; fluorite matrix, train emerges from snowbank above.
Y55 N23R	15	0.2	3	0.1	30	High fracture density andesite flow in frontbank with pebbles of greenish vein quartz to 5 cm.
Y55 N24R	10	0.3	3	0.1	20	Clips of seven quartz breccia boulders to 10 cm, float from above (same as C18R).
Y55 N26R	5	0.1	7	0.2	40	1 cm quartz veins in trachyte dyke subcrop; vein in 10% matrix.
Y55 C18R	25	0.1	1	0.1	—	Quartz breccia float to 15 cm from under snowbank. Like N21, 22R.



**FAR SW ZONE**

SAMPLE No.	Au ppb	Ag ppm	As ppm	DESCRIPTION
Y55 N5R	7900	55.0	—	Composite grab 1 x 5 m quartz vein + py, trace galena.
Y55 N6R	290	1.3	—	Resonance quartz, red Jasper, orange chlorite; float to 10 cm.
Y55 N7R	45	0.1	—	Calcium quartz, red Jasper, orange chlorite; float to 10 cm.
Y55 N8R	25	0.7	—	Quartz vein float to 3 cm.
Y55 N9R	85	0.4	—	Vein-breccia zone in gully, pale green host col by red Jasper veinlets.
Y55 N10R	100	0.1	—	Greenish green sericite altered felsic breccia, coarse quartz; float sample.
Y55 J4R	85	0.9	—	50 m wide subcrop-vein argillized Rt.; stragglers with brecciated silicified host (to 30 cm).
Y55 J6R	2500	4.5	—	Qtz-breccia float as J5R, to 10 cm. From 20 x 10 m area.

**GEOLOGY**

**Eocene**

- Tdy: Dykes: Trachyte, Rhyolite, Andesite, Diorite.
- Rf: YOUNGER FELSIC UNIT
- Rf1: Rhyolite flows, commonly flow-laminated, may contain abundant large spherulites.
- Ivs: INTERMEDIATE VOLCANIC-EPICLASTIC SUITE
- Taf: Trachyandesite flows: green with plagioclase phenocrysts.
- Tafv: Trachyandesite flow breccia: ss above but brecciated with porphyritic matrix.
- Df: Basalt flows: dark-purple glassy flows with sparse plagioclase phenocrysts.
- Taf: Trachyandesite tuffs.
- ss: Epiclastic sediments: green, finely laminated, contain rhyolite and trachyandesite debris.
- Rt: OLDER FELSIC PYROCLASTIC SUITE
- U: UPPER MEMBER
- Rbv: Dense-clast bedded rhyolite breccia: lahar or fluxoturbidite.
- Res: Laminated rhyolitic epiclastic sediments.
- L: LOWER MEMBER
- Rt: Purple rhyolite welded tuff breccia: characteristically contains flattened ash fragments, sparse granodiorite clasts.
- Rt: Purple rhyolite welded lithic tuff.
- Riapt: Green sparse-clast rhyolite unwelded lapilli or lithic tuff: characteristically contains sparse granodiorite clasts.

**MESOZOIC**

- MGD: Granodiorite: coarse grained equigranular.

**PALEOZOIC**

- Pamph: Amphibolite of the Yukon Crystalline Terrane.

**SYMBOLS**

- △: Quartz vein cobbles ≥ 10 cm in diameter.
- : Quartz vein cobbles < 10 cm in diameter.
- : Outcrop.
- : Limit of colluvium, moraine, talus.
- : Geological contact observed, approximate, inferred.
- : Fault observed, inferred.
- : Zone of high fracture density and argillite alteration.
- : Diamond drill hole (1986).

**FIG. 3**

0 50 100 200 300 400 METRES

KERR ADDISON MINES LTD  
**'THE' & 'SAID' PROPERTY**  
 AGIP  
 YUKON TERRITORY  
**GEOLOGY & ROCK SAMPLES ON & NEAR GRID**

SCALE - 1:5000 DATE - AUGUST, 1985  
 DRAWN BY - P.H., J.N. DATA - J.N., S.F., J.M.  
 NTS - 105 D 6 REVISED - NOV., 1986

S1R	<5	0.7
N1R	140	3.6
N2R	<5	2.5
N3R	<5	0.6
N4R	<5	0.6
N5R	<5	0.8
N6R	<5	1.2
N8R	25	1.2
N9R	60	2.7
N10R	110	2.6
N13R	<5	1.2
N14R	<5	1.3
N15R	30	1.3
N16R	50	1.9
N17R	750	1.2
N18R	55	3.9
N19R	6450	1.2
N20R	55	7.5
G18R	85	2.2
G19R	20	0.6
G20R	70	3.0
G21R	40	0.6
G25R	130	0.8
G27R	160	0.5
G29R	<5	0.6
G31R	60	2.8
G3S	<5	2.0
G4S	75	0.5
G5S	10	0.2
G6S	<5	0.2
G7S	<5	0.2
G12S	<5	0.1
G15S	<5	0.2
G32S	10	0.9
C12R	<5	1.0
C13R	20	0.7

SAMPLE No. - Au (ppb), Ag (ppm)

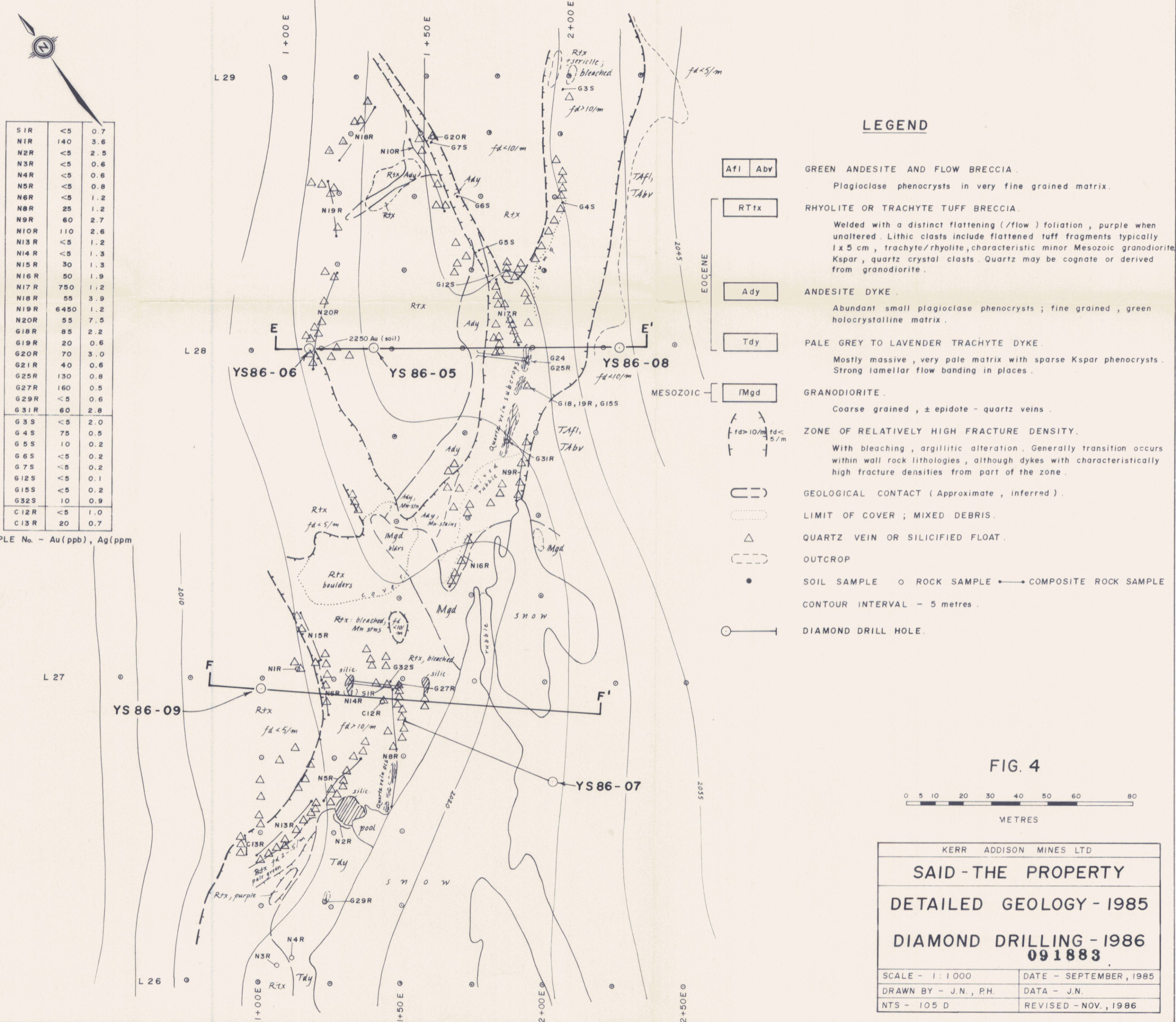

**LEGEND**

- Afl Abv GREEN ANDESITE AND FLOW BRECCIA.  
Plagioclase phenocrysts in very fine grained matrix.
- RTtx RHYOLITE OR TRACHYTE TUFF BRECCIA.  
Welded with a distinct flattening (/flow) foliation, purple when unaltered. Lithic clasts include flattened tuff fragments typically 1 x 5 cm, trachyte/rhyolite, characteristic minor Mesozoic granodiorite. Kspar, quartz crystal clasts. Quartz may be cognate or derived from granodiorite.
- Ady ANDESITE DYKE.  
Abundant small plagioclase phenocrysts; fine grained, green holocrystalline matrix.
- Tdy PALE GREY TO LAVENDER TRACHYTE DYKE.  
Mostly massive, very pale matrix with sparse Kspar phenocrysts. Strong lamellar flow banding in places.
- Mgd GRANODIORITE.  
Coarse grained, ± epidote - quartz veins.
- fd > 10/m fd < 5/m ZONE OF RELATIVELY HIGH FRACTURE DENSITY.  
With bleaching, argillitic alteration. Generally transition occurs within wall rock lithologies, although dykes with characteristically high fracture densities from part of the zone.
- GEOLOGICAL CONTACT (Approximate, inferred).
- LIMIT OF COVER; MIXED DEBRIS.
- △ QUARTZ VEIN OR SILICIFIED FLOAT.
- OUTCROP
- SOIL SAMPLE ○ ROCK SAMPLE → COMPOSITE ROCK SAMPLE
- CONTOUR INTERVAL - 5 metres.
- DIAMOND DRILL HOLE.

FIG. 4

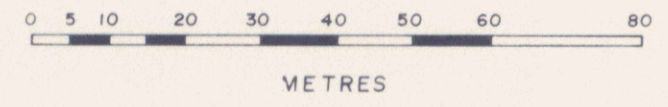

KERR ADDISON MINES LTD	
<b>SAID - THE PROPERTY</b>	
<b>DETAILED GEOLOGY - 1985</b>	
<b>DIAMOND DRILLING - 1986</b>	
<b>091883</b>	
SCALE - 1:1000	DATE - SEPTEMBER, 1985
DRAWN BY - J.N., P.H.	DATA - J.N.
NTS - 105 D	REVISED - NOV., 1986

DDH YS - 86 - 01

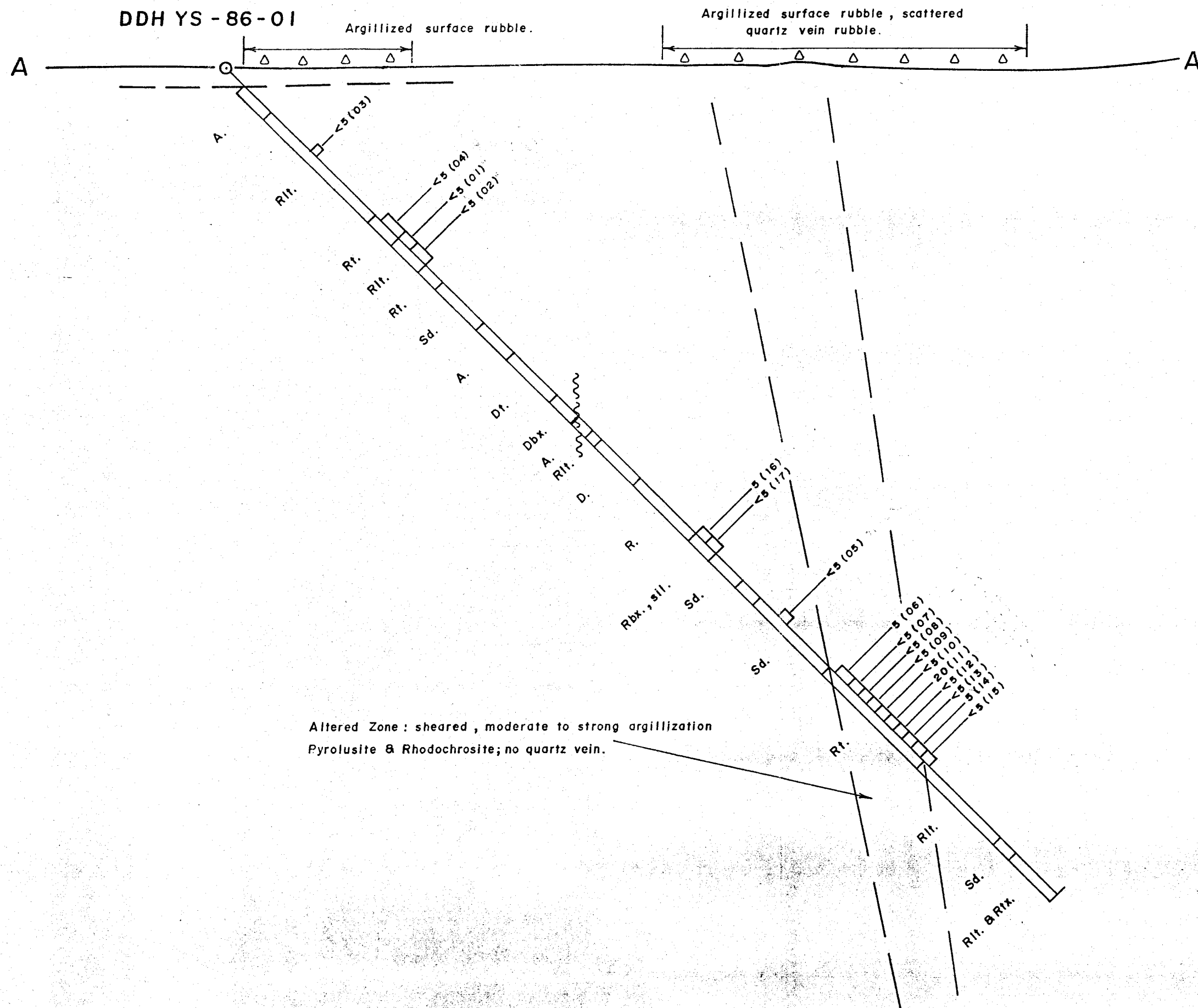

Altered Zone : sheared , moderate to strong argillization  
Pyrolusite & Rhodochrosite; no quartz vein.

**LEGEND**

Rt.	Rhyolite tuff.
Rlt.	Rhyolite lapilli tuff.
Rtx.	Rhyolite tuff breccia.
R.dy.	Rhyolite dyke.
Tt.	Trachyte tuff.
T.dy.	Trachyte dyke.
Dt.	Dacite tuff.
Dbx.	Dacite breccia.
A.	Andesite.
A.dy.	Andesite dyke.
P.dy.	Feldspar porphyry.
Sd.	Epiclastic sediments.
Gd.	Granodiorite.

QV.	Quartz vein.
△	Quartz vein rubble.
arg.	Argillized.
2° bx.	Secondary breccia.
Flt.	Fault.
○	Drill hole collar.

Ag - ppm , Au - ppb ( sample number )  
5 ( 03 )

**FIG. 5**

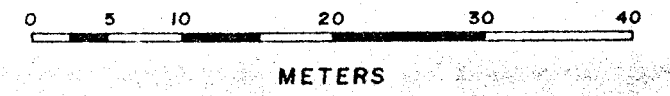

KERR ADDISON MINES LTD	
SAID & THE PROPERTY	
DRILLING 1986	
SECTION A-A'	
GEOLOGY & ASSAYS	
SCALE - 1 : 500	DATE - OCTOBER , 1986
DRAWN BY - P.H. , B.P.	DATA - B.P.
NTS - 105 D/6	REVISED -

DDH YS - 86 - 02

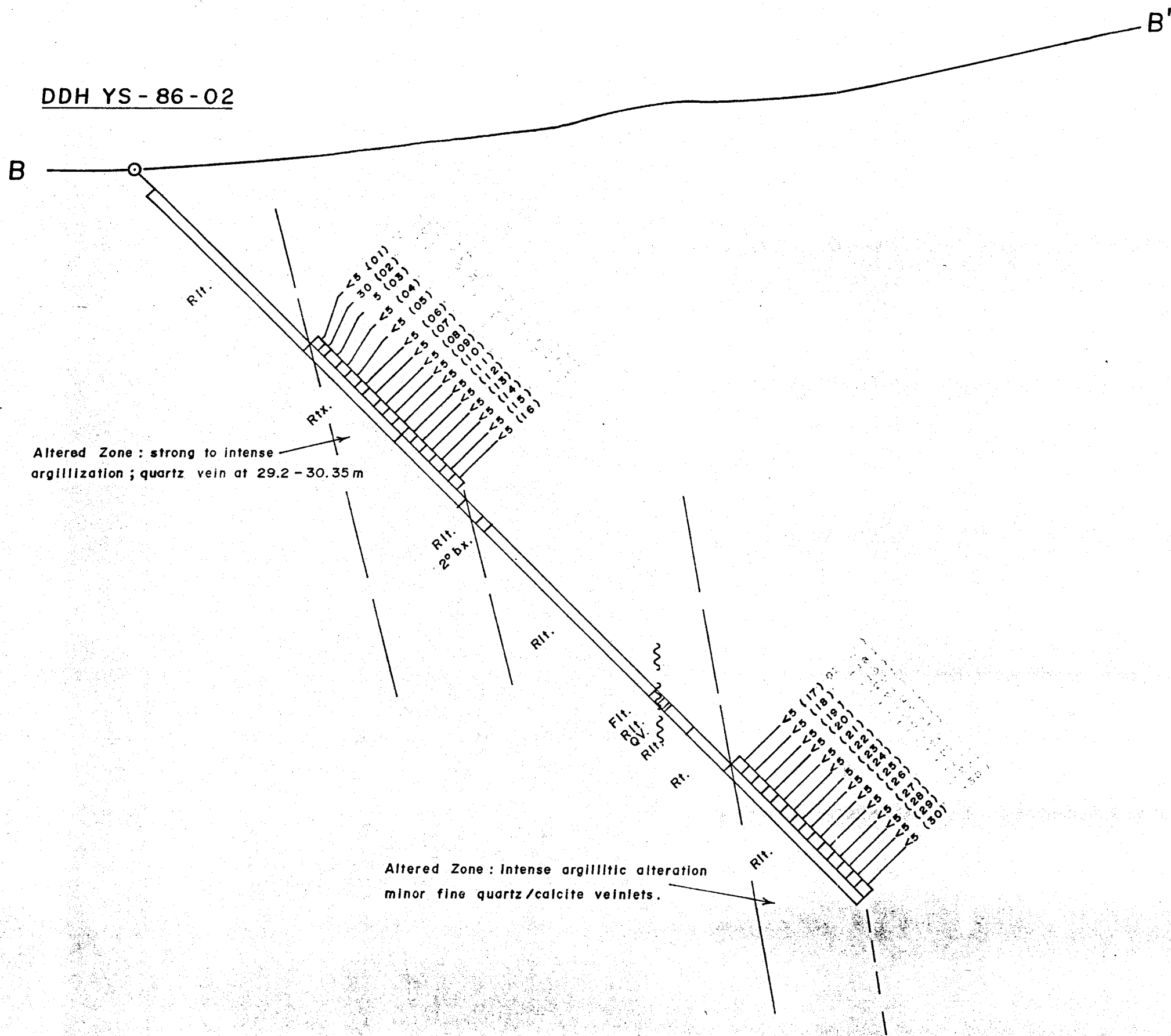

**LEGEND**

Rt.	Rhyolite tuff.
Rlt.	Rhyolite lapilli tuff.
Rtx.	Rhyolite tuff breccia.
Rdy.	Rhyolite dyke.
Tt.	Trachyte tuff.
Tdy.	Trachyte dyke.
Dt.	Dacite tuff.
Dbx.	Dacite breccia.
A.	Andesite.
Ady.	Andesite dyke.
Pdy.	Feldspar porphyry dyke.
Sd.	Epiclastic sediments.
Gd.	Granodiorite.
QV.	Quartz vein.
△	Quartz vein rubble.
arg.	Argillized.
2° bx.	Secondary breccia.
Flt.	Fault.
○	Drill hole collar.

Ag - ppm, Au - ppb (sample number).  
5 (18)

FIG. 6

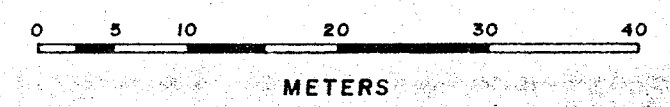

KERR ADDISON MINES LTD	
SAID & THE PROPERTY	
DRILLING 1986	
SECTION B-B'	
GEOLOGY & ASSAYS	
SCALE - 1: 500	DATE - OCTOBER, 1986
DRAWN BY - P.H., B.P.	DATA - B.P.
NTS- 105.D/6	REVISED -

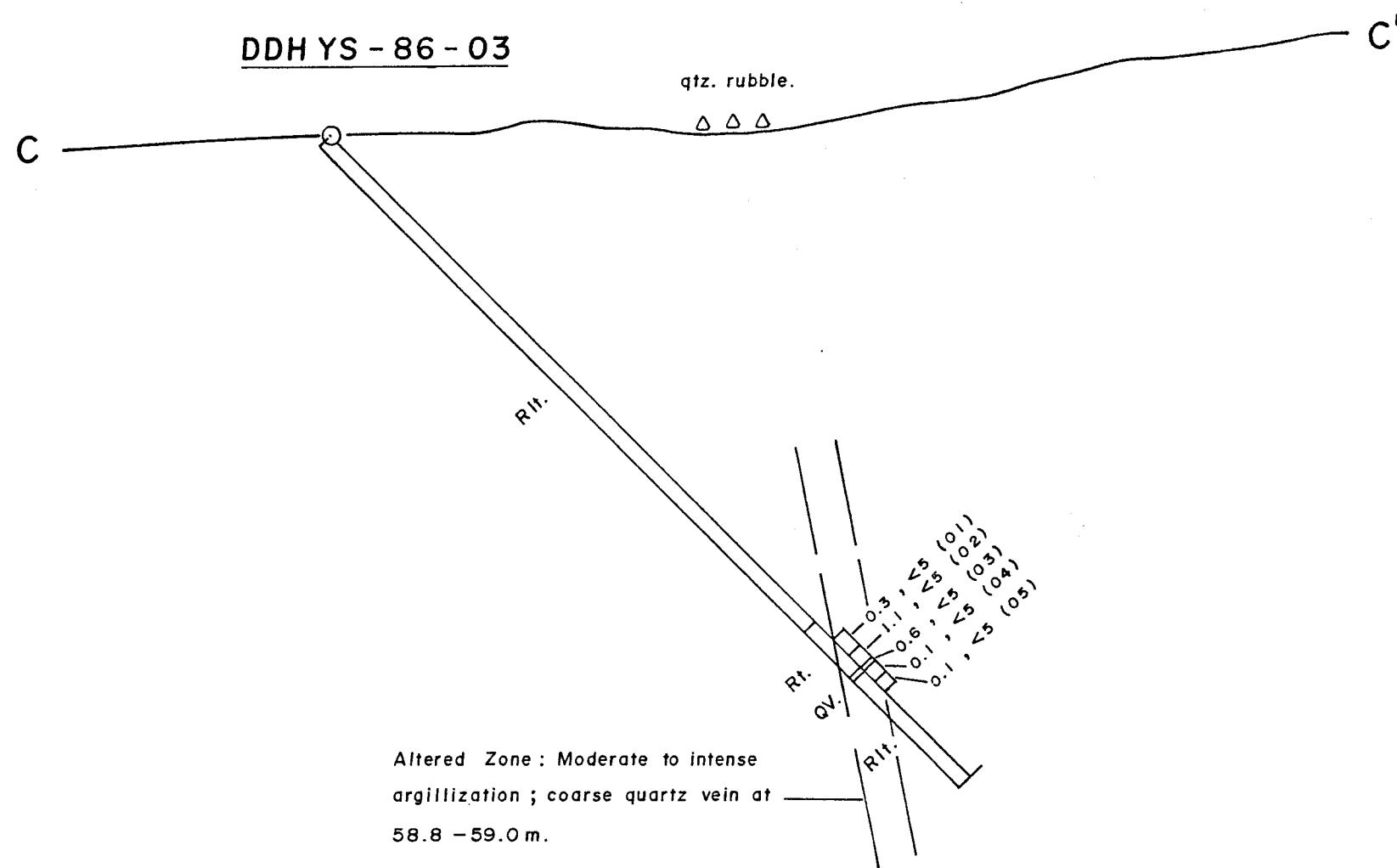

**LEGEND**

Rt.	Rhyolite tuff.
Rlt.	Rhyolite lapilli tuff.
Rtx.	Rhyolite tuff breccia.
Rdy.	Rhyolite dyke.
Tt.	Trachyte tuff.
Tdy.	Trachyte dyke.
Dt.	Dacite tuff.
Dbx.	Dacite breccia.
A.	Andesite.
Ady.	Andesite dyke.
Pdy.	Feldspar porphyry dyke.
Sd.	Epiclastic sediments.
Gd.	Granodiorite.
QV.	Quartz vein.
△	Quartz vein rubble.
arg.	Argillized.
2°bx.	Secondary breccia.
Flt.	Fault.
○—	Drill hole collar.

Ag - ppm , Au - ppb ( sample number ).  
0.3 , 5 ( 01 )

**FIG. 7**



KERR ADDISON MINES LTD	
SAID & THE PROPERTY	
DRILLING 1986	
SECTION C-C'	
GEOLOGY & ASSAYS	
SCALE - 1:500	DATE - OCTOBER, 1986
DRAWN BY - PH. S.P.	DATA - E.P.
ATS - 175 1/76	REVISED -

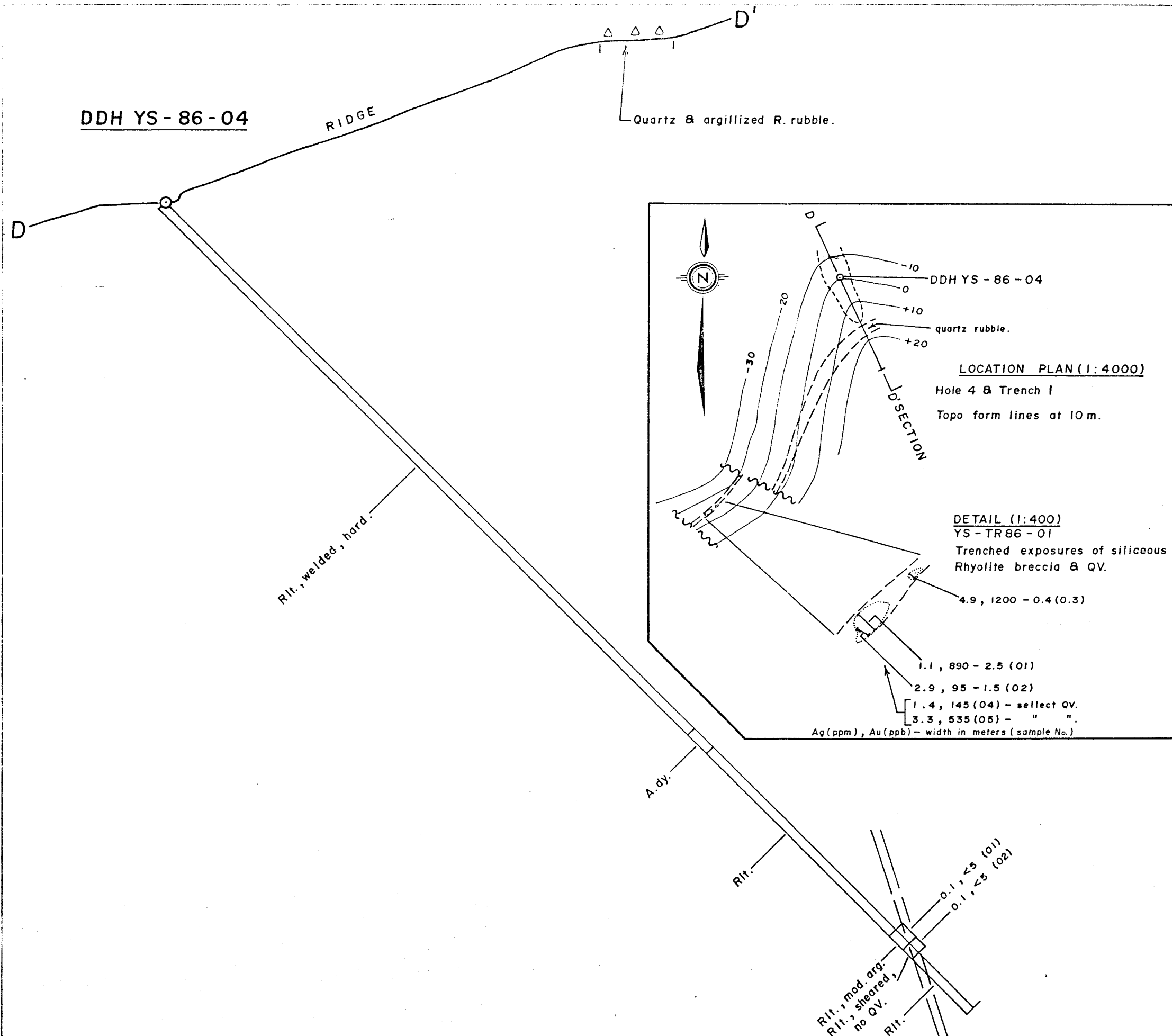

**LEGEND**

Rt.	Rhyolite tuff.
Rlt.	Rhyolite lapilli tuff.
Rtx.	Rhyolite tuff breccia.
R.dy.	Rhyolite dyke.
Tt.	Trachyte tuff.
T.dy.	Trachyte dyke.
Dt.	Dacite tuff.
Dbx.	Dacite breccia.
A.	Andesite.
A.dy.	Andesite dyke.
P.dy.	Feldspar porphyry dyke.
Sd.	Epilastic sediment.
Gd.	Granodiorite.

QV.	Quartz vein.
△	Quartz vein rubble.
arg.	Argillized.
2°bx.	Secondary breccia.
Fit.	Fault.
○	Drill hole collar

Ag (ppm), Au (ppb) (sample number)  
0.1, <5 (01)

FIG. 8



KERR ADDISON MINES LTD	
SAID & THE PROPERTY	
DRILLING 1986	
SECTION D-D'	
GEOLOGY & ASSAYS	
SCALE - 1:500	DATE - OCTOBER, 1986
DRAWN BY - P.H., B.P.	DATA - B.P.
NTS - 105 D/6	REVISED -

DDH YS - 86 - 08

DDH YS - 86 - 06

DDH YS - 86 - 05

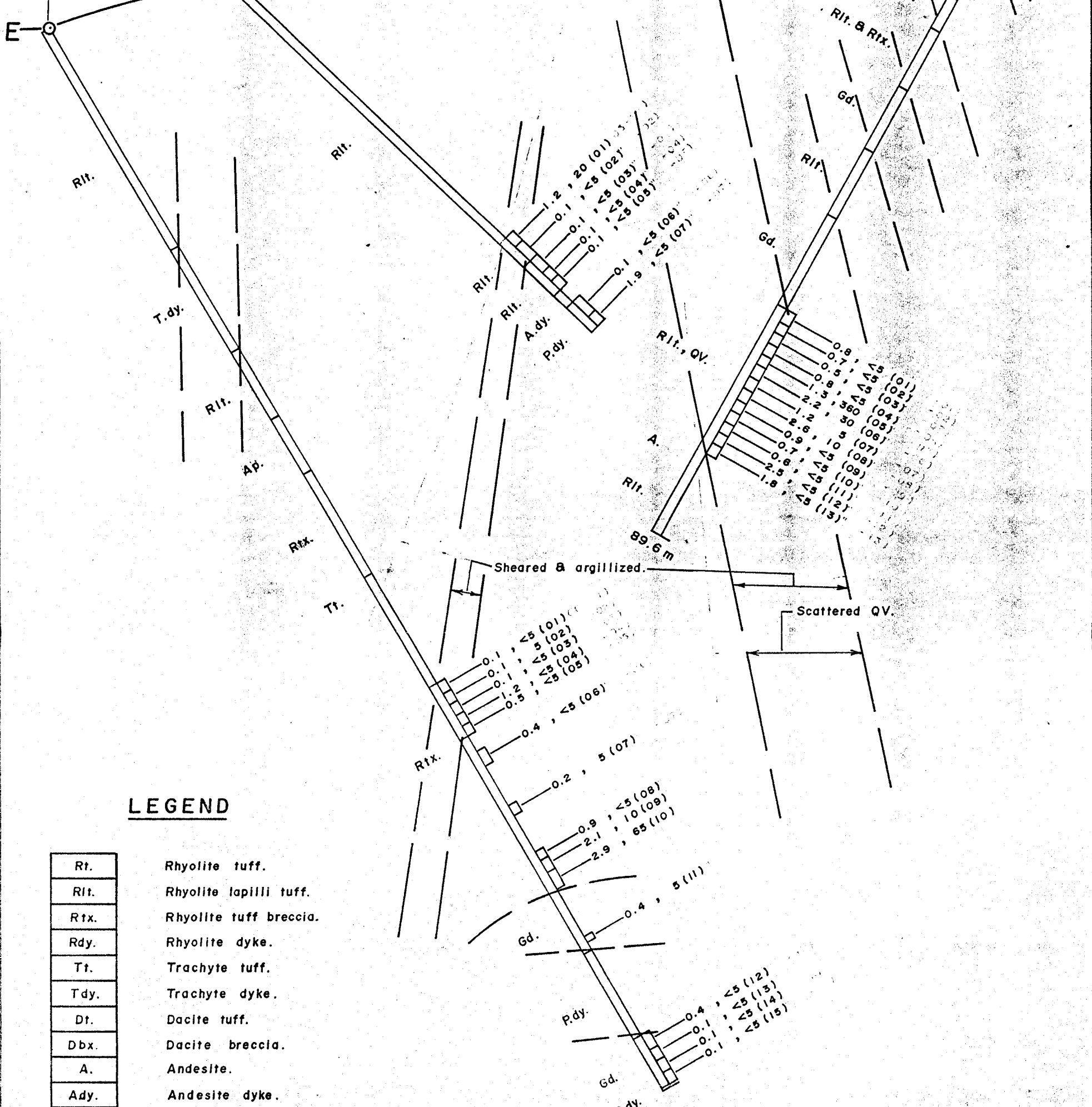

**LEGEND**

Rt.	Rhyolite tuff.
Rlt.	Rhyolite lapilli tuff.
Rtx.	Rhyolite tuff breccia.
Rdy.	Rhyolite dyke.
Tt.	Trachyte tuff.
Tdy.	Trachyte dyke.
Dt.	Dacite tuff.
Dbx.	Dacite breccia.
A.	Andesite.
Ady.	Andesite dyke.
Pdy.	Feldspar porphyry dyke.
Sd.	Epicylastic sediments.
Gd.	Granodiorite.

QV.	Quartz vein.
△	Quartz vein rubble.
arg.	Argillized.
2°bx.	Secondary breccia.
Flt.	Fault.
○---○	Drill hole collar.

Ag - ppm, Au - ppb (sample number).  
0.4, 5 (15)

**FIG. 9**



KERR ADDISON MINES LTD	
SAID & THE PROPERTY	
DRILLING 1986	
SECTION E-E'	
GEOLOGY & ASSAYS	
SCALE - 1:500	DATA - OCTOBER, 1985
DRAWN BY - P.H., B.P.	DATA - B.P.
NTS - 105 D/6	REVISED -

SECTION ON LINE 28 N, AZIMUTH 135°.

# LEGEND

Rt.	Rhyolite tuff.
Rlt.	Rhyolite lapilli tuff.
Rtx.	Rhyolite tuff breccia.
R.dy.	Rhyolite dyke.
Tt.	Trachyte tuff.
T.dy.	Trachyte dyke.
Dt.	Dacite tuff.
Dbx.	Dacite breccia.
A.	Andesite.
A.dy.	Andesite dyke.
P.dy.	Feldspar porphyry dyke.
Sd.	Epiclastic sediments.
Gd.	Granodiorite.

QV.	Quartz vein.
△	Quartz vein rubble.
arg.	Argillized.
2°bx.	Secondary breccia.
Flt.	Fault.
○---○	Drill hole collar.

Ag - ppm , Au - ppb ( sample number ).  
0.6 , 25 (05)

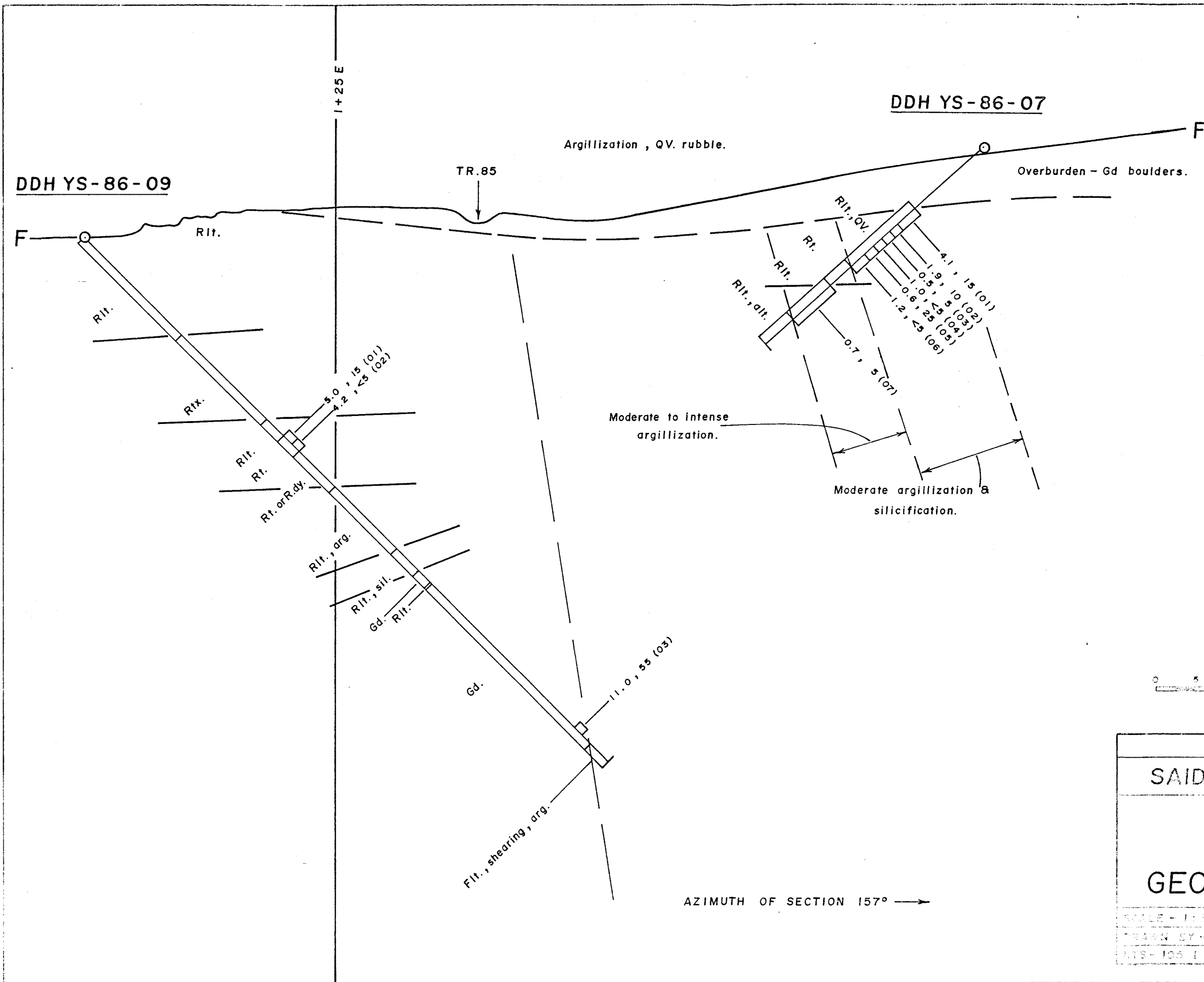

FIG. 10



KERR ADDISON MINES LTD

---

SAID & THE PROPERTY

---

DRILLING 1986  
SECTION F-F'

---

GEOLOGY & ASSAYS

---

SCALE - 1:500	DATE - OCTOBER, 1986
DRAWN BY - R.N. E.P.	DATA - B.P.
NIS-105 (76)	PREPARED -

AZIMUTH OF SECTION 157° →

APPENDIX I

DRILL LOGS

HOLES YS-86-01 to 09

SAID - THE

KERR ADDISON MINES LIMITED

#355

DDH No. YS-86-01 PAGE 1 of 6

SAID THE PROPERTY-Y10

LATITUDE 11+00N DEPARTURE 3+89.5W

CORE SIZE B0 FINAL DEPTH 141.4

1986 DIAMOND DRILLING

DIP AT COLLAR -45° BEARING 137°

STARTED JUNE 27/86 FINISHED JUNE 30/86

COLLAR ELEV. \_\_\_\_\_ LOGGED BY RP

FOOTAGE METERS		%	GRAPHIC LOG					%	DESCRIPTION	MINERALIZATION		ALTERATION		STRUCTURE	ASSAYS		
FROM	TO		RECOVERY	ROCK TYPE	ALTERATION	MINERALIZED ZONE	STRUCTURE TO CORE			MOS2	VOL. %	MODE OF OCCURRENCE	VOL. %	TYPE MODE OF OCCURRENCE	KIND, DENSITY, ETC.	SAMPLE NO.	% Ag
0	3.0								Rubble - casing							ppm	ppb
3.1	7.7		A						Andesite dyke: dark green, fg, massive fresh, well fractured	—	—						
7.7	21.0		RH						Rhyolite lapilli tuff: white to yellow to grey Fragments to 2cm - rd, st rhyolite. Matrix - Qtz, am feld, lith frag Dark brown secondary mineral (bottle or pyroclastic) Penetrated at 9.8 m Core from fac. dendritic			Agilization: moderate to strong Strong to 15.2 decreasing below this 2° bi or pyroclastic	14.3-15.2	YS01-03		<5	
21.0	25.4		RH						Rhyolite lapilli tuff: Blue green with red (jasper) streaks Fresh, massive. Lapilli: Rhy, Qtz, rd Band of fg siliceous tuff @ 22.8 N 45° to axis	—	—						
25.4	26.3		RH						Rhyolite tuff: Light grey, v fg, siliceous finely banded with inclusion of feld xls. Abundant 2° brown mineral (bottle or pyroclastic) Dis. removable after pyrocl.	—	—						

KERR ADDISON MINES LIMITED

SAID THE PROPERTY-Y10

1986 DIAMOND DRILLING

DDH No. YS-86-01 PAGE 2 of 6

CORE SIZE \_\_\_\_\_ FINAL DEPTH \_\_\_\_\_

STARTED \_\_\_\_\_ FINISHED \_\_\_\_\_

LATITUDE \_\_\_\_\_ DEPARTURE \_\_\_\_\_

DIP AT COLLAR \_\_\_\_\_ BEARING \_\_\_\_\_

COLLAR ELEV. \_\_\_\_\_ LOGGED BY \_\_\_\_\_

FOOTAGE		%	GRAPHIC LOG					%	DESCRIPTION	MINERALIZATION		ALTERATION		STRUCTURE		ASSAYS		
FROM	TO		RECOVERY	ROCK TYPE	ALTERATION	MINERALIZED ZONE	STRUCTURE TO CORE			MOS <sub>2</sub>	VOL. %	MODE OF OCCURRENCE	VOL. %	TYPE MODE OF OCCURRENCE	KIND, DENSITY, ETC.	SAMPLE NO.	% Ag	% Au
26.3	29.2			RT														
														26.3 - 29.2	YS-01-04	ppm	ppb	45
29.2	33.8			RT/ve														
														29.2 - 31.1	YS-01-01			45
														31.1 - 33.8	01-02			45
33.8	34.6																	

Rhyolite tuff;  
 - Ocher to amber  
 - dense, vfg  
 - well frac with numerous very fine sucrosic qtz fac filling  
 - Jaspered in spots and fac filling  
 - Dark fac holes (2-3m) of pyroxene  
 QV at 27.6 @ 0° of 27°

Altered Rhyolite tuff & lap. tuff  
 Ocherous, QV to 1cm scattered throughout (5% of vol)  
 In part bx with fine sucrosic qtz infilling.  
 29.2-29.9 RT  
 29.9-32.8 Murky, orgillaceous well frac  
 32.8-33.1 Bicolorated fg sil tuffaceous sed.  
 33.1-33.3 Intensely orgillized RT & tuff  
 33.3-33.8 Welded tuff

Welded rhyolite tuff  
 Mottled green to brown, Fresh  
 Flattened dark shreds. Dense  
 Flow foliation at 45°

KERR ADDISON MINES LIMITED

DDH No. YS-86-01 PAGE 3 of 6  
 CORE SIZE \_\_\_\_\_ FINAL DEPTH \_\_\_\_\_  
 STARTED \_\_\_\_\_ FINISHED \_\_\_\_\_

SAID THE PROPERTY-Y10  
 1986 DIAMOND DRILLING

LATITUDE \_\_\_\_\_ DEPARTURE \_\_\_\_\_  
 DIP AT COLLAR \_\_\_\_\_ BEARING \_\_\_\_\_  
 COLLAR ELEV. \_\_\_\_\_ LOGGED BY \_\_\_\_\_

FOOTAGE		%	GRAPHIC LOG				%	DESCRIPTION	MINERALIZATION		ALTERATION		STRUCTURE	ASSAYS		
FROM	TO		RECOVERY	ROCK TYPE	ALTERATION	MINERALIZED ZONE			STRUCTURE TO CORE	VOL. %	MODE OF OCCURRENCE	VOL. %	TYPE MODE OF OCCURRENCE	KIND, DENSITY, ETC.	SAMPLE NO.	%
34.6	36.9		Rt				Rhyolitic crystal tuft: Dark green, massive, mg. Oth. fld of lithic frags bedding @ 45°									
36.9	42.8		S				Tuffaceous sediment: Interstratified f of mg material Bedding: 35° @ 37.4m 40° @ 38.8m									
43.2	48.9		A				Andesite: Dark to light green, Amygdaloidal flow banded tuft (flattened shards) Massive dense.									
48.9	56.0		Dt				Dacitic tuft: Med grey green, medium hardness Depositional banding 50° @ 49.6m Scattered 1-2mm feldspar phenes in gtz/fld/matrix matrix. Scattered fine frag with epidote / gtz filling.				epidote alt <sup>n</sup> of fld and in frag.					
56.0	59.2		Dbr				Dacite breccia: Angular fragments of med to lt grey dacite. Coarse infilling chlorite, epidote and locally magnetite. Lower 40 cm rusty, oxidized				chlorite-epidote Dacite Breccial silica filled bala 1-3mm					

**KERR ADDISON MINES LIMITED**

**SAID THE PROPERTY-Y10**

1986 DIAMOND DRILLING

DDH No. YS-86-01 PAGE 4 of 6

CORE SIZE \_\_\_\_\_ FINAL DEPTH \_\_\_\_\_

STARTED \_\_\_\_\_ FINISHED \_\_\_\_\_

LATITUDE \_\_\_\_\_ DEPARTURE \_\_\_\_\_

DIP AT COLLAR \_\_\_\_\_ BEARING \_\_\_\_\_

COLLAR ELEV. \_\_\_\_\_ LOGGED BY \_\_\_\_\_

FOOTAGE		%	GRAPHIC LOG					%	DESCRIPTION	MINERALIZATION		ALTERATION		STRUCTURE	ASSAYS							
FROM	TO		RECOVERY	ROCK TYPE	ALTERATION	MINERALIZED ZONE	STRUCTURE TO CORE			MOS <sub>2</sub>	VOL. %	MODE OF OCCURRENCE	VOL. %	TYPE MODE OF OCCURRENCE	KIND, DENSITY, ETC.	SAMPLE NO.	% Ag	% Au				
57.7	59.9								Shear: Muddy oxidized broken core Slip rim faces @ 25° 50° TCA										ppm	ppb		
59.9	62.1		A						Andesite: Dark green, fg, ~ soft White feld planes up to 1mm in matrix of feld of slight charactered matrix													
62.1	63.7		P/A						Lapilli Tuff: Angular and andesite frag													
63.7	70.2		D						Diorite: Med gr gran - brown patchy Fm grained with feldspar planes to 2mm. Dark hard to in hand Med fracturing infilled by ep, mgs, minor gtz													
70.2	79.8		R						Rhyolite: Dark grey to black. Very hard siliceous Irregular voids filled with vfg grey to brown amorphous to st. rounded gtz.													
79.8	81.1		R/A		?				Rhyolite / Dark Breccia Rhyolite & diorite frags infilled by opaline gtz. Epidote in fractures.												YS	
																		79.8 - 81.4	01-16	5		
																		81.4 - 83.1	01-17	45		

KERR ADDISON MINES LIMITED

#35-

DDH No. YS-86-01 PAGE 5 of 6

SAID THE PROPERTY-Y10

CORE SIZE \_\_\_\_\_ FINAL DEPTH \_\_\_\_\_

1986 DIAMOND DRILLING

LATITUDE \_\_\_\_\_ DEPARTURE \_\_\_\_\_

DIP AT COLLAR \_\_\_\_\_ BEARING \_\_\_\_\_

STARTED \_\_\_\_\_ FINISHED \_\_\_\_\_

COLLAR ELEV. \_\_\_\_\_ LOGGED BY \_\_\_\_\_

FOOTAGE		%	GRAPHIC LOG				%	DESCRIPTION	MINERALIZATION		ALTERATION		STRUCTURE	ASSAYS			
FROM	TO		RECO-VERY	ROCK TYPE	ALTERATION	MINERALIZED ZONE			STRUCTURE TO CORE	MoS <sub>2</sub>	VOL. %	MODE OF OCCURRENCE	VOL. %	TYPE MODE OF OCCURRENCE	KIND, DENSITY, ETC.	SAMPLE NO.	A <sub>2</sub> %
83.1	87.8		Sd												ppm	ppb	
							Tuffaceous sed: Dark grey green, fine-medium Fresh, siliceous Dip: 45° @ 83.4 30° @ 84.3										
87.8	90.8						Rhyolite lapilli Tuff: Lt tan to white With minor fine white sp. vils jasper flecks and epidote					mod silicification minor epidote					
90.8	102.7						Tuffaceous sediments: Interbedded fine to coarse, siliceous-epidote bands Redding: 10° @ 90.8 35° @ 91.0 40° @ 92.2 50° @ 98.2 45° @ 101.3										
							93.8-95.3 - Fine wavy banded, light (siliceous) dark (chloritic) green (epidote rich). Aligned approximately with core. Bioterminated							YS	01-05	LS	



KERR ADDISON MINES LIMITED

#35

DDH No. YS-86-02 PAGE 1 of 5  
 CORE SIZE BC FINAL DEPTH 117.4 meters  
 STARTED JULY 1/86 FINISHED July 4

SAID THE PROPERTY-Y10

1986 DIAMOND DRILLING

LATITUDE 8400N DEPARTURE 3475W  
 DIP AT COLLAR -45° BEARING 135°  
 COLLAR ELEV. \_\_\_\_\_ LOGGED BY RP

FOOTAGE		%	GRAPHIC LOG					%	DESCRIPTION	MINERALIZATION		ALTERATION		STRUCTURE KIND, DENSITY, ETC.	ASSAYS		
FROM	TO		RECOVERY	ROCK TYPE	ALTERATION	MINERALIZED ZONE	STRUCTURE TO CORE			MoS <sub>2</sub>	VOL. %	MODE OF OCCURRENCE	VOL. %		TYPE MODE OF OCCURRENCE	SAMPLE NO.	% A <sub>2</sub>
0	3.1																
3.1	42.7							Rubble, boulders of mud Rhyolite lapilli Tuff: siliceous								ppm	ppb
3.1	6.5							Dark gray green, fresh 4.5-4.6 silicified									
6.5	10.4							Rusty broken core with some loose clasts of Gd (9.2-9.7) and Fld ph.					weathering				
10.2	10.4							Sheared, argillized bleached					strong weathering				
10.4	16.9							Dark fresh, oxide banding at 35° 16.0-16.5 lt gray silicified open fac 50°									
16.9	24.0							Lt gray green, sl bleached, siliceous dense packed lapilli, some argillized frag, fac. common at 35° to 50°									
24.0	25.0							Lt gray green Jasper at 24.9									
25.0	28.3							Lt gray green, sl bleaching									
28.3	29.2							Beginning of strongly altered section Light gray to buff, broken pyroclastic common	1?				Arg along fac and altering some clasts	28.2-29.2	YS 02-01		LS











KERR ADDISON MINES LIMITED

DDH No. YS-86-03 PAGE 2 of 2  
 CORE SIZE \_\_\_\_\_ FINAL DEPTH \_\_\_\_\_  
 STARTED \_\_\_\_\_ FINISHED \_\_\_\_\_

**SAID THE PROPERTY-Y10**  
 1986 DIAMOND DRILLING

LATITUDE \_\_\_\_\_ DEPARTURE \_\_\_\_\_  
 DIP AT COLLAR \_\_\_\_\_ BEARING \_\_\_\_\_  
 COLLAR ELEV. \_\_\_\_\_ LOGGED BY \_\_\_\_\_

FOOTAGE		%	GRAPHIC LOG					%	DESCRIPTION	MINERALIZATION		ALTERATION		STRUCTURE	ASSAYS		
FROM	TO		RECOVERY	ROCK TYPE	ALTERATION	MINERALIZED ZONE	STRUCTURE TO CORE			MDS <sub>2</sub>	VOL. %	MODE OF OCCURRENCE	VOL. %	TYPE MODE OF OCCURRENCE	KIND-DENSITY, ETC. / Sample interval	SAMPLE NO.	% Ag
59.0	61.5	100	RH	Ajs	?						50	Argillization: stream to fracture Sensitized confined to flattened shreds	59.0-60.4 60.4-61.5	YS 03-04 03-05	0.1 0.1	45 45	
61.5	64.7	100	RH	Am								Argillization: moderate					
64.7	71.0	EOH										Argillization: slight for first meter then confined to fractures.					
EOH																	





KERR ADDISON MINES LIMITED

DDH No. YS-86-05 PAGE 1 of 2  
 CORE SIZE BQ FINAL DEPTH 58.8 meters  
 STARTED July 14/86 FINISHED JULY 17/86

SAID THE PROPERTY-Y10

1986 DIAMOND DRILLING

LATITUDE 28+00 N DEPARTURE 1+43 N  
 DIP AT COLLAR -44° BEARING 135°  
 COLLAR ELEV. \_\_\_\_\_ LOGGED BY RP

FOOTAGE		%	GRAPHIC LOG				%	DESCRIPTION	MINERALIZATION		ALTERATION		STRUCTURE	ASSAYS			
FROM	TO	RECO-VERY	ROCK TYPE	ALTERATION	MINERALIZED ZONE	STRUCTURE TO CORE	MDS2		VOL. %	MODE OF OCCURRENCE	VOL. %	TYPE MODE OF OCCURRENCE	KIND, DENSITY, ETC.	SAMPLE NO.	% Ag	% Au	
0	42.1	100	RH	sp	/												
							Rhyolite lapilli Tuff: welded Dark brown to maroon matrix (60%) with gray to green & brown clasts (40%) Clasts: Rhyolite, some finely laminated, flattened shreds. Rose Ed clasts. 2.3.6-23.3 fine banded rhyolite @ 20°. very hard, siliceous 0-5.8 broken core 5.7 down core intact shears: 17.4m @ 35° 19.6m @ 65° 20.5m @ 40° rusty, pyroclastic 23.2m @ 30° - rusty, org 4mm calcite vlt @ 35.5m										
42.1	43.6	40	RH				Rhyolite lapilli Tuff: welded as above section but broken core < 5cm pieces and some strong org?					some strong crystallization					
43.6	47.7	85	RH	int org	?		Rhyolite lapilli Tuff: Brown to yellow to grey soft muddy & ground up core. Very much QV, no calcite Pyroclastic common, Trace chadachrosite					Intensely crystallized	43.6-45.1 45.1-47.7	05-01 05-02	1.2 0.1	20 <5	

KERR ADDISON MINES LIMITED

SAID THE PROPERTY-Y10

1986 DIAMOND DRILLING

DDH No. YS-86-05 PAGE 2 of 2  
 CORE SIZE \_\_\_\_\_ FINAL DEPTH \_\_\_\_\_  
 STARTED \_\_\_\_\_ FINISHED \_\_\_\_\_

LATITUDE \_\_\_\_\_ DEPARTURE \_\_\_\_\_  
 DIP AT COLLAR \_\_\_\_\_ BEARING \_\_\_\_\_  
 COLLAR ELEV. \_\_\_\_\_ LOGGED BY \_\_\_\_\_

FOOTAGE		%	GRAPHIC LOG				%	DESCRIPTION	MINERALIZATION		ALTERATION		STRUCTURE	ASSAYS		
FROM	TO		RECOVERY	ROCK TYPE	ALTERATION	MINERALIZED ZONE			STRUCTURE TO CORE	VOL. %	MODE OF OCCURRENCE	VOL. %	TYPE MODE OF OCCURRENCE	KIND, DENSITY, ETC.	SAMPLE NO.	% Ag
47.7	52.6	95	Rt	Ang	?		Rhyolite Lapilli Tuff - Grey green with rusty fac and patches - Soft to muddy core - Very minor Qtz & calcite veins - Prominent pyroxene and rhodochrosite		?		Sl to moderate argillization with short intervals argillized sections sl ser <sup>2</sup> of feld					
												47.7-49.7	04-03	0.1	<5	
												49.7-51.2	04-04	0.1	<5	
												51.2-52.6	04-05	0.1	<5	
52.8	54.6		Ady				Andesite dyke: - light brown - sl porphyritic - 5% plagiophenes - fine grained matrix - sl soft - well fac with common plagioclase and trace rhodochrosite				slight sericitization of feld phenos					
54.6	58.8		P <sub>2</sub>				Feldspar porphyry: - Buff to yellow to grey - soft to muddy core - 10% plagiophenes - Well fac with conspicuous plagioclase and rhodochrosite				Med to intense argillization		54.6-57.3	04-06	0.1	<5
												57.3-58.8	04-07	1.9	<5	
Hole discontinued due to casing & squeezing — END OF HOLE —																





KERR ADDISON MINES LIMITED

SAID THE PROPERTY-Y10

DDH No. YS-86-06 PAGE 3 of 5

CORE SIZE \_\_\_\_\_ FINAL DEPTH \_\_\_\_\_

1986 DIAMOND DRILLING

LATITUDE \_\_\_\_\_ DEPARTURE \_\_\_\_\_

DIP AT COLLAR \_\_\_\_\_ BEARING \_\_\_\_\_

STARTED \_\_\_\_\_ FINISHED \_\_\_\_\_

COLLAR ELEV. \_\_\_\_\_ LOGGED BY \_\_\_\_\_

FOOTAGE		%	GRAPHIC LOG				%	DESCRIPTION	MINERALIZATION		ALTERATION		STRUCTURE	ASSAYS			
FROM	TO	RECOVERY	ROCK TYPE	ALTERATION	MINERALIZED ZONE	STRUCTURE TO CORE	MoS <sub>2</sub>		VOL. %	MODE OF OCCURRENCE	VOL. %	TYPE MODE OF OCCURRENCE	KIND, DENSITY, ETC.	SAMPLE NO.	Ag %	A %	
75.8	78.0		Tz	Ang	/						Amillized, sericitized			ppm	ppm		
							Trachyte tuff light green to buff fine grained, soft sericitic Crushed and amillized 75.7-77.4 Shear @ 75.6m - 25°										
78.0	119.2		Rtz	Ang	?		Rhyolite Lapilli Tuff: Grey green Clasts: rhyolite and granodiorite Matrix: silt, k 5mm Notable introduction of calcite filled fac with some chlorocarbonate - Well fac below 80.5 with calcite - Bleached holes along fac (H green to orange) - Notably here hard in fac zone even harder holes - Poldon fac direction 35 to 40° with some parallel to core. 80.5-84.7 well fac. 84.7-87.8 relatively intact 87.8-91.5 Mod fac, broken 91.5-98.1 Well fac with crack zones dual intense arg <sup>2</sup> below 98.1 fracturing and alteration decrease abruptly (Soft white translucent) Qtz veins rare. 102.7-107.8 Mod fr with calcite, aluminite (?) Min minerals of Fr staining 107.8-110.0 Strong fac along and parallel to core Aluminite (?) and Mn, Pb zone with strong arg <sup>2</sup> 108.4-108.7			SAMPLES: Well fac, calc var, some qtz Mn 95 Well fac, calc var 100 Well fac, 20% mud (intense arg <sup>2</sup> ) 100 Well fac 30% mud ( " ) 100 Well fac 10% mud ( " ) 100 Strong fac of arkose, calc var, int arg Stony fac, arg,			90.8-92.4 06-01 0.1 <5 92.4-93.9 06-02 0.1 5 93.9-95.4 06-03 0.1 <5 95.4-96.9 06-04 1.2 <5 96.9-98.1 06-05 0.5 <5 100.3-102.3 06-06 0.4 <5 107.8-109.1 06-07 0.2 <5		YS		

# KERR ADDISON MINES LIMITED

#355

DDH No. YS-86-06 PAGE 4 of 5

**SAID THE PROPERTY-Y10**

LATITUDE \_\_\_\_\_ DEPARTURE \_\_\_\_\_

CORE SIZE \_\_\_\_\_ FINAL DEPTH \_\_\_\_\_

1986 DIAMOND DRILLING

DIP AT COLLAR \_\_\_\_\_ BEARING \_\_\_\_\_

STARTED \_\_\_\_\_ FINISHED \_\_\_\_\_

COLLAR ELEV. \_\_\_\_\_ LOGGED BY \_\_\_\_\_

FOOTAGE		%	GRAPHIC LOG					%	DESCRIPTION	MINERALIZATION		ALTERATION		STRUCTURE	ASSAYS		
FROM	TO		RECOVERY	ROCK TYPE	ALTERATION	MINERALIZED ZONE	STRUCTURE TO CORE			NBS <sub>2</sub>	VOL. %	MODE OF OCCURRENCE	VOL. %	TYPE MODE OF OCCURRENCE	KIND, DENSITY, ETC.	SAMPLE NO.	% Ag ppm
								110-114.0	Med fr. weak perovskite arg <sup>2</sup>								
								114.0-117.0	Strong frac. crushing	5 cm at veins		Strong arg <sup>2</sup>	114.0-115.2	06-08	0.9	45	
								117.0-117.5	Relatively hard, unfractured			—	115.2-117.0	06-09	2.1	10	
								117.5-117.9	Shear at 15° Arg <sup>2</sup> Mn. Plumite			Extense arg <sup>2</sup>	117.5-118.8	06-10	2.9	65	
								117.9-118.2	Med Frac.								
								118.2-118.8	Crushed Core of Med Mn Plumite			Int. Arg <sup>2</sup>					
								118.8-119.2	Hard, calcite was								
119.2	127.7	100	6d					Granodiorite: - Calc patchy dark green to grey to pink. - Coarse grained - Mat of fine frac with num with alteration halos (sericite, chlorite) - Numerous calcite vlt's, some str vlt's - Some open frac with clays (alunite) and Mn minerals - Disseminated magnetite					Chlor, ser along fine frac.				
												Sample of Perovskite sericite, 5% QV with garnet pyrite, jasper & pyroterite	125.7-126.4	06-11	0.4	5	
127.7	139.0							Feldspar Porphyry Dyke: 10% subhedral plus phenos to 6 mm Med to green well frac									

KERR ADDISON MINES LIMITED

#355

DDH No. YS-86-06 PAGE 5 of 5

SAID THE PROPERTY-Y10

CORE SIZE \_\_\_\_\_ FINAL DEPTH \_\_\_\_\_

1986 DIAMOND DRILLING

LATITUDE \_\_\_\_\_ DEPARTURE \_\_\_\_\_

DIP AT COLLAR \_\_\_\_\_ BEARING \_\_\_\_\_

STARTED \_\_\_\_\_ FINISHED \_\_\_\_\_

COLLAR ELEV. \_\_\_\_\_ LOGGED BY \_\_\_\_\_

FOOTAGE		%	GRAPHIC LOG				%	DESCRIPTION	MINERALIZATION		ALTERATION		STRUCTURE	ASSAYS		
FROM	TO		RECO-VERY	ROCK TYPE	ALTERATION	MINERALIZED ZONE			STRUCTURE TO CORE	MOS <sub>2</sub>	VOL. %	MODE OF OCCURRENCE	VOL. %	TYPE MODE OF OCCURRENCE	KIND, DENSITY, ETC.	SAMPLE NO.
139.0	146.0		Gd													
							Granodiorite: grey green Edwards grained well fractured to shattered Calcite veins common. Qtz veins coarse  4 cm mud slices at 139.8					Mod to pervasive cloudy green alt <sup>n</sup> of pl <sup>g</sup> green "saub" or incipient sensitization Ang <sup>n</sup> - adj. to fractures and strong in crush sections	139.0-141.1 141.1-142.6 142.6-144.2 144.2-146.0	06-12 06-13 06-14 06-15	0.4 0.1 0.1 0.1	LS LS LS LS
146.0	146.3						Feldspar Porphyry 11.5% plagioclase in grey matrix Probably has been muddy core.					Med crystallization				
— END of Hole —																

KERR ADDISON MINES LIMITED

DDH No. YS-86-07 PAGE 1 of 1  
 CORE SIZE TCR FINAL DEPTH 39.0 Meters  
 STARTED July 20/86 FINISHED July 21/86

SAID THE PROPERTY-Y10

1986 DIAMOND DRILLING

LATITUDE 26° 65' N DEPARTURE 2+00E  
 DIP AT COLLAR -42° BEARING 337°  
 COLLAR ELEV. \_\_\_\_\_ LOGGED BY RP

FOOTAGE		%	GRAPHIC LOG					%	DESCRIPTION	MINERALIZATION		ALTERATION		STRUCTURE	ASSAYS		
FROM	TO		RECO- VERY	ROCK TYPE	ALTER- ATION	MINERAL- IZED ZONE	STRUC- TURE TO CORE			MOS <sub>2</sub>	VOL. %	MODE OF OCCURRENCE	VOL. %	TYPE MODE OF OCCURRENCE	KIND, DENSITY, ETC.	SAMPLE NO.	% Ag
0	122																
								Overburden, Granodiorite boulders									
122	238	75	DIA-S1	QV				Rhyolite lapilli Tuff: Rusty buff to gray to bleached white. Moderate to badly broken Numerous cherty to calcedonic quartz veins, no carbonate in these or discrete calcite veins Vens 2-5 30° @ 15.4 m 40° @ 17.9 m	Dense to calcedonic quartz veins		In part mud on " " silicified		43 10 12.2-15.2 56 15 15.2-16.8 100 10 16.8-18.3 100 20 18.3-19.8 80 10 19.8-21.3 48 5 21.3-23.8	07.01 07.02 07.03 07.04 07.05 07.06	4.1 1.9 0.5 1.0 0.6 1.2	15 10 5 45 25 45	
238	274	70	RH-S1	AN				Rhyolite lapilli tuff & Rhyolite Tuff: Light gray to rusty Badly broken, soft Conspicuous pyroxenite No veining				Mod to intense argillization					
274	344		RH-S1					Rhyolite lapilli Tuff: Light gray Silicified, hard Quartz veining, no carbonate						27.4-34.4	07.07	0.7	5
34.4	39.0		RH					Rhyolite lapilli Tuff: Patchy gray to rusty Badly broken, muddy	Prominent rusty frag. 45° @ 35 m 30° @ 37 m 60° @ 38 m			Mod to intense argillization, Oxidized					

Hole discontinued due to  
causing ground





KERR ADDISON MINES LIMITED

SAID THE PROPERTY-Y10

1986 DIAMOND DRILLING

DDH No. YS-86-08 PAGE 3 of 4

CORE SIZE \_\_\_\_\_ FINAL DEPTH \_\_\_\_\_

STARTED \_\_\_\_\_ FINISHED \_\_\_\_\_

LATITUDE \_\_\_\_\_ DEPARTURE \_\_\_\_\_

DIP AT COLLAR \_\_\_\_\_ BEARING \_\_\_\_\_

COLLAR ELEV. \_\_\_\_\_ LOGGED BY \_\_\_\_\_

FOOTAGE		%	GRAPHIC LOG					%	DESCRIPTION	MINERALIZATION		ALTERATION		STRUCTURE		ASSAYS					
FROM	TO		RECO-VERY	ROCK TYPE	ALTERATION	MINERALIZED ZONE	STRUCTURE TO CORE			MoS <sub>2</sub>	VOL. %	MODE OF OCCURRENCE	VOL. %	TYPE MODE OF OCCURRENCE	KIND, DENSITY, ETC.	SAMPLE NO.	%	%			
46.2	58.6	100	Gd						Granodiorite: grey green coarse grained minor Qtz and calcite veining Hematite fractures		Minor Qtz & calcite VHS		hard sericitization and epidotization along fractures								
58.6	58.8								Feldspar porphyry Crystal Tuff mostly very quartz 20% feld crystals to 5mm and large XII - 25µm		—		slight sericitization								
58.8	79.0		Qt						Rhyolite lamelli Tuff: Patched bleached/nuggety Intensely crystallized Scattered Qtz vhs (see samples) soft broken core		SAMPLES INTERVAL	Rec %	Alteration Ang <sup>3</sup> S.1.5 Ser <sup>n</sup>	Mineralization QV Calc Mn Min % Vn Py Rhod.	Sample #	g pp.10	Fe pp.10				
															YS						
										58.8-60.4	100	St	x	✓	5	x	✓	x	08-01	0.8	LS
										60.4-61.9	100	Int	x	x	3	✓	✓	✓	08-02	0.7	LS
										61.9-63.4	100	St	x	✓	5	✓	✓	✓	08-03	0.5	LS
										63.4-64.9	70	Int	x	x	7	✓	✓	✓	08-04	0.8	LS
										64.9-66.8	80	Int	x	x	7	✓	✓	✓	08-05	1.3	360
										66.8-68.0	80	St	x	x	3	✓	✓	✓	08-06	2.2	30
										68.0-69.3	100	Int	x	x	1	x	✓	✓	08-07	1.2	5
										69.3-71.0	100	St	x	x	2	x	✓	✓	08-08	2.6	10
										71.0-72.5	100	Int	x	x	2	x	✓	✓	08-09	0.9	LS
										72.5-74.1	95	Int	✓	x	5	x	✓	✓	08-10	0.7	LS
										74.1-75.6	95	Int	✓	✓	3	✓	✓	✓	08-11	0.6	LS
										75.6-77.1	95	Int	x	x	1	x	✓	✓	08-12	2.5	LS
										77.1-78.6	90	Int	x	x	1	x	✓	✓	08-13	1.8	LS

KERR ADDISON MINES LIMITED  
SAID THE PROPERTY-Y10

DDH No. YS-86-08 PAGE 4 of 4

CORE SIZE \_\_\_\_\_ FINAL DEPTH \_\_\_\_\_

1986 DIAMOND DRILLING

LATITUDE \_\_\_\_\_ DEPARTURE \_\_\_\_\_

DIP AT COLLAR \_\_\_\_\_ BEARING \_\_\_\_\_

STARTED \_\_\_\_\_ FINISHED \_\_\_\_\_

COLLAR ELEV. \_\_\_\_\_ LOGGED BY \_\_\_\_\_

FOOTAGE		%	GRAPHIC LOG					%	DESCRIPTION	MINERALIZATION		ALTERATION		STRUCTURE	ASSAYS		
FROM	TO		RECO-VERY	ROCK TYPE	ALTERATION	MINERALIZED ZONE	STRUCTURE TO CORE			MoS <sub>2</sub>	VOL. %	MODE OF OCCURRENCE	VOL. %	TYPE MODE OF OCCURRENCE	KIND, DENSITY, ETC.	SAMPLE NO.	%
79.0	80.2	100	A	A <sub>2</sub>					Andesite: Feldspar porphyritic Kfd of qtz to wstky very broken core No veining.			Mod crystallization					
80.2	81.7	95	A	A <sub>2</sub>					Andesite: Dark green, wstky Fine grained. Shedding 10° to 30° Badly broken dirty core.			Moderate crystallization					
81.7	88.6	95	RT						Rhyolite tuff: Light green to wstky broken to muddy core No veining			Slight to intense crystallization					
————— END of HOLE —————																	



**KERR ADDISON MINES LIMITED**

DDH No. YS-86-09 PAGE 2 of 4  
 CORE SIZE \_\_\_\_\_ FINAL DEPTH \_\_\_\_\_  
 STARTED \_\_\_\_\_ FINISHED \_\_\_\_\_

**SAID THE PROPERTY-Y10**

1986 DIAMOND DRILLING

LATITUDE \_\_\_\_\_ DEPARTURE \_\_\_\_\_  
 DIP AT COLLAR \_\_\_\_\_ BEARING \_\_\_\_\_  
 COLLAR ELEV. \_\_\_\_\_ LOGGED BY \_\_\_\_\_

FOOTAGE		%	GRAPHIC LOG				%	DESCRIPTION	MINERALIZATION		ALTERATION		STRUCTURE	ASSAYS		
FROM	TO	RECOVERY	ROCK TYPE	ALTERATION	MINERALIZED ZONE	STRUCTURE TO CORE	MDS2		VOL. %	MODE OF OCCURRENCE	VOL. %	TYPE MODE OF OCCURRENCE	KIND, DENSITY, ETC.	SAMPLE NO.	% Ag	% Au
37.5	39.0	90	RT						2 cm vuggy @ 37.8 minor @ elsewhere No carbonate veins Abundant pyrochlore		sl to med arg. Green cloudy feld (sand/scr)	37.5-39.0	09-01	5.0	15	
									green to rusty soft broken core shearing and brecciation, rusty 38.7 to 39.0 @ 40°							
39.0	40.2	100	RT						Rhyolite Tuff cream to buff to grey with patches of iron staining crackle brecciated with fine quartz in places, some open fac with drusy quartz. Pyrochlore common. No carbonates		moderate silification	39.0-40.2	09-02	4.2	15	
									at veining							
40.2	47.0	100							Felsic intrusive or silicified Crystal Tuffs		silicified feldspar					
									light grey to cream, bleached Indistinct silicified feldspar crystals. Prominent fracture/shearing at 20° 44.8-45.0 Shear, strong arg, bleached 45.6-46.0 Strong arg, bleached Abundant pyrochlore. Hard to clay soft core No veining							

KERR ADDISON MINES LIMITED

SAID THE PROPERTY-Y10

1986 DIAMOND DRILLING

DDH No. YS-86-09 PAGE 3 of 4

LATITUDE \_\_\_\_\_ DEPARTURE \_\_\_\_\_

CORE SIZE \_\_\_\_\_ FINAL DEPTH \_\_\_\_\_

DIP AT COLLAR \_\_\_\_\_ BEARING \_\_\_\_\_

STARTED \_\_\_\_\_ FINISHED \_\_\_\_\_

COLLAR ELEV. \_\_\_\_\_ LOGGED BY \_\_\_\_\_

FOOTAGE		%	GRAPHIC LOG					%	DESCRIPTION	MINERALIZATION		ALTERATION		STRUCTURE KIND, DENSITY, ETC.	ASSAYS			
FROM	TO		RECO- VERY	ROCK TYPE	ALTER- ATION	MINERA- LIZED ZONE	STRUC- TURE TO CORE			MDS <sub>2</sub>	VOL. %	MODE OF OCCURRENCE	VOL. %		TYPE MODE OF OCCURRENCE	SAMPLE NO.	%	%
470	58.6	75	RH															
								<p>Rhyolite lapilli Tuff: buff to rusty to black Some large clasts. Rhy clasts in fg siliceous matrix Well fractured - numerous closed and open frac 10" to 40" but no quartz veining. Mostly soft, some hard siliceous veinlets.</p>				went to strong argillization						
58.6	62.8	100	RH															
								<p>Rhyolite lapilli Tuff: light grey to green. Indistinct clasts in strongly silicified rock.</p>				Scattered calcite veinlets			Strongly silicified Minor local argillization			
62.8	65.0	100	Gd															
								<p>Canadinite Dark green to patchy pink and grey Some grained. Network of fine chloritic fractures relatively soft.</p>				Minor calcite veinlets Trace chadachrosite			Chloritized matrix sl to moderate argillization			
65.0	65.3	100	RH															
								<p>Rhyolite lapilli Tuff light grey green upper and lower contacts at 45° and 30° dips.</p>						slight argillization				



APPENDIX II

STATEMENT OF COSTS

<u>LABOR</u> (days)	OFFICE	FIELD	TRAVEL	TOTAL	
R. Potter, Geologist RRI Fulford Harbour B.C. V0S 1C0	6	30	3	39	
			@\$176/day		\$6864.
K. Pope, Assistant Carcross, Yukon	-	11	-	11	
			@\$72/day		\$ 792.
					<u>\$7656.00</u>
<u>HELICOPTER</u>	Personnel, camp, and drill moves Frontier, Hughes 500 D				\$33,748.00
<u>CONTRACT DRILLING</u>	Drilcor Industries Ltd. 17-7449 Hume Ave., Tilbury Industrial Park Delta, B.C. V6G 1C3				
		2969 feet B.Q. @ \$18.50	-		\$54,926.00
		Camp, casing, field labour, materials			<u>\$40,211.00</u>
					\$95,137.00
<u>SAMPLES</u>	Chemex Labs Ltd. 212 Brooksbank Ave., North Vancouver, B.C.				
		Preparation \$3.75, Au \$6.50, Ag \$2.10			
		99 samples x \$12.35			\$1,223.00
		Shipping			<u>160.00</u>
					\$ 1,383.00
<u>TRUCK-</u>	Lease and fuel				\$ 2,101.00
					<u><u>\$140,025.00</u></u>
				TOTAL	\$140,025.00

## APPENDIX III

### SAMPLE PREPARATION AND ANALYSES

All samples of drill core were sent to Chemex Labs Ltd. of North Vancouver, B.C. for treatment by the following procedures:

#### Sample preparation:

Dry, crush entire sample in two stages using jaw and cone crushers, subsample and pulverize using a rotary grinder. Screen sample to -140 mesh and examine screen for metallics. If metallics are present, they are analyzed separately, otherwise the +140 mesh fraction is hand pulverized and homogenized with the original sample.

Cost per sample - \$3.75

#### Analyses:

Gold: Fire assay, atomic absorption

Detection limit 5 ppb.

Cost per sample - \$6.50

Silver: Nitric-aqua regia digestion

Analysis, atomic absorption

Detection limit 0.1 ppm

Cost per sample - \$2.10

APPENDIX IV

STATEMENT OF QUALIFICATIONS

I, Robert Potter, am a Professional Engineer registered with the Association of Professional Engineers of British Columbia. (#7650).

I have 22 years of experience in Mineral Exploration mainly in the Canadian Cordillera. I directed and took part in the 1986 drilling program on the Said The Claims.

A handwritten signature in black ink, appearing to read 'R. Potter', with a long horizontal flourish extending to the right.

Robert Potter, P.Eng.

## APPENDIX V

### SELECTIVE REFERENCES

- Nelson, J., 1985            Assessment Report - Said and The Claims  
1985 Field Program (Phase II)  
Detailed Geology, Grid Geochemistry,  
VLF Survey and Trenching Results.
- Pautler, J., 1985            Assessment Report - (Phase I)  
Said and The Claims  
Geology and Geochemistry
- Pride, Monica J., 1985      Preliminary geological map of Mt. Skukum  
Volcanic Complex 105D/2,3,4,5; 1:25000  
scale map. D.I.A.N.D. Open File
- Wheeler, J.O., 1961         Whitehorse Map Area, Yukon Territory  
105 D G.S.C. Memoir 312