



1986 TRENCHING & GEOCHEMICAL REPORT
ON THE PL 4 CLAIM 091857

Watson Lake Mining District, Y.T., NTS: 105/B-1
Latitude 60°05'N; Longitude 130°21'W

By: M.A. Stammers, B.A., FGAC
CORDILLERAN ENGINEERING

October, 1986

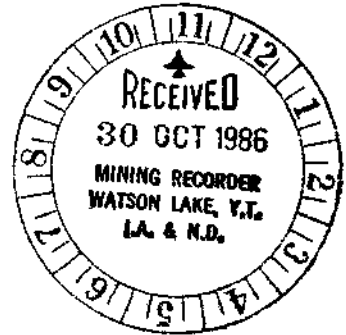

REPORT DISTRIBUTION

Watson Lake Mining Recorder: 2
Field: 1
Original (File): $\frac{1}{4}$

091857

This report has been examined by
the Geological Evaluation Unit
under Section 53 (4) Yukon Quartz
Mining Act and is allowed as
representation work in the amount

C. \$ 4225.00.

D. Emond

for Regional Manager, Exploration and
Geological Services for Commissioner
of Yukon Territory.

1986 TRENCHING & GEOCHEMICAL REPORT

ON THE PL 4 CLAIM

SITUATE IN

Watson Lake Mining District, Yukon Territory (NTS: 105/B-1)
Latitude 60°05'N; Longitude 130°21'W

For

FAIRFIELD MINERALS LTD.

1980-1055 W. Hastings Street
Vancouver, B.C. V6E 2E9

By

Michael A. Stammers, B.A., FGAC
Geologist

CORDILLERAN ENGINEERING

1980-1055 W. Hastings Street
Vancouver, B.C. V6E 2E9

WORK PERIOD: July 21, 1986 to July 27, 1986

DATE SUBMITTED: October, 1986

TABLE OF CONTENTS

<u>Section</u>		<u>Page</u>
1	SUMMARY AND CONCLUSIONS	1
2	RECOMMENDATIONS	3
3	INTRODUCTION	4
	3.1 Location and Access	4
	3.2 Physiography and Climate	4
	3.3 Exploration History	6
	3.4 1986 Exploration Program	6
	3.5 Claim Data	7
4	GEOCHEMISTRY	9
5	TRENCHING REPORT	10
6	BIBLIOGRAPHY	11
7	STATEMENT OF EXPENDITURES	12
8	LIST OF PERSONNEL AND CONTRACTORS	13
9	WRITER'S CERTIFICATE	14
10	APPENDIX: Geochemical Lab Reports	15

Tables

<u>Table 1:</u>	Claims Data	7
<u>Table 2:</u>	Trench Rock Sampling - Anomalous Results	10

Figures

<u>Figure 1:</u>	Location Map	5
<u>Figure 2:</u>	Claim Map	8

Plate

<u>Plate 1:</u>	Summary Map of 1986 Work Program (1:1000)	in pocket
-----------------	---	-----------

SECTION 1

SUMMARY AND CONCLUSIONS

The PL property consists of 70 mineral claims in the Watson Lake Mining District (NTS: 105/B-1) and is located 90 kilometres west of Watson Lake, Yukon Territory. The claims are situated 1.3 kilometres south of Kilometre 1128 of the Alaska Highway. The Tootsee River secondary road passes through the eastern PL claims. Staking of the PL claims was initiated in June 1984 and completed by October 1984. Property acquisition and subsequent work have been conducted by Cordilleran Engineering on behalf of Regional Resources Ltd. Claim ownership was transferred to Fairfield Minerals Ltd. in May, 1986.

The PL claims cover mixed forest and subalpine terrain with poor exposure of rock units. Relief is gentle to moderate with elevations ranging from 925 to 1400 metres above sea level.

During the 1986 field season work included bulldozer trenching and fill-in soil geochemical sampling in the western PL claims area. This assessment report deals only with that work performed on the PL 4 mineral claim.

The geological setting and potential for significant silver-lead-zinc replacement-type mineralization on the PL property is good. A similar environment in the younger McDame-Sylvester Group sequence of rocks exists at the nearby Midway silver-lead-zinc deposits of Regional Resources Ltd. located 13 kilometres to the south.

Six major north-south trending litho-units have been recognized on the PL property. They include: Lower Cambrian or earlier orthoquartzite, quartzite, siltstone, shale, biotite-muscovite schist/phyllite, limestone and dolomite, carbonaceous phyllite and Cretaceous aged granodiorite to quartz-monzonite of the Cassiar Batholith.

Mineralization located to date on the PL claim group includes float occurrences of lead-zinc-silver bearing mangano-siderite and manganese oxides. Results from assay samples collected during the 1984 programme include values to 21.80% Pb, 43.00% Zn, 14.24 oz/ton Ag and 0.017 oz/ton Au.

Bulldozer trenching of soil geochemical anomalies in areas with float mineral boulders turned up only small, poddy occurrences of iron and manganese oxides with minor associated nodules and stringers of galena. Best results from

the three trenches cut on the PL 4 mineral claim include a four metre continuous chip sample taken through a highly fractured limestone section in trench 7 which assayed 1.82% Zn and 0.75 oz/ton Ag.

Fill-in soil geochemistry confirmed continuity of previously indicated Pb-Zn-Ag anomalies.

No further work is recommended at this time.

SECTION 2

RECOMMENDATIONS

No further work on the PL claims is presently recommended. A review of the data should be made prior to the claims expiry in late 1989.

Respectfully submitted

CORDILLERAN ENGINEERING



M. A. Stammers, B.A., FGAC

SECTION 3

INTRODUCTION

This report describes a program of soil sampling and trenching conducted on the PL claim group during the period July 21, 1986 to July 27, 1986.

3.1

LOCATION AND ACCESS

The PL property is located 90 kilometres west of Watson Lake, Yukon at latitude 60°15'N and longitude 130°21'W (Figure 1). The claims are situated 1.3 kilometres south of Kilometre 1128 (Milepost 701) of the Alaska Highway. The Tootsee River secondary road passes through the eastern third of the PL property. In 1986, the Butler Mountain property access road was extended 1.0 kilometre to the south boundary of the PL 4 mineral claim. Field operations were based out of Regional Resources Ltd. Midway camp located 13 kilometres (20 kilometres by road) to the south. Access to the property was by four wheel drive truck.

3.2

PHYSIOGRAPHY AND CLIMATE

The claims cover mixed forest and subalpine terrain. A portion of the northern and western claims lies in an area of old burn with brush and pine secondary growth. Relief on the property is gentle to moderate with occasional steep relief in areas of bluff-forming limestone outcrop. Elevations range from 925 to 1400 metres above sea level.

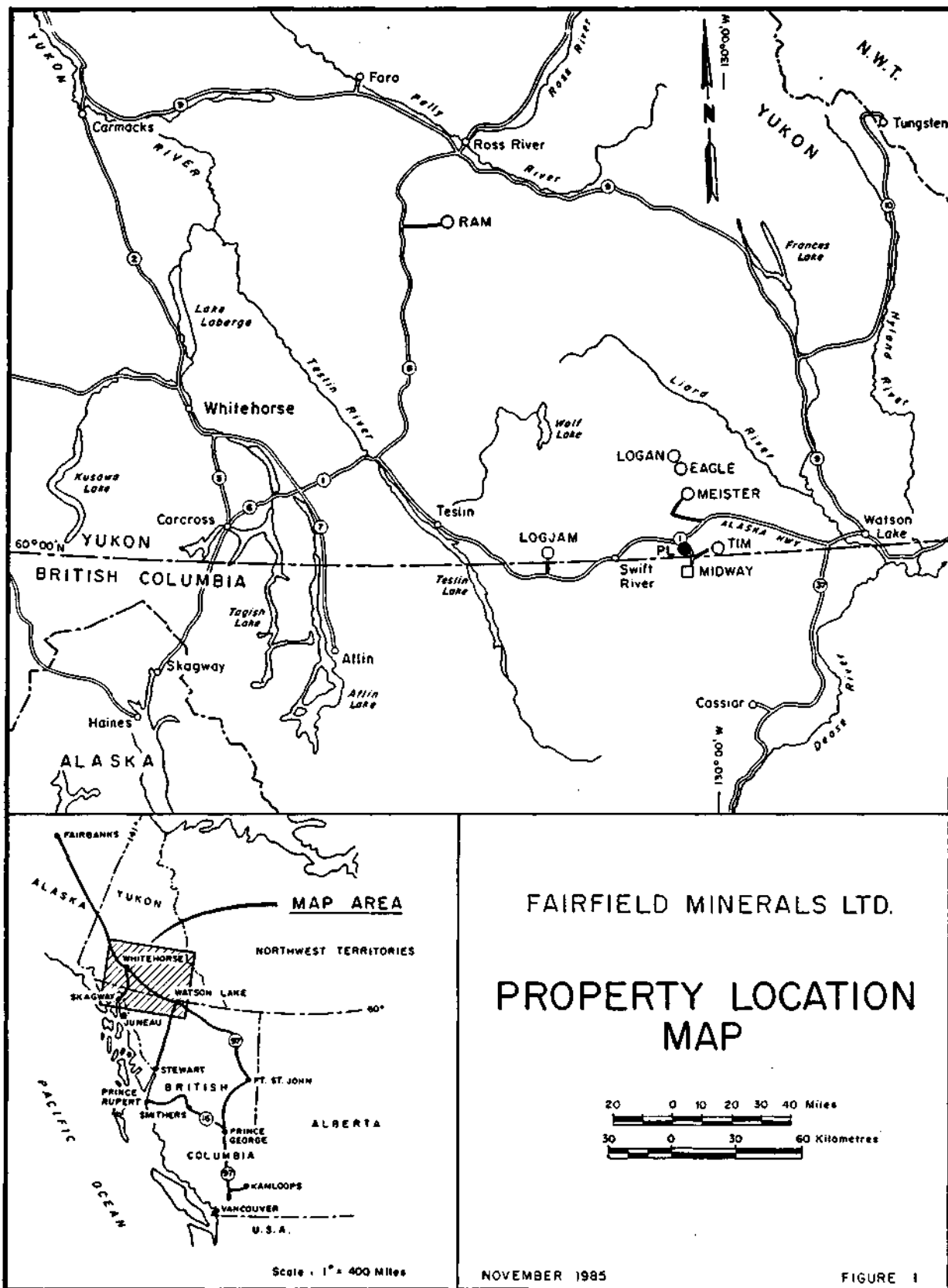

Climate in the PL claims area is characterized by short, warm summers and long, cold winters. Precipitation is light to moderate year around. The best exploration season lasts from early June to late September.

3.3

EXPLORATION HISTORY

The PL 1-60 claims were staked in June 1984 to cover favourable Pb-Zn-Ag mineralization when the ban on acquiring mineral rights in the Alaska Highway Pipeline Corridor was lifted. The PL 61-70 claims were added in July 1984. The PL 1, 2, 13 to 18, 20 and 27 to 30 mineral claims were disallowed following an inquiry into area staking that saw as many as five parties claiming rights in the PL property area. However, restaking and recording of the above listed claims was completed in November 1984 effectively returning much of the disputed ground's ownership to Regional Resources Ltd. The claims were transferred to Fairfield Minerals Ltd. in May, 1986.

The PL property lies immediately north of a large block of claims owned or optioned by Butler Mountain Minerals Corp. Butler Mountain's holdings include the YP, LOLA, LYDIA and TOM claims. Geological, geochemical and geophysical surveys and diamond drilling have been completed on the Pb-Zn-Ag-Au property over the past few years.

3.4

1986 EXPLORATION PROGRAM

A trenching and geochemical exploration program was undertaken on the PL 4 mineral claim between July 21, 1986 to July 27, 1986.

A 1.0 km four wheel drive access road was constructed from an existing road on the Butler Mountain property north to the PL 4 mineral claim.

A total of 18 grid soil samples, 31 trench soil samples, and 29 trench rock samples were collected from the PL 4 mineral claim.

Trenching on the PL 4 mineral claim was done with a D6 C bulldozer owned and operated by Arctic Diamond Drilling Ltd. Three trenches comprising 300 linear metres were cut, mucked and systematically sampled and mapped.

All exploration work was performed by Cordilleran Engineering on behalf of Fairfield Minerals Ltd.

3.5

CLAIM DATA

The PL property consists of 70 contiguous quartz mineral claims located in the Watson Lake Mining District, Yukon Territory (Figure 2). The claims are owned by Fairfield Minerals Ltd. of Vancouver, B.C. The PL 1, 2, 13, 16 to 20, 27 and 29 claims overlap the previously recorded KENT mineral claims and by order of priority right are apportionately less than full size. Table 1 lists the claim data.

Table 1

CLAIM DATA

<u>Claim Name</u>	<u>Record Numbers</u>	<u>Expiry Date(s)</u>
PL 1-2	YA 72517 - 18	December 31, 1989*
PL 3-12	YA 71146 - 155	December 31, 1989
PL 13-18	YA 72519 - 524	December 31, 1989*
PL 19	YA 71162	December 31, 1989
PL 20	YA 72525	December 31, 1989*
PL 21-26	YA 71164 - 169	December 31, 1989
PL 27-30	YA 72526 - 529	December 31, 1989*
PL 31-60	YA 71175 - 203	December 31, 1989
PL 61-70	YA 71329 - 338	December 31, 1989

*Pending expiry date applying 1986 assessment work on these claims.

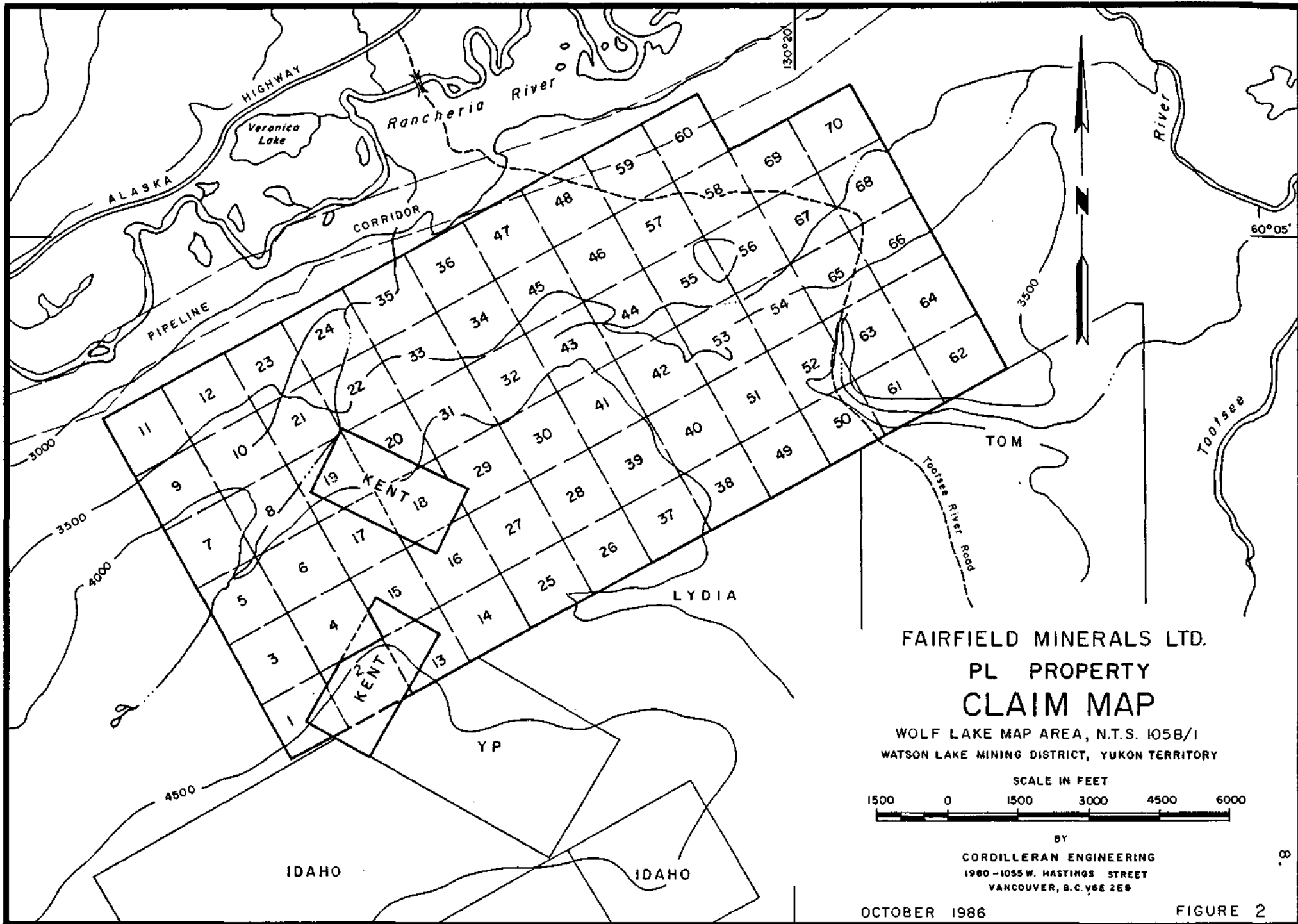

FIGURE 2

SECTION 4

GEOCHEMISTRY

A total of 18 grid soil samples were collected, from the 'B' or 'C' soil horizon, every 50 metres on lines 7+00N and 9+00N. Lines 6+00N, 8+00N and 10+00N were previously sampled giving a net 100 metre line spacing. In addition, 31 soil samples were collected from 'C' horizon material every 10 metres in trenches 1, 6, and 7. Samples were placed in grid-numbered kraft soil bags and the corresponding sample location was marked in the field by a grid numbered piece of plastic flagging tape. Notes were made in the field giving sample depth, colour, texture and local physiography.

After drying the samples in camp, they were shipped to Bondar-Clegg and Company Ltd.'s North Vancouver, B.C. laboratory for sample preparation and analysis. The sieved minus 80-mesh fraction was digested with a hot extraction HNO_3 -HCl solution and lead-zinc-silver analyses were completed using standard atomic absorption techniques. Laboratory analytical reports are appended to this report.

For rock geochemical samples, the same procedure was initiated after crushing the sample and selecting the minus 100-mesh size fraction. Rock samples for assay were crushed to obtain the minus 150-mesh size fraction and after acid digestion were analysed for gold and silver by fire assay and for lead and zinc by atomic absorption.

Results of soil sampling are plotted on Plate 1. For the most part, grid sampling has duplicated or improved previous results. For lead and zinc, the best values include: 1880, 520 and 495 ppm Pb; and 2400, 2200 and 1300 ppm Zn. Silver values are generally low with best values of 2.2, 1.5 and 0.9 ppm.

Results of trench soil sampling are generally higher as samples were collected within known mineralized areas. In trench 1, values to 289 ppm Pb, 1100 ppm Zn and 0.8 ppm Ag were returned. In trench 6, most values returned are strongly anomalous. At the 90.0 metre mark near the east end of the trench values of 3.62% Pb, 2.58% Zn and 11.0 ppm Ag were returned. At 30 m, the sample results were 1135 ppm Pb, 7200 ppm Zn and 3.6 ppm Ag. In trench 7, values to 1.24% Pb, 4000 ppm Zn and 21.0 ppm Ag were obtained.

Anomalous soil geochemical results from grid and trench sampling can be attributed to small oxide mineral bodies and to minor galena and zinc bearing oxides found within fracture fillings in the limestone and dolomite host rocks.

SECTION 5

TRENCHING REPORT

Three trenches comprising 300 linear metres (1800 cubic metres) were completed on the PL 4 mineral claim. Trenches were soil sampled every 10 metres and rock samples collected for analysis over selected intervals. Four continuous rock chip samples were collected over short intervals and sent for assay. Table 2 summarizes anomalous results for both rock geochemistry and assay samples. All analytical results are appended to this report.

Trench 1 exposed variably fractured limestone and dolomite. No significant results were obtained from rock sampling.

Trench 6 cut through moderately fractured dolomite with local mineralization comprising mangano-siderite and minor galena. A one-metre continuous rock chip sample across a mangano-siderite oxide pod ran 1.21% Pb, 6300 ppm Zn and 7.9 ppm Ag. A two metre continuous rock chip sample across a galena-bearing fractured dolomite assayed 0.17% Zn, 0.14% Pb and 0.04 oz/ton Ag.

In trench 7, three small zones of interest broke the otherwise monotonous sequence of limestone and dolomite. Near the west end of the trench two metres of calcite-healed dolomite breccia bearing iron oxides assayed 0.81% Zn, 0.20% Pb and 0.24 oz/ton Ag. A four metre section near the centre of the trench exposed highly fractured limestone with calcite veinlets and swarms. This manganese oxide bearing carbonate assayed 1.82% Zn, 0.27% Pb and 0.75 oz/ton Ag across the 4 metres. A 0.25 metre wide oxide zone was exposed in the eastern end of the trench. A two metre continuous chip sample across this zone and through altered wallrock ran 0.32% Zn, 0.18% Pb and 0.31 oz/ton Ag.

Table 2

TRENCH ROCK SAMPLING - ANOMALOUS RESULTS

<u>Trench No.</u>	<u>Tag No.</u>	<u>Sample Type</u>	<u>Length</u>	<u>Pb</u>	<u>Zn</u>	<u>Ag</u>	<u>Au</u>
1	No anomalous results						
6	17253	Geochem	15 m	570 ppm	2200 ppm	<.2 ppm	-
6	17254	Assay	2 m	0.14 %	0.17 %	0.04 oz/ton	<.002 oz/ton
6	17258	Geochem-Assay	1 m	1.21 %	6300 ppm	7.9 ppm	-
6	17259	Geochem	10 m	322 ppm	330 ppm	<.2 ppm	-
6	17260	Geochem	10 m	640 ppm	1280 ppm	<.2 ppm	-
6	17261	Geochem	10 m	283 ppm	820 ppm	<.2 ppm	-
7	17265	Assay	2 m	0.20 %	0.81 %	0.24 oz/ton	<.002 oz/ton
7	172671A	Assay	4 m	0.27 %	1.82 %	0.75 oz/ton	<.002 oz/ton
7	17275	Assay	2 m	0.18 %	0.32 %	0.31 oz/ton	<.002 oz/ton

SECTION 6

BIBLIOGRAPHY

1. Geological Survey of Canada, Map 10-1960.

2. 1984 Geological, Geochemical and Road Construction Report
on the PL Claim Group, April, 1985.
1984 Yukon Assessment Report.

SECTION 7

STATEMENT OF EXPENDITURES

CANADA } In the matter of a geochemical and trenching report on the PL mineral
TO WIT } claims on behalf of Fairfield Minerals Ltd.

I, Michael A. Stammers, agent for Fairfield Minerals Ltd. of 1980-1055 W. Hastings Street, Vancouver, B.C. V6E 2E9 do solemnly declare; that an exploration program was undertaken on the PL 4 mineral claim during the period July 21, 1986 to July 27, 1986 and that the following expenses were incurred performing the work and in later preparation of the report.

WAGES:

Field:	Geologist/Supervisor	2d x \$160/d x \$1.35*	... 432.00	
	Senior Assistant	3d x 100/d x 1.35	... 405.00	
	Geological Assistant	3d x 68/d x 1.35	... 275.40	
	Senior Sampler	3d x 88/d x 1.35	... 356.40	
	Sampler	3d x 64/d x 1.35	... 259.20	
Office:	Geologist/Report Preparation	2d x 190/d	... <u>380.00</u>	\$2,108.00

*1.35 = overtime and benefits factor

<u>PROFESSIONAL SERVICES & MANAGEMENT FEES:</u>	Cordilleran Engineering	1,482.80
<u>ROOM & BOARD:</u>	Crew & Operator	20d x \$25/d	500.00
<u>GEOCHEMICAL ANALYSIS:</u>	49 Pb-Zn-Ag @ \$4.90/soil sample	... 240.10	
	25 Pb-Zn-Ag @ \$7.25/rock sample	... <u>181.25</u>	421.35
<u>ASSAYS:</u>	4 Pb-Zn-Ag-Au @ \$27.75/sample	111.00
<u>TRENCHING:</u>	Bulldozer trenching and access trail	2,461.80
<u>CONTRACT DRAFTING:</u>		400.00
<u>FREIGHT:</u>		50.00
<u>PRINTING, OFFICE SERVICES:</u>		<u>50.00</u>
			<u>\$7,584.95</u>

And, I make this solemn declaration conscientiously believing it to be true and knowing that it is of the same force and effect as if made under oath and by virtue of the Canada Evidence Act.

Declared before me at Vancouver
in the Province of British Columbia }
this 27 day of October, 1986

Michael Stammers

[Signature]
~~A Commissioner for Oaths for Yukon Territory or Notary Public for Yukon Territory.~~
A NOTARY PUBLIC FOR BRITISH COLUMBIA

SECTION 8

LIST OF PERSONNEL & CONTRACTORSPERSONNEL:

<u>Name/Address</u>	<u>Position</u>	<u>Dates Worked</u>	<u>Days Worked</u>
Louise Gosselin Vancouver, B.C.	Sampler	July 21, 26, 27/1986	3
Kim Meidal Vancouver, B.C.	Geological Assistant	July 21, 26, 27/1986	3
Peter Newman North Vancouver, B.C.	Senior Assistant	July 21, 26, 27/1986	3
Mike Stammers Port Coquitlam, B.C.	Supervisor	July 21, 26/1986	2
Jan Tindle Whistler, B.C.	Senior Sampler	July 21, 26, 27/1986	3

CONTRACTOR:

<u>Name/Address</u>	<u>Equipment</u>	<u>Dates Worked</u>	<u>Days Worked</u>
Arctic Diamond Drilling Whitehorse, Yukon	D6-C Dozer	July 21, 24, 25, 27/1986	4

CORDILLERAN ENGINEERING

1980 GUINNESS TOWER, 1055 WEST HASTINGS STREET, VANCOUVER, B.C. V6E 2E9 TEL: (604) 681-8381

SECTION 9**WRITER'S CERTIFICATE**

I, Michael A. Stammers of Port Coquitlam, British Columbia hereby certify that:

1. I am a geologist residing at 1134 Lombardy Drive, and employed by Cordilleran Engineering of 1980-1055 W. Hastings Street, Vancouver, British Columbia.
2. I have received a B.A. degree in Geology and Geography from McMaster University, Hamilton, Ontario in 1977 and I am a Fellow of the Geological Association of Canada.
3. I have practiced my profession for thirteen years in British Columbia, Yukon and the Northwest Territories.
4. I am the author of this report and the supervisor fo the field work conducted on the PL claims by Cordilleran Engineering during the period July 21 to July 27, 1986.
5. I have no beneficial interest in the claims covered by this report or in Fairfield Minerals Ltd.

CORDILLERAN ENGINEERING



MAS/z
October, 1986
Vancouver, British Columbia

M. A. Stammers, B.A.
Geologist

SECTION 10

APPENDIX: GEOCHEMICAL LAB REPORTS



REPORT: 126-2374

PROJECT: PL

PAGE 1

SAMPLE NUMBER	ELEMENT UNITS	Pb PPM	Zn PPM	Ag PPM	SAMPLE NUMBER	ELEMENT UNITS	Pb PPM	Zn PPM	Ag PPM
SI P 0700N 1300E		13	50	<0.2	SI TRENCH #1 0m		247	290	0.4
SI P 0700N 1350E		17	40	0.2	SI TRENCH #1 10m		239	358	0.8
SI P 0700N 1400E		91	520	<0.2	SI TRENCH #1 20m		89	200	<0.2
SI P 0700N 1450E		204	920	<0.2	SI TRENCH #1 30m		217	1100	0.6
SI P 0700N 1500E		160	300	0.4	SI TRENCH #1 40m		120	188	<0.2
SI P 0700N 1550E		59	184	0.4	SI TRENCH #6 0m		1125	520	1.1
SI P 0700N 1600E		495	1000	0.9	SI TRENCH #6 15m		243	520	0.3
SI P 0700N 1650E		520	1230	0.9	SI TRENCH #6 30m		1125	7200	2.6
SI P 0700N 1700E		312	860	0.4	SI TRENCH #6 40m		765	800	1.0
SI P 0700N 1750E		109	190	<0.2	SI TRENCH #6 50m		405	870	1.1
SI P 0700N 1800E		51	220	<0.2	SI TRENCH #6 60m		960	1340	1.0
SI P 0700N 1850E		86	356	0.2	SI TRENCH #6 70m		1090	1880	1.9
SI P 0700N 1900E		123	510	<0.2	SI TRENCH #6 80m		535	1020	0.7
SI P 0700N 1950E		56	380	<0.2	SI TRENCH #6 90m		>10000	>20000	11.0
SI P 0700N 2000E		95	332	<0.2			2.65	3.2	
SI P 0900N 1300E		155	1300	<0.2	SI TRENCH #6 100m		410	660	0.7
SI P 0900N 1350E		10	82	<0.2	SI TRENCH #7 0m		101	690	0.8
SI P 0900N 1400E		9	122	<0.2	SI TRENCH #7 10m		166	600	1.1
SI P 0900N 1450E		49	230	0.2	SI TRENCH #7 20m		277	790	1.6
SI P 0900N 1500E		28	200	<0.2	SI TRENCH #7 30m		233	520	1.0
SI P 0900N 1550E		117	660	0.2	SI TRENCH #7 40m		319	250	0.7
SI P 0900N 1600E		410	1050	1.5	SI TRENCH #7 50m		395	800	0.8
SI P 0900N 1650E		1880	2400	2.2	SI TRENCH #7 60m		181	340	0.4
SI P 0900N 1700E		455	1070	0.9	SI TRENCH #7 70m		206	480	0.4
SI P 0900N 1750E		332	2300	0.4	SI TRENCH #7 80m		245	356	0.4
					SI TRENCH #7 90m		465	920	1.3
					SI TRENCH #7 100m		301	690	0.9
					SI TRENCH #7 110m		440	1020	1.2
					SI TRENCH #7 120m		>>>>10000	4900	21.0
					SI TRENCH #7 130m		570	1240	1.0
					SI TRENCH #7 140m		700	1860	1.2
					SI TRENCH #7 150m		290	580	0.3

A Company Ltd.
 301 AVE.
 JOHNS, B.C.
 V7P 2R5
 (604) 955-0881
 204-752667

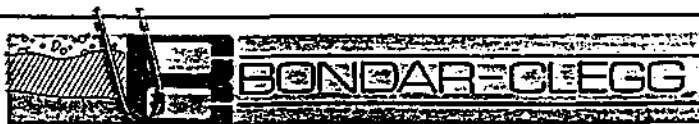

Certificate
 of Analysis

REPORT: 626-3374

PROJECT: PL

PAGE 1

SAMPLE NUMBER	ELEMENT UNITS	Pb PCT	Zn PCT
S1 TRENCH #6 90m		3.62	2.58
S1 TRENCH #7 120m		1.24	

A Company Ltd.
 301 AVE.
 JOHNS, B.C.
 V7P 2R5
 (604) 955-0881
 204-752667



Geochemical
 Lab Report

REPORT: 126-3195

PROJECT: PL

PAGE 1

SAMPLE NUMBER	ELEMENT UNITS	Pb PPM	Zn PPM	Ag PPM	SAMPLE NUMBER	ELEMENT UNITS	Pb PPM	Zn PPM	Ag PPM
R2 17215		19	78	<0.2	R2 17259		322	330	<0.2
R2 17216		12	74	<0.2	R2 17260		640	1280	<0.2
					R2 17261		283	620	<0.2
					R2 17262		73	156	<0.2
					R2 17263		28	85	<0.2
					R2 17264		71	276	<0.2
					R2 17266		87	198	<0.2
					R2 17267		32	88	<0.2
					R2 17268		113	254	<0.2
					R2 17269		54	126	<0.2
					R2 17270		24	56	<0.2
					R2 17271		46	52	<0.2
					R2 17272		104	232	<0.2
					R2 17273		53	204	<0.2
R2 17252		78	134	<0.2	R2 17274		40	210	0.5
R2 17253		570	2200	<0.2	R2 17276		555	140	<0.2
R2 17255		116	224	<0.2	R2 17277		33	168	<0.2
R2 17256		101	225	<0.2					
R2 17257		131	354	<0.2					
R2 17259		>10000	6360	7.9					

Company Ltd.
 1000 Ave.
 Vancouver, B.C.
 V7P 2R5
 Tel: (604) 983-0681
 Fax: 04-352667



BONDAR-CLEGG

Certificate
 of Analysis

REPORT: 426-3181

PROJECT: PL PAGE 1

SAMPLE NUMBER	ELEMENT UNITS	Au OPT	Ag OPT	Pb PCT	Zn PCT	DESCRIPTION
R2 17254		<0.002	0.04	0.14	0.17	TR 6 30.0m-32.0m (2.0m)
R2 17265		<0.002	0.24	0.20	0.81	TR 7 20.0m-22.0m (2.0m)
R2 17271A		<0.002	0.75	0.27	1.82	TR 7 83.0m-87.0m (4.0m)
R2 17275		<0.002	0.21	0.18	0.32	TR 7 120.5m-122.5m (2.0m)

Company Ltd.
 1000 Ave.
 Vancouver, B.C.
 V7P 2R5
 Tel: (604) 983-0681
 Fax: 04-352667



BONDAR-CLEGG

Certificate
 of Analysis

REPORT: 626-3195

PROJECT: PL PAGE 1

SAMPLE NUMBER	ELEMENT UNITS	Pt PCT
R2 17259		1.21

PL 5 | PL 6
PL 3 | PL 4

9+00 N

159, 1300, <

10, 182, <

8, 122, <

49, 230, <

28, 200, <

117, 660, <

410, 1050, 1.5

247, 290, 4
289, 358, 8
89, 200, <
217, 1100, 6
120, 188, <

TRENCH 1

GALENA IN FRACTURED DOLOMITE

TRENCH 6

GALENA IN CALCITE VEINS

MANGANOSIDERITE OXIDE POD

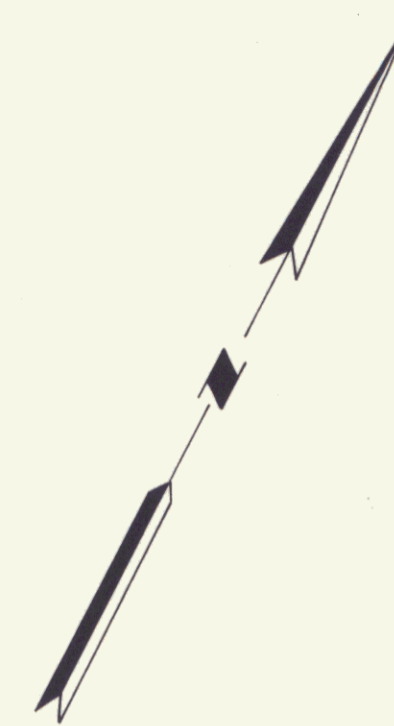

EXPLANATION

- 204, 820, .4 SOIL SAMPLE LOCATION
RESULTS FOR Pb, Zn, Ag IN PARTS PER MILLION
EXCEPT WHERE NOTED
- TRENCH OUTLINE
- ROCK SAMPLE LOCATION
GIVING TAG NUMBER, RESULTS IN TEXT
- ⊕ CLAIM POST LOCATION
- * MINERALIZATION

GRANODIORITE

DOLOMITE / LIMESTONE

7+00 N

13, 50, <

17, 40, <

91, 520, <

204, 820, <

160, 380, 4

59, 184, 4

101, 600, 8
156, 600, 1.1
379, 700, 1.6
283, 520, 1.0
319, 350, 1.7
395, 800, 8
181, 340, 4
206, 1, 680, 4
245, 365, 4
465, 920, 1.3
301, 600, 9
440, 1020, 1.2
1.24% Ag, 1400, 21.0
570, 1240, 1.0
700, 1880, 1.2
290, 580, 8

CALCITE VEINLETS AND SWARMS
1.82% Zn
0.75 oz/ton Ag
over 4m.

TRENCH 7

CALCITE-HEALED DOLOMITE BRECCIA

MANGANOSIDERITE
OXIDE PODS

APPROXIMATE CLAIM BOUNDARY

13+00 E

14+00 E

15+00 E

16+00 E

PL 4 PL 15

PL 2 PL 13

PL 3 | PL 4
PL 1 | PL 2

FAIRFIELD MINERALS LTD. SUMMARY MAP OF 1986 WORK PROGRAM

PL PROPERTY
WOLF LAKE MAP AREA, N.T.S. 105B/1
WATSON LAKE MINING DISTRICT, YUKON TERRITORY

SCALE = 1:1,000

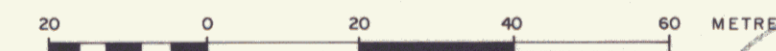

BY
CORDILLERAN ENGINEERING
1980 - 1055 W. HASTINGS STREET
VANCOUVER, B.C. V6E 2E9



OCTOBER 1986

091857

PLATE 1