

HUDSON BAY EXPLORATION AND DEVELOPMENT COMPANY LIMITED

100 - 10 Burns Rd.  
Whitehorse, Yukon Territory Y1A 4Y9  
Telephone (403) 668-4588

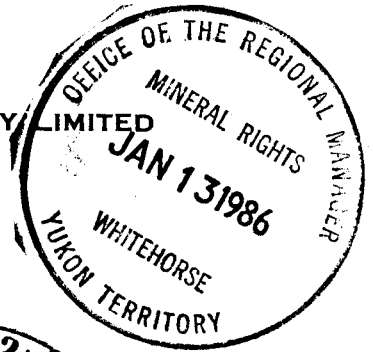

CANYON-GRAND CLAIMS

ROTARY DRILL PROGRAM

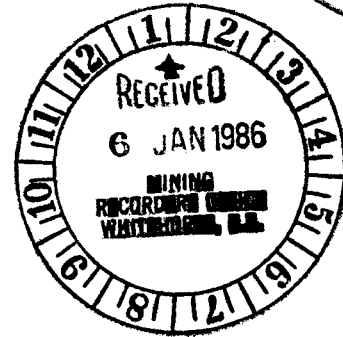

August 30 - September 14, 1985

Location Plans

Assay Sheets

Rock Chip Logs

Invoices

RH 13-19

Whitehorse Mining District  
NTS 105 K 2/3

091727

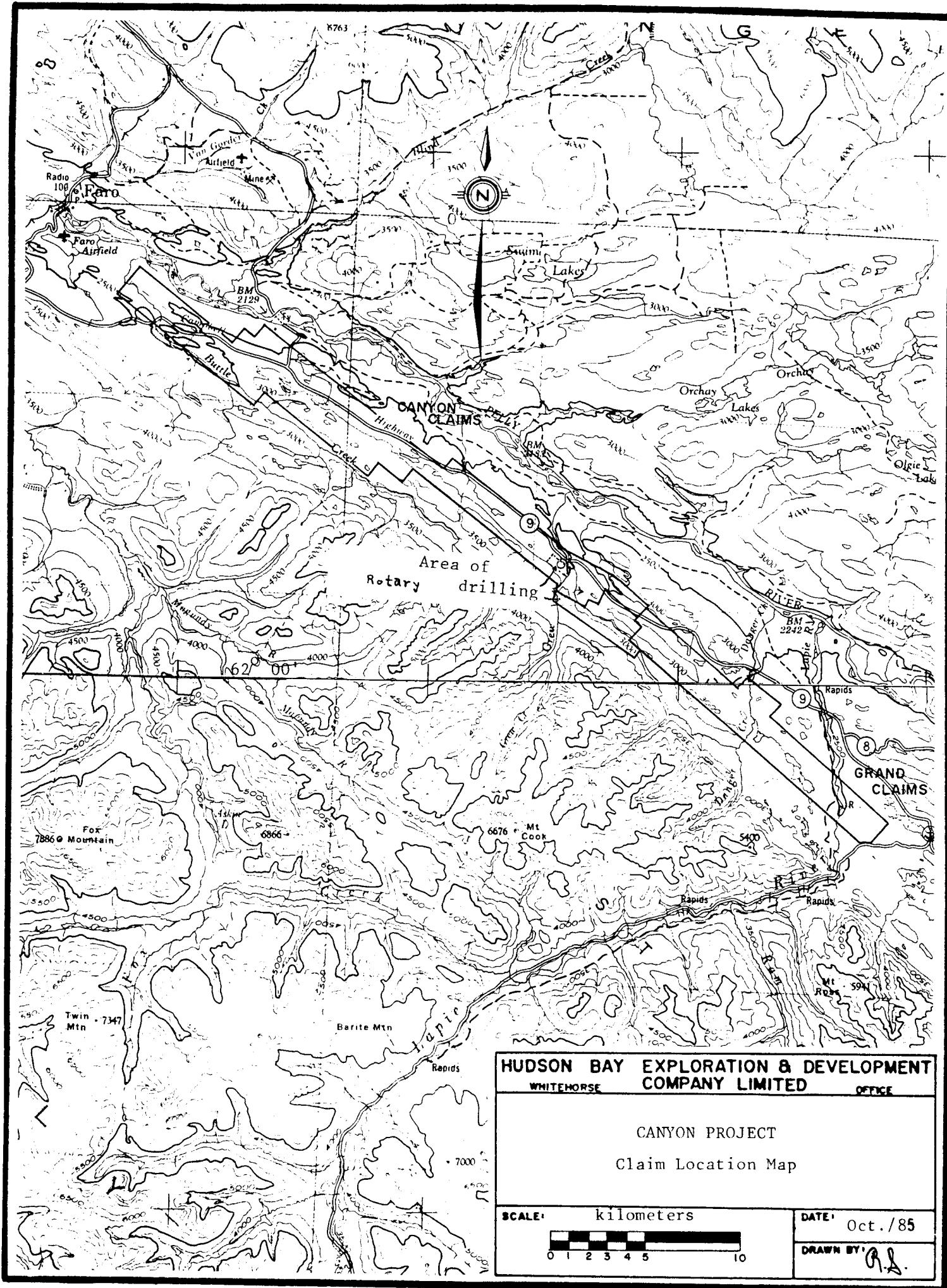

**HUDSON BAY EXPLORATION & DEVELOPMENT  
WHITEHORSE COMPANY LIMITED OFFICE**

**CANYON PROJECT  
Claim Location Map**

**SCALE:** kilometers  
0 1 2 3 4 5 10

**DATE:** Oct./85

**DRAWN BY:** R.L.

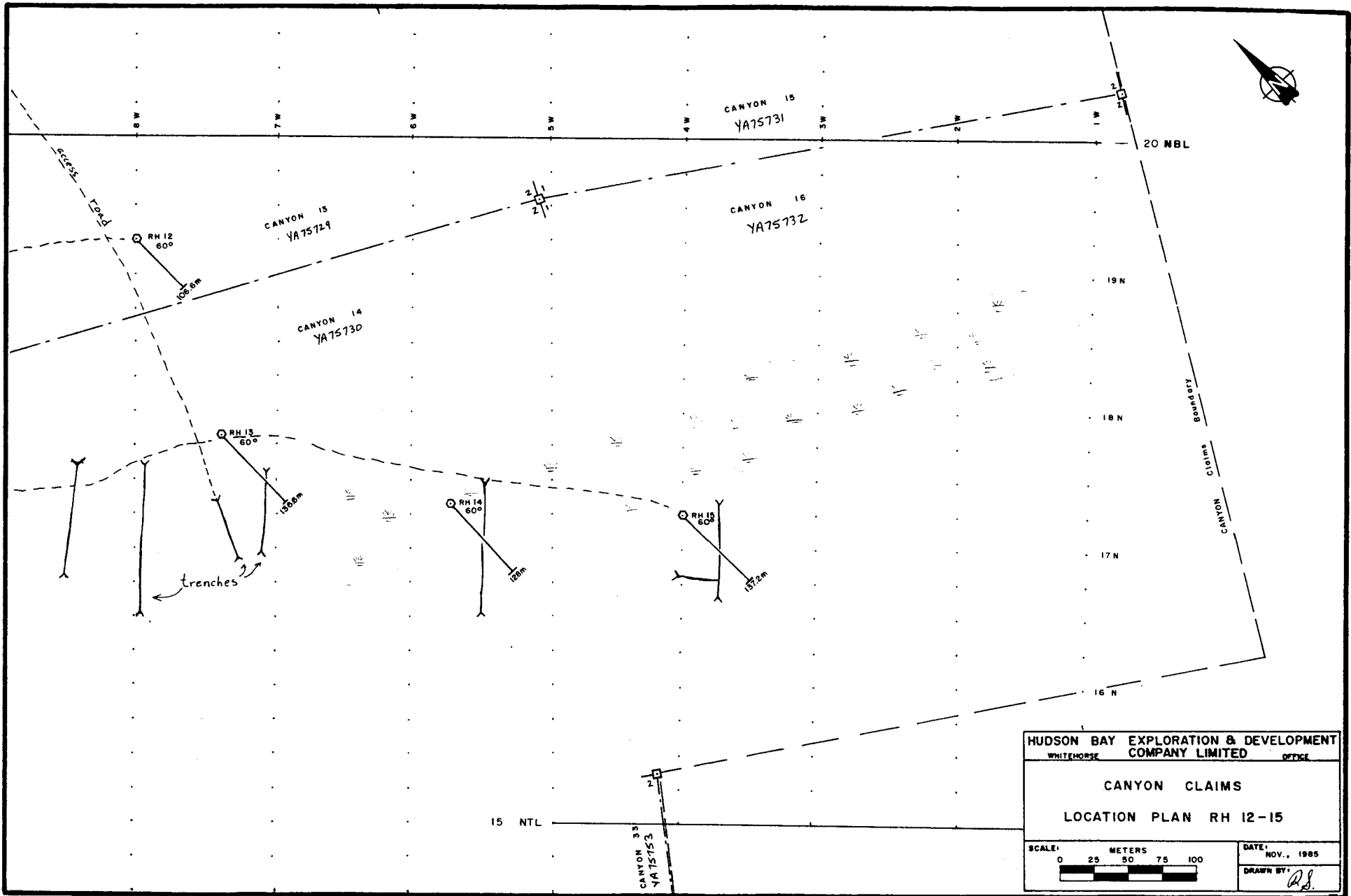

HUDSON BAY EXPLORATION AND DEVELOPMENT COMPANY LIMITED  
Northwest District

Dec 16/85

Project: CANYON (7302)

page 1 of 1

Rotary Drill Hole No.: RH-13	Claim No.: Canyon 14(YA75730)	HOLE SURVEYS (corrected)
Co-ordinates: 7+40W	Hole Size: 4 inch	depth direction dip
17+80N	Date Started: Aug 30/85	
Collar Elev.:	Completed: Sep 04/85	
Azimuth: grid S45E	Logged by: T. Garagan	
Angle: -60	Section: 7+00W	
Hole Depth: 135.64 metres	% Recovery:	

till silver values <5 ppm shown as 2.0  
bedrock silver values <0.2 ppm shown as 0.1

FROM	TO	SAMPLE No.	WIDTH (metres)	WEIGHT (kgm)	GOLD counts	Conc Wt (gm)	Conc. factor	GOLD (ppb)	SILVER (ppm)	ARSENIC (ppm)	ANTINONY (ppm)	IRON (%)
0.00	3.05		3.05									
0.00	1.52	RH13-1	1.52	37	0	11.8	3.136	240	2.0	246	29.0	29.0
1.52	3.05	RH13-2	1.52	42	0	13.5	3.111	410	2.0	256	17.0	10.0

till sampling results for Ba, Cd, Cr, Co, Hf, Ir, La, Mo, Ni, Se, Na, Ta, Th, W, U and Zn are listed in Appendix F.

3.05	135.64		132.59									
3.05	4.57	40866	1.52					2	0.1			
4.57	6.10	40867	1.52					2	0.1			
6.10	7.62	40868	1.52					5	0.1			
7.62	9.14	40869	1.52					15	0.1			
9.14	10.67	40870	1.52					15	0.1			
10.67	12.19	40871	1.52					15	0.1			
12.19	13.72	40872	1.52					30	0.1			
13.72	15.24	40873	1.52					25	0.1			
15.24	16.76	40874	1.52					25	0.1			
16.76	18.29	40875	1.52					25	0.1			
18.29	19.81	40876	1.52					10	0.1			
19.81	21.34	40877	1.52					25	0.1			
21.34	22.86	40878	1.52					20	0.1			
22.86	24.38	40879	1.52					25	0.1			
24.38	25.91	40880	1.52					20	0.1			
25.91	27.43	40881	1.52					55	0.2			
27.43	28.96	40882	1.52					35	0.1			
28.96	30.48	40883	1.52					15	0.1			
30.48	32.00	40884	1.52					10	0.1			
32.00	33.53	40885	1.52					10	0.1			
33.53	35.05	40886	1.52					20	0.1			
35.05	36.58	40887	1.52					30	0.1			
36.58	38.10	40888	1.52					15	0.1			
38.10	39.62	40889	1.52					20	0.1			
39.62	41.15	40890	1.52					35	0.1			
41.15	42.67	40891	1.52					25	0.1			
42.67	44.20	40892	1.52					15	0.1			
44.20	45.72	40893	1.52					20	0.1			
45.72	47.24	40894	1.52					180	0.4			
47.24	48.77	40895	1.52					75	0.1			
48.77	50.29	40896	1.52					40	0.1			
50.29	51.82	40897	1.52					20	0.1			
51.82	53.34	40898	1.52					25	0.1			
53.34	54.86	40899	1.52					20	0.1			
54.86	56.39	40900	1.52					40	0.1			
56.39	57.91	40909	1.52					30	0.1			
57.91	59.44	39858	1.52					85	0.3			
59.44	60.96	39859	1.52					15	0.1			

60.96	62.48	39860	1.52	10	0.1
62.48	64.01	39861	1.52	20	0.3
64.01	65.53	39862	1.52	40	0.3
65.53	67.06	39863	1.52	25	0.2
67.06	68.58	39864	1.52	15	0.2
68.58	70.10	39865	1.52	25	0.1
70.10	71.63	39866	1.52	35	0.2
71.63	73.15	39867	1.52	30	0.3
73.15	74.68	39868	1.52	50	0.2
74.68	76.20	39869	1.52	65	0.2
76.20	77.72	39870	1.52	50	0.2
77.72	79.25	39871	1.52	65	0.2
79.25	80.77	39872	1.52	95	0.1
80.77	82.30	39873	1.52	30	0.1
82.30	83.82	39874	1.52	15	0.1
83.82	85.34	39875	1.52	10	0.1
85.34	86.87	39876	1.52	30	0.1
86.87	88.39	39877	1.52	35	0.1
88.39	89.92	39878	1.52	50	0.1
89.92	91.44	39879	1.52	10	0.1
91.44	92.96	39880	1.52	15	0.1
92.96	94.49	39881	1.52	30	0.1
94.49	96.01	39882	1.52	45	0.1
96.01	97.54	39883	1.52	15	0.1
97.54	99.06	39884	1.52	5	0.1
99.06	100.58	39885	1.52	25	0.1
100.58	102.11	39886	1.52	55	0.1
102.11	103.63	39887	1.52	20	0.1
103.63	105.16	39888	1.52	15	0.1
105.16	106.68	39889	1.52	40	0.1
106.68	108.20	39890	1.52	5	0.1
108.20	109.73	39891	1.52	2	0.1
109.73	111.25	39892	1.52	2	0.1
111.25	112.78	39893	1.52	2	0.1
112.78	114.30	39894	1.52	2	0.1
114.30	115.82	39895	1.52	2	0.1
115.82	117.35	39896	1.52	35	0.1
117.35	118.87	39897	1.52	2	0.1
118.87	120.40	39898	1.52	10	0.1
120.40	121.92	39899	1.52	2	0.1
121.92	123.44	39900	1.52	5	0.1
123.44	124.97	40901	1.52	2	0.1
124.97	126.49	40902	1.52	5	0.1
126.49	128.02	40903	1.52	5	0.1
128.02	129.54	40904	1.52	10	0.1
129.54	131.06	40905	1.52	10	0.1
131.06	132.59	40906	1.52	5	0.1
132.59	134.11	40907	1.52	5	0.1
134.11	135.64	40908	1.52	15	0.1

ASSAY SUMMARY

FROM	TO	WIDTH	GOLD	SILVER	Aq/Au
		(metres)	(ppb)	(ppm)	ratio
-----					

HUDSON BAY EXPLORATION AND DEVELOPMENT COMPANY LIMITED  
Northwest District

Dec 17/85

Project: CANYON (7302)

page 1 of 1

Rotary Drill Hole No.: RH-14	Claim No.: Canyon 14(YA75730)	HOLE SURVEYS (corrected)
Co-ordinates: 5+71W 17+30N	Hole Size: 4 inch	depth direction dip
Collar Elev.:	Date Started: Sep 05/85	
Azimuth: grid 545E	Completed: Sep 07/85	
Angle: -60	Logged by: P. Allen	
Hole Depth: 128.02 metres	Section: 6+00W	
	Z Recovery:	

till silver values <5 ppm shown as 2.0  
bedrock silver values <0.2 ppm shown as 0.1

FROM	TO	SAMPLE No.	WIDTH (metres)	WEIGHT (kgm)	GOLD counts	Conc Wt (gm)	Conc. factor	GOLD (ppb)	SILVER (ppm)	ARSENIC (ppm)	ANTIMONY (ppm)	IRON (%)
0.00	4.57		4.57		glacial till overburden, material concentrated, analyzed by N.A.A.							
0.00	1.52	RH14-1	1.52									
1.52	3.05	RH14-2	1.52	24	0	12.0	2,000	130	2.0	102	12.0	6.0
3.05	4.57	RH14-3	1.52	22	0	11.7	1,880	260	2.0	145	12.0	3.4
till sampling results for Ba, Cd, Cr, Co, Hf, Ir, La, Mo, Ni, Se, Na, Ta, Th, W, U and Zn are listed in Appendix F.												
4.57	128.02		123.44		bedrock, analyzed by A.A.							
4.57	6.10	40910	1.52					5	0.1			
6.10	7.62	40911	1.52					2	0.1			
7.62	9.14	40912	1.52					2	0.1			
9.14	10.67	40913	1.52					20	0.1			
10.67	12.19	40914	1.52					20	0.1			
12.19	13.72	40915	1.52					10	0.1			
13.72	15.24	40916	1.52					5	0.1			
15.24	16.76	40917	1.52					2	0.1			
16.76	18.29	40918	1.52					5	0.4			
18.29	19.81	40919	1.52					10	0.3			
19.81	21.34	40920	1.52					2	0.2			
21.34	22.86	40921	1.52					2	0.2			
22.86	24.38	40922	1.52					10	0.3			
24.38	25.91	40923	1.52					35	0.2			
25.91	27.43	40924	1.52					20	0.1			
27.43	28.96	40925	1.52					15	0.2			
28.96	30.48	40926	1.52					15	0.1			
30.48	32.00	40927	1.52					5	0.1			
32.00	33.53	40928	1.52					10	0.1			
33.53	35.05	40929	1.52					25	0.1			
35.05	36.58	40930	1.52					5	0.1			
36.58	38.10	40931	1.52					5	0.1			
38.10	39.62	40932	1.52					5	0.1			
39.62	41.15	40933	1.52					5	0.1			
41.15	42.67	40934	1.52					2	0.1			
42.67	44.20	40935	1.52					40	0.1			
44.20	45.72	40936	1.52					5	0.1			
45.72	47.24	40937	1.52					2	0.1			
47.24	48.77	40938	1.52					2	0.1			
48.77	50.29	40939	1.52					2	0.1			
50.29	51.82	40940	1.52					10	0.1			
51.82	53.34	40941	1.52					420	0.1			
53.34	54.86	40942	1.52					15	0.1			
54.86	56.39	40943	1.52					2,800	0.1			
56.39	57.91	40944	1.52					2	0.1			
57.91	59.44	40945	1.52					45	0.1			

59.44	60.96	40946	1.52	2	0.1
60.96	62.48	40947	1.52	2	0.1
62.48	64.01	40948	1.52	2	0.2
64.01	65.53	40949	1.52	2	0.1
65.53	67.06	40950	1.52	2	0.2
67.06	68.58	40951	1.52	5	0.1
68.58	70.10	40952	1.52	2	0.2
70.10	71.63	40953	1.52	2	0.1
71.63	73.15	40954	1.52	10	0.2
73.15	74.68	40955	1.52	2	0.2
74.68	76.20	40956	1.52	2	0.1
76.20	77.72	40957	1.52	2	0.2
77.72	79.25	40958	1.52	2	0.2
79.25	80.77	40959	1.52	2	0.1
80.77	82.30	40960	1.52	2	0.1
82.30	83.82	40961	1.52	2	0.7
83.82	85.34	40962	1.52	2	0.1
85.34	86.87	40963	1.52	2	0.1
86.87	88.39	40964	1.52	2	0.1
88.39	89.92	40965	1.52	5	0.1
89.92	91.44	40966	1.52	5	0.1
91.44	92.96	40967	1.52	2	0.2
92.96	94.49	40968	1.52	30	0.3
94.49	96.01	40969	1.52	10	0.1
96.01	97.54	40970	1.52	10	0.1
97.54	99.06	40971	1.52	5	0.1
99.06	100.58	40972	1.52	2	0.1
100.58	102.11	40973	1.52	2	0.1
102.11	103.63	40974	1.52	5	0.1
103.63	105.16	40975	1.52	2	0.1
105.16	106.68	40976	1.52	10	0.1
106.68	108.20	40977	1.52	5	0.1
108.20	109.73	40978	1.52	2	0.1
109.73	111.25	40979	1.52	10	0.1
111.25	112.78	40980	1.52	5	0.1
112.78	114.30	40981	1.52	10	0.2
114.30	115.82	40982	1.52	10	0.1
115.82	117.35	40983	1.52	5	0.1
117.35	118.87	40984	1.52	15	0.1
118.87	120.40	40985	1.52	2	0.1
120.40	121.92	40986	1.52	10	0.1
121.92	123.44	40987	1.52	5	0.1
123.44	124.97	40988	1.52	5	0.1
124.97	126.49	40989	1.52	5	0.1
126.49	128.02	40990	1.52	15	0.1

CHECK ASSAYS

FROM	TO	SAMPLE	GOLD	SILVER	ARSENIC	MERCURY
51.82	53.34	56565	2	0.1	4	55
53.34	54.86	56566	2	0.1	12	75
54.86	56.39	56567	2	0.1	3	35
54.86	56.39	56568	2	0.1	4	40
54.86	56.39	56569	2	0.1	5	35
56.39	57.91	56570	2	0.1	5	30

HUDSON BAY EXPLORATION AND DEVELOPMENT COMPANY LIMITED  
Northwest District

Dec 17/85

Project: CANYON (7302)

page 1 of 1

Rotary Drill Hole No.: RH-15	Claim No.: Canyon 16(YA75732)	HOLE SURVEYS (corrected)
Co-ordinates: 4+00W 17+25N	Hole Size: 4 inch	depth direction dip
Collar Elev.:	Date Started: Sep 07/85	
Azimuth: grid S45E	Completed: Sep 08/85	
Angle: -60	Logged by: K. Galambos	
Hole Depth: 137.16 metres	Section: 4+00W	
	% Recovery:	

till silver values <5 ppm shown as 2.0  
bedrock silver values <0.2 ppm shown as 0.1

FROM	TO	SAMPLE No.	WIDTH (metres)	WEIGHT (kgm)	GOLD counts	Conc Wt (gm)	Conc. factor	GOLD (ppb)	SILVER (ppm)	ARSENIC (ppm)	ANTIMONY (ppm)	IRON (%)
0.00	137.16		137.16		bedrock, analyzed by A.A.							
0.00	1.52	40701	1.52					2	0.1			
1.52	3.05	40702	1.52					2	0.1			
3.05	4.57	40703	1.52					5	0.1			
4.57	6.10	40704	1.52					2	0.1			
6.10	7.62	40705	1.52					2	0.1			
7.62	9.14	40706	1.52					2	0.1			
9.14	10.67	40707	1.52					2	0.1			
10.67	12.19	40708	1.52					2	0.1			
12.19	13.72	40709	1.52					2	0.1			
13.72	15.24	40710	1.52					2	0.1			
15.24	16.76	40711	1.52					2	0.1			
16.76	18.29	40712	1.52					5	0.2			
18.29	19.81	40713	1.52					5	0.1			
19.81	21.34	40714	1.52					15	0.1			
21.34	22.86	40715	1.52					2	0.1			
22.86	24.38	40716	1.52					2	0.5			
24.38	25.91	40717	1.52					2	0.8			
25.91	27.43	40718	1.52					2	0.2			
27.43	28.96	40719	1.52					2	0.1			
28.96	30.48	40720	1.52					5	0.1			
30.48	32.00	40721	1.52					2	1.0			
32.00	33.53	40722	1.52					2	6.7			
33.53	35.05	40723	1.52					2	1.4			
35.05	36.58	40724	1.52					2	0.4			
36.58	38.10	40725	1.52					25	0.9			
38.10	39.62	40726	1.52					10	0.7			
39.62	41.15	40727	1.52					25	0.9			
41.15	42.67	40728	1.52					200	0.6			
42.67	44.20	40729	1.52					15	0.4			
44.20	45.72	40730	1.52					5	5.0			
45.72	47.24	40731	1.52					15	1.5			
47.24	48.77	40732	1.52					10	0.8			
48.77	50.29	40733	1.52					75	1.0			
50.29	51.82	40734	1.52					35	0.4			
51.82	53.34	40735	1.52					40	0.4			
53.34	54.86	40736	1.52					40	0.4			
54.86	56.39	40737	1.52					10	0.4			
56.39	57.91	40738	1.52					20	0.2			
57.91	59.44	40739	1.52					30	0.2			
59.44	60.96	40740	1.52					25	0.2			
60.96	62.48	40741	1.52					25	0.3			
62.48	64.01	40742	1.52					10	0.3			
64.01	65.53	40743	1.52					25	0.3			
65.53	67.06	40744	1.52					10	0.2			

67.06	68.58	40745	1.52	15	0.2
68.58	70.10	40746	1.52	15	0.2
70.10	71.63	40747	1.52	35	0.2
71.63	73.15	40748	1.52	10	0.1
73.15	74.68	40749	1.52	2	0.1
74.68	76.20	40750	1.52	2	0.3
76.20	77.72	40751	1.52	2	0.2
77.72	79.25	40752	1.52	10	0.1
79.25	80.77	40753	1.52	6	0.1
80.77	82.30	40754	1.52	10	0.1
82.30	83.82	40755	1.52	2	0.1
83.82	85.34	40756	1.52	15	0.1
85.34	86.87	40757	1.52	35	0.1
86.87	88.39	40758	1.52	15	0.1
88.39	89.92	40759	1.52	10	0.1
89.92	91.44	40760	1.52	10	0.1
91.44	92.96	40761	1.52	25	0.3
92.96	94.49	40762	1.52	25	0.2
94.49	96.01	40763	1.52	15	0.2
96.01	97.54	40764	1.52	15	0.1
97.54	99.06	40765	1.52	2	0.1
99.06	100.58	40766	1.52	2	0.1
100.58	102.11	40767	1.52	10	0.1
102.11	103.63	40768	1.52	15	0.1
103.63	105.16	40769	1.52	30	0.2
105.16	106.68	40770	1.52	10	0.1
106.68	108.20	40771	1.52	5	0.1
108.20	109.73	40772	1.52	10	0.1
109.73	111.25	40773	1.52	2	0.1
111.25	112.78	40774	1.52	2	0.1
112.78	114.30	40775	1.52	10	0.1
114.30	115.82	40776	1.52	2	0.1
115.82	117.35	40777	1.52	5	0.1
117.35	118.87	40778	1.52	10	0.1
118.87	120.40	40779	1.52	5	0.1
120.40	121.92	40780	1.52	5	0.1
121.92	123.44	40781	1.52	20	0.1
123.44	124.97	40782	1.52	2	0.1
124.97	126.49	40783	1.52	2	0.1
126.49	128.02	40784	1.52	10	0.1
128.02	129.54	40785	1.52	2	0.1
129.54	131.06	40786	1.52	5	0.1
131.06	132.59	40787	1.52	2	0.3
132.59	134.11	40788	1.52	2	0.1
134.11	135.64	40789	1.52	25	0.1
135.64	137.16	40790	1.52	10	0.2

## HUDSON BAY EXPLORATION AND DEVELOPMENT COMPANY LIMITED

DIAMOND DRILL LOG

Claim: CANYON 14

Location: Tarn area

Mining Division Whitehorse

Hole Nº. RH-13

Angle: 60°S

Direction: S(180°)

Depth: 135.6m

Grid Nº.

Co-Ordinates: 7+40W/17+80N

Date Started: Aug. 30/85

Finished: Sept. 4/85

Logged By: T. Garagan

Drilled By: E. Caron Diamond Drilling

DEPTH		DESCRIPTION OF CORE	Page 1 of 5
From	To		
0	10' (3.0m)	Glacial Till	
10'	15' (4.6m)	Fine grained buff to light green partly sericitized rhyolite with 10% medium grained feldspar phenocrysts and 5% medium grained (rarely coarse) quartz eyes; contains 1-2% Mn staining along microfractures and disseminated minor py. minor clay .	
15'	20' (6.1m)	a.a. 2-3% sericite	
20'	25' (7.6m)	a.a. 5-7% sericite alteration, partly oxidized	
25'	30' (9.1m)	a.a. 5-7% sericite alteration, minor qtz flooding, 1 piece of chalcedony minor flow banding, the sample is mostly oxidized	
30'	35' (10.7m)	Rhyolite as above, light green to orange brown in colour. Sample is mainly oxidized, minor qtz flooding	
35'	40' (12.2m)	Oxidized rhyolite a.a., minor chalcedony, minor qtz flooding, 1% pyrite	
40'	45' (13.7m)	Oxidized rhyolite a.a.	
45'	50' (15.2m)	a.a. Mn coated fractures	
50'	55' (16.8m)	a.a. with 25% of the chips are sericitized rhyolite, 1% pyrite	
55'	60' (18.3m)	Fine grained light green sericitized rhyolite as in 10-15' 5% oxidized fragments	
60'	65' (19.8m)	a.a. minor quartz flooding	
65'	85' (25.9)	2.2.	
85'	90' (27.4m)	Fine grained to aphanatic light lime green rhyolite with 5% fine grained to med. grained quartz eyes and 1-3% fine grained feldspar phenocrysts. sericitized matrix and felspar, mod. 5-10% ser. Minor pyrite and Mn coated fractures	

DEPTH		DESCRIPTION OF CORE	Page 2 of 5
From	To		
90'	95' (30.0m)	Sericitized rhyolite aa with 1% pyrite	
95'	100' (30.5m)	aa with 2-3% grey clay gouge material and a 1% coarse grained quartz eyes	
100'	105' (32.0m)	Fine grained to aphanatic sericitized rhyolite a.a.	
105'	110' (37.5m)	Grey aphanatic locally flow banded rholite with 5% medium grained to coarse grained smokey subangular to subrounded qtz eyes and 5-7% medium grained to coarse grained euhedral k fledspar phenocrysts minor carbonate and or sericite filled microfractures	
110'	115' (35.1m)	aa: 1% sericite, minor carbonate filled microfractures	
115'	120' (36.6m)	aa: 1% sericite, minor carbonate filled microfractures	
120'	125' (38.1m)	aa: minor quartz vein material, minor pyrite	
125'	130' (39.6m)	aa: minor quartz vein material, minor pyrite	
130'	135' (41.1m)	aa: fine grained to aphanatic grey to grey green rholite 2-3% sericite, 1-2% pyrite	
135'	140' (42.7m)	aa:	
140'	145' (44.2m)	aa: minor sericite, minor dk green montmorillonite	
145'	150' (45.7m)	aa:	
150'	155' (47.2m)	Light grey aphanatic partly silicified rhyolite with 5% quartz eyes in an aphanatic matrix The rhyolite appears to be silicified and is brecciated with grey fg silica infilling between the mg angular fragments. The fragments are 40% of the brecciated rash and are matrix supported. The colour and texture of the matrix and the clasts are similar contains minor qtz veining and 12% pyrite, 1-2% sericite The chips are bigger than most as a result of the hardness of the rocks.	
155'	160' (48.8m)	Light grey to white silicified rhyolite with 5% qtz eyes a.a. Contains <u>45%</u> quartz vein material- fine grained clear to white qtz with minor carbonate vein material 2-3% pyrite (fg) vein material contains minor brassy yellow sulphide? does not appear to be pyrite.	
160'	165' (50.3m)	Light to med. grey green fine grained to aphanatic partly silicified rhyolite with 5% medium grained quartz eyes. The matrix contains 2-3% sericite 1-2% qtz vein material with brassy sulphide	

DEPTH		DESCRIPTION OF CORE	Page 3 of 5
From	To		
165'	170' (51.8m)	Rhyolite a.a. 3-5% sericite only minor silicification	
170'	175' (53.3m)	Fine grained to aphanatic grey-green rhyolite in the 5% qtz eyes a.a. Tr quartz fluorite vein material 3-5% sericite	
175'	180' (54.9m)	Rhyolite a.a. with 2-3% clear quartz vein material minor clay, 2-3% sericite	
180'	185' (56.4m)	a.a: rhyolite with medium to coarse grained quartz eyes, minor veining, 5% sericite	
185'	190' (57.9m)	Sericitized rhyolite a.a.	
190'	195' (59.4m)	Rhyolite            minor sericite	
195'	200' (61.0m)	Fine grained grey-green sericitized rholite with fine grained to med. grained (sometimes coarse) phenocrysts of round quartz eyes (5-7%) and euhedral K fspar. (6-8%) Contains 2-3% sericite, 1-2% grey partly silicified rhyolite minor quartz vein material	
200'	205' (62.5m)	aa:	
205'	210' (64.0m)	Fine grained grey green rhyolite with minor sericite with 102% fluorite veining, minor qtz, (fluorite green & blue) minor montmorillonite	
210'	215' (65.5m)	aa: minor fluorite	
215'	220' (67.1m)	aa	
220'	225' (68.6m)	aa: minor dolomite veining, pyrite 1-2% 2-5% sericite	
225'	230' (70.1m)	Fine grained to aphanatic lt. grey rhyolite with 5% med. grained qtz eyes (some are coarse grained) minor white quartz veining minor pyrite 1-2% sericite	
230'	235' (71.6m)	aa: minor montmorillonite: 2-3% euhedral feldspar phenocrysts	
235'	240' (73.2m)	aa: rhyolite	
240'	260' (79.2m)	aa: with medium grained to coarse grained qtz eyes	
260'	265' (80.8m)	Lt. grey green aphanatic rhyolite with 5% medium to coarse grained qtz. eyes and 5% medium grained euhedral feldspar minor quartz hematite veins, minor pyrite, 1-2% sericite	
265'	270' (82.3m)	Rhyolite a.a. with minor quartz flooding and micro brecciation 1% fine grained quartz fluorite veining	
270'	275' (83.8m)	Fine grained to aphanatic grey green quartz eye porphyritic rhyolite with 5% sericite and minor silcification. Contains 2-3% grey to clear quartz veins with minor pyrite and carbon seams	

DEPTH		DESCRIPTION OF CORE	Page 4 of 5
From	To		
275'	280' (85.3m)	rhyolite aa with minor fluorite veining	
280'	285' (86.9m)	Rhyolite, fine grained aa minor quartz veing very wet sample	
285'	290' (88.4m)	Rhyolite aa: minor quartz limonite veining, minor chalcedony and pyrite	
290'	295' (89.9m)	Rhyolite aa: minor sericite and pyrite	
295'	300' (91.4m)	Quartz eyes K-feldspar porphyritic rhyolite aa minor chalcedony vein material, 1% sericite, minor pyrite	
300'	305' (93.0m)	Rhyolite aa: minor chalcedony	
305'	310' (94.5m)	Rhyolite aa: minor chalcedony with tr. pyrite	
310'	315' (96.0m)	Aphanatic rhyolite aa: trace chalcedony fluorite veining	
315'	320' (97.5m)	aa: trace pyrite, 2-3% sericite, minor silicification, 1% chalcedony veining	
320'	325' (99.1m)	Rhyolite aa: minor chalcedony, minor sericite and montmorillonite	
325'	330' (100.6m)	Grey green, fine grained quartz eyes K feldspar porphyritic rhyolite as before with 2-3% sericite, 1% chalcedony, minor pyrite	
330'	335' (102.1m)	Rhyolite aa: 3-4% sericitization, 1% chalcedony-pyrite veining and 1% quartz filled microfractures, 2-3% clays, minor silicification and minor carbonate, 3% pyrite, one chip of quartz carbonate filled amygdule	
335'	340' (103.6m)	Fine grained grey rhyolite as before: minor chalcedony and pyrite	
340'	345' (105.2m)	Rhyolite aa: with 2-3% coarse feldspar phenocrysts	
345'	350' (106.7m)	aa: with 1% chalcedony veining, trace fluorite and minor pyrite	
350'	355' (108.2m)	aa:           aa:                           2% trace pyrite	
355'	360' (109.7m)	aa: with 20% clay	
360'	365' (111.3m)	grey to lt grey green fine grained to aphanatic rhyolite with 5% med. grained quartz eyes, 5-7% Kspar phenocrysts and 10% fine grained white plagioclase which gives the rhyolite a spotted texture, 2-3% sericite, 1% pyrite.	
365'	370' (112.8m)	Rhyolite aa: with minor chalcedony, 5% orange-grey clay.	
370'	375' (114.3m)	Rhyolite aa: with 1% banded chalcedony, minor silicification	
375'	380' (115.8m)	aa: with 2-3% veining (chalcedony) and 3-5% sericite, 10% clay	

DEPTH		DESCRIPTION OF CORE	Page 5 of 5
From	To		
380'	385' (117.3m)	Light grey to white aphanatic quartz eye porphyritic (3-5%) rhyolite with minor Kfsp. phenocrysts. Partly silicified with local brecciation, contains 3-4% chalcedony	
385'	390' (118.9m)	Partly silicified rhyolite aa: trace chalcedony, trace pyrite	
390'	395' (120.3m)	Partly silicified rhyolite aa: with 5% chalcedony and trace fluorite, 1% pyrite	
395'	400' (121.9m)	Light grey fine grained rhyolite with 5% quartz eyes and 5-7% feldspar phenocrysts (both med. grained), 1% pyrite, 1% chalcedony	
400'	405' (123.4m)	Rhyolite aa: partly silicified, minor chalcedony, fluorite veining, 1% pyrite, 2-3% sericite	
405'	410' (125.0m)	Rhyolite aa: partly silicified, 1% pyrite, 1-2% sericite	
410'	415' (126.5m)	Light grey to grey green aphanatic to fine grained quartz eye feldspar porphyritic rhyolite with 10% fine to medium grained phenocrysts (qtz:fsp=1:1.5) sericite 5%, pyrite 1%	
415'	420' (128.0m)	Lime green fine grained quartz eye porphyritic sericitized rhyolite (phenocrysts 15%-f-m grained) and light grey aphanatic & silicified rhyolite as in 400-405'. 30% sericite in sericitized rhyolite, 1-2% pyrite, 2-3% chalcedony fluorite veining	
420'	425' (129.5m)	Rhyolite as in 410-415'	
425'	430' (131.1m)	Rhyolite aa: partly silicified, 1% sericite, 1% pyrite	
430'	435' (132.6m)	Rhyolite aa: partly silicified with 1% chalcedony carbonate vein material, 2-3% sericite, 1% pyrite	
435'	440' (134.1m)	Rhyolite aa: partly silicified minor chalcedony, 2-3% pyrite, minor sericite	
440'	445' (135.6m)	Rhyolite aa: 3-5% oxidized pyrite, 1% chalcedony-carbonate veining	

## HUDSON BAY EXPLORATION AND DEVELOPMENT COMPANY LIMITED

DIAMOND DRILL LOG

Claim: CANYON 14

Location: TARN

Mining Division Whitehorse

Hole Nº. RH14

Angle: -60°

Direction: 180°S

Depth: 128m

Grid Nº.

Co-Ordinates: 5+71W/17+30N

Date Started: Sept. 5/85

Finished: Sept. 7/85

Logged By: P. Allen

Drilled By: E. Caron Diamond Drilling

DEPTH		DESCRIPTION OF CORE CHIPS
From	To	
0	15'	Overburden
15' (4.6m)	20' (6.1m)	95% fine grained Rhy, qtz eyes 10%: disseminated sulphate, flow banding? pale green to orange brown color, 60% fragments sericitized to a pale green colour, 5% sericite 40% fragments jarosite clay altered Minor hematite and manganese staining occurring spotty and in thin fracture. Trace sulphides, Minor 1% quartz vein material, 5% dark grey to blk fine grained? Crystal Lithic tuff? small clasts difficult to identify phenocrysts
20'	25' (7.6m)	99% fine grained Rhyolite aa. 1% ? Crystal Tuff, brown/grey colour ? glass shards or cavity filling fluorite pale green colour and irregular shaped. Similar to tuff described in RH10
25'	30' (9.1m)	9% fine grained rhy, pale green to white colour, intense sericite alteration ( 40%); flow banding, 5% crystal lithic tuff aa.feldspar phenocrysts 70%, Rhyolite rock fragments 30%
30'	35' (10.7m)	Fine grained Rhyolite aa trace jarosite clay alteration 1% trace crystal lithic tuff
35'	40' (12.2m)	a.a. Rhyolite
40'	45' (13.7m)	a.a. Rhyolite
45'	50' (15.2m)	Rhyolite a.a. trace Jarosite clay alteration
50'	55' (16.8m)	Rhyolite a.a. intensive sericitization. Qtz veining 3% with ? graphite-steel grey soft 2 to 3.5m grey streak platey or needle like
55'	60' (18.3m)	Rhyolite minor 1% sericite alteration. Lt grey to 20% pale green colour, minor 1% quartz veining

DEPTH		DESCRIPTION OF CORE	Page 2 of 4
From	To		
60'	65' (19.8m)	Rhy. minor sericite 1% alteration. Lt grey to 20@ pale green colour	
65'	70' (21.3m)	Rhyolite 1% sericite alteration. Lt grey to white colour trace carbonate veining	
70'	75' (22.9m)	95% Rhy; 10% sericitized Rhy pale green 90% silicified and hematitized (intensely altered) 5% Crystal Lithic Tuff as before 1-3% qtz carbonate veining with associated hematitization, brecciation and presence of 1 to 3% sulphides abundant calcite	
75'	80' (24.4m)	Rhy; 15% sericitized Rhy, pale green with minor silicification 10% hematitized, silicified intensely altered Rhy with disseminated sulphides Minor to trace crystal lithic tuff (1%) 1% auartz carbonate veining a.a.	
80'	85' (25.9m)	Rhy; 20% sericitized Rhy pale green with trace silicification 5% hematitized silicified intensely altered Rhy. 1% quartz carbonage veining a.a.	
85'	90' (27.4m)	Rhy a.a.	
90'	95' (29.0m)	Sericitized Rhy a.a. trace to minor 1% carbonate veining and replacement of feldspars	
95'	100' (30.5m)	Sericitized Rhy, 10% sericite alteration Minor carbonate veining 1% 1% hematitized Rhy as described previously	
100'	105' (32.0m)	Sericitized Rhy 10% sericite 1% hematitized Rhy a.a. minor carbonate veining 1%, 1% quartz chalcedony veining	
105'	110' (33.5m)	Sericitized Rhy 5% sericite, minor carbonate veining 1%	
110'	115' (35.1m)	Rhy. 5% sericite alteration, trace carbonate and quartz veining 1%	
115'	120' (36.6m)	a.a.	
120'	125' (38.1m)	Rhy. a.a. 10% sericite, 1% quartz carbonate veining	
125'	130' (39.6m)	a.a.	
130'	175' (53.3m)	Rhy. a.a. 10% sericite 1% quartz carbonate veining	
175'	180' (54.9m)	Rhy a.a. 10% sericite 1% fragments more intensely sericitized. Minor to trace silicification 1% quartz carbonate veining	
180'	185' (56.4m)	a.a.	
185'	190' (57.9m)	Rhy. a.a. 10% sericite, 1% quartz carbonate veining Trace? fluorite green	

DEPTH		DESCRIPTION OF CORE	Page 3 of 4
From	To		
190'	195' (59.4m)	Rhy. a.a, 2% quartz veining, 1% quartz carbonate veining	
195'	200' (61.0m)	Rhy. silicified and sericitized (1 to 5% sericite) quartz flooding and quartz carbonate veining, brecciation associated with veining 2% veining	
200'	205' (62.5m)	Rhy. silicified, (minor 1 to 3%) and sericitized (10% sericite) Quartz flooding, carbonate veining 1%	
205'	220' (67.1m)	Rhy. 1% qtz. veining weakly banded, no silicification, 5% sericite	
220'	225' (68.6m)	a.a. 3% qtz. veining with sulphides and hematite associated with veining	
225'	230' (70.1m)	a.a. no hematite associated with veining	
230'	235' (71.6m)	Rhy; 5% sericite, 1% quartz carbonate veining, no silicification	
235'	240' (73.1m)	a.a. trace 1% qtz. carbonate veining	
240'	245' (74.7m)	a.a. trace qtz carbonate veining with hematite associated with veining	
245'	250' (76.2m)	a.a. no hematite associated with veining, trace qtz. carbonate veining	
250'	255' (77.7m)	a.a. note? blue mineral similar to RH 11, associated with calcite veining	
255'	260' (79.2m)	a.a. no blue mineral	
260'	265' (80.8m)	95% sericitized f.g. Rhy with 1 to 5% sericite 5% fresh f.g. rhy. lt. grey to grey, flow banding, trace qtz. carbonate veining, trace hematite associated with	
265'	270' (82.3m)	a.a.	
270'	275' (83.8m)	Fine grained Rhy pale green colour, 10% sericite trace qtz. carbonate veining Note: sample quite clayey in sample bag	
275'	280' (85.3m)	RHy. a.a.	
280'	285' (86.9m)	Rhy. a.a. trace hematite staining associated with sulphides (rusty orange to red)	
285'	290' (88.4m)	a.a. trace qtz. veining, no calcite	
290'	295' (89.9m)	Rhy. 5% sericite trace qtz. carbonate veining	
295'	300' (91.4m)	Rhy. a.a.	
300'	305' (93.0m)	a.a.	
305'	310' (94.5m)	Rhy. a.a. 1% sericite	

DEPTH		DESCRIPTION OF CORE	Page 4 of 4
From	To		
310'	315' (96.0m)	a.a.	
315'	320' (97.5m)	a.a.	
320'	335' (102.1m)	a.a. 1% hematite staining red to orange colour, trace qtz. carbonate veining	
335'	360' (109.7m)	Rhy. a.a. 3% sericite trace qtz carbonate veining	
360'	370' (112.8m)	Rhy. a.a. 1% sericite trace atz carbonate veining Sample very fine sand, no oversize fragments	
370'	405' (123.4m)	Rhy. a.a. 1% sericite trace carbonate veining trace hematite stain with metal filings and sulphides	
405'	410' (125.0m)	Rhy a.a. 1% hematite stain	
410'	420'	As in 370'to 405' , 1% qtz. carbonate veining	

## HUDSON BAY EXPLORATION AND DEVELOPMENT COMPANY LIMITED

DIAMOND DRILL LOG

Claim: CANYON 16

Location: Tarn Trench 4 Area

Mining Division Whitehorse

Hole Nº. RH-15

Angle: -60°N

Direction: 180°

Depth: 450'

Grid Nº.

Co-Ordinates: 4+00W, 17+25N

Date Started: Sept. 7, 1985

Finished: Sept. 8/85

Logged By: K. Galambos

Drilled By: E. Caron Diamond Drilling

DEPTH		DESCRIPTION OF CORE	CHIP	Page 1 of 7
From	To			
0	5' (1.5m)	100% white silicified rhyolite porphyry (qtz eyes) with 5-50% of surface area stained orange-red from pyrite (oxidized bedrock) Tr carbonate, Tr pyrite		
5'	10' (3.0m)	same as 0-5' but with trace green fluorite		
10'	15' (4.6m)	Same as 0-5'		
15'	20' (6.1m)	95% as 0-5' but staining is from 5-100% of surface area 5% light grey fresh rhyolite porphyry (qtz eyes) Tr carbonate, tr pyrite		
20'	25' (7.6m)	as in 15-20' but with 10% fresh unstained rhyolite porphyry Tr pyrite		
25'	30' (9.1m)	as in 15-20' but with 55% fresh unstained rhyolite porphyry Tr pyrite		
30'	35' (10.7m)	as in 15-20' but with 97-98% fresh unstained rhyolite porphyry Tr pyrite		
35'	40' (12.2m)	as in 15-20' but with 99-100% fresh unstained rhyolite porphyry Tr red stained rhyolite, tr pyrite		
40'	45' (13.7m)	Fresh rhyolite porphyry as in 35-40' but with very weak sericite alteration, tr. pyrite		
45'	50' (15.2m)	Fresh rhyolite porphyry as in 35-40' but with flow banding on a few of the pieces, tr pyrite		
50'	55' (16.8m)	99-100% fresh rhyolite porphyry, tr red stained rhyolite as in 15-20' tr carbonate material, tr pyrite		
55'	60' (18.3m)	99-10% fresh rhyolite porphyry Tr red stained rhyolite as in 15-20', tr carbonate material, tr pyrite		
60'	65' (19.8m)	99-100% fresh rhyolite porphyry, tr red stained rhyolite as in 15-20', Tr 1% carbonate material, Tr pyrite		
65'	70' (21.3m)	99-100% rhyolite porphyry with very weak sericite alteration Tr red stained rhyolite as in 15-20' Tr carbonate material, tr pyrite		

DEPTH		DESCRIPTION OF CORE	Page 2 of 7
From	To		
70'	75' (22.9m)	99-100% rhyolite porphyry with weak to moderate sericite alteration Tr red stained rhyolite as in 15-20' Tr carbonate material, tr pyrite	
75'	80' (24.4m)	60% off white moderately silicified rhyolite porphyry 20% light green, weak to moderate sericite altered rhyolite porphyry 20% fresh unaltered rhyolite porphyry, tr carbonate material Tr red stained rhyolite as in 15-20', Tr pyrite	
80'	85' (25.9m)	100% fresh rhyolite porphyry with some pieces showing flow banding Tr pyrite	
85'	90' (27.4m)	80% off white moderately silicified rhyolite porphyry with some remnant flow banding 18-19% very light green, weakly sericite altered rhyolite porphyry 1-2% fresh rhyolite porphyry Tr light grey (opaque) vein material Tr carbonate material, Tr pyrite	
90'	95' (29.0m)	98-99% white-off white moderately silicified rhyolite porphyry 1-2% white to light green moderately sericite altered rhyolite porphyry, Tr carbonate material, Tr pyrite	
95'	100' (30.5m)	100% off white to light pale green; weak-moderately silicified, moderately sericite altered rhyolite porphyry Tr white and grey (opaque) vein material Tr carbonate material Tr pyrite	
100'	105' (32.0m)	98% off white moderately silicified rhyolite porphyry, some still showing pale green sericite alteration 2% white quartz vein material with Tr green and purple fluorite, Tr carbonate material, Tr pyrite	
105'	110' (33.5m)	100% off white moderate-strongly silicified rhyolite porphyry Tr ½% white quartz vein material with Tr green fluorite, Tr carbonate material	
110'	115' (35.1m)	99% off white moderate-strongly silicified rhyolite porphyry 1% White quartz and buff calcite veining with tr green fluorite	
115'	120' (36.6m)	98% off white moderately strongly silicified rhyolite porphyry 2% white quartz and buff calcite veining with tr green and purple fluorite, tr rusty quartz, tr pyrite	
120'	125' (38.1m)	98% off white moderate strongly silicified rhyolite porphyry with remanent sericite alteration 2% clear and white quartz and buff calcite veining, Tr Fluorite(?) Tr pyrite	
125'	130' (39.6m)	99-100% off white-white moderate-strongly silicified rhyolite with remanent sericite alteration and pods of strong sericite alteration. Also remanent flow banding Tr-1% white quartz and buff calcite veining, Tr-pyrite.	
130'	135' (41.1m)	97% off white moderate-strongly silicified rhyolite porphyry with remanent sericite alteration, 2% strong sericite altered rhyolite 1% white quartz and buff calcite veining	
135'	140' (42.7m)	same as 130-135'	
140'	145' (44.2m)	99-100% off white moderate strongly silicified rhyolite porphyry Tr white quartz and buff calcite veining	

DEPTH		DESCRIPTION OF CORE	Page 3 of 7
From	To		
145'	150' (45.7m)	99% off white moderate-strongly silicified rhyolite porphyry with remanent sericite alteration, 1% strong sericite altered rhyolite Tr white quartz and buff calcite veining	
150'	155' (47.2m)	100% off white moderate-strongly silicified rhyolite porphyry with some remanent flow banding, Tr tresh unaltered rhyolite, Tr white veining, Tr rhyolite with remanent sericite alteration Tr pyrite	
155'	160' (48.8m)	93-94% very light green to off white weak-moderately silicified rhyolite with remanent sericite alteration 6-7% clear to light grey vein material (?) fresh rhyolite (?) with trace pyrite	
160'	165' (50.3m)	50% light green weak moderately altered rhyolite 40% fresh unaltered rhyolite porphyry (quartz eyes, feldspars) 10% off white weak moderately silicified rhyolite porphyry	
165'	170' (51.8m)	100% light grey very light green-grey rhyolite porphyry (qtz eyes and feldspars) which has very weak sericite alteration and very minor iron staining, Tr pyrite, Tr white to off white silicified rhyolite, tr carbonate material	
170'	175' (53.3m)	97-98% light grey-green grey rhyolite porphyry with very weak-weak sericite alteration, 2-3% white-off white moderate-strongly silicified rhyolite porphyry (quartz eyes) Tr pyrite, Tr purple fluorite, Tr white quartz and buff calcite veining with associated pyrite	
175'	180' (54.9m)	99% light grey fresh rhyolite porphyry, 1% carbonate material, porbably calcite veining	
180'	185' (56.4m)	99% light grey-grey white weakly silicified rhyolite porphyry 1% light green moderate sericite alteration of rhyolite Tr white to off white-buff quartz veining	
185'	190' (57.9m)	100% off white moderate-strongly silicified rhyolite porphyry Tr yellow-white to white quartz and buff calcite veining Tr fresh loose pyrite	
190'	195' (59.4m)	100% light grey-opaque, weak-moderately silicified rhyolite porphyry Tr light green moderately sericite altered rhyolite Tr white off white strongly silicified rhyolite Tr white-quartz and buff calcite veining	
195'	200' (61.0m)	100% light grey often with tinge of light green (weak sericite alteration) in fairly fresh rhyolite porphyry which may be silifhtly silicified. Tr pyrite, Tr White quartz and buff calcite veining, Tr dark apple green sericite (?) possibly fluorite	
200'	205' (62.5m)	same as 195'-200'	
205'	210' (64.0m)	98% off white moderate to strongly silicified rhyolite porphyry 1-2% white quartz and white-buff carbonate material Tr blue green very soft clay (?) mineral	
210'	215' (65.5m)	98% off white moderately silicified rhyolite porphyry often showing pods of weak-moderate sericite alteration. Tr- $\frac{1}{2}$ % dark green, soft, intensely sericite alteration. $\frac{1}{2}$ -1% white quartz and white buff calcite veining.	

DEPTH		DESCRIPTION OF CORE	Page 4 of 7
From	To		
215'	220' (67.1m)	98% off white moderately silicified rhyolite porphyry sometimes showing pods of weakly sericite alteration 2% buff and white veining Tr pyrite	
220'	225' (68.6m)	same as 215-220'	
225'	230' (70.1m)	98-99% light grey off white fresh to weakly silicified rhyolite porphyry. Tr light green weak-moderate sericite altered rhyolite. 1-2% white-buff calcite veining. Tr-white highly silicified rhyolite Tr white quartz veining, Tr pyrite	
230'	235' (71.6m)	99% light grey off white weak moderately silicified rhyolite porphyry. 1% white buff calcite veining, tr clear and white quartz veining, Tr pyrite	
235'	240' (73.2m)	98% light grey off white, weak moderately silicified rhyolite porphyry. 2% white-buff calcite veining, Tr White strongly silicified rhyolite, Tr blue very soft clay (?) mineral	
240'	245' (74.7m)	96-97% light grey off white, weak and moderately silicified rhyolite with light green pods of weak-moderate sericite alteration 3-4% white calcite vein material Tr dark green strong sericite alteration, Tr pyrite, Tr blue clay.	
245'	250' (76.2m)	99% off white light grey weak -moderate silicified rhyolite porphyry 1% white and buff calcite veining, Tr green moderate strong sericite alteration, Tr blue clay (?), Tr pyrite	
250'	255' (77.7m)	98-99% off white weak-moderately silicified rhyolite porphyry 1-2% white and buff calcite veining, Tr white quartz veining Tr purple fluorite, Tr pyrite	
255'	260' (79.2m)	93-95% light grey off white weak moderately silicified rhyolite porphyry, 5-7% white and buff calcite veining, Tr light green weak moderate sericite alteration, Tr pyrite	
260'	265' (80.8m)	same as 255-260'	
265'	270' (82.3m)	Same as 255-260'	
270'	275' (83.8m)	92-93% off white to light grey, weak-moderately silicified rhyolite porphyry with some weak sericite alteration 5-7% white and buff calcite veining, ½% white quartz and calcite veining with purple fluorite, Tr light green weak moderate sericite alteration, Tr pyrite	
275'	280' (85.3m)	93-95% off white weak-moderately silicified rhyolite porphyry 5-7% white and buff calcite veining, Tr purple Fluorite, Tr pyrite, Tr blue clay	
280'	285' (86.9m)	96-97% off white weak moderately silicified rhyolite porphyry 3-4% white and buff calcite veining, Tr purple fluorite, tr pyrite	
285'	290' (88.4m)	96-97% off white weak-moderately silicified rhyolite porphyry 3-4% white and buff calcite veining, Tr light green moderately sericite alteration, Tr pyrite	
290'	295' (89.9m)	98-99% off white weak moderately silicified rhyolite porphyry 1-2% white and buff calcite veining, Tr pyrite	

## DEPTH

## DESCRIPTION OF CORE

Page 5 of 7

DEPTH		DESCRIPTION OF CORE
From	To	
295'	300' (91.4m)	98-99% off white weak-moderately silicified rhyolite porphyry 1-2% white and buff calcite veining, Tr pyrite, Tr rustyclear quartz veining
300'	305' (93.0m)	98-99% off white weak-moderately silicified rhyolite porphyry 1-2% white and buff calcite veining Tr pyrite
305'	310' (94.5m)	93-95% off white weak-moderately silicified rhyolite porphyry 5-7% white and buff calcite veining, Tr light medium green, weak moderate sericite alteration, Tr rusty clear quartz veining, Tr pyrite
310'	315' (96.0m)	96-98% off white-light grey weak moderately silicified rhyolite porphyry 1-2% light green weak-moderate sericite alteration 1-2% white and buff calcite veining, Tr pyrite
315'	320' (97.5m)	98-99% off white-light grey, weak-moderately silicified rhyolite porphyry 1-2% white quartz vein material Tr buff and white calcite veining, Tr pyrite, Tr dark green strong sericite alteration
320'	325' (99.1m)	same as 315-320'
325'	330' (100.6m)	97-98% light grey off white, weak-moderately silicified rhyolite porphyry 2-3% white and buff calcite veining, Tr pyrite, Tr white quartz veining, Tr rusty vein material, Tr light medium green weak-moderate sericite alteration
330' damp	335' (102.1m)	97-98% light grey to off white weakly silicified rhyolite porphyry with up to 1% iron staining, 2-3% calcite veining, Tr- $\frac{1}{2}$ % pyrite
335' wet sample	340' (103.6m)	99% off white, weak-moderately silicified rhyolite porphyry Tr light green weak-moderate sericite alteration, Tr- $\frac{1}{2}$ % light orange-buff strongly silicified rhyolite porphyry severely clay altered feldspars as well as iron staining and manganese staining throughout Tr dark maroon-brown fuffaceous unit with iron staining, tr pyrite, Tr blue clay associated with pyrite
340'	345' (105.2m)	99% light grey off white weak-moderately silicified rhyolite porphyry, some with remanent moderately strong sericite alteration Tr- $\frac{1}{2}$ % light medium green sericite alteration Tr buff and white quartz veining Tr fresh pyrite with only very minor staining
345'	350' (106.7m)	100% light grey-off white weak-moderately silicified rhyolite porphyry Tr white and buff quartz veining Tr light green, weak to moderate sericite alteration, Tr pyrite
350'	355' (108.2m)	same as 345-350'
355' damp	360' (109.7m)	same as 345-350' but with trace pink fluorite with clear quartz
360' wet sample	365' (111.3m)	same as 345-35' but with trace purple fluorite with clear quartz

DEPTH		DESCRIPTION OF CORE	Page 6 of 7
From	To		
365' wet sample	370' (112.8m)	Same as 345-350 but with Tr. purple fluorite and tr white calcite veining	
370' wet sample	375' (114.3m)	99% light grey-off white weak to moderately silicified rhyolite porphyry, often with remanent light green weak-moderate sericite alteration 1% clear and white quartz veining, Tr medium-dark green, weak-moderate sericite alteration, Tr white calcite veining Tr pyrite, often with iron staining of surrounding rock Tr purple fluorite (?)	
375' damp	380' (115.8m)	98% off white, weak-moderately silicified rhyolite porphyry often with remanent light green sericite alteration 1% clear and white quartz veining Tr-½% light-medium pink (manganese stained?) rhyolite Tr-½% light-medium green sericite alteration Tr white strongly silicified rhyolite Tr purple fluorite, Tr pyrite	
380' damp	385' (117.3m)	90% light grey-off white weak-moderately silicified rhyolite porphyry 10% quartz veining of which about 60% is light pink to dark purple (manganese) stained Tr pyrite with iron staining Tr steel filings accompanied by severe iron staining of surrounding rock Tr white strongly silicified rhyolite Tr carbonate material, Tr manganese staining	
385' damp	390' (118.9m)	99% off white moderately silicified rhyolite porphyry with remanent sericite alteration 1% white strongly silicified rhyolite Tr pyrite with minor staining Tr manganese staining	
390' damp	395' (120.4m)	100% off white moderately silicified rhyolite porphyry with remanent sericite alteration Tr white quartz vein material with slickensides (?) Tr purple fluorite, Tr manganese staining	
395' wet sample	400' (121.9m)	99% off white moderately silicified rhyolite porphyry with remanent sericite alteration 1% white strongly silicified rhyolite Tr white quartz vein material with slickensides? Tr purple manganese staining Tr rusty yellow rhyolite, Tr pyrite, Tr blue clay (?), Tr dark green intense	
400' damp	405' (123.4m)	98-99% light grey-off white weak-moderately silicified rhyolite porphyry 1-2% white veining, some with manganese staining and slickensides(?) Tr manganese staining on rhyolite Tr rusty yellow rhyolite, tr buff calcite, Tr pyrite	
405'	410' (125.0m)	99-100% light grey-off white weak-moderately silicified rhyolite porphyry Tr-1% white veining some with manganese staining and slickensides(?) Tr white highly silicified rhyolite, Tr buff calcite, Tr rusty yellow rhyolite, Tr pyrite with minor staining of surrounding rock	

DEPTH		DESCRIPTION OF CORE	Page 7 of 7
From	To		
410'	415' (126.5m)	99% light grey-off white weak-moderately silicified rhyolite porphyry 1% white quartz veining some with manganese staining and slickensides? Tr steel filings with severe iron staining, Tr white highly silicified rhyolite, Tr white and buff calcite, Tr pyrite	
415'	420' (128.0m)	100% light grey-off white weak-moderately silicified rhyolite porphyry Tr white quartz veining some with manganese staining & slickensides(?) Tr steel filings with severe iron staining, Tr purple fluorite, Tr pyrite	
420'	425' (129.5m)	98-99% light grey-off white weak-moderate silicified rhyolite porphyry 1-2% light green weak-moderate sericite alteration Tr white quartz veining some with manganese staining & slickensides(?) Tr pyrite, Tr buff severely clay altered rhyolite	
425'	430' (131.1m)	99-100% light grey-off white weak-moderately silicified rhyolite porphyry Tr-1% buff severely clay altered rhyolite Tr light green weak-moderate sericite alteration Tr white quartz veining some with manganese staining and slickensides (?) Tr pyrite, Tr steel filings	
430'	435' (132.6m)	93-95% light grey, weak-moderately silicified rhyolite porphyry 5-7% white and clear quartz veining Tr blue clay, Tr steel filings, Tr pyrite, Tr buff severely clay altered rhyolite	
435'	440' (134.1m)	95-100% light grey-off white, weak-moderately silicified rhyolite porphyry Tr- $\frac{1}{2}$ % light grey-white quartz veining, Tr steel filings with strong staining of surrounding rock, Tr rusty yellow rhyolite, Tr buff severely clay altered rhyolite, Tr light green weak-moderate sericite alteration, Tr pyrite, Tr blue green clay(?)	
440'	445' (135.6m)	100% off white-light grey moderately silicified rhyolite porphyry Tr dark grey, fine grained siliceous, granular, mafic tuff? Tr light green moderate sericite alteration, Tr pyrite with moderate staining of surrounding rock Tr clear quartz veining with pyrite, Tr pyrite, Tr clear calcite veining	
445'	450' (137.2m)	100% off white moderately silicified rhyolite porphyry Tr white quartz veining, tr steel filings with strong staining of surrounding rocks	
450'	End of hole		

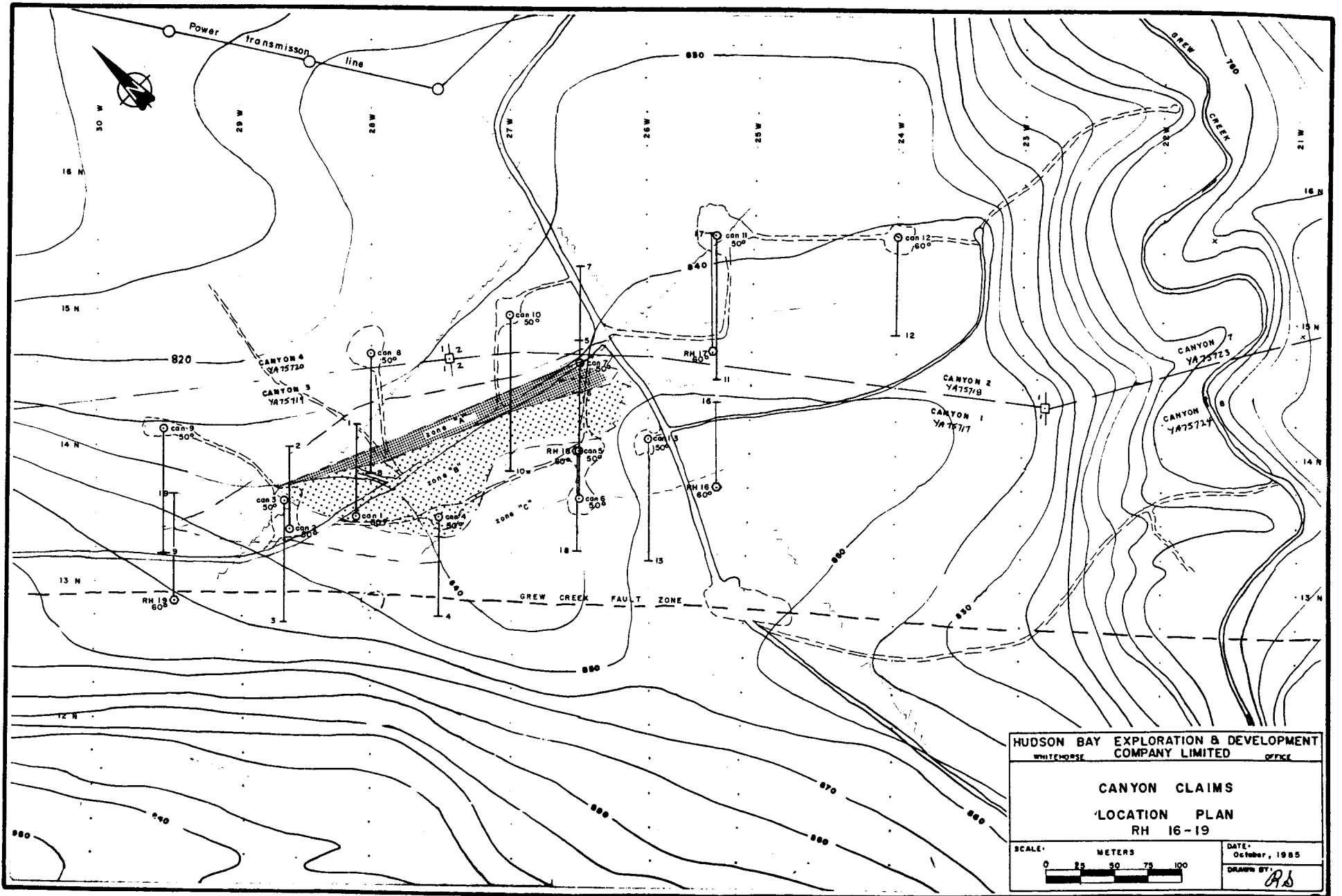

HUDSON BAY EXPLORATION & DEVELOPMENT COMPANY LIMITED		OFFICE
CANYON CLAIMS LOCATION PLAN RH 16-19		
SCALE	METERS	DATE
0 25 50 75 100		October, 1985
		DRAWN BY <i>AS</i>

HUDSON BAY EXPLORATION AND DEVELOPMENT COMPANY LIMITED  
Northwest District

Dec 17/85

Project: CANYON (7302)

page 1 of 1

Rotary Drill Hole No.: RH-16  
Co-ordinates: 25+50W  
13+75N  
Collar Elev.:  
Azimuth: grid NORTH  
Angle: -60  
Hole Depth: 148.44 metres

Claim No.: Canyon 1 (YA75717)  
Hole Size: 4 inch  
Date Started: Sep 09/85  
Completed: Sep 10/85  
Logged by: P. Allen  
Section: 25+50W  
% Recovery:  
HOLE SURVEYS (corrected)  
depth direction dip  
148.44 58.5

silver values (<0.2 ppm shown as 0.1

FROM	TO	SAMPLE No.	WIDTH (metres)	WEIGHT (kgm)	GOLD Conc Wt counts	Conc. (gm) factor	GOLD (ppb)	SILVER (ppm)	ARSENIC (ppm)	ANTIMONY (ppm)	Ag/Au ratio
0.00	51.82		51.82		glacial till overburden.						
51.82	148.44		96.62		bedrock, analyzed by A.A.						
51.82	53.34	40601	1.52				5	0.2			40
53.34	54.86	40602	1.52				10	0.2			20
54.86	56.39	40603	1.52				30	0.2			7
56.39	57.91	40604	1.52				65	0.2			3
57.91	59.44	40605	1.52				35	0.2			6
59.44	60.96	40606	1.52				5	0.2			40
60.96	62.48	40607	1.52				20	0.3			15
62.48	64.01	40608	1.52				20	0.3			15
64.01	65.53	40609	1.52				10	0.2			20
65.53	67.06	40610	1.52				15	0.2			13
67.06	68.58	40611	1.52				55	0.3			5
68.58	70.10	40612	1.52				220	0.4			2
70.10	71.63	40613	1.52				260	0.4			2
71.63	73.15	40614	1.52				60	0.4			7
73.15	74.68	40615	1.52				20	0.9			45
74.68	76.20	40616	1.52				90	0.9			10
76.20	77.72	40617	1.52				95	0.4			4
77.72	79.25	40618	1.52				130	0.5			4
79.25	80.77	40619	1.52				90	0.3			3
80.77	82.30	40620	1.52				80	0.5			6
82.30	83.82	40621	1.52				95	0.5			5
83.82	85.34	40622	1.52				60	0.5			8
85.34	86.87	40623	1.52				40	0.3			8
86.87	88.39	40624	1.52				35	0.3			9
88.39	89.92	40625	1.52				25	0.3			12
89.92	91.44	40626	1.52				45	0.2			4
91.44	92.96	40627	1.52				65	0.2			3
92.96	94.49	40628	1.52				30	0.1			3
94.49	96.01	40629.30	1.52				35	0.1			3
96.01	97.54	40631	1.52				30	0.1			3
97.54	99.06	40632	1.52				35	0.1			3
99.06	100.58	40633	1.52				95	0.1			1
100.58	102.11	40634	1.52				35	0.1			3
102.11	103.63	40635	1.52				45	0.2			4
103.63	105.16	40636	1.52				20	0.1			5
105.16	106.68	40637	1.52				45	0.2			4
106.68	108.20	40638	1.52				70	0.2			3
108.20	109.73	40639	1.52				10	0.1			10
109.73	111.25	40640	1.52				35	0.1			3
111.25	112.78	40641	1.52				30	0.1			3
112.78	114.30	40642	1.52				20	0.2			10
114.30	115.82	40643	1.52				30	0.1			3
115.82	117.35	40644	1.52				20	0.2			10
117.35	118.87	40645	1.52				35	0.1			3

118.87	120.40	40646	1.52	25	0.1	4
120.40	121.92	40647	1.52	30	0.1	3
121.92	123.44	40648	1.52	40	0.1	3
123.44	124.97	40649	1.52	40	0.1	3
124.97	126.49	40650	1.52	95	0.4	4
126.49	128.02	40651	1.52	120	0.6	5
128.02	129.54	40652	1.52	35	0.3	9
129.54	131.06	40653	1.52	35	0.1	3
131.06	132.59	40654	1.52	50	0.2	4
132.59	134.11	40655	1.52	60	0.4	7
134.11	135.64	40656	1.52	60	0.3	5
135.64	137.16	40657	1.52	60	0.2	3
137.16	138.68	40658	1.52	40	0.2	5
138.68	140.21	40659	1.52	35	0.2	6
140.21	141.73	40660	1.52	50	0.1	2
141.73	143.26	40661	1.52	30	0.1	3
143.26	144.78	40662	1.52	45	0.1	2
144.78	146.30	40663	1.52	55	0.3	5
146.30	147.83	40664	1.52	55	0.2	4
147.83	148.44	40665	0.61	50	0.2	4

ASSAY SUMMARY

FROM	TO	WIDTH (metres)	GOLD (ppb)	SILVER (ppm)	Ag/Au ratio
68.58	71.63	3.05	240	0	2

HUDSON BAY EXPLORATION AND DEVELOPMENT COMPANY LIMITED  
Northwest District

Dec 19/85

Project: CANYON (7302)

page 1 of 1

Rotary Drill Hole No.: RH-17	Claim No.: Canyon 2 (YA75718)	HOLE SURVEYS (corrected)
Co-ordinates: 25+50W 14+75N	Hole Size: 4 inch	depth direction dip
Collar Elev.:	Date Started: Sep 11/85	173.26 -59
Azimuth: grid NORTH	Completed: Sep 12/85	
Angle: -60	Logged by: T. Saragan	
Hole Depth: 175.26 metres	Section: 25+50W	
	% Recovery:	

gold values <5 ppb shown as 2.0  
silver values <0.2 ppm shown as 0.1

FROM	TO	SAMPLE No.	WIDTH (metres)	WEIGHT (kgm)	GOLD counts	Conc Wt (gm)	Conc. factor	GOLD (ppb)	SILVER (ppm)	ARSENIC (ppm)	ANTIMONY (ppm)	Ag/Au ratio
0.00	68.58		68.58									
68.58	175.26		106.68									
68.58	70.10	56901	1.52					10	0.2			20
70.10	71.63	56902	1.52					15	0.1			7
71.63	73.15	56903	1.52					20	0.7			35
73.15	74.68	56904	1.52					25	0.3			12
74.68	76.20	56905	1.52					20	0.3			15
76.20	77.72	56906	1.52					20	0.3			15
77.72	79.25	56907	1.52					35	0.3			9
79.25	80.77	56908	1.52					30	0.3			10
80.77	82.30	56909	1.52					15	0.2			13
82.30	83.82	56910	1.52					30	0.2			7
83.82	85.34	56911	1.52					30	0.2			7
85.34	86.87	56912	1.52					25	0.2			8
86.87	88.39	56913	1.52					30	0.3			10
88.39	89.92	56914	1.52					30	0.3			10
89.92	91.44	56915	1.52					30	0.2			7
91.44	92.96	56916	1.52					30	0.1			3
92.96	94.49	56917	1.52					25	0.1			4
94.49	96.01	56918	1.52					45	0.1			2
96.01	97.54	56919	1.52					20	0.1			5
97.54	99.06	56920	1.52					15	0.1			7
99.06	100.58	56921	1.52					10	0.1			10
100.58	102.11	56922	1.52					15	0.2			13
102.11	103.63	56923	1.52					55	0.1			2
103.63	105.16	56924	1.52					15	0.1			7
105.16	106.68	56925	1.52					15	0.1			7
106.68	108.20	56926	1.52					25	0.1			4
108.20	109.73	56927	1.52					20	0.2			10
109.73	111.25	56928	1.52					25	0.2			8
111.25	112.78	56929	1.52					10	0.1			10
112.78	114.30	56930	1.52					15	0.4			27
114.30	115.82	56931	1.52					15	0.1			7
115.82	117.35	56932	1.52					15	0.1			7
117.35	118.87	56933	1.52					30	0.2			7
118.87	120.40	56934	1.52					25	0.2			8
120.40	121.92	56935	1.52					15	0.2			13
121.92	123.44	56936	1.52					15	0.3			20
123.44	124.97	56937	1.52					10	0.2			20
124.97	126.49	56938	1.52					15	0.3			20
126.49	128.02	56939	1.52					25	0.2			8
128.02	129.54	56940	1.52					15	0.5			33
129.54	131.06	56941	1.52					10	0.4			40
131.06	132.59	56942	1.52					15	0.3			20
132.59	134.11	56943	1.52					25	0.3			12

134.11	135.64	56944	1.52	20	4.0	200
135.64	137.16	56945	1.52	25	0.4	16
137.16	138.68	56946	1.52	5	1.9	360
138.68	140.21	56947	1.52	20	0.3	15
140.21	141.73	56948	1.52	30	3.4	113
141.73	143.26	56949	1.52	25	0.4	16
143.26	144.78	56950	1.52	40	0.6	15
144.78	146.30	56951	1.52	20	0.9	45
146.30	147.83	56952	1.52	5	0.2	40
147.83	149.35	56953	1.52	2	0.1	50
149.35	150.88	56954	1.52	5	0.4	80
150.88	152.40	56955	1.52	2	0.6	300
152.40	153.92	56956	1.52	5	0.2	40
153.92	155.45	56957	1.52	2	0.3	150
155.45	156.97	56958	1.52	10	0.1	10
156.97	158.50	56959	1.52	15	0.4	27
158.50	160.02	56960	1.52	15	0.1	7
160.02	161.54	56961	1.52	25	0.1	4
161.54	163.07	56962	1.52	30	0.3	10
163.07	164.59	56963	1.52	20	0.3	15
164.59	166.12	56964	1.52	10	0.3	30
166.12	167.64	56965	1.52	15	0.3	20
167.64	169.16	56966	1.52	10	0.3	30
169.16	170.69	56967	1.52	2	0.2	100
170.69	172.21	56968	1.52	2	0.1	50
172.21	173.74	56969	1.52	5	0.2	40
173.74	175.26	56970	1.52	15	0.1	7

ASSAY SUMMARY

FROM	TO	WIDTH	GOLD	SILVER	Ag/Au
		(metres)	(ppb)	(ppm)	ratio
-----					

HUDSON BAY EXPLORATION AND DEVELOPMENT COMPANY LIMITED  
Northwest District

Dec 19/85

Project: CANYON (7302)

page 1 of 1

Rotary Drill Hole No.: RH-18	Claim No.: Canyon 1 (YA75717)	HOLE SURVEYS (corrected)
Co-ordinates: 26+47W	Hole Size: 4 inch	depth direction dip
13+95N	Date Started: Sep 12/85	
Collar Elev.: 844.68 m	Completed: Sep 13/85	
Azimuth: grid SOUTH	Logged by: P. Allen	
Angle: -60	Section: 26+50W	
Hole Depth: 149.35 metres	% Recovery:	

gold values (<5 ppb shown as 2.0  
silver values (<0.2 ppm shown as 0.1

FROM	TO	SAMPLE No.	WIDTH (metres)	WEIGHT (kgm)	GOLD Conc counts	Wt (gm)	Conc. factor	GOLD (ppb)	SILVER (ppm)	ARSENIC (ppm)	ANTIMONY (ppm)	Ag/Au ratio
0.00	28.96		28.96		glacial till overburden.							
28.96	149.35		120.40		bedrock. analyzed by A.A.							
28.96	30.48	56801	1.52					200	0.8			4
30.48	32.00	56802	1.52					740	1.0			1
32.00	33.53	56803	1.52					400	0.6			2
33.53	35.05	56804	1.52					320	0.5			2
35.05	36.58	56805	1.52					280	0.7			3
36.58	38.10	56806	1.52					400	0.6			2
38.10	39.62	56807	1.52					160	0.4			3
39.62	41.15	56808	1.52					400	0.5			1
41.15	42.67	56809	1.52					120	0.2			2
42.67	44.20	56810	1.52					20	0.2			10
44.20	45.72	56811	1.52					20	0.5			25
45.72	47.24	56812	1.52					45	0.3			7
47.24	48.77	56813	1.52					300	0.5			2
48.77	50.29	56814	1.52					440	0.6			1
50.29	51.82	56815	1.52					420	0.6			1
51.82	53.34	56816	1.52					380	0.6			2
53.34	54.86	56817	1.52					240	0.6			3
54.86	56.39	56818	1.52					65	0.3			5
56.39	57.91	56819	1.52					220	0.5			2
57.91	59.44	56820	1.52					420	0.6			1
59.44	60.96	56821	1.52					700	0.8			1
60.96	62.48	56822	1.52					220	0.6			3
62.48	64.01	56823	1.52					50	0.6			12
64.01	65.53	56824	1.52					35	0.1			3
65.53	67.06	56825	1.52					30	0.3			10
67.06	68.58	56826	1.52					30	0.3			10
68.58	70.10	56827	1.52					40	0.3			8
70.10	71.63	56828	1.52					40	0.4			10
71.63	73.15	56829	1.52					50	0.2			4
73.15	74.68	56830	1.52					30	0.1			3
74.68	76.20	56831	1.52					45	0.2			4
76.20	77.72	56832	1.52					110	0.4			4
77.72	79.25	56833	1.52					85	0.4			5
79.25	80.77	56834	1.52					70	0.3			4
80.77	82.30	56835	1.52					80	0.4			5
82.30	83.82	56836	1.52					60	0.4			7
83.82	85.34	56837	1.52					100	0.3			3
85.34	86.87	56838	1.52					45	0.2			4
86.87	88.39	56839	1.52					60	0.3			5
88.39	89.92	56840	1.52					45	0.3			7
89.92	91.44	56841	1.52					25	0.1			4
91.44	92.96	56842	1.52					35	0.2			6
92.96	94.49	56843	1.52					25	0.1			4

74.47	76.01	56844	1.52		10	0.2	20
96.01	97.54	56845	1.52		25	0.4	16
97.54	99.06	56846	1.52		10	0.1	10
99.06	100.58	56847	1.52		10	0.1	10
100.58	102.11	56848	1.52		15	0.1	7
102.11	103.63	56849	1.52		15	0.1	7
103.63	105.16	56850	1.52		35	0.1	3
105.16	106.68	56851	1.52		10	0.1	10
106.68	108.20	56852	1.52		10	0.1	10
108.20	109.73	56853	1.52		15	0.2	13
109.73	111.25	56854	1.52		20	0.2	10
111.25	112.78	56855	1.52		20	0.1	5
112.78	114.30	56856	1.52		20	0.2	10
114.30	115.82	56857	1.52		25	0.1	4
115.82	117.35	56858	1.52		45	0.4	9
117.35	118.87	56859	1.52		40	0.4	10
118.87	120.40	56860	1.52		40	0.2	5
120.40	121.92	56861	1.52		5	0.2	40
121.92	123.44	56862	1.52		25	0.2	8
123.44	124.97	56863	1.52		20	0.3	15
124.97	126.49	56864	1.52		55	0.3	5
126.49	128.02	56865	1.52		90	0.4	4
128.02	129.54	56866	1.52		75	0.4	5
129.54	131.06	56867	1.52		85	0.4	5
131.06	132.59	56868	1.52		50	0.4	8
132.59	134.11	56869	1.52		50	0.5	10
134.11	135.64	56870	1.52		35	0.2	6
135.64	137.16	56871	1.52		170	0.2	1
137.16	138.68	56872	1.52		30	0.2	7
138.68	140.21	56873	1.52		50	0.6	12
140.21	141.73	56874	1.52		10	0.3	30
141.73	143.26	56875	1.52		25	0.4	16
143.26	144.78	56876	1.52		20	0.2	10
144.78	146.30	56877	1.52		10	0.2	20
146.30	147.83	56878	1.52		20	0.1	5
147.83	149.35	56879	1.52		5	0.1	20
33.53	41.15	56880	7.62	vein material	0.055	0.05 oz/ton	

ASSAY SUMMARY

FROM	TO	WIDTH (metres)	GOLD (ppb)	SILVER (ppm)	Ag/Au ratio
30.48	32.00	1.52	740	1	1
28.96	38.10	9.14	390	1	2
38.10	47.24	9.14	128	0	3
59.44	60.96	1.52	700	1	1
47.24	62.48	15.24	341	1	2
28.96	62.48	33.53	296	1	2

HUDSON BAY EXPLORATION AND DEVELOPMENT COMPANY LIMITED  
Northwest District

Dec 19/85

Project: CANYON (7302)

page 1 of 1

Rotary Drill Hole No.: RH-19	Claim No.: Canyon 3 (YA75719)	HOLE SURVEYS (corrected)
Co-ordinates: 29+50W 12+65N	Hole Size: 4 inch	depth direction dip
Collar Elev.:	Date Started: Sep 13/85	
Azimuth: grid NORTH	Completed: Sep 14/85	
Angle: -60	Logged by: Garagan, Galambos	
Hole Depth: 152.40 metres	Section: 29+50W	
	% Recovery:	

gold values <5 ppb shown as 2.0  
silver values <0.2 ppm shown as 0.1

FROM	TO	SAMPLE No.	WIDTH (metres)	WEIGHT (kgm)	GOLD Conc counts	Conc Wt (gm)	Conc. factor	GOLD (ppb)	SILVER (ppm)	ARSENIC (ppm)	ANTIMONY (ppm)	Ag/Au ratio
0.00	54.86		54.86		glacial till overburden.							
54.86	152.40		97.54		bedrock, analyzed by A.A.							
54.86	56.39	56501	1.52					5	0.2			40
56.39	57.91	56502	1.52					15	0.1			7
57.91	59.44	56503	1.52					2	0.3			150
59.44	60.96	56504	1.52					2	0.1			50
60.96	62.48	56505	1.52					10	0.2			20
62.48	64.01	56506	1.52					2	0.1			50
64.01	65.53	56507	1.52					2	0.1			50
65.53	67.06	56508	1.52					2	0.8			400
67.06	68.58	56509	1.52					2	3.4			1700
68.58	70.10	56510	1.52					2	1.5			750
70.10	71.63	56511	1.52					5	11.0			2200
71.63	73.15	56512	1.52					2	0.3			150
73.15	74.68	56513	1.52					2	1.3			650
74.68	76.20	56514	1.52					2	0.4			200
76.20	77.72	56515	1.52					5	1.3			260
77.72	79.25	56516	1.52					10	0.2			20
79.25	80.77	56517	1.52					2	0.3			150
80.77	82.30	56518	1.52					5	0.3			60
82.30	83.82	56519	1.52					35	0.8			23
83.82	85.34	56520	1.52					10	0.2			20
85.34	86.87	56521	1.52					2	0.3			150
86.87	88.39	56522	1.52					2	0.2			100
88.39	89.92	56523	1.52					2	0.4			200
89.92	91.44	56524	1.52					2	0.1			50
91.44	92.96	56525	1.52					2	0.1			50
92.96	94.49	56526	1.52					2	0.1			50
94.49	96.01	56527	1.52					2	0.1			50
96.01	97.54	56528	1.52					2	0.2			100
97.54	99.06	56529	1.52					2	0.1			50
99.06	100.58	56530	1.52					25	0.3			12
100.58	102.11	56531	1.52					35	0.3			9
102.11	103.63	56532	1.52					5	0.1			20
103.63	105.16	56533	1.52					35	0.3			9
105.16	106.68	56534	1.52					25	0.4			16
106.68	108.20	56535	1.52					25	0.2			8
108.20	109.73	56536	1.52					10	0.2			20
109.73	111.25	56537	1.52					2	0.1			50
111.25	112.78	56538	1.52					2	0.1			50
112.78	114.30	56539	1.52					5	0.1			20
114.30	115.82	56540	1.52					5	0.2			40
115.82	117.35	56541	1.52					2	0.1			50
117.35	118.87	56542	1.52					2	0.1			50
118.87	120.40	56543	1.52					5	0.2			40

120.40	121.92	56544	1.52	2	0.1	50
121.92	123.44	56545	1.52	2	0.2	100
123.44	124.97	56546	1.52	2	0.1	50
124.97	126.49	56547	1.52	10	0.1	10
126.49	128.02	56548	1.52	5	0.1	20
128.02	129.54	56549	1.52	10	0.1	10
129.54	131.06	56550	1.52	2	0.1	50
131.06	132.59	56551	1.52	5	0.3	60
132.59	134.11	56552	1.52	15	0.3	20
134.11	135.64	56553	1.52	10	0.1	10
135.64	137.16	56554	1.52	2	0.1	50
137.16	138.68	56555	1.52	10	0.1	10
138.68	140.21	56556	1.52	20	0.1	5
140.21	141.73	56557	1.52	5	0.1	20
141.73	143.26	56558	1.52	2	0.1	50
143.26	144.78	56559	1.52	5	0.1	20
144.78	146.30	56560	1.52	5	0.1	20
146.30	147.83	56561	1.52	5	0.1	20
147.83	149.35	56562	1.52	2	0.1	50
149.35	150.88	56563	1.52	2	0.1	50
150.88	152.40	56564	1.52	2	0.1	50

ASSAY SUMMARY

FROM	TO	WIDTH (metres)	GOLD (ppb)	SILVER (ppm)	Ag/Au ratio
70.10	71.63	1.52	5	11	2200

## HUDSON BAY EXPLORATION AND DEVELOPMENT COMPANY LIMITED

DIAMOND DRILL LOG

Claim: CANYON 1

Location: Grew Creek

Mining Division Whitehorse

Hole Nº. RH16

Angle: -60°N

Direction: 045°

Depth: 148.4m

Grid Nº.

Co-Ordinates: 13+75N/25+50W

Date Started: Sept. 9/85

Finished: Sept. 10/85

Logged By: P. Allen

Drilled By: E. Caron Diamond Drilling

DEPTH		DESCRIPTION OF CORE CHIPS	Page 1 of 3
From	To		
0	170' (51.8m)	Overburden/till	
170'	175' (53.3m)	70% Andesite flow: lt grey fine grained, 25% feldspar needles, randomly orientated, minor 1% lightic clasts of crystal lithic tuff and rhyolite, 1% felspar phenocrysts weakly maolinized to pale yellow colour 5% Crystal Lithic Tuff; dk grey to brown, fine grained matrix with feldspar and qtz phenocrysts 10% and 5 to 10% rx fragments comprises of 33% rhyolite, 33% andesite flow, 33% crystal lithic tuff fragments; disseminated sulphides, minor silification? 20% Rhyolite, buff to pale green colour, fine grained matrix with 10% feldspar laths, 5% quartz eyes, some felspars appear to be orientated 5% ?chert? fine grained aphanitic black rx	
175'	180' (54.9m)	95% light Crystal tuff a.a. 5% Rhyolite a.a. 1% Andesite flow	
180'	185'	90% lithic crystal tuff a.a. 5% Rhyolite a.a. 5% Andesite flow a.a.	
185'	200' (61.0m)	93% crystal lithic tuff a.a. 5% Rhyolite a.a. 1% Andesite flow a.a. 1% black aphanitic f.g. rx?chert?a.a.	
200'	205' (62.5m)	a.a. high percent of qtz ?silicified? 5% carbonate and chalcedony veining	
205'	210' (64.0m)	a.a. high percent of qtz?silicified? 2% carbonate and chalcedony veining	
210'	225' (68.6m)	Crystal lithic tuff 5% Rhyolite, 1% black aphanitic rx, minor calcite Tr carbonate and chalcedony veining	

DEPTH		DESCRIPTION OF CORE	Page 2 of 3
From	To		
225'	240' (73.2m)	Crystal lithic tuff, 1% Rhyolite, trace carbonate and chalcedony veining	
240'	245' (74.7m)	Crystal lithic tuff, 2% Rhyolite, 1% Andesite flow, 1% black fine grained rx, trace chalcedony, sulphide veining	
245'	250' (76.2m)	Crystal lithic tuff, 5-7% Rhyolite, trace carbonate replacement and ? veining, trace qtz. veining	
250'	275' (83.8m)	Crystal lithic tuff, 1% Rhyolite, trace chalcedony veining, Trace carbonate replacement	
275'	285' (86.9m)	Crystal lithic tuff a.a.; minor silicification, 1% Rhyolite a.a. 2% chalcedony veining (banded) with sulphides associated minor calcite	
285'	300' (91.4m)	Crystal lithic tuff a.a. minor silicification, 2% Rhyolite 3 to 5% chalcedony veining (banded) oversize sulphides associated	
300'	315' (96.0m)	a.a. 2% chalcedony veining (banded)	
315'	345' (105.2m)	a.a. trace to 1% chalcedony veining (banded)	
345'	350' (106.7m)	a.a. 5% chalcedony veining/2% Sulphides 2% Rhyolite with disseminated sulphides, 3% light green/white rx as in 360-365' 5% fine grained dk brown to black crystal tuff; 60% feldspar phenocrysts .3 to .5 cm (Fragmented crystal) marker unit	
350'	355' (108.2m)	40% Crystal tuff a.a. 40% ? Rhyolite 10-20% Chalcedony veining	
355'	360' (109.7m)	5% Crystal tuff marker unit 85% Crystal lithic tuff as before 10% Chalcedony veining	
360'	365' (111.3m)	Crystal Lithic tuff 1% Rhyolite 5% ltgreen/white colour aphaitic matrix with 10% feldspar phenocrysts; pale green to clear colour .3 to 3mm in size, larger? feldspar? randomly orientated? qtz eyes similar in colour to feldspars but irregular shaped ? cavity filling. Minor? veining? minor silification and sulphide replacement ie feldspar laths look embayed 1% chalcedony veining (banded), 1% marker unit crystal tuff	
365'	385' (117.3m)	Crystal lithic tuff, 1% Rhyolite 1% banded chalcedony veining and carbonate veining	
385'	400' (121.9m)	a.a. trace banded chalcedony	
400'	405' (123.4m)	a.a. trace banded chalcedony trace lt grey/white rx as in 360 to 365' 1% Rhyolite	
405'	410' (125.0m)	a.a. trace banded chalcedony, 1% Rhyolite	

DEPTH		DESCRIPTION OF CORE	Page 3 of 3
From	To		
410'	420' (128.0m)	a.a. 5% Lt. grey to pale blue fine grained silicified tuffaceous? rock, feldspar phenocrysts, 10% matrix, v. small and fine laths; 1% qtz eyes, disseminated sulphide 1% clacite trace chalcedony and carbonate veining	
420'	425' (129.5m)	<u>Intensely carbonate altered</u> and chalcedony veined 100% of sample, 40% vein material ?rhyolite??	
425'	430' (131.1m)	Crystal lithic tuff a.a. 10% intensely carbonate altered? Rhyolite? 5% chalcedony veining	
430'	435' (132.6m)	crystal lithic tuff a.a. intensely carbonate alteration Rhyolite a.a. 50% of frags carbonate altered, 1% chalcedony veining	
435'	440' (134.1m)	Silicified crystal lithic tuff Note: 1 cm chips no fines, minor to moderate carbonate alteration trace banded chalcedony	
440'	445' (135.6m)	Crystal lithic tuff minor silicification as described 170-175' Minor carbonate alteration, 1% sulphides	
445'	450' (137.2m)	a.a. 5% lt. blue grey silicified and <u>partially welded</u> tuff as described 410' 1% chalcedony and carbonate veining	
450'	455' (138.7m)	Crystal lithic tuff 1% Rhyolite a.a. 1% Chalcedony and carbonate veining	
455'	460' (140.2m)	Crystal lithic tuff 5% Rhyolite 1% Chalcedony and carbonate veining	
460'	465' (141.7m)	a.a. 2% Rhyolite 1% lt brown to tan fine grained tuffaceous rock; 2% feldspar phenocrysts trace veining	
465'	480' (146.3m)	a.a. 5% Rhyolite Trace veining	
480'	487'	a.a. 1% Chalcedony and carbonate veining	
Encl of hole			

HUDSON BAY EXPLORATION AND DEVELOPMENT COMPANY LIMITED

DIAMOND DRILL LOG

Claim: CANYON 2

Location: Grew Creek

Mining Division Whitehorse

Hole Nº. RH-17

Angle: 60° (59° Acid test) Direction: North

Depth: 175.3m (575') Grid Nº.

Co-Ordinates: 25+50W/14+75N

Date Started: Sept. 11/85

Finished: Sept. 12/85

Logged By: T. Garagan

Drilled By: E. Caron Diamond Drilling Co. Ltd.

DEPTH		DESCRIPTION OF CORE
From	To	
0	225' (68.6m)	Overburden
225'	230' (70.1m)	Light grey to tan brown fine grained porphyritic andesite to dacite. The rock contains 1-2% medium grained euhedral plagioclase phenocrysts and 5-8% very fine grained acicular plagioclase needles with local flow banding in an aphanitic matrix. The sample contains a few chips and light grey medium grained partially silicified crystal lithic tuff with 30% clasts of quartz eyes, feldspar and felsic volcanic in an aphanitic silicified matrix interbedded with flow. 1-2% chalcedony, tr. pyrite
230	235' (71.6m)	Dacite to andesite aa with minor tuff A few of the dacite chips have 5% fine grained 1-2% chalcedony, Tr pyrite
235'	240' (73.2m)	Medium to dark smokey brown to grey brown medium grained crystal lithic tuff with 50-60% angular clasts consisting of quartz eyes (10-15% of clasts, feldspar (35% of clasts) and rhyolite, andesite welded tuff and chert clasts (remaining fragments) and minor felsic tuff? fragments. The rock appears to be partly silicified and the matrix is very fine grained smokey brown. It contains 3-5% fine to medium grained pyrite, . 1% Chalcedony Rock chips consist of 20% dacite to andesite flows
contact is at 71.9m		
240'	245' (74.7m)	Fine grained to coarse grained crystal lithic tuff a.a. with 60% subangular clasts predominately lithic fragments, partly silicified Tr chalcedony, 5% pyrite
245'	250' (76.1m)	Crystal lithic tuff a.a. with minor chalcedony and 4% pyrite cubes and nodules partly silicified
250'	255' (77.7)	Crystal lithic tuff as with 8-10% pyrite (fine to medium grained) minor chalcedony, partly silified 1% fragments black to dark grey ash fill lithic tuff
255'	260' (79.2m)	Medium grained crystal lithic tuff aa with 10% chips of fine grained smokey brown ash crystal tuff Tr black ash a.a. Tr chalcedony 5-8% pyrite

DEPTH		DESCRIPTION OF CORE	Page 2 of 6
From	To		
260'	265' (80.8m)	Grey brown medium grained crystal lithic tuff aa: partly silicified locally welded 5% chalcedony chips with minor pyrite and brecciation, 5% pyrite	
265'	270' (82.3m)	Crystal lithic tuff a.a. trace accretionary lapilli tuff (tuffaceous rock with 70% medium grained spheroids: presumed to be accretionary lapilli) 2-3% chalcedony 5% fine to coarse grained pyrite	
270'	275' (83.8m)	Crystal lithic tuff a.a., locally welded More abundant rhyolite fragment than before - some chips maybe chalcedony 5% pyrite, Tr. chalcedony Note: white chalcedony and massive white rhyolite chips are easily confused	
275'	280' (85.3m)	Crystal lithic tuff a.a. with abundant rhyolite clasts (10-15%) 5% pyrite, 5% chalcedony, Tr bright red to with 15% black ash fall tuff chips Note: white chalcedony and massive white rhyolite chips are easily confused	
280'	285' (86.9m)	Crystal lithic tuff aa with abundant rhyolite clasts (10-15%) 7-8% pyrite, 5% Chalcedony, tr black ash fall tuff 5% clay	
285'	290' (88.4m)	Tuff aa: with 10% rhyolite clasts 5% (?) chalcedony chips 5-10% clay 3-5% pyrite Note: white chalcedony and massive white rhyolite chips are easily confused	
290'	295' (89.9m)	Tuff aa: 20% rhyolite clasts (flow banded and massive white) may also be dyke rock 10% chalcedony 2-4% pyrite Note: white chalcedony and massive white rhyolite chips are easily confused	
295'	300'	Tuff aa: 5% rholite clasts 5% chalcedony, a few of the chips appears to be qtz flooded 1-3% pyrite	
300'	305' (93.0m)	Tuff fine to medium grained, grewy brown aa: 2-3% Rhyolite clasts 5% chalcedony, 2-3% pyrite 1% of the chips are composed of black tuff	
305'	310' (94.5m)	Tuff aa: with 10% pyrite. At least 50% of the pyrite is replacing matrix of the tuff. There are 5-7% chips of white chalcedony	
310'	315' (96.0m)	Rock chips are very small (high clay) Tuff aa: with 5% rhyolite clasts with 2-3% chalcedony (?) 2-4% pyrite	
315'	320' (97.5m)	Tuff aa: 5-8% pyrite. Several of the tuff chips contain pyrite which has replaced the matrix of the tuff. Contains 1-2% white chalcedony	
320'	325' (99.1m)	Tuff aa: with 5% pyrite, 10% of the chips consist of grey aphanitic to fine grained quartz eye porphyritic rhyolite (medium grained to	

DEPTH		DESCRIPTION OF CORE	Page 3 of 6
From	To		
		fine grained phenocrysts) consisting of 5-10% subrounded quartz eye phenocrysts. This maybe a thin dyke as opposed to fragments in the tuff. 1% chips of fine grained black ash fall tuff 1% white chalcedony-carbonate vein material matrix is partly altered to calcite 2-3%	
325'	330' (100.6m)	Tuff aa: with 10% pyrite, trace chalcedony, 5% calcite altered	
330'	335' (102.1m)	aa:	
335'	340' (103.6m)	Tuff aa with 2-3% chalcedony calcite vein material 2-3% carbonate alteration 5-7% pyrite	
340'	345' (105.am)	Tuff aa: fine grained to medium grained with 5-10% pyrite including pyrite "nodules" up to 0.5 cm in diameter 1-2% carbonate-quartz vein material 2-3% carbonate alteration	
345'	350' (106.7m)	Crystal lithic tuff aa: with 7-9% pyrite cubes and nodules. Pyrite is replacing the matrix of the tuff	
350'	355' (108.2m)	Crystal lithic tuff aa: with 5-8% pyrite aa: 3-5% carbonate alteration Tr chalcedony, 5% clay	
355'	360' (109.7m)	Crystal lithic tuff aa: with 5% pyrite disseminated and replacing tuff matrix	
360'	365' (111.3m)	Crystal lithic tuff aa: with 5-8% pyrite aa, minor carbonate alteration	
365'	370' (112.8m)	Crystal lithic tuff aa: with 10% pyrite aa.	
370'	375' (114.3m)	aa: with 5-8% pyrite aa.	
375'	380' (115.8m)	Fine grained to medium grained crystal lithic tuff aa: with 30-40% clasts containing 10% disseminated and nodular pyrite with tr carbonate alteration to feldspar Tr chalcedony	
380'	385' (117.3m)	Crystal lithic tuff aa: with 2-3% coarse grained quartz eyes and tr carbonate veining. Tr chalcedony. 5% pyrite	
385'	390' (118.9m)	Crystal lithic tuff aa: 10% pyrite with pyrite replacing the matrix of the tuff	
390'	395' (120.4)	Crystal lithic tuff aa: in 30% of the chips, an additional 30% of chips consist of a fine grained chocolate brown to medium brown crystal ? lithic tuff with 20% fine grained clasts of felspar, black tuff, rhyolite?, felsic volcanics in a very fine grained brown matrix. This unit shows bedding a few of the chips. There is 20%, most of which (75%) consists of round (water washed) nodules of pyrite and minor carbonaceous material. The remaining consists of fine to medium grained pyrite cubes and tuff with pyrite replacing the matrix. 10% of the chips consist of a aphanitic white rock with fine grained angular fragments of glass or quartz comprising 20% of the rock. This rock may be a vitric tuff.	

## DEPTH

## DESCRIPTION OF CORE

Page 4 of 6

From	To	
		<p>5% of the chips consist of green quartz - fuchsite vein material with 30% fuchsite filling fractures in the quartz vining it a green colour.</p> <p>The remaining chips consist of (1) fine grained poorly sorted sandstone with subangular to subrounded clasts of quartz, feldspar, chert fuchsite-qtz. (2) fine grained andesite with acicular feldspar phenocrysts sec: 225-230'</p> <p>(3) 1% chalcedony</p> <p>Interpretation: this is a bottom of a thick tuff cooling unit where there may have been a brief period of erosion and deposition of a thin chocolate brown tuff</p>
395'	400' (121.9m)	<p>Crystal lithic tuff and fragmented chocolate brown tuff aa. Tr sandstone chips, tr rounded quartz graind Tr chalcedony</p>
400'	405' (123.4m)	<p>Mixture of tuff chips, quarta, rhyolite and rounded pyrite as in 390-395' ? brown tuff and conglomerate 2-3% chalcedony</p>
405'	410' (125.0m)	<p>Rock as above: appears to be a medium grained to very coarse grained tuffaceous rock with subangular to subrounded clasts of tuff rhyolite, quartz, andesite, calcite, feldspar, chert, sandstone, pyrite and possibly chalcedony. This would explain the variation in rock chips and the rounded edges of some of the chips. In this sample chips of tuff, rhyolite, quartz, chalcedony and pyrite all have one or two rounded edges therefore from 390 to is a felsic lithic crystal lapilli tuff</p>
410'	415' (126.5m)	<p>Coarse grained dark brown lithic lapilli aa. and 40% of the chips consist of tan aphanitic andesite to dacite with 10% fine grained acicular plagioclase phenocrysts. The andesite contains minor medium grained quartz calcite filled amygdules. The andesite is partly carbonate altered and contains 5% banded chalcedony veining</p>
415'	420' (128.0m)	<p>Coarse grained dark brown to brown lithic lapilli tuff aa.</p>
420'	425' (129.5m)	<p>Smokey brown to grey brown fine grained to medium grained crystal lithic tuff with 50% clasts as in 235-390' 5-8% pyrite cubes and nodules Tr chalcedony</p>
425'	430' (131.1m)	<p>Crystal lithic tuff aa. with 7-10% pyrite replacing matrix in the tuff. The tuff contains 15% feldspar clasts in this sample</p>
430'	435' (132.6m)	<p>Light brown crystal lithic tuff aa. with 5-8% pyrite (cubes and nodules) and 10% feldspar fragments. Tr banded chalcedon, The tuff is partly silicified</p>
435'	440' (134.1m)	<p>Crystal lithic tuff aa. with 5-10% rhyolite clasts aphanitic white. The tuff appears to have some quartz flooding, 5% pyrite</p>
440'	445' (135.6m)	<p>Crystal lithic tuff aa: 2-3% pyrite, tr quartz flooding</p>
445'	450' (137.2m)	<p>Crystal lithic tuff aa: 5% pyrite</p>
450'	455' (138.7m)	<p>Crystal lithic tuff aa: 5-7% pyrite</p>

DEPTH		DESCRIPTION OF CORE	Page 5 of 6
From	To		
455'	460' (140.2m)	Crystal lithic tuff aa: 5% pyrite, Tr. chalcedony	
460'	465' (141.7m)	Light brown fine grained crystal lithic tuff with 35% clasts consisting of fine grained to medium grained subangular broken feldspar, quartz eyes, rhyolite and felsic tuff. Pyrite partially replaces the matrix and comprises 5% of the rock. A few rhyolite clasts are up to 7 mm across. Tr chalcedony	
465'	470' (143.3m)	Fine grained to medium grained crystal lithic tuff aa: 1-2% pyrite	
470'	475' (144.8m)	Crystal lithic tuff aa: with 5% pyrite, tr carbonate alteration	
		Fault	
475' wet sample	480' (146.3m)	Dark to medium brown fine grained crystal tuff to crystal lithic tuff with fine to medium fragments of feldspar, rhyolite, quartz, plant material, felsic tuff occupying 30% of the rock. The unit have a weak banding. Contains some very coarse pyrite along with fine cubes. Pyrite occupying 5% of the rock	
480' wet sample	485' (147.8m)	Medium brown very fine grained to coarse grained crystal lithic tuff with fragments aa: (subangulate subrounded) in 30-50% of the rock. A few chips show graded bedding from very fine grained ash in the coarse grained Crystal lithic tuff with 5-50% of the chips being rhyolite. 1% chalcedony	
485'	490' (149.4m)	Crystal lithic tuff aa: with 1-2% pyrite, 5-10% clay	
490'	495' (150.9m)	Fine grained chocolate brown tuff to fine to coarse grained crystal lithic tuff aa; the fine frained appear to be interbedded and varies into the coarse grained tuff, contains 2-3% pyrite	
495'	500' (152.4m)	Med. grained crystal lithic tuff aa: with 25% clasts and 3-5% pyrite The tuff has some quartz flooding. Tr. chalcedony.	
500'	505' (153.9m)	Med. grained crystal lithic tuff aa: 3-5% pyrite, Tr chalcedony	
505'	510' (155.4m)	Crystal lithic tuff aa: 5% pyrite	
510'	515' (157.0m)	Fine grained to med. grained crystal lithic tuff aa: 5% pyrite	
515'	520' (158.5m)	very fine grained crystal lithic tuff aa: 8-10% pyrite The tuff appears to be partially silicified. Tr chalcedony.	
520'	525' (160.0m)	Med. grey brown very fine grained tuff and fine to medium grained crystal lithic tuff aa. The two units are compositionally similar and are probably interbedded. 2-3% pyrite	
525'	530' (161.5m)	Chips are a mixture of very fine grained ash tuff and crystal lithic tuff aa: 3-5% pyrite and coarse nodules	
530'	535' (163.0m)	Med. grained crystal lithic tuff aa: 3-5% pyrite	
535'	540' (164.6m)	aa.	
540'	545' (166.1m)	a.a. 3-5% pyrite: 1-2% of chips consist of aphanitic rhyolite	

## DEPTH

## DESCRIPTION OF CORE

Page 6 of 6

From	To	
545'	550' (167.6m)	Dark brown to med. brown fine grained to med grained crystal lithic and ash tuff aa: 2-3% pyrite, Tr. chalcedony
550'	555' (169.2m)	a.a.
555'	560' (170.7m)	Med. grained crystal lithic tuff aa: 5% pyrite
560'	565' (172.2m)	aa. with 20% of the chips consisting of fine grained chocolate ash tuff. 5% pyrite
565'	570' (173.7m)	aa: 5-7% pyrite
570'	575' (175.3m)	Tuff aa: 7% pyrite. Tr chalcedony
		End of hole

## HUDSON BAY EXPLORATION AND DEVELOPMENT COMPANY LIMITED

DIAMOND DRILL LOG

Claim: CANYON 1

Location: Grew Creek

Mining Division Whitehorse

Hole Nº. RH-18

Angle: 60°S

Direction: 045°

Depth: 149.4m

Grid Nº.

Co-Ordinates: 26+50W/14+00N

Date Started: Sept. 12/85

Finished: Sept. 13/85

Logged By: P. Allen

Drilled By: E. Caron Diamond Drilling

DEPTH		DESCRIPTION OF CORE	CHIPS	Page 1 of 4
From	To			
0	95'	Overburden		
95' (29.0m)	100' (30.5m)	Crystal Lithic Tuff: light grey to lt. brown, medium grained partially silicified with 30% to 40% clasts of qtz eyes: feldspar phenocrysts and subangular felsic volcanic rock fragments and fine grained dark grey to black chery rock. Disseminated sulphides, minor carbonate alteration		
100'	105' (32.0m)	aa: 5 to 10% quartz/chalcedony veining (grey to clear)		
105'	110' (33.5m)	a.a. 3% quartz/chalcedony veining (grey to clear) Note: welded tuff fragments in tuff.		
110'	115' (35.0m)	Crystal lithic tuff. 5% dacite/andesite flow; lt grey to blue grey fine grained 30-40% feldspar needles; amygdaloidal andesite 30% amygdules (qtz) subrounded to rounded with 5 to 10% feldspar acicular needles in a fine grained matrix (margin of flow) 3% chalcedony and carbonate veining (grey to clear) 1 clast of black marker unit		
115'	120' (36.6m)	aa: 20% Dacite/andesite flow, 10% chalcedony veining (grey, banded)		
120'	125' (38.1m)	aa: 5% chalcedony veining (grey-clear)		
125'	130' (39.6m)	aa: 10% Dacite.andesite, 3% chalcedony veinong (clear-grey colour) and welded tuff fragments (grey colour) 2 to 3 clasts in tuff		
130'	135' (41.1m)	aa: minor silicification of tuff, 30% chalcedony veining (clear grey colour) minor brecciation of tuff is associated with veining		
135'	140' (42.7m)	aa: (2% welded tuff fragments) 5% chalcedony veining (clear grey banded)		
140'	145' (44.2m)	80% Andesite/Dacite flow; 70% of these fragments buff to light brown colour; med. grained, 35% acicular feldspar and minor? qtz eyes? Amygdaloidal - zoned amygdules with qtz/calcite altering and qtz crystals growing into center of cavity looks flow banded with feldspar orientated approximately same direction. Minor kaolinite alteration of feldspar (pale yellow colour); 30% of flow fragments lt.grey/blue colour as previously described with acicular feldspar		

DEPTH		DESCRIPTION OF CORE	Page 2 of 4
From	To		
		15% black (f. grained aphanitic) tuffaceous unit. Similar to marker unit though predominately comprises of rx fragments 20% of above flow. Angular to subangular fragments. Partially welded. Minor feldspar phenocrysts. Fragments pale pink, grey to buff colour. Fragments look silicified or welded. Silicious texture. 5% banded chalcedony carbonate veining.	
145'	150' (45.7m)	65 to 75% black fine grained tuffaceous unit a.a. 25 to 35% andesite/Dacite flow. lt buff colour to lt grey colour aa: 2 to 3% chalcedony veining; carbonate replacement.	
150'	155' (47.2m)	60% andesite/dacite flow a.a. 40% blk f. grained lithic tuff a.a. 1% chalcedony veining and carbonate replacement	
155'	160' (48.8m)	25 to 30% andesite/dacite flow a.a. 65% Crystal Lithic Tuff - lt. brown to brown colour. Note: partially digested glass (blk) in rx 1% of fragments in tuff trace blk. lithic tuff. 1 to 3 fragments (clasts) partially welded 5% banded chalcedony veining Clasts generally larger than normal 1 cm.	
160'	165' (50.3m)	Crystal lithic tuff 5% Andesite/Dacite flow. Trace chalcedony veining	
165'	180' (54.9m)	Crystal lithic tuff, 1% Andesite/Dacite flow Trace chalcedony veining	
180'	185' (56.4m)	Andesite/Dacite flow as described before; buff colour carbonate altered 3% Crystal lithic tuff - intensely silicified 1 to 3% Banded chalcedony veining 5% Black Lithic crystal tuff - marker unit, moderately silicified; amygdaloidal (opaline mineral)	
185'	190' (57.9m)	Rhyolite; fine grained off white to lt. grey colour; aphanitic matrix with 15% qtz eyes. 3% andesite flow. 5% banded chalcedony (dull grey and opaque)	
190'	195' (59.4m)	Rhyolite a;a; 5-10% banded chalcedony (dull grey to clear grey)	
195'	200' (61.0m)	Rhyolite a.a. 20% banded chalcedony (clear grey)	
200'	205' (62.5m)	Rhyolite R% Banded chalcedony (clear grey)	
205'	230' (70.1m)	Andesite/Dacite flow as before 5% banded chalcedony veining (clear grey)	
230'	235' (71.6m)	a.a. Mod. carbonate alteration 5% banded chalcedony veining (clear grey)	
235'	240' (73.2m)	a.a. 1 to 2% grey to black lithic tuff 3% banded chalcedony veining a.a., minor to trace hematite staining of?feldspar in flow	
240'	245' (74.7m)	30% black f.g. lithic tuff as described 140' 40% grey fine to med. grained lithic crystal tuff more clast dominated 40% rx fragments and crystal fragments. Fragments subangular to subrounded comprised of andesite/dacite. Rx fragments larger size than blk lithic tuff; minor welding and silicification	

DEPTH		DESCRIPTION OF CORE	Page 3 of 4
From	To		
		30% andesite/dacite flow 1% banded chalcedony Minor hematite staining present in andesite and in some clasts of tuffs	
245'	250' (76.2m)	40% black f. grained lithic tuff 55% Grey m. grained lithic tuff 5% Andesite dacite 1% chalcedony veining	
250'	265' (80.8m)	a.a. Note: grey m. grained tuff grading slightly to lt. brown tuff 155' 1% banded chalcedony veining	
265'	270' (82.3m)	Crystal lithic tuff (lt. brown colour) as in 95' 1 to 3% chalcedony veining (banded)	
270'	300' (91.4m)	a.a. trace chalcedony veining	
300'	305' (93.0m)	Andesite/dacite flow as described before with slight alteration of acicular feldspars and glass (plk aphanitic) subangular to subrounded fragments 5% crystal lithic tuff a.a. trace chalcedony veining	
305'	310' (94.5m)	Andesite dacite a.a. 15% crystal lithic tuff a.a. trace chalcedony veining	
310'	315' (96.0m)	Crystal lithic tuff a.a. 5-10% Andesite/dacite Trace chalcedony veining	
315'	320' (97.5m)	Crystal lithic tuff trace chalcedony veining	
320'	325' (99.0m)	55% Crystal lithic tuff 45% Rhyolite fg - aphanitic matrix; matrix dominates 5-10% qtz eyes, buff, white to pale green; dependent on the degree of sericitization	
325'	330' (100.6m)	Rhyolite a.a. 15% Crystal lithic tuff	
330'	335' (102.1m)	Rhyolite 1 to 3% sericite buff to pale green colour (Tarn)	
335'	340' (103.6m)	Rhyolite a.a. minor quartz flooding 2% sulphides, trace blue green miner? clay mineral?	
340'	350' (106.7m)	Crystal Lithic tuff	
350'	390' (118.9m)	a.a. Trace to 1% chalcedony veining	
390'	395' (120.4m)	Crystal lithic tuff, 35% Rhyolite, trace chalcedony veining	
395'	400' (121.9m)	Crystal lithic tuff, 20% Rhyolite	
400'	405' (123.4m)	Crystal lithic tuff, trace chalcedony veining	

DEPTH		DESCRIPTION OF CORE	Page 4 of 4
From	To		
405'	435' (132.6m)	a.a. 10-15 Rhyolite	
435'	445' (135.1m)	a.a., Rhyolite is qtz flooded with minor 1 to 2% chalcedony/qtz veining. Minor silicification in crystal lithic tuff	
445'	450' (137.2m)	Crystal lithic tuff, 5% rhyolite	
450'	455' (138.7m)	Crystal lithic tuff, tr to 1% banded chalcedony veining	
455'	460' (140.2m)	a.a.	
460'	465' (141.7m)	Crystal lithic tuff, 15% rhyolite Note: very fine chips Minor carbonate replacement	
465'	470' (143.3m)	Rhyolite, minor carbonate replacement, trace chalcedony veining	
470'	475' (144.8m)	Crystal lithic tuff, minor carbonate replacement, trace chalcedony veining	
475'	480' (146.3m)	a.a., minor silicification	
480'	485' (147.8m)	a.a., minor silicification, 1 to 2% chalcedony banded veining	
485'	490' (149.4m)	Rhyolite ?Andesite? silicified, 10% banded chalcedony veining Note: at bottom of hole sample was 50 to 70% chalcedony veining	
		END OF HOLE	

HUDSON BAY EXPLORATION AND DEVELOPMENT COMPANY LIMITED

DIAMOND DRILL LOG

Claim: CANYON 3

Location: Grew Creek

Mining Division Whitehorse

Hole Nº: RH-19

Angle: -60°N

Direction: 045°

Depth: 152.4m Grid Nº:

Co-Ordinates: 29+50W/12+65N

Date Started: Sept. 13/85

Finished: Sept. 14/85

Logged By: K. Galambos  
T. Garagan

Drilled By: E. Caron Diamond Drilling

DEPTH		DESCRIPTION OF CORE CHIPS Page 1 of 7
From	To	
0	180'	Overburden and glacial till
180' (54.9m)	185 (56.4m)	Sample consists of glacial till, lithic crystal tuff and andesite flow fragments
185'	190' (57.9m)	50% andesite flow: off white-buff very fine grained matrix with lath like feldspar phenocrysts and/or rounded to oblong quartz amygdules 25-30% lithic crystal tuff; medium to dark grey, fine grained matrix (granular) with off white white rock fragments (commonly andesite flow fragments). white broken feldspar phenocrysts and large (up to 3mm) quartz eyes. Rock fragments make up majority of clasts. 15% calcareous material 3% dark grey black lithic fragments 1-2% white quartz (some banded) and buff calcite veining Tr-1% light medium green sericite altered lithic crystal tuff Tr brown welded tuff material
190'	195' (59.4m)	72-73% andesite flow fragments often attached to black tuffaceous rock 15% fresh lithic crystal tuff 10% calcareous material 2-3% quartz (some chalcedony)veining
195'	200' (61.0m)	84% buff and grey andesite flow with varying percentage of crystals 10% fresh lithic crystal tuff 5% calcareous material 1% quartz veining Tr brown opaque, glassy, welded tuff
200'	205' (62.5m)	90% predominantly light grey, some buff coloured, andesite flow unit with weldspar phenocrysts and few amygdules 5% calcareous material 5% black lithic tuff, some with white and light pink rock fragments Tr-1% quartz veining Tr grey brown welded tuff

DEPTH		DESCRIPTION OF CORE	Page 2 of 7
From	To		
205'	210' (64.0m)	60-65% clear quartz eyes and broken quartz eyes and white broken feldspar phenocrysts 20-25% black-dark grey tuff 10% white and clear calcareous material Tr chocolate brown, very fine grained, ash unit 2-3% quartz veining (some chalcedony)	
210'	215' (65.5m)	50-53% white and clear broken feldspars and quartz eyes 25-30% lithic crystal tuff as in 185-190' 15% white, light grey and clear calcareous material 2-3% dark grey-black lithic tuff Tr-1% quartz veining	
215'	220' (67.1m)	60% broken quartz eyes and feldspar phenocrysts 25% lithic crystal tuff as in 185-190' 10% calcareous material 5% black lithic tuff 1% buff rhyolite with slight manganese staining Tr chocolate brown ash tuff Tr quartz and calcite veining Tr fine grained, light grey (soft) clay altered rhyolite Tr brown welded tuff	
220'	225' (68.6m)	78-79% light grey, fine grained, soft, clay altered rhyolite 5% manganese stained buff colored rhyolite 5% white and light grey calcareous material 5% buff clay altered rhyolite (very soft) 5% lithic crystal tuff as in 185-190' 1% black lithic tuff Tr-1% quartz and calcite veining Tr chocolate brown ash tuff	
225'	230' (70.1m)	60% light grey, fine grained clay altered rhyolite 30% light grey brown; fine grained matrix with very small black lithic clasts (fine grained version of lithic crystal tuff in 185-190') 5% buff clay altered rhyolite 2-3% calcareous material 1% white quartz veining Tr black lithic tuff Tr andesite flow	
230'	235' (71.6m)	40% lithic crystal tuff as in 185-190' but with pyrite 10-15% fine grained lithic crystal tuff as in 225-230' 15% broken quartz eyes and feldspar phenocrysts 10% buff rhyolite with pyrite 5% dark grey black lithic tuff 5-10% light grey and white calcareous material 102% quartz veining Tr sericite altered rhyolite Tr sericite altered tuff	
235'	240' (73.2m)	30% brown grey lithic crystal tuff as in 185-190' 29% dark grey-black lithic tuff 40% buff colored silicified (quartz flooded) andesite 1% white quartz veining, one piece amanganese stained with slickensides (?)	
240'	245' (74.7m)	99% silicified (quartz flooded) andesite flow Tr- $\frac{1}{2}$ % dark grey black tuff, Tr- $\frac{1}{2}$ % white quartz Tr- $\frac{1}{2}$ % calcareous material	

## DEPTH

## DESCRIPTION OF CORE

Page 3 of 7

DEPTH		DESCRIPTION OF CORE
From	To	
245'	250' (76.am)	90% silicified (quartz flooded) andesite flow 5% dark grey-black lithic tuff 2-3% lithic crystal tuff as in 185-190' 2-3% calcareous material 1% white quartz veining Tr light grey clay altered rhyolite
250'	255' (77.7m)	60% dark grey-black lithic tuff 20% brown grey lithic crystal tuff as in 185-190' 18% silicified andesite flow 2% white quartz veining Tr-1% calcareous material
255'	260' (79.2m)	70% brown grey lithic crystal tuff as in 185-190' 15% andesite flow, probably fragments in lithic tuff 10% medium dark brown fine grained lithic crystal tuff 5% dark grey black lithic tuff Tr white quartz veining Tr calcareous material
260'	265'	90% lithic crystal tuff as in 185-190' with an increase in fragments from 255-260' 7-8% andesite flow fragments from lithic crystal tuff 2-3% black lithic tuff fragments
265'	270' (82.3m)	95% lithic crystal tuff as in 185-190' again with large percentage of lithic clasts 2-3% fragments of andesite flow 2-3% black lithic tuff fragments
270'	275' (83.8m)	97% lithic crystal tuff as in 180-190' with large percentage of lithic clasts 2-3% black lithic tuff fragments tr andesite flow Tr clau altered rhyolite Tr calcite vein
275'	280' (85.3m)	90% lithic crystal tuff as in 185-190' with large percentage of lithic fragments 10% andesite flow with greater percentage of vesicles than previously Tr calcareous material Tr quartz veining
280'	285' (86.9m)	98% lithic crystal tuff as in 185-190' with large percentage of lithic fragments 1-2% calcite veining Tr andesite flow fragments other than those contained in lithic tuff
285'	290' (88.4m)	97-98% lithic crystal tuff as in 185-190' with large percentage of lithic fragments 2-3% andesite flow fragments Tr calcareous material
290'	295' (89.9m)	97-98% lithic crystal tuff as in 185-190' with large percentage of lithic fragments 2-3% andesite flow fragments Tr quartz veining Tr calcareous material

DEPTH		DESCRIPTION OF CORE	Page 4 of 7
From	To		
295'	300' (91.4m)	95% lithic crystal tuff as in 185-190' with high percentage of lithic clasts 5% silicified andesite flow Tr lithic crystal tuff with few fragments Tr calcareous material	
300'	305' (93.0m)	95-96% lithic crystal tuff as in 185-190' with high percentage of lithic clasts 3-4% black lithic tuff fragments (few lithic fragments) 1% buff andesite flow fragments Tr calcareous material	
205'	310 (94.5m)	85% andesite flow 12% lithic crystal tuff as in 185-190 with high percentage of lithic clasts 1-2% chocolate brown ash tuff Tr-1% quartz and calcite veining	
310'	315' (96.0m)	63% crystal lithic tuff as in 185-190' with high percentage of lithic clasts 30% andesite flow 5% white quartz veining 1-2% dark grey black lithic tuff with few fragments Tr chocolate brown ash tuff Tr calcareous material	
315'	320' (97.5m)	86-87% andesite flow 10% lithic crystal tuff as in 185-190 with high percentage of lithic clasts 1-2% chocolate brown ash tuff 1-2% quartz veining Tr black ash tuff (fine grained equivalent of lithic tuff?)	
320'	325' (99.1m)	85-87% crystal lithic tuff as in 185-190' with high percentage of lithic clasts 5-7% andesite flow with large percentage of amygdules 5% chocolate brown ash tuff 1-2% black lithic tuff 1% black ash tuff Tr-1% quartz veining	
325'	330' (100.6m)	55% buff, tan to light brown andesite flow with few crystals and only a moderate number of amygdules 15% crystal lithic tuff 15% chocolate brown ash tuff 10% black ash tuff 5% quartz veining	
330'	335' (102.1m)	40% medium brown fine grained lithic tuff and ash tuff 20% manganese stained (buff) rhyolite k9015% black ash tuff 5% off white silicified rhyolite porphyry 5% andesite flow 5% lithic crystal tuff as in 185-190' with large percentate of lithic clasts 1% white quartz veining Tr light medium green moderately sericite altered rhyolite porphyry	
335'	340' (103.6m)	97% lithic crystal tuff as in 185-190' percentage of lithic is noderate to high. 3% andesite flow	

DEPTH		DESCRIPTION OF CORE	Page 5 of 7
From	To		
340'	345' (105.2m)	60% lithic crystal tuff as in 185-190 moderate-high percentage of clasts 15% light grey brown fine grained lithic tuff as in 330-335' 15% andesite flow some silicified with pyrite 10% black ash tuff	
345'	350' (106.7m)	73-75% andesite flow showing some clay alteration, silicification and sericite alteration light medium brown ash tuff 10% quartz and calcite vein? material 5-7% dark grey ash tuff 5% dark grey-black lithic tuff with few clasts 5% lithic crystal tuff as in 185-190' moderate percentage of clasts	
350'	355' (108.4m)	Sample composed of two distinct units in approximately equal proportions 1. Dark brown to grey very fine grained to fine grained ash tuff to lithic crystal tuff. The unit shows some bedding. The clasts in the fine unit comprise approximately 30-40% of the rock and consist of angular fragments of glass shards, rhyolite, andesite, feldspar crystals and rare quartz eyes. The lithic fragments and glass shards dominate at 3:1 with the crystals. The fragments lie in a black to dark brown very fine grained matrix. 2. Buff to light grey brown fine grained plagioclase porphyritic andesite to dacite. The plagioclase phenocrysts comprise 10-15% of the rock and are fine grained and acicular. The unit is also amygdaloidal with fine grained quartz carbonate filled vesicles comprising 1-2% of the rock. The matrix is aphanitic. The andesite is locally silicified and contains 15% banded chalcedony veins and veinlets.	
355'	360' (109.7m)	Dark to med. brown lithic lapilli tuff contains 60% rock fragments in a fine grained andesite matrix. Clasts consist of subangular fragments of pred. andesite, brown and grey ash tuff, lithic tuff and feldspar crystals. 30% of the rock chips consist of the acicular plagioclase porphyritic andesite aa. It is difficult to determine if these are clasts in the tuff or individual flows. More likely clasts in the tuff. There is 1-2% banded chalcedony? clasts or vein material	
360'	365' (111.3m)	Buff to light brown andesite to dacite aa. with tr. chalcedony 10% of the chips consist of grey to dk brown ash tuff	
365'	370' (112.8m)	Buff to light brown andesite aa. with 5% dk brown ash tuff The andesite contains 1-2% m. grained plagioclase phenocrysts along with the fine grained acicular feldspar. The feldspars are locally flow banded. A few of the amygdules in this unit are filled with clay and? pink zeolites 5% of the andesite chips contain 5% xenolithes of rounded dk brown tuff. The tuff balls are round to egg shaped. These may be agglutinates which have fallen in the flows: ie ash fall onto flow during rain. The balls are up 1-2 mm across .  The andesite also contains this fractures filled with tuff: (0-1% of unit) are probably fractures in the top of the flow filled with tuff. This occurs in the same sample as the tuff balls. In addition a few (3%) of these sand ball filled chips are pink in colour. 1% chalcedony.	

DEPTH		DESCRIPTION OF CORE	Page 6 of 7
From	To		
370'	375' (114.3m)	Dark to med. green to green brown fine grained basaltic andesite with 5% fine grained plagioclase (zoned) phenocrysts in a fine grained mesh like matrix composed in part by mafic minerals (chlorite replacing pyroxene?). The rock contains 1% vesicules which may be filled by quartz calcite. The rock is partially altered to carbonate 5% of the remaining chops are andesite, minor brown tuff	
375'	380' (115.8m)	Med. green to yellow brown andesite to basaltic andesite aa. The dk. green unit appears to vary into the lighter coloured andesite. Contains 2-3% sericite as an alteration of the matrix. The matrix is also carbonate altered. 10% of chips consist of the very fine to fine grained brown ash tuff. 1% chalcedony-calcite veinlets	
380'	385' (117.3m)	Med. brown andesite with 2-3% fine grained plagioclase phenocrysts in a very fine grained matrix of plagioclase and 10% chlorite. The rock contains 0.5% magnetite. The feldspars are partly altered to epidote. 1% calcite veining	
385'	390' (118.9m)	Red green to yellow brown andesite with 5% acicular fine grained plagioclase as before (50% of the chips) and very fine grained choc. brown ash tuff aa. (45% of the chips). 5% of the chips consist of andesite aa.	
390'	395' (120.4m)	Yellow brown to brown andesite aa. with 10% chlorite and 1-2% epidote, carbonate altered, tr quartz veinlets	
395'	400' (121.9m)	Andesite aa. 1-2% epidote, tr. quartz veinlets, carbonate altered	
400'	405' (123.4m)	Med. brown to green andesite to basaltic andesite aa. with 2-3% quartz microfraction. Tr epidote. moderately carbonate altered.	
405'	410' (125.0m)	Carbonate altered andesite aa. with 2-4% epidote	
410'	415' (126.5m)	Carbonate altered andesite aa; 1-2% epidote	
415'	420' (128.0m)	Carbonate altered andeiste aa: 1% epidote, Tr quarta	
420'	425' (129.5m)	a.a.	
425'	430' (131.1m)	Tan carbonate altered andesite with 1-2% medium grained epidote altered plagioclase phenocrysts and 5% chlore (disseminated and along microfractures)	
430'	435' (132.6m)	Chlorite and partially carbonate altered andesite a.a.	
435'	440' (134.1m)	a.a.	
440'	445' (135.6m)	a.a.	
445'	450' (137.2m)	a.a.	
450'	455' (138.7m)	andesite aa. with 5% of the chips consisting of a fine grained black lithic crystal tuff with 75% clasts. The clasts consist of feldspar, quartz, andesite, brown tuff & chert. They are all subangular to subrounded.	

DEPTH		DESCRIPTION OF CORE	Page 7 of 7
From	To		
455'	460' (140.2m)	andesite a.a.	
460'	465' (141.7m)	a.a.	
465'	470' (143.3m)	andesite a.a. with 2-3% epidote	
470'	475' (144.8m)	a.a.	
475'	480' (146.3m)	a.a.	
480'	485' (147.8m)	a.a. with 5% chlorite	
485'	490' (149.4m)	dark green tan fine grained basaltic andesite to andesite as before	
490'	495' (150.9m)	a.a.	
495'	500' (152.4m)	Basaltic andesite with 5-10% carbonate alteration, tr. quartz calcite veining	