



DIAMOND DRILLING ASSESSMENT REPORT

ON THE

BEE MINERAL CLAIMS

NTS 105 D-14 - 60°47'N/135°12'W

G. Macdonald, P. Geol.

August 26, 1983
Whitehorse, Yukon

091489



TABLE OF CONTENTS

INTRODUCTION

DRILL PROGRAM

CONCLUSIONS AND RECOMMENDATIONS

This report has been examined by the Geological Evaluation Unit under Section 53 (4) Yukon Quartz Mining Act and is allowed as representation work in the amount of \$ 3,300.00.

for *Kathryn Grapes*
Regional Manager, Exploration and Geological Services for Commission of Yukon Territory.

APPENDIX

DRILL LOGS

STATEMENT OF QUALIFICATIONS

084100

TABLE OF CONTENTS



INTRODUCTION

DRILL PROGRAM

CONCLUSIONS AND RECOMMENDATIONS

APPENDIX

DRILL LOGS

STATEMENT OF QUALIFICATIONS

091489

INTRODUCTION

The Bee claims are located on Claim Sheet 105 D-14, on the east flank of Haeckel Hill. Access to the property is via the old Haeckel ski hill road which leave the Alaska Highway approximately 1 kilometer past the junction of Mayo Road with the Alaska Highway.



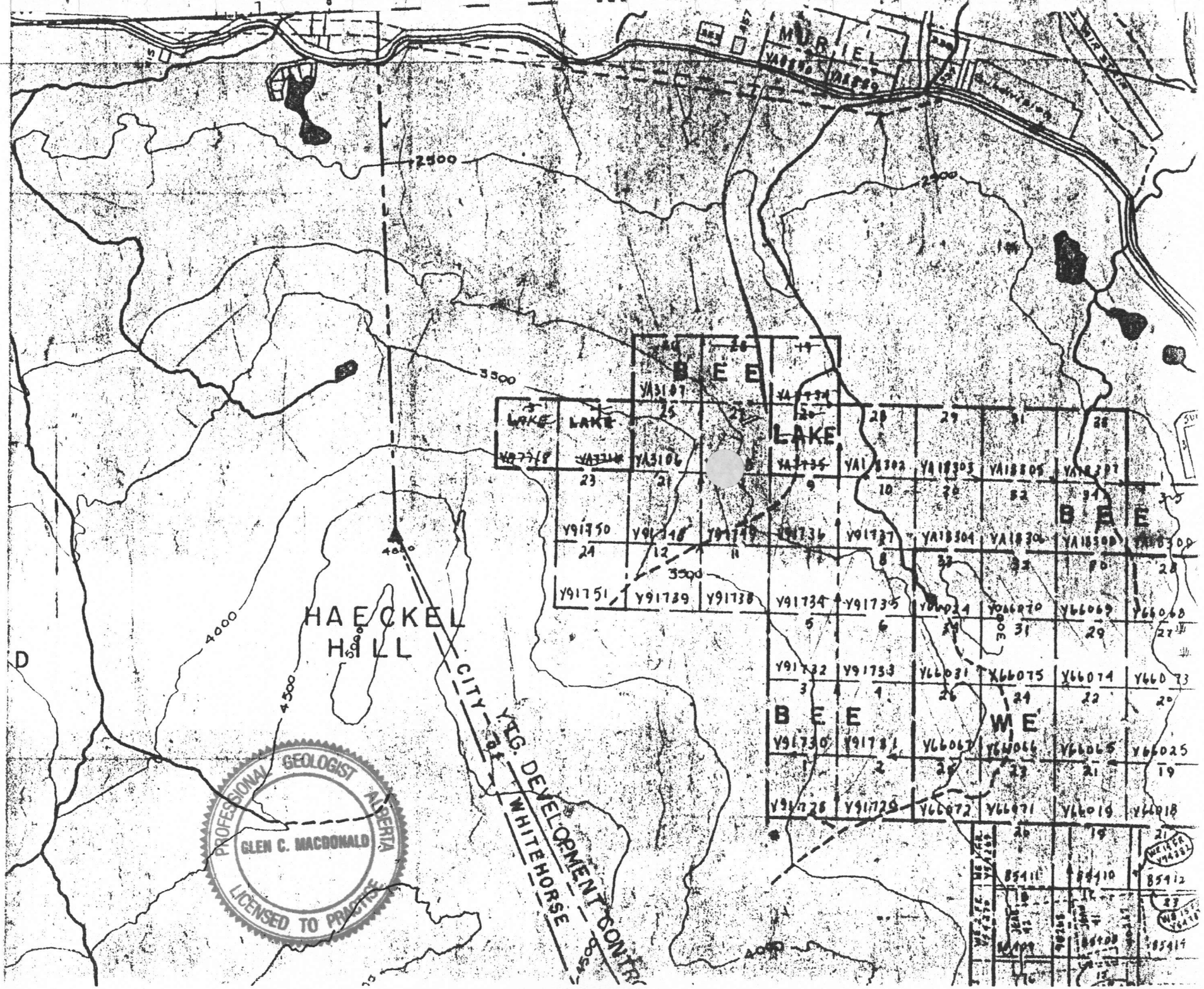

85411 85410 85412
 85413 85414

DIAMOND DRILL PROGRAM

Two drill holes were completed in 1982 on the Bee claims for a total of 191 per cent of the BQ core. The drill was supplied by Aloss Holdings Limited of Whitehorse, Yukon. Movement on the property was facilitated by D-7 Cat, supplied by Whitehorse Welding Ltd. of Whitehorse. The two holes were drilled between August 15 and October 3, 1982.

These drill holes were designed to test a coincident magnetometer and EM anomaly over mineralization exposed in a nearby trench. Hole number 1 was successful in reaching the target zone. Hole number 2 approached the zone at an oblique angle and stopped short of the expected zone.

The drill logs forming an appendix of this report summarize the program.

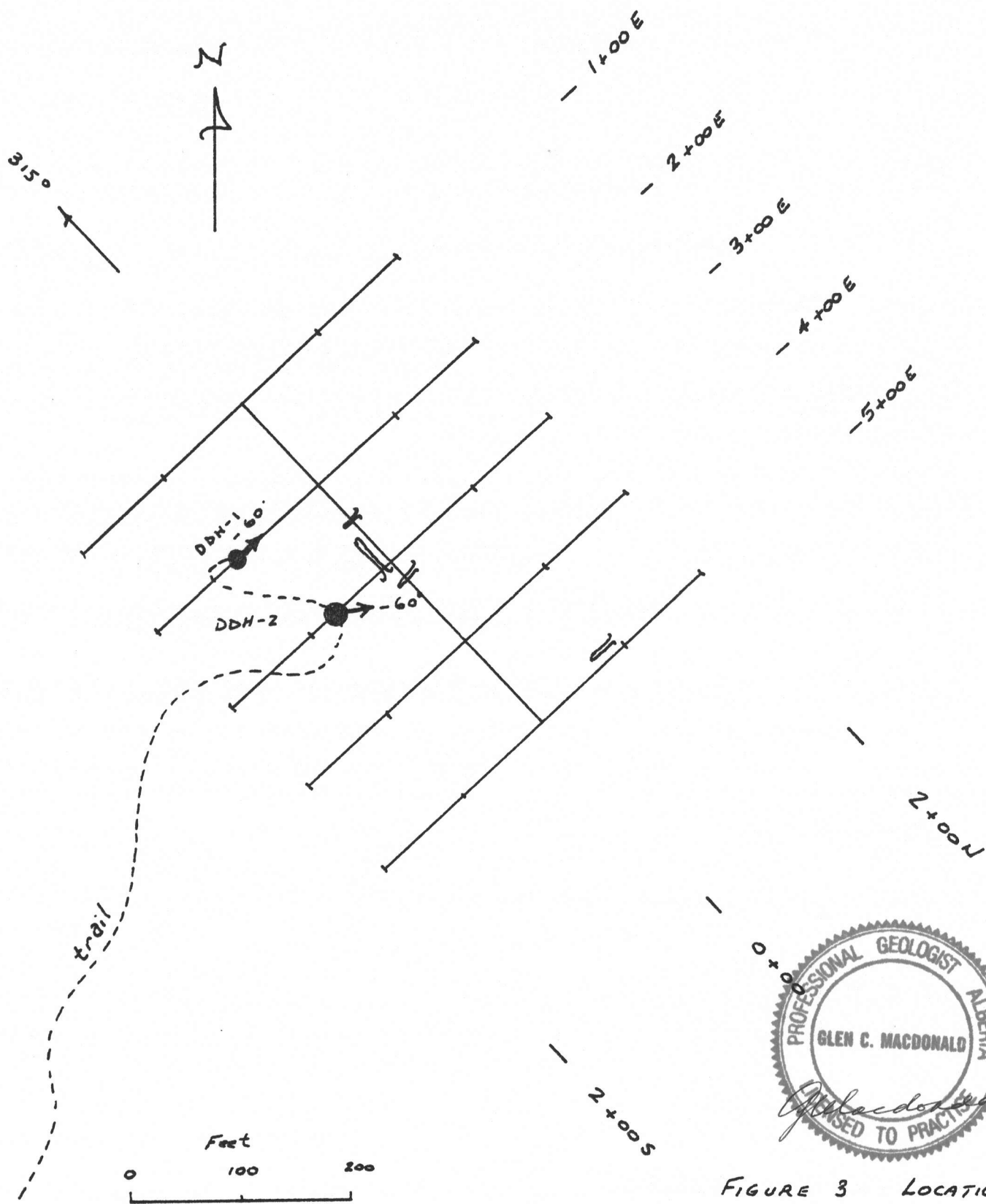

FIGURE 3 LOCATION

- ← Trench
- → Diamond Drill Hole

CONCLUSIONS AND RECOMMENDATIONS

The drill program conducted in 1982 on the Bee claims for Mr. Larry Patenode indicated that the cause of the geophysical anomaly is sulphide mineralization in a quartz-filled fracture zone. The mineralization intersected returned sub-economic grades (see Table 1). However, the width and strike length of the zone suggest that additional exploration work is warranted on the known vein and in the area on the rest of the claims.



Table 1 ASSAY RESULTS OF DRILL HOLE 1

| <u>Footage</u> | <u>Pb(%)</u> | <u>Zn(%)</u> | <u>Ag(opt)</u> | <u>Au(opt)</u> |
|----------------|--------------|--------------|----------------|----------------|
| 86 - 89 | 0.04 | 0.02 | 0.04 | 0.004 |
| 92 - 97 | 1.80 | 1.58 | 0.98 | 0.01 |

APPENDIX

BEE CLAIMS

DIAMOND DRILL LOG

D.D. Hole 1

BQ Core

Coordinates 1+00S/2+00E Bearing -60° N (Grid)

- 0 - 9 Overburden
- 9 - 52 T₁ : Tuffaceous sedimentary rock; grey-white colored unit with a pinkish-greenish mottled appearance; "bleached" equivalent of T₂?
- 52 - 100 T₂ : Dark, brownish-grey tuffaceous sediment.

Notes: (9 - 52)

Rock is commonly brecciated, with fragments to 6 cm; fragments are weakly to moderately altered and corroded with intensity of alteration increasing at depth; pyrrhotite occurs in fragments to 20%+; pyrrhotite not present in fractures; at 32.1 - 32.7 rusty, oxide filled fractures with minor galena (<0.5%), coarse calcite in vugs and fluorite (to 5%).

Fractures and Faults

| | |
|-------------|----------------------|
| 29.0 | 75° C.A. |
| 29.2 | 60° |
| 29.4 | 60° |
| 29.6 - 29.7 | 30° |
| 30.5 - 32 | fault |
| 32.1 - 32.7 | rubbly fracture zone |
| 37.5 | 90° |
| 37.9 | 90° |
| 39.2 | 35° |
| 39.4 | 35° |

Fractures and Faults (Continued)

| | |
|------|-----------|
| 40.0 | 50° - 60° |
| 43 | 50° - 60° |
| 43.2 | 50° - 60° |
| 44.5 | 0° - 20° |
| 47.2 | 45° |
| 47.7 | 40° - 50° |
| 47.9 | 40° - 50° |
| 49.1 | 40° - 50° |
| 50.5 | 20° - 30° |
| 50.0 | 20° - 30° |
| 50.7 | 20° - 30° |

Notes: (52 - 100')

Fractures below 52' have significant alteration envelopes approximately equal to twice the fracture width; some fractures are offset by later quartz-filled fractures; most fractures contain pyrrhotite ± galena, sphalerite, hematite.

Fractures (Continued)

| | |
|-------------|---|
| 53.4 | 80° |
| 53.7 | 75° |
| 54.1 | 60° |
| 54.3 | 60° |
| 54.5 - 54.7 | 60° |
| 61 - 61.5 | 45° |
| 63 - 64 | 50° - 70° (numerous) |
| 69 | 45° |
| 70.8 | 45° |
| 71.8 | 30°/90° |
| 72 - 73 | Zone of small fracture |
| 77 - 79 | Zone of small fracture |
| 77.7 - 78.7 | Quartz vein with 20% pyrrhotite and sphalerite and galena; core angle 50° (not assayed) |
| 81.3 - 84.5 | many irregular fractures |
| 84.5 - 86 | Quartz vein |
| 86 - 89 | Quartz vein (sampled) |
| 89 - 92 | barren section (sampled) |
| 92 - 97 | Quartz-pyrrhotite-galena-sphalerite (ii) |
| 97 - 100 | not assayed |

100' e. o. h.
over all recovery: 90%

| Assays | | | | | | |
|--------|------|------|-------|-------|---------|---------|
| | From | To | Pb(%) | Zn(%) | Ag(opt) | Au(opt) |
| #427 | 86 | - 89 | 0.04 | 0.02 | 0.04 | 0.004 |
| #428 | 92 | - 97 | 1.80 | 1.58 | 0.98 | 0.01 |

BEE CLAIMS

DIAMOND DRILL LOG

D.D. # - 2

BQ Core

0+50S/3+00E Bearing -60° N 30° E (Grid)

- 0 - 15 Overburden or rubble
- 15 - 47 Dark brown; medium grained tuffaceous sediment
- 47 - 50 Light purple; creamy altered zone; numerous quartz-filled fractures with minor pyrrhotite and pyrite (<5%) and trace amounts of galena and sphalerite
- 50 - 57 Grey, altered tuffaceous sediment 10% pyrrhote-pyrite in fracturs and finely disseminated
- 57 - 92 Dark brown, medium grained tuffaceous sediment; very occasional small quartz vein (to 5 cm); 2 - 5% finely disseminated pyrrhotite and pyrite.
- 92 - e.o.h.
recovery: 90% and not assayed.

CERTIFICATE OF QUALIFICATIONS

I, Glen C. Macdonald, with business and residential address in Whitehorse, Yukon, do hereby certify that:

- 1.- I am a consulting professional geologist.
- 2.- I am a graduate of the University of British Columbia (B.Sc. Geology, 1973 and B.A. Economics 1971).
- 3.- I am registered as a Professional Geologist by the Association of Professional Engineers, Geologists and Geophysicists of Alberta (No. 36214).
- 4.- I am a member in good standing of the Canadian Institute of Mining and Metallurgy.
- 5.- I have practiced Mining and Exploration geology in Yukon, northern British Columbia and Northwest Territories since 1973. I began private practice in 1982 after leaving the position of Regional Geologist for Noranda Exploration Company, Limited, Whitehorse, Yukon.

Respectfully submitted,

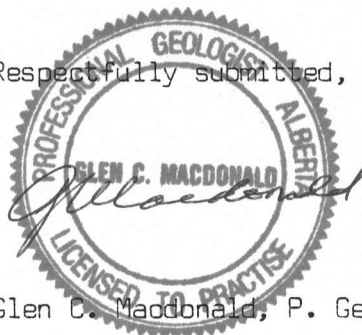

Glen C. Macdonald, P. Geol.