



HUDSON BAY EXPLORATION AND DEVELOPMENT

COMPANY LIMITED

RAB 1 - 136 CLAIMS

YA67577 - YA 67712

1982

ASSESSMENT REPORT

OF

GEOPHYSICS

61°48'N 131°25'W

105 G 14

WATSON LAKE MINING DISTRICT

R. STROSHEIN



YUKON TERRITORY

MARCH-APRIL 1982

091426

This report has been examined by
the Geological Examination Unit
under Section 53-4 Yukon Quartz
Mining Act and is approved as
representing the work to the amount
of \$ 30,600-

Platten

for Regional Director, Exploration and
Geological Services for Commissioner
of Yukon Territory.

TABLE OF CONTENTS

	PAGE NO.
1. SUMMARY.....	1
2. LOCATION AND ACCESS.....	1
3. CLAIM OWNERSHIP.....	1
4. PERSONNEL.....	1
5. GEOLOGY.....	4
6. APEX MAX-MIN II EM SURVEY.....	6
7. PRECISION PROTON MAGNETOMETER SURVEY.....	6
8. CONCLUSIONS AND RECOMMENDATIONS.....	6

APPENDIX I - SUMMARY OF EXPENDITURES

APPENDIX II - QUALIFICATIONS: R. STROSHEIN

LIST OF FIGURES

<u>No:</u>	<u>PAGE NO.</u>
1. LOCATION MAP.....	2
2. CLAIM LOCATION PLAN.....	3
3. GEOLOGY MAP.....	5
4. APEX MAX-MIN II EM PLAN NORTH GRID.....	Pocket
5. APEX MAX-MIN II EM PLAN SOUTH GRID.....	Pocket
6. PRECISION PROTON MAGNETOMETER SURVEY NORTH GRID.....	Pocket
7. PRECISION PROTON MAGNETOMETER SURVEY SOUTH GRID.....	Pocket

1. SUMMARY:

The RAB claims were staked following a regional airborne electro-magnetic and magnetic survey. The claims cover the western end of a geologically favourable belt.

At the eastern end of the belt on the EAGLE and SHALE claims small occurrences of strata bound galena and sphalerite occur near the upper contact of the Mount Mye Formation. The upper contact with the Vangorda Formation is indicated by an increasing carbonaceous content in the "Transition Horizon". The high carbon content of the "Transition Horizon" makes the unit mappable by electro-magnetic means.

The results of the Max-Min II EM and magnetic surveys indicate that the "Transition Horizon" and thus the geologically favourable contact of Mount Mye and Vangorda Formations does occur in several localities on the claim group. Further geophysical as well as geochemical evaluations have been recommended to explore the indicated areas.

2. LOCATION AND ACCESS:

Figure 1.

The RAB claim group is located approximately 50 kilometers east-south-east of Ross River. The claims cover the eastern end of a lake which is located approximately 10 kilometers north of the Pelly River.

The lake is accessible to fixed wing aircraft equipped with floats in the summer or skis in the winter.

A rough 20 kilometers trail is passable to snowmobile or small track vehicles during the winter-spring period.

3. CLAIM OWNERSHIP:

Figure 2.

The RAB claim group consists of 136 Yukon Quartz Mineral Claims as follows:

YA 67577 - YA 67712 RAB 1-136

The claims are wholly owned by Hudson Bay Exploration and Development Company, Limited of 100-10 Burns Road, Whitehorse, Yukon Territory.

4. PERSONNEL:

The linecutting was completed under contract with Voisine Holdings of Whitehorse. The work was completed between March 5 and April 8, 1982.



HUDSON BAY EXPLORATION & DEVELOPMENT
 COMPANY LIMITED OFFICE

YUKON
 TERRITORY
 RAB CLAIMS
 LOCATION MAP

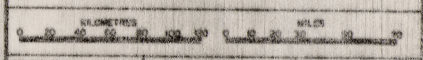

DRAWN BY:	DATE:	PLATE No.:
rs	April/82	1

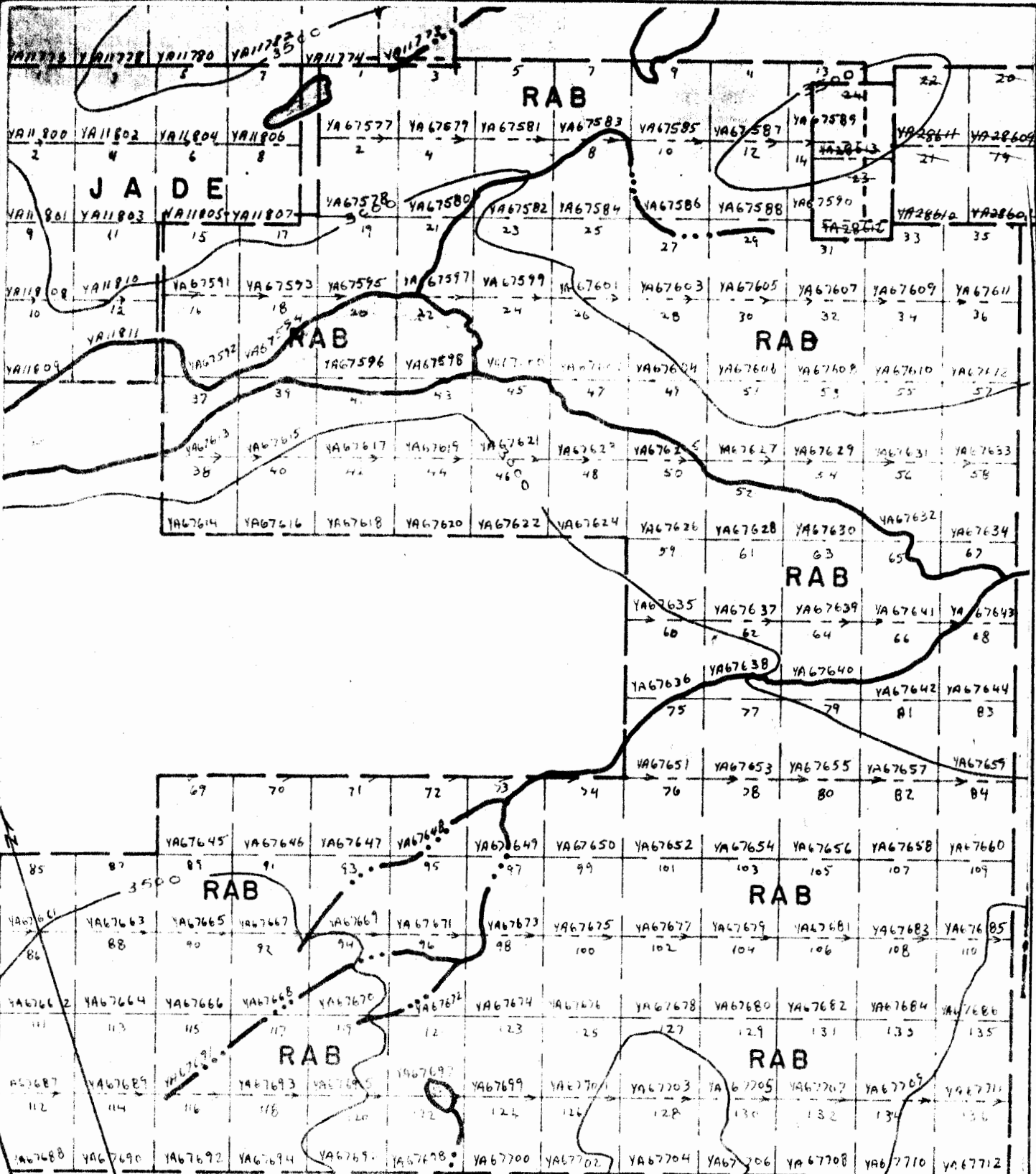

**HUDSON BAY EXPLORATION & DEVELOPMENT
WHITEHORSE COMPANY LIMITED** OFFICE

Figure 2

**RAB CLAIMS
CLAIM LOCATION PLAN**

Watson Lake Mining District 105 G 14

SCALE: 1 inch = 1/2 mile

DATE: April/82

DRAWN BY: rs

The geophysical surveys were carried out by employees of Hudson Bay Exploration and Development. They were as follows:

- A. Vowles - Crew chief and geophysical operator
- S. Tufford - Geophysical operator
- S. Peers - Field assistant
- R. Chippett - Field assistant
- V. Celuszak - Cook and Magnetometer operator

The surveys were carried out between March 21 and April 8, 1982. Several days were required to install the camp prior to the field surveys.

5. GEOLOGY:

Figure 3 is the General Geology of the RAB claims area. This presentation is an interpretation based on the geophysical evaluation and various geological reports available for the area.

The regional setting is three gently undulating formations, the oldest of which is the Mount Mye Formation. This unit is of probably Cambrian to Ordovician age and is composed of light grey green quartz-chlorite phyllite. The upper contact is gradational to the lower graphitic unit of the Vangorda Formation. This lower gradational unit is indicated as the "Transition Horizon" on the figure.

This contact of non-graphitic Mount Mye phyllites and the carbonaceous to graphitic "Transition Horizon" phyllites and shales has associated galena-sphalerite mineralization on the EAGLE and SHALE claims. The contact extends the 13 kilometers from the SHALE claims and can be traced using electro-magnetic methods.

Exploration along this belt has indicated geologically favourable areas for hosting stratabound mineralization.

The upper unit of the Vangorda Formation includes a distinct grey green calcareous quartz-chlorite phyllite as well as minor graphitic shales and bodies of metamorphosed volcanic rocks. These are referred to as greenstone or as tan weathering quartzite.

The youngest formation in the area which overlies the Vangorda Formation in the northern part of the map area is the Menzie Creek Formation. The Menzie Creek Formation is composed of carbonaceous to graphitic shales and phyllites. The Menzie Creek Formation is correlative to the Road River Formation of Ordovician to Mid-Devonian age.

NTS Sheet:
105 G 14

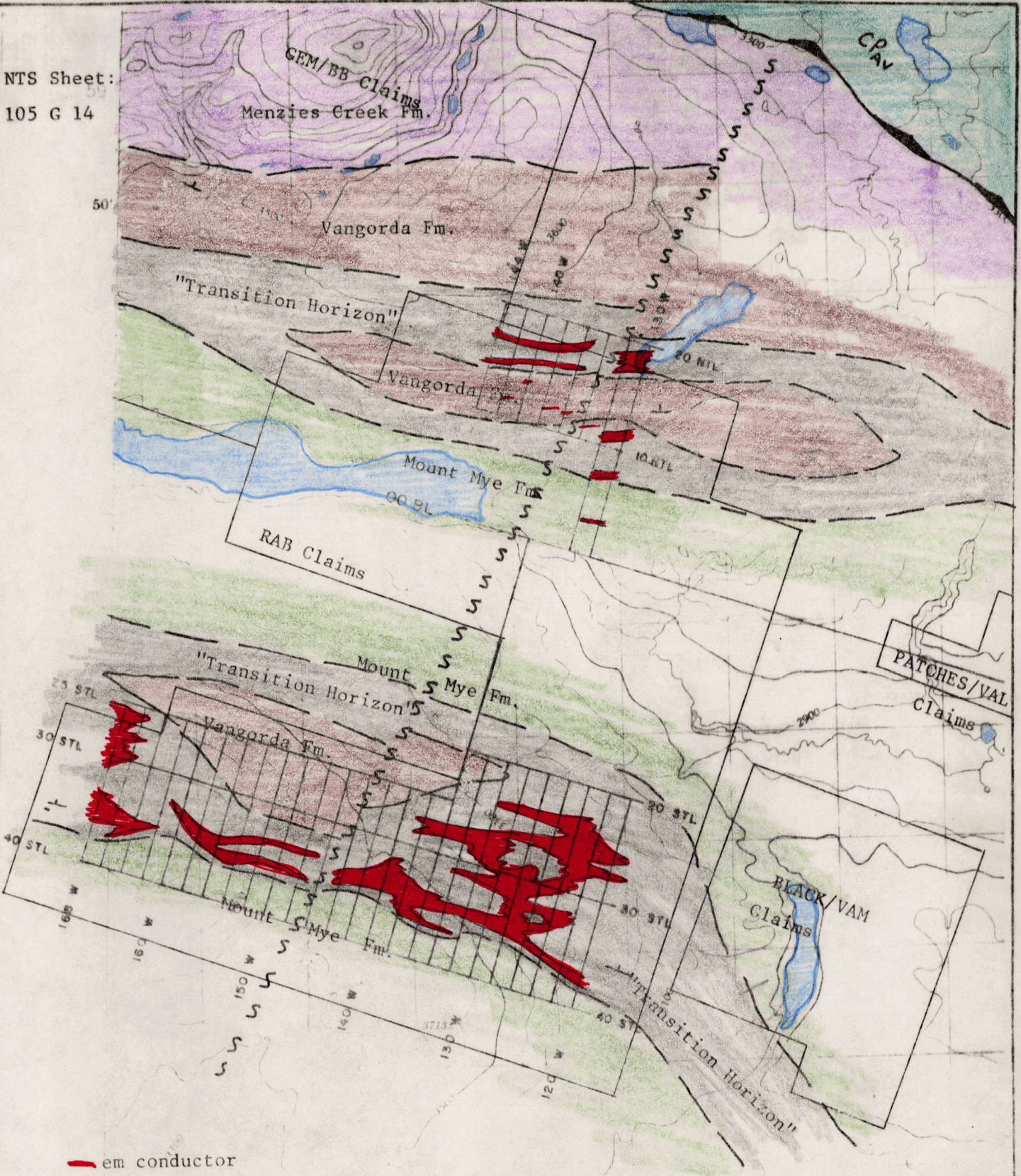

— em conductor

61-45

HUDSON BAY EXPLORATION & DEVELOPMENT
WHITEHORSE COMPANY LIMITED OFFICE

RAB CLAIMS
GENERAL GEOLOGY

Figure 3		DATE:
SCALE:	1 : 50,000	April/82
		DRAWN BY:
		RS

In the northeastern corner of the map area is a cover of Permian basalt CP_{AV}.

A major steeply dipping north-easterly trending fault is indicated on the map. This is interpreted from the blank EM spots on lines 134+00W and 146+00W. The fault also correlates with the topography.

The area is consistent with the north-westerly regional trends. The generally shallow dips suggest that local topography be considered when making local interpretations.

6. APEX MAX-MIN II EM SURVEY:

The results and interpretations of the survey are plotted on Figures 4 and 5.

The Max-Min survey was of a reconnaissance nature. A coil separation of 100 meters and a transmitting frequency of 1777 Hz was used. The survey was carried out over the section lines which were cut at 200 meter intervals along the tie lines.

Prior to the survey all section lines were chained using the secant chaining method. The system allows that slope distances are corrected and stations are picketed at 25 meter horizontal distances.

Readings are obtained at the 25 meter stations along the section lines.

The results indicate shallow north dipping multi-banded conductors.

7. PRECISION PROTON MAGNETOMETER SURVEY:

The results of magnetic survey are plotted on Figure 6 and 7.

Several spot high anomalies occur along lines of the South grid footwall to the EM conductors. These represent important target possibilities and require closer examination.

An alternate interpretation may indicate green stone meta-volcanic bodies. These occur in the upper portion of the Vangorda Formation. This would require a southerly dip on the EM conductors in this area.

8. CONCLUSION AND RECOMMENDATIONS:

The interpretation of the geophysical surveys and geological information suggests that the geologically favourable mineralized horizon occurs at several localities on the property.

The possible areas are: along the south ridge on the south grid, and along the lower slopes of the two sides of the central lake valley.

These conclusions have been surmised from the ground EM survey and basic regional geology. To confirm the present interpretation it is recommended to carry out detailed geological mapping in the immediate area of the claim group.

Further understanding of the geology will lead to closer evaluation of the target horizon. These evaluations will require fill-in lines in selected areas where detailed EM surveys (using various coil separations and different transmitting frequencies) can more closely determine the contact to be followed up by gravimetric and magnetic surveys.

Geochemical evaluation using overburden testing equipment should be used prior to selecting diamond drill targets.

A handwritten signature in cursive script, reading "Robert Stroshein". The signature is written in black ink and is positioned above the typed name.

Robert Stroshein,
Sr. Exploration Geologist.

APPENDIX I - SUMMARY OF EXPENDITURES

INVOICES

No.

032411	Voisine Holdings Linecutting - 76 kilometers @ 220\$/km.	\$ 16,720.00
9226	Air North Charter - March 13, 1982 Camp building gear and supplies	1,200.80
10557	Air North Charter - March 21, 1982 Crew and Supplies to Camp	932.52
10645	Air North Charter - April 8, 1982 Crew and Gear Demobilized	926.82

SALARIES & WAGES (INCLUDES FRINGE BENEFITS)

A. Vowles	22 days @ 125\$/day (Crew Chief)	2,750.00
S. Tufford	22 days @ 100\$/day (Geophysical Operator)	2,200.00
V. Celuzak	22 days @ 100\$/day (Cook Mag-Operator)	2,200.00
S. Peers	21 days @ 75\$/day (Field Assistant)	1,575.00
R. Chippett	21 days @ 65\$/day (Field Assistant)	1,365.00
Camp Costs 105 man days @ 25\$/man day -		<u>2,625.00</u>

Total - \$ 32,495.14

Air North Charter and Training Ltd.

24 Hour Telephone Service 668-2228
Box 4998, Whitehorse, Yukon, Y1A 4S2

CHARTER TICKET
9226

AC F 900 DATE 13 MAR 82

NAME HEIDON BAT EXPLORATION

ADDRESS WILSON BLVD

From	Miles	Hours	Cargo	Passenger-Remarks
To				
WHITEHORSE	145			
UN-NAMED LK	145			Kindred Lumber
MINK CR.	45			Camp Gear
UN-NAMED LK	45			
WHITEHORSE	145			
	380			

Special Instructions		at	Per Hour		
	380	at	2.5 Per Mile	950	00
	Waiting Time	at	Per Hour		
	Extra Landings	at	Per Landing		
	Other	7347-100 FUEL @ 2.25 gal.			250
TOTAL CHARGES				1200	80

[Signature]
Pilot's Signature

WILSE
Base

Charterer's Authorization

Air North Charter and Training Ltd.

24 Hour Telephone Service 668-2228
Box 4998, Whitehorse, Yukon, Y1A 4S2

CHARTER TICKET

10645

AC CF-Mos' DHP-2 DATE 8 April 82
 NAME ~~Robert Stott~~ OR RS.
 ADDRESS _____

From	Miles	Hours	Cargo	Passenger-Remarks
Whitehorse				
To Pelly River Lake	145	1.6	30 drums fuel	
Mink Creek	45	2		
Pelly River Lake	45	2	1000 lbs ^{Boat} To Mink Creek	
Whitehorse	145	1.7	563 lbs	pick up
RAB CLAIMS		3.7		2 press + Boat Richard Cluffett Steve Peers

Special Instructions	at	Per Hour		
	380	at \$95	Per Mile	941 00
Waiting Time	at	Per Hour		
Fuel gals. 81.5	at	Per Gallon		185.82
Other				
TOTAL CHARGES				946 82

7347-12

Al Bender Pilot's Signature Whitehorse Base Robert Stott Charterer's Authorization

APPENDIX II

ROBERT W. STROSHEIN

ADDRESS 181 Alsek,
 Whitehorse, Yukon Territory.
 Y1A 4L8

EDUCATION: B. Sc. (Geological Engineering) from
 University of Saskatchewan
 Graduated in 1973

EMPLOYMENT: 1973 - 1982 Hudson Bay Exploration & Development Co. Ltd.

 Flin Flon Office 1973 - 1975
 Drill Geologist - field supervisor of diamond
 drill projects Northern Manitoba and Saskatchewan.

 Whitehorse Office
 Project Geologist 1975-1980 - field supervisor of
 geological mapping, geophysical, geochemical and
 prospecting programs in the Yukon Territory.
 Included report preparation and assessment.

Senior Exploration Geologist - 1981 - planning,
 monitoring and assessing exploration projects
 conducted in the Yukon Territory.



DEPARTMENT OF INDIAN AFFAIRS AND NORTHERN DEVELOPMENT
YUKON QUARTZ MINING ACT
FORM "C" - APPLICATION FOR A CERTIFICATE OF WORK

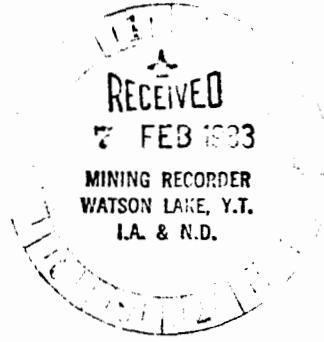

(This form required in duplicate with sketch showing location of work.)

I (Name)	Robert Stroshein	Occupation	Geologist
(Postal Address)	100-10 Burns Rd., Whitehorse, Y. T. Y1A 4Y9		

OFFICE DATE STAMP

MAKE OATH AND SAY, THAT:

- I am the owner, or agent of the owner, of the mineral claim(s) to which reference is made herein.
- I have done, or caused to be done, work on the following mineral claim(s):

(Here list claims on which work was actually done by number and name)

YA 67666	RAB 90
YA 67668	RAB 92
YA 67670	RAB 94
YA 67672	RAB 96
YA 67693	RAB 117
YA 67695	RAB 119

situated at 60°48'N/131°25'W Claim Sheet No. 105-G 14

in the Watson Lake Mining District, to the value of at least 3150.00

dollars, since the 25th day of February 1982

to represent the following mineral claims under the authority of Grouping Certificate No. _____ (Group 9)

(Here list claims to be renewed in numerical order, by grant number and claim name, showing renewal period requested).

YA 67666	RAB 90)	
YA 67668	RAB 92)	
YA 67670	RAB 94)	Request renewal from Feb. 25, 1983
YA 67672	RAB 96)	
YA 67686	RAB 110)	to May 25, 1985. Common Dated.
YA 67693	RAB 117)	
YA 67695	RAB 119)	14 claims @ 2½ years each.
YA 67704	RAB 128)	
YA 67706	RAB 130)	Total of 31½ claim years
YA 67708-67712	RAB 132-136)	

3. The following is a detailed statement of such work: (Set out full particulars of the work done indicating dates work commenced and ended in the twelve months in which such work is required to be done as shown by Section 53.)

8.0 km. of linecutting, secant chaining and MAX-MIN II EM and proton magnetometer surveys between March 5 and April 8, 1982

Sworn before me at Whitehorse, Y. T.
this 1st day of FEBRUARY 1983

Notary Public

Applicant



DEPARTMENT OF INDIAN AFFAIRS AND NORTHERN DEVELOPMENT
YUKON QUARTZ MINING ACT
FORM "C" - APPLICATION FOR A CERTIFICATE OF WORK

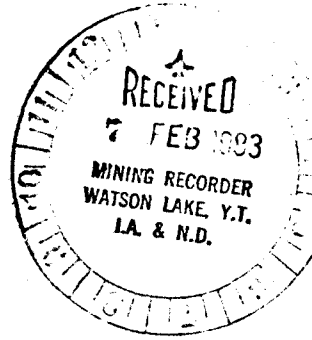

(This form required in duplicate with sketch showing location of work.)

I (Name)	Robert Stroshein	Occupation	Geologist
(Postal Address)	100-10 Burns Rd., Whitehorse, Y. T.		Y1A 4Y9

OFFICE DATE STAMP

MAKE OATH AND SAY, THAT:

- I am the owner, or agent of the owner, of the mineral claim(s) to which reference is made herein.
- I have done, or caused to be done, work on the following mineral claim(s):

(Here list claims on which work was actually done by number and name)

YA 67661 - 67665	RAB 85-89
YA 67687	RAB 111
YA 67689	RAB 113
YA 67691	RAB 115

situated at 61°48'N/131°25'W Claim Sheet No. 105 G 14

in the Watson Lake Mining District, to the value of at least 3600.00

dollars, since the 25th day of February, 1982.

to represent the following mineral claims under the authority of Grouping Certificate No. _____ (Group 8)

(Here list claims to be renewed in numerical order, by grant number and claim name, showing renewal period requested).

YA 67661 - 67665	RAB 85-89)	Request renewal from Feb. 25, 1983 to May 5, 1985. Common dated. 16 claims @ 2½ years each. Total of 36 claim years
YA 67687 - 67692	RAB 111-116)	
YA 67694	RAB 118)	
YA 67696	RAB 120)	
YA 67698	RAB 122)	
YA 67700	RAB 124)	
YA 67702	RAB 126)	

3. The following is a detailed statement of such work: (Set out full particulars of the work done indicating dates work commenced and ended in the twelve months in which such work is required to be done as shown by Section 63.)

10.5 km. of linecutting, secant chaining and MAX-MIN II EM and proton magnetometer surveys between March 5 and April 8, 1982

Sworn before me at Whitehorse, Y. T.

this 1st day of FEBRUARY, 1983

Notary Public

Applicant



DEPARTMENT OF INDIAN AFFAIRS AND NORTHERN DEVELOPMENT
YUKON QUARTZ MINING ACT
FORM "C" - APPLICATION FOR A CERTIFICATE OF WORK

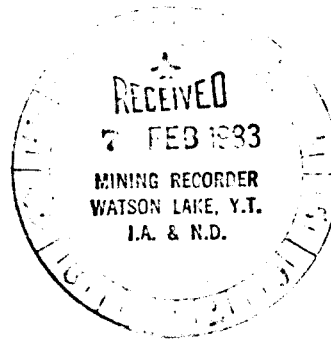

(This form required in duplicate with sketch showing location of work.)

(Name)	Robert Stroshein	Occupation	Geologist
(Postal Address)	100-10 Burns Rd., Whitehorse, Y. T. Y1A 4Y9		

OFFICE DATE STAMP

MAKE OATH AND SAY, THAT:

1. I am the owner, or agent of the owner, of the mineral claim(s) to which reference is made herein.

2. I have done, or caused to be done, work on the following mineral claim(s):

(Here list claims on which work was actually done by number and name)

YA 67697	RAB 121
YA 67699	RAB 123
YA 67701	RAB 125
YA 67703	RAB 127
YA 67705	RAB 129

situated at 61°48'N/131°25'W Claim Sheet No. 105 G.14

in the Watson Lake Mining District, to the value of at least 3375.00

dollars, since the 25th day of February 1982.

to represent the following mineral claims under the authority of Grouping Certificate No. _____ (Group No. 7)

(Here list claims to be renewed in numerical order, by grant number and claim name, showing renewal period requested).

YA 67634	RAB 58)	
YA 67643-67644	RAB 67-68)	Request renewal from Feb. 25, 1983 to
YA 67657-67660	RAB 81-84)	May 25, 1985. Common Dated, 15 Claims @
YA 67683-67685	RAB 107-109)	2½ years each.
YA 67697	RAB 121)	
YA 67699	RAB 123)	
YA 67701	RAB 125)	
YA 67703	RAB 127)	Total of 33 3/4 claim years
YA 67705	RAB 129)	

3. The following is a detailed statement of such work: (Set out full particulars of the work done indicating dates work commenced and ended in the twelve months in which such work is required to be done as shown by Section 53.)

8.5 km. linecutting, secant chaining and MAX-MIN II EM and proton magnetometer surveys between March 5 and April 8, 1982

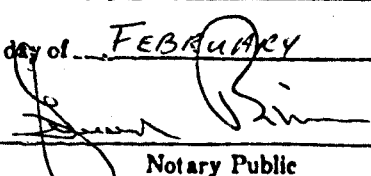
Sworn before me at Whitehorse, Y. T.
this 1st day of FEBRUARY 1983

Notary Public

Applicant

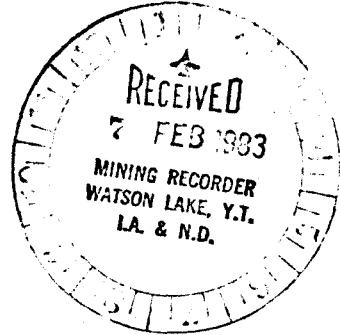

DEPARTMENT OF INDIAN AFFAIRS AND NORTHERN DEVELOPMENT
YUKON QUARTZ MINING ACT
FORM "C" - APPLICATION FOR A CERTIFICATE OF WORK



(This form required in duplicate with sketch showing location of work.)

I (Name)	Robert Stroshein	Occupation	Geologist
(Postal Address)	100-10 Burns Rd., Whitehorse, Y. T. Y1A 4Y9		

OFFICE DATE STAMP

MAKE OATH AND SAY, THAT:

- I am the owner, or agent of the owner, of the mineral claim(s) to which reference is made herein.
- I have done, or caused to be done, work on the following mineral claim(s):

(Here list claims on which work was actually done by number and name)

YA 67645 - 67651 RAB 69-75

situated at 61°48'N/131°25'W Claim Sheet No. 105 G 14

in the Watson Lake Mining District, to the value of at least 3600.00

dollars, since the 25th day of February 19 82.

to represent the following mineral claims under the authority of Grouping Certificate No. _____ (Group No. 6)

(Here list claims to be renewed in numerical order, by grant number and claim name, showing renewal period requested).

YA 67613 - 67614	RAB 37-38)	
YA 67616	RAB 40)	Request renewal from Feb. 25, 1983
YA 67618	RAB 42)	
YA 67620	RAB 44)	to May 25, 1985. Common Dated. 16 Claims
YA 67622	RAB 46)	
YA 67624	RAB 48)	@ 2½ years each.
YA 67635-67636	RAB 59-60)	
YA 67645-67651	RAB 69-75)	Total of 36 claim years

3. The following is a detailed statement of such work: (Set out full particulars of the work done indicating dates work commenced and ended in the twelve months in which such work is required to be done as shown by Section 63.)

9.0 km. linecutting, secant chaining, Max-Min II EM, and proton magnetometer surveys between March 5 and April 8, 1982

Sworn before me at Whitehorse, Y. T.

this 1st day of FEBRUARY 19 83

Notary Public

Applicant



DEPARTMENT OF INDIAN AFFAIRS AND NORTHERN DEVELOPMENT
YUKON QUARTZ MINING ACT
FORM "C" - APPLICATION FOR A CERTIFICATE OF WORK

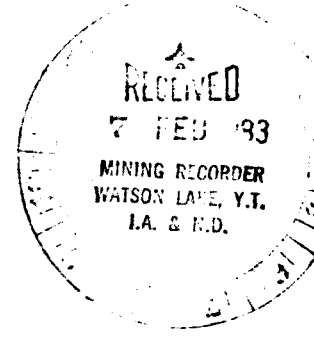

(This form required in duplicate with sketch showing location of work.)

I (Name)	Robert Stroshein	Occupation	Geologist
(Postal Address)	100-10 Burns Rd., Whitehorse, Y. T.		Y1A 4Y9

MAKE OATH AND SAY, THAT:

- I am the owner, or agent of the owner, of the mineral claim(s) to which reference is made herein.
- I have done, or caused to be done, work on the following mineral claim(s):

(Here list claims on which work was actually done by number and name)

YA 67631	RAB 55
YA 67633	RAB 57
YA 67667	RAB 91
YA 67669	RAB 93
YA 67671	RAB 95
YA 67673	RAB 97

situated at 61°48'N/131°25'W Claim Sheet No. 105 G 14
in the Watson Lake Mining District, to the value of at least 2700.00
dollars, since the twenty fifth day of February 19 82,

to represent the following mineral claims under the authority of Grouping Certificate No. _____ (Group No. 5)

(Here list claims to be renewed in numerical order, by grant number and claim name, showing renewal period requested).

YA 67608 - 67612	RAB 32 - 36)	
YA 67631 - 67633	RAB 55 - 57)	Request renewal from Feb. 25, 1983
YA 67667	RAB 91)	
YA 67669	RAB 93)	to May 25, 1985. Common dated
YA 67671	RAB 95)	
YA 67673	RAB 97)	12 claims @ 2½ years each.

Total of 27 Claim years

3. The following is a detailed statement of such work: (Set out full particulars of the work done indicating dates work commenced and ended in the twelve months in which such work is required to be done as shown by Section 53.)

8.0 km. linecutting, secant chaining, Max-Min II EM and proton magnetometer surveys between March 5 and April 8, 1982

Sworn before me at Whitehorse, Y. T.
this 1st day of FEBRUARY 1983

Notary Public

Applicant



DEPARTMENT OF INDIAN AFFAIRS AND NORTHERN DEVELOPMENT
YUKON QUARTZ MINING ACT
FORM "C" - APPLICATION FOR A CERTIFICATE OF WORK

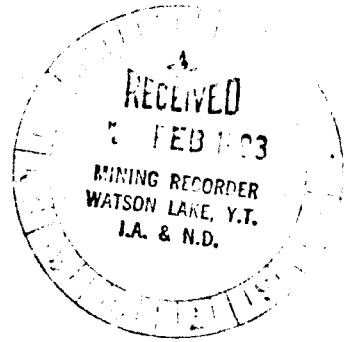

(This form required in duplicate with sketch showing location of work.)

I (Name)	Robert Stroshein	Occupation	Geologist
(Postal Address)	100-10 Burns Rd., Whitehorse, Y. T.		Y1A 4Y9

OFFICE DATE STAMP

MAKE OATH AND SAY, THAT:

- I am the owner, or agent of the owner, of the mineral claim(s) to which reference is made herein.
- I have done, or caused to be done, work on the following mineral claim(s):

(Here list claims on which work was actually done by number and name)

YA 67604	RAB 28
YA 67625	RAB 49
YA 67654	RAB 78
YA 67676	RAB 100
YA 67678 - 67680	RAB 102 - 104

situated at 61°48'N 131°25'W Claim Sheet No. 105 G 14
in the Watson Lake Mining District, to the value of at least 3375.00
dollars, since the twenty fifth day of February 1982,

to represent the following mineral claims under the authority of Grouping Certificate No. _____ (Group No. 4)

(Here list claims to be renewed in numerical order, by grant number and claim name, showing renewal period requested).

YA 67598 - 67602	RAB 22-26)	
YA 67604	RAB 28)	Request renewal from Feb. 25/83
YA 67625	RAB 49)	
YA 67628	RAB 52)	to May 25, 1985. Common dated
YA 67639 - 67640	RAB 63-64)	
YA 67654	RAB 78)	15 claims @ 2½ years each
YA 67676	RAB 100)	
YA 67678 - 67680	RAB 102-104)	Total of 33 3/4 claim years

3. The following is a detailed statement of such work: (Set out full particulars of the work done indicating dates work commenced and ended in the twelve months in which such work is required to be done as shown by Section 53.)

8.5 km. of linecutting, secant chaining, MAX - MIN II EM and proton magnetometer surveys between March 5 and April 8, 1982

Sworn before me at Whitehorse, Y. T.

this 1ST day of FEBRUARY 1983.

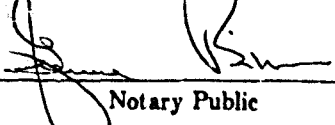
Notary Public

Applicant



DEPARTMENT OF INDIAN AFFAIRS AND NORTHERN DEVELOPMENT
YUKON QUARTZ MINING ACT
FORM "C" - APPLICATION FOR A CERTIFICATE OF WORK

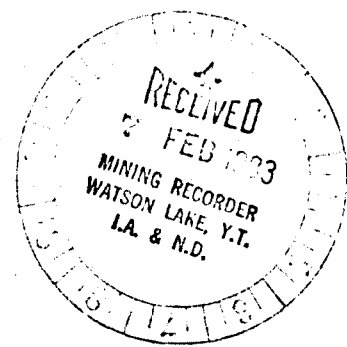

(This form required in duplicate with sketch showing location of work.)

(Name)	Robert Stroshein	Occupation	Geologist
(Postal Address)	100-10 Burns Rd., Whitehorse, Y. T. Y1A 4Y9		

OFFICE DATE STAMP

MAKE OATH AND SAY, THAT:

1. I am the owner, or agent of the owner, of the mineral claim(s) to which reference is made herein.

2. I have done, or caused to be done, work on the following mineral claim(s):

(Here list claims on which work was actually done by number and name)

YA 67619	RAB 43
YA 67621	RAB 45
YA 67623	RAB 47
YA 67652-67653	RAB 76-77
YA 67674-67675	RAB 98-99
YA 67677	RAB 101

situated at 61°48'N 131°25'W Claim Sheet No. 105 G-14

in the Watson Lake Mining District, to the value of at least 3600.00

dollars, since the 25th day of February 19 82.

to represent the following mineral claims under the authority of Grouping Certificate No. _____ (Group No. 3)

(Here list claims to be renewed in numerical order, by grant number and claim name, showing renewal period requested).

YA 67591 - 67593	RAB 15-17)	
YA 67615	RAB 39)	Request renewal from Feb. 25/83
YA 67617	RAB 41)	
YA 67619	RAB 43)	to May 25, 1985. Common Dated.
YA 67621	RAB 45)	
YA 67623	RAB 47)	16 claims @ 2½ years each for a
YA 67626	RAB 50)	
YA 67637-67638	RAB 61-62)	total of 36 claim years
YA 67652-67653	RAB 76-77)	
YA 67674-67676	RAB 98-99)	
YA 67677	RAB 101)	

3. The following is a detailed statement of such work: (Set out full particulars of the work done indicating dates work commenced and ended in the twelve months in which such work is required to be done as shown by Section 53.)

9 km linecutting, secant chaining and MAX-MIN II EM and proton magnetometer surveys between March 5 and April 8, 1982

Sworn before me at Whitehorse, Y. T.

this 1st day of FEBRUARY 1983.

Notary Public

Applicant



DEPARTMENT OF INDIAN AFFAIRS AND NORTHERN DEVELOPMENT
YUKON QUARTZ MINING ACT
FORM "C" - APPLICATION FOR A CERTIFICATE OF WORK

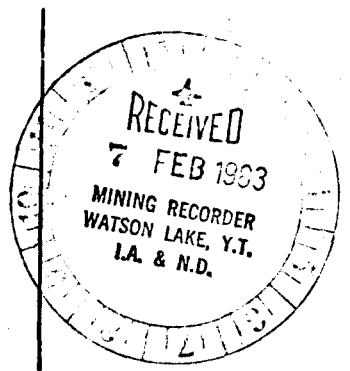

(This form required in duplicate with sketch showing location of work.)

(Name)	Robert Stroshein	Occupation	Geologist
(Postal Address)	100-10 Burns Rd., Whitehorse, Y. T. Y1A 4Y9		

OFFICE DATE STAMP

MAKE OATH AND SAY, THAT:

- I am the owner, or agent of the owner, of the mineral claim(s) to which reference is made herein.
- I have done, or caused to be done, work on the following mineral claim(s):

(Here list claims on which work was actually done by number and name)

YA 67586	RAB 10
YA 67603	RAB 27
YA 67627	RAB 51
YA 67629	RAB 53
YA 67655-67656	RAB 79-80
YA 67681-67682	RAB 105-106
YA 67707	RAB 131

situated at 61°48'N/131°25'W Claim Sheet No. 105 G 14

in the Watson Lake Mining District, to the value of at least 3600.00

dollars, since the twenty fifth day of February 19 82,

to represent the following mineral claims under the authority of Grouping Certificate No. _____ (Group 2)

(Here list claims to be renewed in numerical order, by grant number and claim name, showing renewal period requested).

YA 67586	RAB 10)	Request renewal from Feb. 25, 1983 to May 25, 1985. common dated. 16 claims @ 2½ years each for a total of 36 claim years.
YA 67590	RAB 14)	
YA 67603	RAB 27)	
YA 67605-6707	RAB 29-31)	
YA 67627	RAB 51)	
YA 67629-67630	RAB 53-54)	
YA 67641-67642	RAB 65-66)	
YA 67655-67656	RAB 79-80)	
YA 67681-67682	RAB 105-106)	
YA 67707	RAB 131)	

- The following is a detailed statement of such work: (Set out full particulars of the work done indicating dates work commenced and ended in the twelve months in which such work is required to be done as shown by Section 53.)

9.5 km. of linecutting followed by secant chaining and Max-Min EM II and proton magnetometer surveys. From March 5 to April 8, 1982.

Sworn before me at Whitehorse, Y. T.

this 1ST day of February 19 83

Notary Public

Robert Stroshein
Applicant



DEPARTMENT OF INDIAN AFFAIRS AND NORTHERN DEVELOPMENT
YUKON QUARTZ MINING ACT
FORM "C" - APPLICATION FOR A CERTIFICATE OF WORK



(This form required in duplicate with sketch showing location of work.)

I (Name)	Robert Stroshein	Occupation	Geologist
(Postal Address)	100- 10 Burns Rd., Whitehorse, Y. T.		Y1A 4Y9

OFFICE DATE STAMP

MAKE OATH AND SAY, THAT:

1. I am the owner, or agent of the owner, of the mineral claim(s) to which reference is made herein.

2. I have done, or caused to be done, work on the following mineral claim(s):

(Here list claims on which work was actually done by number and name)

YA 67579 - YA 67585 RAB 1 - 9

situated at 61°48'N/131°25'W Claim Sheet No. 105 G 14

in the WATSON LAKE Mining District, to the value of at least 3600.00

dollars, since the Twenty-Fifth day of February 19 82

to represent the following mineral claims under the authority of Grouping Certificate No. _____ (Group #1)

(Here list claims to be renewed in numerical order, by grant number and claim name, showing renewal period requested).

YA 67577 - YA 67585 RAB 1 - 9) Request renewal from Feb. 25, 1983

YA 67587 - YA 67589 RAB 11 - 13) to May 25, 1985. Common dated

YA 67594 - YA 67597 RAB 18 - 21)

16 Claims @ 2½ years each for total of 36 claim years

3. The following is a detailed statement of such work: (Set out full particulars of the work done indicating dates work commenced and ended in the twelve months in which such work is required to be done as shown by Section 53.)

9.5 km. of linecutting followed by secant chaining, MAX-MIN EM II and proton magnetometer surveys. Between March 5 and April 8, 1982.

Sworn before me at Whitehorse, Y. T.

this 15th day of February 1983

Notary Public

Robert Stroshein

Applicant

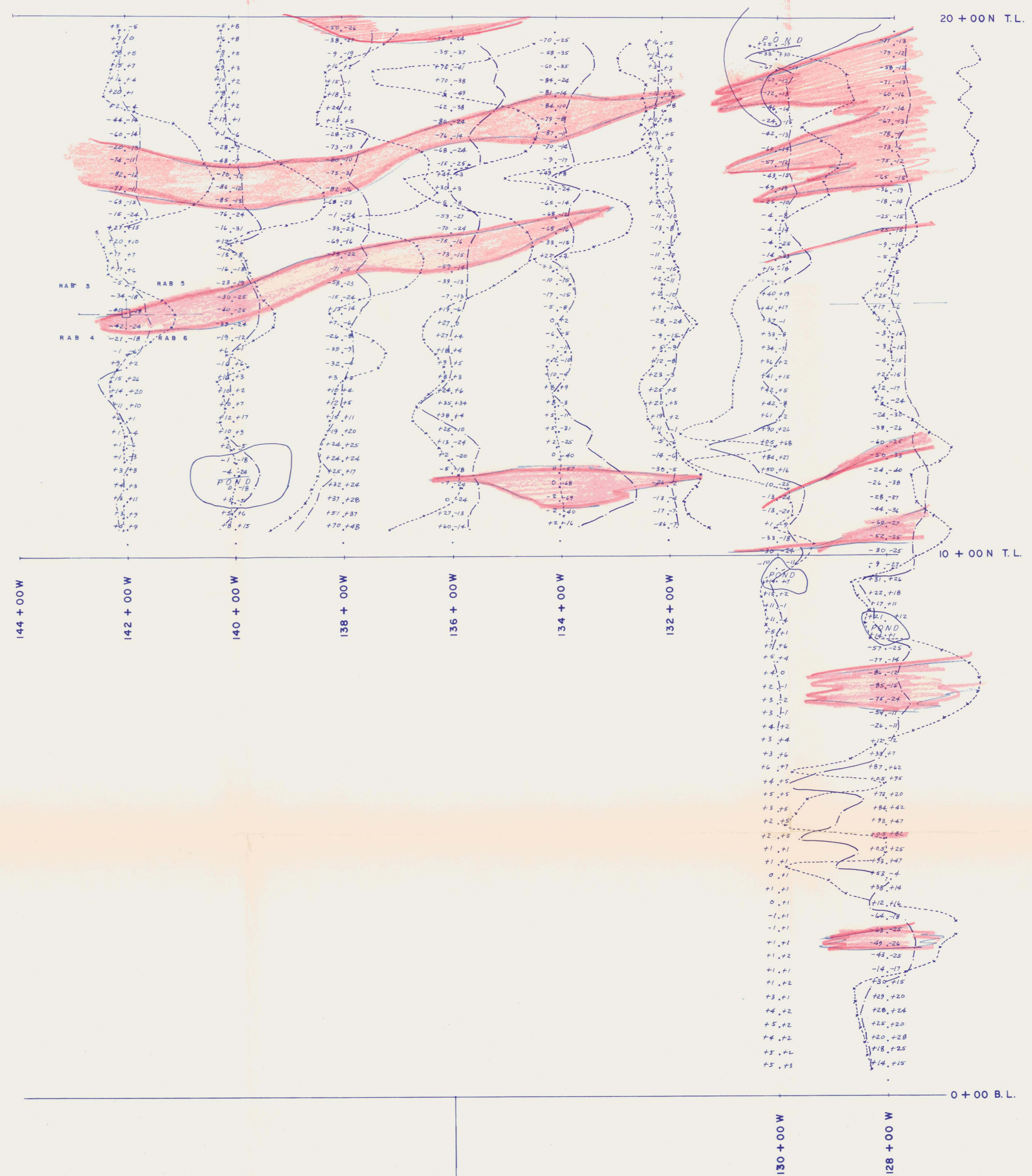
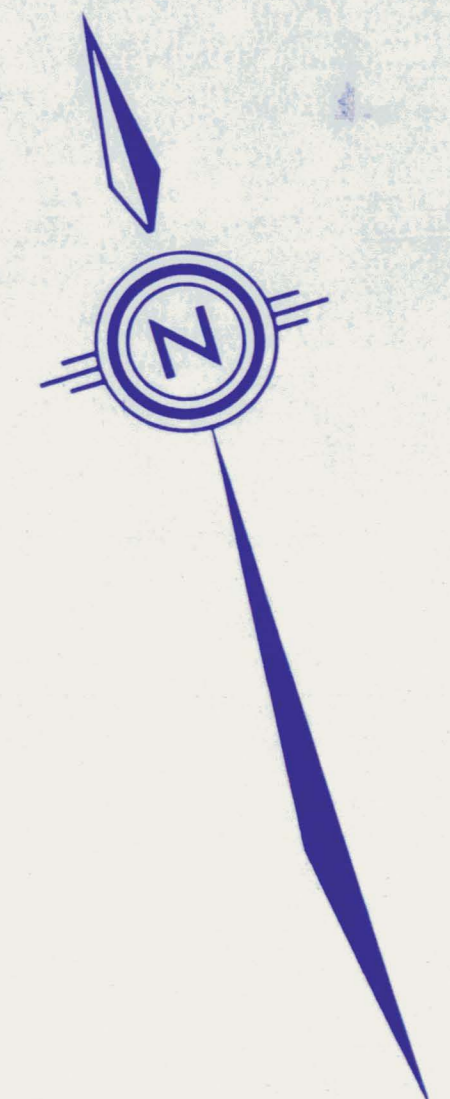
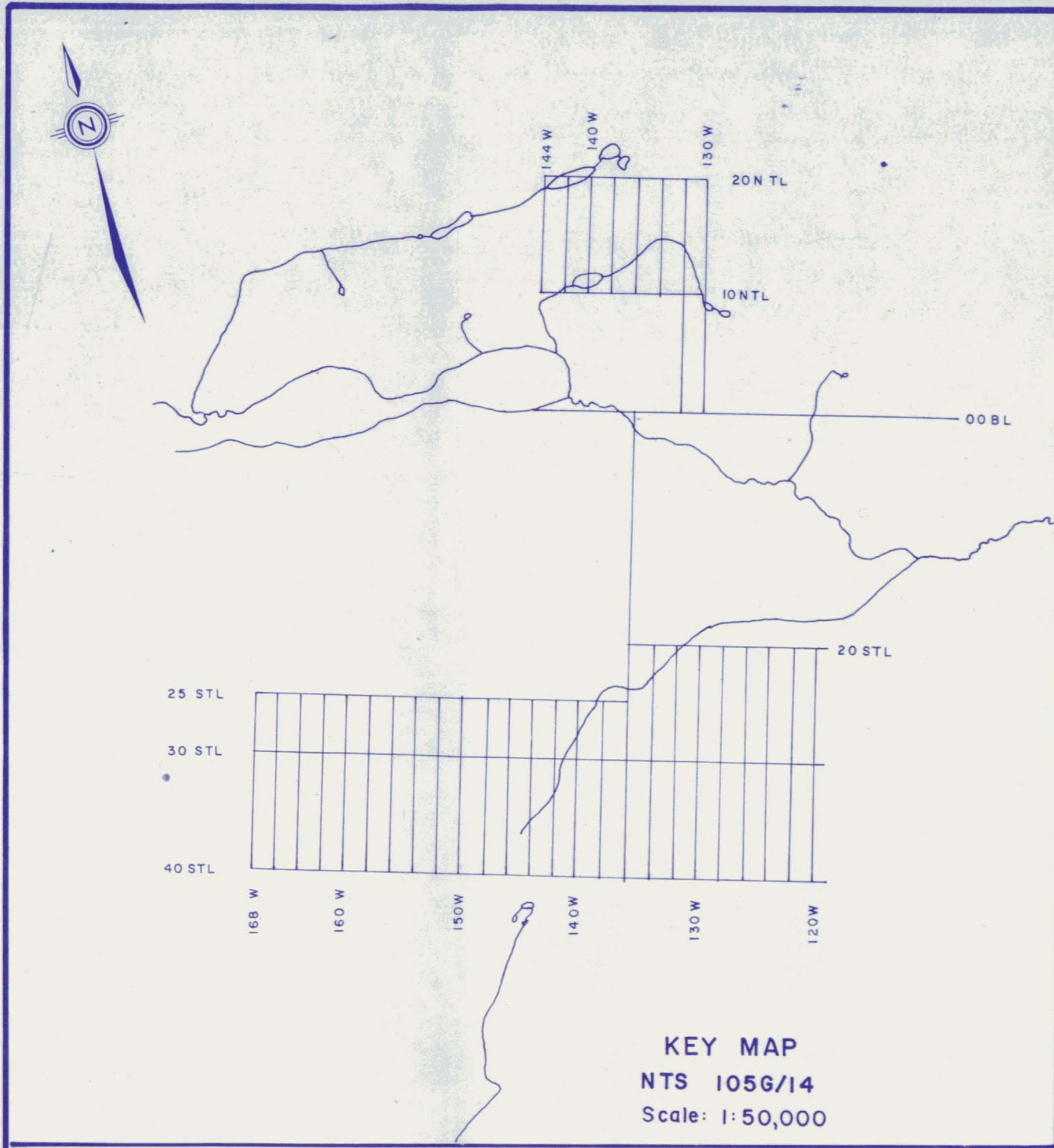

001-0
001.128

Instrument: Apex Max-Min II
Coil Separation: 100 Meters
Frequency: 1777 Hz
Inphase: Plotted to the right
Outphase: Plotted to the left
Known edge of anomaly
Inferred edge of anomaly

HUDSON BAY EXPLORATION & DEVELOPMENT			
WHITEHOUSE		OFFICE	
RAB CLAIMS (NORTH GRID)			
APEX MAX - MIN II SURVEY			
DRAWN BY: GUL	DATE: 10/10/00	PLATE No. 4	
FIELD WORK BY:	REVISED BY:	SCALE: 1:5000	
10/10/00		100 0 100 200m	

138+00 W

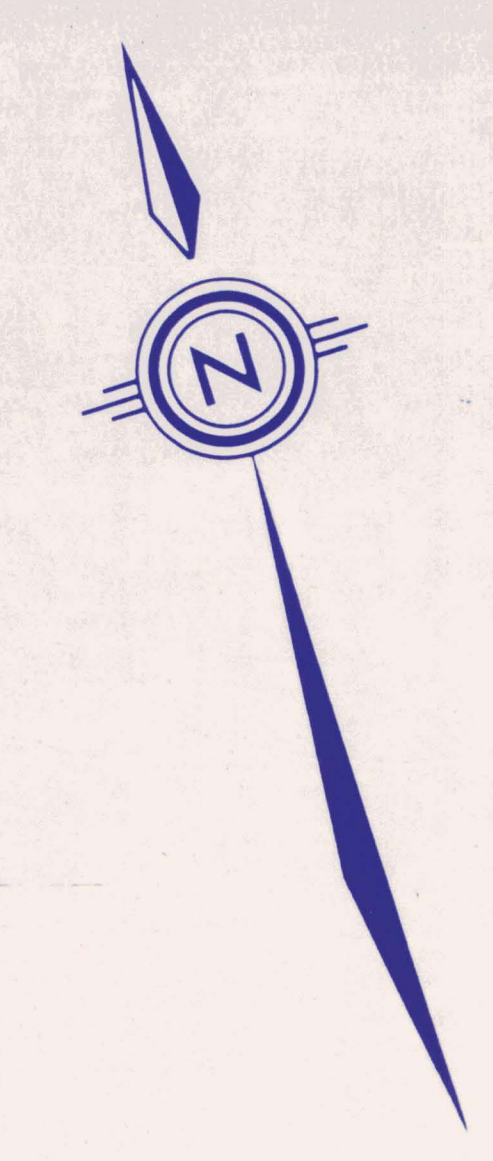
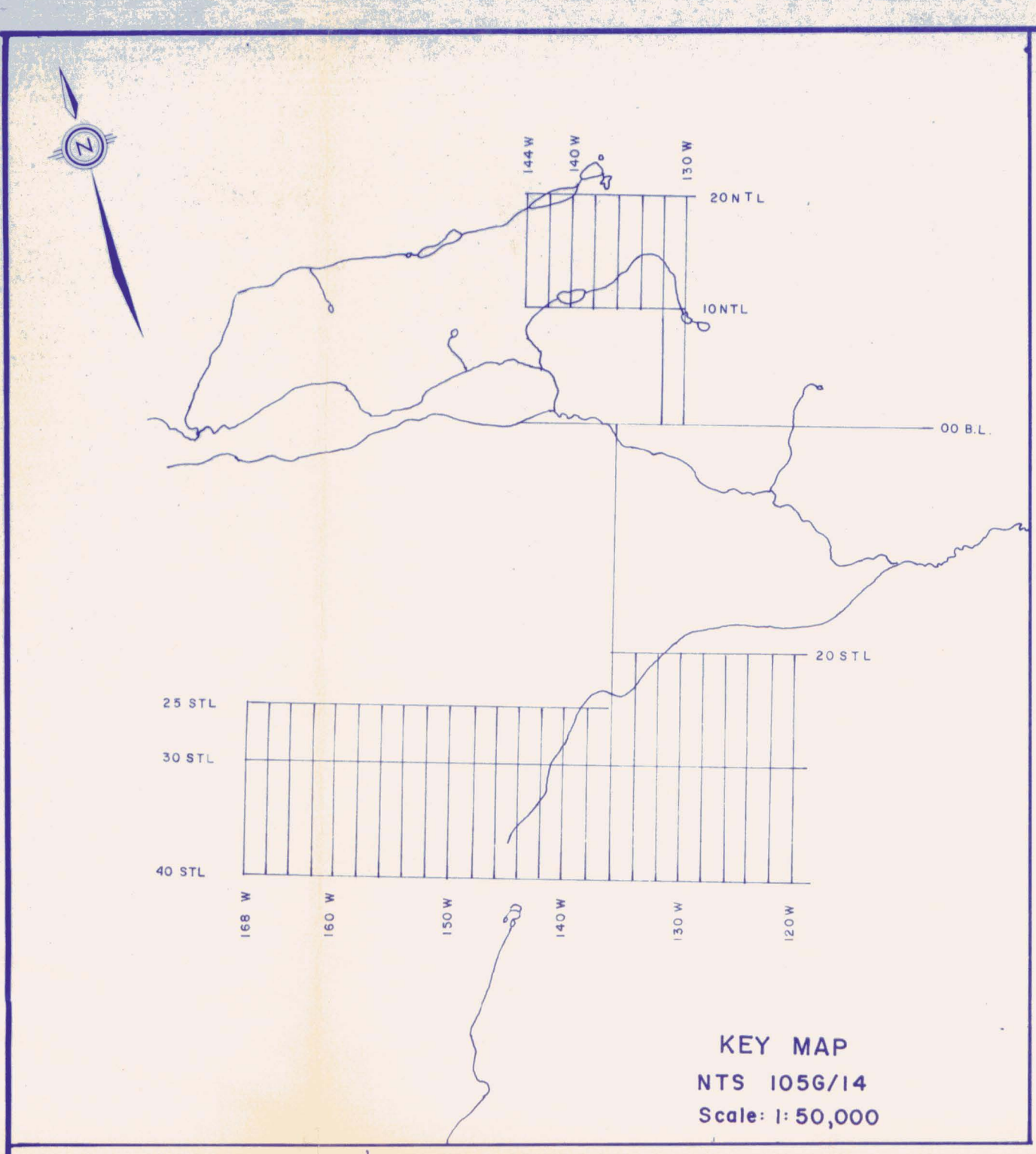

0+00 B.L.

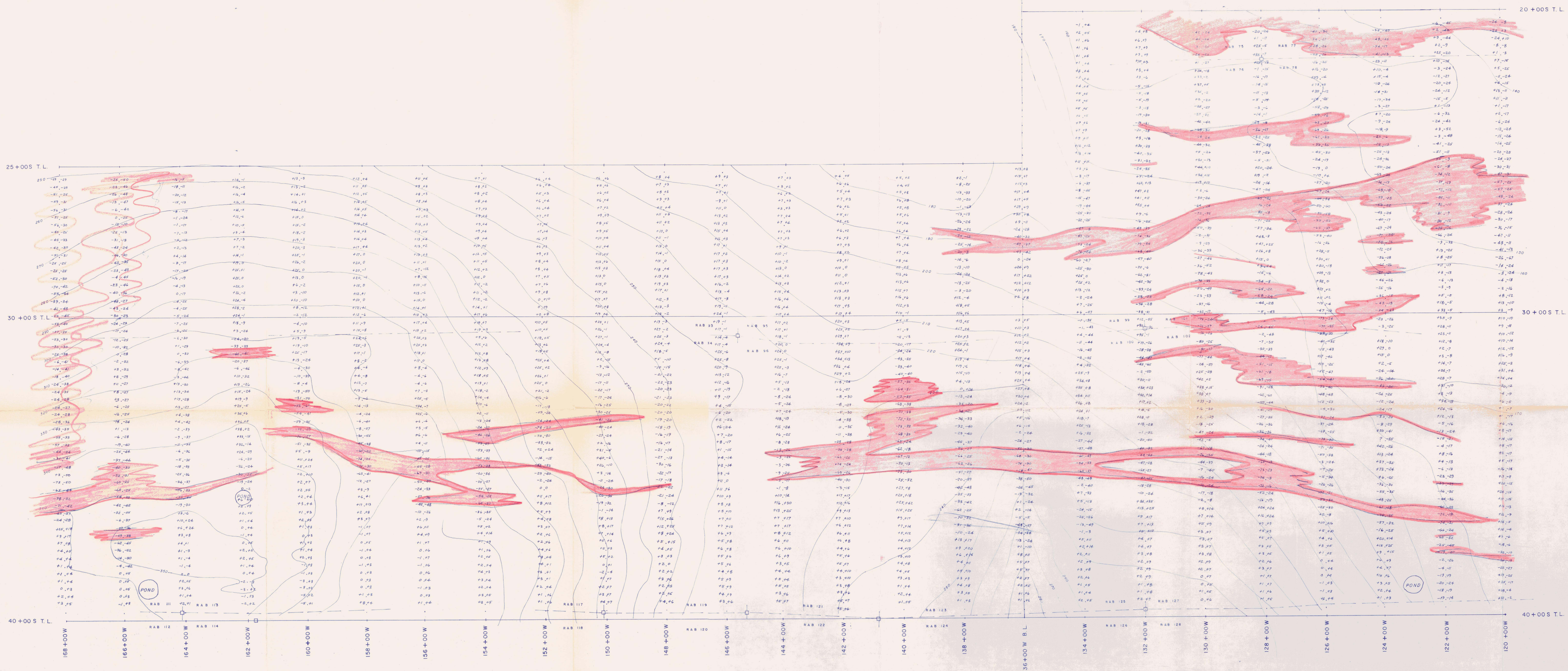

091426

Instrument: Apex Max-Min II
Coil Separation: 100 Meters
Frequency: 1777 Hz
Inphase: Plotted to the right
Outphase: Plotted to the left
Known edge of anomaly: ———
Inferred edge of anomaly: - - - - -

HUDSON BAY EXPLORATION & DEVELOPMENT COMPANY LIMITED
WHITEHORSE OFFICE
RAB CLAIMS (SOUTH GRID)

APEX MAX - MIN II SURVEY

DRAWN BY: C.M. DATE: APR 20 1962 PLATE No. 9
FIELD WORK BY: P.S. REVISED BY: SCALE: 1:5000
100 200m

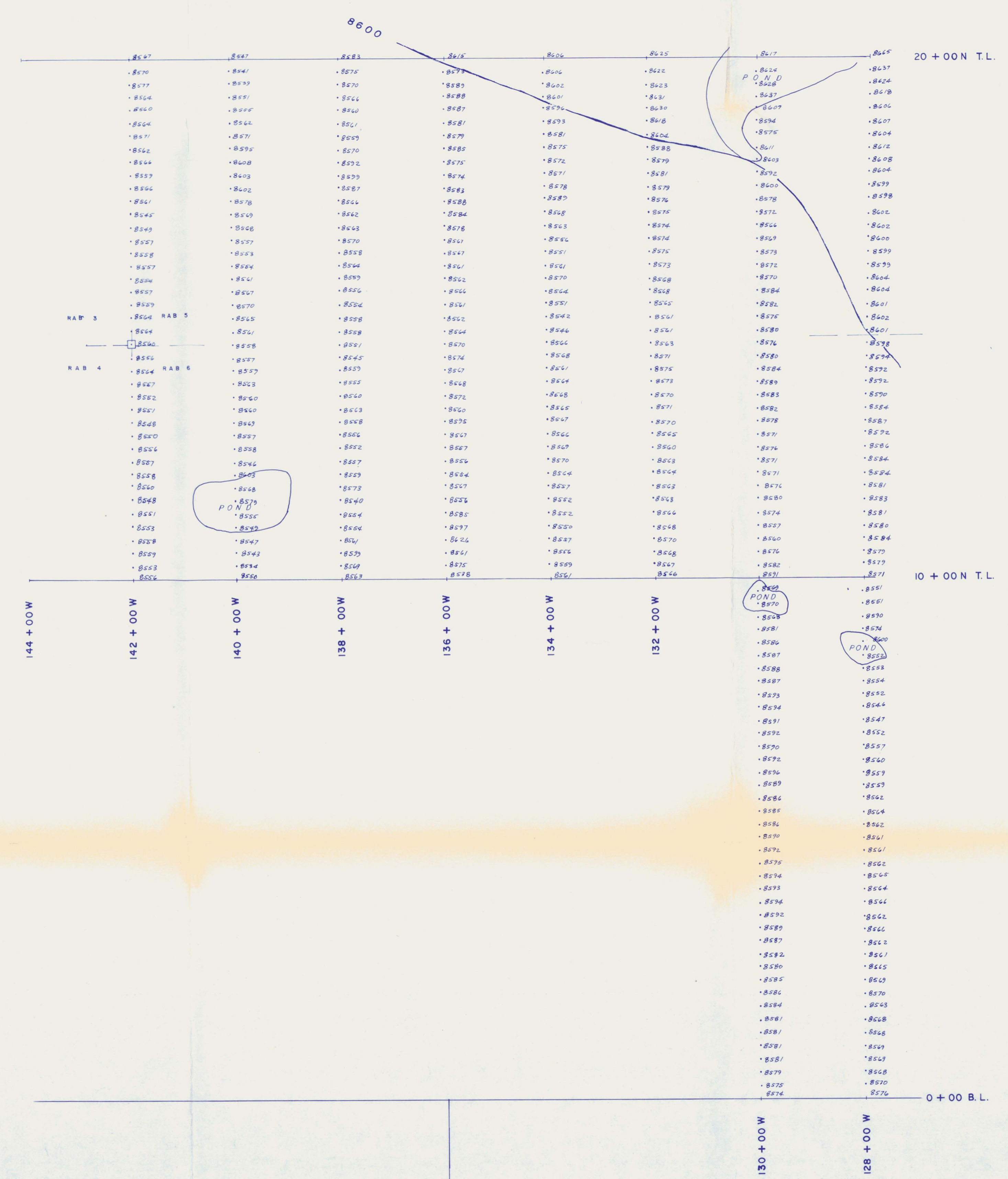
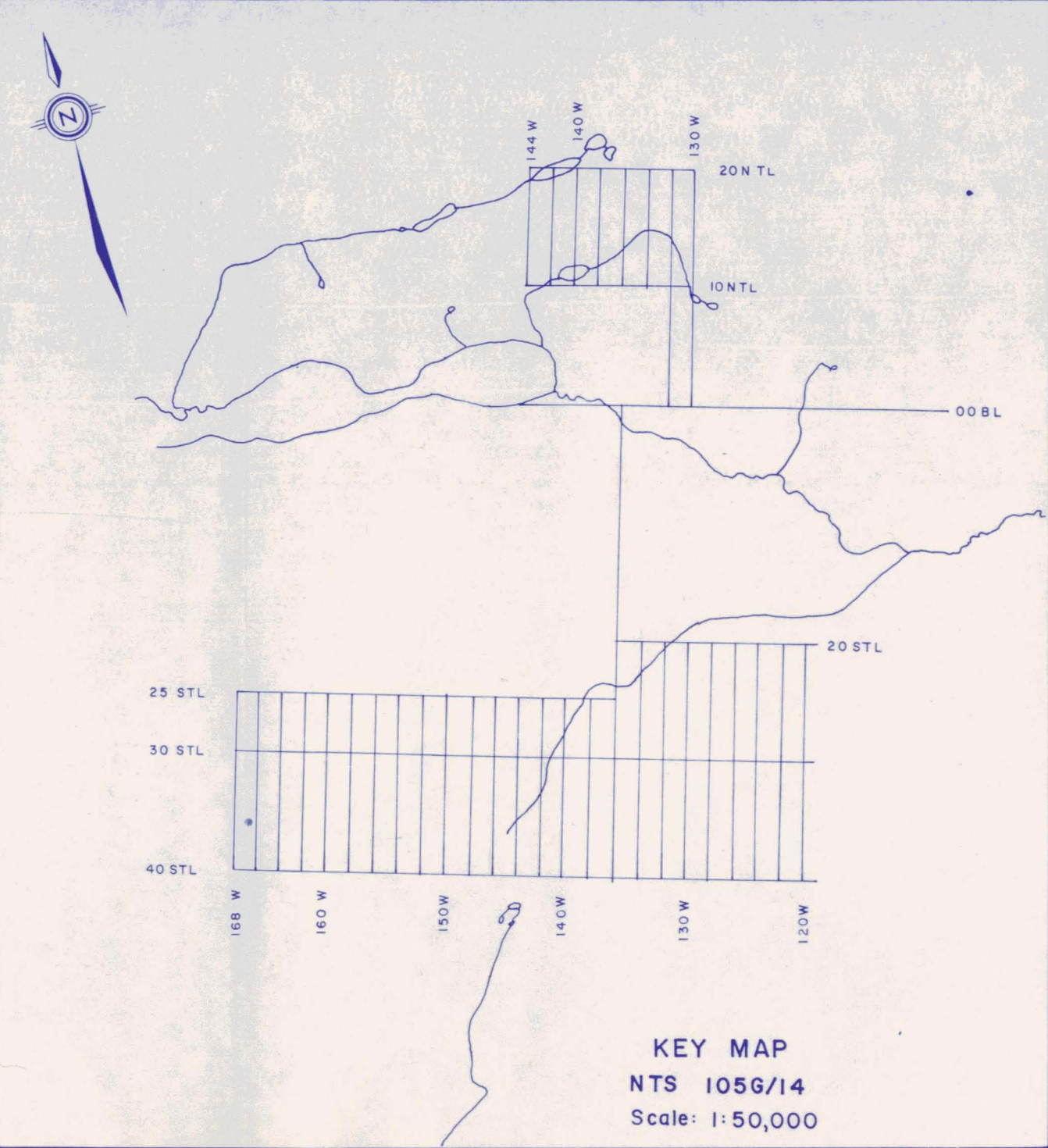

Note: Add 50,000 I to each reading
Instrument: Proton Precision Magnetometer

091426

HUDSON BAY EXPLORATION & DEVELOPMENT
COMPANY LIMITED
RAB CLAIMS (NORTH GRID)
MAGNETOMETER SURVEY

DATE: 10/11/2002 PLATE No. 6
SCALE: 1:5000
FIELD WORK BY: REVISOR: 100 0 100 200m
Y.C.

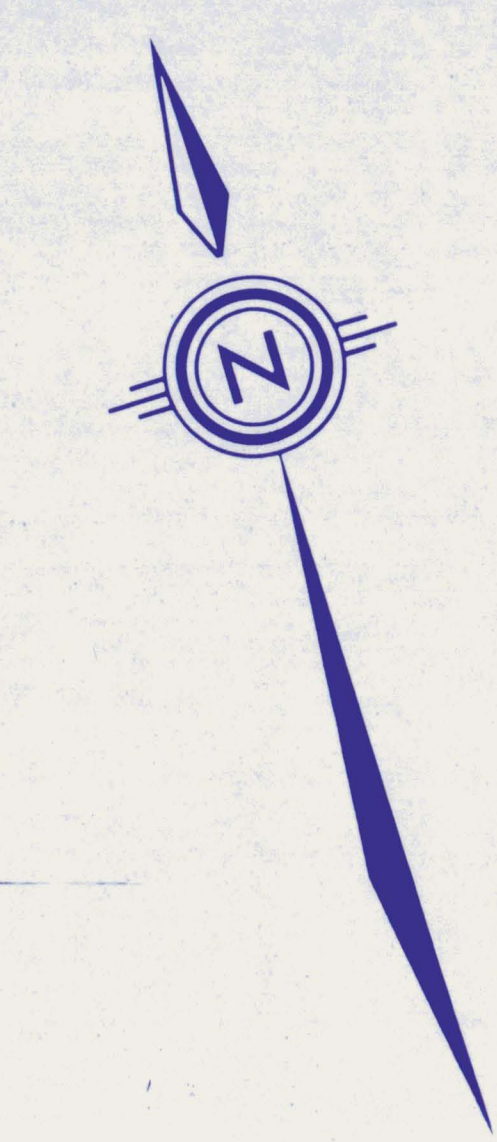
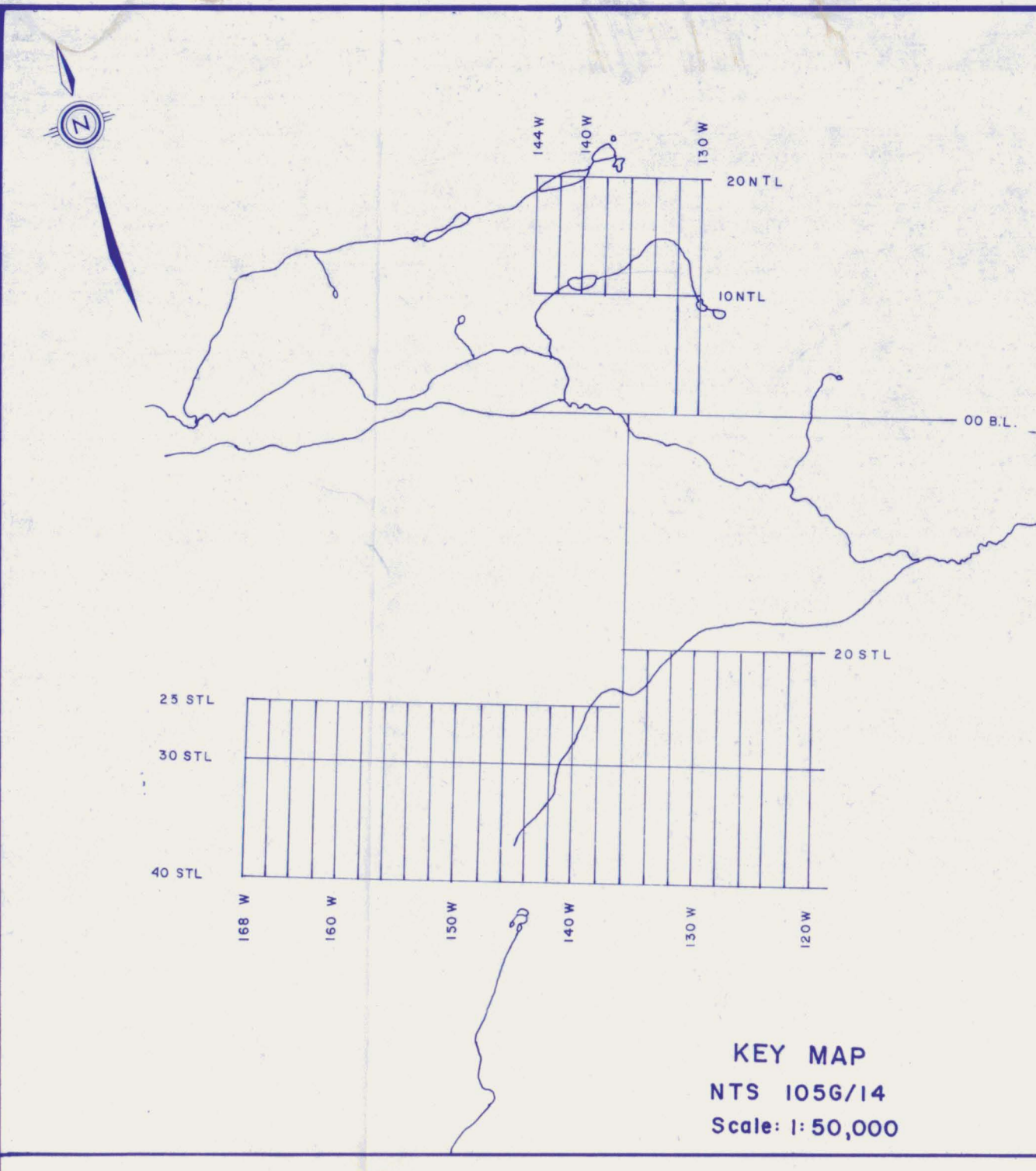

0+00 B.L.

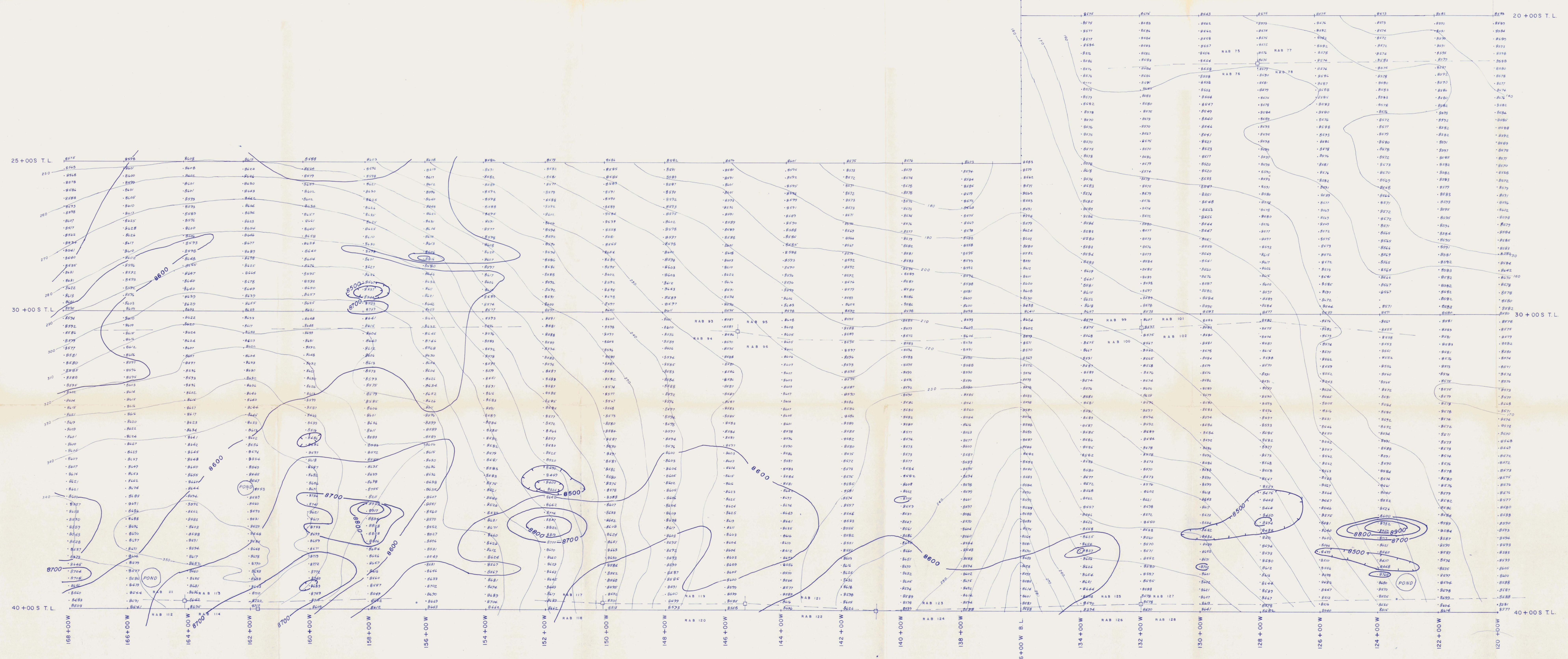

091428

Note: Add 50,000' to each reading
Instrument: Proton Precision Magnetometer
Mag contour 100'
Elevation (relative) contour 100'

HUDSON BAY EXPLORATION & DEVELOPMENT COMPANY LIMITED
OFFICE

RAB CLAIMS (SOUTH GRID)

MAGNETOMETER SURVEY

DRAWN BY: C-21 DATE: 27 1992 PLATE No. 7
FIELD WORK BY: REVISOR: SCALE: 1:5000 PLATE No. 7
v.c. 100 0 100 200m.