

SOIL GEOCHEMICAL SURVEY

FOO CLAIMS

North Anvil Range
Whitehorse Mining District

N.T.S. 105-K-6, 7

Latitude: 62°23'N
Longitude: 133°5'W

Owned By:

Cyprus Anvil Mining Corporation
and
Metallgesellschaft Canada Ltd.

NORTH ANVIL RANGE JOINT VENTURE

D. S. Jennings
March, 1982

091374

CYPRUS ANVIL

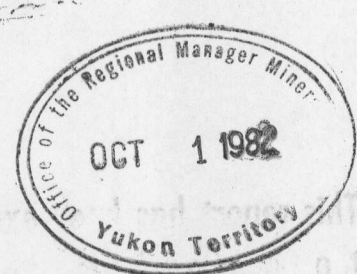

SOIL GEOCHEMICAL SURVEY

FOO CLAIMS

North Anvil Range
Central Yukon Territory



Whitehorse Mining District

N.T.S. 105-K-6, 7

Latitude: 62°23'N

Longitude: 133°5'W

Owned By:

Cyprus Anvil Mining Corporation
and
Metallgesellschaft Canada Ltd.

North Anvil Range Joint Venture

D. S. Jennings, Ph.D.

March, 1982

091374

This report has been prepared by
the Geological Survey of Canada
under Section 55 of the Quartz
Acting for and is a
representation of the amount
of \$ 4,800

P. Watson

Regional Manager, Exploration and
Geological Services for Commissioner
of Yukon Territory.

SOIL GEOCHEMICAL SURVEY

FOO CLAIMS

North Anvil Range

Central Yukon Territory

Whitehorse Mining District

N.T.S. 105-K-6, 7

Latitude: 62° 23' N

Longitude: 133° 2' W

Owned By:

Cyrus Anvil Mining Corporation
and
Metallgesellschaft Canada Ltd.

North Anvil Range Joint Venture

D. S. Jennings, P.E.

091374

March, 1982

TABLE OF CONTENTS

	<u>Page</u>
INTRODUCTION	1
Location	1
Access	1
Topography and Vegetation	1
PROPERTY DESCRIPTION	1
REVIEW OF 1981 PROGRAM	1
GEOLOGY	2
SAMPLING AND ANALYTICAL TECHNIQUES	3
RESULTS AND CONCLUSIONS	3

ILLUSTRATIONS

FIGURE 1	Property Location Map, North Anvil Range Scale 1" = 100 miles
TABLE 1	Summary of Claim Data
APPENDIX I	Statement of Qualifications
APPENDIX II	Summary of Costs
APPENDIX III	Affidavit Supporting Summary of Costs
MAP NO. 1	Foo Claims Cu Geochemistry
MAP NO. 2	Foo Claims Pb Geochemistry
MAP NO. 3	Foo Claims Zn Geochemistry

SOIL GEOCHEMICAL SURVEY

FOO CLAIMS

INTRODUCTION

Location:

The Foo claims form part of the North Anvil Range Joint Venture in the White-horse Mining District on the northeast flank of Anvil Range, about eight kilometers northeast of the town of Faro (Figure 1).

Access:

Access to the property is gained by helicopter from Faro, the Anvil Mine or Grum camp. No overland road access is available..

Topography and Vegetation:

Rolling hills with some areas of moderate relief underlie the immediate area of the survey. Sparse boreal conifers are distributed in this sub-alpine tundra zone dominated by black birch and arctic willow.

PROPERTY DESCRIPTION

A summary of all Foo Mineral Claim data is given in Table 1.

REVIEW OF 1981 PROGRAM

The Foo claims were staked to cover the previously mapped contact of the Mt. Mye and Vangorda Formations in an area of incomplete exploration coverage. This contact is known to host lead-zinc sulfide mineralization in Anvil District along the southwest flank of Anvil Range.

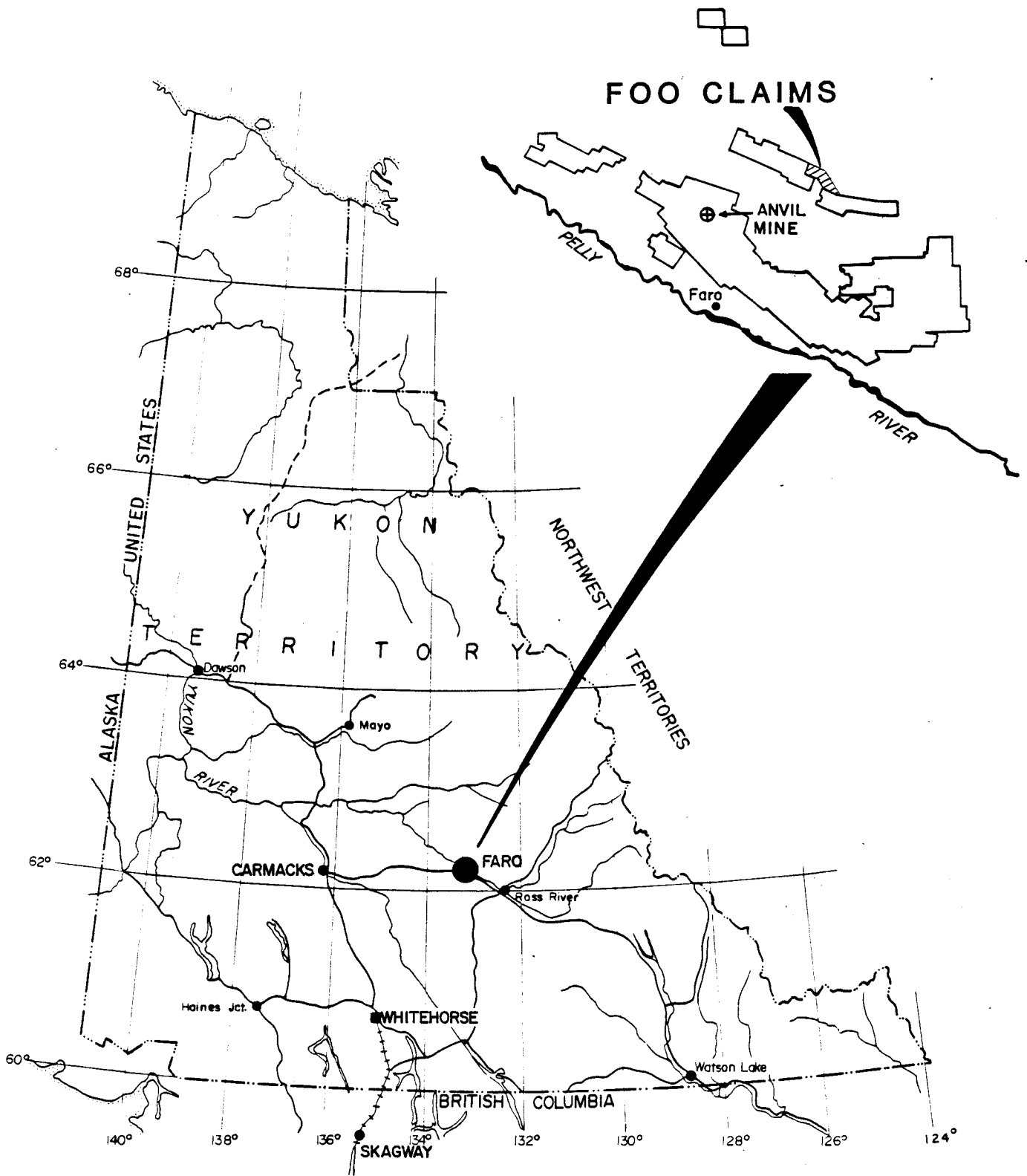

CYPRUS ANVIL MINING CORPORATION FOO CLAIMS LOCATION MAP

YUKON
SCALE: 1" = 100 MILES

TABLE 1

Summary of Claim Data

COMPANY CYPRUS ANVIL CLAIM FOO PROPERTY OWNERSHIP M.D. ... Whitehorse N.T.S. ... 105-K-6 & 7

Claim No.	Grant No.	No. of Claims	Staked by	Recording Date	Transfer Information		Due Date	Assessment Work and Remarks
					To	Date		
16	YA74100	1	Gordon Clark	October 5, 1981	Cyprus Anvil	Feb. 12, 1982	Oct. 5, 1982	
17-24	YA74101-YA74108	8	Andy McDonald	October 5, 1981	"	"	Oct. 5, 1982	
25-32	YA74109-YA74116	8	B. Hall	October 5, 1981	"	"	Oct. 5, 1982	
33	YA74117	1	Klondike Elston	October 5, 1981	"	"	Oct. 5, 1982	
34-35	YA74118-YA74119	2	Klondike Elston	October 5, 1981	"	"	Oct. 5, 1982	
37-40	YA74120-YA74123	4	Klondike Elston	October 5, 1981	"	"	Oct. 5, 1982	
41-44	YA74124-YA74127	4	Alain Hardy	October 5, 1981	"	"	Oct. 5, 1982	
46-47	YA74128-YA74129	2	Alain Hardy	October 5, 1981	"	"	Oct. 5, 1982	
50-56	YA74130-YA74136	7	J. Tomlinson	October 5, 1981	"	"	Oct. 5, 1982	
57-58	YA74165-YA74166	2	R. Tolbert	October 5, 1981	"	"	Oct. 5, 1982	
64	YA74191	1	P. Naki	October 5, 1981	"	"	Oct. 5, 1982	
65-72	YA74157-YA74164	8	D. S. Jennings	October 5, 1981	"	"	Oct. 5, 1982	

An 8.4 kilometer (27,500 feet) cut and picketed baseline was established through the central portion of the Foo group and adjacent Ming and Rog claims (held by Cyprus Anvil) along one of the Foo location lines. Picket lines were turned by compass and topofil chain every 305 meters (1,000 feet) with samples collected from the "B" soil horizon at 30.5 meter (100 foot) intervals along each picket line. Samples were marked with orange flagging tape and designated with grid co-ordinates. The base line was sampled from the same horizon at the same interval.

Alternate samples along the established picket and base lines were analysed for Cu, Pb and Zn by conventional atomic absorption techniques. A total of 1,054 samples was collected. The field work was carried out in September, 1981, with geochemical analysis and compilation of results during the period 5 October, 1981 to 29 January, 1982. Samples are located at Acme Analytical Laboratories in Vancouver.

GEOLOGY

The Foo claims are underlain by greenschist metamorphic grade pelites and metavolcanic rocks of Mt. Mye and Vangorda Formations. These two stratigraphic units span the uppermost Proterozoic to lower Ordovician section in Anvil Range. Five major, massive to disseminated, stratiform, pyritic lead-zinc sulfide deposits (Faro, Grum, Vangorda, DY and Swim), associated with lenticularly developed graphitic pelites, occur at the contact of these two units in Anvil Mining District along the southwest flank of Anvil Range. Because of the similarity in stratigraphic setting of the Foo claims to the producing Anvil District, a soil geochemical survey was completed to round

out basic exploration coverage in this area. No known showings or prospects were located on the Foo group.

SAMPLING AND ANALYTICAL TECHNIQUES

Soil samples were collected by conventional mattock pitting along the cut or topofil-chained grid. Samples were taken from the medium to dark brown soil layer above regolith and beneath the pervasive "White River" ash layer common to the area. Bagged samples were air dried and shipped to Acme Analytical Laboratories in Vancouver where they were kiln dried, sieved, with the -80 mesh fraction digested in hot aqua regia. The resultant solutions were analysed by conventional atomic absorption techniques with a background correction applied to Pb results.

RESULTS AND CONCLUSIONS

Results were plotted on a 1:12,000 (1" = 1,000') orthophotographic base map with contoured intervals of 50 and 100 ppm for Cu and Pb, and 100, 200 and 500 ppm for Zn. This data is compiled on Maps Nos. 1, 2 and 3 included with this report.

Inspection of the data shows uniformly low values in all three metals, suggesting no near surface occurrence of sulfide mineralization. Certainly no geochemical responses typical of sulfides in the main deposit area are apparent. In general, combined Pb+Zn values approaching 1,000 ppm are diagnostic of surficial occurrences in Anvil Range. In this light, no

follow-up work is presently recommended for this area.

Respectfully submitted,

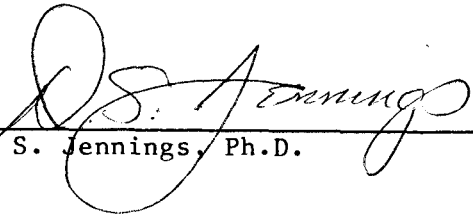
D. S. Jennings, Ph.D.

Cyprus Anvil Mining Corporation

300, 355 Burrard Street
Vancouver, British Columbia
V6C 2G8
Telephone (604) 687-2586

Telex 04508594

APPENDIX I

Statement of Qualifications

I, David S. Jennings, Geologist, with business address in Vancouver, British Columbia, and residential address in West Vancouver, British Columbia, hereby certify that:

1. I graduated from Lehigh University in 1964 with a B.A.Sc. (Honors) degree in Geology and from McMaster University in 1970 with a Ph.D. (Faculty of Science).

2. From 1969 to the present, I have been permanently employed as a research and/or exploration geologist in Canada.

3. I am a Member of the Geological Association of Canada and a member of the Sigma Xi (Research Society, Chapter at Large).

4. I am personally responsible for the supervision of all work on these properties and have actively participated in the field work and interpretation of results.

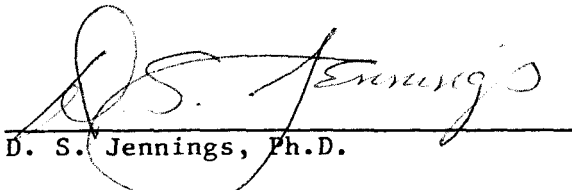
D. S. Jennings, Ph.D.

CYPRUS ANVIL

APPENDIX II

Summary of Costs

Foo Claims

North Anvil Range Joint Venture

5 October, 1981 to 15 April, 1982

Geochemical Analyses:

Acme Analytical Labs., 1,054 samples @ \$2.75 plus \$0.40 preparation, less 10%	\$2,988.09
--	------------

Drafting:

Exclusive Drafting Services	1,584.00
Cyprus Anvil drafting, 3 days @ \$71.25/day	213.75

Supervision and Report Writing:

D. S. Jennings, Chief Geologist	500.00
---------------------------------	--------

TOTAL	<u>5,285.84</u>
-------	-----------------

Cyprus Anvil Mining Corporation

300, 355 Burrard Street
Vancouver, British Columbia
V6C 2G8
Telephone (604) 687-2586

Telex 04508594

APPENDIX III

Affidavit Supporting Summary of Costs

I, D. S. Jennings, Chief Geologist, Cyprus Anvil Mining Corporation, of Vancouver, British Columbia, do hereby state that, to the best of my knowledge, the Statement of Costs in this report is a true account of expenditures incurred from exploration on these properties.

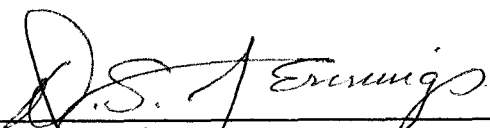

D. S. Jennings

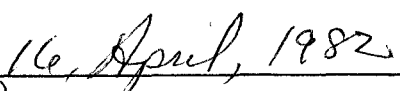

(Date)



Notary Public in and for the
Province of British Columbia

CHARLES H. WILLS
Barrister & Solicitor
26th Floor,
Toronto Dominion Bank Tower,
700 West Georgia Street,
Vancouver, B.C.
V7Y 1E3

CYPRUS ANVIL

EXCLUSIVE DRAFTING SERVICES LTD.

922 - 470 Granville St.

Vancouver, B.C.

V6C 1V5

SOLD TO

Cyprus Ave. L

"Foo Glan" - 8 1982

SHIPPED TO

ADDRESS

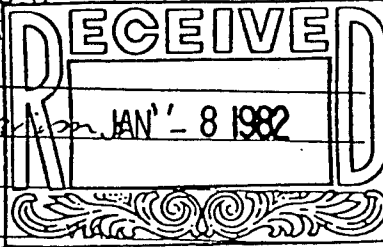

OUR NUMBER

124518

DATE

Jan. 8/82

CUSTOMER'S ORDER

SALESMAN

TERMS

F.O.B.

JAN 11 1982

INVOICE

<i>7 Maps:</i>					
<i>Put on claim Survey Lines</i>					
<i>Put on Values for claim</i>	<i>ACCO-6</i>				
<i>with Grid Line. Label the Map</i>					
<i>+ Fee claims</i>	<i>2204-07</i>				
<i>71 hrs @ 22.00/hr</i>					
			<i>1,562.00</i>		<i>1,562.00</i>
<i>Ob. [Signature]</i>					
			<i>TOTAL</i>	<i>1,562.00</i>	
			<i>EXTENS.</i>		
			<i>TO PAY</i>		
<i>* Please remit yellow copy with Payment.</i>					<i>1,562.00</i>

D32

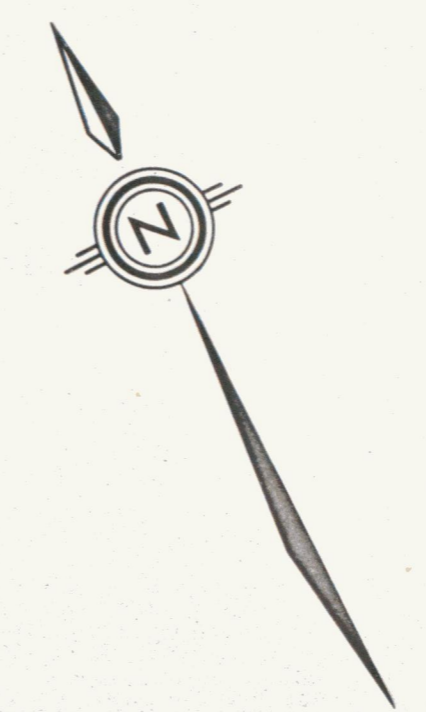
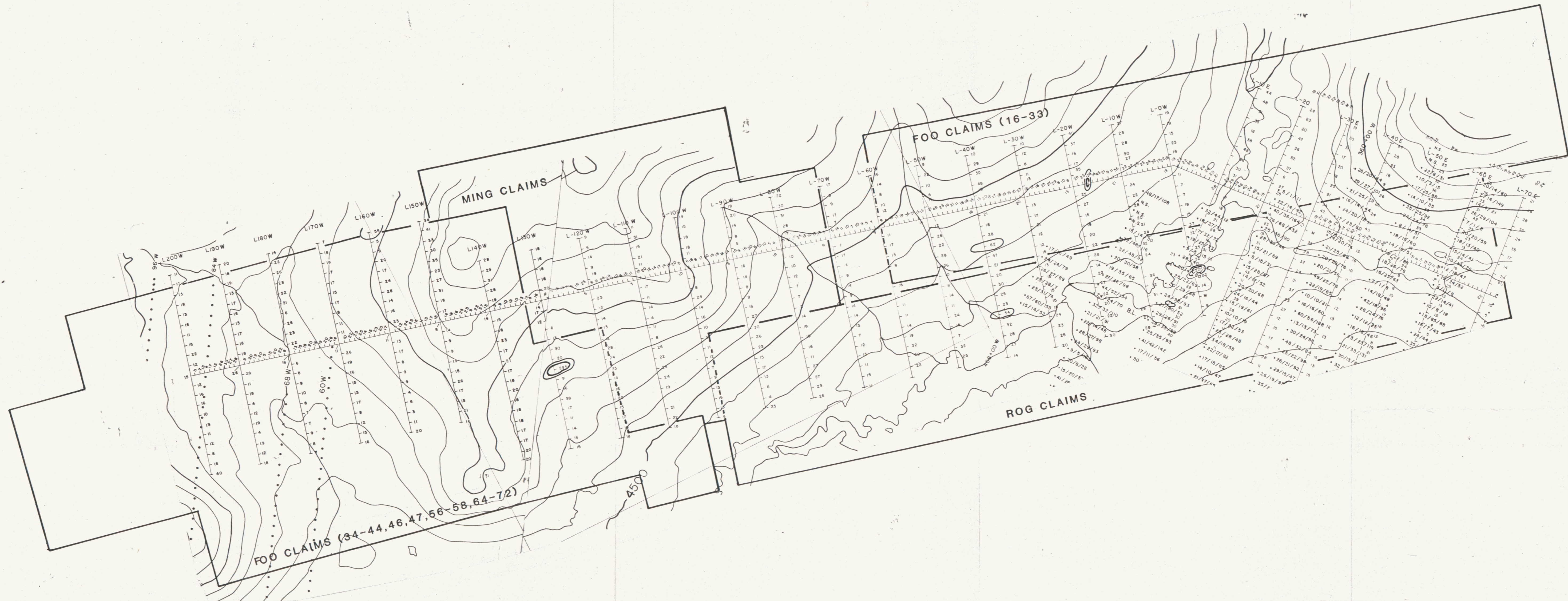

CYPRUS ANVIL MINING CORPORATION	
FOO CLAIMS WHITEHORSE M.D.	
YUKON TERRITORY 091374	
SOIL GEOCHEMICAL SURVEY COPPER RESULTS in p.p.m.	
CONTOUR INTERVAL 50 & 100 ppm	
NTS. 105-K-6,7 SURVEY BY: DSJ DRAWN BY: rwr	DATE: APR. 81

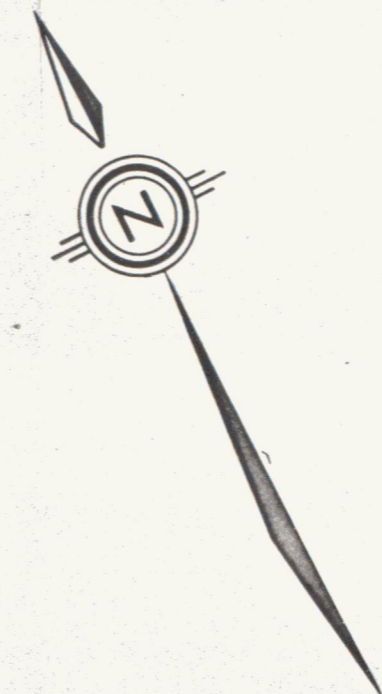
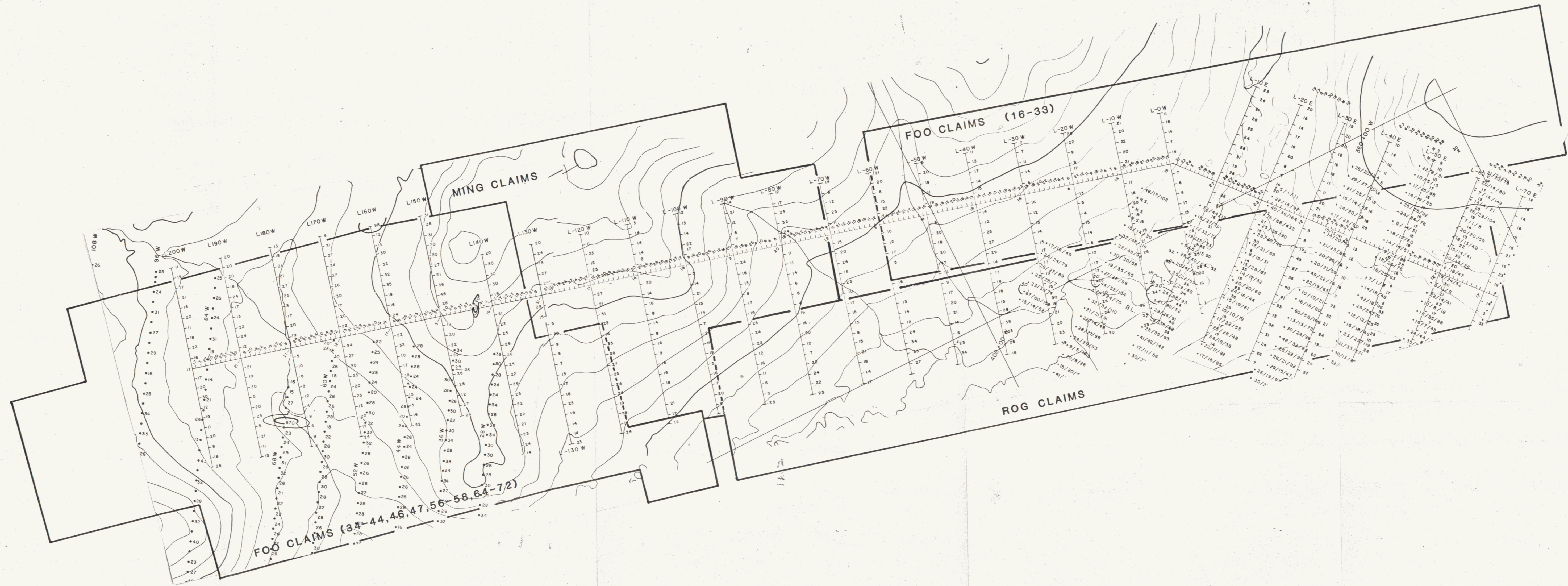

CYPRUS ANVIL MINING CORPORATION	
FOO CLAIMS WHITEHORSE M.D.	
YUKON TERRITORY 091374	
SOIL GEOCHEMICAL SURVEY LEAD RESULTS in p.p.m.	
CONTOUR INTERVAL 50 & 100 ppm	
NTS. I05-K-6,7 SURVEY BY: DSJ DRAWN BY: rwr	DATE: APR. 81

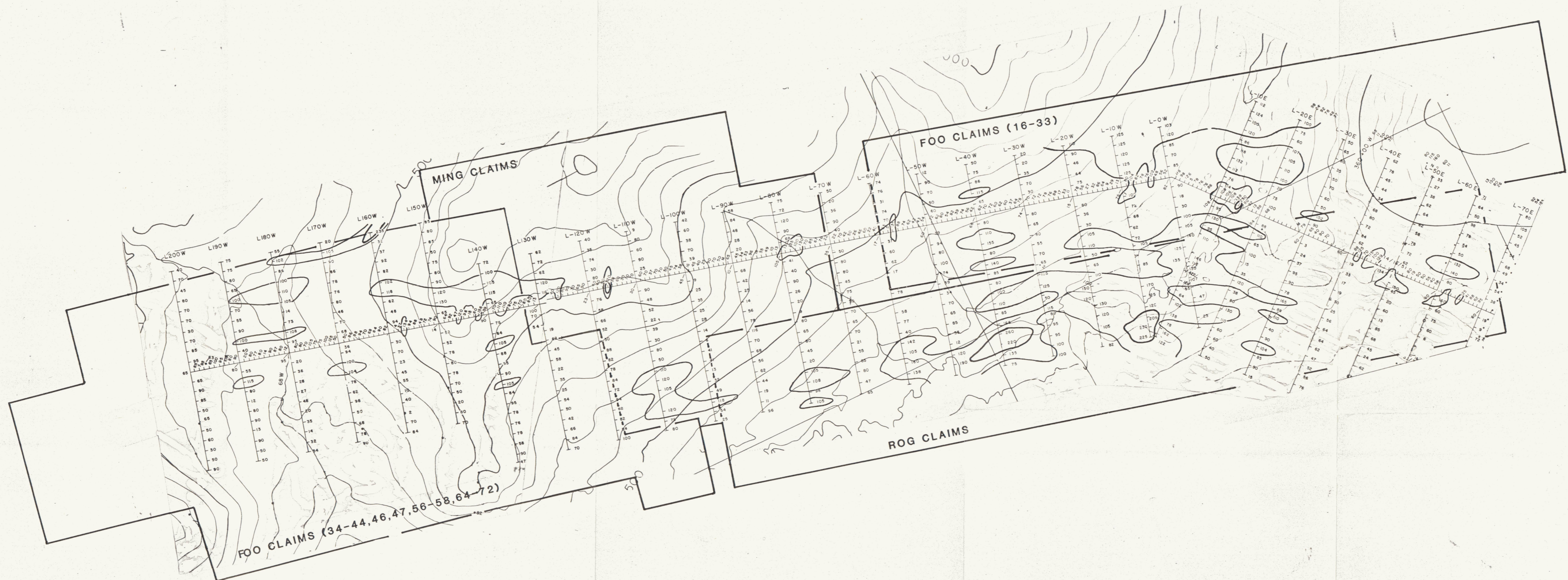

CYPRUS ANVIL MINING CORPORATION	
FOO CLAIMS WHITEHORSE M.D.	
YUKON TERRITORY 091374	
SOIL GEOCHEMICAL SURVEY ZINC RESULTS in p.p.m.	
CONTOUR INTERVAL 100 & 200 ppm	
NTS. 105-K-6,7 SURVEY BY: DSJ DRAWN BY: rwr	DATE: APR. 81