

Dec 31, 1970

1970 DIAMOND DRILL STATISTICS - MOUNT COCKFIELD

BS 38 DRILL - NQ CORE

HOLE No.	DATES		DIP/BEARING	HOLE DEPTH	OVERBURDEN DEPTH	BEDROCK DRILLED	RECOVERY	ASSAYS		
	STARTED	FINISHED						Cu%	Mo%	Core length
Co 1	July 11	July 24	-45°/n84e	859'	35'	824'	100%	.021	.014	824'
Co 2	July 25	July 31	-45°/s84w	712'	9'	703'	100%	.037	.013	703'
Co 3	Aug 1	Aug 8	-45°/n84e	1022'	9'	1013'	100%	.024	.015	1013'
Co 4	Aug 10	Aug 16	-45°/s35w	986'	9'	977'	100%	.022	.010	977'
Co 5	Aug 18	Aug 22	-45°/n84e	500'	32'	468'	95.9%	no assays		
Co 6	Aug 24	Aug 26	-45°/east	505'	11'	494'	99.5%	.029 .022	.112 .078	10' 21'
6 holes		47 days		4,584'	105'	4,479'	99.5%			

001346

PROPERTY Co CLAIM GROUP

UNITED KENO HILL MINES LTD.

DIAMOND DRILL HOLE LOG

HOLE NO. Co 1

SHEET NO. 1

LOCATION Mt. COCKFIELD

LAT. 4760 N

ELEVATION 4390'

STARTED JULY 11, 1970

SECTION FROM 0 TO 60

DEP. 7712 E

COMPLETED JULY 24, 1970

LOGGED BY I.D. & R.E.V.

BEARING N 84° E

DIP -45°

SURVEYS

DIP TEST AT 660'

-38°

DEPTH 859'

PURPOSE

FOOTAGE		MINOR STRUCTURES			FORMATION	CORE SAMPLES						SLUDGE SAMPLES						
FROM	TO	FROM	TO	RECOVERY		SAMPLE NO.	FOOTAGE		WIDTH	W	Cu %	Mo %	SAMPLE NO.	FOOTAGE		W	Cu %	Mo %
						FROM	TO					FROM	TO					
0	35				OVERBURDEN.													
35	850				QUARTZ MONZONITE													
		35	40	5	medium grained light grey in color Phenocrysts of felspar up to 1/5" in diameter also irregular phenocrysts of hornblende with magnetite, also dissem magnetite and occ blebs of pyrite throughout. Fracturing throughout varying in intensity qtz - calcite &ankerite veining minor limonite on fractures. several qtz veins & fractures 4 contain minor Moly 39' Fracture at 5° with minor Chalco.	09551	35	40	5	Tr	.03	.01	06751	35	40	Tr	.03	.02
		40	50	10	as above occ bleb of pyrite 41' hairline qtz vein at 40° minor Chalco & Moly 44' hairline qtz vein at 5° with fine Moly 45' Calcite vein at 40° with minor Moly 47' 1/8" qtz vein at 20° minor slickensided Moly 49' hairline qtz vein at 30° with minor Chalco. 50' 1/8" qtz vein at 45° with minor Chalco & Moly	09552	40	50	10	Tr	.03	.01	06752	40	50	Tr	.06	.01
		50	60	10	as above blebs of magnetite & pyrite 51' hairline qtz at 10° minor Chalco. 60' 1/16" qtz vein at 45° minor Moly	09553	50	60	10	Tr	.02	.01	06753	50	60	Tr	.05	.02

**UNITED KENO HILL MINES LTD.
DIAMOND DRILL HOLE LOG**

PROPERTY

LOCATION LAT. ELEVATION STARTED

DEP. COMPLETED

BEARING DIP SURVEYS

DEPTH PURPOSE

HOLE NO. Co 1

SHEET NO. 2

SECTION FROM 60 TO 90

LOGGED BY I.D. & R.E.V.

FOOTAGE		MINOR STRUCTURES			FORMATION	CORE SAMPLES						SLUDGE SAMPLES						
FROM	TO	FROM	TO	RECOVERY		SAMPLE NO.	FOOTAGE		WIDTH	W	Cu %	Mo %	SAMPLE NO.	FOOTAGE		W	Cu %	Mo %
							FROM	TO						FROM	TO			
	60	70	10		as above 5-6 fractures per foot with 1 out of 6 with a little mineral. dissemin pyrite 62' hairline qt ₃ minor Chalco 64' hairline qt ₃ at 20° minor Chalco 65' hairline qt ₃ vein at 45° minor Chalco. 67' 1/16" qt ₃ vein at 45° minor Moly 68.5' 4" Aplite Dyke - hazy contact	09554	60	70	10	Tr	.02	.01	06754	60	70	Tr	.02	.01
	70	80	10		as above increase in qt ₃ veinlets & fractures Few mineralized quartz uugs.	09555	70	80	10	Tr	.03	Tr	06755	70	80	Tr	.04	.01
	80	90	10		as above slightly altered and darker with chlorite on fractures. Occ limonite on fractures 70' to 78' few 1/8" ankerite veins at 45° with kaolin. occ pyrite. 81' hairline qt ₃ at 20° minor Moly 82' 1/16" qt ₃ vein at 30° minor Moly 82.5' 1/16" qt ₃ vein at 20° minor Moly 83' calcite-ankerite vein at 45° minor Moly 82.5-86' fine grained qt ₃ monzonite 85' 1/16" qt ₃ vein at 30° minor Moly 87.2' 1/16" qt ₃ vein at 30° minor Moly 88' hairline qt ₃ at 20° minor Chalco 88.5' hairline qt ₃ at 45° minor Chalco 89' 1/16" qt ₃ vein at 20° minor Chalco.	09556	80	90	10	Tr	.03	.01	06756	80	90	Tr	.02	.01

UNITED KENO HILL MINES LTD.

DIAMOND DRILL HOLE LOG

HOLE NO. C01
 SHEET NO. 3
 SECTION FROM 90 TO 130
 LOGGED BY I.D. & R.E.V.

PROPERTY

LOCATION LAT. ELEVATION STARTED

DEP. COMPLETED

BEARING DIP SURVEYS

DEPTH PURPOSE

FOOTAGE		MINOR STRUCTURES			FORMATION	CORE SAMPLES						SLUDGE SAMPLES						
FROM	TO	FROM	TO	RECOVERY		SAMPLE NO.	FOOTAGE		WIDTH	W	Cu %	Mo %	SAMPLE NO.	FOOTAGE		W	Cu %	Mo %
							FROM	TO						FROM	TO			
	90	100	10		as above. App 1 fracture per foot ribbon structure 95-100 finer grained & darker, increase in ferromags occ blebs of pyrite. 91' 1/16" qt ₃ vein at 20° fine Moly 92.5' hairline qt ₃ at 10° minor Moly	09557	90	100	10	Tr	.03	Tr	06757	90	100	.12	.11	.01
	100	110	10		as above. 1 fracture per foot short ribbon structure sections - sauss of felspars - pale green. 102' 1" Aplite Dyke - pyrite, Moly & Chalco. 103' 1" Aplite Dyke fine dissem Chalco 103.5' hairline qt ₃ at 10° minor Moly 104' 1/16" qt ₃ vein at 30° with minor Moly 105' hairline qt ₃ at 10° with minor Moly 108' minor dissem Chalco 109' hairline qt ₃ at 15° minor Chalco	09558	100	110	10	Tr	.03	Tr	06758	100	110	.05	.06	.01
	110	120	10		as above. Few 3/4" bands of altered material which is dark & fine grained 117' 1/16" qt ₃ vein at 80° minor Moly.	09559	110	120	10	Tr	.03	Tr	06759	110	120	.05	.06	Tr
	120	130	10		as above short sections with ribbon structure occ blebs of pyrite 121' hairline fracture at 45° minor Chalco 122' 1/4" qt ₃ vein at 30° Good Chalco. 128' 1/8" qt ₃ vein at 5° minor Moly 129' 1 bleb of Moly	09560	120	130	10	Tr	.05	Tr	06760	120	130	.01	.03	Tr

**UNITED KENO HILL MINES LTD.
DIAMOND DRILL HOLE LOG**

PROPERTY

HOLE NO. Co 1

LOCATION LAT. ELEVATION STARTED

SHEET NO. 4

DEP. COMPLETED

SECTION FROM 130 TO 170

BEARING DIP SURVEYS

LOGGED BY I.D. & R.E.V.

DEPTH PURPOSE

FOOTAGE		MINOR STRUCTURES			FORMATION	CORE SAMPLES						SLUDGE SAMPLES						
FROM	TO	FROM	TO	RECOVERY		SAMPLE NO.	FOOTAGE		WIDTH	W	Cu %	Mo %	SAMPLE NO.	FOOTAGE		W	Cu %	Mo %
							FROM	TO						FROM	TO			
	130	140	10		as above with strong foliation or ribbon structure. phenocrysts up to 3/16' of sauss. 132.5' hairline fracture with one bleb of Chalco. 135' 1/8" qt ₃ vein at 45° with minor Moly. 137' 1/16" qt ₃ vein with minor Moly 140' 4" Aplite Dyke minor dissem Chalco.	09561	130	140	10	Tr	.03	Tr	06761	130	140	.02	.04	Tr
	140	150	10		as above - foliated in places. phenocrysts of sauss. also Kaolin - greenish color in places. 148' hairline qt ₃ at 10° with minor Moly 140-141' qt ₃ vein with 3 1/8 veins with Chalco & Moly 147' 9"-149 light green - fine grained alteration zone with sauss. minor dissem Moly & Chalco. 149-150.5 Breccia cemented partially with calcite and qt ₃ minor Moly and Chalco. 150.5-151 - light green alteration zone - sauss.	09562	140	151	11	Tr	.04	.02	06762	140	150	.02	.04	.01
	151	160	9		as above very little foliation 153' Fracture at 5° 1 bleb of Moly 154.5 1/4" qt ₃ vein at 10° minor Moly 159-160' 3 1/8" qt ₃ veins with Moly.	09563	151	160	9	Tr	.02	.01	06763	150	160	.02	.03	.01
	160	170	10		as above slight increase in grain and phenocryst size - very fresh looking rock. App 10 fractures per foot. 11 hairline qt ₃ veins with fine Moly and minor Chalco.	09564	160	170	10		.020	.014	06764	160	170	.02	.03	.02

**UNITED KENO HILL MINES LTD.
DIAMOND DRILL HOLE LOG**

PROPERTY

HOLE NO. Co 1

LOCATION LAT. ELEVATION STARTED

SHEET NO. 5

DEP. COMPLETED

SECTION FROM 170 TO 200

BEARING DIP SURVEYS

LOGGED BY I.D. & R.E.V.

DEPTH PURPOSE

FOOTAGE		MINOR STRUCTURES			FORMATION	CORE SAMPLES						SLUDGE SAMPLES						
FROM	TO	FROM	TO	RECOVERY		SAMPLE NO.	FOOTAGE		WIDTH	W	Cu %	Mo %	SAMPLE NO.	FOOTAGE		W	Cu %	Mo %
							FROM	TO						FROM	TO			
	170	180	10		as above foliation in short sections. Fe stain on a few fractures 170'-179' 7 hairline qt ₃ veins with fine moly and minor Chalco. 179' 1/8" qt ₃ vein at 45° with Chalco	09565	170	180	10	—	.015	.002	06765	170	180	.01	.02	.01
	180	190	10		as above few ankerite veins 180.5' 1/8" fracture with Good Moly 181.5-183' 7" Pinkish color irregular phenocrysts Iron stain on fractures. Fracture at 45° minor Moly 184' Shear at 30° with minor Moly. 186.5'-187' dark, fine grained rich in magnetite 187.5' 1/16" qt ₃ with minor Moly. 188-190' ribbon structure - pinkish color few fractures with minor Moly.	09566	180	190	10	Tr	.02	.03						
	190	200	10		as above 190-192' 3" pinkish color & ribbon structure highly fractured & friable 193' 1/16" qt ₃ vein at 50° minor Moly 194' 1/16" qt ₃ vein at 10° minor Moly 192' 7"-194' 5" app 13 fractures 1/30" wide & qt ₃ veins with moly & minor Chalco 198' 1/16" qt ₃ vein with minor Moly 200' 1/8" qt ₃ vein at 5° minor Moly.	09567	190	200	10	Tr	.02	.03	06766	190	200	.11	.08	.01

**UNITED KENO HILL MINES LTD.
DIAMOND DRILL HOLE LOG**

PROPERTY

HOLE NO. Co 1

LOCATION LAT. ELEVATION STARTED

SHEET NO. 7

DIP. COMPLETED

SECTION FROM 240 TO 290

BEARING DIP. SURVEYS

LOGGED BY I.D. & R.E.V.

DEPTH PURPOSE

FOOTAGE		MINOR STRUCTURES			FORMATION	CORE SAMPLES					SLUDGE SAMPLES							
FROM	TO	FROM	TO	RECOVERY		SAMPLE NO.	FOOTAGE		WIDTH	AG OZ/TON	Cu %	Mo %	SAMPLE NO.	FOOTAGE		W %	Cu %	Mo %
							FROM	TO						FROM	TO			
	240	250	10		as above disseminated blebs of magnetite. A few qt_3 veins $1/16"$ - $1/4"$ but minor Moly & Chalco	09572	240	250	10		.023	.004	06771	240	250	.07	.05	.02
	250	260	10		as above 251' $1/4"$ qt_3 vein at 45° minor Moly. 253' $1/16"$ qt_3 vein at 60° minor Moly 253.5' Fracture with Chalco 255'-260' 4 hairline qt_3 veins with minor Chalco & Mo 258' $1/4"$ qt_3 vein with Good Moly & Chalco minor pyrrhotite	09573	250	260	10		.015	.013	06772	250	260	.02	.02	.01
	260	270	10		as above. Blebs of hornblende & magnetite contain minor pyrrhotite. rock darker with chlorite on fractures. 10 hairline qt_3 veins with minor Moly.	09574	260	270	10		.015	.007						
	270	280	10		as above 270'-275' 3 hairline qt_3 with minor Moly 276' $1/8"$ qt_3 vein at 60° minor Moly 274.5'-276.5' rock fine grained and darker. 278' $1/4"$ qt_3 vein at 10° minor Moly.	09575	270	280	10		.020	.007	06773	270	280	.02	.02	.02
	280	290	10		as above foliated in places. Iron stain on fractures. App 6 fractures & qt_3 veins with Moly 281' $1/8"$ qt_3 vein at 20° minor Moly 283' hairline qt_3 at 60° Good Moly 287' hairline qt_3 at 60° minor Moly 288' $1/8"$ qt_3 vein at 45° Good Moly 289' 2 hairline qt_3 veins at 5° minor Moly	09576	280	290	10		.017	.020	06774	280	290	.03	.03	.03

**UNITED KENO HILL MINES LTD.
DIAMOND DRILL HOLE LOG**

HOLE NO. Co 1
SHEET NO. 10
SECTION FROM 380 TO 420
LOGGED BY I.D. & R.E.V.

PROPERTY _____
LOCATION _____ LAT. _____ ELEVATION _____ STARTED _____
DEP. _____ COMPLETED _____
BEARING _____ DIP _____ SURVEYS _____
DEPTH _____ PURPOSE _____

FOOTAGE		MINOR STRUCTURES			FORMATION	CORE SAMPLES					SLUDGE SAMPLES							
FROM	TO	FROM	TO	RECOVERY		SAMPLE NO.	FOOTAGE		WIDTH	AG OZ/TON	% Cu	% Mo	SAMPLE NO.	FOOTAGE		AG OZ/TON	% Cu	% Mo
							FROM	TO						FROM	TO			
					fairly sharp contact. irregular qtz segregations. Highly fractured 40-50 per foot. Minor calcite & chlorite on tight fractures. Few contain moly & Chalco - 1 per 2 feet.													
	380	390	10		as above quartz monzonite porphyry from 382.5' contains Hornblende & biotite phenocrysts with veinlets of secondary biotite Numerous tight fractures.	09586	380	390	10		.019	.010	06784	380	390		.042	.014
	390	400	10		386.5'-388'- several fractures & quartz veins with Moly as above, coarse grained & dark green Biotite - Hornblende Quartz monzonite Porphyry Highly fractured with chlorite & biotite filled. A few stringers of magnetite 390' Fracture at 20° minor Chalco. 398' 1/16" quartz vein at 30° minor Chalco.	09587	390	400	10		.017	.006	06785	390	400		.031	.007
	400	410	10		as above Biotite-Hornblende Qtz Monzonite Porp. App 20 fractures per foot Increase in felspar phenocrysts, some with dark centers. disseminated Magnetite 403.5' Fracture at 60° minor Chalco 404' Fracture at 20° minor Chalco 406' Shear at 45° with minor Moly	09588	400	410	10		.016	.004	06786	400	410		.033	.005
	410	420	10		as above - highly fractured 412' hairline quartz at 20° minor Chalco 413' " " " " " "	09589	410	420	10		.012	.002	06787	410	420		.022	Nil

**UNITED KENO HILL MINES LTD.
DIAMOND DRILL HOLE LOG**

PROPERTY

LOCATION LAT. ELEVATION STARTED

DEP. COMPLETED

BEARING DIP SURVEYS

DEPTH PURPOSE

HOLE NO. Co 1

SHEET NO. 13

SECTION FROM 520 TO 570

LOGGED BY I.D. & R.E.V.

FOOTAGE		MINOR STRUCTURES			FORMATION	CORE SAMPLES					SLUDGE SAMPLES							
FROM	TO	FROM	TO	RECOVERY		SAMPLE NO.	FOOTAGE		WIDTH	AG OZ/TON	Cu %	Mo %	SAMPLE NO.	FOOTAGE		AG OZ/TON	Cu %	Mo %
							FROM	TO						FROM	TO			
	520	530	10		as above. Two shears filled with calcite - post mineralization and ankerite - Shears parallel to axis of core	09600	520	530	10		.024	.003						
	530	540	10		as above decrease in Hornblende & biotite Phenocrysts minor disssem magnetite. broken in sections. 533' Fracture at 10° minor Chalco 533.5' 1/2" qtz vein at 45° minor Moly 534.5 Fracture at 40° minor Moly 540' Fracture at 10° minor Moly	09601	530	540	10		.024	.004						
	540	550	10		as above 540-541 Post mineral calcite filled shear parallel to core axis. short sections dark in color. 544' & 544.5' 1/8" qtz vein at 20° & 40° minor Moly 546' Fracture with minor Moly & Chalco 549' Shear at 40° slickensided Moly 550' 1/2" qtz vein at 30° with Moly & Chalco	09602	540	550	10		.029	.033	06800	540	550		.025	.006
	550	560	10		as above Fair amount of chlorite 555' Fracture at 5° with Chalco. 557' 1/2" qtz vein at 20° minor Moly.	09603	550	560	10		.042	.007	06801	550	560		.033	.007
	560	570	10		as above. Few small dolomite veins 563' 1/16" qtz vein at 30° minor Moly. 567' 1/16" qtz vein at 45° minor Moly. 568' 8" Fault zone crushed altered chloritic & Kaolin	09604	560	570	10		.033	.003	06802	560	570		.045	.007

**UNITED KENO HILL MINES LTD.
DIAMOND DRILL HOLE LOG**

PROPERTY

LOCATION

BEARING

DEPTH

LAT. ELEVATION STARTED

DEP. COMPLETED

DIP SURVEYS

PURPOSE

HOLE NO. Co1
SHEET NO. 19
SECTION FROM 780 TO 820
LOGGED BY I.D. & R.E.U.

FOOTAGE		MINOR STRUCTURES			FORMATION	CORE SAMPLES						SLUDGE SAMPLES						
FROM	TO	FROM	TO	RECOVERY		SAMPLE NO.	FOOTAGE		WIDTH	AG OZ./TON	% Cu	% Mo	SAMPLE NO.	FOOTAGE		AG OZ./TON	% Cu	% Mo
							FROM	TO						FROM	TO			
					774' 1/4" qtz vein at 60° minor Moly													
	780	790		10	as above 1% fresh pyrite.	09626	780	790	10		.028	.016	06824	780	790		.030	.002
					782' 1/8" qtz vein at 60° minor Moly & Chalco													
					786.5' 1/4" qtz vein at 80° minor Moly													
					788' hairline biotite at 45° minor Chalco													
					789.5' 1/4" qtz vein at 45° Good Moly.													
	790	800		10	as above. A few calcite veins	09627	790	800	10		.021	.049	06825	790	800		.033	.003
					797' 1/8" qtz vein at 40° minor Moly													
					797.5' 1/16" qtz vein at 45° minor Moly													
	800	810		10	as above. Pyrite & pyrrhotite in qtz vein.	09628	800	810	10		.032	.003						
					801' 1/4" qtz vein at 50° minor Moly													
					807' Biotite vein at 40° minor Chalco.													
	810	820		10	as above - pyrite & pyrrhotite as blebs and fracture fillings.	09629	810	820	10		.014	.002	06827	810	820		.029	.003
					810.5' 1/16" qtz vein at 40° minor Moly													
					811' Fracture at 20° minor Chalco													
					812' Fracture at 30° minor Chalco													
					813' Fracture at 40° minor Moly & Chalco													
					815' Fracture at 60° minor Moly													
					818' Fracture at 40° minor Chalco													
					819'-820' 9" DYKE - light colored fine grained non porphyritic quartz monzonite.													
	820	830		10	as above 821'-825' ribbon structure.	09630	820	830	10		.014	.002						

**UNITED KENO HILL MINES LTD.
DIAMOND DRILL HOLE LOG**

PROPERTY

HOLE NO. Co 1

LOCATION LAT. ELEVATION STARTED

SHEET NO. 21

DEP. COMPLETED

SECTION FROM TO

BEARING DIP SURVEYS

LOGGED BY I.D. & R.E.V.

DEPTH PURPOSE

FOOTAGE		MINOR STRUCTURES			FORMATION	CORE SAMPLES					SLUDGE SAMPLES								
FROM	TO	FROM	TO	RECOVERY		SAMPLE NO.	FOOTAGE		WIDTH	AG OZ./TON	% Cu	% Mo	SAMPLE NO.	FOOTAGE		AG OZ./TON	Pb %	Zn %	
							FROM	TO						FROM	TO				
					Hole stopped at 859' because of caving.														
					DIP TEST AT 660' - 38°														
		0	35		OVERBURDEN														
		35	859	824	NQ CORE														
					CORE RECOVERY <u>824</u> 824 = 100%.														
					GRADE		35	859	824		.021	.014							

**UNITED KENO HILL MINES LTD.
DIAMOND DRILL HOLE LOG**

PROPERTY

LOCATION LAT. ELEVATION STARTED

DEP. COMPLETED

BEARING DIP SURVEYS

DEPTH PURPOSE

HOLE NO. Co 2

SHEET NO. 3

SECTION FROM 100 TO 180

LOGGED BY T.D. & R.E.V.

FOOTAGE		MINOR STRUCTURES			FORMATION	CORE SAMPLES						SLUDGE SAMPLES						
FROM	TO	FROM	TO	RECOVERY		SAMPLE NO.	FOOTAGE		WIDTH	AG OZ/TON	Cu %	Mo %	SAMPLE NO.	FOOTAGE		AG OZ/TON	Pb %	Zn %
							FROM	TO						FROM	TO			
		100	110	10	as above 104'-107' rock altered to pinkish color - highly fractured with numerous ankerite veins. 109' 1/8" qtz vein at 35° trace of Chalco	09643	100	110	10		.035	.009						
		110	120	10	as above - dissem magnetite. 115.5' 1/16" qtz vein at 20° with Chalco. 120' few flecks of Chalco.	09644	110	120	10		.031	.007						
		120	130	10	as above 123.5'-127' fine grained slightly porphyritic. 125' 1/8" qtz vein at 20° with Chalco & minor Moly	09645	120	130	10		.035	.003						
		130	140	10	as above - iron stained - minor dissem Chalco 136' 1/16" qtz vein at 45° with minor Moly	09646	130	140	10		.053	.006						
		140	150	10	as above - few low angle qtz - calcite veinlets with bleaching 149' Fracture at 20° with Chalco & Moly	09647	140	150	10		.025	.006						
		150	160	10	as above 151.5' few flecks of Chalco. 153' Fracture at 35° with minor Moly	09648	150	160	10		.042	.005						
		160	170	10	as above 161' 1/16" qtz vein at 60° with minor Chalco 168'-170' scattered blebs of Chalco.	09649	160	170	10		.041	.006						
		170	180	10	as above 175' 1/8" qtz vein at 30° with moly also slickensided moly.	09650	170	180	10		.090	.017						

**UNITED KENO HILL MINES LTD.
DIAMOND DRILL HOLE LOG**

PROPERTY.....

HOLE NO. C. 2

LOCATION..... LAT..... ELEVATION..... STARTED.....

SHEET NO. 5

DEP..... COMPLETED.....

SECTION FROM 230 TO 280

BEARING..... DIP..... SURVEYS.....

LOGGED BY I. D. & R. E. V.

DEPTH..... PURPOSE.....

FOOTAGE		MINOR STRUCTURES			FORMATION	CORE SAMPLES						SLUDGE SAMPLES						
FROM	TO	FROM	TO	RECOVERY		SAMPLE NO.	FOOTAGE		WIDTH	AG OZ/TON	Cu %	Mo %	SAMPLE NO.	FOOTAGE		AG OZ/TON	Pb %	Zn %
							FROM	TO						FROM	TO			
					227'-230'													
					Kaolin & Sauss numerous ankerite - calcite veins bleached creamy grey													
					229'													
					Fracture at 35° with Moly.													
		230	240	10	as above	09656	230	240	10		.044	.002						
					235'													
					7 1/2" Aplite Dyke dense sharp contact at 60°													
					235.5'													
					hairline qtz vein at 40° with Chalco & Moly													
					239'-239.5'													
					dissem Chalco.													
		240	250	10	as above	09657	240	250	10		.047	.005						
					leached in short sections													
					Fractures - iron stained													
					243'													
					Fracture at 5° with minor Chalco													
					250'													
					Few large blebs of Moly & pyrite.													
		250	260	10	as above	09658	250	260	10		.018	.003						
					- leached - calcite & ankerite veins.													
		260	270	10	as above	09659	260	270	10		.024	.005						
					261'													
					Fracture at 75° with Chalco.													
					261.6'-262'													
					qtz vein cut by secondary qtz veins													
					one with Moly													
					264'													
					Fracture at 20° minor Moly													
					269'													
					qtz vein at 40° with Moly													
		270	280	10	as above	09660	270	280	10		.049	.004						
					272'-272.5'													
					Aplite Dyke													
					276'-277'													
					slight sauss with numerous													
					calcite - ankerite veins leached appearance													
					creamy color.													

**UNITED KENO HILL MINES LTD.
DIAMOND DRILL HOLE LOG**

PROPERTY

LOCATION LAT. ELEVATION STARTED

DEP. COMPLETED

BEARING DIP SURVEYS

DEPTH PURPOSE

HOLE NO. Co 2

SHEET NO. 6

SECTION FROM 280 TO 320

LOGGED BY I.D. & R.E.V.

FOOTAGE		MINOR STRUCTURES			FORMATION	CORE SAMPLES						SLUDGE SAMPLES						
FROM	TO	FROM	TO	RECOVERY		SAMPLE NO.	FOOTAGE		WIDTH	AG OZ/TON	Cu %	Mo %	SAMPLE NO.	FOOTAGE		AG OZ/TON	Pb %	Zn %
							FROM	TO						FROM	TO			
		280	290	10	as above - Some fractures 277'-294' 1/6 mineralized qt ₃ veinlets & fractures from 60° to 80° with Chalco & Moly	09661	280	290	10		.041	.009						
		290	300	10	as above Iron stain on fractures. 294' 1/4" qt ₃ vein at 60° with Chalco & Moly. 295' Fracture at 85° with Moly 298.5'-300' dissem Chalco 2 1/8" qt ₃ veins at 60° with Chalco.	09662	290	300	10		.073	.045						
		300	310	10	as above 300.3' qt ₃ vein at 80° with Chalco. 304.5' Fracture at 65° with Moly & Chalco. 305.2'-305.8' Ankerite vein displaced by hairline Moly seam which is displaced by a second Moly seam. Minor dissem Moly.	09663	300	310	10		.051	.007						
		310	320	10	as above. 310' Fracture at 60° with minor Moly & Chalco. 310.5'-311' Fault zone 2 feet of alteration on each side. 312'-312.5' 2 fractures at 60° one with Moly & one with Chalco. 318' 8"-318' 10" qt ₃ feldspar vein with strong Moly minor Chalco altered 1" each side. 319' 1/8" qt ₃ vein at 60° with minor Chalco.	09664	310	320	10		.041	.126						

**UNITED KENO HILL MINES LTD.
DIAMOND DRILL HOLE LOG**

PROPERTY

LOCATION LAT. ELEVATION STARTED

DEP. COMPLETED

BEARING DIP SURVEYS

DEPTH PURPOSE

HOLE NO. Co 2

SHEET NO. 7

SECTION FROM 320 TO 380

LOGGED BY I. D. & R. E. V.

FOOTAGE		MINOR STRUCTURES			FORMATION	CORE SAMPLES						SLUDGE SAMPLES						
FROM	TO	FROM	TO	RECOVERY		SAMPLE NO.	FOOTAGE		WIDTH	AG OZ/TON	Cu %	Mo %	SAMPLE NO.	FOOTAGE		AG OZ/TON	Pb %	Zn %
							FROM	TO						FROM	TO			
		320	330	10	as above fairly good Chalco & Moly. 326' Qt ₃ -felspar vein at 60° with Chalco. 326.9-328 3 fractures at 60° with fine moly.	09665	320	330	10		.043	.028						
		330	340	10	as above - minor Fe stain on fractures. 331' few blebs of Chalco 335' 1/8" qt ₃ vein at 45° with Moly 339' 1/8" qt ₃ vein at 35° with trace of Moly.	09666	330	340	10		.019	.011						
		340	350	10	as above dissem. magnetite 345.5' 1/8" qt ₃ vein at 70° with trace Chalco 348' 1/8" qt ₃ vein at 80° with moly & Chalco.	09667	340	350	10		.018	.006						
		350	360	10	as above 358' 9"-359' 4" Aplite dyke sharp contact at 45° minor Moly. 359'-360' Calcite qt ₃ vein with minor Moly. 360' hairline of Moly at 60°.	09668	350	360	10		.043	.026						
		360	370	10	as above 364' Fracture at 55° with Moly 367.5' 1/8" qt ₃ vein at 80° with Moly.	09669	360	370	10		.045	.019						
		370	380	10	as above minor dissem Chalco. 371.4' qt ₃ vein at 0° with Chalco. 372' qt ₃ vein at 10° with Moly 376' 1/8" qt ₃ vein at 75° with fine moly 379' qt ₃ vein at 10° with fine moly	09670	370	380	10		.047	.016						

**UNITED KENO HILL MINES LTD.
DIAMOND DRILL HOLE LOG**

PROPERTY

LOCATION LAT. ELEVATION STARTED

DEP. COMPLETED

BEARING DIP SURVEYS

DEPTH PURPOSE

HOLE NO. C02
SHEET NO. 12
SECTION FROM 610 TO 670
LOGGED BY I.D. & R.E.V.

FOOTAGE		MINOR STRUCTURES			FORMATION	CORE SAMPLES					SLUDGE SAMPLES							
FROM	TO	FROM	TO	RECOVERY		SAMPLE NO.	FOOTAGE		WIDTH	AG OZ/TON	Cu %	Mo %	SAMPLE NO.	FOOTAGE		AG OZ/TON	Pb %	Zn %
							FROM	TO						FROM	TO			
		610	620	10	as above as above	09694	610	620	10		.023	.033						
					612' 1/8" qt ₃ vein at 45° with strong Moly													
					618' qt ₃ vein at 30° with fine Moly & Chalco													
					620 minor dissem Chalco.													
		620	630	10	as above. Few iron stained fractures some calcite filled - minor flecks of Chalco.	09695	620	630	10		.013	.019						
					622' 2 1/16" qt ₃ veins at 60° with fine Moly													
					623'-623'7" 8 hairline qt ₃ veinlets with minor Moly													
					624' 1/8" qt ₃ vein at 60° with fine Moly.													
					626.2' Calcite vein at 45° with Good Moly.													
		630	640	10	as above	09696	630	640	10		.016	.006						
					631' Calcite vein at 45° with strong Moly.													
					638'-639' unconsolidated material fragments of calcite veins.													
		640	650	10	as above but finer grained & lighter colored less porphyritic	09697	640	650	10		.015	.006						
					642' 1/16" qt ₃ vein fine Moly													
					644' dissem Chalco.													
					644.5' 1/16" qt ₃ vein at 45° with fine Moly.													
					649.5' qt ₃ vein at 45° with fine Moly & Chalco.													
		650	660	10	medium grained Calcite & qt ₃ veinlets minor limonite stain. Very little mineral.	09698	650	660	10		.016	.010						
		660	670	10	as above. Cut by numerous fractures with	09699	660	670	10		.021	.015						

**UNITED KENO HILL MINES LTD.
DIAMOND DRILL HOLE LOG**

HOLE NO. C03
SHEET NO. 2
SECTION FROM 40 TO 80
LOGGED BY I.D., C.P.C. & R.E.V.

PROPERTY _____
LOCATION _____ LAT. _____ ELEVATION _____ STARTED _____
DEP. _____ COMPLETED _____
BEARING _____ DIP _____ SURVEYS _____
DEPTH _____ PURPOSE _____

FOOTAGE		MINOR STRUCTURES			FORMATION	CORE SAMPLES					SLUDGE SAMPLES							
FROM	TO	FROM	TO	RECOVERY		SAMPLE NO.	FOOTAGE		WIDTH	AG OZ/TON	Cu %	Mo %	SAMPLE NO.	FOOTAGE		AG OZ/TON	Pb %	Zn %
							FROM	TO						FROM	TO			
					regular and irregular Consistent dissem magnetite less than 1%. dissem pyrite less than 0.5%. Hornblende occurs as minor constituent. Some biotite altered to chlorite.													
		40	50	10	as above. dissem. pyrite & pyrrhotite. 2-3 fractures per foot 40.5' minor Chalco on fracture at 10° 47'-48' minor blebs of Chalco.	09707	40	50	10		.026	Tr						
		50	60	10	as above - appearance of small white felspar crystals. 2 small qtz veins with minor Chalco & Moly with pyrrhotite & pyrite. Veinlets of biotite. 54' hairline fracture at 15° fine Chalco & pyrite 59' Fracture at 20° with coarse Chalco.	09708	50	60	10		.033	.002						
		60	70	10	as above 62' 2" silicified zone 65' minor Chalco & pyrite with biotite vein at 0° 66' Fracture at 5° with fine Moly 67'-68' 1/4" qtz vein at 5° with good Moly & Chalco 69.5' minor blebs of Chalco.	09709	60	70	10		.037	.004						
		70	80	10	as above - no visible mineral 70'-73' real strong oxidation assoc. with 0°-10° fractures. Weak Kaolinization.	09710	70	80	10		.020	.003						

**UNITED KENO HILL MINES LTD.
DIAMOND DRILL HOLE LOG**

PROPERTY

HOLE NO. C03

LOCATION LAT. ELEVATION STARTED

SHEET NO. 3

DEP. COMPLETED

SECTION FROM 80 TO 130

BEARING DIP SURVEYS

LOGGED BY I.D. CPC & REV

DEPTH PURPOSE

FOOTAGE		MINOR STRUCTURES			FORMATION	CORE SAMPLES					SLUDGE SAMPLES							
FROM	TO	FROM	TO	RECOVERY		SAMPLE NO.	FOOTAGE		WIDTH	AG OZ/TON	Cu %	Mo %	SAMPLE NO.	FOOTAGE		AG OZ/TON	Pb %	Zn %
							FROM	TO						FROM	TO			
	80	90	10		as above several 1" inclusions of fine grained biotite rich rock. Minor Chalco on one fracture	09711	80	90	10		.014	.003						
	90	100	10		as above but medium grained from 97'6" to 100' - a few feldspar phenocrysts 90' 2 1/4" qtz - calcite veins at 30° 92' Calcite filled fractures at 30° 95' Fine Moly on fracture at 5° 96' minor dissem Chalco.	09712	90	100	10		.014	.002						
	100	110	10		as above medium grained few feldspar phenocrysts 101' 1/4" qtz vein at 20° with minor Moly 102'-103' minor blebs of Chalco 105' Fracture at 5° with fine Moly 106.3' Chalco as 1/4" bleb 108' & 110' minor dissem Chalco.	09713	100	110	10		.027	.004						
	110	120	10		as above - coarse grained from 103' increase in number of fractures which are calcite filled 111' Fracture at 40° with Kaolinization 116.5' 1/16" qtz vein at 30° with minor Moly. 117'-120' minor dissem. Chalco. minor sauss.	09714	110	120	10		.014	.006						
	120	130	10		as above increase in feldspar phenocrysts 121' 1/4" qtz vein at 5° minor pyrite. 120'-121' & 124'-126' very mild Kaolinization on fractures	09715	120	130	10		.025	.010						

**UNITED KENO HILL MINES LTD.
DIAMOND DRILL HOLE LOG**

PROPERTY.....

HOLE NO. Co 3

LOCATION..... LAT..... ELEVATION..... STARTED.....

SHEET NO. 6

DEP..... COMPLETED.....

SECTION FROM 200 TO 250

BEARING..... DIP..... SURVEYS.....

LOGGED BY I.D., C.P.C. & R.E.V.

DEPTH..... PURPOSE.....

FOOTAGE		MINOR STRUCTURES			FORMATION	CORE SAMPLES						SLUDGE SAMPLES						
FROM	TO	FROM	TO	RECOVERY		SAMPLE NO.	FOOTAGE		WIDTH	AG OZ/TON	Cu %	Mo %	SAMPLE NO.	FOOTAGE		AG OZ/TON	Pb %	Zn %
							FROM	TO						FROM	TO			
		200	210	10	Intense altered zone with increase in chlorite - some biotite. Real strong saussuritization & kaolinization - qtz eyes few veins of secondary biotite. 201.6-204 Ankerite veins at 60° with trace of Moly 204-208 several fine qtz veins from 10° to 20° 207'-210' - rock lighter grey in color.	09723	200	210	10		.018	.004						
		210	220	10	decrease in alteration - fairly rich in chlorite with biotite appearing stronger. Felspar kaolinized one shows no alteration. Several Ankerite veins at 70°. Two 1/8" qtz veins with Moly	09724	210	220	10		.012	.003						
		220	230	10	coarse biotite quartz monzonite porphyry highly kaolinized with little chlorite. Clean books of biotite 227.5' coarse rosettes of Moly & coarse Chalco. 229' beginning of shear zone. intense saussuritization.	09725	220	230	10		.029	.017						
		230	240	10	Shear zone to 232' highly chloritized with slickensides pyrite, Moly & Chalco. 232'-240' coarse porphyry very little Moly or Chalco. dissem pyrite & magnetite.	09726	230	240	10		.034	.001						
		240	250	10	Coarse grained as above - No visible Moly 245' minor trace of Chalco.	09727	240	250	10		.022	.002						

**UNITED KENO HILL MINES LTD.
DIAMOND DRILL HOLE LOG**

PROPERTY

LOCATION LAT. ELEVATION STARTED

DEP. COMPLETED

BEARING DIP SURVEYS

DEPTH PURPOSE

HOLE NO. C-3
SHEET NO. 10
SECTION FROM 440 TO 510
LOGGED BY I.D., C.P.C. & R.E.U.

FOOTAGE		MINOR STRUCTURES			FORMATION	SAMPLE NO.	CORE SAMPLES					SLUDGE SAMPLES						
FROM	TO	FROM	TO	RECOVERY			FOOTAGE		WIDTH	AG OZ/TON	Cu	Mo	SAMPLE NO.	FOOTAGE		AG OZ/TON	Pb %	Zn %
							FROM	TO						FROM	TO			
	440	450	10		as above. Small trace of dissem Moly & Chalco qt ₃ vein at 15° with minor Moly. 441' Biotite vein at 5° with Moly.	09747	440	450	10		.013	.034						
	450	460	10		as above 455' Fracture at 10° with Moly 459' Fracture at 5° with Moly.	09748	450	460	10		.018	.007						
	460	470	10		as above. Feldspars altered to Kaolin around fractures 465' Fracture at 5° with Moly.	09749	460	470	10		.020	.003						
	470	480	10		as above Kaolinite around fractures 472' minor dissem. Chalco.	09750	470	480	10		.021	.001						
	480	490	10		as above. Dissem pyrite, pyrrhotite & magnetite 3 small qt ₃ veins at 20° with minor Moly and Chalco. at 482', 488' & 489'.	09751	480	490	10		.039	.030						
	490	500	10		as above. Several secondary biotite veins. 493' Fracture at 20° with Moly & biotite 495' Fracture at 10° with Moly & biotite. 497' small qt ₃ vein with Good Moly 498.5' 1/2" qt ₃ vein at 20° with Good Moly. minor Chalco.	09752	490	500	10		.014	.018						
	500	510	10		as above 508'-509' Few very narrow qt ₃ veins with fairly good Moly & Chalco. One fracture with Moly	09753	500	510	10		.022	.012						

**UNITED KENO HILL MINES LTD.
DIAMOND DRILL HOLE LOG**

HOLE NO. C-3
SHEET NO. 13
SECTION FROM 650 TO 710
LOGGED BY I.D., C.P.C. & R.E.V.

PROPERTY _____
LOCATION _____ LAT. _____ ELEVATION _____ STARTED _____
DEP. _____ COMPLETED _____
BEARING _____ DIP _____ SURVEYS _____
DEPTH _____ PURPOSE _____

FOOTAGE		MINOR STRUCTURES			FORMATION	SAMPLE NO.	CORE SAMPLES					SLUDGE SAMPLES			
FROM	TO	FROM	TO	RECOVERY			FOOTAGE	WIDTH	AG OZ./TON	% Cu	% Mo	SAMPLE NO.	FOOTAGE	AG OZ./TON	Pb %
						FROM	TO				FROM	TO			
					646' 1/8" qt ₃ vein at 25° with Moly.										
					648' inclusion of fine grained biotitic rock										
		650	660	10	as above. Feldspars kaolinized around fractures.	09768	650	660	10						
					655' 8" Shear cuts core at 20° chloritized biotite with kaolin on fractures.										
					656.5' Fracture at 20° with minor Moly.										
		660	670	10	as above	09769	660	670	10						
					662' Chalco as fine blebs										
					663' 1/8" qt ₃ vein at 10° with minor Moly & Chalco.										
		670	680	10	as above no visible mineral	09770	670	680	10						
					672' 2" biotitic inclusion										
					676' 1/2" qt ₃ vein at 15° barren										
		680	690	10	as above A few small qt ₃ veins at low angles trace Moly & Chalco.	09771	680	690	10						
					697' 6" kaolinized section minor sauss.										
					699'-700' minor dissemin Chalco. & Moly										
		700	710	10	light colored - silicified zone. Very little biotite. minor dissemin Moly & Chalco. 2 feldspar phenocrysts with Moly cores 700-701' 7" 701' 7"-710 1 small qt ₃ vein containing Moly	09773	700	710	10						
					710' 7"-710 1 small qt ₃ vein containing Moly										
		710	720	10	as above. 3 small qt ₃ veins from 5° to 20° with minor Moly	09774	710	720	10						

**UNITED KENO HILL MINES LTD.
DIAMOND DRILL HOLE LOG**

PROPERTY

HOLE NO. Co 3

LOCATION

SHEET NO. 19

LAT. ELEVATION

SECTION FROM 960 TO 1010

DEP. COMPLETED

LOGGED BY I.D. & R.E.V.

BEARING DIP SURVEYS

DEPTH PURPOSE

FOOTAGE		MINOR STRUCTURES			FORMATION	CORE SAMPLES					SLUDGE SAMPLES							
FROM	TO	FROM	TO	RECOVERY		SAMPLE NO.	FOOTAGE		WIDTH	AG OZ/TON	Cu %	Mo %	SAMPLE NO.	FOOTAGE		AG OZ/TON	Pb %	Zn %
							FROM	TO						FROM	TO			
	960	970	10		as above but darker and finer ground mass. kaolinization around fractures 966' hairline qt ₃ vein at 20° with Moly.	09799	960	970	10		.015	.007						
	970	980	10		as above but lighter colored & coarser grained. 970.9' hairline fracture at 10° with Moly 975' hairline fracture at 15° with Moly 979' hairline fracture at 15° with Moly	09800	970	980	10		.011	.038						
	980	990	10		as above but a bit more hornblende 983' hairline qt ₃ vein at 15° with Moly 985' 1/8" qt ₃ vein at 20° with Moly 986' 1" diameter inclusion biotitic fine gr.	09801	980	990	10		.013	.047						
	990	1000	10		as above 991' hairline vein at 20° with Moly 994' 2" diameter inclusion biotitic-fine gr. 999' 25° hairline of Moly.	09802	990	1000	10		.016	.014						
	1000	1010	10		as above. 1001' few flecks of Chalco 1002'-1003' 2 hairline fractures at 25° with fine Moly & Chalco. 1004' hairline fracture at 5° with fine Moly 1009' hairline fracture at 10° with fine Moly	09803	1000	1010	10		.017	.009						
	1010	1022	12		as above but short sections darker in color	09804	1010	1022	12		.014	.016						

**UNITED KENO HILL MINES LTD.
DIAMOND DRILL HOLE LOG**

HOLE NO. Co 3
SHEET NO. 20
SECTION FROM 1010 TO 1022
LOGGED BY I.D. & R.E.V.

PROPERTY _____
LOCATION _____ LAT. _____ ELEVATION _____ STARTED _____
DEP. _____ COMPLETED _____
BEARING _____ DIP _____ SURVEYS _____
DEPTH _____ PURPOSE _____

FOOTAGE		MINOR STRUCTURES			FORMATION	CORE SAMPLES					SLUDGE SAMPLES								
FROM	TO	FROM	TO	RECOVERY		SAMPLE NO.	FOOTAGE		WIDTH	AG OZ/TON	Cu %	Mo %	SAMPLE NO.	FOOTAGE		AG OZ/TON	Pb %	Zn %	
							FROM	TO						FROM	TO				
					few short sections cut by several calcite veins and slightly kaolinized. Slight grain size change in short sections.														
					1010.5' hairline fracture at 5° with fine moly														
					1018'-1019' hairline filling with flecks of moly and Chalco.														
					1020.5'-1021' hairline fracture at 20° fine moly														
					DIP TEST AT 500' - 38°														
					DIP TEST AT 1000' - 43°														
		0	9		OVERBURDEN														
		9	1022	1013	NQ CORE														
					CORE RECOVERY $\frac{1013}{1013} = 100\%$														
					GRADE		9	1022	1013		.024	.015							

UNITED KENO HILL MINES LTD.
DIAMOND DRILL HOLE LOG

PROPERTY

HOLE NO. C04

LOCATION LAT. ELEVATION STARTED

SHEET NO. 4

DEP. COMPLETED

SECTION FROM 170 TO 250

BEARING DIP SURVEYS

LOGGED BY I.D. & R.E.V.

DEPTH PURPOSE

FOOTAGE		MINOR STRUCTURES			FORMATION	CORE SAMPLES					SLUDGE SAMPLES								
FROM	TO	FROM	TO	RECOVERY		SAMPLE NO.	FOOTAGE		WIDTH	AG OZ/TON	% Cu	% Mo	SAMPLE NO.	FOOTAGE		AG OZ/TON	Pb %	Zn %	
							FROM	TO						FROM	TO				
					166' Narrow qtz-feldspar vein with Trace Chalco at 30°. Same fracture pattern minor Calcite-ankerite														
		170	180	10	as above	09821	170	180	10		.006	.007							
					176' 60° fracture with trace of Moly														
		180	190	10	as above. Few small calcite-ankerite veinlets	09822	180	190	10		Tr	Nil							
					181' Hornblende to chlorite very soft & dark green														
		190	200	10	as above - no visible mineral	09823	190	200	10		Tr	Nil							
					192.5' 1/8" ankerite veinlet at 60°														
					200' 1/8" ankerite-quartz veinlet at 60°														
		200	210	10	as above few fractures limonite stained	09824	200	210	10		.014	Tr							
					205' few small blebs of Chalcopryrite.														
					206'-208' - 1% blebs of pyrite														
					208' hairline of Chalcopryrite														
					208'-210' fractured & broken with heavy kaolinization														
					Hornblende altered to chlorite														
					209' 10" - 210 2" dark fine grained feldspar Porp. Dyke.														
		210	220	10	as above scattered 1% pyrite highly fractured, kaolinized and saussitized	09825	210	220	10		.042	.006							
					limonite on 30°-60° fractures														
		220	230	10	as above fractured & kaolinized dissem pyrite	09826	220	230	10		.016	.003							
		230	240	10	as above, traces of pyrite Usual fractures from 30° to 60° with minor chlorite	09827	230	240	10		.013	Tr							
		240	250	10	as above. No visible mineral.	09828	240	250	10		.009	Nil							

**UNITED KENO HILL MINES LTD.
DIAMOND DRILL HOLE LOG**

PROPERTY

HOLE NO. Co 4

LOCATION LAT. ELEVATION STARTED

SHEET NO. 5

DEP. COMPLETED

SECTION FROM 250 TO 310

BEARING DIP SURVEYS

LOGGED BY I.D. & R.E.V.

DEPTH PURPOSE

FOOTAGE		MINOR STRUCTURES			FORMATION	CORE SAMPLES					SLUDGE SAMPLES							
FROM	TO	FROM	TO	RECOVERY		SAMPLE NO.	FOOTAGE		WIDTH	AG OZ/TON	Cu %	Mo %	SAMPLE NO.	FOOTAGE		AG OZ/TON	Pb %	Zn %
							FROM	TO						FROM	TO			
		250	260	10	as above. No visible mineral	09829	250	260	10		Nil	Nil						
					251'-252' alteration slight Kaolin & chlorite													
		260	270	10	as above. No visible mineral	09830	260	270	10		.004	Nil						
		270	280	10	as above highly fractured	09831	270	280	10		.010	.006						
					271.5-272.5 hairline stringer with Chalco & Moly													
					271.5-280 9 low angle fractures 20°-30° with Kaolin & chlorite	09832	280	290	10		.024	Tr						
		280	290	10	as above fractures at 60° hairline veinlets of ankerite. Minor Kaolin & Chlorite on fractures													
					1 hairline vein of Chalcopyrite at 60°													
		290	300	10	as above	09833	290	300	10		.022	.007						
					290-292.6 fractured & kaolinized													
					1/8" qtz vein at 10° with Chalcopyrite & Pyrite													
					292.6-300'-increase in Feldspar Phenocrysts													
					slight increase in grain size and biotite hornblende to chlorite kaolinization & sauss.													
					296'-298' fractures 45°-60° flecks of Chalco													
300	986				BIOTITE QUARTZ MONZONITE PORPHYRY													
		300	310	10	coarse grained Orthoclase phenocrysts up to 1" in size and pink. Marked increase in biotite and decrease in hornblende. Minor magnetite throughout	09834	300	310	10		.024	.006						

**UNITED KENO HILL MINES LTD.
DIAMOND DRILL HOLE LOG**

PROPERTY

HOLE NO. C 4
SHEET NO. 8
SECTION FROM 410 TO 460
LOGGED BY I.D. & R.E.V.

LOCATION LAT. ELEVATION STARTED

DEP. COMPLETED

BEARING DIP SURVEYS

DEPTH PURPOSE

FOOTAGE		MINOR STRUCTURES			FORMATION	CORE SAMPLES					SLUDGE SAMPLES							
FROM	TO	FROM	TO	RECOVERY		SAMPLE NO.	FOOTAGE		WIDTH	AG OZ/TON	Cu %	Mo %	SAMPLE NO.	FOOTAGE		AG OZ/TON	Pb %	Zn %
							FROM	TO						FROM	TO			
					403' 2 1/4" qt ₃ veins 1" apart with Chalco & Moly 5% pyrite 6" each side.													
					404' 1/4" qt ₃ vein barren at 60°													
					409' 1/4" ankerte vein at 20°													
		410	420	10	as above few small calcite veins - chlorite on fractures. dissemin pyrite & magnetite.	09845	410	420	10		.016	.005						
		420	430	10	as above. One secondary biotite vein little chlorite on fractures.	09846	420	430	10		.031	.007						
					421' 1/4" qt ₃ vein at 20° with fair Moly													
		430	440	10	as above with lighter sections and pinkish Phenocrysts of Feldspar.	09847	430	440	10		.028	.010						
					430'-431' 2 hairline fractures qt ₃ with Moly, Chalco & pyrite													
					434' 1" diameter xenolith.													
					437' 5" qt ₃ -calcite veinlet													
					433'-453' scattered flecks of pyrite & pyrrhotite app 4 fractures per foot with chlorite.													
		440	450	10	as above - light in color	09848	440	450	10		.031	.011						
					445'-450' sheared & fractured - with sauss, Kaolin and chlorite few fractures has traces of Moly & Chalco. 449' 1/8" pyrite vein, minor Moly													
		450	460	10	as above - darker colored. Fractures from 30°-60° with chlorite kaolin and ankerte Secondary biotite veinlets minor Moly on one qt ₃ vein.	09849	450	460	10		.040	.004						

**UNITED KENO HILL MINES LTD.
DIAMOND DRILL HOLE LOG**

HOLE NO. C04
SHEET NO. 10
SECTION FROM 520 TO 600
LOGGED BY I.D. & R.E.V.

PROPERTY _____
LOCATION _____ LAT. _____ ELEVATION _____ STARTED _____
DEP. _____ COMPLETED _____
BEARING _____ DIP _____ SURVEYS _____
DEPTH _____ PURPOSE _____

FOOTAGE		MINOR STRUCTURES			FORMATION	CORE SAMPLES						SLUDGE SAMPLES						
FROM	TO	FROM	TO	RECOVERY		SAMPLE NO.	FOOTAGE		WIDTH	AG OZ/TON	Cu %	Mo %	SAMPLE NO.	FOOTAGE		AG OZ/TON	Pb %	Zn %
							FROM	TO						FROM	TO			
		520	530	10	as above 1% pyrite. 521'-526' much darker in color 525' few flecks of Chalcopyrite 528.6' 1/8" qt ₃ vein with fine moly 529.6' 1/8" qt ₃ vein with Chalcopyrite.	09856	520	530	10		.025	.012						
		530	540	10	as above 1% pyrite 539' fracture with fine smear of Moly	09857	530	540	10		.027	.010						
		540	550	10	as above. cut by numerous irregular fractures crenulated with Chlorite, minor Kaolin & sauss. 542'-545' narrow stringers with some Chalco Moly and pyrite 547 Chalcopyrite with quartz	09858	540	550	10		.048	.004						
		550	560	10	as above minor alteration around fractures 555' 4 inch shear zone with Chalco & pyrite 545'-560' Few fractures at 60° with chlorite	09859	550	560	10		.032	.005						
		560	570	10	as above. little alteration in first 5 feet with very minor mineral. 1% pyrite.	09860	560	570	10		.030	.015						
		570	580	10	as above few fractures minor mineral 577' 1/2" qt ₃ vein at 20° with Chalcopyrite	09861	570	580	10		.021	.007						
		580	590	10	as above 1% pyrite blebs. minor dissem Moly & Chalco. One small qt ₃ vein with minor Moly	09862	580	590	10		.044	.015						
		590	600	10	as above very competent.	09863	590	600	10		.018	.006						

**UNITED KENO HILL MINES LTD.
DIAMOND DRILL HOLE LOG**

PROPERTY.....

HOLE NO. C04

LOCATION..... LAT..... ELEVATION..... STARTED.....

SHEET NO. 12

DEP..... COMPLETED.....

SECTION FROM 680 TO 750

BEARING..... DIP..... SURVEYS.....

LOGGED BY I.D. & R.E.V.

DEPTH..... PURPOSE.....

FOOTAGE		MINOR STRUCTURES			FORMATION	CORE SAMPLES					SLUDGE SAMPLES							
FROM	TO	FROM	TO	RECOVERY		SAMPLE NO.	FOOTAGE		WIDTH	AG OZ/TON	Cu %	Mo %	SAMPLE NO.	FOOTAGE		AG OZ/TON	Pb %	Zn %
							FROM	TO						FROM	TO			
		680	690	10	as above minor alteration around fractures minor dissemin Moly. 681' 5°qtz vein with Chalco. 684.5-685.5 2 1/8" barren quartz veins	09872	680	690	10		.036	.007						
		690	700	10	Kaolinized, saussuritized & chloritized. A few small calcite veins at 20° with minor Chalco	09873	690	700	10		.027	.014						
		700	710	10	as above - kaolinized & saussuritized a few narrow calcite veins. 706'3"-707' Fault Zone - one small seam of Moly	09874	700	710	10		.028	.017						
		710	720	10	as above saussuritized & chloritized several small shears. No visible mineral.	09875	710	720	10		.022	.007						
		720	730	10	slightly altered around some fractures One qtz vein 1/8" at 20° and one fracture at 20° with a little Moly	09876	720	730	10		.014	.007						
		730	740	10	as above little dissemin. Moly 730'-731' highly altered to kaolin minor ankerite 732' 1/8" qtz vein at 25° with Moly & Chalco 733' 4" xenolith - dk - fine grained - micaceous.	09877	730	740	10		.028	.019						
		740	750	10	as above 741'-742' Zhairline veins with biotite, magnetite and pyrite at 20° with minor Moly & Chalco. 744.5' Felspar vein at 35° with Chalcopyrite.	09878	740	750	10		.044	.011						

**UNITED KENO HILL MINES LTD.
DIAMOND DRILL HOLE LOG**

HOLE NO. Co 4
SHEET NO. 13
SECTION FROM 750 TO 790
LOGGED BY I.D. & R.E.V.

PROPERTY _____
LOCATION _____ LAT. _____ ELEVATION _____ STARTED _____
DEP. _____ COMPLETED _____
BEARING _____ DIP _____ SURVEYS _____
DEPTH _____ PURPOSE _____

FOOTAGE		MINOR STRUCTURES			FORMATION	CORE SAMPLES						SLUDGE SAMPLES						
FROM	TO	FROM	TO	RECOVERY		SAMPLE NO.	FOOTAGE		WIDTH	AG OZ/TON	% Cu	% Mo	SAMPLE NO.	FOOTAGE		AG OZ/TON	Pb %	Zn %
							FROM	TO						FROM	TO			
		750	760	10	as above - Slightly altered two very narrow qtz veins at 20° with Trace of Moly and Chalco. 753.5' 1/8" calcite-ankerite vein at 20° 755.5' ankerite & biotite on fractures 759'-760' 1/8" qtz vein at 5° with Moly & Chalco	09879	750	760	10		.015	.024						
		760	770	10	as above very slight alteration 764.5' 1/8" qtz vein at 75° with Moly 766' 2" diameter xenolith.	09880	760	770	10		.028	.020						
NOTE :	→				768' to 907' ALTERED ZONE alternating sections throughout which are essentially short and vary from fresh to those which are altered to chlorite, sauss. and kaolinization. Altered sections shows a high fracture frequency. Occ Ankerite and calcite veinlets and secondary biotite.													
		770	780	10	biotite quartz monzonite porphyry 775' Shear on fracture with Good Moly	09881	770	780	10		.020	.028						
		780	790	10	as above slightly altered in places No visible mineral	09882	780	790	10		.012	.009						

**UNITED KENO HILL MINES LTD.
DIAMOND DRILL HOLE LOG**

PROPERTY

LOCATION LAT. ELEVATION STARTED

DEP. COMPLETED

BEARING DIP SURVEYS

DEPTH PURPOSE

HOLE NO. Co 5

SHEET NO. 7

SECTION FROM 304.5 TO 399.5

LOGGED BY I.D. & R.E.V.

FOOTAGE		MINOR STRUCTURES			FORMATION	CORE SAMPLES					SLUDGE SAMPLES							
FROM	TO	FROM	TO	RECOVERY		SAMPLE NO.	FOOTAGE		WIDTH	AG OZ/TON	Pb %	Zn %	SAMPLE NO.	FOOTAGE		AG OZ/TON	Pb %	Zn %
							FROM	TO						FROM	TO			
	304.5	323.8	19.3															
					Competent minor flecks of biotite. No prominent calcite or quartz veinlets. 312' to 312.6' altered light grey green zone cut by quartz, calcite & ankerite veinlets. Few saussuritized feldspars & minor chlorite on fractures. Pyrite as fracture veinlets.													
	323.8	341.5	18.7															
					as above. 56 pyrite fracture fillings from hairline to 1/8" from 5° to 85°. 2 1/8" quartz veinlets and 10 calcite-ankerite veinlets at 35° to 45°. At 327' minor Chalcopyrite in pyrite fracture filling at 30°.													
	341.5	360.5	19.0															
					As above. 9 pyrite fractures as above app 9 per 5 feet. At 354' 1/2" quartz-calcite-ankerite-felspar vein at 30° with pyrite, magnetite and Chalcopyrite.													
	360.5	379.5	19.0															
					as above but less pyrite fracture fillings. At 360.5' 1/8" at 40° with Magnetite, Chalcopyrite and pyrite. 360.5' to 365' appears a little coarser grained.													
	379.5	399.5	20.0															
					as above. At 380' 1/4" calcite-ankerite veinlet at 20°. 390.5' to 393' abundant cross-cutting calcite-ankerite veinlets with alteration to a light grey green. Saussurization of feldspars.													

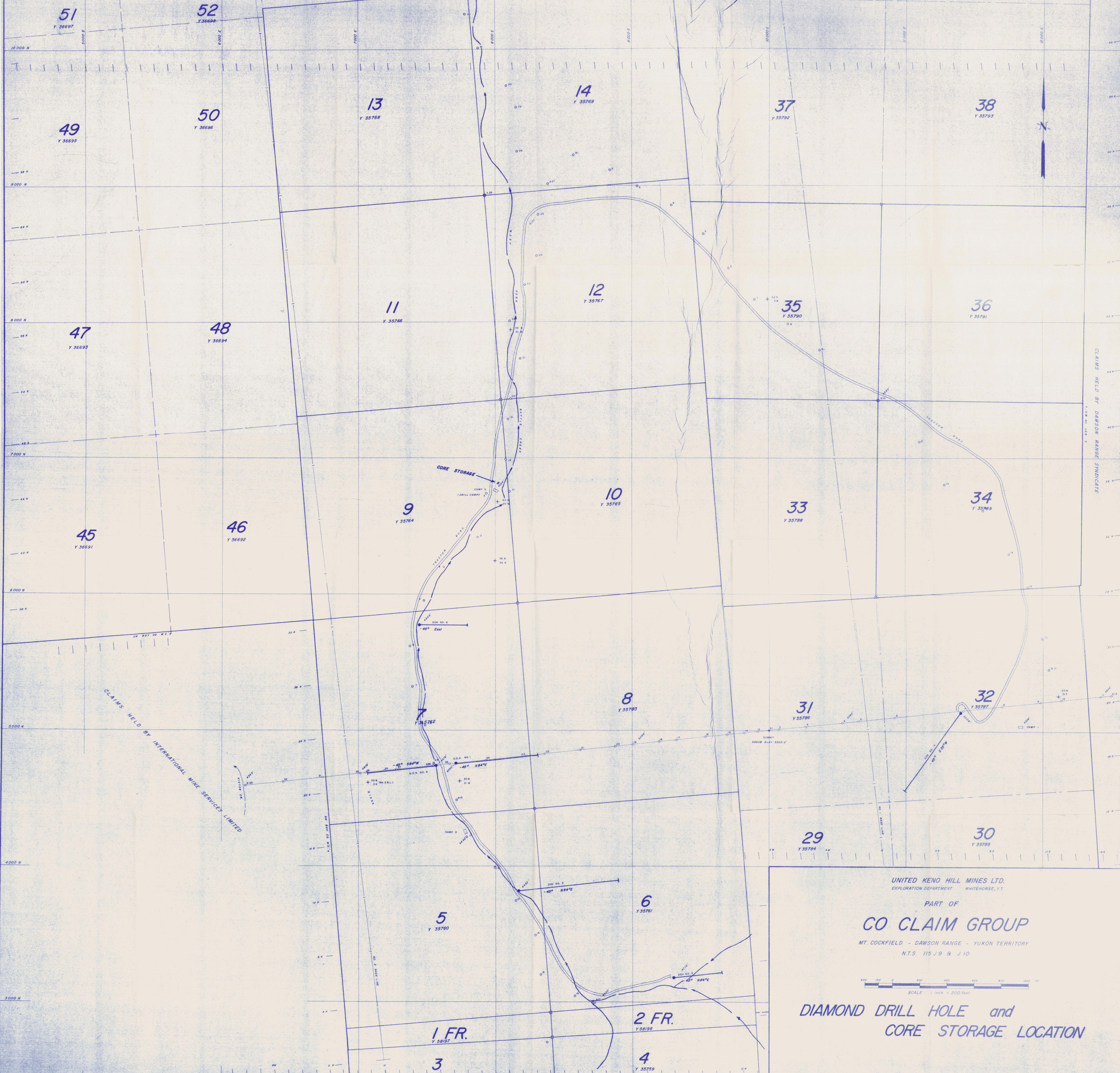

UNITED KENO HILL MINES LTD.
EXPLORATION DEPARTMENT WHITEHORSE, Y.T.

PART OF
CO CLAIM GROUP

MT. COCKFIELD - DAWSON RANGE - YUKON TERRITORY
N.T.S. 115 J 9 & J 10

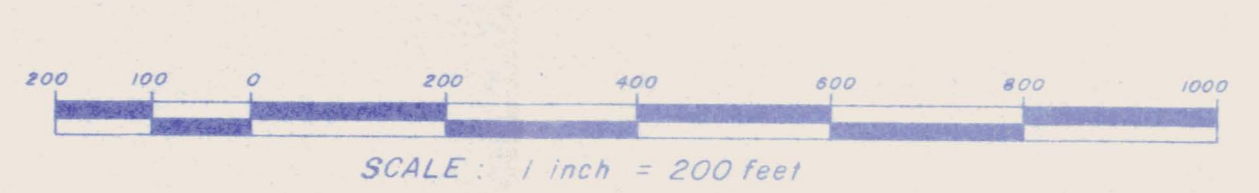

**DIAMOND DRILL HOLE and
CORE STORAGE LOCATION**