

1972 Case Claims OB Drilling

The following holes were drilled on the Case 1 Fr. between August 11 and August 14 inclusive. Hole diameters were 2 3/4" for casing and 2" for rods:

<u>Hole #</u>	<u>T. Depth</u>	<u>Casing</u>	<u>Rods</u>	<u>Dip</u>
A3185	210'	30'	180'	62°
A3186	210'	40'	170'	57°
A3187	210'	40'	170'	57°
	---	---	---	
TOTAL	630'	110'	520'	

Sample storage at Elsa Assay Lab.

LEO 8

CASE 2  
Fr.

LEO 10

LEO 12

LEO 18



POST 1

POST 2

LEO 15

57° A3187

57°

CASE 1 Fr.

62° A3185

POST 2

CASE 3 Fr.

LEO 14

POST 2  
POST 1

ORCHID 13  
Fr.

Scale 1" = 400'  
AUGUST 16, 1972

LEO 13

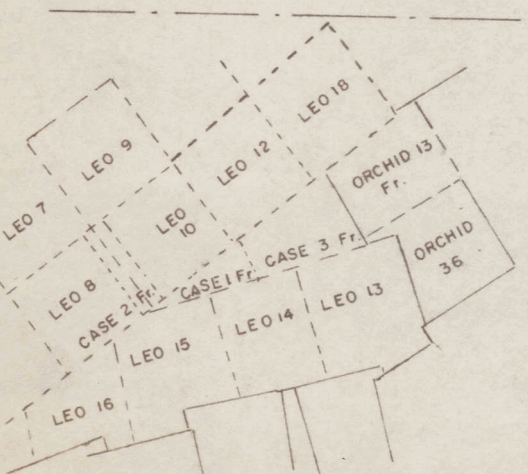

1" = 1/2 mile  
SHEET 105 - M-13  
MT. HALDANE

# UNITED KENO HILL MINES LTD.

## OVERBURDEN DRILL HOLE LOG

Location Silver - King Latitude \_\_\_\_\_ Departure \_\_\_\_\_ Hole No. A 3185  
 Date Drilled Aug 11 '72 Elevation \_\_\_\_\_ Bearing N 40° 30' W Page No. 1 Of 4  
 Casing Depth 30' Overburden Depth 55'-60' Length of Hole 220' Dip 62°

G.Q. Grey Quartzite; G.S. Graphite Schist; S.S. Sericite Schist; Grnst. Greenstone; Qtz. Quartz; Lim. Limonite; Py. Pyrite; Pbs. Galena; ZnS Sphalerite

Footage		Sample No.	Coarse Material (%) (+14 mesh)					Panning Concentrate Mineral Content (%)		Sample No.	Geochemical Results			Assay Results		
From	To		G.Q.	G.S.	S.S.	Grnst.	Qtz.	Lim	grams		Pb. (ppm)	Ag. (ppm)	Ag. (oz/ton)	Pb. (%)	Zn (%)	
0	10	12460	-	-	-	-	-	-	0.4	2 G.S., 3 py., 15g, 4g <sup>to</sup> 12460	16	0.4				
			Ins Sample					to lim, 40 qtz, 6 G.Q.								
10	15	61	-	-	-	-	-	-	0.5	3 py., 3 G.S., 15g, 40 gms	61	14	0.4			
			Ins Sample					40 qtz, 13 G.Q.								
15	20	62	20	to				80	to	0.4 3 py., 35g, 10 to G.S., 40 gms	62	12	0.4			
								40 qtz, 14 G.Q. to lim								
20	25	63	90	to				10	to	0.4 55g, 12 py., 16.5, 60 gms	63	8	0.4			
								5 qtz, 27 G.Q. to lim								
25	30	64	78	to		2		20	to	0.2 25g, 16.5, to lim 20 qtz	64	14	0.4			
								50 gms, 27 G.Q.								
30	35	65	35	to		55		10	to	0.3 80 gms, 55g, 16.5, to lim,	65	16	0.4			
								2 qtz, 12 G.Q.								
35	40	66	53	2		20		25	to	0.3 75g, 1 py., to G.S. to lim,	66	18	0.4			
								80 gms, 2 qtz, 10 G.Q.								
40	45	67	44	1		35		20	to	0.3 12 py., 3 G.S., 45g, 40 gms	67	20	0.4			
								to lim, 20 qtz, 21 G.Q.								
45	50	68	50	to		35		15	to	0.3 105g, 2 py., 78 gms,	68	20	0.4			
								to lim 2 qtz, 8 G.Q.								
50	55	69	30	to		50		20	to	0.3 as above	69	10	0.8			
55	60	70	30	to		20		50	to	0.3 20 G.S., 20 py., 25g,	70	20	0.6			
								28 gms, 15 qtz, to lim, 15 G.Q.								

# UNITED KENO HILL MINES LTD.

## OVERBURDEN DRILL HOLE LOG

Location Silver - King Latitude \_\_\_\_\_ Departure \_\_\_\_\_ Hole No. A 3185  
 Date Drilled Aug 11 1972 Elevation \_\_\_\_\_ Bearing \_\_\_\_\_ Page No. 2 of 4  
 Casing Depth \_\_\_\_\_ Overburden Depth \_\_\_\_\_ Length of Hole 270' Dip \_\_\_\_\_

G.Q. Grey Quartzite; G.S. Graphite Schist; S.S. Sericite Schist; Grnst. Greenstone; Qtz. Quartz; Lim. Limonite; Py. Pyrite; Pbs. Galena; ZnS Sphalerite

Footage		Sample No.	Coarse Material (%) (+14 mesh)						Panning Concentrate Mineral Content (%)		Sample No.	Geochemical Results			Assay Results		
From	To		G.Q.	G.S.	S.S.	Grnst.	Qtz.	Lim	grams	Pb. (ppm)		Ag. (ppm)	Ag. (oz/ton)	Pb. (%)	Zn (%)		
60	65	12471	39	40		1	20	to	0.3	25ppn, 40G.S, 5grmat,	12471	18	0.6				
										10 qtz, 20 G.Q. to lim.							
65	70	72	30	30			40	to	0.2	45G.S, 12ppn, 7grmat	72	16	0.4				
										30 qtz, 5 G.Q.							
70	75	73	15	35			55	to	0.3	15ppn, 50G.S, 7grmat	73	16	0.4				
										to ppn, to lim, 20 qtz, 8 G.Q.							
75	80	74	30	58		2	10	to	0.3	65ppn, 200G.S, 5qtz,	74	18	0.4				
										10 G.Q. to grmat							
80	85	75	25	40		2	33	to	0.3	45ppn, 30 G.S, 7grmat	75	20	0.4				
										10 qtz, 8 G.Q.							
85	90	76	30	29		1	40	to	0.2	5grmat, 45 G.S, 30ppn,	76	16	0.4				
										10 qtz, 10 G.Q. to lim.							
90	95	77	20	60		1	19	to	0.2	25ppn, 3grmat, 50 G.S,	77	16	0.4				
										to lim, 10 qtz, 12 G.Q.							
95	100	78	8	85	to	to	7	to	0.2	60ppn, 25 G.S, 2grmat,	78	20	0.6				
										to lim, 6 qtz, 7 G.Q.							
100	105	79	20	60		to	20	to	0.3	30ppn, 45 G.S, 2grmat, to lim,	79	16	0.4				
										15 qtz, 11 G.Q.							
105	110	80	30	60		to	10		0.2	20ppn, 55 G.S, 2grmat,	80	18	0.6				
										to lim, 5 qtz, 18 G.Q.							
110	115	81	20	65	to	to	15	to	0.3	60 G.S, 13ppn, 2grmat	81	24	0.6				
										to lim, 10 qtz, 15 G.Q.							

DD-219

# UNITED KENO HILL MINES LTD.

## OVERBURDEN DRILL HOLE LOG

Location Silver King Latitude \_\_\_\_\_ Departure \_\_\_\_\_ Hole No. A 3185  
 Date Drilled Aug 21 '72 Elevation \_\_\_\_\_ Bearing \_\_\_\_\_ Page No. 3 Of 4  
 Casing Depth \_\_\_\_\_ Overburden Depth \_\_\_\_\_ Length of Hole 220 Dip \_\_\_\_\_

G.Q. Grey Quartzite; G.S. Graphite Schist; S.S. Sericite Schist; Grnst. Greenstone; Qtz. Quartz; Lim. Limonite; Py. Pyrite; Pbs. Galena; ZnS Sphalerite

Footage		Sample No.	Coarse Material (%) (+14 mesh)						Panning Concentrate Mineral Content (%)		Sample No.	Geochemical Results			Assay Results		
From	To		G.Q.	G.S.	S.S.	Grnst.	Qtz.	Lim	grams	Pb. (ppm)		Ag. (ppm)	Ag. (oz/ton)	Pb. (%)	Zn (%)		
115	120	82	30	50			20	to	0.3	70 G.S., 10 py, 3 grnst	12482	18	0.6				
										to lim, 7 qtz, 10 G.Q.							
120	125	83	35	50			15	to	0.3	25 py, 40 G.S., 3 grnst,	83	18	0.4				
										to lim, 10 qtz, 22 G.Q.							
125	130	84	30	60			10	to	0.4	65 G.S., 20 py, 1 grnst,	84	18	0.4				
										to lim, 5 qtz, 9 G.Q.							
130	135	85	19	71			10	to	0.3	3 py, 80 G.S., 1 grnst,	85	12	0.4				
										to lim, 5 qtz, 11 G.Q.							
135	140	86	35	40			25	to	0.2	35 py, 45 G.S., 2 grnst,	86	16	0.4				
										7 qtz, 13 G.Q.							
140	145	87	10	80			10	to	0.4	17 py, 65 G.S., 3 grnst,	87	10	0.4				
										5 qtz, 10 G.Q.							
145	150	88	10	82			8	to	0.4	45 py, 38 G.S., 3 grnst	88	8	0.4				
										to lim, 5 qtz, 9 G.Q.							
150	155	89	25	60			15	to	0.4	17 py, 55 G.S., 1 grnst,	89	10	0.4				
										to pyrite.							
										to lim, 10 qtz, 17 G.Q.							
155	160	90	15	55			30	to	0.4	40 G.S., 35 py, 5 grnst	90	14	0.4				
										to lim, 10 qtz, 10 G.Q.							
160	165	91	10	60			30		0.6	38 G.S., 35 py, 1 grnst	91	14	0.4				
										to lim, 10 G.Q., 16 qtz.							
165	170	92	15	65			20		0.3	43 G.S., 33 py, 1 grnst	92	6	0.4				
										to lim, 10 qtz, 13 G.Q.							

# UNITED KENO HILL MINES LTD.

## OVERBURDEN DRILL HOLE LOG

Location Silver - King Latitude \_\_\_\_\_ Departure \_\_\_\_\_ Hole No. A 3185  
 Date Drilled Aug 11 '74 Elevation \_\_\_\_\_ Bearing \_\_\_\_\_ Page No. 4 of 4  
 Casing Depth \_\_\_\_\_ Overburden Depth \_\_\_\_\_ Length of Hole 210' Dip \_\_\_\_\_

G.Q. Grey Quartzite; G.S. Graphite Schist; S.S. Sericite Schist; Gmst. Greenstone; Qtz. Quartz; Lim. Limonite; Py. Pyrite; Pbs. Galena; ZnS Sphalerite

Footage		Sample No.	Coarse Material (%) (+14 mesh)						Panning Concentrate Mineral Content (%)		Sample No.	Geochemical Results			Assay Results		
From	To		G.Q.	G.S.	S.S.	Gmst.	Qtz.	Lim	grams	Pb. (ppm)		Ag. (ppm)	Ag. (oz/ton)	Pb. (%)	Zn (%)		
170	175	12493	30	60			10	to	0.8	60ppm, 22G.Q., 1gmst,	12493	12	0.4				
										5qtz, 12G.Q.							
175	180	94	10	70			15	to	0.8	85ppm, 25G.Q., 2gmst,	94	14	0.4				
										3qtz, 5G.Q.							
180	185	95	8	74			18	to	0.2	2gmst, 60G.Q., 15ppm,	95	16	0.4				
										15qtz, 8G.Q.							
185	190	96	10	60			30		0.4	65G.Q., 5ppm, 2gmst,	96	28	0.4				
										to lim, 15qtz, 13G.Q.							
190	195	97	10	75			15	to	0.5	70G.Q., 7ppm, 2gmst, 10qtz,	97	20	0.4				
										11G.Q., to lim.							
195	200	98	10	75			15		0.3	90G.Q., 10ppm, 3gmst,	98	20	0.4				
										to lim, 10qtz, 7G.Q.							
200	205	99	10	65			25	to	0.6	65G.Q., 15ppm, 1gmst,	99	24	0.4				
										10qtz, 9G.Q.							
205	210	12500	10	75			15	to	0.6	70G.Q., 12ppm, 2gmst,	12500	8	0.4				
										10qtz, 6G.Q.							

# UNITED KENO HILL MINES LTD. OVERBURDEN DRILL HOLE LOG

Location Silver - King Latitude \_\_\_\_\_ Departure \_\_\_\_\_ Hole No. A3186  
 Date Drilled Aug 14 1972 Elevation \_\_\_\_\_ Bearing N 40° 30' W Page No. 1 Of 4  
 Casing Depth 40' Overburden Depth 50' - 55' Length of Hole 210' Dip 57°

G.Q. Grey Quartzite; G.S. Graphite Schist; S.S. Sericite Schist; Grnst. Greenstone; Qtz. Quartz; Lim. Limonite; Py. Pyrite; Pbs. Galena; ZnS Sphalerite

Footage		Sample No.	Coarse Material (%) (+14 mesh)						Panning Concentrate Mineral Content (%)		Sample No.	Geochemical Results			Assay Results		
From	To		G.Q.	G.S.	S.S.	Grnst.	Qtz.	Lim	grams	Pb. (ppm)		Ag. (ppm)	Ag. (oz/ton)	Pb. (%)	Zn (%)		
8	10	12401	-	-	-	-	-	-	0.2	206.5, 10 py, 40 grnat	12401	8	0.4				
			Ins Sample						255, 10 qtz to lim								
10	15	02	-	-	-	-	-	-	0.2	106.5, 40 grnat, 255,	02	14	0.4				
			Ins Sample						1 py, to lim, 20 qtz, 276. Q.								
15	20	03	-	-	-	-	-	-	0.1	40 grnat, 255, 10.5, to lim	03	18	0.4				
			Ins Sample						30 qtz, 276. Q.								
20	25	04	10	tk		80	10	tk	0.1	76.5, 755, 1 py, 40 grnat	04	24	0.4				
									to lim, 30 qtz, 166. Q.								
25	30	05	3	tk		90	7	tk	0.3	46.5, 755, 1 py, to lim	05	12	0.4				
									70 grnat, 10 qtz, 126. Q.								
30	35	06	10	tk		50	40	tk	0.2	755, 70 grnat, to lim	06	8	0.4				
									to 6.5, 20 qtz, 36. Q.								
35	40	07	30	tk		60	70	tk	0.3	16.5, 355, 1 py, 65 grnat,	07	6	0.4				
									to lim, 20 qtz, 106. Q.								
40	45	08	15	tk		70	15	tk	0.3	2 py, 2055, 60 grnat, to lim	08	10	0.4				
									10 qtz, 86. Q.								
45	50	09	10	tk		70	20	tk	0.2	1055, 2 py, 63 grnat,	09	6	0.4				
									10 qtz, 156. Q.								
50	55	10	15	tk		40	45	tk	0.2	10 py, 206.5, 45 grnat	10	6	0.6				
									to lim, 255, 10 qtz, 136. Q.								
55	60	11	75	tk		20	5.	tk	0.4	45 py, 306.5, 15 grnat,	11	10	0.6				
									to lim, 196, 96. Q.								

DD-219

# UNITED KENO HILL MINES LTD.

## OVERBURDEN DRILL HOLE LOG

Location Silver - King Latitude \_\_\_\_\_ Departure \_\_\_\_\_ Hole No. A 3186  
 Date Drilled Aug 14 1972 Elevation \_\_\_\_\_ Bearing \_\_\_\_\_ Page No. 2 of 4  
 Casing Depth \_\_\_\_\_ Overburden Depth \_\_\_\_\_ Length of Hole 210' Dip \_\_\_\_\_

G.Q. Grey Quartzite; G.S. Graphite Schist; S.S. Sericite Schist; Grnst. Greenstone; Qtz. Quartz; Lim. Limonite; Py. Pyrite; Pbs. Galena; ZnS Sphalerite

Footage		Sample No.	Coarse Material (%) (+14 mesh)						Panning Concentrate Mineral Content (%)	Sample No.	Geochemical Results			Assay Results		
From	To		G.Q.	G.S.	S.S.	Grnst.	Qtz.	Lim			grams	Pb. (ppm)	Ag. (ppm)	Ag. (oz/ton)	Pb. (%)	Zn (%)
60	65	12412	40	20		20	20	tr	0.2	70 G.S., 3 py, 3 qmat, 5 qtz, tr lim, 19 G.Q.	12412	12	0.6			
65	70	13	10	30		tr	60	tr	0.3	5 qmat, 55 G.S., 20 py, 15 qtz, tr lim, 5 G.Q.	13	20	0.6			
70	75	14	60	10		tr	30	tr	0.2	10 qmat, 15 py, 40 G.S., 20 G.Q., 15 G.Q., tr lim.	14	22	0.4			
75	80	15	69	1			30	tr	0.3	15 qmat, 15 py, 40 G.S., 15 py, 10 qtz, 19 G.Q.	15	8	0.4			
80	85	16	70	5			25	tr	0.2	55 G.S., 3 qmat, tr lim, 10 py, 10 qtz, 22 G.Q.	16	14	0.4			
85	90	17	82	3			15	tr	0.2	65 G.S., 7 py, 5 qmat, 10 qtz, tr lim, 13 G.Q.	17	16	0.4			
90	95	18	70	26			4	tr	0.2	40 G.S., 40 py, 3 qmat, tr lim, 5 qtz, 12 G.Q.	18	8	1.4			
95	100	19	75	5			20	tr	0.2	60 G.S., 25 py, 3 qmat, 2 qtz, tr lim, 10 G.Q.	19	14	1.8			
100	105	20	91	5			4	tr	0.2	50 py, 35 G.S., 1 qmat, tr lim, 1 qtz, 13 G.Q.	20	12	2.0			
105	110	21	97	tr			3	tr	0.1	10 py, 70 G.S., 2 qmat, tr lim, 2 qtz, 16 G.Q.	21	22	0.6			
110	115	22	90	4			6	tr	0.1	30 py, 40 G.S., 2 qmat, 2 qtz, tr lim, 26 G.Q.	22	20	0.4			

DO-219

# UNITED KENO HILL MINES LTD.

## OVERBURDEN DRILL HOLE LOG

Location Silver King Latitude \_\_\_\_\_ Departure \_\_\_\_\_ Hole No. A 3186  
 Date Drilled Aug 14 '72 Elevation \_\_\_\_\_ Bearing \_\_\_\_\_ Page No. 3 Of 4  
 Casing Depth \_\_\_\_\_ Overburden Depth \_\_\_\_\_ Length of Hole 210 Dip \_\_\_\_\_

G.Q. Grey Quartzite; G.S. Graphite Schist; S.S. Sericite Schist; Grnst. Greenstone; Qtz. Quartz; Lim. Limonite; Py. Pyrite; Pbs. Galena; ZnS Sphalerite

Footage		Sample No.	Coarse Material (%) (+14 mesh)					Panning Concentrate Mineral Content (%)		Sample No.	Geochemical Results			Assay Results		
From	To		G.Q.	G.S.	S.S.	Grnst.	Qtz.	Lim	grams		Pb. (ppm)	Ag. (ppm)	Ag. (oz/ton)	Pb. (%)	Zn (%)	
115	120	12423	65	5			30	tr	0.3	55ppm, 20 G.S., 3grmat	12423	28	0.6			
										to lim, 20 qtz, 2 G.Q.						
120	125	24	85	tr			15	tr	0.2	20 G.S., 15 ppm, 5grmat,	24	8	0.6			
										10 qtz, tr lim, 50 G.Q.						
125	130	25	90	5			5	tr	0.2	30 ppm, 22 G.S., 7grmat	25	8	0.4			
										tr lim, 2 qtz, 44 G.Q.						
130	135	26	96	tr			4	tr	0.3	45 ppm, 35 G.S., 5grmat,	26	14	0.4			
										tr lim, 2 qtz, 13 G.Q.						
135	140	27	60	30			10	tr	0.3	10 ppm, 70 G.S., 2grmat,	27	28	0.4			
										tr lim, 3 qtz, 25 G.Q.						
140	145	28	80	14			6	tr	0.2	15 ppm, 75 G.S., 1grmat,	28	18	0.4			
										2 qtz, 7 G.Q.						
145	150	29	80	17			3	tr	0.2	75 G.S., 10 ppm, 2grmat,	29	18	0.4			
										1 qtz, 12 G.Q.						
150	155	30	70	24			6	tr	0.2	15 ppm, 70 G.S., 1grmat	30	36	0.6			
										2 qtz, 2 G.Q.						
155	160	31	86	10			4	tr	0.3	65 G.S., 10 ppm, 2grmat,	31	20	0.4			
										2 qtz, 21 G.Q.						
160	165	32	92	3			5	tr	0.3	12 ppm, 65 G.S., 1grmat, 2 qtz,	32	14	0.4			
										20 G.Q.						
165	170	33	40	tr		40	20	tr	0.1	5 ppm 60 G.S., 10grmat	33	20	0.6			
										10 qtz, 15 G.Q.						

# UNITED KENO HILL MINES LTD.

## OVERBURDEN DRILL HOLE LOG

Location Silver - King Latitude \_\_\_\_\_ Departure \_\_\_\_\_ Hole No. A 3186  
 Date Drilled Aug 14 1972 Elevation \_\_\_\_\_ Bearing \_\_\_\_\_ Page No. 4 Of 4  
 Casing Depth \_\_\_\_\_ Overburden Depth \_\_\_\_\_ Length of Hole 210 Dip \_\_\_\_\_

G.Q. Grey Quartzite; G.S. Graphite Schist; S.S. Sericite Schist; Grnst. Greenstone; Qtz. Quartz; Lim. Limonite; Py. Pyrite; Pbs. Galena; ZnS Sphalerite

Footage		Sample No.	Coarse Material (%) (+14 mesh)						Panning Concentrate Mineral Content (%) grams	Sample No.	Geochemical Results			Assay Results			
From	To		G.Q.	G.S.	S.S.	Grnst.	Qtz.	Lim			Pb. (ppm)	Ag. (ppm)	Ag. (oz/ton)	Pb. (%)	Zn (%)		
170	175	12434	65	20			15	tr	0.2	60 G.S., 10 ppm, 15 grmat, 2 qtz, 13 G.Q.	12434	22	0.4				
175	180	35	93	1			6	tr	0.1	75 G.S., 5 ppm, 3 grmat, 2 qtz, 15 G.Q.	35	18	0.4				
180	185	36	46	1			3	tr	0.4	65 G.S., 20 ppm, 1 grmat, 2 qtz, 12 G.Q.	36	<del>20</del> 20	0.4				
185	190	37	97	1			2	tr	0.4	3 grmat, 20 ppm, 65 G.S., tr lim, 1 qtz, 11 G.Q.	37	20	0.4				
190	195	38	65	30			5	tr	0.1	60 G.S., 10 grmat, 20 ppm, 1 qtz, 9 G.Q., tr lim.	38	14	0.4				
195	200	39	5	tr			70	25	tr	0.1	50 grmat, 55 G.S., 20 G.S., 10 ppm, 10 qtz, 3 G.Q., tr lim.	39	16	1.0			
200	205	40	5	tr			65	30	tr	0.1	40 G.S., 15 ppm, 30 grmat, 10 qtz, 5 G.Q.	40	14	0.4			
205	210	41	35	tr			25	40	tr	0.1	25 ppm, 20 G.S., 3 grmat, 40 qtz, 12 G.Q.	41	8	0.4			

DD-219

# UNITED KENO HILL MINES LTD.

## OVERBURDEN DRILL HOLE LOG

Location Silver-King Latitude \_\_\_\_\_ Departure \_\_\_\_\_ Hole No. A 3187  
 Date Drilled Aug 14 '72 Elevation \_\_\_\_\_ Bearing N 40° 30' W Page No. 1 Of 4  
 Casing Depth 40' Overburden Depth 55'-60' Length of Hole 210 Dip 57°

G.Q. Grey Quartzite; G.S. Graphite Schist; S.S. Sericite Schist; Grnst. Greenstone; Qtz. Quartz; Lim. Limonite; Py. Pyrite; Pbs. Galena; ZnS Sphalerite

Footage		Sample No.	Coarse Material (%) (+14 mesh)						Panning Concentrate Mineral Content (%)		Sample No.	Geochemical Results			Assay Results		
From	To		G.Q.	G.S.	S.S.	Grnst.	Qtz.	Lim	grams	Pb. (ppm)		Ag. (ppm)	Ag. (oz/ton)	Pb. (%)	Zn (%)		
0	10	12442	-	-	-	-	-	-	1.2	16.5, 1ppn, 55g, 40grmat, 12442	10	0.4					
			Ins Sample						20 gts	33 G.Q.							
10	15	443	-	-	-	-	-	-	0.8	55g, 1 G.Q., 1ppn, 37grmat 443	10	0.4					
			Ins. Sample						30 gts	28 G.Q.							
15	20	44	-	-	-	-	-	-	1.4	100.5, 55g, 3ppn, 25grmat, 44	12	0.4					
			Ins Sample						40 gts	17 G.Q., 1 Lim.							
20	25	45	25			50	25	to	0.4	60grmat, 75g, 1 G.Q., 45	14	0.4					
									1ppn, 1 Lim, 20 gts	13 G.Q.							
25	30	46	20			50	30	to	0.6	60grmat, 55g, 1 Lim, 46	16	0.4					
									20 gts	15 G.Q.							
30	35	47	20		to	40	40	to	0.6	75g, 16.5, 75grmat, 1ppn, 47	14	0.8					
									1 Lim, 5 gts	12 G.Q.							
35	40	48	35			35	30	to	0.8	75g, 16.5, 1ppn, 75grmat, 48	16	0.4					
									1 Lim, 10 gts	6 G.Q.							
40	45	49	33	to		33	34	to	0.6	105g, 16.5, 2ppn, 1 Lim, 49	16	0.4					
									77grmat, 17 gts	36 G.Q.!							
45	50	50	25			30	45	to	0.6	155g, 2ppn, 1 Lim, 50	16	0.4					
									1 G.Q., 70grmat, 5 gts	86 G.Q.							
50	55	12251	40	30		10	20	to	0.6	35 G.Q., 30ppn, 15grmat 12251	14	0.4					
									10 gts	10 G.Q.							
55	60	12252	15	74		1	10		0.6	35ppn, 40 G.Q., 10grmat, 252	24	0.4					
									10 gts	5 G.Q.							

DD-219

# UNITED KENO HILL MINES LTD.

## OVERBURDEN DRILL HOLE LOG

Location Silver - King Latitude \_\_\_\_\_ Departure \_\_\_\_\_ Hole No. A 3187  
 Date Drilled Aug 14 '72 Elevation \_\_\_\_\_ Bearing \_\_\_\_\_ Page No. 2 Of 4  
 Casing Depth \_\_\_\_\_ Overburden Depth \_\_\_\_\_ Length of Hole 210 Dip \_\_\_\_\_

G.Q. Grey Quartzite; G.S. Graphite Schist; S.S. Sericite Schist; Grnst. Greenstone; Qtz. Quartz; Lim. Limonite; Py. Pyrite; Pbs. Galena; ZnS Sphalerite

Footage		Sample No.	Coarse Material (%) (+14 mesh)						Panning Concentrate Mineral Content (%)			Sample No.	Geochemical Results			Assay Results		
From	To		G.Q.	G.S.	S.S.	Grnst.	Qtz.	Lim	grams				Pb. (ppm)	Ag. (ppm)		Ag. (oz/ton)	Pb. (%)	Zn (%)
60	65	12253	12	78		2	8	to	0.6	60G.S, 10pyr, 15grmat, 5qtz, 10G.Q.	12253	18	0.4					
65	70	54	10	75			15	to	0.6	55pyr, 10grmat, 20G.S, 10qtz, 5G.Q.	54	16	0.4					
70	75	55	10	50			40		0.3	32grmat, 8pyr, 50G.S, 7qtz, 3G.Q.	55	20	0.4					
75	80	56	5	90			5		0.3	15grmat, 70G.S, 5pyr, 2qtz, 8G.Q.	56	10	0.4					
80	85	57	30	60			10		0.2	80G.S, 5pyr, 3grmat, 5qtz, 7G.Q.	57	8	0.4					
85	90	58	50	10			40		0.2	20pyr, 40G.S, 1grmat, 20qtz, 13G.Q.	58	4	0.4					
90	95	59	75	5			20		0.1	35pyr, 20G.S, 3grmat, 10qtz, 32G.Q.	59	4	0.4					
95	100	60	35	50			15		0.6	55pyr, 35G.S, 1grmat, 7qtz, 2G.Q.	60	14	0.4					
100	105	61	10	80			10		0.6	22pyr, 66G.S, 5qtz, 7G.Q.	61	12	0.4					
105	110	62	20	75			4		0.3	27pyr, 63G.S, 2qtz, 1grmat, 8G.Q.	62	14	0.4					
110	115	63	20	70			10		0.4	20pyr, 1grmat, 69G.S, 5qtz, 5G.Q.	63	28	0.4					

DD-219

# UNITED KENO HILL MINES LTD.

## OVERBURDEN DRILL HOLE LOG

Location Silver King Latitude \_\_\_\_\_ Departure \_\_\_\_\_ Hole No. A3187  
 Date Drilled Aug 14 1972 Elevation \_\_\_\_\_ Bearing \_\_\_\_\_ Page No. 3 of 4  
 Casing Depth \_\_\_\_\_ Overburden Depth \_\_\_\_\_ Length of Hole 210' Dip \_\_\_\_\_

G.Q. Grey Quartzite; G.S. Graphite Schist; S.S. Sericite Schist; Grnst. Greenstone; Qtz. Quartz; Lim. Limonite; Py. Pyrite; Pbs. Galena; ZnS Sphalerite

Footage		Sample No.	Coarse Material (%) (+14 mesh)						Panning Concentrate Mineral Content (%)		Sample No.	Geochemical Results			Assay Results		
From	To		G.Q.	G.S.	S.S.	Grnst.	Qtz.	Lim	grams			Pb. (ppm)	Ag. (ppm)		Ag. (oz/ton)	Pb. (%)	Zn (%)
115	120	12264	8	77			15	0.6	40 py, 42 G.S., 8 qtz	12264	12	0.4					
									to pyrite. 10 G.Q. to grmat.								
120	125	65	8	79		1	12	0.4	65 G.S., 16 py, 2 grmat,	65	16	0.4					
									10 qtz, 7 G.Q.								
125	130	66	6	64			30	1.0	50 py, 40 G.S., 2 grmat,	66	20	0.6					
									6 qtz, 2 G.Q.								
130	135	67	10	65			25	0.9	25 py, 45 G.S., 1 grmat,	67	18	0.6					
									15 qtz, 14 G.Q.								
135	140	68	10	70			20	0.4	75 G.S., 10 py, 10 qtz	68	14	0.4					
									5 G.Q., to grmat.								
140	145	69	20	55			25	1.0	3 grmat, 15 py, 50 G.S.,	69	12	0.4					
									15 qtz, 17 G.Q.								
145	150	70	10	70			20	0.6	65 G.S., 5 py, 15 grmat,	70	12	0.4					
									5 grey qtz, 10 qtz.								
150	155	71	60	35			5	0.6	40 G.S., 40 grmat, 7 py,	71	20	0.4					
									15 qtz, 2 qtz, 10 G.Q.								
155	160	72	8	82			10	0.3	80 G.S., 7 py, 1 grmat,	72	18	0.4					
									5 qtz, 7 G.Q.								
160	165	73	21	67			12	0.6	75 G.S., 2 py, 10 qtz	73	20	0.4					
									13 G.Q.								
165	170	74	8	82			10	0.4	75 G.S., 10 py, 1 grmat,	74	16	0.4					
									5 qtz, 9 G.Q.								

DD-219

# UNITED KENO HILL MINES LTD.

## OVERBURDEN DRILL HOLE LOG

Location Silver King Latitude \_\_\_\_\_ Departure \_\_\_\_\_ Hole No. A 3187  
 Date Drilled Aug 14 1972 Elevation \_\_\_\_\_ Bearing \_\_\_\_\_ Page No. 4 Of 4  
 Casing Depth \_\_\_\_\_ Overburden Depth \_\_\_\_\_ Length of Hole 210' Dip \_\_\_\_\_

G.Q. Grey Quartzite; G.S. Graphite Schist; S.S. Sericite Schist; Grnst. Greenstone; Qtz. Quartz; Lim. Limonite; Py. Pyrite; Pbs. Galena; ZnS Sphalerite

Footage		Sample No.	Coarse Material (%) (+14 mesh)					Panning Concentrate Mineral Content (%)		Sample No.	Geochemical Results			Assay Results		
From	To		G.Q.	G.S.	S.S.	Grnst.	Qtz.	Lim	grams		Pb. (ppm)	Ag. (ppm)	Ag. (oz/ton)	Pb. (%)	Zn (%)	
170	175	12275	6	82			12		0.8	80 G.S., 3 py, 2 grnst, 7 qtz, 8 G.Q.	12275	26	0.4			
175	180	76	8	77			15		0.8	25 py, 65 G.S., 5 qtz, 5 G.Q.	76	12	0.4			
180	185	77	5	75			20		1.0	20 py, 60 G.S., 1 grnst, 10 qtz, 9 G.Q.	77	20	0.4			
185	190	78	15	63			22		1.2	45 py, 40 G.S., 1 grnst, 10 qtz, 5 G.Q.	78	14	0.4			
190	195	79	10	55			35		0.4	50 G.S., 35 py, 1 grnst, 10 qtz, 4 G.Q.	79	10	0.4			
195	200	80	20	50			30		0.6	40 G.S., 30 py, 1 grnst, 15 qtz, 14 G.Q.	80	8	0.4			
200	205	81	55	5			40		0.4	176 G.S., 45 py, 2 grnst, 15 qtz, 21 G.Q.	81	4	0.4			
205	210	82	65	5			30		1.0	10 G.S., 3 grnst, 20 py, 20 qtz, 47 G.Q.	82	4	0.4			

DD-219