

WELCOME NORTH MINES LTD. (N.P.L.)
1027-470 Granville St., Vancouver, B.C. V6C 1V5 Telephone (604) 687-1658



LINECUTTING REPORT
ON THE
RACHEL AND MN CLAIM GROUPS

N.T.S. 105K-2
WHITEHORSE MINING DISTRICT

Swim Lakes

June 22, 1979

H.F. Foster

091214

TABLE OF CONTENTS

	Page
INTRODUCTION	1
MINERAL CLAIMS	1
LINECUTTING	1
FIGURE 1 RACHEL 1-43 MN 1-35 CLAIMS LINECUTTING MAP	2
STATEMENT OF COSTS	
CERTIFICATE	

INTRODUCTION

During the period May 14 to May 26, 1979 linecutting was carried out on the RACHEL and MN claims by McCrory Holdings Ltd. out of Whitehorse. A temporary camp was installed on the property during the time linecutting was being carried out.

MINERAL CLAIMS

The RACHEL and MN claims are composed of the following 78 mineral claims:

<u>CLAIMS</u>	<u>GRANT NUMBERS</u>
MN 1-35	Y79793-Y79827
RACHEL 1-43	Y92705-Y92747

LINECUTTING

A total of 20.45 miles of cutline were repicketed in slope-corrected 50-meter intervals over two grids on the RACHEL and MN mineral claims (Fig. 1). Two tielines were installed on the RACHEL grid at 8+50 meters east and 8+50m west. These cutlines totalled 3.03 miles in length.

RACHEL CLAIMS

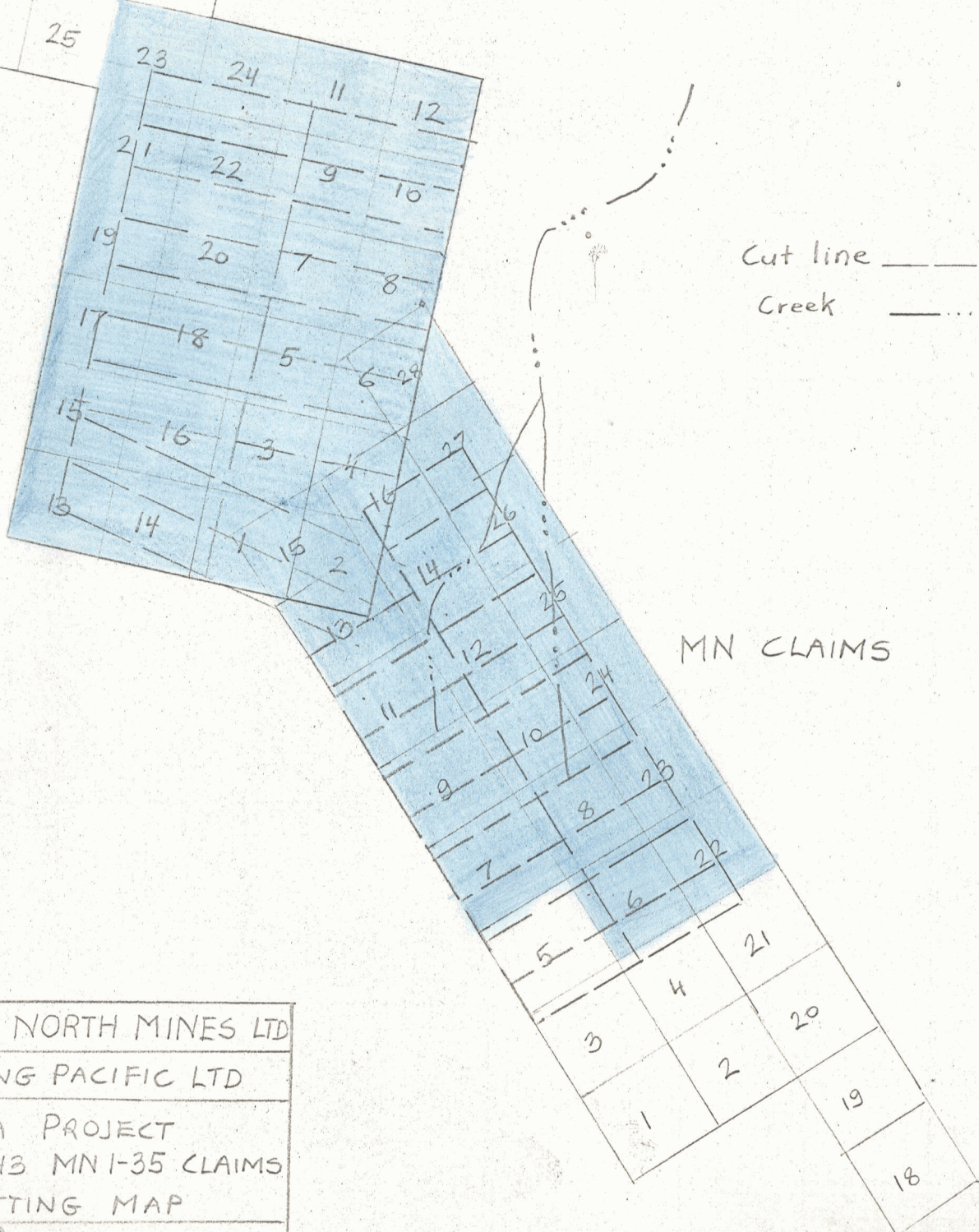

MN CLAIMS

WELCOME NORTH MINES LTD
GETTY MINING PACIFIC LTD
VANGORDA PROJECT
RACHEL 1-43 MN 1-35 CLAIMS
LINECUTTING MAP
Fig 1.



WELCOME NORTH MINES LTD. (N.P.L.)

1027 - 470 Granville St., Vancouver, B.C. V6C 1V5 Telephone (604) 687-1658

STATEMENT OF COST

Linecutting: 3.03 miles @ \$250 per mile	\$ 757.50
Repicketing: 20.45 miles @ \$100 per mile	2,045.00
Helicopter Support: 3.65 hours @ \$350/hour	1,301.66
Drafting and preparation of report	<u>20.00</u>
TOTAL COST	<u>\$4,124.16</u>

May 26, 1979

McCrorry Holdings (Yukon) Ltd.

72 E12th Ave.

Whitehorse, Y.T. Y1A 4K1

Frank Foster

c/o Stirling Expiditing

Ross River, Y.T.

Re: Billing of linecutting and repicketting for Welcome North
Mines Ltd. (NPL) by McCrorry Holdings (Yukon) Ltd.

Linecutting:

Ruth claims	3.91 Miles @ \$250.00 per mile	= \$ 977.50
Rachel claims	3.03 " @ " "	= \$ 757.50
Dot claims	7.95 " @ " "	= <u>\$1987.50</u>
	Sub-total	= \$3722.50

Repicketting:

Rachel claims	20.45 Miles @ \$100.00 per mile	= <u>\$2045.00</u>
	Sub-total	= \$5767.50

Repair of 1978 Ford Crew Cab canopy, 1978 lease		= <u>\$ 350.00</u>
---	--	--------------------

Total		= \$6117.50
-------	--	-------------

Thank You



per McCrorry Holdings (Yukon) Ltd.

c.c.

Welcome North Mines Ltd. (NPL)

1027-470 Granville Street,

Vancouver, B.C. V6C 1V5

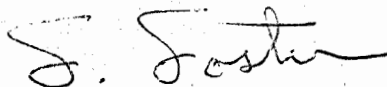

T
N  **T**
TRANS NORTH TURBO AIR LTD.
BOX 4338, WHITEY YUKON Y1A 3T6
TELEPHONE (403)666 • TELEX 036-8-290

ACCOUNT NUMBER	325
31240	
INVOICE DATE	150579
A/C TYPE	5000 G-T 10K
FLIGHT DATE	140579
PURCHASE ORDER NO.	

WELCOME NORTH MINES LTD
CHARTERER
1027 470 GRANVILLE ST
BILLING ADDRESS
Vancouver BC ~~12~~V6C

FUEL & OIL-X	TNTA FUEL USED	HRS.-GALS.	IVS
TNTA	CUST.		

FROM	ROSS R-VOR	MILES	HOURS	ZONE	REMARKS - NO. OF PASS. - FREIGHT LBS.
TO	SWIM LAKE		1.3	B	

#70 - WS 50/
#70 - Vg 50%

Rachel
Leve cutting

PAID
Chk. # 1467
Date May 22/79
Code
Journal

SUB	G.L.	AMOUNT
6255020		45500
6255110		3333

1.3	@ 350 ⁰⁰	455 00
	@	
	@	
	@	

TERMS: EIGHTEEN PERCENT INTEREST PER ANNUM WILL BE CHARGED ON ALL INVOICES NOT PAID WITHIN 30 DAYS OF DATE ISSUED.

WAITING TIME	@	/HR.	
FUEL: 33	@ 1.01 /GAL.		33 33.
FUEL:	@	/GAL.	
MEALS & LODGING			
OTHER			
OTHER			

G. Foster

CHARTERER'S SIGNATURE

Peter Kelly

PILOT'S SIGNATURE

ENGINEER'S NAME

TOTAL \$ 488 33

**FLIGHT REPORT
INVOICE**

CERTIFICATE

I, H. Frank Foster, of 2568 Palmerston Avenue, West Vancouver, British Columbia, DO HEREBY CERTIFY:

- 1) That I am a geologist with a business office at 1027 - 470 Granville Street, Vancouver, B.C.
- 2) That I am a graduate in honours geology of the University of British Columbia (B.Sc. - 1974).
- 3) That I have practiced my profession as a geologist for the past 5 years.
- 4) That to the best of my knowledge and belief, the statement of costs presented in this report LINECUTTING REPORT ON THE RACHEL AND MN CLAIM GROUPS is both correct and true.
- 5) That I hold an interest in the shares of Welcome North Mines Ltd. (N.P.L.), and that I am employed by Welcome North Mines Ltd. (N.P.L.) as a staff geologist.

H. Frank Foster

Sworn before me at the City of Vancouver, in the Province of British Columbia, this 11th day of July, 1979.



A Notary Public in and for the Province of British Columbia

CHRISTOPHER J. BUTLER
901-470 GRANVILLE ST
VANCOUVER, B.C. V6C 1V5
BARRISTER & SOLICITOR

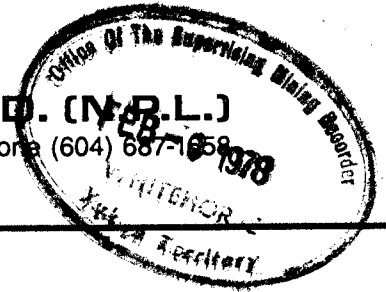

WELCOME NORTH MINES LTD. (N.B.L.)

1027 - 470 Granville St., Vancouver, B.C. V6C 1V5 Telephone (604) 687-1658



REPORT ON
DIAMOND DRILLING PROGRAM
ON THE
RACHEL-MN MINERAL CLAIMS



Latitude 62°14'N

Longitude 132°58'W

N.T.S. 105K-2
WHITEHORSE MINING DISTRICT
YUKON TERRITORY

Work performed during the period August 1 - August 15, 1977

b y

J.D. Guild, P.Eng.
January, 1978

DD-128
091214

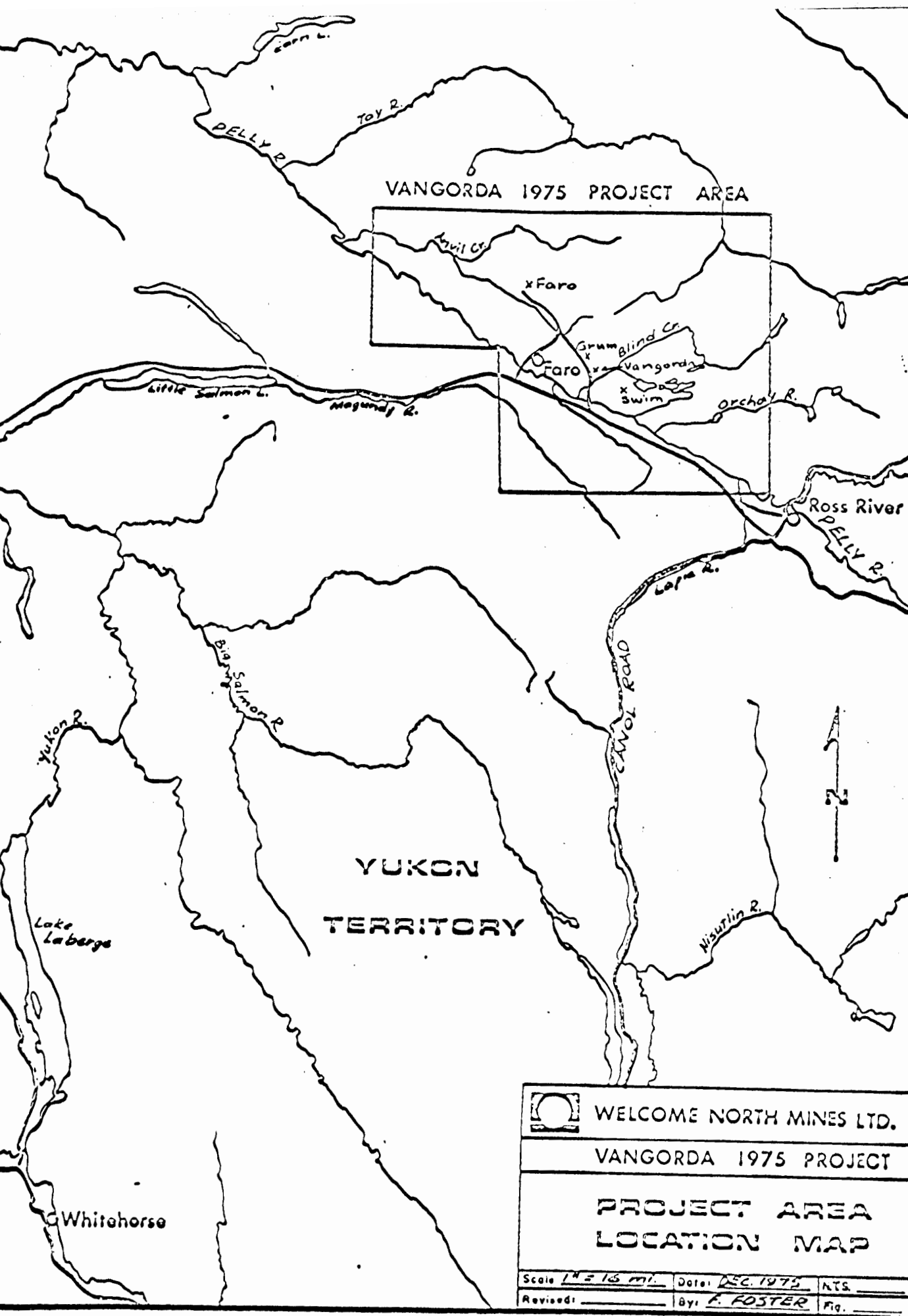

VANGORDA 1975 PROJECT AREA

YUKON
TERRITORY

	WELCOME NORTH MINES LTD.	
	VANGORDA 1975 PROJECT	
	PROJECT AREA LOCATION MAP	

Scale 1" = 10 mi.	Date: DEC. 1975	NTS.
Revised:	By: F. FOSTER	Fig.

INTRODUCTION

The RACHEL 1-43 claims and adjoining BRENDA 1-10 claims were staked by Welcome North Mines in February, 1975 and in May, 1975.

The property was located over what was considered to be a favourable geologic environment for Anvil-Vangorda massive sulphide deposits.

The RACHEL claims were subsequently joint ventured to Getty Mining Pacific Ltd. in March, 1975 as part of the Vangorda 1975 Project. Under the Joint Venture Agreement, Getty Mining Pacific currently holds a 60 percent working interest in the property, with Welcome North as partner with a 40 percent carried interest. The BRENDA claims were staked later in the year under the joint venture agreement. Later, during 1976, the BRENDA claims were disallowed and all staking costs and recording fees refunded to the Vangorda Project. This disallowance was as a result of Cyprus Anvil opting to pay penalty fees in order to hold in good standing their recently lapsed SINK 31-40 claims, over which the BRENDA claims had been staked.

Welcome North, as operator, during the period August 27, 1975, to October 14, 1975, carried out an exploration program consisting of a magnetic survey. Results from this survey are summarized in the report "Geological and Geophysical Report on the RACHEL 1-43 and BRENDA 1-10 Claims" by F. Foster and J.S. Brock, 1976.

The MN 1-35 claims were optioned recently from Claymore Resources Ltd. These claims are tied onto the east of the RACHEL claims (see Fig. 1). The MN claims are located to the north of a large tonnage massive sulphide body located beneath Swim Lake and containing sub-economic concentrations of lead and zinc.

LOCATION AND ACCESS

The RACHEL 1-43 and MN 1-35 claims are located in the Whitehorse Mining District of the Yukon Territory (N.T.S. 105-K-2) at latitude $62^{\circ}14'N.$, and longitude $132^{\circ}58'W.$, 125 miles northeast of Whitehorse, Yukon Territory and 12 miles east of the town of Faro, Yukon Territory (see Fig. 2).

Access to the property can best be gained by helicopter from Faro or by cat' trail from the Kerr-Addison Swim Lake campsite situated 2 miles south of the property on the shore of Swim Lake. The ground access route is serviceable only by tracked vehicle or trail bike. The route provides access to a cat' line grid which extends onto the southern portion of the property.

The property is located below treeline at an elevation of 4000 feet on a broad hilltop two miles north of Swim Lake. The hilltop which is vegetated with dense stands of evergreen in some areas and thick growths of buck brush in others, is largely covered with overburden and outcrop is extremely limited. There are no streams on the RACHEL claims to provide water for a campsite and the nearest stream for such a purpose lies 2000 feet north of the property.

MINERAL CLAIMS

The RACHEL 1-43 and MN 1-35 claim groups consist of the following 78 contiguous mineral claims located in the Whitehorse Mining District of the Yukon Territory (see Fig. 1):

<u>CLAIMS</u>	<u>GRANT NUMBERS</u>	<u>DUE DATE</u>
RACHEL 1-43	Y92705-Y92747	Feb. 24, 1979
MN 1-35	Y79793-Y79827	Jan. 23, 1978



WELCOME NORTH MINES LTD.

VANGORDA 1975 PROJECT

PROPERTY LOCATION MAP

RACHEL 1-43 CLAIMS

Scale 1" = 10 mi	Date DEC 1975	NTS 1054
Revised	By F. FOSTER	Fig 2

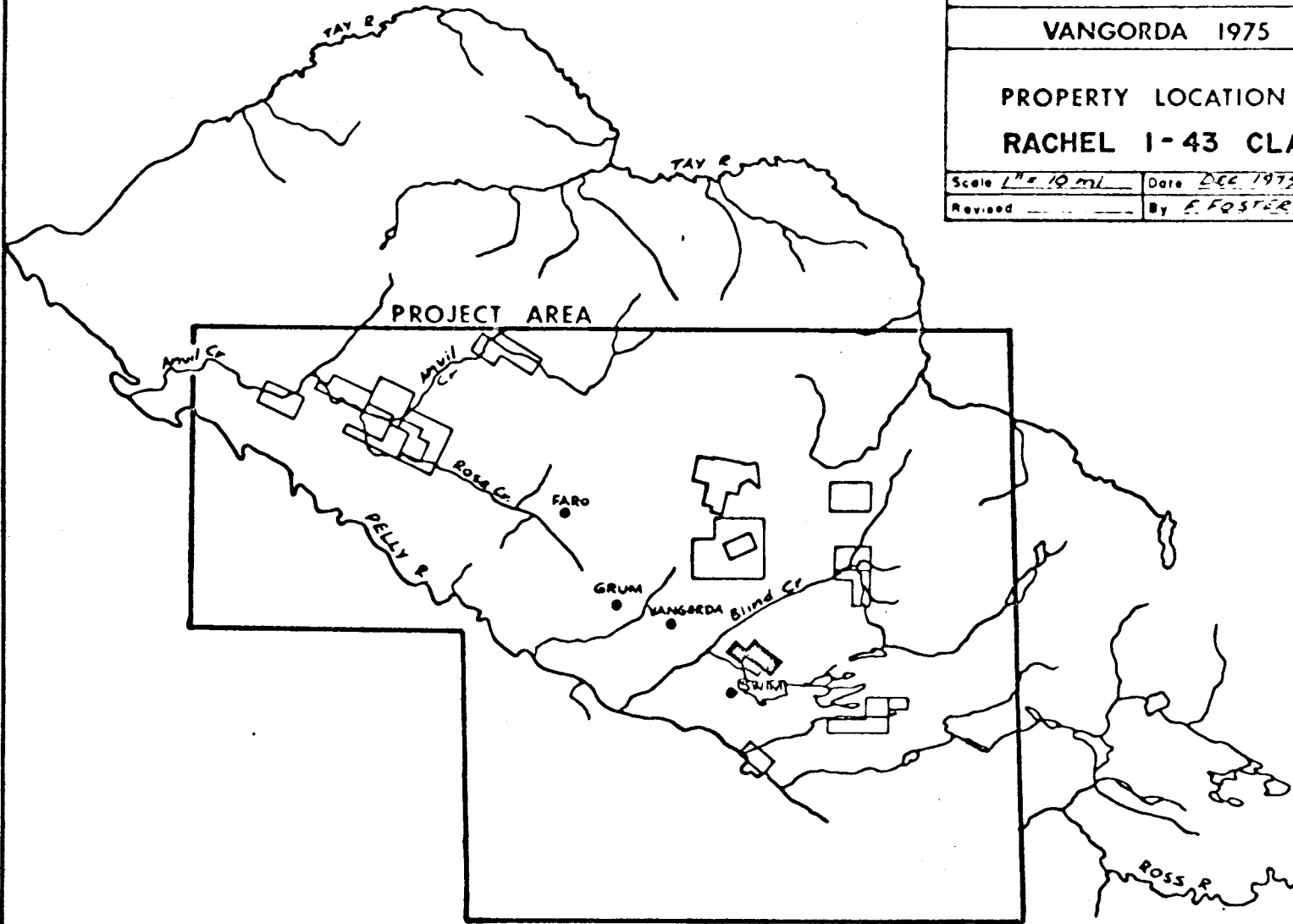

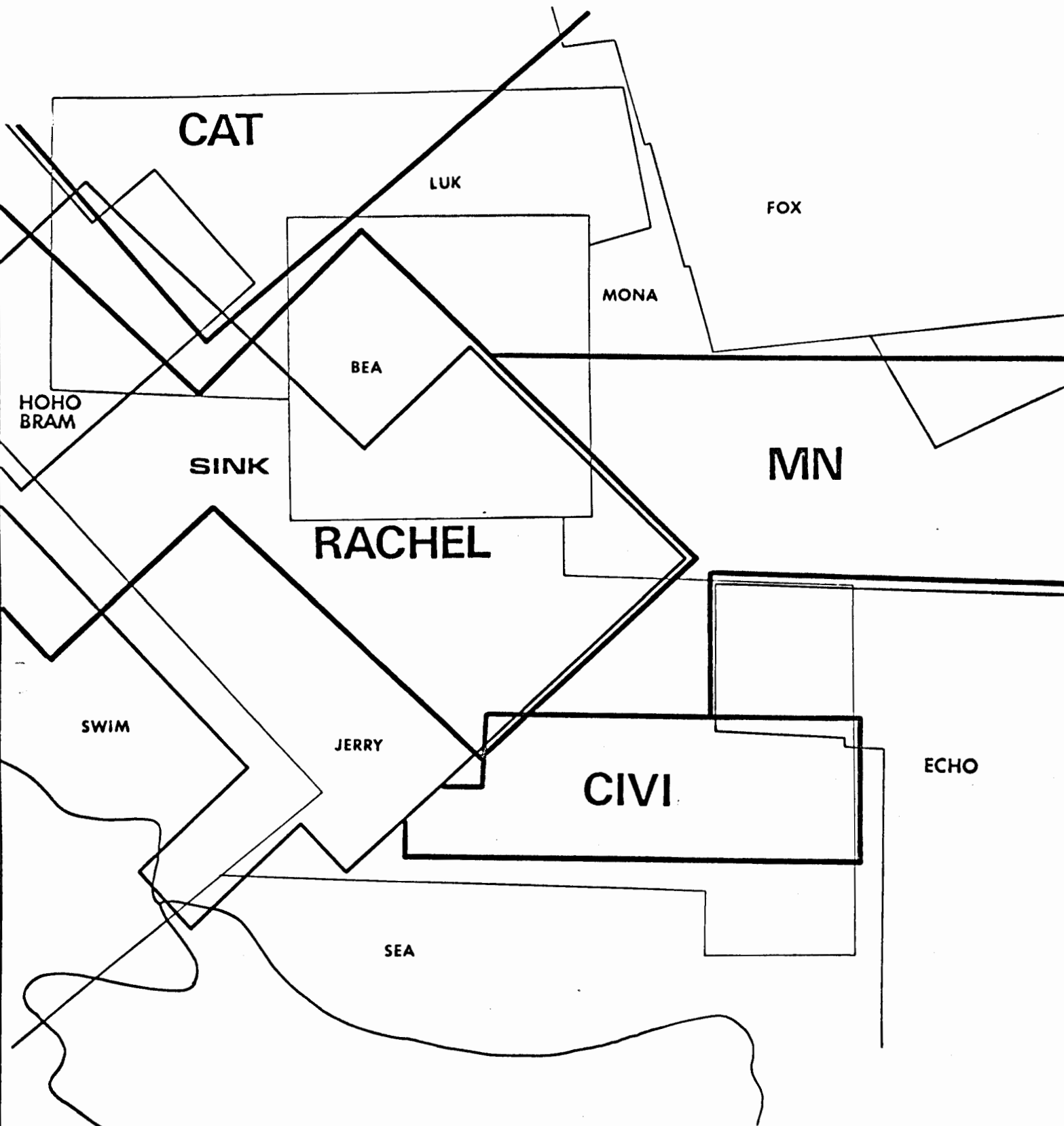

 WELCOME NORTH MINES LTD.
 VANGORDA 1975 PROJECT

Previous Claims in the
 Vicinity of the RACHEL
 and MN Claims

Scale: 1" = 1/2 mile Date: JAN. 1975 NTS. 10562

Revised: _____ By: F. FOSTER Fig. 3

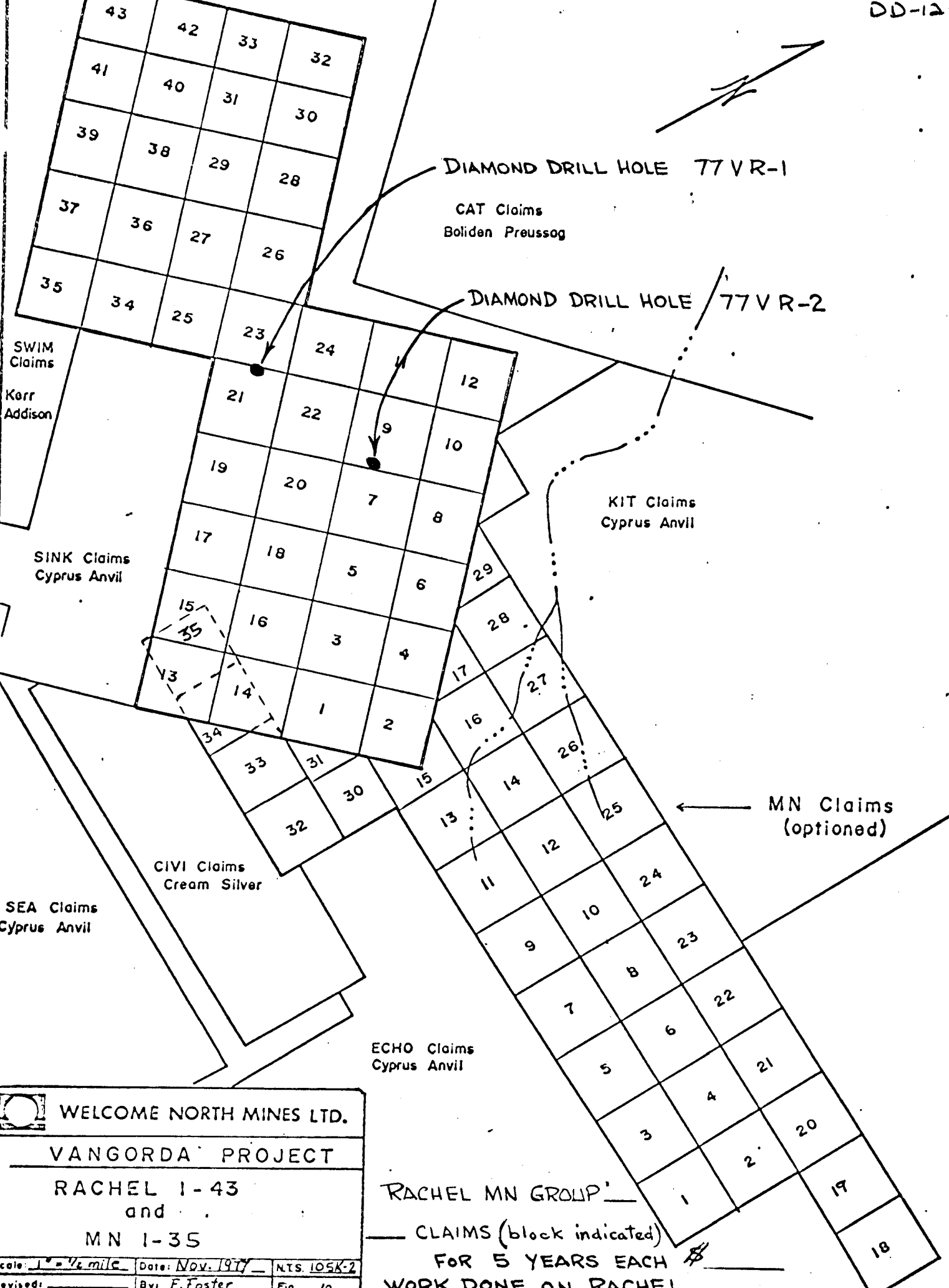
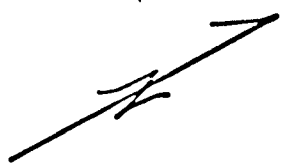

DIAMOND DRILL HOLE 77VR-1

CAT Claims
Boliden Preussag

DIAMOND DRILL HOLE 77VR-2

KIT Claims
Cyprus Anvil

MN Claims
(optioned)

ECHO Claims
Cyprus Anvil

CIVI Claims
Cream Silver

SEA Claims
Cyprus Anvil

SINK Claims
Cyprus Anvil

SWIM Claims
Kerr Addison

RACHEL MN GROUP

— CLAIMS (block indicated)

FOR 5 YEARS EACH

WORK DONE ON RACHEL

WELCOME NORTH MINES LTD.

VANGORDA PROJECT

RACHEL 1-43
and

MN 1-35

REPORT ON DIAMOND DRILLING PROGRAM

RACHEL-MN MINERAL CLAIMS

Two BQ diamond drill holes were drilled on the RACHEL-MN Claim Group in the period August 1-15, 1977.

<u>HOLE NO.</u>	<u>LENGTH</u>	<u>ANGLE</u>	<u>COLLAR GRID CO-ORDINATES</u>	
77VR-1	600'	-90°	64+00N	14+00W
77VR-2	385'	-90°	62+00N	2+00E

The purpose of these holes was to test a large airborne magnetic anomaly which had been verified by ground magnetic and electromagnetic expressions. This anomaly was believed to reflect graphitic phyllites such as host the Grum, Vangorda and Swim deposits. Both holes intersected the desired favourable lithologies but failed to intersect base metal mineralization.

Core from the hole has been boxed and is stored at the warehouse of Welcome North Mines Ltd. in Ross River, Yukon Territory.

Enclosed is a geological log of the holes, a sketch showing the location of drill holes relative to claim boundaries and a statement of representation work done.

Respectfully submitted,

J.D. Guild, P.Eng.

STATEMENT OF COSTS

The following shows a distribution of the total costs incurred by Welcome North Mines Ltd. (N.P.L.) on behalf of the Vangorda Joint Venture in carrying out exploration work on the RACHEL-MN claim group during the 1977 field season. These costs can be invoice supported or in the case of internal costs documented.

The costs can be summarized as follows:

<u>DESCRIPTION</u>	<u>RACHEL/MN</u>
	\$
ASSAYS & GEOCHEMICAL ANALYSIS	373.00
CAMP MAINTENANCE	2,169.17
DISTRICT EXPENSE	558.33
DRILLING	27,078.72
ROTARY WING RELATED TO DRILLING	14,993.30
FIELD EQUIPMENT/SUPPLIES	3,493.92
FIXED WING	25.68
FUEL	804.05
LINECUTTING	4,000.00
ROTARY WING	2,373.15
SALARIES & WAGES	3,828.52
SURVEYS, GEOPHYSICAL	776.38
TRANSPORTATION & MISC.	1,189.06
OVERHEAD	<u>4,483.25</u>
TOTAL	<u><u>66,146.53</u></u>

EXPENDITURES DIRECTLY RELATED TO DIAMOND DRILLING ON
THE RACHEL-MN PROPERTY DURING 1977

\$42,072.02

WELCOME NORTH MINES LTD. (N.P.L.)

1027 - 470 Granville St., Vancouver, B.C. V6C 1V5 Telephone (604) 687-1658

January 9, 1978.

AFFIDAVIT SUPPORTING SUMMARY OF COSTS

 I, JOHN D. GUILD, Geologist

Welcome North Mines Ltd. (N.P.L.) of Vancouver, British Columbia,
do hereby state that to the best of my knowledge and belief the
statement of costs presented in this report "DIAMOND DRILLING ON
THE RACHEL-MN MINERAL CLAIMS"

is both correct and true.

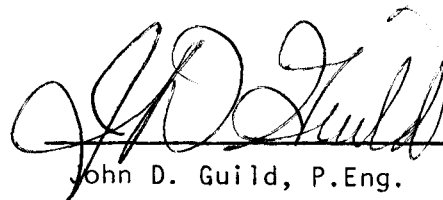

John D. Guild, P.Eng.

SWORN BEFORE ME at the City of
Vancouver, in the Province of
British Columbia, this 13 day
of January, 1978.



A Notary Public in and for the
Province of British Columbia.

CERTIFICATE

I, John D. Guild, of 13291 Woodcrest Drive, Surrey, British Columbia, DO HEREBY CERTIFY:

- 1) That I am a geologist with a business office at 1027 - 470 Granville Street, Vancouver, B.C.
- 2) That I am a graduate in geology of the University of Alberta (BSc. - 1959).
- 3) That I have practiced my profession as a geologist for the past eighteen years.
- 4) That to the best of my knowledge and belief, the statement of costs presented in this report "DIAMOND DRILLING ON THE RACHEL-MN MINERAL CLAIMS" is both correct and true.



John D. Guild, P.Eng.

SWORN BEFORE ME at the City of Vancouver, in the Province of British Columbia, this 13 day of January, 1978.

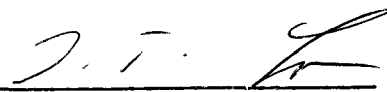

A Notary Public in and for the Province of British Columbia.

ACME ANALYTICAL LABORATORIES LTD.

Assaying & Trace Analysis
6455 Laurel St., Burnaby, B.C. V5B 3B4

Tel: 299-5242

TO

Welcome North Mines Ltd.

RAZ CLAIM GROUP

ANALYSES CERTIFICATE

File No. 7604Type of Samples Cores

105 KG

DIAMOND DRILL HOLES 77 VZ 1 and 77 VZ 2

Disposition _____

43

No.	Sample	Mo	Cu	Pb	Zn						No.
01	77 VR2-210'			35	78						01
02	220			31	88						02
03	230			32	92						03
04	240			31	86						04
05	250			22	118						05
06	260			36	78						06
07	270			28	76						07
08	280			33	72						08
09	290			31	92						09
10	300			28	98						10
11	310			205	62						11
12	320			73	68						12
13	330			36	200						13
14	342			35	182						14
15	350			20	68						15
16	360			22	67						16
17	370			33	74						17
18	380			30	146						18
19	77 VR2-385'			17	126						19
20											20
21	77 VZ1- 35'			28	132						21
22	45			24	120						22
23	55			26	138						23
24	65			27	144						24
25	75			27	142						25
26	85			32	148						26
27	95			31	144						27
28	105			29	142						28
29	115			34	146						29
30	125			29	128						30
31	135			29	148						31
32	145			33	162						32
33	155			35	150						33
34	165			34	152						34
35	175			28	130						35
36	185			26	128						36
37	195			30	124						37
38	205			30	154						38
39	77 VZ1-215'			27	106						39
40											40

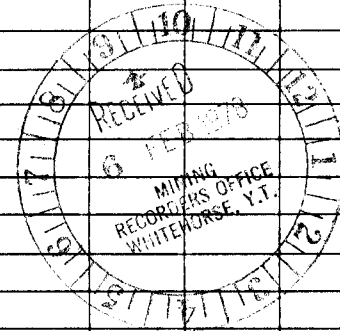

All reports are the confidential property of clients.

All results are in parts per million.

DATE SAMPLES RECEIVED Sept. 20, 1977DATE REPORTS MAILED Sept. 26, 1977ANALYST Deane Joffe

ACME ANALYTICAL LABORATORIES LTD.

Assaying & Trace Analysis
6455 Laurel St., Burnaby, B.C. V5B 3B4

Tel: 299-5242 77VZ-1
77VZ-2

TO
Welcome North Mines Ltd.

File No. 7604

ANALYSES CERTIFICATE

Type of Samples Cores

Disposition _____

44

No.	Sample	Mo	Cu	Pb	Zn						No.
01	77 VZ1-225'			29	122						01
02	235			32	142						02
03	245			27	128						03
04	255			29	106						04
05	265			30	148						05
06	275			44	160						06
07	285			39	136						07
08	295			31	122						08
09	305			30	108						09
10	315			31	4700						10
11	325			32	142						11
12	335			38	146						12
13	345			28	126						13
14	355			32	162						14
15	365			32	143						15
16	375			27	144						16
17	385			40	150						17
18	395			22	112						18
19	405			29	128						19
20	415			36	162						20
21	425			35	154						21
22	435			52	132						22
23	445			31	126						23
24	77 VZ1-454'			32	124						24
25											25
26	77 VZ2- 30'			26	112						26
27	40			30	150						27
28	50			22	92						28
29	60			27	35						29
30	70			17	102						30
31	80			16	445						31
32	90			16	980						32
33	100			13	910						33
34	110			24	275						34
35	120			19	250						35
36	130			21	255						36
37	140			29	445						37
38	150			25	375						38
39	77 VZ2-160'			26	168						39
40											40

All reports are the confidential property of clients.
All results are in parts per million.

DATE SAMPLES RECEIVED Sept. 20, 1977
DATE REPORTS MAILED Sept. 28, 1977
ANALYST *Dean J. [Signature]*

ACME ANALYTICAL LABORATORIES LTD.

Assaying & Trace Analysis
6455 Laurel St., Burnaby, B.C. V5B 3B4

77VZ1 &
Tel: 299-5242
77VZ 2

TO
Wellcome North Mines Ltd.

File No. 7604

Type of Samples Cores

Disposition

ANALYSES CERTIFICATE

45

No.	Sample	Mo	Cu	Pb	Zn						No.
01	77 VZ2-170'			24	430						01
02	180			19	580						02
03	190			23	210						03
04	200			22	380						04
05	210			16	285						05
06	220			45	320						06
07	230			25	455						07
08	240			20	330						08
09	250			19	400						09
10	260			18	225						10
11	270			20	142						11
12	280			34	132						12
13	290			33	230						13
14	300			26	108						14
15	310			30	124						15
16	320			41	136						16
17	330			24	118						17
18	340			40	144						18
19	350			30	114						19
20	77 VZ2-357'			32	162						20
21											21
22											22
23											23
24											24
25											25
26											26
27											27
28											28
29											29
30											30
31											31
32											32
33											33
34											34
35											35
36											36
37											37
38											38
39											39
40											40

All reports are the confidential property of clients.
All results are in parts per million.

DATE SAMPLES RECEIVED Sept. 20, 1977
DATE REPORTS MAILED Sept. 26, 1977
ANALYST Debra J. [Signature]

ACME ANALYTICAL LABORATORIES LTD.

Assaying & Trace Analysis

6455 Laurel St., Burnaby, B.C. V5B 3B4

Tel: 299-5242

TO

Welcome North Mines Ltd.

RACHEL MN CLAIM GROUP
105K 2, 3

ANALYSES CERTIFICATE

File No. 7604

Type of Samples Cores

DIAMOND DRILL HOLES 77 VR1 and 77 VR 2

Disposition _____

41

No.	Sample	Mo	Cu	Pb	Zn						No.
01	<u>77 VR1 - 40'</u>			34	114						01
02	50			71	92						02
03	60			36	56						03
04	70			64	124						04
05	80			340	215						05
06	90			24	62						06
07	100			22	138						07
08	110			13	130						08
09	120			160	215						09
10	130			43	92						10
11	140			30	96						11
12	150			16	92						12
13	160			7	46						13
14	170			12	58						14
15	180			67	26						15
16	190			26	18						16
17	200			25	35						17
18	210			24	38						18
19	220			54	31						19
20	230			16	23						20
21	240			41	28						21
22	250			20	24						22
23	260			21	29						23
24	270			13	27						24
25	280			14	32						25
26	290			17	26						26
27	300			22	28						27
28	310			20	37						28
29	320			26	27						29
30	330			26	33						30
31	340			24	49						31
32	350			23	42						32
33	360			37	41						33
34	370			20	36						34
35	380			19	27						35
36	390			26	53						36
37	<u>77 VR1- 400'</u>			18	36						37
38											38
39											39
40											40

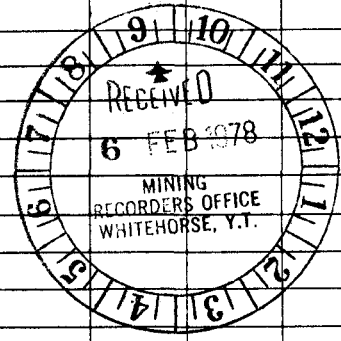

All reports are the confidential property of clients.
All results are in parts per million.

DATE SAMPLES RECEIVED Sept. 20, 1977
DATE REPORTS MAILED Sept. 26, 1977
ANALYST Dean Jeff

ACME ANALYTICAL LABORATORIES LTD.
Assaying & Trace Analysis

Tel: 299-5242

TO

Welcome North Mines Ltd.

6455 Laurel St., Burnaby, B.C. V5B 3B4

File No. 7604

ANALYSES CERTIFICATE

Type of Samples Cores

Disposition _____

42

No.	Sample	Mo	Cu	Pb	Zn						No.
01	77 VR1-410'			25	84						01
02	420			22	52						02
03	430			22	58						03
04	440			27	72						04
05	450			22	72						05
06	460			29	64						06
07	470			24	82						07
08	480			17	26						08
09	490			33	60						09
10	500			31	71						10
11	510			35	67						11
12	520			21	62						12
13	530			31	67						13
14	540			35	68						14
15	550			31	56						15
16	560			30	62						16
17	570			50	80						17
18	580			31	72						18
19	590			19	46						19
20	77 VR1-600'			20	45						20
21											21
22	77 VR2- 30'			132	240			Collar			22
23	34-40			18	122						23
24	47			28	92						24
25	57			35	148						25
26	70			32	255						26
27	80			230	1550						27
28	90			108	128						28
29	100			32	116						29
30	110			48	172						30
31	120			41	106						31
32	130			34	102						32
33	140			35	56						33
34	150			29	56						34
35	160			34	74						35
36	170			36	72						36
37	180			58	68						37
38	190			31	86						38
39	77 VR2-200'			32	82						39
40											40

All reports are the confidential property of clients.
All results are in parts per million.

DATE SAMPLES RECEIVED Sept. 20, 1977
DATE REPORTS MAILED Sept. 26, 1977
ANALYST Dean Jeff

ACME ANALYTICAL LABORATORIES LTD.

Assaying & Trace Analysis

6455 Laurel St., Burnaby, B.C. V5B 3B4

Tel: 299-5242

TO

Welcome North Mines Ltd.

File No. 7604

Type of Samples Cores

Disposition _____

ANALYSES CERTIFICATE

43

No.	Sample	Mo	Cu	Pb	Zn						No.
01	77 VR2-210'			35	78						01
02	220			31	88						02
03	230			32	92						03
04	240			31	86						04
05	250			22	118						05
06	260			36	78						06
07	270			28	76						07
08	280			33	72						08
09	290			31	92						09
10	300			28	98						10
11	310			205	62						11
12	320			73	68						12
13	330			36	200						13
14	342			35	182						14
15	350			20	68						15
16	360			22	67						16
17	370			33	74						17
18	380			30	146						18
19	77 VR2-385'			17	126						19
20											20
21	77 VZ1- 35'			28	132						21
22	45			24	120						22
23	55			26	138						23
24	65			27	144						24
25	75			27	142						25
26	85			32	148						26
27	95			31	144						27
28	105			29	142						28
29	115			34	146						29
30	125			29	128						30
31	135			29	148						31
32	145			33	162						32
33	155			35	150						33
34	165			34	152						34
35	175			28	130						35
36	185			26	128						36
37	195			30	124						37
38	205			30	154						38
39	77 VZ1-215'			27	106						39
40											40

All reports are the confidential property of clients.
All results are in parts per million.

DATE SAMPLES RECEIVED Sept. 20, 1977
DATE REPORTS MAILED Sept. 26, 1977
ANALYST Dean Joffe



WELCOME NORTH MINES LTD. (N.P.L.)
1027 - 470 Granville St., Vancouver, B.C. V6C 1V5 Telephone (604) 687-1658

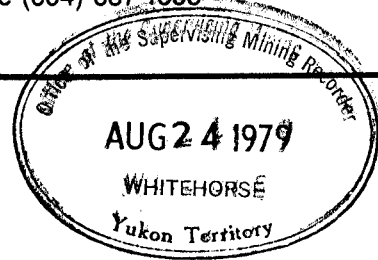

DIAMOND DRILLING REPORT

ON THE

RACHEL AND MN CLAIM GROUPS

N.T.S. 105K-2

WHITEHORSE MINING DISTRICT

Latitude 62°14'N

Longitude 132°58'W



Work Performed During the Period June 10 to July 1, 1979

August 3, 1979

H.F. Foster

091214

TABLE OF CONTENTS

	Page
INTRODUCTION	1
STATEMENT OF COST	6
CERTIFICATE	7
APPENDIX: DIAMOND DRILL LOGS	
FIGURES:	
1. DIAMOND DRILL HOLE LOCATION MAP	2
2. 68VR-1 DIAMOND DRILL HOLE PROFILE	3
3. 79VR-2 DIAMOND DRILL HOLE PROFILE	4
4. 79VM-1 DIAMOND DRILL HOLE PROFILE	5

INTRODUCTION

During the period June 10 to July 1, 1979, Welcome North Mines Ltd. as Operator of the Vangorda Project, a joint venture between Welcome North Mines Ltd. and Getty Canadian Metals, Limited, carried out 403.53 meters (1296 feet) of BQ diamond drilling in three vertical holes on the RACHEL and MN claim groups (N.T.S. 105K-2).

A camp was established on the claims and both the camp and the drill were serviced by helicopters based in Ross River.

This report contains both the lithology logs and graphical representations of geochemical analyses of the drill core (Fig. 1, 2, and 3).

All drill core was removed from the property and placed in storage racks at the Welcome North Mines Ltd. warehouse in Ross River.

Location of drill holes 79VR-1 and 79VR-2 with respect to the RACHEL 8 No. 1 post is as follows:

79VR-1	50 meters north-northwest
79VR-2	175 meters north-northeast

Drill hole 79VM-1 is located 150 meters southwest of MN 3 Post No. 1.

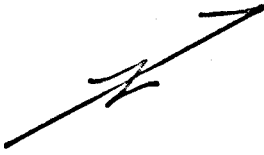

RACHEL

CAT Claims
Boliden Preussag

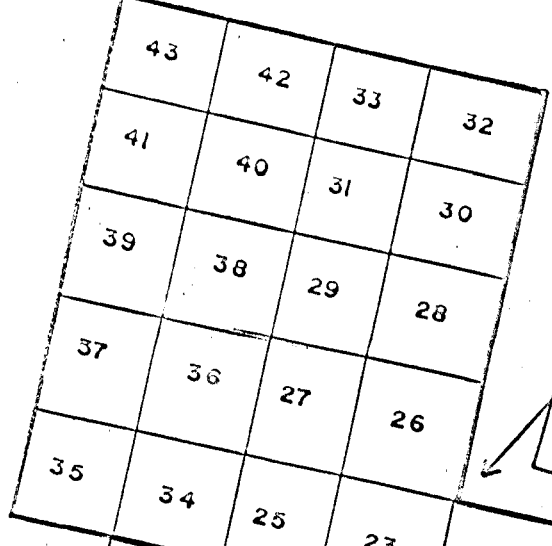

SWIM Claims
Karr Addison

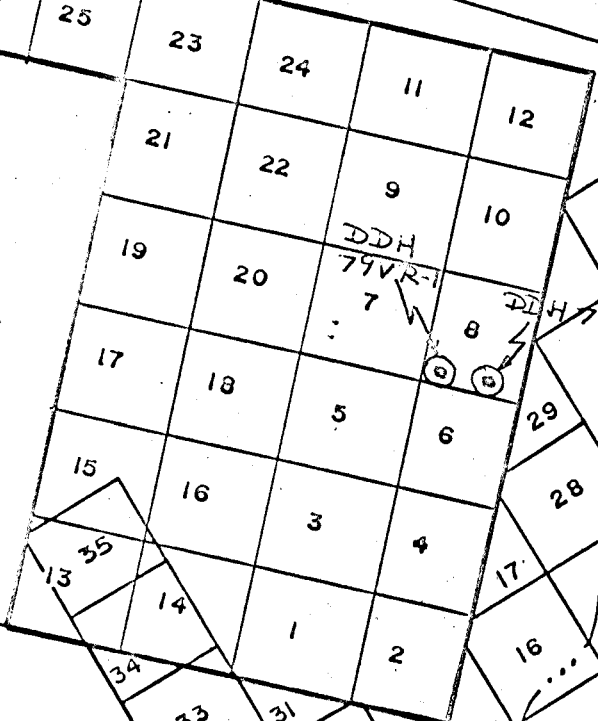

KIT Claims
Cyprus Anvil

SINK Claims
Cyprus Anvil

MN Claims
(optioned)

CIVI Claims
Cream Silver

SEA Claims
Cyprus Anvil

ECHO Claims
Cyprus Anvil

WELCOME NORTH MINES LTD.		
RACHEL CLAIMS		
DIAMOND DRILL HOLE LOCATION MAP		
Scale: 1" = 1/2" 331	Date:	INTS. 105K2
Drawn by:	By:	Fig. 1

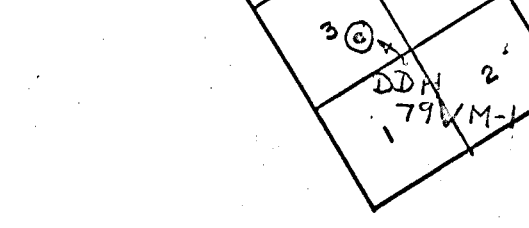

DDH 79VR-1

DEPTH 148.13 m (486 ft)

DIP 0' = -90°
200' = -83°
486' = -73°

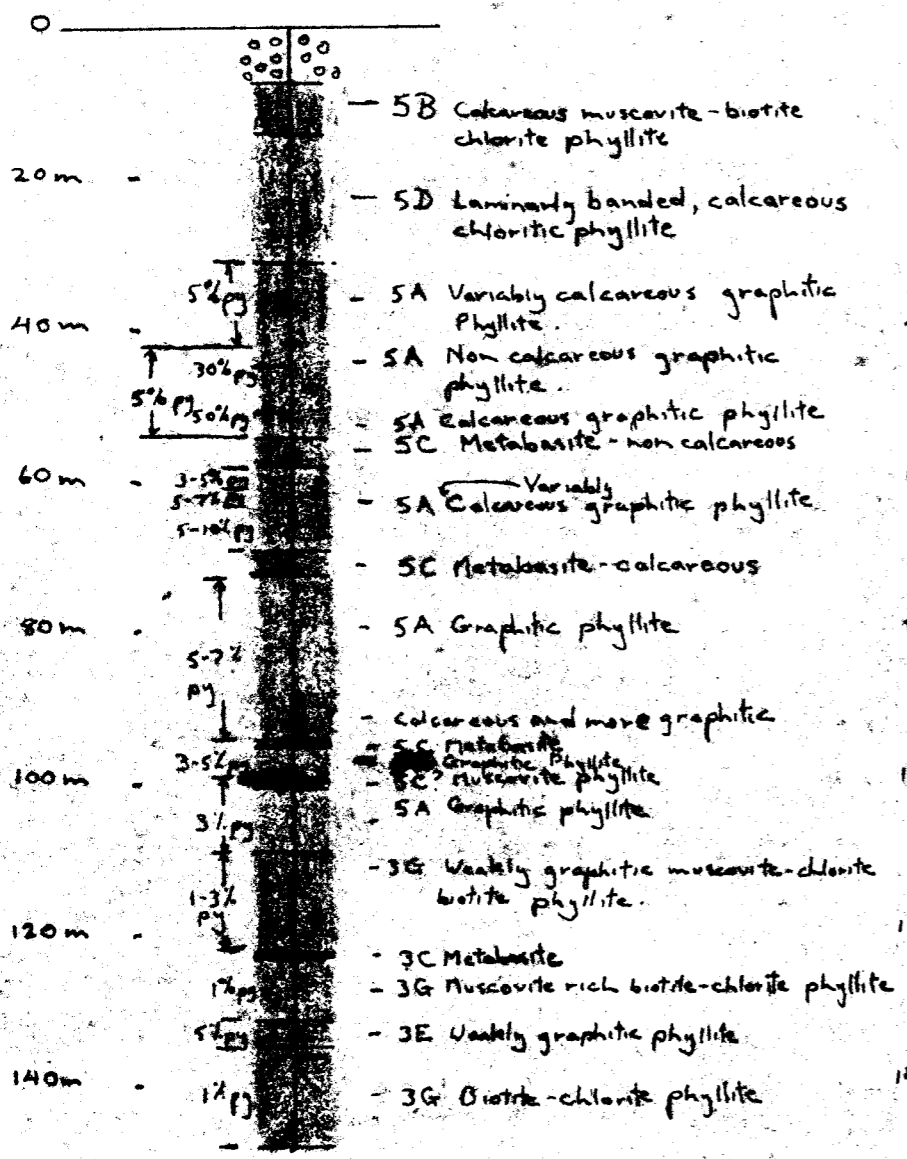

Lead

Values background corrected

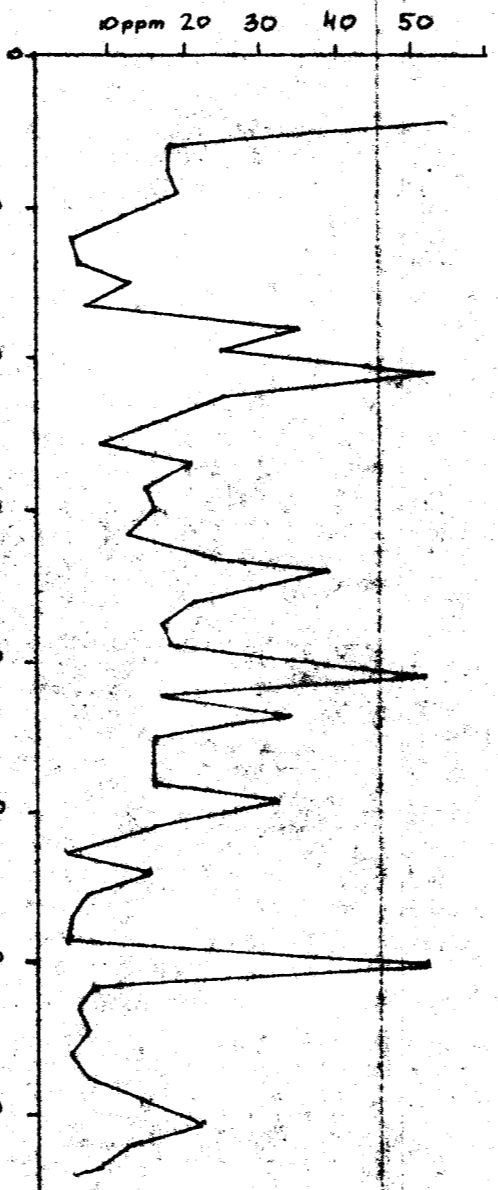

Zinc

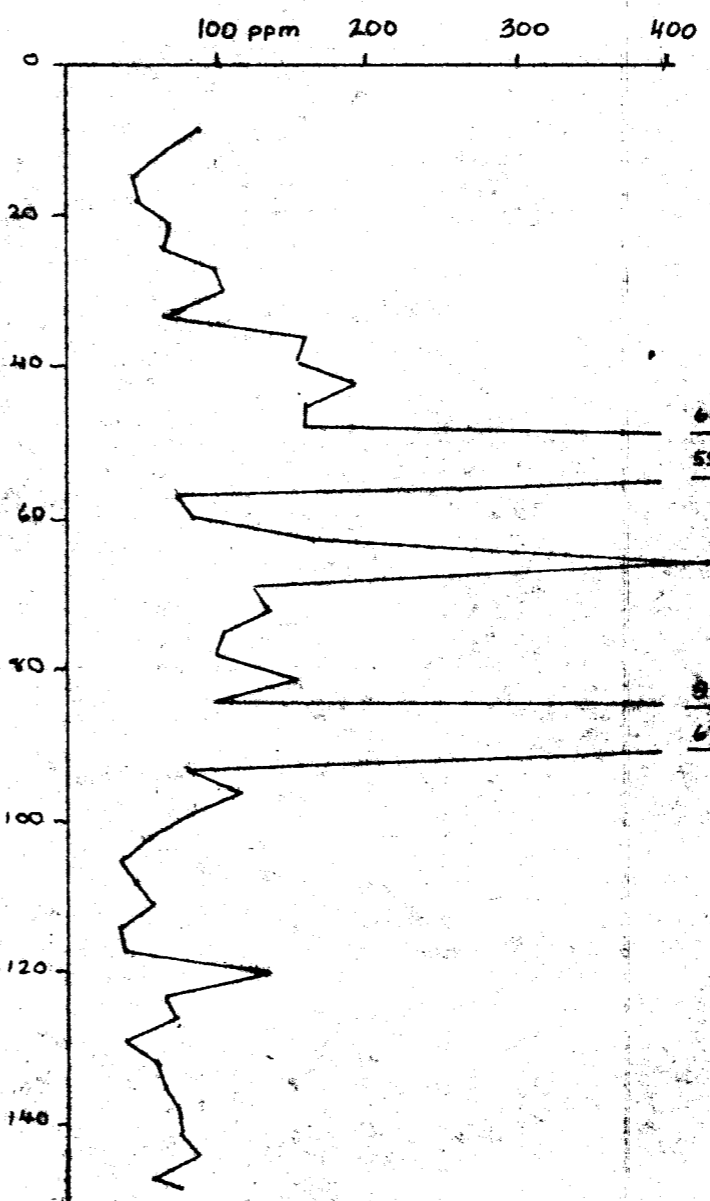

Silver

Values background corrected

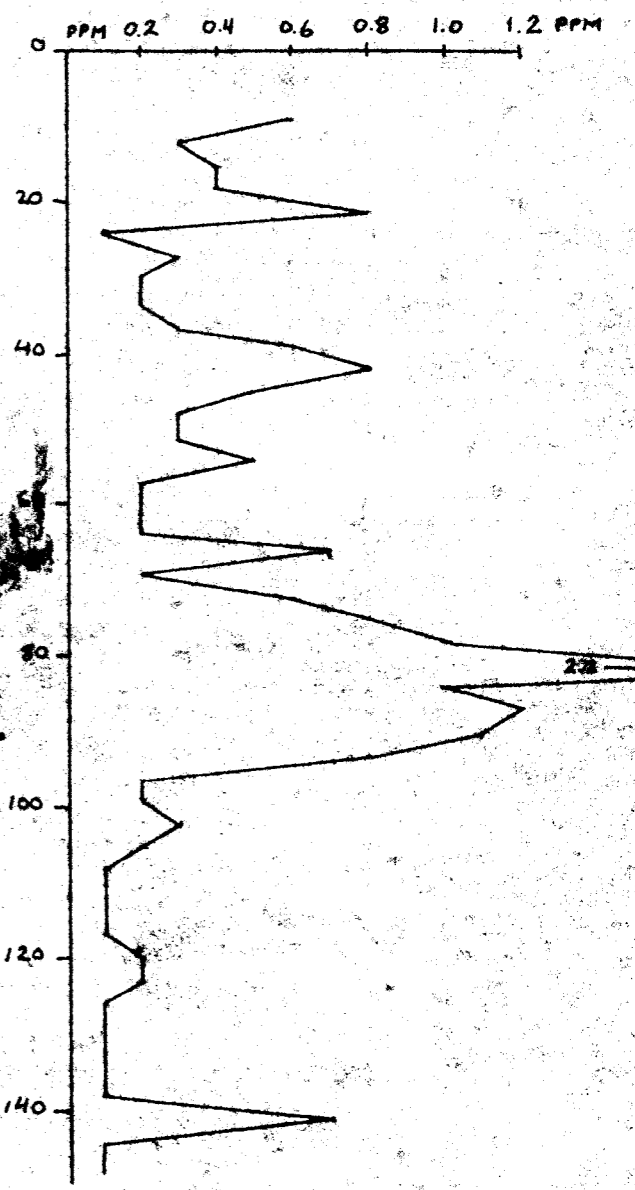

YANGORDA PROJECT
 RACHEL CLAIMS
 DDH 79VR-1
 DIAMOND DRILL HOLE
 PROFILE
 FIG 2

DDH 79VR-2

Depth: 121.9 m

Dip: -90°

LOCATION: Line 48M S+75 E

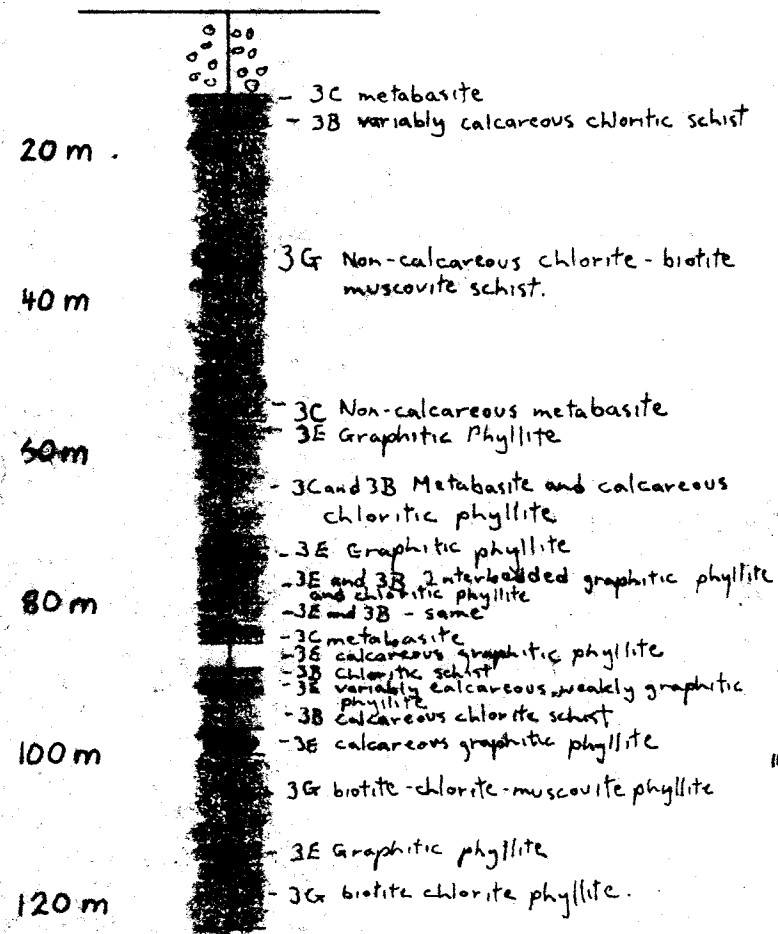

Sulfides 1% or less throughout the hole.

% Recovery

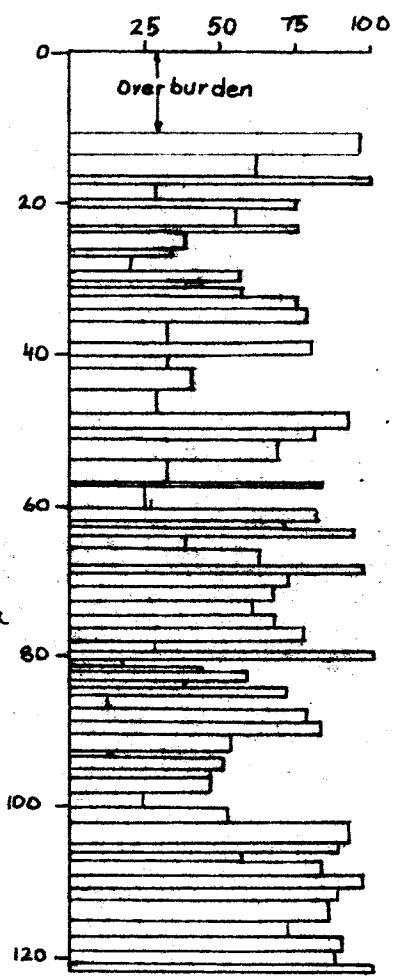

Lead in ppm background corrected

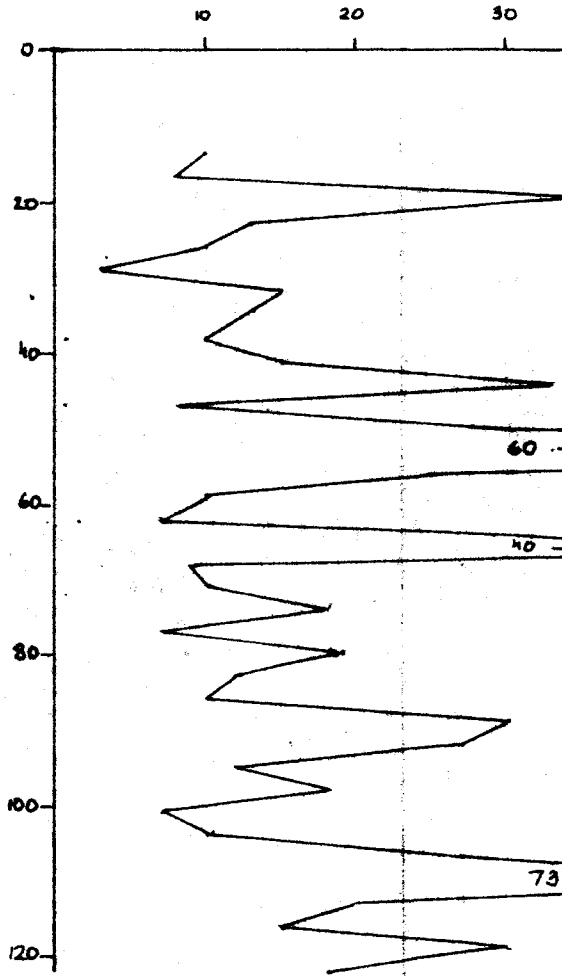

Zinc in ppm

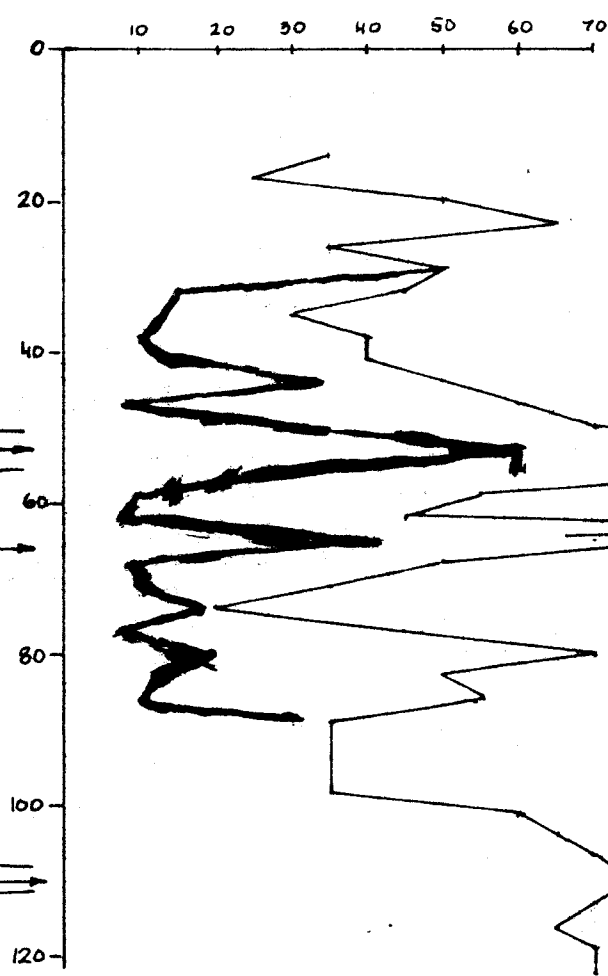

Silver in p.p.m

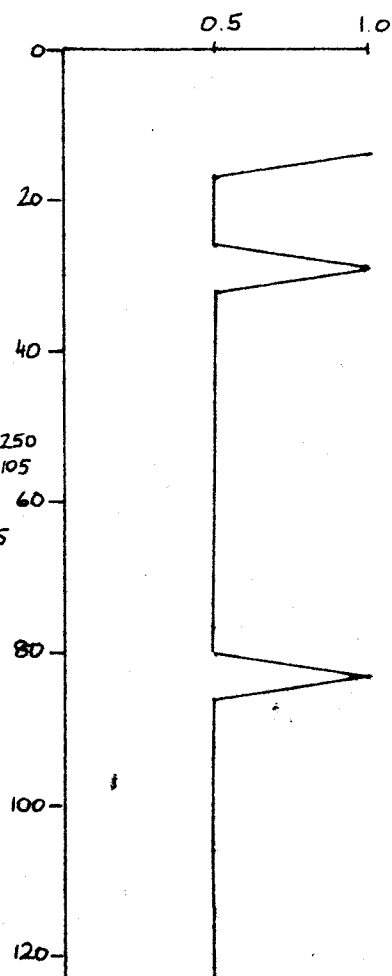

Vangorda Project
 Rachel Claims
 DDH 79 VR-2
 Diamond Drill Hole
 1:1000 Profile Fig 3

DDH 79 VM-1

Depth: 133.5 m

Dip: -90°

Location: Line 112 E
9+755

CORE RECOVERY

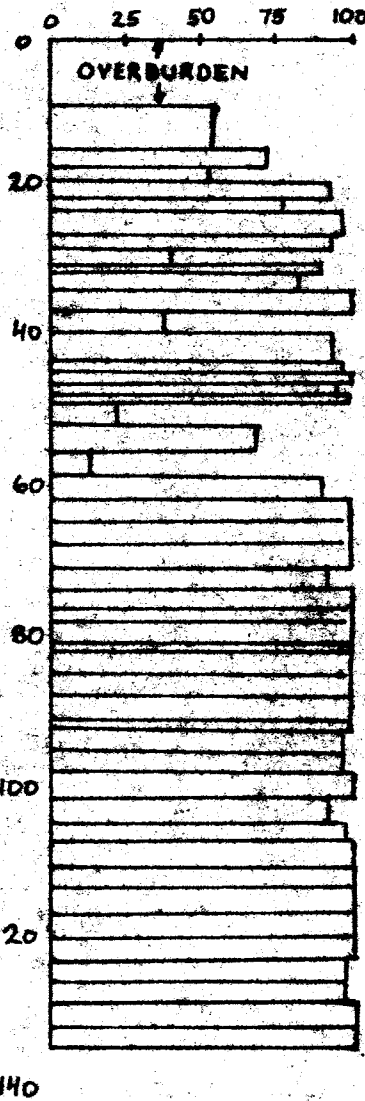

LEAD IN PPM

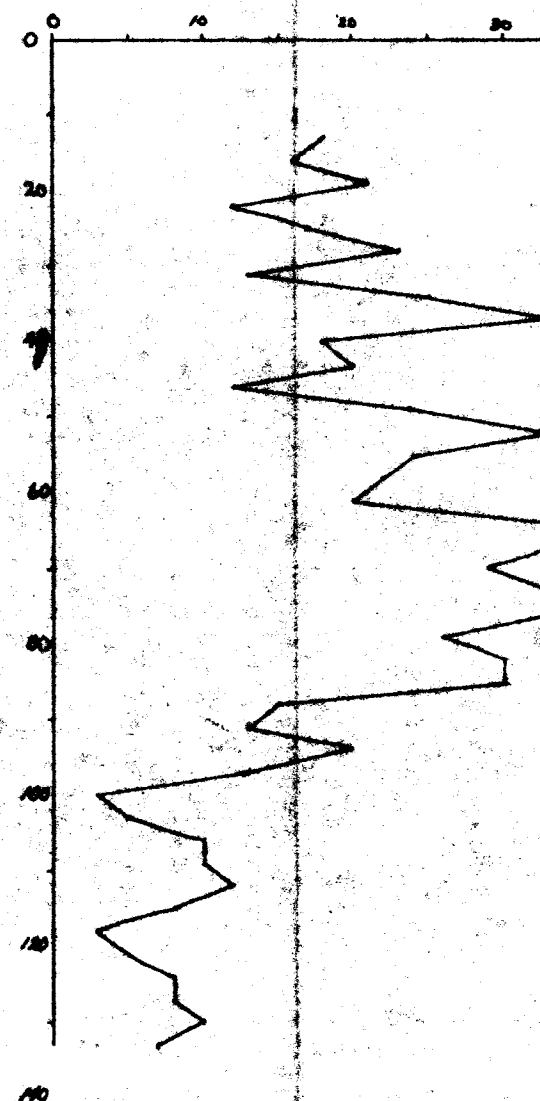

ZINC IN PPM

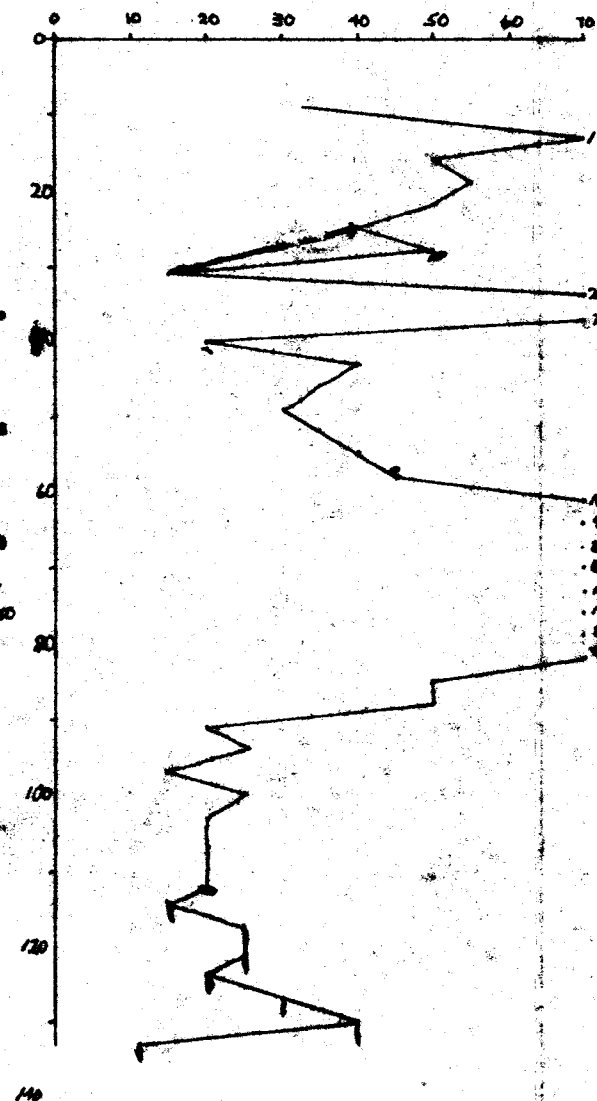

COPPER IN PPM

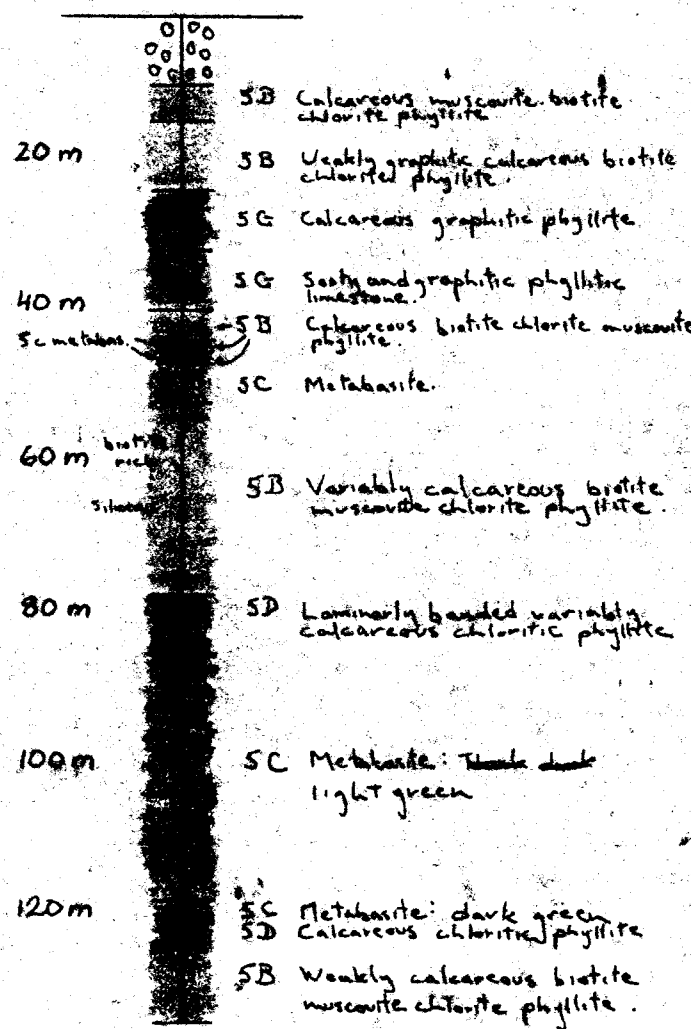
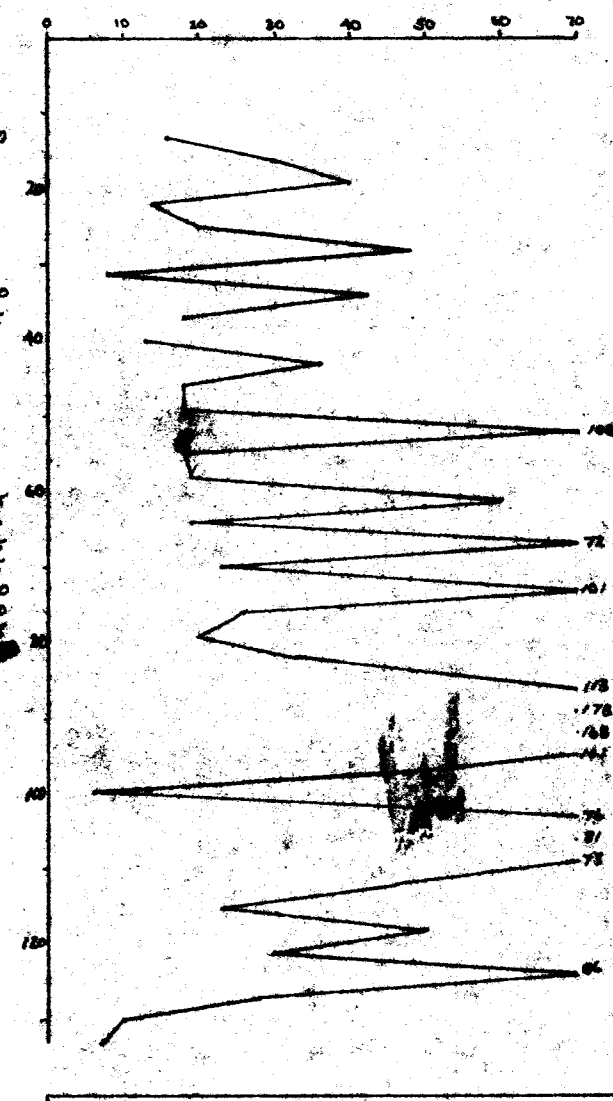

Sulfide content is 1% or less throughout

Vangorda Project
MN Claims
DDH 79 VM-1
Diamond Drill Hole Profile
1:1000



WELCOME NORTH MINES LTD. (N.P.L.)
1027-470 Granville St., Vancouver, B.C. V6C 1V5 Telephone (604) 687-1658

STATEMENT OF COSTS

DDH 79VR-1	Drilling cost	\$11,612.91
DDH 79VR-2	Drilling cost	9,821.86
DDH 79VR-3	Drilling Cost	<u>10,910.79</u>
	TOTAL	<u><u>\$32,345.56</u></u>

CERTIFICATE

I, H. Frank Foster, of 2568 Palmerston Avenue, West Vancouver, British Columbia, DO HEREBY CERTIFY:

- 1) That I am a geologist with a business office at 1027 - 470 Granville Street, Vancouver, B.C.
- 2) That I am a graduate in honours geology of the University of British Columbia (B.Sc. - 1974).
- 3) That I have practiced my profession as a geologist for the past 5 years.
- 4) That to the best of my knowledge and belief, the statement of costs presented in this report "DIAMOND DRILLING REPORT ON THE RACHEL AND MN CLAIM GROUPS" is both correct and true.
- 5) That I hold an interest in the shares of Welcome North Mines Ltd. (N.P.L.), and that I am employed by Welcome North Mines Ltd. (N.P.L.) as a staff geologist.

H F Foster
H. Frank Foster

Sworn before me at the City of Vancouver, in the Province of British Columbia, this 13 day of August, 1979.

J R Jee

A Notary Public in and for the Province of British Columbia.

ARCTIC DIAMOND DRILLING LTD.

184 Industrial Road, Whitehorse, Yukon Y1A 2V1 (403) 667-6434

INVOICE # 2065

July 10, 1979

IN ACCOUNT WITH:

WELCOME NORTH MINES LTD.,
1027 -470 Granville Street
Vancouver, B.C.
V6C 1V5

Drilling charges to July 4, 1979.

Hole # R-1-90'xBQ

Moving

64 Man hrs. @ 17.75 per hr. 1136.00 ✓

Overburden

0-24=24 ft @ 18.85 per ft. 452.40 ✓

Core Drilling

24-488 =464 ft @ 18.85 per ft. 8746.40 ✓

Testing

2 Man Ers @ 17.75 per hr 35.50
1 Machine Hr @ 10.00 per hr 10.00 45.50 ✓

Loss of Water Supply

4 Man hrs @ 17.75 71.00
2 Machine hrs. @ 10.00 20.00 91.00 ✓

Use of Mud

17 Man hrs. @ 17.75 301.75
8½ Machine hrs @ 10.00 per hr 85.00
17 only 50lb bags Mud @ 10.00 170.00
2 bags Quick Troll @ 82.80 165.60 722.35 ✓

Equipment left in hole

2 only 10' length BW Casing 126.00
1 only 5' Lenght BW Casing 36.45
1 only 2' length BW Casing 20.70
1 only BW Casing Shoe 198.00
381.15
Plus 10 % 38.11 419.26 ✓

11,612.91

Hole # R-2-90 ' xBQ

MOVING

63 Man hrs @ 17.75 per hr. 1118.25 ✓

Overburden

0-36=36 ft @ 18.85 per ft 678.60 ✓

Core Drilling

36-400 =364 ft @ 18.85per ft. 6861.40 ✓

c/Fwd..... 8658.25

11,612.9

PAID
Chk. # 1545
Date 7/19/79
Code.....
Journal.....



ARCTIC DIAMOND DRILLING LTD.

184 Industrial Road, Whitehorse, Yukon Y1A 2V1 (403) 667-6434

B/ Fwd.....8658.25.....11612.91

Testing

2 Man hrs. @ 17.75 35.50
1 Machine hr @ 10.00 per hr. 10.00 45.50 ✓

Use of Mud

14 man hrs. @ 17.75 per hr 248.50
7 Machine hrs @ 10.00 perhr 70.00
14 Bags Quick Gell @ 10.00 140.00
2 Boxes Quick Troll @ 82.50 165.60 624.10 ✓

Equipment left in Hole

3 only 10ft lengths BW Casing 189.00

3 only 2 ft lengths BW Casing 62.10

1 only BW Casing Shoe 198.00
449.10

Plus 10 % 44.91 494.01 ✓

9821.86

Rach

Hole # UM-1-90'xNQ

Moving

76 Man hrs @ 17.75 per hr 1349.00 ✓

Standby & waiting for chopper 142.00 ✓

8 Man hrs. @ 17.75 per hr. 142.00 ✓

Overburden 565.50 ✓

0-30=30 ft @ 18.85 per ft. 565.50 ✓

Core Drilling 7690.80 ✓

30-438 = 408 ft @ 18.85 per ft.

Testing

2 Man hrs. @ 17.75 per hr. 35.50

1 Machine hr @ 10.00 10.00 45.50

Use of Mud

8 Man hrs. @ 17.75 per hr. 142.00

4 Machine hrs @ 10.00 per hr. 40.00

8 Bags Quick Gel @ 10.00 80.00

1 Case Quick Trol 82.80 344.80

Equipment left in hole

3 only 10' lengths BW Casing 189.00

2 only 2' lengths NW Casing 46.90

1 only BW Casing Shoe 198.00

1 only NW Casing Shoe 269.00

702.90

Plus 10 % 70.29 773.19

10,910.79

M

c/fwd.....32,345.56

PAID
Chk. # 1545
Date 7/19/79
Code
Journal

7/19/79 MN

APPENDIX

DIAMOND DRILL LOGS

