

NORQUEST JOINT VENTURE

REPORT SHOWING DETAILS OF EXPENDITURES FOR
ASSESSMENT WORK REQUIREMENTS - "COPTER" CLAIM GROUP.

LOCATED AT

61° 23' N. Lat.

128° 25' W. Long.

MINERAL CLAIM SHEET NO. 105-H-8

WATSON LAKE MINING DISTRICT

YUKON TERRITORY

JUNE 15TH TO SEPTEMBER 13TH, 1966

BY

J.W. STOLLERY, P. ENG.

NOVEMBER 21ST, 1966.

091178

TABLE OF CONTENTS

	<u>Page</u>
Introduction	1
Property and Grouping Arrangement	1 & 2
Details of Expenditures on Each Group	3, 4 & 5
APPENDIX 'A' - Invoices in support of expenditures.	
APPENDIX 'B' - Diamond Drill Hole Records.	
APPENDIX 'C' - Writer's Certificate	
MAP - Figure 1 - Key Plan showing drill holes, road constructed and stripping area.	

- - - - -

INTRODUCTION

The purpose of this report is to give the details of expenditures to be applied against assessment work requirements.

During the period from June 15th to September 13th, 1966, Norquest Joint Venture was actively engaged in an exploration program on its "Copter" claim group 128 road miles north of Watson Lake, Yukon Territory.

The work done included diamond drilling, road construction and stripping. This work was carried out by Grant Stewart Construction Ltd., Box 128, Cassiar, B.C. and Cameron McCutcheon Drilling Ltd., 620 - 475 Howe St., Vancouver, B.C., under the supervision of J.W. Stollery, P. Eng., Project Manager for Norquest Joint Venture, 320 - 355 Burrard St., Vancouver 1, B.C.

PROPERTY AND GROUPING ARRANGEMENT

The "Copter" claim group consists of 95 claims and application for grouping under the Yukon Quartz Mining Act has been made in the following manner:-

GROUP 1 - 16 CLAIMS.

	<u>Record No.</u>
Bryan 9	88540
Bryan 10 to 12	88552 - 88554
Bryan 14	88624
Bryan 15	88625
Bryan 23 to 26	88747 - 88750
Bryan 27 to 32	88857 - 88862

GROUP 2 - 16 CLAIMS.

Bryan 1	88551 -
Bryan 2 to 8	88533 - 88539
Bryan 33 to 38	88863 - 88868
Bryan 13	88623
Bryan 16	88626

PROPERTY AND GROUPING ARRANGEMENT
(c'td.)

GROUP 3 - 15 CLAIMS.

	<u>Record No.</u>
Pedro 1 and 2	88547 and 88548
Pedro 3 and 4	88541 and 88542
Pedro 5 and 6	88549 and 88550
Wine 3	88613
Wine 5 to 12	88615 - 88622

GROUP 4 - 16 CLAIMS.

Wine 1 and 2	88611 and 88612
Wine 4	88614
PX 2	88636
PX 4	88638
Ann 17 to 20	88543 - 88546
Ann 21 to 24	88627 - 88630
Ann 31 to 33	89418 - 89420

GROUP 5 - 16 CLAIMS.

Susan 1 and 2	89646 and 89647
Susan 4	89649
PY 2	88564
Ann 8 to 16	88602 - 88610
Ann 25	88751
Ann 29 and 30	89416 and 89417

GROUP 6 - 16 CLAIMS.

Susan 3	89648
Susan 5 to 8	89650 - 89653
OP 1 and 2	88631 and 88632
Ann 1 to 7	88595 - 88601
Ann 26 and 27	88752 and 88753

DETAILS OF EXPENDITURES ON EACH GROUP

Norquest Joint Venture spent a total of \$36,074.57 on diamond drilling, road building and stripping. This figure is supported by enclosed invoices (APPENDIX 'A'). Diamond Drill Hole records are also included with this report (APPENDIX 'B').

The enclosed map gives the location of diamond drill holes, roads and stripping with respect to each claim group.

A more detailed breakdown of costs shows a total of \$22,629.29 was expended on drilling and \$13,445.28 on road building and stripping. On the basis of cost per foot for drilling a total of 1976 feet were drilled at \$11.45/ft.

GROUP 1 -

Work in the amount of \$3,800.00 is required to bring this group up to October 31st, 1969.

This amount was expended in road construction in and to the group.

GROUP 2 -

Work in the amount of \$3,800.00 is required to bring this group up to November 12th, 1969.

This amount was expended in road construction in and to the group.

GROUP 3 -

Work in the amount of \$4,900.00 is required to bring this group up to October 18th, 1970.

This amount was expended in road construction, stripping and diamond drilling.

D.H. #4 - 97 ft. i.e. 97 x \$11.45 = \$1,110.65
Stripping and road building account for the remainder.

DETAILS OF EXPENDITURES ON EACH GROUP
(c'td.)

GROUP 4 -

Work in the amount of \$7,475.00 is required to bring this group up to October 18th, 1971.

This amount was spent primarily in drilling

D.H. #7 - 389 ft.

D.H. #8 - 257 ft.

646 ft. x \$11.45 = \$7,396.70.

The remainder can be accounted for in dozer hours to move and set up the drill.

GROUP 5 -

Work in the amount of \$5,100.00 is required to bring this group up to October 16th, 1971.

This amount was expended through diamond drilling as follows:-

D.H. #2 - 309 ft.

D.H. #5 - 282 ft.

D.H. #6 - 65 ft.

656 ft. x \$11.45 = \$7,511.20.

GROUP 6 -

Work in the amount of \$6,250.00 is required to bring this group up to October 16th, 1971.

This amount was expended through diamond drilling as follows:-

D.H. #1 - 300 ft.

D.H. #3 - 277 ft.

577 ft. x \$11.45 = \$6,606.65.

DETAILS OF EXPENDITURES ON EACH GROUP
(c/td.)

Summary

Total assessment work required	-	\$31,325.00
Total cost of work done	-	\$36,074.57

Respectfully submitted,



J.W. Stollery, P.Eng.
Project Manager,
NORQUEST JOINT VENTURE.

JWS:md

APPENDIX 'A'

INVOICES IN SUPPORT OF EXPENDITURES.

GRANT STEWART CONSTRUCTION LTD.

4027 - 25TH AVENUE S.W. — CALGARY, ALTA.

TEL. 249-3680

Box 128, Cassiar, B.C.

July 13, 1966.

TO: Norquest Joint Venture,
Watson Lake, Yukon.

DATE	PARTICULARS	CHARGES	CREDITS	BALANCE
June 25-30/66	D7 - Cat #3 & Dozer 42 1/2 hrs. @ \$20.00 per hr.	\$850.00		
June 30/66	D7 - Cat #3 & Scraper 3 hrs. @ \$24.00 per hr.	72.00		
Cat Haul - as per attached		154.28		
Scraper Haul - as per attached		112.00		
				\$1,498.28

STATEMENT

*Paid #1,498.28
JWS*

[Handwritten signature]

GRANT STEWART CONSTRUCTION LTD.

4027 - 25TH AVENUE S.W. - CALGARY, ALTA.

TEL. 249-3680

Box 128, Cassiar, B.C.

August 4, 1966.

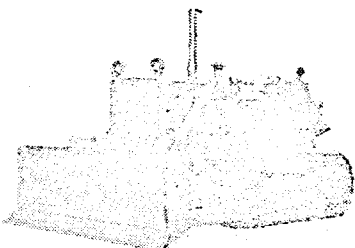

TO: Norquest Joint Venture,
Box 328,
Watson Lake, Yukon.

1314
4370
5684

DATE	PARTICULARS	CHARGES	CREDITS	BALANCE
July 1 - 2	D-7 - Cat #3 & Scraper 15 hrs. @ \$24.00 per hr.	\$ 360.00		
	D-7 - Cat #3 & Dozer 200½ hrs. @ \$20.00 per hr.	\$4,010.00		\$4,370.00

Paid
Aug 10 / 66
[Signature]

STATEMENT

GRANT STEWART CONSTRUCTION LTD.

P.O. BOX 128
CASSIAR, B.C.4027 - 25TH AVE. S.W.
CALGARY, ALBERTASTATEMENT

September 14, 1966.

TO: Norquest Joint Venture,
Box 328,
Watson Lake, Yukon.

<u>Date & Particulars</u>	<u>Charges</u>	<u>Credits</u>	<u>Balance</u>
Aug. 2-31 - D-7 Cat #3 & Dozer Building road and Stripping 270½ hrs. @ \$20.00 per hour	\$5,410.00		
Hauling charges re scraper 224 miles @ 50¢ per mile	112.00		\$5,522.00

ok
 J.S.
 R. C. C.



GRANT STEWART CONSTRUCTION LTD.

4027 - 25TH AVENUE S.W. - CALGARY, ALTA.

TEL. 249-3680

Box 128, Cassiar, B.C.
October 4, 1966.

TO: Norouest Joint Venture,
Box 328,
Watson Lake, Yukon.

DATE	PARTICULARS	CHARGES	CREDITS	BALANCE
Sept. 1 - 13	D7 - Cat #3 & Dozer 87 hrs. @ \$20.00 per hr.	\$1,740.00		
	Cat Haul - as per attached	\$ 315.00		
Sept. 12	2 barrels fuel for stoves 90 gallons @ 39¢/gal	\$ 35.10		\$2,090.10

STATEMENT

Paul J. [Signature]

CAMERON McCUTCHEON DRILLING LIMITED

DIAMOND DRILLING CONTRACTORS

TELEPHONE: 683-1288
 EVES.: 261-0789
 266-7074
 922-3883

12-425 HOWE ST.
 VANCOUVER 1, B.C.

Job 134,
 Invoice 75,
 September 27th, 1966.

Bralorne Pioneer Mines Limited,
 320 - 355 Burrard Street,
 Vancouver 1. B.C.

August 1966 Billing.

Mobilization charge		\$2,800.00
Hole No. 1 0' - 300'		
Hole No. 2 0' - 309'		
Hole No. 3 0' - 277'		
Hole No. 4 0' - 97'		
Hole No. 5 0' - 282'		
Hole No. 6 0' - 65'		
<hr style="width: 20%; margin: 0 auto;"/>		
1,330' @ \$7.50 per ft.		9,975.00
<u>Cost Plus Labour (as attached)</u>	\$1,835.93	
Add 20% Fringe	367.19	
	<hr style="width: 100%;"/>	
	2,203.12	
Aug. 4 1 - NX Casing shoe - 51467	143.20	
1 - BX Casing Shoe - 53093	101.65	
1 - NX Core Bit - 32500	186.28	
1 - NX Reaming Shell - 52416	150.79	
Aug. 7 1 - NX Casing Shoe - 43906	143.20	
Aug.10 1 - NX Casing Shoe - 44815	143.20	
Aug.20 1 - NX Casing Shoe - 36283	143.20	
Aug.22 1 - NX Casing Shoe - 53147	143.20	
Aug. 25 2 - 2' NX Casings @ \$14.49 ea.	28.98	
Aug.26 1 - NX Casing Shoe - 53146	143.20	
1 - BX Casing Shoe - 53100	101.65	
Aug.27 1 - BX Casing Shoe - 53102	101.65	
Aug.28 1 - BX Casing Shoe - 53101	101.65	
Aug. 9 Canadian Longyear Inv.6103878	20.93	
	<hr style="width: 100%;"/>	
	3,855.90	
Add 15% overhead and profit	578.38	4,434.28
Less Board Collected Aug 1-15	\$100.00	
Aug16-31	112.50	(212.50)
	<hr style="width: 100%;"/>	
		<u>\$16,996.78</u>

CAMERON McCUTCHEON DRILLING LIMITED

DIAMOND DRILLING CONTRACTORS

TELEPHONE: 683-1288
 EVES.: 261-0789
 266-7074
 922-3883

12-425 HOWE ST.
 VANCOUVER 1, B.C.

Job 134
 Invoice #88
 November 2, 1966

Bralorne Pioneer Mines Ltd.,
 320 - 355 Burrard Street
 Vancouver 1, B. C.

SEPTEMBER 1966 BILLING

Hole #7	0' - 389'		
Hole #8	0' - 256'		
	<u>645'</u>	@ \$7.50 Per Foot	\$ 4,837.50

<u>Cost Plus Labour</u>	(As Attached)	\$ 607.85
Add 20% Fringe		<u>121.57</u>
		729.42

Cost Plus Supplies & Services

Sept. 2	1 NX Casing Shoe #53150	143.20
	1 BX Casing Shoe #53120	101.65
Sept. 8	1 NX Casing Shoe #44813	143.20
	1 -5' NX Core Barrel	87.58
	1 -5' BX Core Barrel	60.00
	1 BX Core Bit #24393	<u>142.61</u>
		1,407.66
Add 15% Overhead & Profit		<u>211.15</u> 1,618.81

Credit Board Collected Sept 1-15 (102.50)

\$6,353.81
\$6,353.81

COPY

APPENDIX 'B'

DIAMOND DRILL HOLE RECORDS.

DIAMOND DRILL RECORD

 PROPERTY NORQUEST.

 HOLE No. 1
 @ 50° W.

DIP TEST		
Footage	Angle	
	Reading	Corrected

 Hole No. 1 Sheet No. 1 Lat. -
 Section 12+005 2+row Dep. -
 Date Begun AUGUST 4/66 Bearing 558°W
 Date Finished AUGUST 6/66 Elev. Collar. -

 Total Depth 300 FT.
 Logged By JWS.
 Claim Runon #3 89648.
 Core Size 02 WL

DEPTH	DESCRIPTION	SAMPLE No.	WIDTH OF SAMPLE			
0 - 22 FT.	Overburden - coarse sand and gravel - small boulders.					
22 - 300 FT.	Quartz Biotite Schist. Varying amounts of pyrrhotite throughout. Usually found associated with the biotite. Minor amounts of pyrite and a few specks of chalcopyrite also observed throughout the hole. Quartz stringers up to 6" common. From 260 - 300 garnet common. Angles of bedding with core: 60° @ 25 ft. 70° @ 75 ft. 75° @ 150 ft. 90° @ 225 ft. 90° @ 300 ft.					
	Core Recovery 96%.					

DIAMOND DRILL RECORD

PROPERTY No2QUEST.

HOLE No. 2
@ 45° W.

DIP TEST		
Footage	Angle	
	Reading	Corrected

Hole No. 2 Sheet No. 1
 Section 11+00 S 7+00 E.
 Date Begun AUGUST 7/66
 Date Finished AUGUST 9/66.

Lat. -
 Dep. -
 Bearing S 58° W
 Elev. Collar -

Total Depth 309 FT.
 Logged By JWS.
 Claim Section #4 89649
 Core Size 8x4k.

DEPTH	DESCRIPTION	SAMPLE No.	WIDTH OF SAMPLE			
0 - 22	Overburden - sand, gravel, small boulders.					
22 - 180	Quartz Biotite Schist Generally the same as found in D.D.H. #1, with possibly a little more pyrochloite.					angle of bedding with core.
180 - 183	Tenno Granite ?? - massive Minor pyrite in fractures - minor carbonate.					
			70° @ 22 ft			
			75° @ 50 ft.			
			65° @ 105 ft.			
			65° @ 150 ft.			
			80° @ 175 ft.			
183 - 204	Quartz Biotite Schist. - same as 22-180.					
			70° @ 200 ft.			
			80° @ 275 ft.			
			80° @ 300 ft.			
204 - 209	Tenno Granite ?? Same as 180-183.					
209 - 212	Quartz Biotite Schist. same as 183-204.					

DIAMOND DRILL RECORD

PROPERTY NORQUEST.

HOLE No. 3
 @ 45° W.

DIP TEST		
Footage	Angle	
	Reading	Corrected

Hole No. 3 Sheet No. 1 Lat. -
 Section 30+005 00+50 W Dep. -
 Date Begun AUGUST 10/66 Bearing 558° W
 Date Finished AUGUST 15/66 Elev. Collar -

Total Depth 277 FT.
 Logged By JWB.
 Claim Susan #7 89652
 Core Size 82 wt.

DEPTH	DESCRIPTION	SAMPLE No.	WIDTH OF SAMPLE				
0-32	Overburden - sand, gravel, small boulders.						
32-182	Quartz Biotite Schist - Pyrobitite (minor) giving magnetism of varying intensity. Seams thickest about 124'. Soft argillaceous material at 75'. Overall similar to OBS logged in other holes.			Angle of bedding with the hole.			
				50° @ 35'/0			
				70° @ 50'/0			
				75° @ 75'/0			
				75° @ 125'/0			
				75° @ 150'/0			
182-194	Tenon Granite ?? - sections very soft with poor recovery. No pyrobitite. Minor pyrite. Massive. Some carb.			60° @ 240'/0			
194-277	Quartz Biotite Schist - some very soft sections (argillaceous - poor recovery). Minor sulphides. Some clay like material. Some carbonate. Low Recovery 91%						

DIAMOND DRILL RECORD

PROPERTY No 2 QUEST.

HOLE No. 4

⊙ 90°

DIP TEST		
Footage	Angle	
	Reading	Corrected

Hole No. 4 Sheet No. 1
 Section 60400N 1180E.
 Date Begun AUGUST 20/66
 Date Finished AUGUST 21/66

Lat. -
 Dep. -
 Bearing -
 Elev. Collar -

Total Depth 97 FT
 Logged By JWS.
 Claim WINE 3 88613
 Core Size 2x1x1.

DEPTH	DESCRIPTION	SAMPLE No.	WIDTH OF SAMPLE			
0 - 19	<i>Overburden - sand, gravel and small boulders.</i>					
20 - 50	<i>Quartz Biotite Schist.</i>					
	<i>Slightly magnetic - Very minor pyrrhotite, pyrite and some chloropyrite. Similar to PMS logged in other holes.</i>					
			<i>60° @ 25'</i>			
			<i>60° @ 50'</i>			
50 - 60	<i>Quartzite - massive</i>		<i>60° @ 70'</i>			
			<i>60° @ 90'</i>			
60 - 97	<i>Quartz Biotite Schist.</i>					
	<i>Slightly magnetic - unbedded. Minor sulphides.</i>					
	<i>Core Recovery 97%</i>					

DIAMOND DRILL RECORD

PROPERTY No 290687

HOLE No. 5
 @ 55°

DIP TEST		
Footage	Angle	
	Reading	Corrected

Hole No. 5 Sheet No. 1
 Section 28+03 N 9+50 W
 Date Begun Aug 22 / 66
 Date Finished Aug 24 / 66

Lat. _____
 Dep. _____
 Bearing 558°W
 Elev. Collar _____

Total Depth 282
 Logged By JWS
 Claim ANN 12 88606
 Core Size Ø 2.00 L.

DEPTH	DESCRIPTION	SAMPLE No.	WIDTH OF SAMPLE		
0-48	Overburden - Sand, gravel and small boulders.				
48-87	Quartz, pyrite Schist - Minor suspicious pyrite and pyrite. Slightly magnetic. Similar to Q B Schist logged in other holes.			Angle of bedding	
				80° @	58'
				80° @	150'
				80° @	150'
				75° @	200'
87-91	Tenno Granite ?? greenish some slight amount of carbonate.			85° @	250'
				85° @	280'
91-102	QBS same as above.				
102-106	L.A. ?? same as above				
106-230	QBS.				
230-233	L.A.				
233-255	QBS.				
255-260	L.A.				
260-282	QBS.				
	Core recovery - 94%				

DIAMOND DRILL RECORD

 PROPERTY NORQUEST

 HOLE No. 6

@ 55°

DIP TEST		
Footage	Angle	
	Reading	Corrected

 Hole No. 6 Sheet No. 1 Lat. -
 Section 14+00N 40+00W Dep. -
 Date Begun Aug 26/66 Bearing S 10° W
 Date Finished Aug 28/66 Elev. Collar -

 Total Depth 65 ft.
 Logged By JWS.
 Claim ANN 13 88607
 Core Size 82 wk.

DEPTH	DESCRIPTION	SAMPLE No.	WIDTH OF SAMPLE			
0-58	Overburden - sand, gravel and large boulders up to 2'.					Drilling Procedure
58-65	Hole was lost but presumably seen that this is dolomite. Calc-silicate type rock with 2-3" bands of schist which contain some pyritoids and are slightly magnetic. Carbonate content varies but most of the core contains some. No evidence of mineralization.	DS	0-6'	Nx	csq.	
		NS	6-34'	Bx	csq	
		DS	6-22'	Nx	csq remaining over Bx csq.	
		NS	22-34'	Nx	csq remaining over Bx csq	
			34-44'	Bx	csq.	
		DS	44-48'	Bx	csq changed slow at 48'	
	HOLE LOST.		48'-65'	Bx wk - drilled ahead		
						Dolomite at 58'.
	Bx casing broke at 52 ft.	NS	48-52	Bx	csq. casing broke at 52 ft.	
						Angle of bedding
						75° @ 58 ft.

DIAMOND DRILL RECORD

 PROPERTY NORQUEST

 HOLE No. 7

@ 50°

DIP TEST		
Footage	Angle	
	Reading	Corrected

 Hole No. 7 Sheet No. 1
 Section 42+00N 7+00 W
 Date Begun SEPT 2/66
 Date Finished SEPT 6/66

 Lat. -
 Dep. -
 Bearing S 58° W
 Elev. Collar -

 Total Depth 389 ft.
 Logged By JWS.
 Claim WME 1-88611
 Core Size 2x1/2

DEPTH	DESCRIPTION	SAMPLE No.	WIDTH OF SAMPLE			
0 - 20'	Overburden - sand & gravel.					
				Angle of bedding		
20 - 31'	Quartz Biotite Schist - magnetic Visible pyrrhotite and pyrite in small quantities. Mica - bronze.			75° @	25'	
				70° @	50'	
				80° @	100'	
31 - 40'	Quartz type rock - probably a slight facies change within the schist. Primarily massive - some fractures along which minor pyrite and pyrrhotite can be found. Small 2-3" bands of schist included in this section. Slightly magnetic.			75° @	150'	
				70° @	200'	
40 - 53'	Quartz Biotite Schist - same as 20 - 31'.					
53 - 113'	Quartz type rock - same as 31 - 40'. Small amounts of carbonate. The odd spec of cobalt appears to be sphalerite.					

DIAMOND DRILL RECORD

PROPERTY No. 20055

HOLE No. 7

@ 50°

DIP TEST		
Footage	Angle	
	Reading	Corrected

Hole No. 7 Sheet No. 2 Lat. -
 Section 42+00N 7+00W Dep. -
 Date Begun SEPT 2/66 Bearing S 58° W
 Date Finished SEPT 6/66 Elev. Collar -

Total Depth 389 ft.
 Logged By JWS
 Claim WINE 1 88611
 Core Size 02 WH

DEPTH	DESCRIPTION	SAMPLE No.	WIDTH OF SAMPLE		
113 - 166'	Quartz Biotite Schist - same as 20-31'				
				<i>Angle of bedding</i>	
166 - 282	Quartz Biotite Schist and Quartz Carbonate type rock. The schist is distinctly different from that logged earlier in the hole. It is very finely bedded, only very slightly magnetic. The mica is no longer of a bronze color but primarily black. Minor pyrite visible.			75° at 250'	
				75° at 300'	
				80° at 350'	
				80° at 389'	
	Quartz Carbonate type rock - greenish - minor sulphides - some slightly magnetic from pyrite. Massive primarily - one again some type of possible facies change within the schist.				

DIAMOND DRILL RECORD

PROPERTY NOZQUEST

HOLE No. 7

@ 50°

DIP TEST		
Footage	Angle	
	Reading	Corrected

Hole No. 7 Sheet No. 2 Lat. -
 Section 42+00 N 7+00 W Dep. -
 Date Begun SEPT 2/66 Bearing 5 58° W
 Date Finished SEPT 6/66 Elev. Collar -

Total Depth 389 ft.
 Logged By JWS
 Claim WINE 1 - 68611
 Core Size 8 1/2 in.

DEPTH	DESCRIPTION	SAMPLE No.	WIDTH OF SAMPLE			
282 - 284	Granite or Grano Diorite Probably a dike.					
284 - 389	This whole section is a mixture of slightly magnetite schist and carbonate quartz rock. The quartz rock is often a pale green color. At footage 272 blocks of apatite up to 1" occur. Pyrrhotite associated with the apatite gives moderate magnetism. Calc-silicate type host. 335-338 - Granite or Grano Diorite type 335-368 and 376-382 - Calc-silicate with large pink Xala porphy garnet. 382-389 - More fine grained schist. Disseminated pyrite & pyrrhotite can be found throughout. Some small blocks of apatite at 383.					
	Low Recovery 93%					

DIAMOND DRILL RECORD

PROPERTY NORQUEST

HOLE No. 8

(@ 60° W)

DIP TEST		
Footage	Angle	
	Reading	Corrected

Hole No. 8 Sheet No. 1 Lat. -
 Section 42102N 12750 W Dep. -
 Date Begun SEPT 8 1966 Bearing 558° W
 Date Finished SEPT 12 1966 Elev. Collar -

Total Depth 257
 Logged By JWS.
 Claim WINE 1 - 88611
 Core Size 6.25 in.

DEPTH	DESCRIPTION	SAMPLE No.	WIDTH OF SAMPLE			
0 - 40	Overburden - sand & gravel Some boulders up to 4".					Angle of bedding
40 - 126	Massive blocky dike like rock. Some sections appear to be of granitic composition. Possibly grano-diorite.		75°	(C)	126'	
			70°	(C)	155'	
			80°	(C)	200'	
			80°	(C)	250'	
126 - 180	Quartz - biotite schist - very slightly magnetic - finely bedded.					
180 - 193	Massive blocky dike like rock. Same as 40 - 126					
193 - 237	Quartz biotite schist - same as 126 - 180.					
237 - 257	Massive blocky dike like rock Same as 40 - 126					
	Recovery 93%.					

APPENDIX 'C'

WRITER'S CERTIFICATE.

APPENDIX 'C'

WRITER'S CERTIFICATE

I, John W. Stollery, of Vancouver, B.C., hereby certify that:



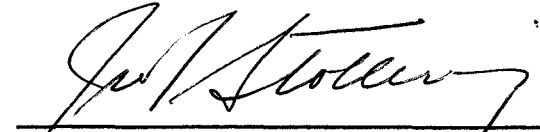

1. I am a Geological Engineer residing at 1275 Haro Street, Vancouver, B.C.
2. I graduated from the Provincial Institute of Mining, Haileybury, Ontario, in 1958 and received a B.Sc. Degree from Michigan Technological University, Houghton, Michigan, U.S.A. in 1961.
3. I am a registered member of the Association of Professional Engineers of Ontario and Quebec. (B.C. pending).
4. During the period of April to the present time I am being retained by Bralorne Pioneer Mines Limited as Project Manager of the Norquest Joint Venture exploration project in the Yukon Territory.
5. I have compiled this report and the field work described herein was carried out under my supervision.

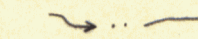
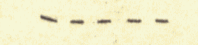

(John W. Stollery, P.Eng.)

Vancouver, B.C.
November 21st, 1966.

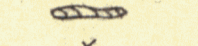
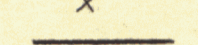
SYMBOLS

-  STREAM
-  ROAD CONSTRUCTION 1966
-  PREVIOUS ROAD CONSTRUCTION
-  DIAMOND DRILL HOLES
-  AREA OF STRIPPING
-  CAMP AREA
-  CLAIM BOUNDARY

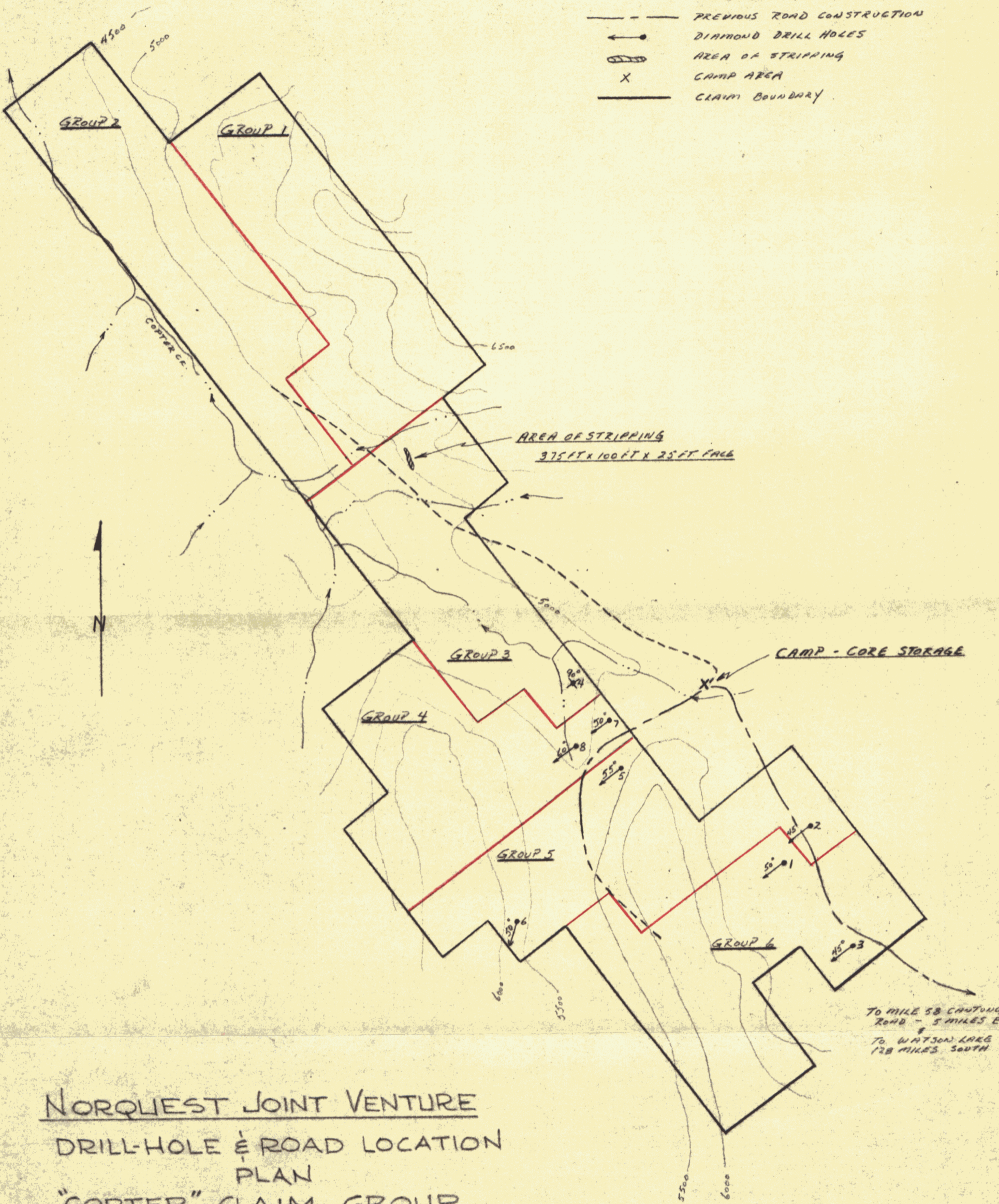

NORQUEST JOINT VENTURE
DRILL-HOLE & ROAD LOCATION
PLAN
"COPTER" CLAIM GROUP
 WATSON LAKE MINING DIST.
 YUKON TERRITORY
 SCALE 1" = 1/2 mi

BY - JW Stollery Nov - 1966