



MATT BERRY MINES LIMITED

COMBINED PROGRESS REPORT

FOR

NOVEMBER & DECEMBER, 1966



Leon F. La Prairie, P.Eng.,
Managing Director

021173

MATT BERRY MINES LTD.

WATSON LAKE MINING DIVISION

FRANCES LAKE AREA
YUKON TERRITORY

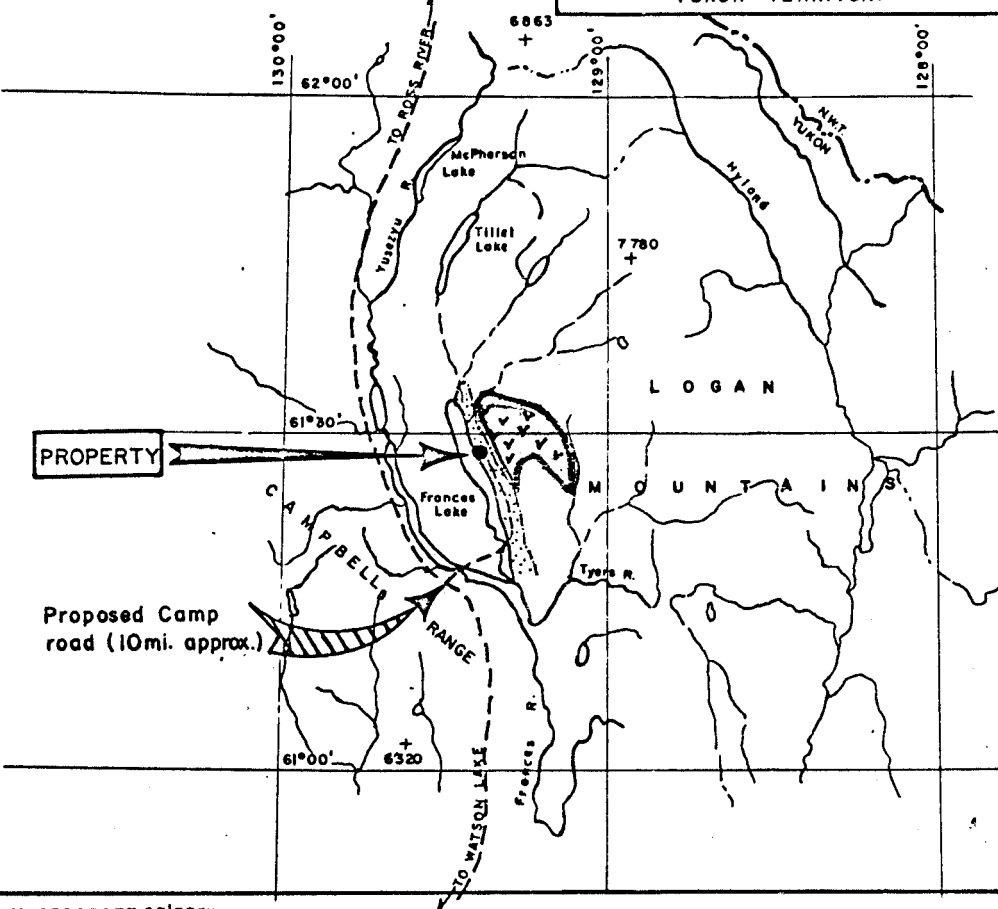

LEGEND

- ACIDIC INTRUSIONS
(Granodiorite, Quartzdiorite & Granite)
- SEDIMENTARY ROCKS
(MONTAGUE GROUP)
- SURFACE MINERALIZATION

Geology from G.S.C. Map 1048A

MATT BERRY MINES LTD.
Group of 52 Mineral Claims.

N.V.-PERDRAFT, Calgary

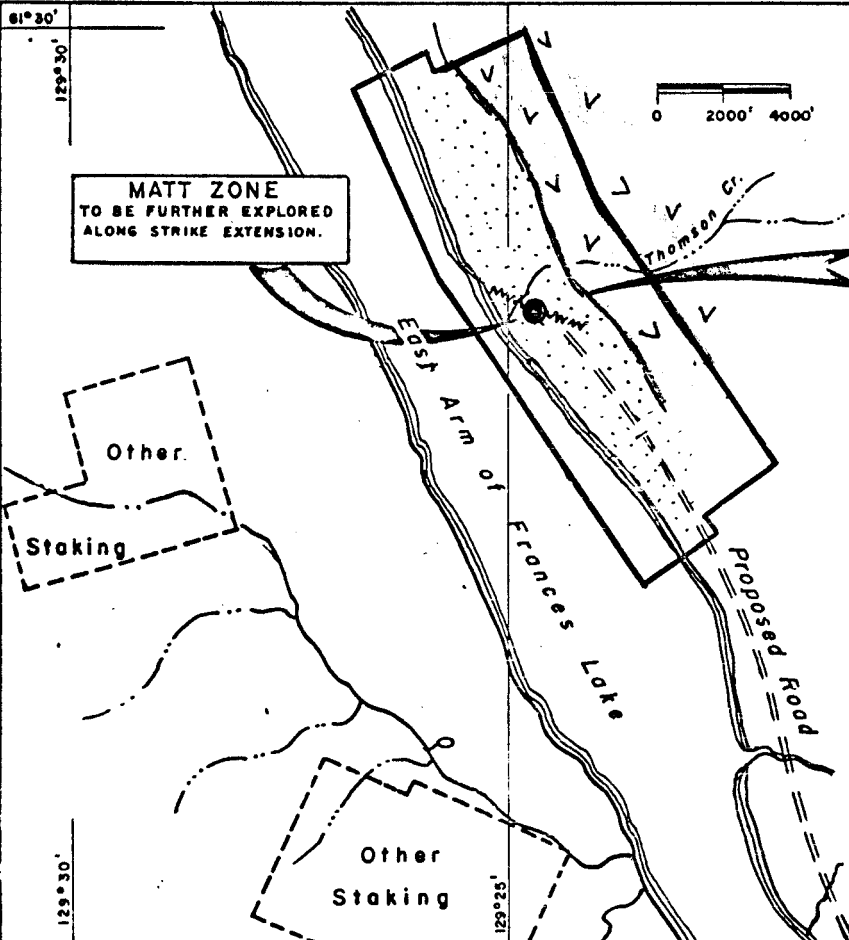

ASSAYS OF SURFACE TRENCH

SILVER, Oz	LEAD %	ZINC %	ANTIMONY %	CHANNEL LENGTH
17.2	11.1	2.6	1.0	22" 70'

PRIME TARGET for additional diamond drilling - Area between southerly end of Matt Zone and intersection of acid intrusion.

LOCATION MAP

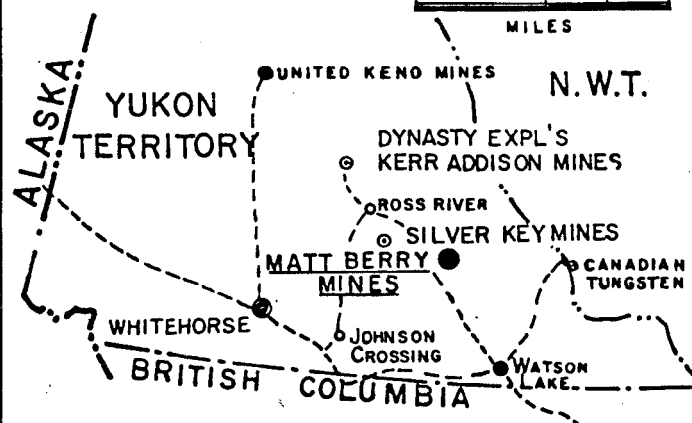

129° 30'

129° 30'

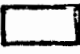
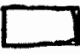
 GROUP 1
 GROUP 2

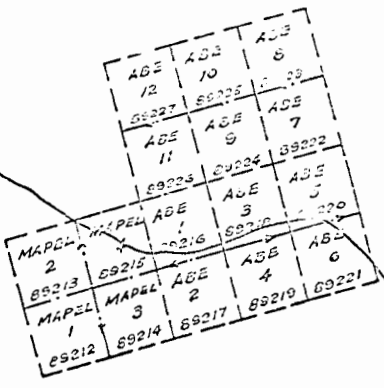
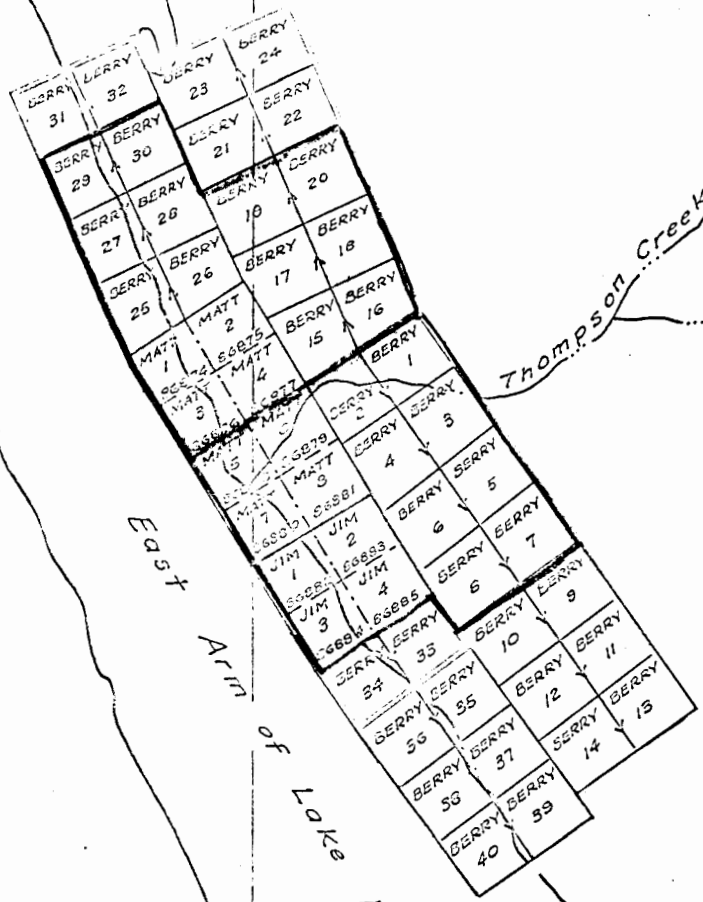

SIMPSON
 TOWER

CLAIM PLAN
MATT BERRY MINES LTD.

NTS SHEET 105 H-6
 WATSON LAKE MINING DIVISION

YUKON — TERRITORY

SCALE: 1" = 0.75 M.

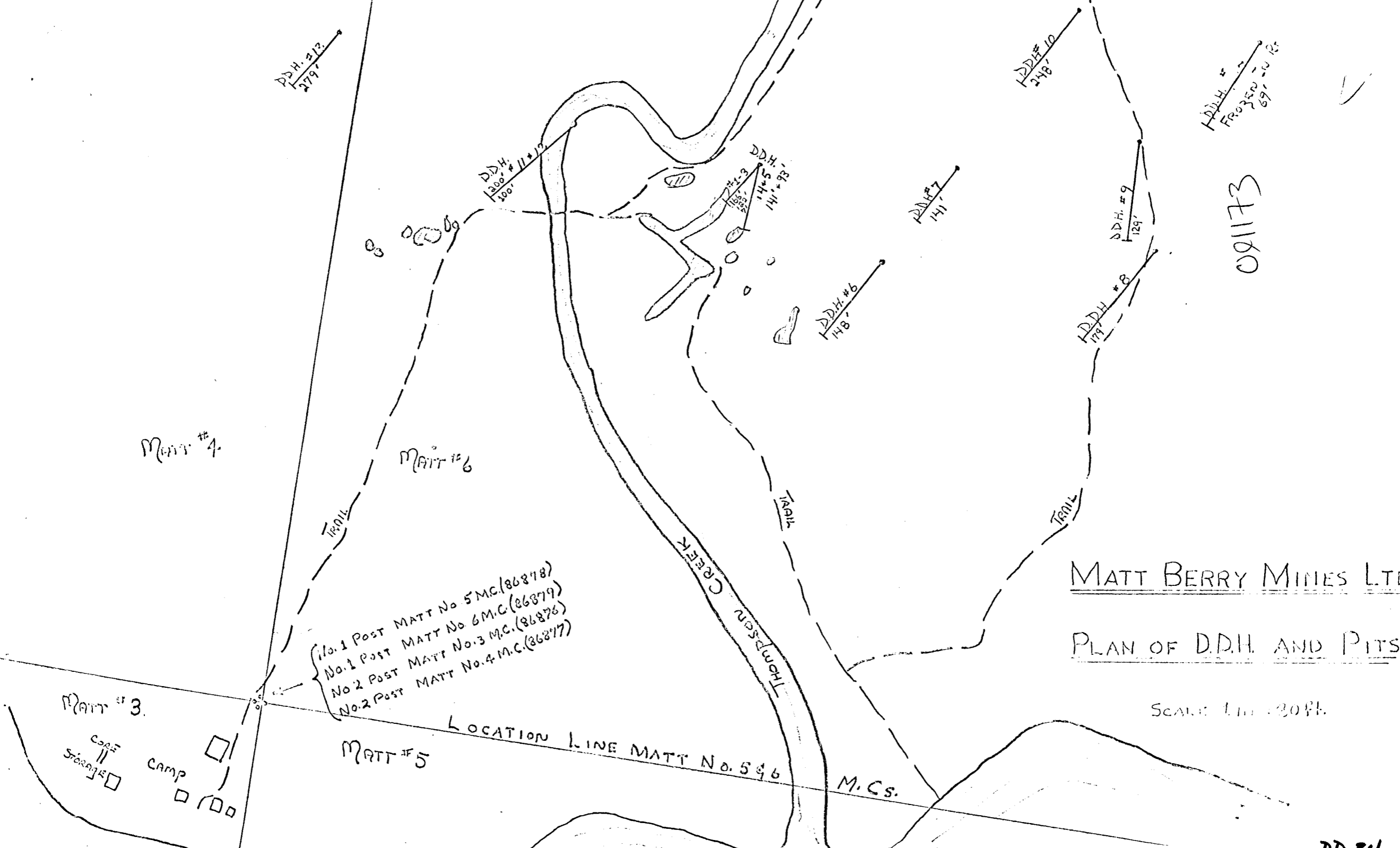

MATT #4

MATT #6

MATT #3

MATT #5

D.D.H. #7
141'

D.D.H. #6
148'

D.D.H. #8
179'

D.D.H. #9
129'

D.D.H. #10
248'

D.D.H. #2
FR. 350' - 67' - 10' 10"

D.D.H. #11
1300' x 11 x 10'
100'

D.D.H. #5
141' x 58'

- No. 1 Post MATT No 5 M.C. (86878)
- No. 1 Post MATT No 6 M.C. (86879)
- No. 2 Post MATT No. 3 M.C. (86876)
- No. 2 Post MATT No. 4 M.C. (86877)

LOCATION LINE MATT No. 5 & 6

M.C.S.

MATT BERRY MINES LTD

PLAN OF D.D.H. AND PITS

SCALE 1" = 30 FT.

09173

200' *130°
60°

Plan of Matt Zone

D.D. Hole locations
D.D. Hole assays

Oct. 31st 1966
1 inch to 100 feet

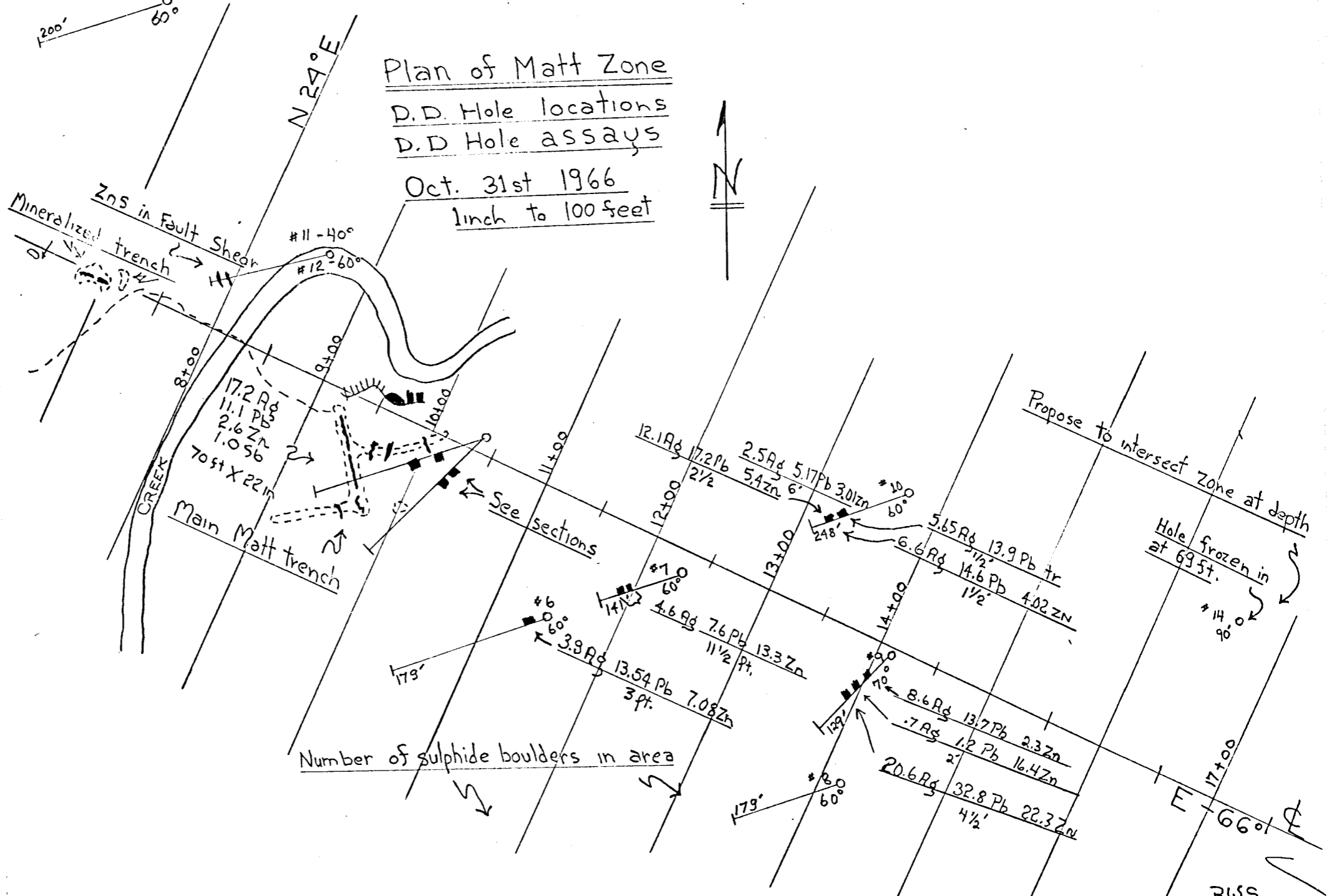

2084

2155

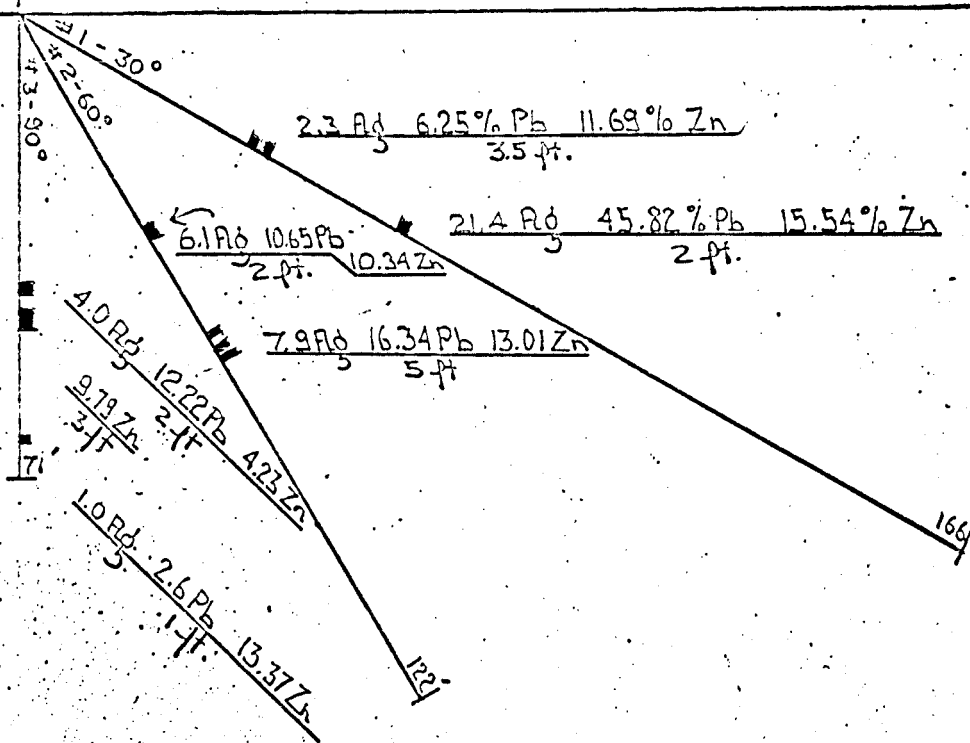

Section S10+00
 Scale 1" 30'
 Sept. 30th 1966

D.D. Holes No's 1-2-3

MATT BERRY MINES LIMITED

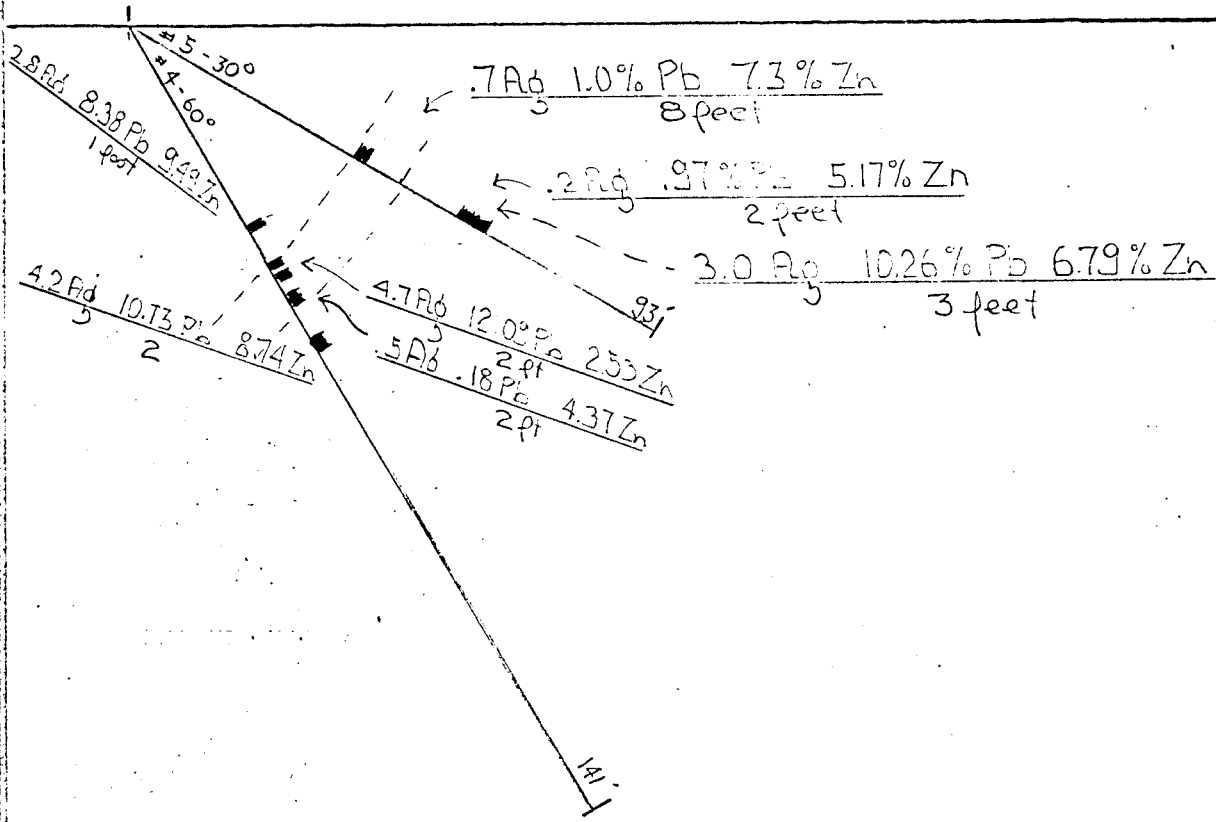

Section S10+50
 Scale 1"-30'
 Sept 30th 1966

D.D. Holes No's 4 & 5

MATT BERRY MINES LIMITED

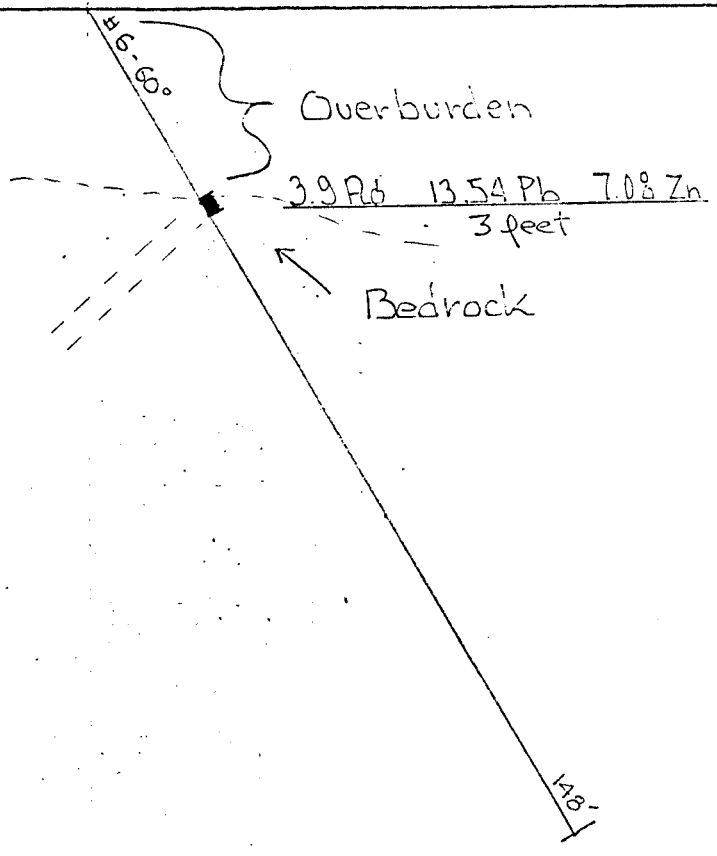

Section S 11+50
Scale 1"-30'
Sept 30th 1966

D. D. Hole No. 6

MATT BERRY MINES LIMITED

DD1173

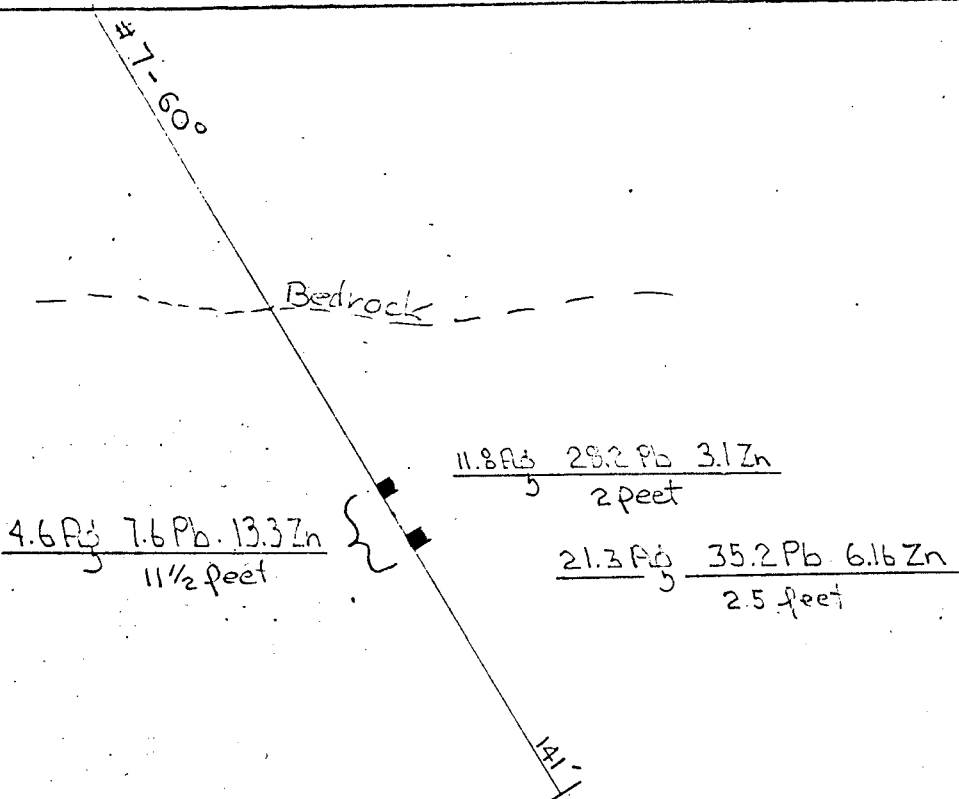

Section 12+00
Scale 1"-30'
Sept. 30th. 1966

D.D. Hole N° 7

MATT BERRY MINES LIMITED

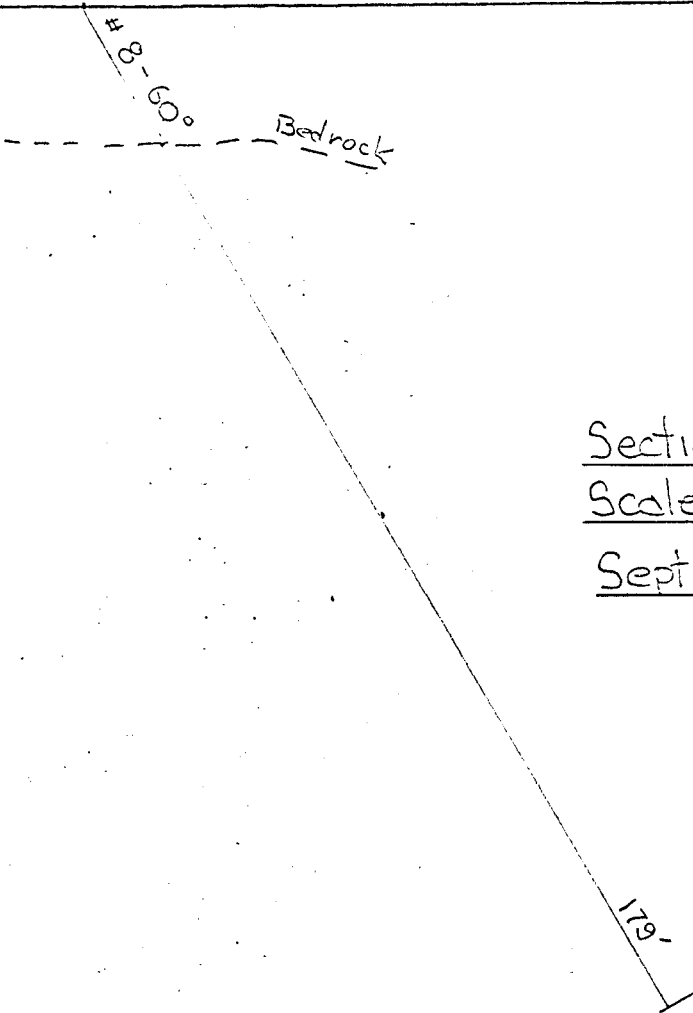

Section 14+00
Scale 1" 30'
Sept 30th 1966

D. D. Hole N^o 8

MATT BERRY MINES LIMITED



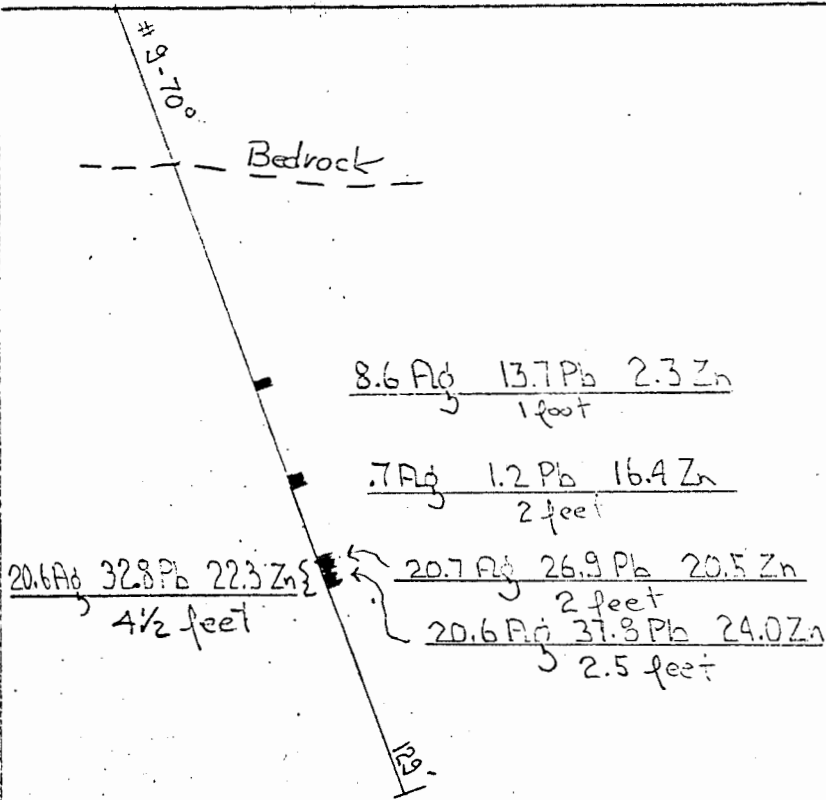

Section 15+50

Scale 1"-30'

Sept. 30th 1966

D. D. Hole No 9.

MATT BERRY MINES LIMITED

#10-70°

D.D. Hole #10

Section 15+00

Scale 1" = 30'

Sept 30th 1966

5.64 Ag 13.9 Pb Tr.

1/2

6.6 Ag 14.6 Pb 4.02 Zn

1/2

2.5 Ag 5.17 Pb 3.01 Zn

6 ft.

12.2 Ag 17.2 Pb 5.4 Zn

1/2

240°

MATT BERRY MINES LIMITED

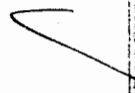

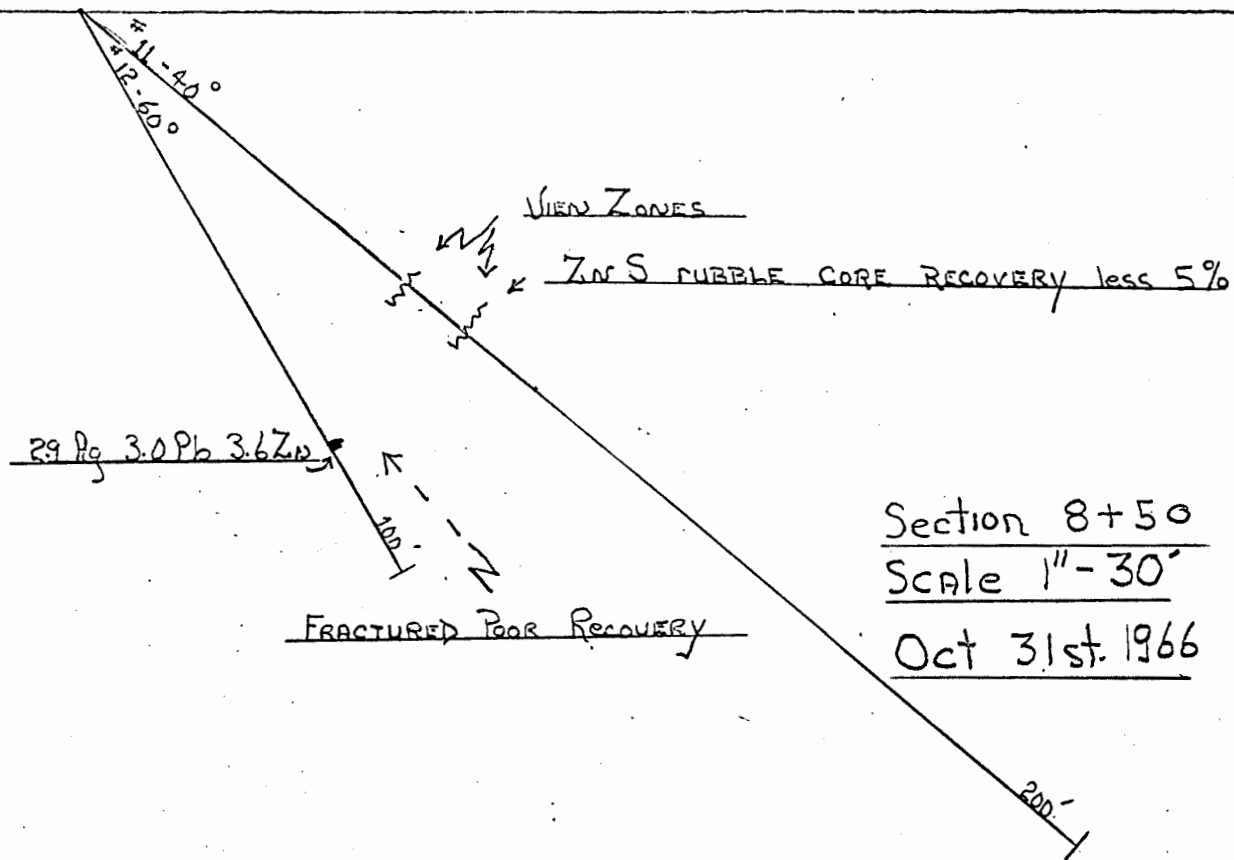

D. D Holes No 11 & 12

MATT BERRY MINES LIMITED



MATT BERRY MINES LIMITED

PROGRESS REPORT

December 31st, 1966.

SUMMARY:

WORK COMPLETED ON PROPERTY:-

Intriguing Silver-Lead-Zinc values over narrow widths have been encountered in diamond drilling along a strike length of better than 800 feet on the company's property on the east side of Frances Lake in the Yukon Territory.

Drilling to date indicates the presence of two (2) to four (4) mineralized veins in the Matt Zone. Silver-Lead-Zinc values are found in veins of massive sulphides in a formation of black shale and associated with a major shear zone.

Insufficient drilling has been completed to provide definite information as to attitude and dimensions of the mineralized structure. From results to date it appears that the veins strike about northwest-southeast and dip to the northeast at about 45°.

The main "Matt Zone" is open on both ends to strike extension and work to date indicates that the zone will extend to depth. The area between the most southerly section in the "Matt Zone" and the granite-sedimentary contact remains a prime target to be explored. Ore values in the Dynasty area to the north are also associated with a granite-sedimentary contact.

RECOMMENDATIONS:

1. It has been recommended that an additional 5,000 feet of drilling be done to further explore the southerly extension of the "Matt Zone". Also there is a large area of rubble, some containing high grade Silver-Lead-Zinc material to the southwest of the drilled area. This should be explored by cross-section drilling.

MATT BERRY MINES LIMITED

PROGRESS REPORT

December 31st, 1966.

RECOMMENDATIONS: (cont'd)

2. A geophysical survey to cover the area immediately adjoining the known veins should be considered.
3. Underground exploration and development of the "Matt Zone" can be done by way of an adit and might be considered as the next phase.

ACCESSIBILITY AND COMMUNICATION:

The Frances Lake 40 mineral claim group can be reached by road and boat travel or seaplane from Watson Lake. The property is approximately 95 miles north of Watson Lake along the Watson Lake - Ross River Road and then about 15 miles by water to the campsite.

CAMP AND EQUIPMENT:

An excellent campsite is located in mid-section of the claim group. The site is on a gravelled ridge and can be serviced by float 'planes.

Field equipment which includes small prospecting tools, two (2) tents with tarpaulins, a Boyles core splitter and a Copco cobra drill and steel is in storage at Watson Lake.

There are two tents and the cookery equipment on the property.

WORK COMPLETED DURING OCTOBER, 1966:DIAMOND DRILLING:-

The field program during October consisted mainly of diamond drilling.

MATT BERRY MINES LIMITED

PROGRESS REPORT

December 31st, 1966.

WORK COMPLETED DURING SEPTEMBER, 1966:DRILLING COMPLETED:

HOLE NO. 1	-	12 ft. casing	166' depth
2	-	15 ft. casing	122'
3	-	12 ft. casing	71'
4	-	12 ft. casing	141'
5	-	8 ft. casing	93'
6	-	34 ft. casing	148'
7	-	25 ft. casing	25'
7A	-	56 ft. casing	141'
8	-	25 ft. casing	178'
9	-	18 ft. casing	18'
10	-	12 BX casing	246'
			<u>1,478'</u>

DRILLING COMPLETED OCTOBER, 1966:

HOLE NO. 11	-	12 ft. casing	194' depth
12	-	10 ft. casing	100' depth
13	-	32 ft. casing	279'
14	-	42 ft. casing	69' (Hole frozen in).
			<u>642'</u>

COMPLETED DURING OCTOBER, 1966	642
COMPLETED DURING SEPTEMBER, 1966	<u>1,478</u>
TOTAL FOOTAGE DRILLED TO DATE -	<u><u>2,120</u></u>

The drilling program was suspended due to freezing conditions.

The casing was left in Hole No. 14 in order that the hole can be completed without re-collaring.

MATT BERRY MINES LTD.

PROGRESS REPORT

December 31st, 1966.

DIAMOND DRILL ASSAY RESULTS:ASSAY RESULTS FROM DRILL HOLE NO. 1 - NO. 9HOLE NO. 1 @ 30° - Section S-10 + 50

WIDTH	FROM	TO	AG	PB	ZN	SB
3.5 ft.	40.0	43.5	2.3 oz.	6.25	11.69	
2 ft.	66.0	68.0	21.4 oz.	45.84	14.54	

HOLE NO. 2 @ 60° - Section S 10 + 50

2 ft.	38	40	6.1 oz.	10.65	10.34	
5 ft.	57	62	7.9 oz.	16.34	13.01	

HOLE NO. 3 @ 90° - Section S 10 + 50

2 ft.	41	43	4.0 oz.	10.65	10.34	
3 ft.	45.5	48½	.6 oz.	.3%	9.79%	
1 ft.	64.5	65.5	1.0 oz.	2.6	13.39%	

HOLE NO. 4 @ 60° - Section S 11 + 00

1 ft.	36	37	2.8 oz.	8.38	9.49	
2 ft.	42	44	4.7 oz.	12.09	2.53	
2 ft.	55	57	4.2 oz.	10.13	8.74	

HOLE NO. 5 @ 90° - Section S 10 + 50

8 ft.	39	47	.7	1.0%	7.30%	
-------	----	----	----	------	-------	--

HOLE NO. 6 @ 60° - Section 11 + 50

3 ft.	34	37	3.9	13.54	7.08	
-------	----	----	-----	-------	------	--

HOLE NO. 7 @ 60° - Section S 12 + 00

11.5 ft.	86	97.5	4.6	7.6	13.3	
----------	----	------	-----	-----	------	--

HOLE NO. 8 NIL.HOLE NO. 9 @ 70° - Section S 15 + 50

1 ft.	61	62	8.6	13.7	2.3	
2 ft.	77	79	.7	1.2	16.4	
4.5 ft.	90.5	95.0	20.6	32.8	22.3	

HOLE NO. 10 @ 70° - Section S 13 + 00

10 ft.	171.0	181.0	2.62	5.51	2.56	
1.5 ft.	202.5	204.0	12.2	17.2	5.4	

Cont'd

MATT BERRY MINES LTD.

PROGRESS REPORT

December 31st, 1966.

DIAMOND DRILL ASSAY RESULTS:

ASSAY RESULTS FROM DRILL HOLE NO. 11 @ 60°

Two veins had been cut, one at 69 feet and one about 79 feet. Core recovery was extremely poor and few inches of Zns recovered was not assayed as the sulphide widths would only be assumed.

HOLE NO. 12 @ 60°

WIDTH	FROM	TO	AG	PB	ZN	SB
2½ ft.	78.5	81.0	2.9	3.0	3.6	

The above intersection is from a fracture zone and appears to be the main MATT ZONE - recovery was extremely poor in area of the sulphides.

HOLE NO. 13 @ 90°

No mineralized intersections were cut and it appears that the hole was set too far to the east to interest the main MATT ZONE.

HOLE NO. 14 @ 90°

Due to winter conditions the hole was frozen in thus ending the drill program.

The purpose of this hole was to extend the main Matt Zone to the south and to depth.

PROPOSED PROGRAM:

When bush flying is resumed it is planned to fly the equipment remaining on the property to Watson Lake for storage.

It is also planned to arrange financing to further explore the Main Matt Zone for the 1967 field season.

MATT BERRY MINES LIMITED

PROGRESS REPORT

December 31st, 1966.

SUMMARY OF CLAIM HOLDINGS:

FRANCES LAKE - WATSON LAKE MINING DIVISION, YUKON TERRITORY

<u>CLAIMS</u>	<u>NO. CLAIMS</u>	<u>EXPIRY DATE</u>
MATT 1-8	8	January 7th, 1967
JIM 1-4	4	January 7th, 1967
BERRY 1-40	40	May 6th, 1967
	<hr/>	
Total Mineral Claim Holdings	52	
	<hr/> <hr/>	

Sufficient assessment work can be recorded to keep claims in good standing for a number of years.

SUITE 1102 - 347 BAY STREET
TORONTO 1, ONTARIO

Telex 02-2773

Telephone:
366-0705

MATT BERRY MINES LIMITED

COMPANY SHARE DATA SUMMARY:

<u>Issued Shares (Qualified for Trading)</u>	<u>Monies Rec'd</u>
Barclay & Crawford (Underwriting) 200,000	\$ 50,000.00
Underwriting Group- Vendor Bonus 15,000	
Datlasaka Mines Ltd. Vendor 60,000	
Management Option (exercised)	
L. A. York 20,000	5,000.00
L. F. La Prairie 35,000	8,750.00
L. F. La Prairie (assigned employee) 9,000	2,250.00
	<hr/>
339,000	\$ 66,000.00

ESCROWED SHARES:

Datlasaka Mines Ltd. - Vendor 540,000	
Underwriters - Bonus 135,000	
Directors 5	5.00
	<hr/>
675,005	\$ 66,005.00

OUTSTANDING OPTIONS -

Expiry Date - May 11th, 1968
at 25 cents per share

Lionel A. York - Mining Engineer 14,000 (Director)	
A.H. Manifold - Geologist (Director) 33,000	
R. T. Dickson - Petroleum Engineer 33,000 (Director)	
L. F. La Prairie - Mining Engineer 56,000 (Director)	

TREASURY SHARES	<u>3,849,995</u>	<u>\$ 66,005.00</u>
-----------------------	------------------	---------------------

CAPITALIZATION ,.....	<u>5,000,000 shares</u>
-----------------------	-------------------------

MONIES RECEIVED	<u>\$ 66,005.</u>
-----------------------	-------------------

LLaP/ds

DIAMOND DRILL RECORD

PROPERTY MATT BERRY MINES LIMITED HOLE No. 1
 SHEET NUMBER 1 SECTION FROM Collar TO 68.0 STARTED AUGUST 31, 1966.
 LATITUDE _____ DATUM _____ COMPLETED SEPTEMBER 4, 1966
 DEPARTURE _____ BEARING _____ ULTIMATE DEPTH 166'
 ELEVATION _____ DIP _____ PROPOSED DEPTH 120'

LOCATION:
 SECTION 10 + 50
 95 FEET COST OF BASE FINE
 4 FEET SOUTH OF 10 + 50
 DIRECTION S 72° W.

DEPTH FEET	FORMATION	SAMPLE NO.	FROM	TO	WIDTH	ASSAY VALUES			
						Ag	Pb	Zn	Sh
0-14	Casing								
14-205	Slatey Schist								
205 - 25	Quartz with occ. flecks of biotite schist bands at 37.5								
25-39.8	Slatey Schist(1" Minor Pyrite)								
39 8-43.8	Quartz with occ. schist bands	1254	40.0	43.5	3.5'	2.3	6.25	11.69	.22
	39.8 - 43.5 Sphalerite & oxidized sphalerite with minor F.G. Galena								.1% C. E
	43.5 - 43.8 (30% galena min.)								
43.8-62.5	slatey schist with occ. qtz. less than 1" wide Stringers & oxidized shalerite & pyrite								
62.5-63.5	Quartz & Schist with minor sphalerite								
635-55	Schist with quartz veinlets containing fine gr. galena								

66.0 - 68.0 Vein massive fine to med 1255 66.0 68.0 2.0 21.4 45.84 14.54 .60 15 C E
 FILLED BY _____ grained galena & shalerite SIGNED _____

DIAMOND DRILL RECORD

PROPERTY MATT BERRY MINES LIMITED HOLE No. 2
 SHEET NUMBER 1 SECTION FROM COLLIAR TO _____ STARTED SEPTEMBER 4, 1966
 LATTITUDE _____ DATUM _____ COMPLETED SEPTEMBER 5, 1966
 DEPARTURE _____ BEARING _____ ULTIMATE DEPTH 122'
 ELEVATION _____ DIP -60° PROPOSED DEPTH 120'

LOCATION: SECTION 10+ 50
 4 FEET SOUTH OF SECTION
 95 FEET EAST OF BASELINE
 DIRECTION S 72° W

DEPTH FEET	FORMATION	SAMPLE NO.	FROM	TO	WIDTH	ASSAY VALUES			
						Ag	Pb	Zn	
0-13'	Casing								
13-18'	Qtz. with slatey schist								
18-38	Slatey Schist (6" Qtz. @ 21.5-22) with many small Qtz. veinlets								
38.-39.5	Qtz. with considerable sphalerite and galena	7796	38	40	2	6.1	10.65	10.34	.02
39.5-43.5	Slatey Schist								
435-455	Quartz with minor slatey schist								
455-580	slatey schist with occ. veinlets of quartz. & sphalerite								
58.0-615	Quartz & slatey schist with heavy sphalerite & galena mineralization	7797	57	60	3	11.6	23.08	13.35	.54
61.5 -	slatey schist - banding	7798	60	62	2	2.3	6.22	12.5	.07
k22	45°								

33
 7.9 Ag 16.34% Pb 13.01% Zn
 5

DIAMOND DRILL RECORD

PROPERTY MATT BERRY MINES LIMITED HOLE No. 3
 SHEET NUMBER _____ SECTION FROM _____ TO _____ STARTED _____
 LATITUDE _____ DATUM _____ COMPLETED _____
 DEPARTURE _____ BEARING _____ ULTIMATE DEPTH _____
 ELEVATION _____ DIP 90° PROPOSED DEPTH 71'

LOCATION: SAME AS HOLE NO. 1 & 2

DIRECTION S 72 W

DEPTH FEET	FORMATION	SAMPLE NO.	FROM	TO	WIDTH	ASSAY VALUES			
						Ag	Pb	Zn	
0-13	Casing								
13-18	Black slates & quartz brecciated and recemented foliated 60°								
18-41	Black slates-contorted and foliated								
41-43	Mineralized quartz and slates - galena & sphalerite - 40% mineralized	7792	41	43	2	4.0	12.22	4.23	.05
43-45½	Black slates with quartz.								

DIAMOND DRILL RECORD

PROPERTY MATT BERRY MINES LIMITED HOLE No. 3
 SHEET NUMBER 2 SECTION FROM _____ TO _____ STARTED _____
 LATITUDE _____ DATUM _____ COMPLETED _____
 DEPARTURE _____ BEARING _____ ULTIMATE DEPTH _____
 ELEVATION _____ DIP _____ PROPOSED DEPTH 71'

DEPTH FEET	FORMATION	SAMPLE NO.	FROM	TO	WIDTH	ASSAY VALUES			
						Ag	Pb	Zn	
45½-48½	Mineralized slates & quartzite	7793	45½	46½	1	0.6	.82	11.35	.09
	20% combined sphalerite & galena	7794	46½	48½	2	0.3	0.06	9.02	.10
48½-64½	Black slates foliation at about 60°-numerous mineralized sections								
64½-65½	Mineralized slates & quartz.- quartz.-galena & sphalerite	7795	64½	65½	1	1.0	2.60	13.37	.19
65½-71	Black Slates								
	About 80% recovery - most loss core in mineralized sections.								

6Ag .31% Pb 9.75% Zn
 6 .82 3 11.35
 1 .12 18.04
 1.0 3.4 23.35
 .8 .31 9.75

DD 84

DIAMOND DRILL RECORD

PROPERTY MATT BERRY MINES LIMITED HOLE No. 4

SHEET NUMBER _____ SECTION FROM _____ TO _____ STARTED _____

LATITUDE _____ DATUM _____ COMPLETED _____

DEPARTURE _____ BEARING _____ ULTIMATE DEPTH _____

ELEVATION _____ DIP 60° PROPOSED DEPTH 141

LOCATION SAME AS NO. 1, 2 & 3.

DIRECTION S 47° W

DEPTH FEET	FORMATION	SAMPLE NO.	FROM	TO	WIDTH	ASSAY VALUES			
						Ag	Pb	Zn	
0-13	Casing								
13-19½	Quartz vein - brecciated sections of shale material								
19½-36	Black slate with sections of quartz. stringer foliation 70%								
36-37	Mineralized quartz vein sphalerite & galena-	7787	36	37	1	2.8	8.38	7.49	.02
37-47½	Black slates with numerous stringer of mineralized quartz with sphalerite	7790	44½	45½	1	3.2	7.86	3.74	.19
		7791	42½	43½	1	11.6	28.43	3.85	.35
						14.8	36.29	7.59	

over 3 ft
4.7 Ag 12.09 % Pb 2.53% Zn
 2

DD84

DIAMOND DRILL RECORD

PAGE 2

PROPERTY MATT BERRY MINES LIMITED HOLE No. 4
 SHEET NUMBER 2 SECTION FROM _____ TO _____ STARTED _____
 LATITUDE _____ DATUM _____ COMPLETED _____
 DEPARTURE _____ BEARING _____ ULTIMATE DEPTH _____
 EL' ELEVATION _____ DIP _____ PROPOSED DEPTH 141

DEPTH FEET	FORMATION	SAMPLE NO.	FROM	TO	WIDTH	ASSAY VALUES			
						Ag	Pb	Zn	
47½-55	Black slates - bedding at 70% - a number of mineralized quartz veins.	7788	47½	49½	2	0.5	0.18	4.37	Tr.
55-57	Quartz vein - fractured and well mineralized galena, sphalerite & pyrite	7789	55	57	2	4.2	10.13	8.74	.14
57-41	Black slates bedding 60° to 75°								
RECOVERY IN MINERALIZED ZONES ESTIMATED TO BE 60%.									

DIAMOND DRILL RECORD

PROPERTY MATT BERRY MINES LIMITED HOLE No. 5

SHEET NUMBER _____ SECTION FROM _____ TO _____ STARTED _____

LATITUDE _____ DATUM _____ COMPLETED _____

DEPARTURE _____ BEARING _____ ULTIMATE DEPTH _____

ELEVATION _____ DIP - 30° PROPOSED DEPTH 93

SAME LOCATION AS NO. 1, 2, 3 & 4.

DIRECTION S 47° W

DEPTH FEET	FORMATION	SAMPLE NO.	FROM	TO	WIDTH	ASSAY VALUES			
						Ag	Pb	Zn	
0 - 9	Casing								
0 - 13½	Black Slates - high contorted								
13½-22	Quartz lenses and slates irregular bedding								
22-39	Black Slates								
39-47	Mineralized zone	7783	39	41	2	1.3	3.32	12.69	Tr.
	irregular lenses of sulphides	7784	41	47	6	0.5	0.40	5.52	.05
	20% mineralized - galena, spaherite & pyrite, patches of black slates.								

7.1 Ag 1.0% Pb 7.30% Zn
8 feet

DD84

DIAMOND DRILL RECORD

PROPERTY MATT BERRY MINES LIMITED HOLE No. 5

SHEET NUMBER 2 SECTION FROM _____ TO _____ STARTED _____

LATITUDE _____ DATUM _____ COMPLETED _____

DEPARTURE _____ BEARING _____ ULTIMATE DEPTH _____

ELEVATION _____ DIP _____ PROPOSED DEPTH 93'

DEPTH FEET	FORMATION	SAMPLE NO.	FROM	TO	WIDTH	ASSAY VALUES			
						As	Pb	Zn	Sb
47-58	Black slates with irregular veinlets of quartz - bedding at 70°								
58-60	Black slates - 15% mineralized sphalerite galena & pyrite - bedding from 45 to 70°	7785	58	60	2	0.2	0.97	5.17	.32
60-63	Black slates with irregular mineralized sections - galena sphalerite & pyrite	7786	60	63	3	3.0	10.26	6.77	1.70
63-93	Black slates - shaly bedding at 45°								

DIAMOND DRILL RECORD

PROPERTY MATT BERRY MINES LIMITED HOLE No. 6

SHEET NUMBER _____ SECTION FROM _____ TO _____ STARTED _____

LATITUDE _____ DATUM _____ COMPLETED _____

DEPARTURE _____ BEARING _____ ULTIMATE DEPTH 148'

ELEVATION _____ DIP -60⁰ PROPOSED DEPTH _____

LOCATION: STATION 71

DEPTH FEET	FORMATION	SAMPLE NO.	FROM	TO	WIDTH	ASSAY VALUES			
						Ag	Pb	Zn	
0-34	Casing overburden								
34-37	Mineralized - sulphides 40% - sphalerite & galena brecciated & fractured - 60% recovery.	7782	34	37	3	3.9	13.54	7.08	1.08
37-41	Slate - mineralized in sections foliation 30%								
41-148	Slate, black, foliated at 30 to 40% - minor stringers of quartz and carbonates								
14 feet of core loss throughout hole									

NO. 7 - 108 feet east of
 NO. 6 - at 50° on sections
 12 + 00

DIAMOND DRILL RECORD

MINT BERRY MINES LTD.

Thompson Creek Property HOLE 7A Logged by R.J. Cathro

Dip- 60° Footage- 141' Date- Sept. 20, 1966

<u>Depth</u>	<u>Recovery(%)</u>	<u>Formation</u>	<u>Sample#</u>	<u>Footage</u>			<u>Rec.</u>
				<u>From</u>	<u>To</u>	<u>Width</u>	
0-54.0		-overburden					
54.0-86.0	95	- <u>Phyllitic Shale</u> - dark grey, soft, strongly schistose @ 85° to core axis, increasing number of narrow quartz stringers and fine crenulations towards 86.0; - (70.0)- 6 inches white chloritic quartz.					
				4.8 15 ----- 11.5			
86.0-88.0	50	<u>Vein Zone</u> - vaguely banded, crushed sulfides well cemented in chloritic milky quartz, some carbonate, 25% PbS, minor ZnS.	6901	86.0	88.0	2.0	1.0
88.0-95.0	95	<u>Phyllitic Shale</u> - as 54.0-86.0 but more strongly contorted. (92.0)- 2 inches disseminated PbS in chloritic quartz stringer.		11.8 Ag		28.2% Pb	3.1% Zn
							.80
95.0-97.5	80	<u>Vein Zone</u> - slightly banded, strongly crushed sulfides in quartz matrix. (95.0-96.0)- 45% PbS, 5% ZnS (96.0-97.5)- 10% PbS, 5% ZnS.	6902 6903	30.6oz Ag		43.3% Pb	11.1% Zn
				21.3oz Ag		35.2% Pb	6.16% Zn
97.5-141	95	<u>Phyllitic Shale</u> - strongly schistose at 75° to core, very little contortion.		15.2 Ag		30.1% Pb	2.9% Zn
							1.0 .74 1.25 -51

DIAMOND DRILL RECORD

Thompson Creek HOLE 8 Logged by R.J. Cathro

Dip- 60° Footage- 181 Sept. 20, 1966

<u>Depth</u>	<u>Recovery (%)</u>	<u>Formation</u>
0-25.0		-overburden
25.0-32.0	95	<u>Phyllitic Shale</u> - dark gray, soft, strongly crushed and contorted schistosity at 45° to core axis.
32.0-39.0	10	<u>Possible Fault Zone</u> - only 6 inches core; gougy chloritic schist, one small piece of disseminated pyrite.
39.0-181.0	95	<u>Phyllitic Shale</u> - schistosity at 80° to core axis. - (48.0-49.5)- white quartz, minor breccia frags. - (51.0-53.0)- white quartz, minor breccia frags. - (53.0-63.0)- 50% patchy white quartz. - (90.0-181.0)- less schistose. - (140.0-146.0)- 50% patchy white quartz. - (150.0-181.0)- scattered patchy white quartz.

DIAMOND DRILL RECORD

Thompson Creek Property HOLE 9A

Logged by R.J. Cathro

Sept. 20, 1966

Dip- 70°

Footage- 129

<u>Depth</u>	<u>Recovery (%)</u>	<u>Formation</u>	<u>Sample#</u>	<u>Footage</u>			<u>Rec.</u>
				<u>From</u>	<u>To</u>	<u>Width</u>	
0-25.0		- overburden					
25.0-61.0	95	<u>Phyllitic Shale</u> - dark grey, soft, strongly schistose at 55° to core axis (52.0-61.0)- strongly contorted.		8.6 Ag	13.7% Pb	23% Zn	.23
61.0-62.5	85	<u>Vein Zone</u> -(61.0-61.5)- white chloritic quartz -(61.5-62.5) 20%PbS, 5%ZnS, strongly crushed.	6904	61.5	62.5	1.0	0.75
62.5-77.0	65	<u>Phyllite shale</u> -as (52.0-61.0)		.7 Ag	1.2% Pb	16.4% Zn	.57
77.0-79.0	75	<u>Vein Zone</u> -25% ZnS, minor PbS, Pyrite in chloritic quartz.	6905	77.0	79.0	2.0	1.5
79.0-90.5	95	<u>Phyllitic Shale</u> -as (52.0-61.0)					1.45
90.5-96.0	95	<u>Vein Zone</u> (\$160) -(90.5-92.5)- strongly crushed massive sulfide zone- 70%PbS, 20%ZnS. -(92.5-95.0)- banded patchy sulfides- 25%PbS, 5% ZnS. -(95.0-96.0)- chloritic quartz.	6906	90.5	92.5	2.0	2.0
			6907	92.5	95.0	2.5	2.5
				20.6 Ag	37.0% Pb	24.0% Zn	1.50
96.0-129.0	95	<u>Phyllitic Shale</u> -Schistosity at 70° to core axis, some contortion and brecciation close to vein zone.					

Ag 20.6 Ag
Pb 32.8%
Zn 22.3%

(\$170)

<u>Depth</u>	<u>Recovery</u> (%)	<u>Formation</u>	<u>Sample</u>	<u>From</u>	<u>Footage</u> <u>To</u> <u>Width</u>	<u>Rec.</u>
179.5-182.5		<u>Vein Zone-</u> (179.5-181.0)- selective replacement along sch. planes- PbS in some, ZnS in others, mainly gtz. gangue & some chloritic carbonate. (181.0-182.5)- gtz. carb. gangue- no mineralization.	6912	179.5	181.0 1.5 6.60 Ag 14.6 Pb	90 4.0 Zn
182.5-202.5		<u>Phyllitic Shale-</u> as before, sch. @ 50°.				
202.5-204.0		<u>Vein Zone-</u> 50% sulfides, 35% PbS, 15% ZnS, strongly crushed; wh. chloritic gtz. & buff carb. gangue.	6913	202.5	204.0 1.5 12.20 Ag 17.2 Pb	90 5.4 Zn
204.0-240.0		<u>Phyllitic Shale-</u> as before- sch. @ 50°-70°.				

Grab from 173.25 to 182.5
 9.25 H. 2.22 Ag 5.00 Cu
 4.3% Pb
 2.0% Zn

ARCHER, CATHRO & ASSOCIATES LTD.

CONSULTING GEOLOGICAL ENGINEERS

P.O. Box 1051
WHITEHORSE

Diamond Drill Record

Matt Berry Mines Ltd.

Thompson Creek Property Hole #10 Logged by R.J. Cathro
Dip- 60° Footage- 248 Date- Sept. 28, 1966

<u>Depth</u>	<u>Recovery</u> (%)	<u>Formation</u>	<u>Sample</u>	<u>Footage</u>			<u>Rec.</u>
				<u>From</u>	<u>To</u>	<u>Width</u>	
0-37.0	-	over burden					
37.0-171.0	95	<u>Phyllitic Shale</u> - as before sch. @ 60°, bedding @ 90° (6.5-62.0) patchy, chloritic quartz. (62.0-67.0) strongly contort. c fine gtz.-carb. stringers. (133.0)(143.0)- 6" wh. gtz.- carb. (142.0) on)- occasional narrow gtz veinlets c small pyritic patches. (161.0)- 6" white gtz. and buff carb. (162.0)- minor ZnS in narrow veinlets.					
171.0-171.5	95	<u>Vein Zone</u> - medium-grained PbS, minor pyrite in chloritic gtz.-carb.- 10% sulfides.	6908	171.0	171.5	0.5	95
				5.64 Ag	13.9% Pb	tr Zn	
171.5-173.25	95	<u>Phyllitic Shale</u> - as before.					
173.25-177.5		<u>Vein Zone</u> - strongly chloritic wh. gtz. & buff carb.- patchy & vaguely banded. (173.25-174.25) 15% ZnS, 15% PbS.	6909	173.25	174.25	1.0	95
		(174.25-176.5) minor patchy stringers- PbS, ZnS- 2% sulfides.	6910	174.25	176.5	2.25	95
		(176.5-177.5) 5% PbS, 5% ZnS.	6911	176.5	177.5	1.0	95
				2.96 Ag	8.0 Pb	8.0 Zn	
				2.04 Ag	3.6 Pb	0.7 Zn	
				3.16 Ag	6.6 Pb	3.2 Zn	
177.5-179.5	95	<u>Phyllitic Shale</u> - as before.					

2.5 Ag 5.17% Pb 3.01% Zn
6 feet

Hole #11

Dip- 60°

Footage about 200

Date- October 1, 1966

<u>Depth</u>	<u>Recovery</u>	<u>Formation</u>
0-12	85	<u>Phyllitic Shale-</u> (12-30)- numerous chloritic qtz. patches narrow veinlets schistosity very contorted. (26.5-30.5)- 1.0' core- gougy shale. (30-69)- minor short contort sections and chloritic qtz. patches; sch. @ various angles to core axis. (67.0-69.0)- 0.75' core.
69.0-69.5	95	<u>Vein Zone-</u> unmineralized, dk. gry vein gtz.- brecciated.
69.5-71.0	35	<u>Phyllitic Shale-</u> 0.5' core.
71.0-79.0	5	<u>Ground Core-</u> only 0.5' recovered- all phyllitic shale.
79.0	79	<u>Vein Zone-</u> only 2" core recovered, 50% ZnS, minor PbS, closely resembles sulfide zones in previous drilling.
79.0-194.0	75	<u>Phyllitic Shale-</u> dissem. pyrite in some places, sch. @ 20°, banding @ 80° to core axis; several gouge sections may indicate small faults. (79.0-83.0)- 0.5' core. (83.0)- 2" muddy gouge. (83.0-86.0)- 1.5' core. (90.0)- 2" muddy gouge. (115.0)- " " " (122.5)- " " " (130.0-142.0)- no core. (142.0-146.0)- 1.0' core. (147.5)- 0.5' zone of banded, pyritic, chloritic qtz (160.0-165.0)- 0.25' core. (174.0-179.0)- 0.25' core- all gouge. (179.0-179.5)- soft, muddy shale.

194.0 on 200 feet

? - core not seen.

DIAMOND DRILL RECORD

MATT BERRY MINES LTD.

Thompson Creek property HOLE 12

Logged by A.R. Archer

Dip- 90

Footage- 100'

Date- Oct. 22, 1966

<u>Depth</u>	<u>Recovery</u> (%)	<u>Formation</u>	<u>Sample#</u>	<u>Footage</u>			<u>Rec.</u>
				<u>From</u>	<u>To</u>	<u>Width</u>	
0-10.0		-overburden					
10-78.5	60	-Phyllitic Shale -dark grey, soft, strongly schistose @ 60° to core axis, core broken, num- erous mud seams and quartz stringers. (54.0-78.5)- becom- ing increasingly chloritic. (70.0-73.0) no core.					
78.5-81.0	75	- <u>Vein Zone</u> -(78.5-79.5)- broken core, several frag- ments with PbS, ZnS, minor chalcopyrite.	7248	78.5 3.38	79.5 4.4	1.0 3.3	0.5
		-(79.5-81.0)- 20% sulfides, strongly chloritic.	7249	79.5 2.6	81.0 2.0	1.5 3.2	1.5
81.0-100.0	100	- <u>Phyllitic Shale</u> -as before; trace pyrrhotite @ 84.0					

DD84
DAIMOND DRILL RECORD

MATT BERRY MINES LTD.

Thompson Creek Property

Hole 14

Logged by A.R. Archer

Dip- 90°

Footage 69.0

Date- Oct. 22, 1966

Depth

Recovery (%)

Formation

0-42.0





-overburden

42.0-69.0

-Phyllitic Shale
-dark grey, soft,
strongly schistose @
80° to core axis.

HOLE FROZEN IN.

LEGEND

-  DIAMOND DRILL HOLE
-  VEIN AT SURFACE
-  BEDROCK EXPOSURE
-  LOCATION LINE

DIAMOND DRILL RESULTS

HOLE NO	ANGLE	FROM	TO	WIDTH	Ag (oz/ton)	%Pb	%Zn	Ag/Pb RATIO
1	30°	40.0	43.5	3.5	2.3	6.25	11.69	.36
		66.0	68.0	2.	21.4	45.84	14.54	.46
2	60°	41.0	40.0	2.	6.1	10.65	10.34	.57
		57.0	62.0	5.	7.9	16.34	13.01	.49
3	90°	41.0	43.0	2.	4.0	10.65	10.34	.37
		45.5	48.5	3.	0.6	0.30	9.79	—
4	60°	64.5	65.5	1.	1.0	2.60	13.39	.39
		36.0	37.0	1.	2.8	8.38	9.49	.35
5	90°	42.0	44.0	2.	4.7	12.09	2.33	.39
		55.0	57.0	2.	4.2	10.13	8.74	.41
6	60°	39.0	47.0	8.	0.7	1.00	7.30	—
7	60°	34.0	37.0	3.	3.9	13.54	7.08	.29
8	60°	86.0	97.0	11.5	4.6	7.60	13.30	.60
9	70°	61.0	62.0	1.	8.6	13.70	2.30	.63
10	70°	77.0	79.0	2.	0.7	1.20	16.40	.58
		90.5	95.0	4.5	20.6	32.80	22.30	.63
11	60°	171.0	181.0	10.	2.6	5.51	2.65	.41
		202.5	204.0	1.5	12.2	17.20	5.40	.71
12	90°	2 inches vein material at 79', core recovery low				2.9	3.00	.97
13	60°	No vein intersected				—	—	—
14	90°	250.5	255.1	2.6	4.5	9.13	21.04	.49
		253.1	255.5	2.4	5.1	14.6	1.58	.35
15	90°	255.5	256.5	1.0	23.3	49.48	5.71	.47
		256.5	258.0	1.5	4.9	9.91	15.39	.49
16	90°	191.5	196.3	4.8	2.93	6.0	6.0	.49
		89.0	91.6	2.6	0.4	0.51	3.09	.78
17	60°	91.6	94.2	2.6	1.8	2.25	9.29	.8
		94.2	95.2	1.0	1.7	4.65	11.16	.34
17	60°	95.2	96.3	1.1	2.9	5.89	7.98	.49
		96.3	98.0	1.7	6.3	10.72	8.08	.59

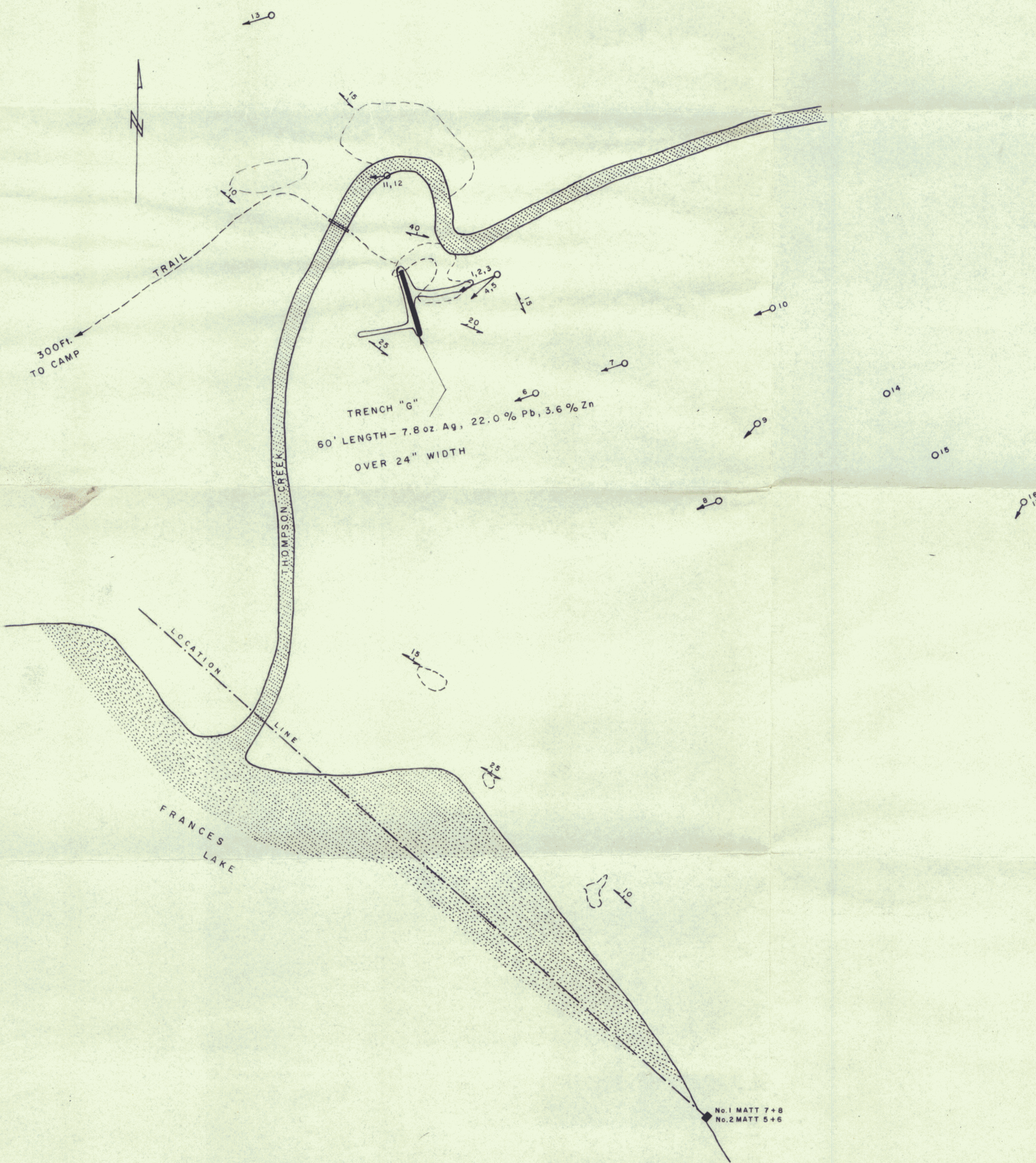

MATT BERRY MINES LTD. FRANCES LAKE PROPERTY YUKON		
ARCHER & CATHRO Consulting Geological Engineers		
DATE	31 Dec. 1968	DWG. No.
DRAWN	W.D. SEIDLER	
SCALE	1" = 100'	