

GEOCHEMICAL, GEOLOGICAL AND PROSPECTING REPORT

TOM 1 - 34 CLAIMS

WATSON LAKE MINING DISTRICT

YUKON TERRITORY

Location

NTS: 105-B-1 W

Latitude: 60°03'42"

Longitude: 130°18'30"

For

**Fairlady Energy Inc.
P.O. Box 1150
Lambeth, Ontario
NOL 1S0**

By

**Peter A. Christopher, Ph.D., P.Eng.
Peter Christopher & Associates Inc.
3707 West 34th Avenue
Vancouver, British Columbia
V6N 2K9**



September 8, 1983

091153

This report has been examined by
the Geological Exploration Act
under Section 53 (A) of the Quartz
Mining Act and the estimated
expense for the work is amount
of \$ 10,050 —

P. Watson

for Regional Manager, Exploration and
Geological Services for Commissioner
of Yukon Territory.

TABLE OF CONTENTS

	<u>PAGE</u>
SUMMARY	1
INTRODUCTION	2
LOCATION AND ACCESS	2
TOPOGRAPHY	3
CLAIMS AND HISTORY	3
WORK PROGRAM	4
PROPERTY GEOLOGY	4
REGIONAL GEOLOGY	5
MINERAL DEPOSITS IN THE AREA	8
GEOCHEMICAL EXAMINATION OF THE TOM CLAIMS	15
GEOPHYSICAL PROSPECTING	17
CONCLUSIONS	18
COST STATEMENT	19
BIBLIOGRAPHY	20
CERTIFICATE	23

LIST OF ILLUSTRATIONS

FIGURE 1	Location Map	1a
FIGURE 2	Claim Map	2a
FIGURE 3	Regional Geology, Rancheria Area	5a
FIGURE 3A	Regional Geology, Midway Area	10a
FIGURE 4	Stratigraphic Column, Midway Deposit Area	10c
MAP 1	Sample Locations	(in pocket)
MAP 2	Geochemistry	(in pocket)

TABLE

TABLE 1	Summary of Run Claim Data	3
TABLE 2	Legend for Figure 3A	10b

SUMMARY

The Tom Claim Group adjoins the "Midway" property of Regional Resources Ltd. (Amax-Procan option) and the YP-Idaho property of Butler Mountain Minerals Corp. and has a similar geological setting to the adjacent properties. Extensive overburden make heavy reliance on geochemical and geophysical methods necessary during early exploration stages. The initial reconnaissance, mainly geochemical program has located Pb, Zn and Ag anomalous conditions which require follow-up. Detailed geochemical sampling has been recommended for the Tom 15 through 26 with Pulse EM follow-up of anomalous trends.

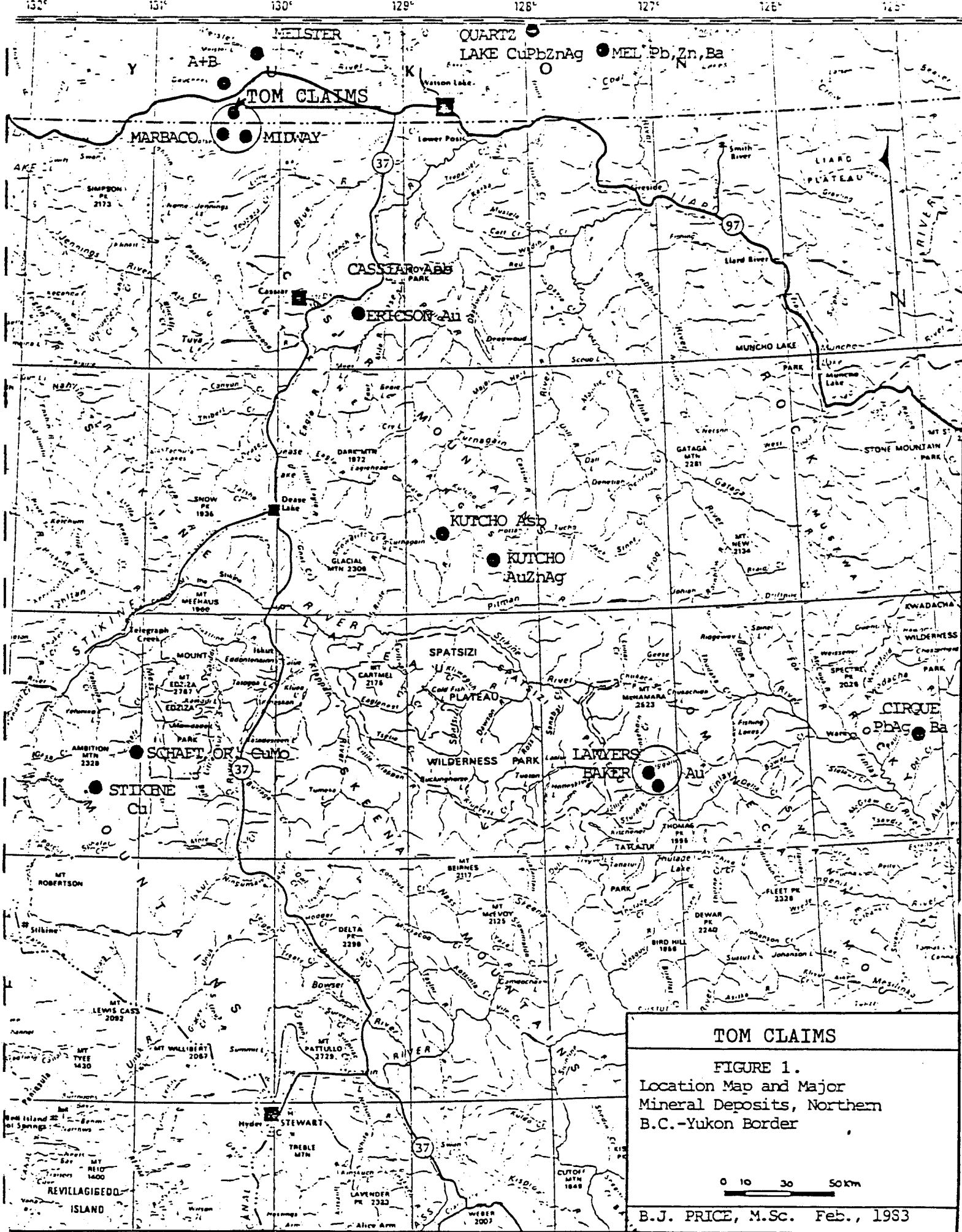

TOM CLAIMS

FIGURE 1.
Location Map and Major
Mineral Deposits, Northern
B.C.-Yukon Border

0 10 30 50 km

B.J. PRICE, M.Sc. Feb., 1983

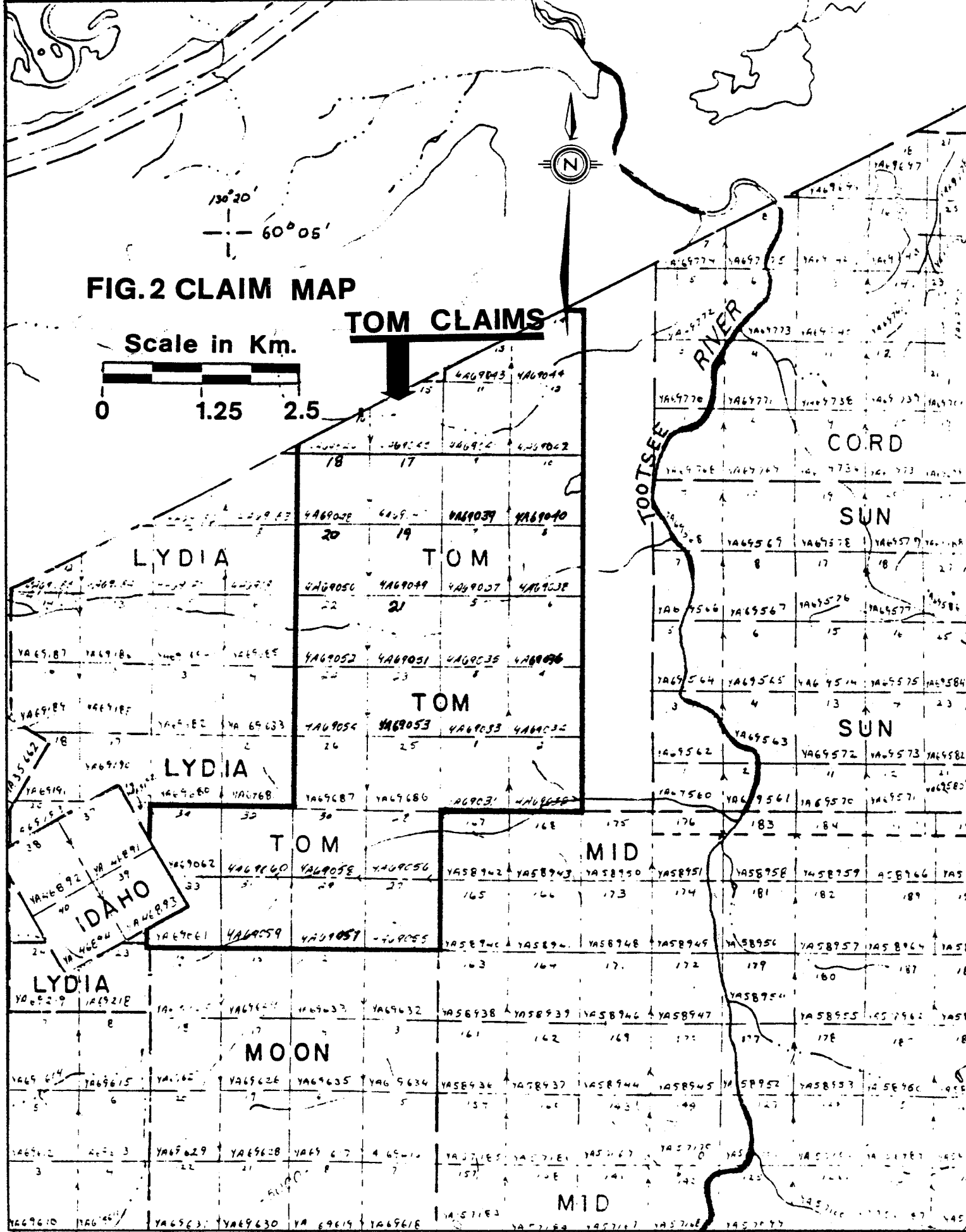

130° 20'
60° 05'

FIG. 2 CLAIM MAP

Scale in Km.

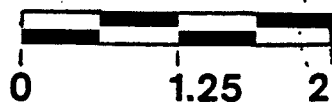

TOM CLAIMS

LYDIA

TOM

TOM

LYDIA

TOM

MID

CORD

SUN

SUN

LYDIA

MOON

MID

TOOTSEE RIVER



Grid of parcel numbers including: 13, 14, 15, 16, 17, 18, 19, 20, 21, 22, 23, 24, 25, 26, 27, 28, 29, 30, 31, 32, 33, 34, 35, 36, 37, 38, 39, 40, 41, 42, 43, 44, 45, 46, 47, 48, 49, 50, 51, 52, 53, 54, 55, 56, 57, 58, 59, 60, 61, 62, 63, 64, 65, 66, 67, 68, 69, 70, 71, 72, 73, 74, 75, 76, 77, 78, 79, 80, 81, 82, 83, 84, 85, 86, 87, 88, 89, 90, 91, 92, 93, 94, 95, 96, 97, 98, 99, 100.

INTRODUCTION

The Tom Property, consisting of the Tom 1 through 34 located mineral claims was examined by the writer on August 3rd and 5th, 1983. The examination was conducted at the request of Ms. Madeline Brett, President of Fairlady Energy Inc. The purpose of the examination was to confirm the location of claim posts that establish the Tom claims and to outline an exploration program for evaluating the mineral potential of the property. A basic exploration program was outlined by the writer and conducted with the aid of Dr. Gary Medford and Mr. Les Demczuk between August 15th and 20th, 1983.

This report contains a summary of exploration work carried out by Peter Christopher & Associates Inc., on claims owned by Fairlady Energy Inc. The claims had been acquired by Fairlady Energy Inc. because of their location between the "Midway" Pb-Zn-Ag-Ba property of Regional Resources Ltd. and the YP-Idaho Pb,Zn,Ag,Au property of Butler Mountain Minerals Corp.

LOCATION AND ACCESS (Figures I & II)

The Tom Property is situated west of the Tootsee river about 120 kilometres (75 miles) west of Watson Lake, Y.T. and 16 kilometres (10 miles) east of Rancheria, a small settlement on the Alaska Highway. The claim area straddles the Tootsee Lake Road which provides access to most of the Tom claims. A four wheel drive road at the south end of the property services the southern part of the claim area and the adjoining Lydia and YP claims. Four wheel drive vehicles can cross the Rancheria River at mile 701 on the Alaska Highway and a bridge at mile 706 provides two wheel drive and trailer access. Good campsites exist at either of the main creeks which drain the property. A trailer and tent camp was established and used during the Stage I program.

Fuel and accommodation are available at Rancheria, and most supplies and services are available at Watson Lake, Y.T. which is serviced by daily jet flights from Whitehorse and Vancouver.

TOPOGRAPHY

The Tom Claims lie between 990 meters (3,250 feet) and 1,290 meters (4,232 feet) which gives the claim area a moderate relief of 300 meters. The claims are situated in the Tootsee River valley and straddle timber line.

CLAIMS AND HISTORY

The Tom 1 to 24 and Tom 27 to 34 claims with grant numbers YA69031 - YA69054 and YA69055 - YA69062 were recorded in September, 1982. The Tom 25 and 26 with grant numbers YA69686/87 were recorded in February, 1983. Table I provides a summary of pertinent claim data. Field confirmation of claim data obtained from claim map 105-B-1 (Department of Northern Affairs and Natural Resources) was made. The maximum possible ground coverage of 20.9 hectares (51.65 acres) per claim is reduced by the Alaska Highway gas pipeline corridor which intersects Claims Tom 13 to Tom 16. Claim post locations are shown on Figure 2 and Maps 1 and 2. All posts were located in the field and tagged.

The area has been staked in the past but the writer has been unable to find any records of previous exploration work.

Table I - Summary of Tom Claim Data

<u>Claim Name</u>	<u>Record #</u>	<u>Date Stacked</u>	<u>Date Work Due</u>	<u>Staker</u>
Tom 1 - 8	YA69031 - YA69038	Sept. 8/82	Sept. 8/83	Gene Legare
Tom 9 - 16	YA69039 - YA69046	Sept. 8/82	Sept. 8/83	Jake Melynychuck
Tom 17 - 24	YA69047 - YA69054	Sept. 8/82	Sept. 8/83	Lois Croffman
Tom 27 - 34	YA69055 - YA69062	Sept. 8/82	Sept. 8/83	Todd Bolton
Tom 25 - 26	YA69687 - YA69686	Feb. 8/83	Feb. 11/84	Doug Schellenberg

The claims were acquired by Fairlady Energy Inc. from W.E. England Drilling Company in February, 1983. W.E. England had staked the area because of significant Pb-Zn-Ag-Au deposits on the adjacent properties of Regional Resources Ltd. and Butler Mountain Minerals.

WORK PROGRAM

An initial program of soil and silt sampling was conducted over parts of the Tom Property. A total of 406 samples were collected at about 50m spacing with traverses along claim lines, claim boundaries and roads. Geological mapping was restricted because of extensive overburden with only two outcrop areas located. VLF-EW traverses were tried along roads but the usefulness of this survey is also restricted by overburden cover. About seven line kilometres of EM was conducted. All stations were flagged and labelled. Topo chains were used for measurements.

PROPERTY GEOLOGY

Two areas of outcrop were located on the property. A small outcrop of shale or argillite occurs along the Tootsee Lake Road near the northern boundary of the claims and a large outcrop of argillite occurs at the southern boundary of the claims (see Map 2 in pocket). Both areas are veined with quartz and carbonate and contain minor pyrite. Angular shale sub-croppings along the Tootsee Lake Road suggest that this unit is extensive near the north end of the property. Outcroppings have similarity to Sylvester Group rocks situated on the adjacent "Midway" property. Quartz-carbonate material is similar to tungsten bearing vein material on the nearby A+B property.

Thick glacial overburden covers much of the claim area and will restrict the usefulness of geological, geophysical and geochemical surveys. Reconnaissance VLF-EM lines run across the southerly creek draining the property produced a weak cross-over which may indicate a structure (fault) in the creek valley.

REGIONAL GEOLOGY (Figure 3)

The area of interest is situated on the east flank of the Cassiar batholith which extends over 300 km southeasterly from Wolf Lake map sheet in the Yukon to the Kechika map area in British Columbia. In the Jennings River and Cassiar-McDame map areas and the south part of Wolf Lake area the eastern flank is underlain by Paleozoic rocks from Cambrian to Carboniferous in age and separable into two or more contrasting assemblages, some of which are believed to be "allocthonous" (i.e., deposited elsewhere and moved into place along flat lying faults) (Gabrielse and Mansy, 1980).

Rocks are described by Poole (Map 10-1960) and by Gabrielse (GSC Paper 68-55, 1968); brief descriptions of the mapped units are summarized below:

Units 1 and 2: (Lower Cambrian)

Unit 1 consists of biotite schists, quartzite, marble and skarn, with areas of extensive sills, dykes and irregular bodies of pegmatites, particularly near the contact with the Cassiar batholith.

Unit 2 contains quartzite, slate and phyllite, quartz grit and fine pebble conglomerate. Adjacent to the batholith the rocks are hornfelsed.

Unit 3: (Lower Cambrian)

This unit, which is host to numerous lead-zinc-silver showings in the area, contains grey limestone, grey to green argillite and slate, and dolomite. The unit is converted to skarn adjacent to the batholith.

Unit 4: (Middle Cambrian to Silurian)

Slates, phyllites and limestone, buff to dark grey, with dolomite and dolomitic limestone partly converted to skarn forms a unit which is difficult to separate from units 2 and 3.

LEGEND

QUATERNARY

- PLEISTOCENE AND RECENT
 18 Glacial (fill) gravel, sand, and silt; lake clay; volcanic ash

TERTIARY (?) AND QUATERNARY

- 17 Vesicular olivine basalt

CRETACEOUS OR TERTIARY

- 16 SEAGULL AND HAKE BATHOLITHS AND STOCKS; mainly biotite leuco-quartz monzonite and alaskite, in places with quartz-tourmaline concentrations and microcline cavities

JURASSIC AND/OR CRETACEOUS

- 15 15a, CASSIAR BATHOLITH; mainly biotite quartz monzonite and granodiorite, in part sheared and altered; 15b, RAM STOCK; saussuritized biotite-hornblende quartz monzonite and granodiorite, in part sheared; 15c, LOGJAM STOCK; mainly biotite-hornblende quartz monzonite with base borders; 15d, mainly biotite quartz monzonite and granodiorite; 15e, mainly biotite-muscovite granodiorite

- 14 Dioritic rocks; diorite, granodiorite, quartz diorite; 14a, includes gneiss, hornblende

- 12 Ultramafic rocks; olivine-bearing clinopyroxenite, dunite; serpentinitized and metamorphosed equivalents

PERMIAN TO JURASSIC (?)

- 12 12a, pebble and cobble conglomerate, graywacke, limestone; minor quartzite, chert; 12b, andesitic volcanic breccia and tuff; minor lava(?) 12c, feldspathic quartzite, subgraywacke, graywacke, quartzite, gneiss, argillite; relatively rich in microcline, may be in part equivalent to 12a and 12b

MISSISSIPPIAN

- LOWER AND MIDDLE MISSISSIPPIAN
 11 Upper Division: chert, slate, argillite, hornfels; minor graywacke; 11a, limestone and dolomite, in part with chert nodules, shars; 11b, sandy and conglomeratic tuff

- CARBONIFEROUS
 10 Lower Division: chert and quartzite pebble and cobble conglomerate, chert, quartzite, slate, argillite, hornfels

DEVONIAN AND MISSISSIPPIAN

- UPPER DEVONIAN AND LOWER MISSISSIPPIAN
 9 Limestone and dolomite, in part with chert nodules, shars

- 8 Chert, hornfels, argillite, slate, phyllite, quartzite, limestone, in part with chert nodules; shars, tremolitic marble, dolomite; 8a, schist and gneiss

- 7 Greenstone, chlorite schist and quartzite, phyllite, slate, argillite, chert; 7a, greenstone, chlorite schist; 7b, argillite, slate, phyllite, chert, subgraywacke, gneiss, conglomerate, saussurite-biotite schist and quartzite; 7c, limestone and dolomite, in part with chert nodules; 7d, quartz-albite-mica gneiss, albite-actinolite schist

SILURIAN AND DEVONIAN

- MIDDLE SILURIAN AND MIDDLE DEVONIAN
 6 Upper part: gray and black fatid dolomite and calcitic dolomite; Lower part: quartzite and dolomitic quartzite

MIDDLE SILURIAN

- 5 Gray-buff dolomite; underlain by thin-bedded shale and limestone, and buff dolomitic siltstone and quartzite

CAMBRIAN TO SILURIAN
 MIDDLE CAMBRIAN TO MIDDLE SILURIAN

- 4 Thin-bedded buff and gray slate, phyllite, and limestone, dark gray slate and limestone; 4a, thin-bedded buff and gray phyllite and limestone; probably Middle and Upper Cambrian; 4b, black slate, argillite, gray dolomite, and dolomitic limestone; probably Ordovician; 4c, hornfels, limestone, shars

CAMBRIAN

LOWER CAMBRIAN

- 3 3a, gray limestone; minor dolomite, slate, and phyllite; 3b, saussuriferous, probably equivalent to 3a; 3c, limestone minor gray and green argillite and slate, dolomite; may be older than 2; 3d, marble, shars

CAMBRIAN AND (?) EARLIER
 LOWER CAMBRIAN AND (?) EARLIER

- 2 Quartzite, minor slate and phyllite, quartz gneiss and (fine pebble conglomerate); 2a, phyllite, minor slate; 2b, hornfels
 1 Probably metamorphic equivalents of 2; 1a, biotite schist and quartzite; 1b, marble and shars; 1c, biotite schist and quartzite with sills, dykes, and irregular bodies of pegmatites; 1d, biotite schist and gneiss

Geological boundary (defined, approximate or assumed)

Bedding (horizontal, inclined, vertical) + / / /

Schistosity, anisotropy, cleavage (horizontal, inclined, vertical) + / / /

Fault (defined, approximate, assumed) - - - - -

Anticline (position approximate) +

Syncline (position approximate) -

Drift ridge or rock groove (direction of ice-movement known, unknown) ↗ ↘

Fossil locality C

MINERAL SYMBOLS

Fluorite F	Tin Sn
Lead Pb	Tungsten W
Silver Ag	Zinc Zn

Geology by W. H. Pooje, 1951 - 1955
 J. A. Roddick and L. M. Green, 1959

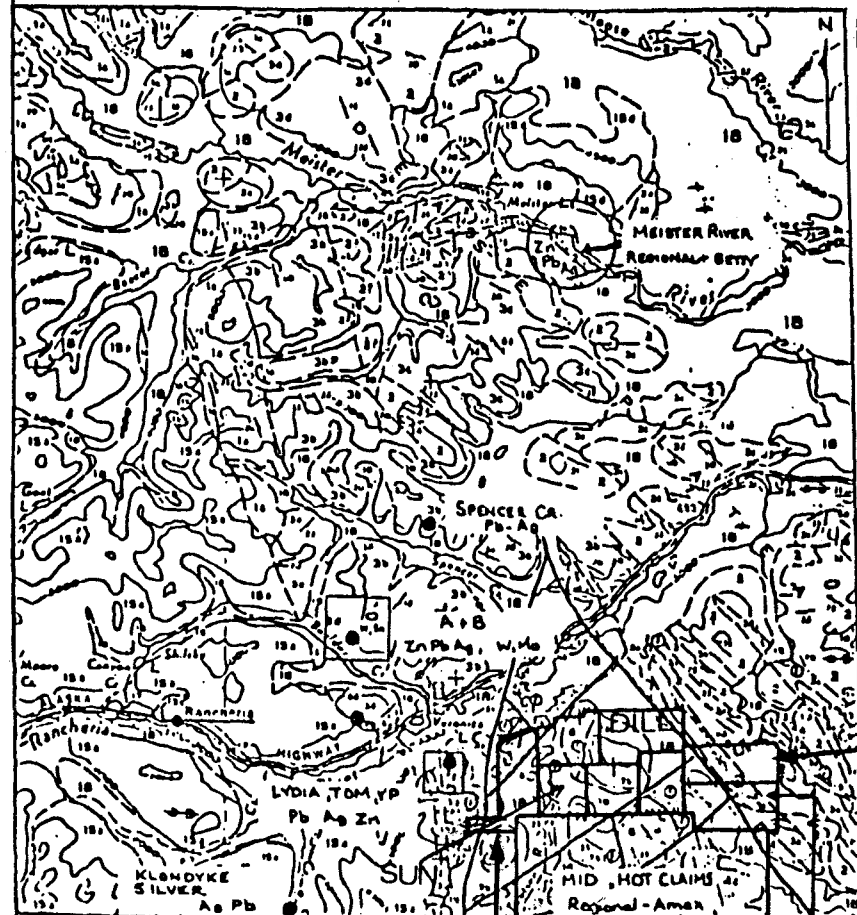

FIGURE 3. Regional geology of Rancharia area, Y.T.
 Portion of G.S.C. Map 10 - 1960 (Wolf Lake). Scale: 1 in = 6.5 miles.

Unit 5: (Ordovician-Silurian)

This unit contains mainly quartzites, dolomitic siltstone and thin-bedded shale and limestone, and is probably equivalent to unit 4 in the adjacent Jennings River map sheet.

McDame Group - Unit 6:

The McDame Group, dark, fetid, dolomites and limestones with abundant fossil debris, forms a distinctive marker unit. Dolomite (intraformational?) breccia is common and white vuggy dolomite may represent reefoid accumulations of fossils, representing shoals in a shallow platform environment. Fossil evidence indicates that the McDame Group is Middle Devonian in age.

Lower Sylvester Group - Unit 7b:

According to Gabrielse (1968) "the contact of the McDame Group with the overlying Sylvester Group is almost invariably a fault." The lower part of the unit is fine-grained, black, locally graphitic slates and phyllites, with grey to black bedded and ribbon cherts. The upper part contains argillites, interbedded with sandstones, grit and conglomerate. Cherty, fine-grained limestone may be present near the top of the unit.

Several barite-silica "exhalite" horizons are present within the lower Sylvester Group in the vicinity of the "Midway" property. Stratigraphy in this area, within the Sylvester Group is described in detail by Hylands (1981), and is shown on the following page, with a diagrammatic stratigraphic section (Figure 4).

Upper Sylvester Group - Units 7a & 8:

Massive volcanic rocks, including flows, breccias, tuffs and agglomerates with aggregate thickness of over 1500 feet form Unit 7; with ultramafic bodies (Unit 8) cutting the volcanics. The volcanics include basalt, dacite and rhyolite flows and coarse-grained equivalent intrusive rocks are said to exist in the unit (Gordey, et al 1982). Most rocks are pervasively altered to "greenstones", making them appear massive.

Cassiar Batholith:

The northwesterly trending elongate Cassiar Batholith underlies the most rugged terrain in the map area. Much of the batholith consists of massive, homogeneous biotite quartz-monzonite, grey in color and medium to coarse grained in texture. Other varieties include muscovite quartz-monzonite, augen gneisses, and later pegmatitic dykes. Alteration and shearing are commonly associated features -- sericitization, chloritization and albitization are prevalent in some areas.

Other granitoid rock types occur in the Jennings River map sheet but are not within the scope of this report.

Dykes:

Greenstone dykes are common in the batholith and also within the adjacent Paleozoic rock units. Some of the dykes are known to be lamprophyres.

Structure:

The Sylvester "allocthon" is characterized by a broad, northwesterly-trending synclinal feature commonly referred to as the McDame Synclinorium. This feature parallels the contact of the Cassiar batholith in a general way but is modified by smaller scale folds conforming to embayments in the batholith, as is seen near the Marbaco property. Tight folding in Cambrian-Silurian rocks is present near Tootsee Lake. Strong northwest to northeast faulting has also affected the area, as is seen in the accompanying geological map (Figure 3). Most faults are steep, normal faults such as the north-trending, easterly dipping fault cutting through the western portion of the Midway property. Faults are marked by depressions and green dykes, some of which are schistose, indicating continued movement.

Low angle faults, probably related to the hypothesized sole fault of the allocthon, are known to cut the Sylvester sequence in the vicinity of the Midway deposit (Hylands, 1981).

A strong shear zone trends northwest through the Cassiar batholith west of Tootsee Lake, and along this feature pervasive shearing and mylonization occurs over widths of 2 miles.

The Sylvester allocthon appears to pinch out in the vicinity of the Alaska Highway in Wolf Lake map area (Figure 3). Major faults mark the northern limit at Spencer Creek. South of Rancheria River, a broad area of Sylvester and McDame group rocks is thought to represent the same mineralized units as at the Midway and Marbaco properties.

MINERAL DEPOSITS IN THE AREA

The most significant development in mineral exploration in the southern Yukon and northern B. C. within the last few years has been the discovery of stratiform silver-lead-zinc mineralization within "exhalite" massive sulphide and silica/barite horizons in the lower portion of the Mississippian-Devonian Sylvester group.

The discovery, by Regional Resources Ltd. and partners Amax of Canada and Procan Exploration Ltd. has resulted in an extensive staking program and re-evaluation of geological data concerning mineral showings adjacent to the "Midway" property.

Several other silver-lead-zinc deposits not as yet of economic size or grade, occur in close proximity, in Cambrian to Middle Devonian strata, and also in high grade veins within the Cassiar Batholith. The Amy, Freer Creek, Silver Tip and YP-Idaho are described briefly, following a description of the Midway property.

Midway Deposit:

The "Midway" deposit, staked by Regional Resources in 1980 and drilled in 1981 and 1982 was discovered as a result of careful exploration of the previously explored Silverknife (Silver Tip) silver-lead-zinc showing, following investigation of strongly anomalous silt sample results in the 1980 regional geochemical survey.

Six drill holes in 1981, totalling 853 meters indicated the presence of 3 mineralized zones dipping southeasterly at about 30 degrees. The lowermost zone observed only in drill core overlies the McDame limestone and varies from 1 to 1.5 meters thick and contains from 2.65 to 23.39% combined lead-zinc and from 1.25 to 22.59 oz/ton silver. This zone is locally absent and may grade laterally into siliceous, pyritic, exhalite. Four of the 6 holes encountered a "dry cavernous opening 15 cm to 150 cm wide" near the McDame-Sylvester contact.

The lower zone consists of weakly bedded to brecciated pyrite, galena, sphalerite and carbonate fragments in an argillaceous matrix.

The middle, or "Discovery" zone, found in outcrop, occurs about 70 meters stratigraphically above the lower zone, within argillite and sandstones.

This zone varies for 0.5m to 11.2 meters in thickness and ranges in grade from 4.56 to 13.36 percent combined Pb-Zn and 1.26 to 5.03 oz/ton silver.

The Upper Zone is about 10 - 20 meters above the Discovery zone, ranges in thickness from 0.40m to 3.17m in thickness and has combined lead-zinc grades ranging from 2.62% to 13.15% and silver grades.

Drilling of 18 additional holes in 1982 has proven 2.78 million tonnes (3.05 M. tons) averaging 13.3 oz/tonne silver, 12% zinc and 6.1% lead with minor but possibly economic quantities of tin, bismuth, gold and copper. (Richardson, Greenshields, Canada Ltd. - research report). Composite samples from core from 8 holes averaged 0.023 oz/ton gold, 0.35% copper, and 0.14% tin. The deposit is now known to exist over an area 2,000 feet (600m) square through a geological section of 100 ft. (30m). Definition of the deposit is not complete.

The exhalite horizons can be traced for at least 14 km along strike on the southwest part of the property and similar horizons are seen 10 km to the northeast. On the northeast side of the property a barite exhalite 4 m-thick has been traced for 5 km in float and outcrop.

The mineralized horizons are believed to represent sulfide rich exhalations deposited on the floor of a rift-controlled basin up to 14 km wide (Hylands, 1981).

The showings respond well to standard geochemical soil and silt sampling techniques; the Discovery showing has a broad coincident Pb-Zn-Ag-Ba anomaly, and seven additional areas have coincident Pb-Zn-Ag anomalies. Airborne EM and magnetometer surveys were flown and ground EM and gravity surveys were done. Two pulse EM anomalies and one vector EM anomaly were verified by drilling.

An idealized stratigraphic section prepared by D. G. McIntyre from company plans is reproduced in Figure 3A and a stratigraphic section used by J. Hylands for the Midway property is reproduced in Figure 4.

Amy (Fosco) Showings:

The Amy deposit is situated approximately two miles north west of the north end of Tootsee Lake. The showings were discovered in 1948 and staked by Hudson Bay Exploration as the Gem Group. In 1949, 8 diamond drill holes were completed totalling 2935 feet, and seven deep trenches traced the mineralized zone for 550 feet with maximum width 7 feet in DDH - 2. The mineralization, galena, tetrahedrite, sphalerite, pyrrhotite and ankerite occurs as a replacement zone in limestone along a limestone-argillite contact and near the surface trace of the granite contact. The zone occupies a shear zone striking north 55-65 degrees west and dipping 60 degrees southwest.

Further work on the property in 1964 by Rancheria Mining Company consisted of soil surveys, magnetometer surveys and underground development.

In the underground workings, the vein in a 66 foot section averaged 5.9 feet wide and assayed 27.4 oz/ton silver, 7.5% zinc and 7.5% lead. Further drifting along the vein in 1965 disclosed a vein length of at least 419 feet. Additional bulldozer trenching on other geochemical anomalies disclosed other veins. Diamond drilling to test continuity consisted of 24 holes totalling 7500 feet.

130°30'

104 O/16

Yukon 130°00' 60°00'

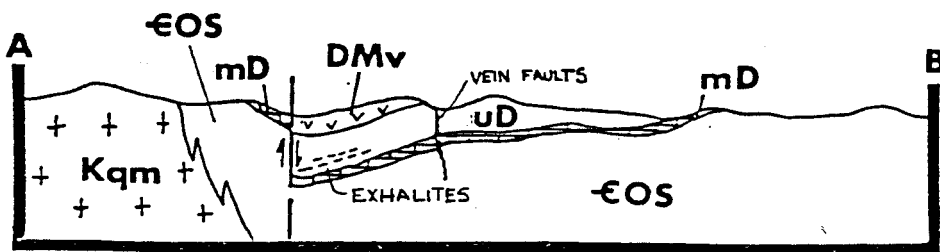
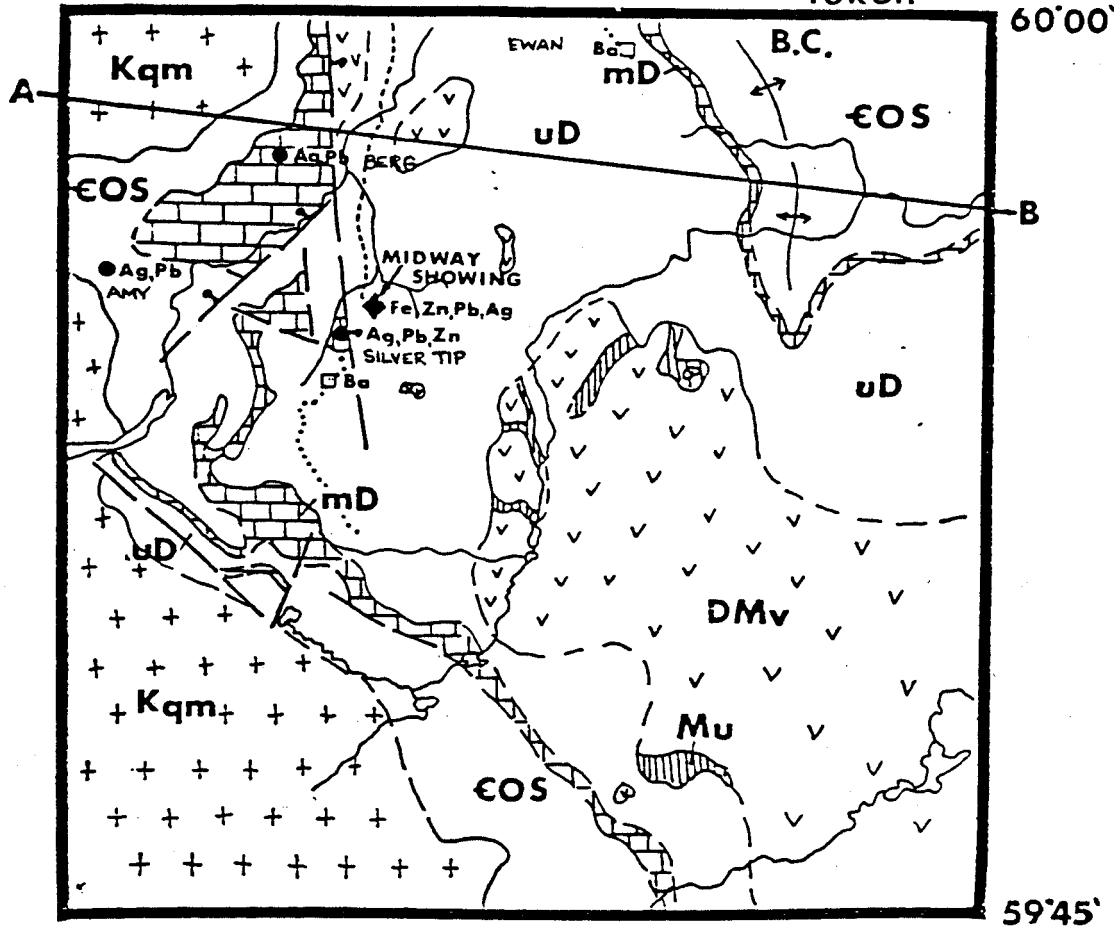

Figure 3a. Generalized geology in vicinity of the Midway showing, Jennings River map-area; geology and legend modified from Gabrielse (1969).

(Source, McIntyre, D.G, 1982. BCDM Paper 82-1)

TABLE II.
Legend for Figure 3a.

CRETACEOUS

CASSIAR BATHOLITH

Kqm Quartz monzonite, granodiorite

MISSISSIPPIAN AND LATER

Mu Serpentinite, dunite, peridotite

UPPER DEVONIAN TO MISSISSIPPIAN

SYLVESTER GROUP (UPPER)

DMv Greenstone, agglomerate; dacitic tuff; minor chert, metadiorite

MIDDLE TO UPPER DEVONIAN

SYLVESTER GROUP (LOWER)

uD Slate, argillite, chert, siltstone, chert-arenite, greywacke, chert pebble conglomerate, minor limestone

MIDDLE DEVONIAN









MCDAME GROUP

mD Dolomite, fossiliferous limestone

CAMBRIAN, ORDOVICIAN, AND SILURIAN

EOS Dolomite, dolomitic sandstone and siltstone, graptolitic black shale, platy siltstone, calcareous phyllite, phyllitic limestone skarn, hornfels, limestone, quartzite

Symbols

High-angle fault; ball on downthrown block	
Antiform	
Contact: defined; assumed	
Road	
Stratabound barite	
Stratabound massive sulphide	
Mineral occurrence in carbonate rocks	
Exhalite horizon	

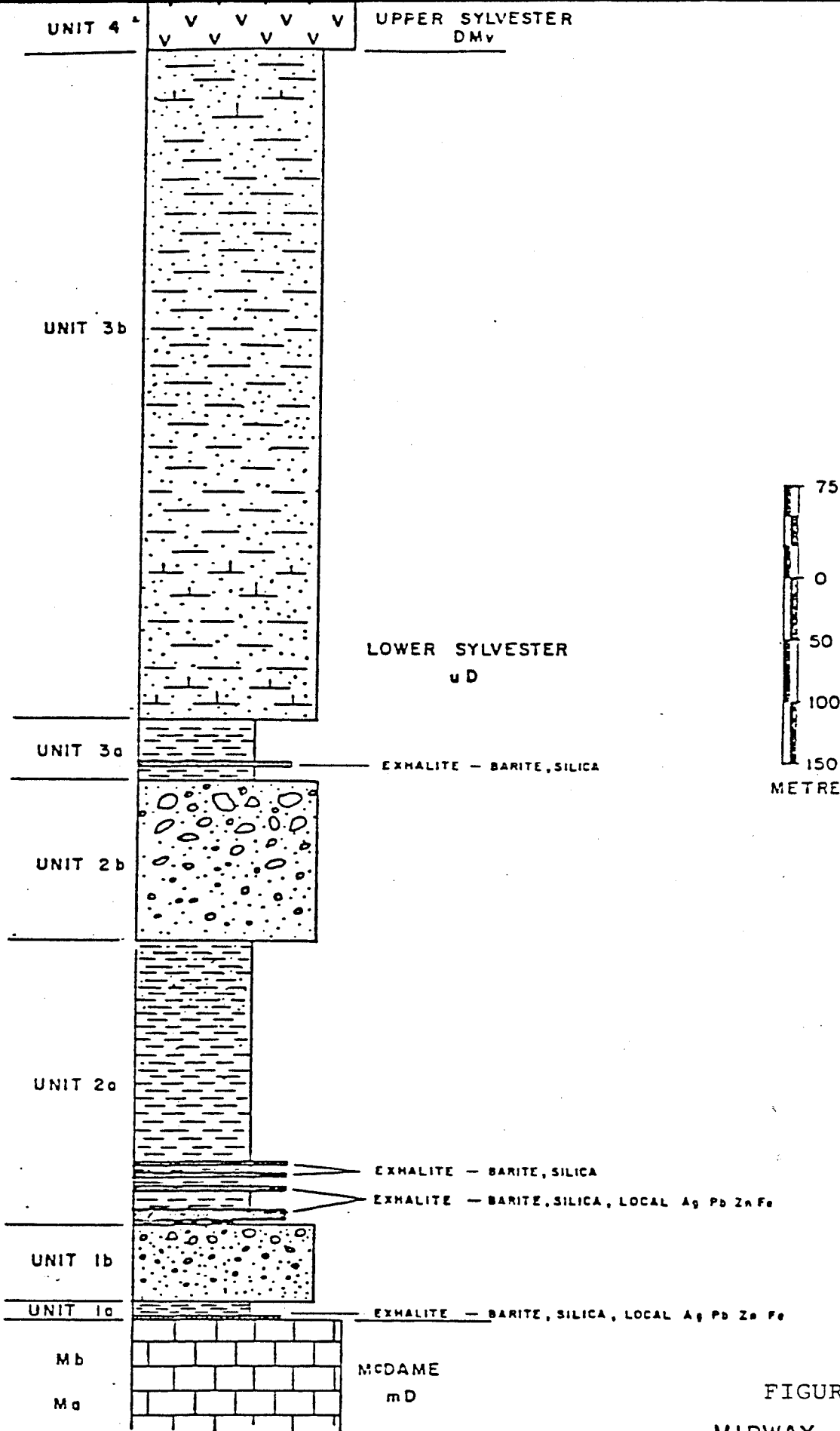

FIGURE 4
MIDWAY PROPERTY

STRATIGRAPHIC SECTION

(Source: Hylands, J. 1981)

The claims lapsed in 1969 and in 1970 the property was restaked by Fosco Mining Limited. Further underground work and drilling was done and a feasibility study was done by Dolmage, Campbell and Associates, who concluded that the deposit contained the following tonnages (diluted):

<u>Category</u>	<u>Tons</u>	<u>Ag(oz/t)</u>	<u>Pb%</u>	<u>Zn%</u>
Measured	11,400	17.10	3.74	6.26
Drill indicated	31,100	6.31	1.78	6.80
Geologically inferred	<u>68,400</u>	no grade assigned		
TOTAL:	<u><u>110,900</u></u>			

The consultants further stated that "A comparison between the grade of drill intercepts near the underground workings and assays from channel samples taken from the drift suggests that the estimated grade in the drill indicated category is probably low by an unknown but significant amount. The reserve estimate outlined in this report should not be considered as limiting the ultimate potential of the deposit".

Bench scale mill tests produced a concentrate acceptable to custom smelters. A detailed underground exploration program was recommended, but immediate production was not recommended at that time because of the weak price for silver (\$1.29 to \$2.57 per ounce).

In 1973, additional surface work was done, confirming sampling completed on the 4450 level, and a 1400 foot crosscut and 220 feet of drifting done on the 4200 feet level.

A second estimate of ore reserves was done by Chapman Wood and Griswold in 1974, who concluded that total ore reserves now were + 140000 tons as follows:

<u>Category</u>	<u>Tons</u>	<u>Grade Ag(oz/t)</u>	<u>Pb%</u>	<u>Zn%</u>
Measured	18,122	13.88	3.27	7.29
Drill indicated	<u>61,727</u>	<u>9.76</u>	<u>2.70</u>	<u>5.63</u>
Total	79,849	10.70	2.84	6.03
Inferred	<u>59,326</u>	no grade assigned		
TOTAL:	<u><u>140,000</u></u>			

The claims were acquired by Marbaco Mines Ltd. in 1980 along with adjacent claims owned by D. Schellenberg. Marbaco performed geochemical surveys and trenching which indicated additional zones could be present.

At present metal prices (\$15/oz Ag, 28¢/lb Pb, 49¢/lb Zn), gross metal value per ton of ore (1974 reserve data) is \$235.50. (The estimated grade of drill indicated reserves is probably still low compared with measured reserves, as in the 1971 calculations). Few recent assay exist for gold but several samples taken from 1949 to 1967 contain 0.01 to 0.02 oz/ton.

Prospects are considered encouraging for discovery of additional mineralized zones at this property.

Some similarities exist between the Amy deposit and the lower most "exhalite" zone at the Midway deposit:

- 1) Both deposits occur near limestone - phyllite contacts.
- 2) Solution caves are found adjacent to both deposits.
- 3) Mineralogy and reserve grades are similar.
- 4) Mineralization is parallel with bedding in both deposits.

The Amy deposit is described in most reports as a strike fault system with characteristics of quartz-siderite-sulphide replacement of limestone in a Shear zone. However, the possibility exists that the deposit represents a remobilized stratiform exhalite deposit, with potential for augmentation of reserves along strike and dip.

Silver Tip Showing (Midway Property)

The Silver Tip showing, a vein or replacement deposit, is situated three miles northeast of Tootsee Lake. Extensive work was done on the property from 1956 to 1968 by several large companies including Conwest, Canex, Noranda, Bralorne Mines

and Peerless Oil and Gas. It now forms part of the Midway property of Regional Resources and partners.

The area is underlain by thick-bedded McDame limestone of Devonian age, overlain by Mississippian-Devonian Sylvester Group phyllites. Gossan zones and galena float are found in several zones trending north-easterly. The largest gossan zone, No. 2, ranges from 15 to 65 feet wide and is 700 feet long and was reported to average 5.7 oz/ton silver, 6.2% lead and 2.9% zinc. Individual pieces of galena from the zone assay about 150 oz/ton silver and 70% lead (BCMM Ann. Report 1968, p. 25-33). The same zone intersected in several drill holes consisted of "frozen mineralized gossan". No. 4 zone, intersected in the upper adit was sampled over 38 feet by taking muck from 175 cars, the average was 13.84 oz/ton silver, and 15.4% lead. The average of the channel samples along 40 feet in the west drift was over five feet, 0.02 oz/ton gold, 12.0 oz/ton silver, and 14.5% lead. The same zone, intersected in the lower adit, approximately 650 feet down the dip of the fault zone, is almost completely oxidized and resembles "soft brown sugar". This almost completely leached material assays 0.2 oz/ton silver, 0.1% lead and 4.5% zinc.

Mineralized zones such as the above are localized on strong faults and fractures in the McDame limestone, along the crest of an anticline and appear to be almost completely oxidized to depths exceeding 600 feet from the surface. Apart from the gossan zones, considerable pyrite with minor sphalerite and galena occurs in the holes drilled in the phyllite, (presumably Sylvester Group), and minor galena and sphalerite occur in quartz and calcite veins and in limestone. To the writer's knowledge, fresh vein material from which the gossans resulted has not been seen on the property.

This vein-replacement deposit, as yet untested by Regional Resources has strong similarities to the Amy deposit of Marbaco Resources. Mineralogy and grades are similar and probably origin by replacement along fault zones in limy horizons seems almost certain. Considering the presence of mineralization over a vertical range of over 650 feet and 5 foot mining width, the eventual development of economic reserves on this portion of the property seems certain.

YP Property:

The YP property, adjacent to the Flo and Lydia claims, situated 4 km south of mile 701 on the Alaska Highway, owned by Flame Petro Minerals Ltd. and currently being explored by Butler Mountain Resources Ltd., has several oxidized vein or replacement zones in limestone of unknown, but probable Cambrian age. Some solid galena was hand-cobbed and shipped from the property in the 1960's. Several large gossan zones, with residual argentiferous galena, are thought to represent oxidized replacement zones of galena-tetrahedrite-sphalerite and other sulphides in siderite gangue, comparable with zones present on the Silver Tip showing of the Midway property. Geochemical surveys, geologic mapping, trenching and drilling were recommended by B.J. Price in 1980. The property was reviewed in 1982 by Glen E. White, P.Eng., who suggested pulse EM surveys in addition to geology and geochemistry, with a 2-stage program with \$40,000 expenditure in Stage I and \$110,000 in Stage II (drilling).

The program is expected to proceed in 1983.

GEOCHEMICAL EXAMINATION OF THE TOM CLAIMS

a) Methodology

A reconnaissance soil geochemical survey was carried out to evaluate the largely overburden covered property. An attempt was made to sample claim lines, claim boundaries and along roads with samples spaced at 50m intervals and sites flagged and labelled.

Soil samples were taken from the B horizon excluding organic material as much as possible. Samples (406) were analyzed for Pb, Zn and Ag at Chemex laboratories using atomic absorption spectrometry. Sample preparation included sieving to -80 mesh, or to -35 mesh with grinding where there was insufficient fines.

Silt samples (6) were taken from drainages during soil sampling traverses and also analyzed for Pb, Zn and Ag.

Results are presented on Map #2 and certificates of analysis are presented in Appendix A. Analytical results were treated by computer to determine statistical parameters. Results of the statistical treatment is presented in Appendix B.

b) Geochemistry

Considering values of 0.5 ppm and greater silver to be of interest, values of 1.0 ppm and silver to be anomalous about 74 of the 406 silver determinations are of interest and 12 are definitely anomalous. The statistical package suggest that silver correlates better with lead than zinc. Two strongly anomalous lead values correlate with anomalous silver at stations CTS 10 and 181 with the strongest silver response of 1.8 ppm for sample DTS-57. Higher silver values generally occur on the more westerly claims which are away from the Tootsee River valley. Better soil development and less glacial overburden occurs in these areas. More detailed sampling is required to define anomalies on the western most claims. At best, scatter bedrock response will be obtained in the more easterly claims.

Statistical treatment of silver values shows a variation from 0.100 ppm to 1.800 ppm for silver with a mean value of 0.275 ± 0.264 at one standard deviation. If the mean plus one standard deviation is considered to be anomalous then values over 0.539 ppm silver should be considered anomalous. Silver values correlate better with lead (0.107) than zinc (0.021).

Lead values vary from 1.000 ppm to 220.00 ppm with a mean of 31.143 ± 21.733 at one standard deviation. Forty samples have over 55 ppm lead and five samples have over 80 ppm lead.

Zinc values vary from 14.000 ppm to 650.000 ppm with a mean of 158.138 ± 100.283 ppm. Value over about 250 ppm appear to be of interest with 27 values over this level.

c) Conclusion

Initial reconnaissance soil and silt sampling has revealed anomalous lead, zinc and silver values with the better bedrock response expected from the westerly Tom Claims. Detailed soil sampling with 100m line spacing and 50m soil stations should be conducted on Tom 15 through 26 inclusive. About 600 samples will be involved. Samples should be analyzed for Pb, Zn and Ag with anomalous samples check for Au, W and Mo. Pulps from anomalous samples obtained during the reconnaissance sampling program should also be analyzed for Au, W and Mo. Anomalous trends should be surveyed using Pulse E.M. which was successful on the adjoining Butler Mountain Minerals property.

GEOPHYSICAL PROSPECTING

a) Methodology

Three road traverses were made to test the usefulness of a Phoenix 2 VLF-EM unit. Two stations (Cutler, Maine and Seattle, Washington) situated at about 70° to one another produced strong audible signals but were not always available. Dip angles and field intensity were measured for two stations at each site. Strong increases in field intensity were not found anywhere on the property and values have not been presented. A weak cross-over is associated with the Creek draining the southern part of the property.

- b) The VLF-EM technique appears to provide useful structural information with stations Cutler, Maine and Seattle, Washington giving the best results. The general usefulness of this method appears to be limited because of overburden which often appears to exceed 30m. A method like Pulse EM should be used where overburden problems are expected.

CONCLUSIONS

Preliminary results of reconnaissance geological, geochemical, geophysical and prospecting traverses on the Tom claims are encouraging. Several anomalous silver, lead and zinc values require follow-up. A detailed geochemical survey of Tom 15 through 26 is warranted with lines at 100m and stations at 50m. Anomalous trends should be checked with Pulse EM or a similar applied current method. Anomalies detected should be checked by trenching or if overburden is considered to be excessive, drilling should be considered. Selection of drilling or trenching sites is contingent on the successful completion of the next geochemical and geophysical program.

Peter A. Christopher P. Eng.

COST STATEMENT

Personnel

P.A. Christopher 3707 West 34th Avenue Vancouver, B.C.	7 days @ \$325 each August 3rd and 5th ½; August 15th - 20th	\$ 2,275
Gary Medford 3582 West 14th Avenue Vancouver, B.C.	Geologist 6 days @ \$275 each August 15th - 20th	1,650
Les Demczuk 1769 East 12th Avenue Vancouver, B.C.	August 16th and 17th 2 days @ \$150 each	300
Mobilization/Demobilization		500
Shipping		100
Room and Board	15 man days @ \$40 each	600
Truck Rental	7 days @ \$120 each	840
E.M. Rental	3 days @ \$25 each	75
Geochemical Costs		
Analyses	1,750	
Statistics	<u>68</u>	
		1,818
Radio and Phone		100
Expendables (Topo chain, flagging, soil bags, tape, etc.)		150
Consulting and Report Writing	4 days @ \$325	1,300
Report Preparation (Drafting, typing, copies, etc.)		<u>450</u>
		<u><u>TOTAL COST \$10,158</u></u>

Peter A. Christopher
Peter A. Christopher, Ph.D.

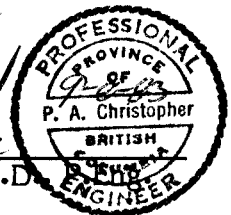

BIBLIOGRAPHY

- R.C. Annis & D.A. Cranstone, et al, (1978), A Survey of Known Mineral Deposits in Canada that are not being mined. M.R. 181 Department Energy, Mines and Resources.
- E.D. Black, (1967), Geochemical and Engineering Evaluation Report. Yukon Silver Properties, Spencer Creek Groups, Caribou Lake Group. Assessment Report for Pacific Giant Steel Ores Ltd.
- Camsell, George E., (1949), Geological and Diamond Drilling Report, Glen 1-38 Mineral Claims. Assessment Report No. 44. BCDM.
- Canadian Mines Handbook, Northern Mines Press, 1971-1980,
- E.P. Chapman, (1971), Report of Examination, Flo and Leo claim groups. Liard M.D. for Fosco Mining Ltd., Assessment Report No. 3566.
- K.J. Christie, (1971), Report on the Andrew Mineral Claims, Watson Lake Mining District, Yukon Territory. Private Report.
- Eccles, L.K., (1980), Geological and Geochemical Report JCS 1 and 2 claims, Liard M.D. Assessment Report No. 7870.
- Eccles, L.K., (1980), Geological and Geochemical Report Bear, Bear 2, JM, JR, TM, BP claims, etc. Dupont of Canada Exploration, unpublished report.
- George Cross Newsletter, 1981, 1982, Various news releases made by Regional Resources.
- Gabrielse, H., (1969), Geology of the Jennings River Map-Area. GSC Paper 68-55, 37pp.
- Gordey, S.P. et al, (1982), Stratigraphy and Structure of Sylvester Allocthon, Southwest McDame Map-Area, Northern British Columbia.
- W.H. Gross, (1964), Geological Geochemical and Geophysical Studies, Amy claim group. Rancheria Mining Company Ltd., BCDM Assessment Report No. 734.
- F. Holcapek, (1974), Report on the Tam 1 - 20 mineral claims. Liard M.D. for Balmoral Mines Ltd. (NPL). Assessment Report No. 4973.

- Stuart S. Holland, (1968), Silver Tip claims. Liard M.D. Summary of Geology and Exploration. B.C. Department Mines Annual Report, p. 24-33.
- Hylands, J., (1980), Midway property, Assessment Report No. 9912. BCDM.
- McArthur, R.G., (1979), Geochemical and Geological Report on Root 1 Mineral Claim. Assessment Report No. 7673. BCDM.
- McArthur, R.G., (1979), Geological Mapping and Diamond Drill Report, Toot 1, Toot 2, and Lake 8-11 Mineral Claims, Assessment Report No. 8125. BCDM.
- McArthur, R.G., (1979), Geological and Geochemical Report, Root 1, Boot, Loot and Road Claims Assessment Report No. 8566. BCDM.
- McDonald, G., (1979), Geological and Geochemical Report, Toot 1, Toot 2, and Lake Mineral Claims. Assessment Report No. 7257. BCDM.
- McIntyre, D.G., (1982), Midway Occurrence Geological Fieldwork, 1982. BCDM Paper 1982-1, pp.162-166.
- Mineral Industry Reports, D.I.A.N.D., Yukon Territory, 1973 - 1977.
- Price, B.J., (1975), Brief Report of the A + B claims near Rancheria, Y.T. Private report for Delphi Resources Ltd.
- Price, Barry J., (1980), Geological Report, YP Silver-Lead Prospect, Watson Lake, M.D., Yukon Territory. Unity Gold Resources, unpublished Company Report.
- Poole, W.H. et al, (1960), Wolfe Lake Map Area, Yukon Territory, G.S.C. Map 10-1960.
- Richardson Greenshields Canada Ltd., December 6, 1982, Regional Resources Ltd., Canadian Research Report, 4pp.
- Schellenberg, D.G., (1981), Soil geochemical field survey on part of ROX claim. Assessment Report. BCDM.
- Teskey, M.F., (1962), A Preliminary Geological and Engineering Evaluation; Susie, Hope and Pete Groups of claims, Yukon Territory for Native Minerals Ltd.
- White, Glen E. and Cruz, E.D., (1973), Geochemical and Geophysical Report. Cone Mountain Mines Ltd., Luck Mineral claims, Y.T.

- White, Glen E. and Parent, D., (1972), Geochemical Report. Cone Mountain Mines Ltd., Luck Mineral claims, Y.T.
- Whiting, B.H., (1980), 1979 Prospecting Report for Tootsee Project, Toots 1-4 claims, Liard, M.D., Assessment Report 8061. BCDM.
- Christopher, P.A., (1983) Geological Report, Tom Claims, Watson Lake Mining District, Yukon Territory. Report for Fairlady Energy Inc. dated February, 1983.

CERTIFICATE

I, Peter A. Christopher, with business address at 3707 West 34th Avenue, Vancouver, British Columbia, do hereby certify that:

- 1) I am a consulting geological engineer registered with the Association of Professional Engineers of British Columbia since 1976.
- 2) I am a Fellow of the Geological Association of Canada and a member of the Society of Economic Geologists.
- 3) I hold a B.Sc. (1966) from the State University of New York at Fredonia, a M.A. (1968) from Dartmouth College and a Ph.D. (1973) from the University of British Columbia.
- 4) I have been practising my profession as a Geologist for over 15 years.
- 5) I have no direct or indirect interest, nor do I expect to receive any interest directly or indirectly in the property or securities of Fairlady Energy Inc.
- 6) I have based this report on all available geological data on the property and adjacent mineral deposits, and on fieldwork conducted by Peter Christopher & Associates Inc. between August 3rd and 20th, 1983.
- 7) I consent to the use of the report by Fairlady Energy Inc. for whatever purposes it deems necessary.

PETER A. CHRISTOPHER, Ph.D., P. ENG.



APPENDIX A. Geochemical Analyses



CHEMEX LABS LTD.

212 BROOKSBANK AVE.
NORTH VANCOUVER, B.C.
CANADA V7J 2C1

TELEPHONE: (604) 984-0221
TELEX: 043-52597

- ANALYTICAL CHEMISTS

- GEOCHEMISTS

- REGISTERED ASSAYERS

*** INVOICE ***

To : CHRISTOPHER, PETER & ASSOC.

Invoice # : I8314C92

3707 WEST 34TH AVE.,
VANCOUVER, B.C.
V6N 2K9

Date : 30-AUG-83
P.C. # : NONE
Project TCM

Invoice for analytical work reported on certificate(s) A8314092-001 to -005

Quantity	Analysed for code description	unit price	amount
195	004 - Pb ppm		
	005 - Zn ppm		
	006 - Ag ppm	3.70	721.50

Sample preparation and other charges :

193	201 - soil + sediment -80 mesh	0.60	115.80
2	203 - -35 mesh sieve + ring	2.00	4.00

TOTAL \$ 841.30

Please pay this amount ----> \$ 841.30
=====

TERMS -- NET 30 DAYS

1.5 % per month (18 % per annum) charged on overdue accounts



MEMBER
CANADIAN TESTING
ASSOCIATION



CHEMEX LABS LTD.

212 BROOKSBANK AVE.
NORTH VANCOUVER, B.C.
CANADA V7J 2C1

TELEPHONE: (604) 984-0221
TELEX: 043-52597

• ANALYTICAL CHEMISTS

• GEOCHEMISTS

• REGISTERED ASSAYERS

CERTIFICATE OF ANALYSIS

TC : CHRISTOPHER, PETER A. & ASSOC.

3707 WEST 34TH AVE.,
VANCOUVER, B.C.
V6N 2K9

CERT. # : A8314092-C01-
INVOICE # : 18314092
DATE : 30-AUG-83
P.C. # : NCNE
TCM

ATTN: P.A. CHRISTOPHER

Sample description	Prep code	Pb ppm	Zn ppm	Ag ppm			
DT83816-C1	201	20	110	0.2	--	--	--
DT83816-C2	201	24	112	0.2	--	--	--
DT83816-C3	201	6	20	0.4	--	--	--
DT83816-C4	201	17	59	0.1	--	--	--
DT83816-C5	201	14	72	0.1	--	--	--
DT83816-C6	201	17	86	0.1	--	--	--
DT83816-C7	201	14	82	0.1	--	--	--
DT83816-C8	201	15	81	0.1	--	--	--
DT83816-C9	201	18	106	0.2	--	--	--
DT83816-10	201	20	146	0.1	--	--	--
DT83816-11	201	17	104	0.1	--	--	--
DT83816-12	201	14	87	0.1	--	--	--
DT83816-13	201	13	87	0.1	--	--	--
DT83816-14	201	18	102	0.1	--	--	--
DT83816-15	201	28	112	0.3	--	--	--
DT83816-16	201	24	101	0.4	--	--	--
DT83816-17	201	9	104	0.2	--	--	--
DT83816-18	201	12	102	0.1	--	--	--
DT83816-19	201	9	160	0.7	--	--	--
DT83816-20	201	10	79	0.9	--	--	--
DT83816-21	201	4	119	0.6	--	--	--
DT83816-22	201	12	105	0.2	--	--	--
DT83816-23	201	12	85	0.1	--	--	--
DT83816-24	201	15	177	0.6	--	--	--
DT83816-25	201	14	125	0.1	--	--	--
DT83816-26	201	24	84	0.3	--	--	--
DT83816-27	201	5	102	0.4	--	--	--
DT83816-28	201	11	158	0.3	--	--	--
DT83816-29	201	12	191	0.4	--	--	--
DT83816-30	201	12	120	0.2	--	--	--
DT83816-31	201	13	103	0.1	--	--	--
DT83816-32	201	12	120	0.1	--	--	--
DT83816-33	201	16	136	0.2	--	--	--
DT83816-34	201	1	36	0.1	--	--	--
DT83816-35	201	13	127	0.3	--	--	--
DT83816-36	201	13	98	0.1	--	--	--
DT83816-37	201	6	56	0.7	--	--	--
DT83816-38	201	21	150	0.2	--	--	--
DT83816-39	201	28	134	0.1	--	--	--
DT83816-40	201	23	106	0.1	--	--	--



Certified by *Hart Bichler*



CHEMEX LABS LTD.

212 BROOKSBANK AVE.
NORTH VANCOUVER, B.C.
CANADA V7J 2C1

• ANALYTICAL CHEMISTS

• GEOCHEMISTS

• REGISTERED ASSAYERS

TELEPHONE: (604) 984-0221
TELEX: 043-52597

CERTIFICATE OF ANALYSIS

TO : CHRISTOPHER, PETER A. & ASSOC.

3707 WEST 34TH AVE.,
VANCOUVER, B.C.
V6N 2K9

CERT. # : A8314092-C02-
INVOICE # : I8314092
DATE : 30-ALG-83
P.C. # : NCNE
TOM

ATTN: P.A. CHRISTOPHER

Sample description	Prep code	Pb ppm	Zn ppm	Ag ppm			
DT83816-41	201	29	132	0.1	--	--	--
DT83816-42	201	22	113	0.1	--	--	--
DT83816-43	201	18	86	0.1	--	--	--
DT83816-44	201	22	150	0.1	--	--	--
DT83816-45	201	29	169	0.1	--	--	--
DT83816-46	201	22	188	0.1	--	--	--
DT83816-47	201	22	87	0.1	--	--	--
DT83816-48	201	14	64	0.3	--	--	--
DT83816-49	201	32	107	0.5	--	--	--
DT83817-50	201	18	73	0.1	--	--	--
DT83817-51	201	21	93	0.2	--	--	--
DT83817-52	201	18	139	0.4	--	--	--
DT83817-53	201	20	137	0.3	--	--	--
DT83817-54	201	18	118	0.1	--	--	--
DT83817-55	201	38	152	0.1	--	--	--
DT83817-56	201	34	111	0.3	--	--	--
DT83817-57	201	33	135	1.8	--	--	--
DT83817-58	201	36	205	0.9	--	--	--
DT83817-59	201	29	128	0.1	--	--	--
DT83817-60	201	17	305	0.1	--	--	--
DT83817-61	201	50	153	0.1	--	--	--
DT83817-62	201	20	74	0.1	--	--	--
DT83817-63	201	48	121	0.2	--	--	--
DT83817-64	201	32	107	0.3	--	--	--
DT83817-65	201	29	560	0.1	--	--	--
DT83817-66	201	19	154	0.3	--	--	--
DT83817-67	201	14	99	0.3	--	--	--
DT83817-68	201	33	94	0.9	--	--	--
DT83817-69	201	32	106	0.2	--	--	--
DT83817-70	201	46	181	0.1	--	--	--
DT83817-71	201	37	97	0.2	--	--	--
DT83817-72	201	46	101	0.7	--	--	--
DT83817-73	201	51	113	0.5	--	--	--
DT83817-74	201	50	260	0.1	--	--	--
DT83817-75	201	40	225	0.6	--	--	--
DT83817-76	201	41	365	0.7	--	--	--
DT83817-77	201	46	132	0.5	--	--	--
DT83817-78	201	57	225	0.5	--	--	--
DT83817-79	201	34	250	0.4	--	--	--
DT83817-80	201	33	163	0.4	--	--	--



Certified by *Hart Bichler*



CHEMEX LABS LTD.

212 BROOKSBANK AVE.
NORTH VANCOUVER, B.C.
CANADA V7J 2C1

• ANALYTICAL CHEMISTS

• GEOCHEMISTS

• REGISTERED ASSAYERS

TELEPHONE: (604) 984-0221
TELEX: 043-52597

CERTIFICATE OF ANALYSIS

TC : CHRISTOPHER, PETER A. & ASSOC.

3707 WEST 34TH AVE.,
VANCOUVER, B.C.
V6N 2K9

CERT. # : A8314092-C03-
INVOICE # : I8314092
DATE : 30-ALG-83
P.C. # : NONE
TCM

ATTN: P.A. CHRISTOPHER

Sample description	Prep code	Pb ppm	Zn ppm	Ag ppm			
DT83817-81	2C1	31	141	0.5	--	--	--
DT83817-82	2C1	79	260	0.3	--	--	--
DT83817-83	201	21	230	0.1	--	--	--
DT83817-84	2C1	47	188	0.3	--	--	--
DT83817-85	2C1	68	305	0.2	--	--	--
DT83817-86	201	55	275	0.1	--	--	--
DT83817-87	201	42	240	0.2	--	--	--
DT83817-88	2C1	37	162	0.2	--	--	--
DT83817-89	201	31	200	0.1	--	--	--
DT83817-90	2C1	35	151	0.1	--	--	--
DT83817-91	201	24	80	0.1	--	--	--
DT83817-92	201	17	74	0.1	--	--	--
DT83817-93	201	18	128	0.1	--	--	--
DT83817-94	2C1	16	102	0.1	--	--	--
DT83817-95	2C1	20	119	0.1	--	--	--
DT83817-96	2C1	27	198	0.1	--	--	--
DT83817-97	201	54	505	1.0	--	--	--
DT83817-98	201	31	265	0.1	--	--	--
DT83817-99	2C1	34	290	0.6	--	--	--
DT83817-100	2C1	35	176	0.2	--	--	--
DT83817-101	201	12	54	0.3	--	--	--
DT83817-102	2C1	16	71	0.1	--	--	--
DT83817-103	2C1	8	81	0.2	--	--	--
DT83817-104	2C1	34	108	0.1	--	--	--
DT83817-105	201	21	112	0.7	--	--	--
DT83817-106	2C1	15	70	0.1	--	--	--
DT83817-107	201	4	22	0.3	--	--	--
DT83817-108	2C1	8	93	0.3	--	--	--
DT83817-109	201	15	124	1.0	--	--	--
DT83817-110	201	17	78	0.3	--	--	--
DT83817-111	2C1	34	189	0.2	--	--	--
DT83817-112	201	24	145	0.1	--	--	--
DT83817-113	201	15	73	0.1	--	--	--
DT83817-114	201	13	151	0.1	--	--	--
DT83817-115	2C1	27	100	0.1	--	--	--
DT83817-116	2C1	44	134	0.2	--	--	--
DT83817-117	2C1	45	181	0.1	--	--	--
DT83817-118	2C1	38	98	0.1	--	--	--
DT83817-119	2C1	30	80	0.3	--	--	--
DT83817-120	2C1	28	67	0.2	--	--	--



MEMBER
CANADIAN TESTING
ASSOCIATION

Certified by *Hart Bichler*



CHEMEX LABS LTD.

212 BROOKSBANK AVE.
NORTH VANCOUVER, B.C.
CANADA V7J 2C1

TELEPHONE: (604) 984-0221
TELEX: 043-52597

• ANALYTICAL CHEMISTS

• GEOCHEMISTS

• REGISTERED ASSAYERS

CERTIFICATE OF ANALYSIS

TO : CHRISTOPHER, PETER A. & ASSOC.

3707 WEST 34TH AVE.,
VANCOUVER, B.C.
V6N 2K9

CERT. # : A8314092-C04-
INV. # : I8314092
DATE : 30-ALG-83
P.C. # : NONE
TCM

ATTN: P.A. CHRISTOPHER

Sample description	Prep code	Pb ppm	Zn ppm	Ag ppm			
DT83817-121	201	34	215	0.1	--	--	--
DT83817-122	201	55	220	0.1	--	--	--
DT83817-123	201	33	136	0.1	--	--	--
DT83817-124	201	21	153	0.1	--	--	--
MTS83815-01	201	13	157	0.9	--	--	--
MTS83815-02	201	17	103	0.8	--	--	--
MTS83815-03	201	15	133	1.2	--	--	--
MTS83815-04	201	15	89	0.3	--	--	--
MTS83815-05	201	12	123	0.8	--	--	--
MTS83815-06	201	16	186	0.5	--	--	--
MTS83815-07	201	19	159	0.6	--	--	--
MTS83815-08	201	14	139	0.4	--	--	--
MTS83815-09	201	15	138	0.5	--	--	--
MTS83815-10	201	12	113	0.1	--	--	--
MTS83815-11	201	10	129	1.0	--	--	--
MTS83815-12	201	17	300	0.5	--	--	--
MTS83815-13	201	18	355	0.9	--	--	--
MTS83815-14	201	9	94	0.2	--	--	--
MTS83815-15	201	10	91	0.3	--	--	--
MTS83815-16	201	20	89	0.3	--	--	--
MTS83815-17	201	31	115	0.3	--	--	--
MTS83815-18	201	28	151	0.6	--	--	--
MTS83815-20	201	23	82	0.2	--	--	--
MTS83815-21	201	29	89	0.3	--	--	--
MTS83816-01	201	25	66	0.2	--	--	--
MTS83816-02	201	20	98	0.4	--	--	--
MTS83816-03	201	14	124	1.0	--	--	--
MTS83816-04	201	15	196	0.7	--	--	--
MTS83816-05	201	30	154	0.6	--	--	--
MTS83816-06	201	34	103	0.4	--	--	--
MTS83816-07	201	43	72	0.6	--	--	--
MTS83816-08	201	51	101	0.1	--	--	--
MTS83816-09	201	39	104	0.4	--	--	--
MTS83816-10	201	39	136	0.4	--	--	--
MTS83816-11	201	43	105	0.5	--	--	--
MTS83816-12	201	54	650	0.4	--	--	--
MTS83816-13	201	52	103	0.6	--	--	--
MTS83816-14	201	28	360	0.2	--	--	--
MTS83816-15	201	30	355	0.4	--	--	--
MTS83816-16	201	37	180	0.9	--	--	--

Hart Buchler

Certified by



MEMBER
CANADIAN TESTING
ASSOCIATION



CHEMEX LABS LTD.

212 BROOKSBANK AVE.
NORTH VANCOUVER, B.C.
CANADA V7J 2C1

- ANALYTICAL CHEMISTS

- GEOCHEMISTS

- REGISTERED ASSAYERS

TELEPHONE: (604) 984-0221

TELEX: 043-52597

CERTIFICATE OF ANALYSIS

TO : CHRISTOPHER, PETER A. & ASSOC.

3707 WEST 34TH AVE.,
VANCOUVER, B.C.
V6N 2K9

CERT. # : A8314092-005-

INVOICE # : 18314092

DATE : 30-AUG-83

P.C. # : NCNE

TCM

ATTN: P.A. CHRISTOPHER

Sample description	Prep code	Pb ppm	Zn ppm	Ag ppm			
MTS83816-17	201	35	465	0.3	--	--	--
MTS83816-18	201	65	220	0.9	--	--	--
MTS83816-19	201	63	191	0.6	--	--	--
MTS83816-20	201	55	195	1.4	--	--	--
MTS83816-21	201	79	190	0.4	--	--	--
MTS83816-23	201	70	105	0.7	--	--	--
MTS83816-24	201	61	120	0.4	--	--	--
MTS83816-25	201	57	265	0.9	--	--	--
MTS83816-26	201	54	136	0.1	--	--	--
MTS83816-27	201	45	196	0.1	--	--	--
MTS83816-28	201	78	410	0.1	--	--	--
MTS83816-29	201	64	235	0.4	--	--	--
MTS83816-30	201	59	185	0.3	--	--	--
MTS83816-31	201	29	260	0.6	--	--	--
MTS83816-32	201	50	138	0.5	--	--	--
MTS83816-33	201	34	141	0.1	--	--	--
MTS83816-34	201	64	210	0.1	--	--	--
MTS83816-35	201	27	135	0.1	--	--	--
MTS83816-36	201	63	134	0.3	--	--	--
MTS83816-37	203	23	83	0.3	--	--	--
MTS83816-39	201	29	78	0.4	--	--	--
MTS83816-40	201	42	60	0.2	--	--	--
MTS83817-01	201	36	480	0.1	--	--	--
MTS83817-02	201	48	230	0.7	--	--	--
MTS83817-03	201	54	136	0.4	--	--	--
MTS83817-04	201	88	169	0.7	--	--	--
MTS83817-05	201	54	435	0.7	--	--	--
MTS83817-06	201	63	126	0.8	--	--	--
MTS83817-07	201	42	180	1.5	--	--	--
MTS83817-08	201	28	168	0.6	--	--	--
MTS83817-09	201	48	205	0.8	--	--	--
MTS83817-10	201	123	470	0.2	--	--	--
MTST83816-1	201	37	115	0.1	--	--	--
MTST83816-2	201	40	182	0.6	--	--	--
MTST83816-3	203	12	72	0.1	--	--	--



Certified by *Hart Bichler*



CHEMEX LABS LTD.

212 BROOKSBANK AVE
NORTH VANCOUVER, B.C.
CANADA V7J 2C1

TELEPHONE: (604) 984-0221
TELEX: 043-52597

• ANALYTICAL CHEMISTS

• GEOCHEMISTS

• REGISTERED ASSAYERS

*** INVOICE ***

To : CHRISTOPHER, PETER & ASSOC.

Invoice # : 18314091

3707 WEST 34TH AVE.,
VANCOUVER, B.C.
V6N 2K9

Date : 31-AUG-83
P.O. # : NONE
Project TCM

Invoice for analytical work reported on certificate(s) A8314091-001 to -006

Quantity	Analysed for code description	unit price	amount
211	004 - Pb ppm		
	005 - Zn ppm		
	006 - Ag ppm	3.70	780.70

Sample preparation and other charges :

21C	201 - soil + sediment -80 mesh	0.60	126.00
1	203 - -35 mesh sieve + ring	2.00	2.00

TOTAL \$ 908.70

Please pay this amount ----> \$ 908.70

TERMS -- NET 30 DAYS

1.5 % per month (18 % per annum) charged on overdue accounts



MEMBER
CANADIAN TESTING
ASSOCIATION



CHEMEX LABS LTD.

212 BROOKSBANK AVE
NORTH VANCOUVER, B.C.
CANADA V7J 2C

• ANALYTICAL CHEMISTS

• GEOCHEMISTS

• REGISTERED ASSAYERS

TELEPHONE: (604) 984-022
TELEX: 043-5259

CERTIFICATE OF ANALYSIS

TO : CHRISTOPHER, PETER A. & ASSOC.

3707 WEST 34TH AVE.,
VANCOUVER, B.C.
V6N 2K9

CERT. # : A8314091-001
INVOICE # : I8314091
DATE : 31-AUG-83
P.O. # : NONE
TOM

ATTN: P.A. CHRISTOPHER

Sample description	Prep code	Pb ppm	Zn ppm	Ag ppm			
CTS83815-01	201	4	24	0.1	--	--	--
CTS83815-02	201	40	56	0.3	--	--	--
CTS83815-03	201	28	75	0.1	--	--	--
CTS83815-04	201	7	45	0.1	--	--	--
CTS83815-05	201	2	19	0.9	--	--	--
CTS83815-06	201	20	59	0.5	--	--	--
CTS83815-07	201	5	54	1.2	--	--	--
CTS83815-08	201	57	138	0.5	--	--	--
CTS83815-09	201	62	154	0.2	--	--	--
CTS83815-10	201	220	390	1.1	--	--	--
CTST83815-11	201	18	103	0.4	--	--	--
CTST83815-12	201	23	145	0.7	--	--	--
CTS83815-13	201	51	90	0.4	--	--	--
CTS83815-14	201	13	71	0.6	--	--	--
CTS83815-15	201	15	79	0.2	--	--	--
CTS83815-16	201	4	54	0.7	--	--	--
CTS83815-17	201	18	141	0.2	--	--	--
CTS83815-18	201	17	70	0.1	--	--	--
CTS83815-19	201	17	69	0.2	--	--	--
CTS83815-20	201	32	192	0.4	--	--	--
CTS83815-21	201	57	169	0.3	--	--	--
CTS83815-22	201	22	175	0.3	--	--	--
CTS83815-23	201	18	64	0.4	--	--	--
CTS83815-24	203	50	90	0.2	--	--	--
CTS83815-25	201	17	54	0.2	--	--	--
CTS83815-26	201	79	148	0.3	--	--	--
CTS83815-27	201	44	365	0.2	--	--	--
CTS83815-28	201	78	390	0.3	--	--	--
CTS83815-29	201	44	177	0.1	--	--	--
CTS83815-30	201	22	165	0.1	--	--	--
CTS83815-31	201	26	154	0.1	--	--	--
CTS83815-32	201	15	138	0.1	--	--	--
CTS83815-33	201	20	81	0.2	--	--	--
CTS83815-34	201	18	84	0.1	--	--	--
CTS83815-35	201	39	220	0.2	--	--	--
CTS83815-36	201	20	103	0.1	--	--	--
CTS83815-37	201	18	99	0.2	--	--	--
CTS83815-38	201	25	73	0.2	--	--	--
CTS83815-39	201	12	85	0.1	--	--	--
CTS83815-40	201	16	73	0.1	--	--	--



MEMBER
CANADIAN TESTING
ASSOCIATION

Certified by *Hart Bichler*



CHEMEX LABS LTD.

212 BROOKSBANK AVE
NORTH VANCOUVER, B.C.
CANADA V7J 2C

TELEPHONE: (604) 984-022
TELEX: 043-5259

• ANALYTICAL CHEMISTS

• GEOCHEMISTS

• REGISTERED ASSAYERS

CERTIFICATE OF ANALYSIS

TO : CHRISTOPHER, PETER A. & ASSOC.

3707 WEST 34TH AVE.,
VANCOUVER, B.C.
V6N 2K9

CERT. # : A8314091-002
INVOICE # : I8314091
DATE : 31-AUG-83
P.O. # : NONE
TOM

ATTN: P.A. CHRISTOPHER

Sample description	Prep code	Pb ppm	Zn ppm	Ag ppm			
CTS83815-41	201	28	235	0.2	--	--	--
CTS83815-42	201	42	147	0.2	--	--	--
CTS83815-43	201	16	83	0.1	--	--	--
CTS83815-44	201	19	159	0.1	--	--	--
CTS83815-45	201	33	105	0.2	--	--	--
CTS83815-46	201	17	61	0.1	--	--	--
CTS83815-47	201	30	56	0.1	--	--	--
CTS83815-48	201	33	91	0.1	--	--	--
CTS83815-49	201	36	91	0.1	--	--	--
CTS83815-50	201	22	85	0.3	--	--	--
CTS83815-51	201	23	84	0.3	--	--	--
CTS83815-52	201	15	245	0.4	--	--	--
CTS83815-53	201	21	78	0.3	--	--	--
CTS83815-54	201	13	62	0.4	--	--	--
CTS83815-55	201	2	14	0.3	--	--	--
CTS83815-56	201	3	29	0.4	--	--	--
CTS83815-57	201	14	90	0.1	--	--	--
CTS83815-58	201	18	225	0.5	--	--	--
CTS83815-59	201	3	31	0.6	--	--	--
CTS83815-60	201	18	78	0.1	--	--	--
CTS83815-61	201	14	73	0.2	--	--	--
CTS83815-62	201	13	81	0.1	--	--	--
CTS83816-63	201	48	143	0.1	--	--	--
CTS83816-64	201	29	155	0.1	--	--	--
CTS83816-65	201	39	168	0.5	--	--	--
CTS83816-66	201	56	184	0.1	--	--	--
CTS83816-67	201	16	82	0.1	--	--	--
CTS83816-68	201	82	167	0.2	--	--	--
CTS83816-69	201	59	197	0.2	--	--	--
CTS83816-70	201	57	225	0.2	--	--	--
CTS83816-71	201	30	154	0.1	--	--	--
CTS83816-72	201	36	79	0.3	--	--	--
CTS83816-73	201	25	91	0.1	--	--	--
CTS83816-74	201	41	77	0.1	--	--	--
CTS83816-75	201	32	103	0.1	--	--	--
CTS83816-76	201	46	144	0.1	--	--	--
CTS83816-77	201	17	188	0.1	--	--	--
CTS83816-78	201	37	102	0.1	--	--	--
CTS83816-79	201	50	137	0.1	--	--	--
CTS83816-80	201	24	94	0.1	--	--	--



MEMBER
CANADIAN TESTING
ASSOCIATION

Certified by *Hart Bichler*



CHEMEX LABS LTD.

212 BROOKSBANK AVE
NORTH VANCOUVER, B.C.
CANADA V7J 2C

• ANALYTICAL CHEMISTS

• GEOCHEMISTS

• REGISTERED ASSAYERS

TELEPHONE: (604) 984-022
TELEX: 043-5259

CERTIFICATE OF ANALYSIS

TO : CHRISTOPHER, PETER A. & ASSOC.

3707 WEST 34TH AVE.,
VANCOUVER, B.C.
V6N 2K9

CERT. # : A8314091-003
INVOICE # : I8314091
DATE : 31-AUG-83
P.O. # : NONE
TOM

ATTN: P.A. CHRISTOPHER

Sample description	Prep code	Pb ppm	Zn ppm	Ag ppm			
CTS83816-81	201	32	380	0.1	--	--	--
CTS83816-82	201	28	220	0.1	--	--	--
CTS83816-83	201	60	280	0.1	--	--	--
CTS83816-84	201	31	415	0.1	--	--	--
CTS83816-85	201	57	210	0.1	--	--	--
CTS83816-86	201	1	95	0.1	--	--	--
CTS83816-87	201	6	70	0.2	--	--	--
CTS83816-88	201	17	285	0.1	--	--	--
CTS83816-89	201	30	136	0.1	--	--	--
CTS83816-90	201	23	97	0.1	--	--	--
CTS83816-91	201	12	36	0.5	--	--	--
CTS83816-92	201	19	171	0.1	--	--	--
CTS83816-93	201	11	73	0.1	--	--	--
CTS83816-94	201	29	114	0.4	--	--	--
CTS83816-95	201	23	74	0.5	--	--	--
CTS83816-96	201	20	69	0.2	--	--	--
CTS83816-97	201	28	350	0.3	--	--	--
CTS83816-98	201	18	76	0.9	--	--	--
CTS83816-99	201	18	250	0.1	--	--	--
CTS83816-100	201	21	144	0.1	--	--	--
CTS83816-101	201	35	86	0.1	--	--	--
CTS83816-102	201	30	81	0.1	--	--	--
CTS83816-103	201	19	90	0.1	--	--	--
CTS83816-104	201	28	178	0.1	--	--	--
CTS83816-105	201	84	500	0.2	--	--	--
CTS83816-106	201	27	280	0.1	--	--	--
CTS83816-107	201	90	385	0.1	--	--	--
CTS83816-108	201	46	300	0.2	--	--	--
CTS83816-109	201	45	390	0.1	--	--	--
CTS83817-110	201	43	290	0.1	--	--	--
CTS83817-111	201	71	180	0.1	--	--	--
CTS83817-112	201	55	260	0.1	--	--	--
CTS83817-113	201	59	180	0.1	--	--	--
CTS83817-114	201	21	132	0.1	--	--	--
CTS83817-115	201	23	176	0.1	--	--	--
CTS83817-116	201	32	174	0.1	--	--	--
CTS83817-117	201	38	135	0.1	--	--	--
CTS83817-118	201	28	90	0.1	--	--	--
CTS83817-119	201	18	124	0.1	--	--	--
CTS83817-120	201	49	330	0.1	--	--	--



MEMBER
CANADIAN TESTING
ASSOCIATION

Certified by *Hart Bichler*



CHEMEX LABS LTD.

212 BROOKSBANK AVE
NORTH VANCOUVER, B.C.
CANADA V7J 2C7

• ANALYTICAL CHEMISTS

• GEOCHEMISTS

• REGISTERED ASSAYERS

TELEPHONE: (604) 984-0227
TELEX: 043-52597

CERTIFICATE OF ANALYSIS

TO : CHRISTOPHER, PETER A. & ASSOC.

3707 WEST 34TH AVE.,
VANCOUVER, B.C.
V6N 2K9

CERT. # : A8314091-004
INVOICE # : I8314091
DATE : 31-AUG-83
P.C. # : NONE
TOM

ATTN: P.A. CHRISTOPHER

Sample description	Prep code	Pb ppm	Zn ppm	Ag ppm			
CTS83817-121	201	38	101	0.1	--	--	--
CTS83817-122	201	45	118	0.1	--	--	--
CTS83817-123	201	41	197	0.1	--	--	--
CTS83817-124	201	47	194	0.5	--	--	--
CTS83817-125	201	50	445	0.2	--	--	--
CTS83817-126	201	61	370	0.1	--	--	--
CTS83817-127	201	57	530	0.5	--	--	--
CTS83817-128	201	37	425	0.1	--	--	--
CTS83817-129	201	42	85	0.1	--	--	--
CTS83817-130	201	45	105	0.1	--	--	--
CTS83817-131	201	30	215	0.1	--	--	--
CTS83817-132	201	47	164	0.2	--	--	--
CTS83817-133	201	33	225	0.2	--	--	--
CTS83817-134	201	35	290	0.1	--	--	--
CTS83817-135	201	37	310	0.1	--	--	--
CTS83817-136	201	19	225	0.1	--	--	--
CTS83817-137	201	34	300	0.1	--	--	--
CTS83817-138	201	26	405	0.1	--	--	--
CTS83817-139	201	46	400	0.1	--	--	--
CTS83817-140	201	63	162	0.4	--	--	--
CTS83817-141	201	20	86	0.1	--	--	--
CTS83817-142	201	12	85	0.1	--	--	--
CTS83817-143	201	9	63	0.1	--	--	--
CTS83817-144	201	7	62	0.1	--	--	--
CTS83817-145	201	14	58	0.1	--	--	--
CTS83817-146	201	11	69	0.1	--	--	--
CTS83817-147	201	4	280	0.2	--	--	--
CTS83817-148	201	12	165	0.1	--	--	--
CTS83817-149	201	11	132	0.4	--	--	--
CTS83817-150	201	18	123	0.2	--	--	--
CTS83817-151	201	11	154	0.2	--	--	--
CTS83817-152	201	11	83	0.1	--	--	--
CTS83817-153	201	31	166	1.0	--	--	--
CTS83817-154	201	19	84	0.5	--	--	--
CTS83817-155	201	14	139	0.1	--	--	--
CTS83817-156	201	9	115	0.8	--	--	--
CTS83817-157	201	11	167	0.4	--	--	--
CTS83817-158	201	15	100	0.2	--	--	--
CTS83817-159	201	17	132	0.1	--	--	--
CTS83817-160	201	18	92	0.1	--	--	--



MEMBER
CANADIAN TESTING
ASSOCIATION

Certified by *Hart Bichler*



CHEMEX LABS LTD.

212 B.P.
NORTH
CANADA
TEL: (604) 271-1111
TELEFAX: (604) 271-1112

- ANALYTICAL CHEMISTS

- GEOCHEMISTS

- REGISTERED ASSAYERS

CERTIFICATE OF ANALYSIS

TO : CHRISTOPHER, PETER A. & ASSOC.

3707 WEST 34TH AVE.,
VANCOUVER, B.C.
V6N 2K9

CERT. # : AN 111111
INVOICE # : IN 111111
DATE : 31 AUG 1991
P.O. # : NONE
TOM

ATTN: P.A. CHRISTOPHER

Sample description	Prep code	Pb ppm	Zn ppm	Ag ppm		
CTS83817-161	201	17	79	0.1	--	--
CTS83817-162	201	12	50	0.1	--	--
CTS83817-163	201	16	58	0.1	--	--
CTS83817-164	201	16	83	0.1	--	--
CTS83817-165	201	25	87	0.1	--	--
CTS83817-166	201	15	79	1.1	--	--
CTS83817-167	201	14	91	0.7	--	--
CTS83817-168	201	13	64	0.4	--	--
CTS83817-169	201	19	57	0.1	--	--
CTS83818-170	201	15	130	0.1	--	--
CTS83818-171	201	11	70	0.1	--	--
CTS83818-172	201	10	49	0.1	--	--
CTS83818-173	201	35	465	0.1	--	--
CTS83818-174	201	61	225	0.1	--	--
CTS83818-175	201	55	220	0.1	--	--
CTS83818-176	201	30	210	0.1	--	--
CTS83818-177	201	24	255	0.1	--	--
CTS83818-178	201	55	255	0.1	--	--
CTS83818-179	201	26	205	0.1	--	--
CTS83818-180	201	37	164	0.1	--	--
CTS83818-181	201	187	200	0.7	--	--
CTS83818-182	201	61	345	0.1	--	--
CTS83818-183	201	44	225	0.1	--	--
CTS83818-184	201	55	300	0.1	--	--
CTS83818-185	201	54	146	0.1	--	--
CTS83818-186	201	34	245	0.1	--	--
CTS83818-187	201	49	305	0.2	--	--
CTS83818-188	201	47	305	0.1	--	--
CTS83818-189	201	46	180	0.1	--	--
CTS83818-190	201	42	205	0.1	--	--
CTS83818-191	201	49	169	0.1	--	--
CTS83818-192	201	66	450	0.3	--	--
CTS83818-193	201	49	240	0.2	--	--
CTS83818-194	201	38	280	0.1	--	--
CTS83818-195	201	40	89	0.1	--	--
CTS83818-196	201	36	215	0.1	--	--
CTS83818-197	201	33	85	0.1	--	--
CTS83818-198	201	29	131	0.1	--	--
CTS83818-199	201	43	148	0.1	--	--
CTS83818-200	201	34	94	0.1	--	--



MEMBER
CANADIAN TESTING
ASSOCIATION

Certified by *Hunt*



CHEMEX LABS LTD.

212 BROOKSBANK AVE.
NORTH VANCOUVER, B.C.
CANADA V7J 2C1

• ANALYTICAL CHEMISTS

• GEOCHEMISTS

• REGISTERED ASSAYERS

TELEPHONE: (604) 984-0221
TELEX: 043-52597

CERTIFICATE OF ANALYSIS

TO : CHRISTOPHER, PETER A. & ASSOC.

3707 WEST 34TH AVE.,
VANCOUVER, B.C.
V6N 2K9

CERT. # : A8314091-006-
INVOICE # : I8314091
DATE : 31-AUG-83
P.C. # : NONE
TOM

ATTN: P.A. CHRISTOPHER

Sample description	Prep code	Pb ppm	Zn ppm	Ag ppm			
CTS83818-201	201	35	131	0.1	--	--	--
CTS83818-202	201	34	168	0.1	--	--	--
CTS83818-203	201	45	78	0.5	--	--	--
CTS83818-204	201	24	117	0.1	--	--	--
CTS83818-205	201	49	142	0.1	--	--	--
CTS83818-206	201	24	240	0.1	--	--	--
CTS83818-207	201	30	176	0.1	--	--	--
CTS83818-208	201	27	151	0.1	--	--	--
CTS83818-209	201	28	177	0.1	--	--	--
CTS83818-210	201	32	138	0.1	--	--	--
CTS83818-211	201	27	56	0.1	--	--	--



MEMBER
CANADIAN TESTING
ASSOCIATION

Certified by *Hart Bichler*

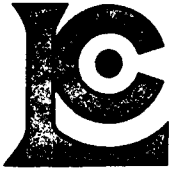

CHEMEX LABS LTD.

212 BROOKSBANK AVE.
NORTH VANCOUVER, B.C.
CANADA V7J 2C1
TELEPHONE: (604) 984-0221
TELEX: 043-52597

• ANALYTICAL CHEMISTS

• GEOCHEMISTS

• REGISTERED ASSAYERS

*** INVOICE ***

To : CHRISTOPHER, PETER & ASSOCIATES INC.

Invoice # : I838C919

3707 WEST 34TH AVE.,
VANCOUVER, B.C.
V6N 2K9

Date : 9-SEP-83

Quantity	Description	Unit Price	Amount
	Preparation of a statistical summary of analytical results reported on certificates A8314091 & A8314092		\$68.00
	Please pay this amount	----->	\$68.00 =====
TERMS -- NET 30 DAYS 1.5% per month (18% per annum) charged on overdue accounts			



MEMBER
CANADIAN TESTING
ASSOCIATION

APPENDIX B Statistical Analysis of Geochemical Values

VARIABLE:	Zn
NUMBER OF OBSERVATIONS:	406
MINIMUM:	14.000
MAXIMUM:	650.000
MEAN:	158.138
STANDARD ERROR OF MEAN:	4.977
STANDARD DEVIATION:	100.283
COEFFICIENT OF VARIATION:	63.415
SKEWNESS:	1.680
KURTOSIS:	3.207

§

VARIABLE:	Ag
NUMBER OF OBSERVATIONS:	406
MINIMUM:	0.100
MAXIMUM:	1.800
MEAN:	0.275
STANDARD ERROR OF MEAN:	0.013
STANDARD DEVIATION:	0.264
COEFFICIENT OF VARIATION:	96.045
SKEWNESS:	2.047
KURTOSIS:	4.986

§

VARIABLE:	Pb
NUMBER OF OBSERVATIONS:	406
MINIMUM:	1.000
MAXIMUM:	220.000
MEAN:	31.143
STANDARD ERROR OF MEAN:	1.079
STANDARD DEVIATION:	21.733
COEFFICIENT OF VARIATION:	69.785
SKEWNESS:	3.042
KURTOSIS:	19.636

§

Peter Christopher & Associates Inc. — project : TOM

CORRELATION MATRIX: (99.0 INDICATES COEFFICIENT COULD NOT BE CALCULATED)

	Pb	Zn	Ag
Pb	1.000	0.478	0.107
Zn	0.478	1.000	0.021
Ag	0.107	0.021	1.000

Peter Christopher & Associates Inc. — project : TOM

NUMBER OF SAMPLES PER VARIABLE PAIR

	Pb	Zn	Ag
Pb	406	406	406
Zn	406	406	406

Symbol	Number of samples at that point
*	1
2	2
3	3
4	4
5	5
6	6
7	7
8	8
9	9
A	10-11
B	12-15
C	16-20
D	21-30
E	31-50
F	> 50

Relationship between X-Y plot symbols
and number of samples

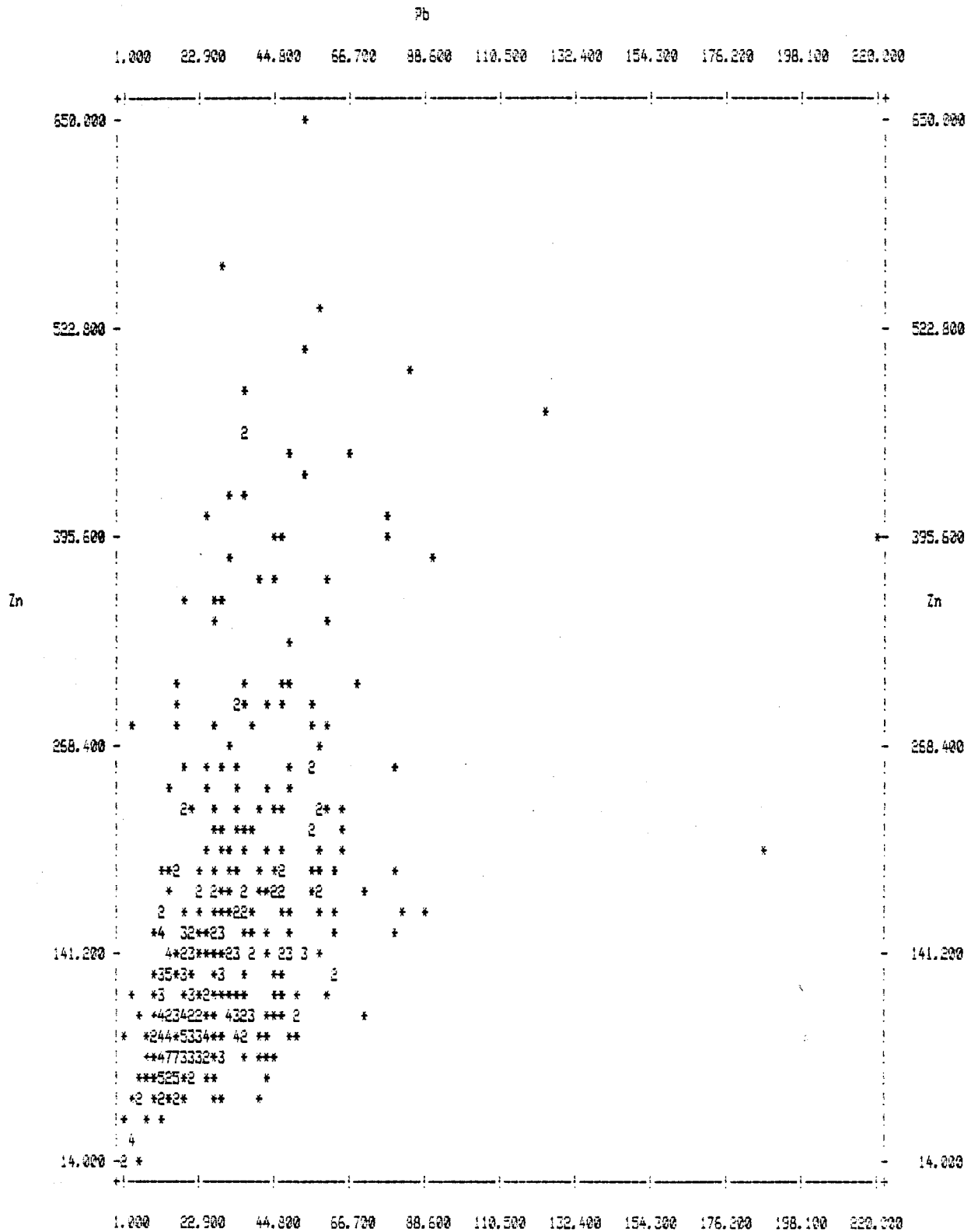

0 POINTS OUT OF RANGE

DATA TITLE : Peter Christopher & Associates Inc. — project : TOM

VARIABLE : Zn

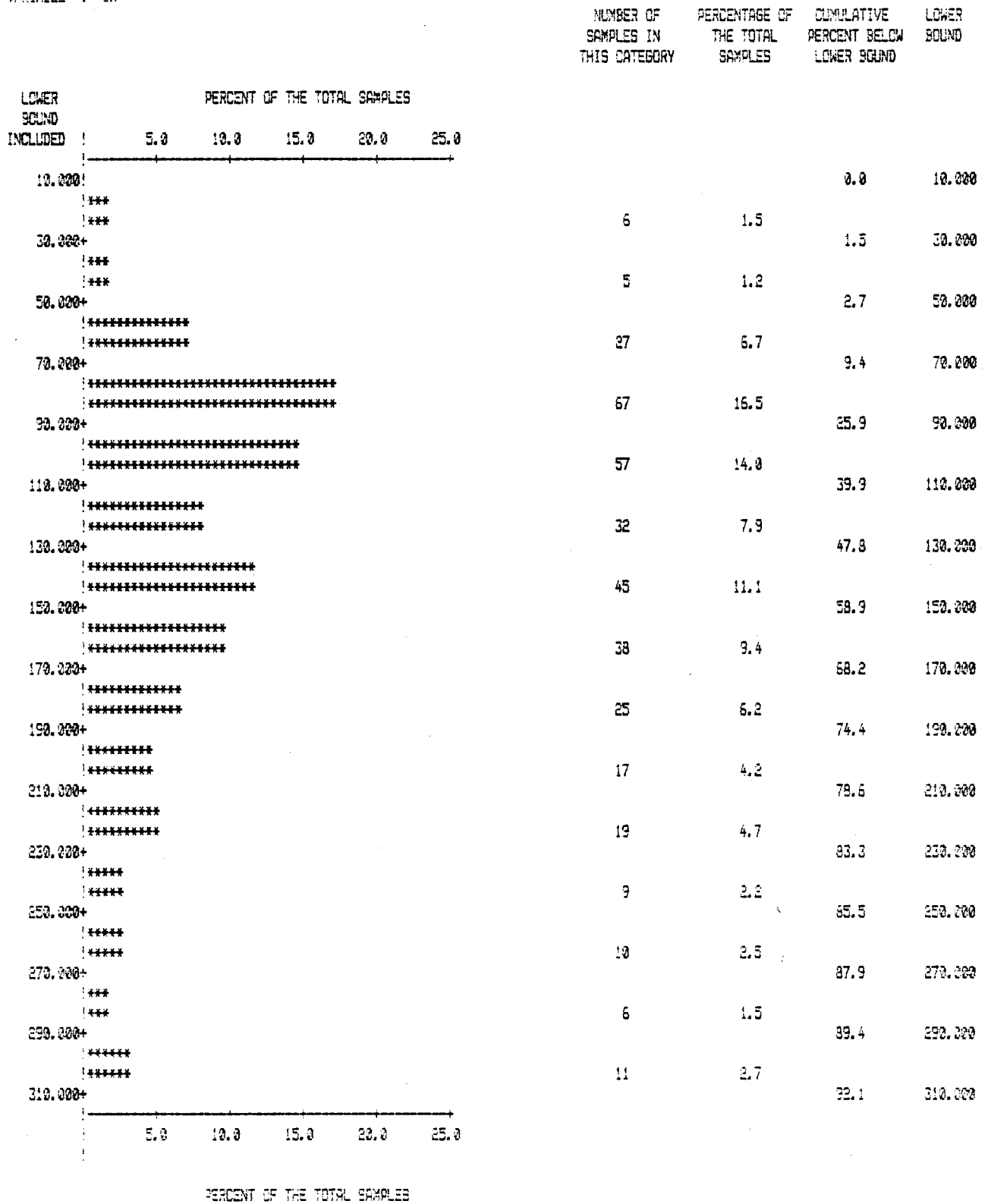

DATA TITLE : Peter Christopher & Associates Inc. -- project : TCM

VARIABLE : P5

LOWER SOUND INCLUDED	PERCENT OF THE TOTAL SAMPLES	NUMBER OF SAMPLES IN THIS CATEGORY	PERCENTAGE OF THE TOTAL SAMPLES	CUMULATIVE PERCENT BELOW LOWER SOUND	LOWER SOUND
0.000	*****			0.0	0.000
5.000+	*****	11	2.7	2.7	5.000
10.000+	*****	14	3.4	6.2	10.000
15.000+	*****	50	12.3	18.5	15.000
20.000+	*****	68	15.7	35.2	20.000
25.000+	*****	44	10.8	46.1	25.000
30.000+	*****	36	8.9	54.9	30.000
35.000+	*****	44	10.8	65.8	35.000
40.000+	*****	29	7.1	72.9	40.000
45.000+	*****	21	5.2	78.1	45.000
50.000+	*****	25	6.4	84.5	50.000
55.000+	*****	16	3.9	88.4	55.000
60.000+	*****	18	4.4	92.9	60.000
65.000+	*****	12	3.0	95.8	65.000
70.000+	**	3	0.7	96.5	70.000
75.000+	**	2	0.5	97.0	75.000
80.000+	***	5	1.2	98.3	80.000

DATA TITLE : Peter Christopher & Associates Inc. — project : TOM

VARIABLE : Ag

LOWER BOUND INCLUDED	PERCENT OF THE TOTAL SAMPLES	NUMBER OF SAMPLES IN THIS CATEGORY	PERCENTAGE OF THE TOTAL SAMPLES	CUMULATIVE PERCENT BELOW LOWER BOUND	LOWER BOUND
0.100+	*****	204	50.2	0.0	0.100
0.200+	*****	57	14.0	50.2	0.200
0.300+	*****	38	9.4	64.3	0.300
0.400+	*****	31	7.6	73.6	0.400
0.500+	****	20	4.9	81.3	0.500
0.600+	*****	29	7.1	86.2	0.600
0.700+		0	0.0	93.3	0.700
0.800+	***	15	3.7	93.3	0.800
0.900+		0	0.0	97.0	0.900
1.000+	I	5	1.2	97.0	1.000
1.100+	I	2	0.5	98.3	1.100
1.200+	I	2	0.5	98.8	1.200
1.300+	I	1	0.2	99.3	1.300
1.400+		0	0.0	99.5	1.400
1.500+	I	1	0.2	99.5	1.500
1.600+		0	0.0	99.8	1.600
1.700+	I	1	0.2	99.8	1.700
1.800+				100.0	1.800

LEGEND

- CTS 83815-167 Sample location & number (soil)
- Stream silt sample
- CP Claim Post
- Four-wheel Drive Road
- Creek (showing flow direction)
- VII Survey station
- Swamp

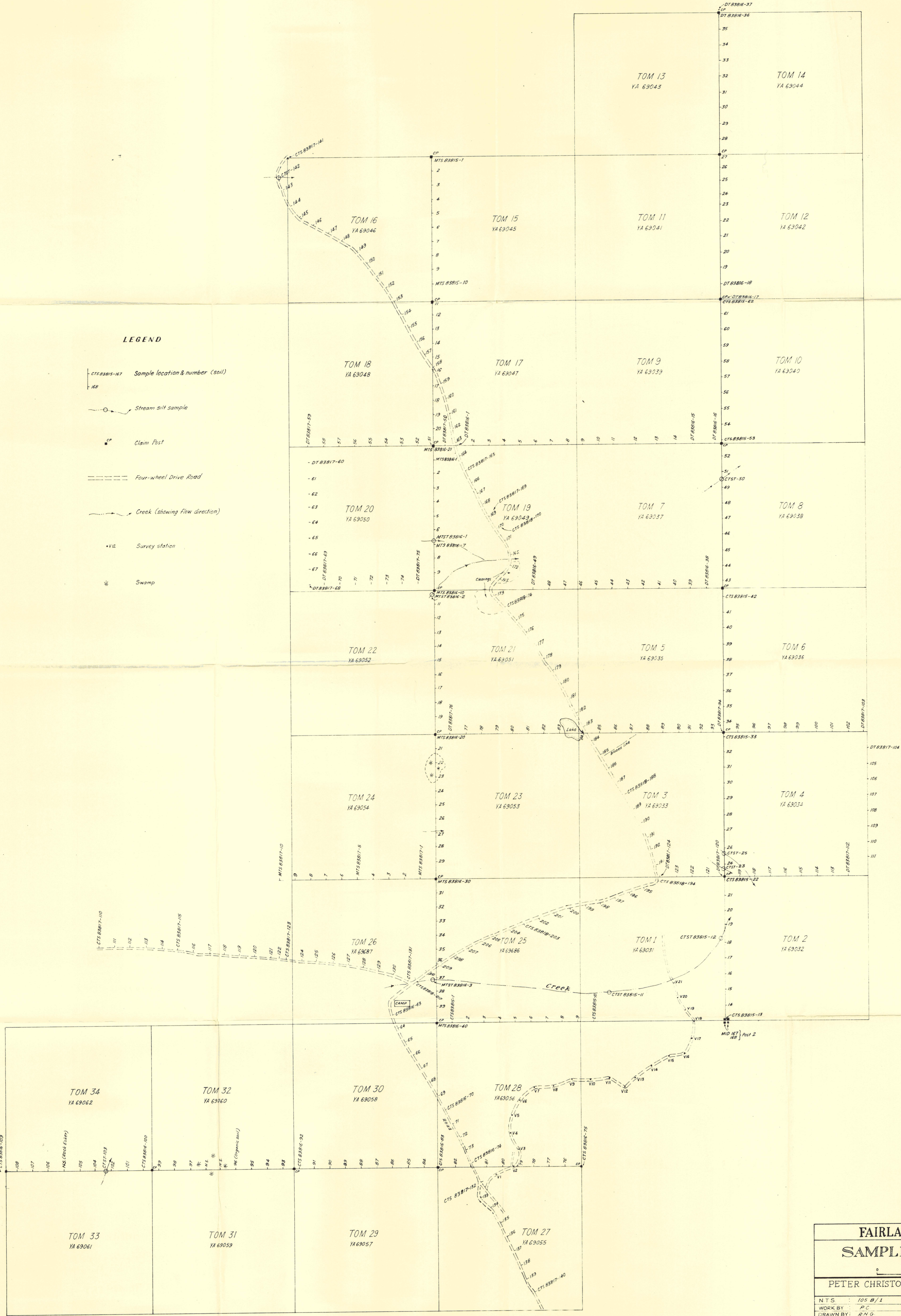

FAIRLADY ENERGY INC.
OS165
SAMPLE LOCATIONS

SCALE 1:5000
0 100 200 300 metres

PETER CHRISTOPHER & ASSOCIATES INC.
VANCOUVER, B.C.

NTS : 105 B / 1	REVISIONS
WORK BY : P.C.	
DRAWN BY : R.N.G.	
DATE : Sept. 1983	

MAP 1

LEGEND

12,85,0.1
9,63,0.1 Lead, Zinc, Silver (in ppm) — soil sample

30,30,0.2 Pb, Zn, Ag (in ppm) — stream silt sample

..... Outcrop outline

CP Clam Post

==== 4-Wheel Drive Road

→ Creek

* Swamp

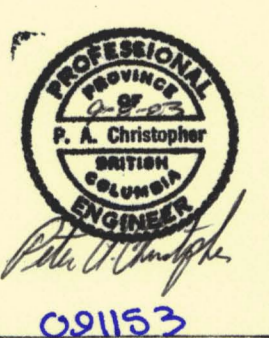
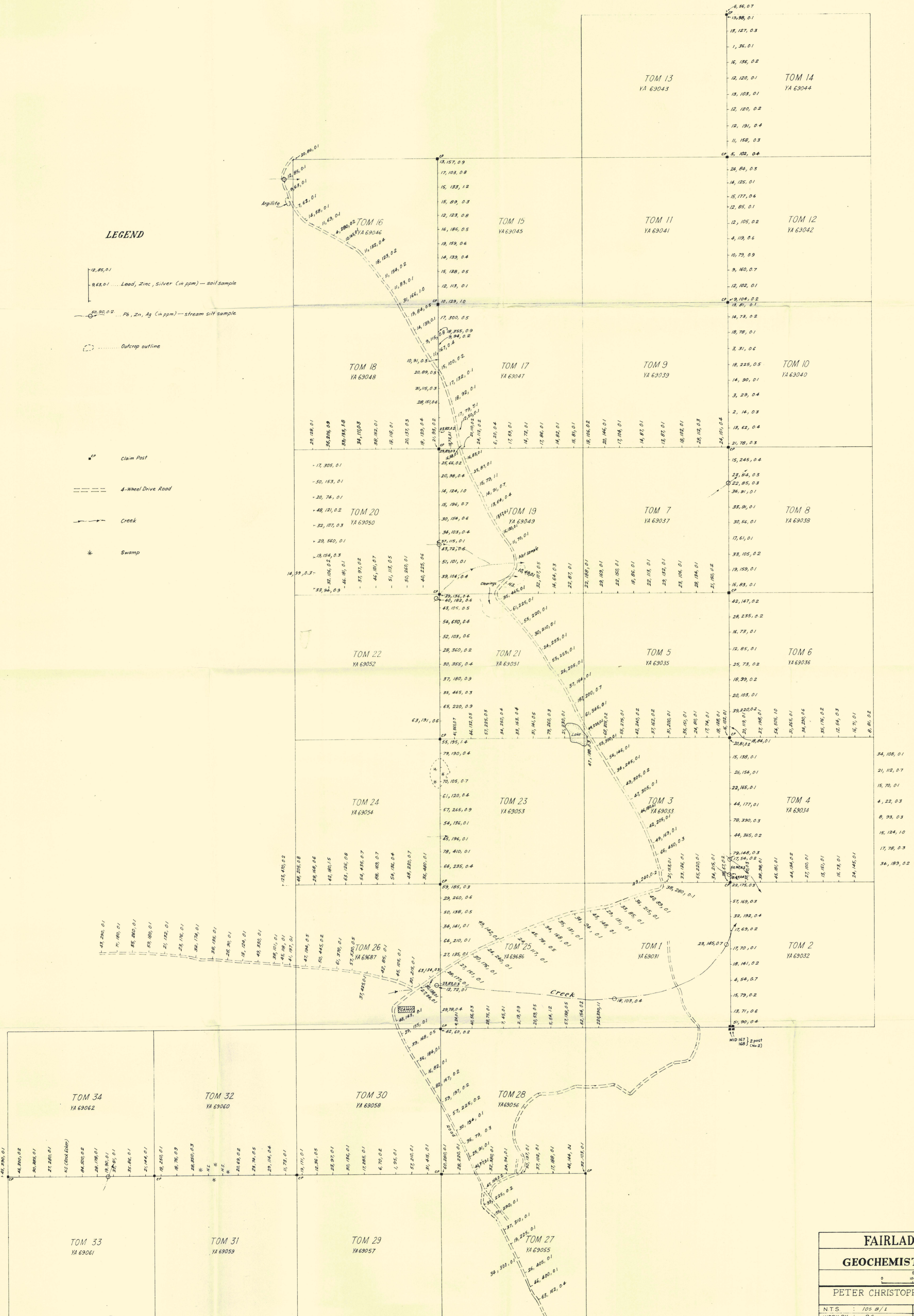

FAIRLADY ENERGY INC.	
GEOCHEMISTRY—Pb, Zn & Ag	
SCALE 1:5000 0 100 200 300 metres	
PETER CHRISTOPHER & ASSOCIATES INC. VANCOUVER, B.C.	
N.T.S. : 105 B/1	REVISIONS
WORK BY : P.C.	
DRAWN BY : P.N.G.	
DATE : Sept 1983	
MAP 2	