

ASSESSMENT REPORT ON DIAMOND DRILLING

on

PEAK NO. 4 Mineral Claim (PEAK Claims)

105-F-10

61°37'

132°48'

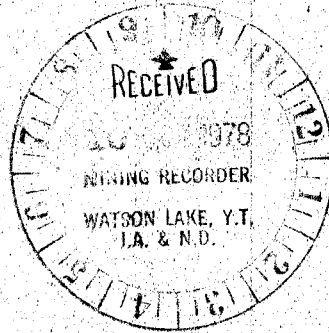

Noranda Exploration Company, Limited  
(No Personal Liability)

G. Macdonald

August 3-8, 1978

091146

TABLE OF CONTENTS

Introduction

Figure 1 - Location Map

Drill Logs

Appendix:

Statement of Qualifications

Statement of Costs

Maps in Pocket:

Grid Map

ASSESSMENT REPORT ON DIAMOND DRILLING  
on  
PEAK NO. 4 Mineral Claim (PEAK Claims)

---

INTRODUCTION

The claims referred to in this report are registered in the name of Noranda Exploration Company Limited (No Personal Liability). Diamond drilling was performed on the following claim:

PEAK No. 4

YA 00868

The PEAK No. 4 is part of the block comprising 32 PEAK claims and 2 PASS fractions.

The property is located 25 miles southwest of Ross River, on map sheet 105-F-10. Access is by helicopter from Ross River.

A drill programme of three holes was initiated August 3, 1978 to investigate geochemical and geophysical anomalies obtained in earlier surveys. A total of 290 feet was drilled in three holes. Core size was EX. Core is stored in Whitehorse.

DRILL LOGS

The following drill logs summarize the results of the programme.

Character samples were assayed of selected sections.

Submitted by:

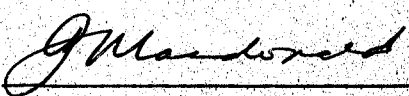
  
\_\_\_\_\_

G. Macdonald,  
Geologist.

September 7, 1978.

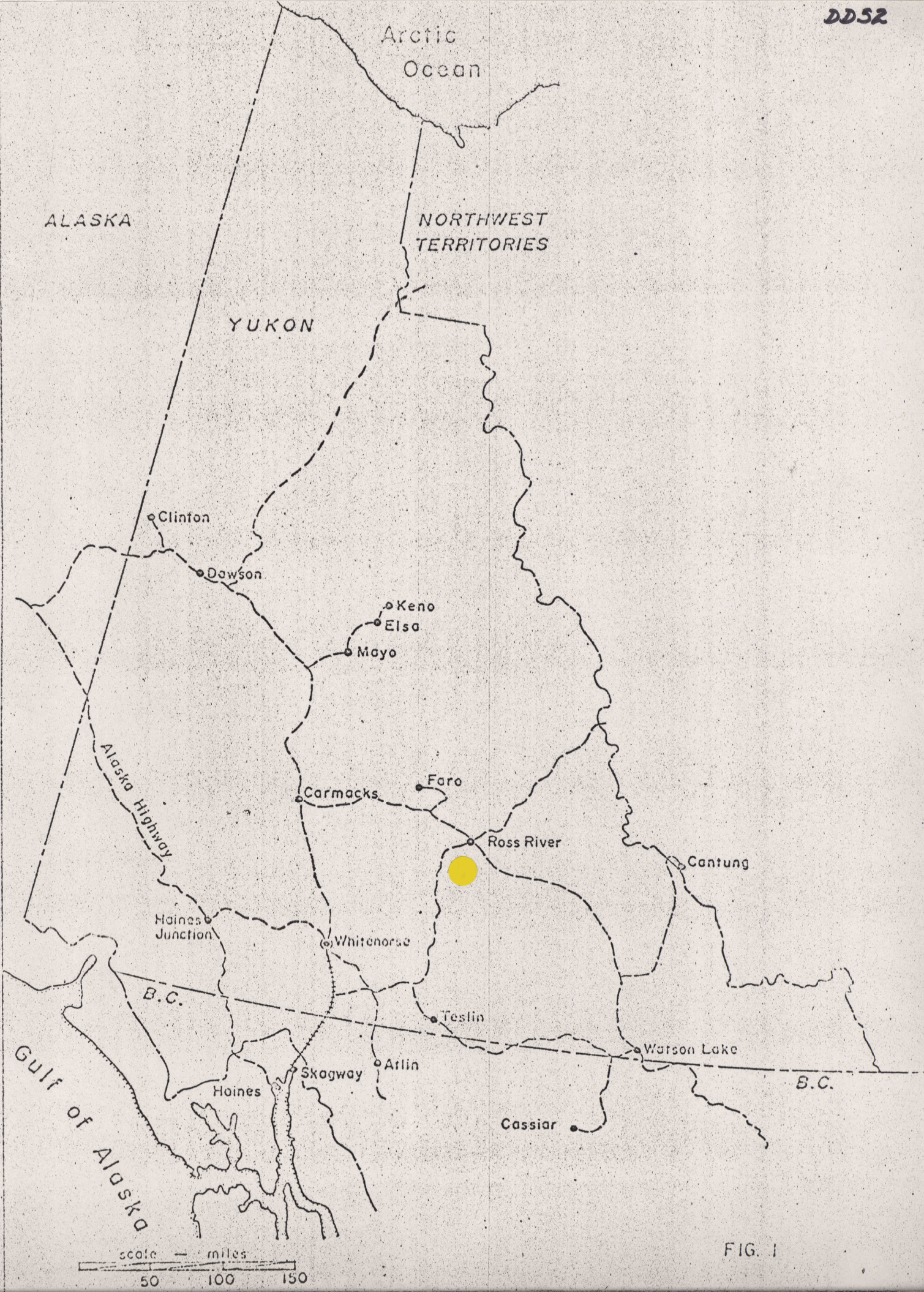

FIG. 1





Collared Aug 5/78	Completed Aug 7/78	Core Size EX	Property PEAK	Project No 916	NTS No. 105-F-10
FIELD COORDINATES			SURVEYED COORDINATES		
Lat. 72+50 N	Elev.	Dip -60°	Lat.	Elev.	Dip
Dep. 96+00 E	Depth	Bearing E	Dep.	Depth	Bearing
					Sheet 1 of 1
					Hole No. P-2

Footage	Rec'y	Graphic Log	Description	% Sulp.	Est. Grade	Sample No.	Lt.				
0-6	35		Overburden								
6-10	35		Slightly limy grey fine grained massive	< 1							
20	35		quartzite; 6-39.5 fault rubble of quartzite breccia;								
30	35		occas. minor galena, barite and pyrite filling fractures	< 1							
40	95		40-97.5: dense massive fine grained	< 1							
50	95		quartzite; slightly limy; occasional	< 1							
60	95		barite and very occasional Pbs in	< 1							
70	95		fractures; 0-5% very fine disseminated pyrite	< 1							
80	95		40-97.5: fractures at 70-90°; 83-83.5: fault;	< 5							
90	95		88-89: occasional galena in fractures	< 5							
	95		97.5 end of hole	< 5							

NORANDA EXPLORATION COMPANY, LIMITED

Collared Aug 7/78	Completed Aug 8/78	Core Size EX	Property PEAK	Project No 916	NTS No. 105-F-10
FIELD COORDINATES			SURVEYED COORDINATES		
Lat. 75+00 N	Elev.	Dip -60°	Lat.	Elev.	Dip
Dep. 92+00 E	Depth 102 feet	Bearing E	Dep.	Depth	Bearing
			Sheet 1 of 1		
			Hole No. P-3		

Footage	Rec'y	Graphic Log	Description	% Sulp.	Est. Grade	Sample No.	Lt.	Pb	Zn	Ag
0-6			Overburden							
6-10	80%		6-46: Slightly limy quartzite							
10-20	95%		Faults @ 8.5-10.0; 17-17.5; 33-33.5; 40-40.5; 45.0-59 Limy quartzite breccia - 40.5-46.0							
30	95%		31.0 bedding (?) @ 30°							
40	95%		46-102 Rubble: black graphitic shale; minor							
50	95%		pyrite; limy in fractures							
60	5%			1						
70	20%			1						
80	20%			1						
80-90	20%		Bedding (?) @ 45° @ 88.0	1		5993		0.04%	0.04%	0.06 oz/ton
100	20%			1						
110			102 end of hole	1		5994		0.04%	0.04%	0.04 oz/ton
			Samples: 5993 - sandy rubble 5994 - 54-102 black shale							

DD52

STATEMENT OF QUALIFICATIONS

I, GLEN MACDONALD, of the City of Whitehorse, Yukon Territory, DO  
CERTIFY THAT:

1. I have been employed as a Geologist by Noranda Exploration Company, Limited (No Personal Liability) since May, 1976.
2. I am a graduate of the University of British Columbia, with a Bachelor of Science degree in Geology.
3. I am a member of the Canadian Institute of Mining and Metallurgy.

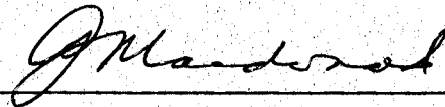

---

G. Macdonald,  
Geologist,  
Noranda Exploration Company, Limited  
(N.P.L.)

NORANDA EXPLORATION COMPANY, LIMITEDSTATEMENT OF COST

PROJECT Pass Peak DATE September 1978  
 TYPE OF REPORT Geology and Drilling

## a) Wages:

No. of Days 4  
 Rate per Day \$ 63.4875  
 Dates: from July 31/78 to August 9/78  
 Total Wages 4 x \$ 63.4875 253.95

## b) Food and Accomodation:

No of days 4  
 Rate per day \$ 27.705  
 Dates: from July 31/78 to August 9/78  
 Total Cost 4 x \$ 27.705 86.82

## c) Transportation:

Ground 58.50  
 Aircraft 3,374.75  
 3,433.25

## d) Instrument Rental:

Type of Instrument  
 No of days  
 Rate per day \$  
 Dates: from to  
 Total Cost X \$

Type of Instrument  
 No of days  
 Rate per day \$  
 Dates: from to  
 Total Cost X \$

NORANDA EXPLORATION COMPANY, LIMITED  
(WESTERN DIVISION)

DETAILS OF ANALYSES COSTS

PROJECT: Pass Peak

September 1978

<u>ELEMENT</u>	<u>NO. OF DETERMINATIONS</u>		<u>COST PER DETERMINATION</u>	<u>TOTAL</u>
Pb	3	Assays	5.50	16.50
Zn	3	"	5.50	16.50
Ag	3	"	5.50	16.50
Ag	1	"	5.00	5.00
W	15	Geochem	2.00	30.00
Cu	4	Geochem	1.00	4.00
Zn	4	"	.60	2.40
Pb	4	"	.60	2.40
Ag	4	"	.60	2.40
Mo	4	"	.60	2.40

98.10

f) Analysis  
(See attached schedule) 98.10

g) Cost of preparation of Report  
Author 1 day @ 73.07 73.07  
Drafting 1 day @ 135.00 135.00  
Typing 1 day @ 100.00 100.00 308.07

h) Other:  
M. Nichiporick, Diamond Drilling  
Contract 5,920.00  
Supervision R.C. Heim, PhD,  
P.Eng., and G.E. Dirom P.Eng.  
2 days @ 180.00 360.00  
6,280.00

Total Cost \$10,460.19

e) Unit costs for Drilling  
~~No of days~~ Dates from July 31/78 to Aug. 9/78  
No of units 88.7m  
Unit costs 101.99301 / m.  
Total Cost \$101.99301 X 88.7m 9,046.78

Geology 1,413.41

10,460.19

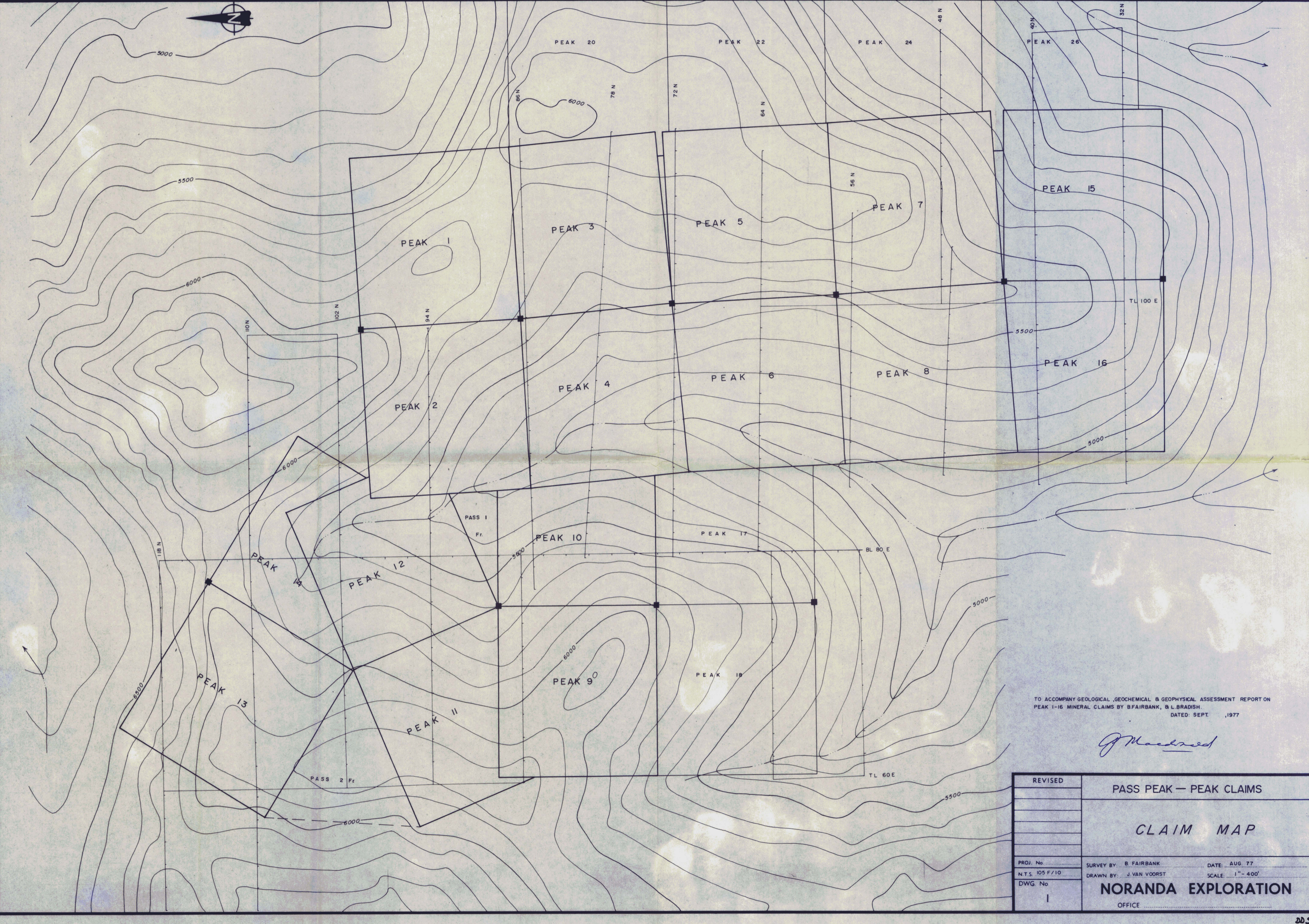

TO ACCOMPANY GEOLOGICAL, GEOCHEMICAL & GEOPHYSICAL ASSESSMENT REPORT ON  
 PEAK 1-16 MINERAL CLAIMS BY B. FAIRBANK, & L. BRADISH.  
 DATED: SEPT 1977

*J. Macdonald*

REVISED	PASS PEAK — PEAK CLAIMS	
	<b>CLAIM MAP</b>	
PROJ. No	SURVEY BY: B. FAIRBANK	DATE: AUG. 77
N.T.S. 105 F/10	DRAWN BY: J. VAN VOORST	SCALE: 1" = 400'
DWG No	<b>NORANDA EXPLORATION</b>	
1	OFFICE: .....	