

April 2nd, 1975.

Hudson Bay Exploration and Development Company Limited.

Angie Mineral Claims, Diamond Drilling 1974.

Forty six Angie Claims are located approximately two miles northeast of Irvine Lake, Claim Sheet 105-B-11, in the Watson Lake Mining Division.

For the purposes of assessment work the forty six claim have been divided into three groups as per "Application to Group Mineral Claims" accompanying this report.

Three holes (AQ) for a total of 1,461 feet, were drilled between September 9th and September 19th, 1974, by S & H Drilling Company Limited.

Hole A-1 was drilled to a depth of 456 feet on Angie 4 mineral claim, Grant Number Y83138.

Hole A-2 was drilled to a depth of 505 feet on Angie 5 mineral claim, Grant Number Y-83139.

Hole A-3 was drilled to a depth of 500 feet on Angie 37 mineral claim, Grant Number Y83301.

The core is stored in the Whitehorse Copper Mines core shack at McRae.

The total direct cost of the above program was \$19,771.35. This figure does not include camp costs, flying or other support services.

- 2 -

The following are included:

1. Diamond Drill Logs A₁ to A₃ inclusive.
2. Drill Record Sheets
3. Location Map.
4. Copy of Invoice from S & H Drilling Company Limited.

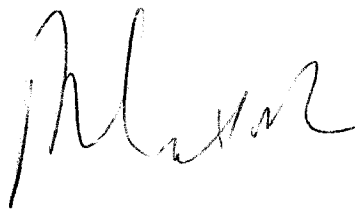

R.T. McIntosh B.Sc. F.G.A.C..

Core stored at Whitehorse Copper Storehouse,
Whitehorse

DIAMOND DRILL RECORD

Date Began Sept. 9, 1974 Date Completed Sept. 12/74

Property Angie Claims Project No. Depth 456'

Hole No. A-1 Co-ord 0700 Horizontal Length

Sheet No. 4705E Direction

Claim No. Elevation Angle -90°

R. Stroshein

DEPTH	NUMBER	WIDTH	ASSAY						WIDTH X ASSAY				AVERAGES			
			AU	AG	CU	ZN	PB	NI	WIDTH	AU	AG	CU	ZN			
0.0	14.0	Casing	14.0													
4.0	63.0	Waste	49.0													
3.0	68.0	27417	5.0				Tr									
8.0	164.0	Waste	96.0													
64.0	165.2	18	1.2	.12		.05	.07									
65.2	456.0	Waste	299.8													
			End of Hole 456'													

Log Diamond Drill Hole

Angie Claims:Hole Number: A-10+00
4+05EDip: -90°
Grid: 03Depth: 456'
Elevation:

Date Started: September 9th, 1974, Finished: September 12th, 1974.

Drilled By: S&H Drilling

Logged By: R. Stroshein, relogged R.T. McIntosh

- 0.0 14.0 Casing, boulders, clay.
- 14.0 50.1 Muscovite quartz schist to gneiss, minor chlorite, sections with biotite, odd speck pyrite in scattered sections, light grey to slightly greenish in color, scattered quartz stringers, granite dikes at 18.0-19.2' 22.0-23.0', 42.0-46.9', core angles at 15' 85° , at 26' 82° , at 34' 87° .
- 50.1 57.1 Grey leucocratic granite, medium fine grained.
- 57.1 73.2 Muscovite quartz schist to gneiss, as 12.6-50.1' core angles generally 80 to 90° .
- 73.2 97.0 Grey leucocratic granite, sections pegmatitic, medium fine grained, parts altered and earthy.
- 97.0 121.6 Quartz muscovite schist to gneiss, light grey to greenish, parts slight chlorite, core angles at 102' 73° , at 108' 78° at 121' 78° .
lost core 103.6-105.6'.
- 121.0 123.1 Lost core.

Log Diamond Drill Hole A-1 Contd. - 2-

- 123.1 132.2 Quartz muscovite schist, finer grained more dense than preceding, chloritic, approaches a phyllite, core angle at 132' 70°.
- 132.2 136.2 Lost core.
- 136.2 140.5 Greyish quartz muscovite schist as 123.1-132.2', odd quartz stringer.
- 140.5 142.0 Grey pegmatite.
- 142.0 336.0 Grey quartz muscovite schist, well bedded, to somewhat massive, parts chloritic, sections very slight pyrite, core angle 142-155' generally 80 to 85°, 164.0-165.2' skarnified with visible galena, core angle at 181' 70°, at 192' 60°, at 202' 80°. odd quartz stringer, 182.0-184.2' pegmatite, parts with biotite, increased chlorite and becomes darker from 200', at 210' .1' quartz stringer with pyrite, core angle at 211' 90°, at 227' 83°, from 237-249' 10 feet lost core, 218-220' quartz with slight pyrite, core angle 150-282' generally 90°, core crumbly and broken, at 281' narrow sections of skarn. from 282-308' core angle generally 80 - 85°, at 309' core angle 68°, from 308-317' increased biotite, at 317.5' .6' pegmatite, 319.9-321.1' pegmatite, at 327' .8' pegmatite, at 329' 1' pegmatite.
- 336.0 338.5 Granite dike, leucocratic, grey to slightly greenish.

Log Diamond Drill Hole A#1 Contd. - 3 -

- 338.5 365.7 Biotite muscovite quartz schist, light grey to brownish, core angles 80-85°, odd quartz blebs, and stringers, sections increased muscovite, 355.2-356.4 granite.
- 365.7 376.0 Light grey leucocratic granite, parts yellowish, sections altered and decomposed, core angle 365.7 28°, muddy at 376'.
- 376.0 423.8 Muscovite quartz schist, greyish to greenish, sections with biotite, odd quartz and pegmatite stringers, core angles 387' 73°, generally 80-85°.
- 423.8 426.3 Grey leucocratic granite, yellowish, medium coarse grained.
- 426.3 439.0 Greyish muscovite quartz schist, minor biotite and chlorite, odd narrow quartz stringer and pegmatite, core angle generally 80-90°.
- 439.0 456.0 Grey leucocratic granite, medium coarse grained, parts pegmatitic.

End of Hole 456'

DIAMOND DRILL RECORD

Date Began Sept. 14/74 Date Completed Sept. 16/74

Property Angie Claims Project No. Depth 505'

Hole No. A-2 Co-ord 16400N Horizontal Length

Sheet No. 0700 Direction

Claim No. Angie 5&6 Elevation Angle -90°

Coordinates Grid 03

Resid

DEPTH	NUMBER	WIDTH	ASSAY						WIDTH X ASSAY				AVERAGES						
			AU	AG	CU	ZN	PB	NI					WIDTH	AU	AG	CU	ZN		
0	12.0	Casing	12.0	2' BW, 12' AW.															
0.0	119.2	Waste	107.2																
9.2	123.0	22603	3.8				.02	.01											
3.0	228.2	Waste	5.2																
8.2	129.1	.04	0.9				.02	.01											
9.1	148.9	Waste	19.8																
8.9	150.2	05	1.3				.02	.01											
0.2	151.5	Waste	1.3																
1.5	157.0	06	5.5				.02	Tr											
7.0	162.0	07	5.0				Tr	.01											
2.0	174.2	Waste	12.2																
4.2	176.5	08	2.3				Tr	Tr											
6.5	187.0	Waste	11.5																
7.0	189.5	09	2.5				Tr	Tr											
9.5	194.4	Waste	4.9																
4.4	197.0	10	2.6				.03	.04											
7.0	505.0	Waste	308.0																
				End of Hole 505'															

Log Diamond Drill Hole.

Angie Claims

Hole Number: A-216+00N,
0+00Dip: -90° Grid: 03
Depth: 505'

Date Started: September 14th, 1974, Completed: Sept. 16th, 1974

Drilled By: S&H Drilling.

Logged By: R.T. McIntosh

- 0.0 6.0 Casing, (cased to 12'. Clay, boulders.
- 6.0 15.0 Quartz chlorite schist to gneiss, well foliated, minor carbonate, greenish to greyish, odd quartz stringers, very slight fine pyrite, sections with epidote, (possibly skarn) Core angle at $14^{\circ} 56^{\circ}$.
- 15.0 22.8 Grey granitic dike, medium coarse grained, core angle $15^{\circ} 52^{\circ}$.
- 22.8 68.4 Quartz chlorite schist to gneiss, minor carbonate, and epidote, greenish to greyish, odd quartz stringer, very minor muscovite, sections somewhat skarnified, very slight fine pyrite, Core angles at $53^{\circ} 49^{\circ}$, at $56^{\circ} 70^{\circ}$, at $67^{\circ} 74^{\circ}$ at $68.4^{\circ} 74^{\circ}$.
- 68.4 71.3 Grey granitic dike, comprised of feldspar and muscovite with minor quartz.
- 71.3 116.7 Chlorite, quartz feldspar schist to gneiss, well foliated, parts epidotized, sections with carbonate, greenish to greyish, very slight fine pyrite, odd speck pyrrhotite, core angles at $79^{\circ} 75^{\circ}$, at $92^{\circ} 73^{\circ}$, at $105^{\circ} 75^{\circ}$.

Log Hole A-2 Contd. - 2 -

- 116.6 151.8 Limestone, greyish to white, sections dark fine grained quartzite with light pyrite, parts chloritic, sections limey mud, minor graphitic, sections brecciated.
- 151.8 162.0 Dark graphitic limestone, brownish, slight to light fine pyrite. Somewhat similar to sections logged as quartzite above.
- 162.0 174.0 White marbelized limestone, massive.
- 174.0 175.6 Dark graphitic limestone, slight fine pyrite.
- 175.6 197.0 Interbedded white and dark graphitic limestone, dark sections with slight pyrite, minor biotite, core angle generally near 90°.
- 197.0 232.0 Grey marbelized limestone, parts faint bedding, core angle 85°, interbedded dark greyish sections up to 3' wide, core angle contacts 75-80°, biotite at 211', parts very slight pyrite, possibly narrow sections skarn.
- 232.0 294.0 Chlorite quartz schist with carbonate, possibly impure somewhat skarnified limestone, parts with epidote, greenish to greyish, variable fine pyrite, garnets at 245', core angles at 236' 76°, at 246' 83°, 257-270' interbedded marbelized limestone, core angles at 250' 65° at 264' 76°, becomes micaceous from 270', 271-285' interbedded marbelized limestone, with parts graphitic, parts fine foliation, core angle 283' 76°.

Log Hole A-2 Contd. - 3 -

- 294.0 319.5 Chlorite muscovite quartz schist to gneiss, well foliated, minor carbonate, sections with epidote, gradational from preceding, core angles at 296' 70°, generally 75-80°, parts very slight pyrite, 312-313' pegmatite.
- 319.5 324.0 Pegmatite, greyish, slight alteration.
- 324.0 360.0 Chlorite muscovite quartz schist, greyish to greenish, fair to well foliated, parts no muscovite, occasional quartz and quartz carbonate stringers, slight pyrite, core angles at 325' 65°, 332' 62° 352' 63°, 350-355' pegmatite.
- 360.0 366.5 Grey pegmatite, medium coarse grained.
- 366.5 372.5 Muscovite chlorite quartz schist, core angle 63°.
- 372.5 376.1 Grey pegmatite, core angle contacts 60°.
- 376.1 394.0 Chlorite muscovite quartz schist, well foliated, parts with epidote, scattered quartz and quartz carbonate stringers, core angles at 377' 68°, at 388' 65°.
- 394.0 408.6 Interbedded impure limestone and chlorite quartz schist, core angle 55°.
- 408.6 426.2 Chlorite muscovite quartz schist, well foliated, parts with epidote, garnets at 410', odd narrow pegmatite stringers, core angle at 412' 72°.
- 426.2 430.2 Grey pegmatite.

Log Hole A-3 Contd . - 4 -

430/2 472.7 Muscovite chlorite quartz schist, well foliated, sections gradational to impure limestone, chlorite decreases from 445', odd narrow quartz and quartz carbonate stringers, core angles at 432' 80°, at 447' 55°, at 471' 66°, odd narrow pegmatite stringers.

472.7 505.0 Impure limestone, greyish, chloritic, faint bedding, sections epidotized, odd speck pyrite, core angles at 483' 60°, at 500' 45°, at 504' 63°.

End of Hole 505'

DIAMOND DRILL RECORD

Date Began Sept. 18, 1974 Date Completed Sept. 19/74

Property Angie Claims Project No. _____ Depth 500'

Hole No. A-3 Co-ord 18/00N Horizontal Length _____

Sheet No. _____ Direction _____

Claim No. _____ Elevation _____ Angle -90°

Grid 01 Coordinates

Reside

DEPTH	NUMBER	WIDTH	ASSAY						WIDTH X ASSAY				AVERAGES					
			AU	AG	CU	ZN	PB	NI	WIDTH	AU	AG	CU	ZN					
0.0	50.0	Casing	50.0	AW casing, clay and boulders														
0.0	86.0	Waste	36.0															
0.0	91.0	30983	5.0				.11											
1.0	247.0	Waste	147.0															
47.0	250.0	84	3.0					.02										
50.0	500.0	Waste	250.0															
			End of Hole 500'															

Log Diamond Drill Hole

Hole Number: A-3

Angie Claims, Yukon.

18+00N
8+10EDip: -90° Depth: 500'
Grid No. 01.

Date Started: September 18, 1974, Finished: September 21, 1974.

Drilled By: S&H Drilling

Logged By: R. Stroshein, R.T. McIntosh

- 0.0 50.0 Casing, clay, boulders. Bedrock at 42'.
- 42.0 91.0 Quartz muscovite rock, muscovite sections somewhat schistose, brecciated, quartz stringers in breccia. Possibly quartzose pegmatite with muscovite schist. oxidized, parts with manganese, sections vein quartz up to 5' wide.
- 91.0 141.3 Muscovite quartz schist, oxidized, oxidization decreases with depth, occasional narrow pegmatite stringers, core angles at $102^{\circ} 35'$, at $122^{\circ} 60'$ at $129^{\circ} 28'$, at $145^{\circ} 70'$.
- 141.3 228.0 Grey fine grained leucocratic granite, parts oxidized, sections with pyrite on slips. 210.5-211.5' mica schist.
- 228.0 236.8 Quartz muscovite schist, foliation not well developed, greyish, slight pyrite, core angle at $83^{\circ} 85'$.
- 236.8 238.5 Grey granite.
- 238.5 258.0 Quartz muscovite schist, (granulite) greyish, very slight pyrite, odd speck galena 247-250', core angles at $250^{\circ} 75'$, at $257^{\circ} 45'$, oxidized 247-258'

Log Diamond Drill Hole A-3 Contd. - 2 -

- 258.0 264.5 Pegmatite, greyish, sections decomposed, inclusions muscovite schist.
- 264.5 320.0 Muscovite biotite quartz schist, brownish to greyish, sections gradational to granulite, biotite decreases towards 320', slight pyrite, core angles at 273' 85°, at 321' 86°, generally 85 to 90°.
- 320.0 371.2 Grey quartz muscovite schist, gradational from preceeding, (granulite) minor biotite, rock generally massive, with faint foliation, odd quartz stringer, very slight pyrite, 369-371' muscovite quartz schist. core angles generally 85°.
- 371.2 430.0 Grey leucocratic granite, fine grained, inclusions greyish granulite, with core angles generally 85°, parts pegmatite,
- 430.0 442.5 Grey granulite, (quartz muscovite schist) core angles generally 80-85°, very slight pyrite.
- 442.5 446.3 Grey leucocratic granite, medium coarse grained.
- 446.3 467.7 Grey granulite, sections gradational to biotite muscovite schist, core angles generally 80-85°.
- 467.7 472.2 Grey leucocratic granite, medium coarse grained.
- 472.2 482.3 Muscovite biotite quartz schist, greyish to brownish, core angles generally 80-85°.
- 482.3 500.0 Grey leucocratic granite, medium coarse grained, pegmatitic.

End of Hole 500'

DIAMOND DRILL RECORD

Date Began Sept. 9, 1974 Date Completed Sept. 12/74

Property Angie Claims Project No. Depth 456'

Hole No. A-1 Co-ord 0700 Horizontal Length

Sheet No. 4705E Direction

Claim No. Elevation Angle -90°

R. Stroshein

DEPTH	NUMBER	WIDTH	ASSAY						WIDTH X ASSAY				AVERAGES				
			AU	AG	CU	ZN	PB	NI	WIDTH	AU	AG	CU	ZN				
0.0	14.0	Casing	14.0														
4.0	63.0	Waste	49.0														
3.0	68.0	27417	5.0				Tr										
8.0	164.0	Waste	96.0														
64.0	165.2	18	1.2	.12		.05	.07										
65.2	456.0	Waste	299.8														
			End of Hole 456'														

Log Diamond Drill Hole

Angie Claims Irvine Lake Y.T.

Grid No. 04 Cross Grid

Hole Number: A-4

15 + 42 W

Angle: 50° Depth: 166'

15 + 95 N

Elevation: 4500' Direction: East

Date Started: August 10, 1975

Finished: August 12, 1975

Drilled by: D. J. Drilling Company Ltd.

Logged by: Ivan Young

0.0 17.0

Casing

17.0 21.6

Quartz chlorite gneiss, carbonates occur in some sections occasional specks of pyrite & pyrrhotite.

21.6 31.3

Well Bedded grey-green marble, sections deeply weathered, iron oxide abundant in these sections.

31.3 46.3

Quartz chlorite mica gneiss, minor amounts of carbonate throughout core, iron oxide in fractures.

46.3 88.2

Light grey-white marble, sections well bedded, some sections massive in appearance. Iron oxide in fractures.

Mineralization:

49.7 - 50.2 Trace - 1% pyrite
Trace - 5% pyrite

70.8 - 88.2 Trace - 3% Fluorite

88.2 116.8

Grey, brecciated quartz & marble, few coarse grained fragments in breccia. Short sections vuggy, iron oxide in fractures.

Mineralization:

88.2 - 90.3 Trace - 3% pyrite
Trace - 1% Fluorite

93.7 - 95.0 Trace pyrite
40% Fluorite

88.2 116.8 Mineralization...contd.

97.0 - 107.7 Trace - 3% pyrite
Trace - 1% Flourite

107.7 - 108.2 Trace - 2% pyrite
25% Flourite

108.2 - 111.3 Trace - 1% pyrite
Trace Flourite

111.3 - 111.8 70% Flourite

116.8 119.0 Sheared quartz muscovite gneiss and marble, iron
oxide abundant.

119.0 158.2 Grey, massive marble, occasional speck of pyrite
in core, short sections well bedded marble in core.

158.2 166.0 Quartz, biotite, chlorite gneiss, carbonates present
in gneiss, occasional quartz stringers, iron oxide
in fractures.

Lost Core: 25.7 - 31.0

32.1 - 37.7

63.7 - 69.4

90.3 - 93.7

95.0 - 97.0

Core Angles: 65° - 75°

End of Hole

Log Diamond Drill Hole

Angie Claims Irvine Lake, Y.T.

Grid No. 04 Cross Grid

Hole Number: A - 5

20 + 25 N
16 + 50 W

Angle: 50° Depth: 317'
Elevation: 4560' Direction: East

Date Started: August 14, 1975 Finished: August 15, 1975

Drilled by: D. J. Drilling Co. Ltd.

Logged by: Ivan Young

0.0	9.0	Casing
9.0	50.5	Grey-green, well bedded marble, few sections quartz chlorite gneiss, iron oxide in occasional fractures.
50.5	145.3	Grey-green-brown, quartz biotite chlorite gneiss. Short sections marble, few sections brecciated quartzite, sections garnetiferous, iron oxide in fractures, numerous quartz and carbonate stringers.
145.3	149.2	Chlorite, muscovite, carbonate, quartz gneiss, sections chlorite schist, well foliated, carbonates in fractures, occasional quartz stringers.
149.2	163.6	Grey-green quartz, muscovite, chlorite gneiss, carbonates in fractures, few quartz and carbonate stringers.
163.6	166.2	Brecciated quartzite, chlorite in breccia. Mineralization: 163.6 - 166.2 Trace - 2% Fluorite
166.2	169.2	Quartz, chlorite, mica gneiss, sections slightly brecciated. Mineralization: 166.2 - 169.2 Trace - 3% Fluorite

169.2 171.3 Quartz-chlorite breccia.

Mineralization:

169.2 - 171.3 Trace - 2% Fluorite

171.3 190.0 Quartz chlorite biotite gneiss, few quartz and carbonate stringers, occasional quartz filled vugs in core. Marble from 176.9' - 178.8'.

Mineralization:

173.0 - 173.3 5% Fluorite
183.5 - 184.0 15% Fluorite
185.2 - 186.2 1% - 3% Fluorite
186.2 - 186.7 50% Fluorite

190.0 205.4 Quartz, chlorite, carbonate gneiss grey-green in color, few quartz stringers, occasional specks of pyrrhotite in core.

205.4 220.9 Quartz, chlorite, mica gneiss, well foliated, sections garnetiferous, minor amounts of pyrrhotite in gneiss.

220.9 323.1 Quartz biotite gneiss, minor amounts of chlorite and carbonate in gneiss.

232.1 317.0 Grey-green marble, some sections well bedded, occasional narrow quartz veins and stringers. Few short sections quartz biotite chlorite gneiss in marble. Occasional specks of pyrrhotite in core.

Lost Core: 120.4 - 123.0

Core Angles: 63° at 46'
76° at 99'
68° at 223'
78° at 273'

End of Hole: 317'

Log Diamond Drill Hole

Angie Claims Irvine Lake, Y.T. Grid No. 4 Cross Grid

Hole Number: A-6

12 + 00 N
15 + 50 W

Dip: -50° Depth: 337'
Elevation: 4445' Direction: East

Date Started: August 17, 1975 Finished: August 19, 1975

Drilled by: D. J. Drilling Co.

Logged by: Ivan Young

0.0	12.0	Casing
12.0	27.7	Quartz chlorite biotite gneiss, generally well foliated. Sections garnetiferous occasional narrow veins rose quartz in core. Carbonate abundant in gneiss iron oxide in fractures. Occasional specks pyrite in core.
27.7	113.0	Grey-green quartz chlorite gneiss, few sections garnetiferous. Occasional band of rose quartz in gneiss, limestone from 89.7' - 91.2' and limestone mud from 107.0' - 110.8'. Iron oxide and carbonates fill fractures. Occasional specks pyrite and pyrrhotite in gneiss.

Mineralization:

100.3 - 102.4,	5% Fluorite
102.4 - 103.3,	30% Fluorite
103.3 - 104.0,	5% Fluorite
104.0 - 104.8,	20% Fluorite
104.8 - 106.0,	5% Fluorite
106.0 - 107.0,	Trace Fluorite

- 113.0 137.4 Quartz biotite gneiss, minor amounts of carbonate and chlorite in gneiss. Occasional rose quartz veins, some sections garnetiferous, iron oxide and carbonates in fractures.
- 1 Mineralization:
 127.8 - 128.1 10% Fluorite Trace pyrite
 136.8 - 136.9 Trace - 1% Fluorite
- 137.4 168.2 Quartz chlorite mica gneiss, iron oxide and carbonate in fractures, Occasional narrow rose quartz veins.
- Mineralization:
 138.2 - 138.7, Trace pyrite
 Trace - 1% Sphalerite
 146.2 - 146.8, 2% pyrite
 1% sphalerite
- 168.2 207.3 Light grey marble, few sections quartz chlorite gneiss, marble generally well bedded, bedding contorted in some sections. Occasional specks pyrite and pyrrhotite in core.
- Mineralization:
 186.3 - 186.5, 2% graphite
- 207.3 223.2 Quartz, chlorite, carbonate gneiss.
- 223.2 232.6 Quartz, biotite chlorite gneiss, carbonates in fractures, occasional quartz stringers, few specks pyrite in gneiss.
- 232.6 259.0 Quartz, chlorite carbonate gneiss, grey-green in colour, short sections marble in gneiss.
- Mineralization:
 237.7 - 238.2, 3% pyrite

Log Diamond Drill Hole A-6 contd. 3-

232.6 259.0 Mineralization: contd:
247.7 - 248.0 3% pyrite
250.0 - 251.8, 1% pyrite
1% pyrrhotite

259.0 262.3 Grey, massive marble
Mineralization:
259 - 259.3, 2% pyrite

262.3 273.0 Quartz, chlorite gneiss, sections vuggy limestone
in gneiss.
Mineralization:
262.3 - 268.7, 2% pyrite, trace pyrrhotite
trace graphite

273.0 275.1 Grey, massive marble

275.1 282.2 Quartz, chlorite, mica gneiss, carbonate abundant
in gneiss. occasional quartz stringers, occasional
pyrite specks in core.

282.2 285.9 Grey, massive marble

285.9 303.1 Quartz chlorite gneiss, carbonate in fractures.
Mineralization:
293.5 - 293.6, 1% pyrite, 1% galena, 1% sphalerite
299.7 - 303.1, 2%-3% pyrite

303.1 307.0 Grey quartzite, sections brecciated
Mineralization:
303.1 - 304.9, 2% - 4% pyrite

307 337.0 Grey-white marble, slightly brecciated from 307'
to 313.9'.

Log Diamond Drill Hole A-6 Contd. 4 -

307 337.0 Mineralization:

313.9 - 316.0, Trace - 1% pyrite

End of Hole 337'

Lost Core: 87.1 - 88.7

Core Angles: 69° at 96', 76° at 222', 69° at 272'.

Log Diamond Drill Hole

Angle Claims Irvine Lake, Yukon T. Grid No: 04 Cross Grid

Hole Number: A - 7

16 + 00 N Angle: 60° Depth: 365'
17 + 00 W Elevation: 4485 Direction: East

Date Started: August 20, 1975 Finished: August 21, 1975

Drilled by: D. J. Drilling Company Ltd.

Logged by: Ivan Young

0.0 12.0 Casing
12.0 42.0 Severely weathered quartz mica gneiss. Abundance of iron oxide, minor amounts of chlorite.
42.0 54.4 Quartz chlorite gneiss, short sections quartz mica gneiss and limestone, occasional quartz and carbonate stringers. Iron oxide in fractures, occasional pyrite specks in core.

Mineralization:

52.3 - 53.0, 2% - 3% pyrite

54.4 75.5 Grey marble, sections massive brecciated from 66.9' - 69.3'

Mineralization:

57.0 - 59.7, 2% pyrite trace Fluorite

60.8 - 61.4, 2% pyrite trace Fluorite

65.4 - 66.9 10% pyrite 1% sphalerite

66.9 - 67.8, 2% pyrite trace graphite
trace sphalerite

67.8 - 68.6, 10% pyrite 1% - 2% graphite
3% sphalerite

68.6 - 69.3, 1% pyrite 30% graphite
trace sphalerite

54.4 75.5 Mineralization..contd.

69.3 - 71.6, Trace - 1% pyrite
Trace - 2% graphite

75.5 139.2 Quartz, chlorite, mica gneiss. Occasional narrow bands of rose quartz in gneiss, sections, garnetiferous iron oxide and carbonates in fractures. Occasional specks pyrite & pyrrhotite in core.

Mineralization:

133.8 - 134.4, 80% Fluorite.

139.2 248.0 Quartz chlorite carbonate gneiss, minor amounts biotite in some sections, sections slightly brecciated. Sections limestone in gneiss.

Mineralization:

159.9 - 160.9, 90% Fluorite

160.9 - 161.8, 2% Fluorite

181.9 - 183.6, 5% pyrite

187.5 - 188.9, 3% pyrite

190.0 - 192.9, 10% fluorite , trace pyrite

193.9 - 194.2, 5% fluorite

197.5 - 197.8, 5% fluorite

199.6 - 201.5, 3% fluorite

201.5 - 203.5, 60% fluorite

230.7 - 233.0, 5% - 7% fluorite

238.4 - 238.9, 15% fluorite

243.7 - 244.6, trace - 1% fluorite

246.7 - 248.0, 2% pyrite, 1% sphalerite, 1% galena

Lgg Diamond Drill Hole A - 7 contd.....3

248.0 250.5 Brecciated quartzite

Mineralization:

249.2 - 250.5, 1% pyrite, 1% sphalerite, 1% galena

250.5 - 365.0 Quartz chlorite carbonate gneiss biotite and garnets
in some sections, numerous quartz stringers.

Occasional specks pyrrhotite in gneiss.

Mineralization:

250.5 - 251.6, trace pyrite, trace galena

2% sphalerite

251.6 - 253.5, trace pyrite, trace galena,
trace sphalerite

253.5 - 257.0, 3% sphalerite
trace - 2% pyrite
trace - 2% galena

257.0 - 258.5, trace - 1% sphalerite
trace galena
trace - 1% pyrite

260.8 - 264.5, trace sphalerite
trace - 1% pyrite
trace galena

289.5 - 290.0, 2% pyrite
trace - 1% sphalerite
trace galena

358.4 - 359.8, 3% pyrite

Lost Core: 17.4 - 26.0, 26.5 - 30.0, 119.4 - 121.5,
265 - 266.0

Core Angles: 60° - 80°

END OF HOLE

S&H DRILLING COMPANY LTD.

DD-15

13135 - 20th Avenue
SURREY, B.C. V4A 1Z1
Phone 531-4134

September 28, 1974

Mr. R. T. McIntosh
Hudson Bay Exploration and
Development Company Limited
Box 4007
Whitehorse, Yukon Territory
Y1A 3S9

Dear Mr. McIntosh:

Re: AQ Diamond Drilling - Irvine
Lake Area, Yukon Territory

Following is our invoice for diamond drilling recently completed in the above area:

1. Travelling Expenses - Vancouver to Watson Lake		\$ 849.70	
2. Travelling Time and Mobilization - 189 hrs. @ \$8.50			1,606.50
3. Hole #A-1 Drilling Casing - 142' @ \$10.00 per ft.	\$ 140.00		
Core Drilling - 442' @ \$9.00 per ft.	<u>3,978.00</u>		4,118.00
3A. Moving and Standby time between Hole #A-1 & #A-2			
86 hrs. @ \$8.50			731.00
4. Hole #A-2 Drilling Casing - 12' @ \$10.00 per ft.	\$ 120.00		
Core Drilling - 488' @ \$9.00 per ft.	4,392.00		
5' @ \$9.75	<u>48.75</u>		4,560.75
5. Moving and setting up between Hole #A-2 & A-3			
66 hrs. @ \$8.50			561.00
6. Hole #A-3 Drilling Casing - 25 ft. @ \$10.00 per ft.	\$ 250.00		
Drilling Casing - 25 to 42' @ Field Costs			
2 AQ Casing Shoes @ \$112.67 -	\$225.34		
2 AQ W/L Coring Bits @ \$164.22	<u>328.44</u>		
	\$553.78		
Plus 15%	<u>83.05</u>	636.83	
24 hrs. @ \$8.50 per hr.		204.00	
Reaming Casing - 10' @ \$2.50		25.00	
Core Drilling - 458' @ \$9.00		<u>4,122.00</u>	5,237.83
7. 54 AQ Core Boxes @ \$3.75			202.50
8. Freight Expenses			<u>407.27</u>
			<u>\$18,274.55</u>

Carried Forward

Brought Forward	\$ 18,271.55
9. Demobilization and Travelling Time - 100 hrs. @ \$8.50	850.00
10. Travelling Expenses - Watson Lake to Vancouver	<u>646.80</u>
Total	<u>\$ 19,771.35</u>

We enclose the pink copies of our invoices for Items No. 1, 8, 9 & 10, also Daily Report Sheets for Item No. 9. Invoices for all the other items were made out in the field and a copy given to your Geologist and we assume you will now have this.

On Item #10, a receipt was not obtained for \$57.00 paid to the Belvedere Hotel, Watson Lake on September 21. We have requested a receipt from them and will send this on to you.

We hope this will be satisfactory. If not, please let us know.

Yours truly,

E. M. Schussler
 (Mrs.) E. M. Schussler
 Sec. - Treas.
 S & H Drilling Company Ltd.

Encl.

Prices O. K.	<i>[Signature]</i>
Ext. O. K.	<i>[Signature]</i>
Contract No.	<i>[Signature]</i>
Check No.	1647 - 07
Approved	<i>[Signature]</i>

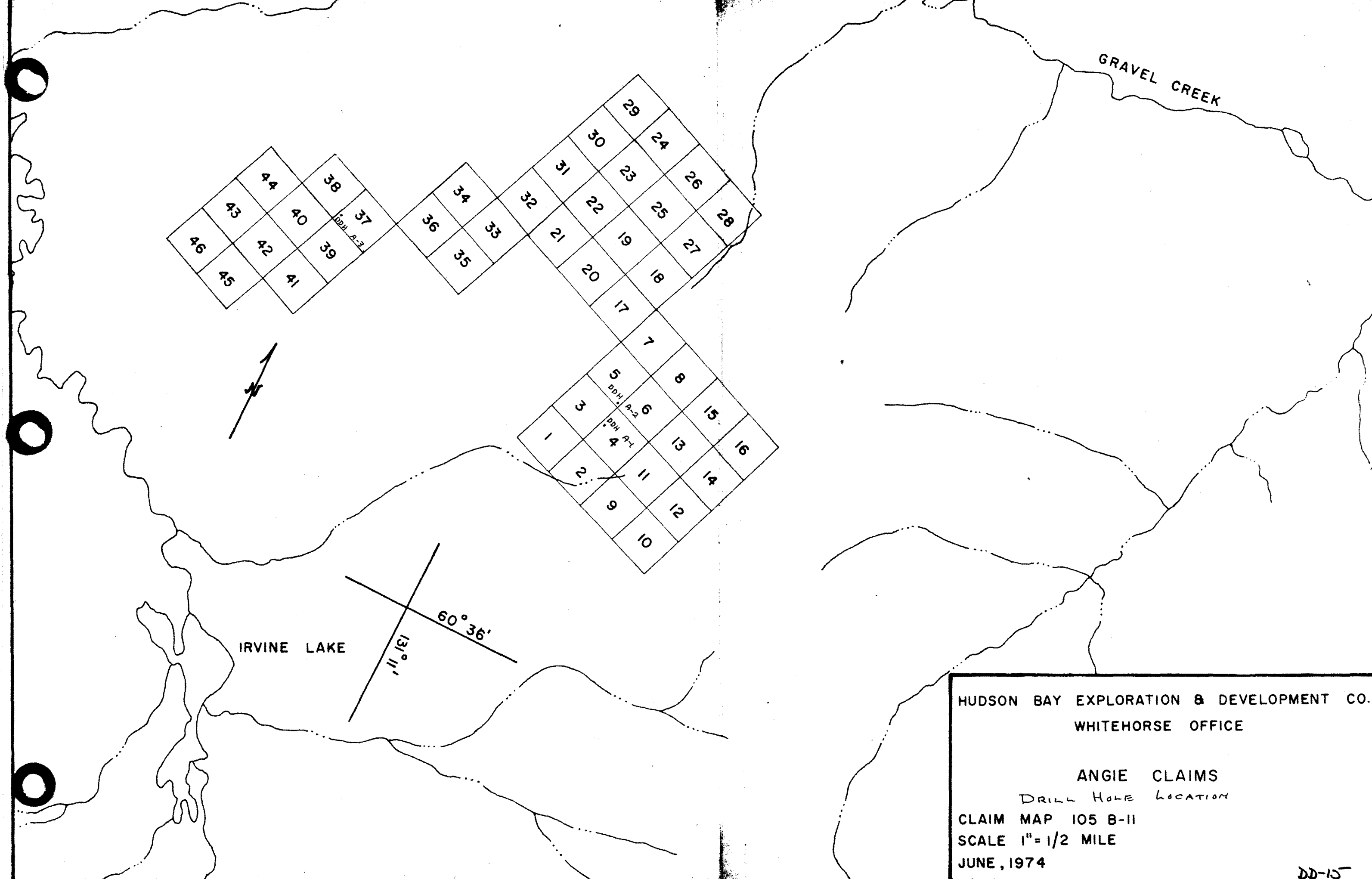

GRAVEL CREEK

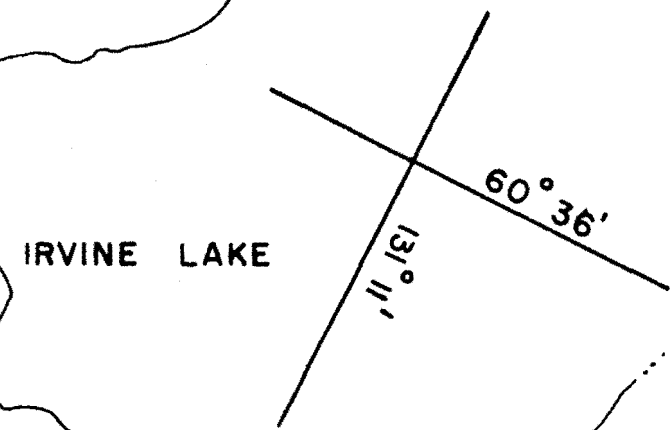
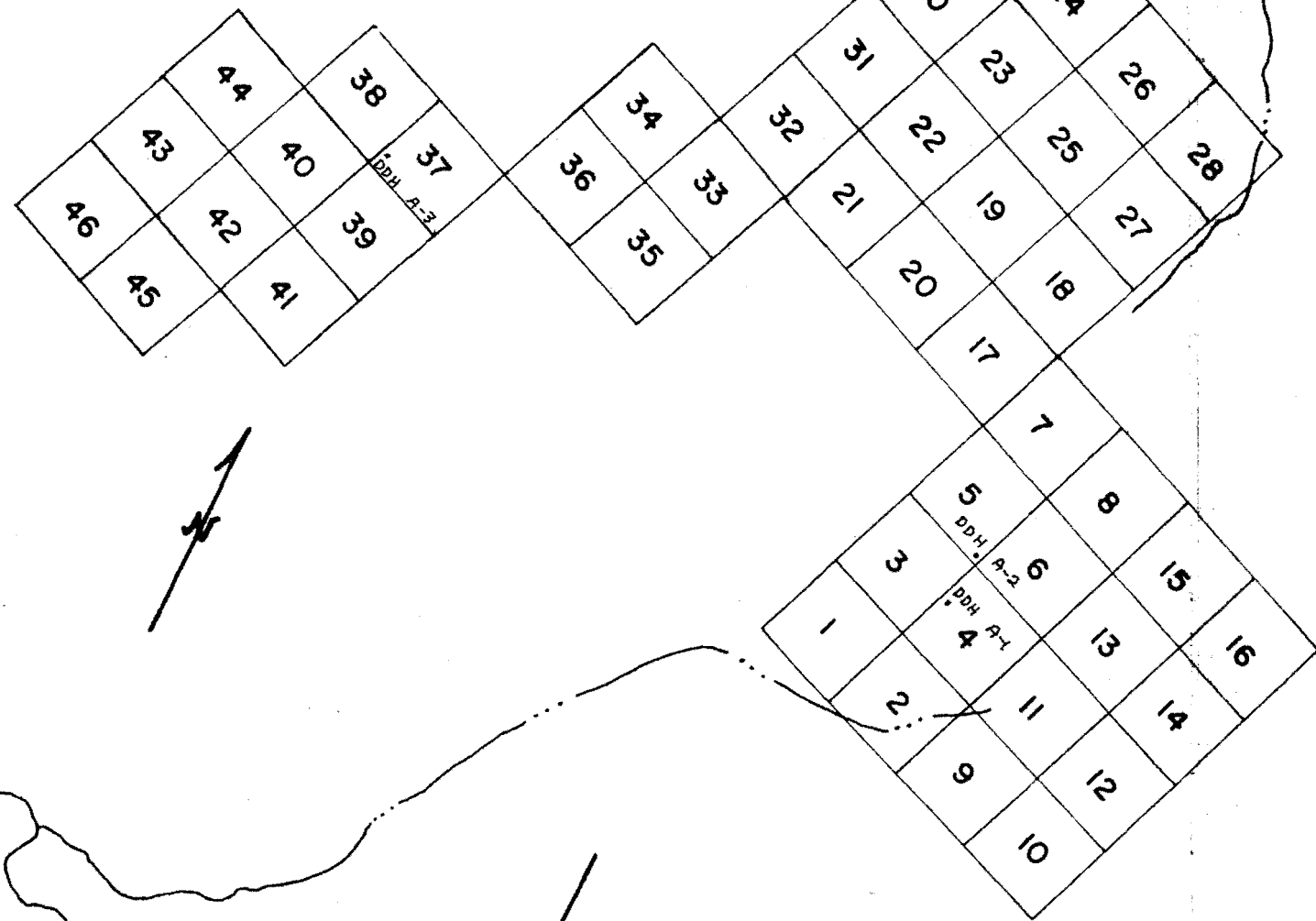

IRVINE LAKE

HUDSON BAY EXPLORATION & DEVELOPMENT CO.
 WHITEHORSE OFFICE

ANGIE CLAIMS
 DRILL HOLE LOCATION

CLAIM MAP 105 B-II
 SCALE 1" = 1/2 MILE
 JUNE, 1974