

SPEC 1 - 52

QUARTZ MINERAL CLAIMS



SPEC 1-12

GRANT # YA49670 - YA49681

SPEC 13 - 52

GRANT # YA49957 - YA49996

REPORT OF EXPENSES CHARGED AGAINST THIS PROPERTY FOR ASSESMENT WORK PURPOSES.

| PAGE TITLE | DOLLAR TOTAL PER PAGE |
|-----------------------------|-----------------------|
| HISTORY OF PROPERTY ---- | \$100.00 |
| LINE CUTTING ----- | \$1400.00 |
| MBW SURVEYS REPORT ---- | \$1000.00 |
| VLF 440SURVEY ----- | \$1250.00 |
| CRONE EM SURVEY ----- | \$300.00 |
| EQUIPMENT RENTAL ----- | \$2030.00 |
| HELICOPTER TIME ----- | \$1765.62 |
| EQUIPMENT PURCHASES ---- | \$1608.86 |
| BONDAR-CLEGG & CO. LTD. --- | \$204.75 |
| MISC. EXPENSES ----- | \$399.88 |

TOTAL OF ALL EXPENSES CLAIMED FOR IN THIS REPORT-\$10059.11

091023

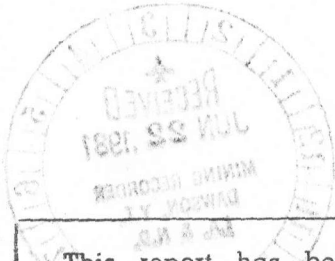

This report has been examined by the Geological Evaluation Unit and is recommended to the Commissioner to be considered as representation work in the amount of \$ 5,200

P. Watson

Resident Geologist or
Resident Mining Engineer

Considered as representation work under Section 53 (4) Yukon Quartz Mining Act.

Commissioner of Yukon Territory

Lode Mining page 108 - 109

para 4 A large number of claims have been staked on Lepine Creek, north of the Klondike River. The claims are staked on a wide band of seritice schist, the ordinary country rock of the district. The schist is often somewhat silicified and, in places, is impregnated with iron. Only one claim, the Great Eastern, was worked during the past season. This claim is situated south of the deep valley of Ruitter Creek, a tributary of Lepine Creek. The schist here are traversed by a wide dike belonging to the recent quartz - porphyry group, and both schist and dike rock are completely decomposed to a depth of at least fifteen feet. This decomposed material constitutes the ore. A tramway, half a mile in length, has been built, and the ore has been trammed down to Ruitter Creek, and treated in a small cyanide plant. The result of the season's operation is not known. Specimens of the ore, collected by the writer, and assayed in the laboratory of the survey, showed only traces of gold.

Book
out of

Mining Records
DAWSON

OFFICE
COPY

CANADA

DEPARTMENT OF MINES

HON. LOUIS CODERRE, MINISTER; A. P. LOW, LL. D., DEPUTY MINISTER

MINES BRANCH

EUGENE HAANEL, PH. D., DIRECTOR.



LODE MINING IN YUKON:

AN INVESTIGATION OF QUARTZ DEPOSITS
IN THE KLONDIKE DIVISION

BY

T. A. MacLean, M. E.

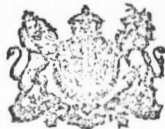

quartz, would have decided definitely whether the property would make a mine.

Surface indications show large proportions of quartz. The tunnel, at an elevation of 900 feet lower, exhibits a comparatively small percentage of quartz. Some values evidently occur in the main surface lead, as shown by the above few samples, and the prospect is sufficiently good to invite a mill test, if that could be arranged at reasonable cost.

HUNKER MINERAL CLAIM.

(*Sam. Thurbur.*)

This claim is located on the same divide as the Dome Lode property. It lies also on the right limit of the right fork of Hunker creek, about 1,000 feet east of the creek bed. The main road passes through it.

Mr. Thurbur started an open-cut into the side hill, above the road, and struck a vein, which appears to strike about S. 75° E. and to dip 40° northerly through the country which has about the same dip southerly. This vein, where exposed, showed a width of about 19 inches. The wall rock is a schist, grading into laminated quartzite, of a grey to greenish colour. Both quartz and country show mineralization, by pyrites, and the quartz contains galena. This vein, for 12 inches of its width, on the footwall, is made up of fairly solid quartz, overlain by about 7 inches of crushed quartz and decomposed schists.

Little work had been done at the time this was visited with Mr. Thurbur, and nothing could be judged as to the continuity of the vein.

Sample No. 191, across 12" of the hard quartz, showed some galena and pyrite, and No. 192, across 7" of the crushed vein-matter, panned considerable iron pyrites, and one colour of gold.

In each case the assay showed no value.

(See assay sheet No. 19, p. 96).

WELLS QUARTZ MINING COMPANY.¹

(*Lepine Creek.*)

A large number of claims have been staked on Lepine creek, north of the Klondike river, most of them being held by the above company.

Dr. Wells, of Dawson, is head of this company, and, on August 16, accompanied the party, which thus consisted of 4 members. The trail on Moosehide mountain was a very rough one over which to get a team of horses, and after negotiating it one way it was thought best to return by driving down Lepine and Rock creeks to Klondike river, the road coming out just opposite Bear creek.

¹ McConnell, R. G., Report on Klondike Gold Fields, Part B, An. Rep. Geol. Sur. Can. 1905, Vol. XIV, p. 65b.

The claims visited on Lepine creek were: the Great Eastern, May McD. mineral claim, Billy Button, and Rose. The Rose mineral claim is on the right limit of Lepine creek, 7 miles above Rock creek, where it enters the latter, which then continues down about $1\frac{1}{2}$ miles to the Klondike river.

Nature of Country.—This is generally sericite schist, which in places has become silicified. Lenses of quartz occur throughout the schists, but are not so plentiful as in many other sections visited. Associated with the schists is a quartz porphyry which traverses a comparatively extensive area.

Development.—This consists of a tunnel, several shafts, or near-shafts, pits, trenches, and open-cuts, which are scattered over a considerable area. No work was in progress during the past season, and many of the openings previously made had caved in.

On the Rose mineral claim, a wide dyke or ledge of bird's eye porphyry is found traversing the slope from the right limit of Ruiter creek. Two samples (Nos. 260 and 261) were taken at various trench exposures, but no values found.

A tunnel had been driven some distance into the side hill, the entry being near the right limit of the creek, but this was in a dangerous condition when visited, and could not be penetrated. There did not appear to be any vein, however. Occasional stringers of quartz were seen in the schists of the dump. A little pyrite was noticed, but no values were found in sample No. 262 taken from this material.

One shaft, said to be 30' deep, was located beside the water ditch of the Yukon Gold Company, about 200 yards northerly from the cabin. This was sunk in silicified schist, which exhibited lenses of quartz. Two trial samples (Nos. 246 and 247) from the dump of this shaft gave no value when assayed.

On the Great Eastern Mineral Claim a second shaft, supposed to be 28 feet deep, was visited. This is in the vicinity of the head of an incline, which was formerly used to run material from an adjoining open-cut to the cyanide plant below. Quartz and schists were both found in the dump of the shaft and sampled, three trial samples being taken, Nos. 248, 249 and 250. No values above traces were found.

The open-cut mentioned above was formed by two trenches cross-cutting each other, one being 120 feet long, and from 5 to 15 feet wide, the other over 40 feet long and 8 to 10 feet wide. This was the source of the ore, referred to by Mr. McConnell¹, which was then being treated by the cyanide plant on Ruiter creek. This ore consists of quartz-porphry dyke matter and country, all of which is completely decomposed to a depth of at least 15 feet.

A couple of samples (Nos. 251 and 252) gave only traces when assayed.

¹McConnell, above cited, p. 102.

On the May McD. Mineral Claim, a couple of pits are opened where it would appear shafts were intended to be sunk. These are only a few feet apart; the larger being 8 feet in diameter and 4 or 5 feet deep.

The schists are here rusty, and again pale green in colour and metamorphosed in a manner similar to that noticed at the Lone Star, Victoria gulch.

One sample (No. 254A) gave an assay as high as 20 cents; three others (253, 254 and 255) only nil and traces.

On the Billy Button Mineral Claim, a shaft about 10 feet deep, and a small pit, or open-cut, are found near each other.

The condition here is similar to that already described, excavated material being chiefly silicified schists. Two samples (Nos. 256 and 257) taken from the pit gave trace and nil respectively, and Nos. 258 and 259 from the dump of the shaft, gave no values.

Nineteen samples were taken from this property, and only one gave any value above traces, i.e., 254A, which showed a value of 20 cents per ton.

WELLS QUARTZ MINING GROUP SAMPLES—ASSAY SHEET NO. 25.

| Sample No. | Material. | Colour. | Weight. | | Minerals in pan. | Location. | Assay in ounces (a) per ton of | | Value per ton. | | Width of sample. | | Check assay (b) | | Remarks. |
|------------|---------------------------|---------------------|---------|-----|------------------|--|--------------------------------|-----|----------------|----|------------------|-----|-----------------|-----|---|
| | | | Lbs. | Oz. | | | Au. | Ag. | \$ | c. | Ft. | In. | Au. | Ag. | |
| 216 | Quartzose and schist..... | Yellowish..... | 3 | 5 | - | Dump of shaft No. 1 beside Yukon Gold ditch..... | nil | - | - | - | nil | nil | nil | nil | Trial sample of banded schist and quartzose material. |
| 217 | Quartz..... | Dull white to rusty | 3 | 1 | - | Dump of shaft same as No. 246..... | nil | - | - | - | nil | nil | nil | nil | Trial sample of banded schist and quartzose material. |
| 218 | Quartz..... | White to rusty.... | 3 | 7 | - | Dump of No. 2 shaft Great Eastern claim..... | trace | - | - | - | 0-01 | nil | nil | nil | Trial sample Great Eastern M. C. |
| 219 | Quartz and schist | Rusty to greenish | 4 | 3 | - | Dump of No. 2 shaft Great Eastern claim..... | trace | - | - | - | nil | nil | nil | nil | Average sample of quartz and schist. |
| 249 | Quartz and schist | Rusty to greenish | 3 | 11 | - | Dump of No. 2 shaft Great Eastern claim..... | nil | - | - | - | trace | nil | nil | nil | Average sample of quartz and schist. |
| 250 | Quartz..... | Rusty..... | 3 | 7 | - | Dump of No. 2 shaft Great Eastern claim..... | trace | - | - | - | trace | nil | nil | nil | Trial sample Great Eastern M. C. |

WELLS QUARTZ MINING GROUP SAMPLES—ASSAY SHEET NO. 25—Continued.

| Sample No. | Material. | Colour. | Weight. | | Minerals in pan. | Location. | Assay in ounces (a) per ton of | | Value per ton. | | Width of sample. | | Check assay (b) | | Remarks. |
|------------|----------------------------|--------------------------------|---------|-----|------------------|--|--------------------------------|-------|----------------|----|------------------|-------|-----------------|-----------------------------------|----------|
| | | | Lbs. | Oz. | | | Au. | Ag. | \$ | c. | Ft. | In. | Au. | Ag. | |
| 251 | Schists metamorphosed..... | Rusty grey greenish..... | 3 | 11 | - | Trench 25' south of No. 2 shaft..... | trace | - | - | 4 | 0 | nil | nil | Trial sample. Great Eastern M. C. | |
| 252 | Schists metamorphosed..... | Rusty..... | 3 | 15 | - | Opposite end of trench 25' from No. 251... | nil | - | - | 4 | 0 | nil | nil | Great Eastern M. C. | |
| 253 | Schists metamorphosed..... | Greenish..... | 3 | 5 | - | 8' dump of pit No. 1 May McD. M. C.... | nil | - | - | - | 0.04 | nil | nil | Trial sample. | |
| 254 | Schists metamorphosed..... | Rusty..... | 4 | 3 | - | 8' pit No. 1 May McD. M. C..... | trace | - | - | 4 | 0 | trace | nil | Sectional sample. | |
| 254A | Schists metamorphosed..... | Rusty..... | 3 | 7 | - | 8' pit No. 1 May McD. M. C..... | 0.01 | trace | 0.20 | 4 | 0 | trace | nil | May McD. M. C. | |
| 255 | Schists metamorphosed..... | Rusty..... | 5 | 5 | - | Pit No. 2 adjoining the 8' pit above..... | nil | - | - | 5 | 0 | nil | nil | May McD. M. C. | |
| 256 | Schistose quartzite..... | Banded white tan greenish..... | 3 | 5 | - | Pit No. 3 on Billy Button M. C..... | trace | - | - | 2 | 0 | trace | nil | Billy Button M. C. | |

(a) Assays conducted by Mr. Wm. C. Sime of Dawson, Y.T.

(b) Check assays conducted by Mr. N. L. Turner, under the direction of Mr. F. G. Wait, Division of Chemistry, Mines Branch, Ottawa.

M.S. 12

| Sample No. | Material. | Colour. | Weight. | | Minerals in pan. | Location. | Assay in ounces (a) per ton of | | Value per ton. | | Width of sample. | | Check assay (b) | | Remarks. |
|------------|-----------------------------------|--------------------------------|---------|-----|------------------|---|--------------------------------|------|----------------|----|------------------|-----|-----------------|-----|--|
| | | | Lbs. | Oz. | | | Au. | Ag. | \$ | c. | Ft. | In. | Au. | Ag. | |
| 257 | Schistose quartzite with quartz.. | Banded white tan greenish..... | 2 | 11 | - | Adjoining No. 250 No. 3 pit..... | nil | - | 2 | 0 | trace | nil | nil | nil | Near N. W. border of Billy Button M. C. |
| 258 | Schistose quartzite with quartz.. | Banded white tan greenish..... | 3 | 9 | - | Dump of shaft adjoining No. 3 pit..... | nil | - | - | - | trace | nil | nil | nil | Near N. W. border of Bully Button M. C. |
| 259 | Schistose quartzite with quartz.. | Banded white tan greenish..... | 3 | 7 | - | Dump of shaft adjoining No. 3 pit..... | nil | - | - | - | trace | nil | nil | nil | Near N. W. border of Billy Button M. C. |
| 260 | Birds Eye porphyry..... | Grey..... | 3 | 7 | - | Open cut on face of hill Rose M. C..... | nil | - | 2 | 0 | trace | nil | nil | nil | Rose M. C. |
| 261 | Birds Eye porphyry..... | Grey..... | 6 | 1 | - | Porphyry ledge exposure on Montrose M. C..... | nil | - | 2 | 0 | trace | nil | nil | nil | Montrose M. C. |
| 262 | Quartz and schist | White to green.... | - | - | Pyrites..... | Tunnel on Rider creek | nil | - | - | - | trace | nil | nil | nil | Trial sample of material on the dump. |
| 263 | Quartz..... | White..... | 3 | 13 | Pyrites..... | Challenge M. C. on McKay gulch near Victoria gulch..... | 0.02 - 0.35 | 0.61 | - | - | trace | nil | nil | nil | Trial sample from Mr. F. E. Akin. This ground was not visited. |

(a) Assays conducted by Mr. Wm. C. Sime of Dawson, Y.T.

(b) Check assays conducted by Mr. N. L. Turner, under the direction of Mr. F. G. Wait, Division of Chemistry, Mines Branch, Ottawa.

History of Property

Researchwork was carried out at the arcives in Whitehorse for 4 days off & on; plus 2 days research at the Dawson mining recorders office.

There was hotel room, meals & flight expenses involved in this work. Therefore I feel it fair to claim some of the costs against this property.

2 Days @ 50.00 per day = 100.00 Dollars

LINE CUTTING

| | | | | |
|---------------|--------------------------|----------|-----------------|------------------|
| Tim Ashley | ceck #356 | cssc | \$200.00 | |
| " | " | " #369 | " | \$200.00 |
| " | " | " #421 | " | \$200.00 |
| | | | <u>-----</u> | \$600.00 |
| John Lodder | " #386 | " | <u>\$600.00</u> | <u>\$600.00</u> |
| Clarke Ashley | " | | | |
| | 4 Days @ 50.00 per day = | \$200.00 | | <u>\$200.00</u> |
| | | | | <u>\$1400.00</u> |

MBW SURVEYS Report

This report is of MBW Surveys prospecting and sampling program ,conducted on Shovel,Bradley & Ruitter Creeks.

The total cost chargedby MBW Surveys is as follows

2 men @ \$250.00 per Day for 4 Days == \$1000.00

Geological Report (prospecting and sampling) conducted on Shovel, Bradley and Rutter Creeks on June 25, 26 and 27 of 1980. Report as follows:

DAY #1 Wednesday, June 25, '80

10:00 am - Landed in camp. Set up camp.

11:30 - 3:00 - Took creek samples along Bradley Cr., north of camp, at 100 meter intervals.
(Bradley samples)

N.B. Permafrost is just below moss overburden & panning of black mud yields nothing, thus, we could only collect samples from river bed. Tried not to pan samples down too much so as to maintain a good size sample.

We travelled down 1000 meters, 100 m. below the entrance of the tributary to Bradley Cr. (Bradley samples to date are #1 to #10.)

3:30 - 6:00 Took samples at 100 m intervals S. along Bradley Cr. to where the creek branches, then we collected 1 sample @ 150 m intervals up each branch. Bradley Cr. becomes a marsh below the entrance of the tributary 1000 m N. of the camp. Sample #10 is an example of the bed of the creek at this point.

Collected sample of gravel from dried
stream bed entering Bradley Cr., just
S. of location of Sample #1 - Sample #11A.

Returned to camp. 6:20 pm.

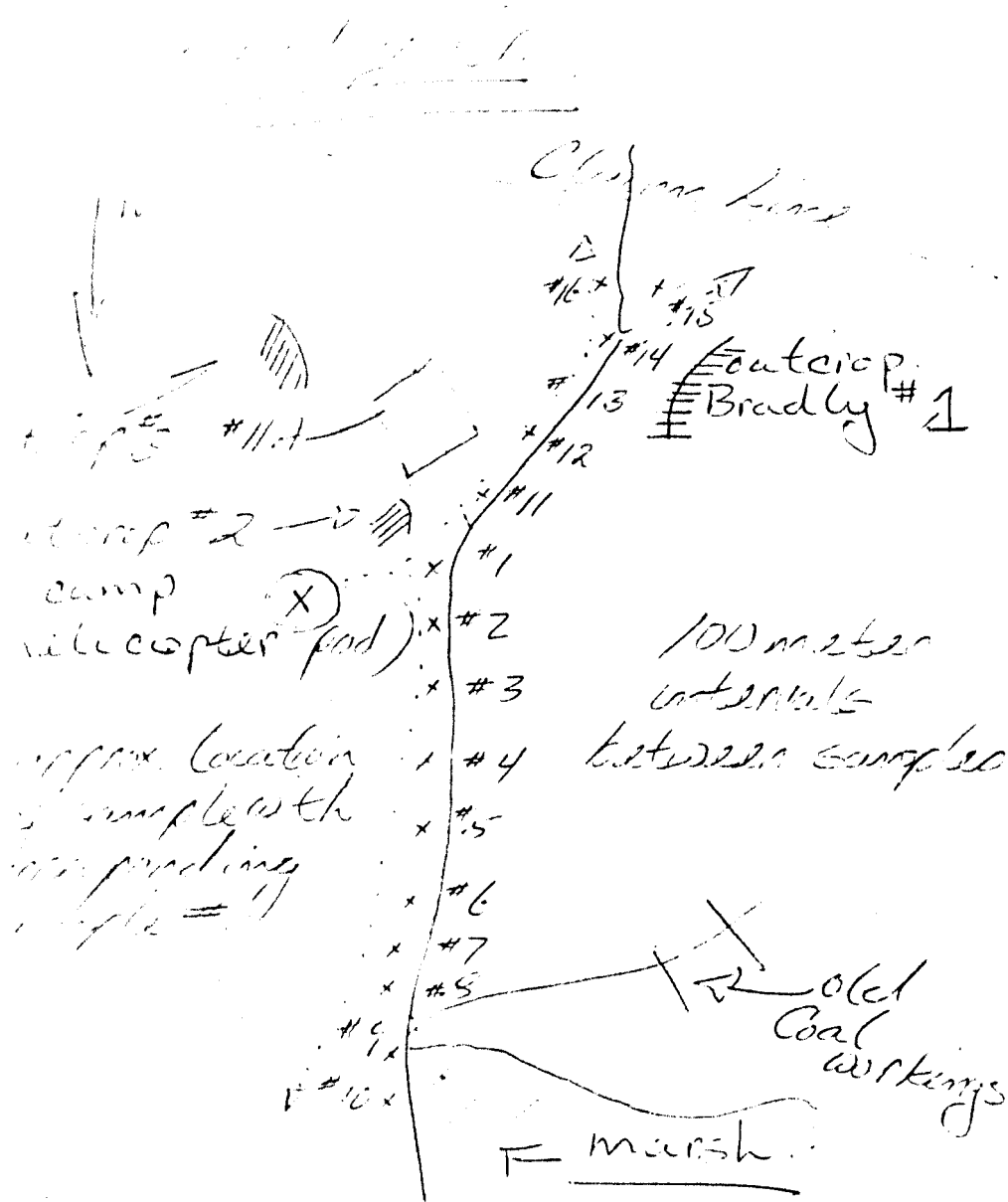

Sample Numbering System
for River samples along
Bradley Cr.

DAY #2 Thursday, June 26, '80

10:00 am - Set out for Ruitter Cr. Inspected outcroppings along Bradley Cr. on it's West Bank along Claim line. - Bradley Outcrop #1 -

Travelled west along Claim line on a bearing of 320° to Ruitter Cr. (Arrive 11:30) Covered terrain on two S branches of Ruitter with little success... as we were unable to locate outcroppings in the dense brush.

Collected a stream sample from each of the two branches (Samples #1 & 2).

Travelled N along Ruitter to site of tailings from previous mining. No outcroppings were encountered.

On the East Bank opposite the tailings we found a large outcropping, represented by Sample Ruitter #1.

Collected a stream sample just upstream from the tailings - Ruitter Cr. #3.

This area was rich in serpentine and quartz and a compact green rock (?).

As the terrain was difficult and the bush thick, it required most of the day to cover the upper section of Ruitter Cr. We were unable to check the outcrop at the mouth of Ruitter. Returned to camp at 7:00 pm.

N.B. It would be advisable to locate outcroppings from the air & mark them on a map before a ground search is attempted. The bush at both Bradley & Ruitter Crks made the locating of outcroppings nearly impossible.

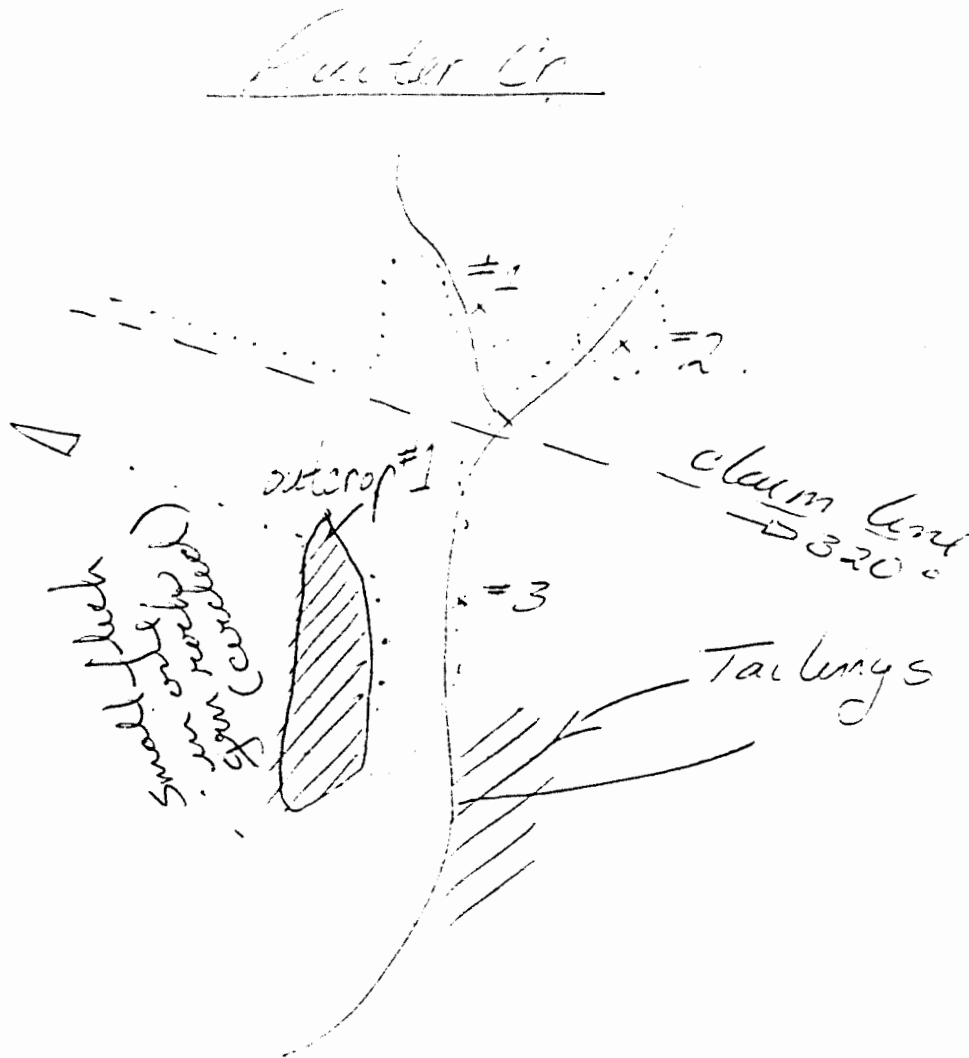

Sample Location Along Ruitter Cr.

Hardrock exploration on Bradley, Shovel and Ruiter Creeks
was carried out.

Shovel Creek

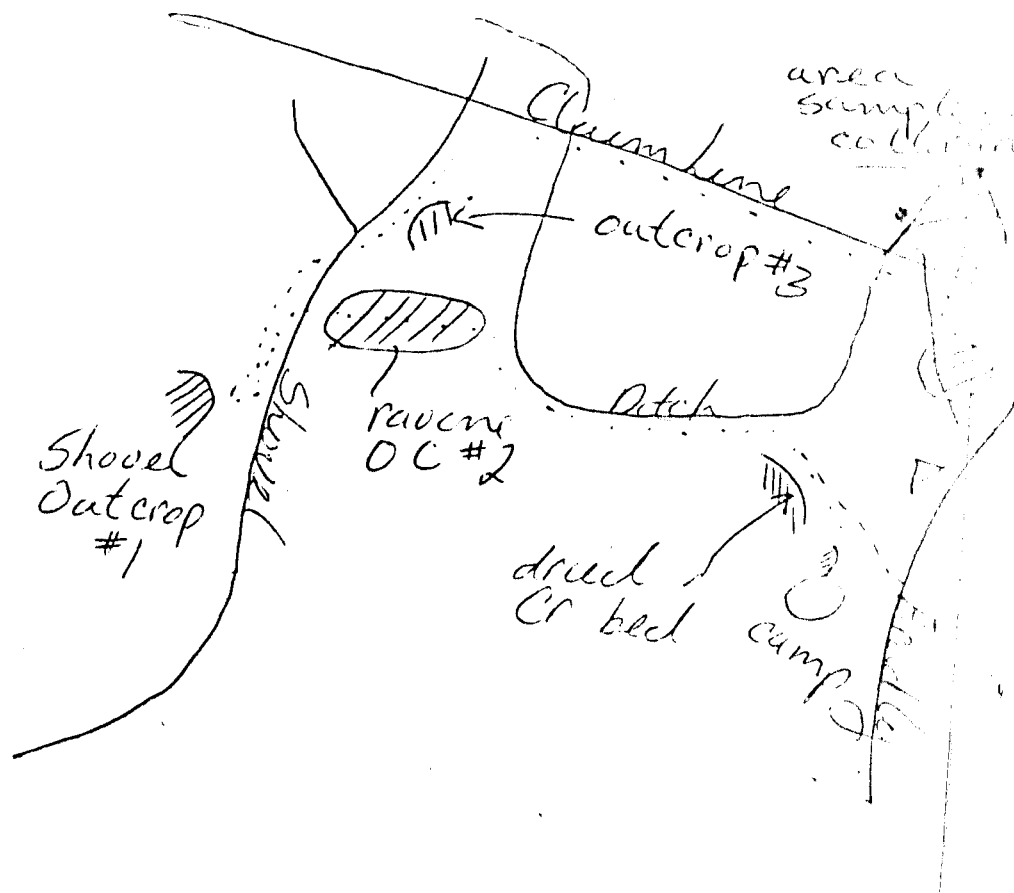

DAY #3 Friday, June 27, '80

10:30 am - Walked along dry tributary of Bradley Cr.
on our way to Shovel Cr.

Located two outcrops, one S of camp and
one East along the dried stream bed.

Mostly quartz mixed with the typical
compact green rock.

Travelled along abandoned ditch to Shovel
Cr. Descended along ravine - mostly quartz
and serpentine with some coal.

Located large outcrop on opposite bank -
almost all that compact green rock.

Travelled up gravel to Claim Line, found
outcropping with coal and quartz (possibly
pyrite) just below Claim Line.

Followed Claim Line to Bradley Cr. Could
find no outcroppings in this region, due
to dense brush.

Collected samples along creek bed, which
should be a good representation of this
area's mineralogy.

Returned to camp. 5:00 pm.

Took down camp. 5:30 - 7:00.

Eric Huggard

S. Smith

Geological consulting over a four day period (June 25-28).
Placer work on Bradley Creek. Hardrock exploration on claims
Spec 1-52. Placer work done on Ruiter and Shovel Cr. as well.

Wednesday
June 25/80

Day #1

10 00 AM - Landed in camp.
- set up camp.

11 30 - 3:00 - took creek samples
along Bradley Cr North
of Camp at 100 meter
intervals

N.B. Permafrost is just
below moss overburden +
panning of black muck
yields nothing thus we
could only collect samples
from river bed. Tried not
to pan samples down too
much so as to maintain
a good size sample.

We traveled down 1000 meters
300m below the entrance of
the tributary to Bradley Cr.

5:30 - 6:00 took samples at 100m
intervals S. along Bradley Cr
to were the Creek branches
then we collected 7 samples
@ 150m intervals up each
branch.

Bradley Cr Samples #1 - #10

Bradley Cr
Samples

#11 - #14

Bradly Cr. Becomes a marsh
below the entrance of the
tributary 1000 m N. of camp
Sample #10 is an example of
the muck found on the
bed of the Cr @ this point

↑ Return to Camp. 6:20 PM.

Collected sample of gravel
from dried stream bed entering
Bradly Cr. Just S of location
of Sample #1. - Sample #11A-

Bradley Cr.

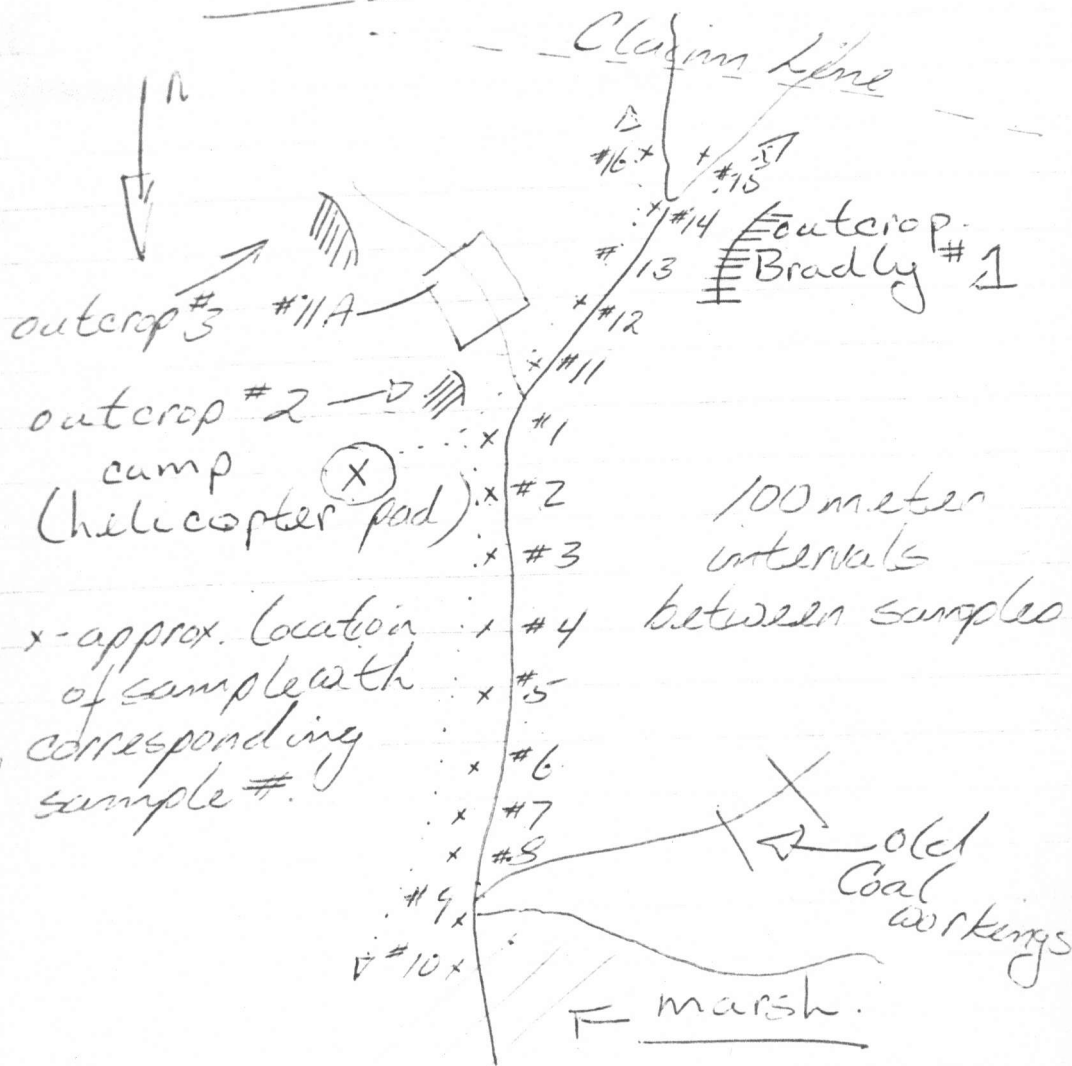

Sample Numbering System
for Placer Samples along
Bradley Cr.

Day #2

Thursday
June 26, 1980

10:00 AM Set out for Rutter Cr.

- Inspected outcrops

along Bradley Cr. on its

West Bank along Claim

Line. - Bradley Cr. Outcrop #1 -

- Traveled west along

Claim line on a bearing of

320° to Rutter Cr. (Arrive 11:30)

- Covered terrain on two S
branches of Rutter with
little success... as we
were unable to locate
outcroppings in the dense
bush

- Collected a stream sample
from each of the 2
branches. (Samples #1 + #2)

- Traveled N along Rutter
to site of tailings from
previous morning. No

outcroppings were encountered

- On the East Bank opposite
the tailing we found a large
outcropping represented by
Sample Rutter #1.

- Collected a stream sample
just upstream from the
tailings - Rutter Cr #3 -

• This area was rich in
serpentine + quartz + a
compact green rock. (?)

• As the terrain was difficult
+ the bush thick it required
most of the day to cover the
~~the~~ upper section of Rutter Cr.
We were unable to check
the outcrop at the mouth of
Rutter.

Returned to Camp 7:00 PM.

N.B. It would be advisable
to locate outcroppings
from the air + mark them
on a map before a ground
search is attempted.

The bush at both Bradley +
Rutter Cr. made the ~~location~~
of locating of outcroppings
nearly impossible.

Rutter Cr.

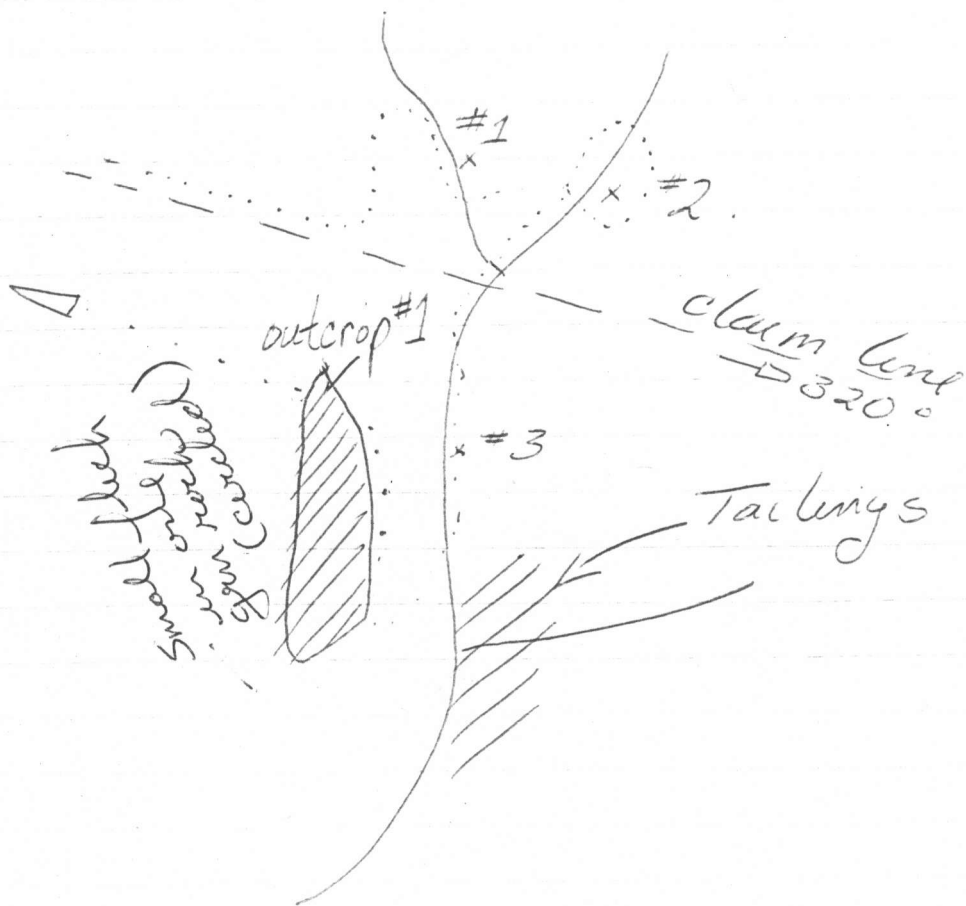

Sample Location Along
Rutter Cr.

Day #3

Friday
June 27/80

10:30 AM. - Walked along dried tributary of Bradley Cr on our way to Shovel Cr. Located 2 outcrops, one S of Camp + one East along the dried stream bed. Mostly Quartz mixed with the typical compact green rock.

- traveled along abandoned ditch to Shovel Cr. Descended along Ravine - mostly Quartz + Serpentine with some coal.

Located large outcrop on opposite bank. - almost all that compact grn rock.

- Traveled up gravel to Claim line, found outcropping with Coal + Quartz, possibly Pyrite, just below Claim line.

Followed Claim line to Bradley Cr.
- Could find no outcroppings in this region due to dense brush.

Collected samples along
Creek bed, which should
be a good representation
of ~~what~~ this area's
mineralogy.

Return to Camp 5:00 PM.

Took down Camp 5:30 - 7:00

Shovel Creek.

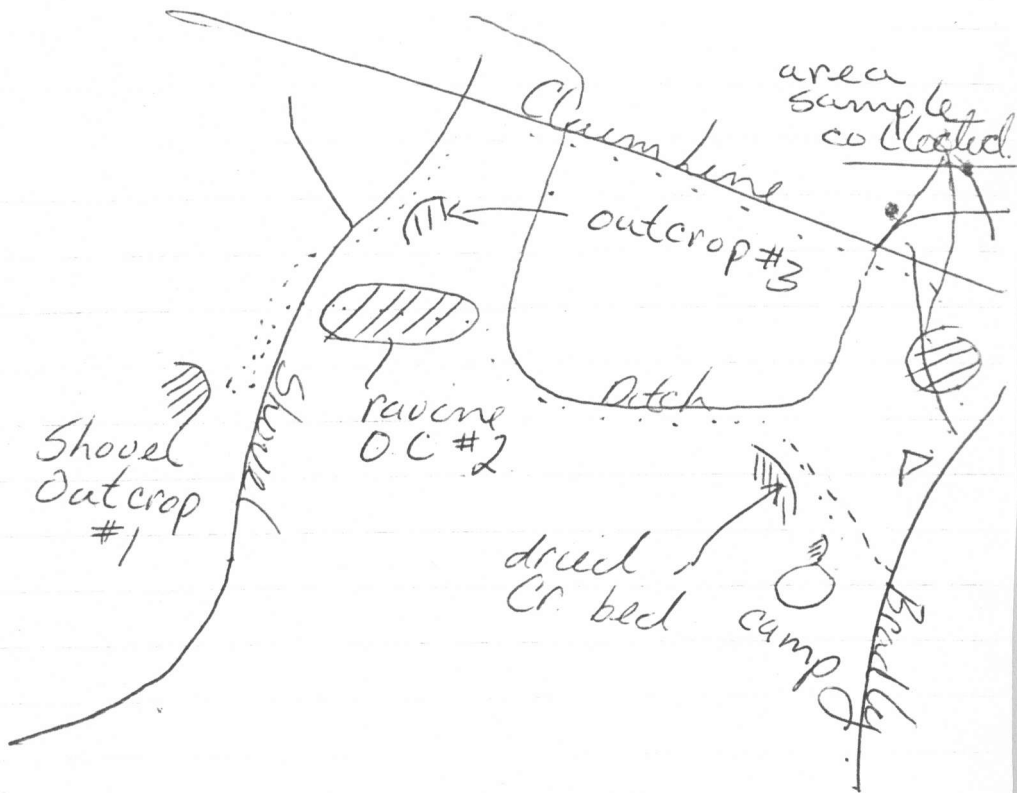

J. Smith

lie Duggard

Geological consulting over a
four day period (June 25-28).

Placer work on Bradley Creek.

Hardrock exploration on claims

spec 1-52. Placer work done on
Ruiter and shovel creek as well.

Hardrock exploration on Bradley,

Shovel and Ruiter Creek was
carried out.

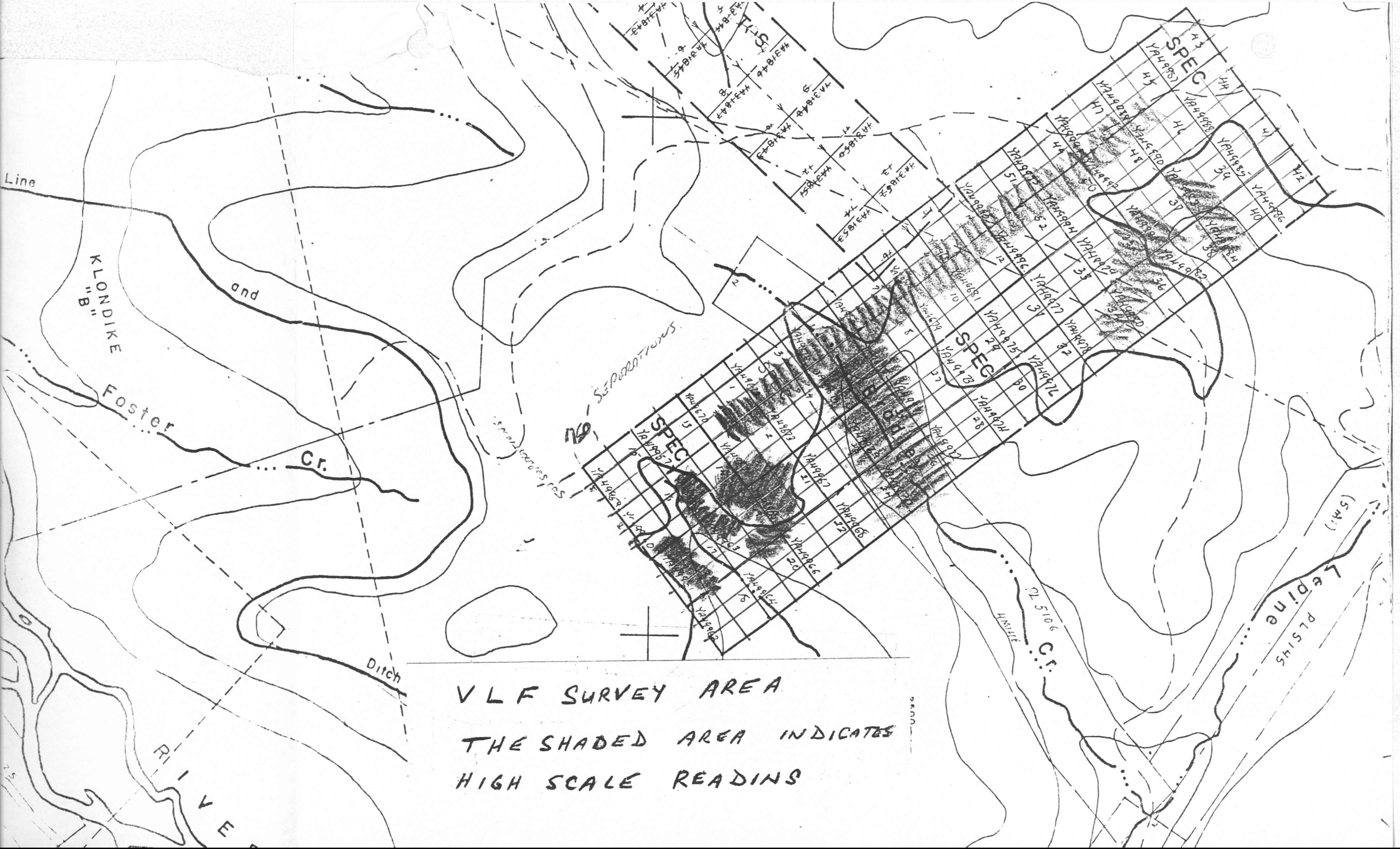

VLF SURVEY AREA
THE SHADED AREA INDICATES
HIGH SCALE READINGS

M-1830 HZ

L-390 HZ

+40
+20
+0
-20
-40
-60
-80
-100
-120
-140
-160

L45 L50 L55 E R15 R30 R45 R60 R75 R90 R105 R120 R135 R150 R165 R180

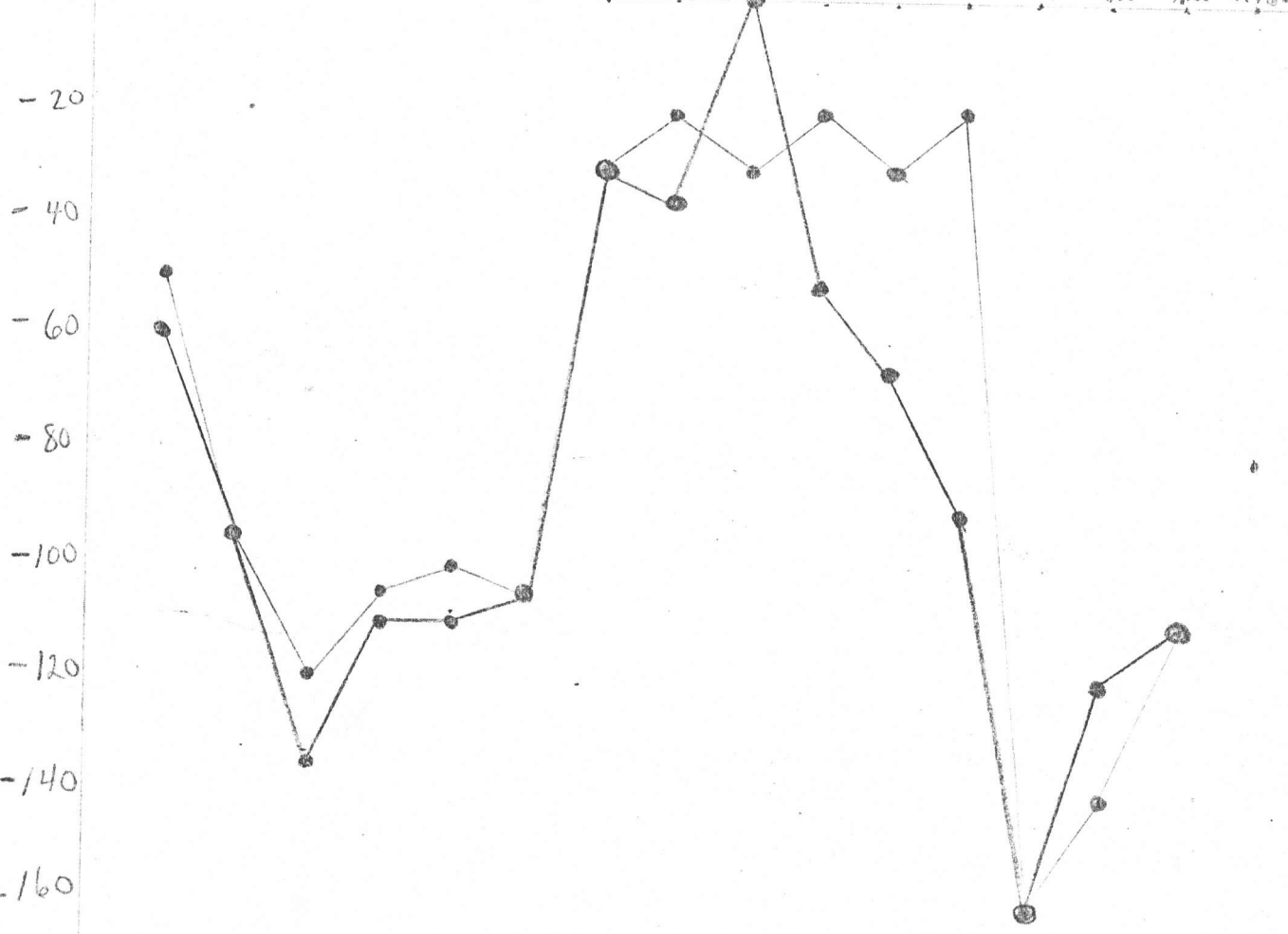

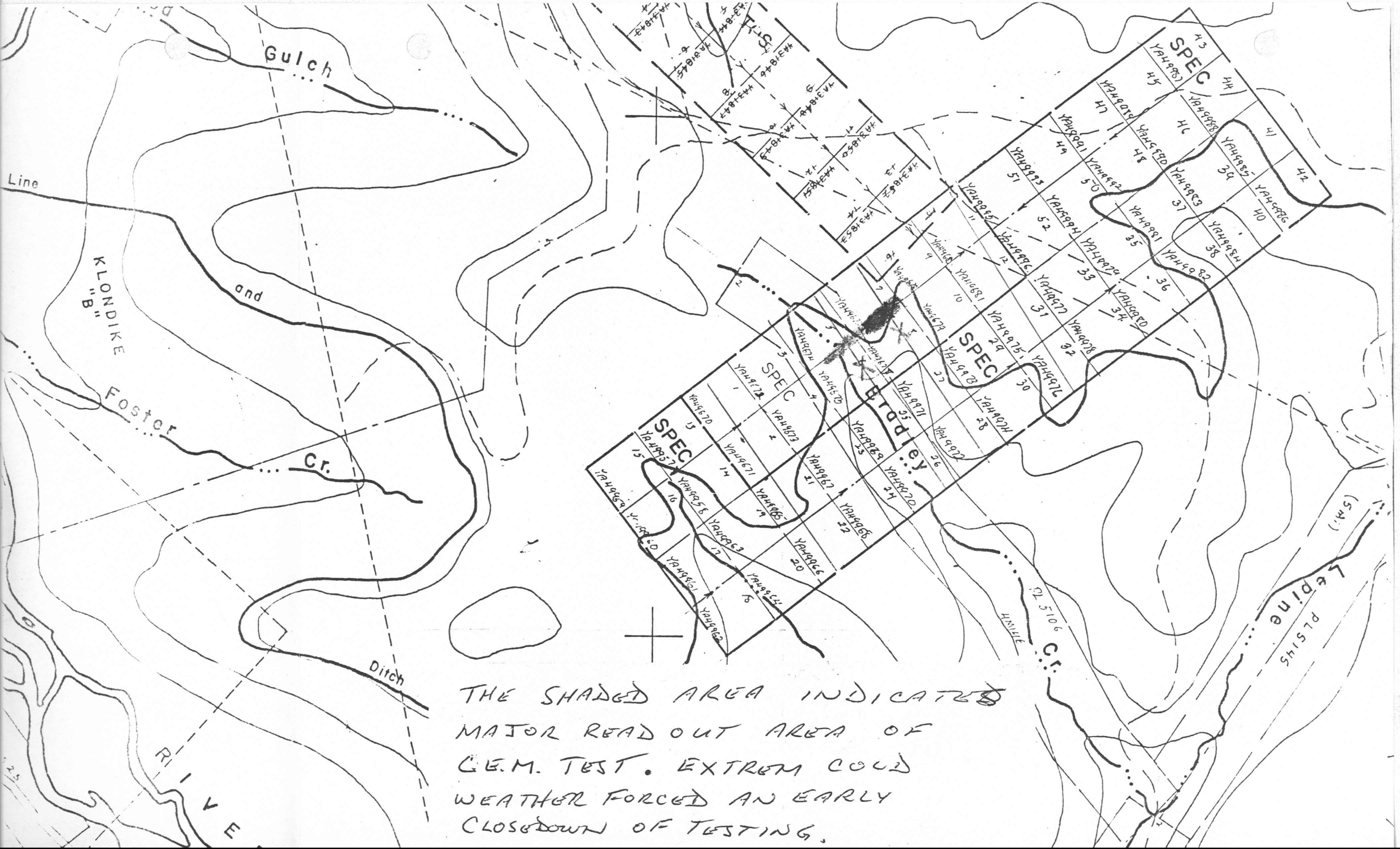

THE SHADED AREA INDICATED
 MAJOR READ OUT AREA OF
 G.E.M. TEST. EXTREM COLD
 WEATHER FORCED AN EARLY
 CLOSURE OF TESTING.

MBW Surveys

205 212 MAIN ST.
WHITEHORSE, YUKON
Y1A 2B1

Morley Barker
Bus. [403] 668-2467
After Hours [403] 633-2974

July 2, 1980

Ashley Exploration
Dawson City, Yukon Terr.

Dear Mr. Ashley:

2 men 4 days prospecting and sampling Shovel Creek, Bradley Creek
and Falter Creek in the Dawson Mining District.

As agreed on 2 men @ \$250.00 per day for 4 days \$1000.00

TOTAL \$1000.00

Yours truly,

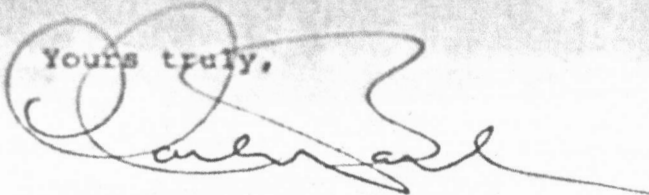

Morley Barker
MBW Surveys

MB/gb

PAID
July 26/80
#138
Soc. Sec. No.

I N V O I C E

V L F 400 GROUND EFFECT REJECTING METAL DETECTOR SURVEY

C. Ashley .

5 Days @ \$50.00 per day = \$250.00

T. Ashley

Check #141 CSSC = \$1000.00

Total labour cost of VLF SURVEY ± \$1250.00

CRONE ELECTROMAGNETIC SURVEY

Horizontal Shootback EM Method

3men 2 Days

T. Ashley 2 Days @ \$50.00 per day = \$100.00

C. Cullem 2 Days @ \$50.00 per day = \$100.00

C. Ashley 2 Days @ \$50.00 per day = \$100.00

Total cost of labour for this test = \$300.00

Extrem cold weather forced an early closedown of this testing.

PROJECT: _____

DATE: _____

OPERATOR: _____

COIL SPACING: _____

| STATIONS | M-1830 HZ. | | | LOW-390 HZ. | | | REMARKS |
|----------------|-----------------------------------|----------------------------|--------|--|------------------------------------|-----------------------|---------------|
| | L | C | R | L | C | R | |
| 240M 200' - 50 | ^{-10 - +10} -40 - -60 | -40 | -80 | ^{-10 - +10} -40 - -70 -40 - +10 | +20 | +10 | 0.5 FIELD |
| 100' 100' | -50 | -60 | -110 ✓ | -50 | -60 | -110 ✓ | FR 1.0 |
| 225M 100' 100' | -60 | -80 | -140 ✓ | -45 to -55 | -75 | -120 ✓ | FR 1.0 |
| 205M 100' | -80 | -80 | -160 ✓ | -80 to -70 -85 to -80 | -90 | -160 ✓ | FR 1.0 1.5 |
| 190M 100' | -10 - -20 -60 | 0 - 10 -20 - -15 -80 | -20 ✓ | -40 -50 - 70 | -45 -45 - 30 -70 - 40 -60 | -80 -100 ✓ -130 | FR 1.0 |
| 175M 100' | -40 | -10 to +10 | -40 ✓ | -40 - 60 | -20 - 30 70 | -75 ✓ | FR 1.0 |
| 160M 100' | ^{+20 to +1} +10 | -30 | -20 ✓ | -40 - 10 -10 +10 REVERSE | -50 | -50 ✓ | FR 1.0 |
| 145M 100' | -10 - 20 | -20 | -30 ✓ | 0 | -5 - +10 FLOW 0 | +0 ✓ | FR 1.0 |
| 130M 100' | -20 | 0 | -20 ✓ | -10 | -30 ⁻²⁵ / ₃₀ | -35 ✓ | FR 1.0 |
| 115M 100' | ^{-20 - -30} -30 | -30 | -30 ✓ | -40 - 20 | 0 | -30 ✓ | FR 1.0 |
| 100M 100' | -60 | -55 | -105 ✓ | -50 | -55 | -105 ✓ | FR 1.0 |
| 85M 100' | -50 | ⁻³⁰ -50 | -100 ✓ | -60 | -60 | -120 ✓ | FR 1.0 |
| 0.125 M 100' | -60 | -45 | -105 ✓ | -50 | -58 | -108 ✓ | FR 1.0 |
| 15M 100' | -60 | -60 ⁻⁵⁵ | -120 ✓ | -70 | -70 ⁻⁶⁵ | -135 ✓ | FR 1.0 |
| 30M 100' | -50 | -50 ⁻⁵⁵ | -95 ✓ | -40 | -60 ⁻⁵⁵ | -95 ✓ | FR 1.0 |
| 100' 100' | -40 | -50 ⁻⁵⁵ | -50 ✓ | -50 | -60 ⁻⁵⁵ | -60 ✓ | FR 1.0 |

EQUIPMENT RENTAL

C.E.M. UNIT

min. 1 month rental from cronegeophysics = \$840.00

Shipping

Toronto to Dawson Via CP to TNTA = 191.52

WHITEHORSE TO TORONTO VIA CP AIR = 69.00

Toronto airport to Crone = 10.40

Total cost for C.E.M. Unit = \$ 1110.92

TILDEN TRUCK RENTAL

Tilden Inv. # 89-41429 -\$920.00

" " # 89-41449 -\$920.00

\$1840.00

1/2 of these invoices to be charged to these claims

\$920.00

Total cost of rental equipment = \$2030.92

018-65193553 F

Address of consignor (address of first carrier and related marks) **WHITEHORSE** Airport of destination **YXX-TC** Flight Day _____ Flight Day _____

To _____ by first carrier _____ to _____ by _____ by _____
 Consignee's account number _____ Consignee's name and address
CRO-E GEOPHYSICS LTD
3607 WPLFE DALE ROAD
MISSISSAUGUA

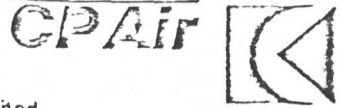
Not negotiable
Air Waybill
 (Air Consignment note)
 Issued by
Canadian Pacific Air Lines, Limited,
Vancouver, B.C., Canada

 Member of International Air Transport Association

If the carriage involves an ultimate destination or stop in a country other than the country of departure, the Warsaw Convention may be applicable and the Convention governs and in most cases limits the liability of carriers in respect of loss of or damage to cargo. Agreed stopping places are those places (other than the places of departure and destination) shown under requested routing and/or those places shown in carriers timetables as scheduled stopping places for the route. Address of first carrier is the airport of departure. SEE CONDITIONS ON REVERSE HEREOF.

Shipper's account number _____ Shipper's name and address
ASHLEY EXPLORATION
WHITEHORSE YT

The shipper certifies that the particulars on the face hereof are correct, agrees to the CONDITIONS ON REVERSE HEREOF, accepts that carrier's liability is limited as stated in 4(c) on the reverse hereof and accepts such value unless a higher value for carriage is declared on the face hereof, subject to an additional charge.

 SIGNATURE OF SHIPPER OR HIS AGENT

Issuing carrier's agent account no. _____ Issuing carrier's agent name and city
YXYFFCP
 Agent's IATA-Code
71 99016

Carrier certifies goods described below were received for carriage subject to the Conditions on reverse hereof, the goods then being in apparent good order and condition except as noted hereon: **27 NOV 80** **WHITEHORSE YT**
 EXECUTED ON _____ (Date) at _____ (Place)

R DAVISON **0950**
 SIGNATURE OF ISSUING CARRIER OR ITS AGENT
 Copies 1, 2 and 3 of this Air Waybill are originals and have the same validity.

Currency _____ Declared value for carriage **NVD** Declared value for customs _____ Amount of insurance **NIL** INSURANCE: If shipper requests insurance in accordance with conditions on reverse hereof, indicate amount to be insured in figures in box marked amount of insurance.

| NO. OF CHARGE AND VALUATION CHARGE | | ALL OTHER CHARGES AT ORIGIN | | Accounting information | | | Nature and quantity of goods (incl. dimensions or volume) |
|------------------------------------|---------------------|-----------------------------|-------------------|------------------------|-------|--|---|
| PREPAID | COLLECT | PREPAID | COLLECT | Rate Charge | Total | | |
| No. of packages | Actual gross weight | Rate class | Chargeable weight | Rate Charge | Total | | |
| PCP | | Commodity item no. | | | | | |
| 2 | 114 | | 51.5K | 1.33 | 69.00 | | GEOPHYSICAL EQUIP |

Prepaid weight charge **69.00** Prepaid valuation charge _____ Due carrier _____ Total other prepaid charges _____ Due agent _____ Total prepaid **69.00** For carrier's use only at destination

Other charges (except weight charge and valuation charge)
 Insurance Charge _____ Carriage Charge _____
PHONE 270 0096 FOR PICKUP
 Correct charges in destination currency
 USD amount
 Total charges

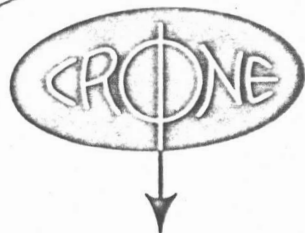

CRONE GEOPHYSICS LIMITED

3607 WOLFEDALE ROAD, MISSISSAUGA, ONTARIO, CANADA L5C 1V8
TELEPHONE: (416) 270-0096 CABLE: CRONGEO, TORONTO TELEX: 06-961260

Australian Branch: 244 Newbridge Road, MOOREBANK, N.S.W. 2170 Telephone: (02) 602-0937, Telex: 71-22922

November 25th, 1980

Ashley Explorations
P.O. Box 70
DAWSON CITY, Yukon

INVOICE 6667

For the rental of:

CEM # 322 & # 153, for the period of Oct 30 - Nov 30/80 \$840.00

Freight charges 10.40

\$850.40

Payment received 840.00

BALANCE \$ 10.40

TERMS: NET 30 DAYS



THE ONLY CANADIAN NAME IN WORLD-WIDE CAR RENTALS

1 OWNER - LOCATEUR

Dawson City -- (403) 993-5514

Tilden Rent-a-car Service

Taylor Chevrolet Oldsmobile Limited
2039 Second Avenue
Whitehorse, Yukon, Y1A 1B4
Phone (403) 667-2521 Telex 036-8-227

| | | |
|---|---|---|
| 4 | 0 | 0 |
| | | |

25 CUSTOMER - LOCATAIRE

Asuncy Enterprises
P.O. Box 70
Dawson City
Yukon (Bradley)
Dawson City

| | | | | |
|---|------------------------------------|--|------------------------|---|
| 2 UNIT NO. UNITÉ | 3 LIC. NO. | 4 MAKE - MARQUE | 5 STYLE | 26 DATE & TIME DATE & HEURE |
| | 145133 | 4X4 | | IN RETOUR <i>June 23/80</i> |
| 6 OWNER STAT-PROPRIÉTAIRE | 7 TO BE CHECKED IN AT - ARRIVERA À | 8 RETURN DATE - DATE DE RETOUR | | 27 DATE & TIME DATE & HEURE |
| <i>Dawson</i> | <i>Dawson</i> | | | OUT DÉPART <i>MAY 26/80</i> |
| 9 CREDIT CARD-CARTE DE CRÉDIT NO. | 10 DESTINATION | | | 28 |
| | | | | MI-KM IN/RETOUR |
| 11 DRIVER'S LIC. - NO CONDUCTEUR | 12 PROV. | EXP. | 13 P.O. - BON DE COMM. | 29 |
| <i>414</i> | <i>YT</i> | | | MI-KM OUT/DÉPART |
| 51 ALTERNATE CAR - AUTRE VOITURE | 14 IN BY RETOUR PAR | | | 30 |
| MI-KM IN/RETOUR | | | | MI-KM DRIVEN/PARCOURUS |
| MI-KM OUT/DÉPART | | | | 31 |
| MI-KM DRIVEN/PARCOURUS | | | | MI-KM ALLOWED/COMPRI |
| 16 REMARKS - REMARQUES <i>Extra Driver Name</i> | | | | 32 |
| INVOICE PAYABLE ON RECEIPT. GÉCI-EST VOTRE FACTURE PAYABLE SUR RÉCEPTION. | | | | MI-KM @ <i>25¢</i> |
| <h1>INVOICE FACTURE</h1> <p>EXTRA 2% PER MONTH (18% P.A.) CHARGED ON OVERDUE ACCOUNTS.</p> <p>INTÉRÊT À 1 1/2% PAR MOIS (18% ANNUEL) SUR COMPTES PASSÉS</p> | | | | 33 ADDITIONAL HOURS HEURES ADDITIONNELLES @ |
| | | | | 34 DAYS JOURS @ |
| FOR THE OWNER POUR LE PROPRIÉTAIRE | | | | 35 WEEKS SEMAINES @ |
| 23 TRAVEL AGENT DE VOYAGE <input type="checkbox"/> | | | | 36 MONTHS MOIS @ <i>875.00</i> |
| 17 COLLISION DAMAGE WAIVER (CDW) - EXONERATION POUR DOMMAGE PAR COLLISION (EDC) | | | | 37 TOTAL TIME & MI/KM TOTAL TEMPS & MI/KM |
| BY CUSTOMER'S INITIALS IN CONSIDERATION OF THE PAYMENT OF | | INT. EN APPOSANT LES INITIALES DU LOCATAIRE EN CONSIDÉRATION DU PAIEMENT DE | | 38 INTERCITY FEE TAXE INTERCITE À <i>T.P.A.</i> |
| <i>S</i> PER DAY | | <i>CLP</i> PAR JOUR | | 39 SUB-TOTAL SOUS-TOTAL |
| CUSTOMERS LIABILITY FOR DAMAGE TO RENTED VEHICLE INCLUDING WINDSHIELD IS LIMITED TO BUT NOTWITHSTANDING PAYMENT OF SAID FEE. CUSTOMER SHALL BE FULLY LIABLE FOR ALL COLLISION DAMAGE IF VEHICLE IS USED, OPERATED OR DRIVEN IN VIOLATION OF ANY OF THE PROVISIONS OF THIS RENTAL AGREEMENT OR OFF HIGHWAYS SERVICED BY FEDERAL, PROVINCIAL, OR MUNICIPAL GOVERNMENTS AND FOR ALL DAMAGES TO VEHICLE BY STRIKING OVERHEAD OBJECTS. | | LA RESPONSABILITÉ DU LOCATAIRE POUR TOUS DOMMAGES CAUSÉS AU VÉHICULE LOUÉ EST LIMITÉE À (PARE-BRISE INCLUS) MAIS NONOBSANT LE PAIEMENT DE CETTE SOMME, LE LOCATAIRE SERA ENTièrement RESPONSABLE POUR TOUT DOMMAGE DU À UNE COLLISION SI LE VÉHICULE EST EMPLOYÉ, MIS EN SERVICE OU CONDUIT EN CONTRAVENTION DE QUELQUE DISPOSITION DE CE CONTRAT OU EN DEHORS DE ROUTES OU VOIES PUBLIQUES ENTRETIENUES PAR LE GOUVERNEMENT FÉDÉRAL, PROVINCIAUX OU MUNICIPAUX, ET POUR TOUT DOMMAGE CAUSÉ AU VÉHICULE RESULTANT D'UNE COLLISION CONTRE UNE SUPERSTRUCTURE, INCLUANT TUNNELS, PONTS ET BRANCHES D'ARBRES. | | 40 TAX TAXE <i>InterCity Fee to</i> % |
| P.S.T. APPLICABLE ON C.D.W. IN QUEBEC AND SASKATCHEWAN ONLY - T.V.P. APPLICABLE AU QUÉBEC ET SASKATCHEWAN. | | | | 41 GASOLINE ESSENCE <i>Extra</i> |
| 18 PERSONAL ACCIDENT INSURANCE (PAI) - ASSURANCE-ACCIDENT PERSONNELLE (AAP) | | | | 42 CDW EDC <i>Per Month @ 45.00</i> |
| CUSTOMER ACCEPTS OR DECLINES PAI AT RATE SHOWN IN SEPARATE BROCHURE. ACCEPTANCE IS PROOF OF COVERAGE UNDER POLICY ISSUED TO LESSOR AS OUTLINED ON SEPARATE BROCHURE. | | LE LOCATAIRE ACCEPTE OU REFUSE AAP AUX FRAIS APPARAISANT DANS LA BROCHURE SÉPARÉE. LE CONSENTEMENT EST LA PREUVE DE COUVERTURE SOUS LA POLICE ÉMISE AU LOCATEUR COMME INDIQUÉ SUR LA BROCHURE SÉPARÉE. | | 43 PAI AAP @ |
| P.S.T. APPLICABLE IN QUEBEC AND SASKATCHEWAN ONLY. - T.V.P. APPLICABLE AU QUÉBEC ET SASKATCHEWAN. | | | | 44 OTHER AUTRES |
| 19 CUSTOMER AUTHORIZES LESSOR TO PROCESS A CREDIT CARD VOUCHER, IF ANY, IN HIS NAME FOR CHARGES HEREUNDER. I HAVE READ THE TERMS & CONDITIONS ON PAGE ONE (OTHER SIDE) AND PAGE 2 OF THIS RENTAL AGREEMENT AND AGREE THERETO. | | LE LOCATAIRE AUTORISE LE LOCATEUR À ÉMETTRE UN TALON DE CARTE DE CRÉDIT, S'IL Y A LIEU, EN SON NOM POUR LES FRAIS CI-DESSOUS. J'AI PRIS CONNAISSANCE DES CLAUSES ET CONDITIONS DE LA PAGE 1 (REVERS) ET DE LA PAGE 2 DE CE CONTRAT DE LOCATION ET JE LES ACCEPTE. | | 45 TOTAL CHARGES COÛT TOTAL <i>920.00</i> |
| X <i>[Signature]</i> | | 46 DEPOSITS DÉPÔTS \$ | | 47 LESS CREDITS À CRÉDITER |
| 20 HOME ADDRESS ADRESSE DOMICILE | | 48 BALANCE DUE SOLDE DÙ | | CASH COMPTANT <input checked="" type="checkbox"/> |
| 21 CITY VILLE | | 49 CASH REFUND - REMBOURSEMENT COMPTANT | | CHARGE À FACTURER <input type="checkbox"/> |
| 22 LOCAL ADDRESS ADRESSE LOCALE | | AMOUNT - MONTANT | | |
| 23 TEL. NO. | | I ACKNOWLEDGE RECEIPT OF ABOVE AMOUNT J'ACCUSE RÉCEPTION DU MONTANT CI-HAUT MENTIONNÉ. | | |
| 24 | | X | | |

50 CUSTOMER IS LIABLE FOR ALL PARKING AND TRAFFIC VIOLATIONS

LOCATAIRE RESPONSABLE POUR TOUTES CONTRAVENTIONS DE STATIONNEMENT OU DE CIRCULATION

DETACH HERE
DÉTACHER ICI



DETACH AND RETURN THIS PORTION WITH YOUR REMITTANCE TO:

DÉTACHER ET RETOURNER CE COUPON AVEC VOTRE REMISE À:

NET DUE - NET DÙ

| | |
|--|--|
| | |
|--|--|

89-41429



THE ONLY CANADIAN NAME IN WORLD-WIDE CAR RENTALS

1 OWNER - LOCATEUR

Dawson City -- (403) 998-5514

Tilden Rent-a-car Service

Taylor Chevrolet Oldsmobile Limited
2088 Second Avenue
Whitehorse, Yukon, Y1A 1B4

Phone (403) 667-2521 Telex 036-8-227

| | | |
|---|---|---|
| 4 | 0 | 0 |
| | | |

25 CUSTOMER - LOCATAIRE

Asiway Expeditions
P.O. Box 70
Dawson City
Yukon (S.A.F.W.)
Driver: C. Reed

| | | | | |
|---|---|--|---|--|
| 2 UNIT NO. UNITE | 3 LIC. NO. <i>144803</i> | 4 MAKE - MARQUE <i>474</i> | 5 STYLE | 26 DATE & TIME DATE & HEURE IN RETOUR <i>Aug 30/80</i> |
| 6 OWNER STAT-PROPRIETAIRE <i>Dawson</i> | 7 TO BE CHECKED IN AT - ARRIVERA A <i>Dawson</i> | 8 RETURN DATE - DATE DE RETOUR | | 27 DATE & TIME DATE & HEURE OUT DEPART <i>Aug 2/80</i> |
| 9 CREDIT CARD-CARTE DE CREDIT NO. | 10 DESTINATION | | | 28 MI-KM IN/RETOUR |
| 11 DRIVER'S LIC. - NO CONDUCTEUR <i>414</i> | 12 PROV. <i>YT</i> | EXP. | 13 P.O. - BON DE COMM. | 29 MI-KM OUT/DEPART |
| 51 ALTERNATE CAR - AUTRE VOITURE | 14 IN BY RETOUR PAR | | 30 MI-KM DRIVEN/PARCOURUS | |
| MI-KM IN/RETOUR | | | 31 MI-KM ALLOWED/COMPRI | |
| MI-KM OUT/DEPART | | | 32 MI-KM @ <i>25</i> | |
| MI-KM DRIVEN/PARCOURUS | | | 33 ADDITIONAL HOURS HEURES ADDITIONNELLES @ | |
| 16 REMARKS - REMARQUES <i>Extra Driver Name</i> | | | | 34 DAYS JOURS @ |
| INVOICE PAYABLE ON RECEIPT. CE CI EST VOTRE FACTURE. PAYABLE SUR RECEPTION. | | | | 35 WEEKS SEMAINES @ |
| INVOICE FACTURE | | | | 36 MONTHS MOIS @ <i>875.00</i> |
| FOR THE OWNER POUR LE PROPRIETAIRE | | | | 37 TOTAL TIME & MI/KM TOTAL TEMPS & MI/KM |
| 23 TRAVEL AGENT DE VOYAGE <input type="checkbox"/> | | | | 38 INTERCITY FEE TO SAUX INTERCITE A <i>T.P.A.</i> |
| 17 COLLISION DAMAGE WAIVER (CDW) - EXONERATION POUR DOMMAGE PAR COLLISION (EDC) | | | | 39 SUB-TOTAL SOUS-TOTAL |
| BY CUSTOMER'S INITIALS IN CONSIDERATION OF THE PAYMENT OF <i>5.00</i> PER DAY | | EN APPOSANT LES INITIALES DU LOCATAIRE EN CONSIDERATION DU PAIEMENT DE _____ PAR JOUR | | 40 TAX TAXE <i>Intercity</i> % |
| CUSTOMERS LIABILITY FOR DAMAGE TO RENTED VEHICLE INCLUDING WINDSHIELD IS LIMITED TO BUT NOTWITHSTANDING PAYMENT OF SAID FEE. CUSTOMER SHALL BE FULLY LIABLE FOR ALL COLLISION DAMAGE IF VEHICLE IS USED, OPERATED OR DRIVEN IN VIOLATION OF ANY OF THE PROVISIONS OF THIS RENTAL AGREEMENT OR OFF HIGHWAYS SERVICED BY FEDERAL, PROVINCIAL, OR MUNICIPAL GOVERNMENTS AND FOR ALL DAMAGES TO VEHICLE BY STRIKING OVERHEAD OBJECTS. | | LA RESPONSABILITE DU LOCATAIRE POUR TOUTS DOMMAGES CAUSES AU VEHICULE LOUE EST LIMITEE A (PARE-BRISE INCLUS) MAIS NONOBTANT LE PAIEMENT DE CETTE SOMME, LE LOCATAIRE SERA ENTIEREMENT RESPONSABLE POUR TOUT DOMMAGE DU A UNE COLLISION SI LE VEHICULE EST EMPLOYE, MIS EN SERVICE OU CONDUIT EN CONTRAVENTION DE QUELQUE DISPOSITION DE CE CONTRAT OU EN DEHORS DE ROUTES OU VOIES PUBLIQUES ENTRETENUES PAR LE GOUVERNEMENT FEDERAL, PROVINCIAUX OU MUNICIPAUX, ET POUR TOUT DOMMAGE CAUSE AU VEHICULE RESULTANT D'UNE COLLISION CONTRE UNE SUPERSTRUCTURE, INCLUANT TUNNELS, PONTS ET BRANCHES D'ARBRES. | | 41 GASOLINE ESSENCE <i>Extra</i> |
| P.S.T. APPLICABLE ON C.D.W. IN QUEBEC AND SASKATCHEWAN ONLY - T.V.P. APPLICABLE AU QUÉBEC ET SASKATCHEWAN. | | | | 42 CDW EDC <i>Per Month @ 45.00</i> |

| | | |
|--|---|--|
| 18 PERSONAL ACCIDENT INSURANCE (PAI) - ASSURANCE-ACCIDENT PERSONNELLE (AAP) | INITIAL ONE INITIALISEZ UNE CASE | 43 PAI AAP @ |
| CUSTOMER ACCEPTS OR DECLINES PAI AT RATE SHOWN IN SEPARATE BROCHURE. ACCEPTANCE IS PROOF OF COVERAGE UNDER POLICY ISSUED TO LESSOR AS OUTLINED ON SEPARATE BROCHURE. | ACCEPTS PAI ACCPETE AAP <input type="checkbox"/> | 44 OTHER AUTRES |
| LE LOCATAIRE ACCEPTE OU REFUSE AAP AUX FRAIS APPARAISANT DANS LA BROCHURE SEPARÉE. LE CONSENTEMENT EST LA PREUVE DE COUVERTURE SOUS LA POLICE ÉMISE AU LOCATEUR COMME INDIQUÉ SUR LA BROCHURE SEPARÉE. | DECLINES PAI REFUSE AAP <input type="checkbox"/> | 45 TOTAL CHARGES COÛT TOTAL <i>920.00</i> |
| P.S.T. APPLICABLE IN QUEBEC AND SASKATCHEWAN ONLY - T.V.P. APPLICABLE AU QUÉBEC ET SASKATCHEWAN. | | 46 DEPOSITS DÉPÔTS \$ |
| 19 CUSTOMER AUTHORIZES LESSOR TO PROCESS A CREDIT CARD VOUCHER, IF ANY, IN HIS NAME FOR CHARGES HEREUNDER. | LE LOCATAIRE AUTORISE LE LOCATEUR À ÉMETTRE UN TALON DE CARTE DE CRÉDIT, S'IL Y A LIEU, EN SON NOM POUR LES FRAIS CI-DESSOUS. | 47 LESS CREDITS À CRÉDITER |
| I HAVE READ THE TERMS & CONDITIONS ON PAGE ONE (OTHER SIDE) AND PAGE 2 OF THIS RENTAL AGREEMENT AND AGREE THERETO. | J'AI PRIS CONNAISSANCE DES CLAUSES ET CONDITIONS DE LA PAGE 1 (REVERS) ET DE LA PAGE 2 DE CE CONTRAT DE LOCATION ET JE L'ACCEPTÉ. | 48 BALANCE DUE SOLDE DÛ <i>920.00</i> |
| 20 HOME ADDRESS ADRESSE DOMICILE | | 49 CASH REFUND - REMBOURSEMENT COMPTANT |
| 21 CITY VILLE | | AMOUNT - MONTANT |
| 22 LOCAL ADDRESS ADRESSE LOCALE | | 23 TEL. NO. |
| 24 | | I ACKNOWLEDGE RECEIPT OF ABOVE AMOUNT J'ACCUSE RECEPTION DU MONTANT CI-HAUT MENTIONNÉ. |

| | | | |
|----------------------------------|--|--|--|
| 20 HOME ADDRESS ADRESSE DOMICILE | | RATES DO NOT INCLUDE GASOLINE TARIFS NE COMPRENNENT PAS L'ESSENCE. | |
| 21 CITY VILLE | | RENTAL AGREEMENT CLOSED SUBJECT TO AUDIT. | |
| 22 LOCAL ADDRESS ADRESSE LOCALE | | CONTRAT DE LOCATION EST CONCLU SAUF VÉRIFICATION FIN D'EXERCICE. | |
| 23 TEL. NO. | | NET DUE - NET DÛ | |
| 24 | | 89-41449 | |

50 CUSTOMER IS LIABLE FOR ALL PARKING AND TRAFFIC VIOLATIONS LOCATAIRE RESPONSABLE POUR TOUTES CONTRAVENTIONS DE STATIONNEMENT OU DE CIRCULATION

DETACH HERE / DÉTACHER ICI

DETACH AND RETURN THIS PORTION WITH YOUR REMITTANCE TO: / DÉTACHER ET RETOURNER CE COUPON AVEC VOTRE REMISE À:

NET DUE - NET DÛ

89-41449

HELICOPTER TIME

TRANS NORTH TURBO AIR receipts

| | | |
|-----------------|---|----------|
| INVOICE # 45371 | = | \$442.75 |
| " # 44596 | = | \$128.60 |
| " #45395 | = | \$241.50 |
| " #44884 | = | \$129.00 |
| " #42270 | = | \$129.00 |
| " #49217 | = | \$171.61 |
| " #54741 | = | \$175.36 |
| " #49375 | = | \$259.80 |
| " #54746 | = | \$ 88.00 |

~~\$1765.62~~
\$1765.62

Clark Askey

45371

INVOICE DATE

AREA
B.C.
YUKON
NWT
ALTA.

CHARTERER

Box 115 - Dawson City

A/C TYPE

AIRCRAFT REGISTRATION C-

Bell 206B FFFF

NG ADDRESS

Yukon, Job 160.

FLIGHT DATE

DAY MONTH YEAR
19 03 80

PURCHASE ORDER NO.

FUEL & OIL-X
TNTA CUST.

TNTA FUEL USED

HRS.-GALS.

FROM

✓ JPY 1.1 hrs DA.

| FROM | MILES | HOURS | ZONE | REMARKS - NO. OF PASS - FREIGHT LBS. |
|----------------------|-------|------------|------|--------------------------------------|
| <i>DAWSON CITY</i> | | | | |
| <i>TO Hepine CK.</i> | | | | <i>Sub-out</i> |
| <i>(2 TRIPS)</i> | | | | <i>LINE CUTTERS</i> |
| <i>RET. DAWSON.</i> | | <i>1.1</i> | | <i>PICK-UPS.</i> |

| SUB | G.L. | AMOUNT |
|-----|------|--------|
| | | |
| | | |
| | | |
| | | |
| | | |

1.1 @ 375⁰⁰ 412 50

TERMS: EIGHTEEN PERCENT INTEREST PER ANNUM WILL BE CHARGED ON ALL INVOICES NOT PAID WITHIN 30 DAYS OF DATE ISSUED.

| | | | |
|------------------------|---|-------------------|--------------|
| WAITING TIME | @ | /HR. | |
| FUEL: <i>24.2 gal.</i> | @ | <i>1.25</i> /GAL. | <i>30 25</i> |
| FUEL: | @ | /GAL. | |
| MEALS & LODGING | | | |
| OTHER | | | |
| OTHER | | | |

Clark Askey
CHARTERER'S SIGNATURE

[Signature]
PILOT'S SIGNATURE

[Signature]
ENGINEER'S NAME

Paid by Travel Express REC

TOTAL \$ *442.75*

FLIGHT REPORT

INVOICE



TRANS NORTH TURBO AIR LTD.
 BOX 4338, WHITEHORSE, YUKON Y1A 3T6

TELEPHONE (403)668-2177 • TELEX 036-8-290

Ashley Exploration
 CHARTERER

BILLING ADDRESS

| | | | | |
|--------------------|-----|-------------------------|------|--------------------------------|
| ACCOUNT NUMBER | | | | |
| 44596 | | | | |
| INVOICE DATE | | | | AREA |
| | | | | B.C. <input type="checkbox"/> |
| | | | | YUKON <input type="checkbox"/> |
| | | | | NWT <input type="checkbox"/> |
| | | | | ALTA. <input type="checkbox"/> |
| A/C TYPE | | AIRCRAFT REGISTRATION C | | |
| Bell 206B | | GT NA | | |
| FLIGHT DATE | DAY | MONTH | YEAR | |
| | 27 | 06 | 80 | |
| PURCHASE ORDER NO. | | | | |

| | | | |
|--------------|----------------|------------|------|
| FUEL & OIL-X | TNTA FUEL USED | HRS.-GALS. | FROM |
| TNTA CUST. | | 03 | DA |

| FROM | MILES | HOURS | ZONE | REMARKS - NO. OF PASS - FREIGHT LBS. |
|---------------|-------|-------|------|--------------------------------------|
| Dawson | | | | |
| TO Bradley Cr | | 03 | | Pick up 2 pass |
| Dawson | | | | Clark Ashley |
| | | 03 | | |

| SUB | G.L. | AMOUNT |
|-----|------|--------|
| | | |
| | | |
| | | |
| | | |
| | | |
| | | |
| | | |

| | | | | |
|----|---|-----|-----|----|
| 03 | @ | 400 | 120 | 00 |
| | @ | | | |
| | @ | | | |
| | @ | | | |

TERMS: EIGHTEEN PERCENT INTEREST PER ANNUM WILL BE CHARGED ON ALL INVOICES NOT PAID WITHIN 30 DAYS OF DATE ISSUED.

| | | | | |
|-----------------|---|-----------|---|----|
| WAITING TIME | @ | /HR. | | |
| FUEL: 6.6 | @ | 130 /GAL. | 8 | 60 |
| FUEL: | @ | /GAL. | | |
| MEALS & LODGING | | | | |
| OTHER | | | | |
| OTHER | | | | |

[Signature]
 CHARTERER'S SIGNATURE

[Signature]
 PILOT'S SIGNATURE

RS / RBW
 ENGINEER'S NAME

PAID by check RS

| | | |
|-------|--------|----|
| TOTAL | \$ 128 | 60 |
|-------|--------|----|

45395

CLARK ASHLEY
CHARTERER

INVOICE DATE

AUTO
P. FROM
NWT
ALTA

BILLING ADDRESS

A/C TYPE: Bell 206B
AIRCRAFT REGISTRATION C: FKEE
FLIGHT DATE: DAY 05, MONTH 04, YEAR 80
PURCHASE ORDER NO.

FUEL & OIL: TMTA FUEL USED: JPT, HRS.-GALS.: .6 hrs., FROM: DA.

| FROM | MILES | HOURS | ZONE | REMARKS - NO. OF PASS - FREIGHT LBS. |
|---------------|-------|-------|------|--------------------------------------|
| DAWSON CITY | | | | |
| TO BRADLEY CK | | | | SRT-OUTS |
| LEPINE CK | | | | |
| (2 TRIPS) | | | | PICK-UPS. |
| RTN. DAWSON. | | .6 | | |

| SUB | G.L. | AMOUNT |
|-----|------|--------|
| | | |
| | | |
| | | |
| | | |

| | | |
|----|----------|--------|
| .6 | @ 375.00 | 225.00 |
| | | |
| | | |
| | | |
| | | |

TERMS: EIGHTEEN PERCENT INTEREST PER ANNUM WILL BE CHARGED ON ALL INVOICES NOT PAID WITHIN 30 DAYS OF DATE ISSUED.

WAITING TIME @ /HR.

FUEL: 13.2 gal @ 1.25 /GAL. 16 50

FUEL: @ /GAL.

MEALS & LODGING

OTHER

OTHER

Ch Ashley
CHARTERER'S SIGNATURE

Paul Webb
PILOT'S SIGNATURE

WATT
ENGINEER'S NAME

PAID by check Recd. TOTAL \$ 241.50

FLIGHT REPORT

INVOICE

T

TELEPHONE 14031668 2177 • TELEX 036 8 290

44884

CLARK ASHLEY
CHARTERER

INVOICE DATE

AREA
B.C.
N.W.
ALTA

A/C TYPE

AIRCRAFT REGISTRATION

Hughes-500 GTNK

FLIGHT DATE
DAY MONTH YEAR
19 05 80

PURCHASE ORDER NO.

NG ADDRESS

FUEL & OIL-TNTA FUEL USED HRS.-GALS. FROM
TNTA CUST. JPY .3hr. DA.

| FROM | MILES | HOURS | ZONE | REMARKS - NO. OF PASS - FREIGHT LBS. |
|------------------|-------|-------|------|--------------------------------------|
| DAWSON CITY | | | | |
| TO BRADLEY CREEK | | | | SET-OUT |
| (2 TRIPS) | | | | Pick-up. |
| RTN. DAWSON. | | .3 | | |

| SUB | G.L. | AMOUNT |
|-----|------|--------|
| | | |
| | | |
| | | |
| | | |

| | | |
|----|---------------------|-------|
| .3 | @ 400 ⁰⁰ | 120 - |
| | @ | |
| | @ | |
| | @ | |

TERMS: EIGHTEEN PERCENT INTEREST PER ANNUM WILL BE CHARGED ON ALL INVOICES NOT PAID WITHIN 30 DAYS OF DATE ISSUED.

| | | | |
|-----------------|--------|-------|-----|
| WAITING TIME | @ | /HR. | |
| FUEL: 7.2gal | @ 1.25 | /GAL. | 9 - |
| FUEL: | @ | /GAL. | |
| MEALS & LODGING | | | |
| OTHER | | | |
| OTHER | | | |

J. MacKenzie
CHARTERER'S SIGNATURE
Paul Watt
PILOT'S SIGNATURE

WATT RBW
ENGINEER'S NAME

MacKenzie #406

pdg by checks

TOTAL \$ 129 -

FLIGHT REPORT
INVOICE

△

Clark Ashley
CHARTERER

42270

| | | | | |
|--------------|--|--|--|-------|
| INVOICE DATE | | | | AREA |
| | | | | B.C. |
| | | | | YUKON |
| | | | | NWT |
| | | | | ALTA. |

BILLING ADDRESS

| | | | |
|-------------|--------------------------|-------|------|
| A/C TYPE | AIRCRAFT REGISTRATION C- | | |
| Bell 206B | GTNE | | |
| FLIGHT DATE | DAY | MONTH | YEAR |
| | 27 | 05 | 80 |

| | | | |
|--------------|----------------|------------|------|
| FUEL & OIL-X | TNTA FUEL USED | HRS.-GALS. | FROM |
| TNTA CUST. | JP4 | .3 hr. | DA. |

| | | | |
|--------------------|--|--|--|
| PURCHASE ORDER NO. | | | |
|--------------------|--|--|--|

| FROM | MILES | HOURS | ZONE | REMARKS - NO. OF PASS - FREIGHT LBS. |
|---|-------|-------|------|---|
| DAWSON CITY BRADLEY CR RTN: DAWSON. | | .3 | | Pick-up JOHN LOTTER, JOAN MacKenzie CLARK Ashley BASIC BRYANT |
| | | | | |
| | | | | |
| | | | | |
| | | | | |
| | | | | |
| | | | | |
| | | | | |
| | | | | |
| | | | | |

| SUB | G.L. | AMOUNT |
|-----|------|--------|
| | | |
| | | |
| | | |
| | | |

| | | | |
|----|-------|-----|---|
| .3 | @ 400 | 120 | - |
| | @ | | |
| | @ | | |
| | @ | | |
| | @ | | |

TERMS: EIGHTEEN PERCENT INTEREST PER ANNUM WILL BE CHARGED ON ALL INVOICES NOT PAID WITHIN 30 DAYS OF DATE ISSUED.

| | | | |
|-----------------|---------|--------------|-----|
| WAITING TIME | @ | /HR. | |
| FUEL: | 7.2 gal | @ 1.25 /GAL. | 9 - |
| FUEL: | @ | /GAL. | |
| MEALS & LODGING | | | |
| OTHER | | | |
| OTHER | | | |

J. MacKenzie
CHARTERER'S SIGNATURE
Paul Wall
PILOT'S SIGNATURE

Watt RBW
ENGINEER'S NAME
MacKenzie #406

Paul Wall RBW
TOTAL \$ 129 -
FLIGHT REPORT INVOICE

Ashley Exploration
CHARTERER

Box 70 Dawson
BILLING ADDRESS

49217

INVOICE DATE

10 | 07 | 80

AREA
D.C.
YUKON
NWT
ALTA.

A/C TYPE

Belboob

AIRCRAFT REGISTRATION C

GTN

FLIGHT DATE

DAY MONTH YEAR
25 | 06 | 80

PURCHASE ORDER NO.

| FUEL & OIL-X | | TNTA FUEL USED | HRS.-GALS. | FROM |
|-------------------------------------|-------|----------------|------------|------|
| TNTA | CUST. | | 04 | DA |
| <input checked="" type="checkbox"/> | | | | |

FROM
Dawson
TO
Bradley Cr
Dawson

| MILES | HOURS | ZONE | REMARKS - NO. OF PASS - FREIGHT LBS. |
|-------|-------|------|--------------------------------------|
| | 0.2 | | 3 pass |
| | 0.2 | | Clark Ashley |
| | 0.4 | | |

| SUB | G.L. | AMOUNT |
|---------|------|--------|
| 8075020 | | 160 00 |
| 8075110 | | 11 61 |

| | |
|-----------|--------|
| 0.4 @ 400 | 160 00 |
| @ | |
| @ | |
| @ | |

TERMS: EIGHTEEN PERCENT INTEREST PER ANNUM WILL BE CHARGED ON ALL INVOICES NOT PAID WITHIN 30 DAYS OF DATE ISSUED.

| | | | |
|-----------------|-----------------|-------|-------|
| WAITING TIME | @ | /HR. | |
| FUEL: | 9 @ 1.29 / GAL. | | 11 61 |
| FUEL: | @ | /GAL. | |
| MEALS & LODGING | | | |
| OTHER | | | |
| OTHER | | | |

[Signature]
CHARTERER'S SIGNATURE

[Signature]
PILOT'S SIGNATURE

BC: / RBCL
ENGINEER'S NAME

TOTAL \$ 171 61

FLIGHT REPORT
INVOICE

54741

Askey EXPLORATION
 CHARTERER

INVOICE DATE _____
 AREA B.C.
 YUKON
 NWT
 ALTA.

ING ADDRESS _____

A/C TYPE *Hughes 500* AIRCRAFT REGISTRATION C *GT N 14*

FLIGHT DATE DAY MONTH YEAR
16 11 80

| | | | |
|-------------------------------------|----------------|--------------|------------|
| FUEL & OIL-X | TNTA FUEL USED | HRS.-GALS. | FROM |
| TNTA CUST. | | | |
| <input checked="" type="checkbox"/> | <i>IPK</i> | <i>.4 hr</i> | <i>2A.</i> |

PURCHASE ORDER NO. _____

| FROM | TO | MILES | HOURS | ZONE | REMARKS - NO. OF PASS. - FREIGHT LBS. |
|---------------------|---------------------|-------|-----------|------|--|
| <i> Dawson City</i> | <i> Branley Cr</i> | | <i>.4</i> | | <i> TWO MEN; BEAR OUT TO PROPERTY. Pick-up clock at 3:00 pm.</i> |
| | <i> (2 TRIPS)</i> | | | | |
| | <i> For Dawson.</i> | | | | |

| SUB | G.L. | AMOUNT |
|-----|------|--------|
| | | |
| | | |
| | | |
| | | |

| | | | |
|-----------|---|---------------|---------------|
| <i>.4</i> | @ | <i>400.00</i> | <i>160.00</i> |
| | @ | | |
| | @ | | |
| | @ | | |

TERMS: NET 30 DAYS
 1.75% INTEREST PER MONTH (21% PER ANNUM)
 WILL BE CHARGED ON ALL OUTSTANDING
 AMOUNTS OVER 30 DAYS

WAITING TIME @ /HR.

FUEL: *9.6 gal* @ *1.60* /GAL. *15 36*

FUEL: @ /GAL.

X *[Signature]*
 CHARTERER'S SIGNATURE

RBW *Real*
 INITIALS PILOT'S NAME

MEALS & LODGING

OTHER

RBW *WATT*
 INITIALS ENGINEER'S NAME

OTHER

FLIGHT ATTENDANT

OTHER

*Paid by
 check*

TOTAL \$ *175 36*

FLIGHT REPORT
 INVOICE

49375

INVOICE DATE

29/08/80

AREA
B.C.
YUKON
N.W.T.
ALTA

A/C TYPE

Bell 206B

AIRCRAFT REGISTRATION C

ETNG

FLIGHT DATE

| DAY | MONTH | YEAR |
|-----|-------|------|
| 18 | 08 | 80 |

PURCHASE ORDER NO.

Ashley Exploration

CHARTERER

BILLING ADDRESS

| FUEL & OIL-X | TNTA FUEL USED | HRS.-GALS. | FROM |
|-------------------------------------|----------------|------------|------|
| TNTA CUST. | | | |
| <input checked="" type="checkbox"/> | | .6 | DA |

| FROM | MILES | HOURS | ZONE | REMARKS - NO. OF PASS. | FREIGHT LBS. |
|------------------|-------|-----------|------|------------------------|--------------|
| Dawson | | | | | |
| TO Bradley Cr | | | | | |
| Dawson | | .3 | | | |
| Bradley Cr | | | | | |
| Dawson | | .3 | | | |
| | | <u>.6</u> | | | |

(Handwritten signature/initials)

| SUB | G.L. | AMOUNT |
|---------|------|--------|
| 8075020 | | 240 00 |
| 8075110 | | 19 80 |

| | | | |
|----|---------------------|-----|----|
| .6 | @ 400 ⁰⁰ | 240 | 00 |
|----|---------------------|-----|----|

TERMS: EIGHTEEN PERCENT INTEREST PER ANNUM WILL BE CHARGED ON ALL INVOICES NOT PAID WITHIN 30 DAYS OF DATE ISSUED.

| | | | | |
|-----------------|-------|-------|----|----|
| WAITING TIME | @ | /HR. | | |
| FUEL: 13-2 | @ 150 | /GAL. | 19 | 80 |
| FUEL: | @ | /GAL. | | |
| MEALS & LODGING | | | | |
| OTHER | | | | |
| OTHER | | | | |

(Handwritten signature)
 CHARTERER'S SIGNATURE

(Handwritten signature)
 PILOT'S SIGNATURE

(Handwritten signature)
 ENGINEER'S NAME

TOTAL \$ 259 80

FLIGHT REPORT
 CUSTOMER COPY

54746

Ashley EXPLORATION
 CHARTERER

| | | | | |
|-----------------------------|-----------|--|-----------|---|
| INVOICE DATE | | | | AREA B.C. <input type="checkbox"/> YUKON <input type="checkbox"/> NWT <input type="checkbox"/> ALTA. <input type="checkbox"/> |
| A/C TYPE <i>Heughson</i> | | AIRCRAFT REGISTRATION C <i>GTNM</i> | | |
| FLIGHT DATE | DAY | MONTH | YEAR | |
| | <i>20</i> | <i>11</i> | <i>80</i> | |
| PURCHASE ORDER NO. | | | | |

ING ADDRESS

| | | | |
|----------------------------|------------------------------|----------------------------|--------------------|
| FUEL & OIL-X TNTA CUST. | TNTA FUEL USED <i>JP4</i> | HRS.-GALS. <i>.2 hr</i> | FROM <i>DA.</i> |
|----------------------------|------------------------------|----------------------------|--------------------|

| FROM | MILES | HOURS | ZONE | REMARKS - NO. OF PASS - FREIGHT LBS. |
|----------------------|-------|-----------|------|--------------------------------------|
| <i>DAWSON CITY</i> | | | | |
| <i>BRADLEY CK.</i> | | | | <i>Pick-up GEAR.</i> |
| <i>Road, Dawson.</i> | | <i>.2</i> | | |

| SUB | G.L. | AMOUNT |
|-----|------|--------|
| | | |
| | | |
| | | |
| | | |

| | | | |
|-----------|---|---------------|--------------|
| <i>.2</i> | @ | <i>400.00</i> | <i>80.00</i> |
| | @ | | |
| | @ | | |
| | @ | | |

TERMS: NET 30 DAYS
 1.75% INTEREST PER MONTH (21% PER ANNUM)
 WILL BE CHARGED ON ALL OUTSTANDING
 AMOUNTS OVER 30 DAYS

X *[Signature]*
 CHARTERER'S SIGNATURE

RBW *[Signature]*
 INITIALS PILOT'S SIGNATURE

RBW *WATT*
 INITIALS CO-PILOT'S NAME

RBW *WATT*
 INITIALS ENGINEER'S NAME

INITIALS FLIGHT ATTENDANT

WAITING TIME @ /HR.

FUEL: *4.5 gal.* @ /GAL. *8.00*

FUEL: @ /GAL.

MEALS & LODGING

OTHER

OTHER

PAID by check

TOTAL \$ *88.00*

FLIGHT REPORT
 INVOICE

EQUIPMENT PURCHASES - - Amortized @30%

PUNJAR DRILL

PURCHASED FROM KEENOCKS PLACER MINES LTD.

CHECK #422 = \$4189.52

MINERAL LIGHT

PURCHASED FROM KEENOCKS PLACER MINES LTD.

CHECK #110 = \$ 173.36

V.L.F. 440 DETECTOR

PURCHASED FROM FALL CONSTRUCTION

CHECK #382 = \$1000.00

TOTAL EQUIPMENT PURCHASES = \$5362.88

\$5362.88 AMORTIZED @ 30% = \$1608.86

DEAKIN EQUIPMENT LTD.

831 POWELL STREET, VANCOUVER, B.C. V6A 1H7
 TELEPHONE: 253-2685

36433

INVOICE NUMBER

No 38884

INVOICE

SOLD TO Keenockx Placer Trained Ltd
 % Linda Seely
 71 Alsek St.
 Whitehorse Y.T.

SHIP TO phone 667 7565
 SAME

| | | | | | |
|---|---------------------------|--|--------------------------------|--------------------------|----------------------------|
| SHIPPING AND INVOICE DATE JUNE 25/80 | SHIPPED VIA L.P.R. Fax | PPD. COLL. CHG. <input type="checkbox"/> <input checked="" type="checkbox"/> <input type="checkbox"/> | TERMS: 1% 10 DAYS NET 30 | YOUR ORDER NO. ploned | DATE ORDERED June 23/80 |
|---|---------------------------|--|--------------------------------|--------------------------|----------------------------|

| QTY. B.O. | QTY. ORDERED | DESCRIPTION | QTY. SHIPPED | UNIT PRICE | AMOUNT |
|-----------|--------------|--------------------------|--------------|------------|--------|
| | 2 | only MS 47 miners lights | 2 | 132.00 | 264.00 |
| | 2 | - tubes for MS 47 | 2 | 16.95 | 33.90 |
| | 4 | - E 409 batteries | 4 | 5.83 | 23.32 |
| | | | | | 321.22 |
| | | | 1/2 | | 160.61 |
| | | | | | 12.95 |
| | | | AIR | | 73.36 |
| | | | | | 321.22 |
| | | | | | 50.00 |
| | | | | | 271.22 |

paid in full

TOTAL 20.56
 white 50.00

AIRBILL #018-65263096F

| | | | |
|---|-----------------|---|----------------------|
| GENERAL TAX INCL. <input type="checkbox"/> EXCL. <input checked="" type="checkbox"/> | FEDERAL TAX NO. | PROVINCIAL TAX NO. <i>out of prov.</i> | TOTAL 321.22 |
| | | | PROV. TAX - |
| | | | FREIGHT/POST. - |
| | | | AMOUNT DUE 321.22 |

BONDAR-CLEGG & CO. LTD.

ASSAY RESULT COSTS

INVOICE # D 1461 = \$175.00

" # D 1746 = \$ 29.75

TOTAL COST OF ASSAY'S ± \$ 204.75



BONDAR-CLEGG & COMPANY LTD.

764 BELFAST ROAD, OTTAWA, ONTARIO, K1G 0Z5 PHONE: 237-3110 TELEX: 053-3548

**Chevron Self Service Center
Dawson City, Yukon**

ATTENTION: Clarke Ashley

INVOICE: **D 1461**

DATE: **August 7, 1980**

REPORT NO: **40 - 197**

PROJECT:

| | | | |
|----------|--|-----------------|------------------------|
| 7 | 32 Element Semi-Quantitative Analyses | @\$25.00 | <u>\$175.00</u> |
|----------|--|-----------------|------------------------|

| | |
|---------------|-------------------------------|
| TOTAL: | <u><u>\$175.00</u></u> |
|---------------|-------------------------------|

BONDAR-CLEGG & COMPANY LTD.

764 BELFAST ROAD, OTTAWA, ONTARIO, K1G 0Z5 PHONE: 237-3110 TELEX: 053-3548

Chevron Self Service Centre
Dawson City, Yukon

ATTENTION: Clarke Ashley

INVOICE: **D 1746**

DATE: **September 11, 1980**

REPORT NO: **40 - 197**

PROJECT:

7
DEC 6

Analyses of Gold

@\$4.25

\$29.75

TOTAL:

\$29.75

MISC. EXPENSES

MAPS

| | | | |
|------------------|-------------------------|-----------|---------|
| YUKON GALLERY | - #2124 | = \$22.50 | |
| " " | - #2006 | = \$17.50 | |
| CAN. MAP OFFICE | - #4537 | = \$17.50 | |
| MINING RECORDERS | - #D-54022 | = \$3.00 | |
| " " | - #D-54250 | = \$3.00 | |
| | TOTAL OF MAPS PURCHASED | = | \$63.50 |

FLAGGING

| | | | |
|-----------|------------|------------|--|
| HORWOOD'S | INV.#12792 | = \$220.80 | |
|-----------|------------|------------|--|

MARKING PAINT

| | | | |
|------------------|-----------|---|---------|
| NORTHERN METALIC | INV.#1861 | = | \$76.70 |
|------------------|-----------|---|---------|

BATTERIES FOR V.L.F. UNIT

| | | | |
|-------------|-------------|---|---------|
| MONTE CARLO | INV.# 14975 | = | \$38.88 |
|-------------|-------------|---|---------|

| | | | |
|----------------------|---|-----------------|--|
| TOTAL MISC. EXPENSES | = | <u>\$399.88</u> | |
|----------------------|---|-----------------|--|

IDA MAP OFFICE
200 RANGE ROAD
WHITEHORSE, YUKON



RECEIPT
No 4537

General Receipt

| | | | |
|----------------------------------|---|-------------|-------------------------|
| DATE 8 Jan 81 | NATURE AND NUMBER OF REMITTANCE Cash | INVOICE NO. | LOCATION Dawson |
| RECEIVED THE SUM OF Seventeen | FOR 1150,000 topo | | 50,100 DOLLARS \$ 17.50 |
| FROM Clarke Ashley | | | |

Clarke Ashley
AUTHORIZED OFFICER

Yukon Gallery

203 Main Street, Whitehorse, Yukon, Canada
667-2391 Y1A 2B2

NAME: Ashley Exploration DATE: Feb 7 19 81
ADDRESS: _____

| QUANTITY | DESCRIPTION | AMOUNT |
|--|-----------------------------------|-----------------------------------|
| 7 | Maps @ 2.50 | 17.50 |
| Pd in Full thanks. | | |
| RECEIVED IN GOOD ORDER BY | | TAX |
| <i>Clarke Ashley</i> | | TOTAL 17.50 |
| <input checked="" type="checkbox"/> CASH | <input type="checkbox"/> C.O.D. | <input type="checkbox"/> CHARGE |
| <input type="checkbox"/> ON ACCT. | <input type="checkbox"/> M. RETD. | <input type="checkbox"/> PAID OUT |

rinx 47

Arctic Star Printing Inc.

2006

Yukon Gallery

203 Main Street, Whitehorse, Yukon, Canada
667-2391 Y1A 2B2

NAME: C. Ashley DATE: March 3 19 81
ADDRESS: _____

| QUANTITY | DESCRIPTION | AMOUNT |
|--|-----------------------------------|-----------------------------------|
| 9 | Maps @ 2.50 | |
| Pd in Full thanks. | | |
| RECEIVED IN GOOD ORDER BY | | TAX |
| <i>Clarke Ashley</i> | | TOTAL 22.50 |
| <input checked="" type="checkbox"/> CASH | <input type="checkbox"/> C.O.D. | <input type="checkbox"/> CHARGE |
| <input type="checkbox"/> ON ACCT. | <input type="checkbox"/> M. RETD. | <input type="checkbox"/> PAID OUT |

Arctic Star Printing

2124

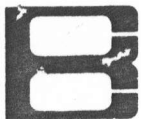

Geochemical Lab Report

FROM: Chevron Self Service Centre

REPORT NUMBER: 40 - 197

PROJECT: _____

DATE: September 11, 1980

| SAMPLE NUMBERS | Au ppb | | | | | | | | |
|----------------|-----------|--|--|--|--|--|--|--|--|
| SNAFU 1 | L5 | | | | | | | | |
| SH OC 3B | L5 | | | | | | | | |
| 3A | L5 | | | | | | | | |
| SH OC 2 | L5 | | | | | | | | |
| 1 | L5 | | | | | | | | |
| BR OC 4 | L5 | | | | | | | | |
| 2 | L5 | | | | | | | | |

L denotes less than

