



NEW IMPERIAL MINES LIMITED  
MINING DIVISION - WHITEHORSE  
YUKON TERRITORY

PROPERTY <u>Cowley Park</u>	Claim No. _____	Strike _____	Lat. _____	Hole No. <u>C.P. # 51</u>
Date <u>Aug 11</u> 19 <u>70</u>	Section No. _____	Dip _____	Dep. _____	Total Depth <u>1480 ft</u>
Logged By <u>D.V. Percival</u>	Plan No. _____	Level <u>Surface</u>	Elev. _____	Page No. <u>2 of 5</u>

FOOTAGE		ROCK CLASSIFICATION EPID. DIOP. GARN. SERP. QTZ/SIL. ACTINO. TREMO. CHLO. CRYSTALLINE. SHEARING. VEINS. FRACTURING. FOLIATION. GRAIN SIZE. TEXTURE	MINERALIZATION		ASSAY DATA							
From	To		TYPE	%	SAMPLE NO.	WIDTH	RECOV.	%CU	%FE	MOLY	AU/AG	INSOL.
63.0	87.1	3/2 <sup>gr</sup> Slightly mineralized Garnet/Diopside/Tremolite Skarn lt. straw brown to mottled red-brown and green, malachite stain scattered along fracture planes, a few Bo stringers at 65-67 Samples 63.0 - 68.0 68.0 - 73.0 73.0 - 78.0 78.0 - 83.0 83.0 - 87.1			2373	5.0	5.0	0.12		.037		
					2374	5.0	4.8	0.10		.015		
					2375	5.0	4.8	0.10		.009		
					2376	5.0	5.0	0.08		.007		
					2377	4.1	3.8	0.08		.045		
87.1	99.1	1/2 <sup>gr</sup> Mineralized Garnet/Diopside/Magnetite Skarn with epidote Brown to green mottled with some lt. green & some black patches 87.1-90 banded garnet along thin qtz veinlets @ 85° to core axis, specks of MnS <sub>2</sub> 90-94 Higher in magnetite than rest of section 20% magnetite, f.g. disc. Cpx & Bo 94-99 Heavy garnet skarn brown scattered Cpx. Samples 87.1 - 90.0 90.0 - 94.0 94.0 - 99.1			2378	2.9	2.9	0.58		.200		
					2379	4.0	4.0	2.02		.469		
					2380	5.1	5.1	1.75		.450		

NEW IMPERIAL MINES LIMITED  
MINING DIVISION - WHITEHORSE  
YUKON TERRITORY

PROPERTY <u>Cowley Park</u>	Claim No. _____	Strike _____	Lat. _____	Hole No. <u>C.P. 51</u>
Date <u>Aug 12</u> 19 <u>70</u>	Section No. _____	Dip _____	Dep. _____	Total Depth <u>1430 ft.</u>
Logged By <u>D.W. Percival</u>	Plan No. _____	Level <u>Surface</u>	Elev. _____	Page No. <u>9 of 5</u>

FOOTAGE		ROCK CLASSIFICATION EPID. DIOP. GARN. SERP. QTZ/SIL. ACTINO. TREMO. CHLO. CRYSTALLINE, SHEARING, VEINS, FRACTURING, FOLIATION, GRAIN SIZE, TEXTURE	MINERALIZATION		ASSAY DATA							
From	To		TYPE	%	SAMPLE NO.	WIDTH	RECOV.	%CU	%FE	MOLY	AU/AG	INSOL.
99.1	105.0	9 <sup>b</sup> Basic Dike Black, fine, uniform, macrocryst, calcite clear fillings, clear @ 200 to core axis										
105.0	120.5	12 <sup>ad</sup> Monotite/Diopside/Epilote Skarn Highly siliceous with large patches of milky quartz containing blebs of MnS <sub>2</sub> Considerable MnS <sub>2</sub> ~ 8% Beginning of section brecciated & broken core hi in macrocryst with garnet and disc 1% Barite & 1% Op. 105.0 - 107.5; High garnet/diopside & epilote 116.0 - 120.5 with <del>low</del> almost no quartz and no MnS <sub>2</sub>										
		Sample 105.0 - 110.0			2381	5.0	4.2	2.40		.267		
		110.0 - 116.5			2382	6.5	6.5	0.65		2.04		
		116.5 - 120.5			2383	4.0	4.0	0.36		.067		
		411 9 <sup>b</sup> Dike @ 109.6 - 110.0										
		120.5 - 130.5			2242	10		.14				









NEW IMPERIAL MINES LIMITED  
MINING DIVISION - WHITEHORSE  
YUKON TERRITORY

PROPERTY <u>Cowley Park</u>	Claim No. _____	Strike _____	Lot. <u>5,035 N</u>	Hole No. <u>02 53</u>
Date <u>Aug 17</u> 19 <u>70</u>	Section No. _____	Dip <u>45°30' N (49° 15' E)</u>	Dep. <u>3,100 F</u>	Total Depth <u>1571 Ft.</u>
Logged By <u>P.W. Percival</u>	Plan No. _____	Level <u>Surface</u>	Elev. <u>2496.7</u>	Page No. <u>1 of 6</u>

FOOTAGE		ROCK CLASSIFICATION EPID. DIOP. GARN. SERP. QTZ/SIL. ACTINO. TREMO. CHLO. CRYSTALLINE. SHEARING. VEINS. FRACTURING. FOLIATION. GRAIN SIZE, TEXTURE	MINERALIZATION		ASSAY DATA							
From	To		TYPE	%	SAMPLE NO.	WIDTH	RECOV.	%CU	%FE	MOLY	AU/AG	INSOL.
0	28.5	Overburden										
28.5	31.5	28 Slightly Mineralized Garnet Skarn Reddish-brown; malachite stain along fractures very light; scattered diss. fig. Cpy Sample 28.5-31.5	Cu	0.20	2384	3.0	2.4	0.70			.075	
31.5	32.2	96 Basic Dike Black to dk. grey, fig; slightly altered; non-magnetic										
32.2	40.5	89 Altered Silicified Diorite Lt. grey, highly siliceous rock fragments with corroded feldspars floating in sugary qtz, some corroded mafics as well, malachite stain lightly along fractures scattered diss. fig. Cpy & small barite lumps; poor recovery Sample 32.2-40.5	Cu	0.20	2385	8.3	4.5	1.05			.008	
40.5	43.0	39 Slightly Mineralized Garnet & Magnetite Skarn Lt. brown to red-brown with dk. red-brown hematite bands 1/4 to 1/2" wide; a few scattered Cpy & sil. aggregations Sample 40.5-43.0	Cu	0.10	2407	2.5	1.5	0.10			.042	

NEW IMPERIAL MINES LIMITED  
MINING DIVISION - WHITEHORSE  
YUKON TERRITORY

PROPERTY <u>Cowley Park</u>	Claim No. _____	Strike _____	Lat. _____	Hole No. <u>C.D. 53</u>
Date <u>Aug. 17</u> 19 <u>70</u>	Section No. _____	Dip _____	Dep. _____	Total Depth <u>1571 ft</u>
Logged By <u>D.W. Percival</u>	Plan No. _____	Level <u>Surface</u>	Elev. _____	Page No. <u>2 of 6</u>

FOOTAGE		ROCK CLASSIFICATION EPID. DIOP. GARN. SERP. QTZ/SIL. ACTINO. TREMO. CHLO. CRYSTALLINE. SHEARING. VEINS. FRACTURING. FOLIATION. GRAIN SIZE, TEXTURE	MINERALIZATION		ASSAY DATA							
From	To		TYPE	%	SAMPLE NO.	WIDTH	RECOV.	%CU	%FE	MOLY	AU/AG	INSOL.
43.0	46.0	3 <sup>a</sup> Dioritic Endoskarn to Altered Diorite m.g., subhedral corroded x-tile, purplish alteration mineral abundant, porous light malachite chain along fractures 2m banded, poor recovery, few visible sulfides Sample 430-460	Cu	0.2	2386	3.0	1.5	0.73		.020		
<del>46.0</del>	49.0	9 <sup>b</sup> Basic Dike Very Altered, fig., dk grey to black with fig. diss. Py & Epn thru-out, alteration due to absorption of diorite & skarn blocks & pieces? Cup < 0.4% Sample 460-490	Cu	0.2	2387	3.0	3.0	0.10		.015		
49.0	53.7	3 <sup>a</sup> Dioritic Endoskarn to Altered Diorite As above Sample 490-537	Cu	0.2	2388	4.7	3.3	0.43		.020		
53.7	67.2	9 <sup>b</sup> Basic Dike As above, sharp lower contact @ 45° to core axis - Samples										
					53.7 - 60.4	2389	6.7	6.7	0.70		.050	
					60.4 - 67.2	2390	6.0	6.0	0.14		.047	
67.2	69.9	1 <sup>0</sup> Magnetite Diopside Skarn Black, dense, 65-70% magnetite, f.a. diss Cup thru-out Cup ~ 30% Sample 67.2-69.9	Cu	0.8	2391	2.6	2.6	0.58		2.28		



NEW IMPERIAL MINES LIMITED  
MINING DIVISION - WHITEHORSE  
YUKON TERRITORY

PROPERTY <u>Cowley Park</u>	Claim No. _____	Strike _____	Lat. _____	Hole No. <u>C.P. 53</u>
Date <u>Aug. 18</u> 19 <u>70</u>	Section No. _____	Dip _____	Dep. _____	Total Depth <u>1571 ft.</u>
Logged By <u>P.W. Percival</u>	Plan No. _____	Level <u>Surface</u>	Elev. _____	Page No. <u>4 of 6</u>

FOOTAGE		ROCK CLASSIFICATION EPID. DIOP. GARN. SERP. QTZ/SIL. ACTINO. TREMO. CHLO. CRYSTALLINE. SHEARING. VEINS. FRACTURING. FOLIATION. GRAIN SIZE. TEXTURE	MINERALIZATION		ASSAY DATA							
From	To		TYPE	%	SAMPLE NO.	WIDTH	RECOV.	%CU	%FE	MOLY	AU/AG	INSOL
85.8	93.0	29 <sup>ds</sup> (Continued) section, coarser grained in lower portion Cpy ≈ 2.0%										
		Samples 85.8-90.0			2395	4.2	4.0	0.48		.012		
		90.0-93.0			2396	3.0	3.0	0.50		.017		
93.0	104.2	1 Massive Chalcopyrite With minor calcite, pyrite & magnetite Brassy-yellow, 1/4" Cpy blebs 93.0-96.5 then massive sulfides soft & crumbly ≈ 5% lead	Cpy	65%		3.5						
		Samples 93.0-96.5	Cu	20%	2397	3.5	3.5	4.50		.013		
		96.5-100.4			2398	3.9	3.5	18.87		TR		
		100.4-104.2			2399	3.8	3.1	21.12		TR		
104.2	111.2	3/2 <sup>+</sup> Garnet Feldspathic Skarn - Fault Gouge White to creamy lt. pink, soft & crumbly sand, leached, some remnant corroded feldspar xtals, minor quartz and some very f.g. diss. Cpy scattered thru-out Difficult to sample accurately due to caving of soft sulfides (Cpy) from above	Cpy	0.5								
		Sample 104.2-111.2	Cu	0.2	2400	7.0	4.5	0.16		.005		







NEW IMPERIAL MINES LIMITED  
MINING DIVISION - WHITEHORSE  
YUKON TERRITORY

PROPERTY <u>Coincidence Park</u>	Claim No. _____	Strike _____	Lat. _____	Hole No. <u>C.P. 54</u>
Date <u>Sept 4<sup>th</sup></u> 19 <u>30</u>	Section No. _____	Dip _____	Dep. _____	Total Depth <u>152.0 ft</u>
Logged By <u>P.W. Percival</u>	Plan No. _____	Level <u>Surface</u>	Elev. _____	Page No. <u>2 of 3</u>

FOOTAGE		ROCK CLASSIFICATION EPID. DIOP. GARN. SERP. QTZ/SIL. ACTINO. TREMO. CHLO. CRYSTALLINE. SHEARING. VEINS. FRACTURING. FOLIATION. GRAIN SIZE, TEXTURE	MINERALIZATION		ASSAY DATA							
From	To		TYPE	%	SAMPLE NO.	WIDTH	RECOV.	%CU	%FE	MOLY	AU/AG	INSOL.
57.5	121.0	30° <sup>a</sup> Barron Garnet/Epidoite Skarn As above but with increased epidote and some diopside, a few scattered bladed radiating xtd aggregations of magnetite rich band @ 113-114, a few widely scattered flecks of Cu										
121.0	125.3	90° <sup>b</sup> Basic Dike Black, aphanitic groundmass with 1/16"-1/8" feldspar laths scattered thru-out upper contact @ 30° to core axis lower @ 30°										
125.3	127.3	30° <sup>a</sup> Barron Garnet/Epidoite Skarn As above Sample 125.3-127.3			2417	2.0	2.0	0.04		.005		
127.3	140.5	80° <sup>b</sup> Dioptric Endoskarn with Mineralized Garnet Skarn Band Green to green & bl. brown, hi in SiO <sub>2</sub> , malachite stain along fractures, scattered hornite blebs and MoS <sub>2</sub> in very thin veins, approx parallel to axis Samples 127.3-132.3 132.3-137.3	MoS <sub>2</sub>	0.2								
			Bo	1.90								
			Cu	0.6								
					2418	5.0	4.7	0.18		.200		
					2419	5.0	5.0	1.13		.067		







NEW IMPERIAL MINES LTD.

WHITEHORSE, YUKON

STATEMENT OF COSTS FOR REPRESENTATION WORK PURPOSES - DECEMBER 31st, 1970

1. Surface drilling Cowley Park Ore Body (Claims Sue 3 and 4).	\$ 8,186.75
2. Overburden stripping Black Cub South Ore Body 190,000 Tons @ 42¢ ton.	80,640.00
✓ 3. Overburden stripping and mining Keewenaw Ore Body	124,506.00 *
✓ 4. Overburden stripping Gem Ore Body	} 237,332.00 *
✓ 5. Little Chief/Gem road construction costs	
6. Little Chief Decline - mining and development costs	511,282.00 *

I certify that the expenditures listed above are the minimum incurred.



\_\_\_\_\_  
O. Chippett,  
Chief Accountant

\* Costs to end of November, 1970.

090945-546060



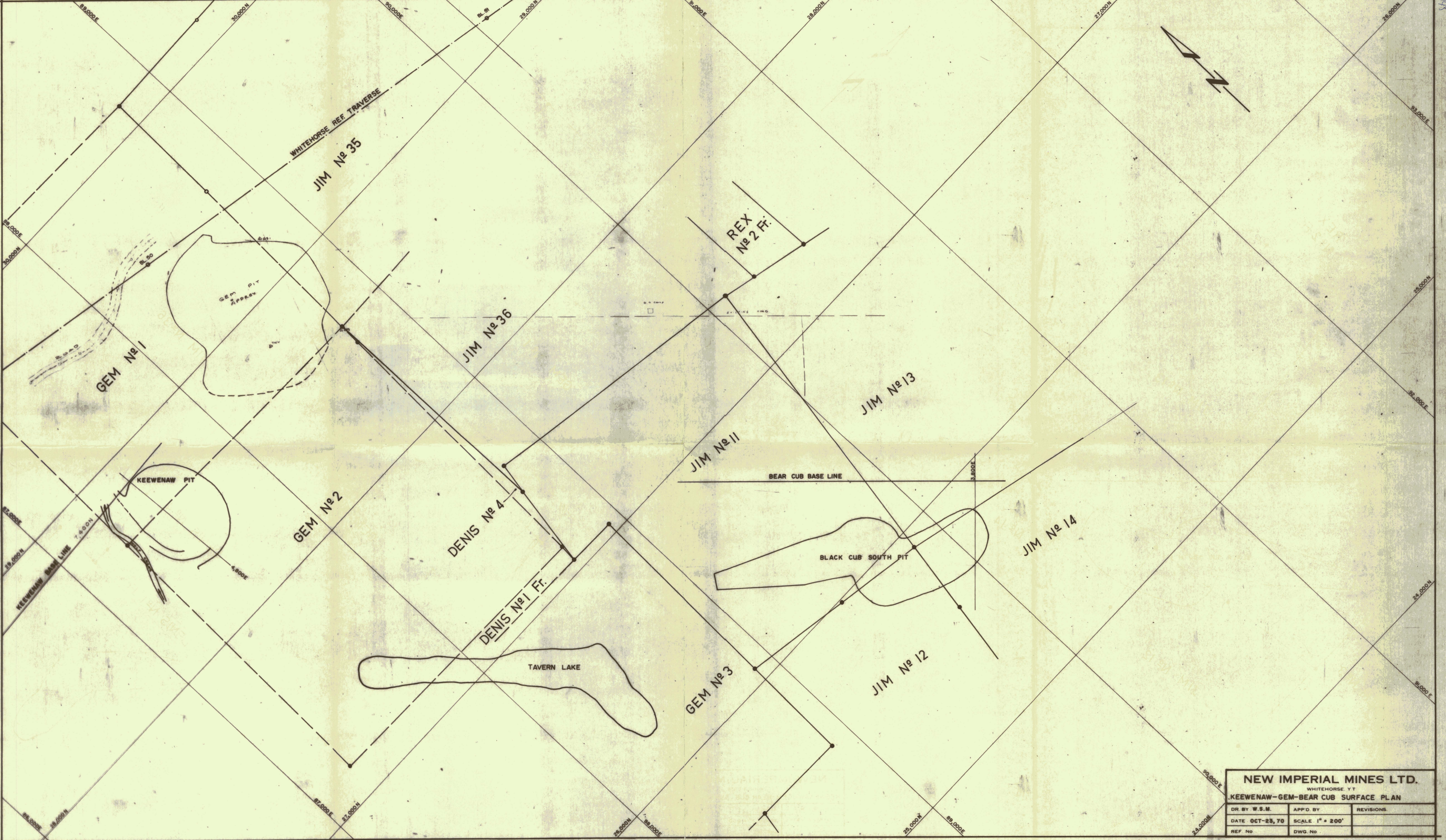

<b>NEW IMPERIAL MINES LTD.</b>		
WHITEHORSE, Y.T.		
<b>KEEWENAW-GEM-BEAR CUB SURFACE PLAN</b>		
DR BY W.S.M.	APP'D BY	REVISIONS
DATE OCT-25, 70	SCALE 1" = 200'	
REF No	DWG. No	



ORO No 1 MC  
 LOT 494  
 GROUP 804

ORO No 2 MC  
 LOT 495  
 GROUP 804

ORO No 3 MC  
 LOT 496  
 GROUP 804

LITTLE CHIEF PIT

1" = 100'

MAIN DECLINE

NEW IMPERIAL MINES LTD.  
 WHITEHORSE, Y.T.

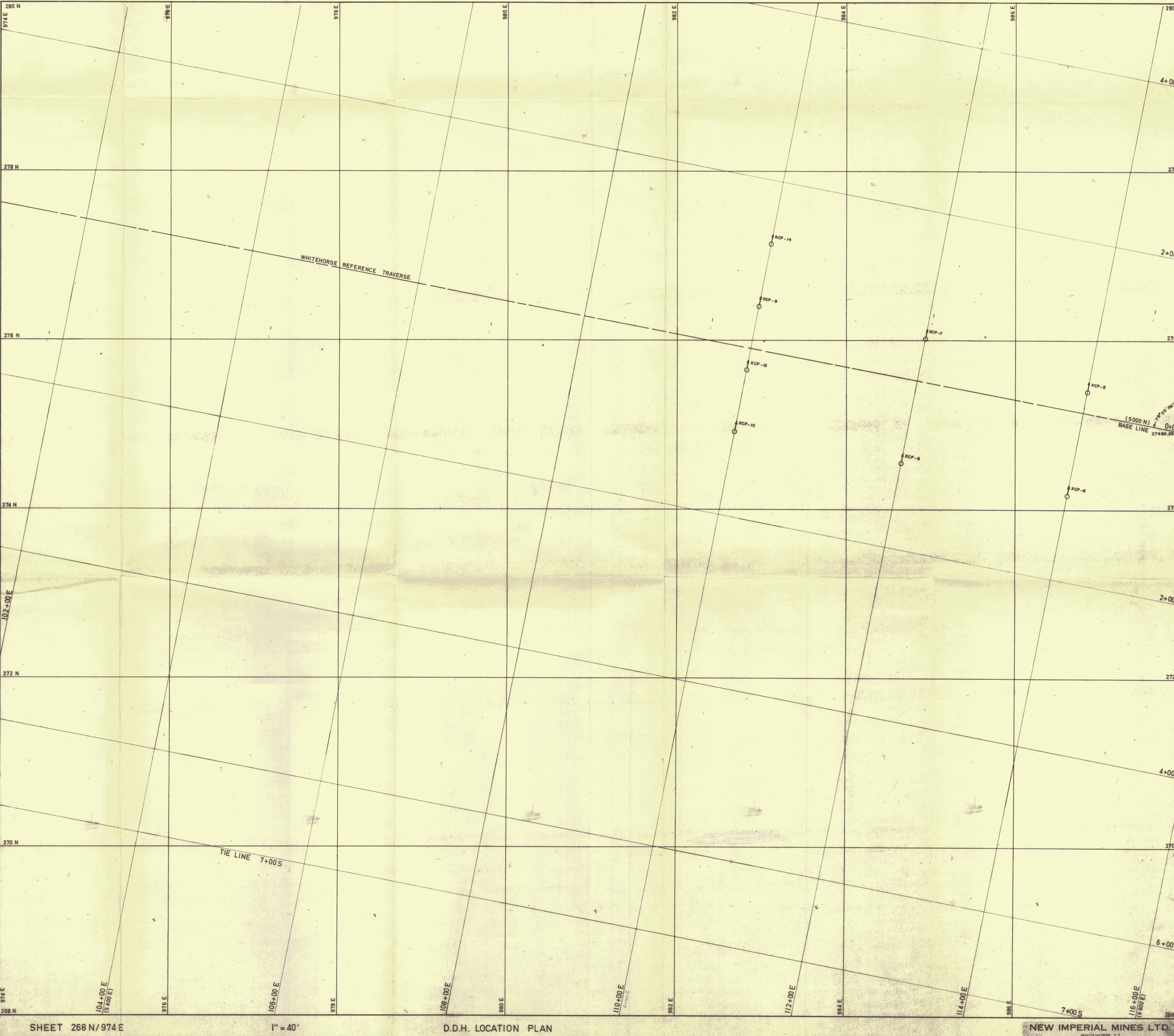

WHITEHORSE REFERENCE TRAVERSE

TIE LINE 7+00 S

(5000 N) BASE LINE 27489.83

