

ASSESSMENT REPORT

ON THE

PRINCESS #1 - 12 MINERAL CLAIM GROUP

GRANT NOS. YA34345-YA34348, YA57492-YA57499

LOWER HIGHLAND LAKE AREA

WATSON LAKE MINING DISTRICT

YUKON TERRITORY

N. Lat. 61°04'

W. Long. 128°15'

105-H-1

for

MAJESTIC MINING CORPORATION
Suite 704
525 Seymour Street
Vancouver, British Columbia

by

DONALD W. TULLY, P. ENG.

December 2, 1981

West Vancouver, B.C.

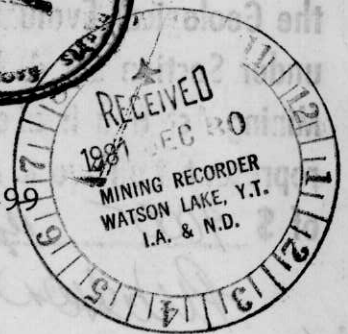
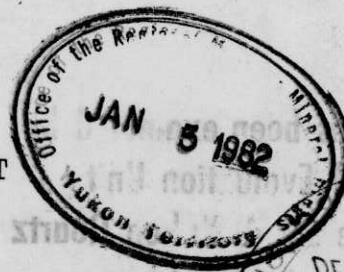

This report has been examined by
the Geological Evaluation Unit
under Section 55 41 Yukon Quartz
Mining Act and is allowed as
representative work in the amount

of \$ 7000 - approved for additional
1600 - total
of 5600 - total
Platterson

for Regional Manager, Exploration and
Geological Services for Commissioner
of Yukon Territory.

105-B-1

MAJESTIC MINING CORPORATION
Suite 704
525 Seymour Street
Vancouver, British Columbia

DONALD W. TULLY, P. ENG.

West Vancouver, B.C.

December 2, 1981

000027

DON TULLY ENGINEERING LTD.
SUITE 102 - 2322 BELLEVUE AVENUE
WEST VANCOUVER, BRITISH COLUMBIA
V6V 1C1

TABLE OF CONTENTS

	<u>Page</u>
INTRODUCTION.....	1
SUMMARY AND CONCLUSIONS.....	1
PROPERTY - LOCATION, ACCESS, PHYSIOGRAPHY AND ENVIRONMENTAL CONSIDERATIONS.....	2
CLAIMS.....	2
HISTORY - PREVIOUS DEVELOPMENT.....	3
REFERENCES.....	4
GEOLOGY.....	4
MINERALIZATION.....	5
RESULTS OF THE 1981 PROGRAM OF GEOCHEMICAL SOIL SAMPLING AND GEOPHYSICAL SURVEYING.....	6
RECOMMENDATIONS.....	9
TIME-COST DISTRIBUTION.....	11
CERTIFICATE.....	12

MAPS

Figure 1 - Location Map.....(Frontispiece)	
Figure 2 - Topographic Map (105-H).....(Follows page 1)	
Figure 3 - Claim Plan (105-H-1).....(Follows page 2)	
Figure 4 - Regional Geology (After GSC 6-1966).....(Follows page 3)	
Figure 5 - Geochemical Soil Survey (South Sheet).....(In Pocket)	
Figure 6 - Geochemical Soil Survey (North Sheet).....(In Pocket)	
Figure 7 - VLF-Electromagnetic Survey (South Sheet).....(In Pocket)	
Figure 8 - VLF-Electromagnetic Survey (North Sheet).....(In Pocket)	
Figure 9 - Magnetometer Survey (South Sheet).....(In Pocket)	
Figure 10 - Magnetometer Survey (North Sheet).....(In Pocket)	

APPENDIX

Assay Certificates #8010-1451A, 1451B, 1453A, 1453B
Field Survey Procedure - R. Wank, Geo-Teck Services Ltd.

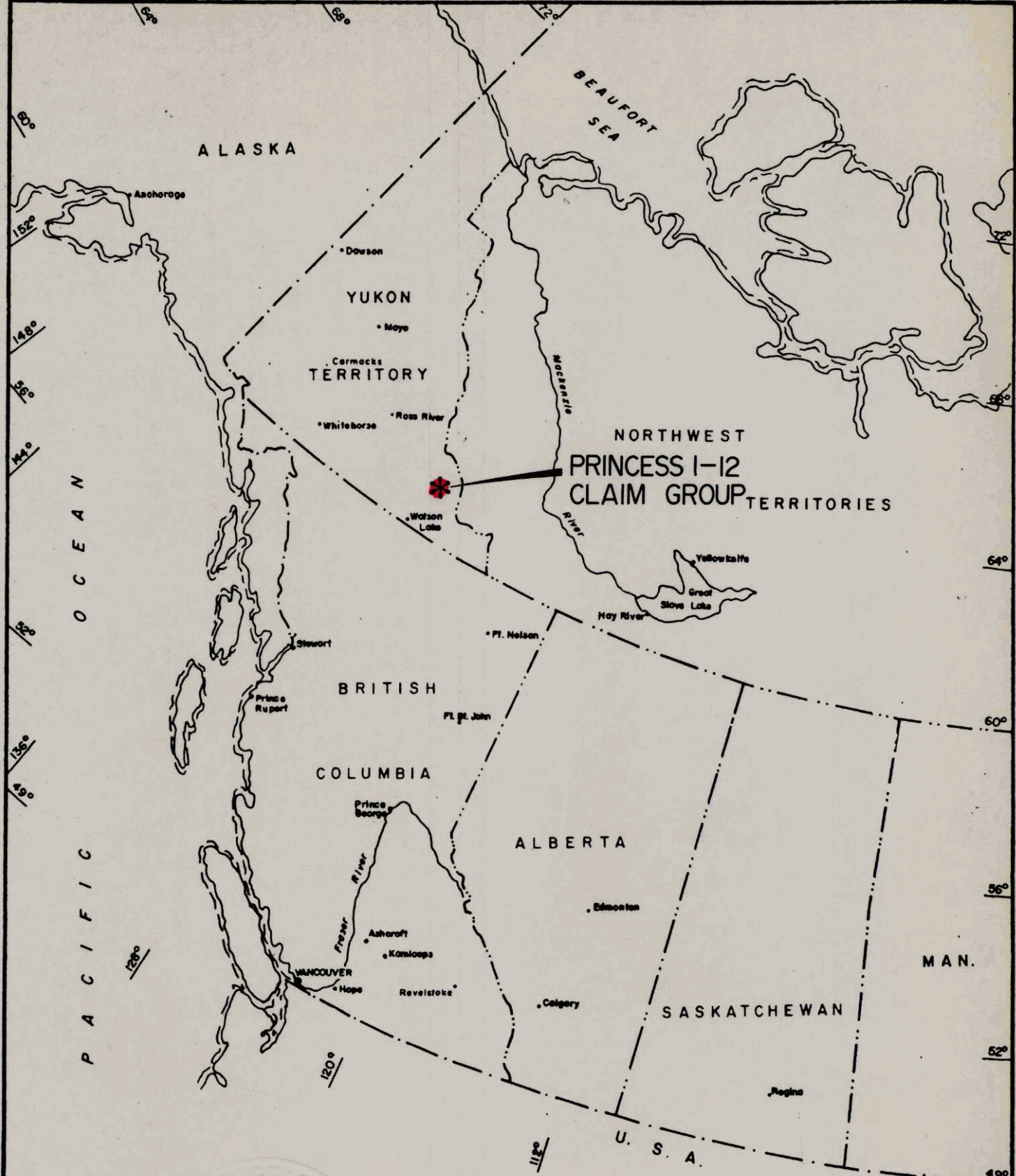
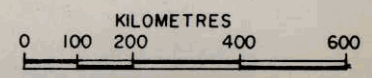

FIGURE 1
PROPERTY LOCATION MAP

DECEMBER 2, 1981

Donald W. Kelly



INTRODUCTION

This report was prepared for Majestic Mining Corporation Ltd., pursuant to a request from the Directors of Majestic Mining Corporation, Suite 704, 525 Seymour Street, Vancouver, British Columbia.

The basis for this report is a personal examination of the property on August 28, 1981.

The purpose of this report is to evaluate the results of the 1981 Program of Geochemical and Geophysical surveying on the claim group.

A program of further mineral exploration is recommended.

SUMMARY AND CONCLUSIONS

The PRINCESS #1-12 claim group is located about 110 kilometres northeast of Watson Lake in the Watson Lake Mining District, Yukon Territory. The property is situated some ten kilometres east of Kilometre Post 63 on the North Nahanni Range (Cantung) Road. Access to the property is best by helicopter at the present time.

From the writer's observations, the sulphide mineralization of pyrite and pyrrhotite appears to follow a limestone-skarn horizon that trends northward through the PRINCESS ground towards pyrite and pyrrhotite occurrences further to the north. Lead-zinc occurrences are known in this limestone horizon to the south of the claimed ground.

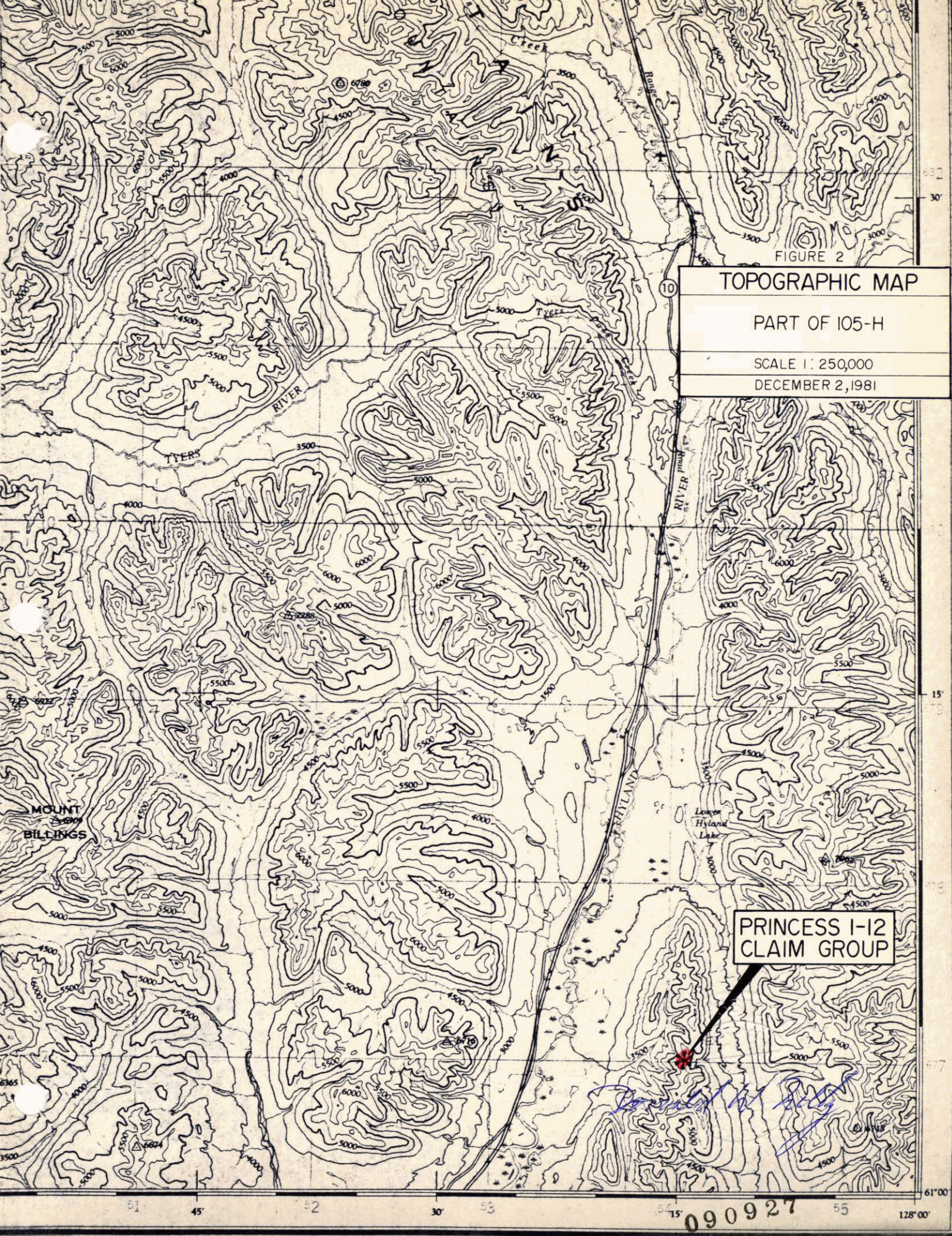

FIGURE 2

TOPOGRAPHIC MAP
PART OF 105-H
SCALE 1: 250,000
DECEMBER 2, 1981

PRINCESS I-12
CLAIM GROUP

090927

Anomalous zones of copper, lead, zinc and silver are indicated from the geochemical soil sampling survey.

Magnetic and VLF-electromagnetic anomalies are indicated from the geophysical surveys.

Additional geochemical and geophysical work is proposed to better define the configuration of the indicated anomalous zones prior to a follow-up program of bulldozer trenching and diamond drill test.

PROPERTY - LOCATION, ACCESS, PHYSIOGRAPHY

The PRINCESS #1-12 mineral claims are located about 110 airline kilometres northeast of Watson Lake, Yukon Territory. The property is situated some ten kilometres east of Kilometre Post 63 on the Cantung road on the west side of the Hyland River. Lower Hyland Lake is about thirteen kilometres to the north of the claim group.

Access to the property at the present time is best by helicopter.

The claims are located on a local height-of-land between elevations 4800 and 6000 feet above sea-level. The topography is relatively steep and the ground is mostly above timberline.

CLAIMS

The property comprises a contiguous group of four mineral claims located in the Watson Lake Mining District. Information on file with the Mining Recorder

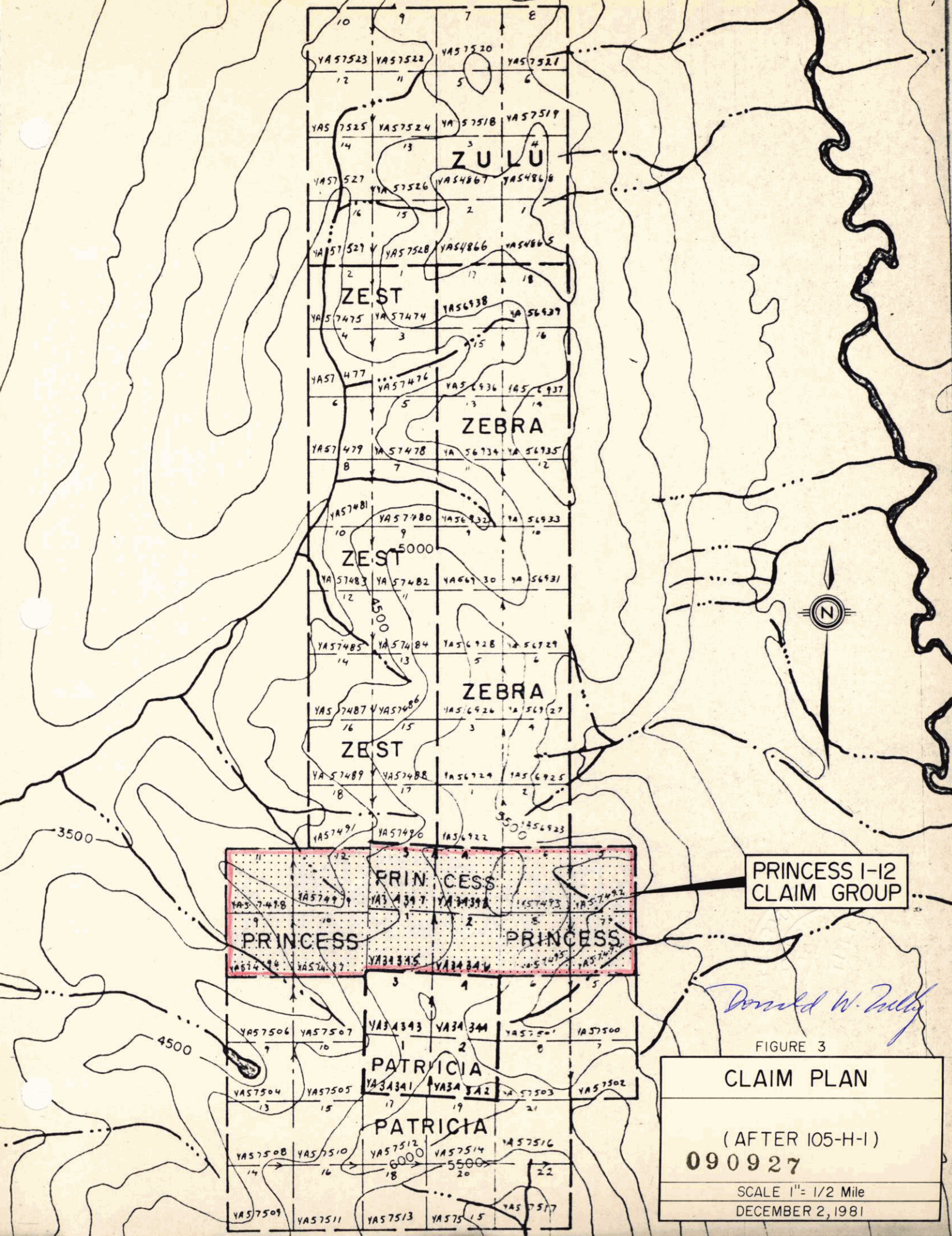

PRINCESS I-12
CLAIM GROUP

Donald W. Pully

FIGURE 3

CLAIM PLAN

(AFTER 105-H-1)

090927

SCALE 1" = 1/2 Mile

DECEMBER 2, 1981

at the Department of Indian Affairs and Northern Development at Watson Lake is as follows:

<u>Claim Name</u>	<u>Grant Numbers</u>	<u>Expiry Date</u>	<u>Recorded Holder</u>
PRINCESS #1- 4	YA34345-YA34348	October 31, 1983	(Majestic Mining Corp. (90%) (Vancliff Resources (Corp. (10%)
PRINCESS #5-12	YA57492-YA57499	March 2, 1982	John C. Turner

The claims are shown on Yukon Claim Sheet 105-H-1 (Figure 3).

HISTORY - PREVIOUS DEVELOPMENT

Prospecting in the mid-1960's in the area immediately south of the PRINCESS claim group showed evidence of copper-gold mineralization. Pyrite, pyrrhotite and chalcopyrite were found in skarn zones along a limestone horizon trending north along the local height-of-land about four miles east of the Hyland River.

From the writer's observations in the field, pyrite and pyrrhotite mineralization occur in gossan zones along the limestone-skarn horizon which trends northerly along the height-of-land towards Lower Hyland Lake.

A program of prospecting was carried out in the 1980 field season. Interesting values in gold, silver, copper and nickel were found in geochemical soil samples from this work program of rehabilitating former trenchings.



Intercalated siltstone and limestone of unit 9 characteristically occurs in wavy, undulatory or anastomosing bands, which on weathering impart a very rough pitted surface. An important regional unconformity at the base of this unit in places sharply bevels Lower Cambrian and older strata. Unit 9 is at least 4,000 feet thick near the Yukon - Northwest Territories boundary, but is itself bevelled by an unconformity beneath unit 11, so that apparently its thickness varies markedly. Exposures of unit 11 are limited to stream cuts along Flat River valley where it overlies unit 9 unconformably. Graptolites collected from the lowermost 500 feet are Upper Ordovician, but as the overlying part of unit 11 is much thicker, it may be in part of Silurian age.

Units 10 and 12 are lithologically correlated with strata previously mapped in adjacent regions.

Unmetamorphosed, predominantly pelitic, strata (13) are believed correlative with Devono-Mississippian rocks in adjacent regions. Characteristic are chert-pebble conglomerate, varicoloured chert, and black quartz-bearing greywacke and gritty quartzite. In the Campbell Range unit 13 includes numerous small bodies of greenstone, many intrusive, but most of the greenstone, mapped as 13b, appears to be volcanic and probably overlies or occurs within the upper part of unit 13. Serpentinite (13c) is thought to be an integral part of the Devono-Mississippian assemblage. A profound angular unconformity occurs at the base of this sequence.

Unit 14 comprises mainly hornfelsed pelitic rocks whose age and correlation are in doubt. Overall lithologic character, lack of regional metamorphism in rocks near the gneissic belt (2) and one collection of Middle or Upper Devonian fossils (near the south boundary at 128° 40' W) suggest that probably most, if not all, of this unit is correlative with Devono-Mississippian strata of unit 13.

Granitic rocks (15) generally have sharply defined contacts, but in the schist-gneiss belt (2) they are commonly bordered by complex zones as much as 1/4 mile wide in which massive plutonic rock is interspersed with lit-par-lit migmatites and partly granitized inclusions. There mapped boundaries are largely arbitrary, based on proportion of intrusive to host rocks.

Outside the complexly deformed central crystalline terrain, regional structures trend northwest except in the northern part of the map-area where they become westerly. Regional metamorphism appears unrelated to Cretaceous (?) granitic intrusion and probably predates the Devono-Mississippian strata. These strata overlie schist and gneiss of unit 1 unconformably and are essentially non-schistose. Northwest-trending regional folds near Flat River, which may be related to tectonism in the central belt, are post Late Ordovician, as they involve rocks of this age and older. These folds clearly predate and are modified by intrusion of granitic rocks.

Sphalerite with minor amounts of galena, pyrrhotite and chalcopryrite occur in silicated calcareous members in several localities throughout the schist-gneiss terrain (2) and in hornfelses that may be equivalent to unit 13. Pyrrhotite with some chalcopryrite was noted in black slate and argillite of unit 13, west of Hyland River road at mile 53. Scheelite is reported in the north-central part of the map-area near 61° 48' in contact zones with calcareous beds of unit 1.

A high-grade tungsten deposit on Flat River is presently being mined by Canada Tungsten Mining Corporation. Scheelite, with pyrrhotite and minor amounts of chalcopryrite occurs with skarn minerals in massive Lower Cambrian limestone. The deposit is several hundred feet from nearest exposed granitic rocks, but within a zone of moderate to high-grade contact metamorphism.

MAP 6-1966
GEOLOGY

090927

FIGURE 4
REGIONAL GEOLOGY
Modified after G.S.C. Map
6-1966

DECEMBER 2, 1981

Printed by the Surveys and Mapping Branch

Donald W. Zully

REFERENCES

1. Report on the PATRICIA claims on behalf of PATMAR RESOURCES CORPORATION dated September 20, 1978 by James W. McLeod, B.Sc.
2. Geological Survey of Canada Map 6-1966, Frances Lake
3. Geological Survey of Canada Aeromagnetic Map #1356G (Scale 1" = 1 mile)
4. Report on the PRINCESS #1-4 Claim Group dated March 23, 1979, by Donald W. Tully and ADDENDUM dated December 21, 1979
5. Report on the PRINCESS #1-4 Claim Group by Donald W. Tully, P.Eng., and dated February 12, 1981

GEOLOGY

Three lithological units underlie the PRINCESS Claim Group, namely a basement complex of gneiss and schist, metasediments and a quartz monzonite intrusive.

<u>Formation</u>	<u>Description</u>	<u>Age</u>
Sand, gravel and glacial debris	Unconsolidated	Quaternary
	(Erosional Unconformity)	
Quartz Monzonite (Unit 15)	Intrusions	Cretaceous (?)
	Tectonic activity	
Skarn Limestone Sediments	Metamorphosed (probably some of Unit 2)	Late Paleozoic
	Probable erosional unconformity tectonic activity	
Basement complex of granitic gneiss and schist		Cambrian or earlier

The regional geology is shown on Geological Survey of Canada Map 6-1966, Frances Lake (Figure 4).

The trend of the geologic horizons is northward with moderate east dips.

Metamorphism from the quartz monzonite intrusives no doubt has been a factor in the skarn and mineralization development in the trenched area in the limestone horizon.

MINERALIZATION

Eleven random soil and rock chip samples were taken during the 1980 field prospecting program on the Princess #1-4 claim group area. According to the prospectors, M. Andersen, D. Dennis and A. Frank, the samples of mineralization were from skarn zones that trend northerly through the claims.

The assay results were as follows:

<u>Sample No.</u>	<u>Gold</u>	<u>Silver</u>	<u>Copper</u>	<u>Lead</u>	<u>Zinc</u>	<u>Nickel</u>
20344	0.28 ppm	2.8 ppm	2000 ppm	14 ppm	64 ppm	50 ppm
20345	0.21 ppm	2.0 ppm	1200 ppm	25 ppm	46 ppm	25 ppm
20346	0.31 ppm	2.2 ppm	1700 ppm	16 ppm	20 ppm	18 ppm
		* * * * *				
20347	0.408 ozs	0.20 ozs	0.41%	0.002%	0.01%	0.007%
20348	0.016 ozs	0.10 ozs	0.37%	0.01%	0.01%	0.04%
		* * * * *				
20349	0.32 ppm	3.1 ppm	2000 ppm	21 ppm	31 ppm	10 ppm
20350	0.22 ppm	1.9 ppm	2000 ppm	13 ppm	35 ppm	10 ppm
0026	0.27 ppm	1.7 ppm	2000 ppm	14 ppm	29 ppm	10 ppm
0027	0.09 ppm	2.2 ppm	2000 ppm	16 ppm	33 ppm	10 ppm
0028	1.5 ppm	0.8 ppm	180 ppm	190 ppm	37 ppm	10 ppm
0029	0.17 ppm	1.7 ppm	2000 ppm	19 ppm	22 ppm	10 ppm

The presence of values in gold, silver, copper and nickel is confirmed by the assay results.

Aeromagnetic map #1356G shows the north-south trend of the basement geological structure.

RESULTS OF THE 1981 PROGRAM OF
GEOCHEMICAL AND GEOPHYSICAL SURVEYING

During the period July 15 through August 20, 1981, a program of geochemical soil sampling and combined VLF - electromagnetic and magnetometer surveying was carried out over the PRINCESS claim group by R. Wank of Geo-Teck Services Ltd., Watson Lake, Yukon Territory.

Mr. Wank has described the survey procedure in his report appended to this report.

Geochemical Soil Sampling Survey (Figures 5 and 6)

A total of 246 geochemical soil samples were taken during the survey. The results of the analyses showed the following:

<u>Metal</u>	<u>No. of Soil Samples</u>	<u>Range of Assay Results</u>
Copper	70	0 - 20 ppm
	99	21 - 40 ppm
	39	41 - 60 ppm
	18	61 - 80 ppm
	20	80+ ppm

Results of analyses showing values in excess of 80 parts per million copper are considered to be anomalous.

Lead	180	0 - 25 ppm
	52	26 - 50 ppm
	11	51 - 75 ppm
	3	75+ ppm

Values in lead in excess of 50 parts per million are considered to be anomalous.

Zinc	135	0 - 100 ppm
	83	101 - 200 ppm
	16	201 - 300 ppm
	12	300+ ppm

Values in Zinc above 300 parts per million are considered to be anomalous.

Silver	9	0.0 - 0.2 ppm
	8	0.3 - 0.4 ppm
	4	0.4+ ppm

Values in silver above 0.4 parts per million are considered to be anomalous. Only those values above 0.1 ppm in silver are shown on Figures 5 and 6.

Copper and lead occur in anomalous quantities on lines 3+00S and 4+00S at 12+00W.

Lead appears to be present in anomalous amounts on Line 0+00 at 11+00W.

Copper is anomalous at Line 1+00N and 6+00W and Line 6+00S at 6+00W and 7+00W.

Silver, copper, lead and zinc appear to be present in anomalous amounts on Line 1+00N at 1+00E.

Silver and copper are anomalous on Line 1+00S at 1+00E.

Lead and zinc are anomalous on Line 10+00S at 3+00W.

Zinc occurs in several locations in anomalous amounts in the area between Line 2+00 and Line 1+00W and Line +00E.

More detailed geochemical soil sampling is recommended for this area to delineate the apparent zones of metal values prior to bulldozer trenching and any diamond drill test.

VLF-Electromagnetic Survey (Figures 7 and 8)

A zone of VLF-electromagnetic apparent conductor anomalies trend north through the central part of the claim area between lines 1+00S and 10+00S. This zone is more or less coincident with the zones of magnetic "Highs".

More detailed electromagnetic surveying is proposed

to define the limits of each of the indicated anomalies.

Magnetometer Survey (Figures 9 and 10)

A pattern of local magnetic "Highs" found along a north trend in the area between Lines 10+00S and 0+00 from 4+50W to 6+00W. The highest reading of total magnetic intensity was 60,204 gammas. These "Highs" appear to correlate with a trend of VLF-electromagnetic conductors in this same area.

Magnetic "Lows" were found scattered over the claimed area with no apparent pattern configuration. The lowest reading of magnetic intensity was 58,823 gammas.

Total magnetic relief over the surveyed area was 1381 gammas.

RECOMMENDATIONS

A survey of the perimeter of the PRINCESS 1-12 claim area is recommended to establish the property boundary with respect to adjoining claim groups.

More detailed geochemical soil sampling is proposed to delineate the outlines of the anomalous zones prior to further development.

More detailed VLF-electromagnetic surveying is also proposed to integrate both the indicated geochemical and magnetic anomalies to the electromagnetic results.

Following a delineation of the indicated anomalous zones a program of bulldozer trenching and a follow-up diamond drill test is proposed.

Respectfully submitted,



Donald W. Tully, P.Eng.

December 2, 1981

CERTIFICATE

I, DONALD WILLIAM TULLY, of the Municipality of West Vancouver, Province of British Columbia, hereby certify as follows:

- 1) I am a Consulting Geologist with an office at Suite 102, 2222 Bellevue Avenue, West Vancouver, British Columbia.
- 2) I am a registered Professional Engineer in the Provinces of British Columbia and Ontario.
- 3) I graduated with a degree of Bachelor of Science, Honours Geology, from McGill University in 1943.
- 4) I have practiced my profession for thirty-six years.
- 5) I have no direct, indirect or contingent interest in the PRINCESS #1-12 mineral claim group, subject of this report, or the Securities of Majestic Mining Corporation, nor do I intend to receive any interest.
- 6) This report dated December 2, 1981 is based upon a personal knowledge of the property from examinations on August 28, 1981 and from personal communications.
7. I have consulted on the PATRICIA, ZEBRA, UNION, ZEST and ZULU mineral claim groups that lie within ten kilometres of the PRINCESS 1-2 claim group during the past five years.
- 8) Written permission is required from the writer to publish this report dated December 2, 1981 in any Prospectus or Statement of Material Facts.

DATED at West Vancouver, British Columbia, this 14th day of December, 1981.



Donald W. Tully, P.Eng.,
Consulting Geologist

APPENDIX

DON TULLY ENGINEERING LTD.
SUITE 102 - 2722 BELLEVUE AVENUE
WEST VANCOUVER, BRITISH COLUMBIA
V7V 1C7

SURVEY PROCEDURES

PRINCESS-

12 CLAIMS

FIELD PERSONNEL - R. N. Wank (Contractor-Watson Lake, Y.T.)
R. Till - Field Technician (Foreman)
S. Melnychuk - Field Technician
C. Wank - Field Technician
F. Close - Field Technician
D. Melnychuk - Field Technician

~~1981~~ JULY 15th
PERIOD OF SURVEY - August 5th to August 20th, 1981

The contract consisted of completing a survey grid, soil samples, magnetometer survey and electromagnetic survey.

The survey grid was completed with compass and hip chain, with base line 0+00#1 running north-south where possible through the property. The base line was marked every 50 meters with blue and orange ribbon, and every 100 meters with a picket.

All survey lines run East West from the base line, at 100 meter spacings. Survey lines are flagged with orange ribbons with marked blue ribbons, blue ribbons designating all 50 and 100 meter stations. Lines run where-ever possible. Steep terrain with cliffs made some areas impossible to survey.

The magnetometer survey was completed with the use of the Gem Systems magnetometer serial #1202. Readings were taken on all survey lines at 50 meter spacings. The intersections of all survey lines and base line was established as base stations for magnetometer.

The Electromagnetic survey was completed with the use of the Phoenix VI-2 units serial #1061-1099. Seattle, Washington (186KH2) was used as the transmitting station. Readings were

(2)

taken every 50 meters along each survey line.

The Geochemical survey was completed by taking chemical samples every 100 meters along all survey lines.

There was a total of 246 samples taken. The samples were then shipped to Chemex Labs Ltd. in Vancouver for analysis of Copper, Lead, Zinc and silver.

Robert Wank
Geo-Teck Services Ltd.



General Testing Laboratories

A Division of SGS Supervision Services Inc.

1001 EAST PENDER ST., VANCOUVER, B.C., CANADA, V6A 1W2
PHONE (604) 254-1647 TELEX 04-507514 CABLE: SUPERVISE

TO:
DON TULLY ENGINEERING LTD.
102 - 2222 Bellvue Avenue
West Vancouver, B.C.
Princess

CERTIFICATE OF ASSAY

No.: 8010-1451 B DATE: Nov. 5/80

We hereby certify that the following are the results of assays on: Geochem samples ← Rock

MARKED	GOLD	SILVER	Copper	Lead	Zinc	Nickel	xxx	xxx
	Au (ppm)	Ag (ppm)	Cu (ppm)	Pb (ppm)	Zn (ppm)	Ni (ppm)		
20344	0.28	2.8	> 2000	14	64	50		
20345	0.21	2.0	1200	25	46	25		
20346	0.31	2.2	1700	16	20	18		

NOTE: REJECTS RETAINED ONE MONTH PULPS RETAINED THREE MONTHS ON REQUEST PULPS AND REJECTS WILL BE STORE FOR A MAXIMUM OF ONE YEAR

ALL REPORTS ARE THE CONFIDENTIAL PROPERTY OF CLIENTS PUBLICATION OF STATEMENTS CONCLUSION OR EXTRACTS FROM OR REGARDING OUR REPORTS IN NOT PERMITTED WITHOUT OUR WRITTEN APPROVAL ANY LIABILITY ATTACHED THERETO IS LIMITED TO THE FEE CHARGED.

[Signature]
L. Wong

PROVINCIAL ASSAYER

Analytical and Consulting Chemists, Bulk Cargo Specialists, Surveyors, Inspectors, Samplers, Weighers

MEMBER: American Society For Testing Materials • The American Oil Chemists Society • Canadian Testing Association
REFEREE AND OR OFFICIAL CHEMISTS FOR: National Institute of Oilseed Products • The American Oil Chemists' Society
OFFICIAL WEIGHMASTERS FOR: Vancouver Board Of Trade



General Testing Laboratories

A Division of SGS Supervision Services Inc.

1001 EAST PENDER ST., VANCOUVER, B.C., CANADA, V6A 1W2
 PHONE (604) 254-1647 TELEX 04-507514 CABLE SUPERVISE

TO: **DOH TULLY ENGINEERING LTD.**
 102 - 2222 Bellvue Avenue,
 West Vancouver, B.C.

Principal

CERTIFICATE OF ASSAY

No.: 8010-1151 ▲ DATE: Nov. 5/80

We hereby certify that the following are the results of assays on: **Ore**

MARKED	GOLD	SILVER	Copper	Lead	Zinc	Nickel	XXX	XXX
	oz/zt	oz/zt	Cu (%)	Pb (%)	Zn (%)	Ni (%)		
20347	0.048	0.20	0.41	0.02	0.01	0.007		

NOTE: REJECTS RETAINED ONE MONTH PULPS RETAINED THREE MONTHS ON REQUEST PULPS AND REJECTS WILL BE STORE FOR A MAXIMUM OF ONE YEAR

REPORTS ARE THE CONFIDENTIAL PROPERTY OF CLIENTS PUBLICATION OF STATEMENTS CONCLUSION OR EXTRACTS FROM OR REGARDING OUR REPORTS IN NOT PERMITTED WITHOUT OUR WRITTEN APPROVAL ANY LIABILITY ATTACHED THERETO IS LIMITED TO THE FEE CHARGED.

L. Wong
 PROVINCIAL ASSAYER

Analytical and Consulting Chemists, Bulk Cargo Specialists, Surveyors, Inspectors, Samplers, Weighers

MEMBER: American Society For Testing Materials • The American Oil Chemists Society • Canadian Testing Association
 REFEREE AND OR OFFICIAL CHEMISTS FOR: National Institute of Oilseed Products • The American Oil Chemists' Society
 OFFICIAL WEIGHMASTERS FOR: Vancouver Board Of Trade



TO: DON TULLY ENGINEERING LTD.
 102 - 2222 Bellvue Avenue
 West Vancouver, B.C.
*Majestic
 Princess*

General Testing Laboratories
 A Division of SGS Supervision Services Inc.

1001 EAST PENDER ST., VANCOUVER, B.C., CANADA, V6A 1W2
 PHONE (604) 254-1647 TELEX 04-507514 CABLE: SUPERVISE

CERTIFICATE OF ASSAY

No.: 6010-1453 A DATE: Nov. 5/80

We hereby certify that the following are the results of assays on: **Ore**

MARKED	GOLD	SILVER	Copper	Lead	zinc	Nickel	Tungsten	xxx
	oz/st	oz/st	Cu (%)	Pb (%)	Zn (%)	NI (%)	WO ₃ (%)	
20348	0.016	0.10	0.37	0.01	0.01	0.004	trace	

NOTE: REJECTS RETAINED ONE MONTH PULPS RETAINED THREE MONTHS. ON REQUEST PULPS AND REJECTS WILL BE STORE FOR A MAXIMUM OF ONE YEAR.
 REPORTS ARE THE CONFIDENTIAL PROPERTY OF CLIENTS. PUBLICATION OF STATEMENTS, CONCLUSION OR EXTRACTS FROM OR REGARDING OUR REPORTS IS NOT PERMITTED WITHOUT OUR WRITTEN APPROVAL. ANY LIABILITY ATTACHED THERETO IS LIMITED TO THE FEE CHARGED.

[Signature]
 L. Wong

PROVINCIAL ASSAYER

Analytical and Consulting Chemists, Bulk Cargo Specialists, Surveyors, Inspectors, Samplers, Weighers

MEMBER: American Society For Testing Materials • The American Oil Chemists Society • Canadian Testing Association
 REFEREE AND OR OFFICIAL CHEMISTS FOR: National Institute of Oilseed Products • The American Oil Chemists' Society
 OFFICIAL WEIGHMASTERS FOR: Vancouver Board Of Trade



General Testing Laboratories

A Division of SGS Supervision Services Inc.

1001 EAST PENDER ST., VANCOUVER, B.C., CANADA, V6A 1W2

PHONE (604) 254-1647 TELEX 04-507514 CABLE SUPERVISE

TO:

DON TULLY ENGINEERING LTD.
102 - 2222 Bellvue Avenue
West Vancouver, B.C.

Princess

CERTIFICATE OF ASSAY

No.: 8010-1453 B DATE: Nov. 5/80

We hereby certify that the following are the results of assays on:

Geochem samples

MARKED	GOLD	SILVER	Copper	Lead	Zinc	Tungsten	XXXX	XXXX
	Au (ppm)	Ag (ppm)	Cu (ppm)	Pb (ppm)	Zn (ppm)	W (ppm)		
0026	0.27	1.7	> 2000	14	29	< 10		
0027	0.09	2.2	> 2000	16	33	< 10		
0028	1.5	0.8	180	190	37	< 10		
0029	0.17	1.7	> 2000	19	22	< 10		
20349	0.32	3.1	> 2000	21	31	< 10		
20350	0.22	1.9	< 2000	13	35	< 10		

NOTE: REJECTS RETAINED ONE MONTH. PULPS RETAINED THREE MONTHS. ON REQUEST PULPS AND REJECTS WILL BE STORE FOR A MAXIMUM OF ONE YEAR.

REPORTS ARE THE CONFIDENTIAL PROPERTY OF CLIENTS. PUBLICATION OF STATEMENTS, CONCLUSION OR EXTRACTS FROM OR REGARDING OUR REPORTS IS NOT PERMITTED WITHOUT OUR WRITTEN APPROVAL. ANY LIABILITY ATTACHED THERETO IS LIMITED TO THE FEE CHARGED.

L. Wong

PROVINCIAL ASSAYER

Analytical and Consulting Chemists, Bulk Cargo Specialists, Surveyors, Inspectors, Samplers, Weighers

MEMBER: American Society For Testing Materials • The American Oil Chemists Society • Canadian Testing Association
REFEREE AND OR OFFICIAL CHEMISTS FOR: National Institute of Oilseed Products • The American Oil Chemists' Society
OFFICIAL WEIGHMASTERS FOR: Vancouver Board Of Trade



CHEMEX LABS LTD.

212 BROOKSBANK AVE
NORTH VANCOUVER B.C.
CANADA V7J 2C1

TELEPHONE (604)964-0221
TELEX 043-52597

• ANALYTICAL CHEMISTS • GEOCHEMISTS • REGISTERED ASSAYERS

CERTIFICATE OF ANALYSIS

TO : TURNEX EXPLORATION SERVICES LTD.
704-525 SEYMDUR ST.
VANCOUVER, B.C.
V6B 3H7

CERT. # : AB113504-003-A
INVOICE # : I8113504
DATE : 05-SEP-81
P.O. # : NONE

ATTN: R. WANK SIEVED TO -35 MESH

Sample description	Prep code	Cu ppm	Pb ppm	Zn ppm	Ag ppm		
L18+00S 2+00W	201	33	14	145	0.1	---	---
L18+00S 3+00W	201	35	32	81	0.1	---	---
L18+00S 4+00W	201	40	39	125	0.1	---	---
L18+00S 5+00W	201	19	13	85	0.1	---	---
L18+00S 6+00W	201	535	11	54	0.1	---	---
L18+00S 7+00W	201	35	20	113	0.1	---	---
L18+00S 8+00W	201	22	20	74	0.1	---	---
L18+00S 10+00W	201	22	8	108	0.1	---	---
L18+00S 11+00W	201	8	9	82	0.1	---	---
L18+00S 12+00W	201	18	10	85	0.1	---	---
L18+00S 13+00W	201	28	14	100	0.1	---	---
L18+00S 13+50W	201	29	9	92	0.1	---	---
L19N 0+00	201	19	40	86	0.1	---	---
L19N 1E	201	30	50	175	0.1	---	---
L19N 2E	201	20	46	125	0.1	---	---
L19N 2+50E	201	39	610	1150	0.8	---	---
L19N 01W	201	33	85	135	0.1	---	---
L19N 02W	201	27	42	144	0.1	---	---
L19N 03W	201	30	52	230	0.1	---	---
L19N 04W	201	28	42	148	0.1	---	---
L19N 05W	201	15	32	52	0.1	---	---
L19N 06W	201	100	60	180	0.4	---	---
L19N 07W	201	19	42	105	0.1	---	---
L19N 08W	201	49	20	116	0.1	---	---
L19N 09W	201	43	72	212	0.1	---	---
L19N 10W	201	22	25	100	0.1	---	---
L19N 11W	201	10	18	46	0.1	---	---
L19N 12W	201	23	17	120	0.1	---	---
L19N 13W	201	35	43	190	0.1	---	---
L20N 1+00E	201	24	80	235	0.1	---	---
L20N 2E	201	28	38	125	0.1	---	---
L20N 2+50E	201	17	10	42	0.1	---	---
L20N 0+00	201	34	95	230	0.1	---	---
L20N 01W	201	16	24	115	0.1	---	---
L20N 02W	201	20	35	110	0.1	---	---
L20N 03W	201	37	40	175	0.1	---	---
L20N 04W	201	31	30	122	0.1	---	---
L20N 05W	201	78	17	150	0.1	---	---
L20N 06W	201	67	21	145	0.1	---	---
L20N 07W	201	138	38	213	0.1	---	---



3

Certified by

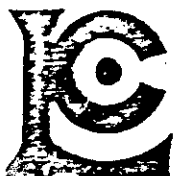

CHEMEX LABS LTD.

13

212 BROOKSBANK AVE
NORTH VANCOUVER B.C.
CANADA V7J 2C1
TELEPHONE (604)984-0221
TELEX 043-52597

• ANALYTICAL CHEMISTS • GEOCHEMISTS • REGISTERED ASSAYERS

CERTIFICATE OF ANALYSIS

TO : TURNEX EXPLORATION SERVICES LTD.
704-525 SEYMDUR ST.
VANCOUVER, B.C.
V6B 3H7

CERT. # : AB113504-002-A
INVOICE # : I8113504
DATE : 05-SEP-81
P.G. # : NONE

ATTN: R. WANK SIEVED TO -35 MESH

Sample description	Prep code	Cu ppm	Pb ppm	Zn ppm	Ag ppm		
L17N 06W	201	13	21	72	0.1	--	--
L17N 07W	201	21	18	124	0.1	--	--
L17N 08W	201	23	24	170	0.1	--	--
L17N 09W	201	13	13	92	0.1	--	--
L17N 10W	201	14	8	83	0.1	--	--
L17N 11W	201	5	4	34	0.1	--	--
L17N 12W	201	32	46	188	0.1	--	--
L17N 13W	201	24	72	285	0.1	--	--
L17+00S 02+00W	201	29	16	90	0.1	--	--
L17+00S 03+00W	201	48	60	212	0.1	--	--
L17+00S 04+00W	201	35	16	116	0.1	--	--
L17+00S 05+00W	201	16	13	46	0.1	--	--
L17+00S 06+00W	201	18	13	49	0.1	--	--
L17+00S 07+00W	201	21	12	70	0.1	--	--
L17+00S 08+00W	201	16	6	82	0.1	--	--
L17+00S 09+00W	201	16	7	88	0.1	--	--
L17+00S 10+00W	201	9	13	58	0.1	--	--
L17+00S 11+00W	201	7	3	45	0.1	--	--
L17+00S 12+00W	201	23	10	65	0.1	--	--
L17+00S 13+00W	201	10	11	43	0.1	--	--
L17+00S 13+50W	201	27	6	49	0.1	--	--
L18N 0+00	201	19	20	48	0.1	--	--
L18N 1E	201	30	40	115	0.1	--	--
L18N 2E	201	35	22	100	0.1	--	--
L18N 2+50E	201	16	15	48	0.1	--	--
L18N 3E	201	55	16	150	0.1	--	--
L18N 3+50E	201	33	30	130	0.1	--	--
L18N 1+00W	201	8	9	40	0.1	--	--
L18N 2W	201	45	25	72	0.1	--	--
L18N 03W	201	32	27	109	0.1	--	--
L18N 04W	201	64	210	300	0.6	--	--
L18N 05W	201	22	16	60	0.1	--	--
L18N 06W	201	15	32	86	0.1	--	--
L18N 07W	201	13	9	24	0.1	--	--
L18N 08W	201	33	140	465	0.6	--	--
L18N 09W	201	9	17	38	0.1	--	--
L18N 10W	201	15	16	71	0.1	--	--
L18N 11W	201	8	30	40	0.1	--	--
L18N 12W	201	102	20	146	0.1	--	--
L18N 13W	201	21	23	120	0.2	--	--

3

Certified by





CHEMEX LABS LTD.

212 BROOKSBANK AVE
 NORTH VANCOUVER B C
 CANADA V7J 2C1
 TELEPHONE (604)984-0221
 TELEX 043-52597

• ANALYTICAL CHEMISTS • GEOCHEMISTS • REGISTERED ASSAYERS

CERTIFICATE OF ANALYSIS

TO : TURNEX EXPLORATION SERVICES LTD.
 704-525 SEYMOUR ST.
 VANCOUVER, B.C.
 V6B 3H7

CERT. # : A8113506-004-A
 INVOICE # : I8113506
 DATE : 04-SEP-81
 P.O. # : NONE

ATTN: R. WANK SIEVED TO -35 MESH

Sample description	Prep code	Cu ppm	Pb ppm	Zn ppm	Ag ppm		
L10S 03W	201	51	150	710	0.8	✓	--
L10S 04W	201	46	22	200	0.1		--
L10S 05W	201	147	14	96	0.1		--
L10S 06W	201	43	9	63	0.1		--
L10S 07W	201	17	12	38	0.1		--
L10S 08W	201	20	15	109	0.1		--
L10S 09W	201	19	11	48	0.1		--
L10S 10W	201	29	14	73	0.2	✓	--
L10S 11W	201	26	5	60	0.1		--
L10S 12W	201	41	9	131	0.2	✓	--
L10S 13W	201	29	25	87	0.1		--
L11N 1E	201	42	26	470	0.1		--
L11N 2E	201	11	12	26	0.4		--
L11N 3E	201	57	42	210	0.1		--
L11N 4E	201	14	10	52	0.1		--
L11N 4+50E	201	30	20	154	0.1		--
L11N 0+00W	201	47	6	235	0.1		--
L11N 01W	201	115	21	321	0.1		--
L11N 02W	201	34	18	118	0.1		--
L11N 03W	201	48	21	133	0.1		--
L11N 04W	201	27	21	130	0.1		--
L11N 05W	201	24	13	81	0.1		--
L11N 06W	201	40	17	224	0.1		--
L11N 07W	201	44	16	195	0.1		--
L11N 08W	201	33	11	190	0.1		--
L11N 09W	201	37	15	235	0.1		--
L11N 10W	201	51	15	128	0.1		--
L11N 11W	201	34	17	190	0.4		--
L11N 12W	201	11	5	18	0.1		--
L11N 13W	201	27	11	140	0.1		--
L11N 13+50W	201	33	26	198	0.1		--
L11S 03W	201	86	19	84	0.1		--
L11S 04W	201	45	10	75	0.1		--
L11S 05W	201	28	8	51	0.1		--
L11S 06W	201	29	14	58	0.1		--
L11S 07W	201	21	12	61	0.1		--
L11S 08W	201	26	16	92	0.1		--
L11S 09W	201	22	20	65	0.1		--
L11S 10W	201	30	8	68	0.2		--
L11S 11W	201	36	13	84	0.1		--

PRINCESS

PRINCESS

Certified by *Hart Bichler*

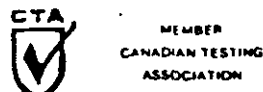



CHEMEX LABS LTD.

212 BROOKSBANK AVE
 NORTH VANCOUVER B C
 CANADA V7J 2C1
 TELEPHONE: (604)984-0221
 TELEX: 043-52597

• ANALYTICAL CHEMISTS • GEOCHEMISTS • REGISTERED ASSAYERS

CERTIFICATE OF ANALYSIS

TO : TURNEX EXPLORATION SERVICES LTD.
 704-525 SEYMOUR ST.
 VANCOUVER, B.C.
 V6B 3H7

CERT. # : A8113506-006-A
 INVOICE # : 18113506
 DATE : 04-SEP-81
 P.O. # : NONE

ATTN: R. WANK SIEVED TO -35 MESH

Sample description	Prep code	Cu ppm	Pb ppm	Zn ppm	Ag ppm		
L13N 13+50WB	201	35	18	84	0.1	--	--
L14N 1+00E	201	46	30	145	0.1	--	--
L14N 2+00E	201	37	42	138	0.1	--	--
L14N 0+00	201	40	310	758	0.5	--	--
L14N 01W	201	35	40	160	0.2	--	--
L14N 02W	201	90	43	300	0.6	--	--
L14N 03W	201	26	26	150	0.2	--	--
L14N 04W	201	37	24	106	0.1	--	--
L14N 05W	201	55	70	165	0.1	--	--
L14N 06W	201	75	33	155	0.1	--	--
L14N 07W	201	45	65	174	0.2	--	--
L14N 08W	201	29	58	180	0.1	--	--
L14N 09W	201	31	33	165	0.1	--	--
L14N 10W	201	18	15	112	0.1	--	--
L14N 11W	201	20	7	98	0.2	--	--
L14N 12W	201	18	13	86	0.1	--	--
L14N 13W	201	44	16	104	0.1	--	--
L15N 0+00	201	11	13	20	0.3	--	--
L15N 1+00E	201	22	18	96	0.2	--	--
L15N 2+00E	201	24	14	60	0.1	--	--
L15N 0+00	201	18	30	98	0.1	--	--
L15N 01W	201	31	39	330	0.1	--	--
L15N 02W	201	27	28	152	0.1	--	--
L15N 03W	201	38	34	228	0.1	--	--
L15N 04W	201	21	27	118	0.1	--	--
L15N 05W	201	42	21	67	0.1	--	--
L15N 06W	201	41	39	148	0.1	--	--
L15N 07W	201	43	25	102	0.1	--	--
L15N 08W	201	20	43	155	0.1	--	--
L15N 09W	201	30	30	136	0.1	--	--
L15N 10W	201	18	5	126	0.1	--	--
L15N 11W	201	34	65	216	0.1	--	--
L15N 12W	201	15	10	16	0.2	--	--
L15N 13W	201	27	38	179	0.1	--	--
L15N 13+50W	201	26	22	128	0.1	--	--
L15S 0+00W	201	56	55	127	0.4 ✓	--	--
L15S 1E	201	94	50	228	0.1	--	--
L15S 2E	201	79	85	285	0.1	--	--
L15S 3E	201	56	35	188	0.1	--	--
L15S 4E	201	55	34	155	0.1	--	--

PRINCIPALS

Certified by Hart Bichler





CHEMEX LABS LTD.

212 BROOKSBANK AVE.
NORTH VANCOUVER, B.C.
CANADA V7J 2C1
TELEPHONE: (604)984-0221
TELEX: 043-52597

• ANALYTICAL CHEMISTS

• GEOCHEMISTS

• REGISTERED ASSAYERS

CERTIFICATE OF ANALYSIS

TO : TURNEX EXPLORATION SERVICES LTD.
704-525 SEYMDUR ST.
VANCOUVER, B.C.
V6B 3H7

CERT. # : A8113506-007-A
INVOICE # : I8113506
DATE : 04-SEP-81
P.O. # : NONE

ATTN: R. WANK SIEVED TO -35 MESH

Sample description	Prep code	Cu ppm	Pb ppm	Zn ppm	Ag ppm		
L155 5E	201	40	35	156	0.1	--	--



MEMBER
CANADIAN TESTING
ASSOCIATION

Certified by *Walter Bichler*

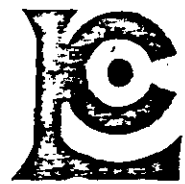

CHEMEX LABS LTD.

212 BROOKSBANK AVE
 NORTH VANCOUVER B.C.
 CANADA V7J 2C1
 TELEPHONE (604)984-0271
 TELEX 043-52597

• ANALYTICAL CHEMISTS

• GEOCHEMISTS

• REGISTERED ASSAYERS

CERTIFICATE OF ANALYSIS

TO : TURNEX EXPLORATION SERVICES LTD.
 704-525 SEYMDUR ST.
 VANCOUVER, B.C.
 V6B 3H7

CERT. # : AB113504-001-A
 INVOICE # : 18113504
 DATE : 05-SEP-81
 P.O. # : NONE

ATTN: R. WANK SIEVED TO -35 MESH

Sample description	Prep code	Cu ppm	Pb ppm	Zn ppm	Ag ppm		
L15S 6E	201	48	90	250	0.1	--	--
L15+00S 0+00E	201	29	42	130	0.1	--	--
L15+00S 1+00E	201	34	19	113	0.1	--	--
L15+00S 2+00E	201	30	19	100	0.1	--	--
L15+00S 3+00E	201	16	12	87	0.1	--	--
L15+00S 4+00E	201	18	22	58	0.2	--	--
L15+00S 5+00E	201	19	20	62	0.1	--	--
L15+00S 6+00E	201	8	12	31	0.1	--	--
L15+00S 7+00E	201	18	10	52	0.1	--	--
L15S 1W	201	41	23	118	0.1	--	--
L15+00S 1+00W	201	21	28	85	0.1	--	--
L16N 1E	201	17	23	50	0.9	--	--
L16N 2E	201	9	16	52	0.1	--	--
L16N 2+50E	201	2	2	5	0.1	--	--
L16N 0+00	201	36	70	260	0.1	--	--
L16N 01W	201	21	90	66	1.4	--	--
L16N 02W	201	10	17	66	0.1	--	--
L16N 03W	201	14	16	36	0.1	--	--
L16N 04W	201	58	23	102	0.1	--	--
L16N 05W	201	42	15	115	0.1	--	--
L16N 06W	201	40	30	133	0.4	--	--
L16N 07W	201	15	15	62	0.2	--	--
L16N 08W	201	21	24	173	0.1	--	--
L16N 09W	201	10	14	68	0.1	--	--
L16N 10W	201	8	12	93	0.1	--	--
L16N 11W	201	7	27	88	0.1	--	--
L16N 12W	201	15	42	185	0.1	--	--
L16N 13W	201	32	78	305	0.1	--	--
L16N 13+50W	201	14	32	105	0.1	--	--
L16S 7E	201	29	31	120	0.1	--	--
L17N 0+00	201	49	105	295	0.1	--	--
L17N 1E	201	25	49	153	0.1	--	--
L17N 2E	201	25	32	120	0.1	--	--
L17N 3E	201	25	34	110	0.1	--	--
L17N 3+50E	201	32	40	132	0.3	--	--
L17N 01W	201	9	25	65	0.7	--	--
L17N 02W	201	11	20	72	0.1	--	--
L17N 03W	201	12	14	70	0.1	--	--
L17N 04W	201	61	90	265	0.1	--	--
L17N 05W	201	27	18	127	0.1	--	--

3

Certified by



MEMBER
 CANADIAN TESTING
 ASSOCIATION

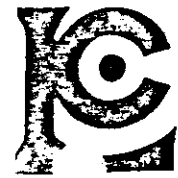

CHEMEX LABS LTD.

212 BROOKSBANK AVE
 NORTH VANCOUVER, B.C.
 CANADA V7J 2C1
 TELEPHONE: (604)984-0221
 TELEX: 043-52597

• ANALYTICAL CHEMISTS • GEOCHEMISTS • REGISTERED ASSAYERS

CERTIFICATE OF ANALYSIS

TO : TURNEX EXPLORATION SERVICES LTD.
 704-525 SEYMDUR ST.
 VANCOUVER, B.C.
 V6B 3H7

CERT. # : A8113505-001-A
 INVOICE # : 18113505
 DATE : 04-SEP-81
 P.O. # : NONE

Pb *Zn*
 0-20 - 0-75 -
 21-20 - 76-150 -
 41-60 - 151-225 -
 61 - +225 -

ATTN: R. WANK SIEVED TO -35 MESH

(240)

Sample description	Prep code	Cu ppm	Pb ppm	Zn ppm	Ag ppm		
B.L. L-165	201	24	13	65	0.1	--	--
B.L. L-175	201	23	10	60	0.1	--	--
B.L. L-185	201	32	10	148	0.1	--	--
B.L. L-195	201	16	5	60	0.1	--	--
B.L. L-205	201	19	12	71	0.1	--	--
B.L. L-215	201	24	15	68	0.1	--	--
B.L. L-225	201	23	16	75	0.1	--	--
B.L. L-235	201	136	26	98	0.1	--	--
B.L. L-245	201	62	45	108	0.1	--	--
B.L. L-255	201	166	12	80	0.1	--	--
B.L. L-265	201	40	12	110	0.1	--	--
B.L. L-275	201	15	4	33	0.1	--	--
B.L. L-285	201	104	18	123	0.1	--	--
B.L. L-305	201	17	12	47	0.1	--	--
B.L. L-315	201	30	16	69	0.1	--	--
B.L. L-325	201	115	21	118	0.1	--	--
B.L. L-335	201	50	30	100	0.1	--	--
B.L. L-345	201	22	20	85	0.1	--	--
B.L. L-355	201	17	22	78	0.1	--	--
B.L. L-365	201	18	50	98	0.1	--	--
B.L. L-375	201	15	30	68	0.1	--	--
B.L. L-385	201	14	24	67	0.1	--	--
B.L. L-395	201	15	24	53	0.1	--	--
B.L. L-405	201	14	85	98	0.1	--	--
B.L. L-415	201	161	35	126	0.2	--	--
B.L. L-425	201	39	31	63	0.1	--	--
LO-S 0E	201	56	38	265	0.2 ✓	--	--
LO-S 1E	201	43	29	150	0.1	--	--
LO-S 2E	201	225	46	230	0.4 ✓	--	--
LO-S 3E	201	37	21	135	0.1	--	--
LO-S 4E	201	33	58	165	0.4 ✓	--	--
LO-S 4+50E	201	36	110	350	0.5 ✓	--	--
LO+00 1+00W	201	60	40	346	0.1	--	--
LO+00 2+00W	201	21	16	75	0.1	--	--
LO+00 3+00W	201	32	20	123	0.1	--	--
LO+00 4+00W	201	33	30	149	0.1	--	--
LO+00 5+00W	201	32	36	123	0.1	--	--
LO+00 6+00W	201	32	50	170	0.1	--	--
LO+00 7+00W	201	19	29	95	0.1	--	--
LO+00 8+00W	201	13	14	47	0.9	--	--

Map 1

Patricia

PRINCETS

Hart Bichler

Certified by





CHEMEX LABS LTD.

212 BROOKSBANK AVE
 NORTH VANCOUVER, B.C.
 CANADA V7J 2C1
 TELEPHONE (604)984-0221
 TELEX: 043-52597

• ANALYTICAL CHEMISTS

• GEOCHEMISTS

• REGISTERED ASSAYERS

CERTIFICATE OF ANALYSIS

TO : TURNEX EXPLORATION SERVICES LTD.
 704-525 SEYMOUR ST.
 VANCOUVER, B.C.
 V6B 3H7

CERT. # : AB113505-005-A
 INVOICE # : 18113505
 DATE : 04-SEP-81
 P.O. # : NONE

ATTN: R. WANK SIEVED TO -35 MESH

Sample description	Prep code	Cu ppm	Pb ppm	Zn ppm	Ag ppm		
L4N 3E	201	9	14	53	0.1	--	--
L4N 4E	201	27	50	210	0.1	--	--
L4N 4+50	201	33	50	182	0.1	--	--
L4N 0+00	201	12	17	43	0.1	--	--
L4N 01W	201	7	13	28	0.1	--	--
L4N 02W	201	73	46	189	0.3	--	--
L4N 03W	201	57	17	118	0.2	--	--
L4N 04W	201	275	39	278	0.1	--	--
L4N 05W	201	40	25	86	0.1	--	--
L4N 06W	201	20	8	35	0.1	--	--
L4N 07W	201	17	18	56	0.1	--	--
L4N 08W	201	18	13	49	0.1	--	--
L4N 09W	201	52	19	95	0.1	--	--
L4N 10W	201	36	13	90	0.1	--	--
L4N 11W	201	39	36	135	0.1	--	--
L4N 12W	201	14	10	68	0.1	--	--
L4N 13W	201	7	6	37	0.1	--	--
L4S 03W ✓	201	18	46	97	0.1	--	--
L4S 04W ✓	201	21	7	80	0.1	--	--
L4S 05W ✓	201	72	16	75	0.1	--	--
L4S 06W ✓	201	22	10	102	0.1	--	--
L4S 07W ✓	201	15	7	26	0.1	--	--
L4S 08W ✓	201	20	4	65	0.1	--	--
L4S 09W ✓	201	11	6	115	0.1	--	--
L4S 10W ✓	201	16	20	66	0.1	--	--
L4S 11W ✓	201	58	27	136	0.1	--	--
L4S 12W ✓	201	198	40	244	0.4	--	--
L4S 13W ✓	201	44	11	103	0.1	--	--
L5N 1E	201	14	18	41	0.3	--	--
L5N 2E	201	16	22	87	0.1	--	--
L5N 3E	201	20	16	73	0.1	--	--
L5N 4E	201	27	36	125	0.1	--	--
L5N 4+50E	201	25	36	123	0.1	--	--
L5N 0+00W	201	12	18	65	0.1	--	--
L5N 01W	201	27	17	130	0.4	--	--
L5N 02W	201	36	23	116	0.1	--	--
L5N 03W	201	40	20	132	0.1	--	--
L5N 04W	201	21	24	23	0.1	--	--
L5N 05W	201	265	10	75	0.1	--	--
L5N 06W	201	56	13	67	0.1	--	--

PRINCESS

Hart Bichler

Certified by

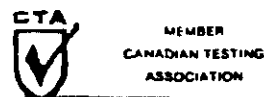



CHEMEX LABS LTD.

212 BROOKSBANK AVE
NORTH VANCOUVER, B.C.
CANADA V7J 2C1
TELEPHONE: (604)984-0221
TELEX: 043-52597

• ANALYTICAL CHEMISTS • GEOCHEMISTS • REGISTERED ASSAYERS

CERTIFICATE OF ANALYSIS

TO : TURNEX EXPLORATION SERVICES LTD.
704-525 SEYMOUR ST.
VANCOUVER, B.C.
V6B 3H7

CERT. # : AB113505-004-A
INVOICE # : 18113505
DATE : 04-SEP-81
P.O. # : NONE

ATTN: R. WANK SIEVED TO -35 MESH

Sample description	Prep code	Cu ppm	Pb ppm	Zn ppm	Ag ppm		
L2S 13W	201	38	18	76	0.1	--	--
L3N 1E	201	21	13	54	0.1	--	--
L3N 2E	201	19	20	74	0.3	--	--
L3N 3E	201	12	20	59	0.1	--	--
L3N 4E	201	13	27	90	0.1	--	--
L3N 4+50E	201	18	70	108	0.1	--	--
L3N 0+00W	201	12	11	99	0.1	--	--
L3N 01W	201	13	9	116	0.1	--	--
L3N 02W	201	245	72	262	0.7	--	--
L3N 03W	201	350	18	96	0.7	--	--
L3N 04W	201	430	210	353	1.1	--	--
L3N 05W	201	105	20	110	0.1	--	--
L3N 06W	201	29	19	76	0.1	--	--
L3N 07W	201	45	32	107	0.1	--	--
L3N 08W	201	40	16	75	0.1	--	--
L3N 09W	201	65	23	103	0.1	--	--
L3N 10W	201	34	32	100	0.1	--	--
L3N 11W	201	42	18	95	0.1	--	--
L3N 13W	201	23	25	115	0.2	--	--
L3S 0+00E ✓	201	23	16	100	0.1	--	--
L3S 1E ✓	201	21	18	82	0.1	--	--
L3S 2E ✓	201	185	11	64	0.1	--	--
L3S 3E ✓	201	25	14	22	0.1	--	--
L3S 4E ✓	201	14	17	49	0.1	--	--
L3S 4+50E ✓	201	52	23	108	0.1	--	--
L3S 1+00W ✓	201	26	18	90	0.1	--	--
L3S 02W ✓	201	20	15	96	0.1	--	--
L3S 03W ✓	201	33	20	86	0.1	--	--
L3S 04W ✓	201	35	28	180	0.1	--	--
L3S 05W ✓	201	36	12	42	0.1	--	--
L3S 06W ✓	201	26	12	62	0.1	--	--
L3S 07W ✓	201	17	10	43	0.1	--	--
L3S 08W ✓	201	11	8	19	0.1	--	--
L3S 09W ✓	201	37	11	80	0.1	--	--
L3S 10W ✓	201	19	9	62	0.1	--	--
L3S 11W ✓	201	38	24	119	0.1	--	--
L3S 12W ✓	201	121	37	133	0.3	--	--
L3S 13W ✓	201	32	15	93	0.1	--	--
L4N 1E	201	11	23	30	0.1	--	--
L4N 2E	201	7	27	23	0.1	--	--

PRINCESS

Hart Buchler

Certified by

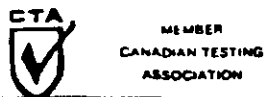



CHEMEX LABS LTD.

212 BROOKSBANK AVE.
 NORTH VANCOUVER, B.C
 CANADA V7J 2C1
 TELEPHONE: (604)984-0221
 TELEX: 043-52597

• ANALYTICAL CHEMISTS • GEOCHEMISTS • REGISTERED ASSAYERS

CERTIFICATE OF ANALYSIS

TO : TURNEX EXPLORATION SERVICES LTD.
 704-525 SEYMOUR ST.
 VANCOUVER, B.C.
 V6B 3H7

CERT. # : A8113505-003-A
 INVOICE # : 18113505
 DATE : 04-SEP-81
 P.O. # : NONE

ATTN: R. WANK SIEVED TO -35 MESH

Sample description	Prep code	Cu ppm	Pb ppm	Zn ppm	Ag ppm		
L1S 12W	201	7	8	40	0.1	--	--
L1S 13W	201	37	25	135	0.1	--	--
L2N 0+00	201	27	24	85	0.1	--	--
L2N 1E	201	104	125	357	0.1	--	--
L2N 2E	201	15	18	61	0.1	--	--
L2N 3E	201	12	23	66	0.1	--	--
L2N 4E	201	25	23	110	0.1	--	--
L2N 4+50E	201	13	39	63	0.1	--	--
L2N 01W	201	210	55	240	0.4	--	--
L2N 02W	201	195	25	188	0.1	--	--
L2N 03W	201	99	150	435	0.5	--	--
L2N 04W	201	69	20	155	0.1	--	--
L2N 05W	201	37	17	110	0.1	--	--
L2N 06W	201	25	9	53	0.1	--	--
L2N 07W	201	29	16	65	0.1	--	--
L2N 08W	201	15	11	50	0.1	--	--
L2N 09W	201	8	9	40	0.1	--	--
L2N 10W	201	16	13	70	0.1	--	--
L2N 11W	201	27	15	108	0.1	--	--
L2N 12W	201	42	35	135	0.5	--	--
L2N 13W	201	18	14	90	0.1	--	--
L2S 0+00 ✓	201	24	17	98	0.1	--	--
L2S 1E ✓	201	62	23	145	0.2	--	--
L2S 2E ✓	201	16	12	47	0.1	--	--
L2S 3E ✓	201	92	27	98	0.1	--	--
L2S 4E ✓	201	41	20	94	0.1	--	--
L2S 4+50E ✓	201	29	26	92	0.1	--	--
L2S 1WA ✓	201	18	22	81	0.1	--	--
L2S 1WB X	201	17	11	70	0.1	--	--
L2S 02W ✓	201	25	24	106	0.1	--	--
L2S 03W	201	16	65	126	0.1	--	--
L2S 04W	201	30	30	135	0.2	--	--
L2S 05W	201	44	25	153	0.1	--	--
L2S 06W	201	30	14	54	0.1	--	--
L2S 07W	201	13	15	42	0.1	--	--
L2S 08W	201	47	23	98	0.2	--	--
L2S 09W	201	69	38	145	0.1	--	--
L2S 10W	201	34	15	70	0.1	--	--
L2S 11W	201	73	19	100	0.1	--	--
L2S 12W	201	38	23	108	0.1	--	--

PRINCESS

Hart Buchler

Certified by





CHEMEX LABS LTD.

212 BROOKSBANK AVE.
 NORTH VANCOUVER, B.C.
 CANADA V7J 2C1
 TELEPHONE: (604)984-0221
 TELEX: 043-52597

• ANALYTICAL CHEMISTS • GEOCHEMISTS • REGISTERED ASSAYERS

CERTIFICATE OF ANALYSIS

TO : TURNEX EXPLORATION SERVICES LTD.
 704-525 SEYMOUR ST.
 VANCOUVER, B.C.
 V6B 3H7

CERT. # : A8113505-002-A
 INVOICE # : 18113505
 DATE : 04-SEP-81
 P.O. # : NONE

ATTN: R. WANK SIEVED TO -35 MESH

Sample description	Prep code	Cu ppm	Pb ppm	Zn ppm	Ag ppm	---	---
L0+00 09+00W	201	23	36	160	0.2	---	---
L0+00 10+00W	201	8	20	160	0.4	---	---
L0+00 11+00W	201	38	640	92	1.3	---	---
L0+00 12+00W	201	9	14	55	0.1	---	---
L0+00 13+00W	201	22	15	105	0.1	---	---
L1N 1E	201	125	410	420	1.5	---	---
L1N 2E	201	21	20	40	0.1	---	---
L1N 3E	201	13	19	68	0.1	---	---
L1N 4E	201	21	43	270	0.1	---	---
L1N 4+50E	201	33	44	212	0.1	---	---
L1N 0+00	201	76	32	290	0.1	---	---
L1N 01W	201	89	31	185	0.1	---	---
L1N 02W	201	62	20	145	0.1	---	---
L1N 03W	201	33	15	102	0.1	---	---
L1N 04W	201	24	17	90	0.1	---	---
L1N 05W	201	19	12	60	0.1	---	---
L1N 06W	201	131	27	123	0.1	---	---
L1N 07W	201	14	7	33	0.1	---	---
L1N 08W	201	11	11	34	0.1	---	---
L1N 09W	201	15	10	78	0.1	---	---
L1N 10W	201	11	14	66	0.2	---	---
L1N 11W	201	10	13	85	0.1	---	---
L1N 12W	201	7	5	42	0.1	---	---
L1N 13W	201	15	15	150	0.1	---	---
L1S 0+00E	201	18	16	113	0.1	---	---
L1S 1+00E	201	550	13	65	1.4	---	---
L1S 2+00E	201	44	38	65	0.4	---	---
L1S 3+00E	201	26	10	42	0.1	---	---
L1S 4+00E	201	49	70	500	0.1	---	---
L1S 4+50E	201	21	44	345	0.1	---	---
L1S 02W	201	21	27	114	0.1	---	---
L1S 03W	201	21	14	64	0.1	---	---
L1S 04W	201	18	12	82	0.1	---	---
L1S 05W	201	19	35	95	0.1	---	---
L1S 06W	201	19	20	92	0.1	---	---
L1S 07W	201	15	25	68	0.1	---	---
L1S 08W	201	6	29	60	0.1	---	---
L1S 09W	201	7	13	32	0.1	---	---
L1S 10W	201	6	10	59	0.3	---	---
L1S 11W	201	10	10	62	0.1	---	---

Princess

Princess

Hart Bickler

Certified by





CHEMEX LABS LTD.

212 BROOKSBANK AVE
 NORTH VANCOUVER, B.C.
 CANADA V7J 2C1
 TELEPHONE: (604)984-0221
 TELEX: 043-52597

• ANALYTICAL CHEMISTS • GEOCHEMISTS • REGISTERED ASSAYERS

CERTIFICATE OF ANALYSIS

TO : TURNEX EXPLORATION SERVICES LTD.
 704-525 SEYMOUR ST.
 VANCOUVER, B.C.
 V6B 3H7

CERT. # : AB113505-006-A
 INVOICE # : I8113505
 DATE : 04-SEP-81
 P.O. # : NONE

ATTN: R. WANK SIEVED TO -35 MESH

Sample description	Prep code	Cu ppm	Pb ppm	Zn ppm	Ag ppm		
L5N 07W	201	96	11	73	0.1	--	--
L5N 08W	201	30	12	59	0.1	--	--
L5N 09W	201	32	23	112	0.1	--	--
L5N 10W	201	18	9	62	0.1	--	--
L5N 11W	201	26	13	31	0.1	--	--
L5N 12W	201	28	25	128	0.1	--	--
L5N 13W	201	23	10	92	0.2	--	--
L5S 04W	201	22	14	92	0.1	--	--
L5S 05W	201	48	16	125	0.1	--	--
L5S 06W	201	52	23	174	0.1	--	--
L5S 07W	201	37	25	120	0.1	--	--
L5S 08W	201	44	12	55	0.1	--	--
5S 09W	201	57	36	166	0.1	--	--
5S 10W	201	61	16	138	0.1	--	--
L5S 11W	201	105	55	310	0.1	--	--
L5S 12W	201	22	12	358	0.1	--	--
L5S 13W	201	47	18	225	0.1	--	--
L6N 1E	201	16	27	76	0.1	--	--
L6N 2E	201	20	32	140	0.1	--	--
L6N 3E	201	33	45	215	0.1	--	--
L6N 4E	201	20	32	90	0.1	--	--
L6N 4+50E	201	21	43	90	0.1	--	--
L6N 0+00	201	10	6	39	0.1	--	--
L6N 01W	201	8	11	35	0.1	--	--
L6N 02W	201	12	16	32	0.1	--	--
L6N 03W	201	77	38	190	0.1	--	--
L6N 4WA	201	87	38	200	0.3	--	--
L6N 4WB	201	42	35	103	0.1	--	--
L6N 05W	201	23	13	75	0.1	--	--
L6N 06W	201	42	13	38	0.1	--	--
L6N 07W	201	21	15	48	0.1	--	--
L6N 08W	201	38	33	110	0.1	--	--
L6N 09W	201	19	11	48	0.1	--	--
L6N 10W	201	9	7	16	0.1	--	--
L6N 11W	201	23	11	59	0.1	--	--
L6N 12W	201	18	15	88	0.1	--	--
L6N 13W	201	15	11	79	0.1	--	--
5S 2+50W	201	60	10	140	0.1	--	--
6S 3W	201	34	33	104	0.1	--	--
L6S 4H	201	101	53	280	0.1	--	--

PRINCESS

PRINCESS

Certified by *Hart Bichler*

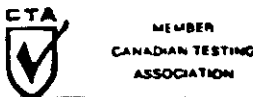



CHEMEX LABS LTD.

212 BROOKSBANK AVE
 NORTH VANCOUVER, B.C.
 CANADA V7J 2C1
 TELEPHONE: (604)984-0221
 TELEX: 043-52597

• ANALYTICAL CHEMISTS • GEOCHEMISTS • REGISTERED ASSAYERS

CERTIFICATE OF ANALYSIS

TO : TURNEX EXPLORATION SERVICES LTD.
 704-525 SEYMOUR ST.
 VANCOUVER, B.C.
 V6B 3H7

CERT. # : A8113506-001-A
 INVOICE # : 18113506
 DATE : 04-SEP-81
 P.O. # : NONE

Pb *Zn*
 0-20 - 0-75 -
 21-40 - 76-150 -
 41-60 - 151-225 -
 + 61 - + 226 -

241

ATTN: R. WANK SIEVED TO -35 MESH

Sample description	Prep code	Cu ppm	Pb ppm	Zn ppm	Ag ppm		
L6S 05W	201	53	40	138	0.1	--	--
L6S 06W	201	250	26	153	0.1	--	--
L6S 07W	201	205	16	136	0.1	--	--
L6S 08W	201	79	26	128	0.1	--	--
L6S 09W	201	70	21	128	0.1	--	--
L6S 10W	201	60	22	163	0.1	--	--
L6S 11W	201	112	37	402	0.1	--	--
L6S 12W	201	103	25	464	0.1	--	--
L6S 13W	201	73	8	310	0.1	--	--
L7N 1E	201	22	52	193	0.2	--	--
L7N 2E	201	11	32	46	0.1	--	--
L7N 3E	201	11	39	51	0.1	--	--
L7N 4E	201	17	27	55	0.1	--	--
L7N 4+50E	201	14	30	70	0.1	--	--
L7N 0+00W	201	65	25	220	0.5	--	--
L7N 01W	201	156	40	310	0.5	--	--
L7N 02W	201	16	11	32	0.1	--	--
L7N 03W	201	16	16	62	0.1	--	--
L7N 04W	201	37	18	83	0.1	--	--
L7N 05W	201	21	15	56	0.1	--	--
L7N 06W	201	45	35	106	0.1	--	--
L7N 07W	201	80	26	116	0.1	--	--
L7N 08W	201	75	33	119	0.1	--	--
L7N 09W	201	26	17	59	0.1	--	--
L7N 10W	201	20	4	98	0.1	--	--
L7N 11W	201	31	15	113	0.1	--	--
L7N 12W	201	16	16	36	0.2	--	--
L7N 13W	201	16	11	71	0.1	--	--
L7N 13+50W	201	12	13	48	0.1	--	--
L7S 06W	201	71	35	150	0.1	--	--
L7S 07W	201	55	27	140	0.1	--	--
L7S 08W	201	69	40	370	0.1	--	--
L7S 09W	201	33	15	65	0.1	--	--
L7S 10W	201	39	15	118	0.1	--	--
L7S 11W	201	51	13	155	0.1	--	--
L7S 12W	201	59	14	162	0.2	--	--
L7S 13W	201	38	15	155	0.1	--	--
L8N 1E	201	30	40	214	0.5	--	--
L8N 2E	201	14	24	87	0.1	--	--
L8N 3E	201	35	120	340	0.2	--	--

Princess

Princess

Certified by *Hart Bichler*





CHEMEX LABS LTD.

212 BROOKSBANK AVE
 NORTH VANCOUVER, B.C.
 CANADA V7J 2C1
 TELEPHONE: (604)984-0221
 TELEX: 043-52597

• ANALYTICAL CHEMISTS • GEOCHEMISTS • REGISTERED ASSAYERS

CERTIFICATE OF ANALYSIS

TO : TURNEX EXPLORATION SERVICES LTD.
 704-525 SEYMOUR ST.
 VANCOUVER, B.C.
 V6B 3H7

CERT. # : AB113506-002-A
 INVOICE # : 18113506
 DATE : 04-SEP-81
 P.O. # : NONE

ATTN: R. WANK SIEVED TO -35 MESH

Sample description	Prep code	Cu ppm	Pb ppm	Zn ppm	Ag ppm		
L8N 4E	201	21	32	133	0.1	--	--
L8N 4+50E	201	25	44	180	0.1	--	--
L8N 0+00W	201	35	17	620	1.0	--	--
L8N 01W	201	33	17	275	0.1	--	--
L8N 02W	201	66	31	238	0.4	--	--
L8N 03W	201	22	20	83	0.1	--	--
L8N 04W	201	48	23	105	0.1	--	--
L8N 05W	201	17	12	43	0.1	--	--
L8N 06W	201	42	18	120	0.1	--	--
L8N 07W	201	37	25	102	0.1	--	--
L8N 08W	201	20	7	35	0.1	--	--
L8N 09W	201	20	12	45	0.1	--	--
BN 10W	201	22	15	50	0.1	--	--
L8N 11W	201	26	19	77	0.1	--	--
L8N 12W	201	17	16	90	0.2	--	--
L8N 13W	201	13	13	34	0.2	--	--
L8N 13+50W	201	22	20	65	0.1	--	--
L8S 03W	201	44	11	116	0.1	--	--
L8S 05W	201	32	8	60	0.1	--	--
L8S 06W	201	34	9	70	0.1	--	--
L8S 07W	201	66	13	110	0.1	--	--
L8S 08W	201	28	6	60	0.1	--	--
L8S 09W	201	25	7	89	0.1	--	--
L8S 10W	201	21	8	72	0.1	--	--
L8S 11W	201	31	8	80	0.1	--	--
L8S 12W	201	22	6	105	0.1	--	--
L8S 13W	201	24	5	75	0.1	--	--
L9N 1E	201	20	40	222	0.8	--	--
L9N 2E	201	12	21	48	0.1	--	--
L9N 3E	201	15	14	56	0.1	--	--
L9N 4E	201	13	18	36	0.1	--	--
L9N 4+50E	201	8	14	32	0.1	--	--
L9N 0+00W	201	8	12	61	0.1	--	--
L9N 01W	201	12	4	12	0.1	--	--
L9N 02W	201	39	5	18	0.3	--	--
L9N 03W	201	73	50	390	0.3	--	--
L9N 04W	201	15	2	34	0.1	--	--
IN 05W	201	16	14	48	0.1	--	--
L9N 06W	201	36	16	140	0.1	--	--
L9N 07W	201	37	26	116	0.4	--	--

PRINCESS

Hart Bichler

Certified by





CHEMEX LABS LTD.

212 BROOKSBANK AVE
 NORTH VANCOUVER, B.C.
 CANADA V7J 2C1
 TELEPHONE: (604)984-0221
 TELEX: 043-52597

• ANALYTICAL CHEMISTS • GEOCHEMISTS • REGISTERED ASSAYERS

CERTIFICATE OF ANALYSIS

TO : TURNEX EXPLORATION SERVICES LTD.
 704-525 SEYMOUR ST.
 VANCOUVER, B.C.
 V6B 3H7

CERT. # : A8113506-005-A
 INVOICE # : I8113506
 DATE : 04-SEP-81
 P.O. # : NONE

ATTN: R. WANK SIEVED TO -35 MESH

Sample description	Prep code	Cu ppm	Pb ppm	Zn ppm	Ag ppm		
L11S 12W } PRINCESS	201	13	3	18	0.1	--	--
L11S 13W }	201	12	5	55	0.1	--	--
L12N 0+00	201	27	25	154	0.1	--	--
L12N 1E	201	21	24	140	0.1	--	--
L12N 2E	201	10	6	23	0.6	--	--
L12N 3E	201	17	19	98	0.1	--	--
L12N 4E	201	14	25	59	0.1	--	--
L12N 4+50E	201	45	80	240	0.1	--	--
L12N 1W	201	180	60	276	0.3	--	--
L12N 2W	201	24	30	57	1.3	--	--
L12N 3W	201	47	23	123	0.2	--	--
L12N 04W	201	45	10	116	0.3	--	--
L12N 05W	201	21	9	66	0.1	--	--
L12N 06W	201	21	11	62	0.1	--	--
L12N 07W	201	18	2	33	0.1	--	--
L12N 08W	201	46	23	133	0.1	--	--
L12N 09W	201	18	3	53	0.1	--	--
L12N 10W	201	54	30	150	0.1	--	--
L12N 11W	201	43	3	76	0.1	--	--
L12N 12W	201	24	10	73	0.1	--	--
L12N 13W	201	34	33	147	0.1	--	--
L12N 13+50	201	46	32	318	0.2	--	--
L13N 1+00E	201	21	30	102	0.2	--	--
L13N 2+00E	201	50	50	185	0.1	--	--
L13N 3+00E	201	33	30	110	0.1	--	--
L13N 0+00	201	39	17	130	0.2	--	--
L13N 01W	201	415	14	81	0.7	--	--
L13N 02W	201	53	60	435	0.5	--	--
L13N 03W	201	61	45	190	0.2	--	--
L13N 04W	201	63	30	115	0.1	--	--
L13N 05W	201	47	14	108	0.1	--	--
L13N 06W	201	63	100	245	0.2	--	--
L13N 07W	201	41	30	128	0.1	--	--
L13N 08W	201	25	32	114	0.1	--	--
L13N 09W	201	19	7	85	0.1	--	--
L13N 10W	201	10	1	23	0.1	--	--
L13N 11W	201	13	13	190	0.1	--	--
L13N 12W	201	15	12	87	0.1	--	--
L13N 13W	201	14	15	88	0.2	--	--
L13N 13+50WA	201	28	12	120	0.1	--	--

Hart Bichler

Certified by





CHEMEX LABS LTD.

212 BROOKSBANK AVE
 NORTH VANCOUVER, B.C.
 CANADA V7J 2C1
 TELEPHONE: (604)984-0221
 TELEX: 043-52597

• ANALYTICAL CHEMISTS • GEOCHEMISTS • REGISTERED ASSAYERS

CERTIFICATE OF ANALYSIS

TO : TURNEX EXPLORATION SERVICES LTD.
 704-525 SEYMOUR ST.
 VANCOUVER, B.C.
 V6B 3H7

CERT. # : A8113506-003-A
 INVOICE # : 18113506
 DATE : 04-SEP-81
 P.O. # : NONE

ATTN: R. WANK SIEVED TO -35 MESH

Sample description	Prep code	Cu ppm	Pb ppm	Zn ppm	Ag ppm		
L9N 08W	201	27	14	65	0.2	--	--
L9N 09W	201	22	22	110	0.1	--	--
L9N 10W	201	9	12	18	0.1	--	--
L9N 11W	201	11	5	14	0.1	--	--
L9N 12W	201	16	3	61	0.1	--	--
L9N 13W	201	20	13	35	0.1	--	--
L9N 13+50W	201	69	18	80	0.9	--	--
L9S 2+50W	201	70	12	270	0.1	--	--
L9S 3+00W	201	51	15	134	0.1	--	--
L9S 4+00W	201	56	15	218	0.1	--	--
L9S 5+00W	201	47	8	115	0.1	--	--
L9S 06W	201	47	5	229	0.1	--	--
9S 07W	201	35	5	90	0.1	--	--
L9S 08W	201	21	17	45	0.1	--	--
L9S 09W	201	26	6	45	0.1	--	--
L9S 10W	201	20	3	64	0.1	--	--
L9S 11W	201	36	5	76	0.1	--	--
L9S 12W	201	54	6	105	0.1	--	--
L9S 13W	201	44	4	41	0.3	--	--
L10N 1E	201	13	7	48	0.1	--	--
L10N 2E	201	12	19	53	1.1	--	--
L10N 3E	201	15	27	80	0.1	--	--
L10N 4E	201	20	25	73	0.1	--	--
L10N 4+50E	201	40	33	104	0.1	--	--
L10N 0+00B.L.	201	28	10	225	0.1	--	--
L10N 01W	201	43	10	78	0.1	--	--
L10N 02W	201	49	55	340	0.1	--	--
L10N 03W	201	72	33	195	0.1	--	--
L10N 04W	201	14	3	28	0.1	--	--
L10N 05W	201	41	20	115	0.1	--	--
L10N 06W	201	23	6	85	0.1	--	--
L10N 07W	201	38	25	95	0.4	--	--
L10N 08W	201	43	42	153	0.1	--	--
L10N 09W	201	26	35	35	0.4	--	--
L10N 10W	201	20	18	68	0.1	--	--
L10N 11W	201	22	31	144	0.1	--	--
L10N 12W	201	15	10	52	0.1	--	--
10N 13W	201	46	40	148	0.1	--	--
L10N 13+50W	201	18	8	38	0.2	--	--
L10S 2+50W	201	62	25	168	0.1	--	--

SPRINGS

SPRINGS

Certified by *Hart Bickler*





Map Key

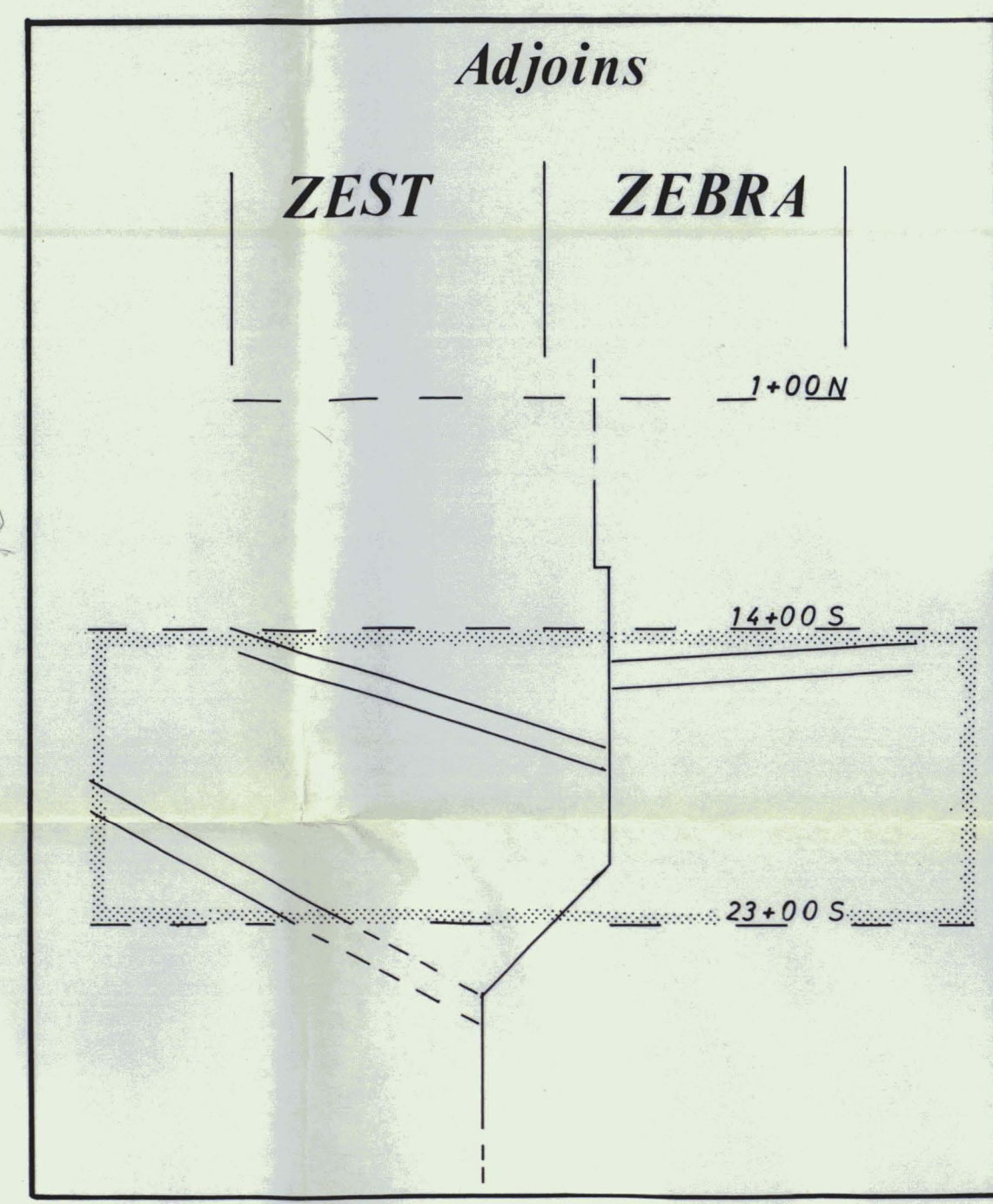

Shaded Area represents THIS Sheet

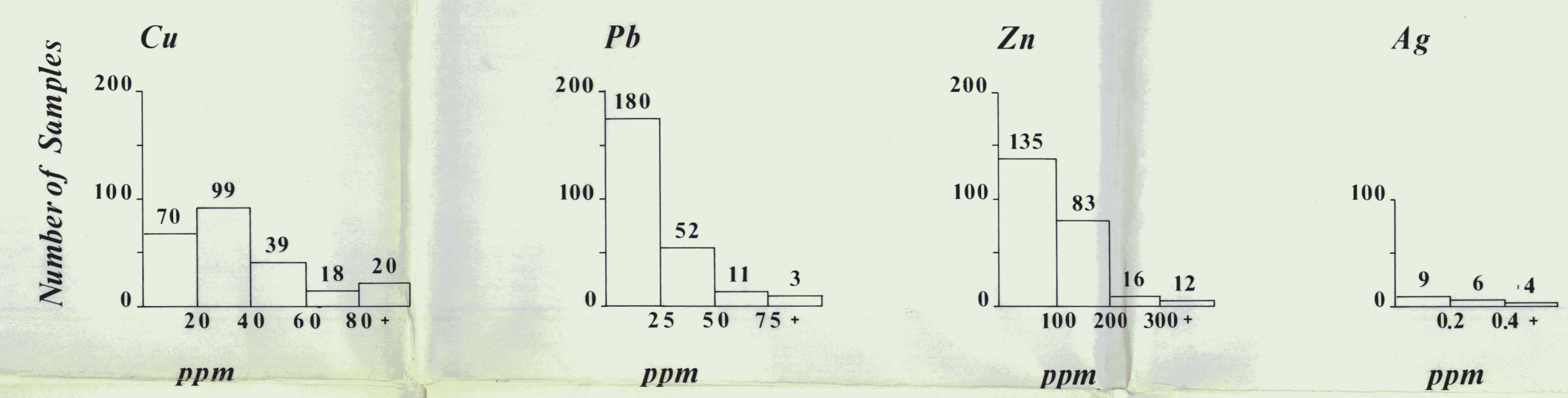

Figure 5

LEGEND

- + Flagged Station (Compass & Chain Survey)
- Claim Post
- ⊙ LCP (Legal Corner Post)
- △ Magnetometer-Survey Base-Station
- ==== Bush Road
- Creek
- ∩ Swamp
- |||| Canyon
- 56800 Magnetometer Readings, gamma
- 120 Electro-Magnetic Survey Field-Strength, %
- E -M " " Profile
- E -M Dip Angle "
- E -M " " Profile
- 67 Geo-Chemical Survey, ppm.
- Contour
- Depression
- o-o- Apparent Electro-Magnetic Conductor Zone

To accompany a Report by Donald W. Tully, P.Eng. dated December 2, 1981.

All Locations. Subject to Survey

MAJESTIC Mining Corporation

GEO-CHEMICAL SURVEY

Figures indicate: Cu, Pb, Zn ppm.

PRINCESS Claim Group 12 Units

WATSON LAKE Mining District

Watson Lake, Yukon Territory

Scale: 1cm = 25m Field Work Period: Jul. 15-Aug. 20, 1981
Metres

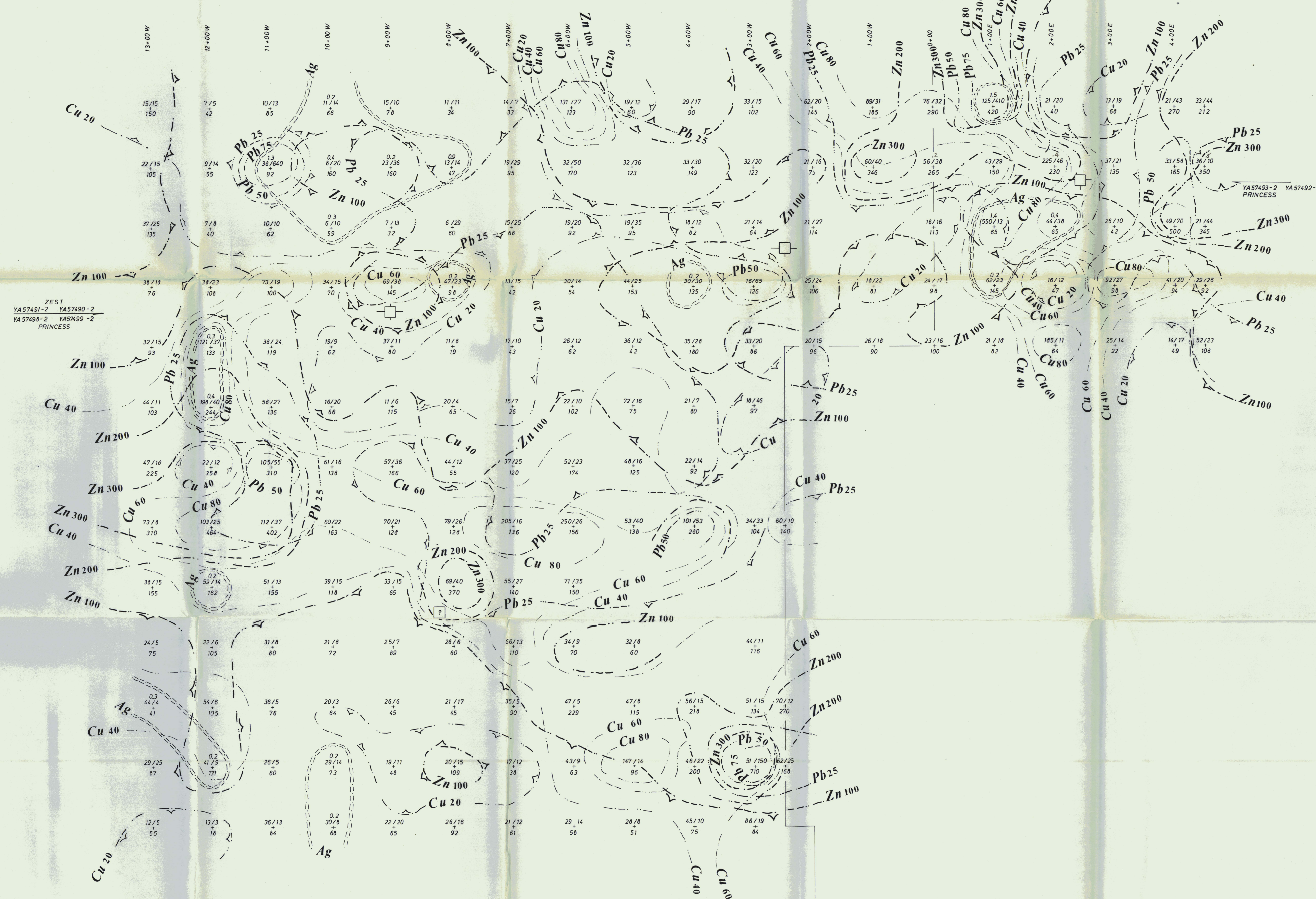

ZEST
 YA57491-2 YA57490-2
 YA57494-2 YA57499-2
 PRINCESS



Map Key

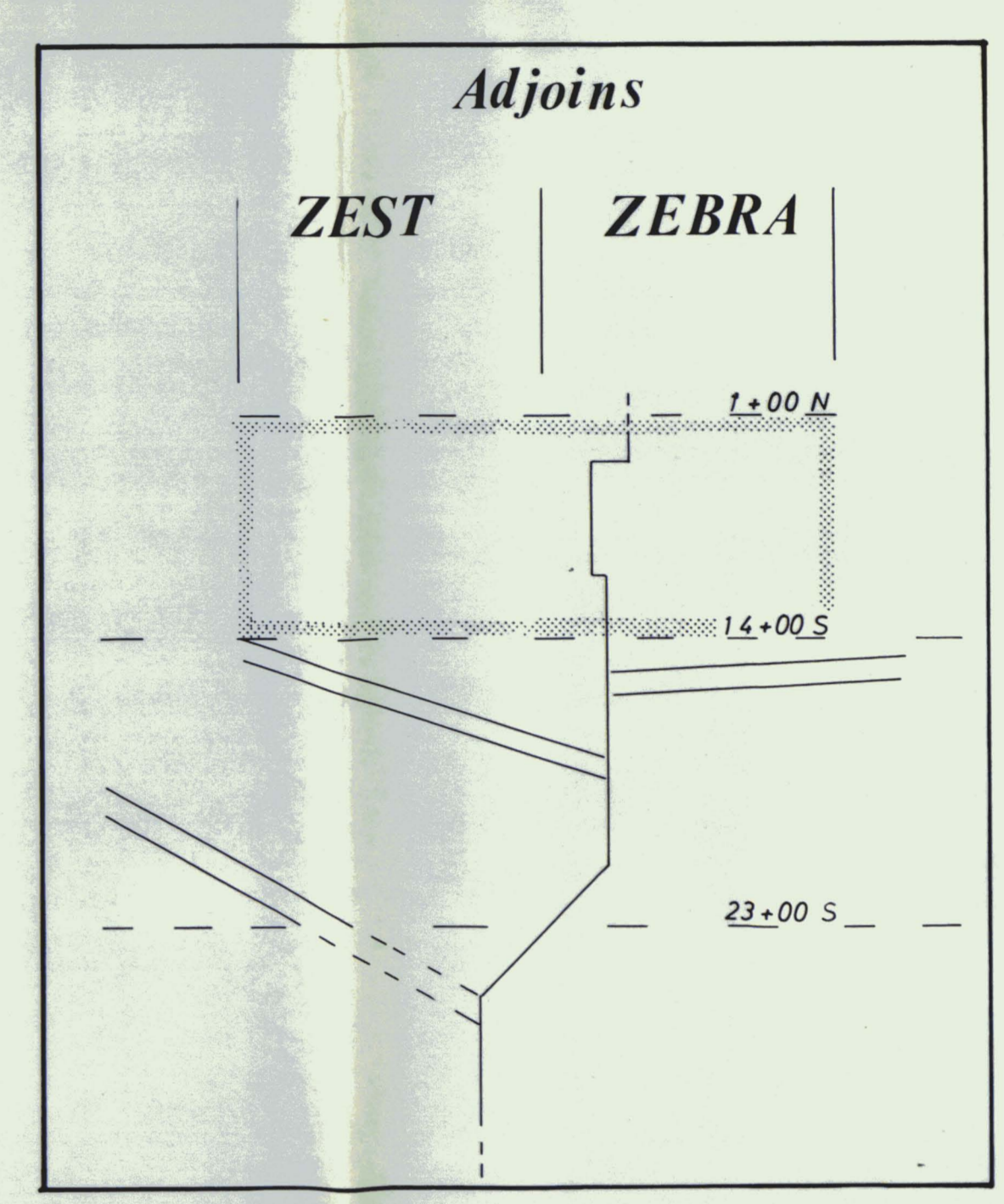

Shaded Area represents THIS Sheet

LEGEND

- + Flagged Station (Compass & Chain Survey)
- Claim Post
- ⊙ LCP (Legal-Corner-Post)
- ⊕ Magnetometer-Survey Base-Station
- ==== Bush Road
- Creek
- /// Swamp
- ||||| Canyon

- 56800 Magnetometer Readings, gama
- 120 Electro-Magnetic Survey Field-Strength, %
- E -M " " Profile
- E -M " " Dip Angle
- E -M " " Profile
- ±20 Geo-Chemical Survey, ppm.
- Contour
- Depression
- Apparent Electro-Magnetic Conductor Zone

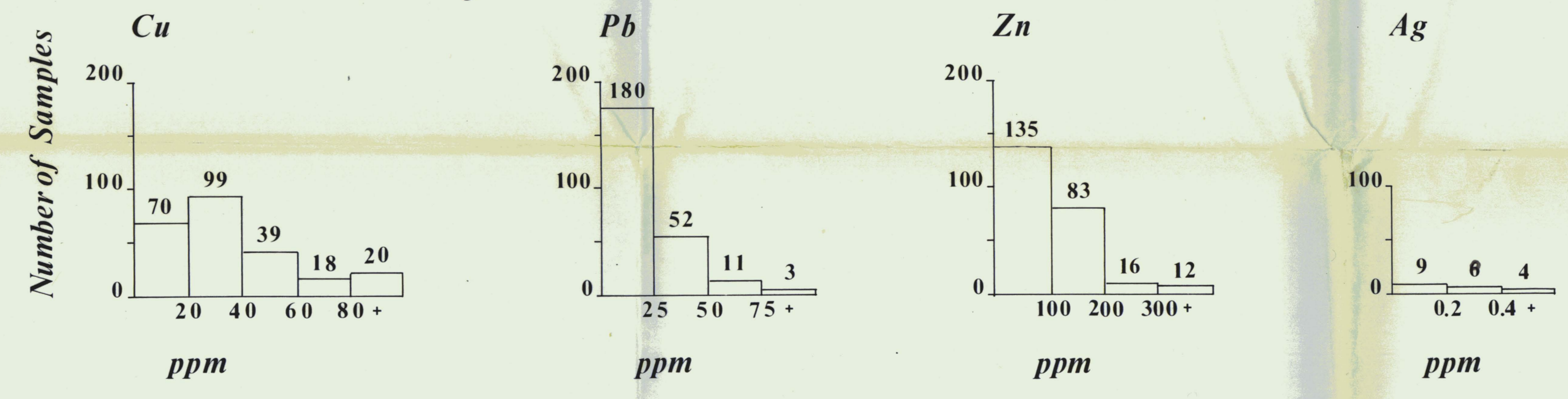

Figure 6

MAJESTIC Mining Corporation

GEO-CHEMICAL SURVEY

Figures indicate: $\frac{Ag}{Cu/Pb}$ ppm.
 $\frac{Zn}{Zn}$

PRINCESS Claim Group 12 Units

WATSON LAKE Mining District

Watson Lake, Yukon Territory Donald W. Tully

Scale: 1cm = 25m Field Work Period: Jul. 15-Aug. 20, 1981
 Metres

To accompany a Report
 by Donald W. Tully, P.Eng.
 dated December 2, 1981.

All Locations.
 Subject to Survey



Direction of Readings
180 kHz ANTENNA

Map Key

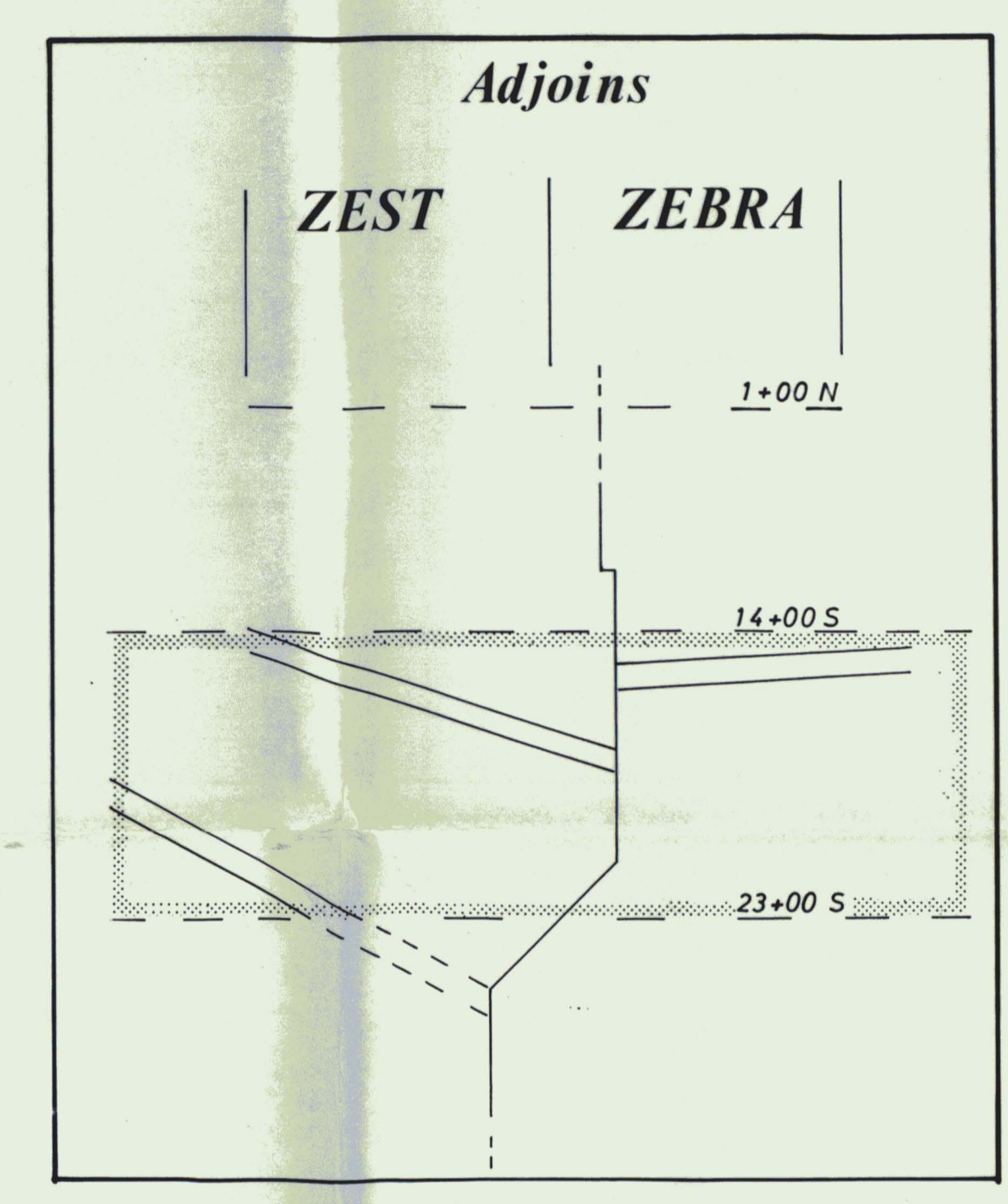

Shaded Area represents THIS Sheet

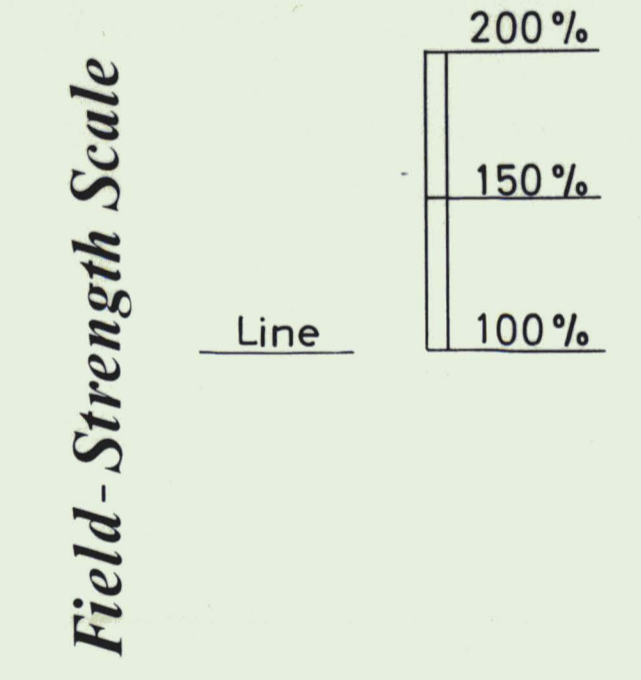

LEGEND

- +— Flagged Station (Compass & Chain Survey)
- Claim Post
- LCP (Legal Corner Post)
- △ Magnetometer-Survey Base-Station
- ==== Bush Road
- - - - Creek
- ⊘ Swamp
- ||||| Canyon

- 56800 Magnetometer Readings, γ
- 120 Electro-Magnetic Survey Field-Strength, %
- - - - E -M " " Profile
- ⊘ E -M Dip Angle °
- 67 E -M " " Profile
- Geo-Chemical Survey, ppm.
- Contour
- Depression
- Apparent Electro-Magnetic Conductor Zone

Figure 7

To accompany a Report
by Donald W. Tully, P. Eng.
dated December 2, 1981.

All Locations.
Subject to Survey

MAJESTIC Mining Corporation	
<i>ELECTRO MAGNETIC SURVEY</i>	
<i>Instrument: PHOENIX EM (VLF-2) No. 1061</i>	
<i>PRINCESS Claim Group</i>	<i>12 Units</i>
WATSON LAKE Mining District	
<i>Watson Lake, Yukon Territory</i>	
<i>Scale: 1cm = 25m Field Work Period: Jul. 15-Aug. 20, 1981</i>	
<i>Metres</i>	

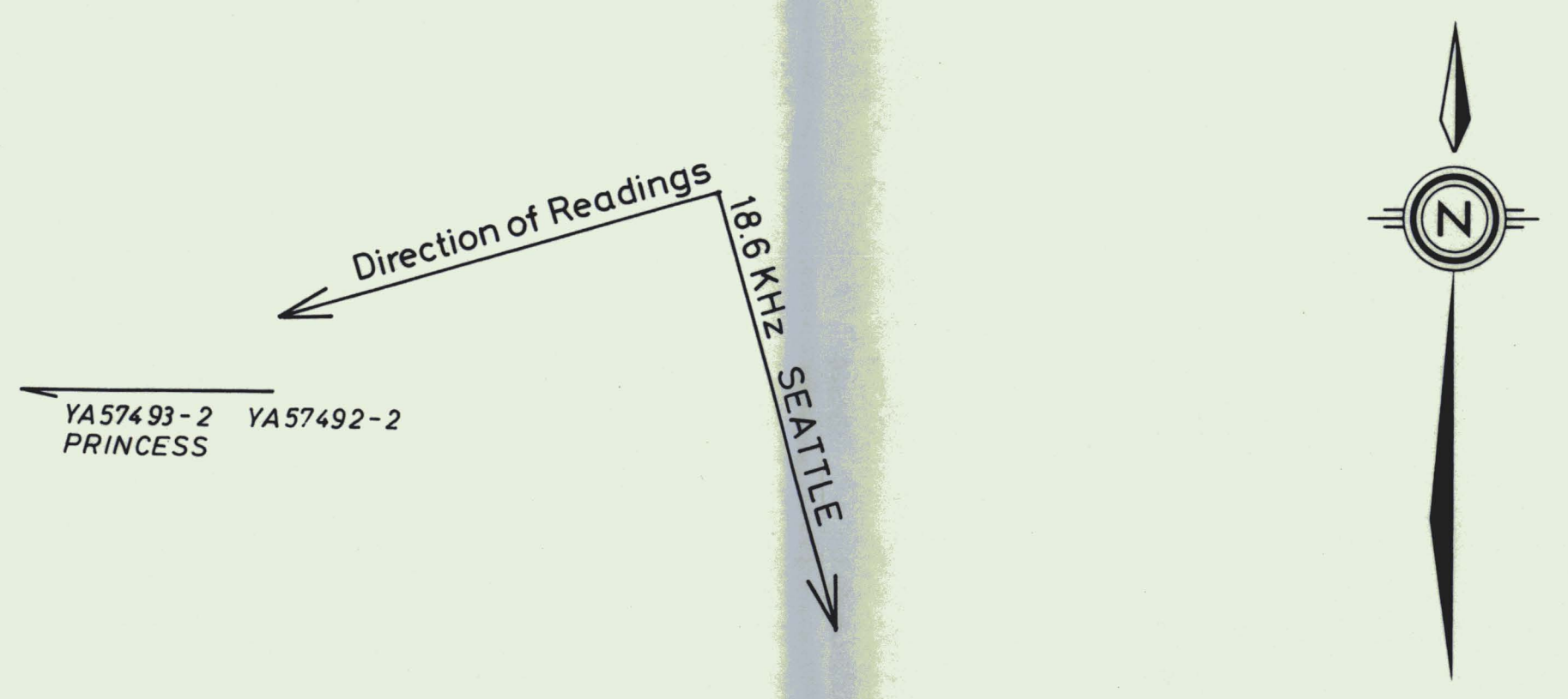
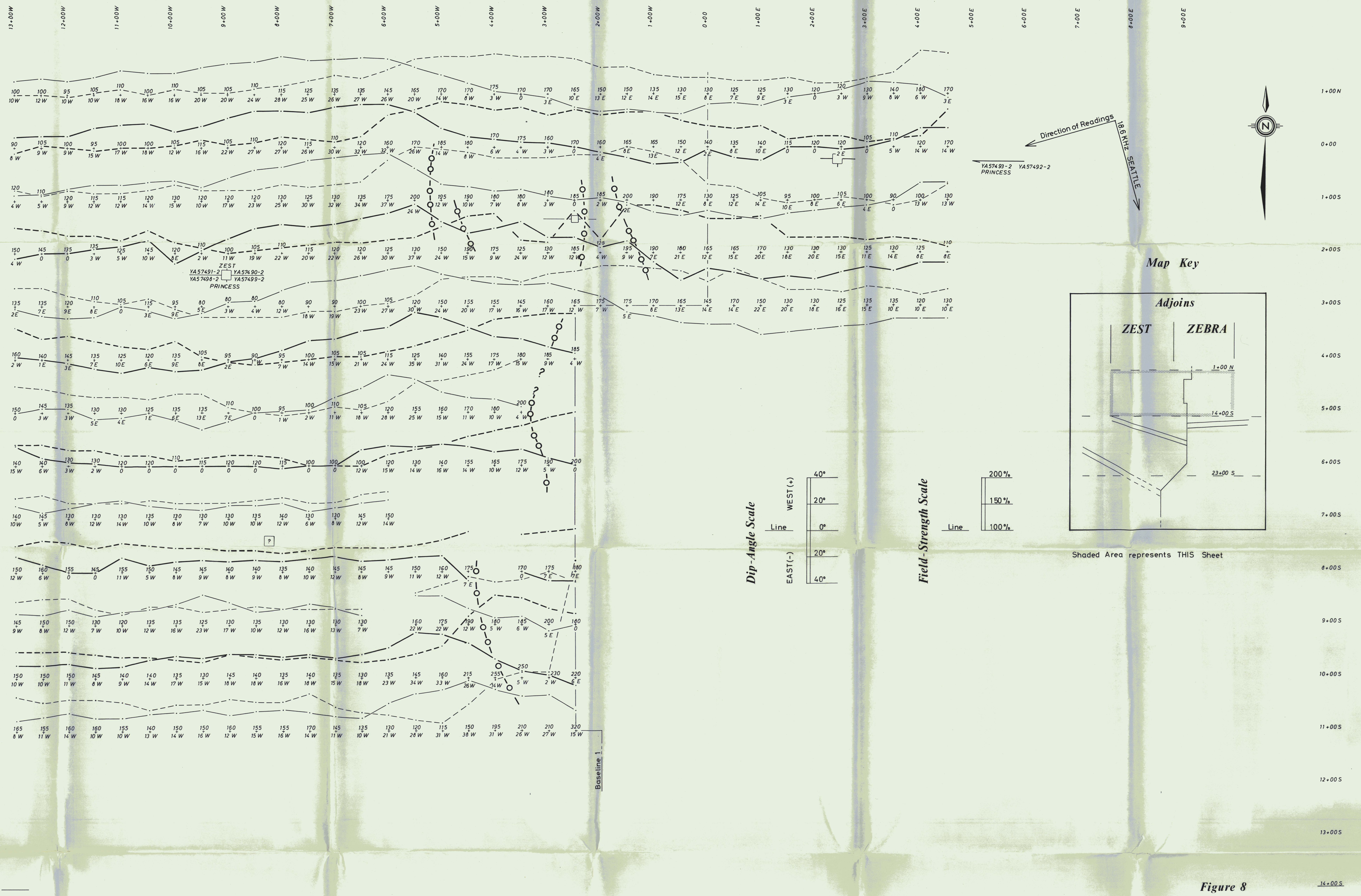

Map Key

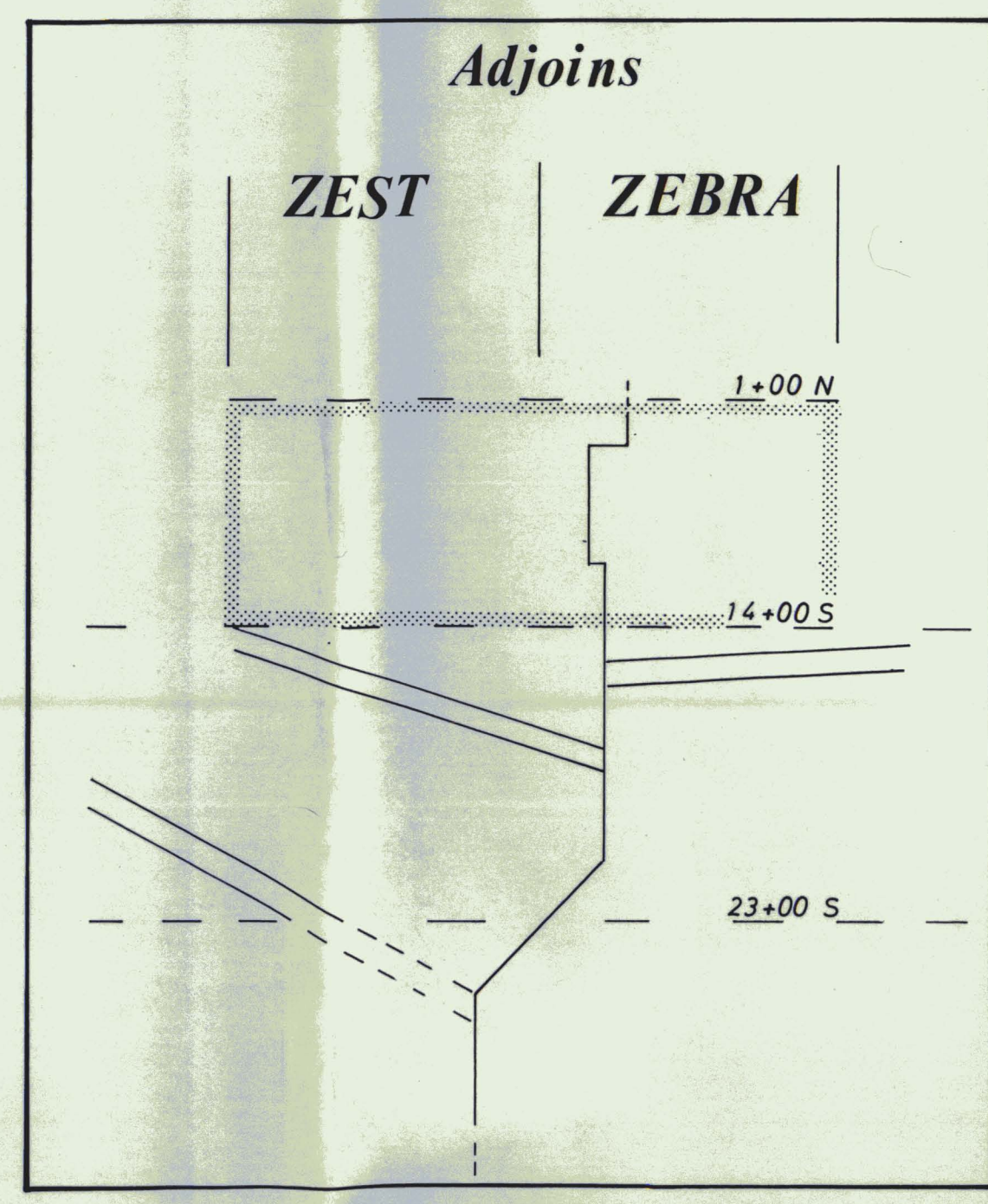

Shaded Area represents THIS Sheet

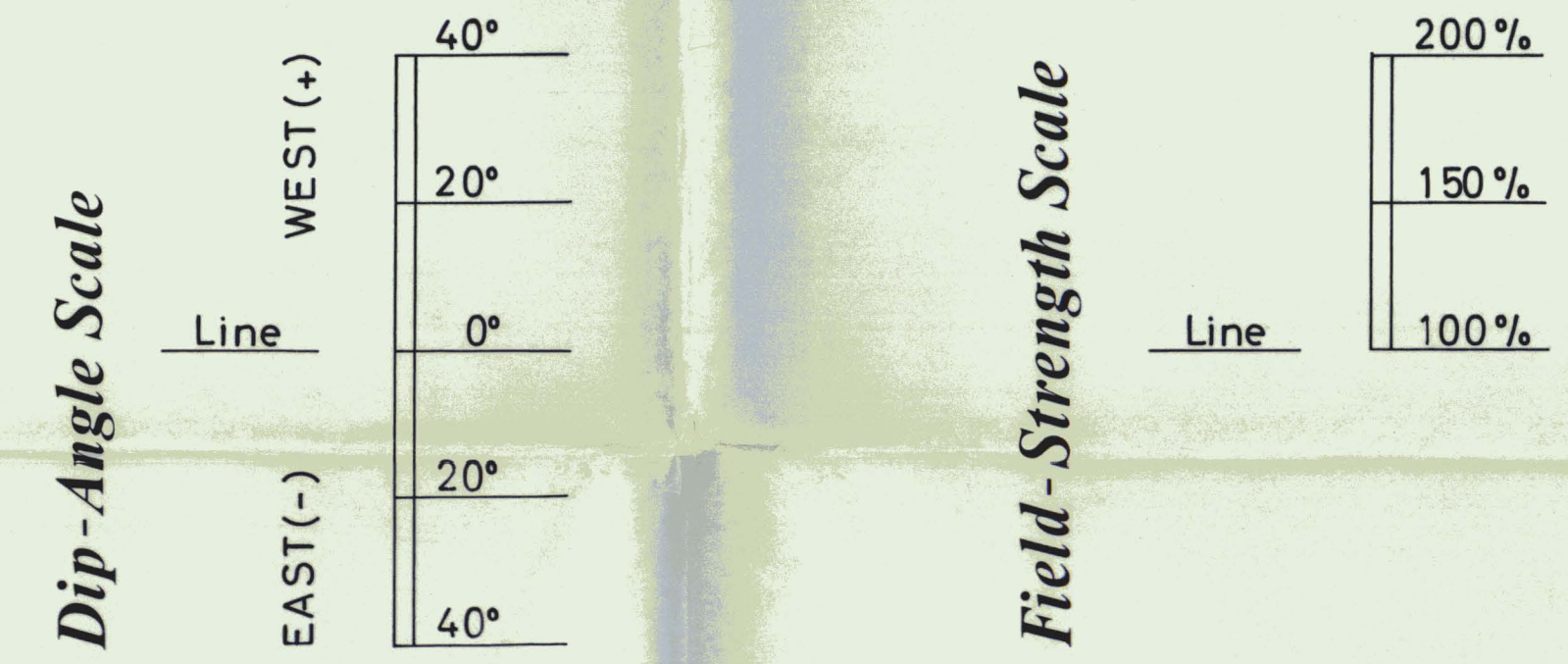

LEGEND

- | | | | |
|------|--|-------|---|
| + | Flagged Station (Compass & Chain Survey) | 56800 | Magnetometer Readings, gama |
| □ | Claim Post | 120 | Electro-Magnetic Survey Field-Strength, % |
| ⊙ | LCP (Legal-Corner-Post) | — | E -M " " Profile |
| △ | Magnetometer-Survey Base-Station | ±20 | E -M " " Dip Angle |
| ==== | Bush Road | 67 | E -M " " Profile |
| --- | Creek | | Geo-Chemical Survey, ppm. |
| ~ | Swamp | | Contour |
| | Canyon | | Depression |
| | | ○-○- | Apparent Electro-Magnetic Conductor Zone |

To accompany a Report
by Donald W. Tully, P.Eng.
dated December 2, 1981.

All Locations.
Subject to Survey

Figure 8

MAJESTIC Mining Corporation	
ELECTRO MAGNETIC SURVEY	
Instrument: PHOENIX EM (VLF-2) No. 1061	
PRINCESS Claim Group	12 Units
WATSON LAKE Mining District	
Watson Lake, Yukon Territory <i>Donald W. Tully</i>	
Scale: 1cm = 25m	Field Work Period: Jul. 15-Aug. 20, 1981
Metres	
090927	



YA57493-2
PRINCESS
YA57492-2

Map Key

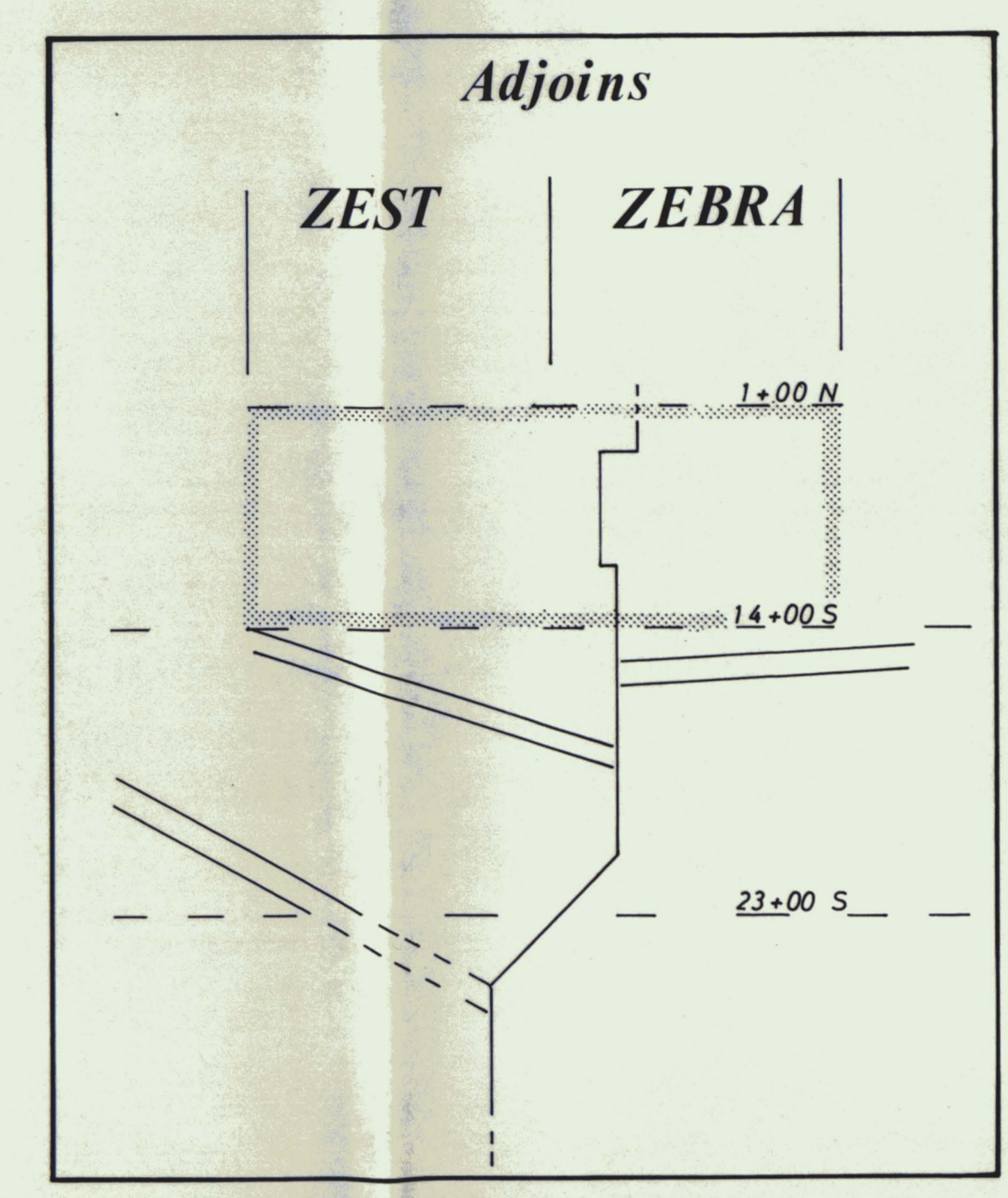

Shaded Area represents THIS Sheet

LEGEND

- + Flagged Station (Compass & Chain Survey)
- Claim Post
- △ LCP (Legal Corner Post)
- Magnetometer-Survey Base-Station
- ==== Bush Road
- Creek
- Swamp
- Canyon

- 56800 Magnetometer Readings, γ
- 120 Electro-Magnetic Survey Field-Strength, %
- E -M " " Profile
- E -M Dip Angle °
- E -M " " Profile
- 67 Geo-Chemical Survey, ppm.
- Contour
- Depression
- Apparent Electro-Magnetic Conductor Zone

To accompany a Report
by Donald W. Tully, P.Eng.
dated December 2, 1981.

All Locations.
Subject to Survey

Figure 10

MAJESTIC Mining Corporation	
MAGNETOMETER SURVEY	
Instrument used: GEM Systems Mag. No. 1202	
Contours plotted in 100-gamma Intervals	
PRINCESS Claim Group	12 Units
WATSON LAKE Mining District	
Watson Lake, Yukon Territory <i>Donald W. Tully</i>	
Scale: 1cm = 25m Field Work Period: Jul. 15-Aug. 20, 1981	
Metres	