



REPORT

ON

COP GROUP

WHITEHORSE MINING DISTRICT
YUKON TERRITORY
90 MILES NORTH WEST OF WHITEHORSE
NTS 115 H-7

FOR

BOLERO MINES LTD. N.P.L.
VANCOUVER, B.C.

BY

A. S. ASHTON, P.ENG.
DELTA, B.C.

AUGUST 22, 1980.

090884

This report was prepared by the
Geological Survey and is recom-
mended to be considered as a
document of the amount of

\$ 536 9.00

~~Commissioner of
Mining Engineer
Consolidation representation work under
Section 2 of the Quartz Mining Act.~~

Ruth Decker

Commissioner of Yukon Territory

From: Mining Recorder at Whitehorse



To: Supervising Mining Recorder at Whitehorse, Y.T.

FOR ACTION:

- ___ New Application for Lease to Prospect: Name _____
- ___ Renewal Appl'n Lease to Prospect: Name _____ No. _____
- ___ Affidavit of Expenditure on Placer Lease: Name _____ No. _____
- ___ Assignment of Prospecting Lease No. _____
- From _____ To _____
- ___ Grouping Appl'n under Sec. 52(2) Placer Mining Act: Owner _____
- ___ Diamond Drill Logs: _____
- Owner: _____ Claim Sheet No. _____
- Quartz Assessment Report: _____
- Claims: COP Claim Sheet No. 115-H-7
- Type of Report: Engineers Report and Assaying
- Submitted By: Bolero Mines Ltd.
- Claims work performed on: COP 3, 5, 7
- \$ Req. for Renewal application: _____

Signature _____
Date: _____

Reply Action

Date Ref _____

090884

Signature _____
Date _____

INDEX

Introduction	1
Summary	1
Location Map	2
Location & Access	3
Claims	3
Claim Map	4
History	5
Geology	5
Geological Map	6
Legend	7
Conclusions & Recommendations	8
Costs	8
Bibliography	10
Certificate	End
Assays	Appendix I

BOLERO MINES LTD. N.P.L.

COP PROPERTY

YUKON TERRITORY

INTRODUCTION

This report was prepared at the request of the Directors of Bolero Mines Ltd. N.P.L. The report is based on a short examination of the property on June 22, 1980, and a survey of the published literature acknowledged in the bibliography.

SUMMARY

The COP group consisting of 14 claims is approximately 90 miles north-west of Whitehorse, Yukon Territory. It is accessible by good roads with the last half mile a good trail.

Interbedded zones of marblized limestone carrying primarily copper minerals and magnetite occur on the property.

Recent exploration on the adjacent New Ridge Mines property indicates extensive zones of flat lying mineralization and the environment on your property is similar.

A two phase program of exploration is recommended for the property at a cost of \$100,000.00.



BOLERO MINES LTD. N.P.L.
 COP PROPERTY
 LOCATION MAP

Scale 1" - 155 Mi.

LOCATION & ACCESS

The claims are located west of the north end of Hopkins Lake, Yukon Territory. The latitude is approximately 61°~~15~~¹⁷' N and Longitude is approximately 136°58' W. The COP Claims are shown on Yukon Territory Claim Map 115 H-7.

The property is approximately 90 miles north-west of Whitehorse, about a quarter-mile west of the Aishihik Road. From Whitehorse, the Alaska Highway is followed westward to Canyon and hence up the Aishihik Road to Mile 32.4.

Access is by a good trail westward around the north end of Hopkins Lake.

CLAIMS

The group consists of 14 claims staked in June 1980 by prospectors D. Lampert and S. Pratt. They are in the Whitehorse Mining District and are located under the Quartz Mining Act. The claims are well staked and fulfil the requirements of the Mining Act.

<u>Claims</u>	<u>Recorded No.</u>	<u>Expiry</u>
COP 1-14 incl.	YA50702 - YA50715 incl.	Jun 23, 1981.

The claims are indicated on Yukon Territory Mineral Map 115 H-7.

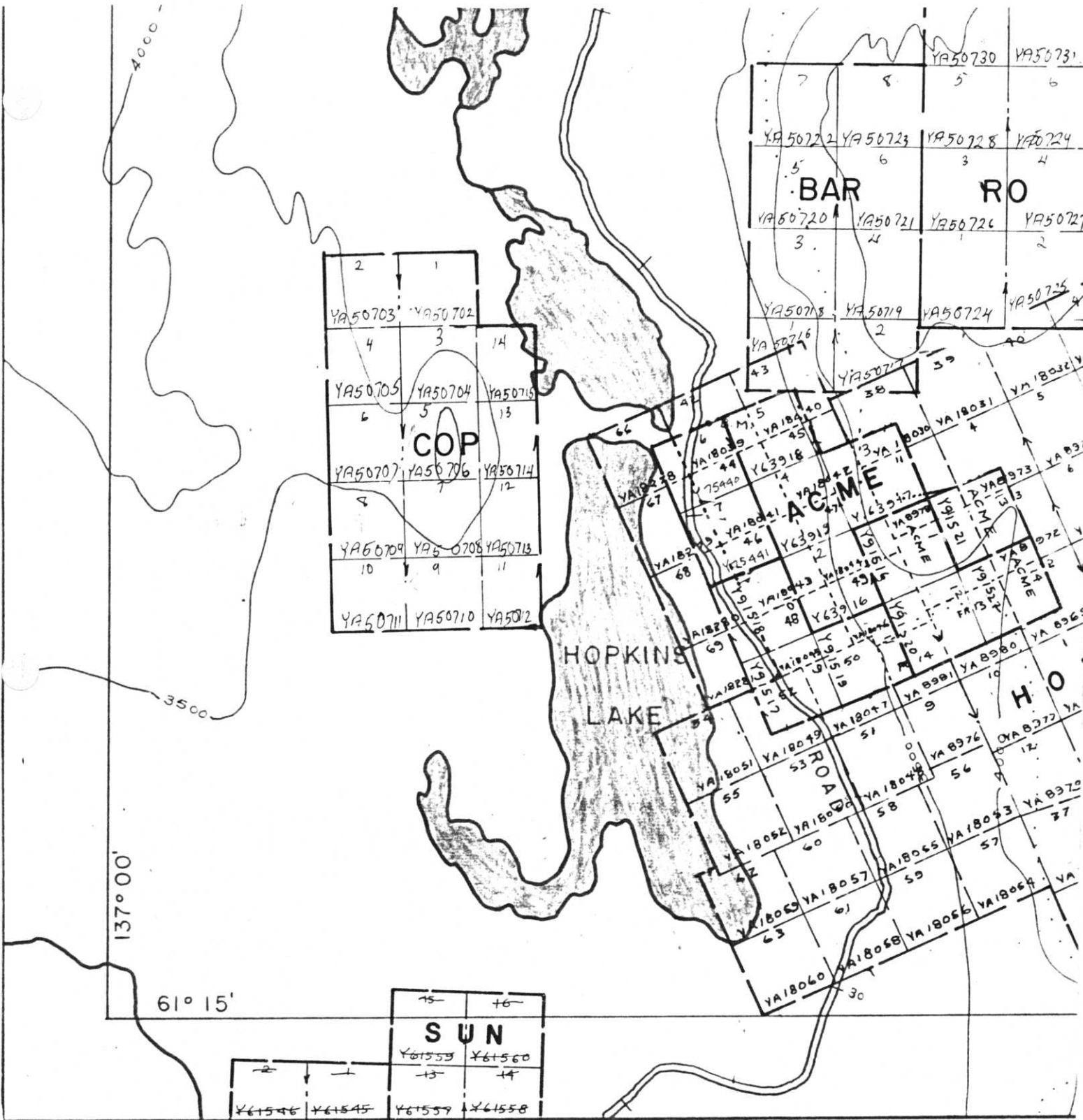

BOLERO MINES LTD. N.P.L.

COP PROPERTY

CLAIM MAP
115 H-7

Scale 1" - 1/2 mi.

HISTORY

Originally the area was staked in 1907 and intermittent work has been carried out over the years. At some date limited drilling was carried out on the property but the results are not available.

Immediately to the east across Hopkins Lake, New Ridge Mines Ltd. is developing what appears to be a bedded or skarn type deposit of copper, which may cover an extensive area.

GEOLOGY

The property lies within the Central Aishihik Metamorphic Belt, a northwest trending belt of metamorphic rocks which varies little throughout its extent.

To the west of Hopkins Lake, there appears to be at least two zones of marble at different horizons within the quartz-biotite schists. The marble zones with the mineralization appear to occur near the contacts with granitic rocks and dykes.

In the upper limey skarn zones, the mineralization is zonal and appears of limited extent. In the lower marble bed rather widely spaced fractures up to 2 feet in width carry the copper mineralization. The lower bed appears to have greater extent and is at least 12 feet thick, lying generally horizontally within the schists.

MESOZOIC

lMdim HORNBLende DIORITE: melanocratic fine-grained equigranular biotite hornblende diorite; may include Ruby Range granodiorite (Rgd) undifferentiated

LOWER CRETACEOUS AND/OR UPPER JURASSIC

lKr TANTALUS FORMATION: chert pebble conglomerate with minor interbedded sandstone and shale

LOWER AND MIDDLE JURASSIC

J LABERGE GROUP: poorly sorted, white and buff weathering, medium bedded to massive sandstone with interbedded pebble and boulder conglomerate and minor shale

Mqmp PORPHYRITIC QUARTZ MONZONITE: porphyritic (pink K-feldspar) medium-grained, hornblende biotite quartz monzonite; includes minor pink quartz monzonite (Rqm) and hornblende granodiorite (Rgdm) undifferentiated

TRIASSIC (?)

Rqm PINK QUARTZ MONZONITE: pink coarse-grained leucocratic quartz monzonite and porphyritic pink quartz monzonite; may include porphyritic quartz monzonite (Mqmp) undifferentiated

Rgdm HORNBLende GRANODIORITE: dark grey weathering, coarse-grained, equigranular biotite hornblende granodiorite to quartz diorite; commonly shows layering or foliation by alignment of mafics; includes pink quartz monzonite (Rqm) and porphyritic quartz monzonite (Mqmp) undifferentiated

Rgd RUBY RANGE GRANODIORITE: medium-grained, equigranular, grey, hornblende biotite granodiorite; includes undifferentiated diorite (lMdim); may include biotite granite (Tg)

Rvb MASSIVE GREEN VOLCANICS: massive dark green epidotized basalt; minor tuff breccia

PROTEROZOIC AND/OR PALEOZOIC

EPm AMPHIBOLITE: dark green fine-grained amphibolite; includes interfoliated schist and gneiss

EPsq HORNFEISED SCHIST: dark purplish brown staurolite cordierite biotite hornfels with relict schistose texture

EPc MARBLE: light grey and white coarsely crystalline, locally finely laminated fetid marble

EPsbq BIOTITE SCHIST: brown grey weathering, recessive, chlorite muscovite biotite quartz schist and micaceous quartzite; garnetiferous; minor amphibolite, marble and skarn

BOLERO MINES LTD. N.P.L.

LEGEND

MAP 17-1973

Two samples were taken from the lower marble - the first #1313, a 2.5 foot sample across a vertical quartz stringer zone, assayed 18.14% Copper, 3.43 oz. Silver and 0.034 oz. Gold; the second sample #1314, some grabs from a narrow zone two to three inches in width, indicated 0.089% Copper, 0.06 oz. Silver and 0.006 oz. Gold per ton.

CONCLUSIONS & RECOMMENDATIONS

The COP claims are sited adjacent to a property which has been subjected to an extensive percussion drilling program. This work has apparently indicated a relatively flat lying extensive zone of potentially economic mineralization. Your property contains a similar favourable lithology with similar structural controls. In consequence, a phased exploration program is recommended.

COSTS

Phase I

Establish Camp	\$ 7,000.00
Grid and Base Lines: 300' intervals, 22.15 mi. @ \$200/mi.	4,430.00
Geological mapping & prospecting	5,000.00
Geophysical Survey - Mag & VLF-EM	7,000.00
Engineering & Supervision	3,500.00
Contingencies	<u>3,070.00</u>
	<u>\$30,000.00</u>

COSTS (Contd.)

Phase II - Contingent on results of Phase I.

Camp Costs	\$ 5,000.00
Detail geophysics	3,000.00
Trenching, stripping and sampling	5,000.00
Diamond drilling 1500 feet @ \$35/ft.	52,500.00
	<hr/>
	65,500.00
Contingencies	4,500.00
	<hr/>
	\$ 70,000.00
	<hr/> <hr/>
Total Phases I & II	<u>\$100,000.00</u>

Respectfully submitted,

A. S. Ashton, P. Eng.

Delta,
British Columbia.

August 22nd, 1980. ✓

BIBLIOGRAPHY

Cairnes, D.D. G.S.C. Summary Report 1909 pp. 26-37.
Reprinted Bostock, 1957, pp. 276-282.

D.J. Tempelman-Kluit G.S.C. Paper 73-41.

D.J. Tempelman-Kluit & R. Currie G.S.C. Paper 77-8.

CERTIFICATE OF QUALIFICATIONS

I, Arthur Sydney Ashton, do hereby certify that:

1. I am a practising geological engineer with residence at 5441 - 7B Avenue, Delta, B.C.
2. I am a graduate of the University of Toronto and have been granted the degree of Bachelor of Applied Science.
3. I have been practising my profession as a geological engineer for thirty years.
4. I am a member of the Association of Professional Engineers of British Columbia and a member of the Association of Professional Engineers of Ontario.
5. Examination of the property was carried out on June 22, 1980.
6. I have no interest directly or indirectly in the property or securities of Bolero Mines Ltd. N.P.L.
7. I grant permission to use this report for the Securities Commission or in a prospectus.

A. S. Ashton, P. Eng.

Delta,
British Columbia.
August 22nd, 1980.

APPENDIX I

General Testing Laboratories

A Division of SGS Supervision Services Inc.

1001 EAST PENDER ST., VANCOUVER, B.C., CANADA, V6A 1W2
 PHONE (604) 254-1647 TELEX 04-507514 CABLE: SUPERVISE



TO:
 A.S. Ashton
 5441 7B Avenue
 Delta, B.C.
 V4M 1S7

CERTIFICATE OF ASSAY

No.: 8007-1556 DATE: July 24, 1980

We hereby certify that the following are the results of assays on:

Ore

MARKED	GOLD	SILVER	Copper	XXX	XXX	XXX	XXX	XXX
	(oz/st)	(oz/st)	Cu (%)					
P.O. # E - 6873								
1313	0.034	3.43	18.14					
1314	0.006	0.06	0.89					

REJECTS RETAINED ONE MONTH. PULPS RETAINED THREE MONTHS. ON REQUEST PULPS AND REJECTS WILL BE STORE FOR A MAXIMUM OF ONE YEAR.

ALL REPORTS ARE THE CONFIDENTIAL PROPERTY OF CLIENTS. PUBLICATION OF STATEMENTS, CONCLUSION OR EXTRACTS FROM OR REGARDING OUR REPORTS IN NOT PERMITTED WITHOUT OUR WRITTEN APPROVAL. ANY LIABILITY ATTACHED THERETO IS LIMITED TO THE FEE CHARGED.

L. WONG

PROVINCIAL ASSAYER

Analytical and Consulting Chemists, Bulk Cargo Specialists, Surveyors, Inspectors, Samplers, Weighers

MEMBER: American Society For Testing Materials • The American Oil Chemists Society • Canadian Testing Association
 REFEREE AND OR OFFICIAL CHEMISTS FOR: National Institute of Oilseed Products • The American Oil Chemists' Society
 OFFICIAL WEIGHMASTERS FOR: Vancouver Board Of Trade



General Testing Laboratories

A Division of SGS Supervision Services Inc.

1001 EAST PENDER ST., VANCOUVER, B.C., CANADA, V6A 1W2
 PHONE (604) 254-1647 TELEX 04-507514 CABLE: SUPERVISE

TO:
BOLERO MINES LTD.
 c/o Canaria Investments
 13th Floor - 409 Granville St.,
 Vancouver, B.C.
 Attn: Mr. Frank Conroy

CERTIFICATE OF ASSAY

No.: **8010-3154** DATE: **Nov. 20/80**

We hereby certify that the following are the results of assays on: **Ore**

MARKED	GOLD	SILVER	XXX	XXX	Copper	XXX	XX	XXX
	oz/st	oz/st			Cu (%)			
B-52371								
TBC 1	0.005	3.88			9.65			
TBC 2	0.050	0.30			1.95			
TBC 3	0.096	1.03			5.02			
TBC 4	0.024	3.22			6.68			



NOTE: REJECTS RETAINED ONE MONTH. PULPS RETAINED THREE MONTHS. ON REQUEST PULPS AND REJECTS WILL BE STORE FOR A MAXIMUM OF ONE YEAR.

ALL REPORTS ARE THE CONFIDENTIAL PROPERTY OF CLIENTS. PUBLICATION OF STATEMENTS, CONCLUSION OR EXTRACTS FROM OR REGARDING OUR REPORTS IS NOT PERMITTED WITHOUT OUR WRITTEN APPROVAL. ANY LIABILITY ATTACHED THERETO IS LIMITED TO THE FEE CHARGED.

L. Wong

PROVINCIAL ASSAYER

Analytical and Consulting Chemists, Bulk Cargo Specialists, Surveyors, Inspectors, Samplers, Weighers

MEMBER: American Society For Testing Materials • The American Oil Chemists Society • Canadian Testing Association
 REFEREE AND OR OFFICIAL CHEMISTS FOR: National Institute of Oilseed Products • The American Oil Chemists' Society
 OFFICIAL WEIGHMASTERS FOR: Vancouver Board Of Trade



TO:
BOLERO MINES LTD.
 1106 - 700 West Pender Street
 Vancouver, B.C.

General Testing Laboratories

A Division of SGS Supervision Services Inc.

1001 EAST PENDER ST., VANCOUVER, B.C., CANADA, V6A 1W2
 PHONE (604) 254-1847 TELEX 04-507514 CABLE: SUPERVISE

CERTIFICATE OF ASSAY

No.: 8106-2254 DATE: June 30/81

We hereby certify that the following are the results of assays on: **Ore**

MARKED	GOLD	SILVER	Copper	XXX	X XX	XXX	XXX	XXX
	oz/st	oz/st	Cu (%)					
1	0.058	3.83	19.27					
2	0.038	0.10	0.60					
3	0.032	1.54	4.22					
4	0.034	1.03	3.38					
5	0.022	0.51	21.73					
6	0.032	0.95	21.95					
7	0.012	0.54	19.03					



NOTE: REJECTS RETAINED ONE MONTH. PULPS RETAINED THREE MONTHS. ON REQUEST PULPS AND REJECTS WILL BE STORE FOR A MAXIMUM OF ONE YEAR.

ALL REPORTS ARE THE CONFIDENTIAL PROPERTY OF CLIENTS. PUBLICATION OF STATEMENTS, CONCLUSION OR EXTRACTS FROM OR REGARDING OUR REPORTS IS NOT PERMITTED WITHOUT OUR WRITTEN APPROVAL. ANY LIABILITY ATTACHED THERETO IS LIMITED TO THE FEE CHARGED.

L. Wong
 PROVINCIAL ASSAYER

Analytical and Consulting Chemists, Bulk Cargo Specialists, Surveyors, Inspectors, Samplers, Weighers

MEMBER: American Society For Testing Materials • The American Oil Chemists Society • Canadian Testing Association
 REFEREE AND OR OFFICIAL CHEMISTS FOR: National Institute of Oilseed Products • The American Oil Chemists' Society
 OFFICIAL WEIGHMASTERS FOR: Vancouver Board Of Trade



TO A → Dave Jennings
Whitehorse Mining Recorder

FROM DE ← Ruth Debicki
Staff Geologist

SECURITY - CLASSIFICATION - DE SÉCURITÉ
OUR FILE / NOTRE RÉFÉRENCE
YOUR FILE / VOTRE RÉFÉRENCE
DATE Nov. 6, 1981

SUBJECT / OBJET: Assessment report, COP claims, 115 H 7

Bolero Mines Ltd., submitted an initial report on their COP claims, 115 H 7, on September 9, 1981. That report was an engineers' report, which described a visit to the property made before the claims were recorded, and included some geochemical results obtained both before and after the claims were recorded. A second report was submitted, which described trenching and pitting done on the property within the renewal year for the claims, and after the renewal year for the claims. The work done after the renewal year was really just putting tags on the posts, etc., and not the sort of work that is eligible for assessment credit.

After long and careful deliberation, punctuated recently by 2 or 3 telephone calls (reported to be URGENT) from the company president, and finally the company lawyer, I have decided that the Schedule allows the following credit to be given for the reports submitted.

- Preparation of the report was done in renewal year, although work was done before claims were recorded.
- Preparation of report by qualified person.....\$500.00
- Assays received during renewal year at \$20.00 each.....\$120.00
- Trenching done during renewal year, and described in the second report was awarded actual costs. Actual costs can be claimed when the work is done by the recorded holder, and the work was done by an agent of the company which is recorded holder of the claims.....\$4749.00
- Total work eligible for credit.....\$5369.00

The lawyer for the company was advised by telephone on November 5, 1981, that the claims would be renewed for 3 years each (14 claims X \$100.00 per annum X 3 years = \$4200.00). Please advise the company of this in writing, and refund the excess of recording fees. Thanks.

Ruth

P.S. I received only one copy of the 2nd report - which I have kept.

BOLERO MINES LTD.
1106 - 700 West Pender St.,
Vancouver, B.C. V6C 1G8



October 9, 1981

Mr. Roy Carlson
1160 Haro Street, Ste. 204,
Vancouver, B.C.

Dear Sir:

Please find enclosed copies of paid invoices as requested,
pertaining to Cop Group of Claims, located in the Yukon.

We trust you will information satisfactory and in order.

Yours very truly,
BOLERO MINES LTD.

A handwritten signature in cursive script, appearing to read "T.M. Bunyan".

T.M. Bunyan
President

TMB:al
enclosures

MR B. BAXTER

HI BLAKE SORRY TO TAKE SO LONG WITH
THIS. WE HAVE BEEN LOOKING FOR THE BILLINGS
FOR LAST FALL'S WORK. BUT FIND OUT IT IS TIED
UP WITH THE ACCTS. THE AMOUNT IS APPROXIMATELY
\$3,500.00 - FOR SETTING UP TENT CAMP, RUNNING LINE
CHECKING CLAIM POSTS, GENERAL PROSPECTING. 2 MEN
5 DAYS, TRANSPORTATION, CAMP & CAMP GEAR ETC.

THANKS

A handwritten signature in cursive script, appearing to read "Roy Carlson".
ROY CARLSON

CARLSON DRILLING

co. ltd.

929 - 510 West Hastings Street, Vancouver, B.C. V6B 1L8

Telephone 688-4024

BOLEK'S MINES

MAY 22^{'81} TO MAY 30^{'81} INC.

2 MEN @ 150⁰⁰ PER EA. 300⁰⁰ X 8 DAYS

\$2400⁰⁰

TRUCK & DAY @ 50⁰⁰ (R. CARLSON'S TRUCK) 300⁰⁰

THUGGER DYNAMITE CAPS FUSE + FUEL 518⁰⁰

HOTEL CAMP & SUPPLYS FOOD 8 DAYS @ 50 EA. 800⁰⁰

AIR FARE VAN TO WHITEHORSE \$365⁵⁰ EA. 731⁰⁰

\$4749⁰⁰

RE ASSEMENT WORT ON COP CLAIMS

1 TO 14.

HOPKINS LAKE AREA MAP # 115-H-7

Paid in Full
July 27/81

C. Baker
Owner

4749.00

1869.50

355.00

6973.50

8/81

~~2077~~

BOHARO MINES

JULY 10TH TO 16TH

1 MAN 6 DAYS @ 150 ⁰⁰	\$ 900 ⁰⁰
TRUCK 2 DAYS @ 50 ⁰⁰	100 ⁰⁰
HOTEL & FOOD 6 @ 75 ⁰⁰	450 ⁰⁰
AIR FARE VAN TO W. HORSE RETURN	357 ⁵⁰
GAS & OIL	62 ⁰⁰

\$ 1869⁵⁰

RE FILEING ASSEMENT WORK ON

COP 1 TO 14 CL. HOPKINS LAKE AREA
MAP # 115-H-7

TRIP TO PROP. WITH ENGINEER. TAGING
POSTS & SAMPLING PITS

[Handwritten signature]

Pay # 6973⁵⁰

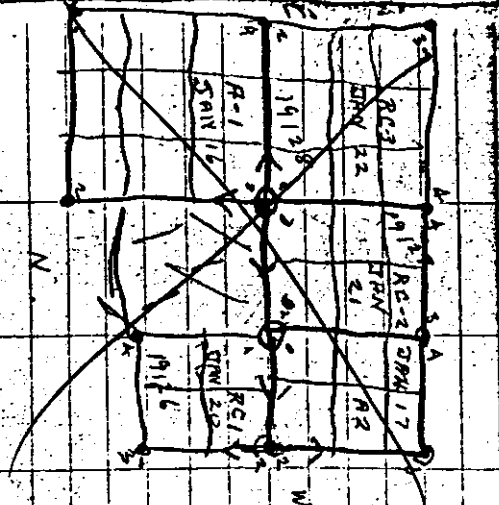

D
 12
 PHILLIPS
 CHASE
 OPTRO

MAY 1981

BOARD MINES LTD HOPKINS LAKE PROPERTY

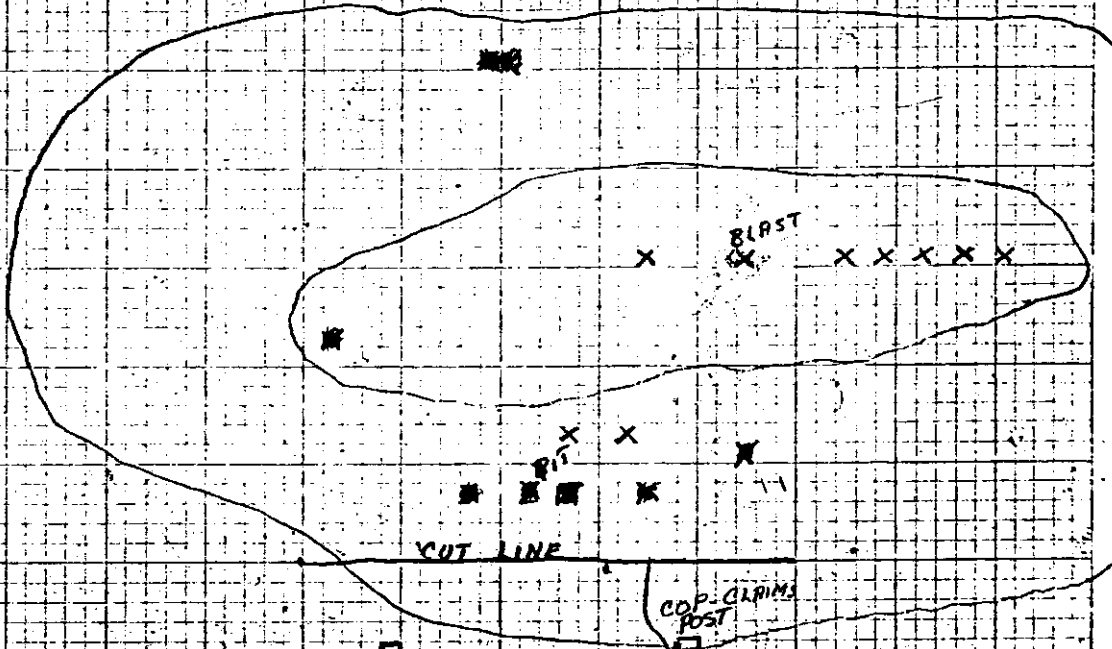

LEGEND

- CLAIM POST
- ← 500' →
- DRILL BLAST PTS
- × BLAST FOR SHAPPLIN

12-13

CO. CLAIM POST

13-14

TRAIL



TO GROUP MINERAL CLAIMS

OFFICE DATE STAMP

OR AGENT(S) OF THE OWNER(S)
MS

NAME(S)

LOCATION

CLAIM SHEET NO.

- #1
- #2
- #3
- #4
- #5
- #6
- #7
- #8
- #9
- #10
- #11
- #12

HOPKINS LAKE

115H-7

IP THE SAID CLAIMS FOR THE PERFORMANCE OF WORK PROVISIONS OF SECTION 52 OF THE YUKON QUARTZ FORM "E"

ABOVE CLAIMS ARE ADJOINING AS SHOWN ON ATTACHED

9 81

owner(s) signature

Indian and Northern Affairs Canada / Affaires indiennes et du Nord Canada

GENERAL RECEIPT

RÉCÉPISSÉ GÉNÉRAL

Date Nature and No. of Remittance — Forme et n° de la remise

Branch Direction Invoice No. — Facture n°

Location — Endroit

14 July 81

Received the sum of — Reçu la somme de

2007

Alber

From — De

John - Purdie & Sons - Juice

For — Pour

4700 DOLLARS \$ 355.00

FOR OFFICE USE ONLY

FORM "E" NO.

RECEIPT NO.

DATE APPLIED.

Botanor Mines Ltd.

1833-700 W. Gordon Street

Vancouver, B.C.

70 Clavin Street 1st Floor

Hopkins Lake Area 115-H-7

M. Martin

Authorized Officer — Fonctionnaire autorisé

4906