



GEOLOGICAL ASSESSMENT REPORT

RPP CLAIMS 090856

(RPP 1-19 YA51223-YA51241)

WHITEHORSE MINING DISTRICT

NTS 105 F/5

LATITUDE - 61° 21' N

LONGITUDE - 133° 54' W

AUGUST 27-30, 1980 AND MAY 28 - JUNE 20, 1981



By: Ronald C. R. Robertson
Phil D. Van Angeren

090856

This report has been examined by the Geological Evaluation Unit and is recommended to the Commissioner to be considered as representation work in the amount of

\$ 1,950.00

~~Resident Geologist or
Resident Mining Engineer~~

~~Considered as representation work under
Section 53 (4) Yukon Quartz Mining Act.~~

Ruth Debicki Oct 1/81
Commissioner of Yukon Territory

for

Re-evaluated Co. request - Nov. 6/81.

This report has been examined by the Geological Evaluation Unit under Section 53 (4) Yukon Quartz Mining Act and is allowed as representation work in the amount of \$ 9,500.00.

R Debicki
Regional Manager, Exploration and Geological Services for Commissioner of Yukon Territory.

Supervising Mining Recorder of Whitehorse, Y.T.

ACTION ARE:

NEW APPL'N for PLACER LEASE to PROSPECT: Name:

RENEWAL APPL'N PLACER LEASE to PROSPECT: Name:

Lease No.

AFFIDAVIT of EXPENDITURE on PLACER LEASE. Name:

Lease No.

ASSIGNMENT of PLACER LEASE No.

From:

To:



GROUPING APPL'N UNDER SEC. 52(2) PLACER MINING ACT.

Owner:

DIAMOND DRILL LOGS:

Claims:

Claim sheet no:

QUARTZ ASSESSMENT REPORT:

Claims: RPP 1-19

Claim sheet no. 105-F-5

Type of report: Ground Magnetic Survey
Electromagnetic
Geochemical ANALYSIS.

Submitted by: AGIP CANADA Ltd.

Cls. work performed on: RPP 1-19

\$ Req. for ren. application \$1950.00

Reevaluated - co. request
for 9500. ~~000~~ Nov 6/81

A. Southwick 10/9/81
Signature

PLY ACTION.

Date Ret.

090856

Signature

TABLE OF CONTENTS

1. INTRODUCTION

- 1.1 General Statement
- 1.2 Location and Access
- 1.3 Physiography

2. GEOLOGY

- 2.1 Introduction
- 2.2 Lithologies and Assemblages
- 2.3 Structure and Metamorphism
- 2.4 Mineralisation

3. WORK PROGRAM

- 3.1 Introduction
- 3.2 1980 Program
- 3.3 1981 Program

4. REFERENCES

APPENDICES

- APPENDIX A - List of Claim Names and Grant Numbers
- APPENDIX B - Analytical Results and Methods.
- APPENDIX C - Personnel and Man-day Distribution.
- APPENDIX D - Statement of Costs
- APPENDIX E - Statement of Qualifications

FIGURES

- FIGURE 1 Distribution of RPP Claims
- FIGURE 2a Geology of RPP Claims
- FIGURE 2b Grid Geology
- FIGURE 3a Grid Geophysics - VLF-EM Profiles
- FIGURE 3b Grid Geophysics - VLF-EM contoured data
- FIGURE 3c Grid Geophysics - Total field magnetic survey
- FIGURE 4a Grid Geochemistry - Sample numbers and gold values
- FIGURE 4b Grid Geochemistry - Copper and Zinc values
- FIGURE 4c Grid Geochemistry - Lead and Silver values

1. INTRODUCTION

1.1 General Statement

This report describes work carried out by AGIP Canada Ltd. on the RPP Claims (RPP 1-19; YA51223 to YA51241) during the periods August.

27 to 30, 1980 and May 29 to June 20, 1981.

Conventional geological, geochemical and geophysical exploration techniques were used to test the base-metal potential of the claim group.

In 1980, the work was carried out by three people camped on the claim block whereas four people operated in 1981, again camped on the claim block.

1.2 Location & Access

The RPP Claims are located within the Whitehorse Mining district, near Mendocina Creek at latitude $61^{\circ}21'$ N and longitude $133^{\circ}54'$ W. (NTS 105 F/5). This is 90 km northeast of Whitehorse. Claim distribution is shown in Figure 1.

Access is from Whitehorse by helicopter. All food and supplies were brought in directly from there.

1.3 Physiography

The RPP Claims are situated in an area covered mainly by moderately steep mountainous terrain ranging in altitude from 1,300 to 1,900 m ASL. The physiography is typical of the Pelly Mts. and the Big Salmon Range; long and wide valleys separated by moderately steep valley walls and high rounded ridges and mountains.

Black spruce and alders are abundant below 1400 m.

meters, whereas low bushes and alpine vegetation are found up to 1700 m altitude.

133° 55'



HAL
(AMAX)

	RPP 1 YA 51223	RPP 3 YA 51225	RPP 5 YA 51227	
	RPP 2 YA 51224	RPP 4 YA 51226	RPP 6 YA 51228	
RPP 19 YA 51241	RPP 7 YA 51229	RPP 9 YA 51231	RPP 11 YA 51233	RPP 15 YA 51237
RPP 18 YA 51240	RPP 8 YA 51230	RPP 10 YA 51232	RPP 12 YA 51234	RPP 16 YA 51238
		RPP 13 YA 51235	RPP 14 YA 51236	RPP 17 YA 51239

61°20'



AGIP CANADA LTD.

DISTRIBUTION OF
RPP CLAIMS
1 to 19

YUKON

Scale: 1:31,680

NTS: 105F/5

Date: AUG. 1981

Author: P.D. v.A.

Drawn by: GTSz

Figure: 1

2. GEOLOGY

2.1 Introduction

The Mendocina Creek area and the RPP claims are located approximately 22 km. east of the Teslin Suture; at this point the Suture Zone is about 12 km. wide. The Mendocina Creek area is a narrow (3 - 7 km), southeast trending belt of metasedimentary and metavolcanic rocks sandwiched between two Cretaceous granitoid intrusions, the Quiet Lake batholith and the Dycer Creek stock. The rocks of this belt seem to be largely of Paleozoic age but may range from Proterozoic to as young as Mesozoic, and exhibit considerable variations in degree of metamorphism and cataclasis. All units believed to occur in this belt are also present within the Teslin Suture Zone to the west and in the Pelly-Cassiar Platform and Nasina Shelf to the east. Thus this belt seems transitional (in terms of tectonic relationships) between the suture zone and the platform.

Within the platform, the relationships between the various rock units are relatively well-known; Lower Paleozoic rocks of Nasina Shelf facies are autochthonous whereas basic volcanic rocks and "Klondike Schist" facies metasedimentary rocks are assigned to the Anvil-Campbell and Nisutlin allochthons, respectively. Within the Teslin Suture Zone these sequences are difficult to separate except on a regional scale. Relationships at local and outcrop scales are extremely complex. In the Mendocina Creek area and the RPP claims the same problem was

encountered; mapping has been carried out entirely on a lithological basis. Since many of the rock types present in and near the RPP claims are known to occur in more than one of the regional assemblages, and there are few distinctive horizons, it has not been possible to assign particular outcrops or lithological units to specific assemblages. Hence our understanding of the local structure and of allochthonous versus autochthonous relationships is at a very early stage.

2.2 Lithologies and Assemblages

The major rock types present within the RPP claim group are dark graphitic quartzites, siltstones and shales (locally limy or dolomitic), rusty weathering pale sericite schists (locally kaolinised(?) and with occasional minor amounts of pyrite and base metal sulphides), quartz - muscovite, quartz - biotite and quartz - chlorite schists, gritty quartz-feldspar schists and chloritic and actinolitic greenstones (metamorphosed andesitic to basaltic volcanic and tuffaceous rocks). Some outcrops of the more felsic schists have a strongly-developed flaser fabric; these have been mapped separately (Figure 2a, b).

Many of the greenstones can probably be assigned to the Permo-Carboniferous volcanic sequence of Anvil-Campbell allochthon, although some similar rocks are locally common in the "Klondike Schist" and the Ordovician-Silurian shelf sequence. A distinctive dark siliceous carbonate rock, with minor amounts of green chromian muscovite, typical of the Anvil-Campbell suite, was noted adjacent to

the property.

Quartz-mica, quartz - chlorite and quartz - feldspar schists may belong to "Klondike Schist" facies units of the Nisutlin allochthon and to autochthonous Ordovician-Silurian sequences of the Omineca Crystalline Belt. Some of these units contain tiny blue quartz grains, typical of "Klondike Schist" sequences.

Dark carbonaceous quartzites, siltstones and shales, and lesser amounts of rusty weathering sericite schist (which host a few small sulphide showings within the RPP claims) are believed to form part of the Ordovician-Silurian Nasina Shelf sequence, although similar black siliceous phyllites and schists are known to occur in some "Klondike Schist" sequences. Thus it has not been possible to assign these units to an autochthonous or allochthonous assemblage in the Mendocina Creek area; local structural relationships compound the problem.

Quartzo-feldspathic schists with strong cataclasis occur at several places within the claim group (Figures 2a, b; Unit 5). Vein quartz segregations show strong rodding within this unit which occurs as several zones of strong deformation rather than a lithological unit. Blastomylonites and coarse-grained muscovite - quartz - feldspar gneisses with a pronounced flaser fabric are exposed over large areas to the south and west of the RPP claims. The gneisses are of granitic composition.

In the western part of the RPP claims, a 30 m wide granitic sill intrudes dark siliceous schists. The sill

is probably an offshoot of the Dycer Creek stock which outcrops approximately 2 km to the north.

2.3 Structure and Metamorphism

Rocks of the Mendocina Creek area and the RPP claims are very strongly deformed. Slices of a variety of lithologies, some of which belong to the Nisutlin and Anvil-Campbell allochthons, are interpreted to have been incorporated into a sequence of Ordovician-Silurian shelf facies sediments by regional movements related to formation of the Teslin Suture Zone. Elsewhere in the Quiet Lake map sheet (NTS 105F) this Ordovician-Silurian sequence is known to be autochthonous; in the area of the RPP claims, these units have been severely disrupted and deformed, and it cannot be shown that this relationship is valid here.

Most units strike approximately east-west, and dips are everywhere steep. Contacts between individual units are rarely seen. Strong folding is widespread and several zones of strong shearing and silicification can be mapped. A number of late faults are shown on Figures 2a, b; these may have been produced by emplacement of the Quiet Lake and Dycer Creek intrusions.

Metamorphic grades are quite variable within the RPP claims; most rocks are of lower greenschist facies, at least. Biotite porphyroblasts are common in many meta-sedimentary units and a few of the metavolcanic units. Some carbonaceous horizons have tiny unidentified porphyroblasts which may be poorly formed andalusites. Garnet

porphyroblasts are locally common in actinolitic greenstones. Porphyroblast development may be a result of thermal metamorphism related to the Quiet Lake and Dycer Creek intrusions, rather than a regional metamorphic effect.

2.4 Mineralisation

Minor amounts of disseminated pyrite occur in sericite schists and dark carbonaceous units. At the showing in the centre of the claim block, several short, narrow lenses of pyrrhotite and pyrite-bearing schist carry minor amounts of sphalerite, galena and chalcopyrite. A second showing consists of a 10 cm wide, 3 m long, band of sericite schist with a few thin laminae of sphalerite.

On a regional scale the Ordovician-Silurian sequence is known to host several base metal deposits and prospects. Smaller showings, such as those described above, are abundant. The position of the RPP claims, close to the Teslin Suture Zone, and the disrupted, discontinuous nature of the rock units in the area makes it unlikely that there is an intact section of the Ordovician-Silurian sequence of sufficiently large size to host an economic base metal deposit. In addition, minor amounts of sulphides occur in some of the greenstones and in some of the "Klondike Schist" facies unit; some anomalous geochemical analyses of stream sediments and soils in the RPP claims are undoubtedly due to contributions from these units.

3. WORK PROGRAM

3.1 Introduction

In 1980, AGIP Canada Ltd. carried out a regional stream sediment sampling programme in the Mendocina Creek area, as follow-up on G.S.C. Open File 564 (Geochemistry in Quiet Lake map sheet 105F). During preliminary mapping, several outcrops of schist with narrow, discontinuous, bands of iron, copper, lead, and zinc sulphides were found and the RPP claims were staked.

Subsequently, a small grid was laid out, for geological, geochemical and geophysical purposes. The geophysical survey and preliminary mapping were done that summer.

In 1981, following study of the geophysical and geological data, part of the grid was extended and most of it was soil sampled and mapped in detail.

3.2 1980 Program

A small grid was laid out over the area believed to be underlain by the graphitic quartzite and sericite schist units which host the base metal showings located earlier. After preliminary mapping all 9.8 km of the grid were surveyed with VLF-EM and magnetometer instruments (Figures 3a, b, c). A Geonics Ltd. EM-16 VLF-EM receiver tuned to Annapolis, Maryland, (Station NSS, 21.4 KHz) was used to collect both in-phase and quadrature data during the electromagnetic survey. All magnetic data was recorded with a Geometrics G-816 proton precession magnetometer and

the data was corrected for diurnal variations using a Geometrics G-846 base-station recorder. These surveys were carried out on August 28 and 29. The VLF-EM data revealed numerous narrow conductors, parallel to the strike of the underlying geology.

Data indicates good near-surface conductivity, the conductors being less than a few meters in thickness and dipping very steeply to the north.

Many of these conductors are truncated, suggesting the presence of cross faults or of strong folding. The magnetic survey data patterns conform to the general east-west strike of the rock units. Magnetic responses are caused by near-surface concentration of magnetite and/or pyrrhotite. There is no clear cut association of VLF-EM conductors and magnetic anomalies.

The electromagnetic data indicate presence of the more graphitic members of the quartzite-sericite schist unit.

Magnetic data suggests the presence of pyrrhotite or magnetite within some of these horizons.

3.3 1981 Program

The southwestern part of the grid was extended in order to cover possible extensions of favourable geological units and of the geophysical anomalies (Figures 3 a, b, c). The grid, with emphasis on the western half, was soil sampled on 50 m intervals and the -80 mesh fraction of each sample was analysed for Cu, Pb, Zn, Ag and Au. A total of 191 samples were collected; analytical results are shown in Figures 4a - c, except for a few Au analyses not yet received.

All anomalous values detected (#11517 - 1500 p.p.m. Cu, #11516 and #11577 - 260 and 210 p.p.m. Pb, #11516 - 4.8 p.p.m. Ag, #11535 - 1390 p.p.m. Zn and #11012 - 200 p.p.b. Au) occur in creek beds where graphitic quartzite and sericite schist are exposed.

Elsewhere favourable rock units and geophysical anomalies are unaccompanied by anomalous geochemistry. This may be a result of the extensive blanket coverage by outwash and talus originating from the cirque on the southern edge of the claim block. This area is underlain by barren, felsic blastomylonite.

Ten continuous chip samples (each over a 5 m interval) were collected within interlayered graphitic quartzite and sericite schist units in the northern portion of the claim block. This was done in order to trace a zinc-rich horizon of sericite schist.

The samples were crushed and pulverized to -200 mesh and analyzed for Cu, Pb, Zn, Ag and Au.

Results indicate high background for zinc but low values for the other elements (Appendix B).

The grid was mapped at a scale of 1:2500 and the claim block was mapped at a scale of 1:10,000 using an enlarged airphoto (#A12176-23). The geology is described in section 2 and shown in Figures 2a, b.

Outcrop distribution is restricted to creeks, where these form gorges, and to ridge tops. No new massive sulphide bands were found other than those found in 1980.

The geology seems to represent an environment similar to that associated with some massive sulphide deposits.

4. REFERENCES

- Tempelman-Kluit, D. J. - "Geology of Quiet Lake and Finlayson Lake Map Sheets 105 F,G", Geol. Survey Canada open-file 486
- Tempelman-Kluit, D. J. - "Geology of Laberge map sheet 105 E", Geol. Surv. Canada open-file 578.
- Tempelman-Kluit, D. J. - (1979) - "Transported cataclasite, ophiolite and granodiorite in Yukon; evidence of arc-continent collision." Geol. Surv. Canada Paper 79-14, 29 p.

APPENDIX A

List of Claim Names and Grant Numbers

RPP 1	YA51223
RPP 2	YA51224
RPP 3	YA51225
RPP 4	YA51226
RPP 5	YA51227
RPP 6	YA51228
RPP 7	YA51229
RPP 8	YA51230
RPP 9	YA51231
RPP 10	YA51232
RPP 11	YA51233
RPP 12	YA51234
RPP 13	YA51235
RPP 14	YA51236
RPP 15	YA51237
RPP 16	YA51238
RPP 17	YA51239
RPP 18	YA51240
RPP 19	YA51241

APPENDIX B
Analytical Results and Methods

1. ANALYTICAL RESULTS

Soil sample locations and results are shown in Figures 4a-c. Chip sample results are listed below:

No.	Cu	Pb	Zn	Ag	Au
13500	52	9	125	0.9	5
13501	95	8	560	1.7	5
13502	62	16	1580	1.3	L5
13503	80	6	1000	0.7	L5
13504	105	7	515	0.6	L5
13505	55	10	505	0.8	L5
13506	50	7	410	0.5	L5
13507	44	6	295	0.5	L5
13508	36	12	480	0.6	10
13509	57	20	1515	1.3	10

All values in ppm except gold, in ppb.

L indicates "less than"

Location of chip samples is indicated on Figure 2a.

2. ANALYTICAL METHODS

All geochemical samples were prepared and analyzed by Bondar-Clegg in Whitehorse.

Soils are sieved to -80 mesh and chip samples are pulverized to -200 mesh and a split of that fraction is analyzed. Copper, lead, zinc and silver are analyzed by dissolving the sample in hot aqua regia and determining the concentration of each element by atomic absorption spectrophotometry.

For gold, the sample is fire assayed. After the bead is prepared, it is dissolved in acid and gold is determined by atomic absorption spectrophotometry.

APPENDIX C

Personnel and Man-Day Distribution

1980 August 27-30th, preliminary geological mapping and geophysical surveys.

D. A. Beauchamp, Area Geologist
 P. D. Van Angeren, Project Geologist
 R. Zajac, Senior Assistant

1981 May 28-June 20

R.C.R. Robertson, Area Geologist (June 15-20 June only)
 P. D. Van Angeren, Project Geologist
 R. S. Morrison, Senior Assistant
 M. Fortier, Intermediate Assistant
 A. Malnasi, Junior Assistant

May 28, 29, mobilization from Whitehorse and camp set up.

May 30, prospecting and geological mapping

May 31 to June 9, soil sampling, extending grid

June 11, 14, 16, grid geology

June 12, 15, 17, geology of claims, prospecting

June 18, 19, chip sampling (MF, AM)
 geology of claims (RR, PVA, RM)

June 20, demobilization to South Canol Road and Whitehorse.

Together with report and map preparation:

R. Robertson	1 day
P. Van Angeren	2 days

APPENDIX D

Statement of Costs

1980Labour

D. A. Beauchamp, 4 days at \$170 per day	\$680.00
P. D. Van Angeren, 4 days at \$85 per day	\$340.00
R. Zajac, 4 days at \$70 per day	\$280.00
D. R. Eaton, Chief Geophysicist, 1 day at \$170 (survey interpretation)	\$170.00
	<u>\$1,470.00</u>

Helicopter

Hughes 500 D helicopter, on contract from Liftair
International Calgary.

2.4 hours at \$325.00 per hour	\$780.00
Fuel estimated at 25 gals. per hr. and \$1.50 /gal.	\$ 90.00
	<u>\$870.00</u>

Instrument Rental

VLF-EM	\$178.65
Ground and base-station magnetometers	\$364.12
	<u>\$542.77</u>

Food, Field Equipment, Camp Supplies

Food estimated at \$15 per manday, for 12 mandays	\$180.00
Field equipment and camp supplies estimated at \$20 per day	<u>\$ 80.00</u>
	<u>\$260.00</u>

TOTAL EXPENDITURES, 1980 \$3,142.77

1981

Labour

R. Robertson, 6 days field plus 1 day report preparation @ \$140/day	\$980.00
R. Van Angeren, 22 days field plus 2 days report preparation @ \$110/day	\$2,640.00
R. Morrison, 22 days field @ \$80/day	\$1,760.00
M. Fortier, 22 days field @ \$75/day	\$1,650.00
A. Malnasi, 22 days field @ \$55/day	\$1,210.00
TOTAL LABOUR COSTS	<u>\$8,240.00</u>

Helicopter

1) Hughes 500D helicopter, on contract from Liftair International, Calgary	
5.3 hrs. at \$379 /hr	\$2,008.70
fuel estimated at 25 gals/hr @ \$1.80/gal	238.50
	<u>\$2,247.20</u>
2) Bell 204 helicopter from Shirley Helicopters, Whitehorse May 28, 1.2 hrs. @ \$800/hr, plus fuel and oil	\$1,109.40
3) Bell 206 L helicopter from Shirley Helicopters Whitehorse.	
June 3, 1.5 hrs @ \$500/hr, plus fuel & oil	\$823.87
June 13, 50% of 2.5 hrs. @ \$500/hr plus fuel and oil	\$716.05
June 20, 50% of 1.85 hrs. @ \$500/hr plus fuel and oil	\$509.55
	<u>\$3,158.87</u>
TOTAL HELICOPTER COSTS	<u>\$5,406.07</u>

Analytical Costs

10 chip samples at \$11.75 each	\$117.50
191 soil samples at \$9.85 each	\$1,881.35
TOTAL ANALYTICAL COSTS	<u>\$1,998.85</u>

Food, Camp Supplies and Field Equipment

Food costs estimated at \$20 per manday;	\$1,880.00
Camp supplies and field equipment, estimated at \$20/day for 22 days	440.00
	<u>\$2,320.00</u>

Drafting and Secretarial Costs
(Report Preparation)

Map preparation, estimated cost	\$650.00
Typing, estimated cost	50.00
	<u>\$700.00</u>

TOTAL EXPENDITURES, 1981	<u>\$18,664.92</u>
--------------------------	---------	--------------------

TOTAL COSTS FOR ASSESSMENT PURPOSES, (AUGUST 27, 1980 - AUGUST 26, 1981)		<u>\$21,807.69</u>
---	--	--------------------

APPENDIX

STATEMENT OF QUALIFICATIONS

I, RONALD CHARLES RAMSAY ROBERTSON, of the City of
Calgary, in the Province of Alberta, hereby certify:

That I am a geologist employed by AGIP Canada Ltd.
and that I caused to be performed and supervised,
the work described in this report.

That I obtained a Bachelor of Science degree with
First Class Honours in Geology from the University
of Aberdeen, Scotland in 1970 and subsequently
carried out graduate studies at McMaster University
Hamilton, Ontario, and at Queen's University,
Kingston, Ontario.

That I have been engaged in mineral exploration on
a full-time and part-time basis for twelve years
of which four have been on mineral exploration pro-
grams in the Yukon Territory and Alaska.

That I am a member of the Canadian Institute of
Mining and Metallurgy, the Society of Mining
Engineers of A.I.M.E. and the Prospectors and Develop-
ers Association.

Signed at Calgary, Alberta, this 26th day of August, A.D.
1981.



RONALD C. R. ROBERTSON

STATEMENT OF QUALIFICATIONS

I, PHIL DERKZEN VAN ANGEREN, of the City of Calgary in the Province of Alberta hereby certify:

That I am a geologist employed by AGIP Canada Ltd. and I caused to be performed the work described in this report.

That I obtained a Bachelor of Science degree with Honours in Geology from McGill University in Montreal in 1977.

That I have been engaged in mineral exploration on a full-time and part-time basis for seven years, three of which have been in the Yukon Territories and British Columbia

Signed at Whitehorse, Yukon Territory, this 27th day of August, 1981.

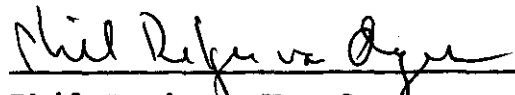

Phil Derkzen Van Angeren

LEGEND

- 6 MAINLY FELSIC BLASTOMYLONITE, MINOR BIOTITE, VERY WELL DEVELOPED FLASER FABRIC
- 5 MAINLY FELSIC MYLONITE, BIOTITE RICH, POORLY DEVELOPED FLASER FABRIC.
- 4 GRANITIC SILL
- 3 MAINLY SERICITE SCHIST. PARTIALLY KAOLINIZED
- 2 MAINLY GRAPHITIC QUARTZITE, MINOR CARBONATE, MINOR SERICITE AND CHLORITE SCHIST
- 1 MAINLY GREENSTONE, MINOR SERICITE SCHIST AND QUARTZ BIOTITE SCHIST.

SYMBOLS

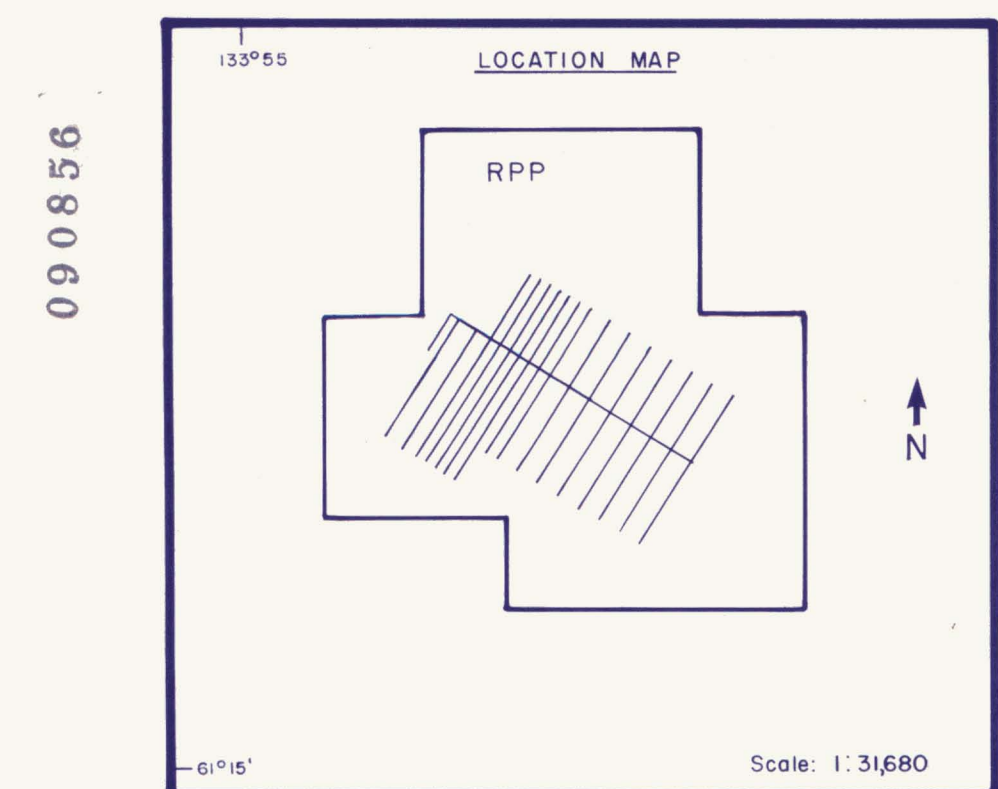
- Geological contact (approx., assumed)
- ~~~~~ Fault (approx., assumed)
- ← Fold axis
- ↔ Schistosity
- ▬ Fracturing
- || Bedding



AGIP CANADA LTD.

RPP CLAIMS GRID
GEOLOGY
4007-C
YUKON

SCALE: 1:2,500	NTS 105F/5	DATE: Aug. 1981
AUTHOR: P.D. v. A.	DRAWN BY: J.S./G.T.Sz.	FIGURE: 2 b

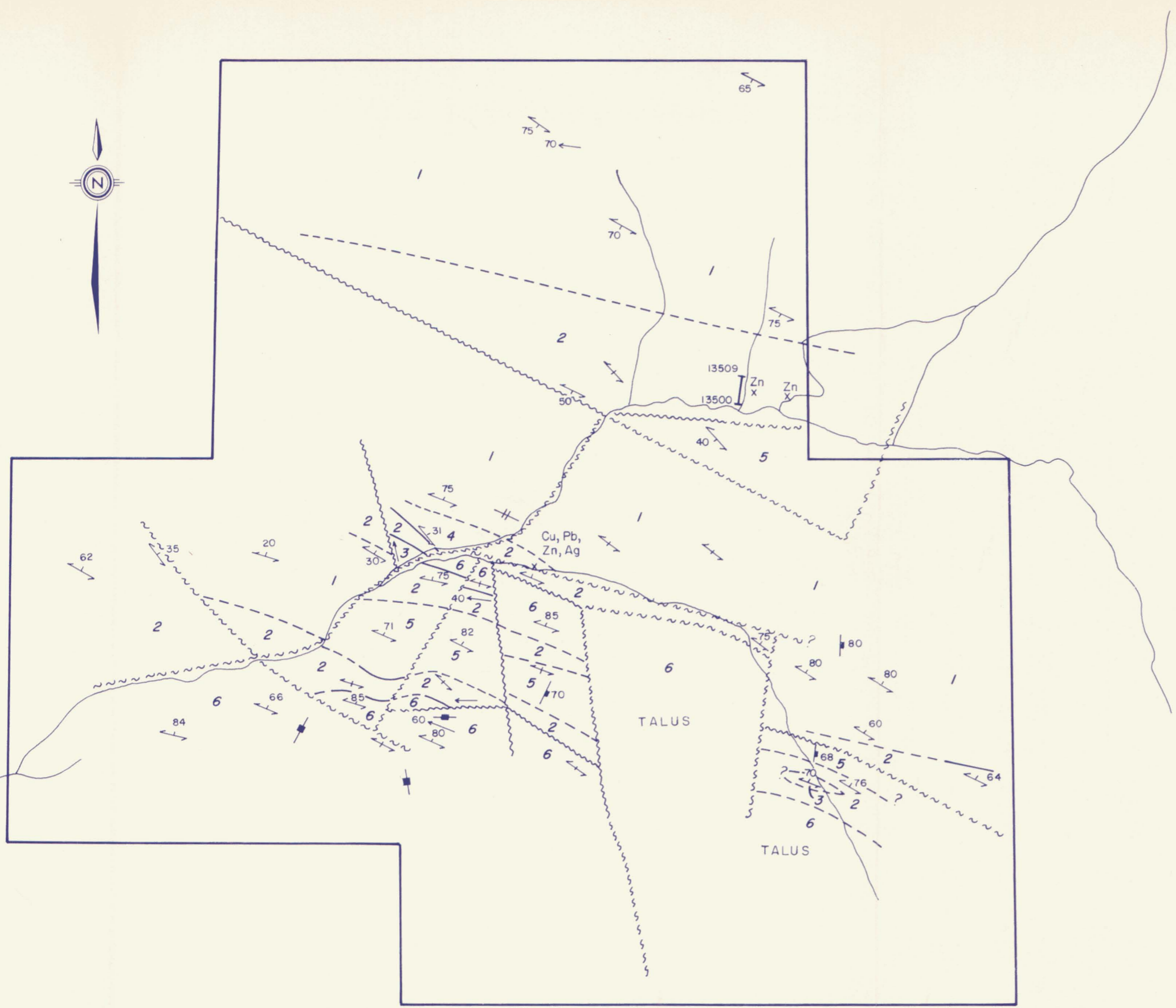

LEGEND

- 6 Felsic Blastomylonite, very well developed flaser fabric
- 5 Felsic mylonite, poorly developed flaser fabric
- 4 Granitic sill
- 3 Sericite schist, partially kaolinized
- 2 Graphitic Quartzite, minor carbonate, minor Sericite and chlorite schist
- 1 Greenstone, minor sericite schist and quartz biotite schist

SYMBOLS

- Geological contact (approximate, assumed)
- ~~~~~ Fault (approximate, assumed)
- ← Fold axis
- ↔ Schistosity
- Fracture
- |— Bedding
- X Sulphide showing
- 13509
13500 Chip samples

Topographic base from enlarged air photograph, uncorrected for radial distortion

AGIP CANADA LTD.		
RPP CLAIMS GEOLOGY		
YUKON		
Scale: 1:110,000	NTS: 105F/5	Date: AUG. 1981
Author: R.S.M.	Drawn by: GTSz	Figure: 2a

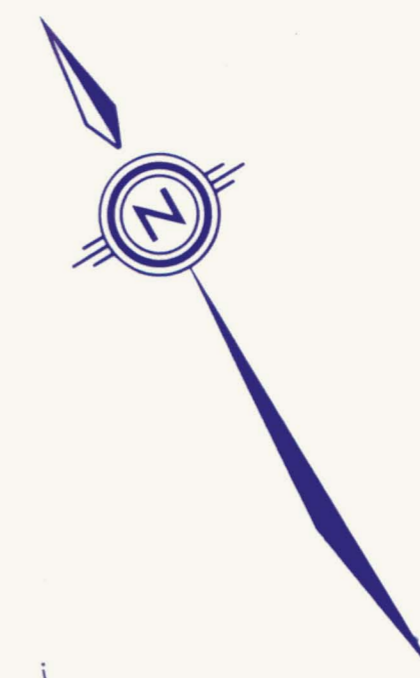

0+00 0+50E 1+00E 1+50E 2+00E 2+50E 3+00E 4+00E 5+00E 6+00E 7+00E 8+00E 9+00E 10+00E

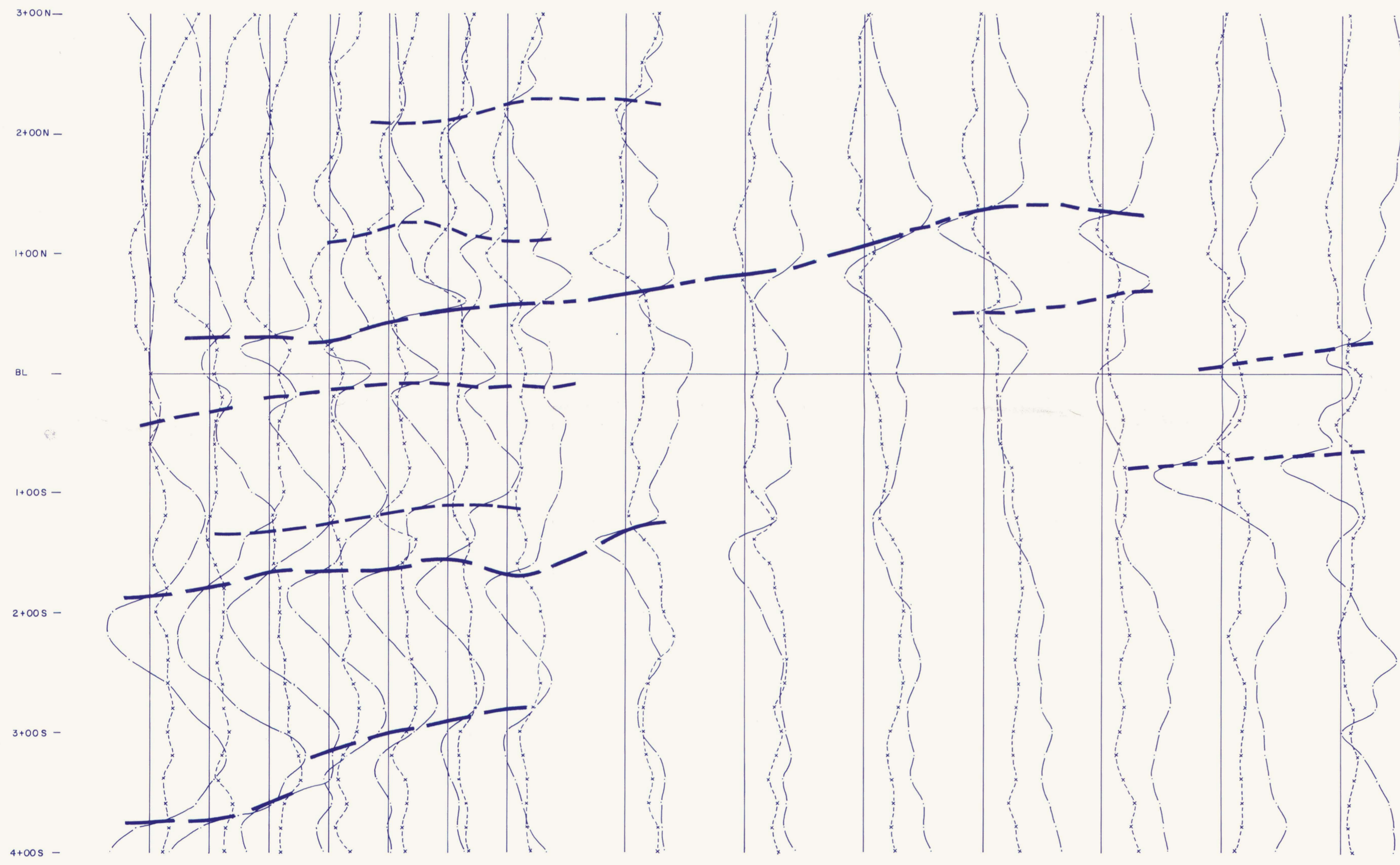

LEGEND

----- GRID LINE

INSTRUMENT: EM-16

TRANSMITTER: ANNAPOLIS, MARYLAND NSS (21.4 kHz)

----- IN PHASE

x---x---x OUT OF PHASE

VERTICAL SCALE: 1cm = 20%

———— DEFINITE CONDUCTOR

- - - - - INFERRED CONDUCTOR

090856

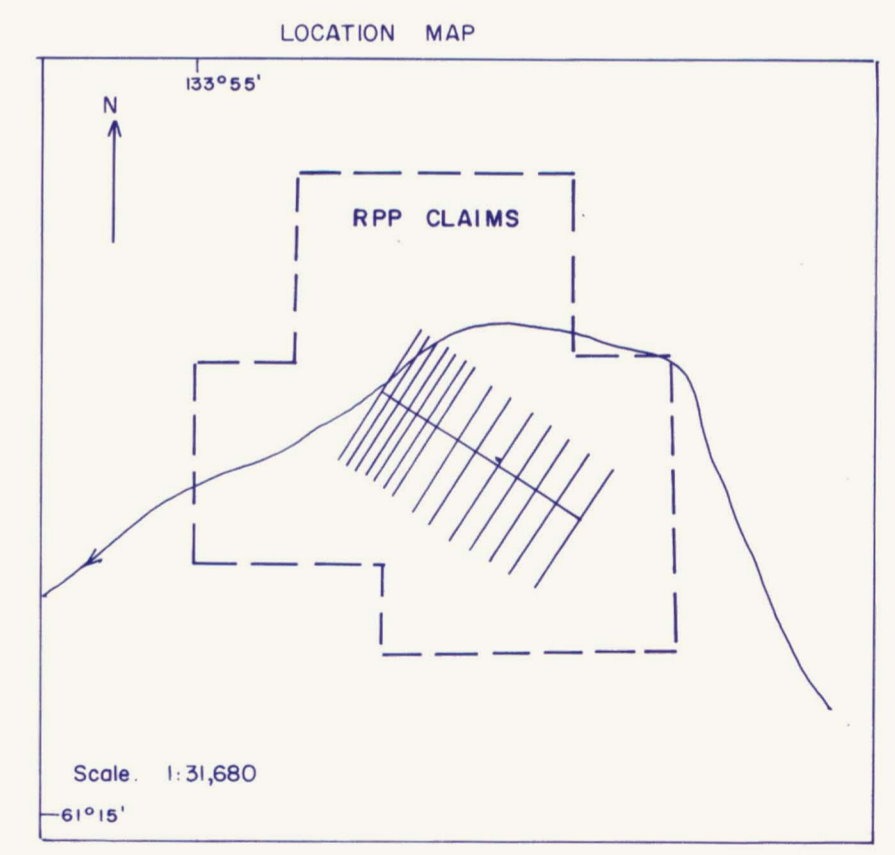

SCALE: 1:2500 NTS: 105 F/5

PROJECT: **RPP CLAIMS**

YUKON

AGIP CANADA LTD.

PROJECT NO. 4007-C

SURVEYED BY AGIP CANADA

DRAWN BY G. T. Sz.

DATE OCTOBER, 1980

APPROVED *[Signature]*

FIGURE 3a

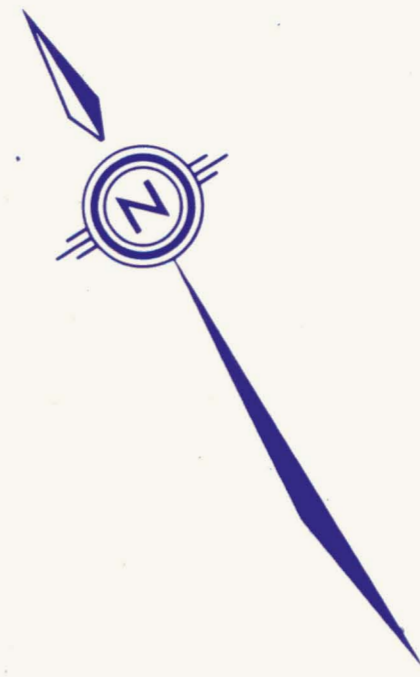

0+00 0+50E 1+00E 1+50E 2+00E 2+50E 3+00E 4+00E 5+00E 6+00E 7+00E 8+00E 9+00E 10+00E

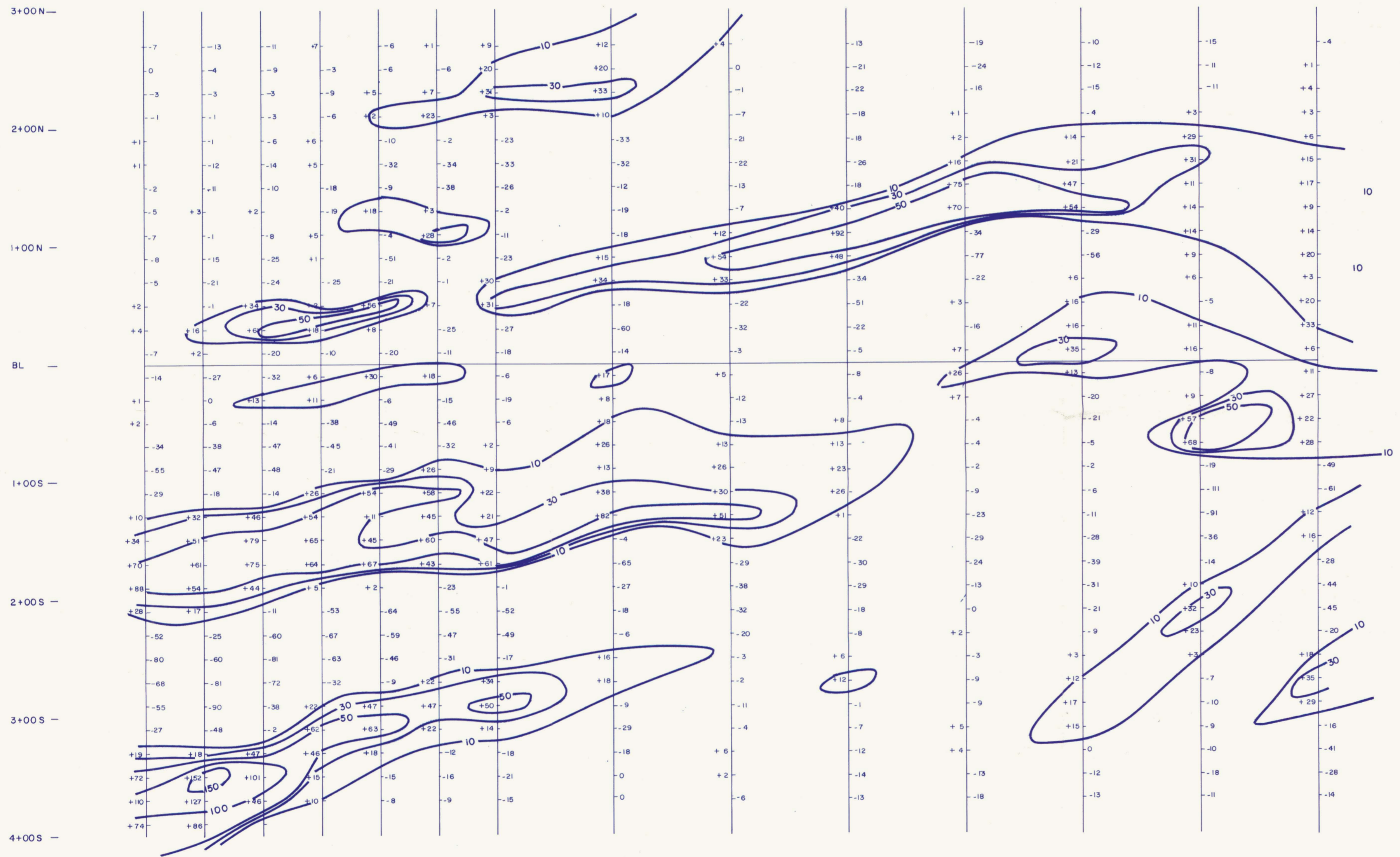

LEGEND

- — — — — GRID LINES
- CONTOURED AT: 10, 30, 50, 100, 150 %
- INSTRUMENT: EM-16
- TRANSMITTER: ANNAPOLIS, MARYLAND NSS (21.4 kHz)

090856

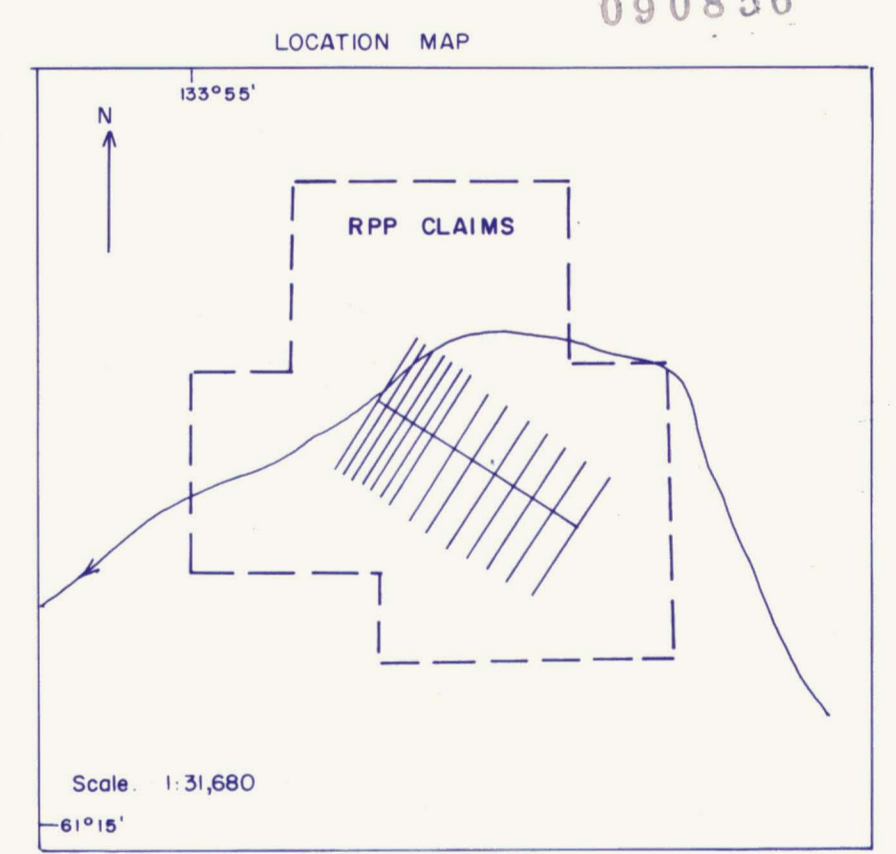

**VLF-EM SURVEY
(FRASER FILTER)
RPP GRID**

SCALE: 1:2500 NTS: 105 F/5

PROJECT: **RPP CLAIMS**
YUKON

PROJECT NO.
4007 C

SURVEYED BY
AGIP CANADA

DRAWN BY
G. T. Sz.

DATE
OCTOBER, 1980

APPROVED

AGIP CANADA LTD.

FIGURE
3 b

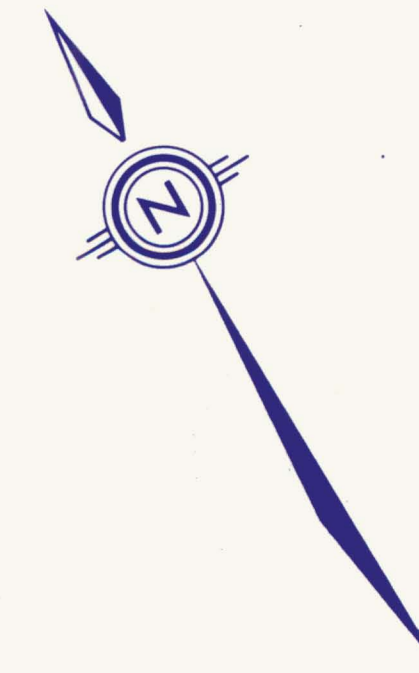

LEGEND

GRID LINES

DATUM: 57,000 GAMMAS

CONTOURED AT: 100 GAMMA INTERVALS

SCALE: 1cm = 25m.

INSTRUMENT: GEOMETRIX G-816 PROTON MAGNETOMETER

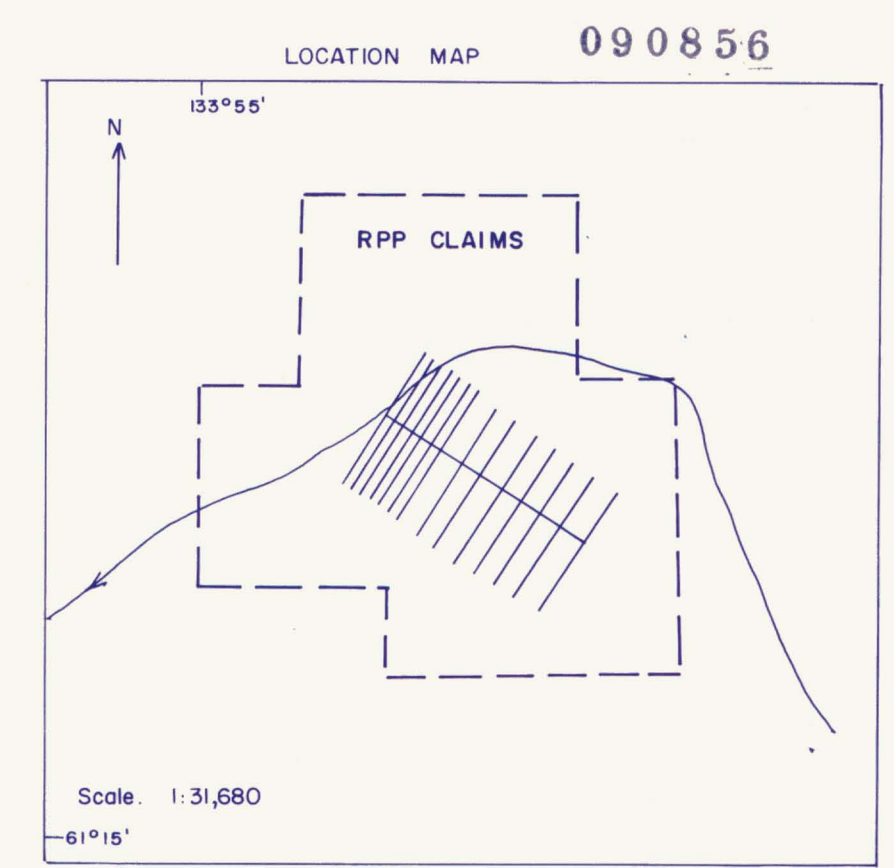

MAGNETIC SURVEY
(TOTAL FIELD)
RPP GRID

SCALE: 1:2500 NTS: 105 F/5

PROJECT: **RPP CLAIMS**
 YUKON

PROJECT NO.
 4007 - C

SURVEYED BY
 AGIP CANADA

DRAWN BY
 G. T. Sz.

DATE
 AUGUST, 1980

APPROVED
[Signature]

AGIP CANADA LTD.

FIGURE
 3 c

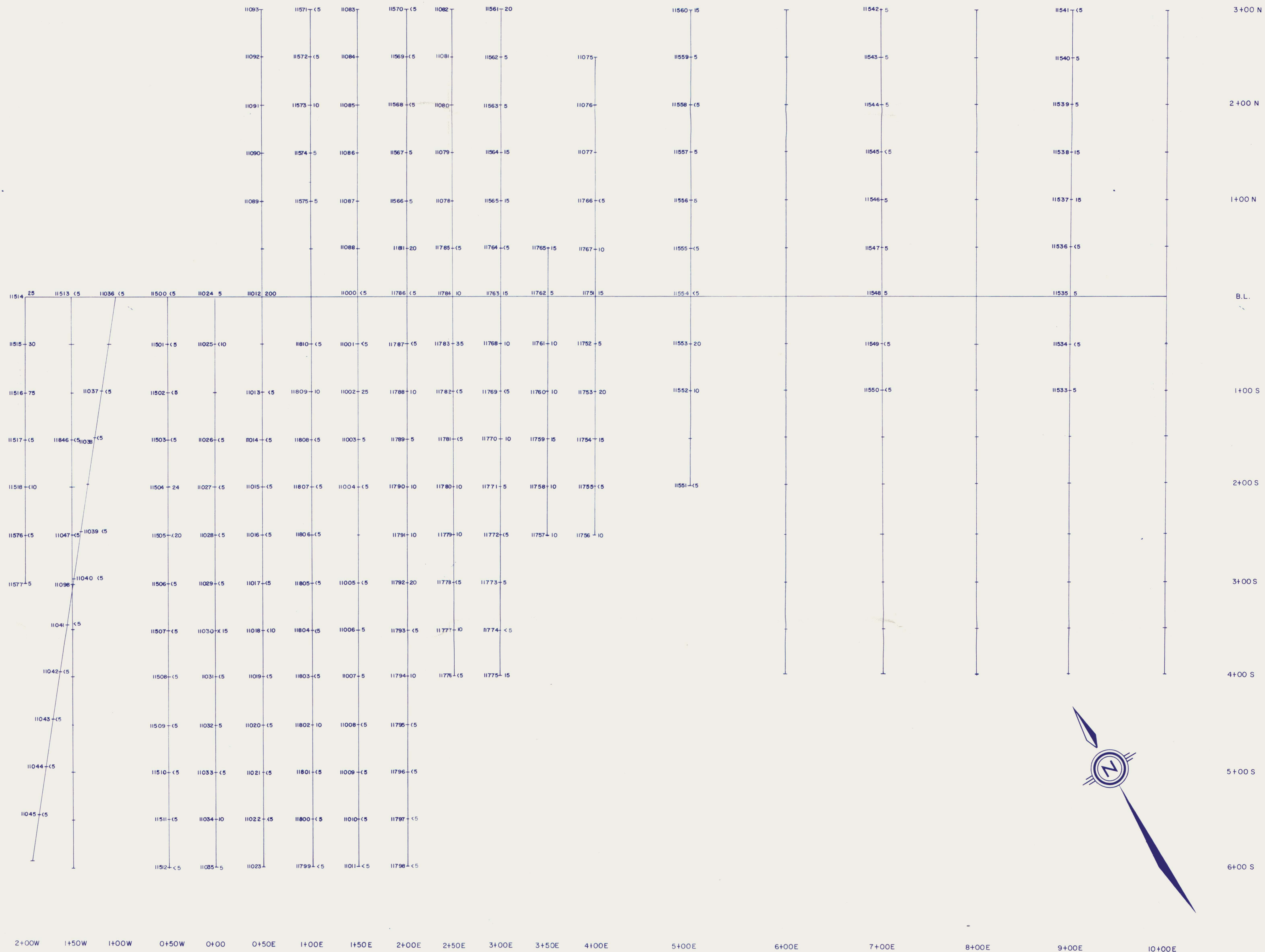

LEGEND

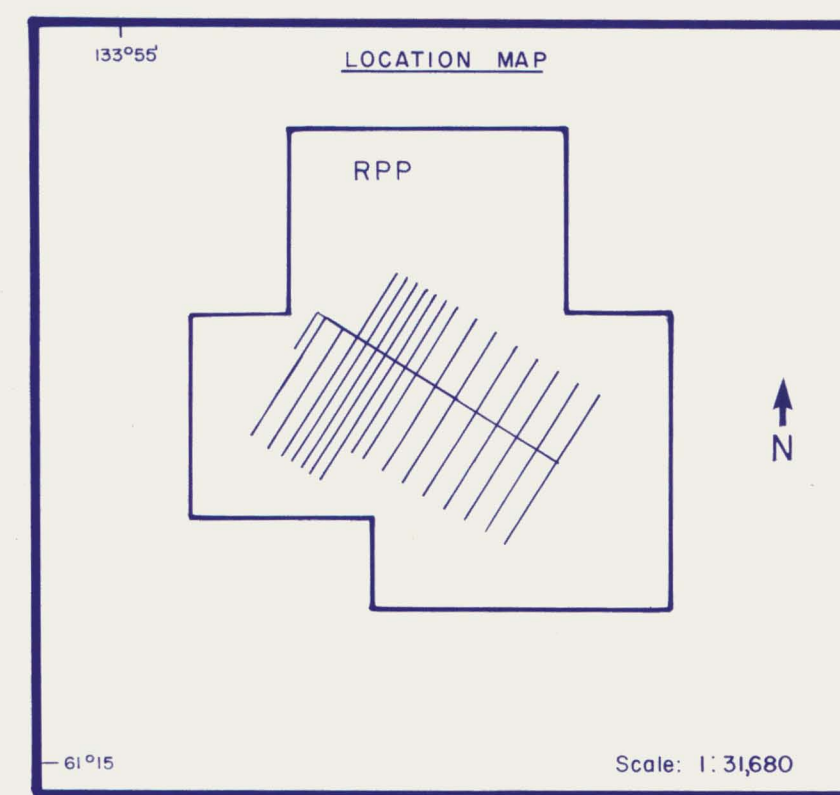
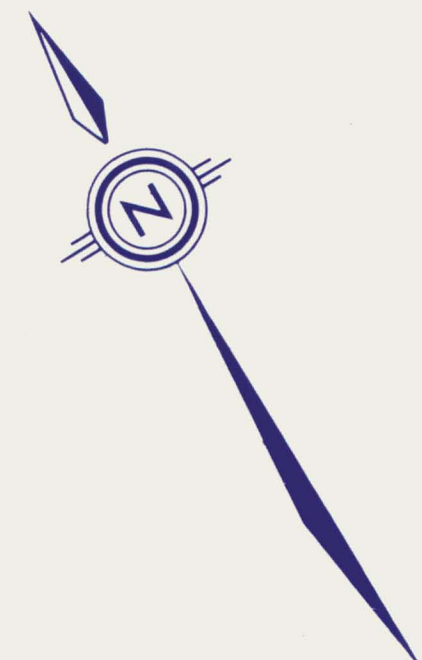
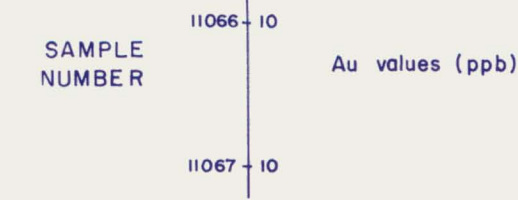

AGIP CANADA LTD.
 RPP CLAIMS GRID
 SOIL GEOCHEMISTRY
 SAMPLE NUMBER AND GOLD (p.p.b.)
 YUKON

SCALE: 1:2500	NTS 105 F/5	DATE: August 1981
AUTHOR: P.D.v.A.	DRAWN BY: J.S.	FIGURE: 4 a

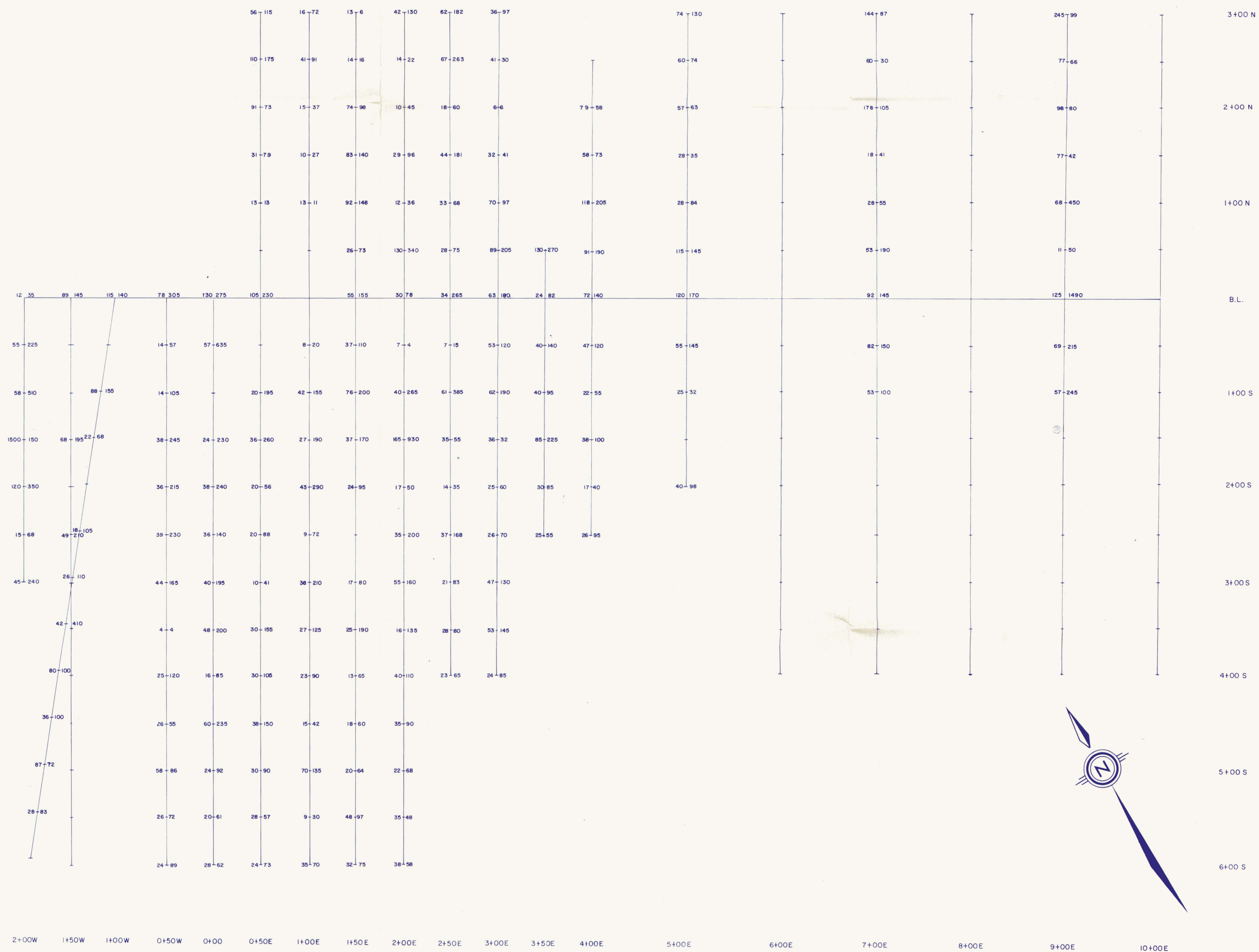

LEGEND

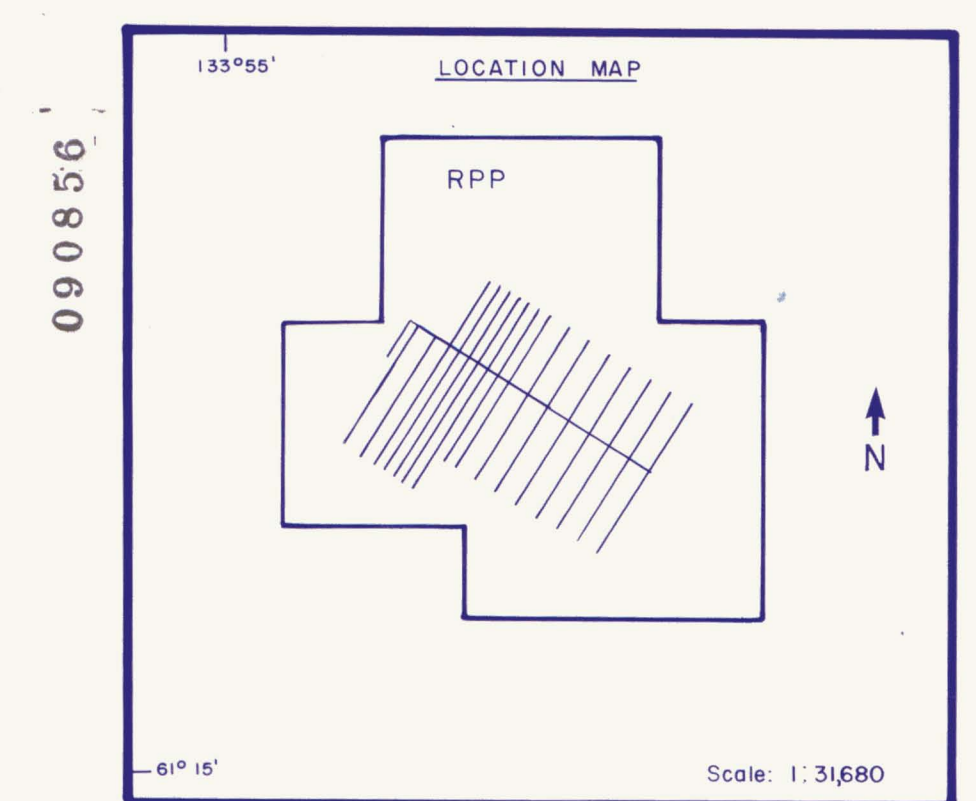
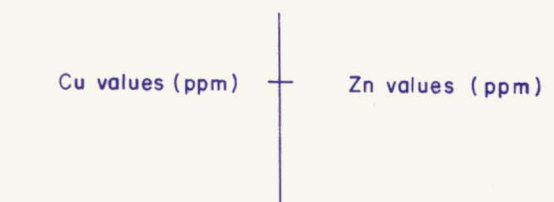

AGIP CANADA LTD.

RPP CLAIMS GRID
SOIL GEOCHEMISTRY
COPPER AND ZINC

YUKON

SCALE: 1:2500	NTS 105 F/5	DATE: August 1981
AUTHOR: P.D. v.A.	DRAWN BY: J.S.	FIGURE: 4 b

LEGEND

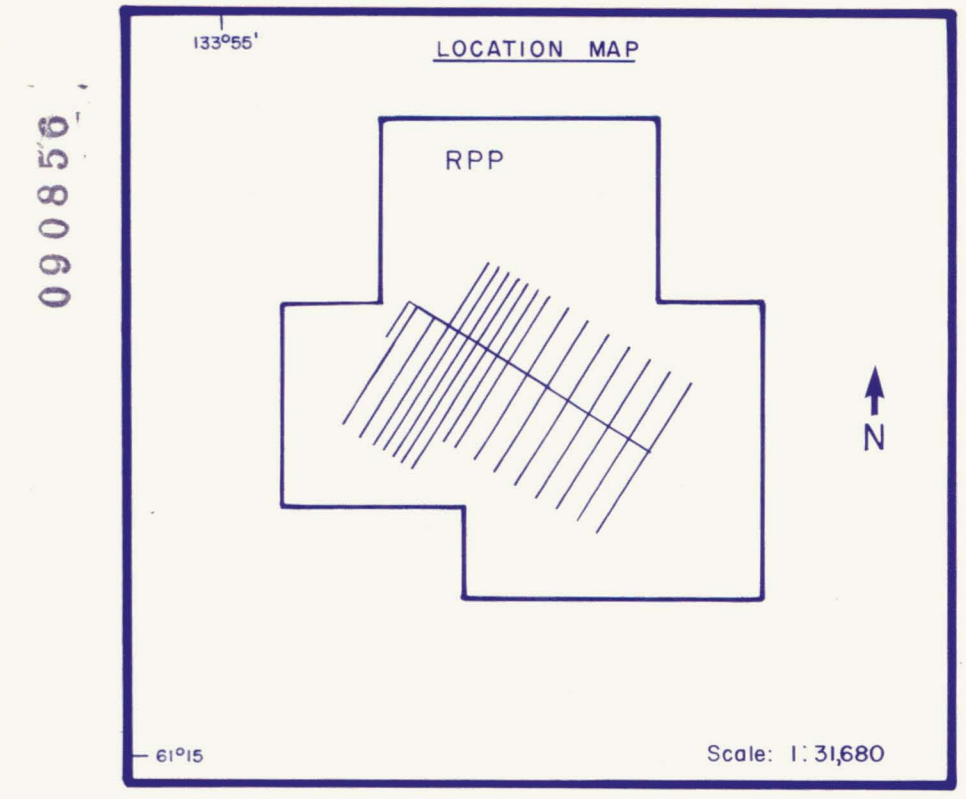
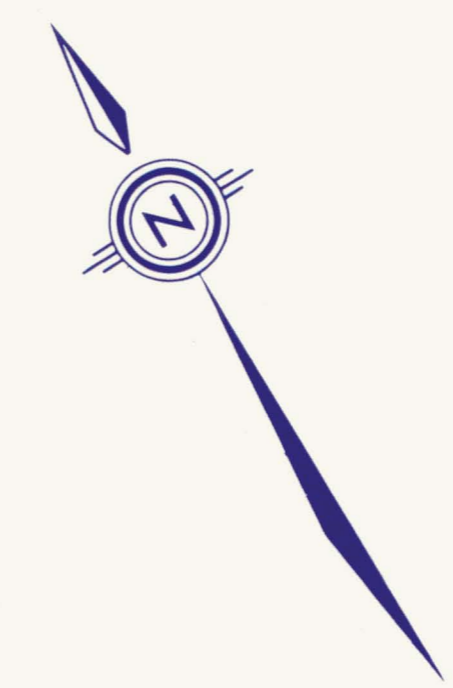
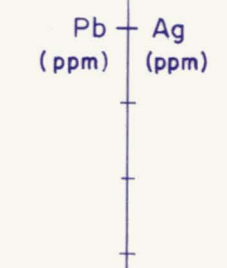

AGIP CANADA LTD.

RPP CLAIMS GRID

SOIL GEOCHEMISTRY

Lead - Silver

4007-C

YUKON

SCALE:	NTS	DATE:
1:2,500	105 F/5	Aug. 1981
AUTHOR:	DRAWN BY:	FIGURE:
P.D. A.	J.S./G.T.Sz.	4 c