

FROM Mining Recorder at Whse

TO Supervising Mining Recorder at Whitehorse, Y.T.



FOR ACTION ARE:

- NEW APPL'N for PLACER LEASE to PROSPECT: Name: _____ Lease No. _____
- RENEWAL APPL'N PLACER LEASE to PROSPECT: Name: _____ Lease No. _____
- AFFIDAVIT of EXPENDITURE on PLACER LEASE. Name: _____ Lease No. _____
- ASSIGNMENT of PLACER LEASE No. _____
From: _____ To: _____
- GROUPING APPL'N UNDER SEC. 52(2) PLACER MINING ACT.
Owner: _____
- DIAMOND DRILL LOGS: CYPRUS Anvil Mining Corporation
Claims: MX 184 430643 Claim sheet no: 105-K-6
- QUARTZ ASSESSMENT REPORT:
Claims: _____ Claim sheet no. _____
Type of report: _____ Submitted by: _____
Cls. work performed on: _____ \$ Req. for ren. application _____

Signature [Signature] 24 Feb 1981
41,846.95

REPLY ACTION.

Date Ret.

090753

Signature _____



CYPRUS ANVIL MINING CORPORATION

DIAMOND DRILL CORE LOG

Hole Number 80-NAR-01

Fabric Orientation Diagram:

Project: North Anvil

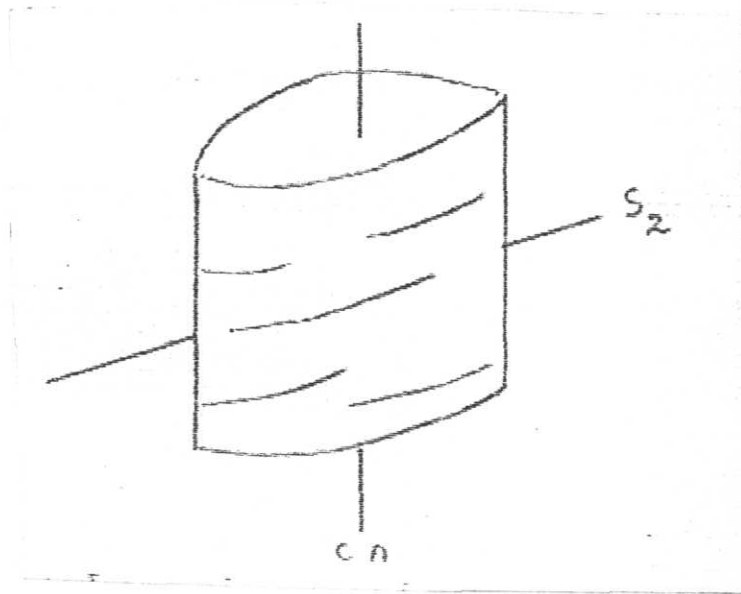

Location: North Anvil Range

Claim: MX 184

Terr. Plane Co-ords.: 22,719,000 N

300,000 E

Grid Co-ords.: _____

Inclination: _____

Elevation: _____

All symmetry determinations looking

NW with S₂ dipping

NE with dip azimuth _____.

Total Depth: 481.3 m.

Purpose: Examine a linear geochemical anomaly, Vangorda Formation

Logged by: B. V. Hall Date(s) Logged: June 18 - June 30, 1980

Drilling Contractor: Arctic Diamond Drill. Core: Size From To Collar Cased and Capped: _____

NQ 18.6 481.3

Started: June 12, 1980 Completed: June 30, 1980

SUMMARY LOG

DDH 80-NAR-01

Meters

0.0 - 18.6	OB	Triconed/ no core
18.6 - 19.7	5B0	Calcareous muscovite-chlorite ± biotite phyllite.
19.7 - 21.6	5D3	Laminarily banded, calcareous, chloritic phyllite.
21.6 - 56.0	5B0	Calcareous muscovite-chlorite ± biotite phyllite.
56.0 - 57.5	5D3	Laminarily banded, calcareous, chloritic phyllite.
57.5 - 128.6	5B0	Calcareous muscovite-chlorite ± biotite phyllite.
128.6 - 133.5	5D3	Laminarily banded, calcareous, chloritic phyllite.
133.5 - 144.4	5B0	Calcareous muscovite-chlorite ± biotite phyllite.
144.4 - 152.1	5D3	Laminarily banded, calcareous, chloritic phyllite.
152.1 - 177.8	5B0	Calcareous muscovite-chlorite ± biotite phyllite.
177.8 - 179.5	5D3	Laminarily banded, calcareous, chloritic phyllite.
179.5 - 182.3	5B0	Calcareous muscovite-chlorite ± biotite phyllite.
182.3 - 195.1	5B0	Calcareous muscovite-chlorite ± biotite phyllite.
195.1 - 203.1	5D3	Laminarily banded, calcareous, chloritic phyllite.
203.1 - 241.0	5C0	Metabasite.
241.0 - 242.1	5D3	Laminarily banded, calcareous, chloritic phyllite.
242.1 - 278.9	5B0	Calcareous muscovite-chlorite ± biotite phyllite.
278.9 - 286.8	5B0	Calcareous muscovite-chlorite ± biotite phyllite.
286.8 - 290.6	5E0	Phyllitic marble and silicated marble.
290.6 - 303.6	5D3	Laminarily banded, calcareous, chloritic phyllite.
303.6 - 344.4	5B7	Calcareous, tuffaceous, muscovite-chlorite ± biotite phyllite.

(Contd.)

Summary Log
DDH 80-NAR-01

Meters

344.4 - 346.2	5D0	Laminarly banded, variably calcareous, chloritic phyllite.
346.2 - 394.4	5B7	Calcareous, tuffaceous, muscovite-chlorite ± biotite phyllite.
394.4 - 398.6	5D3	Laminarly banded, calcareous, chloritic phyllite.
398.6 - 405.9	5A0	Variably calcareous, graphitic phyllite (host unit 4)
405.9 - 453.2	3G0 8	Non-calcareous, chloritic, muscovite-chlorite ± biotite phyllite/schist undifferentiated.
453.2 - 456.0	3B0	Chloritic phyllite/schist.
456.0 - 472.0	3G0 7	Non-calcareous, tuffaceous, muscovite-chlorite ± biotite phyllite/schist undifferentiated.
472.0 - 475.8	3B3	Calcareous, chloritic phyllite/schist.
475.8 - 481.3	3G0	Non-calcareous, muscovite-chlorite ± biotite phyllite/schist undifferentiated.

END OF HOLE

INVOICE

090753

WORK DONE DURING THE PERIOD
JUNE 12 - JUNE 30, 1980,

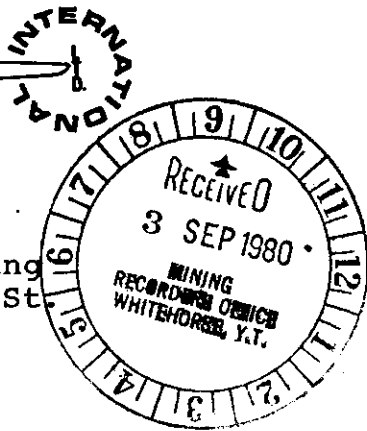

SOLD TO
 [Cyprus Anvil Mining
 330 355 Burrard St.
 Vancouver, B.C.
 V6C 2G8
]

INVOICE No. #1626

DATE: June 1980

INTEREST 1½% PER MONTH
 AFTER 30 DAYS

279000

Hughes 500D C-GVTG

Month	Mins.	Actual
April	6.0	34.1
May	50.0	116.3
June	<u>100.0</u>	<u>164.4</u>
	156.0	314.8

314.8 hrs @ \$315.00 \$99,162.00

Less invoiced:

#1367	\$ 3,118.50
1386	7,623.00
1459	24,412.50
1485	12,222.00
1469	<u>31,500.00</u>

314.8 hrs x \$315 = \$99,162.00

78,876.00

\$20,286.00

Additional charges:

Oil 164.4 hours @ 0.90 147.96

ACCOUNT	AMOUNT
1906-15	10 216 98
1402-15	10 216 98
TOTAL	20 433 96



PAYABLE TO LIFAIR INTERNATIONAL LTD. AT

HANGAR No. 25, McCALL FIELD, CALGARY, CANADA T2P 2G3 Total charges: \$20,433.96

B/Fwd.....

113872.35

Hole #80-K-01-90'xNQ

WORK DONE DURING THE PERIOD

JUNE 12 - JUNE 30, 1980

Moving

186 Man hours @ 19.00 per hour 3534.00

090753

Overburden

0-50=50ft @ 22.45 per ft. 1122.50
 50-93=43ft @ 22.45 per ft. 965.35 2087.85

Core Drilling

93-97 ft = 4 ft @ 21.50 per ft. 86.00

Water Supply

96 Man hours @ 19.00 per hour 1824.00

Travelling Time

20 Man hours @ 19.00 per hour 380.00

Standby Brush Fire

14 Man hours @ 19.00 per hour 266.00

Moving Out - due to fire

96 Man hours @ 19.00 per hour 1824.00

10001.85



Hole#NAR-80-01-90'xNQxBQ

Moving

122 Man hours @ 19.00 per hour 2318.00

Overburden

0-50=50ft @ 22.45 per foot 1122.50
 50-61=11ft @ 22.45 per foot 246.95 1369.45

Core Drilling xNQ

61-831=770ft @ 21.50 per foot 16555.00

Core Drilling xBQ

831-1000=169 ft @ 20.50 per ft. 3464.50
 1000-1579=579 ft @ 22.00 per ft 12738.00 32757.50

Reaming through Cave

51 Man hours @ 19.00 per hr. 969.00
 25½ Machine hrs @ 10.00 per hr. 255.00 1224.00

Testing

11 Man hours @ 19.00 per hr 209.00
 5½ Machine hrs @ 10.00 per hr 55.00 264.00

Travelling Time

34 Man hours @ 19.00 per hour 646.00

Standby - waiting for Helicopter.

47 Man hours @ 19.00 per hr. 893.00

C/Fwd..... 39471.95

123874.20

B/FWD.....39471.95 123874.20

<u>Moving Out</u>		
125 Man hours @ 19.00 per hr.	2375.00	41846.95

Hole # 80-5-03-90'xNQxBQ - Swim Lake
Core Drilling x BQ

2637 - 2936 = 299 ft @ 26.50 per ft. 7923.50

Testing

17 Man hours @ 19.00 per hour 323.00
 8½ Machine hrs @ 10.00 per hr. 85.00 408.00

Travelling time

27 Man hours @ 19.00 per hr. 513.00

Moving Out

84 Man hours @ 19.00 per hr. 1596.00 10440.50

Hole # 80-5-04-90'xNO - SWIM LAKE

Moving

86 Man hours @ 19.00 per hr. 1634.00

Overburden

0-50=50 ft @ 22.45 per ft. 1122.50
 50-131=81 ft @ 22.45 per ft. 1818.45 2940.95

Core Drilling x NO

131-1000=869 ft @ 21.50 per ft. 18683.50
 1000-1838=838 ft @ 23.00 per ft. 19274.00 37957.50

Reaming Through Cave

12 Man hours @ 19.00 per hr 228.00
 6 Machine hrs @ 10.00 per hr. 60.00 288.00

Testing

14 Man hours @ 19.00 per hr 266.00
 7 Machine hrs @ 10.00 per hr 70.00 336.00

Travelling Time

52 Man hours @ 19.00 per hr. 988.00

Moving Out

98 Man hours @ 19.00 per hr 1862.00 46064.45

Use of Cat

40 Man hours @ 19.00 per hr 760.00
 40 Cat hours @ 40.00 per hr 1600.00 2360.00

C/Fwd..... 224586.10

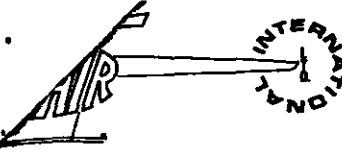

DAILY FLIGHT REPORT

HANGAR 25, INTERNATIONAL AIRPORT
 CALGARY, ALBERTA T2P 2G3
 Phone: 230-1091 Telex: 03-822632



TOTAL = 3518
 No N° 0226

CHARTERER CYRUS ADRIEL MINING SHORT TERM CHARTER
 LONG TERM CHARTER DATE 14/6/80 19__
 ADDRESS COOP. LTD. 330-35 BURRARD ST. AIRCRAFT C - G-VTG
VANCO. B.C. PHONE _____ JOB No. 51
 PILOT NORM SMITH ENGINEER WARREN HILLS PURCHASE ORDER _____

ITINERARY - REMARKS - DESCRIPTION OF JOB, ETC.			ZONE	HOURS	PAX.	FREIGHT
CHARGE: DWANK				.		
FARO - ROSS - DWANK				1.3		
GRUM.				.		
P/U 2517 OUT CALGARY 2518016				(2.6)		
REMARKS AND CREW EXPENSES CHARGEABLE TO CHARTERER				.		
OIL SUPP BY LIFT AIR				.		2.50
WEATHER			FUEL & OIL		TOTAL REVENUE	234.00
V.F.A. O.K.			<input type="checkbox"/> OIL <input checked="" type="checkbox"/> GAS <input type="checkbox"/> TURBO		3.9	238.00
CEILING	VISIBILITY	TEMP.	SUPPLIED BY LIFTAIR: _____ GALS. _____ HRS.		TOTAL NON REVENUE	TOTAL TIME ON CONTRACT
			SUPPLIED BY CHARTERER: <input checked="" type="checkbox"/> GALS. _____ HRS.		.	✓

THE CARRIAGE OF PASSENGERS, BAGGAGE AND GOODS INCLUDING EXTERNAL LOADS BY LIFTAIR IS SUBJECT TO THE TERMS, CONDITIONS AND LIMITATIONS OF LIABILITY SET FORTH IN ITS TARIFF FILED WITH THE A.T.C. AN EXTRACT OF WHICH IS AVAILABLE FOR EXAMINATION AT THE OFFICE OF LIFTAIR INTERNATIONAL LTD.

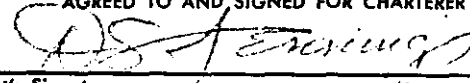
TO CHARTERER WITH INVOICE

AGREED TO AND SIGNED FOR CHARTERER BY:

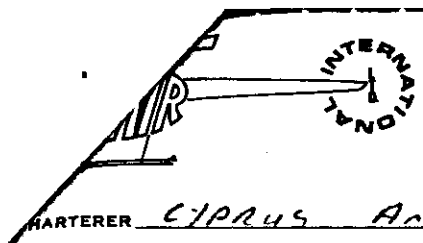
 Pilot's Signature



DAILY FLIGHT REPORT

HANGAR 25, INTERNATIONAL AIRPORT
 CALGARY, ALBERTA T2P 2G3
 Phone: 230-1091 Telex: 03-822632

Nº 02272

CHARTERER CYPRUS ANKIB MINING CORP SHORT TERM CHARTER LONG TERM CHARTER DATE JUNE 17 19 80

ADDRESS LTD. AIRCRAFT C-64TG

PHONE _____ JOB No. 54

PILOT NOAM SAISH ENGINEER WARRIED HILLS PURCHASE ORDER _____

ITINERARY - REMARKS - DESCRIPTION OF JOB, ETC.			ZONE	HOURS	PAX.	FREIGHT
DWORK			9	0		
GAUM - DWORK - (EXTERNAL LOAD) - GAUM				1.3		
GAUM						
CREW CHANGES - SLING MUD - PICK UP CORE				2.9		
FIRE WATCH						
REMARKS AND CREW EXPENSES CHARGEABLE TO CHARTERER						
WEATHER			FUEL & OIL		TOTAL REVENUE	
			<input type="checkbox"/> OIL <input type="checkbox"/> GAS <input type="checkbox"/> TURBO SUPPLIED BY LIFTAIR: _____ GALS. _____ HRS. SUPPLIED BY CHARTERER: _____ GALS. _____ HRS.		4.2	242.9
CEILING	VISIBILITY	TEMP.			TOTAL NON REVENUE	TOTAL TIME ON CONTRACT
						247.0

THE CARRIAGE OF PASSENGERS, BAGGAGE AND GOODS INCLUDING EXTERNAL LOADS BY LIFTAIR IS SUBJECT TO THE TERMS, CONDITIONS AND LIMITATIONS OF LIABILITY SET FORTH IN ITS TARIFF FILED WITH THE A.T.C. AN EXTRACT OF WHICH IS AVAILABLE FOR EXAMINATION AT THE OFFICE OF LIFTAIR INTERNATIONAL LTD.

TO CHARTERER WITH INVOICE

AGREED TO AND SIGNED FOR CHARTERER BY:

 Pilot's Signature



DAILY FLIGHT REPORT

HANGAR 25, INTERNATIONAL AIRPORT
 CALGARY, ALBERTA T2P 2G3
 Phone: 230-1091 Telex: 03-822632

Nº 02274

CHARTERER CYPRUS ANKIL SHORT TERM CHARTER DATE 12-6-80 19
 LONG TERM CHARTER

ADDRESS 330-35 BURNARD ST AIRCRAFT C - GAUL
VANCOUVER PHONE _____ JOB No. 5.5

PILOT Norm SMITH ENGINEER WARREN HILLS PURCHASE ORDER _____

ITINERARY - REMARKS - DESCRIPTION OF JOB, ETC.	ZONE	HOURS	PAX.	FREIGHT
<u>DWONK</u>		.		
<u>GALUM - DWONK RETURN 2 SLING MADE FUEL</u>		<u>2.8</u>		
		.		
		.		
<u>GALUM - SLINGING - FINE CHECK & CREWS</u>		<u>3.9</u>		
		.		
		.		
REMARKS AND CREW EXPENSES CHARGEABLE TO CHARTERER				
<u>OIL SUPP 13Y LIFT AIR</u>				
		.		
WEATHER		FUEL & OIL		TOTAL REVENUE
<u>VFR.</u>		<input type="checkbox"/> OIL <input type="checkbox"/> GAS <input type="checkbox"/> TURBO		<u>5.7</u>
CEILING	VISIBILITY	TEMP.	SUPPLIED BY LIFTAIR: _____ GALS. _____ HRS.	TOTAL NON REVENUE
			SUPPLIED BY CHARTERER: <input checked="" type="checkbox"/> GALS. _____ HRS.	TOTAL TIME ON CONTRACT
				<u>255.6</u>

THE CARRIAGE OF PASSENGERS, BAGGAGE AND GOODS INCLUDING EXTERNAL LOADS BY LIFTAIR IS SUBJECT TO THE TERMS, CONDITIONS AND LIMITATIONS OF LIABILITY SET FORTH IN ITS TARIFF FILED WITH THE A.T.C. AN EXTRACT OF WHICH IS AVAILABLE FOR EXAMINATION AT THE OFFICE OF LIFTAIR INTERNATIONAL LTD.

TO CHARTERER WITH INVOICE

AGREED TO AND SIGNED FOR CHARTERER BY:
[Signature]

Pilot's Signature:
[Signature]

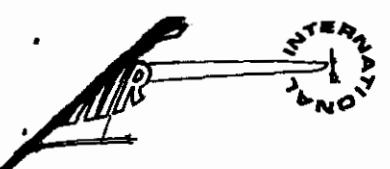

DAILY FLIGHT REPORT

HANGAR 25, INTERNATIONAL AIRPORT
 CALGARY, ALBERTA T2P 2G3
 Phone: 230-1091 Telex: 03-822632



No 02276

CHARTERER CYPRUS ANKIL MINING SHORT TERM CHARTER DATE 21/6/1980
 LONG TERM CHARTER
 ADDRESS CORP LTD. AIRCRAFT C-64TG
330-35 BURBANK ST. VANCOUVER PHONE _____ JOB No. 57
 PILOT NOAM SMITH ENGINEER DAVE CUTLER PURCHASE ORDER _____

ITINERARY - REMARKS - DESCRIPTION OF JOB, ETC.			ZONE	HOURS	PAX.	FREIGHT
CHANGE DOWNK SLING LOAD MUD.			9	0.5		
CHANGE GONZO-FARO-ROSS-MINK LOCAL - FARO				2.2		
GRAM CREWS & SLING ROIDS - MUD FUEL & FIRE REC.				4.6		
REMARKS AND CREW EXPENSES CHARGEABLE TO CHARTERER OIL SUPP BY LIFT AIR						
WEATHER 1/2 R.			FUEL & OIL <input type="checkbox"/> OIL <input checked="" type="checkbox"/> GAS <input type="checkbox"/> TURBO		TOTAL REVENUE	
CEILING	VISIBILITY	TEMP.	SUPPLIED BY LIPTAIR: _____ GALS. _____ HRS.	SUPPLIED BY CHARTERER: <input checked="" type="checkbox"/> GALS. _____ HRS.	7.3	257.1
					TOTAL NON REVENUE	TOTAL TIME ON CONTRACT
						2 1/2 1/2

THE CARRIAGE OF PASSENGERS, BAGGAGE AND GOODS INCLUDING EXTERNAL LOADS BY LIPTAIR IS SUBJECT TO THE TERMS, CONDITIONS AND LIMITATIONS OF LIABILITY SET FORTH IN ITS TARIFF FILED WITH THE A.T.C. AN EXTRACT OF WHICH IS AVAILABLE FOR EXAMINATION AT THE OFFICE OF LIPTAIR INTERNATIONAL LTD.

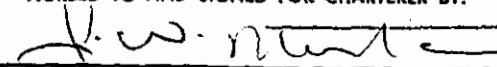
TO CHARTERER WITH INVOICE

AGREED TO AND SIGNED FOR CHARTERER BY:

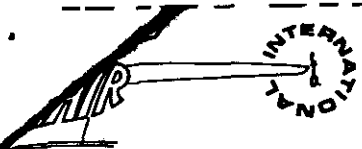
 Pilot's Signature



DAILY FLIGHT REPORT

HANGAR 25, INTERNATIONAL AIRPORT
 CALGARY, ALBERTA T2P 2G3
 Phone: 230-1091 Telex: 03-822632

Nº 02277

CHARTERER CYPRUS ADULT MINING SHORT TERM CHARTER LONG TERM CHARTER DATE 22/6/80
 ADDRESS COOP - 330-35 BURNARD ST WYND. AIRCRAFT C-64TC
 PHONE _____ JOB No. 57
 PILOT W. SMITH ENGINEER DAVID CUTLER PURCHASE ORDER _____

ITINERARY - REMARKS - DESCRIPTION OF JOB. ETC.			ZONE	HOURS	PAX.	FREIGHT
DUNK.			9	1.3		
GRUM						
CARRS - MICH & SLING - SLING 200S				1.9		
REMARKS AND CREW EXPENSES CHARGEABLE TO CHARTERER						
OIL SUPP BY LIFT AIR						244.4
WEATHER			FUEL & OIL		TOTAL REVENUE	
V.F.R.			<input type="checkbox"/> OIL <input checked="" type="checkbox"/> GAS <input type="checkbox"/> TURBO		3.2	217.6
CEILING	VISIBILITY	TEMP.	SUPPLIED BY LIFTAIR: _____ GALS. _____ HRS.		TOTAL NON REVENUE	TOTAL TIME ON CONTRACT
			SUPPLIED BY CHARTERER: <input checked="" type="checkbox"/> GALS. _____ HRS.			

THE CARRIAGE OF PASSENGERS, BAGGAGE AND GOODS INCLUDING EXTERNAL LOADS BY LIFTAIR IS SUBJECT TO THE TERMS, CONDITIONS AND LIMITATIONS OF LIABILITY SET FORTH IN ITS TARIFF FILED WITH THE A.T.C. AN EXTRACT OF WHICH IS AVAILABLE FOR EXAMINATION AT THE OFFICE OF LIFTAIR INTERNATIONAL LTD.

TO CHARTERER WITH INVOICE

AGREED TO AND SIGNED FOR CHARTERER BY:

 Pilot's Signature



DAILY FLIGHT REPORT

HANGAR 25, INTERNATIONAL AIRPORT
 CALGARY, ALBERTA T2P 2G3
 Phone: 230-1091 Telex: 03-822632

No 02278

CHARTERER CYPRUS ANVIL MINING SHORT TERM CHARTER LONG TERM CHARTER DATE 2306 1980



ADDRESS CORP LTD. 330-35 BURBANK ST AIRCRAFT C-64TG
VANC. PHONE _____ JOB No. 58

PILOT WORM SMITH ENGINEER DAVE CUTLER PURCHASE ORDER _____

ITINERARY - REMARKS - DESCRIPTION OF JOB, ETC.			ZONE	HOURS	PAX.	FREIGHT
1) WORK (SLING HARRIER EMUL)			9	1.4		
GRUM.						
CREWS & 4 SLING LOADS FINE RECC.				3.1		
REMARKS AND CREW EXPENSES CHARGEABLE TO CHARTERER						
OIL SUPP BY LIFT AIR						
WEATHER			FUEL & OIL		TOTAL REVENUE	
VFR. O.K.			<input type="checkbox"/> OIL <input checked="" type="checkbox"/> GAS <input type="checkbox"/> TURBO		4.5	267.6
CEILING	VISIBILITY	TEMP.	SUPPLIED BY LIFTAIR: _____ GAL. _____ HRS.		TOTAL NON REVENUE	
			SUPPLIED BY CHARTERER: <input checked="" type="checkbox"/> GAL. _____ HRS.			TOTAL TIME ON CONTRACT 272.1

THE CARRIAGE OF PASSENGERS, BAGGAGE AND GOODS INCLUDING EXTERNAL LOADS BY LIFTAIR IS SUBJECT TO THE TERMS, CONDITIONS AND LIMITATIONS OF LIABILITY SET FORTH IN ITS TARIFF FILED WITH THE A.T.C. AN EXTRACT OF WHICH IS AVAILABLE FOR EXAMINATION AT THE OFFICE OF LIFTAIR INTERNATIONAL LTD.

TO CHARTERER WITH INVOICE

AGREED TO AND SIGNED FOR CHARTERER BY:

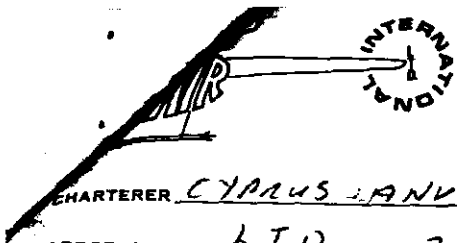
 Pilot's Signature



DAILY FLIGHT REPORT

HANGAR 25, INTERNATIONAL AIRPORT
 CALGARY, ALBERTA T2P 2G3
 Phone: 230-1091 Telex: 03-822632

Nº 02279

CHARTERER CYPRUS LAMVIC MINING CORP SHORT TERM CHARTER DATE 24/06/1980
 LONG TERM CHARTER

ADDRESS L.T.D. 330-35. RIVINGTON ST AIRCRAFT C - GUTC



VARIC. PHONE _____ JOB No. 59

PILOT NOAM SMITH ENGINEER WARREN HILLS PURCHASE ORDER _____

ITINERARY - REMARKS - DESCRIPTION OF JOB, ETC.			ZONE	HOURS	PAX.	FREIGHT
DWORK - FARG - DWORK LOCAL - FARG			9	1.3		
GRUM						
CREWS SLING MUD - CORE & FUEL -				2.1		
FIRE CHECK						
REMARKS AND CREW EXPENSES CHARGEABLE TO CHARTERER						
OIL SUPP BY LIFT AIR						
WEATHER			FUEL & OIL		TOTAL REVENUE	
✓ V.R. O.K.			<input type="checkbox"/> OIL <input checked="" type="checkbox"/> GAS <input type="checkbox"/> TURBO SUPPLIED BY LIFTAIR: _____ GALS. _____ HRS. SUPPLIED BY CHARTERER: ✓ _____ GALS. _____ HRS.		3.4	277.1
CEILING	VISIBILITY	TEMP.			TOTAL NON REVENUE	TOTAL TIME ON CONTRACT
						275.5

THE CARRIAGE OF PASSENGERS, BAGGAGE AND GOODS INCLUDING EXTERNAL LOADS BY LIFTAIR IS SUBJECT TO THE TERMS, CONDITIONS AND LIMITATIONS OF LIABILITY SET FORTH IN ITS TARIFF FILED WITH THE A.T.C. AN EXTRACT OF WHICH IS AVAILABLE FOR EXAMINATION AT THE OFFICE OF LIFTAIR INTERNATIONAL LTD.

TO CHARTERER WITH INVOICE

AGREED TO AND SIGNED FOR CHARTERER BY:

 Pilot's Signature



DAILY FLIGHT REPORT

HANGAR 25, INTERNATIONAL AIRPORT
CALGARY, ALBERTA T2P 2G3
Phone: 230-1091 Telex: 03-822632

No 02280

CHARTERER CYPRUS ANVIL SHORT TERM CHARTER
LONG TERM CHARTER DATE 25/6/1980
ADDRESS 330-35 - BURNARD ST AIRCRAFT C- GUTG
VANCO. B.C. PHONE _____ JOB NO. 60
PILOT NORM SMITH ENGINEER DAVE HILLS PURCHASE ORDER _____

ITINERARY - REMARKS - DESCRIPTION OF JOB, ETC.	ZONE	HOURS	PAX.	FREIGHT
<u>DWONK</u>	<u>9</u>	.		
<u>FARO-DWONK-FARO - SLING HULL & FUEL</u>		<u>4.5</u>		
<u>0430-1200 ^{10.30-11.30} 1200-1940 ¹²⁰⁰⁻¹⁹⁴⁰</u>		.		
<u>CREWS & 3 LOADS TO N. ANVIL + MECHANIC</u>		<u>2.6</u>		
<u>RETURN</u>		.		
<u>1200-1940</u>		.		
REMARKS AND CREW EXPENSES CHARGEABLE TO CHARTERER <u>OIL SUPP 137 LIT AIR</u>		.		
WEATHER <u>V.F.R. OK.</u>	FUEL & OIL <input type="checkbox"/> OIL <input checked="" type="checkbox"/> GAS <input type="checkbox"/> TURBO		TOTAL REVENUE	
CEILING	VISIBILITY	TEMP.	SUPPLIED BY LIFTAIR: _____ GALS. _____ HRS.	<u>7.1</u>
			SUPPLIED BY CHARTERER: <input checked="" type="checkbox"/> GALS. _____ HRS.	<u>275.5</u>
			TOTAL NON REVENUE	<u>2826</u>
			TOTAL TIME ON CONTRACT	

THE CARRIAGE OF PASSENGERS, BAGGAGE AND GOODS INCLUDING EXTERNAL LOADS BY LIFTAIR IS SUBJECT TO THE TERMS, CONDITIONS AND LIMITATIONS OF LIABILITY SET FORTH IN ITS TARIFF FILED WITH THE A.T.C. AN EXTRACT OF WHICH IS AVAILABLE FOR EXAMINATION AT THE OFFICE OF LIFTAIR INTERNATIONAL LTD.

TO CHARTERER WITH INVOICE

AGREED TO AND SIGNED FOR CHARTERER BY: _____
Pilot's Signature [Signature]

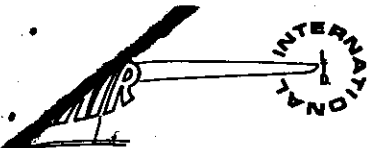

DAILY FLIGHT REPORT

HANGAR 25, INTERNATIONAL AIRPORT
 CALGARY, ALBERTA T2P 2G3
 Phone: 230-1091 Telex: 03-822632

Nº 02281

CHARTERER CYPRES ANVIL MINING SHORT TERM CHARTER DATE 26/6/1980
 LONG TERM CHARTER

ADDRESS _____ AIRCRAFT C-64TG

PHONE _____ JOB No. 61

PILOT NOAM SMITH ENGINEER DAVE CUTLER PURCHASE ORDER _____

ITINERARY - REMARKS - DESCRIPTION OF JOB, ETC.			ZONE	HOURS	PAX.	FREIGHT
Dwork				.		
DRILL MOUNT EFFICIENCY				5.6		
GRAM				.		
CREWS - SLING CORE - SLING MUD & TRANSMISSION				1.7		
- ITAIP N/A MECHANIC				.		
REMARKS AND CREW EXPENSES CHARGEABLE TO CHARTERER				.		
OIL SUPP BY LIFT AIR				.		
WEATHER			FUEL & OIL		TOTAL REVENUE	87
VFR			<input type="checkbox"/> OIL <input checked="" type="checkbox"/> GAS <input type="checkbox"/> TURBO		7.3	282.6
CEILING	VISIBILITY	TEMP.	SUPPLIED BY LIFTAIR: _____ GALS. _____ HRS.		TOTAL NON REVENUE	TOTAL TIME ON CONTRACT
			SUPPLIED BY CHARTERER: <input checked="" type="checkbox"/> GALS. _____ HRS.		.	289.9

THE CARRIAGE OF PASSENGERS, BAGGAGE AND GOODS INCLUDING EXTERNAL LOADS BY LIFTAIR IS SUBJECT TO THE TERMS, CONDITIONS AND LIMITATIONS OF LIABILITY SET FORTH IN ITS TARIFF FILED WITH THE A.T.C. AN EXTRACT OF WHICH IS AVAILABLE FOR EXAMINATION AT THE OFFICE OF LIFTAIR INTERNATIONAL LTD.

TO CHARTERER WITH INVOICE

AGREED TO AND SIGNED FOR CHARTERER BY:
V. N. ...
 Pilot's Signature
W. D. ...



DAILY FLIGHT REPORT

HANGAR 25, INTERNATIONAL AIRPORT
CALGARY, ALBERTA T2P 2G3
Phone: 230-1091 Telex: 03-822632

No 02282

CHARTERER CYPRUS ANVIL MINING CORP SHORT TERM CHARTER LONG TERM CHARTER DATE 27/11/80 1980

ADDRESS LTD 330-35 BURBANK ST AIRCRAFT C-64TG

VANC.

PHONE _____

JOB No. 62

PILOT NOAM SMITH ENGINEER DAVE CUTLER PURCHASE ORDER _____

ITINERARY - REMARKS - DESCRIPTION OF JOB, ETC.	ZONE	HOURS	PAX.	FREIGHT
<u>GANZON</u>	<u>9</u>	.		
<u>FARO - ROSS 12:50 - 13:10 = 20</u>		.		
<u>ROSS MINK 13:45 - 14:15 = 30</u>		.		
<u>MINK LOCAL 14:25 - 15:00 = 35</u>		.		
<u>DWONK</u>		.		
<u>15:00 - 15:30 = 30 16:00 - 17:20 = 1:20</u>		.		
<u>17:20 - 18:05 = 45 (SLING RODS & FUEL</u>		.		
<u>CAUM CREW - MEET OUT TO N. ANVIL - LOCAL (2:10)</u>		.		
<u>FLIGHT RECC. - KIT RECC</u>		.		
REMARKS AND CREW EXPENSES CHARGEABLE TO CHARTERER <u>OIL SUPP BY LIFT AIR</u>		.		

WEATHER			FUEL & OIL		TOTAL REVENUE	TOTAL TIME ON CONTRACT
<u>V. F.R.</u>			<input type="checkbox"/> OIL <input checked="" type="checkbox"/> GAS <input type="checkbox"/> TURBO		<u>4.2</u>	<u>289.9</u>
CEILING	VISIBILITY	TEMP.	SUPPLIED BY LIPTAIR: _____ GALS. _____ HRS.		TOTAL NON REVENUE	
			SUPPLIED BY CHARTERER: <input checked="" type="checkbox"/> GALS. _____ HRS.			<u>296.1</u>

THE CARRIAGE OF PASSENGERS, BAGGAGE AND GOODS INCLUDING EXTERNAL LOADS BY LIPTAIR IS SUBJECT TO THE TERMS, CONDITIONS AND LIMITATIONS OF LIABILITY SET FORTH IN ITS TARIFF FILED WITH THE A.T.C. AN EXTRACT OF WHICH IS AVAILABLE FOR EXAMINATION AT THE OFFICE OF LIPTAIR INTERNATIONAL LTD.

TO CHARTERER WITH INVOICE

AGREED TO AND SIGNED FOR CHARTERER BY:

[Signature]

Pilot's Signature

[Signature]

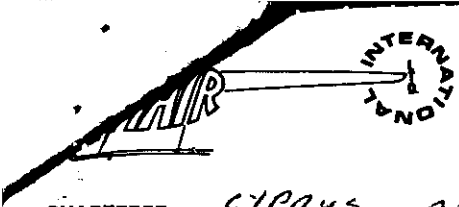

DAILY FLIGHT REPORT

HANGAR 25, INTERNATIONAL AIRPORT
 CALGARY, ALBERTA T2P 2G3
 Phone: 230-1091 Telex: 03-822632

No 02284

CHARTERER CYPRES ANVIL SHORT TERM CHARTER DATE 29/06/1980
 LONG TERM CHARTER

ADDRESS _____ AIRCRAFT C - G4TG

PHONE _____ JOB No. 666

PILOT NORM SMITH ENGINEER DAVE CUTLER PURCHASE ORDER _____

ITINERARY - REMARKS - DESCRIPTION OF JOB, ETC.			ZONE	HOURS	PAX.	FREIGHT
			9	.		
Dwork				.		
Dwork RETURN & CHECK at GONZO + SLING MUD				1.9		
				.		
GRAM				.		
CREWS + TAPPON/ANVIL - SLING CORE				2.0		
E FINE CHECK				.		
				.		
REMARKS AND CREW EXPENSES CHARGEABLE TO CHARTERER				.		
OIL SUPP BY LIFT AIR				.		
				.		
WEATHER			FUEL & OIL		TOTAL REVENUE	
VFR.			<input type="checkbox"/> OIL <input checked="" type="checkbox"/> GAS <input type="checkbox"/> TURBO SUPPLIED BY LIFTAIR: _____ GALS. _____ HRS. SUPPLIED BY CHARTERER: <input checked="" type="checkbox"/> GALS. _____ HRS.		3.9	200.4
CEILING	VISIBILITY	TEMP.			TOTAL NON REVENUE	TOTAL TIME ON CONTRACT
					.	304.3

THE CARRIAGE OF PASSENGERS, BAGGAGE AND GOODS INCLUDING EXTERNAL LOADS BY LIFTAIR IS SUBJECT TO THE TERMS, CONDITIONS AND LIMITATIONS OF LIABILITY SET FORTH IN ITS TARIFF FILED WITH THE A.T.C. AN EXTRACT OF WHICH IS AVAILABLE FOR EXAMINATION AT THE OFFICE OF LIFTAIR INTERNATIONAL LTD.

TO CHARTERER WITH INVOICE

AGREED TO AND SIGNED FOR CHARTERER BY:

 Pilot's Signature
N.O. Smith

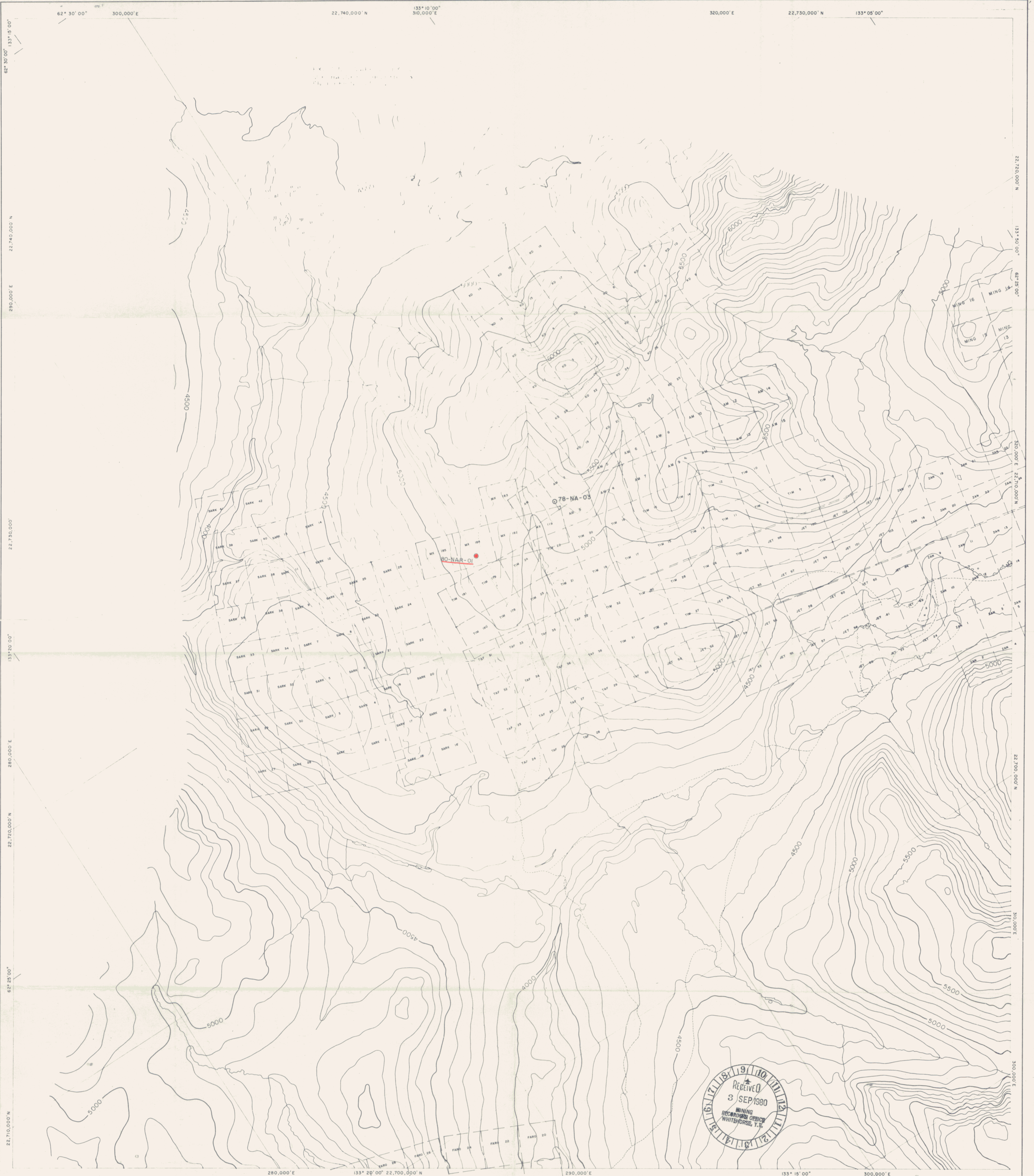

62° 30' 00" 133° 15' 00" 22,740,000' N 300,000' E 133° 10' 00" 310,000' E 320,000' E 22,730,000' N 133° 05' 00" 22,720,000' N 133° 50' 00" 22,740,000' E 290,000' E 133° 20' 00" 22,730,000' N 280,000' E 133° 20' 00" 22,720,000' N 280,000' E 22,710,000' N 280,000' E 133° 25' 00" 22,700,000' N 300,000' E 280,000' E 133° 20' 00" 22,700,000' N 290,000' E 133° 15' 00" 300,000' E

LEGEND

CLAIM POSTS AND LEGAL SURVEYS
(Shown in the field)

PRELIMINARY CLAIM POST AND LINE SURVEYS
(Located in the field)

APPROXIMATE PLAN OF CLAIM POST LOCATIONS
(Not located in the field)

Note: Claim posts with the indicated marker have been located in the field, plotted onto 1976 photography and transferred to the orthophoto.

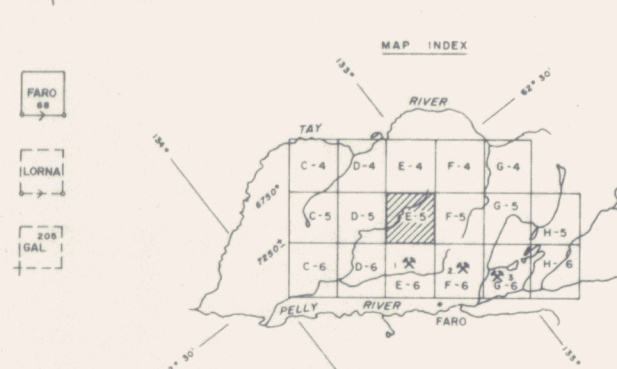

ALL WEATHER ROADS
SECONDARY ROADS
TOPE TRAILS
BRIDGES
PRIMARY STREAMS
SECONDARY STREAMS
SWAMPS
CAMP LOCATIONS
DIAMOND D.H. SITES
ROTARY GRILL SITES
TRIANGULATION STATIONS
100' ELEVATION IN FEET

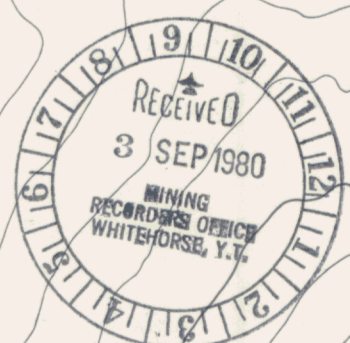

CYPRUS ANVIL MINING CORPORATION

CLAIM SURVEYS

Showing DBH 80-NA-01

REVISED BY: _____ DATE: NOV 18, 1976

Scale 1" = 2000'

DATE: NOV 18, 1976

090753