



REPORT
ON THE
1979 GEOLOGICAL AND GEOCHEMICAL SURVEY
ON THE
BULLDOZER No.1 MINERAL CLAIM
GALENA HILL AREA
MAYO MINING DISTRICT
105-M-14

Latitude $63^{\circ} 54' N$
Longitude $135^{\circ} 21' W$

United Keno Hill Mines Ltd.
T.J. Levicki
Exploration Geologist

January 18, 1980

090569

This report has been examined by the Geological Evaluation Unit and is recommended to the Commissioner to be considered as representation work in the amount of \$ 500.00

J. A. Morris

Resident Geologist or
Resident Mining Engineer

Considered as representation work under
Section 53 (4) Yukon Quartz Mining Act.

B. R. Baxter
B. R. BAXTER

Supervising Mining Recorder

per Commissioner of Yukon Territory

TABLE OF CONTENTS

	<u>PAGE</u>
Location and Access.....	1
General Geology	1
Previous Work	1
1979 Geochemical Survey	1
Sample Analysis	2
Results	2
Conclusions & Recommendations	2
References	3
Statement of Expenditures	4
Affidavit	5

MAPS:

SCALE:

- FIGURE 1: Location of Bulldozer No.1 M.C. 1"=2000'
- FIGURE 2: Location and Geochemical Grid - Bulldozer No.1 M.C. 1"=400'
- FIGURE 3: General Geology 1"=400'
- FIGURE 4: Soil Sampling - Silver Plot 1"=200'
- FIGURE 5: Soil Sampling - Lead Plot 1"=200'
- FIGURE 6: Soil Sampling - Zinc Plot 1"=200'

LOCATION AND ACCESS:

The Bulldozer No. 1 Mineral Claim is located on the lower southeast slope of Galena Hill, approximately 1.5 miles due west of Keno City. It adjoins the Inca Claim to the east, the Edith Cavell No.8 and No.5 to the south, the Edith Cavell No.5, Edbo No.2 and Bobbie No.4 to the west and the Mexico Claim to the north.

The Bulldozer No.1 is a restaking of the former Aztec Claim, which was previously held by Rio Plata Silver Mines.

Access is via the Keno-Mayo road and the Calumet-Galkeno 300 road.

GENERAL GEOLOGY:

Boyle's G.S.C. geological mapping shows the claim area to be located on the Central Quartzite- Upper Schist contact. The contact strikes across the northeast corner of the claim and it dips to the southwest at an unknown angle. The southern part of the claim is therefore schist on surface but should be quartzite at depth below the schist. A major fault has been inferred along the Duncan Crk.-Lightning Crk.-Cristal Lake valley, passing only 500' to the east of the Bulldozer Claim and possibly dipping down through the claim. No veins are known on the claim but U.K.H.M. has not mapped the claim to date.

PREVIOUS WORK:

The Bulldozer claim was previously staked as the Aztec Claim and was owned by Rio Plata Silver Mines Ltd. which did not carry out any exploration on this claim nor did they have any record of previous prospecting by the original owners. Rio Plata had contemplated a reconnaissance prospecting program on the property but allowed the ground to lapse without doing it.

1979 GEOCHEMICAL SURVEY:

An 800'x 1500' geochemical survey grid was sampled on the eastern half of the claim on June 29, July 3 and August 28, 1979. A total of 135 soil samples were taken using a grubhoe to reach the 'B' horizon. The samples were analyzed at U.K.H.M.'s lab in Elsa using standard techniques.

SAMPLE ANALYSIS:

Soil sample analysis was carried out at the Elsa Assay Laboratory under the direction of Mr. Victor Rafuse, Chief Chemist for United Keno Hill Mines Ltd.

The samples were dried and screened through a -80 mesh standard nylon screen. 1.00 grams of the -80 mesh material was digested in a solution of HNO_3 and HCl (aqua regia) for a minimum of 8 hours under heat lamps. After cooling, the samples were brought up to a 20ml. volume with deionized water and were analyzed for silver, lead and zinc by a Perkin Elmer 303 atomic absorption -spectrophotometer. Results were obtained in parts per million.

RESULTS:

Geochemical results for silver, lead and zinc are plotted in parts per million on figures 4,5&6 respectively. All three elements show 3 coincident anomalies, none of which is very large or strong. The northernmost anomaly has a spot high of 145.0 ppm Ag., 5560.0 ppm Pb. and 707.0 ppm Zn.

CONCLUSIONS AND RECOMMENDATIONS:

1. The geochemical soil sampling program on the Bulldozer claim located three coincident Ag.-Pb.-Zn. anomalies with one sample running 145ppm Ag., 5560.0 ppm Pb. and 707.0 ppm Zn. These anomalies are in a parrallel north-south striking orientation 1500' long.
2. These anomalies are immediately beside and downhill from and parrallel to the Keno- Mayo road and are most likely caused by contamination from the road.
3. It is recommended that the remainder of the claim be soil sampled, requiring an additional 105 samples. Geological mapping should also be carried out on the claim at a scale of 1"=400'. Any further work should be dependant on the results of sampling and mapping program.

Respectfully Submitted
United Keno Hill Mines Limited

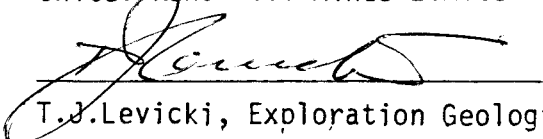
T.J. Levicki, Exploration Geologist

Geochemical Sampling by Ray Donalessen, Geological Assistant
Analysis by Victor Rafuse, Chief Chemist
Supervised by T.J.Levicki, Exploration Geologist

REFERENCES:

- (a) Geology, Geochemistry and Origin of the Pb-Zn-Ag Deposits
of the Keno Hill- Galena Hill Area.
by R.W.Boyle Bulletin 111
- (b) Review Report on the Rio Plata Silver Mines Limited
Properties in the Mayo District, Yukon Territory
Prepared for Peso Silver Mines Limited
by Dr. F. Bianconi
Bianconi-Saager, Geological Consultants
March 1971

STATEMENT OF COSTS FOR SAMPLING PROGRAM

A. Geochemical Survey

1 Man for 3 days @ \$60.00/day.....\$180.00

B. Sample Analysis

135 Samples x 3 Determinations x 0.75/ Det.\$303.75

C. Sampling Equipment and Supplies

Sample Bags, Pickets, Flagging etc.\$ 30.00

TOTAL EXPENDITURE

\$513.75

A F F I D A V I T

I, Terry J. Levicki, of Elsa, in the Yukon Territory, Exploration Geologist,
do solemnly declare:

1. I have caused the above mentioned work to be performed to the best of my ability and have a personal knowledge of the facts and matters herein declared, and
2. I make this solemn declaration conscientiously believing it to be true and knowing that it is of the same force and effect as if made under oath and by virtue of the Canada Evidence Act.

Declared before me at
Mayo, in
the Yukon Territory,
this 8th day of
FEB. 1980.

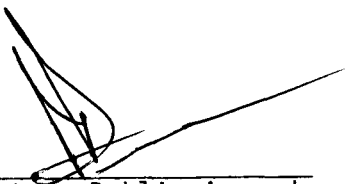

Notary Public in and
for the Yukon Territory



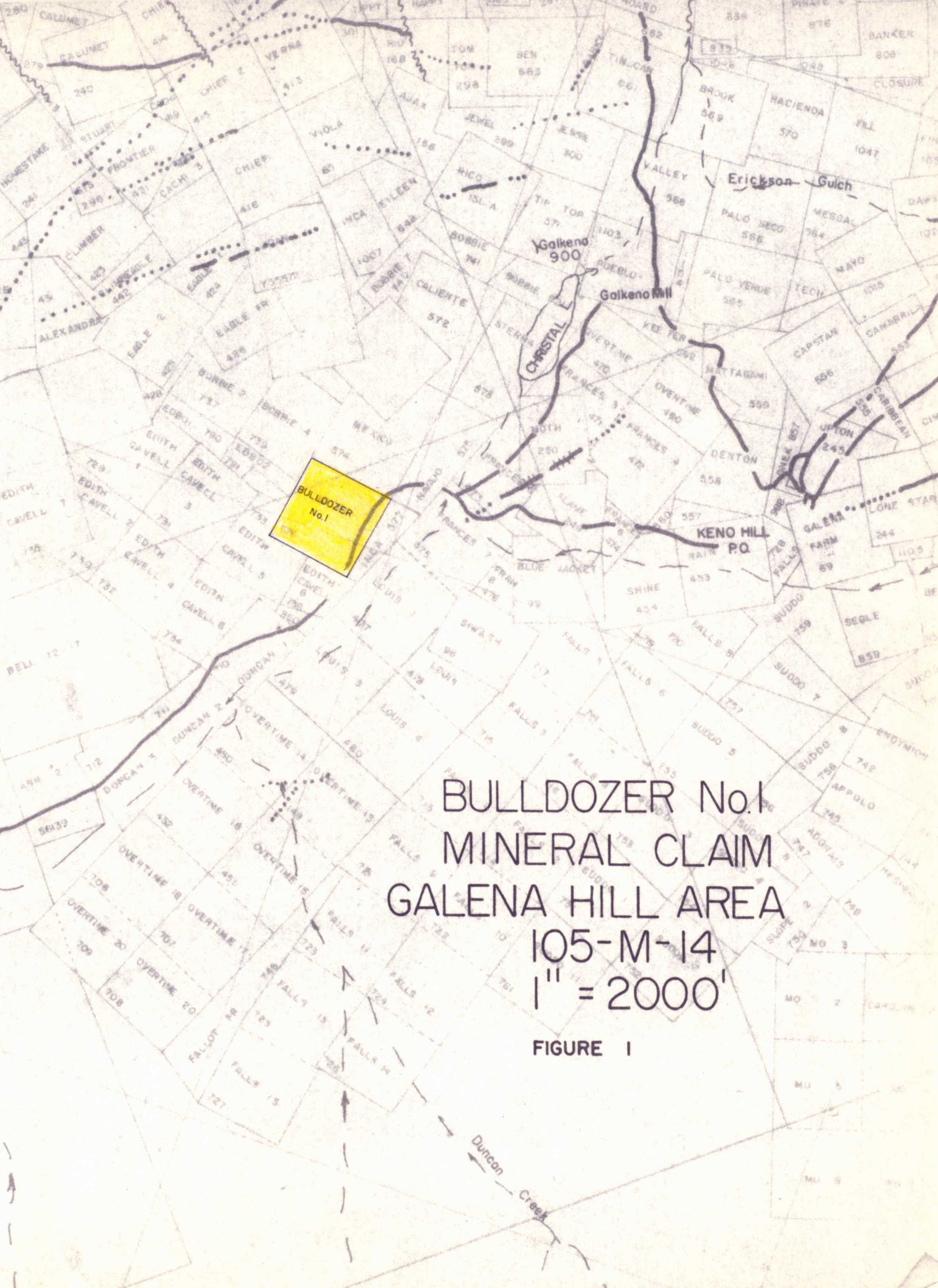

**BULLDOZER
No. 1**

**BULLDOZER No. 1
MINERAL CLAIM
GALENA HILL AREA
105-M-14
1" = 2000'**

FIGURE 1



1979 GEOCHEMICAL SURVEY

LOCATION MAP
BULLDOZER No. 1 M.C.
GALENA HILL
1" = 400'

FIGURE 2



GENERAL GEOLOGY
BULLDOZER No. 1 M.C.
GALENA HILL

1" = 400'

FIGURE 3

GEOLOGY from BOYLE, 1955

SI WASH
98

SALKENO - CALUMET ROAD

LIGHTNING CREEK

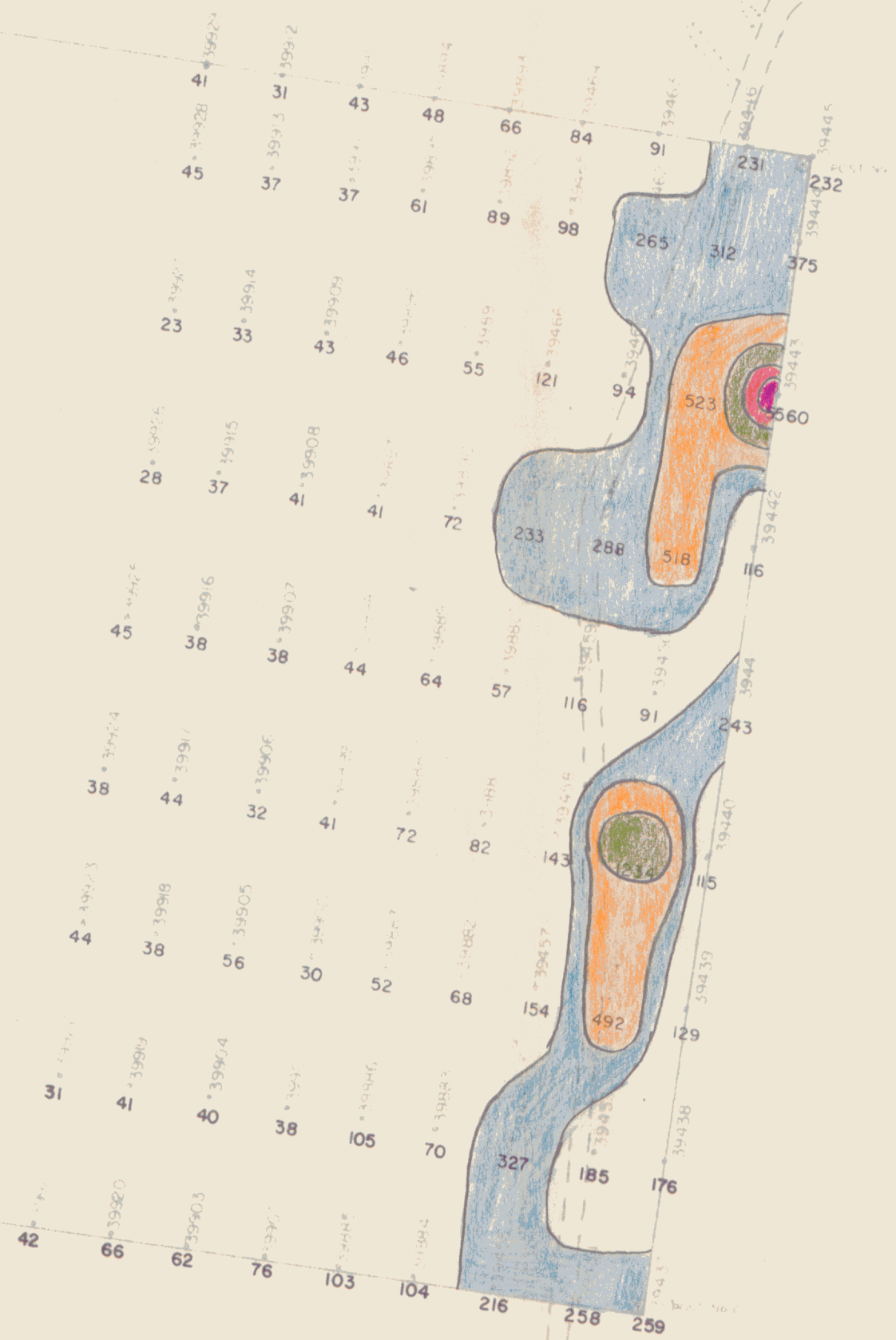

CONTOUR INTERVALS

Color	PPM
White	100-200
Blue	200-400
Orange	400-800
Green	800-1600
Red	1600-3200
Pink	3200-6400

BULLDOZER No. 1 M.C.
LEAD PLOT

ppm
UNITED KENO HILL MINES LTD.

BY _____ DATE _____ SCALE 1" = 200'
DRAWN J.M. 15/01/80
CHECKED _____ DWG. NO. 5

GALKENO - CALUMET ROAD

TO KENO



CONTOUR INTERVALS

PPM	
	100 - 200
	200 - 400
	400 - 800
	800 - 1600

<h1>BULLDOZER No.1 M.C.</h1> <h2>ppm ZINC PLOT</h2>			
UNITED KENO HILL MINES LTD.			
	BY	DATE	SCALE: 1" = 200'
DRAWN	JM	15/01/80	
CHECKED			DWG. NO.6

