

GEOLOGICAL, GEOPHYSICAL and TRENCHING

REPORT

ON

THE EVA CLAIMS 1 - 29
WHITEHORSE MINING DIVISION
YUKON TERRITORY

N. T. S. - 105 F 14

Latitude 61 56'

Longitude 133 24'

FOR

RISBY TUNGSTEN MINES LTD.

905 - 355 Burrard St., Vancouver
British Columbia, Canada
Phone: 685-5226

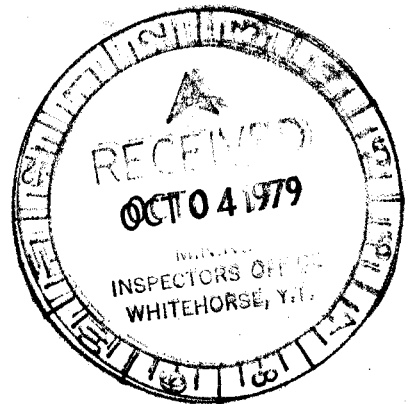

B Y

John M. McAndrew, Consulting Geologist, P. Engr.

Field Examination Period: July 12 - August 4, 1979

090496

This report has been examined by the Geological Evaluation Unit and is recommended to the Commissioner to be considered as representation work in the amount of

\$ 7,200.00

J A Mann

A/ Resident Geologist or
Resident Mining Engineer

Considered as representation work under
Section 53 (4) Yukon Quartz Mining Act.

B. R. BAXTER

Supervising Mining Recorder

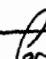
 Commissioner of Yukon Territory

8961 Ursus Crescent,
Surrey, British Columbia,
Canada V3V 6L3
Phone 591-6512

The Board of Directors
Risby Tungsten Mines Ltd.
905 - 355 Burrard St.
Vancouver, B.C.

Gentlemen:

Please find attached my report on the 1979 exploration program on the Eva mineral claims of Risby Tungsten Mines Ltd., located near Ross River, Yukon Territory.

This preliminary program was successful in locating 6 mineral showings; 2 of which grade from 1.16 to 1.70% WO₃ and 12 magnetic anomalies, which exceed 1,500 gammas.

The encouraging results from this program will justify geochemical and magnetometer surveys possibly followed by diamond drilling during the next exploration season.

Thanking you for the opportunity to consult for Risby Tungsten I remain -

Very truly yours

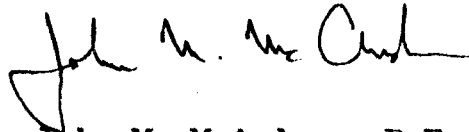

John M. McAndrew, P.Eng.
Consulting Geologist

TABLE OF CONTENTS

	Page No.
Location Map	
Claim Map	
Summary	1 - 2
Photographs - EVA Claims	3
Introduction	4
Location and Access	5 - 6
Physiography	6 - /
History	8 - 10
Claim Status	10 - 11
Geology - General	12
Specific Rock Types	13 - 17
Detailed	17 - 18
Structure	19
Mineralization	19 - 22
Magnetometer Survey - Type of Magnetometer	23
Field Procedure	24
Results	24 - 27
Conclusions	28 - 29
Recommendations	29 - 31
Bibliography	32
Certification of John M. McAndrew	33
Assays from Chemex Labs Ltd.	34 - 36
Table 1 - Metric Linecutting	37 - 39
Table 2 - Trenching Data	40
Table 3 - Magnetometer Survey	41 - 44
In Back Pocket of Report:	
Fig. 1 - Geological Map, Mineralized Showings 1:2000	
Fig. 2 - Magnetometer Survey Mineralized Showings	1:2000

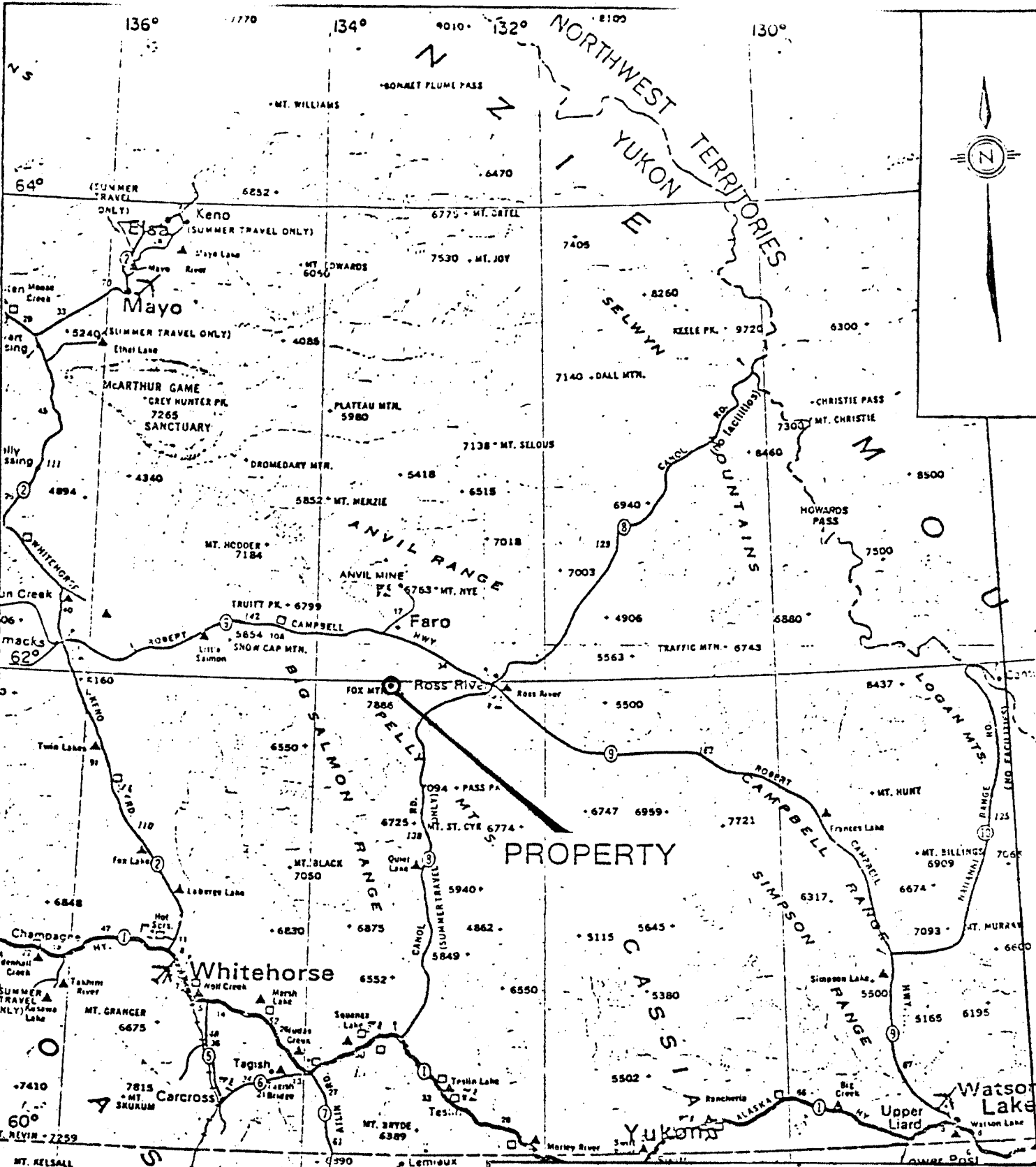

PROPERTY

RISBY TUNGSTEN MINES LTD.

LOCATION MAP

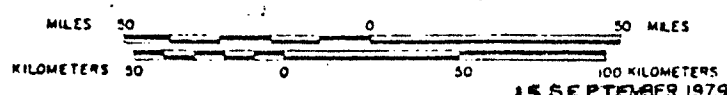

15 SEPTEMBER 1979

WAYLAND S. READ

P. ENG. CONSULTING GEOLOGIST
 COBBLE HILL, B.C., CANADA

JOHN M. McANDREW

P. ENG. CONSULTING GEOLOGIST

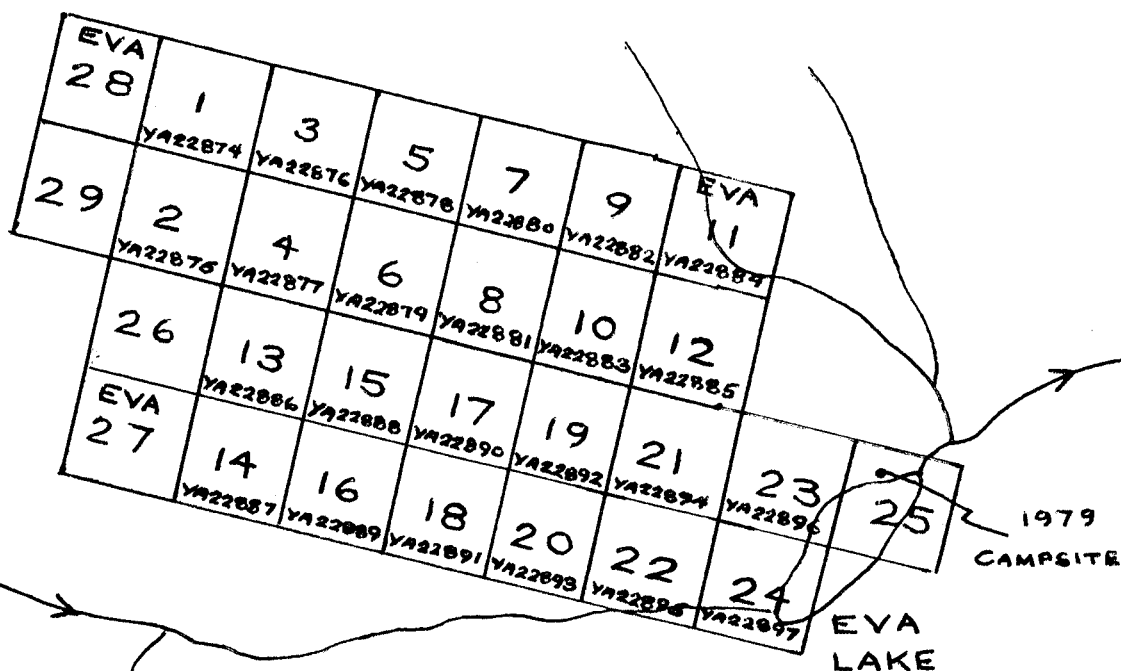

WARKE LAKE

61° 56' N

133° 24' W

RISBY TUNGSTEN MINES LTD.	
CLAIM MAP-EVA GROUP	
MILE 1/2 0 1/2 1 MILE	
KILOMETERS 1/2 0 1/2 1-1/2 KILOMETERS	
N.T.S. 105 F14	
6 SEPTEMBER 15, 1979	
WAYLAND S. READ	P. ENG. CONSULTING GEOLOGIST COBBLE HILL, B.C., CANADA
JOHN M. McANDREW	P. ENG. CONSULTING GEOLOGIST SURREY, B.C.

SUMMARY

This report has been prepared for the Directors of Risby Tungsten Mines Ltd.

During the period July 12 to August 4, 1979 a preliminary exploration program consisting of detailed geological mapping, magnetometer surveys and trenching was conducted on Risby Tungsten's Eva Claims, which lie 52 km. (33 miles) southwest of Ross River, Yukon Territory, Canada.

The claims were acquired in 1978 to cover an area of reported tungsten showings, one of which, assayed 1.66% WO_3 .

The claim group is underlaid by a thick series of Silurian and Devonian sedimentary and metamorphic rocks which strike N 40-60 degrees W and dip 30-60 degrees northeast and are intruded to the south and west by biotite-quartz-monzonite of the Mid-Cretaceous Fox Mountain Stock. The sedimentary and metamorphic sequence is also intruded by numerous dikes and sills of biotite-quartz-monzonite, felsite, aplite, andesite, lamprophyr and quartz diorite.

Six (6) partially exposed zones of mineralization have been located by detailed geological mapping. They all occur within a black, slaty shale and are spread out along a strike length of 785 m. (2,574') and across an approximate width of 90.53 m. (297'). They range in elevation from 1,720 m. (5,643') to 1,911 m. (6,270'). They are from 0.8-10 meters wide and from 8-80 meters long where exposed.

The showings share the following characteristics- distinctive reddish-brown colour; disseminated and massive, weakly to strongly magnetic pyrrhotite; minor disseminations and minute seams of chalcophyrite; calcareous and in part skarnified.

Their greatest difference is in their scheelite content and the reason for this is yet unresolved. Showings 1 and 3-5 are composed almost entirely of massive anhedral to subhedral pyrrhotite and the specimens from these zones appear almost identical yet samples from Showings 1 and 3 range from 0.42-1.92% WO_3 whereas Showings 4 and 5 contain only trace amounts. The scheelite in the various showings occurs as fine to coarse crystals up to 1/2 by 1 cm. and its intense blue-white colour under shortwave ultraviolet light indicates great purity.

Showings 2 and 6 contain appreciably more skarn and calcite but their scheelite content is very low. Although Showing 6 contains fine to coarse grained scheelite the mineralization is erratic.

Summary (cont...)

Faults, sills and quartz veins appear to have acted as conduits and traps for the mineralizing solutions, which formed the showings.

Refer to accompanying Maps 1 and 2 for details of the magnetometer survey, geology, showings, trenches and assays.

Since the scheelite mineralization is associated with weakly to strongly magnetic pyrrhotite a magnetometer survey seemed appropriate to help define the limits of the known showings in areas of cover and locate new concealed zones. Overburden exceeds 50% in some geologically favourable areas so the odds were good.

Background for the Eva Claims appears to be from 600-700 gammas. Negative readings and those about 1,500 gammas were considered anomalous but even readings in excess of 1,000 gammas may be significant since a reading directly above Showing 1, which assayed 1.16% WO_3 , was only 1,035 gammas.

Twelve (12) moderately to strongly magnetic anomalies were completely or partially defined. Two of these define and extend Showings 2 and 3 very well. Many of the anomalies have dimensions far in excess of the known showings. The MacDonald Anomaly averages 40 meters wide along a length of 180 meters, and presents the possibility of finding economic size tonnages on the Eva Group. 10 of the anomalies correspond to areas of partial or total cover. The author feels there is a very good chance that they are indicating the presence of concealed magnetic pyrrhotite.

By carrying out a program of soil sampling in all areas exceeding 1,000 gammas, if overburden conditions are favourable, it may be possible to determine which of the concealed zones of pyrrhotite carries scheelite. Caution is advised in the case of the MacDonald Anomaly, which could be capped by quartzite schist, which might be impervious to upward mobility of the metallic ions.

Results to date on the Eva Claim Group are very encouraging. In just 3 weeks 6 mineral showings were located; 2 of which grade from 1.16 to 1.70% WO_3 .

Numerous moderate to strong magnetic anomalies with dimensions, in some cases, far in excess of the known showings present many possibilities of locating magnetic, scheelite bearing pyrrhotite deposits.

A follow up program of magnetometer and geochemical surveys, detailed geological mapping, possibly followed by diamond drilling has been recommended and outlined. This could be accomplished during one summer season provided the basecamp was moved to the area of the main showings and anomalies (Station 3+00N on Line 34+00W).



EVA CLAIMS LOOKING NORTHWEST



BLASTING ON #1 SHOWING



TRENCHING ON THE EVA CLAIMS

INTRODUCTION

During the period from July 12 to August 4, 1979, the author, accompanied by a crew of five, consisting of a mining technician, driller-blaster, two field assistants and a cook, supervised a program of geological mapping, magnetometer surveys and trenching on the Eva Group of claims.

The purpose of these preliminary surveys were to locate and assess reported zones of scheelite mineralization within the claims, attempt to locate new zones of mineralization and prepare a geological and magnetometer map of the claims.

Prior to the field examination all pertinent background information on the general claim area was assembled in Vancouver, British Columbia and Whitehorse, Yukon Territory.

The work was performed in close association with Wayland S. Read, Consulting Geologist, P. Engr. of Wayland S. Read Limited whose Yukon expertise and crew supplied the author with valuable advice regarding Yukon mobilization problems and scheelite occurrences in the area of interest.

This exploration program was done on behalf of Risby Tungsten Mines Ltd., 905-355 Burrard Street, Vancouver, British Columbia.

LOCATION AND ACCESS

The Eva Group is 52.8 kilometers (33 miles) south 85 degrees west of Ross River, Yukon Territory and 4.8 kilometers (3 miles) north 60 degrees west of Fox Mountain.

Plane connections between Vancouver-Whitehorse and Ross River are such that one can leave Vancouver early in the morning and be on the claims the same day.

The claims are only 4.8 km. (3 miles) due north of the north boundary of Risby Tungsten Mines Ltd. - CAB Group which was under option to Hudson Bay Mining and being drilled this summer. This is a skarn type of scheelite deposit.

For the exact location of the Eva Group refer to the Location and Claim Maps attached to this report.

A tent camp was established on the west shore of a small unnamed lake at the southeast corner of the claims. In this report this lake will be referred to as Eva Lake. This lake was just large enough that a float equipped Porter aircraft could bring in the camp equipment and make weekly supply runs. This accounted for a big saving in flight support for the program; \$120/round trip for the Porter compared to \$375/hour for a Hughes 500 helicopter or \$400/hour for a Jet Ranger.

Unfortunately the Porter was broken down at the time of move out so all supplies were flown out by Jet Ranger to the Canol road where it crosses Fox Creek 29 km. (18 miles) southeast of Eva Lake. From this point they were trucked into Ross River (approximately 32 Km.).

LOCATION AND ACCESS (Cont...)

If at some future date the Eva property advances to the drilling stage it might be worth considering moving the base-camp closer to the known showings. This would save a 305 meter (1,000') climb from Eva Lake to the area of the showings which is very time consuming and could have quite a demoralizing effect on a drill crew faced with this prospect before each shift. At station 3+00N on Line 34+00W there is a large flat grassy area with an ample water supply which would make a fine campsite.

PHYSIOGRAPHY

A topographic base map at a scale of 1:5000 (metric) was prepared from aerial photographs to serve as a base for regional geological mapping on and around the Eva Group. This in turn was enlarged to a scale of 1:2000 (metric) for plotting detailed geology on the claims and results of the magnetometer survey.

The Eva Lake campsite lies at an elevation of 1,426 m. (4,680') and the scheelite showings to the west extend from an elevation of 1,720 m. (5,643') to 1,911 m. (6,270').

The claims are occupied by four major topographic units. Eva 3 - 12 cover and parallel a large valley which is drained to the east by what will be referred to as Jacobsen Creek. This creek empties into Eva Lake and the stream outlet of Eva Lake. Eva 13 - 18 cover another southeasterly trending valley and drainage system (Warke Creek). Warke Creek is the first northern tributary of the major stream draining into the west end of Eva Lake. The claim area is almost equally divided by a central ridge between the two aforementioned valleys. This ridge ranges from 1,678 m. (5,504') to 2,123 m.

PHYSIOGRAPHY (Cont..)

and certain sections of its northern slope are inaccessible. Three mountains which exceed 2,013 m. (6,900') in elevation form a natural-barrier in the western and northwestern portion of the claims. This barrier made it impractical to extend geological reconnaissance and prospecting beyond the present western limit of the claims from the Eva Lake campsite.

Mineral showings 1 - 4 are in an area of gentle relief and 5 and 6 on the steep northeast slope of Warke Mountain in Eva 26 and 27. Certain iron oxide stained zones on this mountain would require an experienced mountaineer for an examination.

Except for a few stunted conifers there are no serviceable trees on or around the Eva Group and all camp lumber and claim posts had to be flown in from Ross River.

Vegetation on the claims is typical northern tundra. On the lower slopes in the southeast portion of the group there are extensive areas of thick "buck brush" and no outcrop was seen.

Outcrop is extensive in the lower sections of Warke and Jacobsen Creeks which served as natural trench for geological mapping. Outcrop is also good along ridge tops and the steep ridge slopes. Invariably individual peaks along the ridges, particularly the main "central ridge" are made up of resistant intrusive dikes and the flat weathered areas of sedimentary and metamorphic rocks. In the flatter portions of the valleys and around showings 1 - 4 outcrop is very patchy and in certain areas of definite interest well below 50%.

PHYSIOGRAPHY (Cont. .)

The weather in this area is more irritating than unpleasant and one should come well equipped with rain gear. During the work period there was one sunny day, one overcast and rain showers and thunder storms every other day. These showers are usually just long enough to get field notes thoroughly soaked before the sun comes out again. As the season advanced the rain became more frequent and persistent. The first week in August there was a light snowfall above the 1,829 m. (6,000') elevation. Mylar field sheets and rite-in-rain notebooks are a must for this region.

Winds often exceed 48 Km. (30 miles) per hour and tents should be well equipped with guy ropes. Coleman space heaters are a necessity for drying clothes and heating the tents at night.

H I S T O R Y

On December, 1969 J. M. Bremner submitted a report to Atlas Explorations Limited titled "Geology and Geochemistry of Northern Part of R. T. Agreement Area, N.T. S. 105-F-14".

This report describes a program of reconnaissance, geological mapping, geochemical stream silt sampling and prospecting in the area of the present Eva Group. This exploration was carried out in the summer of 1969 by 2 men operating out of 5 fly-camps. Quoting from Bremner's report "only one (grab sample) produced an interesting result viz 1.66% WO_3 . This sample was made up from 18 chips collected over an unknown area and consisted of skarn, massive pyrrhotite with thin chalcopyrite veinlets, and scheelite disseminations."

Bremner's report was in the Risby Tungsten files and served as valuable background data for the 1979 Eva program.

HISTORY (Cont..)

It was possible to relocate the showing he mentions (old paint marks along the zone) which will be referred to in this report as Showing 3.

In 1977 D. J. Templeman-Kluit compiled the Quiet Lake Geological Map (105 F) at a scale of 1 inch equals 4 miles based on the work of Wheeler, Green, Roddick, Abbott, Gordey and himself during the years 1958 to 1976. This covers the area of the EVA and CAB groups and served as another useful geological reference.

World tungsten prices increased rapidly in the first quarter of 1977 to above an average of \$180 a metric ton unit (10 kilograms or 22.04 pounds). This strong market created a resurgence in the exploration for and development of tungsten properties throughout Canada and particularly the Yukon Territory.

After reviewing their extensive Yukon files the principals of Risby Tungsten decided to acquire the showing and favourable geological environment described in Bremner's report. This was accomplished during the summer of 1978 and financing arranged to conduct a preliminary exploration program on the Eva group at the start of the 1979 field season.

The Mining Division of the Department of Northern Affairs completed an extensive program of stream sediment sampling within the Quiet Lake (105 F) Map Area in 1978. Their tungsten results were released in the early part of 1979 and showed numerous areas moderately to highly anomalous in tungsten. These have all been staked by various individuals and companies at this time. It is noteworthy that Risby's scheelite deposits on the CAB group showed up as a strong

HISTORY (Cont. . .)

anomaly on this regional study. But the Eva mineralization was not indicated. The probable reason for this is that they sampled the major drainage system in the area of the showings just above where it enters the west end of Eva Lake; at this point the stream is large and fast moving and the dilution factor would be great. Their sample site is approximately 1-1/4 miles downstream from the first scheelite occurrence on "Warke Creek".

CLAIM STATUS

Prior to the field examination Risby Tungsten Mines Ltd. owned the following 24 EVA claims:

<u>CLAIMS</u>	<u>RECORD NUMBER</u>	<u>EXPIRY DATE</u>
EVA 1-24	YA22874 - YA22897	July 19, 1979

During the property examination it was thought expedient to stake EVA 25 to cover the campsite area.

To cover iron oxide stained gossan zones and Mineral Showing 6 it was necessary to stake EVA 26 and 27 west of EVA 13 and 14 respectively.

A large gossan zone observed in the latter days of the program west of EVA 1 and 2 motivated the staking of EVA 28 and 29.

<u>CLAIMS</u>	<u>RECORD NUMBER</u>	<u>EXPIRY DATE</u>
EVA 25		
EVA 26		
EVA 27		
EVA 28		
EVA 29		

CLAIM STATUS (Cont. .)

All new claims were transferred to the ownership of Risby Tungsten Mines Ltd.

While examining the claims it was noted that the northern block consisting of EVAs 1-12 was not as shown on the claim map Sheet 105 F 14 but in actuality shifted one complete claim length to the northwest. The corrected map is attached to this report.

The author would like to take this opportunity to make a few suggestions that would result in significant savings in time and expense for individuals and companies staking in the Yukon Territory:

1) Issue tags that can be attached to the claim posts at the time of staking. After one winters exposure most of the written inscriptions are unreadable. This method has worked well in British Columbia.

2) At a common corner allow claim descriptions to be inscribed on one post. In treeless areas allow claims to be defined by rock kairns with initial and final post descriptions contained in weather and rodent proof canisters. This method is satisfactory in the Northwest Territories.

G E O L O G Y

General - J. M. Bremner's comments on the regional geology in the area of the EVA claims are worth quoting "the northeast part of the area comprises a thick sequence of Paleozoic sediments, which dip gently eastwards at about 35 degrees. They have been uplifted to the west by a quartz-monzonite batholith. Running parallel to the contact, which strikes at about N 55 degrees W, a large number of leucocratic (light coloured) sills have invaded the sedimentary sequence, for up to 5 miles away." "Two areas of mineralization were outlined. One extends for about 4-1/2 miles along the sedimentary-intrusive contact, and consists of gossaned quartzose schists, skarn, and occasionally massive pyrrhotite." The area he refers to in this quote is in part covered by the EVA group.

Referring to Bremner's 1 inch equals 1 mile regional geology map he shows the area northwest of EVA Lake i.e. the EVA claims as being underlain by Cambrian phyllite, quartz-biotite and chlorite schist and skarn and Ordovician/Silurian or Lower Mississippian black slate and shale intruded by Cretaceous granodiorite, quartz-monzonite, granite and gneissic granite.

D. J. Templeman-Kluit's 1 inch equals 4 miles Geology Map of the Quiet Lake Area (105 F) 1977, another valuable source of geological reference, shows the area of the EVA claims as being underlain by a thick sequence of Silurian and (?) Lower Devonian sediments which strike approximately N 40 degrees W and dip from 30 to 45 to the northeast intruded to the west by the Fox Mountain stock. This stock he describes as being moderately resistant., light grey weathering, biotite quartz monzonite, medium to coarse grained equigranular, generally lacking in fabric and locally includes large screens of metamorphic rocks. He dates it as Mid-Cretaceous. According to Templeman-Kluit the sedimentary sequence is made up of dolomitic siltstones and sandstones, and silty and sandy dolomites. These rock types were not seen on the EVA claims by the author.

GEOLOGY (Cont. .)

Specific Rock Types Observed On and Around the EVA Claims. - Typical specimens of all rock types and mineralization occurring on and around the EVA were collected and will be retained for reference purposes and any possible thin section examinations.

All specimens have been subjected to the following tests:

- 1) Free swinging hand magnet.
- 2) 5N hydrochloric acid.
- 3) Examination under 10 and 20 power hand lens.
- 4) Observation under short (1,800 - 3,000 Angstrom Units) and long (3,000 - 4,000 Aus) wave ultraviolet light using a MSL-48 model lamp.

The leucocratic, acidic intrusive rocks were all stained using the hydrofluoric acid - sodium cobaltinitrite method to determine their percentage of orthoclase. The author prefers to classify intrusive rocks by the percentage of potassium feldspar they contain.

Sedimentary Rocks:

Black Shale. - This is the most important unit on the EVA group since all the mineral showings located to date occur within it. In nearly all outcrops the black shale has been altered to the stage where it could more properly be classified as a slate and grouped with the metamorphic rocks.

The shale is grey to jet black, with a moderately to extremely well developed slaty cleavage, oxidation of contained disseminations and seams of iron sulphides has produced a very distinct reddish-brown weathered surface visible for miles. Near intrusive and structural contacts the shale is often well hornfelsized (one can actually measure these hornfels margins), silicified and slaty cleavage so well

GEOLOGY (Cont. . .)

Black Shale (cont.) - developed (EVA 13) that if it was in an accessible area it could probably be used commercially.

Limestone - Lenses of light to dark grey, impure limestone up to 1 meter thick and 7 meters long occur within the slate horizon. In the footwall zone of the Number 4 Showing a band of dark grey limestone .5 meters wide is exposed for a few meters along strike. Some of the skarnified mineral zones are rich in calcite. Do the mineralized skarn zones represent replacement of limestone horizons in the shale?

Chert - A few large outcrops of light to medium grey, well bedded chert occur south of the "central ridge". This chert is locally siliceous and calcareous.

Metamorphic Rocks:

Quartzite Schist - This rock type outcrops extensively on the claims. It is rather similar to the sedimentary chert being light to medium grey but can be differentiated by its well developed schistosity and the black phyllite partings between quartzite layers. It is often reddish-brown on the weathered surface due to oxidation of contained iron sulphides but rarely to the intensity of the slate.

Phyllite - There are large areas of phyllite along the central ridge and the valley of Jacobsen Creek: It is grey to jet black, with a well developed schistosity and locally it is often so highly contorted that it is difficult to obtain a true strike and dip.

GEOLOGY (Cont. . .)Metamorphic Rocks: (cont.)

Phyllite The phyllite is characterized by two types of quartz veining and veinlets, which parallel and cut the schistosity and often exceed 1 meter in thickness. In some areas (central ridge) the veins consist of white quartz, calcite, limonite and minor disseminations of euhedral (cubic) pyrite; while in others, the veins are just white, unmineralized bull quartz. At the start of the program many of these veins were sampled in the hope that they might carry gold but with negative results.

Igneous Intrusive Rocks:

The number and variety of intrusive stocks, dikes and sills on and around the EVA claims is really quite remarkable. Considerable intrusive activity, in the authors opinion, is usually a favourable sign when searching for mineral deposits.

The sedimentary and metamorphic rocks on the EVA group have been intruded and in part metamorphosed by biotite-quartz-monzonite of the Fox Mountain Stock and dikes and sills of biotite-quartz-monzonite, felsite, aplite, andesite, quartz-diorite, lamprophyr and quartz veins up to 1 meter thick.

Intrusive activity in the vicinity of the mineral showings is particularly intense.

Biotite-quartz-monzonite of the Fox Mountain Stock. - Templeman-Kluit has aptly described this rock type, quoting again "a moderately resistant, light grey weathering, biotite quartz monzonite, medium to coarse grained equigranular, generally lacking in fabric and locally includes large screens of metamorphic rocks." He dates it as Mid-Cretaceous.

GEOLOGY (Cont. .)Biotite-quartz-monzonite (Cont.)

In the area of the EVA claims this rock type is usually fine to medium grained, homogeneous, 10-15% biotite, greater than 30% orthoclase and locally iron stained due to the oxidation of minor disseminations of anhedral to euhedral pyrite.

Felsite - A leucocratic, dense, very fine grained rock composed of up to 60% orthoclase, quartz and minute crystals of biotite, locally it may contain disseminations of pyrite which are usually oxidized to brown pits in the rock.

The only basic differences in the felsite and the biotite-quartz-monzonite are grain size and orthoclase content. They are probably just a finer phase of the biotite-quartz-monzonite intrusive and of the same age.

Aplite - Another light-coloured rock, usually white, sugary-grained, up to 60% orthoclase, abundant quartz and well below 5% biotite.

Readily distinguishable from the felsite and biotite-quartz-monzonite by its sugary texture and paucity of biotite. But again it may be just another phase of the biotite-quartz-monzonite.

Andesite - A dark green, very fine grained (aphanitic) rock containing local disseminations of cubic pyrite: Some of the andesite dikes and sills are highly shattered, fragmental and iron oxide stained to a reddish-brown and from a distance can be mistaken for a FeOx stained gossan zones in the slate.

Andesite dikes and sills have been observed cutting biotite-quartz-monzonite, felsite and aplite.

GEOLOGY (Cont. .)Igneous Intrusive Rocks (Cont.)

Lamprophyr - A dark grey to black, aphanitic rock which cuts the biotite-quartz-monzonite, felsite and aplite and has actually been observed in the same channel way as an andesite dike. Due east of station 0+25S on Line 30+00W a lamprophyr dike cuts through slate then parallels the eastern contact of an andesite dike.

The appearance of hornfelsized slate rims along intrusive contacts are very similar to the lamprophyr.

The lamprophyr dikes and sills probably represent the last intrusive event on the EVA claims.

Quartz-diorite - A large dike of very fine grained quartz-diorite intrudes slate and biotite-quartz-monzonite due west of Showing 6.

Detailed Geology of the EVA Claims.

Some of the geological mapping on the EVA Claims was done on the original 1:5000 base map using brunton, altimeter and topolite traverses. Claim boundaries and the grid control system were also plotted on this map but this map was enlarged to 1:2000 (metric) to accomodate 1:2000 geological field mapping, magnetometer survey results and to give a better visual presentation. Refer to the Geological and Magnetometer Survey Maps in the back pocket of this report.

A grid system consisting of an east-west baseline, 1,957 meters long, and north south cross-lines every 100 meters(except in the vicinity of the mineral showings, where they are 25 meters apart) was established to give the best possible control for the detailed geological

GEOLOGY (Cont. . .)Detailed Geology (Cont.) -

and magnetometer survey. The cross-lines vary in length but don't exceed 200 meters to the south or 950 meters to the north. Stations have been established on all lines at 25 meter intervals. From Stations 2+00N, 3+00N and 3+50N on Line 35+00W lines were extended westward for 75, 50 and 294 meters respectively to supply control for mapping Showings 5 and 6. For details of the linecutting refer to attached Table 1.

The sedimentary and metamorphic rocks on the EVA claims generally strike northwest and dip to the northeast, in the area of the showings. The average trend would be about N60°W dipping 60°NE.

The main monzonite-slate contact parallels this trend except west of Line 35+00W where it swings due east-west. Although a few of the lesser intrusives occur as sills the vast majority cut through the country rocks slightly east or west of north.

The number, size and areal extent of these dikes is really quite remarkable, particularly along the central ridge where they form resistant peaks. Refer to the Geological Map in the back pocket of this report.

The extreme western exposure of the slate is cut by a large quartz-diorite dike, which also cuts the Fox Mountain monzonite, which in turn, occupies all the western portion of the claims except for a few small roof pendants of slate in EVA 29.

Except for the biotite-quartz-monzonite dikes the entire upper portion of the central ridge consists of phyllite. This phyllite also occurs along Jacobsen Creek and its northern tributary at Line 16+00W. Many andesite dikes occur along this tributary.

GEOLOGY (Cont. . .)

Structure

Major faulting has been noted on the EVA Group, some of which, may be directly related to some of the mineralization.

Due north of Showing 2 a fault 4.5 meters wide is exposed in Warke Creek. This fault strikes N20°W and dips 80°NE and its slate margins are hornfelsized and silicified. The northern tributary that flows beside Line 34+00W may be a surface expression of this fault.

A fault with distinct mullion structure, parallels the slate bedding, dips 75°NE and forms the footwall of Showing 3. 110 meters further downstream another fault-plane was mapped which may represent a continuation of this fault.

Zones of fracturing are common throughout the claims. Some of the andesite dikes are highly shattered and fragmental. The footwall of Showing 2 consists of rock flour and fragments and gouge about 2 meters wide.

Some of the phyllite is highly contorted and drag folded. A gentle fold in the slate and quartz vein forming the hanging wall of Showing 4 probably acted as a natural trap and reservoir for the mineralized solutions which formed this thick showing.

Mineralization

Six zones of mineralization have been located to date by detailed geological mapping. They all occur in the black, slaty shale and are spread out along a strike length of 780 meters (2,574') and across an approximate width of 90 meters (297'). They range in elevation from 1,719 m. (5,643') to 1,911 m. (6,270'). None of the zones were completely exposed across their width or length but trenching has now exposed the true widths of two.

GEOLOGY - Mineralization (Cont. .)

The mineralized zones have the following similar characteristics:

- 1) Distinctive reddish-brown colour.
- 2) Disseminated and massive pyrrhotite, slightly to strongly magnetic.
- 3) Local disseminations and minute seams of chalcopyrite.
- 4) In part calcareous and skarnified.

Their greatest difference is in their scheelite content and the reason for this is yet to be determined. Showings 1, 3, 4 and 5 are composed almost entirely of massive anhedral to subhedral pyrrhotite and the specimens from these zones appear almost identical yet samples from Showings 1 and 3 range from 0.42 - 1.92% WO_3 whereas Showings 4 and 5 contain only trace amounts. Is the scheelite zonal within the different mineral occurrences? If Showing 4, which consists of massive pyrrhotite, and is over 4 meters wide was tested at various depths what would be the chances of locating zones of scheelite? The scheelite occurs as fine to coarse crystals, up to 1/2 by 1 cm., and its intense blue-white colour under shortwave ultraviolet light indicates great purity.

A brief description of each showing follows. Refer to the map of Geology and Showings in the back pocket for further details on geology, trenching and assays.

Showing 1 - Trench 3 exposed a true width of 1.25 meters and this zone was traced for 18 meters along strike. Its extremities are covered by talus and rock debris. A chip sample across the true width assayed 1.19% WO_3 , 0.13% Cu and 0.03 oz./ton Ag. This showing has a very weak magnetic response although very rich in pyrrhotite. Tetragonal-pyramidal scheelite crystals occur.

GEOLOGY - Mineralization (Cont. .)

Showing 2 - Is exposed along strike for 80 meters and Trenches 1 and 2 cut true widths of 10 and 5 meters respectively. Mineralization along the monzonite-slate contact to the northwest is probably a continuation of Showing 2. Showings 2 and 6 contain appreciably more skarn and calcite and their scheelite content is very low. A grab sample from an iron oxide rich zone of gouge, rock flour and fragments approximately 1 meter wide along the footwall of Showing 2 assayed 2.92% WO_3 and 0.12 oz./ton Ag. This rich section may have been produced by natural weathering and concentration. Showing 2 is highly weathered and Trench 1 did not get into primary sulphides; Trench 2, a meter deeper, was just starting to. But as already pointed out the presence of pyrrhotite does not insure that one will also have scheelite.

Showing 3 - Corresponds to J. M. Bremner's original find and is poorly exposed across 1 meter and along 9 meters in Warke Creek. Like Showing 4 this mineralization was relocated by following massive pyrrhotite float boulders up the creek. Showing 3 is very interesting geologically having a felsite sill hanging wall and a fault footwall. The sill may have acted as a trap and a conduit for mineralizing solutions. Because of the numerous samples taken from this zone the author feels a realistic overall grade would be 1.70% WO_3 , 0.10% Cu, 0.37% Pb and 0.03 ox./ton Au.

Showing 4 - Warke Creek flows over this showing, which is poorly exposed because of creek boulders, across 2 - 4 meters and along 17 meters. At the crest of the gentle anticlinal fold already described, the massive pyrrhotite exceeds 4 meters in width. This was particularly exciting at the time of discovery because of the possible tonnage potential but the scheelite content was disappointing; 0.02% WO_3 although it assayed 0.14% Cu and 0.05 oz./ton Au.

Showing 5 - Was located by following massive pyrrhotite talus up the northeast side of Warke Mountain. The exposed mineralization is 2 meters by 33 and contains trace amounts of WO_3 and 0.16% Cu.

GEOLOGY - Mineralization (Cont.)

Showing 6 - Contains fine and coarse disseminations of scheelite erratically distributed throughout the 0.8 by 8 meters exposure. A chip sample across 0.8 meter assayed 0.07% WO_3 .

Refer to the Table at the back of this report for trenching details.

During the second last day of mapping a very poorly exposed zone of mineralization , 1 by 2 meters, was noted in slate due west of Line 27+00W. Although the small exposure did not lamp it might if properly and more extensively opened up. This mineralization is 420 meters east of Showing 3 and indicates the possibility of finding more showings east of Warke Creek.

Many of the quartz veins occuring in the phyllite and described in the section on rock types were sampled just in case they might be auriferous but with negative results.

MAGNETOMETER SURVEY

Since the scheelite mineralization in the known showings is associated with weakly to strongly magnetic pyrrhotite a magnetometer survey seemed appropriate to help define the limits of the known showings in areas of cover and locate new concealed zones. Overburden exceeds 50% in some of the geologically favourable areas so the odds were good.

Type of Magnetometer:

A Sharpe fluxgate magnetometer Model MF-1, serial number 803331, was used for this survey. This is a hand-held instrument requiring only coarse levelling and is not significantly affected by orientation.

The magnetometer measures the vertical component of the earth's magnetic field to 5 gammas on the lowest scale range. The full scale ranges vary progressively from a minimum of plus or minus 1,000 gammas to a maximum of plus or minus 100,000 gammas. The values can be read directly from the scale.

Temperature compensations have been built into the instrument and the only correction to the readings is for diurnal variation. The variation in each survey loop is assumed to be linear and is determined by subtracting the initial and final readings at any control point. The correction added to each reading in the loop is the product of the total diurnal variation of the loop and the ratio of time elapsed up to the time of reading over the total time elapsed for the loop.

MAGNETOMETER SURVEY (Cont. .)Field Procedure:

Mining technician L. Reichert conducted the magnetometer survey from July 27 to August 2, 1979.

The instrument was set or zeroed for the area and station 29+00W on the baseline given a value of 770 gammas. The baseline was surveyed, corrections in the readings made for diurnal variation and the stations at the junctions of the crosslines with the baseline were used as control points for each survey loop.

Readings were taken facing west at every station on the baseline and every 25 meters on the crosslines. In some particularly anomalous areas station intervals are from 6.25 - 12.5 meters. Diurnal variation was at times too high and some lines had to be resurveyed. Corrections were treated linearly in respect to elapsed time.

Magnetometer Results:

The corrected readings have been plotted on Map 2 (back pocket) and contoured at 500 gamma intervals. Showings 1-6 are also on this map to show their relationship to the magnetic anomalies.

Background for the EVA Claims appears to be from 600 - 700 gammas. Negative readings and those above 1,500 gammas are considered anomalous. The highest reading to date is 5,000 gammas; the lowest minus 900 gammas.

Twelve (12) magnetic anomalies, i.e. greater than 1,500 gammas, have been fully or partially defined. Some anomalous readings were so erratic no attempt was made to

Magnetometer Results (Cont. .)

contour them. One should bear in mind that the contouring of geophysical and geochemical anomalies, unlike topography, can be highly interpretative, particularly when readings are few and widely spaced.

When the clear mylar copy of the magnetometer results is overlaid on a coloured black-line copy of the EVA geology all sorts of intriguing possibilities present themselves. With several exceptions the trend of the anomalies parallel that of the slate and quartzite schist and the slate-monzonite contact. The following is a description of the individual anomalies:

Anomalies 8 and 10: Are obviously due to mineral Showings 2 and 3 respectively.

The fact that Anomaly 8 does not conform exactly to the trend of the mineralization of Showing 2 suggests that this zone may have been displaced by the major fault to the north. In this case Showing 2 and Showing 4 could be the same zone which has been faulted.

Anomaly 10 is a very exact expression of the moderately to strongly magnetic pyrrhotite of Showing 3 and indicates it is at least 30 meters long and may exceed 50. Anomaly 10 also illustrates that any anomaly exceeding 2,000 gammas could be a reflection of significant mineralization since Showing 3 assayed 1.70% WO_3 .

Anomalies 1,2,3,4,6,7,11 and MacDonald: All correspond to areas of cover.

Although it would be probably fairly safe to assume these anomalies are caused by concealed magnetic pyrrhotite zones the big question, unanswerable at this time, - Do they contain

Magnetometer Results (Cont. . .)

scheelite? All of these anomalies except the MacDonald require more magnetometer surveys to give better definition. Except for 1 and 2 they all occur in geologically favourable environments. Anomalies 1 and 2 are in areas of phyllite. To date, no scheelite mineralization has been located in this rock type, but if it was; it certainly would increase the scope of exploration on the EVA Claims.

The MacDonald Anomaly ranges from 30 - 50 meters wide along its 180 meter length and appears to overlap the assumed slate-quartzite schist contact. IF this anomaly is indicating scheelite-bearing pyrrhotite of a commercial grade an adequate tonnage is also possible because of the anomaly size.

Anomaly 5: Is in an area of magnetic pyrrhotite talus (from Showing 5) and the possibility that the magnetometer operator was inadvertently taking readings over concealed mineralized talus should not be overlooked.

Anomaly 9 : Occurs in an area of patchy slate outcrop, from its strength and definition I would say it represents a zone of pyrrhotite mineralization at least 40 meters long.

Because of a time consideration only the general outer limits of areas of patchy outcrop were defined. It would have been too time consuming to map each and every scattered outcrop. Areas of patchy outcrop have been noted on the Geology Map 1.

It is worth noting that a reading directly over Showing 1, which assayed 1.16% WO_3 , was only 1,035 gammas. Pyrrhotite specimens from Showing 1 are only weakly magnetic.

Magnetometer Results (Cont. .)

In view of this should every area of the claims that exceeds 1,000 gammas be considered favourable prospecting ground? The only logical answer to this seems to be "yes" and in areas where magnetic response cannot be explained by examining exposed outcrop, a program of geochemical soil sampling will have to be implemented in areas of cover exceeding 1,000 gammas.

The 4 magnetic lows, which range from 1300 to -900, may represent zones of faulting or alteration. The -300 gammas at Station 2+12.5N on Line 33+50W corresponds with the major fault due north of Showing 2. At Station 2+35N on Line 34+00W erratic highs and lows represent a pyrrhotite mineralized fault zone along the main slate-monzonite contact. No attempt was made to contour the magnetic lows but they have been marked with an asterisk.

CONCLUSIONS

Results to date on the EVA Claim Group are very encouraging. In just 3 weeks 6 mineral showings were located; two of which grade from 1.16% to 1.70% WO_3 .

All the showings located outcrop. In view of the fact that in many geologically favourable environments, i.e. underlaid by slate, cover exceeds 50% the chances of locating concealed zones of mineralization are good.

If the mineralization is directly related to the extensive intrusive activity on the claims, which the author believes it is, at this time, none of the sedimentary or metamorphic formations can be ruled out as favourable hosts for mineralization. The area northwest of Line 34+00W and Station 3+00N has particular potential because of extensive cover and indications that it is mainly underlaid by slate.

There is some evidence that the mineralization may have resulted from replacement of limestone horizons in the slate. Why some of the pyrrhotite rich showings contain abundant scheelite while others carry only trace amounts has yet to be resolved. Some faults and sills have obviously served as conduits and traps for the mineralizing solutions.

The magnetometer proved very effective in locating and outlining the EVA Group type of mineralization. Showings 2 and 3 were very well defined. Besides these 2 showings, 10 other moderate to strong magnetic anomalies, some with dimensions far in excess of the known showings, were completely or partially defined. In all probability these anomalies represent zones of magnetic pyrrhotite mineralization.

CONCLUSIONS (Cont. .)

Since a reading directly over Showing 1 (1.16% WO_3) was only 1,035 gammas all areas exceeding 1,000 gammas merit detailed geological mapping and if there is no outcrop, soil sampling.

The MacDonald Anomaly with an average width of 40 meters and length of 180 meters could represent an economic tonnage provided the concealed mineralization carries a commercial grade of scheelite.

RECOMMENDATIONS

The next exploration program on the EVA Group should consist of magnetometer surveys, soil sampling, detailed geological mapping and dependent on the results of these surveys, diamond drilling. With proper scheduling this could be accomplished in one summer season.

There follows a list of recommendations for such a program. One should never be dogmatic about recommendations and should newly acquired data warrant, the program can be modified.

1. Finish the magnetometer survey on the established grid.
2. Completely define Anomalies 1 - 4, 6, 7 and 11 and any new anomalies by closely spaced magnetometer readings.
3. Expand magnetometer survey to cover all geologically favourable environments; particularly any area thought to be underlaid by slate.

RECOMMENDATIONS (Cont. . .)

4. Soil sample and assay for tungsten any area of cover which exceeds 1,000 gammas. Budget permitting soil sample all geologically favourable environments. One cannot always rely on pyrrhotite giving a magnetic response. Although the pyrrhotite contained no nickel it did have significant values in copper, zinc, gold and silver in some of the showings (1, 2, 3, 4 and 5) and the Bloom Test for heavy metals could be done in conjunction with the soil sampling to define areas copper and/or zinc anomalous at a very modest cost.

5. Get thin section descriptions of specimens from Showings 1 - 4 they might give some idea as to why some of the pyrrhotite carries abundant scheelite and some only trace amounts.

6. Move the basecamp to Station 3+00N on Line 34+00W.

7. Examine by means of fly-camps the slate formation that outcrops in EVA 29 and continues to the northwest. This is the same formation as that which contains the 6 showings on the EVA group.

8. If warranted after magnetometer and soil surveys open up the poorly exposed zone of mineralization due west of Station 1+50S on Line 27+00W.

9. Extend grid lines north starting at Line 29+00W till they drop below 1,000 gammas. Anomalies 1, 2 and the upper limit of Line 35+00W appear to partially define a major magnetic trend that parallels the northwest trend of anomalies 3, 7, 11, MacDonald and 10.

RECOMMENDATIONS (Cont. .)

10. Detailed geological mapping in all anomalous areas.

11. After the completion of the aforementioned program a decision as to physical testing could be made.

A note of caution - the MacDonald Anomaly appears to overly the slate-quartzite schist contact and if the mineralization causing this anomaly is in the slate there is a possibility that the schist forms a capping over the mineralization. This capping could form an imperious layer impeding the upward mobility of metallic ions and one might not get a geochemical anomaly even though mineralization was present at depth. In most areas of interest the overburden is probably less than 10 feet but on an untested property one never knows the maximum thickness of overburden the metallic ions will penetrate. The author has been on claims where it was less than 5 feet. Other factors impeding metallic ion mobility are impervious clay layers, calcareous horizons, organic material and the presence of limonite. A few test pits and samples in areas of known mineralization would be advisable at the start of the soil sampling program.

Respectively submitted by

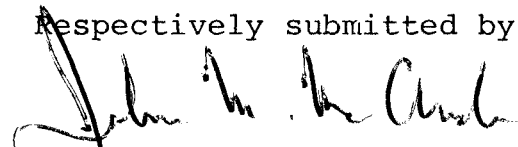

John M. McAndrew, P. Eng.
Consulting Geologist

8961 Ursus Crescent
Surrey, B. C.

September 15, 1979

BIBLIOGRAPHY

- | | | |
|---|--------|---|
| Bateman, A. M. | (1967) | Economic Mineral Deposits, 2nd Edition |
| Brenner, J. M. | (1969) | Geology and Geochemistry of Northern Part of R. T. Agreement Area. |
| Canadian Minerals Yearbook | (1977) | Tungsten. |
| Dana E. S. . | (1951) | Textbook of Mineralogy, 4th Edition |
| Hosking, K. F. | (1979) | The Search for Tungsten Deposits, Bulletin 5, Geological Survey of Malaysia. |
| Read, W. S. | (1978) | Report on CAB Group of Mineral Claims, Risby Tungsten Mines Ltd., 12 December 1978. |
| Templeman-Kluit, D.J. | (1977) | Quiet Lake 105F Map Area. |
| U. S. Bureau of Mines Minerals Yearbook | (1978) | Tungsten. |
| U. S. Department of Mines | (1978) | Tungsten - Mineral Commodities Profiles. |
| Wolf | () | Handbook of Strata-Bound and Stratiform Ore Deposits, Volume 7 |
| Little, H. W. | (1959) | Tungsten Deposits of Canada, Geological Survey of Canada, Economic Series 17 (out of print) |

CERTIFICATION of JOHN M. McANDREW

8961 Ursus Crescent, Surrey, B. C. V3V 6L3 Phone 591-6512

1. Registered as a Professional Engineer by the Association of Professional Engineers of British Columbia, Canada.
2. B. Sc. in Geology from the University of Alberta, Edmonton, Alberta; post graduate courses in surveying, McGill University, Montreal, Quebec.
3. Prior to consulting the author spent seventeen years in exploration, property evaluation, mine geology and production with the following companies:
 - Anaconda American Brass Limited - Copper, Molybdenum, Tungsten.
 - Silver Titan Mines - Silver, Lead, Zinc.
 - Columbia Iron Mining Co. - Coal.
 - Newmont Exploration Ltd. - Nickel, Copper.
 - Iron Ore Company of Canada Ltd. - Direct Shipping Iron Ore.
 - N. W. Byrne Company - Gold.
 - Quebec Cartier Mining Co. Ltd. - Concentrating Iron Ore.
 - Eldorado Mining and Refining Co. - Uranium.
 - International Nickel Co. - Nickel, Copper.
4. I have no direct or indirect interest in the property covered by this report.
5. I supervised all the work while the program was being carried out. I have read this report and personally endorse the facts and concepts contained in the text.

Dated this 15 day of Sept. 1979, in Vancouver, B. C.

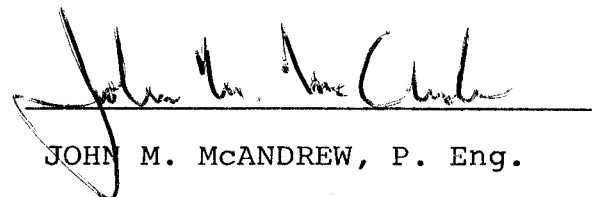

JOHN M. McANDREW, P. Eng.

Consulting Geologist



CHEMEX LABS LTD.

RECEIVED
 CHEMEX LABS LTD.
 10000 101ST AVE. S.W.
 RICHMOND, B.C. V6V 1K2
 TEL: 604-273-1972
 34
 984 022-

• ANALYTICAL CHEMISTS • GEOCHEMISTS • REGISTERED ASSAYERS

CERTIFICATE OF ASSAY

TO: W.S. Read of W.S. Read Ltd.,
 198 Cherry Point Road,
 Cobble Hill, B.C.

EVA PROJECT

CERTIFICATE NO. 65715
 INVOICE NO. 31457
 RECEIVED July 25/79
 ANALYSED July 30/79

ATTN: W.S. Read

CC: McAndrew

SAMPLE NO.	%	%	%	Oz/Ton	
	Cu	Ni	WO ₃	Ag	Au
4351 SHOWING 1	< 0.01	< 0.01	1.19 ←	0.05	0.003
4352 SHOWING 1	< 0.01	< 0.01	0.42 ←	0.05	0.003
4353 SHOWING 4	< 0.01	< 0.01	0.01 ←	0.02	0.048 ←
4354 SHOWING 3	< 0.01	< 0.01	1.92 ←	0.04	0.003
4355 2' THK Q.V.			0.01		< 0.003
4356 Q.V.s up to 1 meter thk - grab.			0.01		< 0.003
4357 qtz cob - < 0.01 lim. Q.V.s - grab.			< 0.01		< 0.003
4358 milky wt. Q.V.s - grab			< 0.01		< 0.003
4359 qtz veined gossan zone - grab.			< 0.01		< 0.003
4360 chip across 1.3 meter Q.V.			0.03		< 0.003
4361 SHOWING 2	< 0.01	< 0.01	0.05	0.05	< 0.003 ←

} QUARTZ VEINS



MEMBER
 CANADIAN TESTING
 ASSOCIATION

REGISTERED ASSAYER IN VICTORIA, BRITISH COLUMBIA

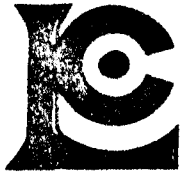

CHEMEX LABS LTD.

35
 1000 AVENUE
 NORTH VANCOUVER, B.C.
 CANADA V7J 2C1
 TELEPHONE [REDACTED] 984 0221
 AREA CODE 604
 TELEEX 64152597

• ANALYTICAL CHEMISTS • GEOCHEMISTS • REGISTERED ASSAYERS

CERTIFICATE OF ASSAY

TO: W. S. Read, P. Eng.,
 198 Cherry Point Road,
 Cobble Hill, B.C.
 VOR 1L0

EVA PROJECT

ATTN:

CC. J. McAndren

CERTIFICATE NO 65791
 INVOICE NO 31731
 RECEIVED July 31/79
 ANALYSED Aug. 8/79

SAMPLE NO.	% Cu	% WO3	% Ni	oz/ton Ag	oz/ton Au
4362 <i>SHOWING 3</i>	0.09	1.32 ✓	<0.01	0.05	0.030 ✓
4363 <i>SHOWING 3</i>	0.08	1.74 ✓	<0.01	0.04	0.026 ✓
4364 <i>SHOWING 4</i>	0.12	0.02 ✓	<0.01	0.02	<0.003
4365 <i>SHOWING 4</i>	0.11	0.01 ✓	<0.01	0.04	<0.003
4366 <i>SHOWING 5</i>	0.16	0.01 ✓	<0.01	0.02 ✓	<0.003
4367 <i>SNR</i>	0.06	2.92 ✓	<0.01	0.12 ✓	<0.003
4368 <i>SHOWING 6</i>	0.03	0.07 ✓	<0.01	0.01	<0.003

REVERSE THESE RESULTS, numbers in bags out of order.



MEMBER
 CANADIAN TESTING
 ASSOCIATION

J. Swaites
 REGISTERED ASSAYER, PROVINCE OF BRITISH COLUMBIA



CHEMEX LABS LTD.

CANADA 36
 TELEPHONE 984-0221
 AREA CODE 604
 TELEX 043 52597

• ANALYTICAL CHEMISTS • GEOCHEMISTS • REGISTERED ASSAYERS

CERTIFICATE OF ASSAY

TO W.S. Read Ltd.
 198 Cherry Point Road
 Cobble Hill, B.C.
 VOR 1L0
 ATTN: W.S. Read

EVA PROJECT

CC: J. McAndrew

CERTIFICATE NO. 65848
 INVOICE NO. 31813
 RECEIVED Aug. 7/79
 ANALYSED Aug. 13/79

SAMPLE NO. :	% Cu	% WO ₃	% Ni	oz/ton Ag	oz/ton Au	
Showing 3 4369 TR 6	0.09	0.68 ✓	0.01	0.02	0.026	← Showing 3
Showing 1 4370 TR 3	0.13	1.16 ✓	0.01	0.08	0.003 ✓	" 1
Showing 4 4371	0.16	0.02 ✓	0.01	0.05	<0.003 ✓	" 4
4372	<0.01	<0.01	<0.01	0.02	<0.003	← across 1 meter of partly exp. mineralized
Showing 2 4373 TR 1	0.03	0.17 ✓	<0.01	0.02	<0.003	Showing 2 TR 1
Showing 2 4374 TR 1	<0.01	0.05 ✓	<0.01	0.02	<0.003	" "
Showing 2 4375 TR 1	<0.01	0.03 ✓	<0.01	0.02	<0.003	" "
Showing 2 4376 TR 1	0.03 ✓	0.92 ✓	<0.01	0.02	<0.003	" "
Showing 2 4377 TR 2	0.07 ✓	0.01 ✓	0.01	0.02	<0.003	Showing 2 TR 2
" 4378 "	0.05 ✓	<0.01 ✓	<0.01	0.04	<0.003	" "
" 4379 "	0.03 ✓	<0.01 ✓	<0.01	0.01	<0.003	" "
" 4380 "	0.04 ✓	<0.01 ✓	<0.01	0.01	<0.003	" "
4381 "	0.03 ✓	0.04 ✓	<0.01	0.01	<0.003	" "
4382	0.03 ✓	0.01 ✓	<0.01	0.02	<0.003	Showing 2 chip across 0.2 meter



MEMBER
 CANADIAN TESTING
 ASSOCIATION

B. J. Tarrant
 REGISTERED ASSAYER, PROVINCE OF BRITISH COLUMBIA

TABLE 1 - METRIC LINECUTTING - EVA GROUP
 July 17 - August 2, 1979

DATE 1979	CLAIMS EVA	L O C A T I O N				MAN/ DAY	SURVEYED BY
		LINE	FROM (M)	TO (M)	DISTANCE (M)		
7.17	15,17	BL	30+00W	25+00W	500	1	J. McAndrew
	17	25+00W	0+00	3+00W	300	1	D. Dick
	8	"	3+00N	4+25N	125		
"	16	BL	30+25W	33+75W	350	1	L. Reichert
	14	"	33+75W	35+00W	125	1	S. Read
	17	"	25+00W	24+00W	100		
	19	"	24+00W	22+00W	200		
7.18	19	22+00W	0+00	2+00N	200	1	J. McAndrew
	10	"	2+00N	6+87N	487	1	D. Dick
"	14	34+00W	0+00	1+25N	125	1	L. Reichert
	13	"	1+25N	3+25N	200	1	S. Read
	16	33+00W	1+00S	1+00N	200		
	13	"	1+00N	2+00N	100		
	16	32+00W	1+00S	0+50N	150		
	15	"	0+50N	1+75N	125		
	16	31+00W	1+00S	0+25N	125		
	15	"	0+25N	2+50N	225		
7.19	13,14	35+00W	0+00	1+50N	150	2	J. McAndrew, D. Dick
	19	BL	22+00W	19+25W	275	2	L. Reichert, S. Read
"	21	"	19+25W	16+00W	325		
	12	16+00W	0+00	4+50N	450		
	11	"	4+50N	8+25N	375		
7.20	14	BL	35+00W	35+57W	57	2	" "
	14	35+57W	0+00	0+47N	47		
	"	35+00W	0+00	1+50N	150		
	13	"	1+50N	6+50N	500		
	4	"	6+50N	9+50N	300		

TABLE 1 - METRIC LINECUTTING - FVA GROUP (CON'T)
July 17 - August 2, 1979

DATE 1979	CLAIMS	LOCATION				MAN/ DAY	SURVEYED BY
		LINE	FROM (M)	TO (M)	DISTANCE (M)		
7.22	13	2+00N	35+00W	35+75W	75	2	L.Reichert,S.Read
	"	3+00N	"	35+50W	50		
	"	3+50N	"	37+25W	225		
	26	"	37+25W	38+00W	75		
7.23	16	30+00W	0+00	1+50S	150	2	" "
	15	29+00W	0+00	0+50S	50		
	18	"	0+50S	1+00S	50		
	17	28+00W	0+00	0+75S	75		
	18	"	0+75S	2+00S	125		
	17	27+00W	0+00	1+25S	125		
	18	"	1+25S	1+50S	25		
	17	26+00W	0+00	1+50S	150		
	"	25+00W	0+00	1+00S	100		
	19	24+00W	0+00	1+50S	150		
	19	23+00W	0-00	1-00S	100		
	"	22+00W	0+00	2+00S	200		
	"	21+00W	0+00	1+00S	100		
7.25	19	20+00W	0+00	1+25N	125	2	L.Reichert,S.Read
	10	"	1+25N	6+00N	475		
	15	29+00W	0+00	4+50N	450		
	16	"	4+50N	4+90N	40		
	21	18+00W	0+00	0+75N	75		
	12	"	0+75N	5+00N	425		
	10	"	5+00N	5+25N	25		
7.26	17	27+00W	0+00	3+75N	375	2	" "
	8	"	3+75N	4+00N	25		
	"	25+10W	4+25N	8+00N	375		
	7	"	8+00N	8+25N	25		

TABLE 1 - METRIC LINECUTTING - EVA GROUP (CON'T)
 July 17 - August 2, 1979

DATE 1979	CLAIMS	LOCATION				MAN/ DAY	SURVEYED BY
		LINE	FROM(M)	TO (M)	DISTANCE (M)		
7.31	16	30+75W	0+50S	0+25N	75	2	S.Read,D.Dick
	15	"	0+25N	1+00N	75		
	16	31+25W	0+50S	0+40N	90		
	15	"	0+40N	1+00N	60		
	16	31+50W	1+00S	0+50N	150		
	15	"	0+50N	1+25N	75		
	16	31+75W	0+50N	1+00S	150		
	15	"	0+50N	1+25N	75		
8.1	16	32+25W	0+75N	0+50S	125	2	" "
	15	"	0+75N	2+00N	125		
	"	32+50W	0+75N	2+00N	125		
	16	"	0+75N	0+50S	125		
	"	32+75W	1+00N	0+50S	150		
	15	"	"	2+00N	100		
	16	33+25W	0+00	1+00N	100		
	13	"	1+00N	3+00N	200		
	16	33+50W	0+00	0+50N	50		
	14	"	0+50	1+00N	50		
	13	"	1+00N	3+00N	200		
	14	33+75W	0+00	1+25N	125		
	13	"	1+25N	3+00N	175		
	8.2	15	30+00W	1+50N	4+75N		
6		"	4+75N	5+00N	25		
15		31+00W	2+50N	5+00N	250		
"		32+00W	1+75N	5+00N	325		
13		33+00W	2+00N	"	300		
"		34+00W	3+25N	"	175		
TOTAL					14,456	28	

TABLE 2 - TRENCHING DATA - EVA CLAIMS
 July 27 - August 2, 1979

Trench No.	EVA Claim No.	VOLUME			Date Started	Date Completed	MAN/DAY	Trenched By
		(M) LxWxH	M ³ (1.31)	Yd ³				
1 (Showing 2)	13	10x1x1	10	13.10	7.27.79	7.28.79	5	D.McLean S.Read D.Dick
2 (Showing 2)	13	6x2x2	24	31.44	7.29.79	7.29.79	2	D.McLean D.Dick
3 (Showing 1)	16	3x2x1	6	7.86	7.30.79	7.30.79	2	D.McLean D.Dick
4 (Showing 3)	15	6x2x3	36	47.16	7.31.79	7.31.79	1	D.McLean
5 (Showing 4)	15	3x2x2	12	15.72	8.1.79	8.1.79	1	D.McLean
6 (Showing 4)	15	4x1x1	4	5.24	8.2.79	8.2.79	1	D.McLean
TOTAL			92	120.52			12	

TABLE 3 - MAGNETOMETER SURVEY - EVA CLAIMS

July 27 - August 2, 1979

Cont. . .

DATE 1979	CLAIMS	LOCATION				MAN/ DAY	SURVEYED BY
		LINE	FROM (M)	TO (M)	DISTANCE (M)		
August 1	16	33+25W	0+00	1+00N	100	1	Leo Reichert
	13	33+25W	1+00N	3+00N	200		"
	16	33+50W	0	0+50N	50		"
	14	33+50W	0+50N	1+00N	50		"
	13	33+50W	1+00N	3+00N	200		"
	14	33+75W	0	1+25N	125		"
	13	33+75W	1+25N	3+00N	175		"
August 2	15	30+00W	1+50N	4+75N	325	1	"
	6	30+00W	4+75N	5+00N	25		"
	15	31+00W	2+50N	5+00N	250		"
	15	32+00W	1+75N	5+00N	325		"
	13	33+00W	2+00N	5+00N	300		"
August 1	13	34+00W	3+75N	5+00N	125	2	"

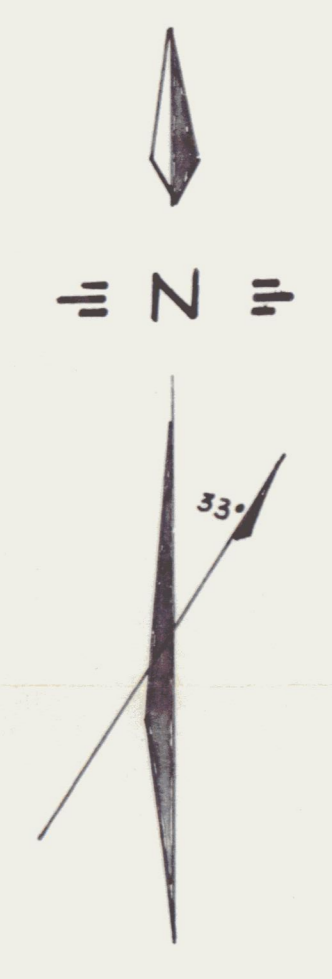

LEGEND

- LAMPROPHYRE
- ANDESITE
- QUARTZ-DIORITE
- FELSITE, APLITE, UNDIFFERENTIATED
- BIOTITE-QUARTZ-MONZONITE
- PHYLLITE
- QUARTZITE SCHIST
- CHERT
- LIMESTONE
- BLACK, SLATY SHALE
- GREY SHALE
- BEDDING STRIKE & DIP
- FAULT
- CREEK
- TRENCH
- CONTACT (ASSUMED)
- MINERALIZED SHOWING (DIMENSIONS, METERS)
- LIMESTONE LENS (DIMENSIONS, METERS)
- QUARTZ VEIN (DIMENSIONS, METERS)
- CLAIM POST
- FRACTURE
- OUTCROP
- TALUS

X MASSIVE PYRRHOTITE
BLAST OR TALUS

1900
ELEVATION IN METERS

SHOWING 2
 Core Sample #367 - 0.05% MoS₂, 0.005% Fe As
 (Core Sample #367)
 Core Sample #366 - 2.32% Cu, 0.06% Co, 0.12% Fe As
 (Core Sample #366)
 Core Sample #365 - 0.17% MoS₂
 4379 0.05% Cu
 4378 0.03% Co
 4376 0.02% Fe As

SHOWING 1
 Core Sample #351 - 1.15% MoS₂
 (Core Sample #351)
 Core Sample #352 - 0.02% Cu
 (Core Sample #352)
 Core Sample #350 - 1.16% MoS₂, 0.03% Fe As
 (Core Sample #350)

SHOWING 3
 Core Sample #363 - 1.64% MoS₂, 0.07% Fe As
 (Core Sample #363)
 Core Sample #362 - 1.02% MoS₂
 (Core Sample #362)
 Core Sample #361 - 1.02% MoS₂, 0.07% Fe As
 (Core Sample #361)
 Core Sample #360 - 1.02% MoS₂
 (Core Sample #360)
 Core Sample #359 - 1.02% MoS₂
 (Core Sample #359)
 Core Sample #358 - 1.02% MoS₂
 (Core Sample #358)
 Core Sample #357 - 1.02% MoS₂
 (Core Sample #357)

SHOWING 4
 Core Sample #353 - 0.17% MoS₂, 0.005% Fe As
 (Core Sample #353)
 Core Sample #354 - 0.02% Cu
 (Core Sample #354)
 Core Sample #355 - 0.17% MoS₂
 (Core Sample #355)
 Core Sample #356 - 0.17% MoS₂
 (Core Sample #356)
 Core Sample #357 - 0.17% MoS₂
 (Core Sample #357)
 Core Sample #358 - 0.17% MoS₂
 (Core Sample #358)
 Core Sample #359 - 0.17% MoS₂
 (Core Sample #359)
 Core Sample #360 - 0.17% MoS₂
 (Core Sample #360)

SHOWING 5
 Core Sample #347 - 0.05% MoS₂
 (Core Sample #347)
 Core Sample #348 - 0.05% MoS₂
 (Core Sample #348)

SHOWING 6
 Core Sample #349 - 0.05% MoS₂
 (Core Sample #349)
 Core Sample #350 - 0.05% MoS₂
 (Core Sample #350)

RISBY TUNGSTEN MINES LTD.
 EVA MINERAL CLAIMS-ROSS RIVER, YUKON, CANADA
 N.T.S. 105 F 14 61° 36' N, 133° 24' W

GEOLOGICAL MAP
MINERALIZED SHOWINGS

SCALE 1:2000

COMPILED BY: J. McAndrew REVISION: No. 1
 DRAWN BY: J. McAndrew
 CONSULTING GEOLOGIST: WAYLAND S. READ COBLE HILL, B.C., CANADA
 P. ENGINEER: JOHN M. McANDREW SURREY, B.C.

To accompany report by J.M. McANDREW, P.Eng., dated 15 September 1979

200349

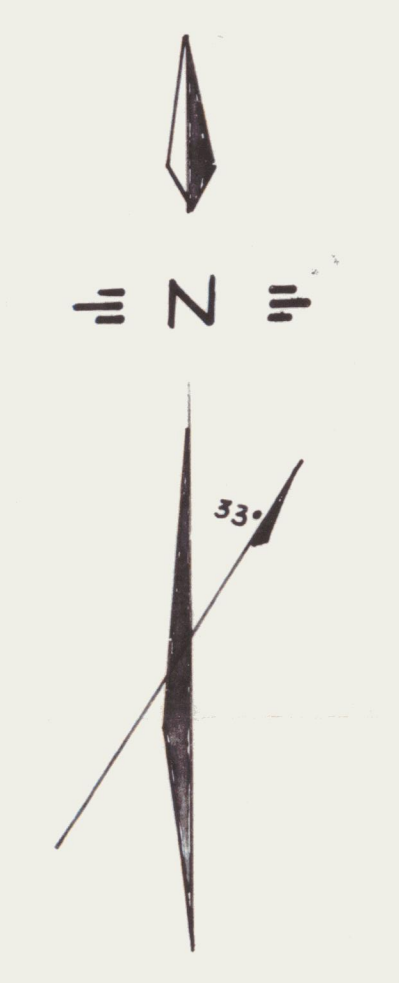


LEGEND

- | | | |
|---|--|---|
| <ul style="list-style-type: none"> LAMPROPHYRE ANDESITE QUARTZ - DIORITE FELSITE, APLITE, UNDIFFERENTIATED BIOTITE - QUARTZ - MONZONITE PHYLLITE QUARTZITE SCHIST CHERT LIMESTONE BLACK, SLATY SHALE GRITTY SHALE | <ul style="list-style-type: none"> BEDDING STRIKE & DIP FAULT CREEK TRENCH CONTACT (ASSUMED) MINERALIZED SHOWING (DIMENSIONS, METERS) LIMESTONE LENS (DIMENSIONS, METERS) QUARTZ VEIN CLAIM POST | <ul style="list-style-type: none"> MAGNETOMETER READINGS (IN GAMMA) GAMMA CONTOUR LINE MAGNETOMETER CONTROL STATION (TO GAMMA) NEGATIVE READING IN GAMMA ANOMALY NUMBER |
|---|--|---|

RISBY TUNGSTEN MINES LTD. EVA MINERAL CLAIMS - ROSS RIVER YUKON, CANADA <small>N.T.S. 105 F 14 61° 56' N, 133° 24' W</small>			
MAGNETOMETER SURVEY MINERALIZED SHOWINGS			
COMPILED BY: J. McAndrew L. Sargent, S. Read	REVISIONS: SCALE: 1:1000	No. 2	
CONDUCTING GEOLGISTS: WAYLAND S. READ COBBLE HILL, B.C. CANADA AND P. ENGINEERS: JOHN M. McANDREW SURREY, B.C.			

John M. McAndrew
 To accompany report by J. M. McAndrew, P.E., dated 15 September 1973