

GEOCHEMICAL REPORT  
ON  
GLEN 1-32 CLAIMS  
MAYO DISTRICT, YUKON TERRITORY  
106C-2  
JULY 9th-13th, 1978

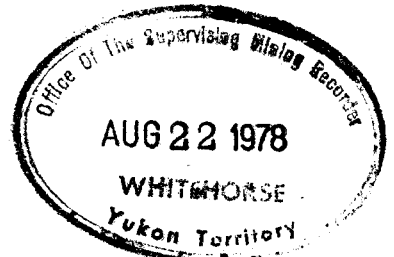

I. S. Thompson, P.Eng.  
August 10, 1978

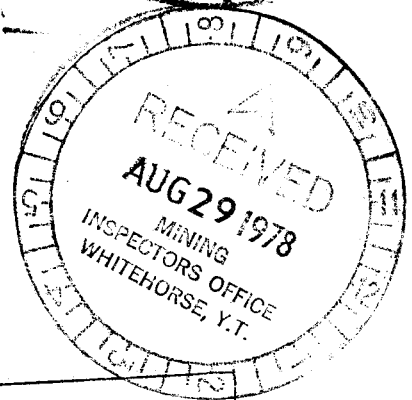

This report has been examined by the Geological Evaluation Unit and is recommended to the Commissioner to be considered as representation work in the amount of

\$3200.00

*[Signature]*

Resident Geologist or  
~~Resident Mining Engineer~~

Considered as representation work under Section 53 (4) Yukon Quartz Mining Act.

*[Signature]*

B. R. BAXTER

~~Supervising Mining Recorder~~  
Commissioner of Yukon Territory

090356

B. & C. LTD.

TABLE OF CONTENTS

	<u>Page</u>
INTRODUCTION	1
GEOLOGY AND GEOMORPHOLOGY	2
GEOCHEMICAL FIELD SAMPLING	3
INTERPRETATION OF RESULTS	4
Silver	4
Lead	4
Zinc	4
Stream Sediments	5
CONCLUSIONS AND RECOMMENDATIONS	6
<del>CERTIFICATE OF QUALIFICATION</del>	<del>7</del>

~~APPENDICES~~

- ~~Appendix A - Statement of Expenses~~
- ~~Appendix B - List of Claims~~
- ~~Appendix C - Personnel Employed~~
- Appendix D - Geochemical Lab Report

LIST OF MAPS

- Map 1 - Detail Geochemical Grid - Ag, Pb, Zn Values 1" = 200'
- Map 2 - Geochemical Survey - Sample Nos. & Elevations 1" = 200'
- Map 3 - Claim Map

## INTRODUCTION

A geochemical survey was carried out by J. Essery of Derry, Michener & Booth, Mining Consultants, assisted by T. Mason of Whitehorse, on the GLEN 7, 8, 9 and 10 claims (YA 15468-15471), Sheet 106C-2, Mayo District, Yukon Territory, from July 9th to July 13th, 1978, inclusive. The short programme was organized and directed by I. S. Thompson, P.Eng. of Derry, Michener & Booth. The assessment credits are to be filed over the entire 32 GLEN claims.

This work was undertaken on behalf of Dejour Mines Limited and Nova-Co Explorations Limited under an option-purchase agreement dated September 27th, 1977 with G. A. Bleiler of TXD Entreprises Limited. The claims lie about 10 miles ENE of Ortel Lake, the nearest lake suitable for fixed wing aircraft and about 3 miles north of the Stewart River.

This work is an extension of the geochemical survey carried out in 1977 by Derry, Michener & Booth for the above companies on the BLACK and IDA claim groups and reported on November 22nd, 1977. To avoid unnecessary repetition the previous descriptions of geology, geomorphology and geochemical field operations have been summarized.

GEOLOGY AND GEOMORPHOLOGY

The GLEN claim group is believed to be underlain by Precambrian quartzites, shales and conglomerates and limestone, lying about 2,000 ft. south of a major east-west-trending thrust fault which has overthrust the Precambrian rocks onto the Ordovician-Silurian Road River limestones and dolomites.

On the four claims sampled no outcrops were seen, the area comprising a forested south-facing slope which descends from higher ground on the BLACK claims. Several scattered, small outcrops of brecciated limestone are known to occur on the BLACK 26 and 28 claims.

A 5 to 10 ft. wide tributary stream flows northeast through the south part of the sampled area; seven samples of fine to medium grained stream silt were collected from it.

The forest soils are clayey podzols with a definite profile development into an upper black organic layer (Ao), a leached grey layer (Ae), a light to red-brown oxidized layer (B) and a slightly stony parent soil (C).

GEOCHEMICAL FIELD SAMPLING

A 3,000 ft. base line, established by pace and compass survey, was flagged along the assumed boundary between the BLACK and the GLEN claim groups and sampling was carried out on four pace and compass lines (lines 15W, 20W, 25W and 30W) each extending 1,500 ft. south of this base line.

Samples of the B zone soils were collected at an average depth of 8 inches at each sample site wherever possible and the elevation recorded and the site flagged. Elevations range from 3,965 ft. on line 25W at the base line to 3,530 ft. where the creek crosses line 15W. A total of 64 soil samples, numbers 508-571 inclusive and 7 stream sediment samples, numbers 501-507 inclusive were collected in this programme.

Samples were shipped to Bondar-Clegg's Whitehorse laboratory where they were oven-dried, crushed lightly and sieved through 80 mesh screening. The -80 mesh fraction was digested completely in a HCl.HNO<sub>3</sub> solution and the resultant solution aspirated into an atomic absorptiometer equipped with cathodes for silver, lead and zinc. The results, as attached, were corrected for background variations for silver and on the attached Figure results for Ag, Pb, and Zn are shown to the right of each sample site.

Stream sediment samples were treated in the same manner.

### INTERPRETATION OF RESULTS

The sample population is too small for statistical reliability and therefore we have compared these values with the larger body of geochemical data collected last year on the BLACK and IDA claim groups. In that survey the following parameters were established:-

<u>Metal</u>	<u>Range</u>	<u>G. Mean (<math>\bar{X}</math>)</u>	<u>Threshold (<math>\bar{X} + 2</math> S.D.)</u>	<u>High Background (<math>\bar{X} + 1</math> S.D.)</u>
Silver	nil - 1.8 ppm	Not Calculated	-	-
Lead	5 - 55	"	-	-
Zinc*	0 - 975	136	474	305

\* + 6 erratic highs up to 3500 ppm Zn.

#### Silver

Range - 0.4 ppm to 1.1 ppm; there is no apparent correlation with anomalous zinc and lead values and therefore silver content is assumed to lie entirely within the background range.

#### Lead

Values range from 13 ppm to 59 ppm, with two erratic highs of 100 ppm and 350 ppm, each associated with anomalous zinc content; other than this there is no particular enrichment of lead in those soils anomalous in zinc.

#### Zinc

Zinc values range from 80 ppm to 650 ppm with eight truly anomalous samples ranging from 1,700 ppm to 6,700 ppm Zn.

Contour lines have been drawn at 305 ppm, 475 ppm and 1,500 ppm Zn representing high background (mean + 1 S.D.), threshold (mean + 2 S.D.) and strongly anomalous (mean + 8 S.D., actually 1,488 ppm).

The zinc values clearly outline two southeasterly-trending anomalies, the western one approximately 1,300 ft. long and about 300 ft. wide with values exceeding 475 ppm Zn, and the eastern one, intersected on line 15W, about 500 ft. long and 200 ft. wide.

The western anomaly appears to be closed off in the southeast; however, the eastern one is open in this direction.

#### Stream Sediments

All of the seven samples appear to be anomalous since they are at least three times the mean zinc content established for this stream last year of 47 ppm total zinc. This is not unexpected since the stream is draining an area of anomalous zinc content in soils.

CONCLUSIONS AND RECOMMENDATIONS

The GLEN claim group, of which only four claims have been partially sampled, are believed to be underlain by a geological formation similar to that reported on the McIntyre properties to the west, where significant lead, silver and zinc mineralization was found initially by geochemical sampling and prospecting. The property which is almost completely forest covered has not been subjected to intensive visual prospecting and therefore the discovery of a zinc anomaly in soils is a definite encouragement.

The geochemical data indicates that moderately strong zinc mineralization should be expected to occur either on the GLEN claims 7, 9 and 10 and/or on the BLACK claim group. Intensive prospecting and further sampling are warranted. In addition, the extent of the anomalous zinc content in stream sediments, to the southeast of the soil anomaly, indicates that additional source mineralization could occur to the south and west of the geochemical grid not yet sampled.

It is therefore recommended that grid soil sampling and prospecting be completed over the entire 32 GLEN claims.

Respectfully submitted,

DERRY, MICHENER & BOOTH



I. S. Thompson,



Toronto, Ontario  
August 10, 1978



# BONDAR-CLEGG & COMPANY LTD.

764 BELFAST ROAD, OTTAWA, ONTARIO, K1G 0Z5

PHONE: 237-3110

Branch: 136B Industrial Rd., Whitehorse, Y.T.

## Geochemical Lab Report

Extraction Ag, Pb, Zn Report No. 48-83  
 Method A.A. From Derry Michener Booth  
 Fraction Used -80 Soils Date August 2, 19 78

SAMPLE NO.	Ag* ppm	Pb* ppm	Zn ppm		SAMPLE NO.	Ag* ppm	Pb* ppm	Zn ppm	
501	0.5	30	260		532	0.7	23	98	
2	0.7	22	185		33	0.9	22	83	
3	0.5	25	300		34	0.7	28	165	
4	0.5	22	210		35	0.7	13	150	
5	0.8	24	255		36	0.6	26	440	
6	0.7	26	250		37	0.6	40	2100	
7	0.9	50	145		38	0.5	33	1700	
8	0.8	29	170		39	0.5	40	530	
9	0.9	32	165		40	0.6	39	145	
10	0.9	37	155		41	0.9	30	138	
11	1.0	31	155		42	0.4	30	142	
12	0.7	27	135		43	1.1	100	6700	
13	0.7	26	125		44	0.8	27	2050	
14	0.7	27	118		45	0.5	22	2200	
15	1.0	26	145		46	0.7	350	2400	
16	0.4	21	165		47	0.5	58	650	
17	1.1	27	135		48	0.6	41	3400	
18	0.5	30	130		49	0.7	20	345	
19	1.0	32	148		50	0.5	30	122	
20	0.7	29	130		51	0.4	32	250	
21	0.4	28	118		52	0.5	48	205	
22	0.6	25	130		53	0.6	42	200	
23	0.5	27	125		54	0.8	30	175	
24	0.8	25	130		55	0.8	27	120	
25	0.9	27	118		56	0.5	31	210	
26	0.6	24	113		57	1.0	38	205	
27	0.7	25	90		58	0.7	22	160	
28	0.9	22	100		59	0.6	20	115	
29	0.7	25	100		60	0.8	23	190	
30	0.9	29	80		61	1.0	26	160	
531	1.0	27	98		562	0.8	27	275	



BLACK 26 BLACK 28

Prev. Sample 392

L-30 W

L-25W

L-20W

(L-45W) Old Grid

L-15 W

BASE LINE

GLEN 7

GLEN 9

GLEN 10

LEGEND

○ 0.7,350,2400 Ag, Pb,Zn in p.p.m

○, ● Soil, stream silt sample

GLEN 9 Claim name + number

□ Assumed claim post

— 1500 p.p.m. Zn

— 475 p.p.m. Zn

— 305 p.p.m. Zn

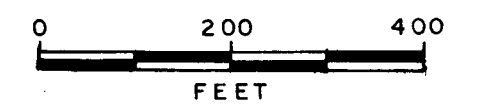

DERRY, MICHENER & BOOTH

DEJOUR MINES LTD.  
NOVA-CO. EXPLORATIONS LTD.

GLEN GROUP CLAIMS 7,8,9,10  
DETAIL GEOCHEMICAL GRID

DATE: JULY 78

BY: J.E./I.S.T.

MAP NO. |

NTS. 106 C/2

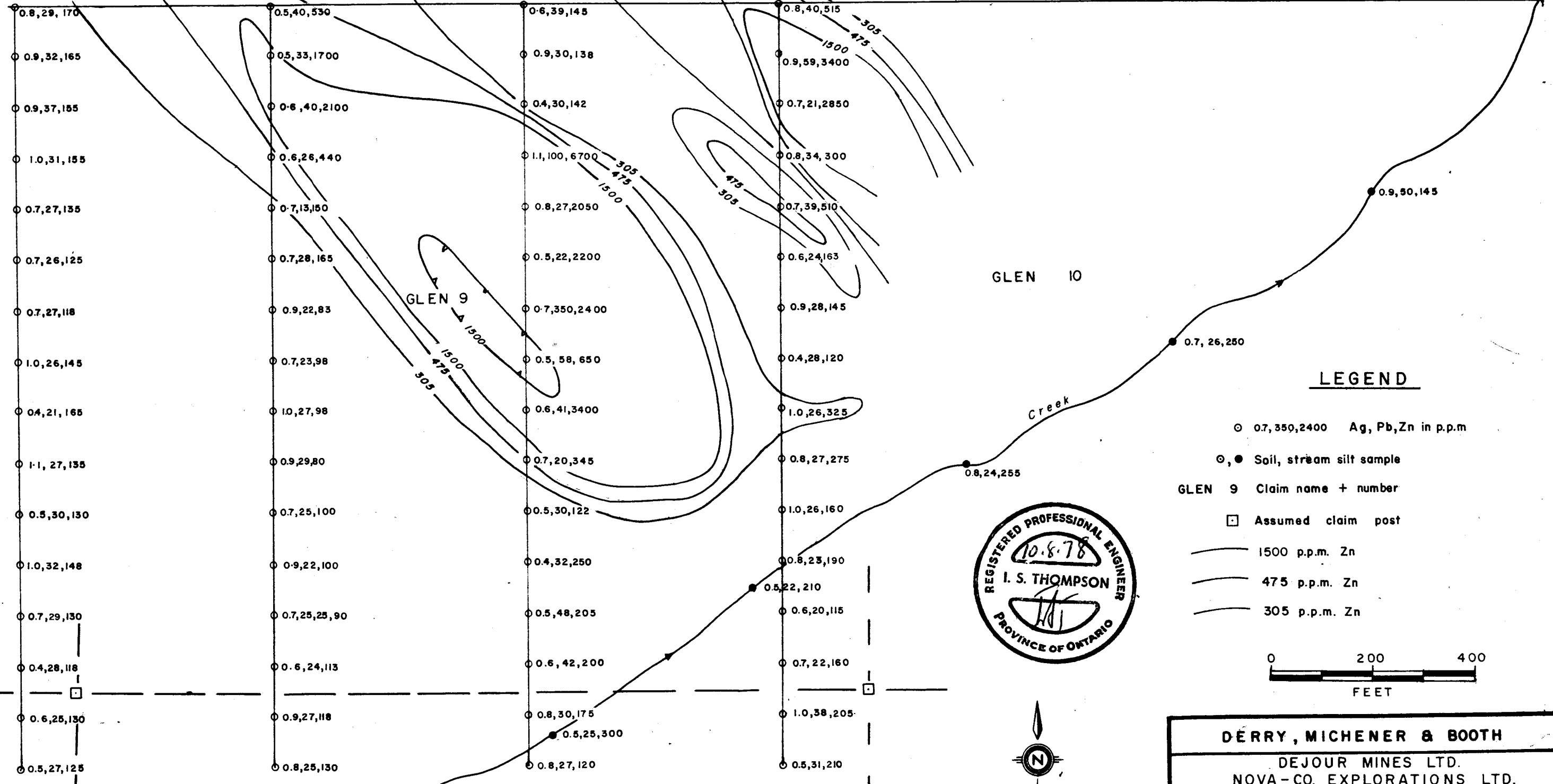

GLEN 8

GLEN 10

Creek

Creek



