



WELCOME NORTH MINES LTD. (N.P.L.)

1027-470 Granville St., Vancouver, B.C. V6C 1V5 Telephone (604) 687-1658

DIAMOND DRILLING PROGRAM

SU, HIGH AND WAY MINERAL CLAIMS

N.T.S. 105F-16

Latitude 61°51'N

Longitude 132°12'W

WATSON LAKE MINING DISTRICT

YUKON TERRITORY

For Work Performed During the Period Nov. 1, 1975 to Jan. 31, 1976

1975

by

John S. Brock

May, 1976

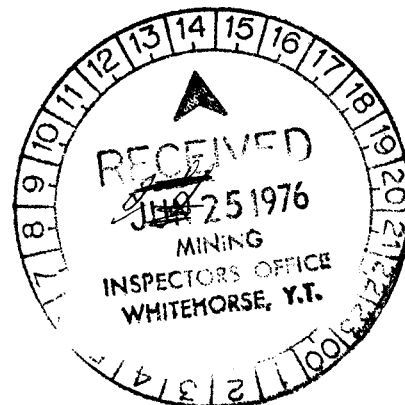

090110



This report has been examined by the Geological Evaluation Unit and is recommended to the Commissioner to be considered as representation work in the amount of

\$29614.31

A handwritten signature in cursive script, appearing to read "D. B. Craig".

Resident Geologist or
Resident Mining Engineer

Considered as representation work under Section 53 (4) Yukon Quartz Mining Act.

A handwritten signature in cursive script, appearing to read "B.R. Baxter".

B.R. BAXTER
Supervising Mining Recorder

A handwritten signature in cursive script, appearing to read "P.L. Commissioner".
Commissioner of Yukon Territory

TABLE OF CONTENTS

| | Page |
|--------------------------|------|
| SUMMARY AND CONCLUSIONS | 1 |
| LOCATION AND ACCESS | 1 |
| MINERAL CLAIMS | 2 |
| DIAMOND DRILLING PROGRAM | 2 |

APPENDICES

| | |
|--------------|--------------------|
| APPENDIX "A" | DIAMOND DRILL LOGS |
| APPENDIX "B" | SUMMARY OF COSTS |
| APPENDIX "C" | PERSONNEL |

FIGURES

| | | |
|----------|--|--------------|
| Figure 1 | Claim Location Map | Frontispiece |
| Figure 2 | Geophysical and Geochemical Profile Compilation | |

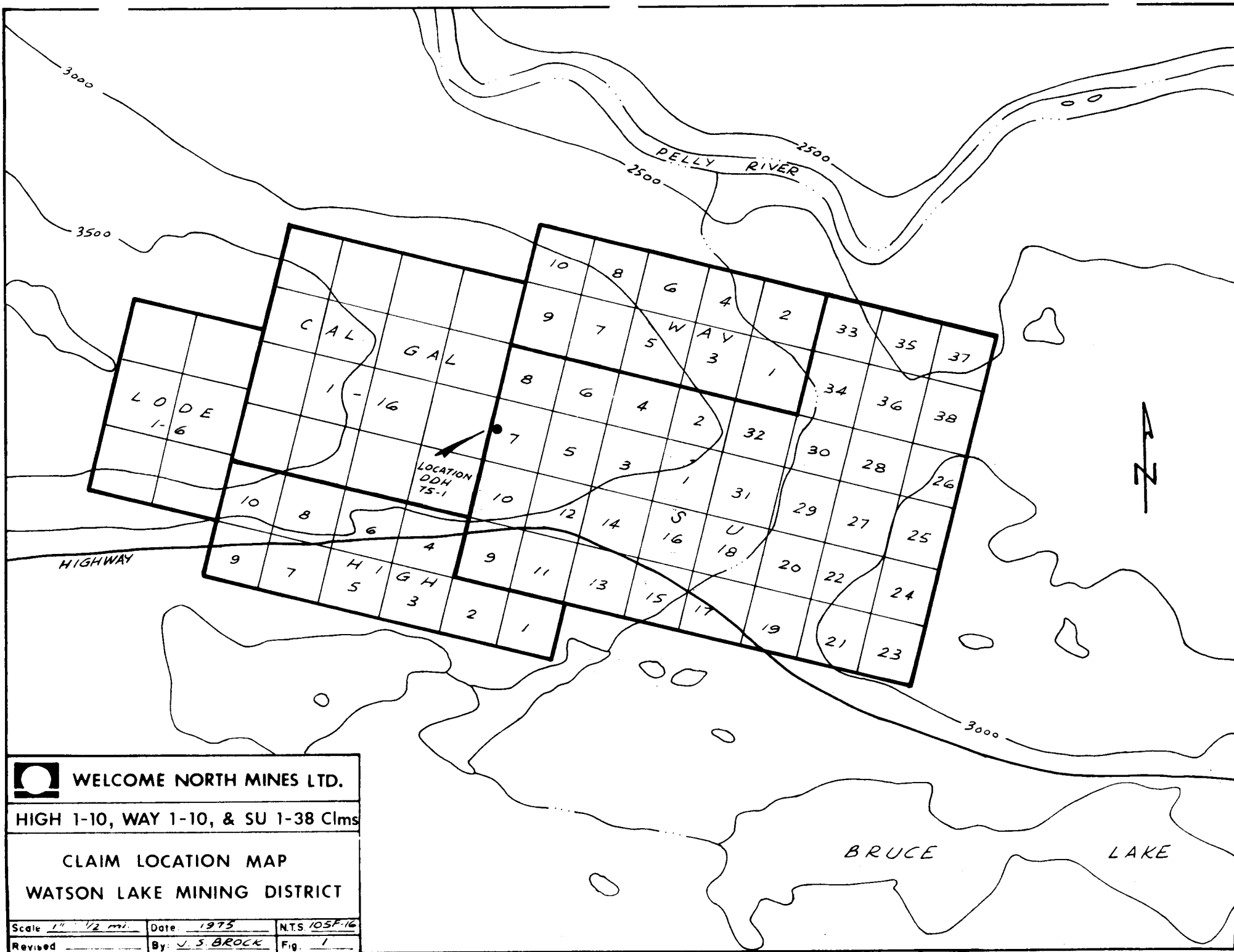

WELCOME NORTH MINES LTD.

HIGH 1-10, WAY 1-10, & SU 1-38 Clms

CLAIM LOCATION MAP
WATSON LAKE MINING DISTRICT

| | | |
|--------------------|----------------|----------------|
| Scale 1" = 1/2 mi. | Date 1975 | N.T.S. 105P-16 |
| Revised | By J. S. BROCK | Fig. 1 |

20.544

SUMMARY AND CONCLUSIONS

The HIGH and WAY mineral claim groups were staked by Welcome North Mines on behalf of a joint venture between Welcome and Mackir Mines Ltd. The adjoining SU claims are presently held by Silver Standard Mines Ltd.

In November, 1975 an agreement was entered into with Silver Standard Mines whereby Welcome North, Mackir Mines and Malabar Silver Mines would have the right to earn a 47.5 percent interest in the SU claims by completing certain work commitments. Accordingly one diamond drill hole, drilled to a depth of 548 feet was drilled on the SU No. 7 mineral claim.

The claims are located over an area of sericite-limonite alteration of Precambrian phyllite rocks. The drill hole is located on-strike to the northwest of a sulphide-rich gossan area that during 1974 and 1975 received some exploration attention by Silver Standard Mines.

The adjoining CAL GAL property to the northwest was acquired in 1975 by Welcome North and Mackir as an exploration target indicative of massive sulphide mineralization. Accordingly, follow-up work consisted of line-cutting gravity surveys and some geochemical soil sampling. A well defined 2.0 milligal response adjacent to the SU No. 7 mineral claim obtained as a result of the gravity program indicated a potential massive sulphide body at depth.

Drill testing of the gravity anomaly was recommended which program was carried out on the SU No. 7 mineral claim during the period November, 1975 to January, 1976.

Drilling to a depth of 548 feet failed to intersect sulphides, as a result of which further gravity surveys are proposed to better delineate the position and geometry of the causative mass. Further drilling is also proposed to a depth of 700 feet to test a second gravity target at depth.

LOCATION AND ACCESS

The SU, HIGH and WAY claims are located east of the Robert Campbell Highway and north of Bruce Creek. Access is by automobile from the settlement

of Ross River, 25 miles by road to the north. A small lake located north of the SU is suitable for float equipped aircraft of the S.T.O.L. type and has been used by such aircraft in the past.

MINERAL CLAIMS

The SU, HIGH and WAY claims consist of the following 58 contiguous mineral claims:

| <u>Name of Claim</u> | <u>Grant No.</u> |
|----------------------|------------------|
| HIGH 1-10 | Y93681-Y93690 |
| WAY 1-10 | Y93691-Y93700 |
| SU 1- 8 | Y83668-Y83675 |
| SU 9-32 | Y93549-Y93572 |
| SU 33-38 | Y93638-Y93643 |

All claims as listed above are located within the Watson Lake Mining Division of the Yukon Territory

DIAMOND DRILLING PROGRAM

The diamond drilling of 1 hole to a vertical depth of 548 feet was completed during the period November 7 to December 3, 1975. During the period January 24 to January 30 an attempt was made to deepen the hole, however drilling problems encountered due to broken ground, loss of water circulation and freezing conditions made that objective impossible.

Diamond drilling failed to intersect sulphides, logs of the holes are attached as Appendix "A" to this report.

Respectfully submitted

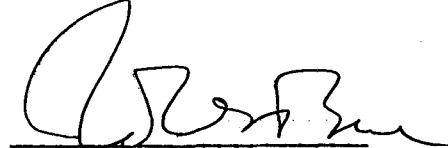

John S. Brock



WELCOME NORTH MINES LTD.

CAL GAL MINERAL CLAIMS

Geophysical - Geochemical
Profile Compilation

Line 0+00

| | | |
|-------------------------|--------------------|---------------|
| Scale: 1 INCH : 400 FT. | Date: OCTOBER 1975 | NTS. 105 F 16 |
| Revised: _____ | By: J. S. BROCK | Plate _____ |

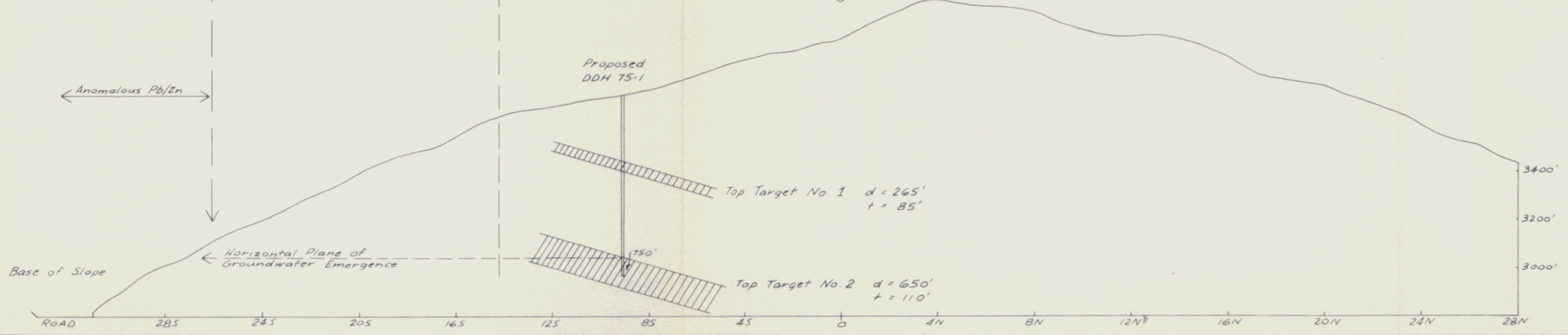
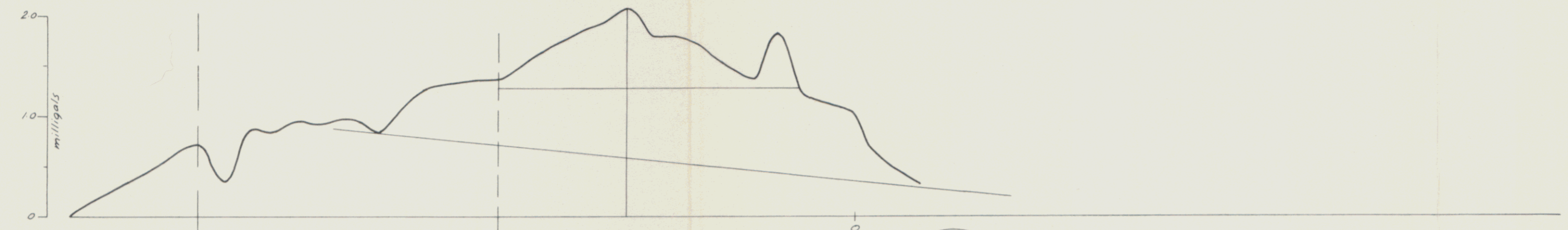
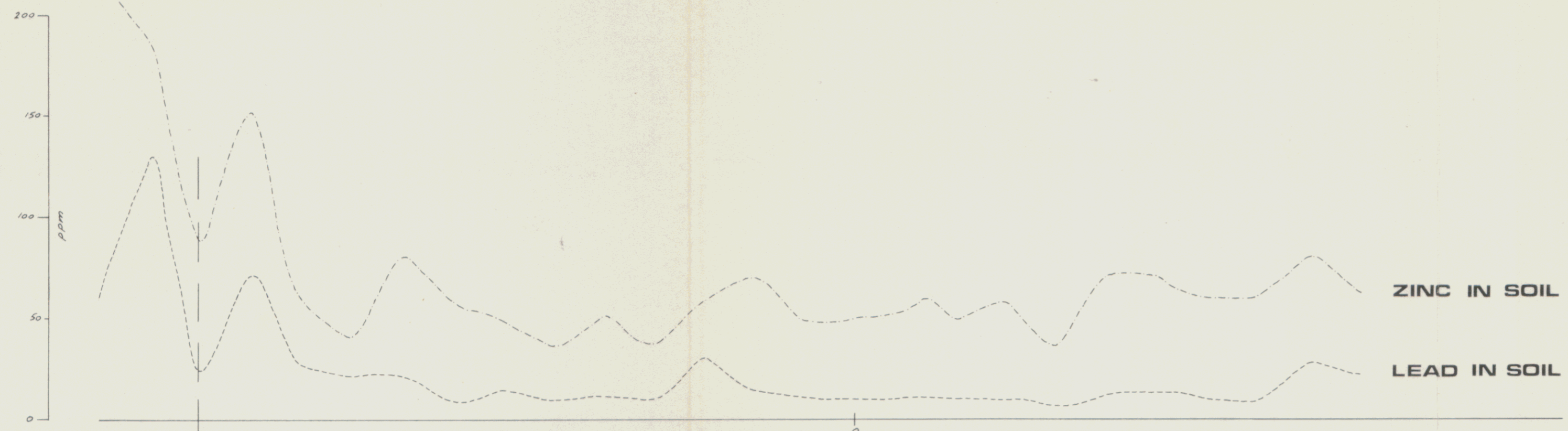

RESIDUAL GRAVITY PROFILE

TOPOGRAPHIC PROFILE

LINE 0+00

APPENDIX "A"

Diamond Drill Record

| | | | |
|-------------------------|---------------|---------|-----|
| COLLAR: | HOLE SURVEY | | |
| NORTH _____ | FOOTAGE | AZIMUTH | DIP |
| EAST _____ | | | |
| ELEVATION _____ | | | |
| LOGGED BY _____ | | | |
| DATE LOGGED _____ | | | |
| MAP REFERENCE NO. _____ | METHOD: _____ | | |

COMPANY NAME WELCOME NORTH MINES LTD. (N.P.L.)

PROPERTY NAME GAL GAL

DRILLING CONTRACTOR _____

ASSAYER _____

PURPOSE OF HOLE _____

HOLE NO. _____

CLAIM NAME _____

COMMENCED _____

FINISHED _____

PROJECT NO. _____

| FROM | TO | RECOVY | DESCRIPTION | SAMPLE | | | | ASSAYS | | | | Schistosity | S ₁ S ₂ |
|-------|-------|--------|--|--------|----|-------|------|--------|--|--|--|-------------|-------------------------------|
| | | | | FROM | TO | WIDTH | NO. | | | | | | |
| 471 | 473 | 0% | | | | | | | | | | | |
| 473 | 478 | 60% | Calcareous light silvery grey green chloritesericite phyllite | | | | | | | | | | |
| 478 | 485 | 0% | | | | | | | | | | | |
| 485 | 488 | 60% | Phyllite: Silvery grey, trace of pyrite, sericite present | | | | | | | | | | 487 |
| 488 | 492 | 80% | Greenstone tuff: Well laminated discontinuous bands of chloritic rock and qtz-carbonate bands. Minor pyrite | | | | | | | | | | 490 |
| 492 | 502 | 80% | Chlorite Phyllite: Thin to thick laminations of green phyllitic bands intercalated with thin white bands of talcy substance and qtz | | | | | | | | | | 500 |
| 502 | 503 | 80% | Greenstone: Green foliated with laminae of qtz. Less than 1% py. | | | | | | | | | | |
| 503 | 508 | 80% | Phyllite: Silvery grey finely laminated and mottled. Minor disseminated pyrite. | | | | | | | | | | |
| 508 | 513 | 70% | Chlorite phyllite: Green chlorite bands 1/8" to 1/4" intercalated with calcite, dolomite and qtz bands of less frequency, Becomes schistose in places over 1" to 3" sections. Becomes more silvery grey in color @ 510 | | | | | | | | | | 510-5 |
| | | | | 513 | | | C- 2 | | | | | | |
| 513 | 525.5 | 60% | Same as below - no pyrite | | | | | | | | | | |
| 525.5 | 528 | 90% | Chlorite phyllite: Qtz vein at 527 with chl. conc. on edges | | | | | | | | | | |
| 528 | 533 | 90% | Same with slightly more abundant dissem. pyrites | | | | | | | | | | 528 |
| 533 | 536 | 90% | Chlorite phyllite: Same as below | | | | | | | | | | |
| 536 | 537 | 70% | Qtz vein with chlorite and earthy hematite | | | | | | | | | | |
| 537 | 545 | 70% | Chlorite phyllite: Thinly banded qtz-chlorite phyllite. Bands | | | | | | | | | | |

